

File No.

T. 30 N R. 31

DUPLICATE

County Lincoln

STATE OF MONTANA
ADMINISTRATOR OF GROUNDWATER CODE
OFFICE OF STATE ENGINEER

JAN 27 1964

Declaration of Vested Groundwater Rights

(Under Chapter 237, Montana Session Laws, 1961)

1. FRED S. THOMPSON, of RT #1 Box 452A LIBBY
(Name of Appropriator) (Address) (Town)
County of LINCOLN State of MONTANA
have appropriated groundwater according to the Montana laws in effect prior to January 1, 1962, as follows:

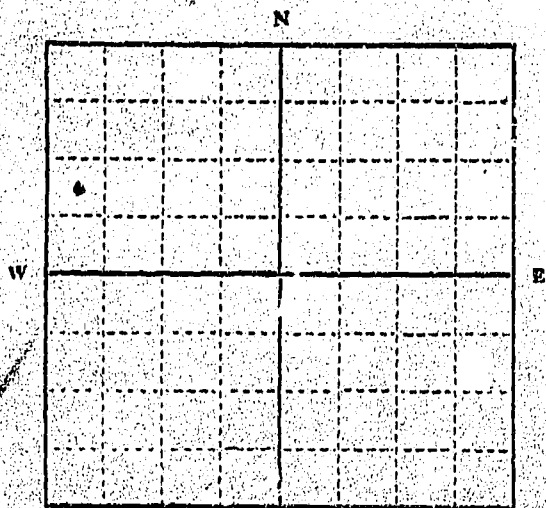

Lot 1, Ender's Acre
NW 1/4 Sec. 14 T. 30 R. 31

Indicate point of appropriation and place of use, if possible. Each small square represents 10 acres.

- 2. The beneficial use on which the claim is based: Household
- 3. Date or approximate date of earliest beneficial use; and how continuous the use has been: 6/1/57
CONTINUOUSLY
- 4. The amount of groundwater claimed (in miner's inches or gallons per minute): 30 GPM
- 5. If used for irrigation, give the acreage and description of the lands to which water has been applied and name of the owner thereof: WATKINS & WARRS Thompson's Highgate
WARRENS 3/4 ACRE
- 6. The means of withdrawing such water from the ground and the location of each well or other means of withdrawal: Pump
on Thompson Property
- 7. The date of commencement and completion of the construction of the well, wells, or other works for withdrawal of groundwater: 6/1/57 UNKNOWN
- 8. The depth of water table: UNKNOWN
- 9. So far as it may be available, the type, size and depth of each well or the general specifications of any other works for the withdrawal of groundwater: UNKNOWN
- 10. The estimated amount of groundwater withdrawn each year: 10,000,000
- 11. The log of formations encountered in the drilling of each well if available: UNKNOWN
- 12. Such other information of a similar nature as may be useful in carrying out the policy of this act, including reference to book and page of any county record:

Signature of Owner: Fred S. Thompson
Date: 12/27/63

Three copies to be filed by the owner with the County Clerk and Recorder of the county in which the well is located.

Please answer all questions. If not applicable, so state, otherwise the form will be returned.

Original to the County Clerk and Recorder; Duplicate to the State Engineer; Triplicate to the Montana Bureau of Mines and Geology, and Quadruplicate for the Appropriator.

#266

INDEXES

STATE OF MONTANA
COUNTY OF LINCOLN

Filed this 27th day of

December A. D. 1963

at 4:15 P. M.

Wm. M. Mansfield
County Clerk

By Verdu
Deputy

GW

File No.....

T. 30 N. R. 31

DUPLICATE

County Lincoln

STATE OF MONTANA
ADMINISTRATOR OF GROUNDWATER CODE
OFFICE OF STATE ENGINEER

JAN 22 1964

Declaration of Vested Groundwater Rights

(Under Chapter 237, Montana Session Laws, 1961)

1. Fay + Florence Tisher, of Box 567 Libby
(Name of Appropriator) (Address) (Town)
County of Lincoln State of Mont
have appropriated groundwater according to the Montana laws in effect prior to January 1, 1962, as follows:

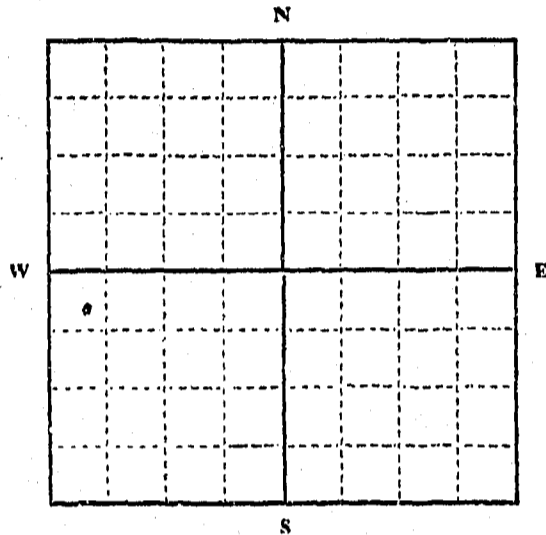

NW 1/4 SW Sec. 14 T. 30 R. 31

Indicate point of appropriation and place of use, if possible. Each small square represents 10 acres.

- 2. The beneficial use on which the claim is based. Home + Trailer Court.
- 3. Date or approximate date of earliest beneficial use; and how continuous the use has been. Many Years Prior to our buying in
- 4. The amount of groundwater claimed (in miner's inches or gallons per minute). Not known - Except 48 g.p.m. 12 trailer court 20 g.p.m.
- 5. If used for irrigation, give the acreage and description of the lands to which water has been applied and name of the owner thereof. No other lands
- 6. The means of withdrawing such water from the ground and the location of each well or other means of withdrawal. Electric pump Back of Main House.

7. The date of commencement and completion of the construction of the well, wells, or other works for withdrawal of groundwater. Not known

8. The depth of water table. Abt. 35 Ft well.

9. So far as it may be available, the type, size and depth of each well or the general specifications of any other works for the withdrawal of groundwater. 4 in casing 35 ft

10. The estimated amount of groundwater withdrawn each year. Enough to supply 14 Dwelling.

11. The log of formations encountered in the drilling of each well if available. Not known

12. Such other information of a similar nature as may be useful in carrying out the policy of this act, including reference to book and page of any county record. Indeterminate

Signature of Owner. Mrs Fay Tisher
Date. 29 Dec 1963

Three copies to be filed by the owner with the County Clerk and Recorder of the county in which the well is located.

Please answer all questions. If not applicable, so state, otherwise the form will be returned.

Original to the County Clerk and Recorder; duplicate to the State Engineer; Triplicate to the Montana Bureau of Mines and Geology, and Quadruplicate for the Appropriator.

#276

INDEXED

STATE OF MONTANA
COUNTY OF LINCOLN

Filed this 30th day of

December A. D. 1963

at 11:00 A.M.

M. M. Marshall
County Clerk

By Verda Leggett
Deputy

File No.

RECEIVED

APR 6 1972

DUPLICATE

MONTANA DEPARTMENT OF MINES AND GEOLOGY

T. R.

County Lincoln

STATE OF MONTANA
ADMINISTRATOR OF GROUNDWATER CODE
OFFICE OF STATE ENGINEER

Notice of Completion of Groundwater
Appropriation by Means of Well

(Under Chapter 237, Montana Session Laws, 1961)

Owner: Robert Wilson Address Libby Mont.

Driller: C. L. Pelly Address " "

Date of Notice of Appropriation of Groundwater

Date well started 9/13/65 Date Completed 9/15/65

Type of well drilled Equipment Used churn
(dug, driven, bored or drilled) (Churn, drill, rotary or other)

Water Use: Domestic Municipal Other Irrigation
Industrial Drainage Stock

Indicate on the diagram the character and thickness of the different strata met with in drilling, such as soil, clay, shale, gravel, rock or sand, etc. Show depth at which water is encountered, thickness and character of water-bearing strata and height to which water rises in the well.

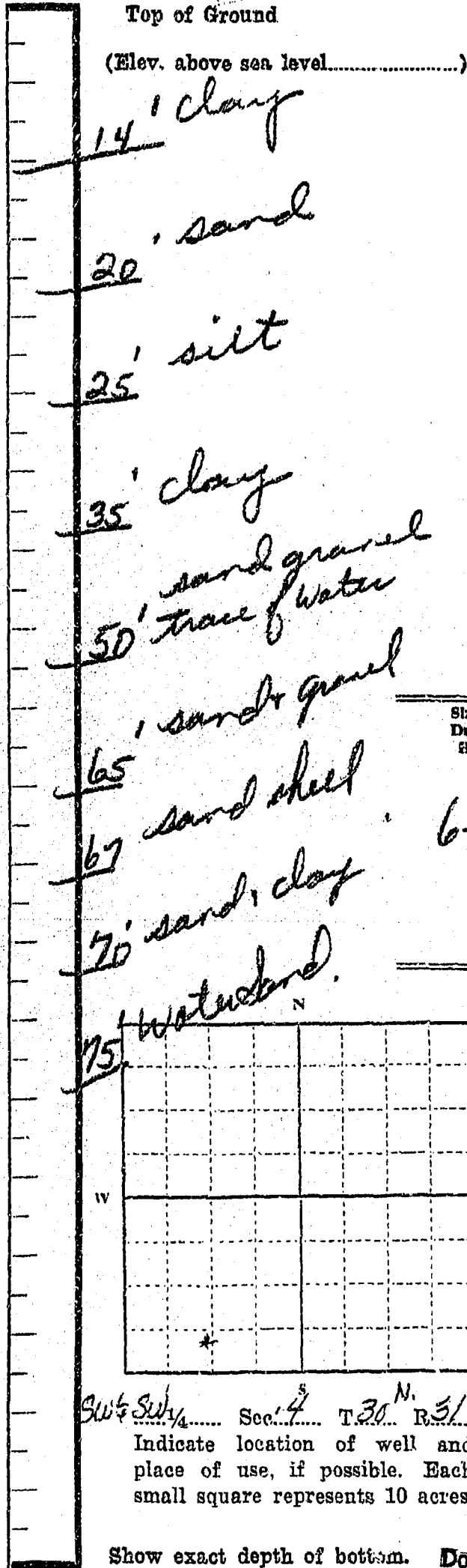

Size of Drilled Hole	Size and Weight of Casing	From (Feet)	To (Feet)	PERFORATIONS		
				Kind Size	From (Feet)	To (Feet)
6 1/4	17 #	-0-	-75-	1/2 Round hole	75'	71'

Static Water Level for non-flowing Well 10' feet.

Shut-in Pressure for Flowing Well

Pumping Water Level 50' feet at 25 gal. per minute.

Discharge in gal. per min. of flowing well

How Tested bailed Length of Test 1 1/2 hours

Remarks: (Gravel packing, cementing, packers, type of shutoff, location of place of use of groundwater if not at well, and any other similar pertinent information, including number of acres irrigated, if used for irrigation)

SW 1/4 Sec. 4 T. 30 N. R. 31 W. R.F. 2.
Indicate location of well and place of use, if possible. Each small square represents 10 acres.

Show exact depth of bottom.

Doc. No. 856
Filed for record this 4th day of April A. D. 19 72 at 3:30 P.M.

Driller's License Number 141
Driller's Signature Clifford Baker

This form to be prepared by driller, and three copies to be filed by the owner with the County Clerk and Recorder in the county in which the well is located.

Please answer all questions. If not applicable, so state, otherwise the form will be returned.

Original to the County Clerk and Recorder; duplicate to the State Engineer; Triplicate to the Montana Bureau of Mines and Geology and Quadruplicate for the Appropriator.

50,149

856

STATE OF MONTANA
COUNTY OF LINCOLN

Filed this 4th day of
April A. D. 1972
at 3:30 P M.
Calvin L. Vaughn County Clerk
By Max Watson Deputy

File No.

RECEIVED

DUPLICATE

APR 6 1972

T. R.

County Lincoln

MONTANA DEPARTMENT OF NATURAL RESOURCES AND CONSERVATION

STATE OF MONTANA
ADMINISTRATOR OF GROUNDWATER CODE
OFFICE OF STATE ENGINEER

Notice of Completion of Groundwater Appropriation by Means of Well

(Under Chapter 237, Montana Session Laws, 1961)

Owner Robert Wilson Address Lilly Mont

Driller C. L. Plog Address Lilly Mont

Date of Notice of Appropriation of Groundwater

Date well started 9/9/65 Date Completed 9/14/65

Type of well drilled Equipment Used Churn
(dug, driven, bored or drilled) (Churn, drill, rotary or other)

Water Use: Domestic Municipal Other Irrigation
Industrial Drainage Stock

Indicate on the diagram the character and thickness of the different strata met with in drilling, such as soil, clay, shale, gravel, rock or sand, etc. Show depth at which water is encountered, thickness and character of water-bearing strata and height to which water rises in the well.

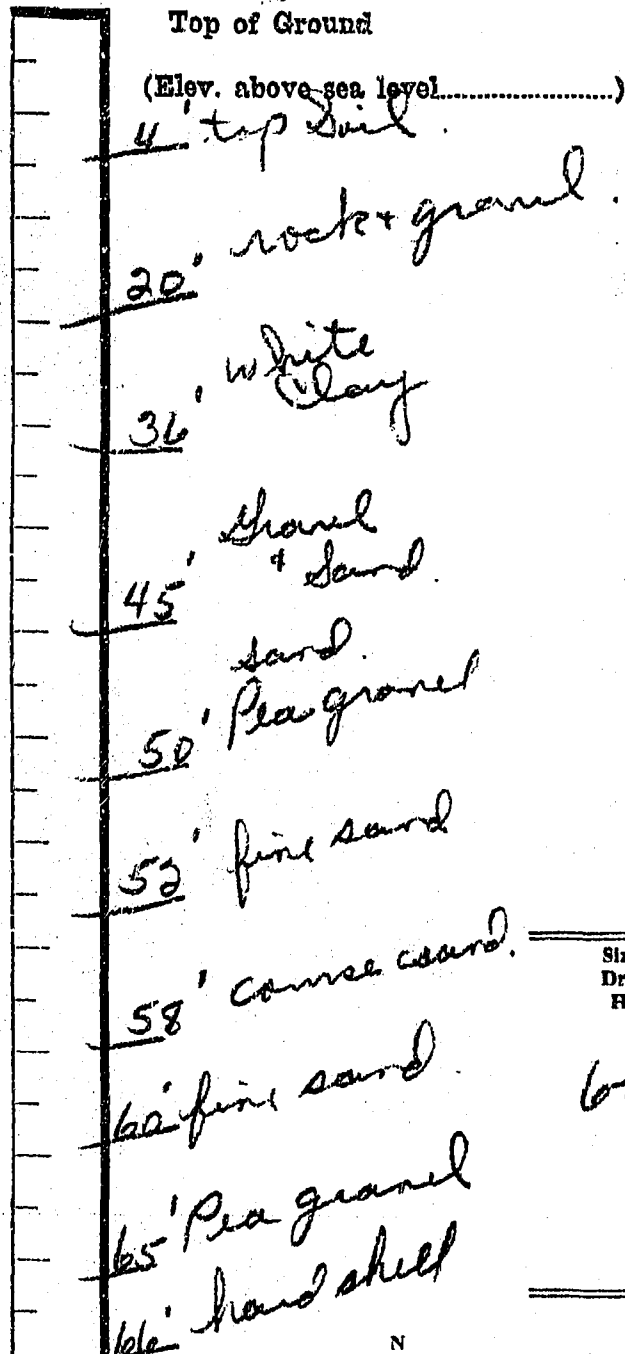

Size of Drilled Hole	Size and Weight of Casing	From (Feet)	To (Feet)	PERFORATIONS		
				Kind Size	From (Feet)	To (Feet)
6 1/4"	17 #	0	77'	1/2 Round Hole	77'	73'

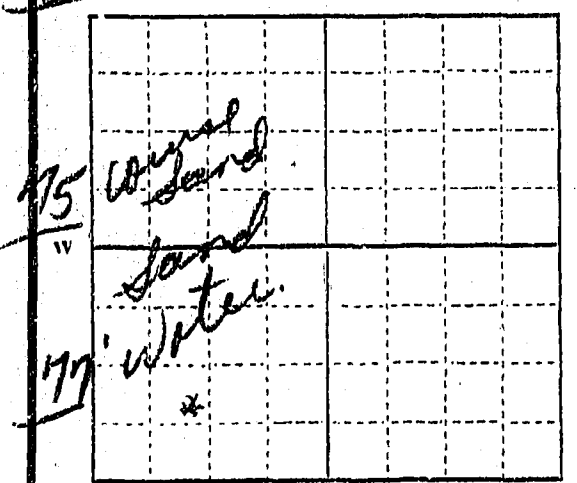

SW 1/4 Sec. 4 T. 30 R. 21

Indicate location of well and place of use, if possible. Each small square represents 10 acres.

Static Water Level for non-flowing Well..... 15 feet.

Shut-in Pressure for Flowing Well.....

Pumping Water Level..... 60 feet at 15 gal. per minute.

Discharge in gal. per min. of flowing well.....

How Tested bailed Length of Test 2 hr.

Remarks: (Gravel packing, cementing, packers, type of shutoff, location of place of use of groundwater if not at well, and any other similar pertinent information, including number of

R.A. 2. acres irrigated, if used for irrigation)

Show exact depth of bottom. Doc. No. 855

Filed for record this 4th day of April A. D. 19 72, at 3:25 o'clock P. M.

Driller's License Number 141
Driller's Signature Clifford J. Becker

This form to be prepared by driller, and three copies to be filed by the owner with the County Clerk and Recorder in the county in which the well is located.

Please answer all questions. If not applicable, so state, otherwise the form will be returned.

Original to the County Clerk and Recorder; duplicate to the State Engineer; Triplicate to the Montana Bureau of Mines and Geology and Quadruplicate for the Appropriator.

50,148

855

STATE OF MONTANA
COUNTY OF LINCOLN

Filed this 11th day of April
at 3:25 P.M. A. D. 1912
By Charles L. Laughon County Clerk
Mae Watson Deputy

File No.

T. 30 N R. 31

DUPLICATE

County LINCOLN

STATE OF MONTANA
ADMINISTRATOR OF GROUNDWATER CODE
OFFICE OF STATE ENGINEER

RECEIVED

MAR 5 1964

Declaration of Vested Groundwater Rights

(Under Chapter 237, Montana Session Laws, 1961)

STATE ENGINEER

1. Wilson, Robert L. & Harriett, of Box 213 LIBBY
(Name of Appropriator) (Address) (Town)

County of LINCOLN State of MONTANA
have appropriated groundwater according to the Montana laws in effect prior to January 1, 1962, as follows:

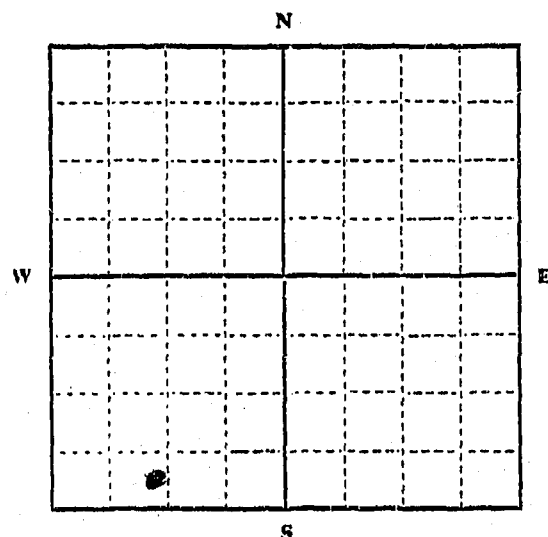

SW 1/4 SW Sec. 14 T. 30 R. 31

Indicate point of appropriation and place of use, if possible. Each small square represents 10 acres.

2. The beneficial use on which the claim is based. Residential

3. Date or approximate date of earliest beneficial use; and how continuous the use has been. JAN 1st 1953
CONTINUOUS SINCE THAT DATE

4. The amount of groundwater claimed (in miner's inches or gallons per minute) 10 gal min

5. If used for irrigation, give the acreage and description of the lands to which water has been applied and name of the owner thereof. PORTION IN SW 1/4 SW 1/4 TRACT 189
1810 AND 1812 SEE PLAT 167-174
400

6. The means of withdrawing such water from the ground and the location of each well or other means of withdrawal. ELECTRIC PUMP
IN WELL

7. The date of commencement and completion of the construction of the well, wells, or other works for withdrawal of groundwater. SEPT 1952 TO OCT 31st 1952

8. The depth of water table. APP 24'-0"

9. So far as it may be available, the type, size and depth of each well or the general specifications of any other works for the withdrawal of groundwater. CLAY SILT GRAVEL & BOULDERS
CASINGS 3 1/2" DEPTH APP 28'-0"

10. The estimated amount of groundwater withdrawn each year. APP 50,000 GAL

11. The log of formations encountered in the drilling of each well if available. CLAY SILT GRAVEL
& BOULDERS

12. Such other information of a similar nature as may be useful in carrying out the policy of this act, including reference to book and page of any county record.

TRACT 189 - PLAT 167 TRACT 1810 PLAT 174 TRACT 1812
PLAT 400

Signature of Owner Robert L. Wilson

Date Dec 31st 1963

Three copies to be filed by the owner with the County Clerk and Recorder of the county in which the well is located.

Please answer all questions. If not applicable, so state, otherwise the form will be returned.

Original to the County Clerk and Recorder; Duplicate to the State Engineer; Triplicate to the Montana Bureau of Mines and Geology, and Quadruplicate for the Appropriator.

361

WINCOX

13 DE 31

1913
 1914
 1915
 1916
 1917
 1918
 1919
 1920
 1921
 1922
 1923
 1924
 1925
 1926
 1927
 1928
 1929
 1930
 1931
 1932
 1933
 1934
 1935
 1936
 1937
 1938
 1939
 1940
 1941
 1942
 1943
 1944
 1945
 1946
 1947
 1948
 1949
 1950
 1951
 1952
 1953
 1954
 1955
 1956
 1957
 1958
 1959
 1960
 1961
 1962
 1963
 1964
 1965
 1966
 1967
 1968
 1969
 1970
 1971
 1972
 1973
 1974
 1975
 1976
 1977
 1978
 1979
 1980
 1981
 1982
 1983
 1984
 1985
 1986
 1987
 1988
 1989
 1990
 1991
 1992
 1993
 1994
 1995
 1996
 1997
 1998
 1999
 2000
 2001
 2002
 2003
 2004
 2005
 2006
 2007
 2008
 2009
 2010
 2011
 2012
 2013
 2014
 2015
 2016
 2017
 2018
 2019
 2020
 2021
 2022
 2023
 2024
 2025
 2026
 2027
 2028
 2029
 2030
 2031
 2032
 2033
 2034
 2035
 2036
 2037
 2038
 2039
 2040
 2041
 2042
 2043
 2044
 2045
 2046
 2047
 2048
 2049
 2050
 2051
 2052
 2053
 2054
 2055
 2056
 2057
 2058
 2059
 2060
 2061
 2062
 2063
 2064
 2065
 2066
 2067
 2068
 2069
 2070
 2071
 2072
 2073
 2074
 2075
 2076
 2077
 2078
 2079
 2080
 2081
 2082
 2083
 2084
 2085
 2086
 2087
 2088
 2089
 2090
 2091
 2092
 2093
 2094
 2095
 2096
 2097
 2098
 2099
 2100

STATE OF MONTANA
 COUNTY OF LINCOLN

Filed this 31st day of
December A. D. 1963.
 at 10:02 M.
M. M. Mansfield
 County Clerk
 By K. S. [unclear] Deputy

File No.

T. 30 N. R. 31

DUPLICATE

County Lincoln

STATE OF MONTANA
ADMINISTRATOR OF GROUNDWATER CODE
OFFICE OF STATE ENGINEER

Notice of Completion of Groundwater
Appropriation by Means of Well

(Under Chapter 237, Montana Session Laws, 1961)

Owner Otis M. Mohrht Address Libby, Mont.

Driller C. S. Plumbing Address Libby, Mont.

Date of Notice of Appropriation of Groundwater 12-27-63

Date well started 6-12-63 Date Completed 6-15-63

Type of well Drilled Equipment Used Churn
(dug, driven, bored or drilled) (Churn, drill, rotary or other)

Water Use: Domestic Municipal Other Irrigation
Industrial Drainage Stock

Indicate on the diagram the character and thickness of the different strata met with in drilling, such as soil, clay, shale, gravel, rock or sand, etc. Show depth at which water is encountered, thickness and character of water-bearing strata and height to which water rises in the well.

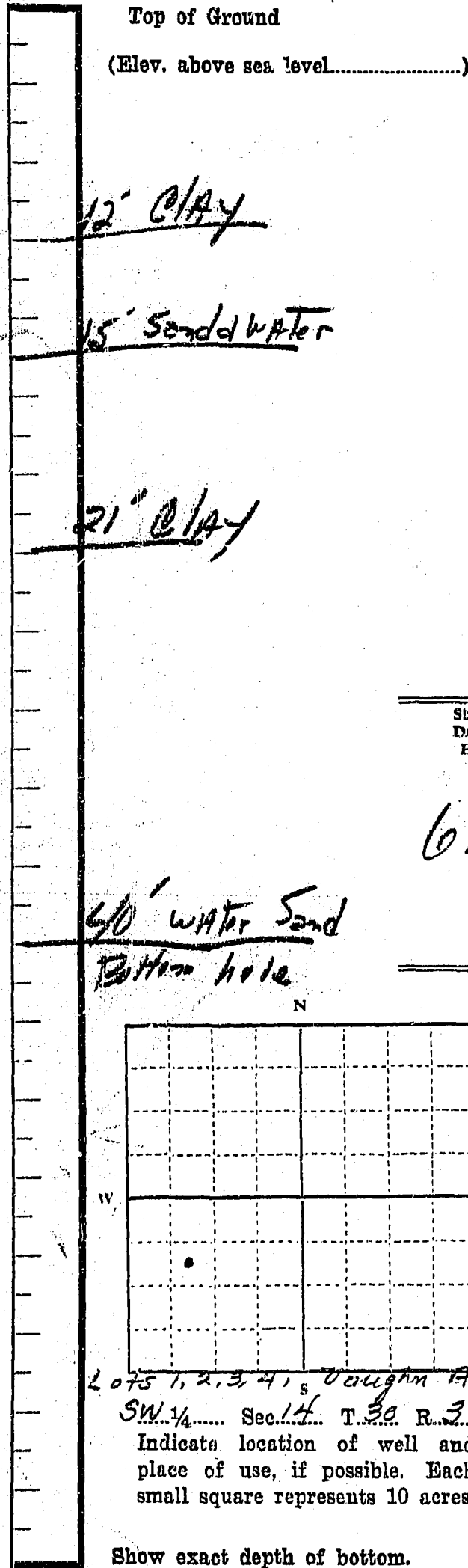

Size of Drilled Hole	Size and Weight of Casing	From (Feet)	To (Feet)	PERFORATIONS		
				Kind Size	From (Feet)	To (Feet)
6 5/8"	6 3/8" 17 #	0'	40'	1/2" Round	34'	40'

Static Water Level for non-flowing Well 20' feet.

Shut-in Pressure for Flowing Well

Pumping Water Level 25 feet at 25 gal. per minute.

Discharge in gal. per min. of flowing well

How Tested Pump Length of Test 48 hrs

Remarks: (Gravel packing, cementing, packers, type of shutoff, location of place of use of groundwater if not at well, and any other similar pertinent information, including number of acres irrigated, if used for irrigation)

Lots 1, 2, 3, 4, 5, 6, 7, 8, 9, 10, 11, 12, 13, 14, 15, 16, 17, 18, 19, 20
SW 1/4 Sec. 14 T. 30 R. 31
Indicate location of well and place of use, if possible. Each small square represents 10 acres.

Show exact depth of bottom.

141
Driller's License Number
Cliff J. Bunker
Driller's Signature

This form to be prepared by driller, and three copies to be filed by the owner with the County Clerk and Recorder in the county in which the well is located.

Please answer all questions. If not applicable, so state, otherwise the form will be returned.

Original to the County Clerk and Recorder; duplicate to the State Engineer; Triplicate to the Montana Bureau of Mines and Geology and Quadruplicate for the Appropriator.

265

EXAMINED

STATE OF MONTANA
COUNTY OF LINCOLN

Filed this 27th day of

December A. D. 1963.

at 11:10 M.

By M. M. Mansfield
County Clerk

By Harold Adams
Deputy

[Faint, illegible text and markings, possibly bleed-through from the reverse side of the page]

File No.....

T. 30 N R. 31 W

DUPLICATE

County Lincoln

STATE OF MONTANA
ADMINISTRATOR OF GROUNDWATER CODE
OFFICE OF STATE ENGINEER

RECEIVED
MAY 27 1963

Declaration of Vested Groundwater Rights

(Under Chapter 237, Montana Session Laws, 1961)

STATE ENGINEER

1. Raymond L. Waldo of Box 143 Libby
(Name of Appropriator) (Address) (Town)
Lincoln Montana
County of State of

have appropriated groundwater according to the Montana laws in effect prior to January 1, 1962, as follows:

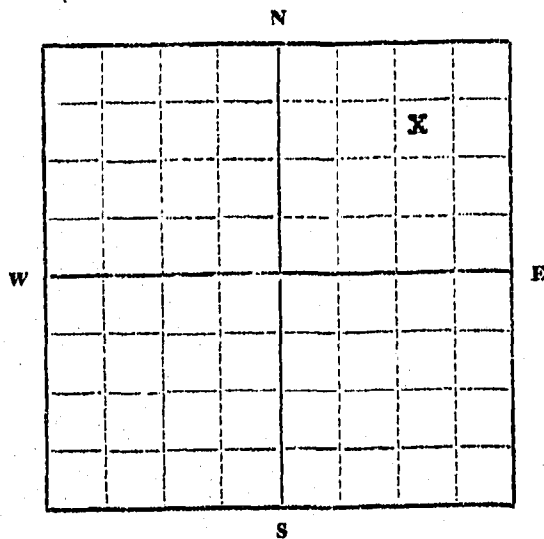

NE 1/4 Sec. 15 T. 30 R. 31

Indicate point of appropriation and place of use, if possible. Each small square represents 10 acres.

2. The beneficial use on which the claim is based domestic use, garden, etc.

3. Date or approximate date of earliest beneficial use, and how continuous, the use has been October, 1954
Used continuously since then.

4. The amount of groundwater claimed (in miner's inches or gallons per minute) 50 gallons per minute

5. If used for irrigation, give the acreage and description of the lands to which water has been applied and name of the owner thereof

6. The means of withdrawing such water from the ground and the location of each well or other means of withdrawal Pressure pump. Pipe line to various outlets. Lot 6, Garren Tracts in Sec. 15, Twp. 30 N., Rgs. 31 W.

7. The date of commencement and completion of the construction of the well, wells, or other works for withdrawal of groundwater October, 1954. Completed in one day.

8. The depth of water table 20 feet

9. So far as it may be available, the type, size and depth of each well or the general specifications of any other works for the withdrawal of groundwater Shallow well - 18 ft. deep

10. The estimated amount of groundwater withdrawn each year used constantly for one family home.

11. The log of formations encountered in the drilling of each well if available not available
Warranty Deed recorded in Book 114, Page 263.

12. Such other information of a similar nature as may be useful in carrying out the policy of this act, including reference to book and page of any county record Warranty Deed, recorded in Book 114, Page 263.

Signature of Owner Raymond L. Waldo

Date May 23, 1963

Three copies to be filed by the owner with the County Clerk and Recorder of the county in which the well is located.

Please answer all questions. If not applicable, so state, otherwise the form will be returned.

Original to the County Clerk and Recorder; duplicate to the State Engineer; Triplicate to the Montana Bureau of Mines and Geology, and Quadruplicate for the Appropriator.

84

STATE OF MONTANA
COUNTY OF LINCOLN

Filed this 23rd day of

May A. D. 1963

at 4:30 P.M.

M. W. Headfield
County Clerk

By W. A. Peterson
Deputy

RECEIVED
NOV 25 1957

MONTANA BUREAU OF MINES AND GEOLOGY
Butte, Montana

T. _____ R. _____
County Lincoln

STATE ENGINEER

WATER WELL LOG

Owner M. EDWARD L. TORREN Address LIBBY, MONT.

Driller J. A. M. E. Address _____

Date Started SEPT 10 Date Completed OCT 31

Location: Sec. 15 T. 30 R. 31 1/4 sec. NE 1/4 NE 1/4 Lot 2

Type of well driven Equipment used weight suspension & electric motor
(Dug, driven, bored, or drilled) (Churn drill, rotary, other)

Water use: Domestic Municipal Stock Irrigation

Industrial Drainage Other: _____

Casing: 0 ft. to 16 ft. Type galvanized pipe Size 2 in.

Casing: _____ ft. to _____ ft. Type _____ Size _____

Casing: _____ ft. to _____ ft. Type _____ Size _____

Perforated or Screened: Ft. 12 to ft. 16 Ft. _____ to ft. _____

Type of screen or perforations 4 in. holes

Static Water level, for non-flowing well: 9 ft below surface feet.

Shut-in pressure, for flowing well: _____ lb./sq. in. on: _____ (date)

Pumping water level 9 ft feet at 1 1/2 gal gal. per min.

How tested: electric pump

Length of test 1 1/2 week

Remarks: (Gravel packing, cementing, packers, type of shut-off, depth of shut-off)

RECEIVED
NOV 10 1959

T. 30 R. 31

County Lincoln

STATE ENGINEER MONTANA BUREAU OF MINES AND GEOLOGY
Butte, Montana

WATER WELL LOG

Owner MEINARD L. TORPEN Address LIBBY MONT.

Driller WIMMACR WELL DRILLING CO. Address

Date Started 10-8-59 Date Completed 10-20-59

Location: Sec. 15 T. 30 R. 31 1/4 sec. NE 1/4 NE 1/4 LOT 2

Type of well DRILLED Equipment used CHURN DRILL
(Dug, driven, bored, or drilled) (Churn drill, rotary, other)

Water use: Domestic Municipal Stock Irrigation

Industrial Drainage Other:

Casing: -3 ft. to 109 ft. Type STEEL Size 6"

Casing: ft. to ft. Type Size

Casing: ft. to ft. Type Size

Perforated or Screened: Ft. to ft. Ft. to ft.

Type of screen or perforations

Static Water level, for non-flowing well: 32 ft. feet.

Shut-in pressure, for flowing well: lb./sq. in. on: (date)

Pumping water level: 109 feet at 6 gal gal. per min. inst.

How tested: Electric Pump

Length of test: 6 hr.

Remarks: (Gravel packing, cementing, packers, type of shut-off, depth of shut-off)

cemented floor of pump house with seal on top of casing to pump

(over)

#24

COUNTY OF MONTANA
COUNTY OF LINCOLN

SS

Filed this 6th day of
November A. D. 1959

at 1:00 P.M.

M. M. Mansfield
County Clerk

By Maie Watson
Deputy

GV

File No.....

T. 30 R. 31

DUPLICATE

County Lincoln

STATE OF MONTANA
ADMINISTRATOR OF GROUNDWATER CODE
OFFICE OF STATE ENGINEER

JAN 27 1964

STATE ENGINEER

Declaration of Vested Groundwater Rights

(Under Chapter 237, Montana Session Laws, 1961)

1. Fay + Florence Fisher, of Box 567 Libby
(Name of Appropriator) (Address) (Town)

County of Lincoln State of Montana
have appropriated groundwater according to the Montana laws in effect prior to January 1, 1962, as follows:

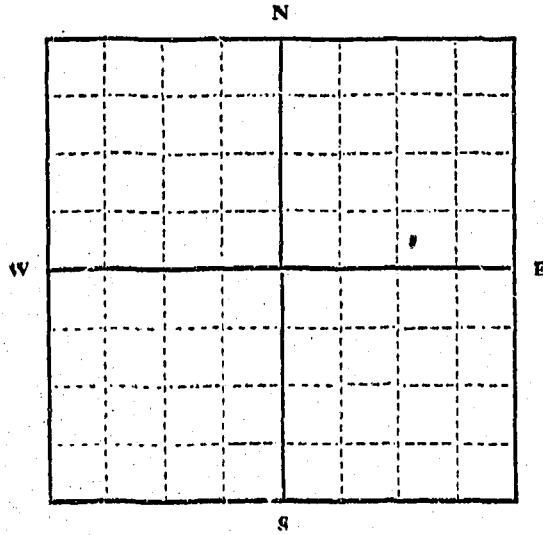

SE 1/4 NE Sec 15 T. 30. R. 31

Indicate point of appropriation and place of use, if possible. Each small square represents 10 acres.

2. The beneficial use on which the claim is based Domestic Water

3. Date or approximate date of earliest beneficial use; and how continuous the use has been Steadily since March 1958

4. The amount of groundwater claimed (in miner's inches or gallons per minute) Not known

5. If used for irrigation, give the acreage and description of the lands to which water has been applied and name of the owner thereof Just for water laws

6. The means of withdrawing such water from the ground and the location of each well or other means of withdrawal Elec. Pump
On Lots 4 + 5

7. The date of commencement and completion of the construction of the well, wells, or other works for withdrawal of groundwater About March 1958

8. The depth of water table.....

9. So far as it may be available, the type, size and depth of each well or the general specifications of any other works for the withdrawal of groundwater 2 1/2 ft

10. The estimated amount of groundwater withdrawn each year Enough For 3 Dwellings

11. The log of formations encountered in the drilling of each well if available Not Available

12. Such other information of a similar nature as may be useful in carrying out the policy of this act, including reference to book and page of any county record None available

Signature of Owner Mrs Fay Fisher

Date Dec 29 1963

Three copies to be filed by the owner with the County Clerk and Recorder of the county in which the well is located.

Please answer all questions. If not applicable, so state, otherwise the form will be returned.

Original to the County Clerk and Recorder; duplicate to the State Engineer; Triplicate to the Montana Bureau of Mines and Geology, and Quadruplicate for the Appropriator.

33849

274

STATE OF MONTANA
COUNTY OF LINCOLN

Filed this 30th day of

December A. D. 1933

at 10:50 A.M.

M. M. Mansfield
County Clerk

By Herda Deputy

File No.....

T. 30 R. 31

DUPLICATE

County Lincoln

STATE OF MONTANA
ADMINISTRATOR OF GROUNDWATER CODE
OFFICE OF STATE ENGINEER

RECEIVED
FEB 17 1964

Declaration of Vested Groundwater Rights

(Under Chapter 237, Montana Session Laws, 1961)

STATE ENGINEER

1. Ralph E. Spencer, of Rt. 1, Box 463 Libby
(Name of Appropriator) (Address) (Town)
County of Lincoln State of Montana
have appropriated groundwater according to the Montana laws in effect prior to January 1, 1962, as follows:

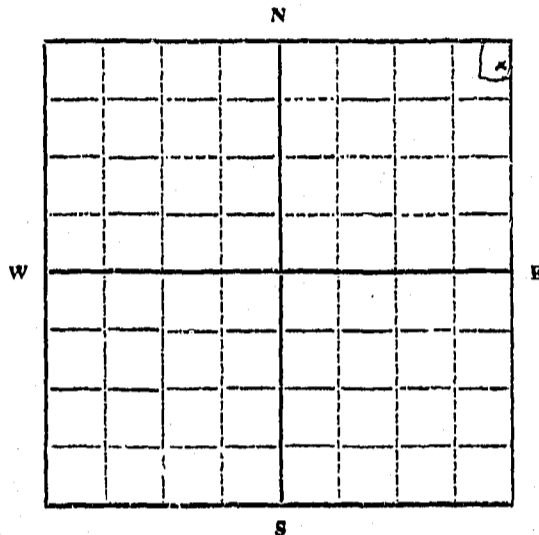

NE 1/4 Sec. 15 T. 30 R. 31

Indicate point of appropriation and place of use, if possible. Each small square represents 10 acres.

- 2. The beneficial use on which the claim is based house use and irrigation of lawns and gardens
- 3. Date or approximate date of earliest beneficial use; and how continuous the use has been Jan. 1951 continual use since
- 4. The amount of groundwater claimed (in miner's inches or gallons per minute) 20 gal. per minute
- 5. If used for irrigation, give the acreage and description of the lands to which water has been applied and name of the owner thereof
two acres lawn and garden
Ralph E. Spencer
Leonard M. Spencer Keneth C. Spencer
- 6. The means of withdrawing such water from the ground and the location of each well or other means of withdrawal
Electric pump

- 7. The date of commencement and completion of the construction of the well, wells, or other works for withdrawal of groundwater Dec. 1950
- 8. The depth of water table 50' (about)
- 9. So far as it may be available, the type, size and depth of each well or the general specifications of any other works for the withdrawal of groundwater
drilled well
6" casing
24' depth
- 10. The estimated amount of groundwater withdrawn each year 1,500,000 gal.
- 11. The log of formations encountered in the drilling of each well if available
15' gravel
50' clay - occasional rocks
20' sand
- 12. Such other information of a similar nature as may be useful in carrying out the policy of this act, including reference to book and page of any county record.....

Signature of Owner Ralph E. Spencer
Date Dec 21, 1963

Three copies to be filed by the owner with the County Clerk and Recorder of the county in which the well is located.
Please answer all questions. If not applicable, so state, otherwise the form will be returned.

Original to the County Clerk and Recorder; duplicate to the State Engineer; Triplicate to the Montana Bureau of Mines and Geology, and Quadruplicate for the Appropriator.

INDEXED

316

(11/24/63)

STATE OF MONTANA
COUNTY OF LINCOLN

Filed this 31st day of

December A. D. 1963

at 7:10 A. M.

Dr. D. Mansfield
County Clerk

By Verla Clayton
Deputy

File No.....

T. 30 R. 3/

DUPLICATE

County Lincoln

STATE OF MONTANA
ADMINISTRATOR OF GROUNDWATER CODE
OFFICE OF STATE ENGINEER

RECEIVED
MAR 5 1964

Declaration of Vested Groundwater Rights

(Under Chapter 237, Montana Session Laws, 1961)

STATE ENGINEER

1. Stuart Leone Risley of Libby
(Name of Appropriator) (Address) (Town)
County of Lincoln State of Montana
have appropriated groundwater according to the Montana laws in effect prior to January 1, 1962, as follows:

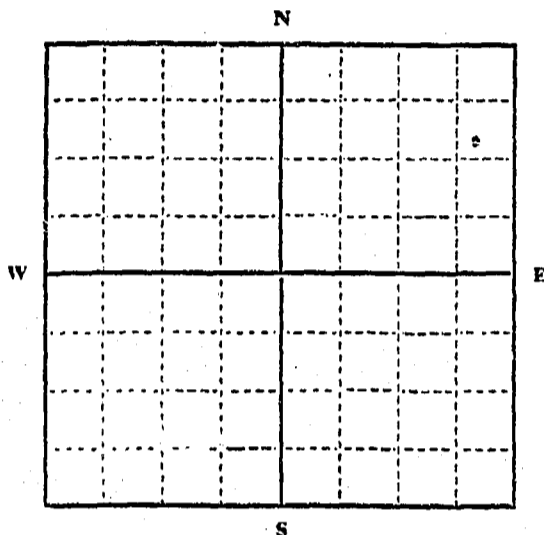

1/4 Sec. 15, T. 30, R. 3/1
Indicate point of appropriation and place of use, if possible. Each small square represents 10 acres.

2. The beneficial use on which the claim is based. Home Use

3. Date or approximate date of earliest beneficial use; and how continuous the use has been. Continuously since 1930

4. The amount of groundwater claimed (in miner's inches or gallons per minute). Approx. 100 gal. per min.

5. If used for irrigation, give the acreage and description of the lands to which water has been applied and name of the owner thereof. Lawn and garden

6. The means of withdrawing such water from the ground and the location of each well or other means of withdrawal. by electric pump. Location - near the house.

7. The date of commencement and completion of the construction of the well, wells, or other works for withdrawal of groundwater. Approx. 1930

8. The depth of water table. Approx. 20 ft.

9. So far as it may be available, the type, size and depth of each well or the general specifications of any other works for the withdrawal of groundwater.

Hand dug well - 25 ft. deep

10. The estimated amount of groundwater withdrawn each year. About 365,000 gal per yr.

11. The log of formations encountered in the drilling of each well if available. None

12. Such other information of a similar nature as may be useful in carrying out the policy of this act, including reference to book and page of any county record. P. R. 13

Part of Sec 5 Block 13 Howard Acres less Risley tracts - Plots 274 + 324

Signature of Owner Stuart Leone Risley
Date 12-31-63

Three copies to be filed by the owner with the County Clerk and Recorder of the county in which the well is located.

Please answer all questions. If not applicable, so state, otherwise the form will be returned.

Original to the County Clerk and Recorder; Duplicate to the State Engineer; Triplicate to the Montana Bureau of Mines and Geology, and Quadruplicate for the Appropriator.

415

INDEXED

STATE OF MONTANA
COUNTY OF LINCOLN

Filed this 31st day of
December A. D. 1963
at 4:59 P. M.
M. W. Mansfield
County Clerk.
By Mae Hatton
Deputy

File No.

T. 30 N. R. 31

DUPLICATE

County Lincoln

STATE OF MONTANA
ADMINISTRATOR OF GROUNDWATER CODE
OFFICE OF STATE ENGINEER

RECEIVED
DEC 19 1963
STATE ENGINEER

Declaration of Vested Groundwater Rights
(Under Chapter 237, Montana Session Laws, 1961)

1. George Rhoades, of Libby
(Name of Appropriator) (Address) (Town)
County of Lincoln State of Montana
have appropriated groundwater according to the Montana laws in effect prior to January 1, 1962, as follows:

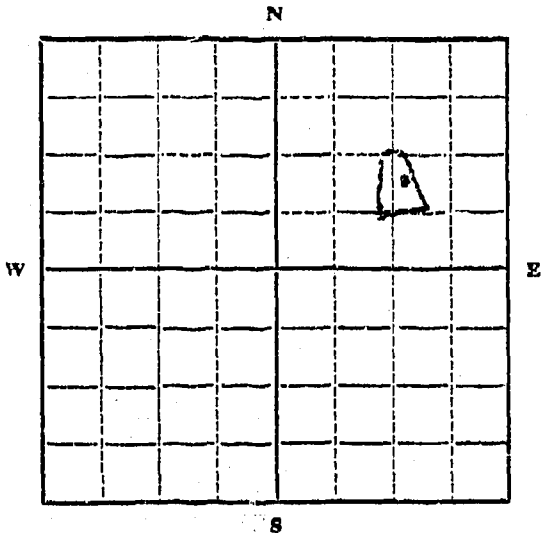

..... 1/4 Sec. 15, T. 30 R. 31.

Indicate point of appropriation and place of use, if possible. Each small square represents 10 acres.

2. The beneficial use on which the claim is based.....
domestic, irrigation and live stock

3. Date or approximate date of earliest beneficial use; and how continuous the use has been.....
used for many years, improved in 1953, use continuous.

4. The amount of groundwater claimed (in miner's inches or gallons per minute).....
10 gal. per min.

5. If used for irrigation, give the acreage and description of the lands to which water has been applied and name of the owner thereof.....
13 acres G.W.R. Part Lots 2, 3, 4 and 5 Howard Acres

6. The means of withdrawing such water from the ground and the location of each well or other means of withdrawal.....
gravity

7. The date of commencement and completion of the construction of the well, wells, or other works for withdrawal of groundwater.....
1953 improved

8. The depth of water table.....
20 ft. below crest of hill

9. So far as it may be available, the type, size and depth of each well or the general specifications of any other works for the withdrawal of groundwater.....
gravity, artesian spring

10. The estimated amount of groundwater withdrawn each year.....
500,000 gal.

11. The log of formations encountered in the drilling of each well if available.....
artesian spring

12. Such other information of a similar nature as may be useful in carrying out the policy of this act, including reference to book and page of any county record.....

Signature of Owner George W Rhoades
Date 17 Dec 1963

Three copies to be filed by the owner with the County Clerk and Recorder of the county in which the well is located.

Please answer all questions. If not applicable, so state, otherwise the form will be returned.

Original to the County Clerk and Recorder; duplicate to the State Engineer; Triplicate to the Montana Bureau of Mines and Geology, and Quadruplicate for the Appropriator.

10398

RECEIVED
CIVIL DIVISION
196

STATE OF MONTANA
COUNTY OF LINCOLN

Filed this 18th day of
December A. D. 1962
at 9:30 A.M.
Walter H. Mansfield
County Clerk
By Mar. H. Olson
Deputy

STATE OF MONTANA
ADMINISTRATOR OF GROUNDWATER CODE
MONTANA WATER RESOURCES BOARD
**NOTICE OF COMPLETION OF GROUNDWATER
APPROPRIATION BY MEANS OF WELL**
Developed after January 1, 1962

(Under Chapter 237 Montana Session Laws, 1961, as amended)

This form to be prepared by driller, and three copies to be filed by the owner with the County Clerk and Recorder in the county in which the well is located, last copy to be retained by driller.

Please answer all questions. If not applicable, so state, otherwise the form may be returned.

Owner Wayne Hartman
Address Libby Mont
Date well started 12-18-72
completed 12-26-72

For Administrator's Use
File # 919
January 17, 1973
GW 1 2:20 P.M.

Type of well Drilled
(Dug, driven, bored or drilled)
Equipment used Churn Drill
(Churn drill, rotary or other)
Water Use: Domestic Municipal Stock Irrigation
Industrial Drainage Other Garden/Lawn

*Describe _____
USE: If used for irrigation, industrial, drainage or other. Explain, state number of acres and location or other data (i.e. Lot, Block and Addition). _____

ESTIMATED ANNUAL WITHDRAWAL

Size of Drilled Hole	Size and Weight of Casing	From (Feet)	To (Feet)	PERFORATIONS		
				Kind Size	From (Feet)	To (Feet)
6"	6800 145	+2	40	1/2" Int.	35'	40'

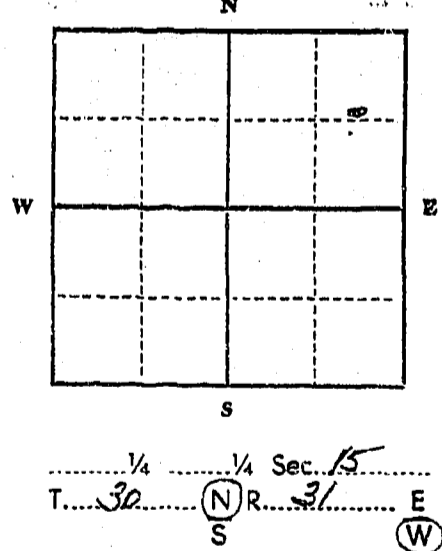

Static water level 15 ft.*
Pumping water level 25 ft.*
at 30 gallons per minute,
measured _____ minutes after pumping began.
*Measured from ground level.
Well developed by Baling
for 3 hours.
Power 230k Pump 1 HP
Remarks: (Gravel packing, cementing, packers, type of shutoff) _____

INDICATE LOCATION OF WELL AND PLACE OF USE, IF POSSIBLE. EACH SMALL SQUARE REPRESENTS 40 ACRES.
Driller's Signature Wayne Hartman
Driller's Address RT 2 Box 508 Libby Mont
293-9240 LICENSE NO. 222

County Lincoln

DRILLER'S LOG

Indicate the character, color, thickness of strata such as soil, clay, sand, gravel, shale, sandstone, etc. Show depth at which water is found and height to which water rises in well.

Top of Ground (Elev. above sea level)		
From (Feet)	To (Feet)	
0	2	Clay
2	22	Coarse sand
22	36	Clay Hardpan
36	40	Water Sand

40 Show exact depth of bottom

15

File No.....

T 30 N R 31 W

DUPLICATE

County Lincoln

STATE OF MONTANA
ADMINISTRATOR OF GROUNDWATER CODE
OFFICE OF STATE ENGINEER

RECEIVED
MAR 5 1964

Declaration of Vested Groundwater Rights

(Under Chapter 237, Montana Session Laws, 1961)

STATE ENGINEER

1. Daniel E. and K. Joan Kershner, of Route 1 Box 314E, Libby, Mont.
(Name of Appropriator) (Address) (Town)

County of Lincoln State of Montana
have appropriated groundwater according to the Montana laws in effect prior to January 1, 1962, as follows:

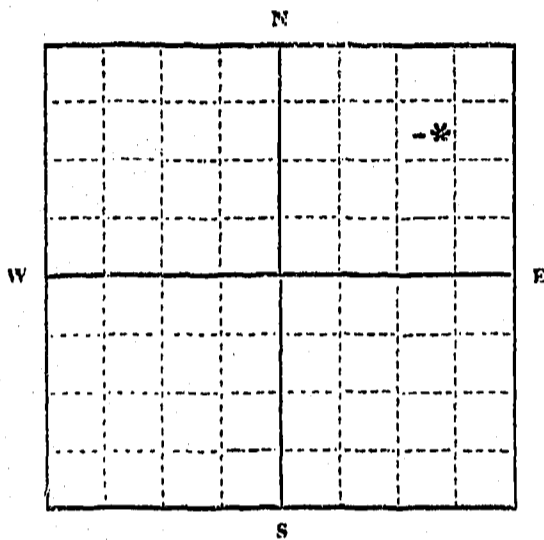

NE 1/4 NE 1/4 Sec. 15, T. 30N, R. 31W

Indicate point of appropriation and place of use, if possible. Each small square represents 10 acres.

2. The beneficial use on which the claim is based.....
Domestic and Irrigation use
3. Date or approximate date of earliest beneficial use; and how continuous the use has been.....
1953 and well is used daily for domestic use
4. The amount of groundwater claimed (in miner's inches or gallons per minute).....
20 gallons per hour
5. If used for irrigation, give the acreage and description of the lands to which water has been applied and name of the owner thereof.....
1/4 acre of lawn and 1/3 acre of grass field
Owner Daniel E & K. Joan Kershner
6. The means of withdrawing such water from the ground and the location of each well or other means of withdrawal.....
Electric shallow well pump. Well is located 20' 00" behind house.
7. The date of commencement and completion of the construction of the well, wells, or other works for withdrawal of groundwater.....
Started construction 1953 and was completed in 1953.
8. The depth of water table.....
6' 0"
9. So far as it may be available, the type, size and depth of each well or the general specifications of any other works for the withdrawal of groundwater.....
Well is 15' 0" deep with an average depth of water at 8' 0". The well is incased with a 18" metal culvert.
10. The estimated amount of groundwater withdrawn each year.....
250,000 gallons
11. The log of formations encountered in the drilling of each well if available.....
unknown
12. Such other information of a similar nature as may be useful in carrying out the policy of this act, including reference to book and page of any county record.....
none

Signature of Owner.....
Daniel E. Kershner

Date.....
Dec 3, 1963

Three copies to be filed by the owner with the County Clerk and Recorder of the county in which the well is located.
Please answer all questions. If not applicable, so state, otherwise the form will be returned.

Original to the County Clerk and Recorder; Duplicate to the State Engineer; Triplicate to the Montana Bureau of Mines and Geology, and Quadruplicate for the Appropriator.

406

INDEXED

C

STATE OF MONTANA
COUNTY OF LINCOLN

Filed this 31st day of
December A. D. 1963

at 11:15 P.M.
M.M. Mansfield
County Clerk.

By Verde H. Jensen
Deputy

RECORDED

NOV 30 1963

C

DEC 31 1963

RECEIVED
MONTANA STATE ARCHIVES
HELENA, MONTANA

RECEIVED
MONTANA STATE ARCHIVES
HELENA, MONTANA

RECEIVED
MONTANA STATE ARCHIVES
HELENA, MONTANA

STATE OF MONTANA
ADMINISTRATOR OF GROUNDWATER CODE
MONTANA WATER RESOURCES BOARD
**NOTICE OF COMPLETION OF GROUNDWATER
APPROPRIATION BY MEANS OF WELL**
Developed after January 1, 1962

DRILLER'S LOG

Indicate the character, color, thickness of strata such as soil, clay, sand, gravel, shale, sandstone, etc. Show depth at which water is found and height to which water rises in well.

(Under Chapter 237 Montana Session Laws, 1961, as amended)

This form to be prepared by driller, and three copies to be filed by the owner with the County Clerk and Recorder in the county in which the well is located, last copy to be retained by driller. Please answer all questions. If not applicable, so state, otherwise the form may be returned.

Owner FRANK LACOUNT

Address SO. HWY 2
LIBBY, MONTANA 59923

Date well started 4/14/71

completed 4/17/71

For Administrator's Use	
File	<u>778</u>
	<u>April 28 1971</u>
	<u>8:40 A.M.</u>
GW 1	

Type of well DRILLED

(Dug, driven, bored or drilled)

Equipment used CHURN DRILL

(Churn drill, rotary or other)

Water Use: Domestic Municipal Stock Irrigation

Industrial Drainage Other * Garden/Lawn

*Describe

USE: If used for irrigation, industrial, drainage or other. Explain, state number of acres and location or other data (i.e. Lot, Block and Addition).

ESTIMATED ANNUAL WITHDRAWAL

Size of Drilled Hole	Size and Weight of Casing	From (Feet)	To (Feet)	PERFORATIONS		
				Kind Size	From (Feet)	To (Feet)
<u>6"</u>	<u>17#</u>	<u>0'</u>	<u>87'</u>	<u>round</u>	<u>0'</u>	<u>87'</u>

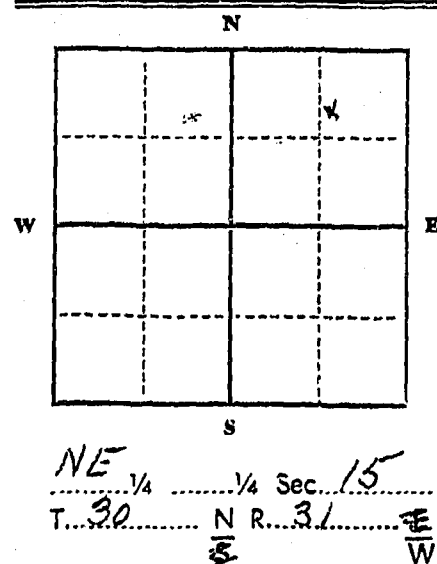

Static water level 40' ft.*
Pumping water level 63' ft.*
at 30 gallons per minute,
measured 15 minutes after pumping
began.

*Measured from ground level.
Well developed by bailing
for 2 1/2 hr. hours.
Power..... Pump..... HP
Remarks: (Gravel packing, cementing,
packers, type of shutoff)

INDICATE LOCATION OF WELL AND PLACE OF USE, IF POSSIBLE. EACH SMALL SQUARE REPRESENTS 40 ACRES.

Driller's Signature Clifford J. Becker

Driller's Address Box "L" Libby Montana 59923

LICENSE NO. 111

Top of Ground (Elev. above sea level)		
From (Feet)	To (Feet)	
<u>0</u>	<u>2</u>	<u>clay</u>
<u>2</u>	<u>16</u>	<u>gravel and water</u>
<u>16</u>	<u>21</u>	<u>water sand</u>
<u>21</u>	<u>74</u>	<u>blue clay with broken rock</u>
<u>74</u>	<u>87</u>	<u>course sand w/water</u>

Show exact depth of bottom

87

48408

File No.

T. 30 R. 31

DUPLICATE

County Lincoln

STATE OF MONTANA
ADMINISTRATOR OF GROUNDWATER CODE
OFFICE OF STATE ENGINEER
JAN 27 1964

Notice of Completion of Groundwater
Appropriation by Means of Well

(Under Chapter 237, Montana Session Laws, 1961)

Owner Alex F. LaCombe Address Libby, Mont.

Driller C.H. Plumbing Address Libby, Mont.

Date of Notice of Appropriation of Groundwater 12-23-63

Date well started 6/20/63 Date Completed 6/24/63

Type of well Drilled Equipment Used Churn
(dug, driven, bored or drilled) (Churn, drill, rotary or other)

Water Use: Domestic Municipal Other Irrigation
Industrial Drainage Stock

Indicate on the diagram the character and thickness of the different strata met with in drilling, such as soil, clay, shale, gravel, rock or sand, etc. Show depth at which water is encountered, thickness and character of water-bearing strata and height to which water rises in the well.

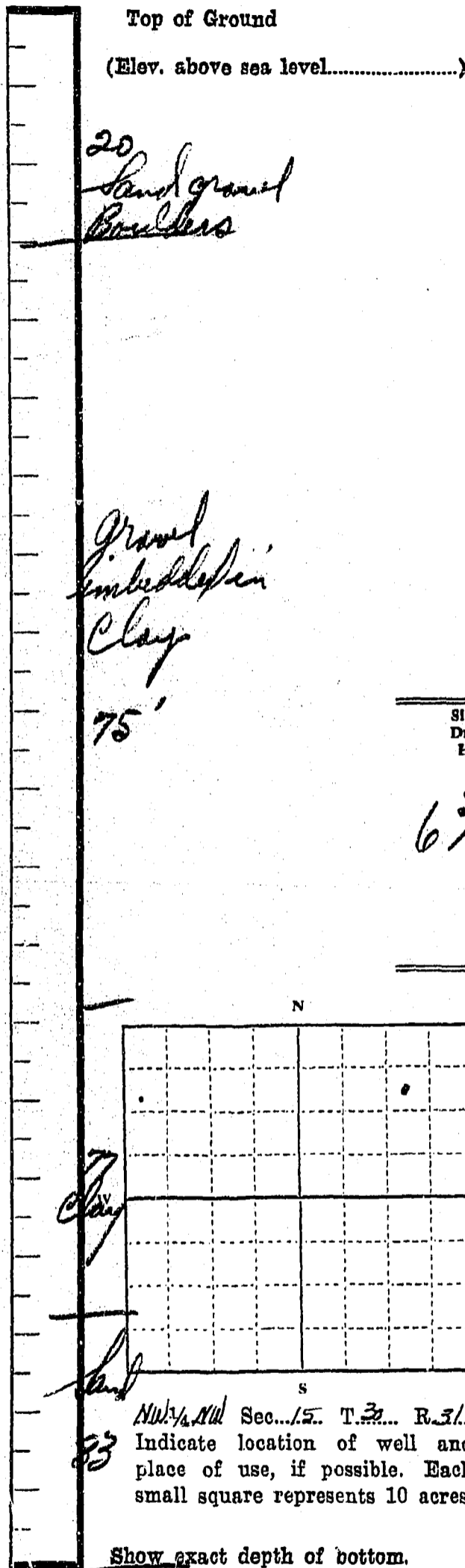

Size of Drilled Hole	Size and Weight of Casing	From (Feet)	To (Feet)	PERFORATIONS		
				Kind Size	From (Feet)	To (Feet)
6 5/8	6 5/8 17#	0	83	1/2 Round	77	83

Static Water Level for non-flowing Well 25 feet.

Shut-in Pressure for Flowing Well

Pumping Water Level 20 feet at 10 gal. per minute.

Discharge in gal. per min. of flowing well

How Tested Boiler Length of Test 2 hrs

Remarks: (Gravel packing, cementing, packers, type of shutoff, location of place of use of groundwater if not at well, and any other similar pertinent information, including number of acres irrigated, if used for irrigation)

141
Driller's License Number
Clifford J. Becker
Driller's Signature

This form to be prepared by driller, and three copies to be filed by the owner with the County Clerk and Recorder in the county in which the well is located.

Please answer all questions. If not applicable, so state, otherwise the form will be returned.

Original to the County Clerk and Recorder; duplicate to the State Engineer; Triplicate to the Montana Bureau of Mines and Geology and Quadruplicate for the Appropriator.

217

INDEXED

STATE OF MONTANA
COUNTY OF LINCOLN

Filed this 23rd day of
December A. D. 1963

at 9:30 P. M.
M. J. Mansfield
County Clerk

By Mac Johnston
Deputy

File No.

T. 3 N. R. 3 W. 15

DUPLICATE

County Lincoln

STATE OF MONTANA
ADMINISTRATOR OF GROUNDWATER CODE
OFFICE OF STATE ENGINEER MAR 5 1964

Notice of Completion of Groundwater Appropriation by Means of Well

(Under Chapter 237, Montana Session Laws, 1961)

Owner: Leo La Belle Address: Libby, Mont.

Driller: C. L. Ploby Address: Libby, Mont.

Date of Notice of Appropriation of Groundwater.....

Date well started Oct 17 Date Completed Oct 20

Type of well Drilled Equipment Used Churn
(dug, driven, bored or drilled) (Churn, drill, rotary or other)

Water Use: Domestic Municipal Other Irrigation
Industrial Drainage Stock

Indicate on the diagram the character and thickness of the different strata met with in drilling, such as soil, clay, shale, gravel, rock or sand, etc. Show depth at which water is encountered, thickness and character of water-bearing strata and height to which water rises in the well.

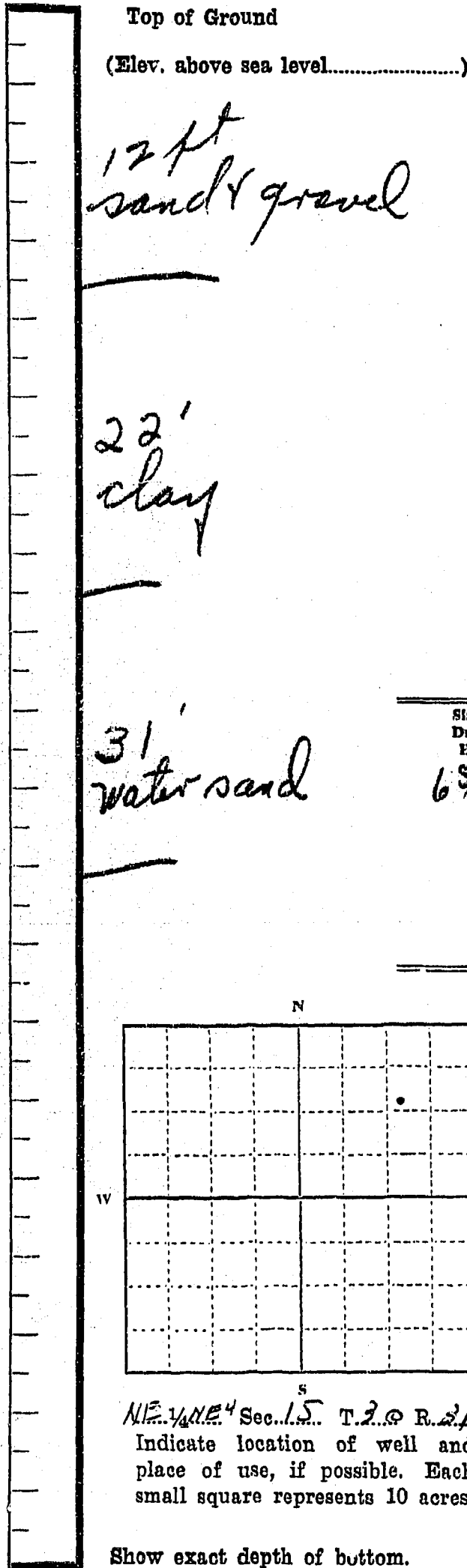

Size of Drilled Hole	Size and Weight of Casing	From (Feet)	To (Feet)	PERFORATIONS		
				Kind Size	From (Feet)	To (Feet)
6 5/8	6 5/8 17#	0	31	1/2 in	25	31

Static Water Level for non-flowing Well..... 22 feet.

Shut-in Pressure for Flowing Well.....

Pumping Water Level..... 16' feet at 20 gal. per minute.

Discharge in gal. per min. of flowing well.....

How Tested..... Bailer Length of Test..... 2 hrs

Remarks: (Gravel packing, cementing, packers, type of shutoff, location of place of use of groundwater if not at well, and any other similar pertinent information, including number of acres irrigated, if used for irrigation).....

141
Driller's License Number

Sherman Marshall
Driller's Signature

This form to be prepared by driller, and three copies to be filed by the owner with the County Clerk and Recorder in the county in which the well is located.

Please answer all questions. If not applicable, so state, otherwise the form will be returned.

Original to the County Clerk and Recorder; duplicate to the State Engineer; Triplicate to the Montana Bureau of Mines and Geology and Quadruplicate for the Appropriator.

INDEXED

2144

STATE OF MONTANA
COUNTY OF LINCOLN

Filed this 10th day of
January A. D. 1964
at 9:35 A.M.
by M. M. Mansfield County Clerk
Mae Nelson Deputy

RECEIVED

County Lincoln

STATE OF MONTANA
ADMINISTRATOR OF GROUNDWATER CODE
MONTANA WATER RESOURCES BOARD
DEPARTMENT OF NATURAL RESOURCES AND CONSERVATION

NOTICE OF COMPLETION OF GROUNDWATER
APPROPRIATION BY MEANS OF WELL

Developed after January 1, 1962

DRILLER'S LOG

Indicate the character, color, thickness of strata such as soil, clay, sand, gravel, shale, sandstone, etc. Show depth at which water is found and height to which water rises in well.

(Under Chapter 237 Montana Session Laws, 1961, as amended)

This form to be prepared by driller, and three copies to be filed by the owner with the County Clerk and Recorder in the county in which the well is located, last copy to be retained by driller. Please answer all questions. If not applicable, so state, otherwise the form may be returned.

Owner M. M. Mansfield
William J. Anderson
 Address Rental Co.
Box 2 Libby Mont.
 Date well started 10-19-71 GW 1
 completed 10-30-71

For Administrator's Use
 File 854, March 22, 1972
1:00 p.m.

Type of well Drilled
 (Dug, driven, bored or drilled)
 Equipment used Churn
 (Churn drill, rotary or other)
 Water Use: Domestic Municipal Stock Irrigation
 Industrial Drainage Other * Garden/Lawn

*Describe _____
 USE: If used for irrigation, industrial, drainage or other. Explain, state number of acres and location or other data (i.e. Lot, Block and Addition). _____

ESTIMATED ANNUAL WITHDRAWAL _____

Size of Drilled Hole	Size and Weight of Casing	From (Feet)	To (Feet)	PERFORATIONS		
				Kind Size	From (Feet)	To (Feet)
6"	19#	0	130	1/2 R	0'	3'

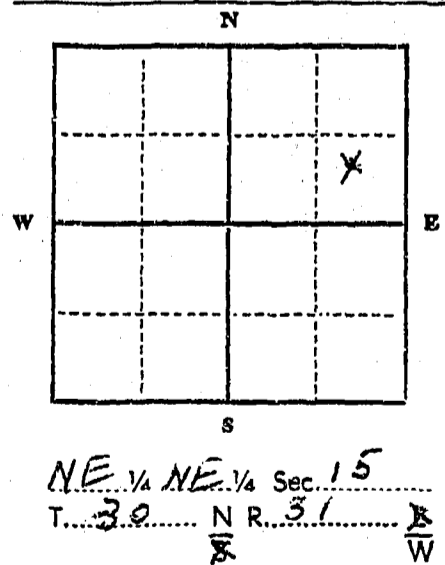

Static water level 25 ft.*
 Pumping water level 35 ft.*
 at 15 gallons per minute
 measured _____ minutes after pumping began.
 *Measured from ground level.
 Well developed by bailed
 for 2 hours.
 Power _____ Pump _____ HP
 Remarks: (Gravel packing, cementing, packers, type of shutoff) _____

Top of Ground		(Elev. above sea level)
From (Feet)	To (Feet)	
0	5	Clay & gravel
5	8	Loose sand & gravel
8	22	Cobblestone in clay
22	63	Clay & gravel
63	76	silt clay
76	81	clay & gravel
81	86	silty clay
86	91	clay & gravel
91	100	silty gravel with 2 gal PM silt
100	107	gravel & water 5 GPM
107	120	Clay
120	134	gravel & water 8 GPM
134	130	clay & gravel water

INDICATE LOCATION OF WELL AND PLACE OF USE, IF POSSIBLE. EACH SMALL SQUARE REPRESENTS 40 ACRES.

Driller's Signature Clifford J. Bucher
 Driller's Address Box 2 Libby Mont.
 LICENSE NO. 141

130 Show exact depth of bottom

50,736

RECEIVED

County Lincoln

STATE OF MONTANA
ADMINISTRATOR OF GROUNDWATER CODE
MONTANA WATER RESOURCES BOARD

MAY 16 1973

DRILLER'S LOG

Indicate the character, color, thickness of strata such as soil, clay, sand, gravel, shale, sandstone, etc. Show depth at which water is found and height to which water rises in well.

NOTICE OF COMPLETION OF GROUNDWATER APPROPRIATION BY MEANS OF WELL

Developed after January 1, 1962

(Under Chapter 237 Montana Session Laws, 1961, as amended)

This form to be prepared by driller, and three copies to be filed by the owner with the County Clerk and Recorder in the county in which the well is located, last copy to be retained by driller. Please answer all questions. If not applicable, so state, otherwise the form may be returned.

Owner Charles W. Martin

Address P. O. Box 943

Libby, Montana 59223

Date well started March 16, 1973

completed March 22, 1973

For Administrator's Use	
File	<u>944</u>
	<u>May 14, 1973</u>
GW	<u>10:10 A.M.</u>

Type of well Drilled

(Dug, driven, bored or drilled)

Equipment used Air Rotary

(Churn drill, rotary or other)

Water Use: Domestic Municipal Stock Irrigation

Industrial Drainage Other * Garden/Lawn

*Describe

USE: If used for irrigation, industrial, drainage or other. Explain, state number of acres and location or other data (i.e. Lot, Block and Addition).

ESTIMATED ANNUAL WITHDRAWAL 80,000 Gal. Per Yr.

Size of Drilled Hole	Size and Weight of Casing	From (Feet)	To (Feet)	PERFORATIONS		
				Kind Size	From (Feet)	To (Feet)
<u>6" I.D. 6 5/8"</u>	<u>O.D. 17.00 lbs. per ft.</u>	<u>0</u>	<u>86</u>	<u>None</u>		

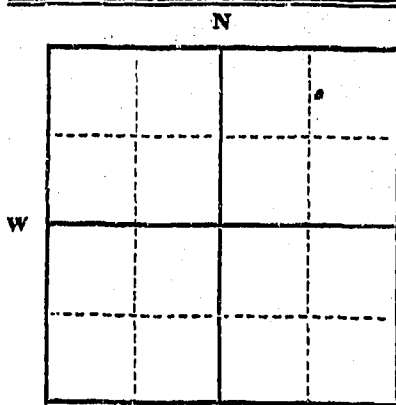

NE 1/4 NE 1/4 Sec. 15
T. 30 N R. 31 E
S W

Static water level 43 ft.*
Pumping water levelft.*
at 15 gallons per minute,
measured 210 minutes after pumping began.

*Measured from ground level.
Well developed by air compressor
for 4 hours.

Power..... Pump..... HP
Remarks: (Gravel packing, cementing, packers, type of shutoff)

INDICATE LOCATION OF WELL AND PLACE OF USE, IF POSSIBLE. EACH SMALL SQUARE REPRESENTS 40 ACRES.

Driller's Signature Wm D Lake

Driller's Address P. O. Box 967

Libby, Montana 59223 LICENSE NO. 152

Top of Ground (Elev. above sea level)		
From (Feet)	To (Feet)	
<u>0</u>	<u>1</u>	<u>Topsoil.</u>
<u>1</u>	<u>12</u>	<u>Clay and Gravel.</u>
<u>12</u>	<u>16</u>	<u>Gravel and some water.</u>
<u>16</u>	<u>70</u>	<u>Layers of colored blms. brown, green, grey & yellow.</u>
<u>70</u>	<u>83</u>	<u>Yellow Clay and Gravel.</u>
<u>83</u>	<u>86</u>	<u>Sand, Gravel and Water.</u>

86 ft. Show exact depth of bottom

53,160

Garren Tracts Lot 9

Sec. 15 T. 30 R. 31

County Lincoln

RECEIVED
JAN 20 1958

MONTANA BUREAU OF MINES AND GEOLOGY
Butte, Montana

STATE ENGINEER

WATER WELL LOG

Owner Lester Nadreau Sr. Address Libby Mont

Driller L.O. Wammack Address Libby Mont

Date Started Sept 15th 57 Date Completed Oct 30th 57

Location: Sec. _____ T. _____ R. _____ 1/4 sec. _____

Type of well Drilled 6" casing Equipment used Wise
(Dug, driven, bored, or drilled) (Churn drill, rotary, other)

Water use: Domestic Municipal Stock Irrigation

Industrial Drainage Other: Sprinkling

Casing: Surface ft. to 97 ft. Type Steel Size Six Inches

Casing: _____ ft. to _____ ft. Type _____ Size _____

Casing: _____ ft. to _____ ft. Type _____ Size _____

Perforated or Screened: Ft. None to ft. _____ Ft. _____ to ft. _____

Type of screen or perforations No screen or perforations

Static Water level, for non-flowing well: approx 55 ft feet.

Shut-in pressure, for flowing well: _____ lb./sq. in. on: _____ (date)

Pumping water level: 94 feet at Six gal. per min.

How tested: Pumps

Length of test: Six hrs

Remarks: (Gravel packing, cementing, packers, type of shut-off, depth of shut-off)

Drilling stopped at 97 ft in course
gravel

(over)

967

STATE OF MONTANA
COUNTY OF LINCOLN

Filed this 20th day of

June A. D. 1973

At 12:30 P. M.

By Calvin L. Vaughn County Clerk

By Mae Watson Deputy

[Faint, illegible handwritten text, possibly a signature or notes]

[Faint, illegible text, possibly a stamp or header]

[Faint, illegible text, possibly a stamp or footer]

C

OW

3015

File No.....

T. 30 N. R. 31 W.

DUPLICATE

County Lincoln

STATE OF MONTANA
ADMINISTRATOR OF GROUNDWATER CODE
OFFICE OF STATE ENGINEER

RECEIVED

MAR 27 1964

Declaration of Vested Groundwater Rights

(Under Chapter 237, Montana Session Laws, 1961)

STATE ENGINEER

1. Howard H. Bell + Daisy S. Bell, of P.O. Box 455 Libby
(Name of Appropriator) (Address) (Town)
County of Lincoln State of Montana
have appropriated groundwater according to the Montana laws in effect prior to January 1, 1962, as follows:

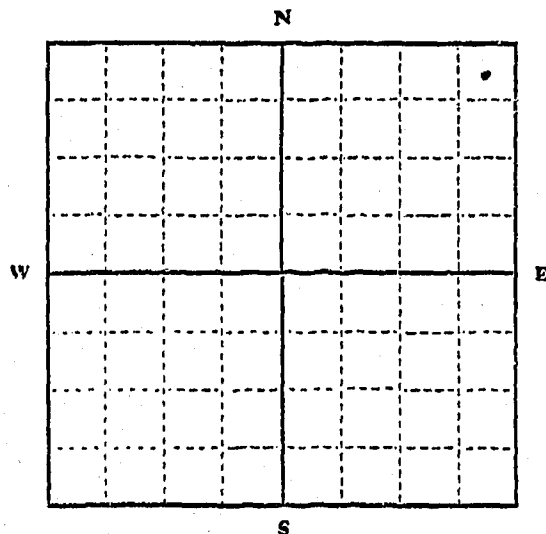

1/4 NE Sec. 15 T. 30 R. 31
Indicate point of appropriation and place of use, if possible. Each small square represents 10 acres.

2. The beneficial use on which the claim is based Domestic Stock Irrigation

3. Date or approximate date of earliest beneficial use; and how continuous the use has been 1955 continuous yearly

4. The amount of groundwater claimed (in miner's inches or gallons per minute) 10 gal per min

5. If used for irrigation, give the acreage and description of the lands to which water has been applied and name of the owner thereof 1/2 acres

6. The means of withdrawing such water from the ground and the location of each well or other means of withdrawal deep well jet pump

7. The date of commencement and completion of the construction of the well, wells, or other works for withdrawal of groundwater 1955

8. The depth of water table 82 ft.

9. So far as it may be available, the type, size and depth of each well or the general specifications of any other works for the withdrawal of groundwater drilled 4 in casing

10. The estimated amount of groundwater withdrawn each year 290,000

11. The log of formations encountered in the drilling of each well if available none

12. Such other information of a similar nature as may be useful in carrying out the policy of this act, including reference to book and page of any county record none

Signature of Owner Daisy S. Bell
Howard H. Bell
Date Dec 31 1963

Three copies to be filed by the owner with the County Clerk and Recorder of the county in which the well is located.

Please answer all questions. If not applicable, so state, otherwise the form will be returned.

Original to the County Clerk and Recorder; Duplicate to the State Engineer; Triplicate to the Montana Bureau of Mines and Geology, and Quadruplicate for the Appropriator.

35519

417

STATE OF MONTANA
COUNTY OF LINCOLN

Filed this 31st day of
December A. D. 1963

at 12:30 P M.
W. M. Mansfield
County Clerk.

By Mae Watson
Deputy

GV

File No.

T. 30 N. R. 31 W. 15

DUPLICATE

County Lincoln

STATE OF MONTANA
ADMINISTRATOR OF GROUNDWATER CODE
OFFICE OF STATE ENGINEER

RECEIVED
MAR 5 1964

Declaration of Vested Groundwater Rights
(Under Chapter 237, Montana Session Laws, 1961)

STATE ENGINEER

1. Howard F. Bell, of Libby,
(Name of Appropriator) (Address) (Town)
County of Lincoln State of Montana
have appropriated groundwater according to the Montana laws in effect prior to January 1, 1962, as follows:

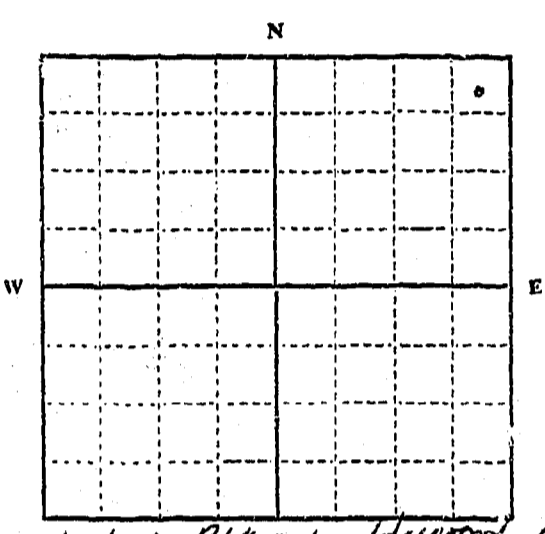

1/2 Lot 2, Bk. 1, Howard Acres.
NE Sec 25 T. 30 R. 31

Indicate point of appropriation and place of use, if possible. Each small square represents 10 acres.

2. The beneficial use on which the claim is based Domestic livestock irrigation

3. Date or approximate date of earliest beneficial use; and how continuous the use has been. 1950 yearly
continuous

4. The amount of groundwater claimed (in miner's inches or gallons per minute) 11 gal per min

5. If used for irrigation, give the acreage and description of the lands to which water has been applied and name of the owner thereof.
1/2 acre Howard F. Bell
1/2 Lot 2 Bk 1 Howard Acres
Sec 24 T. 30 R. 31

6. The means of withdrawing such water from the ground and the location of each well or other means of withdrawal jet pump

7. The date of commencement and completion of the construction of the well, wells, or other works for withdrawal of groundwater 1950

8. The depth of water table 89 feet

9. So far as it be available, the type, size and depth of each well or the general specifications of any other works for the withdrawal of groundwater drilled 6 in. casing to 89 ft.

10. The estimated amount of groundwater withdrawn each year 300,000

11. The log of formations encountered in the drilling of each well if available none

12. Such other information of a similar nature as may be useful in carrying out the policy of this act, including reference to book and page of any county record none

Signature of Owner Howard F. Bell
Date December 31, 1963

Three copies to be filed by the owner with the County Clerk and Recorder of the county in which the well is located.
Please answer all questions. If not applicable, so state, otherwise the form will be returned.

Original to County Clerk and Recorder; Duplicate to the State Engineer; Triplicate to the Montana Bureau of Mines and Geology, and Quadruplicate for the Appropriator. 35103

File No.

T. 30 R. 31 W. 15

DUPLICATE

County Lincoln

STATE OF MONTANA
ADMINISTRATOR OF GROUNDWATER CODE
OFFICE OF STATE ENGINEER

RECEIVED
MAR 5 1964

Declaration of Vested Groundwater Rights
(Under Chapter 237, Montana Session Laws, 1961)

STATE ENGINEER

1. Howard L. Bell, of Libby (Town)
(Name of Appropriator) (Address)
County of Lincoln State of Montana
have appropriated groundwater according to the Montana laws in effect prior to January 1, 1962, as follows:

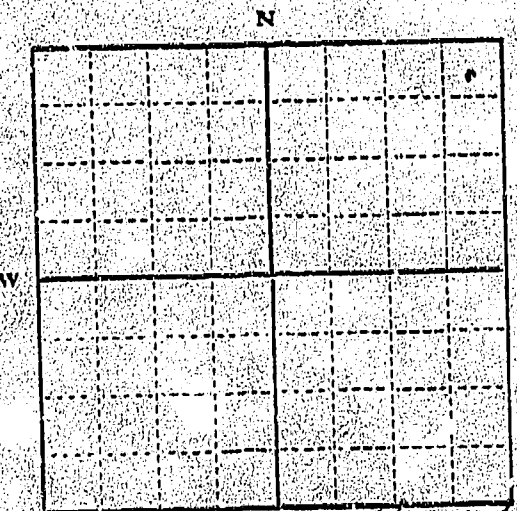

7 1/2 Lot 2, Blk. 51, Howard Acres
1/4 NE Sec. 25 T. 30 R. 31

Indicate point of appropriation and place of use, if possible. Each small square represents 10 acres.

- 2. The beneficial use on which the claim is based Domestic Live stock irrigation
- 3. Date or approximate date of earliest beneficial use; and how continuous the use has been 1950 continuous
- 4. The amount of groundwater claimed (in miner's inches or gallons per minute) 11 gal. per min.
- 5. If used for irrigation, give the acreage and description of the lands to which water has been applied and name of the owner thereof 1/2 acre Howard L. Bell
7 1/2 lot 2 Blk. 51 Howard Acres
Sec. 24 T. 30 R. 31
- 6. The means of withdrawing such water from the ground and the location of each well or other means of withdrawal jet pumps

- 7. The date of commencement and completion of the construction of the well, wells, or other works for withdrawal of groundwater 1950
- 8. The depth of water table 89 feet
- 9. So far as it may be available, the type, size and depth of each well or the general specifications of any other works for the withdrawal of groundwater drilled to max. casing to 89 ft.
- 10. The estimated amount of groundwater withdrawn each year 300,000
- 11. The log of formations encountered in the drilling of each well if available none
- 12. Such other information of a similar nature as may be useful in carrying out the policy of this act, including reference to book and page of any county record none

Signature of Owner Howard L. Bell
Date December 31, 1963

Three copies to be filed by the owner with the County Clerk and Recorder of the county in which the well is located.

Please answer all questions. If not applicable, so state, otherwise the form will be returned.

Original to the County Clerk and Recorder; Duplicate to the State Engineer; Triplicate to the Montana Bureau of Mines and Geology, and Quadruplicate for the Appropriator.

35,08

573

STATE OF MONTANA
COUNTY OF LINCOLN

Filed this 31st day of

December A. D. 1963.

at 11:23 A. M.

M. M. Mansfield
County Clerk

By Leslie Edgemon
Deputy

GW

Approved Stock Form—State Publishing Co., Helena, Montana—4224

File No.

T. 30 N. R. 31

DUPLICATE

County Lincoln

STATE OF MONTANA
ADMINISTRATOR OF GROUNDWATER CODE
OFFICE OF STATE ENGINEER

RECEIVED
MAR 5 1964

Declaration of Vested Groundwater Rights STATE ENGINEER
(Under Chapter 237, Montana Session Laws, 1961)

1. Clarence M. Deery (Name of Appropriator), of RT 30, 436 (Address), Box 303, Libby (Town), Mont. (State)

County of Lincoln have appropriated groundwater according to the Montana laws in effect prior to January 1, 1962, as follows:

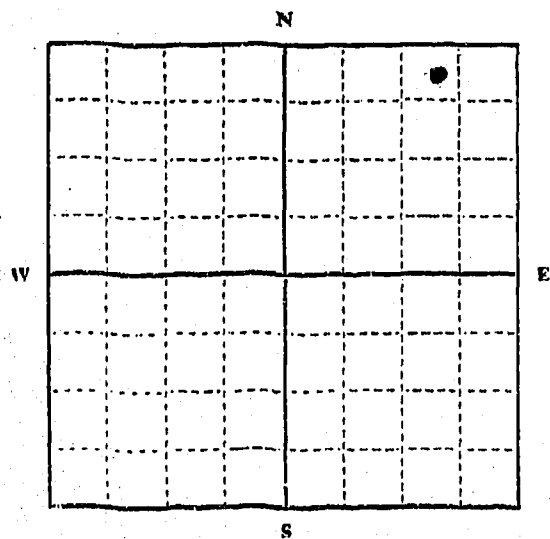

NE 1/4 NE Sec. 15, T. 30, R. 31

Indicate point of appropriation and place of use, if possible. Each small square represents 10 acres.

2. The beneficial use on which the claim is based household

3. Date or approximate date of earliest beneficial use; and how continuous the use has been 1960 continuous household use

4. The amount of groundwater claimed (in miner's inches or gallons per minute) quite a few

5. If used for irrigation, give the acreage and description of the lands to which water has been applied and name of the owner thereof For lawn only

6. The means of withdrawing such water from the ground and the location of each well or other means of withdrawal one well on lot 15 in Gurrin Tract of lots 14-15-16

7. The date of commencement and completion of the construction of the well, wells, or other works for withdrawal of groundwater Approximately 1958

8. The depth of water table 35'

9. So far as it may be available, the type, size and depth of each well or the general specifications of any other works for the withdrawal of groundwater 35' and one well only

10. The estimated amount of groundwater withdrawn each year Household use only

11. The log of formations encountered in the drilling of each well if available Don't know

12. Such other information of a similar nature as may be useful in carrying out the policy of this act, including reference to book and page of any county record none

Signature of Owner Clarence M. Deery

Date 12-31-63

Three copies to be filed by the owner with the County Clerk and Recorder of the county in which the well is located.

Please answer all questions. If not applicable, so state, otherwise the form will be returned.

Original to the County Clerk and Recorder; Duplicate to the State Engineer; Triplicate to the Montana Bureau of Mines and Geology, and Quadruplicate for the Appropriator.

35061

INDEXED

331



STATE OF MONTANA
COUNTY OF LINCOLN

Filed this 3/5 day of

December A. D. 1963

at 9:20 A. M.

Dr. M. Mangold
County Clerk

By Verde Stephens
Deputy

File No.....

T. 30 N R. 31 W

DUPLICATE

County Lincoln

STATE OF MONTANA
ADMINISTRATOR OF GROUNDWATER CODE
OFFICE OF STATE ENGINEER

RECEIVED
SEP 16 1963

Declaration of Vested Groundwater Rights

(Under Chapter 237, Montana Session Laws, 1961)

STATE ENGINEER

1. Mrs. Alma Dutton, of Rt. 1 Box 314 A Libby, Montana
(Name of Appropriator) (Address) (Town)
County of Lincoln State of Montana
have appropriated groundwater according to the Montana laws in effect prior to January 1, 1962, as follows:

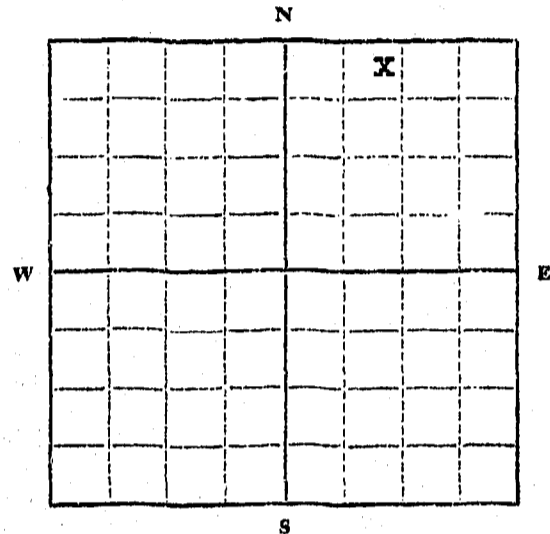

NW 1/4 NE 1/4 Sec 15 T. 30 N R. 31 W

Indicate point of appropriation and place of use, if possible. Each small square represents 10 acres.

Lot 8, Howard Acres

2. The beneficial use on which the claim is based Domestic and Irrigation use

3. Date or approximate date of earliest beneficial use; and how continuous the use has been August 1957 Every Day-Year around

4. The amount of groundwater claimed (in miner's inches or gallons per minute) Eight (8) 1/2 gallons per minute

5. If used for irrigation, give the acreage and description of the lands to which water has been applied and name of the owner thereof Garden, lawn and small field (5 acres) Mrs. Alma Dutton

6. The means of withdrawing such water from the ground and the location of each well or other means of withdrawal Electric deep well pump

7. The date of commencement and completion of the construction of the well, wells, or other works for withdrawal of groundwater August 1957

8. The depth of water table 30 feet

9. So far as it may be available, the type, size and depth of each well or the general specifications of any other works for the withdrawal of groundwater 8 inch steel casing-42 feet deep

10. The estimated amount of groundwater withdrawn each year 120,000 gallons

11. The log of formations encountered in the drilling of each well if available Mr. Klen Boothman Libby, Montana

12. Such other information of a similar nature as may be useful in carrying out the policy of this act, including reference to book and page of any county record None

Signature of Owner Alma Dutton

Date August 11, 1963

Three copies to be filed by the owner with the County Clerk and Recorder of the county in which the well is located.

Please answer all questions. If not applicable, so state, otherwise the form will be returned.

Original to the County Clerk and Recorder; duplicate to the State Engineer; Triplicate to the Montana Bureau of Mines and Geology, and Quadruplicate for the Appropriator.

5895

120

STATE OF MONTANA
 COUNTY OF LINCOLN

Filed this 16 day of
August A. D. 1913
 at 3:10 P.M.
M. M. Mansfield
 County Clerk
 By Elena Vaughn
 Deputy

RECORDED
 CIVIL DIVISION

RECORDED
 CIVIL DIVISION

INDEXED

FILED

SEP 1 1913

CLERK

15

File No.....

T. 30 N R. 31 W

DUPLICATE

County Lincoln

STATE OF MONTANA
ADMINISTRATOR OF GROUNDWATER CODE
OFFICE OF STATE ENGINEER

RECEIVED
SEP 16 1963

Declaration of Vested Groundwater Rights

(Under Chapter 237, Montana Session Laws, 1961)

STATE ENGINEER

1. Mrs. Alma Dutton of Rt. 1 Box 314A Libby, Montana
(Name of Appropriator) (Address) (Town)

County of Lincoln State of Montana

have appropriated groundwater according to the Montana laws in effect prior to January 1, 1962, as follows:

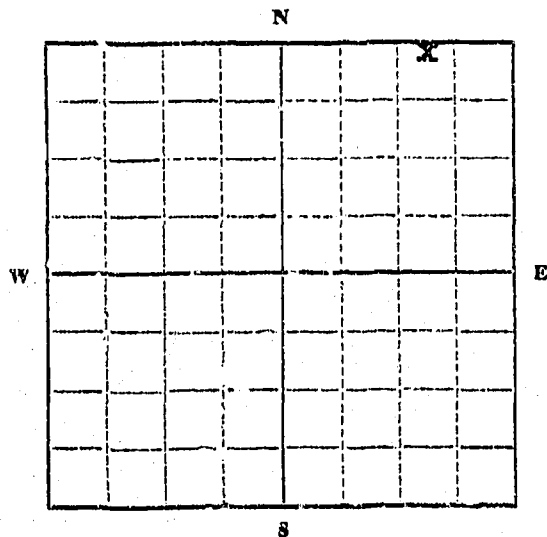

NE 1/4 NE 1/4 Sec. 15 T. 30 N R. 31 W

Indicate point of appropriation and place of use, if possible. Each small square represents 10 acres.

Howard Acres

2. The beneficial use on which the claim is based. Domestic and irrigation use

3. Date or approximate date of earliest beneficial use; and how continuous the use has been. September 1961 Every Day-Year around

4. The amount of ground water claimed (in miner's inches or gallons per minute). Eight (8) gallons per minute

5. If used for irrigation, give the acreage and description of the lands to which water has been applied and name of the owner thereof. Garden, lawn and small field (2 acres) Mrs. Alma Dutton

6. The means of withdrawing such water from the ground and the location of each well or other means of withdrawal. Electric deep well pump

7. The date of commencement and completion of the construction of the well, wells, or other works for withdrawal of groundwater. September 1961

8. The depth of water table. 70 feet

9. So far as it may be available, the type, size and depth of each well or the general specifications of any other works for the withdrawal of groundwater. 6 inch steel casing-82 feet deep

10. The estimated amount of groundwater withdrawn each year. 120,000 gallons

11. The log of formations encountered in the drilling of each well if available. Mr. Wammack - Has move from Libby. Whereabouts Unknown

12. Such other information of a similar nature as may be useful in carrying out the policy of this act, including reference to book and page of any county record. None

Signature of Owner Alma Dutton

Date August 11, 1963

Three copies to be filed by the owner with the County Clerk and Recorder of the county in which the well is located.

Please answer all questions. If not applicable, so state, otherwise the form will be returned.

Original to the County Clerk and Recorder; duplicate to the State Engineer; Triplicate to the Montana Bureau of Mines and Geology, and Quadruplicate for the Appropriator.

5894.

#119

STATE OF MONTANA
COUNTY OF LINCOLN

Filed this 14 day of
August A. D. 1963
at 2:05 P. M.
M. M. Mansfield
County Clerk.
By L. Leann Vaughn
Deputy

15

File No.

T. 30 N. R. 31 W

DUPLICATE

County. Lincoln

STATE OF MONTANA
ADMINISTRATOR OF GROUNDWATER CODE
OFFICE OF STATE ENGINEER

RECEIVED
SEP 16 1963

Declaration of Vested Groundwater Rights
(Under Chapter 237, Montana Session Laws, 1961)

1. Mrs. Alma Dutton, of Route 1, Box 314-A Libby, Montana
(Name of Appropriator) (Address) (Town)
County of Lincoln State of Montana
have appropriated groundwater according to the Montana laws in effect prior to January 1, 1962, as follows:

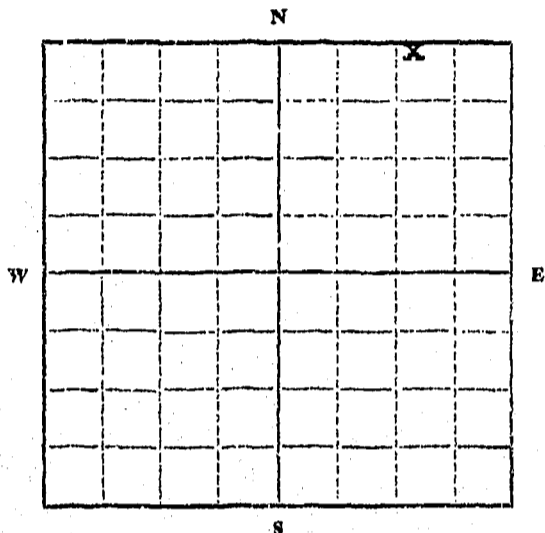

NE 1/4 Sec. 15 T. 30 N. R. 31 W

Indicate point of appropriation and place of use, if possible. Each small square represents 10 acres.

Howard Acres

2. The beneficial use on which the claim is based. Domestic and irrigation use

3. Date or approximate date of earliest beneficial use; and how continuous the use has been. July 1948
Every Day - Year around

4. The amount of groundwater claimed (in miner's inches or gallons per minute). (7) Seven gallons per minute

5. If used for irrigation, give the acreage and description of the lands to which water has been applied and name of the owner thereof. Garden, lawn and small field (1 acre)

6. The means of withdrawing such water from the ground and the location of each well or other means of withdrawal. Electric shallow well pump

7. The date of commencement and completion of the construction of the well, wells, or other works for withdrawal of groundwater. July 1948

8. The depth of water table. (7) Seven feet

9. So far as it may be available, the type, size and depth of each well or the general specifications of any other works for the withdrawal of groundwater. 15 inch steel casing - 10 feet deep

10. The estimated amount of groundwater withdrawn each year. 90,000 gallons

11. The log of formations encountered in the drilling of each well if available. This well was dug by hand by the above mentioned owner.

12. Such other information of a similar nature as may be useful in carrying out the policy of this act, including reference to book and page of any county record. None

Signature of Owner. Alma Dutton

Date. August 11, 1963

Three copies to be filed by the owner with the County Clerk and Recorder of the county in which the well is located.

Please answer all questions. If not applicable, so state, otherwise the form will be returned.

Original to the County Clerk and Recorder; duplicate to the State Engineer; Triplicate to the Montana Bureau of Mines and Geology, and Quadruplicate to the Appropriator.

5893

118

RECEIVED

STATE OF MONTANA
 COUNTY OF LINCOLN

Filed this 16 day of August A. D. 1963
 at 2:00 P. M.
 By M. M. Mansfield County Clerk
James [unclear] Deputy

...

...

...

...

...

GW

File No.

T. 30 N 31 R 31

DUPLICATE

County LINCOLN

STATE OF MONTANA
ADMINISTRATOR OF GROUNDWATER CODE
OFFICE OF STATE ENGINEER

RECEIVED
MAR 27 1964

Declaration of Vested Groundwater Rights

(Under Chapter 237, Montana Session Laws, 1961)

STATE ENGINEER

1. Juryla P. Pleas, of P.O. Box 765
(Name of Appropriator) (Address) (Town)

County of Lincoln State of Montana Libby

have appropriated groundwater according to the Montana laws in effect prior to January 1, 1962, as follows:

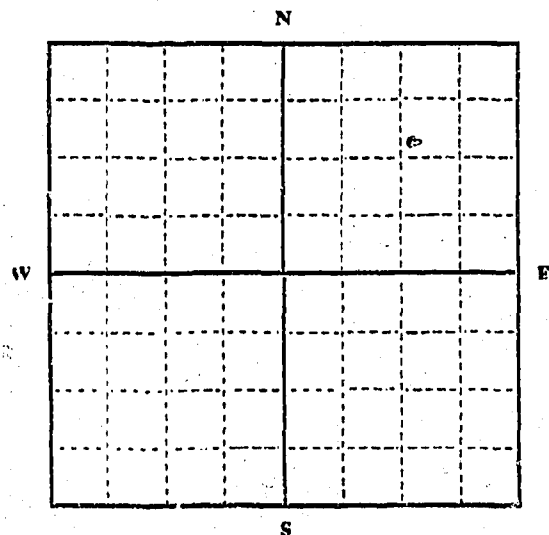

SW 1/4 NE 1/4 Sec. 15 T. 30 R. 31

Indicate point of appropriation and place of use, if possible. Each small square represents 10 acres.

2. The beneficial use on which the claim is based

DOMESTIC AND IRRIGATION USE

3. Date or approximate date of earliest beneficial use; and how continuous the use has been

JUNE 1937
EVERY DAY YEAR AROUND

4. The amount of groundwater claimed (in miner's inches or gallons per minute)

EIGHT (8) GALLONS PER MINUTE

5. If used for irrigation, give the acreage and description of the lands to which water has been applied and name of the owner thereof

GARDEN-LAWN ONE ACRE

6. The means of withdrawing such water from the ground and the location of each well or other means of withdrawal

ELECTRIC SHAFT WELL PUMP

7. The date of commencement and completion of the construction of the well, wells, or other works for withdrawal of groundwater

JUNE 1937

8. The depth of water table

ELEVEN (11) FEET

9. So far as it may be available, the type, size and depth of each well or the general specifications of any other works for the withdrawal of groundwater

THREE (3) FEET DIAMETER
ELEVEN FEET DEEP

10. The estimated amount of groundwater withdrawn each year

100,000.00 GALLONS YEAR

11. The log of formations encountered in the drilling of each well if available

DUG BY FRANK PENTEC DEANIST

12. Such other information of a similar nature as may be useful in carrying out the policy of this act, including reference to book and page of any county record

NONE

Signature of Owner Juryla Pleas

Date 12-31-63

Three copies to be filed by the owner with the County Clerk and Recorder of the county in which the well is located.

Please answer all questions. If not applicable, so state, otherwise the form will be returned.

Original to the County Clerk and Recorder; Duplicate to the State Engineer; Triplicate to the Montana Bureau of Mines and Geology, and Quadruplicate for the Appropriator.

35518

#386 INDEXED

STATE OF MONTANA
COUNTY OF LINCOLN

Filed this 31 day of
December A. D. 1963

at 11:25 A. M.

M. M. Mumford
County Clerk

By Eleanor Vaughn
Deputy

File No.....

T. 30 N. R. 31 W

DUPLICATE

County Lincoln

STATE OF MONTANA
ADMINISTRATOR OF GROUNDWATER CODE
OFFICE OF STATE ENGINEER

Declaration of Vested Groundwater Rights
(Under Chapter 237, Montana Session Laws, 1961)

RECEIVED
AUG 28 1963

STATE ENGINEER

1. Charles F. Pilny, Sr. of Box 66 Libby, Montana
(Name of Appropriator) (Address) (Town)

County of Lincoln State of Montana
have appropriated groundwater according to the Montana laws in effect prior to January 1, 1962, as follows:

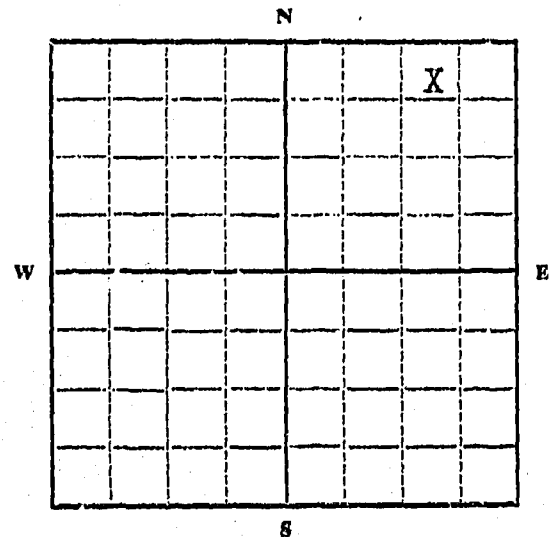

NE 1/4 NE Sec 15 T. 30 N. R. 31 W

Indicate point of appropriation and place of use, if possible. Each small square represents 10 acres.

1/4 Sub-lot 2 of Lot 2 of Block 3 of Howard Acres

2. The beneficial use on which the claim is based... Domestic and Irrigation Use

3. Date or approximate date of earliest beneficial use; and how continuous the use has been... August 1957
Every Day - Year Round

4. The amount of groundwater claimed (in miner's inches or gallons per minute)... Eight (8) Gallons per Minute

5. If used for irrigation, give the acreage and description of the lands to which water has been applied and name of the owner thereof... Garden, Lawn and Small Field (3 Acres)
Charles F. Pilny, Sr.

6. The means of withdrawing such water from the ground and the location of each well or other means of withdrawal... Electric Deep Well Pump

7. The date of commencement and completion of the construction of the well, wells, or other works for withdrawal of groundwater... August 1957

8. The depth of water table... 105 Feet

9. So far as it may be available, the type, size and depth of each well or the general specifications of any other works for the withdrawal of groundwater... 6 Inch Casing - 112 Feet Deep

10. The estimated amount of groundwater withdrawn each year... 150,000 Gallons

11. The log of formations encountered in the drilling of each well if available... Mr. Wammack - Has moved from Libby, Montana - Whereabouts Unknown

12. Such other information of a similar nature as may be useful in carrying out the policy of this act, including reference to book and page of any county record... None

Signature of Owner C. Pilny Sr.

Date August 8, 1963

Three copies to be filed by the owner with the County Clerk and Recorder of the county in which the well is located.

Please answer all questions. If not applicable, so state, otherwise the form will be returned.

Original to the County Clerk and Recorder; duplicate to the State Engineer; Triplicate to the Montana Bureau of Mines and Geology, and Quadruplicate for the Appropriator.

5544

County Lincoln Twp 30 North Rge. 31 West

Sec.	Name of Appropriator	Type of Form	County File No.	Remarks
22	Youngs, Clayton A.		710	
22	Walsh, Joe		68	
22	Wright, James P.		131	
23	Williams, Fred	GW-2	589	
23	Wilson, Bob	GW-2	654	
23	Welsh, Marcella	GW-2	832	
23	Wasserman, Harry	GW-2	951	
23	Tisher, Delwyn	GW-2	221	
23	Thompson, H. R.	GW-2	806	
23	St. Anne, Joe	GW-2	704	
23	Sproull, Donald C.		209	
23	Sielke, Bill		297	
23	State of Montana Highway Comm.	GW-2	844	
23	Seaward, Harold	GW-2	473	
23	Roney, M.	GW-2	154	
23	Orlby, Alan	GW-2	909	
23	Griffin, Paul	GW-2	871	
23	" "	GW-2	648	
23	Haines, H. C.		50	
23	Chesem, Dave J.	GW-2	102	
23	Hill, Frank	GW-2	933	
23	Hill, Ted	GW-	921	
23	Fisher, James H.	GW-	134	
23	First National Bank	GW-	767	
23	Fisher, Henry	GW-	576	
23	Frank, Donald		87	
23	Hansen, Wilhelm E.		400	
23	Coon, Lyle	GW-2	753	
23	Cooper, David E.		300	
23	Collins, Clifford	GW-2	533	
23	Cole, William H.	GW-2	845	
23	Brown, Grace		447	
23	Bundock, Arthur		303	
23	Russell, Ralph	GW-2	271	
23	Berkman, Betty	GW-2	492	
23	Becker, Albert J.	GW-2	150	
23	Becker, Alan P.		322	
23	Becker, Jesse J.		408	
23	Helms, Allen	GW-2	965	
23	Mable, Lewen	GW-2	130	
23	McCally, Vernon	GW-2	474	
23	Hanson, Joseph	GW-2	952	
23	Adkins, Sherrill A.		502	
23	" "		501	
23	Haines, H. C.		109	

Sec.	Name of Appropriator	Type of Form	County File No.	Remarks
23	Nansen, Helen T.		223	
23	Hamilton, Robert P.	GW-2	851	
23	Hanner, W. T.		403	
23	Hayden, Donald B.	GW-2	604	
23	" "		409	
23	Hilbert, W. J.	well log	34	
23	Hood, Floyd	GW-2	827	
23	Hilmgren, Edwin		116	
23	Johnson, Ernest		360	
23	Kempson, H. A.	GW-2	639	
23	Jarvis, Leo	GW-2	797	
23	Miller, Lloyd M.	well log	17	
23	Chambers, Dick		184	
23	Kelly, Don	well log		
23	Riddle, Smith A. M.		394	
23	Rogers, George		197	
23	Rebo, Carl	GW-2	149	
23	Hutton, Charles	GW-2	123	
24	Kalder, Marilyn J.		427	
24	" "		426	
24	Kochler, Elmer	GW-2	541	
24	Kula, Richard M.	GW-2	129	
24	Lamba, Ramona E.	GW-2	896	
24	Myers, Donald W.		186	
24	Bremner, Ronald A.	GW-2	996	
24	Bennild, Clay	GW-2	835	
24	Behling, Frank F.		202	
24	Boy, Richard	GW-2	809	
24	Whitton, Walter H.		352	
24	French, Ellis	GW-2	838	
24	Cherow, Don A.	GW-2	104	
24	Schneppach, Dale	GW-2	772	
24	Thores, Emil		279	
24	" "	GW-2	769	
24	Wood, Merwin K.		89	
24	Wilkinson, Herman	GW-2	964	
25	Neum, Wilma		257	
25	Brusler, Timmy	GW-2	488	
25	Ballie, Herschel E.	GW-2	854	
25	Eastman, William		425	
25	Boy, Lester	GW-2	468	
25	Kepper, A. N. L.	GW-2	915	
25	Ramsay, Charles S.		240	
25	School Dist. #4		384	
25	" "		384	2-SAME FORM
25	Thores, Emil		278	

County WINNEBAGOTwp. 307 North Rge. 2 West

Sec.	Name of Appropriator	Type of Form	County File No.	Remarks
25	Hanes, Emil	GW-2	922	
25	Hill, James	GW-2	159	
25	Woodlin, James	GW-2	689	
25	Table, Charles H. Jr.		212	
25	" "	GW-2	187	
25	Amundson, Elmer	GW-2	546	
25	Johnson, Lester Jr.	GW-2	471	
25	McDonald, David H.	GW-2	124	
25	Marchant, Lawrence	well log		
25	Marrill, W. W. Jr.		127	
25	Johnson, Mildred E.	GW-2	610	
25	Gantz, Dale	GW-2	160	
26	Thurston, Glenn	GW-2	719	
26	Roy, Gerald	GW-2	929	
26	Rine, Ernest	GW-2	694	
26	Rosch, Olive	GW-2	99	
26	Rice, Charles E. Jr.	GW-2	591	
26	Paliga, Joseph		455	
26	Herlinger, Margaret	GW-2	893	
26	Fisher, Fred H.	GW-2	466	
26	1st Baptist Church	GW-2	766	
26	Canbuer, Pauline		251	
26	Coffman, Allen G.	GW-2	862	
26	Bawker, Billie		261	
26	Bawker, Newell		258	
26	" "		259	
26	" "		260	
26	" "	GW-2	861	
26	Bohus, Bonnie L.		105	
26	McKells, Robert E.	GW-2	895	
26	Miller, Clarence E.	GW-2	833	
26	Miller, Gene	GW-2	923	
26	Martinson, Norman	GW-2	465	
26	Stoock, Luther	GW-2	538	
26	" "	GW-2	580	
26	Johnson, Mary	GW-2	451	
26	Hendrickson, James	GW-2	456	
26	Hanson, Thurman	GW-2	592	
27	Schikma, Dave	GW-2	478	
29	Fletcher, Charles	GW-2	889	
34	Mandup, James	GW-2	863	
34	James, General	GW-2	566	
34	Herold, George	GW-2	746	
34	Wick, E. C.	GW-2	470	
34	Childs, All E.	GW-2	214	
35	Halper, Harry Jr.	GW-2	916	

County Lincoln

Twp 30 North Rge 3 West

Sec.	Name of Appropriator	Type of Form	County File No.	Remarks
35	Lamm, Evelyn A.	GW-2	186	
35	Rundst, Walt & Mrs		218	
35	Kreher, Fred	well log	33	
35	Vinson, Richard	GW-2	622	
35	Tisher, Leslie A.		293	
35	Bayano, Walter		182	
35	" "		183	
35	" "		181	
35	Siemer, Robert	GW-2		
35	" "	GW-2	383	
35	Shaper, Mrs	GW-2	527	
35	Runkle, Ray	GW-2	543	
35	Fuller, Frank A.		162	
35	Edmond, Emma		325	
35	Edmond, Karl A.		324	
35	Boh, Robert B.		353	
35	Boewillon, Patrick		450	
35	Boh, Wilbert B.		355	
35	Boewillon, Patrick		449	
36	Klester, Thelma	GW-2	569	
36	Thomas, Paul	GW-2	613	
36	Sprins, Frank M.		423	
36	Rambo, Howard W.		57	
14	Cooper, Fred	GW-2	107	
	Tarpen, Mairna	GW-2	710	
	Johnson, August		452	
	W. M. Humphrey, W. B.	GW-2	459	
	Neils, Robert A.		439	
	Neubauer, Christina	well log		
	Nelson, Robert B.	GW-2	749	
	Phoads, Lucy C.		73	
	Serward, Harold	GW-2	110	
	Siebold, Floyd W.		69	
	Ulrich, Robert	GW-2	756	
5	Westwood Acres	GW-2	688	
14	Knight, Robert E.	GW-2	594	
15	Donneau, Frank & Edna	GW-2	593	
No#	Wilberdt	GW-2	602	
No#	Schmitt, Elmer	GW-2	641	
No#	Simurdek, John & Mary	GW-4	200	
No#	Schneider, John	1961	29	
No#	Parrish, Owen	GW-2	752	

File No.

T. 30 R. 31

DUPLICATE

County Lincoln

STATE OF MONTANA
ADMINISTRATOR OF GROUNDWATER CODE
OFFICE OF STATE ENGINEER

JAN 27 1964

Declaration of Vested Groundwater Rights

(Under Chapter 237, Montana Session Laws, 1961)

1. Clayton A. Youngs, of 412 La. Ave. Libby
(Name of Appropriator) (Address) (Town)

County of Lincoln State of Montana
have appropriated groundwater according to the Montana laws in effect prior to January 1, 1962, as follows:

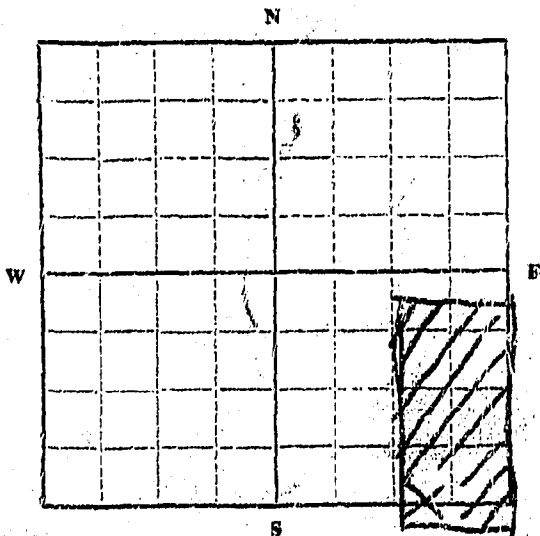

22 Sec. 30 R. 31

Indicate point of appropriation and place of use, if possible. Each small square represents 10 acres.

2. The beneficial use on which the claim is based. Irrigation and watering of stock.

3. Date or approximate date of earliest beneficial use; and how continuous the use has been. 1952 and continually

4. The amount of groundwater claimed (in miner's inches or gallons per minute) 500 gallons per minute

5. If used for irrigation, give the acreage and description of the lands to which water has been applied and name of the owner thereof. 5 acres in south west corner and watered 6 head of horses Clayton A. Youngs

6. The means of withdrawing such water from the ground and the location of each well or other means of withdrawal. Gasoline motor on lift pump in south west 10 acres.

7. The date of commencement and completion of the construction of the well, wells, or other works for withdrawal of groundwater. The well was drilled in 1952.

8. The depth of water table. 146 feet.

9. So far as it may be available, the type, size and depth of each well or the general specifications of any other works for the withdrawal of groundwater. Drilled 3 inch steel casing 146 feet deep.

10. The estimated amount of groundwater withdrawn each year. 3,000,000 gal. per yr.

11. The log of formations encountered in the drilling of each well if available. Unavailable

12. Such other information of a similar nature as may be useful in carrying out the policy of this act, including reference to book and page of any county record.

Signature of Owner Clayton A. Youngs
Date Dec 20 1963

Three copies to be filed by the owner with the County Clerk and Recorder of the county in which the well is located.

Please answer all questions. If not applicable, so state, otherwise the form will be returned.

Original to the County Clerk and Recorder; duplicate to the State Engineer; Triplicate to the Montana Bureau of Mines and Geology, and Quadruplicate for the Appropriator.

33902

210

STATE OF MONTANA
COUNTY OF LINCOLN

Filed this 20 day of

December A. D. 1923

at 1:20 P.M.

M. M. Mansfield
County Clerk.

By Eleana Vaughn
Deputy

File No.....

T. 30 N R. 31 W

DUPLICATE

County LINCOLN

STATE OF MONTANA
ADMINISTRATOR OF GROUNDWATER CODE
OFFICE OF STATE ENGINEER

RECEIVED
APR 8 1963

Declaration of Vested Groundwater Rights

(Under Chapter 237, Montana Session Laws, 1961)

STATE ENGINEER

1. JOE CELBA (Name of Appropriator), of PO BOX 651 LIBBY (Address) (Town)
County of LINCOLN State of MONTANA
have appropriated groundwater according to the Montana laws in effect prior to January 1, 1962, as follows:

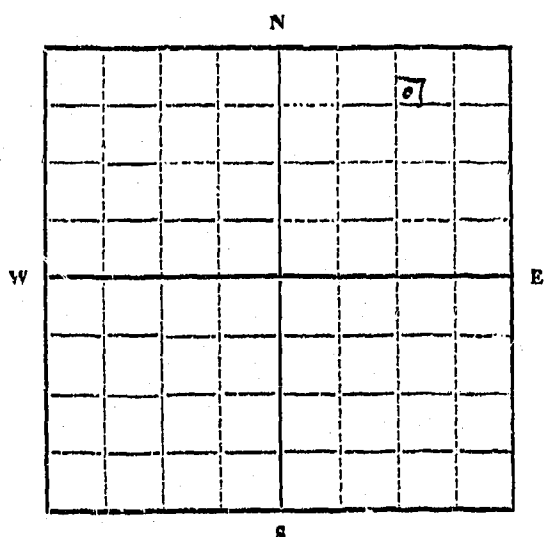

NE 1/4 Sec. 22 T. 30 R. 31 W

Indicate point of appropriation and place of use, if possible. Each small square represents 10 acres.

2. The beneficial use on which the claim is based IRRIGATION
H.O.W.S.E. H.O.C.D. U.S.E.

3. Date or approximate date of earliest beneficial use; and how continuous the use has been June 10, 1957
Continuous

4. The amount of groundwater claimed (in miner's inches or gallons per minute) NONE

5. If used for irrigation, give the acreage and description of the lands to which water has been applied and name of the owner thereof
5 Acres SW 1/4 NE 1/4 NE 1/4 NE 1/4 TRACT 3 A B

Joe Celba

6. The means of withdrawing such water from the ground and the location of each well or other means of withdrawal
Pump

7. The date of commencement and completion of the construction of the well, wells, or other works for withdrawal of groundwater June 1, 1957 finished June 10, 1957

8. The depth of water table 11 feet

9. So far as it may be available, the type, size and depth of each well or the general specifications of any other works for the withdrawal of groundwater
11 feet deep 3 1/2" x 40" wide

10. The estimated amount of groundwater withdrawn each year 600,000 gal

11. The log of formations encountered in the drilling of each well if available none available

12. Such other information of a similar nature as may be useful in carrying out the policy of this act, including reference to book and page of any county record none

Signature of Owner Joe Celba

Date April 2, 1963

Three copies to be filed by the owner with the County Clerk and Recorder of the county in which the well is located.

Please answer all questions. If not applicable, so state, otherwise the form will be returned.

Original to the County Clerk and Recorder; duplicate to the State Engineer; Triplicate to the Montana Bureau of Mines and Geology, and Quadruplicate for the Appropriator.

#68

DEPT. OF REVENUE
LINCOLN COUNTY

STATE OF MONTANA
COUNTY OF LINCOLN
Filed this 3rd day of
April A. D. 1963
at 9:15 P.M.
M. M. Mansfield
County Clerk
By Mae Watson
Deputy

22

File No.

T 30N R 31W

DUPLICATE

County Lincoln

STATE OF MONTANA
ADMINISTRATOR OF GROUNDWATER CODE
OFFICE OF STATE ENGINEER

RECEIVED
SEP 10 1963

Declaration of Vested Groundwater Rights

(Under Chapter 237, Montana Session Laws, 1961)

STATE ENGINEER

1. James P. Hogan (Name of Appropriator), of [Address] (Address) [Town] (Town)
County of Lincoln State of Montana

have appropriated groundwater according to the Montana laws in effect prior to January 1, 1962, as follows:

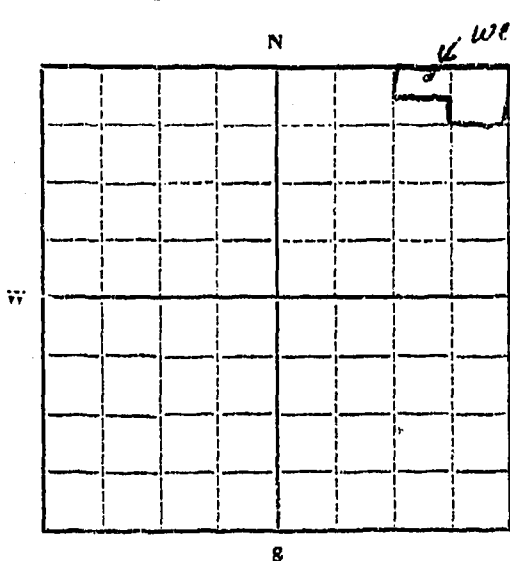

NE 1/4 Sec 22 T 30N R 31W

Indicate point of appropriation and place of use, if possible. Each small square represents 10 acres.

2. The beneficial use on which the claim is based. Domestic & Irrigation

3. Date or approximate date of earliest beneficial use; and how continuous the use has been. Oct. 1954
Has been used continuously since the well was finished

4. The amount of groundwater claimed (in miner's inches or gallons per minute). APPROXIMATELY 20 GPM

5. If used for irrigation, give the acreage and description of the lands to which water has been applied and name of the owner thereof. 15 ACRES North one-half (N1/2) of the North East Quarter of the Northeast Quarter (NE1/4 NE1/4) of tract 3A Sec 22 T 30N R 31W. EXCEPTING 5 ACRES SW 1/4 of the N1/2 of the NE1/4 NE1/4

6. The means of withdrawing such water from the ground and the location of each well or other means of withdrawal. 4" Jet Pump located approximately 400' from the west boundary and 15' from the north boundary

7. The date of commencement and completion of the construction of the well, wells, or other works for withdrawal of groundwater. Oct 1, 1954 started, Oct 20, 1954 completed

8. The depth of water table. 17 feet

9. So far as it may be available, the type, size and depth of each well or the general specifications of any other works for the withdrawal of groundwater.

One hundred Seventy Feet deep Four inch casing drilled well

10. The estimated amount of groundwater withdrawn each year. 75,000

11. The log of formations encountered in the drilling of each well if available. Not available except the first 90' was brown clay

12. Such other information of a similar nature as may be useful in carrying out the policy of this act, including reference to book and page of any county record. None

Signature of Owner James P. Hogan
Date Sept 9, 1963

Three copies to be filed by the owner with the County Clerk and Recorder of the county in which the well is located.

Please answer all questions. If not applicable, so state, otherwise the form will be returned.

Original to the County Clerk and Recorder; duplicate to the State Engineer; Triplicate to the Montana Bureau of Mines and Geology, and Quadruplicate for the Appropriator.

5906.

#131

STATE OF MONTANA
COUNTY OF LINCOLN
Filed this 9th day of
September A. D. 1963
at 10:20 P.M.
By W. M. Mansfield
County Clerk
Verde Hegden
Deputy

File No. OCT 25 1965

T. 30 N R. 31

County Lincoln

DUPLICATE

Bille _____ McDermott _____
Butzerin _____ McNulty _____
Coyle _____ Merton _____
Darlington _____ Sullivan _____

STATE OF MONTANA
ADMINISTRATOR OF GROUNDWATER CODE
OFFICE OF STATE ENGINEER

Top of Ground _____
(Elev. above sea level.....)

Notice of Completion of Groundwater
Appropriation by Means of Well

(Under Chapter 237, Montana Session Laws, 1961)

0'-2' - Fill
2'-10' Boulders, Clay,
and Gravel.
10'-14' Clay and
Gravel.
14'-16' Gravel and
some water.
16'-30' Clay and
Gravel.
30'-65' Clay and
some Gravel.
65'-75' Clay, Gravel,
and Water.

Owner Fred Williams Address Libby, Mont.

Driller William D. Lake Address Libby

Date of Notice of Appropriation of Groundwater.....

Date well started Sept. 28, 1965 Date Completed Oct. 7, 1965

Type of well drilled Equipment Used Churn
(dug, driven, bored or drilled) (Churn, drill, rotary or other)

Water Use: Domestic Municipal Other Irrigation
Industrial Drainage Stock

Indicate on the diagram the character and thickness of the different strata met with in drilling, such as soil, clay, shale, gravel, rock or sand, etc. Show depth at which water is encountered, thickness and character of water-bearing strata and height to which water rises in the well.

Size of Drilled Hole	Size and Weight of Casing	From (Feet)	To (Feet)	PERFORATIONS		
				Kind Size	From (Feet)	To (Feet)
6" I.D.	18.97 Lbs. per ft.	0'	73' 10"	none		

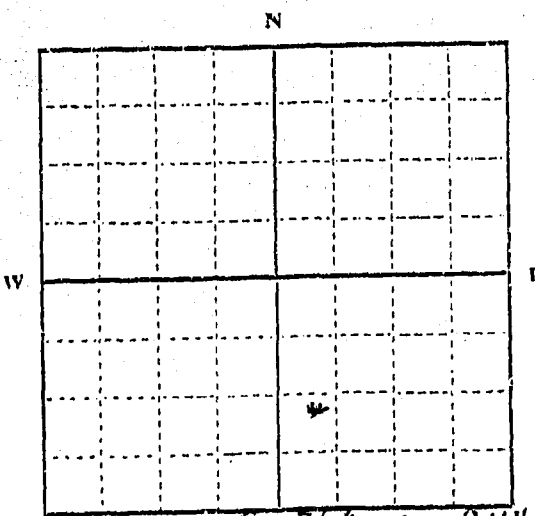

Lot 7, Southaven ANNEX
S.E. 1/4 Sec. 33 T. 32 R. 31
Indicate location of well and place of use, if possible. Each small square represents 10 acres.

Show exact depth of bottom.

Static Water Level for non-flowing Well 23 feet.

Shut-in Pressure for Flowing Well.....

Pumping Water Level 70 feet at 2 1/2 gal. per minute.

Discharge in gal. per min. of flowing well.....

Flow Tested bailer Length of Test 4 hrs.

Remarks: (Gravel packing, cementing, packers, type of shutoff, location of place of use of groundwater if not at well, and any other similar pertinent information, including number of acres irrigated, if used for irrigation).....

152
Driller's License Number
Wm D Lake
Driller's Signature

This form to be prepared by driller, and three copies to be filed by the owner with the County Clerk and Recorder in the county in which the well is located.

Please answer all questions. If not applicable, so state, otherwise the form will be returned.

Original to the County Clerk and Recorder; duplicate to the State Engineer; Triplicate to the Montana Bureau of Mines and Geology and Quadruplicate for the appropriator.

509

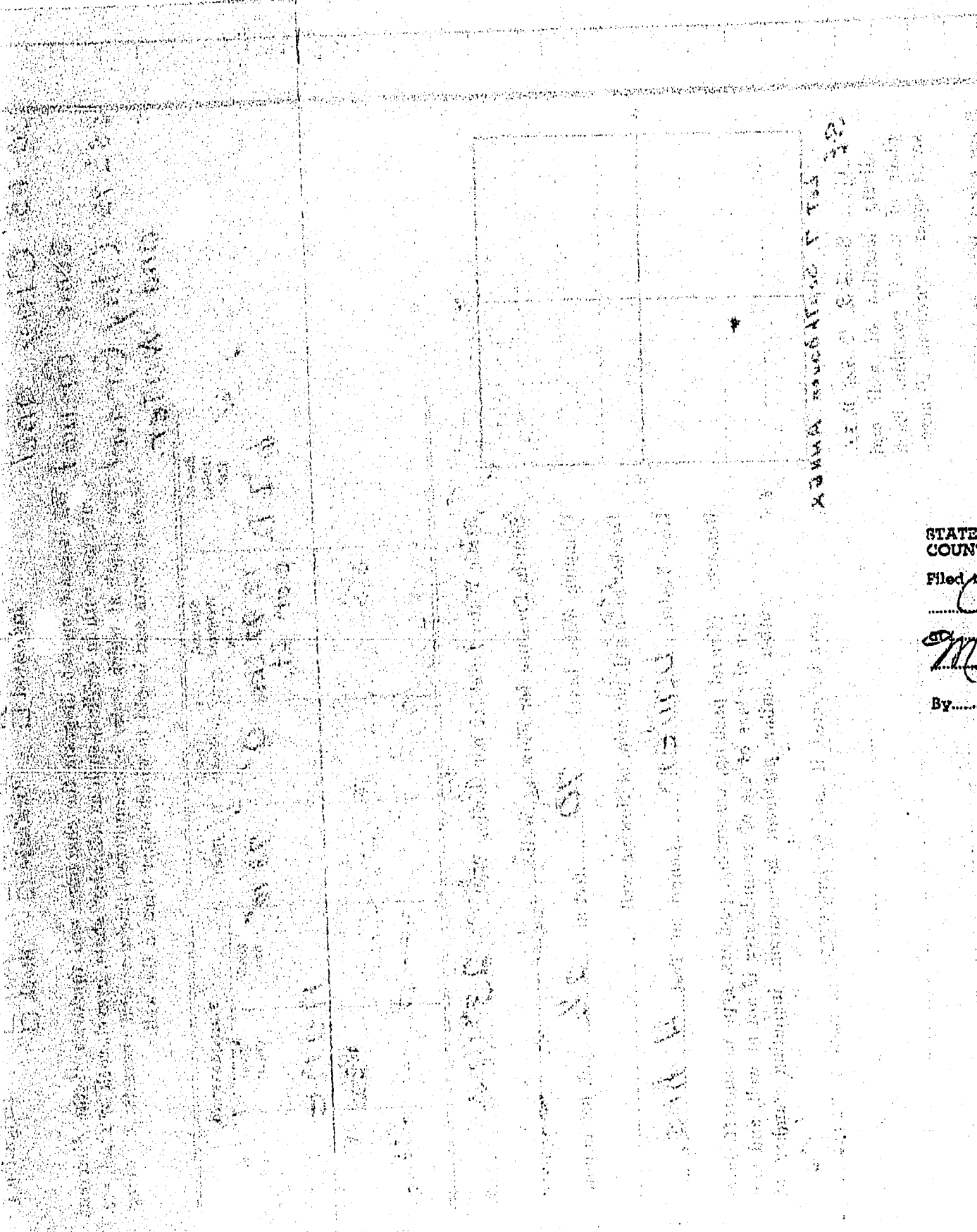

STATE OF MONTANA
 COUNTY OF LINCOLN
 Filed this 22nd day of
October A. D. 1919
8:05 P. M.
 By M. J. Magasfield County Clerk
Mae Stetson Deputy

FILED IN REGISTERED OFFICE
 OF THE COUNTY CLERK
 AT LINCOLN, MONTANA
 THIS 22ND DAY OF OCTOBER
 1919

W 1/4 Sec 10 T 14 N R 10 W

W 1/4 Sec 11 T 14 N R 10 W

W 1/4 Sec 12 T 14 N R 10 W

W 1/4 Sec 13 T 14 N R 10 W

W 1/4 Sec 14 T 14 N R 10 W

W 1/4 Sec 15 T 14 N R 10 W

W 1/4 Sec 16 T 14 N R 10 W

File No.

T. 30 R. 31

DUPLICATE

MONTANA WATER RESOURCES BOARD
RECEIVED

County Lincoln

OCT 9 1968

STATE OF MONTANA
ADMINISTRATOR OF GROUNDWATER CODE
OFFICE OF STATE ENGINEER

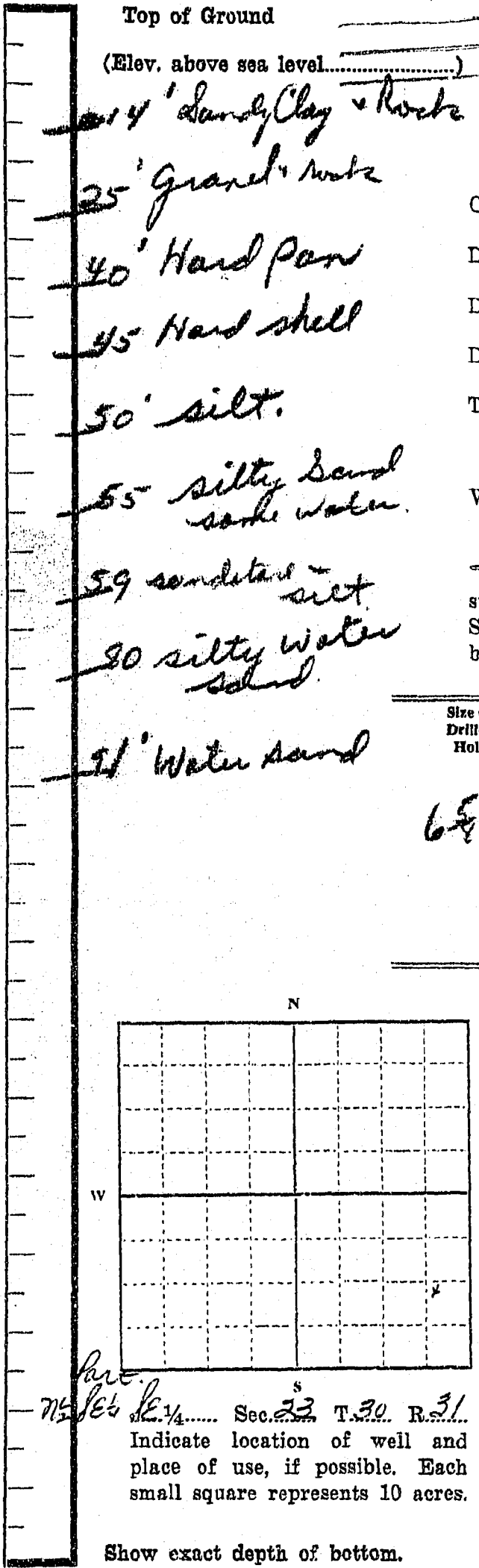

Notice of Completion of Groundwater Appropriation by Means of Well

(Under Chapter 237, Montana Session Laws, 1961)

Owner Bob Wisdom Address Liddy Mont

Driller C. J. Peltz & Co. Address Liddy Mont

Date of Notice of Appropriation of Groundwater.....

Date well started 5-31-68 Date Completed 6-4-68

Type of well drilled Equipment Used Churn
(dug, driven, bored or drilled) (Churn, drill, rotary or other)

Water Use: Domestic Municipal Other Irrigation
Industrial Drainage Stock

Indicate on the diagram the character and thickness of the different strata met with in drilling, such as soil, clay, shale, gravel, rock or sand, etc. Show depth at which water is encountered, thickness and character of water-bearing strata and height to which water rises in the well.

Size of Drilled Hole	Size and Weight of Casing	From (Feet)	To (Feet)	PERFORATIONS		
				Kind Size	From (Feet)	To (Feet)
6 5/8 OD	#17	0	91	1/2" Round	0	4'

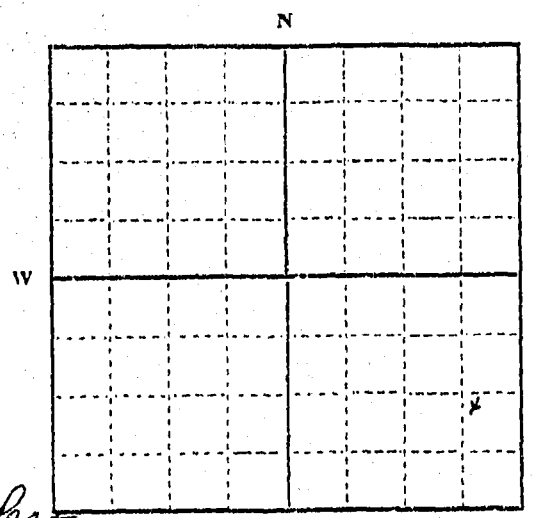

Sec. 23 T. 30 R. 31
Indicate location of well and place of use, if possible. Each small square represents 10 acres.

Show exact depth of bottom.

Static Water Level for non-flowing Well 40 feet.

Shut-in Pressure for Flowing Well.....

Pumping Water Level 70 feet at 15 gal. per minute.

Discharge in gal. per min. of flowing well.....

How Tested baled Length of Test 2 hrs

Remarks: (Gravel packing, cementing, packers, type of shutoff, location of place of use of groundwater if not at well, and any other similar pertinent information, including number of acres irrigated, if used for irrigation).....

Driller's License Number 141

Driller's Signature Clifford J. Tucker

This form to be prepared by driller, and three copies to be filed by the owner with the County Clerk and Recorder in the county in which the well is located.

Please answer all questions. If not applicable, so state, otherwise the form will be returned.

Original to the County Clerk and Recorder; duplicate to the State Engineer; Triplicate to the Montana Bureau of Mines and Geology and Quadruplicate for the Appropriator.

44,677

654

STATE OF MONTANA
COUNTY OF LINCOLN

Filed this 19th day of

September A. D. 1918

at 2:05 P.M.

Clemens L. Jaeger
County Clerk

By Mae Watson Deputy

RECEIVED

County Lincoln

STATE OF MONTANA
ADMINISTRATOR OF GROUNDWATER CODE
MONTANA WATER RESOURCES BOARD

JAN 12 1977

DRILLER'S LOG

NOTICE OF COMPLETION OF GROUNDWATER
APPROPRIATION BY MEANS OF WELL

MONTANA DEPARTMENT OF NATURAL
AND CONSERVATION

Indicate the character, color, thick-
ness of strata such as soil, clay, sand,
gravel, shale, sandstone, etc. Show
depth at which water is found and
height to which water rises in well.

Developed after January 1, 1962

(Under Chapter 237 Montana Session Laws, 1961, as amended)

This form to be prepared by driller, and three copies to be filed
by the owner with the County Clerk and Recorder in the county in
which the well is located, last copy to be retained by driller.

Please answer all questions. If not applicable, so state, otherwise the
form may be returned.

Owner Marcella Welsh

Address Libby,

Montana

Date well started 9-27-71

completed 9-29-71

Type of well drilled

Equipment used Churn

Water Use: Domestic Municipal Stock Irrigation

Industrial Drainage Other * Garden/Lawn

*Describe

USE: If used for irrigation, industrial, drainage or other. Explain,
state number of acres and location or other data (i.e. Lot, Block
and Addition).

ESTIMATED ANNUAL WITHDRAWAL

Size of Drilled Hole	Size and Weight of Casing	From (Feet)	To (Feet)	PERFORATIONS		
				Kind Size	From (Feet)	To (Feet)
<u>6 5/8"</u>	<u>19#</u>	<u>0</u>	<u>55'</u>	<u>1/2" Round</u>	<u>0'</u>	<u>3'</u>

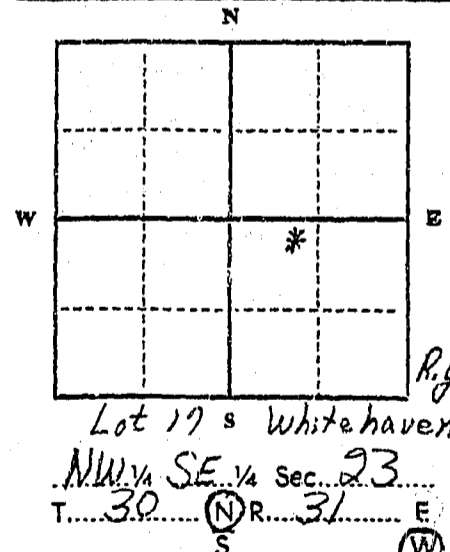

Static water level 30 ft.*
Pumping water level 37 ft.*
at 10 gallons per minute,
measured minutes after pumping
began.
*Measured from ground level.
Well developed by bailed
for 2 hours.
Power Pump HP
Remarks: (Gravel packing, cementing,
packers, type of shutoff)

INDICATE LOCATION OF WELL AND PLACE OF USE, IF POSSIBLE.
EACH SMALL SQUARE REPRESENTS 40 ACRES.

Driller's Signature Clifford J. Bucher

Driller's Address Box 2

Libby, Montana LICENSE NO. 141

Top of Ground (Elev. above sea level)		
From (Feet)	To (Feet)	
<u>0</u>	<u>1</u>	<u>clay</u>
<u>1</u>	<u>10</u>	<u>rock & silt</u>
<u>10</u>	<u>13</u>	<u>sandy silt</u>
<u>13</u>	<u>38</u>	<u>yellow clay & rock</u>
<u>38</u>	<u>55</u>	<u>rock & gravel</u>

55 Show exact depth of bottom

49,718

49,718

832

STATE OF MONTANA
 COUNTY OF LINCOLN
 Filed this 10th day of January A.D. 1922
 at 9:55 A.M.
 by Edward L. Vaughan County Clerk
Verde L. Hayden Deputy

Water Resources Division
 Engineering Bureau
 Groundwater Section
 Sam W. Mitchell Building
 Helena, Montana 59601

Address Libby, Montana
 Location T. R. Sec. 59923
 Doc. No. 832

As the Administrator of the Groundwater Code for the State of Montana, please take note of the following special instructions, in order to properly protect your groundwater right.

Special Instructions:

As indicated in section 10-10-101, the location of the well log

Section:

Section:

4/19/22

49, 218

Water Resources Division
 Engineering Bureau
 Groundwater Section
 Sam W. Mitchell Building
 Helena, Montana 59601

Address Libby, Montana 59923
 Location T. K. Sec.
 Doc. No. 832

As the Administrator of the Groundwater Code for the State of Montana, please take note of the following special instructions, in order to properly protect your groundwater right.

Special Instructions:

Please provide, as indicated in red on the attached form, the location of the well by Township, Range and Section.
 Thank you.

Sent on:
 4/17/72

49,718

Equipment used crain
(Churn drill, rotary or other)

Water Use: Domestic Municipal Stock Irrigation
 Industrial Drainage Other * Garden/Lawn

*Describe
 USE: If used for irrigation, industrial, drainage or other. Explain, state number of acres and location or other data (i.e. Lot, Block and Addition).

ESTIMATED ANNUAL WITHDRAWAL

Size of Drills & Hois	Size and Weight of Casing	From (Feet)	To (Feet)	PERFORATIONS		
				Kind Size	From (Feet)	To (Feet)
6 5/8"	19#	0	55'	1/2 Round	0'	3'

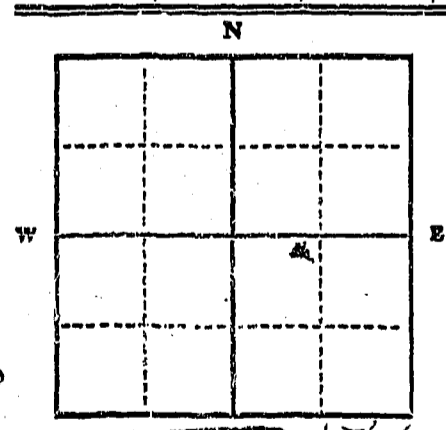

Static water level 20 ft.*
 Pumping water level 37 ft.*
 at 10 gallons per minute,
 measured minutes after pumping began.
 *Measured from ground level.
 Well developed by drilled
 for hours.
 Power..... Pump..... HP
 Remarks: (Gravel packing, cementing, packers, type of shutoff)

Lot 17, Whitehaver
NW 1/4 SK 1/4 Sec. 23
T. 30 N. R. 31 E. 31

INDICATE LOCATION OF WELL AND PLACE OF USE, IF POSSIBLE. EACH SMALL SQUARE REPRESENTS 40 ACRES.

Driller's Signature Clefford J. Buckner
 Driller's Address Box 2
Libby, Montana LICENSE NO. 141

55 Show exact depth of bottom

49,718

RECEIVED

County Lincoln

APR 23 1972
MONTANA DEPARTMENT OF NATURAL RESOURCES

STATE OF MONTANA
ADMINISTRATOR OF GROUNDWATER CODE
MONTANA WATER RESOURCES BOARD

JAN 13 1972

DRILLER'S LOG

NOTICE OF COMPLETION OF GROUNDWATER APPROPRIATION BY MEANS OF WELL

Developed after January 1, 1962

Indicate the character, color, thickness of strata such as soil, clay, sand, gravel, shale, sandstone, etc. Show depth at which water is found and height to which water rises in well.

(Under Chapter 237 Montana Session Laws, 1961, as amended)

This form to be prepared by driller, and three copies to be filed by the owner with the County Clerk and Recorder in the county in which the well is located, last copy to be retained by driller.

Please answer all questions. If not applicable, so state, otherwise the form may be returned.

Owner Marella Welch

Address Libby

Montana

Date well started 9-27-71

completed 9-29-71

Type of well drilled

Equipment used Churn

Water Use: Domestic Municipal Stock Irrigation

Industrial Drainage Other * Garden/Lawn

*Describe _____

USE: If used for irrigation, industrial, drainage or other. Explain, state number of acres and location or other data (i.e. Lot, Block and Addition). _____

ESTIMATED ANNUAL WITHDRAWAL _____

Size of Drilled Hole	Size and Weight of Casing	From (Feet)	To (Feet)	PERFORATIONS		
				Kind Size	From (Feet)	To (Feet)
6 5/8"	19"	0	55'	1/2" Round	0'	3'

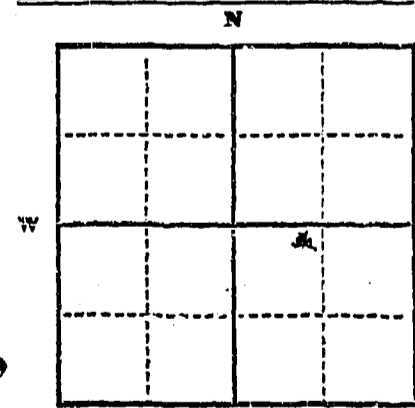

Static water level 30 ft.*
Pumping water level 37 ft.*
at 10 gallons per minute,
measured _____ minutes after pumping began.
*Measured from ground level.
Well developed by drilled
for _____ hours.
Power _____ Pump _____ HP
Remarks: (Gravel packing, cementing, packers, type of shutoff) _____

Lot 17, Whitehaven
NW 1/4, SE 1/4, Sec. 23
T. 30 N. R. 31 E.
3 37

INDICATE LOCATION OF WELL AND PLACE OF USE, IF POSSIBLE. EACH SMALL SQUARE REPRESENTS 40 ACRES.

Driller's Signature Clefford J. Buckner

Driller's Address Box 2

Libby, Montana LICENSE NO. 141

Top of Ground		(Elev. above sea-level)
From (Feet)	To (Feet)	
0	1	Clay
1	10	clay & silt
10	15	clay & silt
15	38	yellow sand & red
38	55	clay & silt

55 Show exact depth of bottom

RECEIVED

County Lincoln

JUN 12 1973

STATE OF MONTANA
ADMINISTRATOR OF GROUNDWATER CODE
MONTANA WATER RESOURCES BOARD

NOTICE OF COMPLETION OF GROUNDWATER
APPROPRIATION BY MEANS OF WELL

Developed after January 1, 1962

DRILLER'S LOG

Indicate the character, color, thickness of strata such as soil, clay, sand, gravel, shale, sandstone, etc. Show depth at which water is found and height to which water rises in well.

(Under Chapter 237 Montana Session Laws, 1961, as amended)

This form to be prepared by driller, and three copies to be filed by the owner with the County Clerk and Recorder in the county in which the well is located, last copy to be retained by driller. Please answer all questions. If not applicable, so state, otherwise the form may be returned.

Owner Harly Wasserman
Address Libby Mont
Date well started 11-22-72
completed 11-24-72

For Administrator's Use	
File	<u>951</u>
Date	<u>May 31, 1973</u>
GW 1	<u>10:40 A.M.</u>

Type of well Drilled
(Dug, driven, bored or drilled)
Equipment used Churn Drill
(Churn drill, rotary or other)
Water Use: Domestic Municipal Stock Irrigation
Industrial Drainage Other * Garden/Lawn

*Describe
USE: If used for irrigation, industrial, drainage or other. Explain, state number of acres and location or other data (i.e. Lot, Block and Addition).

ESTIMATED ANNUAL WITHDRAWAL

Size of Drilled Hole	Size and Weight of Casing	From (Feet)	To (Feet)	PERFORATIONS		
				Kind Size	From (Feet)	To (Feet)
<u>6"</u>	<u>6" 800 177"</u>	<u>41</u>	<u>110</u>	<u>1/2 in.</u>	<u>106</u>	<u>110</u>

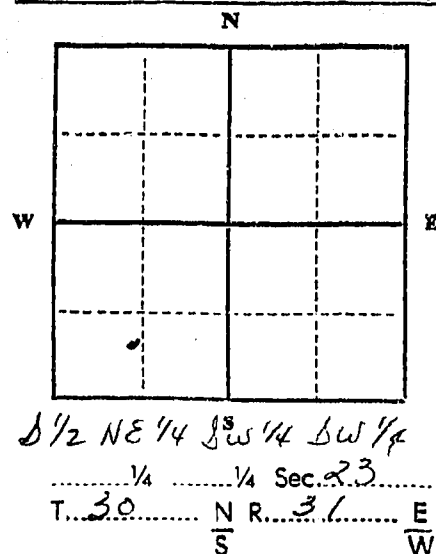

Static water level 70 ft.*
Pumping water level 105 ft.*
at 5 gallons per minute,
measured 5 minutes after pumping began.
* Measured from ground level.
Well developed by Reling
for 3 hours.
Power 220 Pump 1/2 HP
Remarks: (Gravel packing, cementing, packers, type of shutoff)

INDICATE LOCATION OF WELL AND PLACE OF USE, IF POSSIBLE. EACH SMALL SQUARE REPRESENTS 40 ACRES.

Driller's Signature Donald J. McLaughlin
Driller's Address RT 2 Box 508 Libby, Mont

LICENSE NO 222

Top of Ground (Elev. above sea level)		
From (Feet)	To (Feet)	
<u>0</u>	<u>15</u>	<u>Brn. Clay</u>
<u>15</u>	<u>40</u>	<u>Brn. Silt</u>
<u>40</u>	<u>100</u>	<u>Brn. Clay</u>
<u>100</u>	<u>105</u>	<u>Brn. Clay</u>
<u>105</u>	<u>110</u>	<u>Sand & Gravel water</u>

110 Show exact depth of bottom

52,457

951

[Faint handwritten notes, possibly a list of names or numbers]

STATE OF MONTANA
COUNTY OF LINCOLN

Filed this 31st day of

March A. D. 1913

at 10:40 o'clock P. M.

By Calvin L. Bunch County Clerk

By Mae Watson Deputy

[Vertical handwritten notes on the left margin]

[Vertical handwritten notes in the lower center area]