

#922

STATE OF MONTANA
COUNTY OF LINCOLN

Filed this 1st day of
February A. D. 1923
at 2:06 P M
Elmer P. [Signature]
County Clerk
By Pat [Signature]
Deputy

File No.

Sec. 25, T. 30 N. R. 31

DUPLICATE

County Lincoln

STATE OF MONTANA
ADMINISTRATOR OF GROUNDWATER CODE
OFFICE OF STATE ENGINEER DEC 9 1963

Notice of Completion of Groundwater Appropriation by Means of Well

(Under Chapter 287, Montana Session Laws, 1961)

Owner: James Talle Address: Lobby, Mont

Driller: C + L Piby Address: Lobby, Mont

Date of Notice of Appropriation of Groundwater.....

Date well started: Nov 15, 1963 Date Completed: Nov 27, 1963

Type of well: Drilled Equipment Used: Churn
(dug, driven, bored or drilled) (Churn, drill, rotary or other)

Water Use: Domestic Municipal Other Irrigation
Industrial Drainage Stock

Indicate on the diagram the character and thickness of the different strata met with in drilling, such as soil, clay, shale, gravel, rock or sand, etc. Show depth at which water is encountered, thickness and character of water-bearing strata and height to which water rises in the well.

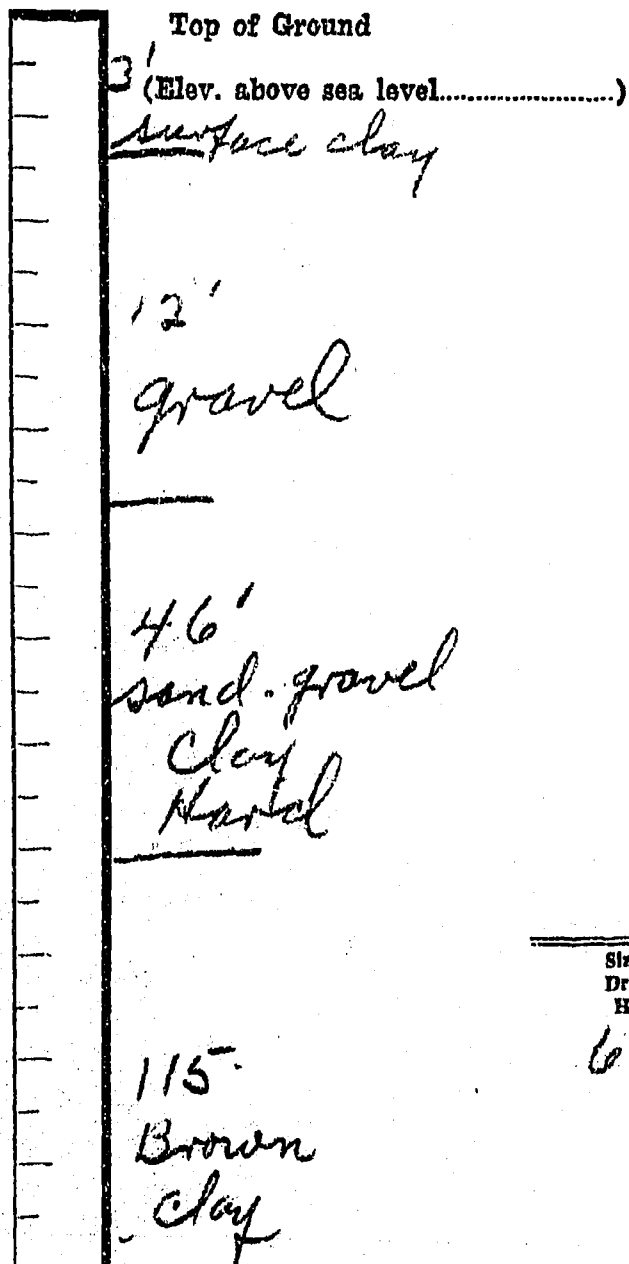

Size of Drilled Hole	Size and Weight of Casing	From (Feet)	To (Feet)	PERFORATIONS		
				Kind Size	From (Feet)	To (Feet)
<u>6 5/8"</u>	<u>6 5/8" 17#</u>	<u>0</u>	<u>126</u>	<u>1/2" rd</u>	<u>120</u>	<u>126</u>

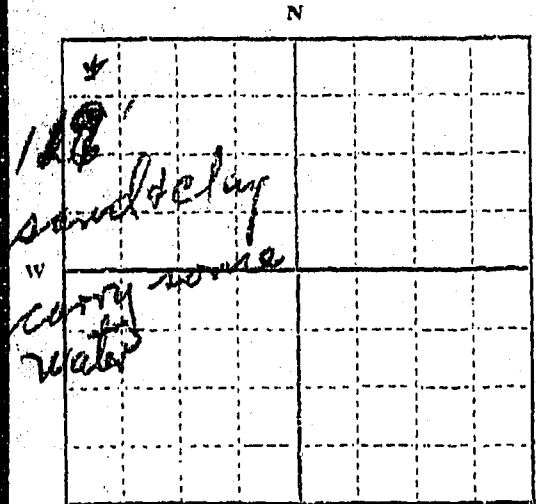

Static Water Level for non-flowing Well..... 80 feet.

Shut-in Pressure for Flowing Well.....

Pumping Water Level..... 35 feet at 20 gal. per minute.

Discharge in gal. per min. of flowing well.....

How Tested: Bailer Length of Test: 4 hrs

Remarks: (Gravel packing, cementing, packers, type of shutoff, location of place of use of groundwater if not at well, and any other similar pertinent information, including number of acres irrigated, if used for irrigation).....

Indicate location of well and place of use, if possible. Each small square represents 10 acres.
126' sand
Show exact depth of bottom.

Sec. 25 T. 30 R. 31 Lot 5, R1K. 3
James Talle

141
Driller's License Number

Sherman M. Moshad
Driller's Signature

This form to be prepared by driller, and three copies to be filed by the owner with the County Clerk and Recorder in the county in which the well is located.

Please answer all questions. If not applicable, so state, otherwise the form will be returned.

Original to the County Clerk and Recorder; duplicate to the State Engineer; Triplicate to the Montana Bureau of Mines and Geology and Quadruplicate for the Appropriator.

INDEXED 159

STATE OF MONTANA
COUNTY OF LINCOLN

Filed this 27th day of
November A. D. 1963
at 12:35 P. M.
W. H. Macfarland
County Clerk
By W. H. Macfarland
Deputy

1/23

File No.....

T. 30 R. 31

DUPLICATE

County Lincoln

LOG

STATE OF MONTANA
ADMINISTRATOR OF GROUNDWATER CODE
STATE WATER CONSERVATION BOARD

Notice of Completion of Groundwater
Appropriation by Means of Well

DEVELOPED AFTER JANUARY 1, 1962

(Under Chapter 237 Montana Session Laws, 1961, as amended)

Top of Ground
(Elev. above sea level.....)

- 0' - 1' Topsoil.
- 1' - 6' Sand, Clay, and Gravel.
- 6' - 20' Clay.
- 20' - 125' Fine Sand.
- 125' - 160' Clay.
- 160' - 173' Fine Sand.
- 173' - 176' Sand and Gravel, with Water.

Owned James or Loretta Worbin Address Box 28

Driller William D. Lake Address Libby, Montana

Date of Notice of appropriation of groundwater.....

Date well started April 16, 1969 Date completed April 18, 1969

Type of well Drilled Equipment used Churn
(Dug, driven, bored or drilled) (Churn drill, rotary or other)

Water use: Domestic Municipal Stock Irrigation
Industrial Drainage Other

Indicate on the diagram the character and thickness of the different strata met with in drilling, such as soil, clay, shale, gravel, rock or sand, etc. Show depth at which water is encountered, thickness and character of water-bearing strata and height to which the water rises in the well.

Size of Drilled Hole	Size and Weight of Casing	From (Feet)	To (Feet)	PERFORATIONS		
				Kind Size	From (Feet)	To (Feet)
6" I.D.	6 5/8" O.D. 17.00 lbs. per foot	0	176		None	

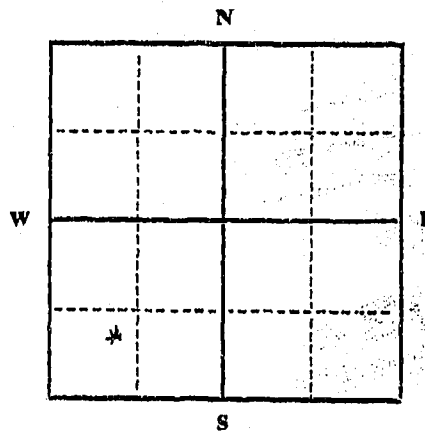

Static Water Level for non-flowing well 25 feet.

Shut-in Pressure for Flowing Well.....

Pumping Water Level 28' 6" feet
at 15 gal. per minute.

Discharge in gal. per min. of flowing well.....

How Tested Pump

Length of Test 12 Hours

Remarks: (Gravel packing, cementing, packers, type of shutoff).....

Sec 25 T. 30 R. 31

Indicate location of well and place of use, if possible. Each small square represents 40 acres.

(Continue on reverse side)

USE—If used for irrigation, industrial, drainage or other. Explain, state number of acres and location or other data (i.e.: Lot, Block and Addition).

Show exact depth of bottom.

This form to be prepared by driller, and three copies to be filed by the owner with the County Clerk and Recorder in the county in which the well is located, tissue copy to be retained by driller.

Please answer all questions. If not applicable, so state, otherwise the form will be returned.

152
Driller's License Number

W D Lake
Driller's Signature.

45,164

INDEXED

684

RECEIVED
 1969 APR 10 10 30 AM
 COUNTY CLERK
 LINCOLN COUNTY
 MONTANA

STATE OF MONTANA
 COUNTY OF LINCOLN
 Filed this 10th day of April A. D. 1969
 at Lincoln County Clerk
 By Mae Watson Deputy

RECEIVED
 1969 APR 10 10 30 AM
 COUNTY CLERK
 LINCOLN COUNTY
 MONTANA

STATE OF MONTANA
 COUNTY OF LINCOLN
 Filed this 10th day of April A. D. 1969
 at Lincoln County Clerk
 By Mae Watson Deputy

C

C

File No.

T. 30N R. 31W

DUPLICATE

County Lincoln

STATE OF MONTANA
ADMINISTRATOR OF GROUNDWATER CODE
OFFICE OF STATE ENGINEER

JAN 27 1964

STATE ENGINEER

Declaration of Vested Groundwater Rights

(Under Chapter 237, Montana Session Laws, 1961)

1. Charles H. Noble Jr, of Po Box 13 Libby
(Name of Appropriator) (Address) (Town)
County of Lincoln State of Montana
have appropriated groundwater according to the Montana laws in effect prior to January 1, 1962, as follows:

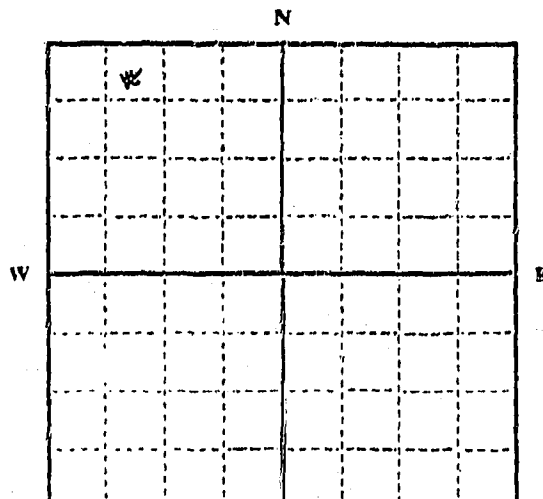

Tract 1, Vests Add. (40+6)
NW 1/4 NW 1/4 Sec 25 T. 30 R. 31

Indicate point of appropriation and place of use, if possible. Each small square represents 10 acres.

2. The beneficial use on which the claim is based... Domestic

3. Date or approximate date of earliest beneficial use; and how continuous the use has been... Sept 1957 - Constant

4. The amount of groundwater claimed (in miner's inches or gallons per minute)... 12.971

5. If used for irrigation, give the acreage and description of the lands to which water has been applied and name of the owner thereof... WATERING LAWN ONLY

6. The means of withdrawing such water from the ground and the location of each well or other means of withdrawal... PUMP 20 ft North of Residence

7. The date of commencement and completion of the construction of the well, wells, or other works for withdrawal of groundwater... Aug. 1957 - Sept 1957

8. The depth of water table... 16 ft.

9. So far as it may be available, the type, size and depth of each well or the general specifications of any other works for the withdrawal of groundwater... Depth 26 ft. Mortared concrete tile 24" wide 16 ft below ground level mortared rock balance 10 ft.

10. The estimated amount of groundwater withdrawn each year... 120,000

11. The log of formations encountered in the drilling of each well, if available... Clay to 12 ft, 1/2 ft gravel + sand 4 ft, hardpan fat 16 ft, 1/2 ft green + red shale, gravel + sand 16 ft to 26 ft.

12. Such other information of a similar nature as may be useful in carrying out the policy of this act, including reference to book and page of any county record... Dug well approx. 80 ft north same acre.

Signature of Owner [Signature]
Date Dec 23, 1963

Three copies to be filed by the owner with the County Clerk and Recorder of the county in which the well is located.
Please answer all questions. If not applicable, so state, otherwise the form will be returned.
Original to the County Clerk and Recorder; Duplicate to the State Engineer; Triplicate to the Montana Bureau of Mines and Geology, and Quadruplicate for the Appropriator.

INDEXED 212

MINIMUM

STATE OF MONTANA
COUNTY OF LINCOLN

Filed this 23rd day of
December, A. D. 1962

at 8:15 A. M.
M. H. Mansfield
County Clerk

By M. H. Watson
Deputy

File No.

T. 30 R. 3

DUPLICATE

County Lincoln

STATE OF MONTANA
ADMINISTRATOR OF GROUNDWATER CODE
OFFICE OF STATE ENGINEER

RECEIVED
DEC 19 1963

Notice of Completion of Groundwater
Appropriation by Means of Well

(Under Chapter 237, Montana Session Laws, 1961)

Owner Charles Noble Address Libby, Mont

Driller C.H. Ploing Address Libby, Mont

Date of Notice of Appropriation of Groundwater.....

Date well started 6/30/63 Date Completed 7/5/63

Type of well Drilled Equipment Used Churn
(dug, driven, bored or drilled) (Churn, drill, rotary or other)

Water Use: Domestic Municipal Other Irrigation
Industrial Drainage Stock

Indicate on the diagram the character and thickness of the different strata met with in drilling, such as soil, clay, shale, gravel, rock or sand, etc. Show depth at which water is encountered, thickness and character of water-bearing strata and height to which water rises in the well.

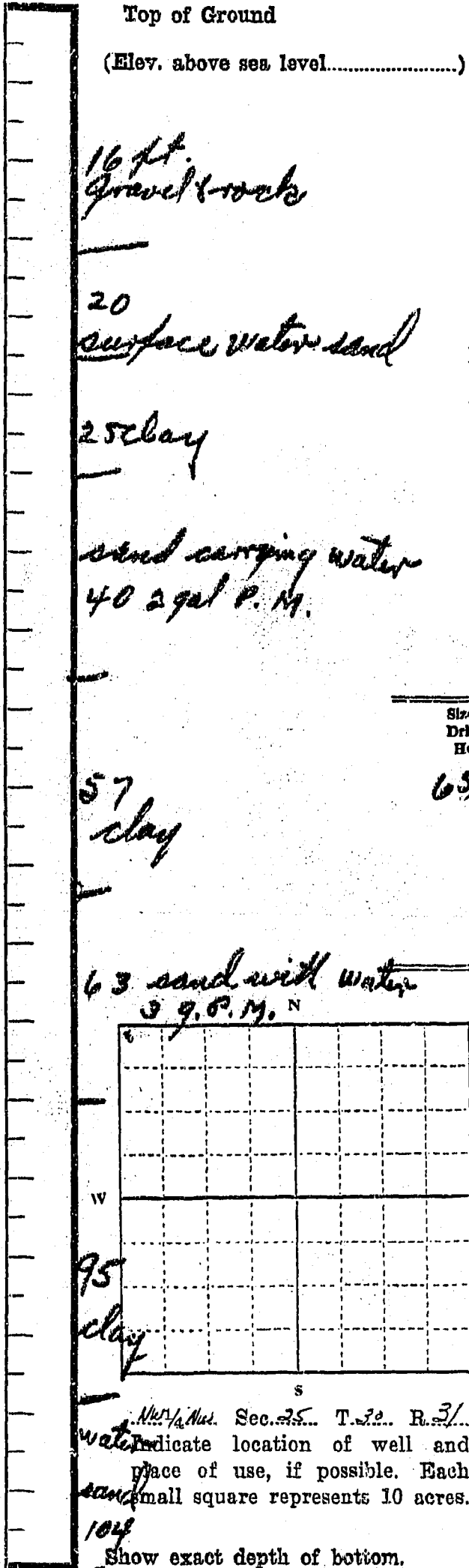

Size of Drilled Hole	Size and Weight of Casing	From (Feet)	To (Feet)	PERFORATIONS		
				Kind Size	From (Feet)	To (Feet)
6 5/8	6 5/8 17 #	0	104	1/2" rd	98	104

Static Water Level for non-flowing Well..... 35 feet.

Shut-in Pressure for Flowing Well.....

Pumping Water Level..... 10 feet at 14 gal. per minute.

Discharge in gal. per min. of flowing well.....

How Tested Bailer & Pump length of Test 2 1/2 hrs.

Remarks: (Gravel packing, cementing, packers, type of shutoff, location of place of use of groundwater if not at well, and any other similar pertinent information, including number of acres irrigated, if used for irrigation).....

141
Driller's License Number

Sherman Moore
Driller's Signature

This form to be prepared by driller, and three copies to be filed by the owner with the County Clerk and Recorder in the county in which the well is located.

Please answer all questions. If not applicable, so state, otherwise the form will be returned.

Original to the County Clerk and Recorder; duplicate to the State Engineer; Triplicate to the Montana Bureau of Mines and Geology and Quadruplicate for the Appropriator.

#187

23 2000
2000
2000

7000
2000
2000

25000

2000
2000
2000

2000
2000
2000

Barry H. ...

STATE OF MONTANA
COUNTY OF LINCOLN
Filed this 12th day of December A. D. 1963
at Helena M. M.
By ... County Clerk
... Deputy

APPOINTMENT BY NOTICE
Notice of Appointment of
COMMISSIONER
OFFICE OF THE COMMISSIONER
STATE OF MONTANA
HELENA, MONTANA

RECEIVED

DATE

OFFICE OF THE COMMISSIONER
STATE OF MONTANA
HELENA, MONTANA

COMMISSIONER

STATE WATER CONSERVATION BOARD

T. 30 R. 31

File No.

MAY 18 1966

County Lincoln

DUPLICATE

Billie McDermott STATE OF MONTANA
 Bureau McNulty ADMINISTRATOR OF GROUNDWATER CODE
 County Morton OFFICE OF STATE ENGINEER
 Darl h... Sullivan
 Dickert

Top of Ground
 (Elev. above sea level.....)

0'-1' Topsoil
 1'-6' Sandy clay
 6'-9' Clay and gravel
 9'-123' Sand and silt
 123'-129' Clay
 129'-145' Heaving sand
 145'-155' Heaving sand and gravel
 155'-160' Gravel and water

Notice of Completion of Groundwater Appropriation by Means of Well

(Under Chapter 237, Montana Session Laws, 1961)

Owner Elmer Amundson Address Libby, Mont.

Driller William D. Lake Address Libby, Mont.

Date of Notice of Appropriation of Groundwater.....

Date well started April 28, 1966 Date Completed May 5, 1966

Type of well drilled Equipment Used churn
 (dug, driven, bored or drilled) (Churn, drill, rotary or other)

Water Use: Domestic Municipal Other Irrigation
 Industrial Drainage Stock

Indicate on the diagram the character and thickness of the different strata met with in drilling, such as soil, clay, shale, gravel, rock or sand, etc. Show depth at which water is encountered, thickness and character of water-bearing strata and height to which water rises in the well.

Size of Drilled Hole	Size and Weight of Casing	From (Feet)	To (Feet)	PERFORATIONS		
				Kid Size	From (Feet)	To (Feet)
6" I.D.	18.97 lbs. per foot	0'	160'		none	

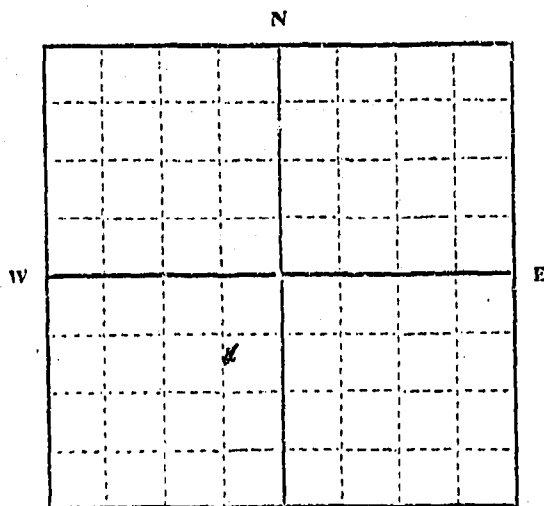

S 1/2 7 1/2 Sec. 25 T. 30. R. 31.
 SW 1/4
 Indicate location of well and place of use, if possible. Each small square represents 10 acres.

Show exact depth of bottom.

Static Water Level for non-flowing Well..... 24 feet.

Shut-in Pressure for Flowing Well.....

Pumping Water Level..... 24 feet at..... 20 gal. per minute.

under Compressor 50 " " 60 " " "

Discharge in gal. per min. of flowing well.....

How Tested bailer Length of Test 2 hrs.

Compressor test 3 hrs.

Remarks: (Gravel packing, cementing, packers, type of shutoff, location of place of use of groundwater if not at well, and any other similar pertinent information, including number of acres irrigated, if used for irrigation).....

152
Driller's License Number

Wm D Lake
Driller's Signature

This form to be prepared by driller, and three copies to be filed by the owner with the County Clerk and Recorder in the county in which the well is located.

Please answer all questions. If not applicable, so state, otherwise the form will be returned.

Original to the County Clerk and Recorder; duplicate to the State Engineer; Triplicate to the Montana Bureau of Mines and Geology and Quadruplicate for the Appropriator.

41066

546

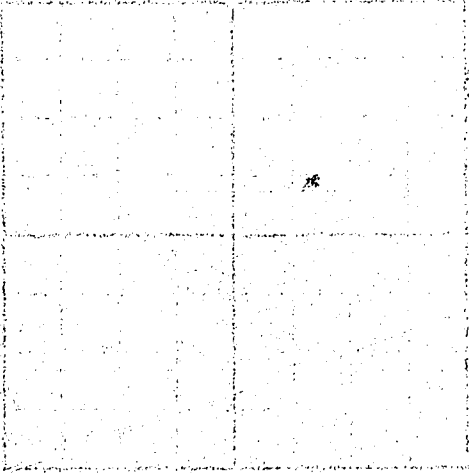

22 1/2
 200
 150
 100
 50
 0

STATE OF MONTANA
 COUNTY OF LINCOLN

Filed this 13th day of
May A. D. 1906
3:35 P.
Eugene J. Dougherty
 County Clerk
 By Mae Hatten
 Deputy

Section	Block	Subsection	Area	Remarks
10	10	10	10	
11	11	11	11	
12	12	12	12	
13	13	13	13	
14	14	14	14	
15	15	15	15	
16	16	16	16	
17	17	17	17	
18	18	18	18	
19	19	19	19	
20	20	20	20	
21	21	21	21	
22	22	22	22	
23	23	23	23	
24	24	24	24	
25	25	25	25	
26	26	26	26	
27	27	27	27	
28	28	28	28	
29	29	29	29	
30	30	30	30	

[Faint handwritten notes or signatures]

File No.

T. 30 N. R. 31 W. 25

DUPLICATE

County Lincoln

STATE OF MONTANA
ADMINISTRATOR OF GROUNDWATER CODE
OFFICE OF STATE ENGINEER

RECEIVED
OCT 29 1964

Notice of Completion of Groundwater Appropriation by Means of Well

(Under Chapter 287, Montana Session Laws, 1961)

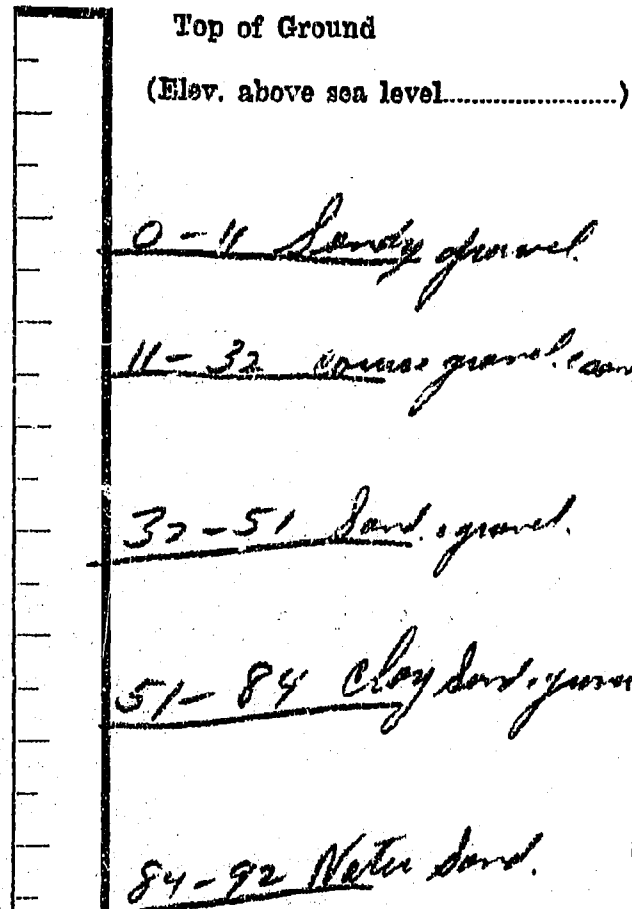

Owner Walter Johnson Jr. Address Libby Mont.

Driller C. L. Plunkett Address Libby Mont.

Date of Notice of Appropriation of Groundwater.....

Date well started 9-18-64 Date Completed 9-23-64

Type of well drilled Equipment Used Churn
(dug, driven, bored or drilled) (Churn, drill, rotary or other)

Water Use: Domestic Municipal Other Irrigation
Industrial Drainage Stock

Indicate on the diagram the character and thickness of the different strata met with in drilling, such as soil, clay, shale, gravel, rock or sand, etc. Show depth at which water is encountered, thickness and character of water-bearing strata and height to which water rises in the well.

Size of Drilled Hole	Size and Weight of Casing	From (Feet)	To (Feet)	PERFORATIONS		
				Kind-Size	From (Feet)	To (Feet)
6 5/8	6 5/8 1 1/2	0	92	6 1/2 x 6	86	92

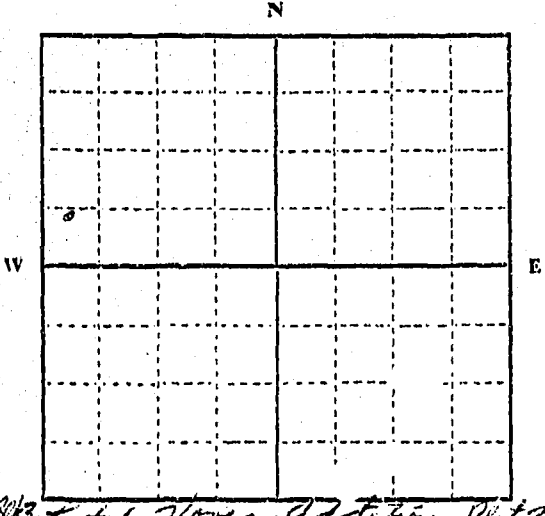

Section 25, T. 30 N., R. 31 W.
Indicate location of well and place of use, if possible. Each small square represents 10 acres.

Show exact depth of bottom.

Static Water Level for non-flowing Well 40 ft. feet.

Shut-in Pressure for Flowing Well.....

Pumping Water Level 67 feet at 15 gal. per minute.

Discharge in gal. per min. of flowing well.....

How Tested Relax Length of Test 1 hr

Remarks: (Gravel packing, cementing, packers, type of shutoff, location of place of use of groundwater if not at well, and any other similar pertinent information, including number of acres irrigated, if used for irrigation).....

#141
Driller's License Number

Don McLeckers
Driller's Signature

This form to be prepared by driller, and three copies to be filed by the owner with the County Clerk and Recorder in the county in which the well is located.

Please answer all questions. If not applicable, so state, otherwise the form will be returned.

Original to the County Clerk and Recorder; duplicate to the State Engineer; Triplicate to the Montana Bureau of Mines and Geology and Quadruplicate for the Appropriator.

38614

471

STATE OF MONTANA
COUNTY OF LINCOLN

Filed this 24th day of

September A. D. 1904

at 3:05 P. M.

By M. M. Mansfield County Clerk

By Mae Wotton Deputy

[Faint, mostly illegible handwritten text, possibly a list or ledger entries.]

File No.

T. 30^N R. 31^W

DUPLICATE

County Lincoln

STATE OF MONTANA
ADMINISTRATOR OF GROUNDWATER
OFFICE OF STATE ENGINEER

RECEIVED
SEP 16 1963

Notice of Completion of Groundwater Appropriation by Means of Well

(Under Chapter 237, Montana Session Laws, 1961)

Owner David D. McDonald Address Libby Montana

Driller C & D Plumbing & Heating Address Libby Montana

Date of Notice of Appropriation of Groundwater.....

Date well started May 17, 62 Date Completed May 20, 62

Type of well Drilled Equipment Used Churn
(dug, driven, bored or drilled) (Churn, drill, rotary or other)

Water Use: Domestic Municipal Other Irrigation
Industrial Drainage Stock

Indicate on the diagram the character and thickness of the different strata met with in drilling, such as soil, clay, shale, gravel, rock or sand, etc. Show depth at which water is encountered, thickness and character of water-bearing strata and height to which water rises in the well.

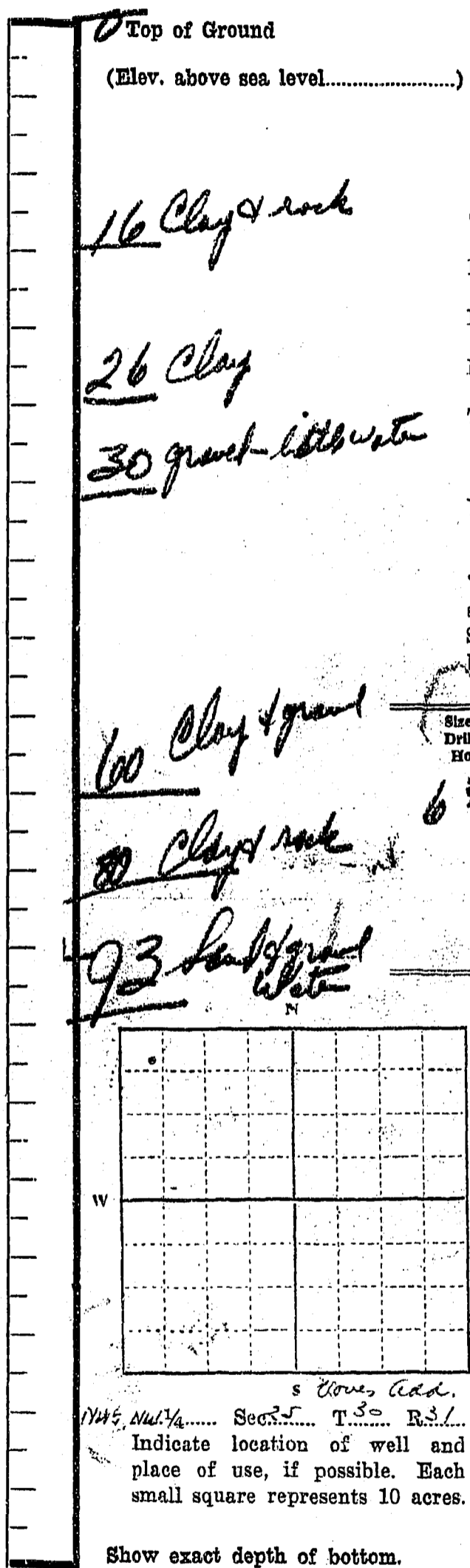

Size of Drilled Hole	Size and Weight of Casing	From (Feet)	To (Feet)	PERFORATIONS		
				Kind Size	From (Feet)	To (Feet)
6 7/8"	6 5/8"	0	93	1/2" Round	87	93

Static Water Level for non-flowing Well 63 feet.

Shut-in Pressure for Flowing Well.....

Pumping Water Level 75 feet at 10 gal. per minute.

Discharge in gal. per min. of flowing well.....

How Tested Bailer Length of Test 4 hrs.

Remarks: (Gravel packing, cementing, packers, type of shutoff, location of place of use of groundwater if not at well, and any other similar pertinent information, including number of acres irrigated, if used for irrigation).....

Show exact depth of bottom.

Driller's License Number 141

Driller's Signature Cliff Becker

This form to be prepared by driller, and three copies to be filed by the owner with the County Clerk and Recorder in the county in which the well is located.

Please answer all questions. If not applicable, so state, otherwise the form will be returned.

Original to the County Clerk and Recorder; duplicate to the State Engineer; Triplicate to the Montana Bureau of Mines and Geology and Quadruplicate for the Appropriator.

#124

STATE OF MONTANA
COUNTY OF LINCOLN

Filed this August 15 day of 1963
A. D. 1963

At M. M. Mansfield County Clerk.
By Eleanor Vaughn Deputy

[Faint, mostly illegible text, possibly a return address or recipient information]

NAME	ADDRESS	CITY	STATE	ZIP
<i>[Handwritten name]</i>	<i>[Handwritten address]</i>	<i>[Handwritten city]</i>	<i>[Handwritten state]</i>	<i>[Handwritten zip]</i>
<i>[Handwritten name]</i>	<i>[Handwritten address]</i>	<i>[Handwritten city]</i>	<i>[Handwritten state]</i>	<i>[Handwritten zip]</i>
<i>[Handwritten name]</i>	<i>[Handwritten address]</i>	<i>[Handwritten city]</i>	<i>[Handwritten state]</i>	<i>[Handwritten zip]</i>
<i>[Handwritten name]</i>	<i>[Handwritten address]</i>	<i>[Handwritten city]</i>	<i>[Handwritten state]</i>	<i>[Handwritten zip]</i>
<i>[Handwritten name]</i>	<i>[Handwritten address]</i>	<i>[Handwritten city]</i>	<i>[Handwritten state]</i>	<i>[Handwritten zip]</i>

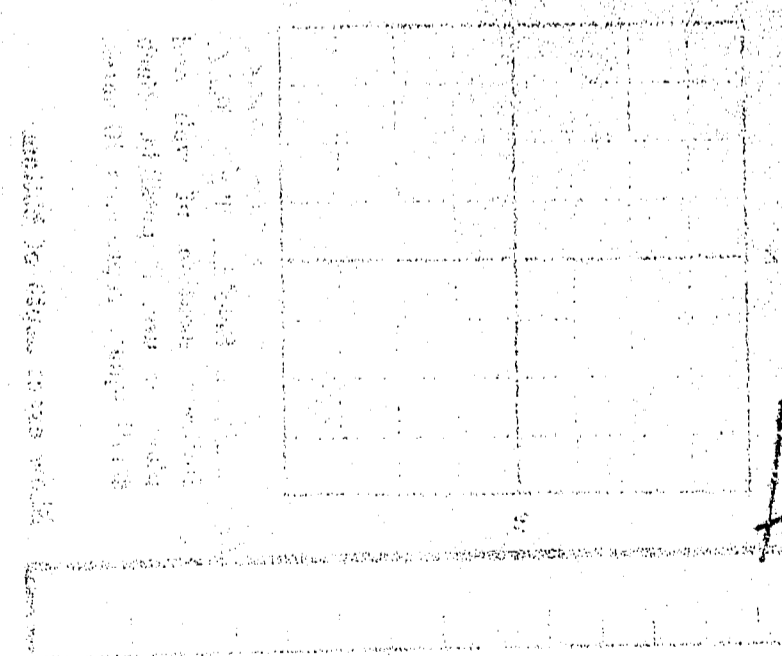

[Vertical text on the left side of the page, possibly a return address or recipient information]

RECEIVED
NOV 29 1957

T. 30 R. 31

County Lincoln

MONTANA BUREAU OF MINES AND GEOLOGY
Butte, Montana

STATE ENGINEER

WATER WELL LOG

Owner Lawrence Merchant Address Box 1011 Libby Mont.

Driller dug by L. B. VANHORN Address Libby Mont.

Date Started Date Completed

Location: Sec. 25 T. 30 R. 31 1/4 sec.

Type of well (Dug, driven, bored, or drilled) Equipment used (Churn drill, rotary, other)

Water use: Domestic Municipal Stock Irrigation
Industrial Drainage Other:

Casing: ft. to ft. Type Size

Casing: ft. to ft. Type Size

Casing: ft. to ft. Type Size

Perforated or Screened: Ft. to ft. Ft. to ft.

Type of screen or perforations

Static Water level, for non-flowing well: feet

Shut-in pressure, for flowing well: lb./sq. in. on: (date)

Pumping water level: feet at gal. per min.

How tested:

Length of test:

Remarks: (Gravel packing, cementing, packers, type of shut-off, depth of shut-off)

This well was already dug when I bought the place. I do not know if it was tested or not. I bought this place Apr. 1st 1954. I haven't tested it. But it furnishes plenty of water house and garden. It maintains a level of about 40" during summer months and about 30" during low stage. I put a cement curb down July of 56

RECEIVED
NOV 20 1957

MONTANA BUREAU OF MINES AND GEOLOGY
Butte, Montana

STATE ENGINEER

WATER WELL LOG

T. 20 R. 31

County... Lincoln

Owner... Lawrence Marchant
L. Address... Fox Tail Libby Mont.

Driller... dug by L. B. Vanhorn
Address... Libby Mont.

Date Started... Date Completed...

Location: Sec. 25 T. 20 R. 31 1/4 sec

Type of well... Equipment used
(Dug, driven, bored, or drilled) (Churn drill, rotary, other)

Water use: Domestic Municipal Stock Irrigation

Industrial Drainage Other:.....

Casing:..... ft. to..... ft. Type..... Size.....

Casing:..... ft. to..... ft. Type..... Size.....

Casing:..... ft. to..... ft. Type..... Size.....

Perforated or Screened: Ft..... to ft..... Ft..... to ft.....

Type of screen or perforations.....

Static Water level, for non-flowing well:..... feet.

Shut-in pressure, for flowing well:..... lb./sq. in. on:..... (dat.)

Pumping water level..... feet at..... gal. per min.

How tested:.....

Length of test.....

Remarks: (Gravel packing, cementing, packers, type of shut-off, depth of shut-off)

This well was already dug when I bought the place. I do not know if it was tested or not. I bought this place Nov. 1st 1954. I haven't tested it. But it furnishes plenty of water house and garden.!! And maintains a level of about 40" during summer months and about 30" during low stage. I put a cement curb down July of 56

(over)

25

File No.....

T. 30 N R. 31 W MM

DUPLICATE

County Lincoln

STATE OF MONTANA
ADMINISTRATOR OF GROUNDWATER CODE
OFFICE OF STATE ENGINEER

RECEIVED
SEP 16 1963

Declaration of Vested Groundwater Rights STATE ENGINEER
(Under Chapter 237, Montana Session Laws, 1961)

1. William L. Merrill of RT #1 Box 381-D Libby
(Name of Appropriator) (Address) (Town)
County of Lincoln State of MONTANA
have appropriated groundwater according to the Montana laws in effect prior to January 1, 1962, as follows:

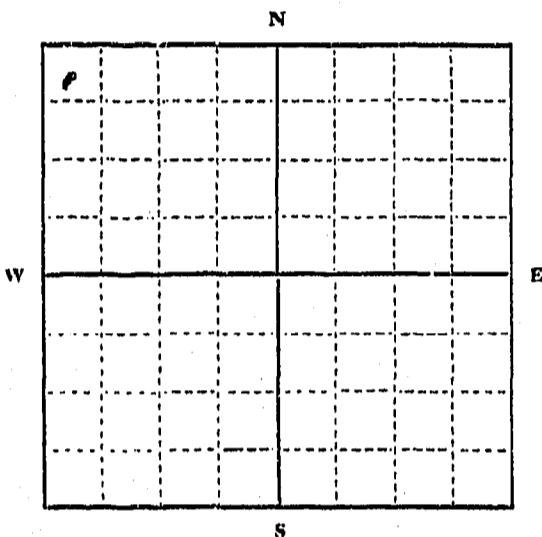

NW 1/4 Sec 25 T. 30 N R. 31 W

Indicate point of appropriation and place of use, if possible. Each small square represents 10 acres.

- 2. The beneficial use on which the claim is based. HOUSEHOLD & LIGHT IRRIGATION
- 3. Date or approximate date of earliest beneficial use; and how continuous the use has been. 5/16/59 - CONTINUOUS USE SINCE
- 4. The amount of groundwater claimed (in miner's inches or gallons per minute). 12 gal PER MINUTE
- 5. If used for irrigation, give the acreage and description of the lands to which water has been applied and name of the owner thereof. 2.40 ACRE OWNED BY William L. Merrill
- 6. The means of withdrawing such water from the ground and the location of each well or other means of withdrawal. 4 1/2 HP JET PUMP LOCATED LOT 3 #3 VOVES ADDITION PIONEER JUNCTION NW 1/4 of NW 1/4 Sec 25
- 7. The date of commencement and completion of the construction of the well, wells, or other works for withdrawal of groundwater. 5/5/59 to 5/16/59
- 8. The depth of water table. 42' deep to 9' from GROUND LEVEL
- 9. So far as it may be available, the type, size and depth of each well or the general specifications of any other works for the withdrawal of groundwater. ONE 6" PIPE 42' DEEP
- 10. The estimated amount of groundwater withdrawn each year. 200,000 gallons
- 11. The log of formations encountered in the drilling of each well if available. NOT AVAILABLE
- 12. Such other information of a similar nature as may be useful in carrying out the policy of this act, including reference to book and page of any county record.

Signature of Owner William L. Merrill
Date 9/4/63

Three copies to be filed by the owner with the County Clerk and Recorder of the county in which the well is located.

Please answer all questions. If not applicable, so state, otherwise the form will be returned.

Original to the County Clerk and Recorder; duplicate to the State Engineer; Triplicate to the Montana Bureau of Mines and Geology, and Quadruplicate for the Appropriator.

5902

C

MISSOURI

MISSOURI

127

MISSOURI

STATE OF MONTANA
 COUNTY OF LINCOLN
 Filed this 4th day of September A. D. 1963
 at 9:40 P. M.
W. M. Mansfield County Clerk
 By Mae Haters Deputy

MISSOURI

MISSOURI

MISSOURI

MISSOURI

MISSOURI

MISSOURI

MISSOURI

MISSOURI

MISSOURI

MISSOURI

MISSOURI

MISSOURI

C

File No.

T. 30 R. 31
County Lincoln

DUPLICATE

MONTANA WATER RESOURCES BOARD

RECEIVED

STATE OF MONTANA
ADMINISTRATOR OF GROUNDWATER CODE
OFFICE OF STATE ENGINEER

Top of Ground

OCT 23 1967

(Elev. above sea-level.....)

Notice of Completion of Groundwater Appropriation by Means of Well

(Under Chapter 237, Montana Session Laws, 1961)

0'-1' Topsoil.
1'-5' Clay.
5'-8' Clay and gravel.
8'-31' Clay.
31'-36' Clay and gravel.
36'-40' Gravel and water.

Owner Mildred Ellen Johnson Address R. 1 Box 1316

Driller William D. Lake Address Libby, Mont.

Date of Notice of Appropriation of Groundwater.....

Date well started Sept 27, 1967 Date Completed Sept 29, 1967

Type of well drilled Equipment Used Churn
(dug, driven, bored or drilled) (Churn, drill, rotary or other)

Water Use: Domestic Municipal Other Irrigation
Industrial Drainage Stock

Indicate on the diagram the character and thickness of the different strata met with in drilling, such as soil, clay, shale, gravel, rock or sand, etc. Show depth at which water is encountered, thickness and character of water-bearing strata and height to which water rises in the well.

Size of Drilled Hole	Size and Weight of Casing	From (Feet)	To (Feet)	PERFORATIONS		
				Kind Size	From (Feet)	To (Feet)
6" I.D.	6 5/8" O.D. 18.97 lbs. per foot	0'	40'	none		

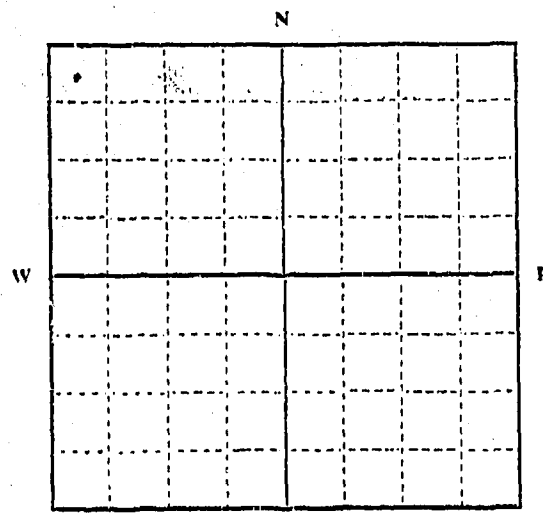

..... 1/4 Sec..... T..... R.....
Indicate location of well and place of use, if possible. Each small square represents 10 acres.

Plot 7 Blk 3 Vores in
Show exact depth of bottom.

NWNWNW 25-30-31

Static Water Level for non-flowing Well..... 14 feet.

Shut-in Pressure for Flowing Well.....

Pumping Water Level..... 30 feet at..... 18 gal. per minute.

Discharge in gal. per min. of flowing well.....

How Tested..... bailer Length of Test..... 2 hrs.

Remarks: (Gravel packing, cementing, packers, type of shutoff, location of place of use of groundwater if not at well, and any other similar pertinent information, including number of acres irrigated, if used for irrigation).....

152
Driller's License Number

Wm D Lake
Driller's Signature

This form to be prepared by driller, and three copies to be filed by the owner with the County Clerk and Recorder in the county in which the well is located.

Please answer all questions. If not applicable, so state, otherwise the form will be returned.

Original to the County Clerk and Recorder; duplicate to the State Engineer; Triplicate to the Montana Bureau of Mines and Geology and Quadruplicate for the Appropriator.

42, 427

610

STATE OF MONTANA
COUNTY OF LINCOLN

Filed this 19th day of
October A. D. 1967

at 9:25 P. M.
Charles J. Vaughn
County Clerk.

By Mar. Nelson
Deputy

[Faint, mostly illegible handwritten notes and signatures in the left and bottom sections of the document.]

File No.

T. 30 N. R. 31

DUPLICATE

County Lincoln

STATE OF MONTANA
ADMINISTRATOR OF GROUNDWATER CODE
OFFICE OF STATE ENGINEER

RECEIVED
DEC 9 1963

Notice of Completion of Groundwater Appropriation by Means of Well

(Under Chapter 237, Montana Session Laws, 1961)

Owner Dale Jantz Address Libby Montana

Driller Sherman Moorhead Address Libby Montana

Date of Notice of Appropriation of Groundwater.....

Date well started Nov 3, 1963 Date Completed Nov 14, 1963

Type of well drilled Equipment Used Churn
(dug, driven, bored or drilled) (Churn, drill, rotary or other)

Water Use: Domestic Municipal Other Irrigation
Industrial Drainage Stock

Indicate on the diagram the character and thickness of the different strata met with in drilling, such as soil, clay, shale, gravel, rock or sand, etc. Show depth at which water is encountered, thickness and character of water-bearing strata and height to which water rises in the well.

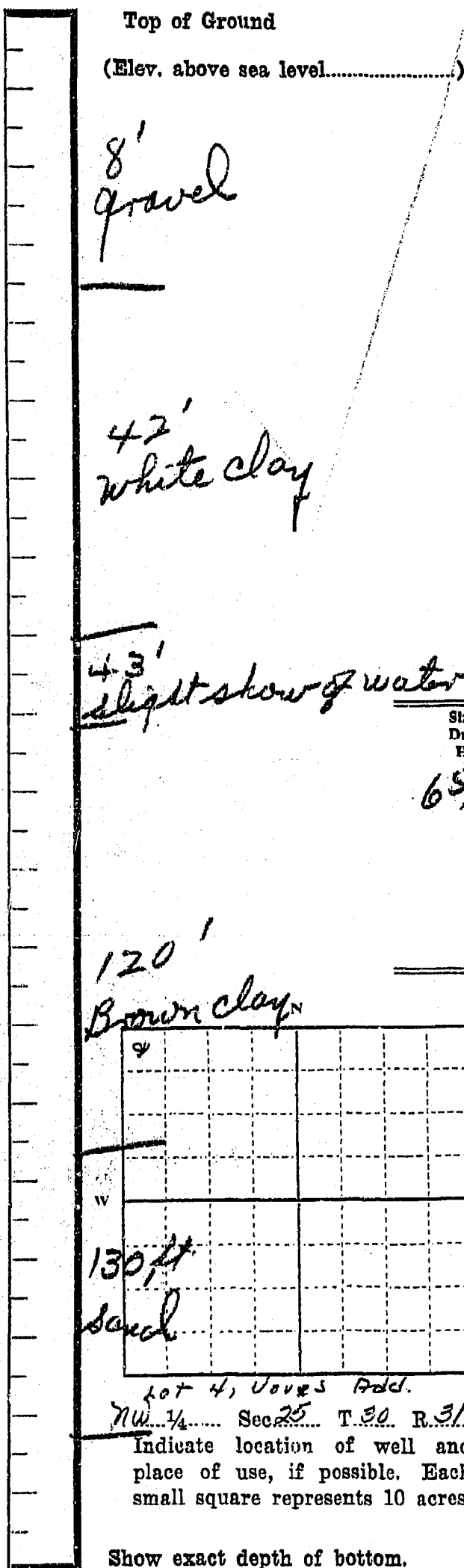

Size of Drilled Hole	Size and Weight of Casing	From (Feet)	To (Feet)	PERFORATIONS		
				Kind Size	From (Feet)	To (Feet)
6 5/8	6 5/8 17#	0	130	1/2" rd	122	130

Static Water Level for non-flowing Well..... 80' feet.

Shut-in Pressure for Flowing Well.....

Pumping Water Level..... 12 feet at 10 gal. per minute.

Discharge in gal. per min. of flowing well.....

How Tested..... Bailer Length of Test..... 4 hrs

Remarks: (Gravel packing, cementing, packers, type of shutoff, location of place of use of groundwater if not at well, and any other similar pertinent information, including number of acres irrigated, if used for irrigation).....

141
Driller's License Number

Sherman Moorhead
Driller's Signature

This form to be prepared by driller, and three copies to be filed by the owner with the County Clerk and Recorder in the county in which the well is located.

Please answer all questions. If not applicable, so state, otherwise the form will be returned.

Original to the County Clerk and Recorder; duplicate to the State Engineer; Triplicate to the Montana Bureau of Mines and Geology and Quadruplicate for the Appropriator.

8247

INDEXED 160

STATE OF MONTANA
COUNTY OF LINCOLN

Filed this 27th day of
November A. D. 1962
at 12:50 P. M.
by M. J. Macfarland County Clerk
Max Wilson Deputy

File No.....

T. 30 R. 31

DUPLICATE

MONTANA WATER RESOURCES BOARD
RECEIVED

County Lincoln

LOG

DEC 4 1969

STATE OF MONTANA
ADMINISTRATOR OF GROUNDWATER CODE
STATE WATER CONSERVATION BOARD

Top of Ground
(Elev. above sea level.....)

**Notice of Completion of Groundwater
Appropriation by Means of Well**
DEVELOPED AFTER JANUARY 1, 1962

(Under Chapter 237, Montana Session Laws, 1961, as amended)

- 0' - 1' Topsoil.
- 1' - 14' Sand, Clay, and Boulders.
- 14' - 40' Clay and Gravel.
- 40' - 73' Sandy Clay.
- 73' - 76' Sand, Gravel, with Water.

Owner John G. Hoover Address Box 565

Driller William D. Lake Address Libby, Montana

Date of Notice of appropriation of groundwater.....

Date well started September 3, 1969 Date completed September 9, 1969

Type of well Drilled Equipment used Churn
(Dug, driven, bored or drilled) (Churn drill, rotary or other)

Water use: Domestic Municipal Stock Irrigation
Industrial Drainage Other

Indicate on the diagram the character and thickness of the different strata met with in drilling, such as soil, clay, shale, gravel, rock or sand, etc. Show depth at which water is encountered, thickness and character of water-bearing strata and height to which the water rises in the well.

Size of Drilled Hole	Size and Weight of Casing	From (Feet)	To (Feet)	PERFORATIONS		
				Kind Size	From (Feet)	To (Feet)
6" I. D.	5/8" O. D.	0	76		None	
	17.00 lbs. per foot					

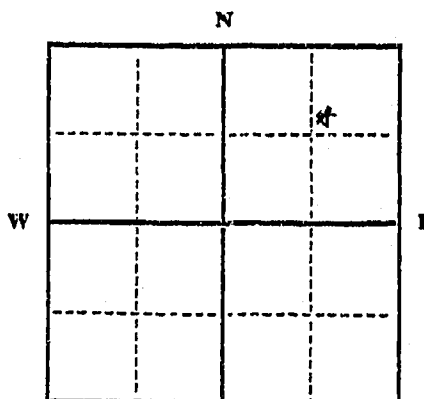

Static Water Level for non-flowing well 27 feet.

Shut-in Pressure for Flowing Well.....

Pumping Water Level..... 50 feet

at..... 18 gal. per minute.

Discharge in gal. per min. of flowing well

How Tested..... Bailer

Length of Test..... 2 hours

Remarks: (Gravel packing, cementing, packers, type of shutoff).....

*Lots 35, 36, 37, 38, Blk. 17,
Pioneer Junction
E 1/2 NE 1/4 Sec. 26, T. 30 R. 31 W.*

Indicate location of well and place of use, if possible. Each small square represents 40 acres.

(Continue on reverse side)

USE—If used for irrigation, industrial, drainage or other. Explain, state number of acres and location or other data (i.e.: Lot, Block and Addition).

Show exact depth of bottom.

This form to be prepared by driller, and three copies to be filed by the owner with the County Clerk and Recorder in the county in which the well is located, tissue copy to be retained by driller.

Please answer all questions. If not applicable, so state, otherwise the form will be returned.

152
Driller's License Number

William D. Lake
Driller's Signature.

45935

STATE OF MONTANA
 COUNTY OF LINCOLN
 DEPARTMENT OF LANDS
 DIVISION OF CONSERVATION
 LANDS AND MINES
 DEPARTMENT OF LANDS
 DIVISION OF CONSERVATION
 LANDS AND MINES

WHEREAS, the Board of Land Commissioners of the State of Montana, by their duly authorized officers, have caused to be filed for record in the office of the County Clerk of Lincoln County, Montana, a certain plat of land, the description of which is as follows:

SECTION 36, TOWNSHIP 20 NORTH, RANGE 10 WEST, OF RANGE 10 WEST, COUNTY OF LINCOLN, MONTANA.

Filed this 21st day of December, A. D. 1969
 at 1:15 P. M.
 By Charles L. Laughlin County Clerk.
Mae Watson Deputy

DEC 4 1969
 COUNTY CLERK'S OFFICE
 LINCOLN, MONTANA

STATE OF MONTANA
ADMINISTRATOR OF GROUNDWATER CODE
MONTANA WATER RESOURCES BOARD

NOTICE OF COMPLETION OF GROUNDWATER
APPROPRIATION BY MEANS OF WELL

Developed after January 1, 1962

(Under Chapter 237 Montana Session Laws, 1961, as amended)

This form to be prepared by driller, and three copies to be filed by the owner with the County Clerk and Recorder in the county in which the well is located, last copy to be retained by driller.

Please answer all questions. If not applicable, so state; otherwise the form may be returned.

Owner Gerald Ray & Bernice M. Ray
Address Rt. 1, Box 903
Libby, Montana 59923
Date well started Oct. 12, 1972
completed Oct. 16, 1972

For Administrator's Use
File <u>929</u>
<u>Feb. 15, 1973</u>
GW 1 <u>2:15 p.m.</u>

Type of well Drilled
(Dug, driven, bored or drilled)

Equipment used Air Rotary
(Churn drill, rotary or other)

Water Use: Domestic Municipal Stock Irrigation
Industrial Drainage Other * Garden/Lawn

*Describe
USE: If used for irrigation, industrial, drainage or other. Explain, state number of acres and location or other data (i.e. Lot, Block and Addition).

ESTIMATED ANNUAL WITHDRAWAL 80,000 Gal. per year

Size of Drilled Hole	Size and Weight of Casing	From (Feet)	To (Feet)	PERFORATIONS		
				Kind Size	From (Feet)	To (Feet)
<u>6" I.D. 6 5/8" O.D.</u>	<u>17.00 lbs. per ft.</u>	<u>0</u>	<u>113</u>	<u>None</u>		

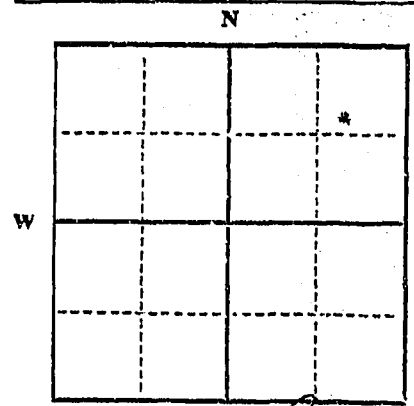

Static water level 45 ft.*
Pumping water level _____ ft.*
at 30-40 gallons per minute,
measured 120 minutes after pumping began.
*Measured from ground level.
Well developed by air compressor
for 2 hours.
Power _____ Pump _____ HP
Remarks: (Gravel packing, cementing, packers, type of shutoff)

Lot 1, Blk. 5, s Pioneer Subdiv.
1/4 Sec. 26
T. 30 N. R. 31 E.

INDICATE LOCATION OF WELL AND PLACE OF USE, IF POSSIBLE. EACH SMALL SQUARE REPRESENTS 40 ACRES.

Driller's Signature Wm D Lake

Driller's Address P. O. Box 967

Libby, Montana 59923 LICENSE NO. 152

County Lincoln

DRILLER'S LOG

Indicate the character, color, thickness of strata such as soil, clay, sand, gravel, shale, sandstone, etc. Show depth at which water is found and height to which water rises in well.

Top of Ground		(Elev. above sea level)
From (Feet)	To (Feet)	
<u>0</u>	<u>1</u>	<u>Topsoil.</u>
<u>1</u>	<u>14</u>	<u>Sand.</u>
<u>14</u>	<u>45</u>	<u>Clay, Gravel, and Boulders.</u>
<u>45</u>	<u>47</u>	<u>Water and Gravel. (2-3 G.P.M.)</u>
<u>47</u>	<u>63</u>	<u>Clay and Gravel.</u>
<u>63</u>	<u>65</u>	<u>Gravel and Water. (3-4 G.P.M.)</u>
<u>65</u>	<u>109</u>	<u>Clay and Gravel.</u>
<u>109</u>	<u>113</u>	<u>Gravel with Water.</u>

113 ft. Show exact depth of bottom

52,452

STATE OF MONTANA
 COUNTY OF LINCOLN
 FILED IN NO. 1567
 VOL. 111
 PAGE 1567

SHERIFF
 CLERK
 JUDGE
 DISTRICT ATTORNEY
 COUNTY ATTORNEY
 TOWNSHIP CLERK
 VOTER REGISTRATION CLERK
 DEPUTY SHERIFF
 DEPUTY CLERK
 DEPUTY JUDGE
 DEPUTY DISTRICT ATTORNEY
 DEPUTY COUNTY ATTORNEY
 DEPUTY TOWNSHIP CLERK
 DEPUTY VOTER REGISTRATION CLERK

INDEXED

929

STATE OF MONTANA
COUNTY OF LINCOLN

Filed this 15th day of
February A. D. 1913
 at 2:15 P. M.
Clayton L. Douglas
 County Clerk
 By James W. Wilson Deputy

RECEIVED
 COUNTY OF LINCOLN
 FEBRUARY 15 1913

File No.

T. 30 R. 31

DUPLICATE

MONTANA WATER RESOURCES BOARD
RECEIVED

County LINCOLN

LOG

JUN 26 1969

STATE OF MONTANA
ADMINISTRATOR OF GROUNDWATER CODE
STATE WATER CONSERVATION BOARD

**Notice of Completion of Groundwater
Appropriation by Means of Well**
DEVELOPED AFTER JANUARY 1, 1962

(Under Chapter 237 Montana Session Laws, 1961, as amended)

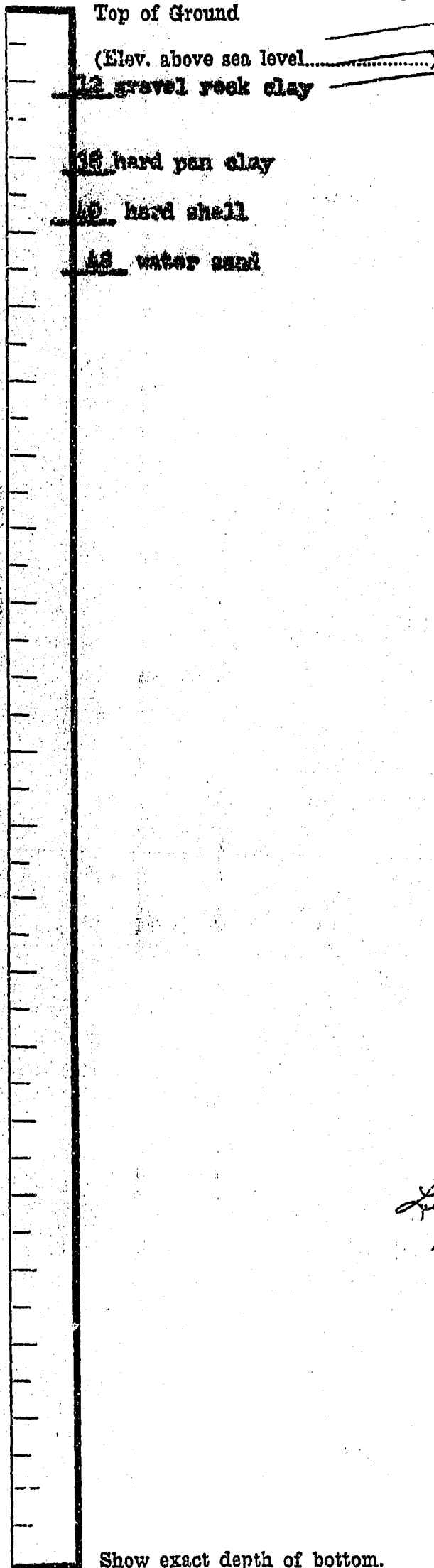

Owner ERNEST RING Address LIBBY, MONTANA

Driller C & L PLUMBING & HEATING Address LIBBY, MONTANA

Date of Notice of appropriation of groundwater.....

Date well started 6/19/69 Date completed 6/19/69

Type of well DRILLED Equipment used CHURN DRILL
(Dug, driven, bored or drilled) (Churn drill, rotary or other)

Water use: Domestic Municipal Stock Irrigation
Industrial Drainage Other

Indicate on the diagram the character and thickness of the different strata met with in drilling, such as soil, clay, shale, gravel, rock or sand, etc. Show depth at which water is encountered, thickness and character of water-bearing strata and height to which the water rises in the well.

Size of Drilled Hole	Size and Weight of Casing	From (Feet)	To (Feet)	PERFORATIONS		
				Kind Size	From (Feet)	To (Feet)
<u>2 5/8 o.d.</u>	<u>17#</u>	<u>0</u>	<u>48'</u>	<u>4 round</u>	<u>0</u>	<u>4'</u>

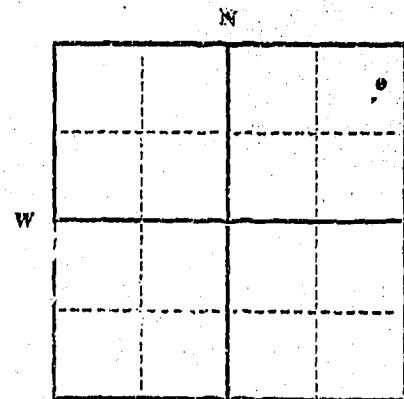

Static Water Level for non-flowing well 30 feet.

Shut-in Pressure for Flowing Well.....

Pumping Water Level..... 30 feet
at..... 15 gal. per minute.

Discharge in gal. per min. of flowing well

How Tested..... FAILED

Length of Test..... 2 hours

Sec 26, T31, R31 Remarks: (Gravel packing, cementing, packers, type of shutoff).....

Indicate location of well and place of use, if possible. Each small square represents 40 acres.

(Continue on reverse side)

USE—If used for irrigation, industrial, drainage or other. Explain, state number of acres and location or other data (i.e.: Lot, Block and Addition).

This form to be prepared by driller, and three copies to be filed by the owner with the County Clerk and Recorder in the county in which the well is located, tissue copy to be retained by driller.

Please answer all questions. If not applicable, so state, otherwise the form will be returned.

Driller's License Number 741

Driller's Signature Clifford Becker

45379

694 INDEXED

DEPARTMENT OF

RECEIVED
MONTANA WATER RESOURCES BOARD

JUN 28 1962

STATE WATER CONSERVATION BOARD
ADMINISTRATION OF GEORNIAN
STATE OF MONTANA

County

Job of Board
The Board shall
The Board shall
The Board shall

Notice of Completion of Geornian

ABANDONED WATER RIGHTS
BY MEANS OF A
COMMISSIONER

ABANDONED WATER RIGHTS
BY MEANS OF A
COMMISSIONER

Notice of Completion of Geornian
ABANDONED WATER RIGHTS
BY MEANS OF A
COMMISSIONER

State of Montana
County of Lincoln

Filed this

STATE OF MONTANA
COUNTY OF LINCOLN

Filed this 24th day of

June 1962 A. D.

at 1:35 P.M.
L. L. ... County Clerk.
Betty ... Deputy

6:00 P.M. 1962

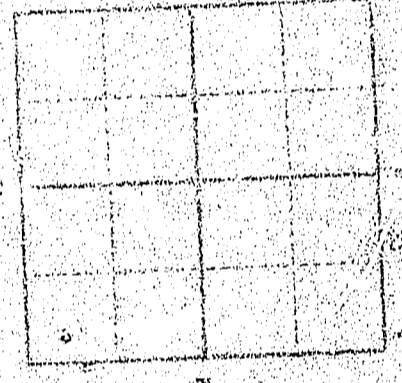

Notice of Completion of Geornian
ABANDONED WATER RIGHTS
BY MEANS OF A
COMMISSIONER

GW 2

Approved Stock Form—State Publishing Co., Helena, Montana—39085

26

File No.

T. 30 N. R. 31 W

DUPLICATE

County Lincoln

STATE OF MONTANA
ADMINISTRATOR OF GROUNDWATER CODE
OFFICE OF STATE ENGINEER
AUG 1 1963

RECEIVED

Notice of Completion of Groundwater Appropriation by Means of Well

(Under Chapter 237, Montana Session Laws, 1961)

Owner Clive Roark Address Box 114 Libby Mont.

Driller C & L Plumbing Address Libby, Montana

Date of Notice of Appropriation of Groundwater

Date well started 6/4/62 Date Completed 6/5/62

Type of well Drilled Equipment Used Churn
(dug, driven, bored or drilled) (Churn, drill, rotary or other)

Water Use: Domestic Municipal Other Irrigation
Industrial Drainage Stock

Indicate on the diagram the character and thickness of the different strata met with in drilling, such as soil, clay, shale, gravel, rock or sand, etc. Show dept. at which water is encountered, thickness and character of water-bearing strata and height to which water rises in the well.

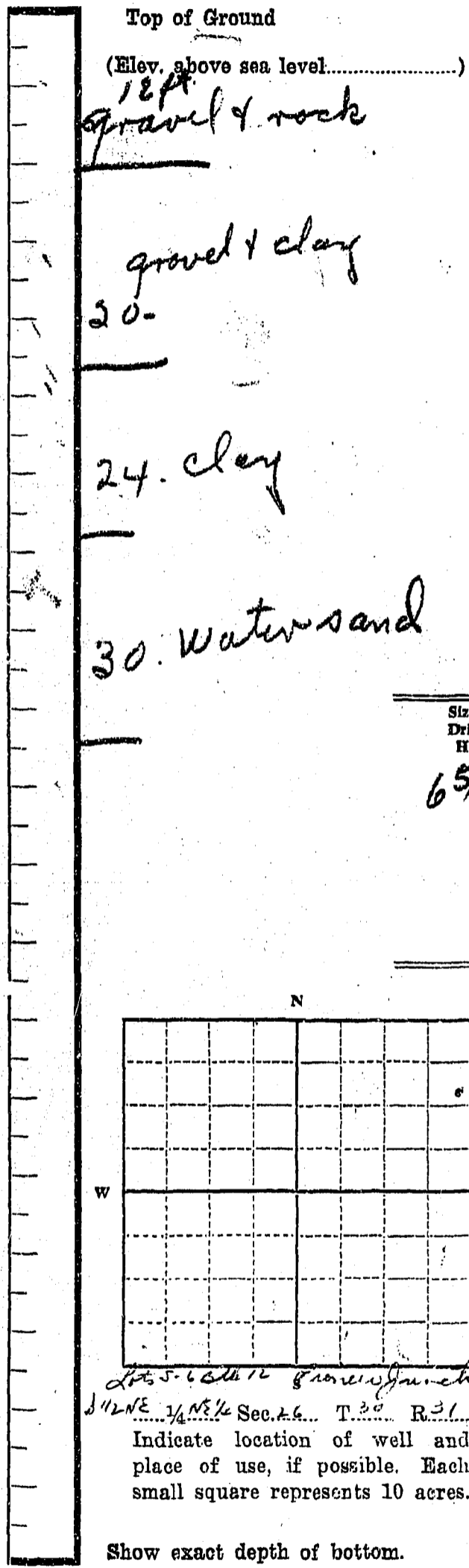

Size of Drilled Hole	Size and Weight of Casing	From (Feet)	To (Feet)	PERFORATIONS		
				Kind Size	From (Feet)	To (Feet)
6 5/8	6 5/8 17 #	0	30	1/2" dd	24	30

Static Water Level for non-flowing Well..... 18 feet.

Shut-in Pressure for Flowing Well.....

Pumping Water Level..... 10 feet at..... 8 gal. per minute.

Discharge in gal. per min. of flowing well.....

How Tested..... Bailer Length of Test..... 3 hrs

Remarks: (Gravel packing, cementing, packers, type of shutoff, location of place of use of groundwater if not at well, and any other similar pertinent information, including number of acres irrigated, if used for irrigation)

141
Driller's License Number

Sherman Moorhead
Driller's Signature

This form to be prepared by driller, and three copies to be filed by the owner with the County Clerk and Recorder in the county in which the well is located.

Please answer all questions. If not applicable, so state, otherwise the form will be returned.

Original to the County Clerk and Recorder; duplicate to the State Engineer; Triplicate to the Montana Bureau of Mines and Geology and Quadruplicate for the Appropriator.

5220

12/21/28

12/21/28

12/21/28

12/21/28

STATE OF MONTANA
COUNTY OF LINCOLN

FILED

12/21/28

12/21/28

12/21/28

#99

STATE OF MONTANA
COUNTY OF LINCOLN

Filed this 29 day of

July A. D. 1928

at 10:30 A.M.

M. M. Mansfield
County Clerk

By Eleanor Thompson
Deputy

RECEIVED
JUN 1 1928

Business return

12/21/28

12/21/28

12/21/28

MONTANA WATER RESOURCES BOARD

File No.....

RECEIVED

T. 30 R. 31

DUPLICATE

AUG 17 1967

County Liberty

LOG

STATE OF MONTANA
ADMINISTRATOR OF GROUNDWATER CODE
OFFICE OF STATE ENGINEER

Top of Ground
(Elev. above sea level.....)

Notice of Completion of Groundwater
Appropriation by Means of Well
DEVELOPED AFTER JANUARY 1, 1962

(Under Chapter 237, Montana Session Laws, 1961)

0'-4' mud
4'-17' sand,
gravel &
water

Owner Charles E. Prince Address Liberty, Mont.

Driller William D. Lake Address Liberty, Mont.

Date of Notice of appropriation of groundwater.....

Date well started July 19, 1967 Date completed July 19, 1967

Type of well drilled Equipment used Churn
(Dug, Driven, bored or drilled) (Churn drill, rotary or other)

Water use: Domestic Municipal Stock Irrigation
Industrial Drainage Other

Indicate on the diagram the character and thickness of the different strata met with in drilling, such as soil, clay, shale, gravel, rock or sand, etc. Show depth at which water is encountered, thickness and character of water-bearing strata and height to which the water rises in the well.

Size of Drilled Hole	Size and Weight of Casing	From (Feet)	To (Feet)	PERFORATIONS		
				Kind Size	From (Feet)	To (Feet)
6" I.D.	6 5/8" O.D. 18.97 lbs. per foot	0'	15'		none	

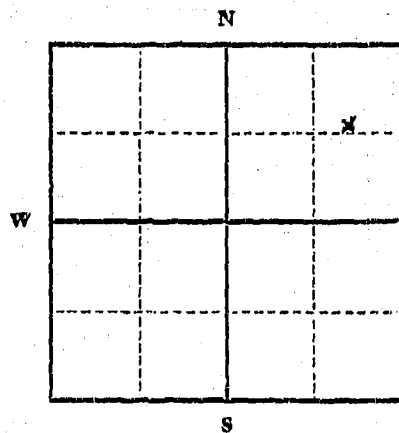

Static Water Level for non-flowing well 3 feet.
Shut-in Pressure for Flowing Well.....
Pumping Water Level..... 9 feet
at..... 20 gal. per minute.
Discharge in gal. per min. of flowing well

How Tested..... pumped
Length of Test..... 1 hour

NE 1/4 Sec. 26 T. 30 R. 31
Indicate location of well and place of use, if possible. Each small square represents 40 acres.

Remarks: (Gravel packing, cementing, packers, type of shutoff).....
.....
.....

(Continue on reverse side)

USE—If used for irrigation, industrial, drainage or other. Explain, state number of acres and location or other data (i.e.: Lot, Block and Addition).

Show exact depth of bottom.

This form to be prepared by driller, and three copies to be filed by the owner with the County Clerk and Recorder in the county in which the well is located, tissue copy to be retained by driller.

152
Driller's License Number

Please answer all questions. If not applicable, so state, otherwise the form will be returned.

Driller's Signature

42,210

MONTANA WATER RESOURCES BOARD

File No.

RECEIVED

T. 30 R. 31

DUPLICATE

AUG 17 1967

County... *Lincoln*

LOG

STATE OF MONTANA
ADMINISTRATOR OF GROUNDWATER CODE
OFFICE OF STATE ENGINEER

Top of Ground
(Elev. above sea level.....)

Notice of Completion of Groundwater
Appropriation by Means of Well
DEVELOPED AFTER JANUARY 1, 1962

Under Chapter 237, Montana Session Laws, 1961)

Owner..... *Charles E. Pycroft* Address..... *Lincoln, Mont.*

Driller..... *William D. Lake* Address..... *Lincoln, Mont.*

Date of Notice of appropriation of groundwater.....

Date well started..... *July 19, 1967* Date completed..... *July 19, 1967*

Type of well..... *drilled* Equipment used..... *Churn*
(Dug, Driven, bored or drilled) (Churn drill, rotary or other)

Water use: Domestic Municipal Stock Irrigation
Industrial Drainage Other

Indicate on the diagram the character and thickness of the different strata met with in drilling, such as soil, clay, shale, gravel, rock or sand, etc. Show depth at which water is encountered, thickness and character of water-bearing strata and height to which the water rises in the well.



*0'-4' mud
4'-17' sand,
gravel &
water*

Size of Drilled Hole	Size and Weight of Casing	From (Feet)	To (Feet)	PERFORATIONS		
				Kind Size	From (Feet)	To (Feet)
<i>6" S.D.</i>	<i>6 5/8" O.D. 18.97 lbs. per foot</i>	<i>0'</i>	<i>15'</i>	<i>none</i>		

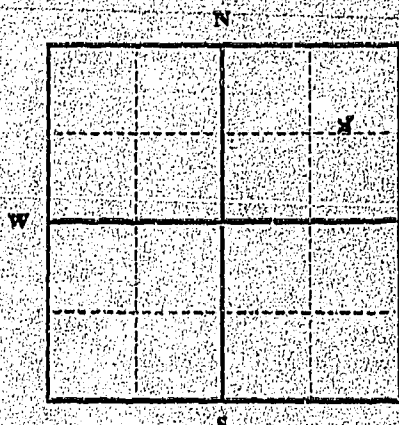

Static Water Level for non-flowing well *8* feet.
Shut-in Pressure for Flowing Well.....
Pumping Water Level..... *9* feet
at..... *20* gal. per minute
Discharge in gal. per min. of flowing well.....
How Tested..... *pump*
Length of Test..... *1 hour*
Remarks: (Gravel packing, cementing, packers, type of shutoff).....

NE 1/4 Sec 26, T. 30, R. 31
Indicate location of well and place of use, if possible. Each small square represents 40 acres.

(Continue on reverse side)

USE—If used for irrigation, industrial, drainage or other. Explain, state number of acres and location or other data (i.e.: Lot, Block and Addition).

Show exact depth of bottom.

This form to be prepared by driller, and three copies to be filed by the owner with the County Clerk and Recorder in the county in which the well is located, tissue copy to be retained by driller.

Please answer all questions. If not applicable, so state, otherwise the form will be returned.

..... *152*
Driller's License Number

.....
Driller's Signature

42,210

INDEXED 591

STATE OF MONTANA
COUNTY OF LINCOLN
GRACE RECORDS
1907

Section	Block	Lot	Acres	Owner	Remarks
1	1	1	40.00
1	1	2	40.00
1	1	3	40.00
1	1	4	40.00
1	1	5	40.00
1	1	6	40.00
1	1	7	40.00
1	1	8	40.00
1	1	9	40.00
1	1	10	40.00

STATE OF MONTANA
COUNTY OF LINCOLN

Filed by 3rd day of August A. D. 1907
at 10:35 AM
By Charles L. Vaughan County Clerk
Max Nelson Deputy

AMENDED STATE TRUSTEES TRUST
IN THE MATTER OF THE ESTATE OF A. S. HAY
BY COMMISSIONER OF LANDS
PLACEMENT OF BOUNDARIES
SECTION 10, T. 12 N., R. 10 E., S. 10
COUNTY OF LINCOLN, MONTANA

GRACE RECORDS
1907

INDEXED

26

File No.....

T. 30 R. 31

DUPLICATE

County Libby

STATE OF MONTANA
ADMINISTRATOR OF GROUNDWATER CODE
OFFICE OF STATE ENGINEER

RECEIVED
MAR 5 1964

Declaration of Vested Groundwater Rights

(Under Chapter 237, Montana Session Laws, 1961)

STATE ENGINEER

1. GEORGE PALIGA, of BOX 286 LIBBY
(Name of Appropriator) (Address) (Town)

County of LINCOLN State of MONTANA

have appropriated groundwater according to the Montana laws in effect prior to January 1, 1962, as follows:

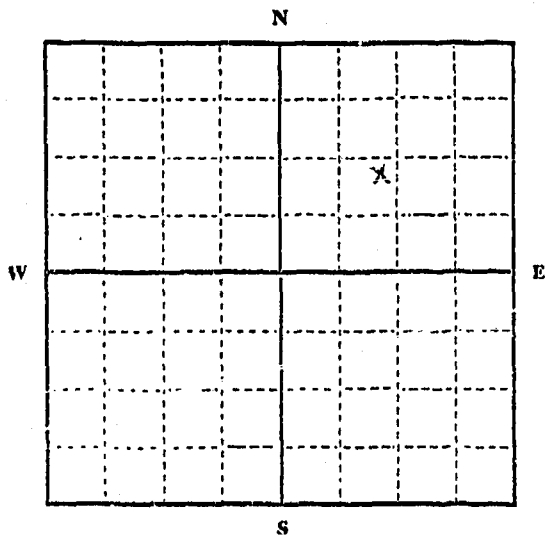

SW 1/4 NE Sec 26 T. 30 R. 31

Indicate point of appropriation and place of use, if possible. Each small square represents 10 acres.

- 2. The beneficial use on which the claim is based HOUSE HOLD USE SPRINKLING, IRRIGATING ECT.
- 3. Date or approximate date of earliest beneficial use; and how continuous the use has been AUGUST 19, 1947
CONTINUOUS USE HAS BEEN STEADY SINCE.
- 4. The amount of groundwater claimed (in miner's inches or gallons per minute) 25
- 5. If used for irrigation, give the acreage and description of the lands to which water has been applied and name of the owner thereof
40 ACRES SW 1/4 NE SEC 26
T-30 R-31 GEORGE PALIGA
- 6. The means of withdrawing such water from the ground and the location of each well or other means of withdrawal ONE WELL WITH ELECTRIC PRESSURE PUMP LOCATED ON NE CORNER OF SAID PROPERTY
- 7. The date of commencement and completion of the construction of the well, wells, or other works for withdrawal of groundwater START - JULY 20 1947 FINISH - AUGUST 19, 1947
- 8. The depth of water table 4 TO 5 FEET
- 9. So far as it may be available, the type, size and depth of each well or the general specifications of any other works for the withdrawal of groundwater DUG WELL FOUR FEET BY FOUR FEET TO A DEPTH OF 16 FEET WITH ELECTRIC PUMP
- 10. The estimated amount of groundwater withdrawn each year 100,000 GALS
- 11. The log of formations encountered in the drilling of each well if available NOT APPLICABLE THIRTEEN FEET OF GRAVEL AND THREE FEET OF HARD PAN
- 12. Such other information of a similar nature as may be useful in carrying out the policy of this act, including reference to book and page of any county record NOT APPLICABLE

Signature of Owner George Paliga
Date 3-20-64

Three copies to be filed by the owner with the County Clerk and Recorder of the county in which the well is located.
Please answer all questions. If not applicable, so state, otherwise the form will be returned.

Original to the County Clerk and Recorder; Duplicate to the State Engineer; Triplicate to the Montana Bureau of Mines and Geology, and Quadruplicate for the Appropriator.

INDEXED

455

STATE OF MONTANA
COUNTY OF LINCOLN

Filed this 20 day of

February A. D. 1864

at 4:00 P. M.

M. M. Mansfield
County Clerk.

By Heenan Laughlin
Deputy

File No.

AUG 21 1972

T 30 R 31

DUPLICATE

County Lincoln

LOG

STATE OF MONTANA
ADMINISTRATOR OF GROUNDWATER CODE
OFFICE OF STATE ENGINEER

Notice of Completion of Groundwater
Appropriation by Means of Well

DEVELOPED AFTER JANUARY 1, 1962

(Under Chapter 237, Montana Session Laws, 1961)

Top of Ground
(Elev. above sea level.....)

0' - 1' Topsoil.
1' - 75' Clay, some
gravel, few boulders.
75' - 110' Light clay
and gravel.
110' - 172' Sandy clay
and gravel.
172' - 177' Sand and
gravel with water.
177' - 185' Clay and
gravel.

Owner Margaret M. Hering Address Libby, Montana

Driller William D. Lake Address Libby, Mont.

Date of Notice of appropriation of groundwater.....

Date well started May 19, 1967 Date completed May 25, 1967

Type of well drilled Equipment used Churn
(Dug, Driven, bored or drilled) (Churn drill, rotary or other)

Water use: Domestic Municipal Stock Irrigation
Industrial Drainage Other

Indicate on the diagram the character and thickness of the different strata met with in drilling, such as soil, clay, shale, gravel, rock or sand, etc. S' w depth at which water is encountered, thickness and character of water-bearing strata and height to which the water rises in the well.

Size of Drilled Hole	Size and Weight of Casing	From (Feet)	To (Feet)	PERFORATIONS		
				Kind Size	From (Feet)	To (Feet)
6" I.D.	6 7/8" O.D. 18.97 lbs. per foot	0	177	12 holes 4" x 4"	172	177

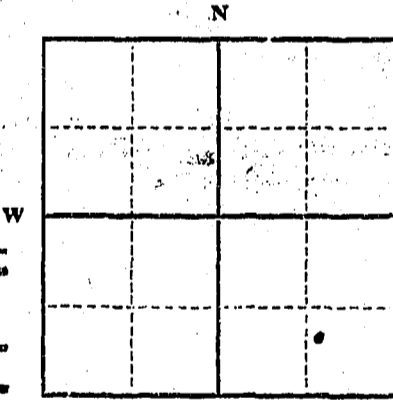

Static Water Level for non-flowing well 143 feet.

Shut-in Pressure for Flowing Well.....

Pumping Water Level: 150 feet
at 6 gal. per minute.

Discharge in gal. per min. of flowing well

How Tested pump

Length of Test 2 hours

Remarks: 9 gal. per min. tested by bailer. 9 hrs.
(Gravel packing, cementing, packers, type of shutoff)

.....

9 gallon per minute in

bailer test.

(Continue on reverse side)

USE—If used for irrigation, industrial, drainage or other. Explain, state number of acres and location or other data (i.e.: Lot, Block and Addition).

Show exact depth of bottom.

This form to be prepared by driller, and three copies to be filed by the owner with the County Clerk and Recorder in the county in which the well is located, tissue copy to be retained by driller.

Please answer all questions. If not applicable, so state, otherwise the form will be returned.

.....
Driller's License Number

William D. Lake
Driller's Signature

RECEIVED

File No.

AUG 21 1972

T. 30 R. 31

DUPLICATE

LOG

MONTANA DEPARTMENT OF NATURAL RESOURCES AND CONSERVATION

County Lincoln

STATE OF MONTANA
ADMINISTRATOR OF GROUNDWATER CODE
OFFICE OF STATE ENGINEER

Notice of Completion of Groundwater Appropriation by Means of Well
DEVELOPED AFTER JANUARY 1, 1962

(Under Chapter 237, Montana Session Laws, 1961)

Top of Ground
(Elev. above sea level.....)

0'-1' Topsoil.

1'-95' Clay, some gravel, few boulders.

95'-110' Tight clay and gravel.

110'-172' Sandy clay and gravel.

172'-177' Sand and gravel with water.

177'-185' Clay and gravel.

Show exact depth of bottom.

Owner: Margaret M. Geringer Address: Libby, Montana

Driller: William D. Lake Address: Libby, Mont.

Date of Notice of appropriation of groundwater.....

Date well started: May 19, 1967 Date completed: May 25, 1967

Type of well: drilled Equipment used: Churn
(Dug, Driven, bored or drilled) (Churn drill, rotary or other)

Water use: Domestic Municipal Stock Irrigation
Industrial Drainage Other

Indicate on the diagram the character and thickness of the different strata met with in drilling, such as soil, clay, shale, gravel, rock or sand, etc. Show depth at which water is encountered, thickness and character of water-bearing strata and height to which the water rises in the well.

Size of Drilled Hole	Size and Weight of Casing	From (Feet)	To (Feet)	PERFORATIONS		
				Kind Size	From (Feet)	To (Feet)
6" I.D.	6 7/8" O.D. 18.97 lbs. per foot	0	177	12 holes 6"x4"	172	177

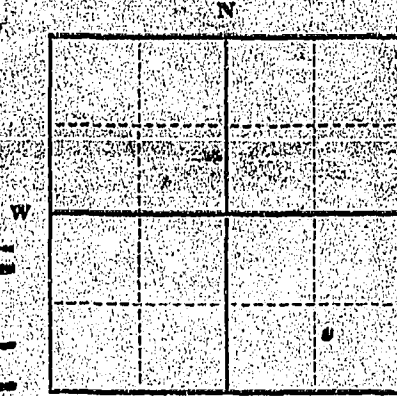

Static Water Level for non-flowing well 172 feet

Shut-in Pressure for Flowing Well.....

Pumping Water Level 170 feet
at 6 gal. per minute.

Discharge in gal. per min. of flowing well

How Tested: pump

Length of Test: 2 hours

Remarks: 9 gals. also tested by bailer 3 hrs
(Gravel packing, cementing, packers, type of shutoff)

9 gallon per minute in bailer test

(Continue on reverse side)

USE—If used for irrigation, industrial, drainage or other. Explain, state number of acres and location or other data (i.e.: Lot, Block and Addition).

This form to be prepared by driller, and three copies to be filed by the owner with the County Clerk and Recorder in the county in which the well is located, tissue copy to be retained by driller.

Please answer all questions. If not applicable, so state, otherwise the form will be returned.

152
Driller's License Number

William D. Lake
Driller's Signature

51,203

893 INDEXED

STATE OF MONTANA
COUNTY OF LINCOLN

Filed this 8th day of August A. D. 1972

at Edwards & Vaughn
County Clerk

By _____ Deputy

RECORDED

1972

INDEXED TO COPY

Refer to index

Produced Pursuant to Court Order in Case No. 89-100-100

SAVING TO CLERK
COUNTY OF LINCOLN
MONTANA

TO BE KEPT IN THE OFFICE OF THE COUNTY CLERK

TO BE KEPT IN THE OFFICE OF THE COUNTY CLERK

TO BE KEPT IN THE OFFICE OF THE COUNTY CLERK

TO BE KEPT IN THE OFFICE OF THE COUNTY CLERK

TO BE KEPT IN THE OFFICE OF THE COUNTY CLERK

FILED	INDEXED	RECORDED	SEARCHED	SERIALIZED	FILED	INDEXED	RECORDED	SEARCHED	SERIALIZED

How many copies to be made of this record?

File No.....

T. 30 N. R. 31 W. 26

DUPLICATE

County Lincoln

STATE OF MONTANA
ADMINISTRATOR OF GROUNDWATER CODE
OFFICE OF STATE ENGINEER

SEP 3 1964

Notice of Completion of Groundwater Appropriation by Means of Well

(Under Chapter 237, Montana Session Laws, 1961)

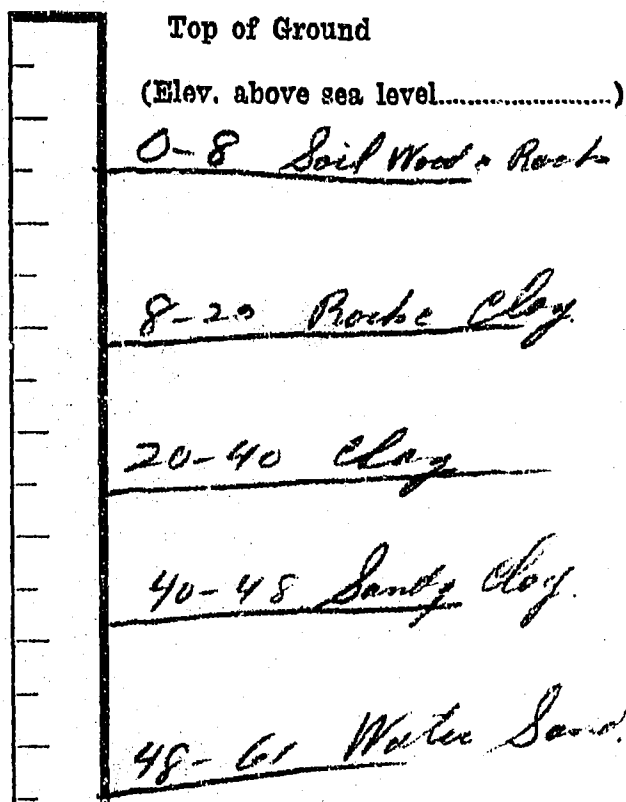

Owner Donald H. Fisher Address Tully Mont.

Driller C. C. Z. ... Address Tully Mont.

Date of Notice of Appropriation of Groundwater.....

Date well started 8-12-64 Date Completed 8-20-64

Type of well Drilled Equipment Used Churn
(dug, driven, bored or drilled) (Churn, drill, rotary or other)

Water Use: Domestic Municipal Other Irrigation
Industrial Drainage Stock

Indicate on the diagram the character and thickness of the different strata met with in drilling, such as soil, clay, shale, gravel, rock or sand, etc. Show depth at which water is encountered, thickness and character of water-bearing strata and height to which water rises in the well.

Size of Drilled Hole	Size and Weight of Casing	From (Feet)	To (Feet)	PERFORATIONS		
				Kind Size	From (Feet)	To (Feet)
<u>6 5/8"</u>	<u>6 5/8" 19 pipe</u>	<u>0</u>	<u>61</u>	<u>1/2" 4.00</u>	<u>55</u>	<u>61</u>

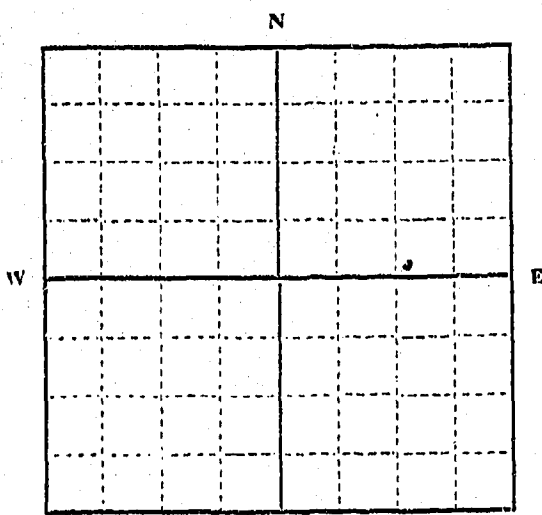

NE 1/4 S
SU 1/4 Sec. 26 T. 30 R. 31
Indicate location of well and place of use, if possible. Each small square represents 10 acres.

Show exact depth of bottom.

Static Water Level for non-flowing Well 25 feet.

Shut-in Pressure for Flowing Well.....

Pumping Water Level 31 feet at 25 gal. per minute.

Discharge in gal. per min. of flowing well.....

How Tested Baled Length of Test 45 mins

Remarks: (Gravel packing, cementing, packers, type of shutoff, location of place of use of groundwater if not at well, and any other similar pertinent information, including number of acres irrigated, if used for irrigation).....

141
Driller's License Number
Donald H. Fisher
Driller's Signature

This form to be prepared by driller, and three copies to be filed by the owner with the County Clerk and Recorder in the county in which the well is located.

Please answer all questions. If not applicable, so state, otherwise the form will be returned.

Original to the County Clerk and Recorder; duplicate to the State Engineer; Triplicate to the Montana Bureau of Mines and Geology and Quadruplicate for the Appropriator.

#466

INDEXED

STATE OF MONTANA
COUNTY OF LINCOLN

Filed this 1st day of

September A. D. 1898

at 9:30 P. M.

M. M. Mansfield
County Clerk

By Elena Dwyer
Deputy

STATE OF MONTANA
ADMINISTRATOR OF GROUNDWATER CODE
MONTANA WATER RESOURCES BOARD

RECEIVED

NOTICE OF COMPLETION OF GROUNDWATER APPROPRIATION BY MEANS OF WELL
Developed after January 1, 1962

(Under Chapter 237 Montana Session Laws, 1961, as amended)

This form to be prepared by driller, and three copies to be filed by the owner with the County Clerk and Recorder in the county in which the well is located, last copy to be retained by driller. Please answer all questions. If not applicable, so state, otherwise the form may be returned.

Owner First Baptist Church

Address Libby, Montana

Date well started 11-2-70

completed 11-14-70

Type of well Drilled

Equipment used Churn

Water Use: Domestic Municipal Stock Irrigation

Industrial Drainage Other Garden/Lawn

*Describe

USE: If used for irrigation, industrial, drainage or other. Explain, state number of acres and location or other data (i.e. Lot, Block and Addition).

ESTIMATED ANNUAL WITHDRAWAL

Size of Drilled Hole	Size and Weight of Casing	From (Feet)	To (Feet)	PERFORATIONS		
				Kind Size	From (Feet)	To (Feet)
6 5/8"	6 5/8" 17#	0	125	3" rd.	120	125

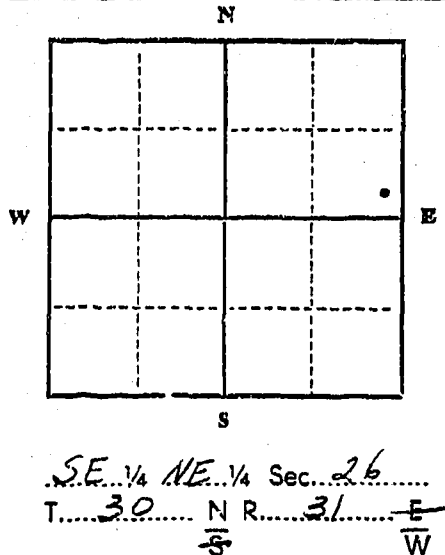

Static water level 75 ft.*
Pumping water level 110 ft.*
at 10 gallons per minute,
measured 60 minutes after pumping
began.
*Measured from ground level.
Well developed by bafter
for 2 hours.
Power..... Pump..... HP
Remarks: (Gravel packing, cementing,
packers, type of shutoff)

INDICATE LOCATION OF WELL AND PLACE OF USE, IF POSSIBLE. EACH SMALL SQUARE REPRESENTS 40 ACRES.

Driller's Signature Clifford J. Bucher

Driller's Address C. & I. Plumbing & Heating, Inc.

Box 1, Libby, Montana 59923 LICENSE NO. 141

DRILLER'S LOG

Indicate the character, color, thickness of strata such as soil, clay, sand, gravel, shale, sandstone, etc. Show depth at which water is found and height to which water rises in well.

Top of Ground (Elev. above sea level)		
From (Feet)	To (Feet)	
0	8	Gravel & Cobble
8	15	Gravel & Sand
15	32	Gravel & Silt
32	45	Boulders
45	47	Hard Sand
47	50	Cemented Sand & Gravel
50	53	Silty Gravel (Seep of water)
53	65	Clay w/ Cobbles
65	90	Silt & Boulders
90	95	Gravel & Sand (seep of water)
95	115	Silty Sand & Gravel
115	120	Silty Sand
120	125	Sandy Gravel (Water)

Show exact depth of bottom

125

48110

766

STATE OF MONTANA
COUNTY OF LINCOLN

Filed this 3rd day of
February A. D. 1921
at 11:30 P. M.
by Clayton P. Vaughan County Clerk
Betty Thacker Deputy

Case No.	Plaintiff	Defendant	Amount	Filed	By	Deputy
1234	John Doe	Jane Smith	\$100.00	2/3/21	Clayton P. Vaughan	Betty Thacker
5678
9012
3456
7890
1122
3344
5566
7788
9900

26

File No.

T. 30 N R. 31 W

DUPLICATE

County Lincoln

STATE OF MONTANA
ADMINISTRATOR OF GROUNDWATER CODE
OFFICE OF STATE ENGINEER

JAN 27 1964
STATE ENGINEER

Declaration of Vested Groundwater Rights

(Under Chapter 237, Montana Session Laws, 1961)

1. Rowland Conover, of Box 462 Libby
(Name of Appropriator) (Address) (Town)
County of Lincoln State of Montana
have appropriated groundwater according to the Montana laws in effect prior to January 1, 1962, as follows:

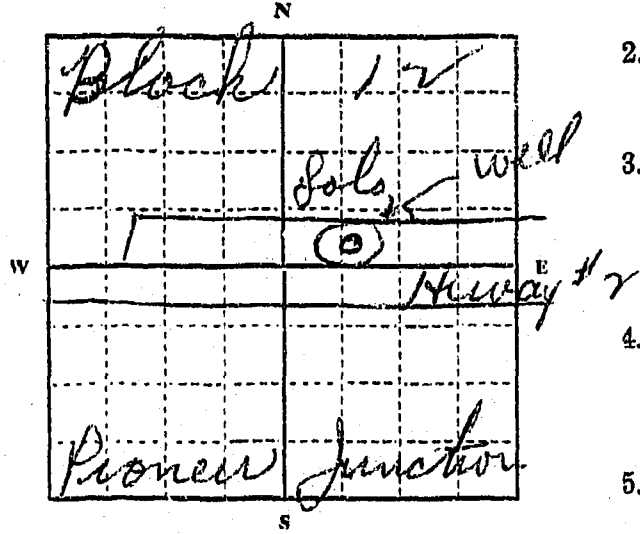

2. The beneficial use on which the claim is based Household-Lawn-Garden

3. Date or approximate date of earliest beneficial use; and how continuous the use has been 1957-1963

4. The amount of groundwater claimed (in miner's inches or gallons per minute) 500 Gals per Hour

5. If used for irrigation, give the acreage and description of the lands to which water has been applied and name of the owner thereof
None

6. The means of withdrawing such water from the ground and the location of each well or other means of withdrawal Pump

E 1/2 N 1/4 Sec. 26 T. 30 R. 31

Indicate point of appropriation and place of use, if possible. Each small square represents 10 acres.

7. The date of commencement and completion of the construction of the well, wells, or other works for withdrawal of groundwater 1957

8. The depth of water table 24 ft.

9. So far as it may be available, the type, size and depth of each well or the general specifications of any other works for the withdrawal of groundwater

"Cased well" - 6" casing - 24 ft.

10. The estimated amount of groundwater withdrawn each year 75,000 Gals

11. The log of formations encountered in the drilling of each well if available

Sand & Gravel

12. Such other information of a similar nature as may be useful in carrying out the policy of this act, including reference to book and page of any county record

None

Signature of Owner

Rowland Conover

Date 12/27-1963

Three copies to be filed by the owner with the County Clerk and Recorder of the county in which the well is located.

Please answer all questions. If not applicable, so state, otherwise the form will be returned.

Original to the County Clerk and Recorder; Duplicate to the State Engineer; Triplicate to the Montana Bureau of Mines and Geology, and Quadruplicate for the Appropriator.

33846

251

STATE OF MONTANA
COUNTY OF LINCOLN

Filed this 27th day of
December A. D. 1963
at Billings A. M.
By W. M. Mansfield County Clerk
Mae Hatten Deputy

RECEIVED

County Lincoln

STATE OF MONTANA
ADMINISTRATOR OF GROUNDWATER CODE
MONTANA WATER RESOURCES BOARD

MAY 10 1972

DRILLER'S LOG

Indicate the character, color, thickness of strata such as soil, clay, sand, gravel, shale, sandstone, etc. Show depth at which water is found and height to which water rises in well.

NOTICE OF COMPLETION OF GROUNDWATER APPROPRIATION BY MEANS OF WELL

Developed after January 1, 1962

(Under Chapter 237 Montana Session Laws, 1961, as amended)

This form to be prepared by driller, and three copies to be filed by the owner with the County Clerk and Recorder in the county in which the well is located, last copy to be retained by driller.

Please answer all questions. If not applicable, so state, otherwise the form may be returned.

Owner Alfred Coffman

Address Trully Road

Date well started 4-1-72

completed 4-6-72

Type of well Drilled

Equipment used Churn Drill

Water Use: Domestic Municipal Stock Irrigation
Industrial Drainage Other * Garden/Lawn

*Describe _____
USE: If used for irrigation, industrial, drainage or other. Explain, state number of acres and location or other data (i.e. Lot, Block and Addition). _____

ESTIMATED ANNUAL WITHDRAWAL

Size of Drilled Hole	Size and Weight of Casing	From (Feet)	To (Feet)	PERFORATIONS		
				Kind Size	From (Feet)	To (Feet)
6 7/8" OP	1 7/8"	+2	108	1/2" sand	104	108

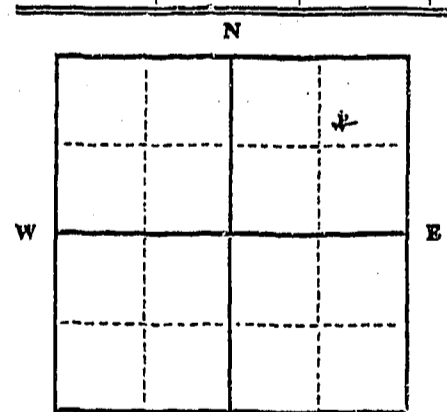

Static water level 4.5 ft.*
Pumping water level 10.5 ft.*
at 10 gallons per minute,
measured 12 minutes after pumping began.

*Measured from ground level.
Well developed by Baling
for 3 hours.
Power 2.30 Pump 1 HP
Remarks: (Gravel packing, cementing, packers, type of shutoff) _____

Lot 28-29-30-31-32
N.E. 1/4 NE 1/4 Sec. 24
T. 30 N. R. 31 E. 3
W

INDICATE LOCATION OF WELL AND PLACE OF USE, IF POSSIBLE. EACH SMALL SQUARE REPRESENTS 40 ACRES.

Driller's Signature Gold Brick Drilling

Driller's Address Donald H. Melcher

Emmett & Trully Road LICENSE NO. 272

Top of Ground (Elev. above sea level)		
From (Feet)	To (Feet)	
0	25	Cobbles & Gravel
25	38	Sandy Gravel
38	39	Thin of water
39	75	Silty Gravel Rock & Clay
75	79	Thin of water
79	100	Silty Gravel
100	108	Water sand

108 Show exact depth of bottom
50,346

862

Division of Agriculture
 Division of Forestry
 Division of Fish and Game
 Division of Land and Water Conservation
 Division of Parks and Recreation
 Division of State Lands
 Division of State Printing
 Division of State Purchasing
 Division of State Transportation
 Division of State Welfare
 Division of State Work
 Division of State Youth

1938
 122
 43
 102
 102
 102

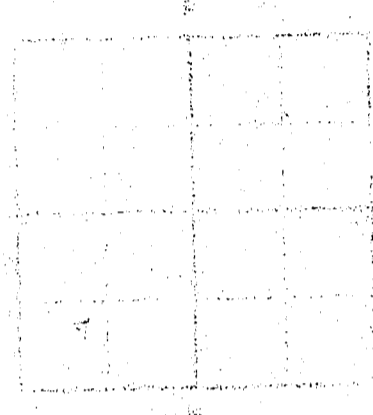

STATE OF MONTANA
COUNTY OF LINCOLN

Filed this 21st day of April, A. D. 1938
 at 4:45 P. M.
Charles L. Vaughn
 County Clerk.
 By Mae Watson Deputy

Deputy

26

File No.

T 30 N R 31 W

DUPLICATE

County Lincoln

STATE OF MONTANA
ADMINISTRATOR OF GROUNDWATER CODE
OFFICE OF STATE ENGINEER

JAN 27 1964

Declaration of Vested Groundwater Rights

(Under Chapter 237, Montana Session Laws, 1961)

1. Billie Bowker, of Rt 1 Box 377 Liberty
(Name of Appropriator) (Address) (Town)

County of Lincoln State of Montana
have appropriated groundwater according to the Montana laws in effect prior to January 1, 1962, as follows:

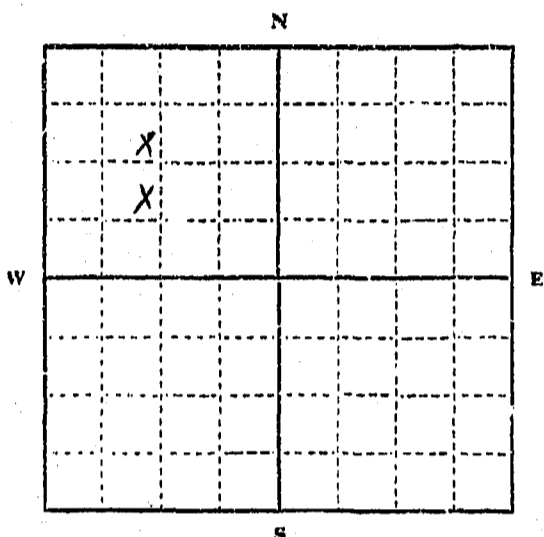

NW 1/4 Sec 26 T30 R31

Indicate point of appropriation and place of use, if possible. Each small square represents 10 acres.

2. The beneficial use on which the claim is based Motel Cafe + Trailer Court

3. Date or approximate date of earliest beneficial use; and how continuous the use has been 1956

4. The amount of groundwater claimed (in miner's inches or gallons per minute) 1000 gal per day - less in winter, more in summer

5. If used for irrigation, give the acreage and description of the lands to which water has been applied and name of the owner thereof Lawn + flowers

6. The means of withdrawing such water from the ground and the location of each well or other means of withdrawal 2 wells at Pioneer Junction

7. The date of commencement and completion of the construction of the well, wells, or other works for withdrawal of groundwater 1956

8. The depth of water table 47 feet 50 feet

9. So far as it may be available, the type, size and depth of each well or the general specifications of any other works for the withdrawal of groundwater Drilled Wells - 47' + 50'

10. The estimated amount of groundwater withdrawn each year 25,000 gals -

11. The log of formations encountered in the drilling of each well if available Not Available

12. Such other information of a similar nature as may be useful in carrying out the policy of this act, including reference to book and page of any county record I don't know

Signature of Owner Billie Bowker

Date 12/26/63

Three copies to be filed by the owner with the County Clerk and Recorder of the county in which the well is located.

Please answer all questions. If not applicable, so state, otherwise

Original to the County Clerk and Recorder; Duplicate to the State Bureau of Mines and Geology, and Quadruplicate for the Appropriator. 33858

File No.

T. 30 N R. 31 W

DUPLICATE

County Lincoln

STATE OF MONTANA
 ADMINISTRATOR OF GROUNDWATER CODE
 OFFICE OF STATE ENGINEER

JAN 27 1964

Declaration of Vested Groundwater Rights

(Under Chapter 237, Montana Session Laws, 1961)

1. Billie Bowker (Name of Appropriator), of Rt. 1, Box 377, Libby (Address) (Town)
 County of Lincoln State of Montana
 have appropriated groundwater according to the Montana laws in effect prior to January 1, 1962, as follows:

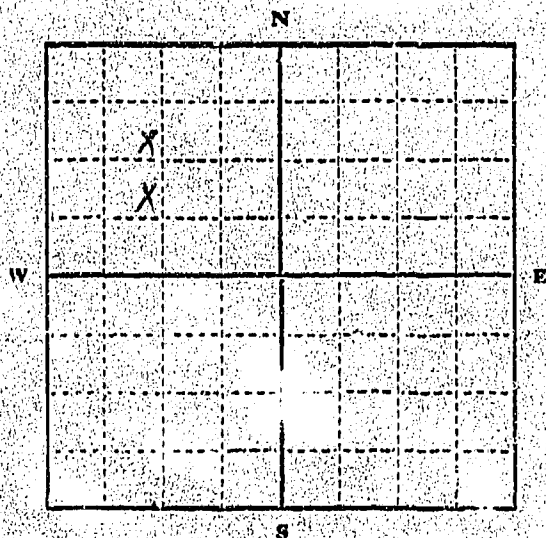

NW 1/4 Sec 26 T30 R31

Indicate point of appropriation and place of use, if possible. Each small square represents 10 acres.

2. The beneficial use on which the claim is based Motor Home + Trailer Court
3. Date or approximate date of earliest beneficial use; and how continuous the use has been 1956
4. The amount of groundwater claimed (in miner's inches or gallons per minute) 1000 gal per day - less in winter, more in summer
5. If used for irrigation, give the acreage and description of the lands to which water has been applied and name of the owner thereof Lawn + flowers
6. The means of withdrawing such water from the ground and the location of each well or other means of withdrawal 2 wells at Pioneer Junction
7. The date of commencement and completion of the construction of the well, wells, or other works for withdrawal of groundwater 1956
8. The depth of water table 47 feet 50 feet
9. So far as it may be available, the type, size and depth of each well or the general specifications of any other works for the withdrawal of groundwater Drilled Wells - 47' - 50 ft
10. The estimated amount of groundwater withdrawn each year 365000 gals -
11. The log of formations encountered in the drilling of each well if available Not Available
12. Such other information of a similar nature as may be useful in carrying out the policy of this act, including reference to book and page of any county record I don't know

Signature of Owner Billie Bowker
 Date 12/26/63

Three copies to be filed by the owner with the County Clerk and Recorder of the county in which the well is located.
 Please answer all questions. If not applicable, so state, otherwise the form will be returned.

Original to the County Clerk and Recorder; Duplicate to the State Engineer; Triplicate to the Montana Bureau of Mines and Geology and Quadruplicate for the Appropriator.

33856

#261

STATE OF MONTANA
COUNTY OF LINCOLN

Filed this 27th day of

December A. D. 1913

at 11:50 P. M.

Dr. W. Mansfield
County Clerk

By Harold H. Johnson
Deputy

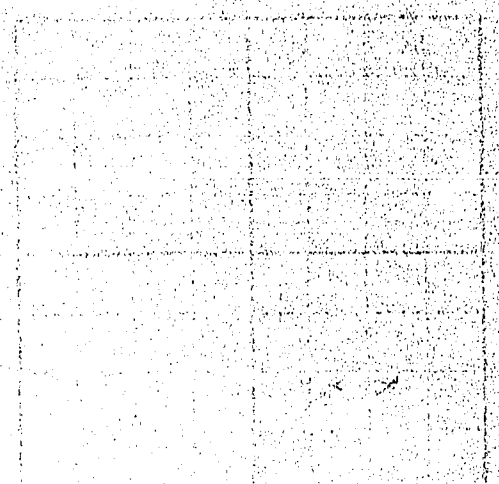

26

File No.

T. 30 N R. 31 W

DUPLICATE

County Lincoln

STATE OF MONTANA
ADMINISTRATOR OF GROUNDWATER CODE
OFFICE OF STATE ENGINEER

JAN 27 1964

Declaration of Vested Groundwater Rights

(Under Chapter 237, Montana Session Laws, 1961)

1. Dewey Bowker, of Rt 1 Box 377 Libby
(Name of Appropriator) (Address) (Town)

County of Lincoln State of Montana
have appropriated groundwater according to the Montana laws in effect prior to January 1, 1962, as follows:

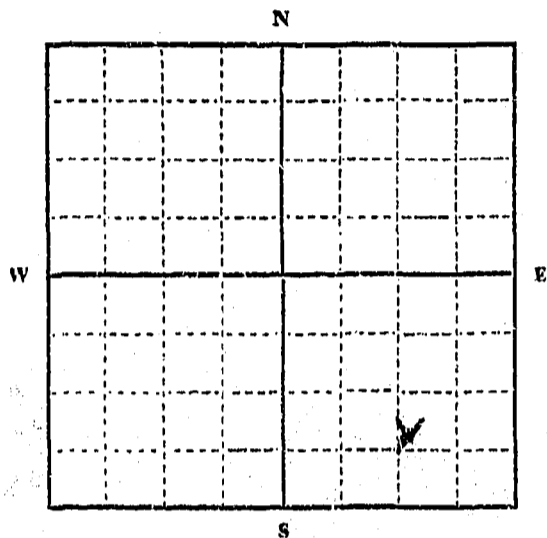

1/4 Sec 26 T. 30 R. 31

Indicate point of appropriation and place of use, if possible. Each small square represents 10 acres.

2. The beneficial use on which the claim is based Home use

3. Date or approximate date of earliest beneficial use; and how continuous the use has been 1956

4. The amount of groundwater claimed (in miner's inches or gallons per minute) 100 gal per day

5. If used for irrigation, give the acreage and description of the lands to which water has been applied and name of the owner thereof lawn

6. The means of withdrawing such water from the ground and the location of each well or other means of withdrawal 1 well dug

7. The date of commencement and completion of the construction of the well, wells, or other works for withdrawal of groundwater 1956

8. The depth of water table 30 ft

9. So far as it may be available, the type, size and depth of each well or the general specifications of any other works for the withdrawal of groundwater 1 well approx 30 ft

10. The estimated amount of groundwater withdrawn each year 36,500 gal

11. The log of formations encountered in the drilling of each well if available Not Available

12. Such other information of a similar nature as may be useful in carrying out the policy of this act, including reference to book and page of any county record I don't know

Signature of Owner Dewey Bowker

Date 12/26/63

Three copies to be filed by the owner with the County Clerk and Recorder of the county in which the well is located.

Please answer all questions. If not applicable, so state, otherwise the form will be returned.

Original to the County Clerk and Recorder; Duplicate to the State Engineer; Triplicate to the Montana Bureau of Mines and Geology, and Quadruplicate for the Appropriator.

33853

#258

INDEXED

STATE OF MONTANA
COUNTY OF LINCOLN

Filed this 27th day of

December A. D. 1963

at 11:35 P. M.

By Wm. M. Thornhill
County Clerk.

Wesley H. Hightower
Deputy

GY

File No.

T. 30 N. R. 31 W

DUPLICATE

County Lincoln

STATE OF MONTANA
ADMINISTRATOR OF GROUNDWATER CODE
OFFICE OF STATE ENGINEER

JAN 27 1964

Declaration of Vested Groundwater Rights
(Under Chapter 237, Montana Session Laws, 1961)

1. Dewey Bowker (Name of Appropriator), Rt. 1 Box 377 Libby (Address) (Town)
County of Lincoln State of Montana
have appropriated groundwater according to the Montana laws in effect prior to January 1, 1962, as follows:

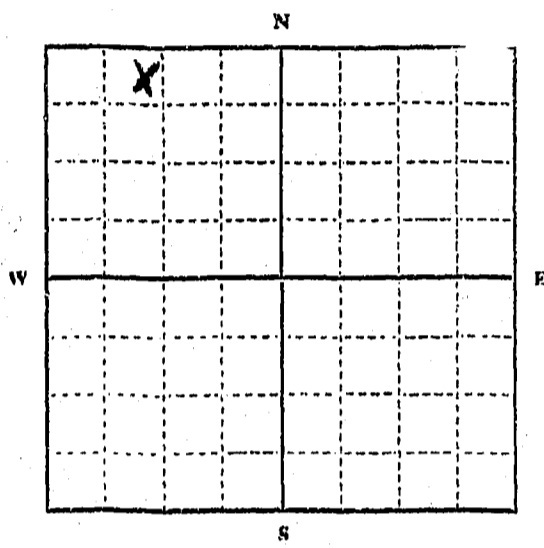

1/4 Sec. 26 T. 30 R. 31

Indicate point of appropriation and place of use, if possible. Each small square represents 10 acres.

2. The beneficial use on which the claim is based Home use

3. Date or approximate date of earliest beneficial use; and how continuous the use has been 1953

4. The amount of groundwater claimed (in miner's inches or gallons per minute) 100 gal per day

5. If used for irrigation, give the acreage and description of the lands to which water has been applied and name of the owner thereof Lawn

6. The means of withdrawing such water from the ground and the location of each well or other means of withdrawal 1 well drilled

7. The date of commencement and completion of the construction of the well, wells, or other works for withdrawal of groundwater 1953

8. The depth of water table 50 ft

9. So far as it may be available, the type, size and depth of each well or the general specifications of any other works for the withdrawal of groundwater 1 well 57 feet drilled

10. The estimated amount of groundwater withdrawn each year 36,500 gal

11. The log of formations encountered in the drilling of each well if available Not Available

12. Such other information of a similar nature as may be useful in carrying out the policy of this act, including reference to book and page of any county record I don't know

Signature of Owner Dewey Bowker

Date 12/26/63

Three copies to be filed by the owner with the County Clerk and Recorder of the county in which the well is located.

Please answer all questions. If not applicable, so state, otherwise the form will be returned.

Original to the County Clerk and Recorder; Duplicate to the State Engineer; Triplicate to the Montana Bureau of Mines and Geology, and Quadruplicate for the Appropriator.

33857

259

STATE OF MONTANA
COUNTY OF LINCOLN

Filed this 27th day of

December A. D. 1963

at 1:40 P. M.

M. M. Mansfield
County Clerk.

By Harold Stegler
Deputy

File No.

T. 30 N. R. 31 W

DUPLICATE

County Lincoln

STATE OF MONTANA
ADMINISTRATOR OF GROUNDWATER CODE
OFFICE OF STATE ENGINEER

JAN 27 1964

Declaration of Vested Groundwater Rights

(Under Chapter 237, Montana Session Laws, 1961)

1. Dowey Bowker, of Rt 1 Box 377 LIBBY
(Name of Appropriator) (Address) (Town)

County of Lincoln State of Montana
have appropriated groundwater according to the Montana laws in effect prior to January 1, 1962, as follows:

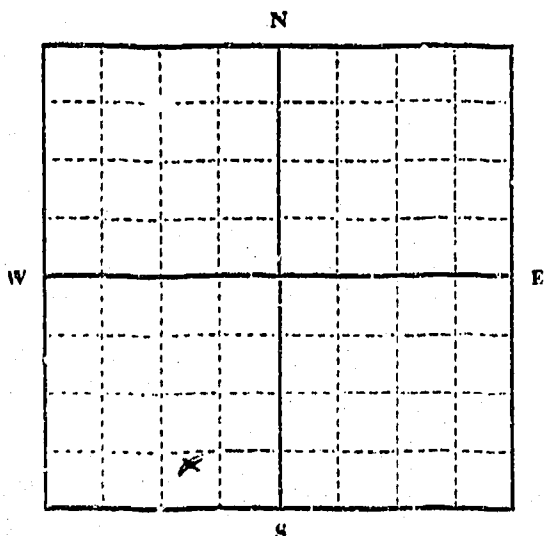

SW 1/4 Sec 22 T30 R31

Indicate point of appropriation and place of use, if possible. Each small square represents 10 acres.

2. The beneficial use on which the claim is based. Welding Shop + Home

3. Date or approximate date of earliest beneficial use; and how continuous the use has been. 1954

4. The amount of groundwater claimed (in miner's inches or gallons per minute) approx 100 gal per day

5. If used for irrigation, give the acreage and description of the lands to which water has been applied and name of the owner thereof. Lawn

6. The means of withdrawing such water from the ground and the location of each well or other means of withdrawal. 1 well drilled

7. The date of commencement and completion of the construction of the well, wells, or other works for withdrawal of groundwater. 1956

8. The depth of water table.

9. So far as it may be available, the type, size and depth of each well or the general specifications of any other works for the withdrawal of groundwater. drilled 40 ft

10. The estimated amount of groundwater withdrawn each year. 36,500 gal

11. The log of formations encountered in the drilling of each well if available. Not Available

12. Such other information of a similar nature as may be useful in carrying out the policy of this act, including reference to book and page of any county record. don't know

Signature of Owner Dowey Bowker

Date 12/26/63

Three copies to be filed by the owner with the County Clerk and Recorder of the county in which the well is located.

Please answer all questions. If not applicable, so state, otherwise the form will be returned.

Original to the County Clerk and Recorder; Duplicate to the State Engineer; Triplicate to the Montana Bureau of Mines and Geology, and Quadruplicate for the Appropriator.

33859

File No.

T. 30 N. R. 31 W

DUPLICATE

County Lincoln

STATE OF MONTANA
ADMINISTRATOR OF GROUNDWATER CODE
OFFICE OF STATE ENGINEER

JAN 27 1964

Declaration of Vested Groundwater Rights

(Under Chapter 237, Montana Session Laws, 1961)

1. Dewey Bowker, of Rt 1, Box 377, LIBBY
(Name of Appropriator) (Address) (Town)
County of Lincoln State of Montana
have appropriated groundwater according to the Montana laws in effect prior to January 1, 1962, as follows:

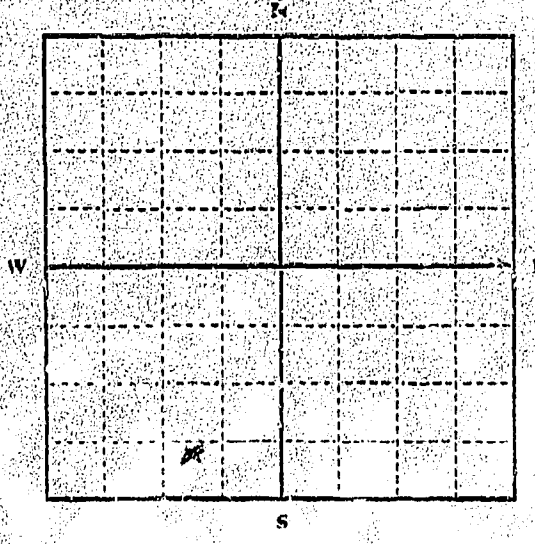

SW 1/4 Sec 26 T 30 R 31

Indicate point of appropriation and place of use, if possible. Each small square represents 10 acres.

- 2. The beneficial use on which the claim is based. Welding Shop + Home
- 3. Date or approximate date of earliest beneficial use; and how continuous the use has been. 1954
- 4. The amount of groundwater claimed (in miner's inches or gallons per minute). approx 100 gal per day
- 5. If used for irrigation, give the acreage and description of the lands to which water has been applied and name of the owner thereof. Lawn
- 6. The means of withdrawing such water from the ground and the location of each well or other means of withdrawal. 1 well drilled
- 7. The date of commencement and completion of the construction of the well, wells, or other works for withdrawal of groundwater. 1956
- 8. The depth of water table.
- 9. So far as it may be available, the type, size and depth of each well or the general specifications of any other works for the withdrawal of groundwater. Drilled 40 ft
- 10. The estimated amount of groundwater withdrawn each year. 36,500 gal
- 11. The log of formations encountered in the drilling of each well if available. Not Available
- 12. Such other information of a similar nature as may be useful in carrying out the policy of this act, including reference to book and page of any county record. I don't know

Signature of Owner Dewey Bowker

Date 12/26/63

Three copies to be filed by the owner with the County Clerk and Recorder of the county in which the well is located.

Please answer all questions. If not applicable, so state, otherwise the form will be returned.

Original to the County Clerk and Recorder; Duplicate to the State Engineer; Triplicate to the Montana Bureau of Mines and Geology, and Quadruplicate for the Appropriator.

33855

260

RECORDED

STATE OF MONTANA
COUNTY OF LINCOLN

Filed this 27th day of

December A. D. 1963

at 1:45 P. M.

W. N. Marshall
County Clerk

By L. A. ...
Deputy

861

STATE OF MONTANA
COUNTY OF LINCOLN

Filed this 18 day of April A. D. 1972
at 4:05 P.M.
Calvin L. Dasher County Clerk
By Mae Watson Deputy

