

File No.....

T. 30 R. 31

DUPLICATE

County Lincoln

STATE OF MONTANA  
ADMINISTRATOR OF GROUNDWATER CODE  
OFFICE OF STATE ENGINEER

RECEIVED  
AUG 12 1963

Declaration of Vested Groundwater Rights

(Under Chapter 237, Montana Session Laws, 1961)

STATE ENGINEER

JENNIE L. Mabel H. Bogusz, of P.O. Box 1077 Libby  
(Name of Appropriator) (Address) (Town)

County of Lincoln State of Montana  
have appropriated groundwater according to the Montana laws in effect prior to January 1, 1962, as follows:

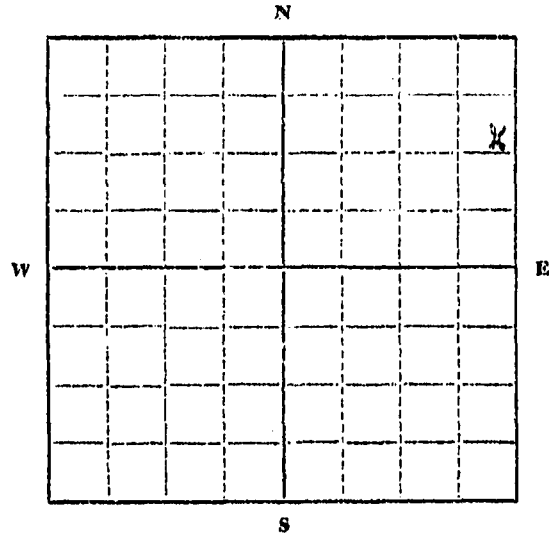

SE 1/4 NE 1/4 Sec. 26 T. 30 R. 31

Indicate point of appropriation and place of use, if possible. Each small square represents 10 acres.

- 2. The beneficial use on which the claim is based.....  
Domestic Needs
- 3. Date or approximate date of earliest beneficial use; and how continuous the use has been.....  
July 5, 1961
- 4. The amount of groundwater claimed (in miner's inches or gallons per minute).....  
9 Gallons
- 5. If used for irrigation, give the acreage and description of the lands to which water has been applied and name of the owner thereof.....  
Domestic Use
- 6. The means of withdrawing such water from the ground and the location of each well or other means of withdrawal.....  
Electric Pump  
70 Feet in from Property Line
- 7. The date of commencement and completion of the construction of the well, wells, or other works for withdrawal of groundwater.....  
July 15, 1961
- 8. The depth of water table.....  
20 Feet
- 9. So far as it may be available, the type, size and depth of each well or the general specifications of any other works for the withdrawal of groundwater.....  
6 inch well 40 Ft. Deep, Drilled
- 10. The estimated amount of groundwater withdrawn each year.....  
500,000 gallons per year
- 11. The log of formations encountered in the drilling of each well if available.....  
Gravel
- 12. Such other information of a similar nature as may be useful in carrying out the policy of this act, including reference to book and page of any county record.....  
Lots 8-9-10-11 Block 14  
Panzer Junction 26-30-31

Jennie L. Bogusz

Signature of Owner.....

Date.....

Three copies to be filed by the owner with the County Clerk and Recorder of the county in which the well is located.

Please answer all questions. If not applicable, so state, otherwise the form will be returned.

Original to the County Clerk and Recorder; duplicate to the State Engineer; Triplicate to the Montana Bureau of Mines and Geology, and Quadruplicate for the Appropriator.

105

RECEIVED

1963

STATE OF MONTANA  
COUNTY OF LINCOLN

Filed this 2nd day of  
August A. D. 1963

at 8:22 P.M.  
M. M. Mansfield  
County Clerk.

By Mae Wilson  
Deputy

RECEIVED

County Lincoln

AUG 21 1972

STATE OF MONTANA  
ADMINISTRATOR OF GROUNDWATER CODE  
MONTANA WATER RESOURCES BOARD

DRILLER'S LOG

NOTICE OF COMPLETION OF GROUNDWATER  
APPROPRIATION BY MEANS OF WELL

Indicate the character, color, thickness of strata such as soil, clay, sand, gravel, shale, sandstone, etc. Show depth at which water is found and height to which water rises in well.

Developed after January 1, 1962

(Under Chapter 237 Montana Session Laws, 1961, as amended)

This form to be prepared by driller, and three copies to be filed by the owner with the County Clerk and Recorder in the county in which the well is located, last copy to be retained by driller.

Please answer all questions. If not applicable, so state, otherwise the form may be returned.

Owner Robert E. Nicholls

Address Rt. 1, Box 868

Libby, Montana 59923

Date well started July 26, 1972

completed August 2, 1972

For Administrator's Use	
File	<u>895</u>
GW	<u>1</u>

Type of well Drilled

(Dug, driven, bored or drilled)

Equipment used Air Rotary

(Churn drill, rotary or other)

Water Use: Domestic  Municipal  Stock  Irrigation

Industrial  Drainage  Other \* Garden/Lawn

\*Describe

USE: If used for irrigation, industrial, drainage or other. Explain, state number of acres and location or other data (i.e. Lot, Block and Addition).

ESTIMATED ANNUAL WITHDRAWAL 80,000 Gal. per year

Size of Drilled Hole	Size and Weight of Casing	From (Feet)	To (Feet)	PERFORATIONS		
				Kind Size	From (Feet)	To (Feet)
<u>6" I.D.</u>	<u>5/8" O.D.</u> <u>17.00 lbs.</u> <u>per ft.</u>	<u>0</u>	<u>112</u>			

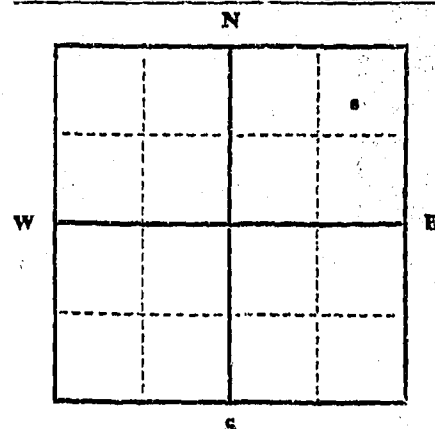

Static water level 51 ft.\*  
Pumping water level 74 ft.\*  
at 2 gallons per minute,  
measured 210 minutes after pumping began.

\*Measured from ground level.  
Well developed by pump  
for 6 hours.  
Power elect. Pump 1/2 HP  
Remarks: (Gravel packing, cementing, packers, type of shutoff)

NE 1/4 NE 1/4 Sec. 26  
T. 30 N R. 31 W

INDICATE LOCATION OF WELL AND PLACE OF USE, IF POSSIBLE. EACH SMALL SQUARE REPRESENTS 40 ACRES.

Driller's Signature William D Lake

Driller's Address P. O. Box 967

Libby, Montana 59923 LICENSE NO. 152

Top of Ground		(Elev. above sea level)
From (Feet)	To (Feet)	
<u>0</u>	<u>1</u>	<u>Topsoil</u>
<u>1</u>	<u>20</u>	<u>Gravel and Boulders</u>
<u>20</u>	<u>22</u>	<u>Gravel and some water</u>
<u>22</u>	<u>62</u>	<u>Clay and Gravel</u>
<u>62</u>	<u>104</u>	<u>Sand Clay, Some Gravel</u>
<u>104</u>	<u>112</u>	<u>Gravel and Water</u>

112 Show exact depth of bottom

HFB.  
H170.

51,199  
51,179



Department of Natural Resources and Conservation  
 Resources Division  
 Engineering Bureau  
 Groundwater Section  
 Sam W. Mitchell Building  
 Helena, Montana 59601

Owner Robert E. Nicholls  
 Address Box 868 Libby, Mt. 59923  
 Location T. 30N R. 31W Sec. 26  
 Doc. No. 895

As the Administrator of the Groundwater Code for the State of Montana, please take note of the following special instructions, in order to properly protect your groundwater right.

Special Instructions:

Please provide, as indicated in red on the attached form, the county filing information.  
 Thank you.

Equipment used ALL START (Churn drill, rotary or other)

Water Use: Domestic  Municipal  Stock  Irrigation   
 Industrial  Drainage  Other  Garden/Lawn

\*Describe  
 USE: If used for irrigation, industrial, drainage or other. Explain, state number of acres and location or other data (i.e. Lot, Block and Addition).

ESTIMATED ANNUAL WITHDRAWAL 50,000 GAL. PER YEAR

Size of Drilled Hole	Size and Weight of Casing	From (Feet)	To (Feet)	PERFORATIONS		
				Kind Size	From (Feet)	To (Feet)
<u>6" I.D. x 5/8"</u>	<u>0.25 lbs. per ft.</u>	<u>0</u>	<u>112</u>			

RECEIVED  
 NOV 29 1972  
 MONTANA DEPARTMENT OF NATURAL RESOURCES AND CONSERVATION

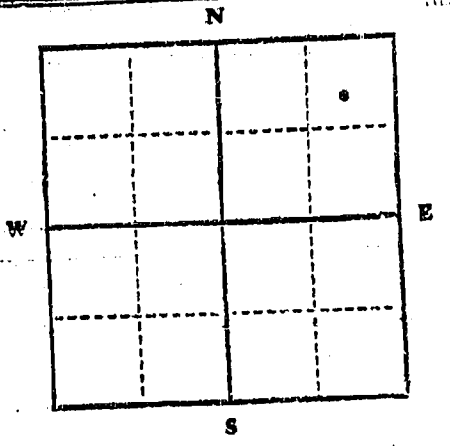

Static water level 51 ft.\*  
 Pumping water level 71 ft.\*  
 at 9 gallons per minute,  
 measured 210 minutes after pumping began.  
 \*Measured from ground level.  
 Well developed by WIRE  
 for 8 hours.  
 Power elect. Pump 3 HP  
 Remarks: (Gravel packing, cementing, packers, type of shutoff)

NE 1/4 NE 1/4 Sec. 26  
T. 30 N. R. 31 W.

INDICATE LOCATION OF WELL AND PLACE OF USE, IF POSSIBLE. EACH SMALL SQUARE REPRESENTS 40 ACRES.

Driller's Signature William D Lake

Driller's Address P.O. Box 967 Libby, Montana 59923 LICENSE NO. 152

112 Show exact depth of bottom

51,199

1-F1B

RECEIVED

County Lincoln

AUG 21 1972

DRILLER'S LOG

STATE OF MONTANA  
ADMINISTRATOR OF GROUNDWATER CODE  
MONTANA WATER RESOURCES BOARD

NOTICE OF COMPLETION OF GROUNDWATER  
APPROPRIATION BY MEANS OF WELL

Developed after January 1, 1962

(Under Chapter 237 Montana Session Laws, 1961, as amended)

This form to be prepared by driller, and three copies to be filed by the owner with the County Clerk and Recorder in the county in which the well is located, last copy to be retained by driller. Please answer all questions. If not applicable, so state, otherwise the form may be returned.

Indicate the character, color, thickness of strata such as soil, clay, sand, gravel, shale, sandstone, etc. Show depth at which water is found and height to which water rises in well.

Owner Robert E. Nicholls

Address Rte. 1, Box 868

Libby, Montana 59923

Date well started July 26, 1972

completed August 2, 1972

For Administrator's Use	
File	<u>895</u>
GW	<u>1</u>

Type of well Drilled (Dug, driven, bored or drilled)

Equipment used Air Rotary (Churn drill, rotary or other)

Water Use: Domestic  Municipal  Stock  Irrigation

Industrial  Drainage  Other \* Garden/Lawn

\*Describe

USE: If used for irrigation, industrial, drainage or other. Explain, state number of acres and location or other data (i.e. Lot, Block and Addition).

ESTIMATED ANNUAL WITHDRAWAL 80,000 gal. per year

Size of Drilled Hole	Size and Weight of Casing	From (Feet)	To (Feet)	PERFORATIONS		
				Kind Size	From (Feet)	To (Feet)
<u>6" I.D. 5/8"</u>	<u>0. 17.00 lbs. per ft.</u>	<u>0</u>	<u>112</u>			

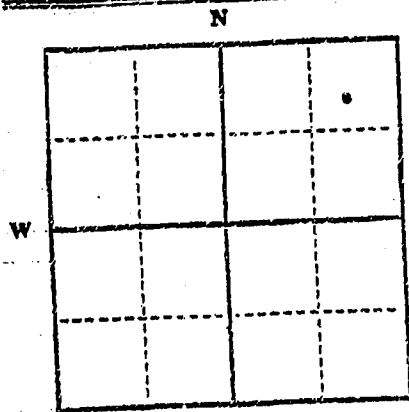

NE 1/4 NE 1/4 Sec. 26  
T. 30 N R. 31 W

INDICATE LOCATION OF WELL AND PLACE OF USE, IF POSSIBLE. EACH SMALL SQUARE REPRESENTS 40 ACRES.

Driller's Signature William D. Lake

Driller's Address P.O. Box 967

Libby, Montana 59923 LICENSE NO. 152

Top of Ground (Elev. above sea level)		
From (Feet)	To (Feet)	
<u>0</u>	<u>1</u>	<u>Topsoil</u>
<u>1</u>	<u>20</u>	<u>Gravel and Boulders</u>
<u>20</u>	<u>22</u>	<u>Gravel and some water</u>
<u>22</u>	<u>62</u>	<u>Clay and Gravel</u>
<u>62</u>	<u>101</u>	<u>Sandy Clay, some gravel</u>
<u>101</u>	<u>112</u>	<u>Gravel and Water</u>

Static water level 51 ft.\*  
Pumping water level 74 ft.\*  
at 9 gallons per minute,  
measured 210 minutes after pumping began.  
\*Measured from ground level.  
Well developed by hand  
for 8 hours.  
Power elect. Pump 2 HP  
Remarks: (Gravel packing, cementing, packers, type of shutoff)

112 Show exact depth of bottom

51,199

HFB

STATE OF MONTANA  
COUNTY OF LINCOLN

Filed this 16 day of August A. D. 1972

at 4:45 P. M.

by Eleanor S. Vaughn

County Clerk.

By \_\_\_\_\_

Ex-1

2

RECEIVED

County Lincoln

STATE OF MONTANA  
ADMINISTRATOR OF GROUNDWATER CODE  
MONTANA WATER RESOURCES BOARD  
NOTICE OF COMPLETION OF GROUNDWATER  
APPROPRIATION BY MEANS OF WELL  
Developed after January 1, 1962

JAN 18 1977

DRILLER'S LOG

Indicate the character, color, thickness of strata such as soil, clay, sand, gravel, shale, sandstone, etc. Show depth at which water is found and height to which water rises in well.

(Under Chapter 237 Montana Session Laws, 1961, as amended)

This form to be prepared by driller, and three copies to be filed by the owner with the County Clerk and Recorder in the county in which the well is located, last copy to be retained by driller. Please answer all questions. If not applicable, so state, otherwise the form may be returned.

Owner CLARENCE E. MILLER  
Clarence E. Miller

Address Box 2  
Libby Montana

For Administrator's Use	
File #	<u>#833, Jan. 10, 1972</u>
Date	<u>11:55 P.M.</u>
GW	<u>1</u>

Date well started 3-25-66  
completed 3-31-66

Type of well drilled  
(Dug, driven, bored or drilled)

Equipment used churn drill  
(Churn drill, rotary or other)

Water Use: Domestic  Municipal  Stock  Irrigation   
Industrial  Drainage  Other  Garden/Lawn

\*Describe Trailer Court

USE: If used for irrigation, industrial, drainage or other. Explain, state number of acres and location or other data (i.e. Lot, Block and Addition).

ESTIMATED ANNUAL WITHDRAWAL

Size of Drilled Hole	Size and Weight of Casing	From (Feet)	To (Feet)	PERFORATIONS		
				Kind Size	From (Feet)	To (Feet)
<u>6 3/8</u>	<u>1 1/2"</u>	<u>0</u>	<u>101</u>	<u>1/2" Round</u>	<u>0</u>	<u>4'</u>

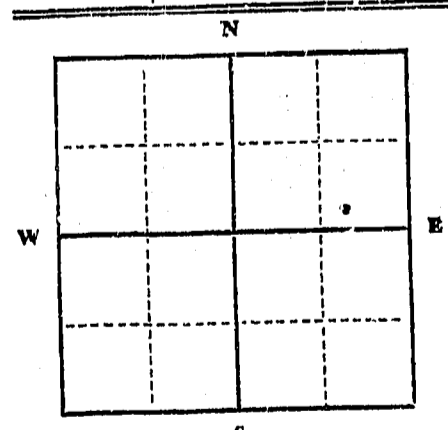

Static water level .....ft.\*  
Pumping water level .....ft.\*  
at 25 gallons per minute,  
measured .....minutes after pumping began.

\*Measured from ground level.  
Well developed by bauling  
for 2 hours.

Power..... Pump..... HP  
Remarks: (Gravel packing, cementing, packers, type of shutoff) .....

SE 1/4 NE 1/4 Sec. 26  
T. 30 N. R. 31

INDICATE LOCATION OF WELL AND PLACE OF USE, IF POSSIBLE EACH SMALL SQUARE REPRESENTS 40 ACRES.

Driller's Signature Clifford J. Becker

Driller's Address Box 2

Libby Montana LICENSE NO. 141  
59983

Top of Ground (Elev. above sea level)		
From (Feet)	To (Feet)	
<u>0</u>	<u>14</u>	<u>Rock</u>
<u>11</u>	<u>16</u>	<u>Shale</u>
<u>16</u>	<u>30</u>	<u>clay &amp; sand</u>
<u>30</u>	<u>40</u>	<u>shells sand &amp; clay</u>
<u>40</u>	<u>50</u>	<u>hard clay &amp; silt</u>
<u>50</u>	<u>52</u>	<u>silt</u>
<u>52</u>	<u>53</u>	<u>hard sandy shell</u>
<u>53</u>	<u>66</u>	<u>sand clay &amp; shells</u>
<u>66</u>	<u>69</u>	<u>sand clay shells &amp; water</u>
<u>69</u>	<u>71</u>	<u>sand &amp; clay</u>
<u>71</u>	<u>75</u>	<u>clay</u>
<u>75</u>	<u>76</u>	<u>half shell</u>
<u>76</u>	<u>79</u>	<u>"</u>
<u>79</u>	<u>83</u>	<u>sand</u>
<u>83</u>	<u>86</u>	<u>sandy shell</u>
<u>86</u>	<u>91</u>	<u>sand &amp; gravel</u>
<u>91</u>	<u>101</u>	<u>sand &amp; water</u>

101 Show exact depth of bottom



833

DEPARTMENT OF REVENUE

STATE OF MONTANA  
COUNTY OF LINCOLN

Handwritten notes and signatures in the upper right section of the document, including a signature that appears to be "C. L. ...".

STATE OF MONTANA  
COUNTY OF LINCOLN

Filed this 13<sup>th</sup> day of  
January A.D. 1922  
at 1:25 P.M.  
by Clemens P. Saenger  
County Clerk  
Ursula S. Steyer  
Deputy

Handwritten notes and signatures in the lower right section of the document, including a signature that appears to be "C. L. ...".

County Lincoln

STATE OF MONTANA  
ADMINISTRATOR OF GROUNDWATER CODE  
MONTANA WATER RESOURCES BOARD

**NOTICE OF COMPLETION OF GROUNDWATER  
APPROPRIATION BY MEANS OF WELL**

Developed after January 1, 1962

(Under Chapter 237 Montana Session Laws, 1961, as amended)

This form to be prepared by driller, and three copies to be filed by the owner with the County Clerk and Recorder in the county in which the well is located, last copy to be retained by driller.

Please answer all questions. If not applicable, so state, otherwise the form may be returned.

Owner Gene Miller

Address Libby, Montana 59923

Date well started August 10, 1972  
completed August 16, 1972

For Administrator's Use  
File 923  
Jul 5, 1973  
GW 1 12:25 p.m.

Type of well Drilled  
(Dug, driven, bored or drilled)

Equipment used Air Rotary  
(Churn drill, rotary or other)

Water Use: Domestic  Municipal  Stock  Irrigation   
Industrial  Drainage  Other  \* Garden/Lawn

\*Describe Trailer Court Well

USE: If used for irrigation, industrial, drainage or other. Explain, state number of acres and location or other data (i.e. Lot, Block and Addition).

ESTIMATED ANNUAL WITHDRAWAL 200,000 Gal. pr. yr.

Size of Drilled Hole	Size and Weight of Casing	From (Feet)	To (Feet)	PERFORATIONS		
				Kind Size	From (Feet)	To (Feet)
<u>6" I.D.</u>	<u>6 5/8" O. D. 17.00 lbs. per ft.</u>	<u>0</u>	<u>100</u>	<u>slots (1/4 per foot)</u>	<u>75</u>	<u>85</u>

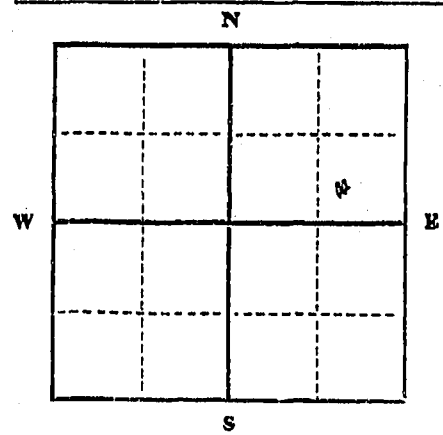

Static water level 45 ft.\*  
Pumping water level 74 ft.\*  
at 20 gallons per minute,  
measured 210 minutes after pumping began.  
\*Measured from ground level.  
Well developed by Pump  
for 4 hours.  
Power elect. Pump 1/2 HP  
Remarks: (Gravel packing, cementing, packers, type of shutoff)

SW 1/4 SE 1/4 NE 1/4 Sec. 26  
T. 30 N R. 31 E

INDICATE LOCATION OF WELL AND PLACE OF USE, IF POSSIBLE. EACH SMALL SQUARE REPRESENTS 40 ACRES.

Driller's Signature Wm D Lake

Driller's Address P.O. Box 567

Libby, Montana 59923 LICENSE NO. 152

**DRILLER'S LOG**

Indicate the character, color, thickness of strata such as soil, clay, sand, gravel, shale, sandstone, etc. Show depth at which water is found and height to which water rises in well.

Top of Ground (Elev. above sea level)

From (Feet)	To (Feet)	
<u>0</u>	<u>2</u>	<u>Topsoil.</u>
<u>2</u>	<u>45</u>	<u>Clay, Gravel and Boulders.</u>
<u>45</u>	<u>75</u>	<u>Clay with some Water.</u>
<u>75</u>	<u>95</u>	<u>Gravel and Water.</u>
<u>95</u>	<u>120</u>	<u>Clay with some Gravel.</u>

100 ft. Show exact depth of bottom.

52361

922

STATE OF MONTANA  
COUNTY OF LINCOLN

Filed this 5<sup>th</sup> day of

February P. D. 1973

at 12:25 P. M.  
Calvin L. Gault  
County Clerk

By Joe Watson  
Deputy

File No. ....

T. 30 N R. 31 W Sec. 26

TRIPLICATE

County LINCOLN

STATE OF MONTANA  
ADMINISTRATOR OF GROUNDWATER CODE  
OFFICE OF STATE ENGINEER

RECEIVED  
AUG 28 1964

Notice of Completion of Groundwater Appropriation by Means of Well

(Under Chapter 237, Montana Session Laws, 1961)

Owner NORMAN MONTGOMERY Address Fetty

Driller W. J. Blumling Address Fetty, Mont.

Date of Notice of Appropriation of Groundwater.....

Date well started 7-31-64 Date Completed 8-2-64

Type of well Drilled Equipment Used Churn  
(dug, driven, bored or drilled) (Churn, drill, rotary or other)

Water Use: Domestic  Municipal  Other  Irrigation   
Industrial  Drainage  Stock

Indicate on the diagram the character and thickness of the different strata met with in drilling, such as soil, clay, shale, gravel, rock or sand, etc. Show depth at which water is encountered, thickness and character of water-bearing strata and height to which water rises in the well.

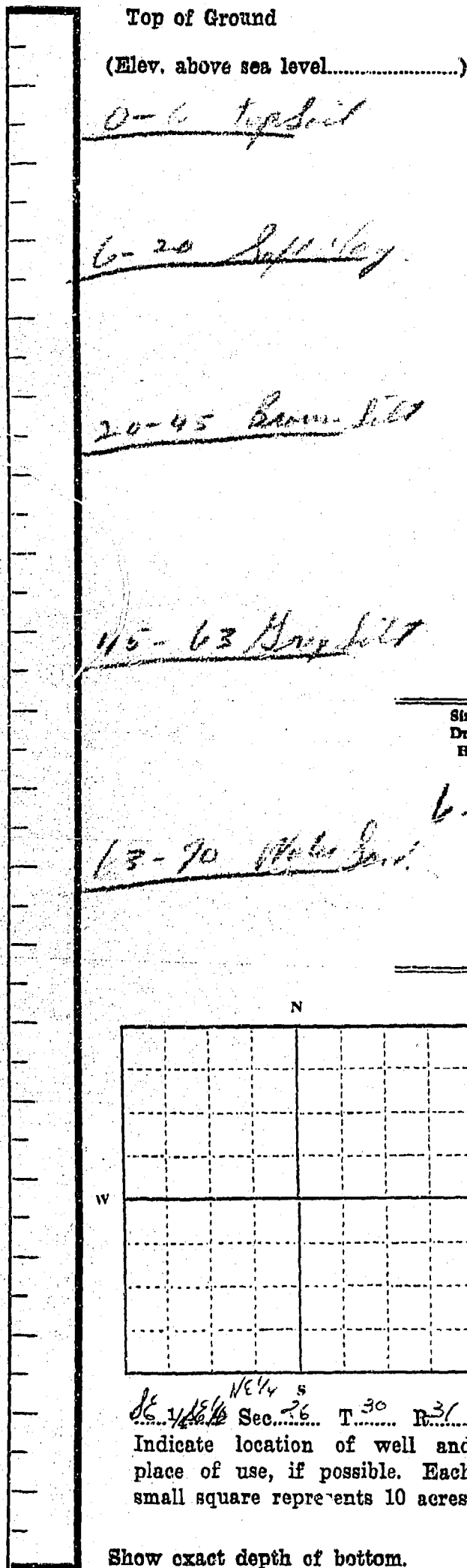

Size of Drilled Hole	Size and Weight of Casing	From (Feet)	To (Feet)	PERFORATIONS		
				Kind Size	From (Feet)	To (Feet)
<u>6 5/8</u>	<u>6 5/8</u> <u>19 lb</u>	<u>0</u>	<u>70</u>	<u>1/2 in</u>	<u>64</u>	<u>70</u>

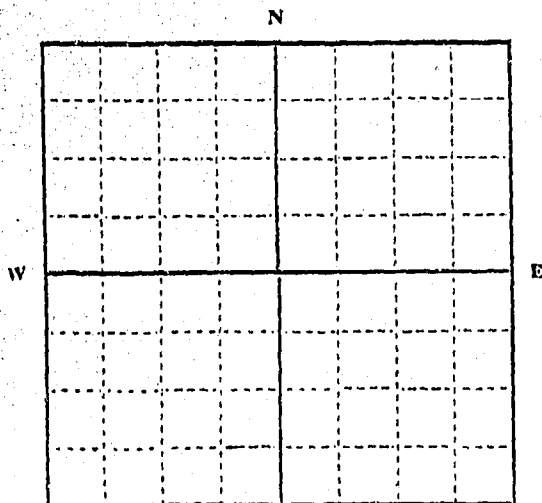

NE 1/4 S 26  
Sec. 26 T. 30 R. 31  
Indicate location of well and place of use, if possible. Each small square represents 10 acres.

Show exact depth of bottom.

Static Water Level for non-flowing Well.....feet.

Shut-in Pressure for Flowing Well.....

Pumping Water Level 35 feet at 40 gal. per minute.

Discharge in gal. per min. of flowing well.....

How Tested Balud Length of Test 1 hr

Remarks: (Gravel packing, cementing, packers, type of shutoff, location of place of use of groundwater if not at well, and any other similar pertinent information, including number of acres irrigated, if used for irrigation).....

#141  
Driller's License Number  
Donald J. [Signature]  
Driller's Signature

This form to be prepared by driller, and three copies to be filed by the owner with the County Clerk and Recorder in the county in which the well is located.

Please answer all questions. If not applicable, so state, otherwise the form will be returned.

Original to the County Clerk and Recorder; duplicate to the State Engineer; Triplicate to the Montana Bureau of Mines and Geology and Quadruplicate for the Appropriator.

38409

# 465

STATE OF MONTANA  
COUNTY OF LINCOLN

Filed this 25 day of  
August A. D. 1964  
at 12:25 P. M.  
M. M. Mansfield  
County Clerk  
By E. J. Deputy

File No.....

STATE WATER CONSERVATION BOARD

T. 30 N R. 31 W

DUPLICATE

APR 18 1966

County Lincoln

Elie \_\_\_\_\_ McDermott \_\_\_\_\_  
 Butzerin \_\_\_\_\_ M. Nelly \_\_\_\_\_  
 Coyle \_\_\_\_\_ Merton \_\_\_\_\_  
 Darlington \_\_\_\_\_ Sullivan \_\_\_\_\_  
 Dickert \_\_\_\_\_

**STATE OF MONTANA**  
**ADMINISTRATOR OF GROUNDWATER CODE**  
**OFFICE OF STATE ENGINEER**

**Notice of Completion of Groundwater**  
**Appropriation by Means of Well**

(Under Chapter 237, Montana Session Laws, 1961)

Owned by Luther Lacock Address Libby Mont.

Driller C. J. P. Kelly Address " "

Date of Notice of Appropriation of Groundwater.....

Date well started 4/2/66 Date Completed 4/12/66

Type of well drilled Equipment Used churn  
 (dug, driven, bored or drilled) (Churn, drill, rotary or other)

Water Use: Domestic  Municipal  Other  Irrigation   
 Industrial  Drainage  Stock

Indicate on the diagram the character and thickness of the different strata met with in drilling, such as soil, clay, shale, gravel, rock or sand, etc. Show depth at which water is encountered, thickness and character of water-bearing strata and height to which water rises in the well.

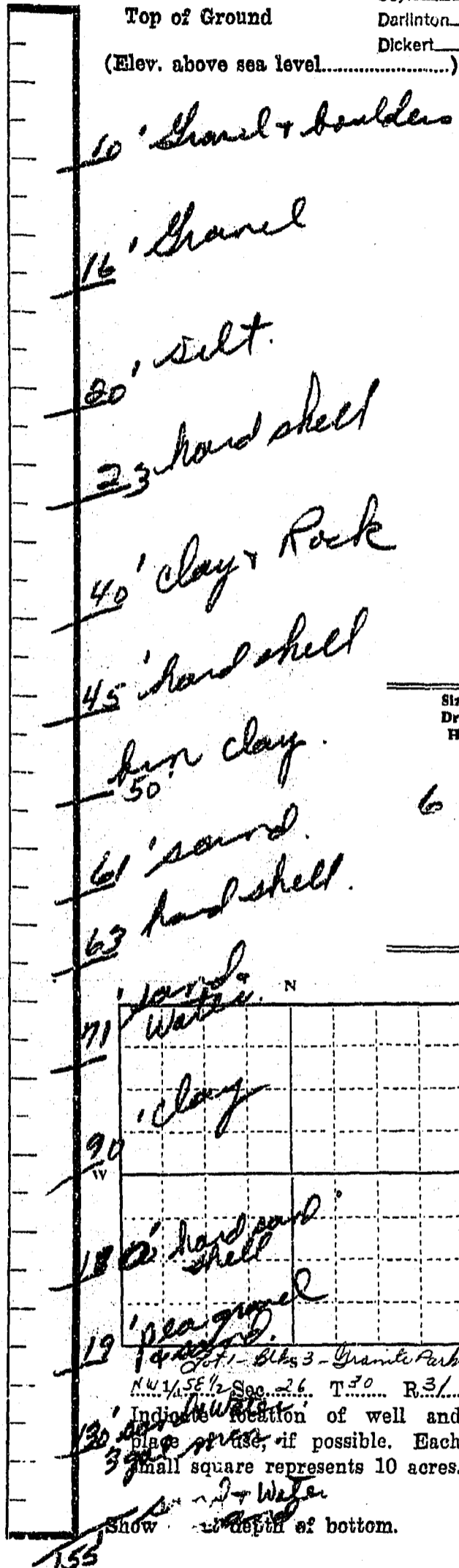

Size of Drilled Hole	Size and Weight of Casing	From (Feet)	To (Feet)	PERFORATIONS		
				Kind Size	From (Feet)	To (Feet)
6"	17#	0	155'	1/2" Round Hole	0	4'

Static Water Level for non-flowing Well..... 50' feet.

Shut-in Pressure for Flowing Well.....

Pumping Water Level..... 140 feet at..... 9 gal. per minute.

Discharge in gal. per min. of flowing well.....

How Tested baled Length of Test..... 2 hours

Remarks: (Gravel packing, cementing, packers, type of shutoff, location of place of use of groundwater if not at well, and any other similar pertinent information, including number of acres irrigated, if used for irrigation).....

Driller's License Number 141

Driller's Signature Clifford J. Becker

This form to be prepared by driller, and three copies to be filed by the owner with the County Clerk and Recorder in the county in which the well is located.

Please answer all questions. If not applicable, so state, otherwise the form will be returned.

Original to the County Clerk and Recorder; duplicate to the State Engineer; Triplicate to the Montana Bureau of Mines and Geology and Quadruplicate for the Appropriator.

40979

#538

STATE MOUNTAIN

STATE OF MONTANA  
COUNTY OF LINCOLN

Filed this 13 day of

April A. D. 1926

at 10:30 A.M.  
Eleanor L. Vaughan  
County Clerk.

By \_\_\_\_\_ Deputy

*[Faint, illegible text and markings, possibly bleed-through from the reverse side of the page]*

File No. ....

STATE WATER CONSERVATION BOARD

T. 30 R. 31

26

DUPLICATE

APR 19 1967

County Lincoln

STATE OF MONTANA  
ADMINISTRATOR OF GROUNDWATER CODE  
OFFICE OF STATE ENGINEER

Top of Ground  
(Elev. above sea level.....)

0'-20' Clay, gravel and boulders.  
20'-56' Clay with some gravel.  
56'-61' Gravel, sand, some water.  
61'-105' Clay and gravel.  
105'-110' Sand, gravel, with water.  
110'-120' Clay and gravel. (2 3/8 G.P.M.)  
120'-128' Gravel, and water with clay (2 3/8 G.P.M.)  
128'-159' Clay and gravel.

### Notice of Completion of Groundwater Appropriation by Means of Well

(Under Chapter 287, Montana Session Laws, 1961)

Owner Luther T. Lacoek Address Libley, Mont.

Driller William D. Lake Address Libley, Mont.

Date of Notice of Appropriation of Groundwater.....

Date well started Nov. 1, 1966 Date Completed Nov. 28, 1966

Type of well drilled Equipment Used Churn  
(dug, driven, bored or drilled) (Churn, drill, rotary or other)

Water Use: Domestic  Municipal  Other  Irrigation   
Industrial  Drainage  Stock

Indicate on the diagram the character and thickness of the different strata met with in drilling, such as soil, clay, shale, gravel, rock or sand, etc. Show depth at which water is encountered, thickness and character of water-bearing strata and height to which water rises in the well.

Size of Drilled Hole	Size and Weight of Casing	From (Feet)	To (Feet)	PERFORATIONS		
				Kind Size	From (Feet)	To (Feet)
6" I.D.	6 3/8" O.D. 18.97 lbs. per foot	0'	150'	16 holes	105'-108'	
				28 holes	119'-126'	
				44 holes	(3/8" x 2")	

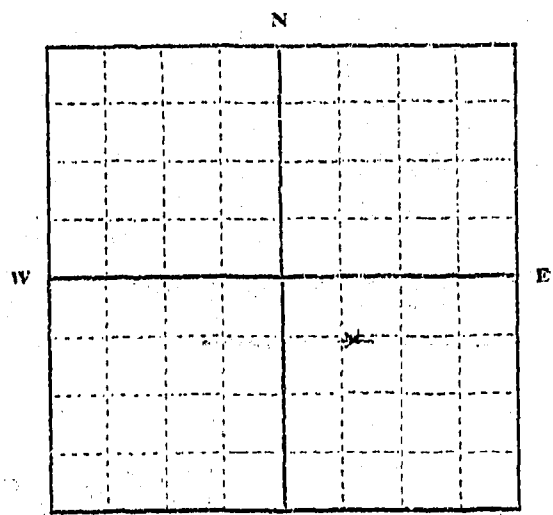

SE 1/4 Sec. 26 T. 30 R. 31  
Indicate location of well and place of use, if possible. Each small square represents 10 acres.

Show exact depth of bottom.

Static Water Level for non-flowing Well 38 feet.

Shut-in Pressure for Flowing Well.....

Pumping Water Level 125 feet at 5 gal. per minute.

Discharge in gal. per min. of flowing well.....

How Tested bailer Length of Test 4 hrs.

Remarks: (Gravel packing, cementing, packers, type of shutoff, location of place of use of groundwater if not at well, and any other similar pertinent information, including number of acres irrigated, if used for irrigation).....

152  
Driller's License Number

William D. Lake  
Driller's Signature

This form to be prepared by driller, and three copies to be filed by the owner with the County Clerk and Recorder in the county in which the well is located.

Please answer all questions. If not applicable, so state, otherwise the form will be returned.

Original to the County Clerk and Recorder; duplicate to the State Engineer; Triplicate to the Montana Bureau of Mines and Geology and Quadruplicate for the Appropriator.

41886



580

STATE OF MONTANA  
COUNTY OF LENOX

Filed this 1<sup>st</sup> day of

April A. D. 1967

at 9:50 P. M.

by Eleanor L. Laughlin County Clerk.

By Mae Watson Deputy

*[Faint, mostly illegible handwritten text, possibly a list or ledger entries, covering the majority of the page.]*

GW 2

Approved Stock Form—State Publishing Co., Helena, Montana—404

File No.....

T. 30 N. 31 R. 31

DUPLICATE

County Lincoln

STATE OF MONTANA  
ADMINISTRATOR OF GROUNDWATER CODE  
OFFICE OF STATE ENGINEER

RECEIVED  
MAR 5 1964  
STATE ENGINEER

Top of Ground  
(Elev. above sea level 2250)

### Notice of Completion of Groundwater Appropriation by Means of Well

(Under Chapter 237, Montana Session Laws, 1961)

Owner James & Mary Johnson Address LIBBY MONT

Driller Same Address -

Date of Notice of Appropriation of Groundwater.....

Date well started Aug. 1962 Date Completed Aug. 1962

Type of well dug Equipment Used.....  
(dug, driven, bored or drilled) (Churn, drill, rotary or other)

Water Use: Domestic  Municipal  Other  Irrigation   
Industrial  Drainage  Stock

Indicate on the diagram the character and thickness of the different strata met with in drilling, such as soil, clay, shale, gravel, rock or sand, etc. Show depth at which water is encountered, thickness and character of water-bearing strata and height to which water rises in the well.

Size of Drilled Hole	Size and Weight of Casing	From (Feet)	To (Feet)	PERFORATIONS		
				Kind Size	From (Feet)	To (Feet)
<u>3ft</u>	<u>3ft</u>	<u>+1</u>	<u>-17</u>	<u>None</u>	<u>-</u>	<u>-</u>

Send all this way

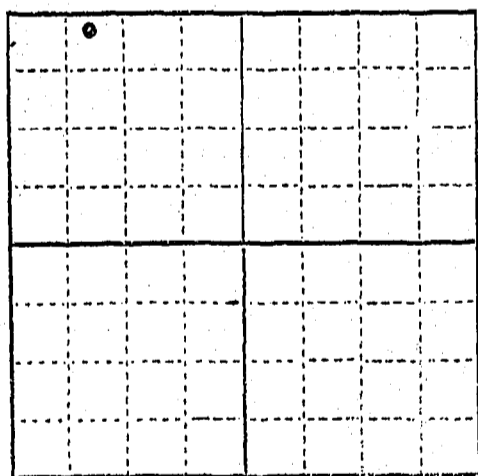

NW 1/4 Sec 26 T. 30 R. 31  
Indicate location of well and place of use, if possible. Each small square represents 10 acres.

17ft Show exact depth of bottom.

Static Water Level for non-flowing Well 13 feet.

Shut-in Pressure for Flowing Well.....

Pumping Water Level 13 feet at 30 gal. per hour minute.

Discharge in gal. per min. of flowing well.....

How Tested Pump Length of Test 1 hr.

Remarks: (Gravel packing, cementing, packers, type of shutoff, location of place of use of groundwater if not at well, and any other similar pertinent information, including number of acres irrigated, if used for irrigation).....

Used for house hold & stock water

None  
Driller's License Number

None  
Driller's Signature

This form to be prepared by driller, and three copies to be filed by the owner with the County Clerk and Recorder in the county in which the well is located.

Please answer all questions. If not applicable, so state, otherwise the form will be returned.

Original to the County Clerk and Recorder; duplicate to the State Engineer; Triplicate to the Montana Bureau of Mines and Geology and Quadruplicate for the Appropriator.

STATE OF MONTANA  
COUNTY OF LINCOLN

Filed this 27<sup>th</sup> day of

January A. D. 1964

at 3:06 P. M.

By Dr. M. Marshall  
County Clerk.

By Ursula H. Nelson  
Deputy

RECEIVED

APR 2 1964

RECEIVED

0

File No. ....

T. 30 N. R. 31 E.

DUPLICATE

County Lincoln

STATE OF MONTANA  
ADMINISTRATOR OF GROUNDWATER CODE  
OFFICE OF STATE ENGINEER

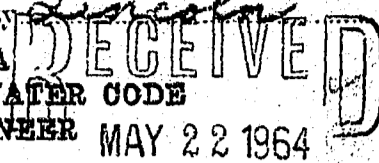

### Notice of Completion of Groundwater Appropriation by Means of Well

(Under Chapter 287, Montana Session Laws, 1961)

Owner James R. Hendricks Address Libby, Mont

Driller C. & S. Plumbers Address Libby

Date of Notice of Appropriation of Groundwater.....

Date well started..... Date Completed.....

Type of well drilled Equipment Used churn  
(dug, driven, bored or drilled) (Churn, drill, rotary or other)

Water Use: Domestic  Municipal  Other  Irrigation   
Industrial  Drainage  Stock

Indicate on the diagram the character and thickness of the different strata met with in drilling, such as soil, clay, shale, gravel, rock or sand, etc. Show depth at which water is encountered, thickness and character of water-bearing strata and height to which water rises in the well.

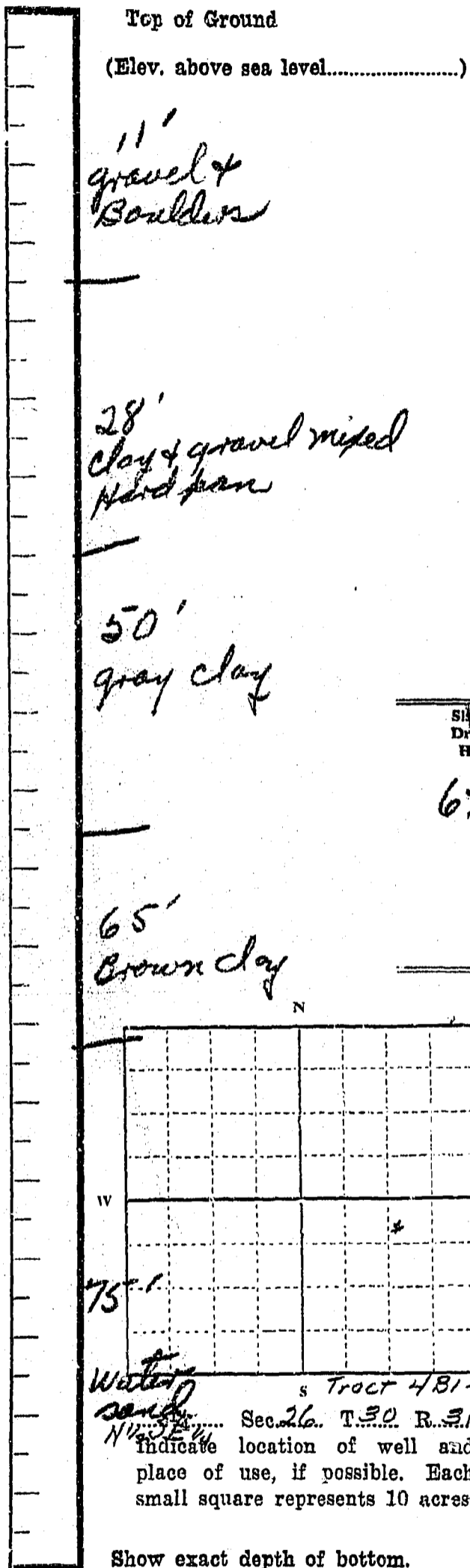

Site of Drilled Hole	Size and Weight of Casing	From (Feet)	To (Feet)	PERFORATIONS		
				Kind Size	From (Feet)	To (Feet)
6 5/8	6 5/8 17#	0	75	1/2 Rd	75	69

Static Water Level for non-flowing Well..... 35 feet.

Shut-in Pressure for Flowing Well.....

Pumping Water Level..... 14 feet at 20 gal. per minute.

Discharge in gal. per min. of flowing well.....

How Tested..... Bailers Length of Test..... 2 hrs.

Remarks: (Gravel packing, cementing, packers, type of shutoff, location of place of use of groundwater if not at well, and any other similar pertinent information, including number of acres irrigated, if used for irrigation).....

141  
Driller's License Number

Sherman Woodland  
Driller's Signature

This form to be prepared by driller, and three copies to be filed by the owner with the County Clerk and Recorder in the county in which the well is located.

Please answer all questions. If not applicable, so state, otherwise the form will be returned.

Original to the County Clerk and Recorder; duplicate to the State Engineer; Triplicate to the Montana Bureau of Mines and Geology and Quaduplicate for the Appropriator.

INDEXED 456

STATE OF MONTANA  
COUNTY OF LINCOLN

Filed this 20th day of April A. D. 1964

at 10:05 P. M.

By M. J. Mansfield County Clerk

By Max Halton Deputy

*[Faint, mostly illegible text and markings, possibly bleed-through from the reverse side of the page.]*

File No.....

MONTANA WATER RESOURCES BOARD

T. 30 R. 31

RECEIVED

DUPLICATE

County Lincoln

AUG 17 1967

LOG

STATE OF MONTANA  
ADMINISTRATOR OF GROUNDWATER CODE  
OFFICE OF STATE ENGINEER

Top of Ground  
(Elev. above sea level.....)

Notice of Completion of Groundwater  
Appropriation by Means of Well

DEVELOPED AFTER JANUARY 1, 1962

(Under Chapter 237, Montana Session Laws, 1961)

0'-8' Clay and gravel.

8'-12' Sandy clay with  
surface water.

12'-51' Sandy clay -  
some gravel.

51'-55' Gravel, clay,  
some water (1/2 gal.)

55'-61' Clay and  
gravel.

61'-65' Gravel, some  
water (2 gal. p.m.)

65'-72' Clay.

72'-78' Gravel with  
water.

Owner Norman Hanson Address Libby, Mont.

Driller William D. Lake Address Libby, Mont.

Date of Notice of appropriation of groundwater.....

Date well started July 27, 1967 Date completed Aug 2, 1967

Type of well drilled Equipment used Churn  
(Dug, Driven, bored or drilled) (Churn drill, rotary or other)

Water use: Domestic  Municipal  Stock  Irrigation   
Industrial  Drainage  Other

Indicate on the diagram the character and thickness of the different strata met with in drilling, such as soil, clay, shale, gravel, rock or sand, etc. Show depth at which water is encountered, thickness and character of water-bearing strata and height to which the water rises in the well.

Size of Drilled Hole	Size and Weight of Casing	From (Feet)	To (Feet)	PERFORATIONS		
				Kind Size	From (Feet)	To (Feet)
6" I.D.	6 3/4" O.D. 18.97 lbs. per foot	0'	78'			none

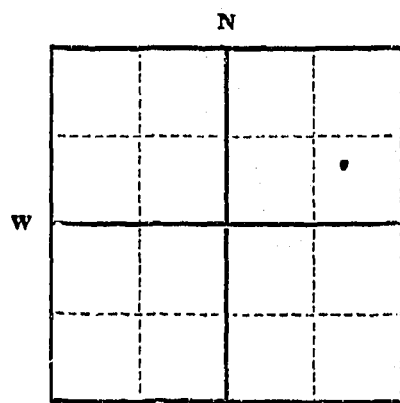

Sec 17 & 18 T. 30 N. R. 31 E.

SE 1/4 NE Sec 26 T. 30 N. R. 31 E.  
Indicate location of well and place of use, if possible. Each small square represents 40 acres.

Static Water Level for non-flowing well.....29 feet.

Shut-in Pressure for Flowing Well.....

Pumping Water Level.....44 feet  
at.....12 gal. per minute.

Discharge in gal. per min. of flowing well.....

How Tested.....pump

Length of Test.....4 1/2 hrs.

Remarks: (Gravel packing, cementing, packers, type of shutoff).....

(Continue on reverse side)

USE—If used for irrigation, industrial, drainage or other. Explain, state number of acres and location or other data (i.e.: Lot, Block and Addition).

Show exact depth of bottom.

This form to be prepared by driller, and three copies to be filed by the owner with the County Clerk and Recorder in the county in which the well is located, tissue copy to be retained by driller.

Please answer all questions. If not applicable, so state, otherwise the form will be returned.

152  
Driller's License Number

William D. Lake  
Driller's Signature

42,209

INDEXED

592

STATE OF MONTANA  
COUNTY OF LINCOLN

Filed this 9th day of August A. D. 1967  
at 12:00 P.M.  
by Clarence L. Vaughn County Clerk  
Mae Watson Deputy

IN WITNESS WHEREOF, I have hereunto set my hand and the seal of said County at the City of Lincoln, Montana, this 9th day of August, 1967.

From District Court and Vol. 10000  
Book 10000  
Page 10000

Section	Block	Lot	Area	Remarks
1	1	1	1.00	
1	1	2	1.00	
1	1	3	1.00	
1	1	4	1.00	
1	1	5	1.00	
1	1	6	1.00	
1	1	7	1.00	
1	1	8	1.00	
1	1	9	1.00	
1	1	10	1.00	
1	1	11	1.00	
1	1	12	1.00	
1	1	13	1.00	
1	1	14	1.00	
1	1	15	1.00	
1	1	16	1.00	
1	1	17	1.00	
1	1	18	1.00	
1	1	19	1.00	
1	1	20	1.00	
1	1	21	1.00	
1	1	22	1.00	
1	1	23	1.00	
1	1	24	1.00	
1	1	25	1.00	
1	1	26	1.00	
1	1	27	1.00	
1	1	28	1.00	
1	1	29	1.00	
1	1	30	1.00	

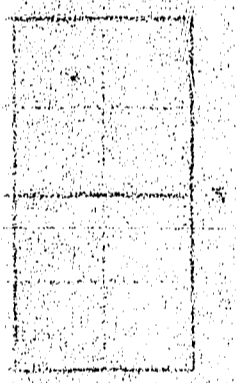

Section 1  
Block 1  
Lot 1

File No. ....

T. 30 N R. 31 W 27

DUPLICATE

County Terrell

STATE OF MONTANA  
ADMINISTRATOR OF GROUNDWATER CODE  
OFFICE OF STATE ENGINEER JAN 6 1965

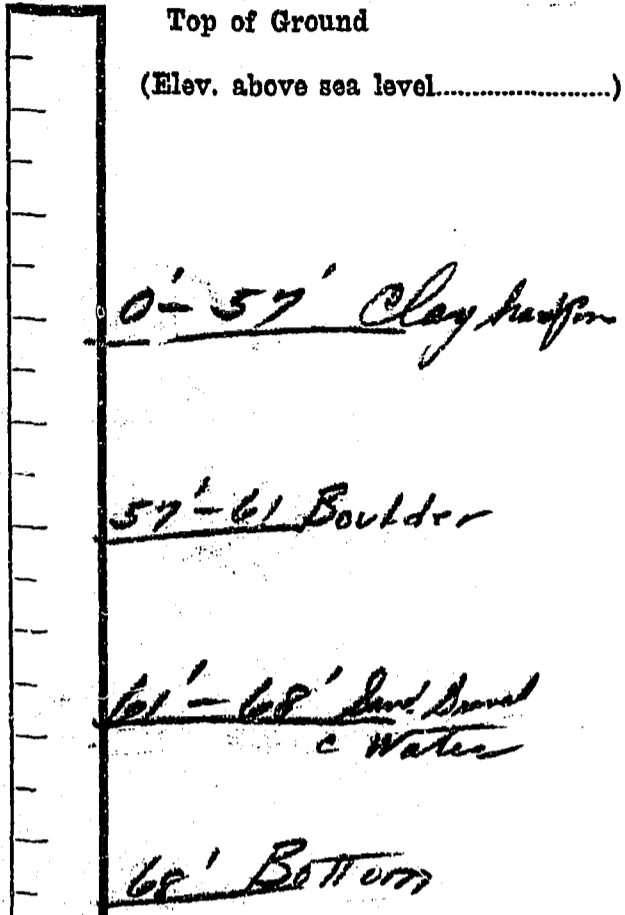
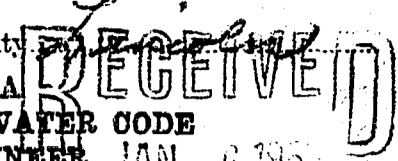

### Notice of Completion of Groundwater Appropriation by Means of Well

(Under Chapter 237, Montana Session Laws, 1961)

Owner Dave Schikora Address Fibby, Mont.

Driller Co. J. Plumbing Address Fibby, Mont.

Date of Notice of Appropriation of Groundwater.....

Date well started 11-28-64 Date Completed 12-3-64

Type of well Tracked Equipment Used Churn  
(dag, driven, bored or drilled) (Churn, drill, rotary or other)

Water Use: Domestic  Municipal  Other  Irrigation   
Industrial  Drainage  Stock

Indicate on the diagram the character and thickness of the different strata met with in drilling, such as soil, clay, shale, gravel, rock or sand, etc. Show depth at which water is encountered, thickness and character of water-bearing strata and height to which water rises in the well.

Size of Drilled Hole	Size and Weight of Casing	From (Feet)	To (Feet)	PERFORATIONS		
				Kind Size	From (Feet)	To (Feet)
6 5/8" OD	19#	0	68	1/2" sand	62'	68'

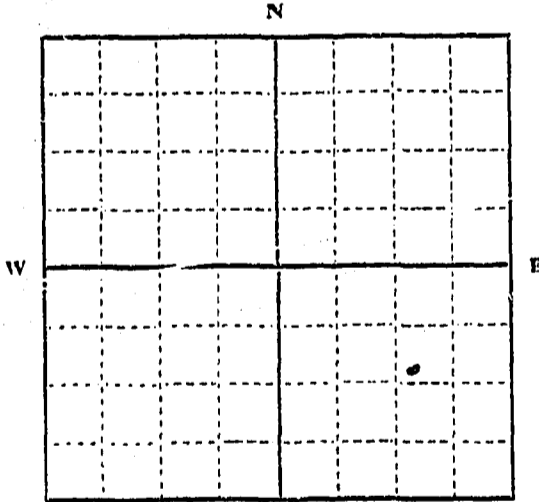

NE 1/4 Sec. 27 T. 30 R. 31.  
Indicate location of well and place of use, if possible. Each small square represents 10 acres.

Show exact depth of bottom.

Static Water Level for non-flowing Well 38 feet.

Shut-in Pressure for Flowing Well.....

Pumping Water Level 48 feet at 30 gal. per minute.

Discharge in gal. per min. of flowing well 300

How Tested Baled Length of Test 1 hr

Remarks: (Gravel packing, cementing, packers, type of shutoff, location of place of use of groundwater if not at well, and any other similar pertinent information, including number of acres irrigated, if used for irrigation).....

141  
Driller's License Number

Donald J. McCracken  
Driller's Signature

This form to be prepared by driller, and three copies to be filed by the owner with the County Clerk and Recorder in the county in which the well is located.

Please answer all questions. If not applicable, so state, otherwise the form will be returned.

Original to the County Clerk and Recorder; duplicate to the State Engineer; Triplicate to the Montana Bureau of Mines and Geology and Quadruplicate for the Appropriator.

38817



478

INDEXED

STATE OF MONTANA  
COUNTY OF LINCOLN

Filed this 10th day of  
December A. D. 1964

at 7:10 P. M.  
M. M. Mansfield  
County Clerk

By Max Weber Deputy

RECEIVED

County Lincoln

STATE OF MONTANA  
ADMINISTRATOR OF GROUNDWATER CODE  
MONTANA WATER RESOURCES BOARD  
MONTANA DEPARTMENT OF NATURAL RESOURCES AND CONSERVATION

AUG 31 1972

DRILLER'S LOG

Indicate the character, color, thickness of strata such as soil, clay, sand, gravel, shale, sandstone, etc. Show depth at which water is found and height to which water rises in well.

NOTICE OF COMPLETION OF GROUNDWATER APPROPRIATION BY MEANS OF WELL

Developed after January 1, 1962

(Under Chapter 237 Montana Session Laws, 1961, as amended)

This form to be prepared by driller, and three copies to be filed by the owner with the County Clerk and Recorder in the county in which the well is located, last copy to be retained by driller. Please answer all questions. If not applicable, so state, otherwise the form may be returned.

Owner Charles Fletcher  
Address Rawlings Tracts  
Libby, Montana 59923  
Date well started June 3, 1972  
completed June 3, 1972

For Administrator's Use	
File <u>889</u>	
<u>July 28, 1972 11:00 am</u>	
GW <u>1</u>	

Type of well Drilled  
(Dug, driven, bored or drilled)  
Equipment used Air Rotary Rig  
(Churn drill, rotary or other)  
Water Use: Domestic  Municipal  Stock  Irrigation   
Industrial  Drainage  Other \* Garden/Lawn

\*Describe \_\_\_\_\_  
USE: If used for irrigation, industrial, drainage or other. Explain, state number of acres and location or other data (i.e. Lot, Block and Addition).

ESTIMATED ANNUAL WITHDRAWAL 120,000 Gal. per Year

Size of Drilled Hole	Size and Weight of Casing	From (Feet)	To (Feet)	PERFORATIONS		
				Kind Size	From (Feet)	To (Feet)
<u>6" I.D.</u>	<u>6 5/8" O.D. 17.00 lbs. per ft.</u>	<u>0</u>	<u>41</u>	<u>None</u>		

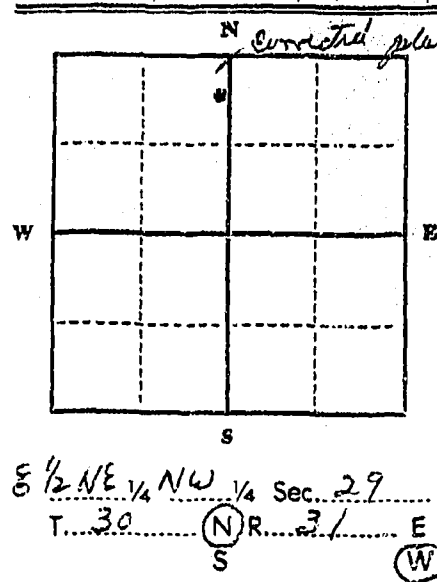

Static water level 18 ft.\*  
Pumping water level \_\_\_\_\_ ft.\*  
at 30-40 gallons per minute,  
measured 120 minutes after pumping began.  
\*Measured from ground level.  
Well developed by Air Compressor  
for 2 hours.  
Power Diesel Pump \_\_\_\_\_ HP  
Remarks: (Gravel packing, cementing, packers, type of shutoff) \_\_\_\_\_

INDICATE LOCATION OF WELL AND PLACE OF USE, IF POSSIBLE. EACH SMALL SQUARE REPRESENTS 40 ACRES.

Driller's Signature Wm D Lake  
Driller's Address P.O. Box 967  
Libby, Montana 59923 LICENSE NO. 152

Top of Ground		(Elev. above sea level)
From (Feet)	To (Feet)	
<u>0</u>	<u>1</u>	<u>Topsoil.</u>
<u>1</u>	<u>18</u>	<u>Sandy Clay.</u>
<u>18</u>	<u>24</u>	<u>Sand.</u>
<u>24</u>	<u>28</u>	<u>Clay, Gravel and Boulders.</u>
<u>28</u>	<u>41</u>	<u>Sand, Gravel and Water.</u>

41 ft. Show exact depth of bottom

889

STATE OF MONTANA  
COUNTY OF LINCOLN

Filed this 28<sup>th</sup> day of July A. D. 1992

at 11:45 P.M.  
Raymond L. Clough  
County Clerk

By Maie Watson  
Deputy

RECEIVED

County Lincoln

STATE OF MONTANA  
ADMINISTRATOR OF GROUNDWATER CODE  
MONTANA WATER RESOURCES BOARD

NOTICE OF COMPLETION OF GROUNDWATER  
APPROPRIATION BY MEANS OF WELL

Developed after January 1, 1962

(Under Chapter 237 Montana Session Laws, 1961, as amended)

This form to be prepared by driller, and three copies to be filed by the owner with the County Clerk and Recorder in the county in which the well is located, last copy to be retained by driller.

Please answer all questions. If not applicable, so state, otherwise the form may be returned.

Owner James Hanley  
Address Box 315  
Libby, Montana  
Date well started February 3, 1968  
completed February 23, 1968

For Administrator's Use  
File 863  
April 24, 1972 9:35 am  
GW 1

Type of well Drilled  
(Dug, driven, bored or drilled)

Equipment used Churn Drill  
(Churn drill, rotary or other)

Water Use: Domestic  Municipal  Stock  Irrigation   
Industrial  Drainage  Other \* Garden/Lawn

\*Describe  
USE: If used for irrigation, industrial, drainage or other. Explain, state number of acres and location or other data (i.e. Lot, Block and Addition).

ESTIMATED ANNUAL WITHDRAWAL 80,000 gal. per year

Size of Drilled Hole	Size and Weight of Casing	From (Feet)	To (Feet)	PERFORATIONS		
				Kind Size	From (Feet)	To (Feet)
<u>6" I.D. 5/8"</u>	<u>0. D. 18.97 lbs. per ft.</u>	<u>0</u>	<u>195</u>		<u>None</u>	

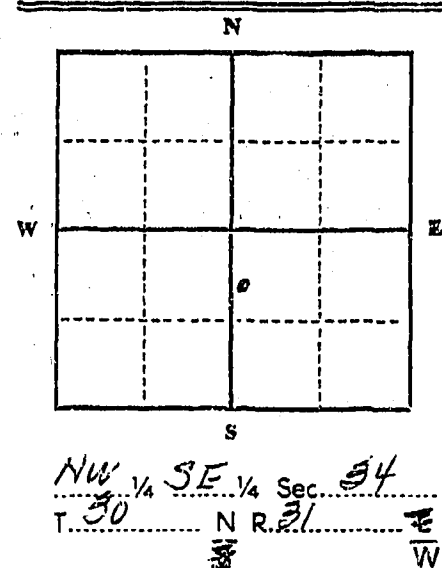

Static water level 121 ft.\*  
Pumping water level 190 ft.\*  
at 2 gallons per minute,  
measured 120 minutes after pumping began.  
\*Measured from ground level.  
Well developed by Bailer  
for 6 hours.  
Power..... Pump..... HP  
Remarks: (Gravel packing, cementing, packers, type of shutoff)

INDICATE LOCATION OF WELL AND PLACE OF USE, IF POSSIBLE. EACH SMALL SQUARE REPRESENTS 40 ACRES.

Driller's Signature Wm D Lake

Driller's Address Box 967  
Libby, Montana 59923

LICENSE NO. 152

DRILLER'S LOG

Indicate the character, color, thickness of strata such as soil, clay, sand, gravel, shale, sandstone, etc. Show depth at which water is found and height to which water rises in well.

Top of Ground (Elev. above sea level)		
From (Feet)	To (Feet)	
<u>0</u>	<u>99</u>	<u>Old Well</u>
<u>99</u>	<u>122</u>	<u>Clay and Gravel</u>
<u>122</u>	<u>125</u>	<u>Clay and Gravel</u>
<u>125</u>	<u>135</u>	<u>Clay, Gravel, some Gravel</u>
<u>135</u>	<u>177</u>	<u>Clay, very little Gravel</u>
<u>177</u>	<u>179</u>	<u>Gravel and some Water</u>
<u>179</u>	<u>190</u>	<u>Clay and some Gravel</u>
<u>190</u>	<u>195</u>	<u>Gravel, with Water, some Clay</u>

195 Show exact depth of bottom

50,347

863

STATE OF MONTANA  
COUNTY OF LINCOLN

Filed this 24<sup>th</sup> day of April A. D. 1972

at 9:35 A. M.

By Edward L. Vaughn County Clerk

By Mae Watson Deputy

File No. ....

T. 30 R. 31

DUPLICATE

STATE WATER CONSERVATION BOARD

County Lincoln

NOV 3 1966

STATE OF MONTANA

ADMINISTRATOR OF GROUNDWATER CODE  
OFFICE OF STATE ENGINEER

Top of Ground  
(Elev. above sea level...)

### Notice of Completion of Groundwater Appropriation by Means of Well

(Under Chapter 237, Montana Session Laws, 1961)

0'-1' Topsoil.  
 1'-7' Sandy clay.  
 7'-50' Clay, gravel, and boulders.  
 50'-90' Clay and gravel.  
 90'-93' Gravel, sand, clay, and some water (3-4 g.p.m.).  
 93'-99' Clay and gravel.  
 99'-103' Gravel and water.

Owner General Jones Address Libby, Mont.

Driller Wm. D. Lake Address Libby, Mont.

Date of Notice of Appropriation of Groundwater.....

Date well started May 23, 1966 Date Completed June 2, 1966

Type of well drilled Equipment Used churn  
(dug, driven, bored or drilled) (Churn, drill, rotary or other)

Water Use: Domestic  Municipal  Other  Irrigation   
Industrial  Drainage  Stock

Indicate on the diagram the character and thickness of the different strata met with in drilling, such as soil, clay, shale, gravel, rock or sand, etc. Show depth at which water is encountered, thickness and character of water-bearing strata and height to which water rises in the well.

Size of Drilled Hole	Size and Weight of Casing	From (Feet)	To (Feet)	PERFORATIONS		
				Kind Size	From (Feet)	To (Feet)
6" I.D.	6 3/8 O.D. 18.97 lbs. per foot	0	103		none	

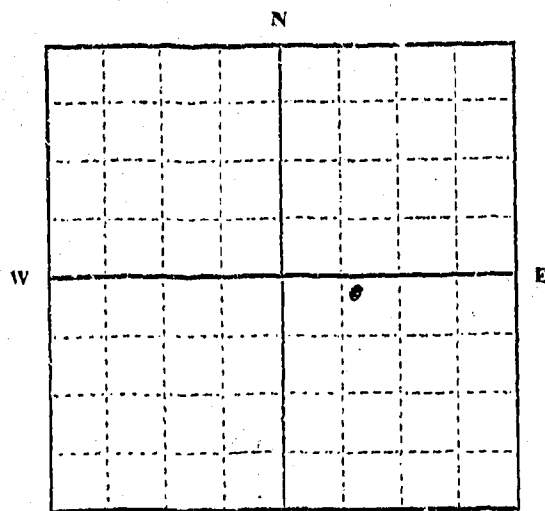

NW 1/4 Sec. 34 T. 30 R. 31

Indicate location of well and place of use, if possible. Each small square represents 10 acres.

Show exact depth of bottom.

Static Water Level for non-flowing Well..... 61 feet.

Shut-in Pressure for Flowing Well.....

Pumping Water Level..... 90 feet at..... 10 gal. per minute.

Discharge in gal. per min. of flowing well.....

How Tested..... pump Length of Test..... 1 1/2 hrs.

Remarks: (Gravel packing, cementing, packers, type of shutoff, location of place of use of groundwater if not at well, and any other similar pertinent information, including number of acres irrigated, if used for irrigation).....

152  
Driller's License Number

Wm. D. Lake  
Driller's Signature

This form to be prepared by driller, and three copies to be filed by the owner with the County Clerk and Recorder in the county in which the well is located.

Please answer all questions. If not applicable, so state, otherwise the form will be returned.

Original to the County Clerk and Recorder; duplicate to the State Engineer; Triplicate to the Montana Bureau of Mines and Geology and Quadruplicate for the Appropriator.

566

STATE OF MONTANA  
COUNTY OF LINCOLN

Filed this 18th day of

October A. D. 1966

at 312 S. 1st St.

Edison & Lough  
County Clerk

By Mae Watson  
Deputy

SMITH

201 0 4.00 8.00

1966

11-102 201-11

13-116 201-11

10-183 201-11

20-140 201-11

1-20 201-11

0-1 201-11

WILLIAMS

11-102

13-116

10-183

20-140

1-20

0-1

STATE OF MONTANA  
COUNTY OF LINCOLN  
DEPARTMENT OF REVENUE  
OFFICE OF THE COUNTY CLERK  
LINCOLN COUNTY

STATE OF MONTANA  
ADMINISTRATOR OF GROUNDWATER CODE  
MONTANA WATER RESOURCES BOARD

NOTICE OF COMPLETION OF GROUNDWATER  
APPROPRIATION BY MEANS OF WELL

Developed after January 1, 1962

(Under Chapter 237 Montana Session Laws, 1961, as amended)

This form to be prepared by driller, and three copies to be filed by the owner with the County Clerk and Recorder in the county in which the well is located, last copy to be retained by driller.

Please answer all questions. If not applicable, so state, otherwise the form may be returned.

Owner George Gerard

Address Libby, Montana

Date well started May 25, 1970

completed June 6, 1970

Type of well Drilled

(Dug, driven, bored or drilled)

Equipment used Churn Drill

(Churn drill, rotary or other)

Water Use: Domestic  Municipal  Stock  Irrigation

Industrial  Drainage  Other \* Garden/Lawn

\*Describe

USE: If used for irrigation, industrial, drainage or other. Explain, state number of acres and location or other data (i.e. Lot, Block and Addition).

ESTIMATED ANNUAL WITHDRAWAL 70,000 gals.

Size of Drilled Hole	Size and Weight of Casing	From (Feet)	To (Feet)	PERFORATIONS		
				Kind Size	From (Feet)	To (Feet)
6" I.D. 6 5/8" O.D.	0	111		None		

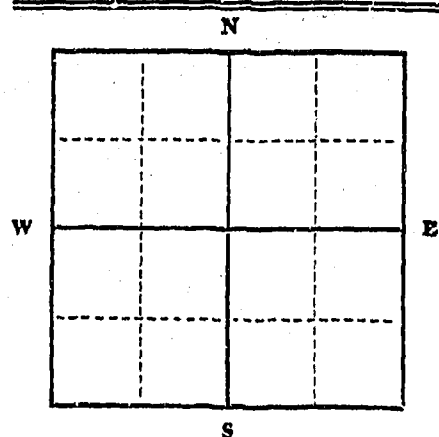

Static water level 82 ft.\*  
Pumping water level 110 ft.\*  
at 2 gallons per minute,  
measured        minutes after pumping began.

\*Measured from ground level.  
Well developed by B Miller  
for 8 hours.

Power        Pump        HP  
Remarks: (Gravel packing, cementing, packers, type of shutoff)

1/4 Sec 34  
T. 3.0 N R. 3.1 E  
S W

INDICATE LOCATION OF WELL AND PLACE OF USE, IF POSSIBLE. EACH SMALL SQUARE REPRESENTS 40 ACRES.

Driller's Signature William D Lake

Driller's Address Box 967, Libby, Montana

LICENSE NO. 152

County Idaho

DRILLER'S LOG

Indicate the character, color, thickness of strata such as soil, clay, sand, gravel, shale, sandstone, etc. Show depth at which water is found and height to which water rises in well.

Top of Ground (Elev. above sea level)		
From (Feet)	To (Feet)	
0	65	Clay
65	87	Clay and Gravel
87	89	Sand, Gravel, and Clay, with 1 GPM Water
89	120	Clay
120	137	Clay and Gravel
137	141	Gravel and Water, h. G.P.M.

141 Show exact depth of bottom

47383



# 146

Well completed on 25 May 1970  
As shown on Survey filed  
Recorded in Volume 117  
Page 104  
State of Montana  
Filed for Record 1970  
11:50 A.M.

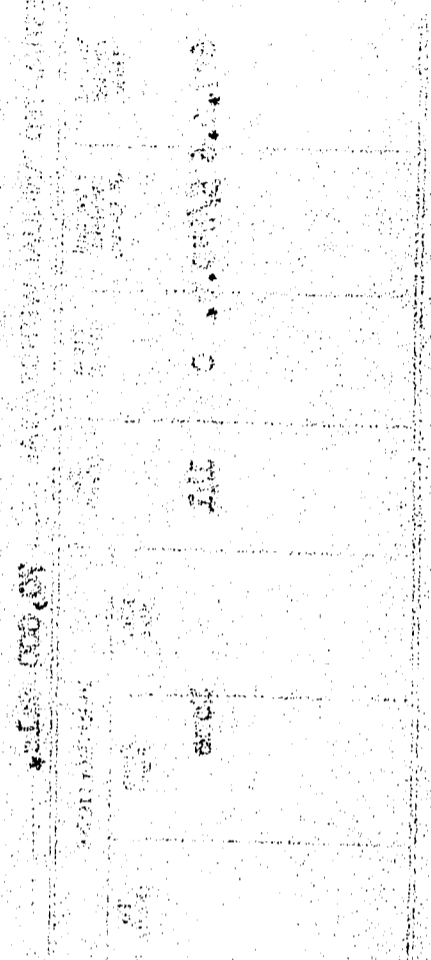

Address: **Lobby, Post Falls**

Date well started **May 25, 1970**  
completed **June 6, 1970**

Type of well **Drilled**

Equipment used **Overton 17 1/2"**

- Water Use: Domestic  Muriatic  Stock  Irrigation
- Industrial  Drainage  Other \* Garden/Lawn

\* Describe \_\_\_\_\_  
USE: If used for irrigation, industrial, drainage or other, state number of acres and location or other data (i.e. Lot, Block and Addition).

File **11:50 A.M.**  
**GW 1**

120	137	CLAY AND GRAVEL
157	111	GRAVEL AND WATER-LOGGED

STATE OF MONTANA  
COUNTY OF LINCOLN  
Filed this **17<sup>th</sup>** day of  
**August** A. D. 19**70**  
**11:50 A.M.**  
By **L. Vaughn** County Clerk  
**Betty Stenhouse** Deputy

County Lincoln

DRILLER'S LOG

Indicate the character, color, thickness of strata such as soil, clay, sand, gravel, shale, sandstone, etc. Show depth at which water is found and height to which water rises in well.

COMPLETION OF GROUNDWATER  
EXPLORATION BY MEANS OF WELL

Developed after January 1, 1962

(Under Chapter 237 Montana Session Laws, 1961, as amended)

This form to be prepared by driller, and three copies to be filed by the owner with the County Clerk and Recorder in the county in which the well is located; last copy to be retained by driller. Please answer all questions. If not applicable, so state, otherwise the form may be returned.

Owner George Gerard

Address Libby, Montana

Date well started May 25, 1970

completed June 6, 1970

Type of well Drilled

Equipment used Churn Drill

Water Use: Domestic  Municipal  Stock  Irrigation

Industrial  Drainage  Other \* Garden/Lawn

\*Describe

USE: If used for irrigation, industrial drainage or other. Explain, state number of acres and location or other data (i.e. Lot, Block and Addition).

ESTIMATED ANNUAL WITHDRAWAL

70,000 Gals.

Size of Drilled Hole	Size and Weight of Casing	From (Feet)	To (Feet)	PERFORATIONS		
				Kind Size	From (Feet)	To (Feet)
<u>6" I.D. x 5/8" O.D.</u>	<u>0</u>	<u>111</u>		<u>See</u>		

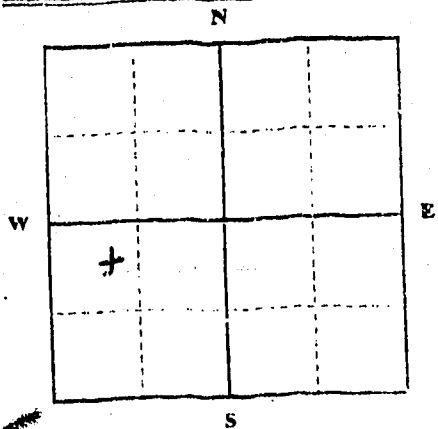

NE 1/4 SW 1/4 Sec. 34  
T. 30 N. R. 31 E.

INDICATE LOCATION OF WELL AND PLACE OF USE, IF POSSIBLE. EACH SMALL SQUARE REPRESENTS 40 ACRES.

Driller's Signature William D. [Signature]

Driller's Address Box 967, Libby, Montana

LICENSE NO. 152

Top of Ground (Elev. above sea level)

From (Feet)	To (Feet)	
<u>0</u>	<u>65</u>	<u>Clay</u>
<u>65</u>	<u>87</u>	<u>Clay and Gravel</u>
<u>87</u>	<u>89</u>	<u>Sand, Gravel, and Clay, with 1 GPM. Water.</u>
<u>89</u>	<u>120</u>	<u>Clay</u>
<u>120</u>	<u>137</u>	<u>Clay and Gravel</u>
<u>137</u>	<u>111</u>	<u>Gravel and Water 1 G.P.M.</u>

111 Show exact depth of bottom

117233

File No. ....

T. 30<sup>N</sup> 31<sup>W</sup> 34

DUPLICATE

County Lincoln

STATE OF MONTANA  
ADMINISTRATOR OF GROUNDWATER CODE  
OFFICE OF STATE ENGINEER

RECEIVED  
OCT 29 1964

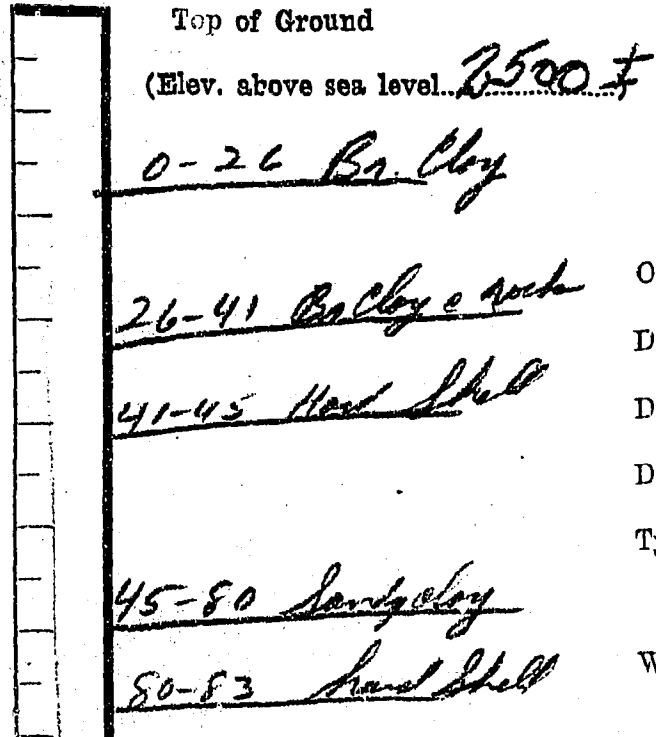

**Notice of Completion of Groundwater Appropriation by Means of Well**  
(Under Chapter 237, Montana Session Laws, 1961)

Owner E. C. Drake Address Libby, Mont.  
 Driller C. J. Blumhagen & Sons Address Libby, Mont.  
 Date of Notice of Appropriation of Groundwater.....  
 Date well started 8-6-64 Date Completed 8-16-64  
 Type of well Drilled Equipment Used Churn  
 (dug, driven, bored or drilled) (Churn, drill, rotary or other)  
 Water Use: Domestic  Municipal  Other  Irrigation   
 Industrial  Drainage  Stock

Indicate on the diagram the character and thickness of the different strata met with in drilling, such as soil, clay, shale, gravel, rock or sand, etc. Show depth at which water is encountered, thickness and character of water-bearing strata and height to which water rises in the well.

Depth of Casing	Size and Weight of Casing	From (Feet)	To (Feet)	PERFORATIONS		
				Kind Size	From (Feet)	To (Feet)
83-153 Sandstone	6 5/8"	0	166	2 1/2"	158	166
153-156 Hard Shell	19"					
156-166 Water Sand						

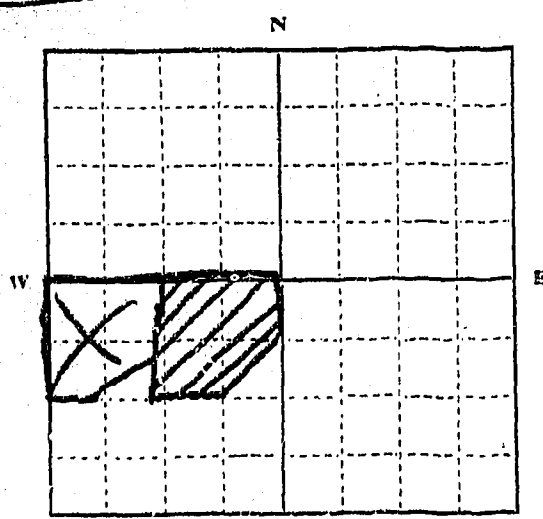

NE 1/4 SW 1/4 Sec 34 T. 30 R. 31  
 Indicate location of well and place of use, if possible. Each small square represents 10 acres.

Show exact depth of bottom.

Static Water Level for non-flowing Well..... 62 feet.  
 Shut-in Pressure for Flowing Well.....  
 Pumping Water Level..... 100 feet at..... 15 gal. per minute.  
 Discharge in gal. per min. of flowing well.....  
 How Tested..... Churn Length of Test..... 40 min  
 Remarks: (Gravel packing, cementing, packers, type of shutoff, location of place of use of groundwater if not at well, and any other similar pertinent information, including number of acres irrigated, if used for irrigation)..... 33 ±

# 141  
 Driller's License Number  
Donald G. Ingleton  
 Driller's Signature

This form to be prepared by driller, and three copies to be filed by the owner with the County Clerk and Recorder in the county in which the well is located.

Please answer all questions. If not applicable, so state, otherwise the form will be returned.

Original to the County Clerk and Recorder; duplicate to the State Engineer; Triplicate to the Montana Bureau of Mines and Geology and Quadruplicate for the Appropriator.

38613

470

INDEXED

STATE OF MONTANA  
COUNTY OF LINCOLN

Filed this 31st day of

September A. D. 19 64

at 4:30 P. M.

by M. W. Mansfield  
County Clerk.

By Mae Hudson  
Deputy

Faint, illegible text and markings, likely bleed-through from the reverse side of the document.

File No. ....

T. 30N R. 31W

DUPLICATE

County Lincoln

STATE OF MONTANA  
ADMINISTRATOR OF GROUNDWATER CODE  
OFFICE OF STATE ENGINEER

JAN 27 1964

Notice of Completion of Groundwater  
Appropriation by Means of Well

(Under Chapter 237, Montana Session Laws, 1961)

Owner Lee E. Childs Address Rt 1 Box 372 Libby, Mont.

Driller C. J. Plog Address Libby, Mont.

Date of Notice of Appropriation of Groundwater 12-23-63

Date well started 11-20-62 Date Completed 11-29-62

Type of well Drilled Equipment Used Churn  
(dug, driven, bored or drilled) (Churn, drill, rotary or other)

Water Use: Domestic  Municipal  Other  Irrigation   
Industrial  Drainage  Stock

Indicate on the diagram the character and thickness of the different strata met with in drilling, such as soil, clay, shale, gravel, rock or sand, etc. Show depth at which water is encountered, thickness and character of water-bearing strata and height to which water rises in the well.

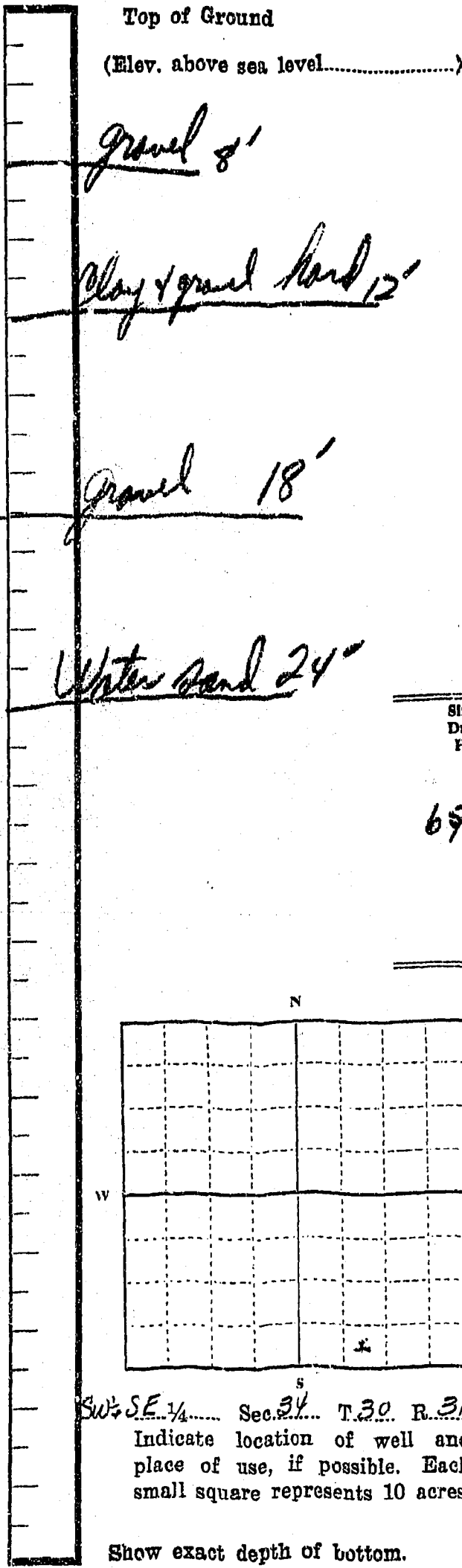

Size of Drilled Hole	Size and Weight of Casing	From (Feet)	To (Feet)	PERFORATIONS		
				Kind Size	From (Feet)	To (Feet)
6 7/8"	17 1/2" 6 5/8"	0'	24'	1/2" Round	18'	24'

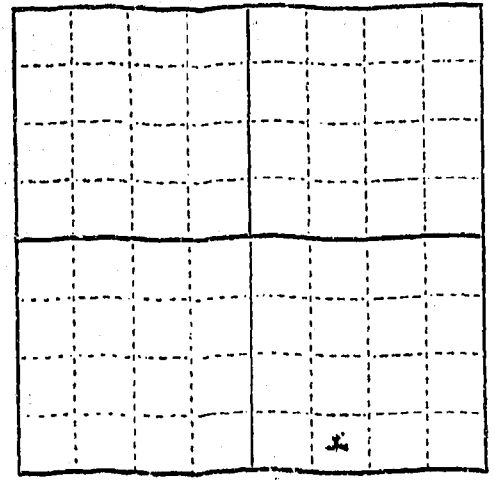

SW 1/4 SE 1/4 Sec. 34 T. 30 R. 31  
Indicate location of well and place of use, if possible. Each small square represents 10 acres.

Show exact depth of bottom.

Static Water Level for non-flowing Well 12' feet.

Shut-in Pressure for Flowing Well .....

Pumping Water Level 12' feet at 20 gal. per minute.

Discharge in gal. per min. of flowing well .....

How Tested Boiler Length of Test 2 hrs.

Remarks: (Gravel packing, cementing, packers, type of shutoff, location of place of use of groundwater if not at well, and any other similar pertinent information, including number of acres irrigated, if used for irrigation) .....

141  
Driller's License Number  
Clifford G. Bunker  
Driller's Signature

This form to be prepared by driller, and three copies to be filed by the owner with the County Clerk and Recorder in the county in which the well is located.

Please answer all questions. If not applicable, so state, otherwise the form will be returned.

Original to the County Clerk and Recorder; duplicate to the State Engineer; Triplicate to the Montana Bureau of Mines and Geology and Quadruplicate for the Appropriator.

214

STATE OF MONTANA  
COUNTY OF LINCOLN

Filed this 23rd day of

December A. D. 1967

at 9:15 P. M.

M. M. Mansfield  
County Clerk

By Mac Peters  
Deputy

File No. ....

RECEIVED

T. 30 R. 31

DUPLICATE

JAN 2 1973

County Lincoln

MONTANA DEPARTMENT OF NATURAL RESOURCES AND CONSERVATION

STATE OF MONTANA ADMINISTRATOR OF GROUNDWATER CODE OFFICE OF STATE ENGINEER

Top of Ground (Elev. above sea level 2600)

Notice of Completion of Groundwater Appropriation by Means of Well

(Under Chapter 237, Montana Session Laws, 1961)

Owner George L. Holm Address Libby, Montana

Driller Unknown Address

Date of Notice of Appropriation of Groundwater

Date well started Date Completed

Type of well (dug, driven, bored or drilled) Equipment Used (Chr. n, drill, rotary or other)

Water Use: Domestic [X] Municipal [ ] Other [ ] Irrigation [ ] Industrial [ ] Drainage [ ] Stock [ ]

Doc. No. #916 Filed for record this 28th day of Dec. A. D. 1972 at 4:45 P. M.

Indicate on the diagram the character and thickness of the different strata met with in drilling, such as soil, clay, shale, gravel, rock or sand, etc. Show depth at which water is encountered, thickness and character of water-bearing strata and height to which water rises in the well.

Table with columns: Size of Drilled Hole (4"), Size and Weight of Casing, From (Feet) (0'), To (Feet) (128'), and PERFORATIONS (Kind Size, From (Feet), To (Feet)).

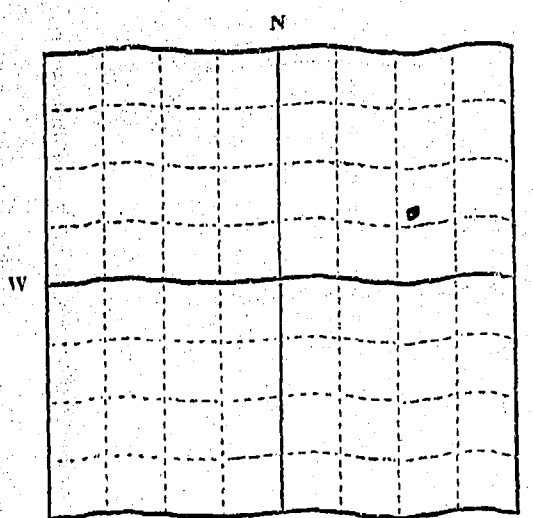

SE 1/4 NE Sec. 35 T. 30 R. 31. Indicate location of well and place of use, if possible. Each small square represents 10 acres.

Show exact depth of bottom.

Static Water Level for non-flowing Well 18 feet

Shut-in Pressure for Flowing Well

Pumping Water Level about 100 feet at 11 gal. per minute

Discharge in gal. per min. of flowing well

How Tested PUMP Length of Test 48 hrs

Remarks: (Gravel packing, cementing, packers, type of shutoff, location of place of use of groundwater if not at well, and any other similar pertinent information, including number of

acres irrigated, if used for irrigation)

This well was existing at the time we purchased land but had not been used. No info except as listed above.

Driller's License Number

Driller's Signature

This form to be prepared by driller, and three copies to be filed by the owner with the County Clerk and Recorder in the county in which the well is located.

Please answer all questions. If not applicable, so state, otherwise the form will be returned.

Original to the County Clerk and Recorder; duplicate to the State Engineer; Triplicate to the Montana Bureau of Mines and Geology and Quadruplicate for the Appropriator.

L. F.

52,006

# 916

MONTANA DEPARTMENT OF NATURAL RESOURCES

STATE OF MONTANA  
COUNTY OF LINCOLN

Filed this 28 day of

December A. D. 19 72

at 4:45 P. M.

Edmond L. Vaughn  
County Clerk

By Verde L. Sigler  
Deputy

Static Water Level for non-flowing Well 18' feet

Shut-in Pressure for Flowing Well \_\_\_\_\_ feet

Pumping Water Level about 100 feet at 11 gal. per minute

Discharge in gal. per min. of flowing well \_\_\_\_\_

How Tested Pump \_\_\_\_\_ length of Test 48 hrs



Department of Natural Resources and Conservation  
 Water Resources Division  
 Engineering Bureau  
 Groundwater Section  
 Sam W. Mitchell Building  
 Helena, Montana 59601

Owner George L. Holm  
 Address Libby, MT 59923  
 Location T. 30N, R. 31W, Sec. 35  
 Doc. No. 916

As the Administrator of the Groundwater Code for the State of Montana, please take note of the following special instructions, in order to properly protect your groundwater right.

**Special Instructions:** Please provide, as indicated in red on the attached form, the dates the well development was started and completed. (If exact dates are not known, estimate as close as possible).

Thank You.

Show depth at which water is encountered, thickness and character of water-bearing strata and height to which water rises in the well.

On 28th Dec. at 7:00 o'clock 4:45 P.M.

Size of Drilled Hole	Size and Weight of Casing	From (Feet)	To (Feet)	PERFORATIONS		
				Kind Size	From (Feet)	To (Feet)
		0'	128'			

RECEIVED  
 JAN 28 1973  
 MONTANA DEPARTMENT OF NATURAL RESOURCES AND CONSERVATION

Static Water Level for non-flowing Well 18' feet.

Shut-in Pressure for Flowing Well.....

Pumping Water Level about 100 feet at 11 gal. per minute.

Discharge in gal. per min. of flowing well.....

How Tested Pump Length of Test 48 hrs

Remarks: (Gravel packing, cementing, packers, type of shutoff, location of place of use of groundwater if not at well, and any other similar pertinent information, including number of acres irrigated, if used for irrigation)

R.J.B. This well was existing at the time we purchased land but had not been used. No info except as listed above.

Show exact depth of bottom.

Driller's License Number.....

Driller's Signature.....

This form to be prepared by driller, and three copies to be filed by the owner with the County Clerk and Recorder in the county in which the well is located.

Please answer all questions. If not applicable, so state, otherwise the form will be returned.

Original to the County Clerk and Recorder; duplicate to the State Engineer; Triplicate to the Montana Bureau of Mines and Geology and Quadruplicate for the Appropriator.

52-106

DUPLICATE

JAN 2 1973

T. 30 R. 31  
County Lincoln

MONTANA DEPARTMENT OF NATURAL RESOURCES AND CONSERVATION  
STATE OF MONTANA  
ADMINISTRATOR OF GROUNDWATER CODE  
OFFICE OF STATE ENGINEER

Top of Ground  
(Elev. above sea level... 2600)

Notice of Completion of Groundwater  
Appropriation by Means of Well

(Under Chapter 237, Montana Session Laws, 1961)

Owner George L. Holm Address Libby, Montana

Driller Unknown Address

Date of Notice of Appropriation of Groundwater

? Date well started 9-5-67 ? Date Completed 9-8-67

Type of well (dug, driven, bored or drilled) Equipment Used (Churn, drill, rotary or other)

Water Use: Domestic [X] Municipal [ ] Other [ ] Irrigation [ ]  
Industrial [ ] Drainage [ ] Stock [ ]

Doc. No. # 916  
Filed for record  
the 28th Dec.  
A. D. 1972 4:45  
o'clock P. M.

Indicate on the diagram the character and thickness of the different strata met with in drilling, such as soil, clay, shale, gravel, rock or sand, etc. Show depth at which water is encountered, thickness and character of water-bearing strata and height to which water rises in the well.

RECEIVED

JAN 28 1973

MONTANA DEPARTMENT OF NATURAL RESOURCES AND CONSERVATION

Size of Drilled Hole	Size and Weight of Casing	From (Feet)	To (Feet)	PERFORATIONS		
				Kind Size	From (Feet)	To (Feet)
4 1/2"		0'	128'			

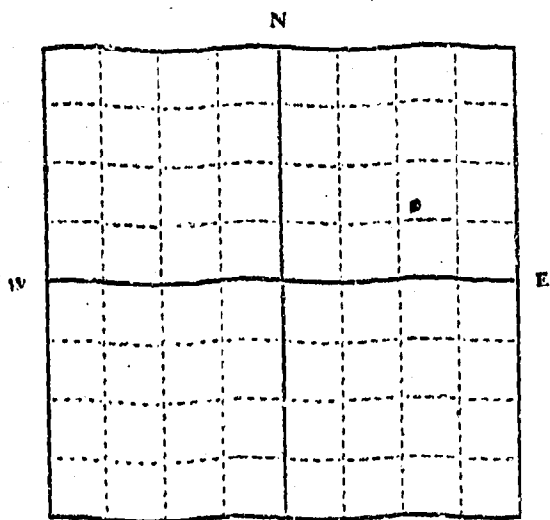

SE 1/4 E Sec. 35 T. 30 R. 31  
Indicate location of well and place of use, if possible. Each small square represents 10 acres.

Show exact depth of bottom.

Static Water Level for non-flowing Well... 18' feet.

Shut-in Pressure for Flowing Well.....

Pumping Water Level... about 100 feet at 11 gal. per minute.

Discharge in gal. per min. of flowing well.....

How Tested... Pump Length of Test... 48 hrs.

Remarks: (Gravel packing, cementing, packers, type of shutoff, location of place of use of groundwater if not at well, and any other similar pertinent information, including number of

acres irrigated, if used for irrigation)

This well was existing at the time we purchased land but had not been used. No info except as listed above.

Driller's License Number

Driller's Signature

This form to be prepared by driller, and three copies to be filed by the owner with the County Clerk and Recorder in the county in which the well is located.

Please answer all questions. If not applicable, so state, otherwise the form will be returned.

Original to the County Clerk and Recorder; duplicate to the State Engineer; Triplicate to the Montana Bureau of Mines and Geology and Quadruplicate for the Appropriator.

52, 106

STATE OF MONTANA  
ADMINISTRATOR OF GROUNDWATER CODE  
MONTANA WATER RESOURCES BOARD

MONTANA WATER RESOURCES BOARD  
RECEIVED

DRILLER'S LOG

NOTICE OF COMPLETION OF GROUNDWATER  
APPROPRIATION BY MEANS OF WELL

Developed after January 1, 1962

Indicate the character, color, thickness of strata such as soil, clay, sand, gravel, shale, sandstone, etc. Show depth at which water is found and height to which water rises in well.

(Under Chapter 237 Montana Session Laws, 1961, as amended)

This form to be prepared by driller, and three copies to be filed by the owner with the County Clerk and Recorder in the county in which the well is located, last copy to be retained by driller.

Please answer all questions. If not applicable, so state, otherwise the form may be returned.

Owner Carolyn J. Laney  
Alan Laney

Address Highway #2, South

Libby, Montana

Date well started May 19, 1971

completed May 31, 1971

Type of well Drilled

(Dug, driven, bored or drilled)

Equipment used Churn Drill

(Churn drill, rotary or other)

Water Use: Domestic  Municipal  Stock  Irrigation

Industrial  Drainage  Other \* Garden/Lawn

\*Describe

USE: If used for irrigation, industrial, drainage or other. Explain, state number of acres and location or other data (i.e. Lot, Block and Addition).

ESTIMATED ANNUAL WITHDRAWAL 150,000 Gal. per year

Size of Drilled Hole	Size and Weight of Casing	From (Feet)	To (Feet)	PERFORATIONS		
				Kind Size	From (Feet)	To (Feet)
6" I. D.	6 5/8" O. D.	0	167			
	17.0 lbs. per ft.					

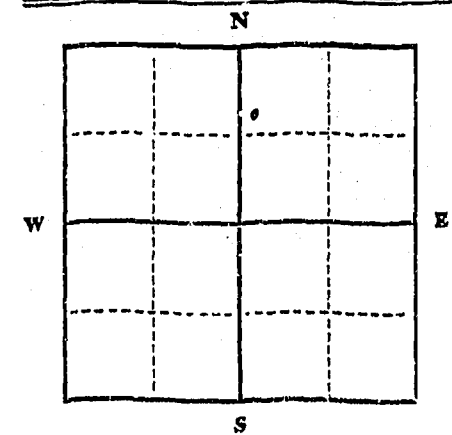

N.W. 1/4 N.E. 1/4 Sec. 35  
T. 30 N. R. 31

Static water level 100 ft.\*  
Pumping water level 150 ft.\*  
at 9 gallons per minute,  
measured 240 minutes after pumping began.

\*Measured from ground level.  
Well developed by Bailer  
for 4 hours.

Power..... Pump..... HP  
Remarks: (Gravel packing, cementing, packers, type of shutoff)

INDICATE LOCATION OF WELL AND PLACE OF USE, IF POSSIBLE. EACH SMALL SQUARE REPRESENTS 40 ACRES.

Driller's Signature Wm D Lake

Driller's Address P. O. Box 967 Libby, Montana 59923

LICENSE NO. 152

Top of Ground (Elev. above sea level)		
From (Feet)	To (Feet)	
0	1	Topsoil
1	18	Sand and Gravel
18	38	Sand
38	70	Sandy Clay
70	71	Boulders
71	130	Sand, Clay, and Gravel
130	131	Gravel and Water (2 gal. per min.)
131	165	Sand, Gravel and Clay
165	167	Gravel and Water

167 Show exact depth of bottom

48757

786

STATE OF MONTANA  
COUNTY OF LINCOLN

Filed (this) 15<sup>th</sup> day of

July A. D. 19 71

at 9:35 P. M.

By Edmund L. Hughes County Clerk

Mae Watson Deputy

*[Faint, mostly illegible text in the lower left section of the document]*

*[Faint, mostly illegible text in the lower right section of the document]*

*[Faint, mostly illegible text in the upper right section of the document]*

*[Faint, mostly illegible text in the lower right section of the document]*

File No. ....

T. 30N R. 31W

DUPLICATE

County.....

STATE OF MONTANA  
ADMINISTRATOR OF GROUNDWATER CODE  
OFFICE OF STATE ENGINEER

R  
JAN 27 1964

Declaration of Vested Groundwater Rights  
(Under Chapter 237, Montana Session Laws, 1961)

1. WALT & LOIS JUNGST, of LIBBY  
(Name of Appropriator) (Address) (Town)  
County of LINCOLN State of MONTANA  
have appropriated groundwater according to the Montana laws in effect prior to January 1, 1962, as follows:

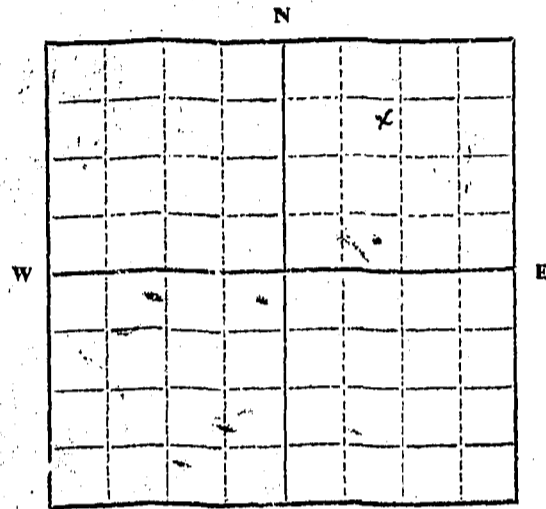

NW 1/4 NE 4 Sec. 35 T. 30N R. 31W

Indicate point of appropriation and place of use, if possible. Each small square represents 10 acres.

2. The beneficial use on which the claim is based. HOUSE AND IRRIGATE

3. Date or approximate date of earliest beneficial use; and how continuous the use has been. JULY 1 - 1960 Continuous

4. The amount of groundwater claimed (in miner's inches or gallons per minute). 5 gal per minute

5. If used for irrigation, give the acreage and description of the lands to which water has been applied and name of the owner thereof. 4 acres + WALT & LOIS JUNGST

6. The means of withdrawing such water from the ground and the location of each well or other means of withdrawal. WELL - JET PUMP

7. The date of commencement and completion of the construction of the well, wells, or other works for withdrawal of groundwater. Summer - 1956

8. The depth of water table. 50 ft

9. So far as it may be available, the type, size and depth of each well or the general specifications of any other works for the withdrawal of groundwater. 150 ft deep - 6" casing

10. The estimated amount of groundwater withdrawn each year.....

11. The log of formations encountered in the drilling of each well if available.....

12. Such other information of a similar nature as may be useful in carrying out the policy of this act, including reference to book and page of any county record.....

Signature of Owner. Walt Jungst

Date. Aug. 22, 63

Three copies to be filed by the owner with the County Clerk and Recorder of the county in which the well is located.

Please answer all questions. If not applicable, so state, otherwise the form will be returned.

Original to the County Clerk and Recorder; duplicate to the State Engineer; Triplicate to the Montana Bureau of Mines and Geology, and Quadruplicate for the Appropriator.

# 218

STATE OF MONTANA  
COUNTY OF LINCOLN

Filed this 23<sup>rd</sup> day of

December A. D. 1963

at 2:00 P. M.

By W. M. Mansfield  
County Clerk

By Ursula Hayden  
Deputy

RECEIVED

CLERK'S OFFICE

CLERK'S OFFICE

C

C

T. 30 R. 31

County Lincoln

MONTANA BUREAU OF MINES AND GEOLOGY  
Butte, Montana

RECEIVED  
SEP 8 1961

WATER WELL LOG

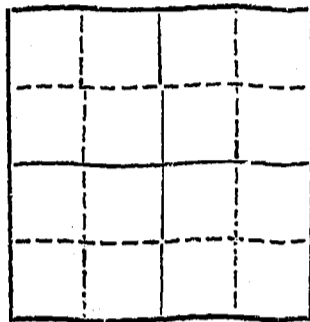

STATE ENGINEER

Owner Fred Koehler Address Box 332 Libby MONT

Driller L.O. WAMMACK Address Libby MONT.

Date Started Aug. 20 - 1961 Date Completed Sept. 3 - 1961

Location: Sec. 35 T. 30 R. 31 1/4 sec. NE 1/4 SW 1/4 SE 1/4

Type of well Drilled (Dug, driven, bored, or drilled) Equipment used Churn Drill (Churn drill, rotary, other)

Water use: Domestic  Municipal  Stock  Irrigation   
Industrial  Drainage  Other: \_\_\_\_\_

Casing: 1 ft. to 107 ft. Type Steel Size 6"

Casing: \_\_\_\_\_ ft. to \_\_\_\_\_ ft. Type \_\_\_\_\_ Size \_\_\_\_\_

Casing: \_\_\_\_\_ ft. to \_\_\_\_\_ ft. Type \_\_\_\_\_ Size \_\_\_\_\_

Perforated or Screened: Ft. \_\_\_\_\_ to ft. \_\_\_\_\_ Ft. \_\_\_\_\_ to ft. \_\_\_\_\_

Type of screen or perforations \_\_\_\_\_

Static Water level, for non-flowing well: 78 ft. feet.

Shut-in pressure, for flowing well: \_\_\_\_\_ lb./sq. in. on: \_\_\_\_\_ (date)

Pumping water level: 35 feet at 6 gal. per min.

How tested: Driller Tested with bailer

Length of test: 1 hour

Remarks: (Gravel packing, cementing, packers, type of shut-off, depth of shut-off)

\_\_\_\_\_  
\_\_\_\_\_  
\_\_\_\_\_  
\_\_\_\_\_  
\_\_\_\_\_

(over)





File No. ....

MONTANA WATER RESOURCES BOARD

T. 30 R. 31

DUPLICATE

RECEIVED

County Lincoln

MAR - 1 1968

STATE OF MONTANA  
ADMINISTRATOR OF GROUNDWATER CODE  
OFFICE OF STATE ENGINEER

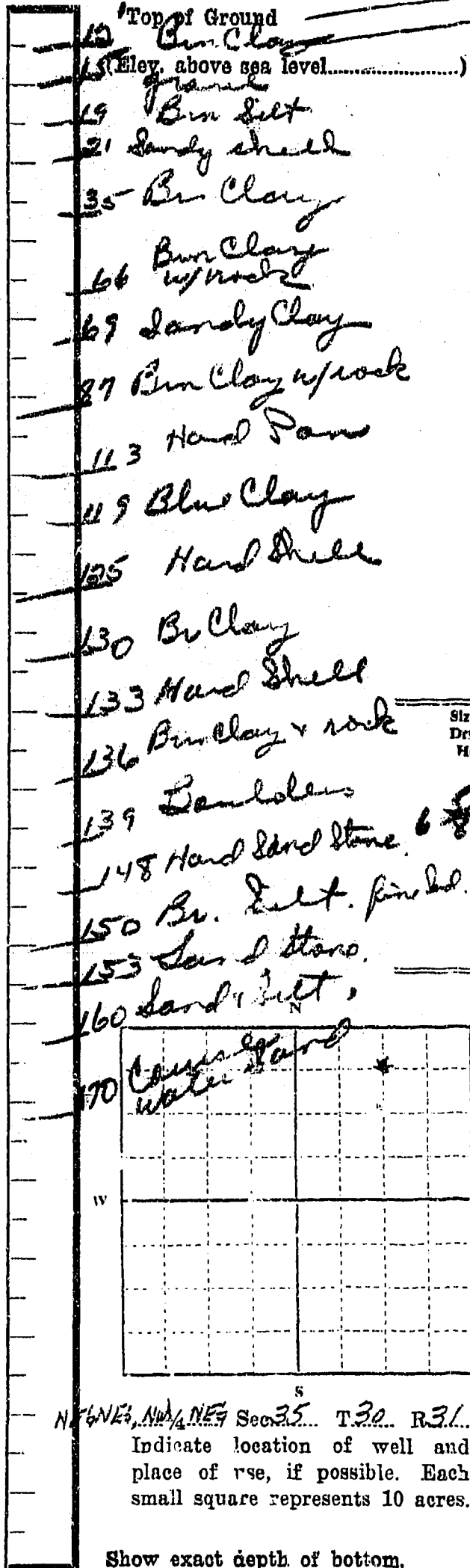

### Notice of Completion of Groundwater Appropriation by Means of Well

Under Chapter 237, Montana Session Laws, 1961

Owner Richard Vinson Address Liddy Montana

Driller C & S Pledge & Sons Address Liddy Mont.

Date of Notice of Appropriation of Groundwater.....

Date well started..... 2-6-67 Date Completed..... 2-11-67

Type of well..... drilled Equipment Used..... Churn  
(dug, driven, bored or drilled) (Churn, drill, rotary or other)

Water Use: Domestic  Municipal  Other  Irrigation   
Industrial  Drainage  Stock

Indicate on the diagram the character and thickness of the different strata met with in drilling, such as soil, clay, shale, gravel, rock or sand, etc. Show depth at which water is encountered, thickness and character of water-bearing strata and height to which water rises in the well.

Size of Drilled Hole	Size and Weight of Casing	From (Feet)	To (Feet)	PERFORATIONS		
				Kind Size	From (Feet)	To (Feet)
	1 1/2"	0	170	1/2 Round	0	4

Static Water Level for non-flowing Well..... 120 feet.

Shut-in Pressure for Flowing Well.....

Pumping Water Level..... 150 feet at..... 15 gal. per minute.

Discharge in gal. per min. of flowing well.....

How Tested..... baled Length of Test..... 2 hr

Remarks: (Gravel packing, cementing, packers, type of shutoff, location of place of use of groundwater if not at well, and any other similar pertinent information, including number of acres irrigated, if used for irrigation).....

N 1/4 NE 1/4, NW 1/4 NE 1/4 Sec 35 T 30 R 31  
Indicate location of well and place of use, if possible. Each small square represents 10 acres.

Show exact depth of bottom.

141  
Driller's License Number

Clifford J. Becker  
Driller's Signature

This form to be prepared by driller, and three copies to be filed by the owner with the County Clerk and Recorder in the county in which the well is located.

Please answer all questions. If not applicable, so state, otherwise the form will be returned.

Original to be filed with County Clerk and Recorder; duplicate to the State Engineer; Triplicate to the Montana Bureau of Mines and Geology and quadruplicate for the Appropriator.

43,695

622

STATE OF MONTANA  
COUNTY OF LINCOLN

Filed 23rd day of

February A. D. 1968

at 2:05 P. M.

By Edward L. Vaughn County Clerk

By Mae Watson Deputy

File No.....

T 30 N R 31

DUPLICATE

County: Lincoln

STATE OF MONTANA  
ADMINISTRATOR OF GROUNDWATER CODE  
OFFICE OF STATE ENGINEER

JAN 27 1964

Declaration of Vested Groundwater Rights

(Under Chapter 237, Montana Session Laws, 1961)

1. Leslie A. and Jacquelyn K. Tisher, of R. R. #1, Box #375A, Libby  
(Name of Appropriator) (Address) (Town)

County of Lincoln State of Montana  
have appropriated groundwater according to the Montana laws in effect prior to January 1, 1962, as follows:

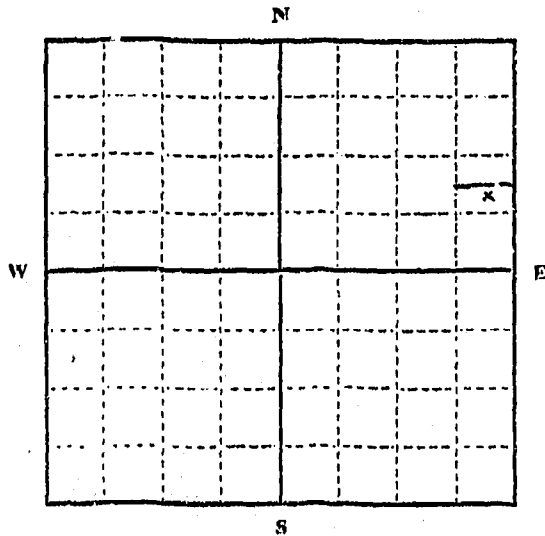

NE 1/4 Sec. 35 T.30N R. 31 W

Indicate point of appropriation and place of use, if possible. Each small square represents 10 acres.

2. The beneficial use on which the claim is based Household, garden and lawn watering, and livestock watering

3. Date or approximate date of earliest beneficial use; and how continuous the use has been Date well was drilled and first used unknown, we acquired the property and began using the well on September 9, 1963.

4. The amount of groundwater claimed (in miner's inches or gallons per minute) Eight (8) gallons per minute.

5. If used for irrigation, give the acreage and description of the lands to which water has been applied and name of the owner thereof Not used for irrigation of crops, we use it to water garden and lawn.

6. The means of withdrawing such water from the ground and the location of each well or other means of withdrawal Well with electric pump located 25 feet east of the south east corner of the dwelling.

7. The date of commencement and completion of the construction of the well, wells, or other works for withdrawal of groundwater Unknown

8. The depth of water table (19) Nineteen feet.

9. So far as it may be available, the type, size and depth of each well or the general specifications of any other works for the withdrawal of groundwater Shallow well, 30 inches wide, 22 feet deep. Has cement curbing.

10. The estimated amount of groundwater withdrawn each year 550,000 gallons a year.

11. The log of formations encountered in the drilling of each well if available Unknown.

12. Such other information of a similar nature as may be useful in carrying out the policy of this act, including reference to book and page of any county record None

Jacquelyn K. Tisher  
Signature of Owner Leslie Tisher

Date Dec 27, 1963

Three copies to be filed by the owner with the County Clerk and Recorder of the county in which the well is located.

Please answer all questions. If not applicable, so state, otherwise the form will be returned.

Original to the County Clerk and Recorder; Duplicate to the State Engineer; Triplicate to the Montana Bureau of Mines and Geology, and Quadruplicate for the Appropriator.

293

FILED

STATE OF MONTANA  
COUNTY OF LINCOLN

Filed this 30th day of  
December A. D. 1962

at 11:45 P. M.  
W. W. Mansfield  
County Clerk

By Mar Hatten  
Deputy

File No.....

T. 36 R. 31

DUPLICATE

County Lincoln

STATE OF MONTANA  
ADMINISTRATOR OF GROUNDWATER CODE  
OFFICE OF STATE ENGINEER

RECEIVED

Declaration of Vested Groundwater Rights 19 1983

(Under Chapter 237, Montana Session Laws, 1961)

STATE ENGINEER

1. Walter Zajonc  
Dorothy E. Zajonc of Altus Rte Libby  
(Name of Appropriator) (Address) (Town)

County of Lincoln State of Mont.

have appropriated groundwater according to the Montana laws in effect prior to January 1, 1962, as follows:

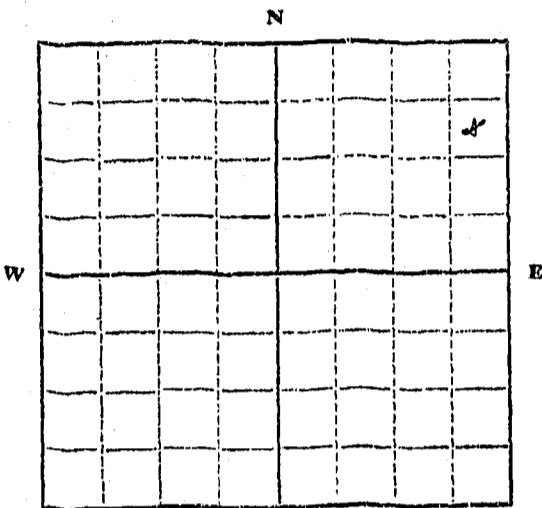

S 1/2 SE 1/4 NE 1/4 NE 1/4

1/4 Sec. 35 T. 3. R. 31

Indicate point of appropriation and place of use, if possible. Each small square represents 10 acres.

2. The beneficial use on which the claim is based household and cattle

3. Date or approximate date of earliest beneficial use; and how continuous the use has been 1930 used ever since

4. The amount of groundwater claimed (in miner's inches or gallons per minute) not determined

5. If used for irrigation, give the acreage and description of the lands to which water has been applied and name of the owner thereof no

6. The means of withdrawing such water from the ground and the location of each well or other means of withdrawal hand pump

7. The date of commencement and completion of the construction of the well, wells, or other works for withdrawal of groundwater 1930 now being rebuilt

8. The depth of water table 14 ft

9. So far as it may be available, the type, size and depth of each well or the general specifications of any other works for the withdrawal of groundwater 4 x 4 ft casing 21 feet deep

10. The estimated amount of groundwater withdrawn each year 5000 gal

11. The log of formations encountered in the drilling of each well if available Gravel

12. Such other information of a similar nature as may be useful in carrying out the policy of this act, including reference to book and page of any county record none

Signature of Owner Dorothy E. Zajonc  
Walter Zajonc

Date 12-13-63

Three copies to be filed by the owner with the County Clerk and Recorder of the county in which the well is located.

Please answer all questions. If not applicable, so state, otherwise the form will be returned.

Original to the County Clerk and Recorder; duplicate to the State Engineer; Triplicate to the Montana Bureau of Mines and Geology, and Quadruplicate for the Director.

10384

182

CLIVE EMMERS

RECEIVED

STATE OF MONTANA  
COUNTY OF LINCOLN

Filed this 13th day of  
December A. D. 1963  
at 12:20 P. M.  
M. M. Magrath  
County Clerk  
By Mae Nelson  
Deputy

GV.

File No. ....

DUPLICATE

RECEIVED  
Approved State Form - State Publishing Co., Helena, Montana 40876  
MAR 2 1964

T. 30 R. 31

County

RECEIVED  
DEC 19 1963

STATE ENGINEER

STATE OF MONTANA  
STATE ENGINEER  
ADMINISTRATOR OF GROUNDWATER CODE  
OFFICE OF STATE ENGINEER

### Declaration of Vested Groundwater Rights

(Under Chapter 237, Montana Session Laws, 1961)

1. Walter Zajonc  
Dorothea E. Zajonc of Star Rt. Libby  
(Name of Appropriator) (Address) (Town)  
County of S State of Montana  
have appropriated groundwater according to the Montana laws in effect prior to January 1, 1962, as follows:

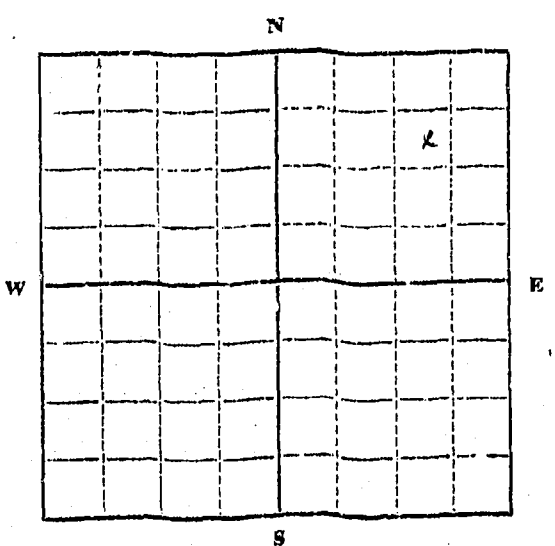

NE 1/4 NE Sec. 35 T. 30 R. 31

Indicate point of appropriation and place of use, if possible. Each small square represents 10 acres.

2. The beneficial use on which the claim is based household
3. Date or approximate date of earliest beneficial use; and how continuous the use has been 1958 and ever since
4. The amount of groundwater claimed (in miner's inches or gallons per minute) 10 gal per minute
5. If used for irrigation, give the acreage and description of the lands to which water has been applied and name of the owner thereof no
6. The means of withdrawing such water from the ground and the location of each well or other means of withdrawal Electric pump
7. The date of commencement and completion of the construction of the well, wells, or other works for withdrawal of groundwater 1958
8. The depth of water table 14 ft
9. So far as it may be available, the type, size and depth of each well or the general specifications of any other works for the withdrawal of groundwater 21 ft 3 ft cement casing
10. The estimated amount of groundwater withdrawn each year 50,000 gal
11. The log of formations encountered in the drilling of each well if available Dirt gravel
12. Such other information of a similar nature as may be useful in carrying out the policy of this act, including reference to book and page of any county record none

Signature of Owner Walter Zajonc  
Dorothea E. Zajonc  
Date 12-13-63

Three copies to be filed by the owner with the County Clerk and Recorder of the county in which the well is located.

Please answer all questions. If not applicable, so state, otherwise the form will be returned.

Original to the County Clerk and Recorder; duplicate to the State Engineer; Triplicate to the Montana Bureau of Mines and Geology, and Quadruplicate for the Appropriator.

10385

183  
RECORDED  
INDEXED  
C3

STATE OF MONTANA  
COUNTY OF LINCOLN

Filed this 13th day of  
December A. D. 1963  
at 12:25 P. M.  
M. M. Mansfield  
County Clerk.  
By Mac Watson Deputy



35

File No. ....

T. 30 N R. 31

DUPLICATE

County Lincoln

STATE OF MONTANA  
ADMINISTRATOR OF GROUNDWATER CODE  
OFFICE OF STATE ENGINEER

RECEIVED  
DEC 19 1963

Declaration of Vested Groundwater Rights

(Under Chapter 237, Montana Session Laws, 1961)

STATE ENGINEER

1. Dorothy E Zajane  
Walter Zajane (Name of Appropriator), of Star Rte Libby (Address) (Town)  
County of Lincoln State of Mont  
have appropriated groundwater according to the Montana laws in effect prior to January 1, 1962, as follows:

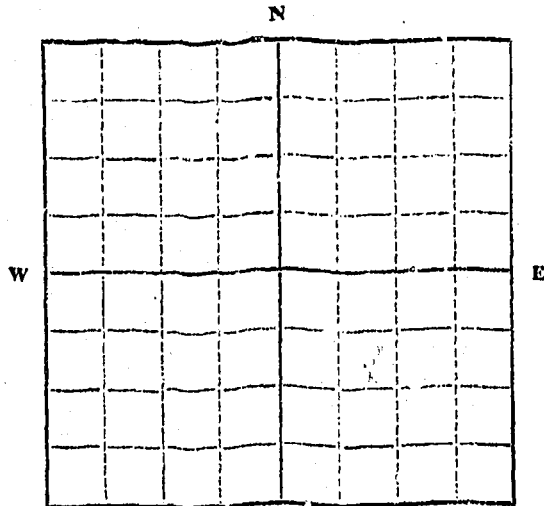

SE 1/4 NW 1/4 SE 1/4  
1/4 Sec. 35 T. 30 R. 31

Indicate point of appropriation and place of use, if possible. Each small square represents 10 acres.

- 2. The beneficial use on which the claim is based. Household & livestock
- 3. Date or approximate date of earliest beneficial use; and how continuous the use has been. 1930 used ever since
- 4. The amount of groundwater claimed (in miner's inches or gallons per minute). 10 gal per minute
- 5. If used for irrigation, give the acreage and description of the lands to which water has been applied and name of the owner thereof. No
- 6. The means of withdrawing such water from the ground and the location of each well or other means of withdrawal. Electric pump
- 7. The date of commencement and completion of the construction of the well, wells, or other works for withdrawal of groundwater. 1930 rebuilt in 1950
- 8. The depth of water table. 70 ft
- 9. So far as it may be available, the type, size and depth of each well or the general specifications of any other works for the withdrawal of groundwater. 4 in casing 1.5 ft deep
- 10. The estimated amount of groundwater withdrawn each year. 50,000 gal
- 11. The log of formations encountered in the drilling of each well if available. Dirt Rock gravel
- 12. Such other information of a similar nature as may be useful in carrying out the policy of this act, including reference to book and page of any county record. none

Dorothy E Zajane  
Signature of Owner Walter Zajane  
Date 12-13-63

Three copies to be filed by the owner with the County Clerk and Recorder of the county in which the well is located.

Please answer all questions. If not applicable, so state, otherwise the form will be returned.

Original to the County Clerk and Recorder; duplicate to the State Engineer; Triplicate to the Montana Bureau of Mines and Geology, and Quadruplicate for the Appropriator.

10383

181

RECORDED  
INDEXED  
CLERK OF DISTRICT COURT

STATE OF MONTANA  
COUNTY OF LINCOLN

Filed this 13th day of

December A. D. 1963

at 5:15 P. M.  
M. M. Mansfield  
County Clerk.

By Mae Nelson  
Deputy

GW 7

File No. ....

ORIGINAL

T. 10N R. 21W

County ... LIBBY

STATE OF MONTANA  
ADMINISTRATOR OF GROUNDWATER CODE  
OFFICE OF STATE ENGINEER

RECEIVED  
MAR 26 1964

Notice of Completion of Groundwater  
Appropriation by Means of Well

(Under Chapter 237, Montana Session Laws, 1961)

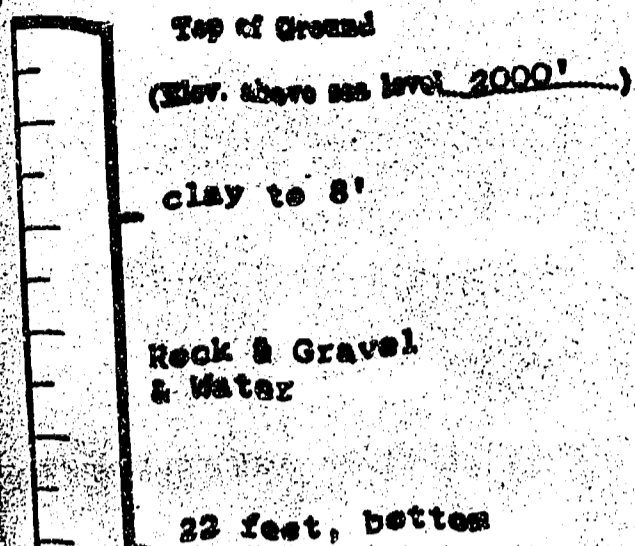

Owner Robert Siemar Address Libby

Driller Robert Siemar Address Libby

Date of Notice of Appropriation of Groundwater .....

Date well started May 1963 Date Completed June 1963

Type of well driven Equipment Used Tractor plate  
(e.g., driven, bored or drilled) (Cable, drill, rotary or other)

Water Use: Domestic  Municipal  Other  Irrigation   
Industrial  Drainage  Stock

Indicate on the diagram the character and thickness of the different strata met with in drilling, such as soil, clay, shale, gravel, rock or sand, etc. Show depth at which water is encountered, thickness and character of water-bearing strata and height to which water rises in the well.

Size of Drilled Hole	Size and Weight of Casing	From Open	To Open	PERFORATIONS		
				From Open	To Open	To Open
5"	2" casing	0'	30'	homemade 5	0	30

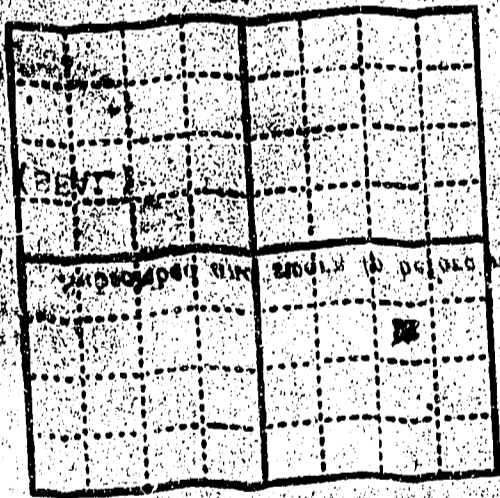

Static Water Level for non-flowing Well not known feet

Static Pressure for Flowing Well not known

Pumping Water Level 30 feet at 327.3 gal. per minute

Discharge in gal. per min. of flowing well 327.3 gpm

Flow Tested and perforated Length of Test 5 days

Remarks: (Gravel packing, cementing, packers, type of shaft, location of place of use of groundwater if not at well, and any other similar pertinent information, including number of acres irrigated, if used for irrigation)

Sec. 25 T. 10 N. 21 W.

Indicate location of well and place of use, if possible. Each small square represents 10 acres.

Show exact depth of bottom.

Driller's Name Robert Siemar

Driller's Signature Robert Siemar

This form to be prepared by driller, and three copies to be filed by the owner with the County Clerk and Recorder in the county in which the well is located.

Please answer all questions. If not applicable, so state, otherwise the form will be returned.

Original to the County Clerk and Recorder; duplicate to the State Engineer; Triplicate to the Montana Bureau of Mines and Geology and Quadruplicate for the Appropriator.

38127

Office of  
M. M. MANSFIELD  
County Clerk and Recorder

LIBBY, MONTANA

March 24, 1964

State Engineer  
Helena,  
Montana

RECEIVED  
MAR 26 1964

STATE ENGINEER

Dear Sir:

Enclosed please find a thermofax copy of a  
GW2 for Robert Siemer.

Did we mail the correct copy of this form  
to you? No

Our index number is 383, and was filed in  
our office on December 31st at 11:22 a.m.

Very truly yours,

M. M. Mansfield  
M. M. MANSFIELD,

Clerk and Recorder

by Wanda Siemer Deputy

enc (1)