

File No.

T. 33 R. 27

DUPLICATE

County Lincoln

STATE OF MONTANA
ADMINISTRATOR OF GROUNDWATER CODE
OFFICE OF STATE ENGINEER

RECEIVED
MAR 5 1964

Declaration of Vested Groundwater Rights

(Under Chapter 237, Montana Session Laws, 1961)

STATE ENGINEER

1. Virgil W. & Ellen E. Newton of Box 61 Trigo
(Name of Appropriator) (Address) (Town)
County of Lincoln State of Montana
have appropriated groundwater according to the Montana laws in effect prior to January 1, 1962, as follows:

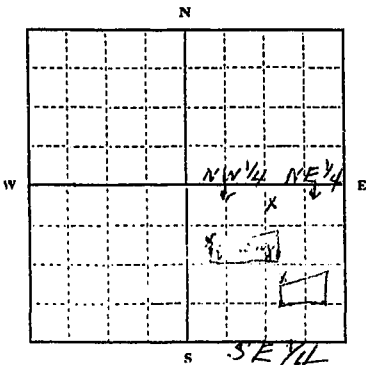

NW 1/4 NE 1/4 SE Sec. 24 T. 33 R. 27

Indicate point of appropriation and place of use, if possible. Each small square represents 10 acres.

2. The beneficial use on which the claim is based Irrigation
Livestock & Domestic

3. Date or approximate date of earliest beneficial use; and how continuous the use has been 6/22/45 - Constant
Annually

4. The amount of groundwater claimed (in miner's inches or gallons per minute) 5 Miners inches - saturated

5. If used for irrigation, give the acreage and description of the lands to which water has been applied and name of the owner thereof
part of a 14 acre field described as follows
part of NW 1/4 & NE 1/4 of SE 1/4 Sec. 24 T. 33 R. 27
Owned by Virgil W. & Ellen E. Newton

6. The means of withdrawing such water from the ground and the location of each well or other means of withdrawal
flowing spring

7. The date of commencement and completion of the construction of the well, wells, or other works for withdrawal of groundwater first used this water 6/22/45

8. The depth of water table 2 to 3 ft.

9. So far as it may be available, the type, size and depth of each well or the general specifications of any other works for the withdrawal of groundwater Water taken from ditch leading south from spring by means of gravity flow irrigation

10. The estimated amount of groundwater withdrawn each year total flow periodically
supplements the irrigation water taken from Coy use Creek - steady stock & domestic use

11. The log of formations encountered in the drilling of each well if available
Not applicable
Welling house 13 feet north of spring

12. Such other information of a similar nature as may be useful in carrying out the policy of this act, including reference to book and page of any county record
Spring house at spring

Signature of Owner Virgil W. Newton
Ellen E. Newton
Date 12/28/63

Three copies to be filed by the owner with the County Clerk and Recorder of the county in which the well is located.

Please answer all questions. If not applicable, so state, otherwise the form will be returned.

Original to the County Clerk and Recorder; Duplicate to the State Engineer; Triplicate to the Montana Bureau of Mines and Geology, and Quadruplicate for the Appropriator.

364

STATE OF MONTANA
COUNTY OF LINCOLN

Filed this 31st day of

December A. D. 1922

at 10:30 A. M.

J. M. Mansfield
County Clerk

By Wesley Hayden
Deputy

224

File No.

T. 33N R. 27W

DUPLICATE

County Lincoln

STATE OF MONTANA
ADMINISTRATOR OF GROUNDWATER CODE
OFFICE OF STATE ENGINEER

RECEIVED
MAR 5 1964

Declaration of Vested Groundwater Rights

(Under Chapter 237, Montana Session Laws, 1961)

STATE ENGINEER

1. Virgil W. & Ethel Newton, of Box 61 Trego
(Name of Appropriator) (Address) (Town)
County of Lincoln State of Montana
have appropriated groundwater according to the Montana laws in effect prior to January 1, 1962, as follows:

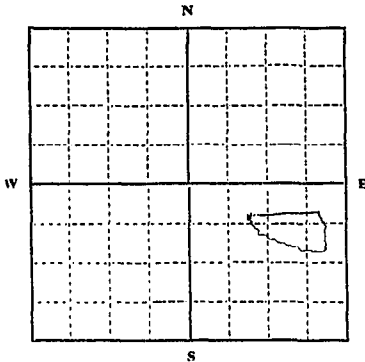

NW
NE 1/4 SE Sec. 24 T. 23 R. 27
Indicate point of appropriation and place of use, if possible. Each small square represents 10 acres.

2. The beneficial use on which the claim is based Sub irrigation
livestock, and irrigation for possibly domestic &
livestock in future by means of pipe line system
3. Date or approximate date of earliest beneficial use; and how continuous the use has been. 6/27/45 - constant annually
4. The amount of groundwater claimed (in miner's inches or gallons per minute) 10 miner inches
5. If used for irrigation, give the acreage and description of the lands to which water has been applied and name of the owner thereof
Parts of S 1/2 S 1/2 NW NE - SW NE, estimated to be
about 15 acres owned by Virgil W. & Ethel Newton
6. The means of withdrawing such water from the ground and the location of each well or other means of withdrawal flowing spring
and smaller springs in surrounding area
7. The date of commencement and completion of the construction of the well, wells, or other works for withdrawal of groundwater. First use of this water 6/27/45
8. The depth of water table. Variable from 1 to 6 feet
9. So far as it may be available, the type, size and depth of each well or the general specifications of any other works for the withdrawal of groundwater.
Spreader ditches, laterals, and natural drainage ditches
10. The estimated amount of groundwater withdrawn each year. Unknown - though all is needed during dry summer season.
11. The log of formations encountered in the drilling of each well if available.
Not applicable
12. Such other information of a similar nature as may be useful in carrying out the policy of this act, including reference to book and page of any county record. They in the future build a dam
creating a storage reservoir to be filled during winter months

Signature of Owner Virgil W. Newton
Ethel Newton
Date 12/30/63

Three copies to be filed by the owner with the County Clerk and Recorder of the county in which the well is located.
Please answer all questions. If not applicable, so state, otherwise the form will be returned.

Original to the County Clerk and Recorder; Duplicate to the State Engineer; Triplicate to the Montana Bureau of Mines and Geology, and Quadruplicate for the Appropriator.

35094

362

INDEX

STATE OF MONTANA
COUNTY OF LINCOLN
Filed this 31st day of
December A. D. 1962
at 10:04 P.M.
M.M. Mansfield
County Clerk
By Verdon Hayden
Deputy

36

File No.

T. 33 N. R. 27

DUPLICATE

County Lincoln

STATE OF MONTANA
ADMINISTRATOR OF GROUNDWATER CODE
OFFICE OF STATE ENGINEER

JAN 27 1964

Declaration of Vested Groundwater Rights

(Under Chapter 237, Montana Session Laws, 1961)

STATE ENGINEER

1. Ronald D. Williams, of St Regis
(Name of Appropriator) (Address) (Town)
County of Mineral State of Montana
have appropriated groundwater according to the Montana laws in effect prior to January 1, 1962, as follows:

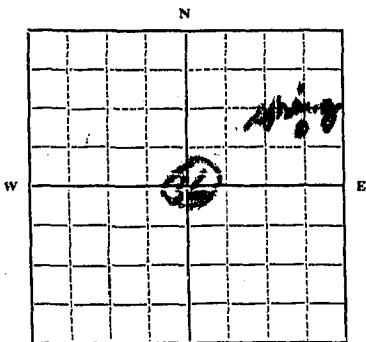

NE 1/4 NE 36 T. 33 N. R. 27 W

Indicate point of appropriation and place of use, if possible. Each small square represents 10 acres.

2. The beneficial use on which the claim is based. Stock water and general use.

3. Date or approximate date of earliest beneficial use; and how continuous the use has been. used since 1910.

4. The amount of groundwater claimed (in miner's inches or gallons per minute) 10 gpm per minute

5. If used for irrigation, give the acreage and description of the lands to which water has been applied and name of the owner thereof
not used for irrigation

6. The means of withdrawing such water from the ground and the location of each well or other means of withdrawal at a running spring.

7. The date of commencement and completion of the construction of the well, or other works for withdrawal of groundwater. Spring was dug out in 1910.

8. The depth of water table. unknown

9. So far as it may be available, the type, size and depth of each well or the general specifications of any other works for the withdrawal of groundwater. none

10. The estimated amount of groundwater withdrawn each year. 2952,000 per year.

11. The log of formations encountered in the drilling of each well if available. Dug out spring

12. Such other information of a similar nature as may be useful in carrying out the policy of this act, including reference to book and page of any county record. none

Signature of Owner Ronald D. Williams

Date

Three copies to be filed by the owner with the County Clerk and Recorder of the county in which the well is located.

Please answer all questions. If not applicable, so state, otherwise the form will be returned.

Original to the County Clerk and Recorder; duplicate to the State Engineer; Triplicate to the Montana Bureau of Mines and Geology, and Quadruplicate for the Appropriator.

248
INDEXED

STATE OF MONTANA
COUNTY OF LINCOLN

Filed 27th day of
December A. D. 1963

of 29 A. M.
W. M. Mansfield
County Clerk

By W. H. Hallen
Deputy

[Faint, illegible handwritten text]

[Faint, illegible handwritten text]

[Faint, illegible handwritten text]

GROUNDWATER INDEX

County Lincoln Twp. 32 North Rge. 34 West

Sec.	Name of Appropriator	Type of Form	County File No.	Remarks
5	U. S. A.			
9	Smith, John B. Jr.		263	
22	Dewick, J. R. & Leonard		79	
22	Ottaway, Frederick	GW-2	608	
22	Mel, Robert I	GW-2	679	
22	Hand, C. B.	GW-2	512	
22	Birney, Mrs. A. V.	GW-2	510	
22	Edstrom, Fred	GW-2	561	
22	Evans, Vaughn	GW-2	927	
26	Palmerwell, C. C.	GW-2	853	
26	Jones, Wm & Ruth	GW-3	112	
27	French, Kenneth	GW-2	724	
27	Hollingsworth, Ray D.		540	
27	Hughart, Keith	GW-2	745	
27	Knudwig, LeRoy M.		170	
27	Jule, John	GW-2	698	
27	Allenberg, Richard	GW-2	840	
27	Patterson, Steve	GW-2	729	
27	Bluhm, Mel	GW-2	715	
27	Bramlet, Wilbur C.	GW-2	981	
27	Heaton, George	GW-2	837	
27	Bushnell, V. F.	GW-2	551	
34	Morgan, Mrs. Maude		138	
34	Mrs. Mee, Robert	GW-2	836	
35	Jones, William & Ruth	GW-3	112	SEE SEC. 26
35	Smith, Albert K.	GW-2	575	
35	Mitchell, Floyd B.	GW-2	782	

File No. B-51-8507-598 T 32N R 34W

ORIGINAL Lincoln Co. Montana County Lincoln

STATE OF MONTANA
ADMINISTRATOR OF GROUNDWATER CODE
OFFICE OF STATE ENGINEER

DECLARATION OF VESTED GROUNDWATER RIGHTS
(Under Chapter 237, Montana Session Laws, 1961)

1. United States of America, Yast Campground, Troy, Montana
(Name of Appropriator) (Address) (Town)

RECEIVED

County of Lincoln State of Montana
have appropriated groundwater according to the Montana laws in effect prior to January 1, 1962, as follows:

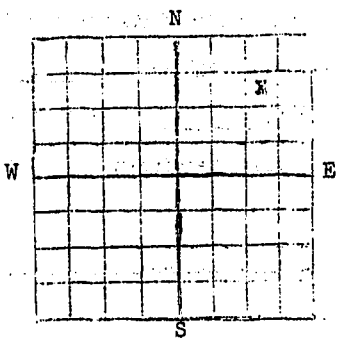

Sec. 5 T32R34
Indicate point of appropriation and place of use, if possible. Each small square represents 10 acres.

2. The beneficial use on which the claim is based Domestic use
3. Date or approximate date of earliest beneficial use; and how continuous the use has been 1956 continuous use
4. The amount of groundwater claimed (in miner's inches or gallons per minute) Surface spring flow - 2 gal. per minute
5. If used for irrigation, give the acreage and description of the lands to which water has been applied and name of the owner thereof Recreational purposes only
6. The means of withdrawing such water from the ground and the location of each well or other means of withdrawal Surface spring Section 5, T32N, R34W.
7. The date of commencement and completion of the construction of the well, wells, or other works for withdrawal of groundwater. 1956
8. The depth of water table Surface spring
9. So far as it may be available, the type, size and depth of each well or the general specifications of any other works for the withdrawal of groundwater Concrete spring box at site of spring
10. The estimated amount of groundwater withdrawn each year 75,000 gallons
11. The log of formations encountered in the drilling of each well if available None
12. Such other information of a similar nature as may be useful in carrying out the policy of this act, including reference to book and page of any county record Recorded: Lincoln County, Libby, Montana - Records Office Book 51
Page 597, 598

J. Anderson At Forest Supervisor
Kootenai National Forest
Signature of Owner Libby, Montana
Date 3-5-62

Three copies to be filed by the owner with the County Clerk and Recorder of the county in which the well is located.

Please answer all questions. If not applicable, so state, otherwise the form will be returned.

Original to the County Clerk and Recorder; duplicate to the State Engineer; Triplicate to the School of Mines and Quadruplicate for the Appropriator.

STATE OF MONTANA

County of Lincoln

ss.

J.E. Sanderson representing the United States having first been duly sworn, deposes and says that he is of lawful age and represents the appropriator and claimant of the order and water right mentioned in the foregoing declaration of vested groundwater rights and the person whose name is subscribed thereto, as representative of the appropriator and claimant, that he knows the contents of said foregoing notice and that the matters and things therein stated are true.

J.E. Sanderson

Act

Forest Supervisor

Kootenai National Forest

Subscribed and sworn to before me, this 6 day of March, 1962

Notary Public for the State of Montana

Residing at Libby, Montana

My Commission expires July 6 1962

File No.

T. 32N R. 34W
County Lincoln

DUPLICATE

STATE OF MONTANA
ADMINISTRATOR OF GROUNDWATER CODE
OFFICE OF STATE ENGINEER

Declaration of Vested Groundwater Rights

(Under Chapter 237, Montana Session Laws, 1961)

RECEIVED
JAN 27 1964
STATE ENGINEER

1. JOHN B SMITH JR of Route #1 Troy
(Name of Appropriator) (Address) (Town)
County of Lincoln State of MONTANA

have appropriated groundwater according to the Montana laws in effect prior to January 1, 1962, as follows:

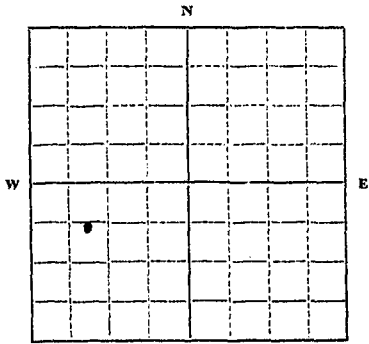

SW $\frac{1}{4}$ Sec. 9 T. 32 R. 34

Indicate point of appropriation and place of use, if possible. Each small square represents 10 acres.

2. The beneficial use on which the claim is based: House Use + Irrigation

3. Date or approximate date of earliest beneficial use; and how continuous the use has been: JANUARY 1955

4. The amount of groundwater claimed (in miner's inches or gallons per minute): 15 Gallon Per Minute

5. If used for irrigation, give the acreage and description of the lands to which water has been applied and name of the owner thereof: 1/4 ACRE JOHN B SMITH JR.

6. The means of withdrawing such water from the ground and the location of each well or other means of withdrawal: 1 1/2" Jet Pump SW 1/4 Sec 9 T 32N R 34W

7. The date of commencement and completion of the construction of the well, wells, or other works for withdrawal of groundwater: December 1954

8. The depth of water table: 24 Feet

9. So far as it may be available, the type, size and depth of each well or the general specifications of any other works for the withdrawal of groundwater: 6 Inch Steel Well Casing 34 Feet in Depth

10. The estimated amount of groundwater withdrawn each year: 50,000 gallon

11. The log of formations encountered in the drilling of each well if available: First 6 feet clay, Next 12 feet Sand, Approximately 16 feet pea gravel, at 34 feet bedrock

12. Such other information of a similar nature as may be useful in carrying out the policy of this act, including reference to book and page of any county record.

Signature of Owner: John B Smith Jr.
Date: Dec 27, 1963

Three copies to be filed by the owner with the County Clerk and Recorder of the county in which the well is located.

Please answer all questions. If not applicable, so state, otherwise the form will be returned.

Original to the County Clerk and Recorder; duplicate to the State Engineer; Triplicate to the Montana Bureau of Mines and Geology, and Quadruplicate for the Appropriator.

#263

INDEXED

STATE OF MONTANA
COUNTY OF LINCOLN
Filed this 27th day of
December A. D. 1953
at 2:00 P. M.
T. M. Mansfield
County Clerk.
By Versa R. H. H.
Deputy

File No.

T. 32N R 34W

DUPLICATE

County Lincoln

(SW?)

STATE OF MONTANA
ADMINISTRATOR OF GROUNDWATER CODE
OFFICE OF STATE ENGINEER

RECEIVED
MAY 10 1963

Declaration of Vested Groundwater Rights

(Under Chapter 237, Montana Session Laws, 1961)

STATE ENGINEER

1. J. R. and Leona M. Devich, of Box 596 Tray
(Name of Appropriator) (Address) (Town)
County of Lincoln State of Montana
have appropriated groundwater according to the Montana laws in effect prior to January 1, 1962, as follows:

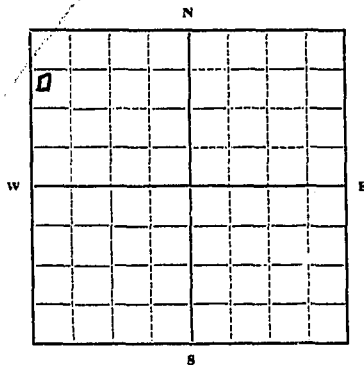

SW, NW 1/4 Sec. 22 T32 R34

Indicate point of appropriation and place of use, if possible. Each small square represents 10 acres.

2. The beneficial use on which the claim is based Household, garden, lawn, bar, guest house, and water for cattle, horses, etc
3. Date or approximate date of earliest beneficial use; and how continuous the use has been 1940 - continuous

4. The amount of groundwater claimed (in miner's inches or gallons per minute) 50 gallons per minute

5. If used for irrigation, give the acreage and description of the lands to which water has been applied and name of the owner thereof could be used on about three acres of wild hay land

6. The means of withdrawing such water from the ground and the location of each well or other means of withdrawal running spring to 1000 gallon tank, and thence pipe line to various outlets

7. The date of commencement and completion of the construction of the well, wells, or other works for withdrawal of groundwater 1940

8. The depth of water table not determined

9. So far as it may be available, the type, size and depth of each well or the general specifications of any other works for the withdrawal of groundwater water flows from hillside to catch basins, into tank, and into pipe lines

10. The estimated amount of groundwater withdrawn each year about 1,000,000 gallons

11. The log of formations encountered in the drilling of each well if available not applicable

12. Such other information of a similar nature as may be useful in carrying out the policy of this act, including reference to book and page of any county record Another spring of similar nature is developed for emergency purposes. The flow is about 700 gallons per minute, and is inter-connected to above pipe lines with a by-pass valve

Signature of Owner J.R. Devich
Date April 17, 1963

Three copies to be filed by the owner with the County Clerk and Recorder of the county in which the well is located.

Please answer all questions. If not applicable, so state, otherwise the form will be returned.

Original to the County Clerk and Recorder; duplicate to the State Engineer; Triplicate to the Montana Bureau of Mines and Geology, and Quadruplicate for the Appropriator.

79

STATE OF MONTANA
COUNTY OF LINCOLN

Filed this 1st day of

May A. D. 1963

at 12:30 P. M.

by M. M. Mansfield
County Clerk.

By Mae Holton
Deputy

File No.

MONTANA WATER RESOURCES BOARD

T. 32 R. 34

DUPLICATE

RECEIVED

County Lincoln

OCT 19 1967

STATE OF MONTANA
ADMINISTRATOR OF GROUNDWATER CODE
OFFICE OF STATE ENGINEER

Top of Ground _____
(Elev. above sea level.....)

Notice of Completion of Groundwater Appropriation by Means of Well

(Under Chapter 237, Montana Session Laws, 1961)

Owner Richard Ottaway Address Box 335 Troy

Driller William D Lake Address Libby, Mont.

Date of Notice of Appropriation of Groundwater.....

Date well started Oct. 10, 1967 Date Completed Oct. 10, 1967

Type of well..... drilled Equipment Used..... Churn
(dug, driven, bored or drilled) (Churn, drill, rotary or other)

Water Use: Domestic Municipal Other Irrigation
Industrial Drainage Stock

Indicate on the diagram the character and thickness of the different strata met with in drilling, such as soil, clay, shale, gravel, rock or sand, etc. Show depth at which water is encountered, thickness and character of water-bearing strata and height to which water rises in the well.

0'-1' Top Soil.
1'-10' Clay and gravel.
10'-13' Gravel, clay and boulders.
13'-22' Clay and gravel.
22'-26' Gravel and boulders.
28'-29' Clay and gravel.
29'-35' Sand, gravel and water.
35'-38' Gravel and water.

Size of Drilled Hole	Size and Weight of Casing	From (Feet)	To (Feet)	PERFORATIONS		
				Kind Size	From (Feet)	To (Feet)
6" O.D.	6 5/8" O.D. 13.97 lbs. per foot	0'	38'		none	

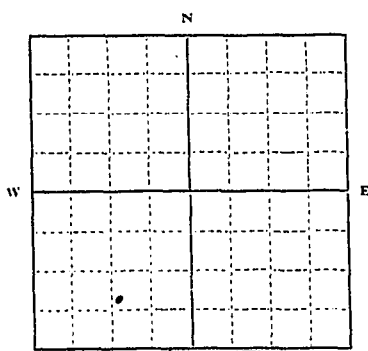

Indicate location of well and place of use, if possible. Each small square represents 10 acres.

Show exact depth of bottom.

Static Water Level for non-flowing Well..... 27 feet.

Shut-in Pressure for Flowing Well.....

Pumping Water Level..... 28 feet at 12 gal. per minute.

Discharge in gal. per min. of flowing well.....

How Tested..... pumps Length of Test..... 2 hrs.

Remarks: (Gravel packing, cementing, packers, type of shutoff, location of place of use of groundwater if not at well, and any other similar pertinent information, including number of acres irrigated, if used for irrigation).....

152
Driller's License Number

Wm D Lake
Driller's Signature

This form to be prepared by driller, and three copies to be filed by the owner with the County Clerk and Recorder in the county in which the well is located.

Please answer all questions. If not applicable, so state, otherwise the form will be returned.

Original to the County Clerk and Recorder; duplicate to the State Engineer; Triplicate to the Montana Bureau of Mines and Geology and Quadruplicate for the Appropriator.

42,412

#608

STATE OF MONTANA
COUNTY OF LINCOLN

Filed this 13th day of

October A. D. 1967

at 3:45 P. M.

Eleanor P. Vaughan
County Clerk.

By _____ Deputy

File No.

T. 32 R. 34

DUPLICATE

County Spokane

LOG

STATE OF MONTANA
ADMINISTRATOR OF GROUNDWATER CODE
STATE WATER CONSERVATION BOARD

Top of Ground
(Elev. above sea level.....)

Notice of Completion of Groundwater
Appropriation by Means of Well
DEVELOPED AFTER JANUARY 1, 1962

(Under Chapter 237 Montana Session Laws, 1961, as amended)

Owner Robert T. Uhl Address Rt 1 Troy Mont

0'-1' Topsoil.

Driller William D. Lake Address Libby, Montana

1'-18' Loose Sand, Gravel and Clay.

Date of Notice of appropriation of groundwater.....

18'-24' Tight Clay and Gravel.

Date well started October 5, 1968 Date completed October 7, 1968

24'-30' Loose Sand and Gravel.

Type of well Drilled Equipment used Churn
(Dug, driven, bored or drilled) (Churn drill, rotary or other)

30'-40' Sand and Water.

Water use: Domestic Municipal Stock Irrigation
Industrial Drainage Other

40'-43' Gravel with Water.

Indicate on the diagram the character and thickness of the different strata met with in drilling, such as soil, clay, shale, gravel, rock or sand, etc. Show depth at which water is encountered, thickness and character of water-bearing strata and height to which the water rises in the well.

Size of Drilled Hole	Size and Weight of Casing	From (Feet)	To (Feet)	PERFORATIONS		
				Kind Size	From (Feet)	To (Feet)
6" I.D.	6 5/8" O.D. 17.00 lbs. per foot	0	43		NONE	

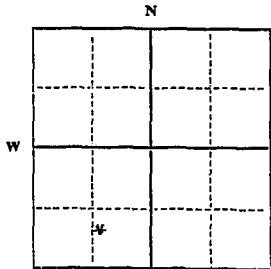

Static Water Level for non-flowing well 30 feet.

Shut-in Pressure for Flowing Well.....

Pumping Water Level..... 31 feet
at..... 15 gal. per minute.

Discharge in gal. per min. of flowing well

How Tested... pump

Length of Test... 2 hours

Lot 14, Blk. 1, Kootenai Vista Remarks: (Gravel packing, cementing, packers, type of shutoff).....

1/4 Sec 22 T. 32 R. 34
Indicate location of well and place of use, if possible. Each small square represents 40 acres.

(Continue on reverse side)

USE—If used for irrigation, industrial, drainage or other. Explain, state number of acres and location or other data (i.e.: Lot, Block and Addition).

Show exact dep'th of bottom.

This form to be prepared by driller, and three copies to be filed by the owner with the County Clerk and Recorder in the county in which the well is located, tissue copy to be retained by driller.

Please answer all questions. If not applicable, so state, otherwise the form will be returned.

152
Driller's License Number

W D Lake
Driller's Signature.

45,041

679

STATE OF MONTANA
COUNTY OF LINCOLN

Filed this 3rd day of

March A. D. 1969

at 12:15 P. M.

Charles J. Hughes
County Clerk.

By Mar. Hutton Deputy

File No.

NOV 15 1965

T. 32 N. R. 34 W. M.P.M.

DUPLICATE

Billie _____ McDermott _____
 Bultr n _____ McNulty _____
 Coyle _____ Morton _____
 Darlington _____ Sullivan _____
 Dickert _____

County Lincoln

STATE OF MONTANA
 ADMINISTRATOR OF GROUNDWATER CODE
 OFFICE OF STATE ENGINEER

Top of Ground
 (Elev. above sea level.....)

**Notice of Completion of Groundwater
 Appropriation by Means of Well**

(Under Chapter 237, Montana Session Laws, 1961)

0'-1' Topsoil.
 1'-18' Sandy Clay.
 18'-39' Tight Clay
 and Gravel.
 39'-43' Clay and
 Gravel.
 43'-53' Sand, Gravel
 and Water.

Owner C. B. Hand Address Tray, Mont.

Driller Wm. D. Lake Address Libby, Mont.

Date of Notice of Appropriation of Groundwater.....

Date well started Oct 25, 1965 Date Completed Oct 28, 1965

Type of well drilled Equipment Used churn
(dug, driven, bored or drilled) (Churn, drill, rotary or other)

Water Use: Domestic Municipal Other Irrigation
 Industrial Drainage Stock

Indicate on the diagram the character and thickness of the different strata met with in drilling, such as soil, clay, shale, gravel, rock or sand, etc. Show depth at which water is encountered, thickness and character of water-bearing strata and height to which water rises in the well.

Size of Drilled Hole	Size and Weight of Casing	From (Feet)	To (Feet)	PERFORATIONS		
				Kind Size	From (Feet)	To (Feet)
6" I.D.	18.97 lbs. per foot.	0'	53'	none		

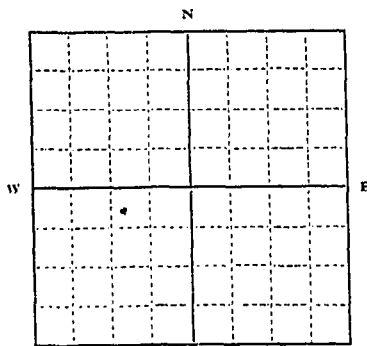

5 W. 1/4 Sec. 22 T. 32 N. R. 34 W. M.P.M. Garden & Lawn

Indicate location of well and place of use, if possible. Each small square represents 10 acres.

Show exact depth of bottom.

Static Water Level for non-flowing Well 40 feet.

Shut-in Pressure for Flowing Well.....

Pumping Water Level 42 feet at 15 gal. per minute.

Discharge in gal. per min. of flowing well.....

How Tested bailer Length of Test 3 hrs.

Remarks: (Gravel packing, cementing, packers, type of shutoff, location of place of use of groundwater if not at well, and any other similar pertinent information, including number of

acres irrigated, if used for irrigation) 1/2 here

152
Driller's License Number

Wm. D. Lake
Driller's Signature

This form to be prepared by driller, and three copies to be filed by the owner with the County Clerk and Recorder in the county in which the well is located.

Please answer all questions. If not applicable, so state, otherwise the form will be returned.

Original to the County Clerk and Recorder; duplicate to the State Engineer; Triplicate to the Montana Bureau of Mines and Geology and Quadruplicate for the Appropriator.

512

INDEXED

STATE OF MONTANA
COUNTY OF LINCOLN

Filed this 9th day of
November A. D. 1905
at 11:15 P. M.
M. M. Mansfield County Clerk
By Eleanor Vaughn Deputy

File No. NOV 15 1965

T. 32 N R. 34 W

DUPLICATE

Billie _____ McDermott _____
Butler _____ McNulty _____
Coyler _____ Morton _____
Darlington _____ Sullivan _____
Top of Ground _____

County Lincoln

STATE OF MONTANA
ADMINISTRATOR OF GROUNDWATER CODE
OFFICE OF STATE ENGINEER

(Elev. above sea level.....)

Notice of Completion of Groundwater Appropriation by Means of Well

(Under Chapter 237, Montana Session Laws, 1961)

0'-1' Topsoil
1'-12' Clay
12'-17' Loose clay
and gravel.
17'-23' Tight clay
and gravel.
23'-40' Loose clay
and gravel.
40'-53' Sand, gravel
and water.

Owner Mrs. A. V. Birrer Address Troy, Mont.
Driller Wm. D. Lake Address Libby, Mont.

Date of Notice of Appropriation of Groundwater.....

Date well started Oct. 29, 1965 Date Completed Nov. 3, 1965

Type of well drilled Equipment Used churn
(dug, driven, bored or drilled) (Churn, drill, rotary or other)

Water Use: Domestic Municipal Other Irrigation
Industrial Drainage Stock

Indicate on the diagram the character and thickness of the different strata met with in drilling, such as soil, clay, shale, gravel, rock or sand, etc. Show depth at which water is encountered, thickness and character of water-bearing strata and height to which water rises in the well.

Size of Drilled Hole	Size and Weight of Casing	From (Feet)	To (Feet)	PERFORATIONS		
				Kind Size	From (Feet)	To (Feet)
6" I.D.	18.97 Lbs. per foot	0'	53'	none		

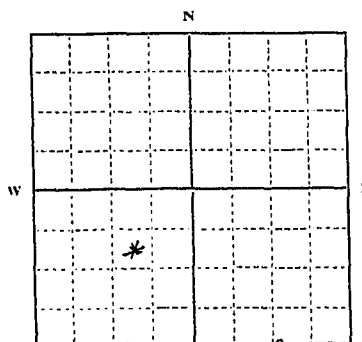

SW 1/4 Sec 22 T. 32 R. 34

Indicate location of well and place of use, if possible. Each small square represents 10 acres.

Show exact depth of bottom.

Static Water Level for non-flowing Well..... 35 feet.

Shut-in Pressure for Flowing Well.....

Pumping Water Level..... 36 feet at 20 gal. per minute.

Discharge in gal. per min. of flowing well.....

How Tested..... bailer Length of Test 2 hrs.

Remarks: (Gravel packing, cementing, packers, type of shutoff, location of place of use of groundwater if not at well, and any other similar pertinent information, including number of acres irrigated, if used for irrigation).....

152
Driller's License Number
Wm D Lake
Driller's Signature

This form to be prepared by driller, and three copies to be filed by the owner with the County Clerk and Recorder in the county in which the well is located.

Please answer all questions. If not applicable, so state, otherwise the form will be returned.

Original to the County Clerk and Recorder; duplicate to the State Engineer; Triplicate to the Montana Bureau of Mines and Geology and Quadruplicate for the Appropriator.

510

INDEXED

STATE OF MONTANA
COUNTY OF LINCOLN

Filed this 2th day of
November A. D. 1965

By M. J. Mansfield
County Clerk

By Mae Peterson
Deputy

[Faint, mostly illegible text, possibly bleed-through from the reverse side of the page]

STATE ARCHIVES COLLECTION UNIT

File No.

SEP 14 1966

T. 22 R. 34

DUPLICATE

Billie..... McDermott..... County Lincoln
 Butler..... McNulty..... STATE OF MONTANA
 Coyle..... Mc..... ADMINISTRATOR OF GROUNDWATER CODE
 Darlington..... Sullivan..... OFFICE OF STATE ENGINEER
 Dickert.....

LOG

Top of Ground

(Elev. above sea level.....)

0'-1' Topsoil.
 1'-18' Loose clay and gravel.
 18'-22' Gravel and boulders.
 22'-28' Sand.
 28'-38' Sand and water.
 38'-43' Gravel and water.

Notice of Completion of Groundwater Appropriation by Means of Well
 DEVELOPED AFTER JANUARY 1, 1962

(Under Chapter 237, Montana Session Laws, 1961)

Owner Fred Edstrom Address Troy, Mont
 Driller William D. Lake Address Libby, Mont.
 Date of Notice of appropriation of groundwater.....
 Date well started Aug. 31, 1966 Date completed Sept. 1, 1966
 Type of well drilled Equipment used churn
 (Dug, Driven, bored or drilled) (Churn drill, rotary or other)
 Water use: Domestic Municipal Stock Irrigation
 Industrial Drainage Other

Indicate on the diagram the character and thickness of the different strata met with in drilling, such as soil, clay, shale, gravel, rock or sand, etc. Show depth at which water is encountered, thickness and character of water-bearing strata and height to which the water rises in the well.

Size of Drilled Hole	Size and Weight of Casing	From (Feet)	To (Feet)	PERFORATIONS		
				Kind Size	From (Feet)	To (Feet)
6" I.D.	18.97 lbs. per foot 6 5/8" O.D.	0'	43'			none

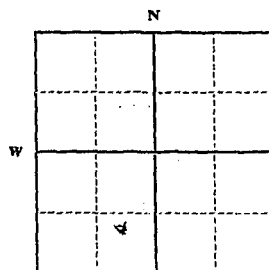

Static Water Level for non-flowing well 28 feet.
 Shut-in Pressure for Flowing Well.....
 Pumping Water Level..... 28 feet
 at..... 15 gal. per minute.
 Discharge in gal. per min. of flowing well

How Tested..... pump
 Length of Test..... 1 1/2 hrs.
 Remarks: (Gravel packing, cementing, packers, type of shutoff).....

Lot 6, Block Kortinaia, SW 1/4, Sec. 22, T. 22, R. 34.
 Indicate location of well and place of use, if possible. Each small square represents 40 acres.

(Continue on reverse side)

USE—If used for irrigation, industrial, drainage or other. Explain, state number of acres and location or other data (i.e.: Lot, Block and Addition).

Show exact depth of bottom.

This form to be prepared by driller, and three copies to be filed by the owner with the County Clerk and Recorder in the county in which the well is located, tissue copy to be retained by driller.

Please answer all questions. If not applicable, so state, otherwise the form will be returned.

Driller's License Number 152

Driller's Signature William D. Lake

41,397

561

STATE OF MONTANA
COUNTY OF LINCOLN

Filed this 27th day of:

September A. D. 1966

at 2125 P. M.

by E. J. [Signature] County Clerk.

By Mae Hitean Deputy

RECEIVED

County Lincoln

STATE OF MONTANA
ADMINISTRATOR OF GROUNDWATER CODE
MONTANA WATER RESOURCES BOARD

NOTICE OF COMPLETION OF GROUNDWATER
APPROPRIATION BY MEANS OF WELL

Developed after January 1, 1962

(Under Chapter 237 Montana Session Laws, 1961, as amended)

This form to be prepared by driller, and three copies to be filed by the owner with the County Clerk and Recorder in the county in which the well is located, last copy to be retained by driller.

Please answer all questions. If not applicable, so state, otherwise the form may be returned.

Owner Vaughn Evans
Address Libby, Montana
Date well started August 3, 1972
completed August 4, 1972

For Administrator's Use	
File	<u>927</u>
	<u>Feb 14, 1973</u>
GW	<u>11:50 A.M.</u>

Type of well Drilled
(Dug, driven, bored or drilled)

Equipment used Air Rotary
(Churn drill, rotary or other)

Water Use: Domestic Municipal Stock Irrigation
Industrial Drainage Other * Garden/Lawn

*Describe
USE: If used for irrigation, industrial, drainage or other. Explain, state number of acres and location or other data (i.e. Lot, Block and Addition).

ESTIMATED ANNUAL WITHDRAWAL 75,000 gal. pr. yr.

Size of Drilled Hole	Size and Weight of Casing	From (Feet)	To (Feet)	PERFORATIONS		
				Kind Size	From (Feet)	To (Feet)
6" I.D.	5/8" O.D. 17.00 lbs. per ft.	0	41		None	

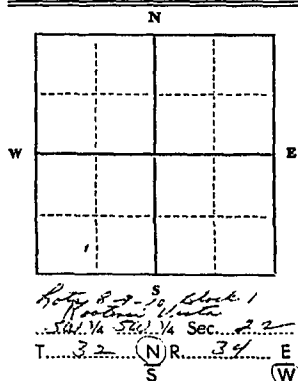

Static water level 18 ft.*
Pumping water level ft.*
at 40-50 gallons per minute,
measured 120 minutes after pumping began.
*Measured from ground level.
Well developed by air compressor
for 2 hours.
Power Pump HP
Remarks: (Gravel packing, cementing, packers, type of shutoff)

INDICATE LOCATION OF WELL AND PLACE OF USE, IF POSSIBLE. EACH SMALL SQUARE REPRESENTS 40 ACRES.

Driller's Signature Wm D. Lake
Driller's Address P.O. Box 967

Libby, Montana 59923 LICENSE NO. 152

DRILLER'S LOG

Indicate the character, color, thickness of strata such as soil, clay, sand, gravel, shale, sandstone, etc. Show depth at which water is found and height to which water rises in well.

Top of Ground (Elev. above sea level) _____

From (Feet)	To (Feet)	Character of Strata
<u>0</u>	<u>1</u>	<u>Topsoil</u>
<u>1</u>	<u>22</u>	<u>Sand, Gravel, and Boulders</u>
<u>22</u>	<u>41</u>	<u>Gravel and Water</u>

41 ft. Show exact depth of bottom

52,454

INDEXED

927

STATE OF MONTANA
COUNTY OF LINCOLN

Filed this 19th day of
February A. D. 1923
at Helena, Mont.
Elmer F. Langbein
County Clerk
By Pat J. J. J. Deputy

RECEIVED

County Lincoln

STATE OF MONTANA
ADMINISTRATOR OF GROUNDWATER CODE 14AR 9 1372
MONTANA WATER RESOURCES BOARD

NOTICE OF COMPLETION OF GROUNDWATER APPROPRIATION BY MEANS OF WELL

Developed after January 1, 1962

DRILLER'S LOG

Indicate the character, color, thickness of strata such as soil, clay, sand, gravel, shale, sandstone, etc. Show depth at which water is found and height to which water rises in well.

(Under Chapter 237 Montana Session Laws, 1961, as amended)
This form to be prepared by driller, and three copies to be filed by the owner with the County Clerk and Recorder in the county in which the well is located, last copy to be retained by driller.
Please answer all questions. If not applicable, so state, otherwise the form may be returned.

Owner C. C. Culverwell

Address Troy, Montana

Date well started Oct. 30, 1971

completed Nov. 15, 1971

For Administrator's Use	
File	<u>853 March 7, 1972</u>
	<u>2125 p.m.</u>
GW 1	

Type of well Drilled
(Dug, driven, bored or drilled)

Equipment used Churn Drill
(Churn drill, rotary or other)

Water Use: Domestic Municipal Stock Irrigation
Industrial Drainage Other * Garden/Lawn

*Describe _____
USE: If used for irrigation, industrial, drainage or other. Explain, state number of acres and location or other data (i.e. Lot, Block and Addition).

ESTIMATED ANNUAL WITHDRAWAL 75,000 gal.

Size of Drilled Hole	Size and Weight of Casing	From (Feet)	To (Feet)	PERFORATIONS		
				Kind Size	From (Feet)	To (Feet)
6" I.D.	6 5/8" O.D. 17.00 lbs. per ft.	0	113			

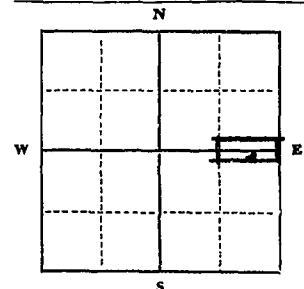

Static water level 9 ft.*
Pumping water level 100 ft.*
at 1 1/2 gallons per minute,
measured 2 1/2 hours after pumping began.
*Measured from ground level.
Well developed by pump
for 18 hours.
Power elec. Pump 1/2 HP
Remarks: (Gravel packing, cementing, packers, type of shutoff)

NE 1/4 SE 1/4 Sec. 26
T. 32 N R. 34 E

INDICATE LOCATION OF WELL AND PLACE OF USE, IF POSSIBLE. EACH SMALL SQUARE REPRESENTS 40 ACRES.

Driller's Signature Wm D. Lake

Driller's Address P.O. Box 967

Libby, Montana 59923 LICENSE NO. 152

Top of Ground (Elev. above sea level)

From (Feet)	To (Feet)	
0	1	Topsoil
1	15	Sand, Gravel, and Boulders
15	55	Clay
55	95	Sandy Clay and some Gravel
95	107	Clay and Gravel
107	113	Sand, Gravel and Water

113 Show exact depth of bottom

50,009

853

STATE OF MONTANA
COUNTY OF LINCOLN

Filed this 7th day of March A. D. 1912
at 2115 Ma Watson Edward Vaughn
County Clerk
By Mae Watson Deputy

GWS

File No.....

DUPLICATE

SW 20

T. 32^N R. 34^W

County Lincoln

STATE OF MONTANA
ADMINISTRATOR OF GROUNDWATER CODE
OFFICE OF STATE ENGINEER

RECEIVED
AUG 12 1963

STATE ENGINEER

Notice of Completion of Groundwater Appropriation Without Well

(Under Chapter 237 Montana Session Laws, 1961)

Date of Appropriation of Groundwater July 1, 1940

Owner William and Ruth Jones Address Troy, Montana

Contractor (if any) none

Address of Contractor

Date Started..... Date Completed July 1, 1940

Describe means of obtaining groundwater without a well "as by sub-irrigation and other natural processes". Include depth to water when applicable. five springs flowing water to surface as indicated on map which springs are tapped by pipe.

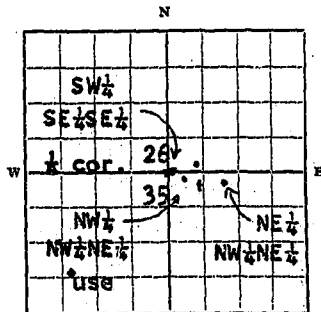

1/4 Sec. 26 35 T. 32. R. 34
Indicate point of appropriation and place of use, if possible.

Quantity of water developed and used with explanation of method used to measure or estimate such amount. If use is intermittent estimate approximate lengths of periods of use estimated 1/10th of one cubic foot per second developed and used. Based on capacity of system.

Signature of Owner Ruth Jones
William Jones

Date Aug 8/63

This form to be prepared by contractor (if any), otherwise by the owner.
Three copies of this notice are to be filed with the County Clerk and Recorder of the county in which the works are located.
Please answer all questions. If not applicable, so state, otherwise the form will be returned.
Original to the County Clerk and Recorder; duplicate to the State Engineer; Triplicate to the School of Mines and Quadruplicate for the Appropriator.

112

STATE OF MONTANA
COUNTY OF LINCOLN

Filed this 8th day of
August A. D. 1963
at 11:35 A.M.
M. M. Marshall County Clerk
By Mae Holman Deputy

846



RECEIVED
 SEP 17
 1972

STATE OF MONTANA
 COUNTY OF LINCOLN

Filed this 1st day of
February A. D. 1972
 at 11:30 A.M.
Deputy Sheriff at Thompson
 County Clerk
 By Betty Mendenhall

Lots 2 & 3 Blk 9
 each lot is 125x200 Total area is 250x400
 Kootenai Vista
 Canned
 Trip Rge
 Sec 27-32-34

Location T. R. Sec.
 Doc. No. #840

Water Code for the State of Montana, please take
 ns, in order to properly protect your ground-

on the enclosed form, the complete location
 on.

Thank you.

RECEIVED

SEP 19 1972

LAND DEPARTMENT OF MONTANA
 BILLINGS, MONTANA 59103

Water Use: Domestic Municipal Stock Irrigation
 Industrial Drainage Other * Garden/Lawn

*Describe
 USE: If used for irrigation, industrial, drainage or other explain,
 state number of acres and location or other data (i.e. Lot, Block
 and Addition).

ESTIMATED ANNUAL WITHDRAWAL gpm

Size of Drilled Hole	Size and Weight of Casing	From (Feet)	To (Feet)	PERFORATIONS		
				Kind Size	From (Feet)	To (Feet)
6" ID	6 5/8" o.d. 17.00 lbs. per ft.	0	10		None	

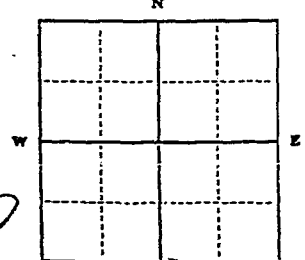

Static water level 33 ft.*
 Pumping water level 31 ft.*
 at 15 gallons per minute,
 measured 21 minutes after pumping
 began.
 *Measured from ground level
 Well developed by
 for 1 hours.
 Power 3 Pump HP
 Remarks: (Gravel packing, cementing,
 packers, type of shutoff)

Lot 2 & 3 Blk 9
 Block 9 Kootenai Vista
 Sec 27
 T. 32 N. R. 34 E.
 S. W.

INDICATE LOCATION OF WELL AND PLACE OF USE, IF POSSIBLE.
 EACH SMALL SQUARE REPRESENTS 40 ACRES.

Location T. R. Sec.
 Doc. No. #840

Groundwater Section
 Sam W. Mitchell Building
 Helena, Montana 59601

As the Administrator of the Groundwater Code for the State of Montana, please take note of the following special instructions, in order to properly protect your groundwater right.

Special Instructions:

Please provide, as indicated in red on the enclosed form, the complete location of the well by township, range and section.

Thank you.

RECEIVED

SEP 19 1972

MONTANA DEPARTMENT OF NATURAL RESOURCES AND CONSERVATION

Water Use: Domestic Municipal Stock Irrigation
 Industrial Drainage Other * Garden/Lawn

*Describe
 USE: If used for irrigation, industrial, drainage or other. Explain, state number of acres and location or other data (i.e. Lot, Block and Addition).

ESTIMATED ANNUAL WITHDRAWAL

Size of Drilled Hole	Size and Weight of Casing	From (Feet)	To (Feet)	PERFORATIONS		
				Kind Size	From (Feet)	To (Feet)
6" ID	6 5/8" o.d. 17.00 lbs. per ft.	0	40		None	

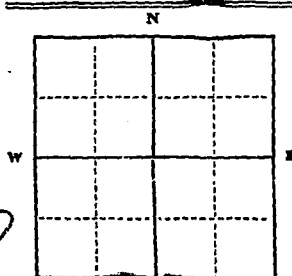

Static water level 33 ft.*
 Pumping water level 31 ft.*
 at 35 gallons per minute,
 measured 21 minutes after pumping began.
 *Measured from ground level.
 Well developed by
 for 4 hours.
 Power 3 Pump HP
 Remarks: (Gravel packing, cementing, packers, type of shutoff)

Block 1, Range 24N, Sec. 27E
 T. 34N R. 24E S. 27E

INDICATE LOCATION OF WELL AND PLACE OF USE, IF POSSIBLE. EACH SMALL SQUARE REPRESENTS 40 ACRES.

SEP 13 1972

County... Lincoln

STATE OF MONTANA
ADMINISTRATOR OF GROUNDWATER CODE
MONTANA WATER RESOURCES BOARD
**NOTICE OF COMPLETION OF GROUNDWATER
APPROPRIATION BY MEANS OF WELL**

Developed after January 1, 1962

(Under Chapter 237 Montana Session Laws, 1961, as amended)

This form to be prepared by driller, and three copies to be filed by the owner with the County Clerk and Recorder in the county in which the well is located, last copy to be retained by driller. Please answer all questions. If not applicable, so state, otherwise the form may be returned.

Owner Richard Allenberg
Address Troy, Montana
Date well started Nov. 17, 1971
completed Nov. 18, 1971

For Administrator's Use	
File #	<u>840 261, 1972</u>
	<u>11:30 a.m.</u>
GW #	

Type of well Drilled (Dug, driven, bored or drilled)
Equipment used Churn Drill (Churn drill, rotary or other)
Water Use: Domestic Municipal Stock Irrigation
Industrial Drainage Other * Garden/Lawn

*Describe USE: If used for irrigation, industrial, drainage or other. Explain, state number of acres and location or other data (i.e. Lot, Block and Addition).

ESTIMATED ANNUAL WITHDRAWAL 200,000 gal.

Size of Drilled Hole	Size and Weight of Casing	From (Feet)	To (Feet)	PERFORATIONS		
				Kind Size	From (Feet)	To (Feet)
6" ID	6 5/8" o.d. 17.00 lbs. per ft.	0	40	None		

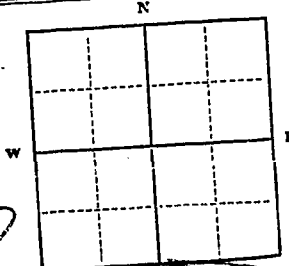

Static water level 33 ft.*
Pumping water level 31 ft.*
at 15 gallons per minute,
measured 21.5 minutes after pumping
began.
*Measured from ground level.
Well developed by churn
for 4 hours.
Power 3 hp Pump 3 HP
Remarks: (Gravel packing, cementing,
packers, type of shutoff)

Block 24 Section 27
T. 32 N R. 34 E
S W

INDICATE LOCATION OF WELL AND PLACE OF USE, IF POSSIBLE.
EACH SMALL SQUARE REPRESENTS 40 ACRES.

Driller's Signature Wm D. Lake

Driller's Address R.O. Box 967

Liberty, Montana 59923 LICENSE NO. 12

40 ft. Show exact depth of bottom

49,814

File No. **RECEIVED**

T. 32 R. 34

DUPLICATE

MAR 16 1970

County Judith

LOG

STATE OF MONTANA
ADMINISTRATOR OF GROUNDWATER CODE
STATE WATER CONSERVATION BOARD

**Notice of Completion of Groundwater
Appropriation by Means of Well**

DEVELOPED AFTER JANUARY 1, 1962

(Under Chapter 237 Montana Session Laws, 1961, as amended)

Top of Ground
(Elev. above sea level.....)

- 0'-1' Topsoil.
- 1'-18' Loose sand and Gravel.
- 18'-24' Clay, Gravel, and Boulders.
- 24'-28' Loose Gravel.
- 28'-32' Sand, Gravel and Water.

Owner Steve & Virginia H. Hildner Address Box 252 Gray

Driller William D. Lake Address Libby, Montana

Date of Notice of appropriation of groundwater.....

Date well started November 5, 1969 Date completed November 10, 1969

Type of well Drilled Equipment used Churn
(Dug, driven, bored or drilled) (Churn drill, rotary or other)

Water use: Domestic Municipal Stock Irrigation
Industrial Drainage Other

Indicate on diagram the character and thickness of the different strata met with in drilling, such as soil, clay, shale, gravel, rock or sand, etc. Show depth at which water is encountered, thickness and character of water-bearing strata and height to which the water rises in the well.

Size of Drilled Hole	Size and Weight of Casing	From (Feet)	To (Feet)	PERFORATIONS		
				Kind Size	From Feet	To (Feet)
6" I.D.	6 5/8" O.D.	0	32			
	17.00 lbs. per foot				None	

Doc. No. 729
Filed for record
this 6 day of March
A. D. 19 70 at 3:52
o'clock P.M.

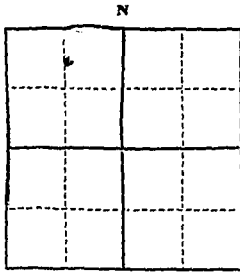

Static Water Level for non-flowing well 27 feet.

Shut-in Pressure for Flowing Well
Pumping Water Level 28 feet

at 15 gal. per minute.

Discharge in gal. per min. of flowing well

How Tested Flow

Length of Test 1 Hour

Remarks: (Gravel packing, cementing, packers, type of shutoff).....

Lot 1 B&B 2 to the NW 1/4 Sec 37 T32 R34
Indicate location of well and place of use, if possible. Each small square represents 40 acres.

(Continue on reverse side)

USE—If used for irrigation, industrial, drainage or other. Explain, state number of acres and location or other data (i.e.: Lot, Block and Addition).

Show exact depth of bottom.

This form to be prepared by driller, and three copies to be filed by the owner with the County Clerk and Recorder in the county in which the well is located, tissue copy to be retained by driller.

Please answer all questions. If not applicable, so state, otherwise the form will be returned.

Driller's License Number

Wm D Lake
Driller's Signature.

46250

729

STATE OF MONTANA
COUNTY OF LINCOLN

Filed this 6th day of

March A. D. 1920

at 3:50 P. M.

Eleanor P. Vaughan
County Clerk

By _____ Deputy

File No.

T. 32 R. 34

DUPLICATE

County Judith

LOG

STATE OF MONTANA
ADMINISTRATOR OF GROUNDWATER CODE
STATE WATER CONSERVATION BOARD

Notice of Completion of Groundwater
Appropriation by Means of Well
DEVELOPED AFTER JANUARY 1, 1962

(Under Chapter 237 Montana Session Laws, 1961, as amended)

Top of Ground
(Elev. above sea level.....)

- 0' - 1' Topsoil.
- 1' - 14' Loose Gravel.
- 14' - 34' Tight Clay, Gravel,
and Boulders.
- 34' - 38' Sand, Gravel,
and Water.

Owner Mel Blalough Address Rt 1 Gray Mont

Driller William D. Lake Address Libby, Montana

Date of Notice of appropriation of groundwater.....

Date well started Sept. 10, 1969 Date completed September 12, 1969

Type of well Drilled Equipment used Churn
(Dug, driven, bored or drilled) (Churn drill, rotary or other)

Water use: Domestic Municipal Stock Irrigation
Industrial Drainage Other

MONTANA WATER RESOURCES BOARD

RECEIVED

NOV 17 1969

Indicate on the diagram the character and thickness of the different strata met with in drilling, such as soil, clay, shale, gravel, rock or sand, etc. Show depth at which water is encountered, thickness and character of water-bearing strata and height to which the water rises in the well.

Size of Drilled Hole	Size and Weight of Casing	From (Feet)	To (Feet)	PERFORATIONS		
				Kind Size	From (Feet)	To (Feet)
6" I. D.	5/8" O. D.	0	38		None	
	17.00 lbs. per foot					

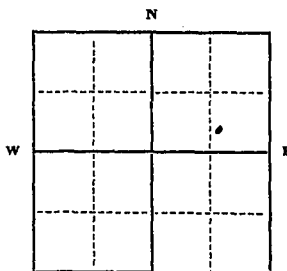

Static Water Level for non-flowing well 32 feet.

Shut-in Pressure for Flowing Well.....

Pumping Water Level..... 32 feet
at..... 10 gal. per minute.

Discharge in gal. per min. of flowing well

How Tested... Bailer.....

Length of Test..... 2 Hours.....

Remarks: (Gravel packing, cementing, packers, type of shutoff).....

Lot 4 Riverland Homes
7 1/2 SE 1/4 Sec. 27 T. 32 R. 34
Indicate location of well and place of use, if possible. Each small square represents 40 acres.

(Continue on reverse side)

USE—If used for irrigation, industrial, drainage or other. Explain, state number of acres and location or other data (i.e.: Lot, Block and Addition).

Show exact depth of bottom.

This form to be prepared by driller, and three copies to be filed by the owner with the County Clerk and Recorder in the county in which the well is located, tissue copy to be retained by driller.

Please answer all questions. If not applicable, so state, otherwise the form will be returned.

152
Driller's License Number

Wm D Lake
Driller's Signature.

15865

INDEXED 715

STATE OF MONTANA
COUNTY OF LINCOLN
Filed this 19th day of
November A. D. 1909
at 8:45 P.M.
Susan J. Vaughn County Clerk.
By Mae Nelson Deputy

981

STATE OF MONTANA
COUNTY OF LINCOLN

Filed this 28th day of

June A. D. 1923

at 10:25 a.m.

Edmond L. Vaughn
County Clerk

By Herald L. Hightower
Esq.

File No. STATE WATER CONSERVATION BOARD

T. 32 R. 34

DUPLICATE

JUL 6 1966

County Lincoln

Bliss McDermott STATE OF MONTANA
Butler McNulty ADMINISTRATOR OF GROUNDWATER CODE
Coble Morton OFFICE OF STATE ENGINEER
Carrington Sullivan

Top of Ground

(Elev. above sea level. Dickert)

Notice of Completion of Groundwater Appropriation by Means of Well

(Under Chapter 237, Montana Session Laws, 1961)

0'-12' loose clay and gravel.
12'-21' Tight clay and gravel.
21'-28' loose clay and gravel.
28'-35' Tight clay and gravel.
35'-40' Gravel and water.

Owner V. A. Bushnell Address Gray, Mont.

Driller William D. Lake Address Libby, Mont.

Date of Notice of Appropriation of Groundwater

Date well started June 13, 1966 Date Completed June 14, 1966

Type of well drilled Equipment Used Churn
(dug, driven, bored or drilled) (Churn, drill, rotary or other)

Water Use: Domestic [X] Municipal [] Other [] Irrigation []
Industrial [] Drainage [] Stock []

Indicate on the diagram the character and thickness of the different strata met with in drilling, such as soil, clay, shale, gravel, rock or sand, etc. Show depth at which water is encountered, thickness and character of water-bearing strata and height to which water rises in the well.

Table with columns: Size of Drilled Hole, Size and Weight of Casing, From (Feet), To (Feet), PERFORATIONS (Kind Size, From (Feet), To (Feet)).

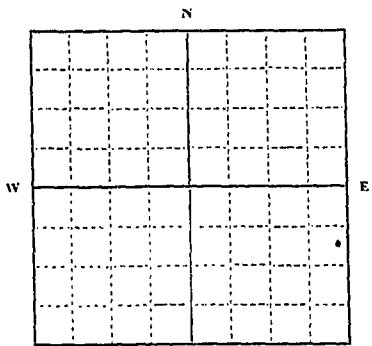

Lots 2+3 B1K 84 Riverbend Homes
NE 1/4 SE Sec. 27 T. 22 R. 34
Indicate location of well and place of use, if possible. Each small square represents 10 acres.

Show exact depth of bottom.

Static Water Level for non-flowing Well 26 feet.

Shut-in Pressure for Flowing Well

Pumping Water Level 28 feet at 8 gal. per minute.

Discharge in gal. per min. of flowing well

How Tested pump Length of Test 1 1/2 hr.

Remarks: (Gravel packing, cementing, packers, type of shutoff, location of place of use of groundwater if not at well, and any other similar pertinent information, including number of acres irrigated, if used for irrigation)

152
Driller's License Number

William D. Lake
Driller's Signature

This form to be prepared by driller, and three copies to be filed by the owner with the County Clerk and Recorder in the county in which the well is located.

Please answer all questions. If not applicable, so state, otherwise the form will be returned.

Original to the County Clerk and Recorder; duplicate to the State Engineer; Triplicate to the Montana Bureau of Mines and Geology and Quadruplicate for the Appropriator.

41198

551

STATE OF MONTANA
COUNTY OF LINCOLN

Filed this 24th day of

June A. D. 1946

at 3:50 P. M.

Eleanor L. Wright
County Clerk

By Mae Nelson

Deputy

File No. _____

MONTANA WATER RESOURCES BOARD
RECEIVED

T. 32 R. 34

DUPLICATE

County Lincoln

LOG

JAN 9 1970

STATE OF MONTANA
ADMINISTRATOR OF GROUNDWATER CODE
STATE WATER CONSERVATION BOARD

Top of Ground
(Elev. above sea level _____)

**Notice of Completion of Groundwater
Appropriation by Means of Well**
DEVELOPED AFTER JANUARY 1, 1962

(Under Chapter 237 Montana Session Laws, 1961, as amended)

- 0'-1' Topsoil.
- 1'-16' Sand, Gravel, and Clay.
- 16'-20' Gravel and Boulders.
- 20'-28' Clay and Gravel.
- 28'-32' Sand and Gravel with Water.

Owner Kenneth French address Tray, Montana

Driller William D. Lake Address Libby, Montana

Date of Notice of appropriation of groundwater _____

Date well started November 20, 1969 Date completed November 25, 1969

Type of well Drilled Equipment used Churn
(Dug, driven, bored or drilled) (Churn drill, rotary or other)

Water use: Domestic Municipal Stock Irrigation
Industrial Drainage Other

Indicate on the diagram the character and thickness of the different strata met with in drilling, such as soil, clay, shale, gravel, rock or sand, etc. Show depth at which water is encountered, thickness and character of water-bearing strata and height to which the water rises in the well.

Size of Drilled Hole	Size and Weight of Casing	From (Feet)	To (Feet)	PERFORATIONS		
				Kind Size	From (Feet)	To (Feet)
6" I.D.	6 5/8" O.D.	0	32	None		
	17.00 lbs. per foot					

Doc. No. 724
Filed for record
this 29 day of December
A. D. 19 69, at 4:05
o'clock P.M.

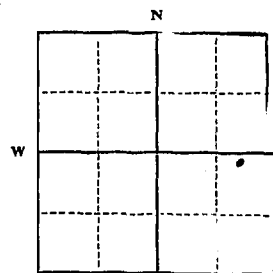

Static Water Level for non-flowing well _____
28 feet.

Shut-in Pressure for flowing Well _____

Pumping Water Level 30 feet
_____ gal. per minute.

Discharge in gal. per min. of flowing well _____

How Tested Surge

Length of Test 1 Hour

Remarks: (Gravel packing, cementing, packers, type of shutoff) _____

1/4 SE Sec 27, T. 32, R. 34
Indicate location of well and place of use, if possible. Each small square represents 40 acres.

(Continue on reverse side)

USE—if used for irrigation, industrial, drainage or other. Explain, state number of acres and location or other data (i.e.: Lot, Block and Addition).

Show exact depth of bottom.

This form to be prepared by driller, and three copies to be filed by the owner with the County Clerk and Recorder in the county in which the well is located, tissue copy to be retained by driller.

Please answer all questions. If not applicable, so state, otherwise the form will be returned.

152
Driller's License Number

W. D. Lake
Driller's Signature.

46016

124

MONTANA WATER RESOURCES BOARD
Groundwater Division
Mitchell Building
Helena, Montana 59601

RECEIVED
NOV 2 1965

STATE OF MONTANA
COUNTY OF MINNOCIN
Filed this 29th day of
December A. D. 1965
at 4:05 P. M.
Elmer L. Thompson
County Clerk
By Verde L. Hayden
Deputy

Recently a copy of a groundwater appropriation form,

- GW 1, Notice of Appropriation of Groundwater
- GW 2, Notice of Completion of Groundwater Appropriation by means of Well
- GW 3, Notice of Completion of Groundwater Appropriation without Well
- GW 4, Declaration of Vested Groundwater Rights (This form is obsolete and was limited by law to use only through 1965)

was forwarded to this office by the County Clerk and Recorder.

This form is identified by

Driller William D. Lake Address Libby, Montana 59923

RECEIVED

SEAL OF MONTANA COMMERCE
THE MONTANA WATER CODE
HELENA, MONTANA

734

And of
A. D. 1965
day of

MONTANA WATER RESOURCES BOARD
Groundwater Division
Mitchell Building
Helena, Montana 59601

MONTANA WATER RESOURCES BOARD
RECEIVED
FEB 20 1970

Recently a copy of a groundwater appropriation form,

- GW 1, Notice of Appropriation of Groundwater
- GW 2, Notice of Completion of Groundwater Appropriation by means of Well
- GW 3, Notice of Completion of Groundwater Appropriation without Well
- GW 4, Declaration of Vested Groundwater Rights (This form is obsolete and was limited by law to use only through 1965)

was forwarded to this office by the County Clerk and Recorder.

This form is identified by

Driller William D. Lake Address Libby, Montana 59923
Location T. 32N., R. 34W., Sec. 27 Document No. 724

The form is complete as filed. This is to inform you that your GW form has been received and no further action is necessary on your part.

- The form is incomplete. Please complete the enclosed copy by providing information where indicated, or as noted here and return the corrected copy to the Montana Water Resources Board in Helena.
Please provide information concerning the Owner and his address for this well. If the same as the driller, so state.
- Other.

County recording information is missing. Please forward this information to the Montana Water Resources Board in Helena.

Douglas B. Smith

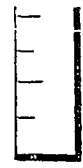

Show exact depth of bottom.

USE—If used for irrigation, industrial, drainage or other. Explain, state number of acres and location or other data (i.e.: Lot, Block and Addition).

.....
.....
.....

This form to be prepared by driller, and three copies to be filed by the owner with the County Clerk and Recorder in the county in which the well is located, tissue copy to be retained by driller.

Please answer all questions. If not applicable, so state, otherwise the form will be returned.

152
Driller's License Number
William D. Lake
Driller's Signature.

46016

Driller William D. Lake Address Libby, Montana
Sec. 27 Document No. 724

MONTANA

State of Montana
County Lincoln

LOG

JAN 2 1970

STATE OF MONTANA
ADMINISTRATOR OF GROUNDWATER CODE
STATE WATER CONSERVATION BOARD

of Ground
(Elev. above sea level _____)

**Notice of Completion of Groundwater
Appropriation by Means of Well**
DEVELOPED AFTER JANUARY 1, 1962

(Under Chapter 237 Montana Session Laws, 1961, as amended)

0'-1' **Topsoil.** Owner Kenneth French Address Troy, Montana

1'-16' **Sand, Gravel, and Clay.** Driller William D. Lake Address Libby, Montana

16'-20' **Gravel and Boulders.** Date of Notice of appropriation of groundwater _____

20'-28' **Clay and Gravel.** Date well started November 20, 1969 Date completed November 25, 1969

28'-32' **Sand and Gravel with Water.** Type of well Drilled Equipment used Churn
(Dug, driven, bored or drilled) (Churn drill, rotary or other)

Water use: Domestic Municipal Stock Irrigation
Industrial Drainage Other

Indicate on the diagram the character and thickness of the different strata met with in drilling, such as soil, clay, shale, gravel, rock or sand, etc. Show depth at which water is encountered, thickness and character of water-bearing strata and height to which the water rises in the well.

Size of Drilled Hole	Size and Weight of Casing	From (Feet)	To (Feet)	PERFORATIONS		
				Kind Size	From (Feet)	To (Feet)
6" I.D.	6 5/8" O.D.	0	32		None	
	17.00 lbs. per foot					

Doc. No. 724
Filed for record
this 29 day of December
A. D. 19 69, at 4:05
o'clock p.M.

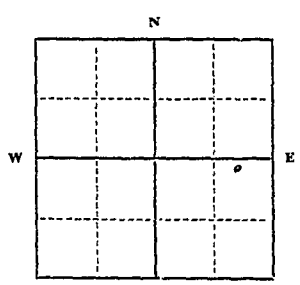

Static Water Level for non-flowing well 28 feet.

Shut-in Pressure for Flowing Well _____

Pumping Water Level 30 feet
at 8 gal. per minute.

Discharge in gal. per min. of flowing well _____

How Tested Pump

Length of Test 1 Hour

Lot 4, B. & 2nd River Bend Home

1/4 SE. Sec. 22, T. 32, R. 34
Indicate location of well and place of use, if possible. Each small square represents 40 acres.

Remarks: (Gravel packing, cementing, packers, type of shutoff) _____

(Continue on reverse side)

USE—If used for irrigation, industrial, drainage or other. Explain, state number of acres and location or other data (i.e.: Lot, Block and Addition).

Show exact depth of bottom.

This form to be prepared by driller, and three copies to be filed by the owner with the County Clerk and Recorder in the county in which the well is located, tissue copy to be retained by driller.

Please answer all questions. If not applicable, so state, otherwise the form will be returned.

152
Driller's License Number

William D. Lake
Driller's Signature.

46016

T. 32 R. 34
County Lincoln

LOG JAN 2 1970

STATE OF MONTANA
ADMINISTRATOR OF GROUNDWATER CODE
STATE WATER CONSERVATION BOARD

Ground
(Elev. above sea level)

Notice of Completion of Groundwater
Appropriation by Means of Well
DEVELOPED AFTER JANUARY 1, 1962

(Under Chapter 23, Montana Session Laws, 1961, as amended)

- 0'-1' Topsoil.
- 1'-16' Sand, Gravel, and Clay.
- 16'-20' Gravel and Boulders.
- 20'-28' Clay and Gravel.
- 28'-32' Sand and Gravel with Water.

Owner Kenneth French Address Troy, Montana

Driller William D. Lake Address Libby, Mont.

Date of Notice of appropriation of groundwater

Date well started November 20, 1969 Date completed November 25, 1969

Type of well Drilled Equipment used Churn
(Lug, driven, bored or drilled) (Churn drill, rotary or other)

Water use: Domestic Municipal Stock Irrigation
Industrial Drainage Other

Indicate on the diagram the character and thickness of the different strata met with in drilling, such as soil, clay, shale, gravel, rock or sand, etc. Show depth at which water is encountered, thickness and character of water-bearing strata and height to which the water rises in the well.

Size of Drilled Hole	Size and Weight of Casing	From (Feet)	To (Feet)	PERFORATIONS		
				Kind Size	From (Feet)	To (Feet)
6" I.D.	6 5/8" o.d.	0	32		None	
	17.00 lbs. per foot					

Doc. No. 724
Filed for record this 29 day of December
A. D. 19 69, at 4:05 o'clock P.M.

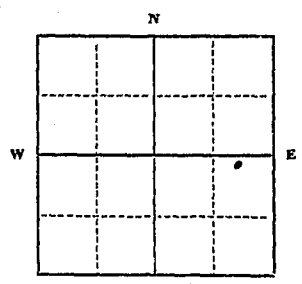

Static Water Level for non-flowing well 26 feet.
Shut-in Pressure for Flowing Well
Pumping Water Level 30 feet
at 8 gal. per minute.
Discharge in gal. per min. of flowing well
How Tested Pump
Length of Test 1 Hour

Lot 4, BIK 2 ⁵ River Bend Home

1/4 SE Sec 27, T. 32, R. 34
Indicate location of well and place of use, if possible. Each small square represents 40 acres.

Remarks: (Gravel packing, cementing, packers, type of shutoff)

(Continue on reverse side)

USE—If used for irrigation, industrial, drainage or other. Explain, state number of acres and location or other data (i.e.: Lot, Block and Addition).

Show exact depth of bottom.

This form to be prepared by driller, and three copies to be filed by the owner with the County Clerk and Recorder in the county in which the well is located, tissue copy to be retained by driller.

Please answer all questions. If not applicable, so state, otherwise the form will be returned.

152
Driller's License Number
William D. Lake
Driller's Signature.

46016

File No. APR 27 1965

T32 N R 34 W
County Lincoln

DUPLICATE

Billo _____ McDermott _____
Butzerin _____ McNulty _____
Coyle _____ Morton _____
Darlington _____
Dickert _____
STATE OF MONTANA
ADMINISTRATOR OF GROUNDWATER CODE
OFFICE OF STATE ENGINEER

Declaration of Vested Groundwater Rights

(Under Chapter 237, Montana Session Laws, 1961)

Ray D Hollingsworth of P.O. Box 463 Troy Mont
(Name of Appropriator) (Address) (Town)
County of Lincoln State of Montana
have appropriated groundwater according to the Montana laws in effect prior to January 1, 1962, as follows:

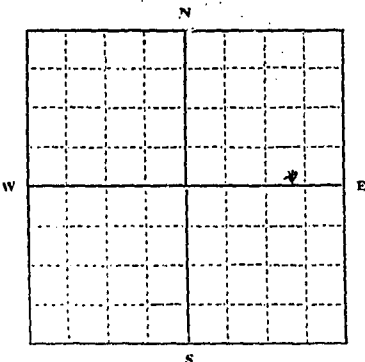

SE 1/4 Sec. 27 T. 32 N. R. 34 W
Indicate point of appropriation and place of use, if possible. Each small square represents 10 acres.

2. The beneficial use on which the claim is based: In the home, cattle irrigation & garden
3. Date or approximate date of earliest beneficial use; and how continuous the use has been: Nov 25 1960 used daily
4. The amount of groundwater claimed (in miner's inches or gallons per minute): 50 thousand
5. If used for irrigation, give the acreage and description of the lands to which water has been applied and name of the owner thereof: _____
Ray D Hollingsworth
6. The means of withdrawing such water from the ground and the location of each well or other means of withdrawal: water pump

7. The date of commencement and completion of the construction of the well, wells, or other works for withdrawal of groundwater: _____
8. The depth of water table: 38 ft well to water
9. So far as it may be available, the type, size and depth of each well or the general specifications of any other works for the withdrawal of groundwater: one well, only one
10. The estimated amount of groundwater withdrawn each year: 5000 gal per year
11. The log of formations encountered in the drilling of each well, if available: the well was dug by hand using a spade shovel & bucket & filling earth and with 7000000 ft
12. Such other information of a similar nature as may be useful in carrying out the policy of this act, including reference to book and page of any county record: _____

Signature of Owner Ray D Hollingsworth
Date April 19 66
Three copies to be filed by the owner with the County Clerk and Recorder of the county in which the well is located.

Please answer all questions. If not applicable, so state, otherwise the form will be returned.
Original to the County Clerk and Recorder; Duplicate to the State Engineer; Triplicate to the Montana Bureau of Mines and Geology, and Quadruplicate for the Appropriator.
11605

540

STATE OF MONTANA
COUNTY OF LINCOLN
Filed this 20th day of
April A. D. 1966
at 9:40 M.
Eleanor L. Vaughn
County Clerk
by Mae Nakson Deputy

745 INDEXED

STATE OF MONTANA
COUNTY OF LINCOLN
Filed this 14th day of
August A. D. 1922
at 2:35 P. M.
William A. Vaughn
County Clerk
By Betty Tombarke
Deputy

GV.

Approved Stock Form—State Publishing Co., Helena, Montana—40876

21
32 R 34

File No.

T. 32 R. 34

DUPLICATE

County. Lincoln

STATE OF MONTANA
ADMINISTRATOR OF GROUNDWATER CODE
OFFICE OF STATE ENGINEER

RECEIVED
DEC 19 1963

Declaration of Vested Groundwater Rights STATE ENGINEER

(Under Chapter 237, Montana Session Laws, 1961)

1. Les Roy M. Knudsvig, of Box 335 Troy
(Name of Appropriator) (Address) (Town)
County of Lincoln State of Montana
have appropriated groundwater according to the Montana laws in effect prior to January 1, 1962, as follows:

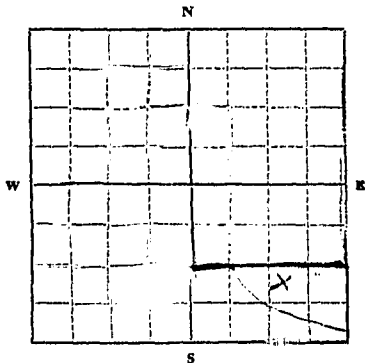

S.E. 1/4 Sec. 27 T. 21N R. 34W

Indicate point of appropriation and place of use, if possible. Each small square represents 10 acres.

- 2. The beneficial use on which the claim is based house hold use and yard watering
- 3. Date or approximate date of earliest beneficial use; and how continuous the use has been Sept. 15, 1960 - Dec. 4, 1963
- 4. The amount of groundwater claimed (in miner's inches or gallons per minute) at least 10 gal per minute
- 5. If used for irrigation, give the acreage and description of the lands to which water has been applied and name of the owner thereof
- 6. The means of withdrawing such water from the ground and the location of each well or other means of withdrawal electric pump

- 7. The date of commencement and completion of the construction of the well, wells, or other works for withdrawal of groundwater Sept. 15, 1960
- 8. The depth of water table 27 feet
- 9. So far as it may be available, the type, size and depth of each well or the general specifications of any other works for the withdrawal of groundwater
- 10. The estimated amount of groundwater withdrawn each year about 1,346,000 gal per year
- 11. The log of formations encountered in the drilling of each well if available Clay coarse gravel and rock
- 12. Such other information of a similar nature as may be useful in carrying out the policy of this act, including reference to book and page of any county record

Signature of Owner Les Roy M. Knudsvig
Date 12/4/63

Three copies to be filed by the owner with the County Clerk and Recorder of the county in which the well is located.

Please answer all questions. If not applicable, so state, otherwise the form will be returned.

Original to the County Clerk and Recorder; duplicate to the State Engineer; Triplicate to the Montana Bureau of Mines and Geology, and Quadruplicate for the Appropriator.

1037²

#170
RECEIVED
CLERK OF DISTRICT COURT
LINCOLN COUNTY, IOWA

STATE OF IOWA
COUNTY OF LINCOLN
Filed this 4th day of
December A. D. 1963
at 1:40 P. M.
M. M. Mansfield
County Clerk.
By Eleanor Chung
Deputy

File No.

T. R.

DUPLICATE

MONTANA WATER RESOURCES BOARD
RECEIVED

County Lincoln

LOG

JUL 14 1969

STATE OF MONTANA
ADMINISTRATOR OF GROUNDWATER CODE
OFFICE OF STATE ENGINEER

Top of Ground

(Elev. above sea level.....)

**Notice of Completion of Groundwater
Appropriation by Means of Well**

DEVELOPED AFTER JANUARY 1, 1962

(Under Chapter 237, Montana Session Laws, 1961)

0' - 16' Clay and gravel
with boulders.

18' - 21' Boulder.

21' - 27' Clay and
gravel.

27' - 29' Gravel.

29' - 35' Sand and
gravel with
water.

Owner John Lytle Address Dray, Montana

Driller William D. Lake Address Libby, Montana

Date of Notice of appropriation of groundwater.....

Date well started July 15, 1967 Date completed July 15, 1967

Type of well drilled Equipment used skirm
(Dug, Driven, bored or drilled) (Churn drill, rotary or other)

Water use: Domestic Municipal Stock Irrigation
Industrial Drainage Other

Indicate on the diagram the character and thickness of the different strata met with in drilling, such as soil, clay, shale, gravel, rock or sand, etc. Show depth at which water is encountered, thickness and character of water-bearing strata and height to which the water rises in the well.

Size of Diameter Pipe	Size and Weight of Casing	From (Feet)	To (Feet)	PERFORATIONS		
				Kind Size	From (Feet)	To (Feet)
2" dia	4" W.P.	0'	35'	none		

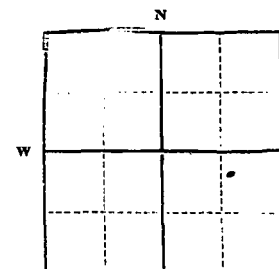

Static Water Level for non-flowing well 28 feet.

Shut-in Pressure for Flowing Well.....

Pumping Water Level 30 feet

at 10 gal. per minute.

Discharge in gal. per min. of flowing well.....

How Tested pump

Length of Test 4 hours

Remarks: (Gravel packing, cementing, packers, type of shutoff).....

1/4 Sec. 27, T. 22, R. 34
Indicate location of well and place of use, if possible. Each small square represents 40 acres.

(Continue on reverse side)

USE—If used for irrigation, industrial, drainage or other. Explain, state number of acres and location or other data (i.e.: Lot, Block and Addition).

Show exact depth of bottom.

This form to be prepared by driller, and three copies to be filed by the owner with the County Clerk and Recorder in the county in which the well is located, tissue copy to be retained by driller

Please answer all questions. If not applicable, so state, otherwise the form will be returned.

152
Driller's License Number

William D. Lake
Driller's Signature

15430

698

STATE OF MONTANA
COUNTY OF LINCOLN

Filed this 10th day of

July A. D. 1967

at 3:30 P. M.

Deborah L. Vaughn
Court Clerk

Betty Strickler
Deputy

JAN 28 1972

County Lincoln

STATE OF MONTANA
ADMINISTRATOR OF GROUNDWATER CODE
MONTANA WATER RESOURCES BOARD

MONTANA DEPARTMENT OF AGRICULTURE
RESOURCES AND CONSERVATION

DRILLER'S LOG

Indicate the character, color, thickness of strata such as soil, clay, sand, gravel, shale, sandstone, etc. Show depth at which water is found and height to which water rises in well.

NOTICE OF COMPLETION OF GROUNDWATER
APPROPRIATION BY MEANS OF WELL

Developed after January 1, 1962

(Under Chapter 237 Montana Session Laws, 1961, as amended)

This form to be prepared by driller, and three copies to be filed by the owner with the County Clerk and Recorder in the county in which the well is located, last copy to be retained by driller.

Please answer all questions. If not applicable, so state, otherwise the form may be returned.

Owner George Yeaden
Address Box 94
Troy, Montana
Date well started Nov. 22, 1971
completed Nov. 30, 1971

For Administrator's Use	
File	<u>837 Jan. 21, 1972</u>
	<u>11:20 a.m.</u>
GW 1	

Type of well Drilled (Dug, driven, bored or drilled)
Equipment used Churn Drill (Churn drill, rotary or other)
Water Use: Domestic Municipal Stock Irrigation
Industrial Drainage Other * Garden/Lawn

Use: If used for irrigation, industrial, drainage or other. Explain, state number of acres and location or other data (i.e. Lot, Block and Addition).

ESTIMATED ANNUAL WITHDRAWAL 80,000 Gal.

Size of Drilled Hole	Size and Weight of Casing	Depth (Feet)	To (Feet)	PERFORATIONS		
				Kind Size	From (Feet)	To (Feet)
<u>6" x 11 5/8" (N.P.)</u>	<u>77'</u>	<u>0</u>	<u>36</u>	<u>None</u>		

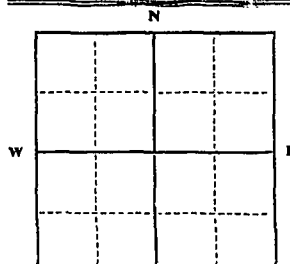

Static water level 32 ft.*
Pumping water level 33 ft.*
at 15 gallons per minute,
measured 2.10 minutes after pumping began.

*Measured from ground level.
Well developed by Pump
for 4 hours.
Power elec. Pump 2 HP
Remarks: (Gravel packing, cementing, packers, type of shutoff)

Lot 12, Range 3, Dist. Pinn.
in 66, Lot 1, Sec. 27
1/4 NW 1/4 Sec. 27
T. 32 (N) R. 24 (E)
T. 32 N. R. 24 W.

INDICATE LOCATION OF WELL AND PLACE OF USE, IF POSSIBLE.
EACH SMALL SQUARE REPRESENTS 40 ACRES.

Driller's Signature Wm D Lake
Driller's Address P.O. Box 967

Libby, Montana 59923 LICENSE NO. 352

Top of Ground (Elev. above sea level)		
From (Feet)	To (Feet)	
<u>0</u>	<u>1</u>	<u>Soil</u>
<u>1</u>	<u>12</u>	<u>Sand and Gravel</u>
<u>12</u>	<u>21</u>	<u>Sand, Gravel, and Boulders</u>
<u>21</u>	<u>32</u>	<u>Sand and Gravel</u>
<u>32</u>	<u>36</u>	<u>Sand, gravel and Water</u>

36 ft. elev. 36 depth of bottom

49,795

837

STATE OF MISSISSIPPI
COUNTY OF LINCOLN

File # 7101 Vol. 1
January 11, 1912 A. D. 1912

By W. H. [Signature]
County Clerk
By M. A. [Signature]

File No.

T. R.

DUPLICATE

County Lincoln

STATE OF MONTANA
ADMINISTRATOR OF GROUNDWATER CODE
OFFICE OF STATE ENGINEER

RECEIVED
OCT 14 1963

Declaration of Vested Groundwater Rights STATE ENGINEER
(Under Chapter 237, Montana Session Laws, 1961)

1. Mrs. Maude Morgan, of P.O. Box 455, Troy,
(Name of Appropriator) (Address) (Town)

County of Lincoln State of Montana
have appropriated groundwater according to the Montana laws in effect prior to January 1, 1962, as follows:

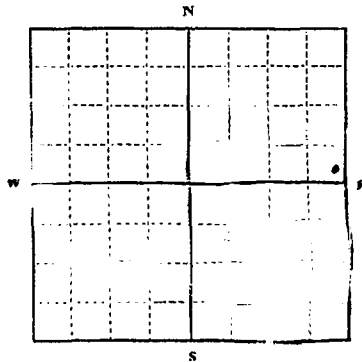

1/4 Sec 34 T. 32 R. 34
Indicate point of appropriation and place of use, if possible. Each small square represents 10 acres.

- 2. The beneficial use on which the claim is based domestic and irrigation
- 3. Date of approximate date of earliest beneficial use; and how continuous the use has been Earliest date construction of well in Lincoln County
- 4. The amount of groundwater claimed (2. water inches or gallons per minute) 100 gpm
- 5. If used for irrigation, the acreage and description of the lands to which water has been applied and name of the owner thereof Irrigation on 70 acres owned by Mrs. Maude Morgan, Lincoln Co., Mont.
- 6. The means of withdrawing water from the ground and the means of each well or other means of withdrawal by electric pump
- 7. The date of commencement and completion of the construction of the well, wells, or other works for withdrawal of groundwater started construction around 1924
- 8. The depth of water table 10 feet
- 9. So far as it may be available, the type and depth of each well or the general specifications of any other works for the withdrawal of groundwater type of well is diameter and size of pump
- 10. The estimated amount of groundwater withdrawn each year Approximately 360 thousand gals.
- 11. The log of formations encountered in the drilling of each well if available top soil and gravel
- 12. Such other information of a similar nature as may be useful in carrying out the policy of this act, including reference to book and page of any county record subdivision

Signature of Owner Mrs. Maude Morgan
Date Oct. 7, 1963

Three copies to be filed by the owner with the County Clerk and Recorder of the county in which the well is located.
Please answer all questions. If not applicable, so state, otherwise the form will be returned.

Original to the County Clerk and Recorder; duplicate to the State Engineer; Triplicate to the Montana Bureau of Mines and Geology, and Quadruplicate for the Appropriator.

138

STATE OF MONTANA
COUNTY OF LINCOLN
Filed this 8th day of
October A. D. 1913
at 11:30 P. M.
W. M. Mansfield
County Clerk.
By Deane Vaughn Deputy