

INDEXED

518

STATE OF MONTANA  
COUNTY OF LINCOLN

Filed this 22nd day of  
December A. D. 1965

at 9:15 A. M.

by M. J. Mansueti  
County Clerk

by Mar. Nelson  
Deputy

GW

Approved Stock Form—State Publishing Co., Helena, Montana—42234

35 30

File No. ....

T 34 R 35W

DUPLICATE

County Lincoln

STATE OF MONTANA  
ADMINISTRATOR OF GROUNDWATER CODE  
OFFICE OF STATE ENGINEER

RECEIVED  
MAR 5 1964

Declaration of Vested Groundwater Rights

(Under Chapter 237, Montana Session Laws, 1961)

STATE ENGINEER

1. Howard I Mee, of Box 37 Trego  
(Name of Appropriator) (Address) (Town)  
County of Lincoln State of Montana  
have appropriated groundwater according to the Montana laws in effect prior to January 1, 1962, as follows:

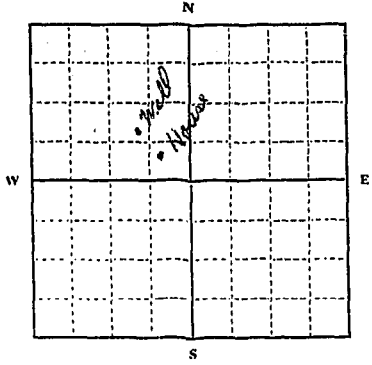

NW 1/4 Sec. 30, T. 34, R. 35

Indicate point of appropriation and place of use, if possible. Each small square represents 10 acres.

- 2. The beneficial use on which the claim is based Home use
- 3. Date or approximate date of earliest beneficial use; and how continuous the use has been Since 1961  
Continuous use
- 4. The amount of groundwater claimed (in miner's inches or gallons per minute) 25 gal. P.M.
- 5. If used for irrigation, give the acreage and description of the lands to which water has been applied and name of the owner thereof  
4 Acre lawn and garden  
Howard Mee
- 6. The means of withdrawing such water from the ground and the location of each well or other means of withdrawal Electric  
pump NW 1/4 Sec. 30, T. 34N, R. 35W.
- 7. The date of commencement and completion of the construction of the well, wells, or other works for withdrawal of groundwater Commenced May 1961, Completed July 1961
- 8. The depth of water table 5 FT.
- 9. So far as it may be available, the type, size and depth of each well or the general specifications of any other works for the withdrawal of groundwater Hand dug, 3 ft. Dia, 15 ft. Deep
- 10. The estimated amount of groundwater withdrawn each year 547, 500 gals.
- 11. The log of formations encountered in the drilling of each well if available Black Top soil,  
Clay, Then Sand And gravel
- 12. Such other information of a similar nature as may be useful in carrying out the policy of this act, including reference to book and page of any county record N/A applicable

Signature of Owner Howard Mee

Date 1-4-64

Three copies to be filed by the owner with the County Clerk and Recorder of the county in which the well is located.

Please answer all questions. If not applicable, so state, otherwise the form will be returned.

Original to the County Clerk and Recorder; Duplicate to the State Engineer; Triplicate to the Montana Bureau of Mines and Geology, and Quadruplicate for the Appropriator.

35170

STATE ENGINEER

RECEIVED

APR 2 9AM

# 448

STATE OF MONTANA  
COUNTY OF LINCOLN

Filed this 20th day of  
January A. D. 1964  
at 9:35 A.M.  
M. M. Mumfield  
County Clerk.  
By Wesley H. Hight Deputy

File No.....

T. 34N R. 25W 31

DUPLICATE

County—Lincoln

STATE OF MONTANA  
ADMINISTRATOR OF GROUNDWATER CODE  
OFFICE OF STATE ENGINEER

RECEIVED  
JAN 8 1966

Declaration of Vested Groundwater Rights

(Under Chapter 237, Montana Session Laws, 1961)

STATE ENGINEER

1. Keith E. & Goldie L. Calvert, of Box 12, Trego,  
(Name of Appropriator) (Address) (Town)

County of Lincoln State of Montana  
have appropriated groundwater according to the Montana laws in effect prior to January 1, 1962, as follows:

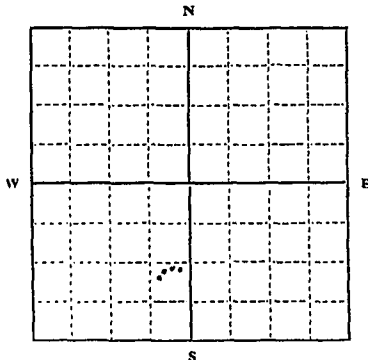

SE 1/4 SW 1/4 Sec. 31 T. 34N R. 25W

Indicate point of appropriation and place of use, if possible. Each small square represents 10 acres.

2. The beneficial use on which the claim is based water for livestock and household use

3. Date or approximate date of earliest beneficial use; and how continuous the use has been approximate date of earliest beneficial use is June 1938 and use has been continuous since 1938.

4. The amount of groundwater claimed (in miner's inches or gallons per minute) one (1) gallon per minute

5. If used for irrigation, give the acreage and description of the lands to which water has been applied and name of the owner thereof not applicable

6. The means of withdrawing such water from the ground and the location of each well or other means of withdrawal The means of withdrawing water is by pump.

7. The date of commencement and completion of the construction of the well, wells, or other works for withdrawal of groundwater Pump was installed in the summer of 1954.

8. The depth of water table about two (2) feet

9. So far as it may be available, the type, size and depth of each well or the general specifications of any other works for the withdrawal of groundwater 1 1/2" pump

10. The estimated amount of groundwater withdrawn each year 383,250 gallons

11. The log of formations encountered in the drilling of each well if available not applicable

12. Such other information of a similar nature as may be useful in carrying out the policy of this act, including reference to book and page of any county record not applicable

Signature of Owner Keith E. Calvert Goldie L. Calvert

Date Nov. 16, 1964

Three copies to be filed by the owner with the County Clerk and Recorder of the county in which the well is located

Please answer all questions. If not applicable, so state, otherwise the form will be returned.

Original to the County Clerk and Recorder; Duplicate to the State Engineer; Triplicate to the Montana Bureau of Mines and Geology, and Quadruplicate for the Appropriator.

479

INDEXED

STATE OF MONTANA  
COUNTY OF LINCOLN

Filed the 10th day of

December A. D. 1964

at 4:35 P. M.

M. M. Mansfield  
County Clerk.

By W. E. Butler  
Deputy

File No. ....

RECEIVED T 34 N R 25 W. M.E.M.

DEC 12 1966

County LINCOLN

DUPLICATE

Libby Reservoir Project  
LOG Stryker Well.

STATE OF MONTANA  
ADMINISTRATOR OF GROUNDWATER CODE  
STATE WATER CONSERVATION BOARD

### Notice of Completion of Groundwater Appropriation by Means of Well DEVELOPED AFTER JANUARY 1, 1962

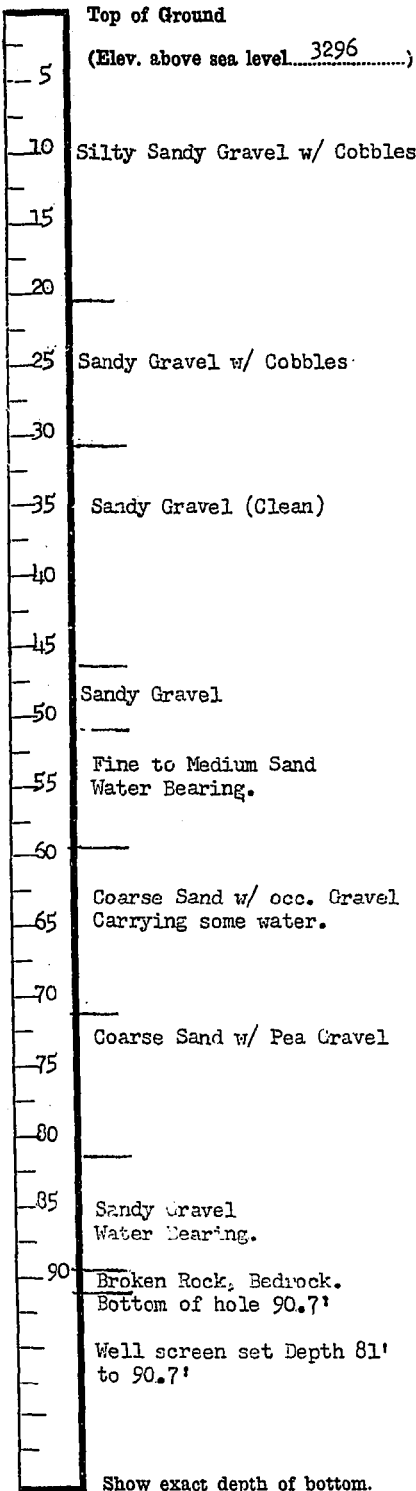

(Under Chapter 237 Montana Session Laws, 1961, as amended) UNITED STATES OF AMERICA, by & through Department of the Army Seattle Dist. Corps of Engineers, 1519 Alaskan Way S. Owner Address Seattle, Wash. 98134

Driller G. & L. Plumbing & Heating, Address Box 1, Libby, Montana 59923

Date of Notice of appropriation of groundwater .....

Date well started 30 April 68 Date completed 20 June 68

Type of well Drilled (Dug, driven, bored or drilled) Equipment used Churn (Churn drill, rotary or other)

Water use: Domestic [X] Municipal [ ] Stock [ ] Irrigation [ ] Industrial [ ] Drainage [ ] Other [ ]

Indicate on the diagram the character and thickness of the different strata met with in drilling, such as soil, clay, shale, gravel, rock or sand, etc. Show depth at which water is encountered, thickness and character of water-bearing strata and height to which the water rises in the well.

Diameter of Drilled Hole	Size and Weight of Casing	From (Feet)	To (Feet)	PERFORATION		
				Kind	Size	T (ft.)
8 in.	2 1/2 in.	0	90.7'			

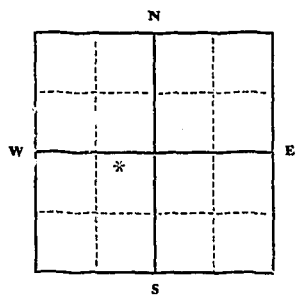

Static Water Level for non-flowing well 31' 8" feet.  
Shut-in Pressure for Flowing Well .....

Pumping Water Level 44' 9" feet at 50 gal. per minute.  
Discharge in gal. per min. of flowing well .....

How Tested Pumped.  
Length of Test 12 Hours  
Remarks: (Gravel packing, cementing, packers, type of shutoff) Placed 50 Slot Stainless Steel Screen 10' Long.

NE 1/4 Sec. 36 T34N R. 25W  
Indicate location of well and place of use, if possible. Each small square represents 40 acres.

USE—If used for irrigation, industrial, drainage or other. Explain, state number of acres and location or other data (i.e.: Lot, Block and Addition).  
Domestic use for railroad section crew quarters.

This form to be prepared by driller, and three copies to be filed by the owner with the County Clerk and Recorder in the county in which the well is located, tissue copy to be retained by driller.  
Please answer all questions. If not applicable, so state, otherwise the form will be returned.  
Owner: UNITED STATES OF AMERICA By M.M. Christiansen  
M. M. CHRISTIANSEN, Chief, Acquisition Branch, Real Estate Division, Seattle District, Corps of Engineers

111  
Driller's License Number  
Driller's Signature Clifford D. Buda  
44,845

665

STATE OF MONTANA  
 COUNTY OF LINCOLN  
 Filed this 12<sup>th</sup> day of  
September A. D. 1968  
 at 11:10 M.  
 By Esther L. Vaughn County Clerk  
Mae Watson Deputy

Very faint, illegible text, possibly bleed-through from the reverse side of the page. Some words like "County of Lincoln" and "State of Montana" are barely discernible.





File No. ....

T. 33 N. 34 W. 8  
R. ....

County Lincoln

STATE OF MONTANA  
ADMINISTRATOR OF GROUNDWATER CODE  
OFFICE OF STATE ENGINEER

RECEIVED  
MAR 5 1964

STATE ENGINEER  
**Notice of Completion of Groundwater Appropriation Without Well**

(Under Chapter 237 Montana Session Laws, 1961)

Date of Appropriation of Groundwater... 1908 - continuous

Owner... E.B. and Wilma M. Finch, Address... Martin City, Montana

Contractor (if any) .....

Address of Contractor .....

Date Started..... Date Completed.....

Describe means of obtaining groundwater without a well "as by sub-irrigation and other natural processes". Include depth to water when applicable. sub-irr. creek, pipes, pumps

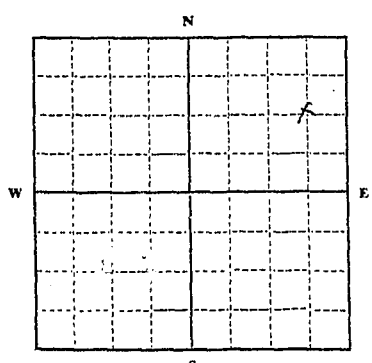

**LINCOLN COUNTY**  
**NE 1/4 Sec. 8 T33 R. 34**

Indicate point of appropriation and place of use, if possible.

Quantity of water developed and used with explanation of method used to measure or estimate such amount. If use is intermittent

estimate approximate lengths of periods of use.....

Signature of Owner E.B. Finch - Wilma M. Finch  
E.B. Finch and Wilma M. Finch

Date... 12-26-63

This form to be prepared by contractor (if any), otherwise by the owner.  
Three copies of this notice are to be filed with the County Clerk and Recorder of the county in which the work is located.  
Please answer all questions. If not applicable, so state, otherwise the form will be returned.  
Original to the County Clerk and Recorder; duplicate to the State Engineer; Triplicate to the Montana Bureau of Mines and Geology and Quadruplicate for the Appropriator.

134 CHAS. G. ...

STATE OF MONTANA  
COUNTY OF LINCOLN  
Filed this 9th day of  
December A. D. 1963  
at Billings M.  
W. J. Mansfield  
County Clerk.  
By Mar. Nelson  
Deputy

GW3

File No. ....

DUPLICATE

T. 33 N. R. 34

County Lincoln

STATE OF MONTANA  
ADMINISTRATOR OF GROUNDWATER CODE  
OFFICE OF STATE ENGINEER

RECEIVED  
MAR 5 1964

Notice of Completion of Groundwater Appropriation Without Well STATE ENGINEER

(Under Chapter 237 Montana Session Laws, 1961)

Date of Appropriation of Groundwater July 1945  
Owner L.H. Mackey Bx 196 Address Troy Montana  
Contractor (if any) None  
Address of Contractor None

Date Started July 1945 Date Completed July 1945

Describe means of obtaining groundwater without a well "as by sub-irrigation and other natural processes". Include depth to water when applicable digging into hill side and damming up basin to hold water

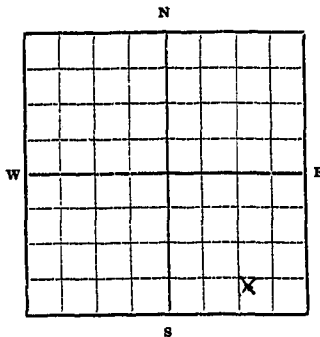

Quantity of water developed and used with explanation of method used to measure or estimate such amount. If use is intermittent estimate approximate lengths of periods of use

SE 1/4 Sec. 9 T. 33. R. 34  
Indicate point of appropriation and place of use, if possible.

basin six foot by six foot by three foot deep use for horse hold only

Signature of Owner L.H. Mackey  
Date 3-64

This form to be prepared by contractor (if any), otherwise by the owner.

Three copies of this notice are to be filed with the County Clerk and Recorder of the county in which the works are located.

Please answer all questions. If not applicable, so state, otherwise the form will be returned.

Original to the County Clerk and Recorder; duplicate to the State Engineer; Triplicate to the School of Mines and Quadruplicate for the Appropriator.

# 446 INDI 188  
~~445~~

CIVIL ENGINEER

NEW YORK

STATE OF MONTANA  
COUNTY OF LINCOLN  
I, \_\_\_\_\_, 13<sup>th</sup> day of  
January, A. D. 1954  
at \_\_\_\_\_ 2:30 P. M.  
by \_\_\_\_\_  
County Clerk  
\_\_\_\_\_ Deputy

CW3

File MONTANA WATER RESOURCES BOARD  
**RECEIVED**  
DUPLICATE

JUL 14 1969

T. 33 R 34  
County Lincoln

STATE OF MONTANA  
ADMINISTRATOR OF GROUNDWATER CODE  
OFFICE OF STATE ENGINEER

**Notice of Completion of Groundwater Appropriation Without Well**

(Under Chapter 227 Montana Session Laws, 1961)

Date of Appropriation of Groundwater July 26-1967  
Owner  Evelyn Potter  Address  Troy, Mont. Box 531   
Contractor (if any) \_\_\_\_\_

Address of Contractor \_\_\_\_\_

Date Started  July 26/67  Date Completed  July 31-67

Describe means of obtaining groundwater without a well "as by sub-irrigation and other natural processes". Include depth to water when applicable.  Developed spring for livestock watering

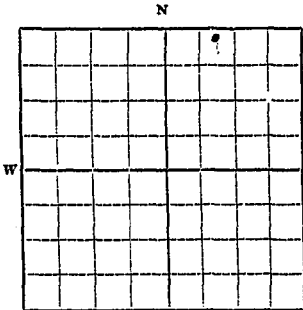

E<sup>2</sup> NW  $\frac{1}{4}$  NE Sec. 16 T. 33 R. 34   
Indicate point of appropriation and place of use, if possible.

Quantity of water developed and used with explanation of method used to measure or estimate such amount. If use is intermittent estimate approximate lengths of periods of use \_\_\_\_\_

developed spring for livestock water all year

Signature of Owner  Evelyn M. Potter

Date  July 9-69

This form to be prepared by contractor (if any), otherwise by the owner.

Three copies of this notice are to be filed with the County Clerk and Recorder of the county in which the works are located.

Please answer all questions. If not applicable, so state, otherwise the form will be returned.

Original to the County Clerk and Recorder; duplicate to the State Engineer; Triplicate to the Montana Bureau of Mines and Geology and Quadruplicate for the Appropriator.

45431

697

RECORDED & INDEXED

STATE OF MONTANA  
COUNTY OF LINCOLN

Filed this 9<sup>th</sup> day of

July A. D. 1909

at 2:30 P. M.

by Edmond L. Langston  
County Clerk

By Verdel J. Stephenson  
Deputy

Department of Natural Resources and Conservation  
 Water Resources Division  
 Engineering Bureau  
 Groundwater Section  
 Sam W. Mitchell Building  
 Helena, Montana 59601

Owner Ellis Schanck  
 Address Troy, Montana 59935  
 Location T.33N.R.34W Sec. 17  
 Doc. No. #883

As the Administrator of the Groundwater Code for the State of Montana, please take note of the following special instructions, in order to properly protect your groundwater right.

Special Instructions: *Please provide the missing information, as indicated in red on the attached form.*

*Thank you.*

*Sent 9/9/92*

50,885

	spring by 1½" pipe, appropriating a minimum of <u>3 miner's inches.</u>
	Quantity of water developed and used with explanation of method used to measure or estimate such amount. If use is intermittent estimate approximate lengths of periods of use.
NW¼ NW¼ Sec. 17, T33N R. 34W.	Expected use constant for domestic, business and irrigation purposes
Indicate point of appropriation and place of use, if possible.	Signature of Owner <u>Ellis Schanck</u>
Doc. No. <u>#883</u>	Date <u>June 30, 1972</u>
Filed for record this <u>30<sup>th</sup></u> day of <u>June</u> A. D. 19 <u>72</u> , at <u>2:45</u> o'clock <u>P.M.</u>	

This form to be prepared by contractor (if any), otherwise by the owner.

Three copies of this notice are to be filed with the County Clerk and Recorder of the county in which the works are located.

Please answer all questions. If not applicable, so state, otherwise the form will be returned.

Original to the County Clerk and Recorder; duplicate to the State Engineer; Triplicate to the Montana Bureau of Mines and Geology and Quadruplicate for the Appropriator.

F.

50,885

File No. \_\_\_\_\_  
DUPLICATE

RECEIVED  
JUL 11 1972

MONTANA DEPARTMENT OF NATURAL  
RESOURCES AND CONSERVATION

T. 33 N. R. 34 W.

County Lincoln

STATE OF MONTANA  
ADMINISTRATOR OF GROUNDWATER CODE  
OFFICE OF STATE ENGINEER

### Notice of Completion of Groundwater Appropriation Without Well

(Under Chapter 237 Montana Session Laws, 1961)

Date of Appropriation of Groundwater 1955

Owner Ellis Schenck Address Troy, Montana

Contractor (if any) none

Address of Contractor \_\_\_\_\_

Date Started \_\_\_\_\_ Date Completed \_\_\_\_\_

Describe means of obtaining groundwater without a well "as by sub-irrigation and other natural processes". Include depth to water when applicable. Water appropriated from natural spring by 1 1/2" pipe, appropriating a minimum of 3 miner's inches.

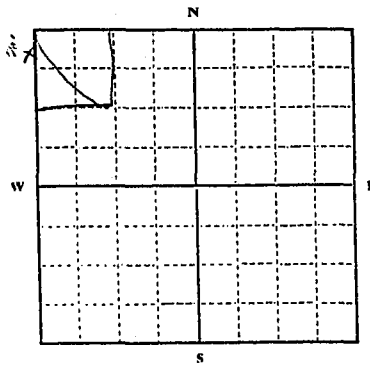

NW 1/4 NW 1/4 Sec. 17, T. 33 N. R. 34 W.

Indicate point of appropriation and place of use, if possible.

Quantity of water developed and used with explanation of method used to measure or estimate such amount. If use is intermittent estimate approximate lengths of periods of use. Expected use constant for domestic, business and irrigation purposes

Doc. No. #883  
Filed for record  
this 30<sup>th</sup> day of June  
A. D. 19 72, at 2:45  
o'clock P.M.

Signature of Owner Ellis Schenck

Date June 30, 1972

This form to be prepared by contractor (if any), otherwise by the owner.

Three copies of this notice are to be filed with the County Clerk and Recorder of the county in which the works are located.

Please answer all questions. If not applicable, so state, otherwise the form will be returned.

Original to the County Clerk and Recorder; duplicate to the State Engineer; Triplicate to the Montana Bureau of Mines and Geology and Quadruplicate for the Appropriator.

F.

50,885



# 883 INDEXED

STATE OF MONTANA  
COUNTY OF LINCOLN

Filed this 30th day of June A.D. 1972  
at 2:45 P.M.  
Telephon L. Vaughn  
County Clerk  
By Betty Stonebocker Deputy

GW1

RECEIVED

File No. JUL 11 1972

T 33N R 34W

DUPLICATE MONTANA DEPARTMENT OF NATURAL RESOURCES AND CONSERVATION

County Lincoln

STATE OF MONTANA ADMINISTRATOR OF GROUNDWATER CODE OFFICE OF STATE ENGINEER

Notice of Appropriation of Groundwater (Under Chapter 237, Montana Session Laws, 1961)

1. I, Ellis Schanck, of State Line Troy (Name of Appropriator) (Address) (Town) County of Lincoln, State of Montana, intend to appropriate groundwater in accordance with Chapter 237, Montana Session Laws of 1961.

2. The beneficial use to which water is to be applied is for domestic, irrigation and business purposes at home and business located on Montana-Idaho (describe lands to be benefited, if for irrigation) State line.

3. The rate of use in gallons per minute or miner's inches of groundwater claimed 3 miner's inches

4. The annual period (inclusive dates) of intended use Beginning July 1, 1972

5. The probable or intended date of first beneficial use July 30, 1972

6. The probable or intended date of commencement and completion of the well\* or wells\* June 30, 1972

7. The location, type, size and depth of well or wells contemplated At location of present spring which is approximately 20-25 feet from southeast corner post near Idaho-Montana state line.

8. The probable or estimated depth of the water table or artesian aquifer about 15 feet.

9. Name, address and license number of the driller engaged self

10. Give such other similar information as may be useful in carrying out the policy of this act. Water to be carried to place of intended use by 1 1/2 inch pipeline and used for domestic, business and irrigation purposes.

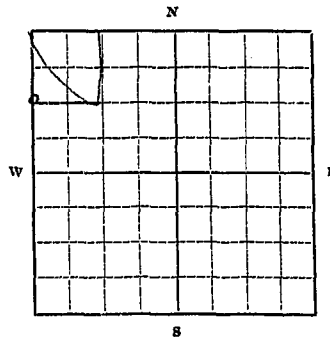

NW 1/4 NW 1/4 Sec. 17 T33N R. 34W

Locate well or other means of development as accurately as possible on the plat.

Doc. No. #884 Filed for record this 30th day of June A. D. 1972 at 2:50 o'clock P. M.

Signature of Appropriator Ellis Schanck Date June 30, 1972

\* As defined in the Code Sec. 1 (c) "Well" means any artificial opening or excavation in the ground, however made, by which groundwater can be obtained or through which it flows under natural pressures or is artificially withdrawn."

Three copies of this notice are to be filed with County Clerk and Recorder of the county in which the well is located.

Please answer all questions. If not applicable, so state, otherwise the form will be returned.

Original to the County Clerk and Recorder; duplicate to the State Engineer; Triplicate to the School of Mines and Quadruplicate for the Appropriator.

50884

# 884 INDEXED

STATE OF MONTANA  
COUNTY OF LINCOLN

Filed this 30<sup>th</sup> day of June A. D. 1922  
at 2150 Pop  
Eleanor J. Daugh  
County Clerk  
By Betty Stonehocker



1911

STATE OF MONTANA  
COUNTY OF LINCOLN

Filed this 20th day of  
November A. D. 1911

at 2:05 P.M.  
Edmond, Oklahoma  
County Clerk

By Mac Wilson  
Deputy

RECORDED & INDEXED  
FEB 15 1912

File No. ....

T. 33 R. 34

DUPLICATE

MONTANA WATER RESOURCES BOARD  
RECEIVED

County Lincoln

SEP 29 1969

STATE OF MONTANA  
ADMINISTRATOR OF GROUNDWATER CODE  
OFFICE OF STATE ENGINEER

Top of Ground  
(Elev. above sea level.....)

### Notice of Completion of Groundwater Appropriation by Means of Well

(Under Chapter 237, Montana Session Laws, 1961)

0  
20' *Silt*  
29' *Sand & Water*  
*Bottom*

Owner Bruce Leighty Address Troy, Montana

Driller Cliff Plbg & Htg. Address Libby, Montana

Date of Notice of Appropriation of Groundwater.....

Date well started 3-12-65 Date Completed 3-15-65

Type of well Drilled Equipment Used Churn  
(dug, driven, bored or drilled) (Churn, drill, rotary or other)

Water Use: Domestic  Municipal  Other  Irrigation   
Industrial  Drainage  Stock

Indicate on the diagram the character and thickness of the different strata met with in drilling, such as soil, clay, shale, gravel, rock or sand, etc. Show depth at which water is encountered, thickness and character of water-bearing strata and height to which water rises in the well.

Size of Drilled Hole	Size and Weight of Casing	From (Feet)	To (Feet)	PERFORATIONS		
				Kind Size	From (Feet)	To (Feet)
6 5/8"	6 5/8" 14#	0	29	1/2" Round	23	29

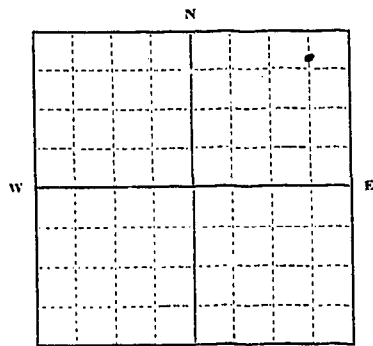

N. 1/4 Sec. 34 T. 33 R. 34

Indicate location of well and place of use, if possible. Each small square represents 10 acres.

Show exact depth of bottom.

Static Water Level for non-flowing Well 20' feet.

Shut-in Pressure for Flowing Well.....

Pumping Water Level 22' feet at 12 gal. per minute.

Discharge in gal. per min. of flowing well.....

How Tested Pump Length of Test 8 hrs.

Remarks: (Gravel packing, cementing, packers, type of shutoff, location of place of use of groundwater if not at well, and any other similar pertinent information, including number of acres irrigated, if used for irrigation).....

# 141  
Driller's License Number  
Clifford Becker  
Driller's Signature

This form to be prepared by driller, and three copies to be filed by the owner with the County Clerk and Recorder in the county in which the well is located.

Please answer all questions. If not applicable, so state, otherwise the form will be returned.

Original to the County Clerk and Recorder; duplicate to the State Engineer; Triplicate to the Montana Bureau of Mines and Geology and Quadruplicate for the Appropriator.

45683

709 INDEXED

STATE OF MONTANA  
COUNTY OF LINCOLN

Filed this 26 day of

September A. D. 1949.

at 4:20 P. M.

Glenora D. Vaughn  
County Clerk

By \_\_\_\_\_ Deputy

GW

File No.....

T. 33 34N R. 34 W  
County. Lincoln

DUPLICATE

STATE OF MONTANA  
ADMINISTRATOR OF GROUNDWATER CODE  
OFFICE OF STATE ENGINEER

RECEIVED  
DEC 19 1963  
STATE ENGINEER

Declaration of Vested Groundwater Rights  
(Under Chapter 237, Montana Session Laws, 1961)

1. Charles P. Emery, of Troy (Name of Appropriator) (Address) (Town)

County of Lincoln State of Montana

have appropriated groundwater according to the Montana laws in effect prior to January 1, 1962, as follows:

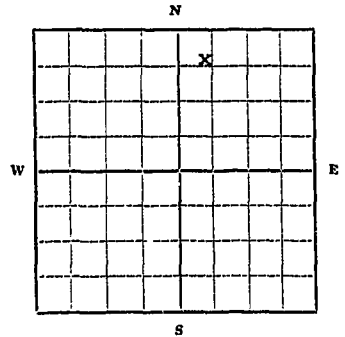

NE 1/4 NE Sec 34 T33N R34W

Indicate point of appropriation and place of use, if possible. Each small square represents 10 acres.

- 2. The beneficial use on which the claim is based Domestic Irrigation
- 3. Date or approximate date of earliest beneficial use; and how continuous the use has been July 1957 to date
- 4. The amount of groundwater claimed (in miner's inches or gallons per minute) 14 gallons per minute
- 5. If used for irrigation, give the acreage and description of the lands to which water has been applied and name of the owner thereof Land described in deed, records of Lincoln County, Clerk and Recorder, Deeds at Book 138, pg. 578
- 6. The means of withdrawing such water from the ground and the location of each well or other means of withdrawal one inch pipe; gravity flow
- 7. The date of commencement and completion of the construction of the well, wells, or other works for withdrawal of groundwater July 1957 - begun and completed
- 8. The depth of water table 5 feet
- 9. So far as it may be available, the type, size and depth of each well or the general specifications of any other works for the withdrawal of groundwater sump metal
- 10. The estimated amount of groundwater withdrawn each year 150,000
- 11. The log of formations encountered in the drilling of each well if available gravel
- 12. Such other information of a similar nature as may be useful in carrying out the policy of this act, including reference to book and page of any county record none available

Signature of Owner / Charles P. Emery

Date December 16, 1963

Three copies to be filed by the owner with the County Clerk and Recorder of the county in which the well is located.

Please answer all questions. If not applicable, so state, otherwise the form will be returned.

Original to the County Clerk and Recorder; duplicate to the State Engineer; Triplicate to the School of Mines and Quadruplicate for the Appropriator.

10391



\_\_\_\_\_  
\_\_\_\_\_  
\_\_\_\_\_  
\_\_\_\_\_  
\_\_\_\_\_

189

STATE OF MONTANA  
COUNTY OF LINCOLN  
Filed this 16th day of  
December A. D. 1923  
at FT. M.  
M. H. Mansfield County Clerk  
By Mae Hatch Deputy

File No. ....

T. 33 R. 34

DUPLICATE

County Lincoln

MONTANA WATER RESOURCES BOARD ADMINISTRATOR OF GROUNDWATER CODE  
OFFICE OF STATE ENGINEER

RECEIVED

JUN 20, 1969

Notice of Completion of Groundwater Appropriation by Means of Well

DEVELOPED AFTER JANUARY 1, 1962

(Under Chapter 237, Montana Session Laws, 1961)

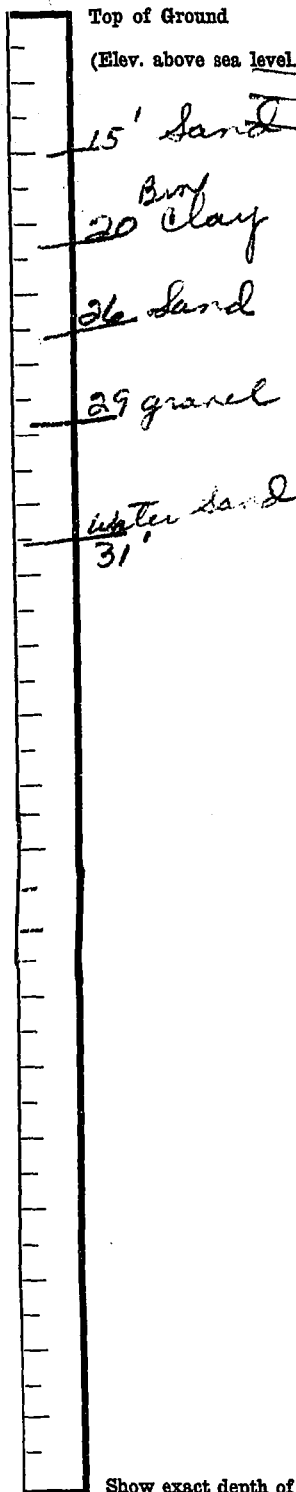

Owner: Leffant Smith Address: Troy Mont

Driller: C. J. P. Berg Address: Lobby Mont

Date of Notice of appropriation of groundwater.....

Date well started 3-25-65 Date completed 3-29-65

Type of well drilled Equipment used Churn  
(Dug, Driven, bored or drilled) (Churn drill, rotary or other)

Water use: Domestic  Municipal  Stock  Irrigation   
Industrial  Drainage  Other

Indicate on the diagram the character and thickness of the different strata met with in drilling, such as soil, clay, shale, gravel, rock or sand, etc. Show depth at which water is encountered, thickness and character of water-bearing strata and height to which the water rises in the well.

Size of Drilled Hole	Size and Weight of Casing	From (Feet)	To (Feet)	PERFORATIONS		
				Kind Size	From (Feet)	To (Feet)
6 5/8 OD	17#	0	31	2 Round	0	4'

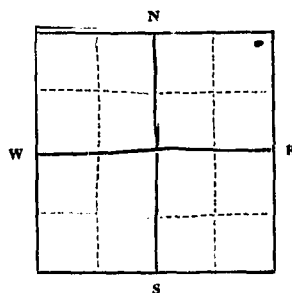

Static Water Level for non-flowing well .....feet.

Shut-in Pressure for Flowing Well.....feet.

Pumping Water Level.....feet  
at.....gal. per minute.

Discharge in gal. per min. of flowing well .....

How Tested.....

Length of Test.....

Remarks: Gravel packing, cementing, packers, type of cutoff).....

NE 1/4 Sec 34 T. 33 R. 34  
Indicate location of well and place of use, if possible. Each small square represents 40 acres.

(Continue on reverse side)

USE—If used for irrigation, industrial, drainage or other. Explain, state number of acres and location or other data (i.e.: Lot, Block and Addition).

Show exact depth of bottom.

This form to be prepared by driller, and three copies to be filed by the owner with the County Clerk and Recorder in the county in which the well is located, tissue copy to be retained by driller.

Please answer all questions. If not applicable, so state, otherwise the form will be returned.

141  
Driller's License Number

Clifford J. Buscher  
Driller's signature

45,338

692

STATE OF MONTANA  
COUNTY OF LINCOLN

File this 17<sup>th</sup> day of

June A. D. 1969

at 3:30 P.M.  
Chas. L. Hughes County Clerk

By Mar. Haton Deputy



SW 9

File No. B-51 Page 591-592 T 33N R 31W

21

ORIGINAL Lincoln Co. Montana County Lincoln

STATE OF MONTANA  
ADMINISTRATOR OF GROUNDWATER CODE  
OFFICE OF STATE ENGINEER

DECLARATION OF VESTED GROUNDWATER RIGHTS  
(Under Chapter 237, Montana Session Laws, 1961)

RECEIVED  
STATE ENGINEER

1. United States of America, Turner Station  
(Name of Appropriator) (Address) (Town)  
Libby, Montana

County of Lincoln State of Montana

have appropriated groundwater according to the Montana laws in effect prior to January 1, 1962, as follows:

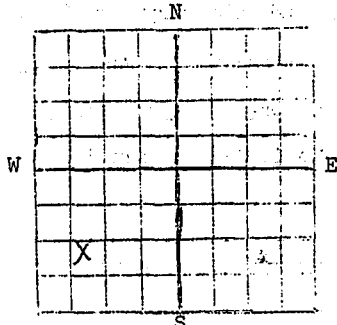

SW 1/4 Sec. 21 T33N R31W  
Indicate point of appropriation and place of use, if possible. Each small square represents 10 acres.

- The beneficial use on which the claim is based water supply for Turner Station and campground
- Date or approximate date of earliest beneficial use; and how continuous the use has been Earliest use 1930 and used continuously each summer since this time.
- The amount of groundwater claimed (in miner's inches or gallons per minute) 30 gal/hour (Average for three months)
- If used for irrigation, give the acreage and description of the lands to which water has been applied and name of the owner thereof This spring supplies water for a Forest summer camp up to 80 men, and is used for developed recreation area.
- The means of withdrawing such water from the ground and the location of each well or other means of withdrawal Water gate and 2" pipe gravity system. Gate approx. 300 yards west of Turner station NESE, Sec. 21, T33N, R31W MP4
- The date of commencement and completion of the construction of the well, wells, or other works for withdrawal of groundwater 1930-1931
- The depth of water table Spring at ground level
- So far as it may be available, the type, size and depth of each well or the general specifications of any other works for the withdrawal of groundwater Spring
- The estimated amount of groundwater withdrawn each year 125,000 gal. per year
- The log of formations encountered in the drilling of each well if available None
- Such other information of a similar nature as may be useful in carrying out the policy of this act, including reference to book and page of any county record Recorded, Lincoln County, Libby, Montana. Book 51 Page 591, 592

J. J. Sullivan Det. Forest Supervisor  
Signature of Owner Kootenai National Forest  
Libby, Montana  
Date 7-5-62

-over-

1699

Three copies to be filed by the owner with the County Clerk and Recorder of the county in which the well is located.

Please answer all questions. If not applicable, so state, otherwise the form will be returned.

Original to the County Clerk and Recorder; duplicate to the State Engineer; Triplicate to the School of Mines and Quadruplicate for the Appropriator.

STATE OF MONTANA

County of Lincoln ss.  
J. E. Sanderson representing  
the United States

\_\_\_\_\_ having first been duly sworn, depose  
and says that he is of lawful age and represents the  
appropriator \_\_\_\_\_ and claimant \_\_\_\_\_ of the order and water right mentioned  
in the foregoing declaration of vested groundwater rights and the person \_\_\_\_\_  
whose name is subscribed thereto, as the appropriator \_\_\_\_\_ and claimant  
\_\_\_\_\_, that he knows the contents of said foregoing notice and  
that the matters and things therein stated are true.

J. E. Sanderson  
\_\_\_\_\_  
Forest Supervisor  
Kootenai National Forest

Subscribed and sworn to before me, this 6 day of March, 1962

\_\_\_\_\_  
Notary Public for the State of Montana  
Residing at Libby, Montana  
My Commission expires July 6 1962



File No. ....

JAN 30 1967

County Lincoln

DUPLICATE

STATE OF MONTANA  
ADMINISTRATOR OF GROUNDWATER CODE  
OFFICE OF STATE ENGINEER

**Notice of Completion of Groundwater Appropriation by Means of Well**

(Under Chapter 237, Montana Session Laws, 1961)

Owner S. E. Huntington Address Legos, Mont.

Driller Homer McClarty Address 945-8th St. Kempell

Date of Notice of Appropriation of Groundwater .....

Date well started Sept 13/66 Date Completed Oct 5/66

Type of well Drilled Equipment Used 2 1/2" W. Encymerz  
(dug, driven, bored or drilled) (Churn, drill, rotary or other) Elie

Water Use: Domestic  Municipal  Stock  Irrigation   
Industrial  Drainage  Other

Indicate on the diagram the character and thickness of the different strata met with in drilling, such as soil, clay, shale, gravel, rock or sand, etc. Show depth at which water is encountered, thickness and character of water-bearing strata and height to which the water rises in the well.

Top of Ground  
(Elev. above sea level 2980)  
1ft Topsoil  
Brown Clay  
21ft.  
Gravel  
Cobbles coarse  
Color  
61ft  
Clay with  
Cobbles  
70ft.  
Dark Clay  
with grit  
110ft  
Clay gray  
with grit  
144ft.  
Course  
sand  
with  
water

Size of Drilled Hole	Size and Weight of Casing	From (Feet)	To (Feet)	PERFORATIONS		
				Kind Size	From (Feet)	To (Feet)
7" OD	23#		148ft			

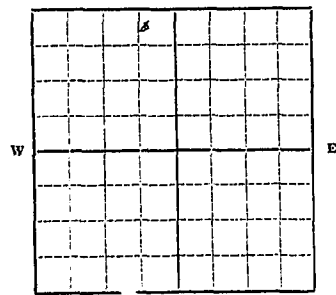

Lot 3. s  
NW 1/4 Sec. 1. T. 33 R. 26

Indicate location of well and place of use, if possible. Each small square represents 10 acres.

148 ft.  
Show exact depth of bottom.

Static Water Level for non-flowing Well.....feet.

Shut-in Pressure for Flowing Well 800 P.H.

Pumping Water Level 39 feet at 30 gal. per minute.

Discharge in gal. per min. of flowing well 24

How Tested Boiler Length of Test 3 hrs

Remarks: (Gravel packing, cementing, packer, type of shutoff, location of place of use of groundwater if not at well, and any other similar pertinent information, including number of acres irrigated, if used for irrigation) .....

Driller's License Number 18  
Driller's Signature Homer McClarty

This form to be prepared by driller, and three copies to be filed by the owner with the County Clerk and Recorder in the county in which the well is located.  
Please answer all questions. If not applicable, so state, otherwise the form will be returned.  
Original to the County Clerk and Recorder; duplicate to the State Engineer; Triplicate to the School of Mines and Quadruplicate for the Appropriator.

1/16/67



567

STATE OF MONTANA  
COUNTY OF LINCOLN

Filed 10th day of  
November A. D. 19 66  
at 2:35 P. M.  
Charles L. Taylor  
County Clerk  
By Mae Watson Deputy

*[Faint, illegible handwritten text, possibly a list or ledger entries]*

STATE WATER CONSERVATION BOARD  
RECEIVED

Approved Stock Form—State Publishing Co., Helena, Montana—42234

File No. SEP 23 1965

T 33 N R 26

DUPLICATE

REFERRED TO

County *Lincoln*

STATE OF MONTANA  
ADMINISTRATOR OF GROUNDWATER CODE  
OFFICE OF STATE ENGINEER

Declaration of Vested Groundwater Rights

(Under Chapter 237, Montana Session Laws, 1961)

1. James T. Smith, of Trego,  
(Name of Appropriator) (Address) (Town)  
County of Lincoln State of Montana  
have appropriated groundwater according to the Montana laws in effect prior to January 1, 1962, as follows:

NE 1/4 NW 1/4 Sec. 1, T. 33 R. 26

Indicate point of appropriation and place of use, if possible. Each small square represents 10 acres.

2. The beneficial use on which the claim is based agricultural use, stock and irrigation, domestic use.

3. Date or approximate date of earliest beneficial use; and how continuous the use has been September 1, 1955

4. The amount of groundwater claimed (in miner's inches or gallons per minute) 700 gallons per day

5. If used for irrigation, give the acreage and description of the lands to which water has been applied and name of the owner thereof N 1/2 NW 1/4 and N 1/2 NE 1/4 of Section 1, T. 33, R. 26

6. The means of withdrawing such water from the ground and the location of each well or other means of withdrawal electric pump - 1 1/2 hp.

7. The date of commencement and completion of the construction of the well, wells, or other works for withdrawal of groundwater July 1, 1955

8. The depth of water table 25 feet

9. So far as it may be available, the type, size and depth of each well or the general specifications of any other works for the withdrawal of groundwater deep well

10. The estimated amount of groundwater withdrawn each year 325,00

11. The log of formations encountered in the drilling of each well if available not available

12. Such other information of a similar nature as may be useful in carrying out the policy of this act, including reference to book and page of any county record None

Signature of Owner *James T. Smith*

Date September 13, 1965

Three copies to be filed by the owner with the County Clerk and Recorder of the county in which the well is located.

Please answer all questions. If not applicable, so state, otherwise the form will be returned.

Original to the County Clerk and Recorder; Duplicate to the State Engineer; Triplicate to the Montana Bureau of Mines and Geology, and Quadruplicate for the Appropriator.

39619

506

STATE OF MONTANA  
COUNTY OF LINCOLN

Filed this 13<sup>th</sup> day of  
September A. D. 1965

at 4:45 P.M.  
M. M. Mansfield  
County Clerk

By Mae Watson Deputy

RECORDED  
INDEXED  
1965  
SEP 13  
LINCOLN COUNTY

File No. 9W2

MONTANA WATER RESOURCES BOARD  
RECEIVED

T. 33 R. 26  
County Blaine  
Lincoln

OCT 17 1966  
STATE OF MONTANA  
ADMINISTRATOR OF GROUNDWATER CODE  
OFFICE OF STATE ENGINEER

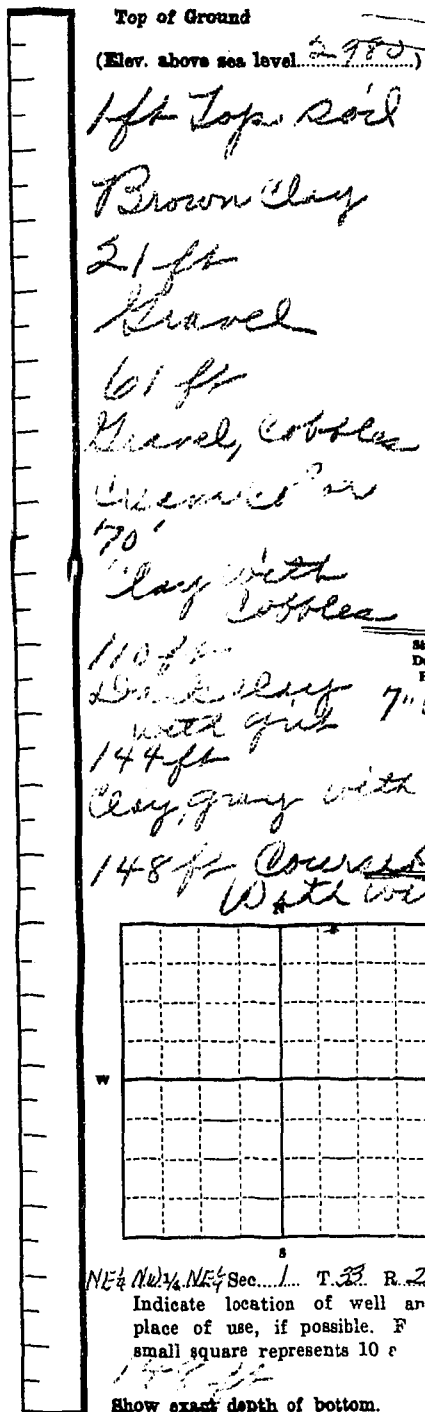

### Notice of Completion of Groundwater Appropriation by Means of Well

(Under Chapter 237, Montana Session Laws, 1961)

Owner Wally Grove Const Co. 2220  
St. Huntington Address  
Driller Homer McClarty Address 945 5th St. 2104

Date of Notice of Appropriation of Groundwater.....  
Date well started Sept 30 66 Date Completed Oct 5/66

Type of well Drilled Equipment Used 22W Bitumens  
(dug, driven, bored or (Churn, drill, rotary or other) Bit  
drilled)

Water Use: Domestic  Municipal  Other  Irrigation   
Industrial  Drainage  Stock

Indicate on the diagram the character and thickness of the different strata met with in drilling, such as soil, clay, shale, gravel, rock or sand, etc. Show depth at which water is encountered, thickness and character of water-bearing strata and height to which water rises in the well.

Size of Drilled Hole	Run and (Height of Casing)	From (Feet)	To (Feet)	PERFORATIONS		
				Kind Size	From (Feet)	To (Feet)
7" OD	23'		148'			

Static Water Level for non-flowing Well..... 39 feet.  
Shut-in Pressure for Flowing Well..... 800 lbs.  
Pumping Water Level 39 feet at 20 gal. per minute.  
Discharge in gal. per min. of flowing well.....  
How Tested Barler Length of Test 2 hrs

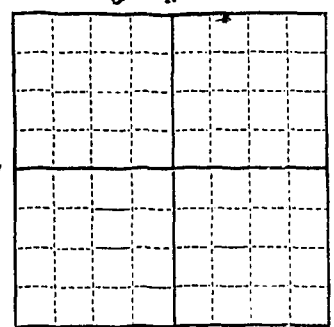

NE 1/4 NW 1/4 NE 1/4 Sec. 1, T. 33, R. 26 W.

Indicate location of well and place of use, if possible. F small square represents 10'

Show exact depth of bottom.

Driller's License Number 18  
Driller's Signature Homer McClarty

This form to be prepared by driller, and three copies to be filed by the owner with the County Clerk and Recorder in the county in which the well is located.

Please answer all questions. If not applicable, so state, otherwise the form will be returned.

Original to the County Clerk and Recorder; duplicate to the State Engineer; Triplicate to the Montana Bureau of Mines and Geology and Quadruplicate for the Appropriator.

44,692

INDEXED

657

STATE OF MONTANA  
COUNTY OF LINCOLN

Filed this 14th day of  
October A. D. 19 68

at 8:35 A.M.

By Shannon L. Vaughan County Clerk  
Mac Station Deputy

File No. ....

T. R. ....

DUPLICATE

MONTANA WATER RESOURCES BOARD  
RECEIVED

County Lincoln

LOG

JAN 27 1969

STATE OF MONTANA  
ADMINISTRATOR OF GROUNDWATER CODE  
STATE WATER CONSERVATION BOARD

**Notice of Completion of Groundwater Appropriation by Means of Well**  
DEVELOPED AFTER JANUARY 1, 1962

(Under Chapter 237 Montana Session Laws, 1961, as amended)

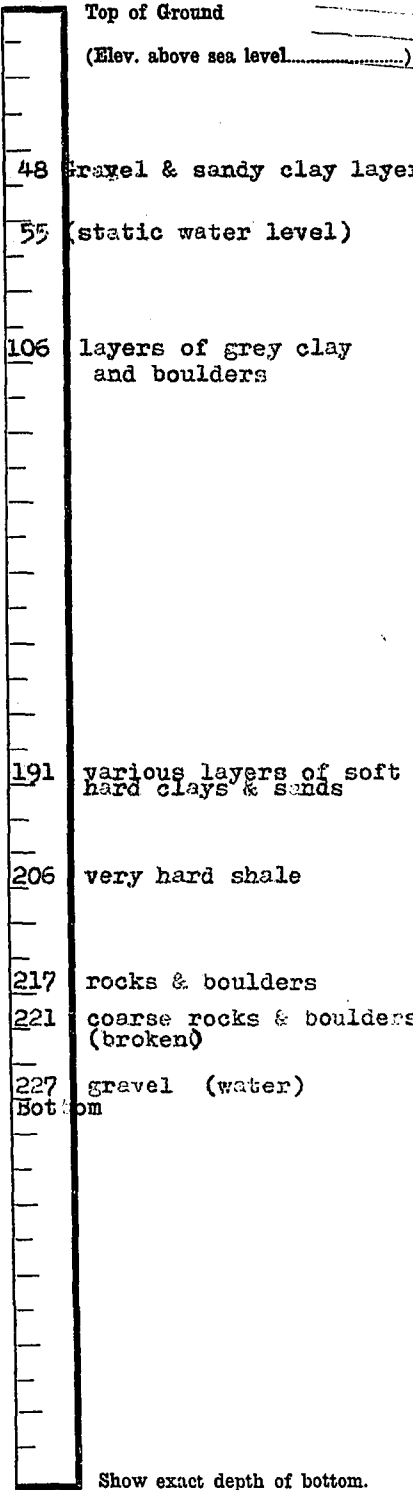

Owner Walsh-Groves Construction Co. Trego, Mont.  
 Driller Thatcher Drilling Co. Eureka, Mont.  
 Date of Notice of appropriation of groundwater Aug. 28, 1967  
 Date well started Aug. 21, 1967 Date completed Aug. 28, 1967  
 Type of well drilled Equipment used Rotary  
 (Dug, driven, bored or drilled) (Churn drill, rotary or other)  
 Water use: Domestic  Municipal  Stock  Irrigation   
 Industrial  Drainage  Other

Indicate on the diagram the character and thickness of the different strata met with in drilling, such as soil, clay, shale, gravel, rock or sand, etc. Show depth at which water is encountered, thickness and character of water-bearing strata and height to which the water rises in the well.

Size of Drilled Hole	Size and Weight of Casing	From (Feet)	To (Feet)	PERFORATIONS		
				Kind Size	From (Feet)	To (Feet)
5"	steel 12#	0	227	slots 1/2" x 4"	218	227

191 various layers of soft and hard clays & sands  
 206 very hard shale  
 217 rocks & boulders  
 221 coarse rocks & boulders (broken)  
 227 gravel (water)  
 Bottom

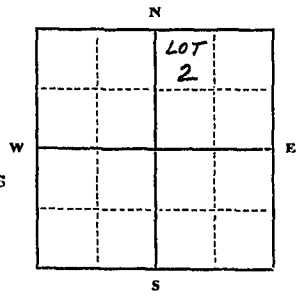

Static Water Level for non-flowing well 55 feet.  
 Shut-in Pressure for Flowing Well.....  
 Pumping Water Level 130 feet  
 at 25 gal. per minute.  
 Discharge in gal. per min. of flowing well.....  
 How Tested Bailer, 4 1/2 hrs.  
 Length of Test 4 1/2 hrs.  
 Remarks: (Gravel packing, cementing, packers, type of shutoff).....  
Welded, flush joints every 21'

Lot #2  
 1/4 Sec. 1, T33N, R26W  
 Indicate location of well and place of use, if possible. Each small square represents 40 acres.

(Continue on reverse side)

USE—If used for irrigation, industrial, drainage or other. Explain, state number of acres and location or other data (i.e.: Lot, Block and Addition).

Show exact depth of bottom.

This form to be prepared by driller, and three copies to be filed by the owner with the County Clerk and Recorder in the county in which the well is located, tissue copy to be retained by driller.

Please answer all questions. If not applicable, so state, otherwise the form will be returned.

Driller's License Number 86

C. Thatcher  
Driller's Signature.

44,938



File No. \_\_\_\_\_  
DUPLICATE

RECEIVED  
MAR 27 1964

Approved Stock Form—State Publishing Co., Helena, Montana—41921  
T. 33 R. 26  
County Lincoln

LOCAL 1000 011  
STATE OF MONTANA  
ADMINISTRATOR OF GROUNDWATER CODE  
OFFICE OF STATE ENGINEER

RECEIVED  
FEB 17 1964

**Declaration of Vested Groundwater Rights**

(Under Chapter 237, Montana Session Laws, 1961) STATE ENGINEER

1. Maurice R. and Eleanor A. Daniel, of P. O. Box 20, Trego, Montana  
(Name of Appropriator) (Address) (Town)  
County of Lincoln State of Montana  
have appropriated groundwater according to the Montana laws in effect prior to January 1, 1962, as follows:

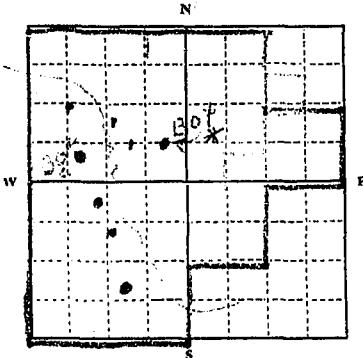

SW 1/4 NE 1/4 Sec. 2 T. 33 R. 26

Indicate point of appropriation and place of use, if possible. Each small square represents 10 acres.

30

- The beneficial use on which the claim is based. Use for domestic and livestock and domestic irrigation.
- Date or approximate date of earliest beneficial use; and how continuous the use has been. 1930—been in continuous use
- The amount of groundwater claimed (in miner's inches or gallons per minute) 10 acre feet or 3,258,500 gallon
- If used for irrigation, give the acreage and description of the lands to which water has been applied and name of the owner thereof. 10 acres hayland, used by previous and present owners also pasture land
- The means of withdrawing such water from the ground and the location of each well or other means of withdrawal. extension wells—have pump in one with pressure tank—two other's boxed rest free flowing.
- The date of commencement and completion of the construction of the well, wells, or other works for withdrawal of groundwater. the boxes and pump well were constructed many years ago by previous owners, and the pump has been replaced and improved several times during the period.
- The depth of water table. Eighteen inches
- So far as it may be available, the type, size and depth of each well or the general specifications of any other works for the withdrawal of groundwater. boxed wells 4 feet now, silted in from approx. 6 ft; one box 2 feet; 0
- The estimated amount of groundwater withdrawn each year. un loaded
- The log of formations encountered in the drilling of each well if available. not available
- Such other information of a similar nature as may be useful in carrying out the policy of this act, including reference to book and page of any county record. records of the Agricultural Stabilization and Conservation Lincoln County records in the Court House, Libby, Mont.  
Photo Map D-21-388-62 7-7-61 (84245)

Signature of Owner X Maurice R. Daniel  
X Eleanor A. Daniel  
Date Dec. 27, 1963

Three copies to be filed by the owner with the County Clerk and Recorder of the county in which the well is located.  
Please answer all questions. If not applicable, so state, otherwise the form will be returned.

Original to the County Clerk and Recorder; Duplicate to the State Engineer; Triplicate to the Montana Bureau of Mines and Geology, and Quadruplicate for the Appropriator. 34926



295

1887



STATE OF MONTANA  
COUNTY OF LINCOLN

Filed this 30th day of  
December A. D. 1963  
at 11:43 A. M.  
M. M. Mansfield  
County Clerk  
By M. A. Nelson Deputy

GW

File No.....

Sec 11 T. 33 R. 26

DUPLICATE

County Lincoln

STATE OF MONTANA  
ADMINISTRATOR OF GROUNDWATER CODE  
OFFICE OF STATE ENGINEER

RECEIVED  
DEC 9 1963  
STATE ENGINEER

Declaration of Vested Groundwater Rights

(Under Chapter 237, Montana Session Laws, 1961)

1. Orlando J. Dennis, of Trego  
(Name of Appropriator) (Address) (Town)

County of Lincoln State of Montana

have appropriated groundwater according to the Montana laws in effect prior to January 1, 1962, as follows:

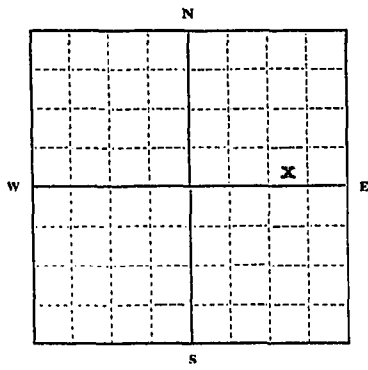

SE 1/4 NE Sec 11 T33 R 26

Indicate point of appropriation and place of use, if possible. Each small square represents 10 acres.

2. The beneficial use on which the claim is based... Human consumption

3. Date or approximate date of earliest beneficial use; and how continuous the use has been... July 1958

4. The amount of groundwater claimed (in miner's inches or gallons per minute)... 3 inches

5. If used for irrigation, give the acreage and description of the lands to which water has been applied and name of the owner thereof  
Household: House and grounds located in S.E. & N.E. 1/4 Sec 11, Township 33, Range 26 M.P.M.

6. The means of withdrawing such water from the ground and the location of each well or other means of withdrawal... 1 Hp electric pump

7. The date of construction and completion of the construction of the well, wells, or other works for withdrawal of groundwater... July 1958

8. The depth of water table... 2 feet

9. So far as it may be available, the type, size and depth of each well or the general specifications of any other works for the withdrawal of groundwater... Crib and culvert framework

10. The estimated amount of groundwater withdrawn each year... 72,000 gallons

11. The log of formations encountered in the drilling of each well if available... N/A

12. Such other information of a similar nature as may be useful in carrying out the policy of this act, including reference to book and page of any county record... N/A

Signature of Owner Orlando J. Dennis  
Date Sub. 1 1963

Three copies to be filed by the owner with the County Clerk and Recorder of the county in which the well is located.

Please answer all questions. If not applicable, so state, otherwise the form will be returned.

Original to the County Clerk and Recorder; duplicate to the State Engineer; Triplicate to the Montana Bureau of Mines and Geology, and Quadruplicate for the Appropriator.

8245

INDEXED

158

STATE OF MONTANA  
COUNTY OF LINCOLN

Filed this 26th day of  
November A. D. 1911  
at 9:10 P.M.  
Billings County Clerk  
By W. R. [Signature] Deputy

File No. ....

T33N R 36 W

County Lincoln

STATE OF MONTANA  
ADMINISTRATOR OF GROUNDWATER  
OFFICE OF STATE ENGINEER

CODE

RECEIVED  
MAR 27 1964

### Notice of Completion of Groundwater Appropriation Without Well

STATE ENGINEER

(Under Chapter 237 Montana Session Laws, 1961)

Date of Appropriation of Groundwater ..... 19\_\_

**Nelson Westwood and**

Owner **Mary Westwood** ..... **Trego, Montana** .....

Contractor (if any) None .....

Address of Contractor .....

Date Started..... 19\_\_ Date Completed..... 19\_\_

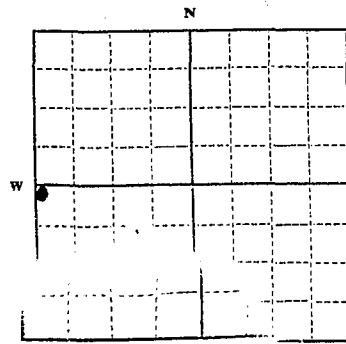

Describe means of obtaining groundwater without a well "as by sub-irrigation and other natural processes". Include depth to water when applicable. All of the water from a spring located on the boundary of our premises runs into a pond, approximately 50' x 100' and 8' deep which we constructed for purposes of agricultural irrigation (sprinkler) and domestic use.

Quantity of water developed and used with explanation of method used to measure or estimate such amount. If use is intermittent

estimate approximate lengths of periods of use. Quantity measured

by pipe size and pumping capacity; water used for agricultural purposes during the normal growing season. Estimated use is 12,000,000 gallons a year.

Signature of Owner: Nelson Westwood  
Mary Westwood

Date: December 26, 1963

SN 1/4 Sec. 12 T33R26W

Indicate point of appropriation and place of use, if possible.

This form to be prepared by contractor (if any), otherwise by the owner.

Three copies of this notice are to be filed with the County Clerk and Recorder of the county in which the works are located.

Please answer all questions. If not applicable, so state, otherwise the form will be returned.

Original to the County Clerk and Recorder; duplicate to the State Engineer; Triplicate to the Montana Bureau of Mines and Geology and Quadruplicate to the appropriator.

35523

12415304

454

STATE OF MONTANA  
COUNTY OF LINCOLN

Filed this 18th day of  
February A. D. 19 67  
at 12:30 P. M.  
M. M. Mansfield  
County Clerk.  
By Mae Nelson  
Deputy

File No. ....

T. 33 R. 26

STATE WATER CONSERVATION BOARD

County Lincoln

SEP 28 1965

STATE OF MONTANA

Billie \_\_\_\_\_ McDermott \_\_\_\_\_ ADMINISTRATOR OF GROUNDWATER CODE  
 Butzerin \_\_\_\_\_ McNulty \_\_\_\_\_ OFFICE OF STATE ENGINEER  
 Coyle \_\_\_\_\_ Morton \_\_\_\_\_  
 Darlington \_\_\_\_\_ Sullivan \_\_\_\_\_  
 Dickert \_\_\_\_\_

**Notice of Completion of Groundwater Appropriation Without Well**

(Under Chapter 237 Montana Session Laws, 1961)

Date of Appropriation of Groundwater 1958

Owner Orlando J. and Ruth L. Dennis Address Trego, Montana

Contractor (if any) none

Address of Contractor none

Date Started 1958 Date Completed 1958

Describe means of obtaining groundwater without a well "as by irrigation and other natural processes". Include depth to water when applicable. by ditch from the overflow

of the spring on Section 12; said ditch is 1 foot wide and two feet deep, and runs West into Section 11 to property of Owners

Quantity of water developed and used with explanation of method used to measure or estimate such amount. If use is intermittent

estimate approximate lengths of periods of use. Water used to irrigate 2 acres of land and for watering up to 30 head of livestock.

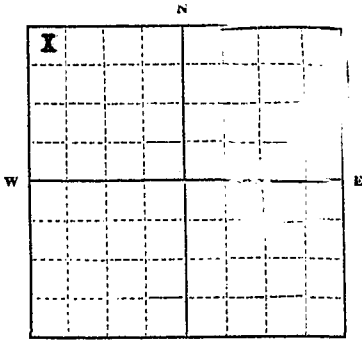

NW 1/4, NW 1/4 Sec. 12, T33, R. 26

Indicate point of appropriation and place of use, if possible. for use in Sec. 11, T33, R26W.

Signature of Owner Orlando J. Dennis

Date September 16, 1965

This form to be prepared by contractor (if any), otherwise by the owner.

Three copies of this notice are to be filed with the County Clerk and Recorder of the county in which the works are located.

Please answer all questions. If not applicable, so state, otherwise the form will be returned.

Original to the County Clerk and Recorder; duplicate to the State Engineer; Triplicate to the Montana Bureau of Mines and Geology and Quadruplicate for the appropriator.

39635

# 507

STATE OF MONTANA  
COUNTY OF LINCOLN  
Filed this 24<sup>th</sup> day of  
September A. D. 1965  
at 4:40 P. M.  
M. M. Mansfield  
County Clerk.  
By Pat B. Bunker  
Deputy

STATE WATER CONSERVATION BOARD

GW 3

NOV 22 1965

File No. Bills..... McDermott.....  
Butler..... McNitt.....  
Coyle..... Morton.....  
Darrinton..... Sullivan.....  
Dickert.....

T. 33 N. 26  
County Lincoln

STATE OF MONTANA  
ADMINISTRATOR OF GROUNDWATER CODE  
OFFICE OF STATE ENGINEER

Notice of Completion of Groundwater Appropriation  
Without Well

(Under Chapter 237 Montana Session Laws, 1961)

Date of Appropriation of Groundwater..... 1945  
Owner..... Charles H. & JoAnn Gilmor..... Address..... Great Falls, Montana

Contractor (if any)..... none

Address of Contractor..... none

Date Started..... 1945 Date Completed..... 1945

Describe means of obtaining groundwater without a well "as by sub-irrigation and other natural processes". Include depth to water when applicable. one spring, stream and by subirrigation

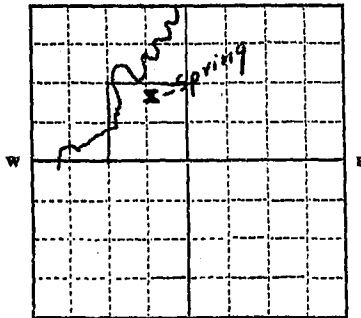

SE 1/4 NW 1/4 Sec. 14, T. 33, R. 26

Indicate point of appropriation and place of use, if possible.

Quantity of water developed and used with explanation of method used to measure or estimate such amount. If use is intermittent

estimate approximate ~~length~~ length of periods of use.....

Domestic use of 90,000 gallons a month all year/ Sub-irrigation is seasonal

Signature of Owner.....

Date September, 20 1965

This form to be prepared by contractor (if any), otherwise by the owner.

Three copies of this notice are to be filed with the County Clerk and Recorder of the county in which the works are located.

Please answer all questions. If not applicable, so state, otherwise the form will be re:

Original to the County Clerk and Recorder; duplicate to the State Engineer; Triplicate to the Montana Bureau of Mines and Geology and Quadruplicate for the Appropriator.

*Handwritten initials*



515

STATE OF MONTANA  
COUNTY OF LINCOLN

Filed this 18th day of  
November A. D. 1965  
at 9:57 P.M.  
M. M. Mansfield  
County Clerk  
By Mae Hillen Deputy

STATE WATER CONSERVATION BOARD

GW 3

NOV 22 1965

File No.

McDermott  
McNulty  
Morton  
Sullivan

T. 33 N R. 26

County Lincoln

STATE OF MONTANA  
ADMINISTRATOR OF GROUNDWATER CODE  
OFFICE OF STATE ENGINEER

### Notice of Completion of Groundwater Appropriation Without Well

(Under Chapter 237 Montana Session Laws, 1961)

Date of Appropriation of Groundwater 1945  
Owner Charles H. & JoAnn Gilmor Address Great Falls, Montana

Contractor (if any) none

Address of Contractor none

Date Started 1945 Date Completed 1945

Describe means of obtaining groundwater without a well "as by sub-irrigation and other natural processes". Include depth to water when applicable. By sub-irrigation for 25 acres of land; two springs and a stream with water used for domestic purposes, garden, lawn and watering 35 to 50 head of livestock.

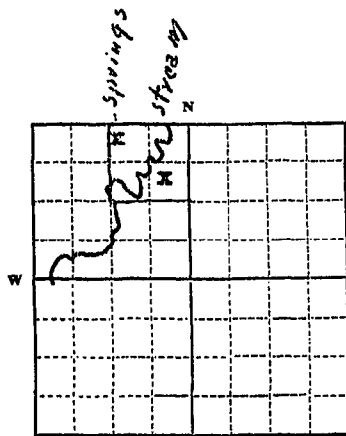

NE 1/4 NW 1/4 Sec. 14 T. 33 R. 26

Indicate point of appropriation and place of use, if possible.

Quantity of water developed and used with explanation of method used to measure or estimate such amount. If use is intermittent

estimate approximate lengths of periods of use. Garden, lawn & domestic use-Quantity 75,000 gallons per month in summer 30,000 gallons in winter. Plus amount necessary to water 35 to 50 head of livestock from stream. Domestic use and livestock watering is all year and sub-irrigation, garden and lawn is seasonal use.

Signature of Owner

Date September 70 1965.

This form to be prepared by contractor (if any), otherwise by the owner.

Three copies of this notice are to be filed with the County Clerk and Recorder of the county in which the works are located.

Please answer all questions. If not applicable, so state, otherwise the form will be returned.

Original to the County Clerk and Recorder; duplicate to the State Engineer; Triplicate to the Montana Bureau of Mines and Geology and Quadruplicate for the Appropriator.

516

STATE OF MONTANA  
COUNTY OF LINCOLN

Filed this 18th day of  
November A. D. 1965  
at 9:10 P. M.  
M. J. Mansfield  
County Clerk  
By Mar Nelson  
Deputy

STATE WATER CONSERVATION BOARD

ow 3

NOV 22 1965

File No. Bill \_\_\_\_\_ McDermott \_\_\_\_\_  
          B. \_\_\_\_\_ McNeil \_\_\_\_\_  
          C. \_\_\_\_\_ Morton \_\_\_\_\_  
          D. \_\_\_\_\_ Sullivan \_\_\_\_\_  
          Dickert \_\_\_\_\_

T. 33 N. W 14  
R. 26  
County Lincoln

STATE OF MONTANA  
ADMINISTRATOR OF GROUNDWATER CODE  
OFFICE OF STATE ENGINEER

**Notice of Completion of Groundwater Appropriation  
Without Well**

(Under Chapter 237 Montana Session Laws, 1961)

Date of Appropriation of Groundwater 1945  
Owner Charles H. & JoAnn Gilmor Address Great Falls, Montana

Contractor (if any) none

Address of Contractor none

Date Started 1945 Date Completed 1945

Describe means of obtaining groundwater without a well "as by sub-irrigation and other natural processes". Include depth to water when applicable. a stream and by sub-irrigation

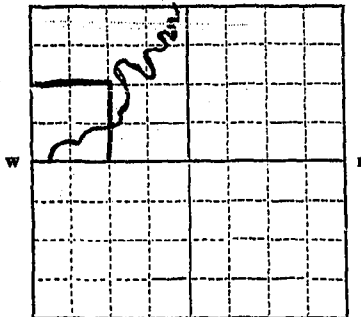

SW  $\frac{1}{4}$  NW  $\frac{1}{4}$  Sec. 14 T. 33 R. 26

Indicate point of appropriation and place of use, if possible.

Quantity of water developed and used with explanation of method used to measure or estimate such amount. If use is intermittent

estimate approximate lengths of periods of use.

Domestic use from stream all year.

Sub-irrigation is seasonal

Signature of Owner

Date September 10 1965

This form to be prepared by contractor (if any), otherwise by the owner.

Three copies of this notice are to be filed with the County Clerk and Recorder of the county in which the works are located.

Please answer all questions. If not applicable, so state, otherwise the form will be returned.

Original to the County Clerk and Recorder; duplicate to the State Engineer; Triplicate to the Montana Bureau of Mines and Geology and Quadruplicate for the Appropriator.

517

STATE OF MONTANA  
COUNTY OF LINCOLN

Filed this 18th day of  
November A. D. 1965  
at 9:15 P. M.  
by M. J. Mansfield  
County Clerk  
By Mar. [Signature] Deputy

RECEIVED

GW 3

Approved Stock Form—State Publishing Co., Helena, Montana—46806

File No. ....

T. 33 N. R. 26 W.

DUPLICATE

County Lincoln

STATE OF MONTANA  
ADMINISTRATOR OF GROUNDWATER CODE  
STATE WATER CONSERVATION BOARD

Notice of Completion of Groundwater Appropriation  
Without Well

Developed After January 1, 1962

(Under Chapter 237 Montana Session Laws, 1961, as amended)

Date of Appropriation of Groundwater June 25, 1973  
Owner Earl L. and Judy A. Hammonsee, Box 44  
Address Trego, Mont. 59934

Contractor (if any) Same

Address of Contractor

Date Started Aug. 20, 1972 Date Completed Aug. 30, 1972

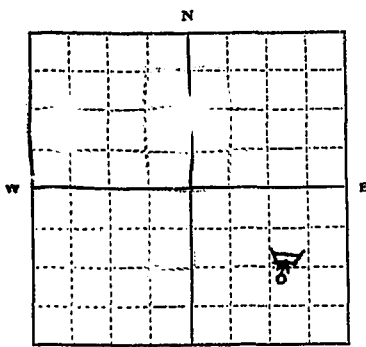

SE 1/4 Sec. 15 T. 33 N. R. 26 W.

Indicate point of appropriation and place of use, if possible.

973  
June 26, 1973  
9:40 A.M.

- Describe means of obtaining groundwater (as by sub-irrigation, developed spring, drains, etc.)  
Developed spring
- Means of withdrawing water (gravity, pump, canal, etc.)  
By means of pump
- Depth of water table  
Surface water
- Use of the water  
Garden, lawn, field and livestock use
- Amount of groundwater claimed (in miner's inches, or gallons per minute)  
20 miner's inches or 225 gals per min
- If used for irrigation, give number of acres and description of land  
20 acres in E 1/2 SE 1/4 Sec. 15, T. 33-N, R. 26-W
- Estimate amount of water used each year  
30 A.F.

Signature of Owner Earl L. Hammonsee  
Judy A. Hammonsee  
Date June 25, 1973

This form to be prepared by contractor (if any), otherwise by the owner.

Three copies of this notice are to be filed with the County Clerk and Recorder of the county in which the works are located.

Please answer all questions. If not applicable, so state, otherwise the form will be returned.

54183

993

STATE OF MONTANA  
COUNTY OF LINCOLN

I, Paul this 26<sup>th</sup> day of

A. D. 1929

at 9:40 P. M.

Shannon L. Vaughn  
County Clerk

By Myra Watson Deputy

RECEIVED

JUL 3 1973

Lincoln

County.....

3 GW 3 Revised 1969  
STATE PUBLISHING CO.-LIT. DIV. STATE DEPARTMENT OF NATURAL  
RESOURCES AND CONSERVATION STATE OF MONTANA

ADMINISTRATOR OF GROUNDWATER CODE  
MONTANA WATER RESOURCES BOARD

NOTICE OF COMPLETION OF GROUNDWATER APPROPRIATION WITHOUT WELL

Developed After January 1, 1962

(Under Chapter 237, Montana Session Laws, 1961, as amended)

This form to be prepared by contractor (if any), otherwise by the owner.  
Three copies of this notice are to be filed with the County Clerk and Recorder of the county in which the works are located.

Please answer all questions. If not applicable, so state, otherwise the form may be returned.

For Administrator's Use

File 986

June 29, 1973

GW 1 12:35 p.m.

Owner L. O. Starling

Address Box 55, Eureka, Montana

Contractor (if any) .....

Address of Contractor .....

Date Started ..... Date Completed .....

1. Describe means of obtaining groundwater (as by sub-irrigation, developed spring, drains, etc.)  
developed spring

2. Means of withdrawing water (gravity, pump, canal, etc.)  
by gravity

3. Depth of water table at surface

4. Use of the water for household and domestic use, fish pond, livestock, wildlife and recreation.

5. Amount of groundwater claimed (in miner's inches or gallons per minute)  
10 miners inches or 112 gallons per minute

6. If used for irrigation, give number of acres and description of land  
N/A

7. Estimate amount of water used each year  
10 miners inches or 112 gallons per minute

8. Months of year spring flows  
12 mo.

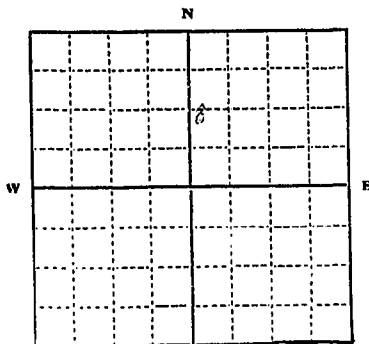

SW NE 22  
1/4 1/4 Sec.  
33 26  
T. N R. 1  
S E  
W

INDICATE POINT OF APPROPRIATION AND PLACE OF USE, IF POSSIBLE.  
Elevation of spring, if known or estimated .....

Signature of Owner .....  
Date June 26, 1973

54927



986

STATE OF MONTANA  
COUNTY OF LINCOLN

Filed this 28<sup>th</sup> day of

June A.D. 1973

at 12:35 P.M.

Charles L. Daugh County Clerk

By Max Watson Deputy

STATE OF MONTANA  
 ADMINISTRATOR OF GROUNDWATER CODE  
 MONTANA WATER RESOURCES BOARD

**NOTICE OF COMPLETION OF GROUNDWATER APPROPRIATION WITHOUT WELL**  
 Developed After January 1, 1962

(Under Chapter 237, Montana Session Laws, 1961, as amended)

This form to be prepared by contractor (if any), otherwise by the owner.  
 Three copies of this notice are to be filed with the County Clerk and Recorder of the county in which the works are located.  
 Please answer all questions. If not applicable, so state, otherwise the form may be returned.

For Administrator's Use

File 993

June 29, 1970

GW 1 2:55 P.M.

Owner Julius and or Mary McDonald

Address Box 93, Fureka, MT 59917

Contractor (if any) None

Address of Contractor \_\_\_\_\_

Date Started June 12, 1970 Date Completed July 30, 1970

1. Describe means of obtaining groundwater (as by well, irrigation, developed spring, drains, etc.) Springs and ditch - the springs are all on our property.

2. Means of withdrawing water (gravity, pump, canal, etc.) Gravity

3. Depth of water table top of ground

4. Use of the water irrigation pasture and crop for the stock to drink.

5. Amount of groundwater claimed (in miner's inches or gallons per minute) 80 miner's inches or 800 gallons per minute

6. If used for irrigation, give number of acres and description of land 80 acres, W 1/2 NE 1/4, NW 1/4 SE 1/4, Sec 27; T-33-N, R-26-W

7. Estimate amount of water used each year 80 miner's inches

8. Months of year spring flows 12 months

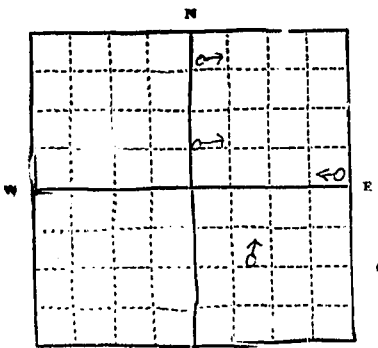

W 1/2 NE 1/4, NW 1/4 NE 1/4 SE 1/4

W 1/2 N.E. 1/4 NW 1/4 SE 1/4 Sec 27

T. 33 N R. 26 W

INDICATE POINT OF APPROPRIATION AND PLACE OF USE, IF POSSIBLE.  
 Elevation of spring, if known or estimated \_\_\_\_\_

Signature of Owner Julius McDonald  
Mary McDonald

Date \_\_\_\_\_

993

STATE OF MONTANA  
COUNTY OF LINCOLN

Filed this 29<sup>th</sup> day of  
June A. D. 1973  
at 2:55 P. M.  
Edward Vaughn  
County Clerk  
By Walter S. Higgins  
Deputy