



988

STATE OF MONTANA  
COUNTY OF LINCOLN

Filed this 28<sup>th</sup> day of June A. D. 1913  
at 4:15 PM  
by Charles P. Laugel County Clerk  
Mae Watson Deputy

RECEIVED  
JUN 28 1913  
COUNTY CLERK  
LINCOLN COUNTY MONTANA

File No. ....

T. 36 N. R. 27 W.

DUPLICATE

County Lincoln

STATE OF MONTANA  
ADMINISTRATOR OF GROUNDWATER CODE  
OFFICE OF STATE ENGINEER DEC 9 1963

### Notice of Completion of Groundwater Appropriation by Means of Well

(Under Chapter 237, Montana Session Laws, 1961)

Owner J. Alfred Peltier Address Eureka, Montana

Driller Olsen & Justin Address Columbia Falls, Montana

Date of Notice of Appropriation of Groundwater None filed

Date well started Sept. 28, 1963 Date Completed Oct. 14, 1963

Type of well Drilled Equipment Used Churn drill  
(dug, driven, bored or drilled) (Churn, drill, rotary or other)

Water Use: Domestic  Industrial  Municipal  Drainage  Other  Irrigation  Stock

Top of Ground  
(Elev. above sea level.....)

0 to 110 ft. loose gravel & sand

110 to 132 ft. tight jacked gravel & sand.

132 to 138 ft. loose coarse sand.

138 to 238 ft. Gray hard pan

238 to 244 ft. silt & sand

244 to 246 ft. water bearing gravel & sand.

Indicate on the diagram the character and thickness of the different strata met with in drilling, such as soil, clay, shale, gravel, rock or sand, etc. Show depth at which water is encountered, thickness and character of water-bearing strata and height to which water rises in the well.

Size of Drilled Hole	Size and Weight of Casing	From (Feet)	To (Feet)	PERFORATIONS		
				Kind Size	From (Feet)	To (Feet)
7"	23 lbs. per ft. 7"	0	246	None		

Static Water Level for non-flowing Well 147 feet.

Shut-in Pressure for Flowing Well non-flowing

Pumping Water Level 165 feet at 15 gal. per minute.

Discharge in gal. per min. of flowing well Non-flowing

How Tested Bailer Length of Test 2 hours

Remarks: (Gravel packing, cementing, packers, type of shutoff, location of place of use of groundwater if not at well, and any other similar pertinent information, including number of acres irrigated, if used for irrigation).....

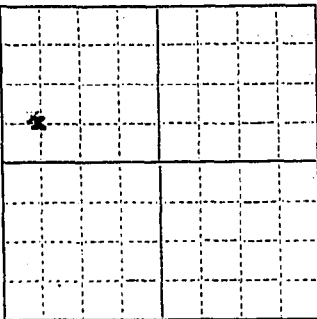

SW 1/4 NW 1/4 Sec. 11 T. 36 R. 27  
Indicate location of well and place of use, if possible. Each small square represents 10 acres.

Show exact depth of bottom.

55

Driller's License Number

By: George D. Justin  
Driller's Signature

This form to be prepared by driller, and three copies to be filed by the owner with the County Clerk and Recorder in the county in which the well is located.

Please answer all questions. If not applicable, so state, otherwise the form will be returned.

Original to the County Clerk and Recorder; duplicate to the State Engineer; Triplicate to the Montana Bureau of Mines and Geology and Quadruplicate for the Appropriator.

8251

INDEXED 164

STATE OF MONTANA  
COUNTY OF LINCOLN

Filed this 2nd day of December A. D. 1963  
at 8:35 A.M.  
M. E. Mansfield  
County Clerk.  
By Mae Katten,  
Deputy

File No. ....

MONTANA WATER RESOURCES BOARD

T 36 N., R 27 W.

DUPLICATE

RECEIVED

County LINCOLN

MAY 22 1970

STATE OF MONTANA  
ADMINISTRATOR OF GROUNDWATER CODE  
OFFICE OF STATE ENGINEER

### Notice of Completion of Groundwater Appropriation by Means of Well

(Under Chapter 237, Montana Session Laws, 1961)

Top of Ground

80 (Elev. above sea level)

140 loose gravel & boulders

215 grey glacial silt with a few sand & gravel pockets

260 silt, layers of brown silt, thin gravel & sand beds

268 hard solidified silt or shale.

Owner Hank Bereday Address Eureka, Mont.

Driller Thatcher Drilling Co. Address Stanford, Mont.

Date of Notice of Appropriation of Groundwater .....

Date well started June 6-65 Date Completed June 30-65

Type of well drilled Equipment Used ROMERY  
(dug, driven, bored or drilled) (Churn, drill, rotary or other)

Water Use: Domestic  Municipal  Other  Irrigation   
Industrial  Drainage  Stock

Indicate on the diagram the character and thickness of the different strata met with in drilling, such as soil, clay, shale, gravel, rock or sand, etc. Show depth at which water is encountered, thickness and character of water-bearing strata and height to which water rises in the well.

Doc. No. 734  
Filed for record this 7 3/8 day of May  
A. D. 19 70, at 9:55 o'clock P. M.

Size of Drilled Hole	Size and Weight of Casing	From (Feet)	To (Feet)	PERFORATIONS		
				Kind Size	From (Feet)	To (Feet)
	5" ID 180	0	163			
	3" ID					
	1 1/2" ID	165	268	200"	200	258

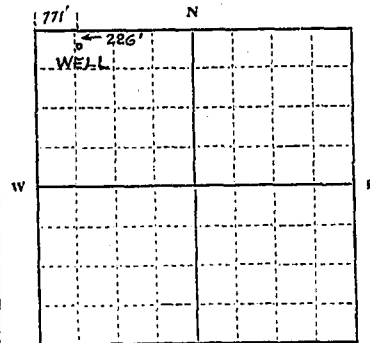

NW 1/4 Sec. 11 T36N, R27W.  
Indicate location of well and place of use, if possible. Each small square represents 10 acres.

Show exact depth of bottom.

Static Water Level for non-flowing Well..... 100' feet.

Shut-in Pressure for Flowing Well.....

Pumping Water Level..... 100' feet at 10 gal. per minute.

Discharge in gal. per min. of flowing well.....

How Tested..... boiler Length of Test 4 hrs.

Remarks: (Gravel packing, cementing, packers, type of shutoff, location of place of use of groundwater if not at well, and any other similar pertinent information, including number of

acres irrigated, if used for irrigation).....

86  
Driller's License Number  
Edward Thatcher  
Driller's Signature

This form to be prepared by driller, and three copies to be filed by the owner with the County Clerk and Recorder in the county in which the well is located.

Please answer all questions. If not applicable, so state, otherwise the form will be returned.

Original to the County Clerk and Recorder; duplicate to the State Engineer; Triplicate to the Montana Bureau of Mines and Geology and Quadruplicate for the Appropriator.

96475

734

STATE OF \_\_\_\_\_  
COUNTY OF \_\_\_\_\_  
Filed this 5 day of  
May A. D. 19 70  
at 9:55 A.M.  
Edward S. Taylor  
County Clerk.  
By Mae Watson Deputy

File No. ....

RECEIVED

County Lincoln

DUPLICATE

NOV 13 1967

STATE OF MONTANA  
ADMINISTRATOR OF GROUNDWATER CODE  
OFFICE OF STATE ENGINEER

Top of Ground

(Elev. above sea level 2980)

1 ft. Top Soil

Gravel

45 ft.

Sand + silt

88 ft.

Push sand

148 ft.

Coarse sand

with silt

with water

168 ft.

Rock Water

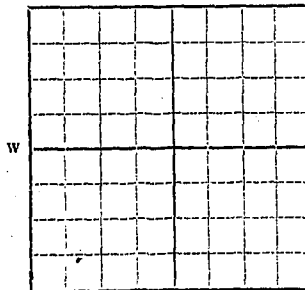

5454 Sec. 11 T. 26 R. 27.

Indicate location of well and place of use, if possible. Each small square represents 10 acres.

223 ft.

Show exact depth of bottom.

Notice of Completion of Groundwater Appropriation by Means of Well

(Under Chapter 237, Montana Session Laws, 1961)

Owner Darwin Stevens Address Eureka, Mont

Driller Homer McCarty Address 945-83 (1st) Lincoln

Date of Notice of Appropriation of Groundwater

Date well started Sept 4/67 Date Completed Sept 13/67

Type of well Drilled Equipment Used 2 1/2" W. B. Pump (Churn, drill, rotary or other) Erie

Water Use: Domestic [ ] Municipal [ ] Stock [ ] Irrigation [ ] Industrial [ ] Drainage [ ] Other [x]

Indicate on the diagram the character and thickness of the different strata met with in drilling, such as soil, clay, shale, gravel, rock or sand, etc. Show depth at which water is encountered, thickness and character of water-bearing strata and height to which the water rises in the well.

Size of Drilled Hole	Size and Weight of Casing	From (Feet)	To (Feet)	PERFORATIONS		
				Kind Size	From (Feet)	To (Feet)
7" OD	23#		174 ft.			

Static Water Level for non-flowing Well 50 feet.

Shut-in Pressure for Flowing Well

Pumping Water Level 85 feet at 25 gal. per minute.

Discharge in gal. per min. of flowing well

How Tested Bailer Length of Test 3 hrs

Remarks: (Gravel packing, cementing, packers, type of shutoff, location of place of use of groundwater if not at well, and any other similar pertinent information, including number of acres irrigated, if used for irrigation)

18  
Driller's License Number

Driller's Signature

This form to be prepared by driller, and three copies to be filed by the owner with the County Clerk and Recorder in the county in which the well is located.

Please answer all questions. If not applicable, so state, otherwise the form will be returned.

Original to the County Clerk and Recorder; duplicate to the State Engineer; Triplicate to the School of Mines and Quadruplicate for the Appropriator.

42,523

012

STATE OF MONTANA  
COUNTY OF LINCOLN

Filed this 10th day of November A. D. 1967

at 2:20 P. M.  
Edward T. Hughes  
County Clerk.

By James Walter  
Deputy

RECEIVED

NOV 10 1967

RECEIVED

NOV 10 1967

NOV 10 1967

NOV 10 1967

NOV 10 1967



RECEIVED

NOV 18 1967

T. 36 N. R. 27 W

County Lincoln

GW 2 H H NEWS

File No.

DUPLICATE

STATE OF MONTANA  
ADMINISTRATOR OF GROUNDWATER CODE  
OFFICE OF STATE ENGINEER

Notice of Completion of Groundwater  
Appropriation by Means of Well

(Under Chapter 237, Montana Session Laws, 1961)

Top of Ground  
(Elev. above sea level 2980)

2 ft. Top Soil  
Gravel  
Cobbles  
51 ft.  
Sand  
122 ft.  
Rock  
Water

Owner Darwin J. Stevens Address Cureka

Driller Homer McClarty Address 945-8th St. N.

Date of Notice of Appropriation of Groundwater

Date well started Aug 17/67 Date Completed Sept 1/67

Type of well Drilled Equipment Used 2 1/4" Pump  
(dug, driven, bored or (Churn, drill, rotary or other) Slick

Water Use: Domestic  Municipal  Stock  Irrigation   
Industrial  Drainage  Other  Sewer  Canal

Indicate on the diagram the character and thickness of the different strata met with in drilling, such as soil, clay, shale, gravel, rock or sand, etc. Show depth at which water is encountered, thickness and character of water-bearing strata and height to which the water rises in the well.

Size of Drilled Hole	Size and Weight of Casing	From (Feet)	To (Feet)	PERFORATIONS		
				Kind Size	From (Feet)	To (Feet)
7" OD	23#	130'				

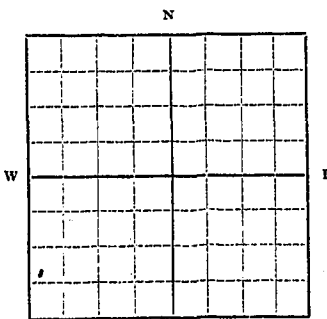

SWS 4/4 Sec. 11 T. 36 R. 27 W

Indicate location of well and place of use, if possible. Each small square represents 10 acres.

200 Show exact depth of bottom.

Static Water Level for non-flowing Well 63 feet.

Shut-in Pressure for Flowing Well

Pumping Water Level 90 feet at 25 gal. per minute.

Discharge in gal. per min. of flowing well

How Tested Bailer Length of Test 4 hrs

Remarks: (Gravel packing, cementing, packers, type of shutoff, location of place of use of groundwater if not at well, and any other similar pertinent information, including number of acres irrigated, if used for irrigation)

18  
Driller's License Number  
Homer McClarty  
Driller's Signature

This form to be prepared by driller, and three copies to be filed by the owner with the County Clerk and Recorder in the county in which the well is located.

Please answer all questions. If not applicable, so state, otherwise the form will be returned.

Original to the County Clerk and Recorder; duplicate to the State Engineer; Triplicate to the School of Mines and Quadruplicate for the Appropriator.

42,524

611

STATE OF MONTANA  
COUNTY OF LINCOLN

Filed this 10th day of

November A. D. 1967

at 2:15 P.

Edwards P. Laughlin

County Clerk

By Jim Walter

Deputy

RECORDED

NOV 13 1967

James A. ...  
...

File No. ....

T. 36 N. R. 27 W

DUPLICATE

County Lincoln

STATE OF MONTANA  
ADMINISTRATOR OF GROUNDWATER CODE  
OFFICE OF STATE ENGINEER

RECEIVED  
MAR 5 1964

Declaration of Vested Groundwater Rights

(Under Chapter 237, Montana Session Laws, 1961)

STATE ENGINEER  
Catherine J. Stevens, Joint Tenants, with R/W

1. Darwin J. Stevens and of Fureka, Montana  
(Name of Appropriator) (Address) (Town)

County of Lincoln State of Montana  
have appropriated groundwater according to the Montana laws in effect prior to January 1, 1962, as follows:

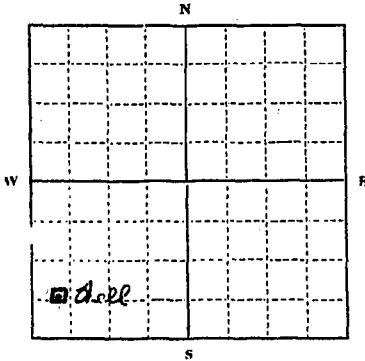

SW 1/4 SW 1/4 Sec. 11, T. 36 N. R. 27 W

Indicate point of appropriation and place of use, if possible. Each small square represents 10 acres.

2. The beneficial use on which the claim is based Water is used for irrigation, livestock, and household use.

3. Date or approximate date of earliest beneficial use; and how continuous the use has been Date of earliest beneficial use was April 1952 and has had continuous use since April 1955.

4. The amount of groundwater claimed (in miner's inches or gallons per minute) 22 miners inches

5. If used for irrigation, give the acreage and description of the lands to which water has been applied and name of the owner thereof 11 acres is used for irrigation in SW 1/4 SW 1/4, Sec. 11, T. 36 N., R. 27 W. Owner - Darwin J. Stevens

6. The means of withdrawing such water from the ground and the location of each well or other means of withdrawal Water is withdrawn by means of a pump.

7. The date of commencement and completion of the construction of the well, wells, or other works for withdrawal of groundwater The date of commencement and completion of construction of well was April 1955.

8. The depth of water table is about 60 feet

9. So far as it may be available, the type, size and depth of each well or the general specifications of any other works for the withdrawal of groundwater Drilled well. Casing - 6" diameter. Depth - 186 feet

10. The estimated amount of groundwater withdrawn each year 22 miner's feet

11. The log of formations encountered in the drilling of each well if available None available

12. Such other information of a similar nature as may be useful in carrying out the policy of this act, including reference to book and page of any county record.

Signature of Owner Darwin J. Stevens

Date 12/31/63  
Catherine J. Stevens

Three copies to be filed by the owner with the County Clerk and Recorder of the county in which the well is located.

Please answer all questions. If not applicable, so state, otherwise the form will be returned.

Original to the County Clerk and Recorder; Duplicate to the State Engineer; Triplicate to the Montana Bureau of Mines and Geology, and Quadruplicate for the Appropriator.

416

born 21 1891  
deceased 1910

married 1910  
born 21 1891  
deceased 1910

2-10-1910

IN WITNESS WHEREOF I have hereunto set my hand and the seal of the County of Lincoln, Montana, this 31st day of December, 1963.

By \_\_\_\_\_  
County Clerk

STATE OF MONTANA  
COUNTY OF LINCOLN

Filed this 31st day of

December, 1963 A. D.

at \_\_\_\_\_ M.

By \_\_\_\_\_  
County Clerk

By \_\_\_\_\_  
Deputy

File No. ....

T. 36N R. 27W

DUPLICATE

County Lincoln

STATE OF MONTANA  
ADMINISTRATOR OF GROUNDWATER CODE  
OFFICE OF STATE ENGINEER

RECEIVED  
MAR 5 1964

Declaration of Vested Groundwater Rights STATE ENGINEER  
(Under Chapter 237, Montana Session Laws, 1961)

1. Norman C. Clark of P. O. Box 186, Eureka, Montana  
(Name of Appropriator) (Address) (Town)  
County of Lincoln State of Montana  
have appropriated groundwater according to the Montana laws in effect prior to January 1, 1962, as follows:

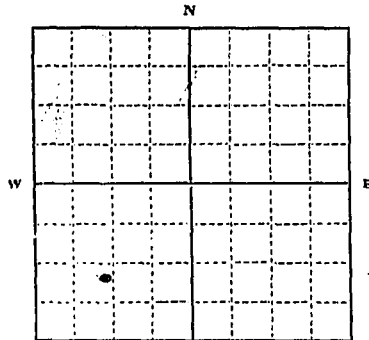

NESW Quarter, S-11-T-36N-R27W.  
1/4 Sec. T. R.

Indicate point of appropriation and place of use, if possible. Each small square represents 10 acres.

2. The beneficial use on which the claim is based. domestic and domestic irrigation

3. Date or approximate date of earliest beneficial use; and how continuous the use has been. June 1957, continuously used since that period.

4. The amount of groundwater claimed (in miner's inches or gallons per minute). between 700 and 800 gallons an hour.

5. If used for irrigation, give the acreage and description of the lands to which water has been applied and name of the owner thereof. domestic irrigation on SW 1/4 SW 1/4 Tract SE, Section 11, T. 36N. R. 27W.

6. The means of withdrawing such water from the ground and the location of each well or other means of withdrawal. Electric pump located NESW

7. The date of commencement and completion of the construction of the well, wells, or other works for withdrawal of groundwater. June 1957, completed in 1957.

8. The depth of water table. Well is down 134 feet, water stands in it 124 feet.

9. So far as it may be available, the type, size and depth of each well or the general specifications of any other works for the withdrawal of groundwater. 5 inch

10. The estimated amount of groundwater withdrawn each year. not logged

11. The log of formations encountered in the drilling of each well if available. top dirt, gravel, sand, clay

12. Such other information of a similar nature as may be useful in carrying out the policy of this act, including reference to book and page of any county record. mapped under the ASU office - Eureka District - Lincoln County, Montana.

Signature of Owner Norman C. Clark

Date December 31, 1963.

Three copies to be filed by the owner with the County Clerk and Recorder of the county in which the well is located.

Please answer all questions. If not applicable, so state, otherwise the form will be returned.

Original to the County Clerk and Recorder; Duplicate to the State Engineer; Triplicate to the Montana Bureau of Mines and Geology, and Quadruplicate for the Appropriator.

420

RECORDED

STATE OF MONTANA  
COUNTY OF LINCOLN

Filed this 31st day of  
December A. D. 1963  
at 12:04 P. M.  
M. M. Mansfield County Clerk.  
By Mae Watson Deputy



11

File No. ....

T. 36N R. 27

DUPLICATE

County Lincoln

STATE OF MONTANA  
ADMINISTRATOR OF GROUNDWATER CODE  
OFFICE OF STATE ENGINEER

RECEIVED  
OCT 28 1963  
STATE ENGINEER

Declaration of Vested Groundwater Rights

(Under Chapter 237, Montana Session Laws, 1961)

1. Rangie M. Broom of R. F. D. Box 65 Bursa  
(Name of Appropriator) (Address) (Town)

County of Lincoln State of Montana  
have appropriated groundwater according to the Montana laws in effect prior to January 1, 1962, as follows:

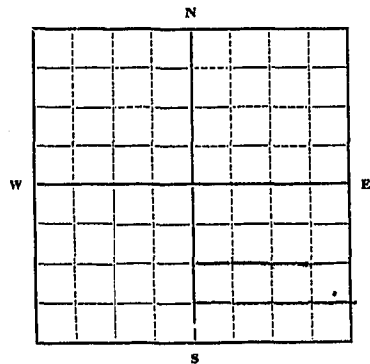

2. The beneficial use on which the claim is based.....  
household and stock water

3. Date or approximate date of earliest beneficial use; and how continuous the use has been. March 29th 1955

4. The amount of groundwater claimed (in miner's inches or gallons per minute) ~~x244~~ 500 miner's inches

5. If used for irrigation, give the acreage and description of the lands to which water has been applied and name of the owner thereof  
none

6. The means of withdrawing such water from the ground and the location of each well or other means of withdrawal.....  
Electric pump

S.E. 1/4 Sec. 11 T. 36 R. 27

Indicate point of appropriation and place of use, if possible. Each small square represents 10 acres.

7. The date of commencement and completion of the construction of the well, wells, or other works for withdrawal of groundwater..... Completion date March 29th 1955

8. The depth of water table..... 52 feet

9. So far as it may be available, the type, size and depth of each well or the general specifications of any other works for the withdrawal of groundwater..... drilled well, 6" diameter, depth 52 feet

10. The estimated amount of groundwater withdrawn each year..... 75,000 gallons

11. The log of formations encountered in the drilling of each well if available..... not available

12. Such other information of a similar nature as may be useful in carrying out the policy of this act, including reference to book and page of any county record..... no record

Signature of Owner Rangie M. Broom

Date Oct. 14th 1963

Three copies to be filed by the owner with the County Clerk and Recorder of the county in which the well is located.

Please answer all questions. If not applicable, so state, otherwise the form will be returned.

Original to the County Clerk and Recorder; duplicate to the State Engineer; Triplicate to the Montana Bureau of Mines and Geology, and Quadruplicate for the Appropriator.

6669

141

STATE OF MONTANA  
COUNTY OF LINCOLN

Filed this 18th day of  
October A. D. 1963.

M. P. Mendel  
County Clerk

By M. P. Mendel  
Deputy



File No. STATE WATER CONSERVATION BOARD

T. 36N R. 27W

DUPLICATE

MAY 1 1967

County Lincoln

LOG STATE OF MONTANA ADMINISTRATOR OF GROUNDWATER CODE OFFICE OF STATE ENGINEER

Top of Ground surface till (Elev. above sea level)

Notice of Completion of Groundwater Appropriation by Means of Well DEVELOPED AFTER JANUARY 1, 1962

(Under Chapter 237, Montana Session Laws, 1961)

Owner Kenneth Gwynn Address Bureka, Mont.

Driller Thatcher Drilling Co. Address Bureka, Mont.

Date of Notice of appropriation of groundwater July 20, 1965

Date well started July 7, 1965 Date completed July 29, 1965

Type of well Drilled Equipment used Rotary (Dug, Driven, Bored or drilled) (Churn drill, rotary or other)

Water use: Domestic Municipal Stock Irrigation Industrial Drainage Other Service Station

5' to 115' rocks, boulders, clay mixture. Brown in color

Indicate on the diagram the character and thickness of the strata met with in drilling, such as soil, clay, shale, gravel, rock or sand, etc. Show depth at which water is encountered, thickness and character of water-bearing strata and height to which the water rises in the well.

Table with columns: Size of Drilled Hole, Size and Weight of Casing, From (Feet), To (Feet), PERFORATIONS (Kind Size, From (Feet), To (Feet)).

115'

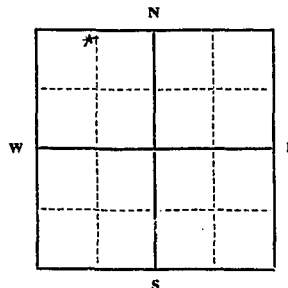

Static Water Level for non-flowing well 120 feet. Shut-in Pressure for Flowing Well. Pumping Water Level 160 feet at 20 gal. per minute. Discharge in gal. per min. of flowing well

115' to 175' Grey clay with a few boulders and sandy layers

How Tested: Barrier Length of Test: 6 hr. Remarks: (Gravel packing, cementing, packers, type of shutoff) Outer annulus or casing sealed off and packed with bentonite slurry 199 back to surface making positive water-tight seal

175'

175 to 205 brown clay and rocks

(Continue on reverse side)

205'

rocks and boulders (Water) Show exact depth of bottom.

215 bottom

USE—If used for irrigation, industrial, drainage or other. Explain, state number of acres and location or other data (i.e.: Lot, Block and Addition).

This form to be prepared by driller, and three copies to be filed by the owner with the County Clerk and Recorder in the county in which the well is located, tissue copy to be retained by driller.

Please answer all questions. If not applicable, so state, otherwise the form will be returned.

36 Driller's License Number

Edmund Thatcher Driller's Signature

411949

RECEIVED BY THE COUNTY CLERK

*[Faint, mostly illegible text, possibly a list or schedule]*

581

*[Handwritten notes, possibly "April 24th"]*

STATE OF MONTANA  
COUNTY OF LINCOLN

Filed this 24th day of April A. D. 1897

at 10:05 P. M.  
Edward L. Vaughn  
County Clerk

By Mac Watson  
Deputy

STATE OF MONTANA  
ADMINISTRATOR OF GROUNDWATER CODE  
MONTANA WATER RESOURCES BOARD

RECEIVED

DEC 16 1970

DRILLER'S LOG

Indicate the character, color, thickness of strata such as soil, clay, sand, gravel, shale, sandstone, etc. Show depth at which water is found and height to which water rises in well.

NOTICE OF COMPLETION OF GROUNDWATER APPROPRIATION BY MEANS OF WELL

Developed after January 1, 1962

(Under Chapter 237 Montana Session Laws, 1961, as amended)

This form to be prepared by driller, and three copies to be filed by the owner with the County Clerk and Recorder in the county in which the well is located, last copy to be retained by driller.

Please answer all questions. If not applicable, so state, otherwise the form may be returned.

Owner: Gwynn Inc  
Kosnik Motor Inc

Address: Barcks, Montana

Date well started: 9-24  
completed: 10-7-70

Type of well: Drilled  
(Dug, driven, bored or drilled)

Equipment used: Churn  
(Churn drill, rotary or other)

Water Use: Domestic  Municipal  Stock  Irrigation   
Industrial  Drainage  Other \* Garden/Lawn

For Administrator's Use

File: 7.6.2  
December 9, 1970  
2:26 P.M.

GW 1

Top of Ground (Elev. above sea level)		
From (Feet)	To (Feet)	
0	10	Gravel w/ silt
10	50	Gravel & Boulders
50	93	Dry Silty Sand & Gravel
93	104	Gravel
104	124	Sand & Pea Gravel
124	126	Sand & Pea Gravel (trace of water)
126	145	Silty Sand
145	158	White Silt
158	168	White Clay w/ gravel
168	172	Boulder
172	182	Fine Silty Sand
182	190	Blue Clay
190	200	Grey Silt
200	204	Fine Silty Sand
204	214	Boulders
214	218	Hard Sandstone
218	219	Silty Clay
219	224	Sand & Gravel
224	230	Gravel & Silty Sand
230	245	Silty Sand (water will not clear)
245	250	Pea Gravel

\*Describe  
USE: If used for irrigation, industrial, drainage or other. Explain, state number of acres and location or other data (i.e. Lot, Block and Addition).

ESTIMATED ANNUAL WITHDRAWAL

Size of Drilled Hole	Size and Weight of Casing	From (Feet)	To (Feet)	PERFORATIONS		
				Kind Size	From (Feet)	To (Feet)
6 5/8"	6 5/8" 17#	0	250	1/2" rd	245	250

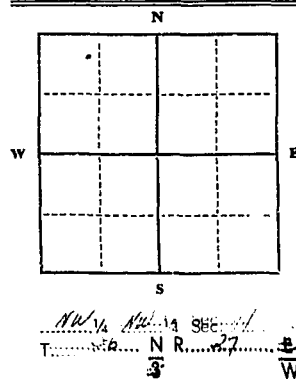

Static water level ..... 125 .....ft.\*  
Pumping water level ..... 150 .....ft.\*  
at ..... 35 .....gallons per minute,  
measured ..... 30 .....minutes after pumping began.  
\*Measured from ground level.  
Well developed by ..... batter .....  
for ..... 4 .....hours.  
Power: ..... 4 ..... Pump ..... HP  
Remarks: (Gravel packing, cementing, packers, type of shutoff) ..... Gravel packed w/ 3/4" gravel from 250 to 235'

INDICATE LOCATION OF WELL AND PLACE OF USE, IF POSSIBLE. EACH SMALL SQUARE REPRESENTS 40 ACRES.

Driller's Signature: Clifford J. Bucker  
Driller's Address: 3 & 1 Plumbing & Heating, Inc.

Box 1, Libby, Montana LICENSE NO. 141

Show exact depth of bottom 250'

417912

762

STATE OF MONTANA  
COUNTY OF LINCOLN  
Filed this 9<sup>th</sup> day of  
December A. D. 1970  
at 2:30 P. M.  
Clayton L. Baugh  
County Clerk  
By Mae Watson  
Deputy

File No. ....

T. 36 N. R. 27 W.

DUPLICATE

County Lincoln

STATE OF MONTANA  
ADMINISTRATOR OF GROUNDWATER CODE  
OFFICE OF STATE ENGINEER

RECEIVED  
JAN 27 1964  
STATE ENGINEER

Declaration of Vested Groundwater Rights

(Under Chapter 237, Montana Session Laws, 1961)

1. Ervin Kinney of Bureka  
(Name of Appropriator) (Address)  
County of Lincoln State of Montana (Town)  
have appropriated groundwater according to the Montana laws in effect prior to January 1, 1962, as follows:

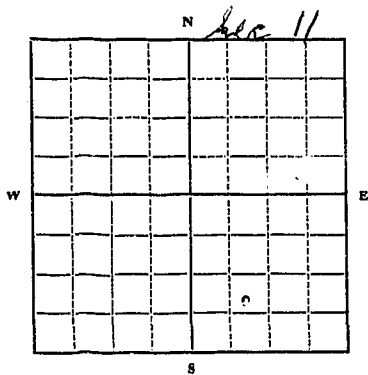

E/S.W. 1/4 Sec. 11 T.36 R.27  
Point of appropriation  
and place of use, if possible.  
Each small square represents 10  
acres.

2. The beneficial use on which the claim is based.....  
Domestic use

3. Date or approximate date of earliest beneficial use; and how con-  
tinuous the use has been..... October 1960

4. The amount of groundwater claimed (in miner's inches or gallons  
per minute)..... 10 miner's inches per minute

5. If used for irrigation, give the acreage and description of the lands  
to which water has been applied and name of the owner thereof  
not applicable

6. The means of withdrawing such water from the ground and the  
location of each well or other means of withdrawal.....  
electric pump

7. The date of commencement and completion of the construction of the well, wells, or other works for with-  
drawal of groundwater..... October 1960

8. The depth of water table..... five feet

9. So far as it may be available, the type, size and depth of each well or the general specifications of any other  
works for the withdrawal of groundwater..... dug well, 36 inch casing, 12 feet deep

10. The estimated amount of groundwater withdrawn each year..... 54,750 gal.

11. The log of formations encountered in the drilling of each well if available. not available

12. Such other information of a similar nature as may be useful in carrying out the policy of this act, including  
reference to book and page of any county record.....

Signature of Owner Ervin L. Kinney  
Date 12-17-63

Three copies to be filed by the owner with the County Clerk and Recorder of the county in which the well is  
located.

Please answer all questions. If not applicable, so state, otherwise the form will be returned.

Original to the County Clerk and Recorder; duplicate to the State Engineer; Triplicate to the Montana Bureau  
of Mines and Geology, and Quadruplicate for the Appropriator.

227-XXXX

STATE OF MONTANA  
COUNTY OF LINCOLN  
Filed this 22<sup>nd</sup> day of  
December A. D. 1963  
at 12:00 P. M.  
M. M. Mansfield  
County Clerk  
By W. E. Nelson  
Deputy

RECEIVED  
DEC 15 1958

STATE ENGINEER MONTANA BUREAU OF MINES AND GEOLOGY  
Butte, Montana

T. 36 N R. 27 W MPM 11  
County Lincoln

RECEIVED  
NOV 17 1958  
FAS

WATER WELL LOG

Sec. 11

X		

Owner: Eureka Ranger Station Address: Eureka, Mont.  
 Administration site  
 Driller: Homer McClary Address: Kelispell  
 Date Started: Oct. 7, 1958 Date Completed: Nov. 7, 1958

Location: Sec. 11 T. 36 N R. 27 W 1/4 sec. NW 1/4 SW 1/4

Type of well: drilled Equipment used: 22 W  
(Dug, driven, bored, or drilled) (Churn drill, rotary, other)

Water use: Domestic  Municipal  Stock  Irrigation

Industrial  Drainage  Other: Ranger Station

Casing: 2 1/2 ft. to 98 ft. Type: thread + collar, welded Size: 8"

Casing: ft. to ft. Type: Size:

Casing: ft. to ft. Type: Size:

Perforated or Screened: Ft. 8 to ft. Ft. to ft.

Type of screen or perforations:

Static Water level, for non-flowing well: 70 ft. feet.

Shut-in pressure, for flowing well: 29 lb./sq. in. on: (date)

Pumping water level: feet at gal. per min. 65

How tested: Pump

Length of test: approx 8 hrs

Remarks: (Gravel packing, cementing, packers, type of shut-off, depth of shut-off)





File No. Book 51 Page 599-600

T. 36N P. 27W

ORIGINAL Lincoln Co. - Montana

County Lincoln

STATE OF MONTANA  
ADMINISTRATOR OF GROUNDWATER CODE  
OFFICE OF STATE ENGINEER

DECLARATION OF VESTED GROUNDWATER RIGHTS  
(Under Chapter 237, Montana Session Laws, 1961)

RECEIVED

1. United States of America

Buraka Ranger Station  
Buraka, Montana

(Name of Appropriator)

(Address)

(Town)

County of Lincoln

State of Montana

STATE ENGINEER

have appropriated groundwater according to the Montana laws in effect prior to January 1, 1962, as follows:

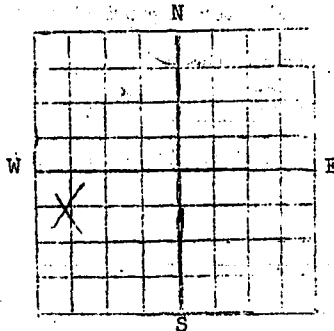

SW 1/4 Sec. 14 T36R27  
Indicate point of appropriation and place of use, if possible. Each small square represents 10 acres.

2. The beneficial use on which the claim is based Domestic use

3. Date or approximate date of earliest beneficial use; and how continuous the use has been October 1959 - Use has been continuous since then.

4. The amount of groundwater claimed (in miner's inches or gallons per minute) 65 gallon per minute from 8" ID casing maximum 2 gallons per minute average.

5. If used for irrigation, give the acreage and description of the lands to which water has been applied and name of the owner thereof Lands only approximately 2 acres.

6. The means of withdrawing such water from the ground and the location of each well or other means of withdrawal 5 HP electric motor with deep well turbine pump. NW 1/4 SW 1/4 Section 11, T36N, R27W.

7. The date of commencement and completion of the construction of the well, wells, or other works for withdrawal of groundwater. Well started 10/7/58  
Well completed 11/7/58

8. The depth of water table 96 feet

9. So far as it may be available, the type, size and depth of each well or the general specifications of any other works for the withdrawal of groundwater Depth of well - 104 ft., Static Level - 78 ft., Draw Down - 5 1/2 ft. @ 65 GPM. Draw down - 4 1/2 ft. @ 30 GPM., 8" ID casing down 98 ft. - casing weighs 29#/ft. Casing is 2 ft. above ground. Screens set at 104 ft. and is open to 98 ft.

10. The estimated amount of groundwater withdrawn each year Enough water for the equivalent of four residences and yard irrigation - 1,051,000 gallons

11. The log of formations encountered in the drilling of each well if available Clay and coarse gravel to 36 ft., clay and sand - 36 to 49 ft., Hard pan and Cement Gravel - 49-64 ft., Hard Pan, light brown color, 64-78 ft., Gravel and Sand - 78-85 ft., Coarse sand and water - 85-98 ft., No water to 96 feet. Coarse sand and gravel - good water - 96-103 ft. Water shut off at 106 ft. is into clay formation.

12. Such other information of a similar nature as may be useful in carrying out the policy of this act, including reference to book and page of any county record Recorded, Lincoln County, Libby, Montana Book 51  
Page 599 600

[Signature] Forest Supervisor  
Kootenai National Forest  
Signature of Owner Libby, Montana  
Date 3-5-62

Three copies to be filed by the owner with the County Clerk and Recorder of the \_\_\_\_\_ county in which the well is located.

Please answer all questions. If not applicable, so state, otherwise the form will be returned.

Original to the County Clerk and Recorder; duplicate to the State Engineer; Triplicate to the School of Mines and Quadruplicate for the Appropriator.

STATE OF MONTANA

County of Lincoln

ss.

J.E. Sanderson representing the United States having first been duly sworn, depose and says that he is of lawful age and represents the appropriator \_\_\_\_\_ and claimant \_\_\_\_\_ of the order and water right mentioned in the foregoing declaration of vested groundwater rights and the person \_\_\_\_\_ whose name is subscribed thereto, as representative of the appropriator \_\_\_\_\_ and claimant \_\_\_\_\_, that he knows the contents of said foregoing notice and that the matters and things therein stated are true.

J. Sanderson  
\_\_\_\_\_  
Act. Forest Supervisor  
Kootenai National Forest  
Libby, Montana

Subscribed and sworn to before me, this 6 day of March, 19 62

\_\_\_\_\_  
Notary Public for the State of Montana  
Residing at Libby, Montana  
My Commission expires July 6 19 62

File No. ....

GW 4

T. 36 N R. 27 W  
County Lincoln

STATE OF MONTANA  
ADMINISTRATOR OF GROUNDWATER CODE  
OFFICE OF STATE ENGINEER

JAN 27 1964

Declaration of Vested Groundwater Rights STATE ENGINEER

(Under Chapter 237, Montana Session Laws, 1961)

1. RODNEY D. WITT AND SHIRLEY V. WITT of Box 302 WHITEISH  
(Name of Appropriator) (Address) (Town)

County of FLATHEAD State of MONTANA  
have appropriated groundwater according to the Montana laws in effect prior to January 1, 1962, as follows:

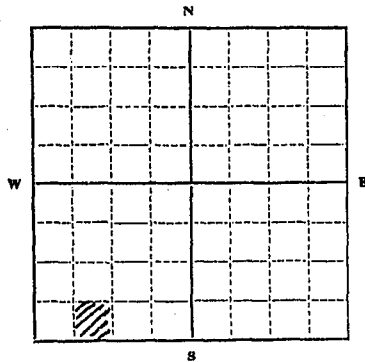

SE 1/4 SW 1/4 Sec. 11 T. 36 R. 27

Indicate point of appropriation and place of use, if possible. Each small square represents 10 acres.

2. The beneficial use on which the claim is based HOUSEHOLD

3. Date or approximate date of earliest beneficial use; and how continuous the use has been AUGUST 1, 1953, CONTINUOUS

4. The amount of groundwater claimed (in miner's inches or gallons per minute) 500 GALLONS PER HOUR

5. If used for irrigation, give the acreage and description of the lands to which water has been applied and name of the owner thereof

6. The means of withdrawing such water from the ground and the location of each well or other means of withdrawal ELECTRIC PUMP; TRACT IN SE 1/4 SW 1/4, Sec. 11, T36N, R27W, LINCOLN COUNTY, MONTANA; N. 645' W. 295' S. 635' E 380', 5 ACRE, T-50

7. The date of commencement and completion of the construction of the well, wells, or other works for withdrawal of groundwater JULY 15, 1953 COMPLETED BASIN JULY 11, 1953

8. The depth of water table 84'

9. So far as it may be available, the type, size and depth of each well or the general specifications of any other works for the withdrawal of groundwater WELL, 84' DEEP, CASED

10. The estimated amount of groundwater withdrawn each year 200,000 GALLONS

11. The log of formations encountered in the drilling of each well if available SAND, CLAY AND GRAVEL

12. Such other information of a similar nature as may be useful in carrying out the policy of this act, including reference to book and page of any county record WELL DRILLER'S REPORT FILED WITH MONTANA STATE BOARD OF HEALTH, HELENA, MONTANA SEPTEMBER 12, 1953

Signature of Owner Rodney D. Witt  
Shirley V. Witt

Date DECEMBER 28, 1963

Three copies to be filed by the owner with the County Clerk and Recorder of the county in which the well is located.

Please answer all questions. If not applicable, so state, otherwise the form will be returned.

Original to the County Clerk and Recorder; duplicate to the State Engineer; Triplicate to the Montana Bureau of Mines and Geology and Quadruplicate for the Appropriator.

287

STATE OF MONTANA  
COUNTY OF LINCOLN

Filed this 30th day of  
December A. D. 1963

at 11:35 A. M.  
M. M. Mansfield  
County Clerk.

By W. E. Watson  
Deputy

File No. ....

T. 36N R. 27W

DUPLICATE

STATE WATER CONSERVATION BOARD

County Lincoln

LOG

JAN 5 1967

STATE OF MONTANA  
ADMINISTRATOR OF GROUNDWATER CODE  
OFFICE OF STATE ENGINEER

5  
32  
25  
39  
58  
71  
120  
731  
143  
144  
150  
161  
211  
229  
BOTTOM

Top of Ground Billie \_\_\_\_\_ McDermott \_\_\_\_\_  
**OVERBURDEN** Butzerin \_\_\_\_\_ McNelly \_\_\_\_\_  
(Elev. above sea level Coyte \_\_\_\_\_) Marston \_\_\_\_\_  
**COARSE GRAVEL CLAY** Darlington \_\_\_\_\_ Sullivan \_\_\_\_\_  
**ROCKS + BOULDERS**  
**SANDY CLAY**  
**ROUGH ROCKS + BOULDERS**  
**HARD CLAY**  
**SOFT GREY CLAY**  
**FINE BROWN SAND**  
**LAYERS OF ROCK, BOULDERS**  
**+ HARD SANDSTONE**  
**VERY SOFT SAND**  
**HARD ROCKS + FORMATION**  
**LAYERS OF SOFT CLAY**  
**+ GRAVEL**  
**HARD GREY CLAY**  
**VERY HARD BROKEN SHALE**  
**+ GRAVEL (WATER)**  
**BOTTOM**

### Notice of Completion of Groundwater Appropriation by Means of Well

DEVELOPED AFTER JANUARY 1, 1962  
(Under Chapter 237, Montana Session Laws, 1961)

Owner THATCHER DRILLING CO Address EUREKA, MONT.  
Driller THATCHER DRILLING CO Address EUREKA, MONT.  
Date of Notice of appropriation of groundwater NOV. 1, 1966  
Date well started SEPT. 13, 1966 Date completed NOV. 10, 1966  
Type of well DRILLED Equipment used ROTARY  
(Dug, Driven, bored or drilled) (Churn drill, rotary or other)  
Water use: Domestic  Municipal  Stock  Irrigation   
Industrial  Drainage  Other

Indicate on the diagram the character and thickness of the different strata met with in drilling, such as soil, clay, shale, gravel, rock or sand, etc. Show depth at which water is encountered, thickness and character of water-bearing strata and height to which the water rises in the well.

Size of Drilled Hole	Size and Weight of Casing	From (Feet)	To (Feet)	PERFORATIONS		
				Kind Size	From (Feet)	To (Feet)
7 7/8	6" 13#	0	143			
	5" 12#	140	229	1/4" X 4" SLOTS	211	229

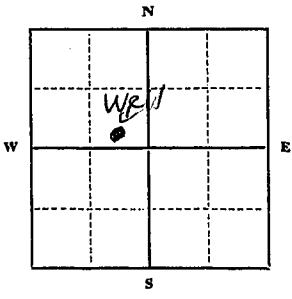

Static Water Level for non-flowing well ..... 76 feet.  
Shut-in Pressure for Flowing Well.....  
Pumping Water Level..... 145 feet  
at..... 13 gal. per minute.  
Discharge in gal. per min. of flowing well .....

How Tested..... BAILER  
Length of Test..... 6 HRS  
Remarks: (Gravel packing, cementing, packers, type of shutoff)..... CASING  
ANNULUS SEALED WITH  
COMMERCIAL BENTONITE

SE 1/4 NW 1/4 Sec. 11 T. 36N R. 27W  
Indicate location of well and place of use, if possible. Each small square represents 40 acres.

(Continue on reverse side)

USE—If used for irrigation, industrial, drainage or other. Explain, state number of acres and location or other data (i.e.: Lot, Block and Addition).

Show exact depth of bottom.

This form to be prepared by driller, and three copies to be filed by the owner with the County Clerk and Recorder in the county in which the well is located, tissue copy to be retained by driller.

Please answer all questions. If not applicable, so state, otherwise the form will be returned.

86  
Driller's License Number  
Edward Thatcher  
Driller's Signature

41606

INDEXED

591

STATE OF MONTANA  
COUNTY OF LINCOLN

Filed this 20th day of

December A. D. 1906

at 2:15

By Calvin P. Laughlin County Clerk

Mac Watson Deputy

1888  
 COUNTY (MILLS)  
 1889  
 1890  
 1891  
 1892  
 1893  
 1894  
 1895  
 1896  
 1897  
 1898  
 1899  
 1900  
 1901  
 1902  
 1903  
 1904  
 1905  
 1906  
 1907  
 1908  
 1909  
 1910  
 1911  
 1912  
 1913  
 1914  
 1915  
 1916  
 1917  
 1918  
 1919  
 1920  
 1921  
 1922  
 1923  
 1924  
 1925  
 1926  
 1927  
 1928  
 1929  
 1930  
 1931  
 1932  
 1933  
 1934  
 1935  
 1936  
 1937  
 1938  
 1939  
 1940  
 1941  
 1942  
 1943  
 1944  
 1945  
 1946  
 1947  
 1948  
 1949  
 1950  
 1951  
 1952  
 1953  
 1954  
 1955  
 1956  
 1957  
 1958  
 1959  
 1960  
 1961  
 1962  
 1963  
 1964  
 1965  
 1966  
 1967  
 1968  
 1969  
 1970  
 1971  
 1972  
 1973  
 1974  
 1975  
 1976  
 1977  
 1978  
 1979  
 1980  
 1981  
 1982  
 1983  
 1984  
 1985  
 1986  
 1987  
 1988  
 1989  
 1990  
 1991  
 1992  
 1993  
 1994  
 1995  
 1996  
 1997  
 1998  
 1999  
 2000  
 2001  
 2002  
 2003  
 2004  
 2005  
 2006  
 2007  
 2008  
 2009  
 2010  
 2011  
 2012  
 2013  
 2014  
 2015  
 2016  
 2017  
 2018  
 2019  
 2020  
 2021  
 2022  
 2023  
 2024  
 2025  
 2026  
 2027  
 2028  
 2029  
 2030  
 2031  
 2032  
 2033  
 2034  
 2035  
 2036  
 2037  
 2038  
 2039  
 2040  
 2041  
 2042  
 2043  
 2044  
 2045  
 2046  
 2047  
 2048  
 2049  
 2050  
 2051  
 2052  
 2053  
 2054  
 2055  
 2056  
 2057  
 2058  
 2059  
 2060  
 2061  
 2062  
 2063  
 2064  
 2065  
 2066  
 2067  
 2068  
 2069  
 2070  
 2071  
 2072  
 2073  
 2074  
 2075  
 2076  
 2077  
 2078  
 2079  
 2080  
 2081  
 2082  
 2083  
 2084  
 2085  
 2086  
 2087  
 2088  
 2089  
 2090  
 2091  
 2092  
 2093  
 2094  
 2095  
 2096  
 2097  
 2098  
 2099  
 2100

GW 2

Approved Stock Form—State Publishing Co., Helena, Montana—42329

File No. ....

MONTANA WATER RESOURCES BOARD

T. 36 N. R. 27 W

DUPLICATE

RECEIVED

County Lincoln

LOG

APR 1 1968

STATE OF MONTANA  
ADMINISTRATOR OF GROUNDWATER CODE  
OFFICE OF STATE ENGINEER

0 Top of Ground  
(Elev. above sea level \_\_\_\_\_)

10 Sandy clay

16 Soft brown clay

24 Hard clay & boulders

31 Coarse sand

42 Layers of gravel, clay & rocks

55 Sandy clay

66 Hard clay & rocks

69 Boulders

81 Various layers of sand

87 Rocks & boulders

111 Very hard clay & boulders

113 1/2 Boulders & gravel (Water)

137 Various clay layers

141 Rough rocks & gravel (Water)

bottom

Show exact depth of bottom.

### Notice of Completion of Groundwater Appropriation by Means of Well

DEVELOPED AFTER JANUARY 1, 1962

(Under Chapter 237, Montana Session Laws, 1961)

Owner: Thatcher Drilling Co. Address:ureka, Mont.

Driller: Thatcher Drilling Co. Address:ureka, Mont.

Date of Notice of appropriation of groundwater: Sept. 12, 1967

Date well started: Aug. 20, 1967 Date completed: Sept. 3, 1967

Type of well: Drilled (Dug, Driven, bored or drilled) Equipment used: Rotary (Churn drill, rotary or other)

Water use: Domestic  Municipal  Stock  Irrigation   
Industrial  Drainage  Other

Indicate on the diagram the character and thickness of the different strata met with in drilling, such as soil, clay, shale, gravel, rock or sand, etc. Show depth at which water is encountered, thickness and character of water-bearing strata and height to which the water rises in the well.

Size of Drilled Hole	Size and Weight of Casing	From (Feet)	To (Feet)	PERFORATIONS		
				Kind Size	From (Feet)	To (Feet)
7 7/8	5" ID 13#	0	111	Slots 1/2" X 1/4"	111 131	113 1/2 111

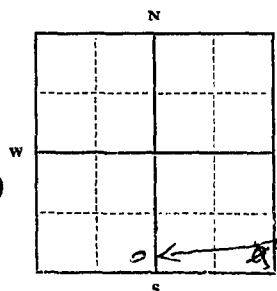

Static Water Level for non-flowing well ..... 10 feet.

Shut-in Pressure for Flowing Well.....

Pumping Water Level..... 15 feet at ..... 25 gal. per minute.

Discharge in gal. per min. of flowing well .....

How Tested..... Bailed

Length of Test..... 3 hours

Remarks: (Gravel packing, cementing, packers, type of shutoff).....

SW 1/4, Sec. 11, T. 36 N. R. 27 W. Casing annulus sealed w/ commercial bentonite.

(Continue on reverse side)

USE—If used for irrigation, industrial, drainage or other. Explain, state number of acres and location or other data (i.e.: Lot, Block and Addition).

This form to be prepared by driller, and three copies to be filed by the owner with the County Clerk and Recorder in the county in which the well is located, tissue copy to be retained by driller.

Please answer all questions. If not applicable, so state, otherwise the form will be returned.

Driller's Name & Number

Driller's Signature

for Thatcher Drilling Co.

44,015

62-6

STATE OF MONTANA  
COUNTY OF LINCOLN

Filed this 27th day of March A. D. 1928  
at 1:45 P. M.  
By Charles L. Veeder County Clerk  
Verde J. Taylor Deputy

RECORDED

INDEXED

APR 1 1928

APR 1 1928

APR 1 1928

APR 1 1928

APR 1 1928

APR 1 1928

APR 1 1928

APR 1 1928

APR 1 1928

APR 1 1928

APR 1 1928

APR 1 1928



STATE WATER CONSERVATION BOARD

File No. ....

SEP 29 1966

T 36 R 27

DUPLICATE

Billie \_\_\_\_\_ McDermott \_\_\_\_\_  
Burr \_\_\_\_\_ McNulty \_\_\_\_\_  
Coble \_\_\_\_\_ Morton \_\_\_\_\_  
Darlington \_\_\_\_\_ Sullivan \_\_\_\_\_  
Dickert \_\_\_\_\_

County Lincoln

STATE OF MONTANA  
ADMINISTRATOR OF GROUNDWATER CODE  
OFFICE OF STATE ENGINEER

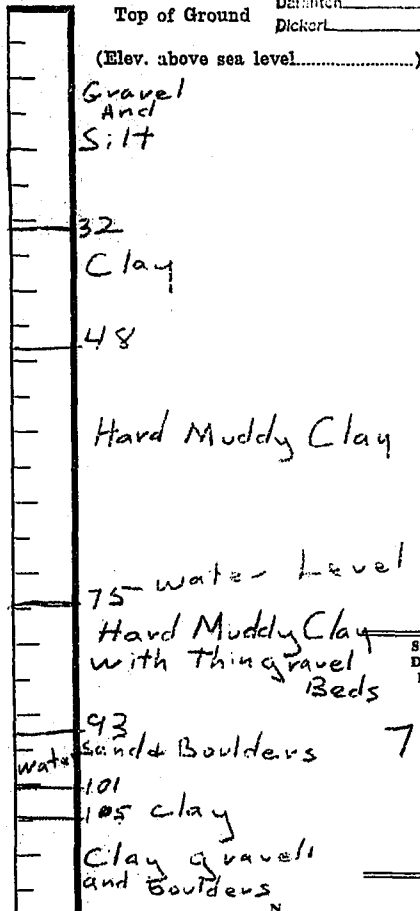

Notice of Completion of Groundwater Appropriation by Means of Well

(Under Chapter 237, Montana Session Laws, 1961)

Owner William H. & Margaret H. Bolea  
Bolens Trailer Park Address Evreka

Driller Thatcher Drilling Co. Address Evreka

Date of Notice of Appropriation of Groundwater July 7, 1966

Date well started June 3, 1966 Date Completed July 7, 1966

Type of well Drilled Equipment Used Rotary  
(dug, driven, bored or drilled) (Churn, drill, rotary or other)

Water Use: Domestic  Municipal  Other  Irrigation   
Industrial  Drainage  Stock

Indicate on the diagram the character and thickness of the different strata met with in drilling, such as soil, clay, shale, gravel, rock or sand, etc. Show depth at which water is encountered, thickness and character of water-bearing strata and height to which water rises in the well.

Size of Drilled Hole	Size and Weight of Casing	From (Feet)	To (Feet)	PERFORATIONS		
				Kind Size	From (Feet)	To (Feet)
7 7/8	6" 17#	0	107' 10"	1/2" x 4"	6" Stainl Screen	93-10' 6"

Static Water Level for non-flowing Well 75 feet.

Shut-in Pressure for Flowing Well \_\_\_\_\_

Pumping Water Level 90 feet at 18 gal. per minute.

Discharge in gal. per min. of flowing well \_\_\_\_\_

How Tested Boiler test pump Length of Test 10 hrs.

Remarks: (Gravel packing, cementing, packers, type of shutoff, location of place of use of groundwater if not at well, and any other similar pertinent information, including number of acres irrigated, if used for irrigation) Set 6"

Nominal screen Stainless with 20 thousands 5' 10" Hs. 93-10' 6"

1/4 Sec. 11 T 36 R 21  
Indicate location of well and place of use, if possible. Each small square represents 10 acres.

Show exact depth of bottom.

86  
Driller's License Number  
Edward Thatcher  
Driller's Signature

This form to be prepared by driller and three copies to be filed by the owner with the County Clerk and Recorder in the county in which the well is located.

Please answer all questions. If not applicable, so state, otherwise the form will be returned.

Original to the County Clerk and Recorder; duplicate to the State Engineer; Triplicate to the Montana Bureau of Mines and Geology and Quadruplicate for the Appropriator.

41, 448

562

STATE OF MONTANA  
COUNTY OF LINCOLN

Filed this 26th day of  
September A. D. 1966

at 9:45 A. M.  
Edward L. Hughes  
County Clerk.

By Mar Watson  
Deputy

RECEIVED

County Lincoln

12

STATE OF MONTANA  
ADMINISTRATOR OF GROUNDWATER CODE  
MONTANA WATER RESOURCES BOARD

AUG 21 1972

DRILLER'S LOG

NOTICE OF COMPLETION OF GROUNDWATER  
APPROPRIATION BY MEANS OF WELL

Developed after January 1, 1962

Indicate the character, color, thickness of strata such as soil, clay, sand, gravel, shale, sandstone, etc. Show depth at which water is found and height to which water rises in well.

(Under Chapter 237 Montana Session Laws, 1961, as amended)

This form to be prepared by driller, and three copies to be filed by the owner with the County Clerk and Recorder in the county in which the well is located, last copy to be retained by driller.

Please answer all questions. If not applicable, so state, otherwise the form may be returned.

Owner Rogers Well & Delores E.

Address 5 Eureka

Montana

Date well started Sept 19, 1971

completed Sept 20, 1971

Type of well Drilled

Equipment used Churn

Water Use: Domestic  Municipal  Stock  Irrigation   
Industrial  Drainage  Other  Garden/Lawn

\*Describe  
USE: If used for irrigation, industrial, drainage or other. Explain, state number of acres and location or other data (i.e. Lot, Block and Addition).

ESTIMATED ANNUAL WITHDRAWAL

Size of Drilled Hole	Size and Weight of Casing	From (Feet)	To (Feet)	PERFORATIONS		
				Kind Size	From (Feet)	To (Feet)
7"	6 3/8 19 16. pack foot	Top	133	/		

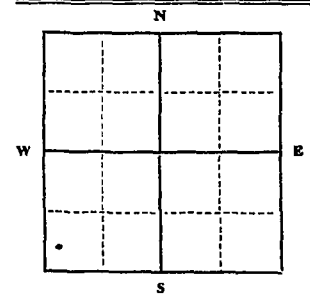

Static water level 100 ft.\*  
Pumping water level 117 ft.\*  
at 12 gallons per minute, measured 120 minutes after pumping began.  
\*Measured from ground level.  
Well developed by hand for 3 hours.  
Power 1/2 HP  
Remarks: (Gravel packing, cementing, packers, type of shutoff)

SW 1/4 SW 1/4 Sec 12  
T. 36 N. R. 27 E

INDICATE LOCATION OF WELL AND PLACE OF USE, IF POSSIBLE. EACH SMALL SQUARE REPRESENTS 40 ACRES.

Driller's Signature David J. Bellmeyer

Driller's Address Rt. 1, Park, Montana 59711

LICENSE NO. 5

Top of Ground (Elev. above sea level)		
From (Feet)	To (Feet)	
0	4	Top Soil
4	11	Gray Clay and Rock
11	42	Gray Clay
42	54	Gravel and Rock
54	97	Heavy Clay Small amount gravel
97	120	Sand and Clay
120	129	Sand and Water
129	133	Gravel and Water

133' Show exact depth of bottom

51,200

# 892

STATE OF MONTANA  
COUNTY OF LINCOLN

Filed this 9<sup>th</sup> day of

August A. D. 1922

at 10:35 P. M.  
Edward R. Vaughn  
County Clerk

By \_\_\_\_\_ Deputy

RECEIVED

FEB 3 1972

County Lincoln

STATE OF MONTANA  
ADMINISTRATOR OF GROUNDWATER CODE  
MONTANA WATER RESOURCES BOARD

MONTANA DEPARTMENT OF NATURAL RESOURCES  
GROUNDWATER CONSERVATION

DRILLER'S LOG

Indicate the character, color, thickness of strata such as soil, clay, sand, gravel, shale, sandstone, etc. Show depth at which water is found and height to which water rises in well.

NOTICE OF COMPLETION OF GROUNDWATER APPROPRIATION BY MEANS OF WELL

Developed after January 1, 1962

(Under Chapter 237 Montana Session Laws, 1961, as amended)

This form to be prepared by driller, and three copies to be filed by the owner with the County Clerk and Recorder in the county in which the well is located, last copy to be retained by driller. Please answer all questions. If not applicable, so state, otherwise the form may be returned.

Owner Dean Evans

Address Evans

Mont

Date well started 12-13-71

completed 12-20-71

For Administrator's Use	
File	<u>839 Jan 31, 1972</u>
	<u>10:05 a.m.</u>
GW	<u>1</u>

Type of well Drilled  
(Dug, driven, bored or drilled)

Equipment used Churn Drill  
(Churn drill, rotary or other)

Water Use: Domestic  Municipal  Stock  Irrigation   
Industrial  Drainage  Other \* Garden/Lawn

\*Describe \_\_\_\_\_  
USE: If used for irrigation, industrial, drainage or other. Explain, state number of acres and location or other data (i.e. Lot, Block and Addition). \_\_\_\_\_

ESTIMATED ANNUAL WITHDRAWAL

Size of Drilled Hole	Size and Weight of Casing	From (Feet)	To (Feet)	PERFORATIONS		
				Kind Size	From (Feet)	To (Feet)
<u>6" OD</u>	<u>6" 17# + 2"</u>	<u>120</u>		<u>1 1/2" 114</u>	<u>120</u>	

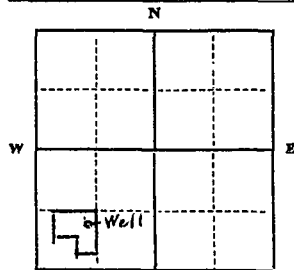

SW 1/4 SW 1/4 Sec. 12  
T. 36 N. R. 27 W.

Static water level 90 ft.\*  
Pumping water level 92 ft.\*  
at 15 gallons per minute,  
measured \_\_\_\_\_ minutes after pumping began.

\*Measured from ground level.  
Well developed by Baling  
for 7 hours.

Power \_\_\_\_\_ Pump \_\_\_\_\_ HP  
Remarks: (Gravel packing, cementing, packers, type of shutoff) \_\_\_\_\_

Dr. G. W. P. 115-120'  
74 C.T. 125

INDICATE LOCATION OF WELL AND PLACE OF USE, IF POSSIBLE. EACH SMALL SQUARE REPRESENTS 40 ACRES.

Driller's Signature Donald J. ...

Driller's Address Gold Brick Drilling Co.

Evans, Mont LICENSE NO. 232

Top of Ground (Elev. above sea level)		
From (Feet)	To (Feet)	
<u>0</u>	<u>4</u>	<u>Top Soil</u>
<u>4</u>	<u>15</u>	<u>Sandy clay</u>
<u>15</u>	<u>40</u>	<u>Sandy gravel</u>
<u>40</u>	<u>100</u>	<u>Sandy silt</u>
<u>100</u>	<u>120</u>	<u>Very fine sand</u>

120 Show exact depth of bottom

49,813

839

STATE OF MONTANA  
COUNTY OF LINCOLN

Filed this 31st day of January 1992  
at Clanton, Lincoln Co., Mont.  
By Mae Watson Clerk

File No. ....

T. 36 N. R. 22 West

DUPLICATE

County LINCOLN

STATE OF MONTANA  
ADMINISTRATOR OF GROUNDWATER CODE  
OFFICE OF STATE ENGINEER

RECEIVED  
MAY 22 1964  
STATE ENGINEER

Top of Ground  
(Elev. above sea level 2610 APPROX)

### Notice of Completion of Groundwater Appropriation by Means of Well

(Under Chapter 237, Montana Session Laws, 1961)

Owner Leonard Dean Evins Address Eureka, Montana

Driller Dale Hudson Address Eureka, Montana

Date of Notice of Appropriation of Groundwater 12 June 1963

Date well started 4 May 1963 Date Completed 18 June 1963

Type of well drilled Equipment Used churn drill  
(dug, driven, bored or drilled) (Churn, drill, rotary or other)

Water Use: Domestic  Municipal  Other  Irrigation   
Industrial  Drainage  Stock

Indicate on the diagram the character and thickness of the different strata met with in drilling, such as soil, clay, shale, gravel, rock or sand, etc. Show depth at which water is encountered, thickness and character of water-bearing strata and height to which water rises in the well.

SOIL  
CLAY  
CLAY  
GRAVEL  
ROCK  
CLAY  
GRAVEL  
SAND

Size of Drilled Hole	Size and Weight of Casing	From (Feet)	To (Feet)	PERFORATIONS		
				Kind Size	From (Feet)	To (Feet)
6 inches	6 inches	same	same	torch cut slots	1 foot	7 feet

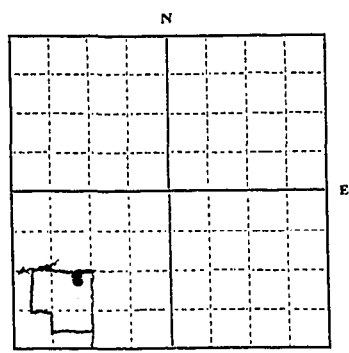

Static Water Level for non-flowing Well 40 feet feet.

Shut-in Pressure for Flowing Well unknown

Pumping Water Level 38 feet feet at 5 gal per minute.

Discharge in gal. per min. of flowing well 5 gal

How Tested jet pump Length of Test 96 hours

Remarks: (Gravel packing, cementing, packers, type of shutoff, location of place of use of groundwater if not at well, and any other similar pertinent information, including number of acres irrigated, if used for irrigation)

Indicate location of well and place of use, if possible. Each small square represents 10 acres.

Show exact depth of bottom.

Driller's License Number

Dale A. Hudson

Driller's Signature

This form to be prepared by driller, and three copies to be filed by the owner with the County Clerk and Recorder in the county in which the well is located.

Please answer all questions. If not applicable, so state, otherwise the form will be returned.

Original to the County Clerk and Recorder; duplicate to the State Engineer; Triplicate to the Montana Bureau of Mines and Geology and Quadruplicate for the Appropriator.

38118

INDEXED

458

STATE OF MONTANA  
COUNTY OF LINCOLN

Filed this 4th day of

May A. D. 1964

at 10:05 A.M.

W. M. Mansfield County Clerk

By Mae Nelson Deputy



File No. ....

T. 36N R. 27W

DUPLICATE

County Lincoln

STATE OF MONTANA  
ADMINISTRATOR OF GROUNDWATER CODE  
OFFICE OF STATE ENGINEER

RECEIVED  
MAR 5 1964

Declaration of Vested Groundwater Rights STATE ENGINEER

(Under Chapter 237, Montana Session Laws, 1961)  
ownership each to the other.

as joint tenants, and not as tenants in common, with rights of sur-

1. James B. Roberts and Lela N. Roberts, Et. L. Eureka, Montana  
(Name of Appropriator) (Address) (Town)

County of Lincoln State of Montana  
have appropriated groundwater according to the Montana laws in effect prior to January 1, 1962, as follows:

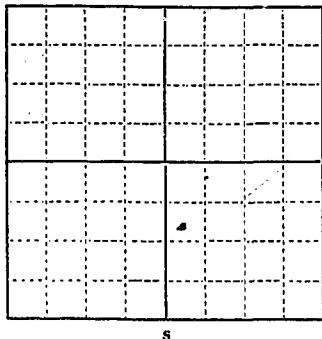

NW 1/4 SE 1/4 Sec. 12, T. 36N R. 27W.

Indicate point of appropriation and place of use, if possible. Each small square represents 10 acres.

- 2. The beneficial use on which the claim is based..... domestic, stockwater, for non commercial gardening.
- 3. Date or approximate date of earliest beneficial use; and how continuous the use has been..... 1944, continuous
- 4. The amount of groundwater claimed (in miner's inches or gallons per minute)..... 500 gallons per day
- 5. If used for irrigation, give the acreage and description of the lands to which water has been applied and name of the owner thereof..... none
- 6. The means of withdrawing such water from the ground and the location of each well or other means of withdrawal..... electric pump

- 7. The date of commencement and completion of the construction of the well, wells, or other works for withdrawal of groundwater..... 1944
- 8. The depth of water table..... 18 feet
- 9. So far as it may be available, the type, size and depth of each well or the general specifications of any other works for the withdrawal of groundwater..... 20 feet deep 3 feet in diameter, 1 1/2" pipe
- 10. The estimated amount of groundwater withdrawn each year..... not logged
- 11. The log of formations encountered in the drilling of each well if available..... earth, sand, gravel
- 12. Such other information of a similar nature as may be useful in carrying out the policy of this act, including reference to book and page of any county record..... none

Signature of Owner *James B. Roberts*  
Date 12/30/63 *Lela N. Roberts*

Three copies to be filed by the owner with the County Clerk and Recorder of the county in which the well is located.

Please answer all questions. If not applicable, so state, otherwise the form will be returned.

Original to the County Clerk and Recorder; Duplicate to the State Engineer; Triplicate to the Montana Bureau of Mines and Geology, and Quadruplicate for the Appropriator.

35096

# 366

STATE OF MONTANA  
COUNTY OF LINCOLN

Filed this 31<sup>st</sup> day of

December A. D. 1963.

at 12:07 P.M.

M. M. Mansfield  
County Clerk.

By Verde Hayden  
Deputy

12

File No. ....

T. 36N R. 27W

DUPLICATE

County LINCOLN

STATE OF MONTANA  
ADMINISTRATOR OF GROUNDWATER CODE  
OFFICE OF STATE ENGINEER

RECEIVED  
MAR 5 1964

Declaration of Vested Groundwater Rights

(Under Chapter 237, Montana Session Laws, 1961)

STATE ENGINEER

I, Maurice E. Bernland, of \_\_\_\_\_, (Name of Appropriator) \_\_\_\_\_, of \_\_\_\_\_, (Address) \_\_\_\_\_, (Town) \_\_\_\_\_

County of Lincoln State of Montana  
have appropriated groundwater according to the Montana laws in effect prior to January 1, 1962, as follows:

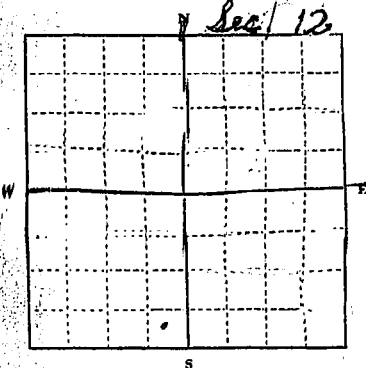

Sec. 12 T. 36N R. 27W  
Indicate point of appropriation and place of use, if possible. Each small square represents 10 acres.

- The beneficial use on which the claim is based  
Stock-Water
- Date or approximate date of earliest beneficial use; and how continuous the use has been
- The amount of groundwater claimed (in miner's inches or gallons per minute)
- If used for irrigation give the acreage and description of the lands to which water has been applied and name of the owner thereof
- The means of withdrawing such water from the ground and the location of each well or other means of withdrawal  
spring
- The date of commencement and completion of the construction of the well, wells, or other works for withdrawal of groundwater
- The depth of water table
- So far as it may be available, the type, size and depth of each well or the general specifications of any other works for the withdrawal of groundwater
- The estimated amount of groundwater withdrawn each year
- The log of formations encountered in the drilling of each well if available
- Such other information of a similar nature as may be useful in carrying out the policy of this act, including reference to book and page of any county record

Signature of Owner Maurice E. Bernland  
Date Dec. 31, 1963

Three copies to be filed by the owner with the County Clerk and Recorder of the county in which the well is located.

Please answer all questions. If not applicable, so state, otherwise the form will be returned.

Original to the County Clerk and Recorder; Duplicate to the State Engineer; Triplicate to the Montana Bureau of Mines and Geology, and Quadruplicate for the Appropriator.

File No.

DUPLICATE

Approved Stock Form - Hills Publishing Co., Helena, Montana - 0234

T. 36N R. 27W

County LINCOLN

STATE OF MONTANA  
ADMINISTRATOR OF GROUNDWATER CODE  
OFFICE OF STATE ENGINEER

RECEIVED

MAR 5 1964

Declaration of Vested Groundwater Rights

(Under Chapter 237, Montana Session Laws, 1961)

STATE ENGINEER

Maurice E. Barnhart of Burke  
(Name of Appropriator) (Address) (Town)  
County of Lincoln State of Montana  
have appropriated groundwater according to the Montana laws in effect prior to January 1, 1962, as follows:

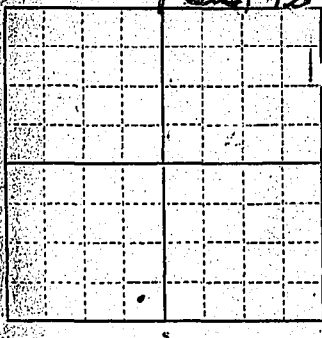

- The beneficial use on which the claim is based...  
Irrigation + STOCK-WATER
- Date or approximate date of earliest beneficial use, and how continuous the use has been... 1953
- The amount of groundwater claimed (in miner's inches or gallons per minute)... 10 miner's inches
- If used for irrigation, give the acreage and description of the lands to which water has been applied and name of the owner thereof... 10 acres in Lincoln County, Montana
- The means of withdrawing such water from the ground and the location of each well or other means of withdrawal... spring

Sec. 12 T. 36N R. 27W  
Indicate point of appropriation and amount. Each small square represents 10 acres.

- The date of commencement and completion of the construction of the well, wells, or other works for withdrawal of groundwater... 1953
- The depth of water table... unknown
- As far as it may be available, the type, size and depth of each well or the general specifications of any other works for the withdrawal of groundwater... a spring
- The estimated amount of groundwater withdrawn each year... 10 miner's inches
- The log of formations encountered in the drilling of each well if available... not available
- Such other information of a similar nature as may be useful in carrying out the policy of this act, including reference to book and page of any county record

Signature of Owner Maurice E. Barnhart  
Date Dec 31, 1963

Three copies to be filed by the owner with the County Clerk and Recorder of the county in which the well is located.  
Please answer all questions. If not applicable, so state, otherwise the form will be returned.

Original to the County Clerk and Recorder; Duplicate to the State Engineer; Triplicate to the Montana Bureau of Mines and Geology, and Quadruplicate for the Appropriator.

413

INDEXED

STATE OF MONTANA  
COUNTY OF LINCOLN

Filed this 31st day of  
December A. D. 1963  
at 11:57 A.M.  
M. M. Mansfield  
County Clerk  
By Mae Nelson  
Deputy

gws

File No.....

T. 36 north 27 west

DUPLICATE

County Lincoln

STATE OF MONTANA  
ADMINISTRATOR OF GROUNDWATER CODE  
OFFICE OF STATE ENGINEER

RECEIVED  
MAR 5 1964

STATE ENGINEER  
**Notice of Completion of Groundwater Appropriation Without Well**

(Under Chapter 237 Montana Session Laws, 1961)

Date of Appropriation of Groundwater September 1st 1936

Owner Agnes Bernhard Address Burton, Montana

Contractor (if any) none

Address of Contractor .....

Date Started..... Date Completed.....

Describe means of obtaining groundwater without a well "as by sub-irrigation and other natural processes". Include depth to water when applicable. sub and springs

natural flow in ground ditches

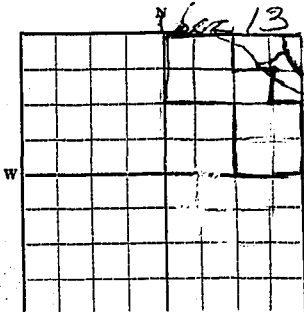

Quantity of water developed and used with explanation of method used to measure or estimate such amount. If use is intermittent estimate approximate lengths of periods of use

NE 1/4 Sec 13 T. 36 N. R. 27 W.

Indicate point of appropriation and place of use, if possible.

Domestic use all year. Irrigation for season.

Signature of Owner Agnes Bernhard

Date December 31st 1963

This form to be prepared by contractor (if any), otherwise by the owner.

Three copies of this notice are to be filed with the County Clerk and Recorder of the county in which the works are located.

Please answer all questions. If not applicable, so state, otherwise the form will be returned.

Original to the County Clerk and Recorder; duplicate to the State Engineer; Triplicate to the School of Mines and Quadruplicate for the Appropriation.

DUPLICATE

County Lincoln

STATE OF MONTANA  
ADMINISTRATOR OF GROUNDWATER CODE  
OFFICE OF STATE ENGINEER

RECEIVED  
MAR 5 1963

STATE ENGINEER

Notice of Completion of Groundwater Appropriation Without Well

(Under Chapter 237 Montana Session Laws, 1961)

Date of Appropriation of Groundwater September 12 1963

Owner Agnes Bernharel Address Burke, Montana

Contractor (if any) none

Address of Contractor

Date Started Date Completed

Describe means of obtaining groundwater without a well "as by sub-irrigation and other natural processes". Include depth to water when applicable. sub and springs

natural flow in ground ditches

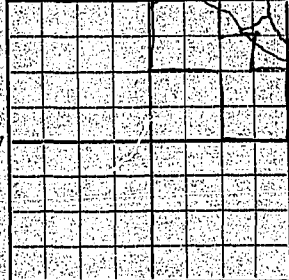

Quantity of water developed and used with explanation of method used to measure or estimate such amount. If use is intermittent estimate approximate lengths of periods of use

29 minor inches estimate.

Domestic use all year. Irrigation for season.

NE 1/4 Sec B T36N R27W

Indicate point of appropriation and place of use, if possible.

Signature of Owner

Agnes Bernharel

Date September 31st 1963

This form to be prepared by contractor (if any), otherwise by the owner.

Three copies of this notice are to be filed with the County Clerk and Recorder of the county in which the works are located.

Please answer all questions. If not applicable, so state, otherwise the form will be returned.

Original to the County Clerk and Recorder; duplicate to the State Engineer; Triplicate to the School of Mines and Quadruplicate for the Appropriator.

414

STATE OF MONTANA  
COUNTY OF LINCOLN

Filed this 31st day of  
December A. D. 1963  
at 11:58 P. M.  
M. M. Mansfield  
County Clerk.  
By Mae Wilson  
Deputy



File No. ....

JUL 25 1966

T. 36 R. 27

DUPLICATE

Billie..... McDonnell  
Butzerin..... McNulty  
Coyle..... Morton  
Darlington..... Sullivan

County Golden

STATE OF MONTANA

ADMINISTRATOR OF GROUNDWATER CODE

OFFICE OF STATE ENGINEER

Top of Ground picknet  
(Elev. above sea level.....)

### Notice of Completion of Groundwater Appropriation by Means of Well

(Under Chapter 237, Montana Session Laws, 1961)

Owner Hartes Berger Address Eureka, Mont.

Driller Thatcher Drilling Address Eureka, Mont.

Date of Notice of Appropriation of Groundwater March 10, 1966

Date well started Feb. 22 Date Completed March 10

Type of well drilled Equipment Used Rotary  
(dug, driven, bored or drilled) (Churn, drill, rotary or other)

Water Use: Domestic  Municipal  Other  Irrigation   
Industrial  Drainage  Stock

Indicate on the diagram the character and thickness of the different strata met with in drilling, such as soil, clay, shale, gravel, rock or sand, etc. Show depth at which water is encountered, thickness and character of water-bearing strata and height to which water rises in the well.

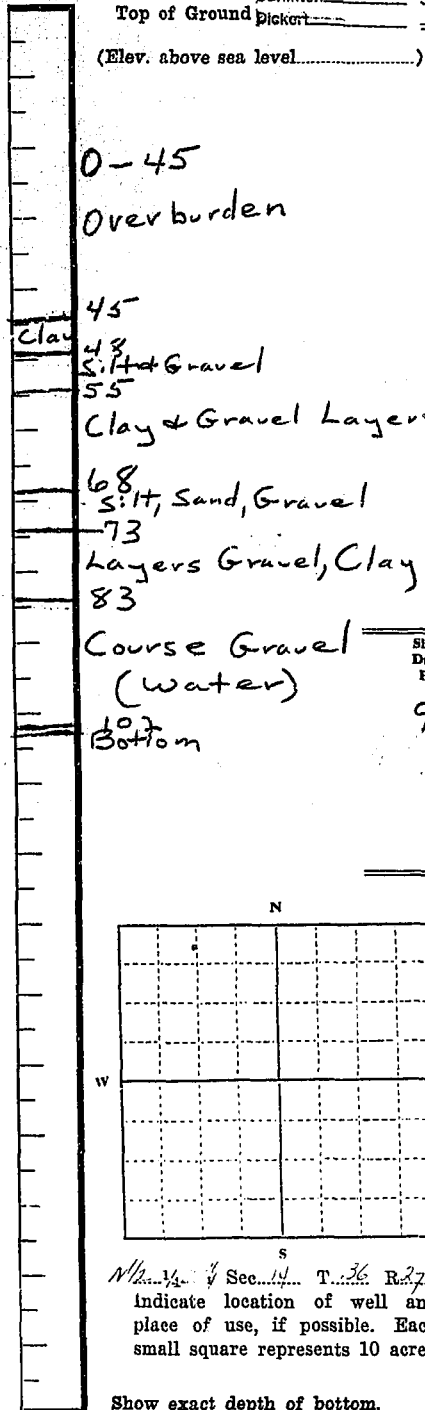

Size of Drilled Hole	Size and Weight of Casing	From (Feet)	To (Feet)	PERFORATIONS		
				Kind Size	From (Feet)	To (Feet)
9"	6" I.D. 19#	0	102	1/4" x 4 5/16" Hs	92	102

Static Water Level for non-flowing Well 50 feet.

Shut-in Pressure for Flowing Well.....

Pumping Water Level 50 feet at 20 gal. per minute.

Discharge in gal. per min. of flowing well.....

How Tested Air Compressor Length of Test 6 hr.

Remarks: (Gravel packing, cementing, packers, type of shutoff, location of place of use of groundwater if not at well, and any other similar pertinent information, including number of

acres irrigated, if used for irrigation).....

No apparent sand problem.

W 1/2 Sec. 14 T. 36 R. 27  
Indicate location of well and place of use, if possible. Each small square represents 10 acres.

Show exact depth of bottom.

86  
Driller's License Number  
Edward Thatcher  
Driller's Signature

This form to be prepared by driller, and three copies to be filed by the owner with the County Clerk and Recorder in the county in which the well is located.

Please answer all questions. If not applicable, so state, otherwise the form will be returned.

Original to the County Clerk and Recorder; duplicate to the State Engineer; duplicate to the Montana Bureau of Mines and Geology and Quadruplicate for the Appropriator.

INDEXED

557

STATE OF MONTANA  
COUNTY OF LINCOLN

Filed this 19<sup>th</sup> day of  
July A. D. 1906  
at 2:30 P.M.  
Elihu A. Hamilton  
County Clerk  
By Walter H. Hays  
Deputy



819

STATE OF MONTANA  
COUNTY OF LINCOLN

Filed this 6<sup>th</sup> day of

December A.D. 1971

at 10:50 A.M.

by Sharon L. Vaughn  
County Clerk

By Mae Watson Deputy

STATE WATER CONSERVATION BOARD  
**RECEIVED**  
 AUG 5 1965

Approved Stock Form—State Publishing Co., Helena, Montana—42234

File No. \_\_\_\_\_

T. 36N R. 27W

DUPLICATE

REFERRED TO \_\_\_\_\_

County Lincoln

STATE OF MONTANA  
 ADMINISTRATOR OF GROUNDWATER CODE  
 OFFICE OF STATE ENGINEER

**Declaration of Vested Groundwater Rights**

(Under Chapter 237, Montana Session Laws, 1961)

1. Frances I. Wunschel, of P.O. Box 69A, of Rt. 1 - Eureka, Montana  
 (Name of Appropriator) (Address) (Town)  
 County of Lincoln State of Montana  
 have appropriated groundwater according to the Montana laws in effect prior to January 1, 1962, as follows:

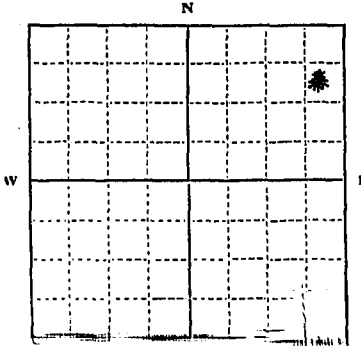

~~SE 1/4~~ - Sec. 14, T-36N R-27W

1/4 Sec. T. R.

Indicate point of appropriation and place of use, if possible. Each small square represents 10 acres.

2. The beneficial use on which the claim is based domestic and irrigation and water livestock

3. Date or approximate date of earliest beneficial use; and how continuous the use has been 1948 - daily use since then

4. The amount of groundwater claimed (in miner's inches or gallons per minute) 4 swipes to the gallon and 30 per minute, making 7 1/2 gallons a minute.

5. If used for irrigation, give the acreage and description of the lands to which water has been applied and name of the owner thereof 2 acres, more or less, on SE 1/4 Sec. 14, T-36N R-27W - Ira D. Spangler & Frances Wunschel

6. The means of withdrawing such water from the ground and the location of each well or other means of withdrawal motor and pump jack, in said location of land above shown in question No. 5 above.

7. The date of commencement and completion of the construction of the well, wells, or other works for withdrawal of groundwater April or May of 1948, completed about a week after it was started.

8. The depth of water table 15 feet thereabouts

9. So far as it may be available, the type, size and depth of each well or the general specifications of any other works for the withdrawal of groundwater electric motor, well 55 feet deep - just the one well

10. The estimated amount of groundwater withdrawn each year no record kept but used year around

11. The log of formations encountered in the drilling of each well if available loam, sand, clay, hard sand, and then gravel

12. Such other information of a similar nature as may be useful in carrying out the policy of this act, including reference to book and page of any county record the only record in the county would be the well diggers forms recorded on the sinking of the well - Mr. Ottenscher, of Karlsruhe, Montana

Signature of Owner Ira D. Spangler  
% Frances I. Wunschel  
 Date July 31st, 1965  
 (Frances I. Wunschel, Appropriator).

Three copies to be filed by the owner with the County Clerk and Recorder of the county in which the well is located.

Please answer all questions. If not applicable, so state, otherwise the form will be returned.

Original to the County Clerk and Recorder; Duplicate to the State Engineer; Triplicate to the Montana Bureau of Mines and Geology, and Quadruplicate for the Appropriator.

39392

GW

STATE WATER CONSERVATION BOARD

RECEIVED  
AUG 5 1965

Approved Stock Form—State Publishing Co., Helena, Montana—42234

File No.

T 36N R 27W

DUPLICATE

REFERRED TO

County Lincoln

STATE OF MONTANA  
ADMINISTRATOR OF GROUNDWATER CODE  
OFFICE OF STATE ENGINEER

Declaration of Vested Groundwater Rights

(Under Chapter 237, Montana Session Laws, 1961)

I, Frances I. Wunschel, of P.O. Box 69A,  
Ht. 1 - Eureka, Montana,  
(Name of Appropriator) (Address) (Town)  
County of Lincoln State of Montana  
have appropriated groundwater according to the Montana laws in effect prior to January 1, 1962, as follows:

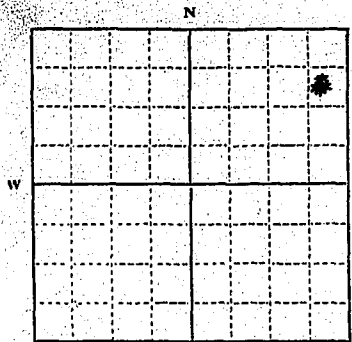

SE 1/4 NE 1/4 - Sec. 14, T-36N R. 27W

1/4 Sec. T. R.

Indicate point of appropriation and place of use, if possible. Each small square represents 10 acres.

2. The beneficial use on which the claim is based domestic and irrigation and water livestock

3. Date or approximate date of earliest beneficial use; and how continuous the use has been 1948 - daily use since then

4. The amount of groundwater claimed (in miner's inches or gallons per minute) 4 swipes to the gallon and 30 per minute, making 7 1/2 gallons a minute.

5. If used for irrigation, give the acreage and description of the lands to which water has been applied and name of the owner thereof 2 acres, more or less, on SE 1/4 NE 1/4 Sec. 14, T-36N R. 27W - Ira D. Spangler - & Frances Wunschel

6. The means of withdrawing such water from the ground and the location of each well or other means of withdrawal motor and pump jack, in said location of land above shown in question # 4 5 above.

7. The date of commencement and completion of the construction of the well, wells, or other works for withdrawal of groundwater April or May of 1949, completed about a week after it was started.

8. The depth of water table 15 feet thereabouts

9. So far as it may be available, the type, size and depth of each well or the general specifications of any other works for the withdrawal of groundwater electric motor, well 55 feet deep - just the one well

10. The estimated amount of groundwater withdrawn each year no record kept but used year ground

11. The log of formations encountered in the drilling of each well if available loam, sand, clay, more sand, and then gravel

12. Such other information of a similar nature as may be useful in carrying out the policy of this act, including reference to book and page of any county record the only record in the county would be the well diggers forms recorded on the sinking of the well - Mr. Ottenbacher, of Kalispell, Montana

Signature of Owner Ira D. Spangler  
& Frances I. Wunschel  
Date July 31st, 1965  
(Frances I. Wunschel, Appropriator).

Three copies to be filed by the owner with the County Clerk and Recorder of the county in which the well is located.

Please answer all questions. If not applicable, so state, otherwise the form will be returned.

Original to the County Clerk and Recorder; Duplicate to the State Engineer; Triplicate to the Montana Bureau of Mines and Geology, and Quadruplicate for the Appropriator.

39392

# 495

STATE OF MONTANA  
COUNTY OF LINCOLN  
FILED  
Filed this 7 day of  
August A. D. 1945  
at 11:15 A.M.  
M. M. Mansfield  
County Clerk  
By Pat Condon  
Deputy

014

File No. ....

T. 36 R. 27

DUPLICATE

County Lincoln

STATE OF MONTANA  
ADMINISTRATOR OF GROUNDWATER CODE  
OFFICE OF STATE ENGINEER

RECEIVED  
MAR 5 1964

Declaration of Vested Groundwater Rights

(Under Chapter 237, Montana Session Laws, 1961)

STATE ENGINEER

tenants, and not as owners in common, with the rights of survivorship  
1 Tom Burch and Lucille Burch, joint/ P. O. Box 964, Eureke, Montana  
(Name of Appropriator) (Address) (Town)  
County of Lincoln State of Montana  
have appropriated groundwater according to the Montana laws in effect prior to January 1, 1962, as follows:

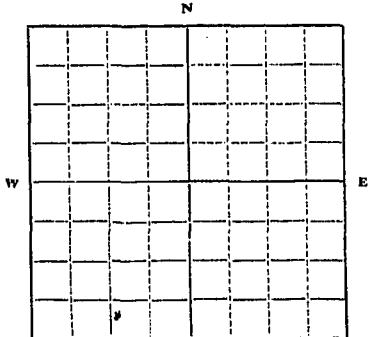

Well is on Lot No. 27,  
Western Addition to the Town  
S. 0. E. 1/4, Sec. 14, T. 36, R. 27 of Eureke, Mont.

Indicate point of appropriation  
and place of use, if possible.  
Each small square represents 10  
acres.

2. The beneficial use on which the claim is based domestic and domestic irrigation
  3. Date or approximate date of earliest beneficial use; and how continuous the use has been January 1957, in continuous use
  4. The amount of groundwater claimed (in miner's inches or gallons per minute) 10 gallons per minute
  5. If used for irrigation, give the acreage and description of the lands to which water has been applied and name of the owner thereof Town Lots Nos. 26, 27 and 28 - owner
  6. The means of withdrawing such water from the ground and the location of each well or other means of withdrawal jacuzzi electric pump - 2 1/2 pipe.
  7. The date of commencement and completion of the construction of the well, wells, or other works for withdrawal of groundwater January 1957 - completed January 1957
  8. The depth of water table 58 feet
  9. So far as it may be available, the type, size and depth of each well or the general specifications of any other works for the withdrawal of groundwater lowered point to 58 feet.
  10. The estimated amount of groundwater withdrawn each year not logged
  11. The log of formations encountered in the drilling of each well if available surface di: river gravel, hardpan, quicksand into river gravel again--drove the point.
  12. Such other information of a similar nature as may be useful in carrying out the policy of this act, including reference to book and page of any county record none
- Signature of Owner Tom Burch  
X Lucille Burch  
Date 12/30/63.

Three copies to be filed by the owner with the County Clerk and Recorder of the county in which the well is located.

Please answer all questions. If not applicable, so state, otherwise the form will be returned.

Original to the County Clerk and Recorder; duplicate to the State Engineer; duplicate to the Montana Bureau of Mines and Geology, and Quadruplicate for the Appropriator.

35097



RECORDED

#367

STATE OF MONTANA  
COUNTY OF LINCOLN

Filed this 31<sup>st</sup> day of  
December A. D. 1962  
at 10:08 A. M.  
M. M. Mansfield  
County Clerk.  
By Leslie Clayton  
Deputy

14

File No. ....

T. 36 N R 27

DUPLICATE

County Lincoln

STATE OF MONTANA  
ADMINISTRATOR OF GROUNDWATER CODE  
OFFICE OF STATE ENGINEER

RECEIVED  
MAR 5 1964

Declaration of Vested Groundwater Rights

(Under Chapter 237, Montana Session Laws, 1961)

STATE ENGINEER

1. Carol K. Burch of P. O. 141, Eureka, Montana  
(Name of Appropriator) (Address) (Town)  
County of Lincoln State of Montana  
have appropriated groundwater according to the Montana laws in effect prior to January 1, 1962, as follows:

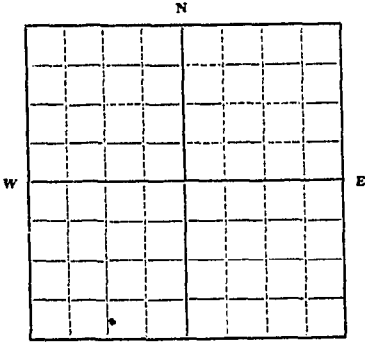

Lot no. 24, Western Addition to Subsec. SW Sec. 14 T 36 R 27 Town of Eureka, Montana

Indicate point of appropriation and place of use, if possible. Each small square represents 40 acres.

2. The beneficial use on which the claim is based...  
domestic and domestic irrigation

3. Date or approximate date of earliest beneficial use; and how continuous the use has been...  
1954

4. The amount of groundwater claimed (in miner's inches or gallons per minute)...  
a half miner's inch.

5. If used for irrigation, give the acreage and description of the lands to which water has been applied and name of the owner thereof...  
only for domestic irrigation

6. The means of withdrawing such water from the ground and the location of each well or other means of withdrawal...  
hand pump

7. The date of commencement and completion of the construction of the well, wells, or other works for withdrawal of groundwater...  
Year 1954 - commercially drilled -

8. The depth of water table...  
86 feet depth well, water stands 60 feet in well

9. So far as it may be available, the type, size and depth of each well or the general specifications of any other works for the withdrawal of groundwater...  
above

10. The estimated amount of groundwater withdrawn each year...  
Not logged

11. The log of formations encountered in the drilling of each well if available...  
not available

12. Such other information of a similar nature as may be useful in carrying out the policy of this act, including reference to book and page of any county record...  
none on record - papers were filed to be recorded on completion of well being drilled.

Signature of Owner Carol K. Burch

Date December 31st, 1963

Three copies to be filed by the owner with the County Clerk and Recorder of the county in which the well is located.

Please answer all questions. If not applicable, so state, otherwise the form will be returned.

Original to the County Clerk and Recorder; duplicate to the State Engineer; Triplicate to the Montana Bureau of Mines and Geology, and Quadruplicate for the Appropriator.

File No.

T. 36 N. R. 27

DUPLICATE

County Lincoln

STATE OF MONTANA  
ADMINISTRATOR OF GROUNDWATER CODE  
OFFICE OF STATE ENGINEER

RECEIVED  
MAR 5 1964

Declaration of Vested Groundwater Rights

(Under Chapter 237, Montana Session Laws, 1961)

STATE ENGINEER

1. Carol K. Burch, of P. O. 141, Bureka, Montana  
(Name of Appropriator) (Address) (Town)

County of Lincoln State of Montana  
have appropriated groundwater according to the Montana laws in effect prior to January 1, 1962, as follows:

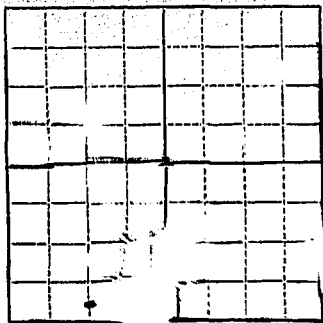

Lot no. 24, Water Addition to only for domestic irrigation  
S10SE1/4 SW Sec. 24, T. 36 N. R. 27 E. of Bureka, Montana.

Indicate point of application and place of withdrawal. Each small square represents 1/4 acres.

2. The beneficial use on which the claim is based  
domestic and domestic irrigation

3. Date of appropriation or earliest beneficial use; and how continuous the use has been  
1954

4. The amount of groundwater claimed (in miner's inches or gallons per minute)  
a half miner's inch.

5. If used for irrigation, give the acreage and description of the lands to which water has been applied and name of the owner thereof.

6. The means of withdrawing such water from the ground and the location of each well or other means of withdrawal.  
hand pump

7. The date of commencement and completion of the construction of the well, wells, or other works for withdrawal of groundwater.  
Year 1954 - commercially drilled -

8. The depth of water table.  
86 feet depth well, water stands 60 ft. in well

9. So far as it may be available, the type, size and depth of each well or the general specifications of any other works for the withdrawal of groundwater.  
above

10. The estimated amount of groundwater withdrawn each year.  
Not logged

11. The log of formations encountered in the drilling of each well if available.  
not available

12. Such other information of a similar nature as may be useful in carrying out the policy of this act, including reference to book and page of any county record.  
none on record - papers were failed to be recorded on completion of well being drilled.

Signature of Owner *Carol K. Burch*

Date December 31st, 1963

Three copies to be filed by the owner with the County Clerk and Recorder of the county in which the well is located.

Please answer all questions. If not applicable, so state, otherwise the form will be returned.

Original to the County Clerk and Recorder; duplicate to the State Engineer; Triplicate to the Montana Bureau of Mines and Geology, and Quadruplicate for the Appropriator.

# 374

INDEXED

STATE OF MONTANA  
COUNTY OF LINCOLN

Filed this 31<sup>st</sup> day of

December A. D. 1963

at 10:31 AM

M. M. Mansfield

County Clerk

By Verde Hayden

Deputy