

File No. 345T. 35N R. 45E

DUPLICATE

County McCone

STATE OF MONTANA
ADMINISTRATOR OF GROUNDWATER CODE
OFFICE OF STATE ENGINEER

RECEIVED
JAN 16 1964

Declaration of Vested Groundwater Rights

(Under Chapter 237, Montana Session Laws, 1961)

STATE ENGINEER

1. Ronald K. J. J. J. of Weldon Hte Wolfpoint
(Name of Appropriator) (Address) (Town)
County of McCone State of Montana
have appropriated groundwater according to the Montana laws in effect prior to January 1, 1962, as follows:

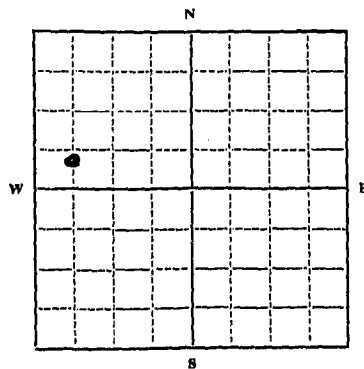

SW 1/4 NW Sec 27 T 35 N R 45 E

Indicate point of appropriation and place of use, if possible. Each small square represents 10 acres.

2. The beneficial use on which the claim is based... Livestock water
3. Date or approximate date of earliest beneficial use; and how continuous the use has been... 1960 May until now
4. The amount of groundwater claimed (in miner's inches or gallons per minute)... 7 gal. per minute
5. If used for irrigation, give the acreage and description of the lands to which water has been applied and name of the owner thereof... No
6. The means of withdrawing such water from the ground and the location of each well or other means of withdrawal... windmill also gas motor pump jack
7. The date of commencement and completion of the construction of the well, wells, or other works for withdrawal of groundwater... 1960
8. The depth of water table... 120 ft.
9. So far as it may be available, the type, size and depth of each well or the general specifications of any other works for the withdrawal of groundwater... drilled 6 in 130
10. The estimated amount of groundwater withdrawn each year... 200,000 gal.
11. The log of formations encountered in the drilling of each well if available... Not available
12. Such other information of a similar nature as may be useful in carrying out the policy of this act, including reference to book and page of any county record... No record

Signature of Owner

Ronald K. J. J. J.
Date Dec 27 1963

Three copies to be filed by the owner with the County Clerk and Recorder of the county in which the well is located.

Please answer all questions. If not applicable, so state, otherwise the form will be returned.

Original to the County Clerk and Recorder; duplicate to the State Engineer; Triplicate to the Montana Bureau of Mines and Geology, and Quadruplicate for the Appropriator.

36316

127096

DOC. NO.

WATER WELL LOG FILE NO. 245

ARNOLD KJELGAARD

TO

THE PUBLIC

STATE OF MONTANA)
)SS.
COUNTY OF McCONE)

OFFICE OF COUNTY CLERK & RECORDER.

Filed this 27th day of Dec. 1963 A.D.,

at 10:40 o'clock a.m.

D. Henry E. Sigal
COUNTY CLERK

FEE \$ 2.00

RECORDED
INDEXED
MONTANA STATE
ENGINEERS

File No.

DUPLICATE

County McCone

STATE OF MONTANA
ADMINISTRATOR OF GROUNDWATER CODE
OFFICE OF STATE ENGINEER DEC 2 1963

Notice of Completion of Groundwater Appropriation by Means of Well

(Under Chapter 237, Montana Session Laws, 1961)

Owner Peter Bartish Address Welf Point, MontanaDriller Daniel G. Haggerty Address Lindsay, Montana

Date of Notice of Appropriation of Groundwater

Date well started Sept. 3, 1963 Date Completed Sept. 6, 1963

Type of well drilled Equipment Used cable tool drill
(dug, driven, bored or (Churn, drill, rotary or
drilled) other)

Water Use: Domestic ☐ Municipal ☐ Other ☐ Irrigation ☐
Industrial ☐ Drainage ☐ Stock ☒

Indicate on the diagram the character and thickness of the different strata met with in drilling, such as soil, clay, shale, gravel, rock or sand, etc. Show depth at which water is encountered, thickness and character of water-bearing strata and height to which water rises in the well.

Size of Drilled Hole	Size and Weight of Casing	From (Feet)	To (Feet)	PERFORATIONS		
				Kind Size	From (Feet)	To (Feet)
5 1/2"	4 1/2" O.D. 11#	0	153	1/8" slots	152	153

(154-153 gray sand)

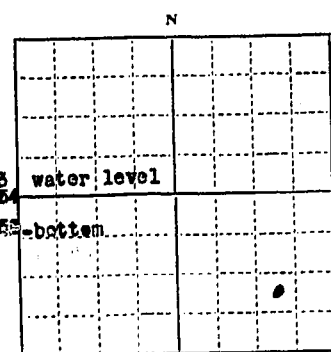

SE 1/4 SE Sec 33 T25 R15

Indicate location of well and place of use, if possible. Each small square represents 10 acres.

Show exact depth of bottom.

Static Water Level for non-flowing Well 12' feet.Shut-in Pressure for Flowing Well not applicablePumping Water Level 153 feet at 5 gal. per minute.Discharge in gal. per min. of flowing well not applicableHow Tested bailed Length of Test 1 hour

Remarks: (Gravel packing, cementing, packers, type of shutoff, location of place of use of groundwater if not at well, and any other similar pertinent information, including number of acres irrigated, if used for irrigation) none

earth back-fill around casing.

13
Driller's License Number

Daniel G. Haggerty
Driller's Signature

This form to be prepared by driller, and three copies to be filed by the owner with the County Clerk and Recorder in the county in which the well is located.

Please answer all questions. If not applicable, so state, otherwise the form will be returned.

Original to the County Clerk and Recorder; duplicate to the State Engineer; Triplicate to the Montana Bureau of Mines and Geology and Quadruplicate for the Appropriator.

7649

126844

Water Well Log # 252
Stat. of Montana } ss.
County of McCone }

Office of Clerk and Recorder.

Filed this 27th day of

November A. D. 1963

at 3:05 o'clock P. M.

[Signature]
Clerk and Recorder

By Deputy

Fee \$2.00

GROUNDWATER INDEX

Page . of

County McCone Twp. 25N Rge. 46E

[illegible]

T. 25N., R. 46E.
MCCONE COUNTY

25N 46E

County Lincoln

1

STATE OF MONTANA
ADMINISTRATOR OF GROUNDWATER CODE
MONTANA WATER RESOURCES BOARD

NOTICE OF COMPLETION OF GROUNDWATER
APPROPRIATION BY MEANS OF WELL

Developed after January 1, 1962

MONTANA WATER RESOURCES BOARD

Indicate the character, color, thickness of strata such as soil, clay, sand, gravel, shale, sandstone, etc. Show depth at which water is found and height to which water rises in well.

NOV 30 1971

(Under Chapter 237 Montana Session Laws, 1961, as amended)

This form to be prepared by driller, and three copies to be filed by the owner with the County Clerk and Recorder in the county in which the well is located, last copy to be retained by driller.

Please answer all questions. If not applicable, so state, otherwise the form may be returned.

Owner Carl J. Gorley

Address Wolf Point

Montana

Date well started 10-5-71

completed 10-11-71

For Administrator's Use

File 138906 # 703

11-26-71

GW 1 Disc P. M.

Type of well Drilled

(Dug, driven, bored or drilled)

Equipment used Rotary

(Churn drill, rotary or other)

Water Use: Domestic ☐ Municipal ☐ Stock ☐ Irrigation ☐

Industrial ☐ Drainage ☐ Other ☒ Garden/Lawn ☐

*Describe

USE: If used for irrigation, industrial, drainage or other. Explain, state number of acres and location or other data (i.e. Lot, Block and Addition).

ESTIMATED ANNUAL WITHDRAWAL

Size of Drilled Hole	Size and Weight of Casing	From (Feet)	To (Feet)	PERFORATIONS		
				Kind Size	From (Feet)	To (Feet)
9"	6"	0	100' 248'	6"	224	244

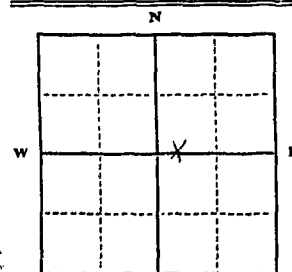

Static water level 160' ft.*
Pumping water level 170' ft.*
at 15 gallons per minute,
measured 15 minutes after pumping began.

*Measured from ground level.

Well developed by Drilling
for 3 hours.

Power Pump HP

Remarks: (Gravel packing, cementing, packers, type of shutoff)

Gravel pack - cement -
water level

S 1/4 SW 1/4 NE 1/4 S

1/4 1/4 Sec 2
T 25 N 46
S 46 E

INDICATE LOCATION OF WELL AND PLACE OF USE, IF POSSIBLE. EACH SMALL SQUARE REPRESENTS 40 ACRES.

Driller's Signature John R. E. Orr

Driller's Address Wolf Point

John R. E. Orr

LICENSE NO. 63

DRILLER'S LOG

Top of Ground (Elev. above sea level)		
From (Feet)	To (Feet)	
0	75	Brown Clay
75	145	Gray Clay
75	145	Gray Sandstone
145	170	Gray Clay
170	230	Gray Sandstone
230	245	Gray Clay

Show exact depth of bottom

244'

49498

138906

WATER WELL LOG FILE #703

State of Montana } ss.
County of McCone }

Office of Clerk and Recorder.

Filed this.....26th..... day of

.....November,..... A. D., 1971

at.....2:00..... o'clock..... P. M.

Gloria H. Brennan
Clerk and Recorder

By Mary L. Lucken
Deputy

Fee \$2.00

T 25 R 46

County McCone

MONTANA BUREAU OF MINES AND GEOLOGY

Butte, Montana

WATER WELL LOG

Weldon Rte.

Owner John Neubauer

Address Wolf Point, Mont.

Driller Dan Haggerty

Address Lindsay, Montana

Date Started Oct. 1, 1960

Date Completed Oct. 5, 1960

Location: Sec 6 T 25 R 46

Sec SW 1/4

Type of Well Drilled

Equipment Used

Churn

(Dug, driven, bored, or drilled)

(Churn drill, rotary, other)

Water use: Domestic

Municipal

Stock

X

Irrigation

Industrial

Drainage

Other:

Casing: 0 ft. to 150 ft. Type Galv. Size 6"

Casing: ft. to ft. Type Size

Casing: ft. to ft. Type Size

Perforated or Screened: Ft. 130 to ft. 150 Ft. to ft.

Type of screen or perforations Round

Static Water level, for non-flowing well: 140 feet

Shut-in pressure, for flowing well: lb./sq.in. on: (date)

Pumping water level 145 feet at 2 gal. per min.

How tested: Daily use by pump

Length of test Used one year

Remarks: (Gravel packing, cementing, packers, type of shut-off, depth of shut-off)

Gravel packing

(over)

Log of Well

Depth, feet

Description of Material Drilled

1708

To

0

150

Unknown

DOC. NO.

123355

WATER WELL LOG FILE NO. 103.

~~State of Montana~~
~~County of McCone~~ } ~~SS~~

Office of Clerk and Recorder.

Filed this 28th

December

A D 19 63

4832

o'clock.....P. M.

Class and Records

Fee zone

25105

Form No. 18
8-60

T 25 R 46

County McCone

MONTANA BUREAU OF MINES AND GEOLOGY

Butte, Montana

WATER WELL LOG

Owner John Neubauer

Weldon Bts.
Address Wolf Point, Mont.

Driller Unknown

Address -

Date Started 1927

Date Completed 1927

Location: Sec 8 T 25 R 46 Section 1

Type of Well Drilled

Equipment Used Churn Drill

(Dug, driven, bored, or drilled)

(Churn drill, rotary, other)

Water use: Domestic ☒

Municipal ☐

Stock ☒

Irrigation ☐

Industrial ☐

Drainage ☐

Other: ☐

Casing: 0 ft. to 210 ft. Type Gals Size 6"

Casing: - ft. to - ft. Type - Size -

Casing: - ft. to - ft. Type - Size -

Perforated or Screened: Ft - to ft - Ft - to ft -

Type of screen or perforations Round

Static Water Level, for non-flowing well: 208 feet

Shut-in pressure, for flowing well: - lb./sq.in. on - (date)

Pumping water level 207 feet at 12 gal. per min

How tested: Daily use by pump

Length of test Period of time

Remarks: (Gravel packing, cementing, packers, type of shut-off, depth of shut-off)

Gravel packing

(over)

Log of Well

[illegible]

File No.

DUPLICATE

T 25 N R 46 E

County McCone

STATE OF MONTANA
ADMINISTRATOR OF GROUNDWATER
OFFICE OF STATE ENGINEER

RECEIVED
APR 24 1963

Notice of Completion of Groundwater
Appropriation by Means of Well ENGINEER

(Under Chapter 237, Montana Session Laws, 1961)

Top of Ground
(Elev. above sea level 2400 ft.)
Clay

36
38 Rock

60 Clay

65 Clay & Coal

75 Blue Clay

79 Coal

130 Clay

180 Blue & Gray Clay

183 Rock

214 Blue Clay

218 Rock

302 Gray Clay

305 Rock

335 Gray Clay

337 Rock

365 Sandstone

380 Brown Clay

397 Rock

399

Indicate location of well and place of use, if possible. Each small square represents 10 acres.

Show exact depth of bottom.

Owner Leonard K. Long Address Wolf Point, Mont.

Driller John M. Dorr Address Wolf Point, Mont.

Date of Notice of Appropriation of Groundwater 4-8-63

Date well started 3-24-63 Date Completed 4-11-63

Type of well drilled Equipment Used rotary
(dug, driven, bored or (Churn, drill, rotary or drilled) other)

Water Use: Domestic ☐ Municipal ☐ Stock ☒ Irrigation ☐
Industrial ☐ Drainage ☐ Other ☐

Indicate on the diagram the character and thickness of the different strata met with in drilling, such as soil, clay, shale, gravel, rock or sand, etc. Show depth at which water is encountered, thickness and character of water-bearing strata and height to which the water rises in the well.

Size of Drilled Hole	Size and Weight of Casing	From (Feet)	To (Feet)	PERFORATIONS		
				Kind Size	From (Feet)	To (Feet)
9"	6" 15 gauge	0	390 ft.	6"	320	390

Static Water Level for non-flowing Well 315 feet.

Shut-in Pressure for Flowing Well

Pumping Water Level 315 feet at 20 gal. per minute.

Discharge in gal. per min. of flowing well

How Tested bailed Length of Test 4 hours

Remarks: (Gravel packing, cementing, packers, type of shutoff, location of place of use of groundwater if not at well, and any other similar pertinent information, including number of

acres irrigated, if used for irrigation) Gravel packed,

bailed 20 gal. per min. with no draw down. This

was as fast as the rig could bail, at that depth.

63
Driller's License Number

Driller's Signature

This form to be prepared by driller, and three copies to be filed by the owner with the County Clerk and Recorder in the county in which the well is located.

Please answer all questions. If not applicable, so state, otherwise the form will be returned.

Original to the County Clerk and Recorder; duplicate to the State Engineer; Triplicate to the School of Mines and Quadruplicate for the Appropriator.

125866

Water Well Log #223

State of Montana } ss.
County of McCone }

Office of Clerk and Recorder

Filed this 22nd day of

April A. D. 19.63.

at 9:05 o'clock A. M.

Philip E. Sigal
Clerk and Recorder

By _____ Deputy

Fee \$2.00

Form #18
8-60

T. 25 R. 46

29

County McCone

MONTANA BUREAU OF MINES AND GEOLOGY

Butte, Montana

WATER WELL LOG

RECEIVED
JAN 4 1962
STATE ENGINEER

Owner John Hjeltnard Address Wolf Point, Mont.

Driller Dan Haggerty Address Lindsay, Mont.

Date Started July 7, 1958 Date Completed July 10, 1958

Location: Sec 29 T 25 R 46 Sec 54 N

Type of Well Drilled Equipment Used Drill
(Dug, driven, bored, or drilled) (Churn drill, rotary, other)

Water use: Domestic ☐ Municipal ☐ Stock ☒ Irrigation ☐

Industrial ☐ Drainage ☐ Other: ☐

Casing: 220 ft. to ft. Type Steel Size 4 inch

Casing: ft. to ft. Type Size

Casing: ft. to ft. Type Size

Perforated or Screened: Ft 200 to ft 220 Ft to ft

Type of screen or perforations slit

Static water level, for non-flowing well: 200 feet

Shut-in pressure, for flowing well: None lb./sq. in. on: (date)

Pumping water level 200 feet at 5 gal. per min.

How tested: Slush bucket

Length of test 12 hours

Remarks: (Gravel packing, cementing, packers, type of shut-off, depth of shut-off)

Gravel packing

(over)

Log of Well

[illegible]

31

County McCone

MONTANA BUREAU OF MINES AND GEOLOGY

Butte, Montana

WATER WELL LOG

RECEIVED
JAN 4 1962
STATE ENGINEER

Owner: John Kjelgaard Address Wolf Point, Mont.

Driller Not known Address - - -

Date Started 1917 Date Completed 1917

Location: Sec 31 T 25 R 46 Sec NE 1 NW 1

Type of Well Drilled Equipment Used drill
(Dug, driven, bored, or drilled) (Churn drill, rotary, other)

Water use: Domestic ☐ Municipal ☐ Stock ☒ Irrigation ☐

Industrial ☐ Drainage ☐ Other: ☐

Casing: 160 ft. to 170 ft. Type galv. Size 4 inch

Casing:	ft.	to	ft.	Type	Size

Casing: _____ ft. to _____ ft. Type _____ Size _____

Perforated or Screened: Ft. to ft. Ft. to ft.

Type of screen or perforations Perforated

Static Water level, for non-flowing well:	Not known.	fee
-------------------------------------------	------------	-----

Shut-in pressure, for flowing well: _____ lb./sq.in.on: _____

Pumping water level 160 feet at Not known gal. per min.

How tested: By pumping

Length of test Whenever used

Remarks: (Gravel packing, cementing, packers, type of shut-off, depth of shut-off)

(over)

Log of Well

[illegible]

GROUNDWATER INDEX

Page . of

County McCone

Twp. 25N

Rge. 47E

[illegible]

T. 25N., R. 47E.
MCCONE COUNTY

RECEIVED
MAY 5 1958

T. 25 R. 17 L
County M/C Cone

STATE ENGINEER

MONTANA BUREAU OF MINES AND GEOLOGY
Butte, Montana

WATER WELL LOG

Owner Mr. John H. Johnson Address Wolf Point, Montana
Driller A & B Drilling Co. Address Scobey, Montana
Date Started 1958 Date Completed 1958
Location: Sec. 1 T. 25 R. 47 1/4 sec. SE 1/4 NE 1/4

Type of well ~~drilled~~ reamed Equipment used cable tool drilling machine
(Dug, driven, bored, or drilled) (Churn drill, rotary, other)

Water use: Domestic ☒ Municipal ☐ Stock ☐ Irrigation ☐

Industrial ☐ Drainage ☐ Other: _____

Casing: 0 ft. to 30 ft. Type steel tar coated Size 6"

Casing: _____ ft. to _____ ft. Type _____ Size _____

Casing: _____ ft. to _____ ft. Type _____ Size _____

Perforated or Screened: Ft. 33 to ft. 78 Ft. _____ to ft. _____

Type of screen or perforations torch slots

Static Water level, for non-flowing well: 55' 6" feet.

Shut-in pressure, for flowing well: _____ lb./sq. in. on: _____ (date) 3C plus

Pumping water level: _____ feet at _____ gal. per min.

How tested: bailer

Length of test: _____

Remarks: (Gravel packing, cementing, packers, type of shut-off, depth of shut-off)
from 33 to 78, the gravel packed

(over)

Log of Well

Depth, feet		Description of Material Drilled
From	To	
		Formation unknown, hole was drilled to 132 feet by reverse
		circulation machine and abandoned as a dry hole, by other drilling
		company.
		We got 20 GPM @ 30', hole is crooked from there down.
		We reamed 8" hole to 10" makes 30 GPM. Coming from 80 to 83' out
		of gravel. Perf. 85 to 78, than gravel packed.
		Water starts 80 to 83'
		GPM. 30 plus
		Static water level - 55'6
		Draw down to 80' @ 30 GPM.
		Total depth - 86 feet.
		Used 30' of 6" casing.
		118122
		State of Missouri
		County of Monroe
		Office of Clerk and Recorder,
		St. Louis, Mo.
		Filed for Record November 1, 1958
		at 2:30 o'clock P.M.
		<i>[Signature]</i>
		Clerk and Recorder
		By <i>[Signature]</i>
		No fee.

RECEIVED

County McCone

STATE OF MONTANA
ADMINISTRATOR OF GROUNDWATER CODE
MONTANA WATER RESOURCES BOARD

NOTICE OF COMPLETION OF GROUNDWATER
APPROPRIATION BY MEANS OF WELL

Developed after January 1, 1962

(Under Chapter 237 Montana Session Laws, 1961, as amended)

This form to be prepared by driller, and three copies to be filed by the owner with the County Clerk and Recorder in the county in which the well is located, last copy to be retained by driller.

Please answer all questions. If not applicable, so state, otherwise the form may be returned.

Owner Floyd Johnson
Address Wolf Point
Montana
Date well started 10-22-71
completed 10-25-71

For Administrator's Use	
File	<u>138796</u>
	<u>November 9, 1971</u>
	<u>4:35 PM</u>
GW 1	

Type of well Drilled
(Dug, driven, bored or drilled)

Equipment used Rotary
(Churn drill, rotary or other)

Water Use: Domestic ☐ Municipal ☐ Stock ☒ Irrigation ☐
Industrial ☐ Drainage ☐ Other ☐ Garden/Lawn ☐

*Describe
USE: If used for irrigation, industrial, drainage or other. Explain, state number of acres and location or other data (i.e. Lot, Block and Addition).

ESTIMATED ANNUAL WITHDRAWAL

Size of Drilled Hole	Size and Weight of Casing	From (Feet)	To (Feet)	PERFORATIONS		
				Kind Size	From (Feet)	To (Feet)
9"	6"	0	105'	6"	85'	105'

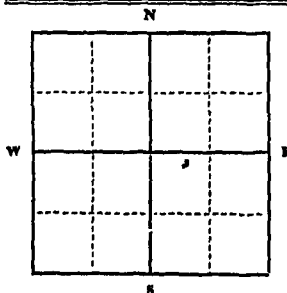

Static water level 50' ft.*
Pumping water level 75' ft.*
at 14 gallons per minute,
measured 14 minutes after pumping
began.
*Measured from ground level.
Well developed by ball
for 3 hours.
Power 1 HP
Remarks: (Gravel packing, cementing,
peckers, type of shutoff)

NW 1/4 35 1/4 Sec. 1
T. 25 N. R. 47 E
S W

INDICATE LOCATION OF WELL AND PLACE OF USE, IF POSSIBLE.
EACH SMALL SQUARE REPRESENTS 40 ACRES.

Driller's Signature John H. Orr
Driller's Address Wolf Point Mont.

Derr Drilling Co

LICENSE NO. 63

DRILLER'S LOG
Indicate the character, color, thickness of strata such as soil, clay, sand, gravel, shale, sandstone, etc. Show depth at which water is found and height to which water rises in well.

Top of Ground (Elev. above sea level)		
From (Feet)	To (Feet)	
		1930
0	30'	Brown Clay
50	55	Brown Sande Clay
55	65	Brown Sande Stone
65	70	Gray Clay
70	95	Gray Sande Stone
95	97	Good
97		Gray Clay

Show exact depth of bottom

105'

49372

138796

WATER WELL LOG FILE NO.702

FLOYD JOHNSON

TO

THE PUBLIC

State of Montana } ss.
County of McCone }

Office of Clerk and Recorder.

Filed this 9th day of
November A. D. 1971

at 4:35 o'clock P. M.

Gloria Brennan
Clerk and Recorder

By _____ Deputy

Fee \$2.00

Probably Surface Water
GWS

File No. 195

T 25N R 47E

DUPLICATE

County McCona

STATE OF MONTANA
ADMINISTRATOR OF GROUNDWATER CODE
OFFICE OF STATE ENGINEER

RECEIVED

STATE ENGINEER

Notice of Completion of Groundwater Appropriation Without Well

(Under Chapter 237 Montana Session Laws, 1961)

Date of Appropriation of Groundwater 1951
Owner Albert J. Dahl Address Weldon Route
McCona County, Montana

Contractor (if any) None

Address of Contractor None

Date Started Not Applicable Date Completed Not Applicable

Describe means of obtaining groundwater without a well "as by
sub-irrigation and other natural processes". Include depth to
water when applicable. surface spring

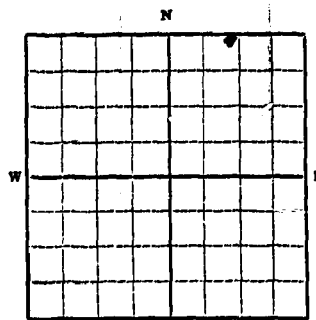

NUJ
Indicate point of appropriation
and place of use, if possible.

Quantity of water developed and used with explanation of meth-
od used to measure or estimate such amount. If use is intermit-

tent estimate approximate lengths of periods of use Used

During summer months - No means available to
measure actual amount of water used in gallons
but during dry years, in particular, all
available water is used.

Signature of Owner Albert J. Dahl

Date January 19, 1962

This form to be prepared by contractor (if any), otherwise by the owner.

Three copies of this notice are to be filed with the County Clerk and Recorder of the county in
which the works are located.

Please answer all questions. If not applicable, so state, otherwise the form will be returned.

Original to the County Clerk and Recorder; duplicate to the State Engineer; Triplicate to the
School of Mines and Quadruplicate for the Appropriator.

1220

DOC. NO. 123528
WATER WELL LOG FILE NO. 195

State of Montana } ss.
County of McCone }

Office of Clerk and Recorder.

Filed this 22nd day of

January A. D. 1962

at 8:10 o'clock A. M.

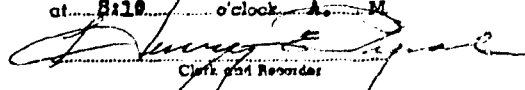
Clerk and Recorder

By _____ Deputy

Fee \$ 2.00

RECEIVED

County CON

STATE OF MONTANA
ADMINISTRATOR OF GROUNDWATER CODE
MONTANA WATER RESOURCES BOARD

NOTICE OF COMPLETION OF GROUNDWATER
APPROPRIATION BY MEANS OF WELL

Developed after January 1, 1962

(Under Chapter 237 Montana Session Laws, 1961, as amended)

This form to be prepared by driller, and three copies to be filed by the owner with the County Clerk and Recorder in the county in which the well is located, last copy to be retained by driller. Please answer all questions. If not applicable, so state, otherwise the form may be returned.

Owner Orion Cucker
Orion Cucker

Address 611 10th St

Location Con

Date well started 7-10-72

completed 7-17-72

Type of well drilled (Dug, driven, bored or drilled)

Equipment used rotary (Churn drill, rotary or other)

Water Use: Domestic ☐ Municipal ☐ Stock ☐ Irrigation ☐
Industrial ☐ Drainage ☐ Other ☒ Garden/Lawn ☐

*Describe

USE: If used for irrigation, industrial, drainage or other. Explain, state number of acres and location or other data (i.e. Lot, Block and Addition).

ESTIMATED ANNUAL WITHDRAWAL

Size of Drilled Hole	Size and Weight of Casing	From (Feet)	To (Feet)	PERFORATIONS		
				Kind Size	From (Feet)	To (Feet)
9"	6"	0	252'	6"	252'	252'

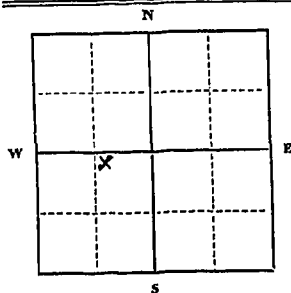

1/4 Sec. 3
T. 25 N. R. 47 E.
S W

INDICATE LOCATION OF WELL AND PLACE OF USE, IF POSSIBLE. EACH SMALL SQUARE REPRESENTS 40 ACRES.

Driller's Signature John H. Berry

Driller's Address 611 10th St

LICENSE NO. 65

DRILLER'S LOG

Indicate the character, color, thickness of strata such as soil, clay, sand, gravel, shale, sandstone, etc. Show depth at which water is found and height to which water rises in well.

Top of Ground (Elev. above sea level)		
From (Feet)	To (Feet)	
75	75	Brown Clay
75	100	gray clay
100	220	gray sandstone
220	252	gray sandstone
252	252	water 1 foot

Show exact depth of bottom

252'

51,280

140106

Water Well Log File # 720

State of Montana } ss.
County of McCone }

Office of Clerk and Recorder.

Filed this 30th day of

August, A. D., 1972

at 2:00 o'clock P. M.

Gloria L. Brennan
Clerk and Recorder

By Mary L. Fickler Deputy
Fee \$2.00

Form No. 18
8-60

T. 25 R. 47

County McCone

MONTANA BUREAU OF MINES AND GEOLOGY
Butte, Montana

Water Well Log

RECEIVED
JAN 4 1962

OWNER T. & S. Stock Co. Address Wolf Point, Mont.

Driller Bob Thomas Address Wolf Point, Mont.

Date Started 2-10-44 Date Completed 2-15-44

Location: Sec. 30 T. 25 R. 47 $\frac{1}{4}$ Sec. nw 1/4 set

Type of well Dug Equipment used Pick & shovel
(Dug, driven, or drilled) (Churn, drill, rotary, other)

Water use: Domestic ☒ Municipal ☐ Stock ☐ Irrigation ☐
Industrial ☐ Drainage ☐ Other ☐

Casing: 0 ft. to 33 ft. Type concrete Size 4 ft. round

Casing: 33 ft. to 36 ft. Type steel Size " "

Casing: ft. to ft. Type Size

Perforated or screened: Ft. 33 to ft. 36 . Ft. to ft.

Type of screen or perforations 5/8" round holes

Static water level, for non-flowing well: 32 feet.

Shut-in pressure, for flowing well: lb./sq. in. on: (date)

Pumping water level 33 feet at 5 gal. per min.

How tested: plunger type pump

Length of test 5 hrs.

Remarks: (Gravel packing, cementing, packers, type of shut-off, depth of shut-off)

(over)

Log of Well

[illegible]

Form No. 18
8-60

T. 25 R. 47

County McCone

MONTANA BUREAU OF MINES AND GEOLOGY
Butte, Montana

JAN 4 1962

Water Well Log

STATE ENGINEER

OWNER T. A. S. Stock Co. Address Wolf Point, Mont.

Driller Bob Thomas Address Wolf Point, Mont.

Date Started 1-3-45 Date Completed 1-8-45

Location: Sec. 30 T. 25 R. 47 $\frac{1}{4}$ Sec. sw 1 sec 30

Type of well Dug Equipment used pick & shovel
(Dug, driven, or drilled) (Churn, drill, rotary, other)

Water use: Domestic ☐ Municipal ☐ Stock ☒ Irrigation ☐

Industrial ☐ Drainage ☐ Other ☐

Casing: 0 ft. to 32 ft. Type wood Size 5x5 sq.

Casing: 32 ft. to 37 ft. Type steel Size 5' round

Casing: ft. to ft. Type Size

Perforated or screened: Ft. 36 to ft. 37 Ft. to ft.

Type of screen or perforations 5/8" round holes

Static water level, for non-flowing well: 32' feet.

Shut-in pressure, for flowing well: lb./sq. in. on: (date)

Pumping water level 31 feet at 7 gal. per min.

How tested: plunger type pump

Length of test 4 hrs.

Remarks: (Gravel packing, cementing, packers, type of shut-off, depth of shut-off)

(over)

Log of Well

[illegible]

Form No. 18
8-60

T. 25 R. 47

County McCone

MONTANA BUREAU OF MINES AND GEOLOGY
Butte, Montana

RECEIVED
JAN 4 1962

Water Well Log

STATE ENGINEER

OWNER T & S Stock Co. Address Wolf Point, Mont.

Driller Bob Thomas Address Wolf Point, Mont.

Date Started 6 - 1931 Date Completed 7 - 1931

Location: Sec. 31 T. 25 R. 47 $\frac{1}{4}$ Sec. NE 1/4

Type of well Dug Equipment used pick & shovel
(Dug, driven, or drilled) (Churn, drill, rotary, other)

Water use: Domestic ☐ Municipal ☐ Stock ☒ Irrigation ☐

Industrial ☐ Drainage ☐ Other ☐

Casing: 0 ft. to 31 ft. Type concrete Size 4 1/2" round

Casing: 31-31 ft. to 36 ft. Type Size

Casing: ft. to ft. Type Size

Perforated or screened: Ft. 36 to ft. 36 . Ft. to ft.

Type of screen or perforations 5/8 round holes

Static water level, for non-flowing well: 32 feet.

Shut-in pressure, for flowing well: lb./sq. in. on: (date)

Pumping water level 33 feet at 6 gal. per min.

How tested: plugger pump

Length of test 3 hrs.

Remarks: (Gravel packing, cementing, packers, type of shut-off, depth of shut-off)

(over)

Log of Well

[illegible]

Page . of

Twp. 25N

Rge. 48E

[illegible]

T. 25N., R. 48E.
MCCONE COUNTY

GW2

File No. 287

DUPLICATE

T. 25 R. 40

County: Montana

STATE OF MONTANA
ADMINISTRATOR OF GROUNDWATER CODE
OFFICE OF STATE ENGINEER DEC 19 1963

Notice of Completion of Groundwater Appropriation by Means of Well

(Under Chapter 237, Montana Session Laws, 1961)

0 Top of Ground
(Elev. above sea level.....2500....)
21 Drift (Slop)
38 Grey
46 Dark Brown
70 Gray
85 Sand Water
Grey

Owner: Fred Schumacher Address: Wolf Point, Montana

Driller: Boone Whitmer & Sons Address: Wolf Point, Montana

Date of Notice of Appropriation of Groundwater MAY 15, 1963

Date well started MAY 14, 1963 Date Completed MAY 15, 1963

Type of well: Drilled (dug, driven, bored or drilled) Equipment Used: Cable Tool (Churn, drill, rotary or other)

Water Use: Domestic ☐ Municipal ☐ Stock ☒ Irrigation ☐
Industrial ☐ Drainage ☐ Other ☐

Indicate on the diagram the character and thickness of the different strata met with in drilling, such as soil, clay, shale, gravel, rock or sand, etc. Show depth at which water is encountered, thickness and character of water-bearing strata and height to which the water rises in the well.

Size of Drilled Hole	Size and Weight of Casing	From (Feet)	To (Feet)	PERFORATIONS		
				Kind Size	From (Feet)	To (Feet)
5-inch	5 1/4" 15#	0	69		None	

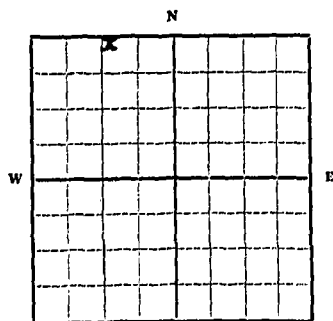

NW 1/4 Sec. 10 T. 25 R. 40

Indicate location of well and place of use, if possible. Each small square represents 10 acres.

Show exact depth of bottom.

Static Water Level for non-flowing Well 40 feet.

Shut-in Pressure for Flowing Well

Pumping Water Level 65 feet at 6 gal. per minute.

Discharge in gal. per min. of flowing well

How Tested: Bailor Length of Test: 1 hour

Remarks: (Gravel packing, cementing, packers, type of shutoff, location of place of use of groundwater if not at well, and any other similar pertinent information, including number of

acres irrigated, if used for irrigation)

83
Driller's License Number

Boone Whitmer
Driller's Signature

This form to be prepared by driller, and three copies to be filed by the owner with the County Clerk and Recorder in the county in which the well is located.

Please answer all questions. If not applicable, so state, otherwise the form will be returned.

Original to the County Clerk and Recorder; duplicate to the State Engineer; Triplicate to the School of Mines and Quadruplicate for the Appropriator.

10405

DOC. NO. 126982

WATER WELL LOG FILE NO. 287

FRED SCHUMACHER

TO

THE PUBLIC

STATE OF MONTANA)
) SS.
COUNTY OF McCONE)

OFFICE OF CLERK AND RECORDER.

Filed this 16th day of December 1963

at 11:45 o'clock a.m.

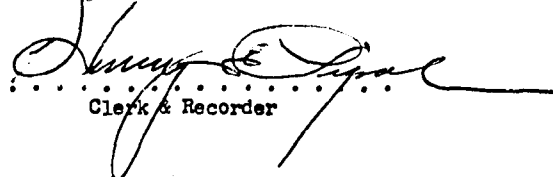
.....
Clerk & Recorder

FEE \$ 2.00

GV

File No. 288

T. 25 N R. 48

County: McCONE

DUPLICATE

STATE OF MONTANA
ADMINISTRATOR OF GROUNDWATER CODE
OFFICE OF STATE ENGINEER

Declaration of Vested Groundwater Rights
(Under Chapter 237, Montana Session Laws, 1961)

RECEIVED
DEC 19 1963

STATE ENGINEER

1. Fred Schumacher of Wolf Point, Montana
(Name of Appropriator) (Address) (Town)
County of McCONE State of Montana
have appropriated groundwater according to the Montana laws in effect prior to January 1, 1962, as follows:

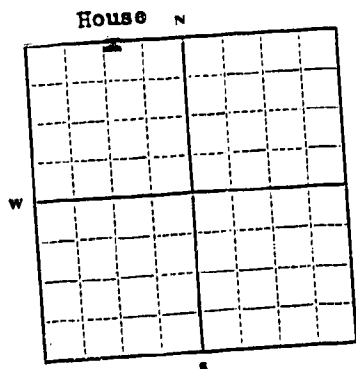

NW 1/4 Sec. 10 T. 25 N. R. 48
Indicate point of appropriation
and place of use, if possible.
Each small square represents 10
acres.

2. The beneficial use on which the claim is based.....
Domestic use
3. Date or approximate date of earliest beneficial use; and how con-
tinuous the use has been..... April 20, 1951
used continuously
4. The amount of groundwater claimed (in miner's inches or gallons
per minute)..... 4 gallons per minute
5. If used for irrigation, give the acreage and description of the lands
to which water has been applied and name of the owner thereof
6. The means of withdrawing such water from the ground and the
location of each well or other means of withdrawal.....
pump

7. The date of commencement and completion of the construction of the well, wells, or other works for with-
drawal of groundwater..... April 17, 1951 to April 20, 1951

8. The depth of water table..... 32 feet

9. So far as it may be available, the type, size and depth of each well or the general specifications of any other
works for the withdrawal of groundwater..... Drilled 6-inch ID size 72 feet depth
20# pipe

10. The estimated amount of groundwater withdrawn each year..... 730,000

11. The log of formations encountered in the drilling of each well if available.....
Drift - 40 ft. Gray - 67 ft. Rock - 69 ft. Water Sand - 72
Brown -

12. Such other information of a similar nature as may be useful in carrying out the policy of this act, including
Driller's book and log of any county record.....
B. Whitman
Driller

Signature of Owner

Date: Dec 16 - 1963

Three copies to be filed by the owner with the County Clerk and Recorder of the county in which the well is
located.

Please answer all questions. If not applicable, so state, otherwise the form will be returned.

Original to the County Clerk and Recorder; duplicate to the State Engineer; Triplicate to the Montana Bureau
of Mines and Geology, and Quadruplicate for the Appropriator.

126983

REC. NO.

WATER WELL LOG FILE NO. 283

FRED SCHUMACHER

TO

THE PUBLIC

STATE OF MONTANA)
)SS.
COUNTY OF McCONE)

OFFICE OF CLERK AND RECORDER.

Filed this 16th day of December 1963

at 11:30 o'clock a.m.

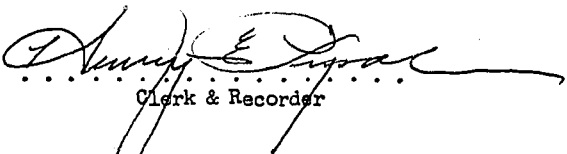
Clerk & Recorder

FEE \$ 2.00

File No. 397T. 25 N. R. 48

DUPLICATE

County McCone

STATE OF MONTANA
ADMINISTRATOR OF GROUNDWATER CODE
OFFICE OF STATE ENGINEER

RECEIVED
JAN 16 1964

Declaration of Vested Groundwater Rights

(Under Chapter 237, Montana Session Laws, 1961)

STATE ENGINEER

1. Chris Schock, of Wolf Point
(Name of Appropriator) (Address) (Town)
County of McCone State of Montana
have appropriated groundwater according to the Montana laws in effect prior to January 1, 1962, as follows:

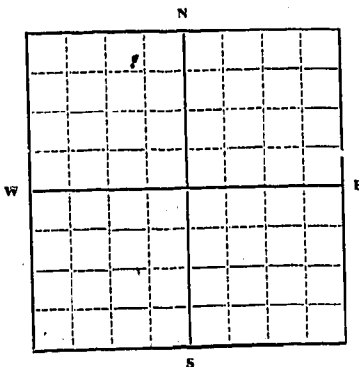

2. 1/4 Sec. 25 T. 48 R.

Indicate point of appropriation
and place of use, if possible.
Each small square represents 10
acres.

2. The beneficial use on which the claim is based house & livestock
3. Date or approximate date of earliest beneficial use; and how continuous the use has been Aug 1952
Continuous
4. The amount of groundwater claimed (in miner's inches or gallons per minute) 10 gal. per min.
5. If used for irrigation, give the acreage and description of the lands to which water has been applied and name of the owner thereof
Garden & lawn
6. The means of withdrawing such water from the ground and the location of each well or other means of withdrawal
electric pressure system
7. The date of commencement and completion of the construction of the well, wells, or other works for withdrawal of groundwater Aug 1952
8. The depth of water table 8.0 ft
9. So far as it may be available, the type, size and depth of each well or the general specifications of any other works for the withdrawal of groundwater
138 ft deep drilled 6 in. casing
10. The estimated amount of groundwater withdrawn each year 450,000
11. The log of formations encountered in the drilling of each well if available
water was hit in
sand rock
12. Such other information of a similar nature as may be useful in carrying out the policy of this act, including reference to book and page of any county record
don't know

Signature of Owner

Chris SchockDate Dec 30

Three copies to be filed by the owner with the County Clerk and Recorder of the county in which the well is located.

Please answer all questions. If not applicable, so state, otherwise the form will be returned.

Original to the County Clerk and Recorder; duplicate to the State Engineer; Triplicate to the Montana Bureau of Mines and Geology, and Quadruplicate for the Appropriator.

36368

DOC. NO.

127156

FOR WELL LOG FILE NO. 397

CHRIS SCHOCK

TO

THE PUBLIC

STATE OF MONTANA)
)SS
COUNTY OF McCONE)

OFFICE OF COUNTY CLERK & RECORDER

Filed this 30th day of Dec., 1963 A.D.

at 12:59 o'clock p.m.

Harvey E. Dyer
COUNTY CLERK

Fees: \$2.00

T 25 R 48
County McCone

24

MONTANA BUREAU OF MINES AND GEOLOGY

Butte, Montana

RECEIVED
JAN 4 1962

WATER WELL LOG

STATE ENGINEER

Owner Martin G. Beck Address Valley Park, Mont.
Driller By Owner Address _____
Date Started 1952 Date Completed 1952
Location: Sec 24 T 25 R 48 $\frac{1}{2}$ Sec NE SW

Type of Well Aug Equipment Used Shovel
(Dug, driven, bored, or drilled) (Churn drill, rotary, other)

Water use: Domestic ☒ Municipal ☐ Stock ☐ Irrigation ☐
Industrial ☐ Drainage ☐ Other: _____

Casing: 0 ft. to 15 ft. Type tile Size 24 in

Casing: _____ ft. to _____ ft. Type _____ Size _____

Casing: _____ ft. to _____ ft. Type _____ Size _____

Perforated or Screened: Ft 0 to ft 13 Ft _____ to ft _____

Type of screen or perforations Perforated

Static Water level, for non-flowing well: 2 feet

Shut-in pressure, for flowing well: _____ lb./sq.in.on: _____ (date)

Pumping water level 2 feet at _____ gal. per min _____

How tested: By Pumping

Length of test 2 min

Remarks: (Gravel packing, cementing, packers, type of shut-off, depth of shut-off)

No packing

(over)

Log of Well

[illegible]

T 25 R 48
County McCone

24

MONTANA BUREAU OF MINES AND GEOLOGY
Butte, Montana

RECEIVED
JAN 4 1962

STATE ENGINEER

WATER WELL LOG

Owner Martin Back Address Holy Hill, Mont.
Driller Dubne Address Unknown
Date Started 1922 Date Completed 1922
Location: Sec 24 T 25 R 48 $\frac{1}{4}$ Sec NESW

Type of Well Bored Equipment Used Boring Machine
(Dug, driven, bored, or drilled) (Churn drill, rotary, other)

Water use: Domestic ☐ Municipal ☐ Stock ☒ Irrigation ☐
Industrial ☐ Drainage ☐ Other: _____

Casing: 0 ft. to 6.5 ft. Type tile Size 1 ft

Casing: _____ ft. to _____ ft. Type _____ Size _____

Casing: _____ ft. to _____ ft. Type _____ Size _____

Perforated or Screened: Ft _____ to ft _____ Ft _____ to ft _____

Type of screen or perforations _____

Static Water level, for non-flowing well: 23 feet

Shut-in pressure, for flowing well: _____ lb./sq.in.on: _____ (date)

Pumping water level 23 feet at _____ gal. per min

How tested: By Pumping - quicksand obstructs flow

Length of test Permanent pumping

Remarks: (Gravel packing, cementing, packers, type of shut-off, depth of shut-off)

No packing of any kind

(over)

Log of Well

[illegible]

File No. 551T. 25N 48E

DUPLICATE

County McCone

STATE OF MONTANA
ADMINISTRATOR OF GROUNDWATER CODE
OFFICE OF STATE ENGINEER

RECEIVED
JAN 16 1964

Notice of Completion of Groundwater Appropriation Without Well

(Under Chapter 237 Montana Session Laws, 1961)

Date of Appropriation of Groundwater.....

Owner George Hubbard Address Bozeman, M.

Contractor (if any)

Address of Contractor

Date Started..... Date Completed.....

Describe means of obtaining groundwater without a well "as by sub-irrigation and other natural processes". Include depth to water when applicable. Natural Spring

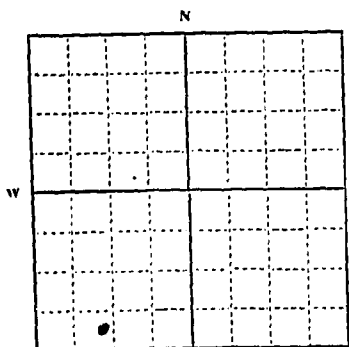

SW 1/4 Sec. 29 T. 25 N. R. 48 E

Indicate point of appropriation
and place of use, if possible.

Quantity of water developed and used with explanation of method used to measure or estimate such amount. If use is intermittent

estimate approximate lengths of periods of use. 9 Mon.

Plenty for 200 head
cattle.

Signature of Owner George HubbardDate 12-28-63

This form to be prepared by contractor (if any), otherwise by the owner.

Three copies of this notice are to be filed with the County Clerk and Recorder of the county in which the works are located.

Please answer all questions. If not applicable, so state, otherwise the form will be returned.

Original to the County Clerk and Recorder; duplicate to the State Engineer; Triplicate to the Montana Bureau of Mines and Geology and Quadruplicate for the Appropriator.

36523

DOC. NO. 127322

WATER WELL LOG FILE NO. 551

GEORGE HUBBARD

TO

THE PUBLIC

STATE OF MONTANA)
)SS
COUNTY OF McCONE)

OFFICE OF COUNTY CLERK & RECORDER

Filed this 3rd day of Jan., 1964 A.D.

at 9:15 o'clock, a.m.

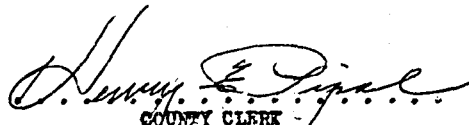
COUNTY CLERK

FEE: \$2.00

RECEIVED
OCT 16 1958

T 26 R 48
County McCone

STATE ENGINEER MONTANA BUREAU OF MINES AND GEOLOGY
Butte, Montana

WATER WELL LOG

Owner Joe Bell Address Wolf Point, Montana
Driller A & B Drilling Co. Address Scobey, Montana
Date Started _____ Date Completed 9/11/58
Location: Sec W 1/2 T 26 R 48 1/4 sec SW 1/4

Type of well Drilled Equipment used able tool drilling machine
(Dug, driven, bored, or drilled) (Churn drill, rotary, other)

Water use: Domestic ☐ Municipal ☐ Stock ☒ Irrigation ☐
Industrial ☐ Drainage ☐ Other: _____

Casing: 0 ft. to 70 ft. Type steel tar coated Size 6"

Casing: _____ ft. to _____ ft. Type _____ Size _____

Casing: _____ ft. to _____ ft. Type _____ Size _____

Perforated or Screened: Ft. 43 to ft. 48 Ft. _____ to ft. _____

Type of screen or perforations torch slot

Static Water level, for non-flowing well: 30 feet.

Shut-in pressure, for flowing well: _____ lb./sq. in. on: _____ (date)

Pumping water level _____ feet at _____ gal. per min.

How tested: gailer

Length of test _____

Remarks: (Gravel packing, cementing, packers, type of shut-off, depth of shut-off)

(over)

Log of Well

Depth, feet		Description of Material Drilled	
From	To		
0	37	brown clay	69' of drilling
37	43	gray shale	70' of 6" casing
43	48	coal in strips	Water strates 43 to 48
48	70	light gray shale	Static water level 30
70		total depth	Draw down - all
			Perf. 43 to 46
			Shot coal w/3 sticks of 40 # powder

~~#117956~~

State of Missouri

Removal of McCone

~~Office of Clerk and Recorder.~~

Filed this 14 day of May 1964

October A.D. 1952

at 2:45 o'clock P.M.

Check and Reminder

7-10

No fee

No fee

Page ____ of ____

County McCone

Twp. 25-11

Rge. 49E

T. 25N., R. 49E.
MCCONE COUNTY

[illegible]

GW3

File No.

DUPLICATE

STATE OF MONTANA
ADMINISTRATOR OF GROUNDWATER CODE
OFFICE OF STATE ENGINEER

T. 25 N R. 49 E
County. *McCone*RECEIVED
MAR 15 1963

STATE ENGINEER

Notice of Completion of Groundwater Appropriation Without Well

(Under Chapter 237 Montana Session Laws, 1961)

Date of Appropriation of Groundwater *1920*
Owner *Leo Hester* Address *Vida, Mont.*
Contractor (if any) *none*
Address of Contractor

Date Started *1920* Date Completed *1920*

Describe means of obtaining groundwater without a well "as by sub-irrigation and other natural processes". Include depth to water when applicable. *It is cased*

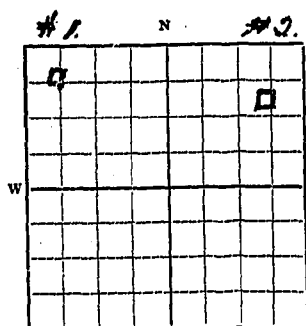

Indicate point of appropriation and place of use, if possible.

with an iron casing forming a basin (with a gravel base. Number 1 will be improved; No. 2 is complete

Quantity of water developed and used with explanation of method used to measure or estimate such amount. If use is intermittent estimate approximate lengths of periods of use *It is used by stock for 10 months of a year.*

Signature of Owner *Leo Hester*

Date *March 13, 1963*

This form to be prepared by contractor (if any), otherwise by the owner.

Three copies of this notice are to be filed with the County Clerk and Recorder of the county in which the works are located.

Please answer all questions. If not applicable, so state, otherwise the form will be returned.

Original to the County Clerk and Recorder; duplicate to the State Engineer; Triplicate to the School of Mines and Quadruplicate for the Appropriator.

125582

WATER WELL LOG # 219

State of Montana }
County of McCone }

Office of Clerk and Recorder.

Filed with 13th Day of

March A. D. 1963

at 2:00 o'clock P. M.

Harry E. Seal
Clerk and Recorder

By Deputy

Fee \$2.00

Form No. 18
8-60

95

T. 25 R. 49
County McCone

MONTANA BUREAU OF MINES AND GEOLOGY
Butte, Montana

Water Well Log

	0	

Owner Leo Hesser Address Vida, Montana
Driller Dan Haggerty Address Lindsay
Date Started November 1st, 1960 Date Completed November 15, 1960
Location: Sec. 15 T. 25 R. 49 $\frac{1}{4}$ sec. NE 1/4

Type of well Drilled Equipment used Churn
(Dug, driven, or drilled) (Churn, drill, rotary, other)

Water use: Domestic ☐ Municipal ☐ Stock ☒ Irrigation ☐
Industrial ☐ Drainage ☐ Other _____

Casing: 0 ft. to 90 ft. Type 6 inch heavy duty casing

Casing: _____ ft. to _____ ft. Type _____ Size _____

Casing: _____ ft. to _____ ft. Type _____ Size _____

Perforated or screened: Ft. _____ to ft. perforated bottom 20 feet. ft. _____ to ft. _____

Type of screen or perforations small holes drilled in casing

Static water level, for non-flowing well: 65 feet.

Shut-in pressure, for flowing well: _____ lb./sq. in. on: _____
(date)

Pumping water level 80 feet at six gal. per min. _____

How tested: Drilling machine

Length of test four hours

Remarks: (Gravel packing, cementing, packers, type of shut-off, depth of shut-off)

Gravel Packed

(over)

Log of Well

Depth feet		Description of Material Drilled
From	To	
0	18'	Brown Clay
18'	27'	Coal
27'	47'	Brown
47'	50'	Blue Clay
50'	52'	Rock
52'	65'	Yellow Sand Dry
65'	66'	Rock
66'	90'	Sand Water,

123352

DOC. NO. 123352

WATER WELL LOG FILE NO. 100

State of Montana

County of

Office of Clerk and Recorder.

Filed this 28th day of

December A. D. 1961

at 2:36 o'clock P. M.

[Signature]

Clerk and Recorder

By

For

Form No. 18
8-60

15

T. 25 R. 49
County McCone

MONTANA BUREAU OF MINES AND GEOLOGY
Butte, Montana

RECEIVED
JAN 4 1962

Water Well Log

STATE ENGINEER

0		

Owner Leo Hesser Address Wida, Montana
Driller Nick Hesser Address Wolf Point, Montana
Date Started July 1st, 1945 Date Completed July 30, 1945
Location: Sec. 15 T. 25 R. 49 $\frac{1}{4}$ sec. NE 1/4

Type of well Dug Equipment used Horse drilling auger
(Dug, driven, or drilled) (Churn, drill, rotary, other)

Water use: Domestic ☒ Municipal ☐ Stock ☐ Irrigation ☐
Industrial ☐ Drainage ☐ Other _____

Casing: 0 ft. to 74 ft. Type Dug Size 18 in ch

Casing: _____ ft. to _____ ft. Type _____ Size _____

Casing: _____ ft. to _____ ft. Type _____ Size _____

Perforated or screened: Ft. 0 to ft. 15. Ft. _____ to ft. _____

Type of screen or perforations Tiled

Static water level, for non-flowing well: 65 feet.

Shut-in pressure, for flowing well: _____ lb./sq. in. on: _____
(date)

Pumping water level 70 feet at 1 gal. per min. _____

How tested: with well machine

Length of test 4 hours

Remarks: (Gravel packing, cementing, packers, type of shut-off, depth of shut-off)

Gravel packed

(over)

Log of Well

[illegible]

RECEIVED

File No. DEC 27 1967

TRIPLICATE

County McCone

LOG Huber Farms: E. S. #1

STATE OF MONTANA
ADMINISTRATOR OF GROUNDWATER CODE
OFFICE OF STATE ENGINEER

Notice of Completion of Groundwater
Appropriation by Means of Well

DEVELOPED AFTER JANUARY 1, 1962

(Under Chapter 237, Montana Session Laws, 1961)

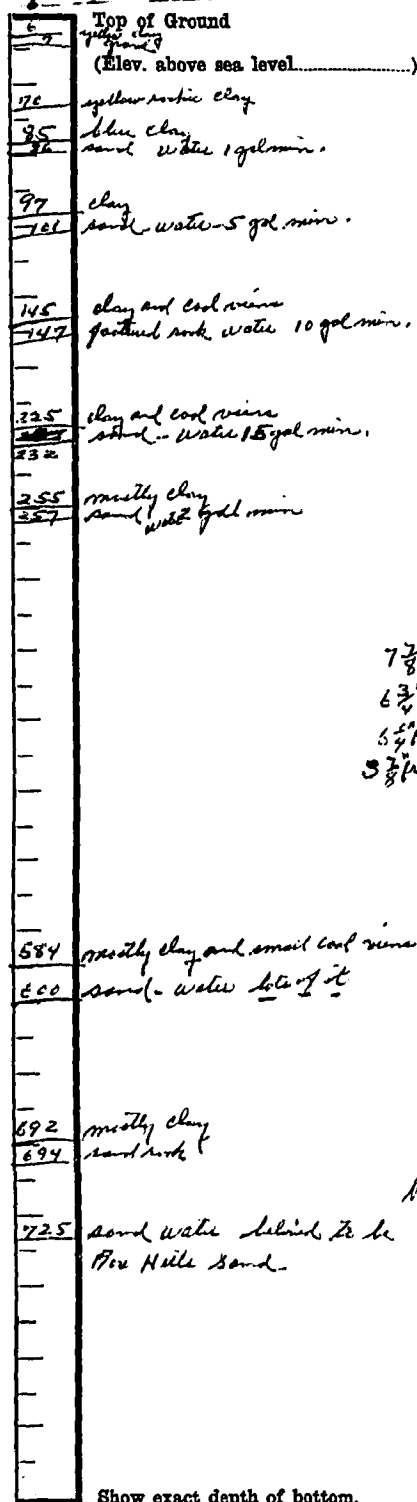

Owner Gaul Huber Address Uda Montana
Driller Walter Dilling Co Address Med Lake Montana
Date of Notice of appropriation of groundwater 9-15-67
Date well started 9-19-67 Date completed 11-5-67
Type of well drilled Equipment used As-Tech
(Dug, Driven, bored or drilled) (Churn drill, rotary or other)
Water use: Domestic ☒ Municipal ☐ Stock ☒ Irrigation ☒
Industrial ☐ Drainage ☐ Other ☐

Indicate on the diagram the character and thickness of the different strata met with in drilling, such as soil, clay, shale, gravel, rock or sand, etc. Show depth at which water is encountered, thickness and character of water-bearing strata and height to which the water rises in the well.

Size of Drilled Hole	Size and Weight of Casing	From (Feet)	To (Feet)	PERFORATIONS		
				Kind Size	From (Feet)	To (Feet)
7 7/8" to 90'	4" I.D.	0	694'	Not applicable		
6 3/4" from 90'-240'	11 lbs per ft					
5 1/2" from 240'-694'						
3 7/8" from 694'-725'						

N E 1/2 Sec 34-25-44

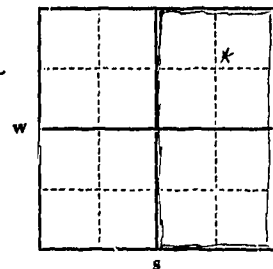

Static Water Level for non-flowing well 347 feet.

Shut-in Pressure for Flowing Well.....

Pumping Water Level 330 feet
at 20 gal. per minute.

Discharge in gal. per min. of flowing well.....

How Tested Submersible pump

Length of Test 11 hours

Remarks: (Gravel packing, cementing, pack-

N 1/2 Sec 34-25-44
Indicate location of well and place of use, if possible. Each small square represents 40 acres.
down through casing and around the outside until it comes to bottom casing and about 100 ft. then the bottom was drilled out into water sand

(Continue on reverse side)

USE—If used for irrigation, industrial, drainage or other. Explain, state number of acres and location or other data (i.e.: Lot, Block and Addition).

25-25-44 T. 6 N. R. 25 E. Sec. 34-25-44

Show exact depth of bottom.

This form to be prepared by driller, and three copies to be filed by the owner with the County Clerk and Recorder in the county in which the well is located, tissue copy to be retained by driller.

Please answer all questions. If not applicable, so state, otherwise the form will be returned.

106
Driller's License Number

Lloyd H. Carlson
Driller's Signature

42,695

133307

Water Well Log #655

State of Montana }
County of McCone } ss.

Office of Clerk and Recorder.

Filed this 21st day of

December A. D., 19.67

at 2:35 o'clock P. M.

Gloria L. Brennan
Clerk and Recorder

By *Aline E. Halber*
Deputy

Fee \$2.00

T. 25N., R. 50E.
MCCONE COUNTY

GROUNDWATER INDEX

Page of

County McCone

Twp. 25.1

Rge. 50 E[illegible]

250 50, E. NFM.

McCons
County

RECEIVED
JAN 16 1964

STATE ENGINEER

(Under Chapter 237, Montana Session Laws, 1961)

A 4x4 grid map with a horizontal line labeled 'W' and a vertical line labeled 'N'. An 'X' is located in the top-right quadrant, specifically in the second column from the right and the second row from the top.

2. The beneficial use on which the claim is based.
Well No. 1, Household and Stock Water
Well No. 2, Household and Stock Water
3. Date or approximate date of earliest beneficial use; and how continuous the use has been.
Well No. 1, 1958, Continuous
Well No. 2, 1915, Continuous
4. The amount of groundwater claimed (in miner's inches or gallons per minute).
Well No. 1, 10 gallons per minute, approximately
Well No. 2, 10 gallons per minute, approximately
5. If used for irrigation, give the acreage and description of the lands to which water has been applied and name of the owner thereof.
Not used for irrigation
6. The means of withdrawing such water from the ground and the location of each well or other means of withdrawal.
Well No. 1, Electric Pump
Well No. 2, Windmill

7. The date of commencement and completion of the construction of the well, wells, or other works for withdrawal of groundwater.
Well No. 1, 1958, Steel Casing, 5"
Well No. 2, 1915, Steel Casing, 5"
8. The depth of water table. Well No. 1, 240 feet deep. Well No. 2, 230 feet deep
9. So far as it may be available, the type, size and depth of each well or the general specifications of any other works for the withdrawal of groundwater.
Well No. 1, 1958, Steel Casing, 5"
Well No. 2, 1915, Steel Casing, 5"
10. The estimated amount of groundwater withdrawn each year. Unknown
11. The log of formations encountered in the drilling of each well if available.
Unknown
12. Such other information of a similar nature as may be useful in carrying out the policy of this act, including reference to book and page of any county record.

Signature of Owner _____

er..... Joseph Moornick
Date..... December 30th, 1963

Please answer all questions. If not applicable, so state, otherwise the form will be returned.

Original to the County Clerk and Recorder; Duplicate to the State Engineer; Triplicate to the Montana Bureau of Mines and Geology, and Quadruplicate for the Appropriator.

Doc. No.

127249

Water Well Log # 490

Joseph Doornak

TO

The Public

State of Montana }
County of McCone } ss

OFFICE OF COUNTY CLERK & RECORDER

Filed this 31st day of December, 1963 A. D.
at 8:33 A. M.

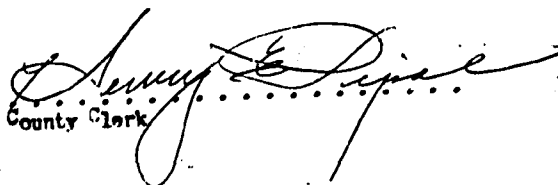
County Clerk

Fee: \$2.00

T - R

County

RECEIVED
JAN 20 1964

1. State ENGINEER

(Under Chapter 237, Montana Session Laws, 1961)

County of Yellowstone State of Montana
have appropriated groundwater according to the Montana laws in effect prior to January 1, 1962, as follows:

Indicate point of appropriation
and place of use, if possible.
Each small square represents 10
acres.

2. The beneficial use on which the claim is based.....
 3. Date or approximate date of earliest beneficial use; and how continuous the use has been.....
 4. The amount of groundwater claimed (in miner's inches or gallons per minute).....
 5. If used for irrigation, give the acreage and description of the lands to which water has been applied and name of the owner thereof.....
 6. The means of withdrawing such water from the ground and the location of each well or other means of withdrawal.....
 7. A description of the construction of the well, wells, or other works for withdrawal.....
 8. The location, size and depth of each well or the general specifications of any other water source.....
 9. The amount of water withdrawn each year.....
 10. The cost of the drilling of each well if available.....
 11. Any other information as may be useful in carrying out the policy of this act, including a copy of the title record.....

Signature of Owner [Signature]

Date: 11/11/2011

Three copies to be filed by the owner with the County Clerk and Recorder of the county in which the well is located.

Please answer all questions. If not applicable, so state, otherwise the form will be returned.

Original to the County Clerk and Recorder; duplicate to the State Engineer; Triplicate to the Montana Bureau of Mines and Geology, and Quadruplicate for the Appropriator.