

2178

307156

I received and filed this instrument for
 record on Monday day of Sept 1921
 at 2.00 o'clock P.M. permanent files
 of Missoula County, State of Montana
 Witness my hand:
 Vermae R. Croyle, County Recorder
 By Marion Dickson Deputy
 Fee \$ 2.00 Cash Paid

Subscribed by 150 Dollars
 or
 Fifty Dollars
 Public Money paid
 State of Montana

RECEIVED

County Missoula

17

STATE OF MONTANA
ADMINISTRATOR OF GROUNDWATER CODE
MONTANA WATER RESOURCES BOARD

DEC 8 1972

DRILLER'S LOG

NOTICE OF COMPLETION OF GROUNDWATER
APPROPRIATION BY MEANS OF WELL

Developed after January 1, 1962

(Under Chapter 237 Montana Session Laws, 1961, as amended)

This form to be prepared by driller, and three copies to be filed by the owner with the County Clerk and Recorder in the county in which the well is located, last copy to be retained by driller.

Please answer all questions. If not applicable, so state, otherwise the form may be returned.

Indicate the character, color, thickness of strata such as soil, clay, sand, gravel, shale, sandstone, etc. Show depth at which water is found and height to which water rises in well.

Owner George Fisher
Address 720 Turner
Missoula
Date well started Nov. 15 1972
completed Nov. 17 1972

For Administrator's Use	
File	<u>325899</u>
Date	<u>Nov. 15, 1972</u>
Time	<u>3:00 PM</u>
GW 1	

Type of well Drilled
(Dug, driven, bored or drilled)
Equipment used Churn Drill
(Churn drill, rotary or other)
Water Use: Domestic Municipal Stock Irrigation
Industrial Drainage Other * Garden/Lawn

*Describe _____
USE: If used for irrigation, industrial, drainage or other. Explain, state number of acres and location or other data (i.e. Lot, Block and Addition).

ESTIMATED ANNUAL WITHDRAWAL 60,000

Size of Drilled Hole	Size and Weight of Casing	From (Feet)	To (Feet)	PERFORATIONS		
				Kind Size	From (Feet)	To (Feet)
<u>6 5/8"</u>	<u>6 5/8" od</u>	<u>18" up</u>	<u>61 ft.</u>	<u>*****</u>	<u>*****</u>	<u>*****</u>
<u>6"</u>	<u>17 lb.</u>					

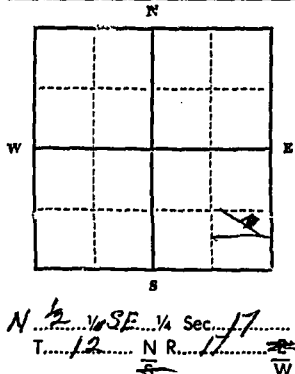

Static water level 30 ft.*
Pumping water level 35 ft.*
at 30 gallons per minute,
measured 60 minutes after pumping began.
*Measured from ground level.
Well developed by collar
for 4 hours.
Power..... Pump..... HP
Remarks: (Gravel packing, cementing, packers, type of shutoff)

Top of Ground		(Elev. above sea level)
From (Feet)	To (Feet)	
0	24	gravel sand cobbles
24	29	reddish brown sand
29	41	sand gravel in clay
41	43	red argill. boulder
43	45	red colored sand
45	58	gravel and sandy water
58	61	clean gravel and water

INDICATE LOCATION OF WELL AND PLACE OF USE, IF POSSIBLE. EACH SMALL SQUARE REPRESENTS 40 ACRES.

Driller's Signature George O. Becke
Driller's Address Box 17
Rayall LICENSE NO. 204

61 feet Show exact depth of bottom

527059

325899

I received and filed this instrument for
record on the 15 day of Oct. 19 1922
at 3:00 o'clock P.M. permanent files
of Missoula County State of Montana
Witness my hand
Vernice A. Criss, County Recorder
By Sandra M. Sloan Deputy
Fee \$4.00 Paid

MISSOULA COUNTY RECORDS
RECORDED
INDEXED
FEB 15 1923

RECEIVED

County MISSOULA

JAN 18 1973

STATE OF MONTANA
ADMINISTRATOR OF GROUNDWATER CODE
MONTANA WATER RESOURCES BOARD
MONTANA DEPARTMENT OF NATURAL RESOURCES AND CONSERVATION

DRILLER'S LOG

Indicate the character, color, thickness of strata such as soil, clay, sand, gravel, shale, sandstone, etc. Show depth at which water is found and height to which water rises in well.

NOTICE OF COMPLETION OF GROUNDWATER APPROPRIATION BY MEANS OF WELL

Developed after January 1, 1962

(Under Chapter 237 Montana Session Laws, 1961, as amended)

This form to be prepared by driller, and three copies to be filed by the owner with the County Clerk and Recorder in the county in which the well is located, last copy to be retained by driller.

Please answer all questions. If not applicable, so state, otherwise the form may be returned.

Owner LES HALLFORD

Address SLIDE ROCK

DRIVE CLINTON

Date well started JAN. 4, 1973

completed JAN. 9, 1973

Type of well DRILLED

Equipment used CHURN

Water Use: Domestic Municipal Stock Irrigation

Industrial Drainage Other * Garden/Lawn

*Describe

USE: If used for irrigation, industrial, drainage or other. Explain, state number of acres and location or other data (i.e. Lot, Block and Addition).

ESTIMATED ANNUAL WITHDRAWAL

Size of Drilled Hole	Size and Weight of Casing	From (Feet)	To (Feet)	PERFORATIONS		
				Kind Size	From (Feet)	To (Feet)
6" I.D. 6-5/8" O.D. 17 lbs. 1/4" side-wall		ground level	50' 6"	none	none	none

Static water level 32 ft.*
Pumping water level 48 ft.*
at 18 minutes after pumping began.
measured 120 minutes after pumping began.
*Measured from ground level.
Well developed by test pump
for 2 hours.
Power 220 Pump 3/4 HP
Remarks: (Gravel packing, cementing, packers, type of shutoff)

120 ACRES

N.E. 1/4 N.W. 1/4 Sec. 17
T. 12 N. R. 17

INDICATE LOCATION OF WELL AND PLACE OF USE, IF POSSIBLE. EACH SMALL SQUARE REPRESENTS 40 ACRES.

Driller's Signature Gerritt Williams

Driller's Address 1558 So. 5th. W. MISSOULA, MONTANA

LICENSE NO. 151

Top of Ground (Elev. above sea level)		
From (Feet)	To (Feet)	
0'	6'	Well pit
6'	16'	Tan clay, gravel and Boulders
16'	46' 6"	Tan clay, sand and gravel
46' 6"	50' 6"	Sand, gravel and water

50' 6" Show exact depth of bottom

52,239

2398

326861

I received and filed this instrument for
record on the 22 day of June 1973
at 2:00 o'clock P. M., permanent files
of Missoula County, State of Montana
Witness my hand:
Dorothy L. Head, County Recorder
By Shirley A. Kelly, Deputy
Fee \$ 2.00 Cash PAID

544

334096

I received and filed this instrument for
record on the 2 day of June 1977
at 9:45 o'clock A M, permanent files
of Missoula County, State of Montana
Witness my hand:
Dorothy L. Head, County Recorder
By Mary Skeels, Deputy
Fee \$ 2.00 cash Paid

File No. _____

T. 12 R. 17 |

TRIPPLICATE

RECEIVED

County Missoula

LOG

STATE OF MONTANA
ADMINISTRATOR OF GROUNDWATER CODE
OFFICE OF STATE ENGINEER

AUG 1971

Notice of Completion of Groundwater
Appropriation by Means of Well
DEVELOPED AFTER JANUARY 1, 1962

(Under Chapter 237, Montana Session Laws, 1961)

Top of Ground _____

(Elev. above sea level _____)
Doc. No. 25922

Filed for record
this 2 day of August
A. D. 19 71, at 2:32
o'clock P.M. Mr. _____
0-----6'

SAND & GRAVEL
6'-----14'

CLAY & GRAVEL
14'-----69'

GRAVEL & WATER (no) raise
64'-----80'

WATER

BOTTOM

Owner WALTER KAMMERER Address CLINTON, MONTANA

Driller BERBE DRILLING Address POLSON, MONT.

Date of Notice of appropriation of groundwater _____

Date well started 11/8/67 Date completed 11/11/67

Type of well DRILLING Equipment used CHURN DRILL
(Dug, driven, bored or drilled) (Churn drill, rotary or other)

Water use: Domestic Municipal Stock Irrigation
Industrial Drainage Other

Indicate on the diagram the character and thickness of the different strata met with in drilling, such as soil, clay, shale, gravel, rock or sand, etc. Show depth at which water is encountered, thickness and character of water-bearing strata and height to which the water rises in the well.

Size of Drilled Hole	Size and Weight of Casing	From (Feet)	To (Feet)	PERFORATIONS		
				Kind Size	From (Feet)	To (Feet)
6"	6 I.D. 17"	5	64'	non-perforated cut torch	2' above shoe	

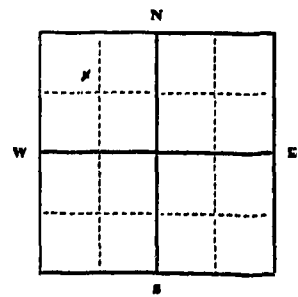

Static Water Level for non-flowing well 68' feet.

Shut-in Pressure for Flowing Well _____

Pumping Water Level 68' feet at 12 gal. per minute.

Discharge in gal. per min. of flowing well _____

How Tested BALED

Length of Test 2 hrs.

Remarks: (Gravel packing, cementing, packers, type of shutoff) 1"
plug in bottom of
the casing

N.W. 1/4, NW Sec. 17, T. 12, R. 17.
Indicate location of well and place of use, if possible. Each small square represents 40 acres.

(Continue on reverse side)

USE—If used for irrigation, industrial, drainage or other. Explain, state number of acres and location or other data (i.e.: Lot, Block and Addition).

Domestic

Show exact depth of bottom.

This form to be prepared by driller, and three copies to be filed by the owner with the County Clerk and Recorder in the county in which the well is located, tissue copy to be retained by driller.

Please answer all questions. If not applicable, so state, otherwise the form will be returned.

163
Driller's License Number

Donald J. Piche
Driller's Signature.

48845

2156

305922

I received and filed this instrument for
record on the 2 day of Aug 1927
at 2:22 o'clock P. M. District Clerk
of Missoula County, State of Montana
Witness my hand
Vernon B. Circus, County Recorder
By Henry J. Kelly Deputy
Fee \$ 2.00 cash Paid J

MISSOULA COUNTY RECORDS
RECORDED
INDEXED
FILED
AUG 27 1927
MISSOULA, MONTANA

File No. _____

T. 12N R. 17W

DUPLICATE

MONTANA WATER RESOURCES BOARD
RECEIVED

County Missoula

LOG

STATE OF MONTANA
ADMINISTRATOR OF GROUNDWATER CODE
OFFICE OF STATE ENGINEER

Top of Ground

(Elev. above sea level _____)

**Notice of Completion of Groundwater
Appropriation by Means of Well**
DEVELOPED AFTER JANUARY 1, 1962

(Under Chapter 237, Montana Session Laws, 1961)

- 0-20 Gravel, cobbles & Brown Clay
- 20-30 Tan Clay and gravel
- 30-98 Water, sand, Gravel & Clay
- 98-102 Water and gravel

Owner Robert M. Hanson Address Danavan Creek

1522 S. 14th W.

Driller Glenn Camp Address Missoula, Montana

Date of Notice of appropriation of groundwater _____

Date well started June 22, 1962 Date completed June 27, 1962

Type of well Drilled Equipment used Churn Drill
(Dug, driven, bored or drilled) (Churn drill, rotary or other)

Water use: Domestic Municipal Stock Irrigation
Industrial Drainage Other

Indicate on the diagram the character and thickness of the different strata met with in drilling, such as soil, clay, shale, gravel, rock or sand, etc. Show depth at which water is encountered, thickness and character of water-bearing strata and height to which the water rises in the well.

Size of Drilled Hole	Size and Weight of Casing	From (Feet)	To (Feet)	PERFORATIONS		
				Kind Size	From (Feet)	To (Feet)
6" I.D.	6" I.D. 17 lb per ft	3" above G.L.	102'			
				NONE		

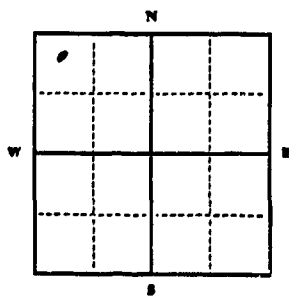

Static Water Level for non-flowing well _____ feet.

Shut-in Pressure for Flowing Well _____

Pumping Water Level 72 feet
at 25 gal. per minute.

Discharge in gal. per min. of flowing well _____

How Tested Test Pump & Bailor

Length of Test 2 hours

Remarks: (Gravel packing, cementing, packers, type of shutoff) _____

NW 1/4 Sec. 17 T. 12N R. 17W

Indicate location of well and place of use, if possible. Each small square represents 40 acres.

(Continue on reverse side)

USE—If used for irrigation, industrial, drainage or other. Explain, state number of acres and location or other data (i.e.: Lot, Block and Addition).

Show exact depth of bottom.

This form to be prepared by driller, and three copies to be filed by the owner with the County Clerk and Recorder in the county in which the well is located, tissue copy to be retained by driller.

Please answer all questions. If not applicable, so state, otherwise the form will be returned.

License 4-7
Driller's License Number

Glenn Camp
Driller's Signature Glenn Camp

44, 270

1804

272531

I received and filed this instrument for
 record on the 1st day of June 1964
 at 1:30 o'clock P.M., permanent files
 of Missouri County, State of Montana
 Witness my hand:
 Verano B. Cross County Register
 By *Donna W. Ramsey*, Deputy
 Fee \$2.00 Paid

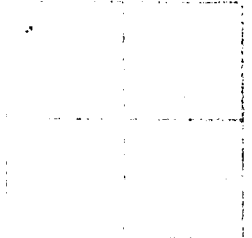

MISSOURI COUNTY
 STATE OF MONTANA

File No. _____

RECEIVED

T. 12^N R. 17^W
County Missoula

DUPLICATE

NOV 24 1967

LOG

STATE OF MONTANA
ADMINISTRATOR OF GROUNDWATER CODE
OFFICE OF STATE ENGINEER

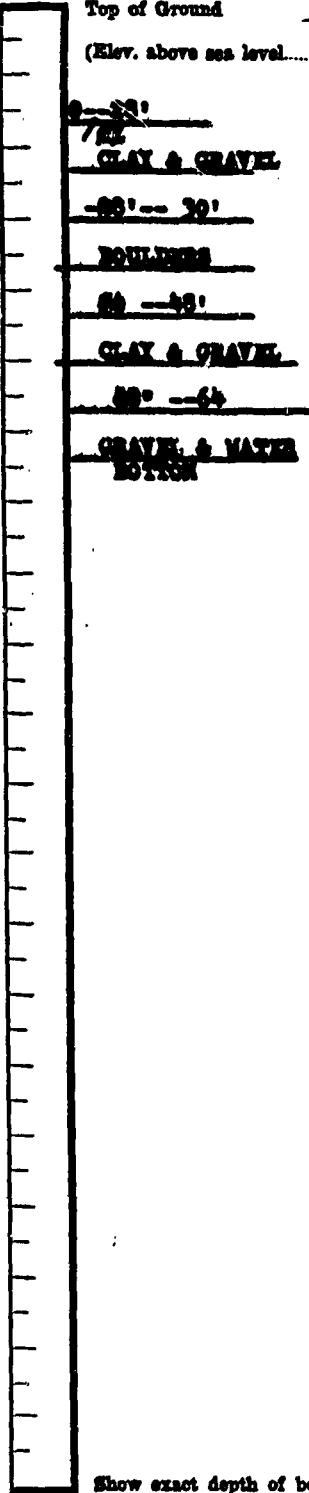

Notice of Completion of Groundwater Appropriation by Means of Well

DEVELOPED AFTER JANUARY 1, 1962

(Under Chapter 237, Montana Session Laws, 1961)

Owner N. E. STEBENS Address BOX 465 Melsa.

Driller BEER DRILLING Address POLSON

Date of Notice of appropriation of groundwater _____

Date well started Aug 23, 1967 Date completed Aug. 25, 1967

Type of well DRILLED Equipment used CHURN DRILL
(Dug, driven, bored or drilled) (Churn drill, rotary or other)

Water use: Domestic Municipal Stock Irrigation
Industrial Drainage Other

Indicate on the diagram the character and thickness of the different strata met with in drilling, such as soil, clay, shale, gravel, rock or sand, etc. Show depth at which water is encountered, thickness and character of water-bearing strata and height to which the water rises in the well.

Size of Drilled Hole	Size and Weight of Casing	From (Feet)	To (Feet)	PERFORATIONS		
				Kind Size	From (Feet)	To (Feet)
6"	6" I.D.	0	64'	None	None	11' to 12' None

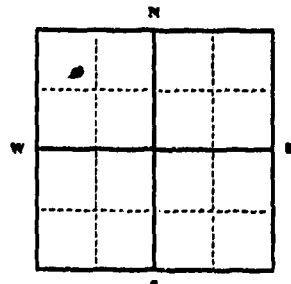

Static Water Level for non-flowing well 45' feet.

Shut-in Pressure for Flowing Well _____

Pumping Water Level 52' feet at 10 gal. per minute.

Discharge in gal. per min. of flowing well _____

How Tested 2 hrs

Length of Test 2 hrs

Remarks: (Gravel packing, cementing, packers, type of shutoff) _____

NW 1/4 Sec. 17, T. 12, R. 17
Indicate location of well and place of use, if possible. Each small square represents 40 acres.

(Continue on reverse side)

USE—If used for irrigation, industrial, drainage or other. Explain, state number of acres and location or other data (i.e.: Lot, Block and Addition)

Domestic

Show exact depth of bottom.

This form to be prepared by driller, and three copies to be filed by the owner with the County Clerk and Recorder in the county in which the well is located, tissue copy to be retained by driller.

Please answer all questions. If not applicable, so state, otherwise the form will be returned.

#163

Driller's License Number

Ronald R. Peake
Driller's Signature.

42,561

1961

RECORDED

265892

I received and filed this instrument for record on the 20 day of Nov, 1961 at 9:00 o'clock A.M., permanent files of Missoula County, State of Montana

Witness my hand:
 Veronique R. Crouse, County Recorder
 By Nancy A. Heath Deputy
 Fee \$ 2.00 Paid Cash

MISSOULA COUNTY, MONTANA

265892

MISSOULA COUNTY, MONTANA

MISSOULA COUNTY, MONTANA

MISSOULA COUNTY, MONTANA

MISSOULA COUNTY, MONTANA

MISSOULA

MISSOULA COUNTY, MONTANA

MISSOULA COUNTY, MONTANA

10

File No. _____

RECEIVED

T. 12 R. 17

DUPLICATE

NOV 4 1970

County Missoula

LOG

STATE OF MONTANA
ADMINISTRATOR OF GROUNDWATER CODE
OFFICE OF STATE ENGINEER

Top of Ground
(Elev. above sea level _____)

Notice of Completion of Groundwater
Appropriation by Means of Well
DEVELOPED AFTER JANUARY 1, 1962

(Under Chapter 237, Montana Session Laws, 1961)

Owner John O. Roske Address Clinton, Mont.

Driller (Same) Address (Same)

Date of Notice of appropriation of groundwater _____

Date well started _____ Date completed _____

Type of well DRIVEN Equipment used Hammer
(Dug, Driven, bored or drilled) (Churn drill, rotary or other)

Water use: Domestic Municipal Stock Irrigation
Industrial Drainage Other

Indicate on the diagram the character and thickness of the different strata met with in drilling, such as soil, clay, shale, gravel, rock or sand, etc. Show depth at which water is encountered, thickness and character of water-bearing strata and height to which the water rises in the well.

2 foot soil

*6 1/2 ft
Blown Sand
Gravel and Rock*

Size of Drilled Hole	Size and Weight of Casing	From (Feet)	To (Feet)	PERFORATIONS		
				Kind Size	From (Feet)	To (Feet)
<i>4 1/2 in.</i>	<i>4 in 1/2 in thick</i>	<i>1 ft</i>	<i>6 1/2 ft.</i>	<i>3 in holes</i>	<i>0 1/2 ft.</i>	<i>6 1/2 ft.</i>

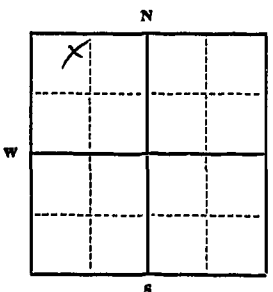

Static Water Level for non-flowing well 35 feet.

Shut-in Pressure for Flowing Well _____

Pumping Water Level 55 feet
at 400 gal. per minute.

Discharge in gal. per min. of flowing well _____

How Tested _____

Length of Test _____

Remarks: (Gravel packing, cementing, packers, type of shutoff) _____

Doc. No. 296391
Filed for record
this 29 day of October
A. D. 19 70, at 11:00
o'clock A. M.

Indicate location of well and place of use, if possible. Each small square represents 40 acres.

(Continue on reverse side)

USE—If used for irrigation, industrial, drainage or other. Explain, state number of acres and location or other data (i.e.: Lot, Block and Addition).

Block 3, Lot 3 Section 12 Township 12
North Range, 17 West

6 1/2 feet
show exact depth of bottom.

This form to be prepared by driller, and three copies to be filed by the owner with the County Clerk and Recorder in the county in which the well is located, tissue copy to be retained by driller.

Please answer all questions. If not applicable, so state, otherwise the form will be returned.

Driller's License Number _____

Driller's Signature _____

47719

2056 296391

I received and filed this instrument for
record on the 29th day of Oct 1970
at 11:00 o'clock A.M. in the County of
Missouri, State of Missouri
Witness my hand
Vernon B. Orman, County Recorder
By M. M. Pennington, Deputy
Fee \$2.00 and Paid

Approved by the Board of Supervisors
 of the County of Missouri
 on the 29th day of October 1970
 at the County Seat of the County of Missouri

File No.

RECEIVED

T. 12 N. R. 17 W

DUPLICATE

NOV 4 1970

County Missoula

LOG

STATE OF MONTANA
ADMINISTRATOR OF GROUNDWATER CODE
OFFICE OF STATE ENGINEER

Top of Ground
(Elev. above sea level.....)

Notice of Completion of Groundwater
Appropriation by Means of Well
DEVELOPED AFTER JANUARY 1, 1963

(Under Chapter 237, Montana Session Laws, 1961)

2 footy soil

Owner John C Roske Address Clinton, Mont.

Driller (Same) Address (Same)

Date of Notice of appropriation of groundwater.....

Date well started 8-10-68 Date completed 8-30-68

Type of well DRIVEN Equipment used NUMMER
(Dug, Driven, bored or drilled) (Churn drill, rotary or other)

Water use: Domestic Municipal Stock Irrigation
Industrial Drainage Other

Indicate on the diagram the character and thickness of the different strata met with in drilling, such as soil, clay, shale, gravel, rock or sand, etc. Show depth at which water is encountered, thickness and character of water-bearing strata and height to which the water rises in the well.

*Below Sand
Gravel and Rock*

Size of Drilled Hole	Size and Weight of Casing	From (Feet)	To (Feet)	PERFORATIONS		
				Kind Size	From (Feet)	To (Feet)
<i>4 1/2 in.</i>	<i>4 in 1/2 in chick</i>	<i>1 ft</i>	<i>65 ft.</i>	<i>3 in holes</i>	<i>57 ft.</i>	<i>65 ft.</i>

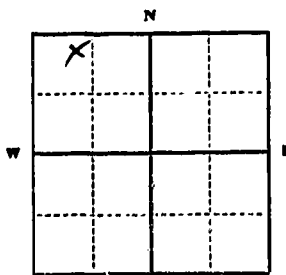

Static Water Level for non-flowing well 3.5 feet.

Shut-in Pressure for Flowing Well.....

Pumping Water Level 5.5 feet
at 400 gal. per minute.

Discharge in gal. per min. of flowing well.....

How Tested.....

Length of Test.....

Remarks: (Gravel packing, cementing, packers, type of shutoff).....

Doc. No. 296391
Filed for record
this 29 day of October
A. D. 19 70, at 11.00
o'clock P.M.

1/4 Sec. 17, T. 12 N. R. 17 W
Indicate location of well and
place of use, if possible. Each
small square represents 40
acres.

(Continue on reverse side)

USE—If used for irrigation, industrial, drainage or other. Explain, state number of acres and location or other data (i.e.: Lot, Block and Addition).

Block 3, Lot 3, Section 17, Township 12,
North Range, 17 West

65 feet
Show exact depth of bottom.

This form to be prepared by driller, and three copies to be filed by the owner with the County Clerk and Recorder in the county in which the well is located, tissue copy to be retained by driller.

Please answer all questions. If not applicable, so state, otherwise the form will be returned.

*Dilled own well
my self*
Driller's License Number
John C Roske
Driller's Signature

457719

Handwritten notes and markings at the top left of the page.

RECEIVED

JUL 19 1976

MONT. DEPT. of NATURAL
RESOURCES & CONSERVATION

Notary Public seal for the State of Montana, Missoula County, containing the name of the notary and the date of commission expiration.

1-
2-
3-
4-
5-
6-
7-
8-
9-
10-
11-
12-
13-
14-
15-
16-
17-
18-
19-
20-
21-
22-
23-
24-
25-
26-
27-
28-
29-
30-
31-
32-

STATE OF MONTANA }
County of Missoula } ss.

JOHN O. ROSKE and MARY ROSKE, his wife, being individually sworn, depose and say:

On the 29th day of October, 1970, at 11:00 a.m., we duly filed for record as Document No 296391, file No 2056, Notice of Completion of Groundwater Appropriation in which our property was described as Block 3, Lot 3, Section 17, Township 12, North, Range 17 West.

We have now been advised that this is an incorrect description, and, therefore, we are requesting that the location of said well be amended to read that it is located in the following-described property, to-wit:

A tract of land located in the SE $\frac{1}{4}$ NW $\frac{1}{4}$ Section 17, T 12N, R 17 W, P.M.M, Missoula County, particularly described as follows:

Beginning at a point in the southwesterly boundary of Lot 3, Block 3 of Donovan Acres, according to the official plat thereof, as filed in the Clerk and Recorder's Office, Missoula County, Montana, which said point is South 1575.5 feet and East 2392.1 feet, more or less, from the Northwest corner of said Section 17; thence S 56° 00' E a distance of 175.5 feet to the true point of beginning of this description: thence, continuing S 56° 00' E, a distance of 134.5 feet; thence S 34° 00' W a distance of 100 feet; thence N 56° 00' W a distance of 129 feet; thence N 30° 51' 18" E a distance of 100.14 feet to the point of beginning.

In all other respects, the Notice is correct, to the best of our knowledge and belief.

John O. Roske
John O. Roske
Mary J. Roske
Mary Roske

SUBSCRIBED and sworn to before me this 13 day of July, 1976.

Clarence B. Hewlett
Notary Public for the State of Montana. Residing at Missoula, Montana. My commission expires September 20, 1978.

ROBERT E. ARRAS
COUNTY CLERK AND RECORDER
MISSOULA COUNTY COURTHOUSE
MISSOULA, MONTANA 59801

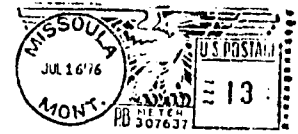

State of Montana
Department of Natural Resources
and Conservation
32 South Ewing
Helena, Montana 59601

Attest
#2056

384294

21
20

In all other respects, the Notice is correct, to the best of

beginning.

N 30.21' E a distance of 100.14 feet to the point of
100 feet; thence N 28.00' W a distance of 133 feet; thence
distance of 134.2 feet; thence 2 34.00' W a distance of
of this description; thence continuing 2 28.00' E a
distance of 122.2 feet to the true point of beginning
Northwest corner of said Section 14; thence 2 28.00' E
121.2 feet and East 330.31 feet, more or less, from the
Missoula County, Montana, which said point is South
of that parcel, as filed in the Clerk and Recorder's Office,
for 3. Block 3 of Denver Aires, according to the official
beginning at a point in the southerly boundary of

described as follows:
1 134. R. T. W. Frank, Missoula County, Burlington
A parcel of land located in the SE 1/4 of Section 14,

whereby, to-wit:

amounted to and that it is located in the following-described

and, therefore, we are redemptive and the receipt of said well be

to have now been realized that there is an increased description,

Block 3, Lot 3, Section 14, Township 13, Range 11 North.

of Grandfather Administration in which the property was described as
recording as Document No 308391, File No 2020, Notice of Completion
of this day of October, 1970, at 11:00 a.m., as duly filed

and said
I. ROBERT and LARA ROBERT, his wife, being individually

I received and filed this instrument for
record on the 15th day of July 1970
at 12:45 o'clock P.M., permanent file
of Missoula County, State of Montana
Witness my hand
Robert E. Jones, County Recorder
By Sharon [Signature] Deputy
Fee \$ 1.00 Paid

MISSOULA

STATE OF MONTANA
ADMINISTRATOR OF GROUNDWATER CODE
MONTANA WATER RESOURCES BOARD

NOTICE OF COMPLETION OF GROUNDWATER
APPROPRIATION BY MEANS OF WELL

Developed after January 1, 1962

(Under Chapter 237 Montana Session Laws, 1961, as amended)

This form to be prepared by driller, and three copies to be filed by the owner with the County Clerk and Recorder in the county in which the well is located, last copy to be retained by driller. Please answer all questions. If not applicable, so state, otherwise the form may be returned.

Owner State of Montana
Department of Highways
Address Helena, Montana

For Administrator's Use	
File #	<u>2232, 312430</u>
GW 1	

Date well started Nov. 18, 1972
completed Nov. 20, 1972

Type of well drilled
(Dug, driven, bored or drilled)

Equipment used churn drill
(Churn drill, rotary or other)

Water Use: Domestic Municipal Stock Irrigation
Industrial Drainage Other Garden/Lawn

*Describe
USE: If used for irrigation, industrial, drainage or other. Explain, state number of acres and location or other data (i.e. Lot, Block and Addition).

ESTIMATED ANNUAL WITHDRAWAL

Size of Drilled Hole	Size and Weight of Casing	From (Foot)	To (Foot)	PERFORATIONS		
				Kind Size	From (Foot)	To (Foot)
6"	19.88# per ft.	0.0	89.0'			

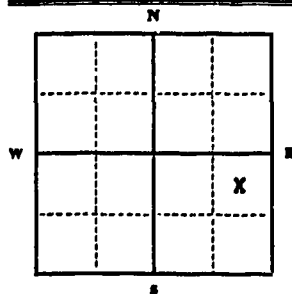

Static water level 83.4 ft.
Pumping water level 83.4 ft.
at 25 gallons per minute,
measured 60 minutes after pumping began.
*Measured from ground level.
Well developed by pumping
for 15 hours.
Power Electric Pump HP
Remarks: (Gravel packing, cementing packers, type of shutoff)

1/4 SE 1/4 Sec. 17
T. 12 N. R. 17 XX
XX W

INDICATE LOCATION OF WELL AND PLACE OF USE, IF POSSIBLE. EACH SMALL SQUARE REPRESENTS 40 ACRES.

Driller's Signature Kenneth R. Healy
Driller's Address Core Drill Section, Shop Yd., Helena, Mont.

LICENSE NO. 208

Top of Ground (Elev. above sea level) 5410.751

From (Foot)	To (Foot)	
0.0	45.5	Very dense brown sandy silty coarse gravel.
45.5	55.5	Dense reddish gray sandy gravel with water.
55.5	58.5	Very dense brown sandy silty coarse gravel.
58.5	89.0	Dense gray sandy gravel with water.

WATER ANALYSIS

pH = 6.8
CO₂ = 7.4 p.p.m.
Phenolphthalein Alkalinity = None
Methyl Orange Alkalinity = 7.82 p.p.m. CaCO₃
Total Solids = 87 p.p.m. CaCO₃
Total Hardness = 22 p.p.m. CaCO₃
Conductivity = 0.1 m. mhos
Water is not incrusting but is corrosive to metal.

89.0' Show exact depth of bottom

#2232

312430

I received and filed this instrument for
 record on the 4 day of July, 1922
 at 9:01 a.m. A.M., permanent files
 of Missoula County, State of Montana
 Witness my hand
Walter A. Clegg County Recorder
 By Maude A. Clegg Deputy
 For 1.00 Paid

RECORDED
 INDEXED
 JUL 11 1922

RECORDED
 INDEXED
 JUL 11 1922

#2257 514291
I received and filed this instrument for
record on the 3 day of April 19 19 19
at 2:47 o'clock P.M. at the Court House
of Missoula County State of Montana
Witness my hand
Vernice R. Crease, County Recorder
By Marie B. Balle, Deputy
For \$ 2.00 Paid

File No.

T. 12^N R. 17^W

Duplicate
~~Quadruplicate~~

County.....

STATE OF MONTANA
ADMINISTRATOR OF GROUNDWATER CODE
OFFICE OF STATE ENGINEER

RECEIVED
JUL 17 1962
STATE ENGINEER

Notice of Completion of Groundwater
Appropriation by Means of Well

(Under Chapter 237, Montana Session Laws, 1961)



Top of Ground
(Elev. above sea level.....)

0
6' pit
13' sand gravel
13' sand gravel
51' sand gravel water

Owner: Mike Herbert Address.....

Driller: John Farrell Address Carter

Date of Notice of Appropriation of Groundwater.....

Date well started Nov 12-1962 Date Completed Nov 13-1962

Type of well: drilled (dug, driven, bored or drilled) Equipment Used: (Chain, drill, rotary or other)

Water Use: Domestic Municipal Other Irrigation
Industrial Drainage Stock

Indicate on the diagram the character and thickness of the different strata met with in drilling, such as soil, clay, shale, gravel, rock or sand, etc. Show depth at which water is encountered, thickness and character of water-bearing strata and height to which water rises in the well.

Size of Drilled Hole	Size and Weight of Casing	From (Feet)	To (Feet)	PERFORATIONS		
				Kind Size	From (Feet)	To (Feet)
5"	5" 13LB	6	51			

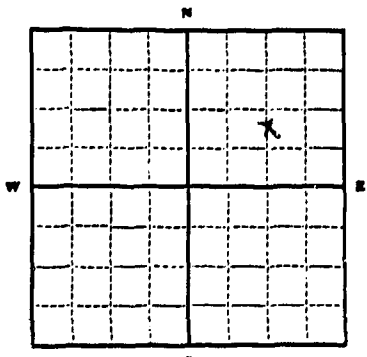

N 1/4 Sec. 18 T. 12 R. 17
Indicate location of well and place of use, if possible. Each small square represents 10 acres.

Show exact depth of bottom.

Static Water Level for non-flowing Well..... 14 feet.

Shut-in Pressure for Flowing Well.....

Pumping Water Level..... 22 feet at 28 gal. per minute.

Discharge in gal. per min. of flowing well.....

How Tested: Bailor Length of Test: 2 hrs

Remarks: (Gravel packing, cementing, packers, type of shutoff, location of place of use of groundwater if not at well, and any other similar pertinent information, including number of acres irrigated, if used for irrigation).....

Driller's License Number 14

John Farrell
Driller's Signature

This form to be prepared by driller, and three copies to be filed by the owner with the County Clerk and Recorder in the county in which the well is located.

Please answer all questions. If not applicable, so state, otherwise the form will be returned.

Original to the County Clerk and Recorder; duplicate to the State Engineer; Triplicate to the Montana Bureau of Mines and Geology and Quadruplicate for the Appropriator.

copy

208394

#214

I received and filed this instrument for
record on the 15 day of July 1963
at 4:45 o'clock P.M. permanent files
of Missoula County, State of Montana
Witness my hand:
MARTIN S. BEHNER, County Recorder
By *[Signature]* Deputy
Fee \$ 2.00 P.M.

MISSOULA COUNTY
RECORDERS OFFICE
JUL 15 1963

File No. _____

T. 12 R. 17

DUPLICATE

STATE OF MONTANA
ADMINISTRATOR OF GROUNDWATER CODE
OFFICE OF STATE ENGINEER

RECEIVED
JAN 3 1963

STATE ENGINEER

Declaration of Vested Groundwater Rights

(Under Chapter 237, Montana Session Laws, 1961)

1. Donald A. Faussett, of Clinton
(Name of Appropriator) (Address) (Town)
County of Missoula State of Montana
have appropriated groundwater according to the Montana laws in effect prior to January 1, 1962, as follows:

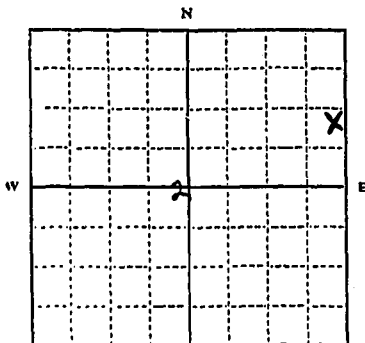

Plat L
SE 1/4 Sec. 2, T. 12 R. 17
Indicate point of appropriation and place of use, if possible. Each small square represents 10 acres.

2. The beneficial use on which the claim is based House hold use for two houses & irrigation lawn, garden, & pasture
3. Date or approximate date of earliest beneficial use; and how continuous the use has been Unknown - (at least 40 years ago for one well & over 20 years for other continuous use as far as known)
4. The amount of groundwater claimed (in miner's inches or gallons per minute) approx. 15 G.P.M. for household pump - approx. 30 G.P.M. for irrigation pump
5. If used for irrigation, give the acreage and description of the lands to which water has been applied and name of the owner thereof We want to irrigate about 1/2 acre garden & 4 to 5 acres pasture & hay on same tract as marked on plat
6. The means of withdrawing such water from the ground and the location of each well or other means of withdrawal 3/4 h.p. pump for household well located on grass field irrigation well is located at about 400 ft. South of buildings - Elec. sprinkler system
7. The date of commencement and completion of the construction of the well, wells, or other works for withdrawal of groundwater Unknown
8. The depth of water table Unknown
9. So far as it may be available, the type, size and depth of each well or the general specifications of any other works for the withdrawal of groundwater Household well is about 65 feet deep, 5 inch diameter casing, irrigation well dug about 15 ft deep on lowest of two bottom land
10. The estimated amount of groundwater withdrawn each year Between 5 and 6 million gal.
11. The log of formations encountered in the drilling of each well if available Unknown
12. Such other information of a similar nature as may be useful in carrying out the policy of this act, including reference to book and page of any county record Unknown

Signature of Owner D. A. Faussett
Date 12/28/63

Three copies to be filed by the owner with the County Clerk and Recorder of the county in which the well is located.

Please answer all questions. If not applicable, so state, otherwise the form will be returned.

Original to the County Clerk and Recorder; Duplicate to the State Engineer; Triplicate to the Montana Bureau of Mines and Geology, and Quadruplicate for the Appropriator.

2007

945

215418

I received and filed this instrument on
 rec. 100 31 at De 1963
 of 100 o'clock M., permanent files
 of Missoula County, State of Montana
 Witness my hand:
Walter S. Edinger County Recorder
 By Walter S. Edinger Deputy
 Fee \$ 2.00 Paid

12th Judicial District
 Missoula County, Montana
 Recorder's Office
 Missoula, Montana
 10/31/63

File No.

T. 12 N. R. 17 W.

DUPLICATE

County

STATE OF MONTANA
ADMINISTRATOR OF GROUNDWATER
OFFICE OF STATE ENGINEER

Notice of Completion of Groundwater Appropriation by Means of Well
(Under Chapter 237, Montana Session Laws, 1961)



Top of Ground
(Elev. above sea level.....)

Well Located at Clinton, Mont

0 to 10' Clay & gravel
10' to 31'-8" Sand, gravel
and water.

Owner William Robert Address 1926 S. 7th W

Driller Glenn Camp 705 Alder Address Missoula, Mont

Date of Notice of Appropriation of Groundwater.....

Date well started 7/26/62 Date Completed 7/30/62-8/1/62

Type of well Drilled Equipment Used Churn drill
(dug, driven, bored or (Churn, drill, rotary or drilled) other)

Water Use: Domestic Municipal Other Irrigation
Industrial Drainage Stock

Indicate on the diagram the character and thickness of the different strata met with in drilling, such as soil, clay, shale, gravel, rock or sand, etc. Show depth at which water is encountered, thickness and character of water-bearing strata and height to which water rises in the well.

Size of Drilled Hole	Size and Weight of Casing	From (Feet)	To (Feet)	PERFORATIONS		
				Kind Size	From (Feet)	To (Feet)
5"	5" I.D. seamless 14 lbs to foot	G.L. to	31'-8"	none		

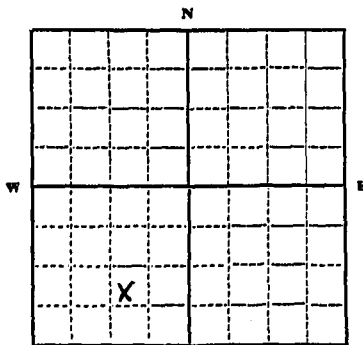

1/4 Sec 22 T. 12 N. R. 17 W
Indicate location of well and place of use, if possible. Each small square represents 10 acres.

Show exact depth of bottom.

Static Water Level for non-flowing Well 5' from G.L. feet.

Shut-in Pressure for Flowing Well.....

Pumping Water Level 20 feet at 30 gal. per minute.

Discharge in gal. per min. of flowing well.....

How Tested Compressor Length of Test 2 hours

Remarks: (Gravel packing, cementing, packers, type of shutoff, location of place of use of groundwater if not at well, and any other similar pertinent information, including number of acres irrigated, if used for irrigation).....

None

License # 7

Driller's License Number

Glenn Camp
Driller's Signature

This form to be prepared by driller, and three copies to be filed by the owner with the County Clerk and Recorder in the county in which the well is located.

Please answer all questions. If not applicable, so state, otherwise the form will be returned.

Original to the County Clerk and Recorder; duplicate to the State Engineer; Triplicate to the Montana Bureau of Mines and Geology and Quadruplicate for the Appropriator.

158

198786

I received and filed this instrument for
record on the... day of Oct... 1962
at... 3:30 o'clock... N... permanent files
of Missoula County, State of Montana
Witness my hand:
MARTIN S. BEHNER, County Recorder
By... Deputy
Fee \$... Paid

MISSOULA COUNTY RECORDS DEPARTMENT
MISSOULA, MONTANA

STATE OF MONTANA
ADMINISTRATOR OF GROUNDWATER CODE
MONTANA WATER RESOURCES BOARD
**NOTICE OF COMPLETION OF GROUNDWATER
APPROPRIATION BY MEANS OF WELL**
Developed after January 1, 1962

DRILLER'S LOG

Indicate the character, color, thickness of strata such as soil, clay, sand, gravel, shale, sandstone, etc. Show depth at which water is found and height to which water rises in well.

(Under Chapter 237 Montana Session Laws, 1961, as amended)

This form to be prepared by driller, and three copies to be filed by the owner with the County Clerk and Recorder in the county in which the well is located, last copy to be retained by driller. Please answer all questions. If not applicable, so state, otherwise the form may be returned.

Owner Don Massa
Address Poor Henry's
Clinton, Montana
Date well started 14 May
completed 18 May

For Administrator's Use	
File	<u>304166</u> <u>June 24, 1971</u> <u>3:30 PM</u>
GW 1	

Type of well Drilled
(Dug, driven, bored or drilled)

Equipment used Churn drill
(Churn drill, rotary or other)

Water Use: Domestic Municipal Stock Irrigation
Industrial Drainage Other Garden/Lawn

*Describe reserve supply Bar, Cafe, Trailer Park
USE: If used for irrigation, industrial, drainage or other. Explain, state number of acres and location or other data (i.e. Lot, Block and Addition).

ESTIMATED ANNUAL WITHDRAWAL 2,000,000 gal.

Size of Drilled Hole	Size and Weight of casing	From (Feet)	To (Feet)	PERFORATIONS		
				Kind	From (Feet)	To (Feet)
6"	68 od 17lb.	18" above ground	59'	XXXXXXX	XXXXXXX	XXXXXXX

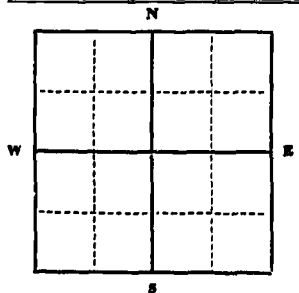

Static water level 178 ft.*
Pumping water level 23' ft.*
at 25 gallons per minute,
measured 60 minutes after pumping
began.
*Measured from ground level.
Well developed by compressor
for 2 hours.
Power 220 ac Pump 1 1/2 HP
Remarks: (Gravel packing, cementing,
packers, type of shutoff)

N.W. 1/4 N.W. 1/4 Sec. 22
T. 12 N R. 17 E
S W

Electric weld joints

INDICATE LOCATION OF WELL AND PLACE OF USE, IF POSSIBLE. EACH SMALL SQUARE REPRESENTS 40 ACRES.

Driller's Signature George Osbe
Driller's Address Box 17 Ravalli, Mont.
LICENSE NO. 204

Top of Ground		(Elev. above sea level)
From (Feet)	To (Feet)	
0	3	<u>sandy topsoil</u>
3	9	<u>gravel, sand, & siltstone</u>
9	16	<u>sand & gravel</u>
16	21	<u>coarse gravel, fine clay, sand</u>
21	53	<u>coarse fine gravel, & silty sand</u>
53	59	<u>coarse gravel, & sand with water</u>

Show exact depth of bottom 59'

198697

2144

304166

I received and filed this Instrument for
record on the 24 day of June, 1971...
at 3:30 o'clock P.M., permanent files
of Missoula County, State of Montana
Witness my hand
Verance S. Crump, County Recorder
By Orville L. Lanning, Deputy
Fee \$ 2.00 Cash Paid

22

File No. _____
DUPLICATE

T. 12 N. R. 17 W
County Missoula

MAY 8 1971

STATE OF MONTANA
ADMINISTRATOR OF GROUNDWATER CODE
OFFICE OF STATE ENGINEER

Notice of Completion of Groundwater Appropriation
Without Well

(Under Chapter 237 Montana Session Laws, 1961)

Doc. No. 302029
Filed for record
this 29 day of April
A. D. 19 71 at 11:15
o'clock A M.

Date of Appropriation of Groundwater April 29/71
Owner Bob Montlin Address Clinton, Montana
Contractor (if any) _____
Address of Contractor _____
Date Started _____ Date Completed _____

Describe means of obtaining groundwater without a well "as by sub-irrigation and other natural processes". Include depth to water when applicable. Spring boils out of ground 7 ft from surface and sub irrigates my lower 2 acres.

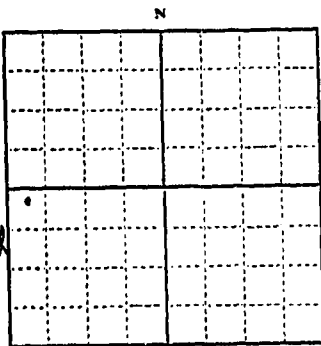

Spring is by pole in south 1/2 section of 22 south

1/4 Sec. 22 T. 12 N. R. 17 W.
Indicate point of appropriation and place of use, if possible.

This spring runs a pipe of water 6" in diameter more -

Quantity of water developed and used with explanation of method used to measure or estimate such amount. If use is intermittent estimate approximate lengths of periods of use. Sub irrigates my lower pasture and could be used to pump from it if I had to.

Signature of Owner Bob Montlin's
Date 4/29/71

This form to be prepared by contractor (if any), otherwise by the owner.

Three copies of this notice are to be filed with the County Clerk and Recorder of the county in which the works are located.

Please answer all questions. If not applicable, so state, otherwise the form will be returned.

Original to the County Clerk and Recorder; duplicate to the State Engineer; Triplicate to the Montana Bureau of Mines and Geology and Quadruplicate for the Appropriator.

48416

219

302029

I received and filed this Instrument for
record on the 29th day of April 1971
at 11:15 o'clock A.M. permanent file
of Missoula County, State of Montana
Witness my hand:
Veranne A. Crouse, County Recorder
By W. M. Crouse, Deputy
Fee 1.00 Paid

STATE OF MONTANA
ADMINISTRATOR OF GROUNDWATER CODE
MONTANA WATER RESOURCES BOARD

NOTICE OF COMPLETION OF GROUNDWATER
APPROPRIATION BY MEANS OF WELL

Developed after January 1, 1962

(Under Chapter 237 Montana Session Laws, 1961, as amended)

This form to be prepared by driller, and three copies to be filed by the owner with the County Clerk and Recorder in the county in which the well is located, last copy to be retained by driller.

Please answer all questions. If not applicable, so state, otherwise the form may be returned.

Owner Robert Montelion 2000 Delta of Montana
Address Clinton, Montana
Box 81
Date well started July 1968
completed July 1968

For Administrator's Use	
File	<u>30-20-30</u>
	<u>April 29, 1971</u>
	<u>11:20 AM</u>
GW 1	

Type of well Deep well driven
(Dug, driven, bored or drilled)
Equipment used other
(Cable drill, rotary or other)

Water Use: Domestic Municipal Stock Irrigation
Industrial Drainage Other Garden/Lawn

*Describe Children play in water

USE: If used for irrigation, industrial, drainage or other. Explain, state number of acres and location or other data (i.e. Lot, Block and Addition). 4 acres now or less

ESTIMATED ANNUAL WITHDRAWAL 2,400 in 8 hrs

Size of Drilled Hole	Size and Weight of Casing	From (Feet)	To (Feet)	PERFORATIONS		
				Kind Size	From (Feet)	To (Feet)
40'	4"	0	40'	Point Blown		

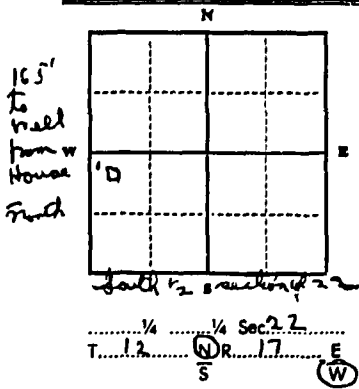

Static water level 2.6 ft.
Pumping water level 1.2 ft.
at 5.0 gallons per minute,
measured 6.0 minutes after pumping began.
*Measured from ground level
Well developed by myself
for 1 hour.
Power Electric Pump 1/2 HP
Remarks: (Gravel packing, cementing, packers, type of shutoff)
commercial

DRILLER'S LOG

Indicate the character, color, thickness of strata such as soil, clay, sand, gravel, shale, sandstone, etc. Show depth at which water is found and height to which water rises in well.

Top of Ground (Elev. above sea level)	
From (Feet)	To (Feet)
0	40
0	40
	<u>Unknown</u>
	<u>Mixed gravel</u>
	<u>Unknown</u>
	<u>well has never been pumped dry</u>

INDICATE LOCATION OF WELL AND PLACE OF USE, IF POSSIBLE. EACH SMALL SQUARE REPRESENTS 40 ACRES.

Driller's Signature Robert E. Montelion
Driller's Address Clinton, Montana

LICENSE NO. _____

40' Show exact depth of bottom

This water has passed the board of health 48426

2120

302020

I received and filed this instrument for
record on the day of 19.....
at 11:20 o'clock P. M. permanent files
of Missoula County, State of Montana
Witness my hand
Verance E. Cross, County Recorder
By *[Signature]* Deputy
Fee \$2.00 Paid *[initials]*

File No.

T. 12 N R. 17 W
County Missoula

DUPLICATE

STATE OF MONTANA
ADMINISTRATOR OF GROUNDWATER CODE
OFFICE OF STATE ENGINEER

RECEIVED
DEC 30 1963
STATE ENGINEER

Top of Ground
(Elev. above sea level _____)

Notice of Completion of Groundwater
Appropriation by Means of Well

(Under Chapter 237, Montana Session Laws, 1961)



0 to 1' Top soil
1' to 21' Sand, gravel
some clay.
21' to 43' Sand, gravel
some clay a little water
43' to 36' Sand, gravel
& water

Owner John Stitt Address Clinton, Mont

Driller Glenn Camp 703 Alder Address Missoula, Montana

Date of Notice of Appropriation of Groundwater.....

Date well started 3/19/63 Date Completed 3/21/63

Type of well Drilled Equipment Used Churn Drill
(aug, driven, bored or drilled) (Churn, drill, rotary or other)

Water Use: Domestic Municipal Other Irrigation
Industrial Drainage Stock

Indicate on the diagram the character and thickness of the different strata met with in drilling, such as soil, clay, shale, gravel, rock or sand, etc. Show depth at which water is encountered, thickness and character of water-bearing strata and height to which water rises in the well.

Size of Drilled Hole	Size and Weight of Casing	From (Feet)	To (Feet)	PERFORATIONS		
				Kind Size	From (Feet)	To (Feet)
5"	5" I.D. seamless 19 lbs to foot	6" above G.L.	to 36'	None		

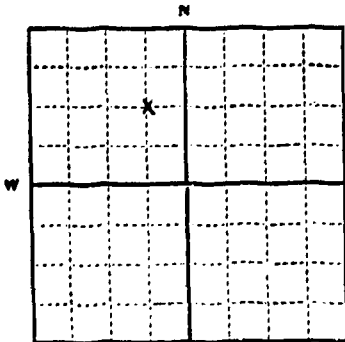

N 1/4 Sec. 22 T. 12 R. 17
Indicate location of well and place of use, if possible. Each small square represents 10 acres.

Show exact depth of bottom.

Static Water Level for non-flowing Well 21' from G.L. feet.

Shut-in Pressure for Flowing Well.....

Pumping Water Level 25 feet at 40 gal. per minute.

Discharge in gal. per min. of flowing well.....

How Tested Compressor Length of Test 1 hr

Remarks: (Gravel packing, cementing, packers, type of shutoff, location of place of use of groundwater if not at well, and any other similar pertinent information, including number of acres irrigated, if used for irrigation).....
None

License # 7

Driller's License Number

Glenn Camp
Driller's Signature

This form to be prepared by driller, and three copies to be filed by the owner with the County Clerk and Recorder in the county in which the well is located.

Please answer all questions. If not applicable, so state, otherwise the form will be returned.

Original to the County Clerk and Recorder; duplicate to the State Engineer; Triplicate to the Montana Bureau of Mines and Geology and Quadruplicate for the Appropriator.

1-582

214886

Copy

I received and filed this instrument for record on the 26 day of June, 1965 at 11:38 o'clock A. M., permanent files of Missoula County, State of Montana

Witness my hand:
 MARTIN S. BEHNER, County Recorder
 By Martin S. Behner Deputy
 Fee \$ 2.00 Paid

nonregistrable
 tax
 stock
 agricultural
 alienable
 alienable
 interest
 usufruct

instrument not to be recorded hereafter until the owner has paid the tax on the instrument and the tax on the instrument has been paid to the county clerk or the county treasurer. If the instrument is not recorded hereafter until the owner has paid the tax on the instrument and the tax on the instrument has been paid to the county clerk or the county treasurer.

DEVELOPMENT

1961	1962	1963	1964	1965	1966	1967	1968	1969	1970

MISSOULA COUNTY, MONTANA

RECORDS AND CLERK

MISSOULA, MONTANA

June 26, 1965

214886

File No. _____

T. 12 N. R. 17 W

DUPLICATE

County Missoula

STATE OF MONTANA
ADMINISTRATOR OF GROUNDWATER CODE
OFFICE OF STATE ENGINEER

RECEIVED
DEC 30 1963

Declaration of Vested Groundwater Rights

(Under Chapter 237, Montana Session Laws, 1961)

STATE ENGINEER

I, John Stitt, of Clinton
(Name of Appropriator) (Address) (Town)

County of Missoula State of Montana
have appropriated groundwater according to the Montana laws in effect prior to January 1, 1962, as follows:

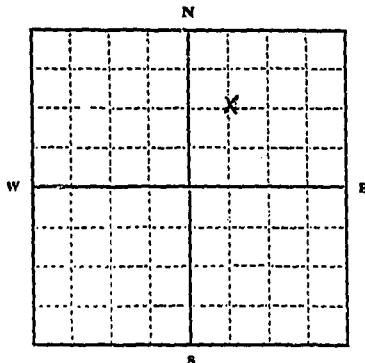

2. The beneficial use on which the claim is based.....
Domestic (includes irrigation for yard)

3. Date or approximate date of earliest beneficial use; and how continuous the use has been.....
1940 continuous use

4. The amount of groundwater claimed (in miner's inches or gallons per minute).....
not available

5. If used for irrigation, give the acreage and description of the lands to which water has been applied and name of the owner thereof.....
None

6. The means of withdrawing such water from the ground and the location of each well or other means of withdrawal.....
Drilled well

NE 1/4 Sec. 22 T. 12 R. 17

Indicate point of appropriation and place of use, if possible. Each small square represents 10 acres.

7. The date of commencement and completion of the construction of the well, wells, or other works for withdrawal of groundwater.....
1940

8. The depth of water table.....
well depth 56 feet

9. So far as it may be available, the type, size and depth of each well or the general specifications of any other works for the withdrawal of groundwater.....
1 Drilled hole size 5", depth 56'

10. The estimated amount of groundwater withdrawn each year.....
Not known

11. The log of formations encountered in the drilling of each well if available.....
Not available

12. Such other information of a similar nature as may be useful in carrying out the policy of this act, including reference to book and page of any county record.....
None

Signature of Owner..... John Stitt

Date..... December 18, 1963

Three copies to be filed by the owner with the County Clerk and Recorder of the county in which the well is located.

Please answer all questions. If not applicable, so state, otherwise the form will be returned.

Original to the County Clerk and Recorder; Duplicate to the State Engineer; Triplicate to the Montana Bureau of Mines and Geology, and Quadruplicate for the Appropriator.

15183

581

214885

C. J. ...
I received and filed this instrument for
record on the *26* day of *Dec*, 19*68*
at *11:18* o'clock *A.M.*, permanent files
of Missoula County, State of Montana
Witness my hand:
MARTIN S. BEHNER, County Recorder
By *Martin S. Behner*
Fee *2.00* Paid

MISSOULA COUNTY RECORDS DEPARTMENT

MISSOULA COUNTY RECORDS DEPARTMENT

X

RECEIVED

County Missoula 27

STATE OF MONTANA
ADMINISTRATOR OF GROUNDWATER CODE
MONTANA WATER RESOURCES BOARD

JUN 22 1972

DRILLER'S LOG

NOTICE OF COMPLETION OF GROUNDWATER APPROPRIATION BY MEANS OF WELL

Developed after January 1, 1962

(Under Chapter 237 Montana Session Laws, 1961, as amended)

This form to be prepared by driller, and three copies to be filed by the owner with the County Clerk and Recorder in the county in which the well is located, last copy to be retained by driller. Please answer all questions. If not applicable, so state, otherwise the form may be returned.

Owner Ray Teague

Address Glendon, Mont.

Date well started 5 June 1972
completed 5 June 72

For Administrator's Use	
File	<u>2293 - 318301</u>
Date	<u>June 20, 1972 9:15 a.m.</u>
GW	<u>1</u>

Type of well Drilled
(Dug, driven, bored or drilled)

Equipment used Churn Drill
(Churn drill, rotary or other)

Water Use: Domestic Municipal Stock Irrigation
Industrial Drainage Other * Garden/Lawn

*Describe _____
USE: If used for Irrigation, industrial, drainage or other. Explain, state number of acres and location or other data (i.e. Lot, Block and Addition). _____

ESTIMATED ANNUAL WITHDRAWAL 60,000

Size of Drilling Hole	Size and Weight of Casing	From (Feet)	To (Feet)	PERFORATIONS		
				Kind	From (Feet)	To (Feet)
<u>6"</u>	<u>6 5/8 17#</u>	<u>18"</u>	<u>51</u>	<u>300X</u>	<u>300X</u>	<u>300X</u>

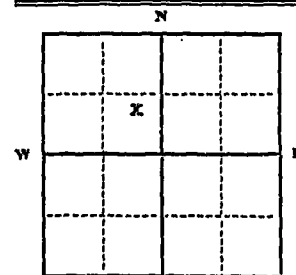

Static water level 19 ft.*
Pumping water level 21 ft.*
at 25 gallons per minute,
measured 60 minutes after pumping
began.
*Measured from ground level.
Well developed by Bailer
for 2 hours.
Power 300X Pump 300X HP
Remarks: (Gravel packing, cementing,
packers, type of shutoff) _____

SE 1/4 NW 1/4 Sec. 22
T. 12 N/R. 17 W. E
S (W)

INDICATE LOCATION OF WELL AND PLACE OF USE, IF POSSIBLE. EACH SMALL SQUARE REPRESENTS 40 ACRES.

Driller's Signature George C. Becker

Driller's Address Box 17

Revelle, Montana LICENSE NO. 204

Top of Ground		(Elev. above sea level)
From (Feet)	To (Feet)	
<u>0</u>	<u>6</u>	<u>Gravel, Cobblestones, Sand</u>
<u>6</u>	<u>11</u>	<u>Sand & gravel</u>
<u>11</u>	<u>22</u>	<u>Clay, Sand, & Gravel</u>
<u>22</u>	<u>28</u>	<u>Sand, Gravel, Some Water</u>
<u>28</u>	<u>46</u>	<u>Clay, Sand, Gravel</u>
<u>46</u>	<u>51</u>	<u>Green Gravel, Some Sand, Water</u>

51 Show exact depth of bottom

50,655

22

File No. _____

T. 12 N. 17 W

DUPLICATE

County Missoula

STATE OF MONTANA
ADMINISTRATOR OF GROUNDWATER CODE
OFFICE OF STATE ENGINEER

RECEIVED
JAN 8 1964

Declaration of Vested Groundwater Rights

(Under Chapter 237, Montana Session Laws, 1961)

STATE ENGINEER

I, Ray Teague, of Clinton,
(Name of Appropriator) (Address) (Town)
County of Missoula, State of Montana
have appropriated groundwater according to the Montana laws in effect prior to January 1, 1962, as follows:

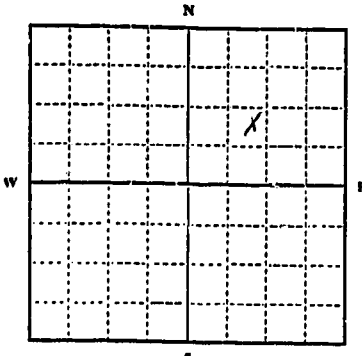

- 2. The beneficial use on which the claim is based. Household Milk House and Lawn Irrigation
- 3. Date or approximate date of earliest beneficial use; and how continuous the use has been. June 1942, Continuous
- 4. The amount of groundwater claimed (in miner's inches or gallons per minute) 400 Gal per hour
- 5. If used for irrigation, give the acreage and description of the lands to which water has been applied and name of the owner thereof
- 6. The means of withdrawing such water from the ground and the location of each well or other means of withdrawal. Electric pump

N. 1/4 SW 1/4 Sec. 22 T. 12 R. 17

Indicate point of appropriation and place of use, if possible. Each small square represents 10 acres.

- 7. The date of commencement and completion of the construction of the well, wells, or other works for withdrawal of groundwater. Started about May 15, completed about June 1st 1942
- 8. The depth of water table. About 18 ft to water
- 9. So far as it may be available, the type, size and depth of each well or the general specifications of any other works for the withdrawal of groundwater. 20 ft of 3.6" Pipe to water and 10 ft 18" pipe
- 10. The estimated amount of groundwater withdrawn each year. 800,000 Gal
- 11. The log of formations encountered in the drilling of each well if available. 3 ft soil and gravel to bottom
- 12. Such other information of a similar nature as may be useful in carrying out the policy of this act, including reference to book and page of any county record

Signature of Owner Ray Teague
Date Dec 27, 1963

Three copies to be filed by the owner with the County Clerk and Recorder of the county in which the well is located.

Please answer all questions. If not applicable, so state, otherwise the form will be returned.

Original to the County Clerk and Recorder; Duplicate to the State Engineer; Triplicate to the Montana Bureau of Mines and Geology, and Quadruplicate for the Appropriator.

19995

795 215203

I received and filed this instrument for
record on this 28th day of Dec 1963
at 9:15 o'clock PM, permanent files
of Missoula County, State of Montana
Witness my hand
Mark S. Berner County Recorder
By Mark S. Berner Deputy
Fee \$ 2.00 Paid

275

306936

I received and filed this instrument for
record on the 7 day of Aug, 1911
at 11:00 o'clock P.M. permanent files
of Missoula County, State of Montana
Witness my hand.
Yvonne A. Crouse, County Recorder
By Marie S. [Signature] Deputy
Fee \$ 2.00 Paid

MISSOULA COUNTY RECORDS
RECEIVED
AUG 10 1911
MISSOULA, MONTANA

STATE OF MONTANA
ADMINISTRATOR OF GROUNDWATER CODE
MONTANA WATER RESOURCES BOARD

NOTICE OF COMPLETION OF GROUNDWATER
APPROPRIATION BY MEANS OF WELL

Developed after January 1, 1962

(Under Chapter 237 Montana Session Laws, 1961, as amended)

This form to be prepared by driller, and three copies to be filed by the owner with the County Clerk and Recorder in the county in which the well is located, last copy to be retained by driller.

Please answer all questions. If not applicable, so state, otherwise the form may be returned.

Owner Orville D. Wilson and Margaret M. Wilson

Address Clinton, Mont.
Box 146

Date well started July 10th 1967
completed July 12th 1967

Type of well drilled
(Dug, driven, bored or drilled)

Equipment used churn drill
(Churn drill, rotary or other)

Water Use: Domestic Municipal Stock Irrigation
Industrial Drainage Other Garden/Lawn

*Describe _____

USE: If used for irrigation, industrial, drainage or other. Explain, state number of acres and location or other data (i.e. Lot, Block and Addition). 1 acre more or less

ESTIMATED ANNUAL WITHDRAWAL 2400 gal. in 24 hrs.

Size of Drilled Hole	Size and Weight of Casing	From (Foot)	To (Foot)	PERFORATIONS		
				Kind	From (Foot)	To (Foot)
40 ft.	6 inch	0 ft.	40 ft.	Churn paul		

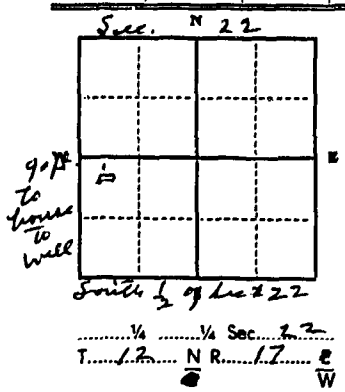

Static water level 26 ft. ft.*
Pumping water level 15 ft.*
at 50 gallons per minute,
measured 60 minutes after pumping
began.
*Measured from ground level.
Well developed by myself
for 1 hours.
Power electric Pump 1/2 HP
Remarks: (Gravel packing, cementing,
packers, type of shutoff) _____

INDICATE LOCATION OF WELL AND PLACE OF USE, IF POSSIBLE. EACH SMALL SQUARE REPRESENTS 40 ACRES.

Driller's Signature Orville D. Wilson

Driller's Address Clinton, Mont.

LICENSE NO. _____
This water has passed the Board of Health

DRILLER'S LOG

Indicate the character, color, thickness of strata such as soil, clay, sand, gravel, shale, sandstone, etc. Show depth at which water is found and height to which water rises in well.

Top of Ground (Elev. above sea level)	
From (Foot)	To (Foot)
	<u>unknown</u>
<u>0 ft.</u>	<u>40 ft.</u>
	<u>15 ft. rise of water in well</u>
	<u>until now I can not pump well dry</u>

40 ft. Show exact depth of bottom

2121

302031

I received and filed this instrument for
record on the 27th day of April 1971
at 11:25 o'clock P.M. permanent files
of Missoula County, State of Montana
Witness my hand
Vernice E. Crouse, County Recorder
By *[Signature]* Deputy
Fee \$ 2.00 Paid *[Signature]*

File No. _____

STATE WATER CONSERVATION BOARD

T. 12N R. 17W

DUPLICATE

JAN 24 1967

County Missoula

LOG

Bk. _____ No. _____ STATE OF MONTANA
Bureau _____ ADMINISTRATOR OF GROUNDWATER CODE
City _____ Helena _____ OFFICE OF STATE ENGINEER
Division _____
Suburban _____

Top of Ground _____
(Elev. above sea level 3400)
Approximate _____
Formations Log:

- 0 - 4 Pit.
- 4 - 26 Fine sandy gravel.
- 26 - 31 Fine sand & gravel mixed in some clay.
- 31 - 34 1/2 Clean coarse gravel. Water.

Notice of Completion of Groundwater Appropriation by Means of Well

DEVELOPED AFTER JANUARY 1, 1962

(Under Chapter 237, Montana Session Laws, 1961)

Betty Jane &/or

Owner Clayton M. Zander Address Clinton, Montana

Driller Liberty Drilling Co. Address Missoula, Montana

Date of Notice of appropriation of groundwater None filed

Date well started 10/12/66 Date completed 10/13/66

Type of well Drilled Equipment used Cable Tools
(Dug, Driven, bored or drilled) (Churn drill, rotary or other)

Water use: Domestic Municipal Stock Irrigation
Industrial Drainage Other

Indicate on the diagram the character and thickness of the different strata met with in drilling, such as soil, clay, shale, gravel, rock or sand, etc. Show depth at which water is encountered, thickness and character of water-bearing strata and height to which the water rises in the well.

Size of Drilled Hole	Size and Weight of Casing	From (Feet)	To (Feet)	PERFORATIONS		
				Kind	From (Feet)	To (Feet)
6"	6 3/8" OD x 1/2"	-4	34 1/2	NONE		

Water rises in the well six feet from surface.

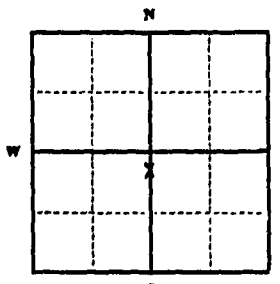

Static Water Level for non-flowing well _____ feet.

Shut-in Pressure for Flowing Well None

Pumping Water Level 30 feet at 100 gal. per minute.

Discharge in gal. per min. of flowing well None-flowing

How Tested Air Lift Pump

Length of Test 1 1/2 hours

Remarks: (Gravel packing, cementing, packers, type of shutoff) All water entering well is coming through the open bottom of six inch casing. Wells with open bottom completions in this area can be depended upon to produce clear sand free water year after year as long as they are not overpumped, i.e., they should

Sec. 22, T. 12N, R. 17W
Indicate location of well and place of use, if possible. Each small square represents 40 acres.

USE—If used for irrigation, industrial, drainage or other. Explain, state number of acres and location or other data (i.e.: Lot, Block and Addition).

15 Acres

Show exact depth of bottom.

Bottom of hole 34 1/2'

This form to be prepared by driller, and three copies to be filed by the owner with the County Clerk and Recorder in the county in which the well is located, tissue copy to be retained by driller.

Please answer all questions. If not applicable, so state, otherwise the form will be returned.

52
Driller's License Number

William F. Bohane
Driller's Signature

41671

23

File No.....

T 12 N. R. 17 W

DUPLICATE

County Missoula

STATE OF MONTANA
ADMINISTRATOR OF GROUNDWATER CODE
OFFICE OF STATE ENGINEER

Notice of Completion of Groundwater Appropriation
Without Well

(Under Chapter 237 Montana Session Laws, 1961)

RECEIVED

NOV 17 1972

DEPARTMENT OF NATURAL RESOURCES

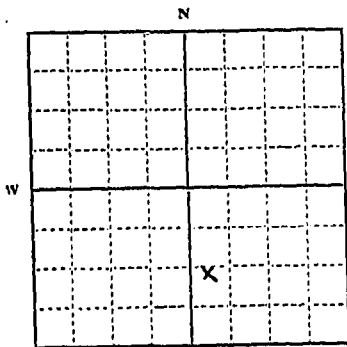

SE 1/4 Sec. 23 T. 12 N. R. 17 W.
Indicate point of appropriation and place of use, if possible.

Date of Appropriation of Groundwater..... November, 1968

Owner... Lila E. Richards Address Clinton, Montana

Contractor (if any)

Address of Contractor

Date Started... May, 1968 Date Completed... November, 1968

Describe means of obtaining groundwater without a well "as by sub-irrigation and other natural processes". Include depth to water when applicable.....

Spring, with tank installed

Quantity of water developed and used with explanation of method used to measure or estimate such amount. If use is intermittent

estimate approximate lengths of periods of use.....

R.J.H. 1" pipe from spring to house, for house and yard use

Doc. No. #2371, 324481
Filed for record
this 10th day of November
A. D. 19 72, at 3:00
o'clock P.M.

Signature of Owner Lila E. Richards

Date November 10, 1972

This form to be prepared by contractor (if any), otherwise by the owner.

Three copies of this notice are to be filed with the County Clerk and Recorder of the county in which the works are located.

Please answer all questions. If not applicable, so state, otherwise the form will be returned.

Original to the County Clerk and Recorder; duplicate to the State Engineer; Triplicate to the Montana Bureau of Mines and Geology and Quadruplicate for the Appropriator.

51,816

43371 324481

I received and filed this instrument for
record on the 10 day of Feb 1911
at 3:00 o'clock P.M. permanent files
of Missoula County State of Montana
Witness my hand
Vernon R. Curran, County Recorder
By *[Signature]* Deputy
Fee \$ 2.00 Paid

223

File No. _____

T. 12 R. 17

DUPLICATE

County Missoula

STATE OF MONTANA
ADMINISTRATOR OF GROUNDWATER CODE
OFFICE OF STATE ENGINEER

RECEIVED
JAN 3 1963

Declaration of Vested Groundwater Rights

(Under Chapter 237, Montana Session Laws, 1962)

STATE ENGINEER

1. Louis A. Richards, of Clinton, Montana
(Name of Appropriator) (Address) (Town)

County of Missoula State of Montana

have appropriated groundwater according to the Montana laws in effect prior to January 1, 1962, as follows:

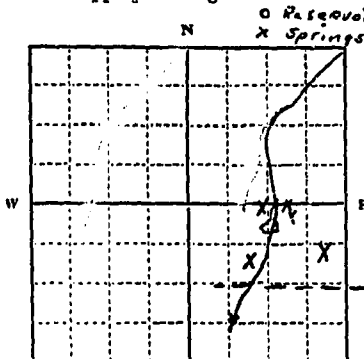

Approx. $\frac{1}{4}$ SE $\frac{1}{4}$ Sec. 23, T.12, R. 17

Indicate point of appropriation and place of use, if possible. Each small square represents 10 acres.

2. The beneficial use on which the claim is based.....
Domestic and irrigation for cropland

3. Date or approximate date of earliest beneficial use; and how continuous the use has been.....
Summer of 1960. Continuous

4. The amount of groundwater claimed (in miner's inches or gallons per minute).....
Unknown

5. If used for irrigation, give the acreage and description of the lands to which water has been applied and name of the owner thereof.....
90 acres, approx. $\frac{1}{4}$ SE $\frac{1}{4}$ Sec. 23, T12, R17
Owner as shown above.

6. The means of withdrawing such water from the ground and the location of each well or other means of withdrawal.....
by reservoir fed by 6 or 8 springs and small unnamed stream

7. The date of commencement and completion of the construction of the well, wells, or other works for withdrawal of groundwater.....
Reservoir started in summer of 1960. This and related improvements completed in 1961, with domestic improvement completed in summer of 1963.

8. The depth of water table.....
Unknown

9. So far as it may be available, the type, size and depth of each well or the general specifications of any other works for the withdrawal of groundwater.....
Earthen dam, approximately 150 on face and approx. 12 ft. deep.
About 150 ft. long upstream.

10. The estimated amount of groundwater withdrawn each year.....
Unknown

11. The log of formations encountered in the drilling of each well if available.....
Clay and gravel

12. Such other information of a similar nature as may be useful in carrying out the policy of this act, including reference to book and page of any county record.....

Signature of Owner Louis A. Richards
Date Dec 31, 1963

Three copies to be filed by the owner with the County Clerk and Recorder of the county in which the well is located.

Please answer all questions. If not applicable, so state, otherwise the form will be returned.

Original to the County Clerk and Recorder; Duplicate to the State Engineer; Triplicate to the Montana Bureau of Mines and Geology, and Quadruplicate for the Appropriator.

20146

1026

2155-00

I received and filed this instrument for
record on the 31 day of Nov 1963
at 2:34 o'clock P.M., pursuant to laws
of Missoula County, State of Montana
Witness my hand:
MARTIN S. BEVIER, County Recorder
By MARTIN S. BEVIER Deputy
Fee \$ 2.00 Paid



24

File No. _____

T. 12N R. 17W

DUPLICATE

MONTANA WATER RESOURCES
RECEIVED
MAY 27 1971

County Missoula

STATE OF MONTANA
ADMINISTRATOR OF GROUNDWATER CODE
OFFICE OF STATE ENGINEER

Notice of Completion of Groundwater Appropriation
Without Well

(Under Chapter 237 Montana Session Laws, 1961)

Doc. No. 303000
Filed for record
this 25 day of May
A. D. 19 71 at 1:04
o'clock P. M.

Date of Appropriation of Groundwater 4/15/71

Owner James E. Baker Address El. Mar. Tr. Co. Standst
Missoula, Mont

Contractor (if any) _____

Address of Contractor _____

Date Started _____ Date Completed _____

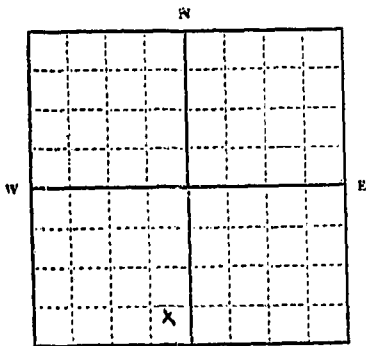

Describe means of obtaining groundwater without a well "as by sub-irrigation and other natural processes". Include depth to water when applicable. Natural Springs And

All other water rising on said Parcel of land

Quantity of water developed and used with explanation of method used to measure or estimate such amount. If use is intermittent

estimate approximate lengths of periods of use 12 Months

Of The Year

S.E. 1/4 Sec. 24 T. 12N R. 17W

Indicate point of appropriation and place of use, if possible.

Signature of Owner James E. Baker

Date 5/25/71

This form to be prepared by contractor (if any), otherwise by the owner.

Three copies of this notice are to be filed with the County Clerk and Recorder of the county in which the works are located.

Please answer all questions. If not applicable, so state, otherwise the form will be returned.

Original to the County Clerk and Recorder; duplicate to the State Engineer; Triplicate to the Montana Bureau of Mines and Geology and Quadruplicate for the Appropriator.

2136

303000

I received and filed this instrument for
record on the 25th day of May 1971
at 1:04 o'clock P.M., permanent files
of Missoula County, State of Montana
Witness my hand
Vernice R. Greuse, County Recorder
By W. J. Cunningham Deputy
Fee \$2.00 1.00 Paid Cash

SEP 8 1966

File No. _____

T. 12N R. 17W

DUPLICATE
~~RESERVED~~

Bill's _____ McDermott _____
Burr's _____ At _____
Carr's _____ M. _____
Dunn's _____

County Missoula

STATE OF MONTANA
ADMINISTRATOR OF GROUNDWATER CODE
OFFICE OF STATE ENGINEER

Notice of Completion of Groundwater Appropriation Without Well

(Under Chapter 237 Montana Session Laws, 1961)

Date of Appropriation of Groundwater January 1966

Owner M. H. Dickinson Address 3210 Paxson St. Missoula

Contractor (if any) _____

Address of Contractor _____

Date Started _____ Date Completed _____

Describe means of obtaining groundwater without a well "as by sub-irrigation and other natural processes". Include depth to water when applicable.

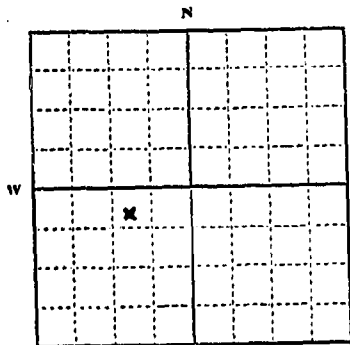

Spring
on Lot 26 Spring Valley Area
sub-irrigation system in Block 8
Phase 1 Feb 0-71 Missoula County

Quantity of water developed and used with explanation of method used to measure or estimate such amount. If use is intermittent

estimate approximate lengths of periods of use _____

S. 1/4 Sec. 24 T. 12N R. 17W

Indicate point of appropriation and place of use, if possible.

All used for domestic purposes

Signature of Owner M. H. Dickinson

Date Aug 23 1966

This form to be prepared by contractor (if any), otherwise by the owner.

Three copies of this notice are to be filed with the County Clerk and Recorder of the county in which the works are located.

Please answer all questions. If not applicable, so state, otherwise the form will be returned.

Original to the County Clerk and Recorder; duplicate to the State Engineer; Triplicate to the Montana Bureau of Mines and Geology and Quadruplicate for the Appropriator.

1644

253581

I received and filed this Instrument for
record on the 2 day of Sept. 1966
at 8:35 o'clock P.M., permanent files
of Missoula County, State of Montana
Witness my hand:
Vermae R. Clouse, County Recorder
By *M. M. C. Conroy*, Deputy
Fee \$2.00 *Paid*

File No. 302996
RECEIVED
DUPLICATE
MAY 27 1971

T. 12N R. 17 W
County Missoula

STATE OF MONTANA
ADMINISTRATOR OF GROUNDWATER CODE
OFFICE OF STATE ENGINEER

**Notice of Completion of Groundwater Appropriation
Without Well**

(Under Chapter 237 Montana Session Laws, 1961)

Doc. No. 302996
Filed for record
this 25 day of May
A. D. 19 71, at 10:30
o'clock P.M.

Date of Appropriation of Groundwater May 22, 1971

Owner Dawn Hunsaker Address Clinton, Montana

Contractor (if any) _____

Address of Contractor _____

Date Started May 22, 1971 Date Completed May 22, 1971

Describe means of obtaining groundwater without a well "as by sub-irrigation and other natural processes". Include depth to water when applicable. from unnamed spring for use of Lot 32, Spring Valley acres, a platted subdivision in NW 1/4 SW 1/4, Sec. 24, T 12 N., R 17 W., M.P.M., Missoula County, Montana.

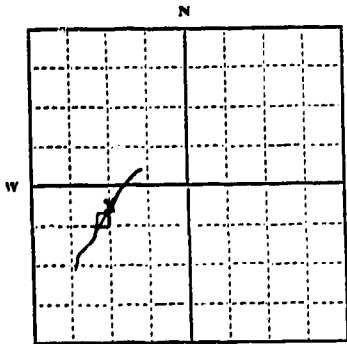

NW 1/4 SW 1/4 Sec. 24, T. 12 N., R. 17 W.
Indicates point of appropriation and place of use, if possible.

Quantity of water developed and used with explanation of method used to measure or estimate such amount. If use is intermittent estimate approximate lengths of periods of use. Will be used for irrigation and household use year round.

Signature of Owner Dawn Hunsaker

Date May 25, 1971

This form to be prepared by contractor (if any), otherwise by the owner.
Three copies of this notice are to be filed with the County Clerk and Recorder of the county in which the works are located.
Please answer all questions. If not applicable, so state, otherwise the form will be returned.
Original to the County Clerk and Recorder; duplicate to the State Engineer; Triplicate to the Montana Bureau of Mines and Geology and Quadruplicate for the Appropriator.

2135

302996

I received and filed this instrument for
 record on the ²⁵ day of May 1971
 at 10:30 o'clock A.M. in Room 1115
 of Missoula County, State of Montana
 Witness my hand
 Vernice R. Croyle, County Recorder
 By W. M. Crampton Deputy
 Fee \$2.00 Paid cash

RECEIVED

Approved Stock Form—State Publishing Co., Helena, Montana—42261

24

File No. _____

1973

T. 12N R. 17W

DUPLICATE

MONTANA DEPARTMENT OF NATURAL RESOURCES AND CONSERVATION

County Missoula

STATE OF MONTANA
ADMINISTRATOR OF GROUNDWATER CODE
OFFICE OF STATE ENGINEER

Notice of Completion of Groundwater Appropriation Without Well

(Under Chapter 237 Montana Session Laws, 1961)

Date of Appropriation of Groundwater April 2 1973

Doc. No. 330352, 5450
Filed for record
this 9th day of April
A. D. 1973 at 1:07
o'clock P.M.

Owner Dawn Neinsake Address Clinton MT

Contractor (if any) _____

Address of Contractor _____

Date Started May 22 1971 Date Completed May 22 1971

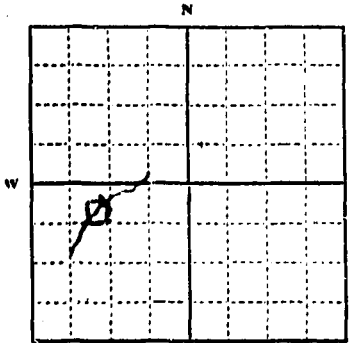

Describe means of obtaining groundwater without a well "as by sub-irrigation and other natural processes". Include depth to water when applicable. from unnamed Spring for use of Cat 32 Spring Valley address platted subdivision in NW 1/4 SW 1/4 Sec 24 T12N R17W MPM Missoula County MT

Quantity of water developed and used with explanation of method used to measure or estimate such amount. If use is intermittent

estimate approximate lengths of periods of use. will be used for irrigation and house hold use you found (this is for filing on certificate 100 minus inch)

1/4 Sec. T. R. Indicate point of appropriation and place of use, if possible.

Signature of Owner Dawn Neinsake

Date April 2 1973

This form to be prepared by contractor (if any), otherwise by the owner.
Three copies of this notice are to be filed with the County Clerk and Recorder of the county in which the works are located.
Please answer all questions. If not applicable, so state, otherwise the form will be returned.
Original to the County Clerk and Recorder; duplicate to the State Engineer; Triplicate to the Montana Bureau of Mines and Geology and Quadruplicate for the Appropriator.