

# 525

240993

I received and filed this Instrument for  
 record on the 31 day of Aug 1965  
 at 10:00 o'clock A.M., permanent files  
 of Missoula County, State of Montana  
 Witness my hand:  
 Veramoe R. Crouse, County Recorder  
 By Northern A. Bennett, Deputy  
 Fee \$ 2.00 cash Paid

RECORDED  
 AUG 31 1965  
 MISSOULA COUNTY REC'D

How Taken 2:35 Length of 100 ft  
 prepared in sep. for map or graphic  
 number None  
 special instructions for None

STATE WATER CONSERVATION BOARD

File No. \_\_\_\_\_

T. 12N R. 19W 21

MAY 3 1966

DUPLICATE

County Missoula

Billie \_\_\_\_\_ McDermott \_\_\_\_\_  
 Butzerin \_\_\_\_\_ McNulty \_\_\_\_\_  
 Coyle \_\_\_\_\_ Morton \_\_\_\_\_  
 Darlington \_\_\_\_\_ Sullivan \_\_\_\_\_

LOG

STATE OF MONTANA

ADMINISTRATOR OF GROUNDWATER CODE

OFFICE OF STATE ENGINEER

Top of Ground \_\_\_\_\_  
 (Elev. above sea level 3,142.1)  
 Formations Log:

**Notice of Completion of Groundwater**  
**Appropriation by Means of Well**

DEVELOPED AFTER JANUARY 1, 1962

(Under Chapter 237, Montana Session Laws, 1961)

Owner Ione C. Inabnit &/or

Address Missoula, Montana

Driller Liberty Drilling Co. Address Missoula, Montana

Date of Notice of appropriation of groundwater None filed

Date well started 5/27/65 Date completed 6/25/65

Type of well Drilled Equipment used Air Rotary  
 (Dug, Driven, bored or drilled) (Churn drill, rotary or other)

Water use: Domestic  Municipal  Stock  Irrigation   
 Industrial  Drainage  Other

Indicate on the diagram the character and thickness of the different strata met with in drilling, such as soil, clay, shale, gravel, rock or sand, etc. Show depth at which water is encountered, thickness and character of water-bearing strata and height to which the water rises in the well.

- 0 - 1 Top soil.
- 1 - 16 Gravel, cobblestones & broken rock with some clay mixed in.
- 16 - 57 Gravel & broken rock imbedded in tan clay.
- 57 - 77 Gravel & broken rock imbedded in purple clay.
- 77 - 85 Broken green & gray rock with gray clay in cracks & seams.
- 85 - 96 Blue rock.
- 96 - 160 Red rock.
- 160 - 166 Broken green rock. Gray clay in cracks & seams.
- 166 - 170 Red rock.
- 170 - 182 Green rock.
- 182 - 204 Red rock.
- 204 - 215 Gray rock.
- 215 - 232 Broken gray rock.
- 232 - 370 Red & gray rock in thin alternate layers. Fractured and broken between 362' & 370'. Water in cracks & seams.
- 370 - 390 Gray rock.

Size of Drilled Hole	Size and Weight of Casing	From (Feet)	To (Feet)	PERFORATIONS		
				Kind Size	From (Feet)	To (Feet)
6"	6 5/8 OD x 1/2"	+1	90' 2"	5 9/16	85	214
	5 9/16 OD	83	214	4 9/16		
	4 9/16 OD	213' 7"	390		362	370

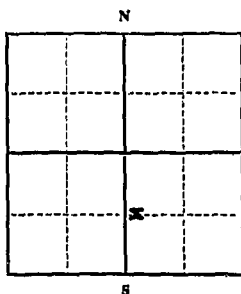

Static Water Level for non-flowing well \_\_\_\_\_ 28 \_\_\_\_\_ feet.

Shut-in Pressure for Flowing Well Non-f

Pumping Water Level 250 \_\_\_\_\_ feet at 20 \_\_\_\_\_ gal. per minute.

Discharge in gal. per min. of flowing well \_\_\_\_\_ Non-flowing

How Tested pump test

Length of Test Twelve hours

Remarks: (Gravel packing, cementing, packers, type of shutoff) All water

entering well is coming through perforations from 362' to 370'

W 1/2 SE 1/4 Sec. 21, T. 12N, R. 19W  
 Indicate location of well and place of use, if possible. Each small square represents 40 acres.

Water rises in well  
 28 feet from surface

(Continue on reverse side)

USE—If used for irrigation, industrial, drainage or other. Explain, state number of acres and location or other data (i.e.: Lot, Block and Addition).

Ten Acres

Show exact depth of bottom.  
 Bottom of hole 390'

This form to be prepared by driller, and three copies to be filed by the owner with the County Clerk and Recorder in the county in which the well is located, tissue copy to be retained by driller.

Please answer all questions. If not applicable, so state, otherwise the form will be turned.

Driller's License Number

William F. Adams  
 Driller's Signature

41020

#1601  
O

249808

I received and filed this instrument as  
 record on the 29 day of April, 1966  
 at 11:02 o'clock P.M. permanent file  
 of Missoula County, State of Montana  
 Witness my hand  
 Verjace H. Clark, County Recorder  
 By Martha S. Head, Deputy  
 Fee \$ 2.00 Paid cash

MISSOULA COUNTY RECORDS

RECORD # 1601

Proseper: Approved by State Auditor  
 for filing of this instrument in  
 the Public Records Office  
 of the State of Montana

File No. \_\_\_\_\_

JUN 15 1966

T. 12N R. 19W

DUPLICATE

Billie \_\_\_\_\_ McDermott \_\_\_\_\_ County Missoula  
 Butzerin \_\_\_\_\_ McNulty \_\_\_\_\_  
 Coyle \_\_\_\_\_ Morton \_\_\_\_\_ STATE OF MONTANA  
 Darlington \_\_\_\_\_ Sullivan \_\_\_\_\_ ADMINISTRATOR OF GROUNDWATER CODE  
 Dickert \_\_\_\_\_ OFFICE OF STATE ENGINEER

Top of Ground \_\_\_\_\_  
 (Elev. above sea level 3142')

### Notice of Completion of Groundwater Appropriation by Means of Well

DEVELOPED AFTER JANUARY 1, 1962

(Under Chapter 237, Montana Session Laws, 1961)

#### Formations Log

- 0 - 2 Black dirt.
- 2 - 18 Gravel & boulders mixed with gray silty clay.
- 18 - 85 Gravel & broken rock imbedded in tan clay.
- 85 - 92 Tan clay with some gravel imbedded.
- 92 - 134 Fine sand & gravel.
- 134 - 137 Clean coarse gravel. Water.

Owner Glenn W. MacLay Address Missoula, Montana

Driller Liberty Drilling Co. Address Missoula, Montana

Date of Notice of appropriation of groundwater None filed

Date well started 4/30/65 Date completed 5/6/65

Type of well Drilled Equipment used Cable Tools  
(Dug, Driven, bored or drilled) (Churn drill, rotary or other)

Water use: Domestic  Municipal  Stock  Irrigation   
Industrial  Drainage  Other

Indicate on the diagram the character and thickness of the different strata met with in drilling, such as soil, clay, shale, gravel, rock or sand, etc. Show depth at which water is encountered, thickness and character of water-bearing strata and height to which the water rises in the well.

Size of Drilled Hole	Size and Weight of Casing	From (Feet)	To (Feet)	PERFORATIONS		
				Kind Size	From (Feet)	To (Feet)
6"	6 5/8" OD x 1/4"	+1	137	NONE		

Water rises in well 92 feet from surface.

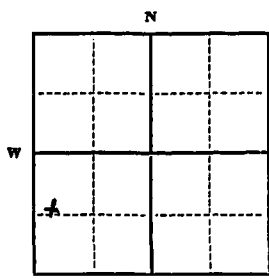

Static Water Level for non-flowing well 92' feet.

Shut-in Pressure for Flowing Well Non-f

Pumping Water Level 112' feet at 75 gal. per minute.

Discharge in gal. per min. of flowing well Non-flowing

How Tested Air Lift Pump

Length of Test Two hours

Tracts 10 & 11 Canyon Village Sec 21 T12N R. 19W

Indicate location of well and place of use, if possible. Each small square represents 40 acres.

Remarks: (Gravel packing, cementing, packers, type of shutoff) All water is entering well through the open bottom of six inch casing. Wells with open bottom completions in this area can be depended upon to produce clear sand free water year after year as long as they are not overpumped, i.e., they should

USE—If used for irrigation, industrial, drainage or other. Explain, state number of acres and location or other data (i.e.: Lot, Block and Addition).

Show exact depth of bottom.

Bottom of hole 137'

This form to be prepared by driller, and three copies to be filed by the owner with the County Clerk and Recorder in the county in which the well is located, tissue copy to be retained by driller.

Please answer all questions. If not applicable, so state, otherwise the form will be returned.

52 Driller's License Number

Walker F. Osborne  
Driller's Signature

41140

109

251103

I received and filed this instrument for record on the 13 day of June 1966 at 1:00 o'clock P.M. permanent files of Missoula County, State of Montana  
 Witness my hand:  
 Verance R. Grange, County Recorder  
 By M.M. Conaway Deputy  
 Fee 2.00

be pumped at rates less than 25 to 50 percent of the tested capacity of the aquifer.

STATE WATER CONSERVATION BOARD

JUN 12 1966

Notice  
 Notice is hereby given that the  
 Board of Water Conservation  
 has received and filed this instrument  
 for record on the 13 day of June 1966  
 at 1:00 o'clock P.M. permanent files  
 of Missoula County, State of Montana  
 Witness my hand:  
 Verance R. Grange, County Recorder  
 By M.M. Conaway, Deputy  
 Fee 2.00

File No. ....

T. 12 N. R. 19. W. 21

DUPLICATE

County: Missoula

STATE OF MONTANA  
ADMINISTRATOR OF GROUNDWATER CODE  
OFFICE OF STATE ENGINEER MAY 20 1965

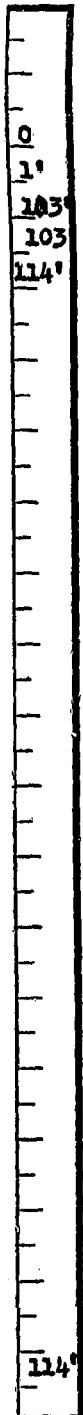
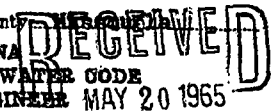

Top of Ground  
(Elev. above sea level.....)

Top Soil  
Gravel Clay  
Water Sand Gravel

### Notice of Completion of Groundwater Appropriation by Means of Well

(Under Chapter 237, Montana Session Laws, 1961)

Owner: Jimmie Mallory Address: Miller Creek

Driller: John Farrell Address: Arlee Mont

Date of Notice of Appropriation of Groundwater.....

Date well started: April 26 1965 Date Completed: May 3 1965

Type of well: Drilled Equipment Used: Churn Drill  
(dug, driven, bored or drilled) (Churn, drill, rotary or other)

Water Use: Domestic  Municipal  Other  Irrigation   
Industrial  Drainage  Stock

Indicate on the diagram the character and thickness of the different strata met with in drilling, such as soil, clay, shale, gravel, rock or sand, etc. Show depth at which water is encountered, thickness and character of water-bearing strata and height to which water rises in the well.

Size of Drilled Hole	Size and Weight of Casing	From (Feet)	To (Feet)	PERFORATIONS		
				Kind Size	From (Feet)	To (Feet)
5"	(3" 14#)	0	115'			

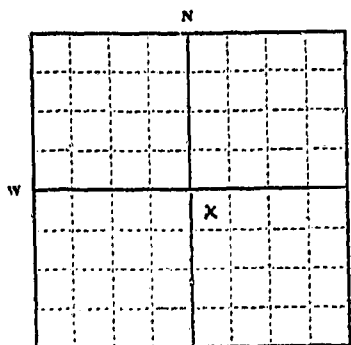

Canyon Village  
Tract 14 3/4 Sec. 24 T. 12 N. R. 19 W.  
Indicate location of well and place of use, if possible. Each small square represents 10 acres.

Show exact depth of bottom.

Static Water Level for non-flowing Well..... 87 feet.

Shut-in Pressure for Flowing Well.....

Pumping Water Level..... 89 feet at 14 gal. per minute.

Discharge in gal. per min. of flowing well.....

How Tested..... Pump Length of Test..... 2 1/2 Hrs

Remarks: (Gravel packing, cementing, packers, type of shutoff, location of place of use of groundwater if not at well, and any other similar pertinent information, including number of acres irrigated, if used for irrigation).....

115' Pipe 1' Above Ground Level

14

Driller's License Number

John Farrell  
Driller's Signature

This form to be prepared by driller, and three copies to be filed by the owner with the County Clerk and Recorder in the county in which the well is located.

Please answer all questions. If not applicable, so state, otherwise the form will be returned.

Original to the County Clerk and Recorder; duplicate to the State Engineer; Triplicate to the Montana Bureau of Mines and Geology and Quadruplicate for the Appropriator.

39137

F1501

236680

I received and filed this instrument for  
record on the 17 day of May, 1965  
at 12:45 o'clock AM, permanent files  
of Missoula County, State of Montana  
Witness my hand:  
Vernice D. Cross, County Recorder  
By M. A. Bennett, Deputy  
Fee 2.00 Paid

MISSOULA COUNTY, MONTANA  
RECORDED IN BOOK 112 PAGE 112





4291

308660

I received and filed this instrument for  
 record on the 15 day of Oct 1974  
 at 10:30 o'clock A.M. permanent files  
 of Missoula County, State of Montana  
 Witness my hand  
 Varance A. Crouse, County Recorder  
 By John P. [Signature] Deputy  
 Fee \$ 2.00 Paid

Mail to: 305 Blaine  
Missoula, Montana

File No. \_\_\_\_\_

T. \_\_\_\_\_ R. \_\_\_\_\_

DUPLICATE

County Missoula

LOG

RECEIVED  
MAY 23 1968

STATE OF MONTANA  
ADMINISTRATOR OF GROUNDWATER CODE  
OFFICE OF STATE ENGINEER



Top of Ground

(Elev. above sea level \_\_\_\_\_)

### Notice of Completion of Groundwater Appropriation by Means of Well DEVELOPED AFTER JANUARY 1, 1962

(Under Chapter 237, Montana Session Laws, 1961)

0-53 Sand, Gravel & Clay

53-58 Clay

58-98 Sand, Gravel & Clay

98-128 Sand, Gravel and  
Water with some  
Streaks of Clay

Owner Rita Ferguson Address Miller Creek

1822 S. 14th W.

Driller Glenn Camp Address Missoula, Montana

Date of Notice of appropriation of groundwater \_\_\_\_\_

Date well started April 19, 1968 Date completed April 25, 1968

Type of well Drilled Equipment used Churn Drill  
(Dug, driven, bored or drilled) (Churn drill, rotary or other)

Water use: Domestic  Municipal  Stock  Irrigation   
Industrial  Drainage  Other

Indicate on the diagram the character and thickness of the different strata met with in drilling, such as soil, clay, shale, gravel, rock or sand, etc. Show depth at which water is encountered, thickness and character of water-bearing strata and height to which the water rises in the well.

Size of Drilled Hole	Size and Weight of Casing	From (Feet)	To (Feet)	PERFORATIONS		
				Kind Size	From (Feet)	To (Feet)
6" I.D.	6" I.D. 17 lb per ft.	8" above G.L.	128' 6"	NONE		

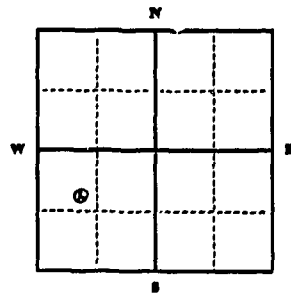

Static Water Level for non-flowing well 98' feet.

Shut-in Pressure for Flowing Well \_\_\_\_\_

Pumping Water Level 98' feet  
at 300 gal. per minute.

Discharge in gal. per min. of flowing well \_\_\_\_\_

How Tested Ballor

Length of Test 2 Hours

Remarks: (Gravel packing, cementing, packers, type of shutoff) \_\_\_\_\_

SW 1/4 Sec. 21, T. 12N, R. 19W  
Indicate location of well and place of use, if possible. Each small square represents 40 acres.

(Continue on reverse side)

USE—If used for irrigation, industrial, drainage or other. Explain, state number of acres and location or other data (i.e.: Lot, Block and Addition).

Show exact depth of bottom.

This form to be prepared by driller, and three copies to be filed by the owner with the County Clerk and Recorder in the county in which the well is located, tissue copy to be retained by driller.

Please answer all questions. If not applicable, so state, otherwise the form will be returned.

License # 7  
Driller's License Number

Glenn Camp  
Driller's Signature Glenn Camp

44,154

# 1791 271461

I received and filed this instrument for  
record on the 20th of May 1968  
at 1:55 o'clock P.M., permanent files  
of Missoula County, State of Montana  
Witness my hand:  
Vernon R. Crouse, County Recorder  
By Marian M. Helberg  
Fee \$ 2.00

File No. \_\_\_\_\_

T. 12N R. 19W 21, 22

DUPLICATE

County Missoula

LOG

28

STATE OF MONTANA  
ADMINISTRATOR OF GROUNDWATER CODE  
OFFICE OF STATE ENGINEER

Top of Ground APPROX.  
(Elev. above sea level 3202')

Notice of Completion of Groundwater  
Appropriation by Means of Well  
DEVELOPED AFTER JANUARY 1, 1962

(Under Chapter 237, Montana Session Laws, 1961)

Formations Log:

- 0 - 84 Gravel mixed in tan clay.
- 84 - 86 Green & gray poorly graded gravel.
- 86 - 99 Poorly graded gravel and broken rock imbedded in tan clay.
- 99 - 101 Badly broken red rock.
- 101 - 112 Badly broken red rock imbedded in tan clay.
- 112 - 113 Broken red rock
- 112 - 121 Broken red rock imbedded in tan clay.
- 121 - 129 Very silty sand & gravel. Some silty water. Too fine and dirty to successfully develop well.
- 129 - 137 Broken rock mixed in light brown clay
- 137 - 148 Very silty sand and gravel. Some silty water.
- 148 - 154 Broken rock imbedded in tan clay.
- 154 - 177 Brown silty sand and clay. Seeps of water.
- 177 - 181 Very silty sand and gravel. Some silty water.
- 181 - 201 Fractured rock. Clay in seams.
- 201 - 213 Fractured rock. Water.

Owner Mr. Robert P. Sanaugh / & Catherine H. Sanaugh  
Address Missoula, Montana

Driller Liberty Drilling Co. Address Missoula, Montana

Date of Notice of appropriation of groundwater None filed

Date well started 6/12/68 Date completed 6/27/68

Type of well Drilled Equipment used Cable Tools  
(Dug, Driven, bored or drilled) (Churn drill, rotary or other)

Water use: Domestic  Municipal  Stock  Irrigation   
Industrial  Drainage  Other

Indicate on the diagram the character and thickness of the different strata met with in drilling, such as soil, clay, shale, gravel, rock or sand, etc. Show depth at which water is encountered, thickness and character of water-bearing strata and height to which the water rises in the well.

Size of Drilled Hole	Size and Weight of Casing	From (Feet)	To (Feet)	PERFORATIONS		
				Kind Size	From (Feet)	To (Feet)
6"	6 5/8" x 4"	+2	209	NONE		

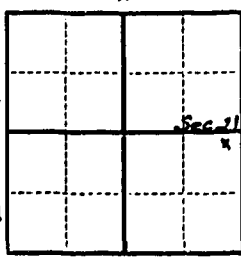

Static Water Level for non-flowing well 128 feet.

Shut-in Pressure for Flowing Well None

Pumping Water Level 180 feet at 45 gal. per minute.

Discharge in gal. per min. of flowing well Non-flowing.

How Tested Air Lift Pump

Length of Test four & one half hrs

Remarks: (Gravel packing, cementing, packers, type of shutoff) All water entering well from fractures in the rock between 209 and 213 feet. Wells in this area can be depended upon to produce clear sand free water year after year as long as they are not overpumped, i.e., they should be pumped at rates not in excess of 40 to 50 (percent of the side) tested capacity of the aquifer.

E 1/4, SE 1/4, See 21 & 1/4 Sec. 22, T12N R19W

Indicate location of well and place of use, if possible. Each small square represents 40 acres.

Water rises in the well 128 feet from surface. Show exact depth of bottom.

Approx. acres

Bottom of well 213'

This form to be prepared by driller, and three copies to be filed by the owner with the County Clerk and Recorder in the county in which the well is located, tinasu copy to be retained by driller.

Please answer all questions. If not applicable, so state, otherwise the form will be returned.

Driller's License Number \_\_\_\_\_  
William P. Robinson  
Driller's Signature

45,282

892

MISSOULA

281483

I received and filed this instrument for record on the 23 day of May 1957 at 11:15 o'clock A.M., permanent files, of Missoula County, State of Montana. (Witness my hand.)  
 Vernace R. Crouse, County Recorder  
 By Monty A. Kasper, Deputy  
 Fee \$ 2.00 cash Gold

MISSOULA COUNTY RECORDS  
 100 SOUTH 1ST AVENUE  
 MISSOULA, MONTANA

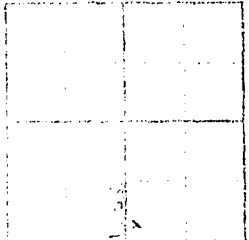

MISSOULA COUNTY RECORDS  
 100 SOUTH 1ST AVENUE  
 MISSOULA, MONTANA

MISSOULA COUNTY RECORDS  
 100 SOUTH 1ST AVENUE  
 MISSOULA, MONTANA

File No. \_\_\_\_\_

T. 12N R. 19W

MONTANA WATER RESOURCES BOARD  
DUPLICATE RECEIVED

County Missoula

MAY 23 1969

STATE OF MONTANA  
ADMINISTRATOR OF GROUNDWATER CODE  
OFFICE OF STATE ENGINEER

### Notice of Completion of Groundwater Appropriation Without Well

Developed After January 1, 1962

(Under Chapter 237 Montana Session Laws, 1961)

Date of Appropriation of Groundwater July 1, 1968  
Route 5, Miller Creek

Owner A. T. Beaudry and JoAnne Beaudry and Address Road, Missoula, Montana  
Contractor (if any) NONE

Address of Contractor NONE

Date Started 7/1/68 Date Completed 7/1/68

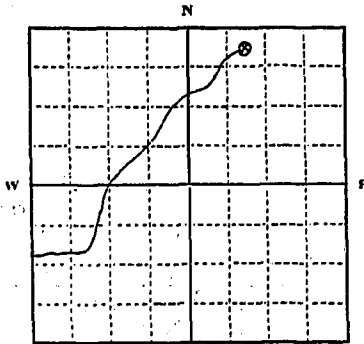

1) Describe means of obtaining groundwater (as by sub-irrigation, developed spring, drains, etc.) Natural spring that flows about a mile and half and then disappears into the ground.

2) Means of withdrawing water (gravity, pump, canal, etc.) Gravity pipe and hose, also by centrifical pump.

3) Depth of water table unknown, but spring flows the year round.

4) Use of the water Irrigation, domestic use, fire prevention, water for garden and stock

5) Amount of groundwater claimed (in miner's inches, or gallons per minute) 15 miners inches

6) If used for irrigation, give number of acres and description of land See reverse side hereof for land

Indicate point of appropriation and place of use, if possible.  
(1) [X] The spring. It is in the NW 1/4 NE 1/4 of Sec. 22, Twp. 12 N., Rge. 19W. Missoula, County, Montana

(2) The solid line represents the flow of the spring. description and acreage.

7) Estimate amount of water used each year 30,000 to 50,000 gallons

Signature of Owner A. T. Beaudry JoAnne Beaudry

Date April 30, 1969

This form to be prepared by contractor (if any), otherwise by the owner.

Three copies of this notice are to be filed with the County Clerk and Recorder of the county in which the works are located.

Please answer all questions. If not applicable, so state, otherwise the form will be returned.

45,259

Missoula

A.T. Beaudry and JoAnne Beaudry

t y are are s

s

s are

s s t y

A.T. Beaudry

JoAnne Beaudry

69

Missoula, Montana

(SEAL)

Question No. (6): If used for irrigation, give number of acres and description of land: All that portion of the SW $\frac{1}{4}$  of Section 22, Twp. 12, North, Rge. 19 West, lying South of the Miller Creek Road as now constructed and North of Miller Creek and bounded on the East by a line 800 feet West of the East boundary line of the SW $\frac{1}{4}$  and bounded on the West by a line which is 2315 feet West of the East boundary line of the SW $\frac{1}{4}$ ; and all that portion of the SW $\frac{1}{4}$  of Section 22, Twp. 12 North of Range 19 West which lies South of Miller Creek and bounded on the east by a line which is 1900 feet West of the East boundary of the SW $\frac{1}{4}$  and bounded on the West by a line which is 2315 feet West of the East boundary of the SW $\frac{1}{4}$  of said Section 22; all in Missoula County, Montana, and containing 20 acres more or less.

28/365

\*1890

I received and filed this instrument for record on the 28th day of May, 1967, at 1:00 o'clock P. M., permanent files of Missoula County, State of Montana. Witness my hand: Veronique R. Crease, County Recorder. By: Harrell, Deputy. Fee \$ 2.00 Paid Cash

File No. ....

T. 12 R. 19 27

TRIPPLICATE

County Missoula

STATE OF MONTANA  
ADMINISTRATOR OF GROUNDWATER CODE  
OFFICE OF STATE ENGINEER

**DECEIVED**  
JUL 12 1965  
STATE ENGINEER



Top of Ground  
(Elev. above sea level.....)

Top Soil

Clay & Gravel

Small Trace Water

Clay & Gravel

Sand Gravel & Water

### Notice of Completion of Groundwater Appropriation by Means of Well

(Under Chapter 237, Montana Session Laws, 1961)

Owner A. T. Beaudry Address Miller Creek

Driller John Farrell Address Arlee

Date of Notice of Appropriation of Groundwater.....

Date well started June 1 1965 Date Completed June 4 1965

Type of well Drilled Equipment Used Churn Drill  
(dug, driven, bored or drilled) (Churn, drill, rotary or other)

Water Use: Domestic  Municipal  Other  Irrigation   
Industrial  Drainage  Stock

Indicate on the diagram the character and thickness of the different strata met with in drilling, such as soil, clay, shale, gravel, rock or sand, etc. Show depth at which water is encountered, thickness and character of water-bearing strata and height to which water rises in the well.

Size of Drilled Hole	Size and Weight of Casing	From (Feet)	To (Feet)	PERFORATIONS		
				Kind Size	From (Feet)	To (Feet)
5"	(14 1/2#)	0	87'			

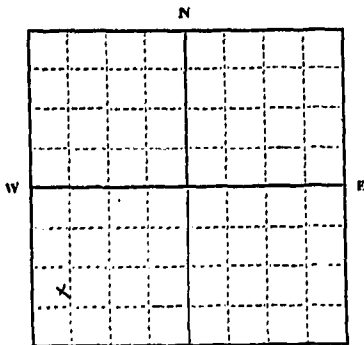

S.W. 1/4 Sec. 22 T. 12 R. 19  
Indicate location of well and place of use, if possible. Each small square represents 10 acres.

Static Water Level for non-flowing Well..... 73' feet.

Shut-in Pressure for Flowing Well.....

Pumping Water Level..... 74' feet at 12 gal. per minute.

Discharge in gal. per min. of flowing well.....

How Tested..... Pump Length of Test..... 1 Hour

Remarks: (Gravel packing, cementing, packers, type of shutoff, location of place of use of groundwater if not at well, and any other similar pertinent information, including number of acres irrigated, if used for irrigation).....

87'

Show exact depth of bottom.

John J. Stiles

NOTARY PUBLIC for the State of Montana  
Residing at Missoula, Montana.  
My commission expires December 1, 1967

This form to be prepared by driller, and three copies to be filed by the owner with the County Clerk and Recorder in the county in which the well is located.

Please answer all questions. If not applicable, so state, otherwise the form will be returned.

Original to the County Clerk and Recorder; duplicate to the State Engineer; Triplicate to the Montana Bureau of Mines and Geology and Quadruplicate for the Appropriator.

14  
Driller's License Number

John Farrell  
Driller's Signature



E, 516

238532

I received and filed this Instrument for  
 record on the..... day of July 1965  
 at 11.00 o'clock AM, permanent files  
 of Missoula County, State of Montana  
 Witness my hand:  
 Vermae B. Crouse, County Recorder  
 By Dorothy A. Runyan Deputy  
 Fee \$ 2.00 Paid  
*Cash*

File No. \_\_\_\_\_

OCT 20 1965

T. 13 N R. 19 W 70

DUPLICATE

Supplementary To

Billie \_\_\_\_\_ McDermott \_\_\_\_\_  
Butcher \_\_\_\_\_ McFluty \_\_\_\_\_  
Darlington \_\_\_\_\_ Sullivan \_\_\_\_\_  
Dickert \_\_\_\_\_

County Missoula

STATE OF MONTANA

ADMINISTRATOR OF GROUNDWATER CODE  
OFFICE OF STATE ENGINEER

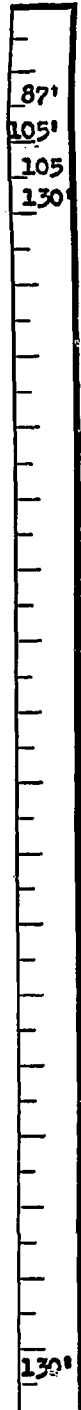

Top of Ground  
(Elev. above sea level.....)

Gravel

Gravel Sand Water

### Notice of Completion of Groundwater Appropriation by Means of Well

(Under Chapter 237, Montana Session Laws, 1965)

Owner A T Beaudry Address Miller Creek

Driller John Farrell Address Arlee

Date of Notice of Appropriation of Groundwater.....

Date well started AUG 12 1965 Date Completed Aug 14 1965

Type of well Drilled Equipment Used Churn Drill  
(dug, driven, bored or (Churn, drill, rotary or drilled) other)

Water Use: Domestic  Municipal  Other  Irrigation   
Industrial  Drainage  Stock

Indicate on the diagram the character and thickness of the different strata met with in drilling, such as soil, clay, shale, gravel, rock or sand, etc. Show depth at which water is encountered, thickness and character of water-bearing strata and height to which water rises in the well.

Size of Drilled Hole	Size and Weight of Casing	From (Feet)	To (Feet)	PERFORATIONS		
				Kind Size	From (Feet)	To (Feet)
5"	(5" 14 1/2)#	0	130'			

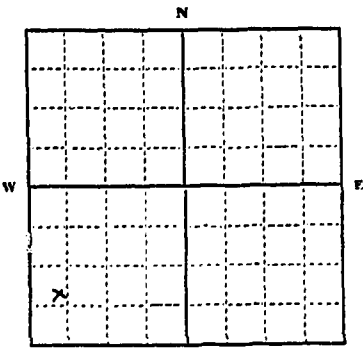

Sec. 21 T. 13 N. R. 19 W. 70  
Indicate location of well and place of use, if possible. Each small square represents 10 acres.

130'

Show exact depth of bottom.

Static Water Level for non-flowing Well..... 102 feet.

Shut-in Pressure for Flowing Well.....

Pumping Water Level..... 126 feet at 12 gal. per minute.

Discharge in gal. per min. of flowing well.....

How Tested..... Pump Length of Test..... 1 Hour

Remarks: (Gravel packing, cementing, packers, type of shutoff, location of place of use of groundwater if not at well, and any other similar pertinent information, including number of acres irrigated, if used for irrigation).....

~~Deepen Well 43'~~

First Drilling Well Went Dry in July 1965

14  
Driller's License Number

John Farrell  
Driller's Signature

This form to be prepared by driller, and three copies to be filed by the owner with the County Clerk and Recorder in the county in which the well is located.

Please answer all questions. If not applicable, so state, otherwise the form will be returned.

Original to the County Clerk and Recorder; duplicate to the State Engineer; Triplicate to the Montana Bureau of Mines and Geology and Quadruplicate for the Appropriator.

1533

242688

I received and filed this instrument for  
record on the 11<sup>th</sup> day of Oct, 1965,  
at 11:15 o'clock A.M., permanent files  
of Missoula County, State of Montana  
Witness my hand:  
Verance R. Crouse, County Recorder  
By Donna A. Crouse, Deputy  
Fee \$ 2.00 Paid



File No.....

T. 12 N R. 19 W

DUPLICATE

County Missoula

STATE OF MONTANA  
ADMINISTRATOR OF GROUNDWATER CODE  
OFFICE OF STATE ENGINEER

Notice of Completion of Groundwater Appropriation  
Without Well

Developed After January 1, 1962

(Under Chapter 237 Montana Session Laws, 1961)

MONTANA WATER RESOURCES DIVISION  
**RECEIVED**  
MAY 16 1969

Date of Appropriation of Groundwater July 1, 1968

Owner Harold J. Knapp Address Route 5

and Gail P. Knapp

Contractor (if any) NONE

Address of Contractor NONE

Date Started 7/1/68 Date Completed 7/1/68

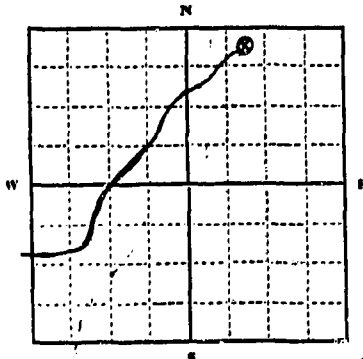

NW 1/4 Sec. 22, T. 12N, R. 19W

Indicate point of appropriation and place of use, if possible.

**LEGEND**

(1) [X] The spring. It is in the NW 1/4 of Sec. 22, Twp. 12 N., Rgs. 19 W., Missoula County, Montana

(2) The solid line represents the flow of the spring.

1) Describe means of obtaining groundwater (as by sub-irrigation, developed spring, drains, etc.) Natural spring that flows about a mile and half and then disappears into the ground

2) Means of withdrawing water (gravity, pump, canal, etc.) Gravity pipe and hose. Also by centrifical pump.

3) Depth of water table unknown, but spring flows the year around.

4) Use of the water Irrigation, domestic use, fire prevention, water for garden and stock.

5) Amount of groundwater claimed (in miner's inches, or gallons per minute) 15 miners inches

6) If used for irrigation, give number of acres and description of land See reverse side hereof for land description and acreage.

7) Estimate amount of water used each year 30,000 to 50,000 gallons

Signature of Owner.....

Date April 30, 1969

This form to be prepared by contractor (if any), otherwise by the owner.

Three copies of this notice are to be filed with the County Clerk and Recorder of the county in which the works are located.

Please answer all questions. If not applicable, so state, otherwise the form will be returned.

45,230

Missoula

Harold J. Knapp and Gail F. Knapp

t y are are s  
s  
s are  
s s t y

Harold J. Knapp

*Harold J. Knapp*

Gail F. Knapp

*Gail F. Knapp 69*

Missoula, Montana

(SEAL)

Question No. (6): If used for irrigation, give number of acres and description of land: A tract of land located in the north half of the Southwest quarter (N<sup>1</sup>/<sub>4</sub>SW<sup>1</sup>/<sub>4</sub>) of Section 22, Twp. 12 North, Rge. 19 West, M.F.M., Missoula County, Montana, more particularly described as follows: Beginning at a point on the east-west center of the section line of said Section 22 that is 765.60 feet East of the quarter corner that is common to Sections 21 and 22 of Twp. 12 North, Rge. 19 West; thence East on and along said east-west center of the section line for a distance of 1349.60 feet; thence south and parallel to the north-south center of the section line of said Section 22 for a distance of 1003.80 feet to the north edge of the Miller Creek Road called Corner B-1; thence westerly on and along the north edge of Miller Creek Road to Corner B (Corner B bears N. 89°47'54"W. a distance of 1349.0 feet from Corner B-1); thence North and parallel to the north-south center of Section line of said Section 22 for 999.04 feet to the point of beginning. The tract contains approximately 30 acres.

1886

281188

I received and filed this instrument for record on the 13... day of May, 1969, at 4:50 o'clock A.M. per instrument files of Missoula County, State of Montana  
Witness my hand:  
Vernon R. Crouse, County Recorder  
By *Charles J. Demuth*, Deputy  
Fee \$ 2.00 Paid *CK*

File # \_\_\_\_\_

T. 12N R. 16W 22

DUPLICATE

County \_\_\_\_\_

STATE OF MONTANA  
ADMINISTRATOR OF GROUNDWATER CODE  
OFFICE OF STATE ENGINEER

RECEIVED  
APR 15 1965

Notice of Completion of Groundwater  
Appropriation by Means of Well

(Under Chapter 237, Montana Session Laws, 1961)

- Top of Ground  
(Elev. above sea level.....)
- 0
- 1' Top Soil
- 1' 61' Shale Rock Clay
- 61' Gravel Water
- 62' Bed Rock Dry
- 70'

Owner Harold G. Knapp Address Miller Creek

Driller John Farrell Address Arlee Mont

Date of Notice of Appropriation of Groundwater.....

Date well started April 6 1965 Date Completed April 10 1965

Type of well Drilled Equipment Used Churn Drill  
(dug, driven, bored or drilled) (Churn, drill, rotary or other)

Water Use: Domestic  Municipal  Other  Irrigation   
Industrial  Drainage  Stock

Indicate on the diagram the character and thickness of the different strata met with in drilling, such as soil, clay, shale, gravel, rock or sand, etc. Show depth at which water is encountered, thickness and character of water-bearing strata and height to which water rises in the well.

Size of Drilled Hole	Size and Weight of Casing	From (Feet)	To (Feet)	PERFORATIONS		
				Kind Size	From (Feet)	To (Feet)
5"	5" (14 1/2) #	0	62'			

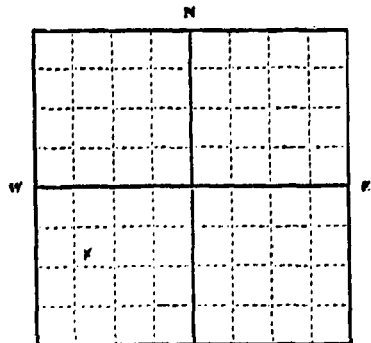

1/4 Sec. 22 T. 12N R. 16W  
Indicate location of well and place of use, if possible. Each small square represents 10 acres.

62'

Show exact depth of bottom.

Static Water Level for non-flowing Well..... 30 feet.

Shut-in Pressure for Flowing Well.....

Pumping Water Level..... 29 feet at..... 7 gal. per minute.

Discharge in gal. per min. of flowing well.....

How Tested Pump Length of Test..... 2 Hrs

Remarks: (Gravel packing, cementing, packers, type of shutoff, location of place of use of groundwater if not at well, and any other similar pertinent information, including number of

acres irrigated, if used for irrigation).....

Drilled 8' 1N Bed Rock Dry

Pulled Casing Back To 62'

14

Driller's License Number

John Farrell  
Driller's Signature

This form to be prepared by driller, and three copies to be filed by the owner with the County Clerk and Recorder in the county in which the well is located.

Please answer all questions. If not applicable, so state, otherwise the form will be returned.

Original to the County Clerk and Recorder; duplicate to the State Engineer; Triplicate to the Montana Bureau of Mines and Geology and Quadruplicate for the Appropriator.

39069

1489

235270

I received and filed this Instrument for  
record on the 13 day of April 1965  
at 9:18 o'clock A.M. permanent files  
of Missoula County, State of Montana  
Witness my hand:  
Verance E. Cross, County Recorder  
By *Debra Turner*, Deputy  
Fee \$ 2.00 Paid *cash*

22

File No. ....

T 12 N R 17 W

DUPLICATE

County Missoula

STATE OF MONTANA  
ADMINISTRATOR OF GROUNDWATER CODE  
OFFICE OF STATE ENGINEER

RECEIVED  
JAN 3 1963  
STATE ENGINEER

Notice of Completion of Groundwater Appropriation  
Without Well

(Under Chapter 237 Montana Session Laws, 1961)

Date of Appropriation of Groundwater JUN 17 27

Owner L. D. McCallough Address MISSOULA, MONT

Contractor (if any) N.C.N.R.

Address of Contractor .....

Date Started JUN 17 27 Date Completed JUN 17 27

Describe means of obtaining groundwater without a well "as by sub-irrigation and other natural processes". Include depth to water when applicable. SOIL FILLED DAM IN FRONT OF SUBJECT SPRING

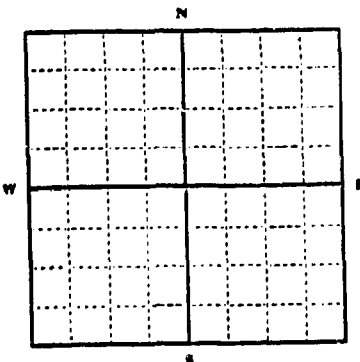

SW 1/4, SW 1/4, NE 1/4, Sec. 22, T. 12 N, R. 17 W  
Indicate point of appropriation and place of use, if possible.

Quantity of water developed and used with explanation of method used to measure or estimate such amount. If use is intermittent

estimate approximate lengths of periods of use. 12 Mo. V.S.S. catch only. DAM approx 6' high by 50' long with 12" H 30 1045,000 gallons.

Signature of Owner L. D. McCallough

Date 12/31/62

This form to be prepared by contractor (if any), otherwise by the owner.

Three copies of this notice are to be filed with the County Clerk and Recorder of the county in which the works are located.

Please answer all questions. If not applicable, so state, otherwise the form will be returned.

Original to the County Clerk and Recorder; duplicate to the State Engineer; Triplicate to the Montana Bureau of Mines and Geology and Quadruplicate for the Appropriator.

20304



1185

Copied

I received and filed this instrument for  
recording at 708 the 31st day of Dec. 1963  
of Missoula County, State of Montana  
Witness my hand  
By Walter D. Baker County Recorder  
Rec'd W.D. Baker Deputy

RECEIVED

NOV 19 1973

County MISSOULA

STATE OF MONTANA  
ADMINISTRATOR OF GROUNDWATER CODE  
MONTANA WATER RESOURCES BOARD

MONT. DEPT. of NATURAL  
RESOURCES & CONSERVATION

NOTICE OF COMPLETION OF GROUNDWATER  
APPROPRIATION BY MEANS OF WELL

Developed after January 1, 1962

DRILLER'S LOG

Indicate the character, color, thick-  
ness of strata such as soil, clay, sand,  
gravel, shale, sandstone, etc. Show  
depth at which water is found and  
height to which water rises in well.

(Under Chapter 237 Montana Session Laws, 1961, as amended)

This form to be prepared by driller, and three copies to be filed  
by the owner with the County Clerk and Recorder in the county in  
which the well is located, last copy to be retained by driller.

Please answer all questions. If not applicable, so state, otherwise the  
form may be returned.

Owner Wilfred A. Sanderson For Administrator's Use

Address Miller Creek File

Missoula, Montana 59801

Date well started Sept. 27, 1973 GW 1

June 3, 1967

completed Sept. 27, 1973 June 7, 1967

Type of well Drilled  
(Dug, driven, bored or drilled)

Equipment used Rotary Drill  
(Churn drill, rotary or other)

Water Use: Domestic  Municipal  Stock  Irrigation

Industrial  Drainage  Other  Garden/Lawn

\*Describe

USE: If used for irrigation, industrial, drainage or other. Explain,  
state number of acres and location or other data (i.e. Lot, Block  
and Addition).

ESTIMATED ANNUAL WITHDRAWAL

Size of Drilled Hole	Size and Weight of Casing	From (Feet)	To (Feet)	PERFORATIONS		
				Kind Size	From (Feet)	To (Feet)
6" ID	6" ID 17 lb per ft.	6"	76"		none	

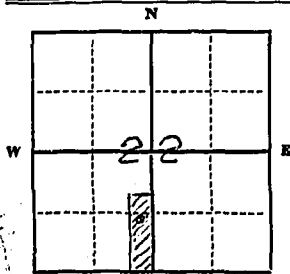

E. 437'  
1/4 SW 1/4 Sec. 22  
T. 12 N. R. 19 E

Static water level 51 ft.\*  
Pumping water level 70 ft.\*  
at 50 gallons per minute,  
measured 2 minutes after pumping  
began.  
\*Measured from ground level.  
Well developed by Air  
for 2 hours.  
Power Does not apply HP  
Remarks: (Gravel packing, cementing,  
packers, type of shutoff)

Top of Ground (Elev. above sea level)		
From (Feet)	To (Feet)	
0	4	Top soil
4	32	Clay, gravel & Broken Rock
32	56 1/2	Water, Gravel, Broken Rock & Some Clay
		Well Deepened
56 1/2	73 1/2	Clay Sand & Gravel (Water)
73 1/2	76 1/2	Gravel (Water)

INDICATE LOCATION OF WELL AND PLACE OF USE, IF POSSIBLE.  
EACH SMALL SQUARE REPRESENTS 40 ACRES.

Driller's Signature Glenn Camp 549-3111  
CAMP WELL DRILLING & PUMP SUPPLY  
Driller's Address 1522 S. 14th W., Missoula, Montana 59801

LICENSE NO. 7

76 1/2 Show exact depth of bottom

2617

340433

I received and filed this instrument for  
 record on the 15 day of Nov. 1953  
 at 11:00 o'clock A.M. in the public files  
 of Missoula County, State of Montana  
 Witness my hand and  
 Dorothy L. Head, County Recorder  
 By Mary Shalby Deputy  
 Fee \$ 2.00 cash Paid

File No. ....

T. 12N R. 19W

22

DUPLICATE

STATE WATER CONSERVATION BOARD

County Missoula

LOG

JUL 24 1967

STATE OF MONTANA  
ADMINISTRATOR OF GROUNDWATER CODE  
OFFICE OF STATE ENGINEER

Top of Ground \_\_\_\_\_  
(Elev. above sea level \_\_\_\_\_)  
Silliman \_\_\_\_\_  
Sullivan \_\_\_\_\_  
Dahlstrom \_\_\_\_\_  
Mortenson \_\_\_\_\_  
Mortenson \_\_\_\_\_  
Sullivan \_\_\_\_\_

### Notice of Completion of Groundwater Appropriation by Means of Well

DEVELOPED AFTER JANUARY 1, 1962

(Under Chapter 237, Montana Session Laws, 1961)

Well on Miller Creek

0 to 4' Top Soil  
4' to 32' Clay, gravel  
& broken rock  
32' to 562' Water, gravel,  
Broken rock & some clay

Owner Wilfred A. Sanderson Address 4022 S. Ave. Hale  
or Wilfred F. Sanderson

Driller Glenn Camp 1522 S. 14th Address Missoula, Mont.

Date of Notice of appropriation of groundwater \_\_\_\_\_

Date well started 6/3/67 Date completed 6/7/67

Type of well Drilled Equipment used Churn drill  
(Dug, driven, bored or drilled) (Churn drill, rotary or other)

Water use: Domestic  Municipal  Stock  Irrigation   
Industrial  Drainage  Other

Indicate on the diagram the character and thickness of the different strata met with in drilling, such as soil, clay, shale, gravel, rock or sand, etc. Show depth at which water is encountered, thickness and character of water-bearing strata and height to which the water rises in the well.

Size of Drilled Hole	Size and Weight of Casing	From (Feet)	To (Feet)	PERFORATIONS		
				Kind Size	From (Feet)	To (Feet)
6"	6" I.D. 17#	2' above G.L.	to 562'-4"	None		

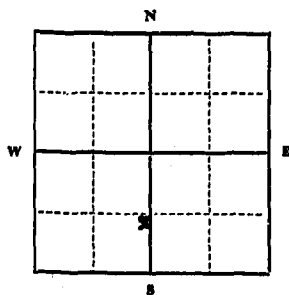

Static Water Level for non-flowing well

From top of casing feet

Shut-in Pressure for Flowing Well \_\_\_\_\_

Pumping Water Level 40 feet  
at 37 1/2 gal. per minute.

Discharge in gal. per min. of flowing well \_\_\_\_\_

How Tested Compressor

Length of Test 1 1/2 hours

Remarks: (Gravel packing, cementing, packers, type of shutoff) \_\_\_\_\_

S2/SW 1/4 Sec. 22 T. 12N R. 19W

Indicate location of well and place of use, if possible. Each small square represents 40 acres.

(Continue on reverse side)

USE—If used for irrigation, industrial, drainage or other. Explain, state number of acres and location or other data (i.e.: Lot, Block and Addition).

Show exact depth of bottom.

This form to be prepared by driller, and three copies to be filed by the owner with the County Clerk and Recorder in the county in which the well is located, tissue copy to be retained by driller.

Please answer all questions. If not applicable, so state, otherwise the form will be returned.

License # 7

Driller's License Number

Glenn Camp  
Driller's Signature.

42,163

1722

262315

I received and filed this Instrument for  
 record on the 14 day of July 1967  
 at 2:45 o'clock P.M. permanent files  
 of Missoula County, State of Montana  
 Witness my hand: -  
Thomas R. Crouse County Recorder  
 By Shirley A. Running Deputy  
 Fee \$ 2.50 Paid

MISSOULA COUNTY RECORDER  
 MISSOULA, MONTANA  
 PHONE 234-1111

RECEIVED

MAR 25 1974

MONT. DEPT. of NATURAL  
RESOURCES & CONSERVATION

Route 5 - Miller Creek Road  
Missoula, Montana 59801  
March 22, 1974

Montana Department of Natural Resources and Conservation  
32 South Ewing  
Helena, Montana 59601

Re: Your letter of 3/18/74

Attention: Ralph Saunders

Dear Mr. Saunders:

In accordance with our telephone conversation today regarding our water rights to our well, I am returning to your office your copy (yellow) of our "Notice of Completion of Groundwater Appropriation by Means of a Well", showing the completion dates of both June 7, 1967 and September 27, 1973; and two starting dates of June 3, 1967 and September 27, 1973. I am also enclosing a copy of Mr. Camp's bill showing charges for 21 feet of pipe and 21 feet of 10/3 submersible electrical cable, being indications that the well was deepened approximately 21 feet. Please be advised that a similar notice for the original well was filed with Missoula County Clerk and Recorder on July 10, 1967. We can furnish you with copies if required. The 1967 notice shows a log identical with the log of the 1973 notice for the first 58½ feet.

The reasons for deepening the well in 1973 was caused by the extremely dry weater, creating a water table below which our existing well did not reach. I assume that our well now has a water table that has again reached the range as existed at the time the well was drilled. Our 2-horsepower submersible pump was installed in 1967 at the time of completion of the well. It is capable of pumping approximately 35 gallons per minute and the same pump is still being used. The deepening of the well was not for the purpose of increasing the water production, but was of necessity to obtain any water from the well.

Hopefully, the actions we have taken will not invalidate our water rights which were established in 1967.

Thank you.

Sincerely,

*Wilfred A. Sanderson*  
Wilfred A. Sanderson

CAMP WELL DRILLING & PUMP SUPPLY  
 1522 SOUTH 14TH STREET MISSOULA, MONTANA 59801 PHONE 406 549-3411

INVOICE NO. 4008

DATE 10/4 1973

SOLD TO Michael Anderson  
 ADDRESS RT 5  
 CITY Missoula MT

SHIP TO \_\_\_\_\_  
 ADDRESS \_\_\_\_\_  
 CITY \_\_\_\_\_

SALESMAN	CUSTOMER'S ORDER	QUOTATION AS OF	TERMS	F.O.B.
	21' 2" Galva Pipe		99	20 79
	21' 10/3 Galva Pipe		35	7 36
	Galva to Check & Install Pump			25 00
				53 15
	Paid by check No. 1138 on Nov 12, 1973			
	Thank You			

Service charges on past due accounts at 1% per month on amounts over \$100.00, minimum charge \$1.00 per month.

Purchase Price \$ \_\_\_\_\_ Payable as follows: \$ \_\_\_\_\_ Cash with order  
 \$ \_\_\_\_\_ Cash upon shipment, Balance \$ \_\_\_\_\_ days from  
 date of shipment, without any deduction for freight, express or exchange charges.  
 Subject to conditions on back of order.

This order has been read by the undersigned and acknowledged to be correct.

Signed \_\_\_\_\_  
 Purchaser Sign Here

File No. \_\_\_\_\_

STATE WATER CONSERVATION BOARD

T. 12 R. 19

DUPLICATE

SEP 27 1966

County Missoula

Bill \_\_\_\_\_ Mr. Dermott STATE OF MONTANA  
 Butcher \_\_\_\_\_ Manly ADMINISTRATOR OF GROUNDWATER CODE  
 Coyle \_\_\_\_\_ Mott OFFICE OF STATE ENGINEER  
 Durbin \_\_\_\_\_ Sullivan \_\_\_\_\_  
 Dickert \_\_\_\_\_

Top of Ground \_\_\_\_\_  
 (Elev. above sea level \_\_\_\_\_)

### Notice of Completion of Groundwater Appropriation by Means of Well

(Under Chapter 237, Montana Session Laws, 1961)

0-1 Broken rock fill  
 1-3 Clay Owner Betty Sharp Address Miller Creek  
 3-8 Gravel & Sand Driller Glenn Camp Address 1522 S. 14 th  
 8-29 Clay, sand & Gravel Address Missoula, Montana  
 29-48 Sand, Gravel Date of Notice of Appropriation of Groundwater \_\_\_\_\_  
 48-63 Water (less than 3 GPM), Sand and Gravel (tight formation) Date well started Sept. 13, 1966 Date Completed Sept. 15, 1966  
 63-68 Water, sand and gravel Type of well Drilled Equipment Used Churn Drill  
 (Aug. driven, bored or drilled) (Churn, drill, rotary or other)  
 Water Use: Domestic  Municipal  Other  Irrigation   
 Industrial  Drainage  Stock

Indicate on the diagram the character and thickness of the different strata met with in drilling, such as soil, clay, shale, gravel, rock or sand, etc. Show depth at which water is encountered, thickness and character of water-bearing strata and height to which water rises in the well.

Size of Drilled Hole	Size and Weight of Casing	From (Feet)	To (Feet)	PERFORATIONS		
				Kind Size	From (Feet)	To (Feet)
6"	6" I.D. 17 lb	0	88' 70'		None	

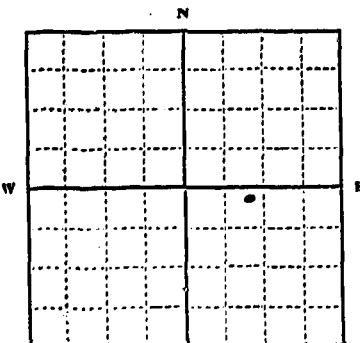

70.1, 26.7 Sec. 22 T. 12 R. 19  
 Indicate location of well and place of use, if possible. Each small square represents 10 acres.

Show exact depth of bottom.

Static Water Level for non-flowing Well 32' from top of pipe  
 Shut-in Pressure for Flowing Well \_\_\_\_\_  
 Pumping Water Level 27 feet at 20 gal. per minute.  
5' Draw Down  
 Discharge in gal. per min. of flowing well \_\_\_\_\_  
 How Tested compressor Length of Test 1 hour

Remarks: (Gravel packing, cementing, packers, type of shutoff, location of place of use of groundwater if not at well, and any other similar pertinent information, including number of acres irrigated, if used for irrigation) \_\_\_\_\_

License # 7  
 Driller's License Number  
Glenn Camp  
 Driller's Signature Glenn Camp

This form to be prepared by driller, and three copies to be filed by the owner with the County Clerk and Recorder in the county in which the well is located.

Please answer all questions. If not applicable, so state, otherwise the form will be returned.

Original to the County Clerk and Recorder; duplicate to the State Engineer; Triplicate to the Montana Bureau of Mines and Geology and Quadruplicate for the Appropriator.

41,441



055

254145

I received and filed this instrument for  
 record on the 25th day of Sept. 1966  
 at 12:15 o'clock P. M. permanent files  
 of Missoula County, State of Montana  
 Witness my hand:  
 Veranda B. Crouse, County Recorder  
 By [Signature] Deputy  
 Fee \$..... Paid

This instrument was recorded in the office of the County Recorder, Missoula County, Montana, on the 25th day of September, 1966, at 12:15 o'clock P. M.

File No. \_\_\_\_\_

T. 12N R. 19W 22

DUPLICATE

RECEIVED  
STATE ENGINEER  
APR 30 1965

STATE OF MONTANA  
ADMINISTRATOR OF GROUNDWATER CODE  
OFFICE OF STATE ENGINEER

Notice of Completion of Groundwater  
Appropriation by Means of Well

(Under Chapter 237, Montana Session Laws, 1961)

Top of Ground  
(Elev. above sea level.....)

0  
2'  
2'  
62'  
62'  
84'

Supr Top Soil

Gravel Clay Boulders

Clay Sand Gravel Water

Owner. James Sylvester Address Miller Creek

Driller. John Farrell Address Arlee Mont

Date of Notice of Appropriation of Groundwater.....

Date well started April 13 1965 Date Completed April 24 1965

Type of well Drilled Equipment Used Churn Drill  
(dug, driven, bored or drilled) (Churn, drill, rotary or other)

Water Use: Domestic  Municipal  Other  Irrigation   
Industrial  Drainage  Stock

Indicate on the diagram the character and thickness of the different strata met with in drilling, such as soil, clay, shale, gravel, rock or sand, etc. Show depth at which water is encountered, thickness and character of water-bearing strata and height to which water rises in the well.

Size of Drilled Hole	Size and Weight of Casing	From (Feet)	To (Feet)	PERFORATIONS		
				Kind Size	From (Feet)	To (Feet)
5"	(5" 14 3/4")	0	8 1/2'			

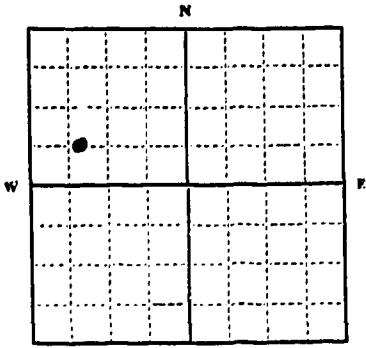

N.W. 1/4 SW Sec. 22 T. 12N R. 19W  
Indicate location of well and place of use, if possible. Each small square represents 10 acres.

Show exact depth of bottom.

Static Water Level for non-flowing Well..... 73 feet.

Shut-in Pressure for Flowing Well.....

Pumping Water Level..... 80 feet at 12 gal. per minute.

Discharge in gal. per min. of flowing well.....

How Tested..... PUMP Length of Test..... 3 Hours

Remarks: (Gravel packing, cementing, packers, type of shutoff, location of place of use of groundwater if not at well, and any other similar pertinent information, including number of acres irrigated, if used for irrigation).....

14  
Driller's License Number  
John Farrell  
Driller's Signature

This form to be prepared by driller, and three copies to be filed by the owner with the County Clerk and Recorder in the county in which the well is located.

Please answer all questions. If not applicable, so state, otherwise the form will be returned.

Original to the County Clerk and Recorder; duplicate to the State Engineer; Triplicate to the Montana Bureau of Mines and Geology and Quadruplicate for the Appropriator.

39095

Missoula  
James Sylvester

's

is

is

's

*James C. Sylvester*

JAMES SYLVESTER

26

April

65

*Benjamin Riddell Davis*  
Missoula, Montana

Nov 9,

66

*copy*

*1494*

*735568*

I received and filed this instrument for  
record on the *27* day of *April*, 19*65*,  
at *10:25* o'clock *A.M.*, permanent files  
of Missoula County, State of Montana  
Witness my hand:  
Vernice R. Clegg, County Recorder  
By *Glass* *Measner*, Deputy  
Fee \$ *9.00* Paid *cash*

File No. \_\_\_\_\_

T. 12N R. 19W 20

DUPLICATE

County Missoula

LOG

FEB 5 1968

STATE OF MONTANA  
ADMINISTRATOR OF GROUNDWATER CODE  
OFFICE OF STATE ENGINEER

Top of Ground \_\_\_\_\_  
(Elev. above sea level \_\_\_\_\_)

Notice of Completion of Groundwater  
Appropriation by Means of Well

DEVELOPED AFTER JANUARY 1, 1962

(Under Chapter 237, Montana Session Laws, 1961)

To deepen previous well

86-87 Blue Clay, rock

87-98 Broken rock Owner James C. Sylvester Address Miller Creek

1822 S. 14th

98-108 Solid rock, little water top of rock Driller Glen Camp Address Missoula, Montana

Date of Notice of appropriation of groundwater \_\_\_\_\_

108-113 Rock, water Date well started JANUARY 18, 1968 Date completed JAN. 18, 1968

113-118 Clay, rock Type of well Drilled Equipment used Churn Drill  
(Dug, driven, bored or drilled) (Churn drill, rotary or other)

Water use: Domestic  Municipal  Stock  Irrigation   
Industrial  Drainage  Other

Indicate on the diagram the character and thickness of the different strata met with in drilling, such as soil, clay, shale, gravel, rock or sand, etc. Show depth at which water is encountered, thickness and character of water-bearing strata and height to which the water rises in the well.

Size of Drilled Hole	Size and Weight of Casing	From (Feet)	To (Feet)	PERFORATIONS		
				Kind Size	From (Feet)	To (Feet)
5 1/2" D.	5 1/2" D. 14 lb per ft.	2' above G.L.	98'	none		

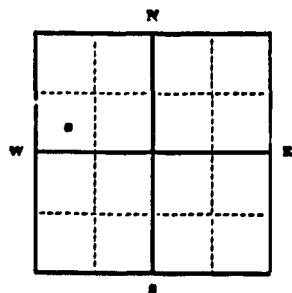

Static Water Level for non-flowing well \_\_\_\_\_

20' drawdown 28' feet.

Shut-in Pressure for Flowing Well \_\_\_\_\_

Pumping Water Level \_\_\_\_\_ feet

at 6 gal. per minute.

Discharge in gal. per min. of flowing well \_\_\_\_\_

How Tested Test Pump

Length of Test 2 hours

Remarks: (Gravel packing, cementing, packers, type of shutoff) \_\_\_\_\_

Indicate location of well and place of use, if possible. Each small square represents 40 acres.

(Continue on reverse side)

USE—If used for irrigation, industrial, drainage or other. Explain, state number of acres and location or other data (i.e.: Lot, Block and Addition).

Show exact depth of bottom.

This form to be prepared by driller, and three copies to be filed by the owner with the County Clerk and Recorder in the county in which the well is located, tissue copy to be retained by driller.

Please answer all questions. If not applicable, so state, otherwise the form will be returned.

License # 7

Driller's License Number

Glen Camp  
Driller's Signature. Glen Camp

42, 193

1774  
DUAL COPY

287791

I received and filed this Instrument for record on the 30 day of June 1968 at 12:30 o'clock P.M. permanent files of Missoula County, State of Montana  
Witness my hand:  
Verance R. Crouse, County Recorder  
By *Ch. R. ...* Deputy  
Fee \$ *...* Paid

DEPARTMENT OF REVENUE  
MONTANA  
DIVISION OF STATE TAXES  
HEALTHY STATE TO LIVE

DIVISION OF CONSTRUCTION  
MONTANA  
DIVISION OF CONSTRUCTION  
MONTANA

W

Department of Revenue  
Montana  
Division of State Taxes  
Healthy State to Live

and (Date of filing)

File No. ....

T. 12 N. R. 19 W. 22

DUPLICATE

County MISSOULA

STATE OF MONTANA  
ADMINISTRATOR OF GROUNDWATER CODE  
OFFICE OF STATE ENGINEER

RECEIVED  
NOV 17 1964

Notice of Completion of Groundwater Appropriation Without Well STATE ENGINEER

(Under Chapter 237 Montana Session Laws, 1961)

Date of Appropriation of Groundwater OCT 12, 1964

Owner PAUL W. WAGES Address 2871 SUNRISE PRAM.  
ALICE M. WAGES MISSOULA, MONT

Contractor (if any) NONE

Address of Contractor NONE

Date Started \_\_\_\_\_ Date Completed \_\_\_\_\_

Describe means of obtaining groundwater without a well "as by sub-irrigation and other natural processes". Include depth to water when applicable. BY DIVERTING SPRING WATER AROUND POINT AT WHICH IT WENT UNDERGROUND BY DITCHING & PIPING TO POINT OF USE.

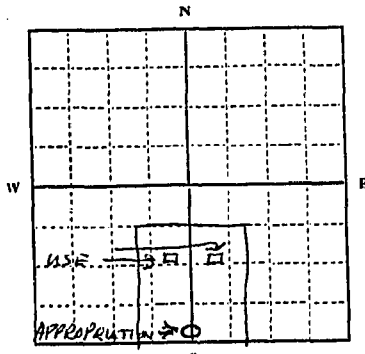

S. 1/4 Sec 22, T. 12 N. R. 19 W.  
Indicate point of appropriation and place of use, if possible.

Quantity of water developed and used with explanation of method used to measure or estimate such amount. If use is intermittent

estimate approximate lengths of periods of use

QUANTITY - 5 GALS PER MIN

MEASURED BY FILLING 10 GAL CAN IN 5 SECONDS

USE - CONSTANT TO MAINTAIN TWO HOUSE HOLS

NECESSARY IRRIGATION

Signature of Owner Paul W. Wages

*Paul W. Wages*  
*Alice M. Wages*

Date OCT 28, 1964

This form to be prepared by contractor (if any), otherwise by the owner.

Three copies of this notice are to be filed with the County Clerk and Recorder of the county in which the works are located.

Please answer all questions. If not applicable, so state, otherwise the form will be returned.

Original to the County Clerk and Recorder; duplicate to the State Engineer; Triplicate to the Montana Bureau of Mines and Geology and Quadruplicate for the Appropriator.

38663

1457

228428

I received and filed this instrument for  
record on the 28 day of Oct 1964  
at 1:00 o'clock P.M., permanent files  
of Missoula County, State of Montana  
Witness my hand:  
Vernon R. Crouse, County Recorder  
By Edna J. Mann, Deputy  
Fee \$ 0.25 Paid

File No. \_\_\_\_\_

DUPLICATE

T. 12 R. 19

County Missoula

STATE OF MONTANA  
ADMINISTRATOR OF GROUNDWATER CODE  
OFFICE OF STATE ENGINEER

RECEIVED  
APR 4 1963

Declaration of Vested Groundwater Rights  
(Under Chapter 237, Montana Session Laws, 1961) STATE ENGINEER

Elsie Holloman  
Inez Holloman (Name of Appropriator), of Bl. 3 Miller Creek (Address) Missoula (Town)

County of Missoula State of Montana  
have appropriated groundwater according to the Montana laws in effect prior to January 1, 1962, as follows:

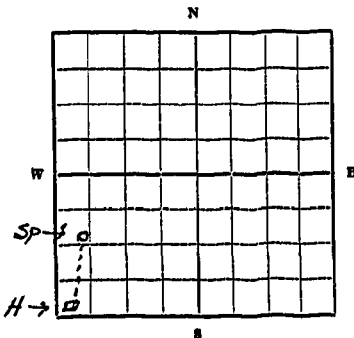

W 1/2 S.W. 1/4 Sec. 23 T. 12 R. 19

Indicate point of appropriation and place of use, if possible. Each small square represents 10 acres.

2. The beneficial use on which the claim is based House Water

3. Date or approximate date of earliest beneficial use; and how continuous the use has been 1944  
continuous

4. The amount of groundwater claimed (in miner's inches or gallons per minute) \_\_\_\_\_

5. If used for irrigation, give the acreage and description of the lands to which water has been applied and name of the owner thereof \_\_\_\_\_

6. The means of withdrawing such water from the ground and the location of each well or other means of withdrawal 6" Pipe Line from Spring to House 145 feet

7. The date of commencement and completion of the construction of the well, wells, or other works for withdrawal of groundwater Spring drilled to house 1944

8. The depth of water table \_\_\_\_\_

9. So far as it may be available, the type, size and depth of each well or the general specifications of any other works for the withdrawal of groundwater \_\_\_\_\_

10. The estimated amount of groundwater withdrawn each year \_\_\_\_\_

11. The log of formations encountered in the drilling of each well if available \_\_\_\_\_

12. Such other information of a similar nature as may be useful in carrying out the policy of this act, including reference to book and page of any county record \_\_\_\_\_

Signature of Owner: Elsie Holloman  
Inez Holloman  
Date: Mar 27, 1963

Three copies to be filed by the owner with the County Clerk and Recorder of the county in which the well is located.

Please answer all questions. If not applicable, so state, otherwise the form will be returned.

Original to the County Clerk and Recorder; duplicate to the State Engineer; Triplicate to the Montana Bureau of Mines and Geology and Quadruplicate for the Appropriator.



#186 Copy

204421

I received and filed this instrument for  
record on the 1st day of April 1968  
at 3:00 o'clock P. M., permanent files  
of Missoula County, State of Montana  
Witness my hand:  
MARTIN S. BEHNER, County Recorder  
By Harlowe Kopp Deputy  
Fee \$ 2.00 Per

File No. \_\_\_\_\_

JUN 28 1966

T. 12 North 19 West

DUPLICATE

Billie \_\_\_\_\_ McDermott  
Butzerin \_\_\_\_\_ McNulty  
Coyle \_\_\_\_\_  
Per: **STATE OF MONTANA**  
**ADMINISTRATOR OF GROUNDWATER CODE**  
Pickart \_\_\_\_\_  
**OFFICE OF STATE ENGINEER**

County Missoula Montana

### Notice of Completion of Groundwater Appropriation Without Well

(Under Chapter 237 Montana Session Laws, 1961)

Date of Appropriation of Groundwater June 23 - 1966  
Owner George R. Hinkle Address 340 Strand  
Contractor (if any) Dawson  
Address of Contractor \_\_\_\_\_

Date Started June 10 1966 Date Completed June 23 1966

Describe means of obtaining groundwater without a well "as by sub-irrigation and other natural processes". Include depth to water when applicable. Spring marked X NO. 1  
ditched and cleared - pipes and  
Containers used for measuring flow.  
Spring used for stock water and  
later to be used for domestic water for cabin  
or home

Quantity of water developed and used with explanation of method used to measure or estimate such amount. If use is intermittent estimate approximate lengths of periods of use. \_\_\_\_\_

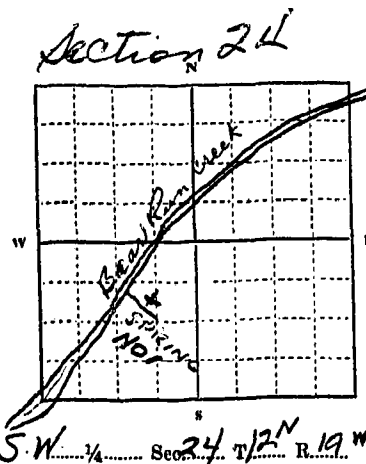

Indicate point of appropriation and place of use, if possible.

Flow of water measured 5 gal  
in 30 seconds or 600 gals per hour  
Water to be used for stock water and  
later for house water year around.

Signature of Owner George R. Hinkle  
Date June 23 1966

This form to be prepared by contractor (if any), otherwise by the owner.  
Three copies of this notice are to be filed with the County Clerk and Recorder of the county in which the works are located.  
Please answer all questions. If not applicable, so state, otherwise the form will be returned.  
Original to the County Clerk and Recorder; duplicate to the State Engineer; Triplicate to the Montana Bureau of Mines and Geology and Quadruplicate for the Appropriator.

614

251440

I received and filed this instrument for  
record on the 24 day of June 1966  
at 3:37 o'clock P.M. permanent files  
of Missoula County, State of Montana  
Witness my hand:  
Veranus H. Cronk, County Recorder  
By *[Signature]*, Deputy  
Fee \$ 2.50 Paid

File No. JUN 28 1966

T 12 N R 19 WEST 14

DUPLICATE

County MISSOURIA

STATE OF MONTANA  
ADMINISTRATOR OF GROUNDWATER CODE  
OFFICE OF STATE ENGINEER

Notice of Completion of Groundwater Appropriation  
Without Well

(Under Chapter 237 Montana Session Laws, 1961)

Date of Appropriation of Groundwater

June 23 1966

Owner

George R Hinkle

Address

340 Strand

Contractor (if any)

owner

Address of Contractor

Date Started

June 10 1966

Date Completed

June 23 1966

Describe means of obtaining groundwater without a well "as by sub-irrigation and other natural processes". Include depth to water when applicable. SPRING MARKED X No 2 DITCHED AND CLEANED PIPE AND CONTAINER USED FOR MEASURING FLOW. SPRING USED FOR STOCK WATER AND LATER TO BE USED FOR WATER FOR DWELLING AND FISH POND

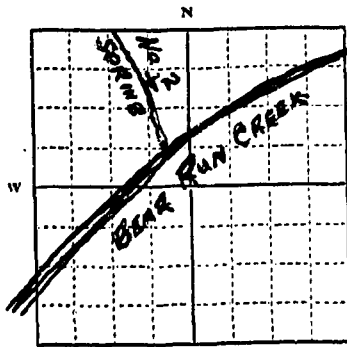

Quantity of water developed and used with explanation of method used to measure or estimate such amount. If use is intermittent

estimate approximate lengths of periods of use. FLOW OF WATER MEASURED 5 gallons in 15 seconds OR 1200 gallons PER HOUR. WATER TO BE USED YEAR AROUND FOR DWELLING - STOCK AND FISH POND

NW 1/4 Sec. 24 12N 19W

Indicate point of appropriation and place of use, if possible.

Signature of Owner

George R Hinkle

Date

June 23rd 1966

This form to be prepared by contractor (if any), otherwise by the owner.

Three copies of this notice are to be filed with the County Clerk and Recorder of the county in which the works are located.

Please answer all questions. If not applicable, so state, otherwise the form will be returned.

Original to the County Clerk and Recorder; duplicate to the State Engineer; Triplicate to the Montana Bureau of Mines and Geology and Quadruplicate for the Appropriator.

#1615

251441

I received and filed this instrument for  
 record on the 24th day of June 1914  
 at 3:50 o'clock P.M. permanent files  
 of Missoula County, State of Montana  
 Witness my hand  
Gracie H. Chase, County Recorder  
 By Jane B. ..., Deputy  
 Fee \$ 2.50 Paid

C

*[Faint, illegible handwritten text]*

STATE WATER CONSERVATION BOARD

JUN 28 1966

Approved Stock Form—State Publishing Co., Helena, Montana 4262

File No. \_\_\_\_\_

DUPLICATE

Name \_\_\_\_\_  
Butcher \_\_\_\_\_  
Coyle \_\_\_\_\_  
Darlington \_\_\_\_\_  
Dickers \_\_\_\_\_  
McDermott \_\_\_\_\_  
McNulty \_\_\_\_\_  
Morton \_\_\_\_\_  
Sullivan \_\_\_\_\_

T 12 N R 19 W

County MISSOULA

STATE OF MONTANA  
ADMINISTRATOR OF GROUNDWATER CODE  
OFFICE OF STATE ENGINEER

Notice of Completion of Groundwater Appropriation  
Without Well

(Under Chapter 237 Montana Session Laws, 1961)

Date of Appropriation of Groundwater JUNE 23 1966  
Owner GEORGE R HINKLE 340 STRAND Address MISSOULA MONT.

Contractor (if any) OWNER

Address of Contractor \_\_\_\_\_

Date Started JUNE 10 1966 Date Completed JUNE 23 1966

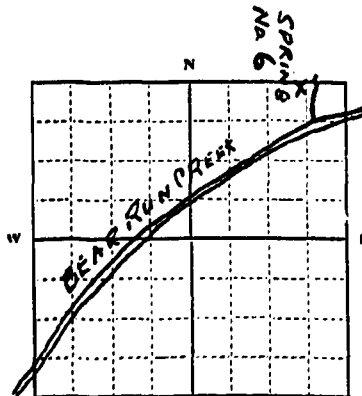

Describe means of obtaining groundwater without a well "as by sub-irrigation and other natural processes". Include depth to water when applicable. SPRING MARKED X NO. 6  
ditched and cleaned Piped to  
CONTAINER FOR MEASURING FLOW  
WATER TO BE USED FOR STOCK-  
FISH POND AND DWELLING

Quantity of water developed and used with explanation of method used to measure or estimate such amount. If use is intermittent

estimate approximate lengths of periods of use. FLOW OF WATER  
MEASURED 10 1/2 GALLONS PER MINUTE  
OR 630 GALLONS PER HOUR WATER  
TO BE USED YEAR AROUND

NE 1/4 Sec. 24 T. 12 N. R. 19 W.

Indicate point of appropriation and place of use, if possible.

Signature of Owner George R Hinkle

Date JUNE 23 1966

This form to be prepared by contractor (if any), otherwise by the owner.

Three copies of this notice are to be filed with the County Clerk and Recorder of the county in which the works are located.

Please answer all questions. If not applicable, so state, otherwise the form will be returned.

Original to the County Clerk and Recorder; duplicate to the State Engineer; Triplicate to the Montana Bureau of Mines and Geology and Quadruplicate for the Appropriator.

#1618

I received and filed this instrument for  
record on the 24 day of June, 1966  
at 3:42 o'clock P.M., permanent files  
of Missoula County, State of Montana  
Witness my hand:  
Vernice R. Crouse, County Recorder  
By James R. Crouse, Deputy  
Fee 2.00 Paid

File No. JUN 28 1966

T. 12 N. R. 19 W. 21  
County MISSOULA

DUPLICATE

Name \_\_\_\_\_  
McDermott \_\_\_\_\_  
Electron \_\_\_\_\_  
McNulty \_\_\_\_\_  
Coyle \_\_\_\_\_  
Moore \_\_\_\_\_  
Carlington \_\_\_\_\_  
Sullivan \_\_\_\_\_  
Sickert \_\_\_\_\_  
STATE OF MONTANA  
ADMINISTRATOR OF GROUNDWATER CODE  
OFFICE OF STATE ENGINEER

### Notice of Completion of Groundwater Appropriation Without Well

(Under Chapter 237 Montana Session Laws, 1961)

Date of Appropriation of Groundwater JUNE 23 1966  
Owner GEORGE R HINKLE 346 STRAW  
Address MISSOULA MONT.

Contractor (if any) OWN

Address of Contractor \_\_\_\_\_

Date Started JUNE 19 1966 Date Completed JUNE 23 1966

Describe means of obtaining groundwater without a well "as by sub-irrigation and other natural processes". Include depth to water when applicable. SPRING MARKED X NO. 5  
ditched and cleaned. Piped to  
CONTAINER FOR MEASURING FLOW  
WATER TO BE USED FOR STOCK-  
FISH POND AND DWELLING

Quantity of water developed and used with explanation of method used to measure or estimate such amount. If use is intermittent estimate approximate lengths of periods of use. FLOW OF  
WATER MEASURED 13 GALLONS  
PER MINUTE OR 780 GALLONS PER  
HOUR WATER TO BE USED  
YEAR AROUND

Signature of Owner George R Hinkle  
Date JUNE 23-1966

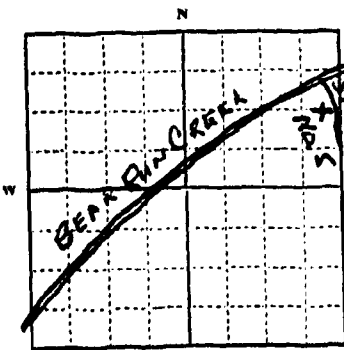

NE 1/4 Sec. 24 T. 12 N. R. 19 W  
Indicate point of appropriation and place of use, if possible.

This form to be prepared by contractor (if any), otherwise by the owner.  
Three copies of this notice are to be filed with the County Clerk and Recorder of the county in which the works are located.  
Please answer all questions. If not applicable, so state, otherwise the form will be returned.  
Original to the County Clerk and Recorder; duplicate to the State Engineer; Triplicate to the Montana Bureau of Mines and Geology and Quadruplicate for the Appropriator.



617

251443

I received and filed this instrument for  
 record on the 24 day of June 1966  
 at 5:45 o'clock P.M., permanent files  
 of Missoula County, State of Montana.  
 Witness my hand:  
 Verunao R. Coyne, County Recorder  
 By Jayne Beckwith, Deputy  
 Fee \$ 2.00 Paid

C

Department of County...

**Notice of Completion of Groundwater Appropriation Without Well**

(Under Chapter 237 Montana Session Laws, 1961)

Date of Appropriation of Groundwater: JUNE 23 1966  
 Owner: GEORGE R HINKIE Address: 3ND STRAND MISSOULA MONT.  
 Contractor (if any) OWNER  
 Address of Contractor \_\_\_\_\_  
 Date Started JUNE 10 1966 Date Completed JUNE 23 1966

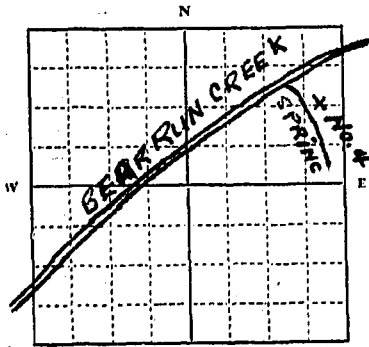

Describe means of obtaining groundwater without a well "as by sub-irrigation and other natural processes". Include depth to water when applicable. SPRING MARKED X dished AND CLEANED. PIPED TO CONTAINER FOR MEASURING FLOW. WATER TO BE USED FOR STOCK - FISH POND AND DWELLING

Quantity of water developed and used with explanation of method used to measure or estimate such amount. If use is intermittent estimate approximate lengths of periods of use. FLOW OF WATER MEASURED 9 3/4 GALLONS PER MINUTE OR 585 GALLONS PER HOUR. WATER TO BE USED YEAR AROUND.

NE 1/4 Sec. 24 12N 19W  
 Indicate point of appropriation and place of use, if possible.

Signature of Owner: George R Hinkie  
 Date: JUNE 23 1966

This form to be prepared by contractor (if any), otherwise by the owner.  
 Three copies of this notice are to be filed with the County Clerk and Recorder of the county in which the works are located.  
 Please answer all questions. If not applicable, so state, otherwise the form will be returned.  
 Original to the County Clerk and Recorder; duplicate to the State Engineer; Triplicate to the Montana Bureau of Mines and Geology and Quadruplicate for the Appropriator.

#1619

251445

I received and filed this instrument for record on the 24 day of June 1966 at 3:51 o'clock P.M., permanent files of Missoula County, State of Montana

Witness my hand:  
 Verence R. Crouse, County Recorder  
 By Gene Beckwith, Deputy  
 Fee 2.00 Paid

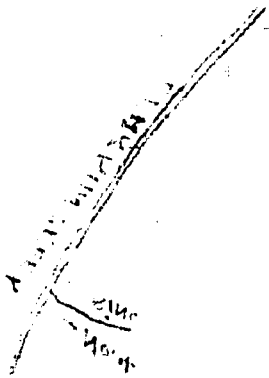

NE SE 1/4 1011

ASSIGNED  
 INLAND T. P. ROAD AREA  
 OR 282 BULLOCKS FIRE BRIGADE  
 MEMPHIS DENY SIGNATURE

George A. HANNA

MISSOURI 18 110221

PROGRAM FOR THE STATE OF MONTANA  
 THE MONTANA STATE DEPARTMENT OF REVENUE  
 HAS RECEIVED FROM THE STATE OF MONTANA  
 THE FOLLOWING INFORMATION:

MISSOURI 18 110221

STATE WATER CONSERVATION BOARD

Approved Stock Form—State Publishing Co., Helena, Montana—42262

JUN 28 1966

File No. \_\_\_\_\_

DUPLICATE

Birch \_\_\_\_\_ McDermott \_\_\_\_\_  
 Butcher \_\_\_\_\_ McNulty \_\_\_\_\_  
 Coyle \_\_\_\_\_ Morton \_\_\_\_\_  
 Darlington \_\_\_\_\_  
 District \_\_\_\_\_

12 N 19 W 24  
 MISSOULA  
 County \_\_\_\_\_

STATE OF MONTANA  
 ADMINISTRATOR OF GROUNDWATER CODE  
 OFFICE OF STATE ENGINEER

**Notice of Completion of Groundwater Appropriation Without Well**

(Under Chapter 237 Montana Session Laws, 1961)

Date of Appropriation of Groundwater June 23 1966

Owner George R Hinkle Address 340 Standard  
MISSOULA MONTANA

Contractor (if any) OWNER

Address of Contractor \_\_\_\_\_

Date Started JUNE 10 1966 Date Completed JUNE 23 1966

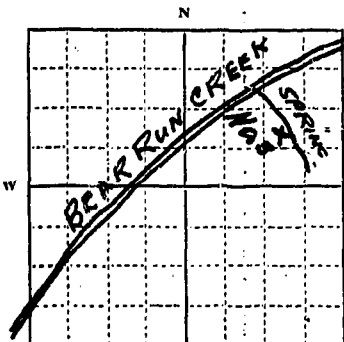

Describe means of obtaining groundwater without a well "as by sub-irrigation and other natural processes" Include depth to water when applicable. SPRING MARKED X No 3  
DUG AND CLEANED. PIPE AND CONTAINER  
USED FOR MEASURING FLOW. WATER TO  
BE USED FOR STOCK - FISH POND  
AND DWELLING.

Quantity of water developed and used with explanation of method used to measure or estimate such amount. If use is intermittent

estimate approximate lengths of periods of use. FLOW OF  
WATER MEASURED 5 GALLONS IN 20 SECONDS  
OR 900 GALLONS PER HOUR. WATER  
TO BE USED YEAR AROUND.

N. E 24 12 N 19 W  
 \_\_\_\_\_ 1/4 \_\_\_\_\_ Sec. \_\_\_\_\_ T. \_\_\_\_\_ R. \_\_\_\_\_

Indicate point of appropriation and place of use, if possible.

Signature of Owner George R Hinkle

Date JUNE 23 1966

This form to be prepared by contractor (if any), otherwise by the owner.

Three copies of this notice are to be filed with the County Clerk and Recorder of the county in which the works are located.

Please answer all questions. If not applicable, so state, otherwise the form will be returned.

Original to the County Clerk and Recorder; duplicate to the State Engineer; Triplicate to the Montana Bureau of Mines and Geology and Quadruplicate for the Appropriator.

81918

I received and filed this instrument for record on the 24th day of June 1902 at 2:47 o'clock P.M. permanent files of Missoula County, State of Montana. Witness my hand: Vermae H. Cradock, County Recorder. By: [Signature] Deputy. Fee \$2.00 Paid.

BEAR HORN CREEK  
3/4  
1/2  
1/4

TO BE USED NEAR AROUND  
OR 300 GALLONS PER HOUR WATER  
NEAR WATER MEASURED 2 1/2 INCH IN DIAMETER  
FLOOR OF  
JUNE 23 1899  
George F. Springer

AND ONE TIME  
BE USED FOR STOCK-FEED ROOM  
USED FOR MEASURING 1/2 IN. WATER TO  
DIPPER AND CLEANER TO BE ONE CONJUNCTIVE  
SHRIMPING MARKED XMS3

JUNE 10 1899 JUNE 23 1899

OWNER:

Frank Springer  
MISSOULA MONTANA  
GEO. J. SPRINGER  
JUNE 23 1899

W P I W R  
A 10221 M

File No. ....

T. 12 N R 20 W 27

DUPLICATE

County Missoula

STATE OF MONTANA  
ADMINISTRATOR OF GROUNDWATER CODE  
OFFICE OF STATE ENGINEER

**DECEIVED**  
SEP 24 1964  
STATE ENGINEER

**Notice of Completion of Groundwater  
Appropriation by Means of Well**

(Under Chapter 237, Montana Session Laws, 1961)

Owner J. Hirning Address Route 3, Missoula, Montana

Driller John Farrell Address Arlee, Montana

Date of Notice of Appropriation of Groundwater.....

Date well started Jan 10 19 64 Date Completed Jan 29 19 64

Type of well Drilled Equipment Used Churn Drill  
(dug, driven, bored or drilled) (Churn, drill, rotary or other)

Water Use: Domestic  Municipal  Other  Irrigation   
Industrial  Drainage  Stock

Indicate on the diagram the character and thickness of the different strata met with in drilling, such as soil, clay, shale, gravel, rock or sand, etc. Show depth at which water is encountered, thickness and character of water-bearing strata and height to which water rises in the well.



Top of Ground (Elev. above sea level.....)  
0  
40' Clay Broken Rock  
41' Sand Little Water  
43'  
65' Clay Small Gravel  
65'  
72' Sand Gravel Water

Size of Drilled Hole	Size and Weight of Casing	From (Feet)	To (Feet)	PERFORATIONS		
				Kind Size	From (Feet)	To (Feet)
6"	6" 14 97#	0'	72'			

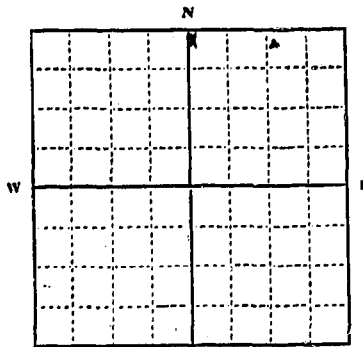

**NE 1/4 Sec. 27, T. 12, R. 20**  
Indicate location of well and place of use, if possible. Each small square represents 10 acres.

72' Show exact depth of bottom.

Used Compressor 3 Hours

Static Water Level for non-flowing Well..... 38' feet.

Shut-in Pressure for Flowing Well.....

Pumping Water Level..... 50' feet at..... 40 gal. per minute.

Discharge in gal. per min. of flowing well.....

How Tested Badler Length of Test 2 Hours

Remarks: (Gravel packing, cementing, packers, type of shutoff, location of place of use of groundwater if not at well, and any other similar pertinent information, including number of acres irrigated, if used for irrigation).....

14  
Driller's License Number

John Farrell  
Driller's Signature

This form to be prepared by driller, and three copies to be filed by the owner with the County Clerk and Recorder in the county in which the well is located.

Please answer all questions. If not applicable, so state, otherwise the form will be returned.

Original to the County Clerk and Recorder; duplicate to the State Engineer; Triplicate to the Montana Bureau of Mines and Geology and Quadruplicate for the Appropriator.

38481

1444

226509

I received and filed this Instrument for  
 record on the 16 day of Sept 1964  
 at 11:40 a.m. Book 226, permanent files  
 of Missoula County, State of Montana  
 Witness my hand:  
 Virginia D. Gouge, County Recorder  
 By: *Alvathy L. Head*, Deputy  
 Fee \$ 2.00 Paid

MISSOULA COUNTY CLERK  
 MISSOULA, MONTANA  
 RECEIVED  
 SEP 16 1964  
 DEPT. OF REVENUE

28 28

File No. ....

T. 12 N. R. 19 W.

DUPLICATE

County Missoula

STATE OF MONTANA  
ADMINISTRATOR OF GROUNDWATER CODE  
OFFICE OF STATE ENGINEER

RECEIVED  
APR 30 1965

Notice of Completion of Groundwater Appropriation  
Without Well

(Under Chapter 237 Montana Session Laws, 1961)

Date of Appropriation of Groundwater 4/1/65

*Origin*

Owner Hal Cooney Address Missoula, Montana

Contractor (if any) None

Address of Contractor .....

Date Started 4/1/65 Date Completed 4/20/65

Describe means of obtaining groundwater without a well "as by sub-irrigation and other natural processes". Include depth to water when applicable.....

Water obtained thru seepage into spring box,

then piped down steep hill side, to building

location on Lots 6 & 7, Section

21, T. 12 N. R. 19 W.

Quantity of water developed and used with explanation of method used to measure or estimate such amount. If use is intermittent

estimate approximate lengths of periods of use.....

Flow of approximately 3 gallons per minute.

Measured into known volume container against

time.

Signature of Owner *Clément* Clément

Date 4/21/65

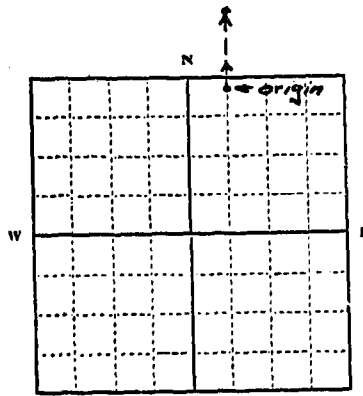

*N.E. 1/4 of Sec. 28, T. 12 N. R. 19 W.*

Indicate point of appropriation and place of use, if possible.

This form to be prepared by contractor (if any), otherwise by the owner.

Three copies of this notice are to be filed with the County Clerk and Recorder of the county in which the works are located.

Please answer all questions. If not applicable, so state, otherwise the form will be returned.

Original to the County Clerk and Recorder; duplicate to the State Engineer; Triplicate to the Montana Bureau of Mines and Geology and Quadruplicate for the Appropriator.

39096



1495

235887

I received and filed this Instrument for  
record on the 27<sup>th</sup> day of Apr. 19. 19. 19.  
at 1.30 o'clock P.M., permanent files  
of Missoula County, State of Montana  
Witness my hand:  
James R. Cross County Recorder  
By *James R. Cross* Deputy  
Fee \$ *2.00* Paid *Cash*

GW2

File No. ....

T 12N R 19W

DUPLICATE

County Missoula

STATE OF MONTANA  
ADMINISTRATOR OF GROUNDWATER CODE  
OFFICE OF STATE ENGINEER

RECEIVED  
JAN 2 1962

### Notice of Completion of Groundwater Appropriation by Means of Well

(Under Chapter 237, Montana Session Laws, 1961)

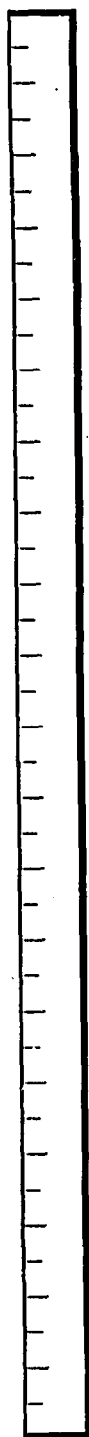

Top of Ground  
(Elev. above sea level.....)

0 to 7' Pit  
7' to 26' Clay, gravel  
and boulder  
26' to 46' Clay & big  
gravel  
46' to 55' Clay  
55' to 75'-3" Sand, water  
and gravel

Owner Fred Fite Address 1620 Vickie Dr.

Driller Glenn Camp 703 Alder Address Missoula, Mont

Date of Notice of Appropriation of Groundwater .....

Date well started 4/18/62 Date Completed 4/23/62

Type of well Drilled Equipment Used Glenn Drill  
(dug, driven, bored or (Churn, drill, rotary or  
drilled) other)

Water Use: Domestic  Municipal  Stock  Irrigation   
Industrial  Drainage  Other

Indicate on the diagram the character and thickness of the different strata met with in drilling, such as soil, clay, shale, gravel, rock or sand, etc. Show depth at which water is encountered, thickness and character of water-bearing strata and height to which the water rises in the well.

Size of Drilled Hole	Size and Weight of Casing	From (Feet)	To (Feet)	PERFORATIONS		
				Kind Size	From (Feet)	To (Feet)
5" I.D.	14lb to foot seamless	7 1/2" above pit floor to 65'-3"		none		

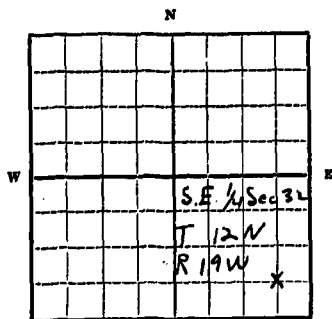

S.E. 1/4 Sec. 32 T 12N R 19W  
Indicate location of well and place of use, if possible. Each small square represents 10 acres.

Static Water Level for non-flowing Well 42'-0" feet.

Shut-in Pressure for Flowing Well .....

Pumping Water Level 46 feet at 60 gal. per minute.

Discharge in gal. per min. of flowing well .....

How Tested Compressor Length of Test 1 hour

Remarks: (Gravel packing, cementing, packers, type of shutoff, location of place of use of groundwater if not at well, and any other similar pertinent information, including number of acres irrigated, if used for irrigation) .....

None

Show exact depth of bottom.

License # 7  
Driller's License Number

Glenn Camp  
Driller's Signature

This form to be prepared by driller, and three copies to be filed by the owner with the County Clerk and Recorder in the county in which the well is located.

Please answer all questions. If not applicable, so state, otherwise the form will be returned.

Original to the County Clerk and Recorder; duplicate to the State Engineer; Triplicate to the School of Mines and Quadruplicate for the Appropriator.

17666

876

215349  
copy

I received and filed this instrument for  
 record on the 21<sup>st</sup> day of Dec. 1963  
 at 12:22 o'clock A.M., permanent files  
 of Missoula County, State of Montana  
 Witness my hand:  
 MARTIN S. BISHNER, County Recorder  
 By Mary [Signature] Deputy  
 Fee 2.00 Paid

MISSOULA COUNTY  
 CLERK OF DISTRICT COURT  
 MISSOULA, MONTANA  
 20-12-63  
 12:22 PM

RECORDED  
 20-12-63  
 MISSOULA, MONTANA

MISSOULA COUNTY  
 CLERK OF DISTRICT COURT  
 MISSOULA, MONTANA  
 20-12-63  
 12:22 PM

File No. \_\_\_\_\_

T 127 R 194

DUPLICATE

STATE OF MONTANA  
ADMINISTRATOR OF GROUNDWATER CODE  
OFFICE OF STATE ENGINEER

RECEIVED  
JUN 16 1965  
STATE ENGINEER

### Notice of Completion of Groundwater Appropriation by Means of Well

(Under Chapter 237, Montana Session Laws, 1961)

Well in Linda Vista

Owner H.S. Jewett Address Missoula, Mont

Driller Glenn Camp 705 Alder Address Missoula, Mont

Date of Notice of Appropriation of Groundwater \_\_\_\_\_

Date well started 5/27/65 Date Completed 5/31/65

Type of well Drilled Equipment used Churn drill  
(dug, driven, bored or drilled) (Churn, drill, rotary or other)

Water Use: Domestic  Municipal  Other  Irrigation   
Industrial  Drainage  Stock

Indicate on the diagram the character and thickness of the different strata met with in drilling, such as soil, clay, shale, gravel, rock or sand, etc. Show depth at which water is encountered, thickness and character of water-bearing strata and height to which water rises in the well.

Top of Ground  
(Elev. above sea level \_\_\_\_\_)

0 to 3' Top soil

3' to 22' Gravel, sand & clay

22' to 50' Sand & clay

50' to 64' Sand

64' to 77' Heaving sand water, & clay

77' to 85' Sand, gravel & clay

85' to 93' Clay, sand & gravel

93' to 96' Sand, gravel & water.

Size of Drilled Hole	Size and Weight of Casing	From (Feet)	To (Feet)	PERFORATIONS		
				Kind	From (Feet)	To (Feet)
9"	5" I.D. 14.62 # to ft	1' above G.L.	to 97'-1"	None		

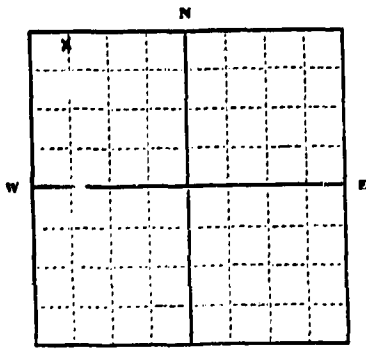

74.4 Sec. 35 T127 R194W  
Indicate location of well and place of use, if possible. Each small square represents 10 acres.

Show exact depth of bottom.

Static Water Level for non-flowing Well 21 feet.

Shut-in Pressure for Flowing Well \_\_\_\_\_

Pumping Water Level 21 feet at 60 gal. per minute.

Discharge in gal. per min. of flowing well \_\_\_\_\_

How Tested Galler & Compression Length of Test 1 hr 25 Min

Remarks: (Gravel packing, cementing, packers, type of shutoff, location of place of use of groundwater if not at well, and any other similar pertinent information, including number of acres irrigated, if used for irrigation) 1/2 ac.

License # 7  
Driller's License Number  
Glenn Camp  
Driller's Signature

This form to be prepared by driller, and three copies to be filed by the owner with the County Clerk and Recorder in the county in which the well is located.

Please answer all questions. If not applicable, so state, otherwise the form will be returned.

Original to the County Clerk and Recorder; duplicate to the State Engineer; Triplicate to the Montana Bureau of Mines and Geology and Quadruplicate for the Appropriator.

39220