

102

227803

I received and filed this Instrument for record on the 17th day of Oct, 1911, at 11:30 o'clock A.M., permanent files of Missoula County, State of Montana

Witness my hand:  
 Veramas B. Clouse, County Recorder  
 By J. Bellinger, Deputy  
 Fee \$ 2.00 Paid

How Typed Double      Printed of Leaf 2 of 2

Discharge to buy balance of Warrant and Return

Printing Warrant      Fee of 2.00

Printed in Pursuance of Section 1031

State of Montana      for non-payment of

RECORDED BY W. B. CLOUSE  
 CLERK OF COUNTY OF MISSOULA

OFFICE OF CLERK OF COUNTY OF MISSOULA  
 VERMILION, MONTANA  
 DIVISION OF RECORDS

**RECEIVED**  
 OCT 17 1911







File No. \_\_\_\_\_

T. 12 N. R. 20 W

DUPLICATE

County Missoula

STATE OF MONTANA  
ADMINISTRATOR OF GROUNDWATER  
OFFICE OF STATE ENGINEER

RECEIVED  
JUL 26 1963

### Notice of Completion of Groundwater Appropriation by Meas. of Well

(Under Chapter 237, Montana Session Laws, 1961)



Top of Ground  
(Elev. above sea level \_\_\_\_\_)

0 to 15' Sand & gravel

15' to 22' Clay

22' to 43' Clay, sand

& gravel

43' to 53' Loose gravel

53' to 55' Water, sand

& clay

55' to 68' Clay

68' to 69' Gravel & water

Well at Linda Vista  
Owner: Seth Mickerson Address: Stevensville, Mont

Driller: Glenn Camp 705 Alder Address: Missoula, Mont

Date of Notice of Appropriation of Groundwater \_\_\_\_\_

Date well started: 7/11/63 Date Completed: 7/15/63

Type of well: Drilled Equipment Used: Churn drill  
(dug, driven, bored or drilled) (Churn, drill, rotary or other)

Water Use: Domestic  Municipal  Other  Irrigation   
Industrial  Drainage  Stock

Indicate on the diagram the character and thickness of the different strata met with in drilling, such as soil, clay, shale, gravel, rock or sand, etc. Show depth at which water is encountered, thickness and character of water-bearing strata and height to which water rises in the well.

Size of Drilled Hole	Size and Weight of Casing	From (Feet)	To (Feet)	PERFORATIONS		
				Kind Size	From (Feet)	To (Feet)
6"	6" I.D. seamless 19 lbs to feet	1'-5" above basement floor to 70'-5"		none		

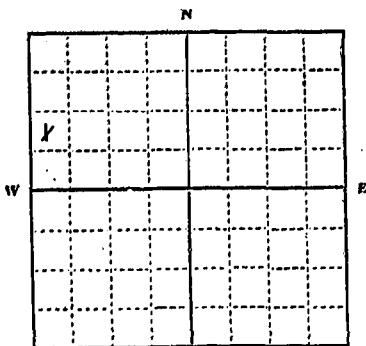

N.W. 1/4 Sec. 12, T. 12, R. 20

Indicate location of well and place of use, if possible. Each small square represents 10 acres.

Well located on W 1/2 of lot 5  
Bk 3 Linda Vista  
Show exact depth of bottom.

Static Water Level for non-flowing Well: 52' from G.S.L. \_\_\_\_\_ feet.

Shut-in Pressure for Flowing Well \_\_\_\_\_

Pumping Water Level: 55' \_\_\_\_\_ feet at 3 \_\_\_\_\_ gal. per minute.

Discharge in gal. per min. of flowing well \_\_\_\_\_

How Tested: Ballor \_\_\_\_\_ Length of Test: 3 hours \_\_\_\_\_

Remarks: (Gravel packing, cementing, packers, type of shutoff, location of place of use of groundwater if not at well, and any other similar pertinent information, including number of acres irrigated, if used for irrigation) \_\_\_\_\_  
\_\_\_\_\_

None

License # 7  
Driller's License Number

Glenn Camp  
Driller's Signature

This form to be prepared by driller, and three copies to be filed by the owner with the County Clerk and Recorder in the county in which the well is located.

Please answer all questions. If not applicable, so state, otherwise the form will be returned.

Original to the County Clerk and Recorder; duplicate to the State Engineer; Triplicate to the Montana Bureau of Mines and Geology and Quadruplicate for the Appropriator.



12

File No. \_\_\_\_\_

T. 12N R. 20W

DUPLICATE

County, Missoula

STATE OF MONTANA  
ADMINISTRATOR OF GROUNDWATER CODE  
OFFICE OF STATE ENGINEER

RECEIVED  
JAN 3 1963

Declaration of Vested Groundwater Rights  
(Under Chapter 237, Montana Session Laws, 1961)

STATE ENGINEER

1. Sherman J. Proce, Jr., of 3329 Darrell Lane Missoula  
(Name of Appropriator) (Address) (Town)

County of Missoula State of Montana  
have appropriated groundwater according to the Montana laws in effect prior to January 1, 1962, as follows:

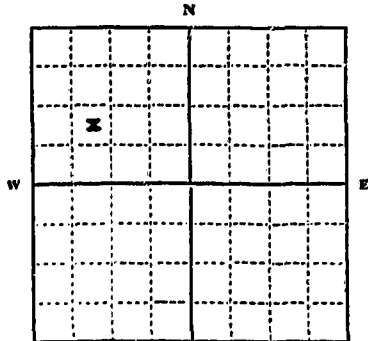

SW NW 12 12 40  
1/4 Sec. T. R.

Indicate point of appropriation and place of use, if possible. Each small square represents 10 acres.

2. The beneficial use on which the claim is based domestic use and irrigation

3. Date or approximate date of earliest beneficial use; and how continuous the use has been February 26, 1957. Continuous

4. The amount of groundwater claimed (in miner's inches or gallons per minute) 5 gallons per minute

5. If used for irrigation, give the acreage and description of the lands to which water has been applied and name of the owner thereof  
One acre of garden and lawn area  
Sherman J. Proce, Jr. owner

6. The means of withdrawing such water from the ground and the location of each well or other means of withdrawal  
Jet pump. Only one well.

7. The date of commencement and completion of the construction of the well, wells, or other works for withdrawal of groundwater February 26, 1957

8. The depth of water table 278 feet

9. So far as it may be available, the type, size and depth of each well or the general specifications of any other works for the withdrawal of groundwater Drilled, 5" casing, 280 ft deep

10. The estimated amount of groundwater withdrawn each year 750,000 gallons

11. The log of formations encountered in the drilling of each well if available  
0-70' red clay gravel, 70'-72' fine sand little water, 72'-178' red clay gravel, 178'-192' dry sand gravel, 192'-278' red clay gravel, 278'-280' water gravel

12. Such other information of a similar nature as may be useful in carrying out the policy of this act, including reference to book and page of any county record None

Signature of Owner Sherman J. Proce, Jr.  
Date December 31, 1963

Three copies to be filed by the owner with the County Clerk and Recorder of the county in which the well is located.

Please answer all questions. If not applicable, so state, otherwise the form will be returned.

Original to the County Clerk and Recorder; Duplicate to the State Engineer; Triplicate to the Montana Bureau of Mines and Geology, and Quadruplicate for the Appropriator.

20172

1052

2155 27

I received and filed this instrument for  
record on the 31 day of Dec. 1963  
at 4:07 o'clock P.M., permanent files  
of Missoula County, State of Montana  
Witness my hand  
MARTIN S. BEHNER, County Recorder  
By Ethel Lane Deputy  
Fee \$ 2.00 Paid



12

File No. \_\_\_\_\_

T. 12 N R 20 W

DUPLICATE

County MISSOULA

STATE OF MONTANA  
ADMINISTRATOR OF GROUNDWATER CODE  
OFFICE OF STATE ENGINEER

RECEIVED  
JAN 3 1964

Declaration of Vested Groundwater Rights  
STATE ENGINEER

(Under Chapter 237, Montana Session Laws, 1961)

1 THOMAS M. RICKETTS, of 3916 DARROLL LANE MISSOULA  
(Name of Appropriator) (Address) (Town)

County of MISSOULA State of MONTANA  
have appropriated groundwater according to the Montana laws in effect prior to January 1, 1962, as follows:

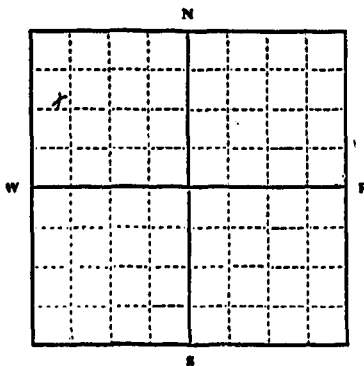

NW 1/4 NW Sec. 12 T. 12 R. 20

Indicate point of appropriation and place of use, if possible. Each small square represents 10 acres.

2. The beneficial use on which the claim is based HOUSEHOLD + IRRIGATION

3. Date or approximate date of earliest beneficial use; and how continuous the use has been DECEMBER 1960  
CONTINUOUS

4. The amount of groundwater claimed (in miner's inches or gallons per minute) 12 GALLONS PER MINUTE

5. If used for irrigation, give the acreage and description of the lands to which water has been applied and name of the owner thereof  
1/2 ACRE NE CORNER, LOT 8, OF BLOCK 2 LINDA VISTA ADDITION  
THOMAS M. RICKETTS

6. The means of withdrawing such water from the ground and the location of each well or other means of withdrawal PUMP,  
NE CORNER OF DWELLING

7. The date of commencement and completion of the construction of the well, wells, or other works for withdrawal of groundwater OCT. 1960

8. The depth of water table APPROXIMATELY 76 FEET

9. So far as it may be available, the type, size and depth of each well or the general specifications of any other works for the withdrawal of groundwater DRIILLED, 5 INCH x 80 FEET DEEP

10. The estimated amount of groundwater withdrawn each year 3,000,000 GALLONS

11. The log of formations encountered in the drilling of each well if available NOT AVAILABLE

12. Such other information of a similar nature as may be useful in carrying out the policy of this act, including reference to book and page of any county record NONE

Signature of Owner Thomas M. Ricketts

Date 12-31-63

Three copies to be filed by the owner with the County Clerk and Recorder of the county in which the well is located.

Please answer all questions. If not applicable, so state, otherwise the form will be returned.

Original to the County Clerk and Recorder; Duplicate to the State Engineer; Triplicate to the Montana Bureau of Mines and Geology, and Quadruplicate for the Appropriator.

20305

1186

*Copy*  
I received and filed this instrument for  
recording at 709 31st Dec 1963  
at the County Clerk's permanent files  
of the County of ... State of Montana  
Witness my hand and seal  
County Recorder  
By *Margaret L. Baker* Deputy  
Recorder

Form No. 18  
8-60

12

*Lorin Clockz Lindahl*  
T. 12N R. 20W

County Missoula

MONTANA BUREAU OF MINES AND GEOLOGY  
Butte, Montana

RECEIVED  
APR 4 1961

WATER WELL LOG

STATE ENGINEER

Owner Charles W. Roscoe Address 3337 Raymond Court

Rte 5 Missoula

Driller Glenn Camp 705 Alder

Address Missoula, Mont

Date Started June 7, 1960

Date Completed June 9, 1960

Location: Sec. 14 T. 12N R. 20W 1/4 sec. \_\_\_\_\_

Type of well Drilled Equipment used Churn drill  
(Dug, driven, bored, or drilled) (Churn, drill, rotary, other)

Water use: Domestic  Municipal  Stock  Irrigation   
Industrial  Drainage  Other \_\_\_\_\_

Casing: 6' below ground level to \_\_\_\_\_ ft. Type seamless Size 5" I.D.

Casing: \_\_\_\_\_ ft. to 75' 2" ft. Type \_\_\_\_\_ Size \_\_\_\_\_

Casing: \_\_\_\_\_ ft. to \_\_\_\_\_ ft. Type \_\_\_\_\_ Size \_\_\_\_\_

Perforated or Screened: Ft. \_\_\_\_\_ to ft. \_\_\_\_\_ . Ft. \_\_\_\_\_ to ft. \_\_\_\_\_

Type of screen or perforations \_\_\_\_\_

Static Water level, for non-flowing well: 56' from ground level \_\_\_\_\_ feet.

Shut-in pressure, for flowing well: \_\_\_\_\_ lb./sq. in. on: \_\_\_\_\_  
(data)

Pumping water level 56' feet at 10 gal. per min. \_\_\_\_\_

How tested: Bailer

Length of test 2 hours

Remarks: (Gravel packing, cementing, packers, type of shut-off, depth of shut-off)

(over)



RECEIVED

County Missoula 12

STATE OF MONTANA  
ADMINISTRATOR OF GROUNDWATER CODE  
MONTANA WATER RESOURCES BOARD

OCT 30 1972

DRILLER'S LOG

NOTICE OF COMPLETION OF GROUNDWATER  
APPROPRIATION BY MEANS OF WELL

Developed after January 1, 1962

Indicate the character, color, thickness of strata such as soil, clay, sand, gravel, shale, sandstone, etc. Show depth at which water is found and height to which water rises in well.

(Under Chapter 237 Montana Session Laws, 1961, as amended)

This form to be prepared by driller, and three copies to be filed by the owner with the County Clerk and Recorder in the county in which the well is located, last copy to be retained by driller.

Please answer all questions. If not applicable, so state, otherwise the form may be returned.

Owner DOUGLAS SHANER

Address 6205 HELENA DR.

MISSOULA, MONTANA

Date well started NOV. 23, 1966

completed DEC. 9, 1966

Type of well DRILLED

Equipment used CHURN

Water Use: Domestic  Municipal  Stock  Irrigation

Industrial  Drainage  Other \* Garden/Lawn

\*Describe

USE: If used for irrigation, industrial, drainage or other. Explain, state number of acres and location or other data (i.e. Lot, Block and Addition).

ESTIMATED ANNUAL WITHDRAWAL

Size of Drilled Hole	Size and Weight of Casing	From (Feet)	To (Feet)	PERFORATIONS		
				Kind Size	From (Feet)	To (Feet)
6" I.D. 6-5/8" O.D. 1/4" side wall 17 lbs.		ground level	221 ft.	none	none	none

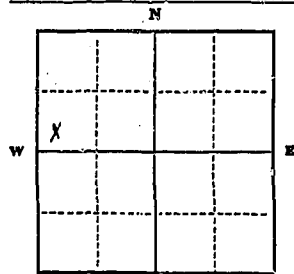

S.W. 1/4 NW 1/4 Sec. 12  
T. 12 N. R. 20 W.

INDICATE LOCATION OF WELL AND PLACE OF USE, IF POSSIBLE. EACH SMALL SQUARE REPRESENTS 40 ACRES.

Driller's Signature [Signature]

Driller's Address 1558 So. 5th W. MISSOULA, MONTANA

LICENSE NO. 151

Top of Ground		(Elev. above sea level)
From (Feet)	To (Feet)	
61	6	well pit
61	37'6"	Tan clay, sand and gravel
37'6"	39'8"	Sand, silt and water seep
39'8"	71'	Tan clay and silt
71'	107'	Gray clay with gravel imbedded
107'	107'	Seep of water
107'	139'	Gravel imbedded in gray clay and silt
139'	155'	Tan clay with gravel imbedded
155'	155'6"	1/2 Gal. per min. water in sand, silt and gravel
155'6"	177'	tan clay with gravel imbedded
177'	179'	siltwater, sand and some gravel mixed
179'	182'10"	Tan clay with gravel imbedded
182'10"	183'8"	Sand, gravel, silt water (1/2 gal per min.)
183'8"	185'	Red clay with gravel imbedded
185'	197'	Tan clay with gravel imbedded
197'	200'	Sand, gravel and silt water (2 gal. per min.)
200'	219'	Gray clay with gravel and wood imbedded
219'	221'	Sand, gravel and water

Static water level 63 ft.\*  
Pumping water level 213 ft.\*  
at 2 gallons per minute,  
measured 5 minutes after pumping began.

\*Measured from ground level.  
Well developed by ball test  
for 7 hrs. hours.

Power..... Pump..... HP  
Remarks: (Gravel packing, cementing, packers, type of shutoff)

221 ft. Show exact depth of bottom

51,708



STATE WATER CONSERVATION BOARD

Approved Stock Form—State Publishing Co., Helena, Montana—42329

GW 2

APR 11 1966

File No. \_\_\_\_\_

T. 12N R. 20W

DUPLICATE

Bliss \_\_\_\_\_ McDermott \_\_\_\_\_  
 Butcher \_\_\_\_\_ McNulty \_\_\_\_\_  
 Coyle \_\_\_\_\_ Morton \_\_\_\_\_ County Missoula  
 Darlington \_\_\_\_\_ Sullivan \_\_\_\_\_  
 Dickert \_\_\_\_\_ ADMINISTRATOR OF GROUNDWATER CODE  
 OFFICE OF STATE ENGINEER

LOG

Top of Ground \_\_\_\_\_  
 (Elev. above sea level 3243')

**Notice of Completion of Groundwater Appropriation by Means of Well**

DEVELOPED AFTER JANUARY 1, 1962

(Under Chapter 237, Montana Session Laws, 1961)

Formations Log:

- 0 - 15 Tan clay.
- 15 - 20 Gravel imbedded in tan clay.
- 20 - 35 Sandy tan clay.
- 35 - 37 Gravel & sand.
- 37 - 42 Sandy clay.
- 42 - 64 Sandy clay & gravel.
- 64 - 68 Fine silty sand & gravel.
- 68 - 76 Fine sand & gravel.
- 76 - 82 Fine sand & gravel. Some silt & very fine sand present.
- 82 - 84 Sand & gravel imbedded in tan clay.

Owner: Verne Smith Address: Missoula, Montana

Driller: Liberty Drilling Co. Address: Missoula, Montana

Date of Notice of appropriation of groundwater None filed

Date well started 11/26/65 Date completed 11/29/65

Type of well Drilled Equipment used Cable Tools  
 (Dug, Driven, bored or drilled) (Churn drill, rotary or other)

Water use: Domestic  Municipal  Stock  Irrigation   
 Industrial  Drainage  Other

Indicate on the diagram the character and thickness of the different strata met with in drilling, such as soil, clay, shale, gravel, rock or sand, etc. Show depth at which water is encountered, thickness and character of water-bearing strata and height to which the water rises in the well.

Size of Drilled Hole	Size and Weight of Casing	From (Feet)	To (Feet)	PERFORATIONS		
				Kind Size	From (Feet)	To (Feet)
6"	6 5/8 OD x 1/4 inch	-0-	70	5 9/16 Shop Made	69	76
				5 9/16 Blank Closed	76	84
				Bottom		

Water rises in well 58 feet from surface.

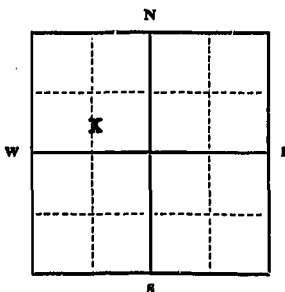

Static Water Level for non-flowing well 58 feet.

Shut-in Pressure for Flowing Well Non-f.  
 Pumping Water Level 64 feet  
 at 11 gal. per minute.

Discharge in gal. per min. of flowing well Non-Flowing

How Tested Air Lift Pump

Length of Test 40 hours

Remarks: (Gravel packing, cementing, packers, type of shutoff) All water entering well is coming through slots in shop made screen.

SE 1/4 NW Sec. 12 T. 12N R. 20W  
 Indicate location of well and place of use, if possible. Each small square represents 40 acres.

(Continue on reverse side)

USE—If used for irrigation, industrial, drainage or other. Explain, state number of acres and location or other data (i.e.: Lot, Block and Addition).

LAWN

Show exact depth of bottom.  
 Bottom of hole 84'

This form to be prepared by driller, and three copies to be filed by the owner with the County Clerk and Recorder in the county in which the well is located, tissue copy to be retained by driller.

Please answer all questions. If not applicable, so state, otherwise the form will be returned.

52  
 Driller's License Number

William F. Adams  
 Driller's Signature

40960

RECORDED

248971

I received and filed this Instrument for record on the 7 day of April, 1966, at 10:15 o'clock A.M., permanent files of Missoula County, State of Montana.

Witness my hand:  
Veronica E. Couse, County Recorder  
 By B. Billing, Deputy  
 Fee \$ 0.00 Paid

NO LONGER VALID FOR RECORDING IN MONTANA

WATER CONSERVATION COVER

600 J. J. R.

See page 10 of this report for details of this project. The project is a part of the Montana Water Conservation Program. The project is a part of the Montana Water Conservation Program. The project is a part of the Montana Water Conservation Program.



RECEIVED

County Missoula

DRILLER'S LOG

NOTICE OF COMPLETION OF GROUNDWATER APPROPRIATION BY MEANS OF WELL

Developed after January 1, 1962

(Under Chapter 237 Montana Session Laws, 1961, as amended)

This form to be prepared by driller, and three copies to be filed by the owner with the County Clerk and Recorder in the county in which the well is located, last copy to be retained by driller.

Please answer all questions. If not applicable, so state, otherwise the form may be returned.

Owner John E. Stargin  
 Address 3117 El Dorado Ln. Missoula, Mont  
 Date well started August 25, 1970  
 completed August 28, 1970

For Administrator's Use  
 File 2470, 331052  
April 24, 1973  
 GW 1 12:35 P.M.

Type of well Drilled  
 Equipment used Churn drill  
 Water Use: Domestic  Municipal  Stock  Irrigation   
 Industrial  Drainage  Other \* Garden/Lawn

\*Describe  
 USE: If used for irrigation, industrial, drainage or other. Explain, state number of acres and location or other data (i.e. Lot, Block and Addition).

ESTIMATED ANNUAL WITHDRAWAL

Size of Drilled Hole	Size and Weight of Casing	From (Feet)	To (Feet)	PERFORATIONS		
				Kind Size	From (Feet)	To (Feet)
6" I.D.	65/8" O.D. 17 lbs 1/2" side walls	Ground level	66' 7"			

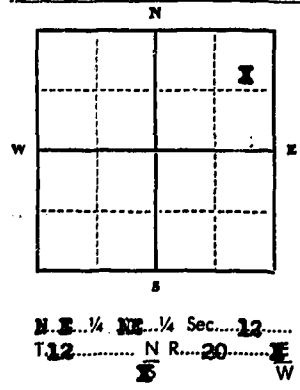

Static water level 40 ft.\*  
 Pumping water level 62 ft.\*  
 at 3 gallons per minute, measured 60 minutes after pumping began.  
 \*Measured from ground level.  
 Well developed by Ball test for 4 hours.  
 Power          Pump          HP  
 Remarks: (Gravel packing, cementing, packers, type of shutoff)

INDICATE LOCATION OF WELL AND PLACE OF USE, IF POSSIBLE. EACH SMALL SQUARE REPRESENTS 40 ACRES.

Driller's Signature Henneth L. Williams  
 Driller's Address 1558 South 5th W.

Missoula, Montana LICENSE NO. 151

Indicate the character, color, thickness of strata such as soil, clay, sand, gravel, shale, sandstone, etc. Show depth at which water is found and height to which water rises in well.

Top of Ground		(Elev. above sea level)
From (Feet)	To (Feet)	
0	4	Topsoil
4	20	Tan clay, gravel & boulders
20	25	Red clay.
25	35	Tan sandy clay.
35	64	Brown clay.
64	66' 7"	Sand-gravel-water

66' 7" Show exact depth of bottom

53,002

2470

331052

I received and filed this instrument for  
 record on the 24 day of Apr, 1973  
 at 12:35 o'clock P. M., permanent files  
 of Missoula County, State of Montana  
 Witness my hand:  
 Dorothy L. Head, County Recorder  
 By Mary Abalich, Deputy  
 Fee \$ 3.00 Paid ✓

MISSOULA COUNTY

SEARCHED	INDEXED
SERIALIZED	FILED
APR 24 1973	
MISSOULA COUNTY	
RECORDS & CLERK	

STATE OF MONTANA  
ADMINISTRATOR OF GROUNDWATER CODE  
MONTANA WATER RESOURCES BOARD

NOTICE OF COMPLETION OF GROUNDWATER  
APPROPRIATION BY MEANS OF WELL

Developed after January 1, 1962

(Under Chapter 237 Montana Session Laws, 1961, as amended)

This form to be prepared by driller, and three copies to be filed by the owner with the County Clerk and Recorder in the county in which the well is located, last copy to be retained by driller.

Please answer all questions. If not applicable, so state, otherwise the form may be returned.

Owner Irving W. Stoble Jr. & Carol F.  
Address 5672 Lower Miller Cr.  
Creek Road,  
Date well started 5-26-65  
completed 5-31-65

For Administrator's Use  
File 29.6115  
October 22, 1970  
11:15 AM  
GW 1

Type of well Drilled  
(Type: driven, bored or drilled)  
Equipment used Churn Drill  
(Churn drill, rotary or other)  
Water Use: Domestic  Municipal  Stock  Irrigation   
Industrial  Drainage  Other  Garden/Lawn

\*Describe \_\_\_\_\_  
USE: If used for Irrigation, Industrial, drainage or other. Explain, state number of acres and location or other data (i.e. Lot, Block and Addition). 1/2 acre

ESTIMATED ANNUAL WITHDRAWAL

Size of Drilled Hole	Size and Weight of Casing	From (Feet)	To (Feet)	PERFORATIONS		
				Kind Size	From (Feet)	To (Feet)
<u>3" ID</u>	<u>5" ID</u> <u>14 lbs</u> <u>per foot</u>	<u>1'</u>	<u>96'</u>			

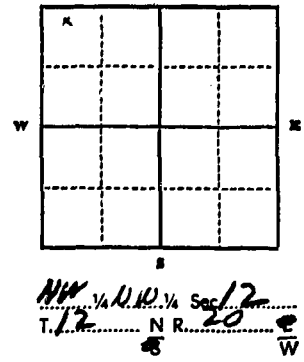

Static water level 97' ft.\*  
Pumping water level 27' ft.\*  
60 gallons per minute,  
measured 70 minutes after pumping began.  
\*Measured from ground level.  
Well developed by Compressor  
for 1/2 hours.  
Power          Pump          HP  
Remarks: (Gravel packing, cementing, packers, type of shutoff) \_\_\_\_\_

INDICATE LOCATION OF WELL AND PLACE OF USE, IF POSSIBLE. EACH SMALL SQUARE REPRESENTS 40 ACRES.

Driller's Signature Philip Bakke  
Driller's Address Camp Well Drilling & Pump Supply  
1522 So. 14th West

LICENSE NO. 7

DRILLER'S LOG

Indicate the character, color, thickness of strata such as soil, clay, sand, gravel, shale, sandstones, etc. Show depth at which water is found and height to which water rises in well.

Top of Ground (Elev. above sea level) \_\_\_\_\_

From (Feet)	To (Feet)	
<u>0</u>	<u>3</u>	<u>Top Soil</u>
<u>3</u>	<u>22</u>	<u>Gravel, sand and clay</u>
<u>22</u>	<u>50</u>	<u>Sand and clay</u>
<u>50</u>	<u>54</u>	<u>Sand</u>
<u>54</u>	<u>77</u>	<u>Sand, water and gravel</u>
<u>77</u>	<u>88</u>	<u>Sand, gravel and clay</u>
<u>88</u>	<u>93</u>	<u>Clay, sand and gravel</u>
<u>93</u>	<u>98</u>	<u>Sand gravel and water</u>

Show exact depth of bottom 98'

47675

2055

296115

I received and filed this instrument for  
 record on the 22<sup>nd</sup> day of Oct, 1970  
 at 11:15 o'clock A.M., permanent files  
 of Missoula County, State of Montana  
 Witness my hand:  
Verance R. Crouse, County Recorder  
 By [Signature], Deputy  
 For 2.00

SEARCHED  
 SERIALIZED  
 INDEXED  
 FILED

STATE OF MONTANA  
ADMINISTRATOR OF GROUNDWATER CODE  
MONTANA WATER RESOURCES BOARD

RECEIVED

MAR 24 1971

DRILLER'S LOG

Indicate the character, color, thickness of strata such as soil, clay, sand, gravel, shale, sandstone, etc. Show depth at which water is found and height to which water rises in well.

NOTICE OF COMPLETION OF GROUNDWATER APPROPRIATION BY MEANS OF WELL

Developed after January 1, 1962

(Under Chapter 237 Montana Session Laws, 1961, as amended)

This form to be prepared by driller, and three copies to be filed by the owner with the County Clerk and Recorder in the county in which the well is located, last copy to be retained by driller. Please answer all questions. If not applicable, so state, otherwise the form may be returned.

Owner Jack Taggart  
Address 6304 Helena Drive  
Missoula, Montana

For Administrator's Use	
File	<u>300577</u>
	<u>MARCH 22, 1971</u>
	<u>4:04 P.M.</u>
GW 1	

Date well started Feb. 16, 1971  
Completed March 2, 1971

Type of well Drilled  
(Dug, driven, bored or drilled)

Equipment used Churn Drill  
(Churn drill, rotary or other)

Water Use: Domestic  Municipal  Stock  Irrigation   
Industrial  Drainage  Other  Garden/Lawn

\*Describe \_\_\_\_\_  
USE: If used for irrigation, industrial, drainage or other. Explain, state number of acres and location or other data (i.e. Lot, Block and Addition).

ESTIMATED ANNUAL WITHDRAWAL

Size of Drilled Hole	Size and Weight of Casing	From (Feet)	To (Feet)	PERFORATIONS		
				Kind Size	From (Feet)	To (Feet)
6" I.D.	6" I.D. 17 lb per ft.	114'	314'			

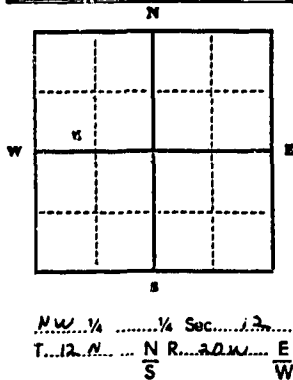

Static water level 52 ft.\*  
Pumping water level 100 ft.\*  
at 15 gallons per minute,  
measured 10 minutes after pumping  
began.  
\*Measured from ground level.  
Well developed by compressor  
for 37 hours.  
Power Does Not Pump Apply HP  
Remarks: (Gravel packing, cementing,  
packers, type of shutoff)

INDICATE LOCATION OF WELL AND PLACE OF USE, IF POSSIBLE. EACH SMALL SQUARE REPRESENTS 40 ACRES.

Driller's Signature J. L. ...  
CAMP WELL DRILLING & PUMP SUPPLY  
Driller's Address 1522 S. 14th W., Missoula, Montana

Top of Ground (Elev. above sea level)		
From (Feet)	To (Feet)	
0	5	Sand & Gravel
5	24	Sandy Clay & Gravel
24	40	Sand, Gravel & Water
40	53	Blue Green Clay
53	59	Sand Gravel, seep of Water
59	70	Gray Clay & Gravel
70	83	Light Brown Clay & Gravel
83	87	Gray Clay & Gravel
87	121	Light Br. Clay & Gravel
121	124	Sand, Gravel & Water
124	136	Pink Clay
136	145	Sandy Clay, Gravel & Seep of Water
145	153	Blue Gray Clay
153	154	Gravel & Water (20 GPM)
154	158	Brown Sandy Clay
158	180	Sand Gravel & Seep of Water
180	185	Sand Gravel & Water (2 GPM)
185	210	Clay and Gravel
210	212	Pink Clay, Gravel & Seep of Water
212	216	Sand, Gravel, Water (14 GPM)
216	227	Brn Clay & Gravel
227	232	Gravel & Water (20 GPM)
232	255	Gray Clay & Gravel
255	259	Acidic Sandy Clay Gravel & Water
259	262	Sand Gravel & Water (4 GPM)
262	266	Brn Sandy Clay Gravel & Water
266	271	Sand, Gravel & Water (5 GPM)
271	272	Gray Clay
272	281	Sand, Gravel & Water (20 GPM)
281	282	Sand and Water
282	292	Pink Clay, Sand, Gravel & Water (5 GPM)
292	302	Br. Clay & Gravel
302	304	Gray Clay & Gravel
304	312	Gray Clay
312	314	Sand, Gravel & Water

2102

520599

I received and filed this instrument for  
record on the 23<sup>rd</sup> day of March, 1971.  
at 10:45 a.m. o'clock, P.M., permanent files  
of Missoula County, State of Montana  
Witness my hand.  
Veronne R. Cross, County Recorder  
By 23<sup>rd</sup> day of March, 1971, Deputy  
Fee \$2.00 *U. R. Cook*

RECEIVED

County MISSOULA 17

STATE OF MONTANA  
ADMINISTRATOR OF GROUNDWATER CODE  
MONTANA WATER RESOURCES BOARD

APR 24 1973

DRILLER'S LOG

Indicate the character, color, thickness of strata such as soil, clay, sand, gravel, shale, sandstone, etc. Show depth at which water is found and height to which water rises in well.

NOTICE OF COMPLETION OF GROUNDWATER APPROPRIATION BY MEANS OF WELL

Developed after January 1, 1962

(Under Chapter 237 Montana Session Laws, 1961, as amended)

This form to be prepared by driller, and three copies to be filed by the owner with the County Clerk and Recorder in the county in which the well is located, last copy to be retained by driller.

Please answer all questions. If not applicable, so state, otherwise the form may be returned.

Owner DARRELL TUCKER

Address 3409 LLOYD CT.

MISSOULA, MONTANA 59801

Date well started JUNE 10, 1971

completed JUNE 17, 1971

Type of well DRILLED

Equipment used CHURN

Water Use: Domestic  Municipal  Stock  Irrigation

Industrial  Drainage  Other  Garden/Lawn

\*Describe

USE: If used for irrigation, industrial, drainage or other. Explain, state number of acres and location or other data (i.e. Lot, Block and Addition).

ESTIMATED ANNUAL WITHDRAWAL

Size of Drilled Hole	Size and Weight of Casing	From (Feet)	To (Feet)	PERFORATIONS		
				Kind	From (Feet)	To (Feet)
6" I.D.	6-5/8" od 17 lbs. 1/8" side-wall	ground level	254'	none	none	none

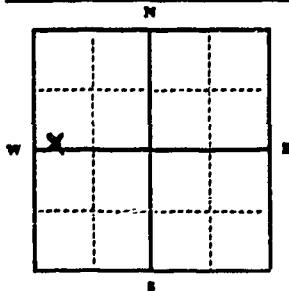

SW 1/4 NW 1/4 Sec. 17  
T. 12 N. R. 20 X  
W

INDICATE LOCATION OF WELL AND PLACE OF USE, IF POSSIBLE. EACH SMALL SQUARE REPRESENTS 40 ACRES.

Driller's Signature Harold L. Williams

Driller's Address 1558 So. 5th W. MISSOULA, MONTANA

LICENSE NO. 151

Top of Ground (Elev. above sea level)		
From (Feet)	To (Feet)	
GL	5'	Top soil & gravel
5'	25'	Tan clay
25'	53'	Tan clay & gravel
53'	104'	green clay
104'	107'	Tan clay & gravel
107'	160'	Brown clay
160'	183'	Sand, gravel & seep of water at 183'
183'	195'	Sand, tan clay & gravel
195'	201'	Sand, gravel & water
201'	208'	Gray clay, sand, gravel & seep of water at 208'
208'	229'	Gray clay & gravel
229'	238'	Pink clay, sand & imbedded gravel
238'	253'	Gray clay & gravel
253'	254'	Sand, gravel and water

254 ft. Show exact depth of bottom

57983

24

330783

I received and filed this instrument for  
record on the 18 day of April, 1973  
at 9:00 o'clock A.M., permanent files  
of Missoula County, State of Montana  
Witness my hand  
Dorothy L. Head, County Recorder  
By [Signature], Deputy  
Fee \$ 2.00 Paid 0



File No.

MONTANA WATER RESOURCES BOARD  
**RECEIVED**

T. 12 R. 20

DUPLICATE

SEP 25 1970

County Missoula

STATE OF MONTANA  
ADMINISTRATOR OF GROUNDWATER CODE  
OFFICE OF STATE ENGINEER

**Notice of Completion of Groundwater  
Appropriation by Means of Well**

(Under Chapter 237, Montana Session Laws, 1961)

Top of Ground  
(Elev. above sea level.....)

0' to 6' Pit

6' to 30' Thin layers of  
Clay, sand & gravel

30' to 38' Clay

38' to 58' Sand, gravel  
& clay

58' to 74' Sand, gravel  
with water

74' to 80' Sand, gravel  
Clay (very little water)

80' to 84' Gravel, some water  
a lot of sand  
Pulled back to 74' from  
top of pit.

Owner Jack Trite Address Linda Vista  
Missoula

Driller Glen Camp 705 Alder Address Missoula

Date of Notice of Appropriation of Groundwater.....

Date well started 2/11/63 Date Completed 2/13/63

Type of well Drilled Equipment Used Churn drill  
(dug, driven, bored or drilled) (Churn, drill, rotary or other)

Water Use: Domestic  Municipal  Other  Irrigation   
Industrial  Drainage  Stock

Indicate on the diagram the character and thickness of the different strata met with in drilling, such as soil, clay, shale, gravel, rock or sand, etc. Show depth at which water is encountered, thickness and character of water-bearing strata and height to which water rises in the well.

	Size and Weight of Casing	From (Feet)	To (Feet)	PERFORATIONS		
				Kind Size	From (Feet)	To (Feet)
5"	5" I.D. seamless 14 lbs	1'-0" above top of pit	to 68'		none	

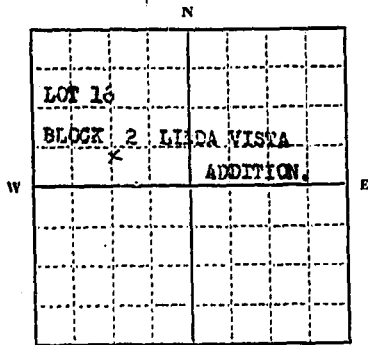

N.W. 1/4 Sec. 12, T. 12, R. 20  
Indicate location of well and place of use, if possible. Each small square represents 10 acres.

Show exact depth of bottom.

Static Water Level for non-flowing Well 58' From G.L., ..... feet.

Shut-in Pressure for Flowing Well.....

Pumping Water Level 62 feet at 12 gal. per minute.

Discharge in gal. per min. of flowing well.....

How Tested Bailer Length of Test 2 hours

Remarks: (Gravel packing, cementing, packers, type of shutoff, location of place of use of groundwater if not at well, and any other similar pertinent information, including number of acres irrigated, if used for irrigation).....

none

Doc. No. 295154  
Filed for record  
this 22 day of September  
A. D. 19 70, at 3:15  
o'clock P.M.

License # 7  
Driller's License Number  
Glen Camp  
Driller's Signature

This form to be prepared by driller, and three copies to be filed by the owner with the County Clerk and Recorder in the county in which the well is located.

Please answer all questions. If not applicable, so state, otherwise the form will be returned.

Original to the County Clerk and Recorder; duplicate to the State Engineer; Triplicate to the Montana Bureau of Mines and Geology and Quadruplicate for the Appropriator.

47551



STATE OF MONTANA  
ADMINISTRATOR OF GROUNDWATER CODE  
MONTANA WATER RESOURCES BOARD

NOTICE OF COMPLETION OF GROUNDWATER  
APPROPRIATION BY MEANS OF WELL

Developed after January 1, 1962

(Under Chapter 237 Montana Session Laws, 1961, as amended)

This form to be prepared by driller, and three copies to be filed by the owner with the County Clerk and Recorder in the county in which the well is located, last copy to be retained by driller.

Please answer all questions. If not applicable, so state, otherwise the form may be returned.

Owner JAMES VOLLER  
Address #3121 Eldora Lane  
Missoula, Mont.

For Administrator's Use	
File	<u>310367</u>
Date	<u>December 7, 1971</u>
Time	<u>1:18 PM</u>

Date well started August 13, 1970  
completed August 17, 1970

Type of well Drilled  
(Dug, driven, bored or drilled)

Equipment used Churn  
(Churn drill, rotary or other)

Water Use: Domestic  Municipal  Stock  Irrigation   
Industrial  Drainage  Other \* Garden/Lawn

\*Describe

USE: If used for irrigation, industrial, drainage or other. Explain, state number of acres and location or other data (i.e. Lot, Block and Addition).

ESTIMATED ANNUAL WITHDRAWAL

Size of Drilled Hole	Size and Weight of Casing	From (Feet)	To (Feet)	PERFORATIONS		
				Kind Size	From (Feet)	To (Feet)
6" O.D. Ground	17 lb level	0	58'7"			
	1/2" side walls.					

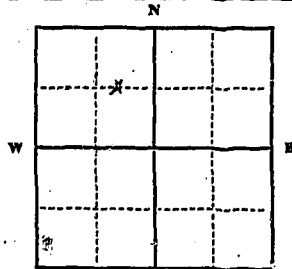

NW 1/4 Sec. 12  
T. 12 N. R. 20 E

Static water level 42 ft.\*  
Pumping water level 65 ft.\*  
at 10 gallons per minute,  
measured 60 minutes after pumping began.

\*Measured from ground level.  
Well developed by Ball test  
for 4 hours.

Power..... Pump..... HP  
Remarks: (Gravel packing, cementing, packers, type of shutoff)

Lot Eight (8) of Block  
Eight of Second Supplement  
Linda Vista Addition,  
Missoula County, Montana

INDICATE LOCATION OF WELL AND PLACE OF USE, IF POSSIBLE. EACH SMALL SQUARE REPRESENTS 40 ACRES.

Driller's Signature Kenneth L. Williams

Driller's Address 1558 South 5th W.

Missoula, Montana LICENSE NO. 151

County Missoula

MONTANA WATER RESOURCES BOARD  
RECEIVED  
DEC 9 1971

DRILLER'S LOG

Indicate the character, color, thickness of strata such as soil, clay, sand, gravel, shale, sandstone, etc. Show depth at which water is found and height to which water rises in well.

Top of Ground (Elev. above sea level)	
From (Feet)	To (Feet)
0	2 ft
2	16
16	30
30	40
40	52
52	54
54	64
64	65
65	70
70	68'7"

68'7" Show exact depth of bottom

49559



RECEIVED

File No. ....

OCT 1 1970

T. 12 R. 20

DUPLICATE

County. Missoula

LOG

STATE OF MONTANA  
ADMINISTRATOR OF GROUNDWATER CODE  
STATE WATER CONSERVATION BOARD

Notice of Completion of Groundwater  
Appropriation by Means of Well  
DEVELOPED AFTER JANUARY 1, 1982

(Under Chapter 237 Montana Session Laws, 1961, as amended)

Owner: RUSSEL L. HARLAN Missoula, Montana  
Address: Route 5, Miller Creek

Driller: KEN WILLIAMS WELL DR. Address: 1559 So. 5th St.  
MISSOULA, MONT.

Date of Notice of appropriation of groundwater.....

Date well started FEB. 16, 1970 Date completed FEB. 20, 1970

Type of well DRILLED Equipment used CHURN  
(Dug, driven, bored or drilled) (Churn drill, rotary or other)

Water use: Domestic  Municipal  Stock  Irrigation   
Industrial  Drainage  Other

Indicate on the diagram the character and thickness of the different strata met with in drilling, such as soil, clay, shale, gravel, rock or sand, etc. Show depth at which water is encountered, thickness and character of water-bearing strata and height to which the water rises in the well.

Top of Ground  
(Elev. above sea level.....)

6L top soil

4' tan clay & gravel

111' water, sand & gravel

123' 6"

Doc. No. 295306  
Filed for record  
this 28 day of September  
A. D. 1970, at 3:10  
o'clock P.M.

Size of Drilled Hole: 6" ID

Size and Weight of Casing: 6-5/8" OD, 17 lbs., 1/4" size wall

From (Feet): Ground level

To (Feet): 123' 6"

PERFORATIONS

Kind Size	From (Feet)	To (Feet)

Static Water Level for non-flowing well ..... 106 feet.

Shut-in Pressure for Flowing Well.....

Pumping Water Level..... 120 feet

at..... 80 gal. per minute.

Discharge in gal. per min. of flowing well .....

How Tested: bail & sub test pump

Length of Test: 6 hrs.

Remarks: (Gravel packing, cementing, packers, type of shutoff).....

EKEY Sec. 13 T. 22N R. 22W

Indicate location of well and place of use, if possible. Each small square represents 40 acres.

(Continue on reverse side)

USE—If used for irrigation, industrial, drainage or other. Explain, state number of acres and location or other data (i.e.: Lot, Block and Addition).

IRRIGATION 30 ACRES OF E 1/4 SE 1/4 SEC 13 T. 22N R. 22W

Show exact depth of bottom.

This form to be prepared by driller, and three copies to be filed by the owner with the County Clerk and Recorder in the county in which the well is located, tissue copy to be retained by driller.

Please answer all questions. If not applicable, so state, otherwise the form will be returned.

151  
Driller's License Number  
Ken Williams  
Driller's Signature.

47573

I received and filed this instrument for record on the 28 day of Sept 1928 at 3:20 o'clock P.M. permanent file of Missouri County, State of North Carolina.  
 Witness my hand  
Vernon S. Crouse, County Recorder  
 By J. H. [Signature], Deputy  
 Fee \$ 1.00 Paid

Duplicate of instrument  
 Duplicate  
 Duplicate

295306

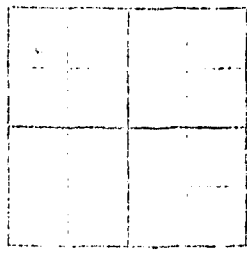

This well is located on the 28 day of Sept 1928 at 3:20 o'clock P.M. permanent file of Missouri County, State of North Carolina.  
 Witness my hand  
Vernon S. Crouse, County Recorder  
 By J. H. [Signature], Deputy  
 Fee \$ 1.00 Paid

Date well started 1928 to 1928 Date completed 1928 to 1928  
 Date of zoning or classification of groundwater

STATE OF MONTANA  
ADMINISTRATOR OF GROUNDWATER CODE  
MONTANA WATER RESOURCES BOARD

NOTICE OF COMPLETION OF GROUNDWATER  
APPROPRIATION BY MEANS OF WELL

Developed after January 1, 1962

(Under Chapter 237 Montana Session Laws, 1961, as amended)

This form to be prepared by driller, and three copies to be filed by the owner with the County Clerk and Recorder in the county in which the well is located, last copy to be retained by driller.

Please answer all questions. If not applicable, so state, otherwise the form may be returned.

Owner William Harlan

Address 115 Dearborn Ave.  
Missoula, Mont.

Date well started April 30, 1970  
completed May 1, 1970

For Administrator's Use	
File	<u>June 17, 1970</u>
	<u>9:00 A.M.</u>
GW	<u>292238</u>

Type of well Drilled  
(Dug, driven, bored or drilled)

Equipment used Churn Drill  
(Churn drill, rotary or other)

Water Use: Domestic  Municipal  Stock  Irrigation   
Industrial  Drainage  Other \* Garden/Lawn

\*Describe \_\_\_\_\_  
USE: If used for irrigation, industrial, drainage or other. Explain, state number of acres and location or other data (i.e. Lot, Block and Addition). \_\_\_\_\_

ESTIMATED ANNUAL WITHDRAWAL unknown

Size of Drilled Hole	Size and Weight of Casing	From (Foot)	To (Foot)	PERFORATIONS		
				Kind Size	From (Foot)	To (Foot)
6"	15 lbs per ft	0	57	3/16x5	46	56

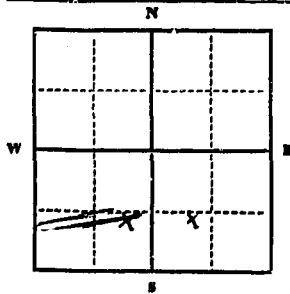

W. 1/2 of SE 1/4 Sec. 13  
T. 12 N. R. 20 E.  
S. (W. 1/2) 22.

INDICATE LOCATION OF WELL AND PLACE OF USE, IF POSSIBLE. EACH SMALL SQUARE REPRESENTS 40 ACRES.

Driller's Signature C. L. Winkle Swaffi Drilling Co.

Driller's Address Box 27, Victor, Mont.

LICENSE NO. 62

DRILLER'S LOG

Indicate the character, color, thickness of strata such as soil, clay, sand, gravel, shale, sandstone, etc. Show depth at which water is found and height to which water rises in well.

Top of Ground		(Elev. above sea level)
From (Foot)	To (Foot)	
0	2	Open hole
2	41	sand, gravel intermittent layers
41	46	Clay
46	51	Sand, Gravel, Clay intermittent layers
51	59	bedrock

59 Show exact depth of bottom

46590

2004

292238

I received and filed this instrument for  
 record on the 17<sup>th</sup> day of June, 1920  
 at 9:00 o'clock A. M. pursuant to the  
 of Missoula County, State of Montana.  
 Witness my hand:  
 Varance H. Crouse, County Recorder  
 By W. H. Crouse, Deputy  
 Fee \$2.00

1	2	3	4	5	6	7	8	9	10	11	12	13	14	15	16	17	18	19	20	21	22	23	24	25	26	27	28	29	30	31

RECORDED  
 JUN 17 9 00 AM '20  
 MISSOULA, MONTANA

MISSOULA, MONTANA



File No. \_\_\_\_\_

T. 12. N. R. 20. W.

DUPLICATE

County Musselshell

STATE OF MONTANA  
ADMINISTRATOR OF GROUNDWATER CODE  
OFFICE OF STATE ENGINEER

RECEIVED  
DEC 10 1963

Declaration of Vested Groundwater Rights  
(Under Chapter 237, Montana Session Laws, 1961)

STATE ENGINEER

1. Daniel O. Maloney of Rt. 3, Musselshell, Musselshell  
(Name of Appropriator) (Address) (Town)

County of Musselshell State of Montana  
have appropriated groundwater according to the Montana laws in effect prior to January 1, 1962, as follows:

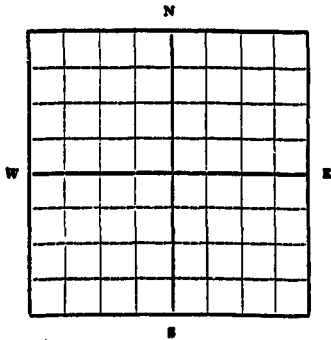

N. 1/4 Sec. 14, T. 12, R. 20, W.

Indicate point of appropriation and place of use, if possible. Each small square represents 10 acres.

- The beneficial use on which the claim is based Domestic, irrigation, stock
- Date or approximate date of earliest beneficial use; and how continuous the use has been 1875  
continuous
- The amount of groundwater claimed (in miner's inches or gallons per minute) 25 inches
- If used for irrigation, give the acreage and description of the lands to which water has been applied and name of the owner thereof lawn & garden
- The means of withdrawing such water from the ground and the location of each well or other means of withdrawal centrifugal pump
- The date of commencement and completion of the construction of the well, wells, or other works for withdrawal of groundwater 1875
- The depth of water table 30 feet
- So far as it may be available, the type, size and depth of each well or the general specifications of any other works for the withdrawal of groundwater dry well
- The estimated amount of groundwater withdrawn each year 1,000 gal day
- The log of formations encountered in the drilling of each well if available none
- Such other information of a similar nature as may be useful in carrying out the policy of this act, including reference to book and page of any county record.

Signature of Owner Daniel O. Maloney  
Date Dec. 9 - 63

Three copies to be filed by the owner with the County Clerk and Recorder of the county in which the well is located.

Please answer all questions. If not applicable, so state, otherwise the form will be returned.

Original to the County Clerk and Recorder; duplicate to the State Engineer; Triplicate to the Montana Bureau of Mines and Geology and Quadruplicate for the Appropriator.

381

214002

*Copy*  
I received and filed this instrument for  
record on the 9 day of Dec, 1963  
at 10:30 o'clock A.M., permanent files  
of Missoula County, State of Montana  
Witness my hand:  
MARTIN S. BEHNER, County Recorder  
By Martin S. Behner Deputy  
Fee \$ 2.00 Paid

File No. \_\_\_\_\_

T. 12 N. R. 20 W.

DUPLICATE

County Missoula

STATE OF MONTANA  
ADMINISTRATOR OF GROUNDWATER CODE  
OFFICE OF STATE ENGINEER

RECEIVED  
DEC 10 1963

Declaration of Vested Groundwater Rights  
(Under Chapter 237, Montana Session Laws, 1961)

STATE ENGINEER

1. Daniel P. Maloney, of R. 3, Missoula, Missoula  
(Name of Appropriator) (Address) (Town)  
County of Missoula State of Montana  
have appropriated groundwater according to the Montana laws in effect prior to January 1, 1962, as follows:

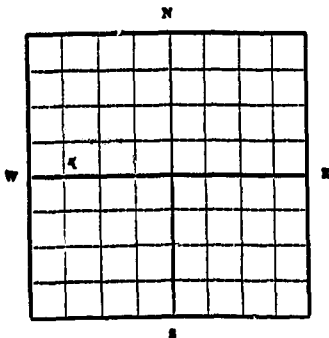

N. 1/4 Sec. 14, T. 12, R. 20 W.

Indicate point of appropriation and place of use, if possible. Each small square represents 10 acres.

- 2. The beneficial use on which the claim is based domestic, irrigation, stock.
- 3. Date or approximate date of earliest beneficial use; and how continuous the use has been 1890  
continuous
- 4. The amount of groundwater claimed (in miner's inches or gallons per minute) 1.0 inches
- 5. If used for irrigation, give the acreage and description of the lands to which water has been applied and name of the owner thereof leas., orchard
- 6. The means of withdrawing such water from the ground and the location of each well or other means of withdrawal centrifugal pump

- 7. The date of commencement and completion of the construction of the well, wells, or other works for withdrawal of groundwater 1890
- 8. The depth of water table 35 feet
- 9. So far as it may be available, the type, size and depth of each well or the general specifications of any other works for the withdrawal of groundwater dry well
- 10. The estimated amount of groundwater withdrawn each year 300 gal. a year
- 11. The log of formations encountered in the drilling of each well if available none
- 12. Such other information of a similar nature as may be useful in carrying out the policy of this act, including reference to book and page of any county record.

Signature of Owner, Daniel P. Maloney  
Date Dec 9 - 63

Three copies to be filed by the owner with the County Clerk and Recorder of the county in which the well is located.

Please answer all questions. If not applicable, so state, otherwise the form will be returned.

Original to the County Clerk and Recorder; duplicate to the State Engineer; Triplicate to the Montana Bureau of Mines and Geology and Quadruplicate for the Appropriator.

378

213 996

*Copy*

I received and filed this instrument for  
 record on the 9 day of July 1966  
 at 7:25 o'clock P.M. permanent files  
 of Missoula County, State of Montana

Witness my hand:  
**MARTIN E. BELKNAP**, County Recorder  
 By [Signature], Deputy  
 Fee \$..... Paid

RECORDED IN BOOK 100 PAGE 100  
 MISSOULA COUNTY, MONTANA  
 JULY 11 1966

10  
15

File No. \_\_\_\_\_

T. 12 R. 20 W. 15

DUPLICATE

STATE OF MONTANA  
ADMINISTRATOR OF GROUNDWATER CODE  
OFFICE OF STATE ENGINEER

County \_\_\_\_\_  
**RECEIVED**  
JAN 5 1964  
STATE ENGINEER

**Declaration of Vested Groundwater Rights**

(Under Chapter 237, Montana Session Laws, 1961)

I, Martin T & Ellen R Beckstrom, of Route #3, Missoula,  
(Name of Appropriator) (Address) (Town)

County of Missoula State of Montana  
have appropriated groundwater according to the Montana laws in effect prior to January 1, 1962, as follows:

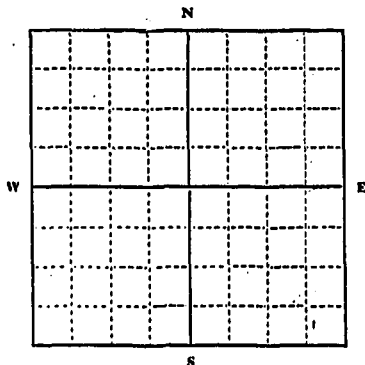

SE 1/4 SW 1/4 S10 T12N R20W  
NE 1/4 NW 1/4 Sec. 15 T. 12N. R. 20W

Indicate point of appropriation and place of use, if possible. Each small square represents 10 acres.

2. The beneficial use on which the claim is based Domestic, irrigation & stock watering
3. Date or approximate date of earliest beneficial use; and how continuous the use has been Approx. 10 years ago
4. The amount of groundwater claimed (in miner's inches or gallons per minute) Approx. 20 gallons per minute
5. If used for irrigation, give the acreage and description of the lands to which water has been applied and name of the owner thereof Lawn irrigation only
6. The means of withdrawing such water from the ground and the location of each well or other means of withdrawal pump

7. The date of commencement and completion of the construction of the well, wells, or other works for withdrawal of groundwater Approx. 10 years ago (1963)
8. The depth of water table unknown
9. So far as it may be available, the type, size and depth of each well or the general specifications of any other works for the withdrawal of groundwater unknown
10. The estimated amount of groundwater withdrawn each year unknown
11. The log of formations encountered in the drilling of each well if available unknown
12. Such other information of a similar nature as may be useful in carrying out the policy of this act, including reference to book and page of any county record none

Signature of Owner Ellen R Beckstrom

Date December 30, 1963

Three copies to be filed by the owner with the County Clerk and Recorder of the county in which the well is located.

Please answer all questions. If not applicable, so state, otherwise the form will be returned.

Original to the County Clerk and Recorder; Duplicate to the State Engineer; Triplicate to the Montana Bureau of Mines and Geology, and Quadruplicate for the Appropriator.

20253

1173

I received and filed this instrument for  
record on the 31<sup>st</sup> day of Dec 19 23  
at 5:30 o'clock P.M., permanent files  
of Missoula County, State of Montana  
Witness my hand  
By Matt J. Kelly County Recorder  
Deputy  
Fee \$ 2.00 Paid

File No. \_\_\_\_\_

T. 12<sup>N</sup> R. 20<sup>W</sup>

DUPLICATE

STATE OF MONTANA  
ADMINISTRATOR OF GROUNDWATER CODE  
OFFICE OF STATE ENGINEER

County \_\_\_\_\_  
**RECEIVED**  
JAN 14 1964

**Declaration of Vested Groundwater Rights** STATE ENGINEER  
(Under Chapter 237, Montana Session Laws, 1961)

1. Paul J. Brager, of Route 3,  
(Name of Appropriator) (Address) (Town)

County of Missoula State of Montana  
have appropriated groundwater according to the Montana laws in effect prior to January 1, 1962, as follows:

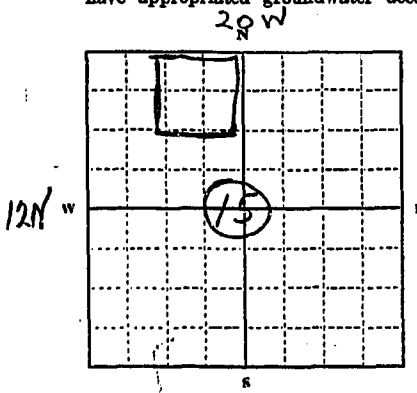

2. The beneficial use on which the claim is based...  
Irrigation, livestock, and farmland

3. Date or approximate date of earliest beneficial use; and how continuous the use has been...  
1944 and since to this date

4. The amount of groundwater claimed (in miner's inches or gallons per minute)...  
36 Gallon per Minute

5. If used for irrigation, give the acreage and description of the lands to which water has been applied and name of the owner thereof...  
7 Acres in tract of land in NE1/4 Sec. 15, T. 12, R. 20W of the principal Paul J. Brager Owner Meridan, Montana

6. The means of withdrawing such water from the ground and the location of each well or other means of withdrawal...  
Withdrawal by turbine pump Located

NE1/4 Sec. 15 T. 12 R. 20W

Indicate point of appropriation and place of use, if possible. Each small square represents 10 acres.

7. The date of commencement and completion of the construction of the well, wells, or other works for withdrawal of groundwater...  
Completed in 1944

8. The depth of water table...  
40 Feet

9. So far as it may be available, the type, size and depth of each well or the general specifications of any other works for the withdrawal of groundwater...  
6" Casing 105' Deep Turbine Pump 36 Gal per minute

10. The estimated amount of groundwater withdrawn each year...  
4,620,000 Gallons

11. The log of formations encountered in the drilling of each well if available...  
Unknown

12. Such other information of a similar nature as may be useful in carrying out the policy of this act, including reference to book and page of any county record...  
Don't know

Signature of Owner Paul J Brager

Date Dec 31-63

Three copies to be filed by the owner with the County Clerk and Recorder of the county in which the well is located.

Please answer all questions. If not applicable, so state, otherwise the form will be returned.

Original to the County Clerk and Recorder; Duplicate to the State Engineer; Triplicate to the Montana Bureau of Mines and Geology, and Quadruplicate for the Appropriator.

32181

Q 64

211336

I received and filed this instrument for  
 record on the 12 day of January 1962  
 at 11:30 o'clock A. M. permanent files  
 of Missoula County, State of Montana  
 Witness my hand:  
 MARTIN S. BEHNER, County Recorder  
 By Martin S. Behner Deputy  
 Fee \$ 2.00 Paid

Q



File No. ....

T. 12 N. R. 20 W. 15

DUPLICATE

RECEIVED  
NOV 6 1964

County Missoula

STATE ENGINEER

STATE OF MONTANA  
ADMINISTRATOR OF GROUNDWATER CODE  
OFFICE OF STATE ENGINEER

Top of Ground

(Elev. above sea level.....)

### Notice of Completion of Groundwater Appropriation by Means of Well

(Under Chapter 237, Montana Session Laws, 1961)

Well 6 miles S. of Missoula

0 to 1' Top soil

1' to 60' Clay & gravel

60' to 75' Clay

75' to 94' Clay & gravel

94' to 100' Broken red rock

100' to 120' Broken red

rock & clay

120' to 134' Broken red

rock & water 3.6 PM.

134' to 142' Red & green

Broken rock 3.6 PM

142' to 150' Red rock

& water

Owner James F. Geils Address.....

Driller Glenn Camp 705 Alder Address Missoula, Montana

Date of Notice of Appropriation of Groundwater.....

Date well started 10/12/64 Date Completed 10/23/64

Type of well Drilled Equipment Used Churn drill  
(dug, driven, bored or drilled) (Churn, drill, rotary or other)

Water Use: Domestic  Municipal  Other  Irrigation   
Industrial  Drainage  Stock

Indicate on the diagram the character and thickness of the different strata met with in drilling, such as soil, clay, shale, gravel, rock or sand, etc. Show depth at which water is encountered, thickness and character of water-bearing strata and height to which water rises in the well.

Size of Drilled Hole	Size and Weight of Casing	From (Feet)	To (Feet)	PERFORATIONS		
				Kind Size	From (Feet)	To (Feet)
6"	6" I.D.					
	10.97 #	1' above G.L.		<u>Hills Knife</u>		
		to 150' 6"		16 holes	131'	135'
		2'-6" open hole		8 holes	145'	146'
				8 holes	133'	138'
<b>Total of 36 holes</b>				24 holes	122'	124'

Static Water Level for non-flowing Well.....feet.

Shut-in Pressure for Flowing Well.....

Pumping Water Level 150 feet at 6 gal. per minute.

Discharge in gal. per min. of flowing well.....

How Tested pump Length of Test 3 hours

Remarks: (Gravel packing, cementing, packers, type of shutoff, location of place of use of groundwater if not at well, and any other similar pertinent information, including number of acres irrigated, if used for irrigation).....

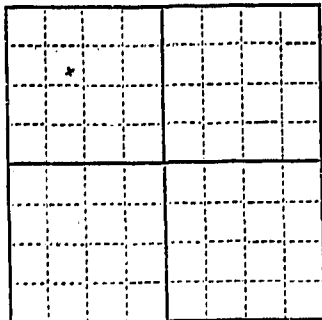

724 1/4 Sec. 15 T. 12. R. 20

Indicate location of well and place of use, if possible. Each small square represents 10 acres.

Show exact depth of bottom.

Licence # 7

Driller's License Number

Driller's Signature Glenn Camp

This form to be prepared by driller, and three copies to be filed by the owner with the County Clerk and Recorder in the county in which the well is located.

Please answer all questions. If not applicable, so state, otherwise the form will be returned.

Original to the County Clerk and Recorder; duplicate to the State Engineer; Triplicate to the Montana Bureau of Mines and Geology and Quadruplicate for the Appropriator.

38633



File No. ....

T. 12 N R 20 113

DUPLICATE

County Missoula

STATE OF MONTANA  
ADMINISTRATOR OF GROUNDWATER  
OFFICE OF STATE ENGINEER



# Notice of Completion of Groundwater Appropriation by Means of Well

(Under Chapter 237, Montana Session Laws, 1961)

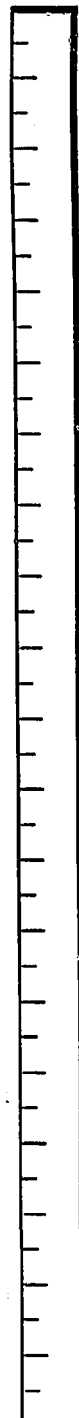

Top of Ground  
(Elev. above sea level.....)

- 0 to 1' Top soil
- 1' to 60' Clay & Gravel
- 60' to 75' Clay
- 75' to 94' Clay & gravel
- 94' to 100' Clay
- 100' to 120' Broken red rock & clay
- 120' to 134' Broken red rock & water
- 134' to 142' Clay & green broken rock
- 142' to 160' Red rock & some water (stopped drilling here and perf. casing) then drilled later.
- 160' to 170' red hard rock
- 170' to 175' Soft broken rock & water
- 175' to 185' Hard red rock
- 185' to 187 Broken rock & water
- 185' to 192' red rock

Well located by the Pines 6 miles S.  
Owner James F. Gates Address Missoula, Mont

Driller Glenn Camp 705 Alder Address Missoula, Mont

Date of Notice of Appropriation of Groundwater.....

Date well started 10/12/64 Date Completed 10/12/64  
Moved back 4/10/65 4/15/65

Type of well Drilled Equipment Used Churn drill  
(dug, driven, bored or drilled) (Churn, drill, rotary or other)

Water Use: Domestic  Municipal  Other  Irrigation   
Industrial  Drainage  Stock

Indicate on the diagram the character and thickness of the different strata met with in drilling, such as soil, clay, shale, gravel, rock or sand, etc. Show depth at which water is encountered, thickness and character of water-bearing strata and height to which water rises in the well.

Size of Drilled Hole	Size and Weight of Casing	From (Feet)	To (Feet)	PERFORATIONS		
				Kind Size	From (Feet)	To (Feet)
6"	6" x D. 18.97	1' above G.L.	to 58'-6"	Mills	151'	155'
6"	5" liner set in	to 190'		Knives	16 holes	
	has a 3' lap into 6" casing				145'	146
					8 holes	134
					133'	
					8 holes	124
					124'	122
Total of 56 holes perforated						

Static Water Level for non-flowing Well 102' from G.L. feet.

Shut-in Pressure for Flowing Well.....

Pumping Water Level 113' feet at 10 gal. per minute.

Discharge in gal. per min. of flowing well.....

How Tested Test pump Length of Test 2 hours

Bailer Tested 15 GPM AT 140'

Remarks: (Gravel packing, cementing, packers, type of shutoff, location of place of use of groundwater if not at well, and any other similar pertinent information, including number of acres irrigated, if used for irrigation).....

NW 1/4 NW Sec 15 T2 R20  
Indicate location of well and place of use, if possible. Each small square represents 10 acres.

Show exact depth of bottom.

License # 7

Driller's License Number

Glenn Camp  
Driller's Signature

This form to be prepared by driller, and three copies to be filed by the owner with the County Clerk and Recorder in the county in which the well is located.

Please answer all questions. If not applicable, so state, otherwise the form will be returned.

Original to the County Clerk and Recorder; duplicate to the State Engineer; Triplicate to the Montana Bureau of Mines and Geology and Quadruplicate for the Appropriator.

3909<sup>0</sup>

#, 493

235826

I received and filed this instrument for  
 record on the 26 day of April, 1965  
 at 2.00 o'clock P.M. permanent files  
 of Missouri Cnty, State of Montana  
 Witness my hand:  
 Verano R. Coyle, County Recorder  
 By Donna A. Rynning, Deputy  
 Fee \$ 2.00 Cash Paid

RECORDED  
 INDEXED  
 APR 26 1965  
 MISSOURI COUNTY, MONTANA

File No. \_\_\_\_\_

**R E C E I V E D**  
AUG 6 1965

T. 12N R. 20W 19

DUPLICATE

County Missoula

LOG

REFERRED TO \_\_\_\_\_

STATE OF MONTANA  
ADMINISTRATOR OF GROUNDWATER CODE  
OFFICE OF STATE ENGINEER

Top of Ground \_\_\_\_\_  
Approx. (Elev. above sea level) 3142'  
Formation Log:

0 - 1 Dirt.  
1 - 50 Gravel & broken rock imbedded in tan clay.  
50 - 96 Broken red rock imbedded in clay.  
96 - 113 Broken red rock imbedded in brown clay.  
113 - 118 Light green rock. Seeps of water.  
118 - 129 Boulder, green.  
129 - 136 Red broken rock. Water.

### Notice of Completion of Groundwater Appropriation by Means of Well

DEVELOPED AFTER JANUARY 1, 1962

(Under Chapter 237, Montana Session Laws, 1961)

**Katherine E. &/or**

Owner J. G. Lamoreaux Address Missoula, Montana

Driller Liberty Drilling Co. Address Missoula, Montana

Date of Notice of appropriation of groundwater None filed

Date well started 7/8/65 Date completed 7/16/65

Type of well Drilled Equipment used Cable Tools  
(Dug, Driven, bored or drilled) (Churn drill, rotary or other)

Water use: Domestic  Municipal  Stock  Irrigation   
Industrial  Drainage  Other

Indicate on the diagram the character and thickness of the different strata met with in drilling, such as soil, clay, shale, gravel, rock or sand, etc. Show depth at which water is encountered, thickness and character of water-bearing strata and height to which the water rises in the well.

Water rises in well 66 ft. from surface.

Size of Drilled Hole	Size and Weight of Casing	From (Feet)	To (Feet)	PERFORATIONS		
				Kind Size	From (Feet)	To (Feet)
6"	6 5/8 OD x 1/4"	+1	136	1/4 x 2 1/2 inch - 24 per foot	124	136

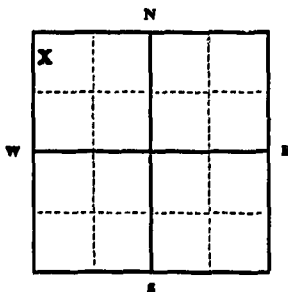

Static Water Level for non-flowing well 66 feet.

Shut-in Pressure for Flowing Well None

Pumping Water Level 150 feet at 8 gal. per minute.

Discharge in gal. per min. of flowing well Non-flowing

How Tested Pump Test

Length of Test 48 hours

Remarks: (Gravel packing, cementing, packers, type of shutoff) All water entering well through perforations in six inch casing

Sec. 15, Title 82, M.C.L.A. Indicate location of well and place of use, if possible. Each small square represents 40 acres.

(Continue on reverse side)

USE—If used for irrigation, industrial, drainage or other. Explain, state number of acres and location or other data (i.e.: Lot, Block and Addition).

1.5 acres

Show exact depth of bottom.

Bottom of hole 136'

This form to be prepared by driller, and three copies to be filed by the owner with the County Clerk and Recorder in the county in which the well is located, tissue copy to be retained by driller.

Please answer all questions. If not applicable, so state, otherwise the form will be returned.

Driller's License Number

Driller's Signature

*William F. Olson*

39400

523

239873

I received and filed this instrument for  
record on the 3 day of Aug 1968  
at 3:30 o'clock P.M. permanent files  
of Missoula County, State of Montana  
Witness my hand:  
Vermae B. Crosson County Recorder  
By *Arleta G. Running* Deputy  
Fee \$ 2.00 Paid

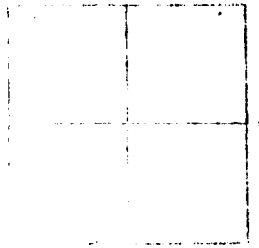

MISSOULA COUNTY RECORDER  
MISSOULA, MONTANA

15

File No .....

T. 12N R. 20W

DUPLICATE

County Missoula

STATE OF MONTANA  
ADMINISTRATOR OF GROUNDWATER CODE  
OFFICE OF STATE ENGINEER

RECEIVED  
SEP 11 1963

Notice of Completion of Groundwater Appropriation Without Well

(Under Chapter 237 Montana Session Laws, 1961)

Date of Appropriation of Groundwater August 16, 1963  
Owner James G. Lamoreaux 2nd  
Katherine E. Lamoreaux Address Missoula, Mont.

Contractor (if any) None

Address of Contractor \_\_\_\_\_

Date Started \_\_\_\_\_ Date Completed \_\_\_\_\_

Describe means of obtaining groundwater without a well "as by sub-irrigation and other natural processes". Include depth to water when applicable.

Surface water (natural spring).  
Pipe for irrigation and domestic use.

Quantity of water developed and used with explanation of method used to measure or estimate such amount. If use is intermittent estimate approximate lengths of periods of use. Use

from April-October annually for  
irrigation of 1 1/2 acres of ground.

Signature of Owner Katherine E. Lamoreaux  
Date Sept 4, 1963

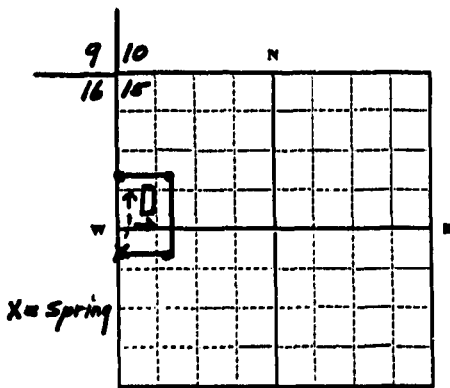

1/4 NW Sec. 15, T. 12N R. 20W  
\* Indicate point of appropriation and place of use, if possible.  
\* See attached diagram

This form to be prepared by contractor (if any), otherwise by the owner.

Three copies of this notice are to be filed with the County Clerk and Recorder of the county in which the works are located.

Please answer all questions. If not applicable, so state, otherwise the form will be returned.

Original to the County Clerk and Recorder; duplicate to the State Engineer; Triplicate to the Montana Bureau of Mines and Geology and Quadruplicate for the Appropriator.

5822.

*Description*

A tract of land located in the NW $\frac{1}{4}$  of Section 15, T.12N., R.20W., Montana Principal Meridian, Missoula County, Montana, more particularly described as follows:-

Beginning at a point which is 418.9 feet S00°01'W from the northwest corner of Section 15, T.12N., R.20W.;

thence S89°59'E for 208.4 feet;  
 thence S00°01'W for 312.6 feet;  
 thence N89°59'W for 208.4 feet;  
 thence N00°01'E for 312.6 feet to the point of beginning.

The tract contains 1.5 acres.

I, R. W. STELLE, CERTIFY THAT I AM A REGISTERED LAND SURVEYOR FOR THE STATE OF MONTANA AND THAT THE HEREIN IS A TRUE REPRESENTATION OF THE SURVEY MADE BY ME.

*R. W. Stelle*  
 8/14/63



Section Line  
 418.9

Point of Beginning

T.12N.

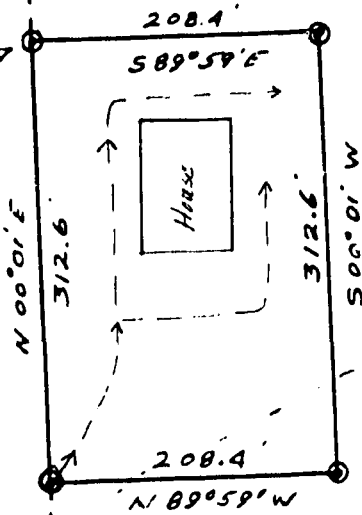

♂ = Spring  
 - - - - - = area to be irrigated

Scale: 1 in. = 100 ft.

- ⊙ = Iron Pin
- - - = Base of hill
- ⬠ = Corner Found

R.20W

8/14/63



RECEIVED  
MAY 11 1959

T. 12 N. R. 20 W. 15

County Missoula

STATE ENGINEER MONTANA BUREAU OF MINES AND GEOLOGY  
Butte, Montana

WATER WELL LOG

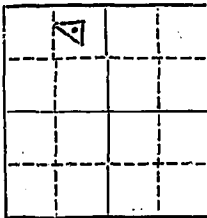

Owner R. L. Stocking *Army Recruiting Office*  
Address #7 Hammond Arcade  
Driller J. L. Camp Address 705 Alder  
Missoula, Mont.  
Date Started April 23, 1959 Date Completed April 28, 1959  
Location: Sec. 15 T. 12 R. 20 1/4 sec. NE 1/4 NW 1/4

Type of well Drilled Equipment used Cable tools  
(Dug, driven, bored, or drilled) (Churn drill, rotary, other)

Water use: Domestic  Municipal  Stock  Irrigation   
Industrial  Drainage  Other: \_\_\_\_\_

Casing: 6' below ground level ft. to 105' - 5" ft. Type 1 1/2" to foot Size 6" I.D.  
standards  
Casing: \_\_\_\_\_ ft. to \_\_\_\_\_ ft. Type \_\_\_\_\_ Size \_\_\_\_\_  
Casing: \_\_\_\_\_ ft. to \_\_\_\_\_ ft. Type \_\_\_\_\_ Size \_\_\_\_\_

Perforated or Screened: Ft. \_\_\_\_\_ to ft. \_\_\_\_\_ Ft. \_\_\_\_\_ to ft. \_\_\_\_\_

Type of screen or perforations \_\_\_\_\_

Static Water level, for non-flowing well: 9.1' from ground level feet.

Shut-in pressure, for flowing well: \_\_\_\_\_ lb./sq. in. on: \_\_\_\_\_ (date)

Pumping water level: 9.1 feet at 16 gal. per min.

How tested: Boilers

Length of test: 2 hours

Remarks: (Gravel packing, cementing, packers, type of shut-off, depth of shut-off)  
\_\_\_\_\_  
\_\_\_\_\_  
\_\_\_\_\_  
\_\_\_\_\_

(over)

**Log of Well**

Depth, feet		Description of Material Drilled
From	To	
0	6'	pit
6'	17'	gravel & clay
9.7'	107'	Clay gravel, makes about 1 1/2 gal of water at 107'
107'	108'	Clay and gravel
108'	110'	gravel and water

By	<i>Kenneth C. Clark</i>	Deputy
Fees \$	50	Paid

I received and filed this instrument for record on the 6<sup>th</sup> day of May, 1957 at 2:30 o'clock p.m. in precinct # 113 of Missouri County, State of Missouri.  
 Witness my hand:  
**MARTIN S. BRINER**  
 County Recorder

#39  
 160961  
 Copy

File No. ....

T. 12 R. 20 W.

DUPLICATE

County Mussieles

STATE OF MONTANA  
ADMINISTRATOR OF GROUNDWATER CODE  
OFFICE OF STATE ENGINEER

RECEIVED  
DEC 10 1963

Declaration of Vested Groundwater Rights  
(Under Chapter 237, Montana Session Laws, 1961)

STATE ENGINEER

1. Daniel O. Maloney, of P.O. Box 100, Mussieles  
(Name of Appropriator) (Address) (Town)

County of Mussieles State of Montana  
have appropriated groundwater according to the Montana laws in effect prior to January 1, 1962, as follows:

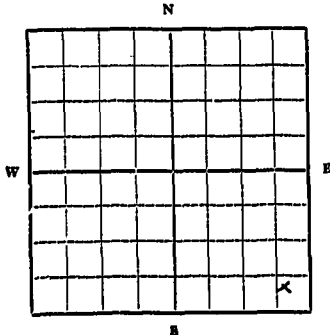

S. 1/4 Sec. 20, T. 12 R. 20 W.

Indicate point of appropriation and place of use, if possible. Each small square represents 10 acres.

2. The beneficial use on which the claim is based domestic irrigation stock

3. Date or approximate date of earliest beneficial use; and how continuous the use has been 1895  
continuous

4. The amount of groundwater claimed (in miner's inches or gallons per minute) 25 inches

5. If used for irrigation, give the acreage and description of the lands to which water has been applied and name of the owner thereof garden, stock

6. The means of withdrawing such water from the ground and the location of each well or other means of withdrawal centrifugal pump

7. The date of commencement and completion of the construction of the well, wells, or other works for withdrawal of groundwater 1895

8. The depth of water table 20 feet

9. So far as it may be available, the type, size and depth of each well or the general specifications of any other works for the withdrawal of groundwater dry well

10. The estimated amount of groundwater withdrawn each year 1000 gals. deep

11. The log of formations encountered in the drilling of each well if available none

12. Such other information of a similar nature as may be useful in carrying out the policy of this act, including reference to book and page of any county record.

Signature of Owner Daniel O. Maloney  
Date Dec 9 - 63

Three copies to be filed by the owner with the County Clerk and Recorder of the county in which the well is located.

Please answer all questions. If not applicable, so state, otherwise the form will be returned.

Original to the County Clerk and Recorder; duplicate to the State Engineer; Triplicate to the Montana Bureau of Mines and Geology and Quadruplicate for the Appropriator.

380

214001

*Copy*  
I received and filed this instrument for  
record on the 7 day of Dec, 1963  
at 4:13 o'clock P.M., permanent files  
of Missoula County, State of Montana  
Witness my hand:  
MARTIN S. BEHNEN, County Recorder  
By [Signature] Deputy  
Fee \$ 3.00 Paid

File No. ....

T. 12 R. 20 22

DUPLICATE

MONTANA WATER RESOURCES BOARD  
**RECEIVED**  
LOG  
JUN 11 1968

County.....

STATE OF MONTANA  
ADMINISTRATOR OF GROUNDWATER CODE  
OFFICE OF STATE ENGINEER

### Notice of Completion of Groundwater Appropriation by Means of Well

DEVELOPED AFTER JANUARY 1, 1962

(Under Chapter 237, Montana Session Laws, 1961)

GL	Top of Ground
28'	(Elev. above sea level.....)
28'	tan clay, sand, gravel & broken rock
57'	purple broken rock
57'	yellow & green rock
99'	seep of water in purple & lavender rock
100'	purple & lavender rock
129'	seep of water in green rock
133'	green rock
147'	purple rock
200'	small seep of rock

Owner... JOHN GILBERTSON ..... Address... RT. 3 BITTERBOT RD.

Driller... KEN WILLIAMS ..... Address... MISSOULA, MONT.  
1558 So. 3th. E.

Date of Notice of appropriation of groundwater.....  
MISSOULA, MONT.

Date well started... MAY 7, 68 ..... Date completed... MAY 21, 68

Type of well... drilled ..... Equipment used... churn  
(Dug, driven, bored or drilled) (Churn drill, rotary or other)

Water use: Domestic  Municipal  Stock  Irrigation   
Industrial  Drainage  Other

Indicate on the diagram the character and thickness of the different strata met with in drilling, such as soil, clay, shale, gravel, rock or sand, etc. Show depth at which water is encountered, thickness and character of water-bearing strata and height to which the water rises in the well.

Size of Drilled Hole	Size and Weight of Casing	From (Feet)	To (Feet)	PERFORATIONS		
				Kind Size	From (Feet)	To (Feet)
6" I.D.	6-5/8" O.D. 17 lbs. 1/2" side wall	ground level	200 ft.	5" well casing liner torch cut 1/2"	99'	200'

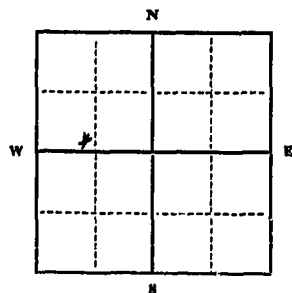

Static Water Level for non-flowing well ..... 90 ..... feet.

Shut-in Pressure for Flowing Well.....

Pumping Water Level... 198 ..... feet  
at... 5 ..... gal. per minute.

Discharge in gal. per min. of flowing well .....

How Tested... bail & sub. test pump

Length of Test... 9 ..... hours

Remarks: (Gravel packing, cementing, packers, type of shutoff).....

W 1/2 NW 1/4 Sec 22 T. 12 R. 20  
Indicate location of well and place of use, if possible. Each small square represents 40 acres.

.....(Continue on reverse side)

USE—If used for irrigation, industrial, drainage or other. Explain, state number of acres and location or other data (i.e.: Lot, Block and Addition).

Show exact depth of bottom.

This form to be prepared by driller, and three copies to be filed by the owner with the County Clerk and Recorder in the county in which the well is located, tissue copy to be retained by driller.

Please answer all questions. If not applicable, so state, otherwise the form will be returned.

151  
Driller's License Number

Ken Williams  
Driller's Signature.

44217

97

271745

I received and filed this instrument for record on the 7 day of May, 1968, at 10:00 o'clock A.M., permanent files of Missoula County, State of Montana.  
Witness my hand:  
Vername B. Couse, County Recorder  
By H. Bellinger, Deputy  
Fee \$ 2.00 Paid

MISSOULA COUNTY RECORDER  
MISSOULA, MONTANA

22

File No. ....

T. 12N R. 20W

DUPLICATE

County Missoula, Montana.

STATE OF MONTANA  
ADMINISTRATOR OF GROUNDWATER CODE  
OFFICE OF STATE ENGINEER

RECEIVED  
DEC 30 1963

Declaration of Vested Groundwater Rights

(Under Chapter 237, Montana Session Laws, 1961)

STATE ENGINEER

I, Darrel W. Hill, of 312 So. 5th St. W. Missoula,  
(Name of Appropriator) (Address) (Town)

County of Missoula State of Montana  
have appropriated groundwater according to the Montana laws in effect prior to January 1, 1962, as follows:

X	X				
X	X				
X	X				
X	X				
X	X				
X	X				

2. The beneficial use on which the claim is based  
Household and irrigation

3. Date or approximate date of earliest beneficial use; and how continuous the use has been.  
contemplate developing acreage and will drill well or wells in near future.

4. The amount of groundwater claimed (in miner's inches or gallons per minute) 3 minors inches to the acre

5. If used for irrigation, give the acreage and description of the lands to which water has been applied and name of the owner thereof  
Forty acres in the SW 1/4 of NW 1/4 and in the

W 1/2 NW 1/4, NW 1/4 SW 1/4, less Pt. Sold.  
1/4 Sec 22 T. 12N R. 20W. 105 Acres. NW 1/4 of the SW 1/4

Indicate point of appropriation and place of use, if possible. Each small square represents 10 acres.

6. The means of withdrawing such water from the ground and the location of each well or other means of withdrawal  
Well and pump

7. The date of commencement and completion of the construction of the well, wells, or other works for withdrawal of groundwater Sometime in 1966.

8. The depth of water table From 170' to 250'

9. So far as it may be available, the type, size and depth of each well or the general specifications of any other works for the withdrawal of groundwater Undetermined.

10. The estimated amount of groundwater withdrawn each year what ever is available.

11. The log of formations encountered in the drilling of each well if available Not available

12. Such other information of a similar nature as may be useful in carrying out the policy of this act, including reference to book and page of any county record Book of deeds 224, Page 383, In office of Clerk & Recorder, Missoula County, Montana.

Signature of Owner Darrel W. Hill

Date December 30th, 1963.

Three copies to be filed by the owner with the County Clerk and Recorder of the county in which the well is located.

Please answer all questions. If not applicable, so state, otherwise the form will be returned.

Original to the County Clerk and Recorder; Duplicate to the State Engineer; Triplicate to the Montana Bureau of Mines and Geology, and Quadruplicate for the Appropriator.

15283

712

215 120

I received and filed this instrument for  
 record on the 30 day of Dec 1963  
 at 10:58 o'clock A.M., permanent files  
 of Missoula County, State of Montana  
 Witness my hand:  
 MARTIN S. BEHNER, County Recorder  
 By [Signature] Deputy  
 Fee \$ 2.00 Paid

MISSOULA COUNTY RECORDS DEPARTMENT  
 600 NORTH GARDNER STREET  
 MISSOULA, MONTANA 59801  
 TEL. 544-1234



File No. \_\_\_\_\_

DUPLICATE

*No filing data?*

RECEIVED  
AUG 5 1964

Approved Stock Form—State Publishing Co., Helena, Montana—41933

T. 12 N. R. 20 West

County Missoula

STATE OF MONTANA  
ADMINISTRATOR OF GROUNDWATER CODE  
OFFICE OF STATE ENGINEER

JUN 27 1964

### Notice of Completion of Groundwater Appropriation by Means of Well

(Under Chapter 237, Montana Session Laws, 1961)

Well at Lolo Creek

Owner John C. Hoe Address Bitterroot Rd

Driller Glenn Camp 705 Alder Address Missoula, Montana

Date of Notice of Appropriation of Groundwater \_\_\_\_\_

Date well started May 5, 1964 Date Completed May 25, 1964

Type of well Drilled Equipment Used Churn drill  
(dug, driven, bored or drilled) (Churn, drill, rotary or other)

Water Use: Domestic  Municipal  Other  Irrigation   
Industrial  Drainage  Stock

Indicate on the diagram the character and thickness of the different strata met with in drilling, such as soil, clay, shale, gravel, rock or sand, etc. Show depth at which water is encountered, thickness and character of water-bearing strata and height to which water rises in the well.

Top of Ground  
(Elev. above sea level.....)  
  
0 to 64' Clay & broken shale.  
64' to 77' Yellow clay  
77' to 95' Purple clay  
a trace of water at 77'  
95' to 95'  
95' to 101' Green clay  
101' to 114' Purple clay & small gravel  
114' to 143' Purple shale  
143' to 198' Green shale  
(water from 190'-193'  
198' to 199' Purple shale  
(no water)

Size of Drilled Hole	Size and Weight of Casing	From (Feet)	To (Feet)	PERFORATIONS		
				Kind Size	From (Feet)	To (Feet)
6"	6" I.D. 18.37 #	2' above G.L. to 190' 1' open below casing	Knife	190'	198'	
5 holes per foot						

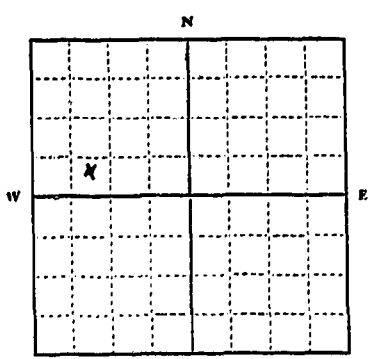

Static Water Level for non-flowing Well 110' feet.

Shut-in Pressure for Flowing Well 186' 10

Pumping Water Level \_\_\_\_\_ feet at \_\_\_\_\_ gal. per minute.

Discharge in gal. per min. of flowing well \_\_\_\_\_

How Tested Bailer Length of Test 3 hours

Remarks: (Gravel packing, cementing, packers, type of shutoff, location of place of use of groundwater if not at well, and any other similar pertinent information, including number of acres irrigated, if used for irrigation) Use of water at house, is 165 feet North of well.

W 1/2 NW 1/4 Sec. 22 T. 12 N. R. 20 W. P.M.M.

Indicate location of well and place of use, if possible. Each small square represents 10 acres.

Show exact depth of bottom.

Licence # 7

Driller's License Number \_\_\_\_\_  
Glenn Camp  
Driller's Signature

This form to be prepared by driller, and three copies to be filed by the owner with the County Clerk and Recorder in the county in which the well is located.

Please answer all questions. If not applicable, so state, otherwise the form will be returned.

Original to the County Clerk and Recorder; duplicate to the State Engineer; Triplicate to the Montana Bureau of Mines and Geology and Quadruplicate for the Appropriator.

38209

1421

223440

I received and filed this instrument for  
 record on the 20 day of July, 1964  
 at 12:30 o'clock P.M., permanent files  
 of Missoula County, State of Montana  
 Witness my hand:  
James R. Gause, County Recorder  
 By Paul Bennett, Deputy  
 Fee \$ 2.00 Paid

C



2274

316561

I received and filed this instrument for  
record on the 11<sup>th</sup> day of May 1972  
at 9:00 o'clock A.M. permanent file  
in Missoula County State of Montana  
Witness my hand  
Thomas R. Green, County Register  
By Thomas R. Green, Deputy  
Fee 2.00 Paid