

copy

#302

212138

I received and filed this instrument for  
record on the 21<sup>st</sup> day of Oct. 1963  
at 2:46 o'clock P.M., permanent files  
of Missoula County, State of Montana  
Witness my hand:  
MARTIN S. BEHNER, County Recorder  
By *Diane [Signature]* Deputy  
Fee \$ *7.00* Paid



File No. \_\_\_\_\_

T. 12N R. 22W

DUPLICATE

County Missoula

LOG

STATE OF MONTANA  
ADMINISTRATOR OF GROUNDWATER CODE  
OFFICE OF STATE ENGINEER

Top of Ground

(Elev. above sea level... 3720... FEB 26

Ground Level  
0 to 3' Top soil

3' to 38' Clay, rock  
& Gravel ( Lt Brown)

38' to 49'  
Clay

49' to 50' clay, gravel  
trace of water  
50 to 53' Clay & gravel  
53' to 54' water, gravel &  
sand  
54' to 58' Decomposed  
granite & water  
58' to 60' Bed rock

**Notice of Completion of Groundwater  
Appropriation by Means of Well**

DEVELOPED AFTER JANUARY 1, 1962

(Under Chapter 237, Montana Session Laws, 1961)

Well at Lewis & Clark Camp ground

Owner Lolo National Forest Address Missoula, Montana

Driller Glenn Camp Address 1522 S. 14th, Missoula

Date of Notice of appropriation of groundwater \_\_\_\_\_

Date well started 2/18/69 Date completed 2/22/69

Type of well Drilled Equipment used Churn drill  
(Dug, driven, bored or drilled) (Churn drill, rotary or other)

Water use: Domestic  Municipal  Stock  Irrigation   
Industrial  Drainage  Other

Indicate on the diagram the character and thickness of the different strata met with in drilling, such as soil, clay, shale, gravel, rock or sand, etc. Show depth at which water is encountered, thickness and character of water-bearing strata and height to which the water rises in the well.

Size of Drilled Hole	Size and Weight of Casing	From (Feet)	To (Feet)	PERFORATIONS		
				Kind Size	From (Feet)	To (Feet)
6"	6" I.O.	2'-3" above G.L.	54'-3"	none		

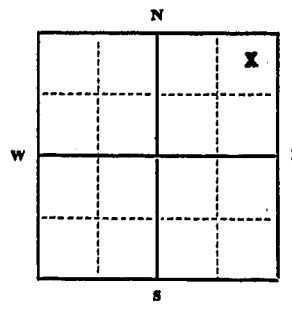

Static Water Level for non-flowing well  
... 33'-6" feet.

Shut-in Pressure for Flowing Well \_\_\_\_\_  
Pumping Water Level 50 feet  
at 10 gal. per minute.

Discharge in gal. per min. of flowing well \_\_\_\_\_

How Tested test pump  
Length of Test 2 hours

Remarks: (Gravel packing, cementing, packers, type of shutoff) 10' of cement

grout.  
S.W.L. 33'6" to start test.

Test pumped @ 12 G.P.M. for  
45 Min DD 53' Covered in 15 min

Cut pump to 11 G.P.M. for 45 Min D.D. 56'  
Cut Pump to 10 G.P.M. for 30 Min W.B. (continue on reverse side)

NE 1/4 NE Sec 29 T. 12N. R. 22W.  
Indicate location of well and place of use, if possible. Each small square represents 40 acres.

USE—If used for irrigation, industrial, drainage or other. Explain, state number of acres and location or other data (i.e.: Lot, Block and Addition).

Show exact depth of bottom.

This form to be prepared by driller, and three copies to be filed by the owner with the County Clerk and Recorder in the county in which the well is located, tissue copy to be retained by driller.

Please answer all questions. If not applicable, so state, otherwise the form will be returned.

License # 7  
Driller's License Number  
Glenn Camp  
Driller's Signature.

45,025

1857

279043

I received and filed this instrument for  
 record on the 24<sup>th</sup> day of Feb 1969  
 at 11:00 o'clock A.M., permanent files  
 of Missoula County, State of Montana  
 Witness my hand:  
 Veramoo R. Coups, County Recorder  
 By J. J. Conroy Deputy  
 Fee \$2.00 Paid cash

STATE OF MONTANA  
 MISSOULA COUNTY  
 RECORDER'S OFFICE  
 2017 2018 2019 2020 2021  
 1 2 3 4 5 6 7 8 9 10 11 12  
 13 14 15 16 17 18 19 20 21 22 23 24 25 26 27 28 29 30 31  
 32 33 34 35 36 37 38 39 40 41 42 43 44 45 46 47 48 49 50 51 52  
 53 54 55 56 57 58 59 60 61 62 63 64 65 66 67 68 69 70 71 72 73 74 75 76 77 78 79 80 81 82 83 84 85 86 87 88 89 90 91 92 93 94 95 96 97 98 99 100  
 101 102 103 104 105 106 107 108 109 110 111 112 113 114 115 116 117 118 119 120 121 122 123 124 125 126 127 128 129 130 131 132 133 134 135 136 137 138 139 140 141 142 143 144 145 146 147 148 149 150 151 152 153 154 155 156 157 158 159 160 161 162 163 164 165 166 167 168 169 170 171 172 173 174 175 176 177 178 179 180 181 182 183 184 185 186 187 188 189 190 191 192 193 194 195 196 197 198 199 200 201 202 203 204 205 206 207 208 209 210 211 212 213 214 215 216 217 218 219 220 221 222 223 224 225 226 227 228 229 230 231 232 233 234 235 236 237 238 239 240 241 242 243 244 245 246 247 248 249 250 251 252 253 254 255 256 257 258 259 260 261 262 263 264 265 266 267 268 269 270 271 272 273 274 275 276 277 278 279 280 281 282 283 284 285 286 287 288 289 290 291 292 293 294 295 296 297 298 299 300 301 302 303 304 305 306 307 308 309 310 311 312 313 314 315 316 317 318 319 320 321 322 323 324 325 326 327 328 329 330 331 332 333 334 335 336 337 338 339 340 341 342 343 344 345 346 347 348 349 350 351 352 353 354 355 356 357 358 359 360 361 362 363 364 365 366 367 368 369 370 371 372 373 374 375 376 377 378 379 380 381 382 383 384 385 386 387 388 389 390 391 392 393 394 395 396 397 398 399 400 401 402 403 404 405 406 407 408 409 410 411 412 413 414 415 416 417 418 419 420 421 422 423 424 425 426 427 428 429 430 431 432 433 434 435 436 437 438 439 440 441 442 443 444 445 446 447 448 449 450 451 452 453 454 455 456 457 458 459 460 461 462 463 464 465 466 467 468 469 470 471 472 473 474 475 476 477 478 479 480 481 482 483 484 485 486 487 488 489 490 491 492 493 494 495 496 497 498 499 500 501 502 503 504 505 506 507 508 509 510 511 512 513 514 515 516 517 518 519 520 521 522 523 524 525 526 527 528 529 530 531 532 533 534 535 536 537 538 539 540 541 542 543 544 545 546 547 548 549 550 551 552 553 554 555 556 557 558 559 560 561 562 563 564 565 566 567 568 569 570 571 572 573 574 575 576 577 578 579 580 581 582 583 584 585 586 587 588 589 590 591 592 593 594 595 596 597 598 599 600 601 602 603 604 605 606 607 608 609 610 611 612 613 614 615 616 617 618 619 620 621 622 623 624 625 626 627 628 629 630 631 632 633 634 635 636 637 638 639 640 641 642 643 644 645 646 647 648 649 650 651 652 653 654 655 656 657 658 659 660 661 662 663 664 665 666 667 668 669 670 671 672 673 674 675 676 677 678 679 680 681 682 683 684 685 686 687 688 689 690 691 692 693 694 695 696 697 698 699 700 701 702 703 704 705 706 707 708 709 710 711 712 713 714 715 716 717 718 719 720 721 722 723 724 725 726 727 728 729 730 731 732 733 734 735 736 737 738 739 740 741 742 743 744 745 746 747 748 749 750 751 752 753 754 755 756 757 758 759 760 761 762 763 764 765 766 767 768 769 770 771 772 773 774 775 776 777 778 779 780 781 782 783 784 785 786 787 788 789 790 791 792 793 794 795 796 797 798 799 800 801 802 803 804 805 806 807 808 809 810 811 812 813 814 815 816 817 818 819 820 821 822 823 824 825 826 827 828 829 830 831 832 833 834 835 836 837 838 839 840 841 842 843 844 845 846 847 848 849 850 851 852 853 854 855 856 857 858 859 860 861 862 863 864 865 866 867 868 869 870 871 872 873 874 875 876 877 878 879 880 881 882 883 884 885 886 887 888 889 890 891 892 893 894 895 896 897 898 899 900 901 902 903 904 905 906 907 908 909 910 911 912 913 914 915 916 917 918 919 920 921 922 923 924 925 926 927 928 929 930 931 932 933 934 935 936 937 938 939 940 941 942 943 944 945 946 947 948 949 950 951 952 953 954 955 956 957 958 959 960 961 962 963 964 965 966 967 968 969 970 971 972 973 974 975 976 977 978 979 980 981 982 983 984 985 986 987 988 989 990 991 992 993 994 995 996 997 998 999 1000

File No. \_\_\_\_\_

T. 12 N. R. 22 E. 29

DUPLICATE

County Missoula

LOG

STATE OF MONTANA  
ADMINISTRATOR OF GROUNDWATER  
OFFICE OF STATE ENGINEER

RECEIVED  
OCT 28 1964

Top of Ground

(Elev. above sea level \_\_\_\_\_)

16 1/2

clay and cobble gravel

12 1/2

rock with a crack about 4" with water

### Notice of Completion of Groundwater Appropriation by Means of Well

DEVELOPED AFTER JANUARY 1, 1962

(Under Chapter 237, Montana Session Laws, 1961)

Owner U.S.D.A. Forest Service Address Missoula

Driller Kane Water Well Drilling Address St. Regis

Date of Notice of appropriation of groundwater 8/31/64

Date well started 9/25/64 Date completed 9/30/64

Type of well drilled Equipment used shure  
(Dug, Driven, bored or drilled) (Churn drill, rotary or other)

Water use: Domestic  Municipal  Stock  Irrigation   
Industrial  Drainage  Other

Indicate on the diagram the character and thickness of the different strata met with in drilling, such as soil, clay, shale, gravel, rock or sand, etc. Show depth at which water is encountered, thickness and character of water-bearing strata and height to which the water rises in the well.

Size of Drilled Hole	Size and Weight of Casing	From (Feet)	To (Feet)	PERFORATIONS		
				Kind Size	From (Feet)	To (Feet)
6" id	6" id 18.4# 0		16 1/2	does not apply		

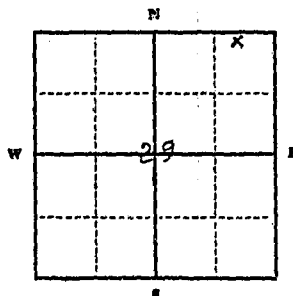

Static Water Level for non-flowing well

16 1/2 feet.

Shut-in Pressure for Flowing Well \_\_\_\_\_

Pumping Water Level \_\_\_\_\_ feet

at 1 1/2 gal. per minute.

Discharge in gal. per min. of flowing well \_\_\_\_\_

How Tested bailing

Length of Test 1 hour

Remarks: (Gravel packing, cementing, packers, type of shutoff) \_\_\_\_\_

1/4 Sec. 29, T. 12N R. 22E  
Indicate location of well and place of use, if possible. Each small square represents 40 acres.

(Continue on reverse side)

USE—If used for irrigation, industrial, drainage or other. Explain, state number of acres and location or other data (i.e.: Lot, Block and Addition).

20 Show exact depth of bottom.

This form to be prepared by driller, and three copies to be filed by the owner with the County Clerk and Recorder in the county in which the well is located, tissue copy to be retained by driller.

Please answer all questions. If not applicable, so state, otherwise the form will be returned.

23 Driller's License Number

Eugene S. Kane  
Driller's Signature

38607

1454

228125

I received and filed this instrument for  
 record on the 22 day of Oct. 19 67  
 at 12:45 o'clock P.M., permanent files  
 of Missouri County, State of Missouri  
 Witness my hand:  
 Virchow H. Cruse, County Recorder  
 By *Joann D. Bolton* Deputy  
 Fee \$ *1.00* Paid

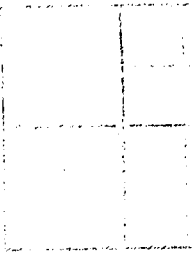

661 58 024

City Missoula

Twp. 12 North Rge. 21 West

Name of Appropriator	Type of Form	County File No.	Remarks
<del>James, Robert</del>	<del>GW 2</del>	<del>266750</del>	19 West
<del>James, Robert</del>	<del>GW 4</del>	<del>27212</del>	"
<del>James, Robert</del>	<del>GW 4</del>	<del>27213</del>	"
<del>James, Robert</del>	<del>GW 2</del>	<del>27214</del>	"
<del>James, Robert</del>	<del>GW 4</del>	<del>21443</del>	"
Zolo Land & Livestock	GW 4	214398	
Moore, Dale	GW 2	306013	
Moore, Dale	GW 2	306077	
Augen, Olive M	GW 2	327117	
Worlet, Emily	GW 2	214749	
Haugen, Olive M	GW 2	327118	
Zolo Land & Livestock	GW 4	214397	
Zolo Land & Livestock	GW 4	214399	
Zolo Land & Livestock	GW 4	214395	
Zolo Land & Livestock	GW 2	214400	
Planty, Fred	GW 2	296987	
Hamilton, Don	GW 2	247795	
Lister, E.W.	GW 4	214938	
Lister, E.W.	GW 2	214836	
Lister, E.W.	GW 2	214937	
MacPherson, Cole L	GW 2	329723	
Skubsted, Eric	GW 2	315116	
Allan, William D	GW 2	320459	
Bonebright, O.D.	1957509	145890	
Collins, James L.	GW 4	215245	
Demot, Ronald E	GW 2	334,331	
Escene, Gordon	GW 2	317152	
Fletcher, A.W.	GW 2	276334	
Graydenes, Marie	GW 2	323843	
Graydenes, Marie	GW 2	330590	
Harbridge, Charles	GW 2	270739	
Jockrisen, Richard	GW 2	284845	
Kirkema, Harold	GW 2	321830	
Harbridge, Robert J	GW 2	260314	
Prelat, James	GW 2	323997	
Thayer, Kenward	GW 4	210911	
Thayer, K.N (mes)	GW 2	294756	
Thayer, K.N (mes)	GW 2	294994	
Thayer, K.N (mes)	GW 2	294755	
Truby, Lowell	GW 2	321463	
Uss, Ernest	GW 2	260700	
Weinard, Gerone	GW 2	243915	
Thayer, Kenward	GW 2	247218	

File No. ....

TRIPPLICATE

T. 12N R. 21W  
County Missoula  
DEC 19 1963

RECEIVED

STATE OF MONTANA  
ADMINISTRATOR OF GROUNDWATER CODE  
OFFICE OF STATE ENGINEER

(Main Ranch Shop)  
STATE ENGINEER  
Side of Road

**Declaration of Vested Groundwater Rights**  
(Under Chapter 237, Montana Session Laws, 1961)

Lolo Land and Livestock Company, a division of C. C. Realty Corporation  
(Name of Appropriator) of Lolo (Address) (Town)

County of Missoula State of Montana  
have appropriated groundwater according to the Montana laws in effect prior to January 1, 1962, as follows:

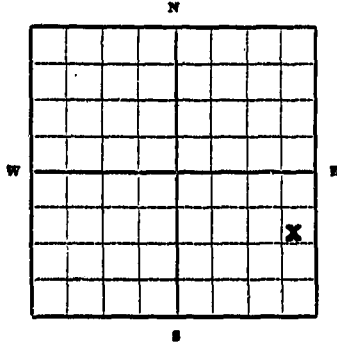

S. 1/4 E. Sec. 29. T12N R21W  
Indicate point of appropriation and place of use, if possible. Each small square represents 10 acres.

- 2. The beneficial use on which the claim is based Stock water
- 3. Date or approximate date of earliest beneficial use; and how continuous the use has been Year of 1900.
- 4. The amount of groundwater claimed (in miner's inches or gallons per minute) 5 gallons per minute
- 5. If used for irrigation, give the acreage and description of the lands to which water has been applied and name of the owner thereof Spring piped to trough. May develop for irrigating pasture below.
- 6. The means of withdrawing such water from the ground and the location of each well or other means of withdrawal Pipe to trough, from Spring.

- 7. The date of commencement and completion of the construction of the well, wells, or other works for withdrawal of groundwater Not available
- 8. The depth of water table Not applicable
- 9. So far as it may be available, the type, size and depth of each well or the general specifications of any other works for the withdrawal of groundwater four (4) foot square box in Spring with 1 1/2" pipe to trough.
- 10. The estimated amount of groundwater withdrawn each year 263,000 gallons
- 11. The log of formations encountered in the drilling of each well if available Not applicable
- 12. Such other information of a similar nature as may be useful in carrying out the policy of this act, including reference to book and page of any county record Not applicable

Signature of Owner [Signature]  
Lolo Land and Livestock Co. D. B. Ozmun, Pres  
a division of C. C. Realty Corporation Date November 25, 1963

Three copies to be filed by the owner with the County Clerk and Recorder of the county in which the well is located.

Please answer all questions. If not applicable, so state, otherwise the form will be returned.

Original to the County Clerk and Recorder; duplicate to the State Engineer; Triplicate to the Montana Bureau of Mines and Geology and Quadruplicate for the Appropriator.

10417



419

214398  
copy

I received and filed this instrument for  
record on the 17 day of Dec 1963  
at 1:05 o'clock P.M., permanent files  
of Missoula County, State of Montana  
Witness my hand:  
MARTIN S. BEHNER, County Recorder  
By Ethel Lane Deputy  
Fee \$ 2.00



#2151

306073

I received and filed this instrument for  
record on the 5<sup>th</sup> day of Aug, 1971  
at 10:00 o'clock P.M. per 2 min files  
of Missoula County, State of Montana  
Witness my hand  
Yvonne A. Cross, County Recorder  
By [Signature] Deputy  
Fee 1.20 Paid

STATE OF MONTANA  
ADMINISTRATOR OF GROUNDWATER CODE  
MONTANA WATER RESOURCES BOARD  
**NOTICE OF COMPLETION OF GROUNDWATER  
APPROPRIATION BY MEANS OF WELL**

Developed after January 1, 1962

(Under Chapter 237 Montana Session Laws, 1961, as amended)

This form to be prepared by driller, and three copies to be filed by the owner with the County Clerk and Recorder in the county in which the well is located, last copy to be retained by driller.

Please answer all questions. If not applicable, so state, otherwise the form may be returned.

Owner Dale Myers  
Address Woodman Ranch  
Lois, Montana  
Date well started July 13, 1979  
completed July 14, 1979

For Administrator's Use	
File	<u>306077</u>
	<u>August 5, 1979</u>
	<u>1:12 PM</u>
GW 1	

Type of well Drilled  
(Dig, driven, bored or drilled)  
Equipment used Churn Drill  
(Churn drill, rotary or other)  
Water Use: Domestic  Municipal  Stock  Irrigation   
Industrial  Drainage  Other  Garden/Lawn

\*Describe \_\_\_\_\_  
USE: If used for irrigation, industrial, drainage or other. Explain, state number of acres and location or other data (i.e. Lot, Block and Addition). \_\_\_\_\_

ESTIMATED ANNUAL WITHDRAWAL

Size of Drilled Hole	Size and Weight of Packer	From (Feet)	To (Feet)	PERFORATIONS		
				Kind Size	From (Feet)	To (Feet)
<u>6" I.D.</u>	<u>17 lb per ft.</u>	<u>Casing</u>	<u>Pulled</u>			

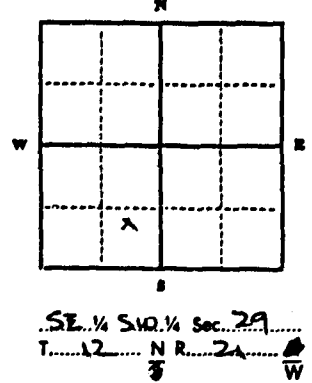

Static water level .....ft.\*  
Pumping water level .....ft.\*  
at .....gallons per minute,  
measured .....minutes after pumping  
began.  
\*Measured from ground level.  
Well developed by .....  
for .....hours.  
Power..... Pump..... HP  
Remarks: (Gravel packing, cementing,  
packers, type of shutoff) .....  
Dry Hole - Casing pulled

Top of Ground (Elev. above sea level)

From (Feet)	To (Feet)	Well # 1
<u>0</u>	<u>1</u>	<u>Black Dirt &amp; gravel</u>
<u>1</u>	<u>9</u>	<u>Clay and gravel</u>
<u>9</u>	<u>29</u>	<u>Clay Gravel &amp; sandstone</u>
<u>29</u>	<u>33</u>	<u>Sand Gravel &amp; water</u>
<u>33</u>	<u>39</u>	<u>Clay and gravel</u>
<u>39</u>	<u>50</u>	<u>Rock</u>

INDICATE LOCATION OF WELL AND PLACE OF USE, IF POSSIBLE. EACH SMALL SQUARE REPRESENTS 40 ACRES.

Driller's Signature Dale Myers  
Camp Well Drilling & Pump Supply  
Driller's Address 1522 S. 14th W., Missoula, Montana 59804

LICENSE NO. 7

50 Show exact depth of bottom

48842

# 2160

306077

I received and filed this instrument for  
record on the 5 day of Aug 18 71  
at 11 o'clock A.M., permanent file  
of Missoula County, State of Montana  
Witness my hand  
Verance B. Crouse, County Recorder  
By Dorothy A. Crouse, Deputy  
Fee \$ 2.00 Cash Paid ✓

1931 1932 1933 1934 1935 1936 1937 1938 1939 1940 1941 1942 1943 1944 1945 1946 1947 1948 1949 1950 1951 1952 1953 1954 1955 1956 1957 1958 1959 1960 1961 1962 1963 1964 1965 1966 1967 1968 1969 1970 1971 1972 1973 1974 1975 1976 1977 1978 1979 1980 1981 1982 1983 1984 1985 1986 1987 1988 1989 1990 1991 1992 1993 1994 1995 1996 1997 1998 1999 2000 2001 2002 2003 2004 2005 2006 2007 2008 2009 2010 2011 2012 2013 2014 2015 2016 2017 2018 2019 2020 2021 2022 2023 2024 2025

STATE OF MONTANA  
ADMINISTRATOR OF GROUNDWATER CODE  
MONTANA WATER RESOURCES BOARD

**NOTICE OF COMPLETION OF GROUNDWATER  
APPROPRIATION BY MEANS OF WELL**

Developed after January 1, 1962

(Under Chapter 237 Montana Session Laws, 1961, as amended)

This form to be prepared by driller, and three copies to be filed by the owner with the County Clerk and Recorder in the county in which the well is located, last copy to be retained by driller.

Please answer all questions. If not applicable, so state, otherwise the form may be returned.

Owner Olive M. Haugen

Address 541 McLeod Ave.  
Missoula, Montana

Date well started 12/23/68

completed 1/4/69

Type of well Drilled  
(Dug, driven, bored or drilled)

Equipment used Cable Tools  
(Churn drill, rotary or other)

Water Use: Domestic  Municipal  Stock  Irrigation   
Industrial  Drainage  Other \* Garden/Lawn

\*Describe

USE: If used for irrigation, industrial, drainage or other. Explain, state number of acres and location or other data (e.g., lot block and address) for the area to be irrigated, etc.

ESTIMATED ANNUAL WITHDRAWAL 9,307,200 gallons

Size of Drilled Hole	Size and Weight of Casing	From (Foot)	To (Foot)	PERFORATIONS		
				Kind Size	From (Foot)	To (Foot)
6"	6 5/8" OD x 1/2"	Plus 3'4"	58	Casing is perforated in place with Mills Knife and 39 and 52'6" 40 53'6"		

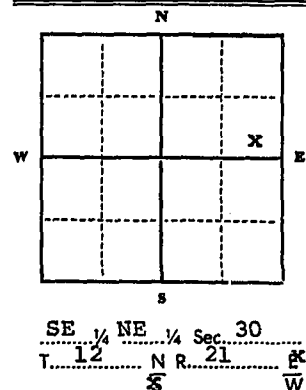

Static water level 10 ft.\*  
 Pumping water level 30 ft.\*  
 at 12 gallons per minute,  
 measured 240 minutes after pumping  
 began.  
 \*Measured from ground level.  
 Well developed by Air Lift Pump  
 for Four hours.  
 Power Gas Pump 30 HP  
 Remarks: (Gravel packing, cementing, packers, type of shutoff) All water entering well through perforations in casing.  
Wells in this area can be depended upon to

INDICATE LOCATION OF WELL AND PLACE OF USE, IF POSSIBLE. EACH SMALL SQUARE REPRESENTS 40 ACRES.

Driller's Signature Liberty Drilling Company

Driller's Address 2500 Reserve Street  
Missoula, Montana

LICENSE NO. 52

**DRILLER'S LOG**

Indicate the character, color, thickness of strata such as soil, clay, sand, gravel, shale, sandstone, etc. Show depth at which water is found and height to which water rises in well.

Top of Ground Approx (Elev. above sea level) 3575'

From (Feet)	To (Feet)	
0	2	Topsoil
2	7	Tan clay
7	22	Claybound gravel
22	27	Silty sand & gravel
27	36	Sand & gravel mixed in tan clay. Seeps of water
36	58	Fractured gray rock. Water

58' Show exact depth of bottom Water rises in the well ten feet from surface.

103

327117

I received and filed this instrument for  
 record on the 19 day of June 1927  
 at 12:05 o'clock P. M., permanent files  
 of Missoula County, State of Montana  
 Witness my hand:  
 Dorothy L. Head, County Recorder  
 By Samuel K. Kelly, Deputy  
 Fee \$ 2.00 each Paid

RECORDED  
 INDEXED  
 JUN 20 1927  
 MISSOULA, MONTANA

GW3

File No. ....

T. 12<sup>N</sup> R. 21<sup>W</sup>

30

DUPLICATE

County Missoula

STATE OF MONTANA  
ADMINISTRATOR OF GROUNDWATER CODE  
OFFICE OF STATE ENGINEER

RECEIVED  
DEC 26 1963

**Notice of Completion of Groundwater Appropriation Without Well**

STATE ENGINEER

(Under Chapter 237 Montana Session Laws, 1961)

Date of Appropriation of Groundwater About 1904

Owner Emily M. Hoyat Address Lolo, Montana

Contractor (if any) No contractor

Address of Contractor .....

Date Started..... Date Completed.....

Describe means of obtaining groundwater without a well "as by sub-irrigation and other natural processes". Include depth to water when applicable.....

This is a spring used for water for household and stock, as well as yard and garden.

Quantity of water developed and used with explanation of method used to measure or estimate such amount. If use is intermittent estimate approximate lengths of periods of use .....

Used continuously for household and stock, and for yard and garden in spring, summer and fall.

Signature of Owner Emily M. Hoyat

Date December 20, 1963

NW 1/4 SE 1/4 Sec. 30 T. 12 R. 21  
Indicate point of appropriation and place of use, if possible.

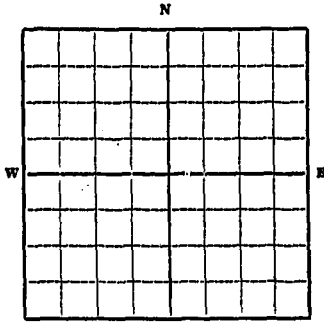

This form to be prepared by contractor (if any), otherwise by the owner.

Three copies of this notice are to be filed with the County Clerk and Recorder of the county in which the works are located.

Please answer all questions. If not applicable, so state, otherwise the form will be returned.

Original to the County Clerk and Recorder; duplicate to the State Engineer; Triplicate to the Montana Bureau of Mines and Geology and Quaduplicate for the Appropriator.

12322



502

314749

I received and filed this instrument for  
record on the 23 day of Dec 1963  
at 3:08 o'clock P.M., permanent files  
of Missoula County, State of Montana  
Witness my hand:  
MARTIN S. BEHNKE, County Recorder  
By *E. J. [Signature]* Deputy  
Fee \$ 1.00 Paid

RECEIVED  
MAY 1969

STATE OF MONTANA  
ADMINISTRATOR OF GROUNDWATER CODE  
MONTANA WATER RESOURCES BOARD

Indicate  
ness of  
gravel,  
depth a  
height :

NOTICE OF COMPLETION OF GROUNDWATER  
APPROPRIATION BY MEANS OF WELL

Developed after January 1, 1962

(Under Chapter 237 Montana Session Laws, 1961, as amended)

This form to be prepared by driller, and three copies to be filed by the owner with the County Clerk and Recorder in the county in which the well is located, last copy to be retained by driller.

Please answer all questions. If not applicable, so state, otherwise the form may be returned.

Top of Ground

From (Feet)	To (Feet)
0	1
1	6
6	24
24	34

Olive M. Haugen

Owner

541 McLeod Ave.

Address

Missoula, Montana

Date well started

1/6/69

completed

1/8/69

For Administrator's Use

File 2404, 327118

Jan. 19, 1973

GW 1 12:06 p.m.

Type of well

Drilled

(Dug, driven, bored or drilled)

Equipment used

Vable Tools

(Churn drill, rotary or other)

Water Use: Domestic  Municipal  Stock  Irrigation

Industrial  Drainage  Other  Garden/Lawn

\*Describe

USE: If used for Irrigation, Industrial, drainage or other. Explain, state number of acres and location or other data (i.e. Lot, Block and Addition). Approx. One Acre

ESTIMATED ANNUAL WITHDRAWAL 7,884,000 gallons

Size of Drilled Hole	Size and Weight of Casing	From (Feet)	To (Feet)	PERFORATIONS		
				Kind Size	From (Feet)	To (Feet)
6"	6" OD x 3"	Plus 1'6"	34	Casing is perforated in place with Mills Knife	24'6"	25

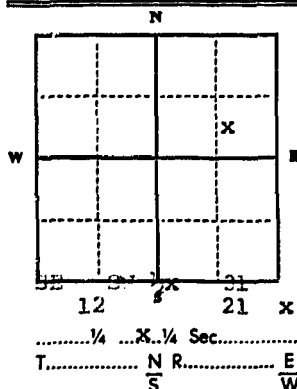

Static water level ..... 3 ..... ft.\*  
Pumping water level ..... 20 ..... ft.\*  
at ..... 15 ..... gallons per minute,  
measured ..... 210 ..... minutes after pumping  
began.

\*Measured from ground level.  
Well developed by Air Lift Pump  
for ..... 3 1/2 ..... hours.  
Power: Gas Pump: 30 HP

Remarks: (Gravel packing, cementing, packers, type of shutoff) all water perforations in six-inch casing. Wells in this area can be depended upon to produce clear sand free water year after year as cont.

INDICATE LOCATION OF WELL AND PLACE OF USE, IF POSSIBLE. EACH SMALL SQUARE REPRESENTS 40 ACRES.

LIBERTY DRILLING COMPANY

Driller's Signature

*Wm. S. Salme*

Driller's Address

2500 Reserve Street

Missoula, Montana

LICENSE NO. 52

34'  
water ris  
three fee

#2111

327115

I received and filed this instrument for record on the 19 day of June 1923 at 12:26 o'clock P. M., permanent files of Missoula County, State of Montana  
Witness my hand:  
Dorothy L. Head, County Recorder  
By Mary Scholten, Deputy  
Fee \$ 2.00 each Paid

Long as they are not overpumped, i.e., they should be pumped at rates not in excess of 50 to 70 percent of the tested capacity of the aquifer.

File No.....

T. 12N R. 21W

TRIPPLICATE

County **Missoula**  
**RECEIVED**  
DEC 19 1963

STATE OF MONTANA  
ADMINISTRATOR OF GROUNDWATER CODE  
OFFICE OF STATE ENGINEER

(Main Ranch, Foreman's  
House and Barn)  
STATE ENGINEER

**Declaration of Vested Groundwater Rights**  
(Under Chapter 237, Montana Session Laws, 1961)

1. **Lolo Land and Livestock Company**, a division of C. C. Realty Corporation, of **Lolo** (Name of Appropriator) (Address) **Lolo** (Town)  
County of **Missoula** State of **Montana**  
have appropriated groundwater according to the Montana laws in effect prior to January 1, 1962, as follows:

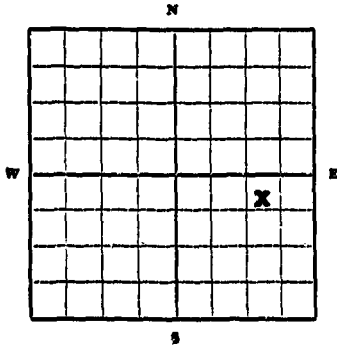

**Sec 32 T12N R21W**

Indicate point of appropriation and place of use, if possible. Each small square represents 10 acres.

- 2. The beneficial use on which the claim is based **Domestic and livestock water**
- 3. Date or approximate date of earliest beneficial use; and how continuous the use has been **Year of 1950, with continuous use.**
- 4. The amount of groundwater claimed (in miner's inches or gallons per minute) **30 gallons per minute**
- 5. If used for irrigation, give the acreage and description of the lands to which water has been applied and name of the owner thereof **Not applicable**
- 6. The means of withdrawing such water from the ground and the location of each well or other means of withdrawal **Electric Pump, NW 1/4 - NE 1/4 - SE 1/4 - Section 32, T12N R21W.**

- 7. The date of commencement and completion of the construction of the well, wells, or other works for withdrawal of groundwater **Year of 1950.**
- 8. The depth of water table **35 feet**
- 9. So far as it may be available, the type, size and depth of each well or the general specifications of any other works for the withdrawal of groundwater **Drilled 70 feet with 8 inch casing.**
- 10. The estimated amount of groundwater withdrawn each year **Approximately 175,000 gallons**
- 11. The log of formations encountered in the drilling of each well if available **Not available**
- 12. Such other information of a similar nature as may be useful in carrying out the policy of this act, including reference to book and page of any county record **Not available**

Signature of Owner *[Signature]*  
**Lolo Land and Livestock Co., D. J. Ozmun, Pres.**  
a division of C. C. Realty Corporation Date **November 25, 1963**

Three copies to be filed by the owner with the County Clerk and Recorder of the county in which the well is located.

Please answer all questions. If not applicable, so state, otherwise the form will be returned.

Original to the County Clerk and Recorder; duplicate to the State Engineer; Triplicate to the Montana Bureau of Mines and Geology and Quadruplicate for the Appropriator.

10416

418

214397

*Copy*

I received and filed this instrument for  
record on the 17 day of Dec, 1967  
at 1:06 o'clock P.M., permanent files  
of Missoula County, State of Montana  
Witness my hand.  
MARTIN S. BERNER, County Recorder  
By Ethel Lane Deputy  
Fee \$ 2.50 Paid

File No. \_\_\_\_\_

T. 12N R. 21W

TRIPPLICATE

STATE OF MONTANA  
ADMINISTRATOR OF GROUNDWATER CODE  
OFFICE OF STATE ENGINEER

RECEIVED  
DEC 19 1963

STATE ENGINEER (Pump)

**Declaration of Vested Groundwater Rights**  
(Under Chapter 237, Montana Session Laws, 1961)

1. Lolo Land and Livestock Company, a division of C. C. Realty Corporation, of Lolo,  
(Name of Appropriator) (Address) (Town)  
County of Missoula State of Montana  
have appropriated groundwater according to the Montana laws in effect prior to January 1, 1962, as follows:

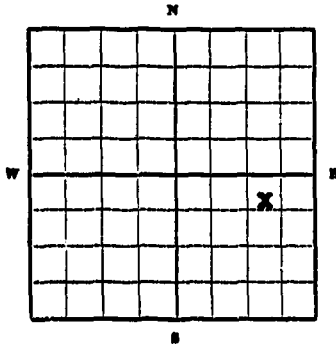

2 1/4 E. Sec. 32 T12NR21W

Indicate point of appropriation and place of use, if possible. Each small square represents 10 acres.

2. The beneficial use on which the claim is based Domestic & limited stock water

3. Date or approximate date of earliest beneficial use; and how continuous the use has been Year of 1890, with continuous use.

4. The amount of groundwater claimed (in miner's inches or gallons per minute) 20 gallons per minute

5. If used for irrigation, give the acreage and description of the lands to which water has been applied and name of the owner thereof Not applicable

6. The means of withdrawing such water from the ground and the location of each well or other means of withdrawal Hand Pump, NW 1/4 NE 1/4 Sec. 32, T12N, R21W.

7. The date of commencement and completion of the construction of the well, wells, or other works for withdrawal of groundwater Since year of 1890

8. The depth of water table 35 feet

9. So far as it may be available, the type, size and depth of each well or the general specifications of any other works for the withdrawal of groundwater Hand dug and rock cribbed.

10. The estimated amount of groundwater withdrawn each year 10,000 gallons

11. The log of formations encountered in the drilling of each well if available Not available

12. Such other information of a similar nature as may be useful in carrying out the policy of this act, including reference to book and page of any county record. Not available

Signature of Owner [Signature]

Lolo Land and Livestock Company, D.B. Ozmun, Pres  
a division of C. C. Realty Corporation Date November 15, 1963

Three copies to be filed by the owner with the County Clerk and Recorder of the county in which the well is located.

Please answer all questions. If not applicable, so state, otherwise the form will be returned.

Original to the County Clerk and Recorder; duplicate to the State Engineer; Triplicate to the Montana Bureau of Mines and Geology and Quadruplicate for the Appropriator.

420

214399

copy

I received and filed this instrument for  
record on the 17 day of Dec 1943  
at 11:0 o'clock P.M., permanent files  
of Missoula County, State of Montana  
Witness my hand:  
MARTIN S. BEHNER, County Recorder  
By Ethel Lane Deputy  
Fee \$ 20<sup>00</sup> Paid

File No. ....

T. 12 N. R. 31 W.

TRIPPLICATE

County Missoula

STATE OF MONTANA  
ADMINISTRATOR OF GROUNDWATER CODE  
OFFICE OF STATE ENGINEER

(Main House Mail)

**Declaration of Vested Groundwater Rights**  
(Under Chapter 237, Montana Session Laws, 1961)

DEC 19 1968

STATE ENGINEER

1. Lolo Land and Livestock Company, a division of C. C. Realty Corporation  
(Name of Appropriator) of Lolo, Montana  
(Address) (Town)  
County of Missoula State of Montana  
have appropriated groundwater according to the Montana laws in effect prior to January 1, 1962, as follows:

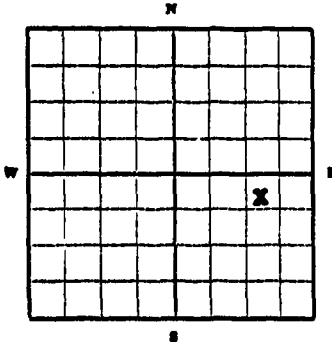

Sec. 32, T12N R. 21W

Indicate point of appropriation and place of use, if possible. Each small square represents 10 acres.

2. The beneficial use on which the claim is based Domestic and livestock water

3. Date or approximate date of earliest beneficial use; and how continuous the use has been since 1950 with continuous use.

4. The amount of groundwater claimed (in miner's inches or gallons per minute) 20 Gallons per minute

5. If used for irrigation, give the acreage and description of the lands to which water has been applied and name of the owner thereof not applicable

6. The means of withdrawing such water from the ground and the location of each well or other means of withdrawal Electric pumps located NW 1/4, NE 1/4, SW 1/4, Section 32, T12N, R21W

7. The date of commencement and completion of the construction of the well, wells, or other works for withdrawal of groundwater Year of 1950

8. The depth of water table Forty (40) feet

9. So far as it may be available, the type, size and depth of each well or the general specifications of any other works for the withdrawal of groundwater Drilled, 80 feet, 8 inch casing.

10. The estimated amount of groundwater withdrawn each year 175,000 gallons

11. The log of formations encountered in the drilling of each well if available not recorded.

12. Such other information of a similar nature as may be useful in carrying out the policy of this act, including reference to book and page of any county record Not available

Signature of Owner [Signature]

Lolo Land and Livestock Co, D.B. Omsun; Pres  
a division of C. C. Realty Corporation  
Date November 25, 1963

Three copies to be filed by the owner with the County Clerk and Recorder of the county in which the well is located.

Please answer all questions. If not applicable, so state, otherwise the form will be returned.

Original to the County Clerk and Recorder; duplicate to the State Engineer; Triplicate to the Montana Bureau of Mines and Geology and Quadruplicate for the Appropriator.



h #416

214295

copy

I received and filed this instrument for  
record on the 17 day of Dec 1963  
at 1:02 o'clock P.M., permanent files  
of Missoula County, State of Montana  
Witness my hand:  
MARTIN S. BEHNER, County Recorder  
By Ethel Lane Deputy  
For \$ 2.00 Paid

33

File No. ....

T 12N R 21 W

TRIPPLICATE

County... Missoula

(Main Ranch-Bradshaw Hse Well)

STATE OF MONTANA  
ADMINISTRATOR OF GROUNDWATER  
OFFICE OF STATE ENGINEER

RECEIVED  
DEC 19 1963  
STATE ENGINEER



Top of Ground  
(Elev. above sea level APP. 3550')

0 - 6 Pit  
6 - 23 Sand, gravel, broken rock and boulders. (Under Chapter 237, Montana Session Laws, 1961)  
23 - 71 Tight decomposed granite Lolo Land and Livestock Co. Address Lolo, Montana  
71 - 72 Tan silty clay with some gravel imbedded. Owner Liberty Drilling Co. Address Missoula, Montana  
72 - 79 Tan to yellow clay with some gravel imbedded. Date of Notice of Appropriation of Groundwater None filed  
79 - 100 Gray to white clay with gray broken rock imbedded. Date well started 9/26/62 Date Completed 11/9/63  
100 - 227 Gray to chalky white clay with gray white and green broken rock imbedded. Water Use: Domestic  Municipal  Other  Irrigation   
227 - 298 Broken gray rock with gray to white clay in cracks and seams. Industrial  Drainage  Stock   
298 - 370 Dark gray to black rock with gray to white clay in cracks and seams. *Indicate on the diagram the character and thickness of the different strata met with in drilling, such as soil, clay, shale, gravel, rock or sand, etc. Show depth at which water is encountered, thickness and character of water-bearing strata and height to which water rises in the well.* Seeps of water from 238' to 526'. SWL 208'.

Size of Drilled Hole	Size and Weight of Casing	From (Feet)	To (Feet)	PERFORATIONS		
				Kind Size	From (Feet)	To (Feet)
6 in	6 5/8" OD 17 # pr ft	5'	350' 3"	Mills Knife	258	349

370 - 526 Broken black and white rock Gray to white clay in cracks and seams.

Static Water Level for non-flowing Well 208 feet.  
Shut-in Pressure for Flowing Well non-flowing  
Pumping Water Level 350 feet at 3 gal. per minute.  
Discharge in gal. per min. of flowing well non-flowing  
How Tested bailor Length of Test 11 hrs

Remarks: (Gravel packing, cementing, packers, type of shutoff, location of place of use of groundwater if not at well, and any other similar pertinent information, including number of acres irrigated, if used for irrigation)

SW 1/4 Sec 33 T 12N R 21W  
Indicate location of well and place of use, if possible. Each small square represents 10 acres.

Show exact depth of bottom.  
Bottom of well 526'

52  
Driller's License Number  
William F. Osborne  
Driller's Signature

This form to be prepared by driller, and three copies to be filed by the owner with the County Clerk and Recorder in the county in which the well is located.

Please answer all questions. If not applicable, so state, otherwise the form will be returned.

Original to the County Clerk and Recorder; duplicate to the State Engineer; Triplicate to the Montana Bureau of Mines and Geology and Quadruplicate for the Appropriator.

10419

421

214400

copy

I received and filed this instrument for  
record on the 17 day of Dec 1933  
at 1:12 o'clock P.M., permanent files  
of Missoula County, State of Montana  
Witness my hand:  
MARTIN S. BLUMER, County Recorder  
By Ethel Lane Deputy  
Fee \$ 2.00 Paid

MISSOURIA WATER RESOURCES BOARD  
**RECEIVED**

County MISSOULA

STATE OF MONTANA  
ADMINISTRATOR OF GROUNDWATER CODE  
MONTANA WATER RESOURCES BOARD  
NOV 23 1970

**NOTICE OF COMPLETION OF GROUNDWATER  
APPROPRIATION BY MEANS OF WELL**

Developed after January 1, 1962

(Under Chapter 237 Montana Session Laws, 1961, as amended)

This form to be prepared by driller, and three copies to be filed by the owner with the County Clerk and Recorder in the county in which the well is located, last copy to be retained by driller.

Please answer all questions. If not applicable, so state, otherwise the form may be returned.

Owner FRED GLANTZ

Address LeLo, Montana

Date well started Oct. 2, 1970

completed Oct. 23, 1970

Type of well Drilled

Equipment used Churn Drill

Water Use: Domestic  Municipal  Stock  Irrigation

Industrial  Drainage  Other  Garden/Lawn

\*Describe

USE: If used for irrigation, industrial, drainage or other. Explain, state number of acres and location or other data (i.e. Lot, Block and Addition).

ESTIMATED ANNUAL WITHDRAWAL

Size of Drilled Hole	Size and Weight of Casing	From (Feet)	To (Feet)	PERFORATIONS		
				Kind Size	From (Feet)	To (Feet)
6" ID	6" ID 17 lb per ft	2 1/2' above g.l.	235'	Mills Knife 3/8 x 3"	105	107
					110	140
					115	145
					120	150
					125	156
					130	166

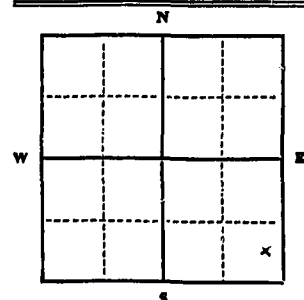

Static water level 40 ft.\*  
Pumping water level 29.4 ft.\*  
at 1 1/2 gallons per minute,  
measured 2 minutes after pumping  
began.

\*Measured from ground level.  
Well developed by Battler  
for 8 hours.

Power            Pump            HP  
Remarks: (Gravel packing, cementing,  
packers, type of shutoff)

SE 1/4 SE 1/4 Sec. 34  
T. 12 N. R. 21

INDICATE LOCATION OF WELL AND PLACE OF USE, IF POSSIBLE. EACH SMALL SQUARE REPRESENTS 40 ACRES.

Driller's Signature Stenna Camp

CAMP WELL DRILLING & PUMP SUPPLY

Driller's Address 1522 S. 14th St.

Missoula, Mont. LICENSE NO. 7

DRILLER'S LOG

Indicate the character, color, thickness of strata such as soil, clay, sand, gravel, shale, sandstone, etc. Show depth at which water is found and height to which water rises in well.

Top of Ground (Elev. above sea level)		
From (Feet)	To (Feet)	
0	1 1/2	Hole
1 1/2	33	Clay, Gravel and Boulders
33	49	Sandy clay and Gravel
49	50	Sand and Water
50	65	Clay and Gravel
65	73	Clay, Gravel & Broken Rock
73	105	Clay and Broken Rock
105	107	Broken Rock
		Water (1 1/2 GPM)
107	235	Disconform granite Rock and clay
235	315	Rock

315 Show exact depth of bottom

47794

9.2061

296987

I received and filed this instrument for  
record on the 18 day of Feb 1978  
at 1:25 o'clock P.M. pursuant to the  
of Missoula County, State of Montana  
Witness my hand:  
Veronica R. Crooks, County Recorder  
By Walter A. Manning Deputy  
Fee \$ 2.00 cash Paid

File No. MAR 10 1965

T. 12 N. R. 21 W.

DUPLICATE

Billie McDermott
Butler McNulty
Co. LOG Mellon
Director Sullivan

County Missoula

STATE OF MONTANA
ADMINISTRATOR OF GROUNDWATER CODE
OFFICE OF STATE ENGINEER

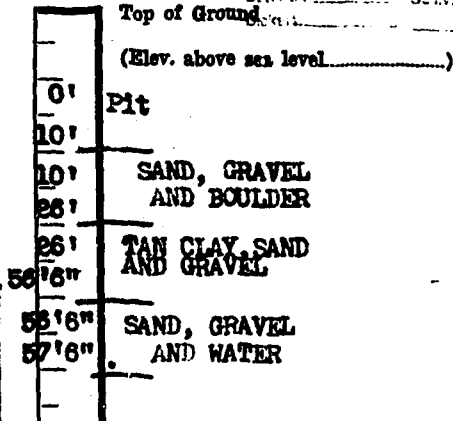

Notice of Completion of Groundwater Appropriation by Means of Well DEVELOPED AFTER JANUARY 1, 1962

(Under Chapter 237, Montana Session Laws, 1961)

Owner Don Hamilton Address Lolo Creek Road

Driller Ken Williams Address 1219 Howell

Date of Notice of appropriation of groundwater

Date well started Feb. 20, 1966 Date completed Feb. 24, 1966

Type of well DRILLED Equipment used CHURN (Dug, Driven, bored or drilled) (Churn drill, rotary or other)

Water use: Domestic [X] Municipal [ ] Stock [ ] Irrigation [ ] Industrial [ ] Drainage [ ] Other [ ]

Indicate on the diagram the character and thickness of the different strata met with in drilling, such as soil, clay, shale, gravel, rock or sand, etc. Show depth at which water is encountered, thickness and character of water-bearing strata and height to which the water rises in the well.

Table with columns: Size of Drilled Hole, Size and Weight of Casing, From (Feet), To (Feet), PERFORATIONS (Kilid Size, From (Feet), To (Feet)). Entry: 6" ID, 6 7/8 OD ground level, 57'6", 19lb. per ft. 1/2" side wall.

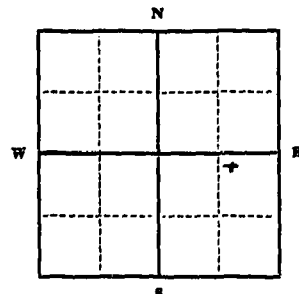

Static Water Level for non-flowing well 48'6" feet.

Shut-in Pressure for Flowing Well

Pumping Water Level 55 feet

at 12 gal. per minute.

Discharge in gal. per min. of flowing well

How Tested BAIL TEST

Length of Test 3 hours

Remarks: (Gravel packing, cementing, packers, type of shutoff)

No. 1/4 Sec. 37, T. 12 N., R. 21 W. WEST
Indicate location of well and place of use, if possible. Each small square represents 40 acres.

(Continue on reverse side)

USE—If used for irrigation, industrial, drainage or other. Explain, state number of acres and location or other data (i.e.: Lot, Block and Addition).

Show exact depth of bottom.

This form to be prepared by driller, and three copies to be filed by the owner with the County Clerk and Recorder in the county in which the well is located, tissue copy to be retained by driller.

Please answer all questions. If not applicable, so state, otherwise the form will be returned.

151 Driller's License Number

Kenneth L. Williams Driller's Signature

40881

581

247795

I received and filed this instrument for  
 record on the 8 day of MAR 19 66  
 at 9:00 o'clock A.M. permanent files  
 of Missoula County, State of Montana  
 Witness my hand:  
 Veranus E. Crouse, County Recorder  
 By *Waretta D. Ramsey*, Deputy  
 Fee \$ 2.00 Paid

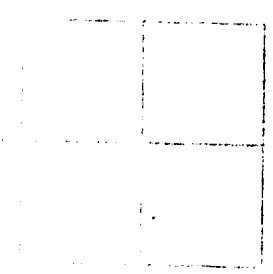

0

File No. ....

T. 12N. R. 21W

DUPLICATE

County Missoula

STATE OF MONTANA  
ADMINISTRATOR OF GROUNDWATER CODE  
OFFICE OF STATE ENGINEER

RECEIVED  
DEC 30 1963

Declaration of Vested Groundwater Rights  
(Under Chapter 237, Montana Session Laws, 1961)

STATE ENGINEER

1. E. W. Lister of Lolo  
(Name of Appropriator) (Address) (Town)

County of Missoula State of Montana

have appropriated groundwater according to the Montana laws in effect prior to January 1, 1962, as follows:

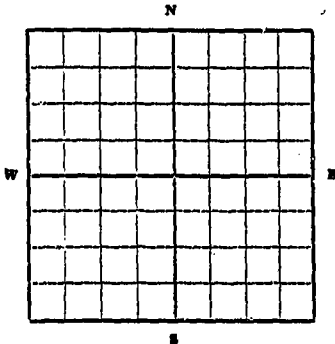

SW 1/4 NW Sec. 34, T12NR21W

Indicate point of appropriation and place of use, if possible. Each small square represents 10 acres.

2. The beneficial use on which the claim is based household use; irrigation of lawn and garden

3. Date or approximate date of earliest beneficial use; and how continuous the use has been Well drilled in 1947; in use continuously since that time.

4. The amount of groundwater claimed (in miner's inches or gallons per minute) 20 gallons per minute.

5. If used for irrigation, give the acreage and description of the lands to which water has been applied and name of the owner thereof Owner: E. W. Lister

6. The means of withdrawing such water from the ground and the location of each well or other means of withdrawal Surface pump - Jacuzzi

7. The date of commencement and completion of the construction of the well, wells, or other works for withdrawal of groundwater Well drilled by A. R. Mowbray in 1947.

8. The depth of water table Approximately 25 to 30 feet.

9. So far as it may be available, the type, size and depth of each well or the general specifications of any other works for the withdrawal of groundwater Drilled well with 8 inch steel casing. water withdrawn by means of Jacuzzi surface pump.

10. The estimated amount of groundwater withdrawn each year Well will pump 20 gals. per minute, but amount used in any given year is not known.

11. The log of formations encountered in the drilling of each well if available Not available to owner, but information may be in files of driller, A. R. Mowbray, Missoula, Montana.

12. Such other information of a similar nature as may be useful in carrying out the policy of this act, including reference to book and page of any county record None.

Signature of Owner E. W. Lister

Date December 23 1963

Three copies to be filed by the owner with the County Clerk and Recorder of the county in which the well is located.

Please answer all questions. If not applicable, so state, otherwise the form will be returned.

Original to the County Clerk and Recorder; duplicate to the State Engineer; Triplicate to the Montana Bureau of Mines and Geology and Quadruplicate for the Appropriator.

15138



536

214838

I received and filed this instrument for  
record on the 26<sup>th</sup> day of Feb 1925  
at 9:45 o'clock A.M., permanent files  
of Missoula County, State of Montana  
Witness my hand:  
MAYNIN S. BEHNER County Recorder  
By *Mat H. [Signature]* Deputy  
Feb 6 1925 Paid

File No. \_\_\_\_\_

T. 12 R 21

DUPLICATE

RECEIVED  
DEC 30 1963

County Hillsboro

STATE OF MONTANA  
ADMINISTRATOR OF GROUNDWATER CODE  
OFFICE OF STATE ENGINEER

Top of Ground  
(Elev. above sea level) STATE ENGINEER

Notice of Completion of Groundwater  
Appropriation by Means of Well

(Under Chapter 237, Montana Session Laws, 1961)

0 to 7' Pit  
7' to 12' Clay  
12' to 18' Clay & shank  
of rock  
18' to 34' Sandy clay  
34' to 39' Gravel, sand  
& water

Owner E.W. Dieter Address Helena, Mont

Driller Glenn Camp 705 Alder Address Missoula, Mont

Date of Notice of Appropriation of Groundwater \_\_\_\_\_

Date well started 9/4/58 Date Completed 9/5/58

Type of well Drilled Equipment Used Churn drill  
(dug, driven, bored or drilled) (Churn, drill, rotary or other)

Water Use: Domestic  Municipal  Other  Irrigation   
Industrial  Drainage  Stock

Indicate on the diagram the character and thickness of the different strata met with in drilling, such as soil, clay, shale, gravel, rock or sand, etc. Show depth at which water is encountered, thickness and character of water-bearing strata and height to which water rises in the well.

Size of Drilled Hole	Size and Weight of Casing	From (Feet)	To (Feet)	PERFORATIONS		
				Kind Hole	From (Feet)	To (Feet)
6"	6" I.O. 19 lb	6' below G.L.	to 35'-6"	None		

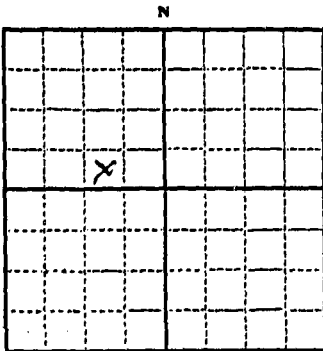

SE 1/4 NW Sec. 34 T. 12 R. 21  
Indicate location of well and place of use, if possible. Each small square represents 10 acres.

Show exact depth of bottom.

Static Water Level for non-flowing Well 40' from G.L. feet.

Shut-in Pressure for Flowing Well Not Flowing

Pumping Water Level 25 feet at 20 gal. per minute.

Discharge in gal. per min. of flowing well Not Flowing

How Tested Bailer Length of Test 2 hours

Remarks: (Gravel packing, cementing, packers, type of shutoff, location of place of use of groundwater if not at well, and any other similar pertinent information, including number of acres irrigated, if used for irrigation) \_\_\_\_\_

None

410 000 # 7  
Driller's License Number

Glenn Camp  
Driller's Signature

This form to be prepared by driller, and three copies to be filed by the owner with the County Clerk and Recorder in the county in which the well is located.

Please answer all questions. If not applicable, so state, otherwise the form will be returned.

Original to the County Clerk and Recorder; duplicate to the State Engineer; Triplicate to the Montana Bureau of Mines and Geology and Quadruplicate for the Appropriator.

534 2nd 1936

I received and filed this instrument for  
record on the 2nd day of Dec 1936  
at 9:40 o'clock P.M., permanent files  
of Missoula County, State of Montana  
Witness my hand:  
MARTIN S. BEHRE, County Recorder  
By Martin S. Behre Deputy  
Fee \$ 2.00 Paid

24

File No. \_\_\_\_\_

T. 12 N R 21 W

DUPLICATE

RECEIVED  
DEC 30 1963

County MISSOULA

STATE OF MONTANA  
ADMINISTRATOR OF GROUNDWATER CODE  
OFFICE OF STATE ENGINEER

Top of Ground  
(Elev. above sea level 3500)

STATE ENGINEER

Notice of Completion of Groundwater  
Appropriation by Means of Well

(Under Chapter 237, Montana Session Laws, 1961)

0-5 MIXED DIRT AND  
COARSE GRAVEL

5-28 GRAVEL MIXED IN  
SILT

28-43 SILT, SAND AND  
GRAVEL

43-47 SILTY SAND

48-59 SAND AND GRAVEL  
GOOD WATER

SWL 19'

Owner E. W. Lister Address Lake, Montana

Driller LIBERTY DRILLING CO. Address MISSOULA, MONTANA

Date of Notice of Appropriation of Groundwater NONE FILED

Date well started 8-8-62 Date Completed 8-10-62

Type of well DRILLED Equipment Used CABLE TOOLS  
(dug, driven, bored or drilled) (Churn, drill, rotary or other)

Water Use: Domestic  Municipal  Other  Irrigation   
Industrial  Drainage  Stock

53'4" . BOTTOM OF WELL

Indicate on the diagram the character and thickness of the different strata met with in drilling, such as soil, clay, shale, gravel, rock or sand, etc. Show depth at which water is encountered, thickness and character of water-bearing strata and height to which water rises in the well.

Size of Drilled Hole	Size and Weight of Casing	From (Feet)	To (Feet)	PERFORATIONS		
				Kind Size	From (Feet)	To (Feet)
	6 5/8" OD x 17 wt	0'	53'4"	NONE		

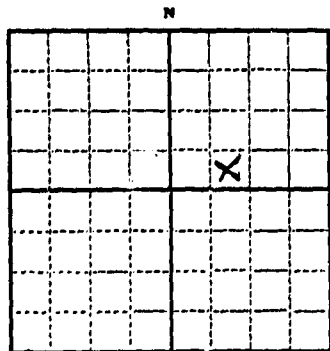

SW 1/4 NE 1/4 Sec. 34 T. 12 N R. 21  
Indicate location of well and place of use, if possible. Each small square represents 10 acres.

Show exact depth of bottom.

Static Water Level for non-flowing Well 19' feet.

Shut-in Pressure for Flowing Well NON-FLOWING

Pumping Water Level 36 feet at 20 gal. per minute.

Discharge in gal. per min. of flowing well NON-FLOWING

How Tested AIR LIFT PUMP Length of Test ONE HOUR

Remarks: (Gravel packing, cementing, packers, type of shutoff, location of place of use of groundwater if not at well, and any other similar pertinent information, including number of

acres irrigated, if used for irrigation) EMERGENCY STEEL RING SHOES WELDED TO BOTTOM OF CASING - ALL WATER ENTERING WELL THROUGH OPEN BOTTOM OF 6" CASING

52  
Driller's License Number

William F. Osborne  
Driller's Signature

This form to be prepared by driller, and three copies to be filed by the owner with the County Clerk and Recorder in the county in which the well is located.

Please answer all questions. If not applicable, so state, otherwise the form will be returned.

Original to the County Clerk and Recorder; duplicate to the State Engineer; Triplicate to the Montana Bureau of Mines and Geology and Quadruplicate for the Appropriator.

15136

545 214837

I received and filed this instrument for record on the 26 day of Dec 1963 at 9:12 o'clock P.M., permanent files of Missoula County, State of Montana  
Witness my hand:  
MARTIN S. BEHRENS County Recorder  
By Mad A. Hill Deputy  
Fee \$ 2.00 Paid

RECORDED  
INDEXED  
FILED  
MISSOULA COUNTY, MONTANA  
DEC 26 1963  
CITY OF MISSOULA

SEARCHED  INDEXED   
SERIALIZED  FILED   
DEC 26 1963  
FBI - MISSOULA

STATE OF MONTANA  
ADMINISTRATOR OF GROUNDWATER CONTROL  
MONTANA WATER RESOURCES BOARD

**RECEIVED**

DRILLER'S LOG

Indicate the character, color, thickness of strata such as soil, clay, sand, gravel, shale, sandstone, etc. Show depth at which water is found and height to which water rises in well.

**NOTICE OF COMPLETION OF GROUNDWATER APPROPRIATION BY MEANS OF WELL**

MAR 29 1973

Developed after January 1, 1962

MONTANA DEPARTMENT OF NATURAL RESOURCES AND CONSERVATION

(Under Chapter 237 Montana Session Laws, 1961, as amended)

This form to be prepared by driller, and three copies to be filed by the owner with the County Clerk and Recorder in the county in which the well is located, last copy to be retained by driller.

Please answer all questions. If not applicable, so state, otherwise the form may be returned.

Owner Cole L. & Thea W. MacPherson

Address Lolo Creek Road  
Lolo, Montana 59847

Date well started 10/26/72  
completed 10/27/72

Type of well Drilled  
(Dug, driven, bored or drilled)

Equipment used Cable Tools  
(Churn drill, rotary or other)

Water Use: Domestic  Municipal  Stock  Irrigation   
Industrial  Drainage  Other  \* Garden/Lawn

\*Describe \_\_\_\_\_  
USE: If used for irrigation, industrial, drainage or other. Explain, state number of acres and location or other data (i.e. Lot, Block and Addition). \_\_\_\_\_

ESTIMATED ANNUAL WITHDRAWAL 23,652,000 gallons

Size of Drilled Hole	Size and Weight of Casing	From (Feet)	To (Feet)	PERFORATIONS		
				Kind Size	From (Feet)	To (Feet)
6"	6 5/8" OD x 1/4"	Plus 2	44	N	O	N

A forged steel drive shoe is welded to bottom of six inch casing

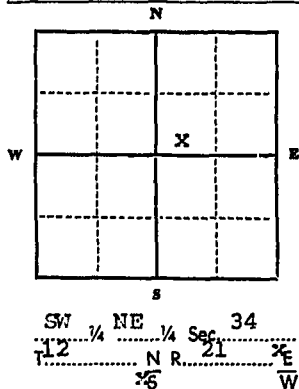

Static water level 7'10" ft.\*  
Pumping water level 21 ft.\*  
at 45 gallons per minute,  
measured 120 minutes after pumping began.  
\*Measured from ground level.  
Well developed by Air Lift Pump  
for two hours.  
Power Gas Pump 30 HP  
Remarks: (Gravel packing, cementing, packers, type of shutoff) All water entering well through open bottom of six inch casing. Wells in this area can be depended  
cont'd

From (Feet)		To (Feet)		
0	1	1	3	Topsoil
1	3	3	11	Tan clayish soil
3	11	11	24	Cobblestones & gravel embedded in tan clay
11	24	24	28	Silty sand & gravel
24	28	28	39	Gravel embedded in light brown clay
28	39	39	44	Cobblestones and gravel mixed in tan silty sand
39	44			Clean coarse sand and gravel. Water

INDICATE LOCATION OF WELL AND PLACE OF USE, IF POSSIBLE. EACH SMALL SQUARE REPRESENTS 40 ACRES.

Driller's Signature Will J. Osborne  
2500 Reserve Street  
Driller's Address \_\_\_\_\_

Missoula, Montana \_\_\_\_\_ LICENSE NO. 52

44' Show exact depth of bottom water rises in well 7'10" from surface.

52,762

2443

329723

I received and filed this instrument for record on the 27 day of March 1973 at 12:45 o'clock P. M., permanent files of Missoula County, State of Montana. Witness my hand: Dorothy L. Head, County Recorder By Mary Shalby, Deputy Fee \$ 2.00 paid.

upon to produce clear sand free water year after year as long as they are not overpumped, i.e., they should be pumped at rates not in excess of 50 to 60 percent of the tested capacity of the aquifer.

MISSOULA COUNTY RECORDS DEPARTMENT  
RECORDS SECTION  
MISSOULA, MONTANA 59802  
PHONE (406) 541-3111  
FAX (406) 541-3112  
WWW.MISSOULA-COUNTY.MT.GOV

STATE OF MONTANA  
ADMINISTRATOR OF GROUNDWATER CODE  
MONTANA WATER RESOURCES BOARD

DRILLER'S LOG

NOTICE OF COMPLETION OF GROUNDWATER  
APPROPRIATION BY MEANS OF WELL

Developed after January 1, 1962

(Under Chapter 237 Montana Session Laws, 1961, as amended)

This form to be prepared by driller, and three copies to be filed by the owner with the County Clerk and Recorder in the county in which the well is located, last copy to be retained by driller.

Please answer all questions. If not applicable, so state, otherwise the form may be returned.

Owner Eric and Betty Skibsted

Address 2920 Salish Court

Missoula, Montana

Date well started 3/3/71

completed 3/15/71

For Administrator's Use	
File #	<u>2260, 31516</u>
Date	<u>April 14, 1972 2:00pm</u>
GW	<u>1</u>

Type of well Drilled

(Dug, driven, bored or drilled)

Equipment used Air Rotary & Cable tools

(Churn drill, rotary or other)

Water Use: Domestic  Municipal  Stock  Irrigation

Industrial  Drainage  Other \* Garden/Lawn

\*Describe

USE: If used for irrigation, industrial, drainage or other. Explain, state number of acres and location or other data (i.e. Lot, Block and Addition). Approximately 25 acres.

ESTIMATED ANNUAL WITHDRAWAL 26,280,000 gallons

Size of Drilled Hole	Size and Weight of Casing	From (Feet)	To (Feet)	PERFORATIONS		
				Kind Size	From (Feet)	To (Feet)
8"	8 5/8" OD x 1/4"	+2	64	Johnson Wire Wound Water Well Screen	64	72

A blank tailpipe with solid casing extends to 73 feet.

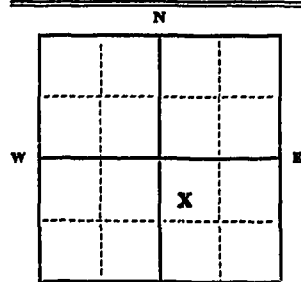

NW 1/4 SE 1/4 Sec. 34

T. 12 N. R. 21 E.

Static water level 32 ft.\*  
Pumping water level 40 ft.\*  
at 100 gallons per minute,  
measured 12 minutes after pumping began.

\*Measured from ground level.  
Well developed by Air Lift  
for 12 hours. Pump  
Power Diesel Pump 150 HP  
Remarks: (Gravel packing, cementing, packers, type of shutoff) All water entering well through slot openings in screen. Wells in this area can be

INDICATE LOCATION OF WELL AND PLACE OF USE, IF POSSIBLE. EACH SMALL SQUARE REPRESENTS 40 ACRES.

Driller's Signature William E. Delano

Driller's Address 2500 Reserve Street

Missoula, Montana LICENSE NO. 52

Indicate the character, color, thickness of strata such as soil, clay, sand, gravel, shale, sandstone, etc. Show depth at which water is found and height to which water rises in well.

Approx.

Top of Ground (Elev. above sea level) 3480'

From (Feet)	To (Feet)	
0	1	Topsoil.
1	26	Boulders and cobblestones mixed with some tan to brown clay.
26	29	Sand and gravel imbedded in micaceous tan to brown clay.
29	37	Cobblestones and boulders imbedded in micaceous tan to brown clay.
37	46	Fine micaceous sand and gravel. Seeps of water.
46	62	Boulders and cobblestones mixed in micaceous tan to brown clay.
62	72	Fine to coarse micaceous sand and gravel. Water.
72	73	Broken rock mixed in brown clay.

73 ft. Show exact depth of bottom water rises in well 32 feet from surface.

59179



# 2260  
~~1000~~

315116

I received and filed this instrument for  
 record on the 11 day of October 1912  
 at 2:00 o'clock P.M. permanent file  
 in Missoula County State of Montana  
 Witness my hand  
 Verano R. Cross, County Recorder  
 By *Thos. M. McKelvie*  
 Fee \$ 2.00 Paid

depended upon to produce clear sand free water year after year as  
 long as they are not overpumped, i.e.; they should be pumped at  
 rates not in excess of 40 to 50 percent of the tested capacity of  
 the aquifer.

**RECEIVED**

County Missoula 35

STATE OF MONTANA  
ADMINISTRATOR OF GROUNDWATER CODE  
MONTANA WATER RESOURCES BOARD  
**NOTICE OF COMPLETION OF GROUNDWATER  
APPROPRIATION BY MEANS OF WELL**  
Developed after January 1, 1962

DRILLER'S LOG  
Indicate the character, color, thickness of strata such as soil, clay, sand, gravel, shale, sandstone, etc. Show depth at which water is found and height to which water rises in well.

(Under Chapter 237 Montana Session Laws, 1961, as amended)

This form to be prepared by driller, and three copies to be filed by the owner with the County Clerk and Recorder in the county in which the well is located, last copy to be retained by driller. Please answer all questions. If not applicable, so state, otherwise the form may be returned.

Owner Elizabeth J. Allen  
William D. Allen  
Address Box 141  
Lolo, Montana 59847  
Date well started Aug. 10, 1972  
completed Aug. 15, 1972

For Administrator's Use	
File <u>320959</u>	<u>Aug. 18, 1972 - 10:00 am</u>
GW <u>1</u>	

Top of Ground (Elev. above sea level)		
From (Feet)	To (Feet)	
0	5	Tan Clay & Gravel
5	20	Yellow Sandy Clay & Gravel
20	29	Sand, Gravel & Clay
29	40	Sand, Gravel & Clay
40	45	Sand, Gravel & Water
45	48	Gravel & Water

Type of well Drilled  
(Dug, driven, bored or drilled)

Equipment used Churn Drill  
(Churn drill, rotary or other)

Water Use: Domestic  Municipal  Stock  Irrigation   
Industrial  Drainage  Other \* Garden/Lawn

\*Describe \_\_\_\_\_

USE: If used for Irrigation, Industrial, drainage or other. Explain, state number of acres and location or other data (i.e. Lot, Block and Addition). \_\_\_\_\_

ESTIMATED ANNUAL WITHDRAWAL

Size of Drilled Hole	Size and Weight of Casing	From (Feet)	To (Feet)	PERFORATIONS		
				Kind Size	From (Feet)	To (Feet)
6" ID	6" ID 17 lb per ft.	1' 6"	42'		none	

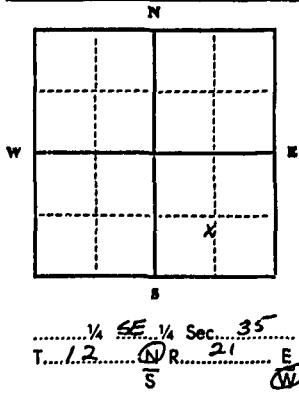

Static water level 26 ft.\*  
Pumping water level 34 ft.\*  
at 20 gallons per minute,  
measured 1 minutes after pumping  
began.  
\*Measured from ground level.  
Well developed by test pump  
for 1 hours.  
Power Electric Pump 3/4 HP  
Remarks: (Gravel packing, cementing,  
packers, type of shutoff) \_\_\_\_\_

INDICATE LOCATION OF WELL AND PLACE OF USE, IF POSSIBLE. EACH SMALL SQUARE REPRESENTS 40 ACRES.

Driller's Signature John Camp  
CAMP WELL DRILLING & PUMP SUPPLY  
Driller's Address 1522 S. 14th St., Missoula, Montana 59801

LICENSE NO. 7

48' Show exact depth of bottom

51,235

2321

320 957

I received and filed this instrument for  
record on the 18 day of Aug 1972  
at 12:00 o'clock A.M. permanent files  
of Missoula County State of Montana  
Witness my hand.  
Veronique R. Cyrise, County Recorder  
By Veronique R. Cyrise, Deputy  
Fee \$ 2.00 Paid ck.

T. 12 N R. 21 W 35  
 County Missoula

MONTANA BUREAU OF MINES AND GEOLOGY  
 Butte, Montana

WATER WELL LOG

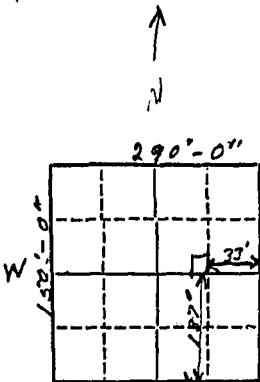

Owner O. D. Bonebright Address Lolo View Acres  
Lolo, Montana  
 Driller Dug well, same as above Address \_\_\_\_\_  
 Date Started August 1, 1957 Date Completed August 15, 1957  
 Location: Sec. 35 T. 12 R. N-21-W 1/4 sec.

Type of well Dug Equipment used Pick & Shovel  
(Dug, driven, bored, or drilled) (Churn drill, rotary, other)

Water use: Domestic  Municipal  Stock  Irrigation   
 Industrial  Drainage  Other: \_\_\_\_\_

Casing: 3 1/2' ft. to 14' ft. Type Steel Size 1 1/2" round

Casing: \_\_\_\_\_ ft. to \_\_\_\_\_ ft. Type \_\_\_\_\_ Size \_\_\_\_\_

Casing: \_\_\_\_\_ ft. to \_\_\_\_\_ ft. Type \_\_\_\_\_ Size \_\_\_\_\_

Perforated or Screened: Ft. 10' to ft. 14' Ft. \_\_\_\_\_ to ft. \_\_\_\_\_

Type of screen or perforations Perforated casing

Static Water level, for non-flowing well: Eight (8) feet.

Shut-in pressure, for flowing well: \_\_\_\_\_ lb./sq. in. on: \_\_\_\_\_ (date)

Pumping water level Nine (9) feet at Seven & one-half gal. per min. 225 min.

How tested: 3/4 h.p. 1st pump

Length of test 10 hrs. continuous pumping

Remarks: (Gravel packing, cementing, packers, type of shut-off, depth of shut-off)  
Rock and gravel packing.

(over)



File No. ....

T. 12 N. R. 21 W.

DUPLICATE

County Missoula

STATE OF MONTANA  
ADMINISTRATOR OF GROUNDWATER CODE  
OFFICE OF STATE ENGINEER

RECORDED  
JAN 3 1964  
STATE ENGINEER

Declaration of Vested Groundwater Rights

(Under Chapter 237, Montana Session Laws, 1961)

1. James L. Collins & Beryl I. Collins, of Box 96, Lolo, (Name of Appropriator) (Address) (Town)

County of Missoula State of Montana have appropriated groundwater according to the Montana laws in effect prior to January 1, 1962, as follows:

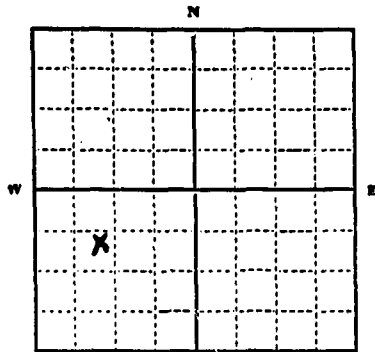

Well in Lot 7  
NW 1/4 SW 1/4 Sec. 35 T. 12N R. 21W  
Indicate point of appropriation and place of use, if possible. Each small square represents 10 acres.

- 2. The beneficial use on which the claim is based... house, water and irrigation.
- 3. Date or approximate date of earliest beneficial use; and how continuous the use has been... January 24, 1959... continuous since that date.
- 4. The amount of groundwater claimed (in miner's inches or gallons per minute) not known.
- 5. If used for irrigation, give the acreage and description of the lands to which water has been applied and name of the owner thereof... Lots 7 and 8 LOLOVIEW ACRES #2 Missoula County... a total of 5.5 acres.
- 6. The means of withdrawing such water from the ground and the location of each well or other means of withdrawal... drilled well with 6" casing... 26 feet 5 inches deep.

- 7. The date of commencement and completion of the construction of the well, wells, or other works for withdrawal of groundwater... well drilled 24th day of January, 1959.
- 8. The depth of water table... static water level... 4 ft. from ground level.
- 9. So far as it may be available, the type, size and depth of each well or the general specifications of any other works for the withdrawal of groundwater... see question 6.
- 10. The estimated amount of groundwater withdrawn each year... not known.
- 11. The log of formations encountered in the drilling of each well if available... 1 to 14 feet, gravel, boulders and clay... 14 to 19 feet, clay, small gravel and water... 19 to 23 feet, small heavy sand gravel and water... 23 to 26'5", good water, gravel and little clay.
- 12. Such other information of a similar nature as may be useful in carrying out the policy of this act, including reference to book and page of any county record... none available.

Signature of Owner *Beryl I. Collins*  
Date 12/27/63

Three copies to be filed by the owner with the County Clerk and Recorder of the county in which the well is located.

Please answer all questions. If not applicable, so state, otherwise the form will be returned.

Original to the County Clerk and Recorder; Duplicate to the State Engineer; Triplicate to the Montana Bureau of Mines and Geology, and Quadruplicate for the Appropriator.

837 215245

RECORDED

I received 43 and filed this instrument for  
 record the 20th day of Dec 1923  
 at 4:30 o'clock P.M., permanent files  
 of Missoula County, State of Montana  
 Witness my hand  
 M. W. S. PIERCE, County Recorder  
 By Mad. J. Palmer Deputy  
200 Paid

RECORDED

County Finley 35

STATE OF MONTANA  
ADMINISTRATOR OF GROUNDWATER CODE  
MONTANA WATER RESOURCES BOARD

NOTICE OF COMPLETION OF GROUNDWATER  
APPROPRIATION BY MEANS OF WELL

Developed after January 1, 1962

(Under Chapter 237 Montana Session Laws, 1961, as amended)

This form to be prepared by driller, and three copies to be filed by the owner with the County Clerk and Recorder in the county in which the well is located, last copy to be retained by driller.

Please answer all questions. If not applicable, so state, otherwise the form may be returned.

Owner Ronald R. Dubois

Address Star Route

Idaho, Montana

Date well started

completed

Type of well driven

Equipment used

Water Use: Domestic  Municipal  Stock  Irrigation

Industrial  Drainage  Other  Garden/Lawn

\*Describe

USE: If used for irrigation, industrial, drainage or other. Explain, state number of acres and location or other data (i.e. Lot, Block and Addition). 1 1/2 acres

ESTIMATED ANNUAL WITHDRAWAL

Size of Drilled Hole	Size and Weight of Casing	From (Feet)	To (Feet)	PERFORATIONS		
				Kind	From (Feet)	To (Feet)
<u>5 inch</u>	<u>6" O.D.</u>	<u>0</u>	<u>30'</u>			

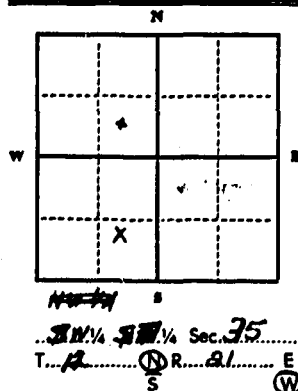

Static water level 15 ft.\*  
Pumping water level 20 ft.\*  
at 25 gallons per minute,  
measured        minutes after pumping  
began.

\*Measured from ground level.  
Well developed by pumping  
for 4 hours.

Power        Pump        HP  
Remarks: (Gravel packing, cementing,  
peckers, type of shutoff)

INDICATE LOCATION OF WELL AND PLACE OF USE, IF POSSIBLE.  
EACH SMALL SQUARE REPRESENTS 40 ACRES.

Driller's Signature

Driller's Address

LICENSE NO.

DRILLER'S LOG

Indicate the character, color, thickness of strata such as soil, clay, sand, gravel, shale, sandstone, etc. Show depth at which water is found and height to which water rises in well.

Top of Ground (Elev. above sea level) 3,223

From (Feet)	To (Feet)	
<u>0</u>	<u>3</u>	<u>top soil</u>
<u>3</u>	<u>20</u>	<u>Gravel + sand</u>
<u>20</u>	<u>35</u>	<u>Gravel + water</u>

Show exact depth of bottom

54891



2575

334331

I received and filed this Instrument for record on the 27 day of June 1973 at 2:50 o'clock P. M., permanent files of Missoula County, State of Montana

Witness my hand:

Dorothy L. Head, County Recorder

By M. M. Conroy Deputy

Fee \$ 2.00

Paid cash

State level notary signature  
Notary Public

RECEIVED

MAY 30 1972

County Missoula 35

3 GW 2 Revised 1969  
STATE PUBLISHING COMPANY

STATE OF MONTANA  
ADMINISTRATOR OF GROUNDWATER CODE DEPARTMENT OF NATURAL  
MONTANA WATER RESOURCES BOARD RESOURCES AND CONSERVATION

NOTICE OF COMPLETION OF GROUNDWATER  
APPROPRIATION BY MEANS OF WELL

Developed after January 1, 1962

(Under Chapter 237 Montana Session Laws, 1961, as amended)

This form to be prepared by driller, and three copies to be filed by the owner with the County Clerk and Recorder in the county in which the well is located, last copy to be retained by driller.

Please answer all questions. If not applicable, so state, otherwise the form may be returned.

Owner Gordon Escene

Address E/I - Max Trailer

Village J. Missoula, Mt.  
59801

Date well started April 12, 1972 GW 1

completed April 20, 1972

For Administrator's Use	
File #	<u>2281, 312153</u>
Date	<u>May 24, 1972 1:34pm</u>

Type of well Drilled

(Dug, driven, bored or drilled)

Equipment used Churned

(Churn drill, rotary or other)

Water Use: Domestic  Municipal  Stock  Irrigation

Industrial  Drainage  Other \* Garden/Lawn

\*Describe

USE: If used for irrigation, industrial, drainage or other. Explain, state number of acres and location or other data (i.e. Lot, Block and Addition).

ESTIMATED ANNUAL WITHDRAWAL

Size of Drilled Hole	Size and Weight of Casing	From (Feet)	To (Feet)	PERFORATIONS		
				Kind Size	From (Feet)	To (Feet)
<u>6" ID</u>	<u>6 5/8 OD 17 LBS 1/4" Side Wall</u>	<u>Ground Level</u>	<u>56 ft.</u>	<u>None</u>	<u>None</u>	<u>None</u>

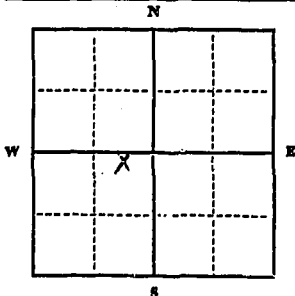

Static water level 59 ft.\*  
Pumping water level 53 ft.\*  
at 14 gallons per minute,  
measured 180 minutes after pumping began.

\*Measured from ground level.  
Well developed by Sub. Test Pump  
for 3 hours.  
Power 220 Pump 3/4 HP  
Remarks: (Gravel packing, cementing, packers, type of shutoff)

SE 1/4 SW 1/4 Sec. 35

T. 12 N. 21 E.  
S. 3 W. 3

INDICATE LOCATION OF WELL AND PLACE OF USE, IF POSSIBLE. EACH SMALL SQUARE REPRESENTS 40 ACRES.

Driller's Signature Kenneth T. Williams

Driller's Address 1558 South Fifth West

LICENSE NO. 151

Top of Ground

(Elev. above sea level)

From (Feet)	To (Feet)	
<u>0L</u>	<u>6"</u>	<u>Black Dirt</u>
<u>6"</u>	<u>4'</u>	<u>Tan Clay</u>
<u>4'</u>	<u>9'</u>	<u>Tan clay, Gravel, &amp; boulders</u>
<u>9'</u>	<u>14'</u>	<u>Tan Clay, Sand, &amp; Gravel</u>
<u>14'</u>	<u>51'</u>	<u>Tan clay, Gravel, &amp; boulders</u>
<u>51'</u>	<u>54'</u>	<u>Tan Clay, Sand, &amp; Gravel</u>
<u>54'</u>	<u>56'</u>	<u>Sand, Gravel &amp; Water</u>

56 Feet Show exact depth of bottom

50422

#2281

317153

I received and filed this instrument for  
record on the 24<sup>th</sup> day of May 1972  
at 1:34 o'clock P.M. permanent files  
in Missoula County, State of Montana  
Witness my hand  
Walter A. Olson, County Recorder  
By Thomas H. Heston Deputy  
Fee \$2.00 cash paid

35

File No. \_\_\_\_\_

T. 12 N. R. 21 West

DUPLICATE

County Missoula

LOG

STATE OF MONTANA  
ADMINISTRATOR OF GROUNDWATER CODE  
OFFICE OF STATE ENGINEER

RECORDED  
NOV 19 1966

Notice of Completion of Groundwater  
Appropriation by Means of Well

DEVELOPED AFTER JANUARY 1, 1962

(Under Chapter 237, Montana Session Laws, 1961)

A.W. and Ellen W. Fetscher

Owner ~~XXXXXXXXXXXX~~ Address ~~XXXXXXXXXXXX~~ (BY Property)

Driller KEN WILLIAMS Address 1219 HOWELL MISSOULA, MONT.

Date of Notice of appropriation of groundwater \_\_\_\_\_

Date well started APRIL 18, 66 Date completed APRIL 23, 66

Type of well DRILLED Equipment used CHURN  
(Dug, Driven, bored or drilled) (Churn drill, rotary or other)

Water use: Domestic  Municipal  Stock  Irrigation   
Industrial  Drainage  Other

Indicate on the diagram the character and thickness of the different strata met with in drilling, such as soil, clay, shale, gravel, rock or sand, etc. Show depth at which water is encountered, thickness and character of water-bearing strata and height to which the water rises in the well.

Top of Ground (Elev. above sea level _____)	LOG
0	top soil
1	tan clay, sand, gravel and scattered boulders
63	seep of water, sand and mica
63	tan clay, sand and gravel
65'6"	sand, gravel and water
66'6"	water

Size of Drilled Hole	Size and Weight of Casing	From (Feet)	To (Feet)	PERFORATIONS		
				Kind Size	From (Feet)	To (Feet)
6" ID	65/800 19 lbs. 1/2" side wall	ground level	66'6"			

Note: Property on Filing Date is owned by: A.W. and Ellen W. Fetscher

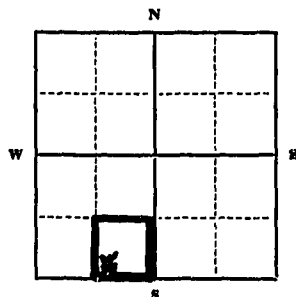

SE 1/4 SW 1/4  
xxxxxx Sec. 35. T. 12 N. R. 21 W  
Indicate location of well and place of use, if possible. Each small square represents 40 acres.

Static Water Level for non-flowing well ..... 60 ..... feet.  
Shut-in Pressure for Flowing Well .....  
Pumping Water Level ..... 65 ..... feet  
at ..... 5 ..... gal. per minute.  
Discharge in gal. per min. of flowing well .....  
How Tested BAIL TEST.  
Length of Test ..... 4 HOURS  
Remarks: (Gravel packing, cementing, packers, type of shutoff) .....

151  
Driller's License Number

Driller's Signature

44, 778

This form to be prepared by driller, and three copies to be filed by the owner with the County Clerk and Recorder in the county in which the well is located, tissue copy to be retained by driller.

Please answer all questions. If not applicable, so state, otherwise the form will be returned.

USE—If used for irrigation, industrial, drainage or other. Explain, state number of acres and location or other data (i.e.: Lot, Block and Addition).

(Continue on reverse side)

Show exact depth of bottom.

1837

276334

I received and filed this instrument for  
 record on the 14<sup>th</sup> day of March 1968  
 at 11:30 o'clock A.M., permanent files  
 of Missoula County, State of Montana  
 Witness my hand:  
 Vernon G. B. C. Missoula County Recorder  
 By *[Signature]* Deputy  
 Fee \$ 2.00 Paid

1968

RECEIVED

County MISSOULA

STATE OF MONTANA  
ADMINISTRATOR OF GROUNDWATER CODE  
MONTANA WATER RESOURCES BOARD

Oct 30 1972

DRILLER'S LOG

NOTICE OF COMPLETION OF GROUNDWATER  
APPROPRIATION BY MEANS OF WELL

Developed after January 1, 1962

Indicate the character, color, thickness of strata such as soil, clay, sand, gravel, shale, sandstone, etc. Show depth at which water is found and height to which water rises in well.

(Under Chapter 237 Montana Session Laws, 1961, as amended)

This form to be prepared by driller, and three copies to be filed by the owner with the County Clerk and Recorder in the county in which the well is located, last copy to be retained by driller.

Please answer all questions. If not applicable, so state, otherwise the form may be returned.

Owner MRS. MARIE E. GREYDANES  
Address LOLO MONTANA  
Date well started SEPT. 14, 1972  
completed SEPT. 20, 1972

For Administrator's Use
File <u>2359-323843</u>
<u>Oct 26, 1972 - 9:40 a.m.</u>
GW <u>1</u>

Type of well DRILLED  
Equipment used CHURN  
Water Use: Domestic  Municipal  Stock  Irrigation   
Industrial  Drainage  Other  Garden/Lawn

\*Describe  
USE: If used for irrigation, industrial, drainage or other. Explain, state number of acres and location or other data (i.e. Lot, Block and Addition).

ESTIMATED ANNUAL WITHDRAWAL

Size of Drilled Hole	Size and Weight of Casing	From (Foot)	To (Foot)	PERFORATIONS		
				Mud Size	From (Foot)	To (Foot)
<u>6" I.D. 3-5/8" OD</u>	<u>ground</u>	<u>level</u>	<u>63' 6"</u>	<u>none</u>	<u>none</u>	<u>none</u>
<u>17 lbs.</u>	<u>1/4" side-wall</u>					

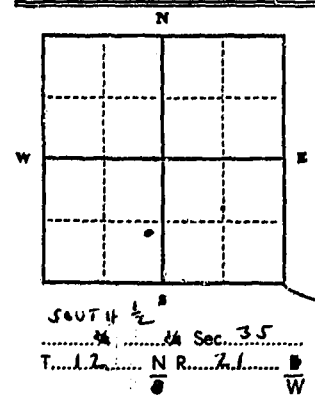

Static water level 49' 6" ft.\*  
Pumping water level 9' ft.\*  
at 8 gallons per minute,  
measured 40 minutes after pumping  
began.

\*Measured from ground level.  
Well developed by sub. test pump  
for 2 hours.  
Power 220 Pump 3/4 HP  
Remarks: (Gravel packing, cementing,  
packers, type of shutoff)  
LOCATION: LOT 24 OF  
ADDITION TO INTEREST  
COUNTY: MISSOULA  
PLATEA SUBDIVISION

INDICATE LOCATION OF WELL AND PLACE OF USE, IF POSSIBLE.  
EACH SMALL SQUARE REPRESENTS 40 ACRES.

Driller's Signature Hennet J. Williams

Driller's Address 1558 So. 5th. W. MISSOULA, MONTANA

LICENSE NO. 151

Top of Ground (Elev. above sea level)		
From (Foot)	To (Foot)	
<u>0'</u>	<u>6"</u>	<u>Black top soil</u>
<u>6"</u>	<u>5'</u>	<u>Tan clay, sand and</u>
		<u>gravel</u>
<u>6'</u>	<u>21'</u>	<u>Tan clay, gravel and</u>
		<u>BOULDERS</u>
<u>21'</u>	<u>62'</u>	<u>Tan clay, sand and</u>
		<u>gravel</u>
<u>62'</u>	<u>63' 6"</u>	<u>Sand, gravel and</u>
		<u>water</u>

63 ft. 6 in. Show exact depth of bottom

#2357

323843

I received and filed this instrument for  
 record on the 26 day of Oct 1972  
 at 9:40 o'clock P.M., permanent file  
 of Missoula County State of Montana  
 Witness my hand  
 Verano R. Creuse, County Register  
 By Carroll H. Hagan, Deputy  
 Fee \$2.00 Paid

RECORDED  
 INDEXED  
 IN YEAR 1972  
 MISSOULA COUNTY  
 MONTANA

MISSOULA COUNTY REGISTER  
 VERANO R. CREUSE  
 BY CARROLL H. HAGAN, DEPUTY

RECEIVED  
County, Missoula 35

STATE OF MONTANA  
ADMINISTRATOR OF GROUNDWATER CODE  
MONTANA WATER RESOURCES BOARD

NOTICE OF COMPLETION OF GROUNDWATER  
APPROPRIATION BY MEANS OF WELL

Developed after January 1, 1962

(Under Chapter 237 Montana Session Laws, 1961, as amended)

This form to be prepared by driller, and three copies to be filed by the owner with the County Clerk and Recorder in the county in which the well is located, last copy to be retained by driller. Please answer all questions. If not applicable, so state, otherwise the form may be returned.

DRILLER'S LOG

Indicate the character, color, thickness of strata such as soil, clay, sand, gravel, shale, sandstone, etc. Show depth at which water is found and height to which water rises in well.

Owner FRANK E. GREYDANUS  
 INFORMATION FROM MISSOULA COUNTY DIRECTOR: Greydanus, Art  
 Address: LOLO CREEK ROAD  
LOLO MONTANA  
 File 2452, 330590  
 Date well started MARCH 12, 1973 GW 1 11:30 A.M.  
 completed MARCH 26, 1973  
 For Administrator's Use  
April 13, 1973

Top of Ground		(Elev. above sea level)
From (Feet)	To (Feet)	
0'	4"	Top soil
4"	81'	Tan clay, gravel and boulders
81'	84'6"	Tan clay, sand and gravel
84'6"	85'6"	Silt, sand and soap of water
85'6"	86'	Tan clay, sand and gravel
86'	87'	Sand, gravel and water

Type of well DRILLED  
 (Dug, driven, bored or drilled)  
 Equipment used CHURN  
 (Churn drill, rotary or other)  
 Water Use: Domestic  Municipal  Stock  Irrigation   
 Industrial  Drainage  Other  Garden/Lawn   
 \*Describe \_\_\_\_\_  
 USE: If used for irrigation, industrial, drainage or other. Explain, state number of acres and location or other data (i.e. Lot, Block and Addition). \_\_\_\_\_

ESTIMATED ANNUAL WITHDRAWAL

Size of Drilled Hole	Size and Weight of Casing	From (Feet)	To (Feet)	PERFORATIONS		
				Kind Size	From (Feet)	To (Feet)
6" I.D.	6-5/8" OD 1 1/4" x 16' gal 17 lbs.	ground level	87 ft.	none	none	none

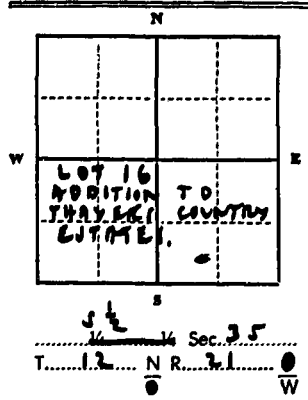

Static water level 67 ft.\*  
 Pumping water level 86 ft.\*  
 at 14 gallons per minute,  
 measured \_\_\_\_\_ minutes after pumping began.  
 \*Measured from ground level.  
 Well developed by ball test  
 for 3 hours.  
 Power \_\_\_\_\_ Pump \_\_\_\_\_ HP  
 Remarks: (Gravel packing, cementing, packers, type of shutoff) \_\_\_\_\_

INDICATE LOCATION OF WELL AND PLACE OF USE, IF POSSIBLE. EACH SMALL SQUARE REPRESENTS 40 ACRES.  
 Driller's Signature Harold J. Williams  
 Driller's Address 1558 So. 5th St. MISSOULA, MONTANA

LICENSE NO. 151

87 ft. Show exact depth of bottom



42452 3 30 890

I received and filed this instrument for  
record on the 13 day of Apr 1973  
at 11:30 o'clock A. M. permanent files  
of Missoula County, State of Montana  
Witness my hand:  
Dorothy L. Head, County Recorder  
By [Signature] Deputy  
Fee \$ 2.00 Paid

File No. \_\_\_\_\_

MONTANA WATER RESOURCES BOARD

T. 12 N. R. 21 W. 24

DUPLICATE

RECEIVED

County Missoula

LOG

APR 30 1968

STATE OF MONTANA  
ADMINISTRATOR OF GROUNDWATER CODE  
OFFICE OF STATE ENGINEER

1	Top of Ground
	(Elev. above sea level _____)
4	tan clay and sand
4	tan clay, boulders
16	and gravel
16	tan clay, sand
48	and gravel
48	tan clay, sand
50	gravel and boulders
50	gravel, sand
51	and water

### Notice of Completion of Groundwater Appropriation by Means of Well DEVELOPED AFTER JANUARY 1, 1932

(Under Chapter 237, Montana Session Laws, 1961)

Owner Charles D. + Nancy E. Harbelle Address 406 Creek Road

Driller Ken Williams Address 1219 Howell

Date of Notice of appropriation of groundwater \_\_\_\_\_

Date well started Feb. 9, 1966 Date completed Feb. 16, 1966

Type of well Drilled Equipment used Churn  
(Dug, driven, bored or drilled) (Churn drill, rotary or other)

Water use: Domestic  Municipal  Stock  Irrigation   
Industrial  Drainage  Other

Indicate on the diagram the character and thickness of the different strata met with in drilling, such as soil, clay, shale, gravel, rock or sand, etc. Show depth at which water is encountered, thickness and character of water-bearing strata and height to which the water rises in the well.

Size of Drilled Hole	Size and Weight of Casing	From (Foot)	To (Foot)	PERFORATIONS		
				Kind Size	From (Foot)	To (Foot)
6" ID	6 7/8" OD 17 lbs per. ft. 1/4" side wall	ground level	51'			

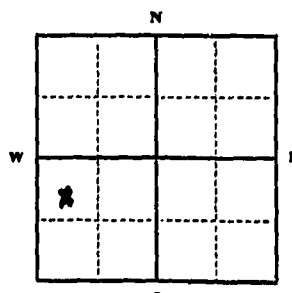

Static Water Level for non-flowing well 44 feet.

Shut-in Pressure for Flowing Well \_\_\_\_\_

Pumping Water Level 50 feet  
at \_\_\_\_\_ gal. per minute.

Discharge in gal. per min. of flowing well \_\_\_\_\_

How Tested Bail Test

Length of Test 5 Hours

Remarks: (Gravel packing, cementing, packers, type of shutoff) \_\_\_\_\_

NW 1/4 SW Sec 25 T12N R21W  
Indicate location of well and place of use, if possible. Each small square represents 40 acres.

(Continue on reverse side)

USE—If used for irrigation, industrial, drainage or other. Explain, state number of acres and location or other data (i.e.: Lot, Block and Addition).

Household use + Garden Irrigation

Show exact depth of bottom.

This form to be prepared by driller, and three copies to be filed by the owner with the County Clerk and Recorder in the county in which the well is located, tissue copy to be retained by driller.

Please answer all questions. If not applicable, so state, otherwise the form will be returned.

157  
Driller's License Number

Kenneth L. Williams  
Driller's Signature.

44,079

1287

270 739

I received and filed this instrument for  
record on the 16 day of April, 1968  
at 2:30 o'clock P.M., permanent files  
of Missoula County, State of Montana  
Witness my hand:  
Vernon R. Crouse County Recorder  
By Walter H. Smith, Deputy  
Fee \$ 2.00 Paid Cash

File No. \_\_\_\_\_

T. 12 N. R. 21 W

35

DUPLICATE

County Missoula

LOG

MONTANA WATER RESOURCES BOARD

RECEIVED

STATE OF MONTANA

ADMINISTRATOR OF GROUNDWATER CODE

OFFICE OF STATE ENGINEER

SEP 29 1969

### Notice of Completion of Groundwater Appropriation by Means of Well DEVELOPED AFTER JANUARY 1, 1962

(Under Chapter 237, Montana Session Laws, 1961)

0	Top soil
1	Thin clay, sand, gravel and scattered boulders
63	seep of water
63	sand and mica
63	Thin clay
65.6	sand and gravel
65.4	sand gravel
66.4	and water

Owner Richard & Marcel Johnson Address Lolo Creek Rd.

Driller Ken Williams Address 1219 Howell

Date of Notice of appropriation of groundwater \_\_\_\_\_

Date well started April 18, 1966 Date completed April 23, 1966

Type of well Drilled Equipment used Churn  
(Dug, driven, bored or drilled) (Churn drill, rotary or other)

Water use: Domestic  Municipal  Stock  Irrigation   
Industrial  Drainage  Other

Indicate on the diagram the character and thickness of the different strata met with in drilling, such as soil, clay, shale, gravel, rock or sand, etc. Show depth at which water is encountered, thickness and character of water-bearing strata and height to which the water rises in the well.

Size of Drilled Hole	Size and Weight of Casing	From (Foot)	To (Foot)	PERFORATIONS		
				Kind Size	From (Foot)	To (Foot)
6" ID	6.5" OD 19 lbs 1/4" side wall	ground level	66' 6"			

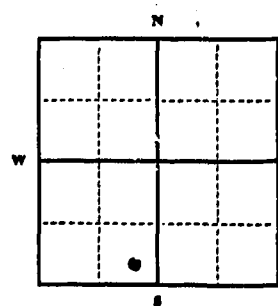

Static Water Level for non-flowing well ..... 60 ..... feet.

Shut-in Pressure for Flowing Well.....

Pumping Water Level..... 65 ..... feet at 5 ..... gal. per minute.

Discharge in gal. per min. of flowing well .....

How Tested... Bail test .....

Length of Test... 4 hours .....

Remarks: (Gravel packing, cementing, packers, type of shutoff).....

Sec. 35 T. 12 N. R. 21 W  
Indicate location of well and place of use, if possible. Each small square represents 40 acres.

(Continue on reverse side)

USE—If used for irrigation, industrial, drainage or other. Explain, state number of acres and location or other data (i.e.: Lot, Block and Addition).

Show exact depth of bottom.

This form to be prepared by driller, and three copies to be filed by the owner with the County Clerk and Recorder in the county in which the well is located, tissue copy to be retained by driller.

Please answer all questions. If not applicable, so state, otherwise the form will be returned.

151  
Driller's License Number

Ken Williams  
Driller's Signature.

45685