

Log of Well

Depth, feet		Description of Material Drilled
From	To	
surface	23ft	yellow clay
23 ft	46ft	hard black soil
46 ft	85 ft	blue-green muck
85 ft	87 ft	gravel

I received and filed the instrument for record on the 3rd day of April, 1964 at 4:11 o'clock P.M. in Department Files at Wisconsin County, State of Michigan.
Witness my hand:
MAYNARD S. BERTNER County Recorder
By: [Signature] Deputy
Fee \$ [blank] Paid

#68

1805/3

RECEIVED

County Missoula

MAY 23 1972

STATE OF MONTANA
ADMINISTRATOR OF GROUNDWATER CODE
MONTANA WATER RESOURCES BOARD

MONTANA DEPARTMENT OF NATURAL RESOURCES AND CONSERVATION

DRILLER'S LOG

NOTICE OF COMPLETION OF GROUNDWATER APPROPRIATION BY MEANS OF WELL

Developed after January 1, 1962

Indicate the character, color, thickness of strata such as soil, clay, sand, gravel, shale, sandstone, etc. Show depth at which water is found and height to which water rises in well.

(Under Chapter 237 Montana Session Laws, 1961, as amended)

This form to be prepared by driller, and three copies to be filed by the owner with the County Clerk and Recorder in the county in which the well is located, last copy to be retained by driller.

Please answer all questions. If not applicable, so state, otherwise the form may be returned.

Owner Paul Bassari

Address 125 Wapitiya Dr.

Missoula, Montana 59801

Date well started April 28, 1972

completed May 2, 1972

Type of well Drilled

Equipment used Churn Drill

Water Use: Domestic Municipal Stock Irrigation

Industrial Drainage Other * Garden/Lawn

*Describe

USE: If used for Irrigation, Industrial, drainage or other. Explain, state number of acres and location or other data (i.e. Lot, Block and Addition).

ESTIMATED ANNUAL WITHDRAWAL

Size of Drilled Hole	Size and Weight of Casing	From (Feet)	To (Feet)	PERFORATIONS		
				Kind Size	From (Feet)	To (Feet)
6" I.D.	6" I.D.	1' 6" above g.l.	35 1/2'	Power Saw slits 1/8" x 4"	35 1/2'	150'
5" I.D. plastic liner		30'	150'			

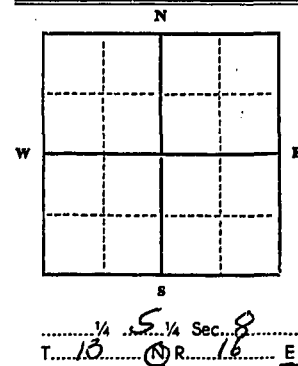

Static water level 22 ft.*
Pumping water level 247 ft.*
at 15 gallons per minute,
measured 15 minutes after pumping began.
*Measured from ground level.
Well developed by test pump
for 2 hours.
Power Electric Pump 1 1/2 HP
Remarks: (Gravel packing, cementing, packers, type of shutoff)

1/4 Sec. 8
T. 10 N. 16 E.
S. W

INDICATE LOCATION OF WELL AND PLACE OF USE, IF POSSIBLE. EACH SMALL SQUARE REPRESENTS 40 ACRES.

Driller's Signature Alvin Camp
Camp Well Drilling & Pump Supply

Driller's Address 1522 S. 14th W. Missoula, Montana 59801

LICENSE NO. 7

Top of Ground (Elev. above sea level)		Well: <u>Potomac Area</u>
From (Feet)	To (Feet)	
0	6	Clay
6	22	Clay & Gravel
22	35	Light tan shale
35	90	Blue Gray Shale & Water
90	95	Gray Shale & Water
95	103	Dark Brown Shale & Water
103	112	Blue Gray Shale
112	138	Dark Brown Shale
138	143	Gray Shale
143	148	Light Brown Shale
148	150	Gray Shale

150' Show exact depth of bottom

50427

2276 316824
I received and filed this instrument for
record on the 11 day of May 1912
at 8:32 o'clock P.M. permanent file
of Missoula County, State of Montana
Witness my hand
Vernice B. Crease, County Recorder
By Thane G. Burkholder, Deputy
Fee \$ 2.00 CR Paid

RECORDED	INDEXED
FILED	FILED
1912	1912
MAY	MAY
11	11
8:32	8:32
P.M.	P.M.
MISSOULA	MISSOULA
MT.	MT.

2296

318439

I received and filed this instrument for
 record on the 22 day of June, 1922
 at 11:30 o'clock A.M. in Sebastian files
 of Sebastian County State of Arkansas
 Witness my hand
Wesley R. Cross County Recorder
 By Wesley R. Cross Deputy
 For 2.00 Paid cash

1922 JUN 22 11 30 AM

RECORDED 32 110

RECEIVED
 JUN 22 1922
 11 30 AM
 SEBASTIAN COUNTY
 ARKANSAS
 RECORDED
 JUN 22 1922
 11 30 AM
 SEBASTIAN COUNTY
 ARKANSAS

RECEIVED
MAY 14 1973

County Missoula **8**

STATE OF MONTANA
ADMINISTRATOR OF GROUNDWATER CODE
MONTANA WATER RESOURCES BOARD

MONTANA DEPARTMENT OF NATURAL
RESOURCES AND CONSERVATION

DRILLER'S LOG

Indicate the character, color, thickness of strata such as soil, clay, sand, gravel, shale, sandstone, etc. Show depth at which water is found and height to which water rises in well.

NOTICE OF COMPLETION OF GROUNDWATER APPROPRIATION BY MEANS OF WELL

Developed after January 1, 1962

(Under Chapter 237 Montana Session Laws, 1961, as amended)

This form to be prepared by driller, and three copies to be filed by the owner with the County Clerk and Recorder in the county in which the well is located, last copy to be retained by driller. Please answer all questions. If not applicable, so state, otherwise the form may be returned.

Owner Gary Tobel
Address Potomac, Montana 59882
Date well started April 3, 1973
completed April 13, 1973

For Administrator's Use	
File	<u>2481, 334, 839</u>
<u>May 10, 1973</u>	
GW 1	<u>2:00 p.m.</u>

Type of well Drilled
(Dug, driven, bored or drilled)
Equipment used Churn Drill
(Churn drill, rotary or other)
Water Use: Domestic Municipal Stock Irrigation
Industrial Drainage Other * Garden/Lawn

*Describe _____
USE: If used for irrigation, industrial, drainage or other. Explain, state number of acres and location or other data (i.e. Lot, Block and Addition). _____

ESTIMATED ANNUAL WITHDRAWAL

Size of Drilled Hole	Size and Weight of Casing	From (Feet)	To (Feet)	PERFORATIONS		
				Kind Size	From (Feet)	To (Feet)
<u>6"ID</u>	<u>6"ID 17 lb per ft. G.I.</u>	<u>1'6"</u>	<u>230'</u>	<u>none</u>		

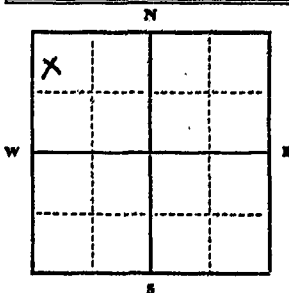

Static water level Flows 4 gpm
Pumping water level 175 ft.*
at 25 gallons per minute,
measured 40 minutes after pumping
began.
*Measured from ground level.
Well developed by compressor
for 2 hours.
Power Gas at Pump apply HP
Remarks: (Gravel packing, cementing,
packers, type of shutoff) _____

R.W. 1/4 1/4 Sec. 8
T. 13 N. R. 16 B
W

INDICATE LOCATION OF WELL AND PLACE OF USE, IF POSSIBLE. EACH SMALL SQUARE REPRESENTS 40 ACRES.

Driller's Signature Elmer Camp
CAMP WELL DRILLING & PUMP SUPPLY
Driller's Address 1822 S. 14th St. Missoula, Montana 59801
Gary L. Tobel LICENSE NO. 7

Top of Ground (Elev. above sea level)		
From (Feet)	To (Feet)	
<u>0</u>	<u>108</u>	<u>Clay, Gravel & Broken Rock</u>
<u>108</u>	<u>148</u>	<u>Clay & Broken Rock</u>
<u>148</u>	<u>158</u>	<u>Broken Rock & Small Sand of Water</u>
<u>158</u>	<u>230</u>	<u>Clay and Broken Rock</u>
<u>230</u>	<u>258</u>	<u>Rock</u>
<u>258</u>	<u>269</u>	<u>Rock & Water</u>
<u>268</u>	<u>305</u>	<u>Rock</u>
<u>305</u>	<u>311</u>	<u>Rock & Water</u>

311' Show exact depth of bottom

2481

33/53 9

I received and filed this instrument for
record on the 7th day of May, 1973
at 2:00 o'clock P.M., permanent files
of Missoula County, State of Montana
Witness my hand:
Dorothy L. Head, County Recorder
By Tom J. Cunningham, Deputy
Fee \$2.00 Paid cash

RECEIVED

JUN 13 1972

County Missoula

8

STATE OF MONTANA
ADMINISTRATOR OF GROUNDWATER CODE
MONTANA WATER RESOURCES BOARD

MONTANA DEPARTMENT OF NATURAL
RESOURCES AND CONSERVATION

DRILLER'S LOG

Indicate the character, color, thickness of strata such as soil, clay, sand, gravel, shale, sandstone, etc. Show depth at which water is found and height to which water rises in well.

NOTICE OF COMPLETION OF GROUNDWATER
APPROPRIATION BY MEANS OF WELL

Developed after January 1, 1962

(Under Chapter 237 Montana Session Laws, 1961, as amended)

This form to be prepared by driller, and three copies to be filed by the owner with the County Clerk and Recorder in the county in which the well is located, last copy to be retained by driller.

Please answer all questions. If not applicable, so state, otherwise the form may be returned.

Owner Lester D. Zimmerman

Address Patmas, Montana

Date well started May 2, 1972

completed May 5, 1972

Type of well Drilled

Equipment used Churn Drill

Water Use: Domestic Municipal Stock Irrigation

Industrial Drainage Other Garden/Lawn

*Describe

USE: If used for irrigation, industrial, drainage or other. Explain, state number of acres and location or other data (i.e. Lot, Block and Addition).

ESTIMATED ANNUAL WITHDRAWAL

Size of Drilled Hole	Size and Weight of Casing	From (Feet)	To (Feet)	PERFORATIONS		
				Kind Size	From (Feet)	To (Feet)
6" I.D.	6" I.D.	16" above g.l.	47' 7"			
5" I.D. liner	5" I.D. plastic	45'	100'	Cut 1/8" x 5"	45'	100'

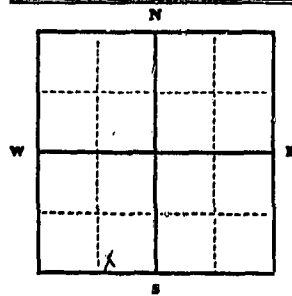

Static water level 31 ft.*
Pumping water level 25 ft.*
at 24 gallons per minute,
measured 15 minutes after pumping began.

*Measured from ground level.
Well developed by foot pump
for 2 1/2 hours.

Power Electric Pump 1 1/2 HP
Remarks: (Gravel packing, cementing, packers, type of shutoff)

1/4 Sec. 8
T. 13 N. R. 16 E.
S. W.

INDICATE LOCATION OF WELL AND PLACE OF USE, IF POSSIBLE. EACH SMALL SQUARE REPRESENTS 40 ACRES.

Driller's Signature Glenn Camp
CAMP WELL DRILLING & PUMP SUPPLY
Driller's Address 1522 S. 14th W., Missoula, Montana 59801

LICENSE NO. 7

Show exact depth of bottom

50,615

Top of Ground (Elev. above sea level)		
From (Feet)	To (Feet)	
0	8	Clay & Gravel
8	22	Clay, Rock & Gravel
22	26	Tan Shale
26	28	Blue Gray Shale
28	51	Dark Gray Shale
51	79	Blue Gray Shale & Water
79	81	Dark Brown Shale & Water
81	83	Blue Gray Shale & Water
83	86	Dark Brown Shale & Water
86	100	Gray Shale

42291

317973

I received and filed this instrument for record on the 13 day of June 1977 at 4:35 o'clock P.M. and it is recorded in vol. _____

Records of the County of
Missoula, State of Montana on page _____

Witness my hand
Vermae R. Cross, County Recorder
By Vermae R. Cross Deputy
Fee \$ 2.00 cash Paid
Return to _____
Address _____ X

MISSOULA COUNTY
RECORDS DEPARTMENT
MISSOULA, MONTANA

GW1

File No.

T 13 N R 16 W 10

DUPLICATE

County MISSOULA

STATE OF MONTANA
ADMINISTRATOR OF GROUNDWATER CODE
OFFICE OF STATE ENGINEER

RECEIVED
NOV 22 1963

Notice of Appropriation of Groundwater
(Under Chapter 237, Montana Session Laws, 1961)

STATE ENGINEER

1. I, Ray B. Hille, of Patmos (Town)
(Name of Appropriator) (Address)
County of Missoula, State of Montana, intend to appropriate groundwater in accordance with Chapter 237, Montana Session Laws of 1961.

2. The beneficial use to which water is to be applied is

Stock water & possibly house water if surf
(describe lands to be benefited, if for irrigation)

3. The rate of use in gallons per minute or miner's inches of groundwater claimed

Unknown

4. The annual period (inclusive dates) of intended use

Yearly - especially winter

5. The probable or intended date of first beneficial use

Spring of 1964

6. The probable or intended date of commencement and completion of the well* or wells*

December to start operation & completion in Spring of 1964

7. The location, type, size and depth of well or wells contemplated

It is a spring well of present building to be piped down to canal to be constructed

8. The probable or estimated depth of the water table or artesian aquifer

Unknown

9. Name, address and license number of the driller engaged

None

10. Give such other similar information as may be useful in carrying out the policy of this act

This is a spring that is being developed for stock water for lower pasture - has been used as is for past 30 years.

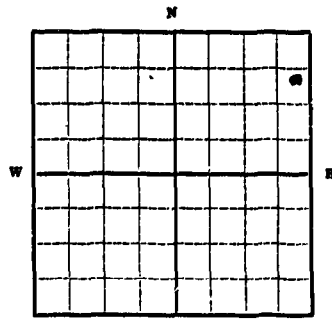

N.E. 1/4 Sec. 10, T. 13, R. 16

Locate well or other means of development as accurately as possible on the plat.

Signature of Appropriator: Ray B. Hille

Date: Nov 20, 1963

* As defined in the Code Sec. 1 (c) "Well" means any artificial opening or excavation in the ground, however made, by which groundwater can be obtained or through which it flows under natural pressures or is artificially withdrawn."

Three copies of this notice are to be filed with County Clerk and Recorder of the county in which the well is located.

Please answer all questions. If not applicable, so state, otherwise the form will be returned.

Original to the County Clerk and Recorder; duplicate to the State Engineer; Triplicate to the School of Mines and Quadruplicate for the Appropriator.

1977

213265

I received and filed this instrument for
 record on the 20 day of Nov 1963
 at 4:00 o'clock P.M. permanent files
 of Missoula County State of Montana
 Witness my hand:
 MARTIN S. BEHNER County Clerk
 By Martin S. Behner
 Fee \$ 2.00 Paid

C

GW3

File No. _____

T. 13^N R. 16

DUPLICATE

County Missoula

STATE OF MONTANA
ADMINISTRATOR OF GROUNDWATER CODE
OFFICE OF STATE ENGINEER

RECEIVED
DEC 10 1963

STATE ENGINEER
Notice of Completion of Groundwater Appropriation Without Well

(Under Chapter 237 Montana Session Laws, 1961)

Date of Appropriation of Groundwater 1925

Owner Marshall Brondum Address Potomac, Montana

Contractor (if any) None

Address of Contractor None

Date Started 1925 Date Completed Unknown

Describe means of obtaining groundwater without a well "as by sub-irrigation and other natural processes". Include depth to water when applicable. Two springs running water through 1 inch pipe after being dug by hand to 6 feet deep. Water is at ground level.

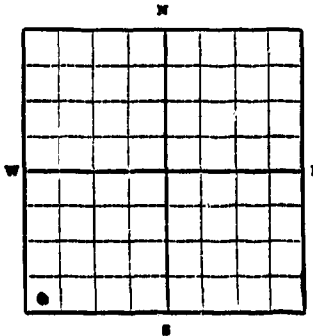

Quantity of water developed and used with explanation of method used to measure or estimate such amount. If use is intermittent estimate approximate lengths of periods of use. Water runs through 1 inch pipe continuously and is used to water livestock and for domestic use.

1/4 Sec. 11 T. 13 R. 16
Indicate point of appropriation and place of use, if possible.

Signature of Owner Marshall Brondum

Date Dec. 3, 1963

This form to be prepared by contractor (if any), otherwise by the owner.

Three copies of this notice are to be filed with the County Clerk and Recorder of the county in which the works are located.

Please answer all questions. If not applicable, so state, otherwise the form will be returned.

Original to the County Clerk and Recorder; duplicate to the State Engineer; Triplicate to the Montana Bureau of Mines and Geology and Quadruplicate for the Appropriator.

373

213966

Copy

I received and filed this instrument for record on the 9 day of Dec, 1968 at 11:00 o'clock A.M., permanent files of Missoula County, State of Montana

Witness my hand:
 MARTIN S. DEHNER, County Recorder
 By Martin S. Dehner Deputy
 Fee \$ 2.00 Paid

MISSOULA COUNTY RECORDS DEPARTMENT
 100 N. 2ND ST. MISSOULA, MONTANA 59801
 PHONE 542-1111

RECORDED
 INDEXED

MISSOULA COUNTY RECORDS DEPARTMENT
 100 N. 2ND ST. MISSOULA, MONTANA 59801
 PHONE 542-1111

GV

13

File No.

NW $\frac{1}{4}$ NW $\frac{1}{4}$ SE $\frac{1}{4}$, Section 13, T. 13N. R. 16

DUPLICATE

County.....

STATE OF MONTANA
ADMINISTRATOR OF GROUNDWATER CODE
OFFICE OF STATE ENGINEER

RECEIVED
DEC 30 1963
STATE ENGINEER

Declaration of Vested Groundwater Rights

(Under Chapter 237, Montana Session Laws, 1961)

We, Russell E. Hall and Muriel J. Hall, of Potomac
(Name of Appropriator) (Address) (Town)

County of Missoula State of Montana
have appropriated groundwater according to the Montana laws in effect prior to January 1, 1962, as follows:

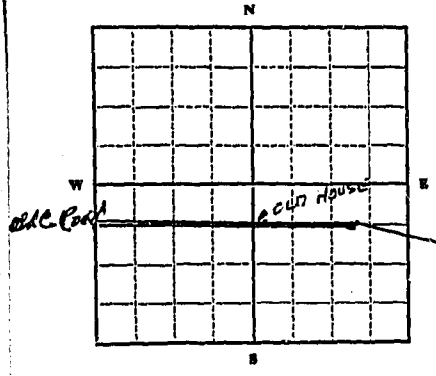

2. The beneficial use on which the claim is based domestic livestock, garden, and lawn

3. Date or approximate date of earliest beneficial use; and how continuous the use has been 1909

4. The amount of groundwater claimed (in miner's inches or gallons per minute) 75 gals. per minute

5. If used for irrigation, give the acreage and description of the lands to which water has been applied and name of the owner thereof garden and lawn--one acre

6. The means of withdrawing such water from the ground and the location of each well or other means of withdrawal PUMP IN NW $\frac{1}{4}$ SE $\frac{1}{4}$, 13-13-16, Plat. H-1 and A; electrical pump draws water in pipe.

1/4 Sec. T. R.

Indicate point of appropriation and place of use, if possible. Each small square represents 10 acres.

7. The date of commencement and completion of the construction of the well, wells, or other works for withdrawal of groundwater 1909

8. The depth of water table 8 ft.

9. So far as it may be available, the type, size and depth of each well or the general specifications of any other works for the withdrawal of groundwater the well when dug was 20 ft. deep.

10. The estimated amount of groundwater withdrawn each year 200,000 gals.

11. The log of formations encountered in the drilling of each well if available gravel and clay

12. Such other information of a similar nature as may be useful in carrying out the policy of this act, including reference to book and page of any county record The old county road runs just to the south of an old house on the foregoing property.

Signature of Owner Russell E. Hall
Muriel J. Hall

Date December 18, 1963

Three copies to be filed by the owner with the County Clerk and Recorder of the county in which the well is located.

Please answer all questions. If not applicable, so state, otherwise the form will be returned.

Original to the County Clerk and Recorder; duplicate to the State Engineer; Triplicate to the Montana Bureau of Mines and Geology, and Quadruplicate for the Appropriator.

15164

562

214864

Copy

I received and filed this instrument for
 record on the 26 day of May 1963
 at 10:24 o'clock A.M., permanent files
 of Missoula County, State of Montana
 Witness my hand:
MARTIN S. BEHNER, County Recorder
 By Martin S. Behner Deputy
 Fee \$2.00 Paid

[Faint, illegible text, likely bleed-through from the reverse side of the page]

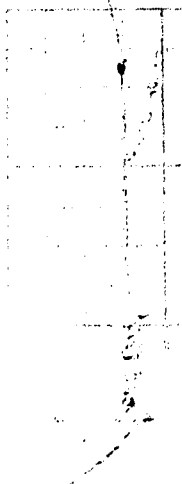

13

File No.

SW 1/4 NW 1/4 SE 1/4

Section 13,

T. 13 N., R. 16 W.

DUPLICATE

County... Missoula

STATE OF MONTANA
ADMINISTRATOR OF GROUNDWATER CODE
OFFICE OF STATE ENGINEER

Declaration of Vested Groundwater Rights

(Under Chapter 237, Montana Session Laws, 1961)

RECEIVED
DEC 30 1963

STATE ENGINEER

Russell E. Hall and Muriel J. Hall, of Potomac
(Name of Appropriator) (Address) (Town)

County of Missoula State of Montana
have appropriated groundwater according to the Montana laws in effect prior to January 1, 1962, as follows:

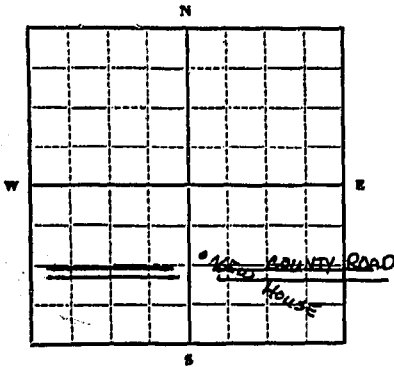

1/4 Sec. T. R.

Indicate point of appropriation and place of use, if possible. Each small square represents 10 acres.

2. The beneficial use on which the claim is based domestic, livestock, garden, and lawn

3. Date or approximate date of earliest beneficial use; and how continuous the use has been 1942; in continuance flow since

4. The amount of groundwater claimed (in miner's inches or gallons per minute) 50 gals. per minute

5. If used for irrigation, give the acreage and description of the lands to which water has been applied and name of the owner thereof 1 1/2 acres, garden and lawn

6. The means of withdrawing such water from the ground and the location of each well or other means of withdrawal Pump and galvanized iron pipe running in a northwesterly direction to a stock water trough and for irrigation.

7. The date of commencement and completion of the construction of the well, wells, or other works for withdrawal of groundwater 1942

8. The depth of water table 16 ft.

9. So far as it may be available, the type, size and depth of each well or the general specifications of any other works for the withdrawal of groundwater drill well, 6" casing, 242 ft. deep

10. The estimated amount of groundwater withdrawn each year 300,000 gals. per year

11. The log of formations encountered in the drilling of each well if available Gravel and different formations of clay to thin hard pan.

12. Such other information of a similar nature as may be useful in carrying out the policy of this act, including reference to book and page of any county record None.

Signature of Owner Russell E. Hall
Muriel J. Hall

Date Jan 24 - 1963

Three copies to be filed by the owner with the County Clerk and Recorder of the county in which the well is located.

Please answer all questions. If not applicable, so state, otherwise the form will be returned.

Original to the County Clerk and Recorder; duplicate to the State Engineer; Triplicate to the Montana Bureau of Mines and Geology, and Quadruplicate for the Appropriator.

15165

563

214865

copy

I received and filed this instrument for
record on the *27th* day of *Dec* 19*63*
at *10:21* o'clock *A.M.*, permanent files
of Missoula County, State of Montana
Witness my hand:
MARTIN E. BEHNER, County Recorder
By *Martin E. Behner* Deputy
Fee \$ *3.00* Paid

GW3

File No.

DUPLICATE

T. 13 R. 16

County Missoula

13

STATE OF MONTANA
ADMINISTRATOR OF GROUNDWATER CODE
OFFICE OF STATE ENGINEER

RECORDED
JAN 3 1964
STATE ENGINEER

Notice of Completion of Groundwater Appropriation Without Well

(Under Chapter 237 Montana Session Laws, 1961)

Date of Appropriation of Groundwater 1913
Owner NINA G, Eugene A and Robert G. Hall
Address Potomac, Montana
Contractor (if any) NONE
Address of Contractor NONE

Date Started 1913 Date Completed 1913

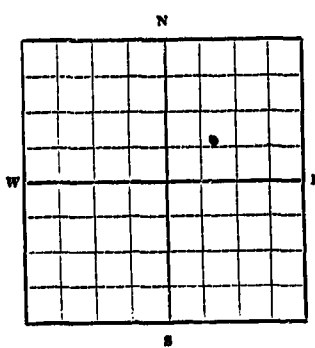

Describe means of obtaining groundwater without a well "as by sub-irrigation and other natural processes". Include depth to water when applicable. Cemented walls connected by pipe line approx 800 feet to dwelling. Gravity flow plus shallow-well pump. Depth of boxed spring 8 feet.

Quantity of water developed and used with explanation of method used to measure or estimate such amount. If use is intermittent estimate approximate lengths of periods of use 25 gal per minute measured and timed by clock. Used in dwelling pump house, Corral + Barn water. Also water lawn in summer.
Signature of Owner Robert G Hall
Date December 27, 1963

SW 1/4, NE 1/4 Sec. 13 T. 13 R. 16
Indicate point of appropriation and place of use, if possible.

This form to be prepared by contractor (if any), otherwise by the owner.
Three copies of this notice are to be filed with the County Clerk and Recorder of the county in which the works are located.
Please answer all questions. If not applicable, so state, otherwise the form will be returned.
Original to the County Clerk and Recorder; duplicate to the State Engineer; Triplicate to the Montana Bureau of Mines and Geology and Quadruplicate for the Appropriator.

337

215894

I received and filed this instrument for record on the 2 day of Jan 1904 at 1:36 o'clock P.M. in Room 115 of Missoula County, State of Montana
Witness my hand
MAYNARD S. BISHOP, County Recorder
By ETHEL D. LANE Deputy
Fee \$ 2.00 Paid

File No. _____

DUPLICATE

T. 13^N R. 16^W -14

County Missoula

STATE OF MONTANA
ADMINISTRATOR OF GROUNDWATER CODE
OFFICE OF STATE ENGINEER
Declaration of Vested Groundwater Rights
(Under Chapter 237, Montana Session Laws, 1961)

RECEIVED
DEC 10 1963
STATE ENGINEER

1 Marshall Brondum, of Potomac
(Name of Appropriator) (Address) (Town)
County of Missoula State of Montana
have appropriated groundwater according to the Montana laws in effect prior to January 1, 1962, as follows:

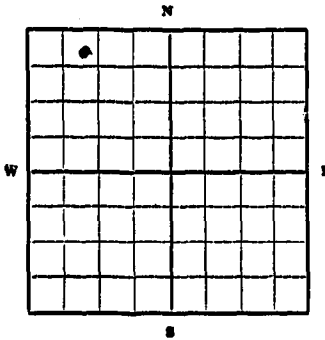

1/4 Sec. 14 T. 13 R. 16

Indicate point of appropriation and place of use, if possible. Each small square represents 10 acres.

2. The beneficial use on which the claim is based For household purposes.
3. Date or approximate date of earliest beneficial use; and how continuous the use has been 1910, Continuous from that date.
4. The amount of groundwater claimed (in miner's inches or gallons per minute) Unknown
5. If used for irrigation, give the acreage and description of the lands to which water has been applied and name of the owner thereof Not applicable.
6. The means of withdrawing such water from the ground and the location of each well or other means of withdrawal Electric pump at farm dwelling.
7. The date of commencement and completion of the construction of the well, wells, or other works for withdrawal of groundwater Unknown. Electric pump used for drawing water.
8. The depth of water table Unknown
9. So far as it may be available, the type, size and depth of each well or the general specifications of any other works for the withdrawal of groundwater Hand dug, 16 feet deep, 8 inch soil pipe, electric pump used for withdrawal of water.
10. The estimated amount of groundwater withdrawn each year For domestic use.
11. The log of formations encountered in the drilling of each well if available Unknown
12. Such other information of a similar nature as may be useful in carrying out the policy of this act, including reference to book and page of any county record Unknown

Signature of Owner Marshall Brondum

Date Nov. 23, 1963

Three copies to be filed by the owner with the County Clerk and Recorder of the county in which the well is located.

Please answer all questions. If not applicable, so state, otherwise the form will be returned.

Original to the County Clerk and Recorder; duplicate to the State Engineer; Triplicate to the Montana Bureau of Mines and Geology and Quadruplicate for the Appropriator.

372

213 915

I received and filed this instrument for
 record on the 9 day of Dec 1960
 at 11:11 o'clock P.M., permanent files
 of Missoula County, State of Montana
 Witness my hand:
 MARTIN S. BEHNER, County Recorder
 By Martin S. Behner Deputy
 Fee \$ 2.00 Paid

RECORDED

INDEXED

MISSOULA COUNTY CLERK

RECORDED

MISSOULA COUNTY CLERK

MISSOULA COUNTY CLERK

MISSOULA COUNTY CLERK

MISSOULA COUNTY CLERK

MISSOULA COUNTY CLERK

GW3

File No. _____

DUPLICATE

T 13⁴ R 16¹⁴

County Missoula

RECEIVED
DEC 10 1963

STATE OF MONTANA
ADMINISTRATOR OF GROUNDWATER CODE
OFFICE OF STATE ENGINEER

STATE ENGINEER

Notice of Completion of Groundwater Appropriation Without Well

(Under Chapter 237 Montana Session Laws, 1961)

Date of Appropriation of Groundwater 1900

Owner Marshall Brondum Address Potomac, Montana

Contractor (if any) None

Address of Contractor None

Date Started Natural Date Completed Not applicable.

Describe means of obtaining groundwater without a well "as by sub-irrigation and other natural processes". Include depth to water when applicable. Natural spring flowing through road culvert under Montana Highway and 20' into a 1 inch pipe.

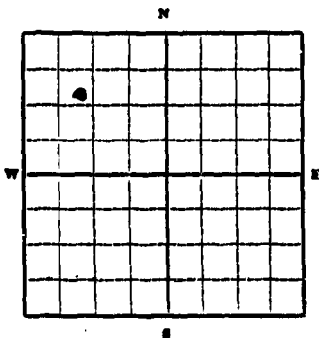

1/4 Sec 14 T 13 R 16
Indicate point of appropriation and place of use, if possible.

Quantity of water developed and used with explanation of method used to measure or estimate such amount. If use is intermittent estimate approximate lengths of periods of use Water runs through 1 inch pipe continuously and is used to water livestock and to irrigate pasture lands.

Signature of Owner Marshall Brondum

Date Dec. 3, 1963

This form to be prepared by contractor (if any), otherwise by the owner.

Three copies of this notice are to be filed with the County Clerk and Recorder of the county in which the works are located.

Please answer all questions. If not applicable, so state, otherwise the form will be returned.

Original to the County Clerk and Recorder; duplicate to the State Engineer; Triplicate to the Montana Bureau of Mines and Geology and Quadruplicate for the Appropriator.

6275

325

213968

Copy

I received and filed this instrument for
 record on the 9 day of Dec 1968
 at 1:20 o'clock P. M., permanent files
 of Missoula County, State of Montana
 Witness my hand:
 MARTIN E. BEHNER, County Recorder
 By Martin E. Behner
 Fee \$ 5.00 Paid

14

File No. _____

T. 12ⁿ R. 16 West

DUPLICATE

County Missoula

STATE OF MONTANA
ADMINISTRATOR OF GROUNDWATER CODE
OFFICE OF STATE ENGINEER

RECEIVED
JAN 3 1964
STATE ENGINEER

Declaration of Vested Groundwater Rights

(Under Chapter 237, Montana Session Laws, 1961)

Leonard E Cook Hazel Blaka Potomac Montana
(Name of Appropriator) (Address) (Town)
County of Missoula State of Montana Potomac
have appropriated groundwater according to the Montana laws in effect prior to January 1, 1962, as follows:

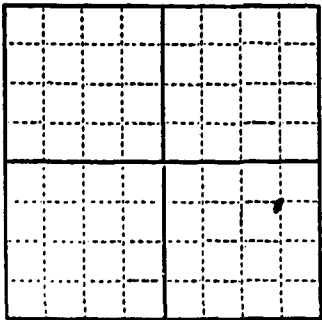

9 E. & 2 E. Sec 4 T. 13. R. 16 W.

Indicate point of appropriation and place of use, if possible. Each small square represents 10 acres.

- 2. The beneficial use on which the claim is based Household and irrigating lawn & garden
- 3. Date or approximate date of earliest beneficial use; and how continuous the use has been Has been used for a good many years (continuous)
- 4. The amount of groundwater claimed (in miner's inches or gallons per minute) 65 gals per min when irrigating lawn and garden.
- 5. If used for irrigation, give the acreage and description of the lands to which water has been applied and name of the owner thereof Plat. R. Sec 14 T. 13. R. 16 West Leonard E & Hazel B. Cook
- 6. The means of withdrawing such water from the ground and the location of each well or other means of withdrawal Electric pump 1 HP motor.

- 7. The date of commencement and completion of the construction of the well, wells, or other works for withdrawal of groundwater unknown.
- 8. The depth of water table Slightly higher (6.5') & under.
- 9. So far as it may be available, the type, size and depth of each well or the general specifications of any other works for the withdrawal of groundwater Drilled 7.5' eight" casing
- 10. The estimated amount of groundwater withdrawn each year 500,000 gal.
- 11. The log of formations encountered in the drilling of each well if available not known.
- 12. Such other information of a similar nature as may be useful in carrying out the policy of this act, including reference to book and page of any county record Does not find no log book

Signature of Owner Leonard E Cook
Date Dec 31 1963

Three copies to be filed by the owner with the County Clerk and Recorder of the county in which the well is located.

Please answer all questions. If not applicable, so state, otherwise the form will be returned.

Original to the County Clerk and Recorder; Duplicate to the State Engineer; Triplicate to the Montana Bureau of Mines and Geology, and Quadruplicate for the Appropriator.

2013

993 - 2154 67

I received and filed this instrument for
record the day of Nov 1887
at 11 o'clock A. M., permanent files
of Missoula County, State of Montana
Witness my hand
Wm S. Beane County Recorder
By Wm S. Beane Deputy
Fee \$ 1.00 Paid

[Faint handwritten text, possibly a signature or date]

GW3

File No.

T. 13^N R. 16^W 14

DUPLICATE

County.

STATE OF MONTANA
ADMINISTRATOR OF GROUNDWATER CODE
OFFICE OF STATE ENGINEER

RECEIVED
JAN 13 1964

Notice of Completion of Groundwater Appropriation Without Well

STATE ENGINEER

(Under Chapter 237 Montana Session Laws, 1961)

Date of Appropriation of Groundwater APRIL 1956
Owner NICK GABRIEL Address POTOMAC MONT.
Contractor (if any) NICK GABRIEL
Address of Contractor TWIN CREEK, MONT.
Date Started APRIL 1956 Date Completed APRIL 1956

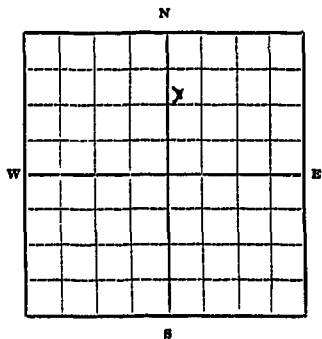

Describe means of obtaining groundwater without a well "as by sub-irrigation and other natural processes". Include depth to water when applicable. SPRING - 15 FT. DEEP GRAVITY FED.

Quantity of water developed and used with explanation of method used to measure or estimate such amount. If use is intermittent estimate approximate lengths of periods of use

SW 1/4 NW 1/4 Sec. 14 T. 13 N. R. 16 W.
Indicate point of appropriation and place of use, if possible.

100 GAL PER DAY USED DAILY

Signature of Owner [Signature]
Date Dec 30, 1963

This form to be prepared by contractor (if any), otherwise by the owner.
Three copies of this notice are to be filed with the County Clerk and Recorder of the county in which the works are located.
Please answer all questions. If not applicable, so state, otherwise the form will be returned.
Original to the County Clerk and Recorder; duplicate to the State Engineer; Triplicate to the Montana Bureau of Mines and Geology and Quadruplicate for the Appropriator.

1-49

216009

copy

I received and filed this instrument for
record on the 6th day of Jan 1949
at 3:00 o'clock P.M., Government Bldg
of Missoula County, State of Montana
Witness my hand:
MARTIN S. BEHNER, County Recorder
By Ethel Lame Deputy:
Fee \$ 2.00 Paid

File No. SE 1/4 NW 1/4, SE 1/4 Sec. 14 T. 13 R. 16 W

DUPLICATE

County Missoula

STATE OF MONTANA
ADMINISTRATOR OF GROUNDWATER CODE
OFFICE OF STATE ENGINEER

RECEIVED
DEC 30 1963

Declaration of Vested Groundwater Rights
(Under Chapter 237, Montana Session Laws, 1961)

HENRY F. HAYES,
1 HENRY HAYES and F. H. HAYES, of Potomac, Montana
(Name of Appropriator) (Address) (Town)
County of Missoula State of Montana
have appropriated groundwater according to the Montana laws in effect prior to January 1, 1962, as follows:

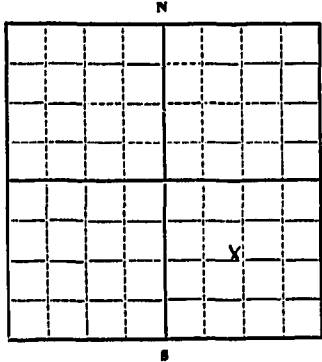

- 2. The beneficial use on which the claim is based. For domestic use at the home of Henry F. Hayes.
3. Date or approximate date of earliest beneficial use; and how continuous the use has been. June, 1894, and continuously thereafter up to the present time.
4. The amount of groundwater claimed (in miner's inches or gallons per minute) twenty (20) gallons per minute.
5. If used for irrigation, give the acreage and description of the lands to which water has been applied and name of the owner thereof. Only use for irrigation is occasionally in the yard at the house.

1/4 Sec. T. R.

Indicate point of appropriation and place of use, if possible. Each small square represents 10 acres.

6. The means of withdrawing such water from the ground and the location of each well or other means of withdrawal. A spring in the Southeast Quarter of the Northwest Quarter (SE 1/4 NW 1/4) of the Southeast Quarter (SE 1/4) of Section 17, Township 13 North, Range 16 West, and an electrical pump pumping the water at rate of 20 gals. a minute through a galvanized pipe about 220 ft. in an easterly direction to the residence of Henry F. Hayes.

- 7. The date of commencement and completion of the construction of the well, wells, or other works for withdrawal of groundwater. About June, 1894.
8. The depth of water table. Two (2) to Four (4) Feet.
9. So far as it may be available, the type, size and depth of each well or the general specifications of any other works for the withdrawal of groundwater. No other wells used for this purpose.
10. The estimated amount of groundwater withdrawn each year. Continuous flow of approximately Twenty (20) inches.
11. The log of formations encountered in the drilling of each well if available. No log of formations encountered.
12. Such other information of a similar nature as may be useful in carrying out the policy of this act, including reference to book and page of any county record. No County record of this appropriation.

*On said described land, which residence is about 150 feet East of the East side line of said described premises.

Signature of Owner Henry Hayes

Date Dec 12, 1963

Three copies to be filed by the owner with the County Clerk and Recorder of the county in which the well is located.

Please answer all questions. If not applicable, so state, otherwise the form will be returned.

Original to the County Clerk and Recorder; duplicate to the State Engineer; Triplicate to the Montana Bureau of Mines and Geology, and Quadruplicate for the Appropriator.

564

214866

Copy

I received and filed this instrument for
record on the 26 day of Dec, 1963
at 10:30 o'clock A.M., permanent files
of Missoula County, State of Montana
Witness my hand:
MARTIN S. BEHNER, County Recorder
By Martin S. Behner, Deputy
Fee \$ 2.00 Paid

File No. _____

T. 13^N R. 16^W 14

DUPLICATE

County _____

STATE OF MONTANA
ADMINISTRATOR OF GROUNDWATER CODE
OFFICE OF STATE ENGINEER

Declaration of Vested Groundwater Rights

(Under Chapter 237, Montana Session Laws, 1961)

RECORDED
JAN 3 1964
STATE ENGINEER

1. Hayes Pat and Forette
Forette Jay (Name of Appropriator), of Pitman (Address)
County of Missoula State of Montana

have appropriated groundwater according to the Montana laws in effect prior to January 1, 1962, as follows:

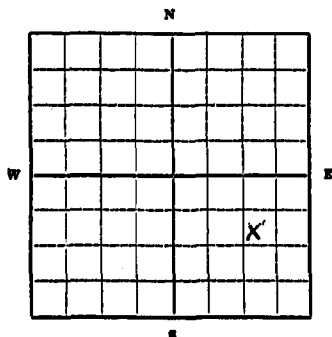

NE 1/4 Sec 14 T. 13. R. 16
Indicate point of appropriation and place of use, if possible. Each small square represents 10 acres.

2. The beneficial use on which the claim is based Household and irrigation

3. Date or approximate date of earliest beneficial use; and how continuous the use has been August, 1957
continual use

4. The amount of groundwater claimed (in miner's inches or gallons per minute) 30 gallons per minute

5. If used for irrigation, give the acreage and description of the lands to which water has been applied and name of the owner thereof 3 acre owned by Hayes and Forette
3 acre owned by Jay Forette

6. The means of withdrawing such water from the ground and the location of each well or other means of withdrawal well pump, electrically impelled

7. The date of commencement and completion of the construction of the well, wells, or other works for withdrawal of groundwater completed June 25, 1957

8. The depth of water table 60 ft

9. So far as it may be available, the type, size and depth of each well or the general specifications of any other works for the withdrawal of groundwater well is drilled to a depth of 117 ft with a one inch casing above 60 ft

10. The estimated amount of groundwater withdrawn each year 1,000,000 gallons

11. The log of formations encountered in the drilling of each well if available found by steam camp, Missoula
No log kept of formations encountered

12. Such other information of a similar nature as may be useful in carrying out the policy of this act, including reference to book and page of any county record.

Signature of Owner Pat Hayes
Date Dec 30, 1963

Three copies to be filed by the owner with the County Clerk and Recorder of the county in which the well is located.

Please answer all questions. If not applicable, so state, otherwise the form will be returned.

Original to the County Clerk and Recorder; duplicate to the State Engineer; Triplicate to the Montana Bureau of Mines and Geology and Quadruplicate for the Appropriator.

20016

817 215-25



I received 20 filed this instrument for
 record on the 26 day of May 1927
 at 9:20 o'clock A.M., permanent files
 of Missoula County, State of Montana
 Witness my hand:
 M. M. J. S. BEHNER, County Recorder
 By M. S. Behner Deputy
 Fee \$ 20

54

File No. _____

T. 13^N R. 16^W

DUPLICATE

County _____

STATE OF MONTANA
ADMINISTRATOR OF GROUNDWATER CODE
OFFICE OF STATE ENGINEER

RECEIVED
JAN 3 1964
STATE ENGINEER

Declaration of Vested Groundwater Rights

(Under Chapter 237, Montana Session Laws, 1961)

1. Raymond F. Koch of Patonae
(Name of Appropriator) (Address) (Town)

County of Missoula State of Montana
have appropriated groundwater according to the Montana laws in effect prior to January 1, 1962, as follows:

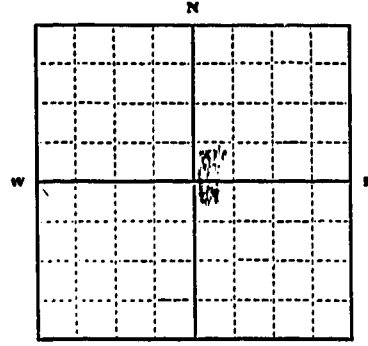

N.E. & E. Sec. 14 T. 13 R. 16 W
Indicate point of appropriation and place of use, if possible. Each small square represents 10 acres.

- 2. The beneficial use on which the claim is based House & slightly under 1 acre for house etc.
- 3. Date or approximate date of earliest beneficial use; and how continuous the use has been 1959 constantly from then drilled
- 4. The amount of groundwater claimed (in miner's inches or gallons per minute) 30 G.P.M.
- 5. If used for irrigation, give the acreage and description of the lands to which water has been applied and name of the owner thereof just under 1 acre for irrigation
Plata H. & D. H.
Raymond & Ruth F. Koch
- 6. The means of withdrawing such water from the ground and the location of each well or other means of withdrawal 21 eyes
Pump 21 H.P.

7. The date of commencement and completion of the construction of the well, wells, or other works for withdrawal of groundwater May 6/1959

8. The depth of water table about 104'

9. So far as it may be available, the type, size and depth of each well or the general specifications of any other works for the withdrawal of groundwater
Drilled well - 112 ft cased 6 1/8" 6" casing

10. The estimated amount of groundwater withdrawn each year 20000 gal house & irrig.

11. The log of formations encountered in the drilling of each well if available
0-2 black dirt 24-90 gray sandstone - water
2-14 tan clay gravel 96-103 cap talc - water
14-59 tan clay 103-110 gray sandstone - water
59-74 tan talc - water 110-112 blue clay

12. Such other information of a similar nature as may be useful in carrying out the policy of this act, including reference to book and page of any county record none

Drilled by
Liberty Well Drilling
Bill Osborn

Signature of Owner Ray F. & Ruth F. Koch
Date Dec 31/1962

Three copies to be filed by the owner with the County Clerk and Recorder of the county in which the well is located.

Please answer all questions. If not applicable, so state, otherwise the form will be returned.

Original to the County Clerk and Recorder; Duplicate to the State Engineer; Triplicate to the Montana Bureau of Mines and Geology, and Quadruplicate for the Appropriator.

20095

990 215464

I received and filed this instrument for
record on the 21st day of Dec 19 67
at 1:24 P.M., permanent files
of Missoula County, State of Montana
Witness my hand
MAYN S. BRIDGES Deputy Recorder
By *Walter S. Nelson* Deputy
Fee \$ *2.00* Paid

File No. _____

T. 13th R. 16th 14

DUPLICATE

County _____

STATE OF MONTANA
ADMINISTRATOR OF GROUNDWATER CODE
OFFICE OF STATE ENGINEER

RECEIVED
JAN 13 1964

Declaration of Vested Groundwater Rights

(Under Chapter 237, Montana Session Laws, 1961) STATE ENGINEER

SPINNEAU AND BRUBAKER of POTOMAC MOUNT
(Name of Appropriator) (Address) (Town)

County of MISSOULA State of MONTANA
have appropriated groundwater according to the Montana laws in effect prior to January 1, 1962, as follows:

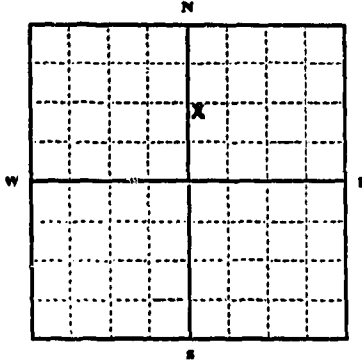

NW 1/4 Sec 14 T13N R16W

Indicate point of appropriation and place of use, if possible. Each small square represents 10 acres.

- 2. The beneficial use on which the claim is based HOUSEHOLD AND BUSINESS USE
- 3. Date or approximate date of earliest beneficial use; and how continuous the use has been FEB. 1949 - USED DAILY FROM THAT DATE
- 4. The amount of groundwater claimed (in miner's inches or gallons per minute) TEN GAL PER MIN
- 5. If used for irrigation, give the acreage and description of the lands to which water has been applied and name of the owner thereof
NO
- 6. The means of withdrawing such water from the ground and the location of each well or other means of withdrawal
WATER PUMP

- 7. The date of commencement and completion of the construction of the well, wells, or other works for withdrawal of groundwater FEB. 1949
- 8. The depth of water table UNKNOWN
- 9. So far as it may be available, the type, size and depth of each well or the general specifications of any other works for the withdrawal of groundwater DRILLED WELL - 165 FT DEEP
6" CASING
- 10. The estimated amount of groundwater withdrawn each year 150 GAL PER DAY
- 11. The log of formations encountered in the drilling of each well if available CLAY FORMATION
WITH VERY LITTLE GRAVEL
- 12. Such other information of a similar nature as may be useful in carrying out the policy of this act, including reference to book and page of any county record NONE

[Signature]
Signature of Owner
Date Dec 30, 1963

Three copies to be filed by the owner with the County Clerk and Recorder of the county in which the well is located.

Please answer all questions. If not applicable, so state, otherwise the form will be returned.

Original to the County Clerk and Recorder; Duplicate to the State Engineer; Triplicate to the Montana Bureau of Mines and Geology, and Quadruplicate for the Appropriator.

350

216010

Copy

I received and filed this instrument by
 record on the 6th day of July, 1944
 at 3:12 o'clock, P. M., pursuant to the
 of Missoula County, State of Montana.
 Witness my hand:
 MARTIN J. BRINER, County Recorder
 By Paul _____, Deputy
 Fee 5.00 Paid

File No. _____

T. 13 N. R. 16 W

DUPLICATE

County MISSOULA

STATE OF MONTANA
ADMINISTRATOR OF GROUNDWATER CODE
OFFICE OF STATE ENGINEER

RECORDED
JAN 3 1968
STATE ENGINEER

Declaration of Vested Groundwater Rights

(Under Chapter 237, Montana Session Laws, 1961)

School Dist # 11, of Potomac
(Name of Appropriator) (Address) (Town)

County of MISSOULA State of MONTANA

have appropriated groundwater according to the Montana laws in effect prior to January 1, 1962, as follows:

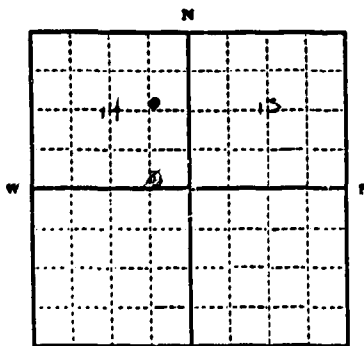

Sec. 14 T. 13 R. 16

Indicate point of appropriation and place of use, if possible. Each small square represents 10 acres.

- 2. The beneficial use on which the claim is based Water for school yard
- 3. Date or approximate date of earliest beneficial use; and how continuous the use has been 1949 this water continuously since
- 4. The amount of groundwater claimed (in miner's inches or gallons per minute) 75 gal per minute
- 5. If used for irrigation, give the acreage and description of the lands to which water has been applied and name of the owner thereof School yard 1 acre
- 6. The means of withdrawing such water from the ground and the location of each well or other means of withdrawal 1 1/2 inch pump

7. The date of commencement and completion of the construction of the well, wells, or other works for withdrawal of groundwater Commenced 1949 - Completed 1949

8. The depth of water table Not known

9. So far as it may be available, the type, size and depth of each well or the general specifications of any other works for the withdrawal of groundwater Capacity, depth 765 feet

10. The estimated amount of groundwater withdrawn each year Not known

11. The log of formations encountered in the drilling of each well if available Clay to sand & gravel. Gravel to clay

12. Such other information of a similar nature as may be useful in carrying out the policy of this act, including reference to book and page of any county record Minutes of School Dist # 11 Potomac Montana

Signature of Owner Robert S. Hall, Jr.

Date Dec 30, 1963

Three copies to be filed by the owner with the County Clerk and Recorder of the county in which the well is located.

Please answer all questions. If not applicable, so state, otherwise the form will be returned.

Original to the County Clerk and Recorder; Duplicate to the State Engineer; Triplicate to the Montana Bureau of Mines and Geology, and Quadruplicate for the Appropriator.

1336

215893

Copy

I received and filed this instrument for
record on the 2 day of Jan, 1964
at 1:34 o'clock P.M., permanent files
of Missoula County, State of Montana
Witness my hand:
MARTIN S. DEWINTER, County Recorder
By Ethel Lane Deputy
Fee \$ 2.00 Paid

File No.

T. 13 N R 16 W 14

DUPLICATE

STATE OF MONTANA
ADMINISTRATOR OF GROUNDWATER CODE
OFFICE OF STATE ENGINEER

RECEIVED
FEB 1 1965
STATE ENGINEER

Top of Ground
(Elev. above sea level.....)

Notice of Completion of Groundwater Appropriation by Means of Well

(Under Chapter 237, Montana Session Laws, 1961)

0 to 20' Dug hole
 20' to 35' Sandy clay & gravel
 35' to 56' Silty sand clay (dirty water)
 56' to 63' Yellow clay
 63' to 96' Soft grey shale & water
 96' to 103' Soft yellow shale & water

Owner Boulah Wills Address Potomac, Montana

Driller Glenn Camp 705 Alder Address Missoula, Montana

Date of Notice of Appropriation of Groundwater.....

Date well started 10/23/64 Date Completed 10/26/64

Type of well Drilled Equipment Used Churn drill
(dug, driven, bored or drilled) (Churn, drill, rotary or other)

Water Use: Domestic Municipal Other Irrigation
Industrial Drainage Stock

Indicate on the diagram the character and thickness of the different strata met with in drilling, such as soil, clay, shale, gravel, rock or sand, etc. Show depth at which water is encountered, thickness and character of water-bearing strata and height to which water rises in the well.

Size of Drilled Hole	Size and Weight of Casing	From (Feet)	To (Feet)	PERFORATIONS		
				Kind Size	From (Feet)	To (Feet)
6"	6" I.D. 18.97# to feet	3" above G.L. to 65'-8" open hole to 103'				None

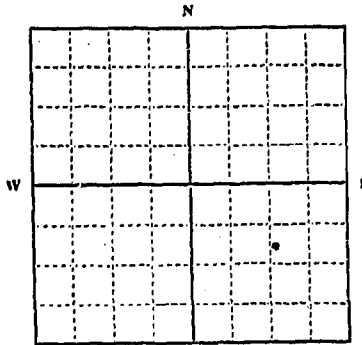

SW 1/4 NE 1/4 Sec 14 T13N R16W
Indicate location of well and place of use, if possible. Each small square represents 10 acres.

Show exact depth of bottom.

Static Water Level for non-flowing Well 21' feet.

Shut-in Pressure for Flowing Well.....

Pumping Water Level 44 feet at 15 gal. per minute.

Discharge in gal. per min. of flowing well.....

How Tested Test PUMP Length of Test 3 hours

Remarks: (Gravel packing, cementing, packers, type of shutoff, location of place of use of groundwater if not at well, and any other similar pertinent information, including number of acres irrigated, if used for irrigation).....

Boulah F. Wills appropriator

License # 7

Driller's License Number

Glenn Camp
Driller's Signature

This form to be prepared by driller, and three copies to be filed by the owner with the County Clerk and Recorder in the county in which the well is located.

Please answer all questions. If not applicable, so state, otherwise the form will be returned.

Original to the County Clerk and Recorder; duplicate to the State Engineer; Triplicate to the Montana Bureau of Mines and Geology and Quadruplicate for the Appropriator.

38922

1472

232114

I received and filed this instrument for record on the 28 day of Jan 1965 at 3:30 o'clock P.M. permanent # 100 of Missoula County, State of Montana

Witness my hand:
 Varance R. Cruise, County Recorder
 By Jenny Beckwith, Deputy
 Fee 2.00 Paid

RECORDED
 FEB 1 1965
 BEGARIN

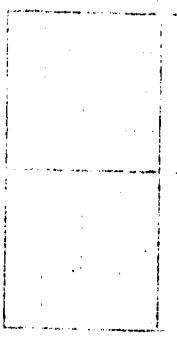

[Faint, mostly illegible text from the reverse side of the document is visible through the paper. Some words like 'Source' and 'to' can be discerned.]

File No.

T. 13 N. R. 16 W. 4

TRIPLICATE

County Missoula

STATE OF MONTANA
ADMINISTRATOR OF GROUNDWATER CODE
OFFICE OF STATE ENGINEER

DECEIVED
JUL 1 1965
STATE ENGINEER

Top of Ground
(Elev. above sea level.....)

**Notice of Completion of Groundwater
Appropriation by Means of Well**

(Under Chapter 237, Montana Session Laws, 1961)

0 to 15' Clay & gravel
15' to 28' Silty Sand Owner Roy O. Wills Address Potomac, Montana
& clay (a little water) Driller Glenn Camp 705 Alder Address Missoula, Montana
28' to 64' Silty sand Date of Notice of Appropriation of Groundwater.....
& gravel (silty water) Date well started 10/20/64 Date Completed 10/23/64
64' to 68' Yellow clay Type of well..... Drilled Equipment Used Churn (All
(dug, driven, bored or (Churn, drill, rotary or
drilled) other)
68' to 132' Soft grey
Shale & water Water Use: Domestic Municipal Other Irrigation
Industrial Drainage Stock

Indicate on the diagram the character and thickness of the different strata met with in drilling, such as soil, clay, shale, gravel, rock or sand, etc. Show depth at which water is encountered, thickness and character of water-bearing strata and height to which water rises in the well.

Size of Drilled Hole	Size and Weight of Casing	From (Feet)	To (Feet)	PERFORATIONS		
				Kind Size	From (Feet)	To (Feet)
6"	6" I.D.	1'-4" above G.L.				
		18.97# to foot	to 68'-11"			
		open hole to 132'		none		

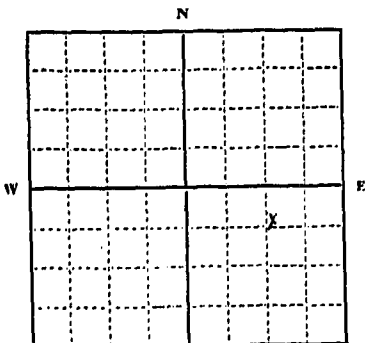

716.466⁴ Sec. 11 T. 13 R. 6
Indicate location of well and place of use, if possible. Each small square represents 10 acres.

Show exact depth of bottom.

Static Water Level for non-flowing Well.....115.....feet.
Shut-in Pressure for Flowing Well.....
Pumping Water Level.....28.....feet at.....15.....gal. per minute.
Discharge in gal. per min. of flowing well.....
How Tested.....pump.....Length of Test.....2 hours.....
Remarks: (Gravel packing, cementing, packers, type of shutoff, location of place of use of groundwater if not at well, and any other similar pertinent information, including number of acres irrigated, if used for irrigation).....

Picked up small amounts of water from 68' to 132' in narrow seams.

License #7
Driller's License Number

Glenn Camp
Driller's Signature

This form to be prepared by driller, and three copies to be filed by the owner with the County Clerk and Recorder in the county in which the well is located.

Please answer all questions. If not applicable, so state, otherwise the form will be returned.

Original to the County Clerk and Recorder; duplicate to the State Engineer; Triplicate to the Montana Bureau of Mines and Geology and Quadruplicate for the Appropriator.

39262

1514
238730

I received and filed this instrument
record on the _____ day of _____ 19____
at _____ o'clock P. M., permanent file
of _____ County, State of Montana
Witness my hand:
Vernice R. Cross, County Recorder
By _____ Deputy
Filed _____

12' to 28' fifty and
a six (a little water)
28' to 64' fifty and
a gravel (with water)
64' to 88' follow six
88' to 125' soft clay
and in a water

10/20/64
10/20/64
10/20/64
10/20/64

125'
open hole to
10.276 to
11-4" above O.L.
G.I.D.

12
12
12
12

Placed up small amount of water from 88'
to 125' in water column
License # 1

15

File No. _____

T. 13 N. R. 16 W

DUPLICATE MONTANA WATER RESOURCES BOARD RECEIVED

County MISSOULA

JUN 23 1969

STATE OF MONTANA ADMINISTRATOR OF GROUNDWATER CODE OFFICE OF STATE ENGINEER

Notice of Completion of Groundwater Appropriation Without Well

(Under Chapter 237 Montana Session Laws, 1961)

Date of Appropriation of Groundwater 5 JUNE 1969
Owner ROY R. WILKS Address POTOMAC
Contractor (if any) NONE
Address of Contractor _____
Date Started _____ Date Completed _____

Describe means of obtaining groundwater without a well "as by sub-irrigation and other natural processes". Include depth to water when applicable. SUB-IRRIGATION AND NATURAL RUN OFF
SINCE STORAGE DAM WAS CONSTRUCTED ON ABOVE WATER, THERE HAS BEEN MUCH MORE WATER.

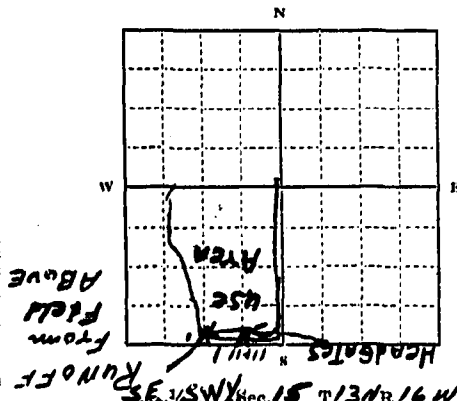

Quantity of water developed and used with explanation of method used to measure or estimate such amount. If use is intermittent estimate approximate lengths of periods of use. QUANTITY VARIES FROM APPROX 40" TO 0" FROM MAY 1 THRU AUGUST 1

Indicate point of appropriation and place of use, if possible.

Signature of Owner Roy R Wilks
Date 5 JUNE 1969

This form to be prepared by contractor (if any), otherwise by the owner.
Three copies of this notice are to be filed with the County Clerk and Recorder of the county in which the works are located.
Please answer all questions. If not applicable, so state, otherwise the form will be returned.
Original to the County Clerk and Recorder; duplicate to the State Engineer; Triplicate to the Montana Bureau of Mines and Geology and Quadruplicate for the Appropriator.

45,347

1702

282289

I received and filed this instrument for record on the 17th day of June, 1929, at 1:05 o'clock P.M., permanent files of Missoula County, State of Montana. Witness my hand: Verance R. Couse, County Recorder By M. M. Thompson, Deputy Fee 5.25 Paid cash

RECEIVED
MAY 23 1929
MISSOULA, MONT.

MISSOULA COUNTY RECORDS
RECEIVED
MAY 23 1929
MISSOULA, MONT.

C

File No.

T 13N R 16W 15

DUPLICATE

County Missoula

STATE OF MONTANA
ADMINISTRATOR OF GROUNDWATER CODE
OFFICE OF STATE ENGINEER

RECEIVED
SEP 30 1964
STATE ENGINEER

Top of Ground
(Elev. above sea level

Notice of Completion of Groundwater Appropriation by Means of Well

(Under Chapter 237, Montana Session Laws, 1961)

0 to 35' Clay & gravel
35' to 38' Shale, clay & water
38' to 68' Clay & gravel
68' to 72' Shale
72' to 77' Shale, gravel & water

Owner Roy R. Bill Wells Address Fortuna, Montana

Driller Glen Camp 705 Alder Address Missoula, Mont

Date of Notice of Appropriation of Groundwater

Date well started July 10, 1964 Date Completed July 13, 1964

Type of well Drilled Equipment Used Churn drill
(dug, driven, bored or drilled) (Churn, drill, rotary or other)

Water Use: Domestic Municipal Other Irrigation
Industrial Drainage Stock

Indicate on the diagram the character and thickness of the different strata met with in drilling, such as soil, clay, shale, gravel, rock or sand, etc. Show depth at which water is encountered, thickness and character of water-bearing strata and height to which water rises in the well.

Size of Drilled Hole	Size and Weight of Casing	From (Feet)	To (Feet)	PERFORATIONS		
				Kind Size	From (Feet)	To (Feet)
6"	6" I.D. 18.97 # to feet	1' above G.L. to 72'-11"	5' open hole in shale rock	None		

Static Water Level for non-flowing Well 27' from G.L. feet.

Shut-in Pressure for Flowing Well

Pumping Water Level 67 feet at 8 gal. per minute.

Discharge in gal. per min. of flowing well

How Tested Ballor Length of Test 1 hour

Remarks: (Gravel packing, cementing, packers, type of shutoff, location of place of use of groundwater if not at well, and any other similar pertinent information, including number of acres irrigated, if used for irrigation)

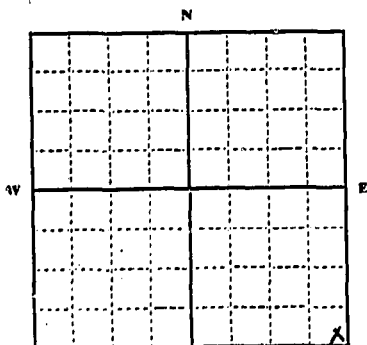

SE 1/4 Sec 4, T13N R16W
Indicate location of well and place of use, if possible. Each small square represents 10 acres.

Show exact depth of bottom.

License # 7

Driller's License Number

Glen Camp
Driller's Signature

This form to be prepared by driller, and three copies to be filed by the owner with the County Clerk and Recorder in the county in which the well is located.

Please answer all questions. If not applicable, so state, otherwise the form will be returned.

Original to the County Clerk and Recorder; duplicate to the State Engineer; Triplicate to the Montana Bureau of Mines and Geology and Quadruplicate for the Appropriator.

38502

1447 226950

I received and filed this instrument for record on the 25 day of Sept. 1966 at 11:25 o'clock A.M., permanent files of Missoula County, State of Montana. Witness my hand: Verance R. Crouse County Recorder By Verance R. Crouse Deputy Fee \$ 2.00 Paid

201 50 201 500000
201 50 201 500000
201 50 201 500000

201 50 201 500000
201 50 201 500000
201 50 201 500000

File No. _____

T 13^N R 16^W

DUPLICATE

County Missoula

STATE OF MONTANA
ADMINISTRATOR OF GROUNDWATER CODE
OFFICE OF STATE ENGINEER AUG 26 1963



Top of Ground
(Elev. above sea level _____)

Notice of Completion of Groundwater Appropriation by Means of Well

(Under Chapter 237, Montana Session Laws, 1961)

0 to 5' Top soil
 5' 25' Clay
 25' to 29' Sand & gravel
 29' to 40' Water, sand & gravel
 40' to 55' Clay
 55' to 90' Shale
 90' to 94' Sandstone, water & clay
 94' 95' water, sand & gravel
 95' to 125' Shale & clay

Owner Ray Hills Address Patmas, Montana

Driller Glenn Camp 705 Alder Address Missoula, Mont

Date of Notice of Appropriation of Groundwater _____

Date well started 7/15/63 Date Completed 7/22/63

Type of well Drilled Equipment Used Shawn drill
(dug, driven, bored or drilled) (Churn, drill, rotary or other)

Water Use: Domestic Municipal Other Irrigation
Industrial Drainage Stock

Indicate on the diagram the character and thickness of the different strata met with in drilling, such as soil, clay, shale, gravel, rock or sand, etc. Show depth at which water is encountered, thickness and character of water-bearing strata and height to which water rises in the well.

Size of Drilled Hole	Size and Weight of Casing	From (Foot)	To (Foot)	PERFORATIONS		
				Kind Size	From (Foot)	To (Foot)
6"	6" I.D. 1" lbs	1' above G.L.				
		to 95'-1"		none		

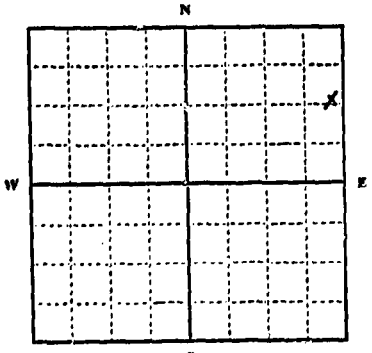

NE 1/4 SE 1/4 Sec. 15 T. 13N R. 16W
Indicate location of well and place of use, if possible. Each small square represents 10 acres.

Show exact depth of bottom.

Static Water Level for non-flowing Well 15' from G.L. feet.

Shut-in Pressure for Flowing Well _____

Pumping Water Level 90 feet at 2 gal. per minute.

Discharge in gal. per min. of flowing well _____

How Tested Bailer Length of Test 2 hours

Remarks: (Gravel packing, cementing, packers, type of shutoff, location of place of use of groundwater if not at well, and any other similar pertinent information, including number of acres irrigated, if used for irrigation)
None

License # 7
Driller's License Number

Glenn Camp
Driller's Signature

This form to be prepared by driller, and three copies to be filed by the owner with the County Clerk and Recorder in the county in which the well is located.

Please answer all questions. If not applicable, so state, otherwise the form will be returned.

Original to the County Clerk and Recorder; duplicate to the State Engineer; Triplicate to the Montana Bureau of Mines and Geology and Quadruplicate for the Appropriator.

5546

250 - copy 2099610

I received and filed this instrument for
record on the 22 day of May, 1963
at 11:30 o'clock AM, pursuant to law
of Missoula County, State of Montana.
Witness my hand:
MARTIN S. BEHNER, County Recorder
By Carlton Kapp Deputy
Fee \$ 2.00 Paid

File No. _____

T. 13N R. 16W

DUPLICATE

MONTANA WATER RESOURCES BOARD
RECEIVED

County Missoula

LOG

MAY 9 1969

STATE OF MONTANA
ADMINISTRATOR OF GROUNDWATER CODE
OFFICE OF STATE ENGINEER

Top of Ground Approx. (Elev. above sea level) 2200'

Notice of Completion of Groundwater Appropriation by Means of Well

DEVELOPED AFTER JANUARY 1, 1962

(Under Chapter 237, Montana Session Laws, 1961)

Formations Log:

- 0 - 1 Gravel & topsoil mixed.
- 1 - 8 Gravel & cobblestones mixed.
- 8 - 21 Fine sand & gravel.
- 21 - 44 Fine to coarse gravel mixed with clay.
- 44 - 49 Cobblestones & gravel imbedded in clay.
- 49 - 51 Fine sand & gravel.
- 51 - 73 Gravel imbedded in gray clay.
- 73 - 78 Fine sand and gravel.
- 78 - 94 Gravel imbedded in tan clay.
- 94 - 102 Clean coarse gravel. Water.

Owner Eilja E. Wiseman Address Missoula, Montana

Driller Liberty Drilling Co. Address Missoula, Montana

Date of Notice of appropriation of groundwater None filed

Date well started 4/21/69 Date completed 4/25/69

Type of well Drilled Equipment used Cable Tools
(Dug, Driven, bored or drilled) (Churn drill, rotary or other)

Water use: Domestic Municipal Stock Irrigation
Industrial Drainage Other

Indicate on the diagram the character and thickness of the different strata met with in drilling, such as soil, clay, shale, gravel, rock or sand, etc. Show depth at which water is encountered, thickness and character of water-bearing strata and height to which the water rises in the well.

Size of Drilled Hole	Size and Weight of Casing	From (Feet)	To (Feet)	PERFORATIONS		
				Kind Size	From (Feet)	To (Feet)
6"	6 5/8" OD x 1/4"	2'2"	102	NONE		

Water rises in the well 71.6" from surface.

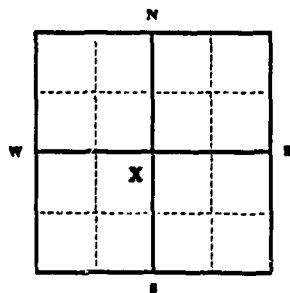

Static Water Level for non-flowing well 71.6 feet.

Shut-in Pressure for Flowing Well None

Pumping Water Level 84 feet at 75 gal. per minute.

Discharge in gal. per min. of flowing well None-flowing

How Tested Air Lift Pump

Length of Test Three hours

Remarks: (Gravel packing, cementing, packers, type of shutoff) All water entering well is coming through open bottom of six inch casing. Wells in this area can be depended upon to produce clear sand free water year after year as long as they are not overpumped, i.e., they should be pumped at rates not in excess of 50 to 60 percent of the tested capacity of the aquifer.

NE 1/4 Sec. 16, T. 13N R. 16W
Indicate location of well and place of use, if possible. Each small square represents 40 acres.

USE—If used for irrigation, industrial, drainage or other. Explain, state number of acres and location or other data (i.e.: Lot, Block and Addition).

Lots 12 and 13, Block 3, West Riverside

Show exact depth of bottom.

Bottom of well 102'

This form to be prepared by driller, and three copies to be filed by the owner with the County Clerk and Recorder in the county in which the well is located, tissue copy to be retained by driller.

Please answer all questions. If not applicable, so state, otherwise the form will be returned.

52
Driller's License Number

William F. Osborne
Driller's Signature

45, 196

1879 - 280985

I received and filed this instrument for record on the 6th day of May 1907 at 3:30 o'clock P.M. permanent files of Missoula County, State of Montana
 Witness my hand:
 Verance H. Croso, County Recorder
 By *Am...* Deputy
 Fee \$ 2.00 Paid *Cash*

1016

MISSOULA COUNTY RECORDERS OFFICE
 MISSOULA, MONTANA
 RECEIVED
 MAY 11 1907
 1016

280985

MISSOULA COUNTY RECORDERS OFFICE

MISSOULA COUNTY RECORDERS OFFICE
 MISSOULA, MONTANA
 RECEIVED
 MAY 11 1907
 1016

RECEIVED

JUN 7 1973

County Missoula

18

STATE OF MONTANA
ADMINISTRATOR OF GROUNDWATER CODE
MONTANA WATER RESOURCES BOARD

DRILLER'S LOG

NOTICE OF COMPLETION OF GROUNDWATER
APPROPRIATION BY MEANS OF WELL

Developed after January 1, 1962

Indicate the character, color, thickness of strata such as soil, clay, sand, gravel, shale, sandstone, etc. Show depth at which water is found and height to which water rises in well.

(Under Chapter 237 Montana Session Laws, 1961, as amended)

This form to be prepared by driller, and three copies to be filed by the owner with the County Clerk and Recorder in the county in which the well is located, last copy to be retained by driller. Please answer all questions. If not applicable, so state, otherwise the form may be returned.

Top of Ground (Elev. above sea level) 3500

Owner Tom Wells
Address Blackfoot
Date well started 5-29-73
completed 5-31-73

For Administrator's Use	
File	<u>2492, 332758</u>
	<u>JUNE 1, 1973</u>
GW 1	<u>1:04 P.M.</u>

From (Feet)	To (Feet)	
0	10	Soil & rock
10	75	Blue clay
75	100	Brown clay with carbon layers
100	150	Blue & grey clay
150	190	Brown clay with carbon layers
190	200	Grey shale
200	220	Grey shale with carbon layers
220	245	Grey shale
245	260	Grey shale with water @ 248 ft.

Type of well Drilled
(Dug, driven, bored or drilled)

Equipment used Air rotary
(Churn drill, rotary or other)

Water Use: Domestic Municipal Stock Irrigation
Industrial Drainage Other * Garden/Lawn

*Describe
USE: If used for irrigation, industrial, drainage or other. Explain, state number of acres and location or other data (i.e. Lot, Block and Addition).

ESTIMATED ANNUAL WITHDRAWAL unknown

Size of Drilled Hole	Size and Weight of Casing	From (Feet)	To (Feet)	PERFORATIONS		
				Kind Size	From (Feet)	To (Feet)
6"	17 lb. per ft.	+1	200	none		
From 10' to 260'						
P.V.C. 4" liner installed				260	160	

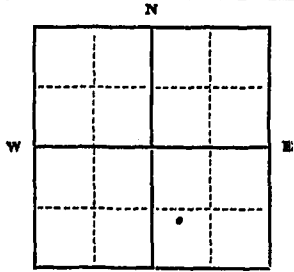

Static water level 87 ft.*
Pumping water levelft.*
at 10gallons per minute,
measuredminutes after pumping
began.
*Measured from ground level.
Well developed by air compressor
for 3 1/2 hours.
Power..... Pump..... HP
Remarks: (Gravel packing, cementing,
packers, type of shutoff)

E 1/2 Sec. 18
T. 13 R. 16 E
S W

INDICATE LOCATION OF WELL AND PLACE OF USE, IF POSSIBLE. EACH SMALL SQUARE REPRESENTS 40 ACRES.

Driller's Signature Bob Jerome
Driller's Address 3726 Mount Ave., Missoula, Mt. 59801

LICENSE NO. 249

260' Show exact depth of bottom

53,393

2492

332738

I received and filed this instrument for
 record on the 1st day of June 1973
 at 1:04 o'clock P. M., permanent files
 of Missoula County, State of Montana
 Witness my hand:
 Dorothy L. Head, County Recorder
 By M. M. Conroy, Deputy
 Fee \$2.00 Paid

FILE OF RECORDS
 BUILDING 1001
 MISSOULA, MONTANA

RECEIVED

GW 3

File No.

DUPLICATE

T. 13 N R. 16 W

County Missoula

STATE OF MONTANA
ADMINISTRATOR OF GROUNDWATER CODE
OFFICE OF STATE ENGINEER

RECEIVED
JAN 3 1963

Notice of Completion of Groundwater Appropriation Without Well

(Under Chapter 237 Montana Session Laws, 1961)

Date of Appropriation of Groundwater 1910
Owner M. N. O. P. Ranch Address 2517 Kiowista Dr
Missoula, Mont
Contractor (if any) NOT applicable
Address of Contractor NOT applicable
Date Started NOT applicable Date Completed NOT applicable

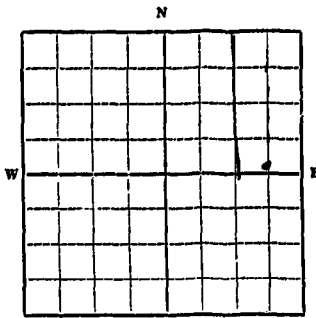

Describe means of obtaining groundwater without a well "as by sub-irrigation and other natural processes". Include depth to water when applicable. Sub-irrigation and other natural processes water rises to surface of ground in system called "Pony Ranch Springs"

Quantity of water developed and used with explanation of method used to measure or estimate such amount. If use is intermittent estimate approximate lengths of periods of use approx 30 minor inches of water used year round for irrigation and stock water measured flow in ditch and eductor

Sec. 21, T. 13, R. 16
Indicate point of appropriation and place of use, if possible.

Signature of Owner M. P. Prunty

Date Dec 30 - 1963

This form to be prepared by contractor (if any), otherwise by the owner.

Three copies of this notice are to be filed with the County Clerk and Recorder of the county in which the works are located.

Please answer all questions. If not applicable, so state, otherwise the form will be returned.

Original to the County Clerk and Recorder; duplicate to the State Engineer; Triplicate to the Montana Bureau of Mines and Geology and Quadruplicate for the Appropriator.

752

215160

copy

I received and filed this instrument for
record on the 30 day of Dec 1962
at 1:40 o'clock P.M., pursuant to law
of Missouri County, State of Missouri
Witness my hand:
MARTIN S. DENVER, County Recorder
By Ethel J. ...
Fee \$ 2.00 Paid

County Missoula Twp. 13 North Rge. 15 West

Sec.	Name of Appropriator	Type of Form	County File No.	Remarks
7	Case, Arnold H.	GW 3	245470	
12	Forest & Conservation Station	GW 4	190423	
13	Case, Arnold H.	GW 3	245476	
14	Hall, Luth J.	GW 4	215368	
15	Case, Arnold H.	GW 3	245475	
16	Case, Arnold H.	GW 3	245474	
17	Case, Arnold H.	GW 3	245472	
17	Case, Arnold H.	GW 3	245471	
17	Case, Arnold H.	GW 2	307775	
18	Case, Arnold H.	GW 4	245473	
20	Pioneer Cattle & Land Co.	GW 3	302338	
21	Clay, Jack J.	GW 3	329201	
21	Clay, Jack J.	GW 2	329202	
21	Mikisell, Raymond H.	GW 2	299139	
21	Person, Sidney	GW 2	329304	
28	Copenhagen, John W.	GW 1	334041	filed GW-16 NO GW-2
29	Hagstotz, John	GW 4	215462	
29	Smithgony, Aury	GW 2	331035	
29	Pioneer Cattle & Land Co.	GW 3	302337	
29	Pioneer Cattle & Land Co.	GW 2	295375	
30	Curry, Robert B. (m.d.)	GW 2	294246	
30	Pioneer Cattle & Land Co.	GW 2	295626	
30	Seelye, Charles L.	GW 2	300859	
34	Adams, Lloyd	GW 4	295429	
34	Wood, Teddne	GW 4	215491	

Mc M N O

File No. _____

T. 13^N R. 15^W

DUPLICATE _____

County Missoula

STATE OF MONTANA
ADMINISTRATOR OF GROUNDWATER CODE
OFFICE OF STATE ENGINEER

Notice of Completion of Groundwater Appropriation Without Well

(Under Chapter 237 Montana Session Laws, 1961)

Date of Appropriation of Groundwater 1902
Owner Arnold H Case Address Potomac, Montana

Contractor (if any) _____

Address of Contractor _____

Date Started _____ Date Completed _____

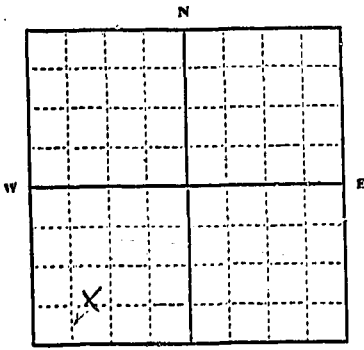

Describe means of obtaining groundwater without a well "as by sub-irrigation and other natural processes". Include depth to water when applicable.

Free flowing spring used for stock water.

Quantity of water developed and used with explanation of method used to measure or estimate such amount. If use is intermittent

estimate approximate lengths of periods of use _____

SW 1/4 Sec 7 T. 13 R. 15W

Indicate point of appropriation and place of use, if possible.

Signature of Owner Arnold H Case

Date 12-28-65

This form to be prepared by contractor (if any), otherwise by the owner.

Three copies of this notice are to be filed with the County Clerk and Recorder of the county in which the works are located.

Please answer all questions. If not applicable, so state, otherwise the form will be returned.

Original to the County Clerk and Recorder; duplicate to the State Engineer; Triplicate to the Montana Bureau of Mines and Geology and Quadruplicate for the Appropriator.

1551

245470

I received and filed this instrument for
 record on the 30th day of Dec 1965
 at 3:00 o'clock P. M. permanent files
 of Missoula County, State of Montana
 Witness my hand:
 Vance R. Crouse, County Recorder
 By *Donna D. Rummey* deputy
 Fee \$ 2.00 *check*

File No.

T. 13 N. R. 15 W.

DUPLICATE

County Missoula

STATE OF MONTANA
ADMINISTRATOR OF GROUNDWATER CODE
OFFICE OF STATE ENGINEER

RECEIVED

Declaration of Vested Groundwater Rights
(Under Chapter 237, Montana Session Laws, 1961)

STATE ENGINEER

1. The Forest and Conservation Experiment Station, School of Forestry, Montana State University
(Name of Appropriator) (Address) Missoula (Town)

County of Missoula State of Montana
have appropriated groundwater according to the Montana laws in effect prior to January 1, 1962, as follows:

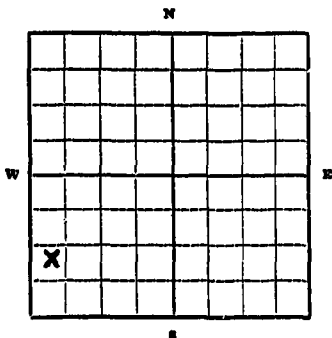

N $\frac{1}{2}$, SW $\frac{1}{4}$, SW $\frac{1}{4}$ Sec. 12, T.13N R.15.W

Indicate point of appropriation and place of use, if possible. Each small square represents 10 acres.

2. The beneficial use on which the claim is based Lubricant Forest Camp water supply

3. Date or approximate date of earliest beneficial use; and how continuous the use has been 1954 continuous use. Heavy use each year during period March through June, moderate use July during September

4. The amount of groundwater claimed (in miner's inches or gallons per minute) 35 gallons per minute

5. If used for irrigation, give the acreage and description of the lands to which water has been applied and name of the owner thereof not applicable

6. The means of withdrawing such water from the ground and the location of each well or other means of withdrawal electric pump, 5 h.p., located in N $\frac{1}{2}$, SW $\frac{1}{4}$, SW $\frac{1}{4}$, Sec. 12, T.13 N., R.15.W

7. The date of commencement and completion of the construction of the well, wells, or other works for withdrawal of groundwater 1954

8. The depth of water table 6 ft.

9. So far as it may be available, the type, size and depth of each well or the general specifications of any other works for the withdrawal of groundwater developed well, encased with concrete pipe, 4 1/2 in. diameter and 12' deep

10. The estimated amount of groundwater withdrawn each year 500,000 gallons per season

11. The log of formations encountered in the drilling of each well if available not available

12. Such other information of a similar nature as may be useful in carrying out the policy of this act, including reference to book and page of any county record not applicable

The Forest and Conservation Experiment Station, School of Forestry
Montana State University
Signature of Owner Ross A. Williams
By: Ross A. Williams, Director

Date 2/18/61

Three copies to be filed by the owner with the County Clerk and Recorder of the county in which the well is located.

Please answer all questions. If not applicable, so state, otherwise the form will be returned.

Original to the County Clerk and Recorder; duplicate to the State Engineer; Triplicate to the School of Mines and Quadruplicate for the Appropriator.

1655

5

190473

I received and filed this instrument for
record on the 6th day of April 1962
at 11:37 o'clock A. M., permanent files
of Missoula County, State of Montana
Witness my hand:
MARTIN S. BEINER, County Recorder
By C. J. [unclear] Deputy
Fee \$ 1.00 Paid

C

MISSOULA COUNTY RECORDS DEPARTMENT
MISSOULA, MONTANA

File STATE WATER CONSERVATION BOARD

T. 13^N R. 15^W 13

DUPLICATE JAN 4 1965

County

Billie _____ McDermott _____ STATE OF MONTANA
 Butcher _____ McHenry _____
 Cook _____ Mc _____ ADMINISTRATOR OF GROUNDWATER CODE
 Davidson _____ Sullivan _____ OFFICE OF STATE ENGINEER
 Ockert _____

Notice of Completion of Groundwater Appropriation Without Well

(Under Chapter 237 Montana Session Laws, 1961)

Date of Appropriation of Groundwater 1933

Owner Arnold H. Case Address Potomac, Mont.

Contractor (if any) _____

Address of Contractor _____

Date Started _____ Date Completed _____

Describe means of obtaining groundwater without a well "as by sub-irrigation and other natural processes". Include depth to water when applicable.

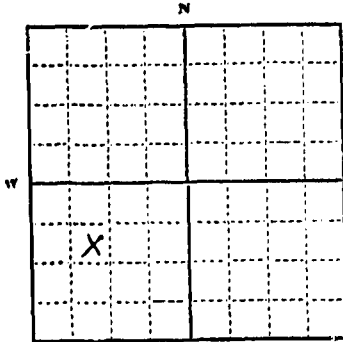

Free flowing spring rising on this property. Used throughout grazing season.

Quantity of water developed and used with explanation of method used to measure or estimate such amount. If use is intermittent

estimate approximate lengths of periods of use _____

PTS W 1/4 Sec 46 T. 13 R. 15
 E
 Indicate point of appropriation and place of use, if possible.

Signature of Owner Arnold H. Case

Date 12-28-1965

This form to be prepared by contractor (if any), otherwise by the owner.

Three copies of this notice are to be filed with the County Clerk and Recorder of the county in which the works are located.

Please answer all questions. If not applicable, so state, otherwise the form will be returned.

Original to the County Clerk and Recorder; duplicate to the State Engineer; Triplicate to the Montana Bureau of Mines and Geology and Quadruplicate for the Appropriator.

40460

E 1557

245476

I received and filed this instrument for
record on the 30 day of Dec, 1917
at 8:15 o'clock P.M., permanent files
of Missoula County, State of Montana
Witness my hand:
Verlanne R. House, County Recorder
By James R. House, Deputy
Fee \$ 2.00 Paid