

35-3
O

213779

copy

I received and filed this instrument for
 record on the 4 day of Dec 1966
 at 10:00 o'clock P.M., permanent files
 of Missoula County, State of Montana
 Witness my hand:
MARTIN S. BEHNER, County Recorder.
 By [Signature] Deputy
 Fee \$ 1.00 Paid

STATE ENGINEER
BECKMAN

[Faint, mostly illegible text, likely bleed-through from the reverse side of the document]

File No. 7

T. 13 N. 19 W.

DUPLICATE

County _____

STATE OF MONTANA
ADMINISTRATOR OF GROUNDWATER CODE
OFFICE OF STATE ENGINEER

RECEIVED
JAN 3 1964

Declaration of Vested Groundwater Rights ENGINEER

(Under Chapter 237, Montana Session Laws, 1961)

Jewell Ferguson
Arvin D. Ferguson of 334 E. Broadway Missoula
(Name of Appropriator) (Address) (Town)

County of Missoula State of Montana
have appropriated groundwater according to the Montana laws in effect prior to January 1, 1962, as follows:

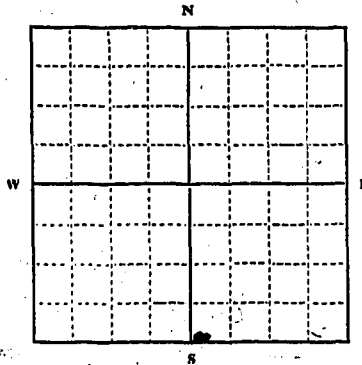

SW 1/4 SE, Sec. 11 T. 13 R. 19

Indicate point of appropriation and place of use, if possible. Each small square represents 10 acres.

2. The beneficial use on which the claim is based Drinking Laundry Bathing and Irrigation for Royal Manor Nursing Home (50 patients)
3. Date or approximate date of earliest beneficial use; and how continuous the use has been October, 1956. The use has been continuous since that date

4. The amount of groundwater claimed (in miner's inches or gallons per minute) 40 gallons

5. If used for irrigation, give the acreage and description of the lands to which water has been applied and name of the owner thereof Four large lots adjoining each other. Lots 1, 2, 3 and 4, Block 7, Monte Vista addition to Missoula. A.D. Ferguson and Jewell Ferguson

6. The means of withdrawing such water from the ground and the location of each well or other means of withdrawal. Pump (jet) located on lot 1

7. The date of commencement and completion of the construction of the well, wells, or other works for withdrawal of groundwater Well was started and completed in October, 1956

8. The depth of water table 25 feet of water in well

9. So far as it may be available, the type, size and depth of each well or the general specifications of any other works for the withdrawal of groundwater Well is 65 ft. deep drilled casing 6 inch pipe jet pump.

10. The estimated amount of groundwater withdrawn each year 80 million gallons

11. The log of formations encountered in the drilling of each well if available First 43 feet was gravel the about 10 ft of clay then another layer of gravel

12. Such other information of a similar nature as may be useful in carrying out the policy of this act, including reference to book and page of any county record. Unknown

Signature of Owner Jewell Ferguson

Date Dec 31, 1963

Three copies to be filed by the owner with the County Clerk and Recorder of the county in which the well is located.

Please answer all questions. If not applicable, so state, otherwise the form will be returned.

Original to the County Clerk and Recorder; Duplicate to the State Engineer; Triplicate to the Montana Bureau of Mines and Geology, and Quadruplicate for the Appropriator.

20027

950 2154 23

Arnim Peterson
Jemell
Wizzonur

Wizzonur
334 E. Broadway
Wizzonur

I received and filed this instrument for record of the County of _____, State of Montana at _____ o'clock _____ M., permanent files of Missable County, State of Montana
Witness my hand:
M. S. B. KINER, County Recorder
By: *M. S. B. Kiner* Deputy
Fee \$ *2.00* Paid

First gate
New pier piece
October 1920
for K. J. ...
Baptist ...
Drinking

to deliver

to Wizzonur
Total 133
Front yard
located on lot 1
Armb (est)

21m 2E 11 13 13

October 1920
well was started and completed in
32 feet of water in well.

pipe set hump.
well is 22 ft. deep - drilled - coring - pipe

File No.

DUPLICATE

T. 13 N
 County Missoula
 RECEIVED
 JUL 17 1963
 STATE ENGINEER

STATE OF MONTANA
 ADMINISTRATOR OF GROUNDWATER CODE
 OFFICE OF STATE ENGINEER

**Notice of Completion of Groundwater Appropriation
 Without Well**

(Under Chapter 237 Montana Session Laws, 1961)

Date of Appropriation of Groundwater..... 1940
 Owner A. J. Klapinyk Address 3004 Dayton
 Contractor (if any) none
 Address of Contractor
 Date Started..... Date Completed.....

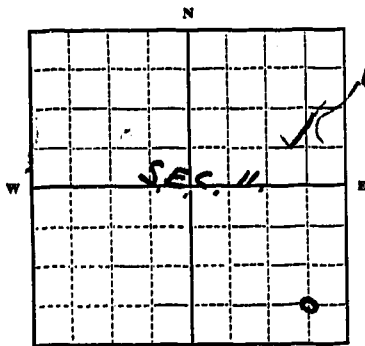

1/4 Sec. 11 T. 13 N. R. 17 W.
 Indicate point of appropriation
 and place of use, if possible.

Describe means of obtaining groundwater without a well "as by
 sub-irrigation and other natural processes". Include depth to
 water when applicable. This is a
spring

Quantity of water developed and used with explanation of method
 used to measure or estimate such amount. If use is intermittent

estimate approximate lengths of periods of use. Spring
flows continuously

Signature of Owner A. J. Klapinyk
 Date 7-10-63

This form to be prepared by contractor (if any), otherwise by the owner.

Three copies of this notice are to be filed with the County Clerk and Recorder of the county in which the works are located.

Please answer all questions. If not applicable, so state, otherwise the form will be returned.

Original to the County Clerk and Recorder; duplicate to the State Engineer; Triplicate to the Montana Bureau of Mines and Geology and Quadruplicate for the Appropriator.

3

208278

I received and filed this instrument for
 record on the 11 day of July, 1963
 at 11:50 o'clock A.M., permanent files
 of Missoula County, State of Montana
 Witness my hand:
 MARTIN S. BEHNER, County Recorder
 By Deputy John Deputy
 Fee \$ 2.00 Paid

208278

MISSOULA COUNTY
 CLERK OF DISTRICT COURT
 MISSOULA, MONTANA

File No. _____

T. 13^N R. 19^W

DUPLICATE

County Missoula

STATE OF MONTANA
ADMINISTRATOR OF GROUNDWATER CODE
OFFICE OF STATE ENGINEER

RECEIVED
JUL 17 1963

Declaration of Vested Groundwater Rights STATE ENGINEER
(Under Chapter 237, Montana Session Laws, 1961)

1. A. J. Klegor of 3004 Brighton Missoula
(Name of Appropriator) (Address) (Town)
County of Missoula State of Montana
have appropriated groundwater according to the Montana laws in effect prior to January 1, 1962, as follows:

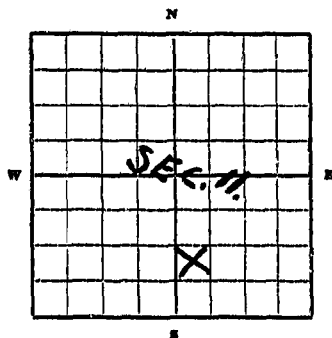

$\frac{1}{4}$ Sec. 11, T. 13^N, R. 19^W
Indicate point of appropriation and place of use, if possible. Each small square represents 10 acres.

- The beneficial use on which the claim is based Domestic Stock drinking water & irrigation
- Date or approximate date of earliest beneficial use; and how continuous the use has been 1940
Continuous use since
- The amount of groundwater claimed (in miner's inches or gallons per minute) unknown
- If used for irrigation, give the acreage and description of the lands to which water has been applied and name of the owner thereof Gardens, Apat & Lawn
approx. 100' x 200'
- The means of withdrawing such water from the ground and the location of each well or other means of withdrawal Electric pump, N.W. quarter of S.W. quarter of the quarter of sec. 11
- The date of commencement and completion of the construction of the well, wells, or other works for withdrawal of groundwater spring of 1940
- The depth of water table estimate 20'
- So far as it may be available, the type, size and depth of each well or the general specifications of any other works for the withdrawal of groundwater Drilled well 6" 29 ft deep
- The estimated amount of groundwater withdrawn each year unknown
- The log of formations encountered in the drilling of each well if available not available
- Such other information of a similar nature as may be useful in carrying out the policy of this act, including reference to book and page of any county record.

Signature of Owner A. J. Klegor
Date 7-10-63

Three copies to be filed by the owner with the County Clerk and Recorder of the county in which the well is located.

Please answer all questions. If not applicable, so state, otherwise the form will be returned.

Original to the County Clerk and Recorder; duplicate to the State Engineer; Triplicate to the Montana Bureau of Mines and Geology and Quadruplicate for the Appropriator.

#219

208276

I received and filed this instrument for
 record on the 11th day of July, 1963
 at 3:25 o'clock P.M., permanent files
 of Missoula County, State of Montana
 Witness my hand:
 MARTIN S. BEHNER, County Recorder
 By Alma S. Sherman Deputy
 Fee \$ 2.00 Paid

RECORDED

STATE ENGINEER

1963

MISSOULA COUNTY RECORDS

File No. _____

DUPLICATE

T 13 N R 19 W
County Missoula

STATE OF MONTANA
ADMINISTRATOR OF GROUNDWATER CODE
OFFICE OF STATE ENGINEER

RECEIVED
JAN 3 1968
STATE ENGINEER

Declaration of Vested Groundwater Rights
(Under Chapter 237, Montana Session Laws, 1961)

1. Ray E. Nelson of Rt. # 4 Missoula
(Name of Appropriator) (Address) (Town)
County of Missoula State of Montana

have appropriated groundwater according to the Montana laws in effect prior to January 1, 1962, as follows:

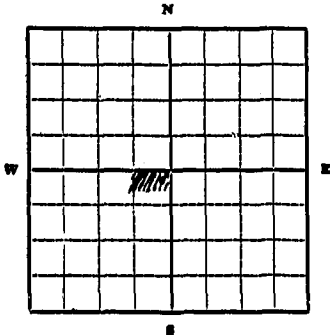

NE 1/4 SW 1/4 Sec. 11 T. 13 R. 19

Indicate point of appropriation and place of use, if possible. Each small square represents 10 acres.

- 2. The beneficial use on which the claim is based House 9 Acres - Lawn, Garden & Hay
- 3. Date or approximate date of earliest beneficial use; and how continuous the use has been 1952 All The Time
- 4. The amount of groundwater claimed (in miner's inches or gallons per minute) 30 G.P.M.
- 5. If used for irrigation, give the acreage and description of the lands to which water has been applied and name of the owner thereof 9 ACRES - IN GARDEN, HAY & LAWN
- 6. The means of withdrawing such water from the ground and the location of each well or other means of withdrawal Myers. T.W.P. 3/4 N.P.

- 7. The date of commencement and completion of the construction of the well, wells, or other works for withdrawal of groundwater 1952
- 8. The depth of water table 24' - BF WATER
- 9. So far as it may be available, the type, size and depth of each well or the general specifications of any other works for the withdrawal of groundwater Drilled Well 6" 98' From G.L.
- 10. The estimated amount of groundwater withdrawn each year For House - 9 ACRES
- 11. The log of formations encountered in the drilling of each well if available Not Available
- 12. Such other information of a similar nature as may be useful in carrying out the policy of this act, including reference to book and page of any county record. NONE

Driller - Glenn Camp
705 Alder, Missoula
Licence # 7

Signature of Owner Ray E. Nelson
Date Dec 23, 1962

Three copies to be filed by the owner with the County Clerk and Recorder of the county in which the well is located.

Please answer all questions. If not applicable, so state, otherwise the form will be returned.

Original to the County Clerk and Recorder; duplicate to the State Engineer; Triplicate to the Montana Bureau of Mines and Geology and Quadruplicate for the Appropriator.

20064

922

215395

Copy

I received and filed this instrument
 record on the 31st day of April 1965
 at 11:36 o'clock A.M. permanent files
 of Missoula County, State of Montana
 Witness my hand
 MARTIN S. BISHOP, County Recorder
 By *M. S. Behner* Deputy
 Fee \$ 2.00 Paid

MISSOULA COUNTY RECORDS
 701 N. 4th St.
 MISSOULA, MONTANA

STATE WATER CONSERVATION BOARD

T 13 R 19

File No. _____

JAN 26 1967

County Missoula

DUPLICATE

LOG

Billie _____
 Butcher _____
 Coyle _____
 Derivation _____
 Dickert _____

STATE OF MONTANA
 ADMINISTRATOR OF GROUNDWATER CODE
 OFFICE OF STATE ENGINEER

Notice of Completion of Groundwater Appropriation by Means of Well
 DEVELOPED AFTER JANUARY 1, 1963

(Under Chapter 237, Montana Session Laws, 1961)

Owner: BATTLE SNAKE MISSION CHURCH
AMERICAN HOMES INC. Address: ROUTE # 1, BILLINGS
MONTANA

Driller: KEN WILLIAMS Address: 1558 So. 5th. W.
MISSOULA, MONT.

Date of Notice of appropriation of groundwater _____

Date well started SEPT. 3, 66 Date completed SEPT. 13, 66

Type of well drilled Equipment used churn
 (Dug, driven, bored or drilled) (Churn drill, rotary or other)

Water use: Domestic Municipal Stock Irrigation
 Industrial Drainage Other

Indicate on the diagram the character and thickness of the different strata met with in drilling, such as soil, clay, shale, gravel, rock or sand, etc. Show depth at which water is encountered, thickness and character of water-bearing strata and height to which the water rises in the well.

0	Top of Ground
44	(Elev. above sea level.....) tan clay, sand, gravel and boulders
44	water, sand, gravel and boulders
51	tan clay, sand, gravel and boulders
51	tan clay, sand, gravel and boulders
62	sand, gravel, boulders and water
62	sand, gravel, boulders and water
84'6"	tan clay, sand, gravel & boulders
84'6"	sand, gravel, water and boulders

Size of Drilled Hole	Size and Weight of Casing	From (Feet)	To (Feet)	PERFORATIONS		
				Kind Size	From (Feet)	To (Feet)
6" I.D.	6 5/8" O.D.	ground level	84'6"			
	1/2" side wall					

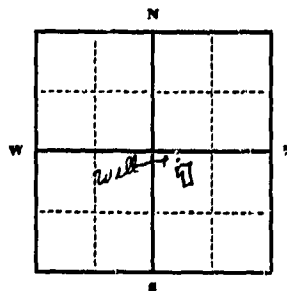

Static Water Level for non-flowing well 49 feet.
 Shut-in Pressure for Flowing Well.....
 Pumping Water Level..... 82 feet
 at 21 gal. per minute.
 Discharge in gal. per min. of flowing well

How Tested: submersible test pump
 Length of Test: 2 1/2 hrs.
 Remarks: (Gravel packing, cementing, packers, type of shutoff)

SE 1/4 Sec. 11 T. 33N. R. 19W.
 Indicate location of well and place of use, if possible. Each small square represents 40 acres.

151

Driller's License Number

Kenneth J. Williams
 Driller's Signature.

4/16/77

Show exact depth of bottom.

This form to be prepared by driller, and three copies to be filed by the owner with the County Clerk and Recorder in the county in which the well is located, tissue copy to be retained by driller.

Please answer all questions. If not applicable, so state, otherwise the form will be returned.

(Continue on reverse side)
 USE—If used for irrigation, industrial, drainage or other. Explain, state number of acres and location or other data (i.e.: Lot, Block and Addition).

0 24 25 26 27 28 29 30 31 32 33 34 35 36 37 38 39 40 41 42 43 44 45 46 47 48 49 50 51 52 53 54 55 56 57 58 59 60 61 62 63 64 65 66 67 68 69 70 71 72 73 74 75 76 77 78 79 80 81 82 83 84 85 86 87 88 89 90 91 92 93 94 95 96 97 98 99 100

1039

257432

I received and filed this instrument for record on the 24th day of Jan 1967 at 9:00 o'clock P.M. in the office of Missoula County, State of Montana. Witness my hand: Veronique H. Croese, County Recorder. By: Dorothy A. Head, Deputy. Fee \$ 3.25 Paid

103 of Orange
103 of Orange
103 of Orange

NOTICED AND RECORDED
Abolition by Warrant of Arrest
Notice of Contention of Controversy
OFFICE OF STATE ENGINEER
ADMINISTRATIVE OF SUPERVISOR

Montana District Lutheran
Church - Missoula
Rev. Robert J. Nelson

Printed in Missoula, Montana

12

File No.

T. 13^N R. 19^W

DUPLICATE

County Missoula

STATE OF MONTANA
ADMINISTRATOR OF GROUNDWATER CODE
OFFICE OF STATE ENGINEER

RECEIVED
JUL 17 1963
STATE ENGINEER

SW

Notice of Completion of Groundwater Appropriation
Without Well

(Under Chapter 237 Montana Session Laws, 1961)

Date of Appropriation of Groundwater 1940

Owner A. J. KRAPF Address 3004 Brighton

Contractor (if any) none

Address of Contractor _____

Date Started _____ Date Completed _____

Describe means of obtaining groundwater without a well "as by sub-irrigation and other natural processes". Include depth to water when applicable.

These are springs

SE. 12.

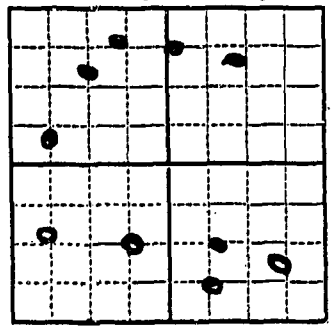

Quantity of water developed and used with explanation of method used to measure or estimate such amount. If use is intermittent

estimate approximate lengths of periods of use spring

Indicate point of appropriation and place of use, if possible.

Flow Continuously

Signature of Owner A. J. Krapf

Date July 10 1963

This form to be prepared by contractor (if any), otherwise by the owner.
Three copies of this notice are to be filed with the County Clerk and Recorder of the county in which the works are located.
Please answer all questions. If not applicable, so state, otherwise the form will be returned.
Original to the County Clerk and Recorder; duplicate to the State Engineer; Triplicate to the Montana Bureau of Mines and Geology and Quadruplicate for the Appropriator.

#212

208277

I received and ~~the~~ ^{the} ~~same~~ ^{same} record on the 11th ^{of} July ¹⁹⁶³
 at 3:30 o'clock P.M.
 of Missoula County, State of Montana
 Witness my hand,
MARTIN S. BERNER, County Recorder
 By Heine Mesman Deputy
 Fee \$ 2.00 Paid

MARTIN S. BERNER

MISSOULA MONTANA

JUL 11 1963

File No. _____

STATE WATER CONSERVATION BOARD

T. 17 N R. 19 W

DUPLICATE

MAR 14 1967

County Missoula

LOG

Billie _____ Mr. Dermott _____ STATE OF MONTANA
Butcher _____ Mr. _____ ADMINISTRATOR OF GROUNDWATER CODE
Coyne _____ Mr. _____ OFFICE OF STATE ENGINEER
Derfington _____ Sullivan _____
Dekert _____

Top of Ground
(Elev. above sea level _____)
0 to 59' Gray clay, gravel & boulders
59' to 63' Tan clay, gravel & boulders
63' to 86' Clay & Gravel
86' to 87' Gravel, boulders & water
87' to 97' Gravel & water
97' to 99' Gravel & water
99' to 103' Blue clay & small gravel
103' to 123' Tight purple clay & gravel
123' to 137' Fractured rock & clay
137' to 151' Mult. colored rock . Stopped at 151'
Perforated from 88' to 97'

Notice of Completion of Groundwater Appropriation by Means of Well

DEVELOPED AFTER JANUARY 1, 1962
(Under Chapter 237, Montana Session Laws, 1961)

Well by Bonnyville Power Line
Owner Montana Power Address Missoula

Driller Glenn Camp 705 Alder Address Missoula

Date of Notice of appropriation of groundwater _____

Date well started 11/3/65 Date completed 12/22/65

Type of well Drilled Equipment used Churn drill
(Dug, Driven, bored or drilled) (Churn drill, rotary or other)

Water use: Domestic Municipal Stock Irrigation
Industrial Drainage Other

Indicate on the diagram the character and thickness of the different strata met with in drilling, such as soil, clay, shale, gravel, rock or sand, etc. Show depth at which water is encountered, thickness and character of water-bearing strata and height to which the water rises in the well.

Size of Drilled Hole	Size and Weight of Casing	From (Feet)	To (Feet)	PERFORATIONS		
				Kind Size	From (Feet)	To (Feet)
12"	12" I.D. 47# to ft.	2'-6" above	G.L. to 104'	Mills knife	88	97
					8 holes to ft total 72 holes	

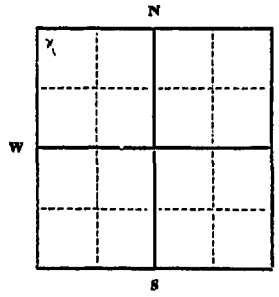

Static Water Level for non-flowing well _____ feet.

Shut-in Pressure for Flowing Well _____ feet

Pumping Water Level _____ feet at _____ gal. per minute.

Discharge in gal. per min. of flowing well _____

How Tested test pump

Length of Test 4 hours

Remarks: (Gravel packing, cementing, packers, type of shutoff) _____
Back filled open hole in bottom, and poured 2' plug in shoes.

(Continue on reverse side)

USE—If used for irrigation, industrial, drainage or other. Explain, state number of acres and location or other data (i.e.: Lot, Block and Addition).

Show exact depth of bottom.

This form to be prepared by driller, and three copies to be filed by the owner with the County Clerk and Recorder in the county in which the well is located, tissue copy to be retained by driller.

Please answer all questions. If not applicable, so state, otherwise the form will be returned.

THE MONTANA POWER CO.
By W. J. Tallent, Vice Pres.
40 E. Broadway, Butte, Mont.,

licence # 7
Driller's License Number

Glenn Camp
Driller's Signature

41799

258791

I received and filed this Instrument for record on the 10 day of March 1967 at 1:04 o'clock P.M. permanent files of Missoula County, State of Montana
Witness my hand:
Varance R. Crouse, County Recorder
By M. M. Conroy, Deputy
Fee \$2.00 Paid

Number of pages recorded
Number of pages for recording
Date of recording
Time of recording

12

File No. _____

T. 13 N. R. 19W

DUPLICATE

County Missoula

STATE OF MONTANA
ADMINISTRATOR OF GROUNDWATER CODE
OFFICE OF STATE ENGINEER

RECEIVED
JAN 3 1963
STATE ENGINEER

Declaration of Vested Groundwater Rights

(Under Chapter 237, Montana Session Laws, 1961)

1. Burley H. & Dorris F. Reeves, of 805 Gary Drive Missoula
(Name of Appropriator) (Address) (Town)
County of Missoula State of Montana
have appropriated groundwater according to the Montana laws in effect prior to January 1, 1962, as follows:

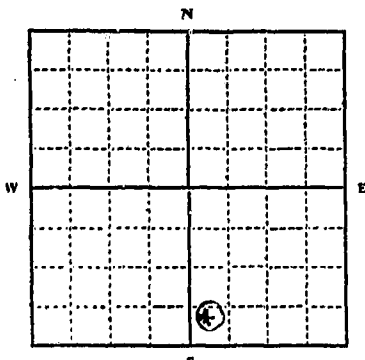

SW SE
1/4 Sec. 12 T. 13N. R. 19W

Indicate point of appropriation and place of use, if possible. Each small square represents 10 acres.

- 2. The beneficial use on which the claim is based Household use and lawn and garden irrigation.
- 3. Date or approximate date of earliest beneficial use; and how continuous the use has been May, 1955 and used continuously to this date.
- 4. The amount of groundwater claimed (in miner's inches or gallons per minute) approximately 20 gallons per minute
- 5. If used for irrigation, give the acreage and description of the lands to which water has been applied and name of the owner thereof Lawn and garden, approx. 1/2 acre and owned by above.
- 6. The means of withdrawing such water from the ground and the location of each well or other means of withdrawal Electric pump in well located against the foundation of house (south side)

- 7. The date of commencement and completion of the construction of the well, wells, or other works for withdrawal of groundwater April 1955
- 8. The depth of water table Twenty to sixty feet (3rd water table)
- 9. So far as it may be available, the type, size and depth of each well or the general specifications of any other works for the withdrawal of groundwater Approx. 69 feet, Drilled and 6 in. steel casing, water pumped by deep well pump.
- 10. The estimated amount of groundwater withdrawn each year approx. 38,000 gallons
- 11. The log of formations encountered in the drilling of each well if available clay and gravel
- 12. Such other information of a similar nature as may be useful in carrying out the policy of this act, including reference to book and page of any county record a concrete well house built to four feet below ground level contains the electric pump

Signature of Owner Burley H. Reeves
Dorris F. Reeves
Date Dec. 27, 1963

Three copies to be filed by the owner with the County Clerk and Recorder of the county in which the well is located.

Please answer all questions. If not applicable, so state, otherwise the form will be returned.

Original to the County Clerk and Recorder; Duplicate to the State Engineer; Triplicate to the Montana Bureau of Mines and Geology, and Quadruplicate for the Appropriator.

19984

784 215192

I received and filed this instrument in
record books 109 of Dec 1963
at 5 o'clock P.M. permanent files
of Missoula County, State of Montana
When my last
By Max J. K... County Recorder
For \$ 20 Deputy
Paid

MISSOULA COUNTY
RECORDS DEPARTMENT
MISSOULA, MONTANA

File No.

DEC 30 1966

T 13N R 19W

DUPLICATE

LOG

County Missoula
STATE OF MONTANA
ADMINISTRATOR OF GROUNDWATER CODE
OFFICE OF STATE ENGINEER

Top of Ground Approx.
(Elev. above sea level 3430')

Notice of Completion of Groundwater Appropriation by Means of Well

DEVELOPED AFTER JANUARY 1, 1962

(Under Chapter 237, Montana Session Laws, 1961)

Formations Log:

- 0 - 6 Dirt.
- 6 - 53 Boulders & broken rock mixed in tan clay.
- 55 - 73 Tan silty clay with gravel, cobblestones & boulders imbedded.
- 73 - 84 Brown & gray clay in thin alternate layers with some gravel imbedded.
- 84 - 93 Gray clay with gravel and boulders imbedded.
- 93 - 116 Lavender to gray clay with gravel & cobblestones imbedded.
- 116 - 144 Gray clay with gravel & cobblestone imbedded.
- 144 - 144 Thin gravel seam with seep of water.
- 144 - 149 Gray clay with gravel and cobblestones imbedded.
- 149 - 171 Dark brown clay & tan silty clay in thin alternate layers. Some gravel imbedded.
- 171 - 178 Gray clay with some gravel imbedded.
- 178 - 188 Tan clay with gravel & cobblestones imbedded.
- 188 - 197 Dirty brown clay with gravel imbedded.
- 197 - 203 Gray & brown clay in thin

Owner Elva H. &/or Robert C. Runke Address Missoula, Montana
Driller Liberty Drilling Co. Address Missoula, Montana

Date of Notice of appropriation of groundwater None filed
Date well started 2/19/64 Date completed 5/19/66
Type of well Drilled Equipment used Air Rotary
(Dug, driven, bored or drilled) (Churn drill, rotary or other)
Water use: Domestic Municipal Stock Irrigation
Industrial Drainage Other

Indicate on the diagram the character and thickness of the different strata met with in drilling, such as soil, clay, shale, gravel, rock or sand, etc. Show depth at which water is encountered, thickness and character of water-bearing strata and height to which the water rises in the well.

Size of Drilled Hole	Size and Weight of Casing	From (Foot)	To (Foot)	PERFORATIONS		
				Kind Size	From (Foot)	To (Foot)
6"	6 5/8" OD x 1/4"	+1	332' 11"	N	O	N

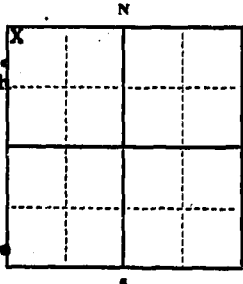

Static Water Level for non-flowing well 65 feet.
Shut-in Pressure for Flowing Well Non-f
Pumping Water Level 495' feet
at 6 gal. per minute.
Discharge in gal. per min. of flowing well Non-flowing

How Tested Pump Test
Length of Test 24 hour
Remarks: (Gravel packing, cementing, packers, type of shutoff) All water is entering well from cracks & seams in the rock below 431 feet.

NW 1/4 Sec. 12 T. 13N R. 19W
Indicate location of well and place of use, if possible. Each small square represents 40 acres.

(Continue on reverse side)
USE—If used for irrigation, industrial, drainage or other. Explain, state number of acres and location or other data (i.e.: Lot, Block and Addition).

cont'd
Show exact depth of bottom. Bottom of hole 1145'

This form to be prepared by driller, and three copies to be filed by the owner with the County Clerk and Recorder in the county in which the well is located, tissue copy to be retained by driller.

Please answer all questions. If not applicable, so state, otherwise the form will be returned.

52
Driller's License Number
William F. Osburn
Driller's Signature.

41587

cont'd:

		alternate layers. Some gravel imbedded.
205	-	217 Gray clay with gravel imbedded.
217	-	228 Black mud with gravel and broken rock imbedded.
228	-	239 Gray clay with gravel imbedded.
239	-	246 Brown clay with gravel imbedded.
246	-	254 Black to dark gray clay with gravel imbedded.
254	-	289 Lavender to gray clay with gravel imbedded.
289	-	301 Gray clay with gravel imbedded.
301	-	306 Green clay with some gravel and broken rock imbedded.
306	-	332 Tan clay with gravel and broken rock imbedded.
332	-	350 Solid rock. Gray and green argillite.
350	-	372 Gray and green argillite in alternate layers.
372	-	431 Gray argillite.
431	-	453 Tan argillite. Seeps of water in cracks and seams.
453	-	514 Tan and green argillite in thin alternate layers.
514	-	561 Green argillite. Seeps of water in cracks and seams.
561	-	583 Gray and green argillite in thin alternate layers.
583	-	608 Gray and brown argillite in thin alternate layers.
		Seeps of water in cracks and seams.
608	-	1145 Gray argillite. Seeps of water in cracks and seams.

Water Log:

Well produced six gallons per minute of clear sand free water on a twenty four hour test with a total lift of 440 feet. Static water level at completion of well was 63 feet from surface. All water is entering well from cracks and seams in the rock below 431 feet.

147°

254733

I received and filed this instrument for record on the _____ day of _____, 19__ A.D.	
at _____ o'clock _____ M., permanent files of Missouri County, State of Montana	Witness my hand:
Vernon R. Crouse, County Recorder	By _____ Deputy
Fee \$ _____	Paid \$ _____

File No.

T. 13^N R. 19^W

DUPLICATE

County

STATE OF MONTANA
 ADMINISTRATOR OF GROUNDWATER CODE
 OFFICE OF STATE ENGINEER

Notice of Completion of Groundwater
 Appropriation by Means of Well

(Under Chapter 237, Montana Session Laws, 1961)

Owner E. C. Barrett Address RT. 4 EAST MSLA.

Driller MOWBRAY Address

Date of Notice of Appropriation of Groundwater

Date well started SEPT. 1945 Date Completed SEPT. 1945

Type of well drilled Equipment Used drill
 (dug, driven, bored or (Churn, drill, rotary or
 drilled) other)

Water Use: Domestic Municipal Other Irrigation
 Industrial Drainage Stock

Indicate on the diagram the character and thickness of the different strata met with in drilling, such as soil, clay, shale, gravel, rock or sand, etc. Show depth at which water is encountered, thickness and character of water-bearing strata and height to which water rises in the well.

Size of Drilled Hole	Size and Weight of Casing	From (Feet)	To (Feet)	PERFORATIONS		
				Kid Size	From (Feet)	To (Feet)
4" hole	4" inside 4" outside	37' 0" to 40' 0" to	37' 0" to 40' 0" to			

Static Water Level for non-flowing Well 10 feet feet.

Shut-in Pressure for Flowing Well

Pumping Water Level .. feet at 50 gal. per minute.

Discharge in gal. per min. of flowing well ..

Flow Tested .. Length of Test ..

Remarks: (Gravel packing, cementing, packers, type of shutoff, location of place of use of groundwater if not at well, and any other similar pertinent information, including number of acres irrigated, if used for irrigation) ..

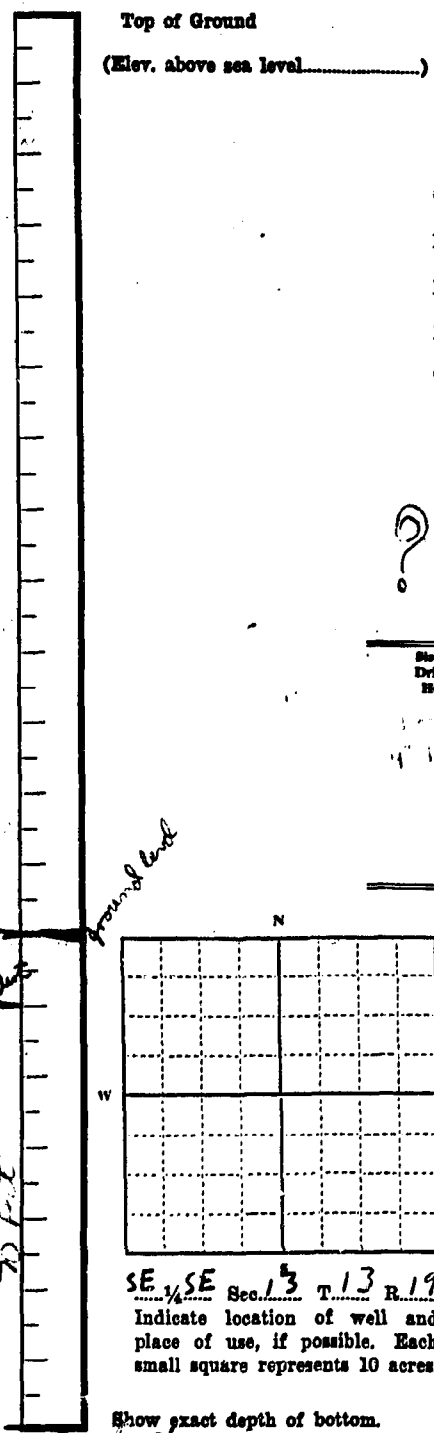

SE $\frac{1}{4}$ SE Sec. 13 T. 13 R. 19
 Indicate location of well and place of use, if possible. Each small square represents 10 acres.

Show exact depth of bottom.

Driller's License Number

E. C. Barrett
 Driller's Signature

This form to be prepared by driller, and three copies to be filed by the owner with the County Clerk and Recorder in the county in which the well is located.

Please answer all questions. If not applicable, so state, otherwise the form will be returned.

Original to the County Clerk and Recorder; duplicate to the State Engineer; Triplicate to the Montana Bureau of Mines and Geology and Quadruplicate for the Appropriator.

077

215552

I received and filed this instrument for
 record on the 31 day of Dec 1963
 at 7:33 o'clock P.M. permanent files
 of Missoula County, State of Montana
 Witness my hand
 MARTIN S. BEJNER, County Recorder
 By Edith Lane Deputy
 Fee \$ 2.00 Paid

0

RECEIVED (PLEASE PRINT) COUNTY CLERK MISSOULA COUNTY MONTANA

GW 2
 File No. _____

DUPLICATE

Approved Stock Form—State Publishing Co., Helena, Montana—59218
 RECEIVED
 JUL 19 1963
 STATE ENGINEER

STATE OF MONTANA
 ADMINISTRATOR OF GROUNDWATER CODE
 OFFICE OF STATE ENGINEER

Notice of Completion of Groundwater Appropriation by Means of Well

(Under Chapter 237, Montana Session Laws, 1961)



Top of Ground
 (Elev. above sea level _____)

0 to 15' Pit

15' to 30' Sand & Gravel

30' to 42' Water, sand & gravel

42' to 45' Clay bound gravel

45' to 56' Loose gravel & water

56' Bottom heavy gravel

Owner: Robert Paschamps Jr. Address: Marshall Grade Missoula

Driller: Glenn Camp 70541200 Address: Missoula

Date of Notice of Appropriation of Groundwater: _____

Date well started: 6/25/63 Date Completed: 6/29/63

Type of well: Drilled Equipment Used: Glenn Drill
 (dug, driven, bored or drilled) (Churn, drill, rotary or other)

Water Use: Domestic Municipal Other Irrigation
 Industrial Drainage Stock

Indicate on the diagram the character and thickness of the different strata met with in drilling, such as soil, clay, shale, gravel, rock or sand, etc. Show depth at which water is encountered, thickness and character of water-bearing strata and height to which water rises in the well.

Size of Drilled Hole	Size and Weight of Casing	From (Feet)	To (Feet)	PERFORATIONS		
				Kind Size	From (Feet)	To (Feet)
10"	10" I.D. 32 lbs to the foot	1 1/2' above bottom	of pit to 56'-6"	Mills Knife	44'	54'
		Total 2 pipe 41'		8" apart		

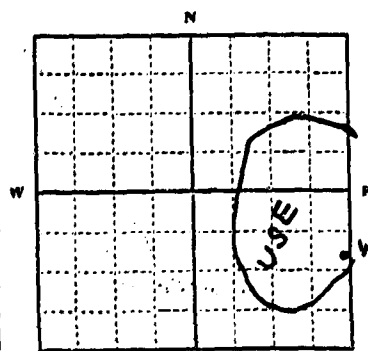

NE 1/4 Sec. 13 T. 12 R. 19
 Indicate location of well and place of use, if possible. Each small square represents 10 acres.

Static Water Level for non-flowing Well: 46' from G.L. feet.

Shut-in Pressure for Flowing Well: _____

Pumping Water Level: 18 feet at 500 gal. per minute.

Discharge in gal. per min. of flowing well: _____

How Tested: Roller Surge & sand pumped 3 hrs
 Length of Test: _____

Remarks: (Gravel packing, cementing, packers, type of shutoff, location of place of use of groundwater if not at well, and any other similar pertinent information, including number of acres irrigated, if used for irrigation) 80 acres

Show exact depth of bottom.

License # 7
 Driller's License Number
Glenn Camp
 Driller's Signature

This form to be prepared by driller, and three copies to be filed by the owner with the County Clerk and Recorder in the county in which the well is located.

Please answer all questions. If not applicable, so state, otherwise the form will be returned.

Original to the County Clerk and Recorder; duplicate to the State Engineer; Triplicate to the Montana Bureau of Mines and Geology and Quadruplicate for the Appropriator.

5085

216 Copy 208478

I received and read this instrument for
record on the 14th day of July
at 10 o'clock A.M. pursuant to the
of Missoula County, State of Montana
Witness my hand:
MARTIN E. BEHNER, County Recorder
By [Signature] Deputy
For 10.00 Paid

MISSOULA COUNTY RECORDER
MISSOULA, MONTANA
RECORDED
INDEXED
JUL 14 1905
MISSOULA COUNTY RECORDER
MISSOULA, MONTANA

JUL 14 1905

13

File No.

T. 13^N R. 19^W

DUPLICATE

County Missoula

STATE OF MONTANA
ADMINISTRATOR OF GROUNDWATER CODE
OFFICE OF STATE ENGINEER

RECEIVED
DEC 30 1963

STATE ENGINEER

Notice of Completion of Groundwater Appropriation
Without Well

(Under Chapter 237 Montana Session Laws, 1961)

Date of Appropriation of Groundwater unknown - Dec 24, 1963

Owner Robert L. DeLong Jr. Address RT 4

Contractor (if any) ---

Address of Contractor ---

Date Started --- Date Completed ---

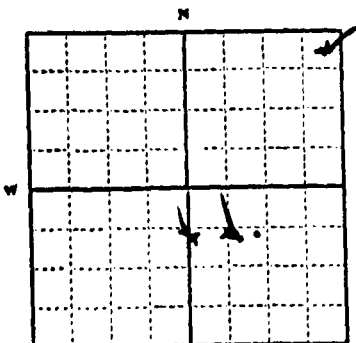

Describe means of obtaining groundwater without a well "as by sub-irrigation and other natural processes". Include depth to water when applicable. Artesian - Pipes

Troughs

Quantity of water developed and used with explanation of method used to measure or estimate such amount. If use is intermittent

estimate approximate lengths of periods of use

Intermittent also year round -
Stock Water - 20 MINERS INCHES

NE 1/4 NE 1/4
NW 1/4 SE 1/4 Sec. 13 T. 13 R. 19
Indicate point of appropriation and place of use, if possible.

Signature of Owner Robert L. DeLong Jr.

Date Dec 26, 1963

This form to be prepared by contractor (if any), otherwise by the owner.
Three copies of this notice are to be filed with the County Clerk and Recorder of the county in which the works are located.
Please answer all questions. If not applicable, so state, otherwise the form will be returned.
Original to the County Clerk and Recorder; duplicate to the State Engineer; Triplicate to the Montana Bureau of Mines and Geology and Quadruplicate for the Appropriator.

-576

214879

Copy
 I received and filed this instrument for
 record on the *26* day of *Dec*, 19*63*
 at *11:04* o'clock *A.M.*, permanent files
 of Missoula County, State of Montana
 Witness my hand:
 MARTIN S. BEHNER, County Recorder
 By *Martin S. Behner*
 Fee \$ *1.00*

MISSOULA COUNTY RECORDS

MISSOULA COUNTY RECORDS
 MISSOULA, MONTANA
 MISSOULA COUNTY RECORDS
 MISSOULA, MONTANA

File No. MONTANA WATER RESOURCES BOARD

T. 13 R. 19

DUPLICATE

RECEIVED

County Missoula

AUG 6 1969 STATE OF MONTANA

ADMINISTRATOR OF GROUNDWATER CODE

OFFICE OF STATE ENGINEER

Notice of Completion of Groundwater Appropriation Without Well

Developed After January 1, 1962

(Under Chapter 237 Montana Session Laws, 1961)

Date of Appropriation of Groundwater August 1, 1969

Owner Robert L. Des-champs III

Address 11 Parsons Drive

Contractor (if any) not applicable

Address of Contractor --

Date Started -- Date Completed --

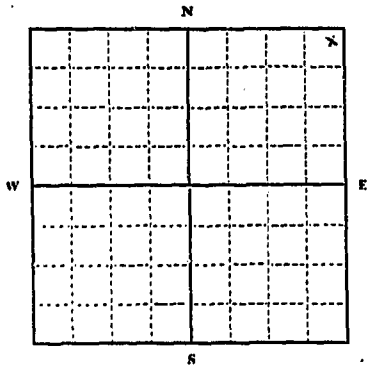

NE 1/4 Sec. 13 T. 13 R. 19

Indicate point of appropriation and place of use, if possible.

1) Describe means of obtaining groundwater (as by sub-irrigation, developed spring, drains, etc.) natural spring

2) Means of withdrawing water (gravity, pump, canal, etc.) gravity

3) Depth of water table surface

4) Use of the water livestock water

5) Amount of groundwater claimed (in miner's inches, or gallons per minute) 10 miner's inches

6) If used for irrigation, give number of acres and description of land not applicable

7) Estimate amount of water used each year 360 miner's inches

Signature of Owner Robert L. Deschamps III

Date Aug 1, 1969

This form to be prepared by contractor (if any), otherwise by the owner.

Three copies of this notice are to be filed with the County Clerk and Recorder of the county in which the works are located.

Please answer all questions. If not applicable, so state, otherwise the form will be returned.

H5505

1925

283553

I received and filed this instrument for
record on the 1st day of Aug, 1969
at 7:00 o'clock P.M., permanent files
of Missouri County, State of Missouri
Witness my hand:
Verance E. Couse, County Recorder
By Gene R. Beahm, Deputy
Paid 7.00

MISSOURI COUNTY RECORDS DEPARTMENT

MONTANA WATER RESOURCES BOARD
Groundwater Division
Mitchell Building
Helena, Montana 59601

Recently a copy of a groundwater appropriation form,

- GW 1, Notice of Appropriation of Groundwater
- GW 2, Notice of Completion of Groundwater Appropriation by means of Well
- GW 3, Notice of Completion of Groundwater Appropriation without Well
- GW 4, Declaration of Vested Groundwater Rights (This form is obsolete and was limited by law to use only through 1965)

was forwarded to this office by the County Clerk and Recorder.

This form is identified by

Owner Robert L. Deschamps III

11 Parsons Drive
Address Missoula, Montana

Location T. 13N., R. 19W., Sec. 13

Document No. 283553

The form is complete as filed. This is to inform you your GW form has been received and no further action is necessary on your part.

The form is incomplete. Please complete the enclosed copy by providing information where indicated, or as noted here and return the corrected copy to the Montana Water Resources Board in Helena.

Please indicate the dates of commencement and completion of spring.

Other.

County recording information is missing. Please forward this information to the Montana Water Resources Board in Helena.

File No. MONTANA WATER RESOURCES BOARD
DUPLICATE RECEIVED

T. 13 R. 19
County Missoula

AUG 6 1969 STATE OF MONTANA

ADMINISTRATOR OF GROUNDWATER CODE
OFFICE OF STATE ENGINEER

Notice of Completion of Groundwater Appropriation Without Well

Developed After January 1, 1962

MONTANA WATER RESOURCES BOARD (Under Chapter 237 Montana Session Laws, 1961)

RECEIVED

SEP 19 1969

Date of Appropriation of Groundwater August 1, 1969

Owner Robert L. Des-champs III Address 11 Parsons Drive

Contractor (if any) not applicable

Address of Contractor

Date Started Aug. 1, 1969 Date Completed Aug. 1, 1969

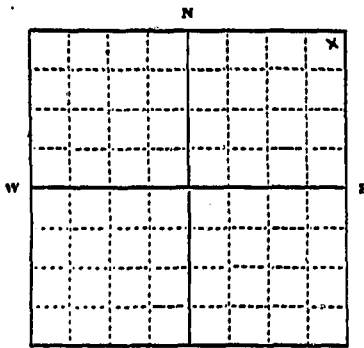

NE 1/4 Sec. 13 T. 13 R. 19

Indicate point of appropriation and place of use, if possible.

1) Describe means of obtaining groundwater (as by sub-irrigation, developed spring, drains, etc.) natural spring

2) Means of withdrawing water (gravity, pump, canal, etc.) gravity

3) Depth of water table surface

4) Use of the water livestock water

5) Amount of groundwater claimed (in miner's inches, or gallons per minute) 10 miner's inches

6) If used for irrigation, give number of acres and description of land not applicable

7) Estimate amount of water used each year 360 miner's inches

Signature of Owner Robert L. Deschamps III

Date Aug. 1, 1969

This form to be prepared by contractor (if any), otherwise by the owner.

Three copies of this notice are to be filed with the County Clerk and Recorder of the county in which the works are located.

Please answer all questions. If not applicable, so state, otherwise the form will be returned.

H2505

13

File No. _____

T 13 R 19 W -

DUPLICATE

County Missoula

STATE OF MONTANA
ADMINISTRATOR OF GROUNDWATER CODE
OFFICE OF STATE ENGINEER

RECEIVED
DEC 26 1963

Declaration of Vested Groundwater Rights

(Under Chapter 237, Montana Session Laws, 1961)

STATE ENGINEER

Robert L. Daxchamps, Jr., of RT #4 Missoula
(Name of Appropriator) (Address) (Town)
County of Missoula State of Montana
have appropriated groundwater according to the Montana laws in effect prior to January 1, 1962, as follows:

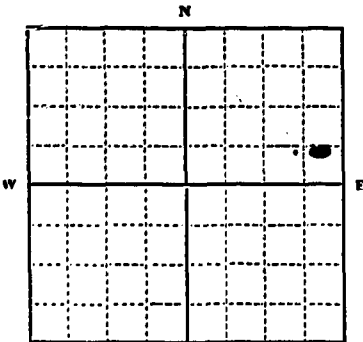

PT NE 1/4
SE 1/4 Sec. 13, T. 13, R. 19 W.

Indicate point of appropriation and place of use, if possible. Each small square represents 10 acres.

2. The beneficial use on which the claim is based Domestic - Stock Water - Irrigation

3. Date of approximate date of earliest beneficial use, and how continuous the use has been 1900 - continuous

4. The amount of groundwater claimed (in miner's inches or gallons per minute) 500 gal - per minute

5. If used for irrigation, give the acreage and description of the lands to which water has been applied and name of the owner thereof
600000 - pt NE 1/4 - SE 1/4
Sec 13 - T 13 - R 19 W -

6. The means of withdrawing such water from the ground and the location of each well or other means of withdrawal Pump -

7. The date of commencement and completion of the construction of the well, wells, or other works for withdrawal of groundwater unknown -

8. The depth of water table 27 ft -

9. So far as it may be available, the type, size and depth of each well or the general specifications of any other works for the withdrawal of groundwater 6 in

10. The estimated amount of groundwater withdrawn each year unknown -

11. The log of formations encountered in the drilling of each well if available unknown -

12. Such other information of a similar nature as may be useful in carrying out the policy of this act, including reference to book and page of any county record.

Signature of Owner Robert L. Daxchamps, Jr.
Date Dec 23, 1963

Three copies to be filed by the owner with the County Clerk and Recorder of the county in which the well is located.

Please answer all questions. If not applicable, so state, otherwise the form will be returned.

Original to the County Clerk and Recorder; Duplicate to the State Engineer; Triplicate to the Montana Bureau of Mines and Geology, and Quadruplicate for the Appropriator.

12310

490

214737

I received and filed this instrument for
 record on the 23 day of Dec, 1943
 at 2:30 o'clock P.M., permanent files
 of Missoula County, State of Montana
 Witness my hand:
MARTIN S. BEHNER, County Recorder
Martin S. Behner, Deputy
 Fee \$ 5.00 Paid

200 800 - for 2000

1400 - 6000000

1400 - 6000000

File No.

T. 13th R. 19 W -

DUPLICATE

County MISSOULA

STATE OF MONTANA
ADMINISTRATOR OF GROUNDWATER CODE
OFFICE OF STATE ENGINEER

RECEIVED
DEC 26 1963

Declaration of Vested Groundwater Rights STATE ENGINEER

(Under Chapter 237, Montana Session Laws, 1961).

Robert L. Deschamps, Jr. of Rt #4 MISSOULA
(Name of Appropriator) (Address) (Town)

County of MISSOULA State of MONTANA
have appropriated groundwater according to the Montana laws in effect prior to January 1, 1962, as follows:

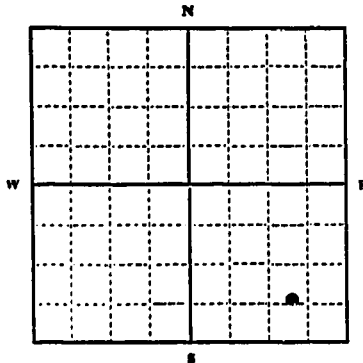

..... 1/4 Sec. T. R.

Indicate point of appropriation and place of use, if possible. Each small square represents 10 acres.

2. The beneficial use on which the claim is based Domestic

3. Date or approximate date of earliest beneficial use; and how continuous the use has been 1930 - constant

4. The amount of groundwater claimed (in miner's inches or gallons per minute) 500 gpm

5. If used for irrigation, give the acreage and description of the lands to which water has been applied and name of the owner thereof

6. The means of withdrawing such water from the ground and the location of each well or other means of withdrawal Pump

7. The date of commencement and completion of the construction of the well, wells, or other works for withdrawal of groundwater unknown

8. The depth of water table 17 ft

9. So far as it may be available, the type, size and depth of each well or the general specifications of any other works for the withdrawal of groundwater tin well - hand dug

10. The estimated amount of groundwater withdrawn each year unknown

11. The log of formations encountered in the drilling of each well if available unknown

12. Such other information of a similar nature as may be useful in carrying out the policy of this act, including reference to book and page of any county record

Signature of Owner

Robert L. Deschamps, Jr.

Date Dec 23, 1963

Three copies to be filed by the owner with the County Clerk and Recorder of the county in which the well is located.

Please answer all questions. If not applicable, so state, otherwise the form will be returned.

Original to the County Clerk and Recorder; Duplicate to the State Engineer; Triplicate to the Montana Bureau of Mines and Geology, and Quadruplicate for the Appropriator.

489

214736

I received and filed this instrument for
 record on the 25 day of Dec, 1963
 at 2:45 o'clock P.M., permanent files
 of Missoula County, State of Montana
 Witness my hand:
MARTIN E. BERNER, County Recorder
 By [Signature] Deputy
 Fee \$ 5.00 P.D. Paid

2004

13

File No. _____

T. 13^N R. 19^W -

DUPLICATE

County MISSOULA

STATE OF MONTANA
ADMINISTRATOR OF GROUNDWATER CODE
OFFICE OF STATE ENGINEER

RECEIVED
DEC 26 1963

Declaration of Vested Groundwater Rights

(Under Chapter 237, Montana Session Laws, 1961)

STATE ENGINEER

Robert L. Deschamps, Jr. of Rt #4 Missoula
(Name of Appropriator) (Address) (Town)

County of MISSOULA State of MONTANA
have appropriated groundwater according to the Montana laws in effect prior to January 1, 1962, as follows:

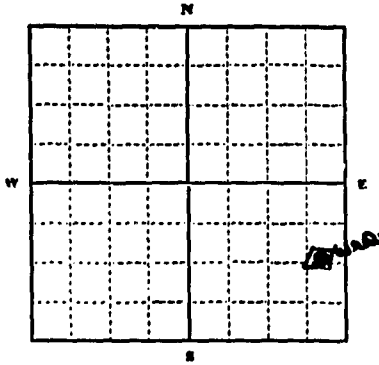

1/4 Sec. T. R.

Indicate point of appropriation and place of use, if possible. Each small square represents 10 acres.

2. The beneficial use on which the claim is based. Domestic - Stock Water - IRRIGATION

3. Date, or approximate date of earliest beneficial use; and how continuous the use has been. 1961 - constant

4. The amount of groundwater claimed (in miner's inches or gallons per minute). 500 gal. per minute

5. If used for irrigation, give the acreage and description of the lands to which water has been applied and name of the owner thereof. 5 acres in SE 1/4 Sec 13 - T 13 - R 19 W.

6. The means of withdrawing such water from the ground and the location of each well or other means of withdrawal. Pump

7. The date of commencement and completion of the construction of the well, wells, or other works for withdrawal of groundwater. Dec - 1961

8. The depth of water table. 25 ft.

9. So far as it may be available, the type, size and depth of each well or the general specifications of any other works for the withdrawal of groundwater. 6 in - 5 ft

10. The estimated amount of groundwater withdrawn each year. unknown

11. The log of formations encountered in the drilling of each well if available. unknown

12. Such other information of a similar nature as may be useful in carrying out the policy of this act, including reference to book and page of any county record.

Signature of Owner Robert Deschamps Jr
Date Rt # 4 Dec 23, 1963

Three copies to be filed by the owner with the County Clerk and Recorder of the county in which the well is located.

Please answer all questions. If not applicable, so state, otherwise the form will be returned.

Original to the County Clerk and Recorder; Duplicate to the State Engineer; Triplicate to the Montana Bureau of Mines and Geology, and Quadruplicate for the Appropriator.

12308

488

214735

I received and filed this instrument for
 record on the 23 day of Dec 1963
 at 9:40 o'clock P.M., permanent files
 of Missoula County, State of Montana
 Witness my hand:
 MARTIN E. BEHNER, County Recorder
 By [Signature] Deputy
 Fee \$ 0.00 Paid

1011-1000

Blanchard - 1000

File No. _____

T. 13^N R. 19^W Sec. 4 200

DUPLICATE

County Missoula

STATE OF MONTANA
ADMINISTRATOR OF GROUNDWATER CODE
OFFICE OF STATE ENGINEER

RECEIVED
JAN 3 1963

Declaration of Vested Groundwater Rights

(Under Chapter 237, Montana Session Laws, 1961)

STATE ENGINEER

William M. Hendricks of OP 2 Missoula
(Name of Appropriator) (Address) (Town)

County of Missoula State of Montana
have appropriated groundwater according to the Montana laws in effect prior to January 1, 1962, as follows:

all wells on Sec 13 East half



2. The beneficial use on which the claim is based Horse, Stock
17 1/2 ac, garden, irrigation

3. Date or approximate date of earliest beneficial use; and how continuous the use has been produced place
March 1951

4. The amount of groundwater claimed (in miner's inches or gallons per minute) don't know

5. If used for irrigation, give the acreage and description of the lands to which water has been applied and name of the owner thereof 5 ac

6. The means of withdrawing such water from the ground and the location of each well or other means of withdrawal Electric pumps

1/4 Sec. T. R.

Indicate point of appropriation and place of use, if possible. Each small square represents 10 acres.

7. The date of commencement and completion of the construction of the well, wells, or other works for withdrawal of groundwater well, were on place where
I bought land March 1951

8. The depth of water table don't know

9. So far as it may be available, the type, size and depth of each well or the general specifications of any other works for the withdrawal of groundwater don't know

No 1 is a drilled well 60 ft. about.
No 2 dug well 15 ft, No 3 dug well 20 ft.
Don't know

10. The estimated amount of groundwater withdrawn each year Don't know

11. The log of formations encountered in the drilling of each well if available don't know

12. Such other information of a similar nature as may be useful in carrying out the policy of this act, including reference to book and page of any county record Don't know

Signature of Owner Wm. Hendricks

Date Dec 31/63

Three copies to be filed by the owner with the County Clerk and Recorder of the county in which the well is located.

Please answer all questions. If not applicable, so state, otherwise the form will be returned.

Original to the County Clerk and Recorder; Duplicate to the State Engineer; Triplicate to the Montana Bureau of Mines and Geology, and Quadruplicate for the Appropriator.

20403

1294

Copy

I received and filed this instrument for
 record in the State of Montana 1963
 at Missoula Co. Clerk's Office, permanent files
 of Missoula County, State of Montana
 Witness my hand:
 By Martin J. Baker County Recorder
Deputy
 Fee \$ 1.00 Paid

THIS INSTRUMENT IS FILED FOR RECORD IN THE OFFICE OF THE COUNTY CLERK OF MISSOULA COUNTY, MONTANA, THIS 12TH DAY OF DECEMBER, 1963, AT 10:30 A.M. THE INSTRUMENT IS FILED IN BOOK 1294, PAGE 1.

RECEIVED

County Missoula, 13

STATE OF MONTANA
ADMINISTRATOR OF GROUNDWATER CODE
MONTANA WATER RESOURCES BOARD

MAR 2 1972

DRILLER'S LOG

MONTANA DEPARTMENT OF NATURAL RESOURCES AND CONSERVATION

Indicate the character, color, thickness of strata such as soil, clay, sand, gravel, shale, sandstone, etc. Show depth at which water is found and height to which water rises in well.

NOTICE OF COMPLETION OF GROUNDWATER APPROPRIATION BY MEANS OF WELL

Developed after January 1, 1962

(Under Chapter 237 Montana Session Laws, 1961, as amended)

This form to be prepared by driller, and three copies to be filed by the owner with the County Clerk and Recorder in the county in which the well is located, last copy to be retained by driller.

Please answer all questions. If not applicable, so state, otherwise the form may be returned.

Owner Robert D. Hoy
Address Rte. 4 Marshall grade
Missoula, Mont.
Date well started 4/4/70
completed 4/9/70

For Administrator's Use	
File #	<u>2238, 313166</u>
Date	<u>Feb. 25, 1972 9:35 a.m.</u>
GW 1	

Type of well drilled
(Dug, driven, bored or drilled)

Equipment used casin drill
(Churn drill, rotary or other)

Water Use: Domestic Municipal Stock Irrigation
Industrial Drainage Other * Garden/Lawn

*Describe _____
USE: If used for irrigation, industrial, drainage or other. Explain, state number of acres and location or other data (i.e. Lot, Block and Addition). _____

ESTIMATED ANNUAL WITHDRAWAL

Size of Drilled Hole	Size and Weight of Casing	From (Feet)	To (Feet)	PERFORATIONS		
				Kind Size	From (Feet)	To (Feet)
8 inch	8 in. I.D. 0 14.02 per ft.	48		NONE		

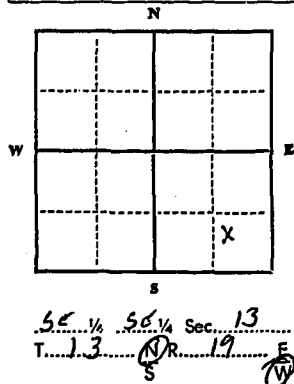

Static water level 7 ft. of top of
Pumping water level 12 ft. of top
at 60 gallons per minute,
measured 5 minutes after pumping began.
*Measured from ground level.
Well developed by compressor
for 3 1/2 hours.
Power _____ Pump _____ HP
Remarks: (Gravel packing, cementing, packers, type of shutoff) _____

INDICATE LOCATION OF WELL AND PLACE OF USE, IF POSSIBLE. EACH SMALL SQUARE REPRESENTS 40 ACRES.

Driller's Signature _____
Driller's Address 304 So. Ave.
Missoula, Mont. LICENSE NO. 71

Top of Ground (Elev. above sea level) <u>3223</u>	
From (Feet)	To (Feet)
0	3 1/2
3 1/2	10
10	27
27	30
30	35
35	42

42 Show exact depth of bottom

49,958

#2238

313166

I received and filed into [unclear] on
 record 25 [unclear] 35 day of [unclear] 1972
 at [unclear] [unclear] [unclear] [unclear] [unclear] [unclear]
 of [unclear] County State of Missouri
 Witness my hand
 [unclear] [unclear] County Recorder
 By [unclear] [unclear]
 For [unclear] [unclear] Prud

Missouri State Level Rate Schedule

RECEIVED

County Missoula

13

MAR 2 1972

STATE OF MONTANA
ADMINISTRATOR OF GROUNDWATER CODE
MONTANA WATER RESOURCES BOARD

INDICATE THE CHARACTER, COLOR, THICKNESS OF STRATA SUCH AS SOIL, CLAY, SAND, GRAVEL, SHALE, SANDSTONE, ETC. SHOW DEPTH AT WHICH WATER IS FOUND AND HEIGHT TO WHICH WATER RISES IN WELL.

NOTICE OF COMPLETION OF GROUNDWATER APPROPRIATION BY MEANS OF WELL

Developed after January 1, 1962

(Under Chapter 237 Montana Session Laws, 1961, as amended)

This form to be prepared by driller, and three copies to be filed by the owner with the County Clerk and Recorder in the county in which the well is located, last copy to be retained by driller. Please answer all questions. If not applicable, so state, otherwise the form may be returned.

Owner Robert D. Hoy
Address Box 2 Marshallville
Missoula, Mont.
Date well started 4/1/70
completed 4/1/70

For Administrator's Use
File # 2237, 313165
Feb. 25, 1972 9:30am
GW 1

Type of well drilled
(Dug, driven, bored or drilled)
Equipment used auger tool
(Churn drill, rotary or other)
Water Use: Domestic Municipal Stock Irrigation
Industrial Drainage Other * Garden/Lawn

*Describe _____
USE: If used for irrigation, industrial, drainage or other. Explain, state number of acres and location or other data (i.e. Lot, Block and Addition). _____

ESTIMATED ANNUAL WITHDRAWAL

Size of Drilled Hole	Size and Weight of Casing	From (Feet)	To (Feet)	PERFORATIONS		
				From (Feet)	To (Feet)	Remarks
3 inch	5 in I.D., 14.02 per ft.	0	42			

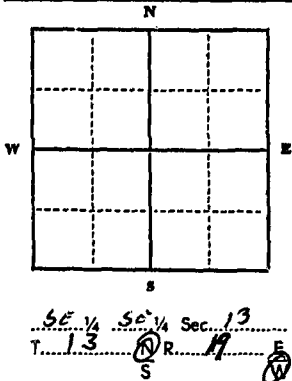

Static water level 7 ft. of top
Pumping water level 12 ft. of top
at _____ gallons per minute,
measured _____ minutes after pumping began.
*Measured from ground level.
Well developed by compressor
for _____ hours.
Power _____ Pump _____ HP
Remarks: (Gravel packing, cementing, packers, type of shutoff) _____

INDICATE LOCATION OF WELL AND PLACE OF USE, IF POSSIBLE. EACH SMALL SQUARE REPRESENTS 40 ACRES.

Driller's Signature _____
Driller's Address 3024 So. 173.
Missoula, Mont.

LICENSE NO. 71

Top of Ground (Elev. above sea level) 3,223

From (Feet)	To (Feet)	Remarks
0	30	top soil
30	11	coarse gravel
10	30	gravel & sand water
20	30	red clay no water
30	35	sand & water
35	42	gravel & water

Show exact depth of bottom

49,957

#2227

313165

I received and filed this instrument for
record on the 25th day of Feb. 1927.
at 9:30 a.m. in the Recorder's Office
of Missoula County State of Montana
Witness my hand
Vernice A. Cross, County Recorder
By Marie G. Guskelle Deputy
Fee \$2.00 Cash Paid

GW: _____

File No. _____

AUG 23 1966

T 13 R 19 13

DUPLICATE

LOG

Name _____ M. District _____
Business _____ M. No. _____
County _____
Production _____
Dicker _____

County Missoula

STATE OF MONTANA
ADMINISTRATOR OF GROUNDWATER CODE
OFFICE OF STATE ENGINEER

0	Top of Ground (Elev. above sea level _____)
16	tan clay, sand, gravel and boulders
16	surface water, sand, gravel and boulders
18	tan clay, sand, and gravel, and boulders
23	tan clay, sand and gravel
34	gray clay with gravel imbedded
52	water in blue and grey shale
53'6"	

Notice of Completion of Groundwater Appropriation by Means of Well

DEVELOPED AFTER JANUARY 1, 1962

(Under Chapter 237, Montana Session Laws, 1961)

Owner MO. E. JOHNSON Address 3717 COTTAGE DR.

Driller KEM WILLIAMS Address 1219 HOWELL ST.

Date of Notice of appropriation of groundwater _____

Date well started MAY 11, 66 Date completed MAY 18, 66

Type of well DRILLED Equipment used CHURN
(Dug, Driven, bored or drilled) (Churn drill, rotary or other)

Water use: Domestic Municipal Stock Irrigation
Industrial Drainage Other

Indicate on the diagram the character and thickness of the different strata met with in drilling, such as soil, clay, shale, gravel, rock or sand, etc. Show depth at which water is encountered, thickness and character of water-bearing strata and height to which the water rises in the well.

Size of Drilled Hole	Size and Weight of Casing	From (Feet)	To (Feet)	PERFORATIONS		
				Kind Size	From (Feet)	To (Feet)
6" ID	6 5/8 O.D.	ground level	53'6"			
	19lbs. per ft. 1/4" side wall					

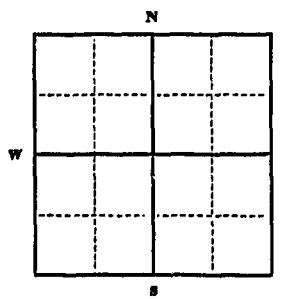

Static Water Level for non-flowing well 18'6" feet.

Shut-in Pressure for Flowing Well _____

Pumping Water Level 45 ft. feet at 2 1/2 gal. per minute.

Discharge in gal. per min. of flowing well _____

How Tested bail test

Length of Test 4 hours

Remarks: (Gravel packing, cementing, packers, type of shutoff) _____

Lot 14 NE 1/4 SW Sec. 13, T. 19, R. _____
Indicate location of well and place of use, if possible. Each small square represents 40 acres.

(Continue on reverse side)

USE—If used for irrigation, industrial, drainage or other. Explain, state number of acres and location or other data (i.e.: Lot, Block and Addition).

Show exact depth of bottom.

This form to be prepared by driller, and three copies to be filed by the owner with the County Clerk and Recorder in the county in which the well is located, tissue copy to be retained by driller.

Please answer all questions. If not applicable, so state, otherwise the form will be returned.

151
Driller's License Number

Kenneth L. Williams
Driller's Signature

41,328

1441

253173

I received and filed this Instrument for
 record on the 19 day of Aug, 1966
 at 2:00 o'clock P.M., per present files
 of Missoula County, State of Montana
 Witness my hand:
 Verance R. Ciguse, County Recorder
 By M. M. Coughlin, Deputy
 Fee \$2.00 Paid ll

MISSOULA COUNTY
 RECORDER'S OFFICE
 MISSOULA, MONTANA

File No.

T. 13 N R. 19 W

DUPLICATE

S.W. 70

County Missoula

STATE OF MONTANA
ADMINISTRATOR OF GROUNDWATER CODE
OFFICE OF STATE ENGINEER

RECEIVED
JUL 17 1963

STATE ENGINEER
Notice of Completion of Groundwater Appropriation Without Well

(Under Chapter 237 Montana Session Laws, 1961)

Date of Appropriation of Groundwater 1940

Owner A. J. Klapwyk Address 3004 Dayton

Contractor (if any) none

Address of Contractor

Date Started..... Date Completed.....

Describe means of obtaining groundwater without a well "as by sub-irrigation and other natural processes". Include depth to water when applicable.

These are springs

Quantity of water developed and used with explanation of method used to measure or estimate such amount. If use is intermittent

estimate approximate lengths of periods of use Springs

Flow continuously

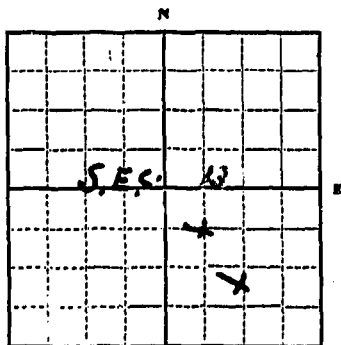

1/4 Sec 13 T. 13 R. 19 W
Indicate point of appropriation and place of use, if possible.

Signature of Owner *A. J. Klapwyk*

Date 7-10-63

This form to be prepared by contractor (if any), otherwise by the owner.

Three copies of this notice are to be filed with the County Clerk and Recorder of the county in which the works are located.

Please answer all questions. If not applicable, so state, otherwise the form will be returned.

Original to the County Clerk and Recorder; duplicate to the State Engineer; Triplicate to the Montana Bureau of Mines and Geology and Quadruplicate for the Appropriator.

#210

208275

I received and filed this instrument for
 record on the 11 day of July, 1963
 at 3:20 o'clock P.M., permanent files
 of Missoula County, State of Montana
 Witness my hand
MARTIN S. BEHLER, County Recorder
 By Deputy
 Fee \$ 2.00 Paid

208275

MISSOULA COUNTY
 CLERK OF DISTRICT COURT
 MISSOULA, MONTANA

RECORDED
 JUL 11 1963

File No. _____

T. 13 N. R. 19 W. 13
County Missoula

DUPLICATE

STATE OF MONTANA
ADMINISTRATOR OF GROUNDWATER CODE
OFFICE OF STATE ENGINEER

RECEIVED
JAN 3 1963

Declaration of Vested Groundwater Rights

(Under Chapter 237, Montana Session Laws, 1961)

STATE ENGINEER

I, A. E. Martinsen, of 223 N. Davis St., Missoula
(Name of Appropriator) (Address) (Town)

County of Missoula State of Montana
have appropriated groundwater according to the Montana laws in effect prior to January 1, 1962, as follows:

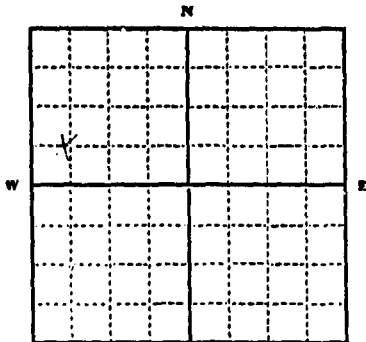

SW, NW Quarter T. 13 R. 19
Lot 37, Cobban-Dynsore Addition
1/4 Sec. T. R.

Indicate point of appropriation and place of use, if possible. Each small square represents 10 acres.

2. The beneficial use on which the claim is based..... Residential and irrigation.

3. Date or approximate date of earliest beneficial use; and how continuous the use has been..... 1957 - Continuously.

4. The amount of groundwater claimed (in miner's inches or gallons per minute)..... 3,000 per hour.

5. If used for irrigation, give the acreage and description of the lands to which water has been applied and name of the owner thereof..... Acres under irrigation - 10 acres pasture land owned by Appropriator.

6. The means of withdrawing such water from the ground and the location of each well or other means of withdrawal..... Electric Pump

7. The date of commencement and completion of the construction of the well, wells, or other works for withdrawal of groundwater..... 1957

8. The depth of water table..... 12 feet.

9. So far as it may be available, the type, size and depth of each well or the general specifications of any other works for the withdrawal of groundwater..... Drilled well - 5" casing - 60 feet depth.

10. The estimated amount of groundwater withdrawn each year..... 37,500,000 gal. per year.

11. The log of formations encountered in the drilling of each well if available..... Not available.

12. Such other information of a similar nature as may be useful in carrying out the policy of this act, including reference to book and page of any county record..... No other information available to my knowledge

Signature of Owner A. E. Martinsen

Date December 26, 1963

Three copies to be filed by the owner with the County Clerk and Recorder of the county in which the well is located.

Please answer all questions. If not applicable, so state, otherwise the form will be returned.

Original to the County Clerk and Recorder; Duplicate to the State Engineer; Triplicate to the Montana Bureau of Mines and Geology, and Quadruplicate for the Appropriator.

19954

64

215162

I received and filed this instrument for
 record on the 17th day of Dec 1947
 at 11:45 o'clock A.M., permanent files
 of Roosevelt County, State of Montana
 Witness my hand:
 MARTIN S. BEHNER, County Recorder
 By Martin S. Behner Deputy
 Fee \$ 1.00 Paid

RECORDED
 INDEXED
 1 - Copy

2171

306714

I received and filed this instrument for
 record on the 20 day of June, 1971
 at 12:00 o'clock P.M., permanent files
 of Missoula County, State of Montana
 Witness my hand
Varmae R. Crouse, County Recorder
 By David D. Johnson, Deputy
 Fee \$2.00 Paid

RECEIVED
 MONTANA WATER RESOURCES BOARD
 AUG 26 1971

RECEIVED
 MONTANA WATER RESOURCES BOARD

14

File No. _____

T. 13 R. 19

DUPLICATE

County _____

STATE OF MONTANA
ADMINISTRATOR OF GROUNDWATER CODE
OFFICE OF STATE ENGINEER

RECEIVED
JAN 3 1963
STATE ENGINEER

Declaration of Vested Groundwater Rights

(Under Chapter 237, Montana Session Laws, 1961)

1. RAY BINGHAM, of 2728 Brayton, Missoula,
(Name of Appropriator) (Address) (Town)

County of Missoula, State of Montana,
have appropriated groundwater according to the Montana laws in effect prior to January 1, 1962, as follows:

			X						

1/4 Sec. T. R.

Indicate point of appropriation and place of use, if possible. Each small square represents 10 acres.

2. The beneficial use on which the claim is based Domestic and irrigation.

3. Date or approximate date of earliest beneficial use; and how continuous the use has been 1897. In continuous use since that time.

4. The amount of groundwater claimed (in miner's inches or gallons per minute) Not known.

5. If used for irrigation, give the acreage and description of the lands to which water has been applied and name of the owner thereof A tract of land in the NW 1/4 NE 1/4 of Section 14, Township 13 North of Range 19 West, M.P.M., which is more particularly described (Continued on back hereof.)

6. The means of withdrawing such water from the ground and the location of each well or other means of withdrawal Drilled well located adjacent to house (approximate center of property).

7. The date of commencement and completion of the construction of the well, wells, or other works for withdrawal of groundwater 1897.

8. The depth of water table About 30 feet.

9. So far as it may be available, the type, size and depth of each well or the general specifications of any other works for the withdrawal of groundwater One drilled well, 4 inch casing, 62 feet deep, 1 H.P. pump.

10. The estimated amount of groundwater withdrawn each year Not known.

11. The log of formations encountered in the drilling of each well if available Not available.

12. Such other information of a similar nature as may be useful in carrying out the policy of this act, including reference to book and page of any county record Not known.

Signature of Owner Ray Bingham

Date December 31, 1963.

Three copies to be filed by the owner with the County Clerk and Recorder of the county in which the well is located.

Please answer all questions. If not applicable, so state, otherwise the form will be returned.

Original to the County Clerk and Recorder; Duplicate to the State Engineer; Triplicate to the Montana Bureau of Mines and Geology, and Quadruplicate for the Appropriator.

20169

Missoula,
RAY BINGHAM,

s

is

is

s

31st. December 63.

Missoula, Montana.
February 15 65.

(Continuation of description)

as follows:

Beginning at the southwest corner of the said NW 1/4 NE 1/4 and running north on the west line of said NW 1/4 NE 1/4 a distance of 858 feet to a point, which said point is hereby designated as the southwest corner and point of beginning of the herein described tract; thence continuing north on the west line of the NW 1/4 NE 1/4 a distance of 164 feet to a point; thence east at right angles and parallel to the north line of said NW 1/4 NE 1/4 a distance of 240 feet to a point; thence south at right angles and parallel to the west line of said NW 1/4 NE 1/4 a distance of 164 feet to a point; thence west at right angles and parallel to the north line of said NW 1/4 NE 1/4 a distance of 240 feet to a point on the west line of said NW 1/4 NE 1/4 which is the southwest corner and point of beginning of the herein described tract of land.

Ray Bingham, owner.

049
215524

I received and filed this instrument for record on the 31 st day of Dec. 1963 at 11:07 o'clock P.M. pursuant to the laws of the State of Montana of Missoula County.	Witness my hand and seal this 15 th day of Feb. 1965.
MARTIN S. BEAVER, County Recorder	By <i>[Signature]</i> Deputy
Fee \$ 2	Paid

14

File No. _____

T. _____ P. _____

DUPLICATE

13 19 W
County Missoula

STATE OF MONTANA
ADMINISTRATOR OF GROUNDWATER CODE
OFFICE OF STATE ENGINEER

Declaration of Vested Groundwater Rights JAN 3 1968

(Under Chapter 237, Montana Session Laws, 1961)

STATE ENGINEER

Bueyer
1. Joseph H. Bueyer, of Missoula,
Missoula County, State of Montana,
have appropriated groundwater according to the Montana laws in effect prior to January 1, 1962, as follows:

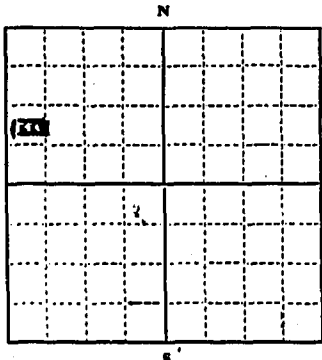

1/4 NW 1/4
indicate point of appropriation and place of use, if possible. Each small square represents 10 acres.

2. The beneficial use on which the claim is based. drinking, personal use and irrigation

3. Date or approximate date of earliest beneficial use; and how continuous the use has been. March 10 1957

and continuity since

4. The amount of groundwater claimed (in miner's inches or gallons per minute). 300 gallons per minute

5. If used for irrigation, give the acreage and description of the lands to which water has been applied and name of the owner thereof

a strip of land situated in the Northwest 1/4 quarter of the northeast quarter (NW 1/4 NE 1/4) section 14, Township 13, Range nineteen (19) North, Range nineteen (19) West approximately 1/2 acre

6 in. 60 ft. well and pump located under dwelling on west end of strip of land described

7. The date of commencement and completion of the construction of the well, wells, or other works for withdrawal of groundwater. March 10 1957 to June 10 1957

8. The depth of water table. varied from surface to 20 ft. below surface

9. So far as it may be available, the type, size and depth of each well or the general specifications of any other works for the withdrawal of groundwater. well as above described under paragraph 6

10. The estimated amount of groundwater withdrawn each year. one million gallons of water per year

11. The log of formations encountered in the drilling of each well if available. not available

12. Such other information of a similar nature as may be useful in carrying out the policy of this act, including reference to book and page of any county record. none available

Signature of Owner Joseph H. Bueyer
Date 31 Dec. 1963

Three copies to be filed by the owner with the County Clerk and Recorder of the county in which the well is located.

Please answer all questions. If not applicable, so state, otherwise the form will be returned.

Original to the County Clerk and Recorder; Duplicate to the State Engineer; Triplicate to the Montana Bureau of Mines and Geology, and Quadruplicate for the Appropriator.

20151

1031

215506

I received and filed this instrument for
record on the 31 day of Dec 1963
at 3:43 o'clock P.M., permanent files
of Missoula County, State of Montana
Witness my hand:
MARTIN S. REHNER, County Recorder
By MARTIN S. REHNER, Deputy
Fee \$ 2.00 Paid

14

File No. _____

T. 13ⁿ R. 19^w

DUPLICATE

County _____

STATE OF MONTANA
ADMINISTRATOR OF GROUNDWATER CODE
OFFICE OF STATE ENGINEER

RECEIVED
JAN 3 1962
STATE ENGINEER

Declaration of Vested Groundwater Rights

(Under Chapter 237, Montana Session Laws, 1961)

Alphonse & Evelyn Donigny of *2224 Brantmore Missoula*
(Name of Appropriator) (Address) (Town)

County of *Missoula* State of *Montana*
have appropriated groundwater according to the Montana laws in effect prior to January 1, 1962, as follows:

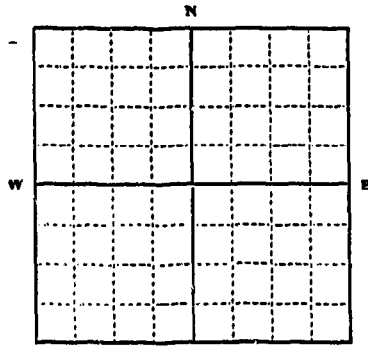

NW 1/4 SE 1/4 Sec. 14, T. 13, R. 19

Indicate point of appropriation and place of use, if possible. Each small square represents 10 acres.

- The beneficial use on which the claim is based. *House hold and Irrigations of lawn & garden*
- Date or approximate date of earliest beneficial use; and how continuous the use has been. *Sept 1950*
Continuous since
- The amount of groundwater claimed (in miner's inches or gallons per minute) *Don't know*
- If used for irrigation, give the acreage and description of the lands to which water has been applied and name of the owner thereof
not applicable
- The means of withdrawing such water from the ground and the location of each well or other means of withdrawal
jet pump
- The date of commencement and completion of the construction of the well, wells, or other works for withdrawal of groundwater
Sept 1950
- The depth of water table. *30 ft*
- So far as it may be available, the type, size and depth of each well or the general specifications of any other works for the withdrawal of groundwater.
Well is 87 feet deep - 6" casing - water 30 ft
- The estimated amount of groundwater withdrawn each year. *Don't know*
- The log of formations encountered in the drilling of each well if available.
Well is 87 feet deep - mostly gravel, also sand at water level
- Such other information of a similar nature as may be useful in carrying out the policy of this act, including reference to book and page of any county record. *Don't know*

Signature of Owner *Alphonse Donigny*
Evelyn Donigny
Date *Dec 31 1961*

Three copies to be filed by the owner with the County Clerk and Recorder of the county in which the well is located.

Please answer all questions. If not applicable, so state, otherwise the form will be returned.

Original to the County Clerk and Recorder; Duplicate to the State Engineer; Triplicate to the Montana Bureau of Mines and Geology, and Quadruplicate for the Appropriator.

20422

1303

Copy
 I received and filed this instrument for
 record on the *21st* day of *October*, 19*08*
 at *Helena*, Clerk of the County, State of Montana
 of Missoula County, State of Montana
 Witness my hand: *[Signature]* County Recorder
 By *[Signature]* Paid
 Fee \$ *2.00*

1303

MISSOULA COUNTY RECORDS

9

File No. _____

DUPLICATE

T. 13^N R. 19^W S. 14
County Missoula

STATE OF MONTANA
ADMINISTRATOR OF GROUNDWATER CODE
OFFICE OF STATE ENGINEER

RECEIVED
DEC 10 1963

Declaration of Vested Groundwater Rights
(Under Chapter 237, Montana Session Laws, 1961)

STATE ENGINEER

1. JOHN P. DRATZ and BETTY L. DRATZ of RR #4, East Battlesnake, MISSOULA
(Name of Appropriator) (Address) (Town)

County of MISSOULA State of MONTANA
have appropriated groundwater according to the Montana laws in effect prior to January 1, 1962, as follows:

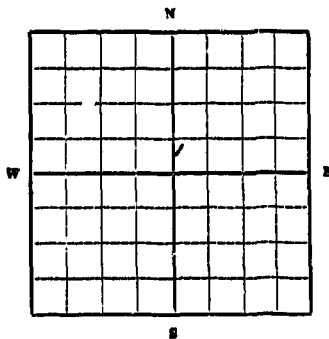

SW 1/4 Sec. 14, T13, R. 19W

Indicate point of appropriation and place of use, if possible. Each small square represents 10 acres.

- 2. The beneficial use on which the claim is based for home use and yard irrigation
- 3. Date or approximate date of earliest beneficial use; and how continuous the use has been Summer 1948 and in continuous use since that time.
- 4. The amount of groundwater claimed (in miner's inches or gallons per minute) approximately 50 gal. per minute--for accuracy check with AR Monray, driller.
- 5. If used for irrigation, give the acreage and description of the lands to which water has been applied and name of the owner thereof approx. 1/2 acre of yard surrounding the house. Owner as listed above.
- 6. The means of withdrawing such water from the ground and the location of each well or other means of withdrawal Deep well pressure pump located beside the house.

7. The date of commencement and completion of the construction of the well, wells, or other works for withdrawal of groundwater One well drilled and completed summer 1948

8. The depth of water table approximately 60 to 70 feet.

9. So far as it may be available, the type, size and depth of each well or the general specifications of any other works for the withdrawal of groundwater 4" casing, drilled well to depth of 70 feet, withdrawn by 3/4 hp electric jet pump; Drilled by Monray Drilling Co., Missoula

10. The estimated amount of groundwater withdrawn each year guess- 10 to 50,000 gal.

11. The log of formations encountered in the drilling of each well if available don't know

12. Such other information of a similar nature as may be useful in carrying out the policy of this act, including reference to book and page of any county record don't know

Signature of Owner Betty L. Dratz
Date 11/7/63

Three copies to be filed by the owner with the County Clerk and Recorder of the county in which the well is located.

Please answer all questions. If not applicable, so state, otherwise the form will be returned.

Original to the County Clerk and Recorder; duplicate to the State Engineer; Triplicate to the Montana Bureau of Mines and Geology and Quadruplicate for the Appropriator.

369

213957

Copy

I received and filed this instrument for record on the 9 day of Dec, 1947, at 9:30 o'clock A.M., permanent file of Missoula County, State of Montana.
 Witness my hand:
MARTIN S. BENNER, County Recorder
Martin S. Benner, Deputy
 Fee \$ 1.00 Paid

RECORDED IN BOOK 117 ON 12/10/47
 MISSOULA COUNTY, MONTANA
 1947

MISSOULA COUNTY, MONTANA

14

File No. _____

T. 13 N. R. 19 W

DUPLICATE

County Missoula

STATE OF MONTANA
ADMINISTRATOR OF GROUNDWATER CODE
OFFICE OF STATE ENGINEER

RECEIVED
JAN 2 1964

Declaration of Vested Groundwater Rights STATE ENGINEER

(Under Chapter 237, Montana Session Laws, 1961)

1. Ray H. & Mila D. Gibbs of 2416 Sycamore Missoula
(Name of Appropriator) (Address) (Town)

County of Missoula State of Montana
have appropriated groundwater according to the Montana laws in effect prior to January 1, 1962, as follows:

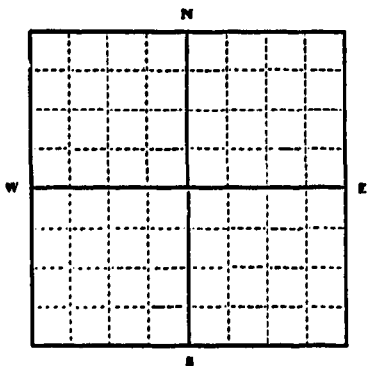

1/4 Sec. T. R.

Indicate point of appropriation and place of use, if possible. Each small square represents 10 acres.

2. The beneficial use on which the claim is based personal house use & irrigation 1 acre

3. Date or approximate date of earliest beneficial use; and how continuous the use has been June 15, 1947 continuous

4. The amount of groundwater claimed (in miner's inches or gallons per minute) 14 gals. per minute

5. If used for irrigation, give the acreage and description of the lands to which water has been applied and name of the owner thereof
1 acre - lot 33 Oxside Addition located in Rattlesnake Valley, SW 1/4 NW 1/4 Section 24 Twp. 13 N. R. 19 W. Ray H. & Mila D. Gibbs

6. The means of withdrawing such water from the ground and the location of each well or other means of withdrawal 2 wells located SW corner at house 1 well pump

7. The date of commencement and completion of the construction of the well, wells, or other works for withdrawal of groundwater Started May 29, 1947 Completed June 15, 1947

8. The depth of water table First water 18 to 20 ft. Second water 40-43 ft

9. So far as it may be available, the type, size, and depth of each well or the general specifications of any other works for the withdrawal of groundwater 6" casing, 50 ft. deep

10. The estimated amount of groundwater withdrawn each year Personal use for family at four. Also irrigate plot 125 x 120

11. The log of formations encountered in the drilling of each well if available Not available

12. Such other information of a similar nature as may be useful in carrying out the policy of this act, including reference to book and page of any county record No county record

Signature of Owner Ray H. & Mila D. Gibbs

Date Dec. 30, 1963

Three copies to be filed by the owner with the County Clerk and Recorder of the county in which the well is located.

Please answer all questions. If not applicable, so state, otherwise the form will be returned.

Original to the County Clerk and Recorder; Duplicate to the State Engineer; Triplicate to the Montana Bureau of Mines and Geology, and Quadruplicate for the Appropriator.

17686