

RECEIVED

Missoula

County

OCT 19 1972

3 GW 2 Revised 1969 STATE PUBLISHING COMPANY

STATE OF MONTANA ADMINISTRATOR OF GROUNDWATER CONTROL MONTANA WATER RESOURCES BOARD MONTANA DEPARTMENT OF NATURAL RESOURCES AND CONSERVATION

DRILLER'S LOG

Indicate the character, color, thickness of strata such as soil, clay, sand, gravel, shale, sandstone, etc. Show depth at which water is found and height to which water rises in well.

NOTICE OF COMPLETION OF GROUNDWATER APPROPRIATION BY MEANS OF WELL

Developed after January 1, 1962

(Under Chapter 237 Montana Session Laws, 1961, as amended)

This form to be prepared by driller, and three copies to be filed by the owner with the County Clerk and Recorder in the county in which the well is located, last copy to be retained by driller. Please answer all questions. If not applicable, so state, otherwise the form may be returned.

Owner Roger Hill Address 3948 S. 3rd West Missoula, Montana Date well started May 9, 1972 completed May 12, 1972

For Administrator's Use File #0355; 323448 Oct 19 1972 10:15 am GW 1

Type of well Drilled Equipment used Churn drill Water Use: Domestic [x] Municipal [] Stock [] Irrigation [] Industrial [] Drainage [] Other []* Garden/Lawn []

*Describe USE: If used for irrigation, industrial, drainage or other. Explain, state number of acres and location or other data (i.e. Lot, Block and Addition).

ESTIMATED ANNUAL WITHDRAWAL \$,000,000 gallons

Table with columns: Size of Drilled Hole, Size and Weight of Casing, From (Feet), To (Feet), PERFORATIONS (Kind Size, From (Feet), To (Feet)).

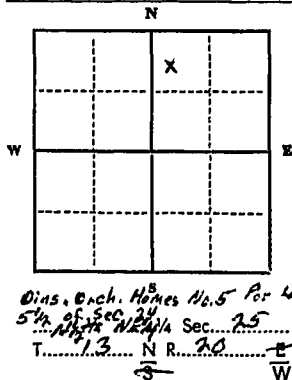

Static water level 8 ft. Pumping water level 15 ft. at 100 gallons per minute, measured 30 minutes after pumping began. *Measured from ground level. Well developed by Compressor for 2 hours. Power Pump HP Remarks: (Gravel packing, cementing, packers, type of shutoff)

Table with columns: From (Feet), To (Feet), and description of strata. Entries include Pit, Topsoil, Sand and gravel, Static water level, Sand and water, Clay, Sand gravel and water, Clay, Sand gravel and water.

INDICATE LOCATION OF WELL AND PLACE OF USE, IF POSSIBLE. EACH SMALL SQUARE REPRESENTS 40 ACRES.

Driller's Signature Charles J. Johnston Driller's Address C.K.C. Drilling, P.O. Box 670, Missoula, Montana LICENSE NO. 185

53 Show exact depth of bottom

51,638

#2355

323446

I received and filed this instrument for
record on the day of 1973.
at 10:15 o'clock A.M., permanent files
of Missoula County, State of Montana
Witness my hand:
Verance R. Crease, County Recorder
By Deputy
Fee \$..... Paid

SEARCHED

INDEXED

SERIALIZED

FILED

MISSOULA COUNTY

1	2	3	4	5	6	7	8	9	10	11	12	13	14	15	16	17	18	19	20	21	22	23	24	25	26	27	28	29	30	31	32	33	34	35	36	37	38	39	40	41	42	43	44	45	46	47	48	49	50	51	52	53	54	55	56	57	58	59	60	61	62	63	64	65	66	67	68	69	70	71	72	73	74	75	76	77	78	79	80	81	82	83	84	85	86	87	88	89	90	91	92	93	94	95	96	97	98	99	100
---	---	---	---	---	---	---	---	---	----	----	----	----	----	----	----	----	----	----	----	----	----	----	----	----	----	----	----	----	----	----	----	----	----	----	----	----	----	----	----	----	----	----	----	----	----	----	----	----	----	----	----	----	----	----	----	----	----	----	----	----	----	----	----	----	----	----	----	----	----	----	----	----	----	----	----	----	----	----	----	----	----	----	----	----	----	----	----	----	----	----	----	----	----	----	----	----	----	----	-----

File No. _____

T. 13 N. R. 30 W. MPM

DUPLICATE

County Missoula

STATE OF MONTANA
 ADMINISTRATOR OF GROUNDWATER CODE
 OFFICE OF STATE ENGINEER

RECEIVED
 DEC 30 1963

Declaration of Vested Groundwater Rights
 (Under Chapter 237, Montana Session Laws, 1961) STATE ENGINEER

1. William C. Hodge, of Route 1 Missoula
 (Name of Appropriator) (Address) (Town)

County of Missoula State of Montana
 have appropriated groundwater according to the Montana laws in effect prior to January 1, 1962, as follows:

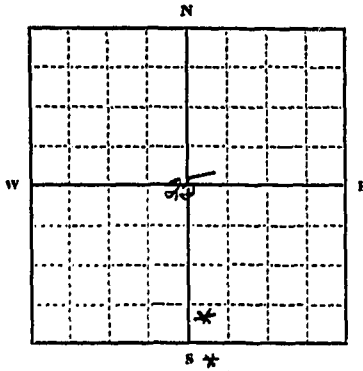

SE 1/4 Sec 25 T. 13 N. R. 30 W

Indicate point of appropriation and place of use, if possible. Each small square represents 10 acres.

2. The beneficial use on which the claim is based Household and irrigation

3. Date or approximate date of earliest beneficial use; and how continuous the use has been July 1953 continuous

4. The amount of groundwater claimed (in miner's inches or gallons per minute) 50 gal/min

5. If used for irrigation, give the acreage and description of the lands to which water has been applied and name of the owner thereof
Two acres described as lots 43 + 44, Sec 25, T. 13 N., R. 30 W., MPM

6. The means of withdrawing such water from the ground and the location of each well or other means of withdrawal Deep well located on lot 44, Sec 25, T. 13 N., R. 30 W., MPM

7. The date of commencement and completion of the construction of the well, wells, or other works for withdrawal of groundwater started Jun 1953, completed Jul 1953

8. The depth of water table Prax 30 ft

9. So far as it may be available, the type, size and depth of each well or the general specifications of any other works for the withdrawal of groundwater 4 inch dia steel casing, welded joints, 70 ft deep

10. The estimated amount of groundwater withdrawn each year prax 2,000,000 gal per year

11. The log of formations encountered in the drilling of each well if available loam for 3 ft, gravel + sand rest of the way

12. Such other information of a similar nature as may be useful in carrying out the policy of this act, including reference to book and page of any county record None -

Signature of Owner William C. Hodge

Date Dec 26, 1963

Three copies to be filed by the owner with the County Clerk and Recorder of the county in which the well is located.

Please answer all questions. If not applicable, so state, otherwise the form will be returned.

Original to the County Clerk and Recorder; Duplicate to the State Engineer; Triplicate to the Montana Bureau of Mines and Geology, and Quadruplicate for the Appropriator.

577

214874

Copy
 I received and filed this instrument for
 record on the...*2nd*...day of...*Dec*...196*8*
 at...*1:25*...o'clock...*A.M.*, permanent office
 of Missoula County, State of Montana
 Witness my hand:
 MARTIN S. BEHNER, County Recorder
 By...*Martin S. Behner*...
 Fee \$...*0.00*...Paid

Handwritten notes and stamps on the right side of the page, including a vertical stamp that reads "MAY 20 1968" and other illegible markings.

File No. _____

T 13N R 20W

DUPLICATE

County Missoula

STATE OF MONTANA
ADMINISTRATOR OF GROUNDWATER CODE
OFFICE OF STATE ENGINEER

RECEIVED
MAY 21 1964

Notice of Completion of Groundwater Appropriation by Means of Well

(Under Chapter 237, Montana Session Laws, 1961)

Owner Lawrence M. Holt Address 1606 S. 4th St W
Missoula

Driller OWNER Address _____

Date of Notice of Appropriation of Groundwater _____

Date well started 5-3-64 Date Completed 5-16-64

Type of well Driven Equipment Used Weight
(dug, driven, bored or (Churn, drill, rotary or drilled) other)

Water Use: Domestic Municipal Other Irrigation
Industrial Drainage Stock

Indicate on the diagram the character and thickness of the different strata met with in drilling, such as soil, clay, shale, gravel, rock or sand, etc. Show depth at which water is encountered, thickness and character of water-bearing strata and height to which water rises in the well.

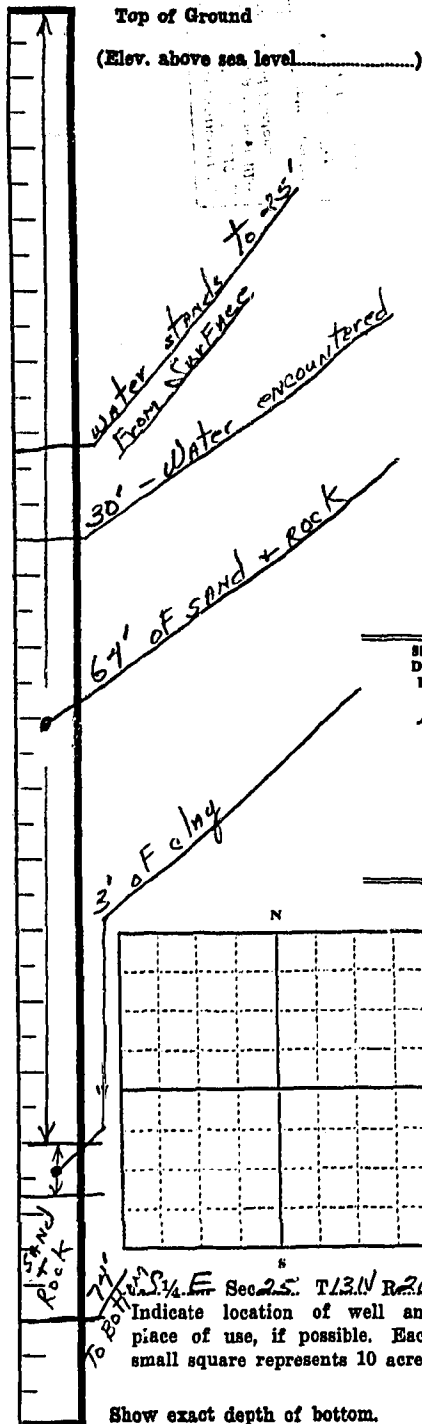

Size of Drilled Hole	Size and Weight of Casing	From (Feet)	To (Feet)	PERFORATIONS		
				Kind Size	From (Feet)	To (Feet)
4"	4" schedule 40 standard pipe	0	74	3/4" x 2"	69'	73 1/2'
				50 Perforations		

Static Water Level for non-flowing Well..... 25 feet.

Shut-in Pressure for Flowing Well..... Not Appl.

Pumping Water Level..... 28 feet at 30 gal. per minute.

Discharge in gal. per min. of flowing well..... Not appl.

How Tested..... Pumped Length of Test..... 7 hours

Remarks: (Gravel packing, cementing, packers, type of shutoff, location of place of use of groundwater if not at well, and any other similar pertinent information, including number of acres irrigated, if used for irrigation)..... Not appl.

Driller's License Number

Lawrence M. Holt
Driller's Signature

This form to be prepared by driller, and three copies to be filed by the owner with the County Clerk and Recorder in the county in which the well is located.

Please answer all questions. If not applicable, so state, otherwise the form will be returned.

Original to the County Clerk and Recorder; duplicate to the State Engineer; Triplicate to the Montana Bureau of Mines and Geology and Quadruplicate for the Appropriator.

021574

I received and filed this instrument for
record on the 19th day of May, 1964,
at 5:20 o'clock A.M., pursuant to title
of Missoula County, State of Montana
Witness my hand:
MARTIN S. BEHNER, County Recorder
By *[Signature]* Deputy
Fee \$ 0.10 Paid

STATE OF MONTANA
ADMINISTRATOR OF GROUNDWATER CODE
MONTANA WATER RESOURCES BOARD

OCT 8 1970

DRILLER'S LOG

Indicate the character, color, thickness of strata such as soil, clay, sand, gravel, shale, sandstone, etc. Show depth at which water is found and height to which water rises in well.

NOTICE OF COMPLETION OF GROUNDWATER APPROPRIATION BY MEANS OF WELL

Developed after January 1, 1962

(Under Chapter 237 Montana Session Laws, 1961, as amended)

This form to be prepared by driller, and three copies to be filed by the owner with the County Clerk and Recorder in the county in which the well is located, last copy to be retained by driller.

Please answer all questions. If not applicable, so state, otherwise the form may be returned.

Owner Ray Y. Nurt
Address 221E 35th Ave
Missoula, Montana
Date well started Sept. 22, 1970
completed Sept. 29, 1970

For Administrator's Use
File <u>295541</u>
<u>October 5, 1970</u>
<u>12:45 P.M.</u>
GW 1

Type of well Drilled
(Dug, driven, bored or drilled)
Equipment used Churn Drill
(Churn drill, rotary or other)
Water Use: Domestic Municipal Stock Irrigation
Industrial Drainage Other * Garden/Lawn

*Describe _____
USE: if used for irrigation, industrial, drainage or other. Explain, state number of acres and location or other data (i.e. Lot, Block and Addition). _____

ESTIMATED ANNUAL WITHDRAWAL

Size of Drilled Hole	Size and Weight of Casing	From (Foot)	To (Foot)	PERFORATIONS		
				Kind	From (Foot)	To (Foot)
6" I.D.	6" I.D. 17 lb per ft. G.L.	4' above G.L.	66' 5"			

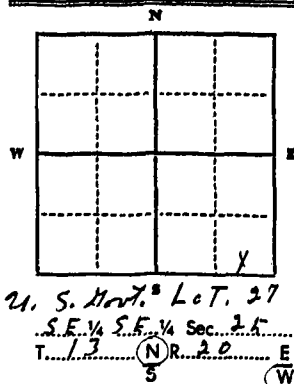

Static water level 21 ft.*
Pumping water level 26 ft.*
at 700 gallons per minute,
measured 2 minutes after pumping
began.
*Measured from ground level.
Well developed by COMPRESSOR
for 1 hours.
Power _____ Pump _____ HP
Remarks: (Gravel packing, cementing,
packers, type of shutoff) _____

INDICATE LOCATION OF WELL AND PLACE OF USE, IF POSSIBLE. EACH SMALL SQUARE REPRESENTS 40 ACRES.

Driller's Signature _____
Camp Well Drilling & Pump Supply
Driller's Address 1522 S. 14th W., Missoula, Montana

Shawn Camp LICENSE NO. 7

Top of Ground (Elev. above sea level)		
From (Foot)	To (Foot)	
<u>0</u>	<u>10</u>	<u>Gravel & Clay</u>
<u>10</u>	<u>22</u>	<u>Sandy Clay</u>
<u>22</u>	<u>63</u>	<u>Sand & Water</u>
<u>63</u>	<u>50</u>	<u>Sand & Clay</u>
<u>50</u>	<u>61</u>	<u>Sand, Gravel & Water</u>
<u>61</u>	<u>66' 5"</u>	<u>Gravel & Water</u>

66' 5" Show exact depth of bottom

47604

File No. _____

MONTANA WATER RESOURCES BOARD

T. 13N R. 20W 22

DUPLICATE

RECEIVED
DEC 19 1966

County Missoula

STATE OF MONTANA
ADMINISTRATOR OF GROUNDWATER CODE
OFFICE OF STATE ENGINEER



Top of Ground _____
(Elev. above sea level _____)

**Notice of Completion of Groundwater
Appropriation by Means of Well**

(Under Chapter 237, Montana Session Laws, 1961)

- 0-13 Heavy gravel & clay
- 13-20 Sand and gravel, some clay
- 20-32 Sand, gravel & water
- 32-35 Clay, sand, & gravel
- 35-52 Sand and water
- 52-55 Sand, gravel & water
- 55-62 Sand and water
- 62-65 Sand, gravel & water

Owner Howard Jansen Address 1722 Clements, Target Range, Missoula

Driller Gleason Camp Address 1522 S. 34, Missoula

Date of Notice of Appropriation of Groundwater _____

Date well started Nov. 8, 1966 Date Completed Nov. 10, 1966

Type of well Drilled Equipment Used Churn Drill
(dug, driven, bored or drilled) (Churn, drill, rotary or other)

Water Use: Domestic Municipal Other Irrigation
Industrial Drainage Stock

Indicate on the diagram the character and thickness of the different strata met with in drilling, such as soil, clay, shale, gravel, rock or sand, etc. Show depth at which water is encountered, thickness and character of water-bearing strata and height to which water rises in the well.

Size of Drilled Hole	Size and Weight of Casing	From (Feet)	To (Feet)	PERFORATIONS		
				Kind Size	From (Feet)	To (Feet)
6"	6" I.D. 17 lb per foot	6" above G.L.	65'		none	

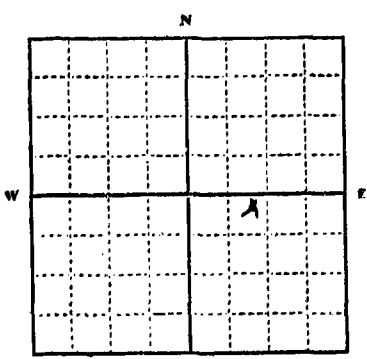

Section 25 T. 13N R. 20W
Indicate location of well and place of use, if possible. Each small square represents 10 acres.

Show exact depth of bottom.

Static Water Level for non-flowing Well 20' from top of pipefoot.

Shut-in Pressure for Flowing Well _____

Pumping Water Level 20 feet at 750 gal. per minute.

Discharge in gal. per min. of flowing well _____

How Tested Compressor Length of Test 2 1/2 hours

Remarks: (Gravel packing, cementing, packers, type of shutoff, location of place of use of groundwater if not at well, and any other similar pertinent information, including number of acres irrigated, if used for irrigation) _____

License # 7
Driller's License Number

Gleason Camp
Driller's Signature Gleason Camp

This form to be prepared by driller, and three copies to be filed by the owner with the County Clerk and Recorder in the county in which the well is located.

Please answer all questions. If not applicable, so state, otherwise the form will be returned.

Original to the County Clerk and Recorder; duplicate to the State Engineer; Triplicate to the Montana Bureau of Mines and Geology and Quadruplicate for the Appropriator.

44,874

#1846

I received and filed this instrument for
record on the 13th day of Dec, 19 68
at 11.55 o'clock P. M., permanent files
of Missoula County, State of Montana
Witness my hand
Valance E. Cupes, County Recorder
By Ruth N. Smith, Deputy
Fee \$ 2.00 Paid Cash

MISSOULA COUNTY RECORDS
MISSOULA, MONTANA

File No. _____

T. 13^N R. 20^W

DUPLICATE

County _____

STATE OF MONTANA
 ADMINISTRATOR OF GROUNDWATER CODE
 OFFICE OF STATE ENGINEER

RECEIVED
 JAN 3 1964
 STATE ENGINEER

Declaration of Vested Groundwater Rights

(Under Chapter 237, Montana Session Laws, 1961)

Herbert A. & Gollie H. Kicker, of 3717 Rt 1 Missoula
 (Name of Appropriator) (Address) (Town)
 County of Missoula State of Montana
 have appropriated groundwater according to the Montana laws in effect prior to January 1, 1962, as follows:

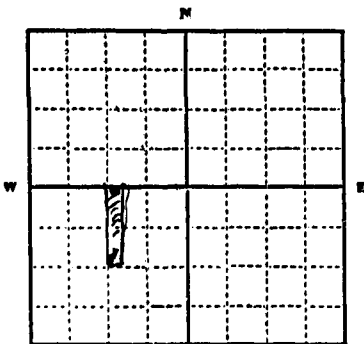

W 1/2 E 1/2 NE 1/4
 SW 1/4 Sec. 25 T. 13N. R. 20W

Indicate point of appropriation and place of use, if possible. Each small square represents 10 acres.

2. The beneficial use on which the claim is based. Domestic & IRRIGATION AND STOCK WATER
3. Date or approximate date of earliest beneficial use; and how continuous the use has been. 1945 - IN CONTINUOUS USE
4. The amount of groundwater claimed (in miner's inches or gallons per minute). 20 gal. per minute
5. If used for irrigation, give the acreage and description of the lands to which water has been applied and names of the owner thereof. ONE ACRE AROUND THE HOUSE
6. The means of withdrawing such water from the ground and the location of each well or other means of withdrawal. Well located 5 feet west of House on W 1/2 E 1/2 NE 1/4 SW 1/4 Sec 25 T. 13N. R. 20W
7. The date of commencement and completion of the construction of the well, wells, or other works for withdrawal of groundwater. 1945 Started Construction & Completed Same Year
8. The depth of water table. 20 feet below ground surface
9. So far as it may be available, the type, size and depth of each well or the general specifications of any other works for the withdrawal of groundwater. Well is 75 feet deep with 6 in casing Myers 1/2 H.P. Electric Pump with 1 1/2 inch suction pipe 6 inch heavy steel well casing in well
10. The estimated amount of groundwater withdrawn each year. 400,000 gallons per year
11. The log of formations encountered in the drilling of each well if available. Not available
12. Such other information of a similar nature as may be useful in carrying out the policy of this act, including reference to book and page of any county record. NONE

Signature of Owner Herbert A. Kicker
 Date Dec 31 1963

Three copies to be filed by the owner with the County Clerk and Recorder of the county in which the well is located.

Please answer all questions. If not applicable, so state, otherwise the form will be returned.

Original to the County Clerk and Recorder; Duplicate to the State Engineer; Triplicate to the Montana Bureau of Mines and Geology, and Quadruplicate for the Appropriator.

1291

Copy
I received and examined the instrument for
recording in the office of the permanent filer
of Michoud County, State of Montana
Witness my hand
County Recorder
By *William S. Ball* Deputy
Per *W.S.B.* Paid

6

File No. _____

STATE WATER CONSERVATION BOARD

T. 13 N. R. 20 W

DUPLICATE

JUL 14 1966

County Missoula

LOG

Dilts _____ McDermott _____
Butzerin _____ McNulty _____
Coyle _____ Morton _____
Darlington _____ Sullivan _____
Dickert _____

STATE OF MONTANA
ADMINISTRATOR OF GROUNDWATER CODE
OFFICE OF STATE ENGINEER

Top of Ground
(Elev. above sea level _____)

Notice of Completion of Groundwater Appropriation by Means of Well

DEVELOPED AFTER JANUARY 1, 1962

(Under Chapter 237, Montana Session Laws, 1961)

0 to 4' Pit
4' to 16' Sand, gravel & cobbles
16' to 22' Clay & gravel
22' to 31' Sand & water
31' to 48' Clay & gravel
48' to 59' Silty sand & water
59' to 62' Sand, gravel & water
62' to 65' Gravel & water

Owner Varn Jakkola Address 3748 S. Ave W

Driller Glenn Camp 705 Alder Address Missoula, Mont

Date of Notice of appropriation of groundwater _____

Date well started 10/30/65 Date completed 11/2/65

Type of well Drilled Equipment used Churn drill
(Dug, Driven, bored or drilled) (Churn drill, rotary or other)

Water use: Domestic Municipal Stock Irrigation
Industrial Drainage Other

Indicate on the diagram the character and thickness of the different strata met with in drilling, such as soil, clay, shale, gravel, rock or sand, etc. Show depth at which water is encountered, thickness and character of water-bearing strata and height to which the water rises in the well.

Size of Drilled Hole	Size and Weight of Casing	From (Feet)	To (Feet)	PERFORATIONS		
				Kind Size	From (Feet)	To (Feet)
5"	5" I.D. 14#	10" above pit floor	to 61'-3"		none	

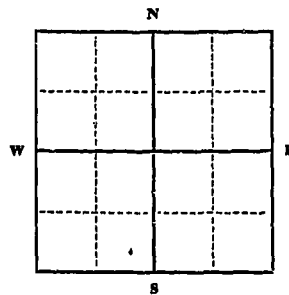

Static Water Level for non-flowing well 20 feet.

Shut-in Pressure for Flowing Well _____

Pumping Water Level 20 feet at 21 gal. per minute with

Discharge in gal. per min. of flowing well _____

How Tested Compressor test 75 G.P.

Length of Test 1 hour Minutes

Remarks: (Gravel packing, cementing, packers, type of shutoff) _____

SE 1/4 SW 1/4 Sec. 25 T. 13. R. 20
Indicate location of well and place of use, if possible. Each small square represents 40 acres.

(Continue on reverse side)

USE—If used for irrigation, industrial, drainage or other. Explain, state number of acres and location or other data (i.e.: Lot, Block and Addition).

Show exact depth of bottom.

This form to be prepared by driller, and three copies to be filed by the owner with the County Clerk and Recorder in the county in which the well is located, tissue copy to be retained by driller.

Please answer all questions. If not applicable, so state, otherwise the form will be returned.

Licence # 7
Driller's License Number

Glenn Camp
Driller's Signature

41220

This instrument is for the purpose of conveying to the State of Montana the right of way for the construction of a road through the lands of the State of Montana.

1622 251969

I received and filed this instrument for record on the 8th day of July, 1966, at 12:05 o'clock P.M. permanent files of Missoula County, State of Montana. Witness my hand:

Veramos R. Crouse, County Recorder
 By M. M. Crouse, Deputy
 Fee \$ 2.00

It. copies to J.E. B.

JUL 11 1966

MISSOULA COUNTY RECORDS

GW1

File No.

T. 13 R. 20W

25

DUPLICATE

County Missoula

STATE OF MONTANA
ADMINISTRATOR OF GROUNDWATER CODE
OFFICE OF STATE ENGINEER

RECEIVED
APR 27 1962

Notice of Appropriation of Groundwater
(Under Chapter 237, Montana Session Laws, 1961)

STATE ENGINEER

- I, Jess U. Kline, of 4022 South Ave. W., Missoula
(Name of Appropriator) (Address) (Town)
County of Missoula, State of Montana, intend to appropriate groundwater in accordance with Chapter 237, Montana Session Laws of 1961.
- The beneficial use to which water is to be applied is domestic and irrigation.
SW 1/4 of Section 25 Township 13 Range 20W Lots 93 and 94
(describe lands to be benefited, if for irrigation) 10 acres more or less
- The rate of use in gallons per minute or miner's inches of groundwater claimed 250 gallons per minute.
- The annual period (inclusive dates) of intended use Year around.
- The probable or intended date of first beneficial use June 1, 1962.
- The probable or intended date of commencement and completion of the well* or wells* June 1, 1962.
- The location, type, size and depth of well or wells contemplated 8 inch diameter, 70 foot
depth, approximate.
- The probable or estimated depth of the water table or artesian aquifer Approximately 70 feet.
- Name, address and license number of the driller engaged Does not apply at this time.
- Give such other similar information as may be useful in carrying out the policy of this act Does not apply at this time.

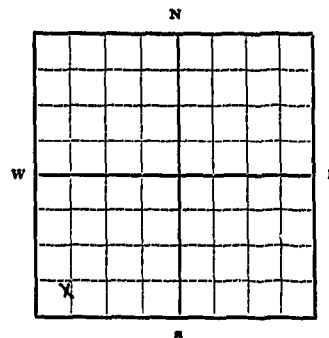

SW 1/4 Sec. 25 T. 13 R. 20W

Locate well or other means of development as accurately as possible on the plat.

Signature of Appropriator Jess U. Kline

Date 4-27-62

* As defined in the Code Sec. 1 (c) "Well" means any artificial opening or excavation in the ground, however made, by which groundwater can be obtained or through which it flows under natural pressures or is artificially withdrawn."

Three copies of this notice are to be filed with County Clerk and Recorder of the county in which the well is located.

Please answer all questions. If not applicable, so state, otherwise the form will be returned.

Original to the County Clerk and Recorder; duplicate to the State Engineer; Triplicate to the School of Mines and Quadruplicate for the Appropriator.

131

Copy

192393

I received and used this instrument for
 record on the 24 day of APRIL, 1962
 at 9:25 o'clock A.M., permanent files
 of Missoula County, State of Montana

Witness my hand:
 MARTIN S. BEHNER, County Recorder
 By Jacky Hennessy Deputy
 Fee \$ 1.00 Paid

RECEIVED 25
T. 13 R. 20 1962

File No.

DUPLICATE

County MISSOULA STATE ENGINEER

STATE OF MONTANA
ADMINISTRATOR OF GROUNDWATER CODE
OFFICE OF STATE ENGINEER

Top of Ground
(Elev. above sea level Approx 3150')

Notice of Completion of Groundwater
Appropriation by Means of Well

(Under Chapter 237, Montana Session Laws, 1961)

0-1 Topsoil
1-27 Sandy clay and
GRAVEL mixed.

Owner JESS V. KLINE Address MISSOULA, MONTANA
Target Range Traction Court

Driller LIBERTY DRILLING CO. Address MISSOULA, MONTANA

27-42 Sand & gravel
1 1/2" water

Date of Notice of Appropriation of Groundwater.....

Date well started MAY 21, 1962 Date Completed MAY 24, 1962

42-45 Tan clay with
gravel imbedded

Type of well Drilled Equipment Used Cable tools
(dug, driven, bored or drilled) (Churn, drill, rotary or other)

45-68 Sand & silt. water.

Water Use: Domestic Municipal Other Irrigation
Industrial Drainage Stock

68-70 Sand & gravel. Water

Indicate on the diagram the character and thickness of the different strata met with in drilling, such as soil, clay, shale, gravel, rock or sand, etc. Show depth at which water is encountered, thickness and character of water-bearing strata and height to which water rises in the well.

70-73 Sand & coarse
gravel

73-90 Sand & scattered
gravel

90-95 Some sand,
gravel & cobbles.
Water

Water 1 1/2" encountered at 27'.
Water rises to 19'4" from
SURFACE

Size of Drilled Hole	Size and Weight of Casing	From (Feet)	To (Feet)	PERFORATIONS		
				Kind Size	From (Feet)	To (Feet)
8 inch	8 5/8" OD 24 #	+ 1'	94'8"	NONE		

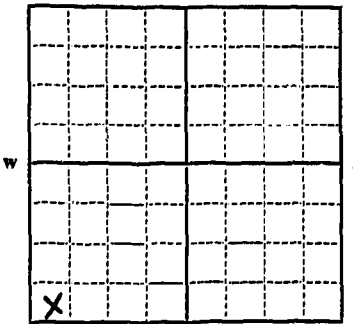

Static Water Level for non-flowing Well 19'4" feet.

Shut-in Pressure for Flowing Well NON-FLOWING

Pumping Water Level 5.6 feet at 300 gal. per minute.

Discharge in gal. per min. of flowing well NON-FLOWING

How Tested AIR LIFT Pump length of Test 3 1/2 HOURS

Remarks: (Gravel packing, cementing, packers, type of shutoff, location of place of use of groundwater if not at well, and any other similar pertinent information, including number of acres irrigated, if used for irrigation).....

S 2 1/4 W 1/4 SW 1/4 Sec. 25 T. 13 R. 20
Indicate location of well and place of use, if possible. Each small square represents 10 acres.

Show exact depth of bottom.

Bottom of Well
is 94'8" FROM
SURFACE.

52
Driller's License Number
William F. Osborne
Driller's Signature

This form to be prepared by driller, and three copies to be filed by the owner with the County Clerk and Recorder in the county in which the well is located.

Please answer all questions. If not applicable, so state, otherwise the form will be returned.

Original to the County Clerk and Recorder; duplicate to the State Engineer; Triplicate to the Montana Bureau of Mines and Geology and Quadruplicate for the Appropriator.

#139

194905

I received and filed this instrument for
record on the 5 day of July, 1962
at 7:00 o'clock A.M., permanent files
of Missoula County, State of Montana
Witness my hand:
MARTIN S. BEHNER, County Recorder
By Barbara Head Deputy
Fee \$ 2.00 Paid

16
MISSOULA COUNTY RECORDS
1962
JULY 5
1962

File No. _____

RECEIVED

T 15N R 20W 25

DUPLICATE

NOV 22 1968

County Missoula

LOG

STATE OF MONTANA
ADMINISTRATOR OF GROUNDWATER CODE
OFFICE OF STATE ENGINEER

Top of Ground _____
Approx. _____
(Elev. above sea level 5327')

Notice of Completion of Groundwater Appropriation by Means of Well

DEVELOPED AFTER JANUARY 1, 1963

(Under Chapter 237, Montana Session Laws, 1961)

Formations Log:

- 0 - 26 Cobblestones & gravel mixed with tan silt.
- 26 - 44 Gray sand & gravel.
- 44 - 63 Fine brown sand. Some water.
- 63 - 76 Fine gray sand & coarse gravel. Water. Materials too fine to successfully develop well.
- 76 - 80 Clean coarse gravel. Water.

Owner Earl E. & Ella G. Lalonde Address Missoula, Montana

Driller Liberty Drilling Co. Address Missoula, Montana

Date of Notice of appropriation of groundwater None filed

Date well started 11/1/68 Date completed 11/4/68

Type of well drilled Equipment used Cable Tools
(Dug, Driven, bored or drilled) (Churn drill, rotary or other)

Water use: Domestic Municipal Stock Irrigation
Industrial Drainage Other

Indicate on the diagram the character and thickness of the different strata met with in drilling, such as soil, clay, shale, gravel, rock or sand, etc. Show depth at which water is encountered, thickness and character of water-bearing strata and height to which the water rises in the well.

Size of Drilled Hole	Size and Weight of Casing	From (Feet)	To (Feet)	PERFORATIONS		
				Kind Size	From (Feet)	To (Feet)
6"	6 5/8" OD x 1/4"	0	80	NONE		

Water rises in the well 25 feet from surface.

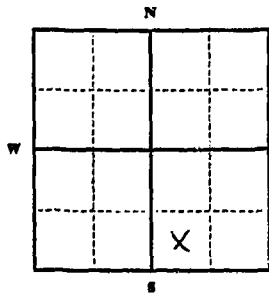

Static Water Level for non-flowing well 25 feet.

Shut-in Pressure for Flowing Well Non-f Pumping Water Level 52 ft at 50 gal. per minute.

Discharge in gal. per min. of flowing well Non-flowing

How Tested Air Lift Pump

Length of Test Three hours

Lot 39
SE 1/4 Sec. 25, T15N R. 20W
Indicate location of well and place of use, if possible. Each small square represents 40 acres.

Remarks: (Gravel packing, cementing, packers, type of shutoff) All water entering well is coming through open bottom of six inch casing. Wells in this area can be depended upon to produce clear sand free water as long as they are not overpumped, i.e., they should be pumped at rates not in excess of 25 to 50 percent of the design capacity of the aquifer.

Approx. 1.1 Acres.

Show exact depth of bottom.
Bottom of hole 80'

This form to be prepared by driller, and three copies to be filed by the owner with the County Clerk and Recorder in the county in which the well is located, tissue copy to be retained by driller.

Please answer all questions. If not applicable, so state, otherwise the form will be returned.

Driller's License Number 58

Driller's Signature William F. Osborne

44, 798

276464

71842

I received and filed this instrument for
 record on the 19th day of Nov 1968
 at 11:20 o'clock A.M., permanent files
 of Missoula County, State of Montana
 Witness my hand:
 Vermae B. Crouse, County Recorder
 By Montana M. [Signature]
 Fee \$20.00 Paid

RECORDED

MISSOULA COUNTY

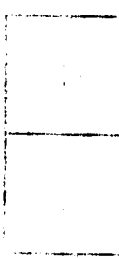

MISSOULA COUNTY
 CLERK OF DISTRICT COURT
 MISSOULA, MONTANA

File No. _____

T. 13 R. 20 S. 25

DUPLICATE

STATE OF MONTANA
ADMINISTRATOR OF GROUNDWATER CODE
OFFICE OF STATE ENGINEER

County _____
RECEIVED
JAN 3 1963
STATE ENGINEER

Declaration of Vested Groundwater Rights

(Under Chapter 237, Montana Session Laws, 1961)

Melvin Larson of 3526 Sunn Rd Missoula
(Name of Appropriator) (Address) (Town)

County of Missoula State of Montana
have appropriated groundwater according to the Montana laws in effect prior to January 1, 1962, as follows:

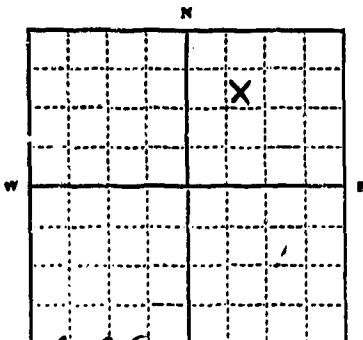

Receivd Sec 9, 9, 10 in 1961
Sec 25 TB R 20

Indicate point of appropriation and place of use, if possible. Each small square represents 10 acres.

2. The beneficial use on which the claim is based domestic + irrigation

3. Date or approximate date of earliest beneficial use; and how continuous the use has been July 15, 1962
continuous

4. The amount of groundwater claimed (in miner's inches or gallons per minute) 400 gallons per minute

5. If used for irrigation, give the acreage and description of the lands to which water has been applied and name of the owner thereof
1 Acre - Melvin Larson

6. The means of withdrawing such water from the ground and the location of each well or other means of withdrawal HP. Surviside pump

7. The date of commencement and completion of the construction of the well, wells, or other works for withdrawal of groundwater July 15, 1962

8. The depth of water table 65 ft.

9. So far as it may be available, the type, size and depth of each well or the general specifications of any other works for the withdrawal of groundwater dotted well with 6" casing 65' deep

10. The estimated amount of groundwater withdrawn each year 750,000 gallons

11. The log of formations encountered in the drilling of each well if available 0-5' dirt, 5-14' sand gravel, 14-26' clean gravel, 26-44' gravel, 44-52' clay, 52-54' sand gravel, 54-55' clay with gravel, 55-61' sandy, 61-63' sand & gravel, 63-65' clean coarse water bearing

12. Such other information of a similar nature as may be useful in carrying out the policy of this act, including reference to book and page of any county record.

Signature of Owner Melvin Larson
Date Dec 31, 1962

Three copies to be filed by the owner with the County Clerk and Recorder of the county in which the well is located.

Please answer all questions. If not applicable, so state, otherwise the form will be returned.

Original to the County Clerk and Recorder; Duplicate to the State Engineer; Triplicate to the Montana Bureau of Mines and Geology, and Quadruplicate for the Appropriator.

1116

I have read and find this to be true.
for the 219th of the 1862
of the Clerk of the Court of
of Milverton County, State of Indiana
Witness my hand and seal this 21st day of
By Mathew H. [Signature] County Recorder
Dec 21 1862

File No. _____

T. 13N R. 20W 25

DUPLICATE

County Missoula

LOG

STATE OF MONTANA

ADMINISTRATOR OF GROUNDWATER CODE

OFFICE OF STATE ENGINEER

Top of Ground _____

Approx. (Elev. above sea level 32061)

Notice of Completion of Groundwater Appropriation by Means of Well

DEVELOPED AFTER JANUARY 1, 1962

(Under Chapter 237, Montana Session Laws, 1961)

Formations Log:

- 0 - 6 Black dirt & boulders.
- 6 - 30 Sand & gravel mixed in clay.
- 30 - 38 Sand and gravel.
- 38 - 48 Fine sand & some gravel. Water. Material too fine to successfully develop well.
- 48 - 57 Clean coarse sand & gravel. Good water.

Owner Eleanor A. &/or Melvick L. Larson Address Missoula, Montana

Driller Liberty Drilling Co. Address Missoula, Montana

Date of Notice of appropriation of groundwater None filed

Date well started 6/6/66 Date completed 6/7/66

Type of well Drilled Equipment used Cable Tools
(Dug, Driven, bored or drilled) (Churn drill, rotary or other)

Water use: Domestic Municipal Stock Irrigation
Industrial Drainage Other

Indicate on the diagram the character and thickness of the different strata met with in drilling, such as soil, clay, shale, gravel, rock or sand, etc. Show depth at which water is encountered, thickness and character of water-bearing strata and height to which the water rises in the well.

Size of Drilled Hole	Size and Weight of Casing	From (Feet)	To (Feet)	PERFORATIONS		
				Kind	From (Feet)	To (Feet)
6"	6 5/8" OD x 1/2"	+2 1/2	57	NONE		

Water rises in the well 10 feet from surface.

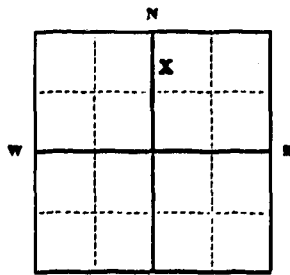

Static Water Level for non-flowing well 10 feet.

Shut-in Pressure for Flowing Well None
Pumping Water Level 30 feet
at 30 gal. per minute.

Discharge in gal. per min. of flowing well

Non-flowing
How Tested Air Lift Pump
Length of Test One hour

Remarks: (Gravel packing, cementing, packers, type of shutoff) All water entering well is coming through the open bottom of six-inch casing. Wells with open bottom completions in this area can be depended upon to produce clear sand free (after one year).

Section 25, T. 20N, R. 20W
Indicate location of well and place of use, if possible. Each small square represents 40 acres.

USE—If used for irrigation, industrial, drainage or other. Explain, state number of acres and location or other data (i.e.: Lot, Block and Addition).

Lot 1, Block 2, Graveland Addition

Show exact depth of bottom.

Bottom of hole 57'

This form to be prepared by driller, and three copies to be filed by the owner with the County Clerk and Recorder in the county in which the well is located, tissue copy to be retained by driller.

Please answer all questions. If not applicable, so state, otherwise the form will be returned.

Driller's License Number

Driller's Signature

William D. Larson

45,208

#1880

281109

I received and filed this instrument for record on the 9 day of May 1929 at 11:30 o'clock A.M. permanent files of Missoula County, State of Montana

Witness my hand:
Wesley H. Griggs, County Recorder
 By [Signature], Deputy
 Fee \$1.00 Paid 66

year as long as they are not overpumped, i.e.: they should be pumped at rates less than 25 to 50 percent of the tested capacity of the aquifer.

2020-05-10 11:30 AM
 State of Montana
 Missoula County

GW 2

File No.

RECEIVED

T. L. S. N. R. 2011 25

DUPLICATE

DEC 2 1970

County Mula

LOG

STATE OF MONTANA
ADMINISTRATOR OF GROUNDWATER CODE
OFFICE OF STATE ENGINEER

Notice of Completion of Groundwater
Appropriation by Means of Well
DEVELOPED AFTER JANUARY 1, 1962

(Under Chapter 237, Montana Session Laws, 1961)

Top of Ground
(Elev. above sea level 3,223)

0 - 3 1/2 top soil

3 1/2 - 8 gravel & sand

8 - 25 gravel sand & water

25 - 40 sand & water

40 - 45 red clay no water

45 - 78 heaving sand & water

78 - 83 gravel & water

Doc. No. 297267
Filed for record
this 30 day of November
A. D. 19 70, at 2:05
o'clock P. M.

Owner Jack L. Lehman Address Norman Dr. Missoula

Driller Harold K. Pickens Address 2624 So. Ave. Missoula

Date of Notice of appropriation of groundwater

Date well started 3/20/70 Date completed 3/24/70

Type of well drilled Equipment used cable tool
(Dug, Driven, bored or drilled) (Churn drill, rotary or other)

Water use: Domestic Municipal Stock Irrigation
Industrial Drainage Other

Indicate on the diagram the character and thickness of the different strata met with in drilling, such as soil, clay, shale, gravel, rock or sand, etc. Show depth at which water is encountered, thickness and character of water-bearing strata and height to which the water rises in the well.

Size of Drilled Hole	Size and Weight of Casing	From (Feet)	To (Feet)	PERFORATIONS		
				Kind Size	From (Feet)	To (Feet)
5 inch	16 lbs. per ft.	0	83	none		

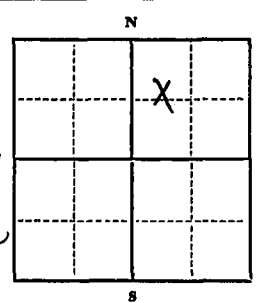

Static Water Level for non-flowing well 5 1/2 ft. of top feet.

Shut-in Pressure for Flowing Well

Pumping Water Level 8 ft. of top feet at 45 gal. per minute.

Discharge in gal. per min. of flowing well

How Tested compressor

Length of Test 3 1/2 hrs.

Remarks: (Gravel packing, cementing, packers, type of shutoff)

N.M. 41 N.E. Sec. 25 T. 13 N. R. 20 W.
Indicate location of well and place of use, if possible. Each small square represents 40 acres.

(Continue on reverse side)

USE—If used for irrigation, industrial, drainage or other. Explain, state number of acres and location or other data (i.e.: Lot, Block and Addition).

Show exact depth of bottom.
83 ft.

This form to be prepared by driller, and three copies to be filed by the owner with the County Clerk and Recorder in the county in which the well is located, tissue copy to be retained by driller.

Please answer all questions. If not applicable, so state, otherwise the form will be returned.

Driller's License Number 71

Driller's Signature Harold K. Pickens

47838

2068

297267

I received and filed this instrument for
 record on the 3rd day of Dec. 1970
 at 2:30 o'clock P.M. pursuant to the
 of Missouri County, State of Missouri
 Witness my hand.
Verance R. Crouse, County Recorder
 By M. J. Crouse, Deputy
 Fee 5.20 Paid Cash

X	

Printed Name of Recorder
 Printed Name of Deputy
 Printed Name of Recorder
 Printed Name of Deputy

25

File No.

T. 13 N. R. 20 W

DUPLICATE

County

STATE OF MONTANA
ADMINISTRATOR OF GROUNDWATER CODE
OFFICE OF STATE ENGINEER

RECEIVED
DEC 30 1963

Declaration of Vested Groundwater Rights STATE ENGINEER

(Under Chapter 237, Montana Session Laws, 1961)

George E Lloyd and of
1 Jean Lloyd, of 3510 South Ave. West Missoula
(Name of Appropriator) (Address) (Town)

County of Missoula State of Montana

have appropriated groundwater according to the Montana laws in effect prior to January 1, 1962, as follows:

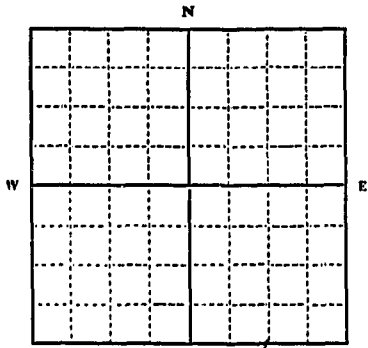

*U.S. Survey # 1

S.E. 1/4 Sec 25 T. 13 N. R. 20 W

Indicate point of appropriation and place of use, if possible. Each small square represents 10 acres.

2. The beneficial use on which the claim is based. household use and irrigation

3. Date or approximate date of earliest beneficial use; and how continuous the use has been. Oct 6-1957 continuous

4. The amount of groundwater claimed (in miner's inches or gallons per minute) 20 gals per minute

5. If used for irrigation, give the acreage and description of the lands to which water has been applied and name of the owner thereof. 1 1/3 acres grass & crops of wheat Owner George E Lloyd and of Jean Lloyd

6. The means of withdrawing such water from the ground and the location of each well or other means of withdrawal. Deep well pump front of acreage

7. The date of commencement and completion of the construction of the well, wells, or other works for withdrawal of groundwater. JUNE 1954 JUNE 1954

8. The depth of water table. app 30 feet

9. So far as it may be available, the type, size and depth of each well or the general specifications of any other works for the withdrawal of groundwater. Depth well 22 ft 5" well casing

10. The estimated amount of groundwater withdrawn each year. 1,500,000 gal per year

11. The log of formations encountered in the drilling of each well if available. not available

12. Such other information of a similar nature as may be useful in carrying out the policy of this act, including reference to book and page of any county record. Book 182 - page 202

Signature of Owner. George E Lloyd
Date Dec 26, 1963

Three copies to be filed by the owner with the County Clerk and Recorder of the county in which the well is located.

Please answer all questions. If not applicable, so state, otherwise the form will be returned.

Original to the County Clerk and Recorder; Duplicate to the State Engineer; Triplicate to the Montana Bureau of Mines and Geology, and Quadruplicate for the Appropriator.

15240

638

214999

I Received and filed this instrument for
 record on the 17 day of Dec 1957
 at 2:00 o'clock P.M., permanent files
 of Missoula County, State of Montana
 Witness my hand:
 MARTIN S. BEHNER, County Recorder
 By [Signature]
 Fee \$ 2.00 Paid

File No. _____

STATE WATER CONSERVATION BOARD

T. 13N R. 20W 25

DUPLICATE

MAY 3 1967

County MISSOULA

LOG

STATE OF MONTANA
ADMINISTRATOR OF GROUNDWATER CODE
OFFICE OF STATE ENGINEER

Top of Ground
(Elev. above sea level 3217')

Notice of Completion of Groundwater
Appropriation by Means of Well

DEVELOPED AFTER JANUARY 1, 1962

(Under Chapter 237, Montana Session Laws, 1961)

Formations Log:

- 0 - 1 Top soil.
- 1 - 17 Sand, gravel & cobbles.
- 17 - 38 Fine sand. Water.
- 38 - 43 Gravel imbedded in clay.
- 43 - 57 Fine sand & gravel.
- 57 - 60 Sand & gravel. Water.
- 60 - 62 1/2 Clean coarse gravel. Water.

Owner: Gladys E. & Kenneth D. Magstadt. Address: Missoula, Montana.

Driller: Liberty Drilling Co. Address: Missoula, Montana.

Date of Notice of appropriation of groundwater: None filed

Date well started: 4/17/67 Date completed: 4/17/67

Type of well: Driven Equipment used: Well Driving Rig
(Dug, driven, bored or drilled) (Churn drill, rotary or other)

Water use: Domestic Municipal Stock Irrigation
Industrial Drainage Other

Indicate on the diagram the character and thickness of the different strata met with in drilling, such as soil, clay, shale, gravel, rock or sand, etc. Show depth at which water is encountered, thickness and character of water-bearing strata and height to which the water rises in the well.

Size of Drilled Hole	Size and Weight of Casing	From (Feet)	To (Feet)	PERFORATIONS		
				Kind Size	From (Feet)	To (Feet)
6"	6 5/8" OD x 3/4"	+1	62'6"	Torch Cut	58'6"	62'6"

The water rises in the well 11'4" from surface.

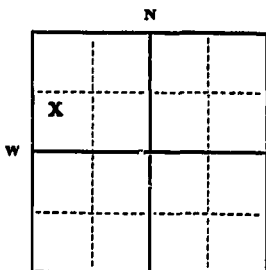

Static Water Level for non-flowing well 11'4" feet.

Shut-in Pressure for Flowing Well None

Pumping Water Level 21 feet at 60 gal. per minute.

Discharge in gal. per min. of flowing well Non-flowing

How Tested: Air Lift Pump

Length of Test: 2 1/2 hrs.

Remarks: (Gravel packing, cementing, packers, type of shutoff) The bottom four feet of casing is perforated and all water entering the well is coming through these perforations. Wells in this area can be depended upon to produce clear sand free water year after year as long as they are not overpumped, i.e., they

SW 1/4 NW Sec. 35 T. 13N R. 20W

Indicate location of well and place of use, if possible. Each small square represents 40 acres.

USE—If used for irrigation, industrial, drainage or other. Explain, state number of acres and location or other data (i.e.: Lot, Block and Addition).

Five Acres

Show exact depth of bottom.

Bottom of hole 62'6"

This form to be prepared by driller, and three copies to be filed by the owner with the County Clerk and Recorder in the county in which the well is located, tissue copy to be retained by driller.

Please answer all questions. If not applicable, so state, otherwise the form will be returned.

52

Driller's License Number

William F. Adams
Driller's Signature.

41, 956

1697

260242

I received and filed this instrument for
 record on the day of May 1947
 at 9:20 o'clock P. M. permanent files
 of Missoula County, State of Montana --
 Witness my hand:
 Verambe R. Creage, County Recorder --
 By W. E. Carrington Deputy
 Fee 5.00 P.M.

should be pumped at rates less than 25 to 50 percent of the tested
 capacity of the aquifer.

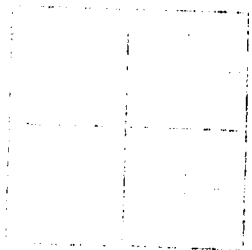

MISSOULA COUNTY RECORDER
 MISSOULA, MONTANA

File No.

FEB 3 1955

T. 13 N. R. 20 W. 2S

DUPLICATE

Billie _____ McDermott _____
106 Lutzerin _____ McNulty _____
Coyle _____ Morton _____
Darlington _____ Sullivan _____
Dickert _____

County Missoula

STATE OF MONTANA
ADMINISTRATOR OF GROUNDWATER CODE
OFFICE OF STATE ENGINEER

Top of Ground _____
(Elev. above sea level _____)

Notice of Completion of Groundwater
Appropriation by Means of Well
DEVELOPED AFTER JANUARY 1, 1962

(Under Chapter 237, Montana Session Laws, 1961)

0 to 6' Pit
6' to 12' Sand & gravel
12' to 16' Clay
16' to 21' Gravel & water
21' to 28' Silty sand
& clay
28' to 43' Clay & gravel
43' to 51' Sand, water
silty clay
51' to 54' gravel &
water

Owner Max J. Malak Address 1010 E. 37th Ave

Driller Glen Camp 705 Alder Address Missoula, Mont

Date of Notice of appropriation of groundwater _____

Date well started 9/30/65 Date completed 10/1/65

Type of well Drilled Equipment used Churn drill
(Dug, Driven, bored or drilled) (Churn drill, rotary or other)

Water use: Domestic Municipal Stock Irrigation
Industrial Drainage Other

Indicate on the diagram the character and thickness of the different strata met with in drilling, such as soil, clay, shale, gravel, rock or sand, etc. Show depth at which water is encountered, thickness and character of water-bearing strata and height to which the water rises in the well.

Size of Drilled Hole	Size and Weight of Casing	From (Feet)	To (Feet)	PERFORATIONS		
				Kind Size	From (Feet)	To (Feet)
6"	6" I.D. 17#	6" above G.L.	to 48'-8"		none	

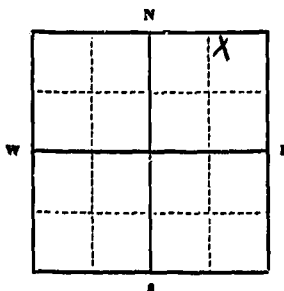

Static Water Level for non-flowing well
.....7.....feet.

Shut-in Pressure for Flowing Well.....

Pumping Water Level.....7.....feet
at.....21.....with 30.....minute.

Discharge in gal. per min. of flowing well
.....

How Tested.....Compressor 100 G.P......

Length of Test.....1 hour.....

Remarks: (Gravel packing, cementing, packers, type of shutoff).....

70C... 1/2 Sec. 25 T. 13 R. 20

Indicate location of well and place of use, if possible. Each small square represents 40 acres.

(Continue on reverse side)

USE—If used for irrigation, industrial, drainage or other. Explain, state number of acres and location or other data (i.e.: Lot, Block and Addition).

Show exact depth of bottom.

This form to be prepared by driller, and three copies to be filed by the owner with the County Clerk and Recorder in the county in which the well is located, tissue copy to be retained by driller.

Please answer all questions. If not applicable, so state, otherwise the form will be returned.

License # 77
Driller's License Number

Glen Camp
Driller's Signature

40797

1571

246476

I received and filed this instrument for
 record on the 1st day of Feb. 1966
 at 12:35 o'clock P.M. permanent files
 of Missoula County, State of Montana
 Witness my hand:
 Verance R. Crouse, County Recorder
 By M. M. Pennington, Deputy
 Fee \$ 2.00 Paid cash

RECORDED IN BOOK 100 PAGE 100
 INDEXED IN BOOK 100 PAGE 100
 MISSOULA COUNTY, MONTANA
 FEBRUARY 1, 1966

File No. _____

T. 15 N. R. 20 W.

DUPLICATE

County Missoula

STATE OF MONTANA
 ADMINISTRATOR OF GROUNDWATER CODE
 OFFICE OF STATE ENGINEER

RECEIVED
 JAN 3 1962

Declaration of Vested Groundwater Rights: ENGINEER

(Under Chapter 237, Montana Session Laws, 1961)

1. Robert W. Manchester of 2114 57th Missoula
 (Name of Appropriator) (Address) (Town)
 County of Missoula State of Montana
 have appropriated groundwater according to the Montana laws in effect prior to January 1, 1962, as follows:

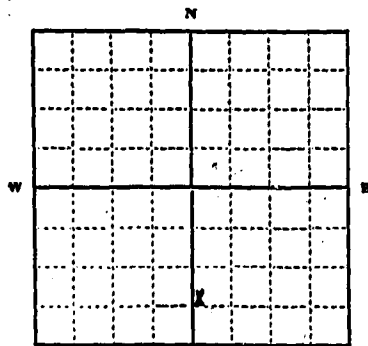

1/4 Sec. 25, T. 15 N. R. 20 W.

Indicate point of appropriation and place of use, if possible. Each small square represents 10 acres.

2. The beneficial use on which the claim is based domestic use and irrigation.

3. Date or approximate date of earliest beneficial use; and how continuous the use has been. September, 1955; continuous to present.

4. The amount of groundwater claimed (in miner's inches or gallons per minute). 22 gallons per minute.

5. If used for irrigation, give the acreage and description of the lands to which water has been applied and name of the owner thereof. one acre, Lot 14, Sec. 25, T. 15 N., R. 20 W. (U.S. Survey No. 1)

6. The means of withdrawing such water from the ground and the location of each well or other means of withdrawal. 4 in. well with one horse pump, Lot 14, Sec. 25, T. 15 N., R. 20 W.

7. The date of commencement and completion of the construction of the well, wells, or other works for withdrawal of groundwater. started October 7, 1955 and completed October 12, 1955.

8. The depth of water table. Approximately 80 ft.

9. So far as it may be available, the type, size and depth of each well or the general specifications of any other works for the withdrawal of groundwater. drilled, 4 in. with casing, 108 ft.

10. The estimated amount of groundwater withdrawn each year. 1,000,000 gallons.

11. The log of formations encountered in the drilling of each well if available. 0 - 4 1/2 ft. top soil & clay
 4 1/2 - 15 ft. boulders & gravel
 15 - 98 ft. sand & gravel (mostly sand)
 98 - 108 ft. gravel & sand

12. Such other information of a similar nature as may be useful in carrying out the policy of this act, including reference to book and page of any county record. with copy

Signature of Owner Robert W. Manchester

Date December 31, 1963

Three copies to be filed by the owner with the County Clerk and Recorder of the county in which the well is located.

Please answer all questions. If not applicable, so state, otherwise the form will be returned.

Original to the County Clerk and Recorder; Duplicate to the State Engineer; Triplicate to the Montana Bureau of Mines and Geology, and Quadruplicate for the Appropriator.

20312

1193

Copy
I received a copy of this instrument
714-31-19-25 permanent files
of Blaine County, State of Montana
By Maude J. Payne Recorder
Paid 2.00 Deputy

*2385

326076

I received and filed this instrument for
 record on the 12th day of Dec 1912
 at 2:00 o'clock P.M. pursuant to law
 of Missouri County State of Missouri
 Witness my hand
 Verano S. Cress, County Recorder
 By _____ Attorney Deputy
 Fee \$ 2.00 _____ Paid

File No. _____

JUN 23 1966

T. 13 R. 20 25

DUPLICATE

Blie _____ McDermott _____
Butzcrin _____ McNulty _____
Coyle _____ Morton _____
Darlinton _____ Sullivan _____
Oekert _____

County Missoula

LOG

STATE OF MONTANA
ADMINISTRATOR OF GROUNDWATER CODE
OFFICE OF STATE ENGINEER

Top of Ground
(Elev. above sea level _____)

0 top soil

2 tan clay, sand and gravel

13 water, sand and gravel

33 tan clay, sand and gravel

37 water and heaving sand

46 water, sand and gravel

53'6" _____

Show exact depth of bottom.

Notice of Completion of Groundwater Appropriation by Means of Well

DEVELOPED AFTER JANUARY 1, 1962

(Under Chapter 237, Montana Session Laws, 1961)

Owner M. P. MORGAN Address 3907 So. 11th Missoula, Mont
Driller KEN WILLIAMS Address 1219 HOWELL ST. MISSOULA, MONT.

Date of Notice of appropriation of groundwater _____

Date well started APRIL 29, 66 Date completed MAY 2, 66

Type of well DRILLED Equipment used CHURN
(Dug, Driven, bored or drilled) (Churn drill, rotary or other)

Water use: Domestic Municipal Stock Irrigation
Industrial Drainage Other

Indicate on the diagram the character and thickness of the different strata met with in drilling, such as soil, clay, shale, gravel, rock or sand, etc. Show depth at which water is encountered, thickness and character of water-bearing strata and height to which the water rises in the well.

Size of Drilled Hole	Size and Weight of Casing	From (Feet)	To (Feet)	PERFORATIONS		
				Kind Size	From (Feet)	To (Feet)
6" I.D.	6 5/8 OD 17 lbs. 1/2" side wall	ground level	53'6"			

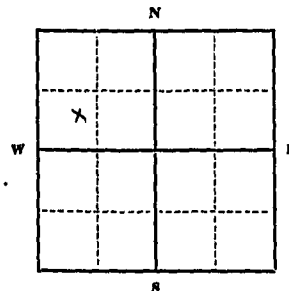

Static Water Level for non-flowing well 10.16" feet.

Shut-in Pressure for Flowing Well _____

Pumping Water Level 461 feet
at 150 gal. per minute.

Discharge in gal. per min. of flowing well _____

How Tested compressor

Length of Test 2 hours

Remarks: (Gravel packing, cementing, packers, type of shutoff) _____

N.W. Sec 25 T. 13 R. 20
Indicate location of well and place of use, if possible. Each small square represents 40 acres.

(Continue on reverse side)

USE—If used for irrigation, industrial, drainage or other. Explain, state number of acres and location or other data (i.e.: Lot, Block and Addition).

This form to be prepared by driller, and three copies to be filed by the owner with the County Clerk and Recorder in the county in which the well is located, tissue copy to be retained by driller.

Please answer all questions. If not applicable, so state, otherwise the form will be returned.

151
Driller's License Number

Ken Williams
Driller's Signature

41162

251322

251322

I received and filed this Instrument for record on the 21 day of June 1966 at 10:15 o'clock A.M., permanent files of Missoula County, State of Montana. Witness my hand: Veronae R. Crouse, County Recorder. By Nancy A. Hunt, Deputy Fee \$ 2.00 Paid cash

STATE WATER CO. REVENUE BOARD

JUN 23 1966

Proposed to be filed in the office of the County Recorder, Missoula County, Montana, on June 21, 1966, at 10:15 A.M. by Veronae R. Crouse, County Recorder. Fee \$2.00. Paid cash.

File No. _____

MONTANA WATER RESOURCES BOARD

T. 13N R. 20W

DUPLICATE

JUL 11 1968

County Missoula

LOG

STATE OF MONTANA
ADMINISTRATOR OF GROUNDWATER CODE
OFFICE OF STATE ENGINEER

Top of Ground
(Elev. above sea level 3227')

Notice of Completion of Groundwater Appropriation by Means of Well

DEVELOPED AFTER JANUARY 1, 1962

(Under Chapter 237, Montana Session Laws, 1961)

Montana Conference Association

Owner Of Seventh Day Adventist Missoula, Montana

Driller Liberty Drilling Co. Address Missoula, Montana

Date of Notice of appropriation of groundwater None Filed

Date well started 8/10/67 Date completed 8/11/67

Type of well Driven Equipment used Well Driving Rig
(Dug, driven, bored or drilled) (Churn drill, rotary or other)

Water use: Domestic Municipal Stock Irrigation
Industrial Drainage Other

Indicate on the diagram the character and thickness of the different strata met with in drilling, such as soil, clay, shale, gravel, rock or sand, etc. Show depth at which water is encountered, thickness and character of water-bearing strata and height to which the water rises in the well.

- Formations Log:**
- 0 - 5 Brown topsoil.
 - 5 - 8 Tan sandy clay.
 - 8 - 15 Boulders & cobblestones.
 - 15 - 32 Silty sand & gravel mixed.
 - 32 - 37 Gravel imbedded in clay.
 - 37 - 41 Clay.
 - 41 - 45 Silty sand.
 - 45 - 52 Gravel imbedded in clay.
 - 52 - 55 Fine sand and gravel.
 - 55 - 60 Clean coarse gravel. Water.

Water rises in the well 7 feet from surface.

Size of Drilled Hole	Size and Weight of Casing	From (Feet)	To (Feet)	PERFORATIONS		
				Kind Size	From (Feet)	To (Feet)
6"	6 5/8" OD x 3/4"	+10"	60'	Torch Cut	56	60

Static Water Level for non-flowing well _____ feet.

Shut-in Pressure for Flowing Well None

Pumping Water Level _____ feet

at _____ gal. per minute.

Discharge in gal. per min. of flowing well Non-flowing

How Tested Air Lift Pump

Length of Test Four hours

Remarks: (Gravel packing, cementing, packers, type of shutoff) The bottom four feet of casing is perforated & all water entering well is coming through these perforations. Wells in this area can be depended upon to produce clear sand free water year after year as long as they are not overpumped i.e., they should be pumped at. (Continue on reverse side)

USE—If used for irrigation, industrial, drainage or other. Explain, state number of acres and location or other data (i.e.: Lot, Block and Addition).

Tract 13, Roseland Orchards Tracts #3

Show exact depth of bottom.
Bottom of hole 60'

This form to be prepared by driller, and three copies to be filed by the owner with the County Clerk and Recorder in the county in which the well is located, tissue copy to be retained by driller.

Please answer all questions. If not applicable, so state, otherwise the form will be returned.

52
Driller's License Number
William F. Osborne
Driller's Signature

44310

107 - 222704

I received and filed this instrument for record on the 9th day of July, 1928, at 11:30 o'clock A.M. in the permanent files of Missoula County, State of Montana. Witness my hand: Veramae R. Crouse, County Recorder. By [Signature] Deputy. Fee \$2.00 Paid [Signature]

rates less than 25 to 50 percent of the tested capacity of the aquifer.

of the...
...
...
...
...
...

File No. _____

T. 13 N 20 W
County Missoula

DUPLICATE

STATE OF MONTANA
ADMINISTRATOR OF GROUNDWATER CODE
OFFICE OF STATE ENGINEER

RECEIVED
JAN 9 1964
STATE ENGINEER

Declaration of Vested Groundwater Rights

(Under Chapter 237, Montana Session Laws, 1961)

I, Selma A. Moor, of 3880 South Ave W, Missoula
(Name of Appropriator) (Address) (Town)
County of Missoula State of Montana
have appropriated groundwater according to the Montana laws in effect prior to January 1, 1962, as follows:

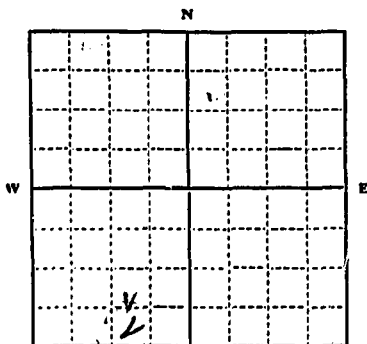

SW 1/4
SW 1/4 Sec. 25 T. 13 R. 20

Indicate point of appropriation and place of use, if possible. Each small square represents 10 acres.

2. The beneficial use on which the claim is based domestic lawn & gardens
3. Date or approximate date of earliest beneficial use; and how continuous the use has been 1930
4. The amount of groundwater claimed (in miner's inches or gallons per minute) unknown
5. If used for irrigation, give the acreage and description of the lands to which water has been applied and name of the owner thereof used for irrigating lawn & garden
6. The means of withdrawing such water from the ground and the location of each well or other means of withdrawal electric pressure pump

7. The date of commencement and completion of the construction of the well, walls, or other works for withdrawal of groundwater 1930
8. The depth of water table 30 ft
9. So far as it may be available, the type, size and depth of each well or the general specifications of any other works for the withdrawal of groundwater 30 ft. electric pump
10. The estimated amount of groundwater withdrawn each year unknown
11. The log of formations encountered in the drilling of each well if available unknown
12. Such other information of a similar nature as may be useful in carrying out the policy of this act, including reference to book and page of any county record none

Signature of Owner Selma A. Moor
Date Dec 31, 1963

Three copies to be filed by the owner with the County Clerk and Recorder of the county in which the well is located.

Please answer all questions. If not applicable, so state, otherwise the form will be returned.

Original to the County Clerk and Recorder; Duplicate to the State Engineer; Triplicate to the Montana Bureau of Mines and Geology, and Quaduplicate for the Appropriator.

20079

954 2154 28

I received and filed this instrument for
record on the 16 day of Dec 19 1907
at 11:30 o'clock A.M. permanent files
of Missoula County, State of Montana
Witness my hand
MARTIN S. BEHNE County Recorder
By *Martin S. Behne* Deputy
Fee \$ 20.00 Paid

U

File No. _____

MONTANA WATER RESOURCES BOARD

T. 13N R. 20W 25

DUPLICATE

RECEIVED

County Missoula

LOG SEP 13 1967

STATE OF MONTANA
ADMINISTRATOR OF GROUNDWATER CODE
OFFICE OF STATE ENGINEER

Top of Ground _____
(Elev. above sea level _____)

Notice of Completion of Groundwater Appropriation by Means of Well

DEVELOPED AFTER JANUARY 1, 1962

(Under Chapter 237, Montana Session Laws, 1961)

0.1.
18"
18"
23'
37'
37'
44
44
53
53
58'

top soil
tan clay, sand, gravel
surface water, sand
tan clay, sand & gravel
water, silt & sand
water, sand & gravel

Owner LARRY NEWMAN Address _____

Driller KEN WILLIAMS Address 1558 So. 5th. W.

Date of Notice of appropriation of groundwater _____

Date well started AUG. 17, 67 Date completed AUG. 18, 67

Type of well drilled Equipment used CHURN
(Dug, driven, bored or drilled) (Churn drill, rotary or other)

Water use: Domestic Municipal Stock Irrigation
Industrial Drainage Other

Indicate on the diagram the character and thickness of the different strata met with in drilling, such as soil, clay, shale, gravel, rock or sand, etc. Show depth at which water is encountered, thickness and character of water-bearing strata and height to which the water rises in the well.

Size of Drilled Hole	Size and Weight of Casing	From (Feet)	To (Feet)	PERFORATIONS		
				Kind Size	From (Feet)	To (Feet)
6" I.D.	6 5/8" O.D. 17 lbs 1/2" side wall	ground level	58' 6"			

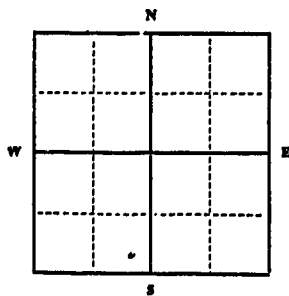

Static Water Level for non-flowing well 18' 6" feet.

Shut-in Pressure for Flowing Well _____ feet

Pumping Water Level 50 feet
at 80 gal. per minute.

Discharge in gal. per min. of flowing well _____

How Tested COMPRESSOR TEST

Length of Test 2 hours

Remarks: (Gravel packing, cementing, packers, type of shutoff) _____

SE 1/4 SW 1/4 Sec. 25 T13N R20W

Indicate location of well and place of use, if possible. Each small square represents 40 acres.

(Continue on reverse side)

USE—If used for irrigation, industrial, drainage or other. Explain, state number of acres and location or other data (i.e.: Lot, Block and Addition).

Show exact depth of bottom.

This form to be prepared by driller, and three copies to be filed by the owner with the County Clerk and Recorder in the county in which the well is located, tissue copy to be retained by driller.

Please answer all questions. If not applicable, so state, otherwise the form will be returned.

151
Driller's License Number

Ken L. Williams
Driller's Signature.

42,311

1736

264013

I received and filed this Instrument for
record on the 11 day of Sept 1967
at 2:25 o'clock P.M., permanent files
of Missoula County, State of Montana
Witness my hand:
Vernon R. Crous, County Recorder
By Robert A. Rasmussen Deputy
Fee \$ 2.00 Paid

STATE OF MONTANA
ADMINISTRATOR OF GROUNDWATER CODE
MONTANA WATER RESOURCES BOARD

NOTICE OF COMPLETION OF GROUNDWATER
APPROPRIATION BY MEANS OF WELL

Developed after January 1, 1962

DRILLER'S LOG

Indicate the character, color, thickness of strata such as soil, clay, sand, gravel, shale, sandstone, etc. Show depth at which water is found and height to which water rises in well.

(Under Chapter 237 Montana Session Laws, 1961, as amended)

This form to be prepared by driller, and three copies to be filed by the owner with the County Clerk and Recorder in the county in which the well is located, last copy to be retained by driller.

Please answer all questions. If not applicable, so state, otherwise the form may be returned.

Owner C. B. Niemeyer

Address 3404 Spurgin Road,

Date well started 1908
completed ?

For Administrator's Use	
File	<u>201431</u>
<u>April 13, 1971</u>	
<u>1:30 p.m.</u>	
GW 1	

Type of well Dug & Driven
(Dug, driven, bored or drilled)

Equipment used Shovel & Maul
(Churn & I, rotary or other)

Water Use: Domestic Municipal Stock Irrigation
Industrial Drainage Other * Garden/Lawn

*Describe Lawn Irrigation

USE: If used for Irrigation, industrial, drainage or other. Explain, state number of acres and location or other data (i.e. Lot, Block and Addition). Lawn Irrigation

ESTIMATED ANNUAL WITHDRAWAL 1,800,000 Gal.

Size of Drilled Hole	Size and Weight of Casing	From (Feet)	To (Feet)	PERFORATIONS		
				Kind Size	From (Feet)	To (Feet)
4"	4"	12'	30'	unknown		

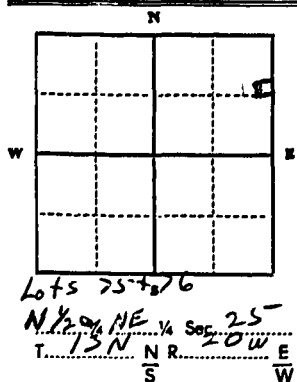

Static water level 16' ft.*
Pumping water level 18' ft.*
at measured gallons per minute,
measured minutes after pumping began.
*Measured from ground level
Well developed by unknown
for hours.
Power Etec Pump 1/2 HP
Remarks: (Gravel packing, cementing, packers, type of shutoff)

Top of Ground		(Elev. above sea level)
From (Feet)	To (Feet)	
<u>0</u>	<u>30'</u>	<u>Gravel</u>
		<u>16' below water</u>

INDICATE LOCATION OF WELL AND PLACE OF USE, IF POSSIBLE. EACH SMALL SQUARE REPRESENTS 40 ACRES.

Driller's Signature J. W. Niemeyer
Driller's Address 3404 Spurgin Rd.

LICENSE NO. none

30' Show exact depth of bottom

2111

301431

I received and filed this instrument for
record on the 13th day of April 1921
at 1:30 o'clock P. M. per my own file
of Missoula County State of Montana
Witness my hand
Vernon R. Crouse, County Recorder
By *J. A. ...* Deputy
Fee \$2.00 Paid *...*

GW 2

Approved Stock Form—State Publishing Co., Helena, Montana—4129

File No. _____

T. 13 N R 20 W 25

DUPLICATE

RECEIVED

County MISSOULA

LOG

FEB 8 - 1971

STATE OF MONTANA
ADMINISTRATOR OF GROUNDWATER CODE
OFFICE OF STATE ENGINEER

Notice of Completion of Groundwater
Appropriation by Means of Well
DEVELOPED AFTER JANUARY 1, 1962

(Under Chapter 237, Montana Session Laws, 1961)

Top of Ground
(Elev. above sea level _____)

0-9 Boulders & Gravel

9-12 Gravel, sand & Water

12-15 Gravel & Clay

15-44 Small Gravel & Sand & Water

44-48'3" Gravel & Water

Owner ORCHARD HOMES
COMMUNITY PARK Address Missoula, Montana
CAMP WELL DRILLING & Address 1522 S. 14th W.

Driller PIKE SUPPLY Address Missoula, Montana

Date of Notice of appropriation of groundwater _____

Date well started MAR 11, 1970 Date completed MAR 12, 1970

Type of well Drilled Equipment used Churn Drill
(Dug, Driven, bored or drilled) (Churn drill, rotary or other)

Water use: Domestic Municipal Stock Irrigation
Industrial Drainage Other Park

Indicate on the diagram the character and thickness of the different strata met with in drilling, such as soil, clay, shale, gravel, rock or sand, etc. Show depth at which water is encountered, thickness and character of water-bearing strata and height to which the water rises in the well.

Size of Drilled Hole	Size and Weight of Casing	From (Feet)	To (Feet)	PERFORATIONS		
				Kind Size	From (Feet)	To (Feet)
6" I.D.	6" I.D. 17 lb per ft.	2' above G.L.	48'3"		none	

Doc. No. 299117
Filed for record
this 1 day of February
A. D. 19 71, at 9:15
o'clock P. M.

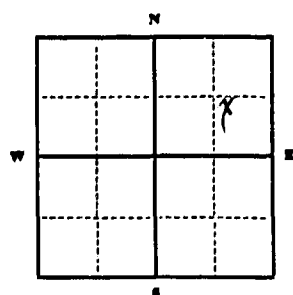

Static Water Level for non-flowing well _____ feet.
Shut-in Pressure for Flowing Well _____
Pumping Water Level _____ feet
at _____ gal. per minute.
Discharge in gal. per min. of flowing well _____
How Tested Air Compressor
Length of Test 3 hours
Remarks: (Gravel packing, cementing, packers, type of shutoff) _____

SE 1/4 NE 1/4 Sec. 25 T. 13 N R. 20 W
Indicate location of well and place of use, if possible. Each small square represents 40 acres.

(Continue on reverse side)

USE—If used for irrigation, industrial, drainage or other. Explain, state number of acres and location or other data (i.e.: Lot, Block and Addition).

Show exact depth of bottom.

This form to be prepared by driller, and three copies to be filed by the owner with the County Clerk and Recorder in the county in which the well is located, these copy to be retained by driller.

Please answer all questions. If not applicable, so state, otherwise the form will be returned.

License # _____
Driller's License Number

Churn Camp
Driller's Signature CAMP WELL
DRILLING & PIPE SUPPLY
48117

2086

299113

I received and filed this instrument for
record on the 1st day of Feb, 1971.
at 11:35 o'clock P.M., permanent time
of Missoula County, State of Montana
Witness my hand:
Vernice B. Crouse, County Recorder
By M. M. Conroy, Deputy
Fee \$ 2.00 Paid

File No.

T. 13 N. R. 20 W. 25

DUPLICATE

County.

STATE OF MONTANA
ADMINISTRATOR OF GROUNDWATER CODE
OFFICE OF STATE ENGINEER

RECEIVED
DEC 30 1963

Declaration of Vested Groundwater Rights
(Under Chapter 237, Montana Session Laws, 1961) STATE ENGINEER

1. Oscar Osborn, of 3426 S. Ave. W. (Name of Appropriator) (Address) (Town)
County of Missoula State of Montana
have appropriated groundwater according to the Montana laws in effect prior to January 1, 1962, as follows:

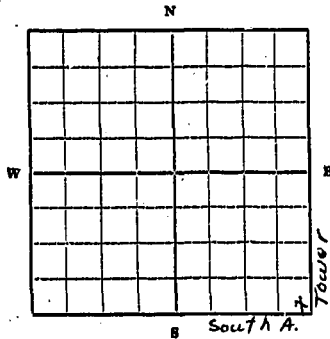

Lot 55
1/4 Sec. 25 T. 13 R. 20

Indicate point of appropriation and place of use, if possible. Each small square represents 10 acres.

2. The beneficial use on which the claim is based House, Garden & Lawn, a swimming pool later

3. Date or approximate date of earliest beneficial use; and how continuous the use has been 1958 all the time

4. The amount of groundwater claimed (in miner's inches or gallons per minute) 30 G.P.M.

5. If used for irrigation, give the acreage and description of the lands to which water has been applied and name of the owner thereof For garden, lawn, shrubbery & trees

6. The means of withdrawing such water from the ground and the location of each well or other means of withdrawal Manual pump 3/4 H.P.

7. The date of commencement and completion of the construction of the well, wells, or other works for withdrawal of groundwater Dec 1957

8. The depth of water table 30'

9. So far as it may be available, the type, size and depth of each well or the general specifications of any other works for the withdrawal of groundwater Drilled well, 3" I.D. 94'-6" deep

10. The estimated amount of groundwater withdrawn each year For house, garden, shrubbery and lawn

11. The log of formations encountered in the drilling of each well if available Not available

12. Such other information of a similar nature as may be useful in carrying out the policy of this act, including reference to book and page of any county record None

Driller Glenn Camp
705 Alder, Missoula
License # 7

Signature of Owner.....

Date December 21, 1963

Three copies to be filed by the owner with the County Clerk and Recorder of the county in which the well is located.

Please answer all questions. If not applicable, so state, otherwise the form will be returned.

Original to the County Clerk and Recorder; duplicate to the State Engineer; Triplicate to the Montana Bureau of Mines and Geology and Quadruplicate for the Appropriator.

545

204847

I received and filed this instrument for
 record on the 20 day of Dec 1963
 at 10 o'clock A.M., permanent files
 of Missoula County, State of Montana
 Witness my hand
 MARY S. BEYNE, County Recorder
 By Mary S. Beyne Deputy
 Fee \$ 2.00 Paid

MISSOULA COUNTY RECORDER
 MISSOULA, MONTANA
 RECEIVED FOR RECORDING
 DECEMBER 20, 1963
 FEE \$2.00
 BY MARY S. BEYNE, COUNTY RECORDER

MISSOULA COUNTY RECORDER
 MISSOULA, MONTANA
 RECEIVED FOR RECORDING
 DECEMBER 20, 1963
 FEE \$2.00
 BY MARY S. BEYNE, COUNTY RECORDER

Doc. No. 305563
Filed for record
this 23 day of July MONTANA WATER RESOURCES BOARD
DUPLICATE A. D. 19 71, at RECEIVED
o'clock 1:00

T. 25
R. 13
County Missoula

JUL 29 1971

STATE OF MONTANA
ADMINISTRATOR OF GROUNDWATER CODE
OFFICE OF STATE ENGINEER

Notice of Completion of Groundwater
Appropriation by Means of Well
DEVELOPED AFTER JANUARY 1, 1962

(Under Chapter 237, Montana Session Laws, 1961)

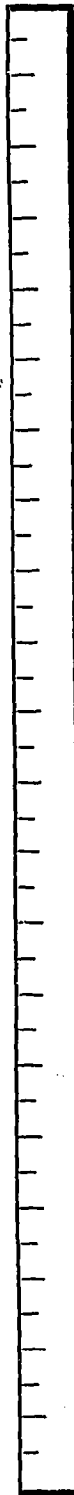

Top of Ground
(Elev. above sea level 31 3,223)

0 - 3 1/2 top soil

3 1/2 - 15 gravel & sand & water

15 - 35 sand & water

35 - 42 gravel sand & water

42 - 46 clay no water

46 - 58 sand & water

58 - 65 gravel & water

Owner Larry Reicher Address 1549 So 11 St
Myra Reicher
Driller Harold K. Pedone Address 3624 So. Ave. Mala.

Date of Notice of appropriation of groundwater.....

Date well started 6/20/65 Date completed 6/22/65

Type of well Driven Equipment used table top
(Dug, Driven, bored or drilled) (Churn drill, rotary or other)

Water use: Domestic Municipal Stock Irrigation
Industrial Drainage Other

Indicate on the diagram the character and thickness of the different strata met with in drilling, such as soil, clay, shale, gravel, rock or sand, etc. Show depth at which water is encountered, thickness and character of water-bearing strata and height to which the water rises in the well.

Size of Drilled Hole	Size and Weight of Casing	From (Feet)	To (Feet)	PERFORATIONS		
				Kind Size	From (Feet)	To (Feet)
4 inch	4 in. I. P. 10.78 lbs. per ft.	0	65	slots	64	59

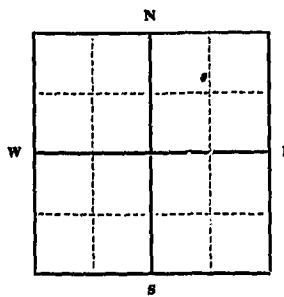

Static Water Level for non-flowing well 5 1/2 ft. of top feet.

Shut-in Pressure for Flowing Well.....

Pumping Water Level 7 ft. of top feet at 45 gal. per minute.

Discharge in gal. per min. of flowing well.....

How Tested compressor

Length of Test 3 hrs.

Remarks: (Gravel packing, cementing, packers, type of shutoff) electric shut-off - domestic water pump

N 21 day Sec. 25 T. 13 R. 20
Indicate location of well and place of use, if possible. Each small square represents 40 acres.

(Continue on reverse side)

USE—If used for irrigation, industrial, drainage or other. Explain, state number of acres and location or other data (i.e.: Lot, Block and Addition).

Acres and addition block 1 - lot 4 Section 25 Township 13 - Range 20

Show exact depth of bottom.

65 ft.

This form to be prepared by driller, and three copies to be filed by the owner with the County Clerk and Recorder in the county in which the well is located, tissue copy to be retained by driller.

Please answer all questions. If not applicable, so state, otherwise the form will be returned.

Driller's License Number

Harold K. Pedone
Driller's Signature

48808

255

305563

I received and filed this instrument for
 record on the 23rd day of July, 1971
 at 2:12 o'clock P.M. between file
of Spencer County, State of Georgia
Witness my hand
Veronica B. Crutch County Recorder
 By W. M. Brantley Deputy
 Fee \$ 2.50 Plidant

RECORDED
 INDEXED
 JUL 23 1971
 SPENCER COUNTY, GEORGIA
 REC'D

RECEIVED
JUL 29 1959
STATE ENGINEER

T. 13 N R. 20 W 25
County Missoula

MONTANA BUREAU OF MINES AND GEOLOGY
Butte, Montana

WATER WELL LOG

X		

Owner George Phillips Address Missoula
Driller John Farrell Address Arlee Mont
Date Started July 7 1959 Date Completed July 9-1959
Location: Sec. 25 T. 13 N R. 20 W 1/4 sec. North West

Type of well X Equipment used X
(Dug, driven, bored, or drilled) (Churn drill, rotary, other)

Water use: Domestic Municipal Stock Irrigation

Industrial Drainage Other: Steel

Casing: 0 ft. to 6 pit ft. Type Steel Size 5"

Casing: 6 ft. to 84 ft. Type _____ Size _____

Casing: _____ ft. to _____ ft. Type _____ Size _____

Perforated or Screened: Ft. _____ to ft. _____ Ft. _____ to ft. _____

Type of screen or perforations _____

Static Water level, for non-flowing well: _____ feet 15

Shut-in pressure, for flowing well: _____ lb./sq. in. on: July 7 - 1959
(date)

Pumping water level 50 feet at 15 gal. per min.

How tested: Bailer

Length of test: 1 Hr

Remarks: (Gravel packing, cementing, packers, type of shut-off, depth of shut-off)

(over)

Log of Well

Depth, feet		Description of Material Drilled
From	To	
0	6	<i>BIT</i>
6	40	<i>heavy gravel sand</i>
40	80	<i>fine sand water</i>
80	84	<i>gravel water</i>

I received and filed this instrument for
 record on the 15 day of July, 1957
 at W. A. S. Colwell, Clerk of the Court, Clerk
 of the County of St. Louis, State of Missouri.
 WITNESSES My hand
WALTER S. BILLYER, County Recorder
 By: W. A. S. Colwell, Deputy
 Fee \$ 1.00 Paid

#13

143061

File No. _____

MONTANA WATER RESOURCES BOARD

T. 13 R. 20 25

DUPLICATE

RECEIVED

County Missoula

LOG

OCT 13 1967

STATE OF MONTANA
ADMINISTRATOR OF GROUNDWATER CODE
OFFICE OF STATE ENGINEER

Top of Ground _____

(Elev. above sea level _____)

Notice of Completion of Groundwater Appropriation by Means of Well

DEVELOPED AFTER JANUARY 1, 1962

(Under Chapter 237, Montana Session Laws, 1961)

0-1 Topsoil

1-5 Sandy Clay

5-10 Sand & Gravel,
Some Clay

10-23 Water, Sand

23-27 Water, Sand & Gravel

27-35 Sand and Water

35-38 Sand, Gravel &
Water

38-49 Sand and Water,
Some Clay

49-53 Sand, Gravel &
Water

Owner William L. Poulson Address Garage 37th & Spurgeon

Driller Glenn Camp Address 1522 S. 14th

Date of Notice of appropriation of groundwater _____

Date well started June 23, 1967 Date completed June 26, 1967

Type of well Drilled Equipment used Churn Drill
(Dug, driven, bored or drilled) (Churn drill, rotary or other)

Water use: Domestic Municipal Stock Irrigation
Industrial Drainage Other

Indicate on the diagram the character and thickness of the different strata met with in drilling, such as soil, clay, shale, gravel, rock or sand, etc. Show depth at which water is encountered, thickness and character of water-bearing strata and height to which the water rises in the well.

Size of Drilled Hole	Size and Weight of Casing	From (Feet)	To (Feet)	PERFORATIONS		
				Kind size	From (Feet)	To (Feet)
6" I.D.	6" I.D. 17 lb per ft	1' above G.L.	53' 11"			None

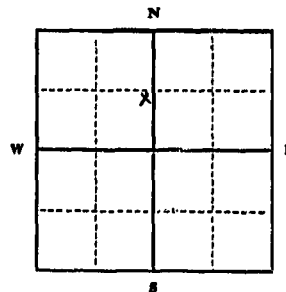

Static Water Level for non-flowing well
4.1' from G. level.

Shut-in Pressure for Flowing Well _____
Pumping Water Level 10'
at 100 gal. per minute.

Discharge in gal. per min. of flowing well _____

How Tested Compressor

Length of Test 2 1/2 hours

Remarks: (Gravel packing, cementing, packers, type of shutoff) _____

Roseland Orchard
Tract #3
Lot #6

SE 1/4 NW Sec 25 T. 13 R. 20
Indicate location of well and place of use, if possible. Each small square represents 40 acres.

(Continue on reverse side)

USE—If used for irrigation, industrial, drainage or other. Explain, state number of acres and location or other data (i.e.: Lot, Block and Addition).

Show exact depth of bottom.

This form to be prepared by driller, and three copies to be filed by the owner with the County Clerk and Recorder in the county in which the well is located, tissue copy to be retained by driller.

Please answer all questions. If not applicable, so state, otherwise the form will be returned.

License # _____
Driller's License Number

Glenn Camp
Driller's Signature. Glenn Camp

42,391

1744

264758

I received and filed this Instrument for
 record on the 19 day of Oct 1947
 at 4:58 o'clock P.M., permanent files
 of Missoula County, State of Montana.
 Witness my hand:
 Verance R. C. County Recorder
Wm. M. Conroy Deputy
 Fee \$ 2.00 Polk

MISSOULA COUNTY RECORDER'S OFFICE
 MISSOULA, MONTANA

File No. _____

T. 13^N R. 20^W 25

DUPLICATE

County Missoula

STATE OF MONTANA
ADMINISTRATOR OF GROUNDWATER CODE
OFFICE OF STATE ENGINEERS

RECEIVED
DEC 13 1963
STATE ENGINEER

Top of Ground
(Elev. above sea level 3,223)

Notice of Completion of Groundwater
Appropriation by Means of Well

(Under Chapter 237, Montana Session Laws, 1961)

- 0-3 1/2 top soil
- 3 1/2-9 1/2 soil & gravel
- 9 1/2-27 gravel & water
- 27-46 sand & small gravel water
- 46-59 gravel & coarse sand
- 59-64 clay & gravel mixed
- 64-68 heaving sand
- 68-73 gravel & water

1211 Rosebrier Dr
Missoula

Owner V. A. Bowers Address Missoula

Driller Harold K. Wickens Address Missoula

Date of Notice of Appropriation of Groundwater none

Date well started Sept. 20 Date Completed Sept. 23

Type of well drilled Equipment Used cable tools
(dug, driven, bored or drilled) (Churn, drill, rotary or other)

Water Use: Domestic Municipal Other Irrigation
Industrial Drainage Stock

Indicate on the diagram the character and thickness of the different strata met with in drilling, such as soil, clay, shale, gravel, rock or sand, etc. Show depth at which water is encountered, thickness and character of water-bearing strata and height to which water rises in the well.

Size of Drilled Hole	Size and Weight of Casing	From (Feet)	To (Feet)	PERFORATIONS		
				Kind Size	From (Feet)	To (Feet)
1 1/2" / 5"	5 1/2" / 17 #	3 ft	73 ft	open	bottom	

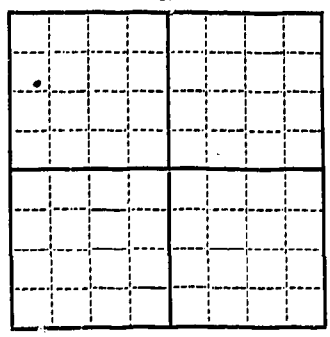

Static Water Level for non-flowing Well 9 1/2 feet.

Shut-in Pressure for Flowing Well _____

Pumping Water Level 65 1/2 feet at 35 gal. per minute.

Discharge in gal. per min. of flowing well 135/137/111

How Tested compressor Length of Test 4 hrs

Remarks: (Gravel packing, cementing, packers, type of shutoff, location of place of use of groundwater if not at well, and any other similar pertinent information, including number of acres irrigated, if used for irrigation) _____

Indicate location of well and place of use, if possible. Each small square represents 10 acres.

Lot 4, Blk 4, Roseland Add. #1
Missoula, Mont.

bottom 73 ft

Driller's License Number 71

Driller's Signature Harold K. Wickens

This form to be prepared by driller, and three copies to be filed by the owner with the County Clerk and Recorder in the county in which the well is located.

Please answer all questions. If not applicable, so state, otherwise the form will be returned.

Original to the County Clerk and Recorder; duplicate to the State Engineer; Triplicate to the Montana Bureau of Mines and Geology and Quadruplicate to the Appropriator.

387

214077

I received and filed this instrument for
 record on the 11 day of Dec, 1968
 at 3:45 o'clock P, permanent files
 of Missoula County, State of Montana
 Witness my hand.
 MARTIN S. BEHNER, County Recorder
 By Martin S. Behner Deputy
 Fee 5.00 Paid

25

File No. _____

T 13 R 20 W

DUPLICATE

County Missoula

STATE OF MONTANA
ADMINISTRATOR OF GROUNDWATER CODE
OFFICE OF STATE ENGINEER

RECEIVED
JAN 3 1964

Declaration of Vested Groundwater Rights

(Under Chapter 237, Montana Session Laws, 1961)

1. Russell K. Price, of 3835 S. 7th W., Missoula
(Name of Appropriator) (Address) (Town)

County of Missoula State of Montana
have appropriated groundwater according to the Montana laws in effect prior to January 1, 1962, as follows:

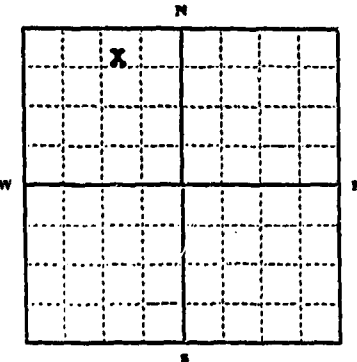

NW ¼ Sec. 25 T. 13 R. 20
Indicate point of appropriation
and place of use, if possible. Each
small square represents 10 acres.

2. The beneficial use on which the claim is based.
Household and lawn irrigation

3. Date or approximate date of earliest beneficial use; and how continu-
ous the use has been. 1951
Continuous use.

4. The amount of groundwater claimed (in miner's inches or gallons
per minute) UNKNOWN

5. If used for irrigation, give the acreage and description of the lands
to which water has been applied and name of the owner thereof.
Lawn irrigation—1/4 acre of 2 1/2 acre tract.
Russell K. or Norma J. Price

6. The means of withdrawing such water from the ground and the loca-
tion of each well or other means of withdrawal. Submersible
pump and well.

7. The date of commencement and completion of the construction of the well, wells, or other works for with-
drawal of groundwater. Approximately 1951.

8. The depth of water table. From top of ground to top of water 14'.

9. So far as it may be available, the type, size and depth of each well or the general specifications of any other
works for the withdrawal of groundwater. Drilled well, 5" casing, 64' deep.

10. The estimated amount of groundwater withdrawn each year. UNKNOWN

11. The log of formations encountered in the drilling of each well if available. not available

12. Such other information of a similar nature as may be useful in carrying out the policy of this act, including
reference to book and page of any county record. Book 1, page 191, line 14. Section 25,
Township 13, Range 20, Seventh Street Acreage, Tracts 4,
NW 1/4 NE 1/4 NW 1/4, Plate E-2.

Signature of Owner Russell K. Price
Norma J. Price
Date 12-31-63

Three copies to be filed by the owner with the County Clerk and Recorder of the county in which the well is located.

Please answer all questions. If not applicable, so state, otherwise the form will be returned.

Original to the County Clerk and Recorder; Duplicate to the State Engineer; Triplicate to the Montana Bureau of
Mines and Geology, and Quadruplicate for the Appropriator. 20044

215313

I received and filed this instrument for
record on the 31 day of Dec, 1966
at 7:12 o'clock A.M., permanent files
of Missoula County, State of Montana
Witness my hand:
MARTIN S. BEINER, County Recorder
By [Signature]
Fee \$ 2.00 Paid