

674

215057

*Copy*  
I received and filed this instrument for  
record on the 20 day of Dec 1911  
at 8:14 o'clock A.M., permanent files  
of Missoula County, State of Montana  
Witness my hand:  
MARTIN S. BRINER, County Recorder  
By Martin S. Briner Deputy  
Fee \$ 2.20 Paid

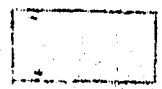

RECEIVED

Missoula 19

SEP 25 1972

County Missoula 15N-19W

3 GW 2 Revised 1969 STATE PUBLISHING COMPANY

STATE OF MONTANA ADMINISTRATOR OF GROUNDWATER CODE MONTANA DEPARTMENT OF NATURAL RESOURCES AND CONSERVATION MONTANA WATER RESOURCES BOARD

DRILLER'S LOG

Indicate the character, color, thickness of strata such as soil, clay, sand, gravel, shale, sandstone, etc. Show depth at which water is found and height to which water rises in well.

NOTICE OF COMPLETION OF GROUNDWATER APPROPRIATION BY MEANS OF WELL

Developed after January 1, 1962

(Under Chapter 237 Montana Session Laws, 1961, as amended)

This form to be prepared by driller, and three copies to be filed by the owner with the County Clerk and Recorder in the county in which the well is located, last copy to be retained by driller.

Please answer all questions. If not applicable, so state, otherwise the form may be returned.

Owner William Longpre

Address 308 So. Grove

Missoula, Montana 59801

Date well started unknown

completed

For Administrator's Use File 2334-322340 Date 20, 1972 - 1:30 p.m. GW 1

Type of well (Dig, driven, bored or drilled)

Equipment used (Churn drill, rotary or other)

Water Use: Domestic [X] Municipal [ ] Stock [ ] Irrigation [ ] Industrial [ ] Drainage [ ] Other [ ]\* Garden/Lawn [X]

\*Describe

USE: If used for irrigation, industrial, drainage or other. Explain, state number of acres and location or other data (i.e. Lot, Block and Addition).

ESTIMATED ANNUAL WITHDRAWAL

Table with columns: Size of Drilled Hole (5" ID), Size and Weight of Casing, From (Feet), To (Feet) (50), PERFORATIONS (Kind Size, From (Feet), To (Feet))

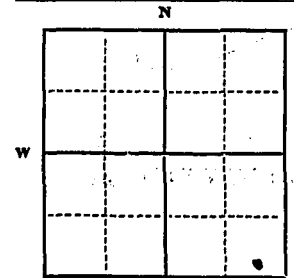

Static water level about 12 ft.\* Pumping water level at ... gallons per minute, measured ... minutes after pumping began. \*Measured from ground level. Well developed by ... for ... hours. Power ... Pump ... HP Remarks: (Gravel packing, cementing, packers, type of shutoff)

SE 1/4 Sec. 19 T. 15 S. R. 19 E.

INDICATE LOCATION OF WELL AND PLACE OF USE, IF POSSIBLE. EACH SMALL SQUARE REPRESENTS 40 ACRES.

Driller's Signature Unknown

Driller's Address

LICENSE NO.

Top of Ground (Elev. above sea level) table with From (Feet) and To (Feet) columns. Handwritten entry: 50ft clay gravel + sandstone

50ft Show exact depth of bottom

51,457

L.F.

#2334

322340

I received and filed this instrument for  
 record on the 28 day of Sept 1972  
 at 3:30 o'clock P.M. permanent files  
 of Missoula County, State of Montana  
 Witness my hand  
 Veranda R. Grout, County Recorder  
 By Veranda R. Grout Deputy  
 Fee \$ 2.00 Paid

Witnessed and signed by me  
 Veranda R. Grout  
 County Recorder  
 Missoula, Montana  
 9/28/72

*Handwritten notes:*  
 10/1/72  
 10/2/72

322340

10/1/72

10/2/72

10/3/72

10/4/72

10/5/72

10/6/72

10/7/72

Department of Natural Resources and Conservation  
Water Resources Division  
Engineering Bureau  
Groundwater Section  
Sam W. Mitchell Building  
Helena, Montana 59601

Owner William Longpre  
Address 308 South Grove Ms1a 59801  
Location T. R. 19w Sec. 19  
Doc. No. 2334 - 322340

As the Administrator of the Groundwater Code for the State of Montana, please take note of the following special instructions, in order to properly protect your groundwater right.

Special Instructions:

Please provide the information, as indicated in red on the attached form.

Thank you.

SEP 25 1972

County...

STATE OF MONTANA ADMINISTRATOR OF GROUNDWATER CODE MONTANA WATER RESOURCES BOARD

DRILLER'S LOG

Indicate the character, color, thickness of strata such as soil, clay, sand, gravel, shale, sandstone, etc. Show depth at which water is found and height to which water rises in well.

NOTICE OF COMPLETION OF GROUNDWATER APPROPRIATION BY MEANS OF WELL

Developed after January 1, 1962

(Under Chapter 237 Montana Session Laws, 1961, as amended)

This form to be prepared by driller, and three copies to be filed by the owner with the County Clerk and Recorder in the county in which the well is located, last copy to be retained by driller.

Please answer all questions. If not applicable, so state, otherwise the form may be returned.

Owner William Longpre Address 308 So. Grove

Table for Administrator's Use: File 2334-322340, Date well started Dec 5, 1943, completed Dec 10, 1943

Missoula, Montana 59801 Date well started... completed... Type of well 6" steel casing Equipment used drilling

Water Use: Domestic [X] Municipal [ ] Stock [ ] Irrigation [ ] Industrial [ ] Drainage [ ] Other [ ]\* Gardien/Lawn [X]

\*Describe... USE: If used for irrigation, industrial, drainage or other. Explain, state number of acres and location or other data (i.e. Lot, Block and Addition).

ESTIMATED ANNUAL WITHDRAWAL

Table with columns: Size of Drilled Hole, Size and Weight of Casing, From (Feet), To (Feet), PERFORATIONS (Kind Size, From (Feet), To (Feet)).

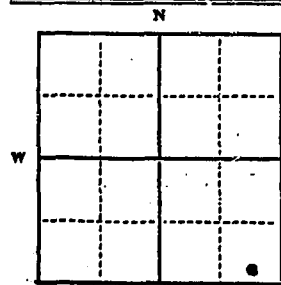

? Static water level about 12 ft.\* ? Pumping water level 28 ft.\* ? at about 100 gallons per minute measured... minutes after pumping began. \*Measured from ground level. Well developed by M. Bray for... hours. Power, electric Pump 1/2 HP. Remarks: (Gravel packing, cementing, packers, type of shutoff) cement packing iron type shutoff

? SE 1/4 Sec 19 T. 25 N. R. 17 E. S 5

INDICATE LOCATION OF WELL AND PLACE OF USE, IF POSSIBLE. EACH SMALL SQUARE REPRESENTS 40 ACRES.

Driller's Signature M. Bray ? Driller's Address Missoula Mont ? License No. ?

Large table for well log entries with columns: Top of Ground (From (Feet), To (Feet)). Entry: 50 ft, clay sand + shale

50 ft Show exact depth of bottom

51,457

FF.

27

File No.....

T. 15N R. 19W

DUPLICATE

County. Missoula,

STATE OF MONTANA  
ADMINISTRATOR OF GROUNDWATER CODE  
OFFICE OF STATE ENGINEER

RECEIVED  
JAN 3 1963

Notice of Appropriation of Groundwater  
(Under Chapter 237, Montana Session Laws, 1961) STATE ENGINEER

- I, Northern Pacific Railway Co., of St. Paul  
(Name of Appropriator) (Address) (Town)  
County of Ramsey, State of Minnesota, intend to appropriate groundwater in accordance with Chapter 237, Montana Session Laws of 1961.
- The beneficial use to which water is to be applied is Water supply for commercial ski area  
on Section 28-15N-19W  
(describe lands to be benefited, if for irrigation)
- The rate of use in gallons per minute or miner's inches of groundwater claimed.....  
2 miners inches
- The annual period (inclusive dates) of intended use.....Year-round
- The probable or intended date of first beneficial use.....January, 1964
- The probable or intended date of commencement and completion of the well\* or wells\*.....  
1964
- The location, type, size and depth of well or wells contemplated.....  
Developed spring
- The probable or estimated depth of the water table or artesian aquifer.....Surface
- Name, address and license number of the driller engaged.....  
Not applicable
- Give such other similar information as may be useful  
in carrying out the policy of this act.....NA

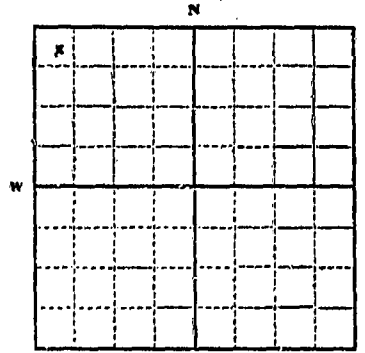

Section 27, T. 15N. R. 19W  
Locate well or other means of development as accurately as possible on the plat.

Signature of Appropriator.....Northern Pacific Railway Co.  
Date.....Dec. 31, 1963

\* As defined in the Code Sec. 1 (c) "Well" means any artificial opening or excavation in the ground, however made, by which groundwater can be obtained or through which it flows under natural pressures or is artificially withdrawn."

Three copies of this notice are to be filed with County Clerk and Recorder of the county in which the well is located.

Please answer all questions. If not applicable, so state, otherwise the form will be returned.

Original to the County Clerk and Recorder; duplicate to the State Engineer; Triplicate to the Montana Bureau of Mines and Geology and Quadruplicate for the Appropriator.

20432

1912

*copy*  
I received and filed this instrument for  
recording at *3:15* o'clock *P.M.* of *Dec* 19*12*  
at *1* o'clock *P.M.* permanent files  
of Missoula County, State of Montana  
Witness my hand:  
By *Deputy* *[Signature]*  
Fee *2.00* Paid

33

File No. GW-1

T. 15N R. 19W

DUPLICATE

County Missoula

STATE OF MONTANA  
ADMINISTRATOR OF GROUNDWATER CODE  
OFFICE OF STATE ENGINEER

RECEIVED  
JAN 3 1964

Declaration of Vested Groundwater Rights

(Under Chapter 237, Montana Session Laws, 1961)

STATE ENGINEER

1. Northern Pacific Ry. Co., of St. Paul  
(Name of Appropriator) (Address) (Town)

County of Ramsey State of Minnesota

have appropriated groundwater according to the Montana laws in effect prior to January 1, 1962, as follows:

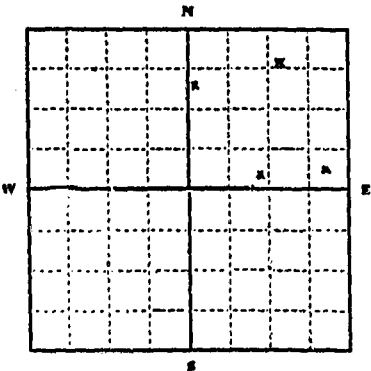

2. The beneficial use on which the claim is based.....  
Water supply for commercial ski area.

3. Date or approximate date of earliest beneficial use; and how continuous the use has been.....  
June 1961 - continuous

4. The amount of groundwater claimed (in miner's inches or gallons per minute).....  
2 miners inches each

5. If used for irrigation, give the acreage and description of the lands to which water has been applied and name of the owner thereof.....  
Not applicable

6. The means of withdrawing such water from the ground and the location of each well or other means of withdrawal.....  
Developed - spring,

NE 1/4 Sec. 33 T. 15N R. 19W

Indicate point of appropriation and place of use, if possible. Each small square represents 10 acres.

7. The date of commencement and completion of the construction of the well, wells, or other works for withdrawal of groundwater.....  
June 1961

8. The depth of water table.....  
Surface

9. So far as it may be available, the type, size and depth of each well or the general specifications of any other works for the withdrawal of groundwater.....  
Developed spring.

10. The estimated amount of groundwater withdrawn each year.....  
Not known

11. The log of formations encountered in the drilling of each well if available.....  
NA

12. Such other information of a similar nature as may be useful in carrying out the policy of this act, including reference to book and page of any county record.....  
NA

Signature of Owner.....  
Northern Pacific Ry. Co.  
Date Dec. 31 1963

Three copies to be filed by the owner with the County Clerk and Recorder of the county in which the well is located.

Please answer all questions. If not applicable, so state, otherwise the form will be returned.

Original to the County Clerk and Recorder; Duplicate to the State Engineer; Triplicate to the Montana Bureau of Mines and Geology, and Quaduplicate for the Appropriator.

20214



1094

215569

I received and filed this instrument for  
record on the 31<sup>st</sup> day of Dec. 1963  
at 4:48 o'clock P.M. permanent files  
of Missoula County, State of Montana  
Witness my hand:  
MARTIN S. BRINER, County Recorder  
By Edna Turner Deputy  
Fee \$ 2.00 Paid

34

File No. ....

T. 15N R. 19W

DUPLICATE

County Missoula

STATE OF MONTANA  
ADMINISTRATOR OF GROUNDWATER CODE  
OFFICE OF STATE ENGINEER

RECEIVED  
JAN 3 1963

Declaration of Vested Groundwater Rights

(Under Chapter 237, Montana Session Laws, 1961)

STATE ENGINEER

1. Northern Pacific Railway Co., of St. Paul  
(Name of Appropriator) (Address) (Town)

County of Ramsey State of Minnesota  
have appropriated groundwater according to the Montana laws in effect prior to January 1, 1962, as follows:

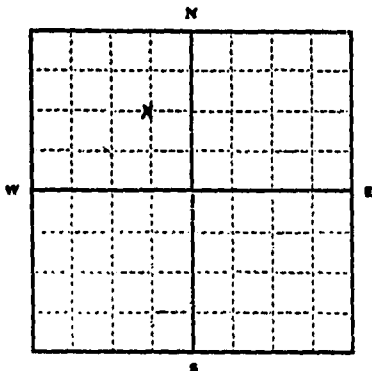

NW 1/4 Sec. 34 T. 15N R. 19W

Indicate point of appropriation and place of use, if possible. Each small square represents 10 acres.

2. The beneficial use on which the claim is based.....

Water supply for commercial ski development in Section 33-15N-19W

3. Date or approximate date of earliest beneficial use; and how continuous the use has been.....

September, 1961 - continuous

4. The amount of groundwater claimed (in miner's inches or gallons per minute).....

10 miners inches

5. If used for irrigation, give the acreage and description of the lands to which water has been applied and name of the owner thereof.....

Not applicable

6. The means of withdrawing such water from the ground and the location of each well or other means of withdrawal.....

Developed spring

7. The date of commencement and completion of the construction of the well, wells, or other works for withdrawal of groundwater.....

September, 1961

8. The depth of water table.....

Surface

9. So far as it may be available, the type, size and depth of each well or the general specifications of any other works for the withdrawal of groundwater.....

Pipe line from headgate in NE 1/4 Section 33  
Stream bed used for intake

10. The estimated amount of groundwater withdrawn each year.....

Not Known

11. The log of formations encountered in the drilling of each well if available.....

NA

12. Such other information of a similar nature as may be useful in carrying out the policy of this act, including reference to book and page of any county record.....

NA

Signature of Owner..... Laurie D. Harvey

Northern Pacific Railway Co.

Date Dec. 31 1963

Three copies to be filed by the owner with the County Clerk and Recorder of the county in which the well is located.

Please answer all questions. If not applicable, so state, otherwise the form will be returned.

Original to the County Clerk and Recorder; Duplicate to the State Engineer; Triplicate to the Montana Bureau of Mines and Geology, and Quadruplicate for the Appropriator.

20 + 27

1308

*copy*

I received and have the instrument for  
No. *838* of *5* *Dec* 19*62*  
of *838* *5* *Dec* 19*62* permanent file  
of *838* *5* *Dec* 19*62* of *838* *5* *Dec* 19*62*  
Witness my hand:  
By *[Signature]*  
Notary Public



RECEIVED 15 27 1962 16

File No. ....

DUPLICATE

Location of well  
SW 1/4 Sec. 16  
T. 1 S. R. 1 S.  
SW 1/4 SW 1/4 SE-NW 1/4

STATE OF MONTANA  
ADMINISTRATOR OF GROUNDWATER CODE  
OFFICE OF STATE ENGINEER

Notice of Completion of Groundwater  
Appropriation by Means of Well

(Under Chapter 237, Montana Session Laws, 1961)



Top of Ground  
(Elev. above sea level.....)

0 to 5' Pit  
5' to 71' Clay, gravel  
and boulder  
71' to 86' Sand & water  
86' to 96'-7" Sand, gravel  
& water

Owner Antoine Anderson Address Billtown, Mont

Driller Glenn Camp 705 Alder Address Missoula, Mont

Date of Notice of Appropriation of Groundwater.....

Date well started 7/12/62 Date Completed 7/21/62

Type of well Drilled Equipment Used Churn drill  
(dug, driven, bored or drilled) (Churn, drill, rotary or other)

Water Use: Domestic  Municipal  Other  Irrigation   
Industrial  Drainage  Stock

Indicate on the diagram the character and thickness of the different strata met with in drilling, such as soil, clay, shale, gravel, rock or sand, etc. Show depth at which water is encountered, thickness and character of water-bearing strata and height to which water rises in the well.

Size of Drilled Hole	Size and Weight of Casing	From (Feet)	To (Feet)	PERFORATIONS		
				Kind Size	From (Feet)	To (Feet)
5" I.D.	5" I.D. 14 lbs Seamless	1 1/2' above bottom of pit to 96'-7"		None		

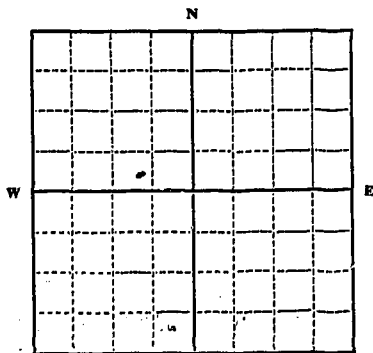

SW 1/4 NW Sec. 16 T. 1 S. R. 1 S.  
Indicate location of well and place of use, if possible. Each small square represents 10 acres.

Show exact depth of bottom.

Static Water Level for non-flowing Well..... 70 from G.L. feet.

Shut-in Pressure for Flowing Well.....

Pumping Water Level..... 70 feet at..... 20 gal. per minute.

Discharge in gal. per min. of flowing well.....

How Tested..... Bailer Length of Test..... 2 Hours

Remarks: (Gravel packing, cementing, packers, type of shutoff, location of place of use of groundwater if not at well, and any other similar pertinent information, including number of

acres irrigated, if used for irrigation).....

None

License # 7

Driller's License Number

Glenn Camp  
Driller's Signature

This form to be prepared by driller, and three copies to be filed by the owner with the County Clerk and Recorder in the county in which the well is located.

Please answer all questions. If not applicable, so state, otherwise the form will be returned.

Original to the County Clerk and Recorder; duplicate to the State Engineer; Triplicate to the Montana Bureau of Mines and Geology and Quadruplicate for the Appropriator.

141

copy

1955 30

I received and filed this instrument for  
 record on the 23 day of July, 1962  
 at 2:00 o'clock P.M., permanent files  
 of Missoula County, State of Montana  
 Witness my hand:  
 MARTIN S. BEHNER, County Recorder  
 By Cheryl Spalding, Deputy  
 Fee \$ 1.00 Paid f

MISSOULA COUNTY, MONTANA  
 DEPARTMENT OF CLERK AND RECORDER  
 MISSOULA, MONTANA



RECEIVED  
FEB 3 - 1971

County Missouri

STATE OF MONTANA  
ADMINISTRATOR OF GROUNDWATER CODE  
MONTANA WATER RESOURCES BOARD

DRILLER'S LOG

NOTICE OF COMPLETION OF GROUNDWATER  
APPROPRIATION BY MEANS OF WELL

Developed after January 1, 1962

Indicate the character, color, thickness of strata such as soil, clay, sand, gravel, shale, sandstone, etc. Show depth at which water is found and height to which water rises in well.

(Under Chapter 237 Montana Session Laws, 1961, as amended)

This form to be prepared by driller, and three copies to be filed by the owner with the County Clerk and Recorder in the county in which the well is located, last copy to be retained by driller.

Please answer all questions. If not applicable, so state, otherwise the form may be returned.

Owner William R. & Dorothy J. Meester  
Address Seelye Lake  
Box 135  
Date well started 10.16.70  
completed 10.23.70

For Administrator's Use	
File <u>29,897.7</u>	<u>January 27, 1971</u> <u>1:16 P.M.</u>
GW 1	

Type of well Drilled  
(Sigsbee, driven, bored or drilled)  
Equipment used Churn Drill  
(Churn drill, rotary or other)  
Water Use: Domestic  Municipal  Stock  Irrigation   
Industrial  Drainage  Other \* Garden/Lawn

\*Describe \_\_\_\_\_  
USE: If used for irrigation, industrial, drainage or other. Explain, state number of acres and location or other data (i.e. Lot, Block and Addition). S.A.

ESTIMATED ANNUAL WITHDRAWAL

Size of Drilled Hole	Size and Weight of Casing	From (Feet)	To (Feet)	PERFORATIONS		
				Kind Size	From (Feet)	To (Feet)
<u>5 7/8</u>	<u>219 lbs + 156 PWF</u>	<u>+1</u>	<u>82</u>	<u>None</u>		

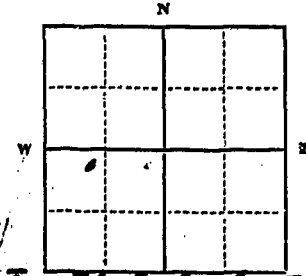

Static water level 14 ft.\*  
Pumping water level 48 ft.\*  
at 24 gallons per minute,  
measured 90 minutes after pumping began.  
\*Measured from ground level.  
Well developed by churn  
for 2 1/2 hours.  
Power \_\_\_\_\_ Pump \_\_\_\_\_ HP  
Remarks: (Gravel packing, cementing, packers, type of shutoff) \_\_\_\_\_

Tract 1 Seelye Lake  
T. 18 N. 15 E. 15 S. W

INDICATE LOCATION OF WELL AND PLACE OF USE, IF POSSIBLE. EACH SMALL SQUARE REPRESENTS 40 ACRES.  
Driller's Signature Robert W. Anderson  
Driller's Address Seelye Lake Mont  
Box 135 LICENSE NO. 103

Top of Ground 4106 (Elev. above sea level)

From (Feet)	To (Feet)	Description
<u>0</u>	<u>2.6</u>	<u>Rock and clay</u> <u>large boulders</u> <u>Some water at 2.6'</u>
<u>26</u>	<u>63</u>	<u>Rock and Silt clay</u> <u>Water - 3 feet from water</u>
<u>63</u>	<u>73</u>	<u>Clay and Rock</u>
<u>73</u>	<u>82</u>	<u>Gravel + water</u>

82 Show exact depth of bottom

48094



2082

278977

received and filed this instrument for  
 record on the 27<sup>th</sup> day of June 1921  
 at 1:16 o'clock P.M. permanent files  
 of Missoula County, State of Montana  
 Witness my hand  
 Verance R. Couse, County Recorder  
 By *M. J. ...* Deputy  
 Fee \$ 2.00 Paid *...*

131  
 133  
 134  
 135  
 136  
 137  
 138  
 139  
 140  
 141  
 142  
 143  
 144  
 145  
 146  
 147  
 148  
 149  
 150

*...*

File No. \_\_\_\_\_

T. 15 N R. 15 W 33

DUPLICATE

*surface water approp*

STATE OF MONTANA  
ADMINISTRATOR OF GROUNDWATER CODE  
OFFICE OF STATE ENGINEER

County Missoula

RECEIVED  
MAR 25 1965

Declaration of Vested Groundwater Rights  
(Under Chapter 237, Montana Session Laws, 1961) STATE ENGINEER

1. Earl Albert Brantner, of Greenough  
(Name of Appropriator) (Address) (Town)  
County of Missoula State of Montana  
have appropriated groundwater according to the Montana laws in effect prior to January 1, 1962, as follows:

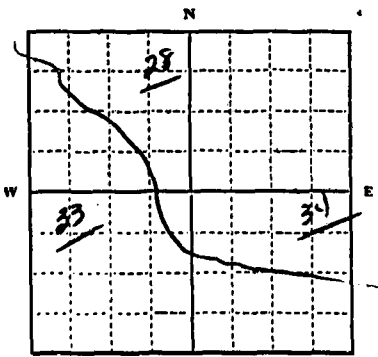

$\frac{1}{4}$  Sec. 28 T. 15 R. 33

Indicate point of appropriation and place of use, if possible. Each small square represents 10 acres.

2. The beneficial use on which the claim is based.....  
irrigation

3. Date or approximate date of earliest beneficial use; and how continuous the use has been.....  
about 1908 when constructed by Brantner

4. The amount of groundwater claimed (in meter's inches or gallons per minute).....  
3 inches from bed rock creek

5. If used for irrigation, give the acreage and description of the lands to which water has been applied and name of the owner thereof.....  
8 1/2 ac. 78 1/4 Sec 28 and 78 1/4, 2 1/2 78 1/4 Sec 33  
July 15, 1965

6. The means of withdrawing such water from the ground and the location of each well or other means of withdrawal.....  
irrigation ditch

7. The date of commencement and completion of the construction of the well, wells, or other works for withdrawal of groundwater.....  
Probably in early 1900 when constructed.

8. The depth of water table.....  
unknown

9. So far as it may be available, the type, size and depth of each well or the general specifications of any other works for the withdrawal of groundwater.....  
8" x 10" running in southeasterly direction.

10. The estimated amount of groundwater withdrawn each year.....

11. The log of formations encountered in the drilling of each well if available.....  
not available

12. Such other information of a similar nature as may be useful in carrying out the policy of this act, including reference to book and page of any county record.....  
unable to find

Signature of Owner Earl A. Brantner

Date Mar 27, 1965

Three copies to be filed by the owner with the County Clerk and Recorder of the county in which the well is located.

Please answer all questions. If not applicable, so state, otherwise the form will be returned.

Original to the County Clerk and Recorder; Duplicate to the State Engineer; Triplicate to the Montana Bureau of Mines and Geology, and Quadruplicate for the Appropriator.

284

234367

I received and filed this instrument for  
 record on the 27 day of March 1965  
 at 2:00 o'clock P.M. permanent files  
 of Missoula County, State of Montana  
 Witness my hand:  
 Vernice H. Craig, County Recorder  
 By Ruth N. Smith, Deputy  
 Fee \$ 2.00 Paid cash

File No. \_\_\_\_\_

T. 15-N R. 15-W 34

DUPLICATE

County \_\_\_\_\_



STATE OF MONTANA  
ADMINISTRATOR OF GROUNDWATER CODE  
OFFICE OF STATE ENGINEER

Declaration of Vested Groundwater Rights STATE ENGINEER

(Under Chapter 237, Montana Session Laws, 1961)

1. Earl Albert Troutman, Greenough  
(Name of Appropriator) (Address) (Town)

County of Musselshell State of Montana  
have appropriated groundwater according to the Montana laws in effect prior to January 1, 1962, as follows:

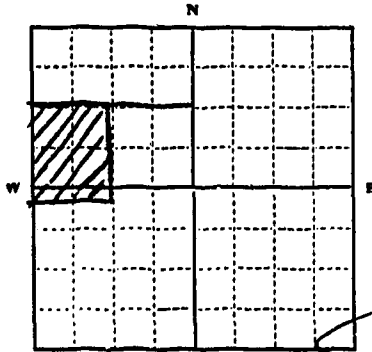

SW 1/4 NW 1/4

pt NW 1/4 SW 1/4 Sec 34 T. 15 R. 15

Indicate point of appropriation and place of use, if possible. Each small square represents 10 acres.

2. The beneficial use on which the claim is based: irrigation

3. Date or approximate date of earliest beneficial use; and how continuous the use has been: About 1927 until present all the time.

4. The amount of groundwater claimed (in miner's inches or gallons per minute): 50 inches of Blainford Creek located Northwest of Sec 34.

5. If used for irrigation, give the acreage and description of the lands to which water has been applied and name of the owner thereof: 2 1/2 NW 1/4 & Pt. SW 1/4 Sec 34 (approx 49.25 ac.) Sec 34, Twp 15, Rge 15

6. The means of withdrawing such water from the ground and the location of each well or other means of withdrawal: irrigation ditches

7. The date of commencement and completion of the construction of the well, wells, or other works for withdrawal of groundwater: about 1927

8. The depth of water table: unknown

9. So far as it may be available, the type, size and depth of each well or the general specifications of any other works for the withdrawal of groundwater: The only well on this property has caved in and will have to be redone.

10. The estimated amount of groundwater withdrawn each year: unknown

11. The log of formations encountered in the drilling of each well if available: unavailable

12. Such other information of a similar nature as may be useful in carrying out the policy of this act, including reference to book and page of any county record: unable to find any records.

Signature of Owner: Earl A. Troutman

Date: Mar 22, 1965

Three copies to be filed by the owner with the County Clerk and Recorder of the county in which the well is located.

Please answer all questions. If not applicable, so state, otherwise the form will be returned.

Original to the County Clerk and Recorder; Duplicate to the State Engineer; Triplicate to the Montana Bureau of Mines and Geology, and Quadruplicate for the Appropriator.

7485

234368

I received and filed this Instrument for  
record on the 22<sup>nd</sup> of May 1965  
at 2:05 o'clock P.M., permanent files  
of Missoula County, State of Montana  
Witness my hand  
Vernon R. Cousins County Recorder  
By Edith H. Smith Deputy  
Fee \$ 2.00 cash paid



STATE OF MONTANA  
 ADMINISTRATOR OF GROUNDWATER CODE  
 MONTANA WATER RESOURCES BOARD

NOTICE OF COMPLETION OF GROUNDWATER  
 APPROPRIATION BY MEANS OF WELL  
 Developed after January 1, 1962

(Under Chapter 237 Montana Session Laws, 1961, as amended)

This form to be prepared by driller, and three copies to be filed by the owner with the County Clerk and Recorder in the county in which the well is located, last copy to be retained by driller.

Please answer all questions. If not applicable, so state, otherwise the form may be returned.

DRILLER'S LOG

Indicate the character, color, thickness of strata such as soil, clay, sand, gravel, shale, sandstone, etc. Show depth at which water is found and height to which water rises in well.

Top of Ground (Elev. above sea level)	
From (Feet)	To (Feet)
0	18
18	30
30	45
45	51

Owner Frank Richards

Address Box 417  
Missoula, Montana

Date well started Sept. 2/71  
 completed Sept. 5/71

For Administrator's Use	
File	<u>391 526387</u>
Date	<u>Dec. 29, 1972</u>
GW	<u>2:20 P.M.</u>

Type of well Drilled  
(Dig, driven, bored or drilled)

Equipment used Cable Tools  
(Cable drill, rotary or other)

Water Use: Domestic  Municipal  Stock  Irrigation   
 Industrial  Drainage  Other \* Garden/Lawn

\*Describe \_\_\_\_\_

USE: If used for irrigation, industrial, drainage or other. Explain, state number of acres and location or other data (i.e. lot, block and Addition). \_\_\_\_\_

ESTIMATED ANNUAL WITHDRAWAL 400,000 gal.

Size of Drilled Hole	Size and Weight of Casing	From (Feet)	To (Feet)	PERFORATIONS		
				Kind	From (Feet)	To (Feet)
6" I.D.	15#	0	51'			

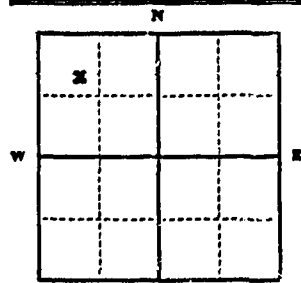

Static water level 30 ft.\*  
 Pumping water level 40 ft.\*  
 at 40 gallons per minute,  
 measured 120 minutes after pumping began.  
 \*Measured from ground level.  
 Well developed by Bailing  
 for two hours.  
 Power..... Pump..... HP  
 Remarks: (Gravel packing, cementing, packers, type of shutoff) \_\_\_\_\_

NW 1/4 SW 1/4 Sec. 9  
 T. 15 N R. 14 22  
22 W

INDICATE LOCATION OF WELL AND PLACE OF USE, IF POSSIBLE. EACH SMALL SQUARE REPRESENTS 40 ACRES.

Driller's Signature \_\_\_\_\_  
 Phone: 62-4356

Driller's Address Box 241, Lincoln, Montana  
St. D. Martin LICENSE NO. 203

51' Show exact depth of bottom

257

326387

I received and filed this instrument for  
 record on the 27 day of March  
 at 2.15 o'clock P. M. permanent file  
 of Missile County State of North  
 Witness my hand  
Veronica R. Cruise County Recorder  
 By [Signature] Deputy  
 Feb 5. 1950 P.M. 1950



RECEIVED

County Missoula

9

STATE OF MONTANA  
 ADMINISTRATOR OF GROUNDWATER CODE  
 MONTANA WATER RESOURCES BOARD

JAN 1973

DRILLER'S LOG

Indicate the character, color, thickness of strata such as soil, clay, sand, gravel, shale, sandstone, etc. Show depth at which water is found and height to which water rises in well.

NOTICE OF COMPLETION OF GROUNDWATER APPROPRIATION BY MEANS OF WELL

Developed after January 1, 1962

(Under Chapter 237 Montana Session Laws, 1961, as amended)

This form to be prepared by driller, and three copies to be filed by the owner with the County Clerk and Recorder in the county in which the well is located, last copy to be retained by driller.

Please answer all questions. If not applicable, so state, otherwise the form may be returned.

Owner Frank Richards

Address Box 417

Missoula, Montana

Date well started Sept. 6/71

completed Sept. 10/71

For Administrator's Use	
File	<u>2592 326388</u>
Date	<u>December 29, 1972</u>
Time	<u>2:25 p.m.</u>

Type of well Drilled

(Dug, driven, bored or drilled)

Equipment used Cable Tools

(Churn drill, rotary or other)

Water Use: Domestic  Municipal  Stock  Irrigation

Industrial  Drainage  Other \* Garden/Lawn

\*Describe

USE: If used for irrigation, industrial, drainage or other. Explain, state number of acres and location or other data (i.e. Lot, Block and Addition).

ESTIMATED ANNUAL WITHDRAWAL 400,000 gal.

Size of Drilled Hole	Size and Weight of Casing	From (Feet)	To (Feet)	PERFORATIONS		
				Kind Size	From (Feet)	To (Feet)
<u>6" I.D.</u>	<u>15#</u>	<u>0</u>	<u>64</u>			

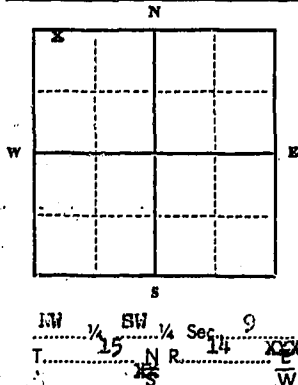

Static water level 3 ft.\*  
 Pumping water level 12 ft.\*  
 at 360 gallons per minute,  
 measured 120 minutes after pumping began.

\*Measured from ground level.  
 Well developed by Pumping  
 for two hours.  
 Power 500 Pump          HP  
 Remarks: (Gravel packing, cementing, packers, type of shutoff)

INDICATE LOCATION OF WELL AND PLACE OF USE, IF POSSIBLE. EACH SMALL SQUARE REPRESENTS 40 ACRES.

Driller's Signature [Signature]  
 Phone 362-4336  
 Driller's Address Box 241, Lincoln, Montana

Top of Ground		(Elev. above sea level)
From (Feet)	To (Feet)	
<u>0</u>	<u>5</u>	<u>top soil</u>
<u>5</u>	<u>40</u>	<u>clay</u>
<u>40</u>	<u>60</u>	<u>sand</u>
<u>60</u>	<u>64</u>	<u>gravel</u>

LICENSE NO. 203

64' Show exact depth of bottom

52,124

2392

326558

I received and filed this instrument for  
record on the 27 day of Dec. 1972  
at 2:30 o'clock P.M. permanent files  
of Missoula County State of Montana  
Witness my hand  
Vermae R. Lewis County Recorder  
By *J. Bellamy* Deputy  
For So. a. a. Paid



9

File No. \_\_\_\_\_

T 15 N R 14 W

RECEIVED  
JUN 8 1972

County Missoula

MONTANA DEPARTMENT OF NATURAL  
RESOURCES AND CONSERVATION

STATE OF MONTANA  
ADMINISTRATOR OF GROUNDWATER CODE  
OFFICE OF STATE ENGINEER

Notice of Appropriation of Groundwater

(Under Chapter 237, Montana Session Laws, 1961)

- I, Frank M. Richards, of P. O. Box 417, Missoula  
(Name of Appropriator) (Address) (Town)  
County of Missoula, State of Montana, intend to appropriate groundwater in accordance with Chapter 237, Montana Session Laws of 1961.
- The beneficial use to which water is to be applied is household and irrigation use  
grass  
(describe lands to be benefited, if for irrigation)
- The rate of use in gallons per minute or miner's inches of groundwater claimed 250 gal.  
per minute
- The annual period (inclusive dates) of intended use yearlong
- The probable or intended date of first beneficial use June 1972
- The probable or intended date of commencement and completion of the well\* or wells\*  
June 11, 1972
- The location, type, size and depth of well or wells contemplated 6 inch well, 65  
feet deep
- The probable or estimated depth of the water table or artesian aquifer 50 feet
- Name, address and license number of the driller engaged M-T Drilling Company,  
Lincoln, Montana
- Give such other similar information as may be useful  
in carrying out the policy of this act \_\_\_\_\_  
\_\_\_\_\_  
\_\_\_\_\_  
\_\_\_\_\_

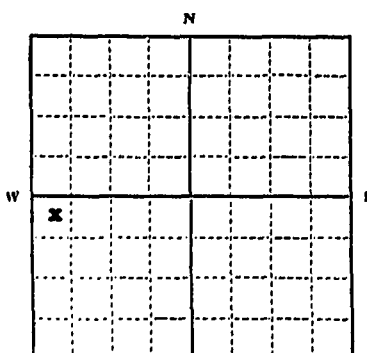

Doc. No. 2282-319596  
Filed for record  
this 5<sup>th</sup> day of June  
A. D. 1972 at 2:30  
P.M. C. M.

SW 1/4 Sec. 9 T15N R14W  
Locate well or other means of  
development as accurately as  
possible on the plat.

Signature of Appropriator Frank M. Richards  
Date 6-5-72

\* As defined in the Code Sec. 1 (c) "Well" means any artificial opening or excavation in the ground, however made, by which groundwater can be obtained or through which it flows under natural pressures or is artificially withdrawn."

Three copies of this notice are to be filed with County Clerk and Recorder of the county in which the well is located.

Please answer all questions. If not applicable, so state, otherwise the form will be returned.

Original to the County Clerk and Recorder; duplicate to the State Engineer; Triplicate to the Montana Bureau of Mines and Geology and Quadruplicate for the Appropriator.

50,556

2287 217596  
I received and filed this instrument for  
record on the 5<sup>th</sup> of Jul. 1972  
at 2:51 P.M. Clerk of the Court  
of Missoula County State of Montana  
Witness my hand  
Martha A. Coyle, County Recorder  
By: *Mary A. Coyle*  
Fee \$.....Paid

August 28, 1972

Mr. Frank M. Richards  
P. O. Box 417  
Missoula, Montana 59801

Dear Mr. Richards:

This is in reference to the enclosed GW-1 form, Notice of Appropriation of Groundwater, that was filed in the Missoula County Courthouse at Missoula, Montana on June 5, 1972 (document number 2287-317596).

The Notice of Appropriation of Groundwater form is simply a "notice" form, which is filed in advance of the commencing of the well construction. Upon well completion the GW-2 form, Notice of Completion of Groundwater Appropriation By Means of Well should be filed.

The GW-1 form, that you have filed does not legally give you or protect your groundwater right. The Groundwater Code specifically states that, "Until a notice of completion (GW-2 form in this case) is filed with respect to any use of groundwater instituted after January 1, 1962, no right to that use of water shall be recognized."

Enclosed is one set (5 sheets to a set) of the GW-2 form in order that you may file your groundwater right properly. Complete the form as accurately and completely as you can and take it to the County Clerk & Recorder for filing.

Also enclosed is a pamphlet entitled, Appropriation and Regulation of Ground Water. Please pay special attention to the areas underlined in red in the first three and one-half pages.

If we can be of further assistance, please feel free to contact us at any time.

Sincerely,

Ronald J. Guse,  
Groundwater Rights Coordinator  
WATER RESOURCES DIVISION

RJG/lk

Enclosures (3)

DEC 2 1971

STATE OF MONTANA  
ADMINISTRATOR OF GROUNDWATER CODE  
MONTANA WATER RESOURCES BOARD  
**NOTICE OF COMPLETION OF GROUNDWATER  
APPROPRIATION BY MEANS OF WELL**  
Developed after January 1, 1962

(Under Chapter 237 Montana Session Laws, 1961, as amended)

This form to be prepared by driller, and three copies to be filed by the owner with the County Clerk and Recorder in the county in which the well is located; last copy to be retained by driller. Please answer all questions. If not applicable, so state, otherwise the form may be returned.

**DRILLER'S LOG**

Indicate the character, color, thickness of strata such as soil, clay, sand, gravel, shale, sandstone, etc. Show depth at which water is found and height to which water rises in well.

Owner State Forester  
Address 2705 Spaurin Road  
Missoula, Montana  
Date well started Oct. 21, 1971  
completed Oct. 25, 1971

For Administrator's Use	
File	<u>310049 #2206</u>
Date	<u>Nov. 29, 1971 4:00 PM</u>
GW	<u>1</u>

Type of well Drilled  
(Dug, driven, bored or drilled)  
Equipment used Churn Drill  
(Churn drill, rotary or other)

Water Use: Domestic  Municipal  Stock  Irrigation   
Industrial  Drainage  Other  Garden/Lawn

\*Describe State Forester's Sperry Grade Station  
USE: If used for irrigation, industrial, drainage or other. Explain, state number of acres and location or other data (i.e. Lot, Block and Addition).

**ESTIMATED ANNUAL WITHDRAWAL**

Size of Drilled Hole	Size and Weight of Casting	From (Foot)	To (Foot)	PERFORATIONS		
				Kind Size	From (Foot)	To (Foot)
<u>6" ID</u>	<u>6" ID 19 lb perft.</u>	<u>2' 9"</u>	<u>48'</u>			

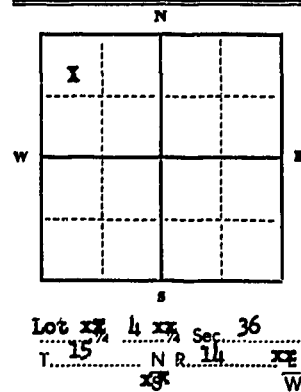

Static water level 30 ft.\*  
Pumping water level 38 ft.\*  
at 13 gallons per minute,  
measured 1/3 minutes after pumping  
began.  
\*Measured from ground level.  
Well developed by test pump  
for 75 hours.  
Power Elec Pump 3/4 HP  
Remarks: (Gravel packing, cementing,  
packers, type of shutoff) 10' of Grout

Top of Ground (Elev. above sea level)

From (Foot)	To (Foot)	Strata
<u>0</u>	<u>4</u>	<u>Boulders, Gravel &amp; Clay</u>
<u>4</u>	<u>23</u>	<u>Gravel &amp; Brown Clay</u>
<u>23</u>	<u>35</u>	<u>Sand &amp; Brown Clay</u>
<u>35</u>	<u>40</u>	<u>Sand Gravel &amp; Water</u>
<u>40</u>	<u>42</u>	<u>Clay Sand &amp; Gravel &amp; Water</u>
<u>42</u>	<u>48</u>	<u>Gravel &amp; Water</u>

INDICATE LOCATION OF WELL AND PLACE OF USE, IF POSSIBLE. EACH SMALL SQUARE REPRESENTS 40 ACRES.

Driller's Signature [Signature]  
CAMP WELL DRILLING & PUMP SUPPLY  
Driller's Address 1522 S. 14th W., Missoula, Montana 59801  
LICENSE NO. 7

48' Show exact depth of bottom

# 2206

310049

I received and filed this instrument for  
record on the 29<sup>th</sup> day of Nov. 1921  
at 4.00 o'clock P.M. permanent files  
of Missoula County, State of Montana  
Witness my hand.  
Vernon R. Crouse, County Recorder  
By Frank Miskala, Deputy  
Fee 1.00 Paid

MONTANA WATER RESOURCE  
**RECEIVE**  
OCT 4 1971

STATE OF MONTANA  
ADMINISTRATOR OF GROUNDWATER CODE  
MONTANA WATER RESOURCES BOARD

**NOTICE OF COMPLETION OF GROUNDWATER  
APPROPRIATION BY MEANS OF WELL**

Developed after January 1, 1962

(Under Chapter 237 Montana Session Laws, 1961, as amended)

This form to be prepared by driller, and three copies to be filed by the owner with the County Clerk and Recorder in the county in which the well is located, last copy to be retained by driller. Please answer all questions. If not applicable, so state, otherwise the form may be returned.

Owner WALTER M. VANNOV  
Address Greenough  
Montana  
Date well started Sept. 1965  
completed Sept. 1965

For Administrator's Use	
File	<u>308142</u> <u>September 30, '71</u> <u>2:30 PM</u>
GW 1	

Type of well Drilled Driven  
(Dug, driven, bored or drilled)  
Equipment used Shank Driver  
(Churn drill, rotary or other)  
Water Use: Domestic  Municipal  Stock  Irrigation   
Industrial  Drainage  Other \* Garden/Lawn

\*Describe \_\_\_\_\_  
USE: If used for Irrigation, Industrial, drainage or other. Explain, state number of acres and location or other data (i.e. Lot, Block and Addition). 2.65 acres used restaurant, residence and truck stop

ESTIMATED ANNUAL WITHDRAWAL 100,000 gallons

Size of Drilled Hole	Size and Weight of Casing	From (Foot)	To (Foot)	PERFORATIONS		
				Kind Rise	From (Foot)	To (Foot)
<u>Driven 1 1/2" pipe</u>	<u>1 1/2" Galvan. Gas pipe</u>	<u>0'</u>	<u>33'</u>	<u>Sand</u>	<u>Point</u>	

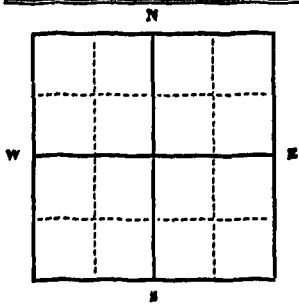

SW 1/4 SE 1/4 Sec. 34  
T. 15 N. R. 14 EX  
SX W

10' below  
Static water level surface ft.\*  
Pumping water level \_\_\_\_\_ ft.\*  
at \_\_\_\_\_ gallons per minute,  
measured \_\_\_\_\_ minutes after pumping  
began. Not tested  
\*Measured from ground level.  
Well developed by \_\_\_\_\_  
for \_\_\_\_\_ hours.  
Power \_\_\_\_\_ Pump \_\_\_\_\_ HP  
Remarks: (Gravel packing, cementing,  
packers, type of shutoff)  
shallow well pump

INDICATE LOCATION OF WELL AND PLACE OF USE, IF POSSIBLE. EACH SMALL SQUARE REPRESENTS 40 ACRES.

Driller's Signature Carl Skerker  
Driller's Address Garrison, Montana

LICENSE NO. \_\_\_\_\_

Top of  
From (Foot)  
61  
9'  
4'  
24'



2157

308142

Received and filed this instrument  
 on the 30 day of Sept.  
 at 3 o'clock P.M., 1902  
 in Lincoln County, State of N.C.  
 Witness my hand:  
 Veranda H. Cruse, County Clerk  
 By *[Signature]* Deputy  
 Fee \$2.00 *[Signature]*

RECORDED  
 111  
 1902  
 308142

RECEIVED  
 DEC 11 1970

County Missoula 35

STATE OF MONTANA  
 ADMINISTRATOR OF GROUNDWATER CODE  
 MONTANA WATER RESOURCES BOARD

NOTICE OF COMPLETION OF GROUNDWATER  
 APPROPRIATION BY MEANS OF WELL

Developed after January 1, 1962

(Under Chapter 237 Montana Session Laws, 1961, as amended)

This form to be prepared by driller, and three copies to be filed by the owner with the County Clerk and Recorder in the county in which the well is located, last copy to be retained by driller. Please answer all questions. If not applicable, so state, otherwise the form may be returned.

Owner Walter Vanney

Address Greeneough, Montana

Date well started Nov. 20, 1970 GW 1

completed Nov. 25, 1970

For Administrator's Use  
 File 2975 S1  
December 8, 1970  
S. O. P. M.

Type of well Drilled  
 (Dug, driven, bored or drilled)

Equipment used Churn Drill  
 (Churn drill, rotary or other)

Water Use: Domestic  Municipal  Stock  Irrigation   
 Industrial  Drainage  Other  Garden/Lawn

\*Describe

USE: If used for irrigation, industrial, drainage or other. Explain, state number of acres and location or other data (i.e. Lot, Block and Addition).

ESTIMATED ANNUAL WITHDRAWAL

Size of Drilled Hole	Size and Weight of Casing	From (Feet)	To (Feet)	PERFORATIONS		
				Kind Size	From (Feet)	To (Feet)
6" ID	6" ID	1' above g.l.	27'		none	

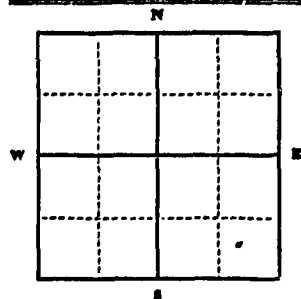

Static water level 17 ft.\*  
 Pumping water level 17 ft.\*  
 at 20 gallons per minute,  
 measured 0 minutes after pumping  
 began.  
 \*Measured from ground level.  
 Well developed by Test Pump  
 for 1 hours.  
 Power Electric Pump 1 HP  
 Remarks: (Gravel packing, cementing,  
 packers, type of shutoff)

INDICATE LOCATION OF WELL AND PLACE OF USE, IF POSSIBLE.  
 EACH SMALL SQUARE REPRESENTS 40 ACRES.

Driller's Signature Walter Vanney  
 Driller's Address CAMP WELL DRILLING & SUPPLY  
1522 S. 14th W. Missoula, Montana

DRILLER'S LOG

Indicate the character, color, thickness of strata such as soil, clay, sand, gravel, shale, sandstone, etc. Show depth at which water is found and height to which water rises in well.

Top of Ground		(Elev. above sea level)
From (Feet)	To (Feet)	
0	8	Well - Clearwater Area
		Black Dirt
8	21	Brown Clay & Gravel
21	27	Gravel & Water

LICENSE NO. 7

27 Show exact depth of bottom

47885

2070

297551

I received and filed this instrument for  
record on the 8<sup>th</sup> day of Dec 1970  
at 3:00 o'clock P. M., permanent file  
in Missouri County, State of Missouri  
Witness my hand:  
Verance R. Cross, County Recorder  
By *M. M. [Signature]* Deputy  
Fee \$2.00

GW 2

File No. ....

DUPLICATE

RECEIVED

MAR 2 1964

T. 15<sup>N</sup> R. 14<sup>W</sup>

County .....

STATE OF MONTANA  
ADMINISTRATOR OF GROUNDWATER CODE  
OFFICE OF STATE ENGINEER

### Notice of Completion of Groundwater Appropriation by Means of Well

(Under Chapter 237, Montana Session Laws, 1961)

Top of Ground  
(Elev. above sea level .....) )

0 to 45' Clay & boulders

45' to 49'-2" Gravel

and water.

Owner: R.L. Clark Address: 329 Plymouth, Missoula

Driller: Glenn Camp 703 Alder Address: Missoula, Mont

Date of Notice of Appropriation of Groundwater .....

Date well started: 5/17/63 Date Completed: 5/20/63

Type of well: drilled Equipment Used: Churn Drill  
(dug, driven, bored or drilled) (Churn, drill, rotary or other)

Water Use: Domestic  Municipal  Other  Irrigation   
Industrial  Drainage  Stock

Indicate on the diagram the character and thickness of the different strata met with in drilling, such as soil, clay, shale, gravel, rock or sand, etc. Show depth at which water is encountered, thickness and character of water-bearing strata and height to which water rises in the well.

Size of Drilled Hole	Size and Weight of Casing	From (Foot)	To (Foot)	PERFORATIONS		
				Kind Size	From (Foot)	To (Foot)
6"	6" I.D. seamless 19 lbs	6" Above S.L.	to 49'-10"	None		

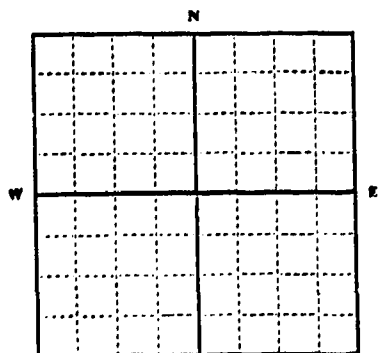

1/4 Sec. 36, T. 15N, R. 14W

Indicate location of well and place of use, if possible. Each small square represents 10 acres.

Show exact depth of bottom.

Static Water Level for non-flowing Well: 35' from S.L. feet.

Shut-in Pressure for Flowing Well .....

Pumping Water Level: 35 feet at 20 gal. per minute.

Discharge in gal. per min. of flowing well .....

How Tested: Ballow Length of Test: 2 hours

Remarks: (Gravel packing, cementing, packers, type of shutoff, location of place of use of groundwater if not at well, and any other similar pertinent information, including number of acres irrigated, if used for irrigation) .....

License # 7  
Driller's License Number

Glenn Camp  
Driller's Signature

This form to be prepared by driller, and three copies to be filed by the owner with the County Clerk and Recorder in the county in which the well is located.

Please answer all questions. If not applicable, so state, otherwise the form will be returned.

Original to the County Clerk and Recorder; duplicate to the State Engineer; Triplicate to the Montana Bureau of Mines and Geology and Quadruplicate for the Appropriator.

33754

216420

*Copy*  
 I received and filed this instrument for record on the 16 day of January, 1926, at 11:12 o'clock A.M. permanent files of Missoula County, State of Montana  
 Witness my hand:  
 MARTIN S. BEHNER, County Recorder  
 By [Signature] Deputy  
 Fee \$        Paid

MISSOULA COUNTY  
 DEPARTMENT OF REVENUE  
 RECEIVED  
 JAN 17 1926  
 MISSOULA, MONTANA

DATE	AMOUNT	RECEIVED BY	REMARKS
13 Jan	100.00	[Signature]	[Illegible]
14 Jan	100.00	[Signature]	[Illegible]
15 Jan	100.00	[Signature]	[Illegible]
16 Jan	100.00	[Signature]	[Illegible]
17 Jan	100.00	[Signature]	[Illegible]
18 Jan	100.00	[Signature]	[Illegible]
19 Jan	100.00	[Signature]	[Illegible]
20 Jan	100.00	[Signature]	[Illegible]
21 Jan	100.00	[Signature]	[Illegible]
22 Jan	100.00	[Signature]	[Illegible]
23 Jan	100.00	[Signature]	[Illegible]
24 Jan	100.00	[Signature]	[Illegible]
25 Jan	100.00	[Signature]	[Illegible]
26 Jan	100.00	[Signature]	[Illegible]
27 Jan	100.00	[Signature]	[Illegible]
28 Jan	100.00	[Signature]	[Illegible]
29 Jan	100.00	[Signature]	[Illegible]
30 Jan	100.00	[Signature]	[Illegible]
31 Jan	100.00	[Signature]	[Illegible]

36

File No. ....

T. 15N R. 14W

DUPLICATE

County Missoula

STATE OF MONTANA  
ADMINISTRATOR OF GROUNDWATER CODE  
OFFICE OF STATE ENGINEER

RECEIVED  
DEC 26 1963

Declaration of Vested Groundwater Rights

(Under Chapter 237, Montana Session Laws, 1961)

STATE ENGINEER

1. Merl Decker, of Greenough, Montana  
(Name of Appropriator) (Address) (Town)

County of Missoula State of Montana  
have appropriated groundwater according to the Montana laws in effect prior to January 1, 1962, as follows:

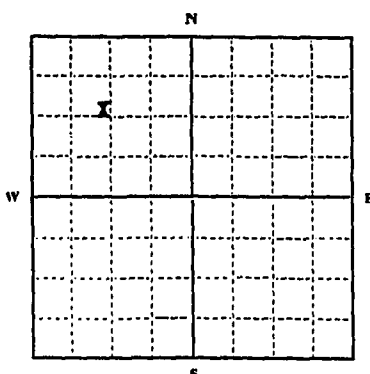

NE 1/4 Sec. 36 T. 15N R. 14W  
Indicate point of appropriation and place of use, if possible. Each small square represents 10 acres.

2. The beneficial use on which the claim is based.....  
household use.

3. Date or approximate date of earliest beneficial use; and how continuous the use has been.....  
June 1954 with use continuous.

4. The amount of groundwater claimed (in miner's inches or gallons per minute).....  
50 GPM

5. If used for irrigation, give the acreage and description of the lands to which water has been applied and name of the owner thereof.....  
Garden and lawn. Merl Decker

6. The means of withdrawing such water from the ground and the location of each well or other means of withdrawal.....  
Shallow well pump under residence.

7. The date of commencement and completion of the construction of the well, wells, or other works for withdrawal of groundwater.....  
June 1954

8. The depth of water table.....  
6 ft.

9. So far as it may be available, the type, size and depth of each well or the general specifications of any other works for the withdrawal of groundwater.....  
driven, sandpoint, 2", 38 ft.

10. The estimated amount of groundwater withdrawn each year.....  
N.A.

11. The log of formations encountered in the drilling of each well if available.....  
N.A.

12. Such other information of a similar nature as may be useful in carrying out the policy of this act, including reference to book and page of any county record.....  
N.A.

Signature of Owner Merl Decker

Date DECEMBER 14, 1963

Three copies to be filed by the owner with the County Clerk and Recorder of the county in which the well is located.

Please answer all questions. If not applicable, so state, otherwise the form will be returned.

Original to the County Clerk and Recorder; Duplicate to the State Engineer; Triplicate to the Montana Bureau of Mines and Geology, and Quadruplicate for the Appropriator.

12305

485  
C

2146 31

I received and filed this instrument for  
record on the 27 day of Dec 1967  
at 11 o'clock A.M., permanent file  
of Missoula County, State of Montana  
Witness my hand:  
By Wm. S. Smith County Recorder  
Fee \$ 2.00 Paid

MISSOULA COUNTY RECORDS DEPARTMENT  
MISSOULA, MONTANA

RECEIVED  
OCT 1 1957

T. 15N R. 14W 36  
County Missoula county

STATE ENGINEER MONTANA BUREAU OF MINES AND GEOLOGY  
Butte, Montana

WATER WELL LOG

7		

Owner RAY JENSEN *Loc'd from 1001* Address 1654 SO 9TH WEST

Driller JOHN FARRELL Address ARLEE MONT

Date Started SEPT 16 1957 Date Completed SEPT 21 1957

Location: Sec. 36 T. 15N R. 14W 1/4 sec. MPM

Type of well DRILLED Equipment used CHURN  
(Dig, driven, bored, or drilled) (Churn drill, rotary, other)

Water use: Domestic  Municipal  Stock  Irrigation

Industrial  Drainage  Other: \_\_\_\_\_

Casing: \_\_\_\_\_ ft. to 39 ft. Type 6" WROT IRON Size 6"

Casing: \_\_\_\_\_ ft. to \_\_\_\_\_ ft. Type \_\_\_\_\_ Size \_\_\_\_\_

Casing: \_\_\_\_\_ ft. to \_\_\_\_\_ ft. Type \_\_\_\_\_ Size \_\_\_\_\_

Perforated or Screened: Ft. \_\_\_\_\_ to ft. \_\_\_\_\_ Ft. \_\_\_\_\_ to ft. \_\_\_\_\_

Type of screen or perforations \_\_\_\_\_

Static Water level, for non-flowing well: 161 feet.

Shut-in pressure, for flowing well: \_\_\_\_\_ lb./sq. in. on: \_\_\_\_\_ (date)

Pumping water level \_\_\_\_\_ feet at \_\_\_\_\_ gal. per min.

How tested: NONE

Length of test \_\_\_\_\_

Remarks: (Gravel packing, cementing, packers, type of shut-off, depth of shut-off)

\_\_\_\_\_  
\_\_\_\_\_  
\_\_\_\_\_  
\_\_\_\_\_

(over)





RECEIVED  
FEB 20 1964

T. 15 N. R. 14 West  
County... Missoula

File No. \_\_\_\_\_  
DUPLICATE

*Filing date?*

STATE ENGINEER  
ADMINISTRATOR OF GROUNDWATER CODE  
OFFICE OF STATE ENGINEER

RECEIVED  
JAN 2 1964  
STATE ENGINEER

**Declaration of Vested Groundwater Rights**  
(Under Chapter 237, Montana Session Laws, 1961)

1. K.L. Jacobsen, of Greenough Montana  
(Name of Appropriator) (Address) (Town)  
County of Missoula State of Montana  
have appropriated groundwater according to the Montana laws in effect prior to January 1, 1962, as follows:

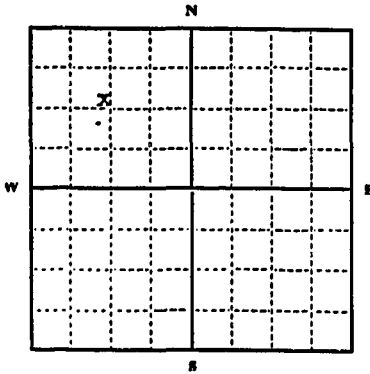

NW 1/4 Sec. 36 T. 15 N. R. 14 W

Indicate point of appropriation and place of use, if possible. Each small square represents 10 acres.

2. The beneficial use on which the claim is based.....  
Household use

3. Date or approximate date of earliest beneficial use; and how continuous the use has been.....  
1954 with continuous use

4. The amount of groundwater claimed (in miner's inches or gallons per minute).....  
50 Gallons pr. Minute

5. If used for irrigation, give the acreage and description of the lands to which water has been applied and name of the owner thereof.....  
Garden and Lawn, K.L. Jacobsen

6. The means of withdrawing such water from the ground and the location of each well or other means of withdrawal.....  
Shallow Well, Pump under Residence

7. The date of commencement and completion of the construction of the well, wells, or other works for withdrawal of groundwater.....  
June 1954

8. The depth of water table.....  
8 ft.

9. So far as it may be available, the type, size and depth of each well or the general specifications of any other works for the withdrawal of groundwater.....  
Driven, Sand Point, 1 1/2" Pipe

10. The estimated amount of groundwater withdrawn each year.....  
N.A.

11. The log of formations encountered in the drilling of each well if available.....  
N.A.

12. Such other information of a similar nature as may be useful in carrying out the policy of this act, including reference to book and page of any county record.....  
N.A.

Signature of Owner K.L. Jacobsen  
Date 12-28-63

Three copies to be filed by the owner with the County Clerk and Recorder of the county in which the well is located.

Please answer all questions. If not applicable, so state, otherwise the form will be returned.

Original to the County Clerk and Recorder; Duplicate to the State Engineer; Triplicate to the Montana Bureau of Mines and Geology, and Quadruplicate for the Appropriator.

1379 216835

I received and filed this instrument for  
record on the 27 day of Jan 1964  
at 3:40 o'clock P.M., permanent files  
of Missoula County, State of Montana  
Witness my hand:  
MARTIN S. BEHNER, County Recorder  
By Ethel L. Linn Deputy  
Fee \$2.00 Paid

RECEIVED

Approved Stock Form - State Publishing Co., Helena, Montana - 42234

36

GV

File No. ....

FEB 7 1964

T. 15N. R. 14W

TRIPPLICATE

County MISSOULA

STATE OF MONTANA  
ADMINISTRATOR OF GROUNDWATER CODE  
OFFICE OF STATE ENGINEER

RECEIVED  
DEC 30 1963

Declaration of Vested Groundwater Rights STATE ENGINEER

(Under Chapter 237, Montana Session Laws, 1961)

1. Office of State Forester, of 1209 Lolo, Missoula, Montana  
(Name of Appropriator) (Address) (Town)

County of Missoula State of Montana  
have appropriated groundwater according to the Montana laws in effect prior to January 1, 1962, as follows:

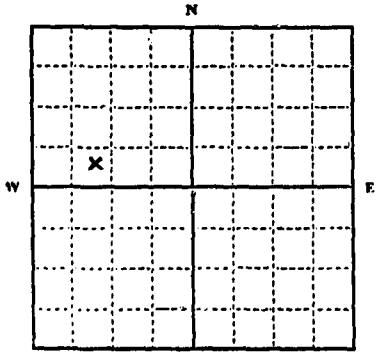

2. The beneficial use on which the claim is based. Household

3. Date or approximate date of earliest beneficial use; and how continuous the use has been. In continuous use since 1944

4. The amount of groundwater claimed (in miner's inches or gallons per minute). 50 gal/minute

5. If used for irrigation, give the acreage and description of the lands to which water has been applied and name of the owner thereof. Not applicable

6. The means of withdrawing such water from the ground and the location of each well or other means of withdrawal. Shallow well pump-located approximately 100' from Clearwater State Ranger Station

NW 1/4 Sec 36 T. 15N R. 14W

Indicate point of appropriation and place of use, if possible. Each small square represents 10 acres.

7. The date of commencement and completion of the construction of the well, wells, or other works for withdrawal of groundwater. Information not available

8. The depth of water table. Eight feet

9. So far as it may be available, the type, size and depth of each well or the general specifications of any other works for the withdrawal of groundwater. Dug well, 6" casing - shallow well pump 50 gal/min capacity

10. The estimated amount of groundwater withdrawn each year. Eight feet - - well is dry each year from Dec. 15th thru March.

11. The log of formations encountered in the drilling of each well if available. Not available

12. Such other information of a similar nature as may be useful in carrying out the policy of this act, including reference to book and page of any county record. Additional information not available

Office of State Forester

Signature of Owner [Signature] Deputy State Forester

Date 12-27-63

Three copies to be filed by the owner with the County Clerk and Recorder of the county in which the well is located.

Please answer all questions. If not applicable, so state, otherwise the form will be returned.

Original to the County Clerk and Recorder; Duplicate to the State Engineer; Triplicate to the Montana Bureau of Mines and Geology, and Quadruplicate for the Appropriator.

34847

215285

194

I received and filed this instrument for  
record on the 7<sup>th</sup> day of Dec 1967  
at 8:45 A.M. o'clock A.M., permanent files  
of Missoula County, State of Montana  
Witness my hand:  
MARTIN S. BEHNER, County Recorder  
By *Martin S. Behner* Deputy  
Fee \$..... Paid

MISSOULA COUNTY



File No. \_\_\_\_\_

MONTANA WATER RESOURCES BOARD

T. 14N R. 23W 2

RECEIVED

DUPLICATE

County Missoula

LOG

11/18 4 1969

STATE OF MONTANA  
ADMINISTRATOR OF GROUNDWATER CODE  
OFFICE OF STATE ENGINEER

Top of Ground \_\_\_\_\_  
Approx. \_\_\_\_\_  
(Elev. above sea level 3000')

**Notice of Completion of Groundwater  
Appropriation by Means of Well**  
DEVELOPED AFTER JANUARY 1, 1962

(Under Chapter 237, Montana Session Laws, 1961)

Formations Log:

- 0 - 38 Brown sandy gravel.
- 38 - 41 Gravel imbedded in tan clay.
- 41 - 82 Sandy tan clay.
- 82 - 133 Fine silty sand & few scattered gravels. Seeps of water.
- 133 - 203 Gray clay with a few gravels imbedded. Seeps of muddy water.
- 203 - 208 Fairly clean gray sand with few gravels mixed in.
- 208 - 212 Red sand & gravel mixed in red clay.
- 212 - 219 Gravel imbedded in reddish brown clay.
- 219 - 227 Reddish brown clay.
- 227 - 242 Tan sand and gravel. Clean water.
- 242 - 246 Tight red gravel. Seeps of water.
- 246 - 248 Red rock.

Owner Northwest Indian Bible School Alberton, Mont. Address \_\_\_\_\_

Driller Liberty Drilling Co. Address Missoula, Montana

Date of Notice of appropriation of groundwater None filed

Date well started 9/17/68 Date completed 10/15/68

Type of well Drilled Equipment used Cable Tools  
(Dug, Driven, bored or drilled) (Churn drill, rotary or other)

Water use: Domestic  Municipal  Stock  Irrigation   
Industrial  Drainage  Other

Indicate on the diagram the character and thickness of the different strata met with in drilling, such as soil, clay, shale, gravel, rock or sand, etc. Show depth at which water is encountered, thickness and character of water-bearing strata and height to which the water rises in the well.

Size of Drilled Hole	Size and Weight of Casing	From (Feet)	To (Feet)	PERFORATIONS		
				Kind Size	From (Feet)	To (Feet)
8"	8 5/8" OD x 1/4"	1.6"	227'	Johnson Wire Wound Water Well Screen with .020 continuous slot opening	from 227	242

A 7 5/8 inch OD blank tailpipe  
with solidly closed bottom extends 242' 248'  
Static Water Level for non-flowing well 74.8 ft.

	x		

Shut-in Pressure for Flowing Well Non-f  
Pumping Water Level 126' feet  
at 225 gal. per minute.  
Discharge in gal. per min. of flowing well Non-flowing

How Tested Air Lift Pump  
Length of Test Thirty hours

Remarks: (Gravel packing, cementing, packers, type of shutoff) All water entering well is coming through slot openings in screen. Wells in this area can be depended upon to produce clear

NW 1/4 SE Sec. 2 T14N R23W  
Indicate location of well and place of use, if possible. Each small square represents 40 acres.

sand free water year after year as long as they are not overpumped, i.e., they should be pumped at rates not in excess of 50 to 60 percent of the tested capacity of the aquifer.

USE—If used for irrigation, industrial, drainage or other. Explain, state number of acres and location or other data (i.e.: Lot, Block and Addition).

Approximately 257 acres.

Show exact depth of bottom.  
Bottom of well 248'

This form to be prepared by driller, and three copies to be filed by the owner with the County Clerk and Recorder in the county in which the well is located, tissue copy to be retained by driller.

Please answer all questions. If not applicable, so state, otherwise the form will be returned.

52  
Driller's License Number

William B. Colburn  
Driller's Signature

15497

# 1924

283513

I received and filed this instrument for  
record on the 31<sup>st</sup> day of July, 1969,  
at 3:40 o'clock P. M. permanent files  
of Missoula County, State of Montana  
Witness my hand:  
Yvonne R. Crouse, County Recorder  
By *Montana M. [Signature]*  
For S. [Signature]

MISSOULA COUNTY RECORDS

5



RECEIVED

County Missoula 12

STATE OF MONTANA  
ADMINISTRATOR OF GROUNDWATER CODE  
MONTANA WATER RESOURCES BOARD  
MONTANA DEPARTMENT OF NATURAL RESOURCES AND CONSERVATION  
**NOTICE OF COMPLETION OF GROUNDWATER APPROPRIATION BY MEANS OF WELL**

MAR 13 1972

DRILLER'S LOG

Indicate the character, color, thickness of strata such as soil, clay, sand, gravel, shale, sandstone, etc. Show depth at which water is found and height to which water rises in well.

Developed after January 1, 1962

(Under Chapter 237 Montana Session Laws, 1961, as amended)

This form to be prepared by driller, and three copies to be filed by the owner with the County Clerk and Recorder in the county in which the well is located, last copy to be retained by driller. Please answer all questions. If not applicable, so state, otherwise the form may be returned.

Owner Karen Armstrong

Address Alberton

Date well started Nov 1971

completed 11/71

Type of well Drilled  
(Dug, driven, bored or drilled)

Equipment used Churn Drill  
(Churn drill, rotary or other)

Water Use: Domestic  Municipal  Stock  Irrigation   
Industrial  Drainage  Other \* Garden/Lawn

\*Describe \_\_\_\_\_  
USE: If used for irrigation, industrial, drainage or other. Explain, state number of acres and location or other data (i.e. Lot, Block and Addition). \_\_\_\_\_

ESTIMATED ANNUAL WITHDRAWAL

Size of Drilled Hole	Size and Weight of Casing	From (Feet)	To (Feet)	PERFORATIONS		
				Kind Size	From (Feet)	To (Feet)
6" id	250 x 6" id	0	175	does not apply		

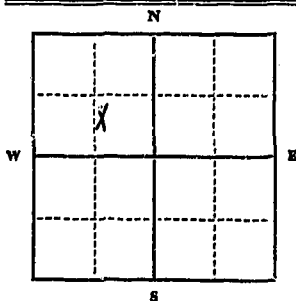

Static water level 18 ft.\*  
Pumping water level 90 ft.\*  
at 15 gallons per minute,  
measured 60 minutes after pumping  
began.

\*Measured from ground level.  
Well developed by bail & pump  
for 32 hours.  
Power 110 Pump 1 HP  
Remarks: (Gravel packing, cementing,  
packers, type of shutoff) \_\_\_\_\_

NE 1/4 13 Sec. 13  
T. 14 R. 23

INDICATE LOCATION OF WELL AND PLACE OF USE, IF POSSIBLE. EACH SMALL SQUARE REPRESENTS 40 ACRES.

Driller's Signature Eugene S. Kane

Driller's Address St. Regis, Montana

LICENSE NO. 23

Top of Ground (Elev. above sea level)		
From (Feet)	To (Feet)	
0	22	gravel, clay
22	40	fine sand water
40	62	hard pack sand
62	95	blue clay
95	143	fine sand clay mix
143	151	clay gravel sand
151	158	gravel sand water
158	170	rock
170	175	fractured rock gravel water

175 Show exact depth of bottom

50,029



STATE OF MONTANA  
ADMINISTRATOR OF GROUNDWATER CODE  
MONTANA WATER RESOURCES BOARD

NOV 26 1971

DRILLER'S LOG

Indicate the character, color, thickness of strata such as soil, clay, sand, gravel, shale, sandstone, etc. Show depth at which water is found and height to which water rises in well.

NOTICE OF COMPLETION OF GROUNDWATER  
APPROPRIATION BY MEANS OF WELL

Developed after January 1, 1962

(Under Chapter 237 Montana Session Laws, 1961, as amended)

This form to be prepared by driller, and three copies to be filed by the owner with the County Clerk and Recorder in the county in which the well is located, last copy to be retained by driller.

Please answer all questions. If not applicable, so state, otherwise the form may be returned.

Owner R.H.B. N. Buery  
Ralph Buery

Address Alberton, Montana

Date well started Nov 1971

completed Nov 1971

Type of well Drilled  
(Dug, driven, bored or drilled)

Equipment used Churn Drill  
(Churn drill, rotary or other)

Water Use: Domestic  Municipal  Stock  Irrigation

Industrial  Drainage  Other \* Garden/Lawn

\*Describe

USE: If used for irrigation, industrial, drainage or other. Explain, state number of acres and location or other data (i.e. Lot, Block and Addition).

ESTIMATED ANNUAL WITHDRAWAL

Size of Drilled Hole	Size and Weight of Casing	From (Feet)	To (Feet)	PERFORATIONS		
				Kind Size	From (Feet)	To (Feet)
6" id	.250 x 6" id	0	165 <sup>3</sup>	does not apply		

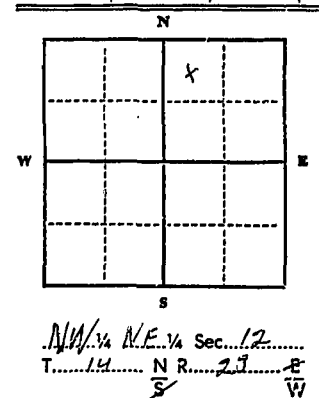

Static water level 13 ft.\*  
Pumping water level 90 ft.\*  
at 25 gallons per minute,  
measured 120 minutes after pumping  
began.  
\*Measured from ground level.  
Well developed by ball & pump  
for 3 hours.  
Power 110 Pump 1 HP  
Remarks: (Gravel packing, cementing,  
packers, type of shutoff)

INDICATE LOCATION OF WELL AND PLACE OF USE, IF POSSIBLE. EACH SMALL SQUARE REPRESENTS 40 ACRES.

Driller's Signature Keystone & Kane

Driller's Address St. Regis, Montana

LICENSE NO. 25

Top of Ground		(Elev. above sea level)
From (Feet)	To (Feet)	
0	15	hardpan gravel
15	20	gravel, sand, water
20	57	fine sand, water
57	85	clay, fine sand, water
85	90	fine sand, water
90	147	fine sand clay water
147	157	clay, sand, gravel water
157	165 <sup>3</sup>	fractured Rock, sand water

165<sup>3</sup> Show exact depth of bottom

#2202

309772

I received and filed this instrument of record on the 19th day of Nov. 1971 at 1:00 o'clock P.M. in the office of Minnsoula County State of Montana. Witness my hand.

Vernice A. Crites, County Recorder

By Shirley G. Galt, Deputy

Fee \$ 2.00 Paid

RECEIVED

THIS NUMBER OF COPIES AND LOCATION OF OTHER COPIES (if any) MUST BE USED FOR INSTRUMENT INFORMATION PURPOSES OF OTHER AGENCIES.

Duplicate  
 Original  
 Other

STATE OF MONTANA  
ADMINISTRATOR OF GROUNDWATER CODE  
MONTANA WATER RESOURCES BOARD

RECEIVED

DRILLER'S LOG

NOTICE OF COMPLETION OF GROUNDWATER  
APPROPRIATION BY MEANS OF WELL

Developed after January 1, 1962

Indicate the character, color, thickness of strata such as soil, clay, sand, gravel, shale, sandstone, etc. Show depth at which water is found and height to which water rises in well.

(Under Chapter 237 Montana Session Laws, 1961, as amended)

This form to be prepared by driller, and three copies to be filed by the owner with the County Clerk and Recorder in the county in which the well is located, last copy to be retained by driller.

Please answer all questions. If not applicable, so state, otherwise the form may be returned.

Owner Pierre Longpre

Address Alberton, Montana

Date well started May 1970

completed May 1970

Type of well drilled

Equipment used churn drill

Water Use: Domestic  Municipal  Stock  Irrigation

Industrial  Drainage  Other  Garden/Lawn

\*Describe

USE: If used for irrigation, industrial, drainage or other. Explain, state number of acres and location or other data (i.e. Lot, Block and Addition).

ESTIMATED ANNUAL WITHDRAWAL

Size of Drilled Hole	Size and Weight of Casing	From (Feet)	To (Feet)	PERFORATIONS		
				Kind Size	From (Feet)	To (Feet)
6" 22	6 x 250	0	172			

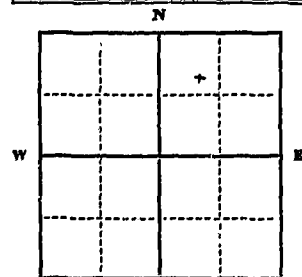

Static water level flowing ft.\*  
Pumping water level .....ft.\*  
at .....gallons per minute,  
measured .....minutes after pumping  
began.  
\*Measured from ground level.  
Well developed by 20  
for .....hours.  
Power..... Pump..... HP  
Remarks: (Gravel packing, cementing,  
packers, type of shutoff) .....

Lots 7 & 8 of Cinderella Estates, a platted subdivision...  
in Missoula County, Montana, according  
to 14 N 25 E to the official recorded plat...  
S W thereof.

INDICATE LOCATION OF WELL AND PLACE OF USE, IF POSSIBLE.  
EACH SMALL SQUARE REPRESENTS 40 ACRES.

Driller's Signature Eugene S. Kane

Driller's Address St. Regis, Montana

LICENSE NO. 23

Top of Ground		(Elev. above sea level)
From (Feet)	To (Feet)	
0	13	gravel & clay
13	96	sandy clay
96	110	hard brown clay
110	140	brown clay
140	146	fine sand & water
146	159	brown clay & gravel
159	161	sandy clay
161	169	hard brown clay
169	172	gravel & water

172 Show exact depth of bottom

# 2009

292575

I received and filed this instrument for  
 record on the 29 day of June 19 70  
 at 3:15 o'clock P.M. permanent files  
 of Missoula County, State of Montana.  
 Witness my hand:  
Jerome B. Crane County Recorder  
 By Barbara L. [Signature] Deputy  
 Fee \$ 2.00 cash paid

MISSOULA COUNTY  
 CLERK OF DISTRICT COURT  
 MISSOULA, MONTANA

RECORDED AND INDEXED

INDEXED

RECORDED

FILED

MISSOULA COUNTY, MONTANA

JUN 29 1970

3:15 P.M.

292575

2009

STATE OF MONTANA  
ADMINISTRATOR OF GROUNDWATER CODE  
MONTANA WATER RESOURCES BOARD

**NOTICE OF COMPLETION OF GROUNDWATER APPROPRIATION BY MEANS OF WELL**  
Developed after January 1, 1962

(Under Chapter 237 Montana Session Laws, 1961, as amended)

This form to be prepared by driller, and three copies to be filed by the owner with the County Clerk and Recorder in the county in which the well is located, last copy to be retained by driller. Please answer all questions. If not applicable, so state, otherwise the form may be returned.

Owner James Angus  
Address St. Regis, Montana

For Administrator's Use  
File June 29, 1970  
3:45 p.m.  
GW 292575

Date well started May 1970  
completed May 1970

Type of well dilled  
(Dig, driven, bored or drilled)  
Equipment used chain dill  
(Chain drill, rotary or other)

Water Use: Domestic  Municipal  Stock  Irrigation   
Industrial  Drainage  Other \* Garden/Lawn

\*Describe  
USE: If used for irrigation, industrial, drainage or other. Explain, state number of acres and location or other data (i.e. Lot, Block and Addition).  
Lot 7 - 35,000 - 45,000  
Lot 8 - 35,000 - 45,000

ESTIMATED ANNUAL WITHDRAWAL 8 - 35,000 - 45,000 gpd

Size of Drilled Hole	Size and Weight of Casing	From (Foot)	To (Foot)	PERFORATIONS		
				Kind Size	From (Foot)	To (Foot)
<u>8</u>	<u>4 1/2</u>	<u>0</u>	<u>172</u>			

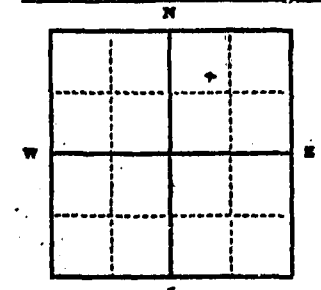

Static water level fluctuating ft.\*  
Pumping water level at 100 ft.\*  
measured minutes after pumping began.  
\*Measured from ground level.  
Well developed by 36 hours.  
Power..... Pump..... HP  
Remarks: (Gravel packing, cementing, packers, type of shutoff)

Lots 7 & 8 of Cinderella Estates, a platted subdivision  
Sect. 14 in Missoula County, Montana, according to the official recorded plat thereof.

INDICATE LOCATION OF WELL AND PLACE OF USE, IF POSSIBLE. EACH SMALL SQUARE REPRESENTS 40 ACRES.

Driller's Signature Reginald A. Kame  
Driller's Address St. Regis, Montana

Indicate the character, color, thickness of strata such as soil, clay, sand, gravel, shale, sandstone, etc. Show depth at which water is found and height to which water rises in well.

Top of Ground (Elev. above sea level)		
From (Foot)	To (Foot)	
<u>0</u>	<u>13</u>	<u>gravel &amp; clay</u>
<u>13</u>	<u>40</u>	<u>sandy clay</u>
<u>40</u>	<u>110</u>	<u>hard brown clay</u>
<u>110</u>	<u>120</u>	<u>brown clay</u>
<u>120</u>	<u>140</u>	<u>thin sand &amp; silt</u>
<u>140</u>	<u>150</u>	<u>green clay &amp; gravel</u>
<u>150</u>	<u>160</u>	<u>sandy clay</u>
<u>160</u>	<u>172</u>	<u>hard brown clay</u>
<u>172</u>	<u>172</u>	<u>gravel &amp; silt</u>

LICENSE NO. 172

Show exact depth of bottom 172

46631

GW - 7

Approved Stock Form—State Publishing Co., Helena, Montana—4657

File No. \_\_\_\_\_

MONTANA WATER CONSERVATION BOARD  
REGISTRATION

T 14 N R 23 W 12

DUPLICATE

County Missoula

LOG

STATE OF MONTANA  
ADMINISTRATOR OF GROUNDWATER CODE  
STATE WATER CONSERVATION BOARD

Notice of Completion of Groundwater  
Appropriation by Means of Well  
DEVELOPED AFTER JANUARY 1, 1962

(Under Chapter 237 Montana Session Laws, 1961, as amended)

Owner William A. Nagy, Jr. Address Alberton Mont.

Driller SAME Address \_\_\_\_\_

Date of Notice of appropriation of groundwater Oct. 2, 1969

Date well started MARCH 1969 Date completed Apr 1, 1969

Type of well Driven Equipment used Driven Hammer  
(Dug, driven, bored or drilled) (Churn drill, rotary or other)

Water use: Domestic  Municipal  Stock  Irrigation   
Industrial  Drainage  Other

Indicate on the diagram the character and thickness of the different strata met with in drilling, such as soil, clay, shale, gravel, rock or sand, etc. Show depth at which water is encountered, thickness and character of water-bearing strata and height to which the water rises in the well.

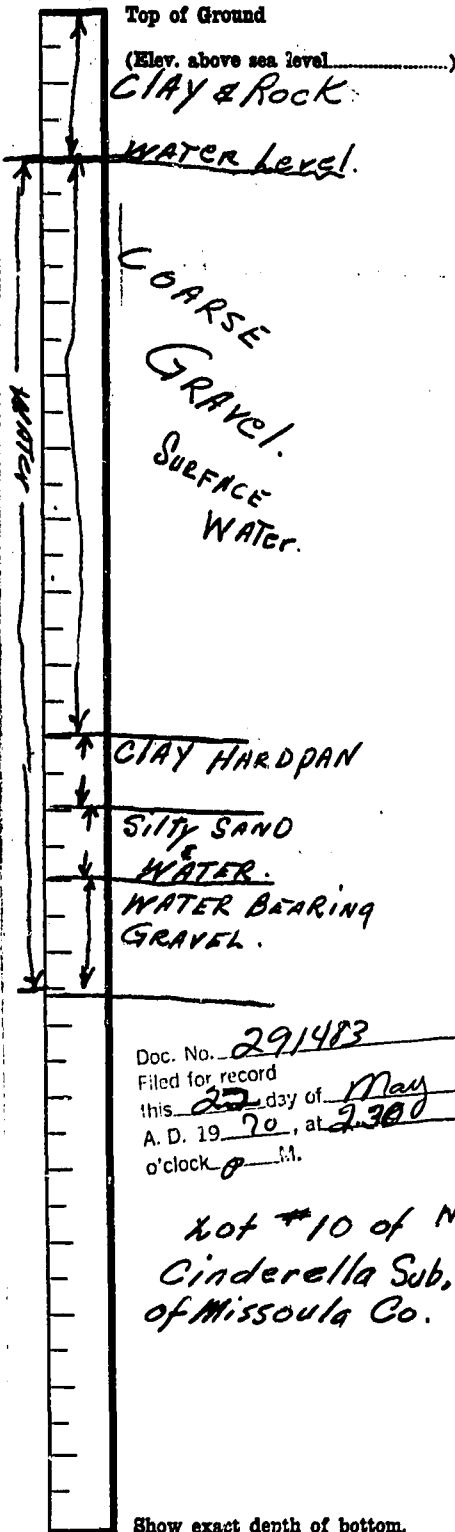

Size of Drilled Hole	Size and Weight of Casing	From (Feet)	To (Feet)	PERFORATIONS		
				Kind Size	From (Feet)	To (Feet)
	5" Double Strength	0	27	1/4" Slots. 2" Long	23' From Top	27' Bottom of Pipe

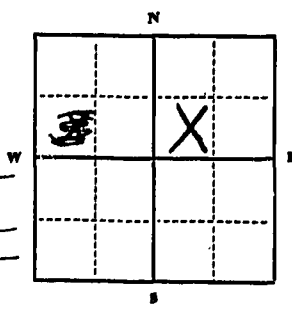

Static Water Level for non-flowing well 23 feet.  
Shut-in Pressure for Flowing Well \_\_\_\_\_  
Pumping Water Level 23 feet  
at 400 gal. per minute.  
Discharge in gal. per min. of flowing well \_\_\_\_\_

How Tested Motor Driven Pump  
Length of Test 24 hrs.

Remarks: (Gravel packing, cementing, packers, type of shutoff) \_\_\_\_\_  
\_\_\_\_\_  
\_\_\_\_\_

Doc. No. 291483  
Filed for record  
this 22 day of May  
A. D. 19 70, at 2:30  
o'clock P.

Lot #10 of N.E. 1/4 Sec. 12, T14N R23W  
Indicate location of well and place of use, if possible. Each small square represents 40 acres.  
Cinderella Sub. of Missoula Co.

(Continue on reverse side)

USE—If used for irrigation, industrial, drainage or other. Explain, state number of acres and location or other data (i.e.: Lot, Block and Addition).

Domestic & Sprinkler Irrigation

Show exact depth of bottom.

This form to be prepared by driller, and three copies to be filed by the owner with the County Clerk and Recorder in the county in which the well is located, tissue copy to be retained by driller.

Please answer all questions. If not applicable, so state, otherwise the form will be returned.

Drilled by Self  
Driller's License Number \_\_\_\_\_  
William Nagy Jr.  
Driller's Signature.

46486



1991

291483

I received and filed this instrument for  
 record on the 22 day of May, 1991  
 at 2:30 o'clock P.M., perchesed files  
 of Missoula County, State of Montana  
 Witness my hand:  
 Veranna B. Crouse, County Recorder  
 By M. M. Crouse Deputy  
 Fee \$ 2.00 Pat Cash

	X

12

File No. \_\_\_\_\_

T. 14N R. 23W

DUPLICATE

County Missoula

STATE OF MONTANA  
ADMINISTRATOR OF GROUNDWATER CODE  
OFFICE OF STATE ENGINEER

RECEIVED  
NOV 26 1963

Declaration of Vested Groundwater Rights

(Under Chapter 237, Montana Session Laws, 1961)

STATE ENGINEER

1. Northern Pacific Railway Co. of N.P. Depot Lothrop  
(Name of Appropriator) (Address) (Town)  
County of Missoula State of Montana  
have appropriated groundwater according to the Montana laws in effect prior to January 1, 1962, as follows:

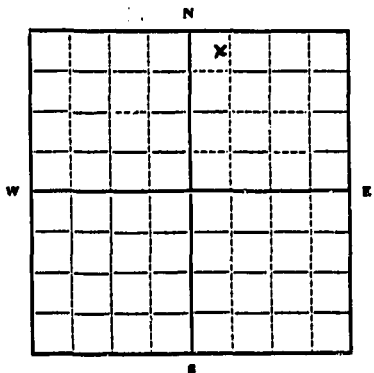

NW 1/4 NE Sec 12 T14N R.23W

Indicate point of appropriation and place of use, if possible. Each small square represents 10 acres.

2. The beneficial use on which the claim is based.....  
Domestic purposes

3. Date or approximate date of earliest beneficial use; and how continuous the use has been.....  
1940 to present

4. The amount of groundwater claimed (in miner's inches or gallons per minute).....  
5 gallons per minute

5. If used for irrigation, give the acreage and description of the lands to which water has been applied and name of the owner thereof.....  
None

6. The means of withdrawing such water from the ground and the location of each well or other means of withdrawal.....  
Jet pump

7. The date of commencement and completion of the construction of the well, wells, or other works for withdrawal of groundwater.....  
Unknown

8. The depth of water table.....  
Unknown

9. So far as it may be available, the type, size and depth of each well or the general specifications of any other works for the withdrawal of groundwater.....  
13 1/2 foot dug well, 16 foot deep

10. The estimated amount of groundwater withdrawn each year.....  
75,000 gallons

11. The log of formations encountered in the drilling of each well if available.....  
None available

12. Such other information of a similar nature as may be useful in carrying out the policy of this act, including reference to book and page of any county record.....  
None

Signature of Owner..... *[Signature]*

Date..... NOV 8 63

Three copies to be filed by the owner with the County Clerk and Recorder of the county in which the well is located.

Please answer all questions. If not applicable, so state, otherwise the form will be returned.

Original to the County Clerk and Recorder; duplicate to the State Engineer; Triplicate to the Montana Bureau of Mines and Geology, and Quadruplicate for the Appropriator.

7529

#330

213198 Copy

I received and filed this instrument for  
record on the 19 day of Nov 1963  
at 2:22 o'clock P. M., permanent files  
of Missoula County, State of Montana  
Witness my hand:  
MARTIN S. DEHNER, County Recorder  
By Orma S. Staley Deputy  
Fee \$ 2.00 Paid

C

RECORDED

File No. \_\_\_\_\_

T. 14 N. 23 W.

DUPLICATE

County Missoula

STATE OF MONTANA  
ADMINISTRATOR OF GROUNDWATER CODE  
OFFICE OF STATE ENGINEER

APR 7 1964

### Notice of Completion of Groundwater Appropriation by Means of Well

(Under Chapter 237, Montana Session Laws, 1961)

- Top of Ground (Elev. above sea level.....)
- 0 to 2' Top soil
- 2' to 11' Sand
- 11' to 20' Sand, clay & gravel
- 20' to 21' Sand & Water
- 21' to 47' Sandy clay
- 47' to 105' Sand
- 105' to 112' Broken rock & sand
- 112' to 135' Broken rock & water

Owner: Cliff Engstrom 2/17/64 Address: Alberton, Montana

Driller: Glenn Camp 705 Alder Address: Missoula, Mont

Date of Notice of Appropriation of Groundwater: \_\_\_\_\_

Date well started: 2/17/64 Date Completed: 2/28/64

Type of well: Drilled Equipment Used: Churn drill  
(dug, driven, bored or drilled) (Churn, drill, rotary or other)

Water Use: Domestic  Municipal  Other  Irrigation   
Industrial  Drainage  Stock

Indicate on the diagram the character and thickness of the different strata met with in drilling, such as soil, clay, shale, gravel, rock or sand, etc. Show depth at which water is encountered, thickness and character of water-bearing strata and height to which water rises in the well.

Size of Drilled Hole	Size and Weight of Casing	From (Feet)	To (Feet)	PERFORATIONS		
				Kind	From (Feet)	To (Feet)
6"	6" I.D. 18.97	1' above G.L.	to 2'-3"	None		

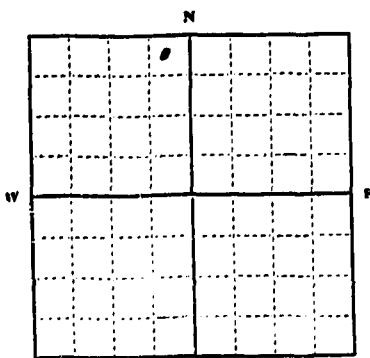

1/4 Sec. 12, T. 14, R. 23  
Indicate location of well and place of use, if possible. Each small square represents 10 acres.

Show exact depth of bottom.

Static Water Level for non-flowing Well: 15' from G.L. feet.

Shut-in Pressure for Flowing Well: \_\_\_\_\_

Pumping Water Level: 112 feet at 5 gal. per minute.

Discharge in gal. per min. of flowing well: \_\_\_\_\_

How Tested: Bailer Length of Test: 3 hours

Remarks: (Gravel packing, cementing, packers, type of shutoff, location of place of use of groundwater if not at well, and any other similar pertinent information, including number of acres irrigated, if used for irrigation).....  
None

License # 7  
Driller's License Number

Glenn Camp  
Driller's Signature

This form to be prepared by driller, and three copies to be filed by the owner with the County Clerk and Recorder in the county in which the well is located.

Please answer all questions. If not applicable, so state, otherwise the form will be returned.

Original to the County Clerk and Recorder; duplicate to the State Engineer; Triplicate to the Montana Bureau of Mines and Geology and Quadruplicate for the Appropriator.

35553