

File No.

T 15 N R 21 W

DUPLICATE

County Missoula

LOG

STATE OF MONTANA
ADMINISTRATOR OF GROUNDWATER CODE
STATE WATER CONSERVATION BOARD

Notice of Completion of Groundwater
Appropriation by Means of Well

DEVELOPED AFTER JANUARY 1, 1962

(Under Chapter 237 Montana Session Laws, 1961, as amended)



Top of Ground
(Elev. above sea level.....)
0- 1 Topsoil
1- 3 Gravel and clay
3- 7 Clay
7- 10 Gravel and clay
10- 19 Clay
19- 80 Gravel and clay
80 Static water level
80-106 1/2 Sand, gravel and water
106 1/2 Exact depth of bottom

Owner GARY K. Dunlop Address Frenchtown, Montana

Driller C.K.C. Drilling Address Box 670, Missoula

Date of Notice of appropriation of groundwater.....

Date well started June 30, 1970 Date completed July 4, 1970

Type of well Drilled Equipment used Churn drill
(Dug, driven, bored or drilled) (Churn drill, rotary or other)

Water use: Domestic Municipal Stock Irrigation
Industrial Drainage Other

Indicate on the diagram the character and thickness of the different strata met with in drilling, such as soil, clay, shale, gravel, rock or sand, etc. Show depth at which water is encountered, thickness and character of water-bearing strata and height to which the water rises in the well.

Size of Drilled Hole	Size and Weight of Casing	From (Feet)	To (Feet)	PERFORATIONS		
				Kind Size	From (Feet)	To (Feet)
6"	6" 17#	1 up	106 1/2	---	---	---

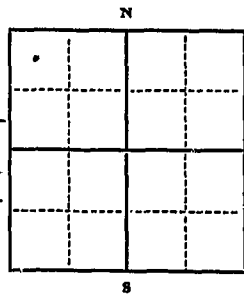

Static Water Level for non-flowing well 80 feet.

Shut-in Pressure for Flowing Well ---

Pumping Water Level 80 feet at 40 gal. per minute.

Discharge in gal. per min. of flowing well ---

How Tested Bailer

Length of Test 3 hours

Remarks: (Gravel packing, cementing, packers, type of shutoff) ---

Doc. No. 292980
Filed for record this 13 day of July A. D. 19 70, at 4:30 o'clock P. M.

NW 1/4 Sec 36 T15N R21W
Indicate location of well and place of use, if possible. Each small square represents 40 acres.

(Continue on reverse side)

USE—If used for irrigation, industrial, drainage or other. Explain, state number of acres and location or other data (i.e.: Lot, Block and Addition).

Show exact depth of bottom.

This form to be prepared by driller, and three copies to be filed by the owner with the County Clerk and Recorder in the county in which the well is located, tissue copy to be retained by driller.

Please answer all questions. If not applicable, so state, otherwise the form will be returned.

185
Driller's License Number

Charles F. Henderson
Driller's Signature.

46670

2015

292980

I received and filed this Instrument for record on the 13 day of July 1978 at 4:30 o'clock P.M., permanent files of Missoula County, State of Montana

Witness my hand:

Ermae R. Crouse, County Recorder

By *Shirley A. Perry*, Deputy

Fee \$ 2.00 Paid

MISSOULA COUNTY RECORDERS OFFICE
 100 WEST 10TH AVENUE
 MISSOULA, MONTANA 59802
 PHONE 544-2222

Prepared in set for trip of the trip will
 at _____
 President _____
 Agent in Charge _____

GROUNDWATER INDEX

County Missoula Twp. 15 N Rge. 20 W

E
F
G
H

Sec.	Name of Appropriator	Type of Form	County File No.	Remarks
12	Mapston, R. Wesley	GU 3	306339	
12	May, Herschel	GU 3	278834	
12	McMahon, Monte	GU 2	321740	
12	Stark, Oscar E.	GU 2	322238	
13	May, Raymond	GU 2	276251	
13	Peterson, James G.	GU 2	289734	
13	Peterson, James G.	GU 2	1221	
13	Peterson, James G.	GU 2	289735	
23	Cluske, Donald L.	GU 2	327248	
23	Hanson, Gary J.	GU 2	299851	
23	Johnson, Harry M.	GU 3	1246	
24	Kramer, Arthur (Jr.)	GU 2	252829	
25	Jensen, Dick	GU 2	299631	
26	Kackner, Claude	GU 3	308337	
26	Cunningham, C.C.	GU 3	307172	
26	Erlundson, Carl	GU 2	269492	
26	Erlundson, Fred	GU 2	198972	
26	Gallagher, Edward	GU 3	293455	
26	Hayes, Robert C.	GU 4	209252	
26	Hayes, Robert C.	GU 4	209249	
26	Hayes, Robert C.	GU 4	209251	
26	Johns, Walter	GU 2	231056	
26	Le arson, Clyde F.	GU 3	215004	
27	Davis, Arthur A.	GU 1	302038	
27	Davis, Arthur A.	GU 3	309594	
27	Willig, Carl	1959 Log	184107	
27	Willig, Carl	GU 4	228435	
34	Thompson, Sam F.	GU 3	215441	
35	Lethbrun, Clarence W.	GU 4	214776	
23	Ryan, Joseph L.	3	215199	
23	" " "	H	215202	

12

File No. _____

T. 15 N. R. 20 W

DUPLICATE RECEIVED

County MISSOULA

STATE OF MONTANA
ADMINISTRATOR OF GROUNDWATER CODE
OFFICE OF STATE ENGINEER

Notice of Completion of Groundwater Appropriation
Without Well

Developed After January 1, 1962

(Under Chapter 237 Montana Session Laws, 1961)

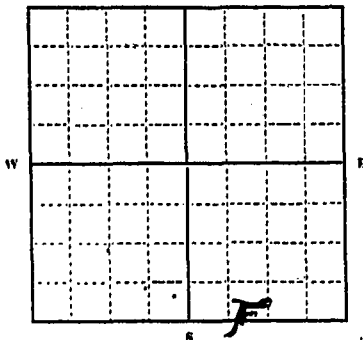
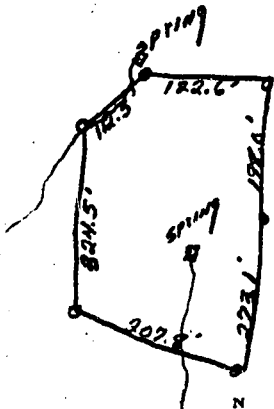

1/4 Sec T R

Indicate point of appropriation and place of use, if possible.

Date of Appropriation of Groundwater FEBRUARY 13, 1968
Owner HERSHEL MOYS Address Box 42, MISSOULA
Contractor (if any) Carl Troll Hopp
Address of Contractor LoLo, Montana
Date Started SEPT, 1968 Date Completed SEPT, 1968

1) Describe means of obtaining groundwater (as by sub-irrigation, developed spring, drains, etc.) Developed Spring

2) Means of withdrawing water (gravity, pump, canal, etc.) PUMP

3) Depth of water table 10'

4) Use of the water Household uses

& irrigation

5) Amount of groundwater claimed (in miner's inches, or gallons per minute) 40 gallons per minute

A parcel of Land located in the SW 1/4 SE 1/4 & the SE 1/4 SE 1/4 of section 12, Township 15 North, Range 20 West

6) If used for irrigation, give number of acres and description of land 1.9 ACRES,

7) Estimate amount of water used each year _____

Signature of Owner Hershel B. Moys

Date 2-13-68

This form to be prepared by contractor (if any), otherwise by the owner.

Three copies of this notice are to be filed with the County Clerk and Recorder of the county in which the works are located.

Please answer all questions. If not applicable, so state, otherwise the form will be returned.

45,009

1856

278834

I received and filed this Instrument for record on the 1st day of Feb 1967 at 2:30 o'clock P.M., permanent files of Missoula County, State of Montana

Witness my hand:

Vernon R. Cousa, County Recorder

By Wm. J. Conway Deputy

Fee \$2.00

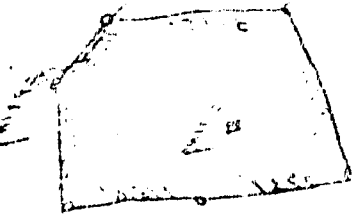

MISSOURIA
1967

MISSOURIA
CALL FOR INFO
MISSOURIA
MISSOURIA

MISSOURIA

MISSOURIA
MISSOURIA

MISSOURIA
MISSOURIA
MISSOURIA
MISSOURIA

2327

321740

I received and filed this instrument for
record on the 2 day of Sept. 1922
at 12.20 o'clock P.M. permanent files
of Missoula County, State of Montana
Witness my hand
Vernon H. Cruise, County Recorder
By Miss M. E. Schaefer, Deputy
Fee \$ 2.00 each

1922

STATE OF MONTANA
ADMINISTRATOR OF GROUNDWATER CODE
MONTANA WATER RESOURCES BOARD

NOTICE OF COMPLETION OF GROUNDWATER
APPROPRIATION BY MEANS OF WELL

Developed after January 1, 1962

(Under Chapter 237 Montana Session Laws, 1961, as amended)

This form to be prepared by driller, and three copies to be filed by the owner with the County Clerk and Recorder in the county in which the well is located, last copy to be retained by driller.

Please answer all questions. If not applicable, so state, otherwise the form may be returned.

Owner Oscar E. and Nellie A. Stark

Address Route 2, Evaro Hill
Missoula, Montana

Date well started 7/28/72
completed 8/1/72

Type of well Drilled
(Dug, driven, bored or drilled)

Equipment used Air Rotary
(Chain drill, rotary or other)

Water Use: Domestic Municipal Stock Irrigation
Industrial Drainage Other Garden/Lawn

For Administrator's Use

File # 332-22238

Sept. 18, 1972 - 11:30 am

GW 1

*Describe _____

USE: if used for Irrigation, industrial, drainage or other. Explain, state number of acres and location or other data (i.e. Lot, Block and Addition). Approximately 10 Acres

ESTIMATED ANNUAL WITHDRAWAL 21,024,000 gallons

Size of Drilled Hole	Size and Weight of Casing	From (Feet)	To (Feet)	PERFORATIONS		
				Kind Size	From (Feet)	To (Feet)
6"	6 5/8" OD x 1/2" +2 5 9/16" OD liner 65		98	Torch Cut	107	128

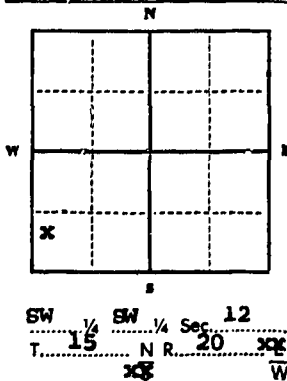

Free flow flowing over top of casing

Static water level _____ ft.

Pumping water level 42 ft. at 40 gallons per minute, measured 180 minutes after pumping began.

*Measured from ground level.

Well developed by Air Lift Pump for Three hours.

Power Diesel Pump 150 HP

Remarks: (Gravel packing, cementing, packers, type of shutoff) All water entering well through open bottom of casing from cracks & seams in rock & perforations in

DRILLER'S LOG

Indicate the character, color, thickness of strata such as soil, clay, sand, gravel, shale, sandstone, etc. Show depth at which water is found and height to which water rises in well.

Top of Ground Approx (Elev. above sea level) 4000'

From (Feet)	To (Feet)	
0	9	Gravel embedded in gray clay
9	21	Gravel embedded in red and brown clay
21	77	Gravel embedded in tan clay
77	79	Gravel with stringers of tan, red & gray clay
79	81	Pink sandstone with stringers of clay
81	99	Pink sandstone with brown and tan rock in thin alternate layers
99	107	Pink sandstone. Seeps
107	123	Pink & purple rock in thin alternate layers
123	127	Light pink sandstone
127	129	Brown & tan sandstone
129	133	Pink - purple sandstone 12 GPM
133	159	Fractured light pink sandstone. 40 GPM Total

INDICATE LOCATION OF WELL AND PLACE OF USE, IF POSSIBLE. EACH SMALL SQUARE REPRESENTS 40 ACRES.

LIBERTY DRILLING COMPANY

Driller's Signature [Signature]

Driller's Address 2500 Reserve Street
Missoula, Montana v LICENSE NO. 52

159 ft. Show exact depth of bottom water rises in well free flow over top of casing two GPM

51,431

2332

3 22238

I received and filed this instrument for
 record on the 18 day of Sept, 1972
 at 11:30 o'clock A. M. Montana
 of Missoula County State of Montana
 Witness my hand
Veronica R. Crease, County Recorder
 By Mary Hallock, Deputy
 Fee \$ 2.00 Cash Paid

liner. Wells in this area can be depended upon to produce clean sand
 free water year after year as long as they are not overpumped, i.e.,
 they should be pumped at rates not in excess of 50 to 60 percent of
 the tested capacity of the aquifer.

File No. _____

T. 157 R 20

DUPLICATE

County Missoula

LOG

STATE OF MONTANA
ADMINISTRATOR OF GROUNDWATER CODE
OFFICE OF STATE ENGINEER

Notice of Completion of Groundwater
Appropriation by Means of Well

DEVELOPED AFTER JANUARY 1, 1962

(Under Chapter 237, Montana Session Laws, 1961)

Top of Ground
(Elev. above sea level _____)

GL top soil

1' tan clay

17' seep of surface water

17' tan clay with sand & gravel imbedded

59' sand, gravel & water

60'

Show exact depth of bottom.

Owner RAYMOND MAYS Address _____

Driller KEN WILLIAMS WELL DR. Address 1558 So. 5th. W.
MISSOULA, MONTANA

Date of Notice of appropriation of groundwater _____

Date well started OCT. 30, 68 Date completed OCT. 31, 68

Type of well DRILLED Equipment used CHURN
(Dug, driven, bored or drilled) (Churn drill, rotary or other)

Water use: Domestic Municipal Stock Irrigation
Industrial Drainage Other

Indicate on the diagram the character and thickness of the different strata met with in drilling, such as soil, clay, shale, gravel, rock or sand, etc. Show depth at which water is encountered, thickness and character of water-bearing strata and height to which the water rises in the well.

Size of Drilled Hole	Size and Weight of Casing	From (Feet)	To (Feet)	PERFORATIONS		
				Kind Size	From (Feet)	To (Feet)
6" I.D.	6-5/8" ground O.D. 17 lbs. 1/2" side-wall		60'			

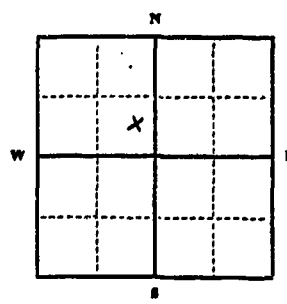

Static Water Level for non-flowing well 19 feet.
Shut-in Pressure for Flowing Well.....
Pumping Water Level..... 55 feet
at..... 25 gal. per minute.
Discharge in gal. per min. of flowing well

How Tested..... ball test
Length of Test..... 4 hours

Remarks: (Gravel packing, cementing, packers, type of shutoff).....

SW 1/4 Sec. 13 T. 157 R. 20
Indicate location of well and place of use, if possible. Each small square represents 40 acres.

(Continue on reverse side)

USE—If used for irrigation, industrial, drainage or other. Explain, state number of acres and location or other data (i.e.: Lot, Block and Addition).

This form to be prepared by driller, and three copies to be filed by the owner with the County Clerk and Recorder in the county in which the well is located, tissue copy to be retained by driller.

Please answer all questions. If not applicable, so state, otherwise the form will be returned.

Driller's License Number 151

Driller's Signature Ken Williams

44,756

File No. _____

T15N R 20W

DUPLICATE

County Missoula

LOG

STATE OF MONTANA
ADMINISTRATOR OF GROUNDWATER CODE
STATE WATER CONSERVATION BOARD

Notice of Completion of Groundwater
Appropriation by Means of Well
DEVELOPED AFTER JANUARY 1, 1963

Top of Ground Approx.
(Elev. above sea level) 3256 ft.

Formations Log:

- 0 - 2 Gravel and top-soil. (Under Chapter 237 Montana Session Laws, 1961, as amended)
- 2 - 33 Tan clay and gravel. James G. and Lucille R. Peterson Address Missoula, Montana
- 33 - 43 Gravel and tan clay. Drilled Liberty Drilling Co. Address Missoula, Montana
- 43 - 46 Silty clay and gravel. Date of Notice of appropriation of groundwater None filed.
- 46 - 49 Fine gravel. Date well started 9/18/69 Date completed 9/23/69
- 49 - 50 Tan clay with gravel mixed in. Type of well Drilled Equipment used Cable tools
(Dug, driven, bored or drilled) (Churn drill, rotary or other)
- 50 - 52 Gravel with stringers of tan clay. Water use: Domestic Municipal Stock Irrigation
Industrial Drainage Other
- 52 - 61 Gray clay with some gravel mixed in. Indicate on the diagram the character and thickness of the different strata met with in drilling, such as soil, clay, shale, gravel, rock or sand, etc. Show depth at which water is encountered, thickness and character of water-bearing strata and height to which the water rises in the well.

Size of Drilled Hole	Size and Weight of Casing	From (Feet)	To (Feet)	PERFORATIONS		
				Kind	From (Feet)	To (Feet)
6"	6 5/8" OD x 1/4"	+1.6'	43'	6" Johnson Argee Iron Wire Wound Water Well Screen	43	51
		51	61	10' tailpipe with a solid closed bottom		

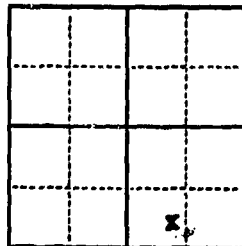

Static Water Level for non-flowing well 30 feet.
 Shut-in Pressure for Flowing Well None
 Pumping Water Level 39 feet
 at 60 gal. per minute.
 Discharge in gal. per min. of flowing well Non-flowing
 How Tested COMPRESSOR TEST
 Length of Test 9 HOURS

Remarks: (Gravel packing, cementing, packers, type of shutoff) All water entering well through the slots in screen.

Water rises in well 30 ft. from surface.

Doc. No. 287734
 Filed for record 25 day of March
1970 at 4:25 pm.

MONTANA WATER RESOURCES BOARD
RECEIVED
 MAR 27 1970

52

Driller's License Number

William F. Colburn
 Driller's Signature.

This form to be prepared by driller, and three copies to be filed by the owner with the County Clerk and Recorder in the county in which the well is located, tissue copy to be retained by driller.

Please answer all questions. If not applicable, so state, otherwise the form will be returned.

Note - this well is 52' long well Doc. No. 287735

46273

1967

289734

I received and filed this instrument for
record on the 25th day of March 1972.
at 4:25 o'clock P.M. permanent files
of Missoula County, State of Montana
Witness my hand.
Veramo R. Crouse, County Recorder
By W. C. Conroy Deputy
Fee \$2.00

OW 2
 File No.
DUPLICATE

Approved Stock Form—State Publishing Co., Helena, Montana—4047
 T 15N R 20W
 County Missoula

STATE OF MONTANA
 ADMINISTRATOR OF GROUNDWATER CODE
 OFFICE OF STATE ENGINEER
RECEIVED
 JAN 3 1964
Notice of Completion of Groundwater Appropriation by Means of Well
 STATE ENGINEER

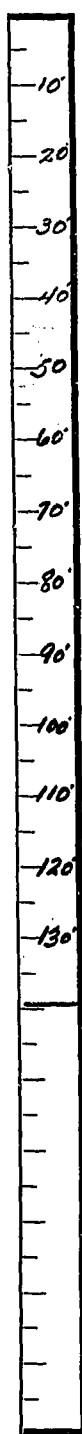

Top of Ground
 (Elev. above sea level 3936)

Owners James G. Peterson Address 1712 Missoula Mont
 Driller Harold K. Pickens Address Missoula Mont
 Date of Notice of Appropriation of Groundwater Dec. 29, 1963
 Date well started 8-15-63 Date Completed 9-2-63
 Type of well drilled Equipment Used cable tool rig
 (dug, driven, bored or drilled) (Churn, drill, rotary or other)
 Water Use: Domestic Municipal Other Irrigation
 Industrial Drainage Stock

Indicate on the diagram the character and thickness of the different strata met with in drilling, such as soil, clay, shale, gravel, rock or sand, etc. Show depth at which water is encountered, thickness and character of water-bearing strata and height to which water rises in the well.

Size of Drilled Hole	Size and Weight of Casing	From (Feet)	To (Feet)	PERFORATIONS		
				Kind Size	From (Feet)	To (Feet)
<u>5 inch</u>	<u>5 inch 14.7"</u>	<u>0</u>	<u>121.7</u>	<u>none</u>	<u>-</u>	<u>-</u>

Clay 40'-117'
Shale 117'-139'
 bottom of well 139'
 bottom of casing 121.7'

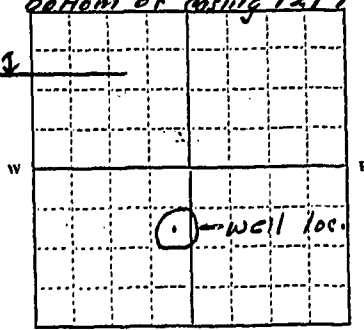

Sec. 13 T. 15N R. 20W
 Indicate location of well and place of use, if possible. Each small square represents 10 acres.

Static Water Level for non-flowing Well 25 feet.
 Shut-in Pressure for Flowing Well _____
 Pumping Water Level 25 feet at 7 gal. per minute.
 Discharge in gal. per min. of flowing well _____
 How Tested pump Length of Test 10 hrs.
 Remarks: (Gravel packing, cementing, packers, type of shutoff, location of place of use of groundwater if not at well, and any other similar pertinent information, including number of acres irrigated, if used for irrigation) water used for household use only

71
 Driller's License Number
Harold K. Pickens
 Driller's Signature

This form to be prepared by driller, and three copies to be filed by the owner with the County Clerk and Recorder in the county in which the well is located.
 Please answer all questions. If not applicable, so state, otherwise the form will be returned.
 Original to the County Clerk and Recorder; duplicate to the State Engineer; Triplicate to the Montana Bureau of Mines and Geology and Quadruplicate for the Appropriator.

1271

I received and read this instrument for
 record at 3:47 P.M. of Dec. 19 63
 at the Clerk's Office, permanent files
 of Missoula County, State of Montana.
 Witness my hand:
 By Martina S. Rehnas Deputy
 253 Clerk Recorder
 Paid

RECORDED
 INDEXED
 1963 DEC 19

MISSOULA COUNTY

open public domain information...
 not a piece of real estate...
 Montana State Archives...
 Helena, Montana

GW

Doc. No. 289735
Filed for record
this 25 day of March
A. D. 19 70, at 4:30
o'clock P.M.
LOG

Approved Stock Form—State Publishing Co., Helena, Montana—4637

13

File No. _____ T. 15N R. 20W
DUPLICATE A. D. 19 70, at 4:30 County Missoula

STATE OF MONTANA
ADMINISTRATOR OF GROUNDWATER CODE
STATE WATER CONSERVATION BOARD

Notice of Completion of Groundwater
Appropriation by Means of Well
DEVELOPED AFTER JANUARY 1, 1962

(Under Chapter 237 Montana Session Laws, 1961, as amended)

James G. and

Owner Lucille B. Peterson Address Missoula, Montana

Driller Liberty Drilling Co. Address Missoula, Montana

Date of Notice of appropriation of groundwater None filed.

Date well started 9/10/69 Date completed 10/9/69

Type of well Drilled Equipment used Cable tools
(Dug, driven, bored or drilled) (Churn drill, rotary or other)

Water use: Domestic Municipal Stock Irrigation
Industrial Drainage Other

Indicate on the diagram the character and thickness of the different strata met with in drilling, such as soil, clay, shale, gravel, rock or sand, etc. Show depth at which water is encountered, thickness and character of water-bearing strata and height to which the water rises in the well.

Top of Ground _____
Approx. _____
(Elev. above sea level 3936 ft.)

Formations Log:

- 0 - 2 Gravel and topsoil.
- 2 - 34 Tan clay and gravel.
- 34 - 46 Gravel mixed in tan clay.
- 46 - 52 Fine gravel. Water.
- 52 - 54 Clay with soil mixed in.
- 54 - 56 Tan clay and gravel.
- 56 - 82 Gray clay.
- 82 - 97 Gray clay with some gravel mixed in.
- 97 - 134 Gray and green clay with gravel mixed in.
- 134 - 139 Gray shale imbedded in clay.
- 139 - 141 Tan clay.
- 141 - 149 Gray clay with gravel mixed in.
- 149 - 153 Yellow clay and gravel.
- 153 - 171 Light tan clay.
- 171 - 174 Orange and white clay in alternate layers.
- 174 - 185 Light tan clay.

Size of Drilled Hole	Size and Weight of Casing	From (Feet)	To (Feet)	PERFORATIONS		
				Kind Size	From (Feet)	To (Feet)
8"	8 5/8" OD x 1/4"	+1'5"	125	Mills knife	46'	52'

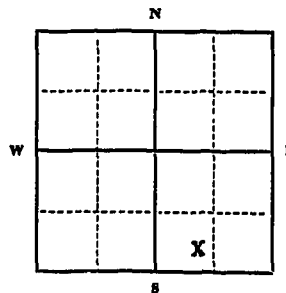

Static Water Level for non-flowing well _____ 31 feet.

Shut-in Pressure for Flowing Well Non-f

Pumping Water Level _____ 41 feet
at _____ 30 gal. per minute.

Discharge in gal. per min. of flowing well _____
Non-flowing

How Tested Railer test
Length of Test 8 hrs.

Remarks: (Gravel packing, cementing, packers, type of shutoff) All water entering well through perforations in casing. Backfilled hole and grouted with 3 feet of cement on top of backfill, to 112 feet.

(Continue on reverse side)

USE—If used for irrigation, industrial, drainage or other. Explain, state number of acres and location or other data (i.e.: Lot, Block and Addition).

Water rises in well
31 ft. from surface.

MONTANA WATER RESOURCES BOARD
RECEIVED

MAR 27 1970

Show exact depth of bottom.
Bottom of well 185'

This form to be prepared by driller, and three copies to be filed by the owner with the County Clerk and Recorder in the county in which the well is located, tissue copy to be retained by driller.

Please answer all questions. If not applicable, so state, otherwise the form will be returned.

52
Driller's License Number

William F. Malone
Driller's Signature.

R.D. Note - this well is 50' from well No. 289734 46274

1966

289735

I received and filed this Instrument for record on the 25 day of March 1966 at 1:30 o'clock P.M., permanent files of Missoula County, State of Montana
 Witness my hand.
 Vermae R. Crouse, County Recorder
 By M. M. Conroy, Deputy
 Fee 5.20 paid

MISSOULA COUNTY RECORDERS OFFICE
 1000 WEST 10TH AVENUE
 MISSOULA, MONTANA 59801

MISSOULA COUNTY RECORDERS OFFICE
 1000 WEST 10TH AVENUE
 MISSOULA, MONTANA 59801

File No.

RECEIVED

T. 15 R. 20

DUPLICATE

JAN 1969

Missoula

LOG

STATE OF MONTANA
ADMINISTRATOR OF GROUNDWATER CODE
OFFICE OF STATE ENGINEER

Top of Ground
(Elev. above sea level.....)

Notice of Completion of Groundwater
Appropriation by Means of Well
DEVELOPED AFTER JANUARY 1, 1962

(Under Chapter 237, Montana Session Laws, 1961)

0'
45'
45'
48'
48'
120'
120'
120'
145'
145'

Clay & Gravel

Little Water

Shale Rock

Shale Rock & Water

Bed Rock

Owner: Frank, Donald L. Clark Evans Mont.

Driller: John Farrell Address: Arlee Mont.

Date of Notice of appropriation of groundwater.....

Date well started: Oct. 1 1969 Date completed: Oct. 11 1969

Type of well: Drilled Equipment used: Churn Drill
(Dug, driven, bored or drilled) (Churn drill, rotary or other)

Water use: Domestic Municipal Stock Irrigation
Industrial Drainage Other

Indicate on the diagram the character and thickness of the different strata met with in drilling, such as soil, clay, shale, gravel, rock or sand, etc. Show depth at which water is encountered, thickness and character of water-bearing strata and height to which the water rises in the well.

Size of Drilled Hole	Size and Weight of Casing	From (Feet)	To (Feet)	PERFORATIONS		
				Kind Size	From (Feet)	To (Feet)
6"	6" 17 #	0	145			

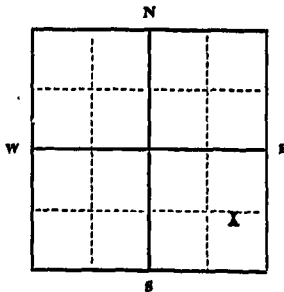

Static Water Level for non-flowing well 40 feet.

Shut-in Pressure for Flowing Well.....

Pumping Water Level..... 100 feet
at..... 8 gal. per minute.

Discharge in gal. per min. of flowing well

How Tested..... Pump

Length of Test..... 2 Hrs

Remarks: (Gravel packing, cementing, packers, type of shutoff).....

NE 1/4 SE Sec. 23 T. 15N R. 20W.
Indicate location of well and place of use, if possible. Each small square represents 40 acres.

(Continue on reverse side)

USE—If used for irrigation, industrial, drainage or other. Explain, state number of acres and location or other data (i.e.: Lot, Block and Addition).

145'

Show exact depth of bottom.

This form to be prepared by driller, and three copies to be filed by the owner with the County Clerk and Recorder in the county in which the well is located, tissue copy to be retained by driller.

Please answer all questions. If not applicable, so state; otherwise the form will be returned.

Driller's License Number

John Farrell
Driller's Signature.

52,308

#107

327248

I received and filed this instrument for record on the 24 day of Jan 1983 at 9:30 o'clock A.M., permanent files of Missoula County, State of Montana
Witness my hand:
Dorothy L. Head, County Recorder
By Maryellen Leiby, Deputy.
Fee \$ 2.00 Paid

MISSOULA COUNTY RECORDER
MISSOULA, MONTANA

2092 299851

I received and filed this instrument for
record on the 26th day of Feb., 1971
at 9:00 o'clock A.M., payment filed
of Missouri County, State of Missouri
Witness my hand
Veronica R. Crouse, County Recorder
By M. M. Crouse, Deputy
Fee \$2.00 Paid cash

23

File No.

T. 15 N. R. 20 W.

DUPLICATE

County MISSOULA

STATE OF MONTANA
ADMINISTRATOR OF GROUNDWATER CODE
OFFICE OF STATE ENGINEER

RECEIVED
JAN 3 1964

Notice of Completion of Groundwater Appropriation
Without Well

(Under Chapter 237 Montana Session Laws, 1961)

Date of Appropriation of Groundwater 1947

Owner HARRY M & DOROTHEA S. JOHNSON Address ROUTE 2 MISSOULA

Contractor (if any) NONE

Address of Contractor NONE

Date Started 1947 Date Completed 1947

Describe means of obtaining groundwater without a well "as by sub-irrigation and other natural processes". Include depth to water when applicable. THREE FLOWING SPRINGS

ONE WITH CONCRETE PIPE APP. 30" X 30" X 30" IN GROUND

ONE WITH CONCRETE CULVERT PIPE PARTIALLY IN GROUND

ONE OPEN SPRING - ALSO THREE OTHER OPEN SPRINGS

WHICH SUBIRRIGATE & PROVIDE STABLE WATER

Quantity of water developed and used with explanation of method used to measure or estimate such amount. If use is intermittent

estimate approximate lengths of periods of use. APPROXIMATE

100 GAL PER HOUR FROM THREE SPRINGS

ESTIMATED TIME FOR FILLING SIX GA TANK

USE IS CONTINUOUS

Signature of Owner Harry Johnson

Dorothea S. Johnson

Date 12-31-63

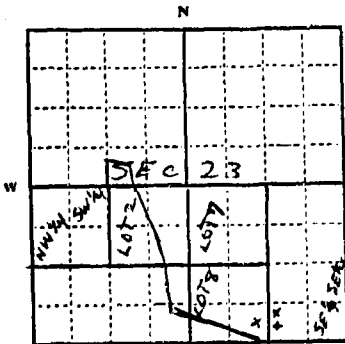

LOT 5 7 + 8 42"
AND SE 1/4 Sec. 23 T. 15 N. R. 20 W
AND NW 1/4 SW 1/4 23 15 N 20 W
Indicate point of appropriation
and place of use, if possible.

This form to be prepared by contractor (if any), otherwise by the owner.

Three copies of this notice are to be filed with the County Clerk and Recorder of the county in which the works are located.

Please answer all questions. If not applicable, so state, otherwise the form will be returned.

Original to the County Clerk and Recorder; duplicate to the State Engineer; Triplicate to the Montana Bureau of Mines and Geology and Quadruplicate for the Appropriator.

20365

1246

copy
I received and filed this instrument for
recording on the *1st* day of *Dec.*, 1963
at *Helena*, the seat of the permanent files
of Mineral County, State of Montana
Witness my hand: *L. B. Smith* Deputy
County Recorder
Per *Martin* *Paul*

File No. _____

AUG 10 1966

T 15 N R 20 24

DUPLICATE

Bill _____
 Editor _____
 Com _____
 Distribution _____
 Dickert _____

McDemott _____

 Sullivan _____

County Missoula
 STATE OF MONTANA
 ADMINISTRATOR OF GROUNDWATER CODE
 OFFICE OF STATE ENGINEER



Top of Ground
(Elev. above sea level _____)

Clay & Gravel

Water & Gravel

Notice of Completion of Groundwater Appropriation by Means of Well

(Under Chapter 237, Montana Session Laws, 1961)
Deletion 1

Owner HERBERT HENRY KRAMER JR Address EVERO MONT

Driller John Farrell Address Arlee Mont

Date of Notice of Appropriation of Groundwater _____

Date well started July 14 1966 Date Completed July 15 1966

Type of well Drilled Equipment Used Churn Drill
 (dug, driven, bored or drilled) (Churn, drill, rotary or other)

Water Use: Domestic Municipal Other Irrigation
 Industrial Drainage Stock

Indicate on the diagram the character and thickness of the different strata met with in drilling, such as soil, clay, shale, gravel, rock or sand, etc. Show depth at which water is encountered, thickness and character of water-bearing strata and height to which water rises in the well.

Size of Drilled Hole (in)	Size and Weight of Casing (in)	From (Feet)	To (Feet)	PERFORATIONS		
				Kind Size	From (Feet)	To (Feet)
6	(6) (18.97#)	0	42			

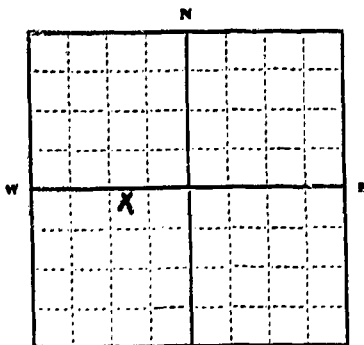

NW 1/4 SW Sec. 24 T. 15 N. R. 20

Indicate location of well and place of use, if possible. Each small square represents 10 acres.

Show exact depth of bottom.

Static Water Level for non-flowing Well 20 feet.

Shut-in Pressure for Flowing Well _____

Pumping Water Level 25 feet at 20 gal. per minute.

Discharge in gal. per min. of flowing well _____

How Tested Boiler Length of Test 1 Hour

Remarks: (Gravel packing, cementing, packers, type of shutoff, location of place of use of groundwater if not at well, and any other similar pertinent information, including number of acres irrigated, if used for irrigation) _____

14
Driller's License Number

John Farrell
Driller's Signature

This form to be prepared by driller, and three copies to be filed by the owner with the County Clerk and Recorder in the county in which the well is located.

Please answer all questions. If not applicable, so state, otherwise the form will be returned.

Original to the County Clerk and Recorder; duplicate to the State Engineer; Triplicate to the Montana Bureau of Mines and Geology and Quadruplicate for the Appropriator.

41304

1636

252827

I received and filed this instrument for
record on the 8 day of Aug. 1966
at 11:30 o'clock AM. per James Isles
of Missoula County, State of Montana
Witness my hand:
Vernice R. Cross County Recorder
By Blair J. Mann Deputy
Fee \$ 2.00 Paid cash

STATE OF MONTANA
ADMINISTRATOR OF GROUNDWATER CODE
MONTANA WATER RESOURCES BOARD

RECEIVED

DRILLER'S LOG

Indicate the character, color, thickness of strata such as soil, clay, sand, gravel, shale, sandstone, etc. Show depth at which water is found and height to which water rises in well.

NOTICE OF COMPLETION OF GROUNDWATER APPROPRIATION BY MEANS OF WELL

Developed after January 1, 1962

(Under Chapter 237 Montana Session Laws, 1961, as amended)

This form to be prepared by driller, and three copies to be filed by the owner with the County Clerk and Recorder in the county in which the well is located, last copy to be retained by driller.

Please answer all questions. If not applicable, so state, otherwise the form may be returned.

Owner Nels Jensen

Address Rte #2, Evaro

Missoula Montana

Date well started Oct 1, 1970

completed Oct 15, 1970

Type of well Drilled

Equipment used Churn Drill

Water Use: Domestic Municipal Stock Irrigation

Industrial Drainage Other Garden/Lawn

Describe

USE: If used for irrigation, industrial, drainage or other. Explain, state number of acres and location or other data (i.e. Lot, Block and Addition).
N/A

ESTIMATED ANNUAL WITHDRAWAL 73,000 Gallons

Size of Drilled Hole	Size and Weight of Casing	From (Feet)	To (Feet)	PERFORATIONS		
				Kind	From (Feet)	To (Feet)
6	1 7/8" 6"	2' above Ground level	382	None		

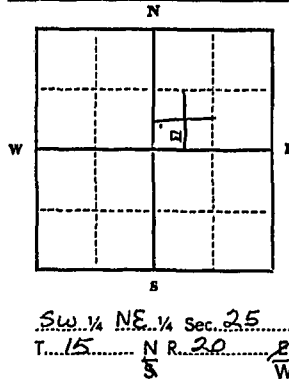

Static water level 70' ft.*
Pumping water level 370' ft.*
at 2 gallons per minute,
measured 180 minutes after pumping began.

*Measured from ground level.
Well developed by Driller
for 6 hours.

Power Elect Pump 2 HP
Remarks: (Gravel packing, cementing, packers, type of shutoff)

Electric Welded Joints
382' TOTAL CASING

INDICATE LOCATION OF WELL AND PLACE OF USE, IF POSSIBLE. EACH SMALL SQUARE REPRESENTS 40 ACRES.

Driller's Signature Donald E. Beale

Driller's Address P.O. Box 1454

POLSON MONT. LICENSE NO. 163

Top of Ground (Elev. above sea level)

From (Feet)	To (Feet)	
0	49	Clay & Gravel
49	50	Gravel and Water (1 GPM)
50	70	Clay and Gravel
70	86	Clay balls and Gravel
86	86	Seep of water
86	381	Clay and Gravel
381	384	Gravel and Water

382' 4" Show exact depth of bottom

48092

2063

299.031

I received and filed this instrument for
 record on the 28th day of March, 1911,
 at 2:30 o'clock P. M. permanent file
 of Missoula County, State of Montana
 Witness my hand
 Verano R. Cross, County Recorder
 By Miss Stone, Deputy
 Fee \$ 2.50 Cash Paid

RECORDED
 MISSOULA COUNTY

MISSOULA COUNTY

MISSOULA COUNTY

MISSOULA COUNTY

MISSOULA COUNTY

MISSOULA COUNTY

MISSOULA COUNTY

MISSOULA COUNTY

MISSOULA COUNTY

MISSOULA COUNTY

MISSOULA COUNTY

MISSOULA COUNTY

MISSOULA COUNTY

MISSOULA COUNTY

MISSOULA COUNTY

MISSOULA COUNTY

File No. _____

T. 15 N. R. 20

DUPLICATE

County Missoula

STATE OF MONTANA
ADMINISTRATOR OF GROUNDWATER CODE
OFFICE OF STATE ENGINEER

Notice of Completion of Groundwater Appropriation
Without Well

(Under Chapter 237 Montana Session Laws, 1961)

Date of Appropriation of Groundwater August 10, 1968
Owner CLAUDE H. & DORIANE LACKNER Address RT#2, Missoula, Mont.

Contractor (if any) none

Address of Contractor _____

Date Started August 8, 1968 Date Completed August 10, 1968

Describe means of obtaining groundwater without a well "as by sub-irrigation and other natural processes". Include depth to water when applicable. Dug into a surface spring to the depth of about four feet & inserted tile pipe & there ran plastic 1" pipe to dwelling.

Quantity of water developed and used with explanation of method used to measure or estimate such amount. If use is intermittent

estimate approximate lengths of periods of use. Quantity of water, 3 gal. per minute, have continuous flow from 1" pipe, timed water as it filled gal. containers.

Signature of Owner Claude J. Lackner
Date Feb 21, 1973

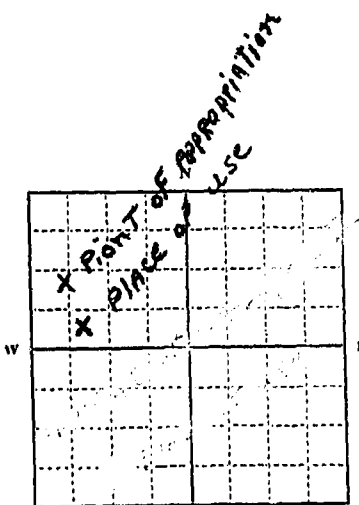

W 1/2 Sec. 26 T. 15 R. 20

Indicate point of appropriation and place of use, if possible.

Doc. No. 2428, 32837
Filed for record
the 23 day of FEBRUARY
A. D. 1973 at 1:30
o'clock P.M.

This form to be prepared by contractor (if any), otherwise by the owner.
Three copies of this notice are to be filed with the County Clerk and Recorder of the county in which the works are located.
Please answer all questions. If not applicable, so state, otherwise the form will be returned.
Original to the County Clerk and Recorder; duplicate to the State Engineer; Triplicate to the Montana Bureau of Mines and Geology and Quadruplicate for the Appropriator.

2422

321337

I received and filed this Instrument for record on the 23rd day of Feb 1973 at 1:30 o'clock P. M., permanent files of Missoula County, State of Montana

Witness my hand:
 Dorothy L. Head, County Recorder
 By [Signature], Deputy
 Fee \$ 2.00 Paid

FILED
 V. D. 78
 MISSOULA COUNTY, MONTANA
 FEB 23 1973
 COUNTY CLERK

STATE OF MONTANA
 DEPARTMENT OF LAND AND WATER RESOURCES BOARD
 RECEIVED

County Missoula

26

STATE OF MONTANA
 ADMINISTRATOR OF GROUNDWATER CODE
 MONTANA WATER RESOURCES BOARD

NOTICE OF COMPLETION OF GROUNDWATER
 APPROPRIATION BY MEANS OF WELL

Developed after January 1, 1962

(Under Chapter 237 Montana Session Laws, 1961, as amended)

This form to be prepared by driller, and three copies to be filed by the owner with the County Clerk and Recorder in the county in which the well is located, last copy to be retained by driller.

Please answer all questions. If not applicable, so state, otherwise the form may be returned.

Owner C. C. Cunningham

Address Evapo Mont

For Administrator's Use	
File <u>307172</u>	
<u>September 2, 1971</u>	
<u>4:30 PM</u>	
Date well started <u>AUG 9, 1971</u>	
completed <u>AUG 11, 1971</u>	
GW <u>1</u>	

Type of well X
 (Dig, driven, bored or drilled)

Equipment used X X
 (Churn drill, rotary or other)

Water Use: Domestic Municipal Stock Irrigation
 Industrial Drainage Other Garden/Lawn

*Describe
 USE: If used for irrigation, industrial, drainage or other. Explain, state number of acres and location or other data (i.e. Lot, Block and Addition).

ESTIMATED ANNUAL WITHDRAWAL

Size of Drilled Hole	Size and Weight of Casing	From (Feet)	To (Feet)	PERFORATIONS		
				Kind Size	From (Feet)	To (Feet)
6"	(6") 21 17#	0	70			

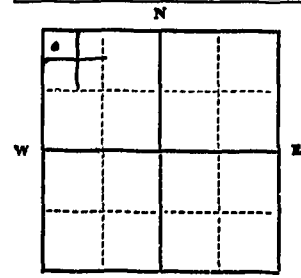

N. W. 1/4 N. W. 1/4 Sec. 26
 T. 15 N. R. 80 W.

INDICATE LOCATION OF WELL AND PLACE OF USE, IF POSSIBLE. EACH SMALL SQUARE REPRESENTS 40 ACRES.

Driller's Signature John Farrell

Driller's Address Evapo Mont

LICENSE NO. 14

DRILLER'S LOG

Indicate the character, color, thickness of strata such as soil, clay, sand, gravel, shale, sandstone, etc. Show depth at which water is found and height to which water rises in well.

Top of Ground		(Elev. above sea level)
From (Feet)	To (Feet)	
0	22	red clay gravel
22	23	little water
23	63	brown clay
63	70	broken rock & water

70 Show exact depth of bottom

49008

NOTICE OF COMPLETION OF EXAMINATION

STATE OF MONTANA
DEPARTMENT OF REVENUE
BOZEMAN, MONTANA

307172

2180

I received and filed this instrument for record on the 20th day of Sept. 1921 at 4:30 o'clock P.M. permanent files of Missoula County, State of Montana. Witness my hand
Veranus R. Greig, County Recorder
By *Marie Tucker*, Deputy
Fee \$2.00 Cash Paid

Table with multiple columns and rows, likely a ledger or record book, with some faint text visible in the header area.

File No. _____

T. 15 N. R. 20 W 24

DUPLICATE

MONTANA WATER RESOURCES BOARD

County Missoula

LOG **RECEIVED**

STATE OF MONTANA
ADMINISTRATOR OF GROUNDWATER CODE
OFFICE OF STATE ENGINEER

Top of Ground _____

MAR 22 1968

(Elev. above sea level _____)

**Notice of Completion of Groundwater
Appropriation by Means of Well**
DEVELOPED AFTER JANUARY 1, 1962

(Under Chapter 237, Montana Session Laws, 1961)

0 to 8'

clay and gravel

Owner: Carl Erlanson Jr. Address: Evare, Mont.

-8 to 17-

Driller: Beebe Drilling Address: Polson, Mont.

Gray Clay & Gravel

Date of Notice of appropriation of groundwater: June 21, 1967

17

7 1/2 to 33'

Date well started: June 20 Date completed: June 21, 1967

Sandy Tan Clay

Type of well: 31 to 34 Equipment used: Churn drill
(Dug, driven, bored or drilled) (Churn drill, rotary or other)

33 to 34

Water use: Domestic Municipal Stock Irrigation
Industrial Drainage Other

Gravel and Water

Indicate on the diagram the character and thickness of the different strata met with in drilling, such as soil, clay, shale, gravel, rock or sand, etc. Show depth at which water is encountered, thickness and character of water-bearing strata and height to which the water rises in the well.

Size of Drilled Hole	Size and Weight of Casing	From (Feet)	To (Feet)	PERFORATIONS		
				Kind Size	From (Feet)	To (Feet)
6"	6" I. D.			none	none	none

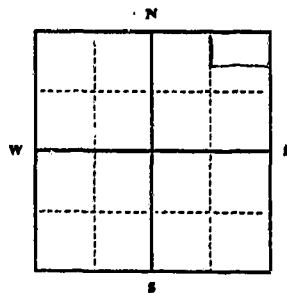

Static Water Level for non-flowing well 2' feet.

Shut-in Pressure for Flowing Well.....

Pumping Water Level..... 2' feet
at 12 gal. per minute.

Discharge in gal. per min. of flowing well

How Tested... Baled

Length of Test..... 2 hrs.

Remarks: (Gravel packing, cementing, packers, type of shutoff).....

W&A/4 Sec. 26 T. 15 N. R. 20 W

Indicate location of well and place of use, if possible. Each small square represents 40 acres.

(Continue on reverse side)

USE—If used for irrigation, industrial, drainage or other. Explain, state number of acres and location or other data (i.e.: Lot, Block and Addition).

Domestic

Show exact depth of bottom.

This form to be prepared by driller, and three copies to be filed by the owner with the County Clerk and Recorder in the county in which the well is located, tissue copy to be retained by driller.

Please answer all questions. If not applicable, so state, otherwise the form will be returned.

163

Driller's License Number

Donald G. Beck
Driller's Signature.

44,001

F 1782

269472

I received and filed this instrument for
record on the 20 day of April 1961
at 11:55 o'clock A.M., pursuant to the
of Missoula County, State of Montana
Witness my hand:
Vernon E. Couser, County Recorder
By Jane Buchanan, Deputy
Fee 2.00 Paid

File No. _____

T. 15^N R. 20^W

26

DUPLICATE

County. MISSOULA

STATE OF MONTANA RECEIVED
ADMINISTRATOR OF GROUNDWATER CODE
OFFICE OF STATE ENGINEER

SWL - Flowing
Top of Ground

(Elev. above sea level 3956')

Notice of Completion of Groundwater
Appropriation by Means of Well

(Under Chapter 237, Montana Session Laws, 1961)

Route #2

0-6 Topsoil

6-24 Gravel & cobbles
imbedded in tan clay

Owner FRED ERLANDSON Address MISSOULA, MONTANA

24-37 Lavender clay, sandy.
small seeps of water

Driller LIBERTY DRILLING CO. Address BOX 830 MSLA, MONT.

37-40 yellow clay with a
few scattered gravel
imbedded

Date of Notice of Appropriation of Groundwater 7/20/61

Date well started Oct. 12, 1961 Date Completed Feb. 5, 1962

Type of well Drilled Equipment Used CABLE TOOLS
(dug, driven, bored or drilled) (Churn, drill, rotary or other)

40-52 Orange clay with
some gravel imbedded

Water Use: Domestic Municipal Stock Irrigation
Industrial Drainage Other

52-79 Tan clay with gravel &
sand seams imbedded

79-87 Orange clay with
gravel & sand seams

Indicate on the diagram the character and thickness of the different strata met with in drilling, such as soil, clay, shale, gravel, rock or sand, etc. Show depth at which water is encountered, thickness and character of water-bearing strata and height to which the water rises in the well.

87-122 Tan clay with some
gravel imbedded

122-154 Tan clay

154-170 Orange clay with
some gravel

170-198 Gray clay

198-246 Broken Purple-gray rock
with gray clay in cracks

246-272 1/2 Solid purple-gray rock

272 1/2 - 275 Broken Purple-gray rock
water

275-277 Solid Purple-gray rock

Size of Drilled Hole	Size and Weight of Casing	From (Feet)	To (Feet)	PERFORATIONS		
				Kind Size	From (Feet)	To (Feet)
7"	7" x 24"	+1 1/2	201' 7"			
	5 1/2" x 17"	190 1/2	277'	Tool 2 1/2" x 1/4"	272	277

Bottom 277'

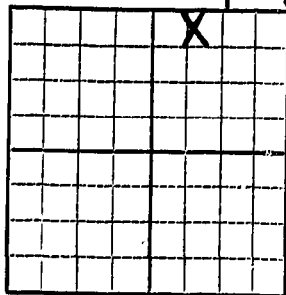

NW 1/4 NE Sec. 26 T. 15. R. 20.

Indicate location of well and place of use, if possible. Each small square represents 10 acres. LOT 2 EVARD TOWNSITE

Show exact depth of bottom.

Bottom 277 FTs

Static Water Level for non-flowing Well... Flowing feet.

Shut-in Pressure for Flowing Well... 6 #

Pumping Water Level... 275' feet at 3 1/2 gal. per minute.

Discharge in gal. per min. of flowing well... SEEP ABOUT 4 GPH

How Tested... Bailed Length of Test... 3 days

Remarks: (Gravel packing, cementing, packers, type of shutoff, location of place of use of groundwater if not at well, and any other similar pertinent information, including number of

acres irrigated, if used for irrigation)

All water coming up inside of casing - capped 2-5-62. Allowed to vent through 1/4" pipe to prevent freezing

52 Driller's License Number

William F. Coburn Driller's Signature

This form to be prepared by driller, and three copies to be filed by the owner with the County Clerk and Recorder in the county in which the well is located.

Please answer all questions. If not applicable, so state, otherwise the form will be returned.

Original to the County Clerk and Recorder; duplicate to the State Engineer; Triplicate to the School of Mines and Quadruplicate for the Appropriator.

0/60

198972

10/11/00 83

I received and filed this instrument for
 record on the 24th day of Oct 1989
 at 11:30 o'clock P.M., permanent files
 of Missoula County, State of Montana
 Witness my hand:
 MARTIN S. BEHNER, County Recorder
 By Eileen J. Hansen, Deputy
 Fee \$ 2.00 Paid

X

RECEIVED
 MISSOULA COUNTY RECORDER
 DEPT. 100
 10/11/00

File No.

T. 15 N. R. 22 W. 26

DUPLICATE

County. Missoula

STATE OF MONTANA
ADMINISTRATOR OF GROUNDWATER CODE
OFFICE OF STATE ENGINEER

Notice of Completion of Groundwater Appropriation
Without Well

Developed After January 1, 1962

(Under Chapter 237 Montana Session Laws, 1961)

Date of Appropriation of Groundwater June 29, 1970
Owner Edward R. Gallagher Box 907
Contractor (if any) none Missoula Montana
Address of Contractor

Date Started June 15, 1970 Date Completed June 29, 1970

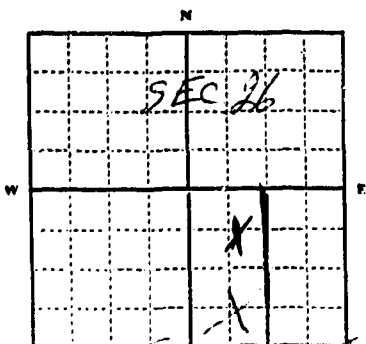

Point of Use
W 1/2 SE 1/4 Sec. 26 T. 15 N. R. 22 W.

Indicate point of appropriation and place of use, if possible.

- 1) Describe means of obtaining groundwater (as by sub-irrigation, developed spring, drains, etc.)
development of spring
- 2) Means of withdrawing water (gravity, pump, canal, etc.)
gravity
- 3) Depth of water table
- 4) Use of the water domestic use
- 5) Amount of groundwater claimed (in miner's inches, or gallons per minute) 40 miner's inches or all of natural flow of spring
- 6) If used for irrigation, give number of acres and description of land for irrigation of 10 acres of meadow land
- 7) Estimate amount of water used each year all of natural flow of spring

Signature of Owner Edward R. Gallagher

Date July 30, 1970

Doc. No. 293455
Filed for record
this 30 day of July
A. D. 19 70, at 6:05
o'clock P. M.

This form to be prepared by contractor (if any), otherwise by the owner.

Three copies of this notice are to be filed with the County Clerk and Recorder of the county in which the works are located.

Please answer all questions. If not applicable, so state, otherwise the form will be returned.

2015

293455

received and filed this instrument for
d on the 30th day of July 1970
at 3:25 o'clock P.M. ~~at~~ ~~the~~
of Missouri County, State of Missouri
Witness my hand.
Veranne R. Couse, County Recorder
By M. M. Longley Deputy
Fee \$2.00

File No.

T. 15N R. 20W

DUPLICATE

County Missoula

STATE OF MONTANA
ADMINISTRATOR OF GROUNDWATER CODE
OFFICE OF STATE ENGINEER

Declaration of Vested Groundwater Rights
(Under Chapter 237, Montana Session Laws, 1961)

RECEIVED
AUG 8 1963

STATE ENGINEER

1. Robert C. Hayes of Rt 2 Missoula
(Name of Appropriator) (Address) (Town)

County of Missoula State of Montana
have appropriated groundwater according to the Montana laws in effect prior to January 1, 1962, as follows:

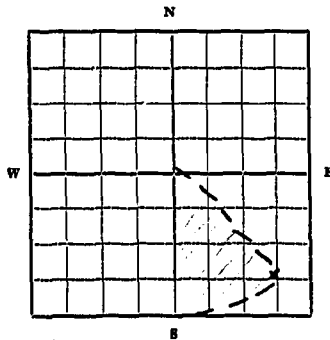

NE 1/4 Sec 26 T. 15N R. 20W

Indicate point of appropriation and place of use, if possible. Each small square represents 10 acres.

2. The beneficial use on which the claim is based Stock use and subsirrigation

3. Date or approximate date of earliest beneficial use; and how continuous the use has been Approx 1910 and continuous since

4. The amount of groundwater claimed (in miner's inches or gallons per minute) Six gallons/minute

5. If used for irrigation, give the acreage and description of the lands to which water has been applied and name of the owner thereof 20 acres in SW 1/4 Sec 26 T. 15N R. 20W N.M. SE NE

6. The means of withdrawing such water from the ground and the location of each well or other means of withdrawal Spring - self flowing

7. The date of commencement and completion of the construction of the well, wells, or other works for withdrawal of groundwater Not applicable

8. The depth of water table Approx 40-60 feet

9. So far as it may be available, the type, size and depth of each well or the general specifications of any other works for the withdrawal of groundwater Not applicable

10. The estimated amount of groundwater withdrawn each year Not applicable

11. The log of formations encountered in the drilling of each well if available Not applicable

12. Such other information of a similar nature as may be useful in carrying out the policy of this act, including reference to book and page of any county record. Not applicable

Signature of Owner Robert C Hayes
Date Aug 5, 1963

Three copies to be filed by the owner with the County Clerk and Recorder of the county in which the well is located.

Please answer all questions. If not applicable, so state, otherwise the form will be returned.

Original to the County Clerk and Recorder; duplicate to the State Engineer; Triplicate to the Montana Bureau of Mines and Geology and Quadruplicate for the Appropriator.

#236 copy 209252

I received and filed this instrument for
record on the 5 day of Aug 1963
at 1:05 o'clock P.M., permanent files
of Missoula County, State of Montana
Witness my hand:
MARTIN S. BEHNER, County Recorder
By Theresa Keppe Deputy
Fee \$ 2.00 Paid

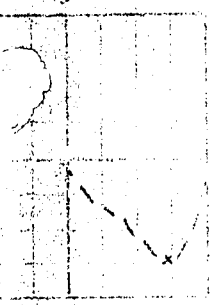

60
100
150
200
250
300
350
400
450
500
550
600
650
700
750
800
850
900
950
1000

Theresa Keppe
Deputy Recorder

File No.

T. 15 R. 20

DUPLICATE

County Missoula

STATE OF MONTANA
ADMINISTRATOR OF GROUNDWATER CODE
OFFICE OF STATE ENGINEER

RECEIVED
AUG 8 1963

Declaration of Vested Groundwater Rights STATE ENGINEER
(Under Chapter 237, Montana Session Laws, 1961)

1. Robert C Hayes (Name of Appropriator), of Rt. 2 (Address) Missoula (Town)
County of Missoula State of Montana

have appropriated groundwater according to the Montana laws in effect prior to January 1, 1962, as follows:

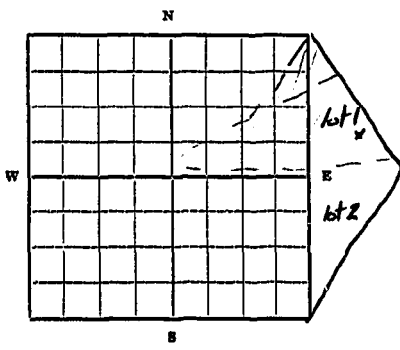

NE 1/4 Sec. 26, T. 15, R. 20
Indicate point of appropriation and place of use, if possible. Each small square represents 10 acres.

- 2. The beneficial use on which the claim is based Household, stock and irrigation
- 3. Date or approximate date of earliest beneficial use; and how continuous the use has been 1930 not used since.
- 4. The amount of groundwater claimed (in miner's inches or gallons per minute) 50 gallons/minute
- 5. If used for irrigation, give the acreage and description of the lands to which water has been applied and name of the owner thereof Never used but anticipate using now to irrigate 15 acres in lot 1 Sec 25 and NE 1/4 Sec 20 same owner
- 6. The means of withdrawing such water from the ground and the location of each well or other means of withdrawal Electric pump on well

- 7. The date of commencement and completion of the construction of the well, wells, or other works for withdrawal of groundwater Well drilled in 1930's exact date unknown
- 8. The depth of water table Approx 40-60 feet
- 9. So far as it may be available, the type, size and depth of each well or the general specifications of any other works for the withdrawal of groundwater 1 1/2" well with 6" casing
- 10. The estimated amount of groundwater withdrawn each year 800,000 gallons
- 11. The log of formations encountered in the drilling of each well if available Not available
- 12. Such other information of a similar nature as may be useful in carrying out the policy of this act, including reference to book and page of any county record This well was drilled in the 1930's but never used due to lack of electric power which has been recently installed.

Signature of Owner Robert C Hayes
Date Aug 5, 1963

Three copies to be filed by the owner with the County Clerk and Recorder of the county in which the well is located.

Please answer all questions. If not applicable, so state, otherwise the form will be returned.

Original to the County Clerk and Recorder; duplicate to the State Engineer; Triplicate to the Montana Bureau of Mines and Geology and Quadruplicate for the Appropriator.

copy
234 209249

I received and filed this instrument for
record on the 5 day of Aug 1963
at 12:50 clock P. M., peremptory files
of Missoula County, State of Montana
Witness my hand:
MARTIN S. BEHNER, County Recorder
By *Darlene Rippe* Deputy
Fee \$ 2.00

Very faint, illegible text, possibly bleed-through from the reverse side of the page.

File No.

T. 15 R. 20

DUPLICATE

County Missoula

STATE OF MONTANA
ADMINISTRATOR OF GROUNDWATER CODE
OFFICE OF STATE ENGINEER

RECEIVED
AUG 8 1963

Declaration of Vested Groundwater Rights
(Under Chapter 237, Montana Session Laws, 1961)

STATE ENGINEER

1. Robert C. Hayes of Rt. 2 Missoula
(Name of Appropriator) (Address) (Town)
County of Missoula State of Montana
have appropriated groundwater according to the Montana laws in effect prior to January 1, 1962, as follows:

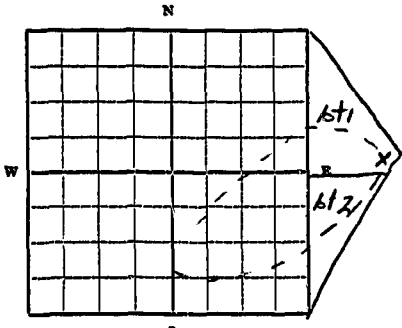

NE 1/4 Sec 26 T15 R20

Indicate point of appropriation and place of use, if possible. Each small square represents 10 acres.

- 2. The beneficial use on which the claim is based stock water and irrigation and sub-irrigation
- 3. Date or approximate date of earliest beneficial use; and how continuous the use has been 1910 and continuous since then
- 4. The amount of groundwater claimed (in miner's inches or gallons per minute) 10 gallons/minute
- 5. If used for irrigation, give the acreage and description of the lands to which water has been applied and name of the owner thereof 1st 1/4 Sec 25 and SE NE Sec 26 T15 R20 W MPM R Apprx 20 acres
- 6. The means of withdrawing such water from the ground and the location of each well or other means of withdrawal Free flowing spring
- 7. The date of commencement and completion of the construction of the well, wells, or other works for withdrawal of groundwater Not Applicable
- 8. The depth of water table Approx 40-60 feet
- 9. So far as it may be available, the type, size and depth of each well or the general specifications of any other works for the withdrawal of groundwater Not Applicable
- 10. The estimated amount of groundwater withdrawn each year Not Applicable
- 11. The log of formations encountered in the drilling of each well if available Not Applicable
- 12. Such other information of a similar nature as may be useful in carrying out the policy of this act, including reference to book and page of any county record. Not Applicable

Signature of Owner Robert C. Hayes
Date Aug 5, 1963

Three copies to be filed by the owner with the County Clerk and Recorder of the county in which the well is located.

Please answer all questions. If not applicable, so state, otherwise the form will be returned.

Original to the County Clerk and Recorder; duplicate to the State Engineer; Triplicate to the Montana Bureau of Mines and Geology and Quadruplicate for the Appropriator.

235 *copy* 209251

I received and filed this instrument for
record on the 5 day of Aug, 1963
at 1:00 o'clock P.M., permanent files
of Missoula County, State of Montana
Witness my hand:
MARTIN S. DEHNER County Recorder
By Carlson Kasper Deputy
Fee \$ 2.00

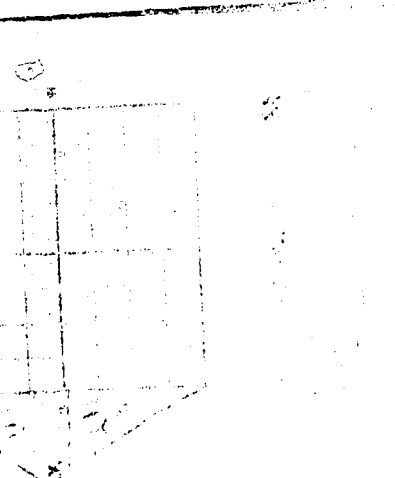

[Faint, illegible handwritten text, possibly a list or notes related to the survey or recording process.]

[Handwritten signature or initials.]

GW 2

File No. _____

DUPLICATE

RECEIVED
JAN 11 1965

Approved Stock Form—State Publishing Co., Helena, Montana 1933

T. 15 N R. 20 W

County Missoula

STATE ENGINEER STATE OF MONTANA
ADMINISTRATOR OF GROUNDWATER CODE
OFFICE OF STATE ENGINEER

RECEIVED
JAN 8 1965

Notice of Completion of Groundwater
Appropriation by Means of Well

(Under Chapter 237, Montana Session Laws, 1961)

0'
9'
9'
11'
11'
35'
35'
36'

Top of Ground
(Elev. above sea level.....)

Clay

Clay Gravel

Clay

Gravel Water

Owner Walter Johns Address Route 2 Evaro Hill

Driller John Farrell Address Arlee Mont

Date of Notice of Appropriation of Groundwater.....

Date well started Nov. 23, 1964 Date Completed Nov. 24, 1964

Type of well Drilled Equipment Used Churn Drill
(dug, driven, bored or drilled) (Churn, drill, rotary or other)

Water Use: Domestic Municipal Other Irrigation
Industrial Drainage Stock

Indicate on the diagram the character and thickness of the different strata met with in drilling, such as soil, clay, shale, gravel, rock or sand, etc. Show depth at which water is encountered, thickness and character of water-bearing strata and height to which water rises in the well.

Size of Drilled Hole	Size and Weight of Casing	From (Feet)	To (Feet)	PERFORATIONS		
				Kind Size	From (Feet)	To (Feet)
6"	6" (18.97) #	0'	36'			

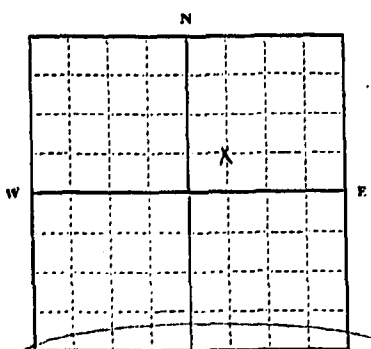

S 24.76 Sec. 26 T. 15 R. 20
Indicate location of well and place of use, if possible. Each small square represents 10 acres.

Static Water Level for non-flowing Well..... 9' feet.

Shut-in Pressure for Flowing Well.....

Pumping Water Level..... 32 feet at..... 6 gal. per minute.

Discharge in gal. per min. of flowing well.....

How Tested..... Pump..... Length of Test..... 1 Hour

Remarks: (Gravel packing, cementing, packers, type of shutoff, location of place of use of groundwater if not at well, and any other similar pertinent information, including number of acres irrigated, if used for irrigation).....

36

Show exact depth of bottom.

Location?

14
Driller's License Number

John Farrell
Driller's Signature

This form to be prepared by driller, and three copies to be filed by the owner with the County Clerk and Recorder in the county in which the well is located.

Please answer all questions. If not applicable, so state, otherwise the form will be returned.

Original to the County Clerk and Recorder; duplicate to the State Engineer; Triplicate to the Montana Bureau of Mines and Geology and Quadruplicate for the Appropriator.

38821

1467

231056

I received and filed this instrument for
 record on the 31 day of Dec 1968
 at 10:45 o'clock A.M., permanent files
 of Missoula County, State of Montana
 Witness my hand:
Verlance R. House, County Recorder
 By Jean Bechtold, Deputy
 Fee 2.00 Paid

RECEIVED

CIVIL ENGINEER

RECEIVED

CIVIL ENGINEER

4/3

JW 3

File No.

DUPLICATE

Section No. 2011

RECEIVED
FEB 14 1964

T. 15 R. 20 W

26

County Missoula

STATE ENGINEER
ADMINISTRATOR OF GROUNDWATER CODE
OFFICE OF STATE ENGINEER

RECEIVED
DEC 30 1963

STATE ENGINEER

Notice of Completion of Groundwater Appropriation Without Well

(Under Chapter 237 Montana Session Laws, 1961)

Date of Appropriation of Groundwater April 13, 1964

Clyde F. Pearson and

Owner Frankie L. Pearson Address Florence, Montana

Contractor (if any) inapplicable

Address of Contractor inapplicable

Date Started April 13, 1964 Date Completed inapplicable

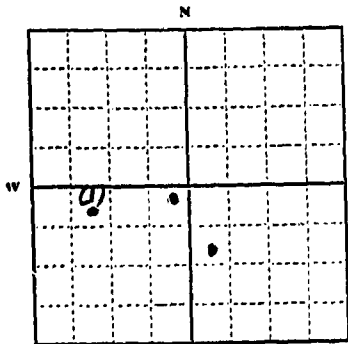

Describe means of obtaining groundwater without a well "as by sub-irrigation and other natural processes". Include depth to water when applicable. Surface, spring water at 3 points

indicated (domestic household use, garden,

stockwater, sub irrigation of approximately 20 acres)

Quantity of water developed and used with explanation of method used to measure or estimate such amount. If use is intermittent

estimate approximate lengths of periods of use Three springs,

210 gallons per minute, broken down to 26 gallons

per minute all uses except sub irrigation. Sub irrigation

to 204 acres based on 1 miner's inch per acre. No. 1

(domestic use spring)

Signature of Owner Clyde F. Pearson

Date December 27, 1963

This form to be prepared by contractor (if any), otherwise by the owner.

Three copies of this notice are to be filed with the County Clerk and Recorder of the county in which the works are located.

Please answer all questions. If not applicable, so state, otherwise the form will be returned.

Original to the County Clerk and Recorder; duplicate to the State Engineer; Triplicate to the Montana Bureau of Mines and Geology and Quadruplicate for the Appropriator.

15245

643

215004

Copy
I received and filed this instrument for
record on the 27 day of Dec 1966
at 2:18 o'clock P.M. permanent files
of Missoula County, State of Montana
Witness my hand:
MARTIN S. BENNER, County Recorder
By Martin S. Benner
Fee 5.00

File No.

T. 15 R. 20 ✓

DUPLICATE RECEIVED

County Missoula

STATE OF MONTANA
ADMINISTRATOR OF GROUNDWATER CODE
OFFICE OF STATE ENGINEER

No. 302088

this 30 day of April

A. D. 1971 at 10:30

o'clock A.M.

Notice of Appropriation of Groundwater

(Under Chapter 237, Montana Session Laws, 1961)

1. I, Arthur A. Davis of Route 2 Evans
(Name of Appropriator) (Address) (Town)
County of Missoula, State of Montana, intend to appropriate groundwater in accordance with Chapter 237, Montana Session Laws of 1961.

2. The beneficial use to which water is to be applied is only for a supply of water for use in a home.
(describe lands to be benefited, if for irrigation)

3. The rate of use in gallons per minute or miner's inches of groundwater claimed unknown.
(not applicable)

4. The annual period (inclusive dates) of intended use all year around

5. The probable or intended date of first beneficial use June 8, 1971

6. The probable or intended date of commencement and completion of the well or wells no well will be put in. A natural spring will be the source of water.

7. The location, type, size and depth of well or wells contemplated The spring will be dug down to have the depth of eight (8) ft.

8. The probable or estimated depth of the water table or artesian aquifer unknown (not applicable)

9. Name, address and license number of the driller engaged none (not applicable)

10. Give such other similar information as may be useful in carrying out the policy of this act. This spring is almost located in the center of the described piece of property. This is where it comes out of the ground.

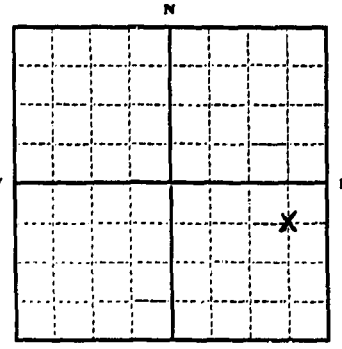

NE 1/4 of SE 1/4 Sec. 27, T. 15N R. 20W
Locate well or other means of development as accurately as possible on the plat.

Signature of Appropriator Arthur A. Davis
Date April 28, 1971

* As defined in the Code Sec. 1 (c) "Well" means any artificial opening or excavation in the ground, however made, by which groundwater can be obtained or through which it flows under natural pressures or is artificially withdrawn."

Three copies of this notice are to be filed with County Clerk and Recorder of the county in which the well is located.

Please answer all questions. If not applicable, so state, otherwise the form will be returned.

Original to the County Clerk and Recorder; duplicate to the State Engineer; Triplicate to the Montana Bureau of Mines and Geology and Quadruplicate for the Appropriator.

2 2123

302088

I received and filed this instrument for
record on the 3rd day of Jan, 1971
at 11:30 o'clock A.M., permanent files
of Missoula County, State of Montana
Witness my hand
Vernice R. Crouse, County Recorder
By William J. Skalaky, Deputy
Fee \$ 2.00 cash Paid

RECEIVED

File No.

T. 15 R. 20

TRIPLICATE

NOV 18 1971

County MISSOULA

STATE OF MONTANA
ADMINISTRATOR OF GROUNDWATER CODE
OFFICE OF STATE ENGINEER

Notice of Completion of Groundwater Appropriation
Without Well

(Under Chapter 237 Montana Session Laws, 1961)

Doc. No. 309594
Filed for record
this 12 day of November
A. D. 19 76, at 3:00
o'clock 1 M.

Date of Appropriation of Groundwater March 13, 1971
Owner Arthur A. Davis Address Route 2 - Evaro
Montana
Contractor (if any) not applicable
Address of Contractor not applicable
Date Started natural existence Date Completed

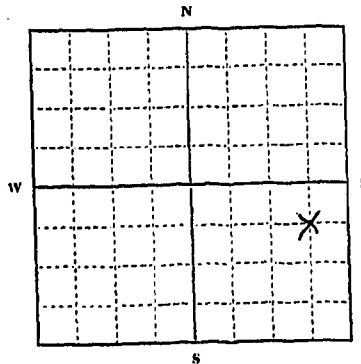

NE 1/4 Sec. 22 T. 15 R. 20
Indicate point of appropriation
and place of use, if possible.

Describe means of obtaining groundwater without a well "as by sub-irrigation and other natural processes". Include depth to water when applicable. This natural spring will be dug out so as to have a depth of eight (8) feet. This way we will have a sufficient water storage supply.

Quantity of water developed and used with explanation of method used to measure or estimate such amount. If use is intermittent estimate approximate lengths of periods of use

Signature of Owner Earl E. Davis
Date April 28, 1971

This form to be prepared by contractor (if any), otherwise by the owner.
Three copies of this notice are to be filed with the County Clerk and Recorder of the county in which the works are located.
Please answer all questions. If not applicable, so state, otherwise the form will be returned.
Original to the County Clerk and Recorder; duplicate to the State Engineer; Triplicate to the Montana Bureau of Mines and Geology and Quadruplicate for the Appropriator.

42199

309594

I received and read the within and
record on the 12th day of Nov 71
at 2:00 P.M. at the Court House
of Missouri County, State of Missouri
Witness my Hand
Veranda H. Stone, County Clerk
By *John H. Johnson*, Deputy
For *W. D. Carl*

T. 15 22 R. 20 21 27

County Lincoln

MONTANA BUREAU OF MINES AND GEOLOGY
Butte, Montana

RECEIVED
AUG 7 1961

WATER WELL LOG

STATE ENGINEER

		X

Owner: Carl Willis Address: Box 807

Driller: Johan Farrell Address: Aslee Mont

Date Started: July 17 - 1961 Date Completed: Aug 1 1961

Location: Sec. 27 T. 15 22 R. 20 21 1/4 sec. S.E.

Type of well: X (Dug, driven, bored, or drilled) Equipment used: X X (Churn drill, rotary, other)

Water use: Domestic Municipal Stock Irrigation

Industrial Drainage Other: _____

Casing: 0 ft. to 39 ft. Type: 13 LB steel Size: 5"

Casing: _____ ft. to _____ ft. Type: _____ Size: _____

Casing: _____ ft. to _____ ft. Type: _____ Size: _____

Perforated or Screened: Ft. 39 to ft. 46 Ft. _____ to ft. _____

Type of screen or perforations: 4" pipe 1/8 slot casing Jonah

Static Water level, for non-flowing well: _____ feet. 11

Shut-in pressure, for flowing well: _____ lb./sq. in. on: Aug 1 - 1961 (date)

Pumping water level: 4.0 feet at _____ gal. per min. 8

How tested: Basin

Length of test: 2 hrs

Remarks: (Gravel packing, cementing, packers, type of shut-off, depth of shut-off)

4" Perforated Liner 4'

(over)

Log of Well

Depth, feet		Description of Material Drilled
From	To	
0	26	Loose shale Rock
26	46	Hard shale Rock
		Water level 39' to 46'

I received and filed this instrument for record on this _____ day of _____ 19__
 at _____
 County of _____ State of _____
 Witness my hand _____
 MARTIN S. LEHNER, County Recorder
 _____ Deputy
 Fee \$ _____ Paid _____

79
184107

File No. _____

T. 15 R. 20 27

DUPLICATE

County Missoula

STATE OF MONTANA
ADMINISTRATOR OF GROUNDWATER
OFFICE OF STATE ENGINEER

STATE ENGINEER
Notice of Completion of Groundwater
Appropriation by Means of Well

(Under Chapter 237, Montana Session Laws, 1961)



Top of Ground
(Elev. above sea level.....)

Top Soil

Shale Rock Clay

Shale Rock Water

Owner Carl Willis Address Evans Mont

Driller John Farrell Address Arlee Mont

Date of Notice of Appropriation of Groundwater.....

Date well started Aug 18 1964 Date Completed Aug 19 1964

Type of well Drilled Equipment Used Churn Drill
(dug, driven, bored or (Churn, drill, rotary or drilled) other)

Motel

Water Use: Domestic Municipal Other Irrigation
Industrial Drainage Stock

Indicate on the diagram the character and thickness of the different strata met with in drilling, such as soil, clay, shale, gravel, rock or sand, etc. Show depth at which water is encountered, thickness and character of water-bearing strata and height to which water rises in the well.

Size of Drilled Hole	Size and Weight of Casing	From (Feet)	To (Feet)	PERFORATIONS		
				Kind Size	From (Feet)	To (Feet)
5"	5" 14#	0	39'			

Static Water Level for non-flowing Well..... 4 feet.

Shut-in Pressure for Flowing Well.....

Pumping Water Level..... 15 feet at..... 17 gal. per minute.

Discharge in gal. per min. of flowing well.....

How Tested Pump Length of Test 2 Hrs

Remarks: (Gravel packing, cementing, packers, type of shutoff, location of place of use of groundwater if not at well, and any other similar pertinent information, including number of acres irrigated, if used for irrigation).....

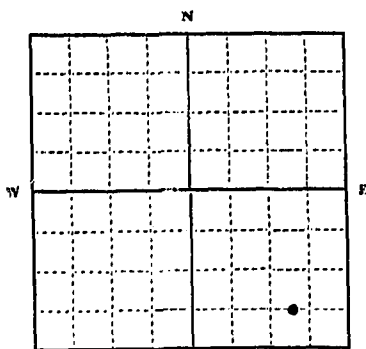

SE 1/4 Sec. 7 T. 20 N. R. 20 W.
Indicate location of well and place of use, if possible. Each small square represents 10 acres.

Show exact depth of bottom.

14
Driller's License Number

John Farrell
Driller's Signature

This form to be prepared by driller, and three copies to be filed by the owner with the County Clerk and Recorder in the county in which the well is located.

Please answer all questions. If not applicable, so state, otherwise the form will be returned.

Original to the County Clerk and Recorder; duplicate to the State Engineer; Triplicate to the Montana Bureau of Mines and Geology and Quadruplicate for the Appropriator.

38624

158

228435

I received and filed this Instrument for
 record on the 28th day of Dec. 1962
 at 11:50 o'clock A.M., permanent files
 of Missoula County, State of Montana
 Witness my hand:
 Vermae R. Clouse, County Recorder
 By J. H. Allings, Deputy
 Fee \$ 2.00 Paid



MISSOULA COUNTY, MONTANA
 COUNTY RECORDER
 VERMAE R. CLOUSE
 DEPUTY
 J. H. ALLINGS

CW 3

File No.

DUPLICATE

T. 15^N R. 20^W 34

County.....

STATE OF MONTANA
ADMINISTRATOR OF GROUNDWATER CODE
OFFICE OF STATE ENGINEER

RECEIVED
JAN 3 1963

STATE ENGINEER

Notice of Completion of Groundwater Appropriation Without Well

(Under Chapter 237 Montana Session Laws, 1961)

Date of Appropriation of Groundwater May 1957
Owner Sam F. Thompson Address 242 So. 4th St. W. Missoula, Mont.

Contractor (if any) None -

Address of Contractor

Date Started May 1957 Date Completed May 1957

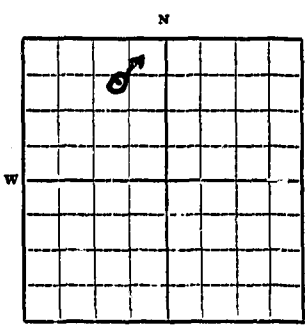

Describe means of obtaining groundwater without a well "as by sub-irrigation and other natural processes". Include depth to water when applicable. Springs, sub-irrigation and natural flow - From ground surface to several feet below surface

Quantity of water developed and used with explanation of method used to measure or estimate such amount. If use is intermittent estimate approximate lengths of periods of use 40 g.p.m. is

NE 1/4 NW 1/4 Sec. 34 T. 15 N R. 20 W

Indicate point of appropriation and place of use, if possible.

inches - Used for domestic, human and animal use - Estimated amount at one a.f.g. - Continuous use with few interruptions.

Signature of Owner Sam F. Thompson

Date December 31, 1963

This form to be prepared by contractor (if any), otherwise by the owner.

Three copies of this notice are to be filed with the County Clerk and Recorder of the county in which the works are located.

Please answer all questions. If not applicable, so state, otherwise the form will be returned.

Original to the County Clerk and Recorder; duplicate to the State Engineer; Triplicate to the Montana Bureau of Mines and Geology and Quadruplicate for the Appropriator.

990 r. 215444

I received and filed this instrument for
record on the 31st day of Dec 1923
at 1:45 P.M. permanent files
of Missoula County, State of Montana
Witness my hand
M. S. BERNIE County Recorder
By *M. S. Bernie* Deputy
Fee \$ 1.00 Paid

GW3

File No. _____

DUPLICATE

T. 15⁰ R. 19^W 7
County Missoula

STATE OF MONTANA
ADMINISTRATOR OF GROUNDWATER CODE
OFFICE OF STATE ENGINEER

RECEIVED
DEC 30 1963

STATE ENGINEER
Notice of Completion of Groundwater Appropriation Without Well

(Under Chapter 237 Montana Session Laws, 1961)

Date of Appropriation of Groundwater 1960

Owner Don Keffler Address Arlee

Contractor (if any) NONE

Address of Contractor NONE

Date Started 1960 Date Completed 1960

Describe means of obtaining groundwater without a well "as by sub-irrigation and other natural processes". Include depth to water when applicable. The water is piped down from an underground spring that is located on our property

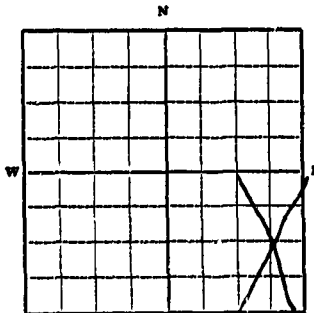

Quantity of water developed and used with explanation of method used to measure or estimate such amount. If use is intermittent estimate approximate lengths of periods of use used only for house in winter and for sprinkling lawn in summer when necessary. The surplus runs down the hill.

E 1/4 SE Sec. 7 T. 15 R. 19
Indicate point of appropriation and place of use, if possible.

Signature of Owner Mrs. Rudolph Anderson

Date Dec. 27, 1963

This form to be prepared by contractor (if any), otherwise by the owner.

Three copies of this notice are to be filed with the County Clerk and Recorder of the county in which the works are located.

Please answer all questions. If not applicable, so state, otherwise the form will be returned.

Original to the County Clerk and Recorder; duplicate to the State Engineer; Triplicate to the Montana Bureau of Mines and Geology and Quadruplicate for the Appropriator.

630

214990

copy
I received and filed the instrument for
record on the *27* day of *Dec*, 19*63*
at *1:30* o'clock *P.M.*, permanent files
of Missoula County, State of Montana
Witness my hand:
MARTIN E. BRINER, County Recorder
By *Martin E. Briner*, Deputy
Fee *5.00* Paid

GW3

File No.

DUPLICATE

T. 15 N R. 19 W

County. Missoula

18

STATE OF MONTANA
ADMINISTRATOR OF GROUNDWATER CODE
OFFICE OF STATE ENGINEER

RECEIVED
JAN 3 1963
STATE ENGINEER

Notice of Completion of Groundwater Appropriation ~~Without~~ Well

(Under Chapter 237 Montana Session Laws, 1961)

Date of Appropriation of Groundwater Sept. 5, 1963

Owner Edward B. Gallagher, Missoula Mont.

Contractor (if any) Sharon C. Gallagher

Address of Contractor

Date Started Sept. 1, 1963 Date Completed Sept. 3, 1963

Describe means of obtaining groundwater without a well "as by sub-irrigation and other natural processes". Include depth to water when applicable. Development of

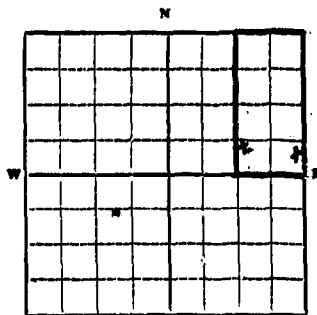

a spring.

Quantity of water developed and used with explanation of method used to measure or estimate such amount. If use is intermit-

tent estimate approximate lengths of periods of use

1/2 NE 1/4 Sec. 18, T. 15 N, R. 19 W

Indicate point of appropriation and place of use, if possible.

Approximately 1.50 miners
inches - water flowed to the
full capacity of a two
inch pipe constantly.

Signature of Owner Edward B. Gallagher

Date Sept. 3, 1963

This form to be prepared by contractor (if any), otherwise by the owner.

Three copies of this notice are to be filed with the County Clerk and Recorder of the county in which the works are located.

Please answer all questions. If not applicable, so state, otherwise the form will be returned.

Original to the County Clerk and Recorder; duplicate to the State Engineer; Triplicate to the Montana Bureau of Mines and Geology and Quadruplicate for the Appropriator.