

35

File No.

T. 9S R. 14E

DUPLICATE

County

STATE OF MONTANA  
ADMINISTRATOR OF GROUNDWATER CODE  
OFFICE OF STATE ENGINEER

RECEIVED  
JAN 6 1964

Declaration of Vested Groundwater Rights

(Under Chapter 237, Montana Session Laws, 1961)

STATE ENGINEER

1. Raymond + Rose Mary Mus, of Cooke City,  
(Name of Appropriator) (Address) (Town)  
County of Park State of Montana  
have appropriated groundwater according to the Montana laws in effect prior to January 1, 1962, as follows:

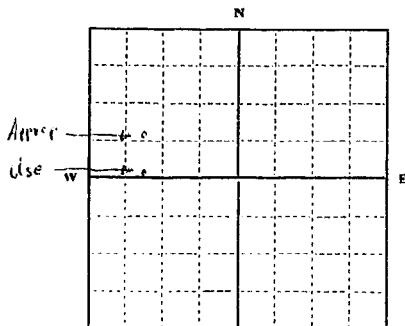

NW 1/4 Sec. 25 T. 9S R. 14E

Indicate point of appropriation and place of use, if possible. Each small square represents 10 acres.  
NE 1/4 of SW 1/4 of NW 1/4

2. The beneficial use on which the claim is based Car only domestic water supply.

3. Date or approximate date of earliest beneficial use; and how continuous the use has been Purchased water rights in 1949, used since.

4. The amount of groundwater claimed (in miner's inches or gallons per minute). Use all of springs output. Spring runs a volume that could pass through a 2 in. pipe with no head.

5. If used for irrigation, give the acreage and description of the lands to which water has been applied and name of the owner thereof Use some output to water lawn.

6. The means of withdrawing such water from the ground and the location of each well or other means of withdrawal Spring is boxed in concrete thence to 1000 gal. square steel storage tank thence through 1/2" pipe to our house.

7. The date of commencement and completion of the construction of the well, wells, or other works for withdrawal of groundwater Concrete box at spring put in 50 yrs ago. Steel tank put in 2 yrs ago.

8. The depth of water table Spring bottom is at 8 feet approx.

9. So far as it may be available, the type, size and depth of each well or the general specifications of any other works for the withdrawal of groundwater Only one spring as described above.

10. The estimated amount of groundwater withdrawn each year 2,500 to 3,000

11. The log of formations encountered in the drilling of each well if available Surface gravel

12. Such other information of a similar nature as may be useful in carrying out the policy of this act, including reference to book and page of any county record Spring title rights (Allen Spring) recorded in vol. 3 of water rights part page 237 of office of the County Clerk & Recorder of Park Co. Mont.

Signature of Owner Raymond B. Mus

Date Dec. 26, 1963

Three copies to be filed by the owner with the County Clerk and Recorder of the county in which the well is located.

Please answer all questions. If not applicable, so state, otherwise the form will be returned.

Original to the County Clerk and Recorder; Duplicate to the State Engineer; Triplicate to the Montana Bureau of Mines and Geology, and Quadruplicate for the Appropriator.

24963

Doc # 98325

Filed this 5<sup>th</sup> day of

January A. D. 1964

at 9:00 o'clock a. m.

Margaret Inoué  
County Clerk and Recorder.

fee \$ 3.00 Dues

File No. ....

T. 9S R. 14E

DUPLICATE

County D. Park

STATE OF MONTANA  
ADMINISTRATOR OF GROUNDWATER CODE  
OFFICE OF STATE ENGINEER

RECEIVED  
DEC 26 1963  
STATE ENGINEER

Declaration of Vested Groundwater Rights

(Under Chapter 237, Montana Session Laws, 1961)

1. United States of America, of Box 5 Gardiner  
(Name of Appropriator) (Address) (Town)

County of Park State of Montana

have appropriated groundwater according to the Montana laws in effect prior to January 1, 1962, as follows:

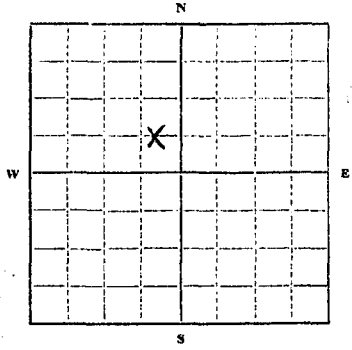

SE 1/4 NW 1/4 Sec 25 T9S R14E

Indicate point of appropriation and place of use, if possible. Each small square represents 10 acres.

2. The beneficial use on which the claim is based Domestic Reeb Special Use

3. Date or approximate date of earliest beneficial use; and how continuous the use has been 1952; yearly

4. The amount of groundwater claimed (in miner's inches or gallons per minute) Estimated - 0.8 miner's inches

5. If used for irrigation, give the acreage and description of the lands to which water has been applied and name of the owner thereof N/A

6. The means of withdrawing such water from the ground and the location of each well or other means of withdrawal Pipeline from a spring located in the SE 1/4 NW 1/4 Section 25, T9S, R14E, PM - Soda Butte Creek drainage

7. The date of commencement and completion of the construction of the well, wells, or other works for withdrawal of groundwater 1952

8. The depth of water table N/A

9. So far as it may be available, the type, size and depth of each well or the general specifications of any other works for the withdrawal of groundwater N/A

10. The estimated amount of groundwater withdrawn each year Estimated - 50,000 gallons

11. The log of formations encountered in the drilling of each well if available N/A

12. Such other information of a similar nature as may be useful in carrying out the policy of this act, including reference to book and page of any county record N/A

United States of America  
Signature of Owner By [Signature]  
District Forest Ranger  
Date 10/22/63

Three copies to be filed by the owner with the County Clerk and Recorder of the county in which the well is located.

Please answer all questions. If not applicable, so state, otherwise the form will be returned.

Original to the County Clerk and Recorder; duplicate to the State Engineer; Triplicate to the Montana Bureau of Mines and Geology, and Quadruplicate for the Appropriator.

Doc 97735

Filed this 23 day of  
Dec A. D. 1963  
at 2:15 o'clock P. M.  
Margaret Mowbray  
County Clerk and Recorder.

by  
fee \$3.00 Richard

GW3

File No.....

T. 9 S R. 14 E

DUPLICATE

County.....

STATE OF MONTANA  
ADMINISTRATOR OF GROUNDWATER CODE  
OFFICE OF STATE ENGINEER

RECEIVED  
JUL 1 - 1963

STATE ENGINEER  
**Notice of Completion of Groundwater Appropriation Without Well**

(Under Chapter 237 Montana Session Laws, 1961)

Date of Appropriation of Groundwater Sept. 26th, 1953  
PO Box 1591  
Owner W. H. Pemberton Address Billings, Montana

Contractor (if any) None

Address of Contractor .....

Date Started Sept. 15th, Date Completed Sept. 26th, 1953

Describe means of obtaining groundwater without a well "as by sub-irrigation and other natural processes". Include depth to water when applicable. 2" Plastic Pipe, from spring to cabin for domestic (and commercial use if wanted) Settling box at spring, water piped to cabin

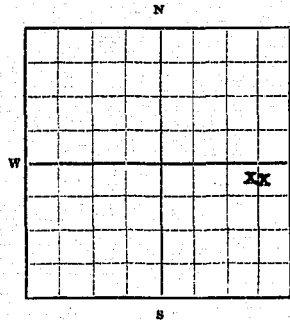

on September Millsite, 5 acres, Mineral Survey #66B, New World Mining District; Section 26, NE 1/4, Township 9 South, Range 14 East, MPM, Park County, State of Montana.

Quantity of water developed and used with explanation of method used to measure or estimate such amount. If use is intermit-

NE 1/4 Sec. 26 T. 9 S. R. 14 E  
Indicate point of appropriation and place of use, if possible.

tent estimate approximate lengths of periods of use .....  
Summer home use presently, but filed for possible commercial use, for motel or other use, as highway to Yellowstone Park thru land.

Notice of Appropriation, Form #17, recorded  
Sept. 26th, 1953, Volume #30, Page 234, Misc. Records, Livingston, Mont.  
Signature of Owner.....

Date June 27th,

This form to be prepared by contractor (if any), otherwise by the owner.

Three copies of this notice are to be filed with the County Clerk and Recorder of the county in which the works are located.

Please answer all questions. If not applicable, so state, otherwise the form will be returned.

Original to the County Clerk and Recorder; duplicate to the State Engineer; Triplicate to the School of Mines and Quadruplicate for the Appropriator.

Doc # 95803

Filed this 28 day of  
June A. D. 1962  
at 1:00 o'clock P. M.  
Margaret Ironical  
County Clerk and Recorder.

By \_\_\_\_\_ Deputy  
Dee 200

RECEIVED

County Park

JUN 23 1970

STATE OF MONTANA  
ADMINISTRATOR OF GROUNDWATER CODE  
MONTANA WATER RESOURCES BOARD

DRILLER'S LOG

NOTICE OF COMPLETION OF GROUNDWATER  
APPROPRIATION BY MEANS OF WELL

Indicate the character, color, thickness of strata such as soil, clay, sand, gravel, shale, sandstone, etc. Show depth at which water is found and height to which water rises in well.

Developed after January 1, 1962

(Under Chapter 237 Montana Session Laws, 1961, as amended)

This form to be prepared by driller, and three copies to be filed by the owner with the County Clerk and Recorder in the county in which the well is located, last copy to be retained by driller. Please answer all questions. If not applicable, so state, otherwise the form may be returned.

Owners: George E. Lewis and Bonnie Louise Miller Lewis

Address: 604 Crawford Drive  
Billings, Mt. 59102

For Administrator's Use	
File	<u>June 23, 1970</u>
	<u>8:02 A.M.</u>
Date well started	<u>June 16, 1970</u>
completed	<u>June 18, 1970</u>

Date well started June 16, 1970 GW 1 182.23

Type of well drilled  
(Dug, driven, bored or drilled)

Equipment used Cable tool  
(Churn drill, rotary or other)

Water Use: Domestic  Municipal  Stock  Irrigation   
Industrial  Drainage  Other  Garden/Lawn

\*Describe  
USE: If used for irrigation, industrial, drainage or other. Explain, state number of acres and location or other data (i.e. Lot, Block and Addition).

ESTIMATED ANNUAL WITHDRAWAL 10,000 gal

Size of Drilled Hole	Size and Weight of Casing	From (Feet)	To (Feet)	PERFORATIONS		
				Kind	From (Feet)	To (Feet)
<u>7"</u>	<u>6 5/8 O.D. 19 lb</u>	<u>2 above</u>	<u>38.6"</u>	<u>none</u>		

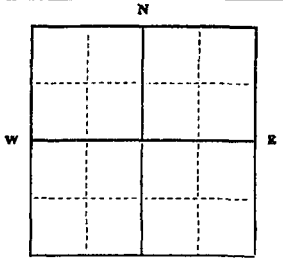

Static water level 12 ft.\*  
Pumping water level 35 ft.\*  
at 7 gallons per minute,  
measured 1 minutes after pumping began.

\*Measured from ground level.  
Well developed by plumping  
for 2 1/2 hours.  
Power 230 volt 3/4 HP

Remarks: (Gravel packing, cementing, packers, type of shutoff) first water at Lot 2 Plat. of Survey No. 515 called "Sun towers" Recorded Vol. 113 Doc. 116, 977

1/4 Sec. 27  
T. 9 R. 14 S. 14 E. 14

INDICATE LOCATION OF WELL AND PLACE OF USE, IF POSSIBLE. EACH SMALL SQUARE REPRESENTS 40 ACRES.

Driller's Signature Howard B. Hulbert  
Driller's Address Rt 1 Bozeman Montana

LICENSE NO. 47

Top of Ground (Elev. above sea level) 7500'

From (Feet)	To (Feet)	Description
<u>0</u>	<u>5</u>	<u>Top soil</u>
<u>5</u>	<u>10</u>	<u>Clay &amp; rock</u>
<u>10</u>	<u>22</u>	<u>clay</u>
<u>22</u>	<u>23</u>	<u>Reddish soil w</u>
<u>23</u>	<u>24</u>	<u>water (little)</u>
<u>24</u>	<u>26</u>	<u>clay &amp; silt</u>
<u>26</u>	<u>27</u>	<u>water</u>
<u>27</u>	<u>28</u>	<u>black soil</u>
<u>28</u>	<u>42</u>	<u>rock</u>
<u>42</u>	<u>49</u>	<u>Gravel &amp; water</u>

39' Show exact depth of bottom

46608

Vol. #  
18223

Dated this 22<sup>nd</sup> day of

June A. D. 1970

at 8:03 o'clock A. M.

Ernest J. Monical  
County Clerk and Recorder.

by \_\_\_\_\_ Deputy

Lee J. ...



File No. STATE

T. 9S R. 14E

DUPLICATE

SEP 15 1966

County BARK

STATE OF MONTANA  
ADMINISTRATOR OF GROUNDWATER CODE  
OFFICE OF STATE ENGINEER

Notice of Completion of Groundwater Appropriation  
Without Well

(Under Chapter 237 Montana Session Laws, 1961)

Date of Appropriation of Groundwater June 15, 1966

Owner Frank G. Reed Address Box 11, Silver Gate Montana

Contractor (if any) --

Address of Contractor --

Date Started June 15, 1966 Date Completed July 22, 1966

Describe means of obtaining groundwater without a well "as by sub-irrigation and other natural processes". Include depth to

water when applicable. Originally ditched from spring to holding reservoir, then in cedar pipe to 3/4" pipe. Completely redone in July, 1966. Remade holding reservoir, installed 1" plastic pipe to new red wood tank- then 1" plastic pipe from tank to four 3/4" pipes for distribution to cabins described below.

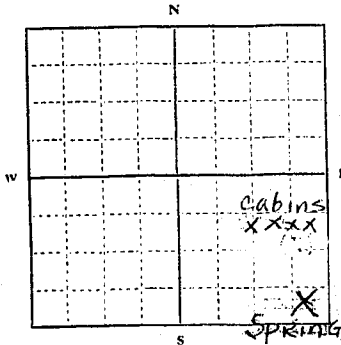

Quantity of water developed and used with explanation of method used to measure or estimate such amount. If use is intermittent 80 miners inches as measured at tank.

estimate approximate lengths of periods of use. Four months in each summer for domestic water supply and for residential use of myself on my lot which is contiguous to East side of SE 1/4 of Sec. 33 and to Wyatt cabin adjacent to my lot, and to Coombs cabin adjacent to Wyatt lot and to Lawhead cabin adjacent to Coombs lot. The water source is from the spring known as the CARROLL spring.

S. E. 1/4 Sec. 33 T. 9S R. 14E

Indicate point of appropriation and place of use, if possible.

Signature of Owner

Frank G. Reed

Date

Sept 7, 1966

This form to be prepared by contractor (if any), otherwise by the owner.

Three copies of this notice are to be filed with the County Clerk and Recorder of the county in which the works are located.

Please answer all questions. If not applicable, so state, otherwise the form will be returned.

Original to the County Clerk and Recorder; duplicate to the State Engineer; Triplicate to the Montana Bureau of Mines and Geology and Quadruplicate for the Appropriator.

111 487

Doc # 107319

Filed Nov 9th Day of  
September A. D. 1966  
at 1:01 o'clock P. M.  
Margaret Munsal  
County Clerk and Recorder.  
By Henry James Lee  
Deputy.  
Fee \$5.00

E 207  
N 3

File No. \_\_\_\_\_ FEB 14 1966 T. \_\_\_\_\_ R. \_\_\_\_\_  
 DUPLICATE Bill \_\_\_\_\_ McDemott \_\_\_\_\_  
 B. \_\_\_\_\_ City \_\_\_\_\_ County \_\_\_\_\_  
 C. \_\_\_\_\_  
 STATE OF MONTANA  
 ADMINISTRATOR OF GROUNDWATER CODE  
 OFFICE OF STATE ENGINEER

**Notice of Completion of Groundwater Appropriation  
 Without Well**

(Under Chapter 287 Montana Session Laws, 1961)

Date of Appropriation of Groundwater... Sept. 20, 1960  
 Owner Adolph F. Favero Address Silver Gate, Mont.  
 Contractor (if any) \_\_\_\_\_  
 Address of Contractor \_\_\_\_\_  
 Date Started Sept. 1, 1960 Date Completed Oct. 1, 1960

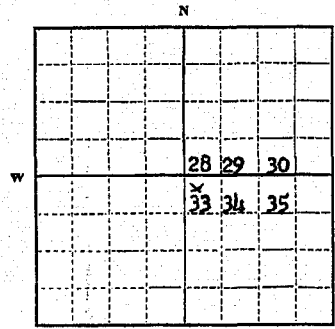

Describe means of obtaining groundwater without a well "as by sub-irrigation and other natural processes". Include depth to water when applicable. Trench and clean out natural springs and build earth dam. Depth not applicable.  
Using full flow at all times. Springs are low in fall and winter

Quantity of water developed and used with explanation of method used to measure or estimate such amount. If use is intermittent estimate approximate lengths of periods of use... April until April (all year) of following year unless snow covered or frozen

Place of use  
SE 1/4 NE 1/4 Sec. 33 T. 9 R. 14  
 Indicate point of appropriation and place of use, if possible.  
Springs and their flow situated 500 ft. northwest from the NW corner of SE 1/4 NE 1/4 of Sec. 33 Twp. 9 So. R. 14 East M.P.M. Park County, Montana

Signature of Owner Adolph F. Favero  
 Date February 1, 1966

This form to be prepared by contractor (if any), otherwise by the owner.  
 Three copies of this notice are to be filed with the County Clerk and Recorder of the county in which the works are located.  
 Please answer all questions. If not applicable, so state, otherwise the form will be returned.  
 Original to the County Clerk and Recorder; duplicate to the State Engineer; Triplicate to the Montana Bureau of Mines and Geology and Quadruplicate for the Appropriator.

Doc # 105444

Filed the 11<sup>th</sup> day of

February A. D. 1966

at 9:25 o'clock A. M.

Margaret Prinsal  
County Clerk and Registrar.

[Signature]  
Deputy

fee \$ 3.00

File No. ....

DUPLICATE

T 9<sup>S</sup> R 14<sup>E</sup> 33  
County Park

STATE OF MONTANA  
ADMINISTRATOR OF GROUNDWATER CODE  
OFFICE OF STATE ENGINEER

RECEIVED  
OCT 22 1963

Declaration of Vested Groundwater Rights  
(Under Chapter 237, Montana Session Laws, 1961)

STATE ENGINEER

1. Constance S. Cooper, of 720 North 31<sup>st</sup> Street, Billings  
(Name of Appropriator) (Address) (Town)  
County of Yellowstone State of Montana  
have appropriated groundwater according to the Montana laws in effect prior to January 1, 1962, as follows:

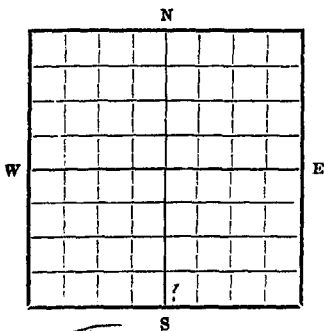

Park County  
1/4 Sec 33 T 9S R 14E

Indicate point of appropriation and place of use, if possible. Each small square represents 10 acres. About 1 1/4 acres.  
(Five at time well was dug.)

2. The beneficial use on which the claim is based Household use at summer cabin

3. Date or approximate date of earliest beneficial use; and how continuous the use has been Summer since 1937

4. The amount of groundwater claimed (in miner's inches or gallons per minute) Unknown

5. If used for irrigation, give the acreage and description of the lands to which water has been applied and name of the owner thereof Not applicable

6. The means of withdrawing such water from the ground and the location of each well or other means of withdrawal Hand pump next to cabin

7. The date of commencement and completion of the construction of the well, wells, or other works for withdrawal of groundwater Fall of 1936 or summer of 1937

8. The depth of water table

9. So far as it may be available, the type, size and depth of each well or the general specifications of any other works for the withdrawal of groundwater

Hand dug, probably about 20 feet

10. The estimated amount of groundwater withdrawn each year several buckets a day, but varying from 10 days to 4 months a year.

11. The log of formations encountered in the drilling of each well if available ?

12. Such other information of a similar nature as may be useful in carrying out the policy of this act, including reference to book and page of any county record Park County, book 83, page 228-221

Original from here was destroyed by Yellowstone Park fire, by burning on south side State Park. Creek and river gate tunnel on other side well is near latter. Some, across creek from highway.

Signature of Owner Constance S. Cooper  
Date September 30, 1963

Three copies to be filed by the owner with the County Clerk and Recorder of the county in which the well is located.

Please answer all questions. If not applicable, so state, otherwise the form will be returned.

Original to the County Clerk and Recorder; duplicate to the State Engineer; Triplicate to the School of Mines and Quadruplicate for the Appropriator.

Doc # 96706

Filed this 21<sup>st</sup> day of

October A. D. 1963

" 8.08 P. M.

Margaret Monical

Clerk and Recorder.

By Victor Gene Lee

Deputy.

Fee \$ 2.00

MONTANA WATER RESOURCES BOARD  
 RECEIVED

County Park

OCT 8 1971

STATE OF MONTANA  
 ADMINISTRATOR OF GROUNDWATER CODE  
 MONTANA WATER RESOURCES BOARD

DRILLER'S LOG

Indicate the character, color, thickness of strata such as soil, clay, sand, gravel, shale, sandstone, etc. Show depth at which water is found and height to which water rises in well.

NOTICE OF COMPLETION OF GROUNDWATER  
 APPROPRIATION BY MEANS OF WELL

Developed after January 1, 1962

(Under Chapter 237 Montana Session Laws, 1961, as amended)

This form to be prepared by driller, and three copies to be filed by the owner with the County Clerk and Recorder in the county in which the well is located, last copy to be retained by driller.

Please answer all questions. If not applicable, so state, otherwise the form may be returned.

Owner Constance and Lyle Cooper

Address 720 NORTH 31  
 B. Hines, Montana

Date well started Oct 12 1971  
 completed Sept 20 1971

For Administrator's Use	
File	<u>122290</u>
	<u>October 5, 1971</u>
	<u>1:23 Am</u>
GW 1	

Type of well well  
 (Dig, driven, bored or drilled)

Equipment used 2" bitum  
 (Churn drill, rotary or other)

Water Use: Domestic  Municipal  Stock  Irrigation   
 Industrial  Drainage  Other \* Garden/Lawn

\*Describe

USE: If used for irrigation, industrial, drainage or other. Explain, state number of acres and location or other data (i.e. Lot, Block and Addition).

ESTIMATED ANNUAL WITHDRAWAL

Size of Drilled Hole	Size and Weight of Casing	From (Feet)	To (Feet)	PERFORATIONS		
				Kind	From (Feet)	To (Feet)
<u>2"</u>	<u>6 1/8 CD 2 1/2 lb</u>					

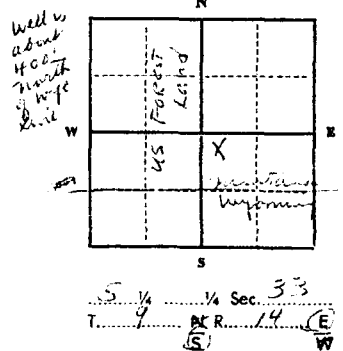

Static water level ..... ft.\*  
 Pumping water level ..... ft.\*  
 at ..... gallons per minute,  
 measured ..... minutes after pumping  
 began.

\*Measured from ground level.  
 Well developed by .....  
 for ..... hours.

Power..... Pump..... HP  
 Remarks: (Gravel packing, cementing,  
 packers, type of shutoff)

INDICATE LOCATION OF WELL AND PLACE OF USE, IF POSSIBLE. EACH SMALL SQUARE REPRESENTS 40 ACRES.

Driller's Signature Harold B. Schubert

Driller's Address

LICENSE NO.

Show exact depth of bottom

49201

Top of Ground		(Elev. above sea level)
From (Feet)	To (Feet)	
0	1	0ft
1	11	60ft
11	15	20ft
15	25	20ft
25	35	20ft
35	45	20ft
45	55	20ft
55	65	20ft
65	75	20ft
75	85	20ft
85	95	20ft
95	105	20ft
105	115	20ft
115	125	20ft
125	135	20ft
135	145	20ft
145	155	20ft
155	165	20ft
165	175	20ft
175	185	20ft
185	195	20ft
195	205	20ft
205	215	20ft
215	225	20ft
225	235	20ft
235	245	20ft
245	255	20ft
255	265	20ft
265	275	20ft
275	285	20ft
285	295	20ft
295	305	20ft
305	315	20ft
315	325	20ft
325	335	20ft
335	345	20ft
345	355	20ft
355	365	20ft
365	375	20ft
375	385	20ft
385	395	20ft
395	405	20ft
405	415	20ft
415	425	20ft
425	435	20ft
435	445	20ft
445	455	20ft
455	465	20ft
465	475	20ft
475	485	20ft
485	495	20ft
495	505	20ft
505	515	20ft
515	525	20ft
525	535	20ft
535	545	20ft
545	555	20ft
555	565	20ft
565	575	20ft
575	585	20ft
585	595	20ft
595	605	20ft
605	615	20ft
615	625	20ft
625	635	20ft
635	645	20ft
645	655	20ft
655	665	20ft
665	675	20ft
675	685	20ft
685	695	20ft
695	705	20ft
705	715	20ft
715	725	20ft
725	735	20ft
735	745	20ft
745	755	20ft
755	765	20ft
765	775	20ft
775	785	20ft
785	795	20ft
795	805	20ft
805	815	20ft
815	825	20ft
825	835	20ft
835	845	20ft
845	855	20ft
855	865	20ft
865	875	20ft
875	885	20ft
885	895	20ft
895	905	20ft
905	915	20ft
915	925	20ft
925	935	20ft
935	945	20ft
945	955	20ft
955	965	20ft
965	975	20ft
975	985	20ft
985	995	20ft
995	1005	20ft

# 122290

Filed this 5<sup>th</sup> day of

October A. D. 1921

at 1:03 o'clock P. M.

Margaret Tronical  
County Clerk and Recorder.

By \_\_\_\_\_ Deputy

Fee \$ 2.00



STATE OF MONTANA  
ADMINISTRATOR OF GROUNDWATER CODE  
MONTANA WATER RESOURCES BOARD

NOV 16 1971

**DRILLER'S LOG**

Indicate the character, color, thickness of strata such as soil, clay, sand, gravel, shale, sandstone, etc. Show depth at which water is found and height to which water rises in well.

**NOTICE OF COMPLETION OF GROUNDWATER APPROPRIATION BY MEANS OF WELL**

Developed after January 1, 1962

(Under Chapter 237 Montana Session Laws, 1961, as amended)

This form to be prepared by driller, and three copies to be filed by the owner with the County Clerk and Recorder in the county in which the well is located, last copy to be retained by driller. Please answer all questions. If not applicable, so state, otherwise the form may be returned.

Owner NELLES, RALPH C. & FLORA  
 Address 918 Alderson Ave.  
Billings, Montana.  
 Date well started Sept 27, 1971 GW 1  
 completed Oct 5, 1971

For Administrator's Use
File <u>122658</u>
<u>November 15, 1971</u>
<u>8:05 AM</u>

Type of well Drilled  
(Dug, driven, bored or drilled)  
 Equipment used Cable Tool  
(Churn drill, rotary or other)  
 Water Use: Domestic  Municipal  Stock  Irrigation   
 Industrial  Drainage  Other \* Garden/Lawn

\*Describe  
 USE: If used for irrigation, industrial, drainage or other. Explain, state number of acres and location or other data (i.e. Lot, Block and Addition).

**ESTIMATED ANNUAL WITHDRAWAL**

Size of Drilled Hole	Size and Weight of Casing	From (Feet)	To (Feet)	PERFORATIONS		
				Kind Size	From (Feet)	To (Feet)
7"	6 5/8 OD 19 lb	2 above	67ft			

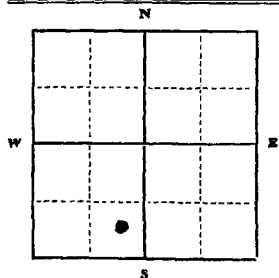

Static water level 9 ft.\*  
 Pumping water level 25 ft.\*  
 at 30 gallons per minute,  
 measured 10 minutes after pumping  
 began.  
 \*Measured from ground level.  
 Well developed by Roller 1 1/2  
for 2 hrs 15 min. 4 hrs pump  
 Power 220v-1 Pump 3/4 HP  
 Remarks: (Gravel packing, cementing,  
 packers, type of shutoff)

SE 1/4 SW 1/4 Sec. 33  
 T. 9 N. R. 14 E.  
 9 (S) W

INDICATE LOCATION OF WELL AND PLACE OF USE, IF POSSIBLE. EACH SMALL SQUARE REPRESENTS 40 ACRES.

Driller's Signature X. Marshall P. Hulbert  
 Driller's Address Rt One Bozeman, Montana  
Hulbert Drilling LICENSE NO. 47

Top of Ground		(Elev. above sea level)
From (Feet)	To (Feet)	
0	5	soil
5	9	water sand gravel
9	25	rock
25	28	sand
28	29	rock
29	33	sand water part
		clear
33	42	clay
42	50	rock & white clay
50	60	clay
60	64	clay
64	67	gravel & water

67ft Show exact depth of bottom

49404

# 128658

Miled 1ms 15<sup>th</sup> day of

November A. D. 1971

8:05 o'clock A M

Margaret Ironical  
County Clerk and Recorder.

By \_\_\_\_\_ Deputy.

Fee \$ 2.00

STATE OF MONTANA  
ADMINISTRATOR OF GROUNDWATER CODE  
MONTANA WATER RESOURCES BOARD

NOV 29 1971

**DRILLER'S LOG**

Indicate the character, color, thickness of strata such as soil, clay, sand, gravel, shale, sandstone, etc. Show depth at which water is found and height to which water rises in well.

**NOTICE OF COMPLETION OF GROUNDWATER APPROPRIATION BY MEANS OF WELL**  
Developed after January 1, 1962

(Under Chapter 237 Montana Session Laws, 1961, as amended)

This form to be prepared by driller, and three copies to be filed by the **owner** with the County Clerk and Recorder in the county in which the well is located, last copy to be retained by driller. Please answer all questions. If not applicable, so state, otherwise the form may be returned.

Owner Doane M. Barcroft

Address 2518 Lewis Cr. Billings, Montana 59102

Date well started Sept. 1 1971 completed Sept. 8 1971

For Administrator's Use	
File	<u>122786</u>
	<u>11-26-71</u> <u>8:07 AM</u>
GW 1	

Type of well Drilled  
(Dug, driven, bored or drilled)

Equipment used Cable Tool  
(Churn drill, rotary or other)

Water Use: Domestic  Municipal  Stock  Irrigation   
Industrial  Drainage  Other  Garden/Lawn

\*Describe \_\_\_\_\_

USE: If used for irrigation, industrial, drainage or other. Explain, state number of acres and location or other data (i.e. Lot, Block and Addition). \_\_\_\_\_

ESTIMATED ANNUAL WITHDRAWAL \_\_\_\_\_

Size of Drilled Hole	Size and Weight of Casing	From (Feet)	To (Feet)	PERFORATIONS		
				Kind Size	From (Feet)	To (Feet)
7"	6 F/8 OD 19 lb	IFT ***	6" above ***	none		

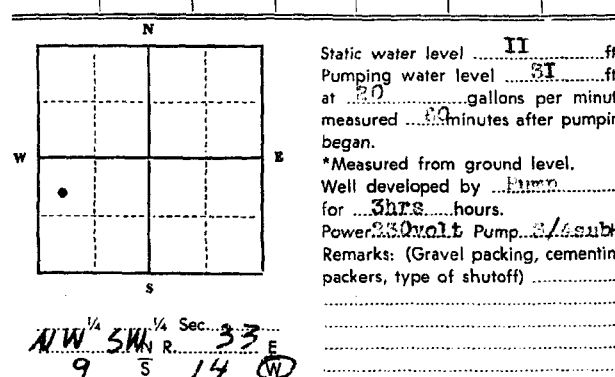

INDICATE LOCATION OF WELL AND PLACE OF USE, IF POSSIBLE. EACH SMALL SQUARE REPRESENTS 40 ACRES.

Driller's Signature Harold P. Hubbert

Driller's Address 6 one Locoma

Top of Ground (Elev. above sea level) \_\_\_\_\_

From (Feet)	To (Feet)	
0	20	Volcanic Ash & rock
20	28	little rock & water
		Volcanic ash
28	50	rock sand muddy water
30	45	clay & small rock
45	50	clay and gravel
50	55	sand gravel & water

Doc # 122786

Miled this 26<sup>th</sup> day of

November A. D. 1921

at 8:07 o'clock A M

Margaret Monical  
County Clerk and Recorder.

By \_\_\_\_\_ Deputy.

Joe L

RECEIVED

OCT 29 1971

STATE OF MONTANA  
ADMINISTRATOR OF GROUNDWATER CODE  
MONTANA WATER RESOURCES BOARD

DRILLER'S LOG

Indicate the character, color, thickness of strata such as soil, clay, sand, gravel, shale, sandstone, etc. Show depth at which water is found and height to which water rises in well.

NOTICE OF COMPLETION OF GROUNDWATER  
APPROPRIATION BY MEANS OF WELL

Developed after January 1, 1962

(Under Chapter 237 Montana Session Laws, 1961, as amended)

This form to be prepared by driller, and three copies to be filed by the owner with the County Clerk and Recorder in the county in which the well is located, last copy to be retained by driller. Please answer all questions. If not applicable, so state, otherwise the form may be returned.

Owner J.W. Bateman  
Address Silver Gate, Montana  
Date well started Sept 1, 1971  
completed Sept 9, 1971  
Type of well Drilled  
Equipment used Cable Tool  
Water Use: Domestic  Municipal  Stock  Irrigation   
Industrial  Drainage  Other \* Garden/Lawn

For Administrator's Use  
File 122499  
Oct. 28, 1971  
Line P. 22  
GW 1

\*Describe  
USE: If used for irrigation, industrial, drainage or other. Explain, state number of acres and location or other data (i.e. Lot, Block and Addition).

ESTIMATED ANNUAL WITHDRAWAL

Size of Drilled Hole	Size and Weight of Casing	From (Feet)	To (Feet)	PERFORATIONS		
				Kind Size	From (Feet)	To (Feet)
7"	6 5/8 OD 19 lb	I above	55 ft	n	one	

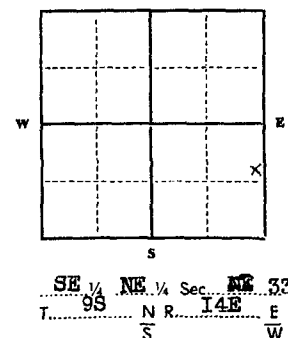

Static water level 4 ft.\*  
Pumping water level 7 ft.\*  
at 20 gallons per minute,  
measured 60 minutes after pumping  
began.  
\*Measured from ground level.  
Well developed by baller & pump  
for 6 hours.  
Power 250 volt Pump 3/4 HP  
Remarks: (Gravel packing, cementing,  
packers, type of shutoff)

Top of Ground (Elev. above sea level)		
From (Feet)	To (Feet)	
0	4	soil
4	20	soil & gravel
20	22	sand & little water
22	34	sand water won't
		clear
34	45	blue clay & rock
45	53	blue silt & sand
53	60	clay
60	62	sand gravel & water

INDICATE LOCATION OF WELL AND PLACE OF USE, IF POSSIBLE. EACH SMALL SQUARE REPRESENTS 40 ACRES.  
Driller's Signature Harold B. Hulbert  
Driller's Address Rt one Bozeman, Montana  
Hulbert Drilling LICENSE NO. 47

57 Show exact depth of bottom

49283

# 122499

Witnessed 20<sup>th</sup> day of

October A. D. 1971

at 1:40 o'clock P. M.

Margaret Monical  
County Clerk and Recorder.

By Joe S. 2<sup>nd</sup> Deputy

File No. ....

RECEIVED

95  
T. 95 N. R. 14 E

DUPLICATE

DEC 16 1969

County Park

LOG

STATE OF MONTANA  
ADMINISTRATOR OF GROUNDWATER CODE  
STATE WATER CONSERVATION BOARD

Notice of Completion of Groundwater  
Appropriation by Means of Well  
DEVELOPED AFTER JANUARY 1, 1962

(Under Chapter 237 Montana Session Laws, 1961, as amended)

Top of Ground  
(Elev. above sea level.....)

0-4 soil  
4-8 soil & gravel  
8-15 soil & gravel  
15-30 blue clay & sand & gravel  
43-45 very little water  
45-50 blue clay & gravel  
50-66 mud sand, gravel & small rock  
66-75 blue clay, sand & gravel  
85-110 sand water clay & volcanic dust  
110-125 sand water & clay  
125-130 sand & water  
130-135 sand clay & water  
135-141 sand gravel & water  
141 clear water

Owner Harold Hulbert Address Rt. 1 Bozeman, Mont.

Driller Harold Hulbert Address Rt. 1 Bozeman, Mont.

Date of Notice of appropriation of groundwater.....

Date well started Oct. 1, 1969 Date completed Oct. 11, 1969

Type of well Drilled Equipment used Cable tool  
(Dug, driven, bored or drilled) (Churn drill, rotary or other)

Water use: Domestic  Municipal  Stock  Irrigation   
Industrial  Drainage  Other

Indicate on the diagram the character and thickness of the different strata with in drilling, such as soil, clay, shale, gravel, rock or sand, etc. Show depth at which water is encountered, thickness and character of water-bearing strata and height to which the water rises in the well.

Size of Drilled Hole	Size and Weight of Casing	From (Feet)	To (Feet)	PERFORATIONS		
				Kind Size	From (Feet)	To (Feet)
7"	6 5/8 O. D. 19 lb	2 above	139'	None		

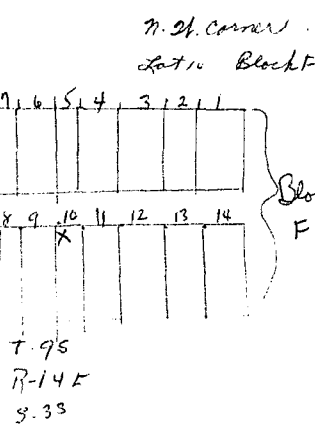

Static Water Level for non-flowing well 2 feet.

Shut-in Pressure for Flowing Well.....

Pumping Water Level..... 9 feet  
at 20 gal. per minute.

Discharge in gal. per min. of flowing well

How Tested..... Bailer & pump

Length of Test..... 5 hrs

Remarks: (Gravel packing, cementing, packers, type of shutoff).....

1/4 Sec. 33 T. 95. R. 14 E  
Indicate location of well and place of use, if possible. Each small square represents 40 acres.

(Continue on reverse side)

USE—If used for irrigation, industrial, drainage or other. Explain, state number of acres and location or other data (i.e.: Lot, Block and Addition).

Show exact depth of bottom.

This form to be prepared by driller, and three copies to be filed by the owner with the County Clerk and Recorder in the county in which the well is located, tissue copy to be retained by driller.

Please answer all questions. If not applicable, so state, otherwise the form will be returned.

47  
Driller's License Number

Harold Hulbert  
Driller's Signature.

15982

Doc # 116776

Made this 15<sup>th</sup> day of

December A. D. 1969

at 8:07 o'clock A M

Margaret Thomas  
County Clerk and Recorder

in presence of John J. Co Deputy



RECEIVED

County Park

STATE OF MONTANA  
ADMINISTRATOR OF GROUNDWATER CODE  
MONTANA WATER RESOURCES BOARD

OCT 20 1971

DRILLER'S LOG

Indicate the character, color, thickness of strata such as soil, clay, sand, gravel, shale, sandstone, etc. Show depth at which water is found and height to which water rises in well.

NOTICE OF COMPLETION OF GROUNDWATER  
APPROPRIATION BY MEANS OF WELL

Developed after January 1, 1962

(Under Chapter 237 Montana Session Laws, 1961, as amended)

This form to be prepared by driller, and three copies to be filed by the owner with the County Clerk and Recorder in the county in which the well is located, last copy to be retained by driller. Please answer all questions. If not applicable, so state, otherwise the form may be returned.

Owner RUPERT V. HAGAN  
+ MAXINE R. HAGAN

Address B.S. 13

SILVER GATE MONT

Date well started AUG 26 1971

completed AUG 31 1971

Type of well Drilled

Equipment used Cable Tool

Water Use: Domestic  Municipal  Stock  Irrigation

Industrial  Drainage  Other \* Garden/Lawn

\*Describe

USE: If used for irrigation, industrial, drainage or other. Explain, state number of acres and location or other data (i.e. Lot, Block and Addition).

ESTIMATED ANNUAL WITHDRAWAL

Size of Drilled Hole	Size and Weight of Casing	From (Feet)	To (Feet)	PERFORATIONS		
				Kind Size	From (Feet)	To (Feet)
7"	1 1/2" OD	1 foot above	64	None		

Lot 12 of BONNUCK TRAIL LODGE  
SITES IN NW 14 OF SEC 34  
30 1/2 YELLOW STONE PLACER MS 3602

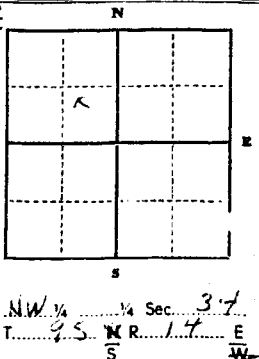

Static water level 16 ft.\*  
Pumping water level 31 ft.\*  
at 20 gallons per minute,  
measured 30 minutes after pumping began.

\*Measured from ground level.  
Well developed by driller pump  
for 5 hours.  
Power 240V Pump 3/4 HP  
Remarks: (Gravel packing, cementing, packers, type of shutoff)

INDICATE LOCATION OF WELL AND PLACE OF USE, IF POSSIBLE. EACH SMALL SQUARE REPRESENTS 40 ACRES.

Driller's Signature Harold B. Schubert

Driller's Address 1234567890, Mont

LICENSE NO. 47

Top of Ground		(Elev. above sea level)
From (Feet)	To (Feet)	
0	20	rock and sand
20	35	mid sand very
		little water
35	65	volcanic rock
		sand
65	68	fine sand water

Show exact depth of bottom

49254

# 122436

Filed this 19<sup>th</sup> day of

October A. D. 1971

at 8:30 o'clock A. M.

Margaret Donical  
County Clerk and Recorder.

By \_\_\_\_\_ Deputy.

See # 2100

RECEIVED

File No. DEC 8 1969

Township Range Section

DUPLICATE

County Park

LOG

STATE OF MONTANA ADMINISTRATOR OF GROUNDWATER CODE STATE WATER CONSERVATION BOARD

Notice of Completion of Groundwater Appropriation by Means of Well DEVELOPED AFTER JANUARY 1, 1962

Top of Ground (Elev. above sea level...) 0-5 soil & rock 5-20 clay & rock 20-40 clay & small Broken rock & gravel 40-43 clay & rock volcanic ash 43-46 clay rock & very little water 46-58 sticky clay 58-66 sand water tested by pump at 4 gal per min. tested 2 1/2 hrs 66-68 gravel 68-87 sticky clay 87-92 sand & clay gravel & clear water 87' Bottom of well

Owner... Address... Driller Harold Hulbert Address Rt I Bozeman, Mont

Date of Notice of appropriation of groundwater... Date well started Sept 1969 Date completed Oct 1969

Type of well Drilled Equipment used Cable Tool (Dug, driven, bored or drilled) (Churn drill, rotary or other) Water use: Domestic [X] Municipal [ ] Stock [ ] Irrigation [ ] Industrial [ ] Drainage [ ] Other [ ]

Indicate on the diagram the character and thickness of the different strata met with in drilling, such as soil, clay, shale, gravel, rock or sand, etc. Show depth at which water is encountered, thickness and character of water-bearing strata and height to which the water rises in the well.

Table with columns: Size of Drilled Hole, Size and Weight of Casing, From (Feet), To (Feet), PERFORATIONS (Kind Size, From (Feet), To (Feet)).

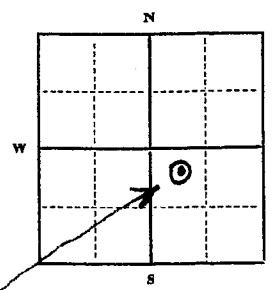

Static Water Level for non-flowing well 47 feet. Shut-in Pressure for Flowing Well... Pumping Water Level 50 feet at 30 gal. per minute. Discharge in gal. per min. of flowing well... How Tested 6 hrs Length of Test... Remarks: (Gravel packing, cementing, packers, type of shutoff)...

1/4 Sec T R Indicate location of well and place of use, if possible. Each small square represents 40 acres.

This well is situated on lot 2, Trikora, on the Banack Trail, near River Falls, Montana (Continued on reverse side)

USE—If used for irrigation, industrial, drainage or other. Explain, state number of acres and location or other data (i.e.: Lot, Block and Addition).

Show exact depth of bottom.

This form to be prepared by driller, and three copies to be filed by the owner with the County Clerk and Recorder in the county in which the well is located, tissue copy to be retained by driller. Please answer all questions. If not applicable, so state, otherwise the form will be returned.

47 Driller's License Number Harold B. Hulbert Driller's Signature

45942

Ab. #116693

Filed this 5<sup>th</sup> day of

December A. D. 1969

at 1:10 o'clock P. M.

Margaret Monroel  
Clerk and Recorder.

By \_\_\_\_\_ Deputy.

Fee \$ 3.00

101  
2019

File No. ....

RECEIVED

T. 15 R. 14E

DUPLICATE

OCT 3 1967

County Park

LOG

STATE OF MONTANA ADMINISTRATOR OF GROUNDWATER CODE STATE WATER CONSERVATION BOARD

Top of Ground

(Elev. above sea level.....)

Notice of Completion of Groundwater Appropriation by Means of Well DEVELOPED AFTER JANUARY 1, 1962

(Under Chapter 237 Montana Session Laws, 1961, as amended)

- 0-2 soil rock
2-10 soil, rock
10-22 clay & rock
22-27 clay
27-29 rock
29-49 clay & rock
49-51 clay & rock
51-52 gravel clay & water (very little)
52-61 sand & very little water
61-64 sand & clay
64-66 sand, clay & little water
66-68 sand Gravel & water
68-76 sand & clay & water
76-92 clay
92-95 clay
95-97 clay, sand & water
97-105 clay
105-108 clay & very little water
108-115- clay sand & water
115-122 clay & rock
122-125 sand & gravel & water
118' Bottom of well

Owner: Dale McCoy & Debbie Ruth McCoy Address: 113 Stanscutt Rd, Joplin, Mo. 64506

Driller: Harold Hulbert Address: Rt. 1, Hazeman, Mont.

Date well started: Sept. 18, 1967 Date completed: Sept. 25, 1967

Type of well: Drilled Equipment used: Churn (Dug, driven, bored or drilled) (Churn drill, rotary or other)

Water use: Domestic [x] Municipal [ ] Stock [ ] Irrigation [ ] Industrial [ ] Drainage [ ] Other [ ]

Indicate on the diagram the character and thickness of the different strata met with in drilling, such as soil, clay, shale, gravel, rock or sand, etc. Show depth at which water is encountered, thickness and character of water-bearing strata and height to which the water rises in the well.

Table with columns: Size of Drilled Hole, Size and Weight of Casing, From (Feet), To (Feet), PERFORATIONS (Kind Size, From (Feet), To (Feet)).

Lot 23 of Beaman Trail Lodge Area A subdivision located in Sec 34, T9S, R14E Park County, Mont.

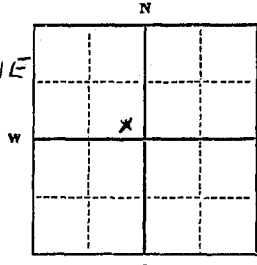

Static Water Level for non-flowing well 60 feet. Shut-in Pressure for Flowing Well. Pumping Water Level 100 feet at 15 gal. per minute. Discharge in gal. per min. of flowing well.

How Tested: Pump Length of Test: 7 hrs

Remarks: (Gravel packing, cementing, packers, type of shutoff)

NW 1/4 Sec. 34 T9S, R14E Indicate location of well and place of use, if possible. Each small square represents 40 acres.

(Continue on reverse side)

USE—If used for irrigation, industrial, drainage or other. Explain, state number of acres and location or other data (i.e.: Lot, Block and Addition).

Show exact depth of bottom.

This form to be prepared by driller, and three copies to be filed by the owner with the County Clerk and Recorder in the county in which the well is located, tissue copy to be retained by driller.

Please answer all questions. If not applicable, so state, otherwise the form will be returned.

47 Driller's License Number Harold B. Hulbert Driller's Signature

42,358

# 110233

called was 2<sup>nd</sup> day of

October A. D. 1967

at 2:25 o'clock P. M.

by Margaret Mawick  
County Clerk and Recorder.

by \_\_\_\_\_ Deputy.

Fee \$ 2.00

File No. ....

MONTANA WATER RESOURCES BOARD

T. 15 R. 14E

RECEIVED

DUPLICATE

County Richmond

LOG

OCT 3 1967

STATE OF MONTANA  
ADMINISTRATOR OF GROUNDWATER CODE  
STATE WATER CONSERVATION BOARD

Top of Ground  
(Elev. above sea level.....)

**Notice of Completion of Groundwater  
Appropriation by Means of Well**  
DEVELOPED AFTER JANUARY 1, 1962

(Under Chapter 237 Montana Session Laws, 1961, as amended)

- 0-1 soil
- 1-6 soil-rock
- 6-17 soil & gravel
- 17-20 rock & shale
- 20-29 mud & gravel
- 29-33 sand, Mud & water
- 33-44 sand & mud
- 44-48 sand, Gravel
- 48-50 gravel & water
- 45' Bottom of well**

Owner J. J. Hill, K. J. Hill, 43 Hancock Address 28 Joplin, Mo 64506  
 Driller Harold Hulbert Address Rt. 1, Bozeman, Mont.  
 Date of Notice of appropriation of groundwater Oct. 2, 1967  
 Date well started Sept. 12, 1967 Date completed Sept 18, 1967

Type of well Drilled Equipment used Churn  
(Dug, driven, bored or drilled) (Churn drill, rotary or other)

Water use: Domestic  Municipal  Stock  Irrigation   
Industrial  Drainage  Other

Indicate on the diagram the character and thickness of the different strata met with in drilling, such as soil, clay, shale, gravel, rock or sand, etc. Show depth at which water is encountered, thickness and character of water-bearing strata and height to which the water rises in the well.

Size of Drilled Hole	Size and Weight of Casing	From (Feet)	To (Feet)	PERFORATIONS		
				Kind Size	From (Feet)	To (Feet)
7"	6 5/8 O, D.	3 above	45' 6"			none

*on Lat 18 / Range 12  
large well located in  
Sec. 34*

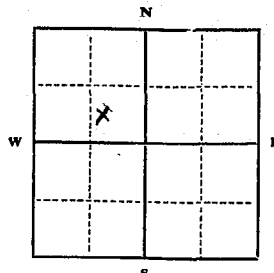

Static Water Level for non-flowing well 24 feet.  
 Shut-in Pressure for Flowing Well.....  
 Pumping Water Level 36 feet  
 at 20 gal. per minute.  
 Discharge in gal. per min. of flowing well .....

How Tested Pump  
Length of Test 8 hrs

NW 1/4 Sec 34 T. 15 R. 14E  
Indicate location of well and place of use, if possible. Each small square represents 40 acres.

Remarks: (Gravel packing, cementing, packers, type of shutoff).....

(Continue on reverse side)

USE—If used for irrigation, industrial, drainage or other. Explain, state number of acres and location or other data (i.e.: Lot, Block and Addition).

Show exact depth of bottom.

This form to be prepared by driller, and three copies to be filed by the owner with the County Clerk and Recorder in the county in which the well is located, tissue copy to be retained by driller.

Please answer all questions. If not applicable, so state, otherwise the form will be returned.

47  
 Driller's License Number  
Harold B. Hulbert  
 Driller's Signature.

42,357

Doc. # 110232

Filed this 2nd day of

October A. D. 1947

3:30 o'clock P. M.

Margaret Monick

Court Clerk and Recorder

Betty Jane Lee  
Secretary

Fee \$2.00



File No. ....

T. 95 R 14E N 10W

DUPLICATE

County Paul County

LOG

STATE OF MONTANA  
ADMINISTRATOR OF GROUNDWATER CODE  
STATE WATER CONSERVATION BOARD

Notice of Completion of Groundwater  
Appropriation by Means of Well  
DEVELOPED AFTER JANUARY 1, 1962

(Under Chapter 237 Montana Session Laws, 1961, as amended)

43 Stonecrest  
Dale Alley & Dollie Ruth Alley St. Joseph, Mo. 64506  
Owner..... Address.....

Driller Harold Hulbert Address Rt. 1, Dozeman, Mont.

Top of Ground  
(Elev. above sea level.....)

- 0-3 soil rock
- 3-20 clay & rock gravel
- 20-23 sand
- 23-34 sand gravel, water
- 34-36 clay & rock
- 36-37 rock
- 37-42 sand & grav el water
- 42-45 sand clay & very little water
- 45-48 black sand & water
- 48-53 black sand & clay colored water
- 53-61 " " "
- 61-64 gravel sand & water water will not clear after 4 hrs
- 64-73 clay
- 73-75 gravel & water sand
- 75-80 gravel & clay
- 80-90 clay & water
- 90-95 clay & sand
- 95-98 sand clay & water
- 98-100 clay

Date of Notice of appropriation of groundwater.....

Date well started Sept 26, 1967 Date completed Sept 31, 1967

Type of well Drilled Equipment used Churn  
(Dug, driven, bored or drilled) (Churn drill, rotary or other)

Water use: Domestic  Municipal  Stock  Irrigation   
Industrial  Drainage  Other

Indicate on the diagram the character and thickness of the different strata met with in drilling, such as soil, clay, shale, gravel, rock or sand, etc. Show depth at which water is encountered, thickness and character of water-bearing strata and height to which the water rises in the well.

Bottom of well 108'  
110'-112' Clay, sand & water  
112'-120' sand, gravel & water  
Bottom of Well 118'

Size of Drilled Hole	Size and Weight of Casing	From (Feet)	To (Feet)	PERFORATIONS		
				Kind Size	From (Feet)	To (Feet)
2"	19 lb	Robert	107			
6	5 1/2" O. D.		118			none

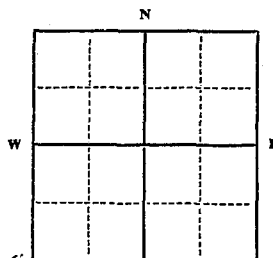

Static Water Level for non-flowing well 58' feet.

Shut-in Pressure for Flowing Well 57'

Pumping Water Level.....feet  
at 20 gal. per minute.

Discharge in gal. per min. of flowing well

How Tested Pump & bailer

Length of Test 6 hrs & 2 hrs

Remarks: (Gravel packing, cementing, packers, type of shutoff).....

1/4 Sec 34 T. 95 R. 14E

Indicate location of well and place of use, if possible. Each small square represents 40 acres.

Lot 9 (Meadow) of Birchwood Tract, Dozeman, Mont.  
Dozeman, Montana (Continue on reverse side)

USE—If used for irrigation, industrial, drainage or other. Explain, state number of acres and location or other data (i.e.: Lot, Block and Addition).

Show exact depth of bottom.

This form to be prepared by driller, and three copies to be filed by the owner with the County Clerk and Recorder in the county in which the well is located, tissue copy to be retained by driller.

Please answer all questions. If not applicable, so state, otherwise the form will be returned.

47  
Driller's License Number

Harold B. Hulbert  
Driller's Signature.

45805

Ac. # 116322

Filed this 3rd day of  
November 1969  
at 8.01 o'clock A.M.  
Margaret Monahan  
Clerk of Court and Registrar  
Betty Ann Lee  
Deputy

Fee \$2.00

MONTANA WATER RESOURCES BOARD  
**RECEIVED**  
NOV 4 1969

File No. ....

T. 9 S. R. 14 E

DUPLICATE

County Park

STATE OF MONTANA  
ADMINISTRATOR OF GROUNDWATER CODE  
OFFICE OF STATE ENGINEER

RECEIVED  
007 84 1963  
STATE ENGINEER

Declaration of Vested Groundwater Rights

(Under Chapter 237, Montana Session Laws, 1961)

1. MARGARET I. REEB and  
GEORGIA REEB RITCHEY  
(Name of Appropriator) of Cooke City, and  
116 South 6th Street, Livingston  
(Address) (Town)  
County of Park State of Montana  
have appropriated groundwater according to the Montana laws in effect prior to January 1, 1962, as follows:

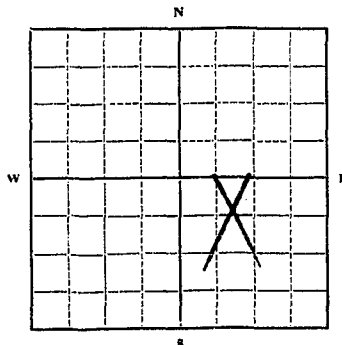

1/4 Sec. T. R.

Indicate point of appropriation and place of use, if possible. Each small square represents 10 acres.

2. The beneficial use on which the claim is based... domestic, commercial, rental, and irrigation

3. Date or approximate date of earliest beneficial use; and how continuous the use has been... September 1, 1937  
Continuous

4. The amount of groundwater claimed (in miner's inches or gallons per minute)... 100 miner's inches

5. If used for irrigation, give the acreage and description of the lands to which water has been applied and name of the owner thereof  
15 acres - (Patent Survey No. 10767)  
Margaret I. Reeb and Georgia Reeb Ritchey

6. The means of withdrawing such water from the ground and the location of each well or other means of withdrawal...  
Four (4") inch pipe  
Water tank - 2' x 4' x 30'

7. The date of commencement and completion of the construction of the well, wells, or other works for withdrawal of groundwater... September 1, 1937

8. The depth of water table... Unknown

9. So far as it may be available, the type, size and depth of each well or the general specifications of any other works for the withdrawal of ground water...  
Pipe  
Water tank - 2' x 4' x 30'

10. The estimated amount of groundwater withdrawn each year... Unknown

11. The log of formations encountered in the drilling of each well if available... No well drilled.

12. Such other information of a similar nature as may be useful in carrying out the policy of this act, including reference to book and page of any county record... Vol. 8 - Affidavit of Representation Book, page 234 - Water lease recorded (Reeb to Cole and Babiluk) #502, Misc. Leases.

Signature of Owner... Margaret I. Reeb  
Date... 5/20/63

Three copies to be filed by the owner with the County Clerk and Recorder of the county in which the well is located.

Please answer all questions. If not applicable, so state, otherwise the form will be returned.

Original to the County Clerk and Recorder; duplicate to the State Engineer; Triplicate to the Montana Bureau of Mines and Geology, and Quadruplicate for the Appropriator.

Doc. # 96729

Filed this 22 day of  
October A.D. 1963  
at 4:30 o'clock PM  
Marquet Monreal

County Clerk and Recorder.  
By Emma Bowers  
Deputy  
Fees \$2.00

*Margaret J. Hill*

X

File No. ....

T. 9 S. R. 14 E.

DUPLICATE

County Park

STATE OF MONTANA  
ADMINISTRATOR OF GROUNDWATER CODE  
OFFICE OF STATE ENGINEER

RECEIVED  
OCT 24 1963

Declaration of Vested Groundwater Rights STATE ENGINEER

(Under Chapter 237, Montana Session Laws, 1961)

MARGARET I. REEB and

Cooke City, and

1. GEORGIA REEB RITCHIEY, of 116 South 6th Street, Livingston, (Address) (Town)

County of P. A. R. K State of MONTANA

have appropriated groundwater according to the Montana laws in effect prior to January 1, 1962, as follows:

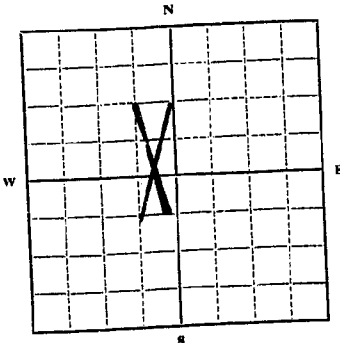

Indicate point of appropriation and place of use, if possible. Each small square represents 10 acres.

- 2. The beneficial use on which the claim is based. domestic, commercial, rental, and irrigation
- 3. Date or approximate date of earliest beneficial use; and how continuous the use has been. September, 1918 - continuous
- 4. The amount of groundwater claimed (in miner's inches or gallons per minute). 100 miner's inches
- 5. If used for irrigation, give the acreage and description of the lands to which water has been applied and name of the owner thereof. 15 acres - (Patent Survey No. 10757) - lots in Cooke City - Margaret I. Reeb and Georgia Reeb Ritchiey
- 6. The means of withdrawing such water from the ground and the location of each well or other means of withdrawal. Four inch (4") pipe from spring

7. The date of commencement and completion of the construction of the well, wells, or other works for withdrawal of groundwater. September, 1918 - pipe system

8. The depth of water table. Unknown -

9. So far as it may be available, the type, size and depth of each well or the general specifications of any other works for the withdrawal of groundwater. Pipe

10. The estimated amount of groundwater withdrawn each year. Unknown

11. The log of formations encountered in the drilling of each well if available. No well drilled.

12. Such other information of a similar nature as may be useful in carrying out the policy of this act, including reference to book and page of any county record.

Water Right filed - Misc. Book 19 - page 90 - George Reeb  
Water Right filed - Val. 21 - page 35 - Ingeborg Reeb

Signature of Owner Margaret I. Reeb  
Date 8/20/63

Three copies to be filed by the owner with the County Clerk and Recorder of the county in which the well is located.

Please answer all questions. If not applicable, so state, otherwise the form will be returned.

Original to the County Clerk and Recorder; duplicate to the State Engineer; Triplicate to the Montana Bureau of Mines and Geology, and Quadruplicate for the Appropriator.

Doc 96730

Filed this 23 day of  
October A. D. 1963  
at 4:30 o'clock P. M.  
Marquet Monach  
County Clerk and Recorder.  
By Emma Powers  
Deputy.  
Fees \$2.00

Marquet Monach



File No. ....

T. 9S R. 15E

DUPLICATE

STATE OF MONTANA  
ADMINISTRATOR OF GROUNDWATER CODE  
OFFICE OF STATE ENGINEER

County Park  
**RECEIVED**  
DEC 26 1963

STATE ENGINEER

**Declaration of Vested Groundwater Rights**

(Under Chapter 237, Montana Session Laws, 1961)

1. United States of America, of Box 5 Gardiner  
(Name of Appropriator) (Address) (Town)  
County of Park State of Montana  
have appropriated groundwater according to the Montana laws in effect prior to January 1, 1962, as follows:

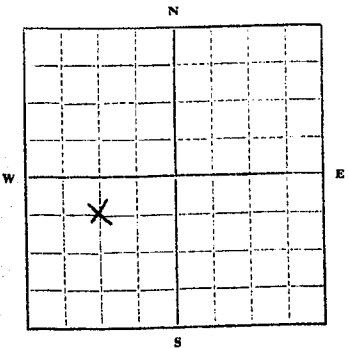

SW 1/4 Sec 28 T9S R15E

Indicate point of appropriation and place of use, if possible. Each small square represents 10 acres.

- 2. The beneficial use on which the claim is based Domestic
- 3. Date or approximate date of earliest beneficial use; and how continuous the use has been 1962; intermittent use daily from June 1 to November 1.
- 4. The amount of groundwater claimed (in miner's inches or gallons per minute) Estimated - 0.4 miner's inches
- 5. If used for irrigation, give the acreage and description of the lands to which water has been applied and name of the owner thereof N/A
- 6. The means of withdrawing such water from the ground and the location of each well or other means of withdrawal Development of a spring for domestic use in Chief Joseph Campground
- 7. The date of commencement and completion of the construction of the well, wells, or other works for withdrawal of groundwater July - 1962 - July - 1962
- 8. The depth of water table N/A
- 9. So far as it may be available, the type, size and depth of each well or the general specifications of any other works for the withdrawal of groundwater N/A
- 10. The estimated amount of groundwater withdrawn each year N/A
- 11. The log of formations encountered in the drilling of each well if available N/A
- 12. Such other information of a similar nature as may be useful in carrying out the policy of this act, including reference to book and page of any county record N/A

Signature of Owner United States of America  
By [Signature]  
District Forest Ranger  
Date 12/26/63

Three copies to be filed by the owner with the County Clerk and Recorder of the county in which the well is located.

Please answer all questions. If not applicable, so state, otherwise the form will be returned.

Original to the County Clerk and Recorder; duplicate to the State Engineer; Triplicate to the Montana Bureau of Mines and Geology, and Quadruplicate for the Appropriator.

12403  
12-27-63



Doc # 97724

Filed this 23rd day of

December A. D. 1963

at 3:15 P. M.

Marquet Monical

County Clerk and Register

for Debbie Jane Lee

for \$ 2.00

GV

File No. ....

DUPLICATE

T. 9S R. 15E

RECEIVED  
DEC 26 1963

STATE OF MONTANA  
ADMINISTRATOR OF GROUNDWATER CODE  
OFFICE OF STATE ENGINEER

STATE ENGINEER

Declaration of Vested Groundwater Rights

(Under Chapter 237, Montana Session Laws, 1961)

1. United States of America, of Box 5 Gardiner  
(Name of Appropriator) (Address) (Town)  
County of Park State of Montana  
have appropriated groundwater according to the Montana laws in effect prior to January 1, 1962, as follows:

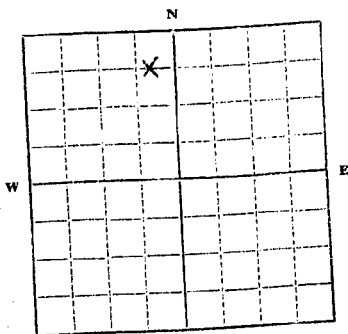

NW 1/4 4 Sec. 29 T. 9S R. 15E

Indicate point of appropriation and place of use, if possible. Each small square represents 10 acres.

- 2. The beneficial use on which the claim is based Domestic  
Cooke Guard Station
- 3. Date or approximate date of earliest beneficial use; and how continuous the use has been 1938; yearly - May-November
- 4. The amount of groundwater claimed (in miner's inches or gallons per minute) Estimated - 4 miner's inches
- 5. If used for irrigation, give the acreage and description of the lands to which water has been applied and name of the owner thereof  
N/A
- 6. The means of withdrawing such water from the ground and the location of each well or other means of withdrawal Pipeling from a spring in the NW4 Section 29, T9S, R15E, Park Soda Butte Creek drainage.
- 7. The date of commencement and completion of the construction of the well, wells, or other works for withdrawal of groundwater 1938
- 8. The depth of water table N/A
- 9. So far as it may be available, the type, size and depth of each well or the general specifications of any other works for the withdrawal of groundwater N/A
- 10. The estimated amount of groundwater withdrawn each year Estimated - 10,000 gallons
- 11. The log of formations encountered in the drilling of each well if available N/A
- 12. Such other information of a similar nature as may be useful in carrying out the policy of this act, including reference to book and page of any county record N/A

Signature of Owner By [Signature]  
District Forest Ranger  
Date 12/2/63

Three copies to be filed by the owner with the County Clerk and Recorder of the county in which the well is located.

Please answer all questions. If not applicable, so state, otherwise the form will be returned.

Original to the County Clerk and Recorder; duplicate to the State Engineer; Triplicate to the Montana Bureau of Mines and Geology, and Quadruplicate for the Appropriator.

12404  
1234

Doc # 97725

Filed this 23rd day of

December A. D. 1 963

at 3:15 o'clock P.M.

Margaret Monroe

County Clerk and Registrar

Doty Jones Secy

for \$2.00

File No. ....

DUPLICATE

RECEIVED  
SEP 11 1963

T. 9 R. 15

County Park

*Filing date?*

STATE OF MONTANA  
ADMINISTRATOR OF GROUNDWATER CODE  
OFFICE OF STATE ENGINEER

RECEIVED  
SEP 20 1963

Declaration of Vested Groundwater Rights  
(Under Chapter 237, Montana Session Laws, 1961)

STATE ENGINEER

1. Richard L. Randall, of Box 103A Cooke City, (Name of Appropriator) (Address) (Town)

County of Park State of Montana have appropriated groundwater according to the Montana laws in effect prior to January 1, 1962, as follows:

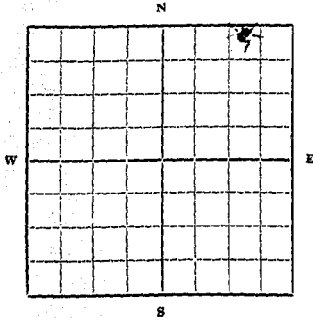

1/4 Sec. T. R.

Indicate point of appropriation and place of use, if possible. Each small square represents 10 acres.

2. The beneficial use on which the claim is based Continuous use for service station, Drive-Inn, Cabins and personal use

3. Date or approximate date of earliest beneficial use; and how continuous the use has been August 29, 1963, continuous use since that date

4. The amount of groundwater claimed (in miner's inches or gallons per minute) 35 gallons per minute tested by bailing 1 hour and running 1 hour

5. If used for irrigation, give the acreage and description of the lands to which water has been applied and name of the owner thereof used for irrigation of lawns and flowers

6. The means of withdrawing such water from the ground and the location of each well or other means of withdrawal Jet pump

7. The date of commencement and completion of the construction of the well, wells, or other works for withdrawal of groundwater started drilling August 23, 1963. Completed well August 29, 1963. Cased with 6 inch steel casing.

8. The depth of water table 12 feet

9. So far as it may be available, the type, size and depth of each well or the general specifications of any other works for the withdrawal of groundwater Depth of well is 23 feet. Cased with 6 inch steel casing.

10. The estimated amount of groundwater withdrawn each year 200,000 gallons

11. The log of formations encountered in the drilling of each well if available 0 - 8 feet, dirt, loam soil and granite rock. 8 to 23 feet, granite sand and granite rock. Good to rapid Gravity.

12. Such other information of a similar nature as may be useful in carrying out the policy of this act, including reference to book and page of any county record.

Signature of Owner *Richard L. Randall*  
Date *Sept. 19, 1963*

Three copies to be filed by the owner with the County Clerk and Recorder of the county in which the well is located.

Please answer all questions. If not applicable, so state, otherwise the form will be returned.

Original to the County Clerk and Recorder; duplicate to the State Engineer; Triplicate to the Montana Bureau of Mines and Geology and Quadruplicate for the Appropriator.

Doc. # 96528

Filed Nov. 30<sup>th</sup> 1963

Sept. A. D. 1963

8:03 a. m.

Margaret Monical  
County Clerk and Recorder.

By \_\_\_\_\_ Deputy.

See 2<sup>nd</sup>



GW3

File No.....

DUPLICATE

T. 10 S. R. 10 E

County..... Park

21

STATE OF MONTANA  
ADMINISTRATOR OF GROUNDWATER CODE  
OFFICE OF STATE ENGINEER

RECEIVED  
JAN 3 1964

Notice of Completion of Groundwater Appropriation Without Well

STATE ENGINEER

(Under Chapter 237 Montana Session Laws, 1961)

Date of Appropriation of Groundwater approximately 1885

Owner Donal Stole Address Shields Route

Contractor (if any) N/A

Address of Contractor N/A

Date Started ap. 1885 Date Completed ap. 1885

Describe means of obtaining groundwater without a well "as by sub-irrigation and other natural processes". Include depth to water when applicable. A. and B. - small amount of excavation done at source of spring to increase the flow; C. has a 1 1/2" pipe inserted into the spring. Depth of water table unknown.

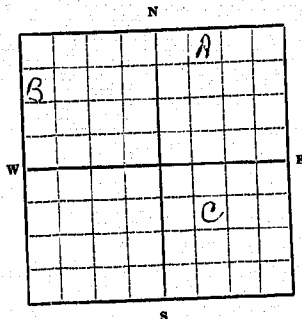

Quantity of water developed and used with explanation of method used to measure or estimate such amount. If use is intermittent estimate approximate lengths of periods of use

1/4 Sec 21 T. 10 S. R. 10 E tent estimate approximate lengths of periods of use approximately 10" for each spring. Used for stockwater and subirrigation.

Signature of Owner Donal Stole

Date December 30, 1963

This form to be prepared by contractor (if any), otherwise by the owner.

Three copies of this notice are to be filed with the County Clerk and Recorder of the county in which the works are located.

Please answer all questions. If not applicable, so state, otherwise the form will be returned.

Original to the County Clerk and Recorder; duplicate to the State Engineer; Triplicate to the School of Mines and Quadruplicate for the Appropriator.

20701

# 98128

Filed this 31st day of  
December A. D. 1963  
" 10.23 o'clock P. M.  
Margaret Monical  
County Clerk and Recorder.  
Lamma Bowers  
Deputy  
Fee \$2.00