

75769
 # ~~1954~~, Filed,
 at _____, 19____,
 M.

STATE OF MONTANA
 ADMINISTRATOR OF GROUNDWATER CODE
 OFFICE OF STATE ENGINEER

Twsp _____ S, Rge _____ E

RECEIVED
 MAR 9 1961

Clerk and Recorder
 \$2.00 fee paid

DECLARATION OF VESTED GROUNDWATER RIGHTS
 (Under Chapter 237, Montana Session Laws, 1961)

1. RANDALL DOW, of _____, County of POWDER RIVER, STATE OF MONTANA, have appropriated groundwater according to the Montana Laws in effect prior to January 1, 1962, as follows:

	SS-50E	SS-50E	SS-50E	4S-50E	SS-50E	SS-50E
	Sec. 1	Sec. 13	Sec. 14	Sec. 25	Sec. 4	Sec. 25
WELLS	No. 1	No. 2	No. 3	No. 4	No. 5	No. 6
Basis of						
2. Beneficial Use						
DATE DRILLED	1951	1956	1956	1955	1951	1951
3. How continuously used						
Amount Claimed						
4. (gal. per minute)						
Irrigated description						
Irrigation owner						
5. Irrigated acreage						
Location (40 acres)	SENE	SESW	SUNE	NESE	NENE	SENE
6. Withdrawal near						
7. Completion date						
8. Water depth table	100'	100'	145'	165'	220'	40'
Type (drilled or dug)	drilled	drilled	drilled	drilled	drilled	drilled
9. Size & Depth	12" - 150'	12" - 165'	12" - 165'	12" - 120'	12" - 220'	12" - 40'
Estimated annual						
10. amount withdrawn						
11. Other information						
12. Log, if available	shale 115'-116'	shale 100'-150' water sand	water sand	water sand	sh or sand	gravel sand

STATE OF MONTANA)
) ss.
 County of Powder River)

Signature of Owner: Randall Dow

Date _____

Randall Dow, Having first been duly sworn, deposes and says that he is of lawful age and is the appropriator and claimant of the order and water right mentioned in the foregoing Declaration of Vested Groundwater Rights and the person whose name is subscribed thereto, as the appropriator and claimant, that he knows the contents of said foregoing notice and that the matters and things therein stated are true.

Subscribed and sworn to before me this _____ day of _____, 19____.
 Clerk & Recorder, Powder River County, Broadus, Montana

Randall Dow
 Signature of Owner

35322

74390-2, Filed,
 at _____, 19____,
 \$2.00 fee paid

STATE OF MONTANA
 ADMINISTRATOR OF GROUNDWATER CODE
 OFFICE OF STATE ENGINEER

Twp 4 S, Rge 50 E

DECLARATION OF VESTED GROUNDWATER RIGHTS
 Clerk and Recorder (Under Chapter 237, Montana Session Laws, 1961)

RECEIVED
 DEC 23 1963
 STATE ENGINEER

1. Smith Ranch, Inc., of Broadus,
 County of POWDER RIVER, State of MONTANA, have appropriated groundwater according to
 the Montana Laws in effect prior to January 1, 1962, as follows:

	4-50	4-50	4-50	4-50	5-50
	Sec. 27	Sec. 31	Sec. 29	Sec. 27	Sec. 18
WELLS	No. 27	No. 28	No. 29	No. 40	No. 11
2. Basis of Beneficial Use	stock	stock	stock	stock	stock
3. DATE OF USE	1929	1943	1961	1959	1944
How continuous	constant	constant	constant	constant	constant
4. Amount claimed (gal. per minute)	12	12	12	12	12
Irrigated description					
Irrigation owner					
5. Irrigated acreage					
6. Location	NWNW	NWNW	NWSW	SESW	SENE
Withdrawal means	windmill	windmill	windmill	windmill	windmill
7. Completion date	1929	1943	1961	1959	1944
8. Water depth table	80'	100'	100'	110'	120'
Type (drilled or dug)	drilled	drilled	drilled	drilled	drilled
9. Size & depth	3" x 100'	4" x 150'	4" x 160'	6" x 425'	4" x 180'
10. Estimated annual Amount withdrawn					
11. Other information					
12. Log, if available					

STATE OF MONTANA)
) ss.
 County of Powder River)

Signature of Owner SMITH RANCH, INC.

/s/ Richard Smith
 Date 11-29-63

Richard Smith having first been duly sworn, deposes and says that he is of lawful age and is the appropriator and claimant of the order and water right mentioned in the foregoing Declaration of Vested Groundwater Rights and the person whose name is subscribed thereto, as the appropriator and claimant, that he knows the contents of said foregoing notice and that the matters and things therein stated are true.

Subscribed and sworn to before me this 29th day of November, 1963
Small deputy

11775-A

File No. 74397
 filed 7-19-63 at 9:05 A.M. \$2.00 fee pd.
 Lucille Godsey, deputy
 Clerk and Recorder

STATE OF MONTANA
 ADMINISTRATOR OF GROUNDWATER CODE
 OFFICE OF STATE ENGINEER
 DECLARATION OF VESTED GROUNDWATER RIGHTS
 (Under Chapter 237, Montana Session Laws, 1961)

Twp 5 S, Rge 21 E
RECEIVED
 JUL 22 1963
 STATE ENGINEER

1. Guy Nash, of Broadus, Montana
 County of POWDER RIVER, State of MONTANA, have appropriated groundwater according to the
 Montana laws in effect prior to January 1, 1962, as follows:

	5-51	5-51	5-50	5-50	5-50	
	z	z	z	z	z	
	Sec. 3	Sec. 3	Sec. 21	Sec. 21	Sec. 21	Sec.
WELLS	No. 1	No. 2	No. 3	No. 4	No. 5	No. 6
2. Basis of Beneficial Use	domestic	stock	stock	stock	stock	
3. Date of use	1945	1948	1940	1940	1940	
How continuous	constant	constant	constant	constant	constant	
4. Amount claimed	4 gpm	5 gpm	4 gpm	4 gpm	4 gpm	
Irrigated description						
5. Irrigation owner						
6. Location	SWNE	SWNE	SWSE	NWSE	NESE	
Withdrawal means	Flow	pump	spring	spring	spring	
7. Completion date	1945	1948	spring	spring	spring	
8. Water depth table	flow	17'	spring	spring	spring	
9. Type	drilled	drilled	spring	spring	spring	
10. Size & depth	6" x 440'	6" x 28'				
11. Estimated annual Amount withdrawn						
12. Other information						
12. Log, if available	#1. 1-9 sandy top soil 9-18 sand 18-58 sand & gravel 58-70 blue clay 70-74 coal 74-115 blue clay 115-119 coal 119-133 brown clay 133-138 hard sand rock 138-140 clay 140-141 coal 141-146 clay 146-148 coal 148-160 shale 160-163 coal		163-166 shale 166-168 coal 168-210 shale 210-221 sand 221-222 rock 222-230 sand 230-233 coal 233-240 shale 240-250 sand & coal 250-277 shale 277-288 sand 288-295 shale 295-332 sand 332-370 shale 370-382 sand 382-386 rock		386-420 sand 420-426 shale	

STATE OF MONTANA)
 County of Powder River) ss.

Signature of Owner Guy Nash
 Date 7-8-63

Guy Nash having first been duly sworn, deposes and says that he is of lawful age and is the appropriator and claimant of the order and water right mentioned in the foregoing declaration of vested groundwater rights and the person whose name is subscribed thereto, as the appropriator and claimant, that he knows the contents of said foregoing notice and that the matters and things therein stated are true.

Subscribed and sworn to before me this
8th day of July, 1963.
Lucille Godsey deputy
 Clerk and Recorder
 Powder River County
 Broadus, Montana

Guy Nash

5100

7169, Filed, (C)
 at _____, 19____,
 at _____ .M.

STATE OF MONTANA
 ADMINISTRATOR OF GROUNDWATER CODE
 OFFICE OF STATE ENGINEER

Twp 5 S, Rge E

Clerk and Recorder
 \$2.00 fee paid

DECLARATION OF VESTED GROUNDWATER RIGHTS
 (Under Chapter 237, Montana Session Laws, 1961)

RECEIVED
 MAR 9 1962

1. Marshall Inc., of _____, _____
 County of POWDER RIVER, STATE OF MONTANA, have appropriated groundwater according to
 the Montana Laws in effect prior to January 1, 1962, as follows:

Marshall Inc.
 1000 Marshall

	SS-50E	SS-51E	SS-50E	4S-50E ✓	4S-50E ✓	SS-51E
	Sec. 20	Sec. 21	Sec. 25	Sec. 25	Sec. 25	Sec. 25
WELLS	No. 1	No. 2	No. 3	No. 4	No. 5	No. 6
Basis of	Stock	Stock	Stock	Stock	Stock	Stock
2. Beneficial Use	Stock	Stock	Stock	Stock	Stock	Stock
DATE DRILLED	1951	1959	1951	1950	1950	1955
3. How continuously used	const.	const.	const.	const.	seasonal	const.
Amount Claimed	27 gpm	27 gpm	27 gpm	47 gpm	27 gpm	27 gpm
4. (gal. per minute)	27 gpm	27 gpm	27 gpm	47 gpm	27 gpm	27 gpm
Irrigated description						
Irrigation owner						
5. Irrigated acreage						
Location (40 acres)	SS-50E	SS-51E	SS-50E	4S-50E	4S-50E	SS-51E
6. Withdrawal means	drilled	drilled	drilled	drilled	drilled	drilled
7. Completion date.	1951	1959	1951	1950	1950	1955
8. Water depth table	130'	150'	80'	170'	110'	90'
Type (drilled or dug)	drilled	drilled	drilled	drilled	drilled	drilled
9. Size & Depth	4" x 120'	4" x 120'	4" x 120'	4" x 220'	4" x 120'	4" x 90'
10. Estimated annual amount withdrawn	270,000	270,000	270,000	390,000	270,000	270,000
11. Other information		small const.				const. - all
12. Log, if available	100-1-10'	100-1-100'		100-210'	100-1-120'	100-1-90'
	shale	shale		shale & sand	shale & sand	shale & sand

STATE OF MONTANA)
) ss.
 County of Powder River)

Signature of Owner: Marshall Inc.
 By Marshall Inc.

Date _____

Marshall Inc., having first been duly sworn, deposes and says that he is of
 lawful age and is the appropriator and claimant of the order and water right mentioned in
 the foregoing Declaration of Vested Groundwater Rights and the person whose name is sub-
 scribed thereto, as the appropriator and claimant, that he knows the contents of said
 foregoing notice and that the matters and things therein stated are true.
 Subscribed and sworn to before me this

_____ day of _____, 19____.
 Clerk & Recorder, Powder
 River County, Broadus, Montana

Marshall Inc.
 By _____

72169, Filed, (C)
 at _____, 19____,
 M.

STATE OF MONTANA
 ADMINISTRATOR OF GROUNDWATER CODE
 OFFICE OF STATE ENGINEER

Twp 5 S, Rge 1 E

Clerk and Recorder
 \$2.00 fee paid

DECLARATION OF VESTED GROUNDWATER RIGHTS
 (Under Chapter 237, Montana Session Laws, 1961)

RECEIVED
 MAR 9 1961

1. Landfill Inc., of _____, _____
 County of POWDER RIVER, STATE OF MONTANA, have appropriated groundwater according to
 the Montana Laws in effect prior to January 1, 1962, as follows:

Landfill Inc.
 10000 Landfill

	SS-50E	SS-51E	SS-50E	4S-50E ✓	4S-50E ✓	SS-51E
	+	+	+	+	+	+
	Sec. 22	Sec. 21	Sec. 25	Sec. 22	Sec. 25	Sec. 23
W E I L L S	No. 1	No. 2	No. 3	No. 4	No. 5	No. 6
2. Beneficial Use	Stock	Stock	Stock	Stock	Stock	Stock
DATE DRILLED	1958	1959	1958	1960	1955	1955
3. How continuously used	seasonal	seasonal	seasonal	const.	seasonal	seasonal
4. Amount Claimed (gal. per minute)	25 gpm	25 gpm	2 gpm	1 gpm	25 gpm	25 gpm
Irrigated description						
Irrigation owner						
5. Irrigated acreage						
Location (40 acres)	SW 1/4	SW 1/4	SW 1/4	SW 1/4	SW 1/4	SW 1/4
6. Withdrawal means	Hand-dug	Hand-dug	Hand-dug	Hand-dug	Hand-dug	Hand-dug
7. Completion date	1958	1959	1958	1960	1955	1955
8. Water depth table	150'	160'	60'	170'	110'	30'
Type (drilled or dug)	drilled	drilled	drilled	drilled	drilled	drilled
9. Size & Depth	4" x 150'	4" x 152'	4" x 130'	4" x 210'	4" x 150'	4" x 93'
10. Estimated annual amount withdrawn	250,000	250,000	200,000	350,000	250,000	250,000
11. Other information	None	None	None	None	None	None
12. Log, if available	1958-1958'	1959-1959'		1960-210'	1955-150'	1955-93'
	hard shale	hard shale		hard sand & shale	hard sand	artesian well - did not flow.

STATE OF MONTANA)
) ss.
 County of Powder River)

Signature of Owner: Landfill Inc.
10000 Landfill, Inc.

Date

Landfill Inc., of _____, _____, having first been duly sworn, deposes and says that he is of
 lawful age and is the appropriator and claimant of the order and water right mentioned in
 the foregoing Declaration of Vested Groundwater Rights and the person whose name is sub-
 scribed thereto, as the appropriator and claimant, that he knows the contents of said
 foregoing notice and that the matters and things therein stated are true.
 Subscribed and sworn to before me this

____th day of _____, 19____.

Clerk & Recorder, Powder
 River County, Broadus, Montana

Landfill Inc.
10000 Landfill, Inc.

RECEIVED

JUL 10 1973

Donovan well

GW -

File No. 92709

Filed: June 27 1973
at 2:19 P. M.

MONTANA DEPARTMENT OF NATURAL
RESOURCES AND CONSERVATION

Charles E. Edwards
Clerk and Recorder

Notice of COMPLETION of Groundwater
Appropriation by Means of Well

Twp. 58 Rge 50 E

Powder River County (Under Chapter 237, Montana Session Laws, 1961)

By Guy B. Boels Deputy OWNER Randall Inc Address Broadus Mont

Top of Ground -
Elev. above sea level. DRILLER Frank Barclay Jr Address Broadus Mont

Date of Notice of Appropriation of Groundwater _____

Date well started Oct 21, 64 Completed Oct 22, 1964

Type of Well drilled Equipment Used _____
(dug, driven, bored, drilled) (churn, drill, rotary, etc)

Water Use: Domestic ; Municipal _____; Stock ; Other _____;
Industrial _____; Drainage _____; Irrigation _____;

Indicate on diagram character and thickness of different strata met in drilling -ei, soil, clay, shale, gravel, rock, sand. Show depth at which water is found, thickness and character of water-bearing strata and height to which water rises in well.

0-11	Surface Soil
16-29	Sand & Gravel
29-61	blue shale
61-75	Sand
75-106	blue shale
106-137	sand
137-252	blue shale
252-285	hard rock
285-285	Sand
285-339	blue shale
339-350	sand
350-470	Clay

Size of Drilled Hole	Size and Weight of Casing	From (feet)	To (feet)	Perforations		
				Kind Size	From (feet)	To (feet)
3"	400' 3" - 1" D. pipe					
	5' 4" - 1" D. casing					

Static Water Level for non-flowing well _____ feet
Shut-in Pressure for Flowing Well 8' 1/2" _____ gal. per min.
Pumping Water Level _____ feet at _____ gal. per minute.
Discharge in Gal. per min. of flowing well 12 gal. per min.
How Tested pumped Length of Test _____

Remarks: (Gravel packing, cementing, packers, type of shut-off, location of use if not at well, other similar pertinent information, including number of acres irrigated, if any.)

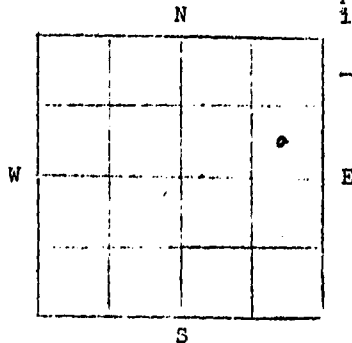

Sec 25, Twp. 58, Rge 50 East.

Driller's License NO. _____

Frank Barclay Jr
Driller's Signature

STATE OF MONTANA)
County of Powder River) ss.

_____ having first been duly sworn, deposes and says that he is of lawful age and the appropriator and claimant of the order and water right mentioned in the foregoing notice of completion of groundwater appropriation by means of well and the person whose name is subscribed thereto, as the appropriator and claimant, that he knows the contents of said foregoing notice and that the matters and things therein stated are true.

Owner's Signature Douglas Randall

Subscribed and sworn to before me, this _____ day of _____, 196_____.

Clerk and Recorder

560000

7777, Filed, (1)
 at 19,
M.

STATE OF MONTANA
 ADMINISTRATOR OF GROUNDWATER CODE
 OFFICE OF STATE ENGINEER

Map 6 S, Rge 7
5

Clerk and Recorder
 \$2.00 fee paid

DECLARATION OF VESTED GROUNDWATER RIGHTS
 (Under Chapter 237, Montana Session Laws, 1961)

RECEIVED
 MAR 9 1962

1. RANDALL INC., of _____,
 County of POWDER RIVER, STATE OF MONTANA, have appropriated groundwater according to
 the Montana Laws in effect prior to January 1, 1962, as follows:

	65-51E	65-51E	65-51E	65-51E	55-50E	55-51E
	+	+	+	+	+	+
	Sec. 1	Sec. 2	Sec. 3	Sec. 4	Sec. 5	Sec. 6
WELLS	No. 1	No. 2	No. 3	No. 4	No. 5	No. 6
2. Beneficial Use						
3. DATE DRILLED	1955	1950	1950	1950	1950	1951
4. How continuously used						
Amount Claimed						
4. (gal. per minute)						
Irrigated description						
Irrigation owner						
5. Irrigated acreage						
Location (40 acres)					NESE	
6. Withdrawal means						
7. Completion date						
8. Water depth table						
Type (drilled or dug)	drilled	drilled	drilled	drilled	drilled	drilled
9. Size & Depth						
Estimated annual						
10. amount withdrawn						
11. Other information	water sand	water sand	water sand	water sand	water sand	water sand
12. Log, if available						

STATE OF MONTANA)
) ss.
 County of Powder River)

Signature of Owner: _____

Randall Inc. Date _____

_____ having first been duly sworn, deposes and says that he is of
 lawful age and is the appropriator and claimant of the order and water right mentioned in
 the foregoing Declaration of Vested Groundwater Rights and the person whose name is sub-
 scribed thereto, as the appropriator and claimant, that he knows the contents of said
 foregoing notice and that the matters and things therein stated are true.
 Subscribed and sworn to before me this

26th day of _____, 1962.

Clerk & Recorder, Powder
 River County, Broadus, Montana

7712, Filed, (L)
 at _____, 19____
 _____ M.

STATE OF MONTANA
 ADMINISTRATOR OF GROUNDWATER CODE
 OFFICE OF STATE ENGINEER

Wp 6 S, Rge 51
 5 30

Clerk and Recorder
 \$2.00 fee paid

DECLARATION OF VESTED GROUNDWATER RIGHTS
 (Under Chapter 237, Montana Session Laws, 1961)

RECEIVED
 MAR 9 1961

1. RANDALL INC., of _____, of _____
 County of POWDER RIVER, STATE OF MONTANA, have appropriated groundwater according to
 the Montana Laws in effect prior to January 1, 1962, as follows:

	65-51E	65-51E	65-51E	65-51E	55-30E	55-51E
	Sec. 2	Sec. 2	Sec. 5	Sec. 5	Sec. 2	Sec. 2
WELLS	No. 1	No. 2	No. 3	No. 4	No. 5	No. 6
2. Beneficial Use	Stock	Stock	Stock	Domestic	Stock	Stock
3. DATE DRILLED	1935	1939	1952	1920	1920	1911
3. How continuously used	Seasonal	Seasonal	Seasonal	Constant	Seasonal	Seasonal
4. Amount Claimed (gal. per minute)	2000	2000	2000	1000	2000	1000
Irrigated description						
5. Irrigation owner						
6. Location (40 acres)					NESE	
6. Withdrawal means						
7. Completion date	1935	1939	1952	1920	1920	1911
8. Water depth table	14'	20'	20'	20'	20'	20'
Type (drilled or dug)	Drilled	Drilled	Drilled	Drilled	Drilled	Drilled
9. Size & Depth	24" x 75'	24" x 110'	24" x 110'	24" x 75'	24" x 110'	24" x 110'
10. Estimated annual amount withdrawn	200,000	200,000	200,000	100,000	200,000	100,000
11. Other information	Lower Sch. school sec.	school sec.	winter	Cart	Cart	
12. Log, if available	Water sand	Water sand	Water sand	Water sand	Water sand	Water sand

STATE OF MONTANA)
) ss.
 County of Powder River)
 Randall Inc.)
 Date _____, 1961.

_____ having first been duly sworn, deposes and says that he is of
 lawful age and is the appropriator and claimant of the order and water right mentioned in
 the foregoing Declaration of Vested Groundwater Rights and the person whose name is sub-
 scribed thereto, as the appropriator and claimant, that he knows the contents of said
 foregoing notice and that the matters and things therein stated are true.
 Subscribed and sworn to before me this
26th day of _____, 19____.

Clerk & Recorder, Powder
 River County, Broadus, Montana

File No. 72288-filed for record STATE OF MONTANA
 July 31, 1962 ADMINISTRATOR OF GROUNDWATER CODE
 (2.00 fee) OFFICE OF STATE ENGINEER
 Helena, Montana
 Clerk and Recorder

4 S. Rce 54 E
 T 55 N R 50 W
 STATE ENGINEER

DECLARATION OF VESTED GROUNDWATER RIGHTS
 (Under Chapter 237, Montana Session Laws, 1961)

1. Joe J. McDowell and Isabel E. McDowell, of Broadus, County of POWDER RIVER, State of MONTANA, have appropriated groundwater according to the Montana laws in effect prior to January 1, 1962, as follows:

WELLS	T 55 N R 50 W			T 55 N R 50 W		
	Sec. 33	Sec. 33	Sec. 25	Sec.	Sec.	Sec.
	No. 1	No. 2	No. 3	No. 4	No. 5	No. 6
2. Beneficial Use	Cafe Store	Domestic	Domestic & Stock			
3. Date of use	1949	1954	1953			
How continuous	constant	constant	constant			
4. Amount claimed	10 gpm	10 gpm	10 gpm			
Irrigated description		lawn & garden	garden			
5. Irrigation owner						
6. Location	SW 33 Sec. 33 4-51	SW 33 Sec. 33 4-51	SW 25 Sec. 25 5-50			
Withdrawal means	Electric pump	Electric pump	Flowing			
7. Completion date	1949	1954	1953			
8. Water depth table	80'	80'	Flow			
Type	drilled	drilled	drilled			
9. Size & depth	1" 175'	1" 186'	500'			
10. Estimated annual amount withdrawn						
11. Other information	1" casing	1" casing	2 1/2" casing			
12. Log, if available		2" casing 300'	350'			

STATE OF MONTANA)
 County of Powder River) ss.

Signature of Owner Joe J. McDowell
Isabel E. McDowell
 Date 7-31-62

Joe J. McDowell and Isabel E. McDowell having first been duly sworn, deposes and says that he is of lawful age and is the appropriator and claimant of the order and water right mentioned in the foregoing declaration of vested groundwater rights and the person whose name is subscribed thereto, as the appropriator and claimant, that he knows the contents of said foregoing notice and that the matters and things therein stated are true.
 Subscribed and sworn to before me this
31st day of July, 1962.

Isabel E. McDowell
 Clerk and Recorder
 Powder River County
 Broadus, Montana

Joe J. McDowell
Isabel E. McDowell
 (1766)

GW:

File No. 72328
Filed June 21, 1962, at 1:00 P.M.
DUPLICATE \$2.00 fee paid
Lucille Godsey, deputy

T. 5 S. R. 80 E

County Fowler River Co.

STATE OF MONTANA
ADMINISTRATOR OF GROUNDWATER CODE
OFFICE OF STATE ENGINEERS
RECEIVED
JUN 25 1962

Notice of Completion of Groundwater Appropriation by Means of Well

(Under Chapter 237, Montana Session Laws, 1961)

Owner Joe J. and Isabel E. McDowell, JRS Address Broadus, Montana

Driller Flex-O-Pipe, Inc. Address Missoula, Mont.

Date of Notice of Appropriation of Groundwater none

Date well started April 1, 1962 Date Completed May 1, 1962

Type of well drilled Equipment Used reverse circulation
(dug, driven, bored or drilled) (Churn, drill, rotary or other)

Water Use: Domestic Municipal Stock Irrigation
Industrial Drainage Other

Indicate on the diagram the character and thickness of the different strata met with in drilling, such as soil, clay, shale, gravel, rock or sand, etc. Show depth at which water is encountered, thickness and character of water-bearing strata and height to which the water rises in the well.

Top of Ground

3' Top Sandy Soil (Elev. above sea level 3300)

18' Light Gravel

4' Heavy Gravel

12' Light Gravel & Sand

4' Heavy Gravel

4' Blue Shale

Indicate location of well and place of use, if possible. Each small square represents 10 acres.

Show exact depth of bottom.

Size of Drilled Hole	Size and Weight of Casing	From (Feet)	To (Feet)	PERFORATIONS		
				Kind Size	From (Feet)	To (Feet)
3"	16 gauge corrugated culvert 18" Dia.	1	44	1" slot	bottom	12' from top

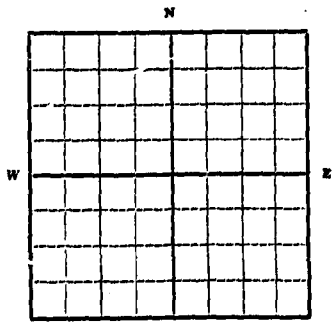

Static Water Level for non-flowing Well 8' feet.

Shut-in Pressure for Flowing Well none

Pumping Water Level 28' feet at 600 gal. per minute.

Discharge in gal. per min. of flowing well none
belt driven

How Tested turbine pump Length of Test 16 hrs.

Remarks: (Gravel packing, cementing, packers, type of shutoff, location of place of use of groundwater if not at well, and any other similar pertinent information, including number of

acres irrigated, if used for irrigation) gravel packed 28' 100' irrigation; approx 100 A. under irrigation

120
Driller's License Number
R. Millard
Driller's Signature

This form to be prepared by driller, and three copies to be filed by the owner with the County Clerk and Recorder in the county in which the well is located.

Please answer all questions. If not applicable, so state, otherwise the form will be returned.

Original to the County Clerk and Recorder; duplicate to the State Engineer; Triplicate to the School of Mines and Quadruplicate for the Appropriator.

927

GW2

26

File No. 72339
Filed June 21, 1962, at 1:05 P.M.
DUPLICATE \$3.50 Fee paid.
Lucille Godsey, deputy

T. 5 S. R. 50E
County Powder River

STATE OF MONTANA
ADMINISTRATOR OF GROUNDWATER
OFFICE OF STATE ENGINEER

RECEIVED
JUN 25 1962

**Notice of Completion of Groundwater
Appropriation by Means of Well**
STATE ENGINEER

(Under Chapter 237, Montana Session Laws, 1961)

Joe J. and Isabel E.

Owner: McDowell, JRS Address Broadus, Montana

Driller: Fles-O-Pipe, Inc. Address Miles City, Mont.

Date of Notice of Appropriation of Groundwater none

Date well started April 1, 1962 Date Completed May 1, 1962

Type of well drilled Equipment Used reverse circulation
(dug, driven, bored or drilled) (Churn, drill, rotary or other)

Water Use: Domestic Municipal Stock Irrigation
Industrial Drainage Other

Indicate on the diagram the character and thickness of the different strata met with in drilling, such as soil, clay, shale, gravel, rock or sand, etc. Show depth at which water is encountered, thickness and character of water-bearing strata and height to which the water rises in the well.

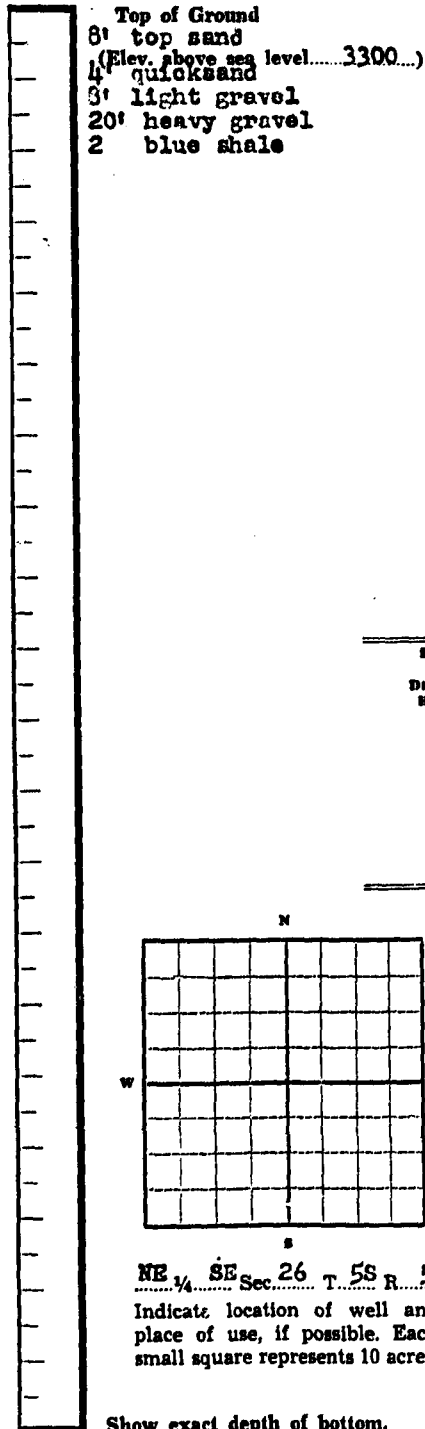

Size of Drilled Hole	Size and Weight of Casing	From (Feet)	To (Feet)	PERFORATIONS		
				Kind Size	From (Feet)	To (Feet)
3"	16 gauge corrugated culvert 18" dia.	0	42	1/2" V	bottom	half

Static Water Level for non-flowing Well 8 feet.

Shut-in Pressure for Flowing Well none

Pumping Water Level 20 feet at 500 gal. per minute.

Discharge in gal. per min. of flowing well none

belt driven

How Tested turbine pump Length of Test 16 hr.

Remarks: (Gravel packing, cementing, packers, type of shutoff, location of place of use of groundwater if not at well, and any other similar pertinent information, including number of

acres irrigated, if used for irrigation) gr. val. packed 32; 100% irrigation; approx. 100 acres under irrigation

Show exact depth of bottom.

120
Driller's License Number

Ra Millard
Driller's Signature

This form to be prepared by driller, and three copies to be filed by the owner with the County Clerk and Recorder in the county in which the well is located.

Please answer all questions. If not applicable, so state, otherwise the form will be returned.

Original to the County Clerk and Recorder; duplicate to the State Engineer; Triplicate to the School of Mines and Quadruplicate for the Appropriator.

928

STATE OF MONTANA
ADMINISTRATOR OF GROUNDWATER CODE
MONTANA WATER RESOURCES BOARD

**NOTICE OF COMPLETION OF GROUNDWATER
APPROPRIATION BY MEANS OF WELL**

Developed after January 1, 1962

(Under Chapter 237 Montana Session Laws, 1961, as amended)

This form to be prepared by driller, and three copies to be filed by the owner with the County Clerk and Recorder in the county in which the well is located, last copy to be retained by driller. Please answer all questions. If not applicable, so state, otherwise the form may be returned.

Owner Randall J. Jones
Address Broadus, MONT

For Administrator's Use	
File	
GW 1	

Date well started June 1971
completed June 2, 1971

Type of well Drilled
(Aug. driven, hired or drilled)
Equipment used Rotary
(Churn drill, rotary or other)
Water Use: Domestic Municipal Stock Irrigation
Industrial Drainage Other * Garden/Lawn

*Describe
USE: If used for irrigation, industrial, drainage or other. Explain, state number of acres and location or other data (i.e. Lot, Block and Addition).

ESTIMATED ANNUAL WITHDRAWAL

Size of Drilled Hole	Size and Weight of Casing	From (Feet)	To (Feet)	PERMEATIONS		
				Kind	From	To
6"	4" 10 lb	+1	130	6X4"	80'	125'

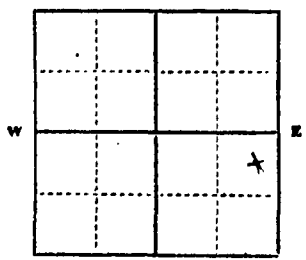

Static water level 85 ft.*
Pumping water level 105 ft.*
at 6 gallons per minute,
measured 120 minutes after pumping
began.
*Measured from ground level.
Well developed by air
for 2 hours.
Power Rig Pump HP
Remarks: (Gravel packing, cementing,
packers, type of shutoff)

Section R.E. 1/4 SE 1/4 Sec. 27
T. 58 N. R. 50 W

INDICATE LOCATION OF WELL AND PLACE OF USE, IF POSSIBLE. EACH SMALL SQUARE REPRESENTS 40 ACRES.

Driller's Signature Warren Jones
Driller's Address Box 241 Broadus Montana

County Powder River

DRILLER'S LOG

Indicate the character, color, thickness of strata such as soil, clay, sand, gravel, shale, sandstone, etc. Show depth at which water is found and height to which water rises in well.

Top of Ground (ft. above sea level)		
From (Feet)	To (Feet)	
0	10	Surface
10	18	Gravel
28	37	dark shale
37	64	light sand
64	84	light blue shale
84	125	Sandstone
125	130	grey shale

FILED REC. NO. 92716
County of Powder River, Montana
I hereby certify that the within
instrument was filed for record in
this office, on the 21 day of
June 1973 at 2:26
o'clock P.M. Fee \$2.00 paid
Charlotte Edwards
County Clerk and Recorder
Dr. Robert B. Baker
Deputy

56027

FILED
JUL 10 1973

County Powder River

STATE OF MONTANA
ADMINISTRATOR OF GROUNDWATER CODE
MONTANA WATER RESOURCES BOARD

DRILLER'S LOG

NOTICE OF COMPLETION OF GROUNDWATER
APPROPRIATION BY MEANS OF WELL

Developed after January 1, 1962

(Under Chapter 237 Montana Session Laws, 1961, as amended)

This form to be prepared by driller, and three copies to be filed by the owner with the County Clerk and Recorder in the county in which the well is located, last copy to be retained by driller. Please answer all questions. If not applicable, so state, otherwise the form may be returned.

Owner Ranch, L.L. Inc.
Address Broadus, Mont.
Date well started July 30, 1970
completed July 31, 1970

For Administrator's Use
File
GW 1

Type of well
Equipment used
Water Use: Domestic Municipal Stock Irrigation
Industrial Drainage Other * Garden/Lawn

*Describe
USE: If used for irrigation, industrial, drainage or other. Explain, state number of acres and location or other data (i.e. Lot, Block and Addition).

ESTIMATED ANNUAL WITHDRAWAL

Size of Drilled Hole	Size and Weight of Casing	From (Feet)	To (Feet)	PERFORATIONS		
				Kind Size	From (Feet)	To (Feet)
9"	4" 10	+2	35	6x7"	20	34

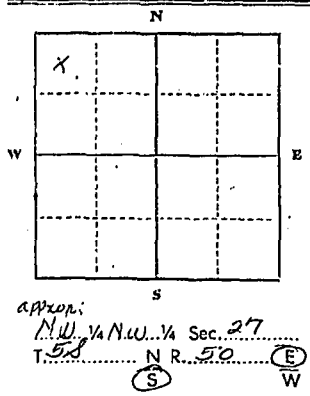

Static water level 18 ft.*
Pumping water level 33 ft.*
at 7 1/2 gallons per minute,
measured 120 minutes after pumping began.
*Measured from ground level.
Well developed by Air
for 3 hours.
Power Rig Pump HP
Remarks: (Gravel packing, cementing, packers, type of shutoff)
Gravel packed

INDICATE LOCATION OF WELL AND PLACE OF USE, IF POSSIBLE. EACH SMALL SQUARE REPRESENTS 40 ACRES.

Driller's Signature Harlan J. Jones
Driller's Address Box 241 Broadus Montana

Top of Ground (Elev. above sea level)

From (Feet)	To (Feet)	
0	7	Surface
7	21	Sandy clay
21	30	Score wash
30	34	Coal
34	35	Blue shale

FILED, Rec. No. 92717
County of Powder River, Montana
I hereby certify that the within instrument was filed for record in this office on the 29 day of June, 1973 at 2:27 o'clock P. M. Fee \$2.00 paid
Charlton Edmonds
County Clerk and Recorder
By: Carlton Edmonds
Deputy

LICENSE NO. 182

35 Show exact depth of bottom

96028

File No. 74980
 Filed: 12-10-1963
 at 3:04 P. M.
Ducille Sobary, Deputy
 Clerk and Recorder
 Powder River County

STATE OF MONTANA
 ADMINISTRATOR OF GROUNDWATER CODE
 OFFICE OF STATE ENGINEER

T SS R 50E 35

RECEIVED
 DEC 23 1963

NOTICE OF COMPLETION OF GROUNDWATER
 APPROPRIATION BY MEANS OF WELL
 (Under Chapter 237, Montana Session Laws, 1961) **STATE ENGINEER**

OWNER Joe McDowell Address Broadus, Mont.

DRILLER Earl Drane Address Broadus, Mont.

Date of Notice of Appropriation of Groundwater _____

Date well started 10-16-63 Completed 10-24-63

Type of well drilled Equipment used rotary
 (dug, driven, bored, drilled) (churn, drill, rotary, other)

Water Use: Domestic Municipal Stock Other
 Industrial Drainage Irrigation

Indicate on diagram character and thickness of different strata met in drilling -ei, soil, clay, shale, gravel, rock, sand. Show depth at which water is found, thickness and character of water-bearing strata and height to which water rises in well.

0-	15	sandy
15-	19	gravel
	23	coal
	118	shale & sand streaks
	119	rock
119-	160	blue shale
	162	rock
	190	blue shale
	191	rock
	230	blue shale
	234	hard rock
	313	shale
	317	rock
	370	shale
	350	sand
	378	shale
	385	rock
	425	shale
	440	sand
	520	sand & shale
	560	shale N
	563	rock
	585	shale
	587	rock
	690	shale
	730	sand flow E
	746	shale

Size of Drilled Hole	Size & Weight of Casing	PERFORATIONS		
		From (feet)	To (feet)	Kind Size
3"	2" std.	0	740	3" slots

23' of 6 1/2" surface pipe

Static Water Level for non-flowing well _____ feet.
 Shut-in Pressure for Flowing Well _____

Pumping Water Level _____ feet at _____ gal. per minute
 Discharge in gal. per min. of flowing well 5

How Tested _____ Length of Test _____

Remarks: (Gravel packing, cementing, packers, type of shutoff, location of use if not at well, other similar pertinent information, including number of acres irrigated, if any)
set at 400'

20
 Driller's License Number
Earl Drane
 Driller's Signature

S.W. 1/4 Sec. 35 T. 5 R. 50

STATE OF MONTANA }
 County of Powder River } SS.

Joe J. McDowell having first been duly sworn, depose^s and say^s that he is of lawful age and is the appropriator and claimant of the order and water right mentioned in the foregoing notice of completion of groundwater appropriation by means of well and the person whose name is subscribed thereto, as the appropriator and claimant, that he knows the contents of said foregoing notice and that the matters and things therein stated are true.

Joe J. McDowell

Subscribed and sworn to before me, this 15th day of November, 1963

Ducille Sobary, Deputy
 Clerk and Recorder
 Powder River County
 Broadus, Montana

11765

75260, Filed,
12-30-63, 19 63
at 11:00 AM.
L. J. ORNSTEIN, deputy
Clerk and Recorder
\$2.00 fee paid

STATE OF MONTANA
ADMINISTRATOR OF GROUNDWATER CODE
OFFICE OF STATE ENGINEER

Twp 6 S, Rge 2 E
RECEIVED
MAR 9 1964

DECLARATION OF VESTED GROUNDWATER RIGHTS
(Under Chapter 237, Montana Session Laws, 1961)

1. William J. Stuver, of Broadus, Montana, County of POWDER RIVER, STATE OF MONTANA, have appropriated groundwater according to the Montana Laws in effect prior to January 1, 1962, as follows:

	6S-52E	5S-50E	6S-52E	5S-51E	5S-51E	5S-51E
	+	+	+	+	+	+
	Sec. 8	Sec. 35	Sec. 9	Sec. 31	Sec. 30	Sec. 30
WELLS	No. 1	No. 2	No. 3	No. 4	No. 5	No. 6
2. Beneficial Use	Stock	Stock	Stock	Stock	Domestic	Stock Domestic
3. DATE DRILLED	1948	1936	1943	1946	1943	1943
4. How continuously used	summer	winter	summer	winter	constant	constant
5. Amount claimed (gal. per minute)	4 gpm	8 gpm	4 gpm	8 gpm	4 gpm	8 gpm
6. Irrigated description						
7. Irrigation owner						
8. Irrigated acreage						
9. Location (40 acres)	NENE	NENE	E/4E/4	SWSW	NWNW	NWNW
10. Withdrawal means	pump	artesian	pump	artesian	artesian	artesian
11. Completion date	1948	1936	1943	1946	1943	1943
12. Water depth table	120'	-0-	40'	-0-	-0-	-0-
13. Type (drilled or dug)	drilled	drilled	drilled	drilled	drilled	drilled
14. Size & Depth	2 1/2" x 200'	2" x 300'	2" x 620'	2" x 125'	2" x 125'	2" x 500'
15. Estimated annual amount withdrawn						
16. Other information						
17. Log, if available			NO LOGS			

STATE OF MONTANA)
) ss.
County of Powder River)

Signature of Owner: William J. Stuver

Date 10/30/63

William J. Stuver having first been duly sworn, deposes and says that he is of lawful age and is the appropriator and claimant of the order and water right mentioned in the foregoing Declaration of Vested Groundwater Rights and the person whose name is subscribed thereto, as the appropriator and claimant, that he knows the contents of said foregoing notice and that the matters and things therein stated are true.
Subscribed and sworn to before me this
30th. day of December, 1963

L. J. ORNSTEIN
Clerk & Recorder, Powder
River County, Broadus, Montana

William J. Stuver

(35374)

County POWDER RIVER Twp. 5 SOUTH Rge. 51 EAST

Sec.	Name of Appropriator	Type of Form	County File No.	Remarks
2	RUSSELL, CHARLES L.		75103	
2	POWDER RIVER COUNTY		78527	
2	MONTANA HIGHWAY COMM.		76414	
3	RUSSELL, CHARLES L.		75103	SEE SEC. 2
3	BOGNER, RICHARD		75043	} SAME FORM
3	" "		75043	
3	STEWART, ADELINE		76960	
3	DRANE, EARL		73694	
3	DRANE, EARL		73694-2	
3	WOOLSTON, LARRY		90657	
3	CAMPER, W.R. & MARY		72446	
3	STABIO, KATHERINE		75292	
3	NASH, GUY		74397	} SAME FORM
3	" "		74397	
4	RUSSELL, LOUIS		75102	
4	GALT, FRED J.		75207	} SAME FORM
4	" " "		75207	
4	RANDALL INC.		75169-3	
5	ALLEN EDWARD W. OVERAM.		74949	
8	RANDALL INC.		75169-6	} SAME FORM
8	" "		75169-6	
8	" "		75169-6	
8	RANDALL INC.	GW-2	92718	
9	RUSSELL, LOUIS		75102	SEE SEC. 4
9	SCHAFFER, CARL & CONZETTA		75266-4	
9	SCHAFFER, CARL		74288	
9	RUSSELL, GLEN W.		75137-2	} SAME FORM
9	" " "		75137-2	
10	RUSSELL, LOUIS		75102	} SEE SEC. 4
10	" "		75102	
11	RUSSELL, CHARLES L.		75103	SEE SEC. 2
13	DRANE, EARL		73694	} SEE SEC. 3
13	" "		73694	
15	RUSSELL, LOUIS		75102	SEE SEC. 4
16	SCHAFFER, CARL & CONZETTA		75266-4	SEE SEC. 9
17	RANDALL INC.		75169-6	SEE SEC. 8
17	RANDALL INC.		75169-5	
17	RANDALL INC.	GW-2	92719	
18	RANDALL INC.		75169-2	
19	RANDALL, INC.		75169-6	SEE SEC. 8
19	RANDALL, INC.		75169-5	SEE SEC. 17
19	RANDALL, INC.	GW-2	82825	
19	RANDALL, INC.	GW-2	82826	
19	RANDALL INC.	GW-2	82827	
19	RANDALL INC.	GW-2	82828	

GROUNDWATER INDEX

County POWDER RIVER Twp. 5 SOUTH Rge. 51 EAST

Sec.	Name of Appropriator	Type of Form	County File No.	Remarks
19	RANDALL INC.	GW-2	82229	
20	RANDALL INC.		75169-5	SEE SEC. 17
21	RANDALL INC.		75169-2	SEE SEC. 12
23	DRANE, EARL		72694	SEE SEC. 3
24	PHILLIPPI, ELLEN A.		75070	
25	RANDALL INC.		75169-5	SEE SEC. 17
25	PHILLIPPI, ELLEN A.		75070	SEE SEC. 24
25	" "		75070	
25	PHILLIPPI, ELLEN		89692	
27	ROBINSON, FRANK P. & VIRGINIA L.		75791	
27	RUSSELL, CHARLES L.		74669	
29	WETHERELT, ALVIN		75119	
30	RANDALL INC.		75169-5	SEE SEC. 17
30	STIVER, WILLIAM J.		75260	SAME FORM
30	" "		75260	
31	" "		75260	
31	RANDALL INC.	GW-2	92714	
31	RANDALL INC.	GW-2	92713	
31	RANDALL INC.		75169-4	
33	RUSSELL, CHARLES L.		75103	SEE SEC. 2
33	WETHERELT, ALVIN		75119	SEE SEC. 29
33	" "		75119	
33	" "		75119	
33	RUSSELL, CHARLES L.		75103-2	
34	CAMPER, W. R. & MARY		72446	SEE SEC. 3
34	RUSSELL, CHARLES L.	GW-2	75885	
34	STEWART, ADELINE	in Broadus	76960	
34	BOGNER, RICHARD	US 51E	75043	SAME FORM
34	" "		75043	
36	PHILLIPPE, ELLEN A.		75070	SEE SEC. 24

75103 Filed,
12/18, 1963,
at 2:10 P. M.

STATE OF MONTANA
ADMINISTRATOR OF GROUNDWATER CODE
OFFICE OF STATE ENGINEER

Twp 5 S, Rge 5 E

Indie Godsey, deputy DECLARATION OF VESTED GROUNDWATER RIGHTS
Clerk and Recorder (Under Chapter 237, Montana Session Laws, 1961)

DEC 23 1963

1. Charles L. Russell, of Broadus, Montana,
County of POWDER RIVER, State of MONTANA, have appropriated groundwater according to
the Montana Laws in effect prior to January 1, 1962, as follows:

	58-52E	58-52E	58-51E	58-51E	58-51E	58-51E
	Sec. 8	Sec. 17	Sec. 21	Sec. 3	Sec. 8	Sec. 33
WELLS	No. 1	No. 2	No. 3	No. 4	No. 5	No. 6
2. Basis of Beneficial Use	Stock	Stock	Stock	Stock	Stock	Stock
3. DATE OF USE	1951	1933	1953	1951	1958	spring
How continuous	6 months	6 months	6 months	constant	6 months	constant
4. Amount claimed (gal. per minute)	8 gpm	6 1/2 gpm	8 gpm	8 gpm	15 gpm	8 gpm
Irrigated description						
Irrigation owner						
5. Irrigated acreage						
6. Location	SENE	SWNE	SWNE	SENE	Lot 4	SENE
Withdrawal means	artesian	artesian	windmill	artesian	artesian	flow
7. Completion date	8-3-1951	1933	1953	1951	8-18-58	-0-
8. Water depth table	-0-	-0-	11'	-0-	-0-	-0-
Type (drilled or dug)	Drilled	Drilled	Drilled	Drilled	Drilled	-0-
9. Size & depth	2" x 1087'	2" x 671'	4" x 801'	2" x 6h0'	2" x 5h0'	-0-
10. Estimated annual amount withdrawn						
11. Other information				Fall off when city well was drilled		
12. Log, if available	Delaw	None	None	None	None	None
Well Number 1						
1 - 30 sand/gravel	199 - 200	rock	465 - 598	shale	990 - 1015	sand
30 - 102 shale	200 - 202	coal	598 - 599	sand streak	1015 - 1017	rock
102 - 103 rock	202 - 237	shale	599 - 603	rock	1017 - 1030	sand
103 - 123 shale	237 - 238	rock	603 - 664	shale	1030 - 1045	shale here
123 - 124 coal	238 - 321	shale	664 - 755	sand/shale	1045 - 1068	sand/shale
124 - 144 shale	321 - 322	rock	755 - 765	shale	1068 - 1087	shale
144 - 148 rock	322 - 330	shale	765 - 766	rock		
148 - 180 shale	330 - 348	sand	766 - 769	sand/shale		
180 - 181 rock	348 - 400	shale	769 - 970	shale		
181 - 199 shale	400 - 465	sand	970 - 990	shale		

STATE OF MONTANA)
County of Powder River)

Signature of Owner - Charles L. Russell

Date 12/18/63

Charles L. Russell having first been duly sworn, deposes and says that he is of lawful age and is the appropriator and claimant of the order and water right mentioned in the foregoing Declaration of Vested Groundwater Rights and the person whose name is subscribed thereto, as the appropriator and claimant, that he knows the contents of said foregoing notice and that the matters and things therein stated are true.

Subscribed and sworn to before me this 18th day of December, 1963.

Charles L. Russell
Indie Godsey, deputy

CHAS. L. RUSSELL
INDIE GODSEY, DEPUTY
COUNTY CLERK
POWDER RIVER

File No. 78527
 Filed: 21 1966
 at 9:45 A. M.

STATE OF MONTANA
 ADMINISTRATOR OF GROUNDWATER CODE
 OFFICE OF STATE ENGINEER WATER CONSERVATION BOARD

T 5 R 51

Charlotte Edwards
 Clerk and Recorder
 Powder River County
 By Myrtle M. Robinson
 Deputy

DEC 5 1965

NOTICE OF COMPLETION OF GROUNDWATER
 APPROPRIATION BY MEANS OF WELL
 (Under Chapter 237, Montana Session Laws, 1961)

OWNER Powder River County Address Broadus, Montana

DRILLER Frank Sandy Jr. Address Broadus, Montana

Date of Notice of Appropriation of Groundwater _____

Date well started April 22, 1966 Completed _____

Type of well drilled Equipment used rotary
 (dug, driven, bored, drilled) (churn, drill, rotary, other)

Water Use: Domestic Municipal Stock Other
 Industrial Drainage Irrigation

Indicate on diagram character and thickness of different strata met in drilling - soil, clay, shale, gravel, rock, sand. Show depth at which water is found, thickness and character of water-bearing strata and height to which water rises in well.

Size of Drilled Hole	Size & Weight of Casing	From To		PERFORATIONS		
		(feet)	(feet)	Kind Size	From (feet)	To (feet)
6"	4"	0	180			

Static Water Level for non-flowing well 150 feet.

Shut-in Pressure for Flowing Well _____

Pumping Water Level _____ feet at _____ gal. per minute

Discharge in gal. per min. of flowing well _____

How Tested pressure Length of Test 1 hour

Remarks: (Gravel packing, cementing, packers, type of shutoff, location of use if not at well, other similar pertinent information, including number of acres irrigated, if any)

Top of Ground (Elev. above sea level) _____
4-8 Surface soil
8-57 sand & gravel
57-78 blue shale
78-107 sand stone
107-157 blue shale
157-169 sand
169-180 blue shale

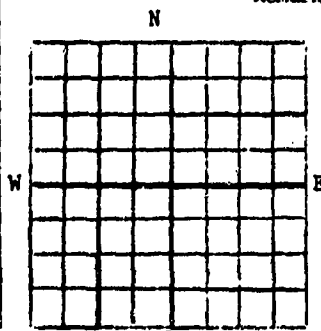

STATE OF MONTANA
 County of Powder River) SS.

Charlotte Edwards, Clerk & Recorder having first been duly sworn, depose and say that she is of lawful age and the appropriator and claimant of the order and water right mentioned in the foregoing notice of completion of groundwater appropriation by means of well and the person whose name subscribed thereto, as the appropriator and claimant, that she knows the contents of said foregoing notice and that the matters and things therein stated are true.

By Charlotte Edwards
 Clerk & Recorder

Subscribed and sworn to before me, this 5th day of July, 1966

41,400.
 41,400

Charlotte Edwards
 Clerk & Recorder

File No. 7634
Filed 12-21-64 at 9:15 A.M.
TRIPPLICATE \$No fee required
Lucille Godsey, deputy
Clerk & Recorder LOG
Powder River County
Top of Ground

T. 5 S. R. 51 E. 2

County Powder River

STATE OF MONTANA
ADMINISTRATOR OF GROUNDWATER CODE
OFFICE OF STATE ENGINEER

RECEIVED
JAN 26 1965

Notice of Completion of Groundwater Appropriation by Means of Well
DEVELOPED AFTER JANUARY 1, 1962

(Under Chapter 237, Montana Session Laws, 1961)

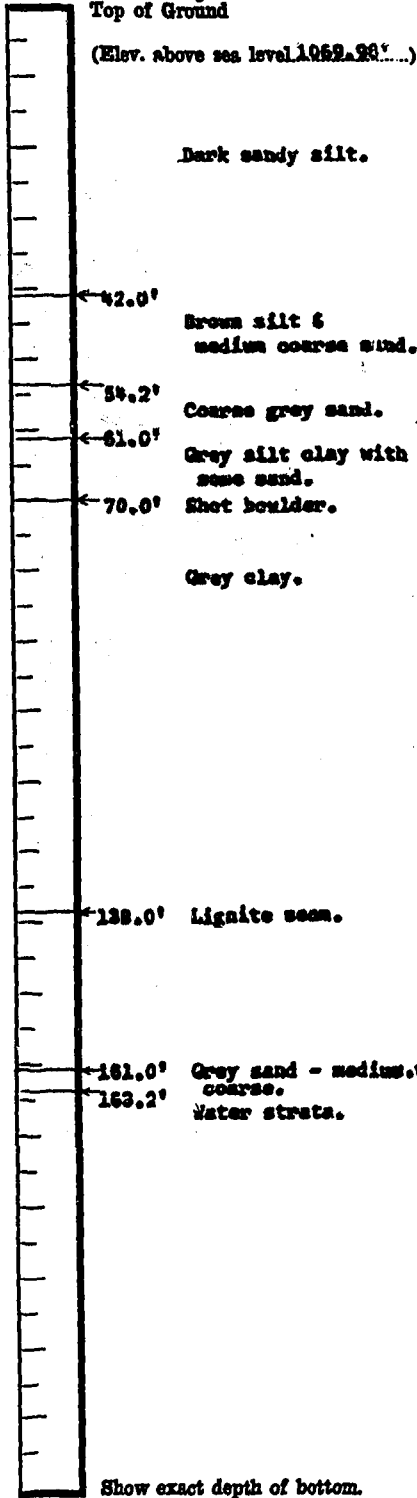

Owner Montana Highway Com. Address Helena, Montana
Driller Montana Highway Com. Address Helena, Montana
Date of Notice of appropriation of groundwater December 14, 1964
Date well started Nov. 23, 1964 Date completed Dec. 9, 1964

Type of well Drilled Equipment used Churn drill
(Dug, Driven, bored or drilled) (Churn drill, rotary or other)
Water use: Domestic Municipal Stock Irrigation
Industrial Drainage Other
Courtesy & Weight Station

Indicate on the diagram the character and thickness of the different strata met with in drilling, such as soil, clay, shale, gravel, rock or sand, etc. Show depth at which water is encountered, thickness and character of water-bearing strata and height to which the water rises in the well.

Size of Drilled Hole	Size and Weight of Casing	From (Feet)	To (Feet)	PERFORATIONS		
				Kind Size	From (Feet)	To (Feet)
6" ID	5" steel 19.88 lbs. per foot.	0.0'	163.2'	None		

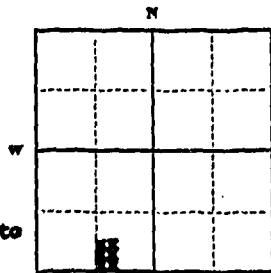

Static Water Level for non-flowing well 82.2 feet.
Shut-in Pressure for Flowing Well None
Pumping Water Level 70.9 feet
at 20 gal. per minute.
Discharge in gal. per min. of flowing well None
How Tested Flow Test
Length of Test 8 hours

Remarks: (Gravel packing, cementing, packers, type of shutoff) None
SW 1/4 SE 1/4
SW 1/4 Sec. 2 T5 S. R. 51 E.
Indicate location of well and place of use, if possible. Each small square represents 40 acres.
WATER ANALYSIS:
pH 7.5
Hardness 7.5
Phenolphthalein Alkalinity None
Methyl Orange 350 P.P.M.
Total Hardness 735 P.P.M.
(Continue on reverse side)

USE—If used for irrigation, industrial, drainage or other. Explain, state number of acres and location or other data (i.e.: Lot, Block and Addition).

Show exact depth of bottom.

This form to be prepared by driller, and three copies to be filed by the owner with the County Clerk and Recorder in the county in which this well is located, tissue copy to be retained by driller.

Please answer all questions. If not applicable, so state, otherwise the form will be returned.

None required

Driller's License Number

Driller's Signature [Signature] Helena, Mont.

38907

75013 Filed,
12-13, 1963,
 at 9:10 A. M.
 \$2.00 fee paid

STATE OF MONTANA
 ADMINISTRATOR OF GROUNDWATER CODE
 OFFICE OF STATE ENGINEER

Twp 4 S, Rge 12 E

RECEIVED
 DEC 23 1963

Isabelle Godwin, County Clerk and Recorder DECLARATION OF VESTED GROUNDWATER RIGHTS
 (Under Chapter 237, Montana Session Laws, 1961)

STATE ENGINEER

1. Richard Cooper, of Brookus, Montana,
 County of POWDER RIVER, State of MONTANA, have appropriated groundwater according to
 the Montana Laws in effect prior to January 1, 1962, as follows:

Noils Subdivision

WELLS	SECS					
	No. 1	No. 2	No. 3	No. 4	No. 5	No. 6
2. Basis of Beneficial Use	Domestic	Domestic				
3. DATE OF USE	1940	1959				
How continuous	constant	5 months				
4. Amount claimed (gal. per minute)	0 gpm	10 gpm				
Irrigated description						
Irrigation owner						
5. Irrigated acreage						
6. Location	Block 3 Lot 8	Block 3 Lot 8				
Withdrawal means	pump	pump				
7. Completion date	1940	1959				
8. Water depth table	36'	12'				
Type (drilled or dug)	Drilled	Drilled				
9. Size & depth	4" x 375'	4" x 22'				
10. Estimated annual Amount withdrawn						
11. Other information						
12. Log, if available						

STATE OF MONTANA)
) ss.
 County of Powder River)

Signature of Owner Richard Cooper

Date 12/13/63

Richard Cooper having first been duly sworn, deposes and says that he is of lawful age and is the appropriator and claimant of the order and water right mentioned in the foregoing Declaration of Vested Groundwater Rights and the person whose name is subscribed thereto, as the appropriator and claimant, that he knows the contents of said foregoing notice and that the matters and things therein stated are true.

Subscribed and sworn to before me this 13th day of December, 1963.

Richard Cooper

1180

File No. 76960
 Filed: April 19 1965
 Clerk and Recorder, Charlotte Edwards
 Powder River County

STATE OF MONTANA
 ADMINISTRATOR OF GROUNDWATER CODE
 OFFICE OF STATE ENGINEER

T1s R 2E
 Precinct

RECEIVED
 MAY 20 1965

NOTICE OF COMPLETION OF GROUNDWATER
 APPROPRIATION BY MEANS OF WELL
 (Under Chapter 237, Montana Session Laws, 1961)

STATE ENGINEER

Top of Ground
 (Elev. above sea
 level _____)

0-10 sandy
 10-54 gravel
 54-130 shale
 130-140 sand
 140-155 shale
 155-160 coal
 160-180 sand
 180-210 shale & coal
 210-212 rock
 212-240 sand & coal
 240-330 shale, sand & coal
 330-440 sand with shale streaks
 440-500 sand flow

OWNER Adeline Stewart Address Broadus, Montana
 DRILLER Earl Drane Address Broadus, Montana
 Date of Notice of Appropriation of Groundwater _____
 Date well started 3-11-64 Completed 3-16-64
 Type of well drilled Equipment used churn, drill, rotary, other
 (dug, driven, bored, drilled) (churn, drill, rotary, other)
 Water Use: Domestic Municipal Stock Other
 Industrial Drainage Irrigation

Indicate on diagram character and thickness of different strata met in drilling -ei, soil, clay, shale, gravel, rock, sand. Show depth at which water is found, thickness and character of water-bearing strata and height to which water rises in well.

Size of Drilled Hole	Size & Weight of Casing		From (feet)	To (feet)	PERFORATIONS		
					Kind Size	From (feet)	To (feet)
4"	9#		0	54			
3 1/2"	2"	std.	0	487	slots	424	484

Static Water Level for non-flowing well _____ feet.
 Shut-in Pressure for Flowing Well _____
 Pumping Water Level _____ feet at _____ gal. per minute
 Discharge in gal. per min. of flowing well _____
 How Tested _____ Length of Test _____

Remarks: (Gravel packing, cementing, packers, type of shutoff, location of use if not at well, other similar pertinent information, including number of acres irrigated, if any)

packer at 400 ft.

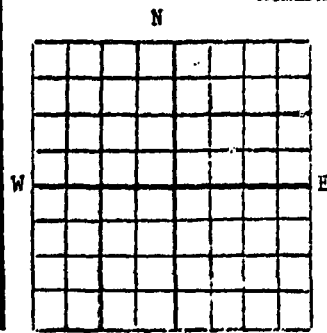

Lot 7, Block 2
 Chienn Subdivision
 Broadus
 Driller's License Number 20
 Driller's Signature Earl Drane

1/4 Sec. T55 R31E (where Lot 7, Blk. 2 is located - Chienn Subdivision - 2)

STATE OF MONTANA
 County of Powder River) SS.

Adeline Stewart having first been duly sworn, depose and say that she of lawful age and is the appropriator and claimant of the order and water right mentioned in the foregoing notice of completion of groundwater appropriation by means of well and the person whose name is subscribed thereto, as the appropriator and claimant, that she knows the contents of said foregoing notice and that the matters and things therein stated are true.

Adeline Stewart

Subscribed and sworn to before me, this 14th day of April, 1965

Charlotte Edwards Clerk and Recorder
 20145

File No. 7360,
 Filed December 11, 1962
 at 9:40 A. M. 32.00 fee pd.
 Lucille Godsey, deputy
 Clerk and Recorder

STATE OF MONTANA
 ADMINISTRATOR OF GROUNDWATER CODE
 OFFICE OF STATE ENGINEER
 DECLARATION OF VESTED GROUNDWATER RIGHTS
 (Under Chapter 237, Montana Session Laws, 1961)

Twp. 1 S, Rge. 42 E

RECEIVED
 MAR 9 1963

1. Carl Oms, of Broadus STATE ENGINEER
 County of POWDER RIVER, State of MONTANA, have appropriated groundwater according to the
 Montana laws in effect prior to January 1, 1962, as follows:

W E L L S						
	Sec. 13	Sec. 23	Sec. 33	Sec. 33	Sec. 33	Lot 1, 2 Blk. 3
	No. 1	No. 2	No. 3	No. 4	No. 5	No. 6
2. Basis of Beneficial Use			stock	stock	stock	domestic
3. Date of use			1940	1940	1945	1958
How continuous			continuous	continuous	continuous	continuous
4. Amount claimed			10 mo	6 mo	8 mo	12 mo
Irrigated description						
Irrigation owner						
5. Irrigated acreage						
6. Location			S23W	S23W	S23W	NENE
Withdrawal means			windmill	windmill	windmill	pump
7. Completion date			1940	1940	1945	1958
8. Water depth table			100'	30'	100'	580'
Type			drilled	drilled	drilled	drilled
9. Size & depth			6" x 200'	4" x 500'	4" x 210'	2" x 580'
Estimated annual amount withdrawn						
10. Other information						
11. Log, if available						

STATE OF MONTANA)
 County of Powder River) ss. Signature of Owner _____

Date _____
 having first been duly sworn, deposes and says that he is of lawful age and is the appropriator and claimant of the order and water right mentioned in the foregoing declaration of vested groundwater rights and the person whose name is subscribed thereto, as the appropriator and claimant, that he knows the contents of said foregoing notice and that the matters and things therein stated are true.
 Subscribed and sworn to before me this _____ day of _____, 19__.

Clerk and Recorder
 Powder River County
 Broadus, Montana

185208

File No. 73694 (2)

STATE OF MONTANA
ADMINISTRATOR OF GROUND WATER CODE
OFFICE OF STATE ENGINEER

Typ S, P.

DECLARATION OF VESTED GROUNDWATER RIGHTS
(Under Chapter 237, Montana Session Laws, 1951) MAR 9 1960

1. Earl Drans, of Broadus STATE ENGINEER
County of POWDER RIVER, State of MONTANA, have appropriated groundwater according to the
Montana laws in effect prior to January 1, 1962, as follows:

Well Sub-Division

WELLS	Well Sub-Division					
	Lot 1, 2 Blk 3					
	Sec.	Sec.	Sec.	Sec.	Sec.	Sec.
	No. 1	No. 2	No. 3	No. 4	No. 5	No. 6
2. Beneficial Use	domestic					
3. Date of use	1960					
How continuous	constant					
4. Amount claimed	15					
Irrigated description						
5. Irrigation owner						
Irrigated acreage						
6. Location						
Withdrawal means	pump					
7. Completion date	1960					
8. Water depth table	155'					
Type	grilled					
9. Size & depth	4" x 175'					
10. Estimated annual amount withdrawn						
11. Other information						
12. Log, if available						

STATE OF MONTANA)
County of Powder River) ss.

Signature of Owner _____

Date _____

having first been duly sworn, deposes and says that he is of lawful age and is the appropriator and claimant of the order and water right mentioned in the foregoing declaration of vested groundwater rights and the person whose name is subscribed thereto, as the appropriator and claimant, that he knows the contents of said foregoing notice and that the matters and things therein stated are true.
Subscribed and sworn to before me this

_____ day of _____, 19__.

35208

Clerk and Recorder
Powder River County
Broadus, Montana

72446
 File No. 72446
 Filed March 29, 1962
 at 7:20 P.M.
 \$2.00 fee paid

STATE OF MONTANA
 ADMINISTRATOR OF GROUNDWATER CODE
 OFFICE OF STATE ENGINEER

Twp 1 S, Rge 51 E
 RECEIVED
 APR 2 1962

DECLARATION OF VESTED GROUNDWATER RIGHTS
 (Under Chapter 237, Montana Session Laws, 1961)

1. W. R. & Mary Camper, of Broadus, STATE ENGINEER
 County of POWDER RIVER, State of MONTANA, have appropriated groundwater according to the
 Montana laws in effect prior to January 1, 1962, as follows:

WELLS	SECTIONS					
	Sec. 34	Sec. 35	Sec. 36	Sec. 37	Sec. 38	Sec. 39
	No. 1	No. 2	No. 3	No. 4	No. 5	No. 6
2. Basis of Beneficial Use	Domestic	Domestic				
3. Date of use	Sept. 1948	April 1961				
4. Amount claimed						
5. Irrigated description						
6. Location		NE NW				
7. Withdrawal means	Pump	Pump				
8. Completion date	Sept. '48	April '61				
9. Water depth table	Flow	Flow				
10. Type	Drilled	Drilled				
11. Size & depth	690'	500'				
12. Estimated annual Amount withdrawn						
13. Other information						
14. Log, if available		0 - 10 Sandy 10 - 41 Sand & gravel 41 - 132 Shale 132 - 134 Rock 134 - 195 Blue shale/coal streaks 195 - 198 Sand 198 - 212 Blue shale/Coal streaks 212 - 242 Blue shale 242 - 252 Shale 252 - 256 Rock 256 - 259 Shale 259 - 260 Rock 260 - 310 Shale 310 - 321 Sand 321 - 323 Rock 323 - 253 Sand 253 - 355 Shale				

STATE OF MONTANA)
 County of Powder River) ss.

Signature of Owner W.R. Camper
 Date March 11, 1962

W. R. and Mary Camper having first been duly sworn, deposes and says that he is of lawful age and is the appropriator and claimant of the order and water right mentioned in the foregoing declaration of vested groundwater rights and the person whose name is subscribed thereto, as the appropriator and claimant, that he knows the contents of said foregoing notice and that the matters and things therein stated are true.

Subscribed and sworn to before me this
29th day of March, 1962.
C. J. ...
 Clerk and Recorder
 Powder River County
 Broadus, Montana

W.R. Camper
March 11, 1962

75292, Filed,
 at 12/31, 1963
 10:15 A.M.

STATE OF MONTANA
 ADMINISTRATOR OF GROUNDWATER CODE
 OFFICE OF STATE ENGINEER

Twp 5 S, Rge 3 E 3

Incl. 10.00 fee paid
 Clerk and Recorder
 \$2.00 fee paid

DECLARATION OF VESTED GROUNDWATER RIGHTS
 (Under Chapter 237, Montana Session Laws, 1961)

RECEIVED
 MAR 9 1964

1. Katherine Stabio, of Broadus, Montana,
 County of POWDER RIVER, STATE OF MONTANA, have appropriated groundwater according to
 the Montana Laws in effect prior to January 1, 1962, as follows: STATE ENGINEER

	Sec. 3	Sec.	Sec.	Sec.	Sec.	Sec.
WELLS	No. 1	No. 2	No. 3	No. 4	No. 5	No. 6
2. Beneficial Use	Garden Stock					
3. How continuously used	constant					
4. Amount Claimed (gal. per minute)	10 gpm					
Irrigated description						
5. Irrigation owner						
6. Location (40 acres)	NESW					
6. Withdrawal means	flow & pump					
7. Completion date	1938					
8. Water depth table	0'					
Type (drilled or dug)	drilled					
9. Size & Depth	2" x 465'					
10. Estimated annual amount withdrawn						
11. Other information						
12. Log, if available	No Log.					

STATE OF MONTANA)
) ss.
 County of Powder River)

Signature of Owner: Katherine Stabio

Date 12/31/63

Katherine Stabio having first been duly sworn, deposes and says that he is of
 lawful age and is the appropriator and claimant of the order and water right mentioned in
 the foregoing Declaration of Vested Groundwater Rights and the person whose name is sub-
 scribed thereto, as the appropriator and claimant, that he knows the contents of said
 foregoing notice and that the matters and things therein stated are true.
 Subscribed and sworn to before me this

31st day of December 19 63
Billie Soderly, deputy
 Clerk & Recorder, Powder
 River County, Broadus, Montana

Katherine Stabio

35398

File No. 71397
 filed 7-1-63 at 9:03 A.M.
 \$2.00 fee pd.
 Lucille Collier, deputy
 Clerk and Recorder

STATE OF MONTANA
 ADMINISTRATOR OF GROUND WATER CODE
 OFFICE OF STATE ENGINEER

5 S, Rge 21
RECEIVED
 JUL 22 1963
STATE ENGINEER

DECLARATION OF VESTED GROUNDWATER RIGHTS
 (Under Chapter 237, Montana Session Laws, 1961)

1. Guy Wash, of Broadus, Montana
 County of POWDER RIVER, State of MONTANA, have appropriated groundwater according to the
 Montana laws in effect prior to January 1, 1962, as follows:

	5-51	5-51	5-50	5-50	5-50	
	✓ x	✓ x				
	x	✓				
	Sec. 3	Sec. 3	Sec. 21	Sec. 21	Sec. 21	Sec.
WELLS	No. 1	No. 2	No. 3	No. 4	No. 5	No. 6
2. Basis of Beneficial Use	domestic	stock	stock	stock	stock	
3. Date of use	1945	1948	1940	1940	1940	
How continuous	constant	constant	constant	constant	constant	
4. Amount claimed	4 gpm	5 gpm	4 gpm	4 gpm	4 gpm	
Irrigated description						
5. Irrigation owner						
Irrigated acreage						
6. Location	SWNE	SWNE	SWSE	WSE	NESE	
Withdrawal means	flow	pump	spring	spring	spring	
7. Completion date	1945	1948	spring	spring	spring	
8. Water depth table	flow	17'	spring	spring	spring	
Type	drilled	drilled	spring	spring	spring	
9. Size & depth	6" x 140'	6" x 28'				
10. Estimated annual amount withdrawn						
11. Other information						
12. Log, if available	#1. 1-9 sandy top soil 9-13 sand 18-58 sand & gravel 58-70 blue clay 70-74 coal 74-115 blue clay 115-119 coal 119-133 brown clay 133-138 hard sand rock 138-140 clay 140-141 coal 141-146 clay 146-148 coal 148-160 shale 160-163 coal		163-166 shale 167-168 coal 168-210 shale 210-221 sand 221-222 rock 222-230 sand 230-233 coal 233-240 shale 240-250 sand & coal 250-277 shale 277-288 sand 288-295 shale 295-332 sand 332-370 shale 370-382 sand 382-386 rock		336-420 sand 420-426 shale	

STATE OF MONTANA)
 County of Powder River) ss.

Signature of Owner Guy Wash

Date 7-2-63

Guy Wash having first been duly sworn, deposes and says that he is of lawful age and is the appropriator and claimant of the order and water right mentioned in the foregoing declaration of vested groundwater rights and the person whose name is subscribed thereto, as the appropriator and claimant, that he knows the contents of said foregoing notice and that the matters and things therein stated are true.

Subscribed and sworn to before me this
3th day of July, 1963.
Lucille Collier deputy
 Clerk and Recorder
 Powder River County
 Broadus, Montana

75102 Filed,
12-18, 1963,
at 2:05 P. M.
\$2.00 fee paid

STATE OF MONTANA
ADMINISTRATOR OF GROUNDWATER CODE
OFFICE OF STATE ENGINEER

Twp 5 S, Rge 2 E

RECEIVED
MAR 9 1964

Lucille Goddy, (deputy
Clerk and Recorder, (Under Chapter 237, Montana Session Laws, 1961).

STATE ENGINEER

1. Louis Russell, of Brodus, Montana,
County of POWDER RIVER, State of MONTANA, have appropriated groundwater according to
the Montana Laws in effect prior to January 1, 1962, as follows:

WELLS	Sec. 10	Sec. 10	Sec. 9	Sec. 25	Sec. 25	Sec. 25
	No. 1	No. 2	No. 3	No. 4	No. 5	No. 6
2. Beneficial Use	Domestic	Stock	Stock	Stock	Stock	Stock
3. DATE OF USE	1947	1957	1953	Spring	1948	
How continuous	constant	6 months	6 months	constant	not used	
4. Amount claimed (gal. per minute)	3 gpm	15 gpm	3 gpm	20 gpm	3 gpm	
Irrigated description						
Irrigation owner						
5. Irrigated acreage						
6. Location	SENE	SENE	SENE	SENE	SENE	
Withdrawal means	pump	artesian	artesian	-0-	flow	
7. Completion date	4-30-47	10-17-57	12-21-53	-0-	7-1-48	
8. Water depth table	Not known			-0-	-0-	
Type (drilled or dug)	Drilled	Drilled	Drilled	spring	drilled	
9. Size & depth	2" x 1010'	2" x 960'	2" x 425'	-0-	2" x 427'	
10. Estimated annual Amount withdrawn					475 deep	
11. Other information						
12. Log, if available	(On reverse side)					

STATE OF MONTANA)
SE.
County of Powder River)

Signature of Owner Louis Russell

Date 12/18/63

Louis Russell having first been duly sworn, deposes and says that he is of lawful age and is the appropriator and claimant of the order and water right mentioned in the foregoing Declaration of Vested Groundwater Rights and the person whose name is subscribed thereto, as the appropriator and claimant, that he knows the contents of said foregoing notice and that the matters and things therein stated are true.

Subscribed and sworn to before me this 18th, day of December, 1963.
Louis Russell
Lucille Goddy, Secretary

Well Number 1 A. L. Drains 4/10/47
 Frank Sandy (cleaned) 7/16/58

1 - 12 Sandy top soil
 12 - 30 Sand and gravel
 30 - 52 Blue shale
 52 - 53 Rock
 53 - 70 Blue shale
 70 - 80 Water sand
 80 - 277 Blue shale
 277 - 278 rock
 278 - 355 Blue shale
 355 - 375 Water sand
 375 - 390 Blue shale
 390 - 437 water sand
 437 - 438 Rock
 438 - 485 Water sand
 485 - 515 blue shale
 515 - 525 Water sand
 525 - 760 Blue shale
 760 - 780 Water sand
 780 - 800 Blue shale
 800 - 810 Water sand
 810 - 811 blue shale
 811 - 820 water sand
 820 - 835 blue shale
 835 - 862 water sand
 862 - 863 rock
 863 - 961 water sand
 961 - 966 rock
 966 - 990 water sand
 990 - 1000 shale
 water

WELL NUMBER 2

Sandy Drilling Co. 10-17-47
 Brocade, Montana

0 - 8 surface soil
 8 - 18 gravel
 18 - 48 blue shale
 48 - 53 water sand
 53 - 182 blue shale
 182 - 208 water sand
 208 - 241 blue shale
 241 - 247 water sand
 247 - 304 blue shale
 304 - 309 water sand
 309 - 375 blue shale
 375 - 425 water sand
 425 - 516 blue shale
 516 - 625 water sand
 625 - 645 blue shale
 645 - 665 water sand
 665 - 725 blue shale
 725 - 836 grey shale
 836 - 950 water sand
 950 - 960 blue shale
 Water

WELL NUMBER 3

Earl Drains 12/24/53

Brocade, Montana

0 - 41 sand & gravel
 41 - 45 rock
 45 - 90 shale
 90 - 95 rock
 95 - 105 shale
 105 - 107 rock
 107 - 175 shale
 175 - 178 rock
 178 - 210 shale
 210 - 212 rock
 212 - 245 shale
 245 - 246 rock
 246 - 250 coal
 250 - 260 shale
 260 - 263 rock
 263 - 290 shale
 290 - 300 coal
 300 - 310 shale
 310 - 322 sand
 322 - 325 rock
 325 - 342 sand
 342 - 370 shale
 370 - 380 sand
 380 - 395 shale
 395 - 405 shale
 405 - 420 sand
 420 - 425 shale
 Water

WELL NUMBER 5

A. L. Drains, driller

1 - 15 sandy top soil
 15 - 45 gravel
 45 - 128 blue shale
 128 - 137 water sand
 137 - 138 rock
 138 - 158 sand
 158 - 198 sand
 198 - 199 rock
 199 - 279 blue shale
 279 - 288 water sand
 288 - 289 rock
 289 - 300 water sand
 300 - 320 blue shale
 320 - 340 water sand
 340 - 357 blue shale
 357 - 370 water sand
 370 - 375 sand rock
 375 - 460 water sand - flow
 460 - 475 shale and sand
 Water

75207 Filed
 12-27-63
 at 2:20 P.M.
 Lucille Galsky, Deputy
 Clerk and Recorder
 \$2.00 fee paid

STATE OF MONTANA
 ADMINISTRATOR OF GROUNDWATER CODE
 OFFICE OF STATE ENGINEER

Twp 5 S, Rge 2 E
 RECEIVED
 MAR 9 1964

DECLARATION OF VESTED GROUNDWATER RIGHTS
 (Under Chapter 237, Montana Session Laws, 1961)

1. Fred J. Gali - N. Louise Gali, of Broadus, Montana STATE ENGINEER
 County of POWDER RIVER, STATE OF MONTANA, have appropriated groundwater according to
 the Montana Laws in effect prior to January 1, 1962, as follows:

	Sec. 4	Sec. 4	Sec.	Sec.	Sec.	Sec.
WELLS	No. 1	No. 2	No. 3	No. 4	No. 5	No. 6
Basis of Beneficial Use	Domestic Stock	Garden Stock				
DATE DRILLED	1960	1958				
3. How continuously used	constant	constant				
4. Amount Claimed (gal. per minute)	100 gpm	180 gpm				
Irrigated description						
Irrigation owner						
8. Irrigated acreage						
Location (40 acres)	NE 1/4	NE 1/4				
6. Withdrawal means	Flow or	Flow or				
7. Completion date	8-1960	1958				
8. Water depth table	artesian -0-	Surface water 25'				
Type (drilled or dug)	drilled	drilled				
9. Size & Depth	40' - 2"	4" x 40'				
10. Estimated annual amount withdrawn	60,000	40,000				
11. Other information						
12. Log, if available						
	<u>NO LOGS</u>					

STATE OF MONTANA)
) ss.
 County of Powder River)

Signature of Owner: Fred J. Gali
N. Louise Gali

Date 12-27-63

Fred J. Gali
N. Louise Gali having first been duly sworn, deposes and says that he is of
 lawful age and is the appropriator and claimant of the order and water right mentioned in
 the foregoing Declaration of Vested Groundwater Rights and the person whose name is sub-
 scribed thereto, as the appropriator and claimant, that he knows the contents of said
 foregoing notice and that the matters and things therein stated are true.
 Subscribed and sworn to before me this

27th day of December, 1963
Lucille Galsky, Deputy
 Clerk & Recorder, Powder
 River County, Broadus, Montana

Fred J. Gali

(55348)

15169, Filed, (3)
 at _____, 19____,
 at _____, M.

STATE OF MONTANA
 ADMINISTRATOR OF GROUNDWATER CODE
 OFFICE OF STATE ENGINEER

Twp 1/5 S, Rge 21 E
 28

Clerk and Recorder
 \$2.00 fee paid

DECLARATION OF VESTED GROUNDWATER RIGHTS
 (Under Chapter 237, Montana Session Laws, 1961)

RECEIVED
 MAR 9 1964

1. Randall, Inc., of Broadus, Montana,
 County of POWDER RIVER, STATE OF MONTANA, have appropriated groundwater according to
 the Montana Laws in effect prior to January 1, 1962, as follows:

W E L L S	43-51E	43-51E	43-51E	55-51E		
	Sec. 28	Sec. 22	Sec. 16	Sec. 4	Sec.	Sec.
No. 1	No. 2	No. 3	No. 4	No. 5	No. 6	
Basis of	Stock	Stock	Stock	Domestic		
2. Beneficial Use	Stock	Stock	Stock	Stock		
DATE DRILLED	1958	1958	1960	1949		
3. How continuously used	2-12 mo.	5-10 mo.	6-10 mo.	constant		
Amount Claimed	3 gpm	3 gpm	6 gpm	1 1/2 to 3 gpm		
4. (gal. per minute)						
Irrigated description						
Irrigation owner						
5. Irrigated acreage						
Location (40 acres)	SESE	NSW	SNW	SWSE		
6. Withdrawal means	windmill	windmill	elec. pump	flow		
7. Completion date	1958	1958	1960	1949		
8. Water depth table	42'	25'	146'	artesian flow		
Type (drilled or dug)	drilled	drilled	drilled	drilled		
9. Size & Depth	4" x 60'	4" x 45'	4" x 170'	2" x 500'		
Estimated annual						
10. amount withdrawn	300,000	300,000	600,000	300,000		
11. Other information	Cyote Crk.	Sand Crk.	Electric	Doyle Res.		
12. Log, if available	42'-60' blue shale water sand	40' sand- stone 40-47' blue shale	146'-165' water sand	495'-580' water sand.		

STATE OF MONTANA)
) ss.
 County of Powder River)
 Randall Inc.,)

Signature of Owner: Randall Inc.
by Incille G. Randall, Sec.

Date 12/26/63

by Incille G. Randall, Sec. having first been duly sworn, deposes and says that he is of
 lawful age and is the appropriator and claimant of the order and water right mentioned in
 the foregoing Declaration of Vested Groundwater Rights and the person whose name is sub-
 scribed thereto, as the appropriator and claimant, that he knows the contents of said
 foregoing notice and that the matters and things therein stated are true.
 Subscribed and sworn to before me this
26th day of December, 1963.

Incille G. Randall, Sec.
 Clerk & Recorder, Powder
 River County, Broadus, Montana

Randall Inc.
by Incille G. Randall, Sec.

74949 . Filed,
 12-10, 1963,
 at 1:02 P. M.
 \$2.00 fee paid

STATE OF MONTANA
 ADMINISTRATOR OF GROUNDWATER CODE
 OFFICE OF STATE ENGINEER

Twp. 5 S. Rge. 57 E.

RECEIVED
 DEC 23 1963

Lucille Godsey, deputy
 Clerk and Recorder

DECLARATION OF VESTED GROUNDWATER RIGHTS
 (Under Chapter 237, Montana Session Laws, 1961)

1. Edward W. Allen and Vera M. Allen of Broadus STATE ENGINEER
 County of POWDER RIVER, State of MONTANA, have appropriated groundwater according to
 the Montana Laws in effect prior to January 1, 1962, as follows:

	Sec. <u>5</u> No. 1	Sec. No. 2	Sec. No. 3	Sec. No. 4	Sec. No. 5	Sec. No. 6
WELLS	domestic & stock					
2. Basis of Beneficial Use	1953 constant					
3. DATE OF USE	63					
4. How continuous						
Amount claimed (gal. per minute)						
5. Irrigated description						
Irrigation owner						
6. Irrigated acreage	SWE pump					
7. Location	1953					
8. Withdrawal means	365'					
9. Completion date	drilled					
10. Water depth table	3" x 380'					
11. Type (drilled or dug)						
12. Size & depth						
Estimated annual						
10. Amount withdrawn						
11. Other information						
12. Log, if available	0-26 surface soil 26-40 sand & gravel 40-65 water sand 65-67 hard rock 67-335 blue shale 335-350 water sand 350-352 hard rock 352-370 water sand 370-380 blue shale					

STATE OF MONTANA)
) ss.

Signature of Owner Edward W. Allen

County of Powder River)
Edward W. Allen and Vera M. Allen

Vera M. Allen
 Date

having first been duly sworn, deposes and says:
 that he is of lawful age and is the appropriator and claimant of the order and water rights
 mentioned in the foregoing Declaration of Vested Groundwater Rights and the person whose
 name is subscribed thereto, as the appropriator and claimant, that he knows the contents
 of said foregoing notice and that the matters and things therein stated are true

Subscribed and sworn to before me this 5th day of December 1963

Lucille Godsey Deputy

11733

75149 Filed, (6)
1963 at M.

STATE OF MONTANA
ADMINISTRATOR OF GROUNDWATER CODE
OFFICE OF STATE ENGINEER

Twp 5 S, Rge 21 E 17

Clerk and Recorder
\$2.00 fee paid

DECLARATION OF VESTED GROUNDWATER RIGHTS
(Under Chapter 237, Montana Session Laws, 1961)

RECEIVED
MAR 9 1964

1. Randall Inc. & Douglas Randall, Pres. of Brookings, Montana
County of POWDER RIVER, STATE OF MONTANA, have appropriated groundwater according to
the Montana Laws in effect prior to January 1, 1962, as follows: **STATE ENGINEER**

	Sec. 17	Sec. 8	Sec. 8	Sec. 8	Sec. 8	Sec. 29
W.R.L.L.S.	No. 1	No. 2	No. 3	No. 4	No. 5	No. 6
1. Basis of Beneficial Use	Stock	Stock	Stock	Stock	Stock	Stock
2. DATE DRILLED	1936	1930	1959	1951	1947	1945
3. How continuously used	seasonal	constant	constant	constant	constant	constant
4. (gals. per minute)	10 gpm	2 gpm	10 gpm	20 gpm	6 gpm	8 gpm
5. Irrigated description						
6. Irrigation owner						
7. Irrigated acreage						
8. Location (40 acres)	SW/4	SW/4	SW/4	SW/4	SW/4	SW/4
9. Withdrawal means	artesian	artesian	artesian	artesian	artesian	artesian
10. Completion date	1936	1930	1959	1951	1947	1945
11. Water depth table	0-0	0-0	ALL FLOWING WELLS			0-0
12. Type (drilled or dug)	Drilled	Drilled	Drilled	Drilled	Drilled	Drilled
13. Size & Depth	20" x 145'	20" x 135'	20" x 1100'	20" x 132'	20" x 950'	20" x 146'
14. Estimated annual amount withdrawn	5,000,000	500,000	5,000,000	10,000,000	1,000,000	4,000,000
15. Other information	house well across river	Beck	Beck bottle well	Settle	Flowing well	Doing well
16. Log, if available	Water sand	Water sand	water sand	water sand	water sand	water sand
	395'-145'	390'-135'	1045'-1100'	361'-132'	836'-950'	132'-146'

STATE OF MONTANA)
County of Powder River)
ss.
Randall Inc.

Signature of Owner: /s/ Randall Inc.
by Douglas Randall, Pres.
Date 22/06/63

by Douglas Randall, Pres. having first been duly sworn, deposes and says that he is of legal age and is the appropriator and claimant of the order and water right mentioned in the foregoing Declaration of Vested Groundwater Rights and the person whose name is subscribed thereto, as the appropriator and claimant, that he knows the contents of said foregoing notice and that the matters and things therein stated are true.
Subscribed and sworn to before me this
26th day of December, 1963.

Clerk & Recorder, Powder River County, Brookings, Montana

35322

[Handwritten signature]

RECEIVED County Powder River

STATE OF MONTANA
ADMINISTRATOR OF GROUNDWATER CODE
MONTANA WATER RESOURCES BOARD

NOTICE OF COMPLETION OF GROUNDWATER
APPROPRIATION BY MEANS OF WELL

Developed after January 1, 1962

(Under Chapter 237 Montana Session Laws, 1961, as amended)

This form to be prepared by driller, and three copies to be filed by the owner with the County Clerk and Recorder in the county in which the well is located, last copy to be retained by driller.

Please answer all questions. If not applicable, so state, otherwise the form may be returned.

Owner Ranch 11, Inc.
Address Broadus, Mont.
Date well started Sept. 21, 1971
completed Sept. 26, 1971

For Administrator's Use
File
GW 1

Type of well _____
(Dig, driven, bored or drilled)

Equipment used _____
(Churn drill, rotary or other)

Water Use: Domestic Municipal Stock Irrigation
Industrial Drainage Other * Garden/Lawn

*Describe artesian

USE: If used for irrigation, industrial, drainage or other. Explain, state number of acres and location or other data (i.e. Lot, Block and Addition).

ESTIMATED ANNUAL WITHDRAWAL

Size of Drilled Hole	Size and Weight of Casing	From (Feet)	To (Feet)	PERFORATIONS	Kind	From (Feet)	To (Feet)
6"	4" 10	0	115				
4"		115	337		9 3/4	1010	
3"	2 3/8	337	1263		10 4/0	1100	
	2"	115	1165	6 1/2"			

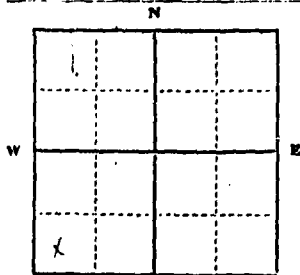

Static water level Flow ft.
Pumping water level Artesian ft.
at 7 gallons per minute,
measured 6 minutes after pumping
began.
*Measured from ground level.
Well developed by Natural flow
for _____ hours.
Power _____ Pump _____ HP
Remarks: (Gravel packing, cementing,
packers, type of shutoff)
Sealed at 337 ft. by flange
packer

Approx. SW 1/4 SW 1/4 Sec. 8
T. 5. S. N. R. 5. 1

INDICATE LOCATION OF WELL AND PLACE OF USE, IF POSSIBLE.
EACH SMALL SQUARE REPRESENTS 40 ACRES.

Driller's Signature Robert L. Jones
Driller's Address Box 241 Broadus Montana

LICENSE NO. 182

DRILLER'S LOG

Indicate the character, color, thickness of strata such as soil, clay, sand, gravel, shale, sandstone, etc. Show depth at which water is found and height to which water rises in well.

Top of Ground (Elev. above sea level)

From (Feet)	To (Feet)
0	18
18	24
24	32
32	47
47	68
68	74
74	98
98	178
178	181
181	268
268	304
304	316
316	381
381	384
384	428
428	447
447	483
483	512
512	546
546	626
626	658
658	678
678	726
726	767
767	803
803	884
884	928
928	939
939	947
947	947
947	952
952	983
983	1006
1006	1045
1045	1091
1091	1109
1109	1112
1112	1208
1208	1236
1236	1263

FILED Rec. No. 92718
County of Powder River, Montana
I hereby certify that the within
instrument was filed for record in
this office, on the 24 day of
June, 1973 at 2:25
o'clock P. M. Fee 3.25 paid
Charles E. Swartz
County Clerk and Recorder
by Robert L. Jones
Deputy

1263 Show exact depth of bottom

5629

75266, Filed, (4)
 19
 at .M.

STATE OF MONTANA
 ADMINISTRATOR OF GROUNDWATER CODE
 OFFICE OF STATE ENGINEER

Trp 5 S. Rce 519

Clerk and Recorder
 \$2.00 fee paid

DECLARATION OF VESTED GROUNDWATER RIGHTS
 (Under Chapter 237, Montana Session Laws, 1961)

RECEIVED
 MAR 9 1964

1. Carl & Conzetta Schaffer, of Broadus, Montana, County of POWDER RIVER, STATE OF MONTANA, have appropriated groundwater according to the Montana Laws in effect prior to January 1, 1962, as follows:

STATE ENGINEER

(About 400' apart)

	Sec. 9	Sec. 16	Sec.	Sec.	Sec.	Sec.
W.E.L.L.S	No. 1	No. 2	No. 3	No. 4	No. 5	No. 6
Basis of						
2. Beneficial Use	Irrigation	Irrigation				
DATE DRILLED	1957	1957				
3. How continuously used	constant	constant				
Amount Claimed						
4. (gal. per minute)	800'	700'				
Irrigated description	new	new				
Irrigation owner	owned	owned				
5. Irrigated acreage	200 A.	200 Acres				
Location (40 acres)	FWW	FWW				
6. Withdrawal means	flow pipe	both wells				
7. Completion date.	1957	1957				
8. Water depth table	35'	27'				
Type (drilled or dug)	drilled	drilled				
9. Size & Depth	36" hole 19" x 55'	36" hole 18" x 55'				
Estimated annual		47'				
10. amount withdrawn						
11. Other information						
12. Log, if available						
	NO LOGS					

STATE OF MONTANA)
) ss.
 County of Powder River)

Signature of Owner: Carl & Conzetta Schaffer

Date 12/30/63

Carl & Conzetta Schaffer having first been duly sworn, deposes and says that he is of lawful age and is the appropriator and claimant of the order and water right mentioned in the foregoing Declaration of Vested Groundwater Rights and the person whose name is subscribed thereto, as the appropriator and claimant, that he knows the contents of said foregoing notice and that the matters and things therein stated are true.

Subscribed and sworn to before me this
30th day of December, 1963.

Clerk & Recorder, Powder
 River County, Broadus, Montana

25380

File No. 71288
 Filed: June 21, 1963
 at 1:15 P.M.

STATE OF MONTANA
 ADMINISTRATOR OF GROUNDWATER CODE
 OFFICE OF STATE ENGINEER

T. 58 R. 51E

Powder River

RECEIVED
 JUN 26 1963

Carl Schaffer deputy
 Clerk and Recorder
 Powder River County

NOTICE OF COMPLETION OF GROUNDWATER
 APPROPRIATION BY MEANS OF WELL
 (Under Chapter 237, Montana Session Laws, 1961) **STATE ENGINEER**

OWNER Carl Schaffer Address Broadus, Mont.
 DRILLER Earl Drane Address Broadus, Mont.
 Date of Notice of Appropriation of Groundwater _____
 Top of Ground (Elev. above sea level) _____
 Date well started 5-1-63 Completed 5-3-63
 Type of well drilled Equipment used rotary
 (dug, driven, bored, drilled) (churn, drill, rotary, other)
 Water Use: Domestic Municipal Stock Other
 Industrial Drainage Irrigation
 Diagram character and thickness of different strata met in drilling - soil, clay, shale, gravel, rock, sand. Show depth at which water is found, thickness and character of water-bearing strata and height to which water rises in well.

Size of Drilled Hole	Size & Weight of Casing	From To (feet)		PERFORATIONS		
		From (feet)	To (feet)	Kind Size	From (feet)	To (feet)
6"	4" 9#	0	310			
3 1/2" std.	2 1/2" std.	310	550	slots	500	550

38' sandy clay
 48 sand clay coal streaks
 115 blue shale
 122 rock
 160 coal & sand mixed
 206 shale
 370 shale with coal sand streaks
 372 rock
 375 shale
 377 rock
 500 shale
 540 water sand
 550 shale

Static Water Level for non-flowing well 40 feet.
 Shut-in Pressure for Flowing Well _____
 Pumping Water Level 84 feet at 8 gal. per minute
 Discharge in gal. per min. of flowing well _____
 How Tested _____ Length of Test 3 hrs.

Remarks: (Gravel packing, cementing, packers, type of shut-off, location of use if not at well, other similar pertinent information, including number of acres irrigated, if any)

packer at 310 ft.

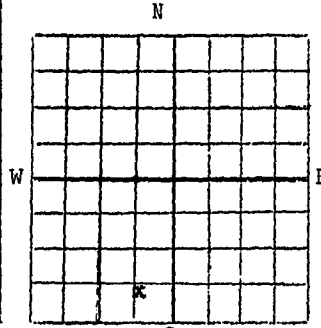

SE 1/4 SW 1/4 Sec. 9 T. 58 R. 51E

STATE OF MONTANA
 County of Powder River) SS.

Carl Schaffer having first been duly sworn, deposes and says that he is of lawful age and is the appropriator and claimant of the order and water right mentioned in the foregoing notice of completion of groundwater appropriation by means of well and the person whose name is subscribed thereto, as the appropriator and claimant, that he knows the contents of said foregoing notice and that the matters and things therein stated are true.

Carl Schaffer
 Driller's Signature

20
 Driller's License Number

Subscribed and sworn to before me, this 10th day of June, 1963

Carl Schaffer
 Clerk and Recorder
 Powder River County
 Broadus, Montana

(4780)

75137 GE, Filed,
 at _____, 19____,
 _____, M.

STATE OF MONTANA
 ADMINISTRATOR OF GROUNDWATER CODE
 OFFICE OF STATE ENGINEER

Twp 5 S, Rge 5E

RECEIVED
 MAR 9 1964

Clerk and Recorder
 \$2.00 fee paid

DECLARATION OF VESTED GROUNDWATER RIGHTS
 (Under Chapter 237, Montana Session Laws, 1961)

1. Glen W. Russell, of Biddle STATE ENGINEER,
 County of POWDER RIVER, STATE OF MONTANA, have appropriated groundwater according to
 the Montana Laws in effect prior to January 1, 1962, as follows:

	Sec. 7	Sec. 8	Sec. 3	Sec. 4	Sec. 5	Sec. 6
W E L L S	No. 1	No. 2	No. 3	No. 4	No. 5	No. 6
2. Beneficial Use	stock	stock				
3. How continuously used	constant	unused				
4. Amount Claimed (gal. per minute)	8	10				
Irrigated description						
5. Irrigated acreage						
6. Withdrawal means	HEAVY flow	HEAVY pump				
7. Completion date	1960	1955				
8. Water depth table	-0-	14'				
9. Size & Depth	drilled 2" x 620'	drilled 4" x 28'				
10. Estimated annual amount withdrawn						
11. Other information						
12. Log, if available						

STATE OF MONTANA)
) ss.
 County of Powder River)

Signature of Owner: /s/ Glen W. Russell

Date _____

_____ having first been duly sworn, deposes and says that he is of
 lawful age and is the appropriator and claimant of the order and water right mentioned in
 the foregoing Declaration of Vested Groundwater Rights and the person whose name is sub-
 scribed thereto, as the appropriator and claimant, that he knows the contents of said
 foregoing notice and that the matters and things therein stated are true.
 Subscribed and sworn to before me this
 _____ day of _____, 19____.

/s/ Glen W. Russell

Clerk & Recorder, Powder
 River County, Broadus, Montana

35301

75169, Filed,
 19, at .M.

STATE OF MONTANA
 (5) ADMINISTRATOR OF GROUNDWATER CODE
 OFFICE OF STATE ENGINEER

Twp S, Rge E
 5 St

Clerk and Recorder
 \$2.00 fee paid

DECLARATION OF VESTED GROUNDWATER RIGHTS
 (Under Chapter 237, Montana Session Laws, 1961)

RECEIVED
 MAR 9 1964

1. Randall Inc., by Douglas Randall, Pres. of Broadus, Montana County of POWDER RIVER, STATE OF MONTANA, have appropriated groundwater according to the Montana Laws in effect prior to January 1, 1962, as follows:

STATE ENGINEER

	Sec. 20	Sec. 19	Sec. 30	Sec. 25	Sec. 17	Sec.
WELLS	No. 1	No. 2	No. 3	No. 4	No. 5	No. 6
Basis of	Stock	Stock	Stock	Stock Domestic	Stock Domestic	
2. Beneficial Use	Stock	Stock	Stock	Stock Domestic	Stock Domestic	
DATE DRILLED	1959	1950	1949	1930	1929	
3. How continuously used	constant	constant	constant	constant	constant	
Amount Claimed						
4. (gal. per minute)	12 gpm	8 gpm	2 gpm	1 gpm	15 gpm	
Irrigated description						
Irrigation owner						
5. Irrigated acreage						
Location (40 acres)	NW1/4	NE1/4	SW1/4	SE1/4	SW1/4	
6. Withdrawal means	artesian	artesian	artesian	artesian	artesian	
7. Completion date	1959	1950	1949	1930	1929	
8. Water depth table	-0-	-0-	-0-	-0-	-0-	
Type (drilled or dug)	Drilled	drilled	drilled	drilled	drilled	
9. Size & Depth	2" x 529'	2" x 538'	2" x 425'	4 1/2"	992'	
Estimated annual						
10. amount withdrawn	6,000,000	4,000,000	1,000,000	500,000	7,500,000	
11. Other information	cow pasture Big p.		Stover	Kds	W Bar House	
	ALL FLOWING WELLS					
12. Log, if available	Water sand 450' - 529'	Water sand 480' - 538'	Water sand 392' - 425'	Water sand 352' - 410'	Water sand 927' - 992'	

STATE OF MONTANA)
) ss.
 County of Powder River)
 Randall Inc.

Signature of Owner: Randall Inc.

by Douglas Randall, Pres.
 Date 12/26/63

by Douglas Randall, Pres., having first been duly sworn, deposes and says that he is of lawful age and is the appropriator and claimant of the order and water right mentioned in the foregoing Declaration of Vested Groundwater Rights and the person whose name is subscribed thereto, as the appropriator and claimant, that he knows the contents of said foregoing notice and that the matters and things therein stated are true.
 Subscribed and sworn to before me this
26th, day of December, 1963.

Clerk & Recorder, Powder
 River County, Broadus, Montana

44229 ✓

7220, Filed, (2)
 _____, 19____,
 at _____ M.

STATE OF MONTANA
 ADMINISTRATOR OF GROUNDWATER CODE
 OFFICE OF STATE ENGINEER

Twp _____ S, Rge _____ E

RECEIVED
 MAR 9 1961

Clerk and Recorder
 \$2.00 fee paid

DECLARATION OF VESTED GROUNDWATER RIGHTS
 (Under Chapter 237, Montana Session Laws, 1961)

1. _____, of _____,
 County of POWDER RIVER, STATE OF MONTANA, have appropriated groundwater according to
 the Montana Laws in effect prior to January 1, 1962, as follows:

Randall Inc.
 2000 Broadus

	SS-50E	SS-51E	SS-50E	45-50E ✓	45-50 ✓	SS-52E
	Sec. 22	Sec. 21 ✓	Sec. 20	Sec. 21	Sec. 20	Sec. 18 ✓
W.E.L.L.S	No. 1	No. 2	No. 3	No. 4	No. 5	No. 6
2. Beneficial Use	Stock	Stock	Stock	Stock	Stock	Stock
3. DATE DRILLED	1941	1947	1941	1940	1950	1950
How continuously used	const.	const.	const.	const.	const.	const.
4. Amount Claimed (gal. per minute)	25 gpm	25 gpm	25 gpm	15 gpm	25 gpm	25 gpm
Irrigated description						
8. Irrigation owner						
9. Irrigated acreage						
6. Location (40 acres)	SS-50E	SS-51E	SS-50E	45-50E	45-50E	SS-52E
Withdrawal means	drilled	drilled	drilled	drilled	drilled	drilled
7. Completion date	1941	1949	1941	1940	1950	1950
8. Water depth table	130'	150'	50'	170'	120'	50'
Type (drilled or dug)	drilled	drilled	drilled	drilled	drilled	drilled
9. Size & Depth	4" x 120'	4" x 122'	4" x 120'	4" x 210'	4" x 120'	4" x 93'
10. Estimated annual amount withdrawn	200,000	200,000	200,000	300,000	200,000	250,000
11. Other information		const. cap.				
12. Log, if available	1941-1941'	1947-1940'		1940-210'	1950-120'	drilled deep water sand did not flow.

STATE OF MONTANA)
) ss.
 County of Powder River)

Signature of Owner: Randall Inc.
2000 Broadus, Montana

Date _____

Randall Inc., having first been duly sworn, deposes and says that he is of
 lawful age and is the appropriator and claimant of the order and water right mentioned in
 the foregoing Declaration of Vested Groundwater Rights and the person whose name is sub-
 scribed thereto, as the appropriator and claimant, that he knows the contents of said
 foregoing notice and that the matters and things therein stated are true.

Subscribed and sworn to before me this
 25th day of _____ 19____

 Clerk & Recorder, Powder
 River County, Broadus, Montana

Randall Inc.
2000 Broadus, Montana
 35320 ✓

75269

75269, Filed, (1)
at _____, 19____,
_____ M.

STATE OF MONTANA
ADMINISTRATOR OF GROUNDWATER CODE
OFFICE OF STATE ENGINEER

Twp _____ S, Rgs _____ E

RECEIVED
MAR 9 1962

Clerk and Recorder
\$2.00 fee paid

DECLARATION OF VESTED GROUNDWATER RIGHTS
(Under Chapter 237, Montana Session Laws, 1961)

1. Landall Inc., of _____, _____
County of POWDER RIVER, STATE OF MONTANA, have appropriated groundwater according to
the Montana Laws in effect prior to January 1, 1962, as follows:

Landall Inc.
2800 Broad

SS-50E ✓ SS-51E ✓ SS-50E ✓ 45-50E ✓ 45-50E ✓ 55-51E

	Sec. 20	Sec. 21	Sec. 22	Sec. 23	Sec. 24	Sec. 25
W E L L S	No. 1	No. 2	No. 3	No. 4	No. 5	No. 6
2. Beneficial Use	Stock	Stock	Stock	Stock	Stock	Stock
DATE DRILLED	1958	1959	1954	1960	1958	1958
3. How continuously used	const.	const.	const.	const.	const.	const.
4. Amount Claimed (gal. per minute)	25 gpm	25 gpm	25 gpm	25 gpm	25 gpm	25 gpm
Irrigated description						
Irrigation owner						
5. Irrigated acreage						
Location (40 acres)						
6. Withdrawal means	drill	drill	drill	drill	drill	drill
7. Completion date	1958	1959	1954	1960	1958	1958
8. Water depth table	150'	150'	10'	170'	140'	50'
Type (drilled or dug)	drilled	drilled	drilled	drilled	drilled	drilled
9. Size & Depth	4" x 270'	4" x 182'	4" x 180'	4" x 210'	4" x 180'	4" x 80'
10. Estimated annual amount withdrawn	250,000	250,000	250,000	250,000	250,000	250,000
11. Other information		const. cap.				const. cap.
12. Log, if available	200-210'	150-160'		170-210'	140-180'	40-100'
	sand shale	sand shale		sand & shale	sand	artesian well - did not flow.

STATE OF MONTANA)
County of Powder River) ss.

Signature of Owner: Landall Inc.
By _____, Sec.

Date _____

Landall Inc., _____, _____, having first been duly sworn, deposes and says that he is of
lawful age and is the appropriator and claimant of the order and water right mentioned in
the foregoing Declaration of Vested Groundwater Rights and the person whose name is sub-
scribed thereto, as the appropriator and claimant, that he knows the contents of said
foregoing notice and that the matters and things therein stated are true.
Subscribed and sworn to before me this

26th day of _____ 1962.

Clerk & Recorder, Powder
River County, Broadus, Montana

35320 ✓

File No. 82825
Filed: 6-11 1968
at 4:00 P. M.

GW - 2

Charlotte Edwards
Clerk and Recorder
Powder River County (Under Chapter 237, Montana Session Laws, 1961)
By Myrtle M. Ridgway, Deputy
Fee \$ 2.00.

Notice of COMPLETION of Groundwater
Appropriation by Means of Well

Twp 5 S. Rge 51 E.

Top of Ground 3030 OWNER Randall Inc. Address Broadus, Mont.
Elev. above sea level. DRILLER Bandy Drilling Address Broadus, Mont.

Date of Notice of Appropriation of Groundwater _____
Date well started June 5, 1968 Completed July 1, 1968
Type of Well bored Equipment Used dry hole digger -
(dug, driven, bored, drilled) (churn, drill, rotary, etc.)
Water Use: Domestic _____; Municipal _____; Stock _____; Other _____;
Industrial _____; Drainage _____; Irrigation X;
Indicate on diagram character and thickness of different strata met in drilling -ei, soil, clay, shale, gravel, rock, sand. Show depth at which water is found, thickness and character of water-bearing strata and height to which water rises in well.

Size of Drilled Hole	Size and Weight of Casing	From (feet)	To (feet)	Perforations		
				Kind Size	From (feet)	To (feet)
<u>36"</u>	<u>16" 3/8" wall</u>	<u>0'</u>	<u>58'</u>	<u>screen</u>	<u>35'</u>	<u>55'</u>

Static Water Level for non-flowing well 12' feet
Shut-in Pressure for Flowing Well _____
Pumping Water Level 40-45 feet at 900 gal. per minute.
Discharge in Gal. per min. of flowing well _____
How Tested pumping Length of Test 48 hrs.
Remarks: (Gravel packing, cementing, packers, type of shut-off, location of use if not at well, other similar pertinent information, including number of acres irrigated, if any.)
Gravel packing

705

Sec 19, Twp. 5 S., Rge 51 East.

MONTANA WATER RESOURCES BOARD

RECEIVED

JUN 13 1968

STATE OF MONTANA)
County of Powder River) ss.

Lucille G. Randall, Sec. having first been duly sworn, deposes and says that he is of lawful age and the appropriator and claimant of the order and water right mentioned in the foregoing notice of completion of groundwater appropriation by means of well and the person whose name is subscribed thereto, as the appropriator and claimant, that he knows the contents of said foregoing notice and that the matters and things therein stated are true.

Owner's Signature Randall Inc. by Lucille G. Randall

Subscribed and sworn to before me, June 11 day of June, 1968.

CHARLOTTE EDWARDS
CLERK & RECORDER
P.O. BOX 100, BROADUS, MONT. 59217

Clerk and Recorder

By Myrtle M. Ridgway, Deputy
(44,225)

File No. 82826
Filed: 6-11 1968
at 4:01 P. M.

GW - 2

Charlotte Edwards
Clerk and Recorder
Powder River County
By Myrtle M. Pillsbury
Deputy

Notice of COMPLETION of Groundwater
Appropriation by Means of Well
(Under Chapter 237, Montana Session Laws, 1961)

Twp. 5S Rge 51E

Top of Ground 3030
Elev. above sea level.

OWNER Randall Inc. Address Broadus, Mont

DRILLER Bandy Drilling Address Broadus, Mont

Date of Notice of Appropriation of Groundwater _____

Date well started May 29, 1965 Completed June 25, 1965

Type of Well bored Equipment Used dry hole digger -
(dug, driven, bored, drilled) (churn, grill, rotary, etc)

Water Use: Domestic ___; Municipal ___; Stock ___; Other ___;
Industrial ___; Drainage ___; Irrigation X;

Indicate on diagram character and thickness of different strata met in drilling - si, soil, clay, shale, gravel, rock, sand. Show depth at which water is found, thickness and character of water-bearing strata and height to which water rises in well.

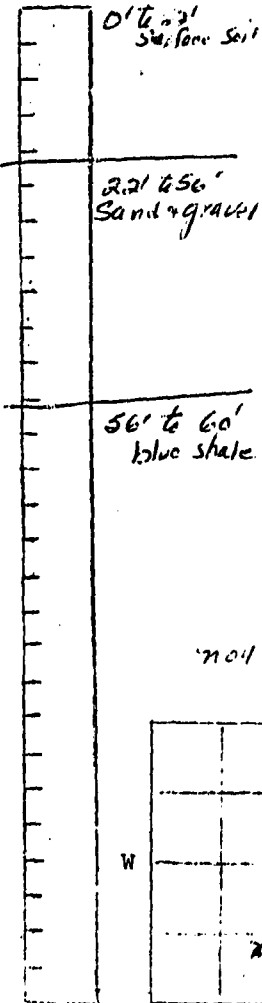

Size of Drilled Hole	Size and Weight of Casing	From (feet)	To (feet)	Perforations			
				Kind	From (feet)	To (feet)	
36"	16"	3/8" wall	0'	60'	Screen	35'	55'

Static Water Level for non-flowing well 12' feet

Shut-in Pressure for Flowing Well _____

Pumping Water Level 45 feet at 900 gal. per minute.

Discharge in Gal. per min. of flowing well _____

How Tested pumped Length of Test 48 hrs.

Remarks: (Gravel packing, cementing, packers, type of shut-off, location of use if not at well, other similar pertinent information, including number of acres irrigated, if any.)

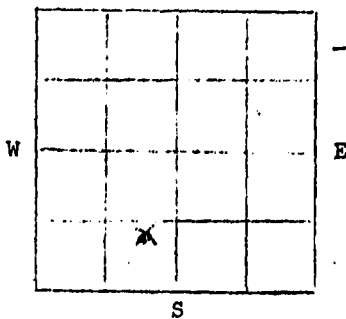

gravel packing

Driller's License No. 16

Frank Bandy Jr.
Driller's Signature

MONTANA WATER RESOURCES BOARD

RECEIVED

JUN 13 1968

Sec 19, Twp. 5 S., Rge 51 East.

STATE OF MONTANA)
County of Powder River) ss.

Lucille G. Randall, Sec. having first been duly sworn, deposes and says that he is of lawful age and the appropriator and claimant of the order and water right mention in the foregoing notice of completion of groundwater appropriation by means of well and the person whose name is subscribed thereto, as the appropriator and claimant, that he knows the contents of said foregoing notice and that the matters and things therein are true.

Owner's Signature Randall Inc., Lucille G. Randall Sec.

Subscribed and sworn to me, this ___ day of _____, 196__.



CHARLOTTE EDWARDS

CLERK AND RECORDER

By Myrtle M. Pillsbury
Deputy

44,226

File No. 82827
Filed: 6-11 1968
at 4:02 P. M.

GW - 2

Charlotte Edwards
Clerk and Recorder
Powder River County (Under Chapter 237, Montana Session Laws, 1961)
By Myrtle M. Ridenour, Deputy
Fee 3.00

Twp. 5 S. Rge 51 E.

Top of Ground 3030
Elev. above sea level.

OWNER Randall Inc Address Broadus, Mont

DRILLER Bundy Drilling Address Broadus, Mont

Date of Notice of Appropriation of Groundwater: _____

Date well started Aug 29, 1965 Completed Sept 6, 1965

Type of Well bored Equipment Used dry hole digger -
(dug, driven, bored, drilled) (churn, drill, rotary, etc)

Water Use: Domestic _____; Municipal _____; Stock _____; Other _____;
Industrial _____; Drainage _____; Irrigation X;

Indicate on diagram character and thickness of different strata met in drilling - s, soil, clay, shale, gravel, rock, sand. Show depth at which water is found, thickness and character of water-bearing strata and height to which water rises in well.

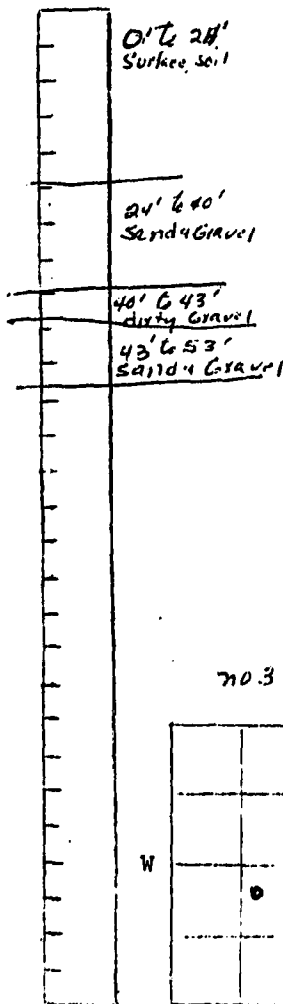

Size of Drilled Hole	Size and Weight of Casing	From (feet)	To (feet)	Perforations		
				Kind	From (feet)	To (feet)
36"	16" 3/8" wall	0	53	Screen	30'	53'

Static Water Level for non-flowing well 12' feet

Shut-in Pressure for Flowing Well _____

Pumping Water Level 45 feet at 500 gal. per minute.

Discharge in Gal. per min. of flowing well _____

How Tested Pumped Length of Test 48 hrs.

Remarks: (Gravel packing, cementing, packers, type of shut-off, location of use if not at well, other similar pertinent information, including number of acres irrigated, if any.)

Gravel Packing

Driller's License NO. 16

Frank Bundy Jr
Driller's Signature

MONTANA WATER RESOURCES BOARD

RECEIVED

JUN 13 1968

Sec 19, Twp. 5 S., Rge 51 East.

STATE OF MONTANA)
County of Powder River) ss.

Lucille G. Randall, Sec. having first been duly sworn, deposes and says that he is of lawful age and the appropriator and claimant of the order and water right mention in the foregoing notice of completion of groundwater appropriation by means of well and the person whose name is subscribed thereto, as the appropriator and claimant, that he knows the contents of said foregoing notice and that the matters and things therein set are true.

Owner's Signature Randall Inc by Lucille G. Randall, Sec.

Subscribed and sworn to before me, this 11 day of June, 1968.



Charlotte Edwards
Clerk and Recorder

By Myrtle M. Ridenour, Deputy

(44,227)

File No. 82828
Filed: 6-11 1968
at 4:03 P. M.

GW - 2

Charlotte Edwards
Clerk and Recorder
Powder River County
By Myrtle M. Ridenour
Deputy

Notice of COMPLETION of Groundwater
Appropriation by Means of Well
(Under Chapter 237, Montana Session Laws, 1961)

Twp. 55 Rge 51E

Top of Ground - 3030
Elev. above sea level.

OWNER Randall Inc Address Broadus, Mont

DRILLER Bandy Drilling Address Broadus, Mont

Date of Notice of Appropriation of Groundwater _____

Date well started June 25, 1965 Completed July 1, 1965

Type of Well bored Equipment Used by hole digger
(dug, driven, bored, drilled) (churn, drill, rotary, etc)

Water Use: Domestic ___; Municipal ___; Stock ___; Other ___;
Industrial ___; Drainage ___; Irrigation X;

Indicate on diagram character and thickness of different strata met in drilling - i.e., soil, clay, shale, gravel, rock, sand. Show depth at which water is found, thickness and character of water-bearing strata and height to which water rises in well.

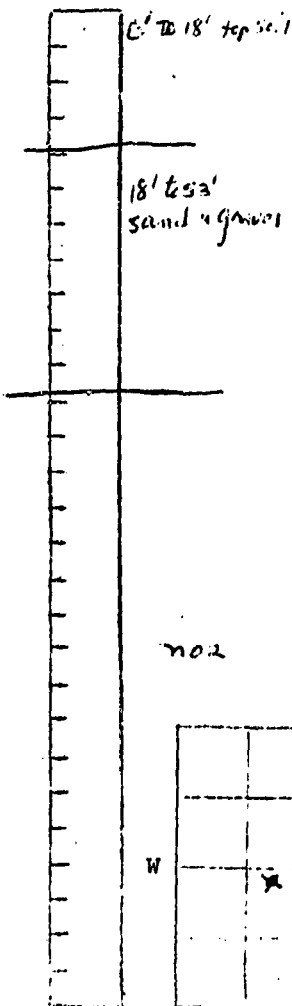

Size of Drilled Hole	Size and Weight of Casing	From (feet)	To (feet)	Perforations		
				Kind	From (feet)	To (feet)
36"	16" 3/8" wall	0	53	screen	30'	53'

Static Water Level for non-flowing well 12' feet

Shut-in Pressure for Flowing Well _____

Pumping Water Level 45' feet at 900 gal. per minute.

Discharge in Gal. per min. of flowing well _____

How Tested prim prod Length of Test 48 hrs

Remarks: (Gravel packing, cementing, packers, type of shut-off, location of use if not at well, other similar pertinent information, including number of acres irrigated, if any.)

102

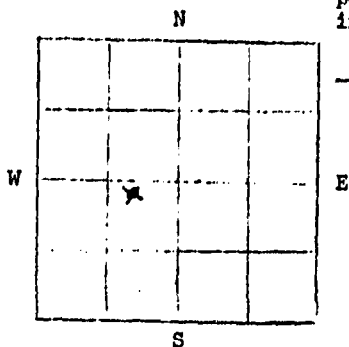

Gravel packing

Driller's License No. 16

Frank Bandy Jr
Driller's Signature

Sec 19, Twp. 55, Rge 51 East.

MONTANA WATER RESOURCES BOARD

RECEIVED

JUN 13 1968

STATE OF MONTANA)
County of Powder River) ss.

Lucille G. Randall, Sec. having first been duly sworn, deposes and says that he is of lawful age and the appropriator and claimant of the order and water right mentioned in the foregoing notice of completion of groundwater appropriation by means of well and the person whose name is subscribed thereto, as the appropriator and claimant, that he knows the contents of said foregoing notice and that the matters and things therein stated are true.

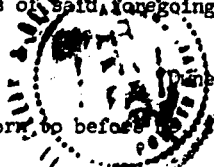

Owner's Signature Randall Inc, by Lucille G. Randall

Subscribed and sworn to before me this 11 day of June, 1968.

Clerk and Recorder

By Myrtle M. Ridenour, Deputy

44,228

File No. 82829
 Filed: 6-11 1968
 at 4:04 P. M.

GW - 2

Charlotte Edwards
 Clerk and Recorder
 Powder River County (Under Chapter 237, Montana Session Laws, 1961)
 By Myrtle M. Pederson, Deputy

Notice of COMPLETION of Groundwater
 Appropriation by Means of Well

Twp 5S Rge 51E

Top of Ground 3030 OWNER Randall Inc Address Broadus, Mont
 Elev. above sea level. DRILLER Randy Drilling Address Broadus, Mont

Date of Notice of Appropriation of Groundwater _____

Date well started June 24 1964 Completed Aug 1964

Type of Well bored Equipment Used by hole digger
 (dug, driven, bored, drilled) (churn, drill, rotary, etc)

Water Use: Domestic ___; Municipal ___; Stock ___; Other ___;
 Industrial ___; Drainage ___; Irrigation X;

Indicate on diagram character and thickness of different strata met in drilling - i, soil, clay, shale, gravel, rock, sand. Show depth at which water is found, thickness and character of water-bearing strata and height to which water rises in well.

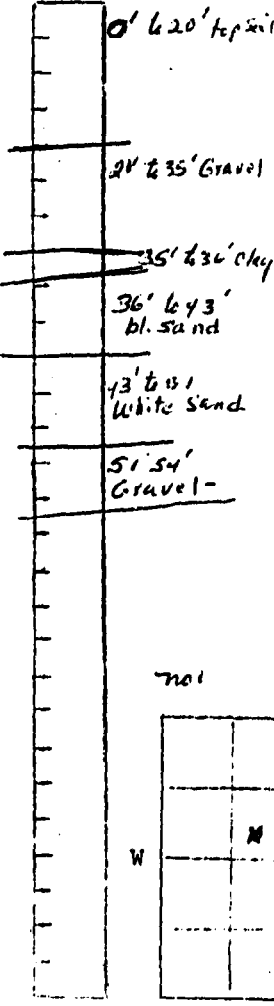

Size of Drilled Hole	Size and Weight of Casing	From (feet)	To (feet)	Perforations		
				Kind	From (feet)	To (feet)
36"	16" 3/8" w/c 11	0	54	Screen	30'	51'

Static Water Level for non-flowing well 12' feet

Shut-in Pressure for Flowing Well _____

Pumping Water Level 40.45' feet at 400 gal. per minute.

Discharge in Gal. per min. of flowing well _____

How Tested Pumped Length of Test 48 hrs.

Remarks: (Gravel packing, cementing, packers, type of shut-off, location of use if not at well, other similar pertinent information, including number of acres irrigated, if any.)

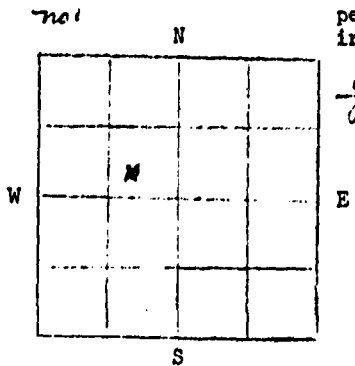

Gravel packing

Driller's License No. 16
Frank Randall Jr.
 Driller's Signature

MONTANA WATER RESOURCES BOARD
RECEIVED
 JUN 19 1968

Sec 19, Twp. 5S, Rge 51 East.

STATE OF MONTANA) ss.
 County of Powder River)

Lucille G. Randall, Sec. having first been duly sworn, deposes and says that he is of lawful age and the appropriator and claimant of the order and water right mention in the foregoing notice of completion of groundwater appropriation by means of well and the person whose name is subscribed thereto, as the appropriator and claimant, that he knows the contents of said foregoing notice and that the matters and things therein set are true.



Owner's Signature Randall Inc, by Lucille G. Randall

Subscribed and sworn to before me, this 11 day of June, 1968.

CHARLOTTE EDWARDS
 CLERK OF POWDER
 BROADUS, MONT. 59317

Clerk and Recorder

Myrtle M. Pederson, Deputy 44,229

7077 Filed,
1953, 1953,
 at 1:00 P. M.
 \$2.00 fee paid

STATE OF MONTANA
 ADMINISTRATOR OF GROUNDWATER CODE
 OFFICE OF STATE ENGINEER

Twp 5 S, Rge 12 E

RECEIVED
 DEC 23 1953

DECLARATION OF VESTED GROUNDWATER RIGHTS
 (Under Chapter 237, Montana Session Laws, 1961)

STATE ENGINEER

1. Ellen A. Phillippi, of Montana,
 County of POWDER RIVER, State of MONTANA, have appropriated groundwater according to
 the Montana Laws in effect prior to January 1, 1962, as follows:

	5-1 ✓	5-1 ✓	5-1 ✓	5-1 ✓	6-12	6-12				
	Sec. 36	Sec. 35	Sec. 24	Sec. 25	Sec. 4	Sec. 3				
WELLS	No. 1	No. 2	No. 3	No. 4	No. 5	No. 6				
2. Beneficial Use	Stock	Domestic	Stock	Stock	Stock	Stock				
3. DATE OF USE	4-20-53	10-11-52	1941	1932	1936	1934				
How continuous	summer	constant	summer	constant	summer	constant				
4. Amount claimed (gal. per minute)	10 gpm	10 gpm	10 gpm	10 gpm	10 gpm	10 gpm				
Irrigated description										
Irrigation owner										
5. Irrigated acreage										
6. Location	NE 1/4	SW 1/4	NE 1/4	SW 1/4	NE 1/4	SW 1/4				
Withdrawal means	well	well	well	well	well	well				
7. Completion date	4-20-53	10-11-52	1941	1932	1936	1934				
8. Water depth table	35'	273'	160'	220'	150'	0'				
Type (drilled or dug)	Drilled	Drilled	Drilled	Drilled	Drilled	Drilled				
9. Size & depth	1" x 173'	2" x 205'	2" x 260'	2" x 250'	3" x 220'	2" x 700'				
10. Estimated annual amount withdrawn										
11. Other information				Well No. 2						
12. Log, if available	Well No. 1			1- 15 12- 20 21- 30 22- 32 23- 33 24- 34 25- 35 26- 36 27- 37 28- 38 29- 39 30- 40 41- 42 43- 44 45- 46 47- 48 49- 50 51- 52 53- 54 55- 56 57- 58 59- 60 61- 62 63- 64 65- 66 67- 68 69- 70 71- 72 73- 74 75- 76 77- 78 79- 80 81- 82 83- 84 85- 86 87- 88 89- 90 91- 92 93- 94 95- 96 97- 98 99- 100 101- 102 103- 104 105- 106 107- 108 109- 110 111- 112 113- 114 115- 116 117- 118 119- 120 121- 122 123- 124 125- 126 127- 128 129- 130 131- 132 133- 134 135- 136 137- 138 139- 140 141- 142 143- 144 145- 146 147- 148 149- 150 151- 152 153- 154 155- 156 157- 158 159- 160 161- 162 163- 164 165- 166 167- 168 169- 170 171- 172 173- 174 175- 176 177- 178 179- 180 181- 182 183- 184 185- 186 187- 188 189- 190 191- 192 193- 194 195- 196 197- 198 199- 200 201- 202 203- 204 205- 206 207- 208 209- 210 211- 212 213- 214 215- 216 217- 218 219- 220 221- 222 223- 224 225- 226 227- 228 229- 230 231- 232 233- 234 235- 236 237- 238 239- 240 241- 242 243- 244 245- 246 247- 248 249- 250 251- 252 253- 254 255- 256 257- 258 259- 260 261- 262 263- 264 265- 266 267- 268 269- 270 271- 272 273- 274 275- 276 277- 278 279- 280 281- 282 283- 284 285- 286 287- 288 289- 290 291- 292 293- 294 295- 296 297- 298 299- 300 301- 302 303- 304 305- 306 307- 308 309- 310 311- 312 313- 314 315- 316 317- 318 319- 320 321- 322 323- 324 325- 326 327- 328 329- 330 331- 332 333- 334 335- 336 337- 338 339- 340 341- 342 343- 344 345- 346 347- 348 349- 350 351- 352 353- 354 355- 356 357- 358 359- 360 361- 362 363- 364 365- 366 367- 368 369- 370 371- 372 373- 374 375- 376 377- 378 379- 380 381- 382 383- 384 385- 386 387- 388 389- 390 391- 392 393- 394 395- 396 397- 398 399- 400 401- 402 403- 404 405- 406 407- 408 409- 410 411- 412 413- 414 415- 416 417- 418 419- 420 421- 422 423- 424 425- 426 427- 428 429- 430 431- 432 433- 434 435- 436 437- 438 439- 440 441- 442 443- 444 445- 446 447- 448 449- 450 451- 452 453- 454 455- 456 457- 458 459- 460 461- 462 463- 464 465- 466 467- 468 469- 470 471- 472 473- 474 475- 476 477- 478 479- 480 481- 482 483- 484 485- 486 487- 488 489- 490 491- 492 493- 494 495- 496 497- 498 499- 500 501- 502 503- 504 505- 506 507- 508 509- 510 511- 512 513- 514 515- 516 517- 518 519- 520 521- 522 523- 524 525- 526 527- 528 529- 530 531- 532 533- 534 535- 536 537- 538 539- 540 541- 542 543- 544 545- 546 547- 548 549- 550 551- 552 553- 554 555- 556 557- 558 559- 560 561- 562 563- 564 565- 566 567- 568 569- 570 571- 572 573- 574 575- 576 577- 578 579- 580 581- 582 583- 584 585- 586 587- 588 589- 590 591- 592 593- 594 595- 596 597- 598 599- 600 601- 602 603- 604 605- 606 607- 608 609- 610 611- 612 613- 614 615- 616 617- 618 619- 620 621- 622 623- 624 625- 626 627- 628 629- 630 631- 632 633- 634 635- 636 637- 638 639- 640 641- 642 643- 644 645- 646 647- 648 649- 650 651- 652 653- 654 655- 656 657- 658 659- 660 661- 662 663- 664 665- 666 667- 668 669- 670 671- 672 673- 674 675- 676 677- 678 679- 680 681- 682 683- 684 685- 686 687- 688 689- 690 691- 692 693- 694 695- 696 697- 698 699- 700 701- 702 703- 704 705- 706 707- 708 709- 710 711- 712 713- 714 715- 716 717- 718 719- 720 721- 722 723- 724 725- 726 727- 728 729- 730 731- 732 733- 734 735- 736 737- 738 739- 740 741- 742 743- 744 745- 746 747- 748 749- 750 751- 752 753- 754 755- 756 757- 758 759- 760 761- 762 763- 764 765- 766 767- 768 769- 770 771- 772 773- 774 775- 776 777- 778 779- 780 781- 782 783- 784 785- 786 787- 788 789- 790 791- 792 793- 794 795- 796 797- 798 799- 800 801- 802 803- 804 805- 806 807- 808 809- 810 811- 812 813- 814 815- 816 817- 818 819- 820 821- 822 823- 824 825- 826 827- 828 829- 830 831- 832 833- 834 835- 836 837- 838 839- 840 841- 842 843- 844 845- 846 847- 848 849- 850 851- 852 853- 854 855- 856 857- 858 859- 860 861- 862 863- 864 865- 866 867- 868 869- 870 871- 872 873- 874 875- 876 877- 878 879- 880 881- 882 883- 884 885- 886 887- 888 889- 890 891- 892 893- 894 895- 896 897- 898 899- 900 901- 902 903- 904 905- 906 907- 908 909- 910 911- 912 913- 914 915- 916 917- 918 919- 920 921- 922 923- 924 925- 926 927- 928 929- 930 931- 932 933- 934 935- 936 937- 938 939- 940 941- 942 943- 944 945- 946 947- 948 949- 950 951- 952 953- 954 955- 956 957- 958 959- 960 961- 962 963- 964 965- 966 967- 968 969- 970 971- 972 973- 974 975- 976 977- 978 979- 980 981- 982 983- 984 985- 986 987- 988 989- 990 991- 992 993- 994 995- 996 997- 998 999- 1000						

STATE OF MONTANA
) ss.
 County of Powder River)

Signature of Owner /s/ Ellen A. Phillippi

Date 12/17/53

Ellen A. Phillippi having first been duly sworn, deposes and says that he is of lawful age and is the appropriator and claimant of the order and water right mentioned in the foregoing Declaration of Vested Groundwater Rights and the person whose name is subscribed thereto, as the appropriator and claimant, that he knows the contents of said foregoing notice and that the matters and things therein stated are true.

Subscribed and sworn to before me this 17th day of December, 1953.

1177

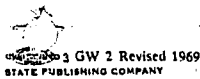

RECEIVED

P-33
County Powder River

STATE OF MONTANA
ADMINISTRATOR OF GROUNDWATER CODE
MONTANA WATER RESOURCES BOARD
NOTICE OF COMPLETION OF GROUNDWATER APPROPRIATION BY MEANS OF WELL
Developed after January 1, 1962

DRILLER'S LOG
Indicate the character, color, thickness of strata such as soil, clay, sand, gravel, shale, sandstone, etc. Show depth at which water is found and height to which water rises in well.

(Under Chapter 237 Montana Session Laws, 1961, as amended)

This form to be prepared by driller, and three copies to be filed by the owner with the County Clerk and Recorder in the county in which the well is located, last copy to be retained by driller.
Please answer all questions. If not applicable, so state, otherwise the form may be returned.

Owner Ellen Phillippi
Address B roadus, Montana
Date well started 5-17-72
completed 5-18-72

For Administrator's Use
File 89692
June 14, 1972 10:20am
GW 1

Top of Ground (Elev. above sea level)

From (Feet)	To (Feet)	
0	12	handy top soil
12	95	blue clay w/coal strks
95	112	blue sand
112	163	blue shale
163	193	blue sand
193	197	blue shale

Type of well drilled
(Dug, driven, bored or drilled)
Equipment used rotary
(Churn drill, rotary or other)
Water Use: Domestic Municipal Stock Irrigation
Industrial Drainage Other * Garden/Lawn
*Describe
USE: If used for irrigation, industrial, drainage or other. Explain, state number of acres and location or other data (i.e. Lot, Block and Addition).

ESTIMATED ANNUAL WITHDRAWAL

Size of Drilled Hole	Size and Weight of Casing	From (Feet)	To (Feet)	PERFORATIONS		
				Kind Size	From (Feet)	To (Feet)
6"	4" 10#	0	197	1x4" slots	165	197

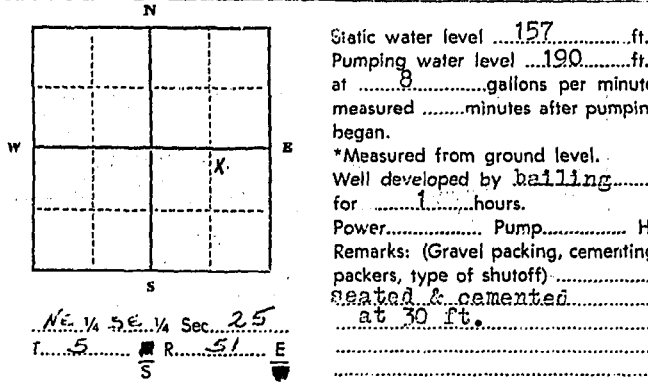

INDICATE LOCATION OF WELL AND PLACE OF USE, IF POSSIBLE. EACH SMALL SQUARE REPRESENTS 40 ACRES.

Driller's Signature Carl Drane
Driller's Address B roadus, Montana

June 14, 1972
June 14, 1972
June 14, 1972
By Carl Drane
Elev. 197

LICENSE NO. 20

197 Show exact depth of bottom
50,620

RECEIVED

County Powder River

STATE OF MONTANA
 ADMINISTRATOR OF GROUNDWATER CODE
 MONTANA WATER RESOURCES BOARD
 MONTANA DEPARTMENT OF NATURAL RESOURCES AND CONSERVATION

NOTICE OF COMPLETION OF GROUNDWATER APPROPRIATION BY MEANS OF WELL

JUN 15 1972

DRILLER'S LOG

Indicate the character, color, thickness of strata such as soil, clay, sand, gravel, shale, sandstone, etc. Show depth at which water is found and height to which water rises in well.

(Under Chapter 237 Montana Session Laws, 1961, as amended)

This form to be prepared by driller, and three copies to be filed by the owner with the County Clerk and Recorder in the county in which the well is located, last copy to be retained by driller. Please answer all questions. If not applicable, so state, otherwise the form may be returned.

Owner Ellen Ph illippi
 Address B roadus, Montana

For Administrator's Use
 File 89692
June 14, 1972 10:02 a.m.
 GW 1

Date well started 5-17-72
 completed 5-18-72

Type of well drilled
 (Dug, driven, bored or drilled)

Equipment used rotary
 (Churn drill, rotary or other)

Water Use: Domestic Municipal Stock Irrigation
 Industrial Drainage Other * Garden/Lawn

*Describe _____
 USE: If used for irrigation, industrial, drainage or other. Explain state number of acres and location or other data (i.e. Lot, Block and Addition): _____

ESTIMATED ANNUAL WITHDRAWAL

Size of Drilled Hole	Size and Weight of Casing	From (Feet)	To (Feet)	PERFORATIONS		
				Kind Size	From (Feet)	To (Feet)
6"	4"	10'	0	197'	1/4" slots	165' - 197'

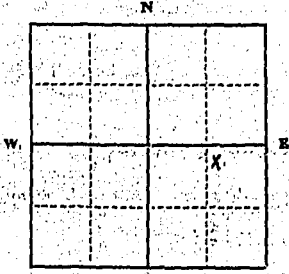

NE 1/4 Sec. 25
T. 5 S. R. 51 E.

Static water level 157 ft.*
 Pumping water level 190 ft.*
 at 8 gallons per minute,
 measured _____ minutes after pumping began.

*Measured from ground level.
 Well developed by bailing
 for 1 hours.
 Power _____ Pump _____ HP
 Remarks: (Gravel packing, cementing, packers, type of shutoff) _____
seated & cemented
at 30 ft.

INDICATE LOCATION OF WELL AND PLACE OF USE, IF POSSIBLE. EACH SMALL SQUARE REPRESENTS 40 ACRES.

Driller's Signature Carl Drone
 Driller's Address B roadus, Montana

Top of Ground (Elev. above sea level)

From (Feet)	To (Feet)	
0	12	sandy top soil
12	95	blue clay w/coal strks
95	112	blue sand
112	168	blue shale
168	193	blue sand
193	197	blue shale

197 ft. depth to water
176 ft. depth to bottom

June 14, 1972
Carl Drone
 Driller
Thomas A. Anderson
 Deputy

LICENSE NO. 20

197 Show exact depth of bottom

(50,620)

75191, Filed,
12/27, 1963,
at 1:00 P.M.

STATE OF MONTANA
ADMINISTRATOR OF GROUNDWATER CODE
OFFICE OF STATE ENGINEER

5 - 27
S, Rge E

RECEIVED
MAR 9 1964

Lucille Godsey, deputy
Clerk and Recorder
\$2.00 fee paid

DECLARATION OF VESTED GROUNDWATER RIGHTS
(Under Chapter 237, Montana Session Laws, 1961)

1. Frank P. Robinson - Virginia L. Robinson, of Harwood, Montana **ENGINEER**,
County of POWDER RIVER, STATE OF MONTANA, have appropriated groundwater according to
the Montana Laws in effect prior to January 1, 1962, as follows:

WELLS	Sec. 27	Sec.	Sec.	Sec.	Sec.	Sec.
	No. 1	No. 2	No. 3	No. 4	No. 5	No. 6
2. Basis of Beneficial Use	Stock					
3. DATE DRILLED	1959					
How continuously used	constant					
4. Amount Claimed (gal. per minute)	10 gpm					
Irrigated description						
Irrigation owner						
5. Irrigated acreage						
Location (40 acres)	SW 1/4					
6. Withdrawal means	windmill					
7. Completion date.	5-9-59					
8. Water depth table	40'					
Type (drilled or dug)	drilled					
9. Size & Depth	4" x 110'					
10. Estimated annual amount withdrawn						
11. Other information						
12. Log, if available	0 - 8 8 - 51 51 - 102 102 - 110	Surface soil sand shale water sand blue shale Water				

STATE OF MONTANA)

Signature of Owner

County of Powder River)

Frank P. Robinson

Virginia L. Robinson

having first been duly sworn, deposes and says that he is of
lawful age and is the appropriator and claimant of the order and water right mentioned in
the foregoing Declaration of Vested Groundwater Rights and the person whose name is sub-
scribed thereto, as the appropriator and claimant, that he knows the contents of said
foregoing notice and that the matters and things therein stated are true.
Subscribed and sworn to before me this

27th. day of December, 1963.

Lucille Godsey, Deputy
Clerk & Recorder, Powder
River County, Broadus, Montana

Frank P. Robinson
Virginia L. Robinson
Date 12/27/63

Frank P. Robinson

35331

File No. 74669
 Filed: 10-22-1963
 at 9:20 A.M.
Billie Godsey deputy
 Clerk and Recorder
 Powder River County
 \$2.00 fee paid

STATE OF MONTANA
 ADMINISTRATOR OF GROUNDWATER CODE
 OFFICE OF STATE ENGINEER

T 5S R 51E

RECEIVED
 OCT 23 1963

NOTICE OF COMPLETION OF GROUNDWATER
 APPROPRIATION BY MEANS OF WELL
 (Under Chapter 237, Montana Session Laws, 1961) STATE ENGINEER

0 Top of Ground
 (Elev. above sea level)
 15 sandy
 35 sandy clay
 45 yellow sand
 63 blue shale & coal
 138 blue shale, coal & sand
 160 rock
 170 blue shale
 194 sand with shale
 218 sandy shale

OWNER Charles L. Russell Address Broadus, Montana

DRILLER Earl Drane Address Broadus, Montana

Date of Notice of Appropriation of Groundwater _____

Date well started 8-20-1963 Completed 8-25-1963

Type of well Drilled Equipment used rotary
 (dug, driven, bored, drilled) (churn, drill, rotary, other)

Water Use: Domestic Municipal Stock Other
 Industrial Drainage Irrigation

Indicate on diagram character and thickness of different strata met in drilling -s, soil, clay, shale, gravel, rock, sand. Show depth at which water is found, thickness and character of water-bearing strata and height to which water rises in well.

Size of Drilled Hole	Size & Weight of Casing	PERFORATIONS		Kind Size	From (feet)	To (feet)
		From (feet)	To (feet)			
5 1/2"	4" 90	0	202	1/2 x 4"	162	202

Static Water Level for non-flowing well 150 feet.

Shut-in Pressure for Flowing Well _____

Pumping Water Level 195 feet at 6 gal. per minute

Discharge in gal. per min. of flowing well _____

How Tested pumping & testing Length of Test 3 hrs.

Remarks: (Gravel packing, cementing, packers, type of shutoff, location of use if not at well, other similar pertinent information, including number of acres irrigated, if any)

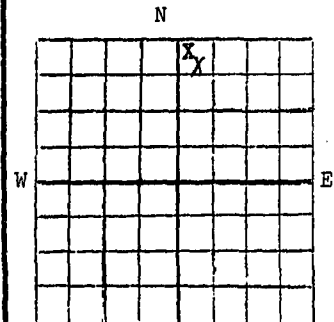

N.W. 1/4 Sec. 37 T.5S R. 51E

STATE OF MONTANA)
 County of Powder River)SS.

Charles L. Russell having first been duly sworn, depose and say that he is not of lawful age and is the appropriator and claimant of the order and water right mentioned in the foregoing notice of completion of groundwater appropriation by means of well and the person whose name is subscribed thereto, as the appropriator and claimant, that he knows the contents of said foregoing notice and that the matters and things therein stated are true.

Charles L. Russell
 Driller's Signature

Subscribed and sworn to before me, this 16th day of Sept., 1963

Billie Godsey, deputy
 Clerk and Recorder, Powder River Co.

6580

75119 Filed,
12/19, 1963,
at 1:40 P. M.
\$2.00 fee paid

STATE OF MONTANA
ADMINISTRATOR OF GROUNDWATER CODE
OFFICE OF STATE ENGINEER

Twp 5 S. Rge. 5 E
RECEIVED
MAR 9 1964

Innille Coffey, deputy Clerk and Recorder
DECLARATION OF VESTED GROUNDWATER RIGHTS
(Under Chapter 237, Montana Session Laws, 1961)

STATE ENGINEER

1. Alvin Wetherelt, of Broadway, Montana, County of POWDER RIVER, State of MONTANA, have appropriated groundwater according to the Montana Laws in effect prior to January 1, 1962, as follows:

	Sec. 29	Sec. 33	Sec. 33	Sec. 33	Sec. 33	Sec.
WELLS	No. 1	No. 2	No. 3	No. 4	No. 5	No. 6
2. Beneficial Use	Stock	Domestic Stock	Stock	Stock	Stock	
3. DATE OF USE	1954	1956	spring	spring		
How continuous	constant	constant	constant	constant		
4. Amount claimed (gal. per minute)	8 gpm	8 gpm	15 gpm	15 gpm		
Irrigated description						
Irrigation owner						
5. Irrigated acreage						
6. Location						
Withdrawal means	artesian	pump	flow	flow		
7. Completion date	3-19-1954	5-25-1956	spring	spring		
8. Water depth table		140'	-0-	-0-		
Type (drilled or dug)	Drilled	Drilled	-0-	-0-		
9. Size & depth	2" x 620'	4" x 111'	-0-	-0-		
10. Estimated annual Amount withdrawn		2" x 189'				
11. Other information	609' cased 260' deep					
12. Log, if available	(See reverse side)					

STATE OF MONTANA)
) ss.
County of Powder River)

Signature of Owner Alvin Wetherelt

Date 12/19/63

Alvin Wetherelt having first been duly sworn, deposes and says that he is of lawful age and is the appropriator and claimant of the order and water right mentioned in the foregoing Declaration of Vested Groundwater Rights and the person whose name is subscribed thereto, as the appropriator and claimant, that he knows the contents of said foregoing notice and that the matters therein stated are true.

Subscribed and sworn to before me this 19th day of December, 1963

Alvin Wetherelt
Innille Coffey, deputy
35230

WELL NUMBER 1

Frank Bandy, Jr.
Brookus, Montana

0 - 10	Surface soil
10 - 20	Blue shale
20 - 30	Sand
30 - 40	Blue shale
40 - 60	Sandy shale
60 - 90	Blue shale
90 - 120	W. sand
120 - 130	Blue shale
130 - 220	water sand
220 - 250	Blue shale
250 - 260	Water sand
260 - 310	Blue shale
310 - 350	Water sand
350 - 370	Blue shale
370 - 510	Water sand
510 - 600	Blue shale
600 - 620	Blue shale

Artesian Water

WELL NUMBER 2

Bandy Drilling Co.
Brookus, Montana

0 - 22	Surface soil
22 - 38	Gravel
38 - 134	Blue shale
134 - 152	Water sand
152 - 192	Blue shale
192 - 232	water sand
232 - 260	blue shale

Water

75260 Filed,
12-30-63, 19 63
at 12:00 AM
L. W. Hill, Clerk
Clerk and Recorder
\$2.00 fee paid

STATE OF MONTANA
ADMINISTRATOR OF GROUNDWATER CODE
OFFICE OF STATE ENGINEER

Twp 6 S, Rge 2 E

RECORDED
MAR 9 1964

DECLARATION OF VESTED GROUNDWATER RIGHTS
(Under Chapter 237, Montana Session Laws, 1961)

1. William J. Stuver, of Broadus, Montana, County of POWDER RIVER, STATE OF MONTANA, have appropriated groundwater according to the Montana Laws in effect prior to January 1, 1962, as follows:

	6S-52E	5S-53E	6S-52E	5S-51E	5S-51E	5S-51E
	+	+	+	+	+	+
	Sec. 8	Sec. 35	Sec. 9	Sec. 31	Sec. 30	Sec. 30
WELLS	No. 1	No. 2	No. 3	No. 4	No. 5	No. 6
1. Basis of Beneficial Use	Stock	Stock	Stock	Stock	Domestic	Stock Domestic
2. DATE DRILLED	1948	1936	1943	1946	1943	1943
3. How continuously used	summer	winter	summer	winter	constant	constant
4. Amount Claimed (gal. per minute)	4 gpm	8 gpm	4 gpm	8 gpm	4 gpm	8 gpm
5. Irrigated description						
6. Irrigation owner						
7. Irrigated acreage						
8. Location (40 acres)	NENE	NENE	E-SE	SWSW	NWNW	NWNW
9. Withdrawal means	pump	artesian	pump	artesian	artesian	artesian
10. Completion date	1948	1936	1943	1946	1943	1943
11. Water depth table	120'	-0-	40'	-0-	-0-	-0-
12. Type (drilled or dug)	drilled	drilled	drilled	drilled	drilled	drilled
13. Size & Depth	2 1/2"x200'	2"x300'	2"x620'	2"x425'	2"x425'	2"x500'
14. Estimated annual amount withdrawn						
15. Other information						
16. Log, if available			NO LOGS			

STATE OF MONTANA)
) ss.
County of Powder River)

Signature of Owner: *William J. Stuver*

Date 10/30/63

William J. Stuver having first been duly sworn, deposes and says that he is of lawful age and is the appropriator and claimant of the order and water right mentioned in the foregoing Declaration of Vested Groundwater Rights and the person whose name is subscribed thereto, as the appropriator and claimant, that he knows the contents of said foregoing notice and that the matters and things therein stated are true.

Subscribed and sworn to before me this 30th day of December, 1963

L. W. Hill
Clerk & Recorder, Powder
River County, Broadus, Montana

William J. Stuver

(35374)

STATE OF MONTANA
ADMINISTRATOR OF GROUNDWATER CODE
MONTANA WATER RESOURCES BOARD
**NOTICE OF COMPLETION OF GROUNDWATER
APPROPRIATION BY MEANS OF WELL**

Developed after January 1, 1962

(Under Chapter 237 Montana Session Laws, 1961, as amended)

This form to be prepared by driller, and three copies to be filed by the owner with the County Clerk and Recorder in the county in which the well is located, last copy to be retained by driller. Please answer all questions. If not applicable, so state, otherwise the form may be returned.

Owner Ranch 11, Inc
Address Broadus, Mont.
Date well started June 18-1968 completed June 18-1968

For Administrator's Use
File _____
GW 1 _____

Type of well Drilled
(Dug, driven, bored or drilled)
Equipment used Rotary
(Churn drill, rotary or other)
Water Use: Domestic Municipal Stock Irrigation
Industrial Drainage Other * Garden/Lawn

*Describe _____
USE: If used for irrigation, industrial, drainage or other. Explain, state number of acres and location or other data (i.e. Lot, Block and Addition). _____

ESTIMATED ANNUAL WITHDRAWAL

Size of Drilled Hole	Size and Weight of Casing	From (Feet)	To (Feet)	PERFORATIONS		
				Kind	From (Feet)	To (Feet)
4 1/2"	2 1/2" 5.89	+2	85	6X4 slot	45	80

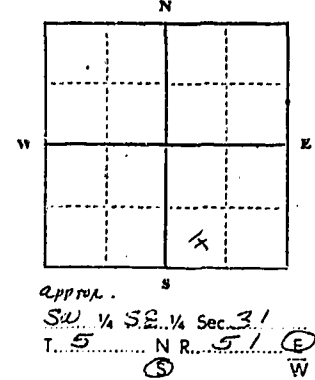

INDICATE LOCATION OF WELL AND PLACE OF USE, IF POSSIBLE. EACH SMALL SQUARE REPRESENTS 40 ACRES.

Driller's Signature Warlan L. Jones
Driller's Address Box 241 Broadus Montana
LICENSE NO. 182

RECEIVED
JUL 10 1968

County Powder River

DRILLER'S LOG

Indicate the character, color, thickness of strata such as soil, clay, sand, gravel, shale, sandstone, etc. Show depth at which water is found and height to which water rises in well.

Top of Ground (Elev. above sea level)		
From (Feet)	To (Feet)	
0	2	Surface Soil
2	26	Sand
26	37	Yellow clay
37	41	Sandy shale
41	73	Sandstone
73	85	Blue shale

FILED Rec. No. 22714
County of Powder River, Montana
I hereby certify that the within instrument was filed for record in this office on the 29 day of June 1968 at 2:24 o'clock P. M. Fee \$2.00 paid
Charlotte Edwards
County Clerk and Recorder
By Delmar P. Parks
Deputy

85 Show exact depth of bottom

56025

STATE OF MONTANA
ADMINISTRATOR OF GROUNDWATER CODE
MONTANA WATER RESOURCES BOARD

RECEIVED
Garry Ufford
Happy Flow
May 10 1973

DRILLER'S LOG

NOTICE OF COMPLETION OF GROUNDWATER
APPROPRIATION BY MEANS OF WELL

Indicate the character, color, thickness of strata such as soil, clay, sand, gravel, shale, sandstone, etc. Show depth at which water is found and height to which water rises in well.

Developed after January 1, 1962

(Under Chapter 237 Montana Session Laws, 1961, as amended)

This form to be prepared by driller, and three copies to be filed by the owner with the County Clerk and Recorder in the county in which the well is located, last copy to be retained by driller. Please answer all questions. If not applicable, so state, otherwise the form may be returned.

Owner Randall, Inc.
Address Broadus, Mont.
Date well started May 7 - 1971
completed May 9 - 1971

For Administrator's Use
File _____
GW 1 _____

Type of well Drilled
Equipment used Rotary
Water Use: Domestic Municipal Stock Irrigation
Industrial Drainage Other Garden/Lawn

*Describe Artesian
USE: If used for irrigation, industrial, drainage or other. Explain, state number of acres and location or other data (i.e. Lot, Block and Addition).

ESTIMATED ANNUAL WITHDRAWAL

Size of Drilled Hole	Size and Weight of Casing	PERFORATIONS		Kind Size	From (Feet)	To (Feet)
		From (Feet)	To (Feet)			
6"	4" 10	89	89			
4"		89	560			
3"		560	840			
	2" 3.62	+2	833	6x4"	615	675
					712	750
					780	833

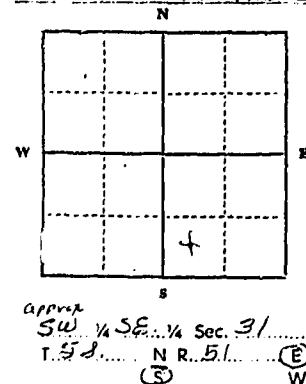

Static water level Flow ft.*
Pumping water level Artesian ft.*
at 6 gallons per minute,
measured 2 hours after pumping
began.
*Measured from ground level.
Well developed by Natural flow
for _____ hours.
Power Artesian Pump _____ HP
Remarks: (Gravel packing, cementing,
packers, type of shutoff)
Sealed by flange packer at
560 ft.

INDICATE LOCATION OF WELL AND PLACE OF USE, IF POSSIBLE. EACH SMALL SQUARE REPRESENTS 40 ACRES.

Driller's Signature Harlan L. Jones
Driller's Address Box 241 Broadus, Montana

Top of Ground (Elev. above sea level)

From (Feet)	To (Feet)	Strata
0	6	Silty sand
6	14	Silty clay
14	19	Shale
19	89	Sandstone
89	109	Grey shale
109	112	Coal
112	135	Sandstone
135	210	Grey shale
210	223	Sandstone
223	229	Coal
229	269	Grey shale
269	318	Sandstone
318	362	Grey shale
362	369	Hard rock
369	378	Sandstone
378	431	Grey shale
431	554	Sandstone
554	614	Grey shale
614	616	Hard rock
616	645	Sandstone
645	647	Hard rock
647	675	Sandstone
675	687	Grey shale
687	693	Sandstone
693	712	Grey shale
712	719	Sandstone
719	776	Grey shale
776	777	Hard rock
777	789	Sandstone
789	791	Hard rock
791	806	Sandstone
806	814	Grey shale
814	831	Sandstone
831	840	Blue shale

FILED Rec. No. 92713
County of Powder River, Montana
I hereby certify that the within
instrument was filed for record in
this office, on the 29 day of
June 1973 at 2:23
o'clock P. M. Fee \$2.00 paid
Charlotte E. Howard
County Clerk and Recorder
By Antonia B. Bantz
Deputy

75169, Filed,
19,
 at _____ M.

(b) STATE OF MONTANA
 ADMINISTRATOR OF GROUNDWATER CODE
 OFFICE OF STATE ENGINEER

Twp 6 S, Rge 5 E

RECEIVED
 MAR 9 1964

Clerk and Recorder
 \$2.00 fee paid

DECLARATION OF VESTED GROUNDWATER RIGHTS
 (Under Chapter 237, Montana Session Laws, 1961)

1. Randall Inc., of Broadus, Montana,
 County of POWDER RIVER, STATE OF MONTANA, have appropriated groundwater according to
 the Montana Laws in effect prior to January 1, 1962, as follows:

Case	60-51E	60-51E	60-51E	60-51E	60-51E	60-51E
	Sec. 9	Sec. 16	Sec. 5	Sec. 6	Sec. 25	Sec. 31
WELLS	No. 1	No. 2	No. 3	No. 4	No. 5	No. 6
2. Beneficial Use	Stock	Stock	Stock	Domestic Stock	Stock	Stock
DATE DRILLED	1935	1940	1952	1930	1930	1941
3. How continuously used	6-10 mo.	6-10 mo.	constant	constant	6-10 mo.	constant
4. (gal. per minute)	3 1/2 gpm	3 1/2 gpm	20 gpm	4 gpm	2 gpm	4 gpm
Irrigated description						
Irrigation owner						
5. Irrigated acreage						
Location (40 acres)	SW 1/4	SW 1/4	SW 1/4	SW 1/4	SW 1/4	SW 1/4
6. Withdrawal means	windmill	windmill	artesian	artesian	artesian	artesian
7. Completion date	1935	1940	1952	1930	1930	1941
8. Water depth table	40'	60'	0	0	0	0
Type (drilled or dug)	Drilled	Drilled	Drilled	Drilled	Drilled	Drilled
9. Size & Depth	4 1/2" x 75'	4 1/2" x 110'	2" x 810'	2" x 750'	2" x 400'	2" x 450'
10. Estimated annual amount withdrawn	300,000	300,000	10,000,000	2,000,000	1,000,000	2,000,000
11. Other information	lower 2nd. sch. well	school sec. well	winter pasture	Carr house	Carr bull past.	Hornor well
12. Log, if available	401-75'	601-110'	7001-810'	6001-750'	3751-400'	4001-450'
	water sand	water sand	water sand	water sand	water sand	water sand

STATE OF MONTANA)
) ss.
 County of Powder River)
 Randall Inc.,
 by Lucille O. Randall, Sec. having first been duly sworn, deposes and says that he is of
 lawful age and is the appropriator and claimant of the order and water right mentioned in
 the foregoing Declaration of Vested Groundwater Rights and the person whose name is sub-
 scribed thereto, as the appropriator and claimant, that he knows the contents of said
 foregoing notice and that the matters and things therein stated are true.
 Subscribed and sworn to before me this
26th day of November, 1963.

Clerk & Recorder, Powder
 River County, Broadus, Montana

75103 Filed, 12/18, 1963 at 3:00 P. M. \$2.00 fee paid

STATE OF MONTANA ADMINISTRATOR OF GROUNDWATER CODE OFFICE OF STATE ENGINEER

Twp 5 S, Rge 2 E

R DEC 23 1963

Loiselle Godwin, deputy Clerk and Recorder DECLARATION OF VESTED GROUNDWATER RIGHTS (Under Chapter 237, Montana Session Laws, 1961)

1. Charles L. Russell, of Broadus, Montana, County of POWDER RIVER, State of MONTANA, have appropriated groundwater according to the Montana Laws in effect prior to January 1, 1962, as follows:

Table with 6 columns (Sec. 23, Sec., Sec., Sec., Sec., Sec.) and 12 rows (WELLS, Basis of Use, DATE OF USE, Amount claimed, Irrigated description, Irrigation owner, Irrigated acreage, Location, Withdrawal means, Completion date, Water depth table, Type (drilled or dug), Size & depth, Estimated annual Amount withdrawn, Other information, Log, if available)

STATE OF MONTANA) ss. County of Powder River)

Signature of Owner Charles L. Russell

Date 12/18/63

Charles L. Russell having first been duly sworn, deposes and says that he is of lawful age and is the appropriator and claimant of the order and water right mentioned in the foregoing Declaration of Vested Groundwater Rights and the person whose name is subscribed thereto, as the appropriator and claimant, that he knows the contents of said foregoing notice and that the matters and things therein stated are true.

Subscribed and sworn to before me this 18th day of December, 1963. Charles L. Russell, Loiselle Godwin, deputy

11234-R

GW

File No. 75895
Filed: 7-29 1964
at 1:00 P.M.
(P. J. M.)
Clerk and Recorder
Powder River County

STATE OF MONTANA
ADMINISTRATOR OF GROUNDWATER CODE
OFFICE OF STATE ENGINEER

T 53 R 513

Powder River
RECEIVED
SEP 2 1964

NOTICE OF COMPLETION OF GROUNDWATER
APPROPRIATION BY MEANS OF WELL
(Under Chapter 237, Montana Session Laws, 1961)

STATE ENGINEER

OWNER Charles L. Russell Address Brookings, Montana
DRILLER Earl Drane Address Brookings, Montana
Date of Notice of Appropriation of Groundwater 7-2-64

Top of Ground
(Elev. above sea
level _____)

0 - 10
10 - 18
18 - 30
30 - 40
40 - 50
50 - 60
60 - 70
70 - 80
80 - 90
90 - 100
100 - 110
110 - 120
120 - 130
130 - 140
140 - 150
150 - 160
160 - 170
170 - 180
180 - 190
190 - 200
200 - 210
210 - 220
220 - 230
230 - 240
240 - 250
250 - 260
260 - 270
270 - 280
280 - 290
290 - 300
300 - 310
310 - 320
320 - 330
330 - 340
340 - 350
350 - 360
360 - 370
370 - 380
380 - 390
390 - 400
400 - 410
410 - 420
420 - 430
430 - 440
440 - 450
450 - 460
460 - 470
470 - 480
480 - 490
490 - 500
500 - 510
510 - 520
520 - 530
530 - 540
540 - 550
550 - 560
560 - 570
570 - 580
580 - 590
590 - 600
600 - 610
610 - 620
620 - 630
630 - 640
640 - 650
650 - 660
660 - 670
670 - 680
680 - 690
690 - 700
700 - 710
710 - 720
720 - 730
730 - 740
740 - 750
750 - 760
760 - 770
770 - 780
780 - 790
790 - 800
800 - 810
810 - 820
820 - 830
830 - 840
840 - 850
850 - 860
860 - 870
870 - 880
880 - 890
890 - 900
900 - 910
910 - 920
920 - 930
930 - 940
940 - 950
950 - 960
960 - 970
970 - 980
980 - 990
990 - 1000

clay
gravel & clay
clay with coal
clay, coal & sand
clay, rock, & coal
sand
shale with rock
rock
sand, shale, coal
shale
rock
shale
sand
sand, shale, rock
shale with thin
hard rock streaks

Date well started _____ Completed _____
Type of well 7-2-64 Equipment used 7-2-64
(dug, driven, percussion drilled) (churn, drill, rotary, other) rotary
Water Use: Domestic Municipal Stock Other
Industrial Drainage Irrigation

Indicate on diagram character and thickness of different strata met in drilling - e.g. soil, clay, shale, gravel, rock, sand. Show depth at which water is found, thickness and character of water-bearing strata and height to which water rises in well.

Size of Hole	Size of Drilled Hole	Weight of Casing (lb)	From (feet)	To (feet)	PERFORATIONS	
					Kind & Size	From (feet) To (feet)
6"	4"	90	0	124	4" slots	14 20 72 122

Static Water Level for non-flowing well _____ feet.
Shut-in Pressure for Flowing Well _____ feet.
Pumping Water Level _____ feet at _____ gal. per minute.
Discharge in gal. per min of flowing well 100
How Tested _____ Length of Test _____

Remarks: (Gravel, casing, cementing, packers, type of shutoff, location of use if not at well, other similar pertinent information, including number of acres irrigated, if any)

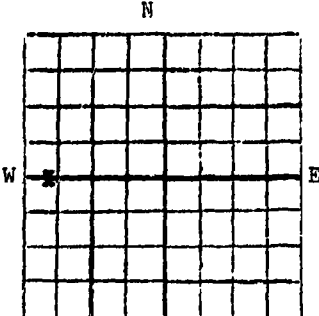

Subdiv. Sec. T. R.
34 34 53 513
STATE OF MONTANA
County of Powder River) SS.

Gravel pack 0-10ft.
drilled to 1200 ft.

30
Driller's License Number
Earl Drane
Driller's Signature

_____ having first been duly sworn, depose and say that Charles L. Russell age and _____ the appropriator and claimant of the order and water right mentioned in the foregoing notice of completion of groundwater appropriation by means of well and the person whose name _____ subscribed thereto, as the appropriator and claimant, that he know the contents of said foregoing notice and that the matters and things therein stated are true.

Charles L. Russell

Subscribed and sworn to before me, this 29th day of July, 1964

Charles W. Edwards
Clerk and Recorder
Brookings, Montana