

73377

DECLARATION OF VESTED GROUND-  
WATER RIGHTS

FRANK LOVELL

RECEIVED  
POWELL COUNTY, MONTANA

February 13th, 19 64  
at \_\_\_\_\_ minutes past 2:45 o'clock  
P. M.

Daniel B. Hertz, Jr.  
Clerk and Recorder

By \_\_\_\_\_ Deputy

Fee \$2.00 Paid

STATE OF MONTANA  
ADMINISTRATOR OF GROUNDWATER CODE  
MONTANA WATER RESOURCES BOARD

NOTICE OF COMPLETION OF GROUNDWATER  
APPROPRIATION BY MEANS OF WELL

Developed after January 1, 1962

(Under Chapter 237 Montana Session Laws, 1961, as amended)

This form to be prepared by driller, and three copies to be filed by the owner with the County Clerk and Recorder in the county in which the well is located, last copy to be retained by driller. Please answer all questions. If not applicable, so state, otherwise the form may be returned.

County Powell

DRILLER'S LOG

Indicate the character, color, thickness of strata such as soil, clay, sand, gravel, shale, sandstone, etc. Show depth at which water is found and height to which water rises in well.

Owner Ken Foreley  
Address Deer Lodge, Montana 59701  
Date well started July 21, 1971  
completed same

For Administrator's Use  
File 87049  
Sept. 14, 1972 - 2:55 p.m.  
GW 1

Type of well Drilled  
(Dug, driven, bored or drilled)

Equipment used Churn Drill  
(Churn drill, rotary or other)

Water Use: Domestic  Municipal  Stock  Irrigation

Industrial  Drainage  Other \* Garden/Lawn

\*Describe .....  
USE: If used for irrigation, industrial, drainage or other. Explain, state number of acres and location or other data (i.e. Lot, Block and Addition). .....

ESTIMATED ANNUAL WITHDRAWAL

Size of Drilled Hole	Size and Weight of Casing	From (Feet)	To (Feet)	PERFORATIONS		
				Kind Size	From (Feet)	To (Feet)
6"	6 5/8" od	+1'	24'	cutting torch	18'	23'

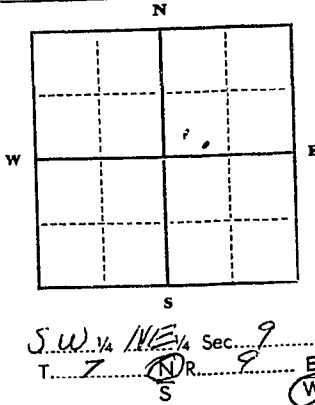

Static water level 6.1 ft.\*  
 Pumping water level 18.1 ft.\*  
 at 20 gallons per minute,  
 measured            minutes after pumping  
 began.  
 \*Measured from ground level.  
 Well developed by bailing  
 for 1 hours.  
 Power            Pump            HP  
 Remarks: (Gravel packing, cementing,  
 packers, type of shutoff)           

Top of Ground (Elev. above sea level)		
From (Feet)	To (Feet)	
0'	1'	top soil
1'	8'	clay and hard pan
8'	16'	sand and gravel
16'	24'	sand and gravel water

INDICATE LOCATION OF WELL AND PLACE OF USE, IF POSSIBLE. EACH SMALL SQUARE REPRESENTS 40 ACRES.

Driller's Signature O'Keefe Contracting Company  
Driller's Address 2304 Harvard Ave.

Butte, Montana LICENSE NO. 8

24' Show exact depth of bottom

51,382

87049

NOTICE OF COMPLETION OF GROUNDWATER  
APPROPRIATION BY MEANS OF WELL

KEN MORELEY

**RECEIVED**  
**POWELL COUNTY, MONTANA**

September 14th 19 72

at \_\_\_\_\_ minutes past 2:55 o'clock

P. M.

*Bonnie J. Miller*

Clerk and Recorder

By \_\_\_\_\_  
Aast. Deputy

Fee \$ 2.00

County Powell

STATE OF MONTANA  
ADMINISTRATOR OF GROUNDWATER CODE  
MONTANA WATER RESOURCES BOARD

**NOTICE OF COMPLETION OF GROUNDWATER  
APPROPRIATION BY MEANS OF WELL**

Developed after January 1, 1962

(Under Chapter 237 Montana Session Laws, 1961, as amended)

This form to be prepared by driller, and three copies to be filed by the owner with the County Clerk and Recorder in the county in which the well is located, last copy to be retained by driller.

Please answer all questions. If not applicable, so state, otherwise the form may be returned.

Owner Ken Morley  
Address Deer Lodge, Montana  
Date well started July 20, 1972 completed same

For Administrator's Use	
File	<u>87048</u>
<u>Sept. 14, 1972 - 2:50 p.m.</u>	

Type of well drilled  
(Dug, driven, bored or drilled)

Equipment used churn drill  
(Churn drill, rotary or other)

Water Use: Domestic  Municipal  Stock  Irrigation   
Industrial  Drainage  Other \* Garden/Lawn

\*Describe  
USE: If used for irrigation, industrial, drainage or other. Explain, state number of acres and location or other data (i.e. Lot, Block and Addition).

ESTIMATED ANNUAL WITHDRAWAL

Size of Drilled Hole	Size and Weight of Casing	From (Feet)	To (Feet)	PERFORATIONS		
				Kind Size	From (Feet)	To (Feet)
6"	6 5/8" o.d. w. 250	+1'	40'	cutting torch	33'	38'

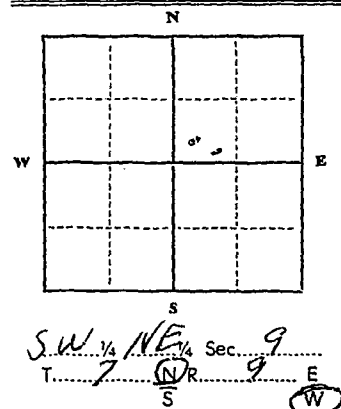

Static water level 16' ft.\*  
Pumping water level at 30' galls. measured 2 minutes began.  
\*Measured from Well developed for 2 days  
Power 1 HP  
Remarks: (Gravel packing, cementing, packers, type of shutoff)

INDICATE LOCATION OF WELL AND PLACE OF USE, IF POSSIBLE. EACH SMALL SQUARE REPRESENTS 40 ACRES.

Driller's Signature O'Keefe Contracting Company  
W. F. Keithfield  
Driller's Address 2804 Harvard Ave.

Butte, Montana 59701 LICENSE NO. 8

**DRILLER'S LOG**

Indicate the character, color, thickness of strata such as soil, clay, sand, gravel, shale, sandstone, etc. Show depth at which water is found and height to which water rises in well.

Top of Ground		(Elev. above sea level)
From (Feet)	To (Feet)	
0'	1'	top soil
1'	12'	clay
12'	16'	sand and gravel
16'	30'	sand and gravel water
30'	33'	dirty sand
33'	40'	sand gravel water

40' Show exact depth of bottom

51,381

87048

NOTICE OF COMPLETION OF GROUNDWATER  
APPROPRIATION BY MEANS OF WELL

KEN MORLEY

**RECEIVED**  
**POWELL COUNTY, MONTANA**

September 14th 1972

at \_\_\_\_\_ minutes past 2:50 o'clock

P.M.

*Bessie L. Miller*

Clerk and Recorder

By

*[Signature]*  
Asst. Deputy

Fee \$ 2.00

RECEIVED

County DeWitt

STATE OF MONTANA  
ADMINISTRATOR OF GROUNDWATER CODE  
MONTANA WATER RESOURCES BOARD

NOTICE OF COMPLETION OF GROUNDWATER  
APPROPRIATION BY MEANS OF WELL

Developed after January 1, 1962

DRILLER'S LOG

Indicate the character, color, thickness of strata such as soil, clay, sand, gravel, shale, sandstone, etc. Show depth at which water is found and height to which water rises in well.

(Under Chapter 237 Montana Session Laws, 1961, as amended)

This form to be prepared by driller, and three copies to be filed by the owner with the County Clerk and Recorder in the county in which the well is located, last copy to be retained by driller.

Please answer all questions. If not applicable, so state, otherwise the form may be returned.

Owner Merle Morman

Address Deer Lodge,

Montana 59722

Date well started 3/18/69

completed 3/20/69

Type of well Drilled

Equipment used Churn drill

Water Use: Domestic  Municipal  Stock  Irrigation

Industrial  Drainage  Other \* Garden/Lawn

\*Describe

USE: If used for irrigation, industrial, drainage or other. Explain, state number of acres and location or other data (i.e. Lot, Block and Addition).

ESTIMATED ANNUAL WITHDRAWAL

Size of Drilled Hole	Size and Weight of Casing	From (Feet)	To (Feet)	PERFORATIONS		
				Kind Size	From (Feet)	To (Feet)
6"	6" I.D. 17 lb.	0'	128'	cutting torch	123'	128'

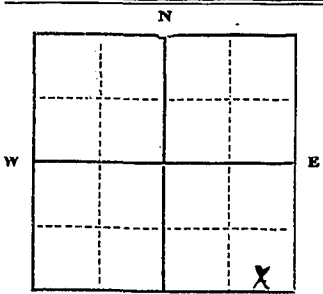

SE 1/4 SE 1/4 Sec. 9  
T. 7 N. R. 9 W.

INDICATE LOCATION OF WELL AND PLACE OF USE, IF POSSIBLE. EACH SMALL SQUARE REPRESENTS 40 ACRES.

Driller's Signature O. KEEFE CONTRACTING COMPANY

Driller's Address 2804 Harvard Avenue

Butte, Montana 59701 LICENSE NO. 8

Top of Ground		(Elev. above sea level)
From (Feet)	To (Feet)	
0'	2'	surface soil
2'	10'	red clay
10'	30'	red clay & gravel
30'	46'	red clay & gravel
46'	90'	clay (broken)
90'	121'	sandy
121'	130'	water
		sandy gravel

128' Show exact depth of bottom

53,090

88199

NOTICE OF COMPLETION OF GROUNDWATER  
APPROPRIATION BY MEANS OF WELL

MERLE MORMAN

RECEIVED  
POWELL COUNTY, MONTANA  
May 3rd 1973  
At \_\_\_\_\_ minutes past 9:45 o'clock  
\_\_\_\_\_ A.M.  
*Bonnie J. Miller*  
Clerk and Recorder  
By \_\_\_\_\_  
Asst. Deputy  
Fee \$ 2.00

File No. ....

T. .... R. ....

DUPLICATE

LOG

County, Jefferson Powell

STATE OF MONTANA  
ADMINISTRATOR OF GROUNDWATER CODE  
STATE WATER CONSERVATION BOARD

**Notice of Completion of Groundwater  
Appropriation by Means of Well**  
DEVELOPED AFTER JANUARY 1, 1962

(Under Chapter 237 Montana Session Laws, 1961, as amended)

Owner Robert A. Smith Address Deer Lodge

Driller C. F. Wroble Address Rte. 1, Millcreek

Anaconda, Montana

Date of Notice of appropriation of groundwater.....

Date well started August 4, 1967 Date completed August 3, 1967

Type of well Drilled Equipment used Churn Drill  
(Dug, driven, bored or drilled) (Churn drill, rotary or other)

Water use: Domestic  Municipal  Stock  Irrigation   
Industrial  Drainage  Other

Indicate on the diagram the character and thickness of the different strata met with in drilling, such as soil, clay, shale, gravel, rock or sand, etc. Show depth at which water is encountered, thickness and character of water-bearing strata and height to which the water rises in the well.



Top of Ground  
(Elev. above sea level.....)

2 ft. Topsoil

91 ft. Sand, Gravel,  
Clay mix  
Intermittent  
layers

93 ft. Sand, Gravel  
Water bearing  
(Packed)  
3 gal. per min.

126 ft. Sand, Gravel,  
Clay mix  
Intermittent  
layers

131 ft. Sand, Gravel  
Water bearing

Size of Drilled Hole	Size and Weight of Casing	From (Feet)	To (Feet)	PERFORATIONS		
				Kind Size	From (Feet)	To (Feet)
6"	28 lbs. per ft.			3/16x5"	126	131

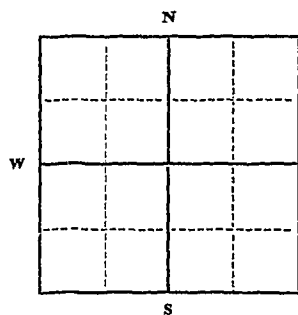

Static Water Level for non-flowing well  
..... 39 feet.

Shut-in Pressure for Flowing Well.....

Pumping Water Level..... 90 feet

at..... 20 gal. per minute.

Discharge in gal. per min. of flowing well  
.....

How Tested Baled

Length of Test 3 hrs.

Remarks: (Gravel packing, cementing, packers, type of shutoff).....

1/4 Sec. 7 T. .... R. ....  
Indicate location of well and place of use, if possible. Each small square represents 40 acres.

(Continue on reverse side)

USE—If used for irrigation, industrial, drainage or other. Explain, state number of acres and location or other data (i.e.: Lot, Block and Addition).

Show exact depth of bottom.

This form to be prepared by driller, and three copies to be filed by the owner with the County Clerk and Recorder in the county in which the well is located, tissue copy to be retained by driller.

Please answer all questions. If not applicable, so state, otherwise the form will be returned.

62  
Driller's License Number

C. F. Wroble  
Driller's Signature

45731



82423

**RECEIVED  
POWELL COUNTY, MONTANA**

October 14th 1969

at \_\_\_\_\_ minutes past 11:20 o'clock

A. M.

Elfa McDonough  
Clerk and Recorder

By \_\_\_\_\_ Deputy

Fee \$ \_\_\_\_\_

MONTANA WATER RESOURCES BOARD  
**RECEIVED**

FEB 18 1970

MONTANA WATER RESOURCES BOARD  
Groundwater Division  
Mitchell Building  
Helena, Montana 59601

Recently a copy of a groundwater appropriation form,

- GW 1, Notice of Appropriation of Groundwater
- GW 2, Notice of Completion of Groundwater Appropriation by means of Well
- GW 3, Notice of Completion of Groundwater Appropriation without Well
- GW 4, Declaration of Vested Groundwater Rights (This form is obsolete and was limited by law to use only through 1965)

was forwarded to this office by the County Clerk and Recorder.

This form is identified by \_\_\_\_\_ S. of Deer Lodge  
Owner Robert A. Smith Address Deer Lodge, Montana 59722  
Location \_\_\_\_\_ Document No. 82423

The form is complete as filed. This is to inform you that your GW form has been received and no further action is necessary on your part.

The form is incomplete. Please complete the enclosed copy by providing information where indicated, or as noted here and return the corrected copy to the Montana Water Resources Board in Helena.

Please indicate exact location of well site by Township, Range, Section.

Other.

County recording information is missing. Please forward this information to the Montana Water Resources Board in Helena.

*Douglas E. Smith*

**USE**—If used for irrigation, industrial, drainage or other. Explain, state number of acres and location of other data (i.e.: Lot, Block and Addition).

Show exact depth of bottom.

This form to be prepared by driller, and three copies to be filed by the owner with the County Clerk and Recorder in the county in which the well is located, tissue copy to be retained by driller.

Please answer all questions. If not applicable, so state, otherwise the form will be returned.

82  
Driller's License Number

*C. E. W. Wells*  
Driller's Signature. *C.M.*

45731

MONTANA WATER RESOURCES BOARD  
**RECEIVED**

FEB 18 1970

MONTANA WATER RESOURCES BOARD  
Groundwater Division  
Mitchell Building  
Helena, Montana 59601

Recently a copy of a groundwater appropriation form,

- GW 1, Notice of Appropriation of Groundwater
- GW 2, Notice of Completion of Groundwater Appropriation by means of Well
- GW 3, Notice of Completion of Groundwater Appropriation without Well
- GW 4, Declaration of Vested Groundwater Rights (This form is obsolete and was limited by law to use only through 1965)

was forwarded to this office by the County Clerk and Recorder.

This form is identified by

Owner Robert A. Smith

S. of Deer Lodge

Address Deer Lodge, Montana 59722

Location \_\_\_\_\_

Document No. 82423

The form is complete as filed. This is to inform you that your GW form has been received and no further action is necessary on your part.

The form is incomplete. Please complete the enclosed copy by providing information where indicated, or as noted here and return the corrected copy to the Montana Water Resources Board in Helena.

Please indicate exact location of well site by Township, Range, Section.

Other.

County recording information is missing. Please forward this information to the Montana Water Resources Board in Helena.

*Douglas G. Smith*

USE—If used for irrigation, industrial, drainage or other. Explain, state number of acres and location or other data (i.e.: Lot, Block and Addition).

Show exact depth of bottom.

This form to be prepared by driller, and three copies to be filed by the owner with the County Clerk and Recorder in the county in which the well is located, tissue copy to be retained by driller.

Please answer all questions. If not applicable, so state, otherwise the form will be returned.

62  
Driller's License Number

*C. J. W. W. W.*  
Driller's Signature. *A.M.*

45731

RECEIVED

FEB 18 1970

T. 7N R. 9W

County Jefferson Powell

DUPLICATE

LOG

STATE OF MONTANA  
ADMINISTRATOR OF GROUNDWATER CODE  
STATE WATER CONSERVATION BOARD

Notice of Completion of Groundwater  
Appropriation by Means of Well

DEVELOPED AFTER JANUARY 1, 1962

(Under Chapter 237 Montana Session Laws, 1961, as amended)

Owner Robert A. Smith Address Deer Lodge

Driller C. F. Wreble Address Ste. 1, Millcreek  
Anaconda, Montana

Date of Notice of appropriation of groundwater.....

Date well started August 4, 1967 Date completed August 8, 1967

Type of well Drilled Equipment used Churn Drill  
(Dug, driven, bored or drilled) (Churn drill, rotary or other)

Water use: Domestic  Municipal  Stock  Irrigation   
Industrial  Drainage  Other

Indicate on the diagram the character and thickness of the different strata met with in drilling, such as soil, clay, shale, gravel, rock or sand, etc. Show depth at which water is encountered, thickness and character of water-bearing strata and height to which the water rises in the well.

91 ft. Sand, Gravel,  
Clay mix  
Intermittent  
layers

93 ft. Sand, Gravel  
Water bearing  
(Passed)  
3 gal. per min.

126 ft. Sand, Gravel,  
Clay mix  
Intermittent  
layers

131 ft. Sand, Gravel  
Water bearing

Size of Drilled Hole	Size and Weight of Casing	From (Feet)	To (Feet)	PERFORATIONS		
				Kind Size	From (Feet)	To (Feet)
6"	28 lbs. per ft.			3/16x5"	126	131

Static Water Level for non-flowing well ..... 39 feet.  
Shut-in Pressure for Flowing Well.....  
Pumping Water Level..... 90 feet  
at..... 20..... gal. per minute.  
Discharge in gal. per min. of flowing well .....  
How Tested Baled  
Length of Test..... 3 hrs.  
Remarks: (Gravel packing, cementing, packers, type of shutoff).....  
.....  
.....  
..... (Continue on reverse side)

SE 1/4 Sec. 9 T. 7N R. 9W  
Indicate location of well and place of use, if possible. Each small square represents 40 acres.

USE—If used for irrigation, industrial, drainage or other. Explain, state number of acres and location or other data (i.e.: Lot, Block and Addition).

Show exact depth of bottom.

This form to be prepared by driller, and three copies to be filed by the owner with the County Clerk and Recorder in the county in which the well is located, tissue copy to be retained by driller.

Please answer all questions. If not applicable, so state, otherwise the form will be returned.

62  
Driller's License Number

C. F. Wreble  
Driller's Signature. C.F.M.

45731

File No. ....

T. T.N. R. R.H.

DUPLICATE

County Powell

STATE OF MONTANA  
ADMINISTRATOR OF GROUNDWATER CODE  
OFFICE OF STATE ENGINEER

RECEIVED  
MAR 17 1964  
STATE ENGINEER

Top of Ground  
(Elev. above sea level.....)

10  
20  
30

0-4 Topsoil  
4-10 gravel  
10-25 silt & sand  
25-36 gravel & sand

### Notice of Completion of Groundwater Appropriation by Means of Well

(Under Chapter 237, Montana Session Laws, 1961)

(Genroe L. Rennifield)  
Owner George Renfield Address Deer Lodge, Montana

Driller C. Keefe Drilling Co. Address Deer Lodge, Montana

Date of Notice of Appropriation of Groundwater.....

Date well started August 15, 1963 Date Completed August 18, 1963

Type of well drilled Equipment Used churn drill  
(dug, driven, bored or drilled) (Churn, drill, rotary or other)

Water Use: Domestic  Municipal  Other  Irrigation   
Industrial  Drainage  Stock

Indicate on the diagram the character and thickness of the different strata met with in drilling, such as soil, clay, shale, gravel, rock or sand, etc. Show depth at which water is encountered, thickness and character of water-bearing strata and height to which water rises in the well.

Size of Drilled Hole	Size and Weight of Casing	From (Feet)	To (Feet)	PERFORATIONS		
				Kind Size	From (Feet)	To (Feet)
6"	6" 17#	0	37	torch	31	36

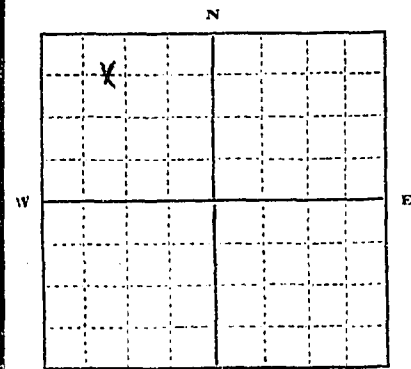

N. 1/4 Sec. 9 T. 7N R. 9E  
Indicate location of well and place of use, if possible. Each small square represents 10 acres.

Show exact depth of bottom.

Static Water Level for non-flowing Well.....feet.

Shut-in Pressure for Flowing Well.....

Pumping Water Level.....25 feet at 25 gal. per minute.

Discharge in gal. per min. of flowing well.....

How Tested centrifugal pump Length of Test 4 hrs.

Remarks: (Gravel packing, cementing, packers, type of shutoff, location of place of use of groundwater if not at well, and any other similar pertinent information, including number of acres irrigated, if used for irrigation).....

License No. 8  
Driller's License Number

Emmett Keefe  
Driller's Signature

This form to be prepared by driller, and three copies to be filed by the owner with the County Clerk and Recorder in the county in which the well is located.

Please answer all questions. If not applicable, so state, otherwise the form will be returned.

Original to the County Clerk and Recorder; duplicate to the State Engineer; Triplicate to the Montana Bureau of Mines and Geology and Quadruplicate for the Appropriator.

35469

73532

NOTICE OF COMPLETION OF GROUND-  
WATER APPROPRIATION BY MEANS OF  
WELL

GEORGE L. RENNIFIELD

RECEIVED  
POWELL COUNTY, MONTANA

March 16th, 19 64  
at \_\_\_\_\_ minutes past 10:55 o'clock  
A.M.

Daniel B. Hertz, Jr.  
Clark and Recorder

By \_\_\_\_\_ Deputy

Fee \$ 2.00 Paid

GW3

File No.....

T. 7N R. 9W

DUPLICATE

County Powell

9

STATE OF MONTANA  
ADMINISTRATOR OF GROUNDWATER CODE  
OFFICE OF STATE ENGINEER

RECEIVED  
JAN 17 1964

Notice of Completion of Groundwater Appropriation Without Well

(Under Chapter 237 Montana Session Laws, 1961)

Date of Appropriation of Groundwater 1931  
Don F. Valiton and

Owner Margaret B. Valiton Address Deer Lodge, Montana

Contractor (if any) .....

Address of Contractor .....

Date Started 1931 Date Completed 1932

Describe means of obtaining groundwater without a well "as by sub-irrigation and other natural processes". Include depth to

water when applicable. a borrow pit was dug alongside of U.S. Highway No. 10 -- on each side of the highway -- at the time it was constructed through owners' lands. (This highway has since been abandoned.) The borrow pits gathered underground water, which has been used since 1931 for stock water; and is suitable for irrigation; and has been used for the latter.

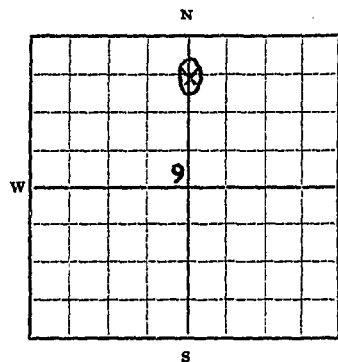

Sec. 9 T. 7N. R. 9W.

Indicate point of appropriation and place of use, if possible.

The above point of appropriation and place of use is more particularly described as: Tracts 101 and 102 and tract lying west of Tracts 91, 92, and 93, of the "Valiton Ranch", according to the plat on file and of record in the office of the County Clerk and Recorder of Powell County, Montana.

Quantity of water developed and used with explanation of method used to measure or estimate such amount. If use is intermit-

tent estimate approximate lengths of periods of use 20% is a small part of the total flow; and this is used year around for stock water and for irrigation, during the growing season.

Signature of Owner Margaret B. Valiton

Robert Valiton  
Date December 31, 1963

This form to be prepared by contractor (if any), otherwise by the owner.

Three copies of this notice are to be filed with the County Clerk and Recorder of the county in which the works are located.

Please answer all questions. If not applicable, so state, otherwise the form will be returned.

Original to the County Clerk and Recorder; duplicate to the State Engineer; Triplicate to the School of Mines and Quadruplicate for the Appropriator.

73076

NOTICE OF COMPLETION OF GROUND-  
WATER APPROPRIATION WITHOUT WELL

DON F. VALITON, ET UX

**RECEIVED**  
**POWELL COUNTY, MONTANA**

December 31st, 19 63  
at \_\_\_\_\_ minutes past 5:09 o'clock  
P.M.

Daniel B. Hertz, Jr.  
Clerk and Recorder

By \_\_\_\_\_  
Deputy

Fee \$2.00 Paid



RECEIVED

File No. ....

APR 14 1973

T. .... R. ....

DUPLICATE

LOG

MONTANA DEPARTMENT OF NATURAL RESOURCES AND CONSERVATION

County Beaumont

STATE OF MONTANA ADMINISTRATOR OF GROUNDWATER CODE STATE WATER CONSERVATION BOARD

Notice of Completion of Groundwater Appropriation by Means of Well DEVELOPED AFTER JANUARY 1, 1962

(Under Chapter 237 Montana Session Laws, 1961, as amended)

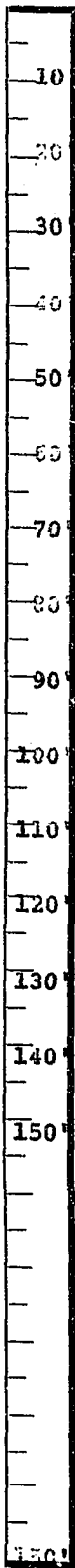

Top of Ground (Elev. above sea level.....)

0'-28' hand dug well

28'-60' sandy clay

90'-107' clay-trace of water

Doc. No. 88044 Filed for record this 6th day of April A. D. 1973 at 4:30 o'clock P.M.

water @ 1gpm water, sand

Owner Richard B. Biehler Address Carvison, Mont

Driller Edmond O. Kiefer Address Beaumont, Montana

Date of Notice of appropriation of groundwater August 2, 1968

Date well started 7/25/68 Date completed 7/26/68

Type of well drilled Equipment used Chubb drill, rotary & other

Water use: Domestic  Municipal  Stock  Irrigation  Industrial  Drainage  Other

Indicate on the diagram the character and thickness of the different strata met with in drilling, such as soil, clay, shale, gravel, rock or sand, etc. Show depth at which water is encountered, thickness and character of water-bearing strata and height to which the water rises in the well.

Table with columns: Size of Drilled Hole, Size and Weight of Casing, From (Feet), To (Feet), PERFORATIONS (Kind Size, From (Feet), To (Feet)).

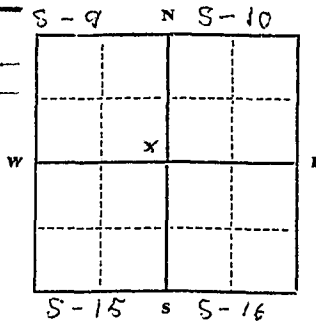

Static Water Level for non-flowing well ..... feet. Shut-in Pressure for Flowing Well ..... Pumping Water Level ..... 145' feet at ..... gal. per minute. Discharge in gal. per min. of flowing well .....

How Tested baller Length of Test 2 hrs

Remarks: (Gravel packing, cementing, packers, type of shutoff) .....

SE 1/4 Sec. 9 T. 1 N. R. 9 W. Indicate location of well and place of use, if possible. Each small square represents 40 acres.

(Continue on reverse side)

USE—If used for irrigation, industrial, drainage or other. Explain, state number of acres and location or other data (i.e.: Lot, Block and Addition).

Show exact depth of bottom.

This form to be prepared by driller, and three copies to be filed by the owner with the County Clerk and Recorder in the county in which the well is located, tissue copy to be retained by driller.

Please answer all questions. If not applicable, so state, otherwise the form will be returned.

Driller's License Number

Driller's Signature Edmond O. Kiefer

52,853.

88044

NOTICE OF COMPLETION OF GROUNDWATER  
APPROPRIATION BY MEANS OF WELL

RICHARD FINKBIENER

FILED FOR RECORD  
APR 11 1973

**RECEIVED**  
**POWELL COUNTY, MONTANA**

April 6th 1973

at \_\_\_\_\_ minutes past 4:30 o'clock

\_\_\_\_\_ P. M.

*Louise J. Miller*  
Clerk and Recorder

By \_\_\_\_\_  
Asst. Deputy

Fee \$ 2.00

GW

Doc. No. 84704

Approved Stock Form—State Publishing Co., Helena, Montana—425-3

File No. Filed for record this 11 day of May

T. 7N R. 9W

DUPLICATE A. D. 19 71, at 10:45 o'clock P.M. MAY 13 1971

County Powell

STATE OF MONTANA ADMINISTRATOR OF GROUNDWATER CODE OFFICE OF STATE ENGINEER

Notice of Completion of Groundwater Appropriation by Means of Well

DEVELOPED AFTER JANUARY 1, 1962

(Under Chapter 237, Montana Session Laws, 1961)

Owner Joe D. HARRIET Gabel Address Deer Lodge Mont.

Driller PRICE - LINDSAY Address C. L. MONT.

Date of Notice of appropriation of groundwater

Date well started Sept. 10, 1955 Date completed Sept. 15, 1955

Type of well Drilled Equipment used Churn Drill

Water use: Domestic [X] Municipal [ ] Stock [ ] Irrigation [ ] Industrial [ ] Drainage [ ] Other [ ]

Top of Ground (Elev. above sea level)

0-16' firm Clay Some sand + gravel

16'-42' firm some what sticky clay

42'-56' firm sandy clay

56'-73' silty sand clay

73'-75' firm sandy clay

75'-88' silty clay

88'-89' fine silty sand (water app. 3.4 P.M.)

89'-104' silty sandy clay

104'-104'6" firm clay Bound Sand + gravel

104'6"-112' silty clay

112'-122' alternate shallow strata of tight sandy clay + water bearing tight fine gravel + sand

STATIC Level app. 82' from ground elev.

Pump should be set at least 115' from ground elev. to free of any trouble from water level fluctuation

Indicate on the diagram the character and thickness of the different strata met with in drilling, such as soil, clay, shale, gravel, rock or sand, etc. Show depth at which water is encountered, thickness and character of water-bearing strata and height to which the water rises in the well.

Table with columns: Size of Drilled Hole, Size and Weight of Casing, From (Feet), To (Feet), PERFORATIONS (Kind Size, From (Feet), To (Feet)).

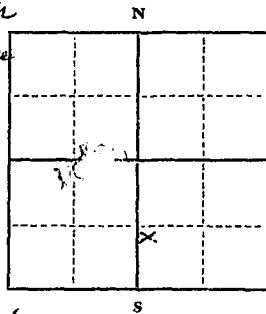

Static Water Level for non-flowing well 86 feet.

Shut-in Pressure for Flowing Well

Pumping Water Level 6.5 feet at 1.5 gal. per minute.

Discharge in gal. per min. of flowing well

How Tested Bailing

Length of Test 3 hrs

Remarks: (Gravel packing, cementing, packers, type of shutoff)

(Continue on reverse side)

USE—If used for irrigation, industrial, drainage or other. Explain, state number of acres and location or other data (i.e.: Lot, Block and Addition).

Show exact depth of bottom.

This form to be prepared by driller, and three copies to be filed by the owner with the County Clerk and Recorder in the county in which the well is located, tissue copy to be retained by driller.

Please answer all questions. If not applicable, so state, otherwise the form will be returned.

Driller Registration No. 206 Driller's License Number

Robert Price Driller's Signature

48463

SL704

NOTICE OF COMPLETION OF GROUNDWATER  
APPROPRIATION BY MEANS OF WELL

JOE D. GABELHIE et ux

RECEIVED

POWELL COUNTY, MONTANA

May 11th 1971

at \_\_\_\_\_ minutes past 4:45 o'clock

P. M.

*Bonnie J. Hiller*  
Clerk and Recorder

By *EP*  
Asst. Deputy

Fee \$ 2.00+

File No. ....

T. 7 N. R. 9 W. 11

DUPLICATE

County: Powell

STATE OF MONTANA  
 ADMINISTRATOR OF GROUNDWATER CODE  
 OFFICE OF STATE ENGINEER

RECEIVED  
 DEC 27 1963  
 STATE ENGINEER

**Declaration of Vested Groundwater Rights**

(Under Chapter 237, Montana Session Laws, 1961)

1. Paul C. Elberson, of Box 565 Deer Lodge  
 (Name of Appropriator) (Address) (Town)  
 County of Powell State of Montana  
 have appropriated groundwater according to the Montana laws in effect prior to January 1, 1962, as follows:

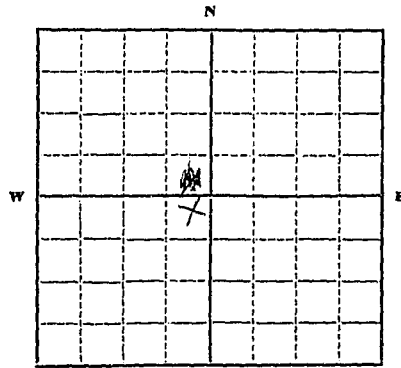

SW 1/4 Sec 11 T. 7 N. R. 9 W.

Indicate point of appropriation and place of use, if possible. Each small square represents 10 acres.

2. The beneficial use on which the claim is based... House Hold
3. Date or approximate date of earliest beneficial use; and how continuous the use has been... 1864 continuous use since that date
4. The amount of groundwater claimed (in miner's inches or gallons per minute)... 25 Gal per minute
5. If used for irrigation, give the acreage and description of the lands to which water has been applied and name of the owner thereof... Does not apply
6. The means of withdrawing such water from the ground and the location of each well or other means of withdrawal... Electric pump at well
7. The date of commencement and completion of the construction of the well, wells, or other works for withdrawal of groundwater... 1864
8. The depth of water table... 20 ft.
9. So far as it may be available, the type, size and depth of each well or the general specifications of any other works for the withdrawal of groundwater... 22 Ft deep 4 Ft Dia Rock sides
10. The estimated amount of groundwater withdrawn each year... 20,000 Gals per Year
11. The log of formations encountered in the drilling of each well if available... None
12. Such other information of a similar nature as may be useful in carrying out the policy of this act, including reference to book and page of any county record... None

Signature of Owner: Paul C. Elberson  
 Date: Dec 26, 1963

Three copies to be filed by the owner with the County Clerk and Recorder of the county in which the well is located.

Please answer all questions. If not applicable, so state, otherwise the form will be returned.

Original to the County Clerk and Recorder; duplicate to the State Engineer; Triplicate to the Montana Bureau of Mines and Geology, and Quadruplicate for the Appropriator.

72910

DECLARATION OF VESTED GROUND-  
WATER RIGHTS

PAUL C. ELBERSON

RECEIVED  
POWELL COUNTY, MONTANA

December 26th, 19 63  
at \_\_\_\_\_ minutes past 9:55 o'clock  
A. M.

Daniel B. Hertz, Jr.  
Clerk and Recorder

By \_\_\_\_\_ Deputy

Fee \$ 2.00 Paid

B

File No. ....

T. 7N. R. 9W.

DUPLICATE

County POWELL

STATE OF MONTANA  
ADMINISTRATOR OF GROUNDWATER CODE  
OFFICE OF STATE ENGINEER

RECEIVED  
NOV 15 1963

Declaration of Vested Groundwater Rights

(Under Chapter 237, Montana Session Laws, 1961)

STATE ENGINEER

1. WALTER J. REILLY, of PO. BOX DEER LODGE  
(Name of Appropriator) (Address) (Town)  
County of POWELL State of MONT  
have appropriated groundwater according to the Montana laws in effect prior to January 1, 1962, as follows:

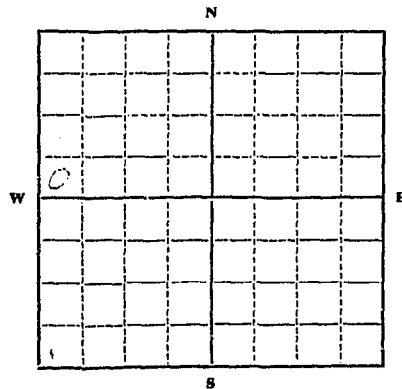

S.W. 1/4 NW 7 Sec. 13 T. 7N. R. 9W

Indicate point of appropriation and place of use, if possible. Each small square represents 10 acres.

2. The beneficial use on which the claim is based. HOUSEHOLD GARDEN & LAWN

3. Date or approximate date of earliest beneficial use; and how continuous the use has been. 1952 UNTIL NOW

4. The amount of groundwater claimed (in miner's inches or gallons per minute) 40 GALS PER MINUTE

5. If used for irrigation, give the acreage and description of the lands to which water has been applied and name of the owner thereof

6. The means of withdrawing such water from the ground and the location of each well or other means of withdrawal. WELL PUMP

7. The date of commencement and completion of the construction of the well, wells, or other works for withdrawal of groundwater.

8. The depth of water table. 10 FT TO 18 FT

9. So far as it may be available, the type, size and depth of each well or the general specifications of any other works for the withdrawal of groundwater. D.R.E. WELL 4 IN. D. CASED 2 1/2 X 20' DEEP

10. The estimated amount of groundwater withdrawn each year. ABOUT 918,800 GALS PER YEAR

11. The log of formations encountered in the drilling of each well if available.

12. Such other information of a similar nature as may be useful in carrying out the policy of this act, including reference to book and page of any county record.

Signature of Owner Walter J. Reilly  
Date 11-13-63

Three copies to be filed by the owner with the County Clerk and Recorder of the county in which the well is located.

Please answer all questions. If not applicable, so state, otherwise the form will be returned.

Original to the County Clerk and Recorder; duplicate to the State Engineer; Triplicate to the Montana Bureau of Mines and Geology, and Quadruplicate for the Appropriator.

7035

72671

DECLARATION OF VESTED GROUND-  
WATER RIGHTS

WALTER J. RILLY

**RECEIVED**  
**POWELL COUNTY, MONTANA**

November 13th, 19 63  
at \_\_\_\_\_ minutes past 9:40 o'clock  
A. M.

Daniel B. Hertz, Jr.  
Clerk and Recorder

By \_\_\_\_\_ Deputy

Fee \$2.00 Paid



File No. ....

T. 7N R. 9W

DUPLICATE

County Powell

STATE OF MONTANA  
ADMINISTRATOR OF GROUNDWATER CODE  
OFFICE OF STATE ENGINEER

RECEIVED  
JAN 17 1964

Declaration of Vested Groundwater Rights  
(Under Chapter 237, Montana Session Laws, 1961)

1. Frank B. Wisner, of Deer Lodge  
(Name of Appropriator) (Address) (Town)  
County of Powell State of Montana  
have appropriated groundwater according to the Montana laws in effect prior to January 1, 1962, as follows:

2. Indicate point of appropriation and place of use, if possible. Each small square represents 10 acres.

2. The beneficial use on which the claim is based

Irrigation, stockwater and domestic use

3. Date or approximate date of earliest beneficial use; and how continuous the use has been

June 2, 1952

4. The amount of groundwater claimed (in miner's inches or gallons per minute)

10 inches

5. If used for irrigation, give the acreage and description of the lands to which water has been applied and name of the owner thereof

Section 13, T7N, R9W

6. The means of withdrawing such water from the ground and the location of each well or other means of withdrawal

free flowing

7. The date of commencement and completion of the construction of the well, wells, or other works for withdrawal of groundwater

June 2, 1952

8. The depth of water table

surface

9. So far as it may be available, the type, size and depth of each well or the general specifications of any other works for the withdrawal of groundwater

Well tapped by means of flume

10. The estimated amount of groundwater withdrawn each year

40 million inches

11. The log of formations encountered in the drilling of each well if available

not applicable

12. Such other information of a similar nature as may be useful in carrying out the policy of this act, including reference to book and page of any county record

no records

Signature of Owner Frank B. Wisner

Date December 31, 1963

Three copies to be filed by the owner with the County Clerk and Recorder of the county in which the well is located.

Please answer all questions. If not applicable, so state, otherwise the form will be returned.

Original to the County Clerk and Recorder; Duplicate to the State Engineer; Triplicate to the Montana Bureau of Mines and Geology, and Quadruplicate for the Appropriator.

73078

DECLARATION OF VESTED GROUND-  
WATER RIGHTS

FRANK B. WISNER

RECEIVED  
POWELL COUNTY, MONTANA

December 31st, 19 63  
at \_\_\_\_\_ minutes past 5:11 o'clock  
P. M.

Daniel B. Hertz, Jr.  
Clerk and Recorder

By \_\_\_\_\_ Deputy

Fee \$2.00 Paid

GW

Approved Stock Form—State Publishing Co., Helena, Montana—42234

File No. ....

T. 7N R. 9W

DUPLICATE

County Powell

STATE OF MONTANA  
ADMINISTRATOR OF GROUNDWATER CODE  
OFFICE OF STATE ENGINEER

RECEIVED  
JAN 17 1964  
STATE ENGINEER

Declaration of Vested Groundwater Rights

(Under Chapter 237, Montana Session Laws, 1961)

Frank B. Wisner

Deer Lodge

I, Frank B. Wisner, of Deer Lodge,  
(Name of Appropriator) (Address) (Town)

County of Powell State of Montana  
have appropriated groundwater according to the Montana laws in effect prior to January 1, 1962, as follows:

	X			

2. The beneficial use on which the claim is based Irrigation,  
stockwater and domestic use

3. Date or approximate date of earliest beneficial use; and how continu-  
ous the use has been 1st Nov. 1955

4. The amount of groundwater claimed (in miner's inches or gallons  
per minute) 25 miners inches

5. If used for irrigation, give the acreage and description of the lands  
to which water has been applied and name of the owner thereof  
Section 14, T7N, R9W

6. The means of withdrawing such water from the ground and the loca-  
tion of each well or other means of withdrawal  
free flowing

NE 1/4 NW 1/4 Sec. 14 T7N R.9W

Indicate point of appropriation  
and place of use, if possible. Each  
small square represents 10 acres.

7. The date of commencement and completion of the construction of the well, wells, or other works for with-  
drawal of groundwater Nov. 1, 1955

8. The depth of water table surface

9. So far as it may be available, the type, size and depth of each well or the general specifications of any other  
works for the withdrawal of groundwater Well tapped by means of flume

10. The estimated amount of groundwater withdrawn each year 40 million gallons

11. The log of formations encountered in the drilling of each well if available  
not available

12. Such other information of a similar nature as may be useful in carrying out the policy of this act, including  
reference to book and page of any county record no record

Signature of Owner Frank B. Wisner

Date December 31, 1963

Three copies to be filed by the owner with the County Clerk and Recorder of the county in which the well is located.

Please answer all questions. If not applicable, so state, otherwise the form will be returned.

Original to the County Clerk and Recorder; Duplicate to the State Engineer; Triplicate to the Montana Bureau of  
Mines and Geology, and Quadruplicate for the Appropriator.

3784

73079

DECLARATION OF VESTED GROUND-  
WATER RIGHTS

FRANK B. WISNER

RECEIVED  
POWELL COUNTY, MONTANA

December 31st, 19 63  
at \_\_\_\_\_ minutes past 5:12 o'clock  
P. M.

\_\_\_\_\_  
Daniel B. Hertz, Jr.  
Clerk and Recorder

By \_\_\_\_\_ Deputy

Fee \$ 2.00 Paid

GW 3

File No. ....

DUPLICATE

T. 7N R. 9W

County Powell

RECEIVED  
NOV 21 1963

STATE OF MONTANA  
ADMINISTRATOR OF GROUNDWATER CODE  
OFFICE OF STATE ENGINEER

STATE ENGINEER

**Notice of Completion of Groundwater Appropriation Without Well**

(Under Chapter 237 Montana Session Laws, 1961)

Date of Appropriation of Groundwater About 1943

Owner Henry Schiele Address Box 533, Deer Lodge

Contractor (if any) Previous owner, Max Moore

Address of Contractor Deer Lodge, Montana

Date Started About 1943 Date Completed About 1943

Describe means of obtaining groundwater without a well "as by sub-irrigation and other natural processes". Include depth to water when applicable. Cleaned spring, developed water and encased spring with concrete box.

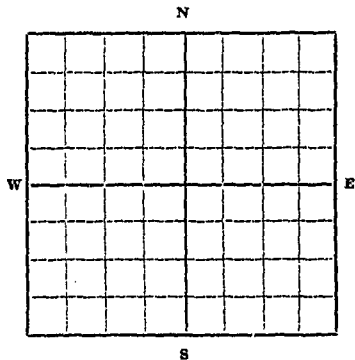

SW 1/4 NE 4 Sec 14 T. 7 R. 9

Indicate point of appropriation and place of use, if possible.

Quantity of water developed and used with explanation of method used to measure or estimate such amount. If use is intermittent estimate approximate lengths of periods of use In spring flows 50", in late summer decreases to 15", and is used for domestic, irrigation, and stock water purposes. Measured by weir.

Signature of Owner Henry Schiele

Date March 18, 1963

This form to be prepared by contractor (if any), otherwise by the owner.

Three copies of this notice are to be filed with the County Clerk and Recorder of the county in which the works are located.

Please answer all questions. If not applicable, so state, otherwise the form will be returned.

Original to the County Clerk and Recorder; duplicate to the State Engineer; Triplicate to the Montana Bureau of Mines and Geology and Quadruplicate for the Appropriator.

7360

72688

NOTICE OF COMPLETION OF GROUNDWATER  
APPROPRIATION WITHOUT WELL

HENRY SCHIELE

RECEIVED  
POWELL COUNTY, MONTANA

November 18th, 19 63  
at \_\_\_\_\_ minutes past 4:00 o'clock  
P.M.

Daniel B. Hertz, Jr.  
Clerk and Recorder

By \_\_\_\_\_ Deputy

Fee \$ 2.00 Paid

GW 3

14

File No. ....

T. 7N R. 9W

DUPLICATE

*50*

County .....

RECEIVED  
NOV 21 1963

STATE OF MONTANA  
ADMINISTRATOR OF GROUNDWATER CODE  
OFFICE OF STATE ENGINEER

STATE ENGINEER

### Notice of Completion of Groundwater Appropriation Without Well

(Under Chapter 237 Montana Session Laws, 1961)

Date of Appropriation of Groundwater July 7, 1963

Owner Henry Schiele Address Box 533, Deer Lodge

Contractor (if any) Self

Address of Contractor .....

Date Started July 7, 1963 Date Completed July 25, 1963

Describe means of obtaining groundwater without a well "as by sub-irrigation and other natural processes". Include depth to water when applicable. Dug ditch to top swamp area and springs and to flow water to Peterson

Creek and to then divert water from Peterson Creek to use for irrigation

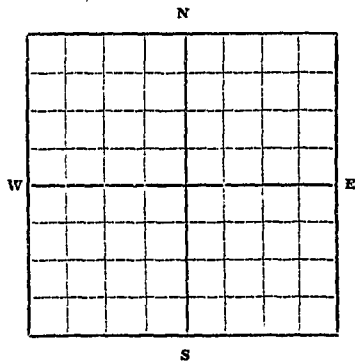

NE 1/4, SE 4, Sec. 14 T. 7N. R. 9W

Indicate point of appropriation and place of use, if possible.

Quantity of water developed and used with explanation of method used to measure or estimate such amount. If use is intermittent estimate approximate lengths of periods of use 80" of water developed and used for irrigation during months of May through October. Measured by weir.

Signature of Owner Henry Schiele

Date November 18, 1963

This form to be prepared by contractor (if any), otherwise by the owner.

Three copies of this notice are to be filed with the County Clerk and Recorder of the county in which the works are located.

Please answer all questions. If not applicable, so state, otherwise the form will be returned.

Original to the County Clerk and Recorder; duplicate to the State Engineer; Triplicate to the Montana Bureau of Mines and Geology and Quadruplicate for the Appropriator.

7379

72687

NOTICE OF COMPLETION OF GROUNDWATER  
APPROPRIATION WITHOUT WELL

HENRY SCHIELE

RECEIVED  
POWELL COUNTY, MONTANA

November 18th, 19 63  
at \_\_\_\_\_ minutes past 3:55 o'clock  
P. M.

Daniel B. Hertz, Jr.  
Clerk and Recorder

By \_\_\_\_\_ Deputy

Fee \$ 2.00 Paid



File No. ....

T. R. ....  
County. ....

DUPLICATE

STATE OF MONTANA  
ADMINISTRATOR OF GROUNDWATER CODE  
OFFICE OF STATE ENGINEER  
**Declaration of Vested Groundwater Rights**  
(Under Chapter 237, Montana Session Laws, 1961)

RECEIVED  
SEP 5 1963  
STATE ENGINEER

1. M. Duane and Nancy L. Young of Box 2 Deer Lodge  
(Name of Appropriator) (Address) (Town)  
County of Powell State of Montana  
have appropriated groundwater according to the Montana laws in effect prior to January 1, 1962, as follows:

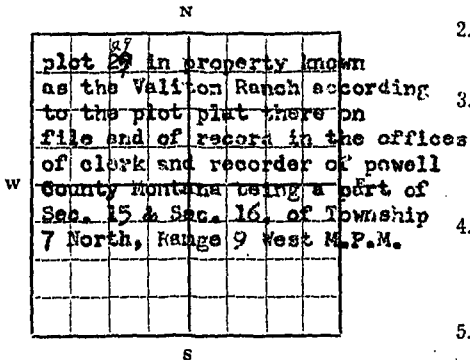

..... 1/4 ..... Sec ..... T ..... R .....  
Indicate point of appropriation and place of use, if possible. Each small square represents 10 acres.

- 2. The beneficial use on which the claim is based General Household, lawn and small garden use
- 3. Date or approximate date of earliest beneficial use; and how continuous the use has been October 1, 1960 - small amount for building purpose
- 4. The amount of groundwater claimed (in miner's inches or gallons per minute) 20 gallons per minute
- 5. If used for irrigation, give the acreage and description of the lands to which water has been applied and name of the owner thereof not used for irrigation
- 6. The means of withdrawing such water from the ground and the location of each well or other means of withdrawal submersible pump

- 7. The date of commencement and completion of the construction of the well, wells, or other works for withdrawal of groundwater September 22, 1960 - September 24, 1961
- 8. The depth of water table 26 feet to water
- 9. So far as it may be available, the type, size and depth of each well or the general specifications of any other works for the withdrawal of groundwater 6 inch casing 40 feet deep
- 10. The estimated amount of groundwater withdrawn each year 70,000 gallons
- 11. The log of formations encountered in the drilling of each well if available 2 feet topsoil, 14 feet sandy clay, 10 feet fine gravel, 14 feet sandy clay
- 12. Such other information of a similar nature as may be useful in carrying out the policy of this act, including reference to book and page of any county record

Signature of Owner M. Duane Young Nancy L. Young  
Date August 26, 1963

Three copies to be filed by the owner with the County Clerk and Recorder of the county in which the well is located.

Please answer all questions. If not applicable, so state, otherwise the form will be returned.

Original to the County Clerk and Recorder; duplicate to the State Engineer; Triplicate to the School of Mines and Quadruplicate for the Appropriator.

5685

72326

DECLARATION OF VESTED GROUND-  
WATER RIGHTS

M. DUANE YOUNG, ET UX

RECEIVED  
POWELL COUNTY, MONTANA

August 28th 1963

at \_\_\_\_\_ minutes past 4:00 o'clock

P. M.

Daniel B. Hertz, Jr.

Clerk and Recorder

By \_\_\_\_\_ Deputy

Fee \$ 2.00 Paid

GW

Approved Stock Form—State Publishing Co., Helena, Montana—41338

File No. ....

T. 7N. R. 9W

DUPLICATE

County Parrell

RECEIVED  
JAN 10 1964

STATE OF MONTANA  
ADMINISTRATOR OF GROUNDWATER CODE  
OFFICE OF STATE ENGINEER

Declaration of Vested Groundwater Rights

(Under Chapter 237, Montana Session Laws, 1961)

STATE ENGINEER

1. Melvin E. Reistad, of R. F. D. 1 Deer Lodge  
(Name of Appropriator) (Address) (Town)  
County of Parrell State of Montana  
have appropriated groundwater according to the Montana laws in effect prior to January 1, 1962, as follows:

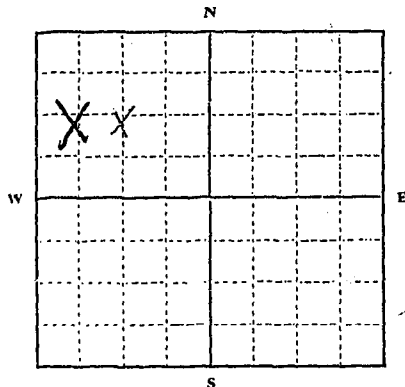

NW 1/4 NW 1/4 Sec. 16 T. 7N. R. 9W

Indicate point of appropriation and place of use, if possible. Each small square represents 10 acres.

2. The beneficial use on which the claim is based. Household and Stock Water

3. Date or approximate date of earliest beneficial use; and how continuous the use has been. 1860 - all the time

4. The amount of groundwater claimed (in miner's inches or gallons per minute). 100 gallons per minute

5. If used for irrigation, give the acreage and description of the lands to which water has been applied and name of the owner thereof. None

6. The means of withdrawing such water from the ground and the location of each well or other means of withdrawal. Electric Pump

7. The date of commencement and completion of the construction of the well, wells, or other works for withdrawal of groundwater. 1860

8. The depth of water table. 8 feet

9. So far as it may be available, the type, size and depth of each well or the general specifications of any other works for the withdrawal of groundwater. (No 1. well) Dug well - concrete lined 3 foot diameter, 70 foot deep (no 2. well) Dug well 1.25 inch diameter, 4 foot square, 50 foot deep

10. The estimated amount of groundwater withdrawn each year. 182,500

11. The log of formations encountered in the drilling of each well if available. granite, sand

12. Such other information of a similar nature as may be useful in carrying out the policy of this act, including reference to book and page of any county record. none that is known

Signature of Owner. Melvin E. Reistad  
Date. Dec. 31 - 1963

Three copies to be filed by the owner with the County Clerk and Recorder of the county in which the well is located.

Please answer all questions. If not applicable, so state, otherwise the form will be returned.

Original to the County Clerk and Recorder; duplicate to the State Engineer; Triplicate to the Montana Bureau of Mines and Geology, and Quadruplicate for the Appropriator.

29342

73042

DECLARATION OF VESTED GROUND-  
WATER RIGHTS

MELVIN E. REISTAD

**RECEIVED**  
**POWELL COUNTY, MONTANA**

December 31st. 19 63  
at \_\_\_\_\_ minutes past 4:35 o'clock  
P.M.

Daniel B. Hertz, Jr.  
Clerk and Recorder

By \_\_\_\_\_ Deputy

Fee \$ 2.00 Paid

File No. ....

T. 7N R. 9W

DUPLICATE

County POWELL

STATE OF MONTANA  
ADMINISTRATOR OF GROUNDWATER CODE  
OFFICE OF STATE ENGINEER

RECEIVED  
DEC 27 1963

Declaration of Vested Groundwater Rights ENGINEER

(Under Chapter 237, Montana Session Laws, 1961)

1. DONALD E. MICHELSON, of 821 MISSOURI AVE. DEER LODGE  
(Name of Appropriator) (Address) (Town)  
County of POWELL State of MONTANA  
have appropriated groundwater according to the Montana laws in effect prior to January 1, 1962, as follows:

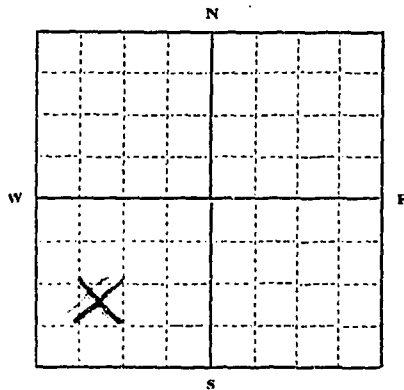

1/4 Sec. T. R.

Indicate point of appropriation and place of use, if possible. Each small square represents 10 acres.

2. The beneficial use on which the claim is based. SAND & GRAVEL PLANT IRRIGATION

3. Date or approximate date of earliest beneficial use; and how continuous the use has been. MARCH, 1952  
USED EVERY YEAR SINCE DRILLING

4. The amount of groundwater claimed (in miner's inches or gallons per minute). 700 G.P.M.

5. If used for irrigation, give the acreage and description of the lands to which water has been applied and name of the owner thereof. 10 ACRES IN NE 1/4 SW 1/4 SEC 20

6. The means of withdrawing such water from the ground and the location of each well or other means of withdrawal. PUMP  
N.E. CORNER OF PROPERTY (NE 1/4 SW 1/4 OF SEC. 20

7. The date of commencement and completion of the construction of the well, wells, or other works for withdrawal of groundwater. FEBRUARY 1952 (CONSTRUCTED & COMPLETED)

8. The depth of water table. 40 FT. FROM TOP OF GROUND

9. So far as it may be available, the type, size and depth of each well or the general specifications of any other works for the withdrawal of groundwater. DRILLED WELL, 8" CASING X 180' DEEP.

10. The estimated amount of groundwater withdrawn each year. 50,000

11. The log of formations encountered in the drilling of each well if available. CONGLOMERATE FOR 52' THEN ALTERNATING FINE GRAVEL AND CLAY SANDS.  
COARSER GRAVEL IN BOTTOM OF WELL

12. Such other information of a similar nature as may be useful in carrying out the policy of this act, including reference to book and page of any county record. /

Signature of Owner: Donald E. Michelson

Date: 12-23-63

Three copies to be filed by the owner with the County Clerk and Recorder of the county in which the well is located.

Please answer all questions. If not applicable, so state, otherwise the form will be returned.

Original to the County Clerk and Recorder; Duplicate to the State Engineer; Triplicate to the Montana Bureau of Mines and Geology, and Quadruplicate for the Appropriator.

72908

DECLARATION OF VESTED GROUND-  
WATER RIGHTS

DONALD E. MICKELSON

RECEIVED  
POWELL COUNTY, MONTANA

December 23rd, 19 63  
at \_\_\_\_\_ minutes past 4:00 o'clock  
P. M.  
Daniel B. Hertz, Jr.  
Clerk and Recorder  
By \_\_\_\_\_ Deputy  
Fee \$2.00 Paid

RECEIVED  
SEP 21 1958

T. \_\_\_\_\_ R. \_\_\_\_\_

County \_\_\_\_\_

STATE ENGINEER

MONTANA BUREAU OF MINES AND GEOLOGY  
Butte, Montana

WATER WELL LOG

Well No 1

x			

Owner W. E. Schuch Address Deer Lodge Mont

Driller \_\_\_\_\_ Address \_\_\_\_\_

Date Started 1972 Date Completed 1972

Location: Sec. 24 T. 7A R. 9W 1/4 sec. 1/4 NW 1/4

Type of well Dug Equipment used Winkler and hand labor  
(Dug, driven, bored, or drilled) (Churn drill, rotary, other)

Water use: Domestic  Municipal  Stock  Irrigation  Garden

Industrial  Drainage  Other: \_\_\_\_\_

Casing: 0 ft. to 28 ft. Type Reinforced Concrete Size 4 ft dia

Casing: \_\_\_\_\_ ft. to \_\_\_\_\_ ft. Type \_\_\_\_\_ Size \_\_\_\_\_

Casing: \_\_\_\_\_ ft. to \_\_\_\_\_ ft. Type \_\_\_\_\_ Size \_\_\_\_\_

Perforated or Screened: Ft. \_\_\_\_\_ to ft. \_\_\_\_\_ Ft. \_\_\_\_\_ to ft. \_\_\_\_\_

Type of screen or perforations: \_\_\_\_\_

Static Water level, for non-flowing well: Varies with season 6 to 13 ft feet.

Shut-in pressure, for flowing well: \_\_\_\_\_ lb./sq. in. on: \_\_\_\_\_ (date)

Pumping water level: \_\_\_\_\_ feet at \_\_\_\_\_ gal. per min.

How tested: \_\_\_\_\_

Length of test: \_\_\_\_\_

Remarks: (Gravel packing, cementing, packers, type of shut-off, depth of shut-off)

Well was originally rocked up. Created in 1919.

(over)





RECEIVED

1958

STATE ENGINEER

MONTANA BUREAU OF MINES AND GEOLOGY  
Butte, Montana

T. \_\_\_\_\_ R. \_\_\_\_\_

County Forsyth

WATER WELL LOG No. 3

X		

Owner W. E. Schurch Address Deer Lodge Mont.

Driller \_\_\_\_\_ Address \_\_\_\_\_

Date Started 1902 Date Completed 1902

Location: Sec. 24 T. 7N R. 9W 1/4 sec. NW 1/4 of NW 1/4

Type of well Dug Equipment used Windlass and hand labor  
(Dug, driven, bored, or drilled) (Churn drill, rotary, other)

Water use: Domestic  Municipal  Stock  Irrigation   
Industrial  Drainage  Other: \_\_\_\_\_

Casing: 0 ft. to 20 ft. Type Concrete Size 4 ft dia.

Casing: 20 ft. to 40 ft. Type Natural Clay Size 4 ft square

Casing: 40 ft. to 58 ft. Type Concrete Size 4 ft dia.

Perforated or Screened: Ft. \_\_\_\_\_ to ft. \_\_\_\_\_ Ft. \_\_\_\_\_ to ft. \_\_\_\_\_

Type of screen or perforations \_\_\_\_\_

Static Water level, for non-flowing well: Varies with season 38 to 58 ft down  
8 to 20 ft deep feet.

Shut-in pressure, for flowing well: \_\_\_\_\_ lb./sq. in. on: \_\_\_\_\_ (date)

Pumping water level \_\_\_\_\_ feet at \_\_\_\_\_ gal. per min.

How tested: \_\_\_\_\_

Length of test \_\_\_\_\_

Remarks: (Gravel packing, cementing, packers, type of shut-off, depth of shut-off)

\_\_\_\_\_  
\_\_\_\_\_  
\_\_\_\_\_  
\_\_\_\_\_

(over)



RECEIVED  
SEP 22 1958

T. \_\_\_\_\_ R. \_\_\_\_\_  
County Beverly

STATE ENGINEER MONTANA BUREAU OF MINES AND GEOLOGY  
Butte, Montana

WATER WELL LOG

Well No. 2.

x		

Owner W.E. Schuch Address Deer Lodge Mont.

Driller \_\_\_\_\_ Address \_\_\_\_\_

Date Started 1898 Date Completed 1898

Location: Sec. 2-4 T. 7N R. 9W 1/4 sec. NW 1/4 of NW 1/4

Type of well Dug (Dug, dri. or drilled) Equipment used Windlass and hand labor (Churn drill, rotary, other)

Water use: Domestic  Municipal  Stock  Irrigation   
Industrial  Drainage  Other: \_\_\_\_\_

Casing: 0 ft. to 38 ft. Type Rocked up Size 3 1/2 dia.

Casing: \_\_\_\_\_ ft. to \_\_\_\_\_ ft. Type \_\_\_\_\_ Size \_\_\_\_\_

Casing: \_\_\_\_\_ ft. to \_\_\_\_\_ ft. Type \_\_\_\_\_ Size \_\_\_\_\_

Perforated or Screened: Ft. \_\_\_\_\_ to ft. \_\_\_\_\_ Ft. \_\_\_\_\_ to ft. \_\_\_\_\_

Type of screen or perforations: \_\_\_\_\_

Static Water level, for non-flowing well: Varies with season 23 to 34 ft feet.

Shut-in pressure, for flowing well: \_\_\_\_\_ lb./sq. in. on: \_\_\_\_\_ (date)

Pumping water level: \_\_\_\_\_ feet at \_\_\_\_\_ gal. per min.

How tested: \_\_\_\_\_

Length of test: \_\_\_\_\_

Remarks: (Gravel packing, cementing, packers, type of shut-off, depth of shut-off)

In about 1910, a 4 inch hole was drilled in bottom of this well 322 ft deep. No additional water bearing strata was found. Clay all the way down. This hole was plugged because water from dug well was flowing slowly down this.



(over)



File No. ....

JAN 21 1970

T. 7 N. R. 10 W.

DUPLICATE

County Powell

STATE OF MONTANA  
ADMINISTRATOR OF GROUNDWATER CODE  
OFFICE OF STATE ENGINEER

Index No. 1628  
Powell Co.  
Book 1, Page 379  
Water Rights  
A Re filing

Notice of Completion of Groundwater Appropriation  
Without Well

Developed After January 1, 1963

(Under Chapter 237 Montana Session Laws, 1961)

Doc. No. 82792  
Filed for record  
this 20 day of January  
A. D. 1970 at Miles  
o'clock a.m.

Date of Appropriation of Groundwater October 21, 1908

Owner Lou C. Kelson Address R #1, Deer Lodge  
(Edward Chapman, Original appropriator) & claimant

Contractor (if any) Unknown

Address of Contractor

Date Started Oct. 1908 Date Completed Oct. 1909

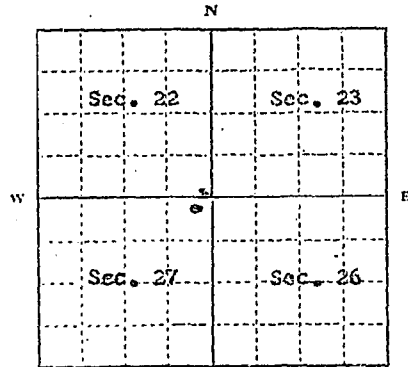

1) Describe means of obtaining groundwater (as by sub-irrigation, developed spring, drains, etc.) Developed springs in S.E. 1/4 of S.E. 1/4 of Sec. No. 22 in T. 7 N. R. 10 W and spring rising in N.E. 1/4 of N.E. 1/4 in Sec. 27, in T. 7 N. R. 10 W. conveyed for use by 3 1/2 mile pipeline to S.E. 1/4 of S.E. 1/4 of Sec. 30 in T. 7 N R. 9 W.

2) Means of withdrawing water (gravity, pump, canal, etc.) Gravity

3) Depth of water table Unknown - Surface

S.E. 1/4 of S.E. 1/4 of Sec. No 22 R10 W  
N.E. 1/4 of N.E. 1/4 Sec. 27 T. 7 N. R. 10 W.

4) Use of the water Domestic purposes, irrigation and other useful and beneficial purposes.

Indicate point of appropriation and place of use, if possible.

5) Amount of groundwater claimed (in miner's inches, or gallons per minute) One cubic foot per second

S.E. 1/4 of S.E. 1/4 of Sec. 30 in T. 7 N. R. 9 W.

6) If used for irrigation, give number of acres and description of land Garden and small pasture

7) Estimate amount of water used each year. Continual use of output

Signature of Owner Lou C. Kelson

Date Jan 20 1970

This form to be prepared by contractor (if any), otherwise by the owner.

Three copies of this notice are to be filed with the County Clerk and Recorder of the county in which the works are located.

Please answer all questions. If not applicable, so state, otherwise the form will be returned.

46085

File No. \_\_\_\_\_

T. 7<sup>N</sup> R. 9<sup>W</sup> 29

DUPLICATE

County Powell

STATE OF MONTANA  
ADMINISTRATOR OF GROUNDWATER CODE  
OFFICE OF STATE ENGINEER

RECEIVED  
MAY 17 1965

Declaration of Vested Groundwater Rights

(Under Chapter 237, Montana Session Laws, 1961)

STATE ENGINEER

1. Eugene C. Morgan, of Rte. 1, Box 10 Deer Lodge  
(Name of Appropriator) (Address) (Town)

County of Powell State of Montana

have appropriated groundwater according to the Montana laws in effect prior to January 1, 1962, as follows:

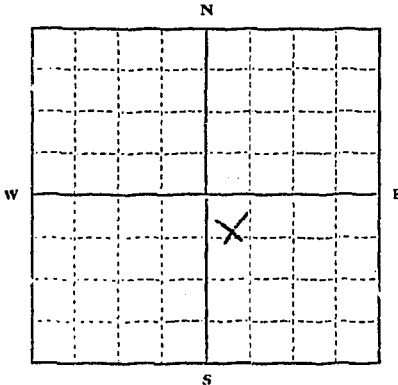

NW 1/4 Sec. 29 T. 7N R. 9W

Indicate point of appropriation and place of use, if possible. Each small square represents 10 acres.

- The beneficial use on which the claim is based Human Consumption & water supply for Greenhouses Lawns, trees, shrubs, etc.
- Date or approximate date of earliest beneficial use; and how continuous the use has been August 1948
- The amount of groundwater claimed (in miner's inches or gallons per minute) 100 gal per MIN estimated
- If used for irrigation, give the acreage and description of the lands to which water has been applied and name of the owner thereof 1 acre Nursery stock & Perennials E.C. Morgan for Haves Greenhouses
- The means of withdrawing such water from the ground and the location of each well or other means of withdrawal 100 yds Piston type pump, 1 pump in Boiler pit of Greenhouses
- The date of commencement and completion of the construction of the well, wells, or other works for withdrawal of groundwater Unknown Pump & well on premises when I purchased Greenhouses in 1948
- The depth of water table 9 feet
- So far as it may be available, the type, size and depth of each well or the general specifications of any other works for the withdrawal of groundwater open well, 4' in Diameter, 16' from surface to bottom of well
- The estimated amount of groundwater withdrawn each year 900,000 gal
- The log of formations encountered in the drilling of each well if available Unknown
- Such other information of a similar nature as may be useful in carrying out the policy of this act, including reference to book and page of any county record The water level in the well has lowered about 2'-3' in past 2 months, since a drainage ditch, for reclaiming swamp land, has been under construction in this area

Signature of Owner Eugene C. Morgan  
Date 5-13-1965

Three copies to be filed by the owner with the County Clerk and Recorder of the county in which the well is located.

Please answer all questions. If not applicable, so state, otherwise the form will be returned.

Original to the County Clerk and Recorder; Duplicate to the State Engineer; Triplicate to the Montana Bureau of Mines and Geology, and Quadruplicate for the Appropriator.

39130

75513

DECLARATION OF VESTED GROUNDWATER  
RIGHTS

EUGENE C. MORGAN

RECEIVED  
POWELL COUNTY, MONTANA

May 14th 1965

at \_\_\_\_\_ minutes past 11:20 o'clock  
\_\_\_\_\_ A. M.

Daniel B. Hertz, Jr.  
Clerk and Recorder

By \_\_\_\_\_  
Deputy

Fee \$2.00 Paid

File No. ....

DUPLICATE

T. 7N R. 9W  
County Howell  
RECEIVED  
JAN 10 1964

STATE OF MONTANA  
ADMINISTRATOR OF GROUNDWATER CODE  
OFFICE OF STATE ENGINEER

Declaration of Vested Groundwater Rights

(Under Chapter 237, Montana Session Laws, 1961)

STATE ENGINEER

1. Melvin E. Reistad, of R. 2, D. 1 Deer Lodge  
(Name of Appropriator) (Address) (Town)  
County of Howell State of Montana  
have appropriated groundwater according to the Montana laws in effect prior to January 1, 1962, as follows:

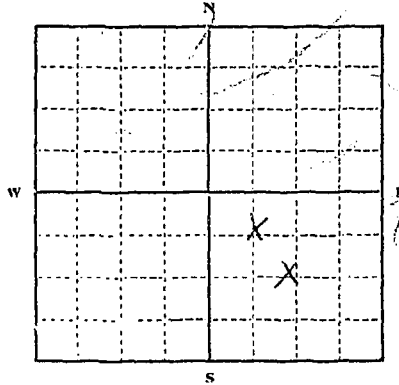

NE 1/4 SE 1 Sec. 29, T. 7N, R. 9W  
Indicate point of appropriation and place of use, if possible. Each small square represents 10 acres.

2. The beneficial use on which the claim is based. Household and Stock Water

3. Date or approximate date of ~~beginning~~ 1935 beneficial use; and how continuous the use has been.

4. The amount of groundwater claimed (in gallons per minute) (No. 1) 60 (in gallons per minute) (No. 2) 60

5. If used for irrigation, give the acreage and description of the lands to which water has been applied and name of the owner thereof

6. The means of withdrawing such water from the ground and the location of each well or other means of withdrawal. Electric pump

7. The date of commencement and completion of the construction of the well, wells, or other works for withdrawal of groundwater. 1885

8. The depth of water table. (No. 1) 8 feet, (No. 2) 12 feet

9. So far as it may be available, the type, size and depth of each well or the general specifications of any other works for the withdrawal of groundwater. (No. 1) Dry well concrete lined 3 feet diameter, 20 feet deep  
(No. 2) Dry well concrete lined 28 in diameter 40 feet deep

10. The estimated amount of groundwater withdrawn each year. 150,000 gallons.

11. The log of formations encountered in the drilling of each well if available. loam gravel  
Sand

12. Such other information of a similar nature as may be useful in carrying out the policy of this act, including reference to book and page of any county record.

Signature of Owner Melvin E. Reistad  
Date Dec 31 - 1963

Three copies to be filed by the owner with the County Clerk and Recorder of the county in which the well is located.

Please answer all questions. If not applicable, so state, otherwise the form will be returned.

Original to the County Clerk and Recorder; duplicate to the State Engineer; Triplicate to the Montana Bureau of Mines and Geology, and Quadruplicate for the Appropriator.

29341



STATE OF MONTANA  
ADMINISTRATOR OF GROUNDWATER CODE  
MONTANA WATER RESOURCES BOARD  
**NOTICE OF COMPLETION OF GROUNDWATER  
APPROPRIATION BY MEANS OF WELL**

Developed after January 1, 1962

(Under Chapter 237 Montana Session Laws, 1961, as amended)

This form to be prepared by driller, and three copies to be filed by the owner with the County Clerk and Recorder in the county in which the well is located, last copy to be retained by driller. Please answer all questions. If not applicable, so state, otherwise the form may be returned.

Owner Al Lowrey  
Address Deer Lodge,  
Montana  
Date well started April 27, 1971  
completed same

For Administrator's Use
File <u>84738</u>
<u>May 19, 1971</u>
<u>4:45 PM</u>

Type of well Drilled  
(Dug, driven, bored or drilled)  
Equipment used Churn Drill  
(Churn drill, rotary or other)  
Water Use: Domestic  Municipal  Stock  Irrigation   
Industrial  Drainage  Other \* Garden/Lawn

\*Describe  
USE: If used for irrigation, industrial, drainage or other. Explain, state number of acres and location or other data (i.e. Lot, Block and Addition).

ESTIMATED ANNUAL WITHDRAWAL

Size of Drilled Hole	Size and Weight of Casing	From (Feet)	To (Feet)	PERFORATIONS		
				Kind Size	From (Feet)	To (Feet)
6"	6 5/8" o.d. x .250	4'	below 70'	cutting torch	59	64'

Static water level 14' ft.\*  
Pumping water level 30' ft.\*  
at 20' gallons per minute,  
measured ..... minutes after pumping began.  
\*Measured from ground level  
Well developed by balling  
for ..... hours.  
Power..... Pump..... HP  
Remarks: (Gravel packing, cementing, packer type of shutoff)

N.W. 1/4 N.E. 1/4 Sec. 29  
T. 7 N. R. 9 E  
S W

INDICATE LOCATION OF WELL AND PLACE OF USE, IF POSSIBLE. EACH SMALL SQUARE REPRESENTS 40 ACRES.

Driller's Signature Keefe Contracting Company  
Driller's Address 2804 Harvard Avenue  
Butte, Montana 59701 LICENSE NO. 8

County Powell

**DRILLER'S LOG**

Indicate the character, color, thickness of strata such as soil, clay, sand, gravel, shale, sandstone, etc. Show depth at which water is found and height to which water rises in well.

Top of Ground (Elev. above sea level)	
From (Feet)	To (Feet)
0'	5'
5'	48'
48'	60'
60'	65'
65'	70'

Well log content:  
Well Fit  
Sand and Gravel  
Heavy Sands - water  
Sand gravel - Water  
Sand gravel - water

70' Show exact depth of bottom

48895

84738

NOTICE OF COMPLETION OF GROUND-  
WATER APPROPRIATION BY MEANS  
OF WELL

AL LOWERY

RECEIVED

POWELL COUNTY, MONTANA

May 19th 1971

at \_\_\_\_\_ minutes past 4:45 o'clock

P. M.

*Bonnie J. Miller*  
Clerk and Recorder

By \_\_\_\_\_  
Asst. Deputy

Fee \$ 2.00+

G.

Approved Stock Form—State Publishing Co., Helena, Montana—42234

File No. MONTANA WATER RESOURCES BOARD  
ENGINEER

T. 7 N. R. 9 W.

DUPLICATE

County Powell

JAN 21 1970 STATE OF MONTANA

Doc. No. 82791 ADMINISTRATOR OF GROUNDWATER CODE

Filed for record OFFICE OF STATE ENGINEER

This 20 day of January

A. D. 1970 at 11:00

o'clock a.m.

### Declaration of Vested Groundwater Rights

(Under Chapter 237, Montana Session Laws, 1961)

1. Lou C. Kelson, of B. F. D. #1 Deer Lodge  
(Name of Appropriator) (Address) (Town)

County of Powell State of MONTANA

have appropriated groundwater according to the Montana laws in effect prior to January 1, 1962, as follows:

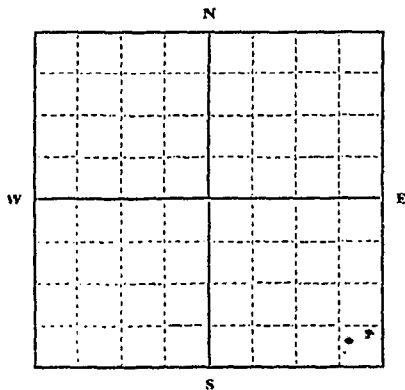

S. E 1/4 S. E 3/4 Sec. 30 T. 7 N. R. 9 W

Indicate point of appropriation and place of use, if possible. Each small square represents 10 acres.

2. The beneficial use on which the claim is based. Domestic - Household, garden and stock

3. Date or approximate date of earliest beneficial use; and how continuous the use has been. Used continuously  
Dug well - 1906  
Drilled well - 1949

4. The amount of groundwater claimed (in miner's inches or gallons per minute). Adequate for domestic use

5. If used for irrigation, give the acreage and description of the lands to which water has been applied and name of the owner thereof  
NONE

6. The means of withdrawing such water from the ground and the location of each well or other means of withdrawal. Electric pumps

7. The date of commencement and completion of the construction of the well, wells, or other works for withdrawal of groundwater. Dug well completed 1906  
Drilled well completed 1949

8. The depth of water table. 70 feet

9. So far as it may be available, the type, size and depth of each well or the general specifications of any other works for the withdrawal of groundwater.  
1906 dug well - 4 ft. dia. cement casing  
1949 drilled well - 6 in. steel casing

10. The estimated amount of groundwater withdrawn each year. Water 300 head cattle  
Household and garden

11. The log of formations encountered in the drilling of each well if available. Not furnished by driller

12. Such other information of a similar nature as may be useful in carrying out the policy of this act, including reference to book and page of any county record. No county record

Signature of Owner Lou C. Kelson

Date Jan 20, 1970

Three copies to be filed by the owner with the County Clerk and Recorder of the county in which the well is located.

Please answer all questions. If not applicable, so state, otherwise the form will be returned.

Original to the County Clerk and Recorder; Duplicate to the State Engineer; Triplicate to the Montana Bureau of Mines and Geology, and Quadruplicate for the Appropriator.

46084

82791

RECEIVED  
POWELL COUNTY, MONTANA

January 20th 19 70

at \_\_\_\_\_ minutes past 11:00 o'clock

A. M.

Elfa McDonough

Clerk and Recorder

By \_\_\_\_\_

Deputy

Fee \$ \_\_\_\_\_

File No.....

T. 7 R. 2

DUPLICATE

County Powell

STATE OF MONTANA  
ADMINISTRATOR OF GROUNDWATER CODE  
OFFICE OF STATE ENGINEER

RECEIVED  
JAN 6 1964

Declaration of Vested Groundwater Rights  
(Under Chapter 237, Montana Session Laws, 1961)

1. Lewis Johnson of RFD Deer Lodge  
(Name of Appropriator) (Address) (Town)  
County of Powell State of Montana  
have appropriated groundwater according to the Montana laws in effect prior to January 1, 1962, as follows:

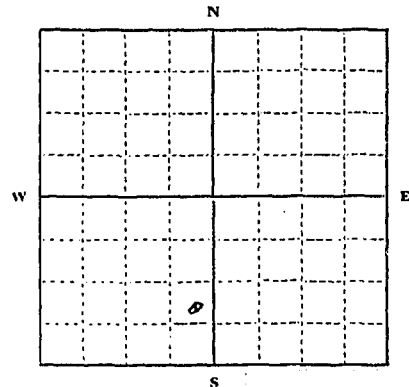

2. The beneficial use on which the claim is based.....  
Household and Stockwater

3. Date or approximate date of earliest beneficial use; and how continuous the use has been.....  
Established in 1930 and has been in continuous use since.

4. The amount of groundwater claimed (in miner's inches or gallons per minute).....  
500 gallons per minute

5. If used for irrigation, give the acreage and description of the lands to which water has been applied and name of the owner thereof.....  
None

6. The means of withdrawing such water from the ground and the location of each well or other means of withdrawal.....  
Electric Pump

SE 1/4 ~~SW~~ Sec. 31 T. 7 R. 2

Indicate point of appropriation and place of use, if possible. Each small square represents 10 acres.

7. The date of commencement and completion of the construction of the well, wells, or other works for withdrawal of groundwater.....  
Refer to No. 3

8. The depth of water table.....  
62ft.

9. So far as it may be available, the type, size and depth of each well or the general specifications of any other works for the withdrawal of groundwater.....  
6" casing (Steel) with depth of 115'

10. The estimated amount of groundwater withdrawn each year.....  
600,000 gallons

11. The log of formations encountered in the drilling of each well if available.....  
None

12. Such other information of a similar nature as may be helpful in carrying out the policy of this act, including reference to book and page of any county record.....  
None

Signature of Owner Lewis Johnson  
Date 12-31-63

Three copies to be filed by the owner with the County Clerk and Recorder of the county in which the well is located.

Please answer all questions. If not applicable, so state, otherwise the form will be returned.

Original to the County Clerk and Recorder; duplicate to the State Engineer; Triplicate to the Montana Bureau of Mines and Geology, and Quadruplicate for the Appropriator.

73018

DECLARATION OF VESTED GROUND-  
WATER RIGHTS

LEWIS JOHNSON

RECEIVED  
POWELL COUNTY, MONTANA

December 31st, 1963  
at \_\_\_\_\_ minutes past 2:36 o'clock  
P.M.

Daniel B. Hertz, Jr.  
Clerk and Recorder

By \_\_\_\_\_ Deputy

Fee \$2.00 Paid

031

File No. ....

T. 1 R. 9

DUPLICATE

County Powell

STATE OF MONTANA  
ADMINISTRATOR OF GROUNDWATER CODE  
OFFICE OF STATE ENGINEER

RECEIVED  
JAN 10 1964

Declaration of Vested Groundwater Rights  
(Under Chapter 237, Montana Session Laws, 1961)

Allen E Johnson, of Deer Lodge R 700  
(Name of Appropriator) (Address) (Town)  
County of Powell State of Montana  
have appropriated groundwater according to the Montana laws in effect prior to January 1, 1962, as follows:

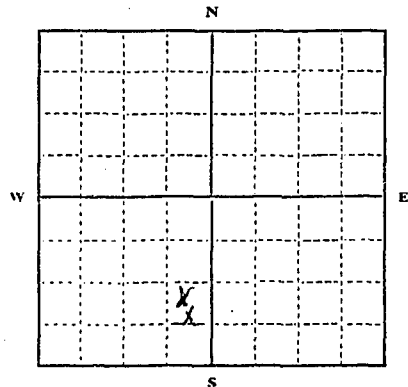

S. 1/4 N. 1/4 Sec. 31 T. 7 R. 9

Indicate point of appropriation and place of use, if possible. Each small square represents 10 acres.

2. The beneficial use on which the claim is based. Household and Cattle

3. Date or approximate date of earliest beneficial use; and how continuous the use has been. ....

4. The amount of groundwater claimed (in miner's inches or gallons per minute). 12 gallons per minute

5. If used for irrigation, give the acreage and description of the lands to which water has been applied and name of the owner thereof. ....

6. The means of withdrawing such water from the ground and the location of each well or other means of withdrawal. Electric Pumps

7. The date of commencement and completion of the construction of the well, wells, or other works for withdrawal of groundwater. no 1 approx 1920  
no 2 1938

8. The depth of water table. no 1 90 ft  
no 2 114 ft

9. So far as it may be available, the type, size and depth of each well or the general specifications of any other works for the withdrawal of groundwater. no 1 concrete 4 ft diameter  
no 2 6" casing

10. The estimated amount of groundwater withdrawn each year. estimated 10 gal <sup>per</sup> minute daily

11. The log of formations encountered in the drilling of each well if available. yes

12. Such other information of a similar nature as may be useful in carrying out the policy of this act, including reference to book and page of any county record. None

Signature of Owner Allen E Johnson

Date. Dec 31, 1963

Three copies to be filed by the owner with the County Clerk and Recorder of the county in which the well is located.

Please answer all questions. If not applicable, so state, otherwise the form will be returned.

Original to the County Clerk and Recorder; duplicate to the State Engineer; Triplicate to the Montana Bureau of Mines and Geology, and Quadruplicate for the Appropriator.

29320

73022

DECLARATION OF VESTED GROUND-  
WATER RIGHTS

ALLEN E. JOHNSON

RECEIVED  
POWELL COUNTY, MONTANA

December 31st, 19 63.  
at \_\_\_\_\_ minutes past 3:05 o'clock

P. M.

Daniel B. Hertz, Jr.  
Clerk and Recorder

By \_\_\_\_\_ Deputy

Fee \$ 2.00 Paid



GW 2

File No. ....

T. 7. N. R. 9. W

DUPLICATE

County Powell

STATE OF MONTANA DECEIVED  
ADMINISTRATOR OF GROUNDWATER CODE  
OFFICE OF STATE ENGINEER JUL 5 - 1963

Notice of Completion of Groundwater Appropriation by Means of Well STATE ENGINEER

(Under Chapter 237, Montana Session Laws, 1961)

Owner *Harvey Elinson* Address *Deer Lodge*

Driller *O. Kufe Drilling Co.* Address *Deer Lodge*

Date of Notice of Appropriation of Groundwater .....

Date well started *Oct. 16, 1962* Date Completed *Oct. 19, 1962*

Type of well *drilled* Equipment Used *Churn*  
(dug, driven, bored or drilled) (Churn, drill, rotary or other)

Water Use: Domestic  Municipal  Stock  Irrigation   
Industrial  Drainage  Other

Indicate on the diagram the character and thickness of the different strata met with in drilling, such as soil, clay, shale, gravel, rock or sand, etc. Show depth at which water is encountered, thickness and character of water-bearing strata and height to which the water rises in the well.

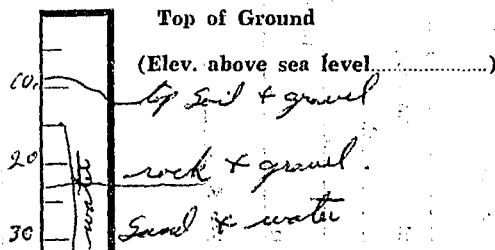

Size of Drilled Hole	Size and Weight of Casing	From (Feet)	To (Feet)	PERFORATIONS		
				Kind Size	From (Feet)	To (Feet)
<i>6"</i>	<i>6" 19#</i>			<i>cutting tool</i>	<i>27'</i>	<i>32'</i>

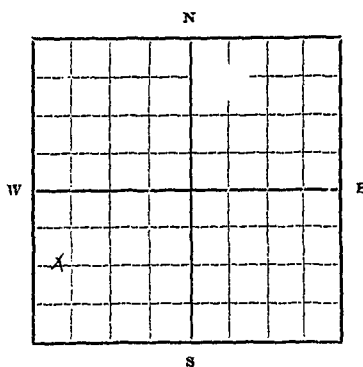

..... 1/4 Sec. 53 T. 7. N. R. 9. W

Indicate location of well and place of use, if possible. Each small square represents 10 acres.

Show exact depth of bottom.

Static Water Level for non-flowing Well *15'* feet.

Shut-in Pressure for Flowing Well .....

Pumping Water Level *15'* feet at *40* gal. per minute.

Discharge in gal. per min. of flowing well .....

How Tested *basic* Length of Test *1 hr.*

Remarks: (Gravel packing, cementing, packers, type of shutoff, location of place of use of groundwater if not at well, and any other similar pertinent information, including number of acres irrigated, if used for irrigation) .....

*O. Kufe Drilling Co.*  
Driller's License Number *43*

*Ed. O. Kufe*  
Driller's Signature

This form to be prepared by driller, and three copies to be filed by the owner with the County Clerk and Recorder in the county in which the well is located.

Please answer all questions. If not applicable, so state, otherwise the form will be returned.

Original to the County Clerk and Recorder; duplicate to the State Engineer; Triplicate to the School of Mines and Quadruplicate for the Appropriator.

4912

72101

NOTICE OF COMPLETION OF GROUNDWATER  
APPROPRIATION BY MEANS OF WELL

HARVEY F. ELIASON

RECEIVED  
POWELL COUNTY, MONTANA

July 2nd, 19 63

at 11:40 minutes past o'clock

A. M.

Daniel B. Hertz, Jr.

Clerk and Recorder

By Deputy

Fee \$ 2.00 Paid

File No. ....

T. .... R. ....

DUPLICATE

County Powell

STATE OF MONTANA  
ADMINISTRATOR OF GROUNDWATER CODE  
OFFICE OF STATE ENGINEER

Declaration of Vested Groundwater Rights

(Under Chapter 237, Montana Session Laws, 1961)

1. John E. and Margaret M. Murray of 901 Pennsylvania Deer Lodge, Mont.  
(Name of Appropriator) (Address) (Town)

County of Powell State of Montana  
have appropriated groundwater according to the Montana laws in effect prior to January 1, 1962, as follows:

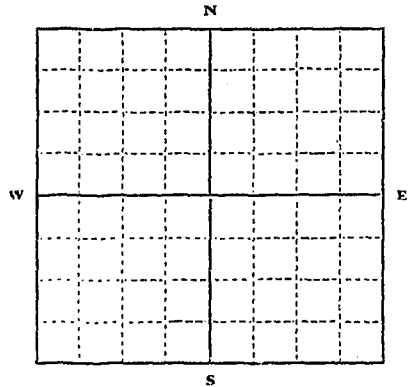

1/4 Sec. T. 7N. R. 5W.

Indicate point of appropriation and place of use, if possible. Each small square represents 10 acres.

2. The beneficial use on which the claim is based. ~~Electric Pump~~  
Irrigate Lawn

3. Date or approximate date of earliest beneficial use; and how continuous the use has been. This well was dug approximately 50 years ago, it was used continuously for about 30 years, and has been inactive since.

4. The amount of groundwater claimed (in miner's inches or gallons per minute). Date unknown at this time

5. If used for irrigation, give the acreage and description of the lands to which water has been applied and name of the owner thereof. About 1/4 acre seeded in grass. owners see above Lots 12-11-10 and 1/2 of lot #9 Block No. 9 College Addition

6. The means of withdrawing such water from the ground and the location of each well or other means of withdrawal. Electric Pump

7. The date of commencement and completion of the construction of the well, wells, or other works for withdrawal of groundwater. commencement unknown Completion 1972

8. The depth of water table. Unknown

9. So far as it may be available, the type, size and depth of each well or the general specifications of any other works for the withdrawal of groundwater. Depth Approx. 50 Feet

10. The estimated amount of groundwater withdrawn each year. Unknown

11. The log of formations encountered in the drilling of each well if available. Unknown

12. Such other information of a similar nature as may be useful in carrying out the policy of this act, including reference to book and page of any county record.

Doc. No. 83653  
Filed for record  
this 8 day of September  
A. D. 19 70, at 4:00  
o'clock P.M.

Signature of Owner John E. Murray  
Margaret M. Murray  
Date Sept 4 1970

Three copies to be filed by the owner with the County Clerk and Recorder of the county in which the well is located.

Please answer all questions. If not applicable, so state, otherwise the form will be returned.

Original to the County Clerk and Recorder; Duplicate to the State Engineer; Triplicate to the Montana Bureau of Mines and Geology, and Quadruplicate for the Appropriator.

417468

83653

RECEIVED  
POWELL COUNTY, MONTANA

September 8th 19 70

at \_\_\_\_\_ minutes past 4:00 o'clock

P. M.

Elfa McDonough  
Clerk and Recorder

By \_\_\_\_\_ Deputy

Fee \$ 2.00 pd.