

#2695

I certify that I received and filed this
instrument of title 21st
day of Dec 1963 at 8:01
o'clock PM.
F. V. Moore
COUNTY RECORDER
By Shirley Keith
DEPUTY

Beagle

Ravalli County

STATE OF MONTANA
ADMINISTRATOR OF GROUNDWATER CODE
OFFICE OF STATE ENGINEER

RECEIVED
JAN 8 1964

DECLARATION OF VESTED GROUNDWATER RIGHTS
(Under Chapter 237, Montana Session Laws, 1961)

1. *Merton S. Beagle*, of *Sweeney Park*, *Florence*
(Name of Appropriator) (Address) (Town)

County of Ravalli, State of Montana, have appropriated groundwater according to the Montana laws in effect prior to January 1, 1962, as follows:

2. The beneficial use on which the claim is based. *Supplementary irrigation*

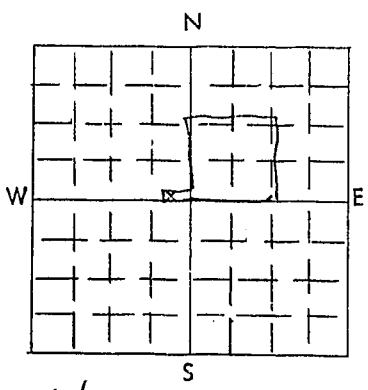

SE 1/4 NW Sec. 22, T. 10, R. 20.
Indicate point of appropriation and place of use, if possible. Each small square represents 10 acres.

3. Date or approximate date of earliest beneficial use; and how continuous the use has been.
1958 Spring, Summer and fall

4. The amount of groundwater claimed (in miner's inches or gallons per minute). *56 gal. / minute*

5. If used for irrigation, give the acreage and description of the lands to which water has been applied and name of the owner thereof. *2 acres of yard & garden*

6. The means of withdrawing such water from the ground and the location of each well or other means of withdrawal.
Electric pump

7. The date of commencement and completion of the construction of the well, wells, or other works for withdrawal of groundwater.
1958

8. The depth of water table. *unknown*

9. So far as it may be available, the type, size and depth of each well or the general specifications of any other works for the withdrawal of groundwater. *dug well, 25 feet deep*

10. The estimated amount of groundwater withdrawn each year. *4,000,000 gal*

11. The log of formations encountered in the drilling of each well if available. *unknown*

12. Such other information of a similar nature as may be useful in carrying out the policy of this act, including reference to book and page of any county record.
None

Signature of Owner:
Date:

Three copies to be filed by the owner with the County Clerk and Recorder of the county in which the well is located
Please answer all questions. If not applicable, so state, otherwise the form will be returned.

Original to the County Clerk and Recorder; duplicate to the State Engineer; Triplicate to the School of Mines and Quadruplicate for the Appropriator

2694

I certify that I received and filed this
Instrument on this 31st
day of Dec 63 at 8:00
o'clock a.
F. H. Moore
COUNTY RECORDER
By Shirley Keith
DEPUTY

File No.

T. 10N R. 20W

DUPLICATE

MONTANA WATER RESOURCES BOARD
RECEIVED
AUG 12 1968

County. Ravalli

STATE OF MONTANA
ADMINISTRATOR OF GROUNDWATER CODE
OFFICE OF STATE ENGINEER

Top of Ground
(Elev. above sea level. 3267)

**Notice of Completion of Groundwater
Appropriation by Means of Well**
DEVELOPED AFTER JANUARY 1, 1962

(Under Chapter 237, Montana Session Laws, 1961)

Formations Log:

0 - 4 Ft. **Norman &/or**
 4 - 21 Gravel, **Owner Carol Herrick** Address **Stevensville, Mont.**
 cobblestones
 imbedded in **Driller Liberty Drilling Co.** Address **Missoula, Montana**
 tan clay. **Date of Notice of appropriation of groundwater. None filed**
 21 - 34 **Tight granitic** **Date well started 10/16/67** **Date completed 10/18/67**
 sand mixed in **tan clay.**
 34 - 37 **Clean, coarse sand and gravel.** **Type of well Drilled** **Equipment used Cable Tools**
Water. (Dug, driven, bored or drilled) (Churn drill, rotary or other)
 Water use: Domestic Municipal Stock Irrigation
 Industrial Drainage Other

Indicate on the diagram the character and thickness of the different strata met with in drilling, such as soil, clay, shale, gravel, rock or sand, etc. Show depth at which water is encountered, thickness and character of water-bearing strata and height to which the water rises in the well.

Size of Drilled Hole	Size and Weight of Casing	From (Feet)	To (Feet)	PERFORATIONS		
				Kind Size	From (Feet)	To (Feet)
6"	6 5/8" by 1/4"	-4	37	NONE		

Water rises in the well 11 feet from surface.

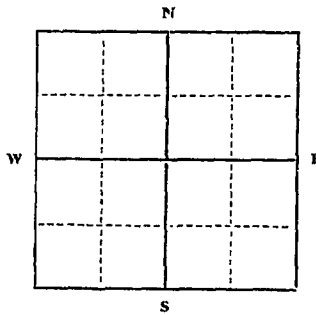

Static Water Level for non-flowing well **11** feet.
 Shut-in Pressure for Flowing Well **None**
 Pumping Water Level **31** feet
 at **30** gal. per minute.
 Discharge in gal. per min. of flowing well
Non-flowing
 How Tested **Air Lift Pump**
 Length of Test **1 1/2 hours**

NE 1/4 Sec. 22 T. 10N R. 20W
Indicate location of well and place of use, if possible. Each small square represents 40 acres.
sand free water year after year not overpumped, i.e., the not in excess of 25 to 50 capacity of the aquifer.

Remarks: (Gravel packing, cementing, pack-
c, type of shutoff) **All water entering well is coming through the open wells six inch casing area can be depended upon to produce clear water as they are pumped at rate the tested (see on reverse side)**

USE—If used for irrigation, industrial, number of acres and location or other. Explain, state (i.e.: Lot, Block and Addition).

Show exact depth of bottom.
Bottom of hole 37'

This form to be prepared by driller, and three copies to be filed by the owner with the County Clerk and Recorder in the county in which the well is located, tissue copy to be retained by driller.

Please answer all questions. If not applicable, so state, otherwise the form will be returned.

52
Driller's License Number
William F. Osborne
Driller's Signature.

44,500

#5064

I certify that I received and filed this
instrument on this 9th
day of Aug, 19 108 at 10:05
o'clock A. M.

F. G. Moore
COUNTY RECORDER

By Joe 2.00
DEPUTY

#5415

I certify that I received and filed this
instrument on this 21st
day of April, 1971, at 3:55
o'clock P.M.
F. G. Moore
COUNTY RECORDER
By Free 2.00
DEPUTY

GW 2

File No.

T 10 N W 22 R 20

DUPLICATE

Ravalli County

STATE OF MONTANA
ADMINISTRATOR OF GROUNDWATER CODE
OFFICE OF STATE ENGINEER

Notice of Completion of Groundwater
Appropriation by Means of Well

(Under Chapter 227, Montana Session Laws, 1961)

Top of Ground (Elev. above sea level...)	Approx. 3490'
0 - 5 Pit	
5 - 8 Sand, gravel and boulders	
8 - 13 Sand, gravel and boulders. Water. SWL 6'.	
13 - 21 Tight silty sand. Few scattered boulders.	
21 - 23 1/2 Gravel and cobblestones imbedded in clay.	
23 1/2 - 24 Sand and gravel. Some water.	
24 - 26 Clean coarse gravel. Good water. Water rises to 6' from surface.	

Owner H. H. Keniston Rt # 1 Box 113
Address Florence, Montana

Driller Liberty Drilling Co. Address Missoula, Montana

Date of Notice of Appropriation of Groundwater None Filed

Date well started 7/27/62 Date Completed 7/28/62

Type of well Drilled Equipment Used Cable tools
(dug, driven, bored or drilled) (Churn, drill, rotary or other)

Water Use: Domestic () Municipal () Stock () Irrigation ()
Industrial () Drainage () Other ()

Indicate on the diagram the character and thickness of the different strata met with in drilling, such as soil, clay, shale, gravel, rock or sand, etc. Show depth at which water is encountered, thickness and character of water-bearing strata and height to which the water rises in the well.

Size of Drilled Hole	Size and Weight of Casing	From (Feet)	To (Feet)	PERFORATIONS		
				Kind Size	From (Feet)	To (Feet)
4 in	4 5/8" OD					
7 in	7" OD X 24 # per foot	3	23'1"	NONE		

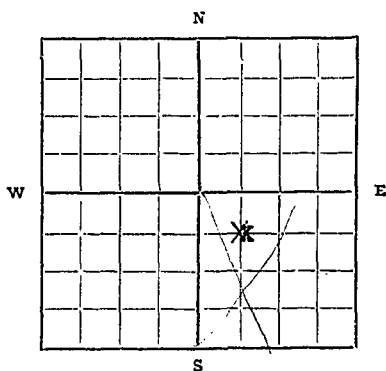

N 1/4 SE 1/4 Sec 22 T 10 R 20
W 1/4 E 1/4 Sec 22 T 10 R 20

Indicate location of well and place of use, if possible. Each small square represents 10 acres.

Show exact depth of bottom

Bottom of Well 26 ft.

Static Water Level for non-flowing Well 6 feet.

Shut-in Pressure for Flowing Well Non-flowing

Pumping Water Level 21 feet at 35 gal. per minute

Discharge in gal., per min. of flowing well Non-flowing

How Tested Pump Length of Test Pumped all one year

Remarks: (Gravel packing, cementing, packers, type of shutoff, Location of place of use of groundwater if not at well, and any other similar pertinent information, including number of acres irrigated, if used for irrigation)

52
Driller's License Number

William F. Osborne
Driller's Signature

This form to be prepared by driller, and three copies to be filed by the owner with the County Clerk and Recorder in the county in which the well is located.

Please answer all questions. If not applicable, so state, otherwise the form will be returned.

Original to the County Clerk and Recorder; duplicate to the State Engineer; Triplicate to the School of Mines and Quadruplicate for the Appropriator.

37656

4091

I certify that I received and filed this
instrument on this 31st
day of Dec. 1963 at 4:20
o'clock P.M.

F. M. Moore
COUNTY RECORDER
By Shirley Keith
DEPUTY

GV.

Approved Stock Form—State Publishing Co., Helena, Montana—42234

File No.

T. 10 N. R. 20 W

DUPLICATE

County Ravalli

STATE OF MONTANA
ADMINISTRATOR OF GROUNDWATER CODE
OFFICE OF STATE ENGINEER

RECEIVED
JAN 8 1964

Declaration of Vested Groundwater Rights STATE ENGINEER
(Under Chapter 237, Montana Session Laws, 1961)

1. W. Henry & Cora A. Keniston, of P.R.F. Florence
(Name of Appropriator) (Address) (Town)

County of Ravalli State of Montana
have appropriated groundwater according to the Montana laws in effect prior to January 1, 1962, as follows:

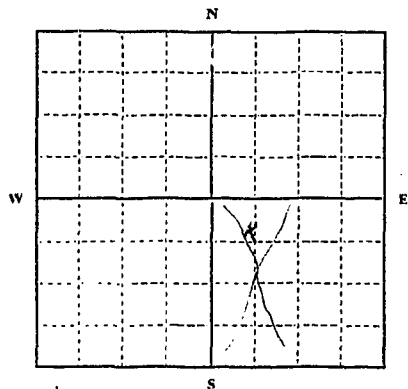

W 1/2 Sec 22 T. 10 N. R. 20 W

Indicate point of appropriation and place of use, if possible. Each small square represents 10 acres.

2. The beneficial use on which the claim is based. Household use
Irrigation - Stock Use

3. Date or approximate date of earliest beneficial use; and how continuous the use has been. 1910 - Daily Use

4. The amount of groundwater claimed (in miner's inches or gallons per minute). 35 gallons per minute

5. If used for irrigation, give the acreage and description of the lands to which water has been applied and name of the owner thereof. Used for garden and lawn

6. The means of withdrawing such water from the ground and the location of each well or other means of withdrawal. By pumping
Well located near house.

7. The date of commencement and completion of the construction of the well, wells, or other works for withdrawal of groundwater. 1910

8. The depth of water table. Five feet

9. So far as it may be available, the type, size and depth of each well or the general specifications of any other works for the withdrawal of groundwater. Three feet across - 18-20 feet deep
Hand dug well and coked up.

10. The estimated amount of groundwater withdrawn each year. 150,000 gallons

11. The log of formations encountered in the drilling of each well if available.

12. Such other information of a similar nature as may be useful in carrying out the policy of this act, including reference to book and page of any county record.

Signature of Owner W. Henry Keniston

Date Dec 28 - 63

Three copies to be filed by the owner with the County Clerk and Recorder of the county in which the well is located.

Please answer all questions. If not applicable, so state, otherwise the form will be returned.

Original to the County Clerk and Recorder; Duplicate to the State Engineer; Triplicate to the Montana Bureau of Mines and Geology, and Quadruplicate for the Appropriator.

27179

#2371

I certify that I received and filed this
instrument on this 30th
day of Dec. 1963 at 9.56
o'clock A. M.

F. W. Moore

COUNTY RECORDER

By Shirley Keith
DEPUTY

GW 3

File No. Duplicate
~~QUADRUPPLICATE~~

T. 10 R. 20
County Basin

STATE OF MONTANA
ADMINISTRATOR OF GROUNDWATER CODE
OFFICE OF STATE ENGINEER

JAN 8 1964
STATE ENGINEER

Notice of Completion of Groundwater Appropriation Without Well

(Under Chapter 237 Montana Session Laws, 1961)

Date of Appropriation of Groundwater 1886
Owner W. Henry Kensted
Address R.R. 1 - Flaming, Mont
Contractor (if any) none
Address of Contractor none

Date Started Unknown Date Completed Unknown

Describe means of obtaining groundwater without a well "as by sub-irrigation and other natural processes". Include depth to water when applicable. Obtained by natural flow and ditch. A natural spring

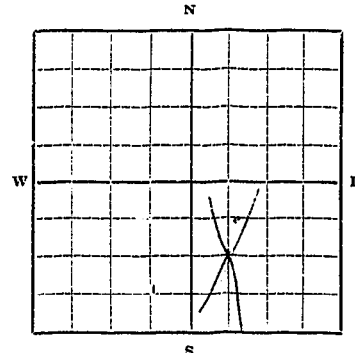

Quantity of water developed and used with explanation of method used to measure or estimate such amount. If use is intermittent estimate approximate lengths of periods of use

W 1/2 Sec 24 Sec. 22 T. 10 R. 20
Indicate point of appropriation and place of use, if possible.

Water is used continuously for stock water & irrigation.

Signature of Owner W. Henry Kensted
Date 12/28/63

This form to be prepared by contractor (if any), otherwise by the owner.

Three copies of this notice are to be filed with the County Clerk and Recorder of the county in which the works are located.

Please answer all questions. If not applicable, so state, otherwise the form will be returned.

Original to the County Clerk and Recorder; duplicate to the State Engineer; Triplicate to the Montana Bureau of Mines and Geology and Quadruplicate for the Appropriator.

#2370

I certify that I received and filed this
instrument on this 30th
day of Dec, 1963, at 9:55
o'clock A.

F. G. Moore
COUNTY RECORDER
BY Shirley Keith
CLERK

STATE OF MONTANA
ADMINISTRATOR OF GROUNDWATER CODE
MONTANA WATER RESOURCES BOARD

NOTICE OF COMPLETION OF GROUNDWATER
APPROPRIATION BY MEANS OF WELL

Developed after January 1, 1962

DRILLER'S LOG

Indicate the character, color, thickness of strata such as soil, clay, sand, gravel, shale, sandstone, etc. Show depth at which water is found and height to which water rises in well.

(Under Chapter 237 Montana Session Laws, 1961, as amended)

This form to be prepared by driller, and three copies to be filed by the owner with the County Clerk and Recorder in the county in which the well is located, last copy to be retained by driller. Please answer all questions. If not applicable, so state, otherwise the form may be returned.

Owner Mrs. Tyne Lehto

Address Ellen Ave.,
Montana

Date well started March 13, 1971
completed March 15, 1971

For Administrator's Use

File 5408
MARCH 30, 1971
1:30 P.M.

GW 1

Type of well Drilled
(Dug, driven, bored or drilled)

Equipment used Churn Drill
(Churn drill, rotary or other)

Water Use: Domestic Municipal Stock Irrigation
Industrial Drainage Other * Garden/Lawn

*Describe _____

USE: If used for irrigation, industrial, drainage or other. Explain, state number of acres and location or other data (i.e. Lot, Block and Addition). _____

ESTIMATED ANNUAL WITHDRAWAL _____

Size of Drilled Hole	Size and Weight of Casing	From (Feet)	To (Feet)	PERFORATIONS		
				Kind Size	From (Feet)	To (Feet)
6" I. O.	6" I. O. 17 lb per ft.	1' 6" above S.L.	41' 6"	none		

N

W

E

S

Static water level 12 ft.*

Pumping water level 22 ft.*

at 20 gallons per minute, measured 1/2 minutes after pumping began.

*Measured from ground level.

Well developed by compressor for 1 hours.

Power Does Pump not apply

Remarks: (Gravel packing, cementing, packers, type of shutoff) _____

22' x 1/4" M. V. Sec. 22

T. 10 N. R. 20 E

S W

INDICATE LOCATION OF WELL AND PLACE OF USE, IF POSSIBLE. EACH SMALL SQUARE REPRESENTS 40 ACRES.

Driller's Signature Glenn Camp
CAMP WELL DRILLING & PUMP SUPPLY

Driller's Address 1522 S. 14th W. Missoula, Montana

LICENSE NO. 7

Top of Ground (Elev. above sea level)		
From (Feet)	To (Feet)	
0	2	Black topsoil
2	20	Gravel & Sandy Clay
20	38	Sand Gravel & Water
38	41' 6"	Gravel & Water

41' 6" Show exact depth of bottom

#5402

I certify that I received and filed this
instrument on this 30th
day of Mar, 1971, at 1:30
o'clock P.M.
F. G. Moore
COUNTY RECORDER
By F. G. Moore
DEPUTY

File No.

T. 10^N R. 20^W 22

DUPLICATE

STATE OF MONTANA
ADMINISTRATOR OF GROUNDWATER CODE
OFFICE OF STATE ENGINEER

County of Blaine
RECEIVED
JAN 8 1962
STATE ENGINEER

Declaration of Vested Groundwater Rights

(Under Chapter 237, Montana Session Laws, 1961)

1. Raymond Maier, of P.O. 1 Florence
(Name of Appropriator) (Address) (Town)
County of Blaine State of Mont
have appropriated groundwater according to the Montana laws in effect prior to January 1, 1962, as follows:

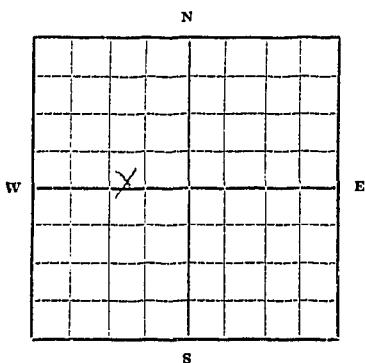

S.E. 1/4, NW Sec. 22, T. 10, R. 20

Indicate point of appropriation and place of use, if possible. Each small square represents 10 acres.

- 2. The beneficial use on which the claim is based household stock water & irrigation
- 3. Date or approximate date of earliest beneficial use; and how continuous the use has been Date unknown - continuous use 1925
- 4. The amount of groundwater claimed (in miner's inches or gallons per minute) 1500 gallons a day
- 5. If used for irrigation, give the acreage and description of the lands to which water has been applied and name of the owner thereof 2 acres
- 6. The means of withdrawing such water from the ground and the location of each well or other means of withdrawal Electric pump

- 7. The date of commencement and completion of the construction of the well, wells, or other works for withdrawal of groundwater unknown
- 8. The depth of water table unknown
- 9. So far as it may be available, the type, size and depth of each well or the general specifications of any other works for the withdrawal of groundwater drilled well about 65 feet deep 6 inch steel casing
- 10. The estimated amount of groundwater withdrawn each year 487500 gallons
- 11. The log of formations encountered in the drilling of each well if available unknown
- 12. Such other information of a similar nature as may be useful in carrying out the policy of this act, including reference to book and page of any county record. none

Signature of Owner Raymond Maier
Date 12-30-63

Three copies to be filed by the owner with the County Clerk and Recorder of the county in which the well is located.

Please answer all questions. If not applicable, so state, otherwise the form will be returned.

Original to the County Clerk and Recorder; duplicate to the State Engineer; Triplicate to the Montana Bureau of Mines and Geology and Quadruplicate for the Appropriator.

27234

#2426

I certify that I received and filed this
instrument on this 30th
day of Dec, 1963 at 10:51
o'clock A.
F. J. Moore
County Recorder
By A. L. Keith
Deputy

File No.

T. 10 N. R. 20 W.

DUPLICATE

County

STATE OF MONTANA
ADMINISTRATOR OF GROUNDWATER CODE
OFFICE OF STATE ENGINEER

RECEIVED
JAN 8 1964

Declaration of Vested Groundwater Rights ENGINEER

(Under Chapter 237, Montana Session Laws, 1961)

I, Alfred & Helen Nissila, of Florence (Town)

County of Beavert State of Montana
have appropriated groundwater according to the Montana laws in effect prior to January 1, 1962, as follows:

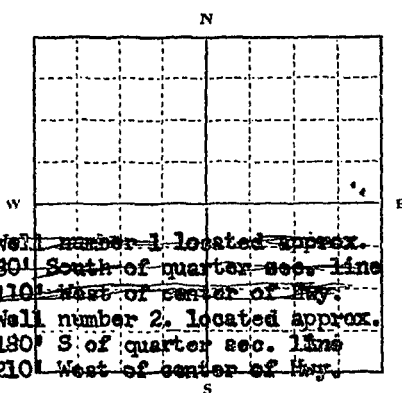

~~1/4 SE~~ Sec. 22 T10N R20W

Indicate point of appropriation and place of use, if possible. Each small square represents 10 acres.

- The beneficial use on which the claim is based Domestic and irrigation
- Date or approximate date of earliest beneficial use; and how continuous the use has been Well number 2 used continuous since 1947 Well number 1 used continuous since 1955
- The amount of groundwater claimed (in miner's inches or gallons per minute) 500 gallons per hour of each well
- If used for irrigation, give the acreage and description of the lands to which water has been applied and name of the owner thereof 1.34 acres located NESE Sec. 22 T10 R20W
- The means of withdrawing such water from the ground and the location of each well or other means of withdrawal deep well centrifugal pumps
- The date of commencement and completion of the construction of the well, wells, or other works for withdrawal of groundwater Well number 2 complete 1947 Well number 1 complete 1955
- The depth of water table 40' on well number 2
- So far as it may be available, the type, size and depth of each well or the general specifications of any other works for the withdrawal of groundwater Wells numbers 1 and 2 are 6" casings depths of wells number 1 and 2 is 51 feet
- The estimated amount of groundwater withdrawn each year well number 2 - 36,000 gallons
- The log of formations encountered in the drilling of each well if available Rock, gravel and sand
- Such other information of a similar nature as may be useful in carrying out the policy of this act, including reference to book and page of any county record Same as recorded deed to land

Signature of Owner Alfred & Helen Nissila
Date Dec. 30, 1963

Three copies to be filed by the owner with the County Clerk; and Recorder of the county in which the well is located.
Please answer all questions. If not applicable, so state, otherwise the form will be returned.

Original to the County Clerk and Recorder; Duplicate to the State Engineer; Triplicate to the Montana Bureau of Mines and Geology, and Quadruplicate for the Appropriator.

#2381

I certify that I received and filed this
instrument on this 30th
day of Dec. 1967 at 10:06
o'clock A. M.
F. H. Moore
COUNTY RECORDER
By Shirley Keith
DEPUTY

File No.

RECEIVED

T. 10N R. 20W

DUPLICATE

JUN 9 1970

County Ravalli

LOG

**STATE OF MONTANA
ADMINISTRATOR OF GROUNDWATER CODE
STATE WATER CONSERVATION BOARD**

Top of Ground
(Elev. above sea level Approx. 3260')

**Notice of Completion of Groundwater
Appropriation by Means of Well**

DEVELOPED AFTER JANUARY 1, 1962

(Under Chapter 237 Montana Session Laws, 1961, as amended)

Owner Konrad & Patricia J.

Address Nonnenmacher Address Florence, Montana

Driller Liberty Drilling Co. Address Missoula, Montana

Date of Notice of appropriation of groundwater None filed

Date well started 5/4/70 Date completed 5/8/70

Type of well Drilled Equipment used Cable Tools
(Dug, driven, bored or drilled) (Churn drill, rotary or other)

Water use: Domestic Municipal Stock Irrigation
Industrial Drainage Other

Indicate on the diagram the character and thickness of the different strata met with in drilling, such as soil, clay, shale, gravel, rock or sand, etc. Show depth at which water is encountered, thickness and character of water-bearing strata and height to which the water rises in the well.

Formations Log:

- 0 - 20 Sand, gravel, cobbles & boulders mixed.
- 20 - 27 Gray silty clay.
- 27 - 37 Light brown silty clay & decomposed granite.
- 37 - 41 Gray decomposed granite.
- 41 - 43 Fractured pink, red & black rock in alternate layers. Some quartzite in decomposed granite.
- 43 - 45 Gray rock & decomposed granite with stringers of silty clay.
- 45 - 48 Boulders mixed with gray clay.
- 48 - 49 Broken rock imbedded in brown clay.
- 49 - 54 Broken gray rock with gray clay in cracks & seams.
- 54 - 62 Broken gray rock. Pink clay in cracks & seams.
- 62 - 66 Dark gray rock.
- 66 - 72 Very broken gray-black rock. Water.

Size of Drilled Hole	Size and Weight of Casing	From (Feet)	To (Feet)	PERFORATIONS		
				Kind Size	From (Feet)	To (Feet)
6"	6 5/8" OD x 1/4"	+2	66	5 9/16" Torch Cut Screen	with solid closed bottom	66 72

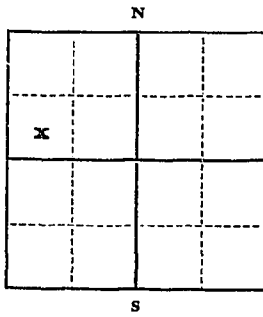

Static Water Level for non-flowing well 4.8" feet.

Shut-in Pressure for Flowing Well Non-f. Pumping Water Level 65 feet

at Nine gal. per minute.

Discharge in gal. per min. of flowing well Non-flowing.

How Tested Pump test

Length of Test Two hours

Remarks: (Gravel packing, cementing, packers, type of shutoff) All water entering well is coming through slot openings in screen.

Water rises in the well to 4.8" from surface.

NW 1/4 Sec. 22 T10N. R20W
Indicate location of well and place of use, if possible. Each small square represents 40 acres.

Doc. No. 5282 (Continue on reverse side)

Filed for record this 8 day of June USE If used for irrigation, industrial, drainage or other. Explain, state number of acres and location or other data (i.e.: Lot, Block and Addition).

A. D. 15 79 at 8:00 o'clock.

Approx. 20 acres (E 1/2 of SW 1/4 of NW 1/4 of

Sec. 22, T10N, R20W

Show exact depth of bottom.

Bottom of well 72'

This form to be prepared by driller, and three copies to be filed by the owner with the County Clerk and Recorder in the county in which the well is located, tissue copy to be retained by driller.

Please answer all questions. If not applicable, so state, otherwise the form will be returned.

52
Driller's License Number

William B. Adams
Driller's Signature.

46551

#5282

I certify that I received and filed this
Instrument on this 8th
day of June, 1970, at 8:00
o'clock A.M.
J. G. Moore
COUNTY RECORDER
By J. G. Moore
DEPUTY

6035

I certify that I received and filed this
instrument on this 29th
day of June, 1973, at 3:06
o'clock P. M.

Darlene E. Hughes
COUNTY RECORDER

By R. E. 2.00
Deputy

6034

I hereby certify I received and filed this
instrument on this 29th
day of June, 19 73, at 3:05
o'clock P.M.
Orlando E. Hughes
COUNTY RECORDER
Fee 2.00
DEPOSY

File No. MAY 8 1967

T 10 R 20

TRIPPLICATE

File No. M. District No. B. Section No. C. Township No. D. Range No.

Ravalli County

STATE OF MONTANA ADMINISTRATOR OF GROUNDWATER CODE OFFICE OF STATE ENGINEER

Top of Ground (Elev. above sea level N.P.A. 500)

Notice of Completion of Groundwater Appropriation by Means of Well

(Under Chapter 237, Montana Session Laws, 1961)

Handwritten notes: Same well as described in filing # 2737-159535 of decedent's estate... rights were 1965... approved by S.C.S.

Owner: James... Address: ... Driller: ... Address: ... Date of Notice of Appropriation of Groundwater: 5/13/67 Date well started: 1960 Date Completed: 1963 Type of well: dug Pond Equipment Used: Bulldozer Water Use: Domestic () Municipal () Stock (x) Irrigation (x) Industrial () Drainage (x) Other ()

Indicate on the diagram the character and thickness of strata met with in drilling, such as soil, clay, shale, gravel, sand, etc. Show depth at which water is encountered, thickness and character of water-bearing strata and height to which the water rises in the well

Handwritten notes: 150 feet sand 2nd foot sand... 150' x 130' x 15'... 4000 ft storage

Table with columns: Size of Drilled Hole, Size and Weight of Casing, From (Feet), To (Feet), PERFORATIONS (Kind Size, From (Feet), To (Feet))

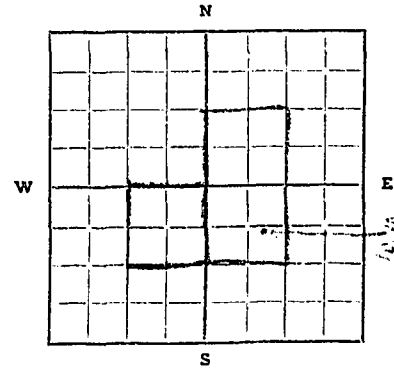

Static Water Level for non-flowing Well ... feet. Shut-in Pressure for Flowing Well ... Pumping Water Level ... feet at ... gal. per minute. Discharge in gal. per min. of flowing well ... How Tested ... Length of Test ... Remarks: (Gravel packing, cementing, packers, type of shutoff, Location of place of use of groundwater if not at well, and any other similar pertinent information, including number of acres irrigated, if used for irrigation)

Indicate location of well and place of use, if possible. Each small square represents 10 acres.

Show exact depth of bottom 15 ft. Same well as described in stated groundwater right filing # 2737-159535 plus 1963 expansion which was originally underpropposed because of limited capacity of pumps on hand at time.

Driller's License Number: Not applicable Driller's Signature: [Signature]

This form to be prepared by driller, and three copies to be filed by the owner with the County Clerk and Recorder in the county in which the well is located. Please answer all questions. If not applicable, so state, otherwise the form will be returned. Original to the County Clerk and Recorder; duplicate to the State Engineer; Triplicate to the School of Mines and Quadruplicate for the Appropriator.

File No. _____ MAY 8 1967

T 10 R 20

TRIPPLICATE

Ravalli County

STATE OF MONTANA
ADMINISTRATOR OF GROUNDWATER CODE
OFFICE OF STATE ENGINEER

Top of Ground _____
(Elev. above sea level 3000)

**Notice of Completion of Groundwater
Appropriation by Means of Well**

(Under Chapter 237, Montana Session Laws, 1961)

*Same well as
in section 10-10-10
with well
number 2737-159535*

Owner James L. ... Address Liberman, Mont.
Driller Raymond ... Address Liberman, Mont.
Date of Notice of Appropriation of Groundwater 5/13/67
Date well started 1960 Date Completed 1963
Type of well Dug Pond Equipment Used Bulldozers
(dug, driven, bored or drilled) (Churn, drill, rotary or other)
Water Use: Domestic () Municipal () Stock (✓) Irrigation (✓)
Industrial () Drainage (✓) Other ()

← Indicate on the diagram the character and thickness of the different strata met with in drilling, such as soil, clay, shale, gravel, rock or sand, etc. Show depth at which water is encountered, thickness and character of water-bearing strata and height to which the water rises in the well.

*100 ft sand
30 ft sand
...
150 x 13 x 12
400 ft storage*

Size of Drilled Hole	Size and Weight of Casing	From (Feet)	To (Feet)	PERFORATIONS		
				Kind Size	From (Feet)	To (Feet)

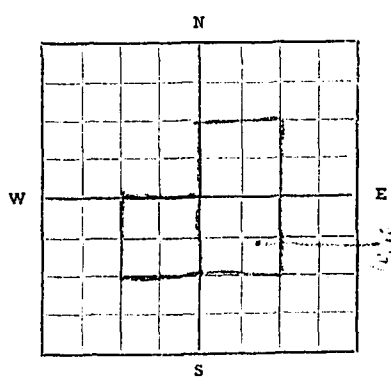

Section _____ T. _____ R. 25
Indicate location of well and place of use, if possible. Each small square represents 10 acres.

Static Water Level for non-flowing Well _____ feet.
Shut-in Pressure for Flowing Well _____
Pumping Water Level _____ feet at _____ gal. per minute.
Discharge in gal., per min. of flowing well _____
How Tested _____ Length of Test _____
Remarks: (Gravel packing, cementing, packers, type of shutoff, Location of place of use of groundwater if not at well, and any other similar pertinent information, including number of acres irrigated, if used for irrigation) _____

Show exact depth of bottom
15 ft Same well as described in pasted ground water report filing # 2737-159535 plus 1963 expansion which was originally underappreciated because of limited capacity of pump in hand at time.

Not applicable
Driller's License Number _____
Raymond ...
Driller's Signature _____

This form to be prepared by driller, and three copies to be filed by the owner with the County Clerk and Recorder in the county in which the well is located.

Please answer all questions. If not applicable, so state, otherwise the form will be returned.

Original to the County Clerk and Recorder; duplicate to the State Engineer; Triplicate to the School of Mines and Quadruplicate for the Appropriator.

#4930

172830

I certify that I received and filed this
instrument on this.....5th.....
day of.....May....., 19..67.. at 2:32
o'clock.....P..M.

F. G. Moore

COUNTY RECORDER

By Rayna M. Sigart

DEPUTY

Fee \$2.00

File No. MAY 8 1967 T. 10 R. 20

DUPLICATE County Ravalli
 STATE OF MONTANA
 ADMINISTRATOR OF GROUNDWATER CODE
 OFFICE OF STATE ENGINEER

Notice of Appropriation of Groundwater
 (Under Chapter 237, Montana Session Laws, 1961)

1. I, James Simpson, of Flora Montana
 (Name of Appropriator) (Address) (Town)
 County of Ravalli, State of Montana, intend to appropriate groundwater in accordance with Chapter 237, Montana Session Laws of 1961.

2. The beneficial use to which water is to be applied is irrigation as well
on any portion of NE 1/4 NW 1/4, NW 1/4 NE 1/4, Sec 22 SW 1/4 SE 1/4 Sec 15.
 (describe lands to be benefited, if for irrigation)

3. The rate of use in gallons per minute or miner's inches of groundwater claimed.....

about 350 g.p.m. or maximum capacity of wellpond

4. The annual period (inclusive dates) of intended use April 1 - Oct 15

5. The ~~probable~~ ^{actual} or intended date of first beneficial use August 66

6. The ~~probable~~ ^{actual} or intended date of commencement and completion of the well* or wells* 1963

Same pond as vented groundwater right filed # 2737-159535

7. The location, type, size and depth of well or wells contemplated dry pond

See detailed vented groundwater right file as in (6)
on Sec. 22 as per map in 1963 to 150 x 130 x 15 ft

8. The probable or estimated depth of the water table or artesian aquifer 19 ft

9. Name, address and license number of the driller engaged Kyle Enderhoff
Steinerville Mont.

10. Give such other similar information as may be useful in carrying out the policy of this act.....

Purpose is to secure appropriation of the maximum amount of the dry pond under all circumstances in addition to general flow, pond has shown great potential from drainage of my own flood irrigation on my own lands immediately above. Original filed appropriation was based upon the capacity of the pond on hand at the time which was much too small

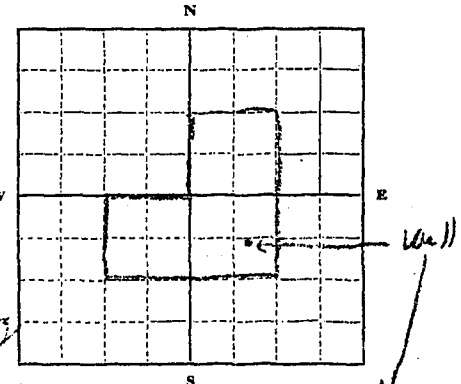

NW 1/4 Sec 22 T 10 R 20
 Locate well or other means of development as accurately as possible on the plat.

Signature of Appropriator James Simpson
 Date May 3, 1967

* As defined in the Code Sec. 1 (c) "Well" means any artificial opening or excavation in the ground, however made, by which groundwater can be obtained or through which it flows under natural pressures or is artificially withdrawn."

Three copies of this notice are to be filed with County Clerk and Recorder of the county in which the well is located.

Please answer all questions. If not applicable, so state, otherwise the form will be returned.

Original to the County Clerk and Recorder; duplicate to the State Engineer; Triplicate to the Montana Bureau of Mines and Geology and Quadruplicate for the Appropriator.

41,963

File No. _____ T. 10 R. 20
 County Revelle

DUPLICATE

STATE OF MONTANA
 ADMINISTRATOR OF GROUNDWATER CODE
 OFFICE OF STATE ENGINEER

Notice of Appropriation of Groundwater
 (Under Chapter 237, Montana Session Laws, 1961)

1. I, James Simpson of Blaine Montana
 (Name of Appropriator) (Address) (Town)
 County of Revelle, State of Montana, intend to appropriate groundwater in accordance with Chapter 237, Montana Session Laws of 1961.

2. The beneficial use to which water is to be applied is Supplemental irrigation as needed
on any portion of NE 1/4 NW 1/4, NW 1/4 NE 1/4, Sec 22 SW 1/4 SE 1/4 Sec 15.
 (describe lands to be benefited, if for irrigation)

3. The rate of use in gallons per minute or miner's inches of groundwater claimed about 350 G.P.M. to maximum capacity of wellpond

4. The annual period (inclusive dates) of intended use April - Oct 15

5. The ~~probable~~ ^{actual} or intended date of first beneficial use August 6, 66

6. The ~~probable~~ ^{actual} or intended date of commencement and completion of the well* or wells* 1963
Same pond as vented ground water except filing # 2737-159535

7. The location, type, size and depth of well or wells contemplated dry pond
See disclosed water ground water in the area (2)
Case SEC 22-20-1963 130 X 15 feet

8. The probable or estimated depth of the water one or artesian aquifer

9. Name, address and license number of the driller engaged Kyle Brinkhoff
Stearnsville Mont.

10. Any such other similar information as may be useful in carrying out the policy of this act.

Request to release appropriation of the maximum capacity of the dry pond under all circumstances in addition to general flow ground has shown great potential from drainage of my own land irrigation in my own lands immediately above. Original filed applying certain was based upon the capacity of the pond in hand at the time which was small

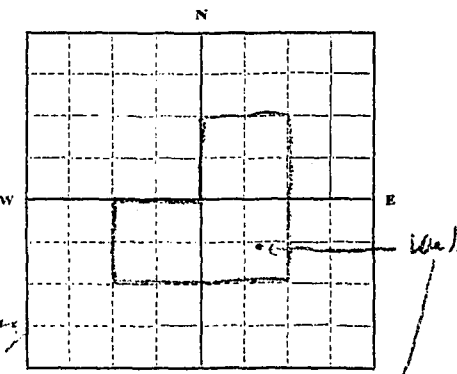

Locate well or other means of development as accurately as possible on the plat.

Signature of Appropriator James Simpson
 Date May 3, 1967

* As defined in the Code Sec. 1 (c) "Well" means any artificial opening or excavation in the ground, however made, by which groundwater can be obtained or through which it flows under natural pressures or is artificially withdrawn."

Three copies of this notice are to be filed with County Clerk and Recorder of the county in which the well is located.

Please answer all questions. If not applicable, so state, otherwise the form will be returned.

Original to the County Clerk and Recorder; duplicate to the State Engineer; Triplicate to the Montana Bureau of Mines and Geology and Quadruplicate for the Appropriator.

11,963

#4926

172812

I certify that I received and filed this
Instrument on this 4th
day of May, 19 67, at 4:20
o'clock P.M.

F. G. Moore
COUNTY RECORDER

By Mary M. Sulz
DEPUTY

Fee \$2.00

File No. MAY 8 1967

T 12 R 20

TRIPPLICATE

Ravalli County

STATE OF MONTANA
ADMINISTRATOR OF GROUNDWATER CODE
OFFICE OF STATE ENGINEER

Notice of Completion of Groundwater
Appropriation by Means of Well

(Under Chapter 237, Montana Session Laws, 1961)

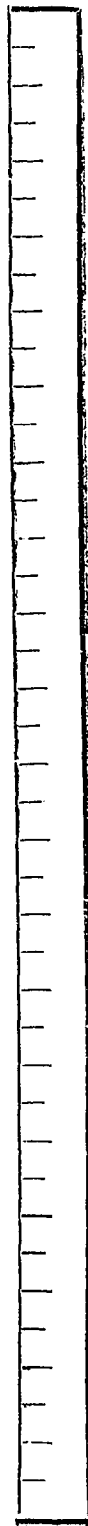

Top of Ground
(Elev. above sea level.....)

Land in the name of...
Owner...
Driller...
Date of Notice...
Date well started...

Owner *James J. ...* Address *...*

Driller *...* Address *...*

Date of Notice of Appropriation of Groundwater *...*

Date well started *...* Date Completed *...*

Type of well *...* Equipment Used *...*
(dug, driven, bored or drilled) (Churn, drill, rotary or other)

Water Use: Domestic () Municipal () Stock () Irrigation ()
Industrial () Drainage () Other ()

← Indicate on the diagram the character and thickness of the different strata met with in drilling, such as soil, clay, shale, gravel, rock or sand, etc. Show depth at which water is encountered, thickness and character of water-bearing strata and height to which the water rises in the well.

Size of Drilled Hole	Size and Weight of Casing	From (Feet)	To (Feet)	PERFORATIONS		
				Kind Size	From (Feet)	To (Feet)
<i>...</i>	<i>...</i>	<i>...</i>	<i>...</i>			

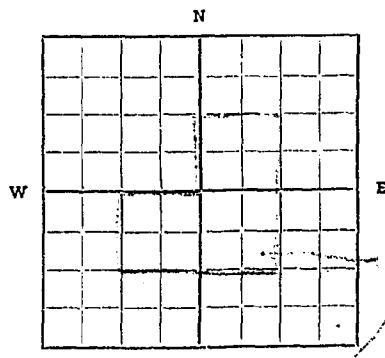

Y. 1/4 Sec. T. R.
Indicate location of well and place of use, if possible. Each small square represents 16 acres.

Static Water Level for non-flowing Well *...* feet.

Shut-in Pressure for Flowing Well *...*

Pumping Water Level *...* feet at *...* gal. per minute.

Discharge in gal., per min. of flowing well *...*

How Tested *...* Length of Test *...*

Remarks: (Gravel packing, cementing, packers, type of shutoff, Location of place of use of groundwater if not at well, and any other similar pertinent information, including number of acres irrigated, if used for irrigation) *...*

Show exact depth of bottom
17 feet

Driller's License Number *...*
Driller's Signature *...*

This form to be prepared by driller, and three copies to be filed by the owner with the County Clerk and Recorder in the county in which the well is located.

Please answer all questions. If not applicable, so state, otherwise the form will be returned.

Original to the County Clerk and Recorder; duplicate to the State Engineer; Triplicate to the School of Mines and Quadruplicate for the Appropriator.

966

GW 2

STATE WATER CONSERVATION DIVISION

File No. _____ DATE MAY 8 1967

T _____ R _____

TRIPPLICATE

Ravalli County

STATE OF MONTANA
ADMINISTRATOR OF GROUNDWATER CODE
OFFICE OF STATE ENGINEER

Notice of Completion of Groundwater
Appropriation by Means of Well

(Under Chapter 237, Montana Session Laws, 1961)

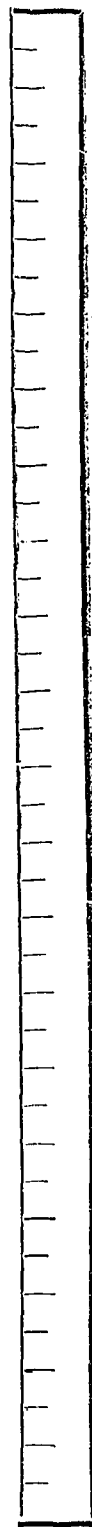

Top of Ground
(Elev. above sea level.....)

Handwritten notes:
Laminar flow capacity
1000 gpm
1000 ft
1000 ft

Owner Address

Driller Address

Date of Notice of Appropriation of Groundwater

Date well started Date Completed

Type of well Equipment Used
(dug, driven, bored or drilled) (Churn, drill, rotary or other)

Water Use: Domestic () Municipal () Stock () Irrigation (✓)
Industrial () Drainage () Other ()

← Indicate on the diagram the character and thickness of the different strata met with in drilling, such as soil, clay, shale, gravel, rock or sand, etc. Show depth at which water is encountered, thickness and character of water-bearing strata and height to which the water rises in the well.

Size of Drilled Hole	Size and Weight of Casing	From (Feet)	To (Feet)	PERFORATIONS		
				Kind Size	From (Feet)	To (Feet)

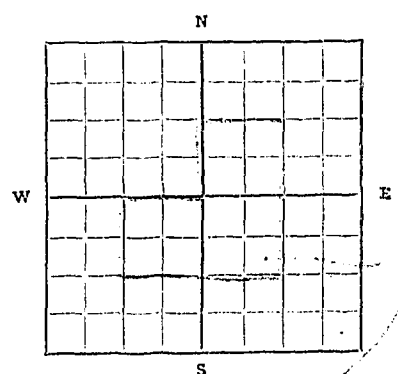

1/4 Sec. T. R.
Indicate location of well and place of use, if possible. Each small square represents 10 acres.

Static Water Level for non-flowing Well feet.

Shut-in Pressure for Flowing Well

Pumping Water Level feet at gal. per minute.

Discharge in gal., per min. of flowing well

How Tested Length of Test

Remarks: (Gravel packing, cementing, packers, type of shutoff, Location of place of use of groundwater if not at well, and any other similar pertinent information, including number of acres irrigated, if used for irrigation)

Show exact depth of bottom

17 feet

Driller's License Number

Handwritten signature
Driller's Signature

This form to be prepared by driller, and three copies to be filed by the owner with the County Clerk and Recorder in the county in which the well is located.

Please answer all questions. If not applicable, so state, otherwise the form will be returned.

Original to the County Clerk and Recorder; duplicate to the State Engineer; Triplicate to the School of Mines and Quadruplicate for the Appropriator.

Handwritten initials: M. J. Baker

#4928

172828

I certify that I received and filed this
Instrument on this 5th
day of May, 19 67, at 2:30
o'clock ^m 2 P.M.

F. G. Moore
COUNTY RECORDER

By Myron M. Hilgert
Fee \$2.00 DEPUTY

G

File No.

T 10 N R 20

DUPLICATE

Ravalli County

STATE OF MONTANA
ADMINISTRATOR OF GROUNDWATER CODE
OFFICE OF STATE ENGINEER

RECEIVED
JAN 17 1964

Declaration of Vested Groundwater Rights
(Under Chapter 237, Montana Session Laws, 1961)

1. James L. Simpson of Florence
(Name of Appropriator) (Address) (Town)

County of Ravalli, State of Montana, have appropriated groundwater according to the Montana laws in effect prior to January 1, 1962, as follows:

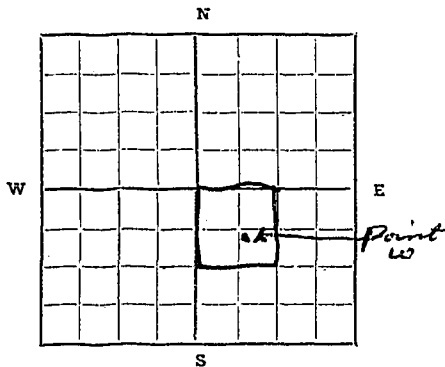

NW 1/4 NE Sec. 22 T. 10. R. 20

Indicate point of appropriation and place of use, if possible. Each small square represents 10 acres.

2. The beneficial use on which the claim is based Irrigation

3. Date or approximate date of earliest beneficial use; and how continuous the use has been 1960 seasonal thereafter as needed.

4. The amount of groundwater claimed (in miner's inches or gallons per minute) 100 gpm

5. If used for irrigation, give the acreage and description of the lands to which water has been applied and name of the owner thereof 10 acres NW 1/4 22 10 20

6. The means of withdrawing such water from the ground and the location of each well or other means of withdrawal ump. Point W on map.

7. The date of commencement and completion of the construction of the well, wells, or other works for withdrawal of groundwater August and November 1960 respectively.

8. The depth of water table one foot

9. So far as it may be available, the type, size and depth of each well or the general specifications of any other works for the withdrawal of groundwater 60' x 100' x 9' deep

10. The estimated amount of groundwater withdrawn each year 30 acre ft.

11. The log of formations encountered in the drilling of each well if available
first foot is silt
second foot is sand
balance is a mixture of clay, gravel & boulder.

12. Such other information of a similar nature as may be useful in carrying out the policy of this act, including reference to book and page of any county record none

Signature of Owner James L. Simpson
Date 12/20/63

Three copies to be filed by the owner with the County Clerk and Recorder of the county in which the well is located.

Please answer all questions. If not applicable, so state, otherwise the form will be returned.

Original to the County Clerk and Recorder; duplicate to the State Engineer; Triplicate to the School of Mines and Quadruplicate for the Appropriator

37200

#2737

I certify that I received and filed this
instrument on this 31st
day of Dec. 1963 at 8:48
o'clock A.
F. V. Moore
COUNTY RECORDER
By Shirley Keith
DEPUTY

GV

File No.

T 10 R 20

DUPLICATE

Ravalli County

STATE OF MONTANA
ADMINISTRATOR OF GROUNDWATER CODE
OFFICE OF STATE ENGINEER

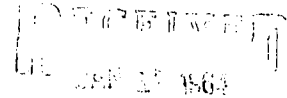

Declaration of Vested Groundwater Rights
(Under Chapter 237, Montana Session Laws, 1961)

1. James Lea Simpson of Florence,
(Name of Appropriator) (Address) (Town)

County of Ravalli, State of Montana, have appropriated groundwater according to the Montana laws in effect prior to January 1, 1962, as follows:

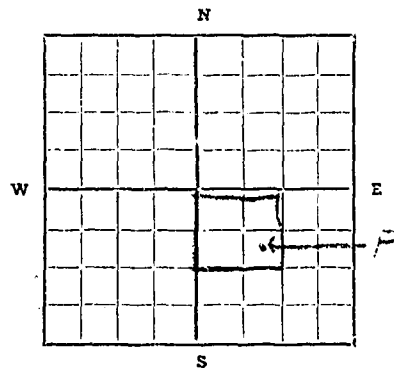

NW 1/4 NE Sec. 22 T. 10 R. 20

Indicate point of appropriation and place of use, if possible. Each small square represents 10 acres.

- 2. The beneficial use on which the claim is based Domestic & Irrigation
- 3. Date or approximate date of earliest beneficial use; and how continuous the use has been 1936 and as necessary thereafter.
- 4. The amount of groundwater claimed (in miner's inches or gallons per minute) 100 gpm
- 5. If used for irrigation, give the acreage and description of the lands to which water has been applied and name of the owner thereof 10 acres. IRMS 22 10 20
- 6. The means of withdrawing such water from the ground and the location of each well or other means of withdrawal Pump Point P on map.

- 7. The date of commencement and completion of the construction of the well, wells, or other works for withdrawal of groundwater June 1935
- 8. The depth of water table one foot
- 9. So far as it may be available, the type, size and depth of each well or the general specifications of any other works for the withdrawal of groundwater 4 foot dia. dug with rock wall, 17 foot deep.
- 10. The estimated amount of groundwater withdrawn each year 30 acre ft.
- 11. The log of formations encountered in the drilling of each well if available fir t foot is soil and a mixture of gravel clay and boulder for the balance.
- 12. Such other information of a similar nature as may be useful in carrying out the policy of this act, including reference to book and page of any county record none

Signature of Owner James Lea Simpson

Date 12/30/62

Three copies to be filed by the owner with the County Clerk and Recorder of the county in which the well is located.

Please answer all questions. If not applicable, so state, otherwise the form will be returned.

Original to the County Clerk and Recorder; duplicate to the State Engineer; Triplicate to the School of Mines and Quadruplicate for the Appropriator.

37199

#12736
C 3

I certify that I received and filed this
Instrument on this 31st
day of Dec 63 at 8:42
o'clock A.
F. G. Moore
By Aberly Keith
DEPUTY

File No.

T 10 R 20

DUPLICATE

Ravalli County

STATE OF MONTANA
ADMINISTRATOR OF GROUNDWATER CODE
OFFICE OF STATE ENGINEER

RECEIVED
JAN 17 1964

Declaration of Vested Groundwater Rights

(Under Chapter 237, Montana Session Laws, 1961)

1. James Lea Simpson of Florence
(Name of Appropriator) (Address) (Town)

County of Ravalli, State of Montana, have appropriated groundwater according to the Montana laws in effect prior to January 1, 1962, as follows:

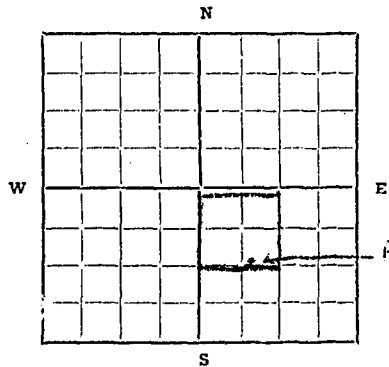

2. The beneficial use on which the claim is based Irrigation

3. Date or approximate date of earliest beneficial use; and how continuous the use has been December 1962, seasonal or nearly thereafter

4. The amount of groundwater claimed (in miner's inches or gallons per minute) 100 gpm

5. If used for irrigation, give the acreage and description of the lands to which water has been applied and name of the owner thereof 10 acres T10E 22 N 20

6. The means of withdrawing such water from the ground and the location of each well or other means of withdrawal Pump Point W on map.

NW 1/4 NE Sec 22 T. 20 R. 20

Indicate point of appropriation and place of use, if possible. Each small square represents 10 acres.

7. The date of commencement and completion of the construction of the well, wells, or other works for withdrawal of groundwater December 6 and December 12 respectively of 1961.

8. The depth of water table six feet.

9. So far as it may be available, the type, size and depth of each well or the general specifications of any other works for the withdrawal of groundwater 100' x 120' x 16' deep

10. The estimated amount of groundwater withdrawn each year 30 acre feet.

11. The log of formations encountered in the drilling of each well if available First foot soil
Second foot sand & gravel
Mixture of clay, gravel & boulder the balance.

12. Such other information of a similar nature as may be useful in carrying out the policy of this act, including reference to book and page of any county record not available.

Signature of Owner James Lea Simpson
Date 12/30/63

Three copies to be filed by the owner with the County Clerk and Recorder of the county in which the well is located.

Please answer all questions. If not applicable, so state, otherwise the form will be returned.

Original to the County Clerk and Recorder; duplicate to the State Engineer; Triplicate to the School of Mines and Quadruplicate for the Appropriator.

37201

#2738

I certify that I received and filed this
Instrument on this 21st
day of Dec. - 63 at 8:44
o'clock A. M.
F. G. Moore
COUNTY RECORDER
By Shirley Keith
DEPUTY

File No. 2128

T. 10 N. R. 20

DUPLICATE

County Ravalli

STATE OF MONTANA
ADMINISTRATOR OF GROUNDWATER CODE
OFFICE OF STATE ENGINEER

RECEIVED
DEC 26 1963

Declaration of Vested Groundwater Rights

(Under Chapter 237, Montana Session Laws, 1961)

1. **Russell G Strong**, of **Florence**
(Name of Appropriator) (Address) (Town)
County of **Ravalli** State of **Montana**
have appropriated groundwater according to the Montana laws in effect prior to January 1, 1962, as follows:

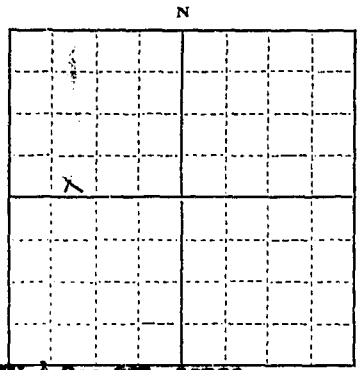

SW 1/4 Sec 22T 10R20

1/4 Sec. T. R.

Indicate point of appropriation and place of use, if possible. Each small square represents 10 acres.

2. The beneficial use on which the claim is based. **Irrigation**

3. Date or approximate date of earliest beneficial use; and how continuous the use has been. **about 1933**

4. The amount of groundwater claimed (in miner's inches or gallons per minute). **50 Gals per minute**

5. If used for irrigation, give the acreage and description of the lands to which water has been applied and name of the owner thereof. **1 acre garden and 7 acres hay land**

6. The means of withdrawing such water from the ground and the location of each well or other means of withdrawal. **Electric pump at house and Gas irrigation pump at Sump 500 feet east of house**

7. The date of commencement and completion of the construction of the well, wells, or other works for withdrawal of groundwater. **1933**

8. The depth of water table. **17 feet at well and 2 feet at sump**

9. So far as it may be available, the type, size and depth of each well or the general specifications of any other works for the withdrawal of groundwater. **Well 17 feet deep and 3 feet in diameter**

Sump, 5 feet deep and 50 feet in diameter

10. The estimated amount of groundwater withdrawn each year. **100,000 gals a year**

11. The log of formations encountered in the drilling of each well if available. **Not available**

12. Such other information of a similar nature as may be useful in carrying out the policy of this act, including reference to book and page of any county record.

Signature of Owner **Russell G Strong**

Date **Dec 17, 1963**

Three copies to be filed by the owner with the County Clerk and Recorder of the county in which the well is located.

Please answer all questions. If not applicable, so state, otherwise the form will be returned.

Original to the County Clerk and Recorder; Duplicate to the State Engineer; Triplicate to the Montana Bureau of Mines and Geology, and Quadruplicate for the Appropriator.

12612

I certify that I received and filed this
instrument on this 23
day of Dec, 19 63 at 4:23
o'clock P.M.

F. A. Moon
COUNTY RECORDER

By _____
DEPUTY

RECEIVED

County RAVALLI

STATE OF MONTANA
ADMINISTRATOR OF GROUNDWATER CODE
MONTANA WATER RESOURCES BOARD
NOTICE OF COMPLETION OF GROUNDWATER
APPROPRIATION BY MEANS OF WELL
Developed after January 1, 1962

DRILLER'S LOG

Indicate the character, color, thickness of strata such as soil, clay, sand, gravel, shale, sandstone, etc. Show depth at which water is found and height to which water rises in well.

(Under Chapter 237 Montana Session Laws, 1961, as amended)
This form to be prepared by driller, and three copies to be filed by the owner with the County Clerk and Recorder in the county in which the well is located, last copy to be retained by driller. Please answer all questions. If not applicable, so state, otherwise the form may be returned.

Owner SAMUEL WOLFE
Address RT1 BX 50
STEVENSVILLE MT
Date well started JULY 12 72
completed JULY 12 72

For Administrator's Use	
File	<u>5918</u>
Date	<u>MAY 29 1972</u>
GW	<u>9:45 A.M.</u>

Type of well DUG
(Dug, driven, bored or drilled)

Equipment used BACKHOE
(Churn drill, rotary or other)

Water Use: Domestic Municipal Stock Irrigation
Industrial Drainage * Garden/Lawn

*Describe _____

USE: If used for irrigation, industrial, drainage or other. Explain, state number of acres and location or other data (i.e. Lot, Block and Addition). _____

ESTIMATED ANNUAL WITHDRAWAL 500 000 GAL

Size of Drilled Hole	Size and Weight of Casing	From (Feet)	To (Feet)	PERFORATIONS		
				Kind Size	From (Feet)	To (Feet)
<u>24"</u>	<u>CORUSASTIC PIPE</u>	<u>0</u>	<u>12'</u>			

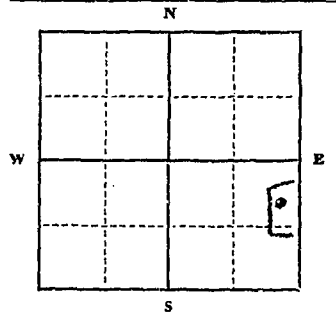

NE SE 1/4 Sec. 22
T. 10 N. R. 20 W.

Static water level 4 ft.*
Pumping water level 6 ft.*
at 100 gallons per minute,
measured 20 minutes after pumping began.
*Measured from ground level.
Well developed by _____
for _____ hours.
Power _____ Pump _____ HP
Remarks: (Gravel packing, cementing, packers, type of shutoff) _____

INDICATE LOCATION OF WELL AND PLACE OF USE, IF POSSIBLE. EACH SMALL SQUARE REPRESENTS 40 ACRES.

Driller's Signature Samuel Wolfe

Driller's Address _____

LICENSE NO. _____

Top of Ground		(Elev. above sea level)
From (Feet)	To (Feet)	
<u>0</u>	<u>12</u>	<u>SAND & GRAVEL</u>

12' Show exact depth of bottom

5918

I certify that I received and filed this
instrument on this 29th
day of May, 19 23, at 9:45
o'clock A.M.
Charles E. Hughes
COUNTY RECORDER
By H. J. ...
DEPUTY

RECEIVED

County avalli

STATE OF MONTANA
ADMINISTRATOR OF GROUNDWATER CODE
MONTANA WATER RESOURCES BOARD

NOTICE OF COMPLETION OF GROUNDWATER
APPROPRIATION BY MEANS OF WELL

Developed after January 1, 1962

(Under Chapter 237 Montana Session Laws, 1961, as amended)

This form to be prepared by driller, and three copies to be filed by the owner with the County Clerk and Recorder in the county in which the well is located, last copy to be retained by driller.

Please answer all questions. If not applicable, so state, otherwise the form may be returned.

Owner Samuel Wolfe
Address Florence, Montana
Date well started Jan. 23, 1973
completed Jan. 31, 1973

For Administrator's Use	
File <u>5919</u>	
<u>MAY 29 1973</u>	
GW 1 <u>9:46 A.M.</u>	

Type of well drilled well
(Dug, driven, bored or drilled)

Equipment used churn drill
(Churn drill, rotary or other)

Water Use: Domestic Municipal Stock Irrigation
Industrial Drainage Other * Garden/Lawn

*Describe
USE: If used for irrigation, industrial, drainage or other. Explain, state number of acres and location or other data (i.e. Lot, Block and Addition).

ESTIMATED ANNUAL WITHDRAWAL 500,000 GAL

Size of Drilled Hole	Size and Weight of Casing	From (Feet)	To (Feet)	PERFORATIONS		
				Kind Size	From (Feet)	To (Feet)
6 1/2	17/16	0	83	3/16x5	75	83

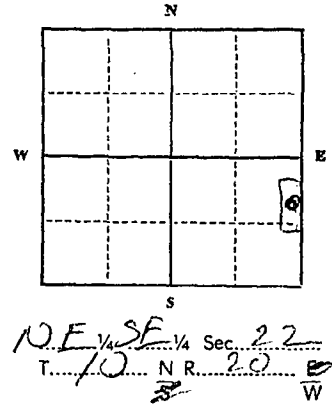

Static water level 31 ft.*
Pumping water level 78 ft.*
at 7 gallons per minute,
measured 60 minutes after pumping
began.
*Measured from ground level.
Well developed by packed
for 24 hours.
Power..... Pump..... HP
Remarks: (Gravel packing, cementing,
packers, type of shutoff) 1 foot of gravel pack

INDICATE LOCATION OF WELL AND PLACE OF USE, IF POSSIBLE. EACH SMALL SQUARE REPRESENTS 40 ACRES.

Driller's Signature Charles Wroble
Driller's Address avalli Drilling Co., Victor, Mont.

LICENSE NO. 200

DRILLER'S LOG

Indicate the character, color, thickness of strata such as soil, clay, sand, gravel, shale, sandstone, etc. Show depth at which water is found and height to which water rises in well.

Top of Ground (Elev. above sea level)		
From (Feet)	To (Feet)	
0	1	topsoil
1	23	sand gravel boulders
23	52	sand and gravel
52	80	water bearing iron clay sand gravel int. and mixed
80	83	sand and gravel water bearing

83 Show exact depth of bottom

52,284

5919

I certify that I received and filed this
instrument on this 29th
day of May, 1972, at 9:46
o'clock A.M.

Darlene E. Hughes
COUNTY RECORDER

By Shirley Keith
CLERK

5920

I certify that I received and filed this
instrument on this 29th
day of May, 1973, at 9:47
o'clock A. M.
Barbara E. Hughes
COUNTY RECORDER
Shirley Keith

File No. ... MAY 8 1967

T 10 R 20

TRIPPLICATE

Bill
Permit
Case
Date
Driller

Ravalli County

STATE OF MONTANA
ADMINISTRATOR OF GROUNDWATER CODE
OFFICE OF STATE ENGINEER

Notice of Completion of Groundwater
Appropriation by Means of Well

(Under Chapter 237, Montana Session Laws, 1961)

Owner Address

Driller Address

Date of Notice of Appropriation of Groundwater

Date well started Date Completed

Type of well Equipment Used
(dug, driven, bored or drilled) (Churn, drill, rotary or other)

Water Use: Domestic () Municipal () Stock (-) Irrigation (-)
Industrial () Drainage (-) Other ()

← Indicate on the diagram the character and thickness of the different strata met with in drilling, such as soil, clay, shale, gravel, rock or sand, etc. Show depth at which water is encountered, thickness and character of water-bearing strata and height to which the water rises in the well.

Top of Ground
(Elev. above sea level.....)

*first foot soil
second foot clay
below clay, gravel
and boulders mixture*

Size of Drilled Hole	Size and Weight of Casing	From (Feet)	To (Feet)	PENETRATIONS		
				Kind Size	From (Feet)	To (Feet)

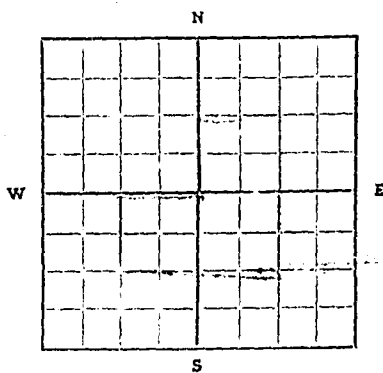

Section 4 Sec. T. R.
Indicate location of well and place of use, if possible. Each small square represents 10 acres.

Show exact depth of bottom

Static Water Level for non-flowing Well feet.

Shut-in Pressure for Flowing Well

Pumping Water Level feet at gal. per minute.

Discharge in gal., per min. of flowing well

How Tested Length of Test

Remarks: (Gravel) packing, cementing, packers, type of shutoff, Location of place of use of groundwater if not at well, and any other similar pertinent information, including number of acres irrigated, if used for irrigation)

Driller's License Number

Driller's Signature

This form to be prepared by driller, and three copies to be filed by the owner with the County Clerk and Recorder in the county in which the well is located.

Please answer all questions. If not applicable, so state, otherwise the form will be returned.

Original to the County Clerk and Recorder; duplicate to the State Engineer; Triplicate to the School of Mines and Quadruplicate for the Appropriator.

41, 965



File No. _____ DATE _____ 1957

T. 10 R. 20

TRIPPLICATE

Ravalli County

STATE OF MONTANA
ADMINISTRATOR OF GROUNDWATER CODE
OFFICE OF STATE ENGINEER

Notice of Completion of Groundwater
Appropriation by Means of Well

(Under Chapter 237, Montana Session Laws, 1961)



Top of Ground
(Elev. above sea level.....)

Owner Address.....

Driller Address.....

Date of Notice of Appropriation of Groundwater

Date well started Date Completed

Type of well Equipment Used

Water Use: Domestic () Municipal () Stock (-) Irrigation (-)
Industrial () Drainage () Other ()

*first foot soil
second foot clay
balance clay, gravel
and boulders mixture*

← Indicate on the diagram the character and thickness of the different strata met with in drilling, such as soil, clay, shale, gravel, rock or sand, etc. Show depth at which water is encountered, thickness and character of water-bearing strata and height to which the water rises in the well.

Size of Drilled Hole	Size and Weight of Casing	From (Feet)	To (Feet)	PERFORATIONS		
				Rind Size	From (Feet)	To (Feet)

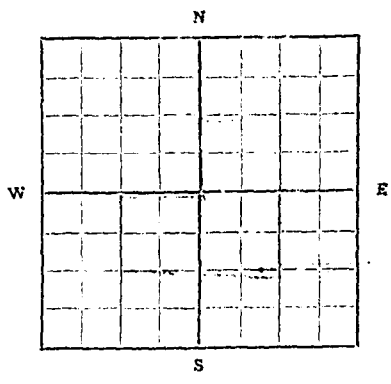

Static Water Level for non-flowing Well feet.

Shut-in Pressure for Flowing Well

Pumping Water: Level feet at gal. per minute.

Discharge in gal., per min. of flowing well

How Tested Length of Test

Remarks: (Gravel packing, cementing, packers, type of shutoff, Location of place of use of groundwater if not at well, and any other similar pertinent information, including number of acres irrigated, if used for irrigation)

..... 1/4 Sec. T. R.
Indicate location of well and place of use, if possible. Each small square represents 1 acre.

Show exact depth of bottom

.....
Driller's License Number

.....
Driller's Signature

This form to be prepared by driller, and three copies to be filed by the owner with the County Clerk and Recorder in the county in which the well is located.
Please answer all questions. If not applicable, so state, otherwise the form will be returned.
Original to the County Clerk and Recorder; duplicate to the State Engineer; Triplicate to the School of Mines and Quadruplicate for the Appropriator.

40 9 6 5

#4929

172829

I certify that I received and filed this
Instrument on this 5th
day of May, 1967, at 2:31
o'clock P.M.

F. G. Moore
COUNTY RECORDER

By Myra M. Sledge
DEPUTY

Fee \$2.00

File No.....

T. 10 N. R. 20 W.

DUPLICATE

County.....

STATE OF MONTANA
ADMINISTRATOR OF GROUNDWATER CODE
OFFICE OF STATE ENGINEER

STATE ENGINEER

Declaration of Vested Groundwater Rights

(Under Chapter 237, Montana Session Laws, 1961)

I, Peter and Mary M. Bugli, of Florence (Town),
(Name of Appropriator) (Address)

County of Ravalli State of Montana
have appropriated groundwater according to the Montana laws in effect prior to January 1, 1962, as follows:

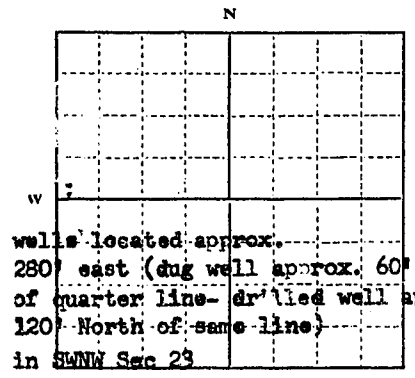

SW 1/4 NW Sec. 23 T10N R. 20W
Indicate point of appropriation and place of use, if possible. Each small square represents 10 acres.

- The beneficial use on which the claim is based domestic water supply and garden irrigation
- Date or approximate date of earliest beneficial use; and how continuous the use has been. 1947 - drilled well - used continuous domestic and garden 1957 - dugwell 14' - garden
- The amount of groundwater claimed (in miner's inches or gallons per minute) 1947 - 600 gallons per hour 1957 - 800 gallons per hour
- If used for irrigation, give the acreage and description of the lands to which water has been applied and name of the owner thereof. 2 acres - located in the SWSNW of Sec. 23, Twp 10 N Range 20W, M.M. - owner Peter & Mary M. Bugli
- The means of withdrawing such water from the ground and the location of each well or other means of withdrawal. 1947 well by deep well jet pump 1957 well by shallow well centrifugal pump

- The date of commencement and completion of the construction of the well, wells, or other works for withdrawal of groundwater. March 1947 - 4" drilled well - 47' deep - steel casing October 1957 - 14" dug well cased with concrete
- The depth of water table. 35' & 12'
- So far as it may be available, the type, size and depth of each well or the general specifications of any other works for the withdrawal of groundwater. 4" cased drilled well 47 feet deep water table to 35' depth 3" dug well 14' - concrete cased - water table 12' depth
- The estimated amount of groundwater withdrawn each year. One million gallons
- The log of formations encountered in the drilling of each well if available. Gravel & sand to water table in both wells
- Such other information of a similar nature as may be useful in carrying out the policy of this act, including reference to book and page of any county record. Irrigation ditch from Sweeney Creek runs through same tract with decreed water rights - decrees filing dates (see abstract)

Signature of Owner Peter Bugli
Date 12-30-62 Mary M. Bugli

Three copies to be filed by the owner with the County Clerk and Recorder of the county in which the well is located.
Please answer all questions. If not applicable, so state, otherwise the form will be returned.
Original to the County Clerk and Recorder. Duplicate to the State Engineer; Triplicate to the Montana Bureau of Mines and Geology, and Quadruplicate for the Appropriator.

#2379

I certify that I received and filed this
instrument of this 30th
day of Dec, 1904
at A. M.
J. Y. Moore
COUNTY RECORDER
By Sherley Keith
DEPUTY

File No.

T. 10 R. 20

DUPLICATE

County Ravalli

LOG

STATE OF MONTANA
ADMINISTRATOR OF GROUNDWATER CODE
STATE WATER CONSERVATION BOARD

Notice of Completion of Groundwater
Appropriation by Means of Well
DEVELOPED AFTER JANUARY 1, 1962

(Under Chapter 237 Montana Session Laws, 1961, as amended)

Owner Bt. S. Chaffin Address Florence Mont

Driller Bill Anderson Address Victor Mont

Date of Notice of appropriation of groundwater.....

Date well started April 12, 72 Date completed April 15, 72

Type of well drilled Equipment used Churn Drill
(Dug, driven, bored or drilled) (Churn drill, rotary or other)

Water use: Domestic Municipal Stock Irrigation
Industrial Drainage Other

Indicate on the diagram the character and thickness of the different strata met with in drilling, such as soil, clay, shale, gravel, rock or sand, etc. Show depth at which water is encountered, thickness and character of water-bearing strata and height to which the water rises in the well.

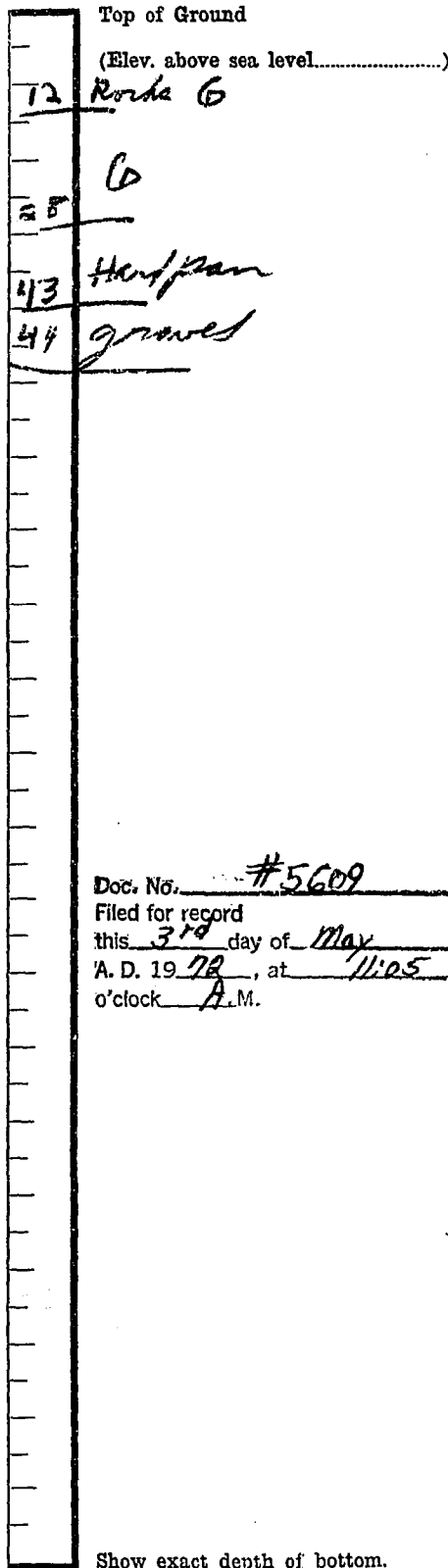

Size of Drilled Hole	Size and Weight of Casing	From (Feet)	To (Feet)	PERFORATIONS		
				Kind Size	From (Feet)	To (Feet)
6 in	3 1/2" wall 6 in	0	44	—	—	—

Static Water Level for non-flowing well 10 feet.

Shut-in Pressure for Flowing Well.....

Pumping Water Level 15 feet at 15 gal. per minute.

Discharge in gal. per min. of flowing well 15 gpm

How Tested sub pump

Length of Test 2 hrs

Remarks: (Gravel packing, cementing, packers, type of shutoff).....

(Continue on reverse side)

USE—If used for irrigation, industrial, drainage or other. Explain, state number of acres and location or other data (i.e.: Lot, Block and Addition).

This form to be prepared by driller, and three copies to be filed by the owner with the County Clerk and Recorder in the county in which the well is located, tissue copy to be retained by driller.

Please answer all questions. If not applicable, so state, otherwise the form will be returned.

33
Driller's License Number
William Anderson
Driller's Signature

50,315

#5609

I certify that I received and filed this
instrument on this 3rd
day of May, 1972, at 11:05
o'clock AM.

F. S. Moore
COUNTY RECORDER

Fee 2.00
DEPUTY

County Pike 20W

STATE OF MONTANA
ADMINISTRATOR OF GROUNDWATER CODE
MONTANA WATER RESOURCES BOARD

RECEIVED

DRILLER'S LOG

Indicate the character, color, thickness of strata such as soil, clay, sand, gravel, shale, sandstone, etc. Show depth at which water is found and height to which water rises in well.

MAR 28 1973

NOTICE OF COMPLETION OF GROUNDWATER
APPROPRIATION BY MEANS OF WELL

DEPARTMENT OF NATURAL
RESOURCES AND CONSERVATION

Developed after January 1, 1962

(Under Chapter 237 Montana Session Laws, 1961, as amended)

This form to be prepared by driller, and three copies to be filed by the owner with the County Clerk and Recorder in the county in which the well is located, last copy to be retained by driller.

Please answer all questions. If not applicable, so state, otherwise the form may be returned.

Owner Dennis Dragotis
Address Florence Mont
Date well started Nov 14-72
completed Nov 17-72

For Administrator's Use	
File <u>5847</u>	<u>MARCH 26, 1973</u>
GW <u>10:57 a.m.</u>	

Type of well drilled
(Dug, driven, bored or drilled)

Equipment used churn drill
(Churn drill, rotary or other)

Water Use: Domestic Municipal Stock Irrigation
Industrial Drainage Other * Garden/Lawn

*Describe
USE: If used for irrigation, industrial, drainage or other. Explain, state number of acres and location or other data (i.e. Lot, Block and Addition).

ESTIMATED ANNUAL WITHDRAWAL

Size of Drilled Hole	Size and Weight of Casing	From (Feet)	To (Feet)	PERFORATIONS		
				Kind Size	From (Feet)	To (Feet)
<u>6 in</u>	<u>250 lb 6 in</u>	<u>0</u>	<u>44</u>	-	-	-

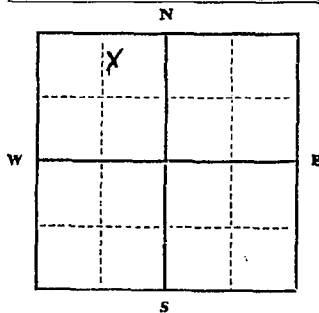

Static water level 26 ft.*
Pumping water level 32 ft.*
at 1.5 gallons per minute,
measured 3.0 minutes after pumping began.

*Measured from ground level.
Well developed by subpump for 2 hours.
Power etc Pump 1/2 HP
Remarks: (Gravel packing, cementing, packers, type of shutoff)

N.E. 1/4 N.W. 1/4 Sec. 23
T. 10 N. R. 20 E. 2
W

INDICATE LOCATION OF WELL AND PLACE OF USE, IF POSSIBLE. EACH SMALL SQUARE REPRESENTS 40 ACRES.

Driller's Signature William Anderson
Driller's Address Box 1, Box 35 J
Victor Mont LICENSE NO. 33

Top of Ground (Elev. above sea level)

From (Feet)	To (Feet)	Description
<u>0</u>	<u>8</u>	<u>clint</u>
<u>8</u>	<u>34</u>	<u>gravel sand</u>
<u>34</u>	<u>43</u>	<u>hard pan</u>
<u>43</u>	<u>44</u>	<u>water gravel</u>

44 Show exact depth of bottom

5847

[Faint handwritten notes]

[Faint handwritten notes]

[Faint handwritten notes]

I certify that I received and filed this instrument on this 26th day of March 1923 at 12:57 o'clock A.M.

Darlene E Hughes
COUNTY RECORDER

By Lee L. Co
Deputy

RECEIVED BY THE CLERK OF THE COURT

[Faint handwritten notes]

File No.

T. 10 N. 20 W. 23

DUPLICATE

County Beavertail

STATE OF MONTANA
ADMINISTRATOR OF GROUNDWATER CODE
OFFICE OF STATE ENGINEER

JAN 17 1962

Declaration of Vested Groundwater Rights
(Under Chapter 237, Montana Session Laws, 1961)

1. Agnes Gow, of Flournoy,
(Name of Appropriator) (Address) (Town)
County of Beavertail State of Montana
have appropriated groundwater according to the Montana laws in effect prior to January 1, 1962, as follows:

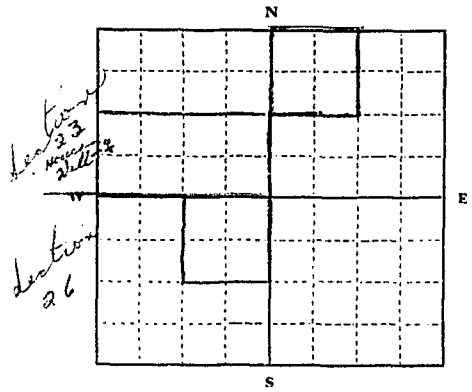

1/4 Sec. 23 T. 10 N. R. 20 W.
Indicate point of appropriation and place of use, if possible. Each small square represents 10 acres.

- 2. The beneficial use on which the claim is based... household, lawn & garden
- 3. Date or approximate date of earliest beneficial use; and how continuous the use has been... for over 50 years
- 4. The amount of groundwater claimed (in miner's inches or gallons per minute)... 6 gallons per minute
- 5. If used for irrigation, give the acreage and description of the lands to which water has been applied and name of the owner thereof... lawn & garden - Agnes Gow owner
- 6. The means of withdrawing such water from the ground and the location of each well or other means of withdrawal... electric pump

- 7. The date of commencement and completion of the construction of the well, wells, or other works for withdrawal of groundwater... construction completed in 1947
- 8. The depth of water table... 10 feet
- 9. So far as it may be available, the type, size and depth of each well or the general specifications of any other works for the withdrawal of groundwater... 2 7/8 feet deep - first 12 feet dug and last 15 feet drilled
- 10. The estimated amount of groundwater withdrawn each year... 40,000 gallons
- 11. The log of formations encountered in the drilling of each well if available... not available
- 12. Such other information of a similar nature as may be useful in carrying out the policy of this act, including reference to book and page of any county record... Book 1 - Page 115 - Line 2

Signature of Owner Agnes Gow
Date Dec 25, 1962

Three copies to be filed by the owner with the County Clerk and Recorder of the county in which the well is located.
Please answer all questions. If not applicable, so state, otherwise the form will be returned.
Original to the County Clerk and Recorder; Duplicate to the State Engineer; Triplicate to the Montana Bureau of Mines and Geology, and Quadruplicate for the Appropriator.

4092

I certify that I received and filed this
instrument on the 31st
day of Dec., 1963, at 4:21
o'clock P. M.
F. G. Moore
COUNTY RECORDER
By: Shirley Keish
DEPUTY

STATE OF MONTANA
ADMINISTRATOR OF GROUNDWATER CODE
MONTANA WATER RESOURCES BOARD

NOTICE OF COMPLETION OF GROUNDWATER
APPROPRIATION BY MEANS OF WELL

Developed after January 1, 1962

(Under Chapter 237 Montana Session Laws, 1961, as amended)

This form to be prepared by driller, and three copies to be filed by the owner with the County Clerk and Recorder in the county in which the well is located, last copy to be retained by driller.

Please answer all questions. If not applicable, so state, otherwise the form may be returned.

Owner John H. ...
Address ... Florence, Montana
Date well started Dec. 7, 1972
completed Jan. 3, 1973

For Administrator's Use
File # 5-783
Jan 3, 1973
9:40 A.M.
GW 1

Type of well drilled well
(Dug, driven, bored or drilled)

Equipment used churn drill
(Churn drill, rotary or other)

Water Use: Domestic Municipal Stock Irrigation
Industrial Drainage Other * Garden/Lawn

*Describe
USE: If used for irrigation, industrial, drainage or other. Explain, state number of acres and location or other data (i.e. Lot, Block and Addition).

ESTIMATED ANNUAL WITHDRAWAL

Size of Drilled Hole	Size and Weight of Casing	From (Feet)	To (Feet)	PERFORATIONS		
				Kind Size	From (Feet)	To (Feet)
8"	17/20	0	20	3/16" x 5	24	29

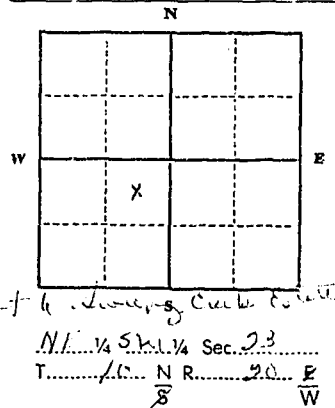

Static water level 23 ft.*
Pumping water level 25 ft.*
at 20 gallons per minute,
measured 30 minutes after pumping
began.
*Measured from ground level.
Well developed by 30 hours.
Power ... Pump ... HP
Remarks: (Gravel packing, cementing,
packers, type of shutoff) ...
...

INDICATE LOCATION OF WELL AND PLACE OF USE, IF POSSIBLE. EACH SMALL SQUARE REPRESENTS 40 ACRES.

Driller's Signature Charles Wroble Jr.

Driller's Address ...

LICENSE NO. ...

DRILLER'S LOG

Indicate the character, color, thickness of strata such as soil, clay, sand, gravel, shale, sandstone, etc. Show depth at which water is found and height to which water rises in well.

Top of Ground (Elev. above sea level)		
From (Feet)	To (Feet)	
1	3	rock hole
3	5	...
5	17	sand gravel some water bearing
17	29	sand gravel brown and some iron water bearing

Show exact depth of bottom 25