

#5783

I certify that I received and filed this  
instrument on this 3rd  
day of Jan, 1973, at 9:40  
o'clock A. M.

Carlene E. Hughes  
COUNTY RECORDER

By \_\_\_\_\_  
DEPUTY



15444

I certify that I received and filed this  
instrument on this 15<sup>th</sup>  
day of June, 1971, at 3:25  
o'clock P.M.  
F. L. Moore  
COUNTY RECORDER  
By F. L. Moore  
DEPUTY

County Beavertail

STATE OF MONTANA  
ADMINISTRATOR OF GROUNDWATER CODE  
MONTANA WATER RESOURCES BOARD

DRILLER'S LOG

Indicate the character, color, thickness of strata such as soil, clay, sand, gravel, shale, sandstone, etc. Show depth at which water is found and height to which water rises in well.

NOTICE OF COMPLETION OF GROUNDWATER  
APPROPRIATION BY MEANS OF WELL

Developed after January 1, 1962

(Under Chapter 237 Montana Session Laws, 1961, as amended)

This form to be prepared by driller, and three copies to be filed by the owner with the County Clerk and Recorder in the county in which the well is located, last copy to be retained by driller.

Please answer all questions. If not applicable, so state, otherwise the form may be returned.

Owner Bob Hitchcock  
Address Glendora, Montana  
Date well started June 3, 1971  
completed June 5, 1971

For Administrator's Use	
File	<u>5444</u>
	<u>June 15, 1971</u>
	<u>3:25 PM</u>

Type of well Drilled  
(Dug, driven, bored or drilled)  
Equipment used Churn Drill  
(Churn drill, rotary or other)  
Water Use: Domestic  Municipal  Stock  Irrigation   
Industrial  Drainage  Other \* Garden/Lawn

\*Describe \_\_\_\_\_  
USE: If used for irrigation, industrial, drainage or other. Explain, state number of acres and location or other data (i.e. Lot, Block and Addition).

ESTIMATED ANNUAL WITHDRAWAL minimum

Size of Drilled Hole	Size and Weight of Casing	From (Feet)	To (Feet)	PERFORATIONS		
				Kind Size	From (Feet)	To (Feet)
6"	17 lbs. per ft.	0	20	3/16x5	19	20

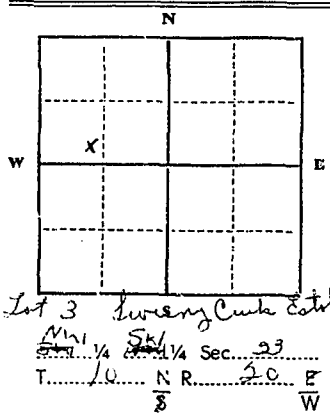

Static water level 11 ft.\*  
Pumping water level 22 ft.\*  
at 15 gallons per minute,  
measured 10 minutes after pumping began.  
\*Measured 10 level.  
Well developed 10  
for 10 HP  
Power 10 HP  
Remarks cementing,  
packers,  
1" pack

INDICATE LOCATION OF WELL AND PLACE OF USE, IF POSSIBLE. EACH SMALL SQUARE REPRESENTS 40 ACRES.  
Driller's Signature Beavertail Drilling Co.  
Driller's Address Box 27, Victoria, Montana

Top of Ground (Elev. above sea level)		
From (Feet)	To (Feet)	
<u>0</u>	<u>0</u>	<u>soil</u>
<u>0</u>	<u>24</u>	<u>sand, gravel, boulders</u> <u>at top of boulder</u>

County \_\_\_\_\_

STATE OF MONTANA  
ADMINISTRATOR OF GROUNDWATER CODE  
MONTANA WATER RESOURCES BOARD  
NOTICE OF COMPLETION OF GROUNDWATER  
APPROPRIATION BY MEANS OF WELL

Developed after January 1, 1962

(Under Chapter 237 Montana Session Laws, 1961, as amended)

This form to be prepared by driller, and three copies to be filed by the owner with the County Clerk and Recorder in the county in which the well is located, last copy to be retained by driller.

Please answer all questions. If not applicable, so state, otherwise the form may be returned.

Owner \_\_\_\_\_  
Address \_\_\_\_\_  
Date well started \_\_\_\_\_  
completed \_\_\_\_\_

For Administrator's Use  
File \_\_\_\_\_  
GW 1 \_\_\_\_\_

Type of well \_\_\_\_\_  
(Dug, driven, bored or drilled)

Equipment used \_\_\_\_\_  
(Churn drill, rotary or other)

Water Use: Domestic  Municipal  Stock  Irrigation   
Industrial  Drainage  Other \* Garden/Lawn

\*Describe \_\_\_\_\_  
USE: If used for irrigation, industrial, drainage or other. Explain, state number of acres and location or other data (i.e. Lot, Block and Addition).

ESTIMATED ANNUAL WITHDRAWAL \_\_\_\_\_

Size of Drilled Hole	Size and Weight of Casing	From (Feet)	To (Feet)	PERFORATIONS		
				Kind Size	From (Feet)	To (Feet)
6"	17 lbs. 1/2" OD	0	20	3/16" S	10	20

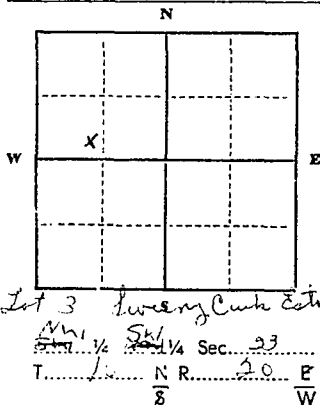

Static water level \_\_\_\_\_ ft.\*  
Pumping water level \_\_\_\_\_ ft.\*  
at \_\_\_\_\_ gallons per minute,  
measured \_\_\_\_\_ minutes after pumping  
began.  
\*Measured from ground level.  
Well developed by \_\_\_\_\_  
for \_\_\_\_\_ hours.  
Power \_\_\_\_\_ Pump \_\_\_\_\_ HP  
Remarks: (Gravel packing, cementing,  
packers, type of shutoff) \_\_\_\_\_

INDICATE LOCATION OF WELL AND PLACE OF USE, IF POSSIBLE.  
EACH SMALL SQUARE REPRESENTS 40 ACRES.

Driller's Signature \_\_\_\_\_

Driller's Address \_\_\_\_\_

LICENSE NO. \_\_\_\_\_

DRILLER'S LOG

Indicate the character, color, thickness of strata such as soil, clay, sand, gravel, shale, sandstone, etc. Show depth at which water is found and height to which water rises in well.

Top of Ground (Elev. above sea level) \_\_\_\_\_

From (Feet)	To (Feet)	
0	20	Gravel
20	30	Sand
30	40	Clay
40	50	Shale
50	60	Sandstone
60	70	Gravel
70	80	Sand
80	90	Clay
90	100	Shale
100	110	Sandstone
110	120	Gravel
120	130	Sand
130	140	Clay
140	150	Shale
150	160	Sandstone
160	170	Gravel
170	180	Sand
180	190	Clay
190	200	Shale
200	210	Sandstone
210	220	Gravel
220	230	Sand
230	240	Clay
240	250	Shale
250	260	Sandstone
260	270	Gravel
270	280	Sand
280	290	Clay
290	300	Shale
300	310	Sandstone
310	320	Gravel
320	330	Sand
330	340	Clay
340	350	Shale
350	360	Sandstone
360	370	Gravel
370	380	Sand
380	390	Clay
390	400	Shale
400	410	Sandstone
410	420	Gravel
420	430	Sand
430	440	Clay
440	450	Shale
450	460	Sandstone
460	470	Gravel
470	480	Sand
480	490	Clay
490	500	Shale
500	510	Sandstone
510	520	Gravel
520	530	Sand
530	540	Clay
540	550	Shale
550	560	Sandstone
560	570	Gravel
570	580	Sand
580	590	Clay
590	600	Shale
600	610	Sandstone
610	620	Gravel
620	630	Sand
630	640	Clay
640	650	Shale
650	660	Sandstone
660	670	Gravel
670	680	Sand
680	690	Clay
690	700	Shale
700	710	Sandstone
710	720	Gravel
720	730	Sand
730	740	Clay
740	750	Shale
750	760	Sandstone
760	770	Gravel
770	780	Sand
780	790	Clay
790	800	Shale
800	810	Sandstone
810	820	Gravel
820	830	Sand
830	840	Clay
840	850	Shale
850	860	Sandstone
860	870	Gravel
870	880	Sand
880	890	Clay
890	900	Shale
900	910	Sandstone
910	920	Gravel
920	930	Sand
930	940	Clay
940	950	Shale
950	960	Sandstone
960	970	Gravel
970	980	Sand
980	990	Clay
990	1000	Shale

\_\_\_\_ Show exact depth of bottom

78608

#5444

I certify that I received and filed this  
instrument on this 15<sup>th</sup>  
day of June 1971 at 3:25  
o'clock P M.

F. L. Moore  
COUNTY RECORDER

By F. L. Moore  
DEPUTY

File No. 2234

T. 10<sup>N</sup> R. 20<sup>W</sup>

DUPLICATE

County Corvallis

STATE OF MONTANA  
ADMINISTRATOR OF GROUNDWATER CODE  
OFFICE OF STATE ENGINEER

RECEIVED  
DEC 31 1963

Notice of Completion of Groundwater Appropriation Without Well

(Under Chapter 237 Montana Session Laws, 1961)

Date of Appropriation of Groundwater April 1960  
Owner John W. Shoemaker Address Flora, Mont  
Contractor (if any) Gardner  
Address of Contractor Corvallis, Mont  
Date Started April 11 Date Completed April 11

Describe means of obtaining groundwater without a well "as by sub-irrigation and other natural processes". Include depth to water when applicable. A water pump  
2' high water 18 feet low  
Size of pump 12 1/2 x 8' W x 12' deep

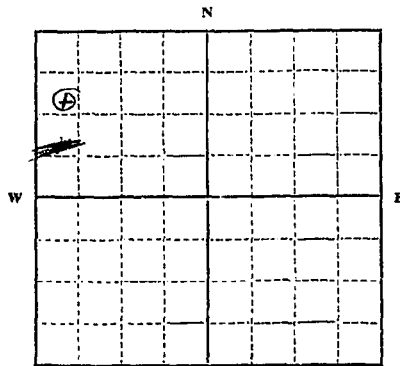

5900' S  
NW 1/4 Sec. 23, T. 10, R. 20  
Indicate point of appropriation and place of use, if possible.

Quantity of water developed and used with explanation of method used to measure or estimate such amount. If use is intermittent estimate approximate lengths of periods of use.  
5 H.P. Electric motor 3" Cent. Pump  
May 1st to Sept 15th  
- 20 million inches -

Signature of Owner John W. Shoemaker  
Date 12/26/63

This form to be prepared by contractor (if any), otherwise by the owner.  
Three copies of this notice are to be filed with the County Clerk and Recorder of the county in which the works are located.  
Please answer all questions. If not applicable, so state, otherwise the form will be returned.  
Original to the County Clerk and Recorder; duplicate to the State Engineer; Triplicate to the Montana Bureau of Mines and Geology and Quadruplicate for the Appropriator.

I certify that I received and filed this  
instrument on this 26  
day of Dec, 1963, at 5:07  
o'clock P.

F. G. Moore  
COURTY RECORDER

By \_\_\_\_\_  
DEPUTY



File No. 2233

15-5-910'

T. 10<sup>N</sup> R. 20<sup>W</sup>

DUPLICATE

County Russell

STATE OF MONTANA  
ADMINISTRATOR OF GROUNDWATER CODE  
OFFICE OF STATE ENGINEER

RECEIVED  
DEC 31 1963

Declaration of Vested Groundwater Rights STATE ENGINEER

(Under Chapter 237, Montana Session Laws, 1961)

1. John W. Shoemaker, of RFD Florence Mont  
(Name of Appropriator) (Address) (Town)

County of \_\_\_\_\_ State of \_\_\_\_\_  
have appropriated groundwater according to the Montana laws in effect prior to January 1, 1962, as follows:

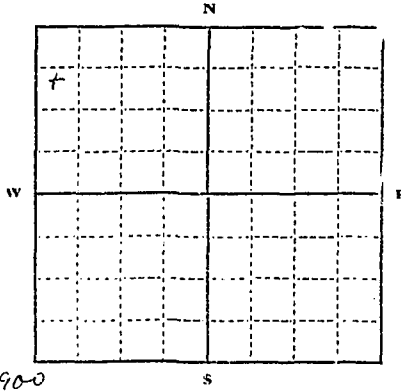

S900

NW of NW Sec. 23 T. 10. R. 20

Indicate point of appropriation and place of use, if possible. Each small square represents 10 acres.

2. The beneficial use on which the claim is based... domestic  
Palm garden & lawn irrigation - stock water

3. Date or approximate date of earliest beneficial use; and how continuous the use has been... 1941 and used continuously thereafter

4. The amount of groundwater claimed (in miner's inches or gallons per minute)... 10 miner inches

5. If used for irrigation, give the acreage and description of the lands to which water has been applied and name of the owner thereof  
Lawn & Garden approx 3 acres

6. The means of withdrawing such water from the ground and the location of each well or other means of withdrawal... water is pumped thru 1/2 H.P. jet pump into storage tank (storage B)

7. The date of commencement and completion of the construction of the well, wells, or other works for withdrawal of groundwater... approximately 1941

8. The depth of water table... 10' high water level 20' low water level

9. So far as it may be available, the size and depth of each well or the general specifications of any other works for the withdrawal of groundwater... Depth of well 28' dug well with cement casing approx 4' diameter

10. The estimated amount of groundwater withdrawn each year... 5,000,000 gallons

11. The log of formations encountered in the drilling of each well if available... clay & gravel

12. Such other information of a similar nature as may be useful in carrying out the policy of this act, including reference to book and page of any county record.

Signature of Owner John W. Shoemaker

Date... 12/26/63

Three copies to be filed by the owner with the County Clerk and Recorder of the county in which the well is located.

Please answer all questions. If not applicable, so state, otherwise the form will be returned.

Original to the County Clerk and Recorder; Duplicate to the State Engineer; Triplicate to the Montana Bureau of Mines and Geology, and Quadruplicate for the Appropriator.

I certify that I received and filed this  
instrument on this 26  
day of Dec, 19 63, at 5:06  
o'clock P.M.

F. R. Mason  
COUNTY RECORDER

By \_\_\_\_\_  
DEPUTY

RECORDED  
INDEXED  
DEC 26 1963  
COUNTY RECORDER

File No. ....

T. 10N R. 20W Sec 23

DUPLICATE

County RODOLPH

LOG

STATE OF MONTANA  
ADMINISTRATOR OF GROUNDWATER CODE  
OFFICE OF STATE ENGINEER

Notice of Completion of Groundwater  
Appropriation by Means of Well

DEVELOPED AFTER JANUARY 1, 1962

(Under Chapter 237, Montana Session Laws, 1961)



Top of Ground  
(Elev. above sea level.....)

0 - 5 sandy loam

5 - 8 sand & coarse  
gravel

8 - 28 coarse sand  
gravel & water

28 - 35 reddish brown  
clay no water

35 - 48 coarse sand  
& water

48 - 52 gravel & water

Doc. No. 5396  
Filed for record  
this 17 day of MARCH  
A. D. 1971 at 9:20  
o'clock A.M.

Owner Charles Walker Address Florence Montana

Driller Harold K. Pickens Address 3624 So. Ave. Missoula

Date of Notice of appropriation of groundwater.....

Date well started 11/16/70 Date completed 11/19/70

Type of well drilled Equipment used cable tool  
(Dug, Driven, bored or drilled) (Churn drill, rotary or other)

Water use: Domestic  Municipal  Stock  Irrigation   
Industrial  Drainage  Other

Indicate on the diagram the character and thickness of the different strata met with in drilling, such as soil, clay, shale, gravel, rock or sand, etc. Show depth at which water is encountered, thickness and character of water-bearing strata and height to which the water rises in the well.

Size of Bored Hole	Size and Weight of Casing	From (Feet)	To (Feet)	PERFORATIONS		
				Kind Size	From (Feet)	To (Feet)
5 inch	5 in. i.d. 18 lbs. per ft.	0	52	none		

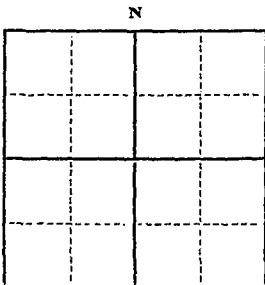

Static Water Level for non-flowing well  
6 ft. of top feet.

Shut-in Pressure for Flowing Well.....

Pumping Water Level 5 ft. of top feet  
at 45 gal. per minute.

Discharge in gal. per min. of flowing well.....

How Tested compressor

Length of Test 3 1/2 hrs.

Remarks: (Gravel packing, cementing, packers, type of shutoff).....

Lot 11  
Sweeney Creek Estates  
1/4 Sec. T. R.  
Indicate location of well and place of use, if possible. Each small square represents 40 acres.

(Continue on reverse side)

USE—If used for irrigation, industrial, drainage or other. Explain, state number of acres and location or other data (i.e.: Lot, Block and Addition).

Show exact depth of bottom.

52 ft.

This form to be prepared by driller, and three copies to be filed by the owner with the County Clerk and Recorder in the county in which the well is located, tissue copy to be retained by driller.

Please answer all questions. If not applicable, so state, otherwise the form will be returned.

71  
Driller's License Number

Harold K. Pickens  
Driller's Signature

48234

#5396

I certify that I received and filed this  
instrument on this 17<sup>th</sup>  
day of Mar. 1920 at 9:20  
o'clock AM.  
F. G. Moore  
COUNTY RECORDER  
By Fee 2.00  
DEPUTY

T. 10NR20 W  
Sec. 23

MONTANA WATER RESOURCES BOARD  
Water Resources Division  
Mitchell Building  
Helena, Montana 59601

Recently a copy of a groundwater appropriation form,

- GW 1, Notice of Appropriation of Groundwater
- GW 2, Notice of Completion of Groundwater Appropriation by means of Well
- GW 3, Notice of Completion of Groundwater Appropriation without Well
- GW 4, Declaration of Vested Groundwater Rights (This form is obsolete and was limited by law to use only through 1965)

was forwarded to this office by the County Clerk and Recorder.

This form is identified by

Owner Charles Walker Address Florence, Montana

Location T. \_\_\_\_\_ R. \_\_\_\_\_ Sec. \_\_\_\_\_ Document No. 5396

This is to inform you that your GW form has been received and is complete as filed.

This is a request for additional information if available. Please complete the enclosed copy by providing information where indicated, or as noted here and return the corrected copy to the Montana Water Resources Board in Helena.

Please provide the location of the well by township, range, and section number on the enclosed form.

Other.

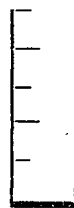

Show exact depth of bottom.

51 ft.

.....(Continue on reverse side)

USE—If used for irrigation, industrial, drainage or other. Explain, state number of acres and location or other data (i.e.: Lot, Block and Addition).

.....  
.....  
.....

This form to be prepared by driller, and three copies to be filed by the owner with the County Clerk and Recorder in the county in which the well is located, tissue copy to be retained by driller.

Please answer all questions. If not applicable, so state, otherwise the form will be returned.

.....71.....  
Driller's License Number

*[Handwritten Signature]*  
Driller's Signature

48721

DUPLICATE

T.....R.....  
County RAVALLI

LOG

STATE OF MONTANA  
ADMINISTRATOR OF GROUNDWATER CODE  
OFFICE OF STATE ENGINEER

Notice of Completion of Groundwater  
Appropriation by Means of Well

DEVELOPED AFTER JANUARY 1, 1962

(Under Chapter 237, Montana Session Laws, 1961)

Top of Ground  
(Elev. above sea level.....)

Owner Charles Walker Address Florence Montana

Driller Harold K. Dickens Address 3324 So. Ave. Missoula

Date of Notice of appropriation of groundwater.....

Date well started 11/16/70 Date completed 11/17/70

0 - 5 sandy loam

Type of well drilled Equipment used air tool  
(Dug, Driven, bored or drilled) (Churn drill, rotary or other)

5 - 9 sand & coarse  
gravel

Water use: Domestic  Municipal  Stock  Irrigation   
Industrial  Drainage  Other

10 - 20 coarse sand  
gravel & water

Indicate on the diagram the character and thickness of the different strata met with in drilling, such as soil, clay, shale, gravel, rock or sand, etc. Show depth at which water is encountered, thickness and character of water-bearing strata and height to which the water rises in the well.

23 - 35 reddish brown  
clay no water

Size of Drilled Hole	Size and Weight of Casing	From (Feet)	To (Feet)	PERFORATIONS		
				Kind Size	From (Feet)	To (Feet)
5 inch	5 in. i.d. 18 lbs. per ft.	0	52	none		

35 - 40 coarse sand  
& water

43 - 52 gravel & water

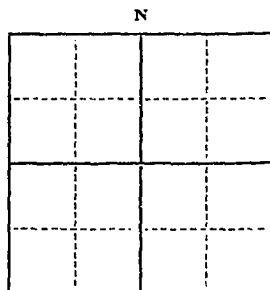

Static Water Level for non-flowing well  
6 ft. of top feet.

Shut-in Pressure for Flowing Well.....

Pumping Water Level 2 ft. of top feet  
at 45 gal. per minute.

Discharge in gal. per min. of flowing well.....

How Tested COMPRESSOR

Length of Test 3 1/2 hrs.

Remarks: (Gravel packing, cementing, packers, type of shutoff).....

Doc. No. 5396  
Filed for record  
17 MAR 21  
A. D. 71 1971  
RAVALLI

LOT 11 S  
Sweeney Creek Estates  
1/4 Sec. T. R.  
Indicate location of well and  
place of use, if possible. Each  
small square represents 40  
acres.

(Continue on reverse side)

USE—If used for irrigation, industrial, drainage or other. Explain, state number of acres and location or other data (i.e.: Lot, Block and Addition).

Show exact depth of bottom.  
87 ft.

This form to be prepared by driller, and three copies to be filed by the owner with the County Clerk and Recorder in the county in which the well is located, tissue copy to be retained by driller.

Please answer all questions. If not applicable, so state, otherwise the form will be returned.

71  
Driller's License Number

[Signature]  
Driller's Signature

48771



5912

I certify that I received and filed this  
instrument on this 22nd  
day of May, 1933, at 11:05  
o'clock A.M.  
D. Eugene E. Hughes  
COUNTY RECORDER  
By W. C. 2.00  
DEPUTY



File No.....

T. 10-N. R. 20-W

DUPLICATE

County. Ravalli

MONTANA DEPARTMENT OF GEOLOGY

STATE OF MONTANA  
ADMINISTRATOR OF GROUNDWATER CODE  
OFFICE OF STATE ENGINEER

Declaration of Vested Groundwater Rights

(Under Chapter 237, Montana Session Laws, 1961)

1. James F. Doyle & Sons, of Florence, (Name of Appropriator) (Address) (Town)

County of Ravalli; State of Montana  
have appropriated groundwater according to the Montana laws in effect prior to January 1, 1962, as follows:

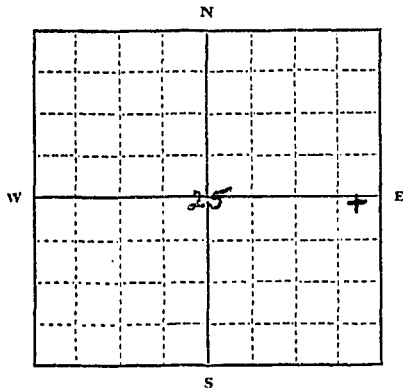

NE 1/4 NE SE Sec. 25, T. 10-N. R. 20-W

Indicate point of appropriation and place of use, if possible. Each small square represents 10 acres.

2. The beneficial use on which the claim is based. Irrigation water

3. Date or approximate date of earliest beneficial use; and how continuous the use has been. June 7, 1968

4. The amount of groundwater claimed (in miner's inches or gallons per minute). 1250 gpm

5. If used for irrigation, give the acreage and description of the lands to which water has been applied and name of the owner thereof. E 1/2 SE 29, E 1/2 NE 29, N 1/2 E 1/2 SE 25, N 1/2 NW 25, N 1/2 SW 25, 30-10-20 James F. Doyle & Sons

6. The means of withdrawing such water from the ground and the location of each well or other means of withdrawal. Electric pump

7. The date of commencement and completion of the construction of the well, wells, or other works for withdrawal of groundwater. 5-20-68, 5-29-68

8. The depth of water table. 3 ft

9. So far as it may be available, the type, size and depth of each well or the general specifications of any other works for the withdrawal of groundwater. 25' wide x 60' long x 12' deep

10. The estimated amount of groundwater withdrawn each year. 35,000,000 gallons

11. The log of formations encountered in the drilling of each well if available. sand & gravel

12. Such other information of a similar nature as may be useful in carrying out the policy of this act, including reference to book and page of any county record.

Signature of Owner James F. Doyle & Sons  
Date June 24-68

Three copies to be filed by the owner with the County Clerk and Recorder of the county in which the well is located.

Please answer all questions. If not applicable, so state, otherwise the form will be returned.

Original to the County Clerk and Recorder; Duplicate to the State Engineer; Triplicate to the Montana Bureau of Mines and Geology, and Quadruplicate for the Appropriator.

#5044

I certify that I received and filed this  
instrument on this 94  
day of June, 1968, at 1:05  
o'clock P.M.  
F. S. Moore  
COUNTY RECORDER  
By F. S. Moore  
DEPUTY



#5437  
①

I certify that I received and filed this  
instrument on this 20th  
day of May 19 71 at 3:15  
o'clock PM  
F. G. Moore  
COUNTY RECORDER  
By J. L. 2.00  
DEPUTY

GW 3

File No.....

T.....R.....

DUPLICATE

County.....Ravalli.....

STATE OF MONTANA  
ADMINISTRATOR OF GROUNDWATER CODE  
MONTANA DEPARTMENT OF  
RESOURCES AND CONSERVATION OFFICE OF STATE ENGINEER

**Notice of Completion of Groundwater Appropriation Without Well**

(Under Chapter 237 Montana Session Laws, 1961)

5982; 198324  
June 27 1973  
11:20 A.M.

Date of Appropriation of Groundwater May 1, 1958.....

Owner Johnie Houtchens. Address Stevensville, Mont.

Contractor (if any) .....

Address of Contractor .....

Date Started 9/1/57..... Date Completed 9/5/57.....

Describe means of obtaining groundwater without a well "as by sub-irrigation and other natural processes". Include depth to water when applicable. Depth 10 feet. 40x60 sump.

Diverted by means of pump......

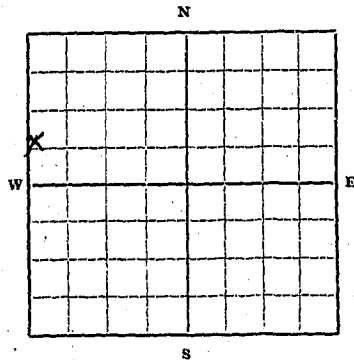

Quantity of water developed and used with explanation of method used to measure or estimate such amount. If use is intermittent estimate approximate lengths of periods of use .....

60 gal. per min. 4 months per year.....

E 1/2 Sec 25 T.10 R.20.....

Indicate point of appropriation and place of use, if possible.

Signature of Owner Johnie Houtchens.....

Date 27th day of June, 1973

This form to be prepared by contractor (if any), otherwise by the owner.

Three copies of this notice are to be filed with the County Clerk and Recorder of the county in which the works are located.

Please answer all questions. If not applicable, so state, otherwise the form will be returned.

Original to the County Clerk and Recorder; duplicate to the State Engineer; Triplicate to the School of Mines and Quadruplicate for the Appropriator.

54437

5982

198324

I certify that I received and filed this  
instrument on this 27th  
day of Jan, 1923, at 11:20  
o'clock A.M.  
Darlene E. Hughes  
COUNTY RECORDER  
By J. H. 200  
DEPUTY

GW 2

File No. ....

T ..... R .....

DUPLICATE

Ravalli County

NOV 10 1967

STATE OF MONTANA  
ADMINISTRATOR OF GROUNDWATER CODE  
OFFICE OF STATE ENGINEER

Top of Ground  
(Elev. above sea level 3500)

Notice of Completion of Groundwater  
Appropriation by Means of Well

(Under Chapter 237, Montana Session Laws, 1961)

Owner John SAKOCHKA Address STEVENSVILLE

Driller John SAKOCHKA Address STEVENSVILLE

Date of Notice of Appropriation of Groundwater NOV. 3

Date well started OCT. 30-67 Date Completed NOV. 2-67

Type of well DRIVEN Equipment Used HAND DRIVER  
(dug, driven, bored or drilled) (Churn, drill, rotary or other)

Water Use: Domestic (X) Municipal ( ) Stock ( ) Irrigation ( )  
Industrial ( ) Drainage ( ) Other ( )

← Indicate on the diagram the character and thickness of the different strata met with in drilling, such as soil, clay, shale, gravel, rock or sand, etc. Show depth at which water is encountered, thickness and character of water-bearing strata and height to which the water rises in the well.

Size of Drilled Hole	Size and Weight of Casing	From (Feet)	To (Feet)	PERFORATIONS		
				Kind Size	From (Feet)	To (Feet)
<u>1 1/4"</u>	<u>1 1/4"</u>	<u>40' feet sleep</u>	<u>40' ft. sleep</u>	<u>1 1/4" SAND POINT</u>	<u>3' sand</u>	<u>Point</u>

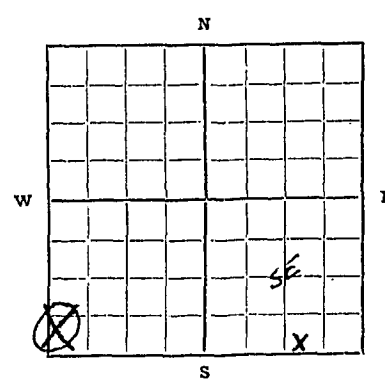

SE 1/4 SE Sec. 25 T. 10 R. 20  
Indicate location of well and place of use, if possible. Each small square represents 10 acres.

Show exact depth of bottom

Static Water Level for non-flowing Well NOT KNOWN feet.  
Shut-in Pressure for Flowing Well NOT KNOWN  
Pumping Water Level 4.0 feet at 8 gal. per minute.  
Discharge in gal., per min. of flowing well 8  
How Tested OPEN PIPE Length of Test OVERNIGHT  
Remarks: (Gravel packing, cementing, packers, type of shutoff, Location of place of use of groundwater if not at well, and any other similar pertinent information, including number of acres irrigated, if used for irrigation) FOR DOMESTIC USE ONLY

NONE  
Driller's License Number  
John Sakochna  
Driller's Signature

This form to be prepared by driller, and three copies to be filed by the owner with the County Clerk and Recorder in the county in which the well is located.

Please answer all questions. If not applicable, so state, otherwise the form will be returned.

Original to the County Clerk and Recorder; duplicate to the State Engineer; Triplicate to the School of Mines and Quadruplicate for the Appropriator.

44,773

#5101

I certify that I received and filed this  
instrument on this 15<sup>th</sup>  
day of Nov., 1968, at 2:46  
o'clock P.M.

F. G. Moore  
COUNTY RECORDER

Fee 2.00  
DEPUTY



File No. ....

RECEIVED

T. 10 N. R. 20 W.

DUPLICATE

OCT 18 1970

County KAUDULLI

LOG

STATE OF MONTANA  
ADMINISTRATOR OF GROUNDWATER CODE  
STATE WATER CONSERVATION BOARD

Notice of Completion of Groundwater  
Appropriation by Means of Well

DEVELOPED AFTER JANUARY 1, 1962

(Under Chapter 237 Montana Session Laws, 1961, as amended)

Top of Ground  
(Elev. above sea level.....)

0--33 Sand & Gravel

33--39 Sand, Gravel & Water

40-- Static Water Level

39--60 Silty sand & Water

60--73 Clay

73--74 3/4 Sand, Gravel  
and Water

74 3/4 Exact Bottom

Owner John A. Van Aken Address Route #1  
Stevensville, Mont.  
Driller C.K.C. Drilling Address Box 670  
Missoula, Montana

Date of Notice of appropriation of groundwater.....  
Date well started June 22, 1970 Date completed June 27, 1970

Type of well Drilled Equipment used Churn Drill  
(Dug, driven, bored or drilled) (Churn drill, rotary or other)

Water use: Domestic  Municipal  Stock  Irrigation   
Industrial  Drainage  Other

Indicate on the diagram the character and thickness of the different strata met with in drilling, such as soil, clay, shale, gravel, rock or sand, etc. Show depth at which water is encountered, thickness and character of water-bearing strata and height to which the water rises in the well.

Size of Drilled Hole	Size and Weight of Casing	From (Feet)	To (Feet)	PERFORATIONS		
				Kind Size	From (Feet)	To (Feet)
6"	6" 17#	1' up	74 3/4'			

Doc. No. 5331  
Filed for record  
this 9 day of October  
A. D. 19 70, at 1:45  
o'clock P. M.

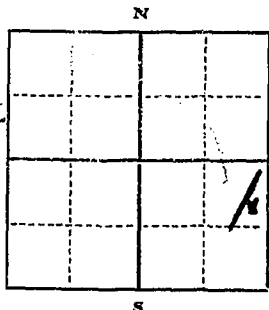

Static Water Level for non-flowing well  
40' feet.

Shut-in Pressure for Flowing Well.....

Pumping Water Level 45' feet  
at 20 gal. per minute.

Discharge in gal. per min. of flowing well

How Tested COMPRESSOR

Length of Test 4 hours

Remarks: (Gravel packing, cementing, packers, type of shutoff).....

NE SE Sec 25 T10N R20W

Indicate location of well and place of use, if possible. Each small square represents 40 acres.

(Continue on reverse side)

USE—If used for irrigation, industrial, drainage or other. Explain, state number of acres and location or other data (i.e.: Lot, Block and Addition).

Show exact depth of bottom.

This form to be prepared by driller, and three copies to be filed by the owner with the County Clerk and Recorder in the county in which the well is located, tissue copy to be retained by driller.

Please answer all questions. If not applicable, so state, otherwise the form will be returned.

185  
Driller's License Number

Charles F. Hultstene  
Driller's Signature

47616

#5331

I certify that I received and filed this  
instrument on this 9<sup>th</sup>  
day of Oct., 19 70, at 1:45  
o'clock P.M.  
J. G. Moore  
COUNTY RECORDER  
BY Lee J. Oo  
DEPUTY

File No. ....

T. 10 N. R. 30 E.

DUPLICATE

County .....

STATE OF MONTANA  
ADMINISTRATOR OF GROUNDWATER CODE  
OFFICE OF STATE ENGINEER

RECEIVED  
JAN 8 1964

STATE ENGINEER

Declaration of Vested Groundwater Rights

(Under Chapter 237, Montana Session Laws, 1961)

1. *Bill Fisher of James H. Wolfe*  
(Name of Appropriator) (Address) (Town)  
County of *Beaumont* State of *Montana*  
have appropriated groundwater according to the Montana laws in effect prior January 1, 1962, as follows:

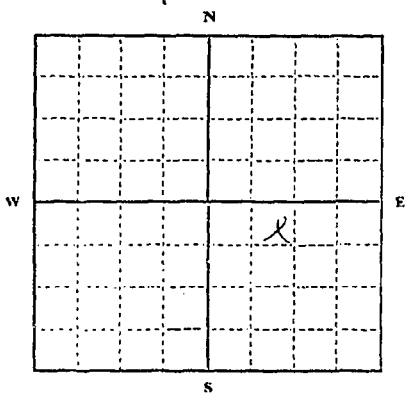

- 2. The beneficial use on which the claim is based *irrigation of garden & home use*
- 3. Date or approximate date of earliest beneficial use; and how continuous the use has been *1956*
- 4. The amount of groundwater claimed (in miner's inches or gallons per minute) *6.00 gpm*
- 5. If used for irrigation, give the acreage and description of the lands to which water has been applied and name of the owner thereof
- 6. The means of withdrawing such water from the ground and the location of each well or other means of withdrawal *5 H.P. Danney hand operated*

*W. 24 1/2 S. E. Sec. 7-6 T. 10. R. 30.*  
Indicate point of appropriation and place of use, if possible. Each small square represents 10 acres.

- 7. The date of commencement and completion of the construction of the well, wells, or other works for withdrawal of groundwater.....
- 8. The depth of water table *about 19 feet below the surface*
- 9. So far as it may be available, the type, size and depth of each well or the general specifications of any other works for the withdrawal of groundwater *6.0 ft 6" casing*
- 10. The estimated amount of groundwater withdrawn each year *3,000 gal home use 2,600 gal during irrigation*
- 11. The log of formations encountered in the drilling of each well if available *not available*
- 12. Such other information of a similar nature as may be useful in carrying out the policy of this act, including reference to book and page of any county record.....

Signature of Owner *Bill Fisher*  
*James H. Wolfe*  
Date *Dec 30 1963*

Three copies to be filed by the owner with the County Clerk and Recorder of the county in which the well is located.  
Please answer all questions. If not applicable, so state, otherwise the form will be returned.

Original to the County Clerk and Recorder; Duplicate to the State Engineer; Triplicate to the Montana Bureau of Mines and Geology, and Quadruplicate for the Appropriator.

# 2633

I certify that I received and filed this  
Instrument on this 30th  
day of Dec. 63. at 2:21  
o'clock P.  
F. G. Moore  
COUNTY CLERK  
By Shirley Keith  
DEPUTY

File No. ....

T10 N R20 W PMM

DUPLICATE

County Ravalli

STATE OF MONTANA  
ADMINISTRATOR OF GROUNDWATER CODE  
OFFICE OF STATE ENGINEER

Declaration of Vested Groundwater Rights

(Under Chapter 237, Montana Session Laws, 1961)

1. Allan & Melba Erickson, of D. Lawrence, Mont.  
(Name of Appropriator) (Address) (Town)  
County of Ravalli State of Montana  
have appropriated groundwater according to the Montana laws in effect prior to January 1, 1962, as follows:

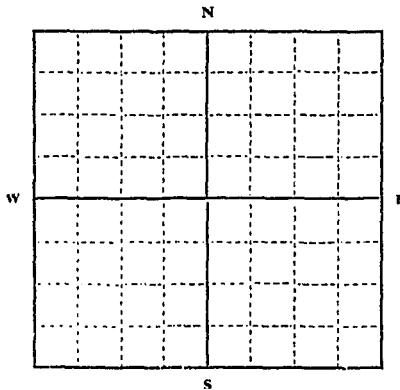

SW 1/4 Sec. 44 T10 N R20 W PMM

Indicate point of appropriation and place of use, if possible. Each small square represents 10 acres.

2. The beneficial use on which the claim is based household, garden & pasture

3. Date or approximate date of earliest beneficial use; and how continuous the use has been Aug 19, 1952  
all summers

4. The amount of groundwater claimed (in miner's inches or gallons per minute) I don't know

5. If used for irrigation, give the acreage and description of the lands to which water has been applied and name of the owner thereof  
Approx 20 acres, garden & pasture  
Allan & Melba Erickson, owners.

6. The means of withdrawing such water from the ground and the location of each well or other means of withdrawal wells with pumps, check is set flow for investigation

7. The date of commencement and completion of the construction of the well, wells, or other works for withdrawal of groundwater about 1949 before was bought property well deepened in about 1954 to control flooding in spring for irrigation

8. The depth of water/table about 12 feet

9. So far as it may be available, the type, size and depth of each well or the general specifications of any other works for the withdrawal of groundwater 12 foot well, pressure 1 lb. p. pumps, puts out 1000 gal per hr for irrigation.  
Household pump, lower part, pressure 3/8 lb. p.  
Centrifugal pump, 2 1/2 ft well.

10. The estimated amount of groundwater withdrawn each year 150,000 - 180,000 gal.

11. The log of formations encountered in the drilling of each well if available

12. Such other information of a similar nature as may be useful in carrying out the policy of this act, including reference to book and page of any county record

Allan & Melba Erickson  
Signature of Owner Melba E. Erickson  
Date 12-30-1963

Three copies to be filed by the owner with the County Clerk and Recorder of the county in which the well is located.

Please answer all questions. If not applicable, so state, otherwise the form will be returned.

Original to the County Clerk and Recorder; Duplicate to the State Engineer; Triplicate to the Montana Bureau of Mines and Geology, and Quadruplicate for the Appropriator.

#4288

I certify that I received and filed this  
instrument on this 7<sup>th</sup>  
day of Jan at 11:45  
o'clock P.M.

F. G. Moore  
COUNTY RECORDER

By Shirley Keith  
DEPUTY

File No. ....

T. L. R. 2000

DUPLICATE

County Missoula

STATE OF MONTANA  
ADMINISTRATOR OF GROUNDWATER CODE  
OFFICE OF STATE ENGINEER

JAN 17 1961  
STATE ENGINEER

Declaration of Vested Groundwater Rights

(Under Chapter 237, Montana Session Laws, 1961)

1. Mike Shopp & Barbara Shopp of Lawrence, Missoula  
(Name of Appropriator) (Address) (Town)  
County of Missoula State of Montana  
have appropriated groundwater according to the Montana laws in effect prior to January 1, 1962, as follows:

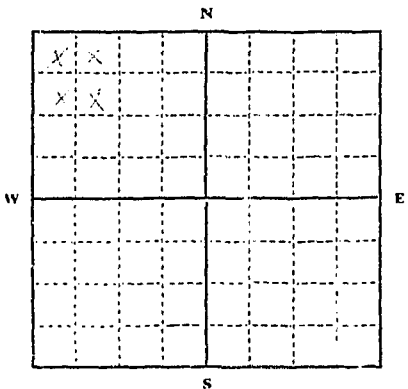

Indicate point of appropriation and place of use, if possible. Each small square represents 10 acres.

2. The beneficial use on which the claim is based. irrigation stock feed

3. Date or approximate date of earliest beneficial use; and how continuous the use has been. April 7, 1961, P.M.  
continuous thereafter

4. The amount of groundwater claimed (in miner's inches or gallons per minute) 40 stock

5. If used for irrigation, give the acreage and description of the lands to which water has been applied and name of the owner thereof  
1/2 acre, Mike & Barbara Shopp

6. The means of withdrawing such water from the ground and the location of each well or other means of withdrawal  
well in the vicinity of house

7. The date of commencement and completion of the construction of the well, wells, or other works for withdrawal of groundwater. Began April 1, 1961 - Completed Apr 7, 1961

8. The depth of water table. 20 feet

9. So far as it may be available, the type, size and depth of each well or the general specifications of any other works for the withdrawal of groundwater.  
well in well hole and 2 foot diameter

10. The estimated amount of groundwater withdrawn each year. 7,200,000 Gal

11. The log of formations encountered in the drilling of each well if available.  
well with sand water depth

12. Such other information of a similar nature as may be useful in carrying out the policy of this act, including reference to book and page of any county record.  
N.A.

Signature of Owner Mike Shopp  
Barbara Shopp  
Date Jan 31, 1961

Three copies to be filed by the owner with the County Clerk and Recorder of the county in which the well is located.  
Please answer all questions. If not applicable, so state, otherwise the form will be returned.

Original to the County Clerk and Recorder; Duplicate to the State Engineer; Triplicate to the Montana Bureau of Mines and Geology, and Quadruplicate for the Appropriator. 37612

File No. ....

T. 1111 R. 1111

DUPLICATE

County Missoula

STATE OF MONTANA  
ADMINISTRATOR OF GROUNDWATER CODE  
OFFICE OF STATE ENGINEER

Declaration of Vested Groundwater Rights

(Under Chapter 237, Montana Session Laws, 1961)

1. W. H. H. H. of Helena, Montana  
(Name of Appropriator) (Address) (Town)

County of Missoula State of Montana

have appropriated groundwater according to the Montana laws in effect prior to January 1, 1962, as follows:

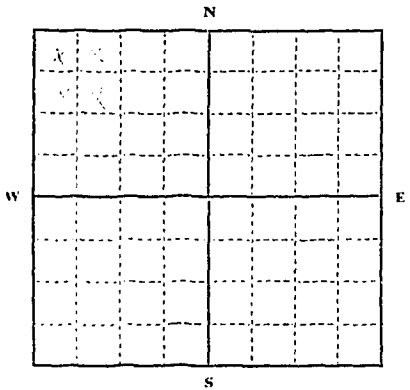

Indicate point of appropriation and place of use, if possible. Each small square represents 10 acres.

2. The beneficial use on which the claim is based. Domestic use

3. Date or approximate date of earliest beneficial use; and how continuous the use has been. Since 1910

4. The amount of groundwater claimed (in miner's inches or gallons per minute). 10 miner's inches

5. If used for irrigation, give the acreage and description of the lands to which water has been applied and name of the owner thereof. None

6. The means of withdrawing such water from the ground and the location of each well or other means of withdrawal. Hand-dug well

7. The date of commencement and completion of the construction of the well, wells, or other works for withdrawal of groundwater. Completed April 7, 1911

8. The depth of water table. 10 feet

9. So far as it may be available, the type, size and depth of each well or the general specifications of any other works for the withdrawal of groundwater.

10. The estimated amount of groundwater withdrawn each year. 10 miner's inches

11. The log of formations encountered in the drilling of each well if available.

12. Such other information of a similar nature as may be useful in carrying out the policy of this act, including reference to book and page of any county record.

Signature of Owner. W. H. H. H.

Date. April 7, 1961

Three copies to be filed by the owner with the County Clerk and Recorder of the county in which the well is located.

Please answer all questions. If not applicable, so state, otherwise the form will be returned.

Original to the County Clerk and Recorder; Duplicate to the State Engineer; Triplicate to the Montana Bureau of Mines and Geology, and Quadruplicate for the Appropriator.

37612



4048

I certify that I received and filed this  
instrument on this 31st  
day of Dec. 19 63 at 3:37  
o'clock P. M.  
F. G. Moore  
COUNTY RECORDER  
By Shirley Keith  
DEPUTY

GW 3

File No.....

T. 10 N. R. 20 W

DUPLICATE

County Revelle

STATE OF MONTANA  
ADMINISTRATOR OF GROUNDWATER CODE  
OFFICE OF STATE ENGINEER

JAN 17 1964

ENGINEER

**Notice of Completion of Groundwater Appropriation Without Well**

(Under Chapter 237 Montana Session Laws, 1961)

Date of Appropriation of Grounawater July 1, 1961  
Owner Mike Phipps  
Address Florence, Montana  
Contractor (if any) None  
Address of Contractor None

Date Started April 1, 1961 Date Completed July 1, 1961

Describe means of obtaining groundwater without a well "as by sub-irrigation and other natural processes". Include depth to water when applicable. Fram Slough 1320 Feet long  
And 50 feet wide and Three Springs  
All 5 Feet deep  
Ditches and Pump

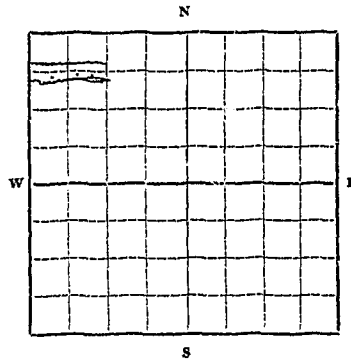

Quantity of water developed and used with explanation of method used to measure or estimate such amount. If use is intermit-

1/4 NW 1/4 Sec. 26 T. 10 N. R. 20 W

Indicate point of appropriation and place of use, if possible.

tent estimate approximate lengths of periods of use .....  
6 inch Pump and Ditches one foot  
Deep and Two Feet wide  
10,000,000 Gals

Signature of Owner

Mike Phipps  
Bonnie Phipps

Date Dec 31, 1963

This form to be prepared by contractor (if any), otherwise by the owner.

Three copies of this notice are to be filed with the County Clerk and Recorder of the county in which the works are located.

Please answer all questions. If not applicable, so state, otherwise the form will be returned.

Original to the County Clerk and Recorder; duplicate to the State Engineer; Triplicate to the Montana Bureau of Mines and Geology and Quadruplicate for the Appropriator.

4049

I certify that I received and filed this  
instrument on this 31st  
day of Dec., 1963, at 3:38  
o'clock P. M.  
F. M. Moore  
COUNTY RECORDER  
By Shirley Keith  
DEPUTY

G

File No. ....

T 10 W R 20 W

DUPLICATE

STATE OF MONTANA  
ADMINISTRATOR OF GROUNDWATER CODE  
OFFICE OF STATE ENGINEER

RECEIVED  
JAN 1962  
STATE ENGINEER

Declaration of Vested Groundwater Rights

(Under Chapter 237, Montana Session Laws, 1961)

1. Marvin and Martha Trask, of Route 1, Florence, (Name of Appropriator) (Address) (Town)

County of Ravalli, State of Montana, have appropriated groundwater according to the Montana laws in effect prior to January 1, 1962, as follows:

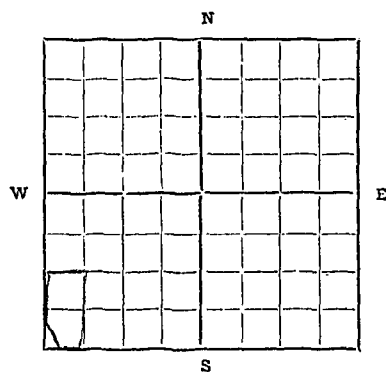

SW 1/4 Sec 26 T.10N R.20W

Indicate point of appropriation and place of use, if possible. Each small square represents 10 acres.

- 2. The beneficial use on which the claim is based well water and sub-irrigation
- 3. Date or approximate date of earliest beneficial use; and how continuous the use has been Sept. 1, 1962, date of purchase to present time
- 4. The amount of groundwater claimed (in miner's inches or gallons per minute) Approximately 250 gal. per minute plus sub-irrigation
- 5. If used for irrigation, give the acreage and description of the lands to which water has been applied and name of the owner thereof Approximately 2 acres to the north, to the west and to the south, for approximately 100 ft. in each direction plus sub-irrigation Marvin Trask
- 6. The means of withdrawing such water from the ground and the location of each well or other means of withdrawal One house well with pressure pump, one irrigation well and one natural swamp hole

- 7. The date of commencement and completion of the construction of the well, wells, or other works for withdrawal of groundwater Both wells were completed prior to purchase approximately 1958-1960.
- 8. The depth of water table Average 3 ft. in high water to 10 feet in low water
- 9. So far as it may be available, the type, size and depth of each well or the general specifications of any other works for the withdrawal of groundwater 1 drilled well 8 inches in diameter and 30 feet deep. 1 irrigation well 4 feet in diameter and 20 feet deep. 1 natural swamp hole approximately 6 feet deep.
- 10. The estimated amount of groundwater withdrawn each year 350,000 gallons
- 11. The log of formations encountered in the drilling of each well if available not available
- 12. Such other information of a similar nature as may be useful in carrying out the policy of this act, including reference to book and page of any county record

Signature of Owner Marvin V. Trask

Date 27 Dec 1963

Three copies to be filed by the owner with the County Clerk and Recorder of the county in which the well is located.

Please answer all questions. If not applicable, so state, otherwise the form will be returned.

Original to the County Clerk and Recorder; duplicate to the State Engineer; Triplicate to the School of Mines and Quadruplicate for the Appropriator.

27351

G .

File No. ....

T 10 W R 20 W

DUPLICATE

Ravalli County

STATE OF MONTANA  
ADMINISTRATOR OF GROUNDWATER CODE  
OFFICE OF STATE ENGINEER

ENGINEER

Declaration of Vested Groundwater Rights

(Under Chapter 237, Montana Session Laws, 1961)

1. Maria and Martha Trask of Route 1, Florence  
(Name of Appropriator) (Address) (Town)

County of Ravalli, State of Montana, have appropriated groundwater according to the Montana laws in effect prior to January 1, 1962, as follows:

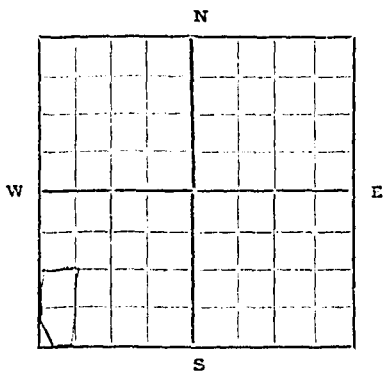

Div. Sec. 1/4 Sec. 26 T. 10 N. R. 20 W  
Indicate point of appropriation and place of use, if possible. Each small square represents 10 acres.

- 2. The beneficial use on which the claim is based Well number and sub-irrigation
- 3. Date or approximate date of earliest beneficial use; and how continuous the use has been Sept. 1, 1962, date of purchase to present time
- 4. The amount of groundwater claimed (in miner's inches or gallons per minute) Approximately 250 gal. per minute plus sub-irrigation
- 5. If used for irrigation, give the acreage and description of the lands to which water has been applied and name of the owner thereof Approximately 2 acres to the north, to the west and to the south, for approximately 100 ft. in each direction plus sub-irrigation-Martha Trask.
- 6. The means of withdrawing such water from the ground and the location of each well or other means of withdrawal one house well with pressure pump, one irrigation well and one natural swamp hole

- 7. The date of commencement and completion of the construction of the well, wells, or other works for withdrawal of groundwater both wells were completed prior to purchase—approximately 1958-1960.
- 8. The depth of water table Average 3 ft. in high water to 1 foot in low water
- 9. So far as it may be available, the type, size and depth of each well or the general specifications of any other works for the withdrawal of groundwater 1 drilled well 6 inches in diameter and 30 feet deep. 1 irrigation well 4 feet in diameter and 20 feet deep. 1 natural swamp hole approximately 6 feet deep.
- 10. The estimated amount of groundwater withdrawn each year 360,000 gallons
- 11. The log of formations encountered in the drilling of each well if available not available
- 12. Such other information of a similar nature as may be useful in carrying out the policy of this act, including reference to book and page of any county record

Signature of Owner Maria & Martha Trask  
Date 27 Dec 1963

Three copies to be filed by the owner with the County Clerk and Recorder of the county in which the well is located.

Please answer all questions. If not applicable, so state, otherwise the form will be returned.

Original to the County Clerk and Recorder; duplicate to the State Engineer; Triplicate to the School of Mines and Quadruplicate for the Appropriator.

27351

#2548

I certify that I have read and filed this

Dec. 30th 63 1:50 P.

F. G. Moore

Sherley Keith  
DEPUTY

File No. ....

T. 10 N. R. 20 E.

DUPLICATE

County Ravalli

STATE OF MONTANA  
ADMINISTRATOR OF GROUNDWATER CODE  
OFFICE OF STATE ENGINEER

JAN 17 1964

Declaration of Vested Groundwater Rights ENGINEER

(Under Chapter 237, Montana Session Laws, 1961)

1. Franne Martin and John Martin, of Polson, (Town)  
(Name of Appropriator) (Address)

County of Ravalli State of Montana  
have appropriated groundwater according to the Montana laws in effect prior to January 1, 1962, as follows:

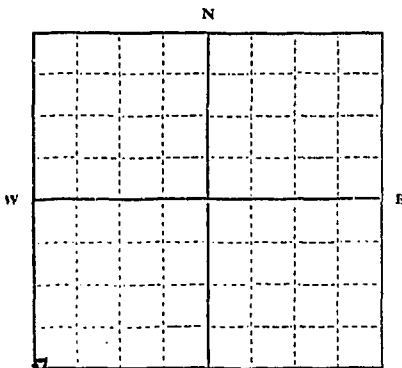

SW 1/4 Sec. 26, T. 10 N. R. 20 W

Indicate point of appropriation and place of use, if possible. Each small square represents 10 acres.

2. The beneficial use on which the claim is based Household use and lawn

3. Date or approximate date of earliest beneficial use; and how continuous the use has been Jan, 1964 - used daily since

4. The amount of groundwater claimed (in miner's inches or gallons per minute) 250 gal. per hour

5. If used for irrigation, give the acreage and description of the lands to which water has been applied and name of the owner thereof none at this water appropriation. watering lawn yet have not cultivated a lawn yet.

6. The means of withdrawing such water from the ground and the location of each well or other means of withdrawal 1 well shallow well jet pumps

7. The date of commencement and completion of the construction of the well, wells, or other works for withdrawal of groundwater July, 1957, saught pump, made well and completed same in July, 1957.

8. The depth of water table It varies - 3 ft. to 8 ft.

9. So far as it may be available, the type, size and depth of each well or the general specifications of any other works for the withdrawal of groundwater Dug well - 3 ft. diameter of concrete pipe; depth 10 ft. Pump + pipes within concrete pipe (6 inch diameter)

10. The estimated amount of groundwater withdrawn each year 145,000

11. The log of formations encountered in the drilling of each well if available small rock + gravel

12. Such other information of a similar nature as may be useful in carrying out the policy of this act, including reference to book and page of any county record Book 2, Page 179 Name 11.

Signature of Owner Franne M. Martin

Date Dec. 29, 1963

Three copies to be filed by the owner with the County Clerk and Recorder of the county in which the well is located.

Please answer all questions. If not applicable, so state, otherwise the form will be returned.

Original to the County Clerk and Recorder; Duplicate to the State Engineer; Triplicate to the Montana Bureau of Mines and Geology, and Quadruplicate for the Appropriator.

# 4244

I certify that I received and filed this  
instrument on this 2nd  
day of Aug. 1864 at 8:19  
o'clock A. M.

F. G. Moore

COUNTY RECORDER

By Shirley Keith  
CLERK



File No. ....

JUL 7 1972

T. 10 R. 20

DUPLICATE

MONTANA DEPARTMENT OF NATURAL RESOURCES AND CONSERVATION

County Ravalli

LOG

STATE OF MONTANA  
ADMINISTRATOR OF GROUNDWATER CODE  
STATE WATER CONSERVATION BOARD

Notice of Completion of Groundwater  
Appropriation by Means of Well  
DEVELOPED AFTER JANUARY 1, 1962

(Under Chapter 237 Montana Session Laws, 1961, as amended)

Owner Bob Chaffin Address Florence Mont  
Driller Bill Anderson Address Victor Mont

Date of Notice of appropriation of groundwater.....

Date well started April 22-72 Date completed April 24-72

Type of well drilled Equipment used Churn drill  
(Dug, driven, bored or drilled) (Churn drill, rotary or other)

Water use: Domestic  Municipal  Stock  Irrigation   
Industrial  Drainage  Other

Indicate on the diagram the character and thickness of the different strata met with in drilling, such as soil, clay, shale, gravel, rock or sand, etc. Show depth at which water is encountered, thickness and character of water-bearing strata and height to which the water rises in the well.

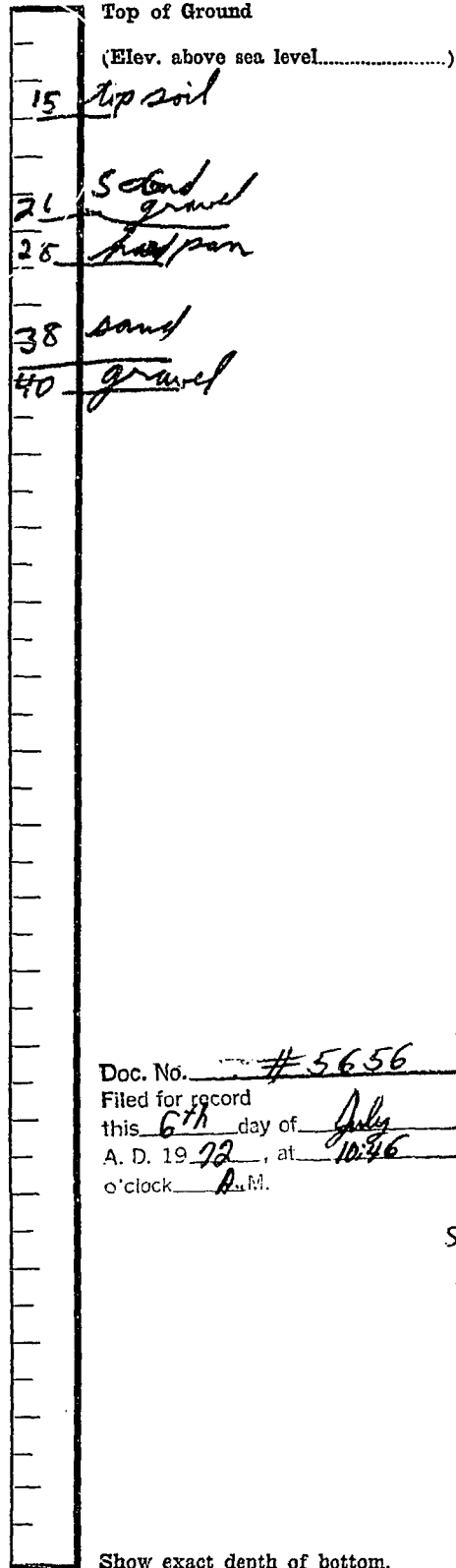

Size of Drilled Hole	Size and Weight of Casing	From (Feet)	To (Feet)	PERFORATIONS		
				Kind Size	From (Feet)	To (Feet)
6 in	250 wall 6 in	0	40	—	—	—

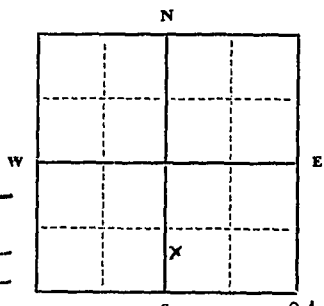

Static Water Level for non-flowing well 15 feet.  
Shut-in Pressure for Flowing Well.....  
Pumping Water Level 18 feet  
at 15 gal. per minute.  
Discharge in gal. per min. of flowing well

Doc. No. #5656  
Filed for record  
this 6th day of July  
A. D. 19 72, at 10:46  
o'clock A.M.

How Tested 25 GPM sub pump  
Length of Test 1 hr  
Remarks: (Gravel packing, cementing, packers, type of shutoff).....

Indicate location of well and place of use, if possible. Each small square represents 40 acres.

(Continue on reverse side)  
USE—If used for irrigation, industrial, drainage or other. Explain, state number of acres and location or other data (i.e.: Lot, Block and Addition).

This form to be prepared by driller, and three copies to be filed by the owner with the County Clerk and Recorder in the county in which the well is located, tissue copy to be retained by driller.

Please answer all questions. If not applicable, so state, otherwise the form will be returned.

33  
Driller's License Number  
William Anderson  
Driller's Signature.

50,844

#5656

I certify that I received and filed this  
instrument on this 6<sup>th</sup>  
day of July 19 72 at 10:46  
o'clock AM M.

F. G. Moore  
COUNTY RECORDER

BY Fee 2.00  
DEPUTY

11  
12  
13  
14  
15  
16  
17  
18  
19  
20  
21  
22  
23  
24  
25  
26  
27  
28  
29  
30  
31

File No.....

T. 16 R. 20

DUPLICATE

County Lawrence

STATE OF MONTANA  
ADMINISTRATOR OF GROUNDWATER CODE  
OFFICE OF STATE ENGINEER

RECEIVED  
JAN 8 1964

STATE ENGINEER

### Notice of Completion of Groundwater Appropriation Without Well

(Under Chapter 237 Montana Session Laws, 1961)

Date of Appropriation of Groundwater Have used since 1915

Owner John H. Crump Address Florence

Contractor (if any) .....

Address of Contractor .....

Date Started..... Date Completed.....

Describe means of obtaining groundwater without a well "as by sub-irrigation and other natural processes". Include depth to water when applicable. It is surface

water that seeps into

my irrigation ditches

Depth varies

Quantity of water developed and used with explanation of method used to measure or estimate such amount. If use is intermittent

estimate approximate lengths of periods of use. It is

used during the irrigating

season for water for

the stock in winter

Signature of Owner John H. Crump

Date Dec 27, 1963

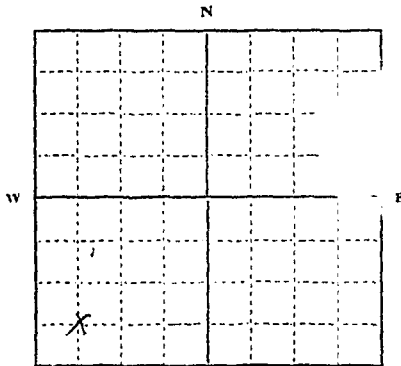

SW 1/4 Sec. 27 T. 16 R. 20

Indicate point of appropriation and place of use, if possible.

This form to be prepared by contractor (if any), otherwise by the owner.

Three copies of this notice are to be filed with the County Clerk and Recorder of the county in which the works are located.

Please answer all questions. If not applicable, so state, otherwise the form will be returned.

Original to the County Clerk and Recorder; duplicate to the State Engineer; Triplicate to the Montana Bureau of Mines and Geology and Quadruplicate for the Appropriator.

#2666

I certify that I received and filed this

on the 30th  
Dec. 63 3:54  
P.M.

F. M. Moore

Sherley Keith

10N-20W  
County \_\_\_\_\_

STATE OF MONTANA  
ADMINISTRATOR OF GROUNDWATER CODE  
MONTANA WATER RESOURCES BOARD  
**NOTICE OF COMPLETION OF GROUNDWATER  
APPROPRIATION BY MEANS OF WELL**

Developed after January 1, 1962

(Under Chapter 237 Montana Session Laws, 1961, as amended)

This form to be prepared by driller, and three copies to be filed by the owner with the County Clerk and Recorder in the county in which the well is located, last copy to be retained by driller.

Please answer all questions. If not applicable, so state, otherwise the form may be returned.

Owner Rob MacLean

Address Highway 400

Florence, Montana

Date well started Nov 5, 1972

completed Nov 8, 1972

For Administrator's Use	
File #	<u>#5759</u>
Date	<u>Dec 14 1972 11:50 am</u>
GW 1	

Type of well drilled well

(Dug, driven, bored or drilled)

Equipment used churn drill

(Churn drill, rotary or other)

Water Use: Domestic  Municipal  Stock  Irrigation

Industrial  Drainage  Other \* Garden/Lawn

\*Describe \_\_\_\_\_

USE: If used for irrigation, industrial, drainage or other. Explain, state number of acres and location or other data (i.e. Lot, Block and Addition). \_\_\_\_\_

ESTIMATED ANNUAL WITHDRAWAL

Size of Drilled Hole	Size and Weight of Casing	From (Feet)	To (Feet)	PERFORATIONS		
				Kind Size	From (Feet)	To (Feet)
6"	1 1/2" / 25'	0	35	1/4" / 25'	33	39

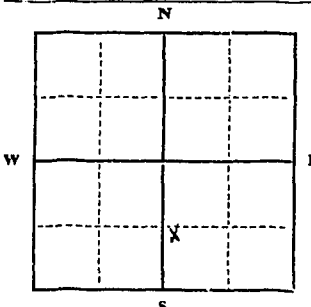

Static water level 20 ft.\*  
 Pumping water level 34 ft.\*  
 at 12 gallons per minute,  
 measured 10 minutes after pumping  
 began.  
 \*Measured from ground level.  
 Well developed by churn  
 for 2 hours.  
 Power \_\_\_\_\_ Pump \_\_\_\_\_ HP  
 Remarks: (Gravel packing, cementing,  
 packers, type of shutoff) \_\_\_\_\_

SW 1/4 SE 1/4 Sec 27  
 T. 10 N R. 20 E  
8 W

INDICATE LOCATION OF WELL AND PLACE OF USE, IF POSSIBLE. EACH SMALL SQUARE REPRESENTS 40 ACRES.

Driller's Signature Charles Wible Jr.

Driller's Address \_\_\_\_\_

LICENSE NO. \_\_\_\_\_

DRILLER'S LOG

Indicate the character, color, thickness of strata such as soil, clay, sand, gravel, shale, sandstone, etc. Show depth at which water is found and height to which water rises in well.

Top of Ground		(Elev. above sea level)
From (Feet)	To (Feet)	
0	12	Topsoil
12	23	Sand gravel some boulders
23	39	Sand and gravel water bearing

39 Show exact depth of bottom

51,945



#5759

I certify that I received and filed this  
instrument on this 1<sup>st</sup>  
day of Dec, 1922, at 11:50  
o'clock A.M.

F. G. Moore  
COUNTY RECORDER

By Fee 2.00  
DEPUTY

File No. 2018

DUPLICATE

T. 10 N W R. 20 27  
County Ravalli

STATE OF MONTANA  
ADMINISTRATOR OF GROUNDWATER CODE  
OFFICE OF STATE ENGINEER

RECEIVED  
DEC 20 1963

Declaration of Vested Groundwater Rights  
(Under Chapter 237, Montana Session Laws 1931)

STATE ENGINEER

1. William P. Decker of Florence, Montana  
(Name of Appropriator) (Address) (Town)  
County of Ravalli State of Montana  
have appropriated groundwater according to the Montana laws in effect prior to January 1, 1962, as follows:

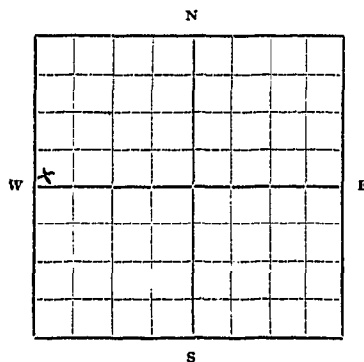

W 1/4 Sec. 27 T. 10 R. 20

Indicate point of appropriation and place of use, if possible. Each small square represents 10 acres.

- 2. The beneficial use on which the claim is based water for cattle, irrigation of garden and lawn, household use.
- 3. Date or approximate date of earliest beneficial use; and how continuous the use has been 1933. Used continuously.
- 4. The amount of groundwater claimed (in miner's inches or gallons per minute) 50
- 5. If used for irrigation, give the acreage and description of the lands to which water has been applied and name of the owner thereof 2/3 acre W. P. Decker
- 6. The means of withdrawing such water from the ground and the location of each well or other means of withdrawal Electric jet pump 25 feet east of house.

- 7. The date of commencement and completion of the construction of the well, wells, or other works for withdrawal of groundwater 1933
- 8. The depth of water table 5 feet
- 9. So far as it may be available, the type, size and depth of each well or the general specifications of any other works for the withdrawal of groundwater drilled well eight inch hole - 48 feet.
- 10. The estimated amount of groundwater withdrawn each year 1,500,000 gallons
- 11. The log of formations encountered in the drilling of each well if available none available
- 12. Such other information of a similar nature as may be useful in carrying out the policy of this act, including reference to book and page of any county record. none

Signature of Owner

William P. Decker

Date December 19, 1963

Three copies to be filed by the owner with the County Clerk and Recorder of the county in which the well is located.

Please answer all questions. If not applicable, so state, otherwise the form will be returned.

Original to the County Clerk and Recorder; duplicate to the State Engineer; Triplicate to the Montana Bureau of Mines and Geology and Quadruplicate for the Appropriator.

11009



I certify that I received and filed this  
instrument on this 19<sup>th</sup>  
day of Dec, 19 63, at 1:20  
o'clock P.M.

F. Y. Moore  
COUNTY RECORDER

By \_\_\_\_\_ DEPUTY

File No.....

T. 10 N. R. 20

DUPLICATE

County DAKOTA

STATE OF MONTANA  
ADMINISTRATOR OF GROUNDWATER CODE  
OFFICE OF STATE ENGINEER

RECEIVED  
JAN 8 1964

STATE ENGINEER

Notice of Completion of Groundwater Appropriation  
Without Well

(Under Chapter 237 Montana Session Laws, 1931)

Date of Appropriation of Groundwater.....

Owner M. P. DECKER Address FLORENCE

Contractor (if any) .....

Address of Contractor .....

Date Started..... Date Completed.....

Describe means of obtaining groundwater without a well "as by sub-irrigation and other natural processes". Include depth to water when applicable.

Spring fed ditch and use water for irrigating and stock water year round.

Quantity of water developed and used with explanation of method used to measure or estimate such amount. If use is intermittent

estimate approximate lengths of periods of use April 1st

to Oct 15th

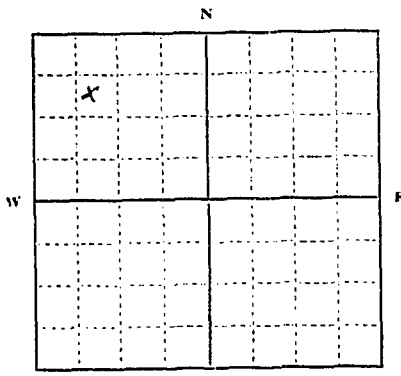

NW 1/4 NW Sec. 27 T. 10 R. 20

Indicate point of appropriation and place of use, if possible.

Signature of Owner M. P. Decker

Date Dec. 30 1963

This form to be prepared by contractor (if any), otherwise by the owner.

Three copies of this notice are to be filed with the County Clerk and Recorder of the county in which the works are located.

Please answer all questions. If not applicable, so state, otherwise the form will be returned.

Original to the County Clerk and Recorder; duplicate to the State Engineer; Triplicate to the Montana Bureau of Mines and Geology and Quadruplicate for the Appropriator.

# 2455

I certify that I received and filed this  
Instrument on this 30th  
day of Dec 1963 at 11:20  
o'clock A.  
F. G. Moore  
COUNTY RECORDER  
Shirley Keith  
DEPUTY



#5706

I certify that I received and filed this  
instrument on this 5<sup>th</sup>  
day of Sept., 1922, at 2:55  
o'clock P.M.

F. S. Moore  
COUNTY RECORDER

by Fee 2.00  
DEPUTY

County Navalli

STATE OF MONTANA  
ADMINISTRATOR OF GROUNDWATER CODE  
MONTANA WATER RESOURCES BOARD

NOTICE OF COMPLETION OF GROUNDWATER  
APPROPRIATION BY MEANS OF WELL

Developed after January 1, 1962

(Under Chapter 237 Montana Session Laws, 1961, as amended)

This form to be prepared by driller, and three copies to be filed by the owner with the County Clerk and Recorder in the county in which the well is located, last copy to be retained by driller.

Please answer all questions. If not applicable, so state, otherwise the form may be returned.

DRILLER'S LOG

Indicate the character, color, thickness of strata such as soil, clay, sand, gravel, shale, sandstone, etc. Show depth at which water is found and height to which water rises in well.

Top of Ground (Elev. above sea level)

From (Feet)	To (Feet)	
0	3	Topsoil
3	10	Sand, gravel-loose
10	17	Sand, gravel Large boulders Tight pressed Water bearing

Owner Ray Hawk  
Address Florence, Montana  
Date well started March 4, 1971  
completed March 6, 1971

For Administrator's Use File # <u>5744</u> <u>Nov 8/1970 3:25pm</u> GW 1
---

Type of well Drilled  
(Dug, driven, bored or drilled)

Equipment used Churn Drill  
(Churn drill, rotary or other)

Water Use: Domestic  Municipal  Stock  Irrigation   
Industrial  Drainage  Other \* Garden/Lawn

\*Describe  
USE: If used for irrigation, industrial, drainage or other. Explain, state number of acres and location or other data (i.e. Lot, Block and Addition).

ESTIMATED ANNUAL WITHDRAWAL unknown

Size of Drilled Hole	Size and Weight of Casting	From (Feet)	To (Feet)	PERFORATIONS		
				Kind Size	From (Feet)	To (Feet)
6"	17 lbs. per ft.	0	28	3/16x5	22	27

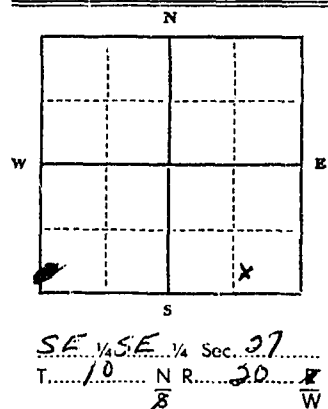

Static water level 5 ft.\*  
Pumping water level 22 ft.\*  
at 25 gallons per minute,  
measured 30 minutes after pumping began.

\*Measured from ground level.  
Well developed by baling &  
for 4 1/2 hours. pumping  
Power          Pump          HP  
Remarks: (Gravel packing, cementing,  
packers, type of shutoff)  
2 foot gravel pack

INDICATE LOCATION OF WELL AND PLACE OF USE, IF POSSIBLE. EACH SMALL SQUARE REPRESENTS 40 ACRES.

Driller's Signature Charles White, Jr. Navalli Drilling Co.

Driller's Address Box 27, Victor, Montana

LICENSE NO. 200

27 Show exact depth of bottom

#5-744

I certify that I received and filed this  
instrument on this 8<sup>th</sup>  
day of Nov., 19 22, at 3:25  
o'clock P. M.  
F. G. Moore  
COUNTY RECORDER  
By Fee 2.00  
DEPUTY

File No. ....

T. .... R. ....

DUPLICATE

MONTANA COUNTY CLERK

County Beavert

LOG

STATE OF MONTANA  
ADMINISTRATOR OF GROUNDWATER CODE  
OFFICE OF STATE ENGINEER

Top of Ground  
(Elev. above sea level.....)

**Notice of Completion of Groundwater  
Appropriation by Means of Well**  
DEVELOPED AFTER JANUARY 1, 1962

(Under Chapter 237, Montana Session Laws, 1961)

0-1 **Topsoil**

1-6 **Sand, gravel & Clay** Owner W. C. Mielke Address Sweeney Creek  
1522 S. 14th W.

6-15 **Cobblestones, sand, Gravel & Clay** Driller Glenn Camp Address Missoula, Montana

Date of Notice of appropriation of groundwater.....

15-45 **Sand, gravel, Clay and water** Date well started April 25, 1968 Date completed April 29, 1968

45-50 **Sand, gravel & Water** Type of well Drill Equipment used Churn Drill  
(Dug, driven, bored or drilled) (Churn drill, rotary or other)

Water use: Domestic  Municipal  Stock  Irrigation   
Industrial  Drainage  Other

Indicate on the diagram the character and thickness of the different strata met with in drilling, such as soil, clay, shale, gravel, rock or sand, etc. Show depth at which water is encountered, thickness and character of water-bearing strata and height to which the water rises in the well

Size of Drilled Hole	Size and Weight of Casing	From (Feet)	To (Feet)	PERFORATIONS		
				Kind Size	From (Feet)	To (Feet)
6" I. D.	6" I. D. 17 lb per ft.	1' above G.L.	50'			

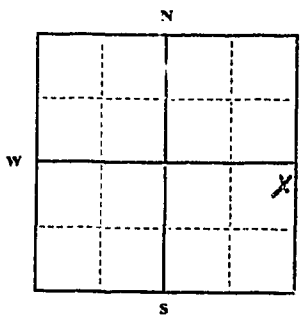

Static Water Level for non-flowing well ..... 7 ..... feet.

Shut-in Pressure for Flowing Well.....

Pumping Water Level..... 25 ..... feet  
at..... 50 ..... gal. per minute.

Discharge in gal. per min. of flowing well .....

How Tested Compressor.....

Length of Test..... 2 hours.....

Remarks: (Gravel packing, cementing, packers, type of shutoff).....

NE SE 1/4 Sec 27 T. 10 R. 20

Indicate location of well and place of use, if possible. Each small square represents 40 acres.

(Continue on reverse side)

USE—If used for irrigation, industrial, drainage or other. Explain, state number of acres and location or other data (i.e.: Lot, Block and Addition).

Show exact depth of bottom.

This form to be prepared by driller, and three copies to be filed by the owner with the County Clerk and Recorder in the county in which the well is located, tissue copy to be retained by driller.

Please answer all questions. If not applicable, so state, otherwise the form will be returned.

License # 7  
Driller's License Number

Glenn Camp  
Driller's Signature. Glenn Camp

44, 111



#5029

176292

I certify that I received and filed this  
instrument on this 7th  
day of May 19 68, at 8:00  
o'clock A. M.

J. S. Moore  
COUNTY RECORDER

By Lee S. O'D  
DEPUTY

File No. ....

T. 10N R. 20W

DUPLICATE

RECEIVED

County. Ravalli

LOG

16

STATE OF MONTANA  
ADMINISTRATOR OF GROUNDWATER CODE  
OFFICE OF STATE ENGINEER

Top of Ground  
(Elev. above sea level. Approx. 3400)

**Notice of Completion of Groundwater  
Appropriation by Means of Well**  
DEVELOPED AFTER JANUARY 1, 1962

**Formations Log:**

- 0 - 1 Dirt.
- 1 - 4 Granitic sand and gravel.
- 4 - 11 Light tan sandy clay.
- 11 - 19 Silty granitic sand. Water.
- 19 - 24 Gray sandy clay.
- 24 - 32 Fine brown sand. Water.
- 32 - 38 Gray sandy clay.
- 38 - 50 Tan clay.

(Under Chapter 257, Montana Session Laws, 1961)

R. Keith &

Owner. Jean E. Osterheld Address. Florence, Montana

Driller. Liberty Drilling Co. Address. Missoula, Montana

Date of Notice of appropriation of groundwater. None filed

Date well started. 1/6/68 Date completed. 1/24/68

Type of well. Drilled Equipment used. Cable Tools  
(Dug, driven, bored or drilled) (Churn drill, rotary or other)

Water use: Domestic  Municipal  Stock  Irrigation   
Industrial  Drainage  Other

Indicate on the diagram the character and thickness of the different strata met with in drilling, such as soil, clay, shale, gravel, rock or sand, etc. Show depth at which water is encountered, thickness and character of water-bearing strata and height to which the water rises in the well.

Water rises in the well two feet from surface.

Size of Drilled Hole	Size and Weight of Casing	From (Feet)	To (Feet)	PERFORATIONS		
				Kind Size	From (Feet)	To (Feet)
6"	6 5/8" OD x 1/2"	+1 1/2'	24'	Johnson Six Inch 60/100 slot wire wound	24	31
				5 9/16" solid closed bottom tailpipe	31	50

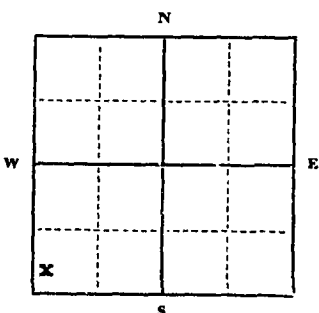

Static Water Level for non-flowing well Two feet.

Shut-in Pressure for Flowing Well Non-f

Pumping Water Level 38 feet at 20 gal. per minute.

Discharge in gal. per min. of flowing well Non-flowing

How Tested UMP Test

Length of Test Ten hours

Remarks: (Gravel packing, cementing, packers, type of shutoff) All water entering well is coming through the slots in screen. Wells in this area can be depended upon to produce clear sand.

SM 1/4 Sec. 27 T. 10N R. 20W  
Indicate location of well and place of use, if possible. Each small square represents 40 acres.

free water year after year as long as they are not over pumped, i.e., they should be pumped at rates not in excess of 50% of the loss (containing water) of the aquifer.

USE—If used for irrigation, industrial, drainage or other. Explain, state number of acres and location or other data (i.e.: Lot, Block and Addition).

Show exact depth of bottom.  
Bottom of hole 50'

This form to be prepared by driller, and three copies to be filed by the owner with the County Clerk and Recorder in the county in which the well is located, tissue copy to be retained by driller.

Please answer all questions. If not applicable, so state, otherwise the form will be returned.

52  
Driller's License Number  
William F. Osborne  
Driller's Signature.

44 9.21

# 5121

I certify that I received and filed this  
Instrument on this 15<sup>th</sup>  
day of Jan, 1969, at 11:30  
o'clock A. M.

F. G. Moore  
COUNTY RECORDER

By Henry G. West  
DEPUTY

Dec 2<sup>nd</sup>

STATE OF MONTANA  
ADMINISTRATOR OF GROUNDWATER CODE  
MONTANA WATER RESOURCES BOARD

NOTICE OF COMPLETION OF GROUNDWATER  
APPROPRIATION BY MEANS OF WELL

Developed after January 1, 1962

(Under Chapter 237 Montana Session Laws, 1961, as amended)

This form to be prepared by driller, and three copies to be filed by the owner with the County Clerk and Recorder in the county in which the well is located, last copy to be retained by driller.

Please answer all questions. If not applicable, so state, otherwise the form may be returned.

Owner Leanis Price

Address Moreno, Mont.

Date well started 10/1/72

completed 11/1/72

Type of well drilled

(Dug, driven, bored or drilled)

Equipment used Churn drill

(Churn drill, rotary or other)

Water Use: Domestic  Municipal  Stock  Irrigation

Industrial  Drainage  Other \* Garden/Lawn

\*Describe

USE: If used for irrigation, industrial, drainage or other. Explain, state number of acres and location or other data (i.e. Lot, Block and Addition).

ESTIMATED ANNUAL WITHDRAWAL

Size of Drilled Hole	Size and Weight of Casing	From (Feet)	To (Feet)	PERFORATIONS		
				Kind Size	From (Feet)	To (Feet)
6"	1 1/2" / 20'	0	33	2 1/2" x 5	29	33

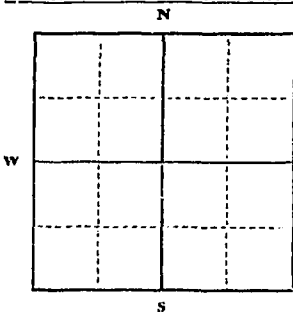

Static water level 11 ft.\*  
Pumping water level 5 ft.\*  
at 20 gallons per minute,  
measured 30 minutes after pumping  
began.

\*Measured from ground level.

Well developed by 12 hours.

Power..... Pump..... HP

Remarks: (Gravel packing, cementing, packers, type of shutoff)

S.E. 1/4 Sec. 27

T. 12 N. R. 20 E.

S. 3 W. 10

INDICATE LOCATION OF WELL AND PLACE OF USE, IF POSSIBLE. EACH SMALL SQUARE REPRESENTS 40 ACRES.

Driller's Signature Charles W. ...

Driller's Address

LICENSE NO.

County ...

DRILLER'S LOG

Indicate the character, color, thickness of strata such as soil, clay, sand, gravel, shale, sandstone, etc. Show depth at which water is found and height to which water rises in well.

Top of Ground (Elev. above sea level)

From (Feet)	To (Feet)	
1	1	soil
1	20	red clay sand
20	25	light brown sand
25	33	gravel and sandstone
		water bearing

Show exact depth of bottom

51,716