

GW 3

Approved Stock Form—State Publishing Co., Helena, Montana—42199

22

File No.....

T. 4-N R. 21W

DUPLICATE

County RAVALLI

STATE OF MONTANA  
ADMINISTRATOR OF GROUNDWATER CODE  
OFFICE OF STATE ENGINEER

RECEIVED  
JAN 8 1964

### Notice of Completion of Groundwater Appropriation Without Well

(Under Chapter 237 Montana Session Laws, 1961)

Date of Appropriation of Groundwater Nov 6-1963

Owner Floyd Seeger - Address Sula, Mont.

Contractor (if any) none

Address of Contractor none

Date Started none Date Completed none

Describe means of obtaining groundwater without a well "as by sub-irrigation and other natural processes". Include depth to water when applicable. Flowing Spring

coming out on top of ground

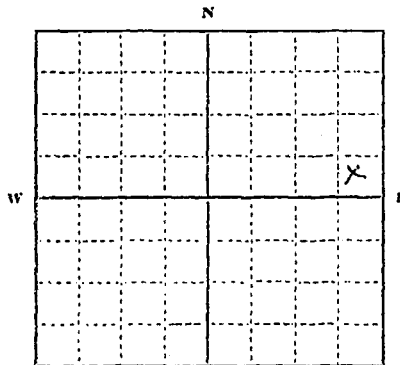

Quantity of water developed and used with explanation of method used to measure or estimate such amount. If use is intermittent

estimate approximate lengths of periods of use.....

Free Flowing Spring producing 100 gallons per minute

use is continuous.

Flow measured in cubic inches

Signature of Owner Floyd Seeger

Marjorie Seeger Date Dec-20-1963

SE 1/4 NE 1/4 Sec 22 T. 4 N. R. 21 W

Indicate point of appropriation and place of use, if possible.

This form to be prepared by contractor (if any), otherwise by the owner.

Three copies of this notice are to be filed with the County Clerk and Recorder of the county in which the works are located.

Please answer all questions. If not applicable, so state, otherwise the form will be returned.

Original to the County Clerk and Recorder; duplicate to the State Engineer; Triplicate to the Montana Bureau of Mines and Geology and Quadruplicate for the Appropriator.

27355

# 2547

I certify that I received and filed this  
instrument on the 30th  
day of Dec 1963 at 1:54  
P. M.

F. G. Moore  
COUNTY RECORDER

BY Shirley Keith  
DEPUTY

GW 2

File No. \_\_\_\_\_

T \_\_\_\_\_ R \_\_\_\_\_

DUPLICATE

STATE WATER CONSERVATION BOARD

Ravalli County

OCT 28 1966

STATE OF MONTANA

ADMINISTRATOR OF GROUNDWATER CODE

OFFICE OF STATE ENGINEER

McDermott

McNulty

### Notice of Completion of Groundwater Appropriation by Means of Well

(Under Chapter 237, Montana Session Laws, 1961)

Owner Floyd Whitlow Address Deerby Mont

Driller Bill Anderson Address Grantsville Mont

Date of Notice of Appropriation of Groundwater \_\_\_\_\_

Date well started Oct 1 - 66 Date Completed Oct 3 - 66

Type of well drilled Equipment Used churn drill  
(dug, driven, bored or drilled) (Churn, drill, rotary or other)

Water Use: Domestic (X) Municipal ( ) Stock ( ) Irrigation ( )  
Industrial ( ) Drainage ( ) Other ( )

← Indicate on the diagram the character and thickness of the different strata met with in drilling, such as soil, clay, shale, gravel, rock or sand, etc. Show depth at which water is encountered, thickness and character of water-bearing strata and height to which the water rises in the well.

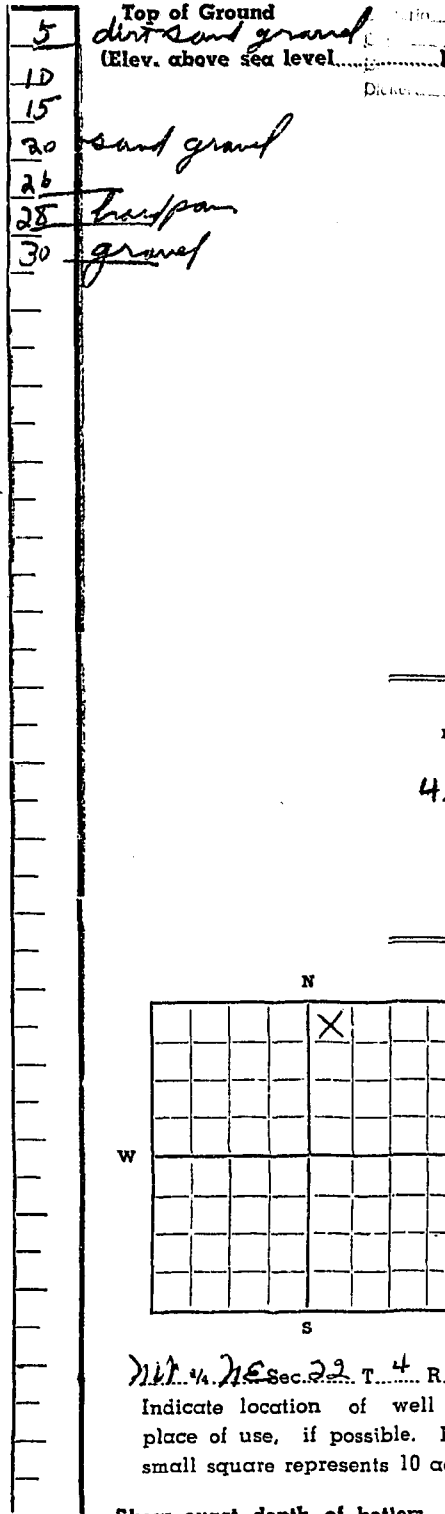

Size of Drilled Hole	Size and Weight of Casing	From (Feet)	To (Feet)	PERFORATIONS		
				Kind Size	From (Feet)	To (Feet)
4 in	10.79 (4 in casing)	0	30			

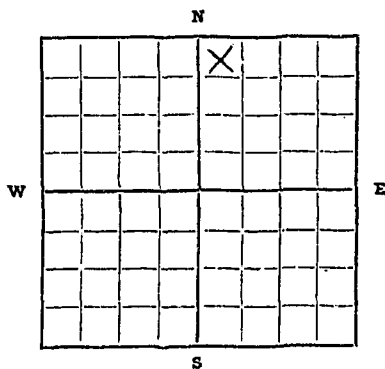

NW 1/4 NE Sec 22 T 4 R 21

Indicate location of well and place of use, if possible. Each small square represents 10 acres.

Show exact depth of bottom \_\_\_\_\_

Static Water Level for non-flowing Well 13 feet.

Shut-in Pressure for Flowing Well \_\_\_\_\_

Pumping Water Level 15 feet at 10 gal. per minute.

Discharge in gal. per min. of flowing well 2.0 per min

How Tested pump Length of Test 2 hrs

Remarks: (Gravel packing, cementing, packers, type of shutoff, Location of place of use of groundwater if not at well, and any other similar pertinent information, including number of acres irrigated, if used for irrigation) \_\_\_\_\_

33  
Driller's License Number

Bill Anderson  
Driller's Signature

This form to be prepared by driller, and three copies to be filed by the owner with the County Clerk and Recorder in the county in which the well is located.

Please answer all questions. If not applicable, so state, otherwise the form will be returned.

Original to the County Clerk and Recorder; duplicate to the State Engineer; Triplicate to the School of Mines and Quadruplicate for the Appropriator.

41,567

#4890

I certify that I received and filed this  
instrument on this 26  
day of Oct., 1966, at 11:50  
o'clock A. M.

J. G. Moore  
COUNTY RECORDER

Fee 2.00  
DEPUTY

*[Faint handwritten notes]*

*[Faint handwritten notes]*

*[Faint handwritten notes]*

30

0

10 30 100

200

T. 4 R. 21

County Beavertail

MONTANA BUREAU OF MINES AND GEOLOGY  
Butte, Montana

RECEIVED

WATER WELL LOG

STATE ENGINEER

D.O. 217

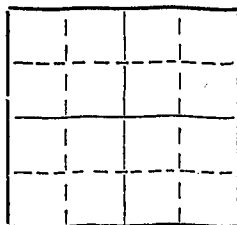

Owner Fred Shaver Address Hamilton Road Post 1

Driller Murray C. Ray Address Hamilton Road

Date Started Oct 22 1961 Date Completed Oct 24 1961

Location: Sec. 23 T. 4 R. 21 1/4 sec. lots 4-7

Type of well Drilled Equipment used Churn drill  
(Dug, driven, bored, or drilled) (Churn drill, rotary, other)

Water use: Domestic  Municipal  Stock  Irrigation   
Industrial  Drainage  Other: \_\_\_\_\_

Casing: 6 in ft. to 40 ft. Type \_\_\_\_\_ Size \_\_\_\_\_

Casing: \_\_\_\_\_ ft. to \_\_\_\_\_ ft. Type \_\_\_\_\_ Size \_\_\_\_\_

Casing: \_\_\_\_\_ ft. to \_\_\_\_\_ ft. Type \_\_\_\_\_ Size \_\_\_\_\_

Perforated or Screened: Ft. None to ft. \_\_\_\_\_ Ft. \_\_\_\_\_ to ft. \_\_\_\_\_

Type of screen or perforations \_\_\_\_\_

Static Water level, for non-flowing well: 23 feet.

Shut-in pressure, for flowing well: \_\_\_\_\_ lb./sq. in. on: \_\_\_\_\_ (date)

Pumping water level: 17 feet at 50 gal. per min. Oct 24 1961

How tested: \_\_\_\_\_

Length of test: \_\_\_\_\_

Remarks: (Gravel packing, cementing, packers, type of shut-off, depth of shut-off)

Well was dug fall of 1903 to 20 feet two inch pipe  
with sand point was drove six feet had both of  
water till February 1961 went dry

(over)



RECEIVED  
JAN 21 1959

STATE ENGINEER

Sec 23

MONTANA BUREAU OF MINES AND GEOLOGY  
Butte, Montana

WATER WELL LOG

T. 4 R. 21

County Ravalli

	X	

Owner Fred Sawyer Address Rt 1 Hamilton, Mont.

Driller Address

Date Started Date Completed 104 Or 1905

Location: Sec. 23 T. 4 R. 21 1/4 sec. SE 1/4

Type of well (Dug, driven, bored, or drilled) Equipment used (Churn drill, rotary, other)

Water use: Domestic  Municipal  Stock  Irrigation   
Industrial  Drainage  Other:

Casing: ft. to 32 ft. Type Galv. Size 2"

Casing: ft. to ft. Type Size

Casing: ft. to ft. Type Size

Perforated or Screened: Ft. to ft. Ft. to ft.

Type of screen or perforations

Static Water level, for non-flowing well: feet

Shut-in pressure, for flowing well: lb./sq. in. on: (date)

Pumping water level: 22 feet feet at gal. per min

How tested:

Length of test:

Remarks: (Gravel packing, cementing, packers, type of shut-off, depth of shut-off)

.....  
.....  
.....  
.....

(over)

File No. 2062

T 4 N R 21 W

DUPLICATE

RECEIVED  
DEC 23 1963

STATE OF MONTANA  
ADMINISTRATOR OF GROUNDWATER CODE  
OFFICE OF STATE ENGINEER

STATE ENGINEER

Declaration of Vested Groundwater Rights

(Under Chapter 237, Montana Session Laws, 1961)

1. Fred Shawver, of Rt. 1 Hamilton  
(Name of Appropriator) (Address) (Town)  
County of Ravalli State of Montana  
have appropriated groundwater according to the Montana laws in effect prior to January 1, 1962, as follows:

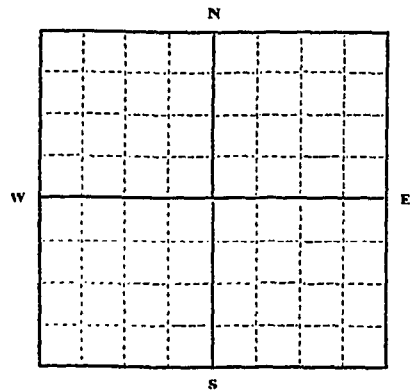

1/4 Sec. T. R.

Indicate point of appropriation and place of use, if possible. Each small square represents 10 acres. Located in Lot 7, Sec. 23, Township 4 North, Range 21 West East of County Road.

2. The beneficial use on which the claim is based. Domestic use, irrigating yard and garden and stock water

3. Date or approximate date of earliest beneficial use; and how continuous the use has been. 1903

4. The amount of groundwater claimed (in miner's inches or gallons per minute) 50 gallons per minute

5. If used for irrigation, give the acreage and description of the lands to which water has been applied and name of the owner thereof 1 acre in Lot 7, Sec. 23, T 4 N, R. 21 W., East of County Road. Estate of Otis Shawver, deceased is owner.

6. The means of withdrawing such water from the ground and the location of each well or other means of withdrawal 6 inch casing, 1 1/2 inch suction and discharge pipes, 3/4 hp. pump.

7. The date of commencement and completion of the construction of the well, wells, or other works for withdrawal of groundwater Well originally dug in 1903. Redrilled in October, 1961

8. The depth of water table. 17 feet.

9. So far as it may be available, the type, size and depth of each well or the general specifications of any other works for the withdrawal of groundwater. 6 inch casing, 1 1/2 inch suction and discharge pipes, pump with 3/4 hp. motor.

10. The estimated amount of groundwater withdrawn each year 100,000 gallons

11. The log of formations encountered in the drilling of each well if available 1 foot surface soil, 19 feet gravel clay sand, 35 feet gravel & sand mixed with clay. 40 feet, pea gravel and water.

12. Such other information of a similar nature as may be useful in carrying out the policy of this act, including reference to book and page of any county record.

Signature of Owner Fred Shawver

Date 12-20-1963

Three copies to be filed by the owner with the County Clerk and Recorder of the county in which the well is located.

Please answer all questions. If not applicable, so state, otherwise the form will be returned.

Original to the County Clerk and Recorder; Duplicate to the State Engineer; Triplicate to the Montana Bureau of Mines and Geology, and Quadruplicate for the Appropriator.



I certify that I received and filed this  
instrument on this.....20th.....  
day of...Dec.....19 63... at 3:53  
o'clock.....P.....M.

*F. G. Moore*  
COUNTY RECORDER

By.....  
DEPUTY

File No. ....

24 N 21 W 26  
T 4 R 4

DUPLICATE

STATE OF MONTANA  
ADMINISTRATOR OF GROUNDWATER CODE  
OFFICE OF STATE ENGINEER

Ravalli County  
JAN 17 1964  
STATE ENGINEER

Declaration of Vested Groundwater Rights  
(Under Chapter 237, Montana Session Laws, 1961)

1. W. L. Heiber of Box 229 Hamletton  
(Name of Appropriator) (Address) (Town)

County of Ravalli, State of Montana, have appropriated groundwater according to the Montana laws in effect prior to January 1, 1962, as follows:

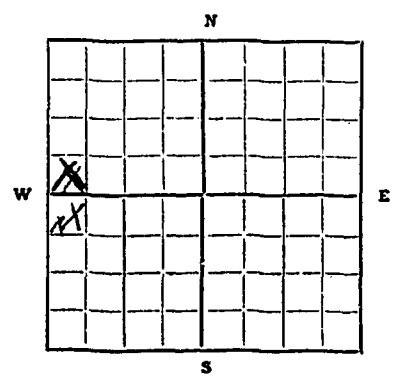

N.W. 1/4 SW. Sec 26 T. 14 R. 21  
Indicate point of appropriation and place of use, if possible. Each small square represents 10 acres.

- 2. The beneficial use on which the claim is based ..... Irrigation
- 3. Date or approximate date of earliest beneficial use; and how continuous the use has been ..... 1957  
6-month a year
- 4. The amount of groundwater claimed (in miner's inches or gallons per minute) ..... 100 gal. per min.
- 5. If used for irrigation, give the acreage and description of the lands to which water has been applied and name of the owner thereof ..... 6 acres  
Pasture, lawn, garden
- 6. The means of withdrawing such water from the ground and the location of each well or other means of withdrawal ..... elec. pump

- 7. The date of commencement and completion of the construction of the well, wells, or other works for withdrawal of groundwater ..... May 1959 Completion 1 day
- 8. The depth of water table ..... 13 ft.
- 9. So far as it may be available, the type, size and depth of each well or the general specifications of any other works for the withdrawal of groundwater ..... 1 House pump  
14' Electric Pump
- 10. The estimated amount of groundwater withdrawn each year ..... 1,000,000
- 11. The log of formations encountered in the drilling of each well if available ..... Top soil 2 ft. gravel & rocks
- 12. Such other information of a similar nature as may be useful in carrying out the policy of this act, including reference to book and page of any county record ..... None  
Tax Notice 1025  
Book 1 page 74 Line 14

Signature of Owner W. L. Heiber  
Date Dec 31 1963

Three copies to be filed by the owner with the County Clerk and Recorder of the county in which the well is located.

Please answer all questions. If not applicable, so state, otherwise the form will be returned.

Original to the County Clerk and Recorder; duplicate to the State Engineer; Triplicate to the School of Mines and Quadruplicate for the Appropriator.

4073

I certify that I received and filed this  
instrument on this 31st  
day of Dec. 1963 at 4:02  
o'clock P.M.  
F. H. Moore  
COUNTY RECORDER  
BY Shirley Keith  
DEPUTY

GW 2

File No. ....

T ..... R .....

DUPLICATE

MONTANA WATER RESOURCES BOARD

Ravalli County

RECEIVED

MAY 16 1968

STATE OF MONTANA  
ADMINISTRATOR OF GROUNDWATER CODE  
OFFICE OF STATE ENGINEER

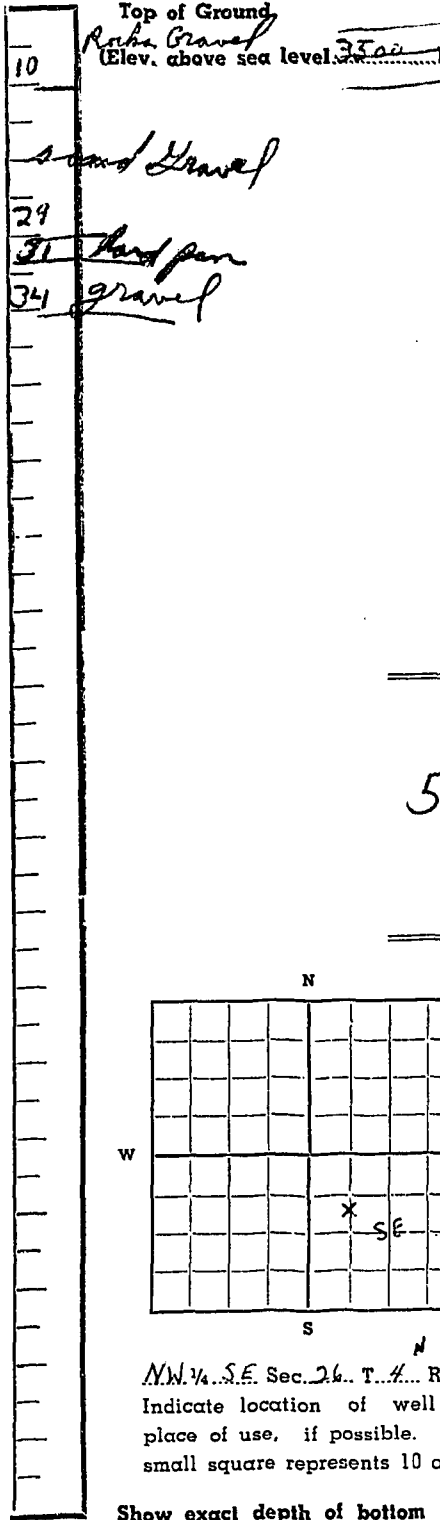

### Notice of Completion of Groundwater Appropriation by Means of Well

(Under Chapter 237, Montana Session Laws, 1961)

Owner Ervin Rickett Address Darby Mont

Driller Bill Anderson Address Grant Tule Lake Mont

Date of Notice of Appropriation of Groundwater .....

Date well started Jan 20, 68 Date Completed Jan 24, 68

Type of well drilly Equipment Used churn drill  
(dug, driven, bored or drilled) (Churn, drill, rotary or other)

Water Use: Domestic (X) Municipal ( ) Stock ( ) Irrigation ( )

Industrial ( ) Drainage ( ) Other ( )

← Indicate on the diagram the character and thickness of the different strata met with in drilling, such as soil, clay, shale, gravel, rock or sand, etc. Show depth at which water is encountered, thickness and character of water-bearing strata and height to which the water rises in the well.

Size of Drilled Hole	Size and Weight of Casing	From (Feet)	To (Feet)	PERFORATIONS		
				Kind Size	From (Feet)	To (Feet)
5 in	14 PWT 5 in	0	34	-	-	-

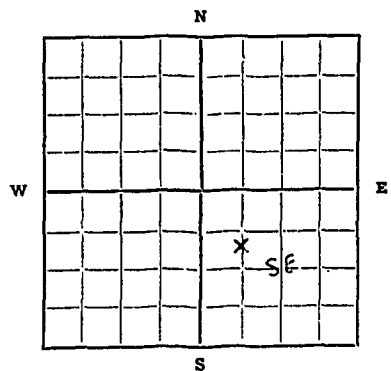

N.W. 1/4 S.E. Sec. 26. T. 4. R. 24.

Indicate location of well and place of use, if possible. Each small square represents 10 acres.

Show exact depth of bottom

Static Water Level for non-flowing Well 4 feet.

Shut-in Pressure for Flowing Well .....

Pumping Water Level 6 feet at 1.0 gal. per minute.

Discharge in gal., per min. of flowing well 25 per min.

How Tested Balance Length of Test 2 hr

Remarks: (Gravel packing, cementing, packers, type of shutoff, Location of place of use of groundwater if not at well, and any other similar pertinent information, including number of acres irrigated, if used for irrigation) .....

33  
Driller's License Number

William Anderson  
Driller's Signature

This form to be prepared by driller, and three copies to be filed by the owner with the County Clerk and Recorder in the county in which the well is located.

Please answer all questions. If not applicable, so state, otherwise the form will be returned.

Original to the County Clerk and Recorder; duplicate to the State Engineer; Triplicate to the School of Mines and Quadruplicate for the Appropriator.

44,137

#5032

176353

I certify that I received and filed this  
instrument on this 13<sup>th</sup>  
day of May, 1968, at 1:45  
o'clock P.M.

J. S. Moore  
COUNTY RECORDER

By J. S. Moore  
DEPUTY

MONTANA WATER RESOURCES BOARD  
Water Resources Division  
Mitchell Building  
Helena, Montana 59601

4-21  
MONTANA WATER RESOURCES BOARD  
RECEIVED  
JUL 18 1970

Recently a copy of a groundwater appropriation form,

- GW 1, Notice of Appropriation of Groundwater
- GW 2, Notice of Completion of Groundwater Appropriation by means of Well
- GW 3, Notice of Completion of Groundwater Appropriation without Well
- GW 4, Declaration of Vested Groundwater Rights (This form is obsolete and was limited by law to use only through 1965)

was forwarded to this office by the County Clerk and Recorder.

This form is identified by

Owner Mr. Norman Davis Address Darby, Montana

Location T.      R.      Sec.      Document No. 5289

This is to inform you that your GW form has been received and is complete as filed.

This is a request for additional information if available. Please complete the enclosed copy by providing information where indicated, or as noted here and return the corrected copy to the Montana Water Resources Board in Helena.

Please indicate the estimated annual withdrawal, and township, range, and section on the enclosed form.

Other.

packers, type or sn010rr) .....  
Lot 7 Bitter Root Park  
T. 14 R. 21 Sec. 26  
S. (N) E. (W)  
SW 1/4 SE 1/4  
SE 1/4 SE 1/4  
SEC 26 T41N R21W

INDICATE LOCATION OF WELL AND PLACE OF USE, IF POSSIBLE.  
EACH SMALL SQUARE REPRESENTS 40 ACRES.

Driller's Signature RAY & SONS WELL DRILLING

Driller's Address RTE 1 HAMILTON

LICENSE NO. 128

Show exact depth of bottom

46612

County 4N-21W  
RAVALLI

STATE OF MONTANA  
ADMINISTRATOR OF GROUNDWATER CODE  
MONTANA WATER RESOURCES BOARD  
**NOTICE OF COMPLETION OF GROUNDWATER  
APPROPRIATION BY MEANS OF WELL**  
Developed after January 1, 1962

**DRILLER'S LOG**

Indicate the character, color, thickness of strata such as soil, clay, sand, gravel, shale, sandstone, etc. Show depth at which water is found and height to which water rises in well.

(Under Chapter 237 Montana Session Laws, 1961, as amended)  
This form to be prepared by driller, and three copies to be filed by the owner with the County Clerk and Recorder in the county in which the well is located, best copy to be retained by driller.  
Please answer all questions. If not applicable, so state, otherwise the form may be returned.

Top of Ground (Elev. above sea level) 3572

Owner Mr. NORMAN DAVIS  
Address DARBY MONT.  
Date well started SEPT. 5-67  
completed 9/8-67

For Administrator's Use	
File	<u>June 24, 1970</u>
	<u>1.16 p.m.</u>
GW 1	<u>5289</u>

Type of well \_\_\_\_\_  
(Dug, driven, bored or drilled)  
Equipment used CABLE TOOL  
(Churn drill, rotary or other)  
Water Use: Domestic  Municipal  Stock  Irrigation   
Industrial  Drainage  Other \* Garden/Lawn

\*Describe \_\_\_\_\_  
USE: If used for irrigation, industrial, drainage or other. Explain, state number of acres and location or other data (i.e. Lot, Block and Addition) \_\_\_\_\_

**ESTIMATED ANNUAL WITHDRAWAL**

House + yard use  
876,000 gal?

Size of Drilled Hole	Size and Weight of Casing	From (Feet)	To (Feet)	PERFORATIONS		
				Kind Size	From (Feet)	To (Feet)
<u>6"</u>	<u>2 1/8 WALL</u>	<u>0</u>	<u>42</u>	<u>none</u>		

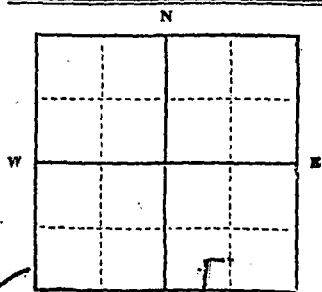

Static water level ..... 4 .....ft.\*  
Pumping water level ... 24 .....ft.\*  
at 10:20 AM ...gallons per minute,  
measured .....minutes after pumping began.  
\*Measured from ground level.  
Well developed by \_\_\_\_\_  
for .....hours.  
Power..... Pump..... HP  
Remarks: (Gravel packing, cementing, packers, type of shutoff) \_\_\_\_\_

Lot 7 Sixty Foot Park  
1/4 Sec. 26  
T. 4 N. R. 21 E. W. 1  
SW 1/4 Sec. 26 T4N R21W  
Sec 26 T4N R21W

INDICATE LOCATION OF WELL AND PLACE OF USE, IF POSSIBLE. EACH SMALL SQUARE REPRESENTS 40 ACRES.

Driller's Signature RAY & SONS WELL DRILLING  
Driller's Address RT. 1 HAMILTON

From (Feet)	To (Feet)	
	<u>8</u>	<u>WATER SAND GRAVEL</u>
	<u>15</u>	<u>GRAVEL</u>
	<u>DD TO 24'</u>	
	<u>26</u>	<u>WATER SAND GRAVEL</u>
	<u>42</u>	<u>F.D.</u>

LICENSE NO 128

Show exact depth of bottom

46612

File No. ....

T. 4 N. R. 21 W.

DUPLICATE

County RAVALLI

STATE OF MONTANA  
ADMINISTRATOR OF GROUNDWATER CODE  
OFFICE OF STATE ENGINEER

ED  
JUN 10 1964  
INEER

Declaration of Vested Groundwater Rights

(Under Chapter 237, Montana Session Laws, 1961)

1. LAWRENCE H. BROWN, of Rt. 1 Box 267 HAMILTON  
(Name of Appropriator) (Address) (Town)  
County of RAVALLI State of MONTANA  
have appropriated groundwater according to the Montana laws in effect prior to January 1, 1962, as follows:

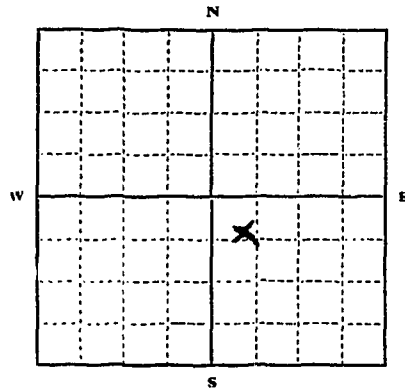

NW 1/4 Sec. 26 T. 4 R. 21

Indicate point of appropriation and place of use, if possible. Each small square represents 10 acres.

- 2. The beneficial use on which the claim is based DOMESTIC IRRIGATION - & STOCK WATER
- 3. Date or approximate date of earliest beneficial use; and how continuous the use has been 1947  
SINCE 12-1-63 BY PARTIAL
- 4. The amount of groundwater claimed (in miner's inches or gallons per minute) 200 GPM
- 5. If used for irrigation, give the acreage and description of the lands to which water has been applied and name of the owner thereof  
W 1/2 - SE 1/4 of lots 6 & 7 SEC 26  
LOT 2 SEC 35  
APPROX 135 ACRES
- 6. The means of withdrawing such water from the ground and the location of each well or other means of withdrawal  
38 FT WELL & PUMP

7. The date of commencement and completion of the construction of the well, wells, or other works for withdrawal of groundwater COMPLETED 1947

8. The depth of water table 10 FT

9. So far as it may be available, the type, size and depth of each well or the general specifications of any other works for the withdrawal of groundwater  
ELECTRIC MOTOR

10. The estimated amount of groundwater withdrawn each year 1,500,000 GALLONS

11. The log of formations encountered in the drilling of each well if available  
UNKNOWN

12. Such other information of a similar nature as may be useful in carrying out the policy of this act, including reference to book and page of any county record

Signature of Owner Lawrence H. Brown

Date Dec 28, 1963

Three copies to be filed by the owner with the County Clerk and Recorder of the county in which the well is located.

Please answer all questions. If not applicable, so state, otherwise the form will be returned.

Original to the County Clerk and Recorder; Duplicate to the State Engineer; Triplicate to the Montana Bureau of Mines and Geology, and Quadruplicate for the Appropriator.



2317

I certify that I received and filed this  
instrument on this 30  
day of Dec, 1963 at 9:02  
o'clock A.M.

F. S. Moore  
COUNTY RECORDER

By.....  
DEPUTY

26

File No. 2061

T. 4 N. R. 21 W.

DUPLICATE

County Ravalli

STATE OF MONTANA  
ADMINISTRATOR OF GROUNDWATER CODE  
OFFICE OF STATE ENGINEER

RECEIVED  
DEC 26 1963

STATE ENGINEER

Notice of Completion of Groundwater Appropriation  
Without Well

(Under Chapter 237 Montana Session Laws, 1961)

Date of Appropriation of Groundwater 1915  
Owner Fred Shawver Address Rt. 1, Hamilton, Mont.  
Contractor (if any) none  
Address of Contractor none  
Date Started 1915 Date Completed 1915

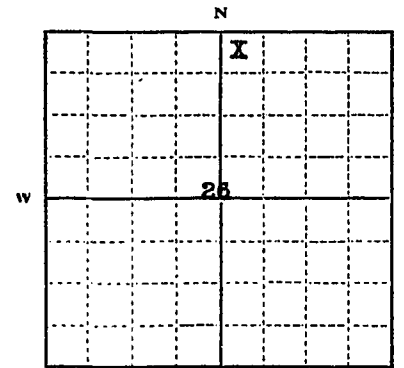

1 in NW 1/4 Sec. 26 T. 4 N. R. 21 W

Indicate point of appropriation and place of use, if possible.

Describe means of obtaining groundwater without a well "as by sub-irrigation and other natural processes". Include depth to water when applicable. Cement box with cement roof, about 8 feet square, excavated to increase flow of natural spring. Water is piped to house and barn. Water at barn is steady flow from 3/4 inch pipe for stock water. Water piped to house is used for domestic water and irrigating yard and garden in summer.

Quantity of water developed and used with explanation of method used to measure or estimate such amount. If use is intermittent

estimate approximate lengths of periods of use. continuous flow from one 3/4 inch pipe and usual intermittent domestic use from 3/4 inch pipe for house. More or less continuous flow from house pipe for yard and garden irrigation in summer. Seepage around box of around 18 miners inches used for stock water.

Signature of Owner Fred Shawver

Date Dec. 20, 1963

This form to be prepared by contractor (if any), otherwise by the owner.  
Three copies of this notice are to be filed with the County Clerk and Recorder of the county in which the works are located.  
Please answer all questions. If not applicable, so state, otherwise the form will be returned.  
Original to the County Clerk and Recorder; duplicate to the State Engineer; Triplicate to the Montana Bureau of Mines and Geology and Quadruplicate for the Appropriator.

12545

I certify that I received and filed this  
instrument on this.....20th.....  
day of.....Dec....., 19.63..... at 3:52  
o'clock.....P.M.

F. B. Moore  
COUNTY RECORDER

By.....  
DEPUTY

GW 3

Approved Stock Form—State Publishing Co., Helena, Montana—2199

26

File No.....

T. H. N. R. 21 W

DUPLICATE

County Blaine

STATE OF MONTANA  
ADMINISTRATOR OF GROUNDWATER CODE  
OFFICE OF STATE ENGINEER

RECEIVED  
JAN 8 1964  
STATE ENGINEER

### Notice of Completion of Groundwater Appropriation Without Well

(Under Chapter 237 Montana Session Laws, 1961)

Date of Appropriation of Groundwater 12-21-63

Owner Marcella K. Clyde Address Rt. 1, Box 227 Hamilton

Contractor (if any) .....

Address of Contractor .....

Date Started..... Date Completed.....

Describe means of obtaining groundwater without a well "as by sub-irrigation and other natural processes". Include depth to water when applicable.

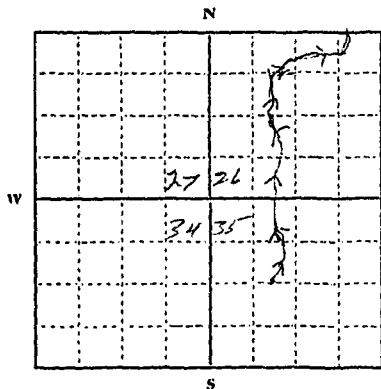

flood irrigation 36 in deep  
springs that divert from spring  
channel at numerous points  
channel shown on plot.

Quantity of water developed and used with explanation of method used to measure or estimate such amount. If use is intermittent

estimate approximate lengths of periods of use.....

300 inches estimated  
used 50% of the time in  
the irrigation season. This water  
has been used since homestead days.

.....1/4..... Sec..... T. H. N. R. 21 W

Indicate point of appropriation and place of use, if possible.

Signature of Owner..... Marcella K. Clyde

Date Dec 30 1963

This form to be prepared by contractor (if any), otherwise by the owner.

Three copies of this notice are to be filed with the County Clerk and Recorder of the county in which the works are located.

Please answer all questions. If not applicable, so state, otherwise the form will be returned.

Original to the County Clerk and Recorder; duplicate to the State Engineer; Triplicate to the Montana Bureau of Mines and Geology and Quadruplicate for the Appropriator.

27445

#2635

I certify that I received and filed this  
instrument on this 30<sup>th</sup>  
day of Dec. 1963, at 3:23  
o'clock P. M.  
F. G. Moore  
COUNTY RECORDER  
By Shirley Keith  
CLERK

STATE OF MONTANA  
ADMINISTRATOR OF GROUNDWATER CODE  
MONTANA WATER RESOURCES BOARD

NOTICE OF COMPLETION OF GROUNDWATER  
APPROPRIATION BY MEANS OF WELL

Developed after January 1, 1962

(Under Chapter 237 Montana Session Laws, 1961, as amended)

This form to be prepared by driller, and three copies to be filed by the owner with the County Clerk and Recorder in the county in which the well is located, last copy to be retained by driller.

Please answer all questions. If not applicable, so state, otherwise the form may be returned.

Owner Norman Davis  
Address Darby Montana  
Date well started June 4, 1972  
completed June 10, 1972

For Administrator's Use	
File	<u>5946</u>
Date	<u>JUNE 13, 1972</u>
GW	<u>1:30 p.m.</u>

Type of well Drilled  
(Dug, driven, bored or drilled)  
Equipment used Cable Tool  
(Churn drill, rotary or other)  
Water Use: Domestic  Municipal  Stock  Irrigation   
Industrial  Drainage  Other \* Garden/Lawn

\*Describe \_\_\_\_\_  
USE: If used for irrigation, industrial, drainage or other. Explain, state number of acres and location or other data (i.e. Lot, Block and Addition).

ESTIMATED ANNUAL WITHDRAWAL

Size of Drilled Hole	Size and Weight of Casing	From (Feet)	To (Feet)	PERFORATIONS		
				Kind Size	From (Feet)	To (Feet)
<u>6 inch</u>	<u>250 wall No. Steel</u>	<u>0</u>	<u>40</u>	<u>NA</u>		

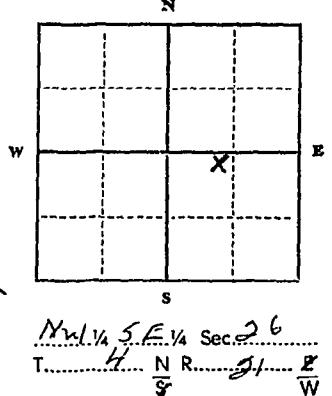

Static water level 29 ft.\*  
Pumping water level 30 ft.\*  
at 15 gallons per minute,  
measured 15 minutes after pumping began.  
\*Measured from ground level.  
Well developed by pu. 15  
for 6 hours.  
Power Elect Pump VV HP  
Remarks: (Gravel packing, cementing, packers, type of shutoff) NA

INDICATE LOCATION OF WELL AND PLACE OF USE, IF POSSIBLE. EACH SMALL SQUARE REPRESENTS 40 ACRES.

Driller's Signature J. J. Jacobson  
Driller's Address 509 N 7th Street  
Hamilton Montana LICENSE NO. 194

County Beavert

DRILLER'S LOG

Indicate the character, color, thickness of strata such as soil, clay, sand, gravel, shale, sandstone, etc. Show depth at which water is found and height to which water rises in well.

Top of Ground		X (Elev. above sea level)
From (Feet)	To (Feet)	
<u>0</u>	<u>15</u>	<u>Gravel Sand Rock and Clay</u>
<u>15</u>	<u>25</u>	<u>Gravel</u>
<u>25</u>	<u>27</u>	<u>Clay bound Sand</u>
<u>27</u>	<u>34</u>	<u>SAND</u>
<u>34</u>	<u>40</u>	<u>Red gravel</u>

40 ft 6 inches Show exact depth of bottom

5946

Handwritten notes and stamps, including a date stamp that appears to be 1923.

I hereby certify that I received and filed this  
Instrument on this 13th  
day of June, 1923, at Libo  
o'clock P. M.

Darlene E. Hughes  
COUNTY RECORDER

By Hand 2.00  
COUNTY

Extremely faint and illegible text, likely bleed-through from the reverse side of the page.

File No. ....

T. 4<sup>N</sup> R. 21<sup>W</sup>

DUPLICATE

County avalli

STATE OF MONTANA  
ADMINISTRATOR OF GROUNDWATER CODE  
OFFICE OF STATE ENGINEER

RECEIVED  
JAN 8 1964

Declaration of Vested Groundwater Rights

(Under Chapter 237, Montana Session Laws, 1961)

1. Marcella K. Clyde  
Hugh L. Clyde (Name of Appropriator), of Rt. 1 Box 227 Hamilton (Address) (Town)  
County of avalli State of Montana  
have appropriated groundwater according to the Montana laws in effect prior to January 1, 1962, as follows:

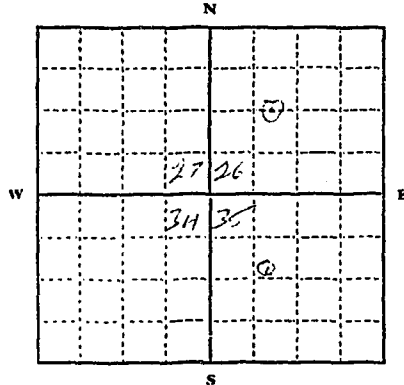

Indicate point of appropriation and place of use, if possible. Each small square represents 10 acres.

- 2. The beneficial use on which the claim is based drinking water
- 3. Date or approximate date of earliest beneficial use; and how continuous the use has been 1890 constant
- 4. The amount of groundwater claimed (in miner's inches or gallons per minute) 50 gal. per min.
- 5. If used for irrigation, give the acreage and description of the lands to which water has been applied and name of the owner thereof yard & garden
- 6. The means of withdrawing such water from the ground and the location of each well or other means of withdrawal Electric & hand pump

- 7. The date of commencement and completion of the construction of the well, wells, or other works for withdrawal of groundwater
- 8. The depth of water table top of the ground
- 9. So far as it may be available, the type, size and depth of each well or the general specifications of any other works for the withdrawal of groundwater spring water
- 10. The estimated amount of groundwater withdrawn each year 2 cu feet
- 11. The log of formations encountered in the drilling of each well if available not available
- 12. Such other information of a similar nature as may be useful in carrying out the policy of this act, including reference to book and page of any county record

Signature of Owner Marcella K. Clyde  
Hugh L. Clyde  
Date Dec 30 1963

Three copies to be filed by the owner with the County Clerk and Recorder of the county in which the well is located.  
Please answer all questions. If not applicable, so state, otherwise the form will be returned.

Original to the County Clerk and Recorder; Duplicate to the State Engineer; Triplicate to the Montana Bureau of Mines and Geology, and Quadruplicate for the Appropriator.



#2636

I certify that I received and filed this  
Instrument on the 30th  
day of Dec. 1963 at 3:24  
o'clock P. M.  
F. G. Moore  
County Clerk  
By Shelby Keith  
2/2/63

e No. 302

T. 4 N. R. 21 W. 26  
County. Ravalli

STATE OF MONTANA  
ADMINISTRATOR OF GROUNDWATER CODE  
OFFICE OF STATE ENGINEER

RECEIVED  
JAN 17 1964

Declaration of Vested Groundwater Rights  
(Under Chapter 237, Montana Session Laws, 1961) STATE ENGINEER

1. Kivian Malone of Rt. 1 Box 222 Hamilton  
(Name of Appropriator) (Address) (Town)

County of Ravalli State of Montana

have appropriated groundwater according to the Montana laws in effect prior to January 1, 1962, as follows:

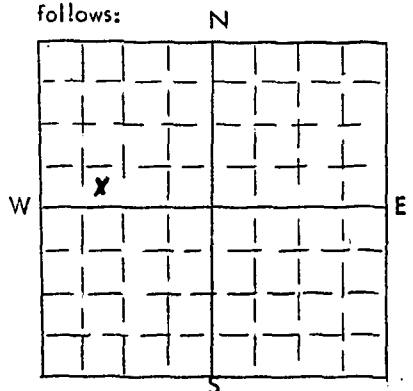

SE SW 1/4 Sec 26 T. 4 N. R. 21 W

Indicate point of appropriation and place of use, if possible. Each small square represents 10 acres.

- 2. The beneficial use on which the claim is based. undeveloped Reserve Supply for Irrigation
- 3. Date or approximate date of earliest beneficial use; and how continuous the use has been. Does not apply. The spring has not been in use.
- 4. The amount of groundwater claimed (in miner's inches or gallons per minute). undetermined
- 5. If used for irrigation, give the acreage and description of the lands to which water has been applied and name of the owner thereof. The Spring sup. s. sub. Irrigation to approx. 1/8 acre of Grass on North Portion of Tract Kivian Malone.
- 6. The means of withdrawing such water from the ground and the location of each well or other means of withdrawal. undeveloped Spring located approx. 300' North & East of Junction of South Boundary and Co. Highway
- 7. The date of commencement and completion of the construction of the well, wells, or other works for withdrawal of groundwater. No Improvement work done.
- 8. The depth of water table. Approx 20 feet
- 9. So far as it may be available, the type, size and depth of each well or the general specifications of any other works for the withdrawal of groundwater. undeveloped Spring
- 10. The estimated amount of groundwater withdrawn each year. unknown
- 11. The log of formations encountered in the drilling of each well if available. Not applicable
- 12. Such other information of a similar nature as may be useful in carrying out the policy of this act, including reference to book and page of any county record. Deed including Water Rights Recorded in Vol. 117 of Deeds Page 63

Signature of Owner Kivian Malone  
Date December 31, 1963

Three copies to be filed by the owner with the County Clerk and Recorder of the county in which the well is located.

Please answer all questions. If not applicable, so state, otherwise the form will be returned. Original to the County Clerk and Recorder; Duplicate to the State Engineer; Triplicate to the Montana Bureau of Mines and Geology, and Quadruplicate for the Appropriator.

# 2817

I certify that I received and filed this  
instrument on this 31st  
day of Dec, 1963, at 10:02  
o'clock 6 M.  
F. W. Moore  
COUNTY RECORDER  
By Dorothy Keith  
DEPUTY

RECORDED  
DEC 31 1963

INDEXED  
DEC 31 1963

File No.  
D.C.P.

T.A.N.R. 20 W 70  
County Ravalli

STATE OF MONTANA  
ADMINISTRATOR OF GROUNDWATER CODE  
OFFICE OF STATE ENGINEER

JAN 17 1964  
STATE ENGINEER

Declaration of Vested Groundwater Rights  
(Under Chapter 237, Montana Session Laws, 1961)

I, Vivian Malone, of Rt. 1 Box 222, Hamilton,  
(Name of Appropriator) (Address) (Town)

County of Ravalli, State of Montana

have appropriated groundwater according to the Montana laws in effect prior to January 1, 1962, as follows:

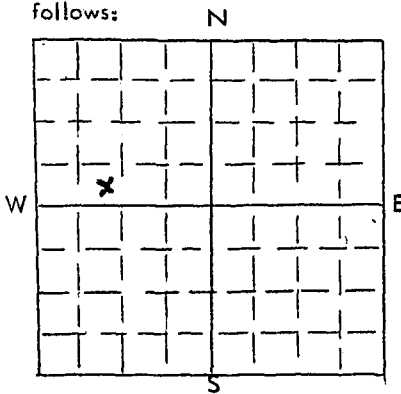

SE SW 1/4, Sec. 26 T. 4 N. R. 21.

Indicate point of appropriation and place of use, if possible. Each small square represents 10 acres.

- The beneficial use on which the claim is based. Provides water for lawn, garden, & fruit trees.
- Date or approximate date of earliest beneficial use; and how continuous the use has been. Sept. 9, 1959, Date of purchase. Well is in constant use during gardening season.
- The amount of groundwater claimed (in miner's inches or gallons per minute). 30 Gallons per Minute
- If used for irrigation, give the acreage and description of the lands to which water has been applied and name of the owner thereof. 3/4 acre adjacent to home extending to road on west and boundary on south & swamp on east. Vivian Malone
- The means of withdrawing such water from the ground and the location of each well or other means of withdrawal. Electric Pump Well Located Approx. 300' East of Co. Highway & 10' North of South Boundary.
- The date of commencement and completion of the construction of the well, wells, or other works for withdrawal of groundwater. The well was dug about 1945
- The depth of water table. 15 feet
- So far as it may be available, the type, size and depth of each well or the general specifications of any other works for the withdrawal of groundwater. open well 15 feet Deep
- The estimated amount of groundwater withdrawn each year. 875,000 Gallons
- The log of formations encountered in the drilling of each well if available. Nothing available
- Such other information of a similar nature as may be useful in carrying out the policy of this act, including reference to book and page of any county record. Dead including water Rights Recorded in Vol. 117 of Deeds Page 63

Signature of Owner Vivian Malone  
Date December 31, 1963

Three copies to be filed by the owner with the County Clerk and Recorder of the county in which the well is located.

Please answer all questions. If not applicable, so state, otherwise the form will be returned.  
Original to the County Clerk and Recorder; Duplicate to the State Engineer; Triplicate to the Montana Bureau of Mines and Geology, and Quadruplicate for the Appropriator.

#2816

I certify that I received and filed this  
instrument on this 31st  
day of Dec, 1963, at 10:01  
o'clock A. M.  
F. G. Moore  
COUNTY RECORDER  
By A. Harley Keith  
DEPUTY

RECORDED  
INDEXED  
FEB 21 1964  
COUNTY CLERK

GW 3

Approved Stock Form—State Publishing Co., Helena, Montana—42262

26

File No.....

T. 4<sup>N</sup> R. 21<sup>W</sup>

DUPLICATE

County.....

STATE OF MONTANA  
ADMINISTRATOR OF GROUNDWATER CODE  
OFFICE OF STATE ENGINEER

RECEIVED  
JAN 31 1964

STATE ENGINEER  
**Notice of Completion of Groundwater Appropriation  
Without Well**

(Under Chapter 237 Montana Session Laws, 1961)

Date of Appropriation of Groundwater June 1949

Owner Sidney M. Wilkerson Address R#1 Hamilton Mont.

Contractor (if any) \_\_\_\_\_

Address of Contractor \_\_\_\_\_

Date Started \_\_\_\_\_ Date Completed \_\_\_\_\_

Describe means of obtaining groundwater without a well "as by sub-irrigation and other natural processes". Include depth to water when applicable.

A Natural Spring

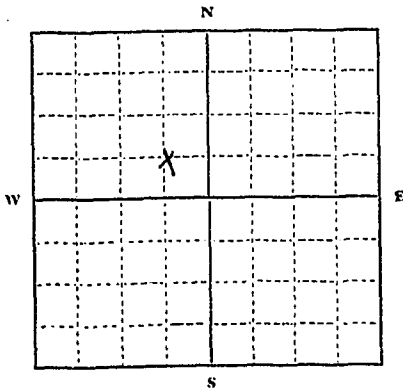

Sw 1/4 NW Sec. 26 T. 4. R. 21

Indicate point of appropriation and place of use, if possible.

Quantity of water developed and used with explanation of method used to measure or estimate such amount. If use is intermittent

estimate approximate lengths of periods of use 10 inches of water - estimated at peak of flow - used for stock water year around and sub-irrigation.

Signature of Owner Sidney M. Wilkerson

Date Jan 28 1964

This form to be prepared by contractor (if any), otherwise by the owner.

Three copies of this notice are to be filed with the County Clerk and Recorder of the county in which the works are located.

Please answer all questions. If not applicable, so state, otherwise the form will be returned.

Original to the County Clerk and Recorder; duplicate to the State Engineer; Triplicate to the Montana Bureau of Mines and Geology and Quadruplicate for the Appropriator.

34770

4380

I certify that I received and filed this  
instrument on this.....30th.....  
day of.....Jan....., 19.64..... at 10:50  
o'clock.....A.....M.

F. A. Moore  
COUNTY RECORDER

By.....  
DEPUTY

File No. ....

T 4 N R 21

DUPLICATE

Ravalli County

STATE OF MONTANA  
ADMINISTRATOR OF GROUNDWATER CODE  
OFFICE OF STATE ENGINEER

RECEIVED  
DEC 6 1963  
STATE ENGINEER

Declaration of Vested Groundwater Rights  
(Under Chapter 237, Montana Session Laws, 1961)

1. Mary Yeatts and Anne C. Fosdal of Rt 1, Box 229, Hamilton  
(Name of Appropriator) (Address) (Town)

County of Ravalli, State of Montana, have appropriated groundwater according to the Montana laws in effect prior to January 1, 1962, as follows:

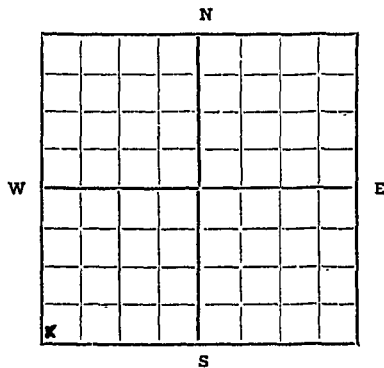

SW 1/4 SW Sec 27 T 4 R 21  
Indicate point of appropriation and place of use, if possible. Each small square represents 10 acres.

- 2. The beneficial use on which the claim is based Supplies all water for household and dairy
- 3. Date or approximate date of earliest beneficial use; and how continuous the use has been Well sunk in 1948 and has been continuous use since. Well is 260 foot deep.
- 4. The amount of groundwater claimed (in miner's inches or gallons per minute) .....
- 5. If used for irrigation, give the acreage and description of the lands to which water has been applied and name of the owner thereof .....
- 6. The means of withdrawing such water from the ground and the location of each well or other means of withdrawal pumped by 3-HP pump and piped to barn and living quarters

7. The date of commencement and completion of the construction of the well, wells, or other works for withdrawal of groundwater Well sunk in 1948

8. The depth of water table .....

9. So far as it may be available, the type, size and depth of each well or the general specifications of any other works for the withdrawal of groundwater 260 foot well 5-inch casing with 3-HP jet pump

10. The estimated amount of groundwater withdrawn each year 15000 gallons

11. The log of formations encountered in the drilling of each well if available .....

12. Such other information of a similar nature as may be useful in carrying out the policy of this act, including reference to book and page of any county record .....

Anne C Fosdal  
Signature of Owner Mary Yeatts Fosdal  
Date 12-5-63

Three copies to be filed by the owner with the County Clerk and Recorder of the county in which the well is located.

Please answer all questions. If not applicable, so state, otherwise the form will be returned.

Original to the County Clerk and Recorder; duplicate to the State Engineer; Triplicate to the School of Mines and Quadruplicate for the Appropriator.

7985



#1896

I certify that I received and filed this  
instrument on this 5th  
day of Dec., 19 63 at 2:55  
o'clock P.M.

F. G. Moore

COUNTY RECORDER

By

*Shirley Keith*  
DEPUTY

RECORDED

INDEXED

27

File No.....

T. 4 N. R. 21 W

DUPLICATE

County Ravalli

STATE OF MONTANA  
ADMINISTRATOR OF GROUNDWATER CODE  
OFFICE OF STATE ENGINEER

RECEIVED  
DEC 6 1963

Notice of Completion of Groundwater Appropriation **ENGINEER**  
Without Well

(Under Chapter 237 Montana Session Laws, 1961)

Date of Appropriation of Groundwater.....

Owner Am. C. of Mary Yeatts Address Rt 1, Box 229, Hamilton  
F. D. S. Del.

Contractor (if any) .....

Address of Contractor .....

Date Started improved 1955 Date Completed same year but  
cattle on this ranch has always drunk out of this

Describe means of obtaining groundwater without a well "as by spring  
sub-irrigation and other natural processes". Include depth to  
water when applicable Natural spring used the

year around for stock water. A 500-gallon  
tank is buried in the ground at source.

Water is pumped from tank to stock  
watering tank 500 feet west of spring.

Quantity of water developed and used with explanation of method  
used to measure or estimate such amount. If use is intermittent

estimate approximate lengths of periods of use. continuous

use. Supplies water for 60 head  
of dairy cattle. An estimated 1000

gallons consumed daily by stock

Signature of Owner Arne C. Fardal  
Mary Yeatts Fardal

Date 12-5-63

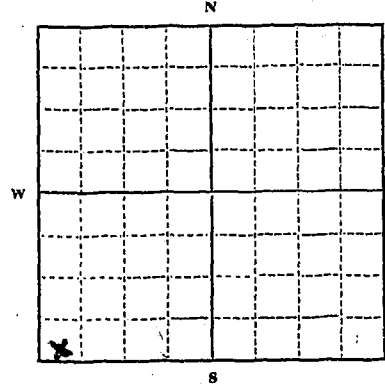

SW 1/4 Sec. 27 T. 4. R. 21

Indicate point of appropriation  
and place of use, if possible.

This form to be prepared by contractor (if any), otherwise by the owner.

Three copies of this notice are to be filed with the County Clerk and Recorder of the county in which the  
works are located.

Please answer all questions. If not applicable, so state, otherwise the form will be returned.

Original to the County Clerk and Recorder; duplicate to the State Engineer; Triplicate to the Montana  
Bureau of Mines and Geology and Quadruplicate for the Appropriator.

7934

#1895

I certify that I received and filed this  
instrument on the 5th  
day of Dec., 1963, at 2:50  
o'clock P.. M.

F. G. Moore

COUNTY RECORDER

By

*L. Shirley Keith*

DEPUTY

27

File No. 2184

T. 4 N R 21

DUPLICATE

County Park

STATE OF MONTANA  
ADMINISTRATOR OF GROUNDWATER CODE  
OFFICE OF STATE ENGINEER

RECEIVED  
DEC 30 1963

STATE ENGINEER  
**Notice of Completion of Groundwater Appropriation  
Without Well**

(Under Chapter 237 Montana Session Laws, 1961)

Date of Appropriation of Groundwater has always been used  
Owner Eric C. Foster Address Rt. 1, Box 29, Hamilton, Mont.  
Contractor (if any) none  
Address of Contractor none  
Date Started natural spring no development needed Date Completed                     

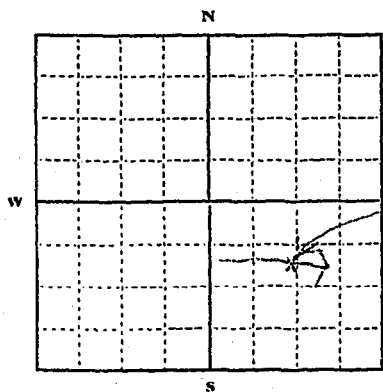

NE 1/4 SE Sec 27 T4 R21

Indicate point of appropriation and place of use, if possible.

Describe means of obtaining groundwater without a well "as by sub-irrigation and other natural processes". Include depth to water when applicable. This is a natural spring in the bottom of a gulch that runs continuously  
spring in bottom of a gulch.

Quantity of water developed and used with explanation of method used to measure or estimate such amount. If use is intermittent

estimate approximate lengths of periods of use. Used for stock water at any time of the year when stock are grazing in this part of farm

Signature of Owner Eric C. Foster  
Date 12-26-63

This form to be prepared by contractor (if any), otherwise by the owner.

Three copies of this notice are to be filed with the County Clerk and Recorder of the county in which the works are located.

Please answer all questions. If not applicable, so state, otherwise the form will be returned.

Original to the County Clerk and Recorder; duplicate to the State Engineer; Triplicate to the Montana Bureau of Mines and Geology and Quadruplicate for the Appropriator.

15675

27

File No. 2184

T. R. E. W.

DUPLICATE

County Ravalli

STATE OF MONTANA  
ADMINISTRATOR OF GROUNDWATER CODE  
OFFICE OF STATE ENGINEER

RECEIVED  
DEC 30 1963

STATE ENGINEER  
**Notice of Completion of Groundwater Appropriation  
Without Well**

(Under Chapter 237 Montana Session Laws, 1961)

Date of Appropriation of Groundwater...  
Owner... Address...  
Contractor (if any) ...  
Address of Contractor ...  
Date Started... Date Completed...

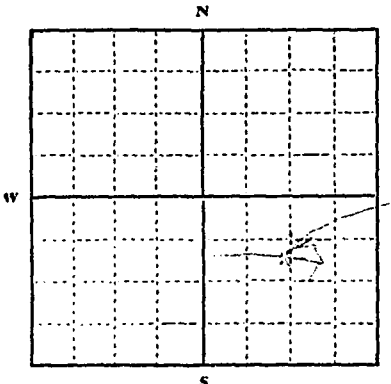

NE 1/4 E Sec. 7 T. 2 R. 11  
Indicate point of appropriation  
and place of use, if possible.

Describe means of obtaining groundwater without a well "as by  
sub-irrigation and other natural processes". Include depth to  
water when applicable. This is a natural spring  
in the bottom of a gulch in the  
mountain side  
spring water for use

Quantity of water developed and used with explanation of method  
used to measure or estimate such amount. If use is intermittent  
estimate approximate lengths of periods of use.  
This water is used for irrigation  
which is done during the  
growing season

Signature of Owner...  
Date... 12-26-63

This form to be prepared by contractor (if any), otherwise by the owner.  
Three copies of this notice are to be filed with the County Clerk and Recorder of the county in which the  
works are located.  
Please answer all questions. If not applicable, so state, otherwise the form will be returned.  
Original to the County Clerk and Recorder; duplicate to the State Engineer; Triplicate to the Montana  
Bureau of Mines and Geology and Quadruplicate for the Appropriator.

15675

I certify that I received and filed this  
instrument on this 26  
day of Nov, 1963 at 4:17  
o'clock P.M.

F. H. Moore  
COUNTY RECORDER

By \_\_\_\_\_  
DEPUTY

NOV 26 1963  
CLERK COUNTY

GW 2

File No. 1666

T 4N R 21W

30

DUPLICATE

Ravalli County

STATE OF MONTANA  
ADMINISTRATOR OF GROUNDWATER CODE  
OFFICE OF STATE ENGINEER

Notice of Completion of Groundwater  
Appropriation by Means of Well

(Under Chapter 237, Montana Session Laws, 1961)

Owner USDA, Forest Service Address Hamilton, Mont.  
229 E. Orr St.

Driller Carl E. Hollenstainer Address Dillon, Montana

Date of Notice of Appropriation of Groundwater ---

Date well started 12/6/61 Date Completed 2/2/62

Type of well drilled Equipment Used drill  
(dug, driven, bored or drilled) (Churn, drill, rotary or other)

Water Use: Domestic (  ) Municipal ( ) Stock ( ) Irrigation ( )  
Industrial ( ) Drainage ( ) Other ( )

← Indicate on the diagram the character and thickness of the different strata met with in drilling, such as soil, clay, shale, gravel, rock or sand, etc. Show depth at which water is encountered, thickness and character of water-bearing strata and height to which the water rises in the well.

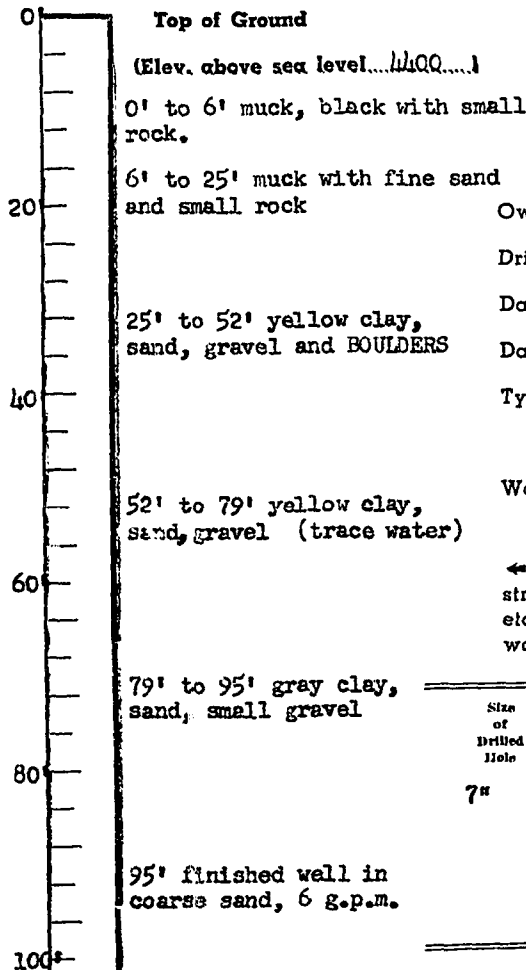

Size of Drilled Hole	Size and Weight of Casing	From (Feet)	To (Feet)	PERFORATIONS		
				Kind Size	From (Feet)	To (Feet)
7"	6" I.D. seamless steel 18.5 lbs. per ft.	0	95	N	O N E	

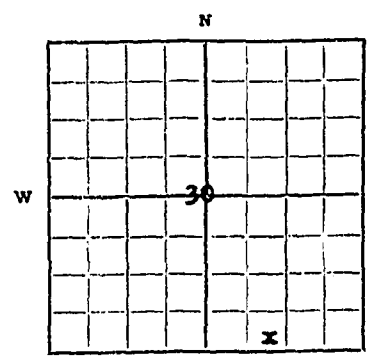

Conto Lake Camp  
SW 1/4 Sec. 30, T4N, R21W.  
Indicate location of well and place of use, if possible. Each small square represents 10 acres.

Show exact depth of bottom

Static Water Level for non-flowing Well 55' feet.  
Shut-in Pressure for Flowing Well ---  
Pumping Water Level 95' feet at 6 gal. per minute.  
Complete draw down in 2 hr. test from 55'  
Discharge in gal., per min. of flowing well ---  
How Tested Bailer Length of Test 2 hrs.

Remarks: (Gravel packing, cementing, packers, type of shutoff, Location of place of use of groundwater if not at well, and any other similar pertinent information, including number of acres irrigated, if used for irrigation)

Hand pump

#9  
Driller's License Number

*Carl E. Hollenstainer*  
Driller's Signature

Contract 12-11-261-1933

This form to be prepared by driller, and three copies to be filed by the owner with the County Clerk and Recorder in the county in which the well is located.

Please answer all questions. If not applicable, so state, otherwise the form will be returned.

Original to the County Clerk and Recorder; duplicate to the State Engineer; Triplicate to the School of Mines and Quadruplicate for the Appropriator.

#1666

I certify that I received and filed this  
instrument on this 29th  
day of Oct, 19 62, at 3:52  
o'clock P. M.

Anthony Hork

COUNTY RECORDER

By

Shirley Keith  
DEPUTY



33

File No. 1979

T. 4 R. 21

DUPLICATE

County Ravalli

STATE OF MONTANA  
ADMINISTRATOR OF GROUNDWATER CODE  
OFFICE OF STATE ENGINEER

RECEIVED  
DEC 18 1963

STATE ENGINEER  
Notice of Completion of Groundwater Appropriation Without Well

(Under Chapter 237 Montana Session Laws, 1961)

Date of Appropriation of Groundwater 9-1-1959  
Owner Fred A Hadel Address R#1 Box 272  
Hamilton Montana  
Contractor (if any) None  
Address of Contractor \_\_\_\_\_  
Date Started 9-1-1959 Date Completed 9-1-1959

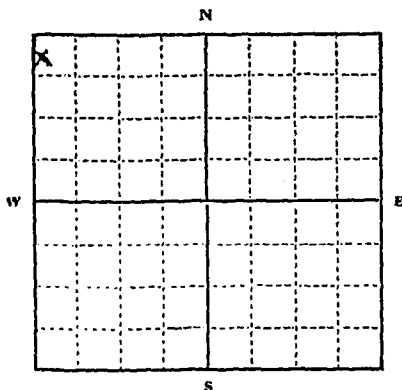

N.W. 1/4 Sec. 33 T. 4 R. 21  
Indicate point of appropriation and place of use, if possible.

Describe means of obtaining groundwater without a well "as by sub-irrigation and other natural processes". Include depth to water when applicable.

Ground Spring from Ground level

Quantity of water developed and used with explanation of method used to measure or estimate such amount. If use is intermittent

estimate approximate lengths of periods of use.

Use the water all during the year for watering the cattle  
Estimate about 15 gallons of water per minute continuous flow

Signature of Owner Fred A Hadel

Date 12-14-1963

This form to be prepared by contractor (if any), otherwise by the owner.

Three copies of this notice are to be filed with the County Clerk and Recorder of the county in which the works are located.

Please answer all questions. If not applicable, so state, otherwise the form will be returned.

Original to the County Clerk and Recorder; duplicate to the State Engineer; Triplicate to the Montana Bureau of Mines and Geology and Quadruplicate for the Appropriator.

10197

I certify that I received and filed this  
instrument on this.....17th.....  
day of Dec. 19 63, at 1:35  
o'clock P M.

F. H. Moore  
COUNTY RECORDER

By.....  
DEPUTY

GW1

File No. 1829

T. 4N R. 21  
County Powell

DUPLICATE

STATE OF MONTANA  
ADMINISTRATOR OF GROUNDWATER CODE  
OFFICE OF STATE ENGINEER

RECEIVED  
OCT 9 1963

Notice of Appropriation of Groundwater  
(Under Chapter 237, Montana Session Laws, 1961) STATE ENGINEER

- I, Norman A. + Dorothy L. Davis, of P.O. Box 323 Darby  
(Name of Appropriator) (Address) (Town)  
County of Powell, State of Montana, intend to appropriate groundwater in accordance with Chapter 237, Montana Session Laws of 1961.
- The beneficial use to which water is to be applied is for livestock  
(describe lands to be benefited, if for irrigation)
- The rate of use in gallons per minute or miner's inches of groundwater claimed 10 gallons per min
- The annual period (inclusive dates) of intended use Oct 15<sup>th</sup> through May 15<sup>th</sup>
- The probable or intended date of first beneficial use Oct 15<sup>th</sup> 1964
- The probable or intended date of commencement and completion of the well\* or wells\* Spring of 1964
- The location, type, size and depth of well or wells contemplated 6" casing approx to water
- The probable depth of the water table or artesian aquifer 6.7 feet
- Name, address and license number of the driller engaged Anderson Bros, Hamilton

10. Give such other similar information as may be useful in carrying out the policy of this act. as there is only 1 small spring on this ranch water must be obtained from additional well

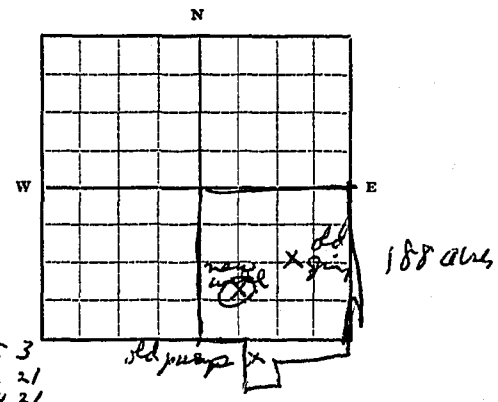

Who owns land # 4 5 3  
 lot 1 4 3 21  
 S 1/2 SE 3 3 4 21  
 lot 2 SW 1/4 E 4 3 21

1/4 Sec. T. R.  
Locate well or other means of development as accurately as possible on the plat.

Signature of Appropriator Norman A. Davis  
Date 10/4/63

\* As defined in the Code Sec. 1 (c) "Well" means any artificial opening or excavation in the ground, however made, by which groundwater can be obtained or through which it flows under natural pressures or is artificially withdrawn."

Three copies of this notice are to be filed with County Clerk and Recorder of the county in which the well is located.

Please answer all questions. If not applicable, so state, otherwise the form will be returned.

Original to the County Clerk and Recorder; duplicate to the State Engineer; Triplicate to the School of Mines and Quadruplicate for the Appropriator.

#1829

I certify that I received and filed this  
instrument on this.....7th.....  
day of....Oct....., 1963.... at 11:20  
o'clock.....A.M.

F. G. Moore

COUNTY RECORDER

By

*Shirley Keith*

DEPUTY

34

File No.....

T 4N R 21W

DUPLICATE

County Paralli

STATE OF MONTANA  
ADMINISTRATOR OF GROUNDWATER CODE  
OFFICE OF STATE ENGINEER

RECORDED  
DEC 31 1963

Notice of Completion of Groundwater Appropriation  
Without Well

STATE ENGINEER

(Under Chapter 237 Montana Session Laws, 1961)

Date of Appropriation of Groundwater aprox. 1918  
~~Dec 27, 63~~

Owner Clyde L. Kidd Address Rt 1. Hamilton

Contractor (if any) .....

Address of Contractor .....

Date Started..... Date Completed.....

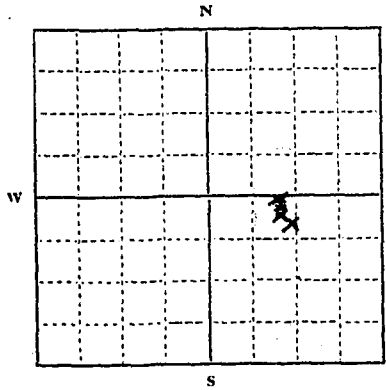

Describe means of obtaining groundwater without a well "as by sub-irrigation and other natural processes". Include depth to water when applicable. Water piped from Spring Boxes 6 foot depth, to house milk house, barn, stock tanks and stock water pond and irrigation.

Quantity of water developed and used with explanation of method used to measure or estimate such amount. If use is intermittent estimate approximate lengths of periods of use.....

N.W. 1/4 S.E. Sec 34 T. 4N R. 21W

Indicate point of appropriation and place of use, if possible.

Approx. 25 inch of water used constantly.

Signature of Owner Margaret J. Kidd

Date Dec. 27, 63

This form to be prepared by contractor (if any), otherwise by the owner.

Three copies of this notice are to be filed with the County Clerk and Recorder of the county in which the works are located.

Please answer all questions. If not applicable, so state, otherwise the form will be returned.

Original to the County Clerk and Recorder; duplicate to the State Engineer; Triplicate to the Montana Bureau of Mines and Geology and Quadruplicate for the Appropriator.

2280

I certify that I received and filed this  
instrument on this 27  
day of Dec. 1963 at 2:30  
o'clock P.M.

F. K. Moore  
COUNTY RECORDER

DEPUTY

RECORDED  
INDEXED

DEC 27 1963

FILED  
COUNTY CLERK

File No. 3111

T. 4 N R. 21 W

DUPLICATE

County RAVALLI

STATE OF MONTANA  
ADMINISTRATOR OF GROUNDWATER CODE  
OFFICE OF STATE ENGINEER

RECEIVED  
DEC 26 1963

Notice of Completion of Groundwater Appropriation  
Without Well

STATE ENGINEER

(Under Chapter 237 Montana Session Laws, 1961)

Date of Appropriation of Groundwater. *Spring has been used on these premises more than 60 yrs*  
Owner. *SIMON or HERMINE HUPFER* Address. *Rt 1 Box 229A HAMILTON, MONT.*  
Contractor (if any) *NONE*  
Address of Contractor *NONE*  
Date Started. *Nature Spring* Date Completed.

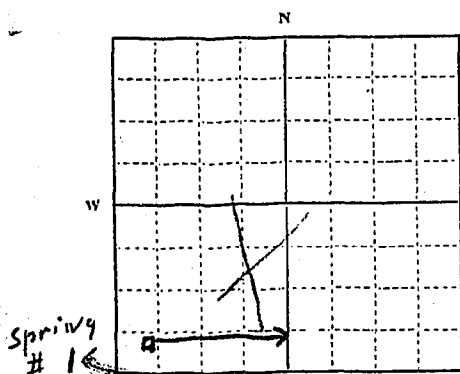

#1 SW 1/4 SW Sec. 34 T. 4 R. 21

Indicate point of appropriation and place of use, if possible.

Describe means of obtaining groundwater without a well "as by sub-irrigation and other natural processes". Include depth to water when applicable. *SPRING #1 is boxed in and water runs thru about 200' of pipe for stock water + SOME IRRIGATION.*

Quantity of water developed and used with explanation of method used to measure or estimate such amount. If use is intermittent estimate approximate lengths of periods of use.

Signature of Owner. *Simon Hupfer*  
Date *12-18-1963*

This form to be prepared by contractor (if any), otherwise by the owner.

Three copies of this notice are to be filed with the County Clerk and Recorder of the county in which the works are located.

Please answer all questions. If not applicable, so state, otherwise the form will be returned.

Original to the County Clerk and Recorder; duplicate to the State Engineer; Triplicate to the Montana Bureau of Mines and Geology and Quadruplicate for the Appropriator.

I certify that I received and filed this  
instrument on this 23  
day of Dec, 1963, at 4:06  
o'clock P. M.

F. H. Moore  
COUNTY RECORDER

By \_\_\_\_\_  
DEPUTY

C



34

File No. 2112

T. 4 N R 21 W

DUPLICATE

County Reynolds

STATE OF MONTANA  
ADMINISTRATOR OF GROUNDWATER CODE  
OFFICE OF STATE ENGINEER

RECEIVED  
DEC 26 1963

Notice of Completion of Groundwater Appropriation Without Well

(Under Chapter 237 Montana Session Laws, 1961)

Date of Appropriation of Groundwater

*Spring have been used on these premises for more than 60 yrs.*

Owner *Hermine or Simon Huffer*

Address *Box 229 A, Rt 1 Hamilton, Mont.*

Contractor (if any) *None*

Address of Contractor *None*

Date Started *These are natural springs* Date Completed

Describe means of obtaining groundwater without a well "as by sub-irrigation and other natural processes". Include depth to water when applicable. *Spring #1 is boxed in and water runs thru about 200' of pipe to house and garden*

*Spring #2 is also boxed in and water runs thru about 200' of pipe for stock water.*

Quantity of water developed and used with explanation of method used to measure or estimate such amount. If use is intermittent

estimate approximate lengths of periods of use *Spring #2 is continuous flow thru a 1 1/2" pipe*

*Spring #1 is continuous flow thru a 1 1/2" pipe*

Signature of Owner *Simon Huffer*

Date *12-18-63*

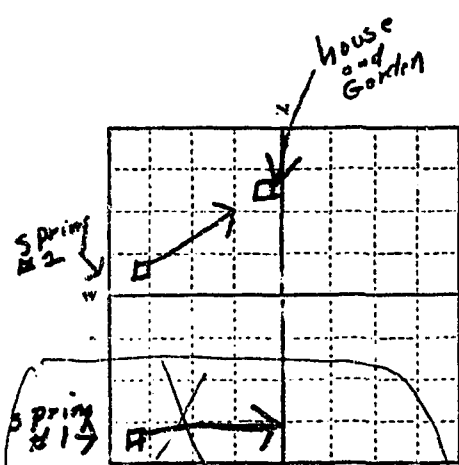

- (1) ~~SW 1/4 SW 34 T. 4 R. 21~~
- (2) ~~SW 1/4 NW 34 T. 4 R. 21~~

Indicate point of appropriation and place of use, if possible.

This form to be prepared by contractor (if any), otherwise by the owner.  
Three copies of this notice are to be filed with the County Clerk and Recorder of the county in which the works are located.  
Please answer all questions. If not applicable, so state, otherwise the form will be returned.  
Original to the County Clerk and Recorder; duplicate to the State Engineer; Triplicate to the Montana Bureau of Mines and Geology and Quadruplicate for the Appropriator.

12596

I certify that I received and filed this  
instrument on this 23  
day of Dec, 1963, at 4:07  
o'clock P.M.

F. H. Moore  
COUNTY RECORDER

By \_\_\_\_\_ DEPUTY

File No. D-2

T. 14 N. R. 21 W. County...

STATE OF MONTANA ADMINISTRATOR OF GROUNDWATER CODE OFFICE OF STATE ENGINEER

Declaration of Vested Groundwater Rights (Under Chapter 237, Montana Session Laws, 1961)

Alan B. and Arlene M. White, of Rt. 1, Box 230, Hamilton, (Name of Appropriator) (Address) (Town)

County of Ravalli State of Montana

have appropriated groundwater according to the Montana laws in effect prior to January 1, 1962, as follows:

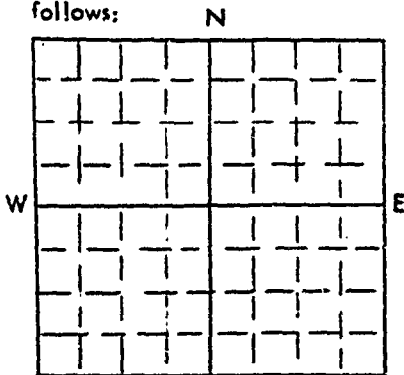

S 1/4 Sec 35 T4N R 21W PA

Indicate point of appropriation and place of use, if possible. Each small square represents 10 acres.

2. The beneficial use on which the claim is based. Houses, garden, lawn, and stock

3. Date or approximate date of earliest beneficial use; and how continuous the use has been. June 19, 1953 to the present date

4. The amount of groundwater claimed (in miner's inches or gallons per minute) 3000 g.p.m.

5. If used for irrigation give the acreage and description of the lands to which water has been applied and name of the owner thereof 1 A. yard and garden. Owner - Alan and Arlene White

6. The means of withdrawing such water from the ground and the location of each well or other means of withdrawal. Electric pump

7. The date of commencement and completion of the construction of the well, wells, or other works for withdrawal of groundwater. June 18, 1953 to June 19, 1953

8. The depth of water table 6 ft.

9. So far as it may be available, the type, size and depth of each well or the general specifications of any other works for the withdrawal of groundwater. Drilled wells, 4" casing, 2.6' of casing, 2.9' from surface

10. The estimated amount of groundwater withdrawn each year 10,800,000 gal.

11. The log of formations encountered in the drilling of each well if available. gravel down 1.6' 1.6' sandstone, with gravel

12. Such other information of a similar nature as may be useful in carrying out the policy of this act, including reference to book and page of any county record.

Signature of Owner Alan B. White Arlene M. White Date Dec 31, 1963

Three copies to be filed by the owner with the County Clerk and Recorder of the county in which the well is located.

Please answer all questions. If not applicable, so state, otherwise the form will be returned. Original to the County Clerk and Recorder; Duplicate to the State Engineer; Triplicate to the Montana Bureau of Mines and Geology, and Quadruplicate for the Appropriator.

3010

I certify that I received and filed this  
instrument on this 31st  
day of Dec., 19 63 at 1:19  
o'clock P. M.

F. G. Moore

COUNTY RECORDER

By Shirley Keith  
DEPUTY

T. 4 R. 21

County Ravalli

MONTANA BUREAU OF MINES AND GEOLOGY  
Butte, Montana

RECEIVED  
JUN 27 1961

WATER WELL LOG

STATE ENGINEER

	X		

Owner Allan White Address Rt 1 Box 230 Hamilton, Mont.

Driller Norman C. Ray Address Hamilton, Mont.

Date Started June 18, 1953 Date Completed June 19, 1953

Location: Sec. 35 T. 4 R. 21 1/4 sec. Part of S1/4 NW1/4 Index 18

Type of well Drilled (Dug, driven, bored, or drilled) Equipment used Drill (Churn drill, rotary, other)

Water use: Domestic [X] Municipal [ ] Stock [ ] Irrigation [X]

Industrial [ ] Drainage [ ] Other: [ ]

Casing: ft. to 26 1/2 ft. Type Size

Casing: ft. to ft. Type Size

Casing: ft. to ft. Type Size

Perforated or Screened: Ft. to ft. Ft. to ft.

Type of screen or perforations

Static Water level, for non-flowing well: 25 feet of water feet.

Shut-in pressure, for flowing well: lb./sq. in. (date)

Pumping water level: feet at 3000 gal. per min. hr.

How tested:

Length of test:

Remarks: (Gravel packing, cementing, packers, type of shut-off, depth of shut-off)

No log

(over)

File No. STATE WATER CONSERVATION BOARD

T. 4 N R 21 W

DUPLICATE JAN 3 1965

County.....

Bill \_\_\_\_\_ STATE OF MONTANA  
 Building \_\_\_\_\_  
 Code \_\_\_\_\_ ADMINISTRATOR OF GROUNDWATER CODE  
 Department \_\_\_\_\_ OFFICE OF STATE ENGINEER  
 District \_\_\_\_\_  
 District \_\_\_\_\_

**Declaration of Vested Groundwater Rights**

(Under Chapter 237, Montana Session Laws, 1961)

1. Marion L. Hayden, of Box 26 Dorby  
 (Name of Appropriator) (Address) (Town)  
 County of Beavert State of Montana  
 have appropriated groundwater according to the Montana laws in effect prior to January 1, 1962, as follows:

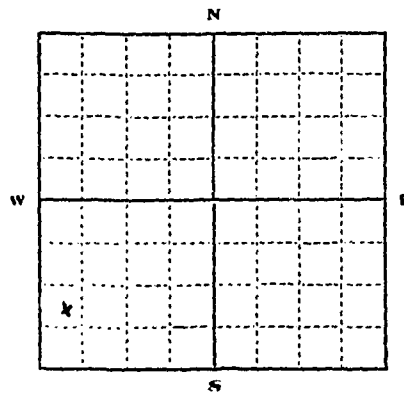

SW 1/4 SW Sec 35 T. 4 R. 21

Indicate point of appropriation and place of use, if possible. Each small square represents 10 acres.

2. The beneficial use on which the claim is based Irrigation of yard and household use.

3. Date or approximate date of earliest beneficial use; and how continuous the use has been Dug in 1875, practically con. to 1962.

4. The amount of groundwater claimed (in miner's inches or gallons per minute) 1000 gallons per hour

5. If used for irrigation, give the acreage and description of the lands to which water has been applied and name of the owner thereof Approximately 2 Acres of yard and garden. Marion L. Hayden.

6. The means of withdrawing such water from the ground and the location of each well or other means of withdrawal By means of electric motor pump. Location on plot.

7. The date of commencement and completion of the construction of the well, wells, or other works for withdrawal of groundwater Dug in 1875 for household use. Used for yard irrigation since 1962.

8. The depth of water table 8 feet in summer

9. So far as it may be available, the type, size and depth of each well on the general specifications of any other works for the withdrawal of groundwater About 17 feet deep. Hand dug and rock lined. About 4 1/2 feet in diameter

10. The estimated amount of groundwater withdrawn each year 20,000 gallons

11. The log of formations encountered in the drilling of each well if available Wash boulders, sand and gravel.

12. Such other information of a similar nature as may be useful in carrying out the policy of this act, including reference to book and page of any county record None.

Signature of Owner Marion L. Hayden

Date 12/30/65

Three copies to be filed by the owner with the County Clerk and Recorder of the county in which the well is located.

Please answer all questions. If not applicable, so state, otherwise the form will be returned.

Original to the County Clerk and Recorder; Duplicate to the State Engineer; Triplicate to the Montana Bureau of Mines and Geology, and Quadruplicate for the Appropriator.

#4720

I certify that I received and filed this  
instrument on this 30th,  
day of Dec. 1965 at 1:55  
o'clock P. M.

*F. G. Moore*  
COUNTY RECORDER

Fee \$2.00

By \_\_\_\_\_  
DEPUTY

GW 2  
File No. 1650

RECEIVED  
SEP 28 1962

T 4 R 21  
W 35

DUPLICATE

Ravalli County

STATE ENGINEER  
STATE OF MONTANA  
ADMINISTRATOR OF GROUNDWATER CODE  
OFFICE OF STATE ENGINEER

RECEIVED  
SEP 28 1962

**Notice of Completion of Groundwater Appropriation by Means of Well ENGINEER**

(Under Chapter 237, Montana Session Laws, 1961)

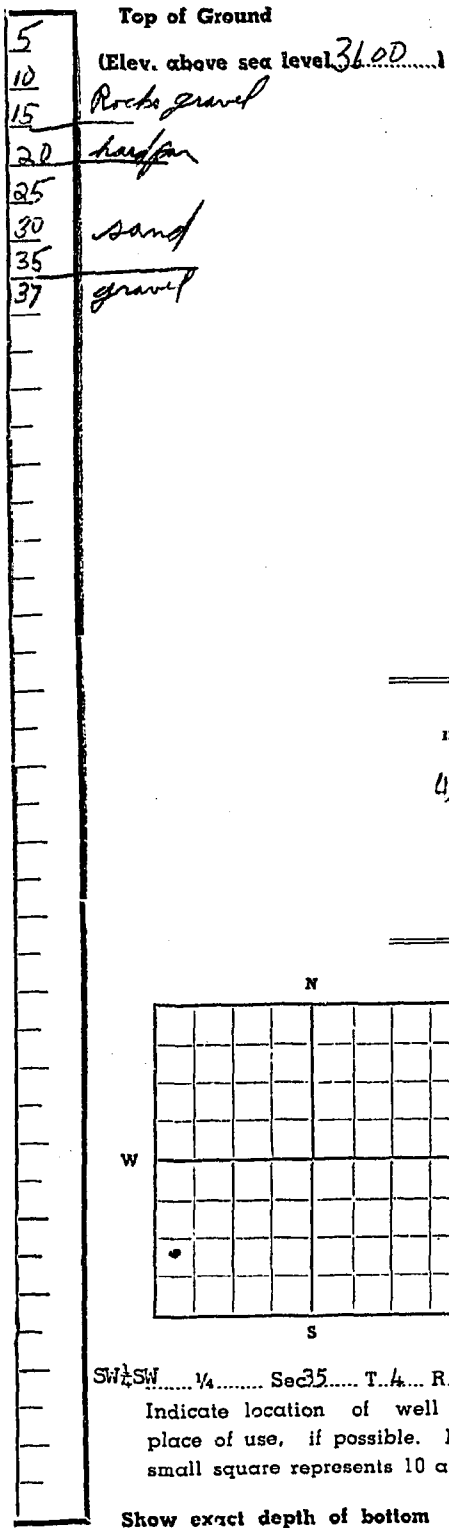

Owner Marian L. Hayden Address Rt #1 Hamilton

Driller Bill Anderson Address #104 51A

Date of Notice of Appropriation of Groundwater

Date well started Sept 24 62 Date Completed Sept 26 62

Type of well drilled Equipment Used Churn drill  
(dug, driven, bored or drilled) (Churn, drill, rotary or other)

Water Use: Domestic () Municipal () Stock ( ) Irrigation ()  
Industrial ( ) Drainage ( ) Other ( )

← Indicate on the diagram the character and thickness of the different strata met with in drilling, such as soil, clay, shale, gravel, rock or sand, etc. Show depth at which water is encountered, thickness and character of water-bearing strata and height to which the water rises in the well.

Size of Drilled Hole	Size and Weight of Casing	From (Feet)	To (Feet)	PERFORATIONS		
				Kind Size	From (Feet)	To (Feet)
4 in	7 1/2 pound 4 in	04	37	none	none	none

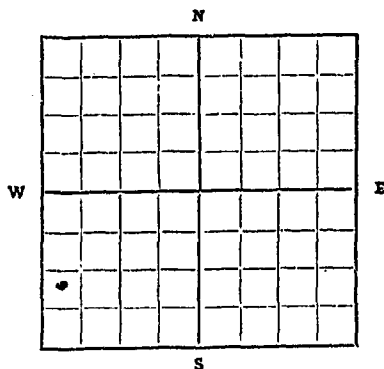

SW 1/4 Sec 35 T. 4 R. 21

Indicate location of well and place of use, if possible. Each small square represents 10 acres.

Show exact depth of bottom

Static Water Level for non-flowing Well 14 feet.

Shut-in Pressure for Flowing Well

Pumping Water Level 18 feet at 20 gal. per minute.

Discharge in gal., per min. of flowing well 25 per min

How Tested 3 hr pump Length of Test 3 hr

Remarks: (Gravel packing, cementing, packers, type of shutoff, Location of place of use of groundwater if not at well, and any other similar pertinent information, including number of

acres irrigated, if used for irrigation)

33

Driller's License Number

Bill Anderson

Driller's Signature

This form to be prepared by driller, and three copies to be filed by the owner with the County Clerk and Recorder in the county in which the well is located.

Please answer all questions. If not applicable, so state, otherwise the form will be returned.

Original to the County Clerk and Recorder; duplicate to the State Engineer; Triplicate to the School of Mines and Quadruplicate for the Appropriator.

2159



I certify that I received and read this  
instrument on this 27th  
day of Sept., 1962, at 11:30  
o'clock A. M.

*Richard Hark*  
COUNTY RECORDER

By \_\_\_\_\_ DEPUTY

RECEIVED  
STATE ENGINEER  
OCT 1 1962



STATE OF MONTANA  
STATE ENGINEER  
SAM W. MITCHELL BUILDING  
HELENA, MONTANA

October 1, 1962

RECEIVED  
STATE ENGINEER  
OCT 3 1962

water well log, your number 1650.  
Give the name and address of  
the person who will please add it  
to your files.



# STATE OF MONTANA

## STATE ENGINEER

SAM W. MITCHELL BUILDING

HELENA, MONTANA

FRED E. BUCK, STATE ENGINEER  
HANS L. BILLE, ASSISTANT

C. S. Heidel, Deputy State Engineer

October 1, 1962

RECEIVED  
OCT 3 1962

STATE ENGINEER

Mr. Anthony Hork  
County Clerk and Recorder  
Ravalli County  
Hamilton, Montana

Dear Mr. Hork:

We are returning the water well log, your number 1650, filed September 27 because it does not give the name and address of the owner. If you have it in your records, will you please add it to this form and return it to us?

Very truly yours,

FRED E. BUCK  
STATE ENGINEER

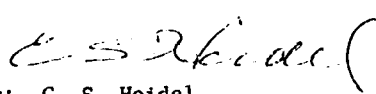
  
By: C. S. Heidel  
Deputy State Engineer

CSH:ba  
Enc.

35

File No.....

T. Y N R 21

DUPLICATE

County.....

STATE OF MONTANA  
ADMINISTRATOR OF GROUNDWATER CODED  
OFFICE OF STATE ENGINEER

JAN 17 1964

Notice of Completion of Groundwater Appropriation  
Without Well

(Under Chapter 237 Montana Session Laws, 1961)

Date of Appropriation of Groundwater June 1953

Owner Alex B. & Arlene M. White  
Address Rt 1 Hamilton Mont.

Contractor (if any) None

Address of Contractor .....

Date Started June 1953 Date Completed June 1953

Describe means of obtaining groundwater without a well "as by sub-irrigation and other natural processes". Include depth to water when applicable Dug 300 F.T. OF drain ditch and opened springs along the length of ditch - which drains into existing Spring Fed creek

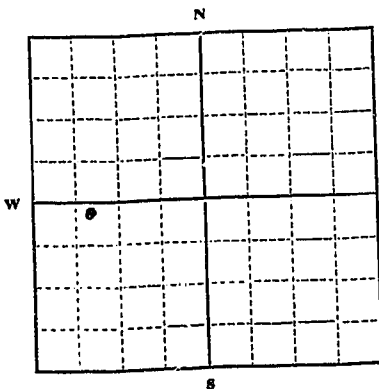

Quantity of water developed and used with explanation of method used to measure or estimate such amount. If use is intermittent

estimate approximate lengths of periods of use Water comes

S 1/2 - NW 1/4 Sec 35 T4N R. 21 W. M. B. M.

Indicate point of appropriation and place of use, if possible.

up in Mid April & dries up again in December. water is used from April to Oct. For irrigation by pump & sprinklers using 11-7 1/2 g.p.m. sprinkler heads - 5000 g.p.h. more or less

Signature of Owner Alex B. White

Date.....

This form to be prepared by contractor (if any), otherwise by the owner.

Three copies of this notice are to be filed with the County Clerk and Recorder of the county in which the works are located.

Please answer all questions. If not applicable, so state, otherwise the form will be returned.

Original to the County Clerk and Recorder; duplicate to the State Engineer; Triplicate to the Montana Bureau of Mines and Geology and Quadruplicate for the Appropriator.

37325

#2861

I certify that I received and filed this  
instrument on this 31st  
day of Dec 1963 at 10:47  
o'clock A. M.  
F. G. Moore  
COUNTY RECORDER  
By Shirley Keith  
DEPUTY