

RECEIVED

County RAVALLI

STATE OF MONTANA  
ADMINISTRATOR OF GROUNDWATER CODE  
MONTANA WATER RESOURCES BOARD

NOTICE OF COMPLETION OF GROUNDWATER  
APPROPRIATION BY MEANS OF WELL

Developed after January 1, 1962

(Under Chapter 237 Montana Session Laws, 1961, as amended)

This form to be prepared by driller, and three copies to be filed by the owner with the County Clerk and Recorder in the county in which the well is located, last copy to be retained by driller.

Please answer all questions. If not applicable, so state, otherwise the form may be returned.

Owner Jack Evans

Address Rt. 1 Box 1179

Hamilton 59840

Date well started 6/15/73

completed 6/18/73

Type of well Drilled

Equipment used Cable tool

Water Use: Domestic ☒ Municipal ☐ Stock ☐ Irrigation ☐

Industrial ☐ Drainage ☐ Other ☐\* Garden/Lawn ☐

\*Describe House & lawn

USE: If used for irrigation, industrial, drainage or other. Explain, state number of acres and location or other data (i.e. Lot, Block and Addition).

ESTIMATED ANNUAL WITHDRAWAL 6 gal per min

Size of Drilled Hole	Size and Weight of Casing	From (Feet)	To (Feet)	PERFORATIONS
<u>7 1/2"</u>	<u>6" I.D.</u> <u>6 5/8" O.D.</u> <u>.025 wall</u> <u>17' length</u>	<u>12"</u> <u>above</u> <u>surface</u>	<u>29 1/2'</u> <u>below</u> <u>ground level</u>	<u>none</u>

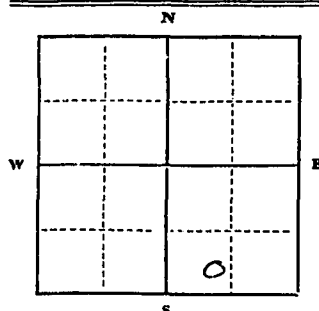

SW 1/4 SE 1/4 Sec. 30

T. 5 N. R. 20 W.

INDICATE LOCATION OF WELL AND PLACE OF USE, IF POSSIBLE. EACH SMALL SQUARE REPRESENTS 40 ACRES.

Driller's Signature Howard Sander

Driller's Address Rt. 1 Box 1182

Hamilton Mont LICENSE NO. 236

DRILLER'S LOG

Indicate the character, color, thickness of strata such as soil, clay, sand, gravel, shale, sandstone, etc. Show depth at which water is found and height to which water rises in well.

Top of Ground (Elev. above sea level) <u>3440</u>		
From (Feet)	To (Feet)	
<u>0</u>	<u>3</u>	<u>Boulders &amp; soil</u>
<u>3</u>	<u>22</u>	<u>Boulders &amp; sand</u>
<u>22</u>	<u>31'</u>	<u>Gravel &amp; water aquifer</u>
		<u>Casing set at</u>
		<u>29 1/2' ft below</u>
		<u>surface</u>

31' Show exact depth of bottom

5443

5989

198353

I certify that I received and filed this  
Instrument on this 27th  
day of June, 1973, at 3:20  
o'clock P.M.

Charles E. Hughes  
COUNTY RECORDER

By W. J. 200  
DEPUTY

STATE OF MONTANA  
ADMINISTRATOR OF GROUNDWATER CODE  
MONTANA WATER RESOURCES BOARD

NOTICE OF COMPLETION OF GROUNDWATER  
APPROPRIATION BY MEANS OF WELL

Developed after January 1, 1962

(Under Chapter 237 Montana Session Laws, 1961, as amended)

This form to be prepared by driller, and three copies to be filed by the owner with the County Clerk and Recorder in the county in which the well is located, last copy to be retained by driller. Please answer all questions. If not applicable, so state, otherwise the form may be returned.

Owner Jack Evans

Address Rt. 1, Box 1179

Hamilton Mont 59840

Date well started 4/18/73

completed 4/20/73

Type of well Drilled

Equipment used Cable tool

Water Use: Domestic ☒ Municipal ☐ Stock ☒ Irrigation ☐

Industrial ☐ Drainage ☐ Other ☐ Garden/Lawn ☐

\*Describe cattle & horses

USE: If used for irrigation, industrial, drainage or other. Explain, state number of acres and location or other data (i.e. Lot, Block and Addition).

ESTIMATED ANNUAL WITHDRAWAL use 6 gal per min

Size of Drilled Hole	Size and Weight of Casing	From (Feet)	To (Feet)	PERFORMANCES
<u>7 7/8"</u>	<u>6" P. 6500 .025 wall 17' pft</u>	<u>12"</u>	<u>195'</u>	<u>none</u>
		<u>active ground surface</u>	<u>below surface</u>	

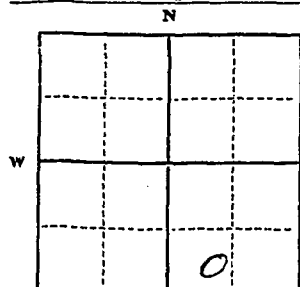

SE 1/4 SE 1/4 Sec. 30  
T. 5 N. R. 20 W.

INDICATE LOCATION OF WELL AND PLACE OF USE, IF POSSIBLE. EACH SMALL SQUARE REPRESENTS 40 ACRES.

Driller's Signature Howard Sander

Driller's Address Rt. 1, Box 1182

Hamilton Mont 59840 LICENSE NO. 236

RECORDED

County FAVALLI

DRILLER'S LOG

Indicate the character, color, thickness of strata such as soil, clay, sand, gravel, shale, sandstone, etc. Show depth at which water is found and height to which water rises in well.

Top of Ground (Elev. above sea level) 3440

From (Feet)	To (Feet)	
<u>0</u>	<u>3</u>	<u>Top soil</u>
<u>3</u>	<u>12</u>	<u>Gravel</u>
<u>12</u>	<u>21</u>	<u>Gravel</u>
		<u>water aquifer</u>
		<u>water set at 195' ft. below surface</u>

21' Show exact depth of bottom

54442

5990

198354

I certify that I received and filed this  
instrument on this 27th  
day of June, 1923, at 2:21  
o'clock P.M.

Darlene E. Hughes  
COUNTY RECORDER

By Gene L. O'S  
DEPUTY

JW 3

Approved Stock Form—State Publishing Co., Helena, Montana—42193

File No. 2149T 5N R 20 30

DUPLICATE

County \_\_\_\_\_

STATE OF MONTANA  
ADMINISTRATOR OF GROUNDWATER CODE  
OFFICE OF STATE ENGINEER

RECEIVED  
DEC 30 1963

STATE ENGINEER

**Notice of Completion of Groundwater Appropriation  
Without Well**

(Under Chapter 237 Montana Session Laws, 1961)

Date of Appropriation of Groundwater Prior to 19581750 McDonaldOwner Glenda Fowler Address Missoula, MontanaContractor (if any) None

Address of Contractor \_\_\_\_\_

Date Started Prior to 1958 Date Completed \_\_\_\_\_Describe means of obtaining groundwater without a well "as by sub-irrigation and other natural processes". Include depth to water when applicable. Spring on NE 1/4 of Section30, Township Five (5) North, Range Twenty(20) West - carried by means of pipe toland set forth in map.

Quantity of water developed and used with explanation of method used to measure or estimate such amount. If use is intermittent

estimate approximate lengths of periods of use \_\_\_\_\_

Used intermittently in Spring and Fallfor stock. Quantity unknown.Signature of Owner Glenda FowlerDate Dec. 23, 1963

This form to be prepared by contractor (if any), otherwise by the owner.

Three copies of this notice are to be filed with the County Clerk and Recorder of the county in which the works are located.

Please answer all questions. If not applicable, so state, otherwise the form will be returned.

Original to the County Clerk and Recorder; duplicate to the State Engineer; Triplicate to the Montana Bureau of Mines and Geology and Quadruplicate for the Appropriator.

15642

I certify that I received and filed this  
instrument on this 26<sup>th</sup>  
day of Dec, 1963, at 8:05  
o'clock A.M.

F. G. Moore  
COUNTY RECORDER

By \_\_\_\_\_  
DEPUTY

RECEIVED  
FEB 11 1964

CLERK

File No. 2148T. SW R. 20W

DUPLICATE

County MISSOULA

STATE OF MONTANA  
ADMINISTRATOR OF GROUNDWATER CODE  
OFFICE OF STATE ENGINEER

JAN 10 1964

STATE ENGINEER

## Declaration of Vested Groundwater Rights

(Under Chapter 237, Montana Session Laws, 1961)

1. Glenda Fowler, of 1750 McDonald Missoula  
(Name of Appropriator) (Address) (Town)  
land located in Ravalli State of Montana  
County of Ravalli  
have appropriated groundwater according to the Montana laws in effect prior to January 1, 1962, as follows:

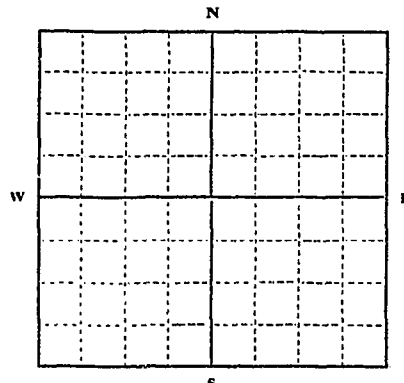

Portion of Lot One (1)  
NW 1/4 NW 30 T. 5N. R. 20W  
NE 1/4 NW 30 T. 5N. R. 20W

Indicate point of appropriation  
and place of use, if possible. Each  
small square represents 10 acres.

2. The beneficial use on which the claim is based.  
household use

3. Date or approximate date of earliest beneficial use; and how continu-  
ous the use has been. prior to 1949 - continuous  
use

4. The amount of groundwater claimed (in miner's inches or gallons  
per minute). (See item 10)

5. If used for irrigation, give the acreage and description of the lands  
to which water has been applied and name of the owner thereof  
Not used for irrigation

6. The means of withdrawing such water from the ground and the loca-  
tion of each well or other means of withdrawal.  
Electric pump

7. The date of commencement and completion of the construction of the well, wells, or other works for with-  
drawal of groundwater. prior to 1949

8. The depth of water table. estimated to be 60 feet Not Known

9. So far as it may be available, the type, size and depth of each well or the general specifications of any other  
works for the withdrawal of groundwater. one well 60 foot depth - drilled - 2" pipe

10. The estimated amount of groundwater withdrawn each year. Estimated 20,000 gallons

11. The log of formations encountered in the drilling of each well if available. not known

12. Such other information of a similar nature as may be useful in carrying out the policy of this act, including  
reference to book and page of any county record.

Signature of Owner Glenda FowlerDate Dec. 23, 1963

Three copies to be filed by the owner with the County Clerk and Recorder of the county in which the well is located.

Please answer all questions. If not applicable, so state, otherwise the form will be returned.

Original to the County Clerk and Recorder; Duplicate to the State Engineer; Triplicate to the Montana Bureau of  
Mines and Geology, and Quadruplicate for the Appropriator.

29351

I certify that I received and filed this  
instrument on this 26<sup>th</sup>  
day of Dec, 1963, at 8:00  
o'clock P.M.

F. S. Moore  
COUNTY RECORDER

By \_\_\_\_\_  
DEPUTY



File No. 4T 5 N R 20 W

DUPLICATE

County RAVALLI

STATE OF MONTANA  
ADMINISTRATOR OF GROUNDWATER CODE  
OFFICE OF STATE ENGINEER

RECEIVED  
JAN 8 1964

Notice of Completion of Groundwater Appropriation Without Well

(Under Chapter 237 Montana Session Laws, 1961)

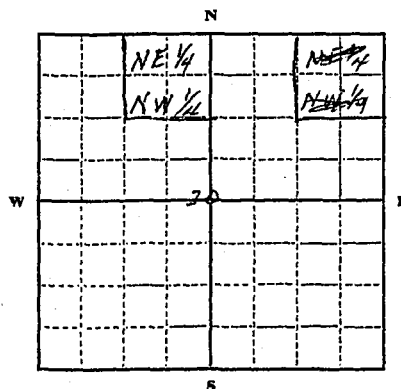

NE 1/4 NW 1/4 Sec. 30 T5N R21W  
Indicate point of appropriation  
and place of use, if possible.

Date of Appropriation of Groundwater About 1922

Owner W.O. & V.D. Lovely address Hamilton Mont.

Contractor (if any) None

Address of Contractor None

Date Started About 1922 Date Completed About 1922

Describe means of obtaining groundwater without a well "as by sub-irrigation and other natural processes". Include depth to water when applicable. Spring. Depth about 2 ft.

to water.

Quantity of water developed and used with explanation of method used to measure or estimate such amount. If use is intermittent

estimate approximate lengths of periods of use About

4 miners inches for stock household, and  
irrigation purposes.

Signature of Owner W.O. & V.D. Lovely

Date Dec 20 1963

This form to be prepared by contractor (if any), otherwise by the owner.

Three copies of this notice are to be filed with the County Clerk and Recorder of the county in which the works are located.

Please answer all questions. If not applicable, so state, otherwise the form will be returned.

Original to the County Clerk and Recorder; duplicate to the State Engineer; Triplicate to the Montana Bureau of Mines and Geology and Quadruplicate for the Appropriator.

File No. ....

T. 5 N R. 20 W

DUPLICATE

County RAVALLI

STATE OF MONTANA  
ADMINISTRATOR OF GROUNDWATER CODE  
OFFICE OF STATE ENGINEER

RECEIVED  
JAN 8 1964

Notice of Completion of Groundwater Appropriation  
Without Well

(Under Chapter 237 Montana Session Laws, 1961)

Date of Appropriation of Groundwater About 1922Owner W.O. & K.D. Level address Hamilton Mont.Contractor (if any) NoneAddress of Contractor NoneDate Started About 1922 Date Completed About 1922

Describe means of obtaining groundwater without a well "as by  
sub-irrigation and other natural processes". Include depth to  
water when applicable. Spring. Depth about 2 ft.

to water.

Quantity of water developed and used with explanation of method  
used to measure or estimate such amount. If use is intermittent

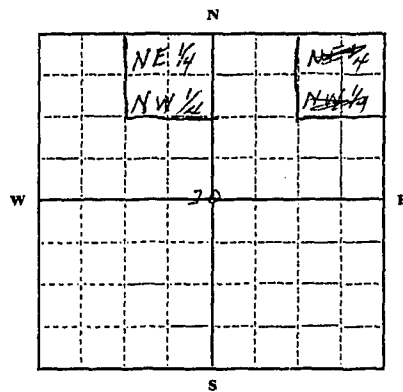
estimate approximate lengths of periods of use About4 miners inches for stock household, andirrigation purposes.Signature of Owner W.O. LevelDate Dec 20 1963NE 1/4 NW 1/4 Sec. 30. T. 5 N. R. 20 W.Indicate point of appropriation  
and place of use, if possible.

This form to be prepared by contractor (if any), otherwise by the owner.

Three copies of this notice are to be filed with the County Clerk and Recorder of the county in which the works are located.

Please answer all questions. If not applicable, so state, otherwise the form will be returned.

Original to the County Clerk and Recorder; duplicate to the State Engineer; Triplicate to the Montana Bureau of Mines and Geology and Quadruplicate for the Appropriator.

#2346

I certify that I received and filed this  
instrument on this 30th  
day of Dec. 1963 at 9:30  
o'clock A. M.

J. H. Moore  
COUNTY RECORDER  
By Shirley Keith  
Deputy

30

File No. ....

DUPLICATE

T. 5 N. R. 20 W.

County Ravalli

STATE OF MONTANA  
ADMINISTRATOR OF GROUNDWATER CODE  
OFFICE OF STATE ENGINEER

RECEIVED  
JAN 8 1964

Notice of Completion of Groundwater Appropriation  
Without Well

(Under Chapter 237 Montana Session Laws, 1961)

Date of Appropriation of Groundwater May 1 1958

Owner W. O. E. D. Lovely Address Hamilton Montana

Contractor (if any) none

Address of Contractor none

Date Started April 15 1958 Date Completed May 1 1958

Describe means of obtaining groundwater without a well "as by sub-irrigation and other natural processes". Include depth to water when applicable. Spring. Water at surface.

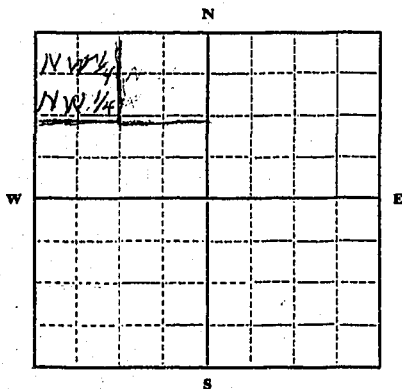

N.W. 1/4 Sec. 30 T. 5 N. R. 20 W.  
Indicate point of appropriation  
and place of use, if possible.

Quantity of water developed and used with explanation of method used to measure or estimate such amount. If use is intermittent

estimate approximate lengths of periods of use. About 5 gals.

per minute measured with a bucket. Developed for stock water.

Signature of Owner H. O. Lovely

Date Dec 20 1963

This form to be prepared by contractor (if any), otherwise by the owner.

Three copies of this notice are to be filed with the County Clerk and Recorder of the county in which the works are located.

Please answer all questions. If not applicable, so state, otherwise the form will be returned.

Original to the County Clerk and Recorder; duplicate to the State Engineer; Triplicate to the Montana Bureau of Mines and Geology and Quadruplicate for the Appropriator.

27152

#2344

I certify that I received and filed this  
instrument on this 30th  
day of Dec. 1963 at 9:29  
o'clock A.M.

F. G. Moore  
County Recorder  
By Shirley Keith  
Clerk

File No. ....

DUPLICATE

T. 5 R. 20 WCounty Beaumont

STATE OF MONTANA  
ADMINISTRATOR OF GROUNDWATER CODE  
OFFICE OF STATE ENGINEER

RECEIVED  
JUN 1 1964

Notice of Completion of Groundwater Appropriation  
Without Well

STATE ENGINEER

(Under Chapter 237 Montana Session Laws, 1961)

Date of Appropriation of Groundwater.....

JACK A. EVANSOwner MARY K. EVANS Address RT. 1 Box 127Contractor (if any) NONEAddress of Contractor NONEDate Started APPROXIMATE Date Completed UNKNOWN

Describe means of obtaining groundwater without a well "as by  
sub-irrigation and other natural processes". Include depth to  
water when applicable.....

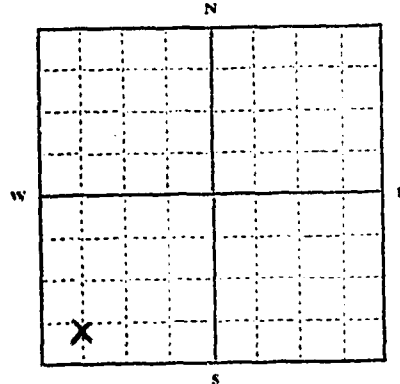
SPRING NATURAL PROCESS

SW 1/4 Sec 31 T5 R20W  
Indicate point of appropriation  
and place of use, if possible.

Quantity of water developed and used with explanation of method  
used to measure or estimate such amount. If use is intermittent

estimate approximate lengths of periods of use.....

5 GAL PER MIN (GUESS)FLows YEAR ROUNDSignature of Owner JACK A. EVANS MARY K. EVANSDate MAY 1964

This form to be prepared by contractor (if any), otherwise by the owner.

Three copies of this notice are to be filed with the County Clerk and Recorder of the county in which the  
works are located.

Please answer all questions. If not applicable, so state, otherwise the form will be returned.

Original to the County Clerk and Recorder; duplicate to the State Engineer; Triplicate to the Montana  
Bureau of Mines and Geology and Quadruplicate for the Appropriator.

# 4462

I certify that I received and filed this  
instrument on this 28th  
day of May 19 64, at 4:30  
o'clock P. M.

*F. S. Moore*  
COUNTY RECORDER

By \_\_\_\_\_ DEPUTY

File No. ....

T. 5-N R. 20 W. 31

DUPLICATE

County RAVALLI

STATE OF MONTANA  
ADMINISTRATOR OF GROUNDWATER CODE  
OFFICE OF STATE ENGINEER

RECEIVED  
JAN 28 1964

STATE ENGINEER  
**Notice of Completion of Groundwater Appropriation  
Without Well**

(Under Chapter 237 Montana Session Laws, 1961)

Date of Appropriation of Groundwater MARCH 1943Owner JACK H. EVANS Address RT 1 Box 127

Contractor (if any) .....

Address of Contractor .....

Date Started UNKNOWN Date Completed MARCH 1943Describe means of obtaining groundwater without a well "as by sub-irrigation and other natural processes". Include depth to water when applicable. Well is ROCKED ONWELLS WITH PIPS FROM WELLTO DRINKING TANK

Quantity of water developed and used with explanation of method used to measure or estimate such amount. If use is intermittent

estimate approximate lengths of periods of use WATERIS ESTIMATED ONLY, AT ABOUT4 G.P.M. WELL RUNS YEARAROUNDSignature of Owner JACK H. EVANS and MARY K. EVANSDate JAN. 24, 1964

This form to be prepared by contractor (if any), otherwise by the owner.

Three copies of this notice are to be filed with the County Clerk and Recorder of the county in which the works are located.

Please answer all questions. If not applicable, so state, otherwise the form will be returned.

Original to the County Clerk and Recorder; duplicate to the State Engineer; Triplicate to the Montana Bureau of Mines and Geology and Quadruplicate for the Appropriator.



4346

I certify that I received and filed this  
instrument on this 24th  
day of Jan., 1964, at 3:15  
o'clock P.M.

*F. S. Moore*  
COUNTY RECORDER

By \_\_\_\_\_  
DEPUTY

GW 3

File No. ....

DUPLICATE

T. 5<sup>N</sup> R. 20<sup>W</sup> 31

County Ravalli  
**RECEIVED**  
 OCT 6 1964

STATE OF MONTANA  
 ADMINISTRATOR OF GROUNDWATER CODE  
 OFFICE OF STATE ENGINEER

STATE ENGINEER

**Notice of Completion of Groundwater Appropriation Without Well**

(Under Chapter 237 Montana Session Laws, 1961)

Date of Appropriation of Groundwater 1908  
 Owner Leonard C. Cuthbert Address Box 21, Hamilton, Mont.  
 Contractor (if any) .....  
 Address of Contractor .....  
 Date Started ..... Date Completed .....

Describe means of obtaining groundwater without a well "as by sub-irrigation and other natural processes". Include depth to water when applicable. Spring dug to a depth of 10 feet - water piped from spring approx. 800 feet to house.

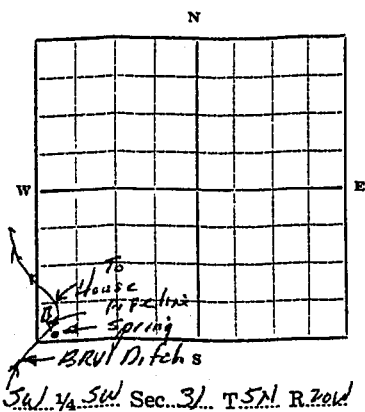

Indicate point of appropriation and place of use, if possible.

Quantity of water developed and used with explanation of method used to measure or estimate such amount. If use is intermittent estimate approximate lengths of periods of use .....  
10 gallons per minute of water developed. Measured by 5 gallon bucket and watch.

Signature of Owner Leonard Cuthbert  
 Date 10/2/64

This form to be prepared by contractor (if any), otherwise by the owner.  
 Three copies of this notice are to be filed with the County Clerk and Recorder of the county in which the works are located.  
 Please answer all questions. If not applicable, so state, otherwise the form will be returned.  
 Original to the County Clerk and Recorder; duplicate to the State Engineer; Triplicate to the Montana Bureau of Mines and Geology and Quadruplicate for the Appropriator.

4515

I certify that I received and filed this  
instrument on this 5<sup>th</sup>  
day of Oct, 19 64, at 10:30  
o'clock 11 M.  
F. H. Moore  
COUNTY RECORDER  
By F. H. Moore  
DEPUTY

File No. 2261T 5 N 20 W

DUPLICATE

STATE OF MONTANA  
ADMINISTRATOR OF GROUNDWATER CODE  
OFFICE OF STATE ENGINEER

Ravalli County

RECEIVED  
DEC 31 1963

## Declaration of Vested Groundwater Rights

(Under Chapter 237, Montana Session Laws, 1961)

STATE ENGINEER

1. Frances Laurretta McGregor of Route 1 Box 143 Hamilton  
(Name of Appropriator) (Address) (Town)

County of Ravalli, State of Montana, have appropriated groundwater according to the Montana laws in effect prior to January 1, 1962, as follows:

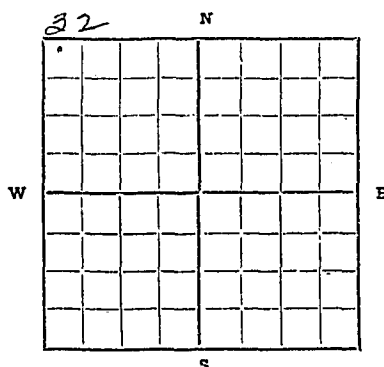

NW 1/4 NW Sec. 32 T. 5 R. 20  
Indicate point of appropriation  
and place of use, if possible.  
Each small square represents 10  
acres.

2. The beneficial use on which the claim is based Household use, yard
3. Date or approximate date of earliest beneficial use; and how continuous the use has been 1943, all the time
4. The amount of groundwater claimed (in miner's inches or gallons per minute) 10 gal. per. min.
5. If used for irrigation, give the acreage and description of the lands to which water has been applied and name of the owner thereof Water yard
6. The means of withdrawing such water from the ground and the location of each well or other means of withdrawal Electric pump, under kitchen, of house
7. The date of commencement and completion of the construction of the well, wells, or other works for withdrawal of groundwater Summer of 1943
8. The depth of water table surface water 7 ft. well 35 ft. deep
9. So far as it may be available, the type, size and depth of each well or the general specifications of any other works for the withdrawal of groundwater Drilled well - 2 in. pipe - 35 ft. deep
10. The estimated amount of groundwater withdrawn each year 954,000 gals a yr
11. The log of formations encountered in the drilling of each well if available not available
12. Such other information of a similar nature as may be useful in carrying out the policy of this act, including reference to book and page of any county record

Signature of Owner

*Frances Laurretta McGregor*

Date Dec 27/63

Three copies to be filed by the owner with the County Clerk and Recorder of the county in which the well is located.

Please answer all questions. If not applicable, so state, otherwise the form will be returned.

Original to the County Clerk and Recorder; duplicate to the State Engineer; Triplicate to the School of Mines and Quadruplicate for the Appropriator.

16749

I certify that I received and filed this  
instrument on this 27  
day of Dec, 19 63, at 2:01  
o'clock P.M.

F. H. Moore  
COUNTY RECORDER

DEPUTY

5 20  
County Range 1.1

Indicate the character, color, thickness of strata such as soil, clay, sand, gravel, shale, sandstone, etc. Show depth at which water is found and height to which water rises in well.

49218

#5512

I certify that I received and filed this  
instrument on this 12<sup>th</sup>  
day of Oct., 1971, at 1:05  
o'clock P.M.

F. G. Moore  
COUNTY RECORDER

By F. G. Moore  
DEPUTY

Ratio *Sup.*

T... *5N* ... R... *20W* ... *32*  
County.....

STATE OF MONTANA  
ADMINISTRATOR OF GROUNDWATER CODE  
OFFICE OF STATE ENGINEER

RECEIVED  
JAN 17 1964

Declaration of Vested Groundwater Rights

(Under Chapter 237, Montana Session Laws, 1961)

FILED ENGINEER

1. *Ralph Holmlund & Helen M. Holmlund* of *Pt 1 Box 134* *Hamilton*  
(Name of Appropriator) (Address) (Town)

County of *Ravalli* State of *Montana*

have appropriated groundwater according to the Montana laws in effect prior to January 1, 1962, as follows:

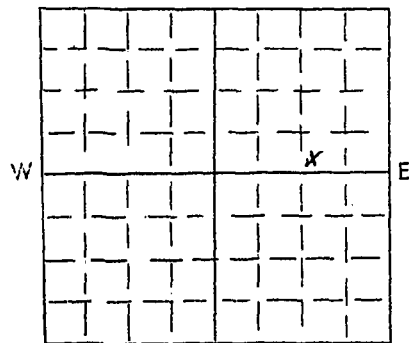

*36A*  
*S.E. 1/4 NE Sec. 32 T. 5. R. 20 W.*  
Indicate point of appropriation  
and place of use, if possible. Each  
small square represents 10 acres.

2. The beneficial use on which the claim is based. *Home use*

3. Date or approximate date of earliest beneficial use; and how  
continuous the use has been. *1947*  
*Used Continually since*

4. The amount of groundwater claimed (in miner's inches or gallons  
per minute) *20 gal per minute*

5. If used for irrigation, give the acreage and description of the land  
to which water has been applied and name of the owner thereof  
*14 acres Ralph Holmlund*

6. The means of withdrawing such water from the ground and the loca-  
tion of each well or other means of withdrawal *Electric pump*

7. The date of commencement and completion of the construction of the well, wells, or other works for  
withdrawal of groundwater *1947*

8. The depth of water table *15 ft*

9. So far as it may be available, the type, size and depth of each well or the general specifications of  
any other works for the withdrawal of groundwater *2 in. casing and depth of*  
*well is 30 ft*

10. The estimated amount of groundwater withdrawn each year *20,000 gal*

11. The log of formations encountered in the drilling of each well; if available *top soil*  
*then gravel then clay*

12. Such other information of a similar nature as may be useful in carrying out the policy of this act,  
including reference to book and page of any county record

Signature of Owner *Helen M Holmlund*  
*Ralph Holmlund*  
Date *Dec 31-1963*

Three copies to be filed by the owner with the County Clerk and Recorder of the county in which the well  
is located.

Please answer all questions. If not applicable, so state, otherwise the form will be returned.

Original to the County Clerk and Recorder; Duplicate to the State Engineer; Triplicate to the Montana  
Bureau of Mines and Geology, and Quadruplicate for the Appropriator.



#4027

I certify that I received and filed this  
instrument on this 31st  
day of Dec., 1963, at 3:16  
o'clock P. M.  
F. Y. Moore  
COUNTY RECORDER  
By Shirley Keith  
DEPUTY

File No. JAN 10 1962T. 5 R. 20

DUPLICATE

Billie McDonaldButzerin McDonaldCoyle McDonaldCoyne McDonald

STATE OF MONTANA

ADMINISTRATOR OF GROUNDWATER CODE

OFFICE OF STATE ENGINEER

## Declaration of Vested Groundwater Rights

(Under Chapter 237, Montana Session Laws, 1961)

1. Ralph Holmlund, of RT 134 Hamilton  
 (Name of Appropriator) (Address) (Town)  
 County of Bozeman State of Montana  
 have appropriated groundwater according to the Montana laws in effect prior to January 1, 1962, as follows:

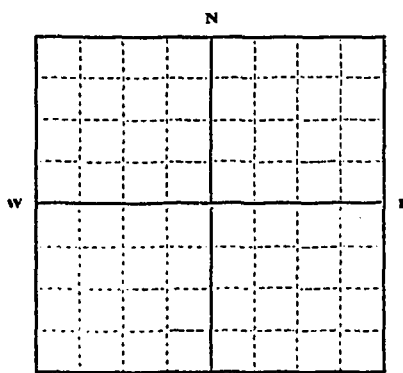
W  $\frac{3}{4}$ SE  $\frac{1}{4}$  NE Sec. 22 T. 5 R. 20

Indicate point of appropriation and place of use, if possible. Each small square represents 10 acres.

2. The beneficial use on which the claim is based Household Law3. Date or approximate date of earliest beneficial use; and how continuous the use has been Sept 19304. The amount of groundwater claimed (in miner's inches or gallons per minute) 600 gal per min5. If used for irrigation, give the acreage and description of to which water has been applied and name of the owner 1-half acre6. The means of withdrawing such water from the ground and the location of each well or other means of withdrawal Electric7. The date of commencement and completion of the construction of the well, wells, or other works for withdrawal of groundwater 19308. The depth of water table 20 ft9. So far as it may be available, the type, size and depth of each well or the general specifications of any other works for the withdrawal of groundwater 1-4 in pipe10. The estimated amount of groundwater withdrawn each year 10,000 gal11. The log of formations encountered in the drilling of each well if available gravel & clay12. Such other information of a similar nature as may be useful in carrying out the policy of this act, including reference to book and page of any county record NoneSignature of Owner Ralph HolmlundDate 12-31-65

Three copies to be filed by the owner with the County Clerk and Recorder of the county in which the well is located.

Please answer all questions. If not applicable, so state, otherwise the form will be returned.

Original to the County Clerk and Recorder; Duplicate to the State Engineer; Triplicate to the Montana Bureau of Mines and Geology, and Quadruplicate for the Appropriator.

40589

~~#4778~~  
#4788

I certify that I received and filed this  
instrument on this 31  
day of Dec, 19 65 at 2:40  
o'clock P.M.  
I. G. Moore  
COUNTY RECORDER  
By Lee 2.00  
DEPUTY

File No.  
DoR

T. 5N R. 20E 32  
County. Ravalli

STATE OF MONTANA  
ADMINISTRATOR OF GROUNDWATER CODE  
OFFICE OF STATE ENGINEER

Declaration of Vested Groundwater Rights  
(Under Chapter 237, Montana Session Laws, 1961)

JAN 17 1964

ENGINEER

1. J. H. Myers, of Route #1, Hamilton, Montana.  
(Name of Appropriator) (Address) (Town)

County of Ravalli State of Montana  
have appropriated groundwater according to the Montana laws in effect prior to January 1, 1962, as follows:

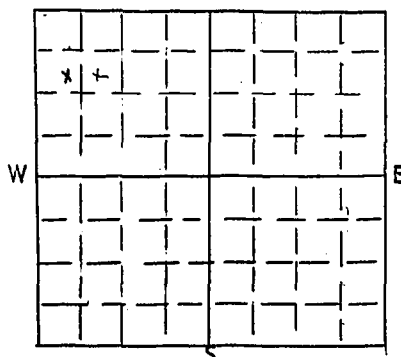

Sec. 1/4, Sec. 32, T. 5, R. 20

Indicate point of appropriation  
and place of use, if possible. Each  
small square represents 10 acres.

2. The beneficial use on which the claim is based. Domestic and Irrigation
3. Date or approximate date of earliest beneficial use; and how continuous the use has been. 1910
4. The amount of groundwater claimed (in miner's inches or gallons per minute). 80 G.P.M.
5. If used for irrigation, give the acreage and description of the lands to which water has been applied and name of the owner thereof. Low Sprinkling
6. The means of withdrawing such water from the ground and the location of each well or other means of withdrawal. Electric Pump
7. The date of commencement and completion of the construction of the well, wells, or other works for withdrawal of groundwater. Unknown, about 1910
8. The depth of water table. 10 ft.
9. So far as it may be available, the type, size and depth of each well or the general specifications of any other works for the withdrawal of groundwater. Dug 30 ft. deep
10. The estimated amount of groundwater withdrawn each year. million gallons
11. The log of formations encountered in the drilling of each well if available. Unknown
12. Such other information of a similar nature as may be useful in carrying out the policy of this act, including reference to book and page of any county record.

Signature of Owner

Date

Three copies to be filed by the owner with the County Clerk and Recorder of the county in which the well is located.

Please answer all questions. If not applicable, so state, otherwise the form will be returned.

Original to the County Clerk and Recorder; Duplicate to the State Engineer; Triplicate to the Montana Bureau of Mines and Geology, and Quadruplicate for the Appropriator.

#4148

I certify that I received and filed this  
instrument on this 31st  
day of Dec, 1963, at 5:24  
o'clock P.M.  
F. G. Moore  
COUNTY RECORDER  
By Shirley Keith  
DEPUTY

File No. 1856

T 5N R 20W 32

DUPLICATE

Ravalli County

STATE OF MONTANA  
ADMINISTRATOR OF GROUNDWATER CODE  
OFFICE OF STATE ENGINEER

RECEIVED  
NOV 6 1963

Declaration of Vested Groundwater Rights  
(Under Chapter 237, Montana Session Laws, 1961)

1. A.J. Patterson of Rt. 1 Box 130 Hamilton  
(Name of Appropriator) (Address) (Town)

County of Ravalli, State of Montana, have appropriated groundwater according to the Montana laws in effect prior to January 1, 1962, as follows:

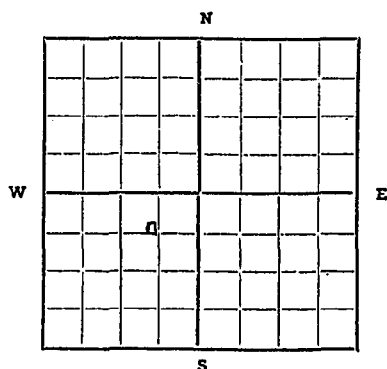

NE 1/4 SW Sec. 32 T. 5 R. 20.  
Indicate point of appropriation  
and place of use, if possible.  
Each small square represents 10  
acres.

2. The beneficial use on which the claim is based Domestic  
Yard & Garden
3. Date or approximate date of earliest beneficial use; and how  
continuous the use has been 60 years  
All Time
4. The amount of groundwater claimed (in miner's inches or gal-  
lons per minute) 1000 G.A.L.
5. If used for irrigation, give the acreage and description of the  
lands to which water has been applied and name of the owner  
thereof Yard & Garden 1 A  
A J Patterson
6. The means of withdrawing such water from the ground and the  
location of each well or other means of withdrawal Electric Pump

7. The date of commencement and completion of the construction of the well, wells, or other works for with-  
drawal of groundwater Hand Pump until 1947
8. The depth of water table 2.0 Ft.
9. So far as it may be available, the type, size and depth of each well or the general specifications of any  
other works for the withdrawal of groundwater Shallow well 6" casing
10. The estimated amount of groundwater withdrawn each year 25000 Gal.
11. The log of formations encountered in the drilling of each well if available 7 ft. black  
loam 13 ft. gravel
12. Such other information of a similar nature as may be useful in carrying out the policy of this act, includ-  
ing reference to book and page of any county record 21-22

Signature of Owner A.J. Patterson

Date 11/4/63

Three copies to be filed by the owner with the County Clerk and Recorder of the county in which the well is lo-  
cated.

Please answer all questions. If not applicable, so state, otherwise the form will be returned.

Original to the County Clerk and Recorder; duplicate to the State Engineer; Triplicate to the School of Mines  
and Quaduplicate for the Appropriator.

6827

I certify that I received and filed this  
instrument on this.....4th.....  
day of.....Nov....., 19...63..., at.....9:05  
o'clock.....A.....M.

F. G. Moore  
COUNTY RECORDER

By.....  
DEPUTY

Fee \$2.00

File No. 2194T. 5N R. 20W

DUPLICATE

County RavalliRECEIVED  
DEC 30 1963STATE OF MONTANA  
ADMINISTRATOR OF GROUNDWATER CODE  
OFFICE OF STATE ENGINEER

STATE ENGINEER

Notice of Completion of Groundwater Appropriation  
Without Well

(Under Chapter 237 Montana Session Laws, 1961)

Date of Appropriation of Groundwater March 1895Owner Delroy N. McPherson Address RT1 Box 130

Contractor (if any) \_\_\_\_\_

Address of Contractor \_\_\_\_\_

Date Started \_\_\_\_\_ Date Completed \_\_\_\_\_

Describe means of obtaining groundwater without a well "as by sub-irrigation and other natural processes". Include depth to water when applicable. It's a free flowing spring, runs year roundflows in a drain ditch

Quantity of water developed and used with explanation of method used to measure or estimate such amount. If use is intermittent

estimate approximate lengths of periods of use. it runsan estimate of about 20 inches  
it runs year round for  
stock water and approximately  
5 months for irrigationSignature of Owner Delroy N. McPhersonDate Dec 26, 1963

This form to be prepared by contractor (if any), otherwise by the owner.

Three copies of this notice are to be filed with the County Clerk and Recorder of the county in which the works are located.

Please answer all questions. If not applicable, so state, otherwise the form will be returned.

Original to the County Clerk and Recorder; duplicate to the State Engineer; Triplicate to the Montana Bureau of Mines and Geology and Quadruplicate for the Appropriator.

*the ground that is irrigated  
is approximately 5 acres in  
the NE 1/4 of Sec 32. T5N R20W*

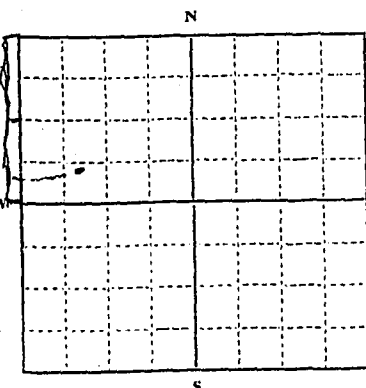
S. W 1/4 N. W 1/4 Sec. 32 T. 5N R. 20WIndicate point of appropriation  
and place of use, if possible.



I certify that I received and filed this  
instrument on this 26  
day of Dec, 19 63, at 4:27  
o'clock M.

F. H. Moore  
COUNTY RECORDER

By \_\_\_\_\_ DEPUTY

RECORDED  
INDEXED  
JAN 1 1964  
STATE OF TEXAS

GW3

File No. 2193

DUPLICATE

T. 5 N R. 20 W 33

County Ravalli

STATE OF MONTANA  
ADMINISTRATOR OF GROUNDWATER CODE  
OFFICE OF STATE ENGINEER

RECEIVED  
DEC 30 1963

STATE ENGINEER  
**Notice of Completion of Groundwater Appropriation Without Well**

(Under Chapter 237 Montana Session Laws, 1961)

*The ground that is irrigated  
is approximately 5 acres in  
the SE 1/4 NE 1/4 of Sec 33 T5N R20W*

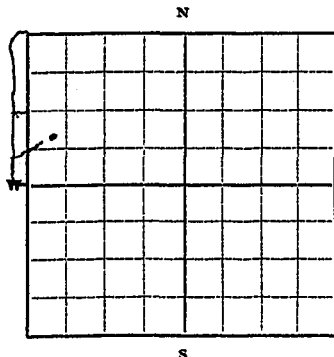

S.W. 1/4 N.W. Sec 33 T5N R20W

Indicate point of appropriation  
and place of use, if possible.

Date of Appropriation of Groundwater March 1895  
Owner Delroyn McFegor Address RT 1 Box 135  
Hamilton, Mont

Contractor (if any) \_\_\_\_\_

Address of Contractor \_\_\_\_\_

Date Started \_\_\_\_\_ Date Completed \_\_\_\_\_

Describe means of obtaining groundwater without a well "as by  
sub-irrigation and other natural processes". Include depth to

water when applicable. what is used for house use  
is dipped up with a bucket.

It's a free flowing spring. The  
balance is used for stock  
water and irrigation

Quantity of water developed and used with explanation of meth-  
od used to measure or estimate such amount. If use is intermit-

tent estimate approximate lengths of periods of use it runs  
an estimate of about 10 inches  
it used year round for  
house and stock water  
and approximately 5 months for  
irrigation

Signature of Owner Delroyn McFegor

Date Dec 26, 1963

This form to be prepared by contractor (if any), otherwise by the owner.

Three copies of this notice are to be filed with the County Clerk and Recorder of the county in  
which the works are located.

Please answer all questions. If not applicable, so state, otherwise the form will be returned.

Original to the County Clerk and Recorder; duplicate to the State Engineer; Triplicate to the  
School of Mines and Quadruplicate for the Appropriator.

I certify that I received and filed this  
instrument on this 26  
day of Dec 19 63 at 4:26  
o'clock P.M.

*F. H. Moore*  
COUNTY RECORDER

By \_\_\_\_\_  
DEPUTY

GW

File No. 2052

T 5 N R 20 W

DUPLICATE

Ravalli County

STATE OF MONTANA  
ADMINISTRATOR OF GROUNDWATER CODE  
OFFICE OF STATE ENGINEER

RECEIVED  
DEC 26 1963

**Declaration of Vested Groundwater Rights**

(Under Chapter 237, Montana Session Laws, 1961)

STATE ENGINEER

1. Marvin F. Bell or Agnes Bell of Rt. 1, Box 139, Hamilton, Montana  
(Name of Appropriator) (Address) (Town)

County of Ravalli, State of Montana, have appropriated groundwater according to the Montana laws in effect prior to January 1, 1962, as follows:

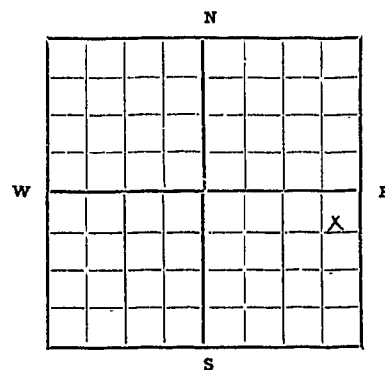

NE 1/4 Sec. 33, T. 5 N, R. 20 W

Indicate point of appropriation and place of use, if possible. Each small square represents 10 acres.

2. The beneficial use on which the claim is based Domestic use and irrigation for garden and lawn.
3. Date or approximate date of earliest beneficial use; and how continuous the use has been Approximately July 1944 with continuous use.
4. The amount of groundwater claimed (in miner's inches or gallons per minute) 50 gallons per minute.
5. If used for irrigation, give the acreage and description of the lands to which water has been applied and name of the owner thereof NE 1/4 Sec. 33 - Twp. 5 N. Rge. 20 W.
6. The means of withdrawing such water from the ground and the location of each well or other means of withdrawal Pump.
7. The date of commencement and completion of the construction of the well, wells, or other works for withdrawal of groundwater Approximately July 15, 1944.
8. The depth of water table Approximately 48 ft.
9. So far as it may be available, the type, size and depth of each well or the general specifications of any other works for the withdrawal of groundwater Drilled 4 inch well.
10. The estimated amount of groundwater withdrawn each year 1/4 million gallons per year.
11. The log of formations encountered in the drilling of each well if available Not available - Drilled by G. Magregor, now deceased.
12. Such other information of a similar nature as may be useful in carrying out the policy of this act, including reference to book and page of any county record None.

Signature of Owner Marvin F. Bell

Date December 20, 1963

Three copies to be filed by the owner with the County Clerk and Recorder of the county in which the well is located.

Please answer all questions. If not applicable, so state, otherwise the form will be returned.

Original to the County Clerk and Recorder; duplicate to the State Engineer; Triplicate to the School of Mines and Quadruplicate for the Appropriator.

12535

I certify that I received and filed this  
instrument on this 20th  
day of Dec 19 63 at 3:42  
o'clock P.M.

F. G. Moore  
COUNTY RECORDER

By \_\_\_\_\_ DEPUTY

e No.  
DUT

T. 5N. R. 20. 33  
County. Ravalli...

STATE OF MONTANA  
ADMINISTRATOR OF GROUNDWATER CODE,  
OFFICE OF STATE ENGINEER

JAN 17 1962

Declaration of Vested Groundwater Rights  
(Under Chapter 237, Montana Session Laws, 1961)

1. R. Marvin Beebe, owner of Rt. 1, Box 137, Hamilton, Montana  
(Name of Appropriator) (Address) (Town)

County of Ravalli, State of Montana  
have appropriated groundwater according to the Montana laws in effect prior to January 1, 1962, as follows:

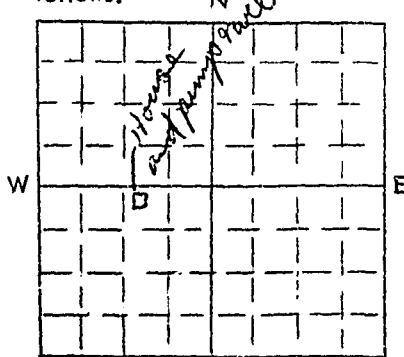

NE 1/4 SW 1/4, Sec 33, T. 5, R. 20

Indicate point of appropriation and place of use, if possible. Each small square represents 10 acres.

2. The beneficial use on which the claim is based: house water and irrigation, lawn garden etc. 2 acres.  
3. Date or approximate date of earliest beneficial use; and how continuous the use has been: May 1950 Continuous

4. The amount of groundwater claimed (in miner's inches or gallons per minute): 1,000 gal per minute

5. If used for irrigation, give the acreage and description of the lands to which water has been applied and name of the owner thereof: 2 acres, house plot & house use

R. Marvin Beebe & Pore R.

6. The means of withdrawing such water from the ground and the location of each well or other means of withdrawal: Pump

7. The date of commencement and completion of the construction of the well, wells, or other works for withdrawal of groundwater: May 1950

8. The depth of water table: 25 ft

9. So far as it may be available, the type, size and depth, of each well or the general specifications of any other works for the withdrawal of groundwater: inch casing - 100 ft deep

10. The estimated amount of groundwater withdrawn each year: 1,000,000 gals.

11. The log of formations encountered in the drilling of each well, if available.

12. Such other information of a similar nature as may be useful in carrying out the policy of this act, including reference to book and page of any county record.

Signature of Owner: R. Marvin Beebe

Date: Dec 31, 1961

Three copies to be filed by the owner with the County Clerk and Recorder of the county in which the well is located.

Please answer all questions. If not applicable, so state, otherwise the form will be returned.

Original to the County Clerk and Recorder, Duplicate to the State Engineer, Triplicate to the Montana Bureau of Mines and Geology, and Quadruplicate for the Appropriator.

4081

I certify that I received and filed this  
instrument on this 31st  
day of Dec., 19 63, at 4:10  
o'clock P. M.

F. Y. Moore

COUNTY RECORDER

By Shirley Keith  
DEPUTY

Form No. 1  
DGP

T. 5 N. R. 20 E. S. 33  
County. Garfield  
JAN 17 1963

STATE OF MONTANA  
ADMINISTRATOR OF GROUNDWATER CODE  
OFFICE OF STATE ENGINEER

Declaration of Vested Groundwater Rights  
(Under Chapter 237, Montana Session Laws, 1961)

STATE ENGINEER

1. Marvin Beebe, of P.O. Box 137, Hamilton  
(Name of Appropriator) (Address) (Town)

County of Garfield, State of Mont  
have appropriated groundwater according to the Montana laws in effect prior to January 1, 1962, as follows:

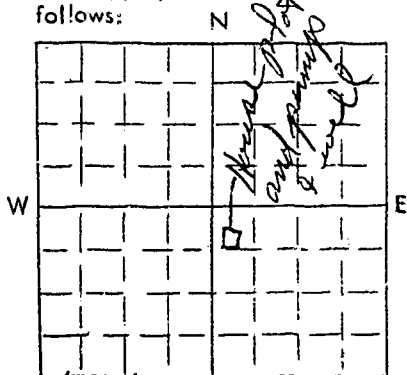

NW 1/4 Sec 33 T. 5 N. R. 20 E.

Indicate point of appropriation and place of use, if possible. Each small square represents 10 acres.

2. The beneficial use on which the claim is based: water for home, plot, lawn, garden, etc.  
3. Date or approximate date of earliest beneficial use; and how continuous the use has been: Sept. 1950  
Continuous

4. The amount of groundwater claimed (in miner's inches or gallons per minute): 1500 gal per min

5. If used for irrigation, give the acreage and description of the lands to which water has been applied and name of the owner thereof

2 acres - house plot  
Marvin Beebe, P.O. Box 137

6. The means of withdrawing such water from the ground and the location of each well or other means of withdrawal: pump  
house plot

7. The date of commencement and completion of the construction of the well, wells, or other works for withdrawal of groundwater: Oct. 1951

8. The depth of water table: (14 to 43 ft)

9. So far as it may be available, the type, size and depth of each well or the general specifications of any other works for the withdrawal of groundwater: 6 inch casing - 4.3 ft deep

10. The estimated amount of groundwater withdrawn each year: 1,400,000 gallons

11. The log of formations encountered in the drilling of each well if available:

12. Such other information of a similar nature as may be useful in carrying out the policy of this act, including reference to book and page of any county record:

Signature of Owner: Marvin Beebe

Date: Dec. 31, 1963

Three copies to be filed by the owner with the County Clerk and Recorder of the county in which the well is located.

Please answer all questions. If not applicable, so state, otherwise the form will be returned.

Original to the County Clerk and Recorder, Duplicate to the State Engineer, Triplicate to the Montana Bureau of Mines and Geology, and Quadruplicate for the Appropriator.



4082

I certify that I received and filed this  
instrument on this 31st  
day of Dec. 1963 at 4:11  
o'clock P. M.

F. G. Moore

COUNTY RECORDER

By Shirley Keith  
DEPUTY

e No.  
DUP.

STATE OF MONTANA  
ADMINISTRATOR OF GROUNDWATER CODE  
OFFICE OF STATE ENGINEER

T. 5 N. 20 W. 13  
County Powell  
JAN 17 1963

Declaration of Vested Groundwater Rights  
(Under Chapter 237, Montana Session Laws, 1961)

1. R. Marvin Beebe..... of P.O. Box 137... Hamilton.....  
(Name of Appropriator) (Address) (Town)

County of Powell..... State of Montana.....  
have appropriated groundwater according to the Montana laws in effect prior to January 1, 1962, as follows:

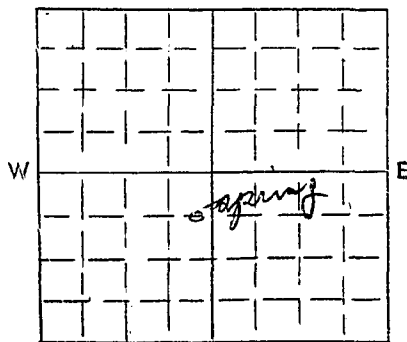

NE 1/4 of SW 1/4, Sec 33, T. 5, R. 20.  
Indicate point of appropriation  
and place of use, if possible. Each  
small square represents 10 acres.

2. The beneficial use on which the claim is based. Stock water & irrigation.....
3. Date or approximate date of earliest beneficial use; and how continuous the use has been. Continuous prior to 1900.....
4. The amount of groundwater claimed (in miner's inches or gallons per minute). 500 gal per min.....
5. If used for irrigation, give the acreage and description of the lands to which water has been applied and name of the owner thereof. Pasture & hay irrigation.....  
R. Marvin Beebe & P.O. Box 137.....
6. The means of withdrawing such water from the ground and the location of each well or other means of withdrawal. Spring water - natural flow.....
7. The date of commencement and completion of the construction of the well, wells, or other works for withdrawal of groundwater.....
8. The depth of water table. Surface spring.....
9. So far as it may be available, the type, size and depth of each well or the general specifications of any other works for the withdrawal of groundwater. Natural spring.....
10. The estimated amount of groundwater withdrawn each year. 500,000.....
11. The log of formations encountered in the drilling of each well if available.....
12. Such other information of a similar nature as may be useful in carrying out the policy of this act, including reference to book and page of any county record.....

Signature of Owner R. Marvin Beebe.....  
Date 12-31-63.....

Three copies to be filed by the owner with the County Clerk and Recorder of the county in which the well is located.

Please answer all questions. If not applicable, so state; otherwise the form will be returned.  
Original to the County Clerk and Recorder; Duplicate to the State Engineer; Triplicate to the Montana Bureau of Mines and Geology; and Quadruplicate for the Appropriator.

4079

I certify that I received and filed this  
instrument on this 31st  
day of Dec., 19 63, at 4:08  
o'clock P.M.  
F. H. Moore  
COUNTY RECORDER  
Shirley Keith  
DEPUTY

e No.

DOP

T. 2 N. R. 20 W. 33  
County Ravalli

STATE OF MONTANA  
ADMINISTRATOR OF GROUNDWATER CODE  
OFFICE OF STATE ENGINEER

JAN 27 1962

Declaration of Vested Groundwater Rights  
(Under Chapter 237, Montana Session Laws, 1961)

STATE ENGINEER

1. R. Marvin Beebe & Pora L. of P. #1 Box 137 Hamilton  
(Name of Appropriator) (Address) (Town)

County of Ravalli State of Montana

have appropriated groundwater according to the Montana laws in effect prior to January 1, 1962, as follows:

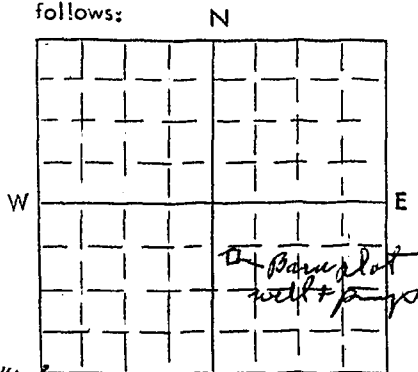

Indicate point of appropriation and place of use, if possible. Each small square represents 10 acres.

2. The beneficial use on which the claim is based Stock Water  
& irrigation
3. Date or approximate date of earliest beneficial use; and how continuous the use has been Sept. 1961
4. The amount of groundwater claimed (in miner's inches or gallons per minute) 500 gal per min
5. If used for irrigation, give the acreage and description of the lands to which water has been applied and name of the owner thereof  
2 acres  
from Stock Water  
R. Marvin Beebe & Pora L.
6. The means of withdrawing such water from the ground and the location of each well or other means of withdrawal Pump
7. The date of commencement and completion of the construction of the well, wells, or other works for withdrawal of groundwater Sept. 1961
8. The depth of water table 10 ft
9. So far as it may be available, the type, size and depth of each well or the general specifications of any other works for the withdrawal of groundwater 2 1/2 feet deep - 4 inch pipe
10. The estimated amount of groundwater withdrawn each year 1,000,000 gal
11. The log of formations encountered in the drilling of each well if available
12. Such other information of a similar nature as may be useful in carrying out the policy of this act, including reference to book and page of any county record

Signature of Owner R. Marvin Beebe  
Date 12-31-1963

Three copies to be filed by the owner with the County Clerk and Recorder of the county in which the well is located.

Please answer all questions. If not applicable, so state, otherwise the form will be returned.

Original to the County Clerk and Recorder; Duplicate to the State Engineer; Triplicate to the Montana Bureau of Mines and Geology, and Quadruplicate for the Appropriator.

376 45

4080

I certify that I received and filed this  
instrument on this 31<sup>st</sup>  
day of Dec., 1963, at 4:09  
o'clock P. M.  
F. H. Moore  
COUNTY RECORDER  
By Shirley Keith  
DEPUTY

File No. 1865

DUPLICATE

T. 5 N. R. 20 E.

County

STATE OF MONTANA  
ADMINISTRATOR OF GROUNDWATER  
OFFICE OF STATE ENGINEERNotice of Completion of Groundwater  
Appropriation by Means of Well

(Under Chapter 237, Montana Session Laws, 1961)

Top of Ground  
(Elev. above sea level.....)

0 to 3' Clay & gravel  
3' to 50' Granite, clay  
& gravel  
50' to 51' Gravel granite  
& a little water  
51' to 57' Clay & granite  
57' to 60' Gravel, granite  
& water  
60' to 62' Clay & granite  
62' to 72' Granite  
72' to 86' Granite & lime  
86' to 94' Rock & granite  
94' to 114' Granite & lime  
114' to 125' Granite & rock  
125' to 200' Granite

Owner..... Ramusai ..... Address..... Hamilton .....  
Driller..... Glenn Camp 703 Alder ..... Address..... Missoula, Mont .....  
Date of Notice of Appropriation of Groundwater.....  
Date well started..... 9/24/63 ..... Date Completed..... 10/9/63 .....  
Type of well..... Drilled ..... Equipment Used..... Churn drill .....  
(dug, driven, bored or drilled) (Churn, drill, rotary or other)  
Water Use: Domestic ☒ Municipal ☐ Other ☐ Irrigation ☐  
Industrial ☒ Drainage ☐ Stock ☐

Indicate on the diagram the character and thickness of the different strata met with in drilling, such as soil, clay, shale, gravel, rock or sand, etc. Show depth at which water is encountered, thickness and character of water-bearing strata and height to which water rises in the well.

	Size of Drilled Hole	Size and Weight of Casing	From (Feet)	To (Feet)	PERFORATIONS		
					Kind Size	From (Feet)	To (Feet)
6"	6" I.D.	6" above G.L.			Mills	57'	60'
19.97 lbs to Ft		to 105'-3"			Knife	5 holes to circle-3 circles	

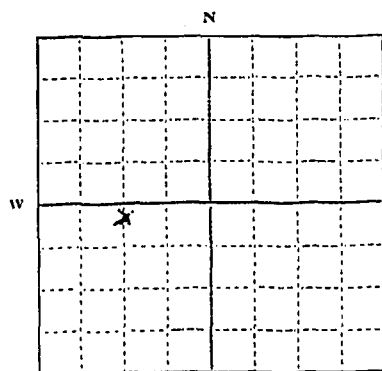

SW 1/4 Sec. 33 T. 5 N. R. 20 E.  
Indicate location of well and place of use, if possible. Each small square represents 10 acres.

Show exact depth of bottom.

Static Water Level for non-flowing Well..... 20 from G.L. ..... feet.

Shut-in Pressure for Flowing Well.....

Pumping Water Level..... 7' from Bottom of Well ..... feet at..... 5 ..... gal. per minute.

Discharge in gal. per min. of flowing well.....

How Tested..... Bailer ..... Length of Test..... 2 hours .....

Remarks: (Gravel packing, cementing, packers, type of shutoff, location of place of use of groundwater if not at well, and any other similar pertinent information, including number of acres irrigated, if used for irrigation).....

None

License # 7  
Driller's License Number

Driller's Signature

This form to be prepared by driller, and three copies to be filed by the owner with the County Clerk and Recorder in the county in which the well is located.

Please answer all questions. If not applicable, so state, otherwise the form will be returned.

Original to the County Clerk and Recorder; duplicate to the State Engineer; Triplicate to the Montana Bureau of Mines and Geology and Quadruplicate for the Appropriator.

7147

I certify that I received and filed this  
instrument on this 14th  
day of Nov., 19 63, at 11:05  
o'clock A.M.

F. S. Moan  
COUNTY RECORDER

By \_\_\_\_\_  
DEPUTY

Fee \$2.00

MONTANA WATER RESOURCES BOARD  
**RECEIVED**

County Ravalli

OCT 13 1970

STATE OF MONTANA  
ADMINISTRATOR OF GROUNDWATER CODE  
MONTANA WATER RESOURCES BOARD

**NOTICE OF COMPLETION OF GROUNDWATER  
APPROPRIATION BY MEANS OF WELL**

Developed after January 1, 1962

(Under Chapter 237 Montana Session Laws, 1961, as amended)

This form to be prepared by driller, and three copies to be filed by the owner with the County Clerk and Recorder in the county in which the well is located, last copy to be retained by driller. Please answer all questions. If not applicable, so state, otherwise the form may be returned.

Owner Mrs. F. X. Ranuzzi

Address Hamilton, Montana

Date well started Sept. 29, 1970

completed Sept. 30, 1970

Type of well Drilled

Equipment used Churn Drill

Water Use: Domestic ☒ Municipal ☐ Stock ☐ Irrigation ☐

Industrial ☐ Drainage ☐ Other ☐ \* Garden/Lawn ☐

\*Describe

USE: If used for irrigation, industrial, drainage or other. Explain, state number of acres and location or other data (i.e. Lot, Block and Addition).

ESTIMATED ANNUAL WITHDRAWAL unknown

Size of Drilled Hole	Size and Weight of Casing	From (Feet)	To (Feet)	PERFORATIONS		
				Kind Size	From (Feet)	To (Feet)
6"	17 lbs. per ft.	0	29	3/16x5	24	29

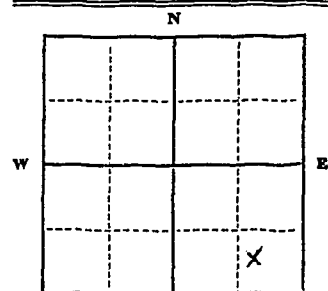

S.E. 1/4 S.E. 1/4 Sec. 33  
T. 5 N. R. 20 E.  
S W

Static water level 8 ft.\*  
Pumping water level 9 ft.\*  
at 20 gallons per minute,  
measured 60 minutes after pumping  
began.

\*Measured from ground level.

Well developed by baling & pumping  
for 8 hours.

Power          Pump          HP

Remarks: (Gravel packing, cementing, packers, type of shutoff)

gravel pack from 27 to 29 feet.

INDICATE LOCATION OF WELL AND PLACE OF USE, IF POSSIBLE. EACH SMALL SQUARE REPRESENTS 40 ACRES.

Driller's Signature Charles Walsh, Jr. Ravalli Drilling Co.

Driller's Address Box 27, Victor, Montana

LICENSE NO. 200

**DRILLER'S LOG**

Indicate the character, color, thickness of strata such as soil, clay, sand, gravel, shale, sandstone, etc. Show depth at which water is found and height to which water rises in well.

Top of Ground		(Elev. above sea level)
From (Feet)	To (Feet)	
0	1	Topsoil
1	29	Intermittent layers Sand, Gravel, Water bearing

28 Show exact depth of bottom

47617



#5330

I certify that I received and filed this  
instrument on this 9th  
day of Oct, 19 70, at 10:00  
o'clock A.M.  
J. S. Moore  
COUNTY RECORDER  
By J. S. Moore  
DEPUTY

52, 515

5804

I certify that I received and filed this  
instrument on this 29th  
day of Jan. 1973 at 1:45  
o'clock P.M.  
Darlene E. Hughes  
COUNTY RECORDER  
By Shirley Keith  
CLERK

File No. ....

T. 20 R. 20

DUPLICATE

County. ....

STATE OF MONTANA  
ADMINISTRATOR OF GROUNDWATER CODE  
OFFICE OF STATE ENGINEER

JAN 17 1964

### Declaration of Vested Groundwater Rights

(Under Chapter 237, Montana Session Laws, 1961)

1. Stella Plettenberg Munson of Rt. 1, Box 141, Hamilton  
(Name of Appropriator) (Address) (Town)

County of Beaumont State of Montana  
have appropriated groundwater according to the Montana laws in effect prior to January 1, 1962, as follows:

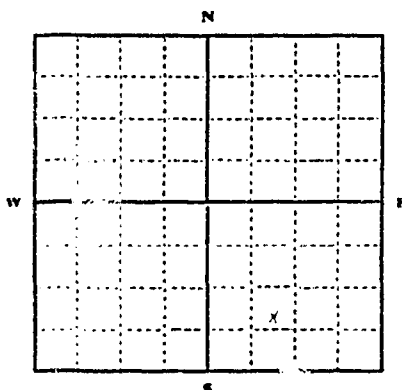

S. 1/2, E. 1/4, Sec. 24, T. 5 N. R. 20 W. of the  
Indicate point of appropriation 1/4 sec. 24  
and place of use, if possible. Each Munson  
small square represents 10 acres.

2. The beneficial use on which the claim is based Domestic  
irrigation

3. Date or approximate date of earliest beneficial use; and how continuous the use has been. 1954  
steady

4. The amount of groundwater claimed (in miner's inches or gallons per minute) 10 gallons

5. If used for irrigation, give the acreage and description of the lands to which water has been applied and name of the owner thereof  
about 2 acres yard  
garden, berries, pasture  
Stella Plettenberg Munson

6. The means of withdrawing such water from the ground and the location of each well or other means of withdrawal  
centrifugal pump

7. The date of commencement and completion of the construction of the well, walls, or other works for withdrawal of groundwater. 1954

8. The depth of water table. 12 ft.

9. So far as it may be available, the type, size and depth of each well or the general specifications of any other works for the withdrawal of groundwater.  
12 foot deep 3.0 inches across  
hand over at end pump enclosed in casing and

10. The estimated amount of groundwater withdrawn each year. 3 million gallons

11. The log of formations encountered in the drilling of each well if available.  
none that I know of

12. Such other information of a similar nature as may be useful in carrying out the policy of this act, including reference to book and page of any county record. none

Signature of Owner Stella Plettenberg Munson  
Lester A. Munson

Date Dec 30 - 1963

Three copies to be filed by the owner with the County Clerk and Recorder of the county in which the well is located.

Please answer all questions. If not applicable, so state, otherwise the form will be returned.

Original to the County Clerk and Recorder; Duplicate to the State Engineer; Triplicate to the Montana Bureau of Mines and Geology, and Quadruplicate for the Appropriator.

37363

#2899

I certify that I received and filed this  
instrument on this 31st  
day of Dec., 19 63, at 11:24  
o'clock A. M.  
F. G. Moore  
COUNTY RECORDER  
By Ashley Keith  
DEPUTY

File No. 2058

T. 5N R. 20E

DUPLICATE

County Ravalli

STATE OF MONTANA  
ADMINISTRATOR OF GROUNDWATER CODE  
OFFICE OF STATE ENGINEER

RECEIVED  
DEC 20 1963

Declaration of Vested Groundwater Rights

(Under Chapter 237, Montana Session Laws, 1961)

STATE ENGINEER

1. Elden Melander, of Rt. Box 140, Hamilton  
(Name of Appropriator) (Address) (Town)

County of Ravalli State of Montana  
have appropriated groundwater according to the Montana laws in effect prior to January 1, 1962, as follows:

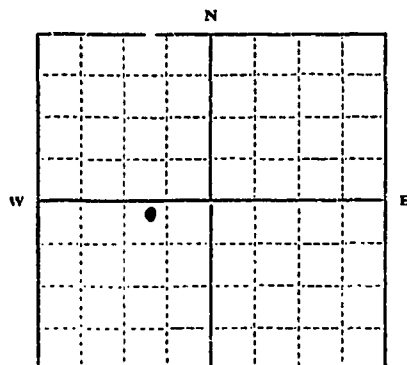

NE SW 34 5 20  
1/4 Sec. T. R.

Indicate point of appropriation  
and place of use, if possible. Each  
small square represents 10 acres.

2. The beneficial use on which the claim is based Stock water  
domestic and lawn, garden, etc.

3. Date or approximate date of earliest beneficial use; and how continu-  
ous the use has been 1947 cont. use

4. The amount of groundwater claimed (in miner's inches or gallons  
per minute) 700 G.P.M.

5. If used for irrigation, give the acreage and description of the lands  
to which water has been applied and name of the owner thereof  
1 acre in NE 1/4 SW Sec 34 T. 5 R. 20

6. The means of withdrawing such water from the ground and the loca-  
tion of each well or other means of withdrawal  
Electric pump

7. The date of commencement and completion of the construction of the well, wells, or other works for with-  
drawal of groundwater 1947

8. The depth of water table 40 feet

9. So far as it may be available, the type, size and depth of each well or the general specifications of any other  
works for the withdrawal of groundwater Drilled well  
6 inch casing  
90 feet deep

10. The estimated amount of groundwater withdrawn each year 300,000 gallons

11. The log of formations encountered in the drilling of each well if available not available

12. Such other information of a similar nature as may be useful in carrying out the policy of this act, including  
reference to book and page of any county record none

Signature of Owner Elden Melander

Date Dec. 20, 1963

Three copies to be filed by the owner with the County Clerk and Recorder of the county in which the well is located.

Please answer all questions. If not applicable, so state, otherwise the form will be returned.

Original to the County Clerk and Recorder; Duplicate to the State Engineer; Triplicate to the Montana Bureau of  
Mines and Geology, and Quadruplicate for the Appropriator.

12542

I certify that I received and filed this  
instrument on this 20th  
day of Dec. 19 63, at 3:49  
o'clock P. M.

*F. H. Moore*  
COUNTY RECORDER

By \_\_\_\_\_  
DEPUTY

File No. 2258

T. 5N R. 20W

DUPLICATE

County Bozeman

STATE OF MONTANA  
ADMINISTRATOR OF GROUNDWATER CODE  
OFFICE OF STATE ENGINEER

RECEIVED  
DEC 31 1963  
STATE ENGINEER

Notice of Completion of Groundwater Appropriation  
Without Well

(Under Chapter 237 Montana Session Laws, 1961)

Date of Appropriation of Groundwater Dec 27, 1963  
Owner Charles & Lona Likes  
Address Hamilton  
Otis and Ruth Likes  
Contractor (if any) \_\_\_\_\_

Address of Contractor \_\_\_\_\_

Date Started \_\_\_\_\_ Date Completed \_\_\_\_\_

Describe means of obtaining groundwater without a well "as by sub-irrigation and other natural processes". Include depth to water when applicable.

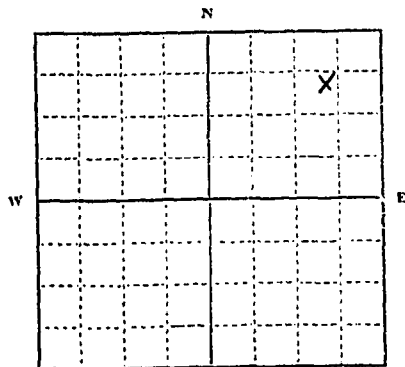

NE 1/4 NE Sec. 35 T. 5 R. 20  
Indicate point of appropriation  
and place of use, if possible.

Natural spring  
10" steady flow

Quantity of water developed and used with explanation of method used to measure or estimate such amount. If use is intermittent

estimate approximate lengths of periods of use.

continuously all year

Signature of Owner Charles & Lona Likes

Date Dec 27, 1963

This form to be prepared by contractor (if any), otherwise by the owner.

Three copies of this notice are to be filed with the County Clerk and Recorder of the county in which the works are located.

Please answer all questions. If not applicable, so state, otherwise the form will be returned.

Original to the County Clerk and Recorder; duplicate to the State Engineer; Triplicate to the Montana Bureau of Mines and Geology and Quadruplicate for the Appropriator.



I certify that I received and filed this  
instrument on this 27  
day of Dec, 1963, at 1:58  
o'clock PM.

F. H. Moore  
COUNTY RECORDER

\_\_\_\_\_  
DEPUTY

RECEIVED  
JAN 1 1964  
CLERK

File No. ....

T. 6N R. 20 W

DUPLICATE

County Beavall

STATE OF MONTANA  
ADMINISTRATOR OF GROUNDWATER CODE  
OFFICE OF STATE ENGINEER

RECEIVED  
DEC 31 1963

STATE ENGINEER

Notice of Completion of Groundwater Appropriation  
Without Well

(Under Chapter 237 Montana Session Laws, 1961)

Date of Appropriation of Groundwater 1940Owner Bitter Root Stock Farm, Inc. Box 271 Hamilton, MontanaContractor (if any) NoneAddress of Contractor NoneDate Started 1940 Date Completed 1940

Describe means of obtaining groundwater without a well "as by  
sub-irrigation and other natural processes". Include depth to  
water when applicable. Natural Spring

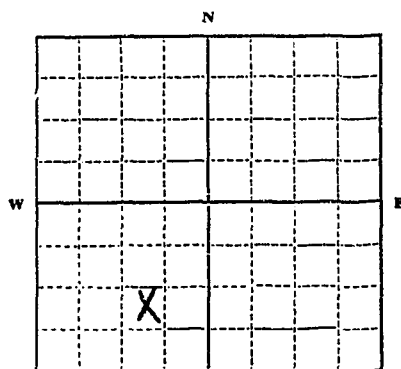
SW  $\frac{1}{4}$  Sec. 36 T. 6N R. 20WIndicate point of appropriation  
and place of use, if possible.

Quantity of water developed and used with explanation of method  
used to measure or estimate such amount. If use is intermittent

estimate approximate lengths of periods of use continuousestimated 10-40 gallons per minuteSignature of Owner Bitter Root Stock Farm, Inc.Signature of Owner ManagerDate 12-24-1963

This form to be prepared by contractor (if any), otherwise by the owner.

Three copies of this notice are to be filed with the County Clerk and Recorder of the county in which the works are located.

Please answer all questions. If not applicable, so state, otherwise the form will be returned.

Original to the County Clerk and Recorder; duplicate to the State Engineer; Triplicate to the Montana Bureau of Mines and Geology and Quadruplicate for the Appropriator.

2291

I certify that I received and filed this  
instrument on this 37  
day of Dec 19 63, at 2:41  
o'clock P.M.

F. J. Moore  
DEPUTY RECORDER

DEPUTY