

File No.

DUPLICATE

T. 51V R 21WCounty Beavert

LOG

STATE OF MONTANA
ADMINISTRATOR OF GROUNDWATER CODE
OFFICE OF STATE ENGINEERNotice of Completion of Groundwater
Appropriation by Means of Well
DEVELOPED AFTER JANUARY 1, 1962

(Under Chapter 237, Montana Session Laws, 1961)

Owner J. Frederick Bell
FRITZ BELLAddress J. Frederick Bell, M. D.
Rocky Mountain Laboratory
Hamilton, MontanaDriller KEN WILLIAMSAddress 1558 So. 5th. W.
MISSOULA, MONT.

Date of Notice of appropriation of groundwater.....

Date well started SEPT. 1, 67Date completed SEPT. 6, 67Type of well drilledEquipment used churn

(Dug, driven, bored or drilled)

(Churn drill, rotary or other)

Water use:

Domestic ☒Municipal ☐Stock ☒Irrigation ☒Industrial ☐Drainage ☐Other ☐

Indicate on the diagram the character and thickness of the different strata met with in drilling, such as soil, clay, shale, gravel, rock or sand, etc. Show depth at which water is encountered, thickness and character of water-bearing strata and height to which the water rises in the well.

Size of Drilled Hole	Size and Weight of Casing	From (Feet)	To (Feet)	PERFORATIONS		
				Kind Size	From (Feet)	To (Feet)
6" I.D.	6 5/8" O.D. 1" size wall 17 lbs.	ground level	37'			

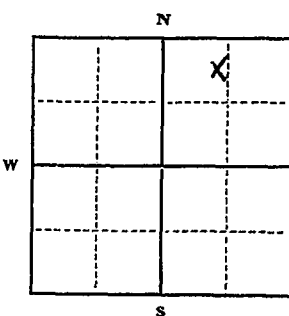
Static Water Level for non-flowing well
716 feet.

Shut-in Pressure for Flowing Well.....

Pumping Water Level.....25 feetat 50 gal. per minute.

Discharge in gal. per min. of flowing well.....

How Tested test pumpLength of Test 4 hours

Remark (Gravel packing, cementing, packers, type of shutoff).....

NE 1/4 SW 1/4 NE 25 T. 5N R. 21W

Indicate location of well and place of use, if possible. Each small square represents 40 acres.

(Continue on reverse side)

USE—If used for irrigation, industrial, drainage or other. Explain, state number of acres and location or other data (i.e.: Lot, Block and Addition).

7 acres irrigation + stock watering

Show exact depth of bottom.

This form to be prepared by driller, and three copies to be filed by the owner with the County Clerk and Recorder in the county in which the well is located, tissue copy to be retained by driller.

Please answer all questions. If not applicable, so state, otherwise the form will be returned.

151
Driller's License NumberKenneth L. Williams
Driller's Signature.

42,330

4968

I certify that I received and filed this
instrument on this 20th
day of Sept, 1967, at 11:25
o'clock P.M.
F. S. Moore
COUNTY RECORDER
By F. S. Moore
Deputy

MONTANA WATER RESOURCES BOARD
RECEIVED
SEP 22 1967

MISS MRS. J. W. SIM

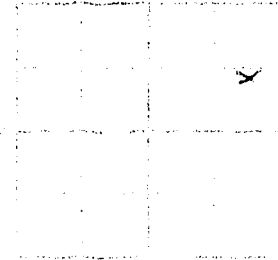

STATE OF MONTANA
ADMINISTRATOR OF GROUNDWATER CODE
MONTANA WATER RESOURCES BOARD

NOTICE OF COMPLETION OF GROUNDWATER
APPROPRIATION BY MEANS OF WELL

Developed after January 1, 1962

(Under Chapter 237 Montana Session Laws, 1961, as amended)

This form to be prepared by driller, and three copies to be filed by the owner with the County Clerk and Recorder in the county in which the well is located, last copy to be retained by driller. Please answer all questions. If not applicable, so state, otherwise the form may be returned.

Owner Eugene Vandewater

Address U. I.

Hamilton, Mt.

Date well started June 5, 1973

completed June 7, 1973

For Administrator's Use

File 5949

June 14, 1973

GW 1 11:45 A.M.

Type of well drilled well

(Dug, driven, bored or drilled)

Equipment used churn drill

(Churn drill, rotary or other)

Water Use: Domestic ☒ Municipal ☐ Stock ☐ Irrigation ☐

Industrial ☐ Drainage ☐ Other ☐ * Garden/Lawn ☐

*Describe

USE: If used for irrigation, industrial, drainage or other. Explain, state number of acres and location or other data (i.e. Lot, Block and Addition).

ESTIMATED ANNUAL WITHDRAWAL

Size of Drilled Hole	Size and Weight of Casing	From (Feet)	To (Feet)	PERFORATIONS		
				Kind Size	From (Feet)	To (Feet)
5"	17.5 lb	0	39	3/16x5	29	39

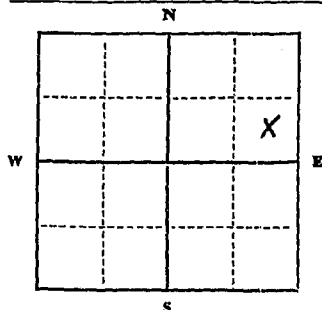

In SE 1/4 NE 1/4 Sec. 27
T. 5 N R. 21 E
S. 8 W

INDICATE LOCATION OF WELL AND PLACE OF USE, IF POSSIBLE. EACH SMALL SQUARE REPRESENTS 40 ACRES.

Driller's Signature Charles Whipple Jr.

Driller's Address Navelli Drilling Co., Victor, Mont.

LICENSE NO. 200

County Mont.

DRILLER'S LOG

Indicate the character, color, thickness of strata such as soil, clay, sand, gravel, shale, sandstone, etc. Show depth at which water is found and height to which water rises in well.

Top of Ground (Elev. above sea level)		
From (Feet)	To (Feet)	
0	1	soil
1	24	fine gravel some boulders
24	39	sand gravel water bearing

39 Show exact depth of bottom

53,574

53,574

5949

I certify that I received and filed this
instrument on this 14th
day of June, 1923, at 11:45
o'clock A. M.

Dwight E. Hughes
COUNTY RECORDER

By Hue 2.00
DEPUTY

File No.

T. 5 N R. 21 W

DUPLICATE

County Ravalli

STATE OF MONTANA
ADMINISTRATOR OF GROUNDWATER CODE
OFFICE OF STATE ENGINEER

R JAN 10 1964

Notice of Completion of Groundwater Appropriation Without Well

(Under Chapter 237 Montana Session Laws, 1961)

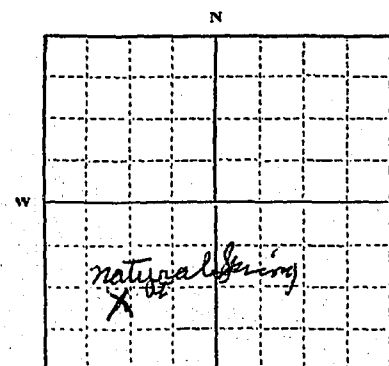
Date of Appropriation of Groundwater Dec 28 - 1963Owner Dale G. and Cathel F. Jennings Address P.O. Box 294 - Hamilton MontContractor (if any) NoneAddress of Contractor NoneHave used this water 25 years.SWSE 1/4 Sec 33 T. 5 R. 21 W

Indicate point of appropriation and place of use, if possible.

Describe means of obtaining groundwater without a well "as by sub-irrigation and other natural processes". Include depth to water when applicable. natural spring coming to the surface with a box to inclose water about 1 1/2 ft deep.

Quantity of water developed and used with explanation of method used to measure or estimate such amount. If use is intermittent

estimate approximate lengths of periods of use Constantly

for stock use also for house use and irrigation. never measured but it has never gone dry.

Signature of Owner Dale G. Jennings
Cathel F. Jennings

Date Dec 28 - 1963

This form to be prepared by contractor (if any), otherwise by the owner.

Three copies of this notice are to be filed with the County Clerk and Recorder of the county in which the works are located.

Please answer all questions. If not applicable, so state, otherwise the form will be returned.

Original to the County Clerk and Recorder; duplicate to the State Engineer; Triplicate to the Montana Bureau of Mines and Geology and Quadruplicate for the Appropriator.

27356

2315

I certify that I received and filed this
instrument on this 30
day of Dec 1963 at 9:00
o'clock A.M.

F. L. Moore
COUNTY RECORDER

By _____ DEPUTY

File No.

T. R.

DUPLICATE

MONTANA STATE WATER CODE
LOG RECEIVEDSTATE OF MONTANA
ADMINISTRATOR OF GROUNDWATER CODE
STATE WATER CONSERVATION BOARDCounty RAVALLI

Top of Ground

MAY 5 1971

(Elev. above sea level.....)

**Notice of Completion of Groundwater
Appropriation by Means of Well**
DEVELOPED AFTER JANUARY 1, 1962

(Under Chapter 237 Montana Session Laws, 1961, as amended)

Owner John McCrossin Address Hamilton MontDriller William Anderson Address Victor MontDoc. No. 5426

Date of Notice of appropriation of groundwater.....

Filed for record

this 4 day of MayDate well started March 22, 67Date completed March 24, 67A. D. 19 71, at 11:56o'clock 4 M.Type of well drilledEquipment used Churn drill

(Dug, driven, bored or drilled)

(Churn drill, rotary or other)

Water use:

Domestic ☒Municipal ☐Stock ☐Irrigation ☐Industrial ☒Drainage ☐Other ☐

Indicate on the diagram the character and thickness of the different strata met with in drilling, such as soil, clay, shale, gravel, rock or sand, etc. Show depth at which water is encountered, thickness and character of water-bearing strata and height to which the water rises in the well.

Size of Drilled Hole	Size and Weight of Casing	From (Feet)	To (Feet)	PERFORATIONS		
				Kind Size	From (Feet)	To (Feet)
6 in	25 lb 6 in	0	39			

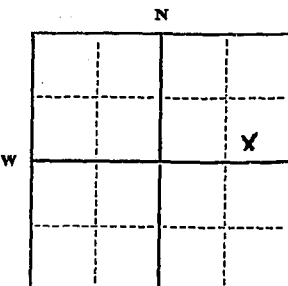
Static Water Level for non-flowing well
13 feet.

Shut-in Pressure for Flowing Well.....

Pumping Water Level 20 feetat 10 gal. per minute.

Discharge in gal. per min. of flowing well

20.9 gpmHow Tested jet pumpLength of Test 24 hr

Remarks: (Gravel packing, cementing, packers, type of shutoff).....

SE 1/4 Sec. 34 T. 57 N. R. 21 W
Indicate location of well and place of use, if possible. Each small square represents 40 acres.

(Continue on reverse side)

USE—If used for irrigation, industrial, drainage or other. Explain, state number of acres and location or other data (i.e.: Lot, Block and Addition).

Show exact depth of bottom.

This form to be prepared by driller, and three copies to be filed by the owner with the County Clerk and Recorder in the county in which the well is located, tissue copy to be retained by driller.

Please answer all questions. If not applicable, so state, otherwise the form will be returned.

Driller's License Number

William Anderson
Driller's Signature.

48429

#5426

I certify that I received and filed this
instrument on this 4th
day of May, 1971, at 11:56
o'clock A.M.

F. S. Moan
COUNTY RECORDER
By F. S. Moan
DEPUTY

	x	

RE: 0 Amos
and

RECEIVED

County

DRILLER'S LOG

Indicate the character, color, thickness of strata such as soil, clay, sand, gravel, shale, sandstone, etc. Show depth at which water is found and height to which water rises in well.

STATE OF MONTANA
ADMINISTRATOR OF GROUNDWATER CODE
MONTANA WATER RESOURCES BOARD

AUG 31 1971

NOTICE OF COMPLETION OF GROUNDWATER APPROPRIATION BY MEANS OF WELL

Developed after January 1, 1962

(Under Chapter 237 Montana Session Laws, 1961, as amended)

This form to be prepared by driller, and three copies to be filed by the **owner** with the County Clerk and Recorder in the county in which the well is located, last copy to be retained by driller.

Please answer all questions. If not applicable, so state, otherwise the form may be returned.

Owner CLIFF MARTINKA

Address

For Administrator's Use

File 54185
August 30, 1971
1:55 A.M.

Date well started **AUG. 24, 1971**

GW 1

completed **AUG. 26, 1971**

Type of well DRILLED

.....
(Dug, driven, bored or drilled)

Equipment used CHURN

.....
(Churn drill, rotary or other)

Water Use: Domestic ☒ Municipal ☐ Stock ☐ Irrigation ☐

Industrial ☐ Drainage ☐ Other ☐* Garden/Lawn ☐

***Describe**

USE: If used for irrigation, industrial, drainage or other. Explain, state number of acres and location or other data (i.e. Lot, Block and Addition).

ESTIMATED ANNUAL WITHDRAWAL

Size of Drilled Hole	Size and Weight of Casing	From (Feet)	To (Feet)	PERFORATIONS		
				Kind Size	From (Feet)	To (Feet)
6" I.D.	6-5/8" OD 17 lbs. 1 1/4" side- wall	Ground level	58'	none	none	none

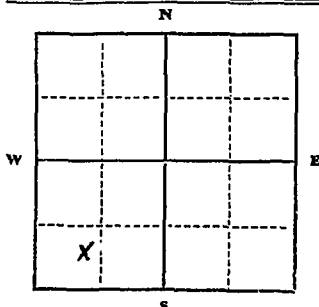

Static water level12.....ft.*
Pumping water level51'6".....ft.*
at5.....gallons per minute,
measured 120 minutes after pumping
began.

*Measured from ground level.
Well developed by bail test.....
for 4.....hours.

Power..... Pump..... HP
Remarks: (Gravel packing, cementing,
packers, type of shutoff)

5h 1/4 5h 1/4 Sec 34
T. 5 N R. 21
8' W

INDICATE LOCATION OF WELL AND PLACE OF USE, IF POSSIBLE.
EACH SMALL SQUARE REPRESENTS 40 ACRES.

Driller's Signature Kenneth L. Williams

Driller's Address 1558 So. 5th W. MISSOULA, MONTANA

LICENSE NO. 151

58 ft Show exact depth of bottom.

48974

#5485

I certify that I received and filed this
instrument on this 30th

day of Oct 19 21 at 11:35
o'clock AM

F. G. Moore
COUNTY RECORDER

By Lee S. Co
DEPUTY

GW 2

File No. _____

DUPLICATE

STATE WATER CONSERVATION BOARD

R E C E I V E D
SEP 13 1965

T 5 N W 21 R 35

Ravalli County

STATE OF MONTANA
ADMINISTRATOR OF GROUNDWATER CODE
OFFICE OF STATE ENGINEER

REFERRED TO _____

5	Top of Ground
10	(Elev. above sea level 3500.)
15	Gravel Rocks
18	Sand
25	Hard Pan
29	Sand
30	Sand
32	Gravel

Notice of Completion of Groundwater Appropriation by Means of Well

(Under Chapter 237, Montana Session Laws, 1961)

Owner Sean Hughes Address Hamilton Mont.Driller Bill Anderson Address Hamilton Mont.

Date of Notice of Appropriation of Groundwater _____

Date well started Sept 9, 65 Date Completed Sept 10, 65Type of well drilled Equipment Used Churn drill
(dug, driven, bored or drilled) (Churn, drill, rotary or other)

Water Use: Domestic (X) Municipal () Stock () Irrigation ()

Industrial () Drainage () Other ()

← Indicate on the diagram the character and thickness of the different strata met with in drilling, such as soil, clay, shale, gravel, rock or sand, etc. Show depth at which water is encountered, thickness and character of water-bearing strata and height to which the water rises in the well.

Size of Drilled Hole	Size and Weight of Casing	From (Feet)	To (Feet)	PERFORATIONS		
				Kind Size	From (Feet)	To (Feet)
4 in	9 pound pipe 4 in	03	32	—	—	—

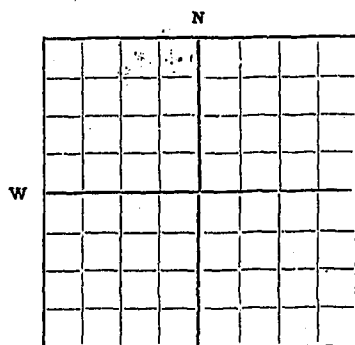
Wards Cove S^{200'} of E 500' 4.

SW 1/4 Sec 35, T2N, R21W

Indicate location of well and place of use, if possible. Each small square represents 10 acres.

Show exact depth of bottom

Static Water Level for non-flowing Well 5 feet.

Shut-in Pressure for Flowing Well _____

Pumping Water Level 7 feet at 15 gal. per minute.Discharge in gal., per min. of flowing well 25 per minHow Tested pump Length of Test 12 hr

Remarks: (Gravel packing, cementing, packers, type of shutoff, Location of place of use of groundwater if not at well, and any other similar pertinent information, including number of

acres irrigated, if used for irrigation) _____

33
Driller's License Number

Bill Anderson
Driller's Signature

This form to be prepared by driller, and three copies to be filed by the owner with the County Clerk and Recorder in the county in which the well is located.

Please answer all questions. If not applicable, so state, otherwise the form will be returned.

Original to the County Clerk and Recorder; duplicate to the State Engineer; Triplicate to the School of Mines and Quadruplicate for the Appropriator.

39588

[Faint handwritten notes and markings]

...OT 09.09.2022

[Faint handwritten notes at the top of the page, mostly illegible.]

[Handwritten notes in the left margin:]
Cousin
John
Wm. H. H.
H. H. H.

[Handwritten notes in the right margin:]
H. H. H.
H. H. H.
H. H. H.

[Main body of handwritten notes, mostly illegible due to fading and bleed-through.]

File No. _____

JAN 5 1966

T

5N

R

35

DUPLICATE

Ravalli County

Bore _____ McDermott _____

Bore _____ McDermott _____

Bore _____ McDermott _____

Bore _____ McDermott _____

STATE OF MONTANA
ADMINISTRATOR OF GROUNDWATER CODE
OFFICE OF STATE ENGINEER

Top of Ground _____

(Elev. above sea level, 3500)

Notice of Completion of Groundwater
Appropriation by Means of Well

(Under Chapter 237, Montana Session Laws, 1961)

Owner Glen W. + Virginia Hashue Address Hamilton MontDriller Bill Anderson Address Hamilton Mont

Date of Notice of Appropriation of Groundwater _____

Date well started Mar 4-65 Date Completed Mar 6-65Type of well drilled Equipment Used Churn drill
(dug, driven, bored or drilled) (Churn, drill, rotary or other)Water Use: Domestic ☒ Municipal () Stock ☒ Irrigation ☒
Industrial () Drainage () Other ()

← Indicate on the diagram the character and thickness of the different strata met with in drilling, such as soil, clay, shale, gravel, rock or sand, etc. Show depth at which water is encountered, thickness and character of water-bearing strata and height to which the water rises in the well.

Size of Drilled Hole	Size and Weight of Casing	From (Feet)	To (Feet)	PERFORATIONS		
				Kind Size	From (Feet)	To (Feet)
4 in	10.79 per ft 4 in	03	35	-	-	-

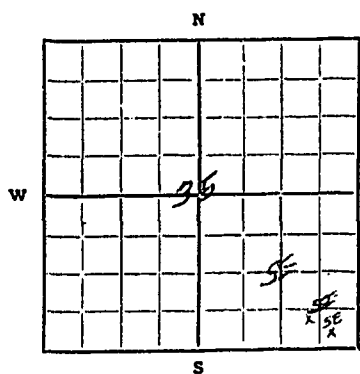

SE 1/4 SE Sec. 35, T.5N. R.21W

Indicate location of well and place of use, if possible. Each small square represents 10 acres.

Show exact depth of bottom

Static Water Level for non-flowing Well 13 feet.

Shut-in Pressure for Flowing Well _____

Pumping Water Level 15 feet at 12 gal. per minute.Discharge in gal., per min. of flowing well 20 gal per minHow Tested pumps Length of Test 18 hr

Remarks: (Gravel packing, cementing, packers, type of shutoff, Location of place of use of groundwater if not at well, and any other similar pertinent information, including number of

acres irrigated, if used for irrigation) _____

33
Driller's License Number

Bill Anderson
Driller's Signature

This form to be prepared by driller, and three copies to be filed by the owner with the County Clerk and Recorder in the county in which the well is located.

Please answer all questions. If not applicable, so state, otherwise the form will be returned.

Original to the County Clerk and Recorder; duplicate to the State Engineer; Triplicate to the School of Mines and Quadruplicate for the Appropriator.

40596

47 99

I certify that I received and filed this
instrument on this 31st
day of Dec., 1965 at 4:45
o'clock P.M.

B. G. Moon
COUNTY RECORDER

By Free 2.00
DEPUTY

RECORDED TO PROTECT THE INTERESTS OF THE PUBLIC IN THE LANDS OF THE STATE OF TEXAS

RECORDED TO PROTECT THE INTERESTS OF THE PUBLIC IN THE LANDS OF THE STATE OF TEXAS

RECORDED TO PROTECT THE INTERESTS OF THE PUBLIC IN THE LANDS OF THE STATE OF TEXAS

RECORDED TO PROTECT THE INTERESTS OF THE PUBLIC IN THE LANDS OF THE STATE OF TEXAS

RECORDED TO PROTECT THE INTERESTS OF THE PUBLIC IN THE LANDS OF THE STATE OF TEXAS

RECORDED TO PROTECT THE INTERESTS OF THE PUBLIC IN THE LANDS OF THE STATE OF TEXAS

RECORDED TO PROTECT THE INTERESTS OF THE PUBLIC IN THE LANDS OF THE STATE OF TEXAS

Mines
40575

4800

I certify that I received and filed this
instrument on this 31
day of Dec, 1945, at 4:46
o'clock P.M.

J. G. Moore
COUNTY RECORDER

By Lee J. Oo
DEPUTY

STATE WATER CONSERVATION BOARD

Approved Stock Form—State Publishing Co., Helena, Montana—42234

35

File No.

JAN 5 1966

T.

5N

R

21W

DUPLICATE

Bille

McDermott

Bullard

McNelly

C. J.

M. R.

D. J.

Sullivan

Dickert

STATE OF MONTANA

ADMINISTRATOR OF GROUNDWATER CODE

OFFICE OF STATE ENGINEER

Declaration of Vested Groundwater Rights

(Under Chapter 237, Montana Session Laws, 1961)

1. Glen W. Virginia Trucking of PO Box 209 Hamilton
 (Name of Appropriator) (Address) (Town)

County of Beavertail State of Montana
 have appropriated groundwater according to the Montana laws in effect prior to January 1, 1962, as follows:

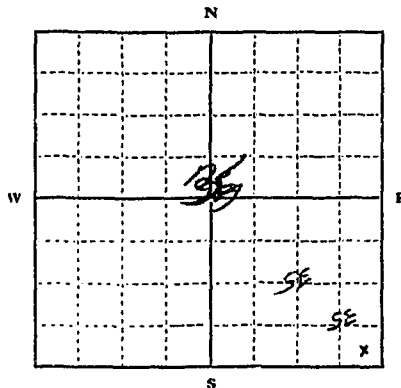

SE 1/4 Sec. 35 T. 5N. R. 21W

Indicate point of appropriation and place of use, if possible. Each small square represents 10 acres.

2. The beneficial use on which the claim is based household & irrigation

3. Date or approximate date of earliest beneficial use; and how continuous the use has been 1911 - continuously

4. The amount of groundwater claimed (in miner's inches or gallons per minute) 6 gal per minute

5. If used for irrigation, give the acreage and description of the lands to which water has been applied and name of the owner thereof 4 ac 200' by 25'

6. The means of withdrawing such water from the ground and the location of each well or other means of withdrawal by electric pump

7. The date of commencement and completion of the construction of the well, wells, or other works for withdrawal of groundwater 1911

8. The depth of water table 13 feet

9. So far as it may be available, the type, size and depth of each well or the general specifications of any other works for the withdrawal of groundwater 21 feet deep 4 in casing driven well

10. The estimated amount of groundwater withdrawn each year 130,080 gallons

11. The log of formations encountered in the drilling of each well if available unavailable

12. Such other information of a similar nature as may be useful in carrying out the policy of this act, including reference to book and page of any county record None

Signature of Owner

Glen W. Virginia TruckingDate Dec 31, 1965

Three copies to be filed by the owner with the County Clerk and Recorder of the county in which the well is located.

Please answer all questions. If not applicable, so state, otherwise the form will be returned.

Original to the County Clerk and Recorder; Duplicate to the State Engineer; Triplicate to the Montana Bureau of Mines and Geology, and Quadruplicate for the Appropriator.

40574

#4801

I certify that I received and filed this
instrument on this 31
day Dec, 19 65, at 4:47
o'clock P.M.

Z. S. Moore
COUNTY RECORDER

By Zee Z. So
DEPUTY

G.

Approved Stock Form—State Publishing Co., Helena, Montana—42234

File No.

T. 5 N R. 21 W

DUPLICATE

County

STATE OF MONTANA
ADMINISTRATOR OF GROUNDWATER CODE
OFFICE OF STATE ENGINEER

RECEIVED
JAN 8 1964

Declaration of Vested Groundwater Rights

(Under Chapter 237, Montana Session Laws, 1961)

1. Sam T. Foss, of P.O. Box 73 Hamilton
(Name of Appropriator) (Address) (Town)
County of Ravalli State of Montana
have appropriated groundwater according to the Montana laws in effect prior to January 1, 1962, as follows:

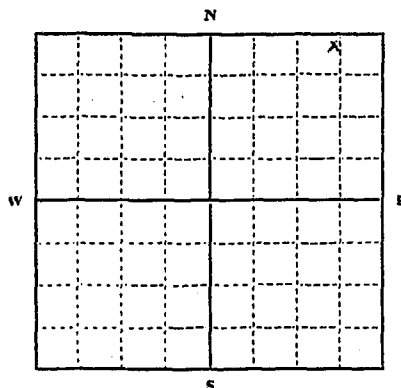

NE 1/4 NE Sec. 31 T. 5 N. R. 21 W.

Indicate point of appropriation
and place of use, if possible. Each
small square represents 10 acres.

2. The beneficial use on which the claim is based Stock Water
And Processing Peat Moss

3. Date or approximate date of earliest beneficial use; and how continuous the use has been. 1960 - Continuously

4. The amount of groundwater claimed (in miner's inches or gallons per minute) 800 gallons per minute

5. If used for irrigation, give the acreage and description of the lands to which water has been applied and name of the owner thereof

6. The means of withdrawing such water from the ground and the location of each well or other means of withdrawal Electric
Motor

7. The date of commencement and completion of the construction of the well, wells, or other works for withdrawal of groundwater. 1960

8. The depth of water table. 30 ft Water table 18 ft 4

9. So far as it may be available, the type, size and depth of each well or the general specifications of any other works for the withdrawal of groundwater.

Dug Well, 4"

10. The estimated amount of groundwater withdrawn each year. 100,000 Gallons

11. The log of formations encountered in the drilling of each well if available. Fractured Rocks

12. Such other information of a similar nature as may be useful in carrying out the policy of this act, including reference to book and page of any county record.

Signature of Owner Sam T. Foss

Date 12-30-63

Three copies to be filed by the owner with the County Clerk and Recorder of the county in which the well is located.

Please answer all questions. If not applicable, so state, otherwise the form will be returned.

Original to the County Clerk and Recorder; Duplicate to the State Engineer; Triplicate to the Montana Bureau of Mines and Geology, and Quadruplicate for the Appropriator.

27430

72620

I certify that I received and filed this
Instrument of 30th
day of Dec. 63 3:08
o'clock P.
F. H. Moore
COUNTY CLERK
By Shirley Keith
DEPUTY

G.

Approved Stock Form—State Publishing Co., Helena, Montana—42234

File No.

DUPLICATE

STATE OF MONTANA
ADMINISTRATOR OF GROUNDWATER CODE
OFFICE OF STATE ENGINEER

T5 North R21 West

County Ravalli

Ward Cove

JAN 17 1964

Declaration of Vested Groundwater Rights

(Under Chapter 237, Montana Session Laws, 1961)

1. J. Fred Bray (Name of Appropriator) of Rt 1 Box 189 (Address) Hamilton (Town)
County of Ravalli State of Montana
have appropriated groundwater according to the Montana laws in effect prior to January 1, 1962, as follows:

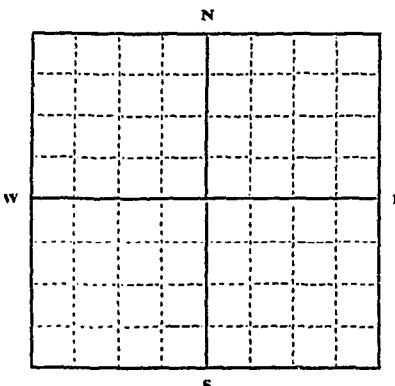

Indicate point of appropriation and place of use, if possible. Each small square represents 10 acres.
1/4 Sec 35 T5 North R21 West
lots 9-15-22 Block 4
3-10
16
Case

2. The beneficial use on which the claim is based domestic and irrigation
3. Date or approximate date of earliest beneficial use; and how continuous the use has been 9 years May 10-1953
year around
4. The amount of groundwater claimed (in miner's inches or gallons per minute) 10 gal per minute
5. If used for irrigation, give the acreage and description of the lands to which water has been applied and name of the owner thereof
For domestic and lawn Lot 22
Fred Bray Rt 1 Box 189 Hamilton Mont
6. The means of withdrawing such water from the ground and the location of each well or other means of withdrawal electric pump
7. The date of commencement and completion of the construction of the well, wells, or other works for withdrawal of groundwater about May 10-1953
8. The depth of water table about 32 ft
9. So far as it may be available, the type, size and depth of each well or the general specifications of any other works for the withdrawal of groundwater 36 ft drilled well
6 in casing
10. The estimated amount of groundwater withdrawn each year 100,000
11. The log of formations encountered in the drilling of each well if available not available
12. Such other information of a similar nature as may be useful in carrying out the policy of this act, including reference to book and page of any county record

Signature of Owner

Date

Three copies to be filed by the owner with the County Clerk and Recorder of the county in which the well is located.

Please answer all questions. If not applicable, so state, otherwise the form will be returned.

Original to the County Clerk and Recorder; Duplicate to the State Engineer; Triplicate to the Montana Bureau of Mines and Geology, and Quadruplicate for the Appropriator.

37433

2969

I certify that I received and filed this
instrument on this 31st
day of Dec. 19 63 at 12:39
o'clock 3 M.
F. S. Moore
COUNTY RECORDER
By Shirley Keith
DEPUTY

STATE WATER CONSERVATION BOARD
RECEIVED
SEP 3 1965

Approved Stock Form—State Publishing Co., Helena, Montana—44887

File No.

T. 5-N R. 21-W

DUPLICATE

REFERRED TO

County Ravalli

STATE OF MONTANA
ADMINISTRATOR OF GROUNDWATER CODE
OFFICE OF STATE ENGINEER

Declaration of Vested Groundwater Rights

(Under Chapter 237, Montana Session Laws, 1961)

1. Floyd W. Colpitts, of Rt. 1, Box 198, Hamilton
(Name of Appropriator) (Address) (Town)
County of Ravalli State of Montana
have appropriated groundwater according to the Montana laws in effect prior to January 1, 1962, as follows:

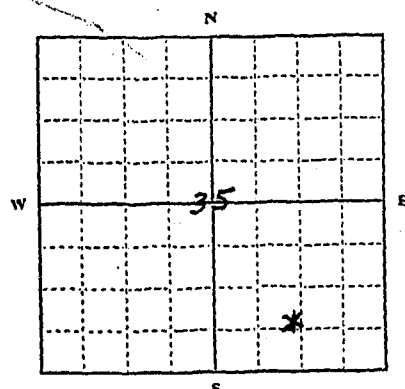

SW 1/4 SE Sec. 35 T. 5-N R. 21-W

Indicate point of appropriation
and place of use, if possible. Each
small square represents 10 acres.

2. The beneficial use on which the claim is based...
Irrigation water
3. Date or approximate date of earliest beneficial use; and how continu-
ous the use has been July 27, 1965.
April through October
4. The amount of groundwater claimed (in miner's inches or gallons
per minute) 500 gallons per minute
5. If used for irrigation, give the acreage and description of the lands
to which water has been applied and name of the owner thereof
lots 5, 6, 7, 8 & 4 Block 4, Woods Cove. About 35 A.
Floyd W. Colpitts - owner
6. The means of withdrawing such water from the ground and the loca-
tion of each well or other means of withdrawal
10 H.P. Electric motor
7. The date of commencement and completion of the construction of the well, wells, or other works for with-
drawal of groundwater. July 27, 1965 started & completed same day
8. The depth of water table Level with top of ground
9. So far as it may be available, the type, size and depth of each well or the general specifications of any other
works for the withdrawal of groundwater. 18 ft wide x 32 ft long x 12 ft deep
10. The estimated amount of groundwater withdrawn each year. 1,000,000 gallons per year
11. The log of formations encountered in the drilling of each well if available. large gravel & sand
12. Such other information of a similar nature as may be useful in carrying out the policy of this act, including
reference to book and page of any county record. Not Applicable

Signature of Owner

Date Sept. 1, 1965

Three copies to be filed by the owner with the County Clerk and Recorder of the county in which the well is located.

Please answer all questions. If not applicable, so state, otherwise the form will be returned.

Original to the County Clerk and Recorder; Duplicate to the State Engineer; Triplicate to the Montana Bureau of
Mines and Geology, and Quadruplicate for the Appropriator.

39525

#4614

166950

I certify that I received and filed this
instrument on this 1st
day of Sept. 19 65 at 9:40
o'clock A. M.

F. G. Moore

COUNTY RECORDER

By Myron M. Lindquist
Fee \$2.00 DEPUTY

File No.

RECEIVEDT. 5 R. 21

DUPLICATE

MAY 21 1968

County Ravalli

LOG

STATE OF MONTANA
ADMINISTRATOR OF GROUNDWATER CODE
STATE WATER CONSERVATION BOARD

Top of Ground

(Elev. above sea level.....)

**Notice of Completion of Groundwater
Appropriation by Means of Well**

DEVELOPED AFTER JANUARY 1, 1962

(Under Chapter 237 Montana Session Laws, 1961, as amended)

Owner Charles Heights, Mont
Ravalli Drilling Co. Address Box 27,
Driller C.F. Wroble Address Victor, Mont.19 ft. Sand, Gravel,
Some Clay

Date of Notice of appropriation of groundwater.....

Date well started Feb. 12, 1968 Date completed Feb. 20, 1968Type of well Drilled Equipment used Churn Drill
(Dug, driven, bored or drilled) (Churn drill, rotary or other)Water use: Domestic ☒ Municipal ☐ Stock ☐ Irrigation ☐
Industrial ☐ Drainage ☐ Other ☐

Indicate on the diagram the character and thickness of the different strata met with in drilling, such as soil, clay, shale, gravel, or sand, etc. Show depth at which water is encountered, thickness and of water-bearing strata and height to which the water rises in the well.

38 ft. Sand, Gravel,
Water bearing

Size of Drilled Hole	Size and Weight of Casing	From (Feet)	To (Feet)	PERFORATIONS		
				Kind Size	From (Feet)	To (Feet)
8"	15 lbs. per ft.			3/16x5	34	38

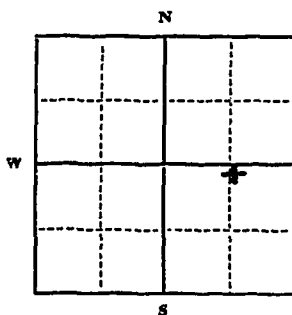
Static Water Level for non-flowing well
..... 9 feet.

Shut-in Pressure for Flowing Well.....

Pumping Water Level..... 25 feetat..... 20 gal. per minute.Discharge in gal. per min. of flowing well
..... N.A.How Tested..... BaledLength of Test..... 1 hr. 45 mins.

Remarks: (Gravel packing, cementing, packers, type of shutoff).....

NE 1/4 Sec. 35, T. 5 N. R. 21 W
Indicate location of well and place of use, if possible. Each small square represents 40 acres.

(Continue on reverse side)

USE—If used for irrigation, industrial, drainage or other. Explain, state number of acres and location or other data (i.e.: Lot, Block and Addition).

Show exact depth of bottom.

This form to be prepared by driller, and three copies to be filed by the owner with the County Clerk and Recorder in the county in which the well is located, tissue copy to be retained by driller.

Please answer all questions. If not applicable, so state, otherwise the form will be returned.

Driller's License Number

Driller's Signature.

44,146

#5034

I certify that I received and filed this

instrument on this 17
day May 1968 at 11:40
o'clock A.M.

J. G. Moore
COUNTY RECORDER

By Lee E. Moore
DEPUTY

GV

File No. 1760

T 5N R 21W

DUPLICATE

Ravalli County

STATE OF MONTANA
ADMINISTRATOR OF GROUNDWATER CODE
OFFICE OF STATE ENGINEER

RECEIVED
JUN 24 1963

Declaration of Vested Groundwater Rights
(Under Chapter 237, Montana Session Laws, 1961)

STATE ENGINEER

1. Floyd W. Calpitts of Rt. 1, Box 198 Hamilton, Montana
(Name of Appropriator) (Address) (Town)

County of Ravalli, State of Montana, have appropriated groundwater according to the Montana laws in effect prior to January 1, 1962, as follows:

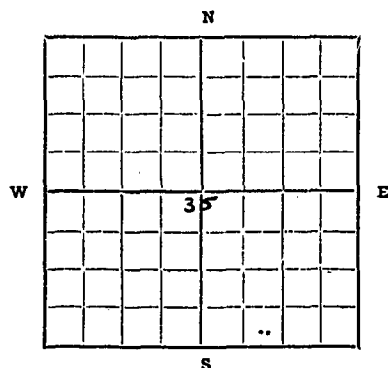

SW 1/4 SE Sec. 35 T. 5N R. 21W

Indicate point of appropriation and place of use, if possible. Each small square represents 10 acres.

2. The beneficial use on which the claim is based Livestock and household use

3. Date or approximate date of earliest beneficial use; and how continuous the use has been about 1940

4. The amount of groundwater claimed (in miner's inches or gallons per minute) about 5 gallons per minute

5. If used for irrigation, give the acreage and description of the lands to which water has been applied and name of the owner thereof

6. The means of withdrawing such water from the ground and the location of each well or other means of withdrawal Electric Water Pump - 1/2 H.P. on each well

7. The date of commencement and completion of the construction of the well, wells, or other works for withdrawal of groundwater started and completed about 1940

8. The depth of water table Household well 35' to 40' - stock well 25' to 32'

9. So far as it may be available, the type, size and depth of each well or the general specifications of any other works for the withdrawal of groundwater Household well has 3" sandpoint at a depth of 35' to the top of 40' to the bottom of sandpoint. Stock well has 1 1/2" sandpoint driven to a depth of 32' to the bottom of sandpoint.

10. The estimated amount of groundwater withdrawn each year 40,000 gallons

11. The log of formations encountered in the drilling of each well if available

12. Such other information of a similar nature as may be useful in carrying out the policy of this act, including reference to book and page of any county record

Signature of Owner F. Lloyd W. Calpitts

Date June 21, 1963

Three copies to be filed by the owner with the County Clerk and Recorder of the county in which the well is located.

Please answer all questions. If not applicable, so state, otherwise the form will be returned.

Original to the County Clerk and Recorder; duplicate to the State Engineer; Triplicate to the School of Mines and Quadruplicate for the Appropriator.

4733

Floyd W. Colpitts

I certify that I received and filed this
instrument on this 21
day of June, 1963, at 1:00
o'clock P. M.

F. G. Moore
COUNTY RECORDER

By _____
Fee \$2.00 ^{Deputy} Paid

File No.

T. R.

DUPLICATE

County. Beavalli

LOG

STATE OF MONTANA
ADMINISTRATOR OF GROUNDWATER CODE
OFFICE OF STATE ENGINEER

Notice of Completion of Groundwater
Appropriation by Means of Well

DEVELOPED AFTER JANUARY 1, 1962

(Under Chapter 237, Montana Session Laws, 1961)

Top of Ground
(Elev. above sea level.....)

1'-Topsoil

22'-Sand Gravel and Boulders

30'-Sand Gravel and Boulders, Water Bearing

Owner Russell Porter Address Charles Heights
C. F. Wroble
Driller Beavalli Drilling Co. Address Victor, Montana

Date of Notice of appropriation of groundwater.....

Date well started Sept. 30, 1969 Date completed Oct. 1, 1969

Type of well drilled Equipment used churn
(Dug, Driven, bored or drilled) (Churn drill, rotary or other)

Water use: Domestic ☒ Municipal ☐ Stock ☐ Irrigation ☐
Industrial ☐ Drainage ☐ Other ☐

Indicate on the diagram the character and thickness of the different strata met with in drilling, such as soil, clay, shale, gravel, rock or sand, etc. Show depth at which water is encountered, thickness and character of water-bearing strata and height to which the water rises in the well.

Size of Drilled Hole	Size and Weight of Casing	From (Feet)	To (Feet)	PERFORATIONS		
				Kind Size	From (Feet)	To (Feet)
6"	15 lbs. per ft.	0	30	3/16x5	25	30

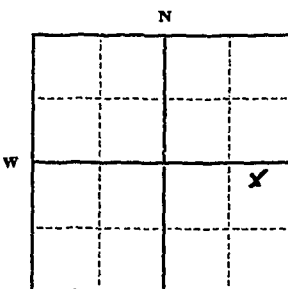

pt. Lot 5 Bldg 3 Wanda Cove

NE 1/4 Sec. 35 T. 5 R. 21
Indicate location of well and place of use, if possible. Each small square represents 40 acres.

Static Water Level for non-flowing well
..... 3 feet.

Shut-in Pressure for Flowing Well.....

Pumping Water Level..... 10 feet

at..... 15 gal. per minute.

Discharge in gal. per min. of flowing well.....

How Tested..... Paled-2 hours

Length of Test..... Pumped-2 hours

Remarks: (Gravel packing, cementing, packers, type of shutoff).....

(Continue on reverse side)

USE—If used for irrigation, industrial, drainage or other. Explain, state number of acres and location or other data (i.e.: Lot, Block and Addition).

Show exact depth of bottom.

This form to be prepared by driller, and three copies to be filed by the owner with the County Clerk and Recorder in the county in which the well is located, tissue copy to be retained by driller.

Please answer all questions. If not applicable, so state, otherwise the form will be returned.

62
Driller's License Number

Driller's Signature

45847

#5212

I certify that I received and filed this
instrument on this 13th
day of Nov, 1969, at 3:15
o'clock P.M.

F. B. Moore
COUNTY RECORDER

By Dec 2.00
DEPUTY

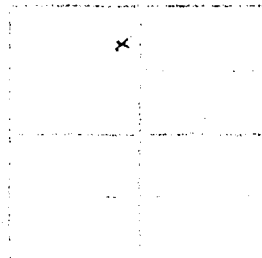

RECORDED
INDEXED
FILED
NOV 13 1969
CLERK
COUNTY OF LOS ANGELES
CALIFORNIA

File No.

T. 5th ... R. 21st ... 26

dupl

Ravalli County

STATE OF MONTANA
ADMINISTRATOR OF GROUNDWATER CODE
OFFICE OF STATE ENGINEER

JAN 17 1964

DECLARATION OF VESTED GROUNDWATER RIGHTS. ENGINEER
(Under Chapter 237, Montana Session Laws, 1961)

1. *Russell & Alta May Porter*, of *P.O. Box 100*, *Hamilton*
(Name of Appropriator) (Address) (Town)
County of Ravalli, State of Montana, have appropriated groundwater according to the Montana laws in effect prior to January 1, 1962, as follows:

2. The beneficial use on which the claim is based. *Household, irrigation, stock water.*

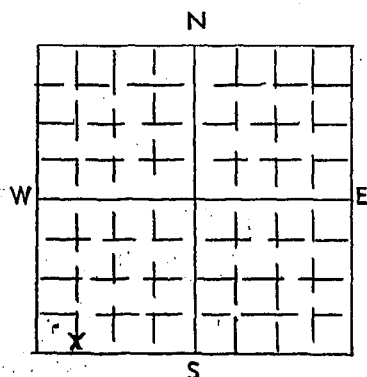

SW 1/4 SW Sec. 36 T. 5 S. R. 21 E.
Indicate point of appropriation and place of use, if possible. Each small square represents 10 acres.

3. Date or approximate date of earliest beneficial use; and how continuous the use has been. *1935*
4. The amount of groundwater claimed (in miner's inches or gallons per minute). *200 gal per min (approx)*
5. If used for irrigation, give the acreage and description of the lands to which water has been applied and name of the owner thereof. *lawns & small gardens near house & stock water in winter*
6. The means of withdrawing such water from the ground and the location of each well or other means of withdrawal. *electric pump*
7. The date of commencement and completion of the construction of the well, wells, or other works for withdrawal of groundwater. *1935*
8. The depth of water table. *2 ft*
9. So far as it may be available, the type, size and depth of each well or the general specifications of any other works for the withdrawal of groundwater. *driven well about 30 ft. cement walls 21*
10. The estimated amount of groundwater withdrawn each year *200 gal per min or 16,272 gal per year*
11. The log of formations encountered in the drilling of each well if available. *unknown*
12. Such other information of a similar nature as may be useful in carrying out the policy of this act, including reference to book and page of any county record.

Signature of Owner. *Russell & Alta May Porter*
Date. *Dec. 31 - 63*

Three copies to be filed by the owner with the County Clerk and Recorder of the county in which the well is located.

Please answer all questions. If not applicable, so state, otherwise the form will be returned.

Original to the County Clerk and Recorder; duplicate to the State Engineer; Triplicate to the School of Mines and Quadruplicate for the Appropriator.

37300

File No.

T. 5 R. 21 36

Alupa

Rayalli County

STATE OF MONTANA
ADMINISTRATOR OF GROUNDWATER CODE
OFFICE OF STATE ENGINEER

JAN 17 1964

DECLARATION OF VESTED GROUNDWATER RIGHTS ENGINEER
(Under Chapter 237, Montana Session Laws, 1961)

1. *Russell J. Alta May Porter*....., of *R. 1 Box 106 Hamilton*.....
(Name of Appropriator) (Address) (Town)
County of Rayalli, State of Montana, have appropriated groundwater according to the Montana laws in effect prior to January 1, 1962, as follows:

2. The beneficial use on which the claim is based. *Household irrigation, stock water.*

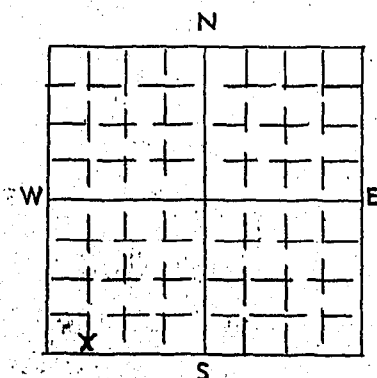

SW 1/4 SW Sec. 36 T. 5 R. 21..
Indicate point of appropriation and place of use, if possible. Each small square represents 10 acres.

3. Date or approximate date of earliest beneficial use; and how continuous the use has been. 1935

4. The amount of groundwater claimed (in miner's inches or gallons per minute). 200 gal. per min. (approx)

5. If used for irrigation, give the acreage and description of the lands to which water has been applied and name of the owner thereof. *lawns & small gardens near house & stock water in winter.*

6. The means of withdrawing such water from the ground and the location of each well or other means of withdrawal. electric pump

7. The date of commencement and completion of the construction of the well, wells, or other works for withdrawal of groundwater. 1935

8. The depth of water table. 20 ft.

9. So far as it may be available, the type, size and depth of each well or the general specifications of any other works for the withdrawal of groundwater. driven well about 30 ft. Cement walls & 1.

10. The estimated amount of groundwater withdrawn each year *800 gal. per min. or 16,272 gal. per day*

11. The log of formations encountered in the drilling of each well if available. sandstone

12. Such other information of a similar nature as may be useful in carrying out the policy of this act, including reference to book and page of any county record.

Signature of Owner. *Russell J. Alta May Porter*

Date. Dec. 31 - 63

Three copies to be filed by the owner with the County Clerk and Recorder of the county in which the well is located.

Please answer all questions. If not applicable, so state, otherwise the form will be returned.

Original to the County Clerk and Recorder; duplicate to the State Engineer; Triplicate to the School of Mines and Quadruplicate for the Appropriator.

37300

#2837

I certify that I received and filed this
instrument on this 31st
day of Dec., 1963, at 10:22
o'clock A. M.

F. G. Moore
COUNTY RECORDER
By Shirley Keith
DEPUTY

File No.

T. 5-4 R. 21

DUPLICATE

County Beaumont

STATE OF MONTANA
ADMINISTRATOR OF GROUNDWATER CODE
OFFICE OF STATE ENGINEER

RECEIVED
JAN 8 1964

Declaration of Vested Groundwater Rights

(Under Chapter 237, Montana Session Laws, 1961)

1. Clem & Edyth M. Larson, of Rt 1 - Box 37 Hamilton
(Name of Appropriator) (Address) (Town)
County of Beaumont State of Mont.
have appropriated groundwater according to the Montana laws in effect prior to January 1, 1962, as follows:

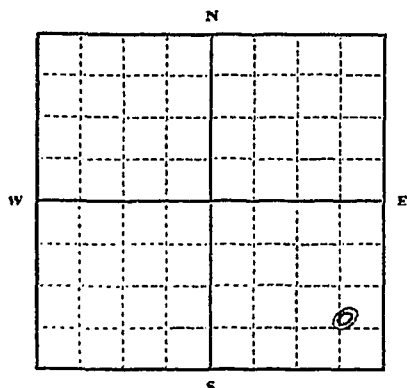

S E 1/4 Sec. 36 T. 5 R. 21

Indicate point of appropriation
and place of use, if possible. Each
small square represents 10 acres.

2. The beneficial use on which the claim is based house and some yard irrigation
3. Date or approximate date of earliest beneficial use; and how continuous the use has been year-round
4. The amount of groundwater claimed (in miner's inches or gallons per minute) 10 g.p.m. per well
5. If used for irrigation, give the acreage and description of the lands to which water has been applied and name of the owner thereof small yard and garden
6. The means of withdrawing such water from the ground and the location of each well or other means of withdrawal pump

7. The date of commencement and completion of the construction of the well, wells, or other works for withdrawal of groundwater unknown
8. The depth of water table unknown
9. So far as it may be available, the type, size and depth of each well or the general specifications of any other works for the withdrawal of groundwater not available for size and depth drilled
10. The estimated amount of groundwater withdrawn each year unknown
11. The log of formations encountered in the drilling of each well if available not available
12. Such other information of a similar nature as may be useful in carrying out the policy of this act, including reference to book and page of any county record none

Signature of Owner Clem Larson
Edyth M. Larson

Date Dec 30, 1963

Three copies to be filed by the owner with the County Clerk and Recorder of the county in which the well is located.

Please answer all questions. If not applicable, so state, otherwise the form will be returned.

Original to the County Clerk and Recorder; Duplicate to the State Engineer; Triplicate to the Montana Bureau of
Mines and Geology, and Quadruplicate for the Appropriator.

27460

#2650

I certify that I received and filed this
instrument on the 30th
day of Dec 1963 at 3:38
o'clock P.
F. Y. Moore
By Shirley Keith
DEPUTY

File No.

T. 5th R. 21st

DUPLICATE

County Havill

STATE OF MONTANA
ADMINISTRATOR OF GROUNDWATER CODE
OFFICE OF STATE ENGINEER

**Notice of Completion of Groundwater Appropriation
Without Well**

(Under Chapter 237 Montana Session Laws, 1961)

Date of Appropriation of Groundwater October 1916Owner Mrs. Grace Jones Address Hamilton, Montana

Contractor (if any)

Address of Contractor

Date Started Date Completed

Describe means of obtaining groundwater without a well "as by sub-irrigation and other natural processes". Include depth to water when applicable.

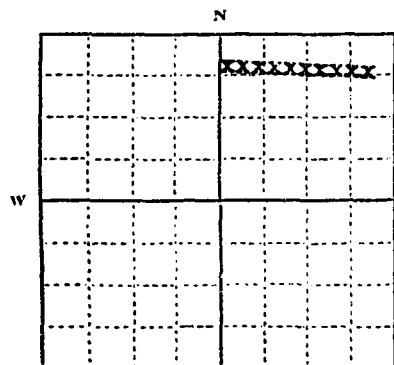

lands south and east of lands of claimant and comes onto lands of claimant by means of a well-defined ditch in draw and feeds into springs on claimant's lands and is used for irrigation purposes on lands of claimant

Quantity of water developed and used with explanation of method used to measure or estimate such amount. If use is intermittent

estimate approximate lengths of periods of use is open

stream all year

N $\frac{1}{2}$ of NE $\frac{1}{4}$ Sec 26 5N 21W

Indicate point of appropriation and place of use, if possible.

Signature of Owner Grace JonesDate February 11, 1964

This form to be prepared by contractor (if any), otherwise by the owner.

Three copies of this notice are to be filed with the County Clerk and Recorder of the county in which the works are located.

Please answer all questions. If not applicable, so state, otherwise the form will be returned.

Original to the County Clerk and Recorder; duplicate to the State Engineer; Triplicate to the Montana Bureau of Mines and Geology and Quadruplicate for the Appropriator.

4415

I certify that I received and filed this
instrument on this.....24th.....
day of.....Feb....., 19 64, at 11:45
o'clock.....A.M.

F. S. Moore
COUNTY RECORDER

By.....
DEPUTY

GW 2

File No. 1629

DUPLICATE

T. 5 N 21 W - 36

County. Ravalli

STATE OF MONTANA
ADMINISTRATOR OF GROUNDWATER CODE
OFFICE OF STATE ENGINEERNotice of Completion of Groundwater
Appropriation by Means of Well

(Under Chapter 237, Montana Session Laws, 1961)

Owner. George H. Oliver Address. Sen. Delving

Driller. William Anderson Address. Rt. 1 Box 51A Hamilton

Date of Notice of Appropriation of Groundwater

Date well started May 9-62 Date Completed May 14-62

Type of well drilled Equipment Used Churn drill
(dug, driven, bored or drilled) (Churn, drill, rotary or other)Water Use: Domestic ☒ Municipal ☐ Stock ☐ Irrigation ☐
Industrial ☐ Drainage ☐ Other ☐

Indicate on the diagram the character and thickness of the different strata met with in drilling, such as soil, clay, shale, gravel, rock or sand, etc. Show depth at which water is encountered, thickness and character of water-bearing strata and height to which the water rises in the well.

Size of Drilled Hole	Size and Weight of Casing	From (Feet)	To (Feet)	PERFORATIONS		
				Kind Size	From (Feet)	To (Feet)
4 in	1079-4 in	0	49	None	None	None

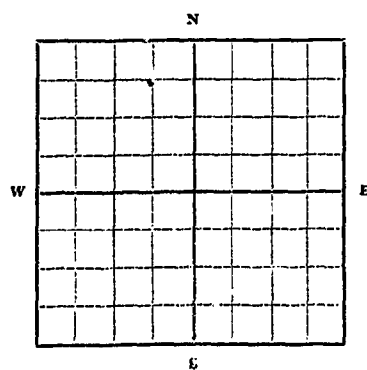
N.W. 1/4 Sec. 36, T. 5, R. 21
Indicate location of well and place of use, if possible. Each small square represents 10 acres.

Show exact depth of bottom.

Static Water Level for non-flowing Well 3 feet.

Shut-in Pressure for Flowing Well

Pumping Water Level 17 feet at 10 gal. per minute.

Discharge in gal. per min. of flowing well 20

How Tested. pump Length of Test 48 h

Remarks: (Gravel packing, cementing, packers, type of shutoff, location of place of use of groundwater if not at well, and any other similar pertinent information, including number of acres irrigated, if used for irrigation)

33
Driller's License Number
William Anderson
Driller's Signature

This form to be prepared by driller, and three copies to be filed by the owner with the County Clerk and Recorder in the county in which the well is located.

Please answer all questions. If not applicable, so state, otherwise the form will be returned.

Original to the County Clerk and Recorder; duplicate to the State Engineer; Triplicate to the School of Mines and Quadruplicate for the Appropriator.

Anthony Hork
COUNTY RECORDER
By *Shirley Keith*
DEPUTY

File No. 2066

T SN R 21W

Ravalli County

RECEIVED
FBI
JUN 26 1968

(Under Chapter 237, Montana Session Laws, 1961)

Driller Carl Anderson Address Rt 1 Box 51 H. Summit

Date of Notice of Appropriation of Groundwater

Date well started Nov 10-62 Date Completed Nov 12-62

Type of well drilled Equipment Used Churn drill
(dug, driven, bored or (Churn, drill, rotary or
drilled) other)

Water Use: Domestic (X) Municipal () Stock () Irrigation ()
Industrial () Drainage () Other ()

← Indicate on the diagram the character and thickness of the different strata met with in drilling, such as soil, clay, shale, gravel, rock or sand, etc. Show depth at which water is encountered, thickness and character of water-bearing strata and height to which the water rises in the well.

Size of Drilled Hole	Size and Weight of Casing	From (Feet)	To (Feet)	PERFORATIONS		
				Kind Size	From (Feet)	To (Feet)
4 in	9 1/2 lb 4 in	0	31	—	—	—

A 10x10 grid with 'N' at the top center and 'W' on the left center.

Static Water Level for non-flowing Well 5 feet.

Shut-in Pressure for Flowing Well

Pumping Water Level 10 feet at 15 gal. per minute.

Discharge in gal., per min. of flowing well 209 gal. per min.

How Tested Baker Length of Test 2 hr

Remarks: (Gravel packing, cementing, packers, type of shutoff, Location of place of use of groundwater if not at well, and any other similar pertinent information, including number of acres irrigated, if used for irrigation)

Savallie^s lot 8 blk 6
 1/4 Sec. T. R.

Indicate location of well and place of use, if possible. Each small square represents 10 acres.

Show exact depth of bottom

33
Driller's License Number
Bill Anderson
Driller's Signature

This form to be prepared by driller, and three copies to be filed by the owner with the County Clerk and Recorder in the county in which the well is located.

Please answer all questions. If not applicable, so state, otherwise the form will be returned.

Original to the County Clerk and Recorder; duplicate to the State Engineer; Triplicate to the School of Mines and Quadruplicate for the Appropriator.

12.550

I certify that I received and filed this
instrument on this 20th
day of Dec., 19 63, at 3:57
o'clock P. M.

F. B. Moore
COUNTY RECORDER

By _____
DEPUTY

[Handwritten signatures and initials, including "11/19/63" and "12/20/63"]

GW 2

File No. _____

DUPLICATE

RECEIVED
AUG 5 1964

T S.N. R 2142 SEC. 2

STATE ENGINEER
STATE OF MONTANA
ADMINISTRATOR OF GROUNDWATER CODE
OFFICE OF STATE ENGINEER

Ravalli County

MAY 13 1964

Notice of Completion of Groundwater
Appropriation by Means of Well

(Under Chapter 237, Montana Session Laws, 1961)

Owner Jack Cory Address Rt. 1 Box 319Driller Gerald Quigley Address Hamilton

Date of Notice of Appropriation of Groundwater _____

Date well started 3-27-64 Date Completed 3-27-64Type of well _____ Equipment Used _____
(dug, driven, bored or (Churn, drill, rotary or
drilled) other)Water Use: Domestic () Municipal () Stock () Irrigation ()
Industrial () Drainage () Other ()

* Indicate on the diagram the character and thickness of the different strata met with in drilling, such as soil, clay, shale, gravel, rock or sand, etc. Show depth at which water is encountered, thickness and character of water-bearing strata and height to which the water rises in the well.

Size of Drilled Hole	Size and Weight of Casing	From (Feet)	To (Feet)	PERFORATIONS		
				Kind Size	From (Feet)	To (Feet)
4 5/8	6 5/8 17.00 LBS. B.H.	8	48	none		

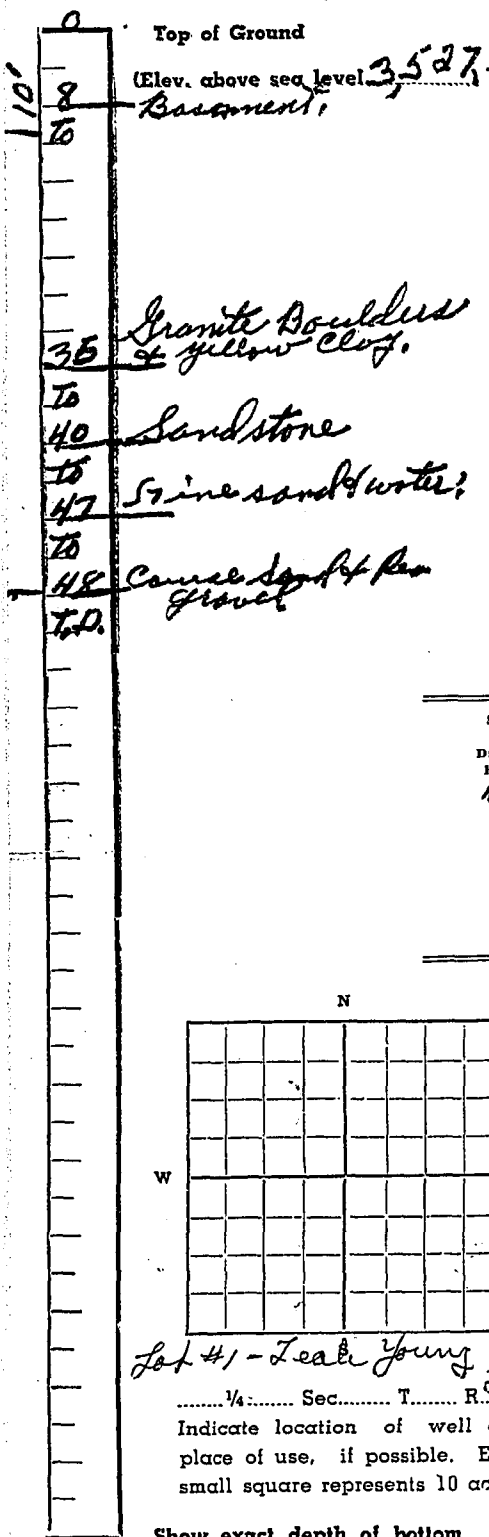
Static Water Level for non-flowing Well 32 feet.

Shut-in Pressure for Flowing Well _____

Pumping Water Level 26 feet at 25 gal. per minute.

Discharge in gal., per min. of flowing well _____

How Tested _____ Length of Test _____

Remarks: (Gravel packing, cementing, packers, type of shutoff, Location of place of use of groundwater if not at well, and any other similar pertinent information, including number of acres irrigated, if used for irrigation) _____

Driller's License Number 128Driller's Signature Gerald Quigley

This form to be prepared by driller, and three copies to be filed by the owner with the County Clerk and Recorder in the county in which the well is located.

Please answer all questions. If not applicable, so state, otherwise the form will be returned.

Original to the County Clerk and Recorder; duplicate to the State Engineer; Triplicate to the School of Mines and Quadruplicate for the Appropriator.

38081

2415

卷之四

一、
二、
三、
四、
五、
六、
七、
八、
九、
十、

COUNTY RECORDER

DEPUTY

The following information was obtained from the records of the
 Bureau of Prisons, Washington, D.C., dated July 10, 1968:
 Name: [REDACTED]
 Date of Birth: [REDACTED]
 Date of Admission: [REDACTED]
 Present Location: [REDACTED] Federal Prison
 Number: [REDACTED]
 Classification: [REDACTED]
 Sentence: [REDACTED]
 Parole Status: [REDACTED]
 Other Information: [REDACTED]

[illegible]

GW 2

File No.

T 5 N R 28 W. Sec. 2

DUPLICATE

Ravalli County

STATE OF MONTANA
ADMINISTRATOR OF GROUNDWATER CODE
OFFICE OF STATE ENGINEER

RECEIVED
JUL 24 1964

Notice of Completion of Groundwater
Appropriation by Means of Well ENGINEER

(Under Chapter 237, Montana Session Laws, 1961)

0
To
5
To
10
To
18
To
24
To
28
To
29
T.D.

Top of Ground
(Elev. above sea level 3,572)
Cut gravel sand.
Boulders and Gravel.
same as above
with clay mix.
flowing sand.
Coarse sand and
water yellow clay.
Coarse sand & lobbles
Gravel.

Owner Dolly Creek Address Box 317A, R1,
Hamilton Mont.
Driller Address
Date of Notice of Appropriation of Groundwater July 10/64
Date well started July 2/64 Date Completed July 10/64
Type of well Drilled Equipment Used
(dug, driven, bored or (Churn, drill, rotary or
drilled) other)
Water Use: Domestic (X) Municipal () Stock () Irrigation (X)
Industrial () Drainage () Other ()

23) Water in hole. ← Indicate on the diagram the character and thickness of the different strata met with in drilling, such as soil, clay, shale, gravel, rock or sand, etc. Show depth at which water is encountered, thickness and character of water-bearing strata and height to which the water rises in the well.

Size of Drilled Hole	Size and Weight of Casing	From (Feet)	To (Feet)	PERFORATIONS		
				Kind Size	From (Feet)	To (Feet)
4"	4" 11 # per ft. Steel Black wall.	0	29	none.		

N

W

S

..... 1/4 Sec. T. R.

Indicate location of well and place of use, if possible. Each small square represents 10 acres.

Show exact depth of bottom

Teale Young Arch.
Lot 9 and 10

Static Water Level for non-flowing Well 6 feet.

Shut-in Pressure for Flowing Well

Pumping Water Level 30 feet at 21 gal. per minute.

Discharge in gal., per min. of flowing well

How Tested Ball's Pump Length of Test 6 hours

Remarks: (Gravel packing, cementing, packers, type of shutoff, Location of place of use of groundwater if not at well, and any other similar pertinent information, including number of

acres irrigated, if used for irrigation)

Well is located in lot 9

Class C 3347
Driller's License Number

Driller's Signature

This form to be prepared by driller, and three copies to be filed by the owner with the County Clerk and Recorder in the county in which the well is located.

Please answer all questions. If not applicable, so state, otherwise the form will be returned.

Original to the County Clerk and Recorder; duplicate to the State Engineer; Triplicate to the School of Mines and Quadruplicate for the Appropriator.

38322

4482

I certify that I received and filed this
instrument on this 22nd
day of July, 1968, at 4:00
o'clock P.M.

F. L. Moore
COUNTY RECORDER

By

DEPUTY

Fee 2.00

D.C.P.

ie No.

T. 5 N. R. 21 W. 12
County. Lawrence.

STATE OF MONTANA
ADMINISTRATOR OF GROUNDWATER CODE
OFFICE OF STATE ENGINEER

JAN 27 1964

Declaration of Vested Groundwater Rights
(Under Chapter 237, Montana Session Laws, 1961)

1. MAXINE Lusk, of R.T. Box 162 Hamilton,
(Name of Appropriator) (Address) (Town)

County of Lawrence State of Montana
have appropriated groundwater according to the Montana laws in effect prior to January 1, 1962, as follows:

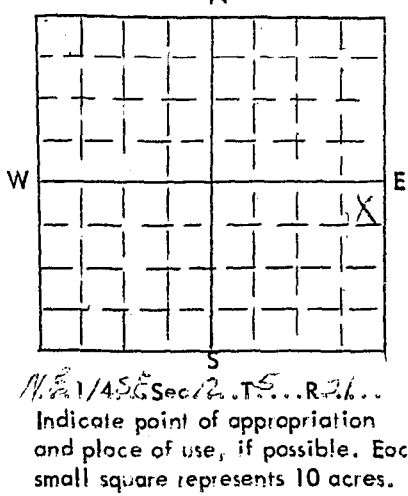

2. The beneficial use on which the claim is based... Domestic well
3. Date or approximate date of earliest beneficial use; and how continuous the use has been... Since 1948
4. The amount of groundwater claimed (in miner's inches or gallons per minute)... 150 per min. - 7.00 Gal. per min.
5. If used for irrigation, give the acreage and description of the lands to which water has been applied and name of the owner thereof... 1/2 acre - 1/2 acre
6. The means of withdrawing such water from the ground and the location of each well or other means of withdrawal... 8.00 ft. - 8.00 ft. - 8.00 ft.
7. The date of commencement and completion of the construction of the well, wells, or other works for withdrawal of groundwater...
8. The depth of water table... 35 ft. - 35 ft.
9. So far as it may be available, the type, size and depth of each well or the general specifications of any other works for the withdrawal of groundwater... 4" well - 4.5 depth
10. The estimated amount of groundwater withdrawn each year... 1000 - 1000 gal.
11. The log of formations encountered in the drilling of each well if available... Gravel - Sand - Hard - 1/2 ft.
12. Such other information of a similar nature as may be useful in carrying out the policy of this act, including reference to book and page of any county record...

Signature of Owner... M. Lusk
Date...

Three copies to be filed by the owner with the County Clerk and Recorder of the county in which the well is located.
Please answer all questions. If not applicable, so state. Otherwise the form will be returned.
Original to the County Clerk and Recorder; Duplicate to the State Engineer; Triplicate to the Montana Bureau of Mines and Geology, and Quadruplicate for the Appropriator.

3031

I certify that I received and filed this
instrument on this 31st
day of dec., 19 63 at 1:40
o'clock P. M.
F. H. Moore
COUNTY RECORDER
By Shirley Keith
DEPUTY

File No STATE WATER CONSERVATION BOARD

T. 5 N. R. 25 W.

DUPLICATE JAN 5 1963

County RAVALLI

BMC. _____ MONTANA STATE OF MONTANA
 E. _____ ADMINISTRATOR OF GROUNDWATER CODE
 C. _____ OFFICE OF STATE ENGINEER
 D. _____

Declaration of Vested Groundwater Rights

(Under Chapter 237, Montana Session Laws, 1961)

1. CARLETON M. AND JOAN B. CLIFFORD, of ROUTE 2, BOX 209-B
 (Name of Appropriator) (Address) (Town)
 County of RAVALLI State of MONTANA
 have appropriated groundwater according to the Montana laws in effect prior to January 1, 1962, as follows:

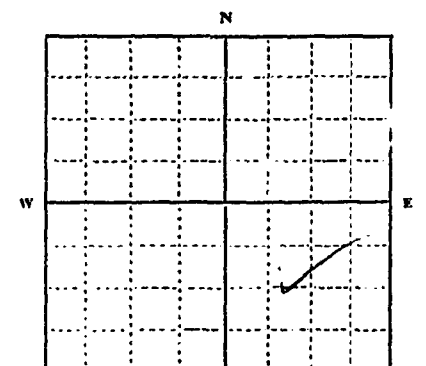

SW 1/4 SE 1/4 AND SE 1/4 AND SW 1/4
 Sec 25 T. 5 N. R. 25 W.

Indicate point of appropriation
 and place of use, if possible. Each
 small square represents 10 acres.

2. The beneficial use on which the claim is based
 HOUSEHOLD AND IRRIGATION IN FUTURE
3. Date or approximate date of earliest beneficial use; and how continuous the use has been
 1963
4. The amount of groundwater claimed (in miner's inches or gallons per minute)
 20 gal/min at present
5. If used for irrigation, give the acreage and description of the lands to which water has been applied and name of the owner thereof
 (future up to 40 acres)
6. The means of withdrawing such water from the ground and the location of each well or other means of withdrawal
 3/4 hp electric pump south of house

7. The date of commencement and completion of the construction of the well, wells, or other works for withdrawal of groundwater
 1963
8. The depth of water table
 APPROX 2'
9. So far as it may be available, the type, size and depth of each well or the general specifications of any other works for the withdrawal of groundwater
 2" 4 inch casing
10. The estimated amount of groundwater withdrawn each year
 500,000 gal./yr.
11. The log of formations encountered in the drilling of each well if available
 No info available
12. Such other information of a similar nature as may be useful in carrying out the policy of this act, including reference to book and page of any county record
 None

Signature of Owner Carleton M. Clifford

Date 12-31-63

Three copies to be filed by the owner with the County Clerk and Recorder of the county in which the well is located.

Please answer all questions. If not applicable, so state. Otherwise the form will be returned.

Original to the County Clerk and Recorder; Duplicate to the State Engineer; Triplicate to the Montana Bureau of Mines and Geology; and Quadruplicate for the Appropriator.

4756

I certify that I received and filed this
instrument on this 31
day of Dec, 1905 at 10:25
o'clock AM.
F. L. Moore
COUNTY RECORDER
By F. L. Moore
DEPUTY

GROUNDWATER INDEX

Page 1 of 4

County Ravalli Twp. 5 North Rge. 20 West

Sec.	Name of Appropriator	Type of Form	County File No.	Remarks
3	Tracy, W. A. & H. D.	GW-3	2343	
3	Drues, James M.	GW-2	4841	
4	Lindberg, Emil	GW-3	2503	
4	" "		2502	
4	Hess, Allen W.	GW-2	4851	
4	Hamilton Golf Course	GW-2	174361	
4	" "		1639	
4	" "	GW-4	1641	
4	" "		1640	
4	Bullack, W. A.	GW-3		
4	" "	GW-2	5661	
4	" "	GW-2	5662	
4	" "		2389	
4	" "	GW-2	5142	
5	Willimer, Louis		2975	
5	Sachran, Alfred H.	GW-3	4524	
5	Thallence, Wilbur P. & May		4166	
5	Foley, John M.		2755	
5	Thallence, Wilbur P. & May		4167	
5	" "		4168	
5	France, David	GW-2	6032	
5	Piereson, Ray & Marie		4214	
5	Valance, Gene & Barbara		4215	
5	" "		4216	
5	Waldo, Bob	GW-2	5533	
5	" "	GW-2	5532	
6	Sickles, Everett W. & Berwin	GW-2	5099	
6	Spencer, M. S.	GW-2	5199	
6	Spicher, Clement	GW-2	5338	
6	" "	GW-2	3337	
6	Stewart, George	GW-2	5340	
6	Morgan, Wendell	GW-2	5518	
6	McMillan, Hugh E.	GW-4	1015	
6	McKinney, Tracy & Ethel E.	GW-4	1736	
6	Stewart, George M.		2936	
6	Stewart, George M.			
6	Squires, Charles		2846	
6	Richie, Ron	GW-2	5288	
6	Goodard, David	GW-2	5423	
6	Johnson, Charles P.		2595	
6	Max, F. E.	well log		
6	" "	well log		
6	" "	well log		
6	Hilgard, Ronald	GW-3	4774	
6	Andrew, William J.		4106	
6	Damschon, Lauren	GW-2	4942	

18 Schaudts, Leland A.
 ? Cook, Edwin B.

GW-2 4626
 GW-4 2756

Sec.	Name of Appropriator	Type of Form	County File No.	Remarks
6	Rissman, R.H. & J. H. & J. H. & J. H.	GW-2	169001	
6	James, Don	GW-2	5401	
6	James, Martin P. & K. H.		4790	
6	Harris, Ward	GW-2		
6	Folk, Richard E. & Mary Ann		7699	
6	Rough, J. E. & B. Marie		2107	
6	Hanson, Harold	GW-2	5493	
6	Ross, Ray E. & Margaret		2865	
6	Filchuk, Dennis	GW-2	5891	
6	Maki, Jacob Dale	GW-4	2348	
6	Lodarski, Mike		2917	
6	McNally, Bill	GW-2	5198	
6	Foss, D. L.	GW-4	1753	
6	" "	GW-3	1252	
6	Hendon, Calvin E.		4737	
6	Anderson, Dean	GW-2	5724	
6	Bede, Frank W. Sr.		2784	
6	Bridge, Lloyd	GW-2	5370	
6	Hamilton, Oboena Hudson	GW-2	167513	
6	Brown, Charles E.		2284	
6	Black, Pauline & Charles	GW-2	5838	
6	Cook, Eulio E.		2757	
6	Nicholson, Joseph Henry		2515	
6	Martinez, Jim	GW-2	5798	
6	Tatraf, Hayden	GW-4	2264	
6	Unliser, Helen & Helen	GW-2	4869	
6	Unliser, L. H.	GW-2	5365	
6	Unliser, Robert A.		2759	
6	Unliser, William & J. H.	GW-2	5927	
7	Burco, E. H.	GW-2	5486	
7	Bersman, Robert J.	GW-2	4539	
7	Allen, Frank A.	GW-2	4896	
7	Mathews, Lester	GW-2	181005	
7	Mack, Richard & L. H.		1765	
7	Middlemist, L. H.		2903	
7	Miller, Richard & L. H.		1862	
7	Anderson, Bill	GW-2	2185	
7	Bell, H. W.	GW-4		
7	Bell, Edward J.		2413	
7	French, Thomas A. Jr.	GW-2	5173	
7	Bell, H. W.	GW-2	5395	
7	" "			
7	Greenup, Fred	GW-2	5800	
7	Johnson, Ray B.	GW-2	5494	
7	" "	GW-2	5480	
7	Gones, Roberto	GW-2	5404	

18 Strand, Leland A.
7 Cook, E. L. & B.

GW-2 4626
GW-4 2756

Sec.	Name of Appropriator	Type of Form	County File No.	Remarks
7	Kent, Dick	GW-2	5309	
7	Monk, Richard & Gertrude	GW-4	1766	
7	Kyle, James E. & Edith M.		4159	
7	Brookdale School Dist		2708	
7	Kraft, Larence & Violet L.		3097	
7	Kraft, Laren	GW-2	5256	
7	Kraft, Laren D. & Edith M.	GW-4	1966	
7	Harkins, Willard T. & Bertha		1920	
7	Malay, Ernest & Ruby E.		4270	
7	Heade, Granville & Georgia		2190	
7	Anderson, William	Well Log		
7	Anderson, William R.	GW-4	2479	
7	Dall, John	GW-4	4332	
7	Duffenbaugh, W. H.		2647	
7	Brookman, Robert & Lucie F.	GW-3	3656	
7	Burkhalter, Ludy		4762	
7	Compbell, Maudie M. & B. W.		1859	
7	Carlson, Edythe E.		2916	
7	Clark, H.	GW-2	4880	
7	Patterson, Dale	GW-2	1887	
7	Parry, Thomas		2369	
7	Parry, E. L.		2921	
7	Whitton, Mrs. Sam		4727	
7	" "	GW-4	4728	
7	Pave, George Thomas		5970	
7	Newman, Clarence		1925	
7	Cunningham, Clark M.		4394	
7	Hay, William	GW-2	5899	
7	Remmick, Thomas E.		2582	
7	" "	GW-2	168062	
7	Remmick, Mary	GW-2	5859	
7	Rousseau, J. H.	GW-3	1878	
7	Schiller, Edward W.	GW-4	2522	
7	" "	GW-2	2522	
7	Dave, Sheridan	GW-2	5921	
7	Spritzer, Peter	GW-2	5812	
7	Stewart, Charles R.	Well Log		
7	" "	Well Log		
7	Squires, Charles	GW-3	2844	
7	Stanford, Thomas T. & Mary		2520	
7	Talbot, Walter G. & Susan		2977	
7	Talbot, Bob	GW-2	2980	
7	Squires, Charles		2846	
7	" "		2845	
7	Thompson, C. W.	GW-2	5489	
7	Van, H.	GW-2	4827	

18 Schauder, Leland A.
 ? Cook, Cleworth B.

GW-2
 GW-4

Sec.	Name of Appropriator	Type of Form	County File No.	Remarks
7	Wondale, R. E.	GW-2	5487	
7	Wood, Henry A.	GW-2	172831	
7	Wilson, George S. & Shirl M.		2359	
7	Whitecat, William & Mabel		2986	
7	Wimberly, Clarence Mary	GW-4	2611	
8	Schoch, Larry	Well Map		
8	Morgan, E. J. & Lyle		2363	
8	Kratz, J. A. & R. B.	GW-3	1919	
8	Kratz, J. A. & R. B.	GW-4	1918	
8	Kratz, H. J. & Clara D.		2710	
8	Kratz, H. J. & Clara D.		2709	
8	Overtor, Rex		3023	
8	Morton, Ellen H. & James, Ray	GW-2	5562	
8	Overtor, Rex	GW-3	3035	
8	Overtor, Rex	GW-2	5375	
8	Overtor, Rex	GW-3	3034	
8	Swallow, James & Anna		7465	
8	Swallow, James	GW-2	165393	
8	Tasler, Robert	GW-2	5820	
8	Thomas, Charles W.		3017	
8	" "	GW-2	3015	
8	" "		3016	
8	Willard, Joe A. & Grace C.		2830	
5/6	Dewitt, Joe	GW2	4889	previously misfiled
5/6	Dutton, Emma Wilcox	GW4	2147	
5/6	George, Walter R. & Muriel W.	GW4	4396	
5/6	Hiles, Hill	GW2	5173	
5/6	Hower, Richard & Joyce	GW4	2901	
5/6	Lickels, Everett	GW2	4979	
6	Anderson, Annie	GW2	4740	
6	Fodness, Lawrence W. & Sandra Z.	GW4	2175	
4/31	Flammus, Howard Z.	GW4	2746	
6	Peacock, Marion	GW2	4577	
6	Pfister, Elsworth B.	GW4	4752	
6	Reynolds, Adelbert E.	GW4	2728	
6	Reynolds, Adelbert E.	GW3	2829	
4/31	Rabbin, Forbes	GW2	4647 167916	
6	Rugman, Frank W. & Nellie A.	GW4	2544	
7	Slawky, Charles E. & Marion	GW4	2542	
7	Lanceford, Frank R.	GW4	2933	
7	Lanceford, Frank R.	GW4	2994	
7	Lanceford, Fred & Christina	GW4	3011	
7	McCune, Ruth	GW4	2346	
7	Masterman, Lou	GW4	3044	
7	Riley, George R. & Betty J.	GW4	2707	
18	Chamberlain, Saint	GW2	4401	
18	Pammy, Mary	GW2	4811	
18	Schardus, Zeland A.	GW2	4626	
7	Cook, Elsworth B.	GW4	2756	

File No.

DUPLICATE

T. 5 N. R. 20 W.

County BRADSHAW

JAN 8 1964

STATE OF MONTANA
ADMINISTRATOR OF GROUNDWATER CODE
OFFICE OF STATE ENGINEER

STATE ENGINEER

**Notice of Completion of Groundwater Appropriation
Without Well**

(Under Chapter 237 Montana Session Laws, 1961)

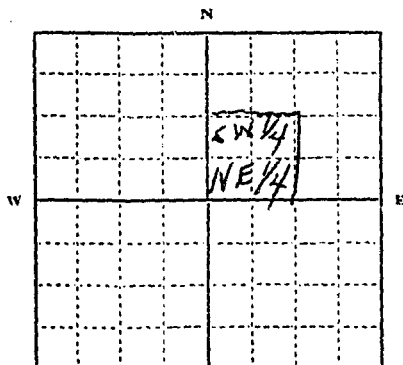
Date of Appropriation of Groundwater June 1 1950Owner M. O. & J. P. Lovely Address HAMILTON MONTContractor (if any) NONEAddress of Contractor NONEDate Started MAY 20 1950 Date Completed June 1 1950Describe means of obtaining groundwater without a well "as by sub-irrigation and other natural processes". Include depth to water when applicable. SPRING. DEPTH TOWATER ABOUT 12 INCHES

SW 1/4 NE 1/4 Sec. 3 T. 5 N. R. 20 W.
Indicate point of appropriation
and place of use, if possible.

Quantity of water developed and used with explanation of method used to measure or estimate such amount. If use is intermittent

estimate approximate lengths of periods of use. ABOUT

1 GAL PER MINUTE MEASURED
WITH A BUCKET DEVELOPED
FOR STOCK WATER

Signature of Owner M. O. LovelyDate Dec 20 1963

This form to be prepared by contractor (if any), otherwise by the owner.

Three copies of this notice are to be filed with the County Clerk and Recorder of the county in which the works are located.

Please answer all questions. If not applicable, so state, otherwise the form will be returned.

Original to the County Clerk and Recorder; duplicate to the State Engineer; Triplicate to the Montana Bureau of Mines and Geology and Quadruplicate for the Appropriator.

#2343

I certify that I received and filed this
instrument on this 30th
day of Nov. 1963 at 9:28
o'clock A. M.
J. H. Moore
CLERK OF COURTS
By Shirley Keith
DEPUTY

GW 2

STATE WATER CONSERVATION BOARD

File No. _____

JUN 1 1966

T 5N R 20W

DUPLICATE

 Blitts _____ McDermott _____
 Butcher _____ McNulty _____
 Coyle _____ Morton _____
 Darlington _____ Sullivan _____
 Dickert _____

Ravalli County

 STATE OF MONTANA
 ADMINISTRATOR OF GROUNDWATER CODE
 OFFICE OF STATE ENGINEER

 Notice of Completion of Groundwater
 Appropriation by Means of Well

(Under Chapter 237, Montana Session Laws, 1961)

Owner James M. Davis Address HamiltonDriller Gerald J. Jorgensen Address HamiltonDate of Notice of Appropriation of Groundwater April 1 - 1966Date well started March 23 - 66 Date Completed 3 - 29 - 66
 Type of well Drilled Equipment Used Cable tools
 (dug, driven, bored or (Churn, drill, rotary or
 drilled) other)

 Water Use: Domestic () Municipal () Stock (X) Irrigation ()
 Industrial () Drainage () Other ()

← Indicate on the diagram the character and thickness of the different strata met with in drilling, such as soil, clay, shale, gravel, rock or sand, etc. Show depth at which water is encountered, thickness and character of water-bearing strata and height to which the water rises in the well.

Size of Drilled Hole	Size and Weight of Casing	From (Feet)	To (Feet)	PERFORATIONS		
				Kind Size	From (Feet)	To (Feet)
6"	Blackwell Steel 2.50 in. 2.00 in. 1.75 ft.	0	125	None		

 0 Top of Ground
 1 Surface soil
 (Elev. above sea level 3,572.1)
 21 Rock (clay shale)
sand grain
 22 water strata
 23 Cobble gravel & gravel
in clay

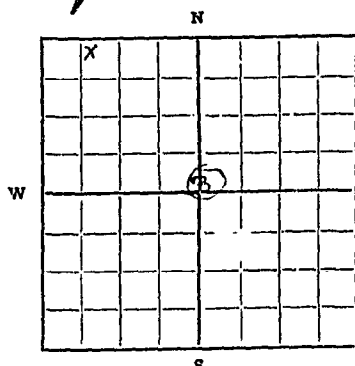
 125 125' to clay
gravel & shale

NW 1/4 NW Sec. 3 T. 5N R. 20W

 Indicate location of well and
 place of use, if possible. Each
 small square represents 10 acres.

Show exact depth of bottom

Static Water Level for non-flowing Well 1.0 feet.

Shut-in Pressure for Flowing Well _____

Pumping Water Level 34 feet at 5 gal. per minute.

Discharge in gal., per min. of flowing well _____

How Tested Bailer Pump Length of Test 1.6 hrs.

Remarks: (Gravel packing, cementing, packers, type of shutoff, Location of place of use of groundwater if not at well, and any other similar pertinent information, including number of

acres irrigated, if used for irrigation) _____

Gravel Packed from 125' to 70'30' open hole for waterReservoir.
128 3519-C
 Driller's License Number

Ray J. Jorgensen
 Driller's Signature

This form to be prepared by driller, and three copies to be filed by the owner with the County Clerk and Recorder in the county in which the well is located.

Please answer all questions. If not applicable, so state, otherwise the form will be returned.

Original to the County Clerk and Recorder; duplicate to the State Engineer; Triplicate to the School of Mines and Quadruplicate for the Appropriator.

#4847

I certify that I received and filed this
instrument on this 26th
day of May, 19 66 at 11:00
o'clock A. M.

F. G. Moon
COUNTY RECORDER

Fee \$2.00

By _____ DEPUTY

RECORDED
INDEXED
STATE OF TEXAS

File No.

T5N R. 20 W. 20

DUPLICATE

County

STATE OF MONTANA
ADMINISTRATOR OF GROUNDWATER CODE
OFFICE OF STATE ENGINEER

RECEIVED
JAN 8 1963
STATE ENGINEER

Notice of Completion of Groundwater Appropriation
Without Well

(Under Chapter 237 Montana Session Laws, 1961)

Date of Appropriation of Groundwater 12/30/63

Owner EMIL Lindberg Address RT 2 & Box 238

Contractor (if any)

Address of Contractor

Date Started..... Date Completed.....

Describe means of obtaining groundwater without a well "as by sub-irrigation and other natural processes". Include depth to water when applicable. Natural Spring

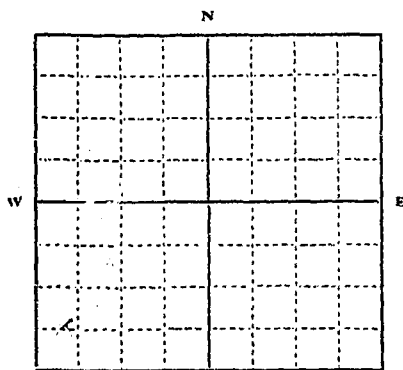

W 1/2 SW 1/4 Sec 4 T5N R. 20W
Indicate point of appropriation
and place of use, if possible.

Quantity of water developed and used with explanation of method used to measure or estimate such amount. If use is intermittent

estimate approximate lengths of periods of use. This water is used for live stock. The quantity in summer is about 85 mince inches in winter about 10 mince inches

Signature of Owner Emil Lindberg

Date Dec 30 1963

This form to be prepared by contractor (if any), otherwise by the owner.

Three copies of this notice are to be filed with the County Clerk and Recorder of the county in which the works are located.

Please answer all questions. If not applicable, so state, otherwise the form will be returned.

Original to the County Clerk and Recorder; duplicate to the State Engineer; Triplicate to the Montana Bureau of Mines and Geology and Quadruplicate for the Appropriator.

#2508

I certify that I received and filed this
instrument on this 30th
day of Dec., 1963 at 1:06
o'clock P. M.
F. G. Moore
COUNTY RECORDER
By Shirley Keith
DEPUTY