

County Maricopa

20 Show exact depth of bottom

52,897

5864

I certify that I received and filed this
instrument on this 11th
day of April, 19 23, at 1:50
o'clock P.M.

Pauline E. Hughes
COUNTY RECORDER

By Her 2.00
Deputy

RECEIVED

County DeWitt

STATE OF MONTANA
ADMINISTRATOR OF GROUNDWATER CODE
MONTANA WATER RESOURCES BOARD

NOTICE OF COMPLETION OF GROUNDWATER
APPROPRIATION BY MEANS OF WELL

Developed after January 1, 1962

(Under Chapter 237 Montana Session Laws, 1961, as amended)

This form to be prepared by driller, and three copies to be filed by the owner with the County Clerk and Recorder in the county in which the well is located, last copy to be retained by driller.

Please answer all questions. If not applicable, so state, otherwise the form may be returned.

Owner Ernie Fingerich

Address Victor, Montana

Date well started March 20, 1973

completed March 29, 1973

For Administrator's Use

File 5871

April 18, 1973

GW 1 9:00 P.M.

Type of well drilled well

(Dug, driven, bored or drilled)

Equipment used Quinn Drill

(Churn drill, rotary or other)

Water Use: Domestic ☐ Municipal ☐ Stock ☐ Irrigation ☐

Industrial ☐ Drainage ☐ Other ☐* Garden/Lawn ☐

*Describe

USE: If used for irrigation, industrial, drainage or other. Explain, state number of acres and location or other data (i.e. Lot, Block and Addition).

ESTIMATED ANNUAL WITHDRAWAL

Size of Drilled Hole	Size and Weight of Casing	From (Feet)	To (Feet)	PERFORATIONS		
				Kind Size	From (Feet)	To (Feet)
6"	17 1/2" Ft	0	26	1/16x5	21	26

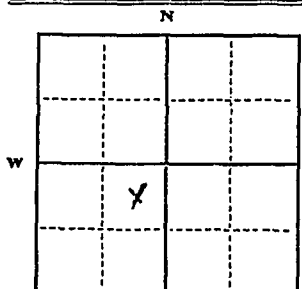

NE 1/4 Sec. 30
T. 8 N. R. 20 W.

Lot 12 Block 25
Victor, Montana

Static water level 14 ft.*
Pumping water level 24 ft.*
at 12 gallons per minute,
measured 5 minutes after pumping
began.

*Measured from ground level.

Well developed by pumping
for 12 hours.

Power Pump HP

Remarks: (Gravel packing, cementing,
packers, type of shutoff)

INDICATE LOCATION OF WELL AND PLACE OF USE, IF POSSIBLE.
EACH SMALL SQUARE REPRESENTS 40 ACRES.

Driller's Signature Charles W. Wible Jr.

Driller's Address DeWitt Drilling Co., Victor, Montana

LICENSE NO. 205

DRILLER'S LOG

Indicate the character, color, thickness of strata such as soil, clay, sand, gravel, shale, sandstone, etc. Show depth at which water is found and height to which water rises in well.

Top of Ground

(Elev. above sea level)

From (Feet)	To (Feet)	
0	1	Drill
1	26	sand gravel water bearing

Show exact depth of bottom

52.949

5871

I certify that I received and filed this
instrument on this 12th
day of April, 1973, at 9:00
o'clock A.M.

Charles E. Hughes
COUNTY RECORDER

By Hee 2.00
Deputy

STATE OF MONTANA
ADMINISTRATOR OF GROUNDWATER CODE
MONTANA WATER RESOURCES BOARD

NOTICE OF COMPLETION OF GROUNDWATER
APPROPRIATION BY MEANS OF WELL

Developed after January 1, 1962

(Under Chapter 237 Montana Session Laws, 1961, as amended)

This form to be prepared by driller, and three copies to be filed by the owner with the County Clerk and Recorder in the county in which the well is located, last copy to be retained by driller.

Please answer all questions. If not applicable, so state, otherwise the form may be returned.

Owner Mel Gaudin

Address Victor, Mont.

Date well started Jan. 14, 1971

completed Jan. 16, 1971

Type of well Drilled

(Dug, driven, bored or drilled)

Equipment used Churn Drill

(Churn drill, rotary or other)

Water Use: Domestic ☒ Municipal ☐ Stock ☐ Irrigation ☐

Industrial ☐ Drainage ☐ Other ☐* Garden/Lawn ☐

*Describe

USE: If used for irrigation, industrial, drainage or other. Explain, state number of acres and location or other data (i.e. Lot, Block and Addition).

ESTIMATED ANNUAL WITHDRAWAL unknown

Size of Drilled Hole	Size and Weight of Casing	From (Feet)	To (Feet)	PERFORATIONS		
				Kind Size	From (Feet)	To (Feet)
6"	17 lbs. per ft.	0	25	3/16x5	20	25

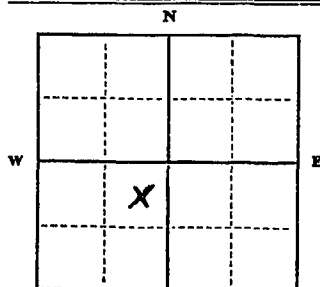

NE SW 1/4 Sec. 30
T. 8 N. R. 20 E. (W)

INDICATE LOCATION OF WELL AND PLACE OF USE, IF POSSIBLE. EACH SMALL SQUARE REPRESENTS 40 ACRES.

Driller's Signature Charles W. Weller, Jr. Ravalli Drilling Co.

Driller's Address Box 27, Victor, Montana

LICENSE NO. 200

County Ravalli

DRILLER'S LOG

Indicate the character, color, thickness of strata such as soil, clay, sand, gravel, shale, sandstone, etc. Show depth at which water is found and height to which water rises in well.

Top of Ground (Elev. above sea level)		
From (Feet)	To (Feet)	
0	5	Topsoil
5	22	Intermittent layers Sand, Gravel (Gray in color) Saturated
22	26	Sand, Gravel (Brown in color) Saturated

25 Show exact depth of bottom

48078

#5381

I certify that I received and filed this
instrument on this 29th
day of Jan., 19 71, at 9:40
o'clock A.M.
F. B. Moore
COUNTY RECORDER
By Lee 2.00
DEPUTY

53,012

5876

I certify that I received and filed this
instrument on this 24th
day of April, 1973, at 1:10
o'clock P.M.

Darlene E. Hughes
COUNTY RECORDER

By J. M. 2.00
Deputy

File No.

T. 8 N. R. 20 30

Sup.

STATE OF MONTANA
ADMINISTRATOR OF GROUNDWATER CODE
OFFICE OF STATE ENGINEER

Ravalli County
JAN 17 1964
STATE ENGINEER

DECLARATION OF VESTED GROUNDWATER RIGHTS

(Under Chapter 237, Montana Session Laws, 1961)

1. Gertrude M. Garrod, of Victor, Montana.
(Name of Appropriator) (Address) (Town)

County of Ravalli, State of Montana, have appropriated groundwater according to the Montana laws in effect prior to January 1, 1962, as follows:

2. The beneficial use on which the claim is based. House and lawn.

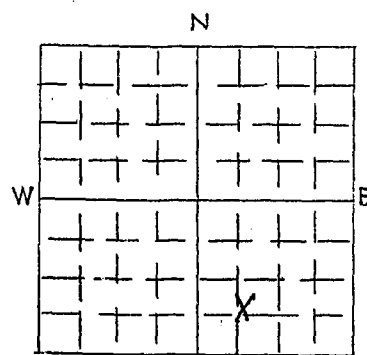

S.W. 1/4 S.E. Sec. 3 A.T.P. R. 20

Indicate point of appropriation and place of use, if possible. Each small square represents 10 acres.

3. Date or approximate date of earliest beneficial use; and how continuous the use has been. 1942 in use since the above date.

4. The amount of groundwater claimed (in miner's inches or gallons per minute). 200 gal. per hour.

5. If used for irrigation, give the acreage and description of the lands to which water has been applied and name of the owner thereof. for lawn only.

6. The means of withdrawing such water from the ground and the location of each well or other means of withdrawal. electric driven pump.

7. The date of commencement and completion of the construction of the well, wells, or other works for withdrawal of groundwater. drilled and completed the year of 1942.

8. The depth of water table. not sure but plenty of water summer and winter.

9. So far as it may be available, the type, size and depth of each well or the general specifications of any other works for the withdrawal of groundwater. 2 in casing, drilled to 35 ft. stopped drilling in very coarse gravel. good clear water at that point. plenty of water.

10. The estimated amount of groundwater withdrawn each year. 8000.

11. The log of formations encountered in the drilling of each well if available. coarse gravel, sand, first hardpan shelf at 12 ft. very coarse gravel and rock at 35 ft. stopped drilling. lots of good clear water.

12. Such other information of a similar nature as may be useful in carrying out the policy of this act, including reference to book and page of any county record. no record.

Signature of Owner Gertrude M. Garrod

Date Jan. 2. 1964.

Three copies to be filed by the owner with the County Clerk and Recorder of the county in which the well is located.

Please answer all questions. If not applicable, so state, otherwise the form will be returned.

Original to the County Clerk and Recorder; duplicate to the State Engineer; Triplicate to the School of Mines and Quadruplicate for the Appropriator.

31838

4275

I certify that I received and filed this
instrument on this 6th
day of Aug., 1964, at 1:07
o'clock P.M.

F. H. Moore

COUNTY RECORDER

By Shirley Keith
DEPUTY

File No. 2181

DUPLICATE

T. 311 R. 20 WCounty RAVALLI

STATE OF MONTANA
ADMINISTRATOR OF GROUNDWATER CODE
OFFICE OF STATE ENGINEER

RECEIVED
DEC 30 1963

Declaration of Vested Groundwater Rights
(Under Chapter 237, Montana Session Laws, 1961)

STATE ENGINEER

1. THEODORE GARRARD, of VICTOR, MONTANA. VICTOR
(Name of Appropriator) (Address) (Town)
County of RAVALLI State of MONTANA
have appropriated groundwater according to the Montana laws in effect prior to January 1, 1962, as follows:

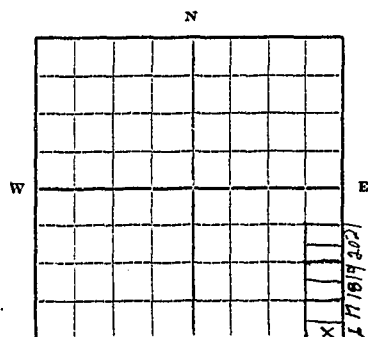

Resub. Townsite Victor
16 to 21

1/4 Sec. T. R.

Indicate point of appropriation and place of use, if possible. Each small square represents 10 acres.

2. The beneficial use on which the claim is based domestic and irrigate.
3. Date or approximate date of earliest beneficial use; and how continuous the use has been 1956 through 1963.
4. The amount of groundwater claimed (in miner's inches or gallons per minute) 20 inches, 900,000 gallons.
5. If used for irrigation, give the acreage and description of the lands to which water has been applied and name of the owner thereof used on lots (16 to 21) THEODORE GARRARD.
6. The means of withdrawing such water from the ground and the location of each well or other means of withdrawal DRAWN BY TWO PUMPS, ABOUT THE MIDDLE OF LOT 16.
7. The date of commencement and completion of the construction of the well, wells, or other works for withdrawal of groundwater 50 feet. 1934
8. The depth of water table 10 feet.
9. So far as it may be available, the type, size and depth of each well or the general specifications of any other works for the withdrawal of groundwater hand dug, size 8 inch casing, 17 feet.
10. The estimated amount of groundwater withdrawn each year 900,000 gallons.
11. The log of formations encountered in the drilling of each well if available none.
12. Such other information of a similar nature as may be useful in carrying out the policy of this act, including reference to book and page of any county record book 1, page 106, line 15.

Signature of Owner

Theodore Garrard
Date 12-26-1963

Three copies to be filed by the owner with the County Clerk and Recorder of the county in which the well is located.

Please answer all questions. If not applicable, so state, otherwise the form will be returned.

Original to the County Clerk and Recorder; duplicate to the State Engineer; Triplicate to the Montana Bureau of Mines and Geology and Quadruplicate for the Appropriator.

15672

I certify that I received and filed this
instrument on this 26
day of Dec 19 63 at 4:14
o'clock P.M.

F. S. Moore
COUNTY RECORDER

By _____ DEPUTY

5866

Original
Copy

I certify that I received and filed this
instrument on this 16th
day of April, 1923, at 1:30
o'clock P.M.

Charles E. Hughes
COUNTY RECORDER

By Wm. J. 200
DEPUTY

STATE OF MONTANA
ADMINISTRATOR OF GROUNDWATER CODE
MONTANA WATER RESOURCES BOARD

RECEIVED

APR 8 1973

NOTICE OF COMPLETION OF GROUNDWATER
APPROPRIATION BY MEANS OF WELL

Developed after January 1, 1962

MONTANA DEPARTMENT OF NATURAL
RESOURCES AND CONSERVATION

8N-20W 30
County Ravalli

DRILLER'S LOG

Indicate the character, color, thickness of strata such as soil, clay, sand, gravel, shale, sandstone, etc. Show depth at which water is found and height to which water rises in well.

(Under Chapter 237 Montana Session Laws, 1961, as amended)

This form to be prepared by driller, and three copies to be filed by the owner with the County Clerk and Recorder in the county in which the well is located, last copy to be retained by driller.

Please answer all questions. If not applicable, so state, otherwise the form may be returned.

Owner Theodore Fed Garrard

Address Victor

MONT.

Date well started Mar 23, 1973

completed Mar 23, 1973

For Administrator's Use

File 5857

April 5, 1973

GW 1 2:40 p.m.

Type of well drilled

(Dug, driven, bored or drilled)

Equipment used Churn drill

(Churn drill, rotary or other)

Water Use: Domestic ☒ Municipal ☐ Stock ☐ Irrigation ☐

Industrial ☐ Drainage ☐ Other ☐ Garden/Lawn ☐

*Describe

USE: If used for irrigation, industrial, drainage or other. Explain, state number of acres and location or other data (i.e. Lot, Block and Addition).

ESTIMATED ANNUAL WITHDRAWAL

Size of Drilled Hole	Size and Weight of Casing	From (Feet)	To (Feet)	PERFORATIONS		
				Kind Size	From (Feet)	To (Feet)
6"	17#5+	0	26	3/16X5	21	26

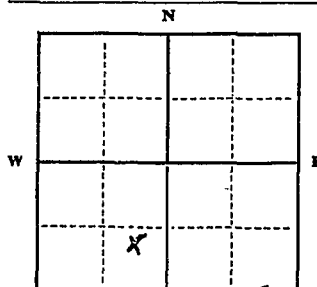

Static water level 15 ft.*
Pumping water level 21 ft.*
at 20 gallons per minute,
measured 10 minutes after pumping began.

*Measured from ground level.

Well developed by pumping
for 12 hours.

Power..... Pump..... HP

Remarks: (Gravel packing, cementing, packers, type of shutoff)

It 20 blk 4 s Victor

SE 1/4 S 1 1/4 Sec. 30

T. 8 N R. 2 E

INDICATE LOCATION OF WELL AND PLACE OF USE, IF POSSIBLE. EACH SMALL SQUARE REPRESENTS 40 ACRES.

Driller's Signature Charles Wroble Jr.

Driller's Address Ravalli Drilling Co.

Victor, Mont.

LICENSE NO 200

Top of Ground (Elev. above sea level)	
From (Feet)	To (Feet)
0	1
1	26
Topsoil	
SAND & Gravel	
water bearing	

26 Show exact depth of bottom

52,833

5857

I certify that I received and filed this
instrument on this 5th
day of April, 1973, at 2:40
o'clock P.M.

Darlene E. Hughes
COUNTY RECORDER

Fee 2.00
DEPUTY

File No.

MONTANA WATER RESOURCES BOARD

RECEIVED

T. R.

DUPLICATE

JUN 2 1969

County Ravalli

LOG

STATE OF MONTANA

ADMINISTRATOR OF GROUNDWATER CODE

STATE WATER CONSERVATION BOARD

Top of Ground

(Elev. above sea level.....)

6'-Open Hole

28'-Sand Gravel and
Boulders
Water Bearing**Notice of Completion of Groundwater
Appropriation by Means of Well**

DEVELOPED AFTER JANUARY 1, 1962

(Under Chapter 237 Montana Session Laws, 1961, as amended)

ELMAOwner Harold Frank Address Victor, MontanaC. F. WrobleDriller Ravalli Drilling Co. Address Victor, Montana

Date of Notice of appropriation of groundwater.....

Date well started May 12, 1969 Date completed May 12, 1969Type of well drilled Equipment used churn
(Dug, driven, bored or drilled) (Churn drill, rotary or other)Water use: Domestic ☒ Municipal ☐ Stock ☐ Irrigation ☐
Industrial ☐ Drainage ☐ Other ☐

Indicate on the diagram the character and thickness of the different strata met with in drilling, such as soil, clay, shale, gravel, rock or sand, etc. Show depth at which water is encountered, thickness and character of water-bearing strata and height to which the water rises in the well.

Size of Drilled Hole	Size and Weight of Casing	From (Feet)	To (Feet)	PERFORATIONS		
				Kind Size	From (Feet)	To (Feet)
6"	17 lbs. per ft.	0	28	1 1/4x5	18	28

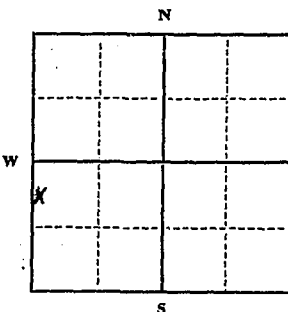
Static Water Level for non-flowing well 4 feet.

Shut-in Pressure for Flowing Well.....

Pumping Water Level 2 12 feetat 30 gal. per minute.

Discharge in gal. per min. of flowing well.....

How Tested Baled-1 hourLength of Test Pumped-1 hour

Remarks: (Gravel packing, cementing, packers, type of shutoff).....

NW 1/4 Sec. 36 T. 8 R. 28

Indicate location of well and place of use, if possible. Each small square represents 40 acres.

(Continue on reverse side)

USE—If used for irrigation, industrial, drainage or other. Explain, state number of acres and location or other data (i.e.: Lot, Block and Addition).

Show exact depth of bottom.

This form to be prepared by driller, and three copies to be filed by the owner with the County Clerk and Recorder in the county in which the well is located, tissue copy to be retained by driller.

Please answer all questions. If not applicable, so state, otherwise the form will be returned.

62

Driller's License Number

C. F. Wroble

Driller's Signature.

45,295

5156

I certify that I received and filed this
instrument on this 29th
day of May 19 69 at 8:45
o'clock A.M.

Z. G. Moore
COUNTY RECORDER

By Fee 2.00
DEPUTY

STATE OF MONTANA
ADMINISTRATOR OF GROUNDWATER CODE
MONTANA WATER RESOURCES BOARD

NOTICE OF COMPLETION OF GROUNDWATER
APPROPRIATION BY MEANS OF WELL

Developed after January 1, 1962

(Under Chapter 237 Montana Session Laws, 1961, as amended)

This form to be prepared by driller, and three copies to be filed by the owner with the County Clerk and Recorder in the county in which the well is located, last copy to be retained by driller.

Please answer all questions. If not applicable, so state, otherwise the form may be returned.

Owner Harold Enger

Address 421 South 4th West

Missoula, Montana

Date well started July 15, 1970

completed July 17, 1970

For Administrator's Use

File 5301
July 28, 1970
2:15 p.m.

GW 1

Type of well Drilled

(Dug, driven, bored or drilled)

Equipment used Churn Drill

(Churn drill, rotary or other)

Water Use: Domestic ☒ Municipal ☐ Stock ☐ Irrigation ☐

Industrial ☐ Drainage ☐ Other ☐* Garden/Lawn ☐

*Describe

USE: If used for irrigation, industrial, drainage or other. Explain, state number of acres and location or other data (i.e. Lot, Block and Addition).

ESTIMATED ANNUAL WITHDRAWAL unknown

Size of Drilled Hole	Size and Weight of Casing	From (Feet)	To (Feet)	PERFORATIONS		
				Kind Size	From (Feet)	To (Feet)
6"	15 lbs. per ft.	0m	73	1.25	61	71

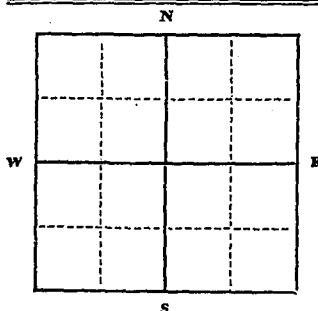

SE 1/4 NE 1/4 Sec. 30
T. 8 N R. 20 W

Static water level 21 ft.*
Pumping water level 27 ft.*
at 12 gallons per minute,
measured 90 minutes after pumping
began.

*Measured from ground level.

Well developed by baling &
for 41 hours. pumping

Power..... Pump..... HP

Remarks: (Gravel packing, cementing, packers, type of shutoff)

INDICATE LOCATION OF WELL AND PLACE OF USE, IF POSSIBLE.
EACH SMALL SQUARE REPRESENTS 40 ACRES.

Driller's Signature C. F. White Ravalli Drilling Co.

Driller's Address Box 27, Victor, Montana

LICENSE NO. 62

County Ravalli

DRILLER'S LOG

Indicate the character, color, thickness of strata such as soil, clay, sand, gravel, shale, sandstone, etc. Show depth at which water is found and height to which water rises in well.

Top of Ground		(Elev. above sea level)
From (Feet)	To (Feet)	
0	1	Topsoil
1	31	Sand, Gravel Gray in color Water bearing
31	59	Sand, Gravel Brown in color Water bearing
59	63	Sand, Gravel Gray in color Water bearing
63	73	Clay - Blue in color

73 Show exact depth of bottom

47247

#5301

I certify that I received and filed this

instrument on this 28th

day of July, 1970, at 8:15

o'clock P.M.

B. L. Moore

COUNTY RECORDER

Fee 2.00

DEPUTY

STATE OF MONTANA
ADMINISTRATOR OF GROUNDWATER CODE
MONTANA WATER RESOURCES BOARD

NOTICE OF COMPLETION OF GROUNDWATER
APPROPRIATION BY MEANS OF WELL

Developed after January 1, 1962

(Under Chapter 237 Montana Session Laws, 1961, as amended)

This form to be prepared by driller, and three copies to be filed by the owner with the County Clerk and Recorder in the county in which the well is located, last copy to be retained by driller.

Please answer all questions. If not applicable, so state, otherwise the form may be returned.

Owner Harold Eager

Address 421 South 4th West

Missoula, Montana

Date well started July 18, 1970

completed July 17, 1970

For Administrator's Use

File 5301
July 28, 1970
2:15 P.M.

GW 1

Type of well Drilled

(Dug, driven, bored or drilled)

Equipment used Churn Drill

(Churn drill, rotary or other)

Water Use: Domestic ☒ Municipal ☐ Stock ☐ Irrigation ☒

Industrial ☐ Drainage ☐ Other ☐* Garden/Lawn ☐

*Describe

USE: If used for irrigation, industrial, drainage or other. Explain, state number of acres and location or other data (i.e. Lot, Block and Addition). irrigation 242 acs. + Domestic

ESTIMATED ANNUAL WITHDRAWAL

unknown 3,000,000 gal.

Size of Drilled Hole	Size and Weight of Casing	From (Feet)	To (Feet)	PERFORATIONS		
6"	15 lbs. per ft.	0	73	Kind Size	From (Feet)	To (Feet)
				4x5	61	71

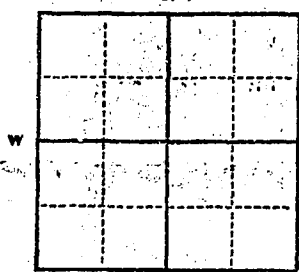

Static water level 21 ft.*
Pumping water level 27 ft.*
at 12 gallons per minute,
measured 90 minutes after pumping
began.

*Measured from ground level.
Well developed by balling for 41 hours. pumping

Power..... Pump..... HP

Remarks: (Gravel packing, cementing, packers, type of shutoff)

SE 1/4 NE 1/4 Sec. 30
T. 2 N R. 20

INDICATE LOCATION OF WELL AND PLACE OF USE, IF POSSIBLE.
EACH SMALL SQUARE REPRESENTS 40 ACRES.

Driller's Signature C. F. W. White Ravalli Drilling Co.

Driller's Address Box 27, Victor, Montana

LICENSE NO. 82

County Ravalli

DRILLER'S LOG

Indicate the character, color, thickness of strata such as soil, clay, sand, gravel, shale, sandstone, etc. Show depth at which water is found and height to which water rises in well.

Top of Ground

(Elev. above sea level)

From (Feet)	To (Feet)	
0	1	Topsoil
1	31	Sand, Gravel Gray in color Water bearing
31	59	Sand, Gravel Brown in color Water bearing
59	68	Sand, Gravel Gray in color Water bearing
68	73	Clay - Blue in color

73

Show exact depth of bottom

47247

STATE OF MONTANA
ADMINISTRATOR OF GROUNDWATER CODE
MONTANA WATER RESOURCES BOARD

NOTICE OF COMPLETION OF GROUNDWATER
APPROPRIATION BY MEANS OF WELL

Developed after January 1, 1962

(Under Chapter 237 Montana Session Laws, 1961, as amended)

This form to be prepared by driller, and three copies to be filed by the owner with the County Clerk and Recorder in the county in which the well is located, last copy to be retained by driller.

Please answer all questions. If not applicable, so state, otherwise the form may be returned.

Owner Harold Rager

Address 421 South 4th West

Minneapolis, Montana

Date well started July 16, 1970

completed July 17, 1970

Type of well Drilled

(Dug, driven, bored or drilled)

Equipment used Churn Drill

(Churn drill, rotary or other)

Water Use: Domestic ☒ Municipal ☐ Stock ☐ Irrigation ☒

Industrial ☐ Drainage ☐ Other ☐ Garden/Lawn ☐

*Describe

USE: If used for irrigation, industrial, drainage or other. Explain, state number of acres and location or other data (i.e. Lot, Block and Addition). irrigation 2 acres + domestic

ESTIMATED ANNUAL WITHDRAWAL

unknown 3,000,000 gal.

Size of Drilled Hole	Size and Weight of Casing	From (Feet)	To (Feet)	PERFORATIONS		
6"	15 lbs. per ft.	0	73	Kind Size	From (Feet)	To (Feet)
				125	61	71



Static water level 21 ft.
Pumping water level 27 ft.
at 12 gallons per minute,
measured 82 minutes after pumping
began.

*Measured from ground level.
Well developed by balancing
for 41 hours. pumping

Power Pump HP

Remarks: (Gravel packing, cementing, packers, type of shutoff)

SE 1/4 NE 1/4 Sec 30

T. 2 N. R. 20 W. 3

INDICATE LOCATION OF WELL AND PLACE OF USE, IF POSSIBLE.
EACH SMALL SQUARE REPRESENTS 40 ACRES.

Driller's Signature C. F. W. Schell Bayall Drilling Co.

Driller's Address Box 27, Victor, Montana

LICENSE NO. 82

County Bayall

DRILLER'S LOG

Indicate the character, color, thickness of strata such as soil, clay, sand, gravel, shale, sandstone, etc. Show depth at which water is found and height to which water rises in well.

Top of Ground

(Blow, above sea level)

From (Feet)	To (Feet)	
0	1	Topsoil
1	21	Sand, Gravel Gray in color Water bearing
21	29	Sand, Gravel Brown in color Water bearing
29	68	Sand, Gravel Gray in color Water bearing
68	73	Clay - Blue in color

Show exact depth of bottom

417247

51,287

#5703

I certify that I received and filed this
Instrument on this 31st
day of Aug, 19 22, at 9:45
o'clock AM.
J. G. Moore
COUNTY RECORDER
By Fee 2.00
DEPUTY

File No.

T. 8N R. 20W

DUPLICATE

County Beavert

STATE OF MONTANA
ADMINISTRATOR OF GROUNDWATER CODE
OFFICE OF STATE ENGINEER

Declaration of Vested Groundwater Rights

(Under Chapter 237, Montana Session Laws, 1961)

RECEIVED
JAN 8 1962
STATE ENGINEER

1. Robert T. Allen, of Victor
(Name of Appropriator) (Address) (Town)
County of Beavert State of Montana
have appropriated groundwater according to the Montana laws in effect prior to January 1, 1962, as follows:

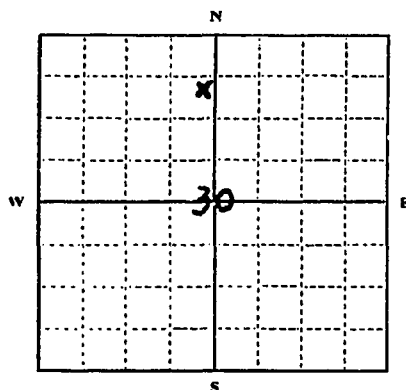
NE $\frac{1}{4}$ Sec 30 T. 8N R. 20W

Indicate point of appropriation
and place of use, if possible. Each
small square represents 10 acres.

2. The beneficial use on which the claim is based Household & Garden - lawn
3. Date or approximate date of earliest beneficial use; and how continuous the use has been 1890 - continuous since then
4. The amount of groundwater claimed (in miner's inches or gallons per minute) 160 gal per min.
5. If used for irrigation, give the acreage and description of the lands to which water has been applied and name of the owner thereof Garden & Lawn $\frac{1}{4}$ - $\frac{1}{2}$ Acre Nellie Garber - Robert T. Allen
6. The means of withdrawing such water from the ground and the location of each well or other means of withdrawal Electric pump - beside residence
7. The date of commencement and completion of the construction of the well, wells, or other works for withdrawal of groundwater Unknown - 1890
8. The depth of water table 22 ft
9. So far as it may be available, the type, size and depth of each well or the general specifications of any other works for the withdrawal of groundwater Combination - Dug - drilled
10. The estimated amount of groundwater withdrawn each year 500,000 gal per yr. est.
11. The log of formations encountered in the drilling of each well if available Unknown
12. Such other information of a similar nature as may be useful in carrying out the policy of this act, including reference to book and page of any county record Unknown

Signature of Owner

Date Dec 23 1963

Three copies to be filed by the owner with the County Clerk and Recorder of the county in which the well is located.

Please answer all questions. If not applicable, so state, otherwise the form will be returned.

Original to the County Clerk and Recorder; Duplicate to the State Engineer; Triplicate to the Montana Bureau of Mines and Geology, and Quadruplicate for the Appropriator.

27332

252

I certify that I received and filed this
instrument on this 30th
day of Dec. 1962 at 7:31
o'clock P.M.
F. B. Moore
COUNTY RECORDER
By Shirley Keith
DEPUTY

54,232

54,232

5968

I hereby certify that I received and filed this
instrument on this 25th
day of June, 1973, at 11:20
o'clock A.M.
Darlene E. Hughes
COUNTY RECORDER
By Shirley Keith
CLERK

RECEIVED

FEB 26 1973

County Bozali

STATE OF MONTANA
ADMINISTRATOR OF GROUNDWATER CODE
MONTANA WATER RESOURCES BOARD

DEPARTMENT OF NATURAL
RESOURCES AND CONSERVATION

NOTICE OF COMPLETION OF GROUNDWATER
APPROPRIATION BY MEANS OF WELL

Developed after January 1, 1962

(Under Chapter 237 Montana Session Laws, 1961, as amended)

This form to be prepared by driller, and three copies to be filed by the owner with the County Clerk and Recorder in the county in which the well is located, last copy to be retained by driller. Please answer all questions. If not applicable, so state, otherwise the form may be returned.

Estate of Maude Jones Ames

Owner Victor, Montana

Date well started Feb. 21, 1973
completed Feb. 22, 1973

For Administrator's Use

File 5819

Feb. 23, 1973

GW 1 2:25 p.m.

Type of well Drilled well

(Dug, driven, bored or drilled)

Equipment used churn drill

(Churn drill, rotary or other)

Water Use: Domestic ☒ Municipal ☐ Stock ☐ Irrigation ☐

Industrial ☐ Drainage ☐ Other ☐* Garden/Lawn ☐

*Describe

USE: If used for irrigation, industrial, drainage or other. Explain, state number of acres and location or other data (i.e. Lot, Block and Addition).

ESTIMATED ANNUAL WITHDRAWAL

Size of Drilled Hole	Size and Weight of Casing	From (Feet)	To (Feet)	PERFORATIONS		
				Kind Size	From (Feet)	To (Feet)
6"	17 1/2"	C	28	3/16x5	23	28

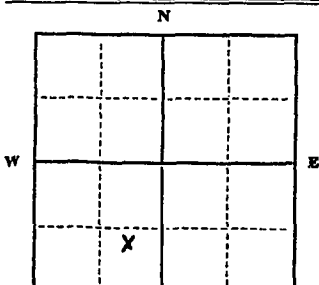

Static water level 15 ft.*
Pumping water level 22 ft.*
at 20 gallons per minute,
measured 60 minutes after pumping
began.

*Measured from ground level.
Well developed by pumping
for 12 hours.

Power..... Pump..... HP

Remarks: (Gravel packing, cementing, packers, type of shutoff) one foot of gravel pack

Int 2 Block H Victor
SE 1/4 SW 1/4 Sec 30
T. 8 N. 80 E. 8 W

INDICATE LOCATION OF WELL AND PLACE OF USE, IF POSSIBLE. EACH SMALL SQUARE REPRESENTS 40 ACRES.

Driller's Signature Charles W. White Jr.

Driller's Address Bozali Drilling Co., Victor, Mont.

LICENSE NO. 250

DRILLER'S LOG

Indicate the character, color, thickness of strata such as soil, clay, sand, gravel, shale, sandstone, etc. Show depth at which water is found and height to which water rises in well.

Top of Ground

(Elev. above sea level)

From (Feet)	To (Feet)	
0	2	<u>Topsoil</u>
2	16	<u>sand gravel and boulder</u>
16	28	<u>sand and gravel water bearing</u>

23

Show exact depth of bottom

52,487

5819

I certify that I received and filed this
instrument on this 23rd
day of Feb, 19 73 at 2:25
o'clock P.M.
Darlene E. Hughes
COUNTY RECORDER
By Jae 2.00
DEPUTY

DRILLER'S LOG

NOV 6 1972

Indicate the character, color, thickness of strata such as soil, clay, sand, gravel, shale, sandstone, etc. Show depth at which water is found and height to which water rises in well.

WATER MONTANA DEPARTMENT OF NATURAL RESOURCES AND CONSERVATION

Developed after January 1, 1962

(Under Chapter 237 Montana Session Laws, 1961, as amended)

This form to be prepared by driller, and three copies to be filed by the **owner** with the County Clerk and Recorder in the county in which the well is located, last copy to be retained by driller.

Please answer all questions. If not applicable, so state, otherwise the form may be returned.

Owner Clarence E. Black Jr. For Administrator's Use

Address Victor, Montana File #5242

Date well started Oct. 15, 1972 GW 1

completed Oct. 14, 1972

Type of well drilled well

(Dug, driven, bored or drilled)

Equipment used Chloroform

(Churn drill, rotary or other)

Water Use: Domestic ☒ Municipal ☐ Stock ☐ Irrigation ☐

Industrial ☐ Drainage ☐ Other ☐* Garden/Lawn ☐

*Describe _____

USE: If used for Irrigation, industrial, drainage or other. Explain, state number of acres and location or other data (i.e. Lot, Block and Addition).

ESTIMATED ANNUAL WITHDRAWAL

Size of Drilled Hole	Size and Weight of Casing	From (Feet)	To (Feet)	PERFORATIONS		
				Kind Size	From (Feet)	To (Feet)
6"	17.. / 46.	0	27	3/16-15	222	27

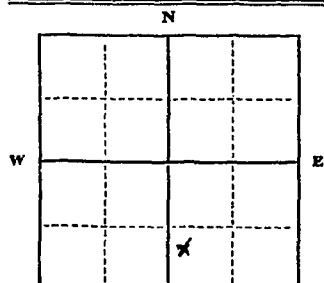

Static water level5.....ft.*
Pumping water level24.....ft.*
at4.5.....gallons per minute,
measured0.....minutes after pumping
began.

*Measured from ground level.

Well developed by ~~1991~~

for 2 hours.

Power _____ Pump _____ HP _____

Remarks: (Gravel packing cementing)

Remarks: (Gravel packing, cementing, packers, type of shutoff)

1. Name of _____

...7...100...01...63...V...04...000...

DES

Ag. 6.....

INDICATE LOCATION OF WELL AND PLACE OF USE, IF POSSIBLE.
EACH SMALL SQUARE REPRESENTS 40 ACRES.

Driller's Signature Charles W. R. Jr.

Driller's Address McVail Drilling Co., Victor, Ont.

LICENSE NO.....2110.....

Show exact depth of bottom

51,750

County Savalli

STATE OF MONTANA
ADMINISTRATOR OF GROUNDWATER CODE
MONTANA WATER RESOURCES BOARD

NOV 6 1972

DRILLER'S LOG

Indicate the character, color, thickness of strata such as soil, clay, sand, gravel, shale, sandstone, etc. Show depth at which water is found and height to which water rises in well.

NOTICE OF COMPLETION OF GROUNDWATER APPROPRIATION BY MEANS OF WELL

Developed after January 1, 1962

(Under Chapter 237 Montana Session Laws, 1961, as amended)

This form to be prepared by driller, and three copies to be filed by the **owner** with the County Clerk and Recorder in the county in which the well is located, last copy to be retained by driller.

Please answer all questions. If not applicable, so state, otherwise the form may be returned.

OWNED BY Blair & Blacker For Administrator's Use

Address Victor, Montana File #5242

Date well started Oct. 13, 1972 GW 1

completed Oct. 14, 1972

Type of well drilled well
(Dug, driven, bored or drilled)

Equipment used chain drill
(Chain drill, rotary or other)

Water Use: Domestic ☒ Municipal ☐ Stock ☐ Irrigation ☐

Industrial ☐ Drainage ☐ Other ☐* Garden/Lawn ☐

*Describe				
-----------	--	--	--	--

USE: If used for Irrigation, industrial, drainage or other. Explain, state number of acres and location or other data (i.e. Lot, Block and Addition).

ESTIMATED ANNUAL WITHDRAWAL

Size of Drilled Hole	Size and Weight of Casing	From (Feet)	To (Feet)	PERFORATIONS		
				Kind Size	From (Feet)	To (Feet)
6"	17#/ft.	0	27	3/16x5	22 1	27

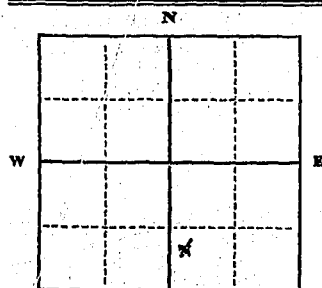

Static water level 5 ft.*
Pumping water level 24 ft.*
at 15 gallons per minute,
measured 60 minutes after pumping
began.

*Measured from ground level.

Well developed by ~~1910~~

for2.....hours.
Power..... Pump..... HP

Remarks: (Gravel packing, cementing,
packers, type of shutoff).....

1 Foot of gravel pack

S.E. 1/4 S.W. 1/4 Sec. 30

T. 8 (N) R. 20

INDICATE LOCATION OF WELL AND PLACE OF USE, IF POSSIBLE.
EACH SMALL SQUARE REPRESENTS 40 ACRES.

Driller's Signature Charles W. Webb Jr

Driller's Address Kavalli Drilling Co., Victor, Mont.

LICENSE NO.....230

27 Show exact depth of bottom

51,750

45742

I certify that I received and filed this
instrument on this 3rd
day of Nov. 19 92 at 1:55
o'clock P. M.

F. G. Moore
COUNTY RECORDER

By Fee 2.00
DEPUTY

G1

File No. 1728

T 8W R 20W 30

DUPLICATE

Ravalli County

STATE OF MONTANA
ADMINISTRATOR OF GROUNDWATER CODE
OFFICE OF STATE ENGINEER

Declaration of Vested Groundwater Rights
(Under Chapter 237, Montana Session Laws, 1961)

RECEIVED
MAY 16 1963
STATE ENGINEER

1. EDWARD A. + MARY BLAIR VICTOR MONTANA
(Name of Appropriator) (Address) (Town)

County of Ravalli, State of Montana, have appropriated groundwater according to the Montana laws in effect prior to January 1, 1962, as follows:

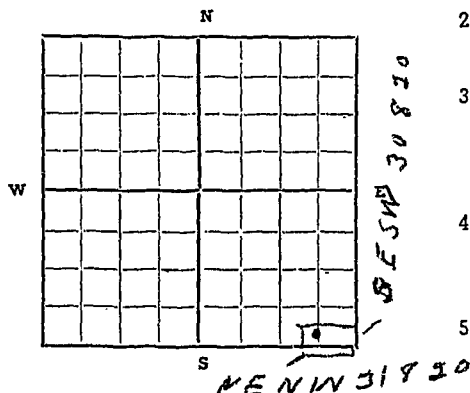

SE 1/4 Sec 30 T. 9 R. 20
Indicate point of appropriation
and place of use, if possible.
Each small square represents 10
acres.

2. The beneficial use on which the claim is based IRRIGATION + STOCK WATER
3. Date or approximate date of earliest beneficial use; and how continuous the use has been SEPT. 1, 1960
approx. 2/3 of the time thru summer
months, stock water in winter
4. The amount of groundwater claimed (in miner's inches or gallons per minute) 3.5 gal. per minute
5. If used for irrigation, give the acreage and description of the lands to which water has been applied and name of the owner thereof 6.62 Acres approx. S 34 1/2
of NW 7 20 NE 7 20 of SE 1/4 30 8 20
approx. N 55 1/2 W 22 0 of E 7 20 of NE NW
31 8 20 EDWARD A. + MARY M. BLAIR
6. The means of withdrawing such water from the ground and the location of each well or other means of withdrawal P.N.M. 2
195' E of W. LINE, 152' S. of N. LINE
525' W. of E. LINE, 193' N. of S. LINE

7. The date of commencement and completion of the construction of the well, wells, or other works for withdrawal of groundwater AUG. 10, 1960
FINISHED MARCH 20, 1961
8. The depth of water table WINTER TIME approx. 9'; SUMMER 2'
9. So far as it may be available, the type, size and depth of each well or the general specifications of any other works for the withdrawal of groundwater dug well
approx. 4 ft square 9 ft deep
pump elec. 2" in. suction + 1 1/2 in. discharge
10. The estimated amount of groundwater withdrawn each year 8,000,000 gal.
11. The log of formations encountered in the drilling of each well if available no log kept
But gravel & sand formation
12. Such other information of a similar nature as may be useful in carrying out the policy of this act, including reference to book and page of any county record water table varies
winter + summer due to irrigation well and
South of Victor

Edward A. Blair
Signature of Owner Mary M. Blair
Date _____

Three copies to be filed by the owner with the County Clerk and Recorder of the county in which the well is located.

Please answer all questions. If not applicable, so state, otherwise the form will be returned.

Original to the County Clerk and Recorder; duplicate to the State Engineer; Triplicate to the School of Mines and Quadruplicate for the Appropriator.

4384

I (we) do hereby certify and find the
improvements on this 14th
day of May 19 63 at 11:05
o'clock A.M.

F. M. Moore
COUNTY RECORDER

By _____ DEPUTY

Fee \$2.00 Pd.

RECORDED
MAY 14 1963
COUNTY CLERK

GW 2

File No. 8
1808

DUPLICATE

T 8N R 20W 30STATE OF MONTANA
ADMINISTRATOR OF GROUNDWATER CODE 1963
OFFICE OF STATE ENGINEERRECEIVED
STATE ENGINEERNotice of Completion of Groundwater
Appropriation by Means of Well

(Under Chapter 237, Montana Session Laws, 1961)

Owner Lloyd Boaz Address Kieler, MontDriller Bill Anderson Address Rt. 1, Box 19, Kieler

Date of Notice of Appropriation of Groundwater

Date well started Aug 5-63 Date Completed Aug 8-63Type of well drilled Equipment Used churn drill
(dug, driven, bored or (Churn, drill, rotary or
drilled) other)Water Use: Domestic (☒) Municipal () Stock () Irrigation ()
Industrial () Drainage () Other ()

← Indicate on the diagram the character and thickness of the different strata met with in drilling, such as soil, clay, shale, gravel, rock or sand, etc. Show depth at which water is encountered, thickness and character of water-bearing strata and height to which the water rises in the well.

Size of Drilled Hole	Size and Weight of Casing	From (Feet)	To (Feet)	PERFORATIONS		
				Kind Size	From (Feet)	To (Feet)
<u>4 in</u>	<u>10.75 pwt</u> <u>4 in</u>	<u>0</u>	<u>38</u>	<u>-</u>	<u>-</u>	<u>-</u>

Top of Ground
(Elev. above sea level 3500)

5
10
15
20
25
27
30
35
37
38

gravel
sand
clay
gravel
sand
gravel

N

W

E

X

Lat 3 Block 38 of Victor township

SW 1/4 Sec 30 T. 8N R. 20W

Indicate location of well and place of use, if possible. Each small square represents 10 acres.

Show exact depth of bottom

Static Water Level for non-flowing Well 3 feet.

Shut-in Pressure for Flowing Well

Pumping Water Level 20 feet at 6 gal. per minute.Discharge in gal., per min. of flowing well 10 per minHow Tested water Length of Test 4 hr

Remarks: (Gravel packing, cementing, packers, type of shutoff, Location of place of use of groundwater if not at well, and any other similar pertinent information, including number of acres irrigated, if used for irrigation)

33
Driller's License NumberBill Anderson
Driller's Signature

This form to be prepared by driller, and three copies to be filed by the owner with the County Clerk and Recorder in the county in which the well is located.

Please answer all questions. If not applicable, so state, otherwise the form will be returned.

Original to the County Clerk and Recorder; duplicate to the State Engineer; Triplicate to the School of Mines and Quadruplicate for the Appropriator.

5417

32
 31
 30
 29
 28
 27
 26
 25
 24
 23
 22
 21
 20
 19
 18
 17
 16
 15
 14
 13
 12
 11
 10
 9
 8
 7
 6
 5
 4
 3
 2
 1

I certify that I received and filed this
 instrument on this 15th
 day of August, 1963, at 8:25
 o'clock A.M.
 F. H. Moore
 COUNTY RECORDER

By _____
 DEPUTY

Fee \$2.00

Bill Simpson

Bill Simpson

10-2-13
 10-2-13

10-2-13
 10-2-13

10-2-13
 10-2-13

47990

#5378

I certify that I received and filed this
instrument on this 11th
day of Jan, 19 71, at 2:15
o'clock P.M.
E. G. Moore
COUNTY RECORDER
BY Lee 2.00
DEPUTY

JAN 12 1971

47990

File No. STATE WATER CONSERVATION BOARD

DUPLICATE

DEC 20 1965

T. 8^N R. 20^WCounty Parade

Billie _____ McDermott _____
 Butcher _____ **STATE OF MONTANA**
 Coyle _____ **ADMINISTRATOR OF GROUNDWATER CODE**
 Darlington _____ Sullivan _____
 Dickert _____ **OFFICE OF STATE ENGINEER**

Declaration of Vested Groundwater Rights

(Under Chapter 237, Montana Session Laws, 1961)

1. Shumock Cafe, of Paulson ST Livingston
 (Name of Appropriator) (Address) (Town)

County of Parade State of Montana
 have appropriated groundwater according to the Montana laws in effect prior to January 1, 1962, as follows:

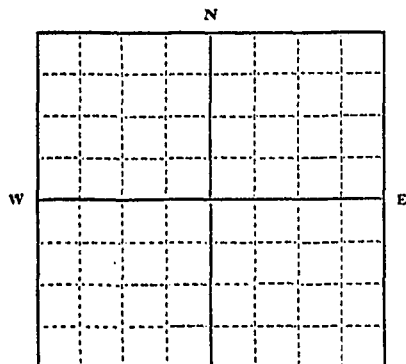

Indicate point of appropriation
 and place of use, if possible. Each
 small square represents 10 acres.

2. The beneficial use on which the claim is based. Household and farm

3. Date or approximate date of earliest beneficial use; and how continuous the use has been. Early

4. The amount of groundwater claimed (in miner's inches or gallons per minute). 1.5 gpm

5. If used for irrigation, give the acreage and description of the lands to which water has been applied and name of the owner thereof. farm

6. The means of withdrawing such water from the ground and the location of each well or other means of withdrawal. Electric Pump

7. The date of commencement and completion of the construction of the well, wells, or other works for withdrawal of groundwater. Not available

8. The depth of water table. 18 feet

9. So far as it may be available, the type, size and depth of each well or the general specifications of any other works for the withdrawal of groundwater. not available

10. The estimated amount of groundwater withdrawn each year. 10,000 gal.

11. The log of formations encountered in the drilling of each well if available. not available

12. Such other information of a similar nature as may be useful in carrying out the policy of this act, including reference to book and page of any county record. None

Signature of Owner. Shumock Cafe
Henry Harrington

Date. Dec 16 1965

Three copies to be filed by the owner with the County Clerk and Recorder of the county in which the well is located.

Please answer all questions. If not applicable, so state, otherwise the form will be returned.

Original to the County Clerk and Recorder; Duplicate to the State Engineer; Triplicate to the Montana Bureau of Mines and Geology, and Quadruplicate for the Appropriator.

40263

File No. STATE WATER CONSERVATION BOARD

DUPLICATE

DEC 20 1965

T. 8 N R. 20 WCounty Parade

Bille _____ McDermott _____
 Butzerin _____ McNulty _____
 Coyle _____ McADMINISTRATOR OF GROUNDWATER CODE
 Darlinton _____ Sullivan _____
 Dickert _____ OFFICE OF STATE ENGINEER

Declaration of Vested Groundwater Rights

(Under Chapter 237, Montana Session Laws, 1961)

1. Shamrock Cafe, of Railroad St Victor
 (Name of Appropriator) (Address) (Town)

County of Parade State of Montana
 have appropriated groundwater according to the Montana laws in effect prior to January 1, 1962, as follows:

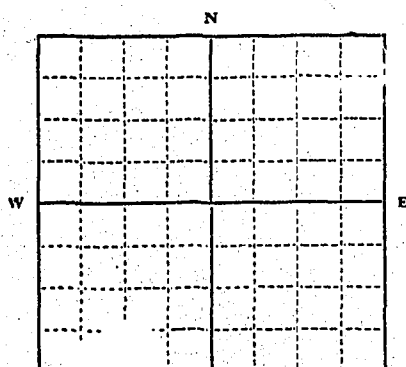

1/4 Sec. 30-8-20
 67 Dec. 30. 8. 20.

Indicate point of appropriation
 and place of use, if possible. Each
 small square represents 10 acres.

2. The beneficial use on which the claim is based. House hold and farm

3. Date or approximate date of earliest beneficial use; and how continuous the use has been. blatly

4. The amount of groundwater claimed (in miner's inches or gallons per minute). 1.5 gal per minute

5. If used for irrigation, give the acreage and description of the lands to which water has been applied and name of the owner thereof. farm

6. The means of withdrawing such water from the ground and the location of each well or other means of withdrawal. Electric Pump

7. The date of commencement and completion of the construction of the well, wells, or other works for withdrawal of groundwater. Not available

8. The depth of water table. 18 feet

9. So far as it may be available, the type, size and depth of each well or the general specifications of any other works for the withdrawal of groundwater. not available

10. The estimated amount of groundwater withdrawn each year. 10,000 gal.

11. The log of formations encountered in the drilling of each well if available. not available

12. Such other information of a similar nature as may be useful in carrying out the policy of this act, including reference to book and page of any county record. None

Signature of Owner Shamrock Cafe

Date Dec 16 1965

Three copies to be filed by the owner with the County Clerk and Recorder of the county in which the well is located.

Please answer all questions. If not applicable, so state, otherwise the form will be returned.

Original to the County Clerk and Recorder; Duplicate to the State Engineer; Triplicate to the Montana Bureau of Mines and Geology, and Quadruplicate for the Appropriator.

40063

#4658

167982

I certify that I received and filed this
instrument on this 16th
day of Dec., 19 65, at 1:50
o'clock P.M.

F. G. Moore

COUNTY RECORDER

By Myrna M. Ludwig
DEPUTY

Fee \$2.00

County.....Revalii

STATE OF MONTANA
ADMINISTRATOR OF GROUNDWATER CODE
MONTANA WATER RESOURCES BOARD

NOTICE OF COMPLETION OF GROUNDWATER APPROPRIATION BY MEANS OF WELL

Developed after January 1, 1962

(Under Chapter 237 Montana Session Laws, 1961, as amended)

This form to be prepared by driller, and three copies to be filed by the **owner** with the County Clerk and Recorder in the county in which the well is located, last copy to be retained by driller.

Please answer all questions. If not applicable, so state, otherwise the form may be returned.

Owner Mrs. Ray Newman

Address Victor, Montana

Date well started March 6, 1973

completed March 6, 1973

Type of well drilled well

(Dug, driven, bored or drilled)

Equipment used Churn drill

.....
(Churn drill, rotary or other)

Water Use: Domestic ☒ Municipal ☐ Stock ☐ Irrigation ☐

Industrial ☐ Drainage ☐ Other ☐* Garden/Lawn ☐

***Describe**

USE: If used for irrigation, industrial, drainage or other. Explain, state number of acres and location or other data (i.e. Lot, Block and Addition).

ESTIMATED ANNUAL WITHDRAWAL

Size of Drilled Hole	Size and Weight of Casing	From (Feet)	To (Feet)	PERFORATIONS		
				Kind Size	From (Feet)	To (Feet)
6"	17 1/2 lb	0	28	3/16 in	23	28

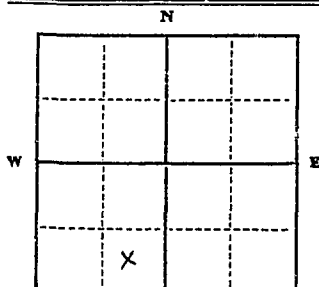

Static water level 12 ft.*
Pumping water level 25 ft.*
at 20 gallons per minute,
measured 30 minutes after pumping
began.

*Measured from ground level.
Well developed by pumping
for 12 hours.

Power..... Pump..... HP
Remarks: (Gravel packing, cementing,
packers, type of shutoff)
1 foot of gravel pack

In Block 526, Victor
In SE $\frac{1}{4}$ SW $\frac{1}{4}$ Sec. 30
T. 8 N R. 20 E
S W

INDICATE LOCATION OF WELL AND PLACE OF USE, IF POSSIBLE.
EACH SMALL SQUARE REPRESENTS 40 ACRES.

Driller's Signature Charles W. Noble Jr.

Driller's Address Ravalli Drilling

Victor Mont. LICENSE NO. 200

LICENSE NO. 200

DRILLER'S LOG

Indicate the character, color, thickness of strata such as soil, clay, sand, gravel, shale, sandstone, etc. Show depth at which water is found and height to which water rises in well.

Top of Ground

(Elev. above sea level)

[illegible]

28

Show exact depth of bottom

52,625

5830

I certify that I received and filed this
instrument on this 13th
day of March, 1923, at 11:55
o'clock A.M.
Charles E. Hughes
COUNTY RECORDER
By Jan 2.00
DEPUTY

#5701

I certify that I received and filed this
instrument on this 28th
day of Aug, 19 72 at 4:20
o'clock P. M.
F. S. Moore
COUNTY RECORDER
By Fee 2.00
DEPUTY

RECEIVED

County Ravalli

STATE OF MONTANA
ADMINISTRATOR OF GROUNDWATER CODE
MONTANA WATER RESOURCES BOARD

DRILLER'S LOG

NOTICE OF COMPLETION OF GROUNDWATER
APPROPRIATION BY MEANS OF WELL

Developed after January 1, 1962

(Under Chapter 237 Montana Session Laws, 1961, as amended)

This form to be prepared by driller and three copies to be filed by the owner with the County Clerk and Recorder in the county in which the well is located, last copy to be retained by driller.

Please answer all questions. If not applicable, so state, otherwise the form may be returned.

Owner Farmers State

Address Victor, Mont.

For Administrator's Use

File 5848

March 22, 1973

Date well started 3-8-73

GW 1 2:45 p.m.

completed 3-9-73

Type of well drilled

(Dug, driven, bored or drilled)

Equipment used rotary

(Churn drill, rotary or other)

Water Use: Domestic ☐ Municipal ☒ Stock ☐ Irrigation ☐

Industrial ☐ Drainage ☐ Other ☐* Garden/Lawn ☐

*Describe

USE: If used for irrigation, industrial, drainage or other. Explain, state number of acres and location or other data (i.e. Lot, Block and Addition).

LOTS 5, 6, 7, 8, 9, 10, 11, & LOT 31
BLOCK 2, VICTOR TOWN SITE

ESTIMATED ANNUAL WITHDRAWAL 500,000 GALS

Size of Drilled Hole	Size and Weight of Casing	From (Feet)	To (Feet)	PERFORATIONS
<u>6"</u>	<u>280 well 19 lbs</u>	<u>0'</u>	<u>84'</u>	<u>none</u>

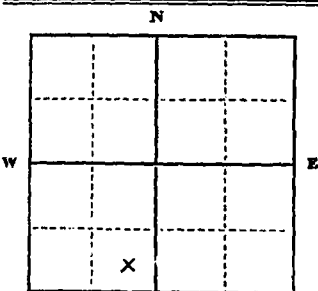

Static water level 38 ft.*
Pumping water level 72 ft.*
at 25 gallons per minute,
measured 60 minutes after pumping began.

*Measured from ground level.
Well developed by A.R.
for 2 hours.

Power..... Pump..... HP
Remarks: (Gravel packing, cementing, packers, type of shutoff)

WELL LOCATION - LOT 31 - BLOCK 2
SE 1/4 SW 1/4 Sec 30 VICTOR TOWN SITE
T. 8 N. R. 20 S. W. W

INDICATE LOCATION OF WELL AND PLACE OF USE, IF POSSIBLE. EACH SMALL SQUARE REPRESENTS 40 ACRES.

Driller's Signature Bill Preston Jr.

Driller's Address Box 977 Hamilton
Mont. 59840 LICENSE NO. 125

Top of Ground (Feet above sea level)	
From (Feet)	To (Feet)
<u>9</u>	<u>10</u> <u>sand + gravel</u>
<u>10</u>	<u>30</u> <u>sand + gravel</u>
<u>30</u>	<u>50</u> <u>yellow clay, gravel</u>
<u>50</u>	<u>70</u> <u>sand</u>
<u>70</u>	<u>74</u> <u>blue clay</u>
<u>74</u>	<u>84</u> <u>productive water</u>
<u>84</u>	<u>94</u> <u>gravel</u>

84' Show exact depth of bottom

5248

I certify that I received and filed this
instrument on this 27th
day of March, 1923, at 2:45
o'clock P. M.

D. Calene E. Hughes
Clerk of the Court

By H. M. 2.00
Deputy

53,764

5963

I certify that I received and filed this
instrument on this 21st
day of June, 19 23, at 2:15
o'clock P.M.
Deane E. Hughes
COUNTY RECORDER
By Her. J. Co.
DEPUTY

STATE OF MONTANA
ADMINISTRATOR OF GROUNDWATER CODE
MONTANA WATER RESOURCES BOARD

NOTICE OF COMPLETION OF GROUNDWATER
APPROPRIATION BY MEANS OF WELL

Developed after January 1, 1962

(Under Chapter 237 Montana Session Laws, 1961, as amended)

This form to be prepared by driller, and three copies to be filed by the owner with the County Clerk and Recorder in the county in which the well is located, last copy to be retained by driller. Please answer all questions. If not applicable, so state, otherwise the form may be returned.

Owner Helen Kittel Roberts
Address Box 73
Victor, Mont. 59875
Date well started 5-1-73
completed 5-20-73

For Administrator's Use	
File	<u>6018</u>
	<u>6-29-73</u>
GW 1	<u>11-25-11-25</u>

Type of well Dug
(Dug, driven, bored or drilled)
Equipment used by hand & backhoe
(Churn drill, rotary or other)
Water Use: Domestic ☐ Municipal ☐ Stock ☐ Irrigation ☐
Industrial ☐ Drainage ☐ Other ☐* Garden/Lawn ☐

*Describe
USE: If used for irrigation, industrial, drainage or other. Explain, state number of acres and location or other data (i.e. Lot, Block and Addition).

ESTIMATED ANNUAL WITHDRAWAL 375,000

Size of Drilled Hole	Size and Weight of Casing	From (Feet)	To (Feet)	PERFORATIONS		
<u>3 ft. diam.</u>	<u>8" CP</u>	<u>2 ft.</u>	<u>12</u>	Kind Size	From (Feet)	To (Feet)
				<u>1/8" x 3" slot</u>	<u>2</u>	<u>12</u>

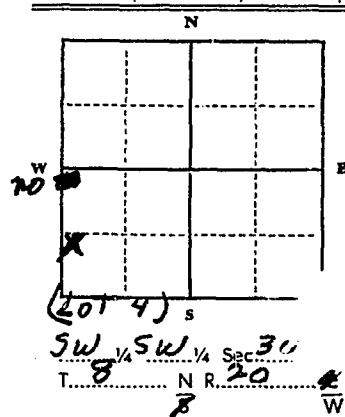

Static water level 2 ft.*
Pumping water level 2 1/2 ft.*
at 10 gallons per minute,
measured 1 minutes after pumping began.
*Measured from ground level.
Well developed by _____
for _____ hours.
Power _____ Pump _____ HP
Remarks: (Gravel packing, cementing, packers, type of shutoff)

INDICATE LOCATION OF WELL AND PLACE OF USE, IF POSSIBLE. EACH SMALL SQUARE REPRESENTS 40 ACRES.

Driller's Signature Helen Kittel Roberts
Driller's Address _____

LICENSE NO. _____

RECEIVED

County _____
DRILLER'S LOG

5. Indicate the character, color, thickness of strata such as soil, clay, sand, gravel, shale, sandstone, etc. Show depth at which water is found and height to which water rises in well.

Top of Ground (Elev. above sea level)

From (Feet)	To (Feet)	
<u>0</u>	<u>12</u>	<u>Soil & gravel</u>
		<u>Water found at</u>
		<u>2 feet</u>
		<u>Water rises to</u>
		<u>2 feet from</u>
		<u>ground level</u>

Show exact depth of bottom

53544

6018

I certify that I received and filed this

Statement on this 29th

day of June, 1923, at 11:25

o'clock A.M.

Charles E. Hays

COUNTY RECORDER

By H. J. O.

DEPUTY

File No. *Sup.*

T. *8^N* R. *2^W* S. *30¹*

Ravalli
Ravalli County

STATE OF MONTANA
ADMINISTRATOR OF GROUNDWATER CODE
OFFICE OF STATE ENGINEER

JAN 17 1964

DECLARATION OF VESTED GROUNDWATER RIGHTS
(Under Chapter 237, Montana Session Laws, 1961)

1. *Ervin Rath* of *Victor* (Town)
(Name of Appropriator) (Address) (Town)
County of *Ravalli*, State of *Montana*, have appropriated groundwater according to the Montana laws in effect prior to January 1, *1940* as follows:

2. The beneficial use on which the claim is based. *Stock*

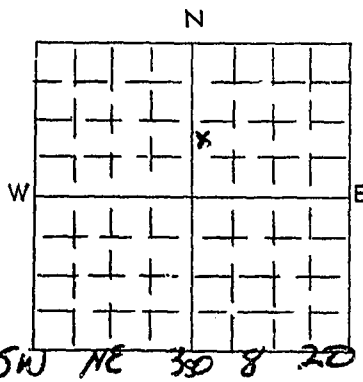

.... 1/4 Sec. T. R.
Indicate point of appropriation and place of use, if possible. Each small square represents 10 acres.

3. Date or approximate date of earliest beneficial use, and how long since the use has been *Stock*
Water Irrigation
1940

4. The amount of groundwater claimed (in miner's inches or gallons per minute) *Continuous*
300 gal per minute

5. If used for irrigation, give the acreage and description of the lands to which water has been applied and name of the owner thereof.

SW 1/4 NE 1/4 30-8-20
6. The means of withdrawing such water from the ground and the location of each well or other means of withdrawal.

7. The date of commencement and completion of the construction of the well, wells or other works for withdrawal of groundwater.

8. The depth of water table. *1940*

9. So far as it may be available, the type, size and depth of each well or the general specifications of any other works for the withdrawal of groundwater.

Surface Water
10 Horse Motor
4 inch

10. The estimated amount of groundwater withdrawn each year.

11. The log of formations encountered in the drilling of each well if available. *77,760,000*

12. Such other information of a similar nature as may be useful in carrying out the policy of this act, including reference to book and page of any county record.

Signature of Owner *Ervin Rath*
Date

Three copies to be filed by the owner with the County Clerk and Recorder of the county in which the well is located.

Please answer all questions. If not applicable, so state, otherwise the form will be returned.

Original to the County Clerk and Recorder; duplicate to the State Engineer; Triplicate to the School of Mines and Quadruplicate for the Appropriator.

#4030

I certify that I received and filed this
instrument on this 31st
day of Dec., 1963, at 3:19
o'clock P. M.
F. G. Moore
COUNTY RECORDER
By Ashley Keith
DEPUTY

File No.

T.

8 N 25 W 30
Ravalli County
D

STATE OF MONTANA
ADMINISTRATOR OF GROUNDWATER CODE
OFFICE OF STATE ENGINEER

JAN 17 1964

DECLARATION OF VESTED GROUNDWATER RIGHTS
(Under Chapter 237, Montana Session Laws, 1961)

STATE ENGINEER

1. Ervin Rath (Name of Appropriator) of St. Ignace (Town) County of Ravalli, State of Montana, have appropriated groundwater according to the Montana laws in effect prior to January 1, 1925, as follows:

2. The beneficial use on which the claim is based.

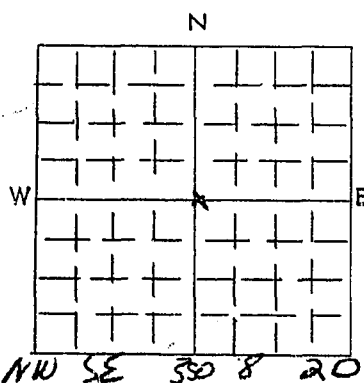

.... 1/4 Sec. T. R.

Indicate point of appropriation and place of use, if possible. Each small square represents 10 acres.

3. The date of commencement and completion of the construction of the well, wells, or other works for withdrawal of groundwater.

4. The depth of water table.

5. So far as it may be available, the type, size and depth of each well or the general specifications of any other works for the withdrawal of groundwater.

6. The estimated amount of groundwater withdrawn each year.

7. The log of formations encountered in the drilling of each well if available.

8. Such other information of a similar nature as may be useful in carrying out the policy of this act, including reference to book and page of any county record.

Signature of Owner Ervin Rath

Date.

Three copies to be filed by the owner with the County Clerk and Recorder of the county in which the well is located.

Please answer all questions. If not applicable, so state, otherwise the form will be returned.

Original to the County Clerk and Recorder; duplicate to the State Engineer; Triplicate to the School of Mines and Quadruplicate for the Appropriator.

39595

4031

I certify that I received and filed this
instrument on this 31st
day of Dec., 1963, at 3:20
o'clock P.M.

F. H. Moore
COUNTY RECORDER
By Shirley Keith
DEPUTY

File No.

T. 8^N 20^W 30^R
Ravalli County

STATE OF MONTANA
ADMINISTRATOR OF GROUNDWATER CODE
OFFICE OF STATE ENGINEER

DECLARATION OF VESTED GROUNDWATER RIGHTS
(Under Chapter 237, Montana Session Laws, 1961)

1. Ervin Rath of Victor
(Name of Appropriator) (Address) (Town)
County of Ravalli, State of Montana, have appropriated groundwater according to the Montana laws in effect
prior to January 1, 1962.

2. The beneficial use on which the claim is based.

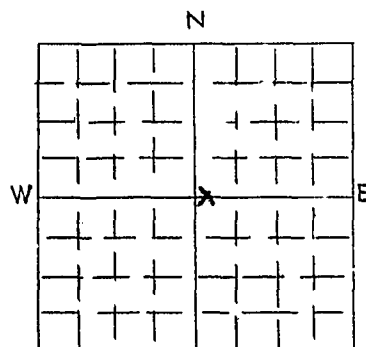

.... 1/4 Sec. T. R.
Indicate point of appropriation and
place of use, if possible. Each small
square represents 10 acres.

3. Date or approximate date of earliest beneficial use, and how
continuous the use has been. Domestic

4. The amount of groundwater claimed (in miner's inches or gallons
per minute). 1955

5. If used for irrigation, give the acreage and description of the
lands to which water has been applied and name of the owner
thereof. 1000 Acres

6. The location of each well or other means of withdrawal
from the ground and the location of each well or other means of withdrawal. NW 1/4 55 14 30-8-20

7. The date of commencement and completion of the construction of the well, wells, or other works for with-
drawal of groundwater. Electric Pump

8. The depth of water table. 1955

9. So far as it may be available, the type, size and depth of each well or the general specifications of any
other works for the withdrawal of groundwater. 4 inch casing

10. The estimated amount of groundwater withdrawn each year. 30 ft

11. The log of formations encountered in the drilling of each well if available. 1,000,000,000

12. Such other information of a similar nature as may be useful in carrying out the policy of this act, including
reference to book and page of any county record.

Signature of Owner Ervin Rath
Date

Three copies to be filed by the owner with the County Clerk and Recorder of the county in which the well is
located.

Please answer all questions. If not applicable, so state, otherwise the form will be returned. 63

Original to the County Clerk and Recorder; duplicate to the State Engineer; Triplicate to the School of Mines
and Quadruplicate for the Appropriator.

#4032

I certify that I received and filed this
instrument on this 31st
day of Nov, 19 63, at 3:21
o'clock P.M.
F. Y. Moore
COUNTY RECORDER
By Shirley Keith
DEPUTY