

RECEIVED

County Beavertail

STATE OF MONTANA
ADMINISTRATOR OF GROUNDWATER CODE
MONTANA WATER RESOURCES BOARD

NOTICE OF COMPLETION OF GROUNDWATER
APPROPRIATION BY MEANS OF WELL
Developed after January 1, 1962

(Under Chapter 237 Montana Session Laws, 1961, as amended)

This form to be prepared by driller, and three copies to be filed by the owner with the County Clerk and Recorder in the county in which the well is located, last copy to be retained by driller.

Please answer all questions. If not applicable, so state, otherwise the form may be returned.

Owner Otto Weigand
and Beth Weigand
Address 2-9-72

Stevensville Mont

Date well started 2-9-72

completed Jun 27, 1973

Type of well drilled
(Dug, driven, bored or drilled)

Equipment used churn drill
(Churn drill, rotary or other)

Water Use: Domestic Municipal Stock Irrigation

Industrial Drainage Other * Garden/Lawn

*Describe

USE: If used for irrigation, industrial, drainage or other. Explain, state number of acres and location or other data (i.e. Lot, Block and Addition).

ESTIMATED ANNUAL WITHDRAWAL 17,520,000 gallons

Size of Drilled Hole	Size and Weight of Casing	From (Feet)	To (Feet)	PERFORATIONS		
				Wind Size	From (Feet)	To (Feet)
<u>6 1/2</u>	<u>2 3/4 OD</u>	<u>0</u>	<u>150</u>			
	<u>New steel pipe</u>					
	<u>17 lb.</u>					

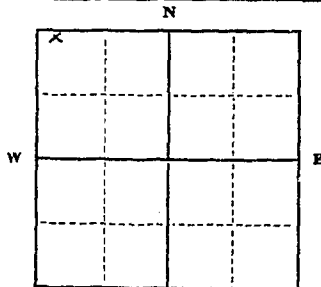

NW 1/4 NW 1/4 Sec. 35
T. 9 N. R. 20 E. 5
S. W.

INDICATE LOCATION OF WELL AND PLACE OF USE, IF POSSIBLE. EACH SMALL SQUARE REPRESENTS 40 ACRES.

Driller's Signature Bill Lester

Driller's Address Box 58 Beavertail

Mont LICENSE NO. 125

DRILLER'S LOG

Indicate the character, color, thickness of strata such as soil, clay, sand, gravel, shale, sandstone, etc. Show depth at which water is found and height to which water rises in well.

Top of Ground (Elev. above sea level)

From (Feet)	To (Feet)	
<u>0</u>	<u>1</u>	<u>Top soil</u>
<u>1</u>	<u>30</u>	<u>gravel boulders</u>
<u>30</u>	<u>40</u>	<u>clay</u>
<u>40</u>	<u>50</u>	<u>sand water</u>
<u>50</u>	<u>80</u>	<u>sand + clay</u>
<u>80</u>	<u>100</u>	<u>clay yellow</u>
<u>100</u>	<u>130</u>	<u>clay</u>
<u>130</u>	<u>137</u>	<u>clay water</u>
<u>137</u>	<u>150</u>	<u>clay</u>
<u>150</u>	<u>153</u>	<u>sand</u>

Static water level 80 ft.*
Pumping water level 140 ft.*
at 10 gallons per minute,
measured 30 minutes after pumping
began.

*Measured from ground level.
Well developed by PUMP
for 3 hours.
Power 220 Pump 3 HP
Remarks: (Gravel packing, cementing,
packers, type of shutoff)

150 Show exact depth of bottom

55551

6011

I certify that I received and filed this
instrument on this 29th
day of June 1923 at 8:00
o'clock A.M.

Darlene E. Hughes
COUNTY RECORDER

BY Hec 2.00
DEPOS

File No. 1968

T 9 N R 20 W

DUPLICATE

Ravalli County

STATE OF MONTANA
ADMINISTRATOR OF GROUNDWATER CODE
OFFICE OF STATE ENGINEER

Declaration of Vested Groundwater Rights
(Under Chapter 237, Montana Session Laws, 1961)

RECEIVED
DEC 18 1968
STATE ENGINEER

1. Kenneth B. Rue of Steersville, Mont. (Name of Appropriator) (Address) (Town)

County of Ravalli, State of Montana, have appropriated groundwater according to the Montana laws in effect prior to January 1, 1962, as follows:

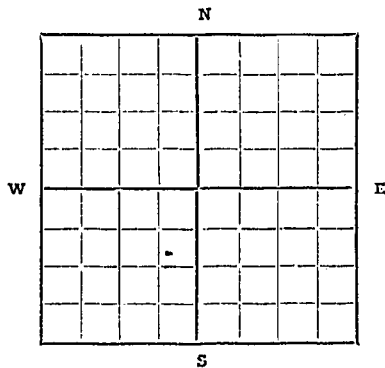

NE 1/4 SW Sec. 35, T. 9, R. 20
Indicate point of appropriation and place of use, if possible. Each small square represents 10 acres.

- 2. The beneficial use on which the claim is based home water and stock water
- 3. Date or approximate date of earliest beneficial use; and how continuous the use has been February 10, 1955 used continuously since
- 4. The amount of groundwater claimed (in miner's inches or gallons per minute) 30 inches
- 5. If used for irrigation, give the acreage and description of the lands to which water has been applied and name of the owner thereof
- 6. The means of withdrawing such water from the ground and the location of each well or other means of withdrawal Collection Pump

- 7. The date of commencement and completion of the construction of the well, wells, or other works for withdrawal of groundwater Feb. 5, 1955 - Feb. 10, 1955
- 8. The depth of water table 18 feet
- 9. So far as it may be available, the type, size and depth of, each well or the general specifications of any other works for the withdrawal of groundwater hand dug well approximately 55 feet deep and about five feet in diameter
- 10. The estimated amount of groundwater withdrawn each year 75,000 gallons
- 11. The log of formations encountered in the drilling of each well if available
- 12. Such other information of a similar nature as may be useful in carrying out the policy of this act, including reference to book and page of any county record

Signature of Owner Kenneth B. Rue
Date 12/16/68

Three copies to be filed by the owner with the County Clerk and Recorder of the county in which the well is located.

Please answer all questions. If not applicable, so state, otherwise the form will be returned.

Original to the County Clerk and Recorder; duplicate to the State Engineer; Triplicate to the School of Mines and Quadruplicate for the Appropriator.

I certify that I received and filed this
instrument on this.....16th.....
day of.....Dec....., 1963..... at.....2:30
o'clock.....P.....M.

F. S. Moore
COUNTY RECORDER

By.....
DEPUTY

STATE OF MONTANA
ADMINISTRATOR OF GROUNDWATER CODE
MONTANA WATER RESOURCES BOARD

NOTICE OF COMPLETION OF GROUNDWATER
APPROPRIATION BY MEANS OF WELL

Developed after January 1, 1962

(Under Chapter 237 Montana Session Laws, 1961, as amended)

This form to be prepared by driller, and three copies to be filed by the owner with the County Clerk and Recorder in the county in which the well is located, last copy to be retained by driller.

Please answer all questions. If not applicable, so state, otherwise the form may be returned.

Owner Tadewak
Address 314 S. SYLVIA ST. BOZEMAN, MONT.
Date well started APR 18, 1972
completed APR 18, 1972

For Administrator's Use	
File #	<u>5602, 19/603</u>
Date	<u>April 18, 1972 2:10 pm</u>
GW #	<u>GW 1</u>

Type of well Grilled
(Dug, driven, bored or drilled)
Equipment used Churn Drill
(Churn drill, rotary or other)
Water Use: Domestic Municipal Stock Irrigation
Industrial Drainage Other * Garden/Lawn

*Describe _____
USE: If used for irrigation, industrial, drainage or other. Explain, state number of acres and location or other data (i.e. Lot, Block and Addition).

ESTIMATED ANNUAL WITHDRAWAL

Size of Drilled Hole	Size and Weight of Casing	From (Feet)	To (Feet)	PERFORATIONS		
				Kind Size	From (Feet)	To (Feet)
6"	7 lbs per ft.	0	35	3/16" x 5	10	13

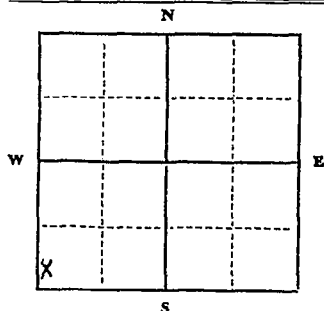

Sh. 1/4 Sh. 1/4 Sec. 35
T. 9 N. R. 20 E.
8 W

INDICATE LOCATION OF WELL AND PLACE OF USE, IF POSSIBLE. EACH SMALL SQUARE REPRESENTS 40 ACRES.

Driller's Signature Charles Wroble Jr.
Driller's Address Victor, Montana 59725
LICENSE NO. _____

County _____

DRILLER'S LOG

Indicate the character, color, thickness of strata such as soil, clay, sand, gravel, shale, sandstone, etc. Show depth at which water is found and height to which water rises in well.

Top of Ground (Elev. above sea level)		
From (Feet)	To (Feet)	
0	1	DIRTY
1	10	DIRTY GRAVEL AND SAND
10	15	SANDY SILT
15	20	SANDY SILT
20	25	SANDY SILT
25	30	SANDY SILT
30	35	SANDY SILT
35	40	SANDY SILT
40	45	SANDY SILT
45	50	SANDY SILT
50	55	SANDY SILT
55	60	SANDY SILT
60	65	SANDY SILT
65	70	SANDY SILT
70	75	SANDY SILT
75	80	SANDY SILT
80	85	SANDY SILT
85	90	SANDY SILT
90	95	SANDY SILT
95	100	SANDY SILT
100	105	SANDY SILT
105	110	SANDY SILT
110	115	SANDY SILT
115	120	SANDY SILT
120	125	SANDY SILT
125	130	SANDY SILT
130	135	SANDY SILT
135	140	SANDY SILT
140	145	SANDY SILT
145	150	SANDY SILT
150	155	SANDY SILT
155	160	SANDY SILT
160	165	SANDY SILT
165	170	SANDY SILT
170	175	SANDY SILT
175	180	SANDY SILT
180	185	SANDY SILT
185	190	SANDY SILT
190	195	SANDY SILT
195	200	SANDY SILT
200	205	SANDY SILT
205	210	SANDY SILT
210	215	SANDY SILT
215	220	SANDY SILT
220	225	SANDY SILT
225	230	SANDY SILT
230	235	SANDY SILT
235	240	SANDY SILT
240	245	SANDY SILT
245	250	SANDY SILT
250	255	SANDY SILT
255	260	SANDY SILT
260	265	SANDY SILT
265	270	SANDY SILT
270	275	SANDY SILT
275	280	SANDY SILT
280	285	SANDY SILT
285	290	SANDY SILT
290	295	SANDY SILT
295	300	SANDY SILT
300	305	SANDY SILT
305	310	SANDY SILT
310	315	SANDY SILT
315	320	SANDY SILT
320	325	SANDY SILT
325	330	SANDY SILT
330	335	SANDY SILT
335	340	SANDY SILT
340	345	SANDY SILT
345	350	SANDY SILT
350	355	SANDY SILT
355	360	SANDY SILT
360	365	SANDY SILT
365	370	SANDY SILT
370	375	SANDY SILT
375	380	SANDY SILT
380	385	SANDY SILT
385	390	SANDY SILT
390	395	SANDY SILT
395	400	SANDY SILT
400	405	SANDY SILT
405	410	SANDY SILT
410	415	SANDY SILT
415	420	SANDY SILT
420	425	SANDY SILT
425	430	SANDY SILT
430	435	SANDY SILT
435	440	SANDY SILT
440	445	SANDY SILT
445	450	SANDY SILT
450	455	SANDY SILT
455	460	SANDY SILT
460	465	SANDY SILT
465	470	SANDY SILT
470	475	SANDY SILT
475	480	SANDY SILT
480	485	SANDY SILT
485	490	SANDY SILT
490	495	SANDY SILT
495	500	SANDY SILT
500	505	SANDY SILT
505	510	SANDY SILT
510	515	SANDY SILT
515	520	SANDY SILT
520	525	SANDY SILT
525	530	SANDY SILT
530	535	SANDY SILT
535	540	SANDY SILT
540	545	SANDY SILT
545	550	SANDY SILT
550	555	SANDY SILT
555	560	SANDY SILT
560	565	SANDY SILT
565	570	SANDY SILT
570	575	SANDY SILT
575	580	SANDY SILT
580	585	SANDY SILT
585	590	SANDY SILT
590	595	SANDY SILT
595	600	SANDY SILT
600	605	SANDY SILT
605	610	SANDY SILT
610	615	SANDY SILT
615	620	SANDY SILT
620	625	SANDY SILT
625	630	SANDY SILT
630	635	SANDY SILT
635	640	SANDY SILT
640	645	SANDY SILT
645	650	SANDY SILT
650	655	SANDY SILT
655	660	SANDY SILT
660	665	SANDY SILT
665	670	SANDY SILT
670	675	SANDY SILT
675	680	SANDY SILT
680	685	SANDY SILT
685	690	SANDY SILT
690	695	SANDY SILT
695	700	SANDY SILT
700	705	SANDY SILT
705	710	SANDY SILT
710	715	SANDY SILT
715	720	SANDY SILT
720	725	SANDY SILT
725	730	SANDY SILT
730	735	SANDY SILT
735	740	SANDY SILT
740	745	SANDY SILT
745	750	SANDY SILT
750	755	SANDY SILT
755	760	SANDY SILT
760	765	SANDY SILT
765	770	SANDY SILT
770	775	SANDY SILT
775	780	SANDY SILT
780	785	SANDY SILT
785	790	SANDY SILT
790	795	SANDY SILT
795	800	SANDY SILT
800	805	SANDY SILT
805	810	SANDY SILT
810	815	SANDY SILT
815	820	SANDY SILT
820	825	SANDY SILT
825	830	SANDY SILT
830	835	SANDY SILT
835	840	SANDY SILT
840	845	SANDY SILT
845	850	SANDY SILT
850	855	SANDY SILT
855	860	SANDY SILT
860	865	SANDY SILT
865	870	SANDY SILT
870	875	SANDY SILT
875	880	SANDY SILT
880	885	SANDY SILT
885	890	SANDY SILT
890	895	SANDY SILT
895	900	SANDY SILT
900	905	SANDY SILT
905	910	SANDY SILT
910	915	SANDY SILT
915	920	SANDY SILT
920	925	SANDY SILT
925	930	SANDY SILT
930	935	SANDY SILT
935	940	SANDY SILT
940	945	SANDY SILT
945	950	SANDY SILT
950	955	SANDY SILT
955	960	SANDY SILT
960	965	SANDY SILT
965	970	SANDY SILT
970	975	SANDY SILT
975	980	SANDY SILT
980	985	SANDY SILT
985	990	SANDY SILT
990	995	SANDY SILT
995	1000	SANDY SILT

Show exact depth of bottom

50,230

#5602

191608

I certify that I received and filed this
instrument on this 18th
day of April, 1972, at 2:10
o'clock P.M.

F. S. Moore
COUNTY RECORDER

By F. S. Moore
DEPUTY

#5438

I certify that I received and filed this
instrument on this 20th
day of May, 1971, at 4:10
o'clock PM
F. G. Moore
COUNTY RECORDER
F. L. 2.00
DEPUTY

5778

I certify that I received and filed this instrument on this 22nd day of Dec, 1922, at 10:15 o'clock A.M.

F. C. Moore
COUNTY RECORDER

By Charles E. Hughes
DEPUTY

W. L. D. 00

RECORDED
INDEXED
DEC 22 1922

100-100
100-100
100-100
100-100

100-100
100-100
100-100
100-100
100-100
100-100
100-100
100-100
100-100
100-100

RECORDED

File No. 2109

T. 2 R. 20W

DUPLICATE

County Beaumont

STATE OF MONTANA
ADMINISTRATOR OF GROUNDWATER CODE
OFFICE OF STATE ENGINEER

RECEIVED
DEC 28 1963

STATE ENGINEER
**Notice of Completion of Groundwater Appropriation
Without Well**

(Under Chapter 237 Montana Session Laws, 1961)

Date of Appropriation of Groundwater Dec 18 1963

Owner John F. Bennett Address Hecla, Wyo.

Contractor (if any) NONE

Address of Contractor NONE

Date Started NONE Date Completed NONE

Describe means of obtaining groundwater without a well "as by sub-irrigation and other natural processes". Include depth to water when applicable. Natural spring
water rising in
when irrigated land
water

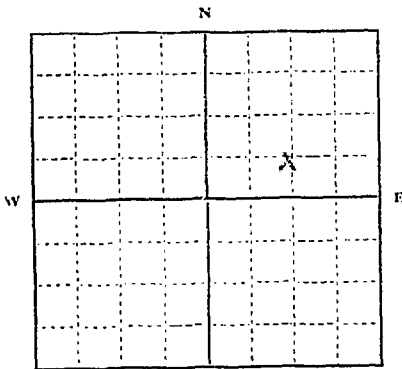

1/4 Sec 36 T 7 R 20

Indicate point of appropriation and place of use, if possible.

2-5 1/2 NE

2-3E NW

Quantity of water developed and used with explanation of method used to measure or estimate such amount. If use is intermittent

estimate approximate lengths of periods of use.....

Approximately 10 to 100 gallons
water is used to irrigate
part of land belonging to
owner for approximately 100
to 150 days per year

Signature of Owner John F. Bennett

Date Dec 18 1963

This form to be prepared by contractor (if any), otherwise by the owner.

Three copies of this notice are to be filed with the County Clerk and Recorder of the county in which the works are located.

Please answer all questions. If not applicable, so state, otherwise the form will be returned.

Original to the County Clerk and Recorder; duplicate to the State Engineer; Triplicate to the Montana Bureau of Mines and Geology and Quadruplicate for the Appropriator.

File No. 2119

T. V. R. ...

DUPLICATE

County ...

STATE OF MONTANA
ADMINISTRATOR OF GROUNDWATER CODE
OFFICE OF STATE ENGINEER

RECEIVED
DEC 26 1963

Notice of Completion of Groundwater Appropriation Without Well

(Under Chapter 237 Montana Session Laws, 1961)

Date of Appropriation of Groundwater ...

Owner ... Address ...

Contractor (if any) ...

Address of Contractor ...

Date Started ... Date Completed ...

Describe means of obtaining groundwater without a well "as by sub-irrigation and other natural processes". Include depth to water when applicable.

Water ...
when ...
...

Quantity of water developed and used with explanation of method used to measure or estimate such amount. If use is intermittent

estimate approximate lengths of periods of use.

Signature of Owner ...

Date ...

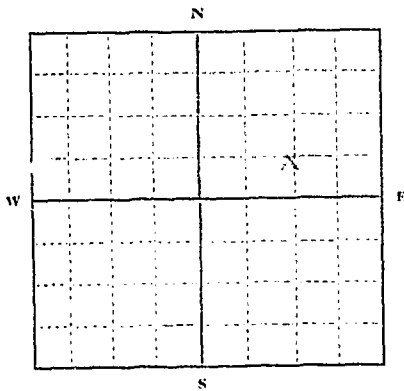

1/4 Sec. 24 T. 2 R. 10
Indicate point of appropriation and place of use, if possible.

4-5 ...
2-3 ...

This form to be prepared by contractor (if any), otherwise by the owner.

Three copies of this notice are to be filed with the County Clerk and Recorder of the county in which the works are located.

Please answer all questions. If not applicable, so state, otherwise the form will be returned.

Original to the County Clerk and Recorder; duplicate to the State Engineer; Triplicate to the Montana Bureau of Mines and Geology and Quadruplicate for the Appropriator.

I certify that I received and filed this
instrument on this 23
day of Dec 1963, at 4:04
o'clock P.M.

F. S. Moore
COUNTY RECORDER

By _____ DEPUTY

36

File No.

T 9N R 20 West

DUPLICATE

County

STATE OF MONTANA
ADMINISTRATOR OF GROUNDWATER CODE
OFFICE OF STATE ENGINEER

RECEIVED
JAN 8 1964

Declaration of Vested Groundwater Rights

(Under Chapter 237, Montana Session Laws, 1961)

1. Daniel W. Cronin, of Star Route Stevensville
(Name of Appropriator) (Address) (Town)
County of Ravalli State of Montana
have appropriated groundwater according to the Montana laws in effect prior to January 1, 1962, as follows:

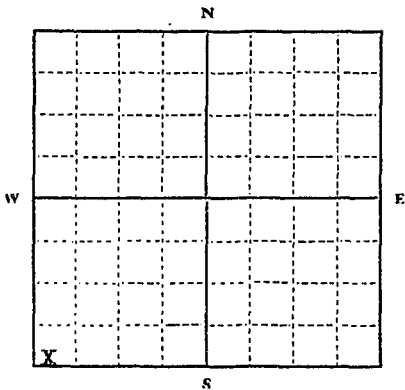

sw 1/4 sw. Sec. 35. T. 9. R. 20.
Indicate point of appropriation
and place of use, if possible. Each
small square represents 10 acres.

- 2. The beneficial use on which the claim is based Household, garden lawn, barn & livestock
- 3. Date or approximate date of earliest beneficial use; and how continuous the use has been May 28, 1889 continuous
- 4. The amount of groundwater claimed (in miner's inches or gallons per minute) 780 gal per flow
- 5. If used for irrigation, give the acreage and description of the lands to which water has been applied and name of the owner thereof Domestic Household and Yard
- 6. The means of withdrawing such water from the ground and the location of each well or other means of withdrawal Clect. Pump

- 7. The date of commencement and completion of the construction of the well, wells, or other works for withdrawal of groundwater May 28, 1889
- 8. The depth of water table 6 to 8 Ft
- 9. So far as it may be available, the type, size and depth of each well or the general specifications of any other works for the withdrawal of groundwater depth 15 Ft
- 10. The estimated amount of groundwater withdrawn each year Unknown
- 11. The log of formations encountered in the drilling of each well if available Not available
- 12. Such other information of a similar nature as may be useful in carrying out the policy of this act, including reference to book and page of any county record.

Signature of Owner Daniel W Cronin
Date

Three copies to be filed by the owner with the County Clerk and Recorder of the county in which the well is located.

Please answer all questions. If not applicable, so state, otherwise the form will be returned.

Original to the County Clerk and Recorder; Duplicate to the State Engineer; Triplicate to the Montana Bureau of Mines and Geology, and Quadruplicate for the Appropriator.

27218

I certify that I received and filed this
document on this 30th
day of Nov. 63 at 10:35
o'clock A.M.
F. G. Moore
Clerk of the Court
By Shirley Keith
Deputy

FILED

III

FILED

III

FILED

FILED

File No.

T. 9N R. 20W

DUPLICATE

County Ravalli

LOG

STATE OF MONTANA
ADMINISTRATOR OF GROUNDWATER CODE
STATE WATER CONSERVATION BOARD

**Notice of Completion of Groundwater
Appropriation by Means of Well**
DEVELOPED AFTER JANUARY 1, 1962

(Under Chapter 237 Montana Session Laws, 1961, as amended)

Owner Stewart Bennett Address Stevensville, Mont.
C. F. Wroble

Driller Ravalli Drilling Co. Address Victor, Montana

Date of Notice of appropriation of groundwater.....

Date well started May 10, 1969 Date completed May 10, 1969

Type of well drilled Equipment used rhurn
(Dug, driven, bored or drilled) (Churn drill, rotary or other)

Water use: Domestic Municipal Stock Irrigation
Industrial Drainage Other

Indicate on the diagram the character and thickness of the different strata met with in drilling, such as soil, clay, shale, gravel, rock or sand, etc. Show depth at which water is encountered, thickness and character of water-bearing strata and height to which the water rises in the well.

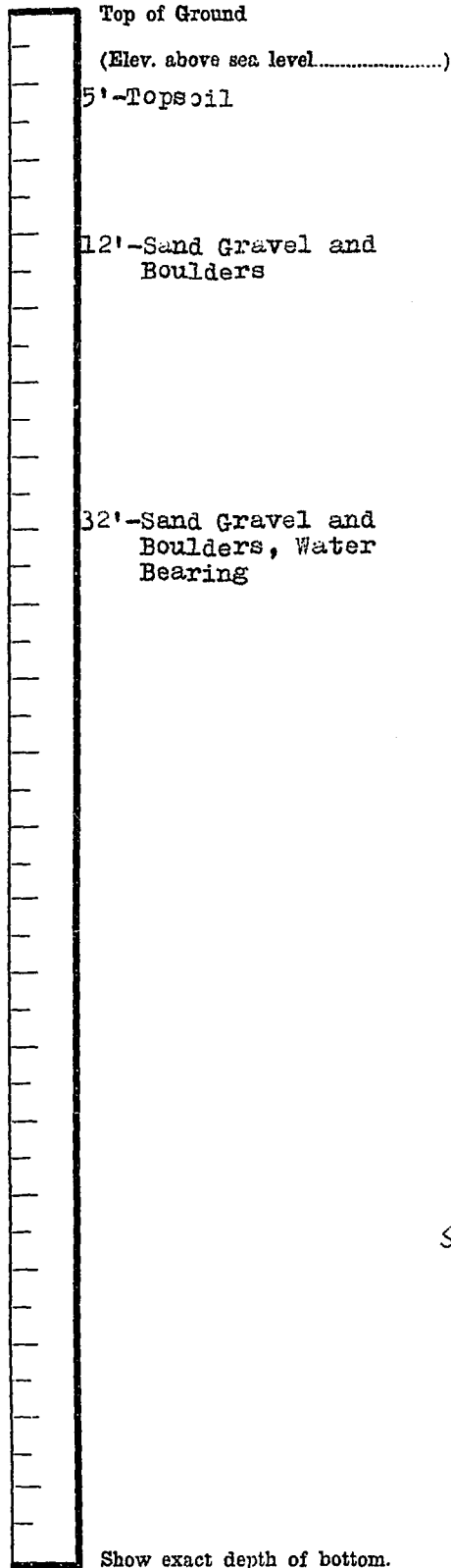

Size of Drilled Hole	Size and Weight of Casing	From (Feet)	To (Feet)	PERFORATIONS		
				Kind Size	From (Feet)	To (Feet)
6"	17 lbs. per ft.	0	32	3/16x5	27	32

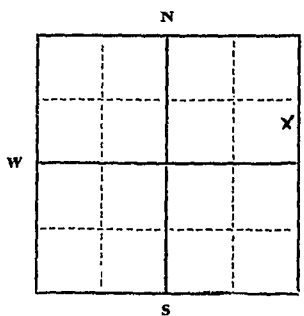

Static Water Level for non-flowing well 9 feet.

Shut-in Pressure for Flowing Well.....

Pumping Water Level..... 12 feet
at..... 20 gal. per minute.

Discharge in gal. per min. of flowing well

How Tested Baled-1 hour

Length of Test..... pumped-1 hour

Remarks: (Gravel packing, cementing, packers, type of shutoff).....

S.E. 1/4 NE Sec. 26 T. 9. R. 20
Indicate location of well and place of use, if possible. Each small square represents 40 acres.

.....(Continue on reverse side)

USE—If used for irrigation, industrial, drainage or other. Explain, state number of acres and location or other data (i.e.: Lot, Block and Addition).

This form to be prepared by driller, and three copies to be filed by the owner with the County Clerk and Recorder in the county in which the well is located, tissue copy to be retained by driller.

Please answer all questions. If not applicable, so state, otherwise the form will be returned.

.....
Driller's License Number

C. F. Wroble
Driller's Signature.

45,292

#5155

I certify that I received and filed this
instrument on this 28th
day of May, 1969, at 2:30
o'clock P.M.

F. S. Moore
COUNTY RECORDER

By Joe A. Co
DEPUTY

File No. 2108

T. 9 N. R. 20 W. 36

DUPLICATE

County Powell

STATE OF MONTANA
ADMINISTRATOR OF GROUNDWATER CODE
OFFICE OF STATE ENGINEER

RECEIVED
DEC 26 1963

Declaration of Vested Groundwater Rights

(Under Chapter 237, Montana Session Laws, 1961)

STATE ENGINEER

1. Stuart Bennett, of Stuart, Montana,
(Name of Appropriator) (Address) (Town)

County of Powell State of Montana
have appropriated groundwater according to the Montana laws in effect prior to January 1, 1962, as follows:

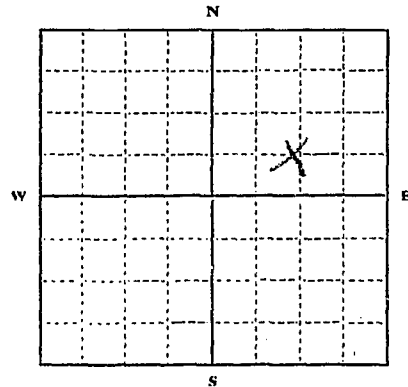

1/4 Sec. T9 R20

Indicate point of appropriation and place of use, if possible. Each small square represents 10 acres.

2 1/2 NE
2 SE NW

2. The beneficial use on which the claim is based, Domestic use for a family & livestock

3. Date or approximate date of earliest beneficial use; and how continuous the use has been July 1, 1958

4. The amount of groundwater claimed (in miner's inches or gallons per minute) 1000 gallons per minute

5. If used for irrigation, give the acreage and description of the lands to which water has been applied and name of the owner thereof
none to date

6. The means of withdrawing such water from the ground and the location of each well or other means of withdrawal Electric

7. The date of commencement and completion of the construction of the well, wells, or other works for withdrawal of groundwater June 1, 1958 completed July 1, 1958

8. The depth of water table 32 feet above water table from top

9. So far as it may be available, the type, size and depth of each well or the general specifications of other works for the withdrawal of groundwater 6 inch casing, jet pump

10. The estimated amount of groundwater withdrawn each year 365000

11. The log of formations encountered in the drilling of each well if available Bill Mackey

12. Such other information of a similar nature as may be useful in carrying out the policy of this act, including reference to book and page of any county record ACR 115

Signature of Owner Stuart Bennett

Date Dec 15, 1963

Three copies to be filed by the owner with the County Clerk and Recorder of the county in which the well is located.

Please answer all questions. If not applicable, so state, otherwise the form will be returned.

Original to the County Clerk and Recorder; Duplicate to the State Engineer; Triplicate to the Montana Bureau of Mines and Geology, and Quadruplicate for the Appropriator.

12592

File No. 2108

P. 9 R. 20 W. 36

DUPLICATE

County Beavertail

STATE OF MONTANA
ADMINISTRATOR OF GROUNDWATER CODE
OFFICE OF STATE ENGINEER

RECEIVED
DEC 26 1963

Declaration of Vested Groundwater Rights

(Under Chapter 237, Montana Session Laws, 1961)

STATE ENGINEER

1. Stewart Bennett, of Stevensville, Montana
(Name of Appropriator) (Address) (Town)

County of Beavertail State of Montana
have appropriated groundwater according to the Montana laws in effect prior to January 1, 1962, as follows:

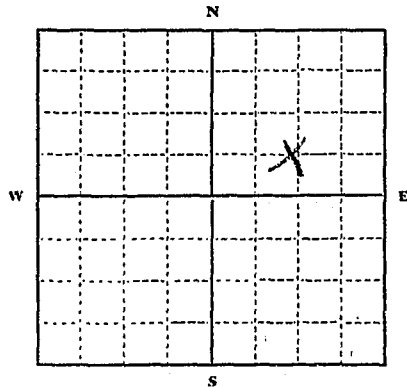

$\frac{1}{4}$ Sec. 36 T. 7 R. 20

Indicate point of appropriation and place of use, if possible. Each small square represents 10 acres.

2 1/2 NE
2 SE NW

2. The beneficial use on which the claim is based Domestic use for 2 family + livestock

3. Date or approximate date of earliest beneficial use; and how continuous the use has been July 1, 1958

4. The amount of groundwater claimed (in miner's inches or gallons per minute) 1000 gallons per 2 hrs.

5. If used for irrigation, give the acreage and description of the lands to which water has been applied and name of the owner thereof
none to irrigate the lawn on 2 acreage family dwelling

6. The means of withdrawing such water from the ground and the location of each well or other means of withdrawal Electric Pump

7. The date of commencement and completion of the construction of the well, wells, or other works for withdrawal of groundwater June 1, 1955 completed July 1, 1958.

8. The depth of water table 32 feet clear water 6 ft from top

9. So far as it may be available, the type, size and depth of each well or the general specifications of any other works for the withdrawal of groundwater 6 inch casing, jet pump

10. The estimated amount of groundwater withdrawn each year. 365,000 gallons

11. The log of formations encountered in the drilling of each well if available. Bill Mackey Beavertail, Montana

12. Such other information of a similar nature as may be useful in carrying out the policy of this act, including reference to book and page of any county record. NONE

Signature of Owner Stewart Bennett

Date Dec. 18, 1963

Three copies to be filed by the owner with the County Clerk and Recorder of the county in which the well is located.

Please answer all questions. If not applicable, so state, otherwise the form will be returned.

Original to the County Clerk and Recorder; Duplicate to the State Engineer; Triplicate to the Montana Bureau of Mines and Geology, and Quadruplicate for the Appropriator.

12592

I certify that I received and filed this
instrument on this 23
day of Dec 19 63 at 4:03
o'clock P.

F. S. Moore
COUNTY RECORDER

By _____ DEPUTY

26

File No.....

T. 9 R. 20

DUPLICATE

County.....

STATE OF MONTANA
ADMINISTRATOR OF GROUNDWATER CODE
OFFICE OF STATE ENGINEER

RECEIVED
JAN 8 1964

Notice of Completion of Groundwater Appropriation
Without Well

STATE ENGINEER

(Under Chapter 237 Montana Session Laws, 1961)

Date of Appropriation of Groundwater.....

Owner Daniel W. Cronin Address Stevensville
Mont

Contractor (if any) none

Address of Contractor

Date Started May 1888 Date Completed.....

Describe means of obtaining groundwater without a well "as by sub-irrigation and other natural processes". Include depth to water when applicable. Natural Flow

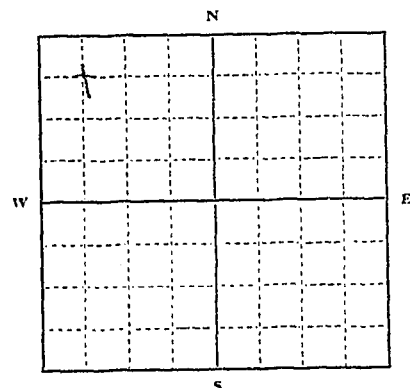

NW 1/4 NW Sec 36 T. 9 R. 20

Indicate point of appropriation and place of use, if possible.

Quantity of water developed and used with explanation of method used to measure or estimate such amount. If use is intermittent

estimate approximate lengths of periods of use.....

All Year

Signature of Owner Daniel W. Cronin

Date Dec. 30, 1963

This form to be prepared by contractor (if any), otherwise by the owner.

Three copies of this notice are to be filed with the County Clerk and Recorder of the county in which the works are located.

Please answer all questions. If not applicable, so state, otherwise the form will be returned.

Original to the County Clerk and Recorder; duplicate to the State Engineer; Triplicate to the Montana Bureau of Mines and Geology and Quadruplicate for the Appropriator.

27217

#2409

I certify that I received and filed this
instrument on this 30th
day of Nov. 1963 at 10:34
o'clock A.
J. H. Moore
CLERK
Shirley Keith
DEPUTY

File No.....

T. 9N R. 20

DUPLICATE

County Beavertail

STATE OF MONTANA
ADMINISTRATOR OF GROUNDWATER CODE
OFFICE OF STATE ENGINEER

STATE ENGINEER

DEC 31 1963

**Notice of Completion of Groundwater Appropriation
Without Well**

(Under Chapter 237 Montana Session Laws, 1961)

Date of Appropriation of Groundwater March 1943

Owner William Henry Dwyer Dwyer Address Stevenville Mont.

Contractor (if any) None

Address of Contractor None

Date Started April 1957 Date Completed April 1957

Describe means of obtaining groundwater without a well "as by sub-irrigation and other natural processes". Include depth to water when applicable.

Spring water for irrigation and stock water

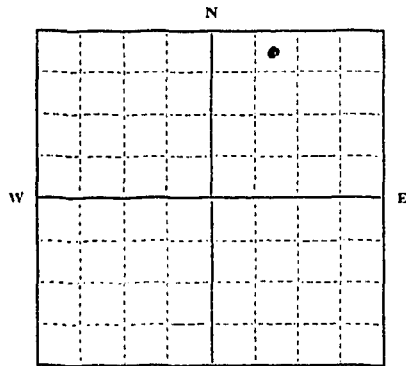

2N 1/2 NE Sec 36 T. 9. R. 20

Indicate point of appropriation and place of use, if possible.

Quantity of water developed and used with explanation of method used to measure or estimate such amount. If use is intermittent

estimate approximate lengths of periods of use.

year round use 10 inches to 30 inches

Signature of Owner William Henry Dwyer

Date Dec 27, 1963

This form to be prepared by contractor (if any), otherwise by the owner.

Three copies of this notice are to be filed with the County Clerk and Recorder of the county in which the works are located.

Please answer all questions. If not applicable, so state, otherwise the form will be returned.

Original to the County Clerk and Recorder; duplicate to the State Engineer; Triplicate to the Montana Bureau of Mines and Geology and Quadruplicate for the Appropriator.

5289

I certify that I received and filed this
instrument on this 27
day of Dec 1963 at 2:39
o'clock P.M.

F. S. Moore
COUNTY RECORDER

BY _____
DEPUTY

GW 2

File No.

DUPLICATE

T 9 N R 36
30

Ravalli County

STATE OF MONTANA
ADMINISTRATOR OF GROUNDWATER CODE
OFFICE OF STATE ENGINEER

RECEIVED
OCT 27 1962

Notice of Completion of Groundwater
Appropriation by Means of Well ENGINEER

(Under Chapter 237, Montana Session Laws, 1961)

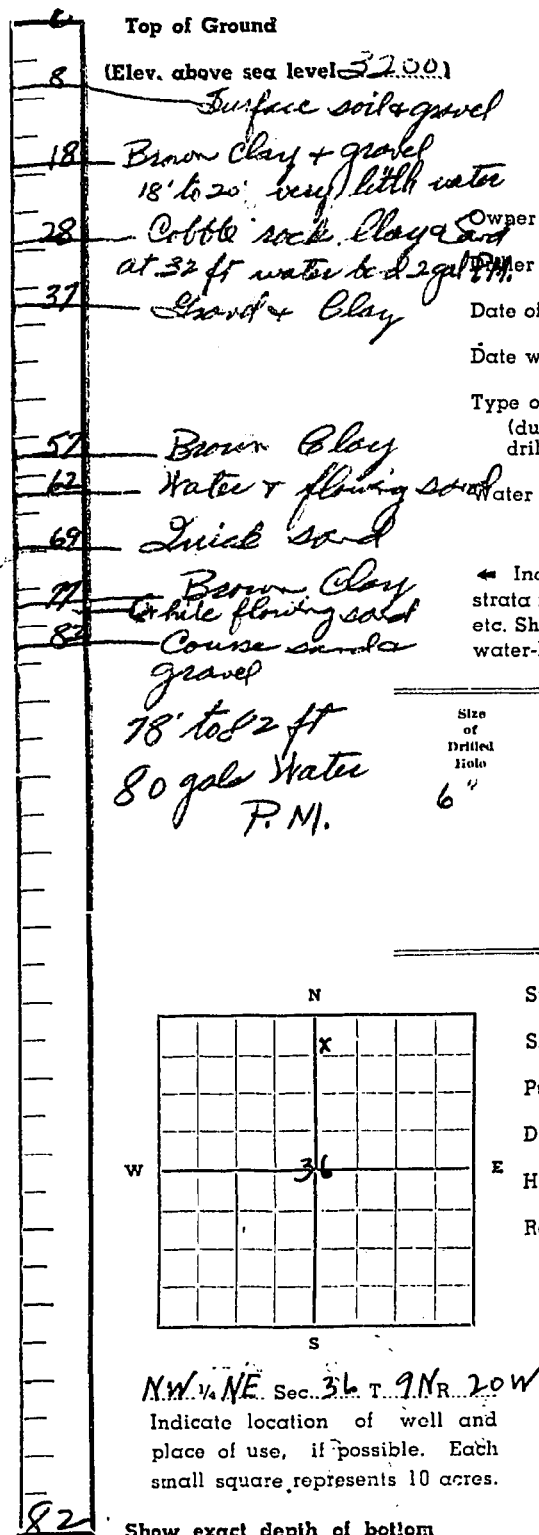

Owner Henry Depter Address Stevensville
Operator Carl D. Quigley Address Hamilton

Date of Notice of Appropriation of Groundwater Oct 31-62

Date well started Oct 22-62 Date Completed Oct 31-62

Type of well Drilled Equipment Used Cable tool
(dug, driven, bored or drilled) (Churn, drill, rotary or other)

Water Use: Domestic (X) Municipal () Stock () Irrigation ()
Industrial () Drainage () Other ()

Indicate on the diagram the character and thickness of the different strata met with in drilling, such as soil, clay, shale, sand, silt, rock or sand, etc. Show depth at which water is encountered, thickness and character of water-bearing strata and height to which the water rises in the well.

Size of Drilled Hole	Size and Weight of Casing	From (Feet)	To (Feet)	PERFORATIONS		
				Hole Size	From (Feet)	To (Feet)
6"	6 7/8" 17 lb 2.50 well	0	80			

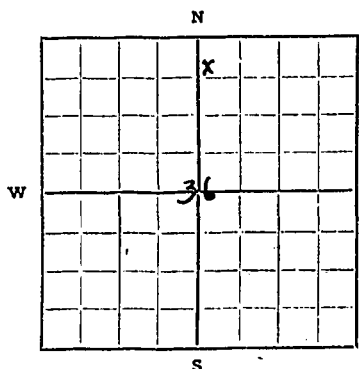

NW 1/4 NE Sec. 36 T. 9N R. 20W

Indicate location of well and place of use, if possible. Each small square represents 10 acres.

Show exact depth of bottom

Static Water Level for non-flowing Well 9 ft. from surface feet.

Shut-in Pressure for Flowing Well None

Pumping Water Level 20 feet at 80 gal. per minute.

Discharge in gal., per min. of flowing well None

How Tested Bailer & Compressor Length of Test 2 1/2 hrs.

Remarks: (Gravel packing, cementing, packers, type of shutoff, Location of place of use of groundwater if not at well, and any other similar pertinent information, including number of acres irrigated, if used for irrigation)

128
Driller's License Number

By Carl D. Quigley
Driller's Signature

This form to be prepared by driller, and three copies to be filed by the owner with the County Clerk and Recorder in the county in which the well is located.

Please answer all questions. If not applicable, so state, otherwise the form will be returned.

Original to the County Clerk and Recorder; duplicate to the State Engineer; Triplicate to the School of Mines and Quadruplicate for the Appropriator.

\$1680

I certify that I received and filed this
instrument on this 14th
day of Dec., 1962, at 3:10
o'clock P.M.

Anthony Hork
COUNTY RECORDER

By Pauline R. MacChese
DEPUTY

\$2.00 pd.

#5489

I certify that I received and filed this
instrument on this 10th
day of Sept. 1971 at 3:50
o'clock P. M.
F. G. Moore
COUNTY RECORDER
By Fee 2.00
DEPUTY

File No. 1699

T. 9 N. R. 20

DUPLICATE

County Ravalli

STATE OF MONTANA RECEIVED ADMINISTRATOR OF GROUNDWATER CODE OFFICE OF STATE ENGINEER FEB 18 1963

Notice of Completion of Groundwater Appropriation by Means of Well

Top of Ground (Elev. above sea level.....)

0 to 6" Top soil
6" to 20' Clay, gravel sand & boulders
20' to 33' Sand, gravel, clay & some water (30 G.P.M. water level 20')
33' 39' Clay & a little Gravel
39' to 55' Sand, gravel, clay a little water (15 G.)
55' to 97' Clay
97' to 100' Sand, fine gravel some water
100' to 105' Sand & clay
105' to 125' Clay
125' to 148' Sand & clay
148' to 168' Sandy clay
168' to 178' Sand, clay & water
178' to 200' Clay
200' to 225' Brown clay
225' to 238' sandy clay some water
238' to 263' Sandy clay
263' to 293' Sand
293' to 309' Sandy Br. clay
309' to 355' Sandy clay
355' to 385' Clay, sand water
385' to 415' Sandy clay
415' to 510' Decomposed granite sand & clay

Owner City of Stevensville Address Stevensville
Driller Glenn Camp 705 Alder Address Missoula, Montana
Date of Notice of Appropriation of Groundwater.....
Date well started 12/11/62 Date Completed 1/15/63

Type of well Drilled Equipment Used Churn drill
(dug, driven, bored or drilled) (Churn, drill, rotary or other)

Water Use: Domestic [] Municipal [] Other [] Irrigation []
Industrial [] Drainage [] Stock []

For city well

Indicate on the diagram the character and thickness of the different strata met with in drilling, such as soil, clay, shale, gravel, rock or sand, etc. Show depth at which water is encountered, thickness and character of water-bearing strata and height to which water rises in the well.

Table with columns: Size of Drilled Hole, Size and Weight of Casing, From (Feet), To (Feet), PERFORATIONS (Kind Size, From (Feet), To (Feet)).

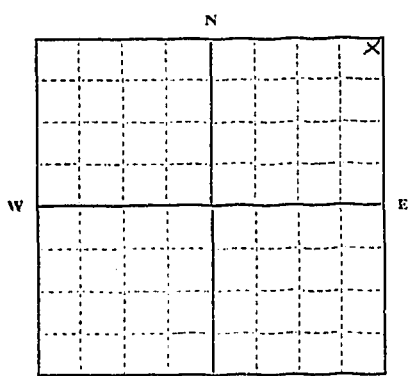

NE 1/4 Sec. 36 T. 9 R. 20

Indicate location of well and place of use, if possible. Each small square represents 10 acres.

Show exact depth of bottom.

Static Water Level for non-flowing Well 18 0' feet.

Shut-in Pressure for Flowing Well.....

Pumping Water Level not tested feet at..... gal. per minute.

Discharge in gal. per min. of flowing well.....

How Tested not enough water Length of Test for a city well

Remarks: (Gravel packing, cementing, packers, type of shutoff, location of place of use of groundwater if not at well, and any other similar pertinent information, including number of

acres irrigated, if used for irrigation).....

Very little water, not enough for a city

well, so the casing was pulled from the

hole

Licence # 7 Driller's License Number

Glenn Camp Driller's Signature

This form to be prepared by driller, and three copies to be filed by the owner with the County Clerk and Recorder in the county in which the well is located.

Please answer all questions. If not applicable, so state, otherwise the form will be returned.

Original to the County Clerk and Recorder; duplicate to the State Engineer; Triplicate to the Montana Bureau of Mines and Geology and Quadruplicate for the Appropriator.

1699

I certify that I received and filed this
instrument on this 13th
day of February, 1963, at 10:51
o'clock A. M.

F. G. Moore
COUNTY RECORDER

By _____
DEPUTY

No Fee

File No. NOV 21 1966

T. S. N. R. 20 W.
Lots 15 & 16, Block 17, Sunnyside
County Ravalli Orchards
No. 4

DUPLICATE

Bills McDermott
Bulfinch McHally
Coyk Morton
Darlington
Dickert
STATE OF MONTANA
ADMINISTRATOR OF GROUNDWATER CODE
OFFICE OF STATE ENGINEER

Notice of Completion of Groundwater Appropriation Without Well

Developed After January 1, 1962

(Under Chapter 237 Montana Session Laws, 1961)

Date of Appropriation of Groundwater July 1966

George N. Morris & Kathryn J. Morris
Owner Address

Contractor (if any) Jack Anderson did excavation

Address of Contractor Stevensville, Mont.

Date Started July 1966 Date Completed Oct. 11, 1966

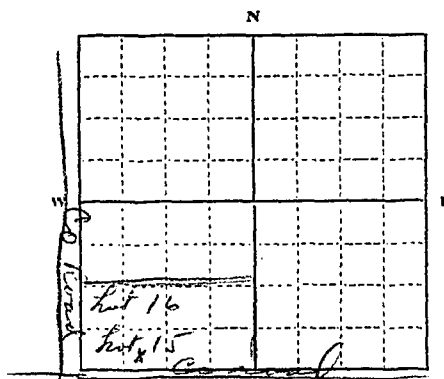

Lots 15 and 16, Block 17
1/4 Sec. T. R.

Sunnyside Orchards No. 4
Indicate point of appropriation
and place of use, if possible.

1) Describe means of obtaining groundwater (as by sub-irrigation, developed spring, drains, etc.) Spring & drains

2) Means of withdrawing water (gravity, pump, canal, etc.) pump

3) Depth of water table 2 feet

4) Use of the water irrigation and stock water

5) Amount of groundwater claimed (in miner's inches, or gallons per minute) 40 miners inches

6) If used for irrigation, give number of acres and description of land 20 acres

7) Estimate amount of water used each year 500 acre feet per year

Signature of Owner G. N. Morris
Kathryn J. Morris
Date Nov. 6, 1966

This form to be prepared by contractor (if any), otherwise by the owner.

Three copies of this notice are to be filed with the County Clerk and Recorder of the county in which the works are located.

Please answer all questions. If not applicable, so state, otherwise the form will be returned.

41,623

File No. NOV 21 1966

T. 20 N. R. 20 W. Lot 15, Block 17, Sunnyside Orchard No. 4
County Ravalli

DUPLICATE

Editor: McBurnett
Publisher: Murphy
Clerk: Martin
Definition: ADMINISTRATOR OF GROUNDWATER CODE
District: OFFICE OF STATE ENGINEER

Notice of Completion of Groundwater Appropriation Without Well

Developed After January 1, 1962

(Under Chapter 237 Montana Session Laws, 1961)

Date of Appropriation of Groundwater July 1966

Owner George H. Morris & Kathryn J. Morris

Contractor (if any) Jack Anderson dig excavation

Address of Contractor Stevensville, Mont.

Date Started July 1966 Date Completed Oct. 11, 1966

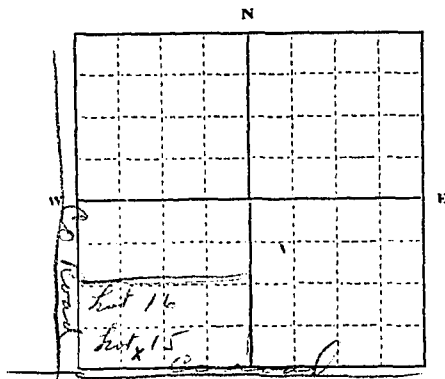

Lots 15 and 16, Block 17
Sunnyside Orchard No. 4

Indicate point of appropriation and place of use, if possible.

1) Describe means of obtaining groundwater (as by sub-irrigation, developed spring, drains, etc.) Spring & drains

2) Means of withdrawing water (gravity, pump, canal, etc.) pump

3) Depth of water table 2 feet

4) Use of the water irrigation and stock water

5) Amount of groundwater claimed (in miner's inches, or gallons per minute) 20 miners inches

6) If used for irrigation, give number of acres and description of land 20 acres

7) Estimate amount of water used each year 500 gals per year

Signature of Owner G. H. Morris
Kathryn J. Morris
Date Oct. 11, 1966

This form to be prepared by contractor (if any), otherwise by the owner.

Three copies of this notice are to be filed with the County Clerk and Recorder of the county in which the works are located.

Please answer all questions. If not applicable, so state, otherwise the form will be returned.

11-15-66

#4849

I certify that I received and filed this
instrument on this 17th
day of Nov 19 66 at 10:05
o'clock A.M.
J. S. Moore
COUNTY RECORDER
Joe L. Oo
DEPUTY

File No.

T 20 R 20

DUPLICATE

Ravalli County

STATE OF MONTANA
ADMINISTRATOR OF GROUNDWATER CODE
OFFICE OF STATE ENGINEER

RECEIVED
DEC 6 1963

Declaration of Vested Groundwater Rights

(Under Chapter 237, Montana Session Laws, 1961)

STATE ENGINEER

1. Agnes S. Brown of Stevensville Mont.
(Name of Appropriator) (Address) (Town)

County of Ravalli, State of Montana, have appropriated groundwater according to the Montana laws in effect prior to January 1, 1962, as follows:

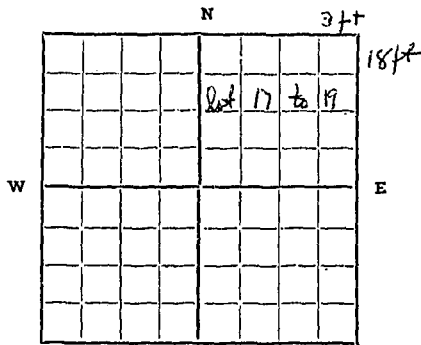

Lots 17 to 19 Stevensville Mont.

1/4 Sec. T. R.
Indicate point of appropriation and place of use, if possible. Each small square represents 10 acres.

- 2. The beneficial use on which the claim is based all household use
- 3. Date or approximate date of earliest beneficial use; and how continuous the use has been from 1917
been used continuously since to 1963
- 4. The amount of groundwater claimed (in miner's inches or gallons per minute) 13 ft dept. to 10 feet
water dept flow 2 gal. a minute
- 5. If used for irrigation, give the acreage and description of the lands to which water has been applied and name of the owner thereof
- 6. The means of withdrawing such water from the ground and the location of each well or other means of withdrawal hand pressure pump

- 7. The date of commencement and completion of the construction of the well, wells, or other works for withdrawal of groundwater
- 8. The depth of water table 10 feet
- 9. So far as it may be available, the type, size and depth of each well or the general specifications of any other works for the withdrawal of groundwater
- 10. The estimated amount of groundwater withdrawn each year
- 11. The log of formations encountered in the drilling of each well if available
- 12. Such other information of a similar nature as may be useful in carrying out the policy of this act, including reference to book and page of any county record

Signature of Owner Agnes S. Brown
Date Nov. 22, 1963

Three copies to be filed by the owner with the County Clerk and Recorder of the county in which the well is located.

Please answer all questions. If not applicable, so state, otherwise the form will be returned.

Original to the County Clerk and Recorder; duplicate to the State Engineer; Triplicate to the School of Mines and Quadruplicate for the Appropriator.

#1891

I certify that I received and filed this
instrument on this.....4th.....
day of.....Dec....., 19.....63....., at.....10:20
o'clock.....A.M.

.....F. G. Moore.....
COUNTY RECORDER

By.....*Shirley Keith*.....
DEPUTY

File No. 1996 2001

T 9 N. R 20 W.

DUPLICATE

County Ravalli

STATE OF MONTANA
ADMINISTRATOR OF GROUNDWATER CODE
OFFICE OF STATE ENGINEER

RECEIVED
DEC 20 1963

STATE ENGINEER

Notice of Completion of Groundwater Appropriation
Without Well

(Under Chapter 237 Montana Session Laws, 1961)

Date of Appropriation of Groundwater 1947

Owner Stephen J. Anderson Address Stevensville, Mont.

Contractor (if any)

Address of Contractor

Date Started Date Completed

Describe means of obtaining groundwater without a well "as by sub-irrigation and other natural processes". Include depth to water when applicable open pit type. Depth of

water about 15 feet. Obtained by sub-irrigation.

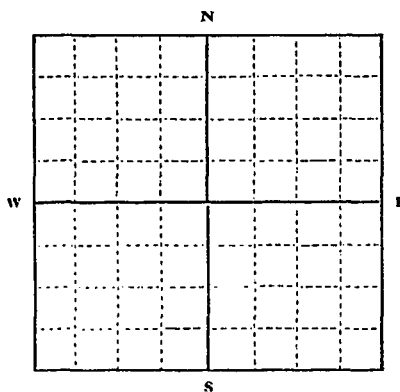

1/4 Sec. T9N R20W

Indicate point of appropriation and place of use, if possible.

South sump on Lot 16, Block 1, Sunnyside Orchards.

Quantity of water developed and used with explanation of method used to measure or estimate such amount. If use is intermittent

estimate approximate lengths of periods of use. 80 miner's

inches or 2 cubic feet, tested by using a

15 horsepower electric irrigation pump, 24

hours a day for 6 months each year, almost

full capacity, for irrigation and livestock water

Signature of Owner Stephen J. Anderson

Date December 17, 1963

This form to be prepared by contractor (if any), otherwise by the owner.

Three copies of this notice are to be filed with the County Clerk and Recorder of the county in which the works are located.

Please answer all questions. If not applicable, so state, otherwise the form will be returned.

Original to the County Clerk and Recorder; duplicate to the State Engineer; Triplicate to the Montana Bureau of Mines and Geology and Quadruplicate for the Appropriator.

10942

I certify that I received and filed this
instrument on this.....18th.....
day of Dec., 19..63 at 3:00
o'clock.....P.M.

F. S. Moore
COUNTY RECORDER

By.....
DEPUTY

File No. 1997 2002

T. 9 N. R. 20 W.

DUPLICATE

County Beaverhead

STATE OF MONTANA
ADMINISTRATOR OF GROUNDWATER CODE
OFFICE OF STATE ENGINEER

RECEIVED
DEC 20 1963

STATE ENGINEER

**Notice of Completion of Groundwater Appropriation
Without Well**

(Under Chapter 237 Montana Session Laws, 1961)

Date of Appropriation of Groundwater 1947

Own Stephen J. Anderson Address Stevensville, Mont.

Contractor (if any)

Address of Contractor

Date Started..... Date Completed.....

Describe means of obtaining groundwater without a well "as by sub-irrigation and other natural processes". Include depth to water when applicable. open pit type. Depth of water about 4 feet. Depth of pit about 15 feet. Obtained by sub-irrigation and other natural processes. Dug with a dragline.

Quantity of water developed and used with explanation of method used to measure or estimate such amount. If use is intermittent estimate approximate lengths of periods of use. 1 cubic foot of water or 40 miner's inches. Estimated by using sump pump.

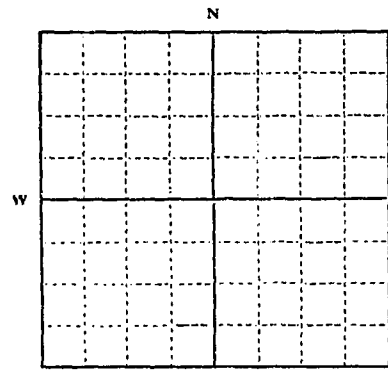

..... 1/4 Sec. T. 9 N. R. 20 W.

Indicate point of appropriation and place of use, if possible.

North sump.
Lot 14, Block 1,
Sunnyside Orchard's

Signature of Owner Stephen J. Anderson

Date December 17, 1963

This form to be prepared by contractor (if any), otherwise by the owner.
Three copies of this notice are to be filed with the County Clerk and Recorder of the county in which the works are located.
Please answer all questions. If not applicable, so state, otherwise the form will be returned.

Original to the County Clerk and Recorder; duplicate to the State Engineer; Triplicate to the Montana Bureau of Mines and Geology and Quadruplicate for the Appropriator.

10994

I certify that I received and filed this
instrument on this 18th
day of Dec 19 63 at 3:05
o'clock P. M.

F. S. Moore
COUNTY RECORDER

By _____ DEPUTY

File No. 1999

T. 9N R. 26W

DUPLICATE

County: Ravalli

STATE OF MONTANA
ADMINISTRATOR OF GROUNDWATER CODE
OFFICE OF STATE ENGINEER

RECEIVED
DEC 20 1963

Notice of Completion of Groundwater Appropriation
Without Well

STATE ENGINEER

(Under Chapter 237 Montana Session Laws, 1961)

Date of Appropriation of Groundwater...1950

Owner Stephen J. Anderson Address Stevensville, Mont.

Contractor (if any)

Address of Contractor

Date Started Date Completed

Describe means of obtaining groundwater without a well "as by sub-irrigation and other natural processes". Include depth to water when applicable...natural spring, flowing

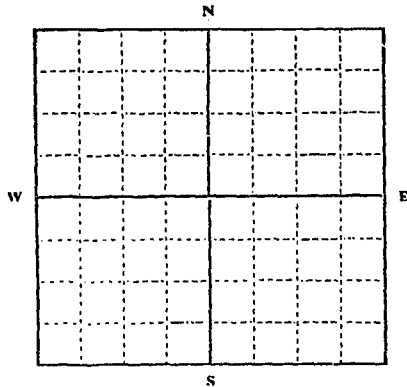

1/4 Sec. T R

Indicate point of appropriation and place of use, if possible.

Lot 13, Block 1,
Sunnyside Orchards

Quantity of water developed and used with explanation of method used to measure or estimate such amount. If use is intermittent

estimate approximate lengths of periods of use. Estimated amount approximately 50 inches steady flow or 1 1/2 cubic foot steady flow.

Signature of Owner Stephen J. Anderson

Date December 17, 1963

This form to be prepared by contractor (if any), otherwise by the owner.

Three copies of this notice are to be filed with the County Clerk and Recorder of the county in which the works are located.

Please answer all questions. If not applicable, so state, otherwise the form will be returned.

Original to the County Clerk and Recorder; duplicate to the State Engineer; Triplicate to the Montana Bureau of Mines and Geology and Quadruplicate for the Appropriator.

10990

I certify that I received and filed this
instrument on this 18th
day of Dec., 19 63, at 2:30
o'clock P. M.

F. G. Moore
COUNTY RECORDER

By _____
DEPUTY

File No. _____
DUPLICATE

RECEIVED

T. 9 R. 20
County Ravalli

1970
STATE OF MONTANA
ADMINISTRATOR OF GROUNDWATER CODE
MONTANA DEPARTMENT OF MINES,
RESOURCES AND CONSERVATION
OFFICE OF STATE ENGINEER

Declaration of Vested Groundwater Rights

(Under Chapter 237, Montana Session Laws, 1961)

1. James D. & Rose Marie Higgins, of Stevensville
(Name of Appropriator) (Address) (Town)
County of Ravalli State of Montana
have appropriated groundwater according to the Montana laws in effect prior to January 1, 1962, as follows:

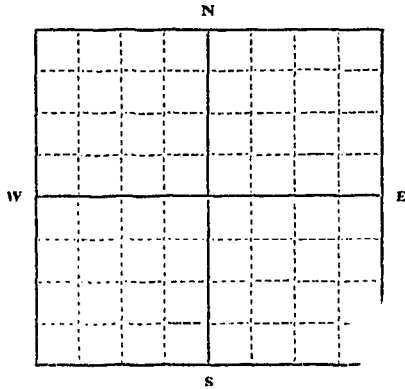

1/4 Sec. T. R.
Indicate point of appropriation and place of use, if possible. Each small square represents 10 acres.

6050
6-79-73
4:33 p.m.

2. The beneficial use on which the claim is based Domestic, Stock, Irrigation, Garden & Lawn, Traylor Court

3. Date or approximate date of earliest beneficial use; and how continuous the use has been March 18, 1970

4. The amount of groundwater claimed (in miner's inches or gallons per minute) 300 GPM

5. If used for irrigation, give the acreage and description of the lands to which water has been applied and name of the owner thereof
Lots 9, 10, 25, 26 & 27, Block 9, Sunny Side Orchard #3

6. The means of withdrawing such water from the ground and the location of each well or other means of withdrawal
Submersible Well Pump

7. The date of commencement and completion of the construction of the well, wells, or other works for withdrawal of groundwater March 9, 1970 - March 18, 1970

8. The depth of water table 15 feet from surface

9. So far as it may be available, the type, size and depth of each well or the general specifications of any other works for the withdrawal of groundwater
Well cased from 2' 6" above surface to 76 feet with 6 inch OD by 1/2 inch Wall Black Steel Water Well Casing. A forged steel drive shoe is welded to bottom of casing. A Johnson Wire Wound Screen with continuous slot opening is set from 76 to 88 feet. A 5 9/16 inch tailpipe with solid closed bottom extends to 102 feet.

10. The estimated amount of groundwater withdrawn each year 42,048,000 gallons

11. The log of formations encountered in the drilling of each well if available
FORMATIONS LOG:
See reverse

12. Such other information of a similar nature as may be useful in carrying out the policy of this act, including reference to book and page of any county record
Volume 109 Deeds Page 94

Signature of Owner *Rose Marie Higgins*

Date _____

Three copies to be filed by the owner with the County Clerk and Recorder of the county in which the well is located.

Please answer all questions. If not applicable, so state, otherwise the form will be returned.

Original to the County Clerk and Recorder; Duplicate to the State Engineer; Triplicate to the Montana Bureau of Mines and Geology, and Quadruplicate for the Appropriator.

55419

6050

I certify that I received and filed this
Instrument on this June
day of 29, 1973, at 10:45
o'clock P. M.
Darlene E. Hughes
COUNTY RECORDER
By Billy T. Luns
DEPUTY
Fee \$2.00

Formations Log:

- 0 - 3 Sandy topsoil
- 3 - 16 Sand and fine gravel
- 16 - 30 Fine tan sand with streaks of clay
- 30 - 42 Fine silty sand and gravel
- 42 - 58 Silty tan sand
- 58 - 62 Clean tan sand
- 62 - 97 Fine to coarse sand and gravel. Water
- 87 - 98 Gravel mixed with gray-green clay
- 98 - 99 Gray granitic sand
- 99 - 102 Sand and clay

File No. 1792

T 9th R 20th

DUPLICATE

Ravalli County

STATE OF MONTANA
ADMINISTRATOR OF GROUNDWATER CODE
OFFICE OF STATE ENGINEER

RECEIVED
JUL 29 1963

Declaration of Vested Groundwater Rights
(Under Chapter 237, Montana Session Laws, 1961)

1. WALTER W. LEA (Name of Appropriator) of STEVENSVILLE MONTANA (Address) (Town)

County of Ravalli, State of Montana, have appropriated groundwater according to the Montana laws in effect prior to January 1, 1962, as follows:

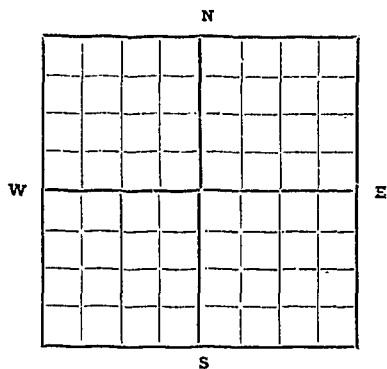

2. The beneficial use on which the claim is based DOMESTIC REQUIREMENTS & IRRIGATION OF LAWN & GARDEN

3. Date or approximate date of earliest beneficial use; and how continuous the use has been FEB., 1948
CONTINUOUS USE

4. The amount of groundwater claimed (in miner's inches or gallons per minute) ?

5. If used for irrigation, give the acreage and description of the lands to which water has been applied and name of the owner thereof LAWN & GARDEN - MAX. 5 ACRES

6. The means of withdrawing such water from the ground and the location of each well or other means of withdrawal 3 1/2" D. DEEP WELL PUMP

..... 1/4..... Sec..... T..... R.....
Indicate point of appropriation and place of use, if possible. Each small square represents 10 acres.

7. The date of commencement and completion of the construction of the well, wells, or other works for withdrawal of groundwater FEB., 1948

8. The depth of water table APPROX. 60 FT.

9. So far as it may be available, the type, size and depth of each well or the general specifications of any other works for the withdrawal of groundwater THE WELL IS CASED WITH 4" I.D. IRON WELL CASING. THE PUMP IS A 3 1/2" D. NET TYPE DEEP WELL PUMP. THE WELL IS APPROX. 80 FT. DEEP.

10. The estimated amount of groundwater withdrawn each year 1,630,200

11. The log of formations encountered in the drilling of each well if available NONE AVAILABLE

12. Such other information of a similar nature as may be useful in carrying out the policy of this act, including reference to book and page of any county record NONE

Signature of Owner Walter W. Lea
Date 7/1/63

Three copies to be filed by the owner with the County Clerk and Recorder of the county in which the well is located.

Please answer all questions. If not applicable, so state, otherwise the form will be returned.

Original to the County Clerk and Recorder; duplicate to the State Engineer; Triplicate to the School of Mines and Quadruplicate for the Appropriator.

I certify that I received and filed this
instrument on this.....25th.....
day of.....July.....19.63... at...1:00
o'clock.....M.

F. J. Moore

COUNTY RECORDER
Fee \$2.00

By.....
DEPUTY

File No. 1821

DUPLICATE

RECEIVED
DABNEY & SONS - State Publishing Co., Helena, Montana
SEP 26 1963 T. 20 R. 20

County Beavalli

STATE ENGINEER
STATE OF MONTANA

ADMINISTRATOR OF GROUNDWATER CODE
OFFICE OF STATE ENGINEER

RECEIVED
SEP 23 1963

Notice of Completion of Groundwater Appropriation Without Well

(Under Chapter 237 Montana Session Laws, 1961)

Date of Appropriation of Groundwater January 1961
Owner Roland v Moody Address Stevensville, Mont.

Contractor (if any)

Address of Contractor

Date Started March 1961 Date Completed March 1961

Describe means of obtaining groundwater without a well "as by sub-irrigation and other natural processes". Include depth to water when applicable.....

A Pit dug about seven feet deep and 100 feet long

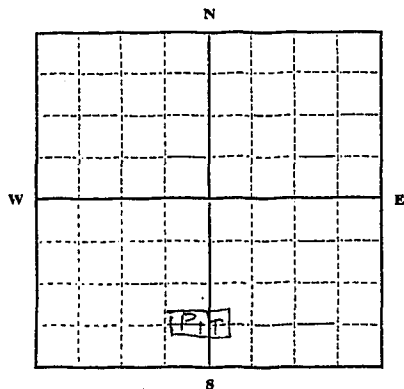

Quantity of water developed and used with explanation of method used to measure or estimate such amount. If use is intermittent

estimate approximate lengths of periods of use.....

App. 80 inches of water developed and used from the May 15 to October 1, of each year.

..... 1/4 Sec..... T..... R.....

Indicate point of appropriation and place of use, if possible.

Sside Orch less W 301' lots Black
of Lots 9 to 11
Sside Orch less W 301'
of Lots 12 17

Ss Or 13 & 14 & 19 to 25 17

Signature of Owner Roland v Moody

Date August 19, 1963.

This form to be prepared by contractor (if any), otherwise by the owner.

Three copies of this notice are to be filed with the County Clerk and Recorder of the county in which the works are located.

Please answer all questions. If not applicable, so state, otherwise this form will be returned.

Original to the County Clerk and Recorder; duplicate to the State Engineer; Triplicate to the Montana Bureau of Mines and Geology and Quadruplicate for the Appropriator.

File No. 1821

DUPLICATE

RECEIVED SEP 26 1963 T. 9th R. 20th

County: Ravalli

STATE ENGINEER STATE OF MONTANA ADMINISTRATOR OF GROUNDWATER CODE OFFICE OF STATE ENGINEER

RECEIVED SEP 23 1963

Notice of Completion of Groundwater Appropriation Without Well

(Under Chapter 237 Montana Session Laws, 1961)

Date of Appropriation of Groundwater: January 1961
Owner: Roland V. Moody Address: Stevensville, Mont.

Contractor (if any)

Address of Contractor

Date Started: March 1961 Date Completed: March 1961

Describe means of obtaining groundwater without a well "as by sub-irrigation and other natural processes". Include depth to water when applicable.

A Pit dug about seven feet deep and 100 feet long

Quantity of water developed and used with explanation of method used to measure or estimate such amount. If use is intermittent

estimate approximate lengths of periods of use.

App. 80 inches of water developed and used from the May 15 to October 1, of each year.

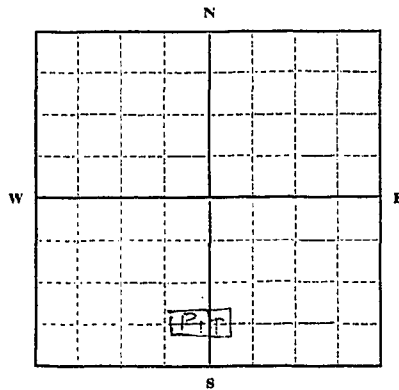

1/4 Sec. T. R.

Indicate point of appropriation and place of use, if possible.

Side Orch less Wood: Black of Lots 3 to 11
Side Orch less Wood: of Lots 12 to 17

Side Or 18 to 19 to 20 to 21

Signature of Owner: Roland V. Moody

Date: August 19, 1963

This form to be prepared by contractor (if any), otherwise by the owner.

Three copies of this notice are to be filed with the County Clerk and Recorder of the county in which the works are located.

Please answer all questions. If not applicable, so state, otherwise the form will be returned.

Original to the County Clerk and Recorder; duplicate to the State Engineer; Triplicate to the Montana Bureau of Mines and Geology and Quadruplicate for the Appropriator.

I certify that I received and filed this
instrument on this.....18th.....
day of Sept.....19 63..... at 11:55
o'clock.....A.M.

F. A. Moore
COUNTY RECORDER

By..... DEPUTY

Fee \$2.00

File No.....

T. 9 N. R. 20 W

DUPLICATE

County Paradee

STATE OF MONTANA
ADMINISTRATOR OF GROUNDWATER CODE
OFFICE OF STATE ENGINEER

23

Declaration of Vested Groundwater Rights
(Under Chapter 237, Montana Session Laws, 1961)

1. Walter Peery and/or Mabel Peery of Route 3 Mustula
(Name of Appropriator) (Address) (Town)

County of Mustula State of Montana
have appropriated groundwater according to the Montana laws in effect prior to January 1, 1962, as follows:

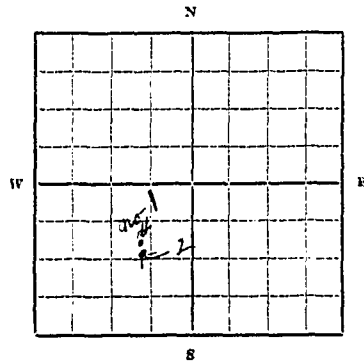

NE $\frac{1}{4}$ of SW $\frac{1}{4}$ Sec..... T..... R.....

Indicate point of appropriation and place of use, if possible. Each small square represents 10 acres.

2. The beneficial use on which the claim is based for domestic use

3. Date or approximate date of earliest beneficial use; and how continuous the use has been 1910 Every day No 1
No 2 1910 off and on Every day

4. The amount of groundwater claimed (in miner's inches or gallons per minute) 600 gal per hr

5. If used for irrigation, give the acreage and description of the lands to which water has been applied and name of the owner thereof Rain and stock water

6. The means of withdrawing such water from the ground and the location of each well or other means of withdrawal
No 1 Hand Pump in dug well 28 ft deep
Electric Pump in No 2

7. The date of commencement and completion of the construction of the well, wells, or other works for withdrawal of groundwater No 2 was dug well till 1958
No 1 1910

8. The depth of water table No 1 25 ft No 2 125 ft

9. So far as it may be available, the type, size and depth of each well or the general specifications of any other works for the withdrawal of groundwater No 2 was drilled to 135 ft 1958
4 inch water 1/2 pipe 40 ft pressure
No 1 still dug well with hand pump

10. The estimated amount of groundwater withdrawn each year not applicable

11. The log of formations encountered in the drilling of each well if available
not applicable

12. Such other information of a similar nature as may be useful in carrying out the policy of this act, including reference to book and page of any county record not applicable see well man
and local records

Signature of Owner Walter Peery and/or Mabel Peery

Date Dec 31 1963

Three copies to be filed by the owner with the County Clerk and Recorder of the county in which the well is located.

Please answer all questions. If not applicable, so state, otherwise the form will be returned.

Original to the County Clerk and Recorder; duplicate to the State Engineer; Triplicate to the Montana Bureau of Mines and Geology and Quadruplicate for the Appropriator.

4337

I certify that I received and filed this
instrument on this 21st
day of Jan 19 64 at 9:30
o'clock A M.

F. S. Moore

COUNTY RECORDER

By _____
DEPUTY

File No.

T. 9N R20W S2E 26

DUPLICATE

County Ravalli

LOG

STATE OF MONTANA
ADMINISTRATOR OF GROUNDWATER CODE
STATE WATER CONSERVATION BOARD

Top of Ground
(Elev. above sea level.....)

**Notice of Completion of Groundwater
Appropriation by Means of Well**

DEVELOPED AFTER JANUARY 1, 1962

(Under Chapter 237 Montana Session Laws, 1961, as amended)



10'-Sand Gravel and Boulders

26'- Sand Gravel and Boulders, Water Bearing

Owner Jack Anderson Address Stevensville, Mont.
C. F. Wroble

Driller Ravalli Drilling Co. Address Victor, Montana

Date of Notice of appropriation of groundwater.....

Date well started April 25, 1969 Date completed April 26, 1969

Type of well drilled Equipment used churn
(Dug, driven, bored or drilled) (Churn drill, rotary or other)

Water use: Domestic Municipal Stock Irrigation
Industrial Drainage Other

Indicate on the diagram the character and thickness of the different strata met with in drilling, such as soil, clay, shale, gravel, rock or sand, etc. Show depth at which water is encountered, thickness and character of water-bearing strata and height to which the water rises in the well.

Size of Drilled Hole	Size and Weight of Casing	From (Feet)	To (Feet)	PERFORATIONS		
				Kind Size	From (Feet)	To (Feet)
6"	17 lbs. per ft.	0	26	4x5	22	27

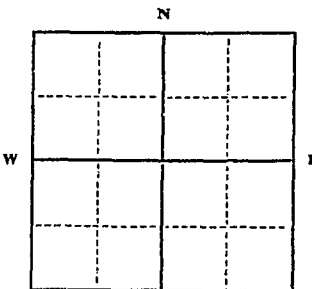

**Lot 16 - Block 1
Stevensville Heights**

1/4 Sec. T. R.
Indicate location of well and place of use, if possible. Each small square represents 40 acres.

Static Water Level for non-flowing well 5 feet.

Shut-in Pressure for Flowing Well.....

Pumping Water Level 10 feet at 25 gal. per minute.

Discharge in gal. per min. of flowing well.....

How Tested Baled and pumped

Length of Test 2 hrs.

Remarks: (Gravel packing, cementing, packers, type of shutoff).....

(Continue on reverse side)

USE—If used for irrigation, industrial, drainage or other. Explain, state number of acres and location or other data (i.e.: Lot, Block and Addition).

Show exact depth of bottom.

This form to be prepared by driller, and three copies to be filed by the owner with the County Clerk and Recorder in the county in which the well is located, tissue copy to be retained by driller.

Please answer all questions. If not applicable, so state, otherwise the form will be returned.

62

Driller's License Number

C. F. Wroble
Driller's Signature.

45,261

#5-151

I certify that I received and filed this
instrument on this 22nd
day of May, 1969, at 1:05
o'clock PM.
D. L. Moore
COUNTY RECORDER
By F. L. O'D
DEPUTY

File No. *100-100*

T...9...N...² R.20.10... SEC 24.5
Ravalli 27
Ravalli County

STATE OF MONTANA
ADMINISTRATOR OF GROUNDWATER CODE
OFFICE OF STATE ENGINEER

DECLARATION OF VESTED GROUNDWATER RIGHTS
(Under Chapter 237, Montana Session Laws, 1961)

1. *James R. Graves*, of *Stevensville* (Town)
County of *Ravalli*, State of Montana, have appropriated groundwater according to the Montana laws in effect
prior to January 1, 1962, as follows: *RAVALLI MONTANA*

2. The beneficial use on which the claim is based.

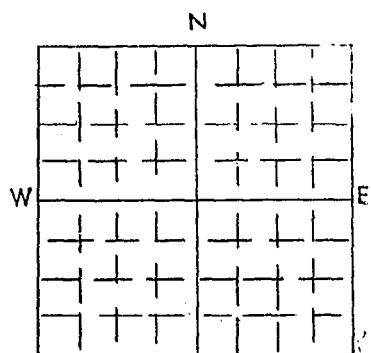

LOT 1 BLK 5 *Small addit*
1/4 Sec. *Stevensville*
Indicate point of appropriation and name
place of use, if possible. Each small
square represents 10 acres.

3. Date or approximate date of earliest beneficial use; and how
continuous the use has been.

4. The amount of groundwater claimed (in miner's inches or gallons
per minute). *July 1961*

5. If used for irrigation, give the acreage and description of the
lands to which water has been applied and name of the owner
thereof.

6. The means of withdrawing such water from the ground and the
location of each well or other means of withdrawal. *Approximately 3 acres*

7. The date of commencement and completion of the construction of the well, wells, or other works for with-
drawal of groundwater. *with a pump*
Location of well - S.E. corner of Pasture

8. The depth of water table. *September 1959*

9. So far as it may be available, the type, size and depth of each well or the general specifications of any
other works for the withdrawal of groundwater. *3 feet*

10. The estimated amount of groundwater withdrawn each year. *2 1/2" Phillips gas line*
driven

11. The log of formations encountered in the drilling of each well if available. *3000 gallons*

12. Such other information of a similar nature as may be desired in carrying out the purpose of this act, including
reference to book and page of any county record, *501 517 -*
very clear

Signature of Owner. *James R. Graves*

Date. *December 31-1963*

Three copies to be filed by the owner with the County Clerk and Recorder of the county in which the well is
located.

Please answer all questions. If not applicable, so state, otherwise the form will be returned.

Original to the County Clerk and Recorder; duplicate to the State Engineer; Triplicate to the School of Mines
and Quadruplicate for the Appropr

#2771

I certify that I received and filed this

..... 31st
day Dec. 63 9:17
at
.....

F. G. Moore

By Shiley Keith

File No.

T. 9N R. 20W Sec 27

DUPLICATE

County.....

STATE OF MONTANA
ADMINISTRATOR OF GROUNDWATER CODE
OFFICE OF STATE ENGINEER

RECEIVED
JAN 4 1963
ENGINEER

Declaration of Vested Groundwater Rights

(Under Chapter 237, Montana Session Laws, 1961)

1. Mabel E. Montgomery, of Stevensville
(Name of Appropriator) (Address) (Town)
County of Pondera State of Montana
have appropriated groundwater according to the Montana laws in effect prior to January 1, 1962, as follows:

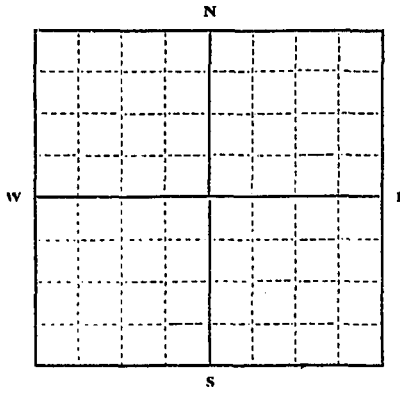

..... 1/4 Sec. T. R.

Indicate point of appropriation and place of use, if possible. Each small square represents 10 acres.

2. The beneficial use on which the claim is based.....

Irrigation of lawn + stock water

3. Date or approximate date of earliest beneficial use; and how continuous the use has been.....

1890 continuous use

4. The amount of groundwater claimed (in miner's inches or gallons per minute).....

20 gallons per minute

5. If used for irrigation, give the acreage and description of the lands to which water has been applied and name of the owner thereof.....

Lawn + stock water (2 acres)

6. The means of withdrawing such water from the ground and the location of each well or other means of withdrawal.....

200' south of house electric pump

7. The date of commencement and completion of the construction of the well, wells, or other works for withdrawal of groundwater.....

1890

8. The depth of water table.....

20' deep

9. So far as it may be available, the type, size and depth of each well or the general specifications of any other works for the withdrawal of groundwater.....

20' deep 3' in diameter

10. The estimated amount of groundwater withdrawn each year.....

2 million gallons

11. The log of formations encountered in the drilling of each well if available.....

no log

12. Such other information of a similar nature as may be useful in carrying out the policy of this act, including reference to book and page of any county record.....

Signature of Owner Mabel E. Montgomery

Date Dec 27, 1963

Three copies to be filed by the owner with the County Clerk and Recorder of the county in which the well is located.

Please answer all questions. If not applicable, so state, otherwise the form will be returned.

Original to the County Clerk and Recorder; Duplicate to the State Engineer; Triplicate to the Montana Bureau of Mines and Geology, and Quadruplicate for the Appropriator.

27348

72540

I certify that I received and filed this
instrument on this 30th
day of Dec. 1963 at 1:47
o'clock P.
F. H. Moore
COUNTY RECORDER
By Shirley Keith
DEPUTY

File No.....

T. 97 R. 20w Sec 27

DUPLICATE

County.....

STATE OF MONTANA
ADMINISTRATOR OF GROUNDWATER CODE
OFFICE OF STATE ENGINEER

RECEIVED
JAN 28 1964

Notice of Completion of Groundwater Appropriation
Without Well

(Under Chapter 237 Montana Session Laws, 1961)

Date of Appropriation of Groundwater.....

Owner Jacob Reich Address Rt. 2, Bx 5.
Hamilton Mont.

Contractor (if any) No.

Address of Contractor

Date Started..... Date Completed.....

Describe means of obtaining groundwater without a well "as by sub-irrigation and other natural processes". Include depth to water when applicable. Over flow water from

seepage ditch, which drains in to Bitterroot river No of my property.

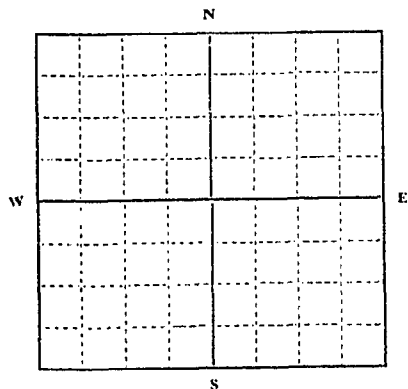

..... 1/4 Sec..... T..... R.....

Indicate point of appropriation and place of use, if possible.

Lot 1, Block 34, Riverview,
Ravalli County; Beginning at the
southeast corner of said lot 1,
thence northerly 133 Ft; thence
westerly 54 Ft; thence 133 Ft.
thence easterly 133 Ft. to place
of beginning.

Quantity of water developed and used with explanation of method used to measure or estimate such amount. If use is intermittent

estimate approximate lengths of periods of use. 7 Months

Signature of Owner Jacob Reich

Date Jan, 27, 64.

This form to be prepared by contractor (if any), otherwise by the owner.

Three copies of this notice are to be filed with the County Clerk and Recorder of the county in which the works are located.

Please answer all questions. If not applicable, so state, otherwise the form will be returned.

Original to the County Clerk and Recorder; duplicate to the State Engineer; Triplicate to the Montana Bureau of Mines and Geology and Quadruplicate for the Appropriator.

4365

Jacob Reich

I certify that I received and filed this
instrument on this.....27th.....
day of Jan.....1964..... at 10:44
o'clock.....A.M.

F. S. Moore
COUNTY RECORDER

By.....
DEPUTY

File No.....

T. 9N R. 20W Sec. 27

DUPLICATE

County... Ravalli

STATE OF MONTANA
ADMINISTRATOR OF GROUNDWATER CODE
OFFICE OF STATE ENGINEER

RECEIVED
APR 22 1964
STATE ENGINEER

Declaration of Vested Groundwater Rights

(Under Chapter 237, Montana Session Laws, 1961)

1. Maxine Robinson, of Stevensville, (Name of Appropriator) (Address) (Town)

County of Ravalli State of Montana have appropriated groundwater according to the Montana laws in effect prior to January 1, 1962, as follows:

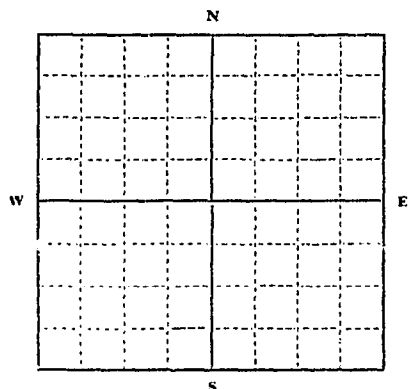

1/4 Sec. T. R.

Indicate point of appropriation and place of use, if possible. Each small square represents 10 acres.

2. The beneficial use on which the claim is based... lawn and garden irrigation

3. Date or approximate date of earliest beneficial use; and how continuous the use has been... June 1948 to Oct. 1963—year

round use, only water supply for household use; since Oct. '63 used only for part of lawn and garden water

4. The amount of groundwater claimed (in miner's inches or gallons per minute)... 20 gal per min

5. If used for irrigation, give the acreage and description of the lands to which water has been applied and name of the owner thereof... Lots 8, 9 and 10, Blk. 5, Robbins Addition

6. The means of withdrawing such water from the ground and the location of each well or other means of withdrawal... Two jet type pumps, 1/2 horsepower each

7. The date of commencement and completion of the construction of the well, wells, or other works for withdrawal of groundwater... June 1948

8. The depth of water table... 25 feet Nov. through May; 12 feet June through Oct.

9. So far as it may be available, the type, size and depth of each well or the general specifications of any other works for the withdrawal of groundwater... 4 foot diameter; concrete casing; 28 feet deep; 2 horsepower jet type pumps

10. The estimated amount of groundwater withdrawn each year... 700,00 gal.

11. The log of formations encountered in the drilling of each well if available... not available

12. Such other information of a similar nature as may be useful in carrying out the policy of this act, including reference to book and page of any county record... none

Signature of Owner... Maxine Robinson
Date... April 21, 1964

Three copies to be filed by the owner with the County Clerk and Recorder of the county in which the well is located.

Please answer all questions. If not applicable, so state, otherwise the form will be returned.

Original to the County Clerk and Recorder; Duplicate to the State Engineer; Triplicate to the Montana Bureau of Mines and Geology, and Quadruplicate for the Appropriator.

35618