

GROUNDWATER INDEX

Page 1 of 1

County Lansdowne Twp. P. L. S. Rge.

Sec.	Name of Appropriator	Type of Form	County File No.	Remarks
	Krausman, Isaac	57 2nd Reg	210455	27N 47E
	Smith, Sarah A.	49 4	219158	27N 47E Sec 22
	Lehman, Benjamin One.	57 2nd Reg	209467	27N 30E Sec 2
	Hickel, Alfred	57 2nd Reg	210992	27N 47E
	Immaculate Conception Church	57 2nd Reg	210351	27N 47E
	Krausman, Isaac	57 2nd Reg	210380	27N 47E
	Krausman, Isaac	57 2nd Reg	210399	27N 47E
	Davis, George	57 2nd Reg	210355	27N 47E
	Davis, George	57 2nd Reg	210356	27N 47E
	Quick, William E.	49 4	220054	
	Strang, David Milo	57 2nd Reg	210440	28N R53E
	Walikowis, Joe Jr.	49 4	228913	
	City of Half Point	57 2nd Reg	210188	27N 47E Sec 22
	City of Half Point	57 2nd Reg	210189	27N 47E
	City of Half Point	57 2nd Reg	210190	27N 47E
	City of Half Point	57 2nd Reg	210192	27N 47E
	Jack, Harold	49 2	234968	

GW

File No.

DUPLICATE

RECEIVED

FEB 11 1964

T. R.

County.

STATE OF MONTANA
ADMINISTRATOR OF GROUNDWATER CODE
OFFICE OF STATE ENGINEER

RECEIVED
DEC 18 1963

STATE ENGINEER

Declaration of Vested Groundwater Rights

(Under Chapter 237, Montana Session Laws, 1961)

1. Glenn E. Quick of Wolf Point
(Name of Appropriator) (Address) (Town)
County of Beaverhead State of Mont.
have appropriated groundwater according to the Montana laws in effect prior to January 1, 1962, as follows:

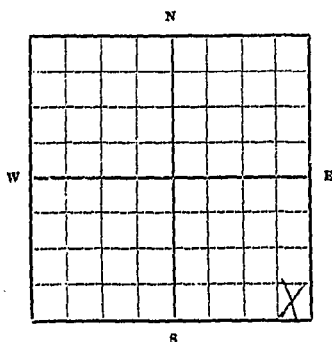

..... 1/4 Sec. T. R.

Indicate point of appropriation
and place of use, if possible.
Each small square represents 10
acres.

2. The beneficial use on which the claim is based House hold and stock
3. Date or approximate date of earliest beneficial use; and how continuous the use has been 1954 - continuous use
4. The amount of groundwater claimed (in miner's inches or gallons per minute) app. 5 gal per min.
5. If used for irrigation, give the acreage and description of the lands to which water has been applied and name of the owner thereof
6. The means of withdrawing such water from the ground and the location of each well or other means of withdrawal jet pump
7. The date of commencement and completion of the construction of the well, wells, or other works for withdrawal of groundwater 1954
8. The depth of water table 5.5 to 6.5 ft.
9. So far as it may be available, the type, size and depth of each well or the general specifications of any other works for the withdrawal of groundwater 2 in steel casing - 20 ft well
10. The estimated amount of groundwater withdrawn each year 10,000 gal
11. The log of formations encountered in the drilling of each well if available clay - 4 ft, gravel 6 ft, shale 10 ft
12. Such other information of a similar nature as may be useful in carrying out the policy of this act, including reference to book and page of any county record.

Signature of Owner Glenn E. QuickDate Dec 16, 1963

Three copies to be filed by the owner with the County Clerk and Recorder of the county in which the well is located.

Please answer all questions. If not applicable, so state, otherwise the form will be returned.

Original to the County Clerk and Recorder; duplicate to the State Engineer; Triplicate to the School of Mines and Quadruplicate for the Appropriator.

9879

File No. 391 Doc. No. 220054

**DECLARATION OF VESTED
GROUNDWATER RIGHTS**

Glenn E. Quick

to

The Public

STATE OF MONTANA.
County of Roosevelt,

ss.

Filed this 16th day of

December, A.D. 1963.

at 3:30 o'clock P. M.

Eleanor A. Schmeltzer
County Recorder

Margaret M. Brown Deputy

Fee \$2.00 pd.

Received from Glenn E. Quick

Wolf Point, Montana

File No. DEC 31 1965

T. R.

DUPLICATE Billie McDermott

County Roosevelt

But MONTANA STATE OF MONTANA

Co. ADMINISTRATOR OF GROUNDWATER CODE

Director OFFICE OF STATE ENGINEER

Declaration of Vested Groundwater Rights

(Under Chapter 237, Montana Session Laws, 1961)

1. Joe Halikonia Jr. of Culberson Montana
 (Name of Appropriator) (Address) (Town)
 County of Roosevelt State of Montana
 have appropriated groundwater according to the Montana laws in effect prior to January 1, 1962, as follows:

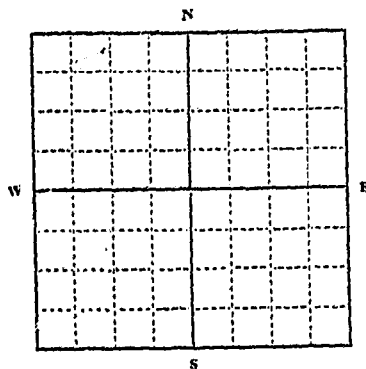

1/4 Sec. T. R.

Indicate point of appropriation and place of use, if possible. Each small square represents 10 acres.

2. The beneficial use on which the claim is based.

Watering livestock and domestic use

3. Date or approximate date of earliest beneficial use; and how continuous the use has been.

Continuous use since
of June 1942

4. The amount of groundwater claimed (in miner's inches or gallons per minute).

500 per min.

5. If used for irrigation, give the acreage and description of the lands to which water has been applied and name of the owner thereof.

not used irrigation

6. The means of withdrawing such water from the ground and the location of each well or other means of withdrawal.

electric pressure system

7. The date of commencement and completion of the construction of the well, wells, or other works for withdrawal of groundwater.

June 1, 1942

8. The depth of water table.

An average of 32 ft

9. So far as it may be available, the type, size and depth of each well or the general specifications of any other works for the withdrawal of groundwater.

6 inch steel casing 192 ft Depth

10. The estimated amount of groundwater withdrawn each year.

350,000 per year

11. The log of formations encountered in the drilling of each well if available.

52 ft. of sand
and balance clay with coal at bottom

12. Such other information of a similar nature as may be useful in carrying out the policy of this act, including reference to book and page of any county record.

Signature of Owner

Joe Halikonia Jr.
Date 12-30-65

Three copies to be filed by the owner with the County Clerk and Recorder of the county in which the well is located.

Please answer all questions. If not applicable, so state, otherwise the form will be returned.

Original to the County Clerk and Recorder; Duplicate to the State Engineer; Triplicate to the Montana Bureau of Mines and Geology, and Quadruplicate for the Appropriator.

46249

File No. 629 Doc. No. 228913

DECLARATION OF VESTED GROUND-
WATER RIGHTS

Joe Walikonis Jr.

T

The Public

STATE OF MONTANA.
County of Roosevelt,

Filed this 30th day of
December, A.D. 1965

at 12:02 o'clock P.M.

Eleanor A. Schmeltzer

County Recorder

Margaret M. Brown

Deputy

Fec \$2.00 pd.

Received from Joe Walikonis Jr.
Culbertson, Montana

File No.

MONTANA WATER RESOURCES BOARD

T. R.

DUPLICATE

RECEIVED

County Prescott

LOG

OCT 5 1967

STATE OF MONTANA
ADMINISTRATOR OF GROUNDWATER CODE
OFFICE OF STATE ENGINEER

Top of Ground

(Elev. above sea level)

**Notice of Completion of Groundwater
Appropriation by Means of Well**

DEVELOPED AFTER JANUARY 1, 1962

(Under Chapter 237, Montana Session Laws, 1961)

Owner Marshall Zuck Address Payson, MontDriller Western Drilling Co. Address Payson, MontDate of Notice of appropriation of groundwater 9-1-67Date well started 8-8-67 Date completed 8-11-67Type of well drilled Equipment used rotary
(Dug, Driven, bored or drilled) (Churn drill, rotary or other)Water use: Domestic ☐ Municipal ☐ Stock ☒ Irrigation ☐
Industrial ☐ Drainage ☐ Other ☐

Indicate on the diagram the character and thickness of the different strata met with in drilling, such as soil, clay, shale, gravel, rock or sand, etc. Show depth at which water is encountered, thickness and character of water-bearing strata and height to which the water rises in the well.

Size of Drilled Hole	Size and Weight of Casing	From (Feet)	To (Feet)	PERFORATIONS		
				Kind Size	From (Feet)	To (Feet)
<u>6 1/4"</u>	<u>7" I.D.</u> <u>11 lb. per ft.</u>	<u>0</u>	<u>118'</u>	<u>flow</u> <u>water</u>	<u>111'</u>	<u>115'</u>

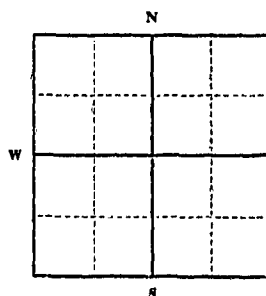
Static Water Level for non-flowing well 58 feet.

Shut-in Pressure for Flowing Well

Pumping Water Level 118 feet
at 35 gal. per minute.

Discharge in gal. per min. of flowing well

How Tested pressureLength of Test 2 hours

Remarks: (Gravel packing, cementing, packers, type of shutoff)

1/4 Sec. T. R.
Indicate location of well and place of use, if possible. Each small square represents 40 acres.at base of main water table
111 ft

(Continue on reverse side)

USE—If used for irrigation, industrial, drainage or other. Explain, state number of acres and location or other data (i.e.: Lot, Block and Addition).

Show exact depth of bottom.

This form to be prepared by driller, and three copies to be filed by the owner with the County Clerk and Recorder in the county in which the well is located, tissue copy to be retained by driller.

Please answer all questions. If not applicable, so state, otherwise the form will be returned.

166
Driller's License NumberL. G. H. ...
Driller's Signature

42,367

INDEXED

File No. 650 Doc. No. 234968

**NOTICE OF COMPLETION OF GROUNDWATER
APPROPRIATION BY MEANS OF WELL**

Gerald Zuck

to

The Public

STATE OF MONTANA.
County of Roosevelt,

ss.

Filed this 4th day of
October, A.D. 1967
at 1:15 o'clock P.M.

Eleanor A. Schmoltzer
County Recorder

Margaret H. Brown Deputy

Fee \$2.00 pd.
Gerald Zuck
Poplar, Montana

Received from.....
.....
.....

GW-1's No GW-2's

GW 1

File No.
MONTANA WATER RESOURCES BOARD

T. R.
County Rosebud

RECEIVED

NOV 21 1967

STATE OF MONTANA
ADMINISTRATOR OF GROUNDWATER CODE
OFFICE OF STATE ENGINEER

Notice of Appropriation of Groundwater

(Under Chapter 237, Montana Session Laws, 1961)

1. Elmer N. Dye of Bainville
(Name of Appropriator) (Address) (Town)
County of Rosebud State of Montana intend to appropriate groundwater in accordance with Chapter 237, Montana Session Laws of 1961.
2. The beneficial use to which water is to be applied is House use for modern home
(describe lands to be benefited, if for irrigation)
3. The rate of use in gallons per minute or miner's inches of groundwater claimed one gallon per minute
4. The annual period (inclusive dates) of intended use
5. The probable or intended date of first beneficial use
6. The probable or intended date of commencement and completion of the well* or wells* 1953
7. The location, type, size and depth of well or wells contemplated Drilled well size 5" casing depth 120'
8. The probable or estimated depth of the water table or artesian aquifer
9. Name, address and license number of the driller engaged Romo Brothers Bainville
10. Give such other similar information as may be useful in carrying out the policy of this act

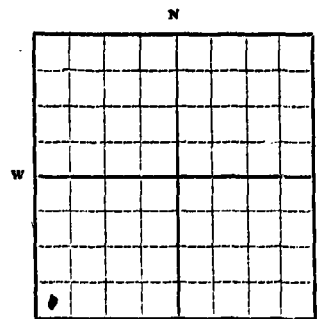

S.W. 1/4 Sec. 27 T29 R59

Locate well or other means of development as accurately as possible on the plat.

Signature of Appropriator Elmer N. Dye

Date

* As defined in the Code Sec. 1 (c) "Well" means any artificial opening or excavation in the ground, however made, by which groundwater can be obtained or through which it flows under natural pressures or is artificially withdrawn."

Three copies of this notice are to be filed with County Clerk and Recorder of the county in which the well is located.

Please answer all questions. If not applicable, so state, otherwise the form will be returned.

Original to the County Clerk and Recorder; duplicate to the State Engineer; Triplicate to the School of Mines and Quadruplicate for the Appropriator.

42,550

File No. 653 Doc. No. 235320

NOTICE OF APPROPRIATION OF
GROUNDWATER

Elmer H. Dye

to

The Public

STATE OF MONTANA.
County of Roosevelt,

ss.

Filed this 17th day of
November, A.D. 1967
at 1:00 o'clock P. M.

Kleanor A. Schmeltzer
County Recorder

Margaret M. Brown
Deputy

Fee \$2.00 pd.

Received from Elmer H. Dye
Bainville, Montana

T 30 R 47

File No. 630 Dec. No. 20114

NOTICE OF APPROPRIATION OF GROUNDWATER

Herbert Roug
to
The public

STATE OF MONTANA,
County of Roosevelt,

Filed this 30th day of
December, A.D. 1965
at 1:45 o'clock P. M.
Mearns A. [unclear]
County Recorder
Raymond P. [unclear] Deputy
Fee \$2.00 pd.

Received from Herbert Roug
Wolf Point, Montana

- (describe lands to be benefited, *general*)
- The rate of use in gallons per minute or miner's inches of groundwater *per minute*
 - The annual period (inclusive dates) of intended use *Full year*
 - The probable or intended date of first beneficial use
 - The probable or intended date of commencement and completion of the well* or wells*
 - The location, type, size and depth of well or wells contemplated *about 40 feet deep*
 - The probable or estimated depth of the water table or artesian aquifer *about 25 ft.*
 - Name, address and license number of the driller engaged *Barr Drilling, Wolf Point, Mont.*
 - Give such other similar information as may be useful in carrying out the policy of this act.

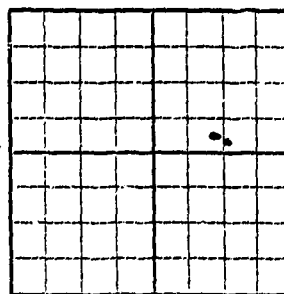

N.E. 1/4 Sec. 24, T30, R47

Locate well or other means of development as accurately as possible on the plat.

Signature of Appropriator *Herbert Roug*

Date *12-30-1965*

*As defined in the Code Sec. 1 (c) "Well" means any artificial opening or excavation in the ground, however made, by which groundwater can be obtained or through which it flows under natural pressures or is artificially withdrawn."

Three copies of this notice are to be filed with County Clerk and Recorder of the county in which the well is located.

Please answer all questions. If not applicable, so state, otherwise the form will be returned.

Original to the County Clerk and Recorder; duplicate to the State Engineer; Triplicate to the School of Mines and Quadruplicate for the Appropriator.

No.
STATE WATER COMMISSION RECORDS
DUPLICATE

T. 30 N. R. 47 E. S. 4
County Roosevelt

STATE OF MONTANA
ADMINISTRATOR OF GROUNDWATER CODE
OFFICE OF STATE ENGINEER

Notice of Appropriation of Groundwater
(Under Chapter 237, Montana Session Laws, 1961)

1. I, HERBERT HOWE, of Wolf Point
(Name of Appropriator) (Address) (Town)
County of Roosevelt, State of Montana, intend to appropriate groundwater in accordance with Chapter 237, Montana Session Laws of 1961.
2. The beneficial use to which water is to be applied is stock water and general farm use
(describe lands to be benefited, if for irrigation)
3. The rate of use in gallons per minute or miner's inches of groundwater claimed 5 gal. per minute
4. The annual period (inclusive dates) of intended use Full year
5. The probable or intended date of first beneficial use
6. The probable or intended date of commencement and completion of the well* or wells*
7. The location, type, size and depth of well or wells contemplated about 40 feet deep
8. The probable or estimated depth of the water table or artesian aquifer about 28 ft.
9. Name, address and license number of the driller engaged Don Drilling, Wolf Point, Mont.
10. Give such other similar information as may be useful in carrying out the policy of this act.....

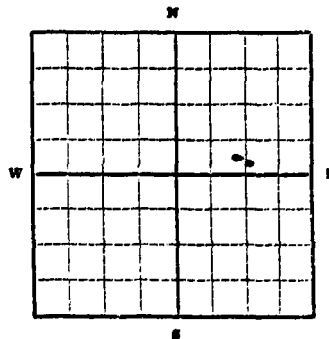

7.E. 1/4 Sec. 24 T. 30. R. 47
Locate well or other means of development as accurately as possible on the plat.

Signature of Appropriator Herbert Howe
Date 12-30-1965

* As defined in the Code Sec. 1 (c) "Well" means any artificial opening or excavation in the ground, however made, by which groundwater can be obtained or through which it flows under natural pressures or is artificially withdrawn."

Three copies of this notice are to be filed with County Clerk and Recorder of the county in which the well is located.

Please answer all questions. If not applicable, so state, otherwise the form will be returned.

Original to the County Clerk and Recorder; duplicate to the State Engineer; Triplicate to the School of Mines and Quadruplicate for the Appropriator.

File No. 630

Doc. No. 228914

NOTICE OF APPROPRIATION OF
GROUNDWATER

Herbert Houg

to

The public

STATE OF MONTANA.
County of Roosevelt, } ss.

Filed this 30th day of
December, A.D. 1965

at 1:45 o'clock P. M.

Eleanor A. Schmeltzer
County Recorder

Margaret M. Brown
Deputy

Fee \$2.00 pd.

Received from Herbert Houg

Wolf Point, Montana

General purpose
(describe lands to be benefited, if for irrigation)

3. The rate of use in gallons per minute or miner's inches of groundwater claimed. 5 gpm.

4. The annual period (inclusive dates) of intended use. 4 mill years

5. The probable or intended date of first beneficial use

6. The probable or intended date of commencement and completion of the well* or wells*

7. The location, type, size and depth of well or wells contemplated. about 10 feet deep

8. The probable or estimated dep't. of the water table or artesian aquifer. about 28 ft.

9. Name, address and license number of the driller engaged. Bow Building, Wolf Point, Mont.

10. Give such other similar information as may be useful in carrying out the policy of this act.



County Roosevelt
RECEIVED

STATE OF MONTANA
ADMINISTRATOR OF GROUNDWATER CODE
MONTANA WATER RESOURCES BOARD
NOTICE OF APPROPRIATION OF GROUNDWATER
(Under Chapter 237, Montana Session Laws, 1961, as amended)

JUL 3 1972

MONTANA DEPARTMENT OF NATURAL
RESOURCES AND CONSERVATION

After filing a notice of appropriation, in order to acquire a right based thereon, the person must, within ninety (90) days, commence actual excavation and diligently prosecute construction of a well and, upon its completion, file a notice of completion with the County Clerk of the county in which the appropriation is located.

Three copies of this notice are to be filed with the County Clerk and Recorder of the county in which the well is located.

Please answer all questions. If not applicable, so state, otherwise the form may be returned.

1. I, Thomas Heidner, of Wolf Point
(Name of Appropriator) (Address) (Town)

County of Roosevelt, State of Montana, intend to appropriate groundwater in accordance with Chapter 237, Montana Session Laws of 1961.

2. The beneficial use to which water is to be applied is Stock water and Irrigation
Block Section 31, Twp. 29 N., Rge. 48 E. NPM.
(describe lands to be benefited, if for irrigation)

3. The rate of use in gallons per minute or miner's inches of groundwater claimed 250 gallons per minute

The estimated amount of groundwater to be used annually unknown

4. The annual period (inclusive dates) of intended use May 1st,

5. The probable or intended date of first beneficial use May 1st

6. The probable or intended date of commencement and completion of the well* or wells* three years ago, made by me

7. The location, type, size and depth of well or wells contemplated Block Sec. 31 15 feet deep

8. The probable or estimated depth of the water-table or artesian aquifer 3 feet water table

9. The name, address, and license number of the driller engaged Thomas Heidner

10. Give such other similar information as may be useful in carrying out the policy of this act

For Administrator's Use

File 790-250350

June 30, 1972 9:20 a.m.

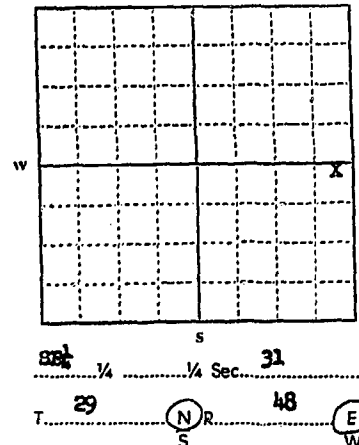

LOCATE WELL OR OTHER MEANS OF DEVELOPMENT AS ACCURATELY AS POSSIBLE ON THE PLAT.

Signature of Appropriator Thomas Heidner Date June 30th, 1972

*As defined in the Code Sec. 1 (c) "well" means any artificial opening or excavation in the ground, however made, by which groundwater can be obtained or through which it flows under natural pressures or is artificially withdrawn.

File No. 709 Doc. No. 250350

**NOTICE OF APPROPRIATION OF GROUND-
WATER**

Thomas Haidner

**to
The Public**

STATE OF MONTANA. } ss.
County of Roosevelt,

Filed this 30th day of
June, A.D. 1972
at 9:20 o'clock A.M.

Eleanor A. Schmeltzer
County Recorder

Margaret M. Brown
Deputy

Fee \$2.00 pd.

Received from Thomas Haidner

Wolf Point, Montana

GW1

File No.

DUPLICATE

RECEIVED

T30 R 56

County Roosevelt

OCT 22 1970

STATE OF MONTANA
ADMINISTRATOR OF GROUNDWATER CODE
OFFICE OF STATE ENGINEER

Notice of Appropriation of Groundwater

(Under Chapter 237, Montana Session Laws, 1961)

1. I, Arthur Swanson, of Froid, Montana
(Name of Appropriator) (Address) (Town)
County of Roosevelt, State of Montana, intend to appropriate groundwater in accordance with Chapter 237, Montana Session Laws of 1961.
2. The beneficial use to which water is to be applied is two wells for house and stock,
(describe lands to be benefited, if for irrigation)
3. The rate of use in gallons per minute or miner's inches of groundwater claimed 05 gallons
4. The annual period (inclusive dates) of intended use all year
5. The probable or intended date of first beneficial use One well approximately 1909,
Second well approximately July, 1948.
6. The probable or intended date of commencement and completion of the well* or wells*
First well 1909, and second well 1948.
7. The location, type, size and depth of well or wells located Mt. NE 1/4, Section 27,
Township 30, Range 56, Curb well, 18 inch depth 65 feet.
8. The probable or estimated depth of the water table or subsurface 50 feet of water
9. Name, address and license number of the driller engaged Unknown local driller
1948 well, of rotary digging, operator licensed
10. Give such other similar information as may be useful in carrying out the policy of this act.
These two wells
are small domestic
use wells within
the farmstead

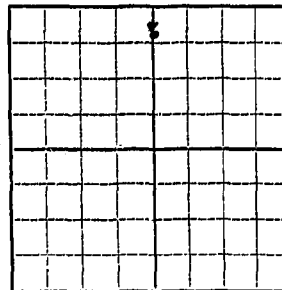

NE 1/4 Sec. 27 T. 30 R. 56

Locate well or other means of development as accurately as possible on the plat.

Doc. No. 684
Filed for record
this 20 day of October
A. D. 19 70, at 4:00
o'clock P. M.

Signature of Appropriator. Arthur Swanson

Date. October 20th, 1970

* As defined in the Code Sec. 1 (c) "Well" means any artificial opening or excavation in the ground, however made, by which groundwater can be obtained or through which it flows under natural pressures or is artificially withdrawn."

Three copies of this notice are to be filed with County Clerk and Recorder of the county in which the well is located.

Please answer all questions. If not applicable, so state, otherwise the form will be returned.

Original to the County Clerk and Recorder; duplicate to the State Engineer; Triplicate to the School of Mines and Quadruplicate for the Appropriator.

47661

INDEXED

FILE NO. _____

DOC. NO. #684

NOTICE OF APPROPRIATION OF GROUNDWATER

Arthur Swanson

TO

The Public

STATE OF MONTANA, }
COUNTY OF ROCSEVELT. } SS.

The within instrument was filed for record

on October 20th, 1970 at 4:00

o'clock P. M., and is duly recorded in

Book _____ of _____ page _____

Eleanor A. Schmeltzer

County Clerk and Recorder

By Margaret M. Brown

Deputy

Fec. \$2.00 Paid.

Arthur Swanson
Froid, Montana 59226

GW1

File No.

DUPLICATE

T 31 N 49 E 10
County San Roosevelt

STATE OF MONTANA
ADMINISTRATOR OF GROUNDWATER CODE
OFFICE OF STATE ENGINEER

RECEIVED
FEB 10 1964

Notice of Appropriation of Groundwater

(Under Chapter 237, Montana Session Laws, 1961)

STATE ENGINEER

1. I, Ramon Iraver, of Seabey (Address) (Town)
(Name of Appropriator)
County of Danville, State of Mont, intend to appropriate groundwater in accordance with Chapter 237, Montana Session Laws of 1961.
2. The beneficial use to which water is to be applied is for cattle & all other live stock and home use
(describe lands to be benefited, if for irrigation)
3. The rate of use in gallons per minute or miner's inches of groundwater claimed 5 gal per minute
4. The annual period (inclusive dates) of intended use as long as there is water
5. The probable or intended date of first beneficial use at once
6. The probable or intended date of commencement and completion of the well* or wells* 1963 & 64
7. The location, type, size and depth of well or wells contemplated SE 1/4 Sec. 10, T 31 N 49 E 14" wood casing - 100 ft deep - 6" steel casing 100' deep - one spring water in core flowing
8. The probable or estimated depth of the water table or artesian aquifer at 40' - 10' down at 100'
9. Name, address and license number of the driller engaged Self drilled

10. Give such other similar information as may be useful in carrying out the policy of this act.....

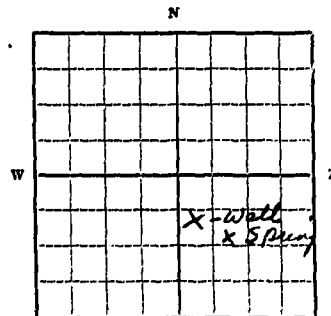

SE 1/4 Sec. 10 T 31 N 49 E
Locate well or other means of development as accurately as possible on the plat.

Signature of Appropriator Ramon Iraver
Date Feb 7, 1964

* As defined in the Code Sec. 1 (c) "Well" means any artificial opening or excavation in the ground, however made, by which groundwater can be obtained or through which it flows under natural pressures or is artificially withdrawn."

Three copies of this notice are to be filed with County Clerk and Recorder of the county in which the well is located.

Please answer all questions. If not applicable, so state, otherwise the form will be returned.

Original to the County Clerk and Recorder; duplicate to the State Engineer; Triplicate to the School of Mines and Quadruplicate for the Appropriator.

34875

File No. #601 Doc. No. 220906

**NOTICE OF APPROPRIATION OF
GROUNDWATER**

Hamon Trower

to

The Public

STATE OF MONTANA. }
County of Roosevelt, } ss.

Filed this 7th day of
February, A.D. 19 64
at 10:00 o'clock A.M.

Eleanor A. Schmeltzer
County Recorder

Margaret M. Brown
Deputy

Fee \$2.00 pd.
Hamon Trower
Scobey, Montana

Received from