

179540

STATE OF MONTANA, COUNTY  
OF ROSEBUD SS. FILED DEC.  
19, 1963 AT 11-AM, CO. CLERK

2<sup>00</sup>

*Howard J. [unclear]*

File No. ....

T. SS R. 44E

DUPLICATE

County Rosebud

STATE OF MONTANA  
ADMINISTRATOR OF GROUNDWATER CODE  
OFFICE OF STATE ENGINEER

RECEIVED  
JAN 10 1964

Notice of Completion of Groundwater Appropriation  
Without Well

STATE ENGINEER

(Under Chapter 237 Montana Session Laws, 1961)

Date of Appropriation of Groundwater 1938Owner U.S.A. - Custer N.F. Address Ashland, MontanaContractor (if any) NAAddress of Contractor NADate Started 1938 Date Completed 1938

Describe means of obtaining groundwater without a well "as by sub-irrigation and other natural processes". Include depth to water when applicable. Spring

Coal Bank Spring

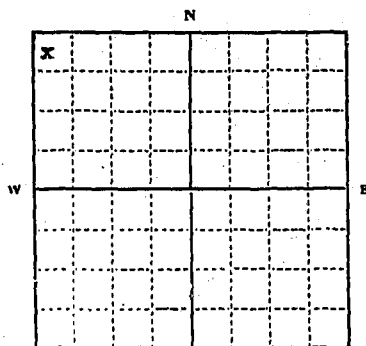
NW  $\frac{1}{4}$  NW Sec. 25 T. 5S R. 44

Indicate point of appropriation and place of use, if possible.

Quantity of water developed and used with explanation of method used to measure or estimate such amount. If use is intermittent

estimate approximate lengths of periods of use.

0.10 gals./min. flow measurement. Used annuallyMay 1 to Dec. 1United States of America Custer National ForestSignature of Owner [Signature]  
By Acting District RangerDate 12/14/63

This form to be prepared by contractor (if any), otherwise by the owner.

Three copies of this notice are to be filed with the County Clerk and Recorder of the county in which the works are located.

Please answer all questions. If not applicable, so state, otherwise the form will be returned.

Original to the County Clerk and Recorder; duplicate to the State Engineer; Triplicate to the Montana Bureau of Mines and Geology and Quz duplicate for the Appropriator.

30276

179554

STATE OF MONTANA, COUNTY  
OF ROSEBUD SS. FILED DEC.  
19, 1963 AT 11-AM, CO. CLERK

*2<sup>nd</sup> Howard T. Smith*

File No. \_\_\_\_\_

T SS R 44E

DUPLICATE

County Rosebud

STATE OF MONTANA  
ADMINISTRATOR OF GROUNDWATER CODE  
OFFICE OF STATE ENGINEER

RECEIVED  
JAN 10 1964

STATE ENGINEER

Notice of Completion of Groundwater Appropriation  
Without Well

(Under Chapter 237 Montana Session Laws, 1961)

Date of Appropriation of Groundwater 1938Owner U.S.A. - Custer N.F. Address Ashland, MontanaContractor (if any) NAAddress of Contractor NADate Started 1938 Date Completed 1938

Describe means of obtaining groundwater without a well "as by  
sub-irrigation and other natural processes". Include depth to  
water when applicable. Spring

Rosie Spring

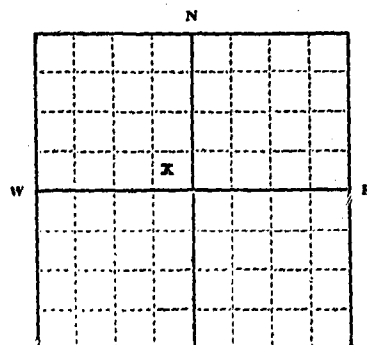
SW  $\frac{1}{4}$  NW Sec. 25 T. 5S R. 44EIndicate point of appropriation  
and place of use, if possible.

Quantity of water developed and used with explanation of method  
used to measure or estimate such amount. If use is intermittent

estimate approximate lengths of periods of use \_\_\_\_\_

0.10 gals/min. flow measurement. Used annuallyMay 1 to Dec. 1.United States of America Custer National ForestSignature of Owner Charles F. NealBy: Acting District RangerDate 12/14/63

This form to be prepared by contractor (if any), otherwise by the owner.

Three copies of this notice are to be filed with the County Clerk and Recorder of the county in which the  
works are located.

Please answer all questions. If not applicable, so state, otherwise the form will be returned.

Original to the County Clerk and Recorder; duplicate to the State Engineer; Triplicate to the Montana  
Bureau of Mines and Geology and Quadruplicate for the Appropriator.

30275

179553

STATE OF MONTANA, COUNTY  
OF ROSEBUD SS- FILED DEC.  
19, 1963 AT 11-AM, CO. CLERK  
*2<sup>00</sup> Howard List*

File No. ....

T. SS R. 44E

DUPLICATE

County Rosebud

STATE OF MONTANA  
ADMINISTRATOR OF GROUNDWATER CODE  
OFFICE OF STATE ENGINEER

RECEIVED  
JAN 10 1964

Notice of Completion of Groundwater Appropriation  
Without Well

STATE ENGINEER

(Under Chapter 237 Montana Session Laws, 1961)

Date of Appropriation of Groundwater 1938Owner U.S.A. - Custer N.F. Address Ashland, MontanaContractor (if any) NAAddress of Contractor NADate Started 1938 Date Completed 1938

Describe means of obtaining groundwater without a well "as by sub-irrigation and other natural processes". Include depth to water when applicable. Spring

Soap Spring

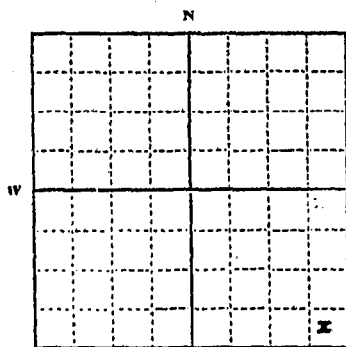
SE 1/4 Sec 26 T. 5S R. 44E

Indicate point of appropriation and place of use, if possible.

Quantity of water developed and used with explanation of method used to measure or estimate such amount. If use is intermittent

estimate approximate lengths of periods of use.....

0.10 gals./min. flow measurement. Used annuallyMay 1 to Dec. 1.

United States of America - Custer National Forest

Signature of Owner Thomas F. Neal

By: Acting District Ranger

Date 12/14/63

This form to be prepared by contractor (if any), otherwise by the owner.

Three copies of this notice are to be filed with the County Clerk and Recorder of the county in which the works are located.

Please answer all questions. If not applicable, so state, otherwise the form will be returned.

Original to the County Clerk and Recorder; duplicate to the State Engineer; Triplicate to the Montana Bureau of Mines and Geology and Quadruplicate for the Appropriator.

30274

179552

STATE OF MONTANA, COUNTY  
OF ROSEBUD SS. FILED DEC.  
19, 1963 AT 11-AM, CO. CLERK

*2<sup>nd</sup> Howard Rich*

GW3

File No. ....

DUPLICATE

T. 58 R. 43

County. Roanoke

STATE OF MONTANA  
ADMINISTRATOR OF GROUNDWATER CODE  
OFFICE OF STATE ENGINEER

RECEIVED  
NOV 12 1963

STATE ENGINEER

**Notice of Completion of Groundwater Appropriation Without Well**

(Under Chapter 237 Montana Session Laws, 1961)

Date of Appropriation of Groundwater Nov. 7 - 1963

Owner Natalie Woodard Address Birney Mont.

Contractor (if any) none

Address of Contractor .....

Date Started 1949 Date Completed 1950

Describe means of obtaining groundwater without a well "as by sub-irrigation and other natural processes". Include depth to water when applicable.

spring is rockd up and piped to a stock water tank

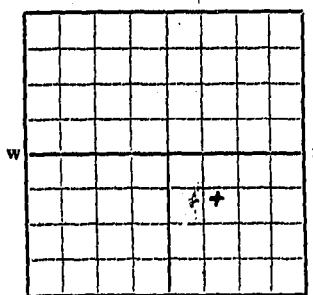

..... 1/4 Sec. 27 T. 58 R. 44  
Indicate point of appropriation and place of use, if possible.

Quantity of water developed and used with explanation of method used to measure or estimate such amount. If use is intermittent estimate approximate lengths of periods of use

June  
this spring to water about 150 head  
of cattle for three months during  
spring of the year

Signature of Owner .....

Date Nov. 7 - 1963

This form to be prepared by contractor (if any), otherwise by the owner.

Three copies of this notice are to be filed with the County Clerk and Recorder of the county in which the works are located.

Please answer all questions. If not applicable, so state, otherwise the form will be returned.

Original to the County Clerk and Recorder; duplicate to the State Engineer; Triplicate to the School of Mines and Quadruplicate for the Appropriator.

6954.



179048

STATE OF MONTANA, )  
COUNTY OF ROSEBUD ) SS.

Filed on the 1<sup>st</sup> day of November

1926 at 2:16 o'clock P.M.

Harold J. ...  
County Clerk & Recorder

By Ellen Clarke  
Deputy

File No. ....

T. 58 R. 44E

DUPLICATE

County ROSEBUD

STATE OF MONTANA  
ADMINISTRATOR OF GROUNDWATER CODE  
OFFICE OF STATE ENGINEER

JAN 10 1964

Notice of Completion of Groundwater  
Appropriation by Means of Well ENGINEER

(Under Chapter 237, Montana Session Laws, 1961)

Top of Ground  
(Elev. above sea level 3500 .....) Feet

0 - 70 - Sandy Shale

70 - 120 - Shale

120 - 135 - Sand &amp; Coal

135 - 220 - Shale

220 - 223 - Rock

223 - 245 - Shale

245 - 247 - Rock

247 - 365 - Shale

365 - 366 - Rock

366 - 400 - Shale

400 - 402 - Coal

402 - 430 - Shale

430 - 445 - Coal

445 - 480 - Shale

480 - Bottom

Owner U.S. Forest Service Address Ashland, Montana

Driller Carl Jerrel Address Miles City, Mont.

Date of Notice of Appropriation of Groundwater None Filed

Date well started 5/10/63 Date Completed 5/15/63

Type of well Drilled Equipment Used Rotary  
(dug, driven, bored or (Churn, drill, rotary or  
drilled) other)

Water Use: Domestic ☐ Municipal ☐ Stock ☒ Irrigation ☐  
Industrial ☐ Drainage ☐ Other ☐

Indicate on the diagram the character and thickness of the different strata met with in drilling, such as soil, clay, shale, gravel, rock or sand, etc. Show depth at which water is encountered, thickness and character of water-bearing strata and height to which the water rises in the well.

Size of Drilled Hole	Size and Weight of Casing	From (Feet)	To (Feet)	PERFORATIONS		
				Kind Size	From (Feet)	To (Feet)
6 inch	4" - 11 lbs	2' above ground	480	Slashes 1/4" x 6"	115	145
					420	480

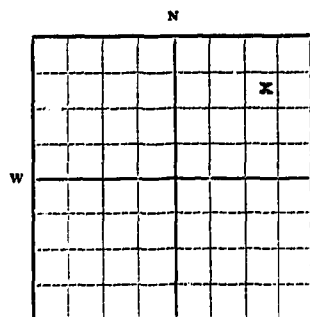

NE 1/4 Sec. 27 T. 58 R. 44E

Indicate location of well and place of use, if possible. Each small square represents 10 acres.

Show exact depth of bottom.

Static Water Level for non-flowing Well 300 feet.

Shut-in Pressure for Flowing Well Not applicable

Pumping Water Level 350 feet at 6 gal. per minute.

Discharge in gal. per min. of flowing well Not applicable

How Tested Drilling Length of Test 2 hours

Remarks: (Gravel packing, cementing, packers, type of shutoff, location of place of use of groundwater if not at well, and any other similar pertinent information, including number of

acres irrigated, if used for irrigation)

None

Driller's License Number 35

Driller's Signature Carl Jerrel

This form to be prepared by driller, and three copies to be filed by the owner with the County Clerk and Recorder in the county in which the well is located.

Please answer all questions. If not applicable, so state, otherwise the form will be returned.

Original to the County Clerk and Recorder; duplicate to the State Engineer; Triplicate to the School of Mines and Quadruplicate for the Appropriator.

30288

179566

STATE OF MONTANA, COUNTY  
OF ROSEBUD SS- FILED DEC.  
19, 1963 AT 11-AM, CO. CLERK  
*2<sup>nd</sup> Howard*

File No. ....

T. 53 R. 11E

DUPLICATE

County Rosebud

STATE OF MONTANA  
ADMINISTRATOR OF GROUNDWATER CODE  
OFFICE OF STATE ENGINEER

RECEIVED  
JAN 10 1964

Notice of Completion of Groundwater Appropriation  
Without Well

(Under Chapter 237 Montana Session Laws, 1961)

Date of Appropriation of Groundwater.....

Owner Forest Service USDA Address Fort Rowes Ranger Station  
Leahland, MontanaContractor (if any) ..... None

Address of Contractor .....

Date Started..... Date Completed \*Approx. 193\*

Describe means of obtaining groundwater without a well "as by sub-irrigation and other natural processes". Include depth to water when applicable. Spring water collection box piped to Stockwater Tank.

\*Completion date of 1938 is based on best knowledge

available. Spring water at this location was most likely used prior to the 1930's.

Quantity of water developed and used with explanation of method used to measure or estimate such amount. If use is intermittent

estimate approximate lengths of periods of use. Spring flows1 gallon per minute by measure. Estimate 50 head ofcattle water at spring each day for 7 months peryear requiring 500 gallons per day.Forest Service USDA

Signature of Owner.....

Charles F. NealDate 12/19/63

NW  
1/4 Sec 29 T. 5S. R. 11E

Indicate point of appropriation  
and place of use, if possible.

This form to be prepared by contractor (if any), otherwise by the owner.

Three copies of this notice are to be filed with the County Clerk and Recorder of the county in which the works are located.

Please answer all questions. If not applicable, so state, otherwise the form will be returned.

Original to the County Clerk and Recorder; duplicate to the State Engineer; Triplicate to the Montana Bureau of Mines and Geology and Quadruplicate for the Appropriator.

179584

STATE OF MONTANA, COUNTY  
OF ROSEBUD SS- FILED DEC.  
19, 1963 AT 11-AM, CO. CLERK

2<sup>10</sup> Howard L. Lutz

File No. ....

T. SS R. ME

DUPLICATE

County Rosebud

STATE OF MONTANA  
ADMINISTRATOR OF GROUNDWATER CODE  
OFFICE OF STATE ENGINEER

## Declaration of Vested Groundwater Rights

(Under Chapter 237, Montana Session Laws, 1961)

JAN 10 1964  
STATE ENGINEER

1. Forest Service USDA of Fort Hovea Ranger Station: Ashland  
(Name of Appropriator) (Address) (Town)  
County of Rosebud State of Montana  
have appropriated groundwater according to the Montana laws in effect prior to January 1, 1962, as follows:

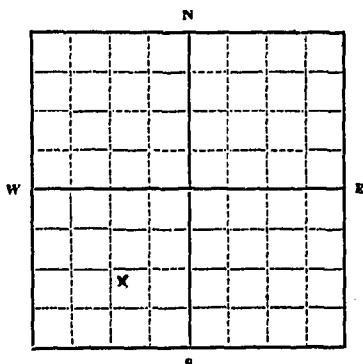

SW  $\frac{1}{4}$  Sec. 33 T. 5S R. ME

Indicate point of appropriation  
and place of use, if possible.  
Each small square represents 10  
acres.

2. The beneficial use on which the claim is based.....  
Livestock water

3. Date or approximate date of earliest beneficial use; and how continuous the use has been.....  
Used during the normal 7 month grazing period May 1 to November 30 since the 1930's.

4. The amount of groundwater claimed (in miner's inches or gallons per minute).....1 quart per minute

5. If used for irrigation, give the acreage and description of the lands to which water has been applied and name of the owner thereof

6. The means of withdrawing such water from the ground and the location of each well or other means of withdrawal.....  
Spring water collection box piped to stockwater tank.

7. The date of commencement and completion of the construction of the well, wells, or other works for withdrawal of groundwater.....Approximately 1937 based on best knowledge available.

8. The depth of water table.....Surface

9. So far as it may be available, the type, size and depth of each well or the general specifications of any other works for the withdrawal of groundwater.....  
Spring water collection box piped to stockwater tank.

10. The estimated amount of groundwater withdrawn each year.....130,000 gallons

11. The log of formations encountered in the drilling of each well if available.....

12. Such other information of a similar nature as may be useful in carrying out the policy of this act, including reference to book and page of any county record.....

Forest Service  
Signature of Owner by Charles J. Neal  
Acting District Ranger  
Date 12/19/63

Three copies to be filed by the owner with the County Clerk and Recorder of the county in which the well is located.

Please answer all questions. If not applicable, so state, otherwise the form will be returned.

Original to the County Clerk and Recorder; duplicate to the State Engineer; Triplicate to the Montana Bureau of Mines and Geology, and Quadruplicate for the Appropriator.

30226

179604

STATE OF MONTANA, COUNTY  
OF ROSEBUD SS. FILED DEC.  
19, 1963 AT 11-AM, CO. CLERK

*Edward J. L.*  
*Sgt. Ellen Clark*

File No. ....

T. 5S R. 44E

DUPLICATE

SPRINGSCounty Rosebud

STATE OF MONTANA  
ADMINISTRATOR OF GROUNDWATER CODE  
OFFICE OF STATE ENGINEER

RECEIVED  
JAN 10 1964

Notice of Completion of Groundwater Appropriation  
Without Well

(Under Chapter 237 Montana Session Laws, 1961)

Date of Appropriation of Groundwater 1940Owner U.S.A. - Custer N.F. Address Ashland, MontanaContractor (if any) NAAddress of Contractor NADate Started 1940 Date Completed 1940

Describe means of obtaining groundwater without a well "as by sub-irrigation and other natural processes". Include depth to water when applicable. Spring

Water Gap Spring

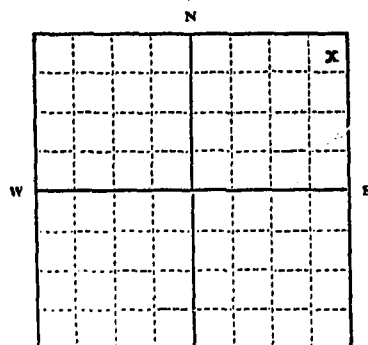

Lot 1

NE  $\frac{1}{4}$  NE Sec. 34 T. 5S R. 44E

Indicate point of appropriation  
and place of use, if possible.

Quantity of water developed and used with explanation of method used to measure or estimate such amount. If use is intermittent

estimate approximate lengths of periods of use.....

0.50 gals./min. flow measurement. Used annuallyMay 1 to Dec. 1.

United States of America - Custer National Forest

Signature of Owner Charles F. Neal

By: Acting District Ranger

Date 12/19/63

This form to be prepared by contractor (if any), otherwise by the owner.

Three copies of this notice are to be filed with the County Clerk and Recorder of the county in which the works are located.

Please answer all questions. If not applicable, so state, otherwise the form will be returned.

Original to the County Clerk and Recorder; duplicate to the State Engineer; Triplicate to the Montana Bureau of Mines and Geology and Quadruplicate for the Appropriator.

30263



179541

STATE OF MONTANA, COUNTY  
OF ROSEBUD SS. FILED DEC.  
19, 1963 AT 11-AM, CO. CLERK

2<sup>nd</sup> Howard Paul

File No. ....

T. SS R. 44E

DUPLICATE

SPRINGSCounty Rosebud

STATE OF MONTANA  
ADMINISTRATOR OF GROUNDWATER CODE  
OFFICE OF STATE ENGINEER

JAN 10 1964

Notice of Completion of Groundwater Appropriation Without Well

(Under Chapter 237 Montana Session Laws, 1961)

Date of Appropriation of Groundwater 1938Owner U.S.A. - Custer N.F. Address Ashland, MontanaContractor (if any) NAAddress of Contractor NADate Started 1938 Date Completed 1938

Describe means of obtaining groundwater without a well "as by sub-irrigation and other natural processes". Include depth to water when applicable. Spring

Lower Big Spring

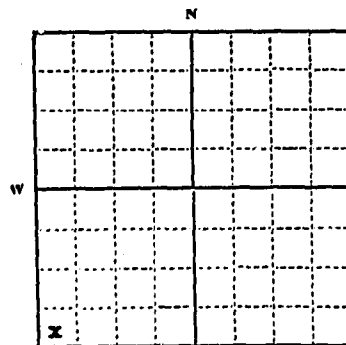

Lot 5  
SW  $\frac{1}{4}$  SW Sec. 35 T. 5S R. 44E

Indicate point of appropriation and place of use, if possible.

Quantity of water developed and used with explanation of method used to measure or estimate such amount. If use is intermittent

estimate approximate lengths of periods of use.

0.60 gals./min. flow measurement. Used annually

May 1 to Dec. 1.

United States of America Custer National Forest

Signature of Owner [Signature]  
By: Acting District Ranger

Date 12/14/63

This form to be prepared by contractor (if any), otherwise by the owner.

Three copies of this notice are to be filed with the County Clerk and Recorder of the county in which the works are located.

Please answer all questions. If not applicable, so state, otherwise the form will be returned.

Original to the County Clerk and Recorder; duplicate to the State Engineer; Triplicate to the Montana Bureau of Mines and Geology and Quadruplicate for the Appropriator.

179542

STATE OF MONTANA, COUNTY  
OF ROSEBUD SS. FILED DEC.  
19, 1963 AT 11-AM, CO. CLERK

24

*Howard L. Lill*

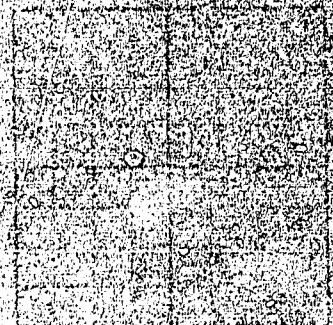

File No. ....

T. SS R. 44E

DUPLICATE

SPRINGSCounty Rosebud

STATE OF MONTANA  
ADMINISTRATOR OF GROUNDWATER CODE  
OFFICE OF STATE ENGINEER

JAN 10 1964

STATE ENGINEER

## Notice of Completion of Groundwater Appropriation Without Well

(Under Chapter 237 Montana Session Laws, 1961)

Date of Appropriation of Groundwater 1938Owner U.S.A. - Custer N.F. Address Ashland, MontanaContractor (if any) NAAddress of Contractor NADate Started 1938 Date Completed 1938Describe means of obtaining groundwater without a well "as by sub-irrigation and other natural processes". Include depth to water when applicable. Spring

Old Road Spring

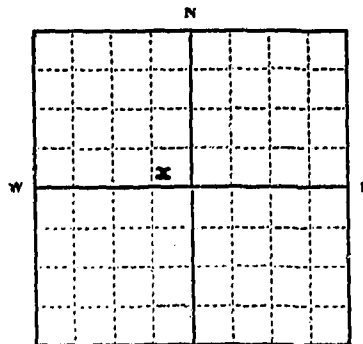
NE 1/4 NW Sec 35 T. 5S R. 44E

Indicate point of appropriation and place of use, if possible.

Quantity of water developed and used with explanation of method used to measure or estimate such amount. If use is intermittent:

estimate approximate lengths of periods of use.

0.50 gals/min. f low measurement. Used annuallyMay 1 to Dec. 1

United States of America / Custer National Forest

Signature of Owner Charles F. Neal

By: Acting District Ranger

Date 12/14/63

This form to be prepared by contractor (if any), otherwise by the owner.

Three copies of this notice are to be filed with the County Clerk and Recorder of the county in which the works are located.

Please answer all questions. If not applicable, so state, otherwise the form will be returned.

Original to the County Clerk and Recorder; duplicate to the State Engineer; Triplicate to the Montana Bureau of Mines and Geology and Quadruplicate for the Appropriator.

30273

179551

STATE OF MONTANA, COUNTY  
OF ROSEBUD SS. FILED DEC.  
19, 1963 AT 11-AM, CO. CLERK

*2<sup>02</sup> Howard Smith*

File No. ....

T. 58 R. 44E

DUPLICATE

County Rosebud

STATE OF MONTANA  
ADMINISTRATOR OF GROUNDWATER CODE  
OFFICE OF STATE ENGINEER

RECEIVED  
JAN 10 1964

Notice of Completion of Groundwater Appropriation  
Without Well

STATE ENGINEER

(Under Chapter 237 Montana Session Laws, 1961)

Date of Appropriation of Groundwater Sept. 23, 1963Owner U.S.A. - Custer N.F. Address Ashland, MontanaContractor (if any) NAAddress of Contractor NADate Started Sept. 17, 1963 Date Completed Sept. 23, 1963

Describe means of obtaining groundwater without a well "as by  
sub-irrigation and other natural processes". Include depth to  
water when applicable. Spring

B utch Spring

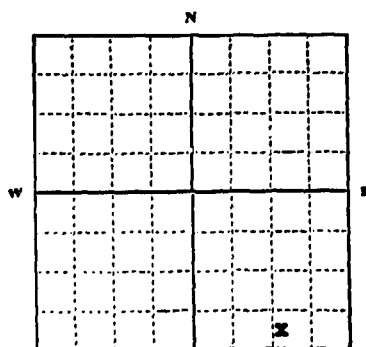
SE  $\frac{1}{4}$  SE Sec. 36 T58 R44EIndicate point of appropriation  
and place of use, if possible.

Quantity of water developed and used with explanation of method  
used to measure or estimate such amount. If use is intermittent

estimate approximate lengths of periods of use.....

0.60 gals/min. flow measurement. Used annuallyMay 1 to Dec. 1 for livestock watering.

United States of America Custer National Forest  
Signature of Owner E. Ashland

By: Acting District RangerDate 12/16/63

This form to be prepared by contractor (if any), otherwise by the owner.

Three copies of this notice are to be filed with the County Clerk and Recorder of the county in which the  
works are located.

Please answer all questions. If not applicable, so state, otherwise the form will be returned.

Original to the County Clerk and Recorder; duplicate to the State Engineer; Triplicate to the Montana  
Bureau of Mines and Geology and Quadruplicate for the Appropriator.

30278

179556

STATE OF MONTANA, COUNTY  
OF ROSEBUD SS. FILED DEC.  
19, 1963 AT 11-AM, CO. CLERK  
2<sup>00</sup> Howard J. Lait

## GROUNDWATER INDEX

Page 1 of 1

County ROSEBUD Twp. 6. SOUTH Rge. 4/ EAST

[illegible]



GW.

Approved Stock Form—State Publishing Co., Helena, Montana—42234

File No. ....

T. 6 N. R. 41 E

DUPLICATE

County Rosebud

STATE OF MONTANA  
ADMINISTRATOR OF GROUNDWATER CODE  
OFFICE OF STATE ENGINEER

### Declaration of Vested Groundwater Rights

(Under Chapter 237, Montana Session Laws, 1961)

I, Warren Brewster, of Burney  
(Name of Appropriator) (Address) (Town)  
County of Rosebud State of Mont.  
have appropriated groundwater according to the Montana laws in effect prior to January 1, 1962, as follows:

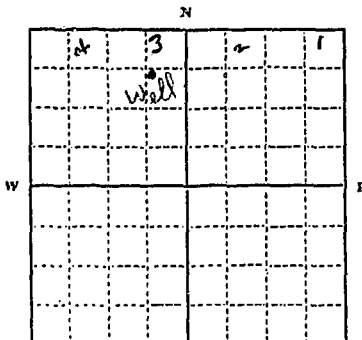

173  
1/4 Sec. T. R.

Indicate point of appropriation  
and place of use, if possible. Each  
small square represents 10 acres.

2. The beneficial use on which the claim is based Stockwater

3. Date or approximate date of earliest beneficial use; and how continuous the use has been 1934-1963

4. The amount of groundwater claimed (in miner's inches or gallons per minute) 5 gal. per Min.

5. If used for irrigation, give the acreage and description of the lands to which water has been applied and name of the owner thereof

6. The means of withdrawing such water from the ground and the location of each well or other means of withdrawal Windmill

7. The date of commencement and completion of the construction of the well, wells, or other works for withdrawal of groundwater 1934

8. The depth of water table 20'

9. So far as it may be available, the type, size and depth of each well or the general specifications of any other works for the withdrawal of groundwater 8.5'

10. The estimated amount of groundwater withdrawn each year

11. The log of formations encountered in the drilling of each well if available

12. Such other information of a similar nature as may be useful in carrying out the policy of this act, including reference to book and page of any county record

Signature of Owner Warren Brewster

Date Dec. 30 1963

Three copies to be filed by the owner with the County Clerk and Recorder of the county in which the well is located.

Please answer all questions. If not applicable, so state, otherwise the form will be returned.

Original to the County Clerk and Recorder; Duplicate to the State Engineer; Triplicate to the Montana Bureau of Mines and Geology, and Quadruplicate for the Appropriator.

34804

180567

STATE OF MONTANA, } ss.  
COUNTY OF ROSEBUD }

Filed on the 34 day of Feb.

at 5:00 o'clock P. M.

James L. Lutz  
County Clerk & Recorder

Ellis J. Clark  
Deputy

File No. ....

T. 6 R 41 E

DUPLICATE

County .....

STATE OF MONTANA  
ADMINISTRATOR OF GROUNDWATER CODE  
OFFICE OF STATE ENGINEER

RECEIVED  
JAN 3 1964

Notice of Completion of Groundwater Appropriation  
Without Well

(Under Chapter 237 Montana Session Laws, 1961)

Date of Appropriation of Groundwater .....

Owner Warren Brewster Address Birney Mont

Contractor (if any) .....

Address of Contractor .....

Date Started 1958 Date Completed 1958

Describe means of obtaining groundwater without a well "as by sub-irrigation and other natural processes". Include depth to water when applicable. Excavated at site with Ballinger

Installed perforated 2" plastic pipe to collect water at bottom of walvein. Conducts water to tank thru 60' 2" plastic pipe

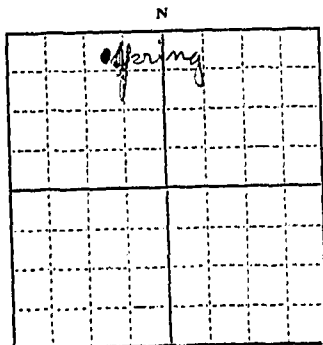

NE 1/4 NW Sec. 7 T. 64 N. R. 41 E

Indicate point of appropriation and place of use, if possible.

Quantity of water developed and used with explanation of method used to measure or estimate such amount. If use is intermittent

estimate approximate lengths of periods of use. Produces

about 2 gal. per min.

Signature of Owner Warren BrewsterDate Dec 30 1963

This form to be prepared by contractor (if any), otherwise by the owner.

Three copies of this notice are to be filed with the County Clerk and Recorder of the county in which the works are located.

Please answer all questions. If not applicable, so state, otherwise the form will be returned.

Original to the County Clerk and Recorder; duplicate to the State Engineer; Triplicate to the Montana Bureau of Mines and Geology and Quadruplicate for the Appropriator.

21213

File No. \_\_\_\_\_

T. 6 S. R. 41 E

DUPLICATE

County \_\_\_\_\_

STATE OF MONTANA  
ADMINISTRATOR OF GROUNDWATER  
OFFICE OF STATE ENGINEER

RECEIVED  
JAN 3 1964

# Notice of Completion of Groundwater Appropriation Without Well

(Under Chapter 237 Montana Session Laws, 1961)

Date of Appropriation of Groundwater \_\_\_\_\_

Owner Warren Brewster Address Birney Mont

Contractor (if any) \_\_\_\_\_

Address of Contractor \_\_\_\_\_

Date Started 1958 Date Completed 1958

Describe means of obtaining groundwater without a well "as by  
sub-irrigation and other natural processes". Include depth to  
water when applicable. Excavated at site with bulldozer

Installed perforated 2" plastic pipe to collect  
water at bottom of coal vein. Conducts water  
to tank thru 6.0" 2" galastic pipe

Quantity of water developed and used with explanation of method  
used to measure or estimate such amount. If use is intermittent

estimate approximate lengths of periods of use. Produces

about 2 gal. per min.

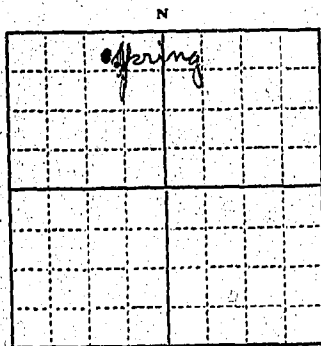

NE 1/4 NW Sec. 7 T. 6 S. R. 41 E

Indicate point of appropriation  
and place of use, if possible.

Signature of Owner Warren BrewsterDate Dec. 30 1963

This form to be prepared by contractor (if any), otherwise by the owner.

Three copies of this notice are to be filed with the County Clerk and Recorder of the county in which the works are located.

Please answer all questions. If not applicable, so state, otherwise the form will be returned.

Original to the County Clerk and Recorder; duplicate to the State Engineer; Triplicate to the Montana Bureau of Mines and Geology and Quadruplicate for the Appropriator.

21213

179970

STATE OF MONTANA, COUNTY  
OF ROSEBUD SS- FILED DEC  
30, 1963, AT 5:00 P.M., CO. CLERK

*Ed. 00*

*Edward Tuit*

*Roland Jean Helld, Dep.*

File No. ....

T. Geo. R. H&E

DUPLICATE

County Rosebud

STATE OF MONTANA  
ADMINISTRATOR OF GROUNDWATER CODE  
OFFICE OF STATE ENGINEER

RECEIVED  
JAN 3 1964

Notice of Completion of Groundwater Appropriation  
Without Well

(Under Chapter 237 Montana Session Laws, 1961)

Date of Appropriation of Groundwater .....

Owner Warren Brewster Briney Address .....

Contractor (if any) .....

Address of Contractor .....

Date Started 1958 Date Completed 1958

Describe means of obtaining groundwater without a well "as by sub-irrigation and other natural processes". Include depth to water when applicable. Excavated at site with Bulldozer

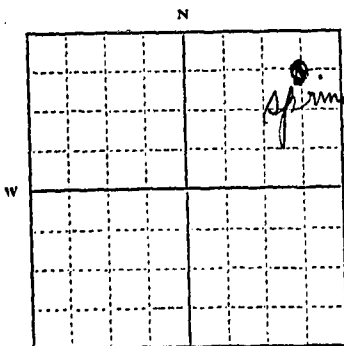

Installed perforated 2" plastic pipe and conducted water to tank thru 200' 2" plastic. Supplies 2 gal per min.

Quantity of water developed and used with explanation of method used to measure or estimate such amount. If use is intermittent

estimate approximate lengths of periods of use.....

N 1/4 NE Sec. 9 T. 60 N. R. 10 E

Indicate point of appropriation and place of use, if possible.

Signature of Owner Warren Brewster

Date Dec. 30 1963

This form to be prepared by contractor (if any), otherwise by the owner.

Three copies of this notice are to be filed with the County Clerk and Recorder of the county in which the works are located.

Please answer all questions. If not applicable, so state, otherwise the form will be returned.

Original to the County Clerk and Recorder; duplicate to the State Engineer; Triplicate to the Montana Bureau of Mines and Geology and Quadruplicate for the Appropriator.

179873

STATE OF MONTANA, COUNTY  
OF ROSEBUD SS- FILED DEC.  
30, 1963, AT 5:00 P. M., CO. CLERK

*22.00*

*Howard L. Laid*  
*David Jean Heltel, Dep.*

File No. ....

T. 620 R 41 E

DUPLICATE

County Rosebud

STATE OF MONTANA  
ADMINISTRATOR OF GROUNDWATER CODE  
OFFICE OF STATE ENGINEER

RECEIVED  
JAN 8 1964

Notice of Completion of Groundwater Appropriation  
Without Well

(Under Chapter 237 Montana Session Laws, 1961)

Date of Appropriation of Groundwater.....

Owner Warren Brewster Address Birney Mont

Contractor (if any) .....

Address of Contractor .....

Date Started 1962 Date Completed 1962

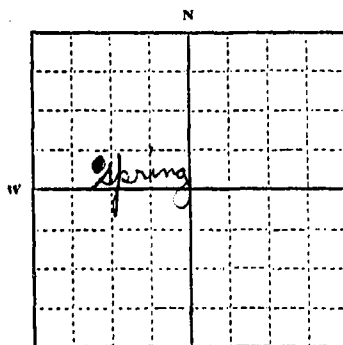

Describe means of obtaining groundwater without a well "as by sub-irrigation and other natural processes". Include depth, to water when applicable. Excavated at site with

Backhoe. Installed 40' 4" plastic perforated. Conducted water to tank thru 100' 2" plastic. Supplies 3 gal per min.

Quantity of water developed and used with explanation of method used to measure or estimate such amount. If use is intermittent

estimate approximate lengths of periods of use.....

1/4 Sec. 12 T. 620 R. 41 E

Indicate point of appropriation and place of use, if possible.

Signature of Owner Warren Brewster

Date Dec. 30, 1963

This form to be prepared by contractor (if any), otherwise by the owner.

Three copies of this notice are to be filed with the County Clerk and Recorder of the county in which the works are located.

Please answer all questions. If not applicable, so state, otherwise the form will be returned.

Original to the County Clerk and Recorder; duplicate to the State Engineer; Triplicate to the Montana Bureau of Mines and Geology and Quadruplicate for the Appropriator.

21211



179968

STATE OF MONTANA, COUNTY  
OF ROSEBUD SS- FILED DEC.  
30, 1963, AT <sup>C. J. M.</sup> M, CO. CLERK

B. J. C. C.

Howard C. C. C.

Louis Jean Hellock

File No. ....

DUPLICATE

STATE OF MONTANA  
ADMINISTRATOR OF GROUNDWATER CODE  
OFFICE OF STATE ENGINEER

County RosebudRECEIVED  
JAN 9 1964

STATE ENGINEER

# Notice of Completion of Groundwater Appropriation Without Well

(Under Chapter 237 Montana Session Laws, 1961)

Date of Appropriation of Groundwater.....

Owner Warren Brewster Address Beincy Mont

Contractor (if any) .....

Address of Contractor .....

Date Started 1962 Date Completed 1962Describe means of obtaining groundwater without a well "as by sub-irrigation and other natural processes". Include depth to water, when applicable. Excavated at site with backhoe

Installed 40' x 4" perforated plastic and  
conducted water to tank thru 100' x 2" plastic  
supplier 2 gal per min.

Quantity of water developed and used with explanation of method used to measure or estimate such amount. If use is intermittent

estimate approximate lengths of periods of use.....

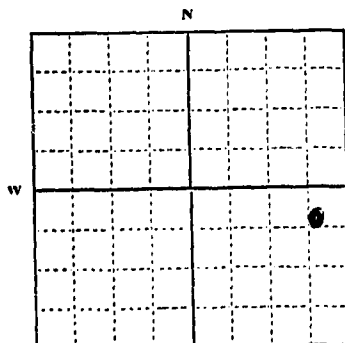

NE 1/4 Sec. 13 T. 6 R. 4 E

Indicate point of appropriation and place of use, if possible.

Signature of Owner Warren BrewsterDate Dec. 30 1963

This form to be prepared by contractor (if any), otherwise by the owner.

Three copies of this notice are to be filed with the County Clerk and Recorder of the county in which the works are located.

Please answer all questions. If not applicable, so state, otherwise the form will be returned.

Original to the County Clerk and Recorder; duplicate to the State Engineer; Triplicate to the Montana Bureau of Mines and Geology and Quadruplicate for the Appropriator.

21215

179972

STATE OF MONTANA, COUNTY  
OF ROSEBUD SS- FILED DEC. 30,  
1963, AT 4:00 P.M., CO. CLERK

R 5.00

*Howard L. Smith*  
*Donna Jean Hild, Dep.*

File No. ....

DUPLICATE

T. 6<sup>th</sup> R. 4<sup>th</sup> E.County Rosebud

STATE OF MONTANA  
ADMINISTRATOR OF GROUNDWATER CODE JAN 3 1964  
OFFICE OF STATE ENGINEER

Notice of Completion of Groundwater Appropriation  
Without Well

(Under Chapter 237 Montana Session Laws, 1961)

Excavated at site with  
bulldozer and installed  
200 feet 2' perforated plastic  
+ 40' 4" tile. Conducted  
water to tank thru 18'  
metal pipe. Supplies  
2 gal. per min.

Date of Appropriation of Groundwater.....

Owner Warren Brewster Address Simsbury

Contractor (if any) .....

Address of Contractor .....

Date Started 1960 Date Completed 1960

Describe means of obtaining groundwater without a well "as by  
sub-irrigation and other natural processes". Include depth to  
water when applicable. NO F. Excavated at site with backhoe  
and installed concrete custom made septic tank.

Conducted water to stock tank thru 200'  
2' plastic. Produces 3 gal. per min.

Quantity of water developed and used with explanation of method  
used to measure or estimate such amount. If use is intermittent

estimate approximate lengths of periods of use.....

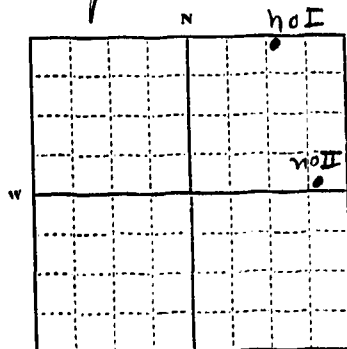

no I NE  $\frac{1}{4}$  NE Sec. 18 T. 6<sup>th</sup> R. 4<sup>th</sup> E.

Indicate point of appropriation  
and place of use, if possible.

Signature of Owner Warren BrewsterDate Dec 30 1963

This form to be prepared by contractor (if any), otherwise by the owner.

Three copies of this notice are to be filed with the County Clerk and Recorder of the county in which the  
works are located.

Please answer all questions. If not applicable, so state, otherwise the form will be returned.

Original to the County Clerk and Recorder; duplicate to the State Engineer; Triplicate to the Montana  
Bureau of Mines and Geology and Quadruplicate for the Appropriator.

21212

179969

STATE OF MONTANA, COUNTY  
OF ROSEBUD SS- FILED DEC.  
30, 1963, AT *CO.* M, CO. CLERK

*P.O.*

*Howard L. L.*

*Donna Jean Hallid, Secy.*

File No. ....

DUPLICATE

T. 6<sup>th</sup> R. 41 E

County. Rosebud

STATE OF MONTANA  
ADMINISTRATOR OF GROUNDWATER CODE  
OFFICE OF STATE ENGINEER

RECEIVED  
JAN 3 1964

Notice of Completion of Groundwater Appropriation  
Without Well

(Under Chapter 237 Montana Session Laws, 1961)

Date of Appropriation of Groundwater.....

Owner. Warren Brewster Address. Birney Mont

Contractor (if any) .....

Address of Contractor .....

Date Started July 1963 Date Completed July 1963Describe means of obtaining groundwater without a well "as by sub-irrigation and other natural processes". Include depth to water when applicable. Excavated at site with

Bulldozer & installed 4" perforated pipe  
at bottom of coal vein. Conducted water  
to tank thru 2" plastic. Produces  
1 gal. per min.

Quantity of water developed and used with explanation of method used to measure or estimate such amount. If use is intermittent

estimate approximate lengths of periods of use.....

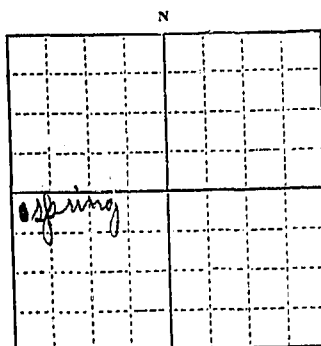

NW 1/4 Sec. 20 T. 6<sup>th</sup> R. 41 E

Indicate point of appropriation  
and place of use, if possible.

Signature of Owner. Warren BrewsterDate. Dec 30 1963

This form to be prepared by contractor (if any), otherwise by the owner.

Three copies of this notice are to be filed with the County Clerk and Recorder of the county in which the works are located.

Please answer all questions. If not applicable, so state, otherwise the form will be returned.

Original to the County Clerk and Recorder; duplicate to the State Engineer; Triplicate to the Montana Bureau of Mines and Geology and Quadruplicate for the Appropriator.

21210

179967

STATE OF MONTANA, COUNTY  
OF ROSEBUD SS- FILED DEC.  
30, 1963, AT 5:10 P. M., CO. CLERK

\$ 2.00

Howard Tait  
Deputy Clerk, Dep.

21310



180681

STATE OF MONTANA, COUNTY  
OF ROSEBUD SS. FILED DEC.  
31, 1963, AT 2<sup>15</sup> PM, CO. CLERK

2<sup>nd</sup> fl Howard J. L.

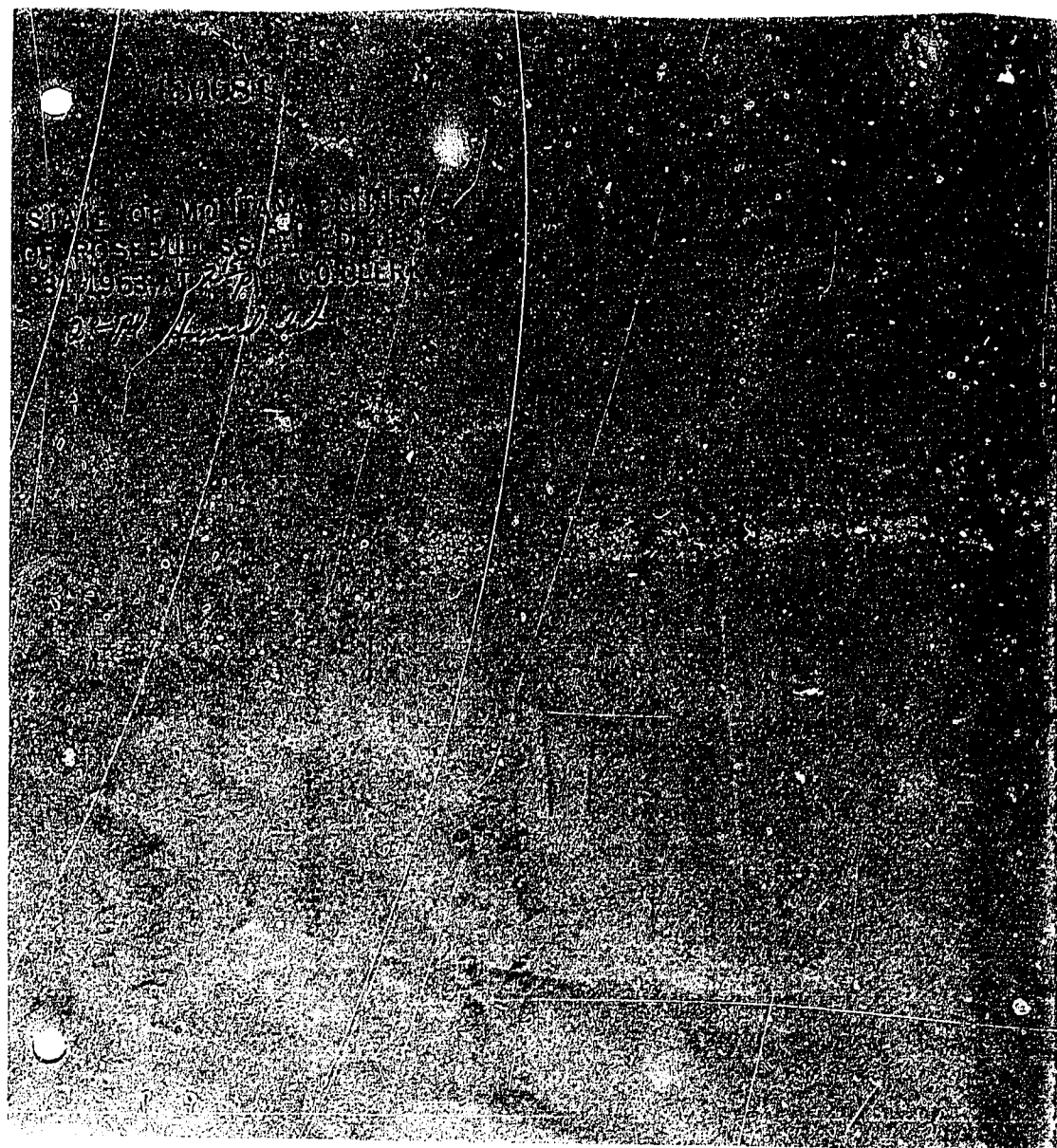

File No. \_\_\_\_\_

T. 640 R. 41 E

DUPLICATE

County Rosebud

STATE OF MONTANA  
ADMINISTRATOR OF GROUNDWATER CODE  
OFFICE OF STATE ENGINEER

RECEIVED  
JAN 3 1964

# Notice of Completion of Groundwater Appropriation Without Well

(Under Chapter 237 Montana Session Laws, 1961)

Date of Appropriation of Groundwater \_\_\_\_\_

Owner Warren Brewster Address Birney Mont

Contractor (if any) \_\_\_\_\_

Address of Contractor \_\_\_\_\_

Date Started 1930 Date Completed 1930

Describe means of obtaining groundwater without a well "as by sub-irrigation and other natural processes". Include depth to water when applicable. Excavated at source with shovel. Conducted water to tank thru 150' 1" metal pipe. supplies 1 gal. per min.

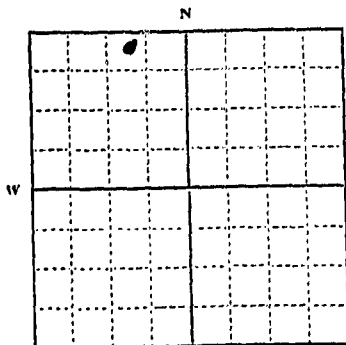

N 2 1/4 NW Sec. 23 T. 64 R. 41 E

Indicate point of appropriation and place of use, if possible.

Quantity of water developed and used with explanation of method used to measure or estimate such amount. If use is intermittent

estimate approximate lengths of periods of use \_\_\_\_\_

Signature of Owner Warren Brewster

Date Dec 30 1963

This form to be prepared by contractor (if any), otherwise by the owner.

Three copies of this notice are to be filed with the County Clerk and Recorder of the county in which the works are located.

Please answer all questions. If not applicable, so state, otherwise the form will be returned.

Original to the County Clerk and Recorder; duplicate to the State Engineer; Triplicate to the Montana Bureau of Mines and Geology and Quadruplicate for the Appropriator.

179971

STATE OF MONTANA, COUNTY  
OF ROSEBUD SS. FILED DEC.  
30, 1963, AT 5:00 PM, CO. CLERK

*Hon. J. L. Clark*  
*Reg. Edw. Clark, Jr.*

File No. \_\_\_\_\_

T. 6 S. R. 11 E

DUPLICATE

County Rosebud

STATE OF MONTANA  
ADMINISTRATOR OF GROUNDWATER CODE  
OFFICE OF STATE ENGINEER

### Declaration of Vested Groundwater Rights

(Under Chapter 237, Montana Session Laws, 1961)

1. Warren Brewster, of Briney  
(Name of Appropriator) (Address) (Town)  
County of Rosebud State of Mont  
have appropriated groundwater according to the Montana laws in effect prior to January 1, 1962, as follows:

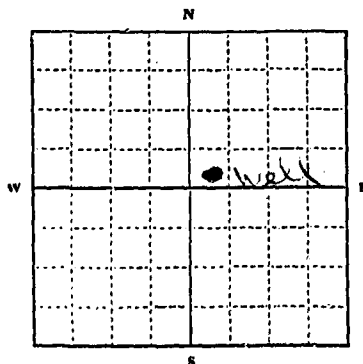

NE 1/4 Sec 29 T. 6 N. R. 11 E

Indicate point of appropriation and place of use, if possible. Each small square represents 10 acres.

2. The beneficial use on which the claim is based Stockwater

3. Date or approximate date of earliest beneficial use; and how continuous the use has been 1934 - 1963

4. The amount of groundwater claimed (in miner's inches or gallons per minute) 3 gal. per min.

5. If used for irrigation, give the acreage and description of the lands to which water has been applied and name of the owner thereof

6. The means of withdrawing such water from the ground and the location of each well or other means of withdrawal Windmill

7. The date of commencement and completion of the construction of the well, wells, or other works for withdrawal of groundwater 1934

8. The depth of water table 200'

9. So far as it may be available, the type, size and depth of each well or the general specifications of any other works for the withdrawal of groundwater 6" casing 2" pipe 13' deep  
barrel 24" deep

10. The estimated amount of groundwater withdrawn each year

11. The log of formations encountered in the drilling of each well if available

12. Such other information of a similar nature as may be useful in carrying out the policy of this act, including reference to book and page of any county record

Signature of Owner Warren Brewster

Date Dec 30, 1963

Three copies to be filed by the owner with the County Clerk and Recorder of the county in which the well is located.

Please answer all questions. If not applicable, so state, otherwise the form will be returned.

Original to the County Clerk and Recorder; Duplicate to the State Engineer; Triplicate to the Montana Bureau of Mines and Geology, and Quadruplicate for the Appropriator.

34801

180564

STATE OF MONTANA, }  
COUNTY OF ROSEBUD } SS.  
Filed on the 3rd day of Feb.  
at 8:00 o'clock A. M.  
Harold J. Lee  
County Clerk & Recorder  
E. C. Clark  
Deputy

## GROUNDWATER INDEX

Page 1 of 1

County ROSEBUD Twp. 6 SOUTH Rge. 42 EAST

[illegible]

RECEIVED

County Bozeman

7

STATE OF MONTANA  
ADMINISTRATOR OF GROUNDWATER CODE  
MONTANA WATER RESOURCES BOARD

DEC 28 1971

DRILLER'S LOG

Indicate the character, color, thickness of strata such as soil, clay, sand, gravel, shale, sandstone, etc. Show depth at which water is found and height to which water rises in well.

NOTICE OF COMPLETION OF GROUNDWATER  
APPROPRIATION BY MEANS OF WELL

Developed after January 1, 1962

(Under Chapter 237 Montana Session Laws, 1961, as amended)

This form to be prepared by driller, and three copies to be filed by the owner with the County Clerk and Recorder in the county in which the well is located, last copy to be retained by driller.

Please answer all questions. If not applicable, so state, otherwise the form may be returned.

Owner Brown Cattle Co.

Address Bozeman, Mont.

Date well started 11-5-71

completed 11-11-71

Type of well drilled

(Dig, driven, bored or drilled)

Equipment used rotary

(Chain drill, rotary or other)

Water Use: Domestic ☐ Municipal ☐ Stock ☒ Irrigation ☐

Industrial ☐ Drainage ☐ Other ☐ Garden/Lawn ☐

\*Describe

USE: If used for Irrigation, Industrial, drainage or other. Explain, state number of acres and location or other data (i.e. Lot, Block and Addition).

ESTIMATED ANNUAL WITHDRAWAL

Size of Drilled Hole	Size and Weight of Casing	From (Feet)	To (Feet)	PERFORATIONS
8"	6" surface	0	45	
4"	2" std.	0	410	4x4" slots 366 410

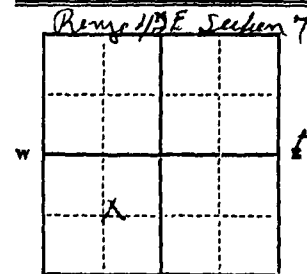

Static water level flowing ft.\*  
Pumping water level 6 ft.\*  
at 6 gallons per minute,  
measured 6 minutes after pumping

\*Measured from ground level.  
Well developed by 6 hours.  
Power 6 Pump 6 HP  
Remarks: (Gravel packing, cementing, packers, type of shutoff)  
coated and cemented at 240 ft.

N.E. 1/4 S.W. 1/4 Sec. 7  
T. 1 N. R. 42 (E) 115E  
(S) 7 W

INDICATE LOCATION OF WELL AND PLACE OF USE, IF POSSIBLE. EACH SMALL SQUARE REPRESENTS 40 ACRES.

Driller's Signature Carl D. Drape

Driller's Address Bozeman, Mont.

LICENSE NO. 20

Top of Ground		(Elev. above sea level)
From (Feet)	To (Feet)	
0	5	top soil
5	43	sand & gravel
43	45	blue clay
45	49	blue rock
49	54	blue clay
54	71	coal
71	100	blue clay
100	147	sandy blue clay
147	153	blue clay
153	155	rock
155	220	blue shale w/coal str.
220	295	blue shale
295	333	blue shale w/coal str.
333	347	blue shale
347	411	blue sand
411	420	blue shale

420 Show exact depth of bottom

49637



198504

STATE OF MONTANA)  
COUNTY OF ROSEBUD)

Filed on the 23rd day of Dec  
at 7/1 o'clock P. M.

Howard L. Lutz  
County Clerk of Rosebud

Betty M. Fontaine  
Deputy

#2

RECORDED

INDEXED

FILED

DEC 23 1985

ROSEBUD

MT

CLERK

DEPUTY

CLERK

GW

Approved Stock Form—State Publishing Co., Helena, Montana—41338

File No. ....

T. 6S R 42E

DUPLICATE

County Richmond

STATE OF MONTANA  
ADMINISTRATOR OF GROUNDWATER CODE  
OFFICE OF STATE ENGINEER

RECEIVED  
DEC 9 1963

Declaration of Vested Groundwater Rights

(Under Chapter 237, Montana Session Laws, 1961)

STATE ENGINEER

1. Dynamis Brunster, of Barney,  
(Name of Appropriator) (Address) (Town)  
County of Richmond State of Montana  
have appropriated groundwater according to the Montana laws in effect prior to January 1, 1962, as follows:

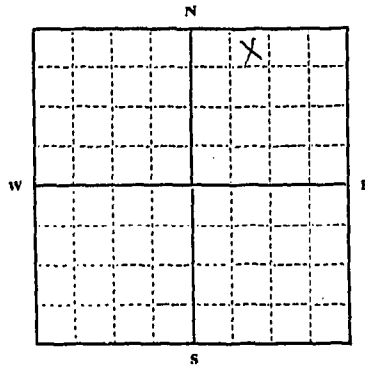

..... 1/4 Sec. 1 T. 6S R. 42E  
Indicate point of appropriation  
and place of use, if possible.  
Each small square represents 10  
acres.

2. The beneficial use on which the claim is based stock water  
for household purposes

3. Date or approximate date of earliest beneficial use; and how con-  
tinuous the use has been 12/1/47

4. The amount of groundwater claimed (in miner's inches or gallons  
per minute) 1.7 gpm for mine

5. If used for irrigation, give the acreage and description of the lands  
to which water has been applied and name of the owner thereof

not used for irrigation

6. The means of withdrawing such water from the ground and the  
location of each well or other means of withdrawal

artesian well

7. The date of commencement and completion of the construction of the well, wells, or other works for with-  
drawal of groundwater completed 12/1/47

8. The depth of water table.....

9. So far as it may be available, the type, size and depth of each well or the general specifications of any other  
works for the withdrawal of groundwater.

5 1/2" casing 6" casing 6 1/2" casing 6 1/2" casing  
" 2 1/2" " 2 1/2" " 2 1/2"  
" 2 " " 2 " " 2 1/2"

10. The estimated amount of groundwater withdrawn each year not known

11. The log of formations encountered in the drilling of each well if available see log attached

12. Such other information of a similar nature as may be useful in carrying out the policy of this act, including  
reference to book and page of any county record

Recorded by Recorder, Richmond County

well near dwelling house

Signature of Owner [Signature]

Date 11/5/63

Three copies to be filed by the owner with the County Clerk and Recorder of the county in which the well is  
located.

Please answer all questions. If not applicable, so state, otherwise the form will be returned.

Original to the County Clerk and Recorder; duplicate to the State Engineer; Triplicate to the Montana Bureau  
of Mines and Geology, and Quadruplicate for the Appropriator.

2158

179316

STATE OF MONTANA, }  
COUNTY OF ROSEBUD } SS:

Filed on the 5<sup>th</sup> day of December

1963 at 11:36 o'clock A.M.

Howard J. Jick  
County Clerk & Recorder

by \_\_\_\_\_ Deputy

GW

Approved Stock Form—State Publishing Co., Helena, Montana—41338

File No. ....

T. 65 R. 42 E

DUPLICATE

County Richmond

STATE OF MONTANA  
ADMINISTRATOR OF GROUNDWATER CODE  
OFFICE OF STATE ENGINEER

# Declaration of Vested Groundwater Rights

(Under Chapter 237, Montana Session Laws, 1961)

RECEIVED  
DEC 9 1963

STATE ENGINEER

1. Pete D. Brown, of S. Helena (Town)  
(Name of Appropriator) (Address)

County of Richmond State of Montana  
have appropriated groundwater according to the Montana laws in effect prior to January 1, 1962, as follows:

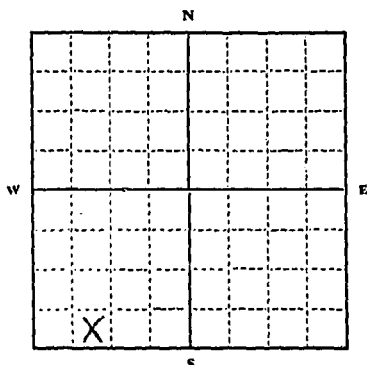

1/4 Sec 6 T 65 R 42 E  
Indicate point of appropriation  
and place of use, if possible.  
Each small square represents 10  
acres.

2. The beneficial use on which the claim is based irrigation

for use at the time of  
use for stock water

3. Date or approximate date of earliest beneficial use; and how con-  
tinuous the use has been 1934

4. The amount of groundwater claimed (in miner's inches or gallons  
per minute) 5 gpm

5. If used for irrigation, give the acreage and description of the lands  
to which water has been applied and name of the owner thereof

not used for irrigation

6. The means of withdrawing such water from the ground and the  
location of each well or other means of withdrawal

Electric Pump

7. The date of commencement and completion of the construction of the well, wells, or other works for with-  
drawal of groundwater not known exactly

8. The depth of water table not known

9. So far as it may be available, the type, size and depth of each well or the general specifications of any other  
works for the withdrawal of groundwater about 40' deep

10. The estimated amount of groundwater withdrawn each year any and no summer

11. The log of formations encountered in the drilling of each well if available

no log available

12. Such other information of a similar nature as may be useful in carrying out the policy of this act, including  
reference to book and page of any county record

Signature of Owner Pete D. Brown

Date 12/9/63

Three copies to be filed by the owner with the County Clerk and Recorder of the county in which the well is  
located.

Please answer all questions. If not applicable, so state, otherwise the form will be returned.

Original to the County Clerk and Recorder; duplicate to the State Engineer; Triplicate to the Montana Bureau  
of Mines and Geology, and Quadruplicate for the Appropriator.

1148

179306

STATE OF MONTANA } SS.  
COUNTY OF ROSEBUD }

Filed on the 5<sup>th</sup> day of December

1922 at 11:30 o'clock A.M.

Howard J. Smith  
County Clerk & Notary

By \_\_\_\_\_ Deputy

File No. ....

T. 65 R. 42E

DUPLICATE

County Beaverhead

STATE OF MONTANA  
ADMINISTRATOR OF GROUNDWATER CODE  
OFFICE OF STATE ENGINEER

JAN 3 1964

STATE ENGINEER

## Declaration of Vested Groundwater Rights

(Under Chapter 237, Montana Session Laws, 1961)

1. Bruce & Arnold Ranch Co., of Beaver  
(Name of Appropriator) (Address) (Town)  
County of Beaverhead State of Montana  
have appropriated groundwater according to the Montana laws in effect prior to January 1, 1962, as follows:

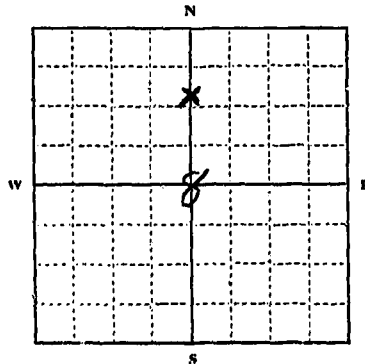

Indicate point of appropriation  
and place of use, if possible.  
Each small square represents 10  
acres.

2. The beneficial use on which the claim is based  
livestock water

3. Date or approximate date of earliest beneficial use; and how con-  
tinuous the use has been  
1950

4. The amount of groundwater claimed (in miner's inches or gallons  
per minute) 15-6 P.M.

5. If used for irrigation, give the acreage and description of the lands  
to which water has been applied and name of the owner thereof

6. The means of withdrawing such water from the ground and the  
location of each well or other means of withdrawal  
electric pump

7. The date of commencement and completion of the construction of the well, wells, or other works for with-  
drawal of groundwater 1950

8. The depth of water table 30'

9. So far as it may be available, the type, size and depth of each well or the general specifications of any other  
works for the withdrawal of groundwater Total depth 60'

10. The estimated amount of groundwater withdrawn each year

11. The log of formations encountered in the drilling of each well if available

12. Such other information of a similar nature as may be useful in carrying out the policy of this act, including  
reference to book and page of any county record

Signature of Owner

Bruce & Arnold Ranch Co.  
By Bruce B. Bruster,  
Date Dec 18, 1963

Three copies to be filed by the owner with the County Clerk and Recorder of the county in which the well is  
located.

Please answer all questions. If not applicable, so state, otherwise the form will be returned.

Original to the County Clerk and Recorder; duplicate to the State Engineer; Triplicate to the Montana Bureau  
of Mines and Geology, and Quadruplicate for the Appropriator.

2111

179867

STATE OF MONTANA, COUNTY  
OF ROSEBUD SS. FILED DEC  
30, 1963, AT 1:00 P.M., CO. CLERK

62.00

*Howard C. Paul*  
*By Betty M. Fontaine*  
*Dep.*

CM  
1/6

RECEIVED

MAY 16 1972

County Bozeman

STATE OF MONTANA  
ADMINISTRATOR OF GROUNDWATER CODE  
MONTANA WATER RESOURCES BOARD

MONTANA DEPARTMENT OF NATURAL  
RESOURCES AND CONSERVATION

NOTICE OF COMPLETION OF GROUNDWATER  
APPROPRIATION BY MEANS OF WELL

Developed after January 1, 1962

DRILLER'S LOG

Indicate the character, color, thickness of strata such as soil, clay, sand, gravel, shale, sandstone, etc. Show depth at which water is found and height to which water rises in well.

(Under Chapter 237 Montana Session Laws, 1961, as amended)

This form to be prepared by driller, and three copies to be filed by the owner with the County Clerk and Recorder in the county in which the well is located, last copy to be retained by driller.

Please answer all questions. If not applicable, so state, otherwise the form may be returned.

Owner Elmer Field  
Address Bismarck  
Mont.  
Date well started Oct. 15 - 1970  
completed Oct. 15 - 1971

For Administrator's Use	
File	<u>881 May 11, 1972</u>
	<u>4:20 p.m.</u>
GW 1	

Type of well drilled (Dug, driven, bored or drilled)  
Equipment used Rotary (Churn drill, rotary or other)  
Water Use: Domestic ☒ Municipal ☐ Stock ☐ Irrigation ☐  
Industrial ☐ Drainage ☐ Other ☐ Garden/Lawn ☐

\*Describe  
USE: If used for irrigation, industrial, drainage or other. Explain, state number of acres and location or other data (i.e. Lot, Block and Addition).

ESTIMATED ANNUAL WITHDRAWAL

Size of Drilled Hole	Size and Weight of Casing	From (Feet)	To (Feet)	PERFORATIONS		
				Kind Size	From (Feet)	To (Feet)
4"	4 inch	0	275	?		
				unknown		

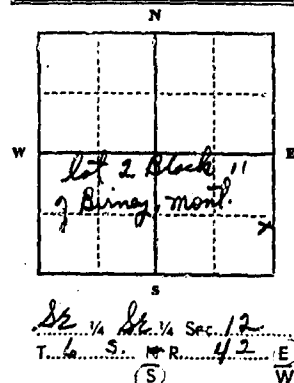

Static water level 50 ft.\*  
Pumping water level unknown\*  
at 5 gallons per minute,  
measured 5 minutes after pumping began.  
\*Measured from ground level.  
Well developed by rotary  
for 5 hours.  
Power 1 HP  
Remarks: (Gravel packing, cementing, packers, type of shutoff)  
well drilled by  
State School 13 near

INDICATE LOCATION OF WELL AND PLACE OF USE, IF POSSIBLE. EACH SMALL SQUARE REPRESENTS 40 ACRES.

Driller's Signature Mont. Bureau of Land Management  
Driller's Address Bismarck, Mont.

LICENSE NO.

Top of Ground (Elev. above sea level) <u>3200</u>		
From (Feet)	To (Feet)	
0	27	Brown clay
27	30	clinker
30	40	gray clay
40	44	coal streak
44	48	gray clay
48	53	carbon shale
53	62	hard sandstone
62	67	gray clay
67	71	sandstone sept.
71	78	gray clay
78	100	coal
100	112	gray clay
112	122	gray clay
122	124	coal
124	149	gray clay
149	165	carbon shale
165	181	gray clay
181	185	hard sandstone
185	252	sandy clay
252	265	coal
265	275	sandy clay

275 feet Show exact depth of bottom

50, 391



881

STATE OF MONTANA,  
COUNTY OF ROSEBUD

Filed on the 11<sup>th</sup> day of May  
1922 at 4:20 o'clock P.M.

Edward J. ...  
County Clerk & Recorder

Betty M. ...  
#220

File No. ....

T. 65 R. 42

DUPLICATE

County Rosebud

STATE OF MONTANA  
ADMINISTRATOR OF GROUNDWATER CODE  
OFFICE OF STATE ENGINEER

RECEIVED  
JAN 3 1964

## Declaration of Vested Groundwater Rights

(Under Chapter 237, Montana Session Laws, 1961) ENGINEER

1. Brewster-Arnold Ranch Co., of Bidney  
(Name of Appropriator) (Address) (Town)  
County of Rosebud State of Montana  
have appropriated groundwater according to the Montana laws in effect prior to January 1, 1962, as follows:

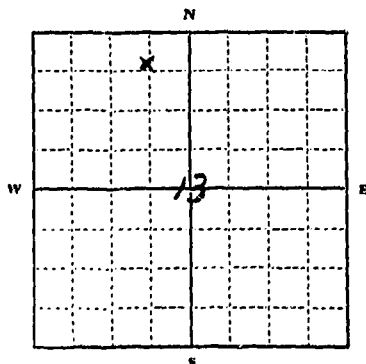

NE 1/4 NW Sec. 13 T. 65 S. R. 42 E

Indicate point of appropriation  
and place of use, if possible.  
Each small square represents 10  
acres.

2. The beneficial use on which the claim is based Domestic Water
3. Date or approximate date of earliest beneficial use; and how continuous the use has been 1946
4. The amount of groundwater claimed (in miner's inches or gallons per minute) 2 C.P.M.
5. If used for irrigation, give the acreage and description of the lands to which water has been applied and name of the owner thereof
6. The means of withdrawing such water from the ground and the location of each well or other means of withdrawal Artesian Flow
7. The date of commencement and completion of the construction of the well, wells, or other works for withdrawal of groundwater 1947
8. The depth of water table 15'
9. So far as it may be available, the type, size and depth of each well or the general specifications of any other works for the withdrawal of groundwater 400 ft
10. The estimated amount of groundwater withdrawn each year
11. The log of formations encountered in the drilling of each well if available
12. Such other information of a similar nature as may be useful in carrying out the policy of this act, including reference to book and page of any county record

Signature of Owner

Date

Three copies to be filed by the owner with the County Clerk and Recorder of the county in which the well is located.

Please answer all questions. If not applicable, so state, otherwise the form will be returned.

Original to the County Clerk and Recorder; duplicate to the State Engineer; Triplicate to the Montana Bureau of Mines and Geology, and Quadruplicate for the Appropriator.

2110

179866

STATE OF MONTANA, COUNTY  
OF ROSEBUD SS- FILED DEC.  
30, 1963, AT 1:00 PM, CO. CLERK

*Shirley Lail*  
*Jy: Ellen Clark, Sp.*

File No. \_\_\_\_\_

DUPLICATE

T. 65 R. 42ECounty Roobaud

STATE OF MONTANA  
ADMINISTRATOR OF GROUNDWATER CODE  
OFFICE OF STATE ENGINEER

JAN 3 1964

# Declaration of Vested Groundwater Rights ENGINEER

(Under Chapter 237, Montana Session Laws, 1961)

Brewster Arnold Roobaud of Birney  
(Name of Appropriator) (Address) (Town)  
County of Roobaud State of Montana  
have appropriated groundwater according to the Montana laws in effect prior to January 1, 1962, as follows:

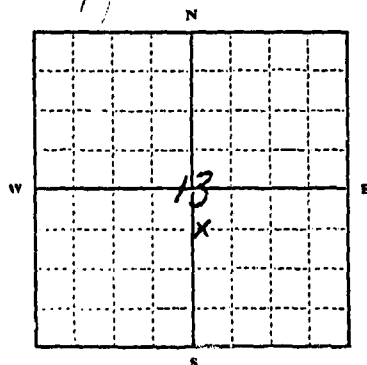

NW 1/4 Sec. 13 T. 65 R. 42 E.

Indicate point of appropriation  
and place of use, if possible.  
Each small square represents 10  
acres.

2. The beneficial use on which the claim is based  
livestock water

3. Date or approximate date of earliest beneficial use; and how continuous the use has been  
1945  
continuous use in the 40' well

4. The amount of groundwater claimed (in miner's inches or gallons per minute) 10 B.P.M.

5. If used for irrigation, give the acreage and description of the lands to which water has been applied and name of the owner thereof

6. The means of withdrawing such water from the ground and the location of each well or other means of withdrawal  
artesian flow

7. The date of commencement and completion of the construction of the well, wells, or other works for withdrawal of groundwater 1945

8. The depth of water table 10'

9. So far as it may be available, the type, size and depth of each well or the general specifications of any other works for the withdrawal of groundwater 420' total depth

10. The estimated amount of groundwater withdrawn each year

11. The log of formations encountered in the drilling of each well if available

12. Such other information of a similar nature as may be useful in carrying out the policy of this act, including reference to book and page of any county record

Signature of Owner Brewster Arnold Roobaud

Date 12/15/63

Three copies to be filed by the owner with the County Clerk and Recorder of the county in which the well is located.

Please answer all questions. If not applicable, so state, otherwise the form will be returned.

Original to the County Clerk and Recorder; duplicate to the State Engineer; Triplicate to the Montana Bureau of Mines and Geology, and Quadruplicate for the Appropriator.

21113