

File No.

T 27 R 35

DUPLICATE

RECEIVED
JAN 1964

STATE OF MONTANA
ADMINISTRATOR OF GROUNDWATER CODE
OFFICE OF STATE ENGINEER

STATE ENGINEER

Declaration of Vested Groundwater Rights

(Under Chapter 237, Montana Session Laws, 1961)

1. John & Daphne Kay of Boxon
(Name of Appropriator) (Address) (Town)
Sanders County of Montana State of
have appropriated groundwater according to the Montana laws in effect prior to January 1, 1962, as follows:

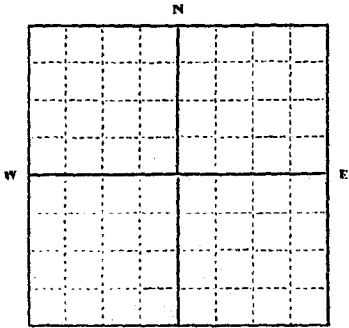

SW SE SE 27 33
1/4 Sec. T. R.

Indicate point of appropriation and place of use, if possible. Each small square represents 10 acres.

- The beneficial use on which the claim is based. Household, trailer court, & irrigation
- Date or approximate date of earliest beneficial use; and how continuous the use has been. App. 1957 Continuous
- The amount of groundwater claimed (in miner's inches or gallons per minute). 1500 Miner's Gallon Per Day
- If used for irrigation, give the acreage and description of the lands to which water has been applied and name of the owner thereof. 5 A. (Garden)
- The means of withdrawing such water from the ground and the location of each well or other means of withdrawal. Pipe Driv.
- The date of commencement and completion of the construction of the well, wells, or other works for withdrawal of groundwater.
- The depth of water table. App. 3 feet
- So far as it may be available, the type, size and depth of each well or the general specifications of any other works for the withdrawal of groundwater. None
- The estimated amount of groundwater withdrawn each year. 600000 App.
- The log of formations encountered in the drilling of each well if available. Unknown
- Such other information of a similar nature as may be useful in carrying out the policy of this act, including reference to book and page of any county record. Unknown

Signature of Owner Daphne E. Kay
Date Dec. 26, 1963

Three copies to be filed by the owner with the County Clerk and Recorder of the county in which the well is located.
Please answer all questions. If not applicable, so state, otherwise the form will be returned.
Original to the County Clerk and Recorder; Duplicate to the State Engineer; Triplicate to the Montana Bureau of Mines and Geology, and Quadruplicate for the Appropriator

21529

423
Indexed

I received and here-
this instrument for record on the

26 day of Dec

1963 at 1:45 o'clock P M

Marathy Dodson

For 100 By County Recorder

L Evelyn Wood Dep

RECEIVED

County SANDERS

STATE OF MONTANA
ADMINISTRATOR OF GROUNDWATER CODE
MONTANA WATER RESOURCES BOARD

06/10/72

DRILLER'S LOG

NOTICE OF COMPLETION OF GROUNDWATER
APPROPRIATION BY MEANS OF WELL

Developed after January 1, 1962

Indicate the character, color, thickness of strata such as soil, clay, sand, gravel, shale, sandstone, etc. Show depth at which water is found and height to which water rises in well.

(Under Chapter 237 Montana Session Laws, 1961, as amended)

This form to be prepared by driller, and three copies to be filed by the owner with the County Clerk and Recorder in the county in which the well is located, last copy to be retained by driller.

Please answer all questions. If not applicable, so state, otherwise the form may be returned.

Owner RAYMOND SPECK

Address BOX 140 A

NOXON, MONTANA

Date well started SEPT 13, 72

completed SEPT 18, 1972

Type of well DRILLED

Equipment used CHAUN DRILL

Water Use: Domestic Municipal Stock Irrigation

Industrial Drainage Other * Garden/Lawn

*Describe

USE: If used for irrigation, industrial, drainage or other. Explain, state number of acres and location or other data (i.e. Lot, Block and Addition).

ESTIMATED ANNUAL WITHDRAWAL

Size of Drilled Hole	Size and Weight of Casing	From (Feet)	To (Feet)	PERFORATIONS		
				Kind Size	From (Feet)	To (Feet)
6"	250 Lbs. 0"	0	73	7/16"	52-55	57

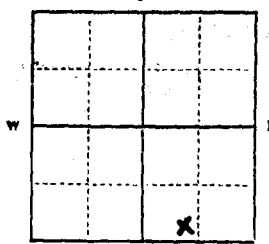

Static water level 49 ft.*
Pumping water level 49 ft.*
at 36 gallons per minute,
measured 15 minutes after pumping began.
*Measured from ground level.
Well developed by SKIP BOGUS
for 6 hours.
Power..... Pump..... HP
Remarks: (Gravel packing, cementing, packers, type of shutoff)

S.W. 1/4 SE 1/4 Sec. 32
T. 27 N. R. 35 W.

INDICATE LOCATION OF WELL AND PLACE OF USE, IF POSSIBLE. EACH SMALL SQUARE REPRESENTS 40 ACRES.

Driller's Signature Wm F Butte

Driller's Address E.A. HOLMAN DRAWING CO.

601 S. PINES RD LICENSE NO. 233
SPOKANE, WASHINGTON

Top of Ground (Elev. above sea level)

From (Feet)	To (Feet)	
0	3	BROWN SAND
3	12	SANDY GRAVEL
12	20	COARSE SAND + FEA GRAVEL
20	39	SAND + GRAVEL
39	42	SANDY CLAY
42	51	SANDY CLAY + GRAVEL
51	58	SANDY GRAVEL (WATER)
58	73	PINK CLAY

73 Show exact depth of bottom

5/559

126244

074

INDEXED

RECEIVED
COUNTY CLERK
JAN 12 1934
COURT HOUSE
MARIETTA, GA

RECORDED IN BOOK 12 PAGE 100

I received and filed
this instrument for record on the 29
day of Sept 12
at 1:34 p.m. 1934
by Reyes Vaughn
County Recorder
for \$1.00 by
Lillian Hollister, Dep

29 12 1934
10 12 1934
11 12 1934
12 12 1934
13 12 1934
14 12 1934
15 12 1934
16 12 1934
17 12 1934
18 12 1934
19 12 1934
20 12 1934
21 12 1934
22 12 1934
23 12 1934
24 12 1934
25 12 1934
26 12 1934
27 12 1934
28 12 1934
29 12 1934
30 12 1934
31 12 1934

File No. 741

T. 27 R. 33

DUPLICATE

County Sanders

MONTANA WATER RESOURCES BOARD
RECEIVED
STATE OF MONTANA
ADMINISTRATOR OF GROUNDWATER CODE
OFFICE OF STATE ENGINEER

Declaration of Vested Groundwater Rights

(Under Chapter 237, Montana Session Laws, 1961)

1. DANIELE HARSH, of START #2 NOXON
(Name of Appropriator) (Address) (Town)

County of SANDERS State of MONTANA

have appropriated groundwater according to the Montana laws in effect prior to January 1, 1962, as follows:

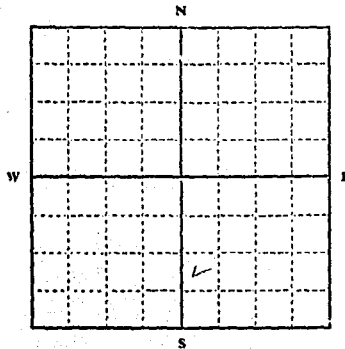

2. The beneficial use on which the claim is based DOMESTIC GARDEN, LAWN, SHRUBS, ETC.

3. Date or approximate date of earliest beneficial use; and how continuous the use has been 1960 TO 1969 HAS BEEN IN USE MOST OF TIME FROM YEARS GIVEN

4. The amount of groundwater claimed (in miner's inches or gallons per minute) FIVE GALLONS PER MINUTE

5. If used for irrigation, give the acreage and description of the lands to which water has been applied and name of the owner thereof NOT APPLICABLE

S. E. 1/4 Sec. 34 T. 27 N. R. 33 W. M. P. M.

Indicate point of appropriation and place of use, if possible. Each small square represents 10 acres.

6. The means of withdrawing such water from the ground and the location of each well or other means of withdrawal ELECTRIC PUMP ABOUT 300 FT. FROM ROLL RIVER NEAR CENTER LINE OF 2 ACRE PROPERTY

7. The date of commencement and completion of the construction of the well, wells, or other works for withdrawal of groundwater DUG WELL STARTED AND COMPLETED IN 1960

8. The depth of water table APPROXIMATELY 15 TO 16 FT.

9. So far as it may be available, the type, size and depth of each well or the general specifications of any other works for the withdrawal of groundwater DUG WELL ABOUT 12 FT DEEP FORTY INCHES IN DIAMETER LINED WITH CONCRETE CONDUIT PIPE

10. The estimated amount of groundwater withdrawn each year 200,000 GALLONS

11. The log of formations encountered in the drilling of each well if available DUG IN GRAVEL FORMATION

12. Such other information of a similar nature as may be useful in carrying out the policy of this act, including reference to book and page of any county record THIS TRACT IS RECORDED IN VOL 82 PAGE 202 RECORDERS OFFICE THOMPSON FALLS, SANDERS COUNTY

Signature of Owner Daniel E. Harsh

Date 1-14-1969

Three copies to be filed by the owner with the County Clerk and Recorder of the county in which the well is located.

Please answer all questions. If not applicable, so state, otherwise the form will be returned.

Original to the County Clerk and Recorder; Duplicate to the State Engineer; Triplicate to the Montana Bureau of Mines and Geology, and Quadruplicate for the Appropriator.

19 727

741

115199

I received and filed

this instrument for record on the 15

of Jan 69

at 1:45 p.m.

Harold J. Anderson
County Recorder

Fee 1.00

File No.

T. 27^N R. 33^W Sec. 11^{1/2} 11
County Sanders 11612

DUPLICATE

STATE OF MONTANA
ADMINISTRATOR OF GROUNDWATER CODE
OFFICE OF STATE ENGINEER

REC'D
JAN 22 1964

Notice of Completion of Groundwater Appropriation
Without Well

(Under Chapter 237 Montana Session Laws, 1961)

Date of Appropriation of Groundwater July 19-62

Owner M.S.F.S. Address NOXON

Contractor (if any) E.A. Weare self developed

Address of Contractor

Date Started July 1-62 Date Completed July 30-62

Describe means of obtaining groundwater without a well "as by sub-irrigation and other natural processes". Include depth to water when applicable.

4x8 concrete reservoir with 2" pipe to house

Quantity of water developed and used with explanation of method used to measure or estimate such amount. If use is intermittent

estimate approximate lengths of periods of use yearly

4x8 Reservoir concrete 2 inch pipe to house

Signature of Owner E.A. Weare

Date 1-20-64

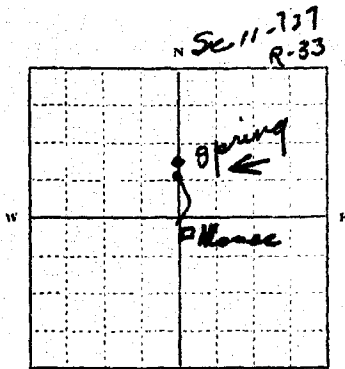

NW 1/4 NE 1/4 Sec 11 T27N R33W
Indicate point of appropriation and place of use, if possible.

This form to be prepared by contractor (if any), otherwise by the owner.
Three copies of this notice are to be filed with the County Clerk and Recorder of the county in which the works are located.
Please answer all questions. If not applicable, so state, otherwise the form will be returned.
Original to the County Clerk and Recorder; duplicate to the State Engineer; Triplicate to the Montana Bureau of Mines and Geology and Quadruplicate for the Appropriator.

605

Indexed

Received and filed

this instrument for recording

on the _____ day of January
1964 at 3:07 P. M.
Nanthy Wadon
County Recorder
By _____

File No.

T. 26 N 34 W

DUPLICATE

County

STATE OF MONTANA
ADMINISTRATOR OF GROUNDWATER CODE
OFFICE OF STATE ENGINEER

RECEIVED

JAN 10 1964

Notice of Completion of Groundwater Appropriation
Without Well

STATE ENGINEER

(Under Chapter 237 Montana Session Laws, 1961)

Date of Appropriation of Groundwater. Dec. 30, 1963

Owner Cecil & Marie Gaff Address Heron, Mont.

Contractor (if any) -

Address of Contractor -

Date Started July 1951 Date Completed Sept. 1951

Describe means of obtaining groundwater without a well "as by sub-irrigation and other natural processes". Include depth to water when applicable. Piped from a concrete spring box

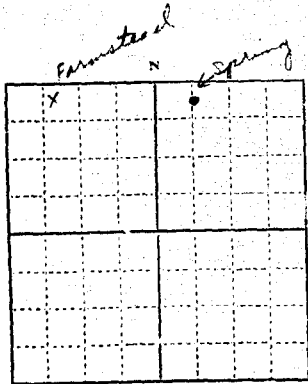

NW NW S 24 34
1/4 Sec 1 T R

Indicate point of appropriation and place of use, if possible.

Quantity of water developed and used with explanation of method used to measure or estimate such amount. If use is intermittent

estimate approximate lengths of periods of use. Water is in constant use for domestic use. Approx. 16 gal per min

Signature of Owner Marie Gaff
Cecil Gaff

Date Dec 30 1963

This form to be prepared by contractor (if any), otherwise by the owner.

Three copies of this notice are to be filed with the County Clerk and Recorder of the county in which the works are located.

Please answer all questions. If not applicable, so state, otherwise the form will be returned.

Original to the County Clerk and Recorder; duplicate to the State Engineer; Triplicate to the Montana Bureau of Mines and Geology and Quadruplicate for the Appropriator.

File No.

T. 24 N 34 W

DUPLICATE

County

STATE OF MONTANA
ADMINISTRATOR OF GROUNDWATER CODE
OFFICE OF STATE ENGINEER

RECEIVED
JAN 10 1964
STATE ENGINEER

Notice of Completion of Groundwater Appropriation
Without Well

(Under Chapter 237 Montana Session Laws, 1961)

Date of Appropriation of Groundwater: Dec. 30, 1963

Owner: Cecil Marie Groff Address: Heron Mont.

Contractor (if any)

Address of Contractor

Date Started: July 1951 Date Completed: Sept. 1951

Describe means of obtaining groundwater without a well "as by sub-irrigation and other natural processes". Include depth to water when applicable. griped frame concrete spring bed

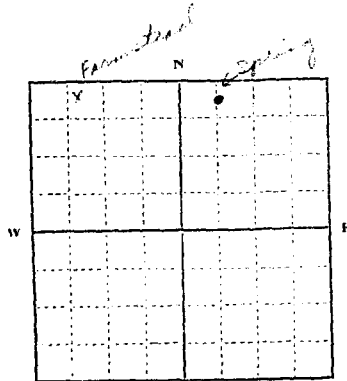

NW NW S 24 34
1/4 Sec. T. R.

Indicate point of appropriation and place of use, if possible.

Quantity of water developed and used with explanation of method used to measure or estimate such amount. If use is intermittent

estimate approximate lengths of periods of use. water is in constant use for domestic use. approx. 16 gal per min

Signature of Owner: Cecil Groff

Date: Dec 30 1963

This form to be prepared by contractor (if any), otherwise by the owner.

Three copies of this notice are to be filed with the County Clerk and Recorder of the county in which the works are located.

Please answer all questions. If not applicable, so state, otherwise the form will be returned.

Original to the County Clerk and Recorder; duplicate to the State Engineer; Triplicate to the Montana Bureau of Mines and Geology and Quadruplicate for the Appropriator.

508
Indexed

I received and filed
this instrument for record on the
6th day of Jan
1964 at 8:02 o'clock A M
Wendy Hodson
County Recorder
Fee 1.00 By

Dixie Vaughn Dep.

File No.

T 76 R 311 W

DUPLICATE

County

STATE OF MONTANA
ADMINISTRATOR OF GROUNDWATER CODE
OFFICE OF STATE ENGINEER

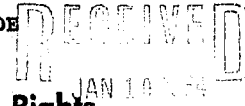

Declaration of Vested Groundwater Rights

(Under Chapter 237, Montana Session Laws, 1961) STATE ENGINEER

1. MELVIN WINCHESTER, of Box 133 HERON
(Name of Appropriator) (Address) (Town)

County of SANDERS State of MONTANA
have appropriated groundwater according to the Montana laws in effect prior to January 1, 1962, as follows:

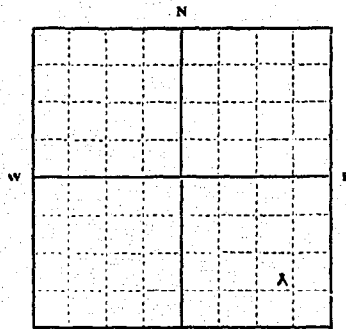

SE SF 3 26 34
1/4 Sec. 3 T 26 R.

Indicate point of appropriation and place of use, if possible. Each small square represents 10 acres.

- 2. The beneficial use on which the claim is based... *Household and stock*
- 3. Date or approximate date of earliest beneficial use; and how continuous the use has been... *1951 in use for 12 years*
- 4. The amount of groundwater claimed (in miner's inches or gallons per minute)... *3 gal per minute*
- 5. If used for irrigation, give the acreage and description of the lands to which water has been applied and name of the owner thereof... *not used for irrigation*
- 6. The means of withdrawing such water from the ground and the location of each well or other means of withdrawal... *Submersible pumps*

7. The date of commencement and completion of the construction of the well, wells, or other works for withdrawal of groundwater... *1951 completed in 1951*

8. The depth of water table... *25 ft*

9. So far as it may be available, the type, size and depth of each well or the general specifications of any other works for the withdrawal of groundwater... *hand dug 30" culvert 27 feet deep*

10. The estimated amount of groundwater withdrawn each year... *15000 gal*

11. The log of formations encountered in the drilling of each well if available... *clay*

12. Such other information of a similar nature as may be useful in carrying out the policy of this act, including reference to book and page of any county record

Signature of Owner *Melvin Winchester*

Date *12-30-63*

Three copies to be filed by the owner with the County Clerk and Recorder of the county in which the well is located.

Please answer all questions. If not applicable, so state, otherwise the form will be returned.

Original to the County Clerk and Recorder; Duplicate to the State Engineer; Triplicate to the Montana Bureau of Mines and Geology, and Quadruplicate for the Appropriator.

571

Budged

I received and filed

this instrument for record on the

6 day of Jan

1964 at 8:10 o'clock a M

Narathy Madan

County Recorder

Fee 1.00 By

Dinpa Vaughn Dep

File No. 765

T. 26 N. 34 W

DUPLICATE

County Sanders

STATE OF MONTANA
ADMINISTRATOR OF GROUNDWATER CODE
OFFICE OF STATE ENGINEER

Declaration of Vested Groundwater Rights

(Under Chapter 237, Montana Session Laws, 1961)

1 Fay C. Rasmussen and Kathleen Rasmussen, of Heron,
(Name of Appropriator) (Address) (Town)

County of Sanders State of Montana

have appropriated groundwater according to the Montana laws in effect prior to January 1, 1962, as follows:

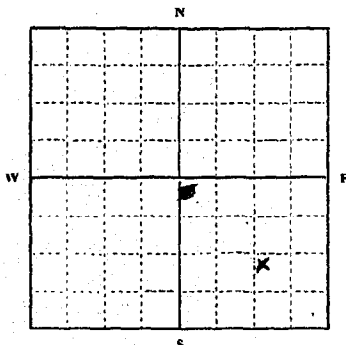

SE 1/4 SE Sec. 7 T. 26 R. 24

Indicate point of appropriation and place of use, if possible. Each small square represents 10 acres.

2. The beneficial use on which the claim is based domestic, stock water and irrigation

3. Date or approximate date of earliest beneficial use; and how continuous the use has been September 10, 1955 and continuous since that time.

4. The amount of groundwater claimed (in miner's inches or gallons per minute) 150 gallons per minute

5. If used for irrigation, give the acreage and description of the lands to which water has been applied and name of the owner thereof 1 acre, in SE 1/4 Sec. 4, T26NR34W Fay C. Rasmussen and Kathleen Rasmussen

6. The means of withdrawing such water from the ground and the location of each well or other means of withdrawal Pump with one horse motor, pressure system 1 1/2 inch pipe.

7. The date of commencement and completion of the construction of the well, wells, or other works for withdrawal of groundwater September 1, 1955, completed September 10, 1955

8. The depth of water table 12 feet

9. So far as it may be available, the type, size and depth of each well or the general specifications of any other works for the withdrawal of groundwater None

10. The estimated amount of groundwater withdrawn each year 100,000 gallons per year

11. The log of formations encountered in the drilling of each well if available Dug well, soil and sediment and gravel, no log available.

12. Such other information of a similar nature as may be useful in carrying out the policy of this act, including reference to book and page of any county record. This well is dug near the bank of Beaver Creek and is supplied by underground water either in Beaver Creek or the near vicinity.

Dec. No. 118413
Filed for record
this 1 day of June
A. D. 1979 at 11:36
o'clock A.

Signature of Owner Fay C. Rasmussen
Kathleen Rasmussen
Date June 1, 1970

Three copies to be filed by the owner with the County Clerk and Recorder of the county in which the well is located.

Please answer all questions. If not applicable, so state, otherwise the form will be returned.

Original to the County Clerk and Recorder; Duplicate to the State Engineer; Triuplicate to the Montana Bureau of Mines and Geology, and Quadruplicate for the Appropriator.

46571

165
INDEXED

118415

I received and filed
this instrument for record on the 1st
day of June 1970
at 11:52 a.m. A
County Recorder

Fee \$1.00
By
Eleanor J. Giddings
Clerk

probate

C. R. Giddings and K. G. Giddings

Department of Natural Resources and Conservation
 Water Resources Division
 Engineering Bureau
 Groundwater Section
 Sam W. Mitchell Building
 Helena, Montana 59601

Owner Carlton M. Clifford
 Address 4001 Hwy 100, Helena, MT 59840
 Location T. 26 N. R. 34 W. Sec. 16
 Doc. No. 810, 124201

*Link of
5/23/77*

As the Administrator of the Groundwater Code for the State of Montana, please take note of the following special instructions, in order to properly protect your groundwater right.

Special Instructions:

Please provide, as indicated in and on the enclosed form, the dates the spring ^{development} started & completed; the method or means used to develop the groundwater; amount of groundwater claimed (in miner's inches or gallons per minute); and estimated water usage each year.

Thank you.

at this source 50,239

Note: The spring should be developed, if not, it may be considered surface water, if used further.

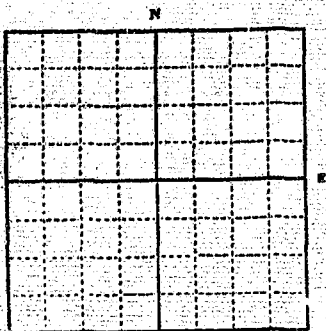

SE 1/4 SW 1/4 Sec 16
 T. 26 N. R. 34 W. E. W.

INDICATE POINT OF APPROPRIATION AND PLACE OF USE, IF POSSIBLE. Elevation of spring, if known or estimated

1. Describe means of obtaining groundwater (as by sub-irrigation, developed spring, drains, etc.) undeveloped natural spring.
2. Means of withdrawing water (gravity, pump, canal, etc.) gravity
3. Depth of water table
4. Use of the water stock water, irrigation, and other useful purposes
5. Amount of groundwater claimed (in miner's inches or gallons per minute)
6. If used for irrigation, give number of acres and description of land part of SW 1/4, Section 16, Township 26 North, Range thirty-four (34) West
7. Estimate amount of water used each year all
8. Months of year spring flows 12 months

Signature of Owner Carlton M. Clifford
 Date 4/12/77

50,239

County Sanders

STATE OF MONTANA
ADMINISTRATOR OF GROUNDWATER CODE
MONTANA WATER RESOURCES BOARD

NOTICE OF COMPLETION OF GROUNDWATER APPROPRIATION WITHOUT WELL

Developed After January 1, 1962

(Under Chapter 237, Montana Session Laws, 1961, as amended)

This form to be prepared by contractor (if any), otherwise by the owner.
Three copies of this notice are to be filed with the County Clerk and Recorder of the county in which the works are located.

Please answer all questions. If not applicable, so state, otherwise the form may be returned.

For Administrator's Use

File 817, 124701

April 18, 1972 1:26 P.M.

GW 1

Owner Carleton M. Clifford

Address Hamilton, Montana

Contractor (if any)

Address of Contractor

Date Started Date Completed

1. Describe means of obtaining groundwater (as by sub-irrigation, developed spring, drains, etc.) undeveloped natural spring.

2. Means of withdrawing water (gravity, pump, canal, etc.) gravity

3. Depth of water table

4. Use of the water stock water, irrigation, and other useful purposes

5. Amount of groundwater claimed (in miner's inches or gallons per minute)

6. If used for irrigation, give number of acres and description of land part of SW $\frac{1}{4}$, Section 16, Township 26 North, Range thirty-four (34) West

7. Estimate amount of water used each year all

8. Months of year spring flows 12 months

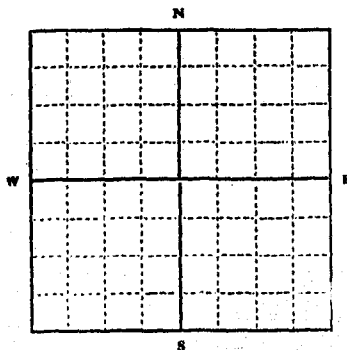

SE $\frac{1}{4}$ SW $\frac{1}{4}$ Sec 16
T. 26 N R. 34 W E
S W

INDICATE POINT OF APPROPRIATION AND PLACE OF USE, IF POSSIBLE.
Elevation of spring, if known or estimated

Signature of Owner Carleton M. Clifford

Date 4/18/72

50,239

SM
INDEXED

124701

Received and filed

the instrument for record on the 18th

day of April 1972

at 1:36 o'clock p.m.

Diana Vaughn

County Recorder

by

Linda Brown, Dep

File No. OCT 28 1965

T. 26 N. R. 34 W. 21

DUPLICATE Bill: McDonnell
Stat: McFarley
Co: Merion
Darlinton: Sullivan
Dickert:

County Sanders

STATE OF MONTANA
ADMINISTRATOR OF GROUNDWATER CODE
OFFICE OF STATE ENGINEER

Declaration of Vested Groundwater Rights
(Under Chapter 237, Montana Session Laws, 1961)

1. Frank Dobravec, of Heron, (Name of Appropriator) (Address) (Town)
County of Sanders State of Montana
have appropriated groundwater according to the Montana laws in effect prior to January 1, 1962, as follows:

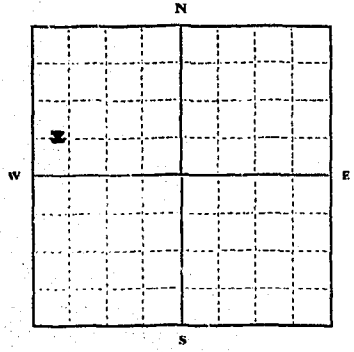

SW 1/4 Sec. 21 T. 28 R. 34

Indicate point of appropriation and place of use, if possible. Each small square represents 10 acres.

- 2. The beneficial use on which the claim is based... household & domestic use
- 3. Date or approximate date of earliest beneficial use; and how continuous the use has been... About 1930, used every day since
- 4. The amount of groundwater claimed (in miner's inches or gallons per minute)... 50 gal per minute
- 5. If used for irrigation, give the acreage and description of the lands to which water has been applied and name of the owner thereof... not used
- 6. The means of withdrawing such water from the ground and the location of each well or other means of withdrawal... Suction pump
- 7. The date of commencement and completion of the construction of the well, wells, or other works for withdrawal of groundwater... Years ago
- 8. The depth of water table... 1 foot
- 9. So far as it may be available, the type, size and depth of each well or the general specifications of any other works for the withdrawal of groundwater... None
- 10. The estimated amount of groundwater withdrawn each year... 1500 gal
- 11. The log of formations encountered in the drilling of each well if available... sand & gravel
- 12. Such other information of a similar nature as may be useful in carrying out the policy of this act, including reference to book and page of any county record

Signature of Owner Frank Dobravec
Date 10-26-65

Three copies to be filed by the owner with the County Clerk and Recorder of the county in which the well is located.
Please answer all questions. If not applicable, so state, otherwise the form will be returned.

Original to the County Clerk and Recorder; Duplicate to the State Engineer; Triplicate to the Montana Bureau of Mines and Geology, and Quadruplicate for the Appropriator.

3973e

664

107262

Subject

I received and filed

this instrument for record on the 25th

day of Oct 19 65

at 9:30 o'clock A M

Renee H. Adams

County Recorder

Fee 1.00

File No. OCT 28 1965

T. 26 R. 33

Billie McDermott
DUPLICATE
McNulty
Morton
Sullivan
Dickert

County Sanders

STATE OF MONTANA
ADMINISTRATOR OF GROUNDWATER CODE
OFFICE OF STATE ENGINEER

Notice of Completion of Groundwater Appropriation Without Well

(Under Chapter 237 Montana Session Laws, 1961)

Date of Appropriation of Groundwater 1961

Owner Phoebe J. Johnson Address Hoxon, Montana

Contractor (if any)

Address of Contractor

Date Started Spring 1961 Date Completed Fall 1961

Describe means of obtaining groundwater without a well "as by sub-irrigation and other natural processes". Include depth to water when applicable.

2 feet to water, and a 6 foot well

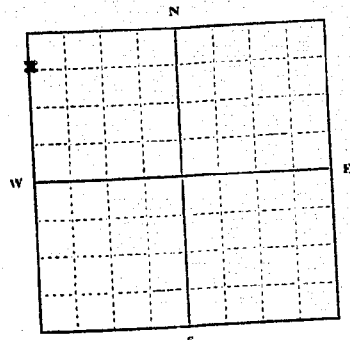

Section 4 T26 R. 33

Indicate point of appropriation and place of use, if possible.

Quantity of water developed and used with explanation of method used to measure or estimate such amount. If use is intermittent

estimate approximate lengths of periods of use.

used for Domestic water with a 3/4" pump

used for Irrigation with a 1" pump

Signature of Owner Phoebe J. Johnson

Date 10-25-65

This form to be prepared by contractor (if any), otherwise by the owner. Three copies of this notice are to be filed with the County Clerk and Recorder of the county in which the works are located.

Please answer all questions. If not applicable, so state, otherwise the form will be returned.

Original to the County Clerk and Recorder; duplicate to the State Engineer; Triplicate to the Montana Bureau of Mines and Geology and Quadruplicate for the Appropriator.

667

107277

Delivered

I received and filed

this instrument for record on the 27

day of Oct 19 65

at 11:30 o'clock a M

Marthy Radson
County Recorder

Fee 1.00 By

Dixie Vaughn Dep

File No.....

T. 26 N. R. 33 W. 4

DUPLICATE

County Headwaters

STATE OF MONTANA
ADMINISTRATOR OF GROUNDWATER CODE
OFFICE OF STATE ENGINEER

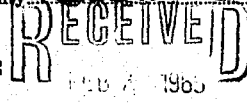

STATE ENGINEER
**Notice of Completion of Groundwater Appropriation
Without Well**

(Under Chapter 237 Montana Session Laws, 1961)

Date of Appropriation of Groundwater Sept. 1962
Owner F. E. Billy South ADDRESS START. NOXON
Contractor (if any) None MONT.
Address of Contractor None
Date Started _____ Date Completed _____

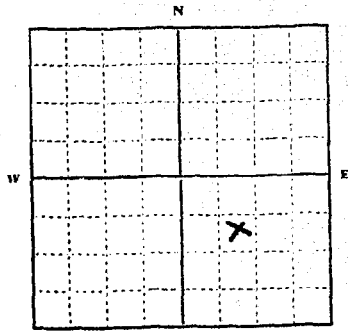

Describe means of obtaining groundwater without a well "as by sub-irrigation and other natural processes". Include depth to water when applicable. SPRING
SURFACE WATER

NW 36 54 26 20
1/4 Sec. T. R.

Indicate point of appropriation and place of use, if possible.

Quantity of water developed and used with explanation of method used to measure or estimate such amount. If use is intermittent estimate approximate lengths of periods of use.
CONTINUOUS SURFACE FLOW
OR YEAR AROUND USE
SEEPS BACK IN GROUND
NO WAY TO MEASURE AMOUNT
Signature of Owner Billy S. South

Date 12-25-1964

This form to be prepared by contractor (if any), otherwise by the owner.
Three copies of this notice are to be filed with the County Clerk and Recorder of the county in which the works are located.
Please answer all questions. If not applicable, so state, otherwise the form will be returned.
Original to the County Clerk and Recorder; duplicate to the State Engineer; Triplicate to the Montana Bureau of Mines and Geology and Quadruplicate for the Appropriator.

31722

648
index 105628

I received and filed
this instrument for record on the
2 day of Feb
19 65 at 1:10 o'clock P
Barthelme
County Recorder
Fee 1.00
By
Dixie Vaughn Reg

File No.

T. 26 N 33 W 4

DUPLICATE

County Sanders

STATE OF MONTANA
ADMINISTRATOR OF GROUNDWATER CODE
OFFICE OF STATE ENGINEER



Declaration of Vested Groundwater Rights

(Under Chapter 237, Montana Session Laws, 1961)

STATE ENGINEER

T. E. & Billy L. South, of STAR Route Naxon
(Name of Appropriator) (Address) (Town)

County of SANDERS State of MONTANA
have appropriated groundwater according to the Montana laws in effect prior to January 1, 1962, as follows:

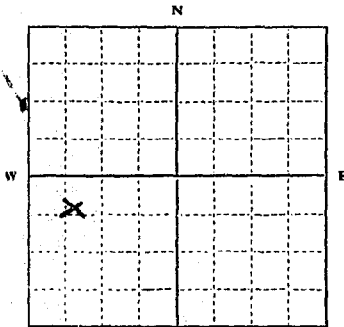

NW SW 4 S 26 33
1/4 Sec. T. R.

Indicate point of appropriation and place of use, if possible. Each small square represents 10 acres.

2. The beneficial use on which the claim is based DRINKING
HOUSEHOLD USE

3. Date or approximate date of earliest beneficial use; and how continuous the use has been. SEPT. 1962
CONTINUOUS

4. The amount of groundwater claimed (in miner's inches or gallons per minute) WELL 40 FT.

5. If used for irrigation, give the acreage and description of the lands to which water has been applied and name of the owner thereof
NOT USED FOR IRRIGATION

6. The means of withdrawing such water from the ground and the location of each well or other means of withdrawal BY PUMP-
BACK PORCH OF HOUSE

7. The date of commencement and completion of the construction of the well, wells, or other works for withdrawal of groundwater, WAS HERE WHEN PLACE WAS
PURCHASED

8. The depth of water table APP. 15 FT.

9. So far as it may be available, the type, size and depth of each well or the general specifications of any other works for the withdrawal of groundwater 40 FT. WELL - CONCRETE
CASED APP. 3 FT. DIAMETER

10. The estimated amount of groundwater withdrawn each year APP. 20,000 GALLONS

11. The log of formations encountered in the drilling of each well if available
NOT AVAILABLE

12. Such other information of a similar nature as may be useful in carrying out the policy of this act, including reference to book and page of any county record
NO RECORD AVAILABLE

Signature of Owner Billy L. South

Date 12-25-1964

Three copies to be filed by the owner with the County Clerk and Recorder of the county in which the well is located.

Please answer all questions. If not applicable, so state, otherwise the form will be returned.

Original to the County Clerk and Recorder; Duplicate to the State Engineer; Triplicate to the Montana Bureau of Mines and Geology, and Quadruplicate for the Appropriator.

36933

649

105629

I received and filed
this instrument for record on the

2 day of Feb

1965 at 1:12 o'clock P M

Nanathy Dodson
County Recorder

By 103

Alvin Vaughn Day

STATE WATER CONSERVATION BOARD

GW 3

Approved Stock Form—State Publishing Co., Helena, Montana—42262

MAY 11 1966

File No.

T. 26 N R. 33 W 5

DUPLICATE

Billie McDermott
 Butzer McMully
 Coyle Morton
 Darlinton Sullivan
 Dicks
STATE OF MONTANA
ADMINISTRATOR OF GROUNDWATER CODE

County Sanders

OFFICE OF STATE ENGINEER

Notice of Completion of Groundwater Appropriation Without Well

(Under Chapter 237 Montana Session Laws, 1961)

Date of Appropriation of Groundwater Nov. 1, 1964

Owner L. H. Schuler Address Noxon, Montana

S.N.F. Depot

Contractor (if any) None

Address of Contractor

Date Started Nov. 1, 1964 Date Completed Under development

Describe means of obtaining groundwater without a well "as by sub-irrigation and other natural processes". Include depth to water when applicable. Several springs in one spot, the largest runs 45 gallons an hour. These springs are being collected in a ditch and siphoned off into a large storage tank for domestic and

irrigation purposes. It is about 10 feet to water and there is enough for further development. Quantity of water developed and used with explanation of method used to measure or estimate such amount. If use is intermittent

estimate approximate lengths of periods of use. Year around

Six months of irrigation

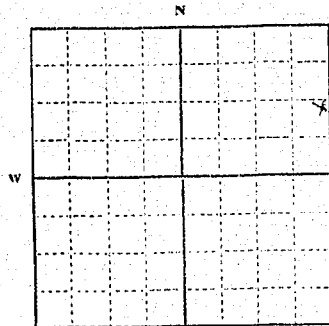

SE NE §
 SE 1/4 NE Sec. 5 T. 26 R. 33

Indicate point of appropriation and place of use, if possible.

Signature of Owner L. H. Schuler

Date Oct. 10, 1965

This form to be prepared by contractor (if any), otherwise by the owner.

Three copies of this notice are to be filed with the County Clerk and Recorder of the county in which the works are located.

Please answer all questions. If not applicable, so state, otherwise the form will be returned.

Original to the County Clerk and Recorder; duplicate to the State Engineer; Triplicate to the Montana Bureau of Mines and Geology and Quadruplicate for the Appropriator.

192 108911

INDEXED

I received and filed
 this instrument for record on the 10
 day of May 1966
 at 10:00 o'clock A M
Stanley Adams
 County Recorder
 Fee 1.00

File No. 740

T. 26N R. 33W

DUPLICATE

County Sanders

STATE OF MONTANA
ADMINISTRATOR OF GROUNDWATER CODE
OFFICE OF STATE ENGINEER

RECEIVED

Notice of Completion of Groundwater Appropriation
Without Well

NOV 4 1968

(Under Chapter 237 Montana Session Laws, 1961)

Date of Appropriation of Groundwater November 1, 1964

Owner Louis N. Schuler Address Noxon, Montana

Contractor (if any) None

Address of Contractor

Date Started Nov. 1, 1964 Date Completed Nov. 1, 1965

Describe means of obtaining groundwater without a well "as by sub-irrigation and other natural processes". Include depth to

water when applicable. Several springs located in the Southeast quarter of the Northeast quarter of Section 5, Township 26 North, Range 33 West, which run approximately 1000 gallons an hour; these springs have been improved by digging to a depth of approximately 15 feet and the water is collected and siphoned into a large storage tank for domestic and irrigation use.

Quantity of water developed and used with explanation of method used to measure or estimate such amount. If use is intermittent

estimate approximate lengths of periods of use

Approximately 1000 gallons an hour, measured by full use of irrigation system. Flow is more or less constant.

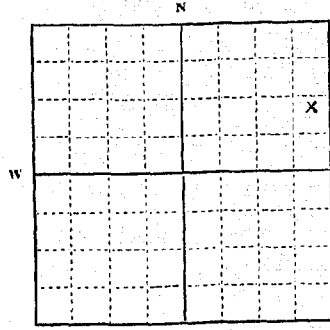

SE 1/4 NE 1/4 Sec. 5 T. 26N R. 33W

Indicate point of appropriation and place of use, if possible.

Signature of Owner Louis N. Schuler

Date October 29, 1968

This form to be prepared by contractor (if any), otherwise by the owner.

Three copies of this notice are to be filed with the County Clerk and Recorder of the county in which the works are located.

Please answer all questions. If not applicable, so state, otherwise the form will be returned.

Original to the County Clerk and Recorder; duplicate to the State Engineer; Triplicate to the Montana Bureau of Mines and Geology and Quadruplicate for the Appropriator.

44, 736

740

114618

INDEXED

I received and filed
 this instrument for record on the 1st
 day of Nov 1968
 at 10:36 o'clock A M
Dorothy Jackson
 County Recorder
 Fee \$1.00 DJ
Charles H. Eldridge
Dy.

File No. 739

T. 26N R. 33W

DUPLICATE

County Sanders

STATE OF MONTANA
ADMINISTRATOR OF GROUNDWATER CODE
OFFICE OF STATE ENGINEER

WATER RESOURCES BOARD
RECEIVED

NOV 4 1968

Notice of Completion of Groundwater Appropriation Without Well

(Under Chapter 237 Montana Session Laws, 1961)

Date of Appropriation of Groundwater June 6, 1967

Owner Louis N. Schuler Address Noxon, Montana

Contractor (if any) None

Address of Contractor

Date Started June 1, 1966 Date Completed June 6, 1967

Describe means of obtaining groundwater without a well "as by sub-irrigation and other natural processes". Include depth to water when applicable. Sub-irrigation resulting in underground springs rising upon highway right-of-way on the Northeastly highway right-of-way of U.S. Highway 10A at approximately Station 326+75 in Section 5 Township 26 North, Range 33 West, M.P.M. Said springs are gathered by perforated drains placed along said highway and are collected and channeled through a culvert running into a reservoir, located on the SWly side of highway R/W thenced piped to SEk of the
Quantity of water developed and used with explanation of method NEk, used to measure or estimate such amount. If use is intermittent said Sec. 5 for domestic estimate approximate lengths of periods of use purposes.

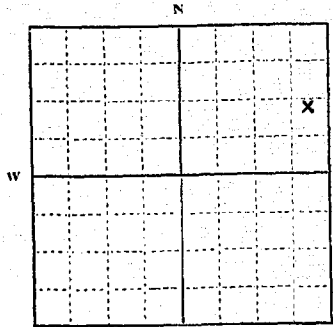

SE 1/4 NEk Sec. 5 T. 26N R. 33W

Indicate point of appropriation and place of use, if possible.

The system flows at the approximate rate of 100 gallons per hour, measured at the system outlet. Encroachment Application and Permit for tapping and maintaining said springs, dated June 6, 1968 and has been obtained from State Highway Commission of Montana.

Signature of Owner Louis N. Schuler

Date October 29, 1968

This form to be prepared by contractor (if any), otherwise by the owner.

Three copies of this notice are to be filed with the County Clerk and Recorder of the county in which the works are located.

Please answer all questions. If not applicable, so state, otherwise the form will be returned.

Original to the County Clerk and Recorder; duplicate to the State Engineer; Triplicate to the Montana Bureau of Mines and Geology and Quadruplicate for the Appropriator.

44, 735

739

114617

INDEXED

I received and filed

this instrument for record on the 14

day of Nov 19 68

at 10:34 o'clock A. M.

Sarahy Jackson
County Recorder

100
By
Edgar R. Edridge
Secy

TO BE FILED
IN THE OFFICE
OF THE COUNTY
CLERK

GW 2

File No.

DUPLICATE

No. 2000
Return OK
STATE ENGINEER

RECEIVED
STATE ENGINEER

T. 26 N. R. 32 W. S. 9
County Sanders

STATE OF MONTANA
ADMINISTRATOR OF GROUNDWATER CODE
OFFICE OF STATE ENGINEER

RECEIVED
STATE ENGINEER

Notice of Completion of Groundwater Appropriation by Means of Well

(Under Chapter 237, Montana Session Laws, 1961)

0	Top of Ground
30	bottom
	(Elev. above sea level.....)
130	clay
131	clay and sand
156	clay
160	clay and sand
174	clay, sand and some water
180	sand with some water
211	sand and clay
260	clay
267	hard clay
277	fine sand
280	sand
287	clay
312	clay, sand and some water
330	silt, sand
357	silt sand
400	clay and rock
418	gravel and water

Owner Melvin Green Address Noxon

Driller Kane Water Well Drilling Address St. Regis

Date of Notice of Appropriation of Groundwater 8/5/61

Date well started 8/5/61 Date Completed 8/27/61

Type of well drilled Equipment Used churn drill
(dug, driven, bored or drilled) (Churn, drill, rotary or other)

Water Use: Domestic Municipal Stock Irrigation
Industrial Drainage Other

Indicate on the diagram the character and thickness of the different strata met with in drilling, such as soil, clay, shale, gravel, rock or sand, etc. Show depth at which water is encountered, thickness and character of water-bearing strata and height to which the water rises in the well.

Size of Drilled Hole	Size and Weight of Casing	From (Feet)	To (Feet)	PERFORATIONS		
				Kind Size	From (Feet)	To (Feet)
6 inch	standard	0	418	none	0	0

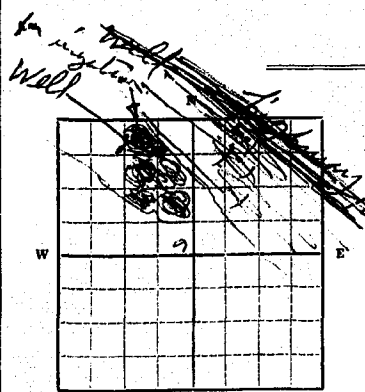

Static Water Level for non-flowing Well 250 feet

Shut-in Pressure for Flowing Well does not apply

Pumping Water Level 150 feet at 15 gal. per minute.

Discharge in gal. per min. of flowing well does not apply

How Tested bailed Length of Test 5 hours

Remarks: (Gravel packing, cementing, packers, type of shutoff, location of place of use of groundwater if not at well, and any other similar pertinent information, including number of acres irrigated, if used for irrigation)

Melvin A. Green

NE. 1/4 Sec. 9, T. 26 N., R. 33 W. 11 M.
Indicate location of well and place of use, if possible. Each small square represents 10 acres.

418 Show exact depth of bottom.

23
Driller's License Number
Engene George Kane
Driller's Signature

This form to be prepared by driller, and three copies to be filed by the owner with the County Clerk and Recorder in the county in which the well is located.

Please answer all questions. If not applicable, so state, otherwise the form will be returned.

Original to the County Clerk and Recorder; duplicate to the State Engineer; Triplicate to the School of Mines and Quadruplicate for the Appropriator.

9
ENGINEER

61
will
irrigation
different
k or sand,
aracter of
well.

To
(Feet)
0

feet.
er minute.
utoff, loca-
l, and any
number of

Kane
and Re-
Mines
2196.

51 99514 INDEXED
I received and filed
this instrument for record on the
1st day of Oct.
1962 at 10:02 o'clock A.M.
Nancy Johnson
County Recorder
Fee 1.00

File No.

T. R.

DUPLICATE

County Southern Co.

STATE OF MONTANA
ADMINISTRATOR OF GROUNDWATER CODE
OFFICE OF STATE ENGINEER

Declaration of Vested Groundwater Rights

(Under Chapter 237, Montana Session Laws, 1961)

I, Ruth E. Griffin, of PO Box 544, Noxon, Montana
(Name of Appropriator) (Address) (Town)

County of Sanders State of Montana
have appropriated groundwater according to the Montana laws in effect Montana January 1, 1962, as follows:

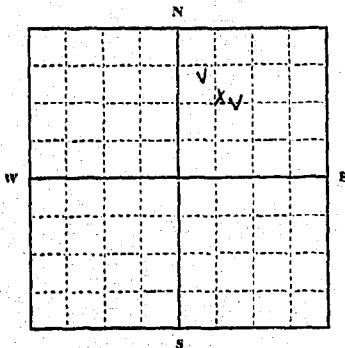

NW 1/4 Sec. 9, T. 26, R. 33W

Indicate point of appropriation and place of use, if possible. Each small square represents 10 acres.

x - well
v - places of use

2. The beneficial use on which the claim is based. domestic and garden at residence, and domestic use at cafe.

3. Date or approximate date of earliest beneficial use; and how continuous the use has been. June 1, 1973, continuous since said date.

4. The amount of groundwater claimed (in miner's inches or gallons per minute). 16 gallons a minute

5. If used for irrigation, give the acreage and description of the lands to which water has been applied and name of the owner thereof. small garden only, owner same as appropriator

6. The means of withdrawing such water from the ground and the location of each well or other means of withdrawal. dug well, 1HP steel pump, well located as marked above

7. The date of commencement and completion of the construction of the well, wells, or other works for withdrawal of groundwater. well commenced Sept 1971, completed June 1, 1973.

8. The depth of water table. 24 feet

9. So far as it may be available, the type, size and depth of each well or the general specifications of any other works for the withdrawal of groundwater. dug well, depth 30 feet

10. The estimated amount of groundwater withdrawn each year. 60,000 gallons

11. The log of formation countered in the drilling of each well if available. not available

12. Such other information of a similar nature as may be useful in carrying out the policy of this act, including reference to book and page of any county record. None

Handwritten notes:
June 22 1973
June 26, 1973
June 27, 1973

Signature of Owner. Ruth E. Griffin

Date. June 1, 1973

Three copies to be filed by the owner with the County Clerk and Recorder of the county in which the well is located.

Please answer all questions. If not applicable, so state, otherwise the form will be returned.

Original to the County Clerk and Recorder; Duplicate to the State Engineer; Triplicate to the Montana Bureau of Mines and Geology; and Quadruplicate for the Appropriator.

895

128395

I received and filed

the original of this instrument on
June 23
10:00 A.M.
Dipin. Naught
County Recorder
Fee \$ 02

RECEIVED
JULY 21 1992

County SANDEW

STATE OF MONTANA
ADMINISTRATOR OF GROUNDWATER CODE
MONTANA WATER RESOURCES BOARD

NOTICE OF COMPLETION OF GROUNDWATER
APPROPRIATION BY MEANS OF WELL

Developed after January 1, 1962

(Under Chapter 237 Montana Session Laws, 1961, as amended)

This form to be prepared by driller, and three copies to be filed by the owner with the County Clerk and Recorder in the county in which the well is located, last copy to be retained by driller.

Please answer all questions. If not applicable, so state, otherwise the form may be returned.

Owner WALTER B. MARIER, SCOTT

Address NOXON BOX 1971

MONTANA 59853

Date well started

completed 1950's

Type of well DRILLED

Equipment used ROTARY DRILL

Water Use: Domestic Municipal Stock Irrigation

Industrial Drainage Other * Garden/Lawn

*Describe

USE: If used for irrigation, industrial, drainage or other. Explain, state number of acres and location or other data (i.e. Lot, Block and Addition).

ESTIMATED ANNUAL WITHDRAWAL

Size of Drilled Hole	Size and Weight of Casing	From (Feet)	To (Feet)	PERFORATIONS		
				Kind Size	From (Feet)	To (Feet)
	6"					

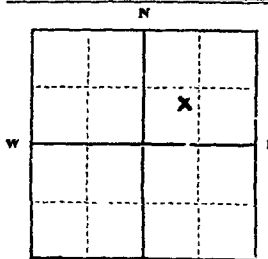

(LOT 4) S
SW 1/4 NE 1/4 Sec. 9
T. 26 N. R. 33 E.

Static water level 50' ft.*
Pumping water level 50' ft.*
at 250' gallons per minute,
measured 16 minutes after pumping
began.

*Measured from ground level.
Well developed by _____
for _____ hours.
Power _____ Pump _____ HP
Remarks: (Gravel packing, cementing,
packers, type of shutoff)

INDICATE LOCATION OF WELL AND PLACE OF USE, IF POSSIBLE. EACH SMALL SQUARE REPRESENTS 40 ACRES.

Driller's Signature _____

Driller's Address DEMING PUMP CO. SPOKANE, WASH.

LICENSE NO. _____

DRILLER'S LOG

Indicate the character, color, thickness of strata such as soil, clay, sand, gravel, shale, sandstone, etc. Show depth at which water is found and height to which water rises in well.

Top of Ground (Elev. above sea level) APPROX. 1900'

From (Feet)	To (Feet)	
0'	2'	TOP SOIL
2'	20'	COARSE GRAVEL
20'	21'	COARSE GRAVEL
21'	20'	COARSE GRAVEL
20'	310'	FINE GRAY SILT
310'	315'	COARSE GRAVEL

315' Show exact depth of bottom

50,992

936

125489

INDEXED

RECEIVED
 JUL 21 1972
 11:35 AM
 COUNTY CLERK
 CLERK'S OFFICE
 COUNTY CLERK

I received and filed
 this instrument for record on the 21
 day of July 1972
 at 11:35 o'clock AM
 Regina Vaughn
 County Recorder
 Fee \$4.00

Lillie Houston, Rep

File No.

T. 23 N. R. 33

DUPLICATE

County Sanders

STATE OF MONTANA
ADMINISTRATOR OF GROUNDWATER CODE
OFFICE OF STATE ENGINEER

RECEIVED
JAN 3 1964

Declaration of Vested Groundwater Rights
(Under Chapter 237, Montana Session Laws, 1961)

1. Mrs. Evelyn Boyd, of Noxon
(Name of Appropriator) (Address) (Town)
County of Sanders State of Montana
have appropriated groundwater according to the Montana laws in effect prior to January 1, 1962, as follows:

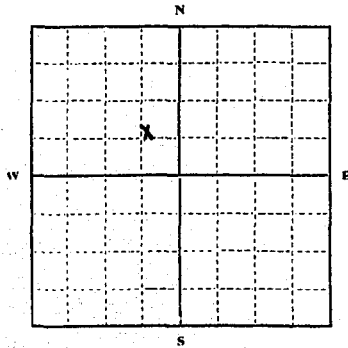

SE 1/4 NW Sec 19 T. 26 R. 33

Indicate point of appropriation and place of use, if possible. Each small square represents 10 acres.

- 2. The beneficial use on which the claim is based.
Domestic use
- 3. Date or approximate date of earliest beneficial use; and how continuous the use has been.
1955 Uses six years.
- 4. The amount of groundwater claimed (in miner's inches or gallons per minute).
350 gallons per minute.
- 5. If used for irrigation, give the acreage and description of the lands to which water has been applied and name of the owner thereof.
Three acres. Mrs. Evelyn Boyd
- 6. The means of withdrawing such water from the ground and the location of each well or other means of withdrawal.
A half horse pump.
- 7. The date of commencement and completion of the construction of the well, wells, or other works for withdrawal of groundwater.
1955
- 8. The depth of water table.
14 ft.
- 9. So far as it may be available, the type, size and depth of each well or the general specifications of any other works for the withdrawal of groundwater.
14 ft. deep and it is an open well.
- 10. The estimated amount of groundwater withdrawn each year.
250,000,000
- 11. The log of formations encountered in the drilling of each well if available.
Sandy soil
- 12. Such other information of a similar nature as may be useful in carrying out the policy of this act, including reference to book and page of any county record.
Never been recorded.

Signature of Owner *Evelyn Boyd*
Date Dec. 30, 1963

Three copies to be filed by the owner with the County Clerk and Recorder of the county in which the well is located.
Please answer all questions. If not applicable, so state, otherwise the form will be returned.

Original to the County Clerk and Recorder; Duplicate to the State Engineer; Triplicate to the Montana Bureau of Mines and Geology, and Quadruplicate for the Appropriator.

443
Indepd

this instrument for record on the
30 day of Dec.
19 63 at 3:22 o'clock P M
Dorothy Dodson
County Recorder
Fee 9 00

912

128541

I received and filed
this instrument for record on the 29
day of June 19 13
at 8:08 o'clock P.M.
Lipe Vaught
County Recorder
Fee 1.50 by

Linda Brown, Dep

INDEXED

10

File No.

T. 26 N 33 W

DUPLICATE

County Beaverhead

STATE OF MONTANA
ADMINISTRATOR OF GROUNDWATER CODE
OFFICE OF STATE ENGINEER

RECEIVED
JAN 3 1964
STATE ENGINEER

Notice of Completion of Groundwater Appropriation Without Well

(Under Chapter 237 Montana Session Laws, 1961)

Date of Appropriation of Groundwater Dec 26, 1963
Owner Adin Mellinger Address Noton, Mont.
Contractor (if any)
Address of Contractor
Date Started Date Completed

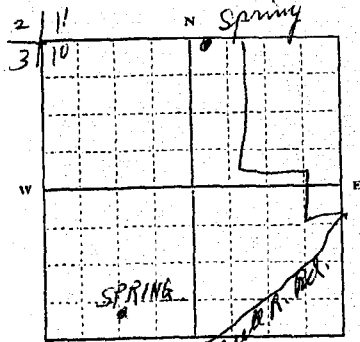

N.W. 1/4 NE Sec. 10. T. 26 R. 33

Indicate point of appropriation and place of use, if possible.

Describe means of obtaining groundwater without a well "as by sub-irrigation and other natural processes". Include depth to water when applicable. There are 2 flowing springs on the 48 1/2 acres. One for livestock and plan to build a camp ground and use the other one for it.

Quantity of water developed and used with explanation of method used to measure or estimate such amount. If use is intermittent estimate approximate lengths of periods of use.....

9 months

Signature of Owner Adin Mellinger
Date Dec 26, 1963

This form to be prepared by contractor (if any), otherwise by the owner.

Three copies of this notice are to be filed with the County Clerk and Recorder of the county in which the works are located.

Please answer all questions. If not applicable, so state, otherwise the form will be returned.

Original to the County Clerk and Recorder; duplicate to the State Engineer; Triplicate to the Montana Bureau of Mines and Geology and Quadruplicate for the Appropriator.

337
of 2420

I received and filed
his instrument for record on the
30 day of Dec
9 63 at 8:18 o'clock A.M.
Clara M. Cleveland
County Recorder
at 100 By

Alvin Vaughn Dep

File No.

T. 26 N. 33 W. 10

DUPLICATE

County, Sanders

STATE OF MONTANA
ADMINISTRATOR OF GROUNDWATER CODE
OFFICE OF STATE ENGINEER

RECEIVED
JAN 3 1964

Declaration of Vested Groundwater Rights ENGINEER

(Under Chapter 237, Montana Session Laws, 1961)

1. Edwin Mellinger, of Wooten,
(Name of Appropriator) (Address) (Town)

County of Sanders State of Montana
I have appropriated groundwater according to the Montana laws in effect prior to January 1, 1962, as follows:

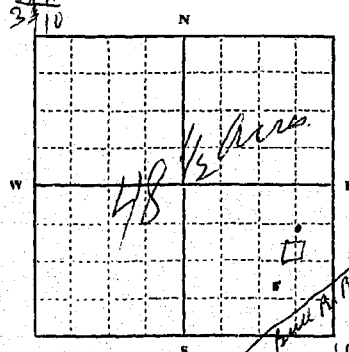

N.W. 1/4 N.E. Sec. 10, T.26, R.33

Indicate point of appropriation and place of use, if possible. Each small square represents 10 acres.

2. The beneficial use on which the claim is based total supply for house & garden & live stock

3. Date or approximate date of earliest beneficial use; and how continuous the use has been since purchased in March 1963

4. The amount of groundwater claimed (in miner's inches or gallons per minute) 10 Gallons

5. If used for irrigation, give the acreage and description of the lands to which water has been applied and name of the owner thereof large garden

6. The means of withdrawing such water from the ground and the location of each well or other means of withdrawal Electric Pump

7. The date of commencement and completion of the construction of the well, wells, or other works for withdrawal of groundwater.

8. The depth of water table 4 feet

9. So far as it may be available, the type, size and depth of each well or the general specifications of any other works for the withdrawal of groundwater There are 2 wells. One east of the house and one about 100' west of the house.

10. The estimated amount of groundwater withdrawn each year app 20,000 Gal

11. The log of formations encountered in the drilling of each well if available 2 wells are both drawn wells, app 20' deep

12. Such other information of a similar nature as may be useful in carrying out the policy of this act, including reference to book and page of any county record

Signature of Owner Edwin Mellinger

Date Dec 26, 1963

Three copies to be filed by the owner with the County Clerk and Recorder of the county in which the well is located.

Please answer all questions. If not applicable, so state, otherwise the form will be returned.

Original to the County Clerk and Recorder; Duplicate to the State Engineer; Triplicate to the Montana Bureau of Mines and Geology, and Quadruplicate for the Appropriator.

334

Indexed

I received and filed
this instrument for record on the

30 day of Dec

1963 at 8:16 o'clock a M

Marthy Jackson
County Recorder

Fee 1.00 By

Wipic Vaughn Dep

310

File No.

T. 26 N. R. 33 W.

DUPLICATE

STATE OF MONTANA
ADMINISTRATOR OF GROUNDWATER CODE
OFFICE OF STATE ENGINEER

RECEIVED

JAN 9 1963

STATE ENGINEER

Declaration of Vested Groundwater Rights

(Under Chapter 237, Montana Session Laws, 1961)

1. Adm Mellinger of Noton
(Name of Appropriator) (Address) (Town)

County of _____ State of Montana

2. I have appropriated groundwater according to the Montana laws in effect prior to January 1, 1962, as follows:

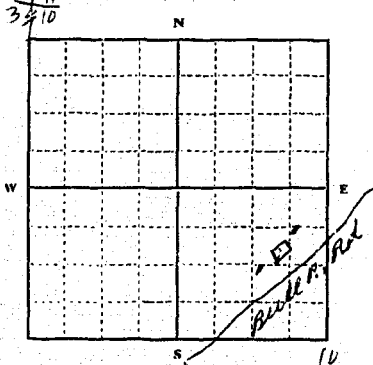

N.W. 1/4 NE. Sec. 10. T. 26. R. 33

Indicate point of appropriation and place of use, if possible. Each small square represents 10 acres.

2. The beneficial use on which the claim is based total supply for house, garden + livestock

3. Date or approximate date of earliest beneficial use; and how continuous the use has been. since purchase in March of 1963

4. The amount of groundwater claimed (in miner's inches or gallons per minute) 10 gallon

5. If used for irrigation, give the acreage and description of the lands to which water has been applied and name of the owner thereof

large garden

6. The means of withdrawing such water from the ground and the location of each well or other means of withdrawal

the Pump

7. The date of commencement and completion of the construction of the well, wells, or other works for withdrawal of groundwater.

8. The depth of water table 4 feet

9. So far as it may be available, the type, size and depth of each well or the general specifications of any other works for the withdrawal of groundwater there are 2 wells, one east of house and one about 100 feet west of house

10. The estimated amount of groundwater withdrawn each year 20,000 Gall per yr

11. The log of formations encountered in the drilling of each well if available. 2 wells are both driven wells app 20' deep

12. Such other information of a similar nature as may be useful in carrying out the policy of this act, including reference to book and page of any county record

Signature of Owner Adm Mellinger

Date Dec 26, 1963

Three copies to be filed by the owner with the County Clerk and Recorder of the county in which the well is located.

Please answer all questions. If not applicable, so state, otherwise the form will be returned.

Original to the County Clerk and Recorder; Duplicate to the State Engineer; Triplicate to the Montana Bureau of Mines and Geology, and Quadruplicate for the Appropriator.

335
Unindexed

I received and E.D.
An instrument for record on the
30 day of May
1963 at 8:14 a.m.
Marybeth Hodson
County Recorder
For [Signature] By
Alice Vaughn [Signature]

File No. 252 MONTANA WATER RESOURCES BOARD
RECEIVED

T. 25 R. 37
County Sanders

TRIPPLICATE

LOG JAN 26 1970

STATE OF MONTANA
ADMINISTRATOR OF GROUNDWATER CODE
OFFICE OF STATE ENGINEER

Top of Ground
(Elev. above sea level 2200 ft.)

Notice of Completion of Groundwater Appropriation by Means of Well DEVELOPED AFTER JANUARY 1, 1962

(Under Chapter 237, Montana Session Laws, 1961)

Owner Louis & Madge Post Address None

Driller None Address None

Date of Notice of appropriation of groundwater September 20, 1969

Date well started Sept. 2, 1969 Date completed Sept. 20, 1969

Type of well Driven Equipment used rod point
(Dug, Driven, bored or drilled) (Churn drill, rotary or other)

Water use: Domestic Municipal Stock Irrigation
Industrial Drainage Other

Acc. No. 117746
Filed for record
this 23 day of January
A. D. 19 70 at 1:00
o'clock P.M.

Indicate on the diagram the character and thickness of the different strata met with in drilling, such as soil, clay, shale, gravel, rock or sand, etc. Show depth at which water is encountered, thickness and character of water-bearing strata and height to which the water rises in the well.



20' sand
4' gravel
24' total depth

Size of Drilled Hole	Size and Weight of Casing	From (Feet)	To (Feet)	PERFORATIONS		
				Kind Size	From (Feet)	To (Feet)
1 1/2"	1 1/2"			1 1/2"	three feet	perforated pipe

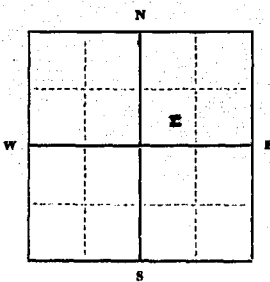

Static Water Level for non-flowing well _____ feet.
 Shut-in Pressure for Flowing Well _____
 Pumping Water Level fourteen feet
 at _____ gal. per minute.
 Discharge in gal. per min. of flowing well _____
 How Tested None estimated
 Length of Test _____
 Remarks: (Gravel packing, cementing, packers, type of shutoff) rod point with foot valve
Pump is operated at 50% pressure.

Sec. 14 T. 25 R. 37
Indicate location of well and place of use, if possible. Each small square represents 40 acres.

(Continue on reverse side)

USE—If used for irrigation, industrial, drainage or other. Explain, state number of acres and location or other data (i.e.: Lot, Block and Addition).

Show exact depth of bottom.

This form to be prepared by driller, and three copies to be filed by the owner with the County Clerk and Recorder in the county in which the well is located, tissue copy to be retained by driller.

Please answer all questions. If not applicable, so state, otherwise the form will be returned.

Driller's License Number

Louis & Madge Post
Driller's Signature

46095

117746

7.50
INDEXED

I received and find

this instrument to amount on the 23rd

of Jan 70

1.00

Twenty Dollars

5/00

By

Edward J. Caldwell

Sup

File No.....

T. 24 R. 22

DUPLICATE

County Sanders

STATE OF MONTANA
ADMINISTRATOR OF GROUNDWATER CODE
OFFICE OF STATE ENGINEER

RECEIVED
JAN 6 1964
STATE ENGINEER

Notice of Completion of Groundwater Appropriation by Means of Well

(Under Chapter 237, Montana Session Laws, 1961)

Owner Madge M. Post Address Home

Driller Madge M. Post Address.....

Date of Notice of Appropriation of Groundwater.....

Date well started 7-22 Date Completed 10 days

Type of well Hand Dug Equipment Used Shovel
(dug, driven, bored or drilled) (Churn, drill, rotary or other)

Water Use: Domestic Municipal Other Irrigation
Industrial Drainage Stock

Indicate on the diagram the character and thickness of the different strata met with in drilling, such as oil, clay, shale, gravel, rock or sand, etc. Show depth at which water is encountered, thickness and character of water-bearing strata and height to which water rises in the well.

Size of Drilled Hole	Size and Weight of Casing	From (Feet)	To (Feet)	PERFORATIONS		
				Kind Size	From (Feet)	To (Feet)
5 X 5	Cased					

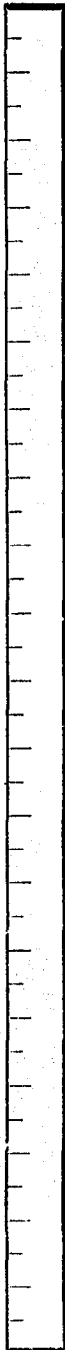

Top of Ground
(Elev. above sea level.....)

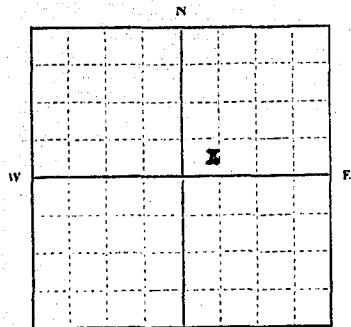

SW 1/4 NE Sec. 10 T. 26 R. 22

Indicate location of well and place of use, if possible. Each small square represents 10 acres.

Show exact depth of bottom.

Static Water Level for non-flowing Well 7 feet feet.

Shut-in Pressure for Flowing Well.....

Pumping Water Level.....feet at.....gal. per minute.

Discharge in gal. per min. of flowing well.....

How Tested..... Length of Test.....

Remarks: (Gravel packing, cementing, packers, type of shutoff, location of place of use of groundwater if not at well, and any other similar pertinent information, including number of acres irrigated, if used for irrigation).....

Driller's License Number.....

Madge M. Post
Driller's Signature

This form to be prepared by driller, and three copies to be filed by the owner with the County Clerk and Recorder in the county in which the well is located.

Please answer all questions. If not applicable, so state, otherwise the form will be returned.

Original to the County Clerk and Recorder; duplicate to the State Engineer; Triplicate to the Montana Bureau of Mines and Geology and Quadruplicate for the Appropriator.

561
Indexed

I received and filed
this instrument for record on the
3rd day of January
1964 at 11:27 o'clock P M
Dorothy Johnson
County Recorder
Fee \$1.00

By
Evelyn Wood
Dep

File No.

T. 20 N. R. 55 W. 70

DUPLICATE

County Sanders

STATE OF MONTANA
ADMINISTRATOR OF GROUNDWATER CODE
OFFICE OF STATE ENGINEER

RECEIVED
JAN 6 1964
STATE ENGINEER

Declaration of Vested Groundwater Rights

(Under Chapter 237, Montana Session Laws, 1961)

1. Madge M. Post of Bozeman (Name of Appropriator) (Address) (Town)

County of Sanders State of Montana
have appropriated groundwater according to the Montana laws in effect prior to January 1, 1962, as follows:

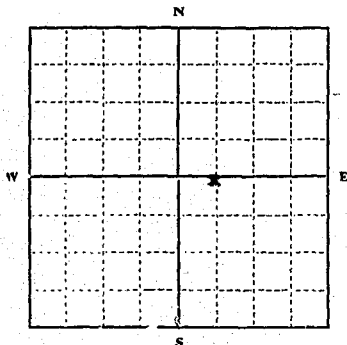

S.W. 1/4, N.E. Sec. 10, T. 26, R. 33

Indicate point of appropriation and place of use, if possible. Each small square represents 10 acres.

2. The beneficial use on which the claim is based. Household & Store use

3. Date or approximate date of earliest beneficial use; and how continuous the use has been. Unknown

4. The amount of groundwater claimed (in miner's inches or gallons per minute). App. 500 per day

5. If used for irrigation, give the acreage and description of the lands to which water has been applied and name of the owner thereof

6. The means of withdrawing such water from the ground and the location of each well or other means of withdrawal. Electric Pump 1 1/2 pipe

7. The date of commencement and completion of the construction of the well, wells, or other works for withdrawal of groundwater. Unknown

8. The depth of water table. Unknown

9. So far as it may be available, the type, size and depth of each well or the general specifications of any other works for the withdrawal of groundwater. Driven well, 1 1/2 pipe App. 21 feet

10. The estimated amount of groundwater withdrawn each year. 200,000 App.

11. The log of formations encountered in the drilling of each well if available. Unknown

12. Such other information of a similar nature as may be useful in carrying out the policy of this act, including reference to book and page of any county record. Unknown

Signature of Owner Madge M. Post

Date Dec 31 - 63

Three copies to be filed by the owner with the County Clerk and Recorder of the county in which the well is located.

Please answer all questions. If not applicable, so state, otherwise the form will be returned.

Original to the County Clerk and Recorder; Duplicate to the State Engineer; Triplicate to the Montana Bureau of Mines and Geology, and Quadruplicate for the Appropriator.

560
indexed

I received and filed
this instrument for record on the
3rd day of January
1964 at 11:25 o'clock P M
Dorothy Jackson
County Recorder
Fee \$1.00
By
Evelyn Wood Dep

GW :

MONTANA WATER RESOURCES BOARD

Approved Stock Form--State Publishing Co., Helena, Montana--42.

File No. 258

RECEIVED

T. 26 R. 33

TRIPPLICATE

JAN 26 1970

County Sanders

LOG

STATE OF MONTANA
ADMINISTRATOR OF GROUNDWATER CODE
OFFICE OF STATE ENGINEER

Top of Ground

(Elev. above sea level 2200 ft.)

Notice of Completion of Groundwater
Appropriation by Means of Well
DEVELOPED AFTER JANUARY 1, 1962

(Under Chapter 237, Montana Session Laws, 1961)

Owner Arthur F. & Mona Vanek Address Poncha

Driller G. Vanek Address Poncha

Date of Notice of appropriation of groundwater August 1965

Date well started August 1965 Date completed August 1965

Type of well Driven Equipment used sand point
(Dug, Driven, bored or drilled) (Churn drill, rotary or other)

Water use: Domestic Municipal Stock Irrigation
Industrial Drainage Other

Indicate on the diagram the character and thickness of the different strata met with in drilling, such as soil, clay, shale, gravel, rock or sand, etc. Show depth at which water is encountered, thickness and character of water-bearing strata and height to which the water rises in the well.



14' sand & clay
14' total depth

Size of Drilled Hole	Size and Weight of Casing	From (Feet)	To (Feet)	PERFORATIONS		
				Kind Size	From (Feet)	To (Feet)
five "	Five "	3'	to 14'	three feet perforated pipe		

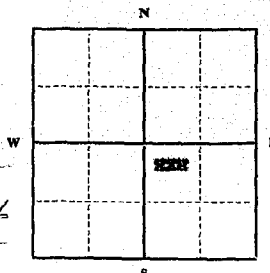

Static Water Level for non-flowing wellfeet.

Shut-in Pressure for Flowing Well.....feet

Pumping Water Level... eightfeet
at gals. per minute.

Discharge in gal. per min. of flowing well

How Tested... estimated

Length of Test.....

Remarks: (Gravel packing, cementing, packers, type of shutoff)

..... sand point with foot valve.

..... Pump is operated at 50# pressure.

.....(Continue on reverse side)

USE--If used for irrigation, industrial, drainage or other. Explain, state number of acres and location or other data (i.e.: Lot, Block and Addition).

Doc. No. 117748
Filed for record
this 23 day of January
A. D. 19 70, at 1:04
o'clock P.M.

Indicate location of well and place of use, if possible. Each small square represents 40 acres.

Show exact depth of bottom.

This form to be prepared by driller, and three copies to be filed by the owner with the County Clerk and Recorder in the county in which the well is located, tissue copy to be retained by driller.

Please answer all questions. If not applicable, so state, otherwise the form will be returned.

Driller's License Number

Arthur F. Vanek
Driller's Signature

46097

738
DEXED

11 7748

I received and filed
this instrument recorded on the 23rd
day of Jan 70
at 11 AM P M
Shirley Sadson
County Recorder
Fee \$1.00 By

Ernest S. Eldridge
Sg.

File No. 257 MONTANA WATER RESOURCES BOARD

T. 25 R. 33

RECEIVED

TRIPLICATE

JAN 26 1970

County Sanders

LOG

STATE OF MONTANA
ADMINISTRATOR OF GROUNDWATER CODE
OFFICE OF STATE ENGINEER

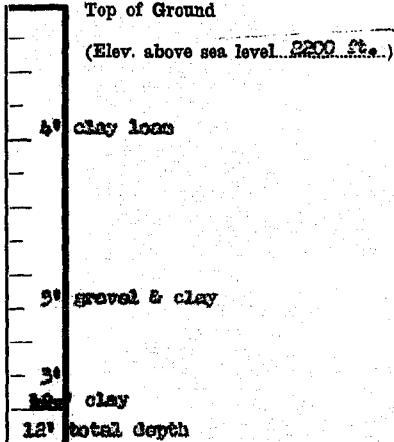

Notice of Completion of Groundwater Appropriation by Means of Well DEVELOPED AFTER JANUARY 1, 1962

(Under Chapter 237, Montana Session Laws, 1961)

Owner Arthur F. & Mona Vanek Address Down

Driller owner Address Down

Date of Notice of appropriation of groundwater August 1964

Date well started July 1964 Date completed August 1964

Type of well hand dug Equipment used shovel & pick
(Dug, Driven, bored or drilled) (Churn drill, rotary or other)

Water use: Domestic Municipal Stock Irrigation
Industrial Drainage Other

Indicate on the diagram the character and thickness of the different strata met with in drilling, such as soil, clay, shale, gravel, rock or sand, etc. Show depth at which water is encountered, thickness and character of water-bearing strata and height to which the water rises in the well.

Size of Drilled Hole	Size and Weight of Casing	From (Feet)	To (Feet)	PERFORATIONS		
				Kind Size	From (Feet)	To (Feet)
4"	4"	1'	12'			

Doc. No. 117747
Filed for record
this 23 day of January
A. D. 19 70, at 1.02
o'clock P. M.

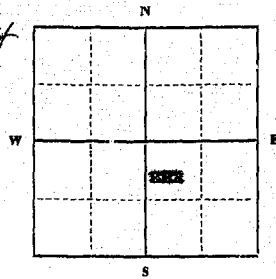

Static Water Level for non-flowing well _____ feet.

Shut-in Pressure for Flowing Well _____ feet.

Pumping Water Level five feet

at fifty gal. per minute.

Discharge in gal. per min. of flowing well _____

How Tested estimated

Length of Test _____

Remarks: (Gravel packing, cementing, packers, type of shutoff) _____

It is constructed of cement

ring with holes in the

FIG. 1-22 Sec. 10, T. 25, R. 33
Indicate location of well and place of use, if possible. Each small square represents 40 acres.

(Continue on reverse side)

USE—If used for irrigation, industrial, drainage or other. Explain, state number of acres and location or other data (i.e.: Lot, Block and Addition).

Show exact depth of bottom.

This form to be prepared by driller, and three copies to be filed by the owner with the County Clerk and Recorder in the county in which the well is located, tissue copy to be retained by driller.

Please answer all questions. If not applicable, so state, otherwise the form will be returned.

Driller's License Number

Arthur F. & Mona Vanek

Driller's Signature

46096

757

117747

INDEXED

I received and filed
this instrument for record on this 23rd
day of Jan 1970
at 1:02 o'clock P
Francis Nelson
County Recorder
Fee 5.00

Leonard J. Erdridge
Twp.