

GN 4

MONTANA

RECEIVED
DEC 31 1963

STATE ENGINEER

OFFICE OF STATE

OF VEDED GROUNDWATER RIGHTS

Chapter 107 Montana Session 1961

1. WILLIAM GURSKI of 1100 290 BUTTE (Town)
 (Name) (Address)
 County of Silver Bow, State of Montana, has appropriated groundwater according to
 the Montana law in effect prior to January 1, 1962, as follows:

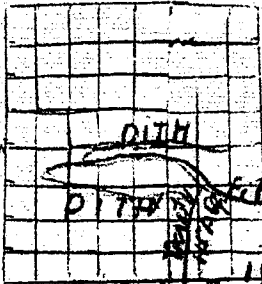

Indicate point of appropriation
 and place of use, if possible.
 Each small square represents 10
 acres.

- The beneficial use or which the claim is based
irrigation
- Date or approximate date of earliest beneficial use; and how continuous the use has been
1905
- The amount of groundwater claimed (in miner's inches 75 gallons per minute)
- If used for irrigation, give the acreage and description of the lands to which water has been applied and name of the owner
4.2 acres REES W.M. GURSKI
- The means of withdrawing such water from the ground and the location of each well or other means of withdrawal
0.176 mi

- The date of commencement and completion of the construction of the well, wells, or other works for withdrawal of groundwater
FISH CREEK and TWO HEART CREEK
- The depth of water table
- So far as it may be available, the type, size and depth of each well or the general specifications of any other works for the withdrawal of groundwater
- The estimated amount of groundwater withdrawn each year
- The log of formations encountered in the drilling of each well if available
- Such other information of a similar nature as may be useful in carrying out the policy of this act, including reference to book and page of any county record

Signature of Owner William Gurski
 Date DEC 30 1963

STATE OF MONTANA)
 COUNTY OF SILVER BOW) ss William Gurski having first been duly sworn,
 depose and say that he of lawful age and
 the appropriator and claimant of the order and water right mentioned in the
 foregoing declaration of vested groundwater rights and the person whose name
 subscribed thereto, as the appropriator and claimant, that he know
 the contents of said foregoing notice and that the papers and things therein stated are
 true.

Subscribed and sworn to before me, this 30 day of DEC 1963 at Butte, Montana.
 Notary Public for the State of Montana, residing at Butte, Montana.
 My commission expires January 1, 1964.

16864

from Fish Creek and Two Heds

February 26, 1964
Mr. William Gurski, Route 1-Box 79E

251166

STATE OF MONTANA,
COUNTY OF SILVER BOW. } ss.

I hereby certify that the within instrument
was filed at my office on the 30th
day of March, D. 1964 at
16 minutes past 11 o'clock A.
Attest My Hand:

WILLIAM T. HUCKHA
Margaret Sand

Attest My hand,
I hereby certify
was filed at my office
day of
COUNTY OF SILVER
STATE OF MONTANA

Mr. William Gurski, Route 1-Box 79B, Butte, Montana

February 26, 1964

December 30, 1963

251166

from Fish Creek and Two Heart Creek.

GW3

File No.

TRIPPLICATE

T. 1 N. R. 6 W. 29

County Silver Bow

STATE OF MONTANA
ADMINISTRATOR OF GROUNDWATER CODE
OFFICE OF STATE ENGINEER

RECEIVED
DEC 31 1963

Notice of Completion of Groundwater Appropriation Without Well

(Under Chapter 237 Montana Session Laws, 1961)

Date of Appropriation of Groundwater

Owner W. H. Stratton Address Rt 1 - Whitehall

Contractor (if any) none

Address of Contractor none

Date Started 1929 Date Completed 1929

Describe means of obtaining groundwater without a well "as by sub-irrigation and other natural processes". Include depth to water when applicable. water surfaced used for cattle

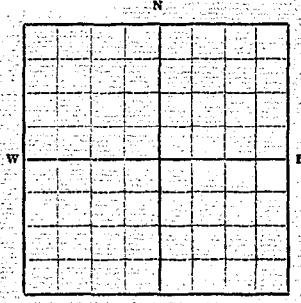

1/4 Sec 29 T. 1 N. R. 6 W.

Indicate point of appropriation and place of use, if possible.

Quantity of water developed and used with explanation of method used to measure or estimate such amount. If use is intermit-

tent estimate approximate lengths of periods of use about 5 inches to each spring used year around.

Signature of Owner William H. Stratton

Date December 28, 1963

This form to be prepared by contractor (if any), otherwise by the owner.

Three copies of this notice are to be filed with the County Clerk and Recorder of the county in which the works are located.

Please answer all questions. If not applicable, so state, otherwise the form will be returned.

Original to the County Clerk and Recorder; duplicate to the State Engineer; Triplicate to the Montana Bureau of Mines and Geology and Quadruplicate for the Appropriator.

16162

251164

STATE OF MONTANA }
COUNTY OF SILVER BOW } ss.

I hereby certify that the within instrument
was filed at my office on the 39
day of March, A. D. 1963,
2 minutes past 11 o'clock A
M. of my hand:

Alvin Tond

GW 4
 Dec 29, T. 1 N. R. 6 W
 Section 26
 Range 6 W
 Township 1 N

RECEIVED
 MAY 7 1964

29
 T 1 N R 6 W
 County Silver Bow
 DEC 31 1963

STATE OF MONTANA
 ADMINISTRATOR OF GROUNDWATER CODE
 OFFICE OF STATE ENGINEER

DECLARATION OF VESTED GROUNDWATER RIGHTS STATE ENGINEER
 (Under Chapter 237, Montana Session Laws, 1961)

1. Joe Torpey, of Four Mile Road, Butte, Montana
 (Name of Appropriator) (Address) (Town)
 County of Silver Bow, State of Montana, have appropriated groundwater according to
 the Montana laws in effect prior to January 1, 1962, as follows:

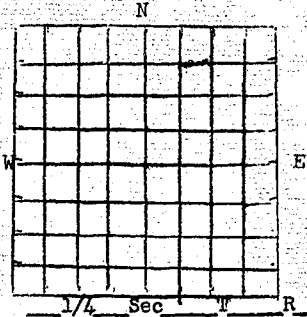

Indicate point of appropriation
 and place of use, if possible.
 Each small square represents 10
 acres.

2. The beneficial use on which the claim is based domestic purposes & in connection with mining operation
3. Date or approximate date of earliest beneficial use; and how continuous the use has been 1960, continuous since that time.
4. The amount of groundwater claimed (in miner's inches or gallons per minute) Flow of stream approx. 12" wide x 2" deep
5. If used for irrigation, give the acreage and description of the lands to which water has been applied and name of the owner thereof None
6. The means of withdrawing such water from the ground and the location of each well or other means of withdrawal Spring rises in mine tunnel, ditch & natural stream / Bed

7. The date of commencement and completion of the construction of the well, wells, 1961 other works for withdrawal of groundwater stream / Bed
8. The depth of water table unknown
9. So far as it may be available, the type, size and depth of each well or the general specifications of any other works for the withdrawal of groundwater Water drawn from stream approx. 12" wide and 2" deep from spring arising in mine tunnel.
10. The estimated amount of groundwater withdrawn each year 20 000 Gallon
11. The log of formations encountered in the drilling of each well if available
12. Such other information of a similar nature as may be useful in carrying out the policy of this act, including reference to book and page of any county record

Signature of Owner Joe Torpey
 Date December 20, 1963

STATE OF MONTANA) ss
 COUNTY OF SILVER BOW)
Joe Torpey having first been duly sworn,
 depose and say that he of lawful age and
 the appropriator and claimant of the order and water right mentioned in the
 foregoing declaration of vested groundwater rights and the person whose name
 subscribed thereto, as the appropriator and claimant, that he know
 the contents of said foregoing notice and that the matters and things therein stated are
 true.

Joe Torpey

Subscribed and sworn to before me, this 20th day of December, 1963
 Notary public for the State of Montana, residing at Butte Commission expires 6/27/66

251008

STATE OF MONTANA,
COUNTY OF SILVER BOW, } ss.

I hereby certify that the within instrument

was filed at my office on the 23

day of March, A. D. 1929

at 6 minutes past 2 o'clock

of the morning

at my office

WILLIAM T. ALLEN
County Clerk

[Signature]

GW3

File No.

TRIPPLICATE

T.1. N. R. 6

County Silver Bow

RECEIVED
MAY 7 1964

STATE OF MONTANA
ADMINISTRATOR OF GROUNDWATER CODE
OFFICE OF STATE ENGINEER

STATE ENGINEER

Notice of Completion of Groundwater Appropriation Without Well

(Under Chapter 237 Montana Session Laws, 1961)

Date of Appropriation of Groundwater 1934

Owner U. S. of America Address

Contractor (if any) NONE

Address of Contractor NONE

Date Started 1934 Date Completed 1934

Describe means of obtaining groundwater without a well "as by sub-irrigation and other natural processes". Include depth to water when applicable. SPIN - collecting water in a box and piping through 1 1/2 inch pipe to stock watering trough

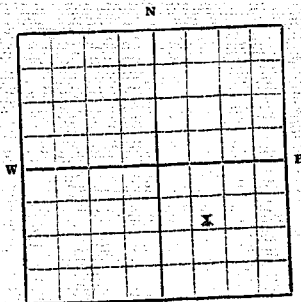

Quantity of water developed and used with explanation of method used to measure or estimate such amount. If use is intermittent estimate approximate lengths of periods of use 01 c.f.g.

SE 1/4 Sec. 20 T.1. N. R. 6

Indicate point of appropriation and place of use, if possible.

developed and used. Amount estimated by ocular comparison to known amount. Used by livestock from June through October.

Signature of Owner [Handwritten Signature]

Date APR 17, 1964

This form to be prepared by contractor (if any), otherwise by the owner.

Three copies of this notice are to be filed with the County Clerk and Recorder of the county in which the works are located.

Please answer all questions. If not applicable, so state, otherwise the form will be returned.

Original to the County Clerk and Recorder; duplicate to the State Engineer; Triplicate to the Montana Bureau of Mines and Geology and Quadruplicate for the Appropriator.

35662

GW3

File No.

TRIPPLICATE

T. L. N. R. 6

County Silver Bow

RECEIVED
MAY 7 1964

STATE OF MONTANA
ADMINISTRATOR OF GROUNDWATER CODE
OFFICE OF STATE ENGINEER

STATE ENGINEER

Notice of Completion of Groundwater Appropriation Without Well

(Under Chapter 237 Montana Session Laws, 1961)

Date of Appropriation of Groundwater 1934

Owner U.S. of America Address

Contractor (if any) None

Address of Contractor None

Date Started 1934 Date Completed 1934

Describe means of obtaining groundwater without a well "as by sub-irrigation and other natural processes". Include depth to water when applicable. spring - collecting water in a box and piping through 1 1/2 inch pipe to stock watering trough

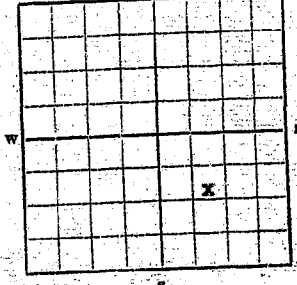

SE 1/4 Sec. 30 T. 1N R. 6 W. 7
Indicate point of appropriation and place of use, if possible.

Quantity of water developed and used with explanation of method used to measure or estimate such amount. If use is intermittent estimate approximate lengths of periods of use. 0.1 c.f.s. developed and used. Amount estimated by regular comparison to known amount. Used by livestock from June through October.

Signature of Owner [Signature]
Date March 17, 1964

This form to be prepared by contractor (if any), otherwise by the owner.

Three copies of this notice are to be filed with the County Clerk and Recorder of the county in which the works are located.

Please answer all questions. If not applicable, so state, otherwise the form will be returned.

Original to the County Clerk and Recorder; duplicate to the State Engineer; Triplicate to the Montana Bureau of Mines and Geology and Quadruplicate for the Appropriator.

35662

253614
253614

STANDARD
COMMUNICATIONS

APR 9 1964

Harold Miller

File No.

T. 1 N. R. 6 W. 30

QUADRUPLICATE

County Silver Bow

STATE OF MONTANA
ADMINISTRATOR OF GROUNDWATER CODE
OFFICE OF STATE ENGINEER

RECEIVED
MAR 6 1963

Notice of Completion of Groundwater Appropriation by Means of Well

(Under Chapter 237, Montana Session Laws, 1961)

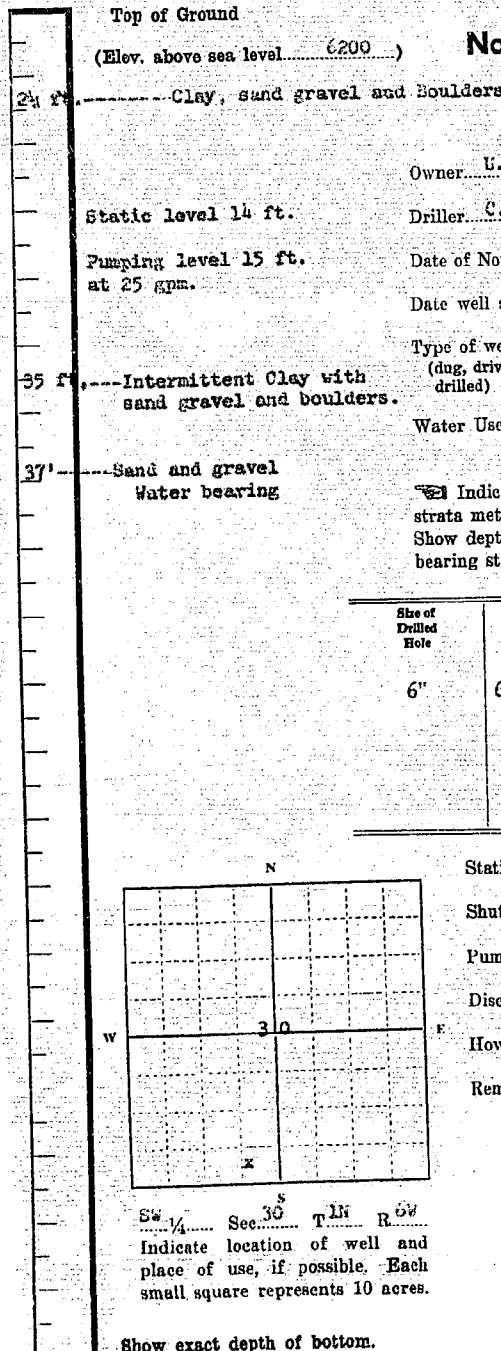

Owner U.S.D.A. Forest Service Address

Driller C. F. Wroble Address Millcreek RFD #1 Montana, Anaconda

Date of Notice of Appropriation of Groundwater

Date well started Nov. 3, 1963 Date Completed Nov. 6, 1963

Type of well Drilled Equipment Used Churn drill
(dug, driven, bored or drilled) (Churn, drill, rotary or other)

Water Use: Domestic Municipal Other Irrigation
Industrial Drainage Stock

Indicate on the diagram the character and thickness of the different strata met with in drilling, such as soil, clay, shale, gravel, rock or sand, etc. Show depth at which water is encountered, thickness and character of water-bearing strata and height to which water rises in the well.

Size of Drilled Hole	Size and Weight of Casing	From (Feet)	To (Feet)	PERFORATIONS		
				Kind Size	From (Feet)	To (Feet)
6"	6" X 19 5/8 lb.	2' above surface	35' 6"	None		

Static Water Level for non-flowing Well..... 14 feet.

Shut-in Pressure for Flowing Well.....

Pumping Water Level..... 15 feet at 25 gal. per minute

Discharge in gal. per min. of flowing well.....

How Tested..... Bailed & Pumped Length of Test..... 1 hr. 1/2 hr.

Remarks: (Gravel packing, cementing, packers, type of shutoff, location of place of use of groundwater if not at well, and any other similar pertinent information, including number of acres irrigated, if used for irrigation).....

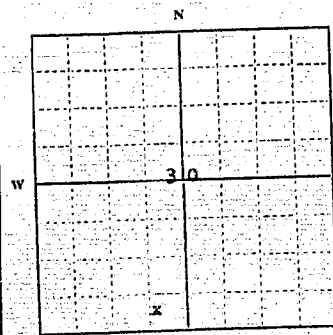

SW 1/4 Sec. 30 T. 1 N. R. 6 W.
Indicate location of well and place of use, if possible. Each small square represents 10 acres.

Show exact depth of bottom.

Exact Depth 37'

62

Driller's License Number

C. F. Wroble
Driller's Signature

This form to be prepared by driller, and three copies to be filed by the owner with the County Clerk and Recorder in the county in which the well is located.

Please answer all questions. If not applicable, so state, otherwise the form will be returned.

Original to the County Clerk and Recorder; duplicate to the State Engineer; Triuplicate to the Montana Bureau of Mines and Geology and Quadruplicate for the Appropriator.

3495

260411

40
Tel. 11
A. D. 1965
9

Margaret Pond
20

GW 3

File No.

T. 1. R. 6. W. 30

DUPLICATE

County Silver Bow

STATE OF MONTANA
ADMINISTRATOR OF GROUNDWATER CODE
OFFICE OF STATE ENGINEER

RECEIVED
JAN 18 1965

Notice of Completion of Groundwater Appropriation Without Well

Developed After January 1, 1962

(Under Chapter 237 Montana Session Laws, 1961)

Date of Appropriation of Groundwater Sept. 16, 1963

Owner U.S. Government Address Mitchell, Montana

Contractor (if any) None

Address of Contractor Not applicable

Date Started 9/11/63 Date Completed 9/16/63

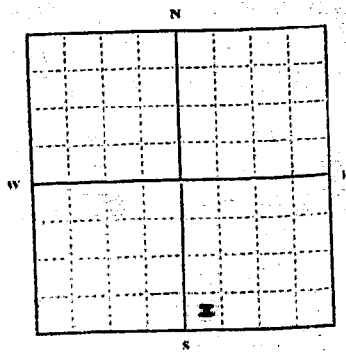

SE 14 Sec. 30 T. 1. R. 6. W.

Indicate point of appropriation and place of use, if possible.

1) Describe means of obtaining groundwater (as by sub-irrigation, developed spring, drains, etc.) developed spring

2) Means of withdrawing water (gravity, pump, canal, etc.) gravity

3) Depth of water table surface

4) Use of the water stock watering

5) Amount of groundwater claimed (in miner's inches, or gallons per minute) 1/2 gallon per minute

6) If used for irrigation, give number of acres and description of land not applicable

7) Estimate amount of water used each year 77,500 gallons

Signature of Owner John S. McVain
Active District Engineer
Date 11/19/64

This form to be prepared by contractor (if any), otherwise by the owner.

Three copies of this notice are to be filed with the County Clerk and Recorder of the county in which the works are located.

Please answer all questions. If not applicable, so state, otherwise the form will be returned.

38876

T 1 R 5 W
County Silver Bow

RECEIVED
SEP 6 1963

STATE OF MONTANA
ADMINISTRATOR OF GROUNDWATER CODE
OFFICE OF STATE ENGINEER

DECLARATION OF VESTED GROUNDWATER RIGHTS
(Under Chapter 237, Montana Session Laws, 1961) STATE ENGINEER

1. William J. Mc Lee, of Box 462 Whitchell
(Name of Appropriator) (Address) (Town)
County of Silver Bow, State of Montana, have appropriated groundwater according to
the Montana laws in effect prior to January 1, 1962, as follows:

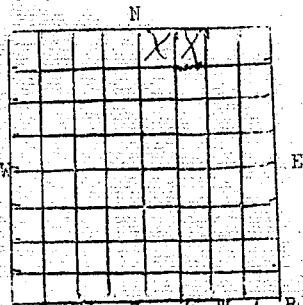

11.2 1/2 Sec 8 W 1 R 5 N
Indicate point of appropriation
and place of use, if possible.
Each small square represents 10
acres.

- 2. The beneficial use on which the claim is based
household irrigation livestock
- 3. Date or approximate date of earliest beneficial use; and how continuous the use has been
1939 continuous
- 4. The amount of groundwater claimed (in miner's inches or gallons per minute)
15 inches
- 5. If used for irrigation, give the acreage and description of the lands to which water has been applied and name of the owner thereof
1 acres Lawn & fruit trees
- 6. The means of withdrawing such water from the ground and the location of each well or other means of withdrawal
pump shallow

- 7. The date of commencement and completion of the construction of the well, wells, or other works for withdrawal of groundwater
1939
- 8. The depth of water table 7 feet
- 9. So far as it may be available, the type, size and depth of each well or the general specifications of any other works for the withdrawal of groundwater
35 feet
- 10. The estimated amount of groundwater withdrawn each year _____
- 11. The log of formations encountered in the drilling of each well if available _____
- 12. Such other information of a similar nature as may be useful in carrying out the policy of this act, including reference to book and page of any county record _____

Signature of Owner William J. Mc Lee
Date Aug 20 1963

STATE OF MONTANA) ss
COUNTY OF SILVER BOW)
_____ having first been duly sworn,
depose and say that _____ he _____ of lawful age and _____
the appropriator _____ and claimant _____ of the order and water right mentioned in the
foregoing declaration of vested groundwater rights and the person _____ whose name
subscribed thereto, as the appropriator _____ and claimant _____, that _____ he _____ know
the contents of said foregoing notice and that the matters and things therein stated are
true.

Subscribed and sworn to before me, this 20 day of Aug, 1963
Notary public for the State of Montana, residing at Salt Lake Commission Expires 4/19/66
5927

248396

15 Aug 200 238

Hayden M. White

GW

TIN R W 35

County _____

STATE OF MONTANA
ADMINISTRATOR OF GROUNDWATER CODE
OFFICE OF STATE ENGINEER

RECEIVED
DEC 31 1968

STATE ENGINEER

DECLARATION OF VESTED GROUNDWATER RIGHTS
(Under Chapter 237, Montana Session Laws, 1961)

1. _____, of _____ (Town)
(name of appropriator) (address)

County of Silver Bow, State of Montana, have appropriated groundwater according to the Montana Laws in effect prior to Jan. 1, 1962, as follows:

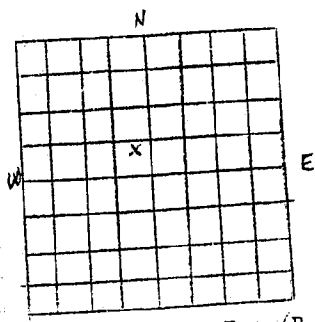

1/4 Sec T14R1W
Indicate point of appropriation and place of use, if possible. Each small square represents 10 acres.

- 2. The beneficial use on which the claim is based _____
- 3. Date or approximate date of earliest beneficial use; and how continuous the use has been _____
- 4. The amount of groundwater claimed (in miner's inches or gallons per minute) _____
- 5. If used for irrigation, give the acreage & description of the lands to which water has been applied & name of the owner thereof _____
- 6. The means of withdrawing such water from the ground and the location of each well or other means of withdrawal _____

7. The date of commencement and completion of the construction of the well, wells, or other works for withdrawal of groundwater _____

8. The depth of water table _____

9. So far as it may be available, the type, size and depth of each well or the general specifications of any other works for the withdrawal of groundwater _____

10. The estimated amount of groundwater withdrawn each year 6297200

11. The log of formations encountered in the drilling of each well if available _____

12. Such other information of a similar nature as may be useful in carrying out the policy of this act, including reference to book and page of any Co. record _____

Date _____ Signature of Owner _____

STATE OF MONTANA)
COUNTY OF SILVER BOW) ss _____ having first been duly
sworn, depose _____ and say that _____ he _____ of
lawful age and _____ the appropriator _____ and
Claimant _____ of the order and water right mentioned in the foregoing declar-
ation of vested groundwater rights and the person _____ subscribed
thereto, as the appropriator _____ and claimant _____, that _____ he _____ know _____ the
contents of said foregoing notice & that the matters & things therein stated
are true. _____

Subscribed and sworn to before me this 30 day of Dec, 1968
Notary public for the St. of Montana, residing at _____
Commission expires Jan 14, 1969

16875

GW

County T. N. R. 1 W. 35

STATE OF MONTANA
ADMINISTRATOR OF GROUNDWATER CODE
OFFICE OF STATE ENGINEER

RECEIVED
DEC 31 1966

STATE ENGINEER

DECLARATION OF VESTED GROUNDWATER RIGHTS
(Under Chapter 237, Montana Session Laws, 1961)

1. [Name], of [Address] (Town) [Town]
(name of appropriator) County of Silver Bow, State of Montana, have appropriated groundwater according to the Montana Laws in effect prior to Jan. 1, 1962, as follows:

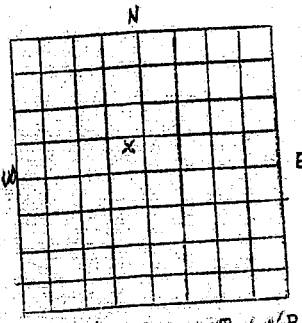

NW 1/4 Sec 35 T. N. R. 1 W.
Indicate point of appropriation and place of use, if possible. Each small square represents 10 acres.

- 2. The beneficial use on which the claim is based [Handwritten]
- 3. Date or approximate date of earliest beneficial use; and how continuous the use has been [Handwritten]
- 4. The amount of groundwater claimed (in miner's inches or gallons per minute) [Handwritten]
- 5. If used for irrigation, give the acreage & description of the lands to which water has been applied & name of the owner thereof [Handwritten]
- 6. The means of withdrawing such water from the ground and the location of each well or other means of withdrawal [Handwritten]
- 7. The date of commencement and completion of the construction of the well, wells, or other works for withdrawal of groundwater [Handwritten]
- 8. The depth of water table [Handwritten]
- 9. So far as it may be available, the type, size and depth of each well or the general specifications of any other works for the withdrawal of groundwater [Handwritten]
- 10. The estimated amount of groundwater withdrawn each year 6297200
- 11. The log of formations encountered in the drilling of each well if available [Handwritten]

12. Such other information of a similar nature as may be useful in carrying out the policy of this act, including reference to book and page of any Co. record

Date [Handwritten] Signature of Owner [Handwritten]

STATE OF MONTANA)
COUNTY OF SILVER BOW) ss [Handwritten] having first been duly
sworn, depose [Handwritten] and say that [Handwritten] he [Handwritten] of
lawful age and [Handwritten] the appropriator [Handwritten] and
Claimant [Handwritten] of the order and water right mentioned in the foregoing declar-
ation of vested groundwater rights and the person whose name [Handwritten] subscribed
thereto, as the appropriator [Handwritten] and claimant [Handwritten], that [Handwritten] he [Handwritten] know [Handwritten] the
contents of said foregoing notice & that the matters & things therein stated
are true. [Handwritten]

Subscribed and sworn to before me this 30 day of Dec, 19 63
Notary public for the St. of Montana, residing at [Handwritten]
Commission expires Jan 14, 1966

251178

STATE OF MONTANA,) ss.
COUNTY OF SILVER BOW,)
I hereby certify that the within instrument
was filed at my office on the _____
day of _____, 19____ at
_____ Montana.
Attest my hand

WILLIAM F. BROWN
County Clerk
W. F. Brown

County of Liberty
State of Montana
June 12, 1973

RECEIVED

County Liberty

STATE OF MONTANA
 DEPARTMENT OF NATURAL RESOURCES AND CONSERVATION
WATER RESOURCES BOARD
OF COMPLETION OF GROUNDWATER APPROPRIATION BY MEANS OF WELL
 Developed after January 1, 1962

DRILLER'S LOG

Indicate the character, color, thickness of strata such as soil, clay, sand, gravel, shale, sandstone, etc. Show depth at which water is found and height to which water rises in well.

(Under Chapter 237 Montana Session Laws, 1961, as amended)
 This form to be prepared by driller, and three copies to be filed by the owner with the County Clerk and Recorder in the county in which the well is located, last copy to be retained by driller. Please answer all questions. If not applicable, so state, otherwise the form may be returned.

Owner Leslie Demmons
 Address Divide, Montana
 Date well started 5/3/73
 completed 5/3/73
 Type of well Drilled
 Equipment used Churn drill
 Water Use: Domestic Municipal Stock Irrigation
 Industrial Drainage Other Garden/Lawn

For Administrator's Use
 File _____
 GW-1 _____

Top of Ground (Elev. above sea level)

From (Feet)	To (Feet)	
0'	1'	Top soil
1'	6'	Sand
6'	20'	Gravel, rocks, sand
20'	30'	Gravel, sand
30'	45'	Gravel, sand Water 20 gpm

*Describe
 USE: If used for irrigation, industrial, drainage or other. Explain, state number of acres and location or other data (i.e. Lot, Block and Addition).

ESTIMATED ANNUAL WITHDRAWAL

Size of Drilled Hole	Size and Weight of Casing	From (Feet)	To (Feet)	PERFORATIONS		
				Kind Size	From (Feet)	To (Feet)
6"	6 3/8" x .250	0 + 1'	45'	Cutting torch		

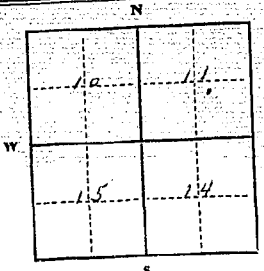

Static water level 17 ft.*
 Pumping water level 30 ft.*
 at 20 gallons per minute,
 measured _____ minutes after pumping began.
 *Measured from ground level.
 Well developed by balling for one and one half hour.
 for _____ hours.
 Power _____ Pump _____ HP
 Remarks: (Gravel packing, cementing, packers, type of shutoff)

INDICATE LOCATION OF WELL AND PLACE OF USE, IF POSSIBLE. EACH SMALL SQUARE REPRESENTS 40 ACRES.

Driller's Signature O'KEEFE CONTRACTING COMPANY
 Driller's Address 2804 Harvard Avenue
Butte, Montana 59701 LICENSE NO. 5

45' Show exact depth of bottom

53,483

T. 15 R. 10 S. 11
 County Silver Bow

STATE OF MONTANA
 ADMINISTRATOR OF GROUNDWATER CODE
 OFFICE OF STATE ENGINEER
 RECEIVED
 MAR 9 1964

Notice of Completion of Groundwater Appropriation by Means of Well
 (Under Chapter 237, Montana Session Laws, 1961)

Top of Ground
 (Elev. above sea level.....)

Owner K. Bray Address Wise River, Mont.
 Driller Carl F. Hollensteiner Address Dillon, Montana

Date of Notice of Appropriation of Groundwater ***
 Date well started Dec. 30, 1963 Date Completed Dec. 31, 1963

Type of well Drilled Equipment Used Churn Drill
 (dug, driven, bored or drilled) (Churn, drill, rotary or other)

Water Use: Domestic Municipal Other Irrigation
 Industrial Drainage Stock

Indicate on the diagram the character and thickness of the different strata met with in drilling, such as soil, clay, shale, gravel, rock or sand, etc. Show depth at which water is encountered, thickness and character of water-bearing strata and height to which water rises in the well.

5 ft dug pit

boulders, gravel and sand to 28'

28 -30 yellow clay

30-32 gravel & sand

finished @ 32 1/2' in pit

total depth 38'

Size of Drilled Hole	Size and Weight of Casing	From (Feet)	To (Feet)	PERFORATIONS		
				Kind Size	From (Feet)	To (Feet)
6"	6" I.D. Blk Std seamless 18.97 lb.	5 ft in pit	32 1/2'	None		

Static Water Level for non-flowing Well..... 15 feet.

Shut-in Pressure for Flowing Well..... ***

Pumping Water Level..... 19 feet at 20 gal. per minute.

Discharge in gal. per min. of flowing well..... ***

How Tested bailler Length of Test 1 hour

Remarks: (Gravel packing, cementing, packers, type of shutoff, location of place of use of groundwater if not at well, and any other similar pertinent information, including number of acres irrigated, if used for irrigation).....

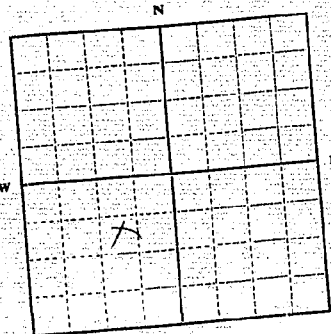

1/4 Sec. 11, T. 15, R. 10, S. 11
 Indicate location of well and place of use, if possible. Each small square represents 10 acres.

Show exact depth of bottom.

License No. 9

Driller's License Number

Driller's Signature

Carl F. Hollensteiner

This form to be prepared by driller, and three copies to be filed by the owner with the County Clerk and Recorder in the county in which the well is located.

Please answer all questions. If not applicable, so state, otherwise the form will be returned.

Original to the County Clerk and Recorder; duplicate to the State Engineer; Triplicate to the Montana Bureau of Mines and Geology and Quadruplicate for the Appropriator.

35436

#252309

STATE OF MONTANA }
COUNTY OF SILVER BOW } ss.

I hereby certify that the within instrument
was filed at my office on the 17
day of Sept A. D. 1967
25 minutes past 7 o'clock
~~Attest my hand:~~

WILLIAM T. ROBERTS
County Clerk

William T. Roberts

STATE WATER CONSERVATION BOARD

File No.

DEC 12 1966

T. S. R. 10 W

TRIPPLICATE

County Silver Bow

LOG Biller: M. Bennett
Burrhead: M. Bennett
Crew: M. Bennett
Drillbit: Sullivan
District: Sullivan
STATE OF MONTANA
ADMINISTRATOR OF GROUNDWATER CODE
OFFICE OF STATE ENGINEER

Top of Ground
(Elev. above sea level.....)

Notice of Completion of Groundwater Appropriation by Means of Well DEVELOPED AFTER JANUARY 1, 1962

(Under Chapter 237, Montana Session Laws, 1961)

0-36 gravel & boulders (tight formation)

Owner: Claude E. Samson Address: Butte, Mont.

36-46 gravel & sand (water bearing)

Driller: Carl F. Hollenstainer Address: Dillon, Mont.

Date of Notice of appropriation of groundwater: ****

Date well started: May 31, 1966 Date completed: June 2, 1966

finished at 46'

Type of well: Drilled Equipment used: Churn drill
(Dug, Driven, bored or drilled) (Churn drill, rotary or other)

Water use: Domestic Municipal Stock Irrigation
Industrial Drainage Other

Indicate on the diagram the character and thickness of the different strata met with in drilling, such as soil, clay, shale, gravel, rock or sand, etc. Show depth at which water is encountered, thickness and character of water-bearing strata and height to which the water rises in the well.

Size of Drilled Hole	Size and Weight of Casing	From (Feet)	To (Feet)	PERFORATIONS		
				Kind Size	From (Feet)	To (Feet)
6"	6" I.D. Black 18.97 lb seamless domestic	1' up	46	None		

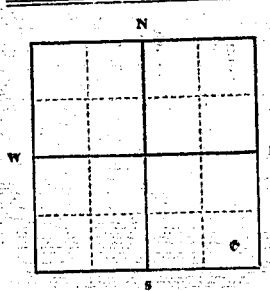

Static Water Level for non-flowing well: 30 feet

Shut-in Pressure for Flowing Well: ***

Pumping Water Level: 130 feet at 20 gal. per minute.

Discharge in gal. per min. of flowing well: ***

How Tested: Miller

Length of Test: 1 hr.

Remarks: (Gravel packing, cementing, packers, type of shutoff) ***

Sec. 14 T. 5 R. 10
Indicate location of well and place of use, if possible. Each small square represents 40 acres.

(Continue on reverse side)

USE—If used for irrigation, industrial, drainage or other. Explain, state number of acres and location or other data (i.e.: Lot, Block and Addition).

Show exact depth of bottom.

This form to be prepared by driller, and three copies to be filed by the owner with the County Clerk and Recorder in the county in which the well is located, tissue copy to be retained by driller.

Please answer all questions. If not applicable, so state, otherwise the form will be returned.

License No. 9

Driller's License Number:

Driller's Signature

411426

27629

STATE OF MONTANA, } ss.
COUNTY OF SILVER BOW, }

I hereby certify that the within instrument
was filed at my office on the _____
day of _____, D. 19____
minutes past _____ o'clock
Attest my hand:

WILLIAM E. [unclear]
County Clerk and
[Signature]

GW 2

File No.

T. 15 R. 10 W

QUADRUPLICATE

County Silver Bow

STATE OF MONTANA
 ADMINISTRATOR OF GROUNDWATER CODE
 OFFICE OF STATE ENGINEER DEC 17 1963

Notice of Completion of Groundwater Appropriation by Means of Well

(Under Chapter 237, Montana Session Laws, 1961)

Owner: Water Works Company Address: Butte Montana

Driller: C. E. Rolfe Address: Mill Creek Hill 1
Agonaide Montana

Date of Notice of Appropriation of Groundwater:

Date well started: October 1962 Date Completed: Dec. 5 1963

Type of well: Churn Drilled Equipment Used: Churn Drill
 (dug, driven, bored or drilled) (Churn, drill, rotary or other)

Water Use: Domestic Municipal Other Irrigation
 Industrial Drainage Stock

Indicate on the diagram the character and thickness of the different strata met with in drilling, such as soil, clay, shale, gravel, rock or sand, etc. Show depth at which water is encountered, thickness and character of water-bearing strata and height to which water rises in the well.

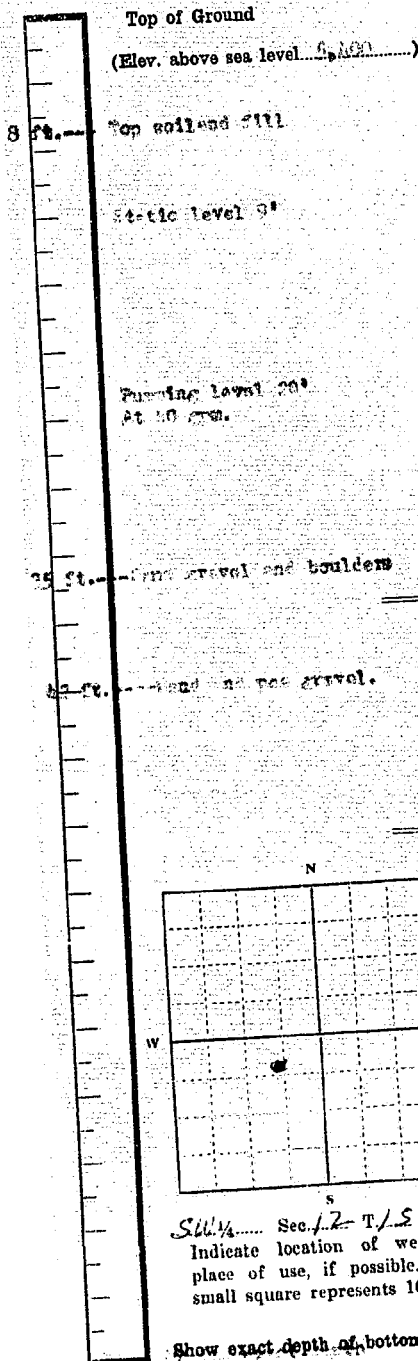

Size of Drilled Hole	Size and Weight of Casing	From (Feet)	To (Feet)	PERFORATIONS		
				Kind Size	From (Feet)	To (Feet)
8"	3" x 27 lb.	Surface	31' 9"	None		
	6" x 195/8 lb.	Surface	37' 9"	None		

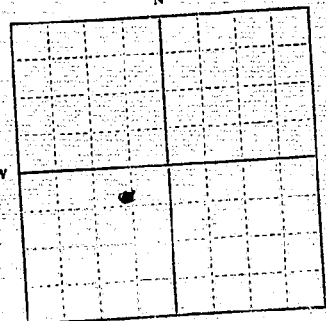

SW 1/4 Sec. 12 T. 15 R. 10 W
 Indicate location of well and place of use, if possible. Each small square represents 10 acres.

Show exact depth of bottom.

Static Water Level for non-flowing Well feet.

Shut-in Pressure for Flowing Well

Pumping Water Level feet at gal. per minute.

Discharge in gal. per min. of flowing well

How Tested: Surf Length of Test: 1 hr.

Remarks: (Gravel packing, cementing, packers, type of shutoff, location of place of use of groundwater if not at well, and any other similar pertinent information, including number of acres irrigated, if used for irrigation)
Gravel pack from 36' to 42'

Driller's License Number

Driller's Signature

This form to be prepared by driller, and three copies to be filed by the owner with the County Clerk and Recorder in the county in which the well is located.

Please answer all questions. If not applicable, so state, otherwise the form will be returned.

Original to the County Clerk and Recorder; duplicate to the State Engineer; Triplicate to the Montana Bureau of Mines and Geology and Quadruplicate for the Appropriator.

250 746
750 746

STATE OF ...
COUNTY OF ...

I hereby certify that
was filed in my office on the ...
day of ...
at least the ...

Elizabeth Meece

STATE OF MONTANA
ADMINISTRATOR OF GROUNDWATER CODE
OFFICE OF STATE ENGINEER

DECLARATION OF VESTED GROUNDWATER RIGHTS
(Under Chapter 237, Montana Session Laws, 1961)

RECEIVED
SEP 6 1963

STATE ENGINEER

1. Emma E. Dupuis, of Armede Montana
(Name of Appropriator) (Address) (Town)
County of Silver Bow, State of Montana, have appropriated groundwater according to the Montana laws in effect prior to January 1, 1962, as follows:

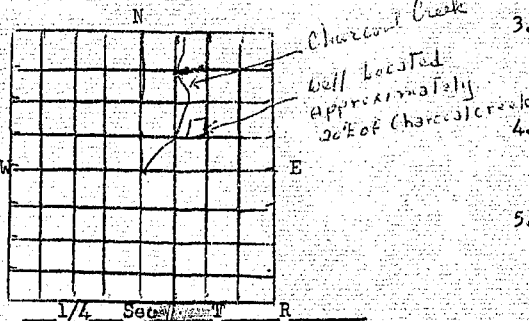

Indicate point of appropriation and place of use, if possible. Each small square represents 10 acres.

- 2. The beneficial use on which the claim is based Domestic & Agricultural
- 3. Date or approximate date of earliest beneficial use; and how continuous the use has been 1950 - Constantly
- 4. The amount of groundwater claimed (in miner's inches or gallons per minute) 30 Miner's inches
- 5. If used for irrigation, give the acreage and description of the lands to which water has been applied and name of the owner thereof 3 1/2 Acres
- 6. The means of withdrawing such water from the ground and the location of each well or other means of withdrawal well

- 7. The date of commencement and completion of the construction of the well, wells, or other works for withdrawal of groundwater 1950
- 8. The depth of water table 25'
- 9. So far as it may be available, the type, size and depth of each well or the general specifications of any other works for the withdrawal of groundwater Two inch Pipe
- 10. The estimated amount of groundwater withdrawn each year 15,000 Gallons
- 11. The log of formations encountered in the drilling of each well if available
- 12. Such other information of a similar nature as may be useful in carrying out the policy of this act, including reference to book and page of any county record

Signature of Owner Emma E. Dupuis

Date Aug 20, 1963

STATE OF MONTANA)
COUNTY OF SILVER BOW) ss

Emma E. Dupuis having first been duly sworn, deposes and says that she is of lawful age and 15 the appropriator and claimant of the order and water right mentioned in the foregoing declaration of vested groundwater rights and the person whose name 15 subscribed thereto, as the appropriator and claimant, that she knows the contents of said foregoing notice and that the matters and things therein stated are true.

Virginia Dupuis

Subscribed and sworn to before me, this 20th day of August, 1963

Notary public for the State of Montana, residing at Butte, Montana, Commission expires 12-19-67.

548 384

City of Aug 10, 1902 203

Hayd McLee

1. No. of ...
2. ...
3. ...
4. ...
5. ...
6. ...
7. ...
8. ...
9. ...
10. ...

GW 4
Injunctive

T 1 S R 10 N
County Silver Bow

STATE OF MONTANA
ADMINISTRATOR OF GROUNDWATER CODE
OFFICE OF STATE ENGINEER

DEC 17 1963

DECLARATION OF VESTED GROUNDWATER RIGHTS
(Under Chapter 237, Montana Session Laws, 1961)

Ralph E. and Jessie N. Jensen, of Box 33, Finkle, Mont. ENGINEER
(Name of Appropriator) (Address) (Town)

County of Silver Bow, State of Montana, have appropriated groundwater according to the Montana laws in effect prior to January 1, 1962, as follows:

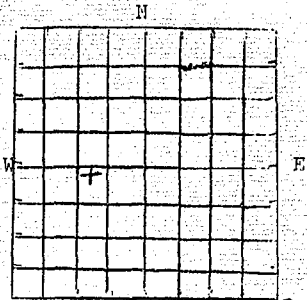

Sec 14, Sec 15 T15 R10N
Indicate point of appropriation and place of use, if possible. Each small square represents 10 acres.

- The beneficial use on which the claim is based
Home hold use & irrigation
- Date or approximate date of earliest beneficial use; and how continuous the use has been?
Oct 3, 1956 every day since
- The amount of groundwater claimed (in miner's inches or gallons per minute)
16 ft of water in 1 in pipe
- If used for irrigation, give the acreage and description of the lands to which water has been applied and name of the owner thereof
one acre
- The means of withdrawing such water from the ground and the location of each well or other means of withdrawal
jet pump
- The date of commencement and completion of the construction of the well, wells, or other works for withdrawal of groundwater
Oct 1, 1956 and Oct 3, 1956 it was completed
- The depth of water table
16 ft
- So far as it may be available, the type, size and depth of each well or the general specifications of any other works for the withdrawal of groundwater
37 ft deep
- The estimated amount of groundwater withdrawn each year
- The log of formations encountered in the drilling of each well if available
after 6 ft of sand it was solid rock
- Such other information of a similar nature as may be useful in carrying out the policy of this act, including reference to book and page of any county record

Signature of Owner

Jessie N. Jensen
Date Oct 24, 1963

STATE OF MONTANA)
COUNTY OF SILVER BOW) ss

Ralph E. Jensen having first been duly sworn, depose and say that he of lawful age and are the appropriator s and claimant s of the order and water right mentioned in the foregoing declaration of vested groundwater rights and the person s whose name are subscribed thereto, as the appropriator s and claimant s, that they know the contents of said foregoing notice and that the matters and things therein stated are true.

Margaret Jensen

Subscribed and sworn to before me, this 24 day of Oct, 1963

Notary public for the State of Montana, residing at Butte Commission expires 1/14/66

249721

544721

STATE OF MONTANA,
COUNTY OF SILVER BURDEAU } ss.

I hereby certify that the within instrument
was filed at my office on 28
day of Oct 10 00 63
at cost my fee u

Wm J. McCee

GW 2

File No.

TRIPLICATE

T 15 R 10 W 12

County Silver BowSTATE OF MONTANA
ADMINISTRATOR OF GROUNDWATER CODE
OFFICE OF STATE ENGINEER SEP 6 1963

RECEIVED

**Notice of Completion of Groundwater
Appropriation by Means of Well** ENGINEER

(Under Chapter 237, Montana Session Laws, 1961)

Top of Ground
(Elev. above sea level.....)6' surface dirt
broken rockClay bound broken rock to
30'

sand to 36 1/2 ft

Finished in coarse & fine sand

Owner Kenneth Melver Address Divide, Mont.Driller Carl E. Hollensteiner Address Dillon, MontanaDate of Notice of Appropriation of Groundwater ***Date well started Mar. 21, 1963 Date Completed Mar. 23, 1963Type of well Drilled Equipment Used Churn Drill
(dug, driven, bored or (Churn, drill, rotary or
drilled) other)Water Use: Domestic Municipal Stock Irrigation
Industrial Drainage Other

Indicate on the diagram the character and thickness of the different strata met with in drilling, such as soil, clay, shale, gravel, rock or sand, etc. Show depth at which water is encountered; thickness and character of water-bearing strata and height to which the water rises in the well.

Size of Drilled Hole	Size and Weight of Casing	From (Feet)	To (Feet)	PERFORATIONS		
				Kind Size	From (Feet)	To (Feet)
6"	6" I.D. Blk. 19 lb	surface	36 1/2	None		

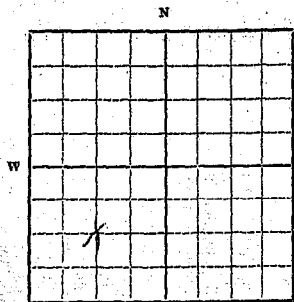
S.E. 1/4 Sec. 12 T. 15 R. 10 W.

Indicate location of well and place of use, if possible. Each small square represents 10 acres.

Show exact depth of bottom.

Static Water Level for non-flowing Well 21 feet.Shut-in Pressure for Flowing Well ***Pumping Water Level 25 feet at 25 gal. per minute.Discharge in gal. per min. of flowing well ***How Tested Slur Length of Test 1 hr

Remarks: (Gravel packing, cementing, packers, type of shutoff, location of place of use of groundwater if not at well, and any other similar pertinent information, including number of

acres irrigated, if used for irrigation)

Montana water well contractor 10
Driller's License NumberDriller's Signature
Carl E. Hollensteiner

This form to be prepared by driller, and three copies to be filed by the owner with the County Clerk and Recorder in the county in which the well is located.

Please answer all questions. If not applicable, so state; otherwise the form will be returned.

Original to the County Clerk and Recorder; duplicate to the State Engineer; Triplicate to the School of Mines and Quadruplicate for the Appropriator.

5728

OF MONTANA } ss.
OF SILVER BOW.

I hereby certify that the within instrument
was filed in my office on the 11th
day of July A. D. 1929 at
10 minutes past 1 o'clock P.
Witness my hand:

William F. Duch
County Clerk and Recorder
By E. M. [Signature]

GW 4

File No.

DUPLICATE

T 15 R 10 12
County Silver

STATE OF MONTANA
ADMINISTRATOR OF GROUNDWATER CODE
OFFICE OF STATE ENGINEER

RECEIVED
JAN 29 1962

Declaration of Vested Groundwater Rights
(Under Chapter 237, Montana Session Laws, 1961)

STATE ENGINEER

Kenneth McIvor and/or Eva McIvor

I, Kenneth McIvor and/or Eva McIvor, of _____, (Address) _____ (Town) _____
(Name of Appropriator) _____ State of _____
County of Silver have appropriated groundwater according to the Montana laws in effect prior to January 1, 1962, as follows:

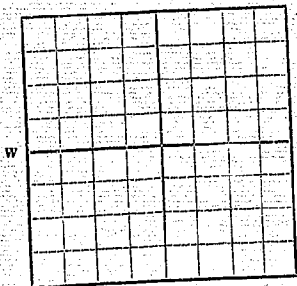

S.E. 1/4 Sec 12 T.15 S. R. 10 west

Indicate point of appropriation and place of use, if possible. Each small square represents 10 acres.

- The beneficial use on which the claim is based Household Use
- Date or approximate date of earliest beneficial use; and how continuous the use has been September 14, 1951
Continuous
- The amount of groundwater claimed (in miner's inches or gallons per minute) 10 (ten) gallon per minute
- If used for irrigation, give the acreage and description of the lands to which water has been applied and name of the owner thereof This well is also used for sprinkling system of property.
- The means of withdrawing such water from the ground and the location of each well or other means of withdrawal well pressure-type well

- The date of commencement and completion of the construction of the well, wells, or other works for withdrawal of groundwater September 14, 1951
- The depth of water table Twenty-seven Feet
- So far as it may be available, the type, size and depth of each well or the general specifications of any other works for the withdrawal of groundwater Depth of well - 30 feet. 6 inch casing.
- The estimated amount of groundwater withdrawn each year
- The log of formations encountered in the drilling of each well if available Unsat. Ala.
- Such other information of a similar nature as may be useful in carrying out the policy of this act, including reference to book and page of any county record None

Signature of Owner Eva McIvor
Kenneth McIvor

Date Jan 8 - 1962

Three copies to be filed by the owner with the County Clerk and Recorder of the county in which the well is located.

Please answer all questions. If not applicable, so state, otherwise the form will be returned.

Original to the County Clerk and Recorder; duplicate to the State Engineer; Triplicate to the School of Mines and Quadruplicate for the Appropriator.

1276

238169

STATE OF MONTANA
COUNTY OF BUTTE
I hereby certify that the above
is a true and correct copy of the
original filed at my office on the
13th day of January, 1898
Attest my hand
Hayes M. Lee

cc: Montana Mines & Geology
Butte, Montana
Mr. Wm. T. Dicklan
County Clerk & Recorder
Butte, Montana

February 14, 1962

Mr. Kenneth Melvor
Divide, Montana

Dear Mr. Melvor:

We have your letter of February 13 and have inserted ~~SR~~ in the description which had originally stated Sec. 12, T. 1 S., R. 10 W. This refers to Form GW 4 which was filed as Document 238169 in Silver Bow County on January 18.

Very truly yours,

FRED E. BUCK
STATE ENGINEER

By: C. S. Heidel
Deputy State Engineer

CSH:ba

cc: Montana Mines & Geology
Butte, Montana

Mr. Wm. T. Duckham
County Clerk & Recorder
Butte, Montana

Lincoln, Mont
Feb. 13 - 1962

Ed E. Buck,
State Engineer

RECEIVED
FEB 14 1962

S. Hiedel
Deputy State Engineer
Helena, Mont

STATE ENGINEER

Sirs,

In regard to the filing
S. E. 4 signed by Ewa & Kenneth
Dvor on January 18 - would
fill in the location, Informa-
tion, this is in the S. E. 4 of
T. 12 N. 15. R. 10 W.

Mr. Buckham's office informed
they had returned the copy
you, before I could get in, -
Butth. with the information.

Thank you.

Kenneth Mc Dvor
Lincoln Mont.

File No. _____

T. 15 R. 10 W

QUADRUPLICATE

JUN 24 1969

County Silver Bow

LOG

STATE OF MONTANA
ADMINISTRATOR OF GROUNDWATER CODE
STATE WATER CONSERVATION BOARD

Top of Ground
(Elev. above sea level _____)

Notice of Completion of Groundwater Appropriation by Means of Well DEVELOPED AFTER JANUARY 1, 1962

(Under Chapter 237 Montana Session Laws, 1961, as amended)

0-4 hand dug pit.

Owner Leroy Jensen Address Billon, Montana

Driller Carl F. Hollenstainer Address Billon, Montana

Date of Notice of appropriation of groundwater _____

4-11 silty sand

Date well started May 9, 1969 Date completed May 10, 1969

Type of well Drilled Equipment used Churn Drill
(Dug, driven, bored or drilled) (Churn drill, rotary or other)

Water use: Domestic Municipal Stock Irrigation
Industrial Drainage Other

11-22 gravel & clay

Indicate on the diagram the character and thickness of the different strata met with in drilling, such as soil, clay, shale, gravel, rock or sand, etc. Show depth at which water is encountered, thickness and character of water-bearing strata and height to which the water rises in the well.

22 boulder

22-34 very sandy clay

Size of Drilled Hole	Size and Weight of Casing	From (Feet)	To (Feet)	PERFORATIONS		
				Kind Size	From (Feet)	To (Feet)
6"	6" I.D.	3' 11" Pit	52	None		

31-53 gravel & sand

53' finished well

Hard rock at 53'

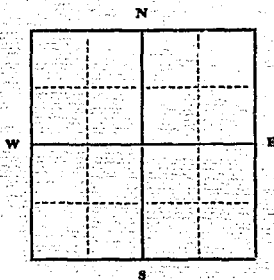

Static Water Level for non-flowing well _____ feet.

Shut-in Pressure for Flowing Well _____ feet.

Pumping Water Level _____ feet
at _____ gal. per minute.

Discharge in gal. per min. of flowing well _____

How Tested Miller

Length of Test 2 hrs

Remarks: (Gravel packing, cementing, packers, type of shutoff) _____

____ Sec. ____ T. ____ R. _____
Indicate location of well and place of use, if possible. Each small square represents 40 acres.

(Continue on reverse side)

USE—If used for irrigation, industrial, drainage or other. Explain, state number of acres and location or other data (i.e. Lot, Block and Addition).

Show exact depth of bottom.

This form to be prepared by driller, and three copies to be filed by the owner with the County Clerk and Recorder in the county in which the well is located, tissue copy to be retained by driller.

Please answer all questions. If not applicable, so state, otherwise the form will be returned.

License 14-9
Driller's License Number

Driller's Signature

45371

289058

STATE OF MONTANA
COUNTY OF SILVER BOW.

I hereby certify that the within and front page of the
copy of 8 Cal 100 D. 23688
is a true and correct copy of the original
as filed in my office.

Henry M. McDevitt
3

RECEIVED

DEC 31 1963

STATE ENGINEER

OFFICE OF STATE

OF VESTED GROUNDWATER RIGHTS
Chapter 237, Montana Session Laws, 1961

1. W. Carl Lindley, of Divide (Town)
(Name) (Address)
County of Silver Bow, State of Montana, have appropriated groundwater according to
the Montana Law in effect prior to January 1, 1962, as follows:

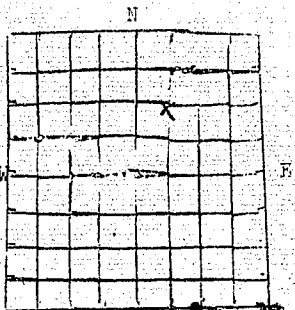

Indicate point of appropriation and place of use, if possible. Each small square represents 10 acres.

2. The beneficial use on which the claim is based Household supply (2 houses) Live Stock water, garden and lawn water

3. Date or approximate date of earliest beneficial use; and how continuous the use has been Summer 1947 - Continuous use since

4. The amount of groundwater claimed (in miner's inches or gallons per minute) 10 g.p.m.

5. If used for irrigation, give the acreage and description of the lands to which water has been applied and name of the owner thereof Lawn and garden adjacent to well approx. 1/2 acre

6. The means of withdrawing such water from the ground and the location of each well or other means of withdrawal Jet pump - electrically driven

7. The date of commencement and completion of the construction of the well, wells, or other works for withdrawal of groundwater Summer 1947

8. The depth of water table 10 ft.

9. So far as it may be available, the type, size and depth of each well or the general specifications of any other works for the withdrawal of groundwater well 40 ft. deep, 6 in. diameter casing.

10. The estimated amount of groundwater withdrawn each year 3 million gallons

11. The log of formations encountered in the drilling of each well if available Unknown

12. Such other information of a similar nature as may be useful in carrying out the policy of this act, including reference to book and page of any county record

Signature of Owner W. Carl Lindley

Date Dec. 30, 1963

STATE OF MONTANA
COUNTY OF SILVER BOW

ss W. Carl Lindley having first been duly sworn, depose and say that he of lawful age and the appropriator and claimant of the order and water right mentioned in the foregoing declaration of vested groundwater rights and the person whose name subscribed thereto, as the appropriator and claimant that he know the contents of said foregoing notice and that the matters and things therein stated are true.

Subscribed and sworn to before me, this 31 day of Dec, 1963

Notary public for the State of Montana, residing at Butte, Mont. Commission expires Aug 14, 1966

16857

257 159

STATE OF MONTANA, } ss.
COUNTY OF SILVER BOW, }

I hereby certify that the within instrument
was filed at my office on the
day of A. D. 19..... at
..... minutes past o'clock
Attest my hand:

WILLIAM E. DUCKHA
County Clerk and Recorder

[Handwritten Signature]

MONTANA

T. 15 R. 9 W 17
County SILVER BOW
RECEIVED
DEC 31 1963

OFFICE OF STATE
OF VESTED GROUNDWATER RIGHTS
Chapter 237, Montana Session Laws, 1961
STATE ENGINEER

1. Lloyd C. Brammer, of Divide
(Name) (Address) (Town)

County of Silver Bow, State of Montana, have appropriated groundwater according to the Montana law in effect prior to January 1, 1962, as follows:

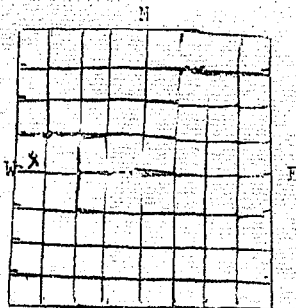

S. W. 1/4, Sec 17, T. 15 R. 9 W.
Indicate point of appropriation and place of use, if possible. Each small square represents 10 acres.

2. The beneficial use or which the claim is based
Household yard + Stock

3. Date or approximate date of earliest beneficial use; and how continuous the use has been
late 1800's Hotel yard + Stock

4. The amount of groundwater claimed (in miner's inches or gallons per minute)
500 - gal or more

5. If used for irrigation, give the acreage and description of the lands to which water has been applied and name of the owner thereof
Over an acre

6. The means of withdrawing such water from the ground and the location of each well or other means of withdrawal
Electric Pump

7. The date of commencement and completion of the construction of the well, wells, or other works for withdrawal of groundwater
late 1800's Constructed by hand

8. The depth of water table
low 18 ft

9. So far as it may be available, the type, size and depth of each well or the general specifications of any other works for the withdrawal of groundwater
5 ft. wide 22 ft. Deep

10. The estimated amount of groundwater withdrawn each year
2 million gal

11. The log of formations encountered in the drilling of each well if available
Soil - sand - gravel

12. Such other information of a similar nature as may be useful in carrying out the policy of this act, including reference to book and page of any county record

Signature of Owner Lloyd C. Brammer
Date December 30, 1963

STATE OF MONTANA)
COUNTY OF SILVER BOW) ss
Lloyd C. Brammer having first been duly sworn, depose and say that he of lawful age and the appropriator and claimant of the order and water right mentioned in the foregoing declaration of vested groundwater rights and the person whose name subscribed thereto, as the appropriator and claimant, that he know the contents of said foregoing notice and that the matters and things therein stated are true.

Leatrice U Hall
16826

Subscribed and sworn to before me, this 30th day of December, 1963
Notary public for the State of Montana, residing at Butte Montana 12/20/66

257175

STATE OF MONTANA } ss.
COUNTY OF SILVER BOW }

I hereby certify that the within instrument
was filed at my office on the 19th
day of August A. D. 1919 at
10 minutes past 10 o'clock AM
Attest my hand

WILLIAM J. BUCHANAN
County Clerk and Recorder

[Signature]
By _____ De

15-9W-17

MONTANA

RECEIVED
JAN 2 1964

OFFICE OF STATE

STATE ENGINEER

OF VESTED GROUNDWATER RIGHTS
Chapter 237, Montana Session Laws, 1961)

1. Andrew and Helen M. Johnson, of Box 35 Divide Mont
(Name) (Address) (Town)
County of Silver Bow, State of Montana, have appropriated groundwater according to
the Montana law in effect prior to January 1, 1962, as follows:

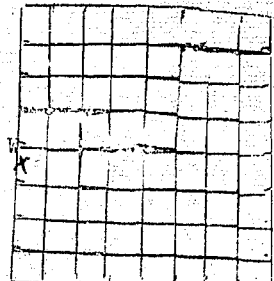

5W 17 Sec 17 T15 R9W
Indicate point of appropriation
and place of use, if possible.
Each small square represents 10
acres.

2. The beneficial use on which the claim is based
House, Garden lawn, Stock
3. Date or approximate date of earliest beneficial use; and how continuous the use has been
1944 Continuous
4. The amount of groundwater claimed (in miner's inches or gallons per minute)
20 Gallon per Minute
5. If used for irrigation, give the acreage and description of the lands to which water has been applied and name of the owner thereof

6. The means of withdrawing such water from the ground and the location of each well or other means of withdrawal
Electric pumps
7. The date of commencement and completion of the construction of the well, wells, or other works for withdrawal of groundwater
1944
8. The depth of water table
14 feet
9. So far as it may be available, the type, size and depth of each well or the general specifications of any other works for the withdrawal of groundwater
8 inch casing 48 feet deep
10. The estimated amount of groundwater withdrawn each year
1.5 million Gallons
11. The log of formations encountered in the drilling of each well if available
Sand Gravel
12. Such other information of a similar nature as may be useful in carrying out the policy of this act, including reference to book and page of any county record

Signature of Owner Helen M. Johnson
Andrew M. Johnson
Date Dec 31 1963

STATE OF MONTANA)
COUNTY OF SILVER BOW) ss

depose and say that _____ having first been duly sworn,
the appropriator _____ and claimant _____ of lawful age and _____
the foregoing declaration of vested groundwater rights and the person _____ whose name
subscribed thereto, as the appropriator _____ and claimant _____, that _____ know
the contents of said foregoing notice and that the matters and things therein stated are
true.

Notary Public for the State of Montana,
Residing at Butte, Montana.
My Commission Expires July 15, 1964.

Frank V. Hayler

Subscribed and sworn to before me, this 31st day of December, 1963
Notary public for the State of Montana, residing at 7-15-47 Commission Expires _____

18180

251 424

STATE OF MICHIGAN)
COUNTY OF SHELLENGUA) ss.

I hereby certify that the within instrument
was filed at my office on the
day of July 1963
at Shelleville in the
county of Shelleville State of Michigan
and my hand

Hayl McEa

GW 4

Sec. 17
T 1 So. R 9 West
County Silver Bow

STATE OF MONTANA
ADMINISTRATOR OF GROUNDWATER CONTROL
OFFICE OF STATE ENGINEER

RECEIVED
JAN 2 1964

DECLARATION OF VESTED GROUNDWATER RIGHTS
(Under Chapter 237, Montana Session Laws, 1962)

1. John Redmond, of Divide Mont
(Name of Appropriator) (Address) (Town)
County of Silver Bow, State of Montana, have appropriated groundwater according to
the Montana laws in effect prior to January 1, 1962, as follows:

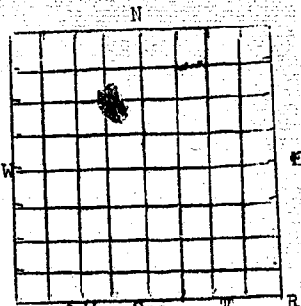

Indicate point of appropriation
and place of use, if possible.
Each small square represents 10
acres.

- 2. The beneficial use on which the claim is based
Household stock water & irrigate
- 3. Date or approximate date of earliest beneficial use; and how continuous the use has been
1954 & 1948
Yearly use
- 4. The amount of groundwater claimed (in miner's inches or gallons per minute)
2 1/2 in casings 75 gpm 40 gpm min
- 5. If used for irrigation, give the acreage and description of the lands to which water has been applied and names of the owner thereof
1/2 Acre garden & 1 room house & 1000 sq ft
SE 1/4 N 1/4 Sec 17 T 1 S R 9 W
- 6. The means of withdrawing such water from the ground and the location of each well or other means of withdrawal
Pump

- 7. The date of commencement and completion of the construction of the well, wells, or other works for withdrawal of groundwater
one well 15 yrs & one 9 yrs
- 8. The depth of water table 60 ft
- 9. So far as it may be available, the type, size and depth of each well or the general specifications of any other works for the withdrawal of groundwater
Drilled 6" casing 78 feet deep
- 10. The estimated amount of groundwater withdrawn each year 22,024,000
- 11. The log of formations encountered in the drilling of each well if available
None
- 12. Such other information of a similar nature as may be useful in carrying out the policy of this act, including reference to book and page of any county record
None

Signature of Owner John Redmond
Date Dec 30 1962

STATE OF MONTANA } ss John Redmond having first been duly sworn,
COUNTY OF SILVER BOW }
depose and say that he of lawful age and
the appropriator and claimant of the order and water right mentioned in the
foregoing declaration of vested groundwater rights and the person whose name
subscribed thereto, as the appropriator and claimant, that he know
the contents of said foregoing notice and that the matters and things therein stated are
true.
Margaret Bond

Subscribed and sworn to before me, this 17 day of DEC, 1962
Notary Public for the State of Montana,
Edmund John Mepner
My Comm. Expires January 14, 1963

251267
251367

STATE OF MONTANA
COUNTY OF SILVER BOULDER
I hereby certify that the foregoing
was filed at my office on the 31st
day of August 1963.
Attest my hand and seal this 31st day of August 1963.

E. M. Olson

T 15 R 9W 17
County SILVER BOW
RECEIVED
DEC 17 1963

STATE OF MONTANA
ADMINISTRATOR OF GROUNDWATER CODE
OFFICE OF STATE ENGINEER

DECLARATION OF VESTED GROUNDWATER RIGHTS
(Under Chapter 237, Montana Session Laws, 1961) STATE ENGINEER

1. RAPHAEL B. SHELTON, of DIVIDE
(Name of Appropriator) (Address) (Town)
County of Silver Bow, State of Montana, have appropriated groundwater according to the Montana laws in effect prior to January 1, 1962, as follows:

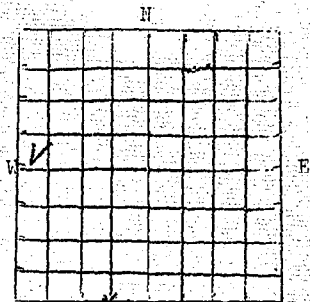

SW 1/4 Sec 17 T 15 R 9W
Indicate point of appropriation and place of use, if possible. Each small square represents 10 acres.

- 2. The beneficial use on which the claim is based
HOUSEHOLD - YARD - STOCK
- 3. Date or approximate date of earliest beneficial use; and how continuous the use has been.
NOV. 1945 - DAILY
- 4. The amount of groundwater claimed (in miner's inches or gallons per minute)
500 G.P.H.
- 5. If used for irrigation, give the acreage and description of the lands to which water has been applied and name of the owner thereof
✓
- 6. The means of withdrawing such water from the ground and the location of each well or other means of withdrawal
1/2 H.P. SET PUMP
- 7. The date of commencement and completion of the construction of the well, wells, or other works for withdrawal of groundwater
NOV. 1945 - NOV. 1945
- 8. The depth of water table
30 FT
- 9. So far as it may be available, the type, size and depth of each well or the general specifications of any other works for the withdrawal of groundwater
DRILLED - 5 3/4" CASING - 42 FT
- 10. The estimated amount of groundwater withdrawn each year
TWO MILLION GAL
- 11. The log of formations encountered in the drilling of each well if available
SOIL - SAND - GRAVEL
- 12. Such other information of a similar nature as may be useful in carrying out the policy of this act, including reference to book and page of any county record

Signature of Owner Raphael B. Shelton
Date _____

STATE OF MONTANA)
COUNTY OF SILVER BOW) ss Raphael B. Shelton, having first been duly sworn, depose and say that he of lawful age and the appropriator and claimant of the order and water right mentioned in the foregoing declaration of vested groundwater rights and the person whose name subscribed thereto, as the appropriator and claimant, that he know the contents of said foregoing notice and that the matters and things therein stated are true.

Subscribed and sworn to before me, this 5 day of December, 1966
Notary public for the State of Montana, residing at Butte Montana
Commission Expires 12/16

250 549

STATE OF MONTANA }
COUNTY OF SILVER BOW }
I hereby certify that the within instrument
was filed at my office on the 2
day of Dec A. D. 1963
45 minutes past 1
Attest my hand: _____
County of _____
Herbert T. Toland

GW 2

File No.

TRIPLICATE

MONTANA WATER RESOURCES BOARD
RECEIVED
 DEC 13 1967

T. R.

County Silver Bow

STATE OF MONTANA
 ADMINISTRATOR OF GROUNDWATER CODE
 OFFICE OF STATE ENGINEER

Notice of Completion of Groundwater Appropriation by Means of Well
 DEVELOPED AFTER JANUARY 1, 1962

(Under Chapter 237, Montana Session Laws, 1961)

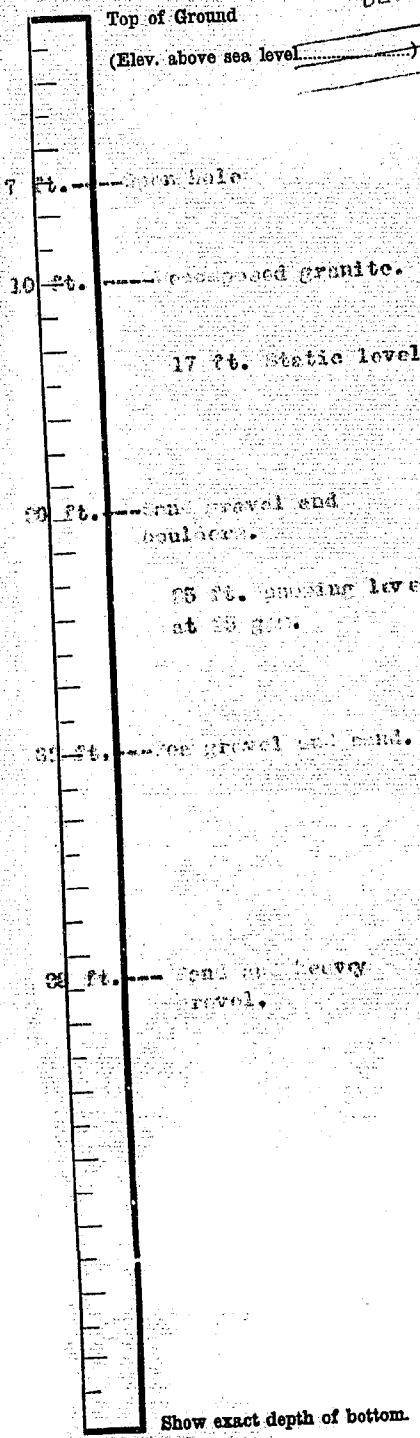

Owner Kail Address Wilde, Montana

Driller G. E. Kriebel, Jr. Address Mill Creek Road 1 Ansonia Montana

Date of Notice of appropriation of groundwater.....

Date well started August 13 1962 Date completed Aug. 24 1964

Type of well Drilled Equipment used Churn Drill
 (Dug, Driven, bored or drilled) (Churn drill, rotary or other)

Water use: Domestic Municipal Stock Irrigation
 Industrial Drainage Other

Indicate on the diagram the character and thickness of the different strata met with in drilling, such as soil, clay, shale, gravel, rock or sand, etc. Show depth at which water is encountered, thickness and character of water-bearing strata and height to which the water rises in the well.

Size of Drilled Hole	Size and Weight of Casing	From (Feet)	To (Feet)	PERFORATIONS		
				Kind Size	From (Feet)	To (Feet)
8"	28 lb.	6'	28'	None		

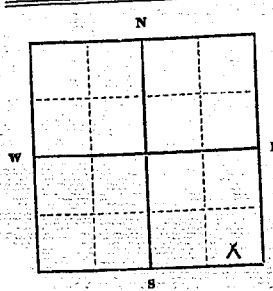

Static Water Level for non-flowing well 17' feet.

Shut-in Pressure for Flowing Well.....

Pumping Water Level 25' feet
 at 25 gal. per minute.

Discharge in gal. per min. of flowing well.....

How Tested Miller

Length of Test 2 1/2 hrs.

Remarks: (Gravel packing, cementing, packers, type of shutoff).....
1 ft. of 5" gravel pack in bottom.

.....(Continue on reverse side)

USE—If used for irrigation, industrial, drainage or other. Explain, state number of acres and location or other data (i.e.: Lot, Block and Addition).

This form to be prepared by driller, and three copies to be filed by the owner with the County Clerk and Recorder in the county in which the well is located, tissue copy to be retained by driller.

Please answer all questions. If not applicable, so state, otherwise the form will be returned.

Driller's License Number 66

Driller's Signature G. E. Kriebel, Jr.

42,680

281953

STATE OF MONTANA, } ss.
COUNTY OF SILVER BOW.

I hereby certify that the within instrument
was filed at my office on the _____ day of _____ 19__

at _____

Hayden J. Miller

GW 4

T 15 R 9W 18

County Silver Bow

STATE OF MONTANA
ADMINISTRATOR OF GROUNDWATER CODE
OFFICE OF STATE ENGINEER

RECEIVED
JAN 2 1964

DECLARATION OF VESTED GROUNDWATER RIGHTS
(Under Chapter 237, Montana Session Laws, 1961)

STATE ENGINEER

1. Otto W. Keil, of Divide Mont.
(Name of Appropriator) (Address) (Town)
County of Silver Bow, State of Montana, have appropriated groundwater according to the Montana laws in effect prior to January 1, 1962, as follows:

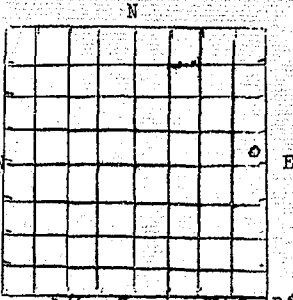

1/4 Sec 18 T15 R9W
Indicate point of appropriation and place of use, if possible. Each small square represents 10 acres.

- 2. The beneficial use on which the claim is based household
- 3. Date or approximate date of earliest beneficial use; and how continuous the use has been April 1931
- 4. The amount of groundwater claimed (in miner's inches or gallons per minute)
- 5. If used for irrigation, give the acreage and description of the lands to which water has been applied and name of the owner thereof
- 6. The means of withdrawing such water from the ground and the location of each well or other means of withdrawal electric pump

- 7. The date of commencement and completion of the construction of the well, wells, or other works for withdrawal of groundwater April 1931
- 8. The depth of water table 10 feet
- 9. So far as it may be available, the type, size and depth of each well or the general specifications of any other works for the withdrawal of groundwater
- 10. The estimated amount of groundwater withdrawn each year
- 11. The log of formations encountered in the drilling of each well if available sand and gravel
- 12. Such other information of a similar nature as may be useful in carrying out the policy of this act, including reference to book and page of any county record

Signature of Owner _____

Date _____

STATE OF MONTANA)
COUNTY OF SILVER BOW) ss

_____ having first been duly sworn, depose and say that _____ he _____ of lawful age and _____ the appropriator _____ and claimant _____ of the order and water right mentioned in the foregoing declaration of vested groundwater rights and the person _____ whose name subscribed thereto, as the appropriator _____ and claimant _____, that _____ he _____ know the contents of said foregoing notice and that the matters and things therein stated are true.

Margaret Keil

Subscribed and sworn to before me, this _____ day of _____, 19 _____

Notary public for the State of Montana, residing at _____

NOTARY PUBLIC for the State of Montana
My Commission Expires _____
15th Commission Expires January 15, 1964

1813

251250
251250

STATE OF MONTANA
COUNTY OF SILVER BOW

I hereby certify that the within instrument
was filed at my office on the 21
day of Dec A. D. 1962
11:00 minutes past noon of clock
attest my hand:

E. No. Allen

STATE PUBLISHING COMPANY

STATE OF MONTANA
 ADMINISTRATOR OF GROUNDWATER CODE
 MONTANA WATER RESOURCES BOARD

OCT 21 1971

DRILLER'S LOG

NOTICE OF COMPLETION OF GROUNDWATER
 APPROPRIATION BY MEANS OF WELL

Developed after January 1, 1962

(Under Chapter 237 Montana Session Laws, 1961, as amended)

This form to be prepared by driller, and three copies to be filed by the owner with the County Clerk and Recorder in the county in which the well is located, last copy to be retained by driller. Please answer all questions. If not applicable, so state, otherwise the form may be returned.

Owner Larry Preston

Address Divide, Montana

Date well started June 3, 1971
 completed June 8, 1971

Type of well Drilled

Equipment used Churn Drill

Water Use: Domestic Municipal Stock Irrigation
 Industrial Drainage Other Garden/Lawn

*Describe _____
 USE: If used for irrigation, industrial, drainage or other. Explain, state number of acres and location or other data (i.e. Lot, Block and Addition).

ESTIMATED ANNUAL WITHDRAWAL

Size of Drilled Hole	Size and Weight of Casing	From (Feet)	To (Feet)	PERFORATIONS		
				Kind Size	From (Feet)	To (Feet)
6"	6 5/8" od x .250	1'	77'			
	5 5/8" od x .250	74'	156'	cutting torch	149'	156'

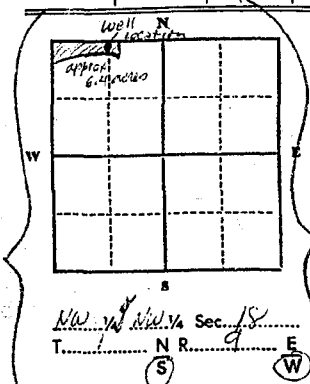

Static water level 62' ft.*
 Pumping water level 90' ft.*
 at 20 gallons per minute,
 measured _____ minutes after pumping began.
 *Measured from ground level.
 Well developed by bailing
 for 3 hours.
 Power _____ Pump _____ HP
 Remarks: (Gravel packing, cementing, packers, type of shutoff)

INDICATE LOCATION OF WELL AND PLACE OF USE, IF POSSIBLE. EACH SMALL SQUARE REPRESENTS 40 ACRES.

Driller's Signature G. Keefe Contracting Company
 Driller's Address 2804 Harvard Ave.

Butte, Montana 59701 LICENSE NO. 8

Indicate the character, color, thickness of strata such as soil, clay, sand, gravel, shale, sandstone, etc. Show depth at which water is found and height to which water rises in well.

Top of Ground (Elev. above sea level)		
From (Feet)	To (Feet)	
0'	1'	top soil
1'	09'	boulders-clay
9'	25'	sandy clay-some rock
25'	50'	cemented sand and gravel
50'	77'	boulders-gravel
77'	151'	rock-(shale)
151'	156'	sand-gravel & water

Show exact depth of bottom

44267

GW 1

File No. _____

STATE WATER CONSERVATION BOARD

T. _____ R. _____
County Silver Bow

QUADREPLICATE

DEC 12 1966

STATE OF MONTANA
ADMINISTRATOR OF GROUNDWATER CODE
OFFICE OF STATE ENGINEER

Top of Ground

(Elev. above sea level 3377)

Notice of Completion of Groundwater Appropriation by Means of Well
DEVELOPED AFTER JANUARY 1, 1962
(Under Chapter 237, Montana Session Laws, 1961)

0-22 heavy gravel & sand

Owner School Dist #1 Address Divide, Montana

Driller Carl F. Hollenstainer Address Dillon, Montana

Date of Notice of appropriation of groundwater _____

22-38 gravel & sand

Date well started Apr. 7, 1966 Date completed Apr. 8, 1966

Type of well Drilled Equipment used Churn Drill
(Dug, Driven, bored or drilled) (Churn drill, rotary or other)

Water use: Domestic Municipal Stock Irrigation
Industrial Drainage Other School Facilities

38-44 light sand

Indicate on the diagram the character and thickness of the different strata met with in drilling, such as soil, clay, shale, gravel, rock or sand, etc. Show depth at which water is encountered, thickness and character of water-bearing strata and height to which the water rises in the well.

44 finished coarse sand & gravel

Size of Drilled Hole	Size and Weight of Casing	From (Feet)	To (Feet)	PERFORATIONS		
				Kind Size	From (Feet)	To (Feet)
6"	New 6" Blk 18.97 lb seamless domestic	1 1/2' up	4 1/2 ft.	None		

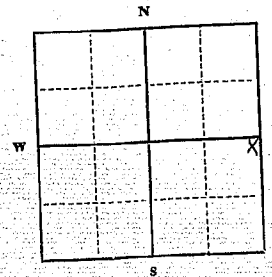

Static Water Level for non-flowing well _____ 25 feet.

Shut-in Pressure for Flowing Well _____ 45

Pumping Water Level _____ 30 feet
at _____ 20 gal. per minute.

Discharge in gal. per min. of flowing well _____ 400

How Tested Bailer

Length of Test 4 hrs

Remarks: (Gravel packing, cementing, packers, type of shutoff) _____

S.E. 1/4 Sec. 18 T. 15 R. 9W

Indicate location of well and place of use, if possible. Each small square represents 40 acres.

(Continue on reverse side)

USE—If used for irrigation, industrial, drainage or other. Explain, state number of acres and location or other data (i.e.: Lot, Block and Addition).

Show exact depth of bottom.

This form to be prepared by driller, and three copies to be filed by the owner with the County Clerk and Recorder in the county in which the well is located, tissue copy to be retained by driller.

Please answer all questions. If not applicable, so state, otherwise the form will be returned.

License No. 9
Driller's License Number

Driller's Signature

411428