

STILLWATER COUNTY
STATE OF MONTANA

File No. 186731

ADMINISTRATOR OF GROUNDWATER CODE
OFFICE OF STATE ENGINEER

Twp 1N, Rge 18 E
18 18E

DECLARATION OF VESTED GROUNDWATER RIGHTS
(Under Chapter 237, Montana Session Laws, 1961)

RECEIVED
JAN 8 1964

1. Nellie Van Oosten, of Reed Point, Montana ENGINEER,

County of Stillwater, State of Montana, have appropriated groundwater according to the Montana laws in effect prior to January 1, 1962, as follows:

1N-18E 1S-18E 1S-18E
Sec. 35 Sec. 1 Sec. 1 Sec. Sec. Sec.

WELLS	<table border="1"> <tr> <td></td> <td></td> <td>*</td> <td></td> <td></td> <td></td> </tr> <tr> <td></td> <td></td> <td></td> <td>*</td> <td></td> <td></td> </tr> <tr> <td>No. 1</td> <td>No. 2</td> <td>No. 3</td> <td>No. 4</td> <td>No. 5</td> <td>No. 6</td> </tr> </table>								*							*			No. 1	No. 2	No. 3	No. 4	No. 5	No. 6
			*																					
			*																					
No. 1	No. 2	No. 3	No. 4	No. 5	No. 6																			
2. Basis of Beneficial Use	household	livestock water	livestock water																					
3. Approx date of Use How continuous?	1917 steady	1939 steady	1960 steady																					
4. Amount claimed in miner's inches or gallons per min.	3 gals. per min.	3 gals. per min.	1000 gals. per min.																					
5. Acres irrigated Description			30 acres for future development																					
Name of Owner	Nellie VanOosten	Nellie VanOosten	Nellie VanOosten																					
6. Location of Well	SE 1/4 Sec 35 1N-18E	NE 1/4 Sec 1 1S-18E	SW 1/4 Sec 1 1S-18E																					
Means of Withdrawal	pump	pump	artesian																					
7. Date-Commencement	1917	1939	Oct. 1939																					
Date-Completion	1917	1939	Dec. 1939																					
8. Depth of water table	100 ft.	100 ft.	400 ft.																					
9. Type, size, depth or specifications of works	6"	6"	6"																					
10. Estimated amount withdrawn annually	35,000	35,000	1,000,000																					
11. Log, if available	NA	NA	NA Drilled by Belco Petroleum Co																					
12. Other information	None	None	None																					

Signature of owner Nellie Van Oosten

Date _____

Please answer all questions. If not applicable, so state, otherwise the form will be returned.

27705

186734

STATE OF MONTANA } ss.
COUNTY OF TERRY

I hereby certify that the above instr:
was filed in my office

on the 31st of December
A. D. 1913 at 11:53 A. M.

Frederick H. Carlson
County Clerk

By _____

RECEIVED

205507

3 GW 3 Revised 1969
2057-1500-1/71

SEP 27 1972

County Hill 36

MONTANA DEPARTMENT OF STATE OF MONTANA
RESOURCES ADMINISTRATION
ADMINISTRATOR OF GROUNDWATER CODE
MONTANA WATER RESOURCES BOARD

50221A

NOTICE OF COMPLETION OF GROUNDWATER APPROPRIATION WITHOUT WELL
Developed After January 1, 1962

(Under Chapter 237, Montana Session Laws, 1961, as amended)

This form to be prepared by contractor (if any), otherwise by the owner.

Three copies of this notice are to be filed with the County Clerk and Recorder of the county in which the works are located.

Please answer all questions. If not applicable, so state, otherwise the form may be returned.

For Administrator's Use

File 205507

Sept. 26, 1972 - 11:20 a.m.

GW 1 _____

Owner W. J. ...

Address ... 59069

Contractor (if any) _____

Address of Contractor _____

Date Started _____ Date Completed _____

1. Describe means of obtaining groundwater (as by sub-irrigation, developed spring, drains, etc.)

2. Means of withdrawing water (gravity, pump, canal, etc.)

3. Depth of water table

4. Use of the water

5. Amount of groundwater claimed (in miner's inches or gallons per minute)

6. If used for irrigation, give number of acres and description of land

7. Estimate amount of water used each year

8. Months of year spring flows

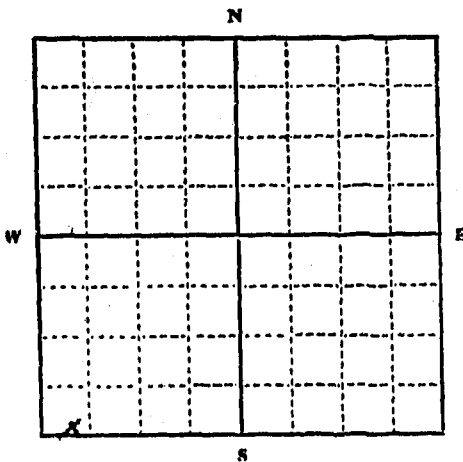

SW 1/4 Sec. 36

T. 1 N R. 14 E

INDICATE POINT OF APPROPRIATION AND PLACE OF USE, IF POSSIBLE.

Elevation of spring, if known or estimated _____

Signature of Owner W. J. ...

Date Sept. 26, 1972

LF

51,481

205507

G.W. 3

Van Coster Ranch Inc.
SW SW Sec 36-17N-18E.

STATE OF MONTANA
COUNTY OF STILLWATER

I hereby certify that the above instru-
ment was filed and indexed in this office
on the 26th day of Sept
A. D. 1957, at 11:20 o'clock A.M.

Julius Shaw
COUNTY RECORDER
By James P. Bishop Deputy

Fee 2.00

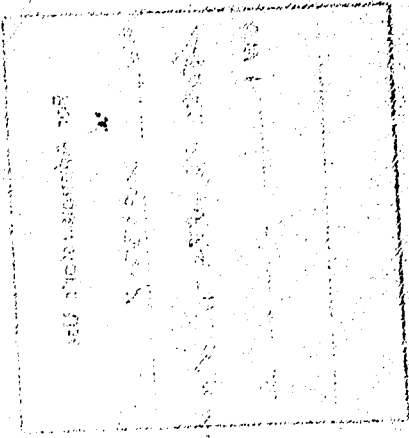

205507

RECORDED
INDEXED

STATE OF MONTANA
COUNTY OF STILLWATER

November 27, 1972

Mrs. Shirley Van Oosten, Secretary
Van Oosten Ranch Inc.
Reed Point, Montana 59069

Dear Mrs. Oosten:

This is in response to your November 20, 1972 letter requesting forms and instructions for filing on an undeveloped spring.

As stated in the form letter, which we sent you several weeks ago, a spring which is developed at its source of extrusion from the ground is considered a developed groundwater source and is therefore under the rules and regulations of Montana's 1961 Groundwater Code, which this Department administers. (A copy of that Code is enclosed for your use, as well as a copy of each type of presently available and legal groundwater right appropriation forms.)

If a spring is not developed, it is considered surface water. The State of Montana has no state administration of surface waters. The "administration" is basically up to each individual and the district courts. The district courts settle all disputes between surface water users when they arise.

Also enclosed is a pamphlet on Surface Water Rights, which would pertain to you in this particular case. We have underlined in red the areas, that specifically refer to filing surface water rights. There is no specific form, that has to be used for filing your surface water right. In many cases a lawyer draws up the appropriation for his client. Many years ago a form was prepared for use in filing surface water rights: the form is titled Notice of Appropriation. We have enclosed two copies of that form for your use. Additional copies can be purchased at most major office supply stores in Montana. When you have completed the form it is to be filed in the local County Clerk & Recorder's Office. (A xerox copy of Montana laws pertaining to appropriating surface waters is enclosed and under lined in red.)

If we can be of further service, please feel free to contact us at any time.

Sincerely,

Ronald J. Guse
Groundwater Rights Coordinator
WATER RESOURCES DIVISION

RJG:tk
Enclosures (8)

Reed Point, Montana 59069
November 20, 1972

Department of Natural Resources and Conservation
Water Resources Division
Mitchell Building
Helena, Montana

Dear Sir:

In reply to your letter about groundwater appropriation of a spring (papers enclosed), this spring has not been developed. It is being used for stock-water in its natural state. I filed at the County Clerk and Recorder's office in Columbus, Montana and this is the form they gave me. They did not inform that there was a different method for such springs.

If there are different form to be filled out, will you please send them to us, with instructions? Thank you.

Yours truly,

Shirley Van Oosten
Van Oosten Ranch Inc.
Shirley Van Oosten, Secretary

RECEIVED

NOV 21 1972

DEPARTMENT OF NATURAL
RESOURCES AND CONSERVATION

AND PLACE OF USE, IF POSSIBLE.
Elevation of spring, if known or estimated

7. Estimate amount of water used each year 200,000
8. Months of year spring flows 12

Van Oosten Ranch Inc
Signature of Owner *Shirley Van Oosten, Secy*
Date Sept. 26, 1972

L.F.

51,481

SEP 27 1972

205507

County Hillwater

MONTANA DEPARTMENT OF STATE OF MONTANA
RESOURCES / ADMINISTRATOR OF GROUNDWATER CODE
MONTANA WATER RESOURCES BOARD

NOTICE OF COMPLETION OF GROUNDWATER APPROPRIATION WITHOUT WELL
Developed After January 1, 1962

(Under Chapter 237, Montana Session Laws, 1961, as amended)

This form to be prepared by contractor (if any), otherwise by the owner.

Three copies of this notice are to be filed with the County Clerk and Recorder of the county in which the works are located.

Please answer all questions. If not applicable, so state, otherwise the form may be returned.

For Administrator's Use

File 205507

Sept. 26, 1972 - 11.20.72

GW 1

RECEIVED

NOV 24 1972

MONTANA DEPARTMENT OF STATE OF MONTANA
RESOURCES AND GROUNDWATER

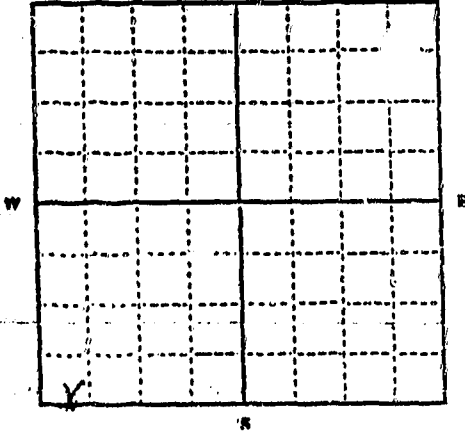

SW 1/4 SW 1/4 Sec. 36

T. 1 N. R. 18 E E

INDICATE POINT OF APPROPRIATION AND PLACE OF USE, IF POSSIBLE.
Elevation of spring, if known or estimated

Owner Van Ooster Ranch Inc.
 Address Reed Point, Mont. 59059
 Contractor (if any) none
 Address of Contractor none
 Date Started not applicable Date Completed not applicable

1. Describe means of obtaining groundwater (as by sub-irrigation, "developed spring, drains, etc.)

natural flow - undeveloped
How developed?

2. Means of withdrawing water (gravity, pump, canal, etc.)

natural flow

3. Depth of water table

not known

4. Use of the water

stock water

5. Amount of groundwater claimed (in miner's inches or gallons per minute)

10 gals per min.

6. If used for irrigation, give number of acres and description of land

not

7. Estimate amount of water used each year

200,000

8. Months of year spring flows

12

Van Ooster Ranch Inc.
 Signature of Owner by Shirley Van Ooster, Secy.
 Date Sept. 26, 1972

H.F.

51,481

STILLWATER COUNTY
STATE OF MONTANA

4-5-6-32

File No. 183691

ADMINISTRATOR OF GROUNDWATER CODE
OFFICE OF STATE ENGINEER

Twp 1 N, Rge 19 E

RECEIVED
DEC 10 1962

DECLARATION OF VESTED GROUNDWATER RIGHTS
(Under Chapter 237, Montana Session Laws, 1961)

1. Almon Williams, of Reed Point, Montana STATE ENGINEER

County of Stillwater, State of Montana, have appropriated groundwater according to the Montana laws in effect prior to January 1, 1962, as follows:

	Sec. 4	Sec. 5	Sec. 6	Sec. 32	Sec.	Sec.
	x	x	x	x		
WELLS	No. 1	No. 2	No. 3	No. 4	No. 5	No. 6
2. Basis of Beneficial Use	Stock	Stock	Stock	Stock		
3. Approx date of Use	1930	1917	1920's	1912		
How continuous?	All time	not in use since 1940	Part time	All time		
4. Amount claimed in miner's inches or gallons per min.	N.A.	N.A.	N.A.	N.A.		
5. Acres irrigated	None	None	None	None		
Description						
Name of Owner						
6. Location of Well	N $\frac{1}{2}$	NE $\frac{1}{2}$	SW $\frac{1}{2}$	SW $\frac{1}{2}$		
Means of With-drawal	Hand pump	-----	Hand Pump	Hand Pump		
7. Date-Commencement						
Date-Completion	See #3	See #3	See #3	See #3	← These are ambiguous	
8. Depth of water table	50 Ft	50 Ft	40 Ft	unknown		
9. Type, size, depth or specifications of works	drilled 6" pipe	drilled N.A.	drilled 6" pipe	drilled 6" pipe		
10. Estimated amount withdrawn annually	10,000 gal	N.A.	5,000 gal	2,000 gal		
11. Log, if available	N.A.	N.A.	N.A.	N.A.		
12. Other information						

Signature of owner Almon Williams

Date Dec. 7, 1962

Please answer all questions. If not applicable, so state, otherwise the form will be returned.

183641

Dec. of Vested Groundwater Rights

Almon Williams

Sec. 4, 5, 6, 32 - 1N - 19E

STATE OF MONTANA ss,
COUNTY OF STILLWATER

I hereby certify that the above instru-
ment was filed and indexed in this office

on the 7th day of December
A. D. 19562, at 3:00 o'clock P. M.

Gertrude H. Colman
Recorder

By Jessie Bishop Deputy

186740

Approved Stock Form—State Publishing Co., Helena, Montana—42214

File No.

T. 2N R. 19E

DUPLICATE

County Stillwater

STATE OF MONTANA
ADMINISTRATOR OF GROUNDWATER CODE
OFFICE OF STATE ENGINEER

RECEIVED
JAN 8 1964
ENGINEER

Declaration of Vested Groundwater Rights

(Under Chapter 237, Montana Session Laws, 1961)

1. Ford Brown of Reed Point, Montana
(Name of Appropriator) (Address) (Town)

County of Stillwater State of Montana
have appropriated groundwater according to the Montana laws in effect prior to January 1, 1962, as follows:

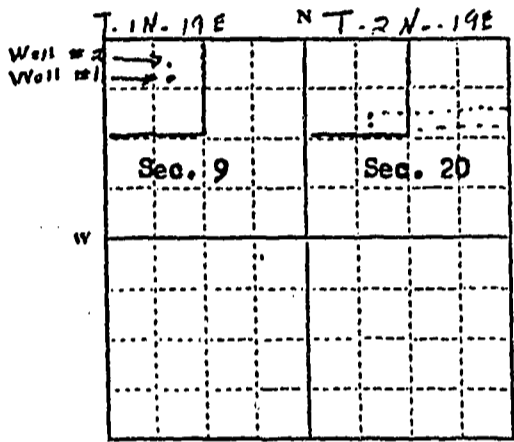

#1 & #2 NW 1/4 Sec. 9 T. 1N R. 19E

Indicate point of appropriation and place of use, if possible. Each small square represents 10 acres.
#3 & #4 NW 1/4 Sec. 20, T. 2N, R. 19E

2. The beneficial use on which the claim is based. Stock Water and Domestic Use

3. Date or approximate date of earliest beneficial use; and how continuous the use has been. 1896 continuous use since

4. The amount of groundwater claimed (in miner's inches or gallons per minute). 5 gallons per minute

5. If used for irrigation, give the acreage and description of the lands to which water has been applied and name of the owner thereof. Well #1 is used for garden and lawn sprinkling

6. The means of withdrawing such water from the ground and the location of each well or other means of withdrawal. pumps electric power

7. The date of commencement and completion of the construction of the well, wells, or other works for withdrawal of groundwater. 1896 thru 1929

8. The depth of water table. 20 feet to 110

9. So far as it may be available, the type, size and depth of each well or the general specifications of any other works for the withdrawal of groundwater.

Well No. 1 - Depth 30 feet hand dug, out put 30 gals per min.
Well No. 2 " 30 feet " " " 30 gals " "
Well No. 3 " 110 feet, sandstone formation, 10 gals per min.
Well No. 4 " 100 feet " " 30 gals per min.

10. The estimated amount of groundwater withdrawn each year.

11. The log of formations encountered in the drilling of each well if available.

12. Such other information of a similar nature as may be useful in carrying out the policy of this act, including reference to book and page of any county record.

Signature of Owner Ford Brown

Date 12-30-1963

Three copies to be filed by the owner with the County Clerk and Recorder of the county in which the well is located.

Please answer all questions. If not applicable, so state, otherwise the form will be returned.

Original to the County Clerk and Recorder; Duplicate to the State Engineer; Triplicate to the Montana Bureau of

GW 3

File No. 126768

DUPLICATE

Approved Stock Form—State Publishing Co., Helena, Montana—42199

T. 19E R. 20E
County Stillwater

JAN 8 1964

STATE OF MONTANA
ADMINISTRATOR OF GROUNDWATER CODE
OFFICE OF STATE ENGINEER

STATE ENGINEER

Notice of Completion of Groundwater Appropriation
Without Well

(Under Chapter 237 Montana Session Laws, 1961)

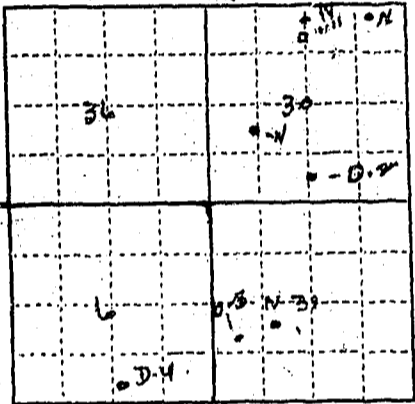
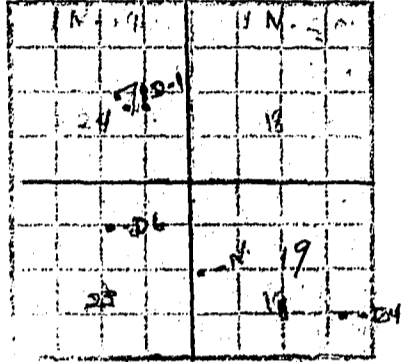

Date of Appropriation of Groundwater 1950

Owner C. L. Pelton Address Absarokee

Contractor (if any) none

Address of Contractor

Date Started Date Completed

Describe means of obtaining groundwater without a well "as by sub-irrigation and other natural processes". Include depth to water when applicable. D-1, D-2, D-4, D-5, D-7 all these springs are cemented and running into tank

D-3 & D-6, are developed into dams.

Quantity of water developed and used with explanation of method used to measure or estimate such amount. If use is intermittent

estimate approximate lengths of periods of use.

D-1 - 1500 gal per day, D-2 - 1000 gal per day
D-3 - 1500 gal per day, D-4 - 1500 gal per day.
D-5 - 1000 gal per day, D-6 - 2000 gal per day
D-7 - 3000 gal per day

Used for stock water

Signature of Owner C. L. Pelton

Date 12.31.63

1/4 Sec. T. R.

Indicate point of appropriation and place of use, if possible.

This form to be prepared by contractor (if any), otherwise by the owner.

Three copies of this notice are to be filed with the County Clerk and Recorder of the county in which the works are located.

Please answer all questions. If not applicable, so state, otherwise the form will be returned.

Original to the County Clerk and Recorder; duplicate to the State Engineer; Triplicate to the Montana Bureau of Mines and Geology and Quadruplicate for the Appropriator.

27737

186768

STATE OF MONTANA ss.
COUNTY OF TILLWATER

I hereby certify that the above instru-
ment was filed in my office
on the 31st of December

at 6:30 P.M.

Gertrude H. Carlson
COUNTY RECORDER

By _____ Deputy

File No. 10-180700

T. 38 20E

N. 29E 19E

County Stillwater

DUPLICATE

STATE OF MONTANA
ADMINISTRATOR OF GROUNDWATER CODE
OFFICE OF STATE ENGINEER

RECEIVED
JAN 8 1964
ENGINEER

Declaration of Vested Groundwater Rights
(Under Chapter 237, Montana Session Laws, 1961)

1. C. R. Bokma, of Columbus
(Name of Appropriator) (Address) (Town)

County of Stillwater State of Montana
have appropriated groundwater according to the Montana laws in effect prior to January 1, 1962, as follows:

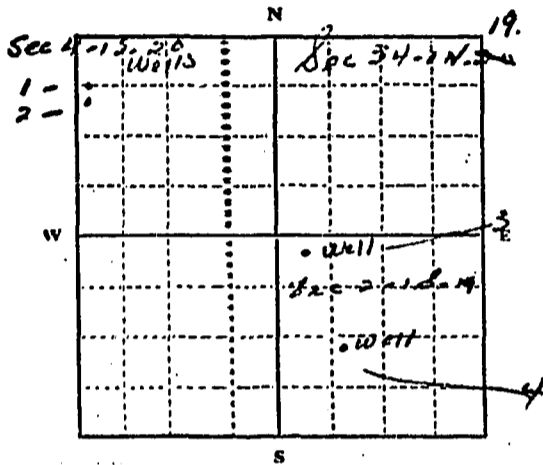

1/4 Sec T R.

Indicate point of appropriation and place of use, if possible. Each small square represents 10 acres.

2. The beneficial use on which the claim is based Stockwater

3. Date or approximate date of earliest beneficial use; and how continuous the use has been Prior to 1942
kept for reserve water

4. The amount of groundwater claimed (in miner's inches or gallons per minute) 1 miner's inch for each well

5. If used for irrigation, give the acreage and description of the lands to which water has been applied and name of the owner thereof
none

6. The means of withdrawing such water from the ground and the location of each well or other means of withdrawal
pumps

7. The date of commencement and completion of the construction of the well, wells, or other works for withdrawal of groundwater Unknown - early 1900's

8. The depth of water table 65' for #1,2,3; #4 - 215'

9. So far as it may be available, the type, size and depth of each well or the general specifications of any other works for the withdrawal of groundwater 1,2,3 are approx 90' deep
#4 - 250' deep All are drilled wells
#1 - concrete casing 2' #2 - 6" galv casing
#3 - 4" galv casing #3 - 7" steel casing

10. The estimated amount of groundwater withdrawn each year 360 miner's inches

11. The log of formations encountered in the drilling of each well if available
NA

12. Such other information of a similar nature as may be useful in carrying out the policy of this act, including reference to book and page of any county record
None

Signature of Owner C. R. Bokma

Date 12-31-63

Three copies to be filed by the owner with the County Clerk and Recorder of the county in which the well is located.

Please answer all questions. If not applicable, so state, otherwise the form will be returned.

Original to the County Clerk and Recorder; Duplicate to the State Engineer; Triplicate to the Montana Bureau of Mines and Geology, and Quadruplicate for the Appropriator.

27700

STILLWATER COUNTY
STATE OF MONTANA

File No. 186483 ADMINISTRATOR OF GROUNDWATER CODE
OFFICE OF STATE ENGINEER

1 North
Twp _____, Rge 20 E. E

DECLARATION OF VESTED GROUNDWATER RIGHTS
(Under Chapter 237, Montana Session Laws, 1961)

RECEIVED
DEC 20 1963

1. Julia Haehner et al by Ernest Lutgen, Renter of Rapelje STATE ENGINEER

County of Stillwater, State of Montana, have appropriated groundwater according to the Montana laws in effect prior to January 1, 1962, as follows:

1 North 20 E.

WELLS	Sec. 1	Sec.	Sec.	Sec.	Sec.	Sec.
	No. 1	No. 2	No. 3	No. 4	No. 5	No. 6
2. Basis of Beneficial Use	Stock water					
3. Approx date of Use	Sept 1961					
How continuous?	continuous					
4. Amount claimed in miner's inches or gallons per min.	10 gal per min					
5. Acres irrigated	none					
Description						
Name of Owner	see above					
6. Location of Well	SE 1/4					
Means of Withdrawal	Elec pump jack					
7. Date-Commencement	Sept 1961					
Date-Completion	Sept 1961					
8. Depth of water table	35'					
9. Type size, depth of specifications of works	140' deep 126' 6" galv casing					
10. Estimated amount withdrawn annually	350,000					
11. Log, if available	1-10 Clay & rock 10-25 Brown clay 25 - 35 grey shale 35 - 50 grey rock 50- 140 grey shale					
12. Other information						

Ernest Lutgen for Ernest Lutgen
Signature of owner Julia Haehner et al

Date December 29th 1963

Please answer all questions. If not applicable, so state, otherwise the form will be returned.

11023

186483

STATE OF MONTANA }
COUNTY OF STILLWATER }^{SS.}

I hereby certify that the above instru-
ment was filed and indexed in this office
on the 19th day of December
A. D. 1963, at 10:30 o'clock A. M.

Gertrude H Calhoun
COUNTY RECORDER

By Juⁿ 20 Deputy

W 3
File No. **185221**

T. **T1N** R. **R20E**

DUPLICATE

County **Stillwater**

**STATE OF MONTANA
ADMINISTRATOR OF GROUNDWATER CODE
OFFICE OF STATE ENGINEER**

RECEIVED
JUL 17 1963

STATE ENGINEER

**Notice of Completion of Groundwater Appropriation
Without Well**

(Under Chapter 237 Montana Session Laws, 1961)

Date of Appropriation of Groundwater **June 15th, 1950**
Owner **Elmer & Selma Hillman** Address **Columbus, Montana**
Contractor (if any) **None**
Address of Contractor **None**
Date Started **June 1st, 1950** Date Completed **June 15th, 1950**

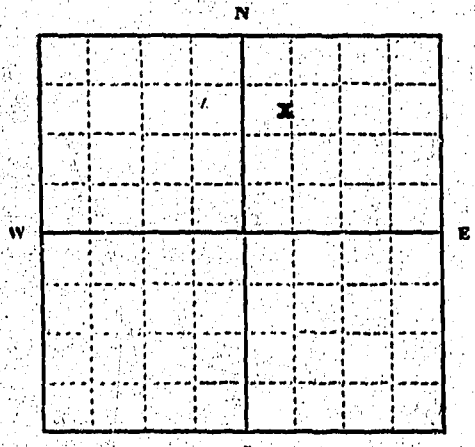

SW 1/4 of NE 1/4 of Sec. 5 T1N R20E
Indicate point of appropriation and place of use, if possible.

Describe means of obtaining groundwater without a well "as by sub-irrigation and other natural processes". Include depth to water when applicable. **This is a spring -**

Dug out and piped out

Quantity of water developed and used with explanation of method used to measure or estimate such amount. If use is intermittent

estimate approximate lengths of periods of use. **This runs a stream about size of lead pencil and is piped into a tank for use year around for stock water.**

Signature of Owner **Elmer Hillman**

Date **July 15th, 1963**

This form to be prepared by contractor (if any), otherwise by the owner.
Three copies of this notice are to be filed with the County Clerk and Recorder of the county in which the works are located.
Please answer all questions. If not applicable, so state, otherwise the form will be returned.
Original to the County Clerk and Recorder; duplicate to the State Engineer; Triplicate to the Montana Bureau of Mines and Geology and Quadruplicate for the Appropriator.

185221

STATE OF MONTANA
COUNTY OF STILLWATER

I hereby certify that the above instrument was filed and indexed in this office on the 11th day of July A. D. 1962 at 2:50 o'clock P.M.

Gertrude H. Culhouse
COUNTY RECORDER

By _____ Deputy

JW 3 186603
File No. 186603

8-9-17-20
Approved Stock Form—State Publishing Co., Helena, Montana—42199

T. 11 N. R. 20 E. S. 9
County Stillwater

DUPLICATE

STATE OF MONTANA
ADMINISTRATOR OF GROUNDWATER CODE
OFFICE OF STATE ENGINEER

RECEIVED
JAN 8 1964

Notice of Completion of Groundwater Appropriation
Without Well

(Under Chapter 237 Montana Session Laws, 1961)

Date of Appropriation of Groundwater 1950
George & Alice Lindemulder
Owner Address Columbus

Contractor (if any) None

Address of Contractor

Date Started Date Completed

Describe means of obtaining groundwater without a well "as by sub-irrigation and other natural processes". Include depth to water when applicable.

No. 1 concrete piped in to house

Balance are natural flowing springs

Quantity of water developed and used with explanation of method used to measure or estimate such amount. If use is intermittent

estimate approximate lengths of periods of use

Approx 1000 gallons per day

Natural flowing springs are used only

fair

Signature of Owner George Lindemulder
Alice Lindemulder

Date December 30th, 1953

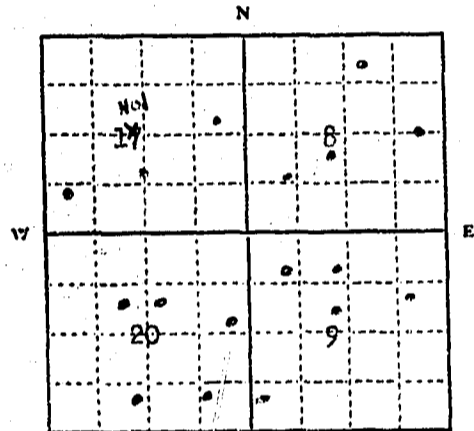

Thruout sections 17, 20, 8 & 9
1/4 Sec. T. 11 N. R. 20 E.

Indicate point of appropriation and place of use, if possible.

This form to be prepared by contractor (if any), otherwise by the owner.

Three copies of this notice are to be filed with the County Clerk and Recorder of the county in which the works are located.

Please answer all questions. If not applicable, so state, otherwise the form will be returned.

Original to the County Clerk and Recorder; duplicate to the State Engineer; Triplicate to the Montana Bureau of Mines and Geology and Quadruplicate for the Appropriator.

186603
File No. 186603

8-9-17-20
Approved Stock Form—State Publishing Co., Helena, Montana—42199

T. 116 R. 20 S. 14. P.M.

DUPLICATE

County Stillwater

STATE OF MONTANA
ADMINISTRATOR OF GROUNDWATER CODE
OFFICE OF STATE ENGINEER

RECEIVED
JAN 8 1964

Notice of Completion of Groundwater Appropriation Without Well

(Under Chapter 237, Montana Session Laws, 1961)

Date of Appropriation of Groundwater 1950

George & Alice Lindemulder
Owner Address Columbus

Contractor (if any) None

Address of Contractor

Date Started Date Completed

Describe means of obtaining groundwater without a well as by sub-irrigation and other natural processes. Include depth to water when applicable.

No. 1. Concrete & piped in to house
balance are natural flowing springs

Quantity of water developed and used with explanation of method used to measure or estimate such amount. If use is intermittent

estimate approximate lengths of periods of use.

No. Approx 1000 gallons per day

Natural flowing springs are some good, some only fair

Signature of Owner *George Lindemulder*
Alice Lindemulder

Date December 30th, 1963

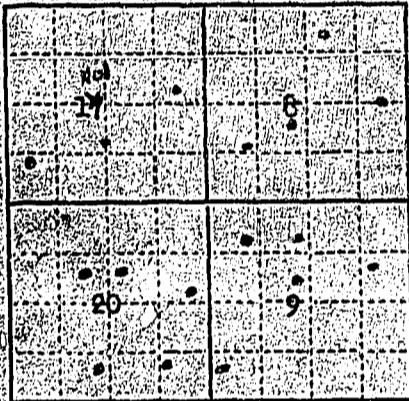

Thruout sections 17, 20, 8 & 9

1/4 Sec. T. 116 R. 20 E.

Indicate point of appropriation and place of use, if possible.

This form to be prepared by contractor (if any), otherwise by the owner.

Three copies of this notice are to be filed with the County Clerk and Recorder of the county in which the works are located.

Please answer all questions. If not applicable, so state, otherwise the form will be returned.

Original to the County Clerk and Recorder; duplicate to the State Engineer; Triplicate to the Montana Bureau of Mines and Geology and Quadruplicate for the Appropriator.

186603

STATE OF MONTANA
COUNTY OF STILLWATER

I hereby certify that the above instru-
ment was filed and indexed in his office
on the 30th day of December
A. D. 1963, at 1:57 o'clock P. M.

Gertrude H. Colburn
COUNTY RECORDER

By _____ Deputy

File No. 193857

JAN 16 1967

T. 1N R. 20E

DUPLICATE

Billie _____ McDermott _____ County S. Yellowstone
Butzeria _____ McNulty _____
Coyle _____
Dadinton _____
McNulty _____
ADMINISTRATOR OF GROUNDWATER CODE
OFFICE OF STATE ENGINEER

LOG

Top of Ground 0-25 heavy Top soil
2-10 Hard shale
(Elev. above sea level) 6-10 Soft shale

Notice of Completion of Groundwater Appropriation by Means of Well DEVELOPED AFTER JANUARY 1, 1962

(Under Chapter 237, Montana Session Laws, 1961)

Owner: George Lindemulda address: Calumbus, Montana

Driller: R.H. Drilling Address: Fish Lake, Montana

Date of Notice of appropriation of groundwater: _____

Date well started: 12/15/66 Date completed: 12/19/66

Type of well: _____ Equipment used: _____
(Dug, Driven, bored or drilled) (Churn drill, rotary or other)

Water use: Domestic Municipal Stock Irrigation
Industrial Drainage Other

Indicate on the diagram the character and thickness of the different strata met with in drilling, such as soil, clay, shale, gravel, rock or sand, etc. Show depth at which water is encountered, thickness and character of water-bearing strata and height to which the water rises in the well.

Size of Drilled Hole	Size and Weight of Casing	From (Feet)	To (Feet)	PERFORATIONS		
				Kind Size	From (Feet)	To (Feet)
6 inch	6 5/8	1+	10 1/2			
	17 1/2					
	4 1/2 Plate	5-	135	3/16 Hole	130	130

71-125 Grey shale

water
125-133 Sandy shale
133-135 Hard shale

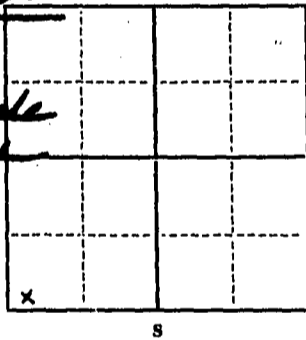

Static Water Level for non-flowing well _____ feet. 50

Shut-in Pressure for Flowing Well _____

Pumping Water Level 12.5 feet at 9 gal. per minute.

Discharge in gal. per min. of flowing well _____

How Tested: Bailer

Length of Test: 2 hrs

Remarks: (Gravel packing, cementing, packers, type of shut-off) _____

SW 1/4 Sec. 9 T. 1N. R. 20E
Indicate location of well and place of use, if possible. Each small square represents 40 acres.

(Continue on reverse side)

USE—If used for irrigation, industrial, drainage or other. Explain, state number of acres and location or other data (i.e.: Lot, Block and Addition).

Show exact depth of bottom.

135 ft.

This form to be prepared by driller, and three copies to be filed by the owner with the County Clerk and Recorder in the county in which the well is located, tissue copy to be retained by driller.

Please answer all questions. If not applicable, so state, otherwise the form will be returned.

NO 27
Driller's License Number

Red L. Hanzey
Driller's Signature

41659

STATE OF MONTANA (ss.
COUNTY OF STILLWATER)

I hereby certify that the above instrument was filed and indexed in this office on the 13th day of January, A. D. 1927, at 2:00 o'clock P.M.

By Shelma Shaw COUNTY RECORDER
Deputy

6

RECORDED AND INDEXED

5

STATE OF MONTANA (ss.
COUNTY OF STILLWATER)

I hereby certify that the above instrument was filed and indexed in this office on the 13th day of January, A. D. 1927, at 2:00 o'clock P.M.

By Shelma Shaw COUNTY RECORDER
Deputy

DATE	FILE NO.	INDEXED	RECORDED	INDEXED	RECORDED
1/13/27	281-11				
1/13/27	281-11				
1/13/27	281-11				
1/13/27	281-11				
1/13/27	281-11				

Handwritten notes in the table include: "281-11", "281-11", "281-11", "281-11", "281-11".

INDEXED
RECORDED

STILLWATER COUNTY
STATE OF MONTANA

File No. 186628

ADMINISTRATOR OF GROUNDWATER CODE
OFFICE OF STATE ENGINEER

Twp 1N, Rge 20E

DECLARATION OF VESTED GROUNDWATER RIGHTS
(Under Chapter 237, Montana Session Laws, 1961)

RECEIVED
JAN 8 1962
STATE ENGINEER

1. Katherine McKeith, of Reed Point

County of Stillwater, State of Montana, have appropriated groundwater according to the Montana laws in effect prior to January 1, 1962, as follows:

WELLS	Sec. 12	Sec.	Sec.	Sec.	Sec.	Sec.
	No. 1	No. 2	No. 3	No. 4	No. 5	No. 6
2. Basis of Beneficial Use	House					
3. Approx date of Use How continuous?	year Planned					
4. Amount claimed in miner's inches or gallons per min.	10 gallons per minute					
5. Acres irrigated Description Name of Owner	none					
6. Location of Well Means of Withdrawal	NE 1/4 Pump					
7. Date-Commencement Date-Completion	1912					
8. Depth of water table	19 1/2 ft.					
9. Type, size, depth or specifications of works	diag 14ft					
10. Estimated amount withdrawn annually	100,000					
11. Log, if available	none					
12. Other information	none					

Signature of owner Katherine M Keith
Date Dec 9 1963

Please answer all questions. If not applicable, so state, otherwise the form will be returned.

27602

186629

STATE OF MONTANA, ss.
COUNTY OF STILLWATER

I hereby certify that the above instru-
ment was filed and indexed in this office
on the 30th day of December
A. D. 1963, at 2:15 o'clock P. M.

Gertrude H. Calhoun
COUNTY CLERK

By _____ Deputy

186767

STILLWATER COUNTY
STATE OF MONTANA

File No. _____ ADMINISTRATOR OF GROUNDWATER CODE
OFFICE OF STATE ENGINEER

Twp. 1N, Rge. 20 E

30/31

DECLARATION OF VESTED GROUNDWATER RIGHTS JAN 8 1964
(Under Chapter 237, Montana Session Laws, 1961)

STATE ENGINEER

1. C. L. Pelton, of Absarokee, Montana

County of Stillwater, State of Montana, have appropriated groundwater according to the Montana laws in effect prior to January 1, 1962, as follows:

	Sec. 30	Sec. 31	Sec.	Sec.	Sec.	Sec.
WELLS	No. 1	No. 2	No. 3	No. 4	No. 5	No. 6
2. Basis of Beneficial Use	Stock use	Domestic & Livestock				
3. Approx date of Use	1961	1947				
How continuous?	not in use	continuous				
4. Amount claimed in miner's inches or gallons per min.	20 gal per min	50 gal per min				
5. Acres irrigated	none	yard & garden				
Description						
Name of Owner		see above				
6. Location of Well	NWNE	SESE				
Means of Withdrawal	elec pump	elec pump				
7. Date-Commencement	dont know	1947				
Date-Completion						
8. Depth of water table	75'	40'				
9. Type, size, depth or specifications of works	drilled well 100' ft deep 6" casing	drilled well 65' deep 6" casing				
10. Estimated amount withdrawn annually	not in use now	300,000				
11. Log, if available	NA	NA				
12. Other information	none	None				

Signature of owner C. L. Pelton

Date 12/31/63

Please answer all questions. If not applicable, so state, otherwise the form will be returned.

27736

186767

STATE OF MONTANA }
COUNTY OF STILLWATER } ss.

I hereby certify that the above instru-
ment was filed in my office

on the 31st day of December

1963, at 3:37 o'clock P.M.

Gertrude H. Carlson

COUNTY CLERK

By _____ Deputy

RECEIVED
MAR 16 1960

T. 1 North R. 21 East 2

County Stillwater

STATE ENGINEER MONTANA BUREAU OF MINES AND GEOLOGY
Butte, Montana

WATER WELL LOG

Owner Lyle Nordahl Address Holt

Driller Albert Heck Address Harlowton Montana

Date Started January 24 1960 Date Completed Jan 26th, 1960

Location: Sec. 2 T. 1N R. 21 E 1/4 sec. NW 1/4

Type of well Drilled Equipment used Cable tool
(Dug, driven, bored, or drilled) (Churn drill, rotary, other)

Water use: Domestic Municipal Stock Irrigation

Industrial Drainage Other: _____

Casing: 1 ft. to 15 ft. Type Iron Size 8 1/2

Casing: _____ ft. to _____ ft. Type _____ Size _____

Casing: _____ ft. to _____ ft. Type _____ Size _____

Perforated or Screened: Ft. _____ to ft. _____ Ft. _____ to ft. _____

Type of screen or perforations _____

Static Water level, for non-flowing well: _____ 15 feet.

Shut-in pressure, for flowing well: _____ lb./sq. in. on: _____ (date)

Pumping water level: 15 feet at 30 gal. per min. 30

How tested: Baler

Length of test: 4 hours

Remarks: (Gravel packing, cementing, packers, type of shut-off, depth of shut-off)



(over)

STILLWATER COUNTY
STATE OF MONTANA

File No. 18572 ADMINISTRATOR OF GROUNDWATER CODE #1 & 2 Twp 2N, Rge 21 E

OFFICE OF STATE ENGINEER
DECLARATION OF VESTED GROUNDWATER RIGHTS
(Under Chapter 237, Montana Session Laws, 1961)

3 TWP 2N Rge 21E
RECEIVED
OCT 4 1963

1. Paul Wunderlin, of Potosi, Wisc STATE ENGINEER
Stillwater County of ~~Stillwater~~, State of Montana, have appropriated groundwater according to the Montana laws in effect prior to January 1, 1962, as follows:

	Sec. 34	Sec. 34	Sec. 3	Sec.	Sec.	Sec.
	X	X	X			
WELLS	No. 1	No. 2	No. 3	No. 4	No. 5	No. 6
2. Basis of Beneficial Use	Stock	House	Stock			
3. Approx date of Use	1955	1955	1951			
How continuous?	Cont.	Cont.	Cont.			
4. Amount claimed in miner's inches or gallons per min.	50 gal	3 gal	6 gal			
5. Acres irrigated	N.A.	N.A.	N.A.			
Description	N.A.	N.A.	N.A.			
Name of Owner	Paul Wunderlin					
6. Location of Well	SW $\frac{1}{4}$	SW $\frac{1}{4}$	SW $\frac{1}{4}$			
Means of Withdrawal	Pump & cylinder	Pressure Pump	Windmill & Pump			
7. Date-Commencement	1955	1955	Approx 1951			
Date-Completion	"	"	"			
8. Depth of water table	40	60	37			
9. Type size, depth of specifications of works	6 in case	6 in case	6 in			
10. Estimated amount withdrawn annually	150,000	250,000	100,000			
11. Log, if available	L. E. Anderson of Billings drilled wells 1 & 2					
12. Other information						

Signature of owner Paul Wunderlin
Date Sept 30 - 63

Please answer all questions. If not applicable, so state, otherwise the form will be returned.

6227

RECEIVED

FEB 16 1959

STATE ENGINEER

MONTANA BUREAU OF MINES AND GEOLOGY
Butte, Montana

T. 1N R. 21E 3
County Stillwater

WATER WELL LOG

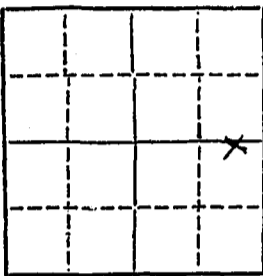

Owner Lyle Nordahl Address Molt, Mont.
Driller Albert Heck Address Harrison, Mont.
Date Started Jan 15 Date Completed Jan 19
Location: Sec. 3 T. 1N R. 21E 1/4 sec. SE

Type of well Drilled Equipment used Cable Tool
(Dug, driven, bored, or drilled) (Churn drill, rotary, other)

Water use: Domestic Municipal Stock Irrigation
Industrial Drainage Other: _____

Casing: 1 ft. to 47 ft. Type Galvanized Size 6" O.D.
Casing: _____ ft. to _____ ft. Type _____ Size _____
Casing: _____ ft. to _____ ft. Type _____ Size _____

Perforated or Screened: Ft. _____ to ft. _____ Ft. _____ to ft. _____

Type of screen or perforations _____

Static Water level, for non-flowing well: _____ 20 feet.

Shut-in pressure, for flowing well: _____ lb./sq. in. on: _____ (date)

Pumping water level: 30 feet at 7 gal. per min. 7

How tested: Pulley

Length of test: 3 Hours

Remarks: (Gravel packing, cementing, packers, type of shut-off, depth of shut-off)

RECEIVED
FEB 16 1959

STATE ENGINEER

MONTANA BUREAU OF MINES AND GEOLOGY
Butte, Montana

T. 1N R. 21E 3
County Stillwater

WATER WELL LOG

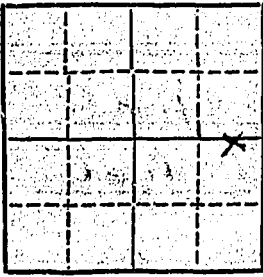

Owner Lyle Nordahl Address Molt Mat
Driller Albert Heck Address Harbortown, Mont
Date Started Jan 15 Date Completed Jan 19
Location: Sec. 3 T. 1N R. 21E $\frac{1}{4}$ sec. SE

Type of well Drilled Equipment used Cable Tool
(Dug, driven, bored, or drilled) (Churn drill, rotary, other)

Water use: Domestic Municipal Stock Irrigation
Industrial Drainage Other: _____

Casing: 1 ft. to 4 7/8 ft. Type Galv. Size 6 1/2 O.D.
Casing: _____ ft. to _____ ft. Type _____ Size _____
Casing: _____ ft. to _____ ft. Type _____ Size _____

Perforated or Screened: Ft. _____ to ft. _____ Ft. _____ to ft. _____

Type of screen or perforations: _____

Static Water level, for non-flowing well: _____ 20 feet.

Shut-in pressure, for flowing well: _____ lb./sq. in. on: _____ (date)

Pumping water level: 30 feet at _____ 7 gal. per min. 7

How tested: Baler

Length of test: 3 Hours

Remarks: (Gravel packing, cementing, packers, type of shut-off, depth of shut-off)

(over)

File No. **204671**

RECEIVED

T. **1N** R. **21E**

DUPLICATE

MAY 30 1972

County **Stillwater**

LOG MONTANA DEPARTMENT OF NATURAL RESOURCES AND CONSERVATION STATE OF MONTANA ADMINISTRATOR OF GROUNDWATER CODE STATE WATER CONSERVATION BOARD



Top of Ground (Elev. above sea level.....)

Notice of Completion of Groundwater Appropriation by Means of Well DEVELOPED AFTER JANUARY 1, 1962

(Under Chapter 237 Montana Session Laws, 1961, as amended)

Owner **Leonard Lutgen** Address **Rapelje, Mont.**

Driller..... Address.....

Date of Notice of appropriation of groundwater **5-23-72**

Date well started **1914** Date completed.....

Type of well **Drilled** Equipment used **cable**
(Dug, driven, bored or drilled) (Churn drill, rotary or other)

Water use: Domestic Municipal Stock Irrigation
Industrial Drainage Other

Indicate on the diagram the character and thickness of the different strata met with in drilling, such as soil, clay, shale, gravel, rock or sand, etc. Show depth at which water is encountered, thickness and character of water-bearing strata and height to which the water rises in the well.

Size of Drilled Hole	Size and Weight of Casing	From (Feet)	To (Feet)	PERFORATIONS		
				Kind Size	From (Feet)	To (Feet)
6"	5"	100'	deep			

STATE OF MONTANA (ss. COUNTY OF STILLWATER)

I hereby certify that the above instrument was filed and indexed in this office

on the day of **MAY 23** 1972 A. D. 195 , at **4:30** o'clock **P.M.**

Shelma G. Kress
COUNTY RECORDER
Deputy

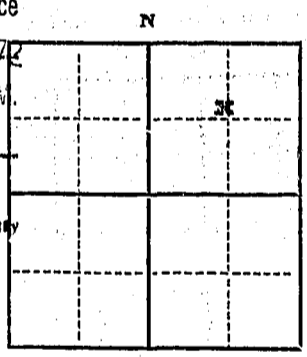

1/4 Sec. **4** T. **1N** R. **21E**
Indicate location of well and place of use, if possible. Each small square represents 40 acres.

Static Water Level for non-flowing wellfeet.
Shut-in Pressure for Flowing Well.....
Pumping Water Level **60'** feet
at **3 gal.** gal. per minute.
Discharge in gal. per min. of flowing well
How Tested.....
Length of Test.....
Remarks: (Gravel packing, cementing, packers, type of shutoff).....

.....(Continue on reverse side)

USE—If used for irrigation, industrial, drainage or other. Explain, state number of acres and location or other data (i.e.: Lot, Block and Addition).

Show exact depth of bottom.

This form to be prepared by driller, and three copies to be filed by the owner with the County Clerk and Recorder in the county in which the well is located, tissue copy to be retained by driller.

Please answer all questions. If not applicable, so state, otherwise the form will be returned.

Driller's License Number

Driller's Signature

59,473

File No.

MAY 30 1972

T.

DUPLICATE

7

County Stillwater

LOG MONTANA DEPARTMENT OF NATURAL RESOURCES AND CONSERVATION STATE OF MONTANA ADMINISTRATOR OF GROUNDWATER CODE STATE WATER CONSERVATION BOARD

Top of Ground

(Elev. above sea level 4450)

Notice of Completion of Groundwater Appropriation by Means of Well

DEVELOPED AFTER JANUARY 1, 1962

(Under Chapter 237 Montana Session Laws, 1961, as amended)

Owner Leonard Lutgen Address Rapelje, Mont.

Driller Address

Date of Notice of appropriation of groundwater 5-23-72

Date well started 1914 Date completed 1914

Type of well Drilled Equipment used cable
(Dug, driven, bored or drilled) (Churn drill, rotary or other)

Water use: Domestic Municipal Stock Irrigation
Industrial Drainage Other

Indicate on the diagram the character and thickness of the different strata met with in drilling, such as soil, clay, shale, gravel, rock or sand, etc. Show depth at which water is encountered, thickness and character of water-bearing strata and height to which the water rises in the well.

Size of Drilled Hole	Size and Weight of Casing	From (Feet)	To (Feet)	PERFORATIONS		
				Kind Size	From (Feet)	To (Feet)
6"	5"	100' deep				

STATE OF MONTANA
COUNTY OF STILLWATER ss.

I hereby certify that the above instrument was duly recorded in this office

on the 23 day of MAY, 1972
A. D. 1972, at 3:40 o'clock P.

W. Helms

COUNTY RECORDER

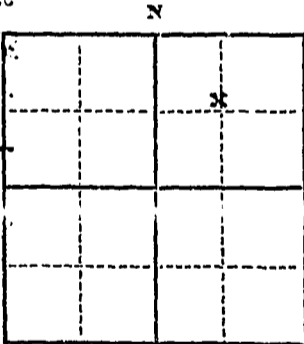

Static Water Level for non-flowing well

40 feet.

Shut-in Pressure for Flowing Well.....

Pumping Water Level 60' feet

at 3 gal. gal. per minute.

Discharge in gal. per min. of flowing well

How Tested.....

Length of Test.....

Remarks: (Gravel packing, cementing, packers, type of shutoff).....

RECEIVED

JUL 19 1972

MONTANA DEPARTMENT OF NATURAL RESOURCES AND CONSERVATION

NE 1/4 Sec. 4 T. 1 N. R. 21 E
Indicate location of well and place of use, if possible. Each small square represents 40 acres.

(Continue on reverse side)

USE—If used for irrigation, industrial, drainage or other. Explain, state number of acres and location or other data (i.e.: Lot, Block and Addition).

100 feet
Show exact depth of bottom.

This form to be prepared by driller, and three copies to be filed by the owner with the County Clerk and Recorder in the county in which the well is located, tissue copy to be retained by driller.

Please answer all questions. If not applicable, so state, otherwise the form will be returned.

? not known
Driller's License Number

? not here anymore
Driller's Signature.

50,473

RECEIVED
FEB 4 1959

T. 1 North R. 21 East M.P.M. 4
County Stillwater

STATE ENGINEER MONTANA BUREAU OF MINES AND GEOLOGY
Butte, Montana

WATER WELL LOG

x			

Owner George Nordahl Jr. Address Rapelje, Montana

Driller Albert Heck Address Harlowton, Montana

Date Started December 30th, 1958 Date Completed Jan 8th, 1959

Location: Sec. 4 T. 1N R. 21E $\frac{1}{4}$ sec. S $\frac{1}{4}$

Type of well Drilled Equipment used Cable tool
(Dug, driven, bored, or drilled) (Churn drill, rotary, other)

Water use: Domestic Municipal Stock Irrigation

Industrial Drainage Other: _____

Casing: 1 ft. to 30 ft. Type Galve Size 6 11

Casing: _____ ft. to _____ ft. Type _____ Size _____

Casing: _____ ft. to _____ ft. Type _____ Size _____

Perforated or Screened: Ft. _____ to ft. _____ Ft. _____ to ft. _____

Type of screen or perforations _____

Static Water level, for non-flowing well: _____ 25 feet.

Shut-in pressure, for flowing well: _____ lb./sq. in. on: _____ (date)

Pumping water level _____ 30 feet at _____ 15 gal. per min. 15

How tested: Raler

Length of test 3 hours

Remarks: (Gravel packing, cementing, packers, type of shut-off, depth of shut-off)

(over)

STILLWATER COUNTY
STATE OF MONTANA

184378

File No. _____ ADMINISTRATOR OF GROUNDWATER CODE
OFFICE OF STATE ENGINEER

Typ 1 N, Rge 21 E
RECEIVED
MAR 20 1963

DECLARATION OF VESTED GROUNDWATER RIGHTS
(Under Chapter 237, Montana Session Laws, 1961)

STATE ENGINEER

1. Ernest Lutgen, Mgr Wunderlin Estate, of Rosalia,

County of Stillwater, State of Montana, have appropriated groundwater according to the Montana laws in effect prior to January 1, 1962, as follows:

	Sec. 8	Sec. 5	Sec.	Sec.	Sec.	Sec.
WELLS	No. 1	No. 2	No. 3	No. 4	No. 5	No. 6
2. Basis of Beneficial Use	Stock & Domestic	Stock				
3. Approx date of Use	1920	Redug 1938				
How continuous?	continuous	continuous				
4. Amount claimed in miner's inches or gallons per min.	8 to 10	3 gal				
5. Acres irrigated	none	none				
Description						
Name of Owner						
6. Location of Well	NE 1/4 NE 1/4	Center Sec				
Means of Withdrawal	Elec Pump	Windmill				
7. Date-Commencement	see 3	1st in 1908				
Date-Completion	see 3	Redug 1938				
8. Depth of water table	22 ft	18 ft				
9. Type, size, depth or specifications of works	6" galv casing 79' deep	6" galv casing 85' deep				
10. Estimated amount withdrawn annually	109,500	55,000				
11. Log, if available	NA	NA				
12. Other information	Filing made by manager of the estate in Montana					

Signature of owner Wunderlin Estate
Ernest Lutgen
Date March 19, 1963

Please answer all questions. If not applicable, so state, otherwise the form will be returned.

184376

STATE OF MONTANA
COUNTY OF STILLWATER

I hereby certify that the above instru-
ment was filed and indexed in this office
on the 19th day of March
A. D. 1963, at 9:30 o'clock A. M.

Hertude H. Calhoun
COUNTY RECORDER

By _____ Deputy

RECEIVED

T. 1N R. 21E 11

County Stillwater

STATE ENGINEER MONTANA BUREAU OF MINES AND GEOLOGY
Butte, Montana

WATER WELL LOG

Owner Clifton Nordahl Address Molt, Montana

Driller Albert Heck Address Harlowton, Mont.

Date Started Feb. 11 Date Completed Feb. 23

Location: Sec. 11 T. 1N R. 21E 1/4 sec. NE 1/4 of Sec. 11

Type of well Drilled (Dug, driven, bored, or drilled) Equipment used Cable Tool (Churn drill, rotary, other)

Use: Domestic Municipal Stock Irrigation

Industrial Drainage Other:

Casing: 1 ft. to 165 ft. Type Galve Size 6 1/2

Casing: ft. to ft. Type Size

Casing: ft. to ft. Type Size

Perforated or Screened: Ft. 65 to ft. 100 Ft. 140 to ft. 165

Type of screen or perforations Drilled Hole 1/2

Static Water level, for non-flowing well: 35 feet.

Shut-in pressure, for flowing well: lb./sq. in. on: (date)

Pumping water level: 40 feet at 3 gal. per min. 3

How tested: Balers

Length of test: 7 hours

Remarks: (Gravel packing, cementing, packers, type of shut-off, depth of shut-off)



(over)

GW 2

186137

Approved Stock Form—State Publishing Co., Helena, Montana—39089

File No.....

T. 1N R. 21E

DUPLICATE

County Stillwater

STATE OF MONTANA
ADMINISTRATOR OF GROUNDWATER
OFFICE OF STATE ENGINEER

RECEIVED
NOV 26 1963

Notice of Completion of Groundwater Appropriation by Means of Well

(Under Chapter 237, Montana Session Laws, 1961)

Owner LESTER NORDAHL Address MOLT

Driller CLYDE SANDO Address 1141 MILES AVE. BILLINGS

Date of Notice of Appropriation of Groundwater.....

Date well started..... Date Completed DEC. 31, 1962

Type of well DRILLED Equipment Used CABLE
(dug, driven, bored or drilled) (Churn, drill, rotary or other)

Water Use: Domestic Municipal Other Irrigation
Industrial Drainage Stock

Indicate on the diagram the character and thickness of the different strata met with in drilling, such as soil, clay, shale, gravel, rock or sand, etc. Show depth at which water is encountered, thickness and character of water-bearing strata and height to which water rises in the well.

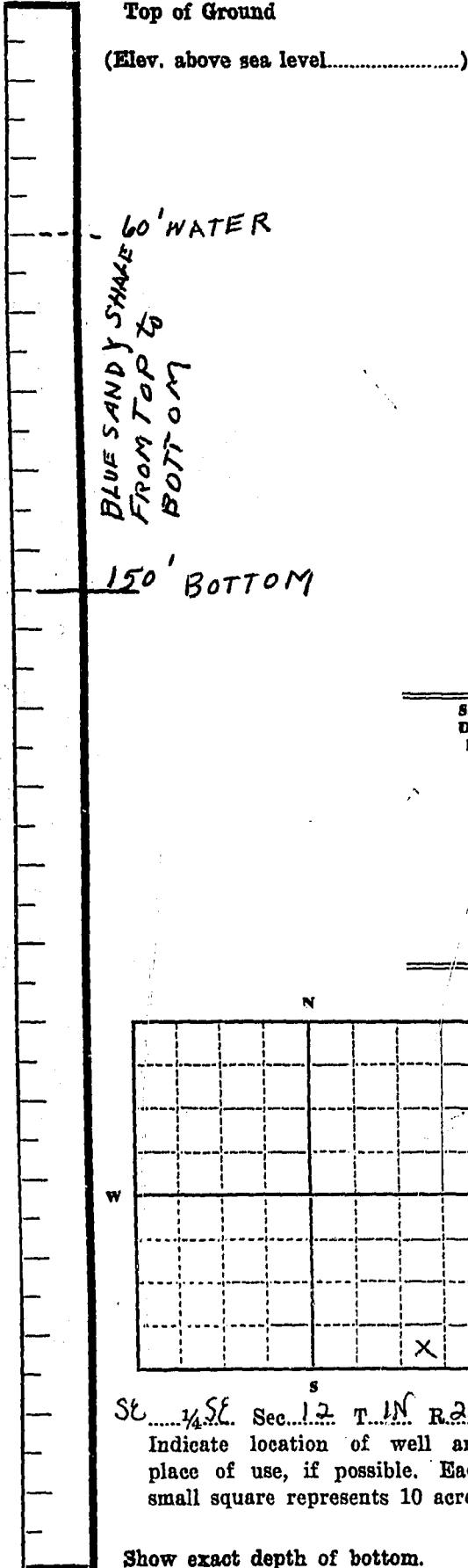

Size of Drilled Hole	Size and Weight of Casing	From (Feet)	To (Feet)	PERFORATIONS		
				Kind Size	From (Feet)	To (Feet)
8"	8" 23 lb.	0	40' 7"			
4"	OPEN	40' 7"	150'			

Static Water Level for non-flowing Well..... 40 feet.

Shut-in Pressure for Flowing Well.....

Pumping Water Level..... feet at 3 gal. per minute.

Discharge in gal. per min. of flowing well.....

How Tested BAILED Length of Test.....

Remarks: (Gravel packing, cementing, packers, type of shutoff, location of place of use of groundwater if not at well, and any other similar pertinent information, including number of acres irrigated, if used for irrigation).....

Driller's License Number 2

Driller's Signature Clyde Sando

This form to be prepared by driller, and three copies to be filed by the owner with the County Clerk and Recorder in the county in which the well is located.

Please answer all questions. If not applicable, so state, otherwise the form will be returned.

Original to the County Clerk and Recorder; duplicate to the State Engineer; Triplicate to the Montana Bureau of Mines and Geology and Quadruplicate for the Appropriator.

1503

186137

STATE OF MONTANA } ss.
COUNTY OF STILLWATER }

I hereby certify that the above instru-
ment was filed and indexed in this office
on the 22 day of November
A. D. 1953, at 1:50 o'clock P. M.

Bertrude H. Cushman
COUNTY RECORDER

By _____ Deputy

Form No. 18
8-60

12

T. 1N R. 21E
County Stillwater

MONTANA BUREAU OF MINES AND GEOLOGY
Butte, Montana

STATE WATER CONSERVATION BOARD
RECEIVED
NOV 29 1961

WATER WELL LOG

REFERRED TO _____

		2	
			x

Owner Norman T Nordahl & Lester O Nordahl Address Molt, Mont
Driller Unknown Address _____
Date Started Drilled about 1911 Date Completed _____
Location: Sec. 12 T. 1N R. 21E $\frac{1}{4}$ sec. South East

Type of well drilled Equipment used _____ Cable _____
(Dug, driven, bored, or drilled) (Churn, drill, rotary, other)

Water use: Domestic Municipal Stock Irrigation
Industrial Drainage Other _____

Casing: 0 ft. to about 8 ft. Type galvanized Size 16"

Casing: 8 ft. to rock ft. Type gal. Size 6"

Casing: _____ ft. to _____ ft. Type _____ Size _____

Perforated or Screened: Ft. _____ to ft. _____. Ft. _____ to ft. _____

Type of screen or perforations _____

Static Water level, for non-flowing well: about 25 feet.

Shut-in pressure, for flowing well: _____ lb./sq. in. on: _____ (date)

Pumping water level _____ feet at _____ gal. per min. 6 gal

How tested: _____ Pump Tested _____

Length of test _____

Remarks: (Gravel packing, cementing, packers, type of shut-off, depth of shut-off)

(over)

Form No. 18
8-60

12

T. 1N R. 21E
County Stillwater

MONTANA BUREAU OF MINES AND GEOLOGY STATE WATER CONSERVATION BOARD
Butte, Montana

RECEIVED
NOV 29 1961

WATER WELL LOG

REFERRED TO.....

	12	
x		

Owner Norman T & Lester O Nordahl Address Molt, Mont
Sam Ward- original driller - deceased
Driller Anderson Drilling Address Billings
Date Started First drilled - 1925 Date Completed redrilled 1950
Location: Sec. 12 T. 1N R. 21E $\frac{1}{4}$ sec. SW

Type of well drilled Equipment used cable
(Dug, driven, bored, or drilled) (Churn, drill, rotary, other)

Water use: Domestic Municipal Stock Irrigation
Industrial Drainage Other _____

Casing: 0 ft. to 31 ft. Type Black pipe Size 6"

Casing: 0 ft. to 105 ft. Type Gal Size 5"

Casing: _____ ft. to _____ ft. Type _____ Size _____

Perforated or Screened: Ft. 50 to ft. 105. Ft. _____ to ft. _____

Type of screen or perforations punched

Static Water level, for non-flowing well: _____ 18 feet.

Shut-in pressure, for flowing well: _____ lb./sq. in. on: _____ (date)

Pumping water level _____ feet at _____ gal. per min. 7

How tested: _____ driller tested _____

Length of test _____

Remarks: (Gravel packing, cementing, packers, type of shut-off, depth of shut-off)

(over)

Form No. 18
8-60

13

T. 1N R. 21E
County Stillwater

MONTANA BUREAU OF MINES AND GEOLOGY
Butte, Montana

STATE WATER CONSERVATION BOARD
RECEIVED
NOV 29 1961

WATER WELL LOG

REFERRED TO.....

	13	
x		

Owner Norman T Nordahl & Lester O Nordahl Address Molt, Mont
Driller unknown Address _____
Date Started Drilled about 1925 Date Completed _____
Location: Sec. 13 T. 1N R. 21E $\frac{1}{4}$ sec. SW

Type of well drilled Equipment used cable
(Dug, driven, bored, or drilled) (Churn, drill, rotary, other)

Water use: Domestic Municipal Stock Irrigation
Industrial Drainage Other _____

Casing: 0 ft. to rock ft. Type black pipe Size 8"

Casing: _____ ft. to _____ ft. Type _____ Size _____

Casing: _____ ft. to _____ ft. Type _____ Size _____

Perforated or Screened: Ft. _____ to ft. _____ Ft. _____ to ft. _____

Type of screen or perforations _____

Static Water level, for non-flowing well: Approx 25 ft feet.

Shut-in pressure, for flowing well: _____ lb./sq. in. on: _____ (date)

Pumping water level _____ feet at _____ gal. per min.

How tested: Not tested Have to clean out before we can test

Length of test _____

Remarks: (Gravel packing, cementing, packers, type of shut-off, depth of shut-off)

This is the South well of 2 drilled in this area

(over)

Form No. 18
8-60

13

T. 1N R. 21E

County _____

MONTANA BUREAU OF MINES AND GEOLOGY STATE WATER CONSERVATION BOARD
Butte, Montana

RECEIVED
NOV 29 1961

WATER WELL LOG

REFERRED TO _____

	N	
X		

Owner Normen T Nordahl & Lester O Nordahl Address Molt, Montana

Driller unknown Address _____

Date Started Drilled about 1925 Date Completed _____

Location: Sec. 13 T. 1N R. 21E $\frac{1}{4}$ sec. SW

Type of well drilled Equipment used by cable
(Dug, driven, bored, or drilled) (Churn, drill, rotary, other)

Water use: Domestic Municipal Stock Irrigation
Industrial Drainage Other _____

Casing: 0 ft. to rock ft. Type Black pipe Size 8"

Casing: _____ ft. to _____ ft. Type _____ Size _____

Casing: _____ ft. to _____ ft. Type _____ Size _____

Perforated or Screened: Ft. _____ to ft. _____. Ft. _____ to ft. _____

Type of screen or perforations _____

Static Water level, for non-flowing well: approximately 25 ft feet.

Shut-in pressure, for flowing well: _____ lb./sq. in. on: _____ (date)

Pumping water level _____ feet at _____ gal. per min.

How tested: not tested have to clean out before we can

Length of test _____

Remarks: (Gravel packing, cementing, packers, type of shut-off, depth of shut-off)

This north well of 2 drilled in this area

(over)

Form No. 18
8-60

13

T. 1N R. 21E
County Stillwater

MONTANA BUREAU OF MINES AND GEOLOGY
Butte, Montana

STATE WATER CONSERVATION BOARD
RECEIVED
NOV 29 1961

WATER WELL LOG

REFERRED TO.....

Owner Normen T Nordahl & Lester O Nordahl Address Molt, Montana
Driller Anderson Drilling Address Billings, Mont
Date Started _____ Date Completed 1950
Location: Sec. 13 T. 1N R. 21E $\frac{1}{4}$ sec. SE

Type of well drilled Equipment used cable
(Dug, driven, bored, or drilled) (Churn, drill, rotary, other)

Water use: Domestic Municipal Stock Irrigation
Industrial Drainage Other _____

Casing: 0 ft. to 110 ft. Type Galvanized Size 5"

Casing: _____ ft. to _____ ft. Type _____ Size _____

Casing: _____ ft. to _____ ft. Type _____ Size _____

Perforated or Screened: Ft. 60 to ft. 110 . Ft. _____ to ft. _____

Type of screen or perforations punched

Static Water level, for non-flowing well: _____ 20 _____ feet.

Shut-in pressure, for flowing well: _____ lb./sq. in. on: _____
(date)

Pumping water level _____ feet at _____ gal. per min. 9 gal

How tested: _____ driller tested

Length of test _____

Remarks: (Gravel packing, cementing, packers, type of shut-off, depth of shut-off)

(over)

STILLWATER COUNTY
STATE OF MONTANA

File No. 186713

ADMINISTRATOR OF GROUNDWATER CODE
OFFICE OF STATE ENGINEER

Twp 11, Rge 1, E 34

DECLARATION OF VESTED GROUNDWATER RIGHTS
(Under Chapter 237, Montana Session Laws, 1961)

RECEIVED
JAN 8 1964

1. Keating Ranch, Inc., of Holt, Montana, STATE ENGINEER,
County of Stillwater, State of Montana, have appropriated groundwater according to the
Montana laws in effect prior to January 1, 1962, as follows:

	Sec. 15	Sec. 22	Sec. 22	Sec. 22	Sec. 15	Sec. 24
WELLS	No. 1	No. 2	No. 3	No. 4	No. 5	No. 6
2. Basis of Beneficial Use	House water	House water	stock water	stock water	stock water	stock water
3. Approx date of Use How continuous?	1918 continuous	1913 continuous	1914 continuous	1963 continuous	1960 continuous	1963 continuous
4. Amount claimed in miner's inches or gallons per min.	5gal/min	5/gal/min	5gal/min	7gal/min	8gal/min	2.5/gal/min
5. Acres irrigated Description Name of Owner	house lawn 1 acre of shelter-belt	house lawn	house lawn	none	none	none
6. Location of Well Means of With- drawal	SE/SE Sec 15-1N-21E	NE-NE 22-1N-21E	NE-NE 22-1N-21E	NE-NE 22-1N-21E	SE-SW 15-1N-21E	SE-SW 31-1S-21E
7. Date-Commencement Date-Completion	Elect pump 1918	elect pump 1913	Elect pump 1914	Elect pump Sept 1963	Elect pump Sept 1960	wind mill Sept 1963
8. Depth of water table	1918 24 Ft.	1913 24 Ft.	1914 29 Ft.	Sept 1963 30 Ft.	Sept 1960 30 Ft.	Sept 1963 120 Ft.
9. Type, size, depth or specifications of works	Dug well 28 Ft.	Dug well 28 Ft.	Dug Well 24 Ft.	Drilled 6 in. case 30 Ft.	Drilled 6 in. case 85 Ft.	Drilled 6 inches 460 Ft.
10. Estimated amount withdrawn annually	700,000 g	700,000 g	700,000 gal	700,000	700,000 gal	500,000 gal
11. Log, if available						
12. Other information						

Signature of owner Keating Ranch, Inc
Date Ted Keating, Pres.
Dec 31, 1963.

Please answer all questions. If not applicable, so state, otherwise the form will be returned.

Gw-1
186713

STATE OF MONTANA
COUNTY OF STILLWATER

I hereby certify that the above instru-
ment was recorded in his office

on the 31st of December

1903 at 10:48 o'clock A.M.

Arthur H. Carlson

COUNTY CLERK

By _____ Deputy

File No. **191808**

STATE WATER CONSERVATION BOARD

T. **1N** R. **21E**

DUPLICATE

JAN 3 1966

County **Stillwater**

Billie Mc Dermott
Director **STATE OF MONTANA**

ADMINISTRATOR OF GROUNDWATER CODE

OFFICE OF STATE ENGINEER

Dickert

15

Notice of Completion of Groundwater Appropriation Without Well

Developed After January 1, 1962

(Under Chapter 237 Montana Session Laws, 1961)

Date of Appropriation of Groundwater.....

Owner..... **Keating Ranch** Address..... **Molt**

Contractor (if any).....

Address of Contractor

Date Started **Aug 1964** Date Completed..... **Sept 1964**

1) Describe means of obtaining groundwater (as by sub-irrigation, developed spring, drains, etc.)..... **Dug Pit**

2) Means of withdrawing water (gravity, pump, canal, etc.)..... **Gravity**

3) Depth of water table.....

4) Use of the water..... **Stock**

5) Amount of groundwater claimed (in miner's inches, or gallons per minute)..... **10**

6) If used for irrigation, give number of acres and description of land.....

7) Estimate amount of water used each year..... **300,000 Gal**

Signature of Owner..... *Keating Ranch, Inc*
Ed Keating

Date..... **Dec 30, 1965**

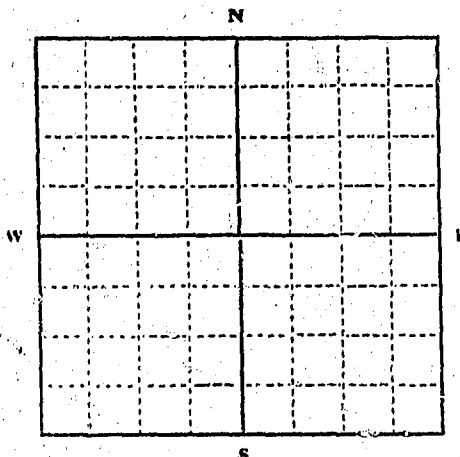

NW 1/4 Sec 15 T1N R21E

Indicate point of appropriation and place of use, if possible.

This form to be prepared by contractor (if any), otherwise by the owner.

Three copies of this notice are to be filed with the County Clerk and Recorder of the county in which the works are located.

Please answer all questions. If not applicable, so state, otherwise the form will be returned.

40409

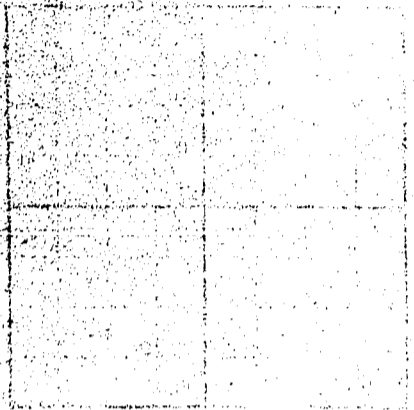

191808

STATE OF MONTANA
COUNTY OF STILLWATER

I hereby certify that the above instrument was filed and indexed in this office on the 30 day of Dec A. D. 1945 at 3:40 o'clock P. M.

COUNTY RECORDER

By _____ Deputy

File No. 191802

T. 11 R. 21E

DUPLICATE

County Stillwater

STATE OF MONTANA
ADMINISTRATOR OF GROUNDWATER CODE
OFFICE OF STATE ENGINEER

15

**Notice of Completion of Groundwater Appropriation
Without Well**

Developed After January 1, 1962

(Under Chapter 237 Montana Session Laws, 1961)

Date of Appropriation of Groundwater.....

Owner Keating Ranch Address Holt, Montana

Contractor (if any).....

Address of Contractor.....

Date Started July 1962 Date Completed July 1962

1) Describe means of obtaining groundwater (as by sub-irrigation,
developed spring, drains, etc.).....

Developed Spring

2) Means of withdrawing water (gravity, pump, canal, etc.).....

Gravity

3) Depth of water table.....

4) Use of the water Stock

5) Amount of groundwater claimed (in miner's inches, or gallons
per minute) 10

6) If used for irrigation, give number of acres and description of
land.....

7) Estimate amount of water used each year 300,000

Signature of Owner Keating Ranch, Inc
Fred Keating
Dat December 30, 1965

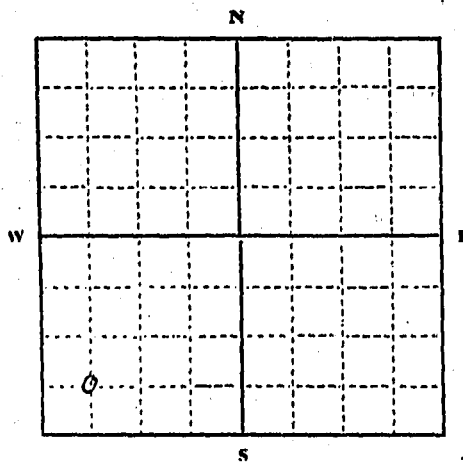

SW 1/4 SW Sec. 15 T. 11 R. 21E
Indicate point of appropriation
and place of use, if possible.

This form to be prepared by contractor (if any), otherwise by the owner.
Three copies of this notice are to be filed with the County Clerk and Recorder of the county in which the
works are located.
Please answer all questions. If not applicable, so state, otherwise the form will be returned.

40402

191802

STATE OF MONTANA
COUNTY OF STILLWATER

I hereby certify that the above instrument was filed and indexed in this office on the 30 day of Dec

A. D. 1956 at 3:20 o'clock P. M.

Gertrude H. Colhoun
COUNTY RECORDER

By _____ Deputy

RECEIVED
FEB 17 1917

T. 1 North R. 21 East

County Stillwater

MONTANA BUREAU OF MINES AND GEOLOGY
Butte, Montana

STATE ENGINEER

WATER WELL LOG

			x

Owner Morris Nordahl Address Rapelje, Montana

Driller Albert Heck Address Harlowtown, Montana

Date Started Feb. 7 Date Completed Feb. 10

Location: Sec. 17 T. 1N R. 21E 1/4 sec. NE 1/4

Type of well Drilled (Dug, driven, bored, or drilled) Equipment used Cable Tool (Churn drill, rotary, other)

Water use: Domestic Municipal Stock Irrigation
Industrial Drainage Other: _____

Casing: 3 ft. to 40 ft. Type Iron Size 6 1/2

Casing: _____ ft. to _____ ft. Type _____ Size _____

Casing: _____ ft. to _____ ft. Type _____ Size _____

Perforated or Screened: Ft. _____ to ft. _____ Ft. _____ to ft. _____

Type of screen or perforations _____

Static Water level, for non-flowing well: 15 feet.

Shut-in pressure, for flowing well: _____ lb./sq. in. on: _____ (date)

Pumping water level: 15 feet at 45 gal. per min. 45

How tested: Baler

Length of test: 3 hours

Remarks: (Gravel packing, cementing, packers, type of shut-off, depth of shut-off)



(over)

