

Form No. 194-132

MAR 16 1967

T. 5S R. 15E

DUPLICATE

Bill: _____ McDermott _____
But: _____ McNulty _____
Coy: _____ Morton _____
Darlin: _____ Sullivan _____

County Stillwater

LOG

STATE OF MONTANA
ADMINISTRATOR OF GROUNDWATER CODE
OFFICE OF STATE ENGINEER

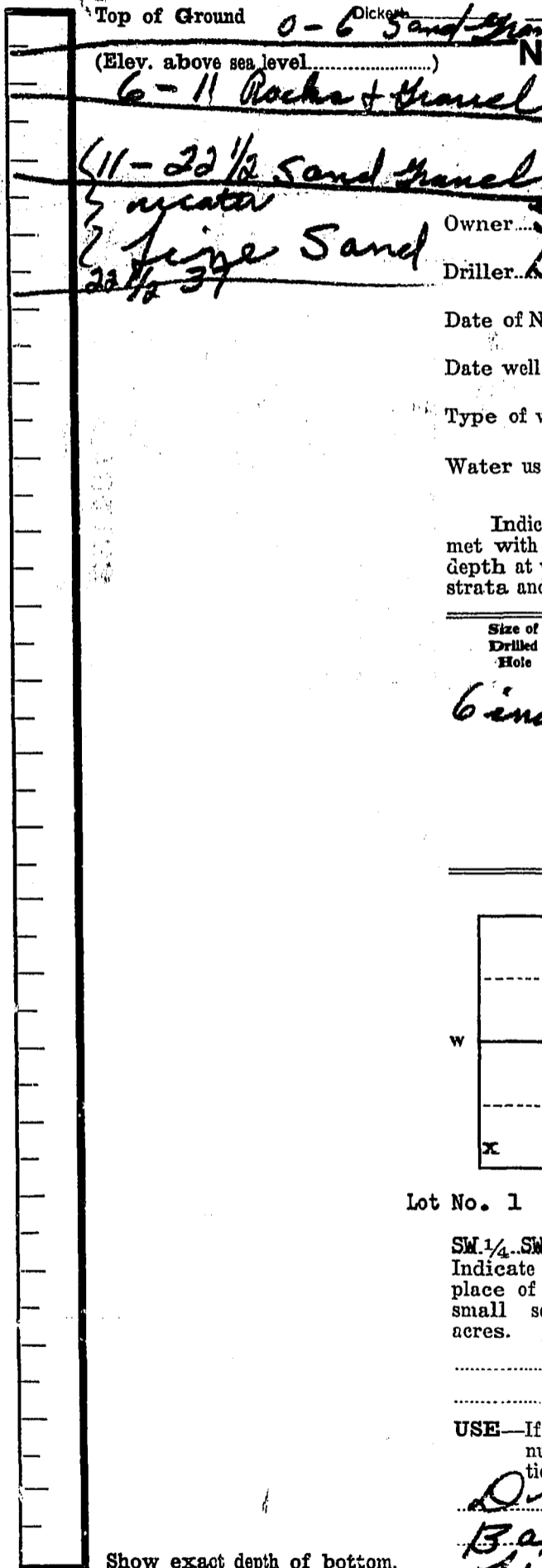

Notice of Completion of Groundwater Appropriation by Means of Well
DEVELOPED AFTER JANUARY 1, 1962

(Under Chapter 237, Montana Session Laws, 1961)

Owner Glen Peterson Address Billings, Mont

Driller B+H Drilling Address 7 West, Mont

Date of Notice of appropriation of groundwater _____

Date well started 3/2/67 Date completed 3/14/67

Type of well Drilled Equipment used Churn Drill
(Dug, driven, bored or drilled) (Churn drill, rotary or other)

Water use: Domestic Municipal Stock Irrigation
Industrial Dr. inage Other

Indicate on the diagram the character and thickness of the different strata met with in drilling, such as soil, clay, shale, gravel, rock or sand, etc. Show depth at which water is encountered, thickness and character of water-bearing strata and height to which the water rises in the well.

Size of Drilled Hole	Size and Weight of Casing	From (Feet)	To (Feet)	PERFORATIONS		
				Kind Size	From (Feet)	To (Feet)
6 inch	6 5/8 18.97	14	23	19 Torch Cuts 1/4x6	17	23

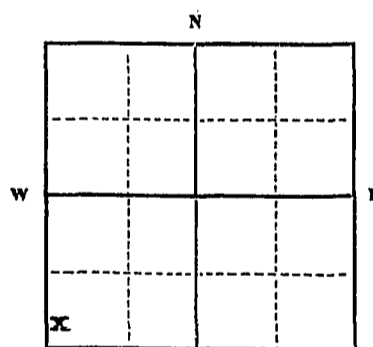

Static Water Level for non-flowing well _____ 9 feet.

Shut-in Pressure for Flowing Well _____

Pumping Water Level _____ 15 feet
at _____ 20 gal. per minute.

Discharge in gal. per min. of flowing well _____

How Tested Bailer

Length of Test 2 hrs

Remarks: (Gravel packing, cementing, packers, type of shutoff) _____

Lot No. 1 Plat # 157930

SW 1/4, Sec. 15, T. 5S, R. 15E
Indicate location of well and place of use, if possible. Each small square represents 40 acres.

(Continue on reverse side)

USE—If used for irrigation, industrial, drainage or other. Explain, state number of acres and location or other data (i.e.: Lot, Block and Addition).

Drilled to 37 ft and Pulled Back to 22 1/2, Because of Fine Sand.

Show exact depth of bottom.

22 1/2.

This form to be prepared by driller, and three copies to be filed by the owner with the County Clerk and Recorder in the county in which the well is located, tissue copy to be retained by driller.

Please answer all questions. If not applicable, so state, otherwise the form will be returned.

NO 27
Driller's License Number

Paul J. Hargan
Driller's Signature.

D

19413²

STATE OF MONTANA 4th ST.
COUNTY OF STILLWATER

I hereby certify that the above instrument was filed and indexed in this office on the 13th day of March A. D. 1967, at 2:15 o'clock P.M.

Thelma Shaw
COUNTY RECORDER

By _____ Deputy

[Faint, mostly illegible handwritten notes and stamps, possibly including 'RECORDED' and 'INDEXED']

[Handwritten notes and stamps, including 'MAY 11 1967' and other illegible text]

File No. 204270

MAR 28 1972

T. 55. R. 15E. 15

DUPLICATE

MONTANA DEPARTMENT OF NATURAL RESOURCES AND CONSERVATION

County Stillwater

LOG

STATE OF MONTANA ADMINISTRATOR OF GROUNDWATER CODE STATE WATER CONSERVATION BOARD

Top of Ground (Elev. above sea level 4897)

0-6" Top Soil
6"-22' Gravel & Boulders
22-42 Gravel & Sand (Water)

Notice of Completion of Groundwater Appropriation by Means of Well DEVELOPED AFTER JANUARY 1, 1962

(Under Chapter 237 Montana Session Laws, 1961, as amended)

Owner Frank & Judy Degele Address Hwy, Mont.

Driller E & H Drilling Address Fishtail, Mont.

Date of Notice of appropriation of groundwater

Date well started 3/24/72 Date completed 3/25/72

Type of well Drilled Equipment used Churn Drill

Water use: Domestic [X] Municipal [] Stock [] Irrigation [] Industrial [] Drainage [] Other []

Indicate on the diagram the character and thickness of the different strata met with in drilling, such as soil, clay, shale, gravel, rock or sand, etc. Show depth at which water is encountered, thickness and character of water-bearing strata and height to which the water rises in the well.

Table with columns: Size of Drilled Hole, Size and Weight of Casing, From (Feet), To (Feet), PERFORATIONS (Kind Size, From (Feet), To (Feet)).

STATE OF MONTANA COUNTY OF STILLWATER

I hereby certify that the above instrument was filed and indexed in this office

on the MAR 24 1972 day of

A. D. 195 at 11:40 o'clock A.M.

County Recorder

By Deputy

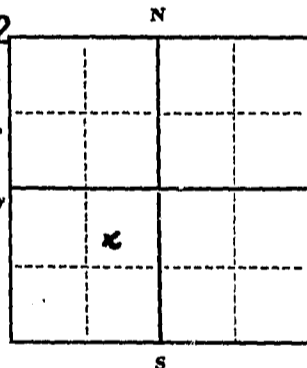

Static Water Level for non-flowing well 20 feet.

Shut-in Pressure for Flowing Well

Pumping Water Level 35 feet at 25 gal. per minute.

Discharge in gal. per min. of flowing well

How Tested Bailer

Length of Test 2 hrs.

Remarks: (Gravel packing, cementing, packers, type of shutoff)

Well will be cemented below pitless when pump is installed.

1/4 Sec. 15 T. 55. R. 15E. Indicate location of well and place of use, if possible. Each small square represents 40 acres.

(Continue on reverse side)

USE—If used for irrigation, industrial, drainage or other. Explain, state number of acres and location or other data (i.e.: Lot, Block and Addition).

Well is for trailer home, location lots 9 & 10

Plat 157930

Show exact depth of bottom.

42 ft.

This form to be prepared by driller, and three copies to be filed by the owner with the County Clerk and Recorder in the county in which the well is located, tissue copy to be retained by driller.

Please answer all questions. If not applicable, so state, otherwise the form will be returned.

No. 27

Driller's License Number

Driller's Signature

Driller's Signature

50,115

File No. **207511**

RECORDED

T. **55** R. **15E**

DUPLICATE

County **Stilwater**

LOG

MONTANA DEPARTMENT OF NATURAL RESOURCES AND CONSERVATION

STATE OF MONTANA ADMINISTRATOR OF GROUNDWATER CODE STATE WATER CONSERVATION BOARD

Top of Ground (Elev. above sea level **5058'**)

Notice of Completion of Groundwater Appropriation by Means of Well

DEVELOPED AFTER JANUARY 1, 1962

(Under Chapter 237 Montana Session Laws, 1961, as amended)

Owner **James E. Langston** Address **Nye, Montana**

Driller Address

Date of Notice of appropriation of groundwater

Date well started Date completed **April 1973**

Type of well **Drilled** Equipment used **Rotary**
(Dug, driven, bored or drilled) (Churn drill, rotary or other)

Office of Clerk & Recorder
Stilwater County, Montana

I hereby certify that the above instrument was filed & indexed in this office on the **JUN 28 1973** day of **JUN 28 1973** at **10:10 AM** at **Stilwater** block **10:10 AM**

Indicate on the diagram the character and thickness of the different strata met with in drilling, such as soil, clay, shale, gravel, rock or sand, etc. Show depth at which water is encountered, thickness and character of water-bearing strata and height to which the water rises in the well.

Size of Drilled Hole	Size and Weight of Casing	From (Feet)	To (Feet)	PERFORATIONS		
				Kind Size	From (Feet)	To (Feet)
4"	4"	0'	25'	None		

Office of Clerk & Recorder
Stilwater County, Montana
DEPUTY

*207511
June 28, 1973*

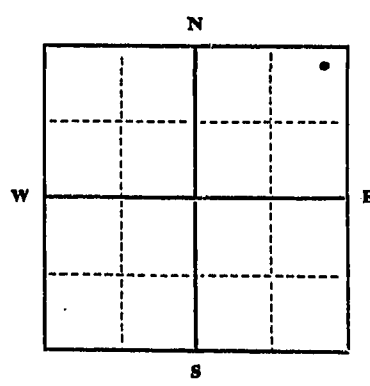

Static Water Level for non-flowing well **10'** feet.

Shut-in Pressure for Flowing Well

Pumping Water Level **15'** feet

at gal. per minute.

Discharge in gal. per min. of flowing well

How Tested

Length of Test

Remarks: (Gravel packing, cementing, packers, type of shutoff)

NE 1/4 Sec. 32 T58 R.15E
Indicate location of well and place of use, if possible. Each small square represents 40 acres.

(Continue on reverse side)

USE—If used for irrigation, industrial, drainage or other. Explain, state number of acres and location or other data (i.e.: Lot, Block and Addition).

25' Show exact depth of bottom.

This form to be prepared by driller, and three copies to be filed by the owner with the County Clerk and Recorder in the county in which the well is located, tissue copy to be retained by driller.

Please answer all questions. If not applicable, so state, otherwise the form will be returned.

Driller's License Number

Driller's Signature.

54449

RECEIVED

3 GW 3 Revised 1969
2057-1300-1/71

County Stillwater

STATE OF MONTANA
ADMINISTRATOR OF GROUNDWATER CODE
MONTANA DEPARTMENT OF NATURAL RESOURCES AND CONSERVATION
MONTANA WATER RESOURCES BOARD

32

NOTICE OF COMPLETION OF GROUNDWATER APPROPRIATION WITHOUT WELL

Developed After January 1, 1962

(Under Chapter 237, Montana Session Laws, 1961, as amended)

This form to be prepared by contractor (if any), otherwise by the owner.

Three copies of this notice are to be filed with the County Clerk and Recorder of the county in which the works are located.

Please answer all questions. If not applicable, so state, otherwise the form may be returned.

For Administrator's Use

File 207510

June 28, 1973

GW 1 10:05 A.M.

Owner James B Langston

Address Nye, Montana

Contractor (if any) _____

Address of Contractor _____

Date Started _____ Date Completed _____

1. Describe means of obtaining groundwater (as by sub-irrigation, developed spring, drains, etc.) Springs

2. Means of withdrawing water (gravity, pump, canal, etc.) gravity & pump

3. Depth of water table ground level

4. Use of the water Domestic & Irrigation

5. Amount of groundwater claimed (in miner's inches or gallons per minute) 25 GPM

6. If used for irrigation, give number of acres and description of land 40 Acres T 5 S, R 15 E
Sec. 32: NE 1/4, 28: SW 1/4

7. Estimate amount of water used each year _____

8. Months of year spring flows June, July & August

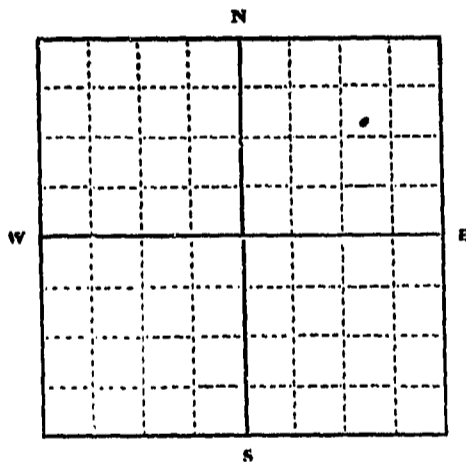

NE 1/4 NE 1/4 Sec. 32

T. 5 S N R. 15 E
S W

INDICATE POINT OF APPROPRIATION AND PLACE OF USE, IF POSSIBLE. Elevation of spring, if known or estimated _____

Signature of Owner _____

Date June 28, 1973

5448

207510

Office of Clerk & Recorder
Stillwater County, Montana

I hereby certify that the above instru-
ment was filed & indexed in this office

on the 28 day of JUN 19, 19

AD 10:05AM at 10:05AM

Shelma Shaw

COUNTY RECORDER

By _____ DEPUTY

RECEIVED JUN 28 1919

RECORDS SECTION
MONTANA DEPARTMENT OF REVENUE

STATE OF MONTANA

RECORDS SECTION

RECORDS SECTION

County Stillwater Twp. 55 Rge. 16E

Sec.	Name of Appropriator	Type of Form	County File No.	Remarks
2	Kirch, Gerald P.	GW3	186584	
3	Kirch, Gerald P.	GW3	186584	see # 2 above
3	Kirch, Gerald P.	GW4	186583	
4	Selleck, Thomas Shirley	GW3	207498	
4	Winge, Peder	GW2	186315	
4	Guthrie, Alvin	GW2	190673	
4	Schwenneker, George	GW3	194036	
4	Winge, Peder + Ird	GW3	202155	
4	Posebud Cemetery District	water well	none	
4	Posebud Cemetery District	water well	none	
5	Sloss, John	water well	none	
5	Sloss, John	water well	none	
6	Martin, Ted A.	GW4	193094	
6	Borland, Fred + Ne.	GW4	185309	
6	Holritz, E. L.	GW4	186622	
6	Long, Sidney, B.	GW4	185254	
6	Guse, Alfred	GW2	207156	
6	Guthrie, Raymond F.	GW3	207605	
6	Kinney, Austin J.	GW2	207314	
6	Bailey, Earl C.	water well	none	
7	Schanck, Wilbur + Flora	GW3	186738	
8	Schanck, Wilbur + Flora	GW3	186738	see # 8 above
9	Morehead, E. D. Jr.	GW4	186744	
10	Hertzler, Edmund + Doris	GW3	186406	
11	Kirch, Gerald	water well	none	
11	Rickman, Winnie T.	GW3	184482	
11	Morehead, E. D. Jr.	GW4	186744	see # 9 above
12	Ostrum, R. M.	GW3	202145	
13	Stovall, Bill	water well	none	
13	School District No. 18	water well	none	
13	Rickman, Dean A.	GW3	184462	
13	Rickman, Dean A.	GW4	184461	
13	Erickson, U. J.	GW2	206852	
13	Kennedy, Ruth L.	GW2	207669	
13	Rickman Dean	GW2	187007	
13	Rickman Winnie T.	GW4	184481	
13	School District # 18	GW4	181639	
14	Rickman, Dean A.	GW3	184462	see # 13 above
14	Morehead, E. D. Jr.	GW4	186744	see # 9 above
14	Delger, Delger	GW2	003055	
19	Chestnut + Spicen	GW3	186772	
23	Kennedy, Ruth L.	GW3	207666	
24	Morehead, E. D. Jr.	GW4	186744	see # 9 above
24	Chestnut + Spicen	GW3	186772	see # 19 above
24	Kennedy, Ruth	GW3	207666	see # 23 above
24	Morehead, E. D.	GW2	192755	
2	Marx, Lois	GW2	207646	

186584

File No.....

T. 5S R. 16E

DUPLICATE

County.....Stillwater

STATE OF MONTANA
ADMINISTRATOR OF GROUNDWATER CODE
OFFICE OF STATE ENGINEER

RECEIVED
DEC 30 1963

STATE ENGINEER

Notice of Completion of Groundwater Appropriation Without Well

(Under Chapter 237 Montana Session Laws, 1961)

Date of Appropriation of Groundwater..... #1 - 1942
#2 - 1957
#3 - 1942
Owner.....Gerald R. Kirsh..... Address.....Fishtail, Montana
Contractor (if any).....Self
Address of Contractor.....
Date Started..... Date Completed.....

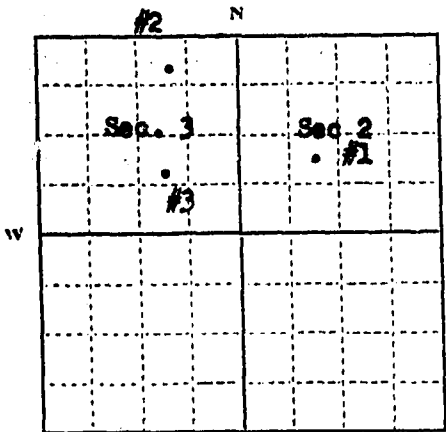

Describe means of obtaining groundwater without a well "as by sub-irrigation and other natural processes". Include depth to water when applicable.....

#1 & #3 - Dug out and rocked up. Pipe installed and piped into stock tanks.

#2 free flowing spring undeveloped.

Quantity of water developed and used with explanation of method used to measure or estimate such amount. If use is intermittent

estimate approximate lengths of periods of use.....

#1 - 30 gal per min. Used approx 6 months each year.

#2 - 100 gal per min. " " " " "

#3 - 15 gal per min " " " " "

- #1 NE 1/4 SW Sec. 2, T5S, R16E
Indicate point of appropriation and place of use, if possible.
- #2 NWNE Sec. 3, T5S, R 16E
- #3 NWSE Sec. 3, T 5S, R 16E

Signature of Owner.....Gerald R. Kirsh

Date.....Dec. 27th, 1963

This form to be prepared by contractor (if any), otherwise by the owner.

Three copies of this notice are to be filed with the County Clerk and Recorder of the county in which the works are located.

Please answer all questions. If not applicable, so state, otherwise the form will be returned.

Original to the County Clerk and Recorder; duplicate to the State Engineer; Triplicate to the Montana Bureau of Mines and Geology and Quadruplicate for the Appropriator.

186584

STATE OF MONTANA }
COUNTY OF STILLWATER }

I hereby certify that the above instru-
ment was filed and indexed in this office
on the 27th day of Dec

A. D. 1963, at 3:35 o'clock P. M.

Gertrude H. Calloun
COUNTY RECORDER

By _____ Deputy

180583

File No.

T. 5S R. 16E

DUPLICATE

County Stillwater

STATE OF MONTANA
ADMINISTRATOR OF GROUNDWATER CODE
OFFICE OF STATE ENGINEER

RECEIVED
DEC 30 1963

Declaration of Vested Groundwater Rights
(Under Chapter 237, Montana Session Laws, 1961)

1. Gerald R. Kirch, of Fishtail
(Name of Appropriator) (Address) (Town)

County of Stillwater State of Mont

have appropriated groundwater according to the Montana laws in effect prior to January 1, 1962, as follows:

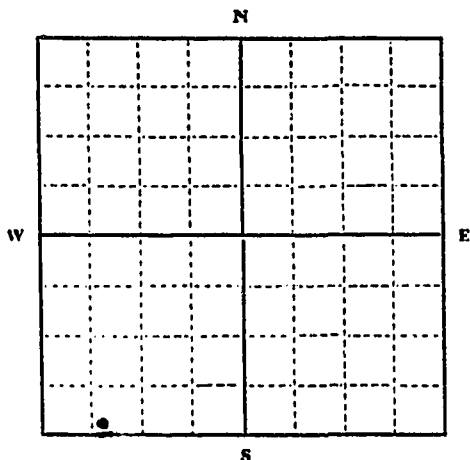

SE 1/4 SW Sec. 3, T5S, R. 16E

Indicate point of appropriation and place of use, if possible. Each small square represents 10 acres.

2. The beneficial use on which the claim is based.....
Domestic

3. Date or approximate date of earliest beneficial use; and how continuous the use has been.....1946 Continuous

4. The amount of groundwater claimed (in miner's inches or gallons per minute).....50 gal per min.

5. If used for irrigation, give the acreage and description of the lands to which water has been applied and name of the owner thereof.....garden

6. The means of withdrawing such water from the ground and the location of each well or other means of withdrawal.....Electric Pump

7. The date of commencement and completion of the construction of the well, wells, or other works for withdrawal of groundwater.....1946

8. The depth of water table.....10 ft.

9. So far as it may be available, the type, size and depth of each well or the general specifications of any other works for the withdrawal of groundwater.....Dug - 3' concrete casing - 14 ft. deep - 1 1/2" copper pipe

10. The estimated amount of groundwater withdrawn each year.....1,000,000

11. The log of formations encountered in the drilling of each well if available.....NA

12. Such other information of a similar nature as may be useful in carrying out the policy of this act, including reference to book and page of any county record.....NA

Signature of Owner Gerald R. Kirch

Date 12 - 27 - 1963

Three copies to be filed by the owner with the County Clerk and Recorder of the county in which the well is located.

Please answer all questions. If not applicable, so state, otherwise the form will be returned.

Original to the County Clerk and Recorder; Duplicate to the State Engineer; Triplicate to the Montana Bureau of Mines and Geology, and Quadruplicate for the Appropriator.

15894

186583

STATE OF MONTANA } ss.
COUNTY OF STILLWATER }

I hereby certify that the above instru-
ment was filed and indexed in this office
on the 27th day of Dec.

A. D. 1953, at _____ o'clock _____ M.

Gertrude H. Calhoun
COUNTY RECORDER

By _____ Deputy

File No. 207498

GAZETTE PRINTING CO.

T. 55 R. 16 E

QUADRUPLICATE

County STILLWATER

MONTANA DEPARTMENT OF INDUSTRIAL RESOURCES AND CONSERVATION

STATE OF MONTANA ADMINISTRATOR OF GROUNDWATER CODE OFFICE OF STATE ENGINEER

Notice of Completion of Groundwater Appropriation Without Well

(Under Chapter 237 Montana Session Laws, 1961)

Office of Clerk & Recorder Stillwater County, Montana

I hereby certify that the above instrument was filed & indexed in this office

on the 16th day of NOV 1982 at 8:25 AM

By [Signature] COUNTY RECORDER

DEPUTY

Date of Appropriation of Groundwater PRIOR TO 1959

Owner THOMAS & SHIRLEY SALLECK Address 16 CAMPBELL DR.

Contractor (if any) NONE

Address of Contractor N/A

Date Started PRIOR TO 59 Date Completed PRIOR TO 59

Describe means of obtaining groundwater without a well "as by sub-irrigation and other natural processes". Include depth to water when applicable. SPRING FLOWING OUT OF GROUND BY NATURAL PROCESSES

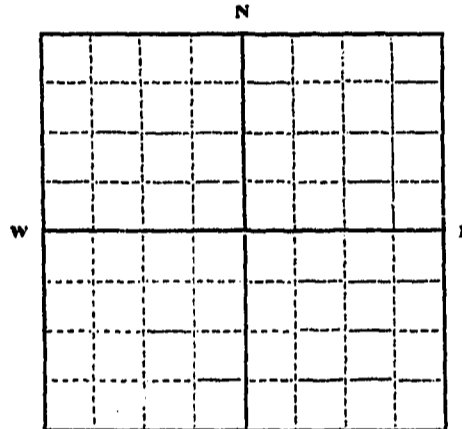

NW 1/4 NE 1/4 SEC 3 E 1/2 NE 1/4 Sec 4 T. 55 R. 16 E

Indicate point of appropriation and place of use, if possible.

207498 June 7

Quantity of water developed and used with explanation of method used to measure or estimate such amount. If use is intermittent

estimate approximate lengths of periods of use. USED FOR STOCK WATER & DRINKING

100,000 GALLONS MONTHLY Signature of Owner [Signature]

Date 6/27/73

This form to be prepared by contractor (if any), otherwise by the owner.

Three copies of this notice are to be filed with the County Clerk and Recorder of the county in which the works are located.

Please answer all questions. If not applicable, so state, otherwise the form will be returned.

Original to the County Clerk and Recorder; duplicate to the State Engineer; Triplicate to the Montana Bureau of Mines and Geology and Quadruplicate for the Appropriator.

File No. 186315

T. 5 S. R. 16 E
County Stillwater

DUPLICATE

STATE OF MONTANA
ADMINISTRATOR OF GROUNDWATER
OFFICE OF STATE ENGINEER

RECEIVED
DEC 9 1963
STATE ENGINEER

Top of Ground 0-5 TOP Soil
(Elev. above sea level.....)

Notice of Completion of Groundwater
Appropriation by Means of Well
(Under Chapter 237, Montana Session Laws, 1961)

Rock & Gravel 5-28- Owner Mr. Peter King Address Fritch, Mont.

29-36 Clay & Sand (water) Driller B.H. Drilling Address Fritch, Mont.

Date of Notice of Appropriation of Groundwater.....
Date well started 5/28/63 Date Completed 6/3/63

Type of well Drilled Equipment Used Churn Drill
(dug, driven, bored or drilled) (Churn, drill, rotary or other)

Water Use: Domestic Municipal Other Irrigation
Industrial Drainage Stock

Indicate on the diagram the character and thickness of the different strata met with in drilling, such as soil, clay, shale, gravel, rock or sand, etc. Show depth at which water is encountered, thickness and character of water-bearing strata and height to which water rises in the well.

Size of Drilled Hole	Size and Weight of Casing	From (Feet)	To (Feet)	PERFORATIONS		
				Kind Size	From (Feet)	To (Feet)
6 in	6 in 19#	14	28		28	32
	5 in Plastic Liner					

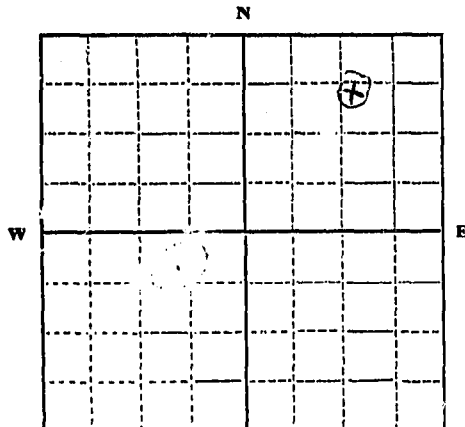

NE 1/4 NE Sec. 34 T. 5 S. R. 16 E
Indicate location of well and place of use, if possible. Each small square represents 10 acres.

Show exact depth of bottom.
36 ft

Static Water Level for non-flowing Well 18 feet.

Shut-in Pressure for Flowing Well.....

Pumping Water Level 24 feet at 20 gal. per minute.

Discharge in gal. per min. of flowing well.....

How Tested Bailers Length of Test 2 hrs.

Remarks: (Gravel packing, cementing, packers, type of shutoff, location of place of use of groundwater if not at well, and any other similar pertinent information, including number of acres irrigated, if used for irrigation).....

No. 27
Driller's License Number

Peter King
Driller's Signature

This form to be prepared by driller, and three copies to be filed by the owner with the County Clerk and Recorder in the county in which the well is located.

Please answer all questions. If not applicable, so state, otherwise the form will be returned.

Original to the County Clerk and Recorder; duplicate to the State Engineer; Triplicate to the Montana Bureau of Mines and Geology and Quadruplicate for the Appropriator.

186315

STATE OF MONTANA, ss.
COUNTY OF STILLWATER

I hereby certify that the above instrument was filed and indexed in this office on the 6th day of December A. D. 1963, at 1:15 o'clock P. M.

Gertrude H. Calhoun
COUNTY RECORDER

By _____ Deputy

[Faint, illegible text and markings, possibly a ledger or index, with some numbers like 28, 35, and 20 visible.]

File No. 190673

DUPLICATE

LOG

STATE OF MONTANA
ADMINISTRATOR OF GROUNDWATER
OFFICE OF STATE ENGINEER

County

JUL 7 1965

Notice of Completion of Groundwater
Appropriation by Means of Well
DEVELOPED AFTER JANUARY 1, 1962

(Under Chapter 237, Montana Session Laws, 1961)

Top of Ground
(Elev. above sea level.....)
Clay & Sand 0-14
Sand & Gravel 14-22
Grey Clay 22-27
27-34 Gravel & Sand
34-40 Grey shale

Owner *Alvin [unclear]* Address *Fishtert, Mont*

Driller *B.H. Drilling* Address *Fishtert, Mont*

Date of Notice of appropriation of groundwater.....

Date well started *7/2/65* Date completed *7/5/65*

Type of well *Drilled* Equipment used *Churn Drill*
(Dug, Driven, bored or drilled) (Churn drill, rotary or other)

Water use: Domestic Municipal Stock Irrigation
Industrial Drainage Other

Indicate on the diagram the character and thickness of the different strata met with in drilling, such as soil, clay, shale, gravel, rock or sand, etc. Show depth at which water is encountered, thickness and character of water-bearing strata and height to which the water rises in the well.

Size of Drilled Hole	Size and Weight of Casing	From (Feet)	To (Feet)	PERFORATIONS		
				Kind Size	From (Feet)	To (Feet)
6 inch	6 5/8 1897	14	34 1/2	Torch Cuts	29	33

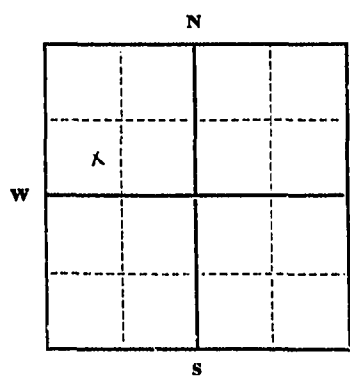

Static Water Level for non-flowing well
.....*9*.....feet.

Shut-in Pressure for Flowing Well.....

Pumping Water Level.....*19*.....feet
at.....*25*.....gal. per minute.

Discharge in gal. per min. of flowing well

How Tested.....*Bailey*.....

Length of Test.....*2 hrs*.....

Remarks: (Gravel packing, cementing, packers, type of shutoff).....

Sec 4 T5S. R1E.
Indicate location of well and place of use, if possible. Each small square represents 40 acres.

(Continue on reverse side)

USE—If used for irrigation, industrial, drainage or other. Explain, state number of acres and location or other data (i.e.: Lot, Block and Addition).

Show exact depth of bottom.
40 ft.

This form to be prepared by driller, and three copies to be filed by the owner with the County Clerk and Recorder in the county in which the well is located, tissue copy to be retained by driller.

Please answer all questions. If not applicable, so state, otherwise the form will be returned.

No 27
Driller's License Number

Red L. Ferguson
Driller's Signature

39276

196673

STATE OF MONTANA ss.
COUNTY OF STILLWATER

I hereby certify that the above instrument was filed and indexed in this office

on the 6th day of July
A. D. 1956 at 10:59 o'clock A.

Gertrude H. Calhoun
COUNTY RECORDER

Deputy

Handwritten notes and signatures on the left side of the page, including "1956" and "July 6th".

Vertical handwritten notes and signatures running down the center of the page.

Vertical handwritten notes and signatures on the right side of the page.

Handwritten notes and signatures in the bottom left corner.

File No. **194936**

T. **59** R. **16E**

TRIPPLICATE WATER RESOURCES BOARD
RECEIVED

County *Stillwater*

STATE OF MONTANA
OCT 24 1967 ADMINISTRATOR OF GROUNDWATER CODE
OFFICE OF STATE ENGINEER

**Notice of Completion of Groundwater Appropriation
Without Well**

Developed After January 1, 1962

(Under Chapter Montana Session Laws, 1961)

Date of Appropriation of Groundwater **August 7, 1967**

Owner **George M Schwenneker** Address **Fishtail, Mont**

Contractor (if any)

Address of Contractor

Date Started Date Completed

1) Describe means of obtaining groundwater (as by sub-irrigation, developed spring, drains, etc.) **3 springs**

#1 & #3 undeveloped springs

#2 dug out and rock & cement wall put in.

2) Means of withdrawing water (gravity, pump, canal, etc.)

all just natural flow

3) Depth of water table

4) Use of the water **stock water**

5) Amount of groundwater claimed (in miner's inches, or gallons per minute) **15 to 20 gallons per minute**

6) If used for irrigation, give number of acres and description of land **NA**

360,000 gallons depending on amount of stock

7) Estimate amount of water used each year

Signature of Owner *George M Schwenneker*

Date **August 7, 1967**

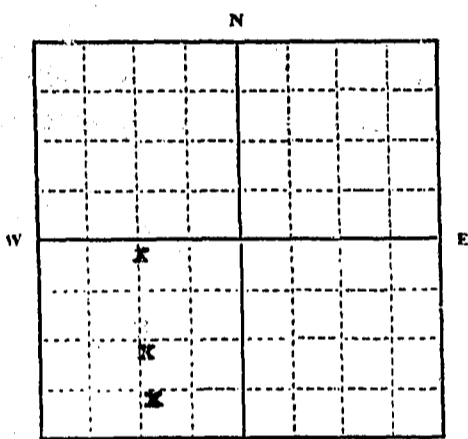

#1 NW 1/4 SW 1/4 Sec 4 T 5 R 16
#2 SW 1/4 SW 1/4 Sec 4 T 59 R 16 E
#3

Indicate point of appropriation and place of use, if possible.

This form to be prepared by contractor (if any), otherwise by the owner.

Three copies of this notice are to be filed with the County Clerk and Recorder of the county in which the works are located.

Please answer all questions. If not applicable, so state, otherwise the form will be returned.

194936

STATE OF MONTANA ss.
COUNTY OF STILLWATER

I hereby certify that the above instru-
ment was filed and indexed in this office
on the 7th day of Aug
A. D. 1967, at 9:30 o'clock A.M.

Thomas S. Shaw
COUNTY CLERK

By _____ Deputy

File No. **202155**

T. R. R. **4**

QUADRUPPLICATE

MAR 30 1971

County **Stillwater**

STATE OF MONTANA
ADMINISTRATOR OF GROUNDWATER CODE
OFFICE OF STATE ENGINEER

Notice of Completion of Groundwater Appropriation
Without Well

Developed After January 1, 1962

(Under Chapter 237 Montana Session Laws, 1961)

STATE OF MONTANA
COUNTY OF STILLWATER

I hereby certify that the above instrument was filed in my office on the **MAR 22 1971** A. D. at **Stillwater** M.

Ed Helms
COUNTY RECORDER

By _____ Deputy

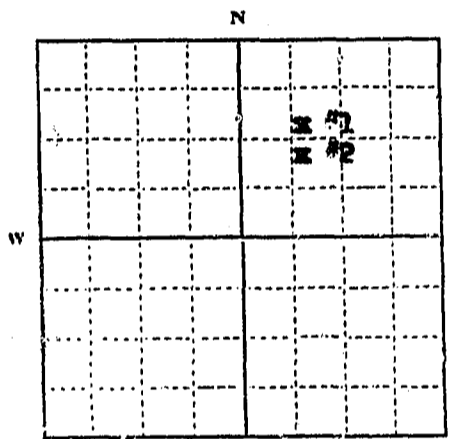

NE NE ^S 1/4 Sec. 4 T. 59 R. 16E

Indicate point of appropriation and place of use, if possible.

Date of Appropriation of Groundwater **March 22, 1971**

Owner **Robert M. & Ina M. Wingo** Address **Fishkill, Mont.**

Contractor (if any) _____

Address of Contractor _____

Date Started _____ Date Completed _____

1) Describe means of obtaining groundwater (as by sub-irrigation, developed spring, drains, etc.) _____

#1 - Developed spring; #2 undeveloped spring

2) Means of withdrawing water (gravity, pump, canal, etc.) _____

Both gravity

3) Depth of water table **Unknown**

4) Use of the water **Stock watering**

5) Amount of groundwater claimed (in mixer's inches, or gallons per minute) _____

10 gal. per min. (estimate) each spring

6) If used for irrigation, give number of acres and description of land _____

7) Estimate amount of water used each year _____

Used year around

for watering cattle.

Signature of Owner _____

Date **3-22-71**

This form to be prepared by contractor (if any), otherwise by the owner.

Three copies of this notice are to be filed with the County Clerk and Recorder of the county in which the works are located.

Please answer all questions. If not applicable, so state, otherwise the form will be returned.

48213

T. 5S R. 16E
County Stillwater

MONTANA BUREAU OF MINES AND GEOLOGY
Butte, Montana

RECEIVED
APR 2 1960

WATER WELL LOG STATE ENGINEER

Owner Rosebud Cemetery District Address Absarokee, Montana

Driller B & H Drilling Address Fishtail, Mont.

Date Started 4/4/60 Date Completed 4/8/60

Location: Sec. 4 T. 5S R. 16E 1/4 sec. NW 1/4 SW 1/4

Type of well Drilled (Dug, driven, bored, or drilled) Equipment used Churn Drill (Churn drill, rotary, other)

Water use: Domestic Municipal Stock Irrigation
Industrial Drainage Other:

Casing: 0 ft. to 65 ft. Type Black Iron Size 6 in. I.D.

Casing: ft. to ft. Type Size

Casing: ft. to ft. Type Size

Perforated or Screened: Ft. to ft. Ft. to ft.

Type of screen or perforations

Static Water level, for non-flowing well: 35 feet.

Shut-in pressure, for flowing well: lb./sq. in. on: (date)

Pumping water level 100 feet at 5 1/2 gal. per min.

How tested: Baler

Length of test One hr

Remarks: (Gravel packing, cementing, packers, type of shut-off, depth of shut-off)
had 3 gal per min used dry ice and got about 5 1/2 or 6 gals per min.

T 5S R 16E

County Stillwater

MONTANA BUREAU OF MINES AND GEOLOGY
Butte, Montana

RECEIVED
APR 15 1961

WATER WELL LOG Form 10 STATE ENGINEER

x	5		

Owner John Sloss Address Fishtail, Mont

Driller B & H Drilling Address Fishtail, Mont

Date Started 4/1/61 Date Completed 4/3/61

Location: Sec. 5 T 5S R 16E 1/4 sec. SW 1/4

Type of well Drilled (Dug, driven, bored, or drilled) Equipment used Churn Drill (Churn drill, rotary, other)

Water use: Domestic Municipal Stock Irrigation
Industrial Drainage Other: _____

Casing: 0 ft. to 157 ft. Type Black Size 55/8

Casing: _____ ft. to _____ ft. Type _____ Size _____

Casing: _____ ft. to _____ ft. Type _____ Size _____

Perforated or Screened: Ft. _____ to ft. _____ Ft. _____ to ft. _____

Type of screen or perforations _____

Static Water level, for non-flowing well: 122 feet.

Shut-in pressure, for flowing well: _____ lb./sq. in. on: _____ (date)

Pumping water level: 110 feet at 15 gal. per min.

How tested: Baler

Length of test: One Hr.

Remarks: (Gravel packing, cementing, packers, type of shut-off, depth of shut-off)



(over)

5

T. 5S R. 16E
County Stillwater

MONTANA BUREAU OF MINES AND GEOLOGY
Butte, Montana

RECEIVED
10 1961

WATER WELL LOG

STATE ENGINEER

	x	
	5	

Owner John Sloss Address Fishtail, Mont
 Driller B & H Drilling Address Fishtail, Mont
 Date Started 10/15/61 Date Completed 10/17/61
 Location: Sec. 5 T. 5S R. 16E 1/4 sec. SE 1/4

Type of well _____ (Dug, driven, bored, or drilled) Equipment used _____ (Churn drill, rotary, other)

Water use: Domestic Municipal Stock Irrigation
 Industrial Drainage Other: _____

Casing: 2 ft. to 133 ft. Type Galv 20 Gauge Size 6 in.

Casing: _____ ft. to _____ ft. Type _____ Size _____

Casing: _____ ft. to _____ ft. Type _____ Size _____

Perforated or Screened: Ft. _____ to ft. _____ Ft. _____ to ft. _____

Type of screen or perforations: _____

Static Water level, for non-flowing well: 117 feet.

Shut-in pressure, for flowing well: _____ lb./sq. in. on: _____ (date)

Pumping water level 128 feet at 10 gal. per min.

How tested: Bailer

Length of test One Hr.

Remarks: (Gravel packing, cementing, packers, type of shut-off, depth of shut-off)

GW:

File No. 186373

T. 45 R. 20E

DUPLICATE

County Stillwater

10

STATE OF MONTANA
ADMINISTRATOR OF GROUNDWATER CODE
OFFICE OF STATE ENGINEER

Notice of Completion of Groundwater Appropriation Without Well

(Under Chapter 237 Montana Session Laws, 1961)

Date of Appropriation of Groundwater 1916
Owner Elizabeth M Reily Address Columbus, Montana
Contractor (if any) Unknown
Address of Contractor --
Date Started 1919 Date Completed 1919

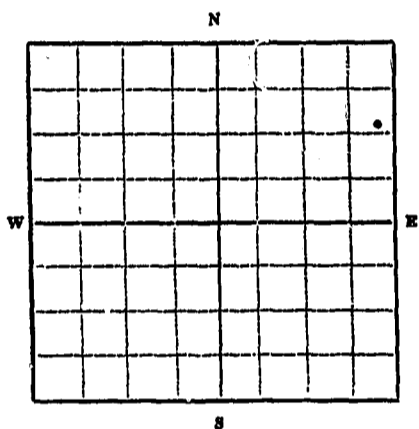

Describe means of obtaining groundwater without a well "as by sub-irrigation and other natural processes". Include depth to water when applicable. Developed in 1919. Completely cemented and springs boxed off. Pumped and piped by hydraulic ram to the house. Overflow piped into tank for stock water.

Quantity of water developed and used with explanation of method used to measure or estimate such amount. If use is intermittent estimate approximate lengths of periods of use Runs 2 - 2" pipes continuously. Used the year around for both house and stock.

SE 1/4 NE Sec 10 T45 R20E
Indicate point of appropriation and place of use, if possible.

Signature of Owner Elizabeth M Reily
Date Dec. 11th, 1963

This form to be prepared by contractor (if any), otherwise by the owner.
Three copies of this notice are to be filed with the County Clerk and Recorder of the county in which the works are located.
Please answer all questions. If not applicable, so state, otherwise the form will be returned.
Original to the County Clerk and Recorder; duplicate to the State Engineer; Triplicate to the Montana Bureau of Mines and Geology and Quadruplicate for the Appropriator.

8752

186373

STATE OF MONTANA
COUNTY OF STILLWATER

I hereby certify that the above instrument was filed and indexed in this office

on the 11th day of December

A. D. 193, at Five o'clock P. M.

Gertrude H. Colson

COUNTY RECORDER

By _____ Deputy

207657 RECEIVED
3 GW 3 Revised 1969
2057-1500-1/71

JUL 18 1973

County Stillwater

10

STATE OF MONTANA
MONTANA ADMINISTRATOR OF GROUNDWATER CODE
RESOURCES MONTANA WATER RESOURCES BOARD

NOTICE OF COMPLETION OF GROUNDWATER APPROPRIATION WITHOUT WELL
Developed After January 1, 1962

(Under Chapter 237, Montana Session Laws, 1961, as amended)

This form to be prepared by contractor (if any), otherwise by the owner.
Three copies of this notice are to be filed with the County Clerk and Recorder of the county in which the works are located.

Please answer all questions. If not applicable, so state, otherwise the form may be returned.

For Administrator's Use	
File	<u>207657</u>
	<u>June 29, 1973</u>
GW 1	

Owner John P. Rouane
 Address Columbus, Mont
 Contractor (if any) self
 Address of Contractor _____
 Date Started _____ Date Completed _____

1. Describe means of obtaining groundwater (as by sub-irrigation, developed spring, drains, etc.)
developed spring

2. Means of withdrawing water (gravity, pump, canal, etc.)
gravity

3. Depth of water table _____

4. Use of the water
livestock

5. Amount of groundwater claimed (in miner's inches or gallons per minute) _____

6. If used for irrigation, give number of acres and description of land _____

7. Estimate amount of water used each year _____

8. Months of year spring flows 1-2 months

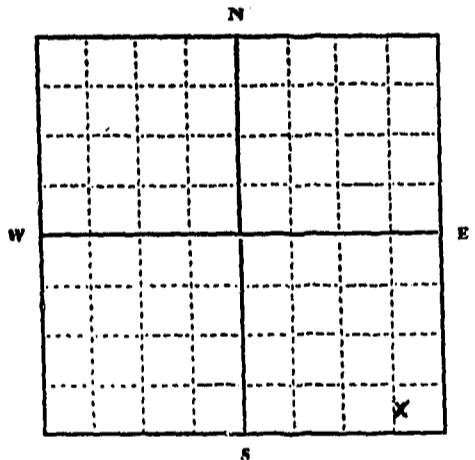

SE 1/4 SE 1/4 Sec. 10
 T. 4 N. R. 20 E. 10
 S. 10 W.

INDICATE POINT OF APPROPRIATION AND PLACE OF USE, IF POSSIBLE.
 Elevation of spring, if known or estimated _____

Signature of Owner John P. Rouane
 Date 6-28-73

56163

207657

Office of Clerk & Recorder
Stillwater County, Montana
I hereby certify that the foregoing instrument was filed & recorded in public records on the 29 day of JUN 1973 at 6:10 PM
Thelma Shaw
COUNTY RECORDER

by _____ DEPUTY

OFFICE OF THE COMMISSIONER OF GEORGETOWN
NORTH CAROLINA
STATE OF NORTH CAROLINA
COUNTY OF GEORGETOWN
RECORDED
JUN 29 1973
6:10 PM

NO INSTRUMENTS HAVE BEEN FILED IN THIS COUNTY SINCE THE DATE OF THE LAST RECORDING IN THIS COUNTY. THE RECORDS OF THIS COUNTY ARE COMPLETELY UP TO DATE AND CORRECT.

207655 RECEIVED
3 GW 3 Revised 1969
2057-1500-1/71

County Stillwater

JUL 18 1973 STATE OF MONTANA
ADMINISTRATOR OF GROUNDWATER CODE

MONTANA DEPARTMENT OF NATURAL RESOURCES
MONTANA WATER RESOURCES BOARD
REGULATORY AND CONSERVATION

14

NOTICE OF COMPLETION OF GROUNDWATER APPROPRIATION WITHOUT WELL
Developed After January 1, 1952

(Under Chapter 237, Montana Session Laws, 1961, as amended)

This form to be prepared by contractor (if any), otherwise by the owner.
Three copies of this notice are to be filed with the County Clerk and Recorder of the county in which the works are located.
Please answer all questions. If not applicable, so state, otherwise the form may be returned.

For Administrator's Use	
File	<u>207655</u>
	<u>April 29, 1973</u>
GW 1	

Owner John P. Richard Ravana
 Address Columbia Point
 Contractor (if any) self
 Address of Contractor _____
 Date Started _____ Date Completed _____

1. Describe means of obtaining groundwater (as by sub-irrigation, developed spring, drains, etc.) _____

2 developed springs

2. Means of withdrawing water (gravity, pump, canal, etc.) _____

gravity

3. Depth of water table _____

10 to 15 ft

4. Use of the water _____

limited

5. Amount of groundwater claimed (in miner's inches or gallons per minute) _____

6. If used for irrigation, give number of acres and description of land _____

7. Estimate amount of water used each year _____

8. Months of year spring flows 12 months

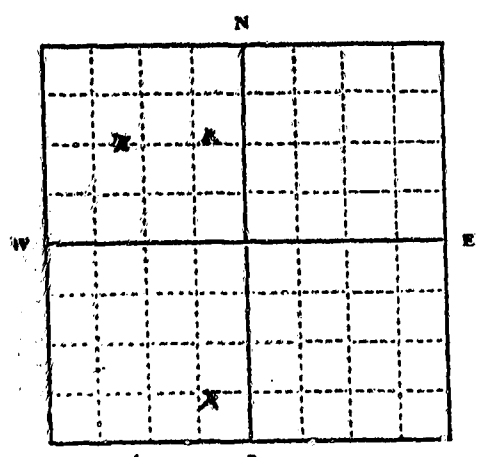

SE 1/4 SW 1/4 Sec 14
NE 1/4 NW 1/4 Sec 14
 T. 4 S. R. 20 E. W

INDICATE POINT OF APPROPRIATION AND PLACE OF USE, IF POSSIBLE.
 Elevation of spring, if known or estimated _____

Signature of Owner John P. Ravana
 Date 6-27-73

56164

207655 RECEIVED

County Stillwater

JUL 18 1973 STATE OF MONTANA
ADMINISTRATOR OF GROUNDWATER CODE
MONTANA DEPARTMENT OF NATURAL RESOURCES AND CONSERVATION
MONTANA WATER RESOURCES BOARD

14

NOTICE OF COMPLETION OF GROUNDWATER APPROPRIATION WITHOUT WELL
Developed After January 1, 1962

(Under Chapter 237, Montana Session Laws, 1961, as amended)

This form to be prepared by contractor (if any), otherwise by the owner.
Three copies of this notice are to be filed with the County Clerk and Recorder of the county in which the works are located.
Please answer all questions. If not applicable, so state, otherwise the form may be returned.

For Administrator's Use	
File	<u>207655</u>
	<u>April 29, 1973</u>
GW 1	

Owner John P. & Pearl Roseana
Address Columbus Mont
Contractor (if any) self
Address of Contractor _____
Date Started _____ Date Completed _____

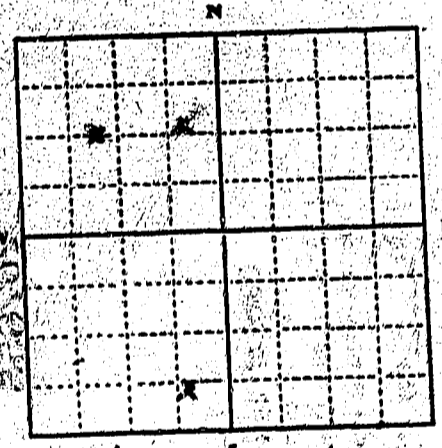

SE 1/4 SW 1/4 Sec 14
NE 1/4 NW 1/4 Sec 14
T. 11 S. R. 20 E.

INDICATE POINT OF APPROPRIATION AND PLACE OF USE, IF POSSIBLE.
Elevation of spring, if known or estimated _____

- Describe means of obtaining groundwater (as by sub-irrigation, developed spring, drains, etc.)
2 developed spring
- Means of withdrawing water (gravity, pump, canal, etc.)
gravity
- Depth of water table 10 to 15
- Use of the water livestock
- Amount of groundwater claimed (in miner's inches or gallons per minute) _____
- If used for irrigation, give number of acres and description of land _____
- Estimate amount of water used each year _____
- Months of year spring flows 12 months

Signature of Owner John P. Roseana
Date 6-28-73

56164

207655

Office of Clerk & Recorder
Stillwater County, Montana

I hereby certify that the above instru-
ment was filed & indexed in this office

on the JUN 29 1913 day of

AD 1913, at 6:00 PM

Thelma Shaw

pd 20c

By _____ DEPUTY

STILLWATER COUNTY
STATE OF MONTANA

File No. 18668 ADMINISTRATOR OF GROUNDWATER CODE
OFFICE OF STATE ENGINEER

Twp 14S, Rge 20 E

DECLARATION OF VESTED GROUNDWATER RIGHTS
(Under Chapter 237, Montana Session Laws, 1961)

JAN 8 1964

STATE ENGINEER

1. Herman A. Hoiness Exr. for, of Columbus, Montana,
Louise Stark Kubischta Est.
County of Stillwater, State of Montana, have appropriated groundwater according to the Montana laws in effect prior to January 1, 1962, as follows:

	Sec. 18	Sec.	Sec.	Sec.	Sec.	Sec.
WELLS	No. 1	No. 2	No. 3	No. 4	No. 5	No. 6
2. Basis of Beneficial Use	Domestic Stock					
3. Approx date of Use	1915					
How continuous?	Cont.					
4. Amount claimed in miner's inches or gallons per min.	35 gal. per min.					
5. Acres irrigated	yard & garden					
Description						
Name of Owner	see above					
6. Location of Well	NESW					
Means of Withdrawal	Elec. pump					
7. Date-Commencement	NA					
Date-Completion						
8. Depth of water table	12'					
9. Type, size, depth or specifications of works	Dug Well					
10. Estimated amount withdrawn annually	350,000					
11. Log, if available	NA					
12. Other information	none					

Hermana Hoiness Executor of estate
Signature of owner *Louise Stark Kubischta*

Date December 31, 1963

Please answer all questions. If not applicable, so state, otherwise the form will be returned.

186688

STATE OF MONTANA ss.
COUNTY OF DEWATER

I hereby certify that the above instru-
ment was filed in my office

on 31st December
1963 at 9:43 o'clock A.M.

Gertrude H. Callison
COURT CLERK & RECORDER

By _____ Deputy

19

Form No. 18
8-60

T. 4S R. 20E

County Stillwater

MONTANA BUREAU OF MINES AND GEOLOGY
Butte, Montana

RECEIVED
AUG 10 1961

WATER WELL LOG

STATE ENGINEER

		X

Owner Ole Pederson Address Columbus, Mont

Driller Ruben Voegele Address Columbus, Mont

Date Started 7/20/61 Date Completed July 20, 61

Location: Sec. 19 T. 4S R. 20 $\frac{1}{4}$ sec. NE

Type of well drilled Equipment used rotary
(Dug, driven, bored, or drilled) (Churn, drill, rotary, other)

Water use: Domestic Municipal Stock Irrigation
Industrial Drainage Other _____

Casing: 0 ft. to 31 ft. Type _____ Size 6 in.

Casing: _____ ft. to _____ ft. Type _____ Size _____

Casing: _____ ft. to _____ ft. Type _____ Size _____

Perforated or Screened: Ft. _____ to ft. _____. Ft. _____ to ft. _____

Type of screen or perforations _____

Static Water level, for non-flowing well: _____ feet.

Shut-in pressure, for flowing well: _____ lb./sq. in. on: _____ (date)

Pumping water level _____ feet at _____ gal. per min. _____

How tested: _____

Length of test _____

Remarks: (Gravel packing, cementing, packers, type of shut-off, depth of shut-off)

(over)

Form No. 18
8-60

19

T. 4S R. 20E
County Stillwater

MONTANA BUREAU OF MINES AND GEOLOGY
Butte, Montana

RECEIVED
AUG 10 1961

WATER WELL LOG

STATE ENGINEER

		*

Owner Arvid Wilson Address Roberts, Mont
Driller Voegele Address Columbus, Mont
Date Started 7/18/61 Date Completed 7/19/61
Location: Sec. 19 T. 4S R. 20E $\frac{1}{4}$ sec. NE

Type of well Drilled Equipment used Rotary Drill
(Dug, driven, bored, or drilled) (Churn, drill, rotary, other)

Water use: Domestic Municipal Stock Irrigation
Industrial Drainage Other _____

Casing: 0 ft. to 35 ft. Type _____ Size 5"

Casing: _____ ft. to _____ ft. Type _____ Size _____

Casing: _____ ft. to _____ ft. Type _____ Size _____

Perforated or Screened: Ft. _____ to ft. _____. Ft. _____ to ft. _____

Type of screen or perforations _____

Static Water level, for non-flowing well: _____ feet.

Shut-in pressure, for flowing well: _____ lb./sq. in. on: _____ (date)

Pumping water level 30 feet at _____ gal. per min. 2

How tested: _____

Length of test _____

Remarks: (Gravel packing, cementing, packers, type of shut-off, depth of shut-off)

(over)

File No. 187038

T. 45 R. 20 E

DUPLICATE

Count Stillwater

STATE OF MONTANA
ADMINISTRATOR OF GROUNDWATER CODE
OFFICE OF STATE ENGINEER

RECEIVED
FEB 3 1964
STATE ENGINEER

Top of Ground 0-4 TOP Soil

(Elev. above sea level.....)

Notice of Completion of Groundwater Appropriation by Means of Well

(Under Chapter 237, Montana Session Laws, 1961)

(water)

4-18 Soft Grey Shale

Owner Robert J. Patterson Address Columbus, Mont

Driller B+H Drilling Address Fichtel, Mont.

Date of Notice of Appropriation of Groundwater.....

Date well started 1/6/64 Date Completed 1/10/64

Type of well Drilled Equipment Used Churn Drill
(dug, driven, bored or drilled) (Churn, drill, rotary or other)

Water Use: Domestic Municipal Other Irrigation
Industrial Drainage Stock

Indicate on the diagram the character and thickness of the different strata met with in drilling, such as soil, clay, shale, gravel, rock or sand, etc. Show depth at which water is encountered, thickness and character of water-bearing strata and height to which water rises in the well.



Size of Drilled Hole	Size and Weight of Casing	From (Feet)	To (Feet)	PERFORATIONS		
				Kind Size	From (Feet)	To (Feet)
6 inch	6 5/8 19#	0	12 1/2			
5 inch lined	16 #	12	110		12	18
					98	104

18-110 Grey Shale

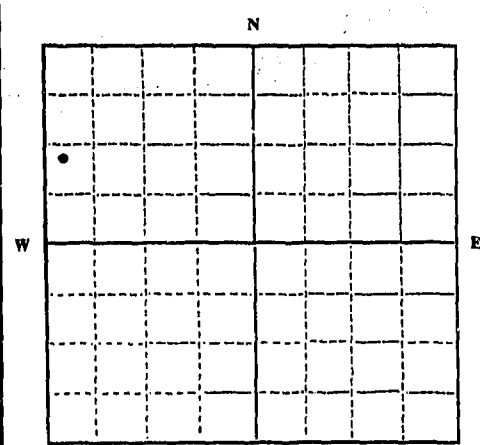

SW 1/4 NW Sec. 21 T. 45 R. 20 E.

Indicate location of well and place of use, if possible. Each small square represents 10 acres.

Show exact depth of bottom.

Static Water Level for non-flowing Well 12 feet.

Shut-in Pressure for Flowing Well.....

Pumping Water Level 100 feet at 2.5 gal. per minute.

Discharge in gal. per min. of flowing well.....

How Tested Bales Length of Test one hr.

Remarks: (Gravel packing, cementing, packers, type of shutoff, location of place of use of groundwater if not at well, and any other similar pertinent information, including number of acres irrigated, if used for irrigation).....

110

No 27
Driller's License Number

Red L Hanger
Driller's Signature

This form to be prepared by driller, and three copies to be filed by the owner with the County Clerk and Recorder in the county in which the well is located.

Please answer all questions. If not applicable, so state, otherwise the form will be returned.

Original to the County Clerk and Recorder; duplicate to the State Engineer; Triplicate to the Montana Bureau of Mines and Geology and Quadruplicate for the Appropriator.

34805

[Faint, mostly illegible text, possibly a recording or index reference]

[Handwritten notes and markings, including what appears to be a date '31st' and some numbers]

[Handwritten notes, possibly '1914' and other illegible text]

187038

STATE OF MONTANA ss.
COUNTY OF STILLWATER

I hereby certify that the above instrument was filed and indexed in this office on the 31st day of January, A. D. 1914, at 11:45 o'clock P.M.
Hester H. Colburn
COUNTY CLERK

By _____ Deputy

23

T. 4S R. 20E
County Stillwater

MONTANA BUREAU OF MINES AND GEOLOGY
Butte, Montana

RECEIVED
JAN 13 1961

WATER WELL LOG

STATE ENGINEER

Owner Tom Patterson Jr. Address Columbus, Mont
Driller B & H Drilling Address Fishtail, Mont
Date Started 1/5/61 Date Completed 1/6/61
Location: Sec. 23 T. 4S R. 20E 1/4 sec. SE 1/4 SW 1/4

Type of well Drilled (Dug, driven, bored, or drilled) Equipment used Churn Drill (Churn drill, rotary, other)

Water use: Domestic Municipal Stock Irrigation
Industrial Drainage Other: _____

Casing: 4 ft. to 18 ft. Type Black Size 6 in

Casing: _____ ft. to _____ ft. Type _____ Size _____

Casing: _____ ft. to _____ ft. Type _____ Size _____

Perforated or Screened: Ft. _____ to ft. _____ Ft. _____ to ft. _____

Type of screen or perforations: _____

Static Water level, for non-flowing well: 16 feet.

Shut-in pressure, for flowing well: _____ lb./sq. in. on: _____ (date)

Pumping water level: 30 feet at 30 gal. per min.

How tested: Baler

Length of test: One Hr.

Remarks: (Gravel packing, cementing, packers, type of shut-off, depth of shut-off)



(over)

23

Form No. 18
8-60

T. 48 R. 202

County Saltwater

RECEIVED
MAY 27 1961

MONTANA BUREAU OF MINES AND GEOLOGY
Butte, Montana

STATE ENGINEER

WATER WELL LOG

Owner Tom Patterson Address Columbus, Mont

Driller B & H Drilling Address Platfall, Mont

Date Started 5/27/61 Date Completed 5/28/61

Location: Sec. 23 T. 48 R. 202 $\frac{1}{4}$ sec. _____

Type of well Drilled Equipment used Churn Drill
(Dug, driven, bored, or drilled) (Churn, drill, rotary, other)

Water use: Domestic Municipal Stock Irrigation
Industrial Drainage Other _____

Casing: 1 ft. to 32 ft. Type Black Size 6 in

Casing: _____ ft. to _____ ft. Type _____ Size _____

Casing: _____ ft. to _____ ft. Type _____ Size _____

Perforated or Screened: Ft. _____ to ft. _____. Ft. _____ to ft. _____

Type of screen or perforations _____

Static Water level, for non-flowing well: 23 feet.

Shut-in pressure, for flowing well: _____ lb./sq. in. on: _____ (date)

Pumping water level 80 feet at 5 gal. per min. _____

How tested: Blow

Length of test One Hr.

Remarks: (Gravel packing, cementing, packers, type of shut-off, depth of shut-off)

(over)

GW 3 180658
File No. _____

45 20
T ~~45~~ R ~~20~~
County of Stillwater

STATE OF MONTANA
ADMINISTRATOR OF GROUNDWATER CODE
OFFICE OF STATE ENGINEER

JAN 8 1964
STATE ENGINEER

Notice of Completion of Groundwater Appropriation Without Well
(Under Chapter 237 Montana Session Laws, 1961)

Date of Appropriation of Groundwater 1917

Owner Louise Kubischta Est by ^{Herman} E. Hoiness Address Columbus

Contractor (if any) _____

Address of Contractor _____

Date Started _____ Date Completed _____

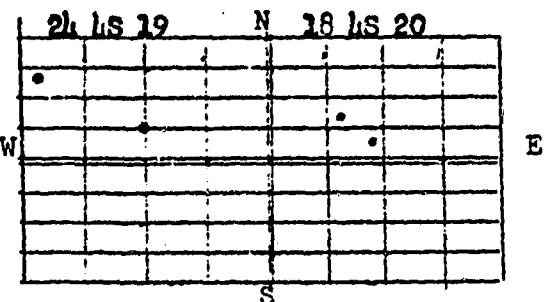

see map 4 Sec. 4 T 4 R 4
Indicate point of appropriation and place of use, if possible.

Describe means of obtaining groundwater without a well "as by sub-irrigation and other natural processes". Include depth to water when applicable
Natural free flowing springs

not developed

Quantity of water developed and used with explanation of method used to measure or estimate such amount. If use is intermittent estimate approximate lengths of periods of use _____

Good live springs that flow year around used for stock use

Signature of Owner Louise Kubischta
Herman E. Hoiness, executor of estate of Louise Kubischta

Date December 21, 1963

STATE OF MONTANA)
County of Carbon) ss.

E. Hoiness Having first been duly sworn, depose and say that he of lawful age and the executor of the appropriator and claimant of the order and water right mentioned in the foregoing notice of completion of groundwater appropriation without well and the person whose name is subscribed thereto, as the appropriator and claimant, that he know is the contents of said foregoing notice and that the matters and things therein stated are true.

Herman E. Hoiness, executor of estate of Louise Kubischta

Subscribed and sworn to before me, this 31 day of December, 19 63

Notary Public for the State of Montana
Residing at Columbus, Montana
My Commission expires Dec 30 19 64

27629

28

Form No. 18
8-60

T. 4S R. 20E

County Stillwater

MONTANA BUREAU OF MINES AND GEOLOGY
Butte, Montana

RECEIVED
MAY 10 1961

WATER WELL LOG

STATE ENGINEER

		X	

Owner Arvid Wilson Address Roberts, Mont

Driller Voegele Address Columbus, Montana

Date Started 7/19/61 Date Completed 7/19/61

Location: Sec. 28 T. 4S R. 20E $\frac{1}{4}$ sec. NE

Type of well Drilled Equipment used Rotary Drill
(Dug, driven, bored, or drilled) (Churn, drill, rotary, other)

Water use: Domestic Municipal Stock Irrigation
Industrial Drainage Other _____

Casing: 0 ft. to 50' ft. Type _____ Size 6"

Casing: _____ ft. to _____ ft. Type _____ Size _____

Casing: _____ ft. to _____ ft. Type _____ Size _____

Perforated or Screened: Ft. _____ to ft. _____. Ft. _____ to ft. _____

Type of screen or perforations _____

Static Water level, for non-flowing well: _____ feet.

Shut-in pressure, for flowing well: _____ lb./sq. in. on: _____
(date)

Pumping water level 30 feet at _____ gal. per min. 3

How tested: _____

Length of test _____

Remarks: (Gravel packing, cementing, packers, type of shut-off, depth of shut-off)

(over)

RECEIVED

207604
3 GW 3 Revised 1969
2057-1500-1/71

JUL 1 1973

County STILLWATER

MONTANA DEPARTMENT OF NATURAL RESOURCES AND CONSERVATION
STATE OF MONTANA
ADMINISTRATOR OF GROUNDWATER CODE
MONTANA WATER RESOURCES BOARD

NOTICE OF COMPLETION OF GROUNDWATER APPROPRIATION WITHOUT WELL

Developed After January 1, 1962

(Under Chapter 237, Montana Session Laws, 1961, as amended)

This form to be prepared by contractor (if any), otherwise by the owner.

Three copies of this notice are to be filed with the County Clerk and Recorder of the county in which the works are located.

Please answer all questions. If not applicable, so state, otherwise the form may be returned.

For Administrator's Use	
File	<u>207604</u>
	<u>June 29, 1973</u>
GW 1	<u>3:42 p.m.</u>

Owner RAYMOND F. GUTHRIE, SR.

Address Nye, Montana

Contractor (if any) None

Address of Contractor N/A

Date Started May 1949 Date Completed May 1949

1. Describe means of obtaining groundwater (as by sub-irrigation, developed spring, drains, etc.)

dug wells 12' deep

2. Means of withdrawing water (gravity, pump, canal, etc.)

pumps

3. Depth of water table 6'

4. Use of the water domestic, irrigation & stock

5. Amount of groundwater claimed (in miner's inches or gallons per minute) 10 gallons per minute each well

6. If used for irrigation, give number of acres and description of land yard and garden - 1 acre

7. Estimate amount of water used each year

unknown

8. Months of year spring flows n/a

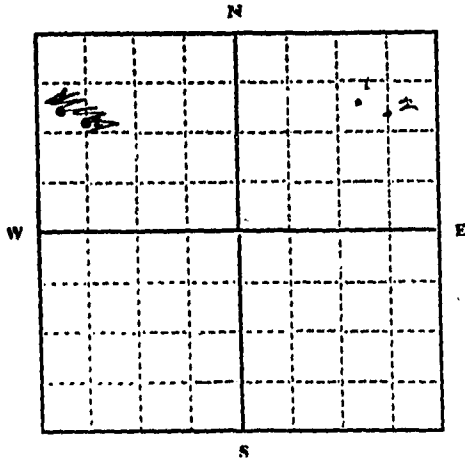

NE 1/4 NE 1/4 Sec. 1

T. 5 R. 15
S E

INDICATE POINT OF APPROPRIATION AND PLACE OF USE, IF POSSIBLE.

Elevation of spring, if known or estimated

Signature of Owner Raymond F. Guthrie, Sr.

Date June 29, 1973

56201

207604

Office of Clerk & Recorder
Stillwater County, Montana

I hereby certify that the above instrument was filed & recorded in this office

on the 29th day of JUN 1973

AD 19 at 3:42 PM

J. Helms Jones
COUNTY RECORDER

By _____ DEPUTY

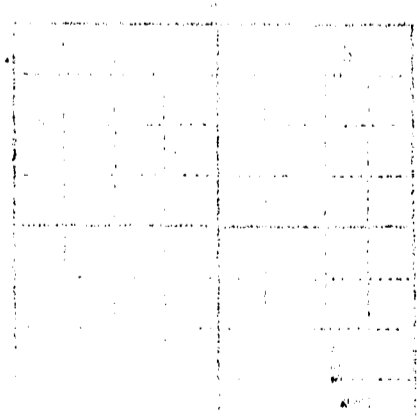

STATE OF MONTANA
COUNTY OF STILLWATER

RECORDED BY _____

INDEXED BY _____

FILED BY _____

GW3

18210

File No.....

Sec. 1 T. 5 South 15 E. M.P.M.

DUPLICATE

County Stillwater

STATE OF MONTANA
ADMINISTRATOR OF GROUNDWATER CODE
OFFICE OF STATE ENGINEER

RECEIVED
APR 24 1962
STATE ENGINEER

Notice of Completion of Groundwater Appropriation Without Well

(Under Chapter 237 Montana Session Laws, 1961)

Date of Appropriation of Groundwater 1915

Owner Peder M. Winge Address Fistail, Mont.

Contractor (if any) None

Address of Contractor None

Date Started 1915 Date Completed 1915 (natural)

Describe means of obtaining groundwater without a well "as by sub-irrigation and other natural processes". Include depth to water when applicable. This is a large natural spring

which forms a lake approximately 1/2 acre in size. This is a gravity spring as located on section plan. No surface digging or widening is necessary, as spring flows constantly creating lake above described.

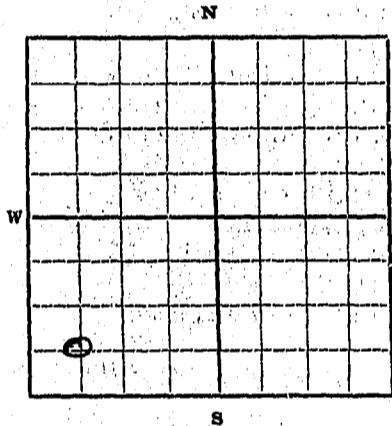

SW 1/4 SW 1/4 of Sec. 1 T. 5 S R. 15 E

Indicate point of appropriation and place of use, if possible.

Quantity of water developed and used with explanation of method used to measure or estimate such amount. If use is intermit-

tent estimate approximate lengths of periods of use The quantity of water flow from this spring exceeds 50 gallons per minute. Use is continuous year-round, never going dry. Water is used as stock water and some garden irrigation.

Signature of Owner Peder M. Winge

Date April 19, 1962

This form to be prepared by contractor (if any), otherwise by the owner.

Three copies of this notice are to be filed with the County Clerk and Recorder of the county in which the works are located.

Please answer all questions. If not applicable, so state, otherwise the form will be returned.

Original to the County Clerk and Recorder; duplicate to the State Engineer; Triplicate to the School of Mines and Quadruplicate for the Appropriator.

o - spring fed 1/2 acre lake

18210-0
STATE OF MONTANA
COUNTY OF STILLWATER
I hereby certify that the above instrument was filed and indexed in this office on the 23 day of April A.D. 1962 at 10:30 o'clock A.M.
Gertrude H. Cochran
COUNTY RECORDER

By _____

190906

R - C E I V E D
AUG 27 1965

File No.

T. R.
5So. 18 E. M.P.M.
County Stillwater

DUPLICATE

REFERRED TO

STATE OF MONTANA
ADMINISTRATOR OF GROUNDWATER CODE
OFFICE OF STATE ENGINEER

Notice of Completion of Groundwater Appropriation
Without Well

(Under Chapter 237 Montana Session Laws, 1961)

No 1 - August 26th, 1965

Date of Appropriation of Groundwater..... No. 2 August 26th, 1965

Owner..... ~~Zootman~~
Pete & Laura A. Zootman Nye, Montana

Contractor (if any) owner

Address of Contractor

Date Started..... No. 1 1948 No. 2 1955
Date Completed.....

Describe means of obtaining groundwater without a well "as by sub-irrigation and other natural processes". Include depth to water when applicable.....

No. 1 Spring cemented and piped to tank

No. 2 Spring cemented and piped to tank

Quantity of water developed and used with explanation of method used to measure or estimate such amount. If use is intermittent

estimate approximate lengths of periods of use.....

No 1 NWSE Sec. 10 T. 5S R. 15 E.

No 2 NWNE Sec. 11 T. 5S R. 15 E.
Indicate point of appropriation and place of use, if possible.

No. 1 - 10 gallons per minute estimated by average

flow through a two inch pipe

No. 2 - 1 gallons per minute estimated by flow

through a 3/4" pipe

Signature of Owner *Pete Zootman Laura A Zootman*

Date..... August 26th, 1965

This form to be prepared by contractor (if any), otherwise by the owner.

Three copies of this notice are to be filed with the County Clerk and Recorder of the county in which the works are located.

Please answer all questions. If not applicable, so state, otherwise the form will be returned.

Original to the County Clerk and Recorder; duplicate to the State Engineer; Triplicate to the Montana Bureau of Mines and Geology and Quadruplicate for the Appropriator.

190906

STATE OF MONTANA } ss.
COUNTY OF STILLWATER }

I hereby certify that the above instrument was filed and indexed in this office on the 26 day of August A. D. 1965, at 8:45 o'clock A. M.

Gertrude H. Colman
COUNTY RECORDER

By _____ Deputy

201422 53-15E-41

County Stillwater

STATE OF MONTANA
ADMINISTRATOR OF GROUNDWATER CODE
MONTANA WATER RESOURCES BOARD

NOV 9 1970

DRILLER'S LOG

Indicate the character, color, thickness of strata such as soil, clay, sand, gravel, shale, sandstone, etc. Show depth at which water is found and height to which water rises in well.

NOTICE OF COMPLETION OF GROUNDWATER APPROPRIATION BY MEANS OF WELL

Developed after January 1, 1962

(Under Chapter 237 Montana Session Laws, 1961, as amended)

This form to be prepared by driller, and three copies to be filed by the owner with the County Clerk and Recorder in the county in which the well is located, last copy to be retained by driller. Please answer all questions. If not applicable, so state, otherwise the form may be returned.

Owner Gilbert Leak

Address Ngay, Mont.

Date well started 9/17/70
completed 9/18/70

Type of well Drilled
(Dug, driven, bored or drilled)

Equipment used Churn drill
(Churn drill, rotary or other)

Water Use: Domestic Municipal Stock Irrigation
Industrial Drainage Other * Garden/Lawn

*Describe _____
USE: If used for irrigation, industrial, drainage or other. Explain, state number of acres and location or other data (i.e. Lot, Block and Addition).

ESTIMATED ANNUAL WITHDRAWAL 400,000 Gals

Size of Drilled Hole	Size and Weight of Casing	From (Feet)	To (Feet)	PERFORATIONS		
				Kind Size	From (Feet)	To (Feet)
6 inch	65/8 18.97	1+	34	Tech Cuts 1/8 X 6	30	34

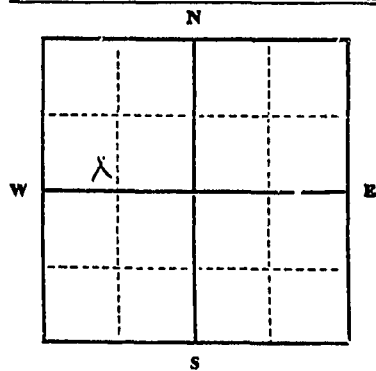

Static water level 4 ft.*
Pumping water level 15 ft.*
at 30 gallons per minute,
measured 5 minutes after pumping
began.

*Measured from ground level.
Well developed by Gravel
for 2 hours.
Power _____ Pump _____ HP
Remarks: (Gravel packing, cementing,
packers, type of shutoff)

Sec. 11
T. 55 N. R. 15E E
S W

INDICATE LOCATION OF WELL AND PLACE OF USE, IF POSSIBLE. EACH SMALL SQUARE REPRESENTS 40 ACRES.

Driller's Signature Doc L. Hargrave

Driller's Address Fishtail, Mont.

LICENSE NO. 37

Top of Ground (Elev. above sea level) 5300

From (Feet)	To (Feet)	
0	3	TOP SOIL
3	14	Shale + 1/2" pebbles
14	34	Sand + gravel

STATE OF MONTANA
COUNTY OF STILLWATER

I hereby certify that the above is true and correct as shown in this office on the 16th day of Nov 1970 at 8:15 o'clock A.M.

Thelma L. Shaw
COUNTY RECORDER

By _____ Deputy

34/15 Show exact depth of bottom

417731

RECEIVED 206687

3 GW 3 Revised 1969
2057-1500-1/71

APR 11 1973

County Stillwater

STATE OF MONTANA
MONTANA DEPARTMENT OF NATURAL RESOURCES AND CONSERVATION
ADMINISTRATOR OF GROUNDWATER CODE
MONTANA WATER RESOURCES BOARD

NOTICE OF COMPLETION OF GROUNDWATER APPROPRIATION WITHOUT WELL
Developed After January 1, 1962

(Under Chapter 237, Montana Session Laws, 1961, as amended)

This form to be prepared by contractor (if any), otherwise by the owner.

Three copies of this notice are to be filed with the County Clerk and Recorder of the county in which the works are located.

Please answer all questions. If not applicable, so state, otherwise the form may be returned.

For Administrator's Use	
File	<u>206687</u>
	<u>March 8, 1973</u>
GW 1	<u>4:15 p.m.</u>

Owner Kenneth M. and Virginia Doze
 Address 1530 Parkhill Drive, Billings, Montana
 Contractor (if any) None - by Owner
 Address of Contractor _____
 Date Started 1964 Date Completed 1965

1. Describe means of obtaining groundwater (as by sub-irrigation, developed spring, drains, etc.) a developed spring.

2. Means of withdrawing water (gravity, pump, canal, etc.) gravity

3. Depth of water table 20 feet

4. Use of the water For domestic and livestock use.

5. Amount of groundwater claimed (in miner's inches or gallons per minute) Approx. 30 gal. per min.

6. If used for irrigation, give number of acres and description of land _____

7. Estimate amount of water used each year Unlimited

8. Months of year spring flows Year round

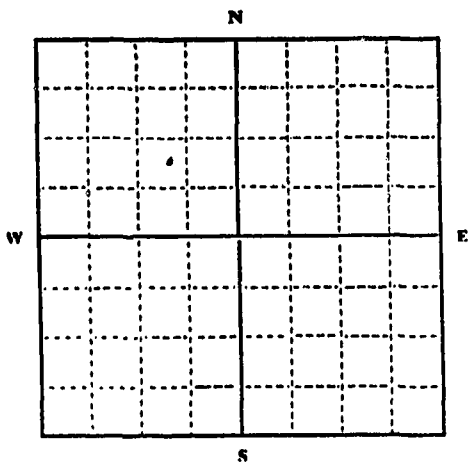

NW 1/4 Sec. 11
T. 5 S. R. 15 E.

INDICATE POINT OF APPROPRIATION AND PLACE OF USE, IF POSSIBLE.
Elevation of spring, if known or estimated 5000 feet

Signature of Owner Kenneth M. Doze
Virginia R. Doze
Date March 8, 1973

NEW TROTTING MACHINES WITHOUT A
SPECIAL LICENSE
EXPIRES 11/1/73

REGISTRATION AS 1981

...

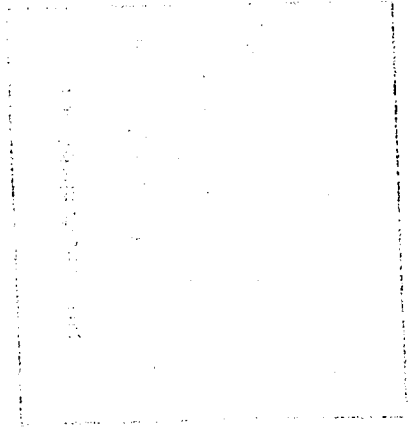

...

Office of Clerk & Recorder
of New York County, New York
I hereby certify that the foregoing instrument was filed & recorded in this office
on the 8 day of MAR 1973
At 4:15 PM
J. Helman
COUNTY RECORDER
By _____ DEPUTY

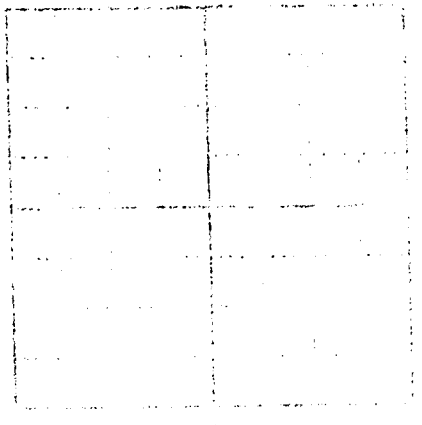

...

...

File No. 207360

T. S R. 15 County Stillwater

DUPLICATE

STATE OF MONTANA
ADMINISTRATOR OF GROUNDWATER CODE
OFFICE OF STATE ENGINEER

Notice of Completion of Groundwater
Appropriation by Means of Well

(Under Chapter 237, Montana Session Laws, 1961)

Owner Henry Waldo Address Tye, Mt.

Driller..... Address.....

Date of Notice of Appropriation of Groundwater.....

Date well started..... Date Completed.....

Type of well..... Equipment Used.....
(dug, driven, bored or drilled) (Churn, drill, rotary or other)

Water Use: Domestic Municipal Other Irrigation
Industrial Drainage Stock

Indicate on the diagram the character and thickness of the different strata met with in drilling, such as soil, clay, shale, gravel, rock or sand, etc. Show depth at which water is encountered, thickness and character of water-bearing strata and height to which water rises in the well.

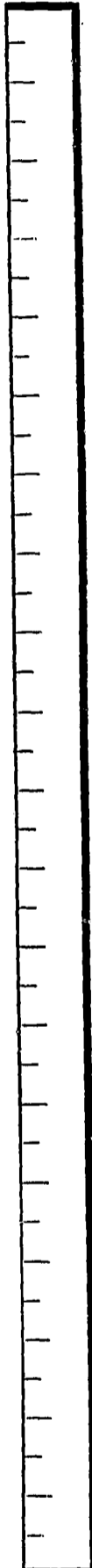

Top of Ground
(Elev. above sea level.....)

Size of Drilled Hole	Size and Weight of Casing	From (Feet)	To (Feet)	PERFORATIONS		
				Kind Size	From (Feet)	To (Feet)

FILE 207360
DATE June 15, 1963
TIME 11:45 A.M.

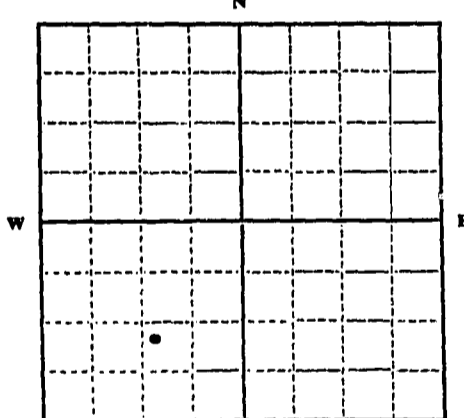

Lot 5 Plat # 457930
SW 1/4 Sec. 15 T. 5S R. 15E
Indicate location of well and place of use, if possible. Each small square represents 10 acres.

Show exact depth of bottom.

Static Water Level for non-flowing Well.....feet.
Shut-in Pressure for Flowing Well.....
Pumping Water Level.....feet at.....gal. per minute.
Discharge in gal. per min. of flowing well.....
How Tested.....Length of Test.....
Remarks: (Gravel packing, cementing, packers, type of shutoff, location of place of use of groundwater if not at well, and any other similar pertinent information, including number of acres irrigated, if used for irrigation).....

36
Driller's License Number
Clyde E. M. Nelson
Driller's Signature

This form to be prepared by driller, and three copies to be filed by the owner with the County Clerk and Recorder in the county in which the well is located.

Please answer all questions. If not applicable, so state, otherwise the form will be returned.

Original to the County Clerk and Recorder; duplicate to the State Engineer; Triplicate to the Montana Bureau of Mines and Geology and Quadruplicate for the Appropriator.

53,562

GW 2

207360

Henry Waldo

Lot 5 Plat # 157930
SW $\frac{1}{4}$ Sec 15 T 5S R 15E

Office of Clerk & Recorder
STILLWATER COUNTY, MONTANA

I hereby certify that the above instru-
ment was filed & indexed in this office

ON THE 15th DAY OF June
A. D. 19 79 AT 11:45 O'CLOCK A.M.

Thelma Brown COUNTY RECORDER

BY Patricia Houghton DEPUTY

Jan 2 79

File No. 187867

T. 5 S R. 15 E 15

DUPLICATE

County Hillwater

STATE OF MONTANA
ADMINISTRATOR OF GROUNDWATER CODE
OFFICE OF STATE ENGINEER

RECEIVED
JUN 16 1964
STATE ENGINEER

Top of Ground
(Elev. above sea level.....)
30' rock & gravel

Notice of Completion of Groundwater
Appropriation by Means of Well

(Under Chapter 237, Montana Session Laws, 1961)

Owner Fred Pfefferoth Address Billings, Mont

Driller C.E. McKeehan Address Laurel, Mont

Date of Notice of Appropriation of Groundwater N.A.

Date well started 5/17/64 Date Completed 5/21/64

Type of well Drilled Equipment Used Cable Tool
(dug, driven, bored or drilled) (Churn, drill, rotary or other)

Water Use: Domestic Municipal Other Irrigation
Industrial Drainage Stock

Indicate on the diagram the character and thickness of the different strata met with in drilling, such as soil, clay, shale, gravel, rock or sand, etc. Show depth at which water is encountered, thickness and character of water-bearing strata and height to which water rises in the well.

Size of Drilled Hole	Size and Weight of Casing	From (Feet)	To (Feet)	PERFORATIONS		
				Kind Size	From (Feet)	To (Feet)
6"	6" Sch. 14 lb	0	30	cut 4x3-6"	26	29'6"

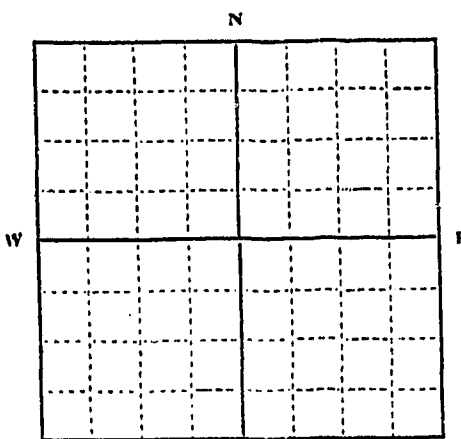

SW 1/4 SW 1/4 Sec. 15 T5 S R. 15 E

Indicate location of well and place of use, if possible. Each small square represents 10 acres.

30' Show exact depth of bottom.

Static Water Level for non-flowing Well 11 feet.

Shut-in Pressure for Flowing Well N.A.

Pumping Water Level 13 feet at 30 gal. per minute.

Discharge in gal. per min. of flowing well

How Tested Pumping Length of Test 30 min

Remarks: (Gravel packing, cementing, packers, type of shutoff, location of place of use of groundwater if not at well, and any other similar pertinent information, including number of acres irrigated, if used for irrigation)

36 Driller's License Number

C.E. McKeehan Driller's Signature

This form to be prepared by driller, and three copies to be filed by the owner with the County Clerk and Recorder in the county in which the well is located.

Please answer all questions. If not applicable, so state, otherwise the form will be returned.

Original to the County Clerk and Recorder; duplicate to the State Engineer; Triplicate to the Montana Bureau of Mines and Geology and Quadruplicate for the Appropriator.

38190

187867

Fred Poffenroth
to
Public

GW-2

SW $\frac{1}{4}$ SW $\frac{1}{4}$ Sec. 15, 58 -- 15E

STATE OF MONTANA } ss.
COUNTY OF STILLWATER }

I hereby certify that the above instru-
ment was filed and indexed in this office
on the 15th day of June

A. D. 1956, at 8:35 o'clock A. M.

Gertrude H Calhoun

COUNTY RECORDER

By Jessie Bishop Deputy

[Faint, illegible handwritten notes and stamps, possibly including a date stamp like 'JUN 15 1956']