

File No. 82508

T. 1 South 14 East

DUPLICATE

County Sweet Grass

STATE OF MONTANA  
ADMINISTRATOR OF GROUNDWATER CODE  
OFFICE OF STATE ENGINEER

Notice of Completion of Groundwater Appropriation  
Without Well

(Under Chapter 237 Montana Session Laws, 1961)

Date of Appropriation of Groundwater 12/30/63Owner Clarence D. Postal Address McLeod, Mont.

Contractor (if any) \_\_\_\_\_

Address of Contractor \_\_\_\_\_

Date Started \_\_\_\_\_ Date Completed \_\_\_\_\_

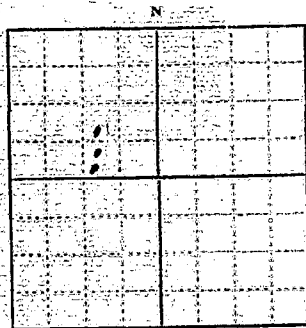
Describe means of obtaining groundwater without a well "as by sub-irrigation and other natural processes". Include depth to water when applicable. natural processesGravity flow

S.E. 1/4 NW 1/4 Sec. 13 T. 1 S. R. 14 E  
Indicate point of appropriation  
and place of use, if possible.

Quantity of water developed and used with explanation of method used to measure or estimate such amount. If use is intermittent

estimate approximate lengths of periods of use. each springruns approximately 10 gal. min.used spring summer + fallSignature of Owner Clarence D. PostalDate Dec 30, 1963

This form to be prepared by contractor (if any), otherwise by the owner.

Three copies of this notice are to be filed with the County Clerk and Recorder of the county in which the works are located.

Please answer all questions. If not applicable, so state, otherwise the form will be returned.

Original to the County Clerk and Recorder; duplicate to the State Engineer; Triplicate to the Montana Bureau of Mines and Geology and Quadruplicate for the Appropriator.

18

87508

STATE OF MONTANA, }  
County of Park Creek } ss.

Filed this 19 day  
of Jan A.D. 1964  
at 145 o'clock P.M.  
Arne Hoem  
By \_\_\_\_\_ Deputy.

JAN 21 1964

*[Faint handwritten notes and signatures]*

File No.

82206

DUPLICATE

T. 15

R. 14E

County

Sweet Grass

STATE OF MONTANA  
ADMINISTRATOR OF GROUNDWATER CODE  
OFFICE OF STATE ENGINEER

RECEIVED  
DEC 26 1963

Notice of Completion of Groundwater Appropriation  
Without Well

STATE ENGINEER

(Under Chapter 287 Montana Session Laws, 1961)

Date of Appropriation of Groundwater

Owned

Helen W. Brekke

Address

H. Lead, Mont.

Contractor (if any)

None

Address of Contractor

None

Date Started

Prior 1928

Date Completed

Prior 1928

Describe means of obtaining groundwater without a well "as by sub-irrigation and other natural processes". Include depth to water when applicable.

1" pipe To Trough

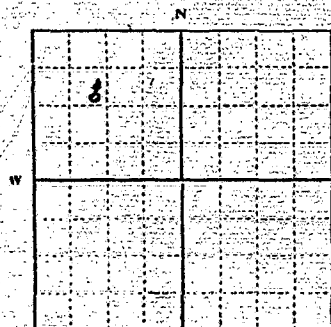

1/4 Sec. 14 T. 15 R. 14E  
Indicate point of appropriation  
and place of use, if possible.

SE 1/4 NW 1/4 NW 1/4 Sec. 14

Quantity of water developed and used with explanation of method used to measure or estimate such amount. If use is intermittent

estimate approximate lengths of periods of use

15 gals per minute estimated  
Flow Through pipe  
stock water - year  
around use

Signature of Owner

Helen W. Brekke

Date

Dec 20, 1963

This form to be prepared by contractor (if any), otherwise by the owner.

Three copies of this notice are to be filed with the County Clerk and Recorder of the county in which the works are located.

Please answer all questions. If not applicable, so state, otherwise the form will be returned.

Original to the County Clerk and Recorder; duplicate to the State Engineer; Triplicate to the Montana Bureau of Mines and Geology and Quadruplicate for the Appropriator.

82206

STATE OF MONTANA,  
County of Sweet Grass,

Filed this 21 day  
of Dec A. D. 1963  
at 4:20 o'clock P.  
Arne  
County Clerk  
by \_\_\_\_\_ Deputy



File No. 82025T 13 R 14E

DUPLICATE

County Sweet Grass

STATE OF MONTANA  
ADMINISTRATOR OF GROUNDWATER CODE  
OFFICE OF STATE ENGINEER

RECEIVED  
DEC 13 1963

Notice of Completion of Groundwater Appropriation  
Without Well

STATE ENGINEER

(Under Chapter 237 Montana Session Laws, 1961)

Date of Appropriation of Groundwater.....

Owner Virgil Broughton

Address.....

Contractor (if any) UNKNOWN

Address of Contractor.....

Date Started UNKNOWN Date Completed Additional tank installed 1961

Describe means of obtaining groundwater without a well "as by sub-irrigation and other natural processes". Include depth to water when applicable. GRAVITY FLOW-

PIPE installed into water bearing layer and piped into stock tanks.

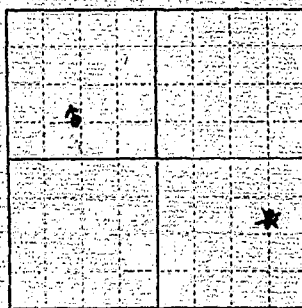

SW NW  
SE NE Sec 14 T13 R14E

Indicate point of appropriation and place of use, if possible.

Quantity of water developed and used with explanation of method used to measure or estimate such amount. If use is intermittent

estimate approximate lengths of periods of use.....

SUMMER AND FALL GRAZING SEASON

8 gals. per minute flow - estimated.

Signature of Owner Virgil BroughtonDate 12/11/63

This form to be prepared by contractor (if any), otherwise by the owner.

Three copies of this notice are to be filed with the County Clerk and Recorder of the county in which the works are located.

Please answer all questions. If not applicable, so state, otherwise the form will be returned.

Original to the County Clerk and Recorder; duplicate to the State Engineer; Triplicate to the Montana Bureau of Mines and Geology and Quadruplicate for the Appropriator.

82025

STATE OF MONTANA }  
County of Sweet Grass } ss.

Filed this 11 day  
of December A. D. 1963  
at 11:55 o'clock A.M.  
Arne Hansen  
County Clerk.

By \_\_\_\_\_  
Notary

File No. 82013

T. 1-S.R. 14-E

DUPLICATE

County Sweet Grass

STATE OF MONTANA  
ADMINISTRATOR OF GROUNDWATER CODE  
OFFICE OF STATE ENGINEER

RECEIVED  
DEC 12 1963

STATE ENGINEER

Notice of Completion of Groundwater Appropriation  
Without Well

(Under Chapter 237 Montana Session Laws, 1961)

Date of Appropriation of Groundwater 12-10-63

Owner Mikkel Breck Address Big Timber, Mont

Contractor (if any) none

Address of Contractor -

Date Started UNKNOWN Date Completed -

Describe means of obtaining groundwater without a well "as by sub-irrigation and other natural processes". Include depth to water when applicable.

gravity flow

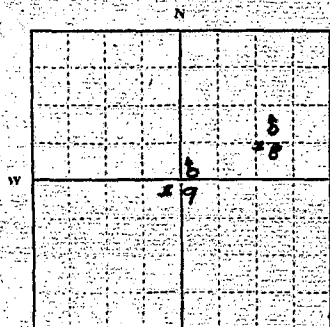

Indicate point of appropriation and place of use, if possible.

8 NWSE NE 1/4 Sec 15  
9 SW SW NE 1/4 Sec 15

Quantity of water developed and used with explanation of method used to measure or estimate such amount. If use is intermittent estimate approximate lengths of periods of use.

8-9-10 gals per minute  
4-6 months yearly

Signature of Owner Mikkel Breck  
Date Dec 10 1963

This form to be prepared by contractor (if any), otherwise by the owner.

Three copies of this notice are to be filed with the County Clerk and Recorder of the county in which the works are located.

Please answer all questions. If not applicable, so state, otherwise the form will be returned.

Original to the County Clerk and Recorder; duplicate to the State Engineer; Triplicate to the Montana Bureau of Mines and Geology and Quadruplicate for the Appropriator.

82013

STATE OF MONTANA }  
County of Sweet Grass }

Filed this 10 day  
of December A. D. 1963  
at 1:35 o'clock P.M.  
Archie H. Hahn  
County Clerk

By \_\_\_\_\_ Notary

File No. 82154T. 14 S. 14 E. 15

DUPLICATE

County Sweet GrassSTATE OF MONTANA  
ADMINISTRATOR OF GROUNDWATER CODE  
OFFICE OF STATE ENGINEER  
DEC 26 1963Top of Ground  
(Elev. above sea level 4200)**Notice of Completion of Groundwater  
Appropriation by Means of Well**

(Under Chapter 237, Montana Session Laws, 1961)

Owner Mr. Dudley Tyler Address Big Timber, Mont.Driller Jim McGehee Address Big Timber, Mont.Date of Notice of Appropriation of Groundwater 11-25-63Date well started 11-29-63 Date Completed 11-30-63Type of well Drilled Equipment Used Rotary  
(dug, driven, bored or (Churn, drill, rotary or  
drilled) other)Water Use: Domestic ☐ Municipal ☐ Other ☐ Irrigation ☐  
Industrial ☐ Drainage ☐ Stock ☒

Indicate on the diagram the character and thickness of the different strata met with in drilling, such as soil, clay, shale, gravel, rock or sand, etc. Show depth at which water is encountered, thickness and character of water-bearing strata and height to which water rises in the well.

Size of Drilled Hole	Size and Weight of Casing	From (Feet)	To (Feet)	PERFORATIONS		
				Kind Size	From (Feet)	To (Feet)
6"	4.036 I.D.	3 FT.	13 FT.	9" X 1/8" 56 TS	7'	13'
	4.5 O.D.	Above Surface	Below			
	11# per FT.					

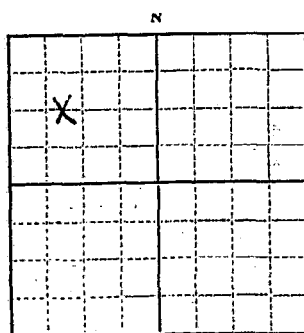
NW 1/4 Sec. 15 T. 15 R. 14E  
Indicate location of well and place of use, if possible. Each small square represents 10 acres.

Show exact depth of bottom.

Static Water Level for non-flowing Well 7 feet.Shut-in Pressure for Flowing Well -Pumping Water Level 9 feet at 10 gal. per minute.Discharge in gal. per min. of flowing well -How Tested Pump Length of Test 4 hours

Remarks: (Gravel packing, cementing, packers, type of shutoff, location of place of use of groundwater if not at well, and any other similar pertinent information, including number of acres irrigated, if used for irrigation).

Concrete Curbings  
by OwnerDriller's License Number 32Driller's Signature James L. McGehee

This form to be prepared by driller, and three copies to be filed by the owner with the County Clerk and Recorder in the county in which the well is located.

Please answer all questions. If not applicable, so state, otherwise the form will be returned.

Original to the County Clerk and Recorder; duplicate to the State Engineer; Triplicate to the Montana Bureau of Mines and Geology and Quadruplicate for the Appropriator.

12714

82154

STATE OF MONTANA }  
County of Sweet Grass }

Filed this 19

of Dec

at 10:30

By

day

A. D. 1963

of A. M.

County Clerk

Deputy

G

Approved Stock Form—State Publishing Co., Helena, Montana—41921

File No. 82205T. 15 R. 14 E

DUPLICATE

County Sweet Grass

STATE OF MONTANA  
ADMINISTRATOR OF GROUNDWATER CODE  
OFFICE OF STATE ENGINEER

RECEIVED  
DEC 28 1963

## Declaration of Vested Groundwater Rights

(Under Chapter 237, Montana Session Laws, 1961)

STATE ENGINEER

Helen W. Brekke, of M<sup>c</sup>Leod  
(Name of Appropriator) (Address) (Town)  
County Sweet Grass State of Montana  
have appropriated groundwater according to the Montana laws in effect prior to January 1, 1962, as follows:

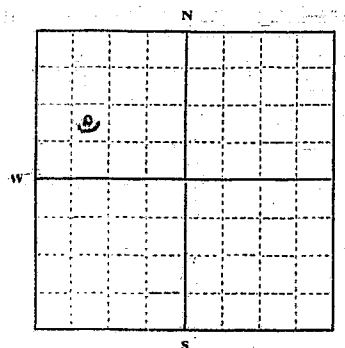

1/4 Sec 15 T. 15 R. 14 E

Indicate point of appropriation and place of use, if possible. Each small square represents 10 acres.

NE 1/4 SW 1/4 NW 1/4 Sec. 15

2. The beneficial use on which the claim is based.  
Household use

3. Date or approximate date of earliest beneficial use; and how continuous the use has been Fall 1947

4. The amount of groundwater claimed (in miner's inches or gallons per minute) 50 gals per minute

5. If used for irrigation, give the acreage and description of the lands to which water has been applied and name of the owner thereof  
NOT USED

6. The means of withdrawing such water from the ground and the location of each well or other means of withdrawal  
Electric Pump

7. The date of commencement and completion of the construction of the well, wells, or other works for withdrawal of groundwater. Started & completed Fall 1947

8. The depth of water table. 25 ft

9. So far as it may be available, the type, size and depth of each well or the general specifications of any other works for the withdrawal of groundwater.  
Drilled well  
6" casing  
36 ft

10. The estimated amount of groundwater withdrawn each year. 250,000 gal.

11. The log of formations encountered in the drilling of each well if available.  
NOT available

12. Such other information of a similar nature as may be useful in carrying out the policy of this act, including reference to book and page of any county record.  
None

Signature of Owner Helen W. Brekke

Date Dec. 20, 1963

Three copies to be filed by the owner with the County Clerk and Recorder of the county in which the well is located.

Please answer all questions. If not applicable, so state, otherwise the form will be returned.

Original to the County Clerk and Recorder; Duplicate to the State Engineer; Triplicate to the Montana Bureau of Mines and Geology, and Quadruplicate for the Appropriator.

12753

82205

STATE OF MONTANA,  
County of Sweet Grass } ss.

Filed this 21 day  
of Dec A.D. 1963  
at 4:15 o'clock P.M.  
Arne Gruen  
County Clerk.  
By \_\_\_\_\_ Deputy.



Form No. 18  
8-60

T. 1 South R. 14 East  
County Sweet Grass

MONTANA BUREAU OF MINES AND GEOLOGY  
Butte, Montana

RECEIVED  
JAN 3 1962

Water Well Log

STATE ENGINEER

Owner Dudley S. Tyler & Alice Tyler Address Big Timber, Montana  
Driller Same Address \_\_\_\_\_  
Date Started Dec. 18, 1961 Date Completed Dec. 18, 1961  
Location: Sec. 16 T. 1 S R. 14 E  $\frac{1}{4}$  sec. SW  $\frac{1}{4}$

Type of well Spring Equipment used none  
(Dug, driven, or drilled) (Churn, drill, rotary, other)

Water use: Domestic ☐ Municipal ☐ Stock ☒ Irrigation ☐  
Industrial ☐ Drainage ☐ Other \_\_\_\_\_

Casing: \_\_\_\_\_ ft. to \_\_\_\_\_ ft. Type \_\_\_\_\_ Size \_\_\_\_\_

Casing: \_\_\_\_\_ ft. to \_\_\_\_\_ ft. Type \_\_\_\_\_ Size \_\_\_\_\_

Casing: \_\_\_\_\_ ft. to \_\_\_\_\_ ft. Type \_\_\_\_\_ Size \_\_\_\_\_

Perforated or screened: Ft. \_\_\_\_\_ to ft. \_\_\_\_\_ . Ft. \_\_\_\_\_ to ft. \_\_\_\_\_

Type of screen or perforations \_\_\_\_\_

Static water level, for non-flowing well: \_\_\_\_\_ feet.

Shut-in pressure, for flowing well: \_\_\_\_\_ lb./sq. in. on: \_\_\_\_\_  
(date)

Pumping water level \_\_\_\_\_ feet at \_\_\_\_\_ gal. per min. 3 - 5

How tested: \_\_\_\_\_

Length of test \_\_\_\_\_

Remarks: (Gravel packing, cementing, packers, type of shut-off, depth of shut-off)

Natural spring and ground water used for stock purposes.

(over)

**Log of well**

79616			
STATE OF MONTANA)			
County of Sweet Grass.			
Filed this	29		
at	Dec	A. D. 19	Oct
	11:14		A. D.
DICK AARIS KING			
County Clerk			
Arthur Thompson			
Deputy			

Form No. 18  
8-60

T. 1 South R. 14 East

County Sweet Grass

MONTANA BUREAU OF MINES AND GEOLOGY  
Butte, Montana

RECEIVED  
JAN 3 1958

Water Well Log STATE ENGINEER

			*

Owner Dudley S. Tyler & Alice Tyler Address Big Timber, Montana

Driller Same Address \_\_\_\_\_

Date Started Jan. 1958 Date Completed Jan. 1958

Location: Sec. 16 T. 1 S R. 14 E  $\frac{1}{2}$  sec. NE 1/4

Type of well Improved spring Equipment used None  
(Dug, driven, or drilled) (Churn, drill, rotary, other)

Water use: Domestic ☒ Municipal ☐ Stock ☒ Irrigation ☐  
Industrial ☐ Drainage ☐ Other \_\_\_\_\_

Casing: 3" X 3" ft. to 30 ft. Type Concrete Size \_\_\_\_\_

Casing: \_\_\_\_\_ ft. to \_\_\_\_\_ ft. Type \_\_\_\_\_ Size \_\_\_\_\_

Casing: \_\_\_\_\_ ft. to \_\_\_\_\_ ft. Type \_\_\_\_\_ Size \_\_\_\_\_

Perforated or screened: Ft. \_\_\_\_\_ to ft. \_\_\_\_\_. Ft. \_\_\_\_\_ to ft. \_\_\_\_\_

Type of screen or perforations \_\_\_\_\_

Static water level, for non-flowing well: \_\_\_\_\_ feet.

Shut-in pressure, for flowing well: \_\_\_\_\_ lb./sq. in. on: \_\_\_\_\_  
(date)

Pumping water level \_\_\_\_\_ feet at \_\_\_\_\_ gal. per min. 5-6

How tested: \_\_\_\_\_

Length of test \_\_\_\_\_

Remarks: (Gravel packing, cementing, packers, type of shut-off, depth of shut-off)

Natural spring that is piped for tenant house use and thence to stock tank.

(over)

[illegible]

Filed this 29 day  
of Dec A. D. 1911  
at 11/10 o'clock A M.  
**DICK ARMSTRONG**  
County Clerk.  
By Esther Thompson  
Deputy.

File No. 82661

T. 15 R. 14E

DUPLICATE

County Sweet Grass

STATE OF MONTANA  
ADMINISTRATOR OF GROUNDWATER CODE  
OFFICE OF STATE ENGINEER

RECEIVED  
JAN 27 1964

Notice of Completion of Groundwater Appropriation  
Without Well

(Under Chapter 237 Montana Session Laws, 1961)

Date of Appropriation of Groundwater 12-30-63

Owner Roland C. Washburn Address Big Timber, Mont

Contractor (if any) \_\_\_\_\_

Address of Contractor \_\_\_\_\_

Date Started \_\_\_\_\_ Date Completed \_\_\_\_\_

Describe means of obtaining groundwater without a well "as by sub-irrigation and other natural processes". Include depth to water when applicable. Spring is developed with a pipe laid in spring source and piped to stock tanks.

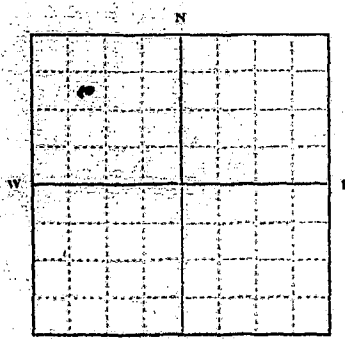

11W/4 NW Sec. 18, T.15, R.14E

Indicate point of appropriation and place of use, if possible.

Quantity of water developed and used with explanation of method used to measure or estimate such amount. If use is intermittent

estimate approximate lengths of periods of use. Spring flows 30 gpm and stays open year around. Will water 150 head of cows

Signature of Owner Roland C. Washburn

Date 12-30-63

This form to be prepared by contractor (if any), otherwise by the owner.

Three copies of this notice are to be filed with the County Clerk and Recorder of the county in which the works are located.

Please answer all questions. If not applicable, so state, otherwise the form will be returned.

Original to the County Clerk and Recorder; duplicate to the State Engineer; Triplicate to the Montana Bureau of Mines and Geology and Quadruplicate for the Appropriator.

82661

STATE OF MONTANA } ss  
County of Sweet Grass }

Filed this 23 day  
of Jan A. D. 1964  
at 1110 o'clock A.M.  
Alvin H. Hines  
By \_\_\_\_\_ Clerk  
Deputy.

File No. 82658T 15 R 14E

DUPLICATE

County Sweetwater

STATE OF MONTANA  
ADMINISTRATOR OF GROUNDWATER CODE  
OFFICE OF STATE ENGINEER

JAN 27 1964

## Declaration of Vested Groundwater Rights

(Under Chapter 237, Montana Session Laws, 1961)

1. Roland C. Woodhouse, of Big Timber (Name of Appropriator) (Address) (Town)  
County of Sweetwater State of Mont  
have appropriated groundwater according to the Montana laws in effect prior to January 1, 1962, as follows:

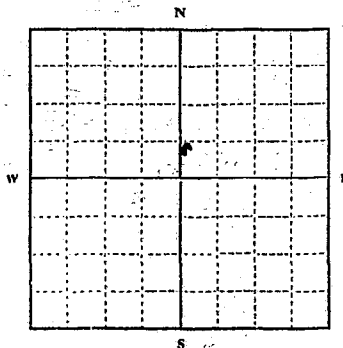

SW 1/4 NE Sec. 19 T. 15. R. 14E

Indicate point of appropriation  
and place of use, if possible. Each  
small square represents 10 acres.

2. The beneficial use on which the claim is based Stock water
3. Date or approximate date of earliest beneficial use; and how continuous the use has been. Est. 1920 used inter-  
mittically yearly
4. The amount of groundwater claimed (in miner's inches or gallons per minute) 25 g.p.m.
5. If used for irrigation, give the acreage and description of the lands to which water has been applied and name of the owner thereof none
6. The means of withdrawing such water from the ground and the location of each well or other means of withdrawal Windmill
7. The date of commencement and completion of the construction of the well, wells, or other works for withdrawal of groundwater Est. Fall 1919
8. The depth of water table 55 ft
9. So far as it may be available, the type, size and depth of each well or the general specifications of any other works for the withdrawal of groundwater. Well is drilled to 70 ft and cased  
completely with 6" casing.
10. The estimated amount of groundwater withdrawn each year 50,000 g.a.
11. The log of formations encountered in the drilling of each well if available none
12. Such other information of a similar nature as may be useful in carrying out the policy of this act, including reference to book and page of any county record

Signature of Owner Roland C. WoodhouseDate 12/30/63

Three copies to be filed by the owner with the County Clerk and Recorder of the county in which the well is located.

Please answer all questions. If not applicable, so state, otherwise the form will be returned.

Original to the County Clerk and Recorder; Duplicate to the State Engineer; Triplicate to the Montana Bureau of  
Mines and Geology, and Quadruplicate for the Appropriator.

34060

82658

STATE OF MONTANA, } ss.  
County of Sweet Grass, }  
Filed this 23 day  
of Jan A. D. 19 64  
at 1110 A. M.  
Arne Haem  
Per Arne Haem  
Deputy.



File No. 82664

T. 15 R. 14E

DUPLICATE

County Sweet Grass

STATE OF MONTANA  
ADMINISTRATOR OF GROUNDWATER CODE  
OFFICE OF STATE ENGINEER

RECEIVED  
JAN 27 1964

STATE ENGINEER

**Notice of Completion of Groundwater Appropriation  
Without Well**

(Under Chapter 237 Montana Session Laws, 1961)

Date of Appropriation of Groundwater 12-30-63

Owner Roland C. Wallman Address Big Timber, Mont

Contractor (if any) \_\_\_\_\_

Address of Contractor \_\_\_\_\_

Date Started \_\_\_\_\_ Date Completed \_\_\_\_\_

Describe means of obtaining groundwater without a well "as by sub-irrigation and other natural processes". Include depth to water when applicable. All springs are surface flow from natural underground water sources.

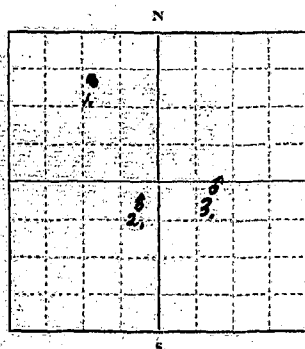

1. NE 1/4 NW Sec. 19 T. 15 R. 14E

Indicate point of appropriation and place of use, if possible.

2. NE 1/4 SW Sec. 19

3. NW 1/4 SE Sec. 19

Quantity of water developed and used with explanation of method used to measure or estimate such amount. If use is intermittent

estimate approximate lengths of periods of use. Springs 1 & 3 flow 50 g.p.m. and are open year around.

Spring No. 2 flows 100 g.p.m. and stays open year around.

Rate

Signature of Owner Roland C. Wallman

Date 12-30-63

This form to be prepared by contractor (if any), otherwise by the owner.

Three copies of this notice are to be filed with the County Clerk and Recorder of the county in which the works are located.

Please answer all questions. If not applicable, so state, otherwise the form will be returned.

Original to the County Clerk and Recorder; duplicate to the State Engineer; Triplicate to the Montana Bureau of Mines and Geology and Quadruplicate for the Appropriator.

82664

STATE OF MONTANA,  
County of Sweet Grass, ss.

Filed this 23 day  
of Jan A.D. 1964  
at 1110 o'clock A.M.  
Arne Haen  
Clerk.  
By \_\_\_\_\_ Deputy.

FILED  
JAN 23 1964  
SWEET GRASS  
MONTANA

File No. 82329T. 15 R. 14E

DUPLICATE

County Sweet Grass

STATE OF MONTANA  
ADMINISTRATOR OF GROUNDWATER CODE  
OFFICE OF STATE ENGINEER

RECEIVED  
JAN 2 1964

STATE ENGINEER  
**Notice of Completion of Groundwater Appropriation  
Without Well**

(Under Chapter 237 Montana Session Laws, 1961)

Date of Appropriation of Groundwater 12/27/63Owner Ed Schmidtkopf address Big Timber, Mont

Contractor (if any) \_\_\_\_\_

Address of Contractor \_\_\_\_\_

Date Started \_\_\_\_\_ Date Completed \_\_\_\_\_

Describe means of obtaining groundwater without a well "as by sub-irrigation and other natural processes". Include depth to water when applicable. Gravity flow

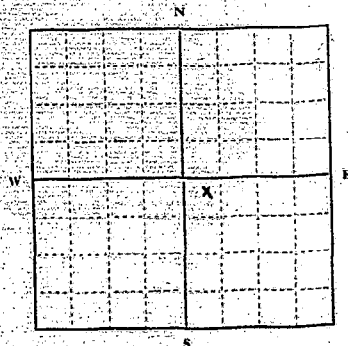

N 1/4 SE Sec. 20, T. 15, R. 14E

Indicate point of appropriation and place of use, if possible.

Quantity of water developed and used with explanation of method used to measure or estimate such amount. If use is intermittent

estimate approximate lengths of periods of use

Years around  
10 gals per min.

Signature of Owner Ed SchmidtkopfDate 12/27/63

This form to be prepared by contractor (if any), otherwise by the owner.

Three copies of this notice are to be filed with the County Clerk and Recorder of the county in which the works are located.

Please answer all questions. If not applicable, so state, otherwise the form will be returned.

Original to the County Clerk and Recorder; duplicate to the State Engineer; Triplicate to the Montana Bureau of Mines and Geology and Quadruplicate for the Appropriator.

82329

STATE OF MONTANA, } ss.  
County of Sweet Grass.

Filed this 28 day

of Dec A. D. 1963

at 3:25 o'clock P.M.

Gene Hume  
County Clerk.

By \_\_\_\_\_  
Deputy.

File No. 82014T. 1-S R 14-E

DUPLICATE

County Sweet Grass

STATE OF MONTANA  
ADMINISTRATOR OF GROUNDWATER CODE  
OFFICE OF STATE ENGINEER

RECEIVED  
DEC 12 1963

Declaration of Vested Groundwater Rights STATE ENGINEER

(Under Chapter 237, Montana Session Laws, 1961)

1. MIKKEL BRECK, of Big Timber  
(Name of Appropriator) (Address) (Town)  
County of Sweet Grass State of Montana  
have appropriated groundwater according to the Montana laws in effect prior to January 1, 1962, as follows:

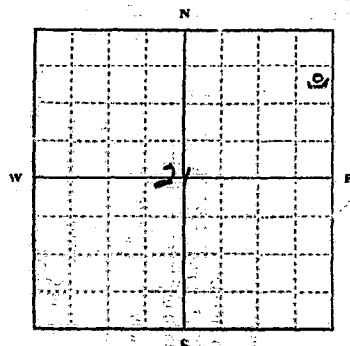

$\frac{1}{4}$  Sec. T. 15 R. 14 E  
Indicate point of appropriation  
and place of use, if possible. Each  
small square represents 10 acres.

SE NE NE  $\frac{1}{4}$  Sec. 21

2. The beneficial use on which the claim is based  
Household + stock water

3. Date or approximate date of earliest beneficial use; and how continuous the use has been Spring 1948  
USED CONTINUOUS

4. The amount of groundwater claimed (in miner's inches or gallons per minute) 50 gals. per minute

5. If used for irrigation, give the acreage and description of the lands to which water has been applied and name of the owner thereof  
NOT USED FOR IRRIGATION

6. The means of withdrawing such water from the ground and the location of each well or other means of withdrawal  
ELECTRIC PUMP

7. The date of commencement and completion of the construction of the well, wells, or other works for withdrawal of groundwater STARTED + COMPLETED SPRING 1948

8. The depth of water table 25 ft.

9. So far as it may be available, the type, size and depth of each well or the general specifications of any other works for the withdrawal of groundwater  
6" casing  
45 ft deep

10. The estimated amount of groundwater withdrawn each year 350,000 gallons

11. The log of formations encountered in the drilling of each well if available  
Rock + gravel

12. Such other information of a similar nature as may be useful in carrying out the policy of this act, including reference to book and page of any county record  
none available

Signature of Owner

Mikkel Breck  
Date Dec 10, 1963

Three copies to be filed by the owner with the County Clerk and Recorder of the county in which the well is located.

Please answer all questions. If not applicable, so state, otherwise the form will be returned.

Original to the County Clerk and Recorder; Duplicate to the State Engineer; Triplicate to the Montana Bureau of Mines and Geology, and Quadruplicate for the Appropriator.

7643

82014

STATE OF MONTANA,  
County of Sweet Grass. }

Filed this 10 day  
of December A. D. 19 63  
at 1:35 o'clock P. M.  
Anna Hain  
(County Clerk)  
By \_\_\_\_\_  
Deputy.

RECEIVED  
JANUARY 10 1964  
COUNTY OF SWEET GRASS  
MONTANA

File No. 82811

T. 13 R. 14E

DUPLICATE

County Sweet Grass

STATE OF MONTANA  
ADMINISTRATOR OF GROUNDWATER CODE  
OFFICE OF STATE ENGINEER

RECEIVED  
DEC 12 1963

Notice of Completion of Groundwater Appropriation  
Without Well

STATE ENGINEER

(Under Chapter 237 Montana Session Laws, 1961)

Date of Appropriation of Groundwater 12-10-63

Owner Mikael Breck Address Big Timber, Mont

Contractor (if any) None

Address of Contractor None

Date Started UNKNOWN Date Completed —

Describe means of obtaining groundwater without a well "as by sub-irrigation and other natural processes". Include depth to water when applicable.

GRAVITY FLOW

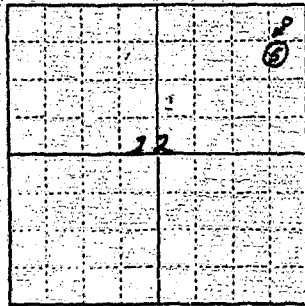

Quantity of water developed and used with explanation of method used to measure or estimate such amount. If use is intermittent

estimate approximate lengths of periods of use.

25-15 gals per minute

5 months winter & summer use

Indicate point of appropriation and place of use, if possible.

5- NENE NE 1/4 Sec 22

Signature of Owner

Mikael Breck

Date Dec 10, 1963

This form to be prepared by contractor (if any), otherwise by the owner.

Three copies of this notice are to be filed with the County Clerk and Recorder of the county in which the works are located.

Please answer all questions. If not applicable, so state, otherwise the form will be returned.

Original to the County Clerk and Recorder; duplicate to the State Engineer; Triplicate to the Montana Bureau of Mines and Geology and Quadruplicate for the Appropriator.

82011

STATE OF MONTANA,  
County of Sweet Grass. } ss.  
Filed this 10 day  
of December A. D. 1963  
at Billings County Clerk.  
Archie Ham  
By \_\_\_\_\_ Deputy.



File No. 82012T 1-S R 14-E

DUPLICATE

County Sandwich

STATE OF MONTANA  
ADMINISTRATOR OF GROUNDWATER CODE  
OFFICE OF STATE ENGINEER

RECEIVED  
DEC 12 1963

STATE ENGINEER

Notice of Completion of Groundwater Appropriation  
Without Well

(Under Chapter 237 Montana Session Laws, 1961)

Date of Appropriation of Groundwater 12-10-63Owner Mikkel Breck Address Big Timber, MontContractor (if any) NONEAddress of Contractor -Date Started UNKNOWN Date Completed -

Describe means of obtaining groundwater without a well "as by  
sub-irrigation and other natural processes". Include depth to  
water when applicable.

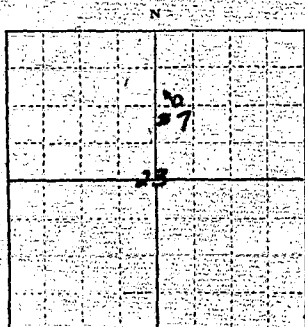
gravity Flow

1/4 Sec 23 T15 R 14E  
Indicate point of appropriation  
and place of use, if possible.

27. SW NW NE 1/4 Sec 23

Quantity of water developed and used with explanation of method  
used to measure or estimate such amount. If use is intermittent

estimate approximate lengths of periods of use

30 gals per minute6 months yearly

Signature of Owner

Mikkel BreckDate Dec 10 1963

This form to be prepared by contractor (if any), otherwise by the owner.

Three copies of this notice are to be filed with the County Clerk and Recorder of the county in which the works are located.

Please answer all questions. If not applicable, so state, otherwise the form will be returned.

Original to the County Clerk and Recorder; duplicate to the State Engineer; Triplicate to the Montana Bureau of Mines and Geology and Quadruplicate for the Appropriator.

82012

STATE OF MONTANA }  
County of Sweet Grass }

Filed this 10 day  
of December A. D. 1963  
at 1:32 o'clock P. M.  
Aime Haeun  
County Clerk

By \_\_\_\_\_  
Deputy

W 3

Approved Stock Form—State Publishing Co., Helena, Montana, 1931B

File No. 82-204

DUPLICATE

T. Sweet Grass  
County

STATE OF MONTANA  
ADMINISTRATOR OF GROUNDWATER CODE  
OFFICE OF STATE ENGINEER

RECEIVED  
DEC 26 1963

STATE ENGINEER

**Notice of Completion of Groundwater Appropriation  
Without Well**

(Under Chapter 237 Montana Session Laws, 1961)

Date of Appropriation of Groundwater 12/29/63  
VALVIA SHAY

Owner..... Address.....

Contractor (if any) .....

Address of Contractor .....

Date Started..... Date Completed.....

Describe means of obtaining groundwater without a well "as by sub-irrigation and other natural processes". Include depth to water when applicable.

Gravity flow

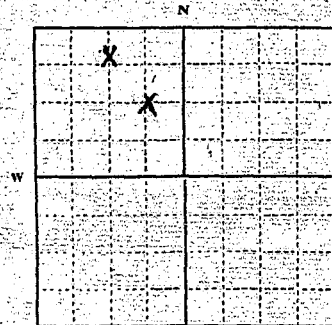

NW 24 15 14E  
1/4 Sec. T. R.

Indicate point of appropriation and place of use, if possible.

Quantity of water developed and used with explanation of method used to measure or estimate such amount. If use is intermittent

estimate approximate lengths of periods of use

Continuous flow

15 gals per min

Signature of Owner Valvia Shay

Date Dec 16 1963

This form to be prepared by contractor (if any), otherwise by the owner.

Three copies of this notice are to be filed with the County Clerk and Recorder of the county in which the works are located.

Please answer all questions. If not applicable, so state, otherwise the form will be returned.

Original to the County Clerk and Recorder; duplicate to the State Engineer; Triplicate to the Montana Bureau of Mines and Geology and Quadruplicate for the Appropriator.

12752

82204

STATE OF MONTANA }  
County of Sweet Grass } ss.

Filed this 21 day

of Nov A. D. 1963

at 3:50 o'clock P.M.

Arne Hain  
County Clerk

By \_\_\_\_\_  
Deputy

GW 3

File No. 52022

DUPLICATE

T. 15 R. 14 E

County San Juan

STATE OF MONTANA  
ADMINISTRATOR OF GROUNDWATER CODE  
OFFICE OF STATE ENGINEER

RECEIVED  
DEC 13 1963

STATE ENGINEER

# Notice of Completion of Groundwater Appropriation Without Well

(Under Chapter 237 Montana Session Laws, 1961)

Date of Appropriation of Groundwater Ed /Owner Ed Roberts Address Big LumberContractor (if any) NONEAddress of Contractor NONEDate Started UNKNOWN Date Completed —

Describe means of obtaining groundwater without a well "as by sub-irrigation and other natural processes". Include depth to water when applicable.

gravity flow

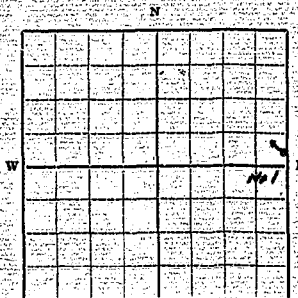

Indicate point of appropriation and place of use, if possible.

No. 1 SE 1/4 SE 1/4 NE 1/4

Quantity of water developed and used with explanation of method used to measure or estimate such amount. If use is intermittent estimate approximate lengths of periods of use

Summer grazing season  
10 gals per minute

Estimated amount of water running in pipe

Signature of Owner Ed RobertsDate Dec 11 1963

This form to be prepared by contractor (if any), otherwise by the owner.

Three copies of this notice are to be filed with the County Clerk and Recorder of the county in which the works are located.

Please answer all questions. If not applicable, so state, otherwise the form will be returned.

Original to the County Clerk and Recorder; duplicate to the State Engineer; Triplicate to the Montana Bureau of Mines and Geology and Quadruplicate for the Appropriator.

9010

24

ED

VEER

3" pipe

0010

82022

STATE OF MONTANA } ss.  
County of Sweet Grass }  
Filed this 11 day  
of November A. D. 1963  
at 10:30 o'clock A. M.  
Gene Ham  
County Clerk  
By \_\_\_\_\_

File No. 82201T. 15 R. 14 E.

DUPLICATE

County Sweet Grass

STATE OF MONTANA  
ADMINISTRATOR OF GROUNDWATER CODE  
OFFICE OF STATE ENGINEER

RECEIVED  
DEC 26 1968

Notice of Completion of Groundwater Appropriation **ENGINEER**  
Without Well

(Under Chapter 237 Montana Session Laws, 1961)

Date of Appropriation of Groundwater

Owner D. L. Shag Address Rt #1 Laurel Mont

Contractor (if any)

Address of Contractor

Date Started

Date Completed

Describe means of obtaining groundwater without a well "as by sub-irrigation and other natural processes". Include depth to water when applicable.

Gravity Flow

Quantity of water developed and used with explanation of method used to measure or estimate such amount. If use is intermittent

estimate approximate lengths of periods of use

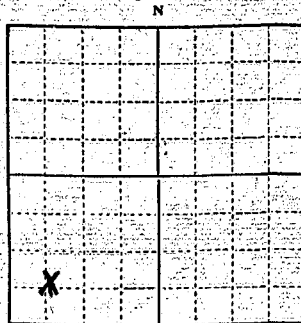
3 gal per minuteSE 1/4 Sec 25 T. 15 R. 14 E.

Indicate point of appropriation and place of use, if possible.

Signature of Owner D. L. ShagDate Dec 20 1968

This form to be prepared by contractor (if any), otherwise by the owner.

Three copies of this notice are to be filed with the County Clerk and Recorder of the county in which the works are located.

Please answer all questions. If not applicable, so state, otherwise the form will be returned.

Original to the County Clerk and Recorder; duplicate to the State Engineer; Triplicate to the Montana Bureau of Mines and Geology and Quadruplicate for the Appropriator.



26  
D

ER

and

82201

STATE OF VIRGINIA

COUNTY OF ROBERTSON

FILED IN

OF

AT

BY

Dec 3 1963

3 35

CLERK

Deputy

749



File No. 82150T. 13 R. 14 E.

DUPLICATE

County Sweet Grass

STATE OF MONTANA  
ADMINISTRATOR OF GROUNDWATER CODE  
OFFICE OF STATE ENGINEER

RECEIVED  
DEC 26 1963

Notice of Completion of Groundwater Appropriation  
Without Well

(Under Chapter 237 Montana Session Laws, 1961)

Date of Appropriation of Groundwater Dec. 1926Owner Arthur E. Ormsby Address Big Timber, MontanaContractor (if any) —Address of Contractor —Date Started Aug. 1931 Date Completed Aug. 1931

Describe means of obtaining groundwater without a well "as by sub-irrigation and other natural processes". Include depth to water when applicable.

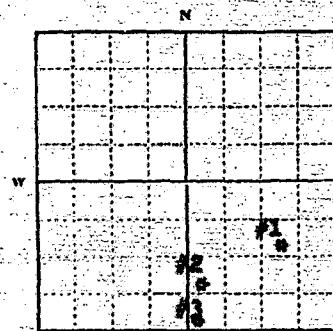
Built wooden water trough in 1931SE  $\frac{1}{4}$  Sec 25 T. 13 R. 14 E

Indicate point of appropriation and place of use, if possible.

Quantity of water developed and used with explanation of method used to measure or estimate such amount. If use is intermittent

estimate approximate lengths of periods of use Year roundEst. #1 - 2 miners inchesEst. #2 - 2 miners inchesEst. #3 - 2 miners inches

Signature of Owner

Arthur E. OrmsbyDate Dec. 18, 1963

This form to be prepared by contractor (if any), otherwise by the owner.

Three copies of this notice are to be filed with the County Clerk and Recorder of the county in which the works are located.

Please answer all questions. If not applicable, so state, otherwise the form will be returned.

Original to the County Clerk and Recorder; duplicate to the State Engineer; Triplicate to the Montana Bureau of Mines and Geology and Quadruplicate for the Appropriator.

82,50

STATE OF MONTANA,

County of Sweet Grass,

Filed this

19

day

of

Dec

A.D. 1963

at

10:00

o'clock

A.M.

By

*Archie H. Hume*

Deputy

File No. 82018

DUPLICATE

Approved Stock Form—State Publishing Co., Helena, Montana—39318

T. 1-S-R-14-E

County Sanford

RECEIVED  
DEC 12 1963

STATE OF MONTANA  
ADMINISTRATOR OF GROUNDWATER CODE  
OFFICE OF STATE ENGINEER

STATE ENGINEER

Notice of Completion of Groundwater Appropriation  
Without Well

(Under Chapter 237 Montana Session Laws, 1961)

Date of Appropriation of Groundwater 12-10-63

Owner Mikkel Breck Address Big Timber, Mont

Contractor (if any) None

Address of Contractor None

Date Started Unknown Date Completed -

Describe means of obtaining groundwater without a well "as by sub-irrigation and other natural processes". Include depth to water when applicable.

20 gals per minute

6 months summer & fall

gravity flow

Quantity of water developed and used with explanation of method used to measure or estimate such amount. If use is intermittent

estimate approximate lengths of periods of use.

20 gals per minute

6 months summer & fall

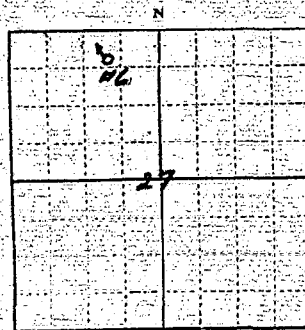

1/4 Sec 27 T.15. R.14E

Indicate point of appropriation and place of use, if possible.

"6" NW 1/4 NW 1/4 Sec 27

Signature of Owner

Mikkel Breck

Date Dec 10, 1963

This form to be prepared by contractor (if any), otherwise by the owner.

Three copies of this notice are to be filed with the County Clerk and Recorder of the county in which the works are located.

Please answer all questions. If not applicable, so state, otherwise the form will be returned.

Original to the County Clerk and Recorder; duplicate to the State Engineer; Triplicate to the Montana Bureau of Mines and Geology and Quadruplicate for the Appropriator.

3647

82-018

STATE OF MONTANA } ss.  
County of Sweet Grass }

Filed this 10 day  
November A. D. 19 63  
at 1:50 o'clock P.M.  
Anne Hansen  
County Clerk  
By \_\_\_\_\_ Deputy

1999

County

STATE OF MONTANA  
ADMINISTRATOR OF GROUNDWATER CODE  
MONTANA WATER RESOURCES BOARD

**NOTICE OF COMPLETION OF GROUNDWATER  
APPROPRIATION BY MEANS OF WELL**

Developed after January 1, 1962

(Under Chapter 237 Montana Session Laws, 1961, as amended)

This form to be prepared by driller, and three copies to be filed by the owner with the County Clerk and Recorder in the county in which the well is located, last copy to be retained by driller.

Please answer all questions. If not applicable, so state, otherwise the form may be returned.

Owner BARBARA A. STONE

Address BIG TIMBER

MONTANA 59011

Date well started April 25, 1971

completed April 30, 1971

Type of well Drilled

(Dug, driven, bored or drilled)

Equipment used ..... Churn Drill

(Churn drill, rotary or other)

Water Use: Domestic ☒ Municipal ☐ Stock ☐ Irrigation ☐

Industrial ☐ Drainage ☐ Other ☐\* Garden/Lawn ☐

**\*Describe**

**USE:** If used for irrigation, industrial, drainage or other. Explain, state number of acres and location or other data (i.e. Lot, Block and Addition).

ESTIMATED ANNUAL WITHDRAWAL

Size of Drilled Hole	Size and Weight of Casing	From (Feet)	To (Feet)	PERFORATIONS		
				Kind Size	From (Feet)	To (Feet)
6"	6 5/8 OD X 17#	1'	39'			
		above ground				

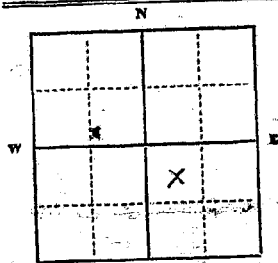

Static water level ..... 28 ..... ft.\*  
Pumping water level ..... 48 ..... ft.\*  
at ..... 20 ..... gallons per minute,  
measured ..... 30 ..... minutes after pumping  
began.

\*Measured from ground level.

Well developed by Pumping  
for 2 hours.

Power..... Pump..... HF.....

Remarks: (Gravel packing, cementing  
packers, type of shutoff) .....

INDICATE LOCATION OF WELL AND PLACE OF USE, IF POSSIBLE.  
EACH SMALL SQUARE REPRESENTS 40 ACRES.

Driller's Signature \_\_\_\_\_

**Driller's Address**

LICENSE NO...17..

## DRILLER'S LOG

Indicate the character, color, thickness of strata such as soil, clay, sand, gravel, shale, sandstone, etc. Show depth at which water is found and height to which water rises in well.

Top of Ground (Elev. above sea level)

[illegible]

18 Show exact depth of bottom

49751

RECEIVED  
DEC 8 1971

County

STATE OF MONTANA  
ADMINISTRATOR OF GROUNDWATER CODE  
MONTANA WATER RESOURCES BOARD

## NOTICE OF COMPLETION OF GROUNDWATER APPROPRIATION BY MEANS OF WELL

**Developed after January 1, 1962**

(Under Chapter 237 Montana Session Laws, 1961, as amended)

This form to be prepared by driller, and three copies to be filed by the owner with the County Clerk and Recorder in the county in which the well is located, last copy to be retained by driller.

Please answer all questions. If not applicable, so state, otherwise the form may be returned.

Owner **BARBARA A. STONE**

Address: **BIG TIMBER**

MONTANA 59011

Date well started **April 25, 1971**

completed April 30, 1971

Type of well Drilled

(Dug, driven, bored or drilled)

Equipment used Churn Drill

(Churn drill, rotary or other)

Water Use: Domestic ☒ Municipal ☐ Stock ☐ Irrigation ☐

Industrial ☐ Drainage ☐ Other ☐\* Garden/Lawn ☐

**\*Describe**

**USE:** If used for irrigation, industrial, drainage or other. Explain, state number of acres and location or other data (i.e. Lot, Block and Addition).

### ESTIMATED ANNUAL WITHDRAWAL

Size of Drill Hole	Size and Weight of Casting	From (Feet)	To (Feet)	PERFORATIONS		
				Kind Size	From (Feet)	To (Feet)
8"	6 5/8 OD X 1 1/4 above ground	1'	39'			

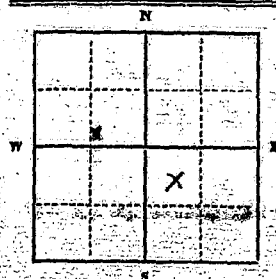

Static water level ..... 28 ..... ft.\*  
Pumping water level ..... 48 ..... ft.\*  
at ..... 20 ..... gallons per minute,  
measured ..... 30 ..... minutes after pumping  
began.

\*Measured from ground level.

Well developed by ~~Pumping~~

for 2 hours.

Power..... Pump..... HP

Remarks: (Gravel packing, cementing,  
packers, type of shutoff) .....

NW 1/4 SE 1/4 Sec 28

T. 15 N R. 14 E.

INDICATE LOCATION OF WELL AND PLACE OF USE, IF POSSIBLE  
EACH SMALL SQUARE REPRESENTS 40 ACRES.

Driller's Signature

Driller's Address

LICENSE NO. 12

## DRILLER'S LOG

Indicate the character, color, thickness of strata such as soil, clay, sand, gravel, shale, sandstone, etc. Show depth at which water is found and height to which water rises in well.

Top of Ground (Elev. above sea level)

[illegible]

**Show exact depth of bottom**

4995

91513

STATE OF MONTANA }  
County of Sweet Grass }  
Filed this 7th day of December 1921  
at 2:25 P.  
Margaret Plaggenberg  
County Clerk  
By Joe. 20 Deputy

Form where indicated in red.

Thank you.

Settled out  
Section 28

Water Use: Domestic ☒ Municipal ☐ Stock ☐ Irrigation ☐  
Industrial ☐ Drainage ☐ Other ☐ Garden/Lawn ☐

\*Describe \_\_\_\_\_  
USE: If used for irrigation, industrial, drainage or other. Explain state number of acres and location or other data (i.e. lot, block, and Addition).

ESTIMATED ANNUAL WITHDRAWAL \_\_\_\_\_

RECEIVED

JAN 10 1922

DEPT. OF AGRICULTURE  
DIVISION OF WATER RESOURCES



Water Resources Division  
Engineering Bureau  
Groundwater Section  
Sam W. Mitchell Building  
Helena, Montana 59601

RECEIVED

JAN 10 1972

MONTANA DEPARTMENT OF NATURAL  
RESOURCES AND CONSERVATION

Owner Ms. Barbara A. Stone  
Address Big Timber, Montana 59011  
Location T. R. Sec.  
Doc. No. 91513

As the Administrator of the Groundwater Code for the State of Montana, please take note of the following special instructions, in order to properly protect your groundwater right.

Special Instructions:

Please indicate the location by township, range and section number on the enclosed form where indicated in red.

Thank you.

-1 South 14 East

Section 28

Water Use: Domestic ☒ Municipal ☐ Stock ☐ Irrigation ☐

Industrial ☐ Drainage ☐ Other ☐ Garden/Lawn ☐

\*Describe

USE: If used for irrigation, industrial, drainage or other. Explain, state number of acres and location or other data (i.e. Lot, Block and Addition).

ESTIMATED ANNUAL WITHDRAWAL

Size of Drilled Hole	Size and Weight of Casing	From (Feet)	To (Feet)	PERFORATIONS		
				Kind Size	From (Feet)	To (Feet)
6"	6 5/8 OD X 17#	1' above ground	39'			

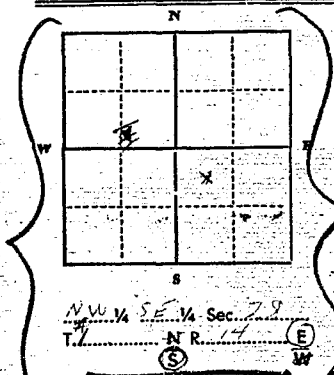

Static water level ..... 26 ..... ft.\*  
Pumping water level ..... 20 ..... ft.\*  
at ..... 20 ..... gallons per minute,  
measured ..... 30 ..... minutes after pumping  
began.

\*Measured from ground level.

Well developed by PUMPING

for ..... 2 ..... hours.

Power ..... Pump ..... HP

Remarks: (Gravel packing, cementing,  
packers, type of shutoff)

INDICATE LOCATION OF WELL AND PLACE OF USE, IF POSSIBLE.  
EACH SMALL SQUARE REPRESENTS 40 ACRES.

Driller's Signature

Milton E. Jones

Driller's Address

Big Timber, Mont.

LICENSE NO. 17

Show exact depth of bottom

49951



ADMINISTRATOR OF GROUNDWATER CODE  
MONTANA WATER RESOURCES BOARD

NOTICE OF COMPLETION OF GROUNDWATER  
APPROPRIATION BY MEANS OF WELL

Developed after January 1, 1962

(Under Chapter 237 Montana Session Laws, 1961, as amended)

This form to be prepared by driller, and three copies to be filed by the owner with the County Clerk and Recorder in the county in which the well is located, last copy to be retained by driller.

Please answer all questions. If not applicable, so state, otherwise the form may be returned.

Owner BARRARA A. STONE

Address RIO TIBER

MONTANA 59011

Date well started April 25, 1971

completed April 30, 1971

Type of well Drilled

(Dug, driven, bored or drilled)

Equipment used Churn Drill

(Churn drill, rotary or other)

Water Use: Domestic ☒ Municipal ☐ Stock ☐ Irrigation ☐

Industrial ☐ Drainage ☐ Other ☐\* Garden/Lawn ☐

\*Describe

USE: If used for irrigation, industrial, drainage or other. Explain, state number of acres and location or other data (i.e. Lot, Block and Addition).

ESTIMATED ANNUAL WITHDRAWAL

Size of Drilled Hole	Size and Weight of Casing	From (Feet)	To (Feet)	PERFORATIONS
6"	6 5/8 OD X 17#	1' above ground	39'	Kind Size From (Feet) To (Feet)
				---

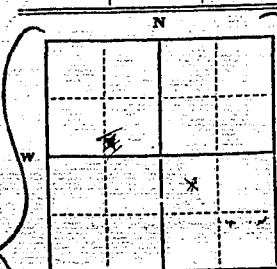

N.W. 1/4 Sec. 28  
T. 7 N. R. 14 E.

INDICATE LOCATION OF WELL AND PLACE OF USE, IF POSSIBLE. EACH SMALL SQUARE REPRESENTS 40 ACRES.

Driller's Signature

Driller's Address

Milton E. Jones  
Bozeman, Mont.

LICENSE NO. 17

DRILLER'S LOG

Indicate the character, color, thickness of strata such as soil, clay, sand, gravel, shale, sandstone, etc. Show depth at which water is found and height to which water rises in well.

Top of Ground

(Elev. above sea level)

From (Feet)	To (Feet)	
Top	10	Top Soil & Sand
10	30	Sand & Gravel with Clay
30	32	Rock
32	34	Sand & Gravel
34	36	Rock
36	40	Sand & Gravel
40	41 1/2	Rock
41 1/2	46	Sand & Gravel
46	48	Rock

RECEIVED

JAN 10 1972

MONTANA DEPARTMENT OF NATURAL RESOURCES AND CONSERVATION

Show exact depth of bottom

499.51

File No.

TRIPLICATE

T. 1 S. R. 11 E.

County Sweet Grass

STATE OF MONTANA  
ADMINISTRATOR OF GROUNDWATER CODE  
OFFICE OF STATE ENGINEER

RECEIVED  
DEC 21 1962

## Declaration of Vested Groundwater Rights

(Under Chapter 237, Montana Session Laws, 1961)

STATE ENGINEER

1. Forster Loveland, of Rural Route Big Timber,  
(Name of Appropriator) (Address) (Town)  
County of Sweet Grass State of Montana  
have appropriated groundwater according to the Montana laws in effect prior to January 1, 1962, as follows:

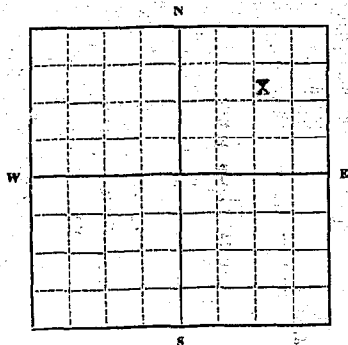

2. The beneficial use on which the claim is based. Household,  
lawn & C livestock

3. Date or approximate date of earliest beneficial use; and how continuous the use has been. 1946 and has been  
continuous  
second well since 1952 and continues to there  
after

4. The amount of groundwater claimed (in miner's inches or gallons per minute) 50 gal per minute in first well  
100 gal per minute in the second one.

5. If used for irrigation, give the acreage and description of the lands to which water has been applied and name of the owner thereof  
None in first well  
Lawn in second well

6. The means of withdrawing such water from the ground and the location of each well or other means of withdrawal  
Hand pump near orchard  
Electric pump in well near house

7. The date of commencement and completion of the construction of the well, wells, or other works for withdrawal of groundwater. 1946 for first well and 1952 for second well

8. The depth of water table. 10 feet in second well but depends on amount of  
water in the Big Timber River.

9. So far as it may be available, the type, size and depth of each well or the general specifications of any other works for the withdrawal of groundwater.  
first well is 16 inch casing  
second well is drilled and it is 32 feet deep with 24 casing.

10. The estimated amount of groundwater withdrawn each year. varies from 10 to 200

11. The log of formations encountered in the drilling of each well if available.  
gravel, quicksand and boulders.

12. Such other information of a similar nature as may be useful in carrying out the policy of this act, including reference to book and page of any county record.

Signature of Owner Torges L. MichaelDate Dec. 11, 1962

Three copies to be filed by the owner with the County Clerk and Recorder of the county in which the well is located.

Please answer all questions. If not applicable, so state, otherwise the form will be returned.

Original to the County Clerk and Recorder; duplicate to the State Engineer; Triuplicate to the Montana Bureau of Mines and Geology, and Quadruplicate for the Appropriator.

2816

File No. \_\_\_\_\_

TRIPLICATE

Approved Stock Form—State Publishing Co., Helena, Montana—38687

T. 1 S. R. 13 E.

County Sweet Grass

STATE OF MONTANA  
ADMINISTRATOR OF GROUNDWATER CODE  
OFFICE OF STATE ENGINEER

RECEIVED  
DEC 21 1962

Declaration of Vested Groundwater Rights

(Under Chapter 237, Montana Session Laws, 1961)

STATE ENGINEER

1. Tarner Loreland of Rural Route Big Timber,  
(Name of Appropriator) (Address) (Town)  
County of Sweet Grass State of Montana  
have appropriated groundwater according to the Montana laws in effect prior to January 1, 1962, as follows:

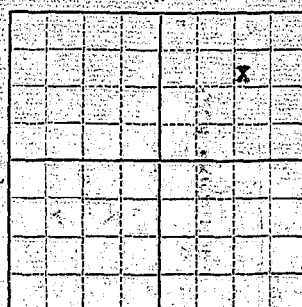

NE 1/4 of Sec. 28, T. 13 R. 14 E.

Indicate point of appropriation  
and place of use, if possible.  
Each small square represents 10  
acres.

2. The beneficial use on which the claim is based household,  
lawn & livestock

3. Date or approximate date of earliest beneficial use; and how con-  
tinuous the use has been 1946 and use has been  
continuous

Second well since 1952 and continues to there  
after

4. The amount of groundwater claimed (in miner's inches or gallons  
per minute) 50 gal per minute in one well  
100 gal per minute in the second one.

5. If used for irrigation, give the acreage and description of the lands  
to which water has been applied and name of the owner thereof  
none in first well  
Lawn in second well

6. The means of withdrawing such water from the ground and the  
location of each well or other means of withdrawal  
Hand pump near orchard  
Electric pump in well near house

7. The date of commencement and completion of the construction of the well, wells, or other works for with-  
drawal of groundwater 1946 for first well and 1952 for second well

8. The depth of water table 10 feet in second well but depends on amount of  
water in the Boulder River.

9. So far as it may be available, the type, size and depth of each well or the general specifications of any other  
works for the withdrawal of groundwater  
First well is dug and it is 10 feet deep

Second well is drilled and it is 32 feet deep with 8" casing.

10. The estimated amount of groundwater withdrawn each year Varies from year to year

11. The log of formations encountered in the drilling of each well if available  
Gravel, quicksand and boulders.

12. Such other information of a similar nature as may be useful in carrying out the policy of this act, including  
reference to book and page of any county record

Signature of Owner Tarner Loreland

Date Dec. 17, 1962

Three copies to be filed by the owner with the County Clerk and Recorder of the county in which the well is  
located.

Please answer all questions. If not applicable, so state, otherwise the form will be returned.

Original to the County Clerk and Recorder; duplicate to the State Engineer; Triplicate to the Montana Bureau  
of Mines and Geology, and Quadruplicate for the Appropriator.

80865

STATE OF MONTANA, }  
County of Sweet Grass. } ss.

Filed this 19th day

of December A. D. 1962

at 2:53 o'clock P.M.

**DICK ARMSTRONG**

County Clerk

By Helene H. H. H. Deputy.

File No.

T. 1 S. R. 14 E

DUPLICATE

County Sweet Grass

STATE OF MONTANA  
ADMINISTRATOR OF GROUNDWATER CODE  
OFFICE OF STATE ENGINEER

## Declaration of Vested Groundwater Rights

(Under Chapter 237, Montana Session Laws, 1961)

RECEIVED  
STATE ENGINEER

1. Torgier Laveland of Rural Route Big Timber,  
(Name of Appropriator) (Address) (Town)  
County of Sweet Grass State of Montana  
have appropriated groundwater according to the Montana laws in effect prior to January 1, 1962, as follows:

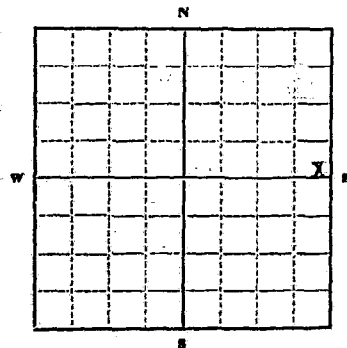

SE 1/4 of Sec. 22 T. 13. R. 14 E

Indicate point of appropriation  
and place of use, if possible.  
Each small square represents 10  
acres.

2. The beneficial use on which the claim is based  
Irrigation and stock
3. Date or approximate date of earliest beneficial use; and how continuous the use has been 1942 and use has been  
continuous
4. The amount of groundwater claimed (in miner's inches or gallons per minute) 100 miner's inches
5. If used for irrigation, give the acreage and description of the lands to which water has been applied and name of the owner thereof  
2 or 3 acres in SE 1/4 of Sec. 22  
Torgier Laveland, owner
6. The means of withdrawing such water from the ground and the location of each well or other means of withdrawal  
Natural flow spring
7. The date of commencement and completion of the construction of the well, wells, or other works for withdrawal of groundwater
8. The depth of water table ground level
9. So far as it may be available, the type, size and depth of each well or the general specifications of any other works for the withdrawal of groundwater  
water flow free in spring of year water flows to Boulder  
river nearly 1 mile
10. The estimated amount of groundwater withdrawn each year water runs free and takes it  
all
11. The log of formations encountered in the drilling of each well if available
12. Such other information of a similar nature as may be useful in carrying out the policy of this act, including reference to book and page of any county record

Signature of Owner Torgier LavelandDate Dec. 17, 1962

Three copies to be filed by the owner with the County Clerk and Recorder of the county in which the well is located.

Please answer all questions. If not applicable, so state, otherwise the form will be returned.

Original to the County Clerk and Recorder; duplicate to the State Engineer; Triplicate to the Montana Bureau of Mines and Geology, and Quadruplicate for the Appropriator.

File No.

DUPLICATE

T 1 S. R 14 E

County Sweet Grass

STATE OF MONTANA  
ADMINISTRATOR OF GROUNDWATER CODE  
OFFICE OF STATE ENGINEER

## Declaration of Vested Groundwater Rights

(Under Chapter 237, Montana Session Laws, 1961)

RECEIVED  
STATE ENGINEER

1. Torgar Loveland of Rural Route B 14 Timber,  
(Name of Appropriator) (Address) (Town)  
County of Sweet Grass State of Montana  
have appropriated groundwater according to the Montana laws in effect prior to January 1, 1962, as follows:

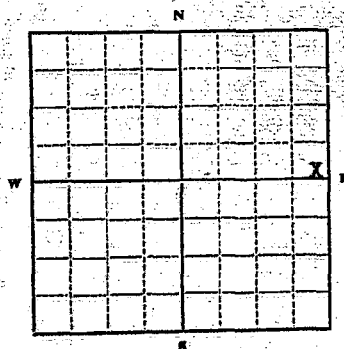

NE 1/4 of Sec. 28 T.13. R. 14 E

Indicate point of appropriation  
and place of use, if possible.  
Each small square represents 10  
acres.

2. The beneficial use on which the claim is based.....  
Irrigation and stock
3. Date or approximate date of earliest beneficial use; and how continuous the use has been.....  
1942 and use has been continuous
4. The amount of groundwater claimed (in miner's inches or gallons per minute).....  
100 miner's inches
5. If used for irrigation, give the acreage and description of the lands to which water has been applied and name of the owner thereof.....  
2 or 3 acres in SE 1/4 of Sec. 28  
Torgar Loveland, owner
6. The means of withdrawing such water from the ground and the location of each well or other means of withdrawal.....  
Natural flow spring

7. The date of commencement and completion of the construction of the well, wells, or other works for withdrawal of groundwater.....
8. The depth of water table.....  
Ground level
9. So far as it may be available, the type, size and depth of each well or the general specifications of any other works for the withdrawal of groundwater.....  
Water flow free in spring of year water flows to Boulder river nearly 1 mile.
10. The estimated amount of groundwater withdrawn each year.....  
water runs free and I use it all
11. The log of formations encountered in the drilling of each well if available.....
12. Such other information of a similar nature as may be useful in carrying out the policy of this act, including reference to book and page of any county record.....

Signature of Owner

Torgar Loveland

Date Dec. 19, 1962

Three copies to be filed by the owner with the County Clerk and Recorder of the county in which the well is located.

Please answer all questions. If not applicable, so state, otherwise the form will be returned.

Original to the County Clerk and Recorder; duplicate to the State Engineer; Triplicate to the Montana Bureau of Mines and Geology; and Quadruplicate for the Appropriator.

80864

STATE OF MONTANA }  
County of Sweet Grass } ss.

Filed this 19th day  
of December A. D. 1962  
at 2:47 o'clock P. M.  
**DICK ARMSTRONG**  
County Clerk  
By Helen Johnson  
Deputy.



RECEIVED  
DEC 8 1971

County Sweet Grass

STATE OF MONTANA  
ADMINISTRATOR OF GROUNDWATER CODE  
MONTANA WATER RESOURCES BOARD

NOTICE OF COMPLETION OF GROUNDWATER APPROPRIATION WITHOUT WELL  
Developed After January 1, 1962

(Under Chapter 237, Montana Session Laws, 1961, as amended)

This form to be prepared by contractor (if any), otherwise by the owner.  
Three copies of this notice are to be filed with the County Clerk and Recorder of the county in which the works are located.  
Please answer all questions. If not applicable, so state, otherwise the form may be returned.

For Administrator's Use

File 9514  
December 7, 1971  
2:30 PM

GW 1

Owner Barbara Stone  
Address Big Timber, Montana  
Contractor (if any) David Jarrett  
Address of Contractor Big Timber, Montana  
Date Started 12-12-71 Date Completed 12-14-71

1. Describe means of obtaining groundwater (as by sub-irrigation, developed spring, drains, etc.) Spring  
Development

2. Means of withdrawing water (gravity, pump, canal, etc.)

3. Depth of water table Ground surface

4. Use of the water Stock water

5. Amount of groundwater claimed (in miner's inches or gallons per minute) 10 gallons per minute

6. If used for irrigation, give number of acres and description of land 1 acre

7. Estimate amount of water used each year all the water out of spring

8. Months of year spring flows year around

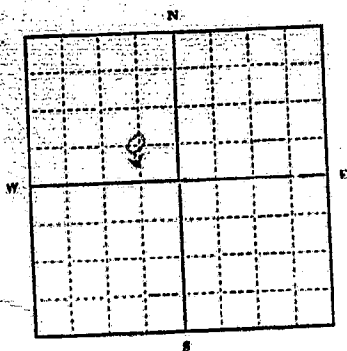

25 1/4 Sec. 25

T. 15 N R. 14E E

(S)

INDICATE POINT OF APPROPRIATION AND PLACE OF USE, IF POSSIBLE. Elevation of spring, if known or estimated 7100 ft

Signature of Owner Barbara Stone

Date 12-14-71



MONTANA WATER RESOURCES BOARD  
RECEIVED  
DEC 8 1971

3 GW 3 Revised 1969  
191-1500-10/69

County Sweet Grass

STATE OF MONTANA  
ADMINISTRATOR OF GROUNDWATER CODE  
MONTANA WATER RESOURCES BOARD

NOTICE OF COMPLETION OF GROUNDWATER APPROPRIATION WITHOUT WELL

Developed After January 1, 1962

(Under Chapter 237, Montana Session Laws, 1961, as amended)

This form to be prepared by contractor (if any), otherwise by the owner.

Three copies of this notice are to be filed with the County Clerk and Recorder of the county in which the works are located.

Please answer all questions. If not applicable, so state, otherwise the form may be returned.

For Administrator's Use

File 9/5/74  
December 7, 1971  
2:30 PM

GW 1 1

Owner Barbara Stone  
Address Big Timber, Montana  
Contractor (if any) David Jarrett  
Address of Contractor Big Timber, Montana  
Date Started 10-12-71 Date Completed 10-14-71

1. Describe means of obtaining groundwater (as by sub-irrigation, developed spring, drains, etc.) Spring  
Development

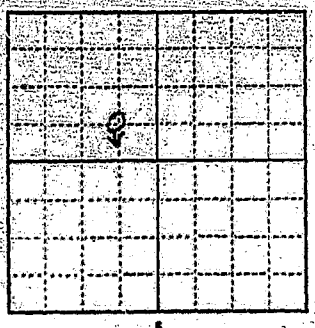

2. Means of withdrawing water (gravity, pump, canal, etc.)

3. Depth of water table Over ground surface

4. Use of the water Stock water

5. Amount of groundwater claimed (in miner's inches or gallons per minute) 10 gallons per minute

6. If used for irrigation, give number of acres and description of land 1 acre

7. Estimate amount of water used each year All that comes out of spring

8. Months of year spring flows year around

SE 1/4 NW 1/4 Sec. 28  
T. 15 N. R. 14 E. E  
S 1/2 W

INDICATE POINT OF APPROPRIATION AND PLACE OF USE, IF POSSIBLE.  
Elevation of spring, if known or estimated 4405'

Signature of Owner [Signature]

Date 1-1-72

44552

91514

STATE OF MONTANA, } ss.  
County of Sweet Grass.  
Filed this 7th day  
of December 11  
at 2:30 P.M.  
Margaret Shepperson  
By fee 2.00 Deputy

NOTICE OF CANCELLATION OF A DEED, A PART OF THE RECORDS OF THE PUBLIC LANDS

NO. 13

1 South 14 East  
County Sweet Grass

MONTANA BUREAU OF MINES AND GEOLOGY  
Butte, Montana

RECEIVED  
JAN 3 1962

Water Well Log

STATE ENGINEER

X	Owner <u>Hazel B. Weller</u>	Address <u>Big Timber, Montana</u>
	Driller _____	Address _____
	Date Started _____	Date Completed _____
	Location: Sec. <u>30 T. 1 S. R. 14 E</u> sec. <u>NE 1/4 NW 1/4 SW 1/4 NW 1/4</u>	

Type of well Spring Equipment used \_\_\_\_\_  
(dug, driven, or drilled) (Churn, drill, rotary, other)

Water uses: Domestic ☐ Municipal ☐ Stock ☒ Irrigation ☐  
Industrial ☐ Drainage ☐ Other \_\_\_\_\_

Casing: \_\_\_\_\_ ft. to \_\_\_\_\_ ft. Type \_\_\_\_\_ Size \_\_\_\_\_

Casing: \_\_\_\_\_ ft. to \_\_\_\_\_ ft. Type \_\_\_\_\_ Size \_\_\_\_\_

Casing: \_\_\_\_\_ ft. to \_\_\_\_\_ ft. Type \_\_\_\_\_ Size \_\_\_\_\_

Perforated or screened: Ft. \_\_\_\_\_ to ft. \_\_\_\_\_ Ft. \_\_\_\_\_ to ft. \_\_\_\_\_

Type of screen or perforations \_\_\_\_\_

Static water level, for non-flowing well: \_\_\_\_\_ feet.

Shut-in pressure, for flowing well: \_\_\_\_\_ lb./sq. in. on: \_\_\_\_\_ (date)

Pumping water level \_\_\_\_\_ feet at \_\_\_\_\_ gal. per min.

How tested: \_\_\_\_\_

Length of test \_\_\_\_\_

Remarks: (Gravel packing, cementing, packers, type of shut-off, depth of shut-off)

Natural spring used for stock water

(over)

## Description of Material Drilled

Q  
E-1

**Ex. 3**

County of Sweet Grass.

Filed this... 2

1	2	3	4	5	6	7	8	9	10	11	12	13	14	15	16	17	18	19	20	21	22	23	24	25	26	27	28	29	30	31	32	33	34	35	36	37	38	39	40	41	42	43	44	45	46	47	48	49	50	51	52	53	54	55	56	57	58	59	60	61	62	63	64	65	66	67	68	69	70	71	72	73	74	75	76	77	78	79	80	81	82	83	84	85	86	87	88	89	90	91	92	93	94	95	96	97	98	99	100	101	102	103	104	105	106	107	108	109	110	111	112	113	114	115	116	117	118	119	120	121	122	123	124	125	126	127	128	129	130	131	132	133	134	135	136	137	138	139	140	141	142	143	144	145	146	147	148	149	150	151	152	153	154	155	156	157	158	159	160	161	162	163	164	165	166	167	168	169	170	171	172	173	174	175	176	177	178	179	180	181	182	183	184	185	186	187	188	189	190	191	192	193	194	195	196	197	198	199	200	201	202	203	204	205	206	207	208	209	210	211	212	213	214	215	216	217	218	219	220	221	222	223	224	225	226	227	228	229	230	231	232	233	234	235	236	237	238	239	240	241	242	243	244	245	246	247	248	249	250	251	252	253	254	255	256	257	258	259	260	261	262	263	264	265	266	267	268	269	270	271	272	273	274	275	276	277	278	279	280	281	282	283	284	285	286	287	288	289	290	291	292	293	294	295	296	297	298	299	300	301	302	303	304	305	306	307	308	309	310	311	312	313	314	315	316	317	318	319	320	321	322	323	324	325	326	327	328	329	330	331	332	333	334	335	336	337	338	339	340	341	342	343	344	345	346	347	348	349	350	351	352	353	354	355	356	357	358	359	360	361	362	363	364	365	366	367	368	369	370	371	372	373	374	375	376	377	378	379	380	381	382	383	384	385	386	387	388	389	390	391	392	393	394	395	396	397	398	399	400	401	402	403	404	405	406	407	408	409	410	411	412	413	414	415	416	417	418	419	420	421	422	423	424	425	426	427	428	429	430	431	432	433	434	435	436	437	438	439	440	441	442	443	444	445	446	447	448	449	450	451	452	453	454	455	456	457	458	459	460	461	462	463	464	465	466
---	---	---	---	---	---	---	---	---	----	----	----	----	----	----	----	----	----	----	----	----	----	----	----	----	----	----	----	----	----	----	----	----	----	----	----	----	----	----	----	----	----	----	----	----	----	----	----	----	----	----	----	----	----	----	----	----	----	----	----	----	----	----	----	----	----	----	----	----	----	----	----	----	----	----	----	----	----	----	----	----	----	----	----	----	----	----	----	----	----	----	----	----	----	----	----	----	----	----	-----	-----	-----	-----	-----	-----	-----	-----	-----	-----	-----	-----	-----	-----	-----	-----	-----	-----	-----	-----	-----	-----	-----	-----	-----	-----	-----	-----	-----	-----	-----	-----	-----	-----	-----	-----	-----	-----	-----	-----	-----	-----	-----	-----	-----	-----	-----	-----	-----	-----	-----	-----	-----	-----	-----	-----	-----	-----	-----	-----	-----	-----	-----	-----	-----	-----	-----	-----	-----	-----	-----	-----	-----	-----	-----	-----	-----	-----	-----	-----	-----	-----	-----	-----	-----	-----	-----	-----	-----	-----	-----	-----	-----	-----	-----	-----	-----	-----	-----	-----	-----	-----	-----	-----	-----	-----	-----	-----	-----	-----	-----	-----	-----	-----	-----	-----	-----	-----	-----	-----	-----	-----	-----	-----	-----	-----	-----	-----	-----	-----	-----	-----	-----	-----	-----	-----	-----	-----	-----	-----	-----	-----	-----	-----	-----	-----	-----	-----	-----	-----	-----	-----	-----	-----	-----	-----	-----	-----	-----	-----	-----	-----	-----	-----	-----	-----	-----	-----	-----	-----	-----	-----	-----	-----	-----	-----	-----	-----	-----	-----	-----	-----	-----	-----	-----	-----	-----	-----	-----	-----	-----	-----	-----	-----	-----	-----	-----	-----	-----	-----	-----	-----	-----	-----	-----	-----	-----	-----	-----	-----	-----	-----	-----	-----	-----	-----	-----	-----	-----	-----	-----	-----	-----	-----	-----	-----	-----	-----	-----	-----	-----	-----	-----	-----	-----	-----	-----	-----	-----	-----	-----	-----	-----	-----	-----	-----	-----	-----	-----	-----	-----	-----	-----	-----	-----	-----	-----	-----	-----	-----	-----	-----	-----	-----	-----	-----	-----	-----	-----	-----	-----	-----	-----	-----	-----	-----	-----	-----	-----	-----	-----	-----	-----	-----	-----	-----	-----	-----	-----	-----	-----	-----	-----	-----	-----	-----	-----	-----	-----	-----	-----	-----	-----	-----	-----	-----	-----	-----	-----	-----	-----	-----	-----	-----	-----	-----	-----	-----	-----	-----	-----	-----	-----	-----	-----	-----	-----	-----	-----	-----	-----	-----	-----	-----	-----	-----	-----	-----	-----	-----	-----	-----	-----	-----	-----	-----	-----	-----	-----	-----	-----	-----	-----	-----	-----	-----	-----	-----	-----	-----	-----	-----	-----	-----	-----	-----	-----

[illegible]

NAME	DATE	TIME	LOCATION	REMARKS
DICK ARMSTRONG				

By Richard A. Moore

11

# GROUNDWATER INDEX

Page / of /

County Sweet Grass Twp. 15 Rge. 15 E

[illegible]

File No. 82684

DUPLICATE

STATE OF MONTANA  
ADMINISTRATOR OF GROUNDWATER CODE  
OFFICE OF STATE ENGINEER

T 15 R 15E  
County Sweet Grass

JAN 27 1964

Declaration of Vested Groundwater Rights

(Under Chapter 237, Montana Session Laws, 1961)

1. Harold J. Esp  
(Name of Appropriator), of \_\_\_\_\_  
(Address)

(Town)

County of Sweet GrassState of Montana

have appropriated groundwater according to the Montana laws in effect prior to January 1, 1962, as follows:

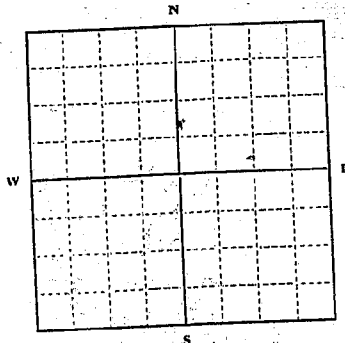
SW 1/4 NE Sec 1 T15 R15E

Indicate point of appropriation and place of use, if possible. Each small square represents 10 acres.

2. The beneficial use on which the claim is based. Stock water  
Pomona3. Date or approximate date of earliest beneficial use; and how continuous the use has been. 1930 Ever since4. The amount of groundwater claimed (in miner's inches or gallons per minute). 25 gal per min.

5. If used for irrigation, give the acreage and description of the lands to which water has been applied and name of the owner thereof

6. The means of withdrawing such water from the ground and the location of each well or other means of withdrawal. Electric Pump7. The date of commencement and completion of the construction of the well, wells, or other works for withdrawal of groundwater. 1930 Hand Pump Till 1950 Electric Pump8. The depth of water table. 30 ft.9. So far as it may be available, the type, size and depth of each well or the general specifications of any other works for the withdrawal of groundwater. 70 ft. Deep Drilled Steel Case Well10. The estimated amount of groundwater withdrawn each year. 25000 gal.11. The log of formations encountered in the drilling of each well if available. Dark Chalk Shale  
Distill.

12. Such other information of a similar nature as may be useful in carrying out the policy of this act, including reference to book and page of any county record

Signature of Owner

Harold J. Esp by Paul R. EspDate Dec 30, 1963

Three copies to be filed by the owner with the County Clerk and Recorder of the county in which the well is located.

Please answer all questions. If not applicable, so state, otherwise the form will be returned.

Original to the County Clerk and Recorder; Duplicate to the State Engineer; Triplicate to the Montana Bureau of Mines and Geology, and Quadruplicate to the Appropriator.

34083



82684

STATE OF MONTANA, } ss.  
County of Sweet Grass.

Filed this 23 day  
of Jan A. D. 1964  
at 348 o'clock P.M.  
Arne Haum  
County Clerk.

By \_\_\_\_\_ Deputy.

GW

Approved Stock Form—State Publishing Co., Helena, Montana—42234

File No. 82525T. 15 R. 15E

DUPLICATE

County Sweet Grass

STATE OF MONTANA  
ADMINISTRATOR OF GROUNDWATER CODE  
OFFICE OF STATE ENGINEER

Declaration of Vested Groundwater Rights

(Under Chapter 237, Montana Session Laws, 1961)

JAN 31 1964  
STATE ENGINEER

1. Samuel A. Duffey, of Ing. Timber  
(Name of Appropriator) (Address) (Town)  
County of Sweet Grass State of Mont  
have appropriated groundwater according to the Montana laws in effect prior to January 1, 1962, as follows:

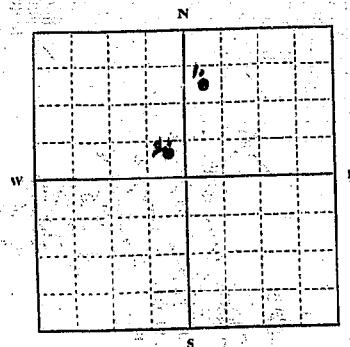

1. NW 1/4, NE Sec. 2, T. 15, R. 15E

Indicate point of appropriation and place of use, if possible. Each small square represents 10 acres.

2. SW 1/4, NW Sec. 2

2. The beneficial use on which the claim is based Both wells are used for household & stock water
3. Date or approximate date of earliest beneficial use; and how continuous the use has been. No. 1 - 1958  
No. 2 - 1947
4. The amount of groundwater claimed (in miner's inches or gallons per minute) No. 1 - 30 gpm  
No. 2 - 30 gpm
5. If used for irrigation, give the acreage and description of the lands to which water has been applied and name of the owner thereof  
Both wells are used to water  
40 acre lawn and garden at both locations.
6. The means of withdrawing such water from the ground and the location of each well or other means of withdrawal. Both wells are equipped with electrical pumps

7. The date of commencement and completion of the construction of the well, wells, or other works for withdrawal of groundwater. No. 1 drilled Aug 1958  
No. 2 drilled in Aug 1947

8. The depth of water table. Both wells table is 12 ft.

9. So far as it may be available, the type, size and depth of each well or the general specifications of any other works for the withdrawal of groundwater. No. 1 is drilled to 30 ft. and completely cased with 4" metal casing  
No. 2 is drilled to 40 ft. and completely cased with 6" metal casing.

10. The estimated amount of groundwater withdrawn each year. No. 1 - 400,000 gal No. 2 - 400,000 gal

11. The log of formations encountered in the drilling of each well if available. none

12. Such other information of a similar nature as may be useful in carrying out the policy of this act, including reference to book and page of any county record.

Signature of Owner

Date Dec 31 1963

Three copies to be filed by the owner with the County Clerk and Recorder of the county in which the well is located.

Please answer all questions. If not applicable, so state, otherwise the form will be returned.

Original to the County Clerk and Recorder; Duplicate to the State Engineer; Triplicate to the Montana Bureau of Mines and Geology, and Quadruplicate for the Appropriator.

33207