

File No. 825-32

T...R

County

DUPLICATE

STATE OF MONTANA
ADMINISTRATOR OF GROUNDWATER CODE
OFFICE OF STATE ENGINEER

22 1962

Declaration of Vested Groundwater Rights

(Under Chapter 237, Montana Session Laws, 1961)

1. Kim J. Hutton, of Bozeman (Address) Bozeman (Town)
(Name of Appropriator)
County of Bozeman State of Montana
have appropriated groundwater according to the Montana laws in effect prior to January 1, 1962, as follows:

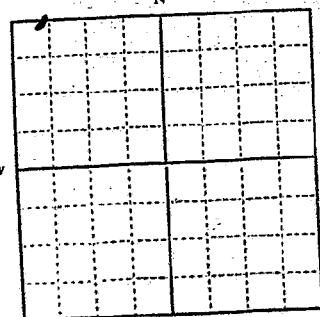

71 W. 1/4 Sec. 56 T. 27 R. 16 E.

Indicate point of appropriation and place of use, if possible. Each small square represents 10 acres.

- N
1. A map showing the location of the well, well, or other works for withdrawal of groundwater. Each small square represents 10 acres.
2. The beneficial use on which the claim is based. Stock Water
3. Date or approximate date of earliest beneficial use; and how continuous the use has been. Dec 17, 1963
4. The amount of groundwater claimed (in miner's inches or gallons per minute) 10 gals per minute
5. If used for irrigation, give the acreage and description of the lands to which water has been applied and name of the owner thereof
6. The means of withdrawing such water from the ground and the location of each well or other means of withdrawal. Pump
for diversion
7. The date of commencement and completion of the construction of the well, wells, or other works for withdrawal of groundwater. Sept 4, 1963
8. The depth of water table. 12 ft.
9. So far as it may be available, the type, size and depth of each well or the general specifications of any other works for the withdrawal of groundwater. 54 ft deep 4 in casing
10. The estimated amount of groundwater withdrawn each year. 150000 gals
11. The log of formations encountered in the drilling of each well if available. 1 ft. shale, sand, etc.
12. Such other information of a similar nature as may be useful in carrying out the policy of this act, including reference to book and page of any county record

Signature of Owner

Date Dec. 27 ap

Three copies to be filed by the owner with the County Clerk and Recorder of the county in which the well is located.

Please answer all questions. If not applicable, so state, otherwise the form will be returned.

Please answer all questions in ink.

Original to the County Clerk and Recorder; Duplicate to the State Engineer; Triplicate to the Montana Bureau of Mines and Geology, and Quadruplicate for the Appropriator.

33662

82532

STATE OF MONTANA }
County of Sweet Grass. } ss.

Filed this 20 day of Jan 1964

at 815 Street A. D.

Archie Hahn
County Clerk

By _____
Deputy

GROUNDWATER INDEX

Page 1 of 1

County Sweet Grass Twp. 27 Rge. 17E

[illegible]

File No. 82622T. 2 N R. 17 E

DUPLICATE

County. Sweet Grass

STATE OF MONTANA
ADMINISTRATOR OF GROUNDWATER CODE
OFFICE OF STATE ENGINEER

JAN 24 1964

Declaration of Vested Groundwater Rights

(Under Chapter 237, Montana Session Laws, 1961)

1. Nellie H. Redland, of Reed Point, Montana,
(Name of Appropriator) (Address) (Town)
County of Sweet Grass State of Montana
have appropriated groundwater according to the Montana laws in effect prior to January 1, 1962, as follows:

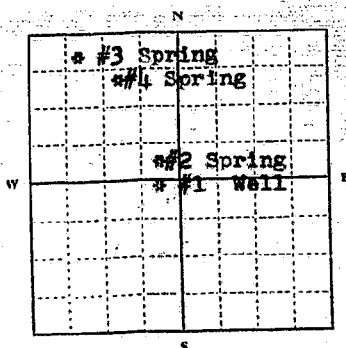

NW 1/4 Sec. 1 T. 2N R. 17 E

Indicate point of appropriation and place of use, if possible. Each small square represents 10 acres.

2. The beneficial use on which the claim is based on livestock use.
3. Date or approximate date of earliest beneficial use; and how continuous the use has been 1949 and continuous thereafter
4. The amount of groundwater claimed (in miner's inches or gallons per minute) All springs would average between 3 to 5 miner's inches each.
5. If used for irrigation, give the acreage and description of the lands to which water has been applied and name of the owner thereof
—
6. The means of withdrawing such water from the ground and the location of each well or other means of withdrawal
#1 Well has hand pump
7. The date of commencement and completion of the construction of the well, wells, or other works for withdrawal of groundwater Well was there in 1949 when we bought the place.
8. The depth of water table 40 feet
9. So far as it may be available, the type, size and depth of each well or the general specifications of any other works for the withdrawal of groundwater Well is 80 feet deep with a 6 inch casing.
10. The estimated amount of groundwater withdrawn each year See #4 above.
11. The log of formations encountered in the drilling of each well if available.
12. Such other information of a similar nature as may be useful in carrying out the policy of this act, including reference to book and page of any county record

Signature of Owner

Nellie H. RedlandDate Dec. 30, 1963

Three copies to be filed by the owner with the County Clerk and Recorder of the county in which the well is located.

Please answer all questions. If not applicable, so state, otherwise the form will be returned.

Original to the County Clerk and Recorder; Duplicate to the State Engineer; Triplicate to the Montana Bureau of Mines and Geology, and Quadruplicate for the Appropriator.

388-3

82622

STATE OF MONTANA, } ss.
County of Pryor Creek.

Filed this 22 day

of Jan A. D. 1964

at 905 A. M.

By Arne Harn

Notary

File No. 82222T 2N R 17E

DUPLICATE

County Sweet Grass

STATE OF MONTANA
ADMINISTRATOR OF GROUNDWATER CODE
OFFICE OF STATE ENGINEER

RECEIVED
DEC 26 1963

Declaration of Vested Groundwater Rights STATE ENGINEER
(Under Chapter 237, Montana Session Laws, 1961)

1. ALBERT STUBER, of Big Timber,
(Name of Appropriator) (Address) (Town)
County of Sweet Grass State of Montana
have appropriated groundwater according to the Montana laws in effect prior to January 1, 1962, as follows:

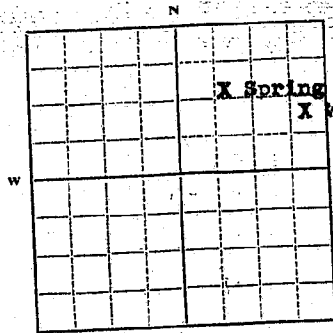

2. The beneficial use on which the claim is based on
livestock use

3. Date or approximate date of earliest beneficial use; and how continuous the use has been 1962 and continuous
thereafter

4. The amount of groundwater claimed (in miner's inches or gallons per minute) Spring--- 5 miner's inches
Well---unknown

5. If used for irrigation, give the acreage and description of the lands to which water has been applied and name of the owner thereof

6. The means of withdrawing such water from the ground and the location of each well or other means of withdrawal
Well--- hand pump
Spring--- piped into tank

7. The date of commencement and completion of the construction of the well, wells, or other works for withdrawal of groundwater Well was dug before 1945.

8. The depth of water table Probably 50 feet in well

9. So far as it may be available, the type, size and depth of each well or the general specifications of any other works for the withdrawal of groundwater
6 inch casing in well and probably about 60 feet deep.

10. The estimated amount of groundwater withdrawn each year See # 4 above

11. The log of formations encountered in the drilling of each well if available

12. Such other information of a similar nature as may be useful in carrying out the policy of this act, including reference to book and page of any county record

Signature of Owner Albert StuberDate Dec. 20, 1963

Three copies to be filed by the owner with the County Clerk and Recorder of the county in which the well is located.

Please answer all questions. If not applicable, so state, otherwise the form will be returned.

Original to the County Clerk and Recorder; duplicate to the State Engineer; Triplicate to the Montana Bureau of Mines and Geology, and Quadruplicate for the Appropriator.

12770

82222

STATE OF MONTANA, }
County of Sweet Grass. } ss.

Filed this: 23 day

of 1963 A. D.

at 8:35 o'clock P. M.

By Anne H. H. County Clerk

Deputy

File No. F 2628T. 2 N R 17 ECounty Sweet Grass

DUPLICATE

STATE OF MONTANA
ADMINISTRATOR OF GROUNDWATER CODE
OFFICE OF STATE ENGINEER

JAN 24 1964

Declaration of Vested Groundwater Rights

(Under Chapter 237, Montana Session Laws, 1961)

1. Nellie H. Redland, of Reed Point,
(Name of Appropriator) (Address) (Town)
County of Sweet Grass State of Montana
have appropriated groundwater according to the Montana laws in effect prior to January 1, 1962, as follows:

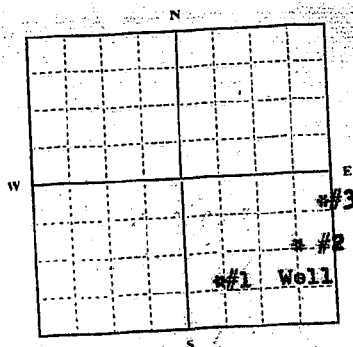

SE 1/4 Sec. 2 T. 2N R. 17 E

Indicate point of appropriation
and place of use, if possible. Each
small square represents 10 acres.

2. The beneficial use on which the claim is based on use
for livestock

3. Date or approximate date of earliest beneficial use; and how continu-
ous the use has been 1941 and continuous
thereafter

4. The amount of groundwater claimed (in miner's inches or gallons
per minute) #2 and #3 and unimproved springs
that flow about 5 to 7 miner's inches the
year around.

5. If used for irrigation, give the acreage and description of the lands
to which water has been applied and name of the owner thereof

6. The means of withdrawing such water from the ground and the loca-
tion of each well or other means of withdrawal
Hand pump and windmill

7. The date of commencement and completion of the construction of the well, wells, or other works for with-
drawal of groundwater Unknown

8. The depth of water table 30 feet

9. So far as it may be available, the type, size and depth of each well or the general specifications of any other
works for the withdrawal of groundwater Well is 60 feet deep and has a
6 inch casing

10. The estimated amount of groundwater withdrawn each year See #4 above

11. The log of formations encountered in the drilling of each well if available

12. Such other information of a similar nature as may be useful in carrying out the policy of this act, including
reference to book and page of any county record

Signature of Owner Nellie H. RedlandDate Dec. 30, 1963

Three copies to be filed by the owner with the County Clerk and Recorder of the county in which the well is located.

Please answer all questions. If not applicable, so state, otherwise the form will be returned.

Original to the County Clerk and Recorder; Duplicate to the State Engineer; Triplicate to the Montana Bureau of
Mines and Geology, and Quadruplicate for the Appropriator.

33829

826 28

STATE OF MONTANA } ss.
County of Sweet Grass }

Filed this 22 day

of Jan 19 1904

at 905 P.M.

Archie H. Hain

County Clerk

Deputy

GV

File No.

TRIPPLICATE

T. 24 R. 17 E

County San Juan

STATE OF MONTANA
ADMINISTRATOR OF GROUNDWATER CODE
OFFICE OF STATE ENGINEER

RECEIVED
JUN 20 1962

Declaration of Vested Groundwater Rights
(Under Chapter 237, Montana Session Laws, 1961)

1. Wayne J. Billings of Billings, Montana
(Name of Appropriator) (Address) (Town)
County of Sweet Grass State of Montana
have appropriated groundwater according to the Montana laws in effect prior to January 1, 1962, as follows:

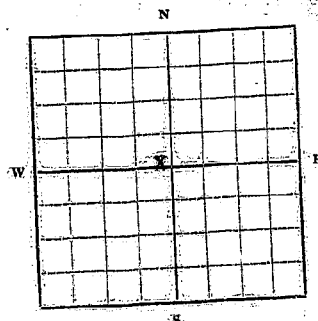

Sec. 36 T. 24 R. 17E
Indicate point of appropriation
and place of use, if possible.
Each small square represents 10
acres.

2. The beneficial use on which the claim is based livestock
3. Date or approximate date of earliest beneficial use; and how continuous the use has been June 1, 1952
4. The amount of groundwater claimed (in miner's inches or gallons per minute) 1 gallon per minute
5. If used for irrigation, give the acreage and description of the lands to which water has been applied and name of the owner thereof N.A.
6. The means of withdrawing such water from the ground and the location of each well or other means of withdrawal Windmill

7. The date of commencement and completion of the construction of the well, wells, or other works for withdrawal of groundwater commencement - May 1962
completion - June 1962

8. The depth of water table sixty-five feet

9. So far as it may be available, the type, size and depth of each well or the general specifications of any other works for the withdrawal of groundwater
Depth is 165 feet. Casing is 15 feet. 6 5/8" I.D.
Iron type casing.

10. The estimated amount of groundwater withdrawn each year 100,000 gallons

11. The log of formations encountered in the drilling of each well if available
15-20' red rock 135-140' gray shale
25-30' brown rock and clay 55-95' gray shale 140-145' 11" ht. gray
35-40' gray rock 125-135' gray rock shale
40-45' 135-135' 11" ht. gray rock

12. Such other information of a similar nature as may be useful in carrying out the policy of this act, including reference to book and page of any county record

Signature of Owner

Date June 17, 1962

Three copies to be filed by the owner with the County Clerk and Recorder of the county in which the well is located.

Please answer all questions. If not applicable, so state, otherwise the form will be returned.

Original to the County Clerk and Recorder; duplicate to the State Engineer; Triplicate to the School of Mines and Quadruplicate for the Appropriator.

File No.

TRIPLICATE

STATE OF MONTANA
ADMINISTRATOR OF GROUNDWATER CODE
OFFICE OF STATE ENGINEER

T 2 N R 17 E

County Sweet Grass

RECEIVED
JUN 20 1962

Declaration of Vested Groundwater Rights
(Under Chapter 237, Montana Session Laws, 1961)

1. Wayne J. Sullivan of St. Vincent, Montana
(Name of Appropriator) (Address) (Town)
County of Sweet Grass State of Montana
have appropriated groundwater according to the Montana laws in effect prior to January 1, 1962, as follows:

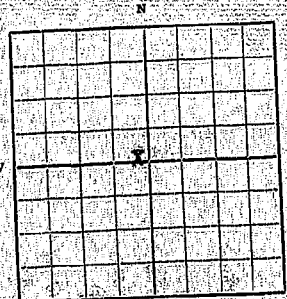

SE 1/4 Sec 8 T 2 N R 17 E
Indicate point of appropriation and place of use, if possible. Each small square represents 10 acres.

2. The beneficial use on which the claim is based livestock
3. Date or approximate date of earliest beneficial use; and how continuous the use has been June 18, 1962
4. The amount of groundwater claimed (in miner's inches or gallons per minute) 4 gallons per minute
5. If used for irrigation, give the acreage and description of the lands to which water has been applied and name of the owner thereof N/A
6. The means of withdrawing such water from the ground and the location of each well or other means of withdrawal Pump & windmill
7. The date of commencement and completion of the construction of the well, wells, or other works for withdrawal of groundwater Commencement --- May 1962
Completion --- June 1962
8. The depth of water table sixty-five feet
9. So far as it may be available, the type, size and depth of each well or the general specifications of any other works for the withdrawal of groundwater Depth is 165 feet. Casing is 15 feet. 6 5/8" o. d.
Iron type casing.
10. The estimated amount of groundwater withdrawn each year 100,000 gallons
11. The log of formations encountered in the drilling of each well if available
1-25' brown rock and clay 25-40' red rock 40-110' gray shale
25-50' gray rock 50-65' light gray rock 65-75' gray rock 75-90' gray shale 90-110' light gray shale 110-125' gray rock 125-135' light gray rock
12. Such other information of a similar nature as may be useful in carrying out the policy of this act, including reference to book and page of any county record

Signature of Owner

Date June 19, 1962

Three copies to be filed by the owner with the County Clerk and Recorder of the county in which the well is located.

Please answer all questions. If not applicable, so state, otherwise the form will be returned.

Original to the County Clerk and Recorder; duplicate to the State Engineer; Triplicate to the School of Mines and Quadruplicate for the Appropriator.

80273

STATE OF MONTANA,
County of Sweet Grass, ss.

Filed this 19 day

of June A. D. 1902

at 4:32 o'clock P. M.

DICK ARMSTRONG

By Catherine Thompson
County Clerk.
Deputy.

whole
gray
ble

g

is

nes

895

GW

File No. 82093

DUPLICATE

T 2N R 17ECounty SWEET GRASS

STATE OF MONTANA
ADMINISTRATOR OF GROUNDWATER CODE
OFFICE OF STATE ENGINEER

JAN 27 1964

Declaration of Vested Groundwater Rights
(Under Chapter 237, Montana Session Laws, 1961)

1. PETER L. POSTAD, of Box 777 BIG TIMBER
(Name of Appropriator) (Address) (Town)
County of SWEET GRASS State of MONTANA
have appropriated groundwater according to the Montana laws in effect prior to January 1, 1962, as follows:

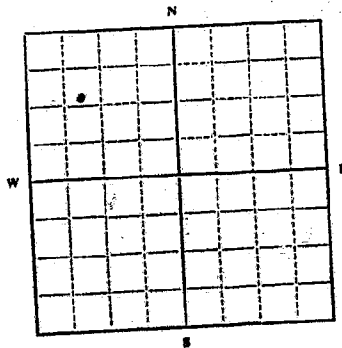

NW $\frac{1}{4}$ Sec. 10 T 2N R 17E

Indicate point of appropriation
and place of use, if possible.
Each small square represents 10
acres.

2. The beneficial use on which the claim is based.
HOUSE HOLD AND LIVE STOCK
3. Date or approximate date of earliest beneficial use; and how continuous the use has been. 1914
USE INTER MITTANT
4. The amount of groundwater claimed (in miner's inches or gallons per minute). 10 GALLONS A MINUTE
5. If used for irrigation, give the acreage and description of the lands to which water has been applied and name of the owner thereof.
6. The means of withdrawing such water from the ground and the location of each well or other means of withdrawal.
PUMP
7. The date of commencement and completion of the construction of the well, wells, or other works for withdrawal of groundwater. APPROX 1914
8. The depth of water table. 30 FEET
9. So far as it may be available, the type, size and depth of each well or the general specifications of any other works for the withdrawal of groundwater. 6 IN CASING 70 FEET DEEP
10. The estimated amount of groundwater withdrawn each year. UNDETERMINED
11. The log of formations encountered in the drilling of each well if available. NOT AVAILABLE
12. Such other information of a similar nature as may be useful in carrying out the policy of this act, including reference to book and page of any county record.

Signature of Owner

Peter L. PostadDate 12-30-63

Three copies to be filed by the owner with the County Clerk and Recorder of the county in which the well is located.

Please answer all questions. If not applicable, so state, otherwise the form will be returned.

Original to the County Clerk and Recorder; duplicate to the State Engineer; Triplicate to the Montana Bureau of Mines and Geology, and Quadruplicate for the Appropriator.

3498

82693

STATE OF MONTANA } ss.
County of Beaver Head }
Filed this 7.3 day
of Jan A 1964
at 710 P. M.
Anne Blain
Deputy.

AWC

8273C

2N R. 17E

10

STATE OF MONTANA
ADMINISTRATOR OF GROUNDWATER CODE
OFFICE OF STATE ENGINEER

SWEET GRASS COUNTY

27 1964

DECLARATION OF VESTED GROUNDWATER RIGHTS
(Under Chapter 237, Montana Session Laws, 1961)

PETER L. ROSTAD, of BIG TIMBER
(Name of appropriator) (Address) (Town)

County of Sweet Grass, State of Montana have appropriated groundwater according to the Montana Laws in effect prior to January 1, 1962, as follows:

		N
	1-8	
W	2-2	
	3-8	
		S

2. The beneficial use on which the claim is based

GRAZING

3. Date or approximate date of earliest beneficial use; and how continuous the use has been. 1896 CONTINUOUS

4. The amount of groundwater claimed (in miner inches or gallon per minute) NO. 1 1 GAL. A MIN NO. 2 7 GAL. NO. 3 20 GAL. A MIN

5. If used for irrigation, give the acreage and description of the lands to which water has been applied and name of the owner thereof

GRAZING

Sec 10 T 2N R 17E

6. The means of withdrawing such water from the ground and the location of each well or other means of withdrawal NATURAL FLOW

7. The date of commencement and the completion of the construction of the well, walls, or other works for withdrawal of groundwater

8. Depth of water table

9. So far as it may be available, the type, size and depth of each well or the general specifications of the other works for the withdrawal of groundwater

10. The estimated amount of groundwater withdrawn each year

11. The log of formations encountered in the drilling of each well if available

12. Such other information of a similar nature as may be useful in carrying out the policy of this act, including reference page of county records and book number

SIGNATURE OF OWNER Peter L. Rostad
DATE 12-30-63

STATE OF MONTANA
COUNTY OF SWEET GRASS) ss.

Peter L. Rostad HAVING FIRST BEEN DULY SWORN, DEPOSES AND SAYS THAT HE (IS, ARE) OF LAWFUL AGE AND (IS, ARE) THE APPROPRIATOR AND CLAIMANT OF THE ORDER AND WATER RIGHT MENTIONED IN THE FOREGOING DECLARATION OF VESTED GROUNDWATER RIGHTS AND THE PERSON WHOSE NAME SUBSCRIBED THEREIN, AS THE APPROPRIATOR AND CLAIMANT, THAT HE KNOWS THE CONTENTS OF SAID FOREGOING NOTICE AND THAT THE MATTERS AND THINGS THEREIN STATED ARE TRUE.

Peter L. Rostad

SUBSCRIBED and SWORN to before me, this 31 day of Dec, 1963

Gene Haum
Notary Public for the state of Mont.
residing at Big Timber, Mont
Commission expires Jan 7 1967

FILED FOR RECORD on the _____ day of _____ 19____ at _____
clock _____, and recorded in book _____ pages _____
records of Sweet Grass County, Montana.

82736

STATE OF MONTANA. } ss.

County of Sweet Grass.

Filed this 23 day

of Jan A D 1964

at 1015 Court St.

Archie H. Hahn

By Deputy.

File No. 87738

T 2N R 17E

DUPLICATE

County SWEET GRASS

STATE OF MONTANA
ADMINISTRATOR OF GROUNDWATER CODE
OFFICE OF STATE ENGINEER

JAN 27 1964
STATE ENGINEER

Notice of Completion of Groundwater Appropriation
Without Well

(Under Chapter 237 Montana Session Laws, 1961)

FIRST WATER USE ABOUT 1896

Date of Appropriation of Groundwater 12-30-63

Owner PETER L. ROSTAD Address BIG TIMBER

Contractor (if any) _____

Address of Contractor _____

Date Started _____ Date Completed _____

Describe means of obtaining groundwater without a well "as by sub-irrigation and other natural processes". Include depth to water when applicable. NATURAL FLOW FROM NATURAL SOURCES

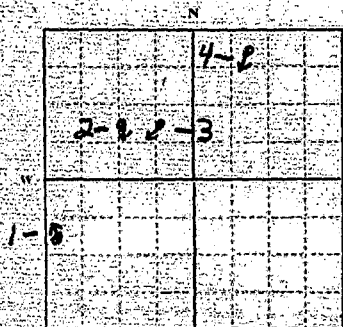

1/4 Sec. 11 T2N R17E
Indicate point of appropriation and place of use, if possible.

Quantity of water developed and used with explanation of method used to measure or estimate such amount. If use is intermittent

estimate approximate lengths of periods of use USED FOR LIVESTOCK DURING GRAZING PERIOD SPRING FLOW No. 1

25 GAL. A MIN. No. 2 7 GAL. A MIN. No. 3 27 GAL. A MIN. No. 4 12 GAL. A MIN.

Signature of Owner Peter L. Rostad

Date 12-30-63

This form to be prepared by contractor (if any), otherwise by the owner.

Three copies of this notice are to be filed with the County Clerk and Recorder of the county in which the works are located.

Please answer all questions. If not applicable, so state, otherwise the form will be returned.

Original to the County Clerk and Recorder; duplicate to the State Engineer; Triplicate to the Montana Bureau of Mines and Geology and Quadruplicate for the Appropriator.

82738

STATE OF MONTANA

County of Sweet Grass

Filed this

25

day

of

Jan

A. D. 1964

at

1015

St. Helena

Archie Shuman

Clerk

By

Deputy

File No. 82625

T 2 N R 17 E

DUPLICATE

County Sweet Grass

STATE OF MONTANA
ADMINISTRATOR OF GROUNDWATER CODE
OFFICE OF STATE ENGINEER

R JAN 24 1964

Notice of Completion of Groundwater Appropriation
Without Well

(Under Chapter 237 Montana Session Laws, 1961)

Date of Appropriation of Groundwater 1941

Owner Nellie H. Redland Address Reed Point, Montana

Contractor (if any) -

Address of Contractor -

Date Started 1941 Date Completed 1941

Describe means of obtaining groundwater without a well "as by sub-irrigation and other natural processes". Include depth to water when applicable. All these springs are unimproved and used for livestock purposes.

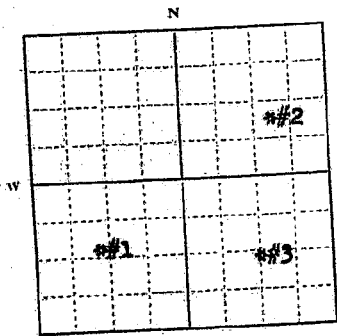

NE, S 1/4 Sec 12 T 2 N R 17 E

Indicate point of appropriation and place of use, if possible.

Quantity of water developed and used with explanation of method used to measure or estimate such amount. If use is intermittent

estimate approximate lengths of periods of use. These springs

flow the year around and average between

2 to 3 miner's inches.

Signature of Owner Nellie H. Redland

Date Dec. 30, 1963

This form to be prepared by contractor (if any), otherwise by the owner.

Three copies of this notice are to be filed with the County Clerk and Recorder of the county in which the works are located.

Please answer all questions. If not applicable, so state, otherwise the form will be returned.

Original to the County Clerk and Recorder; duplicate to the State Engineer; Triplicate to the Montana Bureau of Mines and Geology and Quadruplicate for the Appropriator.

82625

STATE OF MONTANA

County of Silver Grass

Filed this 22 day

of Jan A. D. 1964

at 905 of Rock A. M.

Am. Home

C. V. Rk.

By Deputy

File No. 82690

DUPLICATE

T. T. N. R. R. I. E.
County SWEET GRASS

STATE OF MONTANA
ADMINISTRATOR OF GROUNDWATER CODE
OFFICE OF STATE ENGINEER

RECEIVED
JAN 27 1964

Notice of Completion of Groundwater Appropriation Without Well

(Under Chapter 237 Montana Session Laws, 1961)

Date of Appropriation of Groundwater FIRST USE ABOUT 1896
12-30-63

Owner PETER L. ROSTAD Address BIG TIMBER

Contractor (if any) _____

Address of Contractor _____

Date Started _____ Date Completed _____

Describe means of obtaining groundwater without a well "as by sub-irrigation and other natural processes". Include depth to water when applicable. NATURAL FLOW FROM

NATURAL SOURCES. STREAM FLOW

VARIABLE FROM A FEW FEET TO

FULL LENGTH OF STREAM.

STREAM IS INTERMITTANT

Quantity of water developed and used with explanation of method used to measure or estimate such amount. If use is intermittent

estimate approximate lengths of periods of use. USED THRU

GRAZING PERIOD AND FOR

IRRIGATION PURPOSES. SPRING

NO. 1. FLOW 3 GAL. A MIN. NO. 2 FLOW

5 GAL. A MIN. NO. 3. FLOW 15 GAL. A MIN.

NO. 4 7 GAL. A MIN. NO. 5 7 GAL. A MIN.

Signature of Owner Peter L. Rostad
Date 12-30-63

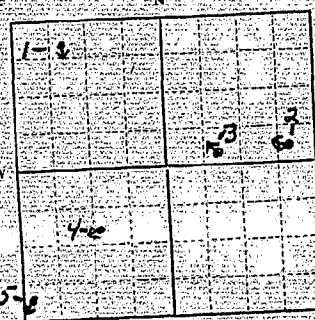

1/4 Sec. 12 T2N R17E
Indicate point of appropriation and place of use, if possible.

This form to be prepared by contractor (if any), otherwise by the owner.

Three copies of this notice are to be filed with the County Clerk and Recorder of the county in which the works are located.

Please answer all questions. If not applicable, so state, otherwise the form will be returned.

Original to the County Clerk and Recorder; duplicate to the State Engineer; Triplicate to the Montana Bureau of Mines and Geology and Quadruplicate for the Appropriator.

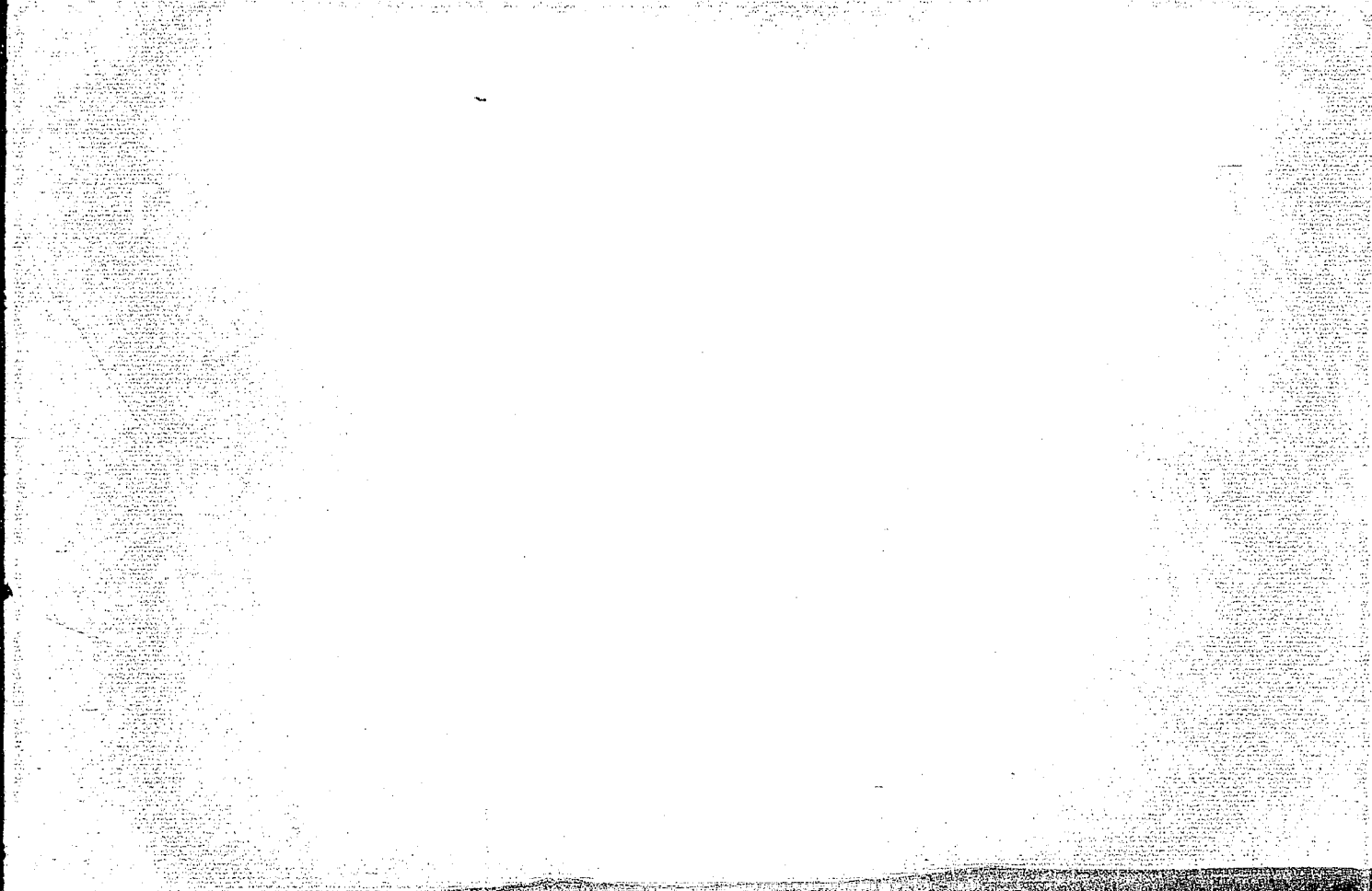

8W

82737

2N R. 17E

14

STATE OF MONTANA
ADMINISTRATOR OF GROUNDWATER CODE
OFFICE OF STATE ENGINEER

SWEET GRASS COUNTY
27 1964

DECLARATION OF VESTED GROUNDWATER RIGHTS
(Under Chapter 237, Montana Session Laws, 1961)

Peter L. Postad of Big Timber
County of Sweet Grass, State of Montana have appropriated groundwater according
to the Montana Laws in effect prior to January 1, 1962, as follows:

2-1	4-3
8-2	5-4
10-3	6-9

2. The beneficial use on which the claim is based GRAZING

3. Date or approximate date of earliest beneficial use; and how continuous the use has been. 1896

4. The amount of groundwater claimed (in miner inches or gallon per minute) Not 3 GPM MIN
Not 3 GPM Not 3.8 GPM Not 9 GPM Not 2 GPM

5. Used for irrigation, give the acreage and description of the lands to which water has been applied and name of the owner thereof
GRAZING

Sec 14 T 2N R 17E

6. The means of withdrawing such water from the ground and the location of each well or other means of withdrawal NATURAL FLOW

7. The date of commencement and the completion of the construction of the well, wells, or other works for withdrawal of groundwater
8. Depth of water table

9. So far as it may be available, the type, size and depth of each well or the general specifications of the other works for the withdrawal of groundwater

10. The estimated amount of groundwater withdrawn each year

11. The log of formations encountered in the drilling of each well if available

12. Such other information of a similar nature as may be useful in carrying out the policy of this act, including reference page of county records and book number

SIGNATURE OF OWNER Peter L. Postad
DATE 12-30-63

STATE OF MONTANA)
COUNTY OF SWEET GRASS)ss.

Peter L. Postad HAVING FIRST BEEN DULY SOWN, DEPOSES AND SAYS THAT HE (IS, ARE) OF LAWFUL AGE AND (IS, ARE) THE APPROPRIATOR AND CLAIMANT OF THE ORDER AND WATER RIGHT MENTIONED IN THE FOREGOING DECLARATION OF VESTED GROUNDWATER RIGHTS AND THE PERSON WHOSE NAME SUBSCRIBED THEREOF, AS THE APPROPRIATOR AND CLAIMANT, THAT HE KNOWS THE CONTENTS OF SAID FOREGOING NOTICE AND THAT THE MATTERS AND THINGS THEREIN STATED ARE TRUE.

Peter L. Postad
Notary Public for the state of Mont.
residing at Big Timber, Mont.
Commission expires Jan 7 1967

SUBSCRIBED and SIGNED to before me, this 31 day of Dec, 1963.

FILED FOR RECORD on the _____ day of _____ 19____ at _____ o'clock _____ M., and recorded in book _____ pages _____ records of Sweet Grass County, Montana.

34123

82737

STATE OF MONTANA, } ss.
County of Sweet Grass, }

Filed this 25 day
of Jan A.D. 1964
at 1015 a. Pl.
Arne Haum
County Clerk
By _____ Deputy

File No. 82735T. 2 N R. 12 E

DUPLICATE

County SWEET GRASS

STATE OF MONTANA
ADMINISTRATOR OF GROUNDWATER CODE
OFFICE OF STATE ENGINEER

JAN 27 1964

STATE ENGINEER

Notice of Completion of Groundwater Appropriation
Without Well

(Under Chapter 237 Montana Session Laws, 1961)

FIRST USED ABOUT
1896Date of Appropriation of Groundwater 12-30-63Owner Peter L. Rosita Address BIG TIMBER

Contractor (if any) _____

Address of Contractor _____

Date Started _____ Date Completed _____

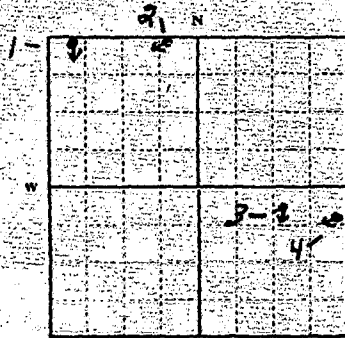
Describe means of obtaining groundwater without a well "as by sub-irrigation and other natural processes". Include depth to water when applicable. NATURAL FLOWFROM NATURAL SOURCES

1/4 Sec. 15, T2N R12E

Indicate point of appropriation and place of use, if possible.

Quantity of water developed and used with explanation of method used to measure or estimate such amount. If use is intermittent

estimate approximate lengths of periods of use. USED FORLIVESTOCK DURING GRAZINGPERIOD SPRING FLOW NO. 1 10 GAL.A MIN. NO. 2 7 GAL. A MIN. NO. 34 GAL. A MIN. NO. 4 4 GAL. A MIN.Signature of Owner Peter L. RositaDate 12-30-63

This form to be prepared by contractor (if any), otherwise by the owner.

Three copies of this notice are to be filed with the County Clerk and Recorder of the county in which the works are located.

Please answer all questions. If not applicable, so state, otherwise the form will be returned.

Original to the County Clerk and Recorder; duplicate to the State Engineer; Triplicate to the Montana Bureau of Mines and Geology and Quadruplicate for the Appropriator.

82735

STATE OF MONTANA

County of Sweet Grass

Filed this 25th day of

Jan 1963

By *Dean*

Notary Public

My Comm. Expires

1963

Notary

GW

Approved Stock Form—State Publishing Co., Helena, Montana—42234

File No. 87621

T. 2N R. 17E

County Sweet Grass

DUPLICATE

STATE OF MONTANA
ADMINISTRATOR OF GROUNDWATER CODE
OFFICE OF STATE ENGINEER

JAN 24 1963

Declaration of Vested Groundwater Rights

(Under Chapter 237, Montana Session Laws, 1961)

1. Paul M. Goldberg of Big Timber (Name of Appropriator) (Address) (Town)
County of Sweet Grass State of Montana
have appropriated groundwater according to the Montana laws in effect prior to January 1, 1962, as follows:

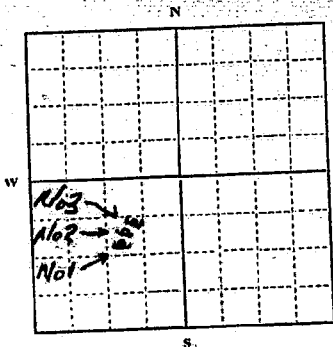

1/4 Sec. 20 T. 2N R. 17E

Indicate point of appropriation and place of use, if possible. Each small square represents 10 acres.

Three Wells

SW 1/4 NE 1/4 SW 1/4 Sec 20

2. The beneficial use on which the claim is based STOCK WATER? Household
3. Date or approximate date of earliest beneficial use; and how continuous the use has been 1914 Approximate
4. The amount of groundwater claimed (in miner's inches or gallons per minute) 10 gallons per minute for all three wells
5. If used for irrigation, give the acreage and description of the lands to which water has been applied and name of the owner thereof No. 2 well used to irrigate garden about 1 Acre
6. The means of withdrawing such water from the ground and the location of each well or other means of withdrawal 905 ft. on all 3 wells
7. The date of commencement and completion of the construction of the well, wells, or other works for withdrawal of groundwater 1914 approximate
8. The depth of water table 12 ft.
9. So far as it may be available, the type, size and depth of each well or the general specifications of any other works for the withdrawal of groundwater All three wells 30 ft deep
Rocked up
Dug wells
10. The estimated amount of groundwater withdrawn each year 100,000 gals for each well
11. The log of formations encountered in the drilling of each well if available not available
12. Such other information of a similar nature as may be useful in carrying out the policy of this act, including reference to book and page of any county record none

Signature of Owner

Paul M. Goldberg
Date Dec. 30, 1963

Three copies to be filed by the owner with the County Clerk and Recorder of the county in which the well is located.

Please answer all questions. If not applicable, so state, otherwise the form will be returned.

Original to the County Clerk and Recorder; Duplicate to the State Engineer; Triplicate to the Montana Bureau of Mines and Geology, and Quadruplicate for the Appropriator.

33822

82621

STATE OF MONTANA }
County of Sweet Grass }

Filed this 27 day

of Jan A. D. 1964

at 820 o'clock A.M.

By Arne Haum
County Clerk

By _____
Deputy

File No. 82695T. 2 N. R. 17 E

DUPLICATE

County SWEET GRASS

STATE OF MONTANA
ADMINISTRATOR OF GROUNDWATER CODE
OFFICE OF STATE ENGINEER

JAN 27 1964

STATE ENGINEER

Declaration of Vested Groundwater Rights

(Under Chapter 237, Montana Session Laws, 1961)

PETER L. POSTAD, of Box 777 BIG TIMBER
(Name of Appropriator) (Address) (Town)
County of SWEET GRASS State of MONTANA
have appropriated groundwater according to the Montana laws in effect prior to January 1, 1962, as follows:

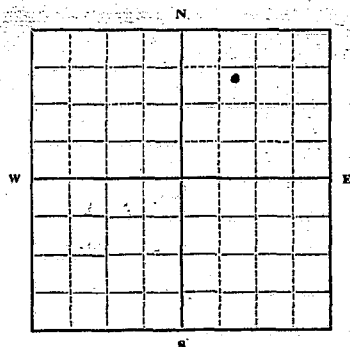
NE $\frac{1}{4}$ Sec. 22 T. 2 N. R. 17 E

Indicate point of appropriation
and place of use, if possible.
Each small square represents 10
acres.

2. The beneficial use on which the claim is based. HOUSEHOLD
AND IRRIGATION AND LIVESTOCK

3. Date or approximate date of earliest beneficial use; and how continuous the use has been. 1930
USE INTERMITTANT

4. The amount of groundwater claimed (in miner's inches or gallons per minute) 1.5 GALLON A MINUTE

5. If used for irrigation, give the acreage and description of the lands to which water has been applied and name of the owner thereof
GARDEN AND LAWN

6. The means of withdrawing such water from the ground and the location of each well or other means of withdrawal
ENGINE AND PUMP

7. The date of commencement and completion of the construction of the well, wells, or other works for withdrawal of groundwater. ABOUT 1930

8. The depth of water table. 30 FEET

9. So far as it may be available, the type, size and depth of each well or the general specifications of any other works for the withdrawal of groundwater.
6 IN CASING DEPTH 103 FEET

10. The estimated amount of groundwater withdrawn each year. UNDETERMINED

11. The log of formations encountered in the drilling of each well if available. NOT AVAILABLE

12. Such other information of a similar nature as may be useful in carrying out the policy of this act, including reference to book and page of any county record.

Signature of Owner

Peter L. PostadDate 12-30-63

Three copies to be filed by the owner with the County Clerk and Recorder of the county in which the well is located.

Please answer all questions. If not applicable, so state, otherwise the form will be returned.

Original to the County Clerk and Recorder; duplicate to the State Engineer; Triplicate to the Montana Bureau of Mines and Geology, and Quadruplicate for the Appropriator.

34093

82695

STATE OF MONTANA,)
County of Sweet Grass.) ss.

Filed this 23 day

of Jan A.D. 1964

at 710 O'Clock P.M.

Arne Haim

County Clerk.

By _____ Deputy.

File No. 82689T 2N R 17E

DUPLICATE

County SWEET GRASS

STATE OF MONTANA
ADMINISTRATOR OF GROUNDWATER CODE
OFFICE OF STATE ENGINEER

JAN 27 1964

Notice of Completion of Groundwater Appropriation
Without Well

(Under Chapter 237, Montana Session Laws, 1961)

FIRST USE ABOUT 1896

Date of Appropriation of Groundwater 12-30-63Owner PETER L. ROSTAD Address BIG TIMBER

Contractor (if any) _____

Address of Contractor _____

Date Started _____

Date Completed _____

Describe means of obtaining groundwater without a well "as by sub-irrigation and other natural processes". Include depth to water when applicable. NATURAL FLOWFROM NATURAL SOURCESVARIABLE STREAM FLOWINTERMITTENT

Quantity of water developed and used with explanation of method used to measure or estimate such amount. If use is intermittent

estimate approximate lengths of periods of use USED FORGRAZING PURPOSES ANDIRRIGATION SPRING NO. 1FLOW 10 GAL A MIN. NO. 2 20 GALA MIN. NO. 3 17 GAL A MIN. NO. 4 10 GALA MIN.Signature of Owner Peter L. RostadDate 12-30-63

This form to be prepared by contractor (if any), otherwise by the owner.

Three copies of this notice are to be filed with the County Clerk and Recorder of the county in which the works are located.

Please answer all questions. If not applicable, so state, otherwise the form will be returned.

Original to the County Clerk and Recorder; duplicate to the State Engineer; Triplicate to the Montana Bureau of Mines and Geology and Quadruplicate for the Appropriator.

82689

STATE OF MONTANA
County of Sweet Grass

Filed this 23 day
of Jan A.D. 1969
at 710 P.M.
Arne Hansen
By _____ Deputy

File No. 82688T. 2 N R. 17 ECounty SWEET GRASS

DUPLICATE

STATE OF MONTANA
ADMINISTRATOR OF GROUNDWATER CODE
OFFICE OF STATE ENGINEER

JAN 27 1964

STATE ENGINEER

Notice of Completion of Groundwater Appropriation Without Well

(Under Chapter 237 Montana Session Laws, 1961)

Date of Appropriation of Groundwater FIRST USED ABOUT 1896
12-30-63Owner PETER L. RASTAL Address BIG TIMBER

Contractor (if any) _____

Address of Contractor _____

Date Started _____

Date Completed _____

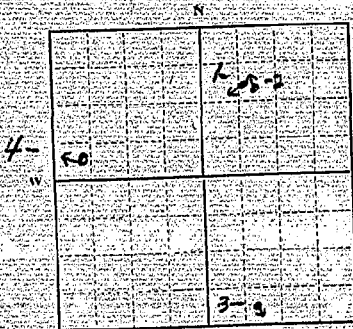
Describe means of obtaining groundwater without a well "as by sub-irrigation and other natural processes". Include depth to water when applicable. NATURAL FLOW FROMNATURAL SOURCES VARIABLE
FLOW STREAM INTERMITTANT

1/4 Sec. 23 T2 N R17 E
Indicate point of appropriation
and place of use, if possible.

Quantity of water developed and used with explanation of method used to measure or estimate such amount. If use is intermittent estimate approximate lengths of periods of use. USED FORGRAZING PURPOSES ANDIRRIGATION SPRING NO. 1FLOW 10 GAL A MIN. NO. 2 7 GALA MIN. NO. 3 4 GAL A MIN.

No. 4 Spring
30 GAL A MIN.

Signature of Owner Peter L. RastalDate 12-30-63

This form to be prepared by contractor (if any), otherwise by the owner.

Three copies of this notice are to be filed with the County Clerk and Recorder of the county in which the works are located.

Please answer all questions. If not applicable, so state, otherwise the form will be returned.

Original to the County Clerk and Recorder; duplicate to the State Engineer; Triplicate to the Montana Bureau of Mines and Geology and Quadruplicate for the Appropriator.

82688

STATE OF MONTANA }
County of Sweet Grass }
Filed this 23 day
of Jan 1964
at 710 P.M.
Wm. H. Hume
County Clerk
By _____ Deputy

FILE NO. 82724

2N 17E

STATE OF MONTANA
ADMINISTRATOR OF GROUNDWATER CODE
OFFICE OF STATE ENGINEER

SWEET GRASS COUNTY

JAN 27 1964

DECLARATION OF VESTED GROUNDWATER RIGHTS
(Under Chapter 237, Montana Session Laws, 1963)

STATE ENGINEER

PETER L. ROSTAD, of BIG TIMBER
County of Sweet Grass, State of Montana Have appropriated groundwater according
to the Montana Laws in effect prior to January 1, 1962, as follows:

N		
	4-8 3	
	3-8 5	
W	2-8 8	E
	1-8 8	
	S	

2. The beneficial use on which the claim is based.

GRAZING

3. Date or approximate date of earliest beneficial use; and how continuous the use has been.

1896 CONTINUOUS IN

4. The amount of groundwater claimed in inches or gallon per minute

SPRING FLOW

No. 1 2 GAL A MIN No. 2 12 GAL No. 3 11 GAL.

5. If used for irrigation, the description of the lands to which water has been applied and name of the owner thereof

FOR GRAZING

Sec 29 2N 17E

6. The means of withdrawing such water from the ground and the location of each well or other means of withdrawal

NATURAL FLOW

7. The date of commencement and the completion of the construction of the well, wells, or other works for withdrawal of groundwater

8. Depth of water table

9. So far as it may be available, the type, size and depth of each well or the general specifications of the other works for the withdrawal of groundwater

10. The estimated amount of groundwater withdrawn each year

11. The log of formations encountered in the drilling of each well if available

12. Such other information of a similar nature as may be useful in carrying out the policy of this act, including reference page of county records and book number

SIGNATURE OF OWNER
DATE

Peter L. Rostad
12-30-63

STATE OF MONTANA)
COUNTY OF SWEET GRASS)ss.

Peter L. Rostad HAVING FIRST BEEN DULY SOWN, DEPOSES AND SAYS THAT HE (IS, ARE) OF LAWFUL AGE AND (IS, ARE) THE APPROPRIATOR AND CLAIMANT OF THE ORDER AND WATER RIGHT MENTIONED IN THE FOREGOING DECLARATION OF VESTED GROUNDWATER RIGHTS AND THE PERSON WHOSE NAME SUBSCRIBED THEREIN, AS THE APPROPRIATOR AND CLAIMANT, THAT HE KNOWS THE CONTENTS OF SAID FOREGOING NOTICE AND THAT THE MATTERS AND THINGS THEREIN STATED ARE TRUE.

Peter L. Rostad

SUBSCRIBED and SWORN to before me, this 31 day of Dec, 1963.

Arne Haugen

Notary Public for the state of Mont.
residing at Big Timber, Mont.
Commission expires Jan 7 1967

FILED FOR RECORD on the 31 day of Dec, 1963 at Big Timber
o'clock 11 P., and recorded in book 1963 Pages 1963
records of Sweet Grass County, Montana.

34120

82734

STATE OF MONTANA, } ss.
County of Sweet Grass.

Filed this 25 day

of Jan A.D. 1968

at 1015 A.M.

Arne Haim

By Arne Haim Clerk

Deputy.

File No. 22691T. 2N R. 17E

DUPLICATE

County SWEET GRASS

STATE OF MONTANA
ADMINISTRATOR OF GROUNDWATER CODE
OFFICE OF STATE ENGINEER

RECEIVED
JAN 27 1964

Notice of Completion of Groundwater Appropriation
Without Well

(Under Chapter 237 Montana Session Laws, 1961)

USE STARTED
APPROX 1890

Date of Appropriation of Groundwater 12-30-63Owner PETER L. POSTAD Address BIG TIMBER

Contractor (if any) _____

Address of Contractor _____

Date Started _____ Date Completed _____

Describe means of obtaining groundwater without a well "as by sub-irrigation and other natural processes". Include depth to water when applicable. NATURAL FLOWSTREAM LENGTH VARIABLEDEPENDING ON RAIN FALLFROM A FEW FEET TO SEVERALHUNDRED

Quantity of water developed and used with explanation of method used to measure or estimate such amount. If use is intermittent

estimate approximate lengths of periods of use USEDMOSTLY THRU GROWING SEASONOR WHEN WE HAVE STOCKIN PASTURE

1/4 Sec 26 T2N R17E

Indicate point of appropriation and place of use, if possible.

SPRING FLOW

NO. 1. 15 GAL. A MIN.

NO. 2 17 GAL. A MIN.

NO. 3 17 GAL. A MIN.

Signature of Owner Peter L. PostadDate 12-30-63

This form to be prepared by contractor (if any), otherwise by the owner.

Three copies of this notice are to be filed with the County Clerk and Recorder of the county in which the works are located.

Please answer all questions. If not applicable, so state, otherwise the form will be returned.

Original to the County Clerk and Recorder; duplicate to the State Engineer; Triuplicate to the Montana Bureau of Mines and Geology and Quadruplicate for the Appropriator.

82691

STATE MONTANA } ss.
County West Gross }
Filed this 23 day
of Jan A.D. 1964
at 710 o'clock P.M.
Rene Horn
County Clerk
By _____
Deputy

GW

Approved Stock Form—State Publishing Co., Helena, Montana—39089

File No. 82694T. 2N R. 17E
County SWEET GRASS

DUPLICATE

STATE OF MONTANA
ADMINISTRATOR OF GROUNDWATER CODE
OFFICE OF STATE ENGINEER

JAN 27 1964

Declaration of Vested Groundwater Rights

(Under Chapter 237, Montana Session Laws, 1961)

PETER L. POSTAD, (Name of Appropriator) of Box 777 (Address) BIG TIMBER (Town)
County of SWEET GRASS State of MONTANA
have appropriated groundwater according to the Montana laws in effect prior to January 1, 1962, as follows:

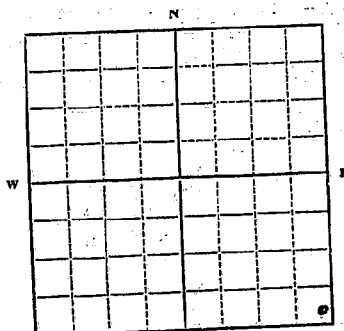
SE $\frac{1}{4}$ Sec. 26 T. 2N R. 17E

Indicate point of appropriation
and place of use, if possible.
Each small square represents 10
acres.

2. The beneficial use on which the claim is based.
HOUSEHOLD AND LIVESTOCK
3. Date or approximate date of earliest beneficial use; and how continuous the use has been. 1916 APPROX.
USE INTERMITTANT
4. The amount of groundwater claimed (in miner's inches or gallons per minute). 15 GALLONS A MINUTE
5. If used for irrigation, give the acreage and description of the lands to which water has been applied and name of the owner thereof.
6. The means of withdrawing such water from the ground and the location of each well or other means of withdrawal.
PUMP

7. The date of commencement and completion of the construction of the well, wells, or other works for withdrawal of groundwater. APPROX 1916
8. The depth of water table. 40 FEET
9. So far as it may be available, the type, size and depth of each well or the general specifications of any other works for the withdrawal of groundwater. WIN CASING DEPTH 75 FEET
10. The estimated amount of groundwater withdrawn each year. UNDETERMINED
11. The log of formations encountered in the drilling of each well if available. NOT AVAILABLE
12. Such other information of a similar nature as may be useful in carrying out the policy of this act, including reference to book and page of any county record.

Signature of Owner

Peter L. Postad

Date

12-30-63

Three copies to be filed by the owner with the County Clerk and Recorder of the county in which the well is located.

Please answer all questions. If not applicable, so state, otherwise the form will be returned.

Original to the County Clerk and Recorder; duplicate to the State Engineer; Triplicate to the Montana Bureau of Mines and Geology, and Quadruplicate for the Appropriator.

3409

82694

STATE OF MONTANA	
County of Sweet Grass	
Filed this	23 day
of	Jan A. D. 1964
at	710 P.M.
By <u>Ben Hein</u> County Clerk	
Deputy	

File No. 82692T. 21 R. 17E

DUPLICATE

County SWEET GRASS

STATE OF MONTANA
ADMINISTRATOR OF GROUNDWATER CODE
OFFICE OF STATE ENGINEER

JAN 27 1964

Notice of Completion of Groundwater Appropriation
Without Well

(Under Chapter 237 Montana Session Laws, 1961)

Date of Appropriation of Groundwater 12-3-63Owner Peter L. Rotal Address Big Timber

Contractor (if any) _____

Address of Contractor _____

Date Started _____

Date Completed _____

Describe means of obtaining groundwater without a well "as by sub-irrigation and other natural processes". Include depth to water when applicable. NATURAL FLOW

Flow is variable. It flows
from a matter of a few feet
to a mile or more depending
on how much rain fall we have

Quantity of water developed and used with explanation of method used to measure or estimate such amount. If use is intermittent estimate approximate lengths of periods of use.

$\frac{1}{4}$ Sec. 27 TAN RITE

Indicate point of appropriation and place of use, if possible.

MOSTLY THRU THE GROWING

SEASON AND WHEN EVER WE

SPRING FLOW

NO. 1 15 GAL. A MIN.

NO. 2 10 GAL. A MIN.

NO. 3 20 GAL. A MIN.

Signature of Owner

Peter L. Rotal

Date 12-3-63

This form to be prepared by contractor (if any), otherwise by the owner.

Three copies of this notice are to be filed with the County Clerk and Recorder of the county in which the works are located.

Please answer all questions. If not applicable, so state, otherwise the form will be returned.

Original to the County Clerk and Recorder; duplicate to the State Engineer; Triplicate to the Montana Bureau of Mines and Geology and Quadruplicate for the Appropriator.

82-692

STATE OF MONTANA,
County of Sweet Grass,

That this 23 day
of Jan A.D. 1964
at 7:10 o'clock P.M.
Archie H. [Signature]
County Clerk
By _____ Deputy

File No. 82623

T. 2 N R 17 E

DUPLICATE

County Sweet Grass

STATE OF MONTANA
ADMINISTRATOR OF GROUNDWATER CODE
OFFICE OF STATE ENGINEER

JAN 24 1964

STATE ENGINEER

**Notice of Completion of Groundwater Appropriation
Without Well**

(Under Chapter 237 Montana Session Laws, 1961)

Date of Appropriation of Groundwater 1921

Owner Nellie H. Redland Address Reed Point, Montana

Contractor (if any) _____

Address of Contractor _____

Date Started 1921 Date Completed _____

Describe means of obtaining groundwater without a well "as by sub-irrigation and other natural processes". Include depth to water when applicable. Natural flow

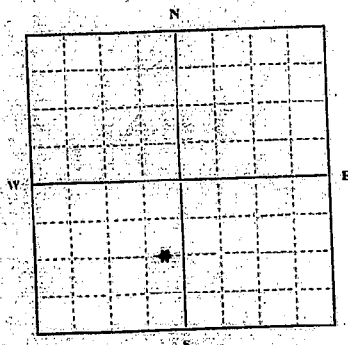

Quantity of water developed and used with explanation of method used to measure or estimate such amount. If use is intermittent

estimate approximate lengths of periods of use Spring

SW 1/4 Sec 28 T. 2N R. 17E

Indicate point of appropriation and place of use, if possible.

flows the year around approximately 6 miner's inches.

Signature of Owner Nellie H. Redland

Date Dec. 20, 1963

This form to be prepared by contractor (if any), otherwise by the owner.

Three copies of this notice are to be filed with the County Clerk and Recorder of the county in which the works are located.

Please answer all questions. If not applicable, so state, otherwise the form will be returned.

Original to the County Clerk and Recorder; duplicate to the State Engineer; Triplicate to the Montana Bureau of Mines and Geology and Quadruplicate for the Appropriator.

82623

STATE OF MONTANA, } ss.
County of Sweet Grass, }

Filed this 22 day

of Jan A D 19

at 9 05 o'clock A. M.

Anne Hansen
County Clerk.

By _____ Deputy

File No. S 2760T 2N R 17E

DUPLICATE

County Sweet Grass

STATE OF MONTANA
ADMINISTRATOR OF GROUNDWATER CODE
OFFICE OF STATE ENGINEER

R JAN 27 1964

STATE ENGINEER
**Notice of Completion of Groundwater Appropriation
Without Well**

(Under Chapter 237 Montana Session Laws, 1961)

Date of Appropriation of Groundwater 12 - 31 - 63Owner Ronald H. Halverson Address Big Timber, Mont.Contractor (if any) ownerAddress of Contractor sameDate Started 1959 Date Completed 1959

Describe means of obtaining groundwater without a well "as by sub-irrigation and other natural processes". Include depth to water when applicable. Spring is developed with 2 1 ft. square wood collection box over the spring with a pipe from collection box to stock tank.

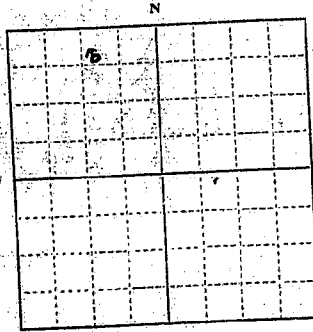

NE 1/4 NW Sec. 34 T2N R17E
Indicate point of appropriation
and place of use, if possible.

Quantity of water developed and used with explanation of method used to measure or estimate such amount: If use is intermittent

estimate approximate lengths of periods of use. Spring flows 10 g. per sec. and is open year around. ~~644~~ 150 cows water here year around.

Signature of Owner Ronald HalversonDate 12/31/63

This form to be prepared by contractor (if any), otherwise by the owner.

Three copies of this notice are to be filed with the County Clerk and Recorder of the county in which the works are located.

Please answer all questions. If not applicable, so state, otherwise the form will be returned.

Original to the County Clerk and Recorder; duplicate to the State Engineer; Triplicate to the Montana Bureau of Mines and Geology and Quadruplicate for the Appropriator.

82760

STATE OF MONTANA,
County of Sweet Grass, } ss.

Filed this 25 day
of Jan A. D. 1964
at 145 o'clock P.M.
Arne Haem
County Clerk
By _____ Deputy.

FILED
JAN 25 1964
SWEET GRASS COUNTY
MONTANA

FILED
JAN 25 1964
SWEET GRASS COUNTY
MONTANA

FILED
JAN 25 1964
SWEET GRASS COUNTY
MONTANA

File No. 82762T. 2N R. 17E

DUPLICATE

County Sweet Grass

STATE OF MONTANA
ADMINISTRATOR OF GROUNDWATER CODE
OFFICE OF STATE ENGINEER

JAN 27 1964

Declaration of Vested Groundwater Rights

(Under Chapter 237, Montana Session Laws, 1961)

1. Ronald Halverson, of Big Timber (Name of Appropriator) (Address) (Town)
County of Sweet Grass State of Montana
have appropriated groundwater according to the Montana laws in effect prior to January 1, 1962, as follows:

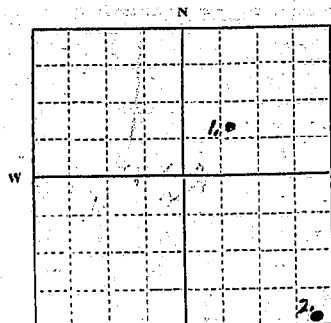

1. SW 1/4 NE Sec 34 T. 21 N. R. 17 E

Indicate point of appropriation
and place of use, if possible. Each
small square represents 10 acres.

2. SE 1/4 SE Sec. 34

2. The beneficial use on which the claim is based. No. 1. house
hold + stock No. 2. Stock

3. Date or approximate date of earliest beneficial use; and how continu-
ous the use has been. No. 1 - 1930 and continuous
use. No. 2 - 1920 use has been
intermittent

4. The amount of groundwater claimed (in miner's inches or gallons
per minute). No. 1 - 20 gpm
No. 2 - 10 gpm

5. If used for irrigation, give the acreage and description of the lands
to which water has been applied and name of the owner thereof
none

6. The means of withdrawing such water from the ground and the loca-
tion of each well or other means of withdrawal. pump-jack
and gasoline motor for the two wells

7. The date of commencement and completion of the construction of the well, wells, or other works for with-
drawal of groundwater. 1930 (est) for No. 1 No. 2 - 1920 est

8. The depth of water table. No. 1. 40 ft No. 2. Not known

9. So far as it may be available, the type, size and depth of each well or the general specifications of any other
works for the withdrawal of groundwater. No. 1 is 60 ft. deep cased completely
with 6" casing. No. 2 is a cased well of unknown depth
cased with 6" casing.

10. The estimated amount of groundwater withdrawn each year. No. 1 - 4000 gal No. 2 not in use now

11. The log of formations encountered in the drilling of each well if available. none

12. Such other information of a similar nature as may be useful in carrying out the policy of this act, including
reference to book and page of any county record.

Signature of Owner

Ronald HalversonDate 12/31/63

Three copies to be filed by the owner with the County Clerk and Recorder of the county in which the well is located.

Please answer all questions. If not applicable, so state, otherwise the form will be returned.

Original to the County Clerk and Recorder; Duplicate to the State Engineer; Triplicate to the Montana Bureau of
Mines and Geology, and Quadruplicate for the Appropriator.

34147

52762

STATE OF MONTANA }
County of Sweet Grass. } ss.

Filed this 25 day

of Jan 10 1964

at 145 P.M.

Arne Lamm
County Clerk

By Deputy

GROUNDWATER INDEX

Page 1 of 1

County Sweet Grass Twp. 27 Rge. 18 E

[illegible]

File No. 22299

T. 2N R. 18E

DUPLICATE

County Sweet Grass

STATE OF MONTANA
ADMINISTRATOR OF GROUNDWATER CODE
OFFICE OF STATE ENGINEER

RECEIVED
DEC 30 1963

Notice of Completion of Groundwater Appropriation Without Well

(Under Chapter 237 Montana Session Laws, 1961)

Date of Appropriation of Groundwater Dec 26, 1963

Owner Alma L. Moffitt Address Big Timber Mont.

Contractor (if any) none

Address of Contractor _____

Date Started _____ Date Completed _____

Describe means of obtaining groundwater without a well "as by sub-irrigation and other natural processes". Include depth to water when applicable. All springs are surface flow from natural underground water sources.

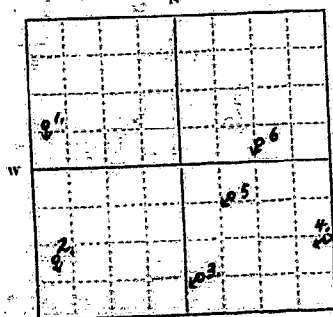

SW ac. for
1. 1/4 NW Sec. 5 T2N R18E
Indicate point of appropriation and place of use, if possible.

2. SW 1/4, SW 1/4, Sec. 5
3. SW 1/4, SE 1/4, Sec. 5
4. SE 1/4, SE 1/4, Sec. 5
5. NW 1/4, SE 1/4, Sec. 5
6. SE 1/4, NE 1/4, Sec. 5

Quantity of water developed and used with explanation of method used to measure or estimate such amount. If use is intermittent

estimate approximate lengths of periods of use. Springs No. 1 & No. 2 flow 8 g.p.m. and Springs No. 3, 4, 5 & 6 flow 5 g.p.m. All springs are used year around and water 150 head ft.
C.O.W.S.

Signature of Owner Alma L. Moffitt

Date Dec 26, 1963

This form to be prepared by contractor (if any), otherwise by the owner.

Three copies of this notice are to be filed with the County Clerk and Recorder of the county in which the works are located.

Please answer all questions. If not applicable, so state, otherwise the form will be returned.

Original to the County Clerk and Recorder; duplicate to the State Engineer; Triplicate to the Montana Bureau of Mines and Geology and Quadruplicate for the Appropriator.

82299

STATE OF MONTANA, }
County of Sweet Grass }

Filed this 26 day

of Dec A. D. 1963

at 5:45 o'clock P. M.

Arue Ham
County Clerk.

By _____ Deputy.

GW3

File No. 82207

DUPLICATE

T. 3N R. 18E
County Sweet GrassSTATE OF MONTANA
ADMINISTRATOR OF GROUNDWATER CODE
OFFICE OF STATE ENGINEERRECEIVED
DEC 26 1963

STATE ENGINEER

Notice of Completion of Groundwater Appropriation Without Well

(Under Chapter 237 Montana Session Laws, 1961)

Date of Appropriation of Groundwater 1915Owner Gilbert OplandAddress Big Timber Mont

Contractor (if any) _____

Address of Contractor _____

Date Started _____

Date Completed _____

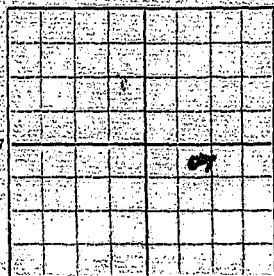
Describe means of obtaining groundwater without a well "as by sub-irrigation and other natural processes" Include depth to water when applicable. Gravity Flowto SurfaceQuantity of water developed and used with explanation of method used to measure or estimate such amount. If use is intermittent estimate approximate lengths of periods of use year1/4 Sec. 6 T. 3N R. 18E
Indicate point of appropriation and place of use, if possible.NE NW SE 1/4 Sec 6RoundRound20 million inchSignature of Owner Gilbert OplandDate 12-20-63

This form to be prepared by contractor (if any), otherwise by the owner.

Three copies of this notice are to be filed with the County Clerk and Recorder of the county in which the works are located.

Please answer all questions. If not applicable, so state, otherwise the form will be returned.

Original to the County Clerk and Recorder; duplicate to the State Engineer; Triplicate to the Montana Bureau of Mines and Geology and Quadruplicate for the Appropriator.

12755

82207

STATE OF MONTANA
County of Sweet Grass

Filed this 21 day
of Dec A.D. 1963
at 4.25 P.M.
Clara Harris
County Clerk
By _____ Deputy

EX 11E
and 11E2

1012
1012

1012

1012

1012

1012

1012

1012

1012

1012

File No. 82796

DUPLICATE

T. 2N R. 18ECounty Sweet Grass

STATE OF MONTANA
ADMINISTRATOR OF GROUNDWATER CODE
OFFICE OF STATE ENGINEER

RECEIVED
DEC 30 1963

STATE ENGINEER
**Notice of Completion of Groundwater Appropriation
Without Well**

(Under Chapter 237 Montana Session Laws, 1961)

Date of Appropriation of Groundwater Dec 26, 1963Owner Alma L. Moffett Big Timber

Contractor (if any) _____

Address of Contractor _____

Date Started _____

Date Completed _____

Describe means of obtaining groundwater without a well: "as by sub-irrigation and other natural processes". Include depth to water when applicable. All springs are surface
flow from natural underground water

SOURCES _____

Quantity of water developed and used with explanation of method used to measure or estimate such amount. If use is intermittent

estimate approximate lengths of periods of use SpringsNo. 1 + 3 flow 6 g.p.m. 2nd spring No. 2flows 8 g.p.m. Springs are open year around
and water 100 head of cows.

Signature of Owner _____

Alma L. MoffettDate Dec 26, 1963

This form to be prepared by contractor (if any), otherwise by the owner.

Three copies of this notice are to be filed with the County Clerk and Recorder of the county in which the works are located.

Please answer all questions. If not applicable, so state, otherwise the form will be returned.

Original to the County Clerk and Recorder; duplicate to the State Engineer; Triplicate to the Montana Bureau of Mines and Geology and Quadruplicate for the Appropriator.

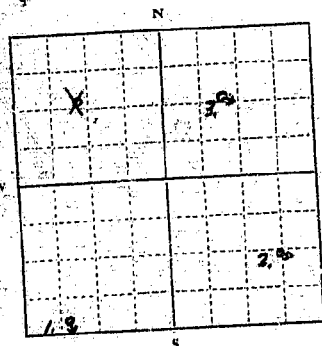

1. SW 1/4 SW, Sec. 6 T2N R18E

Indicate point of appropriation and place of use, if possible.

2. SE 1/4 SE, Sec. 6 T2N R18E

3. NW 1/4 NE, Sec. 6 " "

15926

82296

STATE OF MONTANA }
County of Sweet Grass } ss.

Filed this 26 day
of May A.D. 1912
at 5:30 o'clock P.M.
Wm. H. Hume
County Clerk.
By _____
Deputy.

File No. 82298

DUPLICATE

Approved Stock Form—State Publishing Co., Helena, Montana—41921

T. 2N R. 18E
County Sweet Grass

STATE OF MONTANA
ADMINISTRATOR OF GROUNDWATER CODE
OFFICE OF STATE ENGINEER

RECEIVED
DEC 30 1963

Declaration of Vested Groundwater Rights
(Under Chapter 237, Montana Session Laws, 1961)

I, Alma L. Moffett, of Big Timber Montana
(Name of Appropriator) (Address) (Town)
County of Sweet Grass State of Montana
have appropriated groundwater according to the Montana laws in effect prior to January 1, 1962, as follows:

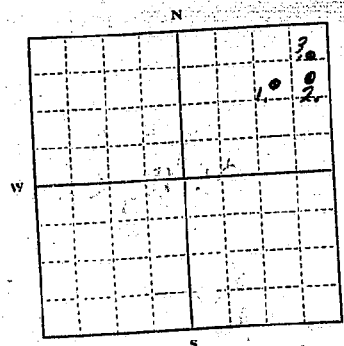

1. NE 1/4 NE Sec. 6, T2N R. 18E

Indicate point of appropriation and place of use, if possible. Each small square represents 10 acres.

2. NE 1/4 NE

3. NE 1/4, NE

2. The beneficial use on which the claim is based. No. 1 + 2 for stock; No. 3 household.
3. Date or approximate date of earliest beneficial use; and how continuous the use has been. No. 1 + 3 drilled in 1949. No. 2 dug in 1910. Use has been continuous.
4. The amount of groundwater claimed (in miner's inches or gallons per minute). No. 1 - 5 g.p.m. No. 2 - 8 g.p.m. No. 3 - 8 g.p.m.
5. If used for irrigation, give the acreage and description of the lands to which water has been applied and name of the owner thereof. (none)
6. The means of withdrawing such water from the ground and the location of each well or other means of withdrawal. All wells are pumped electrically.

7. The date of commencement and completion of the construction of the well, wells, or other works for withdrawal of groundwater. No. 1 - 11 months 1949. No. 2 dug in 1910. No. 3 drilled 11 months 1949. No. 2 dug 1960.
8. The depth of water table. No. 1 40 ft.; No. 2 - 10 ft.; No. 3 - 30 ft.
9. So far as it may be available, the type, size and depth of each well or the general specifications of any other works for the withdrawal of groundwater. No. 1 80 ft. deep 6 inch casing + cased completely; No. 2 is 4 ft. diameter 20 ft. deep and cased with 2" pipe at 4 ft. diameter pipe; No. 3 is 29.0 ft. deep cased completely.
10. The estimated amount of groundwater withdrawn each year. No. 1 - 100,000 gal.; No. 2 100,000 gal. No. 3 200,000
11. The log of formations encountered in the drilling of each well if available. none
12. Such other information of a similar nature as may be useful in carrying out the policy of this act, including reference to book and page of any county record.

Signature of Owner

Alma L. Moffett
Date Dec 26 1963

Three copies to be filed by the owner with the County Clerk and Recorder of the county in which the well is located.

Please answer all questions. If not applicable, so state, otherwise the form will be returned.

Original to the County Clerk and Recorder; Duplicate to the State Engineer; Triplicate to the Montana Bureau of Mines and Geology, and Quadruplicate for the Appropriator.

15928

82295

STATE OF MONTANA, }
County of Sweet Grass. } ss.
Filed this 26
of 1863
at 5:40 P. M.
Archie Ham
County Clerk.
Duly.

AS ATTEST TO BEAR
WITNESS TO THE
ATTEST STATE OF MONTANA

Archie Ham

File No. 827-24

DUPLICATE

T. 2 N. R. 18 E

County Sweet Grass

STATE OF MONTANA
ADMINISTRATOR OF GROUNDWATER CODE
OFFICE OF STATE ENGINEER

DEC 26 1963

STATE ENGINEER

Notice of Completion of Groundwater Appropriation
Without Well

(Under Chapter 237, Montana Session Laws, 1961)

Date of Appropriation of Groundwater 1962Owner ALBERT STUBER Address Big Timber, Mont.Contractor (if any) -Address of Contractor -Date Started 1962 Date Completed 1962

Have used it since I purchased ranch
Describe means of obtaining groundwater without a well "as by
sub-irrigation and other natural processes" Include depth to
water when applicable. Natural process

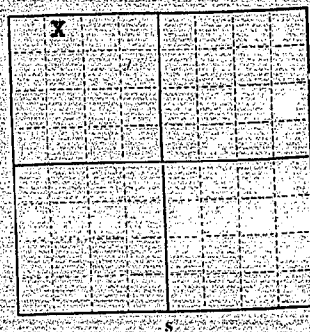

NW 1/4 Sec. 7 T. 2 N. R. 18 E

Indicate point of appropriation
and place of use, if possible.Quantity of water developed and used with explanation of method
used to measure or estimate such amount. If use is intermittentestimate approximate lengths of periods of use 6 or 7miner's inches the entire yearSignature of Owner Albert StuberDate Dec. 20, 1963

This form to be prepared by contractor (if any), otherwise by the owner.

Three copies of this notice are to be filed with the County Clerk and Recorder of the county in which the
works are located.

Please answer all questions. If not applicable, so state, otherwise the form will be returned.

Original to the County Clerk and Recorder; duplicate to the State Engineer; Triplicate to the Montana
Bureau of Mines and Geology and Quadruplicate for the Appropriator.

82224

STATE OF MONTANA } ss
County of Sweet Grass }
Filed this 23 day
of June A. D. 1919
at 8:45 o'clock A.M.
Amie H. Hume
County Clerk
By _____ Deputy

File No. 82626T 2 N R 18 E

DUPLICATE

County Sweet Grass

STATE OF MONTANA
ADMINISTRATOR OF GROUNDWATER CODE
OFFICE OF STATE ENGINEER

R
JAN 24 1964

Notice of Completion of Groundwater Appropriation Without Well

(Under Chapter 237 Montana Session Laws, 1961)

Date of Appropriation of Groundwater 1941Owner Nellie H. Redland Address Need Point, MontanaContractor (if any) -Address of Contractor -Date Started 1941 Date Completed 1941

Describe means of obtaining groundwater without a well "as by
sub-irrigation and other natural processes" Include depth to
water when applicable. Used for livestock

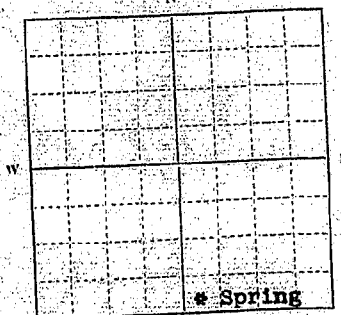

SE 1/4 Sec. 7 T2N R18E

Indicate point of appropriation
and place of use, if possible.

Quantity of water developed and used with explanation of method
used to measure or estimate such amount. If use is intermittent
estimate approximate lengths of periods of use. This spring

flows the year around and averages 3 to 4
miner's inches.

Signature of Owner Nellie H. RedlandDate Dec. 30, 1963

This form to be prepared by contractor (if any), otherwise by the owner.

Three copies of this notice are to be filed with the County Clerk and Recorder of the county in which the works are located.

Please answer all questions. If not applicable, so state, otherwise the form will be returned.

Original to the County Clerk and Recorder; duplicate to the State Engineer; Triplicate to the Montana Bureau of Mines and Geology and Quadruplicate for the Appropriator.