

291063

FILED

DEC 31 1963

Office of County Clerk
Teton County, Montana

G. F. MONKMAN

[Handwritten signature]

[Faint, illegible text, possibly bleed-through from the reverse side of the page]

File No. _____

T 21N R 5W

DUPLICATE

County Teton

STATE OF MONTANA
ADMINISTRATOR OF GROUNDWATER CODE
OFFICE OF STATE ENGINEER

JAN 10 1964

Declaration of Vested Groundwater Rights ENGINEER
(Under Chapter 237, Montana Session Laws, 1961)

1. Wayne L. Randall, of Choteau
(Name of Appropriator) (Address) (Town)

County of Teton State of Montana

have appropriated groundwater according to the Montana laws in effect prior to January 1, 1962, as follows:

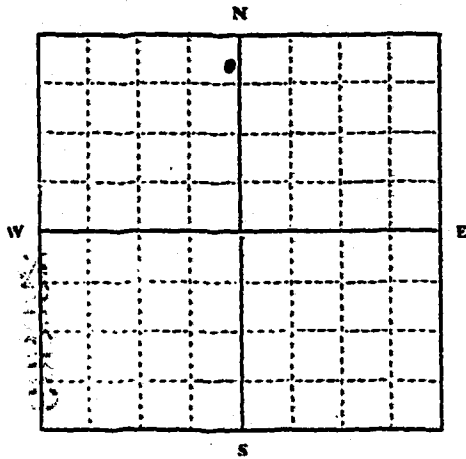

NW 1/4 SE Sec. 7 T21N R. 5W

Indicate point of appropriation and place of use, if possible. Each small square represents 10 acres.

2. The beneficial use on which the claim is based household and livestock use
3. Date or approximate date of earliest beneficial use; and how continuous the use has been 1940 and continuous use
4. The amount of groundwater claimed (in miner's inches or gallons per minute) 12 gallons per minute
5. If used for irrigation, give the acreage and description of the lands to which water has been applied and name of the owner thereof none
6. The means of withdrawing such water from the ground and the location of each well or other means of withdrawal drilled
7. The date of commencement and completion of the construction of the well, wells, or other works for withdrawal of groundwater 1940
8. The depth of water table 25 feet
9. So far as it may be available, the type, size and depth of each well or the general specifications of any other works for the withdrawal of groundwater 8 inch drilled well 60 feet deep
10. The estimated amount of groundwater withdrawn each year 125,000 gallons
11. The log of formations encountered in the drilling of each well if available none
12. Such other information of a similar nature as may be useful in carrying out the policy of this act, including reference to book and page of any county record none

Signature of Owner Wayne L. Randall
Date Dec 30, 1963

Three copies to be filed by the owner with the County Clerk and Recorder of the county in which the well is located.

Please answer all questions. If not applicable, so state, otherwise the form will be returned.

Original to the County Clerk and Recorder; Duplicate to the State Engineer; Triplicate to the Montana Bureau of Mines and Geology, and Quadruplicate for the Appropriator.

30579

290809

FILED

DEC 30 1963

Office of County Clerk
Ft. Ronne County, Montana

Rae M. D. Monkman
County Clerk
Deputy

TR

GW

File No. _____

T 22 R 5
T 22 R 5

DUPLICATE

County Teton

STATE OF MONTANA
ADMINISTRATOR OF GROUNDWATER CODE
OFFICE OF STATE ENGINEER

RECEIVED
JAN 10 1964

Declaration of Vested Groundwater Rights

(Under Chapter 237, Montana Session Laws, 1961)

STATE ENGINEER

1. Nick Vlinker, of Choteau
(Name of Appropriator) (Address) (Town)

County of Teton State of Montana
have appropriated groundwater according to the Montana laws in effect prior to January 1, 1962, as follows:

See Plat N attached.

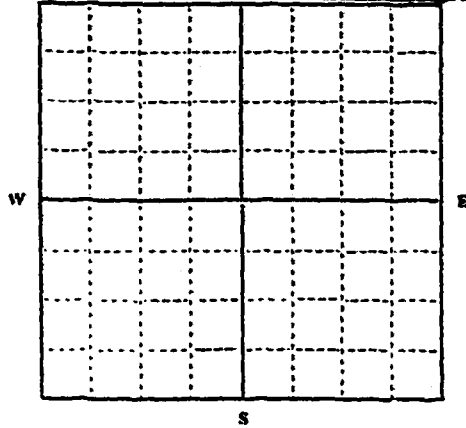

1/4 Sec. T R.

Indicate point of appropriation and place of use, if possible. Each small square represents 10 acres.

2. The beneficial use on which the claim is based Domestic use and water for livestock.

3. Date or approximate date of earliest beneficial use; and how continuous the use has been 1933 and used continuously ever since that time.

4. The amount of groundwater claimed (in miner's inches or gallons per minute) 55 Miners Inches.

5. If used for irrigation, give the acreage and description of the lands to which water has been applied and name of the owner thereof
No irrigation

6. The means of withdrawing such water from the ground and the location of each well or other means of withdrawal
Springs, reservoirs and 7 wells as shown on attached plat.

7. The date of commencement and completion of the construction of the well, wells, or other works for withdrawal of groundwater 1933, 1943, 1953 and 1955. Wells drilled or dug at these intervals.

8. The depth of water table Varies, wells drilled to the following depths: Sec. 1, 10 ft., Sec. 1, 22-6, dug 15 ft. Other wells ranged from 30 ft., 40 ft., 90 ft., and 130 ft.

9. So far as it may be available, the type, size and depth of each well or the general specifications of any other

9. 7 wells as shown on attached plat.
Sec. 9: 2 wells drilled 130 ft. deep with 4" casings. Drilled 1943.
1 well drilled 30 ft. deep, 24" casing. All 3 Electric pumps.
Sec. 10: 1 well dug 10 ft. deep, wood cribbing, 6 ft. by 6 ft.
Sec. 14: 1 well drilled in 1955, 90 ft. deep, 4" casing.
Sec. 15: 1 well drilled in 1953, 40 ft. deep, 4" casing.
Twp. 22 N., Rge. 6 W.
Sec. 1: 1 well dug in 1943, 15 ft. deep, wooden crib 5 feet in diameter. All well in Sections 10, 14, 15, and Sec. 1, Wind driven.

12. Such other information of a similar nature as may be useful in carrying out the policy of this act, including reference to book and page of any county record No County records of previous water rights.

Signature of Owner Nick Vlinker

Date December 19, 1963.

Three copies to be filed by the owner with the County Clerk and Recorder of the county in which the well is located.

Please answer all questions. If not applicable, so state, otherwise the form will be returned.

Original to the County Clerk and Recorder; Duplicate to the State Engineer; Triplicate to the Montana Bureau of Mines and Geology, and Quadruplicate for the Appropriator.

30441

290568

FILED

DEC 19 1963

4:45 o'clock
Office of County Clerk
Teton County, Montana

G. E. MONKMAN
County Clerk

Don Mc Donnell

JAN 10 1964

Name of Appropriator. Nick Vinker ENGINEER

GW 4

LIST NO. _____

Twp. 22 N. Township No. 22 North Range No. 5 West Mer.
Rge. 6 W.

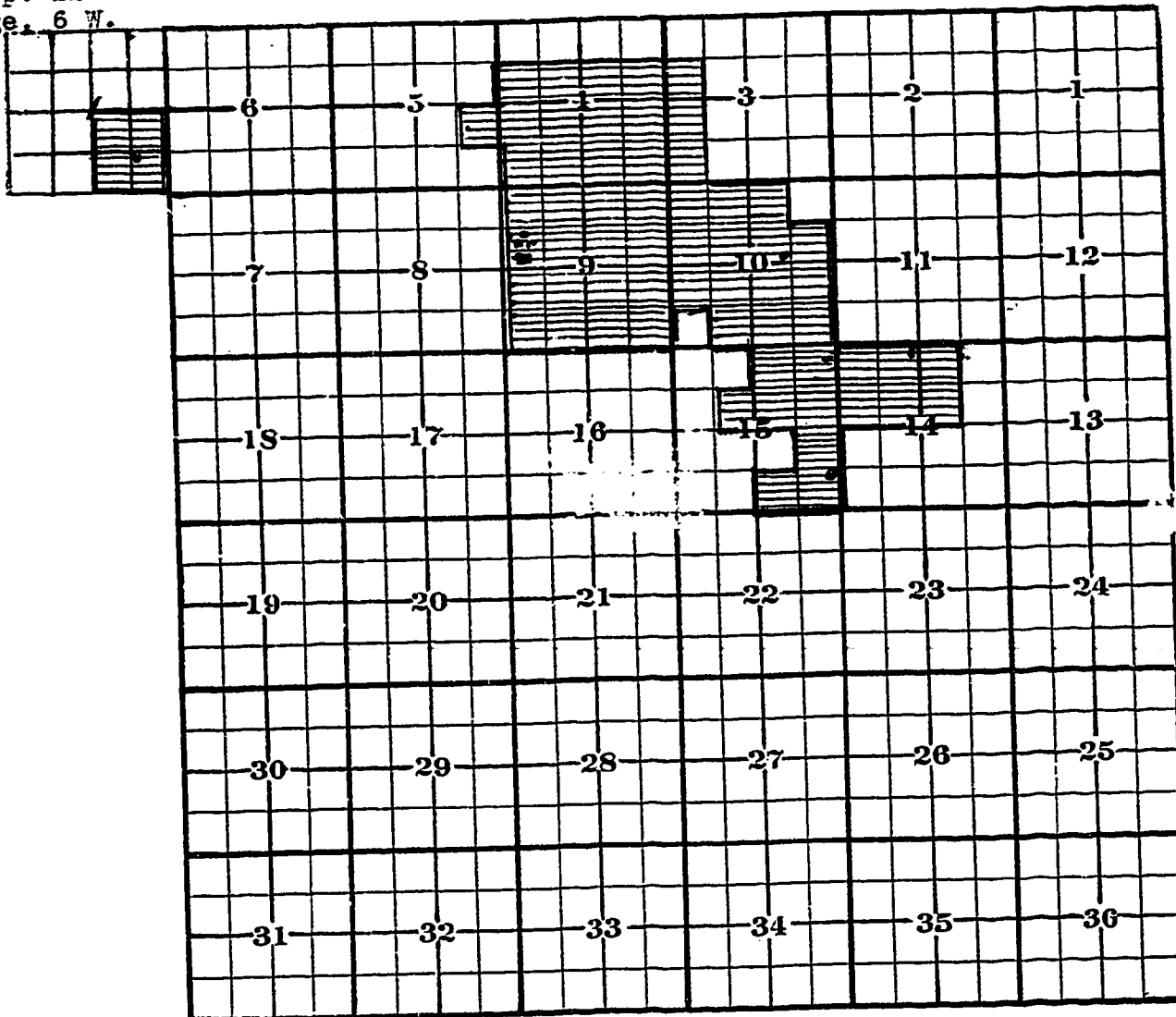

Residence & Farm Bldgs. Sec.
Location of 7 wells.

SCALE 80 CHAINS TO AN INCH

13

File No.

T. 21 N R. 5 W

DUPLICATE

County. Jetson

STATE OF MONTANA
ADMINISTRATOR OF GROUNDWATER CODE
OFFICE OF STATE ENGINEER

Declaration of Vested Groundwater Rights
(Under Chapter 237, Montana Session Laws, 1961)

RECEIVED
DEC 19 1963

STATE ENGINEER

I, Edwin Pearson, of Fairfield,
(Name of Appropriator) (Address) (Town)
County of Jetson State of Montana
have appropriated groundwater according to the Montana laws in effect prior to January 1, 1962, as follows:

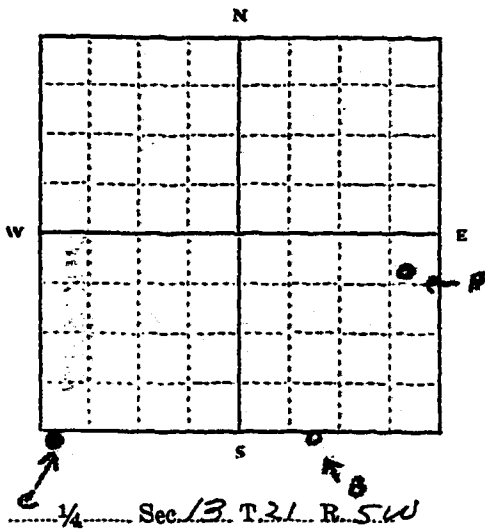

Indicate point of appropriation and place of use, if possible. Each small square represents 10 acres.

2. The beneficial use on which the claim is based. domestic use & some garden irrigation

3. Date or approximate date of earliest beneficial use; and how continuous the use has been. 1942 has been used continuously

4. The amount of groundwater claimed (in miner's inches or gallons per minute) 50 gal per min.

5. If used for irrigation, give the acreage and description of the lands to which water has been applied and name of the owner thereof

6. The means of withdrawing such water from the ground and the location of each well or other means of withdrawal. well pump

7. The date of commencement and completion of the construction of the well, wells, or other works for withdrawal of groundwater. 1942 + 1948

8. The depth of water table. approximately 45 ft

9. So far as it may be available, the type, size and depth of each well or the general specifications of any other works for the withdrawal of groundwater. 1 - 50 deep 6" casing electric hand pump 6" 30 ft deep 5" casing hand pump 6" 30 ft deep 6" casing

10. The estimated amount of groundwater withdrawn each year. 500,000

11. The log of formations encountered in the drilling of each well if available

12. Such other information of a similar nature as may be useful in carrying out the policy of this act, including reference to book and page of any county record

Signature of Owner

Edwin J. Pearson

Date. Dec 16, 1963

Three copies to be filed by the owner with the County Clerk and Recorder of the county in which the well is located.

Please answer all questions. If not applicable, so state, otherwise the form will be returned.

Original to the County Clerk and Recorder; Duplicate to the State Engineer; Triplicate to the Montana Bureau of Mines and Geology, and Quadruplicate for the Appropriator.

10557

DEFERRED

290447

FILED
DEC 16 1963

At 11:45 o'clock
Office of County Clerk
Teton County, Montana
G. E. MONKMAN
County Clerk
Rae McDonald
Deputy

RECEIVED BY STATE
COUNTY CLERK

STATE EXHIBIT
[RECEIVED]

Handwritten notes and signatures:
- Vertical scribbles and lines on the right side of the page.
- A signature that appears to be "Rae McDonald" written vertically.
- Other illegible handwritten marks and initials.

10/17

File No. _____

T. 21 N R. 5 W

DUPLICATE

County Teton

STATE OF MONTANA
ADMINISTRATOR OF GROUNDWATER CODE
OFFICE OF STATE ENGINEER

RECORDED
JAN 10 1964
STATE ENGINEER

Notice of Completion of Groundwater Appropriation
Without Well

(Under Chapter 237 Montana Session Laws, 1961)

From what I can learn
Date of Appropriation of Groundwater About 1912 and prior
Eva Lucille Forsyth and
Owner Oliver L. Forsyth Address Fairfield, Montana
Contractor (if any) None - natural springs and seepage
Address of Contractor _____

Date Started natural Date Completed _____

Describe means of obtaining groundwater without a well "as by sub-irrigation and other natural processes". Include depth to water when applicable. natural flow and seepage except have installed a pipe in one spring SW 1/4 Sec. 16; T21N; R5W

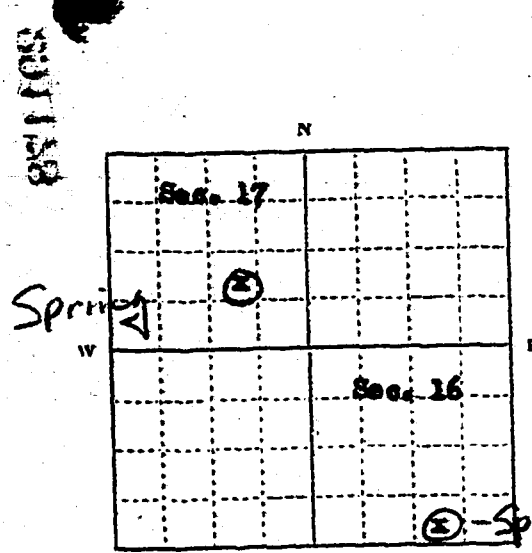

Quantity of water developed and used with explanation of method used to measure or estimate such amount. If use is intermittent

estimate approximate lengths of periods of use. Used entire year for stock water. Much drains into coulees and eventually into Sun River. Seepage and springs thru a coulee in Sections 16, 18, 17 and 21. Two pronounced springs as indicated on map above. Actual quantity or flow of springs unknown.

SW 1/4 Sec. 17 and
SE 1/4 Sec. 16 T. 21 N R. 5 W
Indicate point of appropriation and place of use, if possible.

Signature of Owner Oliver L. Forsyth
Eva Lucille Forsyth

Date Dec. 31, 1963

This form to be prepared by contractor (if any), otherwise by the owner.

Three copies of this notice are to be filed with the County Clerk and Recorder of the county in which the works are located.

Please answer all questions. If not applicable, so state, otherwise the form will be returned.

Original to the County Clerk and Recorder; duplicate to the State Engineer; Triplicate to the Montana Bureau of Mines and Geology and Quadruplicate for the Appropriator.

29 FILED

DEC 31 1963

5 o'clock
Office of County Clerk
Teton County, Montana
G. E. MOELKWAAL

County Clerk
Stella Cordova
Seal

Fee 20

RECORDED & INDEXED TO 41144

RECORDED TO 41144
INDEXED TO 41144
RECORDED TO 41144

RECORDED TO 41144

RECORDED TO 41144

RECORDED TO 41144

RECORDED TO 41144

RECORDED TO 41144

RECORDED TO 41144

RECORDED TO 41144

RECORDED TO 41144

File No. _____

T 21 N R 5 W

County Teton

DUPLICATE

STATE OF MONTANA
ADMINISTRATOR OF GROUNDWATER CODE
OFFICE OF STATE ENGINEER

RECORDED
JAN 10 1964
STATE ENGINEER

Declaration of Vested Groundwater Rights

(Under Chapter 237, Montana Session Laws, 1961)

I, Eva Lucille and Oliver L. Forsyth, of Fairfield
(Name of Appropriator) (Address) (Town)

County of Teton State of Montana
have appropriated groundwater according to the Montana laws in effect prior to January 1, 1962, as follows:

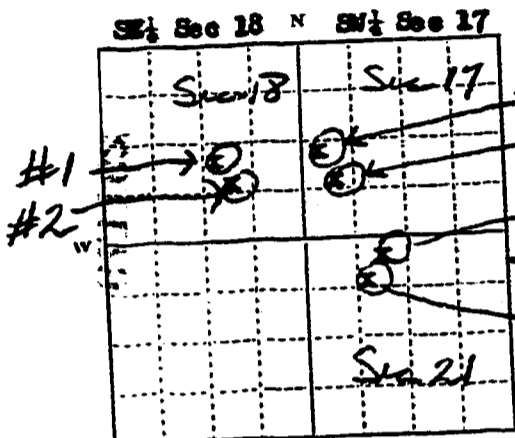

SW 1/4 Sec 18, S
SW 1/4 Sec 17 and
NW 1/4 Sec 21 T21N R.5W

Indicate point of appropriation and place of use, if possible. Each small square represents 10 acres.

2. The beneficial use on which the claim is based
All 6 wells used for stock water. In addition #1 and #3 used in dwelling for personal water consumption.
3. Date or approximate date of earliest beneficial use; and how continuous the use has been Approximate dates for all 6 was 1942

4. The amount of groundwater claimed (in miner's inches or gallons per minute) #1- 12 gal #2- 10 gal. #3- 15 gal; #4- 15 gal. #5- 8 gal per min; #6- 10 gal.

5. If used for irrigation, give the acreage and description of the lands to which water has been applied and name of the owner thereof
none used for irrigation

6. The means of withdrawing such water from the ground and the location of each well or other means of withdrawal
#1- electric #2- manual #3- electric; #4- electric #5 and #6 both manual

7. The date of commencement and completion of the construction of the well, wells, or other works for withdrawal of groundwater all six in about 1942

8. The depth of water table #1- 15 ft; #2- 15 ft.; #3- 15 ft.; #4- 15 ft. #5- 25 ft.; #6- 25 ft.

9. So far as it may be available, the type, size and depth of each well or the general specifications of any other works for the withdrawal of groundwater #1- 25 ft.; #2- 25 ft.; #3- 20 ft.; #4- 30 ft.; #5- 80 ft.; #6- 80 ft. - all wells have 6" casings

10. The estimated amount of groundwater withdrawn each year #1- 72,000; #2- 60,000; 250,000 gal on #3; #4- 310,000 gal.; #5- 60,000; #6- 50,000 galen.

11. The log of formations encountered in the drilling of each well if available
unknown

12. Such other information of a similar nature as may be useful in carrying out the policy of this act, including reference to book and page of any county record none

Signature of Owner Oliver L. Forsyth
Eva Lucille Forsyth

Date Dec. 31, 1963

Three copies to be filed by the owner with the County Clerk and Recorder of the county in which the well is located.

Please answer all questions. If not applicable, so state, otherwise the form will be returned.

Original to the County Clerk and Recorder; Duplicate to the State Engineer; Triplicate to the Montana Bureau of Mines and Geology, and Quadruplicate for the Appropriator.

30912

291179

FILED

DEC 31 1963

5 o'clock
Office of County Clerk
Teton County, Montana

[Signature]
G. E. MONKMAN

County Clerk

Stella Wideman

Jan 2

File No. _____

T. 21N R. 4W

DUPLICATE

County Teton

STATE OF MONTANA
ADMINISTRATOR OF GROUNDWATER CODE
OFFICE OF STATE ENGINEER

RECEIVED
JAN 10 1964

Declaration of Vested Groundwater Rights

(Under Chapter 237, Montana Session Laws, 1961)

Wm. L. Olson and Marthele Olson, of Fairfield
(Name of Appropriator) (Address) (Town)

County of Teton State of Montana

have appropriated groundwater according to the Montana laws in effect prior to January 1, 1962, as follows:

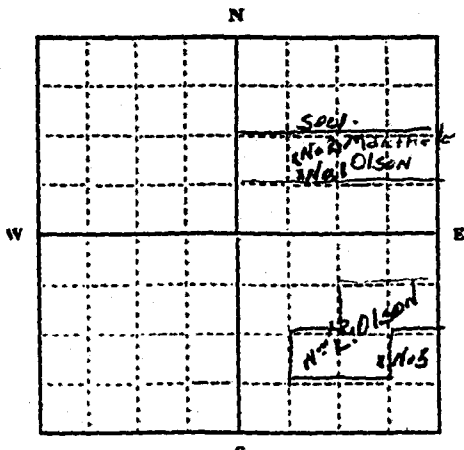

1/2 Sec - T 21N R 4W

Indicate point of appropriation and place of use, if possible. Each small square represents 10 acres.

- 2. The beneficial use on which the claim is based Household use, Stock water and yard irrigation
- 3. Date or approximate date of earliest beneficial use; and how continuous the use has been continuous since 1942
- 4. The amount of groundwater claimed (in miner's inches or gallons per minute) each well 50 gallons per minute
- 5. If used for irrigation, give the acreage and description of the lands to which water has been applied and name of the owner thereof Owner Marthele Olson building site on N1/2 of Sec. 1, T1N, 4W.
- 6. The means of withdrawing such water from the ground and the location of each well or other means of withdrawal Electric pumps, two wells N1/2 Sec. 1 and one well N1/2 E1/2 of Sec. 12 Twp. 21N. Rge. 4W.

- 7. The date of commencement and completion of the construction of the well, wells, or other works for withdrawal of groundwater As itemized above No. 1-1941; No. 2 1956 and No. 3 1944.
- 8. The depth of water table Nos. 1 and two about 45 feet No. 3 165 feet.
- 9. So far as it may be available, the type, size and depth of each well or the general specifications of any other works for the withdrawal of groundwater All drilled wells with 6" casing Nos. 1 and two 70' No. 3 170 feet.
- 10. The estimated amount of groundwater withdrawn each year 200,000 gals -
- 11. The log of formations encountered in the drilling of each well if available not available

12. Such other information of a similar nature as may be useful in carrying out the policy of this act, including reference to book and page of any county record Not available

Signature of Owner W.L. Olson
Date December 30th, 1963

Three copies to be filed by the owner with the County Clerk and Recorder of the county in which the well is located.
Please answer all questions. If not applicable, so state, otherwise the form will be returned.

Original to the County Clerk and Recorder; Duplicate to the State Engineer; Triplicate to the Montana Bureau of Mines and Geology, and Quadruplicate for the Appropriator.

30757

291007

FILED
DEC 31 1963

Office of County Clerk
Tribal County, Montana

G. E. MONKMAN
County Clerk

[Handwritten signature]

[Handwritten number]

[Faint handwritten notes on the left side of the page]

[Faint, mostly illegible text in the middle section of the page]

[Faint, mostly illegible text on the right side of the page]

File No. _____

T 21 N 4 W

DUPLICATE

County _____

STATE OF MONTANA
ADMINISTRATOR OF GROUNDWATER CODE
OFFICE OF STATE ENGINEER

JAN 10 1964

Declaration of Vested Groundwater Rights

(Under Chapter 237, Montana Session Laws, 1961)

1. Lillian C + Colben B. Kolste, of Fairfield Mont.
(Name of Appropriator) (Address) (Town)

County of Teton State of Mont.

have appropriated groundwater according to the Montana laws in effect prior to January 1, 1962, as follows:

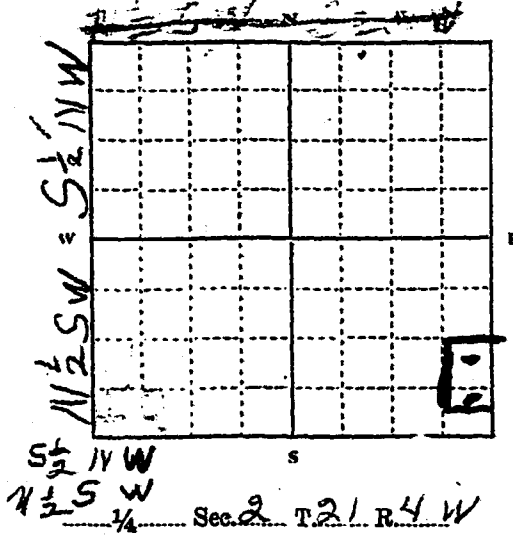

Indicate point of appropriation and place of use, if possible. Each small square represents 10 acres.

2. The beneficial use on which the claim is based Household & Stock water
3. Date or approximate date of earliest beneficial use; and how continuous the use has been Drilled in 1947 + continuous use 2 wells.
4. The amount of groundwater claimed (in miner's inches or gallons per minute) 5 gal a minute on each well.
5. If used for irrigation, give the acreage and description of the lands to which water has been applied and name of the owner thereof not used for irrigation
6. The means of withdrawing such water from the ground and the location of each well or other means of withdrawal Electric pumps on both wells. 1 at barn - 1 at barn.
7. The date of commencement and completion of the construction of the well, wells, or other works for withdrawal of groundwater both wells - March 1947.
8. The depth of water table both wells 250 feet deep.
9. So far as it may be available, the type, size and depth of each well or the general specifications of any other works for the withdrawal of groundwater both drilled, 4 inch casing and hole 250 feet deep.
10. The estimated amount of groundwater withdrawn each year 400,000 gal a year.
11. The log of formations encountered in the drilling of each well if available not available.
12. Such other information of a similar nature as may be useful in carrying out the policy of this act, including reference to book and page of any county record not available.

Signature of Owner Lillian C. Kolste
Colben B. Kolste
Date Dec. 27 - 1963

Three copies to be filed by the owner with the County Clerk and Recorder of the county in which the well is located.
Please answer all questions. If not applicable, so state, otherwise the form will be returned.

Original to the County Clerk and Recorder; Duplicate to the State Engineer; Triplicate to the Montana Bureau of Mines and Geology, and Quadruplicate for the Appropriator.

290751

FILED
DEC 27 1963

11 o'clock
Office of County Clerk
Teton County, Montana

G. E. MONKMAN

County Clerk

R. W. McDaniel

Deputy

2.00

RECEIVED
TETON COUNTY CLERK
DEC 27 1963

RECEIVED
TETON COUNTY CLERK
DEC 27 1963

RECEIVED
TETON COUNTY CLERK
DEC 27 1963

File No. _____

T 21 R 4W

DUPLICATE

County Teton

STATE OF MONTANA
ADMINISTRATOR OF GROUNDWATER CODE
OFFICE OF STATE ENGINEER

RECEIVED
JAN 10 1964
STATE ENGINEER

Declaration of Vested Groundwater Rights

(Under Chapter 237, Montana Session Laws, 1961)

1. Charles W. and Arlene VanderPus, of RR. #2 Fairfield, Montana
(Name of Appropriator) (Address) (Town)

County of Teton State of Montana
have appropriated groundwater according to the Montana laws in effect prior to January 1, 1962, as follows:

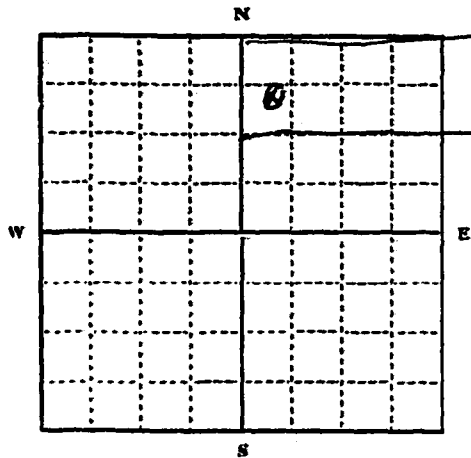

NE 1/4 NE 1/4
Sec. 7 T. 21N R. 4W

Indicate point of appropriation and place of use, if possible. Each small square represents 10 acres.

2. The beneficial use on which the claim is based
Household use
3. Date or approximate date of earliest beneficial use; and how continuous the use has been
Fall of 1940 and continuous.
4. The amount of groundwater claimed (in miner's inches or gallons per minute)
5 gallons per minute
5. If used for irrigation, give the acreage and description of the lands to which water has been applied and name of the owner thereof
none
6. The means of withdrawing such water from the ground and the location of each well or other means of withdrawal
electric pressure pump
7. The date of commencement and completion of the construction of the well, wells, or other works for withdrawal of groundwater
Fall 1940
8. The depth of water table
15 feet
9. So far as it may be available, the type, size and depth of each well or the general specifications of any other works for the withdrawal of groundwater
49 feet deep, 6 inch casing.
10. The estimated amount of groundwater withdrawn each year
73,000 gal.
11. The log of formations encountered in the drilling of each well if available
none
12. Such other information of a similar nature as may be useful in carrying out the policy of this act, including reference to book and page of any county record
none

Signature of Owner Charles VanderPus
Arlene VanderPus

Date 12-26-1963

Three copies to be filed by the owner with the County Clerk and Recorder of the county in which the well is located.

Please answer all questions. If not applicable, so state, otherwise the form will be returned.

Original to the County Clerk and Recorder; Duplicate to the State Engineer; Triplicate to the Montana Bureau of Mines and Geology, and Quadruplicate for the Appropriator.

30560

290784

FILED
DEC 27 1963

At 2 o'clock P
Office of County Clerk
Teton County, Montana

J. C. Johnson
County Clerk
by Lillian Wedin
Deputy

Fee 2.00

RECEIVED
CLERK OF DISTRICT COURT
TETON COUNTY, MONTANA
DEC 27 1963

File No. _____

T 21N R 4W

DUPLICATE

County Teton

STATE OF MONTANA
ADMINISTRATOR OF GROUNDWATER CODE
OFFICE OF STATE ENGINEER

JAN 10 1964
STATE ENGINEER

Declaration of Vested Groundwater Rights

(Under Chapter 237, Montana Session Laws, 1961)

Harry G. and Clair G. Lederer, of Fairfield
(Name of Appropriator) (Address) (Town)

County of Teton State of Montana

have appropriated groundwater according to the Montana laws in effect prior to January 1, 1962, as follows:

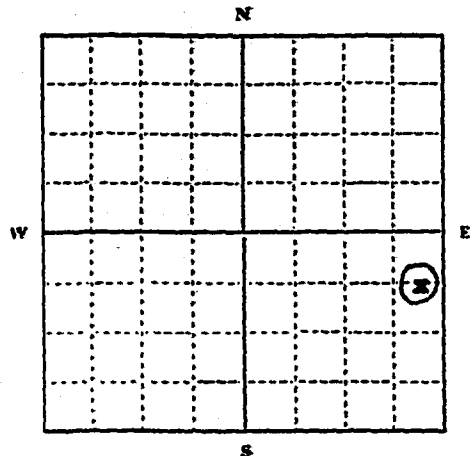

SE 1/4 S Sec. 21N T. 4W R. _____

Indicate point of appropriation and place of use, if possible. Each small square represents 10 acres.

2. The beneficial use on which the claim is based
stock water

3. Date or approximate date of earliest beneficial use; and how continuous the use has been. 1947 continuous use

4. The amount of groundwater claimed (in miner's inches or gallons per minute) 10 gal per minute

5. If used for irrigation, give the acreage and description of the lands to which water has been applied and name of the owner thereof
none

6. The means of withdrawing such water from the ground and the location of each well or other means of withdrawal
Pump with pump jack

7. The date of commencement and completion of the construction of the well, wells, or other works for withdrawal of groundwater. 1947

8. The depth of water table. 100 feet

9. So far as it may be available, the type, size and depth of each well or the general specifications of any other works for the withdrawal of groundwater. 5" casing 100 ft deep

10. The estimated amount of groundwater withdrawn each year. 100,000 gal. per year

11. The log of formations encountered in the drilling of each well if available.
no log

12. Such other information of a similar nature as may be useful in carrying out the policy of this act, including reference to book and page of any county record.
no other

Signature of Owner Clair G. Lederer
Harry G. Lederer

Date Dec. 26, 1963

Three copies to be filed by the owner with the County Clerk and Recorder of the county in which the well is located.

Please answer all questions. If not applicable, so state, otherwise the form will be returned.

Original to the County Clerk and Recorder; Duplicate to the State Engineer; Triplicate to the Montana Bureau of Mines and Geology, and Quadruplicate for the Appropriator.

30587

FILED

290817 DEC 30 1963

9:30 o'clock
Office of County Clerk
Teton County, Montana

G. E. MONKMAN

County Clerk

By Stella Wilson

Fee 2.00

RECEIVED
TETON COUNTY CLERK
DEC 30 1963
9:30 AM

RECEIVED

Approved Stock Form—State Publishing Co., Helena, Montana—2245

8

File No. JUN 15 1973

T21N R4W

County Teton

DUPLICATE

MONTANA DEPARTMENT OF NATURAL RESOURCES AND CONSERVATION STATE OF MONTANA

ADMINISTRATOR OF GROUNDWATER CODE OFFICE OF STATE ENGINEER

Notice of Completion of Groundwater Appropriation Without Well

Developed After January 1, 1962

(Under Chapter 237 Montana Session Laws, 1961)

Date of Appropriation of Groundwater

Owner Schwartz, Stewart Address Fairfield

Contractor (if any)

Address of Contractor

Date Started Date Completed

1) Describe means of obtaining groundwater (as by sub-irrigation, developed spring, drains, etc.)

Spring

2) Means of withdrawing water (gravity, pump, canal, etc.)

gravity

3) Depth of water table

ground level

4) Use of the water

Stock & other

5) Amount of groundwater claimed (in miner's inches, or gallons per minute)

all

6) If used for irrigation, give number of acres and description of land

7) Estimate amount of water used each year

approx. 1000 gal. per hr. (12 mo)

Signature of Owner

Stewart Schwartz

Date 6-14-73

SCALE

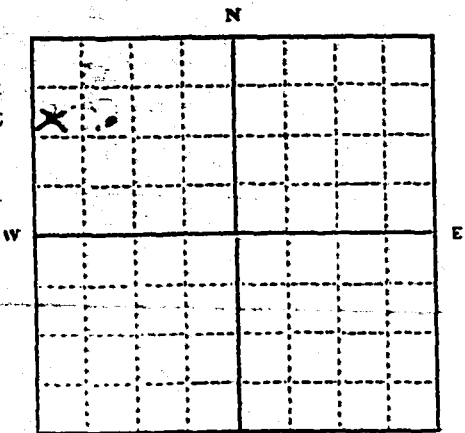

NW 1/4 NW Sec. 8 T. 21 R. 4 W

Indicate point of appropriation and place of use, if possible.

File 314530 Date JUNE 14, 1973 Time 3:45 P.M.

This form to be prepared by contractor (if any), otherwise by the owner.

Three copies of this notice are to be filed with the County Clerk and Recorder of the county in which the works are located.

Please answer all questions. If not applicable, so state, otherwise the form will be returned.

53,528

314530

FILED MAR 14 1973
At 3:45 o'clock P.M.
OFFICE OF COUNTY CLERK, TETON COUNTY MONT.
MARY N. AGER, County Clerk
Nena A. Ager, Deputy
Fees 2.00 pd

Division of Compensation & Personnel Administration

Alison Galt

FROM: [illegible]

TO: [illegible]

RE: [illegible]

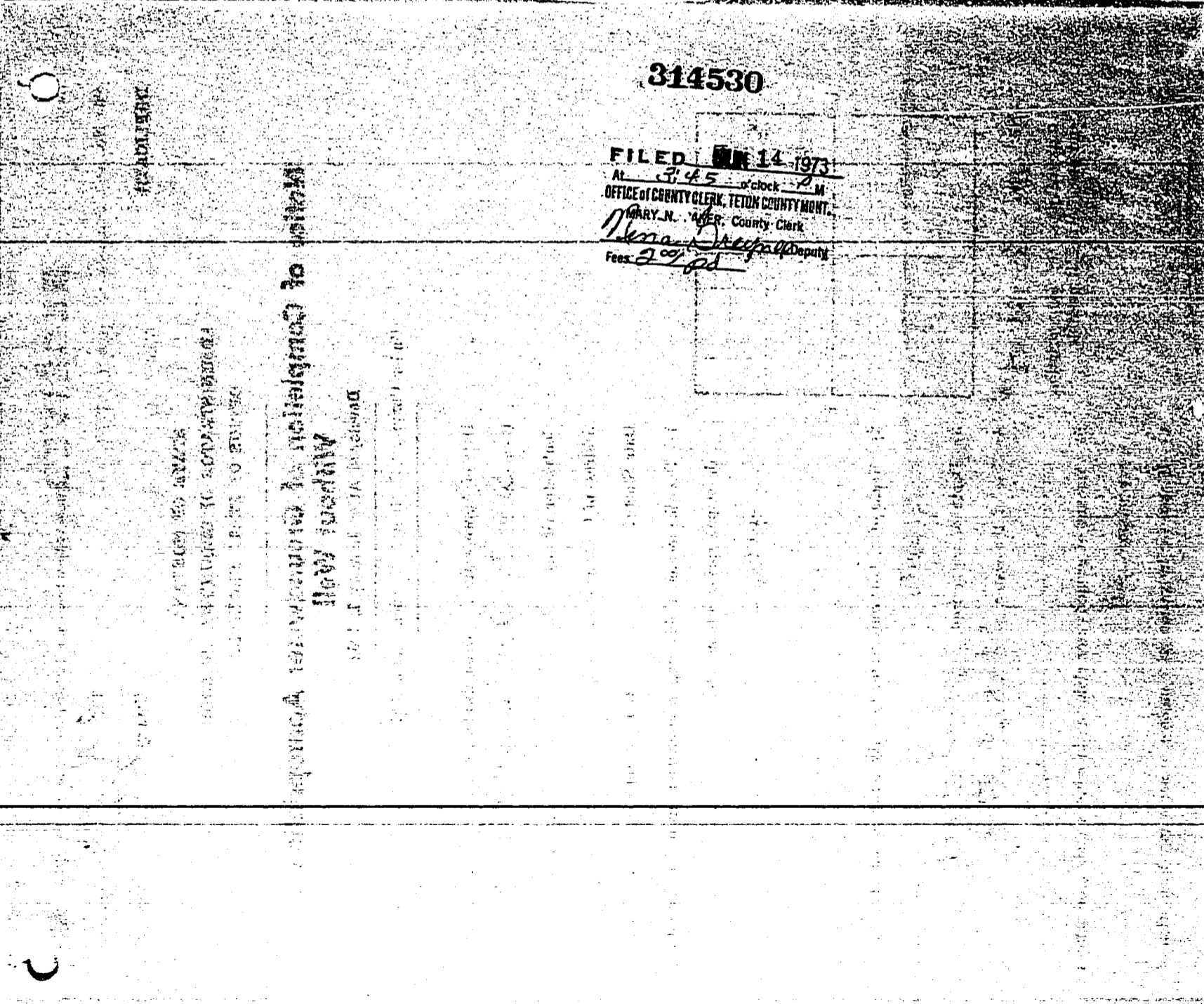

RECEIVED

8

File No.

T. 21N R. 4W

DUPLICATE

JUN 15 1973

County Teton

MONTANA DEPARTMENT OF NATURAL RESOURCES AND CONSERVATION

STATE OF MONTANA ADMINISTRATOR OF GROUNDWATER CODE OFFICE OF STATE ENGINEER

Notice of Completion of Groundwater Appropriation Without Well

Developed After January 1, 1962

(Under Chapter 237 Montana Session Laws, 1961)

Date of Appropriation of Groundwater

Owner Schwartz, Stewart Address Fairfield

Contractor (if any)

Address of Contractor

Date Started Date Completed

1) Describe means of obtaining groundwater (as by sub-irrigation, developed spring, drains, etc.)

Spring

2) Means of withdrawing water (gravity, pump, canal, etc.)

gravity

3) Depth of water table ground level

4) Use of the water Stock + other

5) Amount of groundwater claimed (in miner's inches, or gallons per minute) all

6) If used for irrigation, give number of acres and description of land

7) Estimate amount of water used each year

Approx. 1000 gal per hr (12 mo)

Signature of Owner Stewart Schwartz

Date 6-14-73

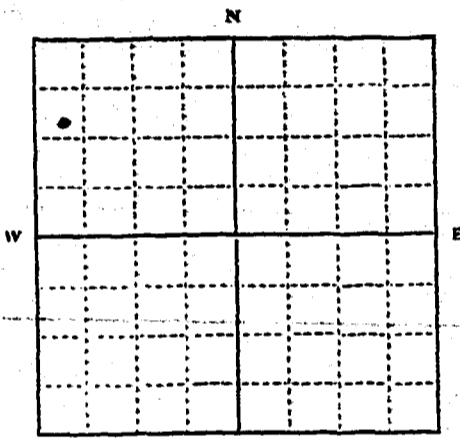

NW 1/4 NW Sec. 9 T. 21 R. 4W

Indicate point of appropriation and place of use, if possible.

File 314531 Date JUNE 14, 1973 TIME 3:50 PM

This form to be prepared by contractor (if any), otherwise by the owner.

Three copies of this notice are to be filed with the County Clerk and Recorder of the county in which the works are located.

Please answer all questions. If not applicable, so state, otherwise the form will be returned.

53,527

314531

FILED JUN 14 1973

At 3:50 o'clock P.M.

OFFICE OF COUNTY CLERK, TETCH COUNTY, MONTANA

MARY N. BAKER County Clerk

Phana Skrymgeour Deputy

File 70/11

29

File No. _____

T 21 N 4 W

DUPLICATE

County _____

STATE OF MONTANA
ADMINISTRATOR OF GROUNDWATER CODE
OFFICE OF STATE ENGINEER

R
JAN 10 1964
STATE ENGINEER

Declaration of Vested Groundwater Rights

(Under Chapter 237, Montana Session Laws, 1961)

1. Ray Madson, of Fairfield
(Name of Appropriator) (Address) (Town)

County of Teton State of Montana
have appropriated groundwater according to the Montana laws in effect prior to January 1, 1962, as follows:

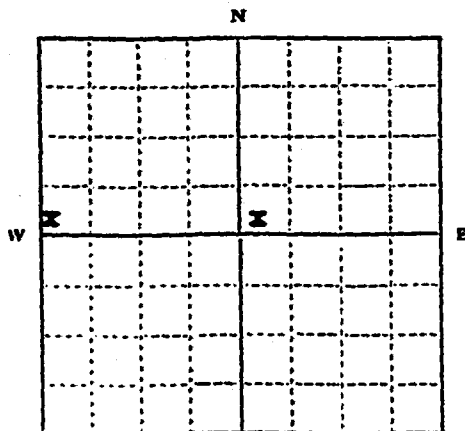

No. 1 SW $\frac{1}{4}$ NW $\frac{1}{4}$ Sec 9 T 21N R 4W
No 2 SW $\frac{1}{4}$ NE $\frac{1}{4}$ Sec 9 T 21N R 4W

Indicate point of appropriation and place of use, if possible. Each small square represents 10 acres.

2. The beneficial use on which the claim is based Domestic

3. Date or approximate date of earliest beneficial use; and how continuous the use has been Well No. 1 1940
Well No. 2 1944

4. The amount of groundwater claimed (in miner's inches or gallons per minute) No. 1 - 10 gals per min
No. 2 - not in use

5. If used for irrigation, give the acreage and description of the lands to which water has been applied and name of the owner thereof lawn, garden, house use & livestock

6. The means of withdrawing such water from the ground and the location of each well or other means of withdrawal Centrif pump

7. The date of commencement and completion of the construction of the well, wells, or other works for withdrawal of groundwater No. 1 1940
No. 2 1944

8. The depth of water table No. 1 is 6'; No. 2 is 10' to 12'

9. So far as it may be available, the type, size and depth of each well or the general specifications of any other works for the withdrawal of groundwater No. 1 is 40' deep, steel casing 6" diam
No. 2 is 20' deep, steel casing 18" diam.

10. The estimated amount of groundwater withdrawn each year 500,000 gals

11. The log of formations encountered in the drilling of each well if available No. 1 is loam - gravel
No. 2 is same

12. Such other information of a similar nature as may be useful in carrying out the policy of this act, including reference to book and page of any county record None

Signature of Owner

Ray Madson

Date December 31, 1963

Three copies to be filed by the owner with the County Clerk and Recorder of the county in which the well is located.

Please answer all questions. If not applicable, so state, otherwise the form will be returned.

Original to the County Clerk and Recorder; Duplicate to the State Engineer; Triplicate to the Montana Bureau of Mines and Geology, and Quadruplicate for the Appropriator.

30915

291180B

FILED

Dec 31-03

5

Office of County Clerk
Tulsa, Oklahoma

G. E. MONKMAN
County Clerk

R. M. D. M.

Recd

File No. _____

T 21 N R 4 W

DUPLICATE

County Teton

STATE OF MONTANA
ADMINISTRATOR OF GROUNDWATER CODE
OFFICE OF STATE ENGINEER

R

JAN 10 1964

Declaration of Vested Groundwater Rights

(Under Chapter 237, Montana Session Laws, 1961)

STATE ENGINEER

1. Joseph Adamson, of Rte 2 Fairfield
(Name of Appropriator) (Address) (Town)
County of Teton State of Montana
have appropriated groundwater according to the Montana laws in effect prior to January 1, 1962, as follows:

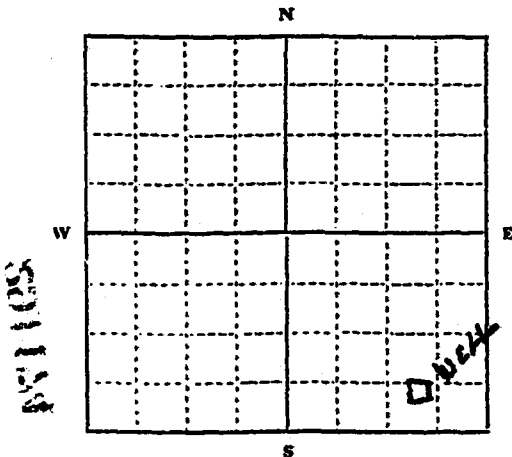

SE 1/4 Sec. 9 T21N R4W

Indicate point of appropriation and place of use, if possible. Each small square represents 10 acres.

2. The beneficial use on which the claim is based livestock + domestic

3. Date or approximate date of earliest beneficial use; and how continuous the use has been 1941 - Continuous

4. The amount of groundwater claimed (in miner's inches or gallons per minute) 50 gal per Min.

5. If used for irrigation, give the acreage and description of the lands to which water has been applied and name of the owner thereof
no

6. The means of withdrawing such water from the ground and the location of each well or other means of withdrawal
Electric Pump

7. The date of commencement and completion of the construction of the well, wells, or other works for withdrawal of groundwater
1941

8. The depth of water table 8 feet

9. So far as it may be available, the type, size and depth of each well or the general specifications of any other works for the withdrawal of groundwater
5" casing - 36 feet deep

10. The estimated amount of groundwater withdrawn each year 400,000 gal

11. The log of formations encountered in the drilling of each well if available
clay-loam + gravel

12. Such other information of a similar nature as may be useful in carrying out the policy of this act, including reference to book and page of any county record

Signature of Owner _____

Date _____

Three copies to be filed by the owner with the County Clerk and Recorder of the county in which the well is located.

Please answer all questions. If not applicable, so state, otherwise the form will be returned.

Original to the County Clerk and Recorder; Duplicate to the State Engineer; Triplicate to the Montana Bureau of Mines and Geology, and Quadruplicate for the Appropriator.

30907

291174

FILED

DEC 31 1963

5 o'clock
Office of County Clerk
Teton County, Montana

B. E. MONTGOMERY
B. E. MONTGOMERY
20 Deputy

0

1

112

File No. _____

T 21 N R 4 W

DUPLICATE

County TETON

STATE OF MONTANA
ADMINISTRATOR OF GROUNDWATER CODE
OFFICE OF STATE ENGINEER

RECEIVED
JAN 10 1964

Declaration of Vested Groundwater Rights
(Under Chapter 237, Montana Session Laws, 1961)

I OTTO H. SENELOW of PAINTERS (Name of Appropriator) (Address) (Town)

County of TELEGRAPH State of MONTANA
I have appropriated groundwater according to the Montana laws in effect prior to January 1, 1962, as follows:

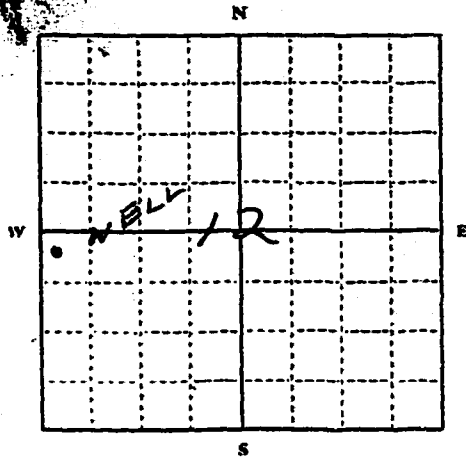

SW 1/4 SW Sec 12 T11N R.4W

Indicate point of appropriation and place of use, if possible. Each small square represents 10 acres.

2. The beneficial use on which the claim is based _____

~~Stock water & house use~~

3. Date or approximate date of earliest beneficial use; and how continuous the use has been. 1942 used for house hold until 1962, when house was moved. Now maintained for stock watering purposes.

4. The amount of groundwater claimed (in miner's inches or gallons per minute) 50 gal. per min.

5. If used for irrigation, give the acreage and description of the lands to which water has been applied and name of the owner thereof

~~not used for irrigation~~

10 to 20 acres T11N R.4W
well on lot 17

6. The means of withdrawing such water from the ground and the location of each well or other means of withdrawal _____

~~Presently there is a hand pump installed.~~

7. The date of commencement and completion of the construction of the well, wells, or other works for withdrawal of groundwater. 1942

8. The depth of water table. 3ft. to water

9. So far as it may be available, the type, size and depth of each well or the general specifications of any other works for the withdrawal of groundwater. 5in casing depth of well 102 ft.

10. The estimated amount of groundwater withdrawn each year. 5000 gal. to keep well active.

11. The log of formations encountered in the drilling of each well if available. no log available

12. Such other information of a similar nature as may be useful in carrying out the policy of this act, including reference to book and page of any county record. not previously recorded.

Signature of Owner Otto H. Senelow

Date DECEMBER 31, 1963

Three copies to be filed by the owner with the County Clerk and Recorder of the county in which the well is located.

Please answer all questions. If not applicable, so state, otherwise the form will be returned.

Original to the County Clerk and Recorder; Duplicate to the State Engineer; Triplicate to the Montana Bureau of Mines and Geology, and Quadruplicate for the Appropriator.

30841

291104

FILED

DEC 31 1963

4 o'clock
Office of County Clerk
Teton County, Montana

G. E. MONKMAN

County Clerk

Rae McDonald

Deputy

24

File No. _____

T 21 N R 4 W

DUPLICATE

County Teton

STATE OF MONTANA
ADMINISTRATOR OF GROUNDWATER CODE
OFFICE OF STATE ENGINEER

RECEIVED
SEP 20 1963

Declaration of Vested Groundwater Rights

(Under Chapter 237, Montana Session Laws, 1961)

STATE ENGINEER

1. Alfred Crawshaw of Fairfield
(Name of Appropriator) (Address) (Town)
County of Teton State of Montana
have appropriated groundwater according to the Montana laws in effect prior to January 1, 1962, as follows:

| | | | | | |
|--|--|--|--|--|--|
| | | | | | |
| | | | | | |
| | | | | | |
| | | | | | |
| | | | | | |
| | | | | | |
| | | | | | |
| | | | | | |

SW 1/4 Sec. 14 T21N R. 4W

Indicate point of appropriation and place of use, if possible. Each small square represents 10 acres.

- 2. The beneficial use on which the claim is based: Yard, House use and stock watering
- 3. Date or approximate date of earliest beneficial use; and how continuous the use has been: Constantly
(1) Dug well - 1924
(2) Drilled well - 1958
- 4. The amount of groundwater claimed (in miner's inches or gallons per minute): Ample & sufficient for above purposes.
- 5. If used for irrigation, give the acreage and description of the lands to which water has been applied and name of the owner thereof: Not used for irrigating other than incidental garden and yard usage.
- 6. The means of withdrawing such water from the ground and the location of each well or other means of withdrawal: Hand and electrical pumps.

- 7. The date of commencement and completion of the construction of the well, wells, or other works for withdrawal of groundwater: (1) Dug well - fall of 1924
(2) drilled well - Dec., 1958
- 8. The depth of water table: Variable. Averages about 12 feet.
- 9. So far as it may be available, the type, size and depth of each well or the general specifications of any other works for the withdrawal of groundwater: (1) Dug well - 4 feet diameter by 18 feet deep cased down to 14 inch diameter.
(2) Drilled well - 50 feet deep.
- 10. The estimated amount of groundwater withdrawn each year: Ample and sufficient.
- 11. The log of formations encountered in the drilling of each well if available: Not available, but mostly soil clay, sandstone and shale.
- 12. Such other information of a similar nature as may be useful in carrying out the policy of this act, including reference to book and page of any county record: None

Signature of Owner Alfred Crawshaw
Ethel M. Crawshaw
Date Sept 12 - 63

Three copies to be filed by the owner with the County Clerk and Recorder of the county in which the well is located.

Please answer all questions. If not applicable, so state, otherwise the form will be returned.

Original to the County Clerk and Recorder; duplicate to the State Engineer; Triplicate to the Montana Bureau of Mines and Geology, and Quadruplicate for the Appropriator.

289305

FILED

SEP 18 1963

2:30 o'clock
Office of County Clerk
Teton County, Montana

B. E. Mankin
County Clerk
B. E. Mankin
D. C.

File No. _____

T. 21 N R. 4 W
County Letour

DUPLICATE

STATE OF MONTANA
ADMINISTRATOR OF GROUNDWATER CODE
OFFICE OF STATE ENGINEER

RECEIVED
JAN 10 1964
STATE ENGINEER

Declaration of Vested Groundwater Rights

(Under Chapter 237, Montana Session Laws, 1961)

1 Kermit Dale, of Fairfield
(Name of Appropriator) (Address) (Town)

County of Letour State of Montana
have appropriated groundwater according to the Montana laws in effect prior to January 1, 1962, as follows:

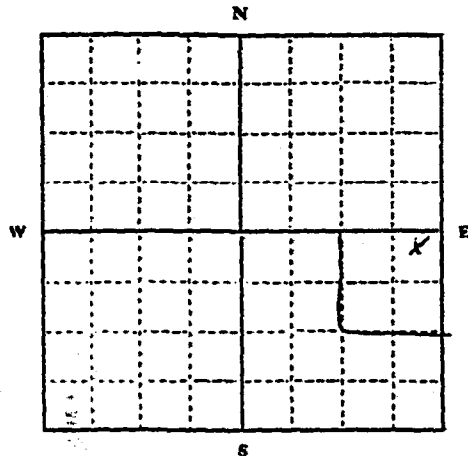

SE 1/4 Sec. 17 T. 21 N. R. 4 W

Indicate point of appropriation and place of use, if possible. Each small square represents 10 acres.

2. The beneficial use on which the claim is based Domestic

3. Date or approximate date of earliest beneficial use; and how continuous the use has been about 1941

4. The amount of groundwater claimed (in miner's inches or gallons per minute) 50 gal per min

5. If used for irrigation, give the acreage and description of the lands to which water has been applied and name of the owner thereof lawn & garden

6. The means of withdrawing such water from the ground and the location of each well or other means of withdrawal pump

7. The date of commencement and completion of the construction of the well, wells, or other works for withdrawal of groundwater about 1941

8. The depth of water table 3'-15'

9. So far as it may be available, the type, size and depth of each well or the general specifications of any other works for the withdrawal of groundwater a dug well about 4' diameter about 15' deep

10. The estimated amount of groundwater withdrawn each year 200,000 gal per year

11. The log of formations encountered in the drilling of each well if available mostly gravel

12. Such other information of a similar nature as may be useful in carrying out the policy of this act, including reference to book and page of any county record.

Signature of Owner Kermit Dale

Date _____

Three copies to be filed by the owner with the County Clerk and Recorder of the county in which the well is located.

Please answer all questions. If not applicable, so state, otherwise the form will be returned.

Original to the County Clerk and Recorder; Duplicate to the State Engineer; Triplicate to the Montana Bureau of Mines and Geology, and Quadruplicate for the Appropriator.

30639

290872

FILED

DEC 30 1963

At clock *PK*
Office of County Clerk
Teton County, Montana

G. E. MONKMAN
County Clerk

John L. White
Deputy *el*
Jan 2 1964

POSTMASTER

OFFICE OF COUNTY CLERK

DEPARTMENT OF REVENUE

STATE OF MONTANA

Handwritten notes

Handwritten notes

Handwritten notes

Handwritten notes

Handwritten notes

Handwritten notes

Handwritten notes

Handwritten notes

Handwritten notes

Handwritten notes

Handwritten notes

Handwritten notes

Handwritten notes

0

C

17

File No. _____

T 21N R 3W

DUPLICATE

County Teton

STATE OF MONTANA
ADMINISTRATOR OF GROUNDWATER CODE
OFFICE OF STATE ENGINEER

RECEIVED
JAN 10 1964

Declaration of Vested Groundwater Rights

(Under Chapter 237, Montana Session Laws, 1961)

STATE ENGINEER

1. Harry G. and Clair G. Lederer, of Fairfield
(Name of Appropriator) (Address) (Town)
County of Teton State of Montana

have appropriated groundwater according to the Montana laws in effect prior to January 1, 1962, as follows:

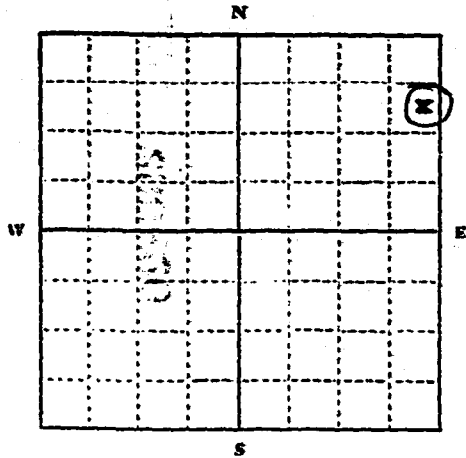

NE 1/4 Sec. 12 T21N R3W

Indicate point of appropriation and place of use, if possible. Each small square represents 10 acres.

2. The beneficial use on which the claim is based stock water and dwelling personal use

3. Date or approximate date of earliest beneficial use; and how continuous the use has been 1947 continuous use

4. The amount of groundwater claimed (in miner's inches or gallons per minute) 10 gal. per minute

5. If used for irrigation, give the acreage and description of the lands to which water has been applied and name of the owner thereof none

6. The means of withdrawing such water from the ground and the location of each well or other means of withdrawal Electric pressure pump

7. The date of commencement and completion of the construction of the well, wells, or other works for withdrawal of groundwater 1947

8. The depth of water table 100 ft.

9. So far as it may be available, the type, size and depth of each well or the general specifications of any other works for the withdrawal of groundwater 5" casing 100 ft deep

10. The estimated amount of groundwater withdrawn each year 350,000 gal per year

11. The log of formations encountered in the drilling of each well if available no log

12. Such other information of a similar nature as may be useful in carrying out the policy of this act, including reference to book and page of any county record no other

Signature of Owner Clair G. Lederer
Harry G. Lederer

Date Dec. 26, 1963

Three copies to be filed by the owner with the County Clerk and Recorder of the county in which the well is located.

Please answer all questions. If not applicable, so state, otherwise the form will be returned.

Original to the County Clerk and Recorder; Duplicate to the State Engineer; Triplicate to the Montana Bureau of Mines and Geology, and Quadruplicate for the Appropriator.

30590

290820

FILED

DEC 30 1963

9:30
Office of County Clerk
Teton County, Montana
G. E. MONKMAN

Lydell
County Clerk
el

Page 2

290820
DEC 30 1963

Plaintiff's Exhibit

Plaintiff's Exhibit

FILED
DEC 30 1963
Office of County Clerk
Teton County, Montana
G. E. MONKMAN

FILED
DEC 30 1963
Office of County Clerk
Teton County, Montana
G. E. MONKMAN

FILED
DEC 30 1963
Office of County Clerk
Teton County, Montana
G. E. MONKMAN

18

File No. _____

T 21 R 4

DUPLICATE

County _____

STATE OF MONTANA
ADMINISTRATOR OF GROUNDWATER CODE
OFFICE OF STATE ENGINEER

JAN 10 1964

Declaration of Vested Groundwater Rights ENGINEER

(Under Chapter 237, Montana Session Laws, 1961)

I, Herman A. Schwarz, of Fairfield
(Name of Appropriator) (Address) (Town)
County of Beacon State of Montana
have appropriated groundwater according to the Montana laws in effect prior to January 1, 1962, as follows:

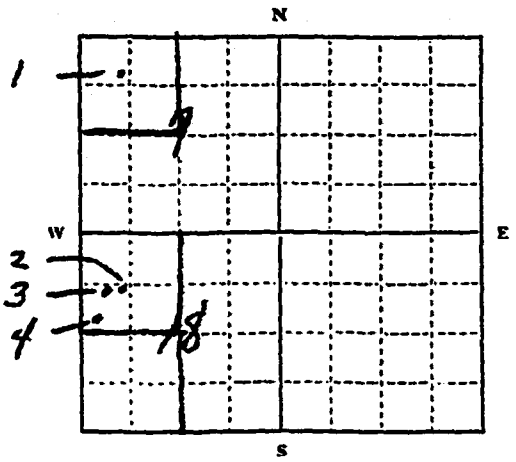

- 2. The beneficial use on which the claim is based household use and livestock
- 3. Date or approximate date of earliest beneficial use; and how continuous the use has been 1942 ever since
- 4. The amount of groundwater claimed (in miner's inches or gallons per minute) Well No 1 4 gal per min, No 2 3 gal per min, No 3 10 gal per min, No 4 3 gal per min
- 5. If used for irrigation, give the acreage and description of the lands to which water has been applied and name of the owner thereof

1/4 Sec. T. R.

Indicate point of appropriation and place of use, if possible. Each small square represents 10 acres.

1-well in NW 1/4 NW 1/4 sec 7, T20N, R4W
3-well in SW 1/4 NW 1/4 sec 11, T21N, R4W

- 6. The means of withdrawing such water from the ground and the location of each well or other means of withdrawal Well No 1 hand pump, Wells No 2, 3, 4 Electric pumps

- 7. The date of commencement and completion of the construction of the well, wells, or other works for withdrawal of groundwater Well No 1 1943, Well No 2 1942, Well No 3 1963, Well No 4 1958

- 8. The depth of water table Wells No 1 and 3 11 ft., Well No 2 200 ft., well no 4 48 ft.

- 9. So far as it may be available, the type, size and depth of each well or the general specifications of any other works for the withdrawal of groundwater
No 1 livestock, hand dug, 16 ft.
No 2 household, 6 in, 208 ft.
No 3 livestock, hand dug, 16 ft.
No 4 household, 6 in, 55 ft.

- 10. The estimated amount of groundwater withdrawn each year No 1-175,000 gal, No 2-185,000 gal, No 3-800,000 gal, No 4-950,000 gal

- 11. The log of formations encountered in the drilling of each well if available

- 12. Such other information of a similar nature as may be useful in carrying out the policy of this act, including reference to book and page of any county record

Signature of Owner Herman A. Schwarz
Date Dec 30, 1963

Three copies to be filed by the owner with the County Clerk and Recorder of the county in which the well is located.

Please answer all questions. If not applicable, so state, otherwise the form will be returned.

Original to the County Clerk and Recorder; Duplicate to the State Engineer; Triplicate to the Montana Bureau of Mines and Geology, and Quadruplicate for the Appropriator.

30876

291142

FILED

DEC 31 1963

5 o'clock

Office of County Clerk
Teton County, Montana

G. E. MONKMAN

County Clerk

Stella Wideman

REC'D

Handwritten notes and signatures on the right side of the document, including a signature that appears to be "Stella Wideman" and other illegible text.

21

File No. _____

T 21 N R 4 W

DUPLICATE

County Teton

STATE OF MONTANA
ADMINISTRATOR OF GROUNDWATER CODE
OFFICE OF STATE ENGINEER

RECEIVED
JAN 10 1964

Declaration of Vested Groundwater Rights
(Under Chapter 237, Montana Session Laws, 1961)

1. Orion W Divine, of Fairfield
(Name of Appropriator) (Address) (Town)

County of Teton State of Montana
have appropriated groundwater according to the Montana laws in effect prior to January 1, 1962, as follows:

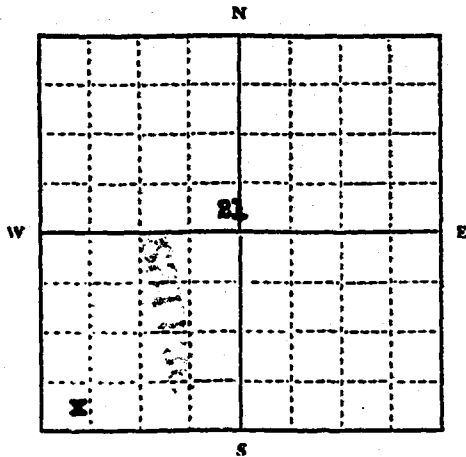

1/4 Sec. T. R.

Indicate point of appropriation and place of use, if possible. Each small square represents 10 acres.

2. The beneficial use on which the claim is based Domestic

3. Date or approximate date of earliest beneficial use; and how continuous the use has been 1940

4. The amount of groundwater claimed (in miner's inches or gallons per minute) 6 gals per min

5. If used for irrigation, give the acreage and description of the lands to which water has been applied and name of the owner thereof house, garden & lawn

6. The means of withdrawing such water from the ground and the location of each well or other means of withdrawal Centrif.

7. The date of commencement and completion of the construction of the well, wells, or other works for withdrawal of groundwater 1940

8. The depth of water table 8' to 12'

9. So far as it may be available, the type, size and depth of each well or the general specifications of any other works for the withdrawal of groundwater 52' deep, steel casing, 6" dia

10. The estimated amount of groundwater withdrawn each year 350,000 gals

11. The log of formations encountered in the drilling of each well if available Clay, shale, gravel

12. Such other information of a similar nature as may be useful in carrying out the policy of this act, including reference to book and page of any county record None

Signature of Owner Orion W Divine

Date December 27, 1963

Three copies to be filed by the owner with the County Clerk and Recorder of the county in which the well is located.

Please answer all questions. If not applicable, so state, otherwise the form will be returned.

Original to the County Clerk and Recorder; Duplicate to the State Engineer; Triplicate to the Montana Bureau of Mines and Geology, and Quadruplicate for the Appropriator.

30871

291136

FILED

DEC 31 1963

5:00 o'clock PM

Office of County Clerk
Teton County, Montana

R. E. Houtman
County Clerk

Fee 2.00 Deputy

GROUNDWATER INDEX

County Teton Twp. 21N Rge. 3W

| Sec. | Name of Appropriator | Type of Form | County File No. | Remarks |
|--------|----------------------|--------------|-----------------|-------------------|
| 1 | Cunningham, Maude | 6W 4 | 292223 | |
| 1 | Hursting, Mary A | 4 | 290875 | |
| 2 | Squires, C.L. | 3 | 291141 | |
| 2 | Ely, Roland A. | 2 | 292231 | |
| 2 | Rosney, Beatrice E. | 4 | 291127 | |
| 2,3 | Ely, Roland | 4 | 290723 | |
| 2 | Scott, Gerald R. | 4 | 290628 | |
| 2 | Walsh, Michael | 4 | 290765 | |
| 3 | Lee, Dale W. | 4 | 288645 | |
| 3 | Gilbert, R.L. | 4 | 289072 | |
| 3 | Fiseman, Joan | 4 | 291119 | |
| 3 | Fischer, Edward | 4 | 290843 | |
| 3 | Town + Fairfield | 2 | 288255 | |
| 3 | Allen, Donald M. | 4 | 2 1126 | Unreadable File # |
| 3 | Teton Dairy Inc. | 2 | 309496 | |
| 4 | Krause, Sumner A. | 4 | 290897 | |
| 4 | Harris, Frank H. | 2 | 290690 | |
| 4 | Geiger, Harold W. | 4 | 291056 | |
| 4 | Fairfield, Tennie | 4 | 288252 | |
| 9/10 | Quinn, Joe + Mary | 3 | 291161 | |
| 10 | Brady, Arthur | 3 | 290927 | |
| 11 | Larson, Danny F. | 4 | 290845 | |
| 11 | Brady, Arthur | 4 | 290826 | |
| 11 | Squires, C.L. | 4 | 291134 | |
| 12 | Harris, David | 4 | 290726 | |
| 12 | Evans, Jean | 4 | 290995 | |
| 17 | Geiger, Harold | 2 | 310472 | |
| 17, 18 | Geiger, Harold | 3 | 291055 | |
| 31 | Pearson, Lewis | 4 | 291114 | |
| 79 | Pearson, Lewis | 3 | 291115 | |
| 115 | Ely, Roland | 2 | 290322 | |

File No. _____

T. 21 R. 3W

DUPLICATE

County Teton

STATE OF MONTANA
ADMINISTRATOR OF GROUNDWATER CODE
OFFICE OF STATE ENGINEER

RECEIVED
STATE ENGINEER
JAN 10 1963

Declaration of Vested Groundwater Rights

(Under Chapter 237, Montana Session Laws, 1961)

1. Maudie Belle Cunningham of Fairfield (Name of Appropriator) (Address) (Town)
County of Teton State of Montana
have appropriated groundwater according to the Montana laws in effect prior to January 1, 1962, as follows:

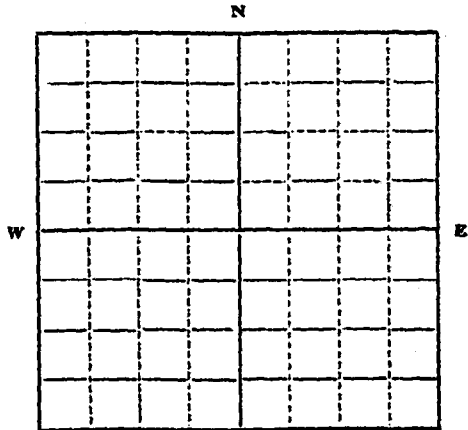

Rt 2 - SW 1/4 NE 1/4
1/4 Sec. 1 T. 21 R. 3W

Indicate point of appropriation and place of use, if possible. Each small square represents 10 acres.

- The beneficial use on which the claim is based stock water for general purposes
- Date approximate date of earliest beneficial use, and how continuous the use has been 1955 - continuous daily
- The amount of groundwater claimed (in miner's inches or gallons per minute) 100 gal per minute
- If used for irrigation, give the acreage and description of the lands to which water has been applied and name of the owner thereof
- The means of withdrawing such water from the ground and the location of each well or other means of withdrawal electric pump
- The date of commencement and completion of the construction of the well, wells, or other works for withdrawal of groundwater 1955
- The depth of water table Approximately 12 ft.
- So far as it may be available, the type, size and depth of each well or the general specifications of any other works for the withdrawal of groundwater drilled well 38 ft. also other water flowing onto and leaving the above parcel described.
- The estimated amount of groundwater withdrawn each year 3,000,000
- The log of formations encountered in the drilling of each well if available
- Such other information of a similar nature as may be useful in carrying out the policy of this act, including reference to book and page of any county record

Signature of Owner Maudie Belle Cunningham
Date Dec. 30, 1963

Three copies to be filed by the owner with the County Clerk and Recorder of the county in which the well is located.

Please answer all questions. If not applicable, so state, otherwise the form will be returned.

Original to the County Clerk and Recorder; duplicate to the State Engineer; Triplicate to the Montana Bureau of Mines and Geology, and Quadruplicate for the Appropriator.

30668

290903

FILED

DEC 30 1963

At 2:30 o'clock
Office of County Clerk
Teton County, Montana

G. E. MONKMAN
County Clerk
Rae McDaniel
Deputy
29

File No. _____

T 21 N R 3 W

DUPLICATE

County _____

STATE OF MONTANA
ADMINISTRATOR OF GROUNDWATER CODE
OFFICE OF STATE ENGINEER

RECEIVED
JAN 10 1964

Declaration of Vested Groundwater Rights

(Under Chapter 237, Montana Session Laws, 1961)

STATE ENGINEER

1. Mary A. Armstrong, of Fairfield
(Name of Appropriator) (Address) (Town)
County of Teton State of Montana
have appropriated groundwater according to the Montana laws in effect prior to January 1, 1962, as follows:

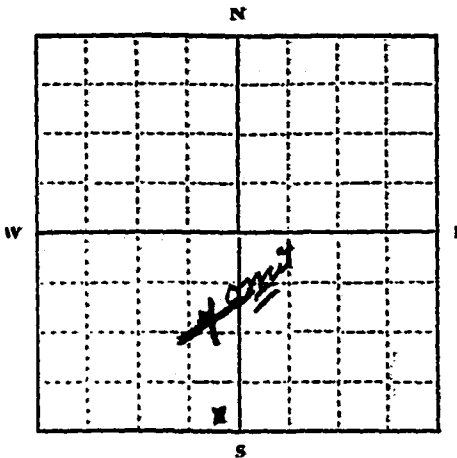

SE 1/4 SW Sec. 1 T21 R. 3

Indicate point of appropriation and place of use, if possible. Each small square represents 10 acres.

2. The beneficial use on which the claim is based Domestic, Livestock, Irrigation

3. Date or approximate date of earliest beneficial use; and how continuous the use has been 1910 Continuous

4. The amount of groundwater claimed (in miner's inches or gallons per minute) 120

5. If used for irrigation, give the acreage and description of the lands to which water has been applied and name of the owner thereof 1 Acre

6. The means of withdrawing such water from the ground and the location of each well or other means of withdrawal Pump
T 21 No. N. 1 W.

7. The date of commencement and completion of the construction of the well, wells, or other works for withdrawal of groundwater Fall of 1910

8. The depth of water table 22 Ft.

9. So far as it may be available, the type, size and depth of each well or the general specifications of any other works for the withdrawal of groundwater Not Available

10. The estimated amount of groundwater withdrawn each year 2 Million Gallon

11. The log of formations encountered in the drilling of each well if available Not Available

12. Such other information of a similar nature as may be useful in carrying out the policy of this act, including reference to book and page of any county record Not Available

Signature of Owner Mary A. Armstrong

Date 12-30-63

Three copies to be filed by the owner with the County Clerk and Recorder of the county in which the well is located.

Please answer all questions. If not applicable, so state, otherwise the form will be returned.

Original to the County Clerk and Recorder; Duplicate to the State Engineer; Triplicate to the Montana Bureau of Mines and Geology, and Quadruplicate for the Appropriator.

30595

290825

FILED
DEC 30 1963

10 o'clock
Office of County Clerk
Teton County, Montana

G. E. MONKMAN

County Clerk

Rae M. Donnell
Denver

Fee *2.00*

2

File No.

T. 21 N. R. 3 W

DUPLICATE

County Letran

STATE OF MONTANA
ADMINISTRATOR OF GROUNDWATER CODE
OFFICE OF STATE ENGINEER

RECEIVED
JAN 10 1964

Notice of Completion of Groundwater Appropriation
Without Well

(Under Chapter 237 Montana Session Laws, 1961)

Date of Appropriation of Groundwater 3-17-39
Owner C. L. Spuris Address Fairfield, Mont
Contractor (if any) Marsh
Address of Contractor Unknown
Date Started 1937 Date Completed 1937

Describe means of obtaining groundwater without a well "as by sub-irrigation and other natural processes". Include depth to water when applicable.

Natural Springs for irrigation

Quantity of water developed and used with explanation of method used to measure or estimate such amount. If use is intermittent

estimate approximate lengths of periods of use

Continued, for stock

Signature of Owner C. L. Spuris

Date Dec. 30-1963

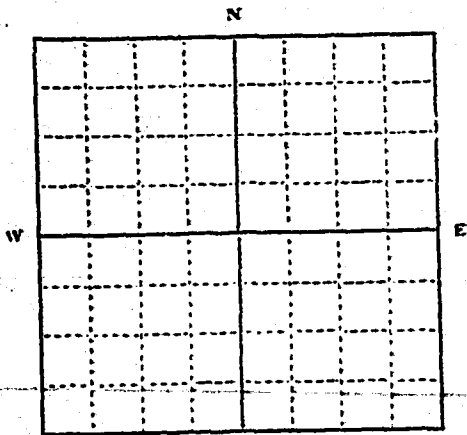

W 1/2 Sec. 2 T. 21 N. R. 3 W.
Indicate point of appropriation and place of use, if possible.

This form to be prepared by contractor (if any), otherwise by the owner.

Three copies of this notice are to be filed with the County Clerk and Recorder of the county in which the works are located.

Please answer all questions. If not applicable, so state, otherwise the form will be returned.

Original to the County Clerk and Recorder; duplicate to the State Engineer; Triplicate to the Montana Bureau of Mines and Geology and Quadruplicate for the Appropriator.

30875

File No.

T-211 R-311

DUPLICATE

County *Blaine*

STATE OF MONTANA
ADMINISTRATOR OF GROUNDWATER CODE
OFFICE OF STATE ENGINEER

RECEIVED
MONTANA

Notice of Completion of Groundwater Appropriation
Without Well

(Under Chapter 23 of Montana Session Laws 1961)

Date of Appropriation of Groundwater *2-11-63*

Owner *O. L. Spivak*

Contractor (if any) *Marsh*

Address of Contractor *Helena, MT*

Date Started *2/11/63* Date Completed *2/11/63*

Describe means of obtaining groundwater without a well, as by
sub-irrigation and other natural processes. Include depth to
water when applicable.

Natural Spring for irrigation

| | | | |
|--|--|--|--|
| | | | |
| | | | |
| | | | |
| | | | |
| | | | |
| | | | |
| | | | |
| | | | |
| | | | |
| | | | |

Quantity of water developed and used with explanation of method
used to measure or estimate such amount. If use is intermittent,
estimate approximate lengths of periods of use.

Continuous for stock

Sec. 2 T-211 R-311
Indicate point of appropriation
and place of use, if possible.

Signature of Owner *O. L. Spivak*

Date *Feb 30-1963*

This form to be prepared by contractor (if any), otherwise by the owner.

Three copies of this notice are to be filed with the County Clerk and Recorder of the county in which the
works are located.

Please answer all questions. If not applicable, so state, otherwise the form will be returned.

Original to the County Clerk and Recorder; dupl. to the State Engineer; Triplicate to the Montana
Bureau of Mines and Geology and Quadruplicate for the Appropriator.

50875

291141

FILED

DEC 31 1963

Office of County Clerk
Teton County, Montana

G. E. MONKMAN
County Clerk

Willa Williams
Deputy

Fee 2.00

File No. _____

MONTANA WATER RESOURCES BOARD

T. 21 N R 3 W

DUPLICATE

LOG

RECEIVED

County Teton

AUG 5 1968

STATE OF MONTANA
ADMINISTRATOR OF GROUNDWATER CODE
STATE WATER CONSERVATION BOARD

Top of Ground

(Elev. above sea level _____)

**Notice of Completion of Groundwater
Appropriation by Means of Well**
DEVELOPED AFTER JANUARY 1, 1962

(Under Chapter 237 Montana Session Laws, 1961, as amended)

Owner Rolland A. Ely Address Fairfield, Mont.

Driller Pat Byrne Address Great Falls, Mont.

Date of Notice of appropriation of groundwater _____

Date well started 6-17-1968 Date completed 6-18-1968

Type of well Drilled Equipment used Churn drill
(Dug, driven, bored or drilled) (Churn drill, rotary or other)

Water use: Domestic Municipal Stock Irrigation
Industrial Drainage Other

Indicate on the diagram the character and thickness of the different strata met with in drilling, such as soil, clay, shale, rock or sand, etc. Show depth at which water is encountered, thickness and character of water-bearing strata and height to which the water rises in the well.

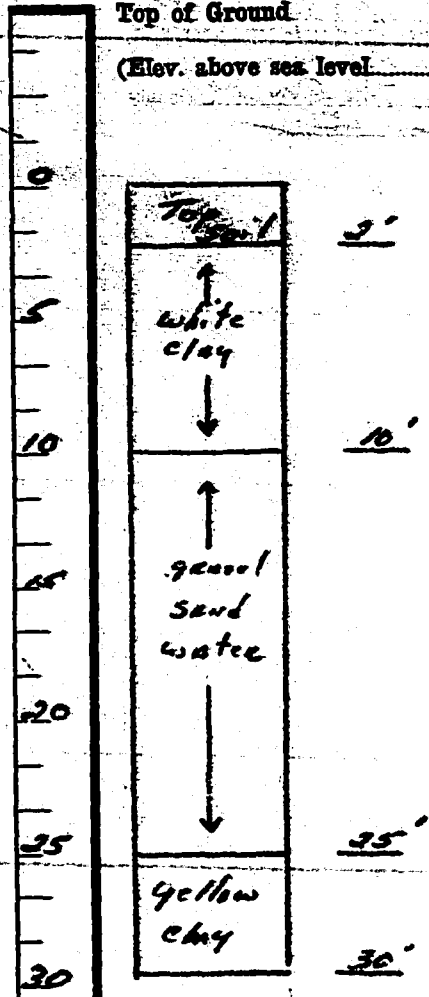

| Size of Drilled Hole | Size and Weight of Casing | From (Feet) | To (Feet) | PERFORATIONS | | |
|----------------------|---------------------------|-------------|-----------|----------------|-------------|-----------|
| | | | | Kind Size | From (Feet) | To (Feet) |
| 7" | 2 1/2" 24# | 0 | 24 | Not Perforated | | |

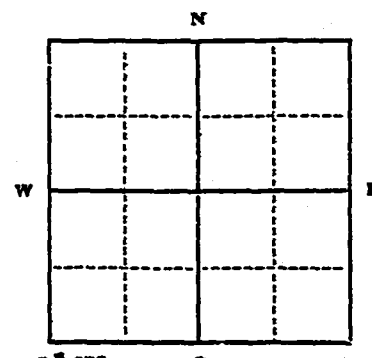

Static Water Level for non-flowing well _____ feet.

Shut-in Pressure for Flowing Well _____

Pumping Water Level 24 feet

at 40 gal. per minute.

Discharge in gal. per min. of flowing well _____

How Tested Bailer

Length of Test 1 hour

Remarks: (Gravel packing, cementing, packers, type of shutoff) _____

S 1/4
Pt. N 1/4
Pt. E 1/4 Sec 2 T. 21 N R. 3 W

Indicate location of well and place of use, if possible. Each small square represents 40 acres.

(Continue on reverse side)

USE—If used for irrigation, industrial, drainage or other. Explain, state number of acres and location or other data (i.e.: Lot, Block and Addition).

Show exact depth of bottom.

This form to be prepared by driller, and three copies to be filed by the owner with the County Clerk and Recorder in the county in which the well is located, tissue copy to be retained by driller.

Please answer all questions. If not applicable, so state, otherwise the form will be returned.

135
Driller's License Number

Pat Byrne
Driller's Signature

44,478

RECEIVED

303231

FILED

FILED AUG 21 1968

At 11:45 o'clock P.M.
OFFICE OF COUNTY CLERK, TETON COUNTY MONT.
GE. MONKMAN, County Clerk
Paul McDonald Deputy
Fees 3.00

MISSOURI TO STATE
DEPARTMENT OF REVENUE
OFFICE OF THE COMMISSIONER
REVENUE AND TAXATION
COLUMBIA, MISSOURI

(Faint, mirrored text, likely bleed-through)

| |
|----------|
| 10/10/68 |
| 10/10/68 |
| 10/10/68 |
| 10/10/68 |
| 10/10/68 |
| 10/10/68 |
| 10/10/68 |

0
1
2
3
4
5
6
7
8
9
10

File No. _____

T21 N R 3 West

DUPLICATE

County Teton

STATE OF MONTANA
ADMINISTRATOR OF GROUNDWATER CODE
OFFICE OF STATE ENGINEER

RECEIVED
JAN 10 1964

Declaration of Vested Groundwater Rights

(Under Chapter 237, Montana Session Laws, 1961)

STATE ENGINEER

I, **BEATRICE E. RANSEY**, of **Fairfield**
(Name of Appropriator) (Address) (Town)
County of **Teton** State of **Montana**
have appropriated groundwater according to the Montana laws in effect prior to January 1, 1962, as follows:

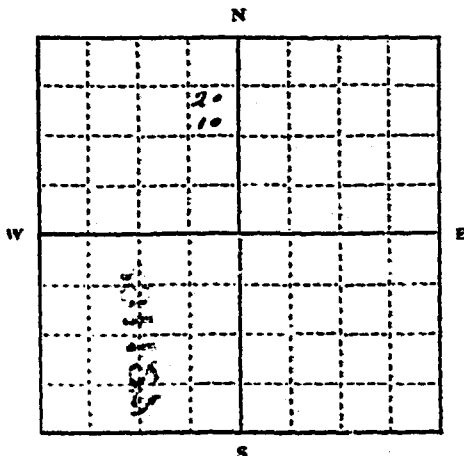

SE 1/4 Sec. 2 T21N R.3 W.

Indicate point of appropriation and place of use, if possible. Each small square represents 10 acres.

2. The beneficial use on which the claim is based: **cattle; domestic use**

3. Date or approximate date of earliest beneficial use; and how continuous the use has been: **#1 about 1942; #2 about March, 1961**

4. The amount of groundwater claimed (in miner's inches or gallons per minute): **#1: 22 gallons per minute; #2: 15 gallons per minute**

5. If used for irrigation, give the acreage and description of the lands to which water has been applied and name of the owner thereof

6. The means of withdrawing such water from the ground and the location of each well or other means of withdrawal: **electric pumps**

7. The date of commencement and completion of the construction of the well, wells, or other works for withdrawal of groundwater

8. The depth of water table: **#1 - 53 feet deep; #2 - 47 feet deep**

9. So far as it may be available, the type, size and depth of each well or the general specifications of any other works for the withdrawal of groundwater: **8" casing in wells**

10. The estimated amount of groundwater withdrawn each year: **4,051,500 gallons**

11. The log of formations encountered in the drilling of each well if available: **mainly gravel**

12. Such other information of a similar nature as may be useful in carrying out the policy of this act, including reference to book and page of any county record

Signature of Owner *Beatrice E. Ransey*
Date **December 27, 1963**

Three copies to be filed by the owner with the County Clerk and Recorder of the county in which the well is located.

Please answer all questions. If not applicable, so state, otherwise the form will be returned.

Original to the County Clerk and Recorder; Duplicate to the State Engineer; Triplicate to the Montana Bureau of Mines and Geology, and Quadruplicate for the Appropriator.

30863

0

RECEIVED
DEC 31 1963

RECEIVED
DEC 31 1963

RECEIVED
DEC 31 1963

RECEIVED
DEC 31 1963

RECEIVED
DEC 31 1963

291127

FILED

DEC 31 1963
Office of County Clerk
Teton County, Montana

MONKMAN
County Clerk

Allen [Signature]
Deputy

910

RECEIVED
DEC 31 1963

RECEIVED
DEC 31 1963

RECEIVED
DEC 31 1963

RECEIVED
DEC 31 1963

2/3

File No. _____

T. 21N R. 3W well #1-2-3

DUPLICATE

County Teton

STATE OF MONTANA
ADMINISTRATOR OF GROUNDWATER CODE
OFFICE OF STATE ENGINEER

RECEIVED
JAN 10 1964
STATE ENGINEER

Declaration of Vested Groundwater Rights

(Under Chapter 237, Montana Session Laws, 1961)

1. Holland and Larue Ely, of Fairfield
(Name of Appropriator) (Address) (Town)

County of Teton State of Montana
have appropriated groundwater according to the Montana laws in effect prior to January 1, 1962, as follows:

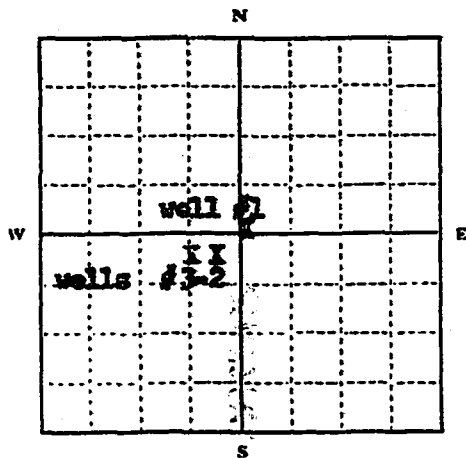

#1 SW 1/4 NW 1/4 Sec. 2 T21N R 3W
#2-3 NE 1/4 SE 1/4 Sec. 3 T21N R 3W

Indicate point of appropriation and place of use, if possible. Each small square represents 10 acres.

Lawns & gardens one acre adjacent to buildings which is
#1 SW 1/4 NW 1/4 Sec. 2 T 21N R 3W #2-3 NE 1/4 SE 1/4 Sec. 3, T21N,
R 3W. BY: Holland & Ely BY: Larue Ely
Holland Ely Larue Ely

2. The beneficial use on which the claim is based Household,
Stock, lawn & garden.

3. Date or approximate date of earliest beneficial use; and how continu-
ous the use has been #1 since 1937
#2 since 1940
#3 since 1906

4. The amount of groundwater claimed (in miner's inches or gallons
per minute) all wells 10 plus gallons

5. If used for irrigation, give the acreage and description of the lands
to which water has been applied and name of the owner thereof

Lawns & gardens one acre adjacent to buildings which is
#1 SW 1/4 NW 1/4 Sec. 2 T 21N R 3W #2-3 NE 1/4 SE 1/4 Sec. 3, T21N,
R 3W. BY: Holland & Ely BY: Larue Ely
Holland Ely Larue Ely

6. The means of withdrawing such water from the ground and the loca-
tion of each well or other means of withdrawal Electric Pump
#1 SW 1/4 NW 1/4 Sec. 2, T 21N, R 3W
#2-3 NE 1/4 SE 1/4 Sec. 3, T 21N, R 3W

7. The date of commencement and completion of the construction of the well, wells, or other works for with-
drawal of groundwater well #1 1937 #2 1940 #3 1906

8. The depth of water table well #1 15 ft. #2 15 ft. #3 15 ft.

9. So far as it may be available, the type, size and depth of each well or the general specifications of any other
works for the withdrawal of groundwater 2 in. galvanized pipe in all wells, well #1 approx. 40 ft.
well #2 approx. 40 ft., well #3 approx. 30 ft.

10. The estimated amount of groundwater withdrawn each year six million approx. in #1
three million approx. in #2 & 3.

11. The log of formations encountered in the drilling of each well if available all wells having approx.
10 to 12 feet soil and gravel depth unknown.

12. Such other information of a similar nature as may be useful in carrying out the policy of this act, including
reference to book and page of any county record a great variation according to strata and
their depth.

Signature of Owner Holland & Ely Larue Ely
Date Dec 27 1963

Three copies to be filed by the owner with the County Clerk and Recorder of the county in which the well is located.

Please answer all questions. If not applicable, so state, otherwise the form will be returned.

Original to the County Clerk and Recorder; Duplicate to the State Engineer; Triplicate to the Montana Bureau of
Mines and Geology, and Quadruplicate for the Appropriator.

30559

290783

FILED

DEC 27 1963

2 o'clock
Office of County Clerk
Teton County, Montana

G. E. MONKMAN

County Clerk

Rae McDaniel
Deputy

20

File No. _____

T. 21 R. 3W
County _____

DUPLICATE

STATE OF MONTANA
ADMINISTRATOR OF GROUNDWATER CODE
OFFICE OF STATE ENGINEER

RECEIVED
JAN 10 1964

Declaration of Vested Groundwater Rights

(Under Chapter 237, Montana Session Laws, 1961)

1. Gerard R. Stett of Fairfield
(Name of Appropriator) (Address) (Town)

County of DeWitt State of Montana
have appropriated groundwater according to the Montana laws in effect prior to January 1, 1962, as follows:

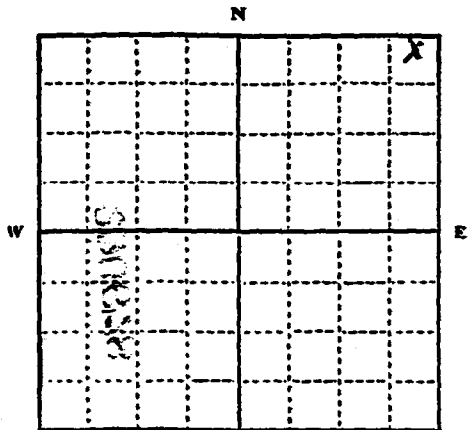

Lots 12 SWNE^s
1/4 Sec. 2 T. 21 R. 3W

Indicate point of appropriation and place of use, if possible. Each small square represents 10 acres.

2. The beneficial use on which the claim is based Home lawns flowers shrubs cattle water

3. Date or approximate date of earliest beneficial use; and how continuous the use has been 1937
daily

4. The amount of groundwater claimed (in miner's inches or gallons per minute) 250 gal per min.

5. If used for irrigation, give the acreage and description of the lands to which water has been applied and name of the owner thereof
not used for irrigation, flower lands used to water lawns flowers etc.

6. The means of withdrawing such water from the ground and the location of each well or other means of withdrawal
Hydraulic well pump at dwelling

7. The date of commencement and completion of the construction of the well, wells, or other works for withdrawal of groundwater 1937 commenced & completed

8. The depth of water table 20 ft.

9. So far as it may be available, the type, size and depth of each well or the general specifications of any other works for the withdrawal of groundwater
drilled to depth of 25 ft. with 4 in casing

10. The estimated amount of groundwater withdrawn each year 500,000 gal.

11. The log of formations encountered in the drilling of each well if available not available

12. Such other information of a similar nature as may be useful in carrying out the policy of this act, including reference to book and page of any county record none

Signature of Owner Gerard R. Stett

Date Dec 23, 1963

Three copies to be filed by the owner with the County Clerk and Recorder of the county in which the well is located.

Please answer all questions. If not applicable, so state, otherwise the form will be returned.

Original to the County Clerk and Recorder; Duplicate to the State Engineer; Triplicate to the Montana Bureau of Mines and Geology, and Quadruplicate for the Appropriator.

2
C
RECEIVED
TETON COUNTY CLERK
JAN 2 1964
TETON COUNTY, MONTANA

290678

FILED
DEC 26 1963
Office of County Clerk
Teton County, Montana
E. E. MONKMAN
County Clerk
Rae McDonald
Deputy
24

AMOUNT OF \$100.00
PAID TO THE COUNTY OF TETON
MONTANA
FOR THE YEAR 1963
BY THE TETON COUNTY CLERK
E. E. MONKMAN
ON DECEMBER 26, 1963
IN PRESENCE OF THE TETON COUNTY CLERK
RAE McDONALD
DEPUTY

File No. _____

T21 N R3W

DUPLICATE

County Teton

STATE OF MONTANA
ADMINISTRATOR OF GROUNDWATER CODE
OFFICE OF STATE ENGINEER

RECEIVED
JAN 10 1964

Declaration of Vested Groundwater Rights

(Under Chapter 237, Montana Session Laws, 1961)

STATE ENGINEER

I, Michael Walsh, of Fairfield, Montana
(Name of Appropriator) (Address) (Town)

County of Teton State of Montana

have appropriated groundwater according to the Montana laws in effect prior to January 1, 1962, as follows:

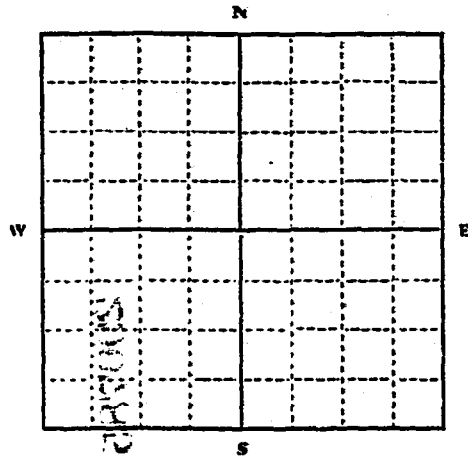

W 1/4 Sec 2 T 21 R 3W

Indicate point of appropriation and place of use, if possible. Each small square represents 10 acres.

2. The beneficial use on which the claim is based Household, Stock, lawn and garden.

3. Date or approximate date of earliest beneficial use; and how continuous the use has been since 1913

4. The amount of groundwater claimed (in miner's inches or gallons per minute) 10 plus gallons

5. If used for irrigation, give the acreage and description of the lands to which water has been applied and name of the owner thereof Lawn and garden—one acre adjacent to buildings which is North 1/4 - S.W., Sec. 2, T 21, R 3W.

BY: Michael Walsh
Michael Walsh

6. The means of withdrawing such water from the ground and the location of each well or other means of withdrawal Electric pump & windmill. N 1/4, S.W., Sec 2, T 21, R 3W.

7. The date of commencement and completion of the construction of the well, wells, or other works for withdrawal of groundwater 1913

8. The depth of water table 12 feet

9. So far as it may be available, the type, size and depth of each well or the general specifications of any other works for the withdrawal of groundwater 2 in. galvanized pipe in hand dug well, approx. 33 ft.

10. The estimated amount of groundwater withdrawn each year Approx. 3,000,000 gal.

11. The log of formations encountered in the drilling of each well if available 16 feet of topsoil and 17 ft. of gravel.

12. Such other information of a similar nature as may be useful in carrying out the policy of this act, including reference to book and page of any county record _____

Signature of Owner Michael Walsh

Date Dec 27-1963

Three copies to be filed by the owner with the County Clerk and Recorder of the county in which the well is located.

Please answer all questions. If not applicable, so state, otherwise the form will be returned.

Original to the County Clerk and Recorder; Duplicate to the State Engineer; Triplicate to the Montana Bureau of Mines and Geology, and Quadruplicate for the Appropriator.

30561

ORIGINAL

290785

FILED

DEC 27 1963

At 2 o'clock B.
Office of County Clerk
Teton County, Montana

G. E. MONKMAN
County Clerk

Rae M. Donald
20

Page



File No. _____

T 21 No. R 3 West

DUPLICATE

County Teton

STATE OF MONTANA
ADMINISTRATOR OF GROUNDWATER CODE
OFFICE OF STATE ENGINEER

RECEIVED
JUN 20 1963

Declaration of Vested Groundwater Rights
(Under Chapter 237, Montana Session Laws, 1961)

STATE ENGINEER

1. DALE N. LEE, of FAIRFIELD
(Name of Appropriator) (Address) (Town)

County of TETON State of MONTANA
have appropriated groundwater according to the Montana laws in effect prior to January 1, 1962, as follows:

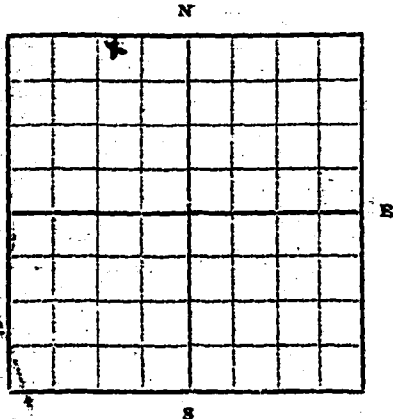

NE 1/4 Sec 3 T.21N. R. 3W. M. R. 11

Indicate point of appropriation and place of use, if possible. Each small square represents 10 acres.

2. The beneficial use on which the claim is based HOUSE AND IRRIGATION

3. Date or approximate date of earliest beneficial use; and how continuous the use has been JUNE 20, 1960 - CONTINUOUS

4. The amount of groundwater claimed (in miner's inches or gallons per minute) 17 gallons

5. If used for irrigation, give the acreage and description of the lands to which water has been applied and name of the owner thereof 8 TA. DALE N. LEE

6. The means of withdrawing such water from the ground and the location of each well or other means of withdrawal ELECTRIC PUMP

7. The date of commencement and completion of the construction of the well, wells, or other works for withdrawal of groundwater JUNE 18 - JUNE 19 - 1960

8. The depth of water table APP. 18 FT. - VAR.

9. So far as it may be available, the type, size and depth of each well or the general specifications of any other works for the withdrawal of groundwater

DRILLED - CASED TO 24 FT. - 6 IN. STEEL

10. The estimated amount of groundwater withdrawn each year 500,000 GALS.

11. The log of formations encountered in the drilling of each well if available NOT AVAILABLE

12. Such other information of a similar nature as may be useful in carrying out the policy of this act, including reference to book and page of any county record NONE

Signature of Owner Dale N. Lee

Date 6-19-1963

Three copies to be filed by the owner with the County Clerk and Recorder of the county in which the well is located.

Please answer all questions. If not applicable, so state, otherwise the form will be returned.

Original to the County Clerk and Recorder; duplicate to the State Engineer; Triplicate to the School of Mines and Quadruplicate for the Appropriator.