

28

File No.

T. 26N R. 4W

DUPLICATE

County Teton

STATE OF MONTANA
ADMINISTRATOR OF GROUNDWATER CODE
OFFICE OF STATE ENGINEER

RECEIVED
JAN 10 1964
STATE ENGINEER

Declaration of Vested Groundwater Rights

(Under Chapter 237, Montana Session Laws, 1961)

1. Leonard & Dorothy Viebrock, of Choteau, (Name of Appropriator) (Address) (Town)
County of Teton State of Montana
have appropriated groundwater according to the Montana laws in effect prior to January 1, 1962, as follows:

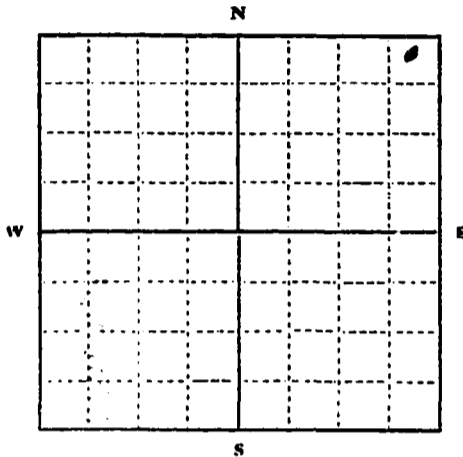

NE 1/4 Sec. 28 T 26N R. 4W

Indicate point of appropriation and place of use, if possible. Each small square represents 10 acres.

- 2. The beneficial use on which the claim is based
household and stock
- 3. Date or approximate date of earliest beneficial use; and how continuous the use has been
1928
periodically
- 4. The amount of groundwater claimed (in miner's inches or gallons per minute)
15 gal
- 5. If used for irrigation, give the acreage and description of the lands to which water has been applied and name of the owner thereof
None
- 6. The means of withdrawing such water from the ground and the location of each well or other means of withdrawal
Pump
- 7. The date of commencement and completion of the construction of the well, wells, or other works for withdrawal of groundwater
~~approximately 1961/62/1962~~ 1928
- 8. The depth of water table
approximately 60 feet
- 9. So far as it may be available, the type, size and depth of each well or the general specifications of any other works for the withdrawal of groundwater
Drilled - 5 1/2 in. steel casing. Estimated 65 feet
- 10. The estimated amount of groundwater withdrawn each year
100,000 gal.
- 11. The log of formations encountered in the drilling of each well if available
Not available
- 12. Such other information of a similar nature as may be useful in carrying out the policy of this act, including reference to book and page of any county record
None

Signature of Owner Leonard & Dorothy Viebrock

Date

Three copies to be filed by the owner with the County Clerk and Recorder of the county in which the well is located.

Please answer all questions. If not applicable, so state, otherwise the form will be returned.

Original to the County Clerk and Recorder; Duplicate to the State Engineer; Triplicate to the Montana Bureau of Mines and Geology, and Quadruplicate for the Appropriator.

30594

290824

FILED

DEC 30 1963

At 10 o'clock AM
Office of County Clerk
Teton County, Montana

County Clerk

WINKMAN

B. M. Dwyer
Deputy

24

... geology and hydrogeology...
... earlier, this...
... as a...
... Miller...
... as that...
... water...
... in the...
... the...
... GW 3

File No. **RECEIVED**

T. 26 N R. 4 W

DUPLICATE

County Teton

STATE OF MONTANA
DEPARTMENT OF NATURAL RESOURCES
ADMINISTRATOR OF GROUNDWATER CODE
OFFICE OF STATE ENGINEER

Notice of Completion of Groundwater Appropriation Without Well

Developed After January 1, 1962

(Under Chapter 237 Montana Session Laws, 1961)

Date of Appropriation of Groundwater March 22, 1973
Owner Crumple Horn Inc., Address Chilton, Mont
Contractor (if any).....
Address of Contractor.....
Date Started..... Date Completed.....

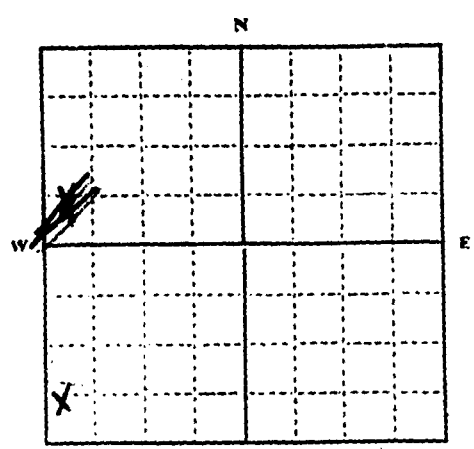

SW SW 30 26 N 4 W
1/4 Sec. 36 T. 26 R. 4 W.

Indicate point of appropriation and place of use, if possible.

Doc. No. 313869
Filed for record
this 22nd day of MARCH
A. D. 1973, at 11:35
o'clock P.M.

- 1) Describe means of obtaining groundwater (as by sub-irrigation, developed spring, drains, etc.).....
Pump from Spring Cooke
- 2) Means of withdrawing water (gravity, pump, canal, etc.).....
Pumps
- 3) Depth of water table.....
- 4) Use of the water.....
Irrigation
- 5) Amount of groundwater claimed (in miner's inches, or gallons per minute).....
2600 gal per minute
- 6) If used for irrigation, give number of acres and description of land.....
160A NW 1/4 - Sec 36 T26N R4W
- 7) Estimate amount of water used each year.....
32000

Signature of Owner Crumple Horn Inc. by [Signature]
Date March 22, 1973

This form to be prepared by contractor (if any), otherwise by the owner.
Three copies of this notice are to be filed with the County Clerk and Recorder of the county in which the works are located.
Please answer all questions. If not applicable, so state, otherwise the form will be returned.

313869

FILED MAR 22 1973
At 11:35 o'clock A.M.
OFFICE of COUNTY CLERK, TETON COUNTY MONT.
MARY N. BAKER County Clerk
Lina Bremer Deputy
Fees 2.00

June
1st
Tel
e

File No. _____

T _____ R _____

35

DUPLICATE

County TETON

LOG

STATE OF MONTANA
ADMINISTRATOR OF GROUNDWATER CODE
OFFICE OF STATE ENGINEER

Notice of Completion of Groundwater
Appropriation by Means of Well

DEVELOPED AFTER JANUARY 1, 1962

(Under Chapter 237, Montana Session Laws, 1961)

Owner Roger Weist Address Choteau

Driller Ray Anderson Address Choteau

Date of Notice of appropriation of groundwater _____

Date well started Mar 30, 72 Date completed Mar 30, 72

Type of well drilled Equipment used rotary
(Dug, driven, bored or drilled) (Churn drill, rotary or other)

Water use: Domestic Municipal Stock Irrigation
Industrial Drainage Other

Indicate on the diagram the character and thickness of the different strata met with in drilling, such as soil, clay, shale, gravel, rock or sand, etc. Show depth at which water is encountered, thickness and character of water-bearing strata and height to which the water rises in the well.

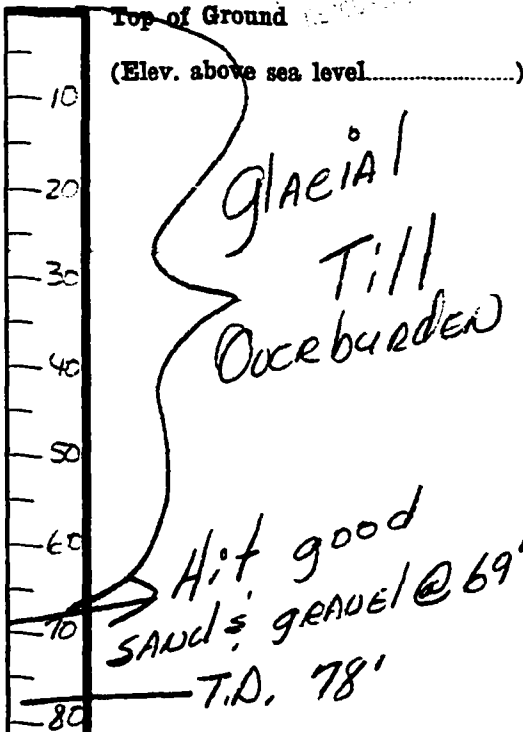

Size of Drilled Hole	Size and Weight of Casing	From (Feet)	To (Feet)	PERFORATIONS		
				Kind Size	From (Feet)	To (Feet)
6 1/4"	4 1/2" O.D. 160# TEST PVC PLAST.	0	78	3/8" holes drilled 5 sides	68	78

5 1/2 SW 1/4 NW 1/4
NE 1/4 of Section 35,
Township 26 North,
Range 4 West

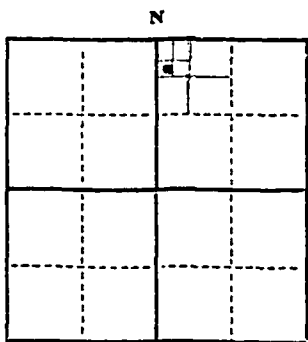

Static Water Level for non-flowing well _____ feet.

Shut-in Pressure for Flowing Well N.A.

Pumping Water Level 20 feet
at 100 gal. per minute.

Discharge in gal. per min. of flowing well _____

How Tested Air

Length of Test 1 1/2 hrs.

Remarks: (Gravel packing, cementing, packers, type of shutoff) _____

Doc. No. 311226

Filed for record

this 19th day of May

A. D. 19 72, at 1010

o'clock A.M.

Indicate location of well and place of use, if possible. Each small square represents 40 acres.

(Continue on reverse side)

USE—If used for irrigation, industrial, drainage or other. Explain, state number of acres and location or other data (i.e.: Lot, Block and Addition).

Not applicable

Show exact depth of bottom.

This form to be prepared by driller, and three copies to be filed by the owner with the County Clerk and Recorder in the county in which the well is located, tissue copy to be retained by driller.

Please answer all questions. If not applicable, so state, otherwise the form will be returned.

189
Driller's License Number

Raymond L. Anderson
Driller's Signature.

50,431

311776

FILED MAY 19 1952
At 10:00 o'clock A.M.
OFFICE OF COUNTY CLERK, TETON COUNTY MONT.
MARY N. BAKER, County Clerk
L. Maynard DEPUTY
Fees 2.00 Paid

File No.

T 26 N R 4W

DUPLICATE

County

STATE OF MONTANA
ADMINISTRATOR OF GROUNDWATER CODE
OFFICE OF STATE ENGINEER

RECEIVED
JAN 10 1964

Declaration of Vested Groundwater Rights

(Under Chapter 237, Montana Session Laws, 1961) STATE ENGINEER

I, Arthur H. & Ella C. Weist, of Choteau
(Name of Appropriator) (Address) (Town)
County of Teton State of Montana
have appropriated groundwater according to the Montana laws in effect prior to January 1, 1962, as follows:

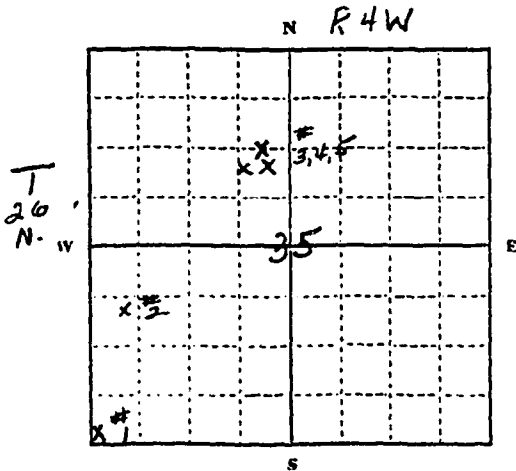

1/4 Sec. 35 T26N R4W

Indicate point of appropriation and place of use, if possible. Each small square represents 10 acres.

2. The beneficial use on which the claim is based household, lawn, stock and irrigation

3. Date or approximate date of earliest beneficial use; and how continuous the use has been Year-around-use

4. The amount of groundwater claimed (in miner's inches or gallons per minute)

5. If used for irrigation, give the acreage and description of the lands to which water has been applied and name of the owner thereof
1. S. 34. S. Sec. 35 T26 N R 4W 20 acres
2. S. 34. S. Sec. 35 T26 N R 4W 20 acres
~~2. S. 34. S. Sec. 35 T26 N R 4W~~

6. The means of withdrawing such water from the ground and the location of each well or other means of withdrawal two flowing wells, continually --description in No. 5
three pumping wells --NE SE NW Sec. 35 T26N R 4W

7. The date of commencement and completion of the construction of the well, wells, or other works for withdrawal of groundwater 1905--one pumping well and one flowing well
1920--one flowing well 1947 & 1949--two pumping wells

8. The depth of water table 64 feet to 80 feet

9. So far as it may be available, the type, size, and depth of each well or the general specifications of any other works for the withdrawal of groundwater 6 in. casings varying from 64 feet to 80 feet 4 in. cylinder pumps 1 piston pump

10. The estimated amount of groundwater withdrawn each year 750,000 per well

11. The log of formations encountered in the drilling of each well if available sand, clay and gravel

12. Such other information of a similar nature as may be useful in carrying out the policy of this act, including reference to book and page of any county record

Doc. No. 290930
Filed for record
this 30 day of December
A. D. 1963, at 3:30
o'clock P.M.

Signature of Owner Arthur H. Weist
Ella C. Weist
Date

Three copies to be filed by the owner with the County Clerk and Recorder of the county in which the well is located.

Please answer all questions. If not applicable, so state, otherwise the form will be returned.

Original to the County Clerk and Recorder; Duplicate to the State Engineer; Triplicate to the Montana Bureau of Mines and Geology, and Quadruplicate for the Appropriator.

30693

290930

FILED
DEC 20 1953
3:30
U.S. DISTRICT COURT
SOUTHERN DISTRICT OF CALIFORNIA
SAN FRANCISCO
E. MONKMAN
Stella Wilson
20

STATE OF MONTANA
ADMINISTRATOR OF GROUNDWATER CODE
MONTANA WATER RESOURCES BOARD

NOTICE OF COMPLETION OF GROUNDWATER
APPROPRIATION BY MEANS OF WELL

Developed after January 1, 1962

(Under Chapter 237 Montana Session Laws, 1961, as amended)

This form to be prepared by driller, and three copies to be filed by the owner with the County Clerk and Recorder in the county in which the well is located, last copy to be retained by driller.

Please answer all questions. If not applicable, so state, otherwise the form may be returned.

State of Montana
Owner Raymond W. Anderson
Address Helena, Montana 59604
Lessee: most
Date well started 7/29/71 GW 1
completed 7/30/71

For Administrator's Use	
<u>310004</u>	<u>August 29 1971</u>
<u>2:15 P.M.</u>	

Type of well Drilled
(Dug, driven, bored or drilled)
Equipment used Rotary
(Churn drill, rotary or other)
Water Use: Domestic Municipal Stock Irrigation
Industrial Drainage Other * Garden/Lawn

*Describe
USE: If used for irrigation, industrial, drainage or other. Explain, state number of acres and location or other data (i.e. Lot, Block and Addition).

ESTIMATED ANNUAL WITHDRAWAL 2,000,000 gal.

Size of Drilled Hole	Size and Weight of Casing	From (Feet)	To (Feet)	PERFORATIONS		
				Kind Size	From (Feet)	To (Feet)
<u>6 1/4</u>	<u>4 1/2" O.D. PVC Plastic 160'</u>	<u>0</u>	<u>102</u>	<u>3/8" Hole Drilled 4 sides</u>	<u>82</u>	<u>102</u>

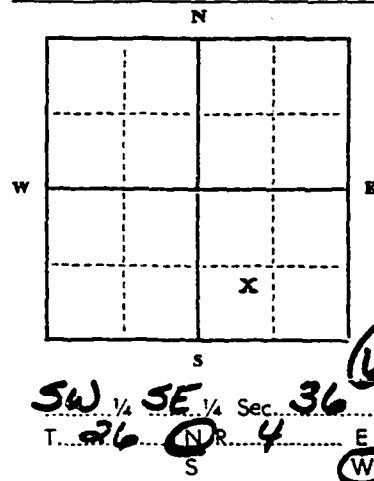

Static water level 9 ft.*
Pumping water level 9 ft.*
at 30 gallons per minute,
measured 30 minutes after pumping began.
*Measured from ground level.
Well developed by HR
for 2 hours.
Power..... Pump..... HP
Remarks: (Gravel packing, cementing, packers, type of shutoff)

INDICATE LOCATION OF WELL AND PLACE OF USE, IF POSSIBLE. EACH SMALL SQUARE REPRESENTS 40 ACRES.

Driller's Signature Raymond W. Anderson
Driller's Address Box # 645
Choteau, Montana LICENSE NO. 181

DRILLER'S LOG

Indicate the character, color, thickness of strata such as soil, clay, sand, gravel, shale, sandstone, etc. Show depth at which water is found and height to which water rises in well.

Top of Ground (Elev. above sea level)	
From (Feet)	To (Feet)
<u>0</u>	<u>77</u>
	<u>Sandy loam & heavy clay</u>
<u>77</u>	<u>98</u>
	<u>Small fine gravel</u>
<u>98</u>	<u>102</u>
	<u>hard clay</u>
<u>102</u>	<u>109</u>
	<u>Very hard cap with water sand & gravel</u>

Top of well 102'

109 Show exact depth of bottom

STATE OF MONTANA
ADMINISTRATOR OF GROUNDWATER CODE
MONTANA WATER RESOURCES BOARD

RECEIVED
MONTANA WATER RESOURCES BOARD
August 20 1971

DRILLER'S LOG

Indicate the character, color, thickness of strata such as soil, clay, sand, gravel, shale, sandstone, etc. Show depth at which water is found and height to which water rises in well.

NOTICE OF COMPLETION OF GROUNDWATER APPROPRIATION BY MEANS OF WELL

Developed after January 1, 1962

(Under Chapter 237 Montana Session Laws, 1961, as amended)

This form to be prepared by driller, and three copies to be filed by the owner with the County Clerk and Recorder in the county in which the well is located, last copy to be retained by driller.

Please answer all questions. If not applicable, so state, otherwise the form may be returned.

State of Montana
 Owner Dept. of State Lands
 Address Helena, Montana 59601
 Lessee: Ernest Weist
Agawam, Montana
 Date well started 7/29/71 GW 1
 completed 7/30/71
 Type of well Drilled
 (Dug, driven, bored or drilled)
 Equipment used Lotary
 (Chain drill, rotary or other)
 Water Use: Domestic Municipal Stock Irrigation
 Industrial Drainage Other * Garden/Lawn

For Administrator's Use
310004
August 20 1971
2:15 PM

*Describe _____
 USE: If used for irrigation, industrial, drainage or other. Explain, state number of acres and location or other data (i.e. Lot, Block and Addition). _____

ESTIMATED ANNUAL WITHDRAWAL 3,000,000 gal.

Size of Drilled Hole	Size and Weight of Casing	From (Feet)	To (Feet)	PERFORATIONS		
				Kind Size	From (Feet)	To (Feet)
<u>6 1/4</u>	<u>4 1/2 C.O. PVC Plastic 160'</u>	<u>0</u>	<u>102</u>	<u>3/16 1/2" Drilled 4 sides</u>	<u>82</u>	<u>102</u>

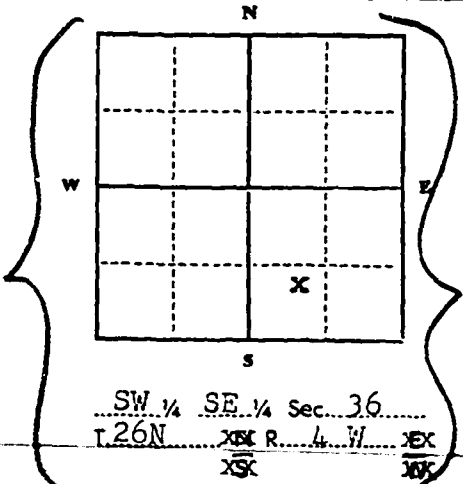

Static water level 9 ft.*
 Pumping water level 9 ft.*
 at 25 gallons per minute,
 measured 2 minutes after pumping
 began.
 *Measured from ground level.
 Well developed by 1 1/2
 for 2 hours.
 Power _____ Pump _____ HP
 Remarks: (Gravel packing, cementing,
 packers, type of shutoff) _____
Get seal top 42'
plastic on 42'

INDICATE LOCATION OF WELL AND PLACE OF USE, IF POSSIBLE. EACH SMALL SQUARE REPRESENTS 40 ACRES.
 Driller's Signature Raymond L. Anderson
 Driller's Address Box # 645
Choteau, Montana LICENSE NO. 181

Top of Ground (Elev. above sea level)

From (Feet)	To (Feet)	Description
<u>0</u>	<u>11</u>	<u>Sandy stream bed</u>
<u>11</u>	<u>17</u>	<u>clay</u>
<u>17</u>	<u>18</u>	<u>small sand</u>
<u>18</u>	<u>19</u>	<u>clay</u>
<u>19</u>	<u>102</u>	<u>fine sand</u>
<u>102</u>	<u>107</u>	<u>band of gravel</u>

Soft mud 102'

107 Show exact depth of bottom
48912

36

File No.

T. 26 N. R. 40

DUPLICATE

County Teton

STATE OF MONTANA
ADMINISTRATOR OF GROUNDWATER CODE
OFFICE OF STATE ENGINEER

RECEIVED
DEC 18 1963

Declaration of Vested Groundwater Rights STATE ENGINEER

(Under Chapter 237, Montana Session Laws, 1961)

1. Ernest A. Weist, of Chateau, Montana
(Name of Appropriator) (Address) (Town)

County of Teton State of Montana

have appropriated groundwater according to the Montana laws in effect prior to January 1, 1962, as follows:

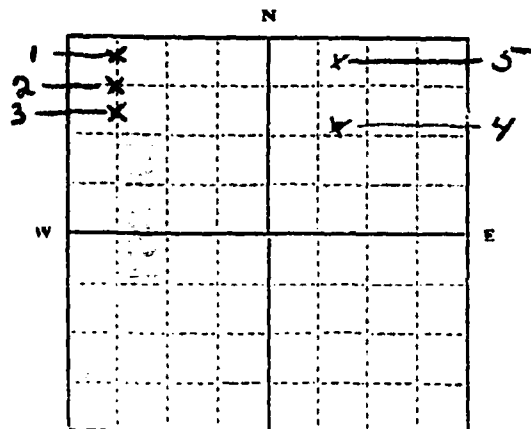

- 1 - NW 1/4 36 Sec. 26 T. 26 R. 4W
- 2 - NW 1/4 Sec. 36 T. 26 R. 4W
- 3 - NW 1/4 Sec. 36 T. 26 R. 4W
- 4 - NW 1/4 Sec. 25 T. 26 R. 4W
- 5 - SE 1/4 Sec. 24 T. 26 R. 4W

Indicate point of appropriation and place of use, if possible. Each small square represents 10 acres.

2. The beneficial use on which the claim is based Household use and stock water.

3. Date or approximate date of earliest beneficial use; and how continuous the use has been. October 1940 steady all years
1-1940 2-1946 3-1948 4-1930 5-1958

4. The amount of groundwater claimed (in miner's inches or gallons per minute) 4 gallons per minute for these and all flowing

5. If used for irrigation, give the acreage and description of the lands to which water has been applied and name of the owner thereof None are used for irrigation

6. The means of withdrawing such water from the ground and the location of each well or other means of withdrawal. They are flowing wells

7. The date of commencement and completion of the construction of the well, wells, or other works for withdrawal of groundwater. The wells all flowed the time they were drilled

8. The depth of water table. 8.5' to 120'

9. So far as it may be available, the type, size and depth of each well or the general specifications of any other works for the withdrawal of groundwater. #1 - 2" casing - 84 feet

#2 - 2" casing - 84 feet | #4 - 2" casing - 80 feet

#3 - 6" casing - 90 feet | #5 - 4" casing - 120 feet

10. The estimated amount of groundwater withdrawn each year. all flowing wells ? Continuous flow - year around.

11. The log of formations encountered in the drilling of each well if available. There isn't any.

12. Such other information of a similar nature as may be useful in carrying out the policy of this act, including reference to book and page of any county record. none

Doc. No. 290364
Filed for record
this 11 day of December
A. D. 1963, at 2:30
o'clock P. M.

Signature of Owner Ernest A. Weist
Date Dec 11, 1963

Three copies to be filed by the owner with the County Clerk and Recorder of the county in which the well is located.

Please answer all questions. If not applicable, so state, otherwise the form will be returned.

Original to the County Clerk and Recorder; Duplicate to the State Engineer; Triplicate to the Montana Bureau of Mines and Geology, and Quadruplicate for the Appropriator.

4498

290364

FILED

DEC 11 1963

At 2:30 o'clock
Clara J. Conroy Clerk
Teton County, Montana

G. E. MONKMAN
County Clerk

Bea M. Dancy

Fee 2⁰⁰

File No. _____

T 26 R 3W 4

DUPLICATE

County _____

STATE OF MONTANA
ADMINISTRATOR OF GROUNDWATER CODE
OFFICE OF STATE ENGINEER

JAN 10 1964

Declaration of Vested Groundwater Rights ENGINEER
(Under Chapter 237, Montana Session Laws, 1961)

1. Ray Raven of Bozeman Mont.
(Name of Appropriator) (Address) (Town)
County of Bozeman State of Montana
have appropriated groundwater according to the Montana laws in effect prior to January 1, 1962, as follows:

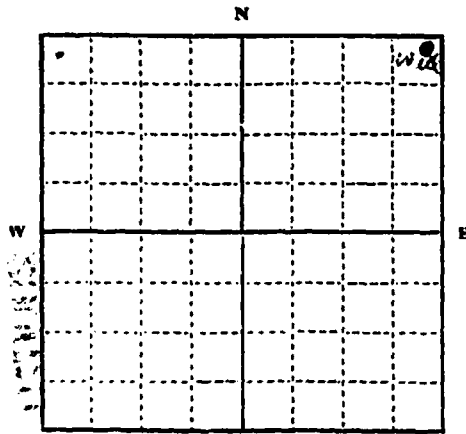

S 5 NE 4
Indicate point of appropriation and place of use, if possible. Each small square represents 10 acres.

2. The beneficial use on which the claim is based Domestic and stock

3. Date or approximate date of earliest beneficial use; and how continuous the use has been. It flows since it was drilled Fall of 56 in Oct.

4. The amount of groundwater claimed (in miner's inches or gallons per minute) 1 gal. per minute

5. If used for irrigation, give the acreage and description of the lands to which water has been applied and name of the owner thereof

6. The means of withdrawing such water from the ground and the location of each well or other means of withdrawal It flows

7. The date of commencement and completion of the construction of the well, wells, or other works for withdrawal of groundwater. fall of 1956 October

8. The depth of water table. 115 feet

9. So far as it may be available, the type, size and depth of each well or the general specifications of any other works for the withdrawal of groundwater. Drilled with old screw auger rig with a 4 inch bit.

10. The estimated amount of groundwater withdrawn each year. 525,600 gal.

11. The log of formations encountered in the drilling of each well if available.

12. Such other information of a similar nature as may be useful in carrying out the policy of this act, including reference to book and page of any county record.

Doc. No. 290679
Filed for record
this 26 day of December
A. D. 19 63 at 8:00
o'clock P.M.

Signature of Owner Ray Raven
Date 12/23/63

Three copies to be filed by the owner with the County Clerk and Recorder of the county in which the well is located.

Please answer all questions. If not applicable, so state, otherwise the form will be returned.

Original to the County Clerk and Recorder; Duplicate to the State Engineer; Triplicate to the Montana Bureau of Mines and Geology, and Quadruplicate for the Appropriator.

30484

290679

FILED

DEC 23 1963

At _____
Office of County Clerk
Teton County, Montana

E. E. MONKMAN

County Clerk

Paul Mc Donald
Deputy

Page 2 of 2

File No. _____

T. 26N R. 3W

DUPLICATE

County Fulton

See also plat

STATE OF MONTANA
ADMINISTRATOR OF GROUNDWATER CODE
OFFICE OF STATE ENGINEER

RECEIVED
JAN 10 1964

Notice of Completion of Groundwater Appropriation Without Well

(Under Chapter 237 Montana Session Laws, 1961)

Date of Appropriation of Groundwater _____

Owner Robert P. Krapp Address Conrad

Contractor (if any) _____

Address of Contractor _____

Date Started _____ Date Completed _____

Describe means of obtaining groundwater without a well "as by sub-irrigation and other natural processes". Include depth to water when applicable.

Natural Springs - Gravity flow

Quantity of water developed and used with explanation of method used to measure or estimate such amount. If use is intermittent

estimate approximate lengths of periods of use _____

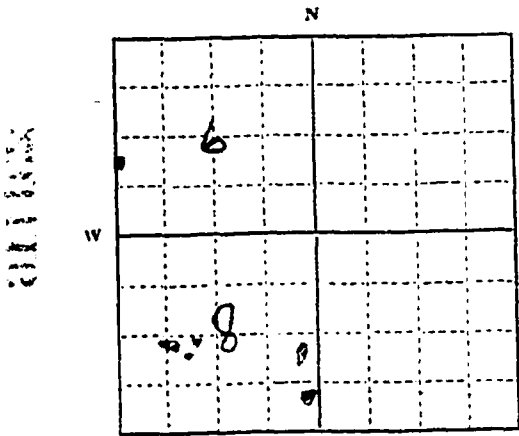

E 1/2 SE 1/4 Sec 2 T26 R. 3W

Indicate point of appropriation and place of use, if possible.

60,000 gallons per day

365 days a year - continuous

N 1/2 SW 1/4 Sec 8 T26 R. 3W

40,000 gallons per day

Signature of Owner Robert P. Krapp

Date Dec 31, 1962

N 1/4 SW 1/4 Sec 6 - 26N 3W

This form to be prepared by contractor (if any), otherwise by the owner.

Three copies of this notice are to be filed with the County Clerk and Recorder of the county in which the works are located.

Please answer all questions. If not applicable, so state, otherwise the form will be returned.

Original to the County Clerk and Recorder; duplicate to the State Engineer; Triplicate to the Montana Bureau of Mines and Geology and Quadruplicate for the Appropriator.

291116

FILED

DEC 31 1963

At _____ o'clock
Office of County Clerk
Yellow County, Montana

G. E. MONKMAN

County Clerk

John W. ...
Deputy

JAN 20 1964

LIST NO. _____

Township No. 23 N Range No. 5 W Mer. STAT - ENGINEER

6	5	4	3	2	1
7	8	9	10	11	12
18	17	16	15	14	13
19	20	21	22	23	24
30	29	28	27	26	25
31	32	33	34	35	36

NW $\frac{1}{4}$, SW $\frac{1}{4}$ Sec 21 23 N 5 W SCALE 80 CHAINS TO AN INCH

Quantity of blue - 100,000 yellow per day
205 blue per yr.
1000 appropriate

stat to H. A. [unclear] Sec 21, 17 to 3

RECEIVED
JAN 10 1964

STATE ENGINEER

LIST NO. _____

Township No. 26 N Range No. 4 W Mer.

6	5	4	3	2	1
7	8	9	10	11	12
18	17	16	15	14	13
19	20	21	22	23	24
30	29	28	27	26	25
31	32	33	34	35	36

$N\frac{1}{2}$ $NE\frac{1}{4}$ Sec 2 - 26N 4W
Flowing 70,000 gals. Per day
365 day per yr.

SCALE 80 CHAINS TO AN INCH

1898
appropriated

Robert P. Krupp

Dec 31, 1963

RECEIVED
JAN 10 1964

STATE ENGINEER

LIST NO. _____

Township No. 27 Range No. 4 W Mer.

6	5	4	3	2	1
7	8	9	10	11	12
18	17	16	15	14	13
19	20	21	22	23	24
30	29	28	27	26	25
31	32	33	34	35	36

$S\frac{1}{2}$ SW $\frac{1}{4}$ Sec 35 27N WW 1898

SCALE 80 CHAINS TO AN INCH

Gravity flow - 90,000 gal Per day - appropriated
365 day per yr -

Robert P. Krupp Dec 31, 1963

File No.

T. **26 N R. 3 W**

DUPLICATE

County **TETON**

STATE OF MONTANA
ADMINISTRATOR OF GROUNDWATER CODE
OFFICE OF STATE ENGINEER

RECEIVED
DEC 16 1963

Declaration of Vested Groundwater Rights

(Under Chapter 237, Montana Session Laws, 1961)

1. **Joseph Eyraud**, of **400 Fifth St. No., Great Falls,**
(Name of Appropriator) (Address) (Town)

County of **Cascade** State of **Montana**
have appropriated groundwater according to the Montana laws in effect prior to January 1, 1962, as follows:

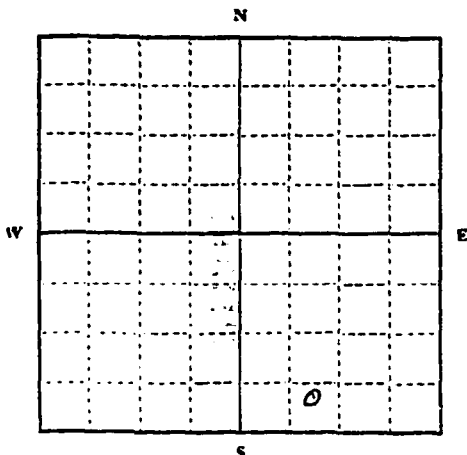

SW SE 1/4 Sec. 28 T. 26 N R. 3 W.

Indicate point of appropriation and place of use, if possible. Each small square represents 10 acres.

2. The beneficial use on which the claim is based **Household use and water livestock**

3. Date or approximate date of earliest beneficial use; and how continuous the use has been **October 1939**
Use every day.

4. The amount of groundwater claimed (in miner's inches or gallons per minute) **10 gallons per minute**

5. If used for irrigation, give the acreage and description of the lands to which water has been applied and name of the owner thereof **no irrigation**

6. The means of withdrawing such water from the ground and the location of each well or other means of withdrawal **Water pump with electric motor**

7. The date of commencement and completion of the construction of the well, wells, or other works for withdrawal of groundwater **June 5 to July 10, 1939**

8. The depth of water table **10 feet**

9. So far as it may be available, the type, size and depth of each well or the general specifications of any other works for the withdrawal of groundwater **4-inch pipe, 120 foot depth**

10. The estimated amount of groundwater withdrawn each year **75,000 gallons**

11. The log of formations encountered in the drilling of each well if available **Clay**

12. Such other information of a similar nature as may be useful in carrying out the policy of this act, including reference to book and page of any county record

Signature of Owner *Joseph Eyraud*

Date **December 9, 1963**

Three copies to be filed by the owner with the County Clerk and Recorder of the county in which the well is located.

Please answer all questions. If not applicable, so state, otherwise the form will be returned.

Original to the County Clerk and Recorder; Duplicate to the State Engineer; Triplicate to the Montana Bureau of Mines and Geology, and Quadruplicate for the Appropriator.

290346

FILED

DEC 11 1963

at 10:15 o'clock P.M.

Office of County Clerk
Teton County, Montana

G. E. MONKMAN
G. E. Monkman
County Clerk

Dee McDonald
Deputy

Fees 2.00

File No.

T. 26 R. 30

DUPLICATE

County Teton

STATE OF MONTANA
ADMINISTRATOR OF GROUNDWATER CODE
OFFICE OF STATE ENGINEER

RECEIVED
DEC 16 1963

Declaration of Vested Groundwater Rights STATE ENGINEER

(Under Chapter 237, Montana Session Laws, 1961)

1. Ernest A. Weiss, of R.R. 2 Chateau
(Name of Appropriator) (Address) (Town)

County of Teton State of Montana
have appropriated groundwater according to the Montana laws in effect prior to January 1, 1962, as follows:

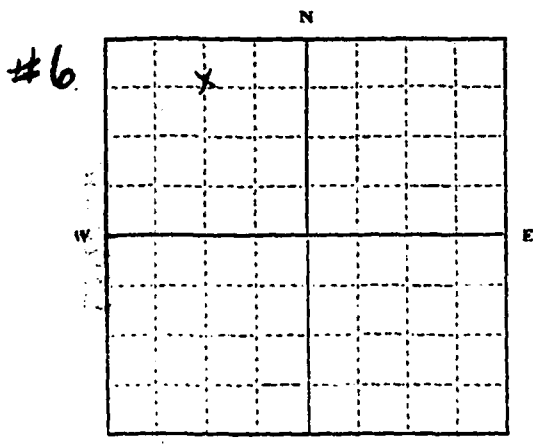

NW 1/4 Sec 30 T. 26 R. 30

Indicate point of appropriation and place of use, if possible. Each small square represents 10 acres.

2. The beneficial use on which the claim is based household use - stock water

3. Date or approximate date of earliest beneficial use; and how continuous the use has been Sept 1953 - Continuous use

4. The amount of groundwater claimed (in miner's inches or gallons per minute) about 4 gal per minute

5. If used for irrigation, give the acreage and description of the lands to which water has been applied and name of the owner thereof None

6. The means of withdrawing such water from the ground and the location of each well or other means of withdrawal flowing well

7. The date of commencement and completion of the construction of the well, wells, or other works for withdrawal of groundwater immediate flow

8. The depth of water table 85 feet

9. So far as it may be available, the type, size and depth of each well or the general specifications of any other works for the withdrawal of groundwater

#6 - 4" casing - 120 feet

10. The estimated amount of groundwater withdrawn each year ? Continuous flow

11. The log of formations encountered in the drilling of each well if available

None

12. Such other information of a similar nature as may be useful in carrying out the policy of this act, including reference to book and page of any county record

none

Doc. No. 290,365
Filed for record
this 11 day of December
A. D. 1963, at 2:30
o'clock P. M.

Signature of Owner Ernest A. Weiss
Date Dec 11, 1963

Three copies to be filed by the owner with the County Clerk and Recorder of the county in which the well is located.

Please answer all questions. If not applicable, so state, otherwise the form will be returned.

Original to the County Clerk and Recorder; Duplicate to the State Engineer; Triplicate to the Montana Bureau of Mines and Geology, and Quadruplicate for the Appropriator.

290365

FILED

DEC. 11 1963

2:30 o'clock P.M.
Office of County Clerk
Teton County, Montana

G. E. MONKMAN

County Clerk

R. M. Donald
Deputy

2nd

File No.

T. 26N R. 2W

DUPLICATE

County Teton

STATE OF MONTANA

ADMINISTRATOR OF GROUNDWATER CODE

OFFICE OF STATE ENGINEER

RECEIVED
JUL 12 1963
STATE ENGINEER

RECEIVED
JUL 12 1963
STATE ENGINEER

Declaration of Vested Groundwater Rights
(Under Chapter 237, Montana Session Laws, 1961)

1. Geraldine A. Harkins, of Collins, Montana
(Name of Appropriator) (Address) (Town)

County of Teton State of Montana

have appropriated groundwater according to the Montana laws in effect prior to January 1, 1962, as follows:

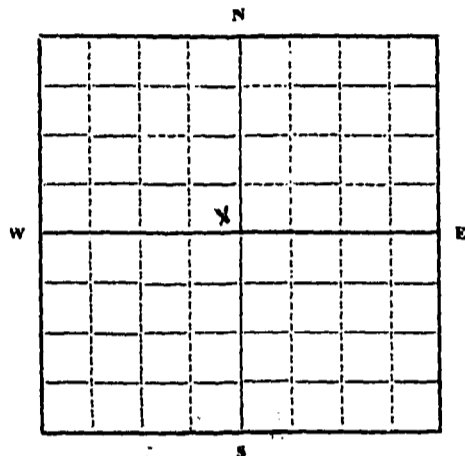

SE 1/4 NW 1/4 Sec. 27 T. 26N R. 2W

Indicate point of appropriation and place of use, if possible. Each small square represents 10 acres.

2. The beneficial use on which the claim is based for household purposes and for irrigation of garden and yard near house.

3. Date or approximate date of earliest beneficial use; and how continuous the use has been March 15, 1961;
use has been continuous since March 15, 1961.

4. The amount of groundwater claimed (in miner's inches or gallons per minute) one gallon per minute.

5. If used for irrigation, give the acreage and description of the lands to which water has been applied and name of the owner thereof not used for irrigation except for small yard and garden.

6. The means of withdrawing such water from the ground and the location of each well or other means of withdrawal one well located in SE 1/4 NW 1/4, Sec. 27, Twp. 26N, Rge. 2W, Teton County, Montana; culvert 3 ft. in diameter placed in ground in depth of 18 ft.

7. The date of commencement and completion of the construction of the well, wells, or other works for withdrawal of groundwater March 15, 1961

8. The depth of water table 5 ft. below surface.

9. So far as it may be available, the type, size and depth of each well or the general specifications of any other works for the withdrawal of groundwater one well consisting of a culvert 3 ft. in diameter placed in ground to a depth of 18 ft.

10. The estimated amount of groundwater withdrawn each year 100,000.00 gallons

11. The log of formations encountered in the drilling of each well if available no log available.

12. Such other information of a similar nature as may be useful in carrying out the policy of this act, including reference to book and page of any county record well is not a flowing well, however, said well produces a good supply of water when pumped with an electric pump.

Signature of Owner Geraldine A. Harkins

Date June 28, 1963

Three copies to be filed by the owner with the County Clerk and Recorder of the county in which the well is located.

Please answer all questions. If not applicable, so state, otherwise the form will be returned.

Original to the County Clerk and Recorder; duplicate to the State Engineer; Triplicate to the Montana Bureau of Mines and Geology, and Quadruplicate for the Appropriator.

5003
4552

STATE ENGINEER

STATE ENGINEER

288822

FILED

JUL 17 1963

At 11 o'clock A.M.
Office of County Clerk
Teton County, Montana

E. MONKMAN
County Clerk
Bar M. Donald
Deputy

Fee 2⁰⁰

File No.

T. 26 N. R. 2 West
County Butte

DUPLICATE

STATE OF MONTANA
ADMINISTRATOR OF GROUNDWATER CODE
OFFICE OF STATE ENGINEER

RECEIVED
JAN 10 1964

Declaration of Vested Groundwater Rights

(Under Chapter 237, Montana Session Laws, 1961)

STATE ENGINEER

1. Gus H. Keller, of Brady
(Name of Appropriator) (Address) (Town)

County of Butte State of Montana
have appropriated groundwater according to the Montana laws in effect prior to January 1, 1962, as follows:

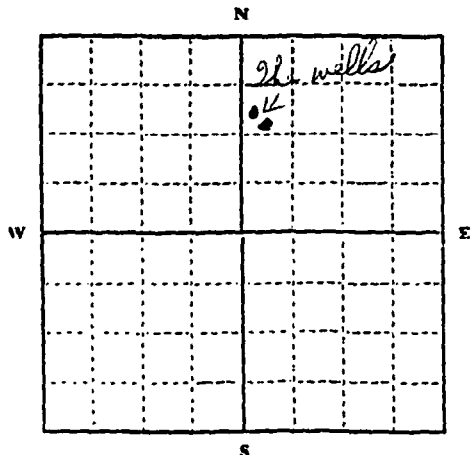

NE 1/4 of Sec 27 T 26 N R 2 W

Indicate point of appropriation and place of use, if possible. Each small square represents 10 acres.

2. The beneficial use on which the claim is based Household, stock water & irrigate garden

3. Date or approximate date of earliest beneficial use; and how continuous the use has been. 1940 & continuous use since that time

4. The amount of groundwater claimed (in miner's inches or gallons per minute) 20 gallons per minute

5. If used for irrigation, give the acreage and description of the lands to which water has been applied and name of the owner thereof
Gus Keller owner
NE 1/4 Sec 27 T 26 N R 2 W

6. The means of withdrawing such water from the ground and the location of each well or other means of withdrawal
Electric pumps

7. The date of commencement and completion of the construction of the well, wells, or other works for withdrawal of groundwater. 1940

8. The depth of water table. 12 ft.

9. So far as it may be available, the type, size and depth of each well or the general specifications of any other works for the withdrawal of groundwater
Concrete 4.8 in diameter 16 ft long

10. The estimated amount of groundwater withdrawn each year. 2 million gallons

11. The log of formations encountered in the drilling of each well if available. 2 ft of top soil & gravel 14 ft

12. Such other information of a similar nature as may be useful in carrying out the policy of this act, including reference to book and page of any county record.

Signature of Owner Gus Keller
Date Dec 27, 1963

Three copies to be filed by the owner with the County Clerk and Recorder of the county in which the well is located.

Please answer all questions. If not applicable, so state, otherwise the form will be returned.

Original to the County Clerk and Recorder; Duplicate to the State Engineer; Triplicate to the Montana Bureau of Mines and Geology, and Quadruplicate for the Appropriator.

30778

291030

FILED

DEC 31 1963

at 12:30 o'clock

Office of County Clerk
Teton County, Montana

G. E. MONKMAN

County Clerk
Rae M. Donner
22

GW

File No.

DUPLICATE

26
T~~35~~ 2W 36
County Teton

STATE OF MONTANA
ADMINISTRATOR OF GROUNDWATER CODE
OFFICE OF STATE ENGINEER

Declaration of Vested Groundwater Rights

(Under Chapter 237, Montana Session Laws, 1961)

RECEIVED
JAN 10 1964

1. Roy J. Keller of Brady Mont.
(Name of Appropriator) (Address) (Town) ST
County of Teton State of Montana

have appropriated groundwater according to the Montana laws in effect prior to January 1, 1962, as follows:

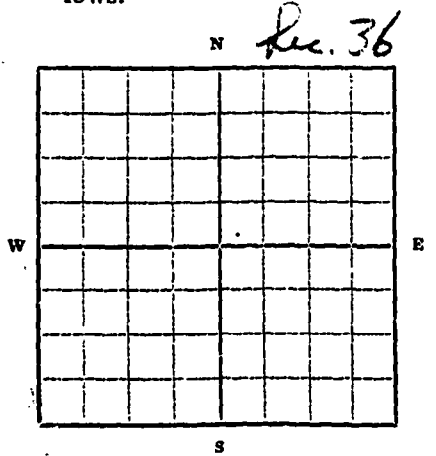

1/4 Sec 35 T26N 2W

Indicate point of appropriation and place of use, if possible. Each small square represents 10 acres.

2. The beneficial use on which the claim is based Household, livestock + irrigation

3. Date or approximate date of earliest beneficial use; and how continuous the use has been 1900 continuous

4. The amount of groundwater claimed (in miner's inches or gallons per minute) 3,000

5. If used for irrigation, give the acreage and description of the lands to which water has been applied and name of the owner thereof 10 acres Roy Keller

6. The means of withdrawing such water from the ground and the location of each well or other means of withdrawal Pumps
2 in S.W.N.E. 35
1 in S.W.N.W. 36

7. The date of commencement and completion of the construction of the well, wells, or other works for withdrawal of groundwater 1900 - 1940 - 1950

8. The depth of water table 14 ft. 18 ft. 24 ft.

9. So far as it may be available, the type, size and depth of each well or the general specifications of any other works for the withdrawal of groundwater 4 ft wide 2 wells 14 ft deep 1
1 = 2 ft wide 24 ft deep 18 ft deep 1

10. The estimated amount of groundwater withdrawn each year unlimited

11. The log of formations encountered in the drilling of each well if available sand + gravel then clay

12. Such other information of a similar nature as may be useful in carrying out the policy of this act, including reference to book and page of any county record

Signature of Owner Roy Keller

Date 12/29/63

Three copies to be filed by the owner with the County Clerk and Recorder of the county in which the well is located.

Please answer all questions. If not applicable, so state, otherwise the form will be returned.

Original to the County Clerk and Recorder; duplicate to the State Engineer; Triplicate to the School of Mines and Quadruplicate for the Appropriator.

30621

290851

FILED

DEC 30 1963

11 o'clock
Office of County Clerk
Teton County, Montana

G. E. MONKMAN
County Clerk

L. Della C. [Signature]
Deputy
7-200-300

Teton CO.
T25N R9W

File No.....

DUPLICATE

T25N R9W
Windy Ford No. 1
County ~~DEER~~ **BEAUFORT**

STATE OF MONTANA
ADMINISTRATOR OF GROUNDWATER CODE
OFFICE OF STATE ENGINEER

RECEIVED
Aug. 1962
STATE ENGINEER

Notice of Completion of Groundwater Appropriation by Means of Well

(Under Chapter 237, Montana Session Laws, 1961)

Owner Forest Service Address Chateau, MONT.

Drilled Whitaker Well Address Augusta, MONT.
Drilling

Date of Notice of Appropriation of Groundwater.....

Date well started JUNE 19, 1962 Date Completed JUNE 20, 1962

Type of well drilled Equipment Used CHURN
(dug, driven, bored or drilled) (Churn, drill, rotary or other)

Water Use: Domestic Municipal Other Irrigation
Industrial Drainage Stock

Indicate on the diagram the character and thickness of the different strata met with in drilling, such as soil, clay, shale, gravel, rock or sand, etc. Show depth at which water is encountered, thickness and character of water-bearing strata and height to which water rises in the well.

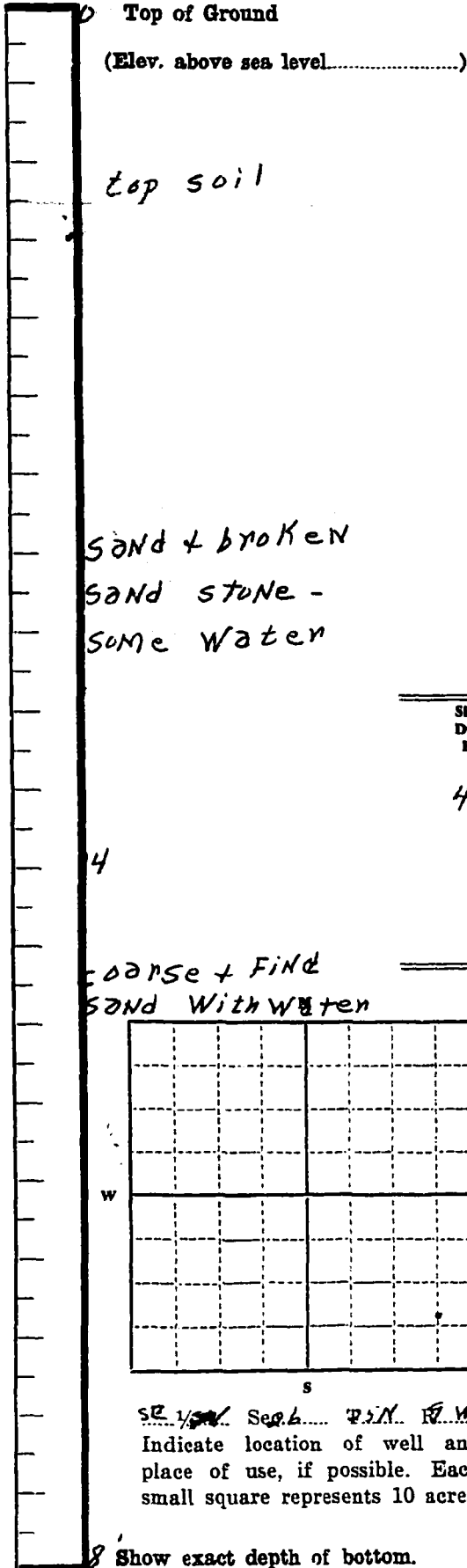

Size of Drilled Hole	Size and Weight of Casing	From (Feet)	To (Feet)	PERFORATIONS		
				Kind Size	From (Feet)	To (Feet)
4 1/2	4 1/2 O.D. gal.	0'	18'	3/4 x 4"	13'	18'

Static Water Level for non-flowing Well..... 5' feet.

Shut-in Pressure for Flowing Well.....

Pumping Water Level..... 5' feet at 15 gal. per minute.

Discharge in gal. per min. of flowing well.....

How Tested baul Length of Test 45 MIN.

Remarks: (Gravel packing, cementing, packers, type of shutoff, location of place of use of groundwater if not at well, and any other similar pertinent information, including number of acres irrigated, if used for irrigation).....

No. 10

Driller's License Number

Edsel Whitaker

Driller's Signature

Forest Service - By: Robert C Brown
Acting DFR

This form to be prepared by driller, and three copies to be filed by the owner with the County Clerk and Recorder in the county in which the well is located.

Please answer all questions. If not applicable, so state, otherwise the form will be returned.

Original to the County Clerk and Recorder; duplicate to the State Engineer; Triplicate to the Montana Bureau of Mines and Geology and Quadruplicate for the Appropriator.

285135

FILED

AUG 3 1962

at 3:00 o'clock P.

Office of County Clerk
Teton County, Montana

H. S. Moulton
County Clerk

2:00 P.

26

File No.

T. 25N. R. 9W
Windy Ford No 2
County FEY

DUPLICATE

STATE OF MONTANA
ADMINISTRATOR OF GROUNDWATER CODE
OFFICE OF STATE ENGINEER

RECEIVED
11 Aug.

Notice of Completion of Groundwater Appropriation by Means of Well

(Under Chapter 237, Montana Session Laws, 1961)

Owner Forest Service Address Choteau, MONT.

Driller Whitaker Well Drilling Address Augusta, MONT.

Date of Notice of Appropriation of Groundwater.....

Date well started JUNE 18, 1962 Date Completed JUNE 19, 1962

Type of well drilled Equipment Used churn drill
(dug, driven, bored or drilled) (Churn, drill, rotary or other)

Water Use: Domestic Municipal Other Irrigation
Industrial Drainage Stock

Indicate on the diagram the character and thickness of the different strata met with in drilling, such as soil, clay, shale, gravel, rock or sand, etc. Show depth at which water is encountered, thickness and character of water-bearing strata and height to which water rises in the well.

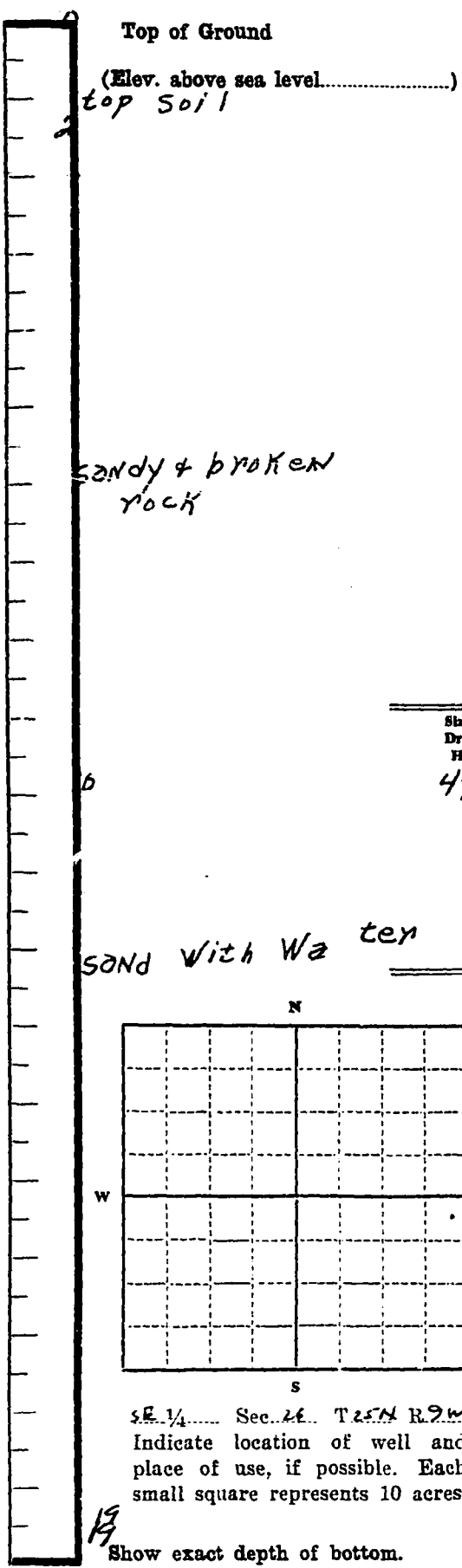

Size of Drilled Hole	Size and Weight of Casing	From (Feet)	To (Feet)	PERFORATIONS		
				Kind & Size	From (Feet)	To (Feet)
4 1/2	4 1/2 O.D. 6 1/2 lb. gal.	0	19	2 1/4	19'	19'

Static Water Level for non-flowing Well.....feet.

Shut-in Pressure for Flowing Well.....

Pumping Water Level.....feet at.....gal. per minute.

Discharge in gal. per min. of flowing well.....

How Tested..... bail Length of Test..... 1 hr.

Remarks: (Gravel packing, cementing, packers, type of shutoff, location of place of use of groundwater if not at well, and any other similar pertinent information, including number of acres irrigated, if used for irrigation).....

Driller's License Number 25-10

Driller's Signature [Signature]

Forest Service, Dept. of Agriculture
Whitaker Well Drilling

This form to be prepared by driller, and three copies to be filed by the owner with the County Clerk and Recorder in the county in which the well is located.

Please answer all questions. If not applicable, so state, otherwise the form will be returned.

Original to the County Clerk and Recorder; duplicate to the State Engineer; Triplicate to the Montana Bureau of Mines and Geology and Quadruplicate for the Appropriator.

1934

285134

FILED

AUG 3 1962

at 3:00 o'clock P.M.

Office of County Clerk
Teton County, Montana

[Signature]
County Clerk

Deputy

Page 200 of 200

GW3

File No.....

T25N R. 6W

DUPLICATE

County...Teton.....

STATE OF MONTANA
ADMINISTRATOR OF GROUNDWATER CODE
OFFICE OF STATE ENGINEER

RECEIVED
JAN 10 1964

STATE ENGINEER

Notice of Completion of Groundwater Appropriation Without Well

(Under Chapter 237 Montana Session Laws, 1961)

Date of Appropriation of Groundwater December 10, 1963

Owner Ora Knowlton, Jr. Address Byzant, Montana

Contractor (if any) Dave Nesbit

Address of Contractor Choteau, Montana

Date Started June 1, 1963 Date Completed June 1, 1963

Describe means of obtaining groundwater without a well "as by sub-irrigation and other natural processes". Include depth to water when applicable. Spring was dug with dragline.

Measures 30 ft. by 30 ft. by 5 ft. in depth. Sub-

irrigates 15 acres of SENE. Sec. 25.

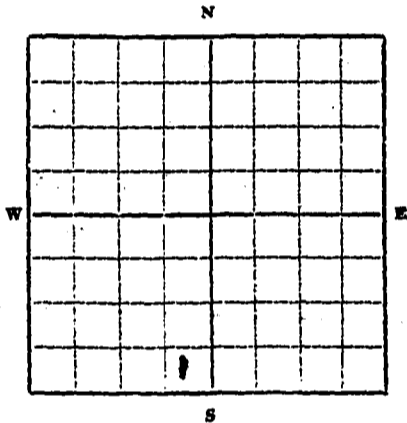

SE 1/4 SW Sec. 2 T.25N R.6W

Indicate point of appropriation and place of use, if possible.

Quantity of water developed and used with explanation of method used to measure or estimate such amount. If use is intermittent estimate approximate lengths of periods of use Spring

is used for stock water the year around. This spring
runs 20 miner's inches from outlet 15 inches wide and
3 to 4 inches deep.

Signature of Owner Ora Knowlton Jr

Date Dec 19 1963

This form to be prepared by contractor (if any), otherwise by the owner.

Three copies of this notice are to be filed with the County Clerk and Recorder of the county in which the works are located.

Please answer all questions. If not applicable, so state, otherwise the form will be returned.

Original to the County Clerk and Recorder; duplicate to the State Engineer; Triplicate to the Montana Bureau of Mines and Geology and Quadruplicate for the Appropriator.

290544

FILED

DEC 19 1963

3 o'clock
Office of County Clerk
Teton County, Montana

G. E. MONKMAN

County Clerk

Raymond

Deputy

200

File No.

T. 25 N R. 8 West

DUPLICATE

County Teton

STATE OF MONTANA
ADMINISTRATOR OF GROUNDWATER CODE
OFFICE OF STATE ENGINEER

RECEIVED
FEB 19 1962

Declaration of Vested Groundwater Rights
(Under Chapter 237, Montana Session Laws, 1961)

STATE ENGINEER

1. Alfred Bertram Guthrie Jr. of Choteau
(Name of Appropriator) (Address) (Town)

County of Teton State of Montana
have appropriated groundwater according to the Montana laws in effect prior to January 1, 1962, as follows:

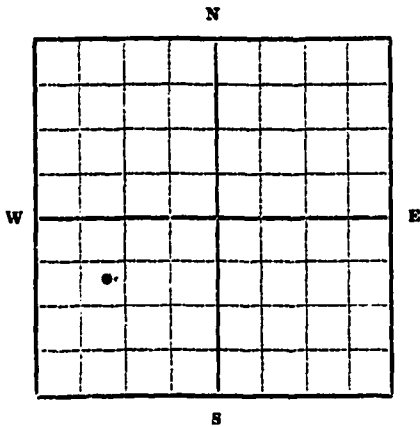

NW 1/4, SW Sec. 26, T. 25, R. 8

Indicate point of appropriation and place of use, if possible. Each small square represents 10 acres.

2. The beneficial use on which the claim is based Domestic use only.

3. Date or approximate date of earliest beneficial use; and how continuous the use has been July, 1960; used continually since.

4. The amount of groundwater claimed (in miner's inches or gallons per minute) 50 gallons per minute

5. If used for irrigation, give the acreage and description of the lands to which water has been applied and name of the owner thereof

6. The means of withdrawing such water from the ground and the location of each well or other means of withdrawal Electrical powered water pump.

7. The date of commencement and completion of the construction of the well, wells, or other works for withdrawal of groundwater July, 1960; commenced and completed on the same date.

8. The depth of water table 10 feet

9. So far as it may be available, the type, size and depth of each well or the general specifications of any other works for the withdrawal of groundwater 6 inch water well casing sunk to a depth of 25 feet.

10. The estimated amount of groundwater withdrawn each year 20,000 gallons

11. The log of formations encountered in the drilling of each well if available Not available.

12. Such other information of a similar nature as may be useful in carrying out the policy of this act, including reference to book and page of any county record None

Signature of Owner *Alfred Bertram Guthrie Jr.*
Date January 27, 1962

Three copies to be filed by the owner with the County Clerk and Recorder of the county in which the well is located.

Please answer all questions. If not applicable, so state, otherwise the form will be returned.

Original to the County Clerk and Recorder; duplicate to the State Engineer; Triplicate to the School of Mines and Quadruplicate for the Appropriator.

1499

282737

FILED

FEB 15 1962

At 3:30 o'clock P.M.

Office of County Clerk
Teton County, Montana

J. E. M. Merman
County Clerk

Rae McDonald
Deputy

Page 2

STATE OF MONTANA
ADMINISTRATOR OF GROUNDWATER CODE
MONTANA WATER RESOURCES BOARD

NOTICE OF COMPLETION OF GROUNDWATER
APPROPRIATION BY MEANS OF WELL

Developed after January 1, 1962

(Under Chapter 237 Montana Session Laws, 1961, as amended)

This form to be prepared by driller, and three copies to be filed by the owner with the County Clerk and Recorder in the county in which the well is located, last copy to be retained by driller.

Please answer all questions. If not applicable, so state, otherwise the form may be returned.

Owner Walt McNeill

Address Choteau
Montana

Date well started 7/19/71
completed 7/20/71

Type of well Drilled
(Dug, driven, bored or drilled)

Equipment used Rotary
(Churn drill, rotary or other)

Water Use: Domestic Municipal Stock Irrigation
Industrial Drainage Other * Garden/Lawn

*Describe
USE: If used for irrigation, industrial, drainage or other. Explain, state number of acres and location or other data (i.e. Lot, Block and Addition).

ESTIMATED ANNUAL WITHDRAWAL 11,000 gal.

Size of Drilled Hole	Size and Weight of Casing	From (Feet)	To (Feet)	PERFORATIONS		
				Kind Size	From (Feet)	To (Feet)
<u>6 1/2"</u>	<u>4 1/2" PVC Plastic</u>	<u>0</u>	<u>67'</u>	<u>3/4" holes drilled on 4 sides 6" apart</u>	<u>47'</u>	<u>67'</u>

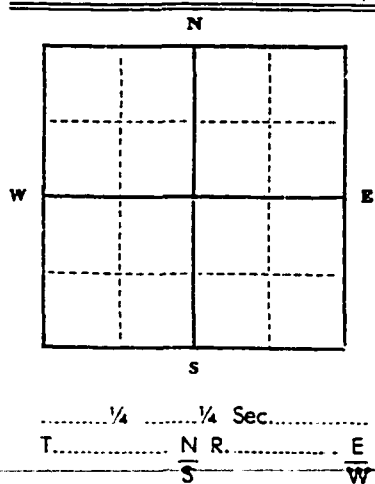

Static water level 50 ft.*
Pumping water level 22 ft.*
at 5 gallons per minute,
measured 60 minutes after pumping began.

*Measured from ground level.
Well developed by 1 1/2 hours.
for 2 hours.

Power Pump HP
Remarks: (Gravel packing, cementing, packers, type of shutoff)
Gravel Packed
to 7.0

INDICATE LOCATION OF WELL AND PLACE OF USE, IF POSSIBLE. EACH SMALL SQUARE REPRESENTS 40 ACRES.

Driller's Signature Raymond G. Anderson

Driller's Address Box 645
Choteau, Mont LICENSE NO. 189

25 N 8 W 27
County Teton

DRILLER'S LOG

Indicate the character, color, thickness of strata such as soil, clay, sand, gravel, shale, sandstone, etc. Show depth at which water is found and height to which water rises in well.

Top of Ground (Elev. above sea level)	
From (Feet)	To (Feet)
<u>0</u>	<u>8</u>
<u>8</u>	<u>67</u>
<u>0-8</u>	<u>Sandy brown</u>
<u>8-67</u>	<u>Sand Gravel Bedrock</u>
<u>64-67</u>	<u>hard black grey shale</u>
	<u>Water came in shale</u>
	<u>just above shale</u>

67' Show exact depth of bottom

RECEIVED
AUG 1 1971

MONTANA WATER RESOURCES BOARD

County Teton

STATE OF MONTANA
ADMINISTRATOR OF GROUNDWATER CODE
MONTANA WATER RESOURCES BOARD

RECEIVED

DRILLER'S LOG

AUG 1 1971

Indicate the character, color, thickness of strata such as soil, clay, sand, gravel, shale, sandstone, etc. Show depth at which water is found and height to which water rises in well.

NOTICE OF COMPLETION OF GROUNDWATER
APPROPRIATION BY MEANS OF WELL

Developed after January 1, 1962

(Under Chapter 237 Montana Session Laws, 196 as amended)

This form to be prepared by driller, and three copies to be filed by the owner with the County Clerk and Recorder in the county in which the well is located, last copy to be retained by driller.

Please answer all questions. If not applicable, so state, otherwise the form may be returned.

Owner Walt Whitcomb

Address Choteau
Montana

Date well started 7/19/71
completed 7/20/71

Type of well Dug
(Dug, driven, bored or drilled)

Equipment used Rotary
(Cable drill, rotary or other)

Water Use: Domestic Municipal Stock Irrigation
Industrial Drainage Other * Garden/Lawn

*Describe
USE: If used for irrigation, industrial, drainage or other. Explain, state number of acres and location or other data (i.e. Lot, Block and Addition).

ESTIMATED ANNUAL WITHDRAWAL 11000 gpm

Size of Drilled Hole	Size and Weight of Casing	From (Feet)	To (Feet)	PERFORATIONS		
				Kind Size	From (Feet)	To (Feet)
6 1/4"	4 1/2" PVC Packer	0	67'	3/4" hole drilled out casing in part	47'	67'

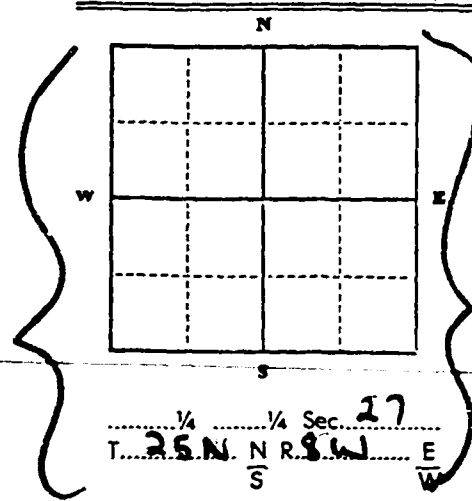

Static water levelft.*
 Pumping water levelft.*
 atgallons per minute,
 measuredminutes after pumping
 began.
 *Measured from ground level.
 Well developed by
 forhours.
 Power..... Pump..... HP
 Remarks: (Gravel packing, cementing,
 packers, type of shutoff)
Completed by [Signature]
to [Signature]

INDICATE LOCATION OF WELL AND PLACE OF USE, IF POSSIBLE. EACH SMALL SQUARE REPRESENTS 40 ACRES.

Driller's Signature [Signature]

Driller's Address Box # 645

Choteau, Mont LICENSE NO. 189

Top of Ground (Elev. above sea level)		
From (Feet)	To (Feet)	
0	2	Dark brown
2	8	Dark brown silty clay
8	14	Dark brown silty clay
14	24	Dark brown silty clay
24	34	Dark brown silty clay
34	44	Dark brown silty clay
44	54	Dark brown silty clay
54	64	Dark brown silty clay
64	67	Dark brown silty clay

67' Show exact depth of bottom

48893

GW

Approved Stock Form—State Publishing Co., Helena, Montana—1921

027

File No.

T. 25 N. R. 8 W.

DUPLICATE

County Teton

STATE OF MONTANA
ADMINISTRATOR OF GROUNDWATER CODE
OFFICE OF STATE ENGINEER

JAN 10 1964

Declaration of Vested Groundwater Rights

(Under Chapter 237, Montana Session Laws, 1961)

1. Malcolm J. Lussenden, of Box 146 Choteau
(Name of Appropriator) (Address) (Town)
County of Teton State of Montana
have appropriated groundwater according to the Montana laws in effect prior to January 1, 1962, as follows:

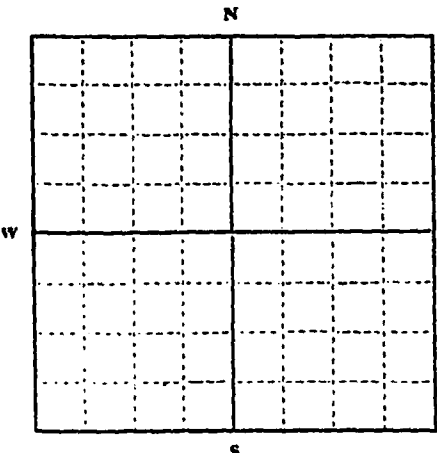

1/4 Sec. T.25N.R.8.W.

Indicate point of appropriation and place of use, if possible. Each small square represents 10 acres.

- 2. The beneficial use on which the claim is based. Stock water, and irrigation
- 3. Date or approximate date of earliest beneficial use; and how continuous the use has been. Approximately 1904, and continuous every since.
- 4. The amount of groundwater claimed (in miner's inches or gallons per minute). Unknown.
- 5. If used for irrigation, give the acreage and description of the lands to which water has been applied and name of the owner thereof. The acres that are irrigated are listed on the attached suppliment. The owners of the land are Kaiserman and Lussenden.
- 6. The means of withdrawing such water from the ground and the location of each well or other means of withdrawal. This information is listed on the attached suppliment.
- 7. The date of commencement and completion of the construction of the well, wells, or other works for withdrawal of groundwater. All are prior to 1960.
- 8. The depth of water table. Seven to twelve Feet.
- 9. So far as it may be available, the type, size and depth of each well or the general specifications of any other works for the withdrawal of groundwater. This information is listed on the attached suppliment.
- 10. The estimated amount of groundwater withdrawn each year. Unknown.
- 11. The log of formations encountered in the drilling of each well if available. Not available.
- 12. Such other information of a similar nature as may be useful in carrying out the policy of this act, including reference to book and page of any county record.

Signature of Owner

Malcolm Lussenden

Date December 14, 1963

Three copies to be filed by the owner with the County Clerk and Recorder of the county in which the well is located.

Please answer all questions. If not applicable, so state, otherwise the form will be returned.

Original to the County Clerk and Recorder; Duplicate to the State Engineer; Triplicate to the Montana Bureau of Mines and Geology, and Quadruplicate for the Appropriator.

30450

N. W. $\frac{1}{4}$ of the S. W. $\frac{1}{4}$ of section 9. 1 well with electric pump, and 1 flowing spring, for stock water and irrigation.

N. E. $\frac{1}{4}$ of the N. E. $\frac{1}{4}$ of section 27. 1 dug pit, 10 feet deep and 100 feet square, for stock water.

N. W. $\frac{1}{4}$ of the N. W. $\frac{1}{4}$ of section 10. 1 flowing spring for stock water.

N. E. $\frac{1}{4}$ of the N. E. $\frac{1}{4}$ of section 9. 1 flowing spring for stock water, and 1 irrigation. Irrigates parts of the North $\frac{1}{2}$ of section 10.

S. W. $\frac{1}{4}$ of the N. E. $\frac{1}{4}$ of section 16. 1 stock water pit, 8 feet deep, and 60 feet square.

S. W. $\frac{1}{4}$ of the N. W. $\frac{1}{4}$ of section 4. 1 flowing spring for stock water.

S. E. $\frac{1}{4}$ of the N. W. $\frac{1}{4}$ of section 21. 1 flowing spring for stock water and irrigation.

S. E. $\frac{1}{4}$ of the S. E. $\frac{1}{4}$ of section 21. 2 flowing springs for stock water, and irrigation.

N. E. $\frac{1}{4}$ of the S. E. $\frac{1}{4}$ of section 11. 1 dug pit, 40 feet square, and seven feet deep, for stock water.

S. W. $\frac{1}{4}$ of the N. W. $\frac{1}{4}$ of section 15. 1 dug pit 12 feet deep, and 70 feet square, for stock water.

N. E. $\frac{1}{4}$ of section 18. 2 flowing springs, used for stock water and irrigation of parts of sections 9 and 10, and has been used continuously since 1915.

All the above are in township 25 N., range 8 W. The amount of water used is unknown.

290592

FILED

DEC 30 1951

Office of County Clerk
Tolan County, Missouri

County Clerk

H. H. H. H. H.
DORRIS

N. W. of the S. W. of section 9. 1 well with electric pump. 1 flowing spring, for stock water and irrigation.

N. E. of the N. W. of section 27. 1 dug pit, ten feet deep, and 100 feet square, for stock water.

N. W. of the N. E. of section 15. 1 flowing spring for stock water.

N. E. of the N. W. of section 9. 1 flowing spring for stock water, and irrigation. Irrigates parts of the N. E. of section 15.

N. E. of the N. W. of section 16. 1 stock water pit, 5 feet deep, and 50 feet square.

N. E. of the N. W. of section 4. 1 flowing spring for stock water.

N. E. of the N. W. of section 21. 1 flowing spring for stock water, and irrigation.

N. E. of the N. W. of section 21. 2 flowing springs for stock water, and irrigation.

N. E. of the N. W. of section 11. 1 dug pit, 5 feet deep, and 7 feet deep, for stock water and irrigation.

N. E. of the N. W. of section 15. 1 dug pit, 10 feet deep, and 10 feet square, for stock water.

N. E. of the N. W. of section 15. 2 flowing springs, used for stock water, and irrigation on parts of sections 9 and 10, which has been and continuously since 1880.

If there are any in township 25 N., range 10 E., the location of which is unknown.

N. W. $\frac{1}{4}$ of the N. W. $\frac{1}{4}$ of section 9. 1 well with electric pump. 1 flowing spring for stock water and irrigation.

N. E. $\frac{1}{4}$ of the N. E. of section 27. 1 dug pit, ten feet deep, and 100 feet square, for stock water.

N. W. $\frac{1}{4}$ of the N. E. $\frac{1}{4}$ of section 19. 1 flowing spring for stock water.

N. E. $\frac{1}{4}$ of the S. E. $\frac{1}{4}$ of section 9. 1 flowing spring for stock water, and irrigation. Irrigates parts of the S. $\frac{1}{4}$ of section 10.

S. W. $\frac{1}{4}$ of the N. E. $\frac{1}{4}$ of section 16. 1 stock water pit, 8 feet deep, and 60 feet square.

S. W. $\frac{1}{4}$ of the S. E. $\frac{1}{4}$ of section 4. 1 flowing spring for stock water.

S. E. $\frac{1}{4}$ of the S. W. $\frac{1}{4}$ of section 21. 1 flowing spring, for stock water, and irrigation.

S. E. $\frac{1}{4}$ of the N. E. $\frac{1}{4}$ of section 21. 2 flowing springs for stock water, and irrigation.

S. E. $\frac{1}{4}$ of the S. E. $\frac{1}{4}$ of section 11. 1 dug pit, 40 feet deep, and 7 feet deep, for stock water and irrigation.

S. E. $\frac{1}{4}$ of the N. W. $\frac{1}{4}$ of section 15. 1 dug pit, 12 feet deep, and 70 feet square, for stock water.

S. E. $\frac{1}{4}$ of section 18. 2 flowing springs, used for stock water, and irrigation on parts of sections 9 and 10, which has been used continuously since 1916.

All the above are in township 25 N., range 8 W. The amount of water used is unknown.

STATE OF MONTANA
ADMINISTRATOR OF GROUNDWATER CODE
MONTANA WATER RESOURCES BOARD

OCT 13 1971

DRILLER'S LOG

Indicate the character, color, thickness of strata such as soil, clay, sand, gravel, shale, sandstone, etc. Show depth at which water is found and height to which water rises in well.

NOTICE OF COMPLETION OF GROUNDWATER APPROPRIATION BY MEANS OF WELL

Developed after January 1, 1962

(Under Chapter 237 Montana Session Laws, 1961, as amended)

This form to be prepared by driller, and three copies to be filed by the owner with the County Clerk and Recorder in the county in which the well is located, last copy to be retained by driller. Please answer all questions. If not applicable, so state, otherwise the form may be returned.

Owner Harold G. Hinman and/or Marian Hinman

Address Chateau
Montana

For Administrator's Use
File 310263
October 12, 1971
5:00 PM
GW 1

Date well started Sept 4, 1971
completed Sept 7, 1971

Type of well Drilled (Dug, driven, bored or drilled)

Equipment used Rotary (Churn drill, rotary or other)

Water Use: Domestic Municipal Stock Irrigation
Industrial Drainage Other * Garden/Lawn

*Describe Cabin Site Well

USE: If used for irrigation, industrial, drainage or other. Explain, state number of acres and location or other data (i.e. Lot, Block and Addition).

ESTIMATED ANNUAL WITHDRAWAL 200,000 gal.

Size of Drilled Hole	Size and Weight of Casing	From (Feet)	To (Feet)	PERFORATIONS		
				Kind Size	From (Feet)	To (Feet)
<u>6 1/4"</u>	<u>4 1/2" C.O. PVC Plastic 160' TCS</u>	<u>0</u>	<u>67</u>	<u>3/8" hole</u>	<u>47</u>	<u>50</u>

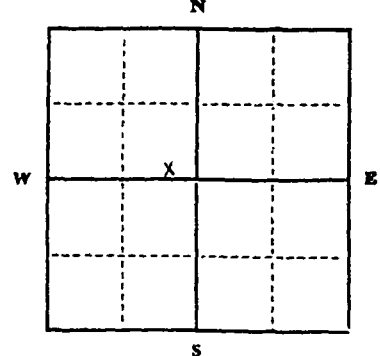

Static water level 30 ft.*
Pumping water level 35 ft.*
at 30 gallons per minute,
measured 30 minutes after pumping began.
*Measured from ground level.
Well developed by 111
for 2 hours.
Power Pump HP
Remarks: (Gravel packing, cementing, packers, type of shutoff)

SE 1/4 NW 1/4 Sec 27
T. 35 N N R. 82 W E
S W

INDICATE LOCATION OF WELL AND PLACE OF USE, IF POSSIBLE. EACH SMALL SQUARE REPRESENTS 40 ACRES.

Driller's Signature [Signature]

Driller's Address
Montana LICENSE NO. 187

Top of Ground (Elev. above sea level)	
From (Feet)	To (Feet)
<u>0</u>	<u>2</u>
<u>8</u>	<u>65</u>
<u>12</u>	<u>67</u>

SOIL & ROCK
65' SAND, GRAVEL
CEMENT MORTAR
HARD SHALE
WATER 30' ON TOP OF SHALE

67' Show exact depth of bottom
19548

310268

FILED OCT 12 1971

At 5:00 o'clock P. M.

OFFICE OF COUNTY CLERK, TETON COUNTY MONT.

MARY N. BAKER, County Clerk

John M. ... Deputy
From *...*

File No.

T. R.

DUPLICATE

County

STATE OF MONTANA
ADMINISTRATOR OF GROUNDWATER CODE
OFFICE OF STATE ENGINEER

RECEIVED
JAN 10 1964

Declaration of Vested Groundwater Rights

(Under Chapter 237, Montana Session Laws, 1961)

Robert F. Zion & Lola M. Zion
1. Forrest L. Zion & Claire B. Zion , of Choteau
(Name of Appropriator) (Address) (Town)

County of Teton State of Montana
have appropriated groundwater according to the Montana laws in effect prior to January 1, 1962, as follows:

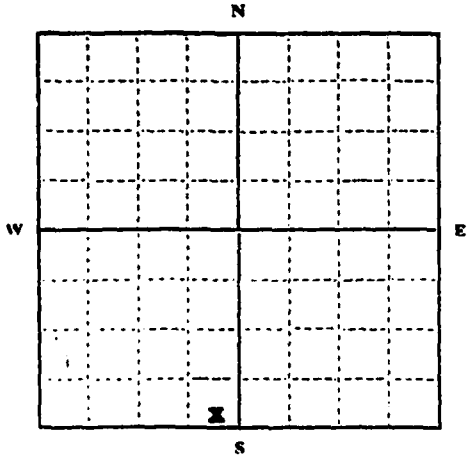

S.E. 1/4 S.M. Sec 28 T25 R8

Indicate point of appropriation and place of use, if possible. Each small square represents 10 acres.

2. The beneficial use on which the claim is based

Lawn, Household, stock

3. Date or approximate date of earliest beneficial use; and how continuous the use has been

1960

4. The amount of groundwater claimed (in miner's inches or gallons per minute)

100 gallons per minute

5. If used for irrigation, give the acreage and description of the lands to which water has been applied and name of the owner thereof

6. The means of withdrawing such water from the ground and the location of each well or other means of withdrawal

Pump inside dwelling

7. The date of commencement and completion of the construction of the well, wells, or other works for withdrawal of groundwater

1960

8. The depth of water table

8 feet

9. So far as it may be available, the type, size and depth of each well or the general specifications of any other works for the withdrawal of groundwater

12" Sandpoint

10. The estimated amount of groundwater withdrawn each year

500,000 Gallons

11. The log of formations encountered in the drilling of each well if available

12. Such other information of a similar nature as may be useful in carrying out the policy of this act, including reference to book and page of any county record

*Robert F. Zion
Lola M. Zion
Forrest L. Zion
Claire B. Zion*

Signature of Owner

Date 12/26/63

Three copies to be filed by the owner with the County Clerk and Recorder of the county in which the well is located.

Please answer all questions. If not applicable, so state, otherwise the form will be returned.

Notary Public for the State of Montana

Clarence D. Gillie

Original to the County Clerk and Recorder; Duplicate to the State Engineer; Triplicate to the Montana Bureau of Mines and Geology, and Quadruplicate for the Appropriator.

30732

290977

FILED

DEC 31 1963

At 9:30 o'clock
Office of County Clerk
Teton County, Montana

G. E. MONKMAN

County Clerk

Barry McDonald
Deputy

Fee 2.00

File No. _____

R E C E I V E D
AUG 24 1965

Tax _____

28

DUPLICATE

County _____

REFERRED TO _____

STATE OF MONTANA
ADMINISTRATOR OF GROUNDWATER CODE
OFFICE OF STATE ENGINEER

**Notice of Completion of Groundwater Appropriation
Without Well**

Developed After January 1, 1962

(Under Chapter 237 Montana Session Laws, 1961)

Date of Appropriation of Groundwater 8/23/65

Owner E. C. Blodman Address Edmonton Mont

Contractor (if any) _____

Address of Contractor _____

Date Started 1964 Date Completed 1962

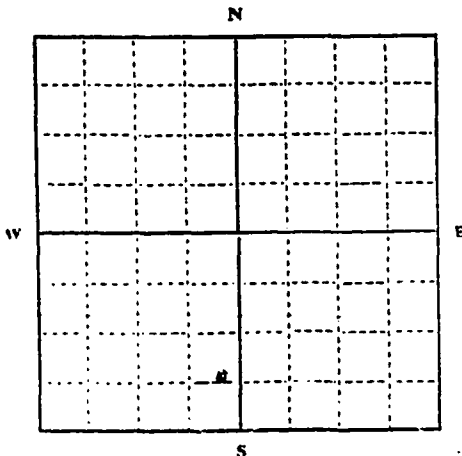

Section _____ Township _____ Range _____

Indicate point of appropriation and place of use, if possible.

1) Describe means of obtaining groundwater (as by sub-irrigation, developed spring, drains, etc.)

This is a gravity well. It is gravity fed. It has a pump and a storage tank in it. It is a pipe well.

2) Means of withdrawing water (gravity, pump, canal, etc.)

3) Depth of water table _____

4) Use of the water for household use

5) Amount of groundwater claimed (in miner's inches, or gallons per minute) 1.5 gal per minute

6) If used for irrigation, give number of acres and description of land

7) Estimate amount of water used each year _____

Signature of Owner E. C. Blodman

Date 8/23/65

This form to be prepared by contractor (if any), otherwise by the owner.

Three copies of this notice are to be filed with the County Clerk and Recorder of the county in which the works are located.

Please answer all questions. If not applicable, so state, otherwise the form will be returned.

39469

File No.

RECEIVED
AUG 24 1965

T554 R 8 W 28

DUPLICATE

County Jefferson

REFERRED TO

STATE OF MONTANA

ADMINISTRATOR OF GROUNDWATER CODE

OFFICE OF STATE ENGINEER

Notice of Completion of Groundwater Appropriation Without Well

Developed After January 1, 1962

(Under Chapter 237 Montana Session Laws, 1961)

Date of Appropriation of Groundwater 8/23/65

Owner E. C. Blair Address Choteau Mont

Contractor (if any).....

Address of Contractor

Date Started 1934 Date Completed 1962

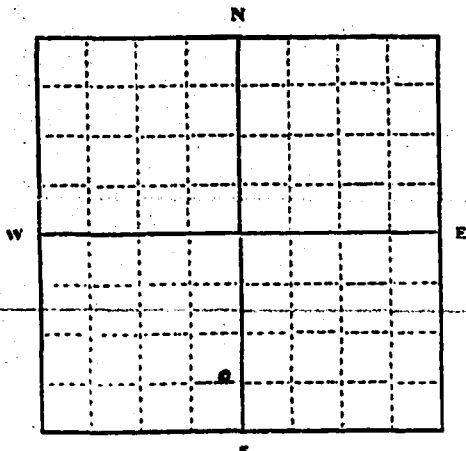

S. 1/4 Sec. 4 T. 5 R. 4 W.

Indicate point of appropriation and place of use, if possible.

1) Describe means of obtaining groundwater (as by sub-irrigation, developed spring, drains, etc.) This is a spring and is gravity flow, and has been dug out and a galvanized tank in it with a pipe for overflow.

2) Means of withdrawing water (gravity, pump, canal, etc.).....

gravity

3) Depth of water table..... unknown

4) Use of the water..... for house use

5) Amount of groundwater claimed (in miner's inches, or gallons per minute)..... 1 inch pipe constantly.

6) If used for irrigation, give number of acres and description of land..... no irrigation.

7) Estimate amount of water used each year..... unknown

Signature of Owner E. C. Blair

Date 8/23/65

This form to be prepared by contractor (if any), otherwise by the owner.

Three copies of this notice are to be filed with the County Clerk and Recorder of the county in which the works are located.

Please answer all questions. If not applicable, so state, otherwise the form will be returned.

205867

RECEIVED
AUG 23 1965
CLERK OF DISTRICT COURT
TETON COUNTY, MONTANA

FILED

AUG 23 1965

At 9 o'clock
Office of County Clerk
Teton County, Montana

G. E. MONKMAN
County Clerk

Rae McDonald

[Signature]

Legal Address
C. M. Cruickshank
P.O. Box 46
Vallejo Calif. 94521

County Teton

STATE OF MONTANA
ADMINISTRATOR OF GROUNDWATER CODE
MONTANA WATER RESOURCES BOARD
RECEIVED

DRILLER'S LOG

NOTICE OF COMPLETION OF GROUNDWATER
APPROPRIATION BY MEANS OF WELL
Developed after January 1, 1962

Indicate the character, color, thickness of strata such as soil, clay, sand, gravel, shale, sandstone, etc. Show depth at which water is found and height to which water rises in well.

(Under Chapter 237 Montana Session Laws, 1961, as amended)

This form to be prepared by driller, and three copies to be filed by the owner with the County Clerk and Recorder in the county in which the well is located, last copy to be retained by driller.

Please answer all questions. If not applicable, so state, otherwise the form may be returned.

Owner C. M. Cruickshank - PO Box 355
Mr. Cruickshank

Address Choteau, Mont.

Date well started 7/1/71

completed 7/2/71

Type of well Drilled

Equipment used Rotary

Water Use: Domestic Municipal Stock Irrigation
Industrial Drainage Other * Garden/Lawn

*Describe
USE: If used for irrigation, industrial, drainage or other. Explain, state number of acres and location or other data (i.e. Lot, Block and Addition).

ESTIMATED ANNUAL WITHDRAWAL 500,000

Size of Drilled Hole	Size and Weight of Casing	From (Feet)	To (Feet)	PERFORATIONS		
				Kind Size	From (Feet)	To (Feet)
6 1/4"	4 1/2" PVC Plastic	0	40	3/8" Holes Drilled on Sides	20	40

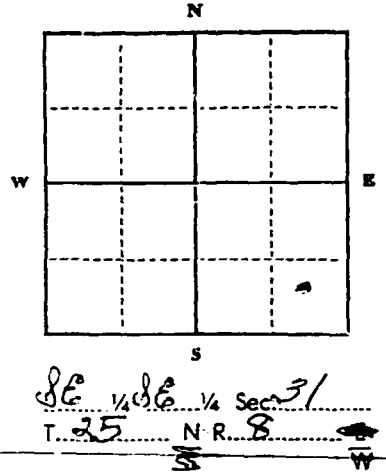

Static water level 7 ft.*
Pumping water level 10 ft.*
at 12 gallons per minute,
measured 30 minutes after pumping began.
*Measured from ground level.
Well developed by Air
for 3 hours.
Power..... Pump..... HP
Remarks: (Gravel packing, cementing, packers, type of shutoff)
GRAVEL PACKED

INDICATE LOCATION OF WELL AND PLACE OF USE, IF POSSIBLE. EACH SMALL SQUARE REPRESENTS 40 ACRES.
Driller's Signature Raymond L. Anderson
Driller's Address Box # 645
Choteau, Montana LICENSE NO. 189

Top of Ground (Elev. above sea level)		
From (Feet)	To (Feet)	
0	10	Loam & Boulders
10	32	Sand Gravel Boulders
32	40	Hard Green to Black Shale
WATER ZONE		
AT 37'		

40' Show exact depth of bottom

310653

FILED DEC 2 1971
At 2:10 o'clock P.M.
OFFICE of COUNTY CLERK, TETON COUNTY, MONT.
MARY N. BAKER, County Clerk
L. Maynard Deputy
Page 2 of 2

File No.

RECEIVED

T. R. 33

DUPLICATE

MAY 15 1972

County Seton

MONTANA DEPARTMENT OF NATURAL RESOURCES AND CONSERVATION

STATE OF MONTANA ADMINISTRATOR OF GROUNDWATER CODE OFFICE OF STATE ENGINEER

Top of Ground

(Elev. above sea level.....)

Notice of Completion of Groundwater Appropriation by Means of Well

(Under Chapter 237, Montana Session Laws, 1961)

Approval of a partnership of Robert W. Jensen, Dr. Crabtree & James M. Crawford

Owner Jensen, Dr. Crabtree & James M. Crawford Address Choteau

Driller Ray Anderson Address Choteau

Date of Notice of Appropriation of Groundwater.....

Date well started Nov. 27, 1971 Date Completed Nov. 27, 1971

Type of well drilled Equipment Used rotary
(dug, driven, bored or drilled) (Churn, drill, rotary or other)

Water Use: Domestic Municipal Other Irrigation
Industrial Drainage Stock

Indicate on the diagram the character and thickness of the different strata met with in drilling, such as soil, clay, shale, gravel, rock or sand, etc. Show depth at which water is encountered, thickness and character of water-bearing strata and height to which water rises in the well.

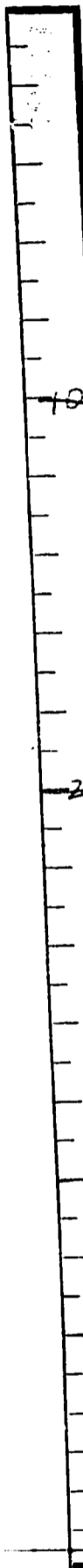

GLACIAL Till
LOAM
Boulders
CLAYS

MORE
Consolidated
But still conglomerate.

Size of Drilled Hole	Size and Weight of Casing	From (Feet)	To (Feet)	PERFORATIONS		
				Kind Size	From (Feet)	To (Feet)
6 1/4"	4 1/2" O.D. PVC PLASTIC 166# TEST	0	40	3/8" Holes Drilled 5 sides 6" APART	20	40

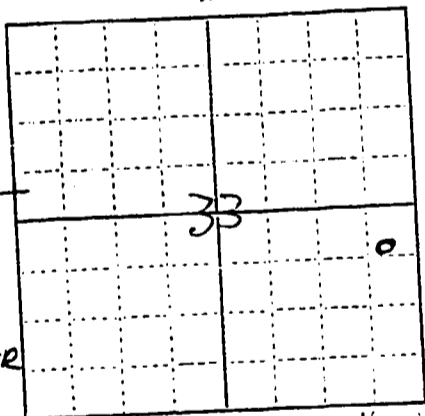

NE 1/4 Sec. 33 T.25 R.8
Indicate location of well and place of use, if possible. Each small square represents 10 acres.

30'-37' LARGE GRAVEL
Show exact depth of bottom. SOME SAND.

40 T.O.

Static Water Level for non-flowing Well..... 12 feet

Shut-in Pressure for Flowing Well.....

Pumping Water Level..... 18 feet at 10 gal. per minute.

Discharge in gal. per min. of flowing well.....

How Tested Air Length of Test 2 hours

Remarks: (Gravel packing, cementing, packers, type of shutoff, location of place of use of groundwater if not at well, and any other similar pertinent information, including number of

acres irrigated, if used for irrigation) Gravel

packed with 1/2" washed gravel from surface to T.O.

Doc. No. 311722

Driller's License Number 189

Filed for record this 11th day of May

Raymond L. Anderson
Driller's Signature

A. D. 19 72 at 3:45 o'clock P. M.

This form to be prepared by driller, and three copies to be filed by the owner with the County Clerk and Recorder in the county in which the well is located.

Please answer all questions. If not applicable, so state. otherwise the form will be returned.

Original to the County Clerk and Recorder; duplicate to the State Engineer; Triplicate to the Montana Bureau of Mines and Geology and Quadruplicate for the Appropriator.

50,382

311727

MAY 11 1972

FILED

At 3:45 o'clock P M

OFFICE of COUNTY CLERK, TETON COUNTY MONT.

MARY N. BAKER, County Clerk

Lorraine Meyer Deputy

Fee 2.00 Paid