

28N 34E
Valley CO.

File No.

DUPLICATE

Approved Stock Form—State Publishing Co., Helena, Montana—41921

T. 28 N. R. 34

County Valley

STATE OF MONTANA
ADMINISTRATOR OF GROUNDWATER CODE
OFFICE OF STATE ENGINEER

JAN 16 1964

Declaration of Vested Groundwater Rights

(Under Chapter 237, Montana Session Laws, 1961)

1. Earl Porter of Malta
(Name of Appropriator) (Address)
County of Valley State of MONTANA
have appropriated groundwater according to the Montana laws in effect prior to January 1, 1962, as follows:

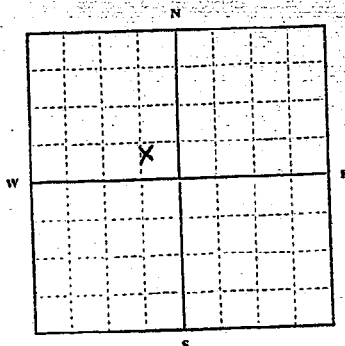

SE 1/4 NW Sec. 19 T. 28 R. 34

Indicate point of appropriation and place of use, if possible. Each small square represents 10 acres.

2. The beneficial use on which the claim is based
Stock Water
3. Date or approximate date of earliest beneficial use; and how continuous the use has been
1951
4. The amount of groundwater claimed (in miner's inches or gallons per minute)
10 gal Per Min
5. If used for irrigation, give the acreage and description of the lands to which water has been applied and name of the owner thereof
6. The means of withdrawing such water from the ground and the location of each well or other means of withdrawal
PUMP JACK + GAS ENGINE

7. The date of commencement and completion of the construction of the well, wells, or other works for withdrawal of groundwater
1951
8. The depth of water table
320 Feet
9. So far as it may be available, the type, size and depth of each well or the general specifications of any other works for the withdrawal of groundwater
Drilled (6" steel casing) 500 feet
10. The estimated amount of groundwater withdrawn each year
800,000
11. The log of formations encountered in the drilling of each well if available
Not Available
12. Such other information of a similar nature as may be useful in carrying out the policy of this act, including reference to book and page of any county record

Signature of Owner

Earl Porter

Date 12/30/63

Three copies to be filed by the owner with the County Clerk and Recorder of the county in which the well is located.

Please answer all questions. If not applicable, so state, otherwise the form will be returned.

Original to the County Clerk and Recorder; Duplicate to the State Engineer; Triplicate to the Montana Bureau of Mines and Geology, and Quadruplicate for the Appropriator.

3213

439279

18691

STATE OF MINNESOTA
County of _____

Filed for record

DEC 31 1963

⁴⁴⁵
MARY LOU THE CLARK Recorder

By _____

RECORDED
INDEXED
JAN 1 1964
CLERK OF DISTRICT COURT

Re: _____

28N35E
Valley Co.

WATER RIGHTS BUREAU
RECORDS SECTION
RETURN TO PENTHOUSE

RECEIVED
JUN 11 1959

T. 28 R. 35
County Valley

STATE ENGINEER MONTANA BUREAU OF MINES AND GEOLOGY
Butte, Montana

WATER WELL LOG

	2	

Owner Tom Fisher Address Saco
Driller Carl P. Lin Address Saco
Date Started 6/2/58 Date Completed 6/6/58
Location: Sec. 7 T. 28 R. 35 1/4 sec. SW 1/4

Type of well Drilled Equipment used Churn drill
(Dug, driven, bored, or drilled) (Churn drill, rotary, other)

Water use: Domestic ☐ Municipal ☐ Stock ☒ Irrigation ☐
Industrial ☐ Drainage ☐ Other:

Casing: Top ft. to 93 ft. Type Galv. Steel Size 6"
Casing: ft. to ft. Type Size
Casing: ft. to ft. Type Size
Perforated or Screened: Ft. to ft. Ft. to ft.

Type of screen or perforations
Static Water level, for non-flowing well: 12.25 feet.

Shut-in pressure, for flowing well: lb./sq. in. (date)

Pumping water level: 12.25 feet at 10 gal. per min.

How tested: PLUMP 189

Length of test: 21.0

Remarks: (Gravel packing, cementing, packers, type of shut-off, depth of shut-off)

(over)

Log of Well

[illegible]

STATE OF MONTANA, ss.
County of Valley.

County of Valley.

Filed for record

1959 0 1 1959

9:02 o'clock ~~11~~

County Recorder

By		Deputy
----	--	--------

Log of Well:

[illegible]

10-256

STATE OF MONTANA,
County of Valley.
Filed for record

JUN 10 1959

at	9.00 York	M.
	Mary Ann	
	County Recorder	

37	Deputy
----	--------

VALLEY COUNTY
T.28N R.37-E

WATER RIGHTS BUREAU
RECORDS SECTION

RETURN TO PENTHOUSE

File No.

T. 28 N. R. 37 E.

DUPLICATE

County. Valley

STATE OF MONTANA
ADMINISTRATOR OF GROUNDWATER CODE
OFFICE OF STATE ENGINEER

Declaration of Vested Groundwater Rights

(Under Chapter 237, Montana Session Laws, 1961)

1. Bernard & Claudia Blomen of Nashua Mont.
(Name of Appropriator) (Address) (Town)
County of Valley State of Mont.
have appropriated groundwater according to the Montana laws in effect prior to January 1, 1962, as follows:

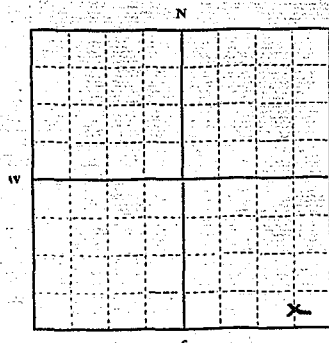

SE 1/4 Sec 24, T. 28 N. R. 37 E.

Indicate point of appropriation and place of use, if possible. Each small square represents 10 acres.

2. The beneficial use on which the claim is based: Stock use
3. Date or approximate date of earliest beneficial use; and how continuous the use has been: Early 1900's none use
at present
4. The amount of groundwater claimed (in miner's inches or gallons per minute): 20 gpm per min
5. If used for irrigation, give the acreage and description of the lands to which water has been applied and name of the owner thereof:
6. The means of withdrawing such water from the ground and the location of each well or other means of withdrawal: Pump

7. The date of commencement and completion of the construction of the well, wells, or other works for withdrawal of groundwater: Early 1900's
8. The depth of water table: 10 ft approx
9. So far as it may be available, the type, size and depth of each well or the general specifications of any other works for the withdrawal of groundwater: Drilled, 6 in, 170 ft approx
10. The estimated amount of groundwater withdrawn each year: 2 million gall
11. The log of formations encountered in the drilling of each well if available: None available
12. Such other information of a similar nature as may be useful in carrying out the policy of this act, including reference to book and page of any county record:

Signature of Owner: Wm. Blomen
Bernard & Claudia Blomen
Dec 31, 1963

Three copies to be filed by the owner with the County Clerk and Recorder of the county in which the well is located

Please answer all questions. If not applicable, so state, otherwise the form will be returned.

Original to the County Clerk and Recorder; Duplicate to the State Engineer; Triplicate to the Montana Bureau of Mines and Geology; and Quadruplicate for the Appropriator.

37044

439207

18619

DEC 31 1963

4:00 P.M.
MARY LUCY BIRD *Recorder*
V. B. - 1963

Page 1 of 1

Twp. 28 N

Rge. **38E**

[illegible]

GV.

File No.

DUPLICATE

STATE OF MONTANA
ADMINISTRATOR OF GROUNDWATER CODE
OFFICE OF STATE ENGINEER

T. 28 R. 38
County Valley
JAN 16 1964

Declaration of Vested Groundwater Rights

(Under Chapter 237, Montana Session Laws, 1961)

1. Ludwig Obeng, of Heavens Mount,
(Name of Appropriator) (Address) (Town)
County of Valley State of Mont.
have appropriated groundwater according to the Montana laws in effect prior to January 1, 1962, as follows:

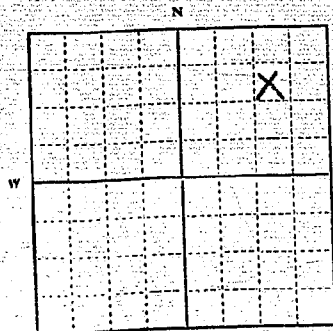

Lot 1, Sec. 1, T. 28 R. 38

Indicate point of appropriation and place of use, if possible. Each small square represents 10 acres.

2. The beneficial use on which the claim is based
Livestock
3. Date or approximate date of earliest beneficial use; and how continuous the use has been
January 1910
4. The amount of groundwater claimed (in miner's inches or gallons per minute)
20 gallons per minute
5. If used for irrigation, give the acreage and description of the lands to which water has been applied and name of the owner thereof
Not used for land irrigation
6. The means of withdrawing such water from the ground and the location of each well or other means of withdrawal
Pump & electric motor + windmill
7. The date of commencement and completion of the construction of the well, wells, or other works for withdrawal of groundwater
Jan. 1910
8. The depth of water table
27 feet
9. So far as it may be available, the type, size and depth of each well or the general specifications of any other works for the withdrawal of groundwater
70 feet deep
10. The estimated amount of groundwater withdrawn each year
Unknown
11. The log of formations encountered in the drilling of each well if available.

12. Such other information of a similar nature as may be useful in carrying out the policy of this act, including reference to book and page of any county record.

Signature of Owner Ludwig Obeng
Date 12-27-63

Three copies to be filed by the owner with the County Clerk and Recorder of the county in which the well is located.
Please answer all questions. If not applicable, so state, otherwise the form will be returned.

Original to the County Clerk and Recorder; Duplicate to the State Engineer; Triplicate to the Montana Bureau of Mines and Geology, and Quadruplicate for the Appropriator.

36854

438783 18239

STATE OF MONTANA,
County of Valley.

Filed for record

DEC 27 1963

at 3:00 o'clock P.M.
MARY LOU EIDE Clerk & Recorder
Valley County
By _____ Deputy

T. 28 N R. 38 E 11
County Valley

2312

MONTANA BUREAU OF MINES AND GEOLOGY
Butte, Montana

WATER WELL LOG

X			

Owner Wm. H. Hannon Address Wagon
Driller Walter Lane Address Glaspord Mont.
Date Started Sept 17 Date Completed Sept 27
1 1/3 mi S Location: Sec. 11 T. 28 N R. 38 E 1/4 Sec.

Type of well drilled Equipment used Antares
(Dug, driven, bored, or drilled) (Churn drill, rotary, other)

Water use: Domestic ☒ Municipal ☐ Stock ☐ Irrigation ☐
Industrial ☐ Drainage ☐ Other: _____

Casing: _____ ft. to _____ ft. Type _____ Size 4 in gal

Casing: _____ ft. to _____ ft. Type _____ Size _____

Casing: _____ ft. to _____ ft. Type _____ Size _____

Perforated or Screened: Ft. _____ to ft. _____ Ft. _____ to ft. _____

Type of screen or perforations _____

Static Water level, for non-flowing well: 18 ft feet.

Shut-in pressure, for flowing well: _____ lb./sq. in. on: _____ (date)

Pumping water level 23 ft feet at 13 gal. per min.

How tested: Submersible Pump

Length of test 45 min

Remarks: (Gravel packing, cementing, packers, type of shut-off, depth of shut-off)

RECEIVED
SEP 23 1957
STATE ENGINEER

T. 28 N R. 38 E 11
County Valley

MONTANA BUREAU OF MINES AND GEOLOGY
Butte, Montana

WATER WELL LOG

X		

Owner: Ernest Hedman Address: Wagon
Driller: Walter Lure Address: Blasgow Mont.
Date Started: Sept 17 Date Completed: Sept 27
1st mo 30
Location: Sec. 11 T. 28 N R. 38 E 1/4 sec

Type of well: drilled (Dug, driven, bored, or drilled) Equipment used: Rotary (Cable drill, rotary, other)

Water use: Domestic ☒ Municipal ☐ Stock ☐ Irrigation ☐
Industrial ☐ Drainage ☐ Other: _____

Casing: _____ ft. to _____ ft. Type: _____ Size: 4 in gal
Casing: _____ ft. to _____ ft. Type: _____ Size: _____
Casing: _____ ft. to _____ ft. Type: _____ Size: _____

Perforated or Screened: Ft. _____ to ft. _____ Ft. _____ to ft. _____

Type of screen or perforations: _____

Static Water level, for non-flowing well: 18 ft feet

Shut-in pressure, for flowing well: _____ lb./sq. in. on: _____ (date)

Pumping water level: 23 ft feet at 13 gal per min

How tested: Submersible Pump

Length of test: 48 hrs

Remarks: (Gravel packing, cementing, packers, type of shut-off, depth of shut-off)

(over)

[illegible]

15654

GW

Approved Stock Form—State Publishing Co., Helena, Montana—42234

File No.

T. 28 R. 38

DUPLICATE

County Valley

STATE OF MONTANA
ADMINISTRATOR OF GROUNDWATER CODE
OFFICE OF STATE ENGINEER

JAN 16 1964

Declaration of Vested Groundwater Rights

(Under Chapter 237, Montana Session Laws, 1961)

1. RAY. H. UP HAUS of P.O. Box 14 Glasgow
(Name of Appropriator) (Address) (Town)
County of Valley State of Mont
have appropriated groundwater according to the Montana laws in effect prior to January 1, 1962, as follows:

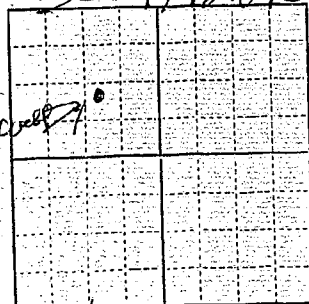

SE NW

Sec. 17, T. 28, R. 38

Indicate point of appropriation and place of use, if possible. Each small square represents 10 acres.

2. The beneficial use on which the claim is based.

Stock water

3. Date or approximate date of earliest beneficial use; and how continuous the use has been.

always in use

4. The amount of groundwater claimed (in miner's inches or gallons per minute).

200 gals per 24 hours

5. If used for irrigation, give the acreage and description of the lands to which water has been applied and name of the owner thereof.

6. The means of withdrawing such water from the ground and the location of each well or other means of withdrawal.

well pump

7. The date of commencement and completion of the construction of the well, wells, or other works for withdrawal of groundwater.

1953

8. The depth of water table.

350 ft

9. So far as it may be available, the type, size and depth of each well or the general specifications of any other works for the withdrawal of groundwater.

400 ft deep 4 in casing

10. The estimated amount of groundwater withdrawn each year.

11. The log of formations encountered in the drilling of each well if available.

12. Such other information of a similar nature as may be useful in carrying out the policy of this act, including reference to book and page of any county record.

Signature of Owner

Ray H. Uphaus
Date Dec 31 1963

Three copies to be filed by the owner with the County Clerk and Recorder of the county in which the well is located.

Please answer all questions. If not applicable, so state, otherwise the form will be returned.

Original to the County Clerk and Recorder; Duplicate to the State Engineer; Triplicate to the Montana Bureau of Mines and Geology, and Quadruplicate for the Appropriator.

37032

439195

18607

OFFICE OF THE
County of Valley

DEC 31 1963

4100 P

MARY LOU EDDY, Clerk & Recorder
Valley County

File No.

DUPLICATE

T 28 R 38

County Valley

STATE OF MONTANA
ADMINISTRATOR OF GROUNDWATER CODE
OFFICE OF STATE ENGINEER

JAN 16 1964

Declaration of Vested Groundwater Rights

(Under Chapter 237, Montana Session Laws, 1961)

I, John A. Wesca, of Box 133 Glasgow
(Name of Appropriator) (Address) (Town)
County of Valley State of Montana
have appropriated groundwater according to the Montana laws in effect prior to January 1, 1962, as follows:

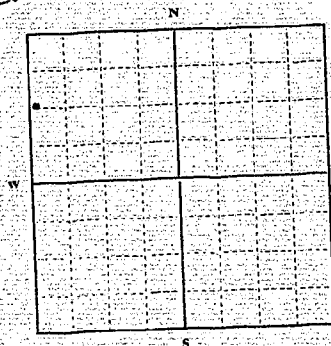

N 1/4 NW 1/4 Sec. 24 T 28 R 38

Indicate point of appropriation
and place of use, if possible.
Each small square represents 10
acres.

2. The beneficial use on which the claim is based Stock water
3. Date or approximate date of earliest beneficial use; and how continuous the use has been Oct 10, 1948
Sept 1, 1954
4. The amount of groundwater claimed (in miner's inches or gallons per minute) 5 gal per min.
N.T.
5. If used for irrigation, give the acreage and description of the lands to which water has been applied and name of the owner thereof
1/4 sec 24
6. The means of withdrawing such water from the ground and the location of each well or other means of withdrawal 1 lift pump
lift pump
7. The date of commencement and completion of the construction of the well, wells, or other works for withdrawal of groundwater Oct 10, 1948
Sept 15 1954
8. The depth of water table 48' casing
48' casing
9. So far as it may be available, the size and depth of each well or the general specifications of any other works for the withdrawal of groundwater 325'
325'
10. The estimated amount of groundwater withdrawn each year 1-28 cfs
1-28 cfs
11. The log of formations encountered in the drilling of each well if available
well drilled to 325 ft.
to the sand
12. Such other information of a similar nature as may be useful in carrying out the policy of this act, including reference to book and page of any county record.

Signature of Owner

Date Dec 20, 1963

Three copies to be filed by the owner with the County Clerk and Recorder of the county in which the well is located.

Please answer all questions. If not applicable, so state, otherwise the form will be returned.

Original to the County Clerk and Recorder; duplicate to the State Engineer; Triplicate to the Montana Bureau of Mines and Geology, and Quadruplicate for the Appropriator.

37095

439258

18670

STATE OF MONTANA,
County of Valley.

Filed for record.

DEC 31 1963

4:30
MARY LOU EDE Clerk & Recorder
Valley County

County ValleyTwp. 28NRge. 39E

Sec.	Name of Appropriator	Type of Form	County File No.	Remarks
2	Archem Fault, William	Well log	15872	
2	Cherry Cr. sub' water			
	Users Assn.	" "	403113	
2	Cherry Cr. Assn.	" "	16220	
2	" " "	GW 2	442274	
2	Halverson, Marlen	2	20712	
2	Hutton, Thera P	GW 4	439173	
2	" " "	4	439174	
2	Holt, Kenneth	GW 2	20645	
2	Knickeren, Maxim	2	19371	
2	Miller, Ken	Well log	16154	
2	Peters & Blick	" "	409853	
2	Riggin, Walter	GW 2	19675	
2	Stall, Will	Well log	403885	
2	Tressler, Byron and Melvin Lawe	" "	424015	
2	Unsforth, Danil	" "	425065	
3	Billingsley, Mrs. Gail	GW 4	438762	
3	DeBray, Porline H.	"	438666	
3	Kornitz, Jim G.	"	436540	
3	Scott, Floyd	Well log	413801	
3	" "	" "	423461	
4	Olsen, Anna M.	GW 4	438981	
4	" " "	4	438981	
4	Riley, William	GW 2	20563	
5	Fisher, W.C.	GW 4	439072	
5	Mullen, Thomas R.	"	438974	
5	Walker, Albert	"	439365	
7	Wason, Elvire	"	422992	
8	Upkars, Ray H.	"	439197	
9	Bretz, K.E., Leo E. & Rose E.	GW 2	471680	
9	Nelson, Lloyd	GW 4	439023	
10	Blanchard, George W.	GW 2	19130	
10	Myers, Preston D.	GW 4	438323	
11	Anderson, Morris E.	GW 2	20339	
11	Blanchard, Willis M.	GW 4	438356	
11	Cane, Lloyd	Well log	15292	
11	Cotton, Alvin B. and Marvella E.	GW 4	438866	
11	Eide, Chester H. Sr.	"	439297	
11/12	Lester, George	Well log	15871	
11	MacIntyre, J.H.	GW 4	439151	
11	Sossiba, Leon W. Jr.	GW 2	439035	
12	City of Glasgow	GW 4	438377	
12	" " "	GW 2	20324	
12	Dr Smith Clinic	Well log	411537	

GROUNDWATER INDEX

Page 2 of 2

County Valley

Twp. 28N

Rge. 39E

Ser.	Name of Appropriator	Type of Form	County File No.	Remarks
12	Dix, Glen	well log	415221	
12	Glasgow Reedy Mix	" "	407024	
12	Grendchamp, Alfred	GW 2	20784	
12	Markle, O.E., C.D. & R.D.	GW 4	432854	
12	Nilson, Thor	"	432266	
12	Pippin, Lester	well log	409352	
12	" "	" "	15290	
12	" "	" "	411782	
12	Reedy Mix Cement	" "	415258	
12	Schatt, Royal & Agnes	GW 4	439148	
12	Schatt, Royal M.	well log	15290	
12	Swanson, Edwin	GW 2	19488	
13	Beiley, Manson H. Jr.	GW 4	439123	
13	Christensen, James O.	"	439061	
13	Conetson, Mrs. Mercedes	GW 2	459014	
13	Hallett, George S.	GW 4	427945	
13	Hansen, Robert & Jean	well log	15241	
13	Overland, Art	" "	423803	
13	Schatt, Royal M.	GW 4	427817	
14	McIntyre, J.H.	"	439153	
16	Dix Glen	GW 2	432850	
17	Uphaus, Ray H.	GW 4	439196	
18	Newton, Kenneth	"	432748	
18	Uphaus, William N.	"	427177	
18	" "	GW 2	20533	
20	Olsen, George G.	GW 4	432983	
22	Aitken, William	GW 2	19655	
22	Hagen, Elmer & Blanche	GW 4	439071	
23	Dix Glen	GW 2	432949	
23	Pittenger, Robert E.	GW 4	432777	
24	Britzman, Jew W. and widmer J.	"	439009	
25	Wittmayer, Howard & Robert	"	439118	
26	Aitken, Walter J.	"	432620	
28	Billingsley, C. Hulso	"	432968	
28	" "	"	432970	
30	Engstrom, Adolph	"	432192	
31	Rahde, Richard	GW 2	19303	
32	Dix, Glen	2	432951	
32	Olsen & ?	GW 4	427525	
?	Sampson, Arthur P. and Constance	GW 4	439125	

RECEIVED

JUL 1 1958

STATE ENGINEER

MONTANA BUREAU OF MINES AND GEOLOGY
Butte, Montana

T. 28N R. 39E

County Valley

2

WATER WELL LOG

William Archambault

Owner ~~Butt~~

Address Glasgow

Driller Walter Luse

Address Glasgow

Date Started April 15
NE 8E

Date Completed 17

Location: Sec. 2 T. 28 R. 39 1/4 sec. Lot 4

Type of well (Dug, driven, bored, or drilled) Equipment used (Churn drill, rotary, other)

Water use: Domestic ☒ Municipal ☐ Stock ☐ Irrigation ☐

Industrial ☐ Drainage ☐ Other:

Casing: ft. to ft. Type Black Size 4 1/2

Casing: ft. to ft. Type Size

Casing: ft. to ft. Type Size

Perforated or Screened: Ft. to ft. Ft. to ft.

Type of screen or perforations

Static Water level, for non-flowing well: 15 ft from top feet.

Shut-in pressure, for flowing well: lb./sq. in. on (date)

Pumping water level: 18 feet at 11 gal. per min.

How tested: Pumped

Length of test: 8 hrs

Remarks: (Gravel packing, cementing, packers, type of shut-off, depth of shut-off)

(over)

Log of Well

[illegible]

15824

RECEIVED

STATE ENGINEER

17 1958

MONTANA BUREAU OF MINES AND GEOLOGY
Butte, Montana

T. 28 N R 39 E 2

County Valley

WATER WELL LOG

Owner Henry Brock and Water Users Assn Address West of Glasgow

Driller W. J. Budy Address West of Glasgow

Date Started April 22, 1957 Date Completed April 26, 1957

Location: Sec. 2 T. 28 R. 39 1/4 sec. NE

Type of well

Drilled

(Dug, driven, bored, or d-filled)

Equipment used

Rotary

(Cable drill, rotary, other)

Water use: Domestic ☐

Municipal ☒

Stock ☐

Irrigation ☐

Industrial ☐

Drainage ☐

Other:

Casing: 0 ft. to 60 ft. Type Black Iron Size 5 3/4 IS

Casing: _____ ft. to _____ ft. Type _____ Size _____

Casing: _____ ft. to _____ ft. Type _____ Size _____

Perforated or Screened: Ft. 55 to ft. 60 Ft. _____ to ft. _____

Type of screen or perforations Shaded casing

Static Water level, for non-flowing well: 16 feet.

Shut-in pressure, for flowing well: _____ lb./sq. in. on: _____ (date)

Pumping water level: 20 feet at 90 gal. per min.

How tested: draw down curve

Length of test 16 hrs

Remarks: (Gravel packing, cementing, packers, type of shut-off, depth of shut-off)

(over)

Log of Well

[illegible]

403113

1578

STATE OF MONTANA,
County of Valley.
Filed for record

JUL 17 1958

11	00	0'clock	2 mi
----	----	---------	------

County Recorder

By W. H. C. C. Deputy

Well No. 2
RECEIVED
JUN 25 1951

T. 28N R. 39E 2
County Valley

MONTANA BUREAU OF MINES AND GEOLOGY
Butte, Montana
STATE ENGINEER

WATER WELL LOG

		X	

Owner: Buckwater Bros. Address: E. 6th St. W.
Driller: J. L. Palmer Address: ...
Date Started: 1/16/59 Date Completed: 1/18/59
Location: Sec. 3 T. 28 R. 39 1/4 sec. 24

Type of well: (Dug, driven, bored, or drilled) Equipment used: (Churn drill, rotary, other)

Water use: Domestic ☒ Municipal ☐ Stock ☐ Irrigation ☐
Industrial ☐ Drainage ☐ Other: _____

Casing: 1 1/2 ft. to 6 7/8 ft. Type: BH-4 Size: 6"

Casing: 7 ft. to 21 ft. Type: 1 1/2" Size: 1 1/2"

Casing: _____ ft. to _____ ft. Type: _____ Size: _____

Perforated or Screened: Ft. _____ to ft. _____ Ft. _____ to ft. _____

Type of screen or perforations: _____

Static Water level, for non-flowing well: _____ feet.

Shut-in pressure, for flowing well: _____ lb./sq. in. on _____ (date)

Pumping water level: _____ feet at _____ gal. per min.

How tested: _____

Length of test: _____

Remarks: (Gravel packing, cementing, packers, type of shut-off, depth of shut-off)

2.
RECEIVED
JUN 26 1954

MONTANA BUREAU OF MINES AND GEOLOGY
Butte, Montana
STATE ENGINEER

WATER WELL LOG

		X

Owner Cherry Creek Water Ass. Address Butte, Mont.
Driller Carl Palm Address Butte
Date Started 6/16/54 Date Completed 6/18/54
Location: NINE in State Highway Right of Way
Sec. 2 T. 28 R. 39 S. 2

Type of well Drilled Equipment used Lucan
(Dug, driven, bored, or drilled) (Churn drill, rotary, other)

Water use: Domestic ☒ Municipal ☐ Stock ☐ Irrigation ☐
Industrial ☐ Drainage ☐ Other ☐

Casing 2 1/2 ft. to 62 9 ft. Type BH Size 6
Casing 7 ft. to 71 ft. Type B-L Size 6
Casing ft. to ft. Type Size

Perforated or Screened: Ft. to ft. Ft. to ft.

Type of screen or perforations

Static Water level, for non-flowing well: 36.5 feet

Shut-in pressure, for flowing well: lb./sq. in. on: (date)

Pumping water level: 35 feet at 50 gal. per min.

How tested:

Length of test:

Remarks: (Gravel packing, cementing, packers, type of shut-off, depth of shut-off)

(over)

Log of Well

[illegible]

16280

Log of Well

State of Montana,
 County of Valer.

ss. I, *John B. [Signature]*, Clerk of said County, do hereby certify that the within and foregoing is a true and correct copy of the original as the same appears from the records of said County.

Given under my hand and seal of said County, at the City of Helena, this 25th day of April, 1956.

John B. [Signature]
 Clerk

By _____
 Deputy

16280

File No.

DUPLICATE

STATE WATER CONSERVATION BOARD

R E C E I V E D
 JUL 29 1965

 T. 28 R. 39 2
 County VALLEY

LOG

 STATE OF MONTANA
 ADMINISTRATOR OF GROUNDWATER CODE
 OFFICE OF STATE ENGINEER

REFERRED TO

Top of Ground

(Elev. above sea level 2800)
**Notice of Completion of Groundwater
 Appropriation by Means of Well**
 DEVELOPED AFTER JANUARY 1, 1962

(Under Chapter 237, Montana Session Laws, 1961)

0-31 Clay31-64 Sand + Small Gravel Cherry Creek64-65 Coarse Gravel
 Owner Water Ass. Address Glasgow
 Driller Carl Palm Address Saco

Date of Notice of appropriation of groundwater

Date well started 7/14 Date completed 7/19/65
 Type of well Drilled Equipment used Churn
 (Dug, Driven, bored or drilled) (Churn drill, rotary or other)

 Water use: Domestic ☒ Municipal ☐ Stock ☐ Irrigation ☐
 Industrial ☐ Drainage ☐ Other ☐

Indicate on the diagram the character and thickness of the different strata met with in drilling, such as soil, clay, shale, gravel, rock or sand, etc. Show depth at which water is encountered, thickness and character of water-bearing strata and height to which the water rises in the well.

Size of Drilled Hole	Size and Weight of Casing	From (Feet)	To (Feet)	PERFORATIONS		
				Kind Size	From (Feet)	To (Feet)
<u>10"</u>	<u>8" ID</u> <u>24 LB.</u>	<u>Top</u>	<u>65 FT</u>			

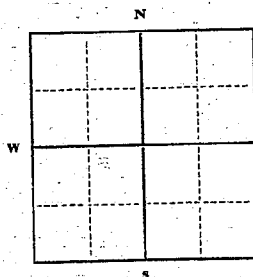
 Static Water Level for non-flowing well
23 feet.

Shut-in Pressure for Flowing Well

 Pumping Water Level 25 feet
 at 60 gal. per minute.

Discharge in gal. per min. of flowing well

How Tested balancingLength of Test 4 hrs.

Remarks: (Gravel packing, cementing, packers, type of shutoff)

(Continue on reverse side)

USE—If used for irrigation, industrial, drainage or other. Explain, state number of acres and location or other data (i.e.: Lot, Block and Addition).

Show exact depth of bottom.

This form to be prepared by driller, and three copies to be filed by the owner with the County Clerk and Recorder in the county in which the well is located, tissue copy to be retained by driller.

Please answer all questions. If not applicable, so state, otherwise the form will be returned.

NO-25
 Driller's License Number

Carl Palm
 Driller's Signature

39346

448474

19300

RECORDED
JUL 27 1965

OFFICE OF THE
CLERK OF THE
DISTRICT COURT
VALLEY, MONTANA

[Faint, mostly illegible handwritten notes and stamps, possibly including "JUL 27 1965" and "VALLEY, MONTANA"]

STATE OF MONTANA, }
County of Valley, } ss
Filed for record

JUL 27 1965

at 8:00 o'clock A. M.
Pharys
County Recorder
By _____ Deputy

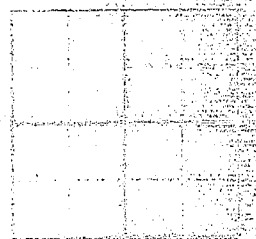

STATE OF MONTANA
ADMINISTRATOR OF GROUNDWATER CODE
MONTANA WATER RESOURCES BOARD

NOTICE OF COMPLETION OF GROUNDWATER
APPROPRIATION BY MEANS OF WELL

Developed after January 1, 1962

(Under Chapter 237 Montana Session Laws, 1961, as amended)

This form to be prepared by driller, and three copies to be filed by the owner with the County Clerk and Recorder in the county in which the well is located, last copy to be retained by driller. Please answer all questions. If not applicable, so state, otherwise the form may be returned.

Owner Marlen Halverson

Address Box 1109

Glasgow, Mt.

Date well started 10-24-72

completed 10-26-72

For Administrator's Use

File M-20712

Oct. 4, 1972 10:00 a.m.

GW 1

Type of well _____ (Dug, driven, bored or drilled)

Equipment used _____ (Churn drill, pump or other)

Water Use: Domestic ☒ Municipal ☐ Stock ☐ Irrigation ☐

Industrial ☐ Drainage ☐ Other ☐ * Garden/Lawn ☐

*Describe _____

USE: If used for irrigation, industrial, drainage or other. Explain, state number of acres and location or other data (i.e. Lot, Block and Addition).

ESTIMATED ANNUAL WITHDRAWAL _____

Size of Drilled Hole	Size and Weight of Casing	From (Feet)	To (Feet)	PERFORATIONS		
				Kind Size	From (Feet)	To (Feet)
<u>5 1/2"</u>	<u>8" 10' x 10' x 10'</u>					
	<u>4" 10' x 10' x 10'</u>					

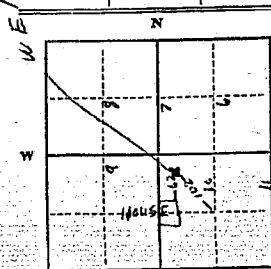

NW 1/4 SE 1/4 Sec. 2
T. 28 N. R. 39 E. S. 8

INDICATE LOCATION OF WELL AND PLACE OF USE, IF POSSIBLE. EACH SMALL SQUARE REPRESENTS 40 ACRES.

Driller's Signature Walter Luce

Driller's Address Glasgow, Mont

LICENSE NO. 47

County Valley

DRILLER'S LOG

Indicate the character, color, thickness of strata such as soil, clay, sand, gravel, shale, sandstone, etc. Show depth at which water is found and height to which water rises in well.

Top of Ground

(Elev. above sea level)

From (Feet)	To (Feet)	
1	50	Gravel
50	43	Shale
43	20	Gravel
20	10	Shale
10	84	Sand & Gravel

84 ft. Show exact depth of bottom

51,542

M 20712

STATE OF MONTANA }
 County of Valley } ss.
 Filed for Record

OCT - 4 1972

at 10:00 o'clock A.M.

Mary Law Gude
 County Recorder

By *Pauline Gude* Deputy

File No. _____

DUPLICATE

County

Valley

STATE OF MONTANA
ADMINISTRATOR OF GROUNDWATER CODE
OFFICE OF STATE ENGINEER

Declaration of Vested Groundwater Rights
(Under Chapter 237, Montana Session Laws, 1961)

1. Theralf Hutton of RIM (Address) GL 2590W (Town)
County of Valley State of MONT
have appropriated groundwater according to the Montana laws in effect prior to January 1, 1962, as follows:

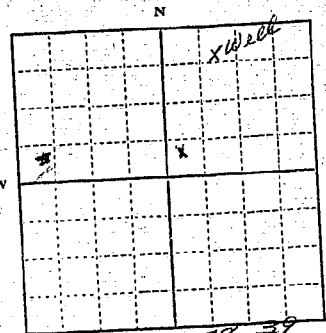

2. The beneficial use on which the claim is based Home water use + garden

3. Date or approximate date of earliest beneficial use; and how continuous the use has been 8-20-57

4. The amount of groundwater claimed (in miner's inches or gallons per minute) 10 gals per minute

5. If used for irrigation, give the acreage and description of the lands to which water has been applied and name of the owner thereof
Less than 1 acre
L-2 lying north of Hwy way

6. The means of withdrawing such water from the ground and the location of each well or other means of withdrawal
Centrifugal Pump

7. The date of commencement and completion of the construction of the well, wells, or other works for withdrawal of groundwater 8-20-57

8. The depth of water table

9. So far as it may be available, the type, size and depth of each well or the general specifications of any other works for the withdrawal of groundwater
Depth 50 FT 4 inch PIP CASING
drilled well

10. The estimated amount of groundwater withdrawn each year 80,000 gals

11. The log of formations encountered in the drilling of each well if available Top soil - clay
shale - gravel

12. Such other information of a similar nature as may be useful in carrying out the policy of this act, including reference to book and page of any county record

Signature of Owner

Theralf Hutton
Mrs Hazel Hutton

Date

Dec 31 1963

Three copies to be filed by the owner with the County Clerk and Recorder of the county in which the well is located.

Please answer all questions. If not applicable, so state, otherwise the form will be returned.

Original to the County Clerk and Recorder; Duplicate to the State Engineer; Triplicate to the Montana Bureau of Mines and Geology, and Quadruplicate for the Appropriator.

37012

439174

18587

STATE OF MONTANA
County of Valley

Filed for record

DEC 31 1963

300
MARY LOU ~~W~~ ^W Recorder
Valley County

By _____ Deputy

GW

Approved Stock Form—State Publishing Co., Helena, Montana—42234

File No.

DUPLICATE

T. 28 N. R. 39 E.

County Valley

STATE OF MONTANA
ADMINISTRATOR OF GROUNDWATER CODE
OFFICE OF STATE ENGINEER

JAN 16 1964

Declaration of Vested Groundwater Rights

(Under Chapter 237, Montana Session Laws, 1961)

1. Therail Hutton, of R.I.W.B-192 G.L. 95 G.W.
(Name of Appropriator) (Address) (Town)
County of Valley State of MONT.
have appropriated groundwater according to the Montana laws in effect prior to January 1, 1962, as follows:

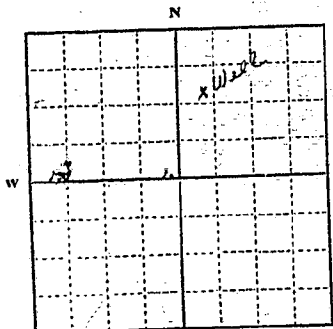

Indicate point of appropriation and place of use, if possible. Each small square represents 10 acres.

2. The beneficial use on which the claim is based Home water use + garden

3. Date or approximate date of earliest beneficial use; and how continuous the use has been 2-8-52 - all year

4. The amount of groundwater claimed (in miner's inches or gallons per minute) 15 gal. per minute

5. If used for irrigation, give the acreage and description of the lands to which water has been applied and name of the owner thereof less than 1 acre that pt. 12 lying south of highway

6. The means of withdrawing such water from the ground and the location of each well or other means of withdrawal centrifugal pump

7. The date of commencement and completion of the construction of the well, wells, or other works for withdrawal of groundwater 2-8-52

8. The depth of water table 25 Feet

9. So far as it may be available, the type, size and depth of each well or the general specifications of any other works for the withdrawal of groundwater depth 61 ft 6 inch pipe - casing drilled well

10. The estimated amount of groundwater withdrawn each year 100,000 gal

11. The log of formations encountered in the drilling of each well if available Top soil - clay - shale - gravel

12. Such other information of a similar nature as may be useful in carrying out the policy of this act, including reference to book and page of any county record

Signature of Owner

Date Dec. 31, 1963

Three copies to be filed by the owner with the County Clerk and Recorder of the county in which the well is located.

Please answer all questions. If not applicable, so state, otherwise the form will be returned.

Original to the County Clerk and Recorder; Duplicate to the State Engineer; Triplicate to the Montana Bureau of Mines and Geology, and Quadruplicate for the Appropriator.

37011

439173

18586

STATE OF MICHIGAN
COUNTY OF VALLEY
TOWNSHIP OF

DEC 8 1 1963

3:00

MARY LOU BEEGLER, Recorder
Valley County

County Valley 2

STATE OF MONTANA
ADMINISTRATOR OF GROUNDWATER CODE
MONTANA WATER RESOURCES BOARD

NOTICE OF COMPLETION OF GROUNDWATER APPROPRIATION BY MEANS OF WELL

Developed after January 1, 1962

(Under Chapter 237 Montana Session Laws, 1961, as amended)

This form to be prepared by driller, and three copies to be filed by the owner with the County Clerk and Recorder in the county in which the well is located, last copy to be retained by driller.

Please answer all questions. If not applicable, so state, otherwise the form may be returned.

Owner Kenneth Holt

Address London

For Administrator's Use

File **20645**

June 5, 1922 11:00 am

Date well started 4/18/72

[GW 1]

completed 4/24/72

Type of well

(Dug, driven, bored or drilled)

Equipment used Charm drill

(Churn drill, rotary or other)

Water Use: Domestic ☒ Municipal ☐ Stock ☒ Irrigation ☐

Industrial ☐ Drainage ☐ Other ☐* Garden/Lawn ☐

***Describe**

USE: If used for irrigation, industrial, drainage or other. Explain, state number of acres and location or other data (i.e. Lot, Block and Addition).

ESTIMATED ANNUAL WITHDRAWAL

Size of Drilled Hole	Size and Weight of Casting	From (Feet)	To (Feet)	PERFORATIONS		
				Kind Size	From (Feet)	To (Feet)
5/8	4 1/2 D 3 1/2 in 12.					

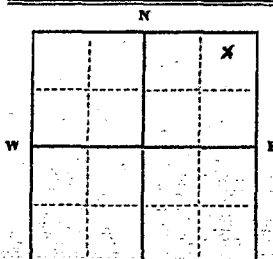

Static water level 28.4 ft.*

Pumping water level 35.4 ft.*
at 16 gallons per minute
measured _____ minutes after pumping
began.

*Measured from ground level.

Well developed by drilling
for 1 hours.

Power..... Pump..... HF.....

Remarks: (Gravel packing, cementing
packers, type of shutoff)

Lot 3⁸
T. = 2 1/4 Sec. 2
N. R. 37

INDICATE LOCATION OF WELL AND PLACE OF USE, IF POSSIBLE.
EACH SMALL SQUARE REPRESENTS 40 ACRES.

Driller's Signature

Driller's Address

LICENSE NO. 44

DRILLER'S LOG

Indicate the character, color, thickness of strata such as soil, clay, sand, gravel, shale, sandstone, etc. Show depth at which water is found and height to which water rises in well.

Top of Ground

(Elev. above sea level)

[illegible]

Show exact depth of bottom

50,525

20645

STATE OF MONTANA
County of Valley

Filed for Record

JUN - 5 1972

11:00

A.M.

Mary Ann Ellis

County Recorder

Mary Ann Ellis

County

File No.

AUG 8 1966

T. 28 N. R. 39 E

TRIPLICATE

LOG

 Billie McDermott
 Butcher McNulty
 Coyle Morgan
 Darlington Sullivan
 Dickert
County Valley

STATE OF MONTANA

ADMINISTRATOR OF GROUNDWATER CODE

OFFICE OF STATE ENGINEER

Top of Ground

(Elev. above sea level.....)

Notice of Completion of Groundwater Appropriation by Means of Well

DEVELOPED AFTER JANUARY 1, 1962

(Under Chapter 237, Montana Session Laws, 1961)

Owner Maxim Kiborian Address GlasgowDriller Walter Luse Address Glasgow

Date of Notice of appropriation of groundwater.....

Date well started July 26 Date completed July 28Type of well..... Equipment used Rotary
(Dug, Driven, bored or drilled) (Churn drill, rotary or other)
 Water use: Domestic ☐ Municipal ☐ Stock ☒ Irrigation ☐
 Industrial ☐ Drainage ☐ Other ☐

Indicate on the diagram the character and thickness of the different strata met with in drilling, such as soil, clay, shale, gravel, rock or sand, etc. Show depth at which water is encountered, thickness and character of water-bearing strata and height to which the water rises in the well.

Size of Drilled Hole	Size and Weight of Casing	From (Feet)	To (Feet)	PERFORATIONS		
				Kind Size	From (Feet)	To (Feet)
5 in	4 1/2" D. Galve 6 x 5 1/2 per ft					

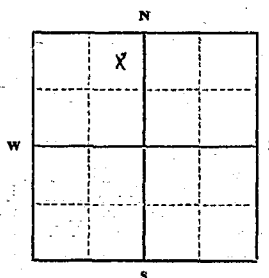
Static Water Level for non-flowing well 30 ft from top feet.

Shut-in Pressure for Flowing Well.....

Pumping Water Level 40 feetat 10 gal. per minute.

Discharge in gal. per min. of flowing well.....

How Tested purgeLength of Test 2 hrs.

Remarks: (Gravel packing, cementing, packers, type of shutoff).....

NE 1/4 Sec 2, T28 R39
 Indicate location of well and place of use, if possible. Each small square represents 40 acres.

(Continue on reverse side)

USE—If used for irrigation, industrial, drainage or other. Explain, state number of acres and location or other data (i.e.: Lot, Block and Addition).

Show exact depth of bottom.

This form to be prepared by driller, and three copies to be filed by the owner with the County Clerk and Recorder in the county in which the well is located, tissue copy to be retained by driller.

Please answer all questions. If not applicable, so state, otherwise the form will be returned.

Driller's License Number 44Driller's Signature Walter Luse

412,86

19571

STATE OF MONTANA, } ss.
County of Valley.
Filed for record

AUG 5 1966

at 3:30 o'clock P.M.
Mary Jane Gidd
County Recorder
Marjorie White Deputy

RECEIVED

MAR 12 1959

STATE ENGINEER

MONTANA BUREAU OF MINES AND GEOLOGY
Butte, Montana

WATER WELL LOG

T. 22N R. 39E

County Valley

Owner Ken Miller Address Glasgow

Driller Carl Palm Address Saco

Date Started 3/1/59 Date Completed 3/3/59

Location: Sec 2 T. 22N R. 39E 1/4 sec

Type of well Drilled Equipment used Churn
(Dug, driven, bored, or drilled) (Churn drill, rotary, other)

Water use: Domestic ☐ Municipal ☐ Stock ☐ Irrigation ☒

Industrial ☐ Drainage ☐ Other:

Casing: Top ft. to 77 ft. Type B.L.H. Steel Size 6"

Casing: ft. to ft. Type Size

Casing: ft. to ft. Type Size

Perforated or Screened: Ft. to ft. Ft. to ft.

Type of screen or perforations

Static Water level, for non-flowing well: 30 feet

Shut-in pressure, for flowing well: lb./sq. in. on: (date)

Pumping water level 33 feet at 40 gal. per min.

How tested: by pumping

Length of test 1 hr

Remarks: (Gravel packing, cementing, packers, type of shut-off, depth of shut-off)

(over)

VALLEY COUNTY

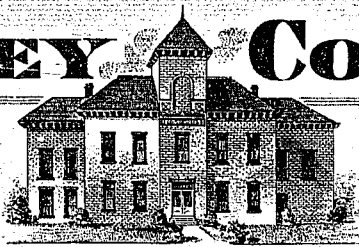

MARY LOU EIDE, Clerk and Recorder
DAN OAKLAND, Assessor
H. O. DOHLEN, Treasurer
RUTH PUTZ, Supt. of Schools
HUGH BORTON, Sheriff-Coroner
GUNNAR BREKKE, Pub. Administrator

GORDON T. WHITE, County Attorney
BLANCHE GROTHAN, Clerk of Court
JAMES T. SHEA, District Judge

COMMISSIONERS
EARL DALEY, Chairman
MAURICE ARNOLD, Member
JOHN MAXNESS, Member

Glasgow, Montana

March 12, 1959

State Engineer
Helena, Montana

Dear Sir:

Yesterday we mailed you two Water Well Log's, one for Glasgow Ready Mix and one for Ken Miller. We misplaced our one copy of the Water Well Log of Ken Miller and were wondering if we could have gotten it in your envelope by mistake.

Would you please check if you have two for Mr. Miller and if so mail me one copy back? Thanks.

Sincerely,

Mary Lou Eide
Clerk and Recorder

RECEIVED
MAR 13 1959

STATE ENGINEER

*Returned
3/13/59*

RECEIVED
AUG 14 1959

409853

16323

T. 28 N. R. 39 E. 2
County Valley

STATE ENGINEER MONTANA BUREAU OF MINES AND GEOLOGY
Butte, Montana

WATER WELL LOG

Owner Peters & Blick Address Glasgow, Montana

Driller Simpson Drilling Co. Address Glasgow, Montana
Emmett Gendron

Date Started July 15, 1959 Date Completed July 16, 1959

Location: Sec. 2 T. 28 R. 39 NE $\frac{1}{4}$ sec.

Type of well drilled Equipment used churn
(Dug, driven, bored, or drilled) (Churn drill, rotary, other)

Water use: Domestic ☐ Municipal ☐ Stock ☐ Irrigation ☐
Industrial ☒ Drainage ☐ Other: _____

Casing: 0 ft. to 98 ft. Type screw joint Size 4 inch

Casing: _____ ft. to _____ ft. Type _____ Size _____

Casing: _____ ft. to _____ ft. Type _____ Size _____

Perforated or Screened: Ft. 91 to ft. 93 Ft. _____ to ft. _____

Type of screen or perforations drilled $\frac{1}{4}$ inch holes

Static Water level, for non-flowing well: 30 feet

Shut-in pressure, for flowing well: _____ lb./sq. in. on: _____ (date)

Pumping water level 50 feet at 25 gal. per min.

How tested: hailer 2 hours

Length of test 2 hours

Remarks: (Gravel packing, cementing, packers, type of shut-off, depth of shut-off)

(over)

Log of Well

[illegible]

409853

16323

File No. _____

STATE WATER CONSERVATION BOARD

T. 28 N. R. 39 E. 2

DUPLICATE

LOG

FEB 9 1967

STATE OF MONTANA

County ValleyADMINISTRATOR OF GROUNDWATER CODE
OFFICE OF STATE ENGINEER

Top of Ground

(Elev. above sea level 2780)**Notice of Completion of Groundwater
Appropriation by Means of Well**

DEVELOPED AFTER JANUARY 1, 1962

(Under Chapter 237, Montana Session Laws, 1961)

0-2 hardpan2-10 Clay10-14 Gravel14-37 Sandy yellow clay37-45 Blue Clay45-47 Gravel47-70 Sandy Blue Clay70-73 Sand Gravel & waterOwner Walter B. Rigg Address GL 2590 WDriller Carl Palm Address See

Date of Notice of appropriation of groundwater _____

Date well started 6/17 Date completed 6/19/65Type of well Drilled Equipment used Churn
(Dug, Driven, bored or drilled) (Churn drill, rotary or other)Water use: Domestic ☒ Municipal ☐ Stock ☐ Irrigation ☐
Industrial ☐ Drainage ☐ Other ☐

Indicate on the diagram the character and thickness of the different strata met with in drilling, such as soil, clay, shale, gravel, rock or sand, etc. Show depth at which water is encountered, thickness and character of water-bearing strata and height to which the water rises in the well.

Size of Drilled Hole	Size and Weight of Casing	From (Feet)	To (Feet)	PERFORATIONS		
				Kind Size	From (Feet)	To (Feet)
5"	4 1/2 ID 6.75 LB 62 L	Top	13			

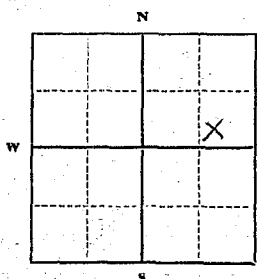
Static Water Level for non-flowing well 24 feet.

Shut-in Pressure for Flowing Well _____

Pumping Water Level 53 feet
at 15 gal. per minute.

Discharge in gal. per min. of flowing well _____

How Tested B.L. 49Length of Test 2 hr.

Remarks: (Gravel packing, cementing, packers, type of shutoff) _____

SE 1/4 NE Sec. 2 T. 28 N. R. 39 E.
Indicate location of well and place of use, if possible. Each small square represents 40 acres.

(Continue on reverse side)

USE—If used for irrigation, industrial, drainage or other. Explain, state number of acres and location or other data (i.e.: Lot, Block and Addition).

Show exact depth of bottom.

This form to be prepared by driller, and three copies to be filed by the owner with the County Clerk and Recorder in the county in which the well is located, tissue copy to be retained by driller.

Please answer all questions. If not applicable, so state, otherwise the form will be returned.

Driller's License Number 46-25Driller's Signature Carl Palm

41710

19675

STATE OF MONTANA, }
County of Valley, } ss.
Filed for record

FEB - 8 1967

at 9:30 o'clock P. M.

Mary Lou Hill
County Recorder

Marilyn Kitzinger Deputy

RECEIVED
SEP 25 1958

STATE ENGINEER

MONTANA BUREAU OF MINES AND GEOLOGY
Butte, Montana

T. 28 N R 39 E

County *Valley*

WATER WELL LOG

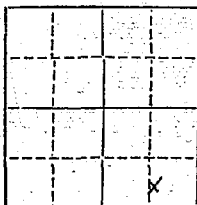

Owner *WILLIAM STAHL* Address *CLASSON*

Driller *Carl Palm* Address *Saco*

Date Started *9/18/58* Date Completed *9/19/58*

Location: Sec. *2* T. *28 N* R. *39 E* *SW 1/4 SE 1/4*

Type of well *S Drilled* Equipment used *Churn*
(Dug, driven, bored, or drilled) (Churn drill, rotary, other)

Water use: Domestic ☒ Municipal ☐ Stock ☐ Irrigation ☐

Industrial ☐

Drainage ☐

Other: _____

Casing: *top* ft. to *45* ft. Type: *2 BLK* Size *4 I.D.*

Casing: _____ ft. to _____ ft. Type _____ Size _____

Casing: _____ ft. to _____ ft. Type _____ Size _____

Perforated or Screened: Ft. _____ to ft. _____ Ft. _____ to ft. _____

Type of screen or perforations _____

Static Water level, for non-flowing well: *20* feet.

Shut-in pressure, for flowing well: _____ lb./sq. in. on: _____ (date)

Pumping water level *22* feet at *5* gal per min.

How tested: *PUMPING*

Length of test: *3 hr.*

Remarks: (Gravel packing, cementing, packers, type of shut-off, depth of shut-off)

(over)

Log of Well

[illegible]

403885

1966

T. 28 N R. 32 E Sec. 2

County Yellow

MONTANA BUREAU OF MINES AND GEOLOGY
Butte, Montana

RECEIVED
2011

WATER WELL LOG

STATE ENGINEER

Owner Byron Tressler & Melvin Lowe Address 6625200

Driller Carl Palm Address Saco

Date Started 8/1/61 Date Completed 8/13/61

Lot 15 of Irvin's Cherry Creek Sub-division
Location: Sec. _____ T. _____ R. _____ 1/4 sec. _____

Type of well Drilled Equipment used Churn
(Dug, driven, bored, or drilled) (Churn drill, rotary, other)

Water use: Domestic ☒ Municipal ☐ Stock ☐ Irrigation ☐

Industrial ☐ Drainage ☐ Other: _____

Casing: Top ft. to 104 ft. Type 5" 7540 626 Size 4 1/2 ID

Casing: _____ ft. to _____ ft. Type _____ Size _____

Casing: _____ ft. to _____ ft. Type _____ Size _____

Perforated or Screened: Ft. _____ to ft. _____ Ft. _____ to ft. _____

Type of screen or perforations _____

Static Water level, for non-flowing well: 30 feet.

Shut-in pressure, for flowing well: _____ lb./sq. in. on: _____ (date)

Pumping water level 40 feet at 1.2 gal. per min.

How tested: PUMPING

Length of test 3 hrs

Remarks: (Gravel packing, cementing, packers, type of shut-off, depth of shut-off)

(over)

Log of Well

STATE OF MONTANA,
County of Valley, } ss.
Filed for record
AUG 21 1961
9:00 o'clock A.M.
Mary Jane Davis
County Recorder
By Pauline Jackson, Deputy

124015

17014

T. 28N R. 24E Sec. 1
County Valley

MONTANA BUREAU OF MINES AND GEOLOGY
Butte, Montana

RECEIVED

WATER WELL LOG
(Orvil H. Hunsch)

STATE ENGINEER

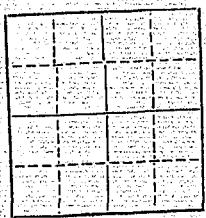

Owner Orvil Hunsch Address Glasgow
Driller Walter Luce Address Glasgow
Date Started Aug 31 Date Completed Sept 5
Location: Sec. T. R. 1/4 sec. Sub. Division

Type of well (Dug, driven, bored, or drilled) Equipment used (Churn drill) rotary, other

Water use: Domestic ☒ Municipal ☐ Stock ☐ Irrigation ☐
Industrial ☐ Drainage ☐ Other:

Casing: gal ft. to ft. Type Size 4 1/4 gal
Casing: ft. to ft. Type Size
Casing: ft. to ft. Type Size

Perforated or Screened: Ft. to ft. Ft. to ft.

Type of screen or perforations

Static Water level, for non-flowing well: 32 ft from top feet.

Shut-in pressure, for flowing well: lb/sq. in. on: (date)

Pumping water level: 02 feet at 15 gal. per min.

How tested: Pumped

Length of test: 2 hrs.

Remarks: (Gravel packing, cementing, packers, type of shut-off, depth of shut-off)

Log of Well

[illegible]

STATE OF MONTANA, } ss.
County of Valley.
Filed for record

1961
F E 1965

at 11:45 o'clock 2 M.

County Recorder

B. J. Vanhook, Deputy

File No.

DUPLICATE

T. 28 N. R. 39 E.
County Valley

STATE OF MONTANA
ADMINISTRATOR OF GROUNDWATER CODE
OFFICE OF STATE ENGINEER

RECORDED
JAN 16 1964

Declaration of Vested Groundwater Rights

(Under Chapter 237, Montana Session Laws, 1961)

Mrs. Gale Billingsley, of Box 746 Glasgow
(Name of Appropriator) (Address) (Town)

County of Valley State of Montana
have appropriated groundwater according to the Montana laws in effect prior to January 1, 1962, as follows:

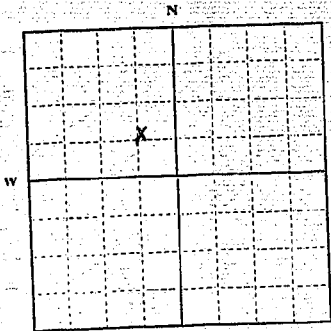

SE NW
1/4 Sec. 3 T. 28 R. 39

Indicate point of appropriation and place of use, if possible. Each small square represents 10 acres.

2. The beneficial use on which the claim is based
Stock Water
3. Date or approximate date of earliest beneficial use; and how continuous the use has been. 1926
Used year around till 1950
Now it is used from Nov. to April
each year
4. The amount of groundwater claimed (in miner's inches or gallons per minute). Eight gallons
5. If used for irrigation, give the acreage and description of the lands to which water has been applied and name of the owner thereof
6. The means of withdrawing such water from the ground and the location of each well or other means of withdrawal.
With a cylinder pump
7. The date of commencement and completion of the construction of the well, wells, or other works for withdrawal of groundwater. 1926
8. The depth of water table. Twenty feet
9. So far as it may be available, the type, size and depth of each well or the general specifications of any other works for the withdrawal of groundwater. drilled well with four inch casing eighty feet deep
10. The estimated amount of groundwater withdrawn each year. 1,296,000 gallons
11. The log of formations encountered in the drilling of each well if available. Not available
12. Such other information of a similar nature as may be useful in carrying out the policy of this act, including reference to book and page of any county record. None

Signature of Owner Mrs. Gale Billingsley
Date Dec. 26, 1963

Three copies to be filed by the owner with the County Clerk and Recorder of the county in which the well is located.

Please answer all questions. If not applicable, so state, otherwise the form will be returned.

Original to the County Clerk and Recorder; Duplicate to the State Engineer; Triplicate to the Montana Bureau of Mines and Geology, and Quadruplicate for the Appropriator.

36833

438762

18218

STATES OF MONTANA, } ss.
County of Valley,

Filed for record

DEC 27 1963

at 1:00 o'clock P.M.
MARY LOU BIDE Clerk & Recorder
Valley County

By _____ Deputy

T. 28 R. 39
County Valley

County Yakima

RECEIVED
DEC 30 1963

STATE ENGINEER

(Under Chapter 237, Montana Session Laws, 1961)

1. PAULINE H. De BRAY, of Box 987 GLASGOW
(Name of Appropriator) (Address) (Town)
County of VALLEY State of MONTANA
have appropriated groundwater according to the Montana laws in effect prior to January 1, 1962, as follows:

A 10x10 grid with a coordinate system. The vertical axis is labeled 'N' at the top and 'S' at the bottom. The horizontal axis is labeled 'W' on the left and 'E' on the right. A point 'X' is marked at the intersection of the 3rd row from the bottom and the 4th column from the left.

~~610, SWSW 1 cor⁸ Acc 3, 28, 39 = 52~~
~~62, 3, NW 1/4 10, 28, 39 = 85~~
 1/4 Sec. T. R.

Indicate point of appropriation and place of use, if possible. Each small square represents 10 acres.

Lot 10, Sec 3
T.28 R.39

2. The beneficial use on which the claim is based House use,
BARNYARD USE, AND STOCK USE
3. Date or approximate date of earliest beneficial use; and how continuous the use has been 1945 It has been
in use every year since 1945
4. The amount of groundwater claimed (in miner's inches or gallons per minute) Not applicable
5. If used for irrigation, give the acreage and description of the lands to which water has been applied and name of the owner thereof
Not used for irrigation
6. The means of withdrawing such water from the ground and the location of each well or other means of withdrawal
Electric motor on pump
- Completion of the construction of the well, wells, or other works for withdrawal of water
Not deep but water is 22 feet from top of ground
- Type, size and depth of each well or the general specifications of any other water
1 inch casings, 1 1/2 inch pipes, and
- Water withdrawn each year { Enough to water: 2 horses,
20 cattle, 150 sheep and also
for house use
- in the drilling of each well if available
own well
- Not applicable
- Nature as may be useful in carrying out the policy of this act, including county record Not recorded anywhere
Walter Luse

Signature of Owner Jacqueline H. DeWet Day

Date December 26, 1963

Three copies to be filed by the owner with the County Clerk and Recorder of the county in which the well is located.

Please answer all questions. If not applicable, so state, otherwise the form will be returned.

Original to the County Clerk and Recorder; duplicate to the State Engineer; Triplicate to the Montana Bureau of Mines and Geology, and Quadruplicate for the Appropriator.

16033

438666

18160

STATE OF MONTANA } ss.
County of Valley.

Filed for Record

DEC 26 1962

11:00 a.m. *2* M.
MARY LOUISE Clark & Recorder
Valley County, Mont.
Pauline Jackson Deputy

File No. _____

DUPLICATE

T. 28 R. 29
County ValleySTATE OF MONTANA
ADMINISTRATOR OF GROUNDWATER CODE
OFFICE OF STATE ENGINEERRECEIVED
AUG 30 1963

Declaration of Vested Groundwater Rights

(Under Chapter 237, Montana Session Laws, 1961)

STATE ENGINEER

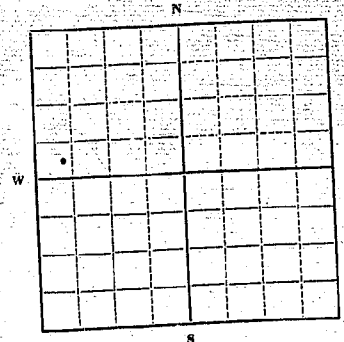
1. JIM G. KAUNTZ of Rte 1-41 Glasgow
(Name of Appropriator) (Address) (Town)
County of Valley State of Montana
have appropriated groundwater according to the Montana laws in effect prior to January 1, 1962, as follows:

NW 1/4 Sec. 3 T. 28 R. 29

Indicate point of appropriation
and place of use, if possible.
Each small square represents 10
acres.

2. The beneficial use on which the claim is based Domestic
Live Stock
3. Date or approximate date of earliest beneficial use; and how continuous the use has been 8-17-59
CONTINUOUS
4. The amount of groundwater claimed (in miner's inches or gallons per minute) Well Tested at 60 G.P.M.
Present Pump Cap. 12 G.P.M.
5. If used for irrigation, give the acreage and description of the lands to which water has been applied and name of the owner thereof
none
6. The means of withdrawing such water from the ground and the location of each well or other means of withdrawal PUMP
7. The date of commencement and completion of the construction of the well, wells, or other works for withdrawal of groundwater Started 8-13-59 Comp. 8-17-59
8. The depth of water table 28 FT.
9. So far as it may be available, the type, size and depth of each well or the general specifications of any other works for the withdrawal of groundwater D. 11111 - 6 in 121 FT.
10. The estimated amount of groundwater withdrawn each year 2,112,400
11. The log of formations encountered in the drilling of each well if available 0-35 Runy silt
35-80 Sandy Blue Clay 80-90 fine sand 90-117 Blue clay
117-121 coarse sand, gravel & water
12. Such other information of a similar nature as may be useful in carrying out the policy of this act, including reference to book and page of any county record unknown

Signature of Owner Jim G. KauntzDate Aug. 29, 1963

Three copies to be filed by the owner with the County Clerk and Recorder of the county in which the well is located.

Please answer all questions. If not applicable, so state, otherwise the form will be returned.

Original to the County Clerk and Recorder; duplicate to the State Engineer; Triplicate to the Montana Bureau of Mines and Geology, and Quadruplicate for the Appropriator.

5620