

File No.

AUG 8 1966

T. 9N R. 12E

DUPLICATE

 Billie _____ McDermott _____
 Buntz _____ McNulty _____
 Coyle _____ Morton _____
 Darlington _____ Sullivan _____
 Dickert _____
County W. Natland

STATE OF MONTANA

ADMINISTRATOR OF GROUNDWATER CODE

OFFICE OF STATE ENGINEER

Top of Ground

354 (Elev. above sea level.....)

Cement Gravel

30

Drain Sandy clay

334

Gray shaleBottom of Hole

Notice of Completion of Groundwater Appropriation by Means of Well

(Under Chapter 237, Montana Session Laws, 1961)

Owner O.C. PICKENS Address TWO DOT, MONTANADriller Albert Heck Address Harlemont frontDate of Notice of Appropriation of Groundwater 7/15/66Date well started 7/7/66 Date Completed 7/15/66
 Type of well Drilled Equipment Used Cable Tool
 (dug, driven, bored or (Churn, drill, rotary or
 drilled) other)

 Water Use: Domestic ☐ Municipal ☐ Other ☐ Irrigation ☐
 Industrial ☐ Drainage ☐ Stock ☒

Indicate on the diagram the character and thickness of the different strata met with in drilling, such as soil, clay, shale, gravel, rock or sand, etc. Show depth at which water is encountered, thickness and character of water-bearing strata and height to which water rises in the well.

Size of Drilled Hole	Size and Weight of Casing	From (Feet)	To (Feet)	PERFORATIONS		
				Kind Size	From (Feet)	To (Feet)
<u>7 1/2"</u>	<u>6" 9.10. Iron 15 lb ft</u>	<u>0</u>	<u>98</u>	<u>3 1/2" x 4"</u>	<u>68</u>	<u>98</u>

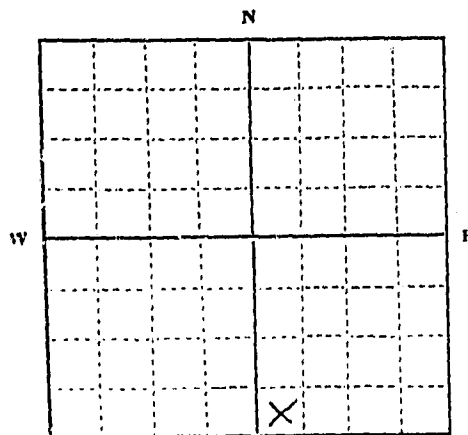

SE 1/4 Sec. 31 T. 9N R. 12E

Indicate location of well and place of use, if possible. Each small square represents 10 acres.

Show exact depth of bottom.

Static Water Level for non-flowing Well 50 feet.Shut-in Pressure for Flowing Well 10 gal/minPumping Water Level 65 feet at 11 gal. per minute.

Discharge in gal. per min. of flowing well _____

How Tested Balor Length of Test 4 Hours

Remarks: (Gravel packing, cementing, packers, type of shutoff, location of place of use of groundwater if not at well, and any other similar pertinent information, including number of acres irrigated, if used for irrigation)

Driller's License Number 114Driller's Signature Albert Heck

This form to be prepared by driller, and three copies to be filed by the owner with the County Clerk and Recorder in the county in which the well is located.

Please answer all questions. If not applicable, so state, otherwise the form will be returned.

Original to the County Clerk and Recorder; duplicate to the State Engineer; Triplicate to the Montana Bureau of Mines and Geology and Quadruplicate for the Appropriator.

RECORDS & CLERK OF THE COUNTY OF WHEATLAND

DEPT. OF REVENUE

STATISTICS

STATE OF MONTANA
COUNTY OF WHEATLAND

you are hereby notified to appear
before me to record your return

Wheatland, Montana

July 27th 1966

72935-

State of Montana, }
County of Wheatland, }

I hereby certify that the within
instrument was filed for record in this
office on the 27th day of

July 1966 at 9:45-

o'clock P.M., and was duly recorded

in Book 8 of Water Rights

Page 347-348

Lucretia Hicks

County Recorder

By Deputy Recorder

Page 1 of 1

County Westland Twp. 9N Rge. 13E

[illegible]

GW 4

FILE No. _____

T 9 N R 13
WHEATLAND COUNTY, MONT.

STATE OF MONTANA
ADMINISTRATOR OF GROUNDWATER CODE
OFFICE OF STATE ENGINEER

RECEIVED
JAN 29 1964

DECLARATION OF VESTED GROUNDWATER RIGHTS
(UNDER CHAPTER 237, MONTANA SESSION LAWS 1961)

1. LULA F. RICE, OF CHILOQUIN, OREGON
(NAME OF APPROPRIATOR) (ADDRESS) (TOWN)
COUNTY OF WHEATLAND, STATE OF MONTANA, HAVE APPROPRIATED GROUNDWATER ACCORD-
ING TO THE MONTANA LAWS IN EFFECT PRIOR TO JANUARY 1, 1962, AS FOLLOWS:

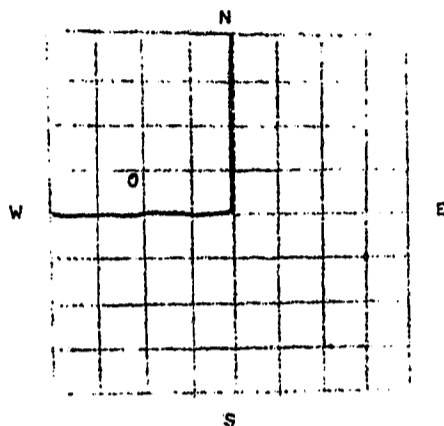

NW 1/4 SEC 5 T 9 R 13

INDICATE POINT OF APPROPRIATION
AND PLACE OF USE, IF POSSIBLE.
EACH SMALL SQUARE REPRESENTS 10
ACRES.

2. THE BENEFICIAL USE ON WHICH THE CLAIM IS
BASED Stock and Domestic

3. DATE OR APPROXIMATE DATE OF EARLIEST BENE-
FICIAL USE; AND HOW CONTINUOUS THE USE HAS BEEN:
1850 - Continuous use

4. THE AMOUNT OF GROUNDWATER CLAIMED (IN MINER
INCHES OR GALLONS PER MINUTE)
600 gallons per minute

5. IF USED FOR IRRIGATION, GIVE THE ACREAGE
AND DESCRIPTION OF THE LANDS TO WHICH WATER HAS
BEEN APPLIED AND NAME OF THE OWNER THEREOF _____

6. THE MEANS OF WITHDRAWING SUCH WATER FROM THE GROUND AND THE LOCATION OF
EACH WELL OR OTHER MEANS OF WITHDRAWAL
spring - natural flow

7. THE DATE OF COMMENCEMENT AND COMPLETION OF THE CONSTRUCTION OF THE WELL,
WELLS, OR OTHER WORKS FOR WITHDRAWAL OF GROUNDWATER
spring improved - concrete box constructed 1890

8. DEPTH OF WATER TABLE spring - natural flow

9. SO FAR AS IT MAY BE AVAILABLE, THE TYPE, SIZE AND DEPTH OF EACH WELL OR
THE GENERAL SPECIFICATIONS OF ANY OTHER WORKS FOR THE WITHDRAWAL OF GROUND-
WATER _____

10. THE ESTIMATED AMOUNT OF GROUNDWATER WITHDRAWN EACH YEAR
sufficient for 2,000 sheep and 200 head of cattle

11. THE LOG OF FORMATIONS ENCOUNTERED IN THE DRILLING OF EACH WELL IF AVAIL-
ABLE spring - natural flow

12. SUCH OTHER INFORMATION OF A SIMILAR NATURE AS MAY BE USEFUL IN CARRYING
OUT THE POLICY OF THIS ACT, INCLUDING REFERENCE PAGE OF COUNTY RECORDS AND
BOOK NUMBER _____

Oregon
STATE OF MONTANA)

SIGNATURE OF OWNER Lula F. Rice
DATE Dec 3, 1963

: ss.

COUNTY OF ~~WHEATLAND~~

LULA F. RICE HAVING FIRST BEEN DULY SWORN, DEPOSES
AND SAYS THAT SHE (IS, ARE) OF LAWFUL AGE AND (IS ARE) THE APPROPRIATOR
AND CLAIMANT OF THE ORDER AND WATER RIGHT MENTIONED IN THE FOREGOING
DECLARATION OF VESTED GROUNDWATER RIGHTS AND THE PERSON WHOSE NAME IS
SUBSCRIBED THERETO, AS THE APPROPRIATOR AND CLAIMANT, THAT SHE
KNOWS THE CONTENTS OF SAID FOREGOING NOTICE AND THAT THE MATTERS AND
THINGS THEREIN STATED ARE TRUE.

SUBSCRIBED AND SWORN TO BEFORE ME, THIS 3rd DAY OF December 1963

Frank W. Chisum
NOTARY PUBLIC FOR THE STATE OF MONTANA
RESIDING AT Chiloquin, Oregon
MY COMMISSION EXPIRES April 19, 1965

(FILE THREE COPIES OF THIS REPORT WITH THE COUNTY CLERK AND RECORDER, RE-
TAIN THE 4th COPY FOR YOUR FILES.)

34351

70257

State of Montana ss.
County of Wheatland

I hereby certify that the within
instrument was filed of record in this

office on the 6th

day of June 1963 at 2:32

o'clock P. M.

in Book 15 of

Page 469

Water Rights

Lucretia Hicks
County Recorder

Deputy Recorder

GW 4

FILE NO. _____

T 9 N R 13
WHEATLAND COUNTY, MONTSTATE OF MONTANA
ADMINISTRATOR OF GROUNDWATER CODE
OFFICE OF STATE ENGINEER

JAN 29 1964

DECLARATION OF VESTED GROUNDWATER RIGHTS
(UNDER CHAPTER 237, MONTANA SESSION LAWS, 1961) ENGINEER

1. OSCAR HAGBERG, LEASEE, OF NARLINGTON, MONTANA
(NAME OF APPROPRIATOR) (ADDRESS) (TOWN)
COUNTY OF WHEATLAND, STATE OF MONTANA, HAVE APPROPRIATED GROUNDWATER ACCORD-
ING TO THE MONTANA LAWS IN EFFECT PRIOR TO JANUARY 1, 1962, AS FOLLOWS:

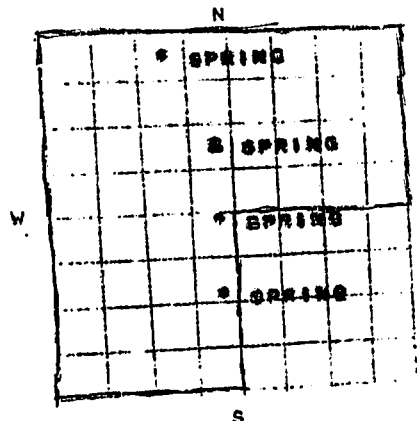

2. THE BENEFICIAL USE ON WHICH THE CLAIM IS
BASED STOCK AND DOMESTIC

3. DATE OR APPROXIMATE DATE OF EARLIEST BENE-
FICIAL USE; AND HOW CONTINUOUS THE USE HAS BEEN
1959

4. THE AMOUNT OF GROUNDWATER CLAIMED (IN MINER
INCHES OR GALLONS PER MINUTE
APPROXIMATELY 100 MINERS INCHES PER MINUTE

5. IF USED FOR IRRIGATION, GIVE THE ACREAGE
AND DESCRIPTION OF THE LANDS TO WHICH WATER HAS
BEEN APPLIED AND NAME OF THE OWNER THEREOF _____

1/4 Sec 6 T.9 R.13
INDICATE POINT OF APPROPRIATION
AND PLACE OF USE, IF POSSIBLE.
EACH SMALL SQUARE REPRESENTS 10
ACRES.

6. THE MEANS OF WITHDRAWING SUCH WATER FROM THE GROUND AND THE LOCATION OF
EACH WELL OR OTHER MEANS OF WITHDRAWAL all NATURAL FLOW - SPRINGS
near and in Iron Springs Creek

7. THE DATE OF COMMENCEMENT AND COMPLETION OF THE CONSTRUCTION OF THE WELL,
WELLS, OR OTHER WORKS FOR WITHDRAWAL OF GROUNDWATER _____

8. DEPTH OF WATER TABLE UNKNOWN

9. SO FAR AS IT MAY BE AVAILABLE, THE TYPE, SIZE AND DEPTH OF EACH WELL OR
THE GENERAL SPECIFICATIONS OF ANY OTHER WORKS FOR THE WITHDRAWAL OF GROUND-
WATER _____

10. THE ESTIMATED AMOUNT OF GROUNDWATER WITHDRAWN EACH YEAR
all NATURAL FLOW - SPRINGS

11. THE LOG OF FORMATIONS ENCOUNTERED IN THE DRILLING OF EACH WELL IF AVAIL-
ABLE NONE

12. SUCH OTHER INFORMATION OF A SIMILAR NATURE AS MAY BE USEFUL IN CARRYING
OUT THE POLICY OF THIS ACT, INCLUDING REFERENCE PAGE OF COUNTY RECORDS AND
BOOK NUMBER _____

SIGNATURE OF OWNER Oscar Hagberg-lessee
DATE DECEMBER 27th, 1963
STATE OF MONTANA)
: SS.

COUNTY OF WHEATLAND)
OSCAR HAGBERG - LEASEE

HAVING FIRST BEEN DULY SWORN, DEPOSE
AND SAYS THAT HE (IS, ARE,) OF LAWFUL AGE AND (IS ARE) THE APPROPRIATOR
AND CLAIMANT OF THE ORDER AND WATER RIGHT MENTIONED IN THE FOREGOING
DECLARATION OF VESTED GROUNDWATER RIGHTS AND THE PERSON WHOSE NAME
SUBSCRIBED THERETO, AS THE APPROPRIATOR AND CLAIMANT, THAT HE
KNOW THE CONTENTS OF SAID FOREGOING NOTICE AND THAT THE MATTERS AND
THINGS THEREIN STATED ARE TRUE.

SUBSCRIBED AND SWORN TO BEFORE ME, THIS 27th DAY OF Dec 1963

Lucenia Hicks Coolick
NOTARY PUBLIC FOR THE STATE OF MONTANA
RESIDING AT _____
MY COMMISSION EXPIRES _____

(FILE THREE COPIES OF THIS REPORT WITH THE COUNTY CLERK AND RECORDER, RE-
TAIN THE 4th COPY FOR YOUR FILES.)

34463

70416

State of Montana, } ss.
County of Wheatland.

I hereby certify that the within
instrument was filed for record in this
office on the 27th day of

Dec 63 at 11:55

o'clock A.M., and was duly recorded,

In Book 15 of

Page 607

Lucretia Hicks
County Recorder

37

Deputy Recorder

GW 4

File No. _____

T 9N R 13E
WHEATLAND COUNTY, MONT.

STATE OF MONTANA
ADMINISTRATOR OF GROUNDWATER CODE
OFFICE OF STATE ENGINEER

JAN 29 1964

DECLARATION OF VESTED GROUNDWATER RIGHTS
(UNDER CHAPTER 237, MONTANA SESSION LAWS, 1961)

1. MRS. LULA F. RICE, OF CHILLOQUIN, OREGON
(NAME OF APPROPRIATOR) (ADDRESS) (TOWN)
COUNTY OF WHEATLAND, STATE OF MONTANA, HAVE APPROPRIATED GROUNDWATER ACCORD-
ING TO THE MONTANA LAWS IN EFFECT PRIOR TO JANUARY 1, 1962, AS FOLLOWS:

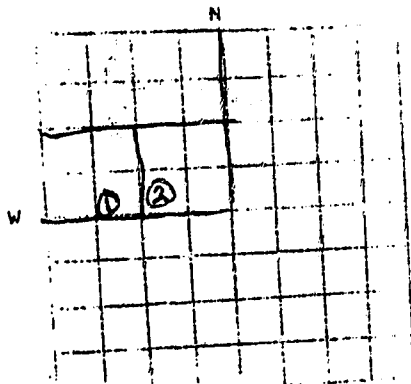

2. THE BENEFICIAL USE ON WHICH THE CLAIM IS
BASED Stock Water
Two (2) Springs

3. DATE OR APPROXIMATE DATE OF EARLIEST BENE-
FICIAL USE; AND HOW CONTINUOUS THE USE HAS BEEN
1875 - Continuous

4. THE AMOUNT OF GROUNDWATER CLAIMED (IN MINER
INCHES OR GALLONS PER MINUTE)
Springs - Natural Flow

5. IF USED FOR IRRIGATION, GIVE THE ACREAGE
AND DESCRIPTION OF THE LANDS TO WHICH WATER HAS
BEEN APPLIED AND NAME OF THE OWNER THEREOF _____

SW 1/4 NW 1/4 - Well #1 s
Well #2 SE 1/4 NW 1/4 Sec 8 T 9N R 13E

INDICATE POINT OF APPROPRIATION
AND PLACE OF USE, IF POSSIBLE.
EACH SMALL SQUARE REPRESENTS 10
ACRES.

6. THE MEANS OF WITHDRAWING SUCH WATER FROM THE GROUND AND THE LOCATION OF
EACH WELL OR OTHER MEANS OF WITHDRAWAL Springs - Natural Flow

7. THE DATE OF COMMENCEMENT AND COMPLETION OF THE CONSTRUCTION OF THE WELL,
WELLS, OR OTHER WORKS FOR WITHDRAWAL OF GROUNDWATER 1875
Springs - Natural Flow

8. DEPTH OF WATER TABLE Natural Flow

9. SO FAR AS IT MAY BE AVAILABLE, THE TYPE, SIZE AND DEPTH OF EACH WELL OR
THE GENERAL SPECIFICATIONS OF ANY OTHER WORKS FOR THE WITHDRAWAL OF GROUND-
WATER Springs - Natural Flow

10. THE ESTIMATED AMOUNT OF GROUNDWATER WITHDRAWN EACH YEAR sufficient
to water 200 head of cattle - 2,000 head of sheep

11. THE LOG OF FORMATIONS ENCOUNTERED IN THE DRILLING OF EACH WELL IF AVAIL-
ABLE _____

12. SUCH OTHER INFORMATION OF A SIMILAR NATURE AS MAY BE USEFUL IN CARRYING
OUT THE POLICY OF THIS ACT, INCLUDING REFERENCE PAGE OF COUNTY RECORDS AND
BOOK NUMBER _____

SIGNATURE OF OWNER Mrs. Lula F. Rice
DATE Dec. 19, 1963

STATE OF OREGON)
KLAMATH)
COUNTY KLAMATH)
SS. MRS. LULA F. RICE

HAVING FIRST BEEN DULY SWORN, DEPOSES
AND SAYS THAT SHE (IS, WAS) OF LAWFUL AGE AND (IS, WAS) THE APPROPRIATOR
AND CLAIMANT OF THE ORDER AND WATER RIGHT MENTIONED IN THE FOREGOING
DECLARATION OF VESTED GROUNDWATER RIGHTS AND THE PERSON WHOSE NAME IS
SUBSCRIBED THERETO, AS THE APPROPRIATOR AND CLAIMANT, THAT SHE
KNOW S THE CONTENTS OF SAID FOREGOING NOTICE AND THAT THE MATTERS AND
THINGS THEREIN STATED ARE TRUE.

SUBSCRIBED AND SWORN TO BEFORE ME, THIS 23rd DAY OF December 1963

Mark W. Olson
NOTARY PUBLIC FOR THE STATE OF MONTANA
RESIDING AT Chiloquin, Oregon
MY COMMISSION EXPIRES April 19, 1965

(FILE THREE COPIES OF THIS REPORT WITH THE COUNTY CLERK AND RECORDER, RE-
TAIN THE 4th COPY FOR YOUR FILES.)

34446

70399

State of Montana, } ss.
County of Wheatland.

I hereby certify that the within
instrument was filed for record in this

office on the 26th day of

Sept 19 63 9:58

o'clock P. M., and was duly recorded

in Book 15 of Water Rights

Page 580

Lucretia Niels
County Recorder

Deputy Recorder

File No. 73196

STATE WATER CONSERVATION BOARD

T. 9N R. 13E

DUPLICATE

JAN 9 1967

County Heatland

STATE OF MONTANA
 ADMINISTRATOR OF GROUNDWATER CODE
 OFFICE OF STATE ENGINEER

Billie _____
 Butzerin _____
 Coyle _____
 Darlington _____
 Dickert _____

Notice of Completion of Groundwater Appropriation by Means of Well

(Under Chapter 237, Montana Session Laws, 1961)

Top of Ground
 (Elev. above sea level)
10 ft Brown sand
15 ft Brown clay
10 ft Light gray shale

Owner _____ Address _____
 Driller Albert Heck Address Harlowton Montana

Date of Notice of Appropriation of Groundwater _____

Date well started 11/25 Date Completed 12/2

Type of well Drilled Equipment Used Cable Tool
 (dug, driven, bored or (Churn, drill, rotary or
 drilled) other)

Water Use: Domestic ☐ Municipal ☐ Other ☐ Irrigation ☐
 Industrial ☐ Drainage ☐ Stock ☒

Indicate on the diagram the character and thickness of the different strata met with in drilling, such as soil, clay, shale, gravel, rock or sand, etc. Show depth at which water is encountered, thickness and character of water-bearing strata and height to which water rises in the well.

Size of Drilled Hole	Size and Weight of Casing	From (Feet)	To (Feet)	PERFORATIONS		
<u>7 1/2"</u>	<u>Iron casing 6 1/2" I.D. 13 lb ft</u>	<u>0</u>	<u>145 ft</u>	Kind Size <u>4x3</u>	From (Feet) <u>115</u>	To (Feet) <u>145</u>
				<u>3 in</u>		

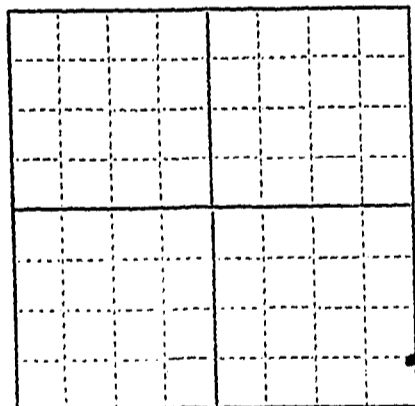

89 1/4 Sec. 10 T. 9N R. 13E

Indicate location of well and place of use, if possible. Each small square represents 10 acres.

Show exact depth of bottom.

Static Water Level for non-flowing Well 115 feet.

Shut-in Pressure for Flowing Well _____

Pumping Water Level 115 feet at 15 gal. per minute.

Discharge in gal. per min. of flowing well _____

How Tested Balor Length of Test 3 Hours

Remarks: (Gravel packing, cementing, packers, type of shutoff, location of place of use of groundwater if not at well, and any other similar pertinent information, including number of acres irrigated, if used for irrigation)

Driller's License Number 114

Albert Heck
 Driller's Signature

This form to be prepared by driller, and three copies to be filed by the owner with the County Clerk and Recorder in the county in which the well is located.

Please answer all questions. If not applicable, so state, otherwise the form will be returned.

Original to the County Clerk and Recorder; duplicate to the State Engineer; Triplicate to the Montana Bureau of Mines and Geology and Quadruplicate for the Appropriator.

41618

73196

State of Montana, } ss.
County of Wheatland.

I hereby certify that the within
instrument was filed for record in this

office on the 30th day of
December 19 66 at 2:50

o'clock P M., and was duly recorded
in Book 82 of Water Rights
Page 355-356

Lucretia Hicks
County Recorder

By Deputy Recorder

Fee \$4.00

File No. 73197

JAN 9 1967

T. 9N R. 13E

DUPLICATE

Sille _____ McDermott _____
 Butzerin _____ Martelly _____
 Coyle _____ Martelly _____
 Darlington _____ Sullivan _____
 Dickert _____

County Wheatland

STATE OF MONTANA
 ADMINISTRATOR OF GROUNDWATER CODE
 OFFICE OF STATE ENGINEER

Notice of Completion of Groundwater
 Appropriation by Means of Well

(Under Chapter 237, Montana Session Laws, 1961)

Owner _____ Address _____

Driller Albert Heck Address Harlow, Montana

Date of Notice of Appropriation of Groundwater _____

Date well started 12/14 Date Completed 1/2/68

Type of well Drilled Equipment Used Cable Tool
 (dug, driven, bored or (Churn, drill, rotary or
 drilled) other)

Water Use: Domestic ☐ Municipal ☐ Other ☐ Irrigation ☐
 Industrial ☐ Drainage ☐ Stock ☒

Indicate on the diagram the character and thickness of the different strata met with in drilling, such as soil, clay, shale, gravel, rock or sand, etc. Show depth at which water is encountered, thickness and character of water-bearing strata and height to which water rises in the well.

Size of Drilled Hole	Size and Weight of Casing	From (Feet)	To (Feet)	PERFORATIONS		
				Kind Size	From (Feet)	To (Feet)
<u>7 1/2"</u>	<u>6" 11.5 lb</u> <u>13 lb ft</u> <u>Iron</u>	<u>0</u>	<u>110</u>	<u>5.5 inch 1 1/4</u> <u>3 x 1/4</u>	<u>80</u>	<u>110</u>

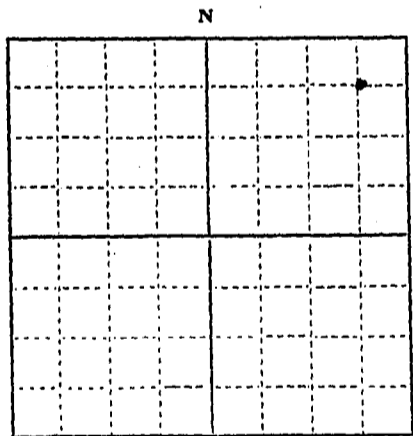

N 1/4 Sec. 23 T. 9N R. 13E
 Indicate location of well and place of use, if possible. Each small square represents 10 acres.

Show exact depth of bottom.

Static Water Level for non-flowing Well _____ feet.

Shut-in Pressure for Flowing Well _____

Pumping Water Level _____ feet at _____ gal. per minute.

Discharge in gal. per min. of flowing well _____

How Tested Balance Length of Test 3 Hours

Remarks: (Gravel packing, cementing, packers, type of shutoff, location of place of use of groundwater if not at well, and any other similar pertinent information, including number of acres irrigated, if used for irrigation) _____

Driller's License Number 114Driller's Signature Albert Heck

This form to be prepared by driller, and three copies to be filed by the owner with the County Clerk and Recorder in the county in which the well is located.

Please answer all questions. If not applicable, so state, otherwise the form will be returned.

Original to the County Clerk and Recorder; duplicate to the State Engineer; Triplicate to the Montana Bureau of Mines and Geology and Quadruplicate for the Appropriator.

41619

73197

State of Montana, }
County of Wheatland } ss.

I hereby certify that the within
instrument was filed for record in this

office on the 30th day of

December 1966 at 2:55-

o'clock M., and was duly

in Book 82 of Water Rights

Page 357-358

Lucretia Hicks
County Recorder

By _____
Deputy Recorder

Fee \$4.00

GW 4
FILE NO. _____

T 9 N R 13E
WHEATLAND COUNTY

STATE OF MONTANA
ADMINISTRATOR OF GROUNDWATER CODE
OFFICE OF STATE ENGINEER

RECEIVED
JAN 29 1964

DECLARATION OF VESTED GROUNDWATER RIGHTS
(UNDER CHAPTER 237, MONTANA SESSION LAWS, 1961)

1. Muir Ranch Company, OF Box 156 - Harlowton, Montana
(NAME OF APPROPRIATOR) (ADDRESS) (TOWN)
COUNTY OF WHEATLAND, STATE OF MONTANA, HAVE APPROPRIATED GROUNDWATER ACCORD-
ING TO THE MONTANA LAWS IN EFFECT PRIOR TO JANUARY 1, 1962, AS FOLLOWS:

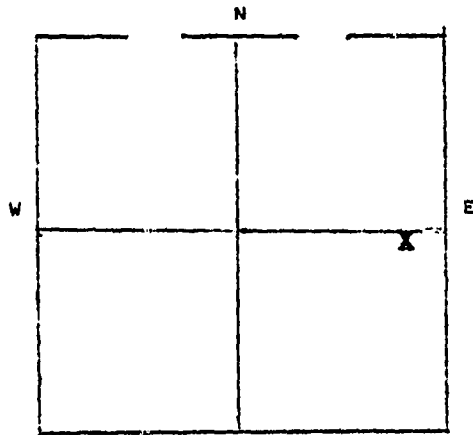

SEC 24 T 9N R 13E
INDICATE APPROPRIATION

2. THE BENEFICIAL USE ON WHICH THE CLAIM IS
BASED livestock water (spring)

3. DATE OR APPROXIMATE DATE OF EARLIEST
BENEFICIAL USE; AND HOW CONTINUOUS THE USE
HAS BEEN. _____

4. THE AMOUNT OF GROUNDWATER CLAIMED (IN
MINER INCHES OR GALLONS PER MINUTE 15 gal.

5. IF USED FOR IRRIGATION, GIVE THE ACREAGE
AND DESCRIPTION OF THE LANDS TO WHICH WATER
HAS BEEN APPLIED AND NAME OF THE OWNER THERE
OF no

6. THE MEANS OF WITHDRAWING SUCH WATER FROM THE GROUND AND THE LOCATION OF
EACH WELL OR OTHER MEANS OF WITHDRAWAL natural flow

7. THE DATE OF COMMENCEMENT AND THE COMPLETION OF THE CONSTRUCTION OF THE
WELL, WELLS, OR OTHER WORKS FOR WITHDRAWAL OF GROUNDWATER unknown

8. DEPTH OF WATER TABLE _____

9. SO FAR AS IT MAY BE AVAILABLE, THE TYPE, SIZE AND DEPTH OF EACH WELL OR
THE GENERAL SPECIFICATIONS OF ANY OTHER WORKS FOR THE WITHDRAWAL OF GROUND-
WATER _____

10. THE ESTIMATED AMOUNT OF GROUNDWATER WITHDRAWN EACH YEAR unlimited

11. THE LOG OF FORMATIONS ENCOUNTERED IN THE DRILLING OF EACH WELL IF AVAIL-
ABLE _____

12. SUCH OTHER INFORMATION OF A SIMILAR NATURE AS MAY BE USEFUL IN CARRYING
OUT THE POLICY OF THIS ACT, INCLUDING REFERENCE PAGE OF COUNTY RECORDS AND
BOOK NUMBER _____

SIGNATURE OF OWNER Muir Ranch Company
By: Nick Muir
DATE December 27, 1963

STATE OF MONTANA } ss.
COUNTY OF WHEATLAND }
Muir Ranch Company

HAVING FIRST BEEN DULY SWORN, DEPOSES
AND SAYS THAT HE (IS, ARE,) OF LAWFUL AGE AND (IS, ARE) THE APPROPRIATOR AND CLAIMANT OF THE ORDER AND WATER RIGHT MENTIONED IN THE FOREGOING
DECLARATION OF VESTED GROUNDWATER RIGHTS AND THE PERSON WHOSE NAMES are
SUBSCRIBED THE ETO, AS THE APPROPRIATOR AND CLAIMANT, THAT HE
KNOW THE CONTENTS OF SAID FOREGOING NOTICE AND THAT THE MATTERS AND THINGS
THEREIN STATED ARE TRUE.

Muir Ranch Company
By: Nick Muir

SUBSCRIBED AND SWORN TO BEFORE ME, THIS 27th DAY OF December, 19 63

70460

Marian Langston
NOTARY PUBLIC FOR THE STATE OF MONTANA
RESIDING AT Harlowton, Montana
MY COMMISSION EXPIRES September 3, 1966

FILED FOR RECORD ON THE 30 DAY OF Dec, 19 63 AT 1:25
O'CLOCK P M., AND RECORDED IN BOOK 1582, PAGES 3
RECORDS OF WHEATLAND COUNTY, MONTANA.

34499

GW 2

File No.

DUPLICATE

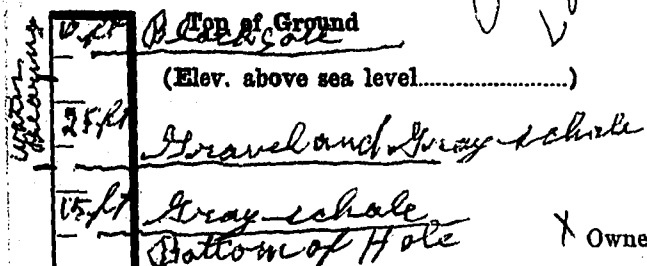

RECEIVED

FEB 28 1964

County *Wheatland*STATE OF MONTANA
ADMINISTRATOR OF GROUNDWATER CODE
OFFICE OF STATE ENGINEER

Notice of Completion of Groundwater Appropriation by Means of Well

(Under Chapter 237, Montana Session Laws, 1961)

Owner *W.C. Perkins* Address *2007 Del. Union Town*
Driller *Albert Heck* Address *Harlemont Mont*

Date of Notice of Appropriation of Groundwater.....

Date well started *8/18*Date Completed *8/19*

Type of well *Drilled*
(dug, driven, bored or drilled)

Equipment Used *Cable Tool*
(Churn, drill, rotary or other)

Water Use: Domestic ☐ Municipal ☐ Other ☐ Irrigation ☐
Industrial ☐ Drainage ☐ Stock ☒

Indicate on the diagram the character and thickness of the different strata met with in drilling, such as soil, clay, shale, gravel, rock or sand, etc. Show depth at which water is encountered, thickness and character of water-bearing strata and height to which water rises in the well.

Size of Drilled Hole	Size and Weight of Casing	From (Feet)	To (Feet)	PERFORATIONS		
				Kind Size	From (Feet)	To (Feet)
				<i>1/2" x 4 1/2"</i>	<i>10</i>	<i>30</i>

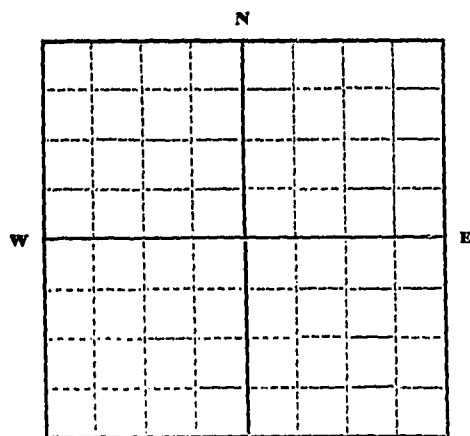

1/4 Sec. *30* T. *9* R. *13*
Indicate location of well and place of use, if possible. Each small square represents 10 acres.

Show exact depth of bottom.

Static Water Level for non-flowing Well..... *10* feet.

Shut-in Pressure for Flowing Well.....

Pumping Water Level..... *30* feet at..... *30* gal. per minute.

Discharge in gal. per min. of flowing well.....

How Tested *Baker* Length of Test *3 Hours*

Remarks: (Gravel packing, cementing, packers, type of shutoff, location of place of use of groundwater if not at well, and any other similar pertinent information, including number of acres irrigated, if used for irrigation).....

Driller's License Number *114*Driller's Signature *Albert Heck*Driller's Signature *Albert Heck*

This form to be prepared by driller, and three copies to be filed by the owner with the County Clerk and Recorder in the county in which the well is located.

Please answer all questions. If not applicable, so state, otherwise the form will be returned.

Original to the County Clerk and Recorder; duplicate to the State Engineer; Triplicate to the Montana Bureau of Mines and Geology and Quadruplicate for the Appropriator.

34348

70252

STATE OF MONTANA
COUNTY OF WHEATLAND

NOTARIAL PUBLIC
My Comm. Expires 12/31/64

State of Montana, }
County of Wheatland, } ss.

I hereby certify that the within
instrument was filed for record in this

5th

day of

Dec

1963 at 1:40

In Book

15

Page

463-464

Water Rights

Lucretia Hicks

County Recorder

Deputy Recorder

File No.

CORRECTS Book 15 page 465

T. 9N R. 13E

QUADRUPLICATE

County Missoula

Top Gray Soil

STATE OF MONTANA

ADMINISTRATOR OF GROUNDWATER CODE

OFFICE OF STATE ENGINEER

AUG 3 1964

Top of Ground

CORRECTED

(Elev. above sea level.....)

Cement Gravel

Notice of Completion of Groundwater Appropriation by Means of Well

(Under Chapter 237, Montana Session Laws, 1961)

Tower

Owner W. C. PickensAddress 2000 Fidelity UnionDriller Albert HeckAddress Harlowton, Montana

Date of Notice of Appropriation of Groundwater.....

Date well started 9/22/63Date Completed 9/26/63Type of well Drilled
(dug, driven, bored or drilled)Equipment Used Cable
(Churn, drill, rotary or other)Water Use: Domestic ☐Municipal ☐Other ☐Irrigation ☐Industrial ☐Drainage ☐Stock ☒

Indicate on the diagram the character and thickness of the different strata met with in drilling, such as soil, clay, shale, gravel, rock or sand, etc. Show depth at which water is encountered, thickness and character of water-bearing strata and height to which water rises in the well.

Size of Drilled Hole	Size and Weight of Casing	From (Feet)	To (Feet)	PERFORATIONS		
				Kind Size	From (Feet)	To (Feet)
7 1/2"	6"	1	61 1/2'	4x1 1/2"	2	61 1/2'

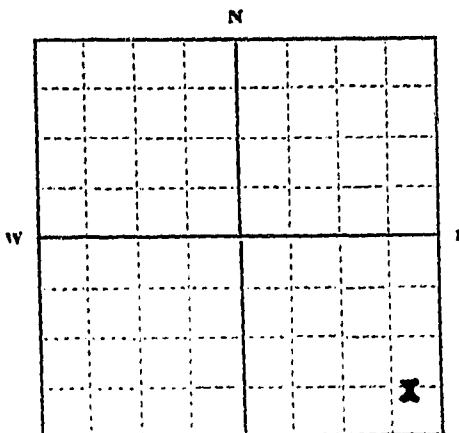

52 1/4 Sec. 33S 9N 13E

Indicate location of well and place of use, if possible. Each small square represents 10 acres.

Show exact depth of bottom.

Static Water Level for non-flowing Well 20 feet.

Shut-in Pressure for Flowing Well.....

Pumping Water Level 50 feet at 8 gal. per minute.

Discharge in gal. per min. of flowing well.....

How Tested Baler Length of Test Hours

Remarks: (Gravel packing, cementing, packers, type of shutoff, location of place of use of groundwater if not at well, and any other similar pertinent information, including number of acres irrigated, if used for irrigation).....

Driller's License Number

Albert Heck

Driller's Signature

This form to be prepared by driller, and three copies to be filed by the owner with the County Clerk and Recorder in the county in which the well is located.

Please answer all questions. If not applicable, so state, otherwise the form will be returned.

Original to the County Clerk and Recorder; duplicate to the State Engineer; Triplicate to the Montana Bureau of Mines and Geology and Quadruplicate for the Appropriator.

38348

State of Montana,
County of Wheatland. } ss.

I hereby certify that the within
instrument was filed for record in this

office on the 20th day of
July 13th at 11:05
o'clock A.M., and was duly recorded
in Book 82 of Water Right
Page 281-282

Lucretia L. Lusk
County Recorder

By Fer #00
Jack Walker
Woodstock, Mont
Deputy Recorder

File No. 73198

STATE WATER CONSERVATION BOARD

JAN 9 1967

T. 9N R. 13E

DUPLICATE

County Wheatland

State of Montana
 ADMINISTRATOR OF GROUNDWATER CODE
 OFFICE OF STATE ENGINEER

Top of Ground

(Elev. above sea level.....)

Notice of Completion of Groundwater Appropriation by Means of Well

(Under Chapter 237, Montana Session Laws, 1961)

40ft Brown clay
 10ft Brown sand Rock
 70ft Brown clay
 110ft Brown sand Rock
 110ft Bottom of Hole

Owner..... Address.....
 Driller Wilbert Heck Address Harborton Montana

Date of Notice of Appropriation of Groundwater.....

Date well started 12/24 Date Completed 12/24

Type of well Drilled Equipment Used Cable Tool
 (dug, driven, bored or drilled) (Churn, drill, rotary or other)

Water Use: Domestic ☐ Municipal ☐ Other ☐ Irrigation ☐
 Industrial ☐ Drainage ☐ Stock ☒

Indicate on the diagram the character and thickness of the different strata met with in drilling, such as soil, clay, shale, gravel, rock or sand, etc. Show depth at which water is encountered, thickness and character of water-bearing strata and height to which water rises in the well.

Size of Drilled Hole	Size and Weight of Casing	From (Feet)	To (Feet)	PERFORATIONS		
				Kind Size	From (Feet)	To (Feet)
<u>7 1/4"</u>	<u>6" 22 lb</u>	<u>0</u>	<u>110</u>	<u>8" 22 lb</u>	<u>8</u>	<u>110</u>

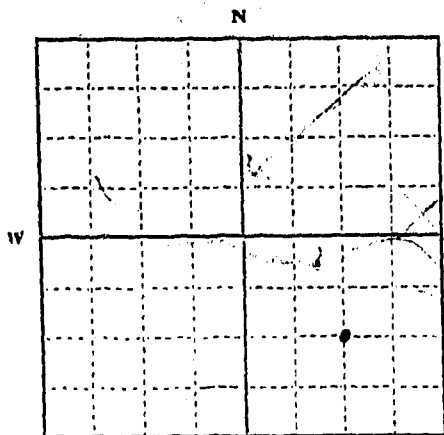

NE 1/4 Sec 35 T. 9. R. 13E
 Indicate location of well and place of use, if possible. Each small square represents 10 acres.

Show exact depth of bottom.

Static Water Level for non-flowing Well..... 0 feet.

Shut-in Pressure for Flowing Well.....

Pumping Water Level..... 8.0 feet at..... 8 gal. per minute.

Discharge in gal. per min. of flowing well.....

How Tested Water Length of Test 3 Hours

Remarks: (Gravel packing, cementing, packers, type of shutoff, location of place of use of groundwater if not at well, and any other similar pertinent information, including number of acres irrigated, if used for irrigation).....

Driller's License Number 114Driller's Signature Wilbert Heck

This form to be prepared by driller, and three copies to be filed by the owner with the County Clerk and Recorder in the county in which the well is located.

Please answer all questions. If not applicable, so state, otherwise the form will be returned.

Original to the County Clerk and Recorder; duplicate to the State Engineer; Triplicate to the Montana Bureau of Mines and Geology and Quadruplicate for the Appropriator.

41620

73198

State of Montana, }
County of Wheatland. } ss.

I hereby certify that the within
instrument was filed for record in this

office on the 30th day of

December 19 66 at 3:00

o'clock P. M., and was filed

in Book 82 of Water Rights

Page 359-360

Lucetia Hicks
County Recorder

Fee \$4.00 Deputy Recorder

GROUNDWATER INDEX

Page 1 of 7

County Wheatland Twp. 9N Rge. 14E

[illegible]

GW 4

FILE NO. _____

T 9N R 14E

WHEATLAND COUNTY, MONT

STATE OF MONTANA
ADMINISTRATOR OF GROUNDWATER CODE
OFFICE OF STATE ENGINEER

RECEIVED
JAN 29 1964

DECLARATION OF VESTED GROUNDWATER RIGHTS
(UNDER CHAPTER 237, MONTANA SESSION LAW 1961) ENGINEER

1. NELS NELSON, OF HARLOWTON, MONTANA
(NAME OF APPROPRIATOR) (ADDRESS) (TOWN)
COUNTY OF WHEATLAND, STATE OF MONTANA, HAVE APPROPRIATED GROUNDWATER ACCORD-
ING TO THE MONTANA LAWS IN EFFECT PRIOR TO JANUARY 1, 1962, AS FOLLOWS:

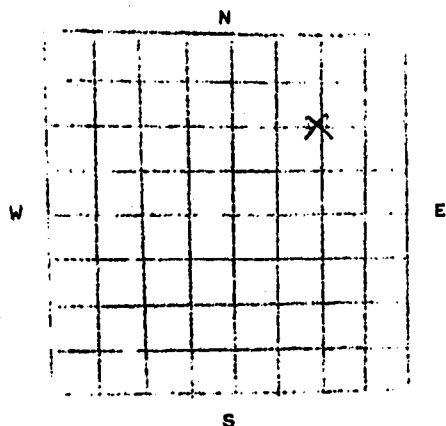

NE 1/4 SEC 12 9N R14E

INDICATE POINT OF APPROPRIATION
AND PLACE OF USE, IF POSSIBLE.
EACH SMALL SQUARE REPRESENTS 10
ACRES.

2. THE BENEFICIAL USE ON WHICH THE CLAIM IS
BASED Stock Water

3. DATE OR APPROXIMATE DATE OF EARLIEST BENE-
FICIAL USE; AND HOW CONTINUOUS THE USE HAS BEEN
1957

4. THE AMOUNT OF GROUNDWATER CLAIMED (IN MINER
INCHES OR GALLONS PER MINUTE
Three (3) gallons per minute

5. IF USED FOR IRRIGATION, GIVE THE ACREAGE
AND DESCRIPTION OF THE LANDS TO WHICH WATER HAS
BEEN APPLIED AND NAME OF THE OWNER THEREOF _____

6. THE MEANS OF WITHDRAWING SUCH WATER FROM THE GROUND AND THE LOCATION OF
EACH WELL OR OTHER MEANS OF WITHDRAWAL Electric Pump - Automatic

7. THE DATE OF COMMENCEMENT AND COMPLETION OF THE CONSTRUCTION OF THE WELL,
WELLS; OR OTHER WORKS FOR WITHDRAWAL OF GROUNDWATER 1957

8. DEPTH OF WATER TABLE _____

9. SO FAR AS IT MAY BE AVAILABLE, THE TYPE, SIZE AND DEPTH OF EACH WELL OR
THE GENERAL SPECIFICATIONS OF ANY OTHER WORKS FOR THE WITHDRAWAL OF GROUND-
WATER six-inch (6") cased well - 300 feet total depth.

10. THE ESTIMATED AMOUNT OF GROUNDWATER WITHDRAWN EACH YEAR sufficient
to water 1,000 sheep or equivalent cattle.

11. THE LOG OF FORMATIONS ENCOUNTERED IN THE DRILLING OF EACH WELL IF AVAIL-
ABLE Clay and Gravel - 300 feet total depth

12. SUCH OTHER INFORMATION OF A SIMILAR NATURE AS MAY BE USEFUL IN CARRYING
OUT THE POLICY OF THIS ACT, INCLUDING REFERENCE PAGE OF COUNTY RECORDS AND
BOOK NUMBER _____

STATE OF MONTANA) SIGNATURE OF OWNER Nels Nelson
DATE Dec 26, 1963
: ss.
COUNTY OF WHEATLAND)

NELS NELSON HAVING FIRST BEEN DULY SWORN, DEPOSES
AND SAYS THAT HE (IS, ARE,) OF LAWFUL AGE AND (IS ARE) THE APPROPRIATOR
AND CLAIMANT OF THE ORDER AND WATER RIGHT MENTIONED IN THE FOREGOING
DECLARATION OF VESTED GROUNDWATER RIGHTS AND THE PERSON IS WHOSE NAME IS
SUBSCRIBED THERETO, AS THE APPROPRIATOR AND CLAIMANT, THAT HE
KNOWS THE CONTENTS OF SAID FOREGOING NOTICE AND THAT THE MATTERS AND
THINGS THEREIN STATED ARE TRUE.

SUBSCRIBED AND SWORN TO BEFORE ME, THIS 26th DAY OF December, 1963

Nels Nelson
Notary Public for the State of Montana
RESIDING AT Harlowton, Montana
MY COMMISSION EXPIRES Nov. 19, 1964

(FILE THREE COPIES OF THIS REPORT WITH THE COUNTY CLERK AND RECORDER, RE-
TAIN THE 4th COPY FOR YOUR FILES.)

34458

GW 4

FILE NO. _____

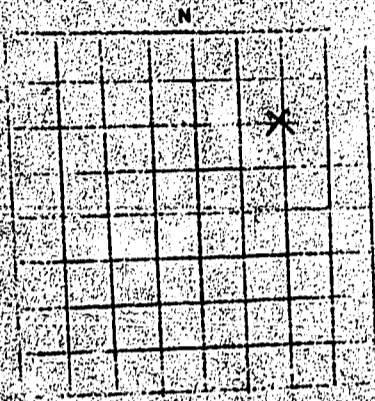
T 9N R 14E
WHEATLAND COUNTY, MONTSTATE OF MONTANA
ADMINISTRATOR OF GROUNDWATER CODE
OFFICE OF STATE ENGINEERRECEIVED
JAN 29 1964DECLARATION OF VESTED GROUNDWATER RIGHTS
(UNDER CHAPTER 237, MONTANA SESSION LAW 1961)
STATE ENGINEER1. NELS NELSON, OF HARLOWTON, MONTANA
(NAME OF APPROPRIATOR) (ADDRESS) (TOWN)
COUNTY OF WHEATLAND, STATE OF MONTANA, HAVE APPROPRIATED GROUNDWATER ACCORD-
ING TO THE MONTANA LAWS IN EFFECT PRIOR TO JANUARY 1, 1962, AS FOLLOWS:2. THE BENEFICIAL USE ON WHICH THE CLAIM IS
BASED Stock Water3. DATE OR APPROXIMATE DATE OF EARLIEST BENEFICIAL USE; AND HOW CONTINUOUS THE USE HAS BEEN
19574. THE AMOUNT OF GROUNDWATER CLAIMED (IN MINER
INCHES OR GALLONS PER MINUTE)
Three (3) gallons per minute5. IF USED FOR IRRIGATION, GIVE THE ACREAGE
AND DESCRIPTION OF THE LANDS TO WHICH WATER HAS
BEEN APPLIED AND NAME OF THE OWNER THEREOF

NE 1/4 SEC 12 9N R14E

INDICATE POINT OF APPROPRIATION
AND PLACE OF USE, IF POSSIBLE.
EACH SMALL SQUARE REPRESENTS 10
ACRES.6. THE MEANS OF WITHDRAWING SUCH WATER FROM THE GROUND AND THE LOCATION OF
EACH WELL OR OTHER MEANS OF WITHDRAWAL Electric Pump - Automatic7. THE DATE OF COMMENCEMENT AND COMPLETION OF THE CONSTRUCTION OF THE WELL
WELLS, OR OTHER WORKS FOR WITHDRAWAL OF GROUNDWATER 1957

8. DEPTH OF WATER TABLE

9. SO FAR AS IT MAY BE AVAILABLE, THE TYPE, SIZE AND DEPTH OF EACH WELL OR
THE GENERAL SPECIFICATIONS OF ANY OTHER WORKS FOR THE WITHDRAWAL OF GROUND-
WATER Six-inch (6") cased well - 300 feet total depth10. THE ESTIMATED AMOUNT OF GROUNDWATER WITHDRAWN EACH YEAR Sufficient
to water 1,000 sheep or equivalent cattle11. THE LOG OF FORMATIONS ENCOUNTERED IN THE DRILLING OF EACH WELL IF AVAIL-
ABLE Clay and Gravel - 300 feet total depth12. SUCH OTHER INFORMATION OF A SIMILAR NATURE AS MAY BE USEFUL IN CARRYING
OUT THE POLICY OF THIS ACT, INCLUDING REFERENCE PAGE OF COUNTY RECORDS AND
BOOK NUMBERSTATE OF MONTANA)
COUNTY OF WHEATLAND)
NELS NELSONSIGNATURE OF OWNER
DATENels Nelson
Dec 26, 1963

NELS NELSON

HAVING FIRST BEEN DULY SWORN, DEPOSES
AND SAYS THAT HE (IS, ~~XXX~~) OF LAWFUL AGE AND (IS ~~ARE~~) THE APPROPRIATOR
AND CLAIMANT HE OF THE ORDER AND WATER RIGHT MENTIONED IN THE FOREGOING
DECLARATION OF VESTED GROUNDWATER RIGHTS AND THE PERSON WHOSE NAME IS
SUBSCRIBED THERETO, AS THE APPROPRIATOR AND CLAIMANT, THAT HE
KNOWS THE CONTENTS OF SAID FOREGOING NOTICE AND THAT THE MATTERS AND
THINGS THEREIN STATED ARE TRUE.SUBSCRIBED AND SWORN TO BEFORE ME, THIS 26th DAY OF December, 1963Nels Nelson
Jordan R. Wickman
NOTARY PUBLIC FOR THE STATE OF MONTANA
RESIDING AT Harlowton, Montana
MY COMMISSION EXPIRES Nov. 19, 1964(FILE THREE COPIES OF THIS REPORT WITH THE COUNTY CLERK AND RECORDER, RE-
TAIN THE 4th COPY FOR YOUR FILES.)

34458

70411

State of Montana, } ss.
County of Wheatland, }

I hereby certify that the within
instrument was filed for record in this

Office on the 26th day of

Dec 1963 at 4:12
o'clock P.M. and was duly recorded

in Book 15 of
Page 602

Water Rights
Loretta Hicks
County Recorder

By _____ Deputy Recorder

FILE NO. 75421

WHEATLAND COUNTY

Doc. No. 75421
Filed for record
this 2 day of September
A. D. 1970, at 1:25
o'clock P. M.

STATE OF MONTANA
ADMINISTRATOR OF GROUNDWATER CODE
OFFICE OF STATE ENGINEER

DECLARATION OF VESTED GROUNDWATER RIGHTS
(UNDER CHAPTER 237, MONTANA SESSION LAWS, 1961)

SEP 14 1970

1. Lawrence W. JENKINS of Harlowton, Wheatland Co., Montana
(NAME OF APPROPRIATOR) (ADDRESS) (TOWN)

COUNTY OF WHEATLAND, STATE OF MONTANA, HAS APPROPRIATED GROUNDWATER ACCORDING TO THE MONTANA LAWS IN EFFECT PRIOR TO JANUARY 1, 1962, AS FOLLOWS:

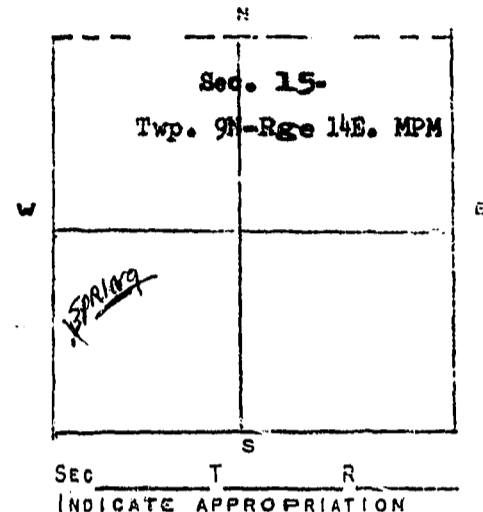

2. THE ~~watering livestock~~ with possible ~~use~~ of a dam in future.

3. DATE OR APPROXIMATE DATE OF EARLIEST BENEFICIAL USE, ~~AND HOW CONTINUOUS THE USE HAS BEEN.~~ Since 1942

4. THE AMOUNT OF GROUNDWATER CLAIMED (IN MINER INCHES OR GALLONS PER MINUTE

5. IF USED FOR IRRIGATION, GIVE THE ACREAGE AND DESCRIPTION OF THE LANDS TO WHICH WATER HAS BEEN APPLIED AND NAME OF THE OWNER THERE OF. ~~Possibly irrigate 25 acres of hay in Sec. 15-9N-14E~~
Flows about 60 gal. per minute

6. THE MEANS OF WITHDRAWING SUCH WATER FROM THE ~~GROUND~~ ^{Gas pump and 4" pipe line} AND THE LOCATION OF EACH WELL OR OTHER MEANS OF WITHDRAWAL.

7. THE DATE OF COMMENCEMENT AND THE COMPLETION OF THE CONSTRUCTION OF THE WELL, WELLS, OR OTHER WORKS FOR WITHDRAWAL OF GROUNDWATER ¹⁹⁷¹
~~surface/spring~~

8. DEPTH OF WATER TABLE

9. SO FAR AS IT MAY BE AVAILABLE, THE TYPE, SIZE AND DEPTH OF EACH WELL OR THE GENERAL SPECIFICATIONS OF ANY OTHER WORKS FOR THE WITHDRAWAL OF GROUNDWATER ^{spring}
~~natural spring~~

10. THE ESTIMATED AMOUNT OF GROUNDWATER WITHDRAWN EACH YEAR ^{and dam forming reservoir}

11. THE LOG OF FORMATIONS ENCOUNTERED IN THE DRILLING OF EACH WELL IF AVAILABLE ^{spring}

12. SUCH OTHER INFORMATION OF A SIMILAR NATURE AS MAY BE USEFUL IN CARRYING OUT THE POLICY OF THIS ACT, INCLUDING REFERENCE PAGE OF COUNTY RECORDS AND BOOK NUMBER

SIGNATURE OF OWNER Lawrence W. Jenkins
DATE Aug. 8, 1970

STATE OF MONTANA } SS.
COUNTY OF WHEATLAND } Lawrence W. Jenkins

HAVING FIRST BEEN DULY SWORN, DEPOSES AND SAYS THAT HE (IS, ARE,) OF LAWFUL AGE AND (IS, ARE) THE APPROPRIATOR AND CLAIMANT OF THE ORDER AND WATER RIGHT MENTIONED IN THE FOREGOING DECLARATION OF VESTED GROUNDWATER RIGHTS AND THE PERSON WHOSE NAMES SUBSCRIBED HERETO, AS THE APPROPRIATOR AND CLAIMANT, THAT HE KNOW THE CONTENTS OF SAID FOREGOING NOTICE AND THAT THE MATTERS AND THINGS THEREIN STATED ARE TRUE.

SUBSCRIBED AND SWORN TO BEFORE ME, THIS 8 DAY OF Aug, 1970

75421

Laurence W. Jenkins 70
Greg Corbett
NOTARY PUBLIC FOR THE STATE OF MONTANA
RESIDING AT Harlowton, Mont.
My COMMISSION EXPIRES April 13-1973

FILED FOR RECORD ON THE 3rd DAY OF Sept 1970 AT 1:25 O'CLOCK P M., AND RECORDED IN BOOK 82, PAGES 397-398, RECORDS OF WHEATLAND COUNTY, MONTANA.

Lucretia Hicks
CLERK AND RECORDER

47506

GW 4
FILE NO. _____

9N R 14E
WHEATLAND COUNTY

STATE OF MONTANA
ADMINISTRATOR OF GROUNDWATER CODE
OFFICE OF STATE ENGINEER

RECEIVED
JAN 29 1964

DECLARATION OF VESTED GROUNDWATER RIGHTS
(UNDER CHAPTER 237, MONTANA SESSION LAWS, 1961)

1. Muir Ranch Company, of Box 156 Harlowton, Montana
(NAME OF APPROPRIATOR) (ADDRESS) (TOWN)
COUNTY OF WHEATLAND, STATE OF MONTANA, HAVE APPROPRIATED GROUNDWATER ACCORD-
ING TO THE MONTANA LAWS IN EFFECT PRIOR TO JANUARY 1, 1962, AS FOLLOWS:

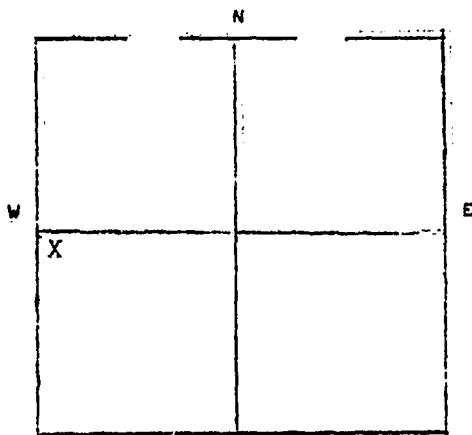

Sec 18 T 9N R 14E
INDICATE APPROPRIATION

2. THE BENEFICIAL USE ON WHICH THE CLAIM IS
BASED livestock water (well)

3. DATE OR APPROXIMATE DATE OF EARLIEST
BENEFICIAL USE; AND HOW CONTINUOUS THE USE
HAS BEEN. 1915

4. THE AMOUNT OF GROUNDWATER CLAIMED (IN
MINER INCHES OR GALLONS PER MINUTE 10 gal.

5. IF USED FOR IRRIGATION, GIVE THE ACREAGE
AND DESCRIPTION OF THE LANDS TO WHICH WATER
HAS BEEN APPLIED AND NAME OF THE OWNER THERE
OF no

6. THE MEANS OF WITHDRAWING SUCH WATER FROM THE GROUND AND THE LOCATION OF
EACH WELL OR OTHER MEANS OF WITHDRAWAL Pump - gas motor

7. THE DATE OF COMMENCEMENT AND THE COMPLETION OF THE CONSTRUCTION OF THE
WELL, WELLS, OR OTHER WORKS FOR WITHDRAWAL OF GROUNDWATER 1915

8. DEPTH OF WATER TABLE 150 feet

9. SO FAR AS IT MAY BE AVAILABLE, THE TYPE, SIZE AND DEPTH OF EACH WELL OR
THE GENERAL SPECIFICATIONS OF ANY OTHER WORKS FOR THE WITHDRAWAL OF GROUND-
WATER 100 feet - 6" casing, 50 feet 5" casing

10. THE ESTIMATED AMOUNT OF GROUNDWATER WITHDRAWN EACH YEAR 500,000 gal.

11. THE LOG OF FORMATIONS ENCOUNTERED IN THE DRILLING OF EACH WELL IF AVAIL-
ABLE none

12. SUCH OTHER INFORMATION OF A SIMILAR NATURE AS MAY BE USEFUL IN CARRYING
OUT THE POLICY OF THIS ACT, INCLUDING REFERENCE PAGE OF COUNTY RECORDS AND
BOOK NUMBER _____

SIGNATURE OF OWNER By: Muir Ranch Company
Nick Muir
DATE December 27, 1963

STATE OF MONTANA } ss.
COUNTY OF WHEATLAND }

Muir Ranch Company HAVING FIRST BEEN DULY SWORN, DEPOSES
AND SAYS THAT they (xx, ARE,) OF LAWFUL AGE AND (xx, ARE) THE APPROPRIATORS
AND CLAIMANTS OF THE ORDER AND WATER RIGHT MENTIONED IN THE FOREGOING
DECLARATION OF VESTED GROUNDWATER RIGHTS AND THE PERSON whose names
SUBSCRIBED THERETO, AS THE APPROPRIATORS AND CLAIMANTS, THAT they
KNOW THE CONTENTS OF SAID FOREGOING NOTICE AND THAT THE MATTERS AND THINGS
THEREIN STATED ARE TRUE.

Muir Ranch Company
By: Nick Muir

SUBSCRIBED AND SWORN TO BEFORE ME, THIS 27th DAY OF December, 1963

70469

Marian Langston
NOTARY PUBLIC FOR THE STATE OF MONTANA
RESIDING AT Harlowton, Montana
MY COMMISSION EXPIRES Sept 3, 1966

FILED FOR RECORD ON THE 30 DAY OF Dec 1963 AT 1:35
O'CLOCK P M., AND RECORDED IN BOOK 15821, PAGES 12
RECORDS OF WHEATLAND COUNTY, MONTANA.

Loretta Hicks 34508
CLERK AND RECORDER

GW 4

File No. _____

T 9N R 14E
WHEATLAND COUNTY, MONT.STATE OF MONTANA
ADMINISTRATOR OF GROUNDWATER CODE
OFFICE OF STATE ENGINEER

JAN 29 1964

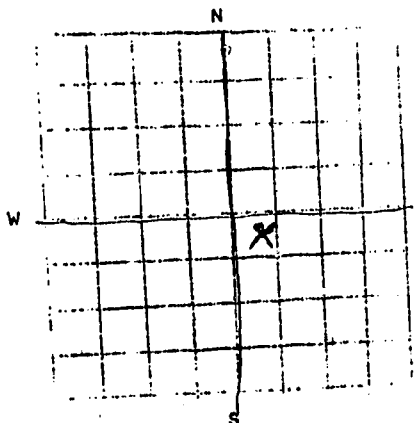
DECLARATION OF VESTED GROUNDWATER RIGHTS
(UNDER CHAPTER 237, MONTANA SESSION LAWS 1961)1. SAMUEL V. DALGARNO, OF HARLOWTON, MONTANA
(NAME OF APPROPRIATOR) (ADDRESS) (TOWN)
COUNTY OF WHEATLAND, STATE OF MONTANA, HAVE APPROPRIATED GROUNDWATER ACCORD-
ING TO THE MONTANA LAWS IN EFFECT PRIOR TO JANUARY 1, 1962, AS FOLLOWS:2. THE BENEFICIAL USE ON WHICH THE CLAIM IS
BASED STOCK WATER3. DATE OR APPROXIMATE DATE OF EARLIEST BENE-
FICIAL USE; AND HOW CONTINUOUS THE USE HAS BEEN
1930 CONTINUOUS USE4. THE AMOUNT OF GROUNDWATER CLAIMED (IN MINER
INCHES OR GALLONS PER MINUTE 5 GALLONS
PER MINUTE5. IF USED FOR IRRIGATION, GIVE THE ACREAGE
AND DESCRIPTION OF THE LANDS TO WHICH WATER HAS
BEEN APPLIED AND NAME OF THE OWNER THEREOF _____S.E. 1/4 SEC 19 T 9 R 14EINDICATE POINT OF APPROPRIATION
AND PLACE OF USE, IF POSSIBLE.
EACH SMALL SQUARE REPRESENTS 10
ACRES.6. THE MEANS OF WITHDRAWING SUCH WATER FROM THE GROUND AND THE LOCATION OF
EACH WELL OR OTHER MEANS OF WITHDRAWAL NATURAL FLOW CONTROLLED
BY SPRING BOX AND PIPE TO TROUGHS7. THE DATE OF COMMENCEMENT AND COMPLETION OF THE CONSTRUCTION OF THE WELL,
WELLS, OR OTHER WORKS FOR WITHDRAWAL OF GROUNDWATER 19308. DEPTH OF WATER TABLE DOES NOT APPLY - NATURAL SPRING9. SO FAR AS IT MAY BE AVAILABLE, THE TYPE, SIZE AND DEPTH OF EACH WELL OR
THE GENERAL SPECIFICATIONS OF ANY OTHER WORKS FOR THE WITHDRAWAL OF GROUND-
WATER NOT APPLICABLE10. THE ESTIMATED AMOUNT OF GROUNDWATER WITHDRAWN EACH YEAR TOTAL FLOW11. THE LOG OF FORMATIONS ENCOUNTERED IN THE DRILLING OF EACH WELL IF AVAIL-
ABLE _____12. SUCH OTHER INFORMATION OF A SIMILAR NATURE AS MAY BE USEFUL IN CARRYING
OUT THE POLICY OF THIS ACT, INCLUDING REFERENCE PAGE OF COUNTY RECORDS AND
BOOK NUMBER _____SIGNATURE OF OWNER Samuel V. DalgarnoDATE Dec 20, 1963

STATE OF MONTANA)

: ss.

COUNTY OF WHEATLAND)

Samuel V. DalgarnoHAVING FIRST BEEN DULY SWORN, DEPOSES
AND SAYS THAT HE (IS, ARE,) OF LAWFUL AGE AND (IS ARE) THE APPROPRIATOR
AND CLAIMANT OF THE ORDER AND WATER RIGHT MENTIONED IN THE FOREGOING
DECLARATION OF VESTED GROUNDWATER RIGHTS AND THE PERSON WHOSE NAME
SUBSCRIBED THERETO, AS THE APPROPRIATOR AND CLAIMANT, THAT HE
KNOW THE CONTENTS OF SAID FOREGOING NOTICE AND THAT THE MATTERS AND
THINGS THEREIN STATED ARE TRUE.SUBSCRIBED AND SWORN TO BEFORE ME, THIS 20 DAY OF Dec 1963Lucretia Nicks Cochran
NOTARY PUBLIC FOR THE STATE OF MONTANA
RESIDING AT _____
MY COMMISSION EXPIRES _____(FILE THREE COPIES OF THIS REPORT WITH THE COUNTY CLERK AND RECORDER, RE-
TAIN THE 4th COPY FOR YOUR FILES.)

34425

70371

State of Montana, } ss.
County of Wheatland, }

I hereby certify that the within
instrument was filed for record in this

office on the

20

o'clock

P. M.

in Book

15

Page

555-556

at

63

day of

4

was duly recorded

Valer Rights
Lucyelia Hicks
County Recorder

By

Deputy Recorder

GW 4

FILE NO. _____

T 9 N 14
WHEATLAND COUNTY, MONT.STATE OF MONTANA
ADMINISTRATOR OF GROUNDWATER CODE
OFFICE OF STATE ENGINEERRECEIVED
JAN 29 1964
STATE ENGINEERDECLARATION OF VESTED GROUNDWATER RIGHTS
(UNDER CHAPTER 237, MONTANA SESSION LAWS, 1961)1. Eric & Ann Anderson, OF Box 81 Harlowton, Mont.
(NAME OF APPROPRIATOR) (ADDRESS) (TOWN)

COUNTY OF WHEATLAND, STATE OF MONTANA, HAVE APPROPRIATED GROUNDWATER ACCORDING TO THE MONTANA LAWS IN EFFECT PRIOR TO JANUARY 1, 1962, AS FOLLOWS:

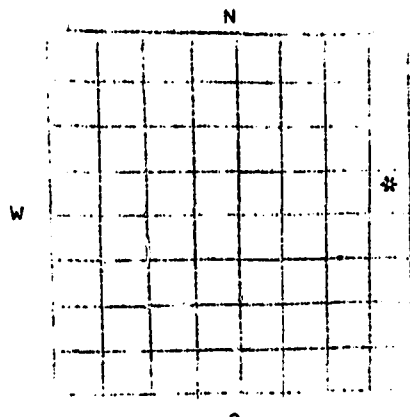
2. THE BENEFICIAL USE ON WHICH THE CLAIM IS BASED Stockwater3. DATE OR APPROXIMATE DATE OF EARLIEST BENEFICIAL USE; AND HOW CONTINUOUS THE USE HAS BEEN
May 1st, 1957 purchased
continuous since4. THE AMOUNT OF GROUNDWATER CLAIMED (IN MINER INCHES OR GALLONS PER MINUTE 20 gals. per min.
approximately

5. IF USED FOR IRRIGATION, GIVE THE ACREAGE AND DESCRIPTION OF THE LANDS TO WHICH WATER HAS BEEN APPLIED AND NAME OF THE OWNER THEREOF _____

SE 1/4 NE Sec 20 T 9 R 14

INDICATE POINT OF APPROPRIATION AND PLACE OF USE, IF POSSIBLE. EACH SMALL SQUARE REPRESENTS 10 ACRES.

6. THE MEANS OF WITHDRAWING SUCH WATER FROM THE GROUND AND THE LOCATION OF EACH WELL OR OTHER MEANS OF WITHDRAWAL none, it is a live spring

7. THE DATE OF COMMENCEMENT AND COMPLETION OF THE CONSTRUCTION OF THE WELL, WELLS, OR OTHER WORKS FOR WITHDRAWAL OF GROUNDWATER _____

8. DEPTH OF WATER TABLE _____

9. SO FAR AS IT MAY BE AVAILABLE, THE TYPE, SIZE AND DEPTH OF EACH WELL OR THE GENERAL SPECIFICATIONS OF ANY OTHER WORKS FOR THE WITHDRAWAL OF GROUNDWATER _____

10. THE ESTIMATED AMOUNT OF GROUNDWATER WITHDRAWN EACH YEAR _____

11. THE LOG OF FORMATIONS ENCOUNTERED IN THE DRILLING OF EACH WELL IF AVAILABLE _____

12. SUCH OTHER INFORMATION OF A SIMILAR NATURE AS MAY BE USEFUL IN CARRYING OUT THE POLICY OF THIS ACT, INCLUDING REFERENCE PAGE OF COUNTY RECORDS AND BOOK NUMBER _____

SIGNATURE OF OWNER Eric Anderson
STATE OF MONTANA) DATE 11-23-63
: SS.
COUNTY OF WHEATLAND)Eric Anderson HAVING FIRST BEEN DULY SWORN, DEPOSES AND SAYS THAT HE (IS, ARE,) OF LAWFUL AGE AND (IS ARE) THE APPROPRIATOR AND CLAIMANT OF THE ORDER AND WATER RIGHT MENTIONED IN THE FOREGOING DECLARATION OF VESTED GROUNDWATER RIGHTS AND THE PERSON WHOSE NAME SUBSCRIBED THERETO, AS THE APPROPRIATOR AND CLAIMANT, THAT HE KNOWS THE CONTENTS OF SAID FOREGOING NOTICE AND THAT THE MATTERS AND THINGS THEREIN STATED ARE TRUE.SUBSCRIBED AND SWORN TO BEFORE ME, THIS 23 DAY OF Dec 1963Lucretia Hicks, Co Clerk
NOTARY PUBLIC FOR THE STATE OF MONTANA
RESIDING AT _____
MY COMMISSION EXPIRES _____

(FILE THREE COPIES OF THIS REPORT WITH THE COUNTY CLERK AND RECORDER, RETAIN THE 4th COPY FOR YOUR FILES.)

34441

70392

State of Montana, } ss.
County of Wheatland, }

I hereby certify that the within
instrument was filed for record in this

office on the 23 day of

Dec 19 63 at 3:30

o'clock P. M. and was duly recorded

in Book 15 of Water Rights

Page 572

Lucretia Hicks
County Recorder

By _____ Deputy Recorder

Form No. 18
8-60

T. 9 ~~W~~ N R. 14 E
County Wheatland

MONTANA BUREAU OF MINES AND GEOLOGY
Butte, Montana

RECEIVED
JAN 2 1962

Water Well Log

STATE ENGINEER

Owner Lawrence Jenkins Address Herndon

Driller _____ Address _____

Date Started _____ Date Completed _____

Location: Sec. 22 T. 9 N R. 14 E $\frac{1}{4}$ sec. NE $\frac{1}{4}$

Type of well Dug (Dug, driven, or drilled) Equipment used _____ (Churn, drill, rotary, other)

Water use: Domestic ☒ Municipal ☒ Stock ☒ Irrigation ☐
Industrial ☐ Drainage ☐ Other _____

Casing: _____ ft. to _____ ft. Type _____ Size _____

Casing: _____ ft. to _____ ft. Type _____ Size _____

Casing: _____ ft. to _____ ft. Type _____ Size _____

Perforated or screened: Ft. _____ to ft. _____. Ft. _____ to ft. _____

Type of screen or perforations _____

Static water level, for non-flowing well: _____ feet.

Shut-in pressure, for flowing well: _____ lb./sq. in. on: _____ (date)

Pumping water level _____ feet at _____ gal. per min. _____

How tested: _____

Length of test _____

Remarks: (Gravel packing, cementing, packers, type of shut-off, depth of shut-off)

(over)

Form No. 18
8-60

T. 9 N R. 14 E
County Wheatland

MONTANA BUREAU OF MINES AND GEOLOGY
Butte, Montana

RECEIVED
JAN 2 1961

Water Well Log

		*

Owner Lawrence W Jenkins Address STATE ENGINEER

Driller _____ Address _____

Date Started _____ Date Completed _____

Location: Sec. 24 T. 9 N R. 14 E $\frac{1}{4}$ sec. 28⁴

Type of well dug (Dug, driven, or drilled) Equipment used _____ (Churn, drill, rotary, other)

Water use: Domestic ☐ Municipal ☐ Stock ☒ Irrigation ☐
Industrial ☐ Drainage ☐ Other _____

Casing: _____ ft. to _____ ft. Type _____ Size _____

Casing: _____ ft. to _____ ft. Type _____ Size _____

Casing: _____ ft. to _____ ft. Type _____ Size _____

Perforated or screened: Ft. _____ to ft. _____. Ft. _____ to ft. _____

Type of screen or perforations _____

Static water level, for non-flowing well: _____ feet.

Shut-in pressure, for flowing well: _____ lb./sq. in. on: _____ (date)

Pumping water level _____ feet at _____ gal. per min.

How tested: _____

Length of test _____

Remarks: (Gravel packing, cementing, packers, type of shut-off, depth of shut-off)

(over)

Form No. 18
8-60

T. 7 N R. 14 E
County Wheatland

MONTANA BUREAU OF MINES AND GEOLOGY
Butte, Montana

RECEIVED
JAN 2 1962

Water Well Log

STATE ENGINEER

	X	

Owner Lawrence W. Jenkins Address Harlowton
Driller _____ Address _____
Date Started _____ Date Completed _____
Location: Sec. 24 T. 7 N R. 14 E $\frac{1}{4}$ sec. NE

Type of well drilled Equipment used _____
(Dug, driven, or drilled) (Churn, drill, rotary, other)

Water use: Domestic ☐ Municipal ☐ Stock ☒ Irrigation ☐
Industrial ☐ Drainage ☐ Other _____

Casing: _____ ft. to _____ ft. Type _____ Size _____

Casing: _____ ft. to _____ ft. Type _____ Size _____

Casing: _____ ft. to _____ ft. Type _____ Size _____

Perforated or screened: Ft. _____ to ft. _____. Ft. _____ to ft. _____

Type of screen or perforations _____

Static water level, for non-flowing well: _____ feet.

Shut-in pressure, for flowing well: _____ lb./sq. in. on: _____
(date)

Pumping water level _____ feet at _____ gal. per min.

How tested: _____

Length of test _____

Remarks: (Gravel packing, cementing, packers, type of shut-off, depth of shut-off)

(over)

GW 4
FILE NO. _____

T 9N R 14E
WHEATLAND COUNTY

STATE OF MONTANA
ADMINISTRATOR OF GROUNDWATER CODE
OFFICE OF STATE ENGINEER

JAN 29 1964

DECLARATION OF VESTED GROUNDWATER RIGHTS
(UNDER CHAPTER 237, MONTANA SESSION LAWS, 1961)

ENGINEER

1. Muir Ranch Company, of Box 156 Harlowton, Montana
(NAME OF APPROPRIATOR) (ADDRESS) (TOWN)
COUNTY OF WHEATLAND, STATE OF MONTANA, HAVE APPROPRIATED GROUNDWATER ACCORD-
ING TO THE MONTANA LAWS IN EFFECT PRIOR TO JANUARY 1, 1962, AS FOLLOWS:

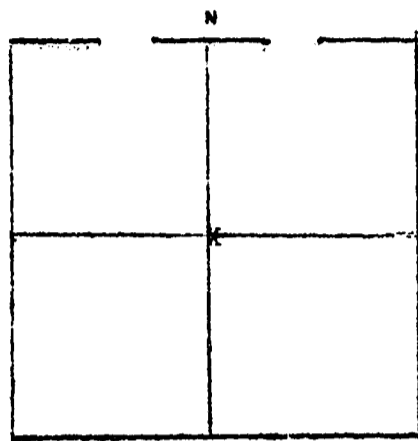

Sec 26 T 9N R 14E
(INDICATE APPROPRIATION)

2. THE BENEFICIAL USE ON WHICH THE CLAIM IS
BASED livestock water (well)

3. DATE OR APPROXIMATE DATE OF EARLIEST
BENEFICIAL USE; AND HOW CONTINUOUS THE USE
HAS BEEN. livestock water (well)

4. THE AMOUNT OF GROUNDWATER CLAIMED (IN
MINER INCHES OR GALLONS PER MINUTE unlimited

5. IF USED FOR IRRIGATION, GIVE THE ACREAGE
AND DESCRIPTION OF THE LANDS TO WHICH WATER
HAS BEEN APPLIED AND NAME OF THE OWNER THERE
OF no

6. THE MEANS OF WITHDRAWING SUCH WATER FROM THE GROUND AND THE LOCATION OF
EACH WELL OR OTHER MEANS OF WITHDRAWAL Pump - gas motor

7. THE DATE OF COMMENCEMENT AND THE COMPLETION OF THE CONSTRUCTION OF THE
WELL, WELLS, OR OTHER WORKS FOR WITHDRAWAL OF GROUNDWATER 1915

8. DEPTH OF WATER TABLE 150 feet

9. SO FAR AS IT MAY BE AVAILABLE, THE TYPE, SIZE AND DEPTH OF EACH WELL OR
THE GENERAL SPECIFICATIONS OF ANY OTHER WORKS FOR THE WITHDRAWAL OF GROUND-
WATER 100 feet - 6" casing, 50 feet - 5" casing

10. THE ESTIMATED AMOUNT OF GROUNDWATER WITHDRAWN EACH YEAR 100,000 gal.

11. THE LOG OF FORMATIONS ENCOUNTERED IN THE DRILLING OF EACH WELL IF AVAIL-
ABLE none

12. SUCH OTHER INFORMATION OF A SIMILAR NATURE AS MAY BE USEFUL IN CARRYING
OUT THE POLICY OF THIS ACT, INCLUDING REFERENCE PAGE OF COUNTY RECORDS AND
BOOK NUMBER _____

SIGNATURE OF OWNER By: Muir Ranch Company
Nick Muir

DATE December 27, 1963

STATE OF MONTANA } ss.
COUNTY OF WHEATLAND }

Muir Ranch Company HAVING FIRST BEEN DULY SWORN, DEPOSES
AND SAYS THAT they (~~is~~, ARE,) OF LAWFUL AGE AND (~~is~~, ARE) THE APPROPRIATOR S
AND CLAIMANT S OF THE ORDER AND WATER RIGHT MENTIONED IN THE FOREGOING
DECLARATION OF VESTED GROUNDWATER RIGHTS AND THE PERSONS S WHOSE NAMES
SUBSCRIBED THERETO, AS THE APPROPRIATOR S AND CLAIMANT S, THAT they
KNOW THE CONTENTS OF SAID FOREGOING NOTICE AND THAT THE MATTERS AND THINGS
THEREIN STATED ARE TRUE.

Muir Ranch Company
By: Nick Muir

SUBSCRIBED AND SWORN TO BEFORE ME, THIS 27th DAY OF December, 19 63

70464

Marian Langston
NOTARY PUBLIC FOR THE STATE OF MONTANA
RESIDING AT Harlowton, Montana
MY COMMISSION EXPIRES Sept. 3, 1966

FILED FOR RECORD ON THE 30 DAY OF Dec 1963 AT 1:29
O'CLOCK P M., AND RECORDED IN BOOK #82, PAGES 7
RECORDS OF WHEATLAND COUNTY, MONTANA. Lucretia Hicks
Clk & Recorder 34503

GW 4

FILE NO. _____

T 9^N R 14^E

WHEATLAND COUNTY, MONT.

STATE OF MONTANA
ADMINISTRATOR OF GROUNDWATER CODE
OFFICE OF STATE ENGINEER

JAN 29 1964

DECLARATION OF VESTED GROUNDWATER RIGHTS
(UNDER CHAPTER 237, MONTANA SESSION LAWS, 1961)

1. JOHN DALGARNO, OF HARLOWTON, MONTANA
(NAME OF APPROPRIATOR) (ADDRESS) (TOWN)

COUNTY OF WHEATLAND, STATE OF MONTANA, HAVE APPROPRIATED GROUNDWATER ACCORDING TO THE MONTANA LAWS IN EFFECT PRIOR TO JANUARY 1, 1962, AS FOLLOWS:

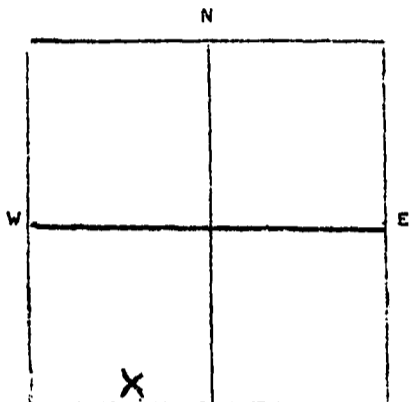

2. THE BENEFICIAL USE ON WHICH THE CLAIM IS BASED DOMESTIC, STOCK WATER

3. DATE OR APPROXIMATE DATE OF EARLIEST BENEFICIAL USE; AND HOW CONTINUOUS THE USE HAS BEEN.

4. 1912 CONTINUOUS USE
THE AMOUNT OF GROUNDWATER CLAIMED (IN MINER INCHES OR GALLONS PER MINUTE) 10 GALLONS PER MINUTE

5. IF USED FOR IRRIGATION, GIVE THE ACREAGE AND DESCRIPTION OF THE LANDS TO WHICH WATER HAS BEEN APPLIED AND NAME OF THE OWNER THEREOF _____

SW 1/4 SEC 28 T 9 R 14 E
INDICATE APPROPRIATION

6. THE MEANS OF WITHDRAWING SUCH WATER FROM THE GROUND AND THE LOCATION OF EACH WELL OR OTHER MEANS OF WITHDRAWAL PUMP AND PUMP JACK

7. THE DATE OF COMMENCEMENT AND THE COMPLETION OF THE CONSTRUCTION OF THE WELL, WELLS, OR OTHER WORKS FOR WITHDRAWAL OF GROUNDWATER 1912

8. DEPTH OF WATER TABLE 25 FT

9. SO FAR AS IT MAY BE AVAILABLE, THE TYPE, SIZE AND DEPTH OF EACH WELL OR THE GENERAL SPECIFICATIONS OF ANY OTHER WORKS FOR THE WITHDRAWAL OF GROUNDWATER 6 IN CASING, 180 FT TOTAL DEPTH

10. THE ESTIMATED AMOUNT OF GROUNDWATER WITHDRAWN EACH YEAR 18000 GALLONS

11. THE LOG OF FORMATIONS ENCOUNTERED IN THE DRILLING OF EACH WELL IF AVAILABLE BLUE SHALE, CLAY, SAND STONE

12. SUCH OTHER INFORMATION OF A SIMILAR NATURE AS MAY BE USEFUL IN CARRYING OUT THE POLICY OF THIS ACT, INCLUDING REFERENCE PAGE OF COUNTY RECORDS AND BOOK NUMBER _____

SIGNATURE OF OWNER John Dalgarno
DATE DECEMBER 20, 1963

STATE OF MONTANA)
COUNTY OF WHEATLAND) ss.

John Dalgarno HAVING FIRST BEEN DULY SWORN, DEPOSES AND SAYS THAT HE (IS, ARE,) OF LAWFUL AGE AND (IS, ARE) THE APPROPRIATOR AND CLAIMANT OF THE ORDER AND WATER RIGHT MENTIONED IN THE FOREGOING DECLARATION OF VESTED GROUNDWATER RIGHTS AND THE PERSON WHOSE NAME SUBSCRIBED THERETO, AS THE APPROPRIATOR AND CLAIMANT, THAT HE KNOW THE CONTENTS OF SAID FOREGOING NOTICE AND THAT THE MATTERS AND THINGS THEREIN STATED ARE TRUE.

SUBSCRIBED AND SWORN TO BEFORE ME, THIS 20 DAY OF Dec, 1963

Lucretia Hicks, Co Clerk
NOTARY PUBLIC FOR THE STATE OF MONTANA
RESIDING AT _____
MY COMMISSION EXPIRES _____

70350

State of Montana, } ss.
County of Wheatland, }

I hereby certify that the within
instrument was filed for record in this

office on the 20th day of

Dec 1963 9:45-

o'clock A.M. and recorded

in Book 15 of Water Rights

Page 528

Lucretia Hicks

County Recorder

By _____

Deputy Recorder

Form No. 18
8-60

T. 9 R. 14
County WHEATLAND

MONTANA BUREAU OF MINES AND GEOLOGY
Butte, Montana

RECEIVED
DEC 29 1961

Water Well Log

STATE ENGINEER

Owner JANE DALGARNO Address HARLOWTON, MONT.
Driller FRANK BUCKLEY Address HARLOWTON, MONT.
Date Started 4/5/47 Date Completed 4/15/47
Location: Sec. 30 T. 9 R. 14 $\frac{1}{4}$ sec. NE $\frac{1}{4}$ SEC 30

Type of well DRIILLED Equipment used _____
(Dug, driven, or drilled) (Churn, drill, rotary, other)

Water use: Domestic ☒ Municipal ☐ Stock ☒ Irrigation ☐
Industrial ☐ Drainage ☐ Other _____

Casing: 1 ft. to 163 ft. Type GALVANIZED Size 6 in

Casing: _____ ft. to _____ ft. Type _____ Size _____

Casing: _____ ft. to _____ ft. Type _____ Size _____

Perforated or screened: Ft. _____ to ft. _____. Ft. _____ to ft. _____

Type of screen or perforations _____

Static water level, for non-flowing well: 30 ft feet.

Shut-in pressure, for flowing well: _____ lb./sq. in. on: _____
(date)

Pumping water level 30 feet at 1 1/2 gal. per min. _____

How tested: BALER

Length of test 1 HOUR

Remarks: (Gravel packing, cementing, packers, type of shut-off, depth of shut-off)

(over)

Log of Well

[illegible]

GW 4

FILE NO. _____

T 9N R 14E
WHEATLAND COUNTY, MONT.STATE OF MONTANA
ADMINISTRATOR OF GROUNDWATER CODE
OFFICE OF STATE ENGINEER

JAN 29 1964

DECLARATION OF VESTED GROUNDWATER RIGHTS
(UNDER CHAPTER 237, MONTANA SESSION LAWS, 1961). ENGINEER1. JANE DALGARNO, OF HARLOWTON, MONTANA
(NAME OF APPROPRIATOR) (ADDRESS) (TOWN)

COUNTY OF WHEATLAND, STATE OF MONTANA, HAVE APPROPRIATED GROUNDWATER ACCORDING TO THE MONTANA LAWS IN EFFECT PRIOR TO JANUARY 1, 1962, AS FOLLOWS:

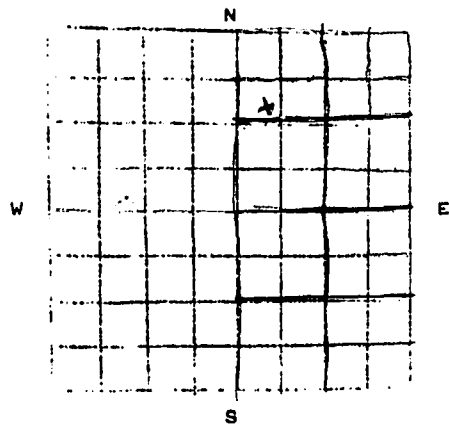
2. THE BENEFICIAL USE ON WHICH THE CLAIM IS BASED DOMESTIC, STOCK WATER3. DATE OR APPROXIMATE DATE OF EARLIEST BENEFICIAL USE; AND HOW CONTINUOUS THE USE HAS BEEN 1925 - CONTINUOUS USE4. THE AMOUNT OF GROUNDWATER CLAIMED (IN MINER INCHES OR GALLONS PER MINUTE) 10 GALLONS PER MINUTE

5. IF USED FOR IRRIGATION, GIVE THE ACREAGE AND DESCRIPTION OF THE LANDS TO WHICH WATER HAS BEEN APPLIED AND NAME OF THE OWNER THEREOF _____

N.E. 1/4 SEC. 30 T 9N R 14E
INDICATE POINT OF APPROPRIATION AND PLACE OF USE, IF POSSIBLE. EACH SMALL SQUARE REPRESENTS 10 ACRES.6. THE MEANS OF WITHDRAWING SUCH WATER FROM THE GROUND AND THE LOCATION OF EACH WELL OR OTHER MEANS OF WITHDRAWAL NATURAL FLOW CONTROLLED BY SPRING BOX AND PIPE TO TROUGH7. THE DATE OF COMMENCEMENT AND COMPLETION OF THE CONSTRUCTION OF THE WELL, WELLS, OR OTHER WORKS FOR WITHDRAWAL OF GROUNDWATER 19258. DEPTH OF WATER TABLE DOES NOT APPLY - NATURAL SPRING9. SO FAR AS IT MAY BE APPLICABLE, THE TYPE, SIZE AND DEPTH OF EACH WELL OR THE GENERAL SPECIFICATIONS OF ANY OTHER WORKS FOR THE WITHDRAWAL OF GROUNDWATER NOT APPLICABLE10. THE ESTIMATED AMOUNT OF GROUNDWATER WITHDRAWN EACH YEAR TOTAL FLOW

11. THE LOG OF FORMATIONS ENCOUNTERED IN THE DRILLING OF EACH WELL IF AVAILABLE _____

12. SUCH OTHER INFORMATION OF A SIMILAR NATURE AS MAY BE USEFUL IN CARRYING OUT THE POLICY OF THIS ACT, INCLUDING REFERENCE PAGE OF COUNTY RECORDS AND BOOK NUMBER _____

STATE OF MONTANA) SIGNATURE OF OWNER Jane Dalgarno
DATE Dec 20th 1963
: SS.COUNTY OF WHEATLAND)
Jane Dalgarno HAVING FIRST BEEN DULY SWORN, DEPOSES AND SAYS THAT HE (IS, ARE,) OF LAWFUL AGE AND (IS ARE) THE APPROPRIATOR AND CLAIMANT OF THE ORDER AND WATER RIGHT MENTIONED IN THE FOREGOING DECLARATION OF VESTED GROUNDWATER RIGHTS AND THE PERSON WHOSE NAME SUBSCRIBED THERETO, AS THE APPROPRIATOR AND CLAIMANT, THAT HE KNOW THE CONTENTS OF SAID FOREGOING NOTICE AND THAT THE MATTERS AND THINGS THEREIN STATED ARE TRUE.SUBSCRIBED AND SWORN TO BEFORE ME, THIS 26 DAY OF Dec 1963Lucretia Hicks Co Clerk
NOTARY PUBLIC FOR THE STATE OF MONTANA
RESIDING AT _____
MY COMMISSION EXPIRES _____

(FILE THREE COPIES OF THIS REPORT WITH THE COUNTY CLERK AND RECORDER, RETAIN THE 4th COPY FOR YOUR FILES.)

34445

70398

State of Montana, }
County of Wheatland, }

I hereby certify that the within
instrument was filed for record in this

office on the 26th day of

Dec 1963 1:28

o'clock P. M., and was

in Book 15 of Water Rights

Page 579

Lucretia Hicks

County Recorder

By

Deputy Recorder

GW 4
File No. _____

STATE OF MONTANA
ADMINISTRATOR OF GROUNDWATER CODE
Office of the State Engineer
* * * * *

WHEATLAND COUNTY

NOV 10 1964

NOV 16 1964

DECLARATION OF VESTED GROUNDWATER RIGHTS

(Under Chapter 237, Montana Session Laws, 1961)

1. JANE DALGARNO, of HARLOWTON MONTANA
Name of Appropriator (Address) (Town)

County of Wheatland, State of Montana, have appropriated Groundwater according to the Montana Laws in effect prior to January 1, 1962, as follows:

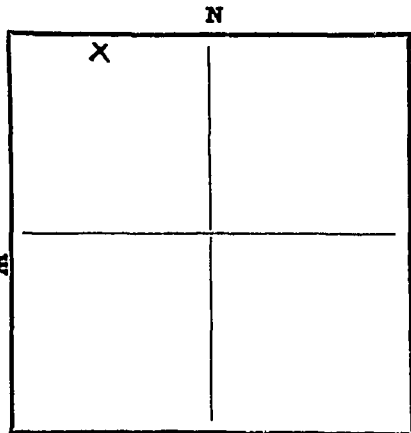

N.W. $\frac{1}{4}$ Sec 30 T 9N R 14E
Indicate Appropriation

2. The beneficial use on which the claim is based
STOCK WATER

3. Date or approximate date of earliest beneficial use; and how continuous the use has been: SEPT 25, 1964
CONTINUOUS USE

4. The amount of groundwater claimed (in miner inches or gallons per minute) 15 GALLONS PER MINUTE

5. If used for irrigation, give the acreage and description of the lands to which water has been applied and name of the owner thereof:

6. The means of withdrawing such water from the ground and the location of each well or other means of withdrawal: NATURAL FLOW CONTROLLED BY SPRING
BOX AND PIPE TO TROUGH

7. The date of commencement and the completion of the construction of the well, wells, or other works for withdrawal of groundwater: SEPT 25, 1964 COMPLETED SEPT 28, 1964

8. Depth of water table: DOES NOT APPLY - NATURAL SPRING

9. So far as it may be available, the type, size and depth of each well or the general specifications of any other works for the withdrawal of groundwater: 4 FOOT LENGTH OF COULVERT 36 IN.
DIAMETER + 345 FT 1/4 IN. PLASTIC PIPE

10. The estimated amount of groundwater withdrawn each year: TOTAL FLOW

11. The log of formations encountered in the drilling of each well if available:

12. Such other information of a similar nature as may be useful in carrying out the policy of this act, including reference page of county records and book number:

SIGNATURE OF OWNER: Jane Dalgarno

Date OCT 30 1964

STATE OF MONTANA

COUNTY OF WHEATLAND

Jane Dalgarno having first been duly sworn, deposes and says that he...
(is, are) of lawful age and (is, are) the appropriator... and claimant... of the order and water right mentioned in the foregoing declaration of vested groundwater rights and the person... whose named... subscribed thereto, as the appropriator... and claimant..., that he... knows the contents of said foregoing notice and that the matters and things therein stated are true.

SUBSCRIBED and SWORN to before me, this 5th day of November, 1964

71438

Notary Public for the State of Montana

Residing at

My Commission expires

Filed for record on the 5th day of November, 1964 at 11:30
o'clock A M., and recorded in Book 82, Pages 283-284, records of
Wheatland County, Montana.

Lucretia Hicks
Clerk and Recorder

38672

Form No. 18
8-60

T. 9 N R. 14 E

County Wheatland

MONTANA BUREAU OF MINES AND GEOLOGY
Butte, Montana

RECEIVED
MAY 17 1961

WATER WELL LOG

STATE ENGINEER

Owner Jane Dalgarno Address Harlowton, Montana

Driller Albert Heck Address Harlowton, Montana

Date Started May 3, 1961 Date Completed May 5, 1961

Location: Sec. 32 T. 9 R. 14 E $\frac{1}{4}$ sec. NW corner NW $\frac{1}{4}$ SW $\frac{1}{4}$

Type of well drilled Equipment used Cable tool
(Dug, driven, bored, or drilled) (Churn, drill, rotary, other)

Water use: Domestic ☐ Municipal ☐ Stock ☒ Irrigation ☐
Industrial ☐ Drainage ☐ Other _____

Casing: 1 ft. to 85 ft. Type 20 gauge Size 6 inch
galvanized casing

Casing: _____ ft. to _____ ft. Type _____ Size _____

Casing: _____ ft. to _____ ft. Type _____ Size _____

Perforated or Screened: Ft. 30 to ft. 85. Ft. _____ to ft. _____

Type of screen or perforations $\frac{1}{4}$ " holes

Static Water level, for non-flowing well: _____ feet.

Shut-in pressure, for flowing well: _____ lb./sq. in. on: _____
(date)

Pumping water level 30 feet at 30 gal. per min. 1

How tested: Baler

Length of test 3 hours

Remarks: (Gravel packing, cementing, packers, type of shut-off, depth of shut-off)

(over)

Log of Well

[illegible]

GW 4
FILE NO. _____

9N R 14E
WHEATLAND COUNTY

34

STATE OF MONTANA
ADMINISTRATOR OF GROUNDWATER CODE
OFFICE OF STATE ENGINEER

JAN 29 1964

DECLARATION OF VESTED GROUNDWATER RIGHTS
(UNDER CHAPTER 237, MONTANA SESSION LAWS, 1961)

1. Muir Ranch Company, of Box 156, Harlowton, Montana
(NAME OF APPROPRIATOR) (ADDRESS) (TOWN)

COUNTY OF WHEATLAND, STATE OF MONTANA, HAVE APPROPRIATED GROUNDWATER ACCORDING TO THE MONTANA LAWS IN EFFECT PRIOR TO JANUARY 1, 1962, AS FOLLOWS:

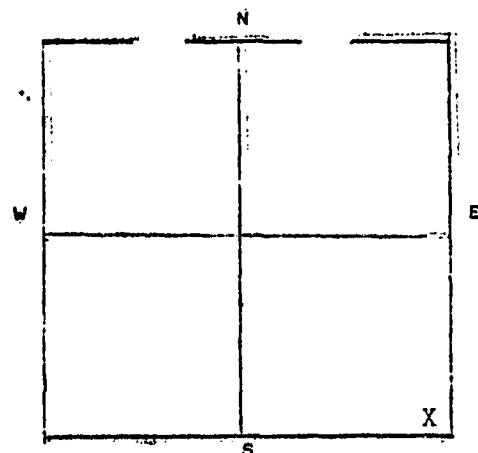

SEC 34 T 9N R 14E
INDICATE APPROPRIATION

2. THE BENEFICIAL USE ON WHICH THE CLAIM IS BASED livestock water (well)

3. DATE OR APPROXIMATE DATE OF EARLIEST BENEFICIAL USE; AND HOW CONTINUOUS THE USE HAS BEEN. 1915

4. THE AMOUNT OF GROUNDWATER CLAIMED (IN MINER INCHES OR GALLONS PER MINUTE 10 gal.

5. IF USED FOR IRRIGATION, GIVE THE ACREAGE AND DESCRIPTION OF THE LANDS TO WHICH WATER HAS BEEN APPLIED AND NAME OF THE OWNER THERE OF no

6. THE MEANS OF WITHDRAWING SUCH WATER FROM THE GROUND AND THE LOCATION OF EACH WELL OR OTHER MEANS OF WITHDRAWAL Pump - gas motor

7. THE DATE OF COMMENCEMENT AND THE COMPLETION OF THE CONSTRUCTION OF THE WELL, WELLS, OR OTHER WORKS FOR WITHDRAWAL OF GROUNDWATER 1915

8. DEPTH OF WATER TABLE 150 feet

9. SO FAR AS IT MAY BE AVAILABLE, THE TYPE, SIZE AND DEPTH OF EACH WELL OR THE GENERAL SPECIFICATIONS OF ANY OTHER WORKS FOR THE WITHDRAWAL OF GROUNDWATER 100 Feet - 6" casing, 50 feet - 5" casing

10. THE ESTIMATED AMOUNT OF GROUNDWATER WITHDRAWN EACH YEAR 100,000 gals

11. THE LOG OF FORMATIONS ENCOUNTERED IN THE DRILLING OF EACH WELL IF AVAILABLE none

12. SUCH OTHER INFORMATION OF A SIMILAR NATURE AS MAY BE USEFUL IN CARRYING OUT THE POLICY OF THIS ACT, INCLUDING REFERENCE PAGE OF COUNTY RECORDS AND BOOK NUMBER _____

SIGNATURE OF OWNER Muir Ranch Company
By: Nick Muir
DATE December 27, 1963

STATE OF MONTANA } ss.
COUNTY OF WHEATLAND }

Muir Ranch Company HAVING FIRST BEEN DULY SWORN, DEPOSES AND SAYS THAT they (is, are,) OF LAWFUL AGE AND (is, are) THE APPROPRIATOR s AND CLAIMANTS OF THE ORDER AND WATER RIGHT MENTIONED IN THE FOREGOING DECLARATION OF VESTED GROUNDWATER RIGHTS AND THE PERSONS WHOSE NAMES SUBSCRIBED THERETO, AS THE APPROPRIATOR s AND CLAIMANTS, THAT they KNOW THE CONTENTS OF SAID FOREGOING NOTICE AND THAT THE MATTERS AND THINGS THEREIN STATED ARE TRUE.

Muir Ranch Company,
By: Nick Muir

SUBSCRIBED AND SWORN TO BEFORE ME, THIS 27th DAY OF December, 1963

70463

Marian Langston
NOTARY PUBLIC FOR THE STATE OF MONTANA
RESIDING AT Harlowton, Montana
MY COMMISSION EXPIRES Sept. 3, 1966

FILED FOR RECORD ON THE 30 DAY OF Dec 1963 AT 11:28
O'CLOCK P M., AND RECORDED IN BOOK 82, PAGES 6 34502
RECORDS OF WHEATLAND COUNTY, MONTANA. Lucretia Nicks, Clerk & Recorder

FILE NO.

STATE OF MONTANA
ADMINISTRATOR OF GROUNDWATER CODE
OFFICE OF STATE ENGINEER

WHEATLAND COUNTY

JAN 29 1964

DECLARATION OF VESTED GROUNDWATER RIGHTS
(UNDER CHAPTER 237, MONTANA SESSION LAW 1963)

STATE ENGINEER

1. Muir Ranch Company OF Box 156 Harlowton, Montana
(NAME OF APPROPRIATOR) (ADDRESS) (TOWN)
COUNTY OF WHEATLAND, STATE OF MONTANA, HAVE APPROPRIATED GROUNDWATER ACCORD-
ING TO THE MONTANA LAWS IN EFFECT PRIOR TO JANUARY 1, 1962, AS FOLLOWS:

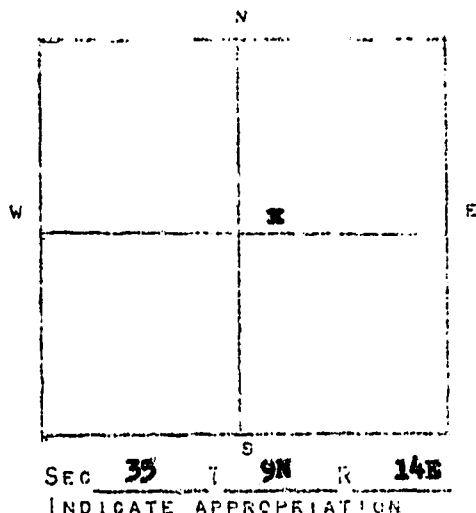

2. THE BENEFICIAL USE ON WHICH THE CLAIM IS
BASED livestock water (well)

3. DATE OR APPROXIMATE DATE OF EARLIER
BENEFICIAL USE; AND HOW CONTINUOUS THE USE
HAS BEEN. December 13, 1963

4. THE AMOUNT OF GROUNDWATER CLAIMED (IN
MINER INCHES OR GALLONS PER MINUTE 4 gal.

5. IF USED FOR IRRIGATION, GIVE THE ACREAGE
AND DESCRIPTION OF THE LANES TO WHICH WATER
HAS BEEN APPLIED AND NAME OF THE OWNER THERE
OF no

6. THE MEANS OF WITHDRAWING SUCH WATER FROM THE GROUND AND THE LOCATION OF
EACH WELL OR OTHER MEANS OF WITHDRAWAL Pump - gas motor

7. THE DATE OF COMMENCEMENT AND THE COMPLETION OF THE CONSTRUCTION OF THE
WELL, WELLS, OR OTHER WORKS FOR WITHDRAWAL OF GROUNDWATER From 11/15/63
to 12/13/63

8. DEPTH OF WATER TABLE Flow of water at 52 feet, water raises to 25 feet from top
of well.

9. SO FAR AS IT MAY BE AVAILABLE, THE TYPE, SIZE AND DEPTH OF EACH WELL, OR
THE GENERAL SPECIFICATIONS OF ANY OTHER WORKS FOR THE WITHDRAWAL OF GROUND-
WATER 55 feet of 6" casing, 10 feet of 5" casing, total of 65 feet

10. THE ESTIMATED AMOUNT OF GROUNDWATER WITHDRAWN EACH YEAR 100,000 gal.

11. THE LOG OF FORMATIONS ENCOUNTERED IN THE DRILLING OF EACH WELL IF AVAIL-
ABLE 0'-8' gravel; 8'-52' yellow shale; 52'-62' light gray shale; 62'-65' dark
gray shale.

12. SUCH OTHER INFORMATION OF A SIMILAR NATURE AS MAY BE USEFUL IN CARRYING
OUT THE POLICY OF THIS ACT, INCLUDING REFERENCE PAGE OF COUNTY RECORDS AND
BOOK NUMBER

SIGNATURE OF OWNER

Muir Ranch Company

By: Rick Muir

DATE December 27, 1963

STATE OF MONTANA SS
COUNTY OF WHEATLAND)

Muir Ranch Company

HAVING FIRST BEEN DULY SWORN, DEPOSES
AND SAYS THAT they (xx ARE) OF LAWFUL AGE AND (xx ARE) THE APPROPRIATOR
AND CLAIMANT a OF THE ORDER AND WATER RIGHT MENTIONED IN THE FOREGOING
DECLARATION OF VESTED GROUNDWATER RIGHTS AND THE PERSON a WHOSE NAMES
SUBSCRIBED THE ETC., AS THE APPROPRIATOR a AND CLAIMANT a, THAT they
KNOW THE CONTENTS OF SAID FOREGOING NOTICE AND THAT THE MATTERS AND THINGS
THEREIN STATED ARE TRUE.

Muir Ranch Company

By: Rick Muir

SUBSCRIBED AND SWORN TO BEFORE ME, THIS 27th DAY OF December, 1963.

Mariane Langston
NOTARY PUBLIC FOR THE STATE OF MONTANA
RESIDING AT Harlowton, Montana
My Commission Expires Sept. 3, 1966

FILED FOR RECORD ON THE 30 DAY OF Dec 19 63 AT 1:30
O'CLOCK P M., AND RECORDED IN BOOK 1582 PAGES 8
RECORDS OF WHEATLAND COUNTY, MONTANA.

Lucretia Hicks
CLERK AND RECORDER

34504

N 4
FILE NO. _____

T 9N R 14 E
WHEATLAND COUNTY

STATE OF MONTANA
ADMINISTRATOR OF GROUNDWATER CODE
OFFICE OF STATE ENGINEER

JAN 29 1964

DECLARATION OF VESTED GROUNDWATER RIGHTS
(UNDER CHAPTER 237, MONTANA SESSION LAWS, 1963) STATE ENGINEER

1. Muir Ranch Company, OF Box 156 Harlowton, Montana
(NAME OF APPROPRIATOR) (ADDRESS) (TOWN)
COUNTY OF WHEATLAND, STATE OF MONTANA, HAVE APPROPRIATED GROUNDWATER ACCORD-
ING TO THE MONTANA LAWS IN EFFECT PRIOR TO JANUARY 1, 1962, AS FOLLOWS:

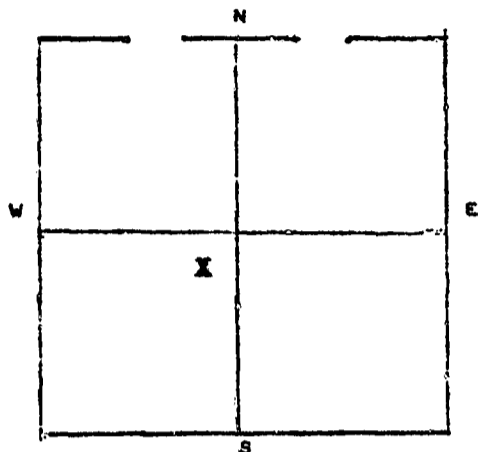

SEC 22 T 22 R 14E
INDICATE APPROPRIATION

2. THE BENEFICIAL USE ON WHICH THE CLAIM IS
BASED livestock water (well)

3. DATE OR APPROXIMATE DATE OF EARLIEST
BENEFICIAL USE; AND HOW CONTINUOUS THE USE
HAS BEEN. December 13, 1963

4. THE AMOUNT OF GROUNDWATER CLAIMED (IN
MINER INCHES OR GALLONS PER MINUTE 4 gal.

5. IF USED FOR IRRIGATION, GIVE THE ACREAGE
AND DESCRIPTION OF THE LANDS TO WHICH WATER
HAS BEEN APPLIED AND NAME OF THE OWNER THERE
OF no

6. THE MEANS OF WITHDRAWING SUCH WATER FROM THE GROUND AND THE LOCATION OF
EACH WELL OR OTHER MEANS OF WITHDRAWAL Pump - gas motor

7. THE DATE OF COMMENCEMENT AND THE COMPLETION OF THE CONSTRUCTION OF THE
WELL, WELLS, OR OTHER WORKS FOR WITHDRAWAL OF GROUNDWATER From 11/15/63 to 20
12/13/63

8. DEPTH OF WATER TABLE Flow of water at 60 feet raises to 20 feet from top of well

9. SO FAR AS IT MAY BE AVAILABLE, THE TYPE, SIZE AND DEPTH OF EACH WELL OR
THE GENERAL SPECIFICATIONS OF ANY OTHER WORKS FOR THE WITHDRAWAL OF GROUND-
WATER 90 feet - 6" casing

10. THE ESTIMATED AMOUNT OF GROUNDWATER WITHDRAWN EACH YEAR 100,00 gal.

11. THE LOG OF FORMATIONS ENCOUNTERED IN THE DRILLING OF EACH WELL IF AVAIL-
ABLE 0'-12' - gray shale; 12'-59' - yellow clay shale; 59'-63' - light gray shale; 63'-69' - light gray shale; 69'-78' - light gray shale; 78'-90' - dark gray shale.

12. SUCH OTHER INFORMATION OF A SIMILAR NATURE AS MAY BE USEFUL IN CARRYING
OUT THE POLICY OF THIS ACT, INCLUDING REFERENCE PAGE OF COUNTY RECORDS AND
BOOK NUMBER _____

SIGNATURE OF OWNER Muir Ranch Company
By: Nick Muir
DATE December 27, 1963

STATE OF MONTANA } ss.
COUNTY OF WHEATLAND }

Muir Ranch Company HAVING FIRST BEEN DULY SWORN, DEPOSES
AND SAYS THAT he (IS, ARE,) OF LAWFUL AGE AND (he, ARE) THE APPROPRIATOR and
AND CLAIMANT of the ORDER AND WATER RIGHT MENTIONED IN THE FOREGOING
DECLARATION OF VESTED GROUNDWATER RIGHTS AND THE PERSON whose NAMES
SUBSCRIBED THERETO, AS THE APPROPRIATOR and CLAIMANT is, THAT he knows
KNOW THE CONTENTS OF SAID FOREGOING NOTICE AND THAT THE MATTERS AND THINGS
THEREIN STATED ARE TRUE.

Muir Ranch Company
By: Nick Muir

SUBSCRIBED AND SWORN TO BEFORE ME, THIS 27th DAY OF December, 19 63

70468

Marion Langston
NOTARY PUBLIC FOR THE STATE OF MONTANA
RESIDING AT Harlowton, Montana
MY COMMISSION EXPIRES Sept. 3, 1966

FILED FOR RECORD ON THE 30 DAY OF Dec 19 63 AT 1:34
O'CLOCK P M., AND RECORDED IN BOOK 1582, PAGES 11

REGDROS OF WHEATLAND COUNTY, MONTANA.

Lucretia Hicks 345.7
CLERK AND RECORDER

GROUNDWATER INDEX

Page 1 of 1

County Wheatland Twp. 94 Pge. 15 E

[illegible]

GW 4

File No. _____

T 9-N R 15-E
WHEATLAND COUNTY, MONT

STATE OF MONTANA
ADMINISTRATOR OF GROUNDWATER CODE
OFFICE OF STATE ENGINEER

RECORDED
JAN 29 1964

DECLARATION OF VESTED GROUNDWATER RIGHTS
(UNDER CHAPTER 237, MONTANA SESSION LAWS, 1961)

1. HAROLD J LODE, OF HARLOWTON MONTANA
(NAME OF APPROPRIATOR) (ADDRESS) (TOWN)

COUNTY OF WHEATLAND, STATE OF MONTANA, HAVE APPROPRIATED GROUNDWATER ACCORDING TO THE MONTANA LAWS IN EFFECT PRIOR TO JANUARY 1, 1962, AS FOLLOWS:

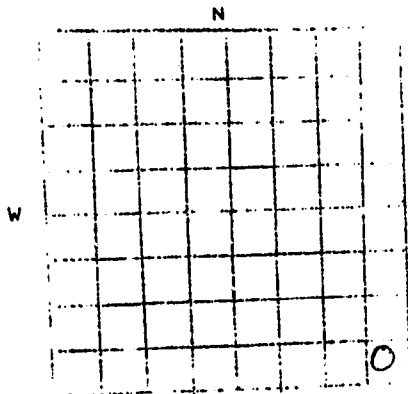

2. THE BENEFICIAL USE ON WHICH THE CLAIM IS BASED STOCK WATER

3. DATE OR APPROXIMATE DATE OF EARLIEST BENEFICIAL USE; AND HOW CONTINUOUS THE USE HAS BEEN SEPT 1945 - USED CONTINUOUSLY

4. THE AMOUNT OF GROUNDWATER CLAIMED (IN MINER INCHES OR GALLONS PER MINUTE) 10 GALS. PER MINUTE

5. IF USED FOR IRRIGATION, GIVE THE ACREAGE AND DESCRIPTION OF THE LANDS TO WHICH WATER HAS BEEN APPLIED AND NAME OF THE OWNER THEREOF _____

S.E. 1/4 SEC 7 T9N R15E

INDICATE POINT OF APPROPRIATION AND PLACE OF USE, IF POSSIBLE. EACH SMALL SQUARE REPRESENTS 10 ACRES.

6. THE MEANS OF WITHDRAWING SUCH WATER FROM THE GROUND AND THE LOCATION OF EACH WELL OR OTHER MEANS OF WITHDRAWAL WINDMILL + ELECTRIC PUMP

7. THE DATE OF COMMENCEMENT AND COMPLETION OF THE CONSTRUCTION OF THE WELL, WELLS, OR OTHER WORKS FOR WITHDRAWAL OF GROUNDWATER 1945

8. DEPTH OF WATER TABLE 100 FT

9. SO FAR AS IT MAY BE AVAILABLE, THE TYPE, SIZE AND DEPTH OF EACH WELL OR THE GENERAL SPECIFICATIONS OF ANY OTHER WORKS FOR THE WITHDRAWAL OF GROUNDWATER DRILLED, SIX INCH CASING, DEPTH 200 FT

10. THE ESTIMATED AMOUNT OF GROUNDWATER WITHDRAWN EACH YEAR 75,000 GALS.

11. THE LOG OF FORMATIONS ENCOUNTERED IN THE DRILLING OF EACH WELL IF AVAILABLE _____

12. SUCH OTHER INFORMATION OF A SIMILAR NATURE AS MAY BE USEFUL IN CARRYING OUT THE POLICY OF THIS ACT, INCLUDING REFERENCE PAGE OF COUNTY RECORDS AND BOOK NUMBER _____

STATE OF MONTANA)
COUNTY OF WHEATLAND)
: ss.

SIGNATURE OF OWNER Harold J Lode
DATE Dec 10 1963

Harold J Lode
AND SAYS THAT HE (IS, ARE,) OF LAWFUL AGE AND (IS ARE) THE APPROPRIATOR AND CLAIMANT OF THE ORDER AND WATER RIGHT MENTIONED IN THE FOREGOING

DECLARATION OF VESTED GROUNDWATER RIGHTS AND THE PERSON WHOSE NAME SUBSCRIBED THERETO, AS THE APPROPRIATOR AND CLAIMANT, THAT HE KNOW THE CONTENTS OF SAID FOREGOING NOTICE AND THAT THE MATTERS AND THINGS THEREIN STATED ARE TRUE.

SUBSCRIBED AND SWORN TO BEFORE ME, THIS 12 DAY OF Dec 1963

Lucretia Hicks Co Clerk
NOTARY PUBLIC FOR THE STATE OF MONTANA
RESIDING AT _____
MY COMMISSION EXPIRES _____

(FILE THREE COPIES OF THIS REPORT WITH THE COUNTY CLERK AND RECORDER, RETAIN THE 4th COPY FOR YOUR FILES.)

70286

State of Montana, }
County of Wheatland: } ss.

I hereby certify that the within
instrument was filed for record in this

office on the 12th day of

Dec 1963 at 4:14

o'clock P.M., and was duly recorded

in Book 15 of Water Rights

Page 477

Lucretia Hicks

County Recorder

By _____
Deputy Recorder

GW 4

FILE NO. _____

T. 9 N R. 15 E
WHEATLAND COUNTY, MONTSTATE OF MONTANA
ADMINISTRATOR OF GROUNDWATER CODE
OFFICE OF STATE ENGINEERDECLARATION OF VESTED GROUNDWATER RIGHTS
(UNDER CHAPTER 237, MONTANA SESSION LAWS, 1961)

JAN 29 1964

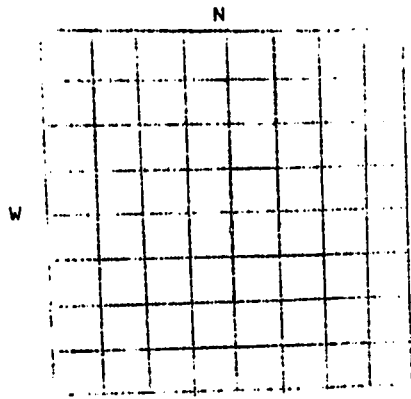
1. HAROLD J LODE, OF HARLOWTON MONTANA
(NAME OF APPROPRIATOR) (ADDRESS) (TOWN)COUNTY OF WHEATLAND, STATE OF MONTANA, HAVE APPROPRIATED GROUNDWATER ACCORD-
ING TO THE MONTANA LAWS IN EFFECT PRIOR TO JANUARY 1, 1962, AS FOLLOWS:2. THE BENEFICIAL USE ON WHICH THE CLAIM IS
BASED STOCK WATER (SPRING)3. DATE OR APPROXIMATE DATE OF EARLIEST BENE-
FICIAL USE; AND HOW CONTINUOUS THE USE HAS BEEN
1943 - RUNS CONTINUOUSLY - USED
INTERMITTENTLY4. THE AMOUNT OF GROUNDWATER CLAIMED (IN MINER
INCHES OR GALLONS PER MINUTE 15 GALS.5. IF USED FOR IRRIGATION, GIVE THE ACREAGE
AND DESCRIPTION OF THE LANDS TO WHICH WATER HAS
BEEN APPLIED AND NAME OF THE OWNER THEREOF _____N.E. 1/4 SEC 9 T9N R15EINDICATE POINT OF APPROPRIATION
AND PLACE OF USE, IF POSSIBLE.
EACH SMALL SQUARE REPRESENTS 10
ACRES.6. THE MEANS OF WITHDRAWING SUCH WATER FROM THE GROUND AND THE LOCATION OF
EACH WELL OR OTHER MEANS OF WITHDRAWAL PIPES TO TANKS7. THE DATE OF COMMENCEMENT AND COMPLETION OF THE CONSTRUCTION OF THE WELL,
WELLS, OR OTHER WORKS FOR WITHDRAWAL OF GROUNDWATER 1944

8. DEPTH OF WATER TABLE _____

9. SO FAR AS IT MAY BE AVAILABLE, THE TYPE, SIZE AND DEPTH OF EACH WELL OR
THE GENERAL SPECIFICATIONS OF ANY OTHER WORKS FOR THE WITHDRAWAL OF GROUND-
WATER _____10. THE ESTIMATED AMOUNT OF GROUNDWATER WITHDRAWN EACH YEAR _____
5,000,000 - GALS.11. THE LOG OF FORMATIONS ENCOUNTERED IN THE DRILLING OF EACH WELL IF AVAIL-
ABLE _____12. SUCH OTHER INFORMATION OF A SIMILAR NATURE AS MAY BE USEFUL IN CARRYING
OUT THE POLICY OF THIS ACT, INCLUDING REFERENCE PAGE OF COUNTY RECORDS AND
BOOK NUMBER _____STATE OF MONTANA)
: SS.

COUNTY OF WHEATLAND)

Harold J. LodeHAROLD J. LODE, HAVING FIRST BEEN DULY SWORN, DEPOSES
AND SAYS THAT HE (IS, ARE,) OF LAWFUL AGE AND (IS ARE) THE APPROPRIATOR
AND CLAIMANT _____ OF THE ORDER AND WATER RIGHT MENTIONED IN THE FOREGOING
DECLARATION OF VESTED GROUNDWATER RIGHTS AND THE PERSON _____ WHOSE NAME
SUBSCRIBED THERETO, AS THE APPROPRIATOR _____ AND CLAIMANT _____, THAT HE
KNOW _____ THE CONTENTS OF SAID FOREGOING NOTICE AND THAT THE MATTERS AND
THINGS THEREIN STATED ARE TRUE.SUBSCRIBED AND SWORN TO BEFORE ME, THIS 12 DAY OF FEES 1963Lucretia Hicks, Co Clerk
NOTARY PUBLIC FOR THE STATE OF MONTANA
RESIDING AT _____
MY COMMISSION EXPIRES _____(FILE THREE COPIES OF THIS REPORT WITH THE COUNTY CLERK AND RECORDER, RE-
TAIN THE 4th COPY FOR YOUR FILES.)

34359

70287

State of Montana.
County of Wheatland.
I, _____, hereby certify

State of Montana
County of Wheatland
I hereby certify that the within
instrument was filed for record in this
12th day of

office on the 12th day of 63 at 4.

o'clock. 15 M. an

In Book

In Book
Page 478

Book 478
Lucretia Nick
County Recorder

By

Deputy Recorder

GW 4
FILE NO. _____

T 9 R 15
WHEATLAND COUNTY

STATE OF MONTANA
ADMINISTRATOR OF GROUNDWATER CODE
OFFICE OF STATE ENGINEER

DECLARATION OF VESTED GROUNDWATER RIGHTS

(UNDER CHAPTER 237, MONTANA SESSION LAWS, 1961)

JAN 29 1964

H.A. Butgens OF Harlemont STATE ENGINEER
(NAME OF APPROPRIATOR) (ADDRESS) (TOWN)

COUNTY OF WHEATLAND, STATE OF MONTANA, HAVE APPROPRIATED GROUNDWATER ACCORDING TO THE MONTANA LAWS IN EFFECT PRIOR TO JANUARY 1, 1962, AS FOLLOWS:

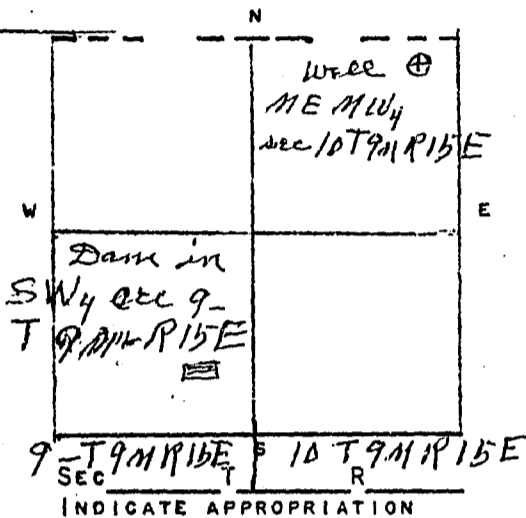

2. THE BENEFICIAL USE ON WHICH THE CLAIM IS BASED Water for cattle

3. DATE OR APPROXIMATE DATE OF EARLIEST BENEFICIAL USE; AND HOW CONTINUOUS THE USE HAS BEEN. Well 1915 Dam 1942

4. THE AMOUNT OF GROUNDWATER CLAIMED (IN MINER INCHES OR GALLONS PER MINUTE _____

5. IF USED FOR IRRIGATION, GIVE THE ACREAGE AND DESCRIPTION OF THE LANDS TO WHICH WATER HAS BEEN APPLIED AND NAME OF THE OWNER THERE OF _____

6. THE MEANS OF WITHDRAWING SUCH WATER FROM THE GROUND AND THE LOCATION OF EACH WELL OR OTHER MEANS OF WITHDRAWAL Well windmill or engine Dam from floodwater Well ME ME4 sec 10-T9 R15 E

7. THE DATE OF COMMENCEMENT AND THE COMPLETION OF THE CONSTRUCTION OF THE WELL, WELLS, OR OTHER WORKS FOR WITHDRAWAL OF GROUNDWATER Well 1915 Dam 1942

8. DEPTH OF WATER TABLE 2

9. SO FAR AS IT MAY BE AVAILABLE, THE TYPE, SIZE AND DEPTH OF EACH WELL OR THE GENERAL SPECIFICATIONS OF ANY OTHER WORKS FOR THE WITHDRAWAL OF GROUNDWATER Well around 100 ft common well pipe

10. THE ESTIMATED AMOUNT OF GROUNDWATER WITHDRAWN EACH YEAR use well when dam dry

11. THE LOG OF FORMATIONS ENCOUNTERED IN THE DRILLING OF EACH WELL IF AVAILABLE _____

12. SUCH OTHER INFORMATION OF A SIMILAR NATURE AS MAY BE USEFUL IN CARRYING OUT THE POLICY OF THIS ACT, INCLUDING REFERENCE PAGE OF COUNTY RECORDS AND BOOK NUMBER _____

SIGNATURE OF OWNER H.A. Butgens
DATE Dec 30 1963

STATE OF MONTANA } ss.
COUNTY OF WHEATLAND }

H.A. Butgens HAVING FIRST BEEN DULY SWORN, DEPOSES AND SAYS THAT HE (IS, ARE,) OF LAWFUL AGE AND (IS, ARE) THE APPROPRIATOR AND CLAIMANT OF THE ORDER AND WATER RIGHT MENTIONED IN THE FOREGOING DECLARATION OF VESTED GROUNDWATER RIGHTS AND THE PERSON WHOSE NAMES SUBSCRIBED THERETO, AS THE APPROPRIATOR AND CLAIMANT, THAT HE KNOW THE CONTENTS OF SAID FOREGOING NOTICE AND THAT THE MATTERS AND THINGS THEREIN STATED ARE TRUE.

SUBSCRIBED AND SWORN TO BEFORE ME, THIS 31 DAY OF December, 1963

Lucinda Hicks Clerk
NOTARY PUBLIC FOR THE STATE OF MONTANA
RESIDING AT _____
MY COMMISSION EXPIRES _____

FILED FOR RECORD ON THE 31 DAY OF Dec, 1963 AT 10:44

O'CLOCK AM, AND RECORDED IN BOOK 82, PAGES 251

RECORDS OF WHEATLAND COUNTY, MONTANA. Lucinda Hicks Clerk & Recorder 34728

70698

GW 4
FILE NO.

STATE OF MONTANA
ADMINISTRATOR OF GROUNDWATER CODE
OFFICE OF STATE ENGINEER
* * * *

WHEATLAND COUNTY

RECEIVED
FEB 3 1964

DECLARATION OF VESTED GROUNDWATER RIGHTS
(UNDER CHAPTER 237, MONTANA SESSION LAWS, 1961) STATE ENGINEER

1. Rachel McConnell Dahl OF Harlowton, Montana
(NAME OF APPROPRIATOR) (ADDRESS) (TOWN)

COUNTY OF WHEATLAND, STATE OF MONTANA, HAVE APPROPRIATED GROUNDWATER ACCORD-
ING TO THE MONTANA LAWS IN EFFECT PRIOR TO JANUARY 1, 1962, AS FOLLOWS:

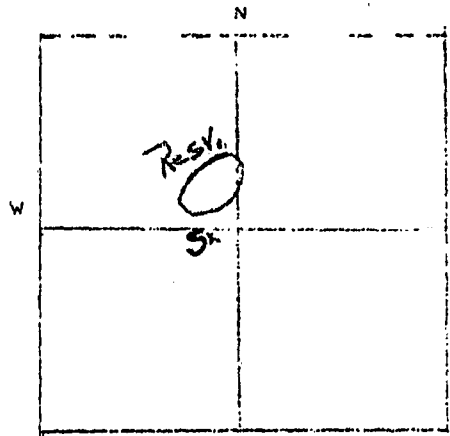

SEC T R
INDICATE APPROPRIATION

2. THE BENEFICIAL USE ON WHICH THE CLAIM IS
BASED Stock water

3. DATE OR APPROXIMATE DATE OF EARLIEST
BENEFICIAL USE; AND HOW CONTINUOUS THE USE
HAS BEEN 1931 continuous use

4. THE AMOUNT OF GROUNDWATER CLAIMED (IN
MINER INCHES OR GALLONS PER MINUTE
12 gal. per minute

5. IF USED FOR IRRIGATION, GIVE THE ACREAGE
AND DESCRIPTION OF THE LANDS TO WHICH WATER
HAS BEEN APPLIED AND NAME OF THE OWNER THERE

6. THE MEANS OF WITHDRAWING SUCH WATER FROM THE GROUND AND THE LOCATION OF
EACH WELL OR OTHER MEANS OF WITHDRAWAL Dams - adjacent springs

7. THE DATE OF COMMENCEMENT AND THE COMPLETION OF THE CONSTRUCTION OF THE
WELL, WELLS, OR OTHER WORKS FOR WITHDRAWAL OF GROUNDWATER

8. DEPTH OF WATER TABLE

9. SO FAR AS IT MAY BE AVAILABLE, THE TYPE, SIZE AND DEPTH OF EACH WELL OR
THE GENERAL SPECIFICATIONS OF ANY OTHER WORKS FOR THE WITHDRAWAL OF GROUND-
WATER

10. THE ESTIMATED AMOUNT OF GROUNDWATER WITHDRAWN EACH YEAR

11. THE LOG OF FORMATIONS ENCOUNTERED IN THE DRILLING OF EACH WELL IF AVAIL-
ABLE

12. SUCH OTHER INFORMATION OF A SIMILAR NATURE AS MAY BE USEFUL IN CARRYING
OUT THE POLICY OF THIS ACT, INCLUDING REFERENCE PAGE OF COUNTY RECORDS AND
BOOK NUMBER

SIGNATURE OF OWNER Rachel McConnell Dahl
DATE Dec. 27, 1963

STATE OF MONTANA) SS.
COUNTY OF WHEATLAND;

Rachel McConnell Dahl

HAVING FIRST BEEN DULY SWORN, DEPOSES
AND SAYS THAT SHE (IS, ARE,) OF LAWFUL AGE AND () (BE) THE APPROPRIATOR
AND CLAIMANT OF THE ORDER AND WATER RIGHT MENT ED IN THE FOREGOING
DECLARATION OF VESTED GROUNDWATER RIGHTS AND THE PERSON WHOSE NAMES is
SUBSCRIBED HERETO, AS THE APPROPRIATOR AND CLAIMANT, THAT SHE
KNOWS THE CONTENTS OF SAID FOREGOING NOTICE AND THAT THE MATTERS AND THINGS
THEREIN STATED ARE TRUE.

SUBSCRIBED AND SWORN TO BEFORE ME, THIS 31 DAY OF December, 1963

70601

Lucretia Hicks, Co. Clerk
NOTARY PUBLIC FOR THE STATE OF MONTANA
RESIDING AT
MY COMMISSION EXPIRES

FILED FOR RECORD ON THE 31 DAY OF Dec 19 63 AT 9:03
O'CLOCK a M., AND RECORDED IN BOOK 82, PAGES 149-150
RECORDS OF WHEATLAND COUNTY, MONTANA.

Lucretia Hicks, Co. Clerk

34806

GW 4
FILE NO.

12-9-15

12-9-15-6
WHEATLAND COUNTY

STATE OF MONTANA
ADMINISTRATOR OF GROUNDWATER CODE
OFFICE OF STATE ENGINEER

RECEIVED
JAN 29 1964

DECLARATION OF VESTED GROUNDWATER RIGHTS
(UNDER CHAPTER 237, MONTANA SESSION LAWS 1961)

1. Rachel McConnell Dahl OF Harlowton Montana
(NAME OF APPROPRIATOR) (ADDRESS) (TOWN)

COUNTY OF WHEATLAND, STATE OF MONTANA, HAVE APPROPRIATED GROUNDWATER ACCORD-
ING TO THE MONTANA LAWS IN EFFECT PRIOR TO JANUARY 1, 1962, AS FOLLOWS:

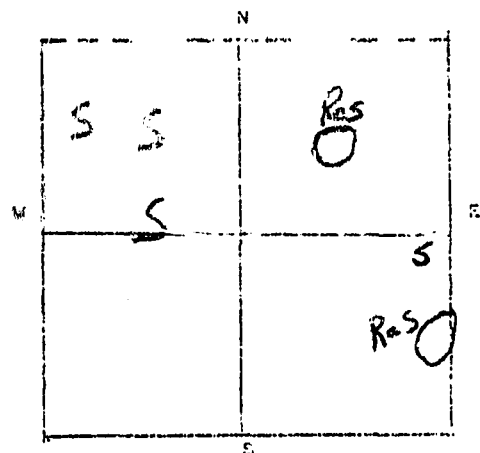

SEC T R
INDICATE APPROPRIATION

2. THE BENEFICIAL USE ON WHICH THE CLAIM IS
BASED Stock water

3. DATE OR APPROXIMATE DATE OF EARLIES
BENEFICIAL USE; AND HOW CONTINUOUS THE USE
HAS BEEN. 1939 Continuous use

4. THE AMOUNT OF GROUNDWATER CLAIMED (IN
MINER INCHES OR GALLONS PER MINUTE 15 gal. per min.

5. USED FOR IRRIGATION, GIVE THE ACREAGE
AND DESCRIPTION OF THE LANDS TO WHICH WATER
HAS BEEN APPLIED AND NAME OF THE OWNER THERE

6. THE MEANS OF WITHDRAWING SUCH WATER FROM THE GROUND AND THE LOCATION OF
EACH WELL OR OTHER MEANS OF WITHDRAWAL. Dam & adjacent springs

7. THE RATE OF COMMENCEMENT AND THE COMPLETION OF THE CONSTRUCTION OF THE
WELL, WELLS, OR OTHER WORKS FOR WITHDRAWAL OF GROUNDWATER

8. DEPTH OF WATER TABLE

9. SO FAR AS IT MAY BE AVAILABLE, THE TYPE, SIZE AND DEPTH OF EACH WELL OR
THE GENERAL SPECIFICATIONS OF ANY OTHER WORKS FOR THE WITHDRAWAL OF GROUND-
WATER

10. THE ESTIMATED AMOUNT OF GROUND WATER WITHDRAWN EACH YEAR

11. THE LOG OF FORMATIONS ENCOUNTERED IN THE DRILLING OF EACH WELL IF AVAIL-
ABLE

12. SUCH OTHER INFORMATION OF A SIMILAR NATURE AS MAY BE USEFUL IN CARRYING
OUT THE POLICY OF THIS ACT, INCLUDING REFERENCE PAGE OF COUNTY RECORDS AND
BOOK NUMBER

SIGNATURE OF OWNER Rachel McConnell Dahl
DATE Dec. 22, 1963

STATE OF MONTANA } ss.
COUNTY OF WHEATLAND }

Rachel McConnell Dahl HAVING FIRST BEEN DULY SWORN, DEPOSES
AND SAYS THAT SHE (IS, ARE) OF LAWFUL AGE AND (IS, ARE) THE APPROPRIATOR
AND CLAIMANT OF THE ORDER AND WATER RIGHT MENTIONED IN THE FOREGOING
DECLARATION OF VESTED GROUNDWATER RIGHTS AND THE PERSON WHOSE NAME is
SUBSCRIBED THERE TO, AS THE APPROPRIATOR AND CLAIMANT, THAT HE
KNOWS THE CONTENTS OF SAID FOREGOING NOTICE AND THAT THE MATTERS AND THINGS
THEREIN STATED ARE TRUE

SUBSCRIBED AND SWORN TO BEFORE ME, THIS 30th DAY OF December, 1963

Lucretia Hicks, Co Clerk
NOTARY PUBLIC FOR THE STATE OF MONTANA
RESIDING AT
M. COMMISSION EXPIRES

76597
FILED FOR RECORD ON THE 31 DAY OF December, 1963 AT 8:59
O'CLOCK a M., AND RECORDED IN BOOK 82, PAGES 145
RECORDS OF WHEATLAND COUNTY, MONTANA.

Lucretia Hicks, Clerk & Recorder
CLERK AND RECORDER

County Wheatland

MONTANA BUREAU OF MINES AND GEOLOGY
Butte, Montana

RECEIVED
AUG 14 1961

WATER WELL LOG

STATE ENGINEER

Owner **Robert E. Fulton** Address **Harlowton, Montana**

Driller *Don Butler* Address *Harborton Mont.*

Date Started **July 14, 1961** Date Completed **July 31, 1961**

Location: Sec. **13** T. **9** R. **15** $\frac{1}{4}$ sec. **58**

Type of well Drilled Equipment used Cable Tool
(Dug, driven, bored, or drilled) (Shurn, drill, rotary, other)

Water use: Domestic ☐ Municipal ☐ Stock ☒ Irrigation ☐
Industrial ☐ Drainage ☐ Other _____

Casing: 1 ft. to 101 ft. Type ~~Galvanneal~~ Size 6"

Casing: 1 ft. to 23 ft. Type Iron Size 8"

Casing: _____ ft. to _____ ft. Type _____ Size _____

Perforated or Screened: Ft. _____ to ft. _____. Ft. _____ to ft. _____.

Type of screen or perforations _____

Static Water level, for non-flowing well: _____ feet.

Shut-in pressure, for flowing well: _____ lb./sq. in. on: _____ (date)

Pumping water level 60 ft. feet at 7 Gal gal. per min.

How tested: **Bailer**

Length of test 4 Hrs.

Remarks: (Gravel packing, cementing, packers, type of shut-off, depth of shut-off)

(over)

Log of Well

[illegible]

GW 4

FILE NO. _____

9N 15E
WHEATLAND COUNTYSTATE OF MONTANA
ADMINISTRATOR OF GROUNDWATER CODE
OFFICE OF STATE ENGINEER

JAN 29 1964

DECLARATION OF VESTED GROUNDWATER RIGHTS
(UNDER CHAPTER 237, MONTANA SESSION LAWS, 1961)

1. **ROBERT E. FULTON** OF **HARLOWTON, MONTANA**
(NAME OF APPROPRIATOR) (ADDRESS) (TOWN)
COUNTY OF WHEATLAND, STATE OF MONTANA, HAVE APPROPRIATED GROUNDWATER ACCORD-
ING TO THE MONTANA LAWS IN EFFECT PRIOR TO JANUARY 1, 1962, AS FOLLOWS:

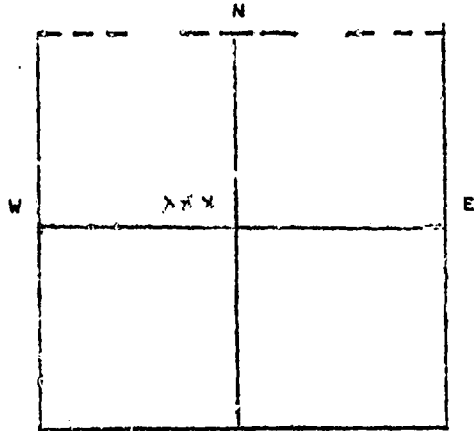

2. THE BENEFICIAL USE ON WHICH THE CLAIM IS
BASED **Stock Water**

3. DATE OR APPROXIMATE DATE OF EARLIEST
BENEFICIAL USE; AND HOW CONTINUOUS THE USE
HAS BEEN. **1930 - Continuous Use**

4. THE AMOUNT OF GROUNDWATER CLAIMED (IN
MINER INCHES OR GALLONS PER MINUTE **20 gallons per minute**

5. IF USED FOR IRRIGATION, GIVE THE ACREAGE
AND DESCRIPTION OF THE LANDS TO WHICH WATER
HAS BEEN APPLIED AND NAME OF THE OWNER THERE
OF _____

SE 1/4 SEC 13 T 9N R 15E
INDICATE APPROPRIATION

6. THE MEANS OF WITHDRAWING SUCH WATER FROM THE GROUND AND THE LOCATION OF
EACH WELL OR OTHER MEANS OF WITHDRAWAL **Spring - natural artesian flow**

7. THE DATE OF COMMENCEMENT AND THE COMPLETION OF THE CONSTRUCTION OF THE
WELL, WELLS, OR OTHER WORKS FOR WITHDRAWAL OF GROUNDWATER _____

8. DEPTH OF WATER TABLE **Spring - natural flow**

9. SO FAR AS IT MAY BE AVAILABLE, THE TYPE, SIZE AND DEPTH OF EACH WELL OR
THE GENERAL SPECIFICATIONS OF ANY OTHER WORKS FOR THE WITHDRAWAL OF GROUND-
WATER **unimproved**

10. THE ESTIMATED AMOUNT OF GROUNDWATER WITHDRAWN EACH YEAR
approximately 1,000,000 gallons per year

11. THE LOG OF FORMATIONS ENCOUNTERED IN THE DRILLING OF EACH WELL IF AVAIL-
ABLE **Spring - Natural Flow**

12. SUCH OTHER INFORMATION OF A SIMILAR NATURE AS MAY BE USEFUL IN CARRYING
OUT THE POLICY OF THIS ACT, INCLUDING REFERENCE PAGE OF COUNTY RECORDS AND
BOOK NUMBER _____

SIGNATURE OF OWNER Robert E. Fulton
DATE **December 31, 1963**

STATE OF MONTANA } ss.
COUNTY OF WHEATLAND }

ROBERT E. FULTON

HAVING FIRST BEEN DULY SWORN, DEPOSES
AND SAYS THAT HE (IS, ARE,) OF LAWFUL AGE AND (IS, ARE) THE APPROPRIATOR
AND CLAIMANT OF THE ORDER AND WATER RIGHT MENTIONED IN THE FOREGOING
DECLARATION OF VESTED GROUNDWATER RIGHTS AND THE PERSON WHOSE NAMES
SUBSCRIBED THERETO, AS THE APPROPRIATOR AND CLAIMANT, THAT HE
KNOWS THE CONTENTS OF SAID FOREGOING NOTICE AND THAT THE MATTERS AND THINGS
THEREIN STATED ARE TRUE.

SUBSCRIBED AND SWORN TO BEFORE ME, THIS **31st** DAY OF **December**, 19 **63**

Robert E. Fulton
NOTARY PUBLIC FOR THE STATE OF MONTANA
RESIDING AT **Harlowton, Montana**
MY COMMISSION EXPIRES **Nov. 19, 1964**

FILED FOR RECORD ON THE **31** DAY OF **Dec** 19 **63** AT **9:20**
O'CLOCK **2** M., AND RECORDED IN BOOK **82**, PAGES **175**
RECORDS OF WHEATLAND COUNTY, MONTANA.

Loretta Hicks
CLERK AND RECORDER

34654

FILE NO. _____

STATE OF MONTANA
ADMINISTRATOR OF GROUNDWATER CODE
OFFICE OF STATE ENGINEER

14 9 N 15-6 14
WHEATLAND COUNTY

JAN 29 1964

DECLARATION OF VESTED GROUNDWATER RIGHTS
(UNDER CHAPTER 237, MONTANA SESSION LAWS, 1961)

1. Rachel McConnell Dahl OF Harlowton, Mont.
(NAME OF APPROPRIATOR) (ADDRESS) (TOWN)

COUNTY OF WHEATLAND, STATE OF MONTANA, HAVE APPROPRIATED GROUNDWATER ACCORDING TO THE MONTANA LAWS IN EFFECT PRIOR TO JANUARY 1, 1962, AS FOLLOWS:

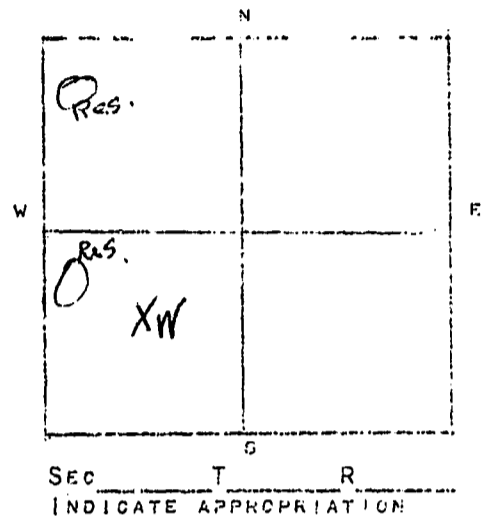

2. THE BENEFICIAL USE ON WHICH THE CLAIM IS BASED Stock water

3. DATE OR APPROXIMATE DATE OF EARLIEST BENEFICIAL USE; AND HOW CONTINUOUS THE USE HAS BEEN. 1947 continuous use

4. THE AMOUNT OF GROUNDWATER CLAIMED (IN MINER INCHES OR GALLONS PER MINUTE) 5 gal per min

5. IF USED FOR IRRIGATION, GIVE THE ACREAGE AND DESCRIPTION OF THE LANDS TO WHICH WATER HAS BEEN APPLIED AND NAME OF THE OWNER THERE

6. THE MEANS OF WITHDRAWING SUCH WATER FROM THE GROUND AND THE LOCATION OF EACH WELL OR OTHER MEANS OF WITHDRAWAL well, dam

7. THE DATE OF COMMENCEMENT AND THE COMPLETION OF THE CONSTRUCTION OF THE WELL, WELLS, OR OTHER WORKS FOR WITHDRAWAL OF GROUNDWATER

8. DEPTH OF WATER TABLE

9. SO FAR AS IT MAY BE AVAILABLE, THE TYPE, SIZE AND DEPTH OF EACH WELL OR THE GENERAL SPECIFICATIONS OF ANY OTHER WORKS FOR THE WITHDRAWAL OF GROUNDWATER Depth 100' size casing 6" shale & clay.

10. THE ESTIMATED AMOUNT OF GROUNDWATER WITHDRAWN EACH YEAR

11. THE LOG OF FORMATIONS ENCOUNTERED IN THE DRILLING OF EACH WELL IF AVAILABLE

12. SUCH OTHER INFORMATION OF A SIMILAR NATURE AS MAY BE USEFUL IN CARRYING OUT THE POLICY OF THIS ACT, INCLUDING REFERENCE PAGE OF COUNTY RECORDS AND BOOK NUMBER

SIGNATURE OF OWNER Rachel McConnell Dahl

DATE Dec. 27, 1963

STATE OF MONTANA) ss.
COUNTY OF WHEATLAND)

Rachel McConnell Dahl

HAVING FIRST BEEN DULY SWORN, DEPOSES AND SAYS THAT HE (SHE, ARE,) OF LAWFUL AGE AND (SHE, ARE,) THE APPROPRIATOR AND CLAIMANT OF THE ORDER AND WATER RIGHT MENTIONED IN THE FOREGOING DECLARATION OF VESTED GROUNDWATER RIGHTS AND THE PERSON WHOSE NAMES SUBSCRIBED THEREON, AS THE APPROPRIATOR AND CLAIMANT, THAT HE KNOWS THE CONTENTS OF SAID FOREGOING NOTICE AND THAT THE MATTERS AND THINGS THEREIN STATED ARE TRUE.

SUBSCRIBED AND SWORN TO BEFORE ME, THIS 30th DAY OF December, 1963.

Rachel McConnell Dahl

Lucretia Hicks Co Clerk
NOTARY PUBLIC FOR THE STATE OF MONTANA

RESIDING _____
MY COMMISSION EXPIRES _____

70594
FILED FOR RECORD ON THE 31 DAY OF December 1963 AT 8:56 O'CLOCK A M., AND RECORDED IN BOOK 82 PAGES 142
RECORDS OF WHEATLAND COUNTY, MONTANA.

Lucretia Hicks
Clerk & Recorder
CLERK AND RECORDER

34631

GV 4

FILE NO.

9 N R 15 E 16
WHEATLAND COUNTY
9 M 15 E

STATE OF MONTANA
ADMINISTRATOR OF GROUNDWATER CODE
OFFICE OF STATE ENGINEER
* * * *

DECLARATION OF VESTED GROUNDWATER RIGHTS
(UNDER CHAPTER 237, MONTANA SESSION LAWS, 1961)

JAN 29 1964
STATE ENGINEER

1. I, W. B. Britton (NAME OF APPLICATOR) OF Montana (ADDRESS) COUNTY OF WHEATLAND, MONTANA, HAVE APPROPRIATED GROUNDWATER ACCORDING TO THE MONTANA LAWS IN EFFECT PRIOR TO JANUARY 1, 1962, AS FOLLOWS:

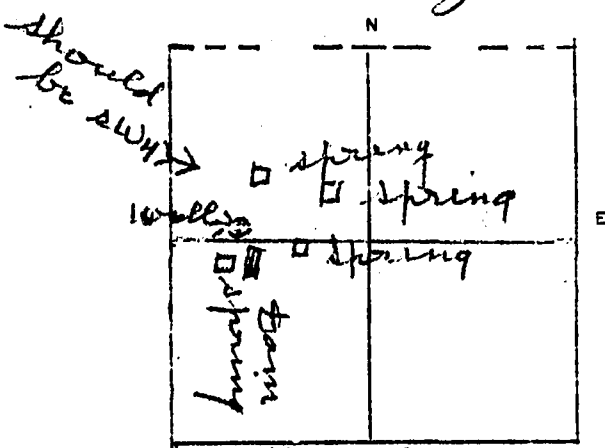

SEC. 16 T. 9 N R. 15 E
INDICATE APPROPRIATION 15 E

2. THE BENEFICIAL USE ON WHICH THE CLAIM IS BASED _____

3. DATE OR APPROXIMATE DATE OF EARLIEST BENEFICIAL USE, AND HOW CONTINUOUS THE USE HAS BEEN. for water for live stock

4. THE AMOUNT OF GROUNDWATER CLAIMED (IN MINER INCHES OR GALLONS PER MINUTE) 15-18-19-24

5. IF USED FOR IRRIGATION, GIVE THE ACREAGE AND DESCRIPTION OF THE LANDS TO WHICH WATER HAS BEEN APPLIED AND NAME OF THE OWNER THERE OF _____

6. THE MEANS OF WITHDRAWING SUCH WATER FROM THE GROUND AND THE LOCATION OF EACH WELL OR OTHER MEANS OF WITHDRAWAL _____

7. THE DATE OF COMMENCEMENT AND THE COMPLETION OF THE CONSTRUCTION OF THE WELL, WELLS, OR OTHER WORKS FOR WITHDRAWAL OF GROUNDWATER _____

8. DEPTH OF WATER TABLE Dam 1718 well 1922

9. SO FAR AS IT MAY BE AVAILABLE, THE TYPE, SIZE AND DEPTH OF EACH WELL OR THE GENERAL SPECIFICATIONS OF ANY OTHER WORKS FOR THE WITHDRAWAL OF GROUNDWATER _____

10. THE ESTIMATED AMOUNT OF GROUNDWATER WITHDRAWN EACH YEAR 12

11. THE LOG OF FORMATIONS ENCOUNTERED IN THE DRILLING OF EACH WELL IF AVAILABLE used for house

12. SUCH OTHER INFORMATION OF A SIMILAR NATURE AS MAY BE USEFUL IN CARRYING OUT THE POLICY OF THIS ACT, INCLUDING REFERENCE PAGE OF COUNTY RECORDS AND BOOK NUMBER _____

SIGNATURE OF OWNER _____

DATE W. B. Britton
Dec 31 63

STATE OF MONTANA } ss.
COUNTY OF WHEATLAND }

W. B. Britton

HAVING FIRST BEEN DULY SWORN, DEPOSES AND SAYS THAT HE (IS, ARE,) OF LAWFUL AGE AND (IS, ARE) THE APPROPRIATOR AND CLAIMANT OF THE ORDER AND WATER RIGHT MENTIONED IN THE FOREGOING DECLARATION OF VESTED GROUNDWATER RIGHTS AND THE PERSON WHOSE NAMES SUBSCRIBED THERETO, AS THE APPROPRIATOR AND CLAIMANT, THAT HE KNOW THE CONTENTS OF SAID FOREGOING NOTICE AND THAT THE MATTERS AND THINGS THEREIN STATED ARE TRUE.

SUBSCRIBED AND SWORN TO BEFORE ME, THIS 31 DAY OF Dec 1963
Lucilia Neaks

NOTARY PUBLIC FOR THE STATE OF MONTANA
RESIDING AT _____
MY COMMISSION EXPIRES 10-31-68

70696

FILED FOR RECORD ON THE 31 DAY OF Dec 1963 AT 82
O'CLOCK 9 M., AND RECORDED IN BOOK 249, PAGES 249
RECORDS OF WHEATLAND COUNTY, MONTANA. Lucilia Neaks

CLERK AND RECORDER

34726

GW 4

File No. _____

T. 9N R. 15E 17
WHEATLAND COUNTY, MONTSTATE OF MONTANA
ADMINISTRATOR OF GROUNDWATER CODE
OFFICE OF STATE ENGINEER

JAN 29 1964

DECLARATION OF VESTED GROUNDWATER RIGHTS
(UNDER CHAPTER 237, MONTANA SESSION LAWS, 1961) SIDE ENGINEER1. HAROLD J LODE, OF HARLOWTON MONTANA
(NAME OF APPROPRIATOR) (ADDRESS) (TOWN)

COUNTY OF WHEATLAND, STATE OF MONTANA, HAVE APPROPRIATED GROUNDWATER ACCORDING TO THE MONTANA LAWS IN EFFECT PRIOR TO JANUARY 1, 1962, AS FOLLOWS:

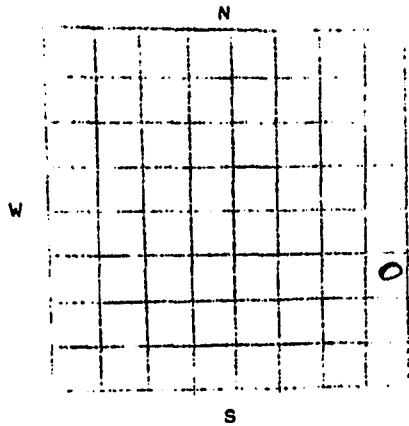
2. THE BENEFICIAL USE ON WHICH THE CLAIM IS BASED STOCK WATER (SPRING)3. DATE OR APPROXIMATE DATE OF EARLIEST BENEFICIAL USE; AND HOW CONTINUOUS THE USE HAS BEEN: LAND ACQUIRED 1943 - USED INTERMITTENTLY RUNS CONTINUOUSLY4. THE AMOUNT OF GROUNDWATER CLAIMED (IN MINER INCHES OR GALLONS PER MINUTE) 10 GALS.

5. IF USED FOR IRRIGATION, GIVE THE ACREAGE AND DESCRIPTION OF THE LANDS TO WHICH WATER HAS BEEN APPLIED AND NAME OF THE OWNER THEREOF _____

S.E. 1/4 SEC. 17 T9N R15E

INDICATE POINT OF APPROPRIATION _____

AND PLACE OF USE, IF POSSIBLE. _____

EACH SMALL SQUARE REPRESENTS 10 ACRES.

6. THE MEANS OF WITHDRAWING SUCH WATER FROM THE GROUND AND THE LOCATION OF EACH WELL OR OTHER MEANS OF WITHDRAWAL PIPES TO TANKS7. THE DATE OF COMMENCEMENT AND COMPLETION OF THE CONSTRUCTION OF THE WELL, WELLS, OR OTHER WORKS FOR WITHDRAWAL OF GROUNDWATER 1945

8. DEPTH OF WATER TABLE _____

9. SO FAR AS IT MAY BE AVAILABLE, THE TYPE, SIZE AND DEPTH OF EACH WELL OR THE GENERAL SPECIFICATIONS OF ANY OTHER WORKS FOR THE WITHDRAWAL OF GROUNDWATER _____

10. THE ESTIMATED AMOUNT OF GROUNDWATER WITHDRAWN EACH YEAR _____

250,000 GALS.

11. THE LOG OF FORMATIONS ENCOUNTERED IN THE DRILLING OF EACH WELL IF AVAILABLE _____

12. SUCH OTHER INFORMATION OF A SIMILAR NATURE AS MAY BE USEFUL IN CARRYING OUT THE POLICY OF THIS ACT, INCLUDING REFERENCE PAGE OF COUNTY RECORDS AND BOOK NUMBER _____

STATE OF MONTANA) SIGNATURE OF OWNER Harold J Lode
DATE Feb. 10 1963

COUNTY OF WHEATLAND)

Harold J Lode HAVING FIRST BEEN DULY SWORN, DEPOSES AND SAYS THAT HE (IS, ARE,) OF LAWFUL AGE AND (IS ARE) THE APPROPRIATOR AND CLAIMANT OF THE ORDER AND WATER RIGHT MENTIONED IN THE FOREGOING DECLARATION OF VESTED GROUNDWATER RIGHTS AND THE PERSON WHOSE NAME SUBSCRIBED THERETO, AS THE APPROPRIATOR AND CLAIMANT, THAT HE KNOW THE CONTENTS OF SAID FOREGOING NOTICE AND THAT THE MATTERS AND THINGS THEREIN STATED ARE TRUE.SUBSCRIBED AND SWORN TO BEFORE ME, THIS 12 DAY OF Dec 1963Lucretia Hicks
NOTARY PUBLIC FOR THE STATE OF MONTANA
RESIDING AT _____
MY COMMISSION EXPIRES _____

(FILE THREE COPIES OF THIS REPORT WITH THE COUNTY CLERK AND RECORDER, RETAIN THE 4th COPY FOR YOUR FILES.)

34361