

County Yellowstone Twp. 1 N Rge. 27E

Sec.	Name of Appropriator	Type of Form	County File No.	Remarks
5	Schroeder, Lewis J.	GW 4	721758	
5	Schroeder, Lewis J.	GW 4	721757	
5	Schroeder, Lewis J.	GW 4	721756	
8	Stanhope, Clyde R.	GW 3	938187	
8	Stanhope, Clyde R.	GW 3	938186	
9	O'Donnell, Mrs R A	GW 4	721494	
14	Herren, Joe	GW 2	913768	
15	O'Donnell, Bob	GW 2	824706	
16	Herman, John	GW 2	885896	
17	Schleining, John A.	GW 4	721792	
18	Daugherty, Emerald, John & William	GW 2	937362	
18	Daugherty, Emerald, John & William	GW 3	937309	
18	Daugherty, Emerald, John & William	GW 3	937362	
18	Daugherty, Emerald, John & William	GW 2	937367	
18	Daugherty, Emerald, John & William	GW 2	937363	
18	Daugherty, Emerald, John & William	GW 2	937365	
18	Daugherty, Emerald, John & William	GW 2	937364	
18	Herren, Marie & Michael	GW 2	937554	
18	Kemmel, Reinhold	GW 4	719457	
18	Kemmel, Reinhold	GW 4	719456	
18	Kemmel, Reinhold	GW 2	725193	
19	Daugherty, Emerald, John & William	GW 3	937304	See Sec 18 above
19	Daugherty, Emerald, John & William	GW 3	937362	See Sec 18 above
19	Daugherty, Emerald, John & William	GW 2	92300	
19	Daugherty, Emerald, John & William	GW 2	937364	
19	Daugherty, Emerald, John & William	GW 2	937365	
19	Daugherty, Emerald, John & William	GW 2	937367	
19	Daugherty, Emerald, John & William	GW 2	937368	
19	Popelka, Richard	GW 4	721417	
19	Popelka, Oliver & Chloee	1957W411 Log		
19	Popelka, Oliver & Chloee	1957W411 Log		
19	T. W. ...	GW 4	721414	

File No.

T. 1. N. R. 27. E.

County. Yellowstone.

ORIGINAL

STATE OF MONTANA
ADMINISTRATOR OF GROUNDWATER CODE
OFFICE OF STATE ENGINEER

RECEIVED
JAN 2 1964

DECLARATION OF VESTED GROUNDWATER RIGHTS
(Under Chapter 237, Montana Session Laws, 1961)

STATE ENGINEER

1. Lewis J. Schoeder of Route 3 Billings
(Name of Appropriator) (Address) (Town)

County of Yellowstone State of Montana
have appropriated groundwater according to the Montana laws in effect prior to
January 1, 1962, as follows:

SW Sec. 5 T. 11. N. 27. E.
Indicate point of appropriation
and place of use, if possible.
Each small square represents
10 acres.

2. The beneficial use on which the claim is based
house hold use

3. Date or approximate date of earliest beneficial
use; and how continuous the use has been
1918 continuous use

4. The amount of groundwater claimed (in miner's
inches or gallons per minute)

5. If used for irrigation, give the acreage and
description of the lands to which water has been
applied and name of the owner thereof
not for irrigating

6. The means of withdrawing such water from the
ground and the location of each well or other
means of withdrawal
motor driven pump with pressure tank

7. The date of commencement and completion of the construction of the well, wells,
or other works for withdrawal of groundwater

8. The depth of water table 6 ft.

9. So far as it may be available, the type, size and depth of each well or the gen-
eral specifications of any other works for the withdrawal of groundwater
3" wide 10 ft deep dug well with tile curbing

10. The estimated amount of groundwater withdrawn each year 100,000

11. The log of formations encountered in the drilling of each well if available
soil to gravel

12. Such other information of a similar nature as may be useful in carrying out the
policy of this act, including reference to book and page of any county record
unknown

Signature of Owner Lewis J. Schoeder

Three copies to be filed by the owner with the County Clerk and Recorder of the
county in which the well is located.

Please answer all questions. If not applicable, so state, otherwise the form will
be returned.

Original to the County Clerk & Recorder; Duplicate to the State Engineer; Triplicate
to the Montana Bureau of Mines and Geology, and quadruplicate for the appropriator

721758

STATE OF MONTANA,
County of Blaine

The instrument was recorded in my office
this 4.01 day of P at DEC 31 1963 M.

*Paul
J. Co.*

File No.

T. I. N. R. 27 E.

ORIGINAL

County

STATE OF MONTANA
ADMINISTRATOR OF GROUNDWATER CODE
OFFICE OF STATE ENGINEER

RECEIVED
JAN 2 1964

DECLARATION OF VESTED GROUNDWATER RIGHTS
(Under Chapter 237, Montana Session Laws, 1953) STATE ENGINEER

1. Lewis J. Schroeder of Route 3 Billings
(Name of Appropriator) (Address) (Town)

County of Yellowstone State of Montana
have appropriated groundwater according to the Montana Laws in effect prior to
January 1, 1962, as follows:

		X			

S.W. Sec. 5 T. 1 N. R. 27 E.
Indicate point of appropriation
and place of use, if possible.
Each small square represents
10 acres.

- The beneficial use on which the claim is based
watering stock
- Date or approximate date of earliest beneficial
use; and how continuous the use has been
1913
- The amount of groundwater claimed (in miner's
inches or gallons per minute) 5
- If used for irrigation, give the acreage and
description of the lands to which water has been
applied and name of the owner thereof
not for irrigating
- The means of withdrawing such water from the
ground and the location of each well or other
means of withdrawal
water driven pump

7. The date of commencement and completion of the construction of the well, wells,
or other works for withdrawal of groundwater

8. The depth of water table 6 ft.

9. So far as it may be available, the type, size and depth of each well or the gen-
eral specifications of any other works for the withdrawal of groundwater
6 ft. wide 10 ft deep dug well with 2 1/2 in curbing

10. The estimated amount of groundwater withdrawn each year 300,000

11. The log of formations encountered in the drilling of each well if available
soil to gravel

12. Such other information of a similar nature as may be useful in carrying out the
policy of this act, including reference to book and page of any county record
none

Signature of Owner Lewis J. Schroeder
Date Dec. 31, 1963

Three copies to be filed by the owner with the County Clerk and Recorder of the
county in which the well is located.

Please answer all questions. If not applicable, so state, otherwise the form will
be returned.

Original to the County Clerk & Recorder; Duplicate to the State Engineer; Triplicate
to the Montana Bureau of Mines and Geology, and Quadruplicate for the appropriator

721757

721757

STATE OF NEW YORK
County of ... ss.
his said ... DEC 31 1963
is 4.13 P
...
Jauntje
22

File No.

T. IN R. 27 E

ORIGINAL

County

STATE OF MONTANA
ADMINISTRATOR OF GROUNDWATER CODE
OFFICE OF STATE ENGINEER

RECEIVED
JAN 2 1964

DECLARATION of VESTED GROUNDWATER RIGHTS
(Under Chapter 237, Montana Session Laws, 1961)

STATE ENGINEER

1. Lewis J. Schroeder -----, of Rate 3 ----- Billings -----
(Name of Appropriator) (Address) (Town)

County of Yellowstone ----- State of Montana -----
have appropriated groundwater according to the Montana laws in effect prior to
January 1, 1962, as follows:

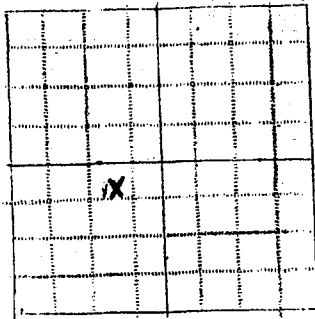

SW 1/4 - Sec 4 T. 14 N. R. 27 E
Indicate point of appropriation
and place of use, if possible.
Each small square represents
10 acres.

2. The beneficial use on which the claim is based
watering lawn -----

3. Date or approximate date of earliest beneficial
use; and how continuous the use has been -----
1943 -----

4. The amount of groundwater claimed (in miner's
inches or gallons per minute) -----
10 -----

5. If used for irrigation, give the acreage and
description of the lands to which water has been
applied and name of the owner thereof -----
1/2 acre lawn -----

6. The means of withdrawing such water from the
ground and the location of each well or other
means of withdrawal -----
motor driven pump -----

7. The date of commencement and completion of the construction of the well, wells,
or other works for withdrawal of groundwater -----

8. The depth of water table -----
6 ft -----

9. So far as it may be available, the type, size and depth of each well or the gen-
eral specifications of any other works for the withdrawal of groundwater -----
drilled with 6 in well casing 25 ft deep -----

10. The estimated amount of groundwater withdrawn each year -----
500,000 -----

11. The log of formations encountered in the drilling of each well if available
sub soil & gravel -----

12. Such other information of a similar nature as may be useful in carrying out the
policy of this act, including reference to book and page of any county record -----
unknown -----

Signature of Owner- Lewis J. Schroeder -----
Date- Dec 21, 1963 -----

Three copies to be filed by the owner with the County Clerk and Recorder of the
county in which the well is located.
Please answer all questions. If not applicable, so state, otherwise the form will
be returned.
Original to the County Clerk & Recorder; Duplicate to the State Engineer; Triplicate
to the Montana Bureau of Mines and Geology, and Quadruplicate for the appropriator

721756

STATE OF TEXAS
County of Tarrant

This instrument is effective as of
this 31 day of DEC 1963
at 4.02 P

By J. J. [Signature]
2nd [Signature]

File No.

RECEIVED

T. 1 N R. 27 E

TRIPLICATE

JUL 3 1973

County Yellowstone

STATE OF MONTANA
ADMINISTRATOR OF GROUNDWATER CODE
OFFICE OF STATE ENGINEER

Notice of Completion of Groundwater Appropriation Without Well

(Under Chapter 237 Montana Session Laws, 1961)

938187
June 29, 1973
8:09 A.M.

Date of Appropriation of Groundwater June 28th 1973
Owner Clyde R. Stankup address 313 3rd ST. W.
Contractor (if any) None
Address of Contractor _____
Date Started years Ago Date Completed Same

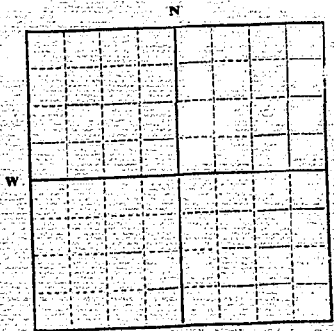

Describe means of obtaining groundwater without a well "as by sub-irrigation and other natural processes". Include depth to water when applicable. Water on surface of ground + seepage causes sub-irr.

Quantity of water developed and used with explanation of method used to measure or estimate such amount. If use is intermittent

estimate approximate lengths of periods of use. Spring is boxed in 2nd is used for household use + future use with include fish pond

6' x 1/2" Sec. 8 T. 14 R. 27 E
Indicate point of appropriation and place of use, if possible.

Tract 3 @ 1/5 # 1225

Signature of Owner Clyde R. Stankup
Date June 28th 1973

This form to be prepared by contractor (if any), otherwise by the owner.

Three copies of this notice are to be filed with the County Clerk and Recorder of the county in which the works are located.

Please answer all questions. If not applicable, so state, otherwise the form will be returned.

Original to the County Clerk and Recorder; duplicate to the State Engineer; Triplicate to the Montana Bureau of Mines and Geology and Quadruplicate for the Appropriator.

938187

STATE OF MONTANA, }
County of Yellowstone, } ss.
This instrument was filed in my office
this 29 day of JUN 1973
at Billings in the County of Yellowstone M.
MERRILL M. KLEIN, DT
County Clerk & Recorder
By [Signature] Deputy

29

73
File No.

T. 1 N. R. 27 E

TRIPPLICATE RECEIVED

County *Hill*

STATE OF MONTANA
ADMINISTRATOR OF GROUNDWATER CODE
OFFICE OF STATE ENGINEER

Notice of Completion of Groundwater Appropriation Without Well

(Under Chapter 237 Montana Session Laws, 1961)

938186
6-29-73
8:28 A.M.

Date of Appropriation of Groundwater *6-28-73*

Owner *Clyde R. Stanhope* Address *313 3rd St W*

Contractor (if any) *None*

Address of Contractor

Date Started *None* Date Completed *Same*

Describe means of obtaining groundwater without a well "as by sub-irrigation and other natural processes". Include depth to water when applicable. *Water on surface of Creek Bed.*

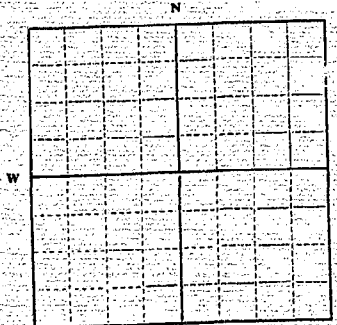

Section *8* T. *1 N.* R. *27 E*
Indicate point of appropriation and place of use, if possible.

Quantity of water developed and used with explanation of method used to measure or estimate such amount. If use is intermittent

estimate approximate lengths of periods of use. *Approx. Times*

when *Irrigation ditch is not in*

use *Approx Oct to May*

Approx *1/2 gal per minute flow*

Tract 5 C/S # 1225

Signature of Owner *Clyde R. Stanhope*

Date *June 28th 1973*

This form to be prepared by contractor (if any), otherwise by the owner.

Three copies of this notice are to be filed with the County Clerk and Recorder of the county in which the works are located.

Please answer all questions. If not applicable, so state, otherwise the form will be returned.

Original to the County Clerk and Recorder; duplicate to the State Engineer; Triplicate to the Montana Bureau of Mines and Geology and Quadruplicate for the Appropriator.

55743

938186

STATE OF MONTANA, } ss.
County of Yellowstone. }
This instrument was filed in my office
this 23 day JUN 23 1973
at 8:28 o'clock AM M.
MERRILL A. MCQUINN
County Clerk & Recorder
By Jaw Deputy
25

O'DONNELL LIVESTOCK & RANCH CORP.
BILLINGS MT

T. 1N R. 27E
County Yellowstone

WATER CODE
NUMBER

Water Rights
Laws, 1961)

RECEIVED
JAN 2 1964
STATE ENGINEER

Name of Appropriator: Rte. # 2 Billings
(Address) (Town)

County of Yellowstone State of Montana
have appropriated groundwater according to the Montana laws in effect prior to January 1, 1962, as follows:

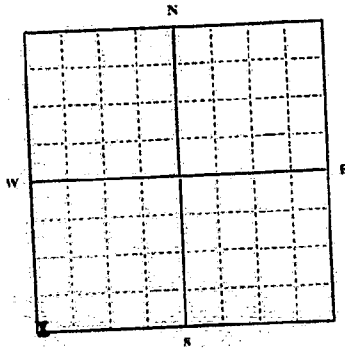

SWS 1/4 Sec. 9 T. 1N R. 27E
Indicate point of appropriation and place of use, if possible. Each small square represents 10 acres.

- 2. The beneficial use on which the claim is based.
Stock use
- 3. Date or approximate date of earliest beneficial use; and how continuous the use has been. Approx. 1950 & continuous use.
- 4. The amount of groundwater claimed (in miner's inches or gallons per minute). Don't know.
- 5. If used for irrigation, give the acreage and description of the lands to which water has been applied and name of the owner thereof.
- 6. The means of withdrawing such water from the ground and the location of each well or other means of withdrawal.
Electric Pump

7. The date of commencement and completion of the construction of the well, wells, or other works for withdrawal of groundwater. Don't know

8. The depth of water table. 90 feet

9. So far as it may be available, the type, size and depth of each well or the general specifications of any other works for the withdrawal of groundwater.
Drilled well, 500 feet, 6 inch casing.

10. The estimated amount of groundwater withdrawn each year Don't know

11. The log of formations encountered in the drilling of each well if available.
Driller - Clyde Sande of Billings may have logs.

12. Such other information of a similar nature as may be useful in carrying out the policy of this act, including reference to book and page of any county record.

Signature of Owner R. A. O'Donnell
Mrs. R. A. O'Donnell by
R. A. O'Donnell, Agent

Date 12-31-63

Three copies to be filed by the owner with the County Clerk and Recorder of the county in which the well is located.

Please answer all questions. If not applicable, so state, otherwise the form will be returned.

Original to the County Clerk and Recorder; Duplicate to the State Engineer; Triuplicate to the Montana Bureau of Mines and Geology, and Quadruplicate for the Appropriator.

File No.

T. 1N. R. 27E

DUPLICATE

County Yellowstone

STATE OF MONTANA
 ADMINISTRATOR OF GROUNDWATER CODE
 OFFICE OF STATE ENGINEER

RECEIVED
 JAN 2 1964
 STATE ENGINEER

Declaration of Vested Groundwater Rights

(Under Chapter 237, Montana Session Laws, 1961)

1. (Mary E. O'Donnell) Mrs. R. A. O'Donnell of Rts. # 2 Billings
 (Name of Appropriator) (Address) (Town)

County of Yellowstone State of Montana
 have appropriated groundwater according to the Montana laws in effect prior to January 1, 1962, as follows:

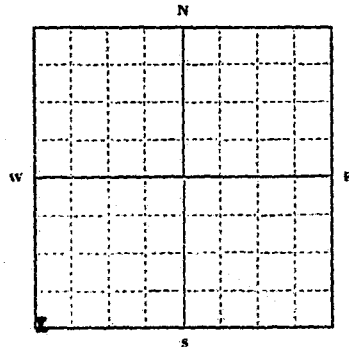

5/8 Sec. 9 T. 1N. R. 27E

Indicate point of appropriation and place of use, if possible. Each small square represents 10 acres.

2. The beneficial use on which the claim is based.....
 Stock use

3. Date or approximate date of earliest beneficial use; and how continuous the use has been.....
 Approx. 1950 & continuous use

4. The amount of groundwater claimed (in miner's inches or gallons per minute).....
 Don't know

5. If used for irrigation, give the acreage and description of the lands to which water has been applied and name of the owner thereof

6. The means of withdrawing such water from the ground and the location of each well or other means of withdrawal
 Electric Pump

7. The date of commencement and completion of the construction of the well, wells, or other works for withdrawal of groundwater.....
 Don't know

8. The depth of water table.....
 90 feet

9. So far as it may be available, the type, size and depth of each well or the general specifications of any other works for the withdrawal of groundwater.....
 Drilled well, 500 feet, 6 inch casing

10. The estimated amount of groundwater withdrawn each year.....
 Don't know

11. The log of formations encountered in the drilling of each well if available.....
 Driller - Clyde Sands of Billings may have logs

12. Such other information of a similar nature as may be useful in carrying out the policy of this act, including reference to book and page of any county record

Mrs. R. A. O'Donnell by
 R. A. O'Donnell, Agent
 Signature of Owner R. A. O'Donnell

Date 12-31-63

Three copies to be filed by the owner with the County Clerk and Recorder of the county in which the well is located.

Please answer all questions. If not applicable, so state, otherwise the form will be returned.

Original to the County Clerk and Recorder; Duplicate to the State Engineer; Triplicate to the Montana Bureau of Mines and Geology, and Quadruplicate for the Appropriator.

18266

1

721494

STATE OF MONTANA,
County of Yellowstone.

This instrument was filed in my office

this DEC 8 1963

at 9:53 o'clock 7 M. 11

by [Signature] Deputy

[Signature]

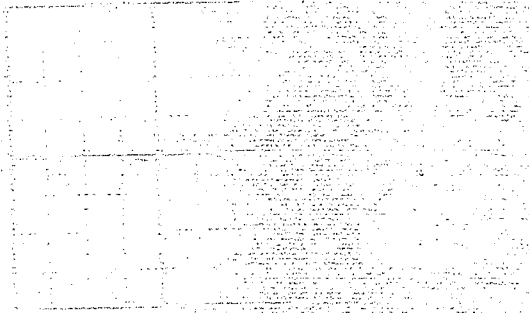

RECEIVED

County Yellowstone

STATE OF MONTANA
ADMINISTRATOR OF GROUNDWATER CODE
MONTANA WATER RESOURCES BOARD

AUG 11 1972

DRILLER'S LOG

NOTICE OF COMPLETION OF GROUNDWATER
APPROPRIATION BY MEANS OF WELL

MONTANA DEPARTMENT OF NATURAL
RESOURCES AND CONSERVATION

Indicate the character, color, thickness of strata such as soil, clay, sand, gravel, shale, sandstone, etc. Show depth at which water is found and height to which water rises in well.

Developed after January 1, 1962

(Under Chapter 237 Montana Session Laws, 1961, as amended)

This form to be prepared by driller, and three copies to be filed by the owner with the County Clerk and Recorder in the county in which the well is located, last copy to be retained by driller.

Please answer all questions. If not applicable, so state, otherwise the form may be returned.

Owner Joe Herren

Address Box 249 Bridge

Mont

Date well started 9-10-71

completed 9-12-71

For Administrator's Use
file 913768
August 11, 1972 3:40pm.
GW 1

Type of well DRILLED
(Dug, driven, bored or drilled)

Equipment used ROTARY
(Churn drill, rotary or other)

Water Use: Domestic Municipal Stock Irrigation
Industrial Drainage Other * Garden/Lawn

*Describe 20,010

USE: If used for irrigation, industrial, drainage or other. Explain, state number of acres and location or other data (i.e. Lot, Block and Addition).

ESTIMATED ANNUAL WITHDRAWAL

Size of Drilled Hole	Size and Weight of Casing	From (Feet)	To (Feet)	PERFORATIONS		
				Kind Size	From (Feet)	To (Feet)
<u>6 3/4</u>	<u>5" PLASTIC</u>	<u>1+</u>	<u>50</u>	<u>1/8" slots</u>	<u>20</u>	<u>50</u>

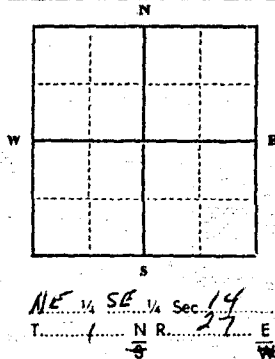

Static water level 17 ft.*
Pumping water level 45 ft.*
at 3 gallons per minute,
measured 30 minutes after pumping
began.
*Measured from ground level.
Well developed by BAILEY
for 3 hours.
Power N.A., Pump N.A. HP
Remarks: (Gravel packing, cementing,
packers, type of shut-off) PACKERS
@ 12 FT. Cement
7 ft TOP

INDICATE LOCATION OF WELL AND PLACE OF USE, IF POSSIBLE. EACH SMALL SQUARE REPRESENTS 40 ACRES.

Driller's Signature J. J. Barr

Driller's Address 3143 PRAIRIE DRIVE
BILLINGS MONT LICENSE NO. 197

Top of Ground		(Elev. above sea level)
From (Feet)	To (Feet)	
<u>0</u>	<u>5</u>	<u>TOP SOIL</u>
<u>5</u>	<u>35</u>	<u>BROWN SANDSTONE</u>
<u>35</u>	<u>50</u>	<u>SHALE</u>
		<u>WATER @ 22 FT.</u>
		<u>WATER LEVEL 1972</u>

50 Show exact depth of bottom

51,147

913768

STATE OF MONTANA } ss.
County of Yellowstone }
This instrument was filed in my office
this 11 day of AUG 11 1972
at 3:40 o'clock P M.
MERRILL H. KLUNDT
County Clerk & Recorder
By Jaw Deputy
29

864706

STATE OF MONTANA,)
County of Yellowstone,) ss.
This instrument was filed in my office
this JUL 16 1970 of 19__
at 2:14 o'clock P.M.
MEREDITH H. ROUNDT
County Clerk & Recorder
By [Signature] Deputy

200

885896

1:00
JUL 7 1971
P
Deputy

File No.

11 21 17

ORIGINAL

County.....

STATE OF MONTANA
ADMINISTRATOR OF GROUNDWATER CODE
OFFICE OF STATE ENGINEER

RECEIVED
JAN 2 1964

DECLARATION of VESTED GROUNDWATER RIGHTS
(Under Chapter 237, Montana Session Laws, 1962) STATE ENGINEER

1. Donald A. Schilling, of Billings,
(Name of Appropriator) (Address) (Town)

County of Blaine State of Montana
have appropriated groundwater according to the Montana laws in effect prior to
January 1, 1962, as follows:

NE NE Sec. 17 T. W R. 27E
Indicate point of appropriation
and place of use, if possible.
Each small square represents
10 acres.

- 2. The beneficial use on which the claim is based - Household
- 3. Date or approximate date of earliest beneficial use; and how continuous the use has been - 1953
- 4. The amount of groundwater claimed (in miner's inches or gallons per minute) - 10 gpm
- 5. If used for irrigation, give the acreage and description of the lands to which water has been applied and name of the owner thereof - none
- 6. The means of withdrawing such water from the ground and the location of each well or other means of withdrawal - water pump

- 7. The date of commencement and completion of the construction of the well, wells, or other works for withdrawal of groundwater - not known
- 8. The depth of water table - not known
- 9. So far as it may be available, the type, size and depth of each well or the general specifications of any other works for the withdrawal of groundwater - not known
- 10. The estimated amount of groundwater withdrawn each year - 200,000
- 11. The log of formations encountered in the drilling of each well if available - not known
- 12. Such other information of a similar nature as may be useful in carrying out the policy of this act, including reference to book and page of any county record - not known

Signature of Owner - Donald A. Schilling
Date - Dec 31, 1962

Three copies to be filed by the owner with the County Clerk and Recorder of the County in which the well is located.
Please answer all questions. If not applicable, so state, otherwise the form will be returned.
Original to the County Clerk & Recorder; Duplicate to the State Engineer; Triplicate to the Montana Bureau of Mines and Geology, and Quadruplicate for the appropriator

File No.

14 21 17
County.....

ORIGINAL

STATE OF MONTANA
ADMINISTRATOR OF GROUNDWATER CONTROL
OFFICE OF STATE ENGINEER

RECEIVED
JAN 2 1964

DECLARATION OF VESTED GROUNDWATER RIGHTS
(Under Chapter 237, Montana Session Laws, 1957) STATE ENGINEER

1. J. W. A. Schlemmer, of Box 2, Billings
(Name of Appropriator) (Address) (Town)

County of Billings State of Montana
have appropriated groundwater according to the Montana laws in effect prior to
January 1, 1962, as follows:

None - Sec. 17, N.W. R. 27E
Indicate point of appropriation
and place of use, if possible.
Each small square represents
10 acres.

2. The beneficial use on which the claim is based
Household

3. Date or approximate date of earliest beneficial
use; and how continuous the use has been
1953

4. The amount of groundwater claimed (in miner's
inches or gallons per minute) 10 gpm

5. If used for irrigation, give the acreage and
description of the lands to which water has been
applied and name of the owner thereof
None

6. The means of withdrawing such water from the
ground and the location of each well or other
means of withdrawal Electric Pump

7. The date of commencement and completion of the construction of the well, wells,
or other works for withdrawal of groundwater Not known

8. The depth of water table Not known

9. So far as it may be available, the type, size and depth of each well or the gen-
eral specifications of any other works for the withdrawal of groundwater
Not known

10. The estimated amount of groundwater withdrawn each year 300,000

11. The log of formations encountered in the drilling of each well if available
Not known

12. Such other information of a similar nature as may be useful in carrying out the
policy of this act, including reference to book and page of any county record
Not known

Signature of Owner J. W. A. Schlemmer
Date Dec 31, 1963

Three copies to be filed by the owner with the County Clerk and Recorder of the
County in which the well is located.
Please answer all questions. If not applicable, so state, otherwise the form will
be returned.

Original to the County Clerk & Recorder; Duplicate to the State Engineer; Triplicate
to the Montana Bureau of Mines and Geology, and Quaduplicate for the appropriator

721792

STATE OF MONTANA,
County of Yellowstone,

This instrument was filed in my office
this DEC 31 1968 day of 19

at 4:37 o'clock 8 M.

Edmon S. Redding,
County Clerk & Recorder

By 7774 Deputy

STATE OF MONTANA, }
County of Yellowstone } ss.

EMERALD DAUGHERTY having first been duly sworn, deposes and
says that he is of lawful age and is one of the appropriators
and claimants of the order and water right mentioned in the foregoing notice of
completion of groundwater appropriation by means of well and the persons whose name
subscribed thereto, as the appropriator and claimant,
that he knows the contents of said foregoing notice and that the matters and things
therein stated are true.

Emerald Daugherty

Subscribed and sworn to before me, this 22nd day of June, 1973.

David L. Johnson
Notary Public for the State of Montana.

Residing at Billings, Montana

My Commission expires July 2, 1974

937366

JUL 11 1973
2:56
Deputy
Zer

STATE OF MONTANA,
County of Yellowstone } ss.

EMERALD DAUGHERTY having first been duly sworn, deposes and
says that he is of lawful age and is one of the appropriators
and claimants of the order and water right mentioned in the foregoing notice of
completion of groundwater appropriation by means of well and the persons whose name
subscribed thereto, as the appropriator and claimant,
that he knows the contents of said foregoing notice and that the matters and things
therein stated are true.

Emerald Daugherty

Subscribed and sworn to before me, this 22nd day of June, 1973.

David L. Johnson
Notary Public for the State of Montana.

Residing at Billings, Montana

My Commission expires July 2 1974.

937367

JUN 22 1973
2:57
CDB
722

STATE OF MONTANA
ADMINISTRATOR OF GROUNDWATER CODE
MONTANA WATER RESOURCES BOARD
**NOTICE OF COMPLETION OF GROUNDWATER
APPROPRIATION BY MEANS OF WELL**
Developed after January 1, 1962

DRILLER'S LOG

Indicate the character, color, thickness of strata such as soil, clay, sand, gravel, shale, sandstone, etc. Show depth at which water is found and height to which water rises in well.

(Under Chapter 237 Montana Session Laws, 1961, as amended)

This form to be prepared by driller, and three copies to be filed by the owner with the County Clerk and Recorder in the county in which the well is located, last copy to be retained by driller. Please answer all questions. If not applicable, so state, otherwise the form may be returned.

Owner Emerald, John and
William Daugherty

Address 631 Avenue C
Billings, Montana

Date well started August 1965
completed August 1965

For Administrator's Use	
File	<u>937363</u>
	<u>June 22, 1973</u>
GW 1	<u>2:53 p.m.</u>

Type of well Dug
(Dug, driven, bored or drilled)

Equipment used Backhoe
(Cable drill, rotary or other)

Water Use: Domestic Municipal Stock Irrigation
Industrial Drainage Other * Garden/Lawn

*Describe _____
USE: If used for irrigation, industrial, drainage or other. Explain, state number of acres and location or other data (i.e. Lot, Block and Addition).

ESTIMATED ANNUAL WITHDRAWAL 1,500,000 gallons

Size of Drilled Hole	Size and Weight of Casing	From (Feet)	To (Feet)	PERFORATIONS		
				Kind Size	From (Feet)	To (Feet)
<u>2'</u>	<u>2' ground 14 gauge</u>	<u>11'</u>	<u>11'</u>	<u>1/2" hole</u>	<u>8'</u>	<u>11'</u>

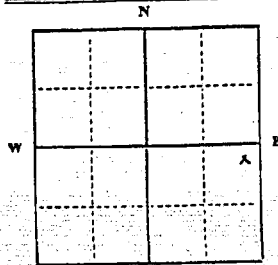

NE 1/4 SE 1/4 Sec. 18
T. 1 N. R. 27 E.
X XV

INDICATE LOCATION OF WELL AND PLACE OF USE, IF POSSIBLE. EACH SMALL SQUARE REPRESENTS 40 ACRES.

Driller's Signature _____
Driller's Address 631 Avenue C

Billings, Montana LICENSE NO. None

Top of Ground (Elev. above sea level) _____

From (Feet)	To (Feet)	
0	1	<u>all gravel</u>
1	2	
2	3	
3	4	
4	5	<u>water found and height</u>
5	6	
6	7	
7	8	
8	9	
9	10	
10	11	

Static water level 4 ft.*
Pumping water level 8 ft.*
at 30 gallons per minute,
measured 10 minutes after pumping
began.
*Measured from ground level.
Well developed by N/A
for _____ hours.
Power Electric Pump 1/2 HP
Remarks: (Gravel packing, cementing,
packers, type of shutoff)
Gravel, float switch

11' Show exact depth of bottom

WELL # 6
53,910

STATE OF MONTANA,
County of Yellowstone } ss.

EMERALD DAUGHERTY having first been duly sworn, deposes and
says that he is of lawful age and is one of the appropriators
and claimants of the order and water right mentioned in the foregoing notice of
completion of groundwater appropriation by means of well and the persons whose name
subscribed thereto, as the appropriator and claimant,
that he knows the contents of said foregoing notice and that the matters and things
therein stated are true.

Emerald Daugherty

Subscribed and sworn to before me, this 22nd day of June, 1973.

David L. Johnson
Notary Public for the State of Montana.

Residing at Billings, Montana.

My Commission expires July 2 1974.

937363

NOTARY PUBLIC
COUNTY OF YELLOWSTONE
STATE OF MONTANA
JUN 23 1973
2:53
By *David* Deputy
74

File No.

T. 1 N R 27 E
County Yellowstone

ORIGINAL

STATE OF MONTANA
ADMINISTRATOR OF GROUNDWATER CODE
OFFICE OF STATE ENGINEER

Notice of Completion of Groundwater Appropriation
Without Well

(Under Chapter 237 Montana Session Laws, 1961)

Date of Appropriation of Groundwater Prior to 1959
Owner Emerald, John & William Daugherty Address 631 Avenue C., Billings
Contractor (if any) None
Address of Contractor N/A

Date Started Prior to 59 Date Completed Prior to 1959

Describe means of obtaining groundwater without a well "as by sub-irrigation and other natural processes". Include depth to water when applicable. Spring flowing out of ground by natural processes

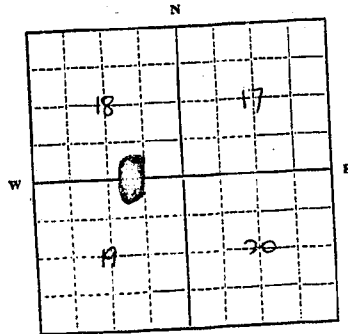

Quantity of water developed and used with explanation of method used to measure or estimate such amount. If use is intermittent

SW 1/4 SE 1/4 Sec. 18, T. 1 N, R. 27 E estimate approximate lengths of periods of use. Used
NW 1/4 NE 1/4 Sec. 19, T. 1 N, R. 27 E for stock water, throughout calendar

Indicate point of appropriation and place of use, if possible.

year; flow approximately 300 gallons per minute. Annual use - approximately 500,000 gallons annually.

937362
June 22, 1973
2:52 p.m.

Signature of Owner Emerald Daugherty
Date June 22, 1973

This form to be prepared by contractor (if any), otherwise by the owner.

Three copies of this notice are to be filed with the County Clerk and Recorder of the county in which the works are located.

Please answer all questions. If not applicable, so state, otherwise the form will be returned.

Original to the County Clerk and Recorder; duplicate to the State Engineer; Triplicate to the Montana Bureau of Mines and Geology and Quadruplicate for the Appropriator.

937362

STATE OF MONTANA

County of Yellowstone } ss.

Emerald Daugherty having first been duly sworn, deposes and says that he is of lawful age and is one of the appropriators and claimants of the order and water right mentioned in the foregoing notice of completion of groundwater appropriation without well and the person whose name is subscribed thereto, as the appropriator and claimant, that he knows the contents of said foregoing notice and that the matters and things therein stated are true.

Emerald Daugherty

Subscribed and sworn to before me, this 22nd day of June, 1973

David L. Johnson
Notary Public for the State of Montana.

Residing at Billings, Montana

My Commission expires July 1, 1974

937362

STATE OF MONTANA
COUNTY OF YELLOWSTONE
this 22nd day of June 1973
ss. D.L.J.
Notary Public
By John 2nd

RECEIVED

GAZETTE PRINTING

Spring

GW 3

File No.....

T 1 N R 27 E

ORIGINAL

County... Yellowstone

STATE OF MONTANA
ADMINISTRATOR OF GROUNDWATER CODE
OFFICE OF STATE ENGINEER

Notice of Completion of Groundwater Appropriation
Without Well

(Under Chapter 237 Montana Session Laws, 1961)

937309
11:06 A.M.
June 22, 1973

Date of Appropriation of Groundwater... Prior to 1959

Owner... Emerald, John & William Daugherty Address... 631 Avenue C

Contractor (if any) ... none

Address of Contractor ... N/A

Date Started... Prior to '57 Date Completed... Prior to '59

Describe means of obtaining groundwater without a well "as by sub-irrigation and other natural processes". Include depth to water when applicable... Spring flowing out of ground by natural processes

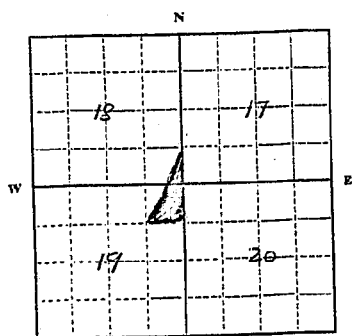

SE 1/4 SE 1/4 Sec. 18, T.1N, R.27E
NE 1/4 NE 1/4 Sec. 19, T.1N, R.27E
Indicate point of appropriation and place of use, if possible.

Quantity of water developed and used with explanation of method used to measure or estimate such amount. If use is intermittent

estimate approximate lengths of periods of use... Used for stock water, throughout calendar year; flow approximately 300 gallon per minute; use is approximately 500,000 gal. annually
Signature of Owner... Emerald Daugherty

Date... June 22, 1973

This form to be prepared by contractor (if any), otherwise by the owner.

Three copies of this notice are to be filed with the County Clerk and Recorder of the county in which the works are located.

Please answer all questions. If not applicable, so state, otherwise the form will be returned.

Original to the County Clerk and Recorder; duplicate to the State Engineer; Triplicate to the Montana Bureau of Mines and Geology; and Quadruplicate for the Appropriator.

53979

STATE OF MONTANA

County of Yellowstone } ss.

Emerald Daugherty having first been duly sworn, deposes and says that he is of lawful age and one of the appropriators and claimants of the order and water right mentioned in the foregoing notice of completion of groundwater appropriation without well and the person whose name is subscribed thereto, as the appropriator and claimant, that he knows the contents of said foregoing notice and that the matters and things therein stated are true.

Emerald Daugherty

Subscribed and sworn to before me, this 22nd day of June, 1973

David L. Johnson
Notary Public for the State of Montana.

Residing at Billings, Montana

My Commission expires July 2 1974

937309

STATE OF MONTANA } ss.
County of Yellowstone }
I, David L. Johnson, Notary Public in my office
this 22nd day of June, 1973.
at Billings at 11:06 A.M.
BY David L. Johnson Deputy
Joe

STATE OF MONTANA
ADMINISTRATOR OF GROUNDWATER CODE
MONTANA WATER RESOURCES BOARD

**NOTICE OF COMPLETION OF GROUNDWATER
APPROPRIATION BY MEANS OF WELL**

Developed after January 1, 1962

(Under Chapter 237 Montana Session Laws, 1961, as amended)

This form to be prepared by driller, and three copies to be filed by the owner with the County Clerk and Recorder in the county in which the well is located, last copy to be retained by driller.

Please answer all questions. If not applicable, so state, otherwise the form may be returned.

Owner Emerald, John and
William Daugherty

Address 631 Avenue C

Billings, Montana

Date well started August 1965

completed August 1965

For Administrator's Use	
File	<u>93.7365</u>
Date	<u>June 22, 1967</u>
Time	<u>2:55 p.m.</u>

Type of well Dug

(Dug, driven, bored or drilled)

Equipment used Backhoe

(Churn drill, rotary or other)

Water Use: Domestic Municipal Stock Irrigation

Industrial Drainage Other * Garden/Lawn

*Describe _____
USE: If used for irrigation, industrial, drainage or other. Explain, state number of acres and location or other data (i.e. Lot, Block and Addition).

ESTIMATED ANNUAL WITHDRAWAL 1,500,000 gallons

Size of Drilled Hole	Size and Weight of Casing	From (Feet)	To (Feet)	PERFORATIONS		
				Kind Size	From (Feet)	To (Feet)
<u>2'</u>	<u>2' ground 14 gauge</u>	<u>11'</u>	<u>11'</u>	<u>1/2" hole</u>	<u>8'</u>	<u>11'</u>

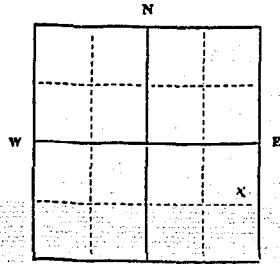

NE 1/4 SE 1/4 Sec. 18
T. 1 N. R. 27 E.
X

INDICATE LOCATION OF WELL AND PLACE OF USE, IF POSSIBLE. EACH SMALL SQUARE REPRESENTS 40 ACRES.

Driller's Signature [Signature]

Driller's Address 631 Avenue C

Billings, Montana

LICENSE NO. None

DRILLER'S LOG
Indicate the character, color, thickness of strata such as soil, clay, sand, gravel, shale, sandstone, etc. Show depth at which water is found and height to which water rises in well.

Top of Ground (Elev. above sea level)		
From (Feet)	To (Feet)	
0	1	<u>all gravel</u>
1	2	
2	3	
3	4	
4	5	<u>water found and height</u>
5	6	
6	7	
7	8	
8	9	
9	10	
10	11	

11' Show exact depth of bottom

WELL # 8

53908

pick-
and,
now
and
well.

height

bottom

- 8

08:

STATE OF MONTANA, }
County of Yellowstone } ss.

EMERALD DAUGHERTY having first been duly sworn, deposes and says that he is of lawful age and is one of the appropriators and claimants of the order and water right mentioned in the foregoing notice of completion of groundwater appropriation by means of well and the persons whose name subscribed thereto, as the appropriator and claimant, that he knows the contents of said foregoing notice and that the matters and things therein stated are true.

Emerald Daugherty

Subscribed and sworn to before me, this 22nd day of June, 1973

David L. Johnson
Notary Public for the State of Montana.

Residing at Billings, Montana

My Commission expires July 2 1974

937365

STATE OF MONTANA, }
County of Yellowstone } ss.
This document was filed in my office
on JUN 22 1973 at 2:55 o'clock P. M.
By MARSHALL H. ALONDI
County Clerk & Recorder

**STATE OF MONTANA
ADMINISTRATOR OF GROUNDWATER CODE
MONTANA WATER RESOURCES BOARD**

**NOTICE OF COMPLETION OF GROUNDWATER
APPROPRIATION BY MEANS OF WELL**

Developed after January 1, 1962

DRILLER'S LOG

Indicate the character, color, thickness of strata such as soil, clay, sand, gravel, shale, sandstone, etc. Show depth at which water is found and height to which water rises in well.

(Under Chapter 237 Montana Session Laws, 1961, as amended)

This form to be prepared by driller, and three copies to be filed by the owner with the County Clerk and Recorder in the county in which the well is located, last copy to be retained by driller. Please answer all questions. If not applicable, so state, otherwise the form may be returned.

Owner Emerald, John and
William Daugherty

Address 631 Avenue C

Billings, Montana

Date well started August 1965

completed August 1965

For Administrator's Use	
File	<u>937364</u>
	<u>JUNE 22, 1973</u>
GW	<u>12:54 p.m.</u>

Type of well Dug
(Dug, driven, bored or drilled)

Equipment used Backhoe
(Chain drill, rotary or other)

Water Use: Domestic Municipal Stock Irrigation
Industrial Drainage Other * Garden/Lawn

*Describe
USE: If used for irrigation, industrial, drainage or other. Explain, state number of acres and location or other data (i.e. Lot, Block and Addition).

ESTIMATED ANNUAL WITHDRAWAL 1,500,000 gallons

Size of Drilled Hole	Size and Weight of Casing	From (Feet)	To (Feet)	PERFORATIONS		
				Kind Size	From (Feet)	To (Feet)
<u>2'</u>	<u>2' ground 14 gauge</u>	<u>11'</u>	<u>1/2"</u>	<u>8'</u>	<u>11'</u>	

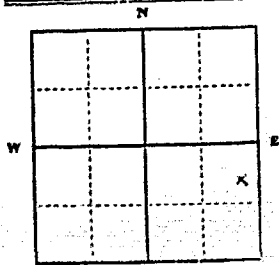

NE 1/4 SE 18
T. 1 N. R. 27 E
X

INDICATE LOCATION OF WELL AND PLACE OF USE, IF POSSIBLE. EACH SMALL SQUARE REPRESENTS 40 ACRES.

Driller's Signature _____

Driller's Address 631 Avenue C

Billings, Montana

LICENSE NO None

Top of Ground		(Elev. above sea level)
From (Feet)	To (Feet)	
0	1	<u>all gravel</u>
1	2	
2	3	
3	4	
4	5	<u>water found and height</u>
5	6	
6	7	
7	8	
8	9	
9	10	
10	11	

Static water level 4 ft.*
Pumping water level 8 ft.*
at 30 gallons per minute,
measured 10 minutes after pumping
began.
*Measured from ground level.
Well developed by N/A
for _____ hours,
Power Electric Pump 1/2 HP
Remarks: (Gravel packing, cementing,
packers, type of shutoff)
Gravel, float switch

11' Show exact depth of bottom

WELL 117

53909

STATE OF MONTANA,
County of Yellowstone } ss.

EMERALD DAUGHERTY having first been duly sworn, deposes and
says that he is of lawful age and is one of the appropriators
and claimants of the order and water right mentioned in the foregoing notice of
completion of groundwater appropriation by means of well and the persons whose name
subscribed thereto, as the appropriator and claimant,
that he knows the contents of said foregoing notice and that the matters and things
therein stated are true.

Emerald Daugherty

Subscribed and sworn to before me, this 22nd day of June, 1973.

David L. Johnson
Notary Public for the State of Montana.

Residing at Billings, Montana

My Commission expires July 2 1974

937364

250
Fred
200

938554

STATE OF MONTANA, }
County of Yellowstone. }

This instrument was filed in my office
this 28 day of 1973

at 4:25 o'clock P. M.

MERRIL F. KLUNDT
County Clerk & Recorder

By [Signature] Deputy

700

File No.

T. 1. N. R. 27E

18

DUPLICATE

County Yellowstone

STATE OF MONTANA
ADMINISTRATOR OF GROUNDWATER CODE
OFFICE OF STATE ENGINEER

RECEIVED
DEC 6 1963

Declaration of Vested Groundwater Rights

(Under Chapter 237, Montana Session Laws, 1961)

STATE ENGINEER

1. Reinhold Kessel, of Route #2 Billings
(Name of Appropriator) (Address) (Town)
County of Yellowstone State of Montana
have appropriated groundwater according to the Montana laws in effect prior to January 1, 1962, as follows:

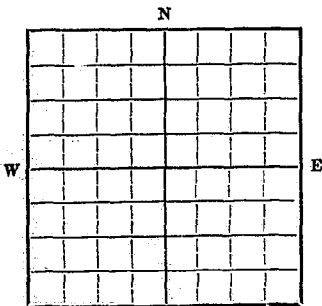

Situated in S field near barn
36 lot 3+4 + S 1/2 NE 1/4
1/4 Sec 1, T. 14 N. R. 27 E

Indicate point of appropriation and place of use, if possible. Each small square represents 10 acres.

- 2. The beneficial use on which the claim is based Seedlot
- 3. Date or approximate date of earliest beneficial use; and how continuous the use has been 1941
- 4. The amount of groundwater claimed (in miner's inches or gallons per minute) 50 gals Per minute
- 5. If used for irrigation, give the acreage and description of the lands to which water has been applied and name of the owner thereof not used for irrigation
- 6. The means of withdrawing such water from the ground and the location of each well or other means of withdrawal Electric water systems located near barn
- 7. The date of commencement and completion of the construction of the well, wells, or other works for withdrawal of groundwater about 1941
- 8. The depth of water table 6 ft.
- 9. So far as it may be available, the type, size and depth of each well or the general specifications of any other works for the withdrawal of groundwater drilled well 8 in casing 35 ft deep
- 10. The estimated amount of groundwater withdrawn each year not known about 4000 gals per day
- 11. The log of formations encountered in the drilling of each well if available not known
- 12. Such other information of a similar nature as may be useful in carrying out the policy of this act, including reference to book and page of any county record we bought this farm in 1951 from W. S. Lehman

Signature of Owner Reinhold Kessel
Date Dec. 5, 1963

Three copies to be filed by the owner with the County Clerk and Recorder of the county in which the well is located.

Please answer all questions. If not applicable, so state, otherwise the form will be returned.

Original to the County Clerk and Recorder; duplicate to the State Engineer; Triplicate to the School of Mines and Quadruplicate for the Appropriator.

7870

719457

STATE OF MONTANA,
County of Yellowstone,

This instrument was filed in
this 5 day of April 1963

at 10:42 o'clock
James H. Redding
County Clerk & Recorder

By Jaw
Jaw

When
Each county returns abstracting
and index
improve by

and
by
and
and

DUPLICATE

T. N. R. 296
County Yellowstone

STATE OF MONTANA
ADMINISTRATOR OF GROUNDWATER CODE
OFFICE OF STATE ENGINEER

RECEIVED
DEC 6 1963

Declaration of Vested Groundwater Rights

(Under Chapter 237, Montana Session Laws, 1961)

STATE ENGINEER

1. Reinhold Kambel of Route #2 Billings Montana
(Name of Appropriator) (Address) (Town)
County of Yellowstone State of Montana
have appropriated groundwater according to the Montana laws in effect prior to January 1, 1962, as follows:

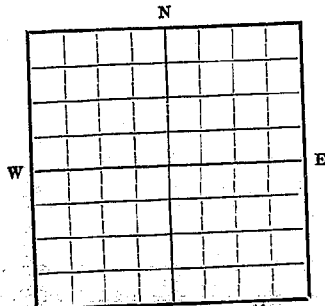

I rated next to dwelling
26 Lot 2 & 4 S 1/4 NE 1/4
1/4 Sec. 11, T. 1 N. R. 27 E

Indicate point of appropriation and place of use, if possible. Each small square represents 10 acres.

2. The beneficial use on which the claim is based Household and lawn

3. Date or approximate date of earliest beneficial use; and how continuous the use has been 1941 steady use

4. The amount of groundwater claimed (in miner's inches or gallons per minute) 50 gals per minute

5. If used for irrigation, give the acreage and description of the lands to which water has been applied and name of the owner thereof 1/4 acre of lawn

6. The means of withdrawing such water from the ground and the location of each well or other means of withdrawal electric water system located next to dwelling

7. The date of commencement and completion of the construction of the well, wells, or other works for withdrawal of groundwater About 1941

8. The depth of water table 2 ft

9. So far as it may be available, the type, size and depth of each well or the general specifications of any other works for the withdrawal of groundwater drilled well, 3 in. well casing 35 ft deep

10. The estimated amount of groundwater withdrawn each year Not known about 1500 gals per day

11. The log of formations encountered in the drilling of each well if available Not known

12. Such other information of a similar nature as may be useful in carrying out the policy of this act, including reference to book and page of any county record We bought this farm in 1951 from W. S. Johnson

Signature of Owner Reinhold Kambel
Date Dec 5 1963

Three copies to be filed by the owner with the County Clerk and Recorder of the county in which the well is located.

Please answer all questions. If not applicable, so state, otherwise the form will be returned.

Original to the County Clerk and Recorder; duplicate to the State Engineer; Triplicate to the School of Mines and Quadruplicate for the Appropriator.

719456

STATE OF MONTANA,
County of Yellowstone,

This instrument was filed in my office

this 5 day of Dec 1963

at 10:40 o'clock A M

Edison S. Redding,
County Clerk & Recorder

By [Signature] Deputy
[Signature]

MAR 14 1967

T. 1 N. R. 27 E

File No.

DUPLICATE

Bill: McDermott
 Bureau: ... County: Yellowstone
 Code: STATE OF MONTANA
 Director: ADMINISTRATOR OF GROUNDWATER CODE
 District: OFFICE OF STATE ENGINEER

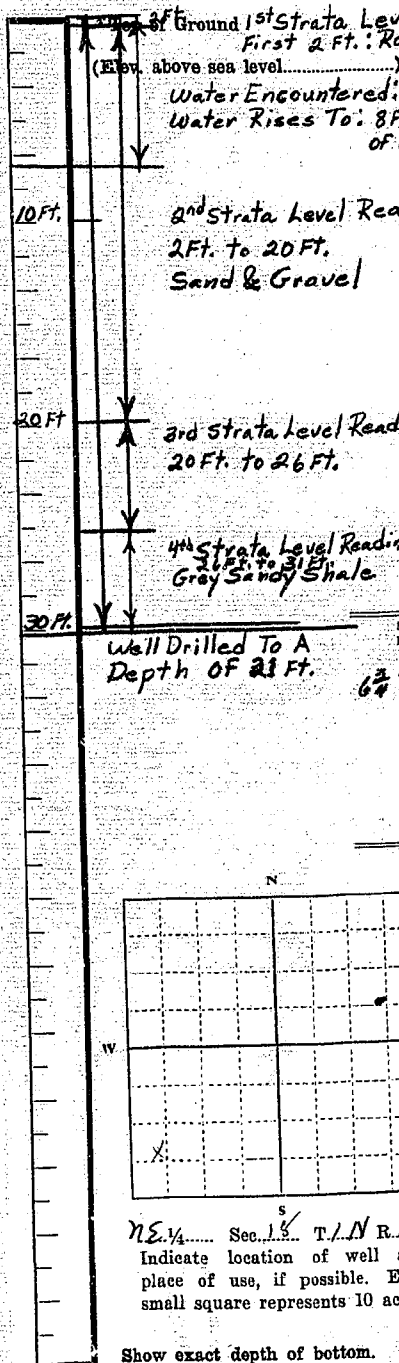

Notice of Completion of Groundwater Appropriation by Means of Well

(Under Chapter 237, Montana Session Laws, 1961)

Owner: Melvin F. Ellis Address: 4028 2nd Ave. South Billings, Montana
 Driller: Melvin F. Ellis Address: 4028 2nd Ave. South Billings, Montana

Date of Notice of Appropriation of Groundwater:
 Date well started: Jan. 9, 1967 Date Completed: January 12, 1967

Type of well: Drilled Equipment Used: Drill
 (dig, driven, bored or drilled) (Churn, drill, rotary or other)

Water Use: Domestic Municipal Other Irrigation
 Industrial Drainage Stock

Indicate on the diagram the character and thickness of the different strata met with in drilling, such as soil, clay, shale, gravel, rock or sand, etc. Show depth at which water is encountered, thickness and character of water-bearing strata and height to which water rises in the well.

Size of Drilled Hole	Size and Weight of Casing	From (Feet)	To (Feet)	PERFORATIONS		
				Kind Size	From (Feet)	To (Feet)
<u>6 7/8" Hole</u>	<u>6 I.D. Standard Casing</u>	<u>Top - Ground Level</u>	<u>Bottom - 31'</u>			

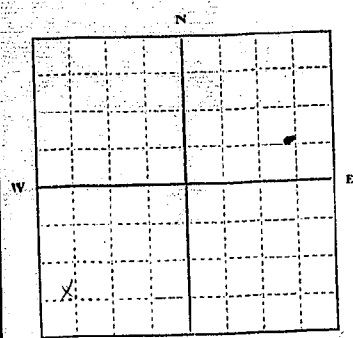

NE 1/4 Sec. 14 T. 1 N. R. 27 E
 Indicate location of well and place of use, if possible. Each small square represents 10 acres.

Show exact depth of bottom.

Static Water Level for non-flowing Well feet.
 Shut-in Pressure for Flowing Well
 Pumping Water Level feet at gal. per minute.
 Discharge in gal. per min. of flowing well
 How Tested Length of Test

Remarks: (Gravel packing, cementing, packers, type of shutoff, location of place of use of groundwater if not at well, and any other similar pertinent information, including number of acres irrigated, if used for irrigation)

165
 Driller's License Number
Melvin Ellis
 Driller's Signature

This form to be prepared by driller, and three copies to be filed by the owner with the County Clerk and Recorder in the county in which the well is located.

Please answer all questions. If not applicable, so state, otherwise the form will be returned.

Original to the County Clerk and Recorder; duplicate to the State Engineer; Triplicate to the Montana Bureau of Mines and Geology and Quadruplicate for the Appropriator.

795193

STATE OF MONTANA,
County of Yellowstone,

This instrument was filed by me on

MAR 13 1987 of

Edmon S. Hedding

Edmon S. Hedding,
County Clerk & Recorder

Edmon S. Hedding Deputy

STATE OF MONTANA
ADMINISTRATOR OF GROUNDWATER CODE
MONTANA WATER RESOURCES BOARD

**NOTICE OF COMPLETION OF GROUNDWATER
APPROPRIATION BY MEANS OF WELL**

Developed after January 1, 1962

(Under Chapter 237 Montana Session Laws, 1961, as amended)

This form to be prepared by driller, and three copies to be filed by the owner with the County Clerk and Recorder in the county in which the well is located, last copy to be retained by driller. Please answer all questions. If not applicable, so state, otherwise the form may be returned.

Owner Emerald, John and
William Daugherty

Address 631 Avenue C

Billings, Montana

Date well started May, 1964

completed May, 1964

Type of well Dug
(Dug, driven, bored or drilled)

Equipment used Backhoe
(Churn drill, rotary or other)

Water Use: Domestic Municipal Stock Irrigation

Industrial Drainage Other * Garden/Lawn

*Describe _____
USE: If used for irrigation, industrial, drainage or other. Explain, state number of acres and location or other data (i.e. Lot, Block and Addition). _____

ESTIMATED ANNUAL WITHDRAWAL 1,500,000 gallons

Size of Drilled Hole	Size and Weight of Casing	From (Feet)	To (Feet)	PERFORATIONS		
				Kind Size	From (Feet)	To (Feet)
2'	2' 14 gauge	ground	11'	1/2" hole	8'	11'

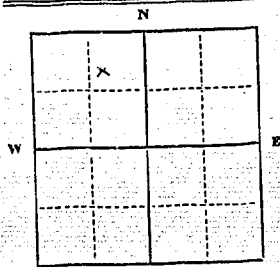

NE 1/4 NW 1/4 Sec. 19
T. 1 N. R. 27 E. XX
3 XX

INDICATE LOCATION OF WELL AND PLACE OF USE, IF POSSIBLE. EACH SMALL SQUARE REPRESENTS 40 ACRES.

Driller's Signature Emerald Daugherty

Driller's Address 631 Avenue C

Billings, Montana LICENSE NO. None

DRILLER'S LOG

Indicate the character, color, thickness of strata such as soil, clay, sand, gravel, shale, sandstone, etc. Show depth at which water is found and height to which water rises in well.

Top of Ground		(Elev. above sea level)
From (Feet)	To (Feet)	
0	1	all gravel
1	2	
2	3	
3	4	
4	5	water found and height
5	6	
6	7	
7	8	
8	9	
9	10	
10	11	

Static water level 4 ft.*
Pumping water level 8 ft.*
at 30 gallons per minute,
measured 10 minutes after pumping began.
*Measured from ground level.
Well developed by N/A
for hours.
Power Electric Pump 1/4 HP
Remarks: (Gravel packing, cementing, packers, type of shutoff)
Gravel, float switch

11' Show exact depth of bottom

Well # 3
53983

STATE OF MONTANA.
County of Yellowstone } ss.

EMERALD DAUGHERTY having first been duly sworn, depose s and
say s that he is of lawful age and is one of the appropriator s
and claimant s of the order and water right mentioned in the foregoing notice of
completion of groundwater appropriation by means of well and the person s whose name
subscribed thereto, as the appropriator and claimant,
that he know s the contents of said foregoing notice and that the matters and things
therein stated are true.

Emerald Daugherty

Subscribed and sworn to before me, this 22nd day of June, 1973.

David L. Johnson
Notary Public for the State of Montana.

Residing at Billings, Montana

My Commission expires July 2, 1974

937306

JUN 22 1973

11.03

John

bottom

3

9983

Yellowstone
County

STATE OF MONTANA
ADMINISTRATOR OF GROUNDWATER CODE
MONTANA WATER RESOURCES BOARD
**NOTICE OF COMPLETION OF GROUNDWATER
APPROPRIATION BY MEANS OF WELL**
Developed after January 1, 1962

(Under Chapter 237 Montana Session Laws, 1961, as amended)

This form to be prepared by driller, and three copies to be filed by the owner with the County Clerk and Recorder in the county in which the well is located, last copy to be retained by driller. Please answer all questions. If not applicable, so state, otherwise the form may be returned.

Owner Emerald, John and William Daugherty

Address 631 Avenue C

Billings, Montana

Date well started May, 1964

completed May, 1964

Type of well Dug
(Dug, driven, bored or drilled)

Equipment used Backhoe
(Churn drill, rotary or other)

Water Use: Domestic Municipal Stock Irrigation

Industrial Drainage Other * Garden/Lawn

*Describe

USE: If used for irrigation, industrial, drainage or other. Explain, state number of acres and location or other data (i.e. Lot, Block and Addition).

ESTIMATED ANNUAL WITHDRAWAL 1,500,000 gallons

Size of Drilled Hole	Size and Weight of Casing	From (Feet)	To (Feet)	PERFORATIONS		
				Kind Size	From (Feet)	To (Feet)
2'	2' 14 gauge	ground	11'	1/2" hole	8'	11'

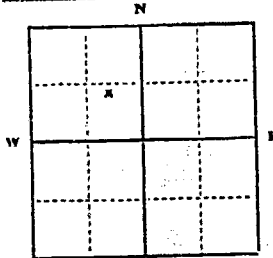

SE 1/4 NW 1/4 Sec. 19
T. 1 N. R. 27 E.
S. XX

INDICATE LOCATION OF WELL AND PLACE OF USE, IF POSSIBLE. EACH SMALL SQUARE REPRESENTS 40 ACRES.

Driller's Signature Emerald Daugherty

Driller's Address 631 Avenue C

Billings, Montana

LICENSE NO. None

11' Show exact depth of bottom

DRILLER'S LOG

Indicate the character, color, thickness of strata such as soil, clay, sand, gravel, shale, sandstone, etc. Show depth at which water is found and height to which water rises in well.

Top of Ground		(Elev. above sea level)
From (Feet)	To (Feet)	
0	1	all gravel
1	2	
2	3	
3	4	
4	5	water found and height
5	6	
6	7	
7	8	
8	9	
9	10	
10	11	

53,985

STATE OF MONTANA,
County of Yellowstone } ss.

EMERALD DAUGHERTY having first been duly sworn, depose S and
say S that he is of lawful age and is one of the appropriator-S
..... and claimantS of the order and water right mentioned in the foregoing notice of
completion of groundwater appropriation by means of well and the person S whose name
..... subscribed thereto, as the appropriator and claimant
that he know S the contents of said foregoing notice and that the matters and things
therein stated are true.

Emerald Daugherty

Subscribed and sworn to before me, this 22nd day of June, 19 73

David L. Johnson
Notary Public for the State of Montana.

Residing at Billings, Montana

My Commission expires July 2, 19 74

937304

JUL 28 1973

11-01

John
2

STATE OF MONTANA
ADMINISTRATOR OF GROUNDWATER CODE
MONTANA WATER RESOURCES BOARD
**NOTICE OF COMPLETION OF GROUNDWATER
APPROPRIATION BY MEANS OF WELL**
Developed after January 1, 1962

(Under Chapter 237 Montana Session Laws, 1961, as amended)
This form to be prepared by driller, and three copies to be filed by the owner with the County Clerk and Recorder in the county in which the well is located, last copy to be retained by driller. Please answer all questions. If not applicable, so state, otherwise the form may be returned.

Owner Emerald, John and William Daugherty
Address 631 Avenue C
Billings, Montana
Date well started May, 1964
completed May, 1964

For Administrator's Use
File 9373.05
June 22, 1964
GW 1 11:02 A.M.

Type of well Dug
(E.g. driven, bored or drilled)
Equipment used Backhoe
(Chain drill, rotary or other)
Water Use: Domestic Municipal Stock Irrigation
Industrial Drainage Other Garden/Lawn

*Describe _____
USE: If used for irrigation, industrial, drainage or other. Explain, state number of acres and location or other data (i.e. Lot, Block and Addition).

ESTIMATED ANNUAL WITHDRAWAL 1,500,000 gallons

Size of Drilled Hole	Size and Weight of Casing	From (Feet)	To (Feet)	PERFORATIONS		
				Kind Size	From (Feet)	To (Feet)
2'	2' 14 gauge	ground	11'	1/2" hole	8'	11'

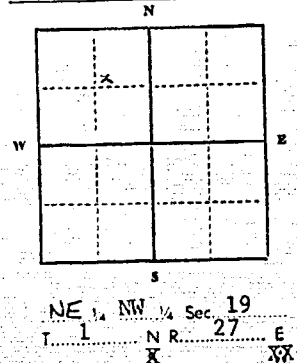

Static water level 4 ft.*
Pumping water level 8 ft.*
at 30 gallons per minute,
measured 10 minutes after pumping
began.
*Measured from ground level.
Well developed by N/A
for hours.
Power Electric pump 1/4 HP
Remarks: (Gravel packing, cementing,
packers, type of shutoff)
Gravel, float switch

INDICATE LOCATION OF WELL AND PLACE OF USE, IF POSSIBLE.
EACH SMALL SQUARE REPRESENTS 40 ACRES.

Driller's Signature Emerald Daugherty
Driller's Address 631 Avenue C
Billings, Montana LICENSE NO. None

DRILLER'S LOG
Indicate the character, color, thickness of strata such as soil, clay, sand, gravel, shale, sandstone, etc. Show depth at which water is found and height to which water rises in well.

Top of Ground		(Elev. above sea level)
From (Feet)	To (Feet)	
0	1	all gravel
1	2	
2	3	
3	4	
4	5	water found and height
5	6	
6	7	
7	8	
8	9	
9	10	
10	11	

11' Show exact depth of bottom

53984
Well 112

STATE OF MONTANA,
County of Yellowstone } ss.

EMERALD DAUGHERTY having first been duly sworn, depose S and
say S that he is of lawful age and is one of the appropriator S
and claimants of the order and water right mentioned in the foregoing notice of
completion of groundwater appropriation by means of well and the person S whose name
subscribed thereto, as the appropriator and claimant,
that he know S the contents of said foregoing notice and that the matters and things
therein stated are true.

Emerald Daugherty

Subscribed and sworn to before me, this 22nd day of June, 19 73.

David L. [Signature]
Notary Public for the State of Montana.

Residing at Billings, Montana

My Commission expires July 2 19 74

937305

JUN 28 1973
11:02

David
20

STATE OF MONTANA
ADMINISTRATOR OF GROUNDWATER CODE
MONTANA WATER RESOURCES BOARD
**NOTICE OF COMPLETION OF GROUNDWATER
APPROPRIATION BY MEANS OF WELL**
Developed after January 1, 1962

DRILLER'S LOG

Indicate the character, color, thickness of strata such as soil, clay, sand, gravel, shale, sandstone, etc. Show depth at which water is found and height to which water rises in well.

(Under Chapter 237 Montana Session Laws, 1961, as amended)

This form to be prepared by driller, and three copies to be filed by the owner with the County Clerk and Recorder in the county in which the well is located, last copy to be retained by driller.
Please answer all questions. If not applicable, so state, otherwise the form may be returned.

Owner Emerald, John and William Daugherty

Address 631 Avenue C
Billings, Montana

Date well started May, 1964
completed May, 1964

Type of well Dug
(Dug, driven, bored or drilled)

Equipment used Backhoe
(Churn drill, rotary or other)

Water Use: Domestic Municipal Stock Irrigation
Industrial Drainage Other * Garden/Lawn

*Describe
USE: If used for irrigation, industrial, drainage or other. Explain, state number of acres and location or other data (i.e. Lot, Block and Addition).

ESTIMATED ANNUAL WITHDRAWAL 1,500,000 gallons

Size of Drilled Hole	Size and Weight of Casing	From (Feet)	To (Feet)	PERFORATIONS		
				Kind Size	From (Feet)	To (Feet)
2'	2' ground 14 gauge		11'	1/4" hole	8'	11'

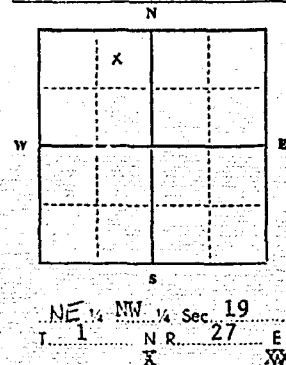

Static water level 4 ft.*
Pumping water level 8 ft.*
at 30 gallons per minute,
measured 10 minutes after pumping began.

*Measured from ground level.
Well developed by N/A
for hours.
Power Electric Pump 1/4 HP
Remarks: (Gravel packing, cementing, packers, type of shutoff)
Gravel, float switch

Top of Ground		(Elev. above sea level)
From (Feet)	To (Feet)	
0	1	all gravel
1	2	
2	3	
3	4	
4	5	water found and height
5	6	
6	7	
7	8	
8	9	
9	10	
10	11	

INDICATE LOCATION OF WELL AND PLACE OF USE, IF POSSIBLE. EACH SMALL SQUARE REPRESENTS 40 ACRES.

Driller's Signature Emerald Daugherty

Driller's Address 631 Avenue C
Billings, Montana

LICENSE NO. None

11' Show exact depth of bottom

53,982
Well 44

STATE OF MONTANA,
County of Yellowstone } ss.

EMERALD DAUGHERTY having first been duly sworn, depose s. and
say s. that he is of lawful age and is one of the appropriator s
and claimant s of the order and water right mentioned in the foregoing notice of
completion of groundwater appropriation by means of well and the person s whose name
subscribed thereto, as the appropriator and claimant,
that he know s the contents of said foregoing notice and that the matters and things
therein stated are true.

Emerald Daugherty

Subscribed and sworn to before me, this 22nd day of June, 19 73

David L. Johnson
Notary Public for the State of Montana.

Residing at Billings, Montana

My Commission expires July 2 19 74

937308

JUN 22 1973
11-04
A
Jaw
Deputy

STATE OF MONTANA,
County of Yellowstone } ss.

EMERALD DAUGHERTY having first been duly sworn, depose S and
say S that he is of lawful age and is one of the appropriator S
and claimant S of the order and water right mentioned in the foregoing notice of
completion of groundwater appropriation by means of well and the person S whose name
subscribed thereto, as the appropriator and claimant,
that he know S the contents of said foregoing notice and that the matters and things
therein stated are true.

Emerald Daugherty

Subscribed and sworn to before me, this 22nd day of June, 19 73.

David L. Johnson
Notary Public for the State of Montana.

Residing at Billings, Montana

My Commission expires July 2, 19 74

937308

JUN 22 1973

1605 A

REC'D
JUN 22 1973
2

GYM

File No.

T.1.N. R27E

DUPLICATE

County Yellowstone

STATE OF MONTANA
ADMINISTRATOR OF GROUNDWATER CODE
OFFICE OF STATE ENGINEER

Declaration of Vested Groundwater Rights
(Under Chapter 237, Montana Session Laws, 1961)

RECEIVED
JAN 2 1964
STATE ENGINEER

1. Richard Popelka, of 332 Lake Hill Dr. Billings
(Name of Appropriator) (Address) (Town)

County of Yellowstone State of Montana
have appropriated groundwater according to the Montana laws in effect prior to January 1, 1962, as follows:

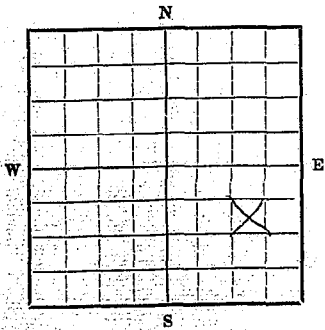

R27E 1/4 NESE Sec. 19 T.1N R.27

Indicate point of appropriation and place of use, if possible. Each small square represents 10 acres.

2. The beneficial use on which the claim is based
Watering Livestock-domestic use

3. Date or approximate date of earliest beneficial use; and how continuous the use has been
Well was there when property acquired.

4. The amount of groundwater claimed (in miner's inches or gallons per minute)
10 gal per minute

5. If used for irrigation, give the acreage and description of the lands to which water has been applied and name of the owner thereof
Garden use

6. The means of withdrawing such water from the ground and the location of each well or other means of withdrawal
Pump

7. The date of commencement and completion of the construction of the well, wells, or other works for withdrawal of groundwater
Well was there when property acquired.

8. The depth of water table 35 Ft.

9. So far as it may be available, the type, size and depth of each well or the general specifications of any other works for the withdrawal of groundwater
100' deep 70' pipe 8" pipe

10. The estimated amount of groundwater withdrawn each year approx 50,000

11. The log of formations encountered in the drilling of each well if available Not available

12. Such other information of a similar nature as may be useful in carrying out the policy of this act, including reference to book and page of any county record None to my knowledge.

Signature of Owner Richard Popelka
Date 12-30-63

Three copies to be filed by the owner with the County Clerk and Recorder of the county in which the well is located.

Please answer all questions. If not applicable, so state, otherwise the form will be returned.

Original to the County Clerk and Recorder; duplicate to the State Engineer; Triplicate to the School of Mines and Quadruplicate for the Appropriator.

Mortimer

18231

721417

STATE OF MONTANA,
County of Yellowstone,

This instrument was filed in my office
this DEC 30 1963
at 8:27 o'clock A.M.

Edmon S. Redding,
County Clerk & Recorder

By [Signature] Deputy

200

Form No. 18
8-60

T. 1N R. 27E

County Yellowstone

MONTANA BUREAU OF MINES AND GEOLOGY
Butte, Montana

RECEIVED
JUL 27 1961

STATE ENGINEER

Water Well Log

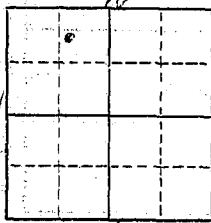

Owner Alvin & Chlie Leplack Address RT 2

Driller Alvin Leplack Address RT 2

Date Started July 8, 1961 Date Completed July 10, 1961

Location: Sec. 19 T. 1N R. 27E $\frac{1}{4}$ sec. SW of 19

Type of well Driven Equipment used Chen. Co. Steel Hammer
(dug, driven, or drilled) (churn, drill, rotary, other)

Water use: Domestic Municipal Stock Irrigation
Industrial Drainage Other _____

Casing: 50 ft. to _____ ft. Type galvanized Size 3"

Casing: _____ ft. to _____ ft. Type _____ Size _____

Casing: _____ ft. to _____ ft. Type _____ Size _____

Perforated or screened: Ft. _____ to ft. _____ . Ft. _____ to ft. _____

Type of screen or perforations None

Static water level, for non-flowing well: 30 feet feet.

Shut-in pressure, for flowing well: None lb./sq. in. on: _____ (date)

Pumping water level 20 feet at 2.5 gal. per min. end

How tested: Time clock

Length of test 2 hours

Remarks: (Gravel packing, cementing, packers, type of shut-off, depth of shut-off)

None

(over)

