

Form No. 18  
8-60

T. 17N R. 27E

County Yellowstone

MONTANA BUREAU OF MINES AND GEOLOGY  
Butte, Montana

RECEIVED

Water Well Log

STATE ENGINEER

7

Owner Adrian & Chas. Kephart Address RTD

Driller Edward Madson Address RTD

Date Started Aug 12 1961 Date Completed Aug 15 1961

Location: Sec. 19 T. 17N R. 27E 1/4 sec. 19-19

Type of well None (Dug, driven, or drilled) Equipment used Steel Hammer (Churn, drill, rotary, other)

Water use: Domestic  Municipal  Stock  Irrigation

Industrial  Drainage  Other \_\_\_\_\_

Casing: 42 ft. to \_\_\_\_\_ ft. Type galvanized Size 2"

Casing: \_\_\_\_\_ ft. to \_\_\_\_\_ ft. Type \_\_\_\_\_ Size \_\_\_\_\_

Casing: \_\_\_\_\_ ft. to \_\_\_\_\_ ft. Type \_\_\_\_\_ Size \_\_\_\_\_

Perforated or screened: Ft. \_\_\_\_\_ to ft. \_\_\_\_\_ . Ft. \_\_\_\_\_ to ft. \_\_\_\_\_

Type of screen or perforations None

Static water level, for non-flowing well: 30-foot feet.

Shut-in pressure, for flowing well: None lb./sq. in. on: \_\_\_\_\_ (date)

Pumping water level 20 feet at 25 gal. per min. 1961

How tested: Pinpoint

Length of test 5 hours

Remarks: (Gravel packing, cementing, packers, type of shut-off, depth of shut-off)

None

(over)



GW-1

File No. ....

DUPLICATE

T. 1. N. R. 27. E. ....

County Yellowstone

STATE OF MONTANA  
ADMINISTRATOR OF GROUNDWATER CODE  
OFFICE OF STATE ENGINEER

DEC 30 1963

Declaration of Vested Groundwater Rights

(Under Chapter 237, Montana Session Laws, 1961) STATE ENGINEER

1. Margaret J. Trask, of 530 Avenue D, Billings, Montana  
(Name of Appropriator) (Address) (Town)  
County of Yellowstone State of Montana  
have appropriated groundwater according to the Montana laws in effect prior to January 1, 1962, as follows:

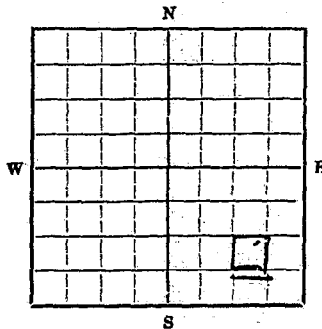

NW 1/4 of the SE 1/4 of the  
SE 1/4 of Sec. 19, T. 1 R. 27 E  
Indicate point of appropriation  
and place of use, if possible.  
Each small square represents 10  
acres.

- 2. The beneficial use on which the claim is based watering stock and garden
- 3. Date or approximate date of earliest beneficial use; and how continuous the use has been xxx and an indeterminate period of years before
- 4. The amount of groundwater claimed (in miner's inches or gallons per minute) unknown
- 5. If used for irrigation, give the acreage and description of the lands to which water has been applied and name of the owner thereof small garden in blocked off ten acres
- 6. The means of withdrawing such water from the ground and the location of each well or other means of withdrawal electric pump, well

- 7. The date of commencement and completion of the construction of the well, wells, or other works for withdrawal of groundwater unknown
- 8. The depth of water table unknown--approximately 90 feet
- 9. So far as it may be available, the type, size and depth of each well or the general specifications of any other works for the withdrawal of groundwater unknown--Approx. 6" casing. Probably a dug well--approx. 90 feet. (May have been drilled later)
- 10. The estimated amount of groundwater withdrawn each year unknown
- 11. The log of formations encountered in the drilling of each well if available unknown
- 12. Such other information of a similar nature as may be useful in carrying out the policy of this act, including reference to book and page of any county record

Signature of Owner Margaret Trask  
Date December 28, 1963

Three copies to be filed by the owner with the County Clerk and Recorder of the county in which the well is located.

Please answer all questions. If not applicable, so state, otherwise the form will be returned.

Original to the County Clerk and Recorder; duplicate to the State Engineer; Triplicate to the School of Mines and Quadruplicate for the Appropriator.

721144

9:39  
A  
County Clerk & Recorder  
Dennis F.  
9/2

THIS IS TO CERTIFY THAT  
THE ABOVE IS A TRUE AND  
CORRECT COPY OF THE  
ORIGINAL AS FILED IN  
THE OFFICE OF THE  
COUNTY CLERK & RECORDER  
ON THIS 10th DAY OF  
SEPTEMBER 1953.

WITNESSED MY HAND AND  
OFFICE OF THE COUNTY CLERK  
& RECORDER AT  
MARIETTA, GEORGIA  
THIS 10th DAY OF  
SEPTEMBER 1953.

File No. ....  
DUPLICATE

T. 1 N R. 27 E  
County of Yellowstone

STATE OF MONTANA  
ADMINISTRATOR OF GROUNDWATER CODE  
OFFICE OF STATE ENGINEER

**Declaration of Vested Groundwater Rights**  
(Under Chapter 237, Montana Session Laws, 1961)

1. Carm Hampton, of Route # 2 - Billings  
(Name of Appropriator) (Address) (Town)  
County of Yellowstone State of Montana  
have appropriated groundwater according to the Montana laws in effect prior to January 1, 1962, as follows:

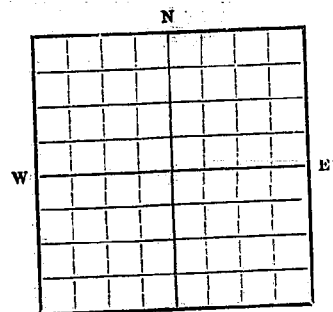

- 2. The beneficial use on which the claim is based Domestic + Household use
- 3. Date or approximate date of earliest beneficial use; and how continuous the use has been July 1 - 1961  
Used daily since that date
- 4. The amount of groundwater claimed (in miner's inches or gallons per minute) 5 gallons per minute
- 5. If used for irrigation, give the acreage and description of the lands to which water has been applied and name of the owner thereof Not used for irrigation
- 6. The means of withdrawing such water from the ground and the location of each well or other means of withdrawal Deep well jet

- 7. The date of commencement and completion of the construction of the well, wells, or other works for withdrawal of groundwater Commencement - June 1 - 1961  
Completion - June 25 - 1961
- 8. The depth of water table 6.6'
- 9. So far as it may be available, the type, size and depth of each well or the general specifications of any other works for the withdrawal of groundwater Type - Drilled well  
Size - 8"  
Depth - 89' 9"
- 10. The estimated amount of groundwater withdrawn each year 55,000 gallons per year
- 11. The log of formations encountered in the drilling of each well if available 25' sand, 6' sand stone - 18" clay,  
then sand to 67' then hit bedrock.
- 12. Such other information of a similar nature as may be useful in carrying out the policy of this act, including reference to book and page of any county record Let 8 - Block 1 - Household  
in small east corner of 40' from the south  
boundary in the above described lot located  
in Yellowstone County is recorded in the captioned

Signature of Owner Carm Hampton  
Date June 18 1963

Three copies to be filed by the owner with the County Clerk and Recorder of the county in which the well is located.  
Please answer all questions. If not applicable, so state, otherwise the form will be returned.  
Original to the County Clerk and Recorder; duplicate to the State Engineer; Triplicate to the School of Mines and Quadruplicate for the Appropriator.

709133

STATE OF MONTANA } ss.  
County of Yellowstone }

This instrument was filed in my office

this JUN 18 1963 day of \_\_\_\_\_ 19\_\_

at 120 o'clock P M.

R. A. Mikelson, Acting County Clerk & Recorder

By [Signature] Deputy

GV

File No.

T. L. N. R. 27 E. 11th

County Yellowknife

DUPLICATE

STATE OF MONTANA  
ADMINISTRATOR OF GROUNDWATER CODE  
OFFICE OF STATE ENGINEER

RECEIVED  
DEC 30 1963

Declaration of Vested Groundwater Rights

(Under Chapter 237, Montana Session Laws, 1961) STATE ENGINEER

1. Harriet J. and Joe Josephson, of 3604 Old Hardin Rd, Billings (Address) (Town)  
(Name of Appropriator)

County of Yellowknife State of Montana  
have appropriated groundwater according to the Montana laws in effect prior to January 1, 1962, as follows:

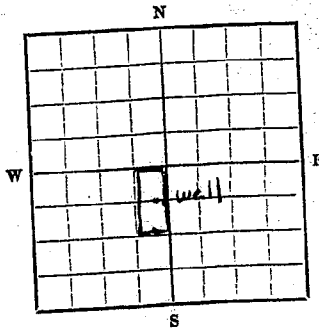

SE 1/4 of NE 1/4 of the  
SW 1/4 of Sec. 20, T. 1 N., R. 27 E

Indicate point of appropriation and place of use, if possible. Each small square represents 10 acres.

2. The beneficial use on which the claim is based stock, garden, household

3. Date or approximate date of earliest beneficial use; and how continuous the use has been continuously since winter of 1958. (well was drilled)

4. The amount of groundwater claimed (in miner's inches or gallons per minute) 15 gal. per minute (tested for four hours)

5. If used for irrigation, give the acreage and description of the lands to which water has been applied and name of the owner thereof small garden plot & meadow (2-3 acres) next to house in E of NE 1/4 of the SW 1/4 of Sec. 20, Township 1 North, Range 27 East, M.P.M.

6. The means of withdrawing such water from the ground and the location of each well or other means of withdrawal Electric pump. Well as located on plat herein.

7. The date of commencement and completion of the construction of the well, wells, or other works for withdrawal of groundwater well completed in winter of 1959. (started 12/16/59)

8. The depth of water table Pumping level 63 feet--static level 53

9. So far as it may be available, the type, size and depth of each well or the general specifications of any other works for the withdrawal of groundwater Drilled well; 6" steel 6" O.D. casing perforated at 90 feet & casing extends to 119 feet. Note: well drilled to 320 feet to attempt to find other water level, which is in vicinity--much better. But filled back to 110 feet

10. The estimated amount of groundwater withdrawn each year unknown; stock feed yard, etc.

11. The log of formations encountered in the drilling of each well if available 0-1', Top; 1-35' brown sticky shale; 35-60 soft sandy shale; 60-87 sand; 87-92 gravel & sand (15 gal. per min.) 92-115 sandy shale; 115-126 dark shale; 126-132 sand rock; (water @ 3 gal. per min.) 132-190 dark shale; 190-225 sandy shale; 225-230 sand rock & water 1 gal. per min; 232-252 dark shale (small amt of water at 263'-- log below 263' is of similar nature as any of above & carrying out the point of this log, and log is on back and page of any county record

unknown--Leroy S. Johnson, driller.

Signature of Owner

Date December 28, 1963

Three copies to be filed by the owner with the County Clerk and Recorder of the county in which the well is located.

Please answer all questions. If not applicable, so state, otherwise the form will be returned.

Original to the County Clerk and Recorder; duplicate to the State Engineer; Triplicate to the School of Mines and Quadruplicate for the Appropriator.

16151

721142

STATEMENT  
County of Row  
This instrument was filed for  
this day of DEC 8 1963  
at 9:37 o'clock A. M.  
Edouard S. Redding,  
County Clerk & Recorder  
By Jaw Deputy  
260

RECORDED  
INDEXED  
DEC 11 1963

RECORDED  
INDEXED  
DEC 11 1963



File No. ....

STATE WATER CONSERVATION BOARD

T. 27 N. R. 27 E  
County Yellowstone

DUPLICATE

JUL 19 1967

Bliss ..... McDermott  
Bushman ..... Murphy  
Coyle .....  
Darrington .....  
Sullivan .....  
STATE OF MONTANA  
ADMINISTRATOR OF GROUNDWATER CODE  
OFFICE OF STATE ENGINEER

Top of Ground  
(Elev. above sea level .....)

### Notice of Completion of Groundwater Appropriation by Means of Well

(Under Chapter 237, Montana Session Laws, 1961)

Owner EUGENE SPEER Address 234 STARLITE DR. BILLINGS  
Driller C. LYDE SANDO Address 1141 MILES AVE, BILLINGS

Date of Notice of Appropriation of Groundwater.....  
Date well started May 21, 1967 Date Completed May 26, 1967

Type of well DRILLED Equipment Used CABLE  
(duc, driven, bored or drilled) (Churn, drill, rotary or other)

Water Use: Domestic  Municipal  Other  Irrigation   
Industrial  Drainage  Stock

Indicate on the diagram the character and thickness of the different strata met with in drilling, such as soil, clay, shale, gravel, rock or sand, etc. Show depth at which water is encountered, thickness and character of water-bearing strata and height to which water rises in the well.



water at 85 ft.

Size of Drilled Hole	Size and Weight of Casing	From (Feet)	To (Feet)	PERFORATIONS		
				Kind Size	From (Feet)	To (Feet)
12"	10" galv.	0'	120'	Stamped 1/4" 3"	0	20

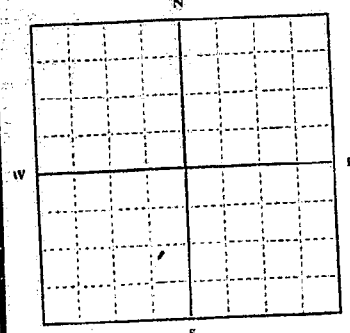

SW 1/4 Sec. 22 T. 27 N. R. 27 E

Indicate location of well and place of use, if possible. Each small square represents 10 acres.

See 7-B, BLD 2, Emerald Hills Sub  
Show exact depth of bottom. average strata

Static Water Level for non-flowing Well 60 feet.  
Shut-in Pressure for Flowing Well.....  
Pumping Water Level..... feet at 3 gal. per minute.  
Discharge in gal. per min. of flowing well.....  
How Tested Bailer Length of Test 60 min.

Remarks: (Gravel packing, cementing, packers, type of shutoff, location of place of use of groundwater if not at well, and any other similar pertinent information, including number of acres irrigated, if used for irrigation).....

2  
Driller's License Number

Clyde Sando  
Driller's Signature

This form to be prepared by driller, and three copies to be filed by the owner with the County Clerk and Recorder in the county in which the well is located.

Please answer all questions. If not applicable, so state, otherwise the form will be returned.

Original to the County Clerk and Recorder; duplicate to the State Engineer; Triplicate to the Montana Bureau of Mines and Geology and Quadruplicate for the Appropriator.

42,160

802673

STATE  
County

This instrument was recorded in my office  
this JUL 18 1967 1967  
at 11:04 o'clock A. M.  
**MAE HOFF, ACTING**  
By [Signature] Deputy

RECEIVED

File No. \_\_\_\_\_  
DUPLICATE JUL 6 1972

T. 146 N. R. 27 East M.P.M.  
County Yellowstone

MONTANA DEPARTMENT OF NATURAL RESOURCES AND CONSERVATION  
STATE OF MONTANA  
ADMINISTRATOR OF GROUNDWATER CODE  
OFFICE OF STATE ENGINEER

### Notice of Completion of Groundwater Appropriation Without Well

(Under Chapter 237 Montana Session Laws, 1961)

Date of Appropriation of Groundwater 6-6-77

Owner Joe Steffen Address Box 1 Lewis

Contractor (if any) \_\_\_\_\_

Address of Contractor \_\_\_\_\_

Date Started 5-26-77 Date Completed \_\_\_\_\_

Describe means of obtaining groundwater without a well "as by sub-irrigation and other natural processes". Include depth to water when applicable. natural flow by Spring

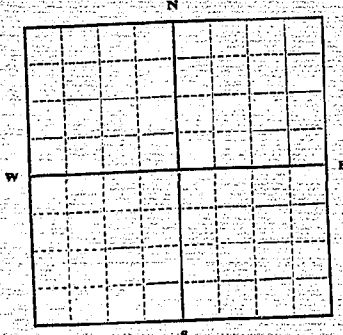

NW 1/4 of SW 1/4 Sec. 22 T. 146 N. R. 27 E. S. 1 M.P.M.  
Indicate point of appropriation and place of use, if possible.

Quantity of water developed and used with explanation of method used to measure or estimate such amount. If use is intermittent estimate approximate lengths of periods of use.

for watering horses + irrigating

Signature of Owner Joe Steffen  
Date 6-6-77

This form to be prepared by contractor (if any), otherwise by the owner.

Three copies of this notice are to be filed with the County Clerk and Recorder of the county in which the works are located.

Please answer all questions. If not applicable, so state, otherwise the form will be returned.

Original to the County Clerk and Recorder; duplicate to the State Engineer; Triplicate to the Montana Bureau of Mines and Geology and Quadruplicate for the Appropriator.

Doc. No. 908720  
Filed for record  
this 5th day of June  
A. D. 19 77, at 12:50  
o'clock P.M.

908720

Sam W. Mitchell  
Section  
Helena, Montana 59601

As the Administrator of the Groundwater Code for the State of Montana, please take note of the following special instructions, in order to properly protect your ground-

Special Instructions:

*as indicated in red on the map.* Please provide the missing information

**NOTE:**

underground springs are usually

appreciated in an existing well and are therefore

Thank you.

Sent on 4/1/62

STATE OF MONTANA  
County of ...  
APR 5 1962

12:50

by *[Signature]* Deputy

*[Signature]*

Address: 101 St. Joe  
Location: T. 1 N., R. 20 E., S. 11 N.  
Doc. No.: 908720  
5442

GV

File No.

DUPLICATE

T. 1 N. R. 27 E

County Yellowstone

STATE OF MONTANA  
ADMINISTRATOR OF GROUNDWATER CODE  
OFFICE OF STATE ENGINEER

RECEIVED  
DEC 30 1963

**Declaration of Vested Groundwater Rights**  
(Under Chapter 237, Montana Session Laws, 1961)

1. John + Joe Herren of B of 1762 Billings  
(Name of Appropriator) (Address) (Town)  
County of Yellowstone State of Mont.  
have appropriated groundwater according to the Montana laws in-effect prior to January 1, 1962, as follows:

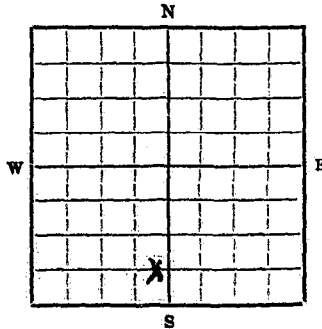

S. E. 1/4 S. W. Sec 25 T. 1 N. R. 27 E

Indicate point of appropriation and place of use, if possible. Each small square represents 10 acres.

2. The beneficial use on which the claim is based Stock water

3. Date or approximate date of earliest beneficial use; and how continuous the use has been 1947 - continuous

4. The amount of groundwater claimed (in miner's inches or gallons per minute) 15 gal

5. If used for irrigation, give the acreage and description of the lands to which water has been applied and name of the owner thereof not

6. The means of withdrawing such water from the ground and the location of each well or other means of withdrawal pump

7. The date of commencement and completion of the construction of the well, wells, or other works for withdrawal of groundwater 1947

8. The depth of water table 30 ft.

9. So far as it may be available, the type, size and depth of each well or the general specifications of any other works for the withdrawal of groundwater unknown

10. The estimated amount of groundwater withdrawn each year unknown

11. The log of formations encountered in the drilling of each well if available unknown

12. Such other information of a similar nature as may be useful in carrying out the policy of this act, including reference to book and page of any county record unknown

Signature of Owner Joe Herren

Date Dec. 30, 1963

Three copies to be filed by the owner with the County Clerk and Recorder of the county in which the well is located.

Please answer all questions. If not applicable, so state, otherwise the form will be returned.

Original to the County Clerk and Recorder; duplicate to the State Engineer; Triplicate to the School of Mines and Quadruplicate for the Appropriator.

16314

721353

STATE OF MONTANA  
County of Yellowstone  
This instrument is valid in my office  
on DEC 30 1968  
4:30 P M  
By MR  
200

GW-1

File No. ....

DUPLICATE

T. 1 N R. 27 E 25  
County Yellowstone

STATE OF MONTANA  
ADMINISTRATOR OF GROUNDWATER CODE  
OFFICE OF STATE ENGINEER

RECEIVED  
DEC 30 1963

**Declaration of Vested Groundwater Rights** STATE ENGINEER  
(Under Chapter 237, Montana Session Laws, 1961)

1. John & Joe Herren of Box 1762 Billings  
(Name of Appropriator) (Address) (Town)  
County of Yellowstone State of Mont.  
have appropriated groundwater according to the Montana laws in effect prior to January 1, 1962, as follows:

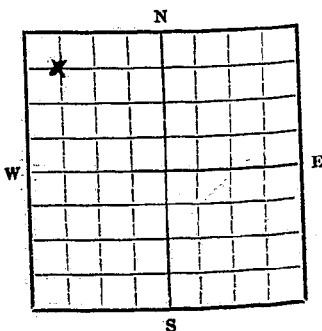

NW 1/4 NW Sec 25 T. 1 N R. 27 E

Indicate point of appropriation and place of use, if possible. Each small square represents 10 acres.

- 2. The beneficial use on which the claim is based Stock water
- 3. Date or approximate date of earliest beneficial use; and how continuous the use has been 1950 - Continuous
- 4. The amount of groundwater claimed (in miner's inches or gallons per minute) 10 gal
- 5. If used for irrigation, give the acreage and description of the lands to which water has been applied and name of the owner thereof
- 6. The means of withdrawing such water from the ground and the location of each well or other means of withdrawal Pump

- 7. The date of commencement and completion of the construction of the well, wells, or other works for withdrawal of groundwater 1950
- 8. The depth of water table 38.0
- 9. So far as it may be available, the type, size and depth of each well or the general specifications of any other works for the withdrawal of groundwater unknown
- 10. The estimated amount of groundwater withdrawn each year unknown
- 11. The log of formations encountered in the drilling of each well if available unknown
- 12. Such other information of a similar nature as may be useful in carrying out the policy of this act, including reference to book and page of any county record unknown

Signature of Owner Joe Herren  
Date Dec. 30, 1963

Three copies to be filed by the owner with the County Clerk and Recorder of the county in which the well is located.

Please answer all questions. If not applicable, so state, otherwise the form will be returned.

Original to the County Clerk and Recorder; duplicate to the State Engineer; Triplicate to the School of Mines and Quadruplicate for the Appropriator.

16310

721349

STATE OF MONTANA  
County of Yellowstone

This instrument was filed in my office  
this DEC 30 1963 19  
at 4:26 o'clock P.M.  
Edison S. Hedding,  
County Clerk & Recorder  
By M. H. Deputy





933629

STATE OF MONTANA }  
County of Yellowstone } ss.  
This document was filed in my office

on MAY 8 1973 at 4:10 P.M.

Deemken Deputy

Jew

File No. YWR

STATE WATER CONSERVATION BOARD

T. 1 N. R. 27 E

DUPLICATE

JAN 4 1967

County Yellowstone

Blk.  
Burr.  
Covr.  
Dirt.  
Sicker

STATE OF MONTANA  
ADMINISTRATOR OF GROUNDWATER CODE  
OFFICE OF STATE ENGINEER

### Notice of Completion of Groundwater Appropriation by Means of Well

(Under Chapter 237, Montana Session Laws, 1961)

Owner THOMAS A. JOHNSTON Address 3016 11<sup>th</sup> No. BILLINGS

Driller R. D. Toland Address Box 116 Belfry

Date of Notice of Appropriation of Groundwater.....

Date well started Dec. 1, 1966 Date Completed Dec. 18, 1966

Type of well Drilled Equipment Used Churn  
(dug, driven, bored or drilled) (Churn, drill, rotary or other)

Water Use: Domestic  Municipal  Other  Irrigation   
Industrial  Drainage  Stock

Indicate on the diagram the character and thickness of the different strata met with in drilling, such as soil, clay, shale, gravel, rock or sand, etc. Show depth at which water is encountered, thickness and character of water-bearing strata and height to which water rises in the well.

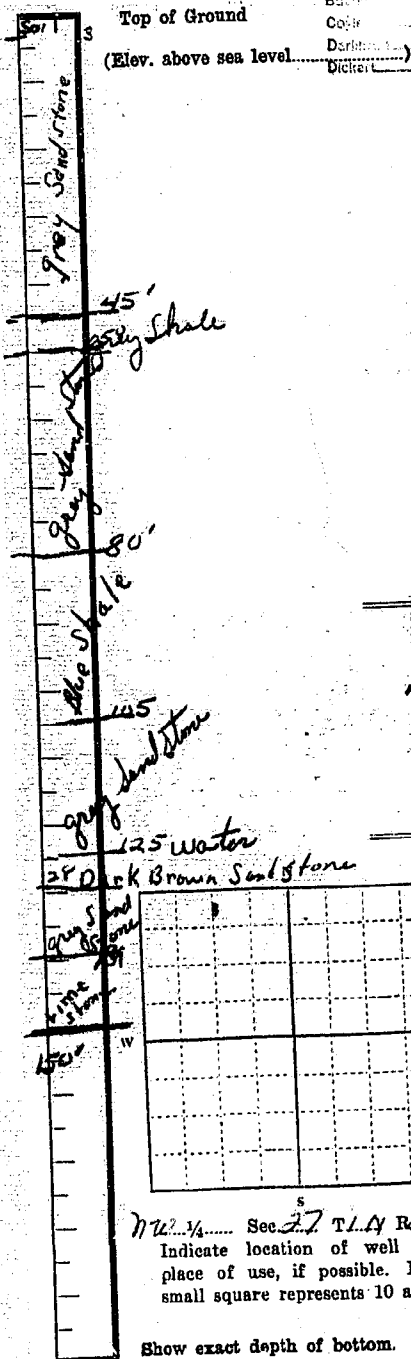

Size of Drilled Hole	Size and Weight of Casing	From (Feet)	To (Feet)	PERFORATIONS		
				Kind Size	From (Feet)	To (Feet)
7 in	70.0 23 lb	0'	122'	None		

Static Water Level for non-flowing Well..... 105 feet.

Shut-in Pressure for Flowing Well.....

Pumping Water Level..... 145 feet at 5 gal. per minute.

Discharge in gal. per min. of flowing well.....

How Tested Bailed Length of Test 2 hrs

Remarks: (Gravel packing, cementing, packers, type of shutoff, location of place of use of groundwater if not at well, and any other similar pertinent information, including number of acres irrigated, if used for irrigation).....

139  
Driller's License Number

Russell H. Toland  
Driller's Signature

This form to be prepared by driller, and three copies to be filed by the owner with the County Clerk and Recorder in the county in which the well is located.

Please answer all questions. If not applicable, so state, otherwise the form will be returned.

Original to the County Clerk and Recorder; duplicate to the State Engineer; Triplicate to the Montana Bureau of Mines and Geology and Quadruplicate for the Appropriator.

41593

791014

STATE OF MONTANA,  
County of Yellowstone,

This instrument was filed in my office  
this JAN 3 day of 1967  
at 12:30 o'clock P M.

Edwin S. Redding,  
County Clerk & Recorder  
By [Signature] Deputy

*[Handwritten notes and scribbles at the top of the page]*

*[Vertical handwritten note]*

*[Handwritten note]*

*[Handwritten note]*

*[Handwritten note]*

*[Handwritten note]*

*[Handwritten note]*

GW 2

File No. ....

T. J. N. R. 27E

County YELLOWSTONE

DUPLICATE

STATE OF MONTANA  
ADMINISTRATOR OF GROUNDWATER CODE  
OFFICE OF STATE ENGINEER

JAN 15 1964

**Notice of Completion of Groundwater Appropriation by Means of Well**

(Under Chapter 237, Montana Session Laws, 1961)

Owner Clyde Sando Address 1141 Miles Ave. Billings, Mont.

Driller Clyde Sando Address same

Date of Notice of Appropriation of Groundwater January 13, 1964

Date well started Dec. 31, 1963 Date Completed Jan. 11, 1964

Type of well Drilled Equipment Used Cable  
(dug, driven, bored or drilled) (Churn, drill, rotary or other)

Water Use: Domestic  Municipal  Other  Irrigation   
Industrial  Drainage  Stock

Indicate on the diagram the character and thickness of the different strata met with in drilling, such as soil, clay, shale, gravel, rock or sand, etc. Show depth at which water is encountered, thickness and character of water-bearing strata and height to which water rises in the well.

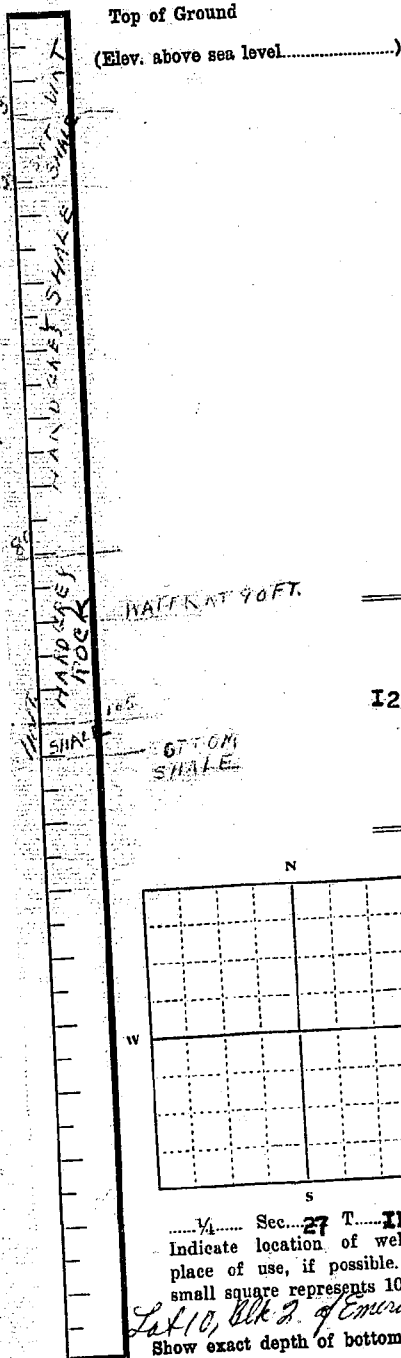

Size of Drilled Hole	Size and Weight of Casing	From (Feet)	To (Feet)	PERFORATIONS		
				Kind Size	From (Feet)	To (Feet)
I2 inch	I2" 45lb.	0	27ft.	None		

Static Water Level for non-flowing Well 75 feet.

Shut-in Pressure for Flowing Well.....

Pumping Water Level 90 feet at 50 gal. per minute.

Discharge in gal. per min. of flowing well.....

How Tested bailed Length of Test 2hrs.

Remarks: (Gravel packing, cementing, packers, type of shutoff, location of place of use of groundwater if not at well, and any other similar pertinent information, including number of acres irrigated, if used for irrigation).....

Driller's License Number

Clyde Sando  
Driller's Signature

This form to be prepared by driller, and three copies to be filed by the owner with the County Clerk and Recorder in the county in which the well is located.

Please answer all questions. If not applicable, so state, otherwise the form will be returned.

Original to the County Clerk and Recorder; duplicate to the State Engineer; Triplicate to the Montana Bureau of Mines and Geology and Quadruplicate for the Appropriator.

33216

1722035

STATE OF MONTANA  
County of Yellowstone

This instrument was filed in my office  
this 14 day of JAN 19 1908  
at 1:40 o'clock P. M.  
By [Signature] Deputy  
Thomas H. Redding,  
County Clerk & Recorder

8  
2.00

GW-

T. 11 R. 27  
 County Yellowstone

DUPLICATE

STATE OF MONTANA  
 ADMINISTRATOR OF GROUNDWATER CODE  
 OFFICE OF STATE ENGINEER

RECEIVED  
 DEC 30 1963  
 STATE ENGINEER

Declaration of Vested Groundwater Rights  
 (Under Chapter 237, Montana Session Laws, 1961)

1. Yos. C. Darby, of Billings, Montana (Town)  
 (Name of Appropriator) (Address)  
 County of Yellowstone State of Montana  
 have appropriated groundwater according to the Montana laws in effect prior to January 1, 1962, as follows:

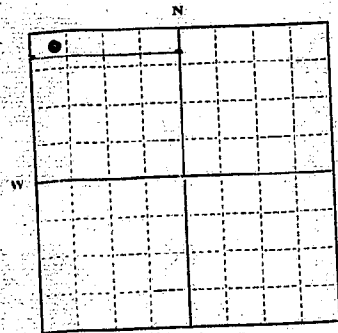

$\frac{1}{4}$  Sec. 29 T. 11 N. R. 27 E.  
 Indicate point of appropriation and place of use, if possible. Each small square represents 10 acres.

2. The beneficial use on which the claim is based  
Stock Water
3. Date or approximate date of earliest beneficial use; and how continuous the use has been 1935 Off and on as water was needed.  
More will be used as time goes on especially in the summer months.
4. The amount of groundwater claimed (in miner's inches or gallons per minute) 25 gallons per minute
5. If used for irrigation, give the acreage and description of the lands to which water has been applied and name of the owner thereof
6. The means of withdrawing such water from the ground and the location of each well or other means of withdrawal  
Pitcher pump
7. The date of commencement and completion of the construction of the well, wells, or other works for withdrawal of groundwater As far as can be determined it was drilled and completed in 1935
8. The depth of water table 25 feet
9. So far as it may be available, the type, size and depth of each well or the general specifications of any other works for the withdrawal of groundwater 60 foot depth with 3 inch pipe
10. The estimated amount of groundwater withdrawn each year 18,000 gallons per year
11. The log of formations encountered in the drilling of each well if available Unknown
12. Such other information of a similar nature as may be useful in carrying out the policy of this act, including reference to book and page of any county record

Signature of Owner Yos. C. Darby

Date Dec 30 1963

Three copies to be filed by the owner with the County Clerk and Recorder of the county in which the well is located.

Please answer all questions. If not applicable, so state, otherwise the form will be returned.

Original to the County Clerk and Recorder; Duplicate to the State Engineer; Triplicate to the Montana Bureau of Mines and Geology, and Quadruplicate for the Appropriator.

16236

721248

STATE OF MONTANA,  
County of Yellowstone,

This instrument was filed in my office

on 1-19 DEC 30 1948

at 11 o'clock A.M.  
Myself, Recorder

John  
Qu. Deputy



GV 4

File No. ....

DUPLICATE

T 1<sup>st</sup> R 27 2<sup>nd</sup>  
County Yellowstone

STATE OF MONTANA  
ADMINISTRATOR OF GROUNDWATER CODE  
OFFICE OF STATE ENGINEER

RECEIVED  
JAN 2 1964

**Declaration of Vested Groundwater Rights** ENGINEER  
(Under Chapter 237, Montana Session Laws, 1961)

1. P. M. Hike (Name of Appropriator)  
Deerfoot Lane Billings (Address) (Town)  
County of Yellowstone State of Mont  
have appropriated groundwater according to the Montana laws in effect prior to January 1, 1962, as follows:

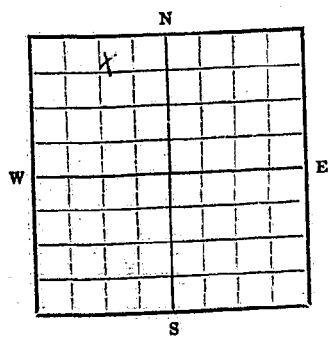

E. M. W. N. Sec. 29. T. 27. R. 27  
2. Indicate point of appropriation and place of use, if possible. Each small square represents 10 acres.

- 2. The beneficial use on which the claim is based Stock Water
- 3. Date or approximate date of earliest beneficial use; and how continuous the use has been Since Billings
- 4. The amount of groundwater claimed (in miner's inches or gallons per minute) 8 gal.
- 5. If used for irrigation, give the acreage and description of the lands to which water has been applied and name of the owner thereof None
- 6. The means of withdrawing such water from the ground and the location of each well or other means of withdrawal spring

- 7. The date of commencement and completion of the construction of the well, wells, or other works for withdrawal of groundwater 1938
- 8. The depth of water table
- 9. So far as it may be available, the type, size and depth of each well or the general specifications of any other works for the withdrawal of groundwater Drilled with 6 in casing
- 10. The estimated amount of groundwater withdrawn each year 350,000
- 11. The log of formations encountered in the drilling of each well if available not available
- 12. Such other information of a similar nature as may be useful in carrying out the policy of this act, including reference to book and page of any county record

Signature of Owner P. M. Hike  
Date Dec 31, 1963

Three copies to be filed by the owner with the County Clerk and Recorder of the county in which the well is located.

Please answer all questions. If not applicable, so state, otherwise the form will be returned.

Original to the County Clerk and Recorder; duplicate to the State Engineer; Triplicate to the School of Mines and Quadruplicate for the Appropriator.

18301

721531

STATE OF MONTANA,  
County of Yellowstone, (22)  
This instrument was filed in my office  
this DEC 21 1933  
at 10:31 o'clock A.M.  
I, SAK  
Notary Public for Montana

RECEIVED

County: \_\_\_\_\_

STATE OF MONTANA  
ADMINISTRATOR OF GROUNDWATER CODE  
MONTANA WATER RESOURCES BOARD

DRILLER'S LOG

Indicate the character, color, thickness of strata such as soil, clay, sand, gravel, shale, sandstone, etc. Show depth at which water is found and height to which water rises in well.

NOTICE OF COMPLETION OF GROUNDWATER APPROPRIATION BY MEANS OF WELL

Developed after January 1, 1962

(Under Chapter 237 Montana Session Laws, 1961, as amended)

This form to be prepared by driller, and three copies to be filed by the owner with the County Clerk and Recorder in the county in which the well is located, last copy to be retained by driller. Please answer all questions. If not applicable, so state, otherwise the form may be returned.

Owner \_\_\_\_\_

Address \_\_\_\_\_

Date well started \_\_\_\_\_

completed \_\_\_\_\_

Type of well \_\_\_\_\_

(Dug, driven, bored or drilled)

Equipment used \_\_\_\_\_

(Churn drill, rotary or other)

Water Use: Domestic  Municipal  Stock  Irrigation

Industrial  Drainage  Other  Garden/Lawn

\*Describe \_\_\_\_\_

USE: If used for irrigation, industrial, drainage or other. Explain, state number of acres and location or other data (i.e. Lot, Block and Addition).

ESTIMATED ANNUAL WITHDRAWAL 200,000

Size of Drilled Hole	Size and Weight of Casing	From (Feet)	To (Feet)	PERFORATIONS		
				Mtd Size	From (Feet)	To (Feet)
		0	2			
		4	125	4	25	
					25	

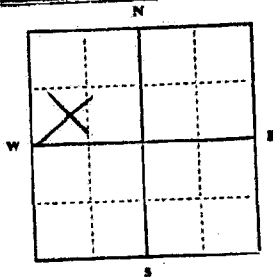

Static water level \_\_\_\_\_ ft.\*  
Pumping water level \_\_\_\_\_ ft.\*  
at \_\_\_\_\_ gallons per minute,  
measured \_\_\_\_\_ minutes after pumping  
began.

\*Measured from ground level.

Well developed by \_\_\_\_\_  
for \_\_\_\_\_ hours.

Power \_\_\_\_\_ Pump \_\_\_\_\_ HP

Remarks: (Gravel packing, cementing, packers, type of shutoff) \_\_\_\_\_

SW 1/4 N 1/4 Sec. 29  
T. 1 S. R. 27 E. W

INDICATE LOCATION OF WELL AND PLACE OF USE, IF POSSIBLE. EACH SMALL SQUARE REPRESENTS 40 ACRES.

Driller's Signature \_\_\_\_\_

Driller's Address \_\_\_\_\_

LICENSE NO. \_\_\_\_\_

Show exact depth of bottom \_\_\_\_\_

55172

STATE OF MONTANA ADMINISTRATOR OF GROUNDWATER CODE MONTANA WATER RESOURCES BOARD NOTICE OF COMPLETION OF GROUNDWATER APPROPRIATION BY MEANS OF WELL

Developed after January 1, 1962

(Under Chapter 237 Montana Session Laws, 1961, as amended)

This form to be prepared by driller, and three copies to be filed by the owner with the County Clerk and Recorder in the county in which the well is located, last copy to be retained by driller. Please answer all questions. If not applicable, so state, otherwise the form may be returned.

Owner, Address, Date well started, Type of well, Equipment used, Water Use: Domestic, Municipal, Stock, Irrigation, Industrial, Drainage, Other, Garden/Lawn.

For Administrator's Use File 138515 6.29.73 GW 1 11.45 a.m.

\*Describe USE: If used for irrigation, industrial, drainage or other. Explain, state number of acres and location or other data (i.e. Lot, Block and Addition). ESTIMATED ANNUAL WITHDRAWAL 200,000

Table with columns: Size of Drilled Hole, Size and Weight of Casing, From (Feet), To (Feet), PERFORATIONS (Kind Size, From (Feet), To (Feet)).

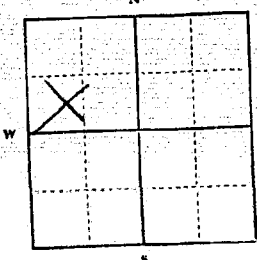

Static water level ... ft.\* Pumping water level ... ft.\* at ... gallons per minute, measured ... minutes after pumping began. \*Measured from ground level. Well developed by ... hours. Power ... Pump ... HP Remarks: (Gravel packing, cementing, packers, type of shutoff)

SW 1/4 N 1/2 Sec. 29 T. 1 N. R. 27 E. W.

INDICATE LOCATION OF WELL AND PLACE OF USE, IF POSSIBLE. EACH SMALL SQUARE REPRESENTS 40 ACRES.

Driller's Signature, Driller's Address

County.....

DRILLER'S LOG

Indicate the character, color, thickness of strata such as soil, clay, sand, gravel, shale, sandstone, etc. Show depth at which water is found and height to which water rises in well.

Large table for Driller's Log with columns: From (Feet), To (Feet). Includes 'Top of Ground (Elev. above sea level)'.

Show exact depth of bottom

LICENSE NO.

55772

938315

STATE OF MONTANA, } ss.  
County of Yellowstone, }

This instrument was filed in my office

this JUN 28 1966 day of \_\_\_\_\_

at 11:42 o'clock A M.

MERRILL H. KLUNDT  
County Clerk & Recorder

By J. Sullivan Deputy  
2.00

GW 4

File No. ....

T. <sup>N</sup> R. <sup>27</sup> 30

DUPLICATE

County .....

STATE OF MONTANA  
ADMINISTRATOR OF GROUNDWATER CODE  
OFFICE OF STATE ENGINEER

**Declaration of Vested Groundwater Rights**

(Under Chapter 237, Montana Session Laws, 1961)

RECEIVED  
DEC 30 1963  
STATE ENGINEER

1. Don Finley of A 2 Billings  
(Name of Appropriator) (Address) (Town)  
County of Hell Creek State of Mont  
have appropriated groundwater according to the Montana laws in effect prior to January 1, 1962, as follows:

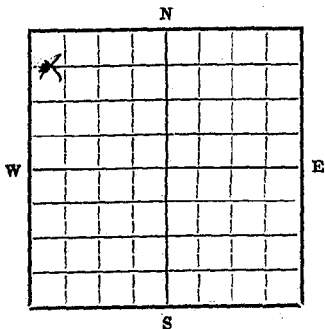

N.W. 1/4 Sec 20 T. 17 R. 27

Indicate point of appropriation and place of use, if possible. Each small square represents 10 acres.

2. The beneficial use on which the claim is based black water

3. Date or approximate date of earliest beneficial use; and how continuous the use has been about 1910, but hasn't been used the last 10 yrs.

4. The amount of groundwater claimed (in miner's inches or gallons per minute) couldn't pump it dry

5. If used for irrigation, give the acreage and description of the lands to which water has been applied and name of the owner thereof None

6. The means of withdrawing such water from the ground and the location of each well or other means of withdrawal Pump

7. The date of commencement and completion of the construction of the well, wells, or other works for withdrawal of groundwater Don't know

8. The depth of water table about 60 ft

9. So far as it may be available, the type, size and depth of each well or the general specifications of any other works for the withdrawal of groundwater drilled bit in - 60 ft

10. The estimated amount of groundwater withdrawn each year Don't know

11. The log of formations encountered in the drilling of each well if available None

12. Such other information of a similar nature as may be useful in carrying out the policy of this act, including reference to book and page of any county record None

Signature of Owner Don Finley

Date Dec 26-1963

Three copies to be filed by the owner with the County Clerk and Recorder of the county in which the well is located.

Please answer all questions. If not applicable, so state, otherwise the form will be returned.

Original to the County Clerk and Recorder; duplicate to the State Engineer; Triplicate to the School of Mines and Quadruplicate for the Appropriator.

72128

STATE OF MONTANA  
County of Yellowstone 83

This instrument was filed in office  
this DEC 7 1913  
at 2:47 P. M.

County Clerk & Recorder

By J. L. D. Deputy

\$ 2.00

RECEIVED

YELLOWSTONE COUNTY, MONTANA  
County

OCT 18 1972

STATE OF MONTANA  
ADMINISTRATOR OF GROUNDWATER CODE  
MONTANA WATER RESOURCES BOARD  
**NOTICE OF COMPLETION OF GROUNDWATER  
APPROPRIATION BY MEANS OF WELL**  
Developed after January 1, 1962  
(Under Chapter 237 Montana Session Laws, 1961, as amended)

INDICATE THE CHARACTER, COLOR, THICKNESS OF STRATA SUCH AS SOIL, CLAY, SAND, GRAVEL, SHALE, SANDSTONE, ETC. SHOW DEPTH AT WHICH WATER IS FOUND AND HEIGHT TO WHICH WATER RISES IN WELL.

**DRILLER'S LOG**

This form to be prepared by driller, and three copies to be filed by the owner with the County Clerk and Recorder in the county in which the well is located, last copy to be retained by driller. Please answer all questions. If not applicable, so state, otherwise the form may be returned.

Owner W.A. + FRIEDA  
Altmaier  
Address 215 Greenwood Ave.  
Billings, Mont

For Administrator's Use	
File	<u>918695</u>
Date	<u>Oct. 12, 1972 2:00 P.M.</u>
GW 1	

Date well started 9/14/72  
completed 9/16/72

Type of well DRILLED  
(Dug, driven, bored or drilled)  
Equipment used CABLE  
(Cable drill, rotary or other)  
Water Use: Domestic  Municipal  Stock  Irrigation   
Industrial  Drainage  Other  Garden/Lawn

\*Describe  
USE: If used for irrigation, industrial, drainage or other. Explain, state number of acres and location or other data (i.e. Lot, Block and Addition).

ESTIMATED ANNUAL WITHDRAWAL

Size of Drilled Top	Size and Weight of Pipe	From (Feet)	To (Feet)	PERFORATIONS		
				Kind Size	From (Feet)	To (Feet)
<u>7 7/8</u>	<u>6 5/8 17-87</u>	<u>0</u>	<u>95</u>	<u>CUT 1/8</u>	<u>80</u>	<u>93</u>

N

W

E

S

Static water level 45 ft.\*  
Pumping water level 43 ft.\*  
at 20 gallons per minute,  
measured 60 minutes after pumping  
began.  
\*Measured from ground level.  
Well developed by BAILEY  
for 5 hours.  
Power          Pump          HP  
Remarks: (Gravel packing, cementing,  
packers, type of shutoff)  
GRAVEL PACKED  
PIPE EXT 2'  
ABOVE GRUND  
DRIVE SHOES USED

N.W. 1/4 SW 1/4 Sec. 30 R. 17  
T. 1 N. R. 27 E. S. 1 W.

INDICATE LOCATION OF WELL AND PLACE OF USE, IF POSSIBLE. EACH SMALL SQUARE REPRESENTS 40 ACRES.

Driller's Signature H + D DRILLING  
Driller's Address 1035 WINE MILLER AVE  
Billings Mont LICENSE NO. 184  
R. Leary  
I-F  
I-L

Top of Ground (Elev. above sea level)	
From (Feet)	To (Feet)
<u>0</u>	<u>2</u> TOP SOIL
<u>2</u>	<u>33</u> SANDY CLAY
<u>53</u>	<u>76</u> CLAY
<u>76</u>	<u>80</u> FINE SAND
<u>80</u>	<u>95</u> SAND - GRAVEL
	WATER FROM <u>76' TO 95'</u>
	<u>40 GALS PER MIN</u>

95 Show exact depth of bottom  
51,630



918695

Sam W. Mitchell Building  
Helena, Montana 59601

As the Administrator of the Groundwater Code for the State of Montana, please take note of the following special instructions, in order to properly protect your ground-

Special Instructions:

Please provide, as indicated in red on the attached form, the location of the township - either 1 North or 1 South.

Thank you.

Location T. 17 R. 27E Sec. 30 59101  
Doc. No. 918695

STATE OF MONTANA  
OCT 17 1972  
3:00 P M  
*[Signature]*  
*[Signature]*

Yellowstone  
County

OCT 18 1972

STATE OF MONTANA  
ADMINISTRATOR OF GROUNDWATER CODE  
MONTANA WATER RESOURCES BOARD

NOTICE OF COMPLETION OF GROUNDWATER  
APPROPRIATION BY MEANS OF WELL

Developed after January 1, 1962

(Under Chapter 237 Montana Session Laws, 1961, as amended)

This form to be prepared by driller, and three copies to be filed by the owner with the County Clerk and Recorder in the county in which the well is located, last copy to be retained by driller. Please answer all questions. If not applicable, so state, otherwise the form may be returned.

DRILLER'S LOG  
Indicate the character, color, thickness of strata such as soil, clay, sand, gravel, shale, sandstone, etc. Show depth at which water is found and height to which water rises in well.

Owner W J + FRIDA ALTMAYER  
Address 215 GREENWOOD AVE BILLINGS MONT  
Date well started 9/14/72  
completed 9/16/72  
Type of well DRILLED  
Equipment used CABLE  
Water Use: Domestic  Municipal  Stock  Irrigation   
Industrial  Drainage  Other \* Garden/Lawn

For Administrator's Use  
File 918695  
Oct 17, 1972 2:00 P.M.  
GW 1

Top of Ground (Elev. above sea level)

From (Feet)	To (Feet)	
0	2	TOP SOIL
2	53	WINDY CLAY
53	76	CLAY
76	80	FINE SAND
80	95	SAND - GRAVEL
		WATER FROM 76' TO 95'
		LD GRATER MIN

\*Describe  
USE: If used for irrigation, industrial, drainage or other. Explain, state number of acres and location or other data (i.e. Lot, Block and Addition).

ESTIMATED ANNUAL WITHDRAWAL

Size of Drilled Hole	Size and Weight of Casing	From (Feet)		To (Feet)		PERFORATIONS	
		From	To	Kind	From	To	
7"	6 3/8 17-87	0	95	cut	90	93	

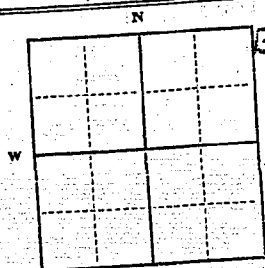

Static water level 45 ft.\*  
Pumping water level 43 ft.\*  
at 30 gallons per minute,  
measured 60 minutes after pumping  
began.  
\*Measured from ground level.  
Well developed by SAIHER  
for 2 hours.  
Power: \_\_\_\_\_ Pump \_\_\_\_\_ HP  
Remarks: (Gravel packing, cementing,  
packers, type of shutoff)  
GRASS PACKED

INDICATE LOCATION OF WELL AND PLACE OF USE, IF POSSIBLE.  
EACH SMALL SQUARE REPRESENTS 40 ACRES.

Driller's Signature L D DRILLING  
Driller's Address 1035 WINE MILLER AVE BILLINGS MONT  
Tom R. Leaper  
I-F.

95 Show exact depth of bottom  
51,632

GW 2

File No. 689995 Filed 8-21-62 @ 8:40 AM

T. 1N R. 27E

County Yellowstone

DUPLICATE

#200 See P4

STATE OF MONTANA  
ADMINISTRATOR OF GROUNDWATER CODE  
OFFICE OF STATE ENGINEER

RECEIVED  
AUG 22 1962

**Notice of Completion of Groundwater Appropriation by Means of Well**  
(Under Chapter 237, Montana Session Laws, 1961)

Owner Ralph W. K. Kozick Address B. Hays Road  
Driller Don H. Kozick Address B. Hays Road  
Date of Notice of Appropriation of Groundwater.....  
Date well started 7-23-62 Date Completed 7-24-62  
Type of well drilled Equipment Used Rotary  
(dug, driven, bored or drilled) (Churn, drill, rotary or other)  
Water Use: Domestic  Municipal  Other  Irrigation   
Industrial  Drainage  Stock

Indicate on the diagram the character and thickness of the different strata met with in drilling, such as soil, clay, shale, gravel, rock or sand, etc. Show depth at which water is encountered, thickness and character of water-bearing strata and height to which water rises in the well.

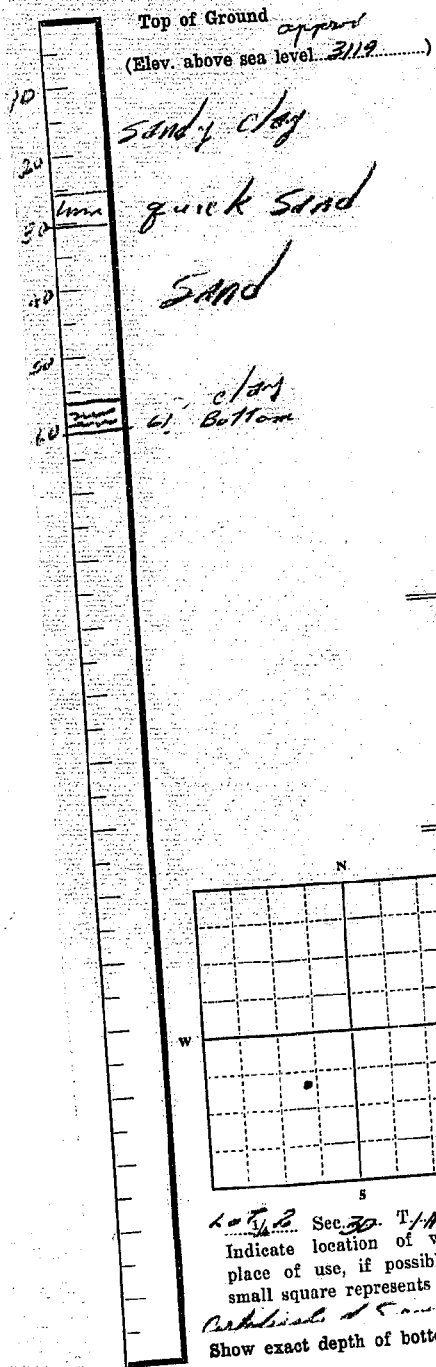

Size of Drilled Hole	Size and Weight of Casing	From (Feet)	To (Feet)	PERFORATIONS		
				Kind Size	From (Feet)	To (Feet)
1'	6" 30 gal galv.	0	61	1/2 x 3/8 Slots	47	61

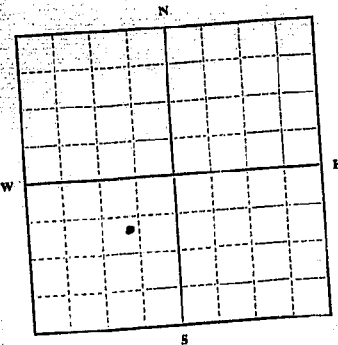

Lot 2, Sec. 30, T. 1N, R. 27E  
Indicate location of well and place of use, if possible. Each small square represents 10 acres.  
Show exact depth of bottom.

Static Water Level for non-flowing Well 24' 6" feet.  
Shut-in Pressure for Flowing Well Not Flowing  
Pumping Water Level 35 feet at 28 gal. per minute.  
Discharge in gal. per min. of flowing well Not Flowing  
How Tested 1.25' Baker length of Test 3 HRS  
Remarks: (Gravel packing, cementing, packers, type of shutoff, location of place of use of groundwater if not at well, and any other similar pertinent information, including number of acres irrigated, if used for irrigation) None

#15  
Driller's License Number  
Don H. Kozick  
Driller's Signature

This form to be prepared by driller, and three copies to be filed by the owner with the County Clerk and Recorder in the county in which the well is located.  
Please answer all questions. If not applicable, so state, otherwise the form will be returned.  
Original to the County Clerk and Recorder; duplicate to the State Engineer; Triplicate to the Montana Bureau of Mines and Geology and Quadruplicate for the Appropriator.

File No. ....

T. .... R. ....

TRIPPLICATE

County .....

STATE OF MONTANA  
ADMINISTRATOR OF GROUNDWATER CODE  
OFFICE OF STATE ENGINEER

Notice of Completion of Groundwater Appropriation  
Without Well

(Under Chapter 237 Montana Session Laws, 1961)

935904  
6-29-73  
11:30 A.M.

Date of Appropriation of Groundwater: 1959

Owner: Robert C. Nelson Address: 392' Dry Gulch A

Contractor (if any) .....

Address of Contractor .....

Date Started .....

Date Completed .....

Describe means of obtaining groundwater without a well "as by sub-irrigation and other natural processes". Include depth to water when applicable. This is a spring

4' line a pond 20' across.

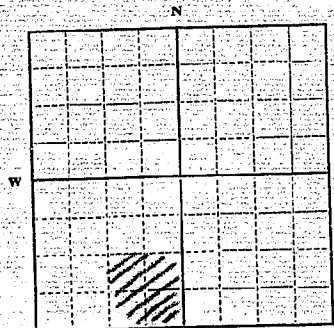

SE 1/4 Sec. 30 T. 1 N. R. 27 E

Indicate point of appropriation and place of use, if possible.

Quantity of water developed and used with explanation of method used to measure or estimate such amount. If use is intermittent estimate approximate lengths of periods of use.

ALL YEAR

Signature of Owner: Robert C. Nelson

Date: 29 June 73

This form to be prepared by contractor (if any), otherwise by the owner.

Three copies of this notice are to be filed with the County Clerk and Recorder of the county in which the works are located.

Please answer all questions. If not applicable, so state, otherwise the form will be returned.

Original to the County Clerk and Recorder; duplicate to the State Engineer; Triplicate to the Montana Bureau of Mines and Geology and Quadruplicate for the Appropriator.

D  
EER

n □

erent  
, etc.  
water-

To  
feet)

61

feet.

minute.

ng

1/2

off, loca-  
and any  
number of

Recorder

Bureau of

1999

55182

938304

STATE OF LOUISIANA }  
County of [unclear] } ss.

This instrument was filed in my office

on APR 29 1973 at 11:31 AM

at 11:31 AM

Notary Public for the State of Louisiana

County Clerk & Recorder

*Paul*  
20

Deputy

File No. ....

DUPLICATE

T 1 N R 27 E <sup>30</sup>

County Yellowstone

STATE OF MONTANA  
ADMINISTRATOR OF GROUNDWATER CODE  
OFFICE OF STATE ENGINEER

**Declaration of Vested Groundwater Rights**  
(Under Chapter 237, Montana Session Laws, 1961)

RECEIVED  
JAN 2 1964

STATE ENGINEER

1. Richard Pobelka, of 532 Lake Elm Dr. Billings  
(Name of Appropriator) (Address) (Town)

County of Yellowstone State of Montana  
have appropriated groundwater according to the Montana laws in effect prior to January 1, 1962, as follows:

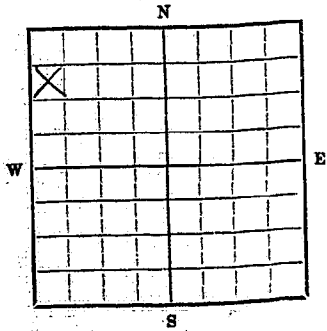

Certificate of Sur 920 Tract 3  
N 1/4, Sec 30, T1N R27E

Indicate point of appropriation and place of use, if possible. Each small square represents 10 acres.

2. The beneficial use on which the claim is based  
Watering livestock and domestic use

3. Date or approximate date of earliest beneficial use; and how continuous the use has been  
February 1, 1952 - continuous

4. The amount of groundwater claimed (in miner's inches or gallons per minute)  
10 gal per minute

5. If used for irrigation, give the acreage and description of the lands to which water has been applied and name of the owner thereof  
Garden use sometimes

6. The means of withdrawing such water from the ground and the location of each well or other means of withdrawal  
Pressure pump

7. The date of commencement and completion of the construction of the well, wells, or other works for withdrawal of groundwater  
February 1, 1952

8. The depth of water table 20 feet

9. So far as it may be available, the type, size and depth of each well or the general specifications of any other works for the withdrawal of groundwater  
3" casing 57' deep 47' of water-filled well

10. The estimated amount of groundwater withdrawn each year approx. 100,000

11. The log of formations encountered in the drilling of each well if available  
Not available

12. Such other information of a similar nature as may be useful in carrying out the policy of this act, including reference to book and page of any county record  
None to my knowledge

Signature of Owner Richard Pobelka  
Date 12-30-63

Three copies to be filed by the owner with the County Clerk and Recorder of the county in which the well is located.

Please answer all questions. If not applicable, so state, otherwise the form will be returned.

Original to the County Clerk and Recorder; duplicate to the State Engineer; Triplicate to the School of Mines and Quadruplicate for the Appropriator.

*Fairly*

18229

721418

STATE OF MONTANA,  
County of Yellowstone,

This instrument was filed in my office  
this DEC 30 1983

at 8:35 o'clock A. M.

Edmon S. Redding,  
County Clerk & Recorder

By [Signature] Deputy

8/2/80

File No. GW2  
 DUPLICATE

MONTANA WATER RESOURCES BOARD  
**RECEIVED**  
 OCT 24 1968

T. 1N R. 27E  
 County Yellowstone

STATE OF MONTANA  
 ADMINISTRATOR OF GROUNDWATER CODE  
 OFFICE OF STATE ENGINEER

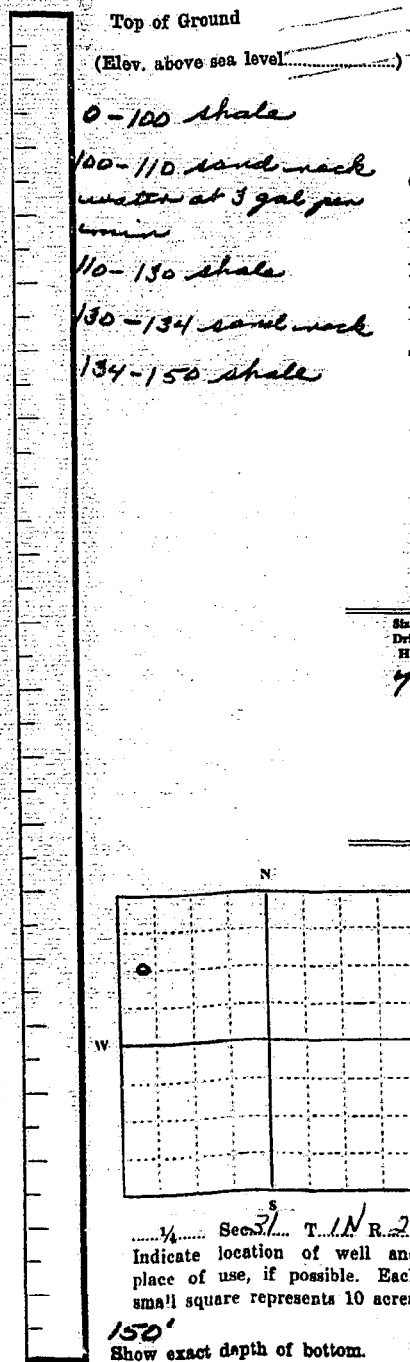

**Notice of Completion of Groundwater  
 Appropriation by Means of Well**

(Under Chapter 237, Montana Session Laws, 1961)

Owner Ruby Allen Address Bellings, Mont.  
 Driller David D. Mulling Address Bellings, Mont.  
 Date of Notice of Appropriation of Groundwater.....  
 Date well started 8/8/68 Date Completed 8/11/68  
 Type of well drilled Equipment Used Casey Tool  
 (aug, driven, bored or drilled) (Churn, drill, rotary or other)  
 Water Use: Domestic  Municipal  Other  Irrigation   
 Industrial  Drainage  Stock

Indicate on the diagram the character and thickness of the different strata met with in drilling, such as soil, clay, shale, gravel, rock or sand, etc. Show depth at which water is encountered, thickness and character of water-bearing strata and height to which water rises in the well.

Size of Drilled Hole	Size and Weight of Casing	From (Feet)	To (Feet)	PERFORATIONS		
				Kind Size	From (Feet)	To (Feet)
7"	16ga 6"	71	150	cut	100	140

Static Water Level for non-flowing Well 100 feet.  
 Shut-in Pressure for Flowing Well.....  
 Pumping Water Level 4 to 5 feet at 3 gal. per minute.  
 Discharge in gal. per min. of flowing well.....  
 How Tested Bailing Length of Test 30 minutes  
 Remarks: (Gravel packing, cementing, packers, type of shutoff, location of place of use of groundwater if not at well, and any other similar pertinent information, including number of acres irrigated, if used for irrigation).....

36  
 Driller's License Number  
David D. Mulling  
 Driller's Signature

This form to be prepared by driller, and three copies to be filed by the owner with the County Clerk and Recorder in the county in which the well is located.

Please answer all questions. If not applicable, so state, otherwise the form will be returned.

Original to the County Clerk and Recorder; duplicate to the State Engineer; Triplicate to the Montana Bureau of Mines and Geology and Quadruplicate for the Appropriator.

44, 712



829883

STATE OF MONTANA }  
County of Yellowstone } ss.

(This instrument was filed in my office

this OCT 23 1969 of 19

at 4:07 o'clock P. M.

W. E. McConnell  
County Clerk & Recorder

By [Signature] Deputy

*[Faint, mostly illegible text and markings, possibly bleed-through from the reverse side of the page. Some vertical lines and scattered characters are visible.]*

GW 2

File No. ....

DUPLICATE

T.1.N. R. 27E

County Yellowstone

STATE OF MONTANA  
ADMINISTRATOR OF GROUNDWATER CODE  
OFFICE OF STATE ENGINEER

RECEIVED  
MAR 18 1964

**Notice of Completion of Groundwater Appropriation by Means of Well**

(Under Chapter 237, Montana Session Laws, 1961)

Owner M. J. McFarland Address Billings

Driller Billmeyer & Sons Address Billings

Date of Notice of Appropriation of Groundwater.....

Date well started Feb 25/69 Date Completed Feb 28/69

Type of well drilled Equipment Used Churn  
(dug, driven, bored or drilled) (Churn, drill, rotary or other)

Water Use: Domestic  Municipal  Other  Irrigation   
Industrial  Drainage  Stock

Indicate on the diagram the character and thickness of the different strata met with in drilling, such as soil, clay, shale, gravel, rock or sand, etc. Show depth at which water is encountered, thickness and character of water-bearing strata and height to which water rises in the well.

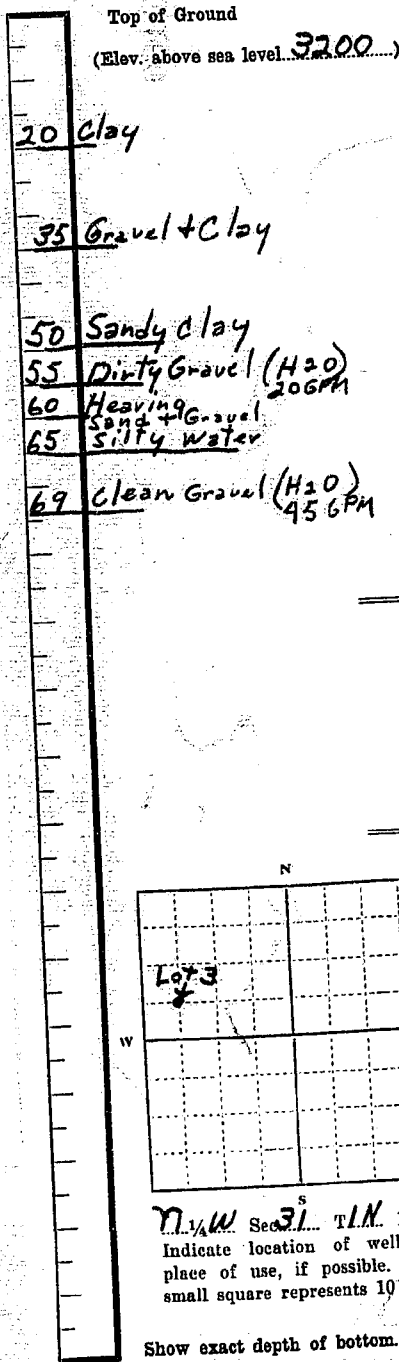

Size of Drilled Hole	Size and Weight of Casing	From (Feet)	To (Feet)	PERFORATIONS		
				Kind Size	From (Feet)	To (Feet)
6	6" x 17#	TOP	68.5	cutting Torch	69	67

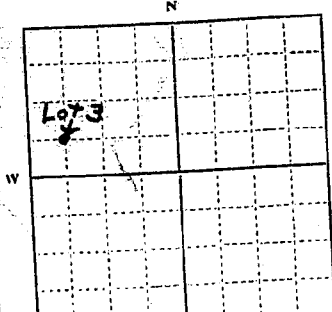

N. 1/4 W. Sec 31, T.1.N. R.27E  
Indicate location of well and place of use, if possible. Each small square represents 10 acres.

Show exact depth of bottom.

Static Water Level for non-flowing Well..... 36 feet.

Shut-in Pressure for Flowing Well.....

Pumping Water Level..... 46 feet at 45 gal. per minute.

Discharge in gal. per min. of flowing well.....

How Tested Drilling Rig Length of Test 2 Hr.

Remarks: (Gravel packing, cementing, packers, type of shutoff, location of place of use of groundwater if not at well, and any other similar pertinent information, including number of acres irrigated, if used for irrigation) large well

Have would produce several hundred G.P.M.

Mont. No. 5  
Driller's License Number  
JR Billmeyer  
Driller's Signature

This form to be prepared by driller, and three copies to be filed by the owner with the County Clerk and Recorder in the county in which the well is located.

Please answer all questions. If not applicable, so state, otherwise the form will be returned.

Original to the County Clerk and Recorder; duplicate to the State Engineer; Triplicate to the Montana Bureau of Mines and Geology and Quadruplicate for the Appropriator.

727160

STATE OF MONTANA,  
County of Yellowstone ss.

This instrument was filed in my office

this MAR 17 1964 19

at 1:00 P. M.

F. E. S. [unclear]  
County Clerk

[Signature] Deputy

20

Doc. No. 885823  
 Filed for record  
 this 6 day of July  
 File No. A.D. 19 77, at 1:20  
 o'clock P.M. MONTANA WATER RESOURCES BOARD  
 DUPLICATE RECEIVED

Approved Stock Form—State Publishing Co., Helena, Montana—39311

T. T.N.R. R. 27E

YELLOWSTONE COUNTY, MONTANA

STATE OF MONTANA  
 ADMINISTRATOR OF GROUNDWATER CODE  
 OFFICE OF STATE ENGINEER

JUL 7 1971

Notice of Completion of Groundwater  
 Appropriation by Means of Well

(Under Chapter 237, Montana Session Laws, 1961)

Owner John Myer Address Bullinger Mont

Driller E.E. McKeehan Address Laurel Mont

Date of Notice of Appropriation of Groundwater.....

Date well started 8/1/64 Date Completed 8/4/64

Type of well drilled Equipment Used Cable Tool  
 (dug, driven, bored or drilled) (Churn, drill, rotary or other)

Water Use: Domestic  Municipal  Other  Irrigation   
 Industrial  Drainage  Stock

Indicate on the diagram the character and thickness of the different strata met with in drilling, such as soil, clay, shale, gravel, rock or sand, etc. Show depth at which water is encountered, thickness and character of water-bearing strata and height to which water rises in the well.

Top of Ground  
 (Elev. above sea level.....)

70 ft clay  
6' gravel  
9' shale

Size of Drilled Hole	Size and Weight of Casing	From (Feet)	To (Feet)	PERFORATIONS		
				Kind Size	From (Feet)	To (Feet)
<u>6"</u>	<u>6" J.D. 14 lb</u>	<u>0</u>	<u>72"</u>	<u>cut 1/2 x 3-6"</u>	<u>72</u>	<u>75</u>
<u>12'</u>	<u>5" 18 lb</u>	<u>74</u>	<u>76</u>	—	—	—

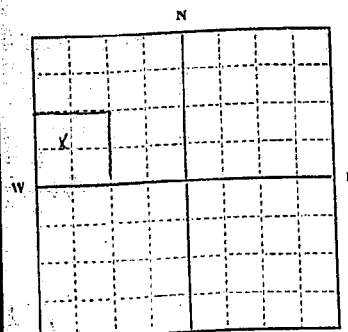

Sec. 31 T. 1 N. R. 27 E

Indicate location of well and place of use, if possible. Each small square represents 10 acres.

36'  
 Show exact depth of bottom.

Static Water Level for non-flowing Well 61 feet.

Shut-in Pressure for Flowing Well.....

Pumping Water Level 65 feet at 24 gal. per minute.

Discharge in gal. per min. of flowing well.....

How Tested Flowing Length of Test 30 min

Remarks: (Gravel packing, cementing, packers, type of shutoff, location of place of use of groundwater if not at well, and any other similar pertinent information, including number of acres irrigated, if used for irrigation).....

36  
 Driller's License Number

E.E. McKeehan  
 Driller's Signature

This form to be prepared by driller, and three copies to be filed by the owner with the County Clerk and Recorder in the county in which the well is located.

Please answer all questions. If not applicable, so state, otherwise the form will be returned.

Original to the County Clerk and Recorder; duplicate to the State Engineer; Triplicate to the Montana Bureau of Mines and Geology and Quadruplicate for the Appropriator.

48707

885823

Doc. No. 885823

STATE OF MONTANA, }  
County of Yellowstone, } ss.

This instrument was filed in my office

the 8 day of 1971

at 1:20 o'clock P. M.

by MERVIN B. KLUNDE  
County Clerk

By [Signature] Deputy

200

Doc. No. 885824  
 File No. \_\_\_\_\_  
 this 6 day of July  
 DUPLICATE A. D. 19 71 at 10:22  
 o'clock P. M.

T. 1 N R. 2 E  
 YELLOWSTONE COUNTY, MONTANA  
 County

STATE OF MONTANA  
 ADMINISTRATOR OF GROUNDWATER CODE  
 OFFICE OF STATE ENGINEER

JUL 7 1971

**Notice of Completion of Groundwater Appropriation by Means of Well**  
 (Under Chapter 237, Montana Session Laws, 1961)

Owner John Myers Address Blg. Mont.  
1035 WINEMILLER LANE  
 Driller L. D. DRILLING Address BILLINGS MONT

Date of Notice of Appropriation of Groundwater \_\_\_\_\_  
 Date well started 2/27/71 Date Completed 3/9/71

Type of well DRILLED Equipment Used CABLE  
 (dug, driven, bored or drilled) (Churn, drill, rotary or other)

Water Use: Domestic  Municipal  Other  Irrigation   
 Industrial  Drainage  Stock

Indicate on the diagram the character and thickness of the different strata met with in drilling, such as soil, clay, shale, gravel, rock or sand, etc. Show depth at which water is encountered, thickness and character of water-bearing strata and height to which water rises in the well.

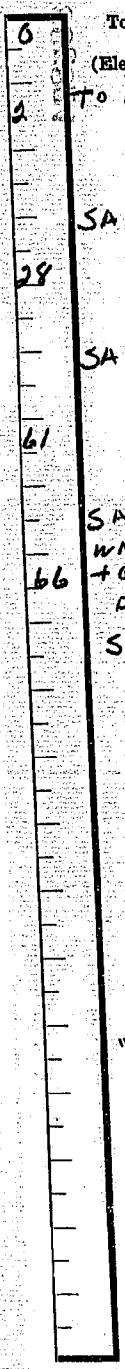

Size of Drilled Hole	Size and Weight of Casing	From (Feet)	To (Feet)	PERFORATIONS		
				Kind Size	From (Feet)	To (Feet)
11" TO 61"	6 5/8"	0	66	4" 2"	60	65
61" TO 66"	18-97#			4"		

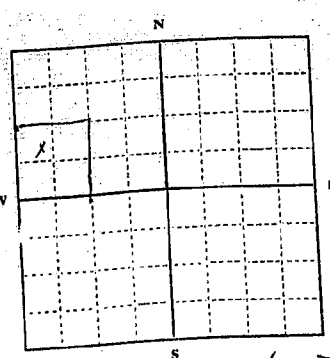

SW 1/4 Sec. 31 T. 1 N R. 2 E

Indicate location of well and place of use, if possible. Each small square represents 10 acres.

Show exact depth of bottom.

Static Water Level for non-flowing Well 12 feet.  
 Shut-in Pressure for Flowing Well \_\_\_\_\_  
 Pumping Water Level 12 feet at 25 gal. per minute.  
 Discharge in gal. per min. of flowing well \_\_\_\_\_  
 How Tested BAILER Length of Test 5 HRS

Remarks: (Gravel packing, cementing, packers, type of shutoff, location of place of use of groundwater if not at well, and any other similar pertinent information, including number of acres irrigated, if used for irrigation)

DRIVE SHOE USED GRAVEL PACKED FROM 28' TO 61'

MONT 188  
 Driller's License Number  
[Signature]  
 Driller's Signature

This form to be prepared by driller, and three copies to be filed by the owner with the County Clerk and Recorder in the county in which the well is located.

Please answer all questions. If not applicable, so state, otherwise the form will be returned.

Original to the County Clerk and Recorder; duplicate to the State Engineer; Triplicate to the Montana Bureau of Mines and Geology and Quadruplicate for the Appropriator.

48706

885824

STATE OF MONTANA, } ss.  
County of Yellowstone, }

This instrument was filed in my office  
this 11 6 of 1927

at 1:22 o'clock P.M.

MERRILL H. KLUNDT  
County Clerk & Recorder

By [Signature] Deputy

200

*[Faint, mostly illegible handwritten notes and stamps, possibly including a date like 'MAY 23' and other markings.]*

County Yellowstone

STATE OF MONTANA  
ADMINISTRATOR OF GROUNDWATER CODE  
MONTANA WATER RESOURCES BOARD  
**NOTICE OF COMPLETION OF GROUNDWATER  
APPROPRIATION BY MEANS OF WELL**  
Developed after January 1, 1962

JAN 26 1971

**DRILLER'S LOG**  
Indicate the character, color, thickness of strata such as soil, clay, sand, gravel, shale, sandstone, etc. Show depth at which water is found and height to which water rises in well.

(Under Chapter 237 Montana Session Laws, 1961, as amended)

This form to be prepared by driller, and three copies to be filed by the owner with the County Clerk and Recorder in the county in which the well is located, last copy to be retained by driller. Please answer all questions. If not applicable, so state, otherwise the form may be returned.

Owner WERN SWANNICK  
Address H. W. WY 87 BUSINESS  
MONTANA  
Date well started 1-20-71  
completed 1-23-71

For Administrator's Use  
File # 875486  
January 25, 1971  
3:10 P.M.  
GW 1

Type of well DRILLED  
(Dug, driven, bored or drilled)  
Equipment used ROTARY  
(Churn drill, rotary or other)  
Water Use: Domestic  Municipal  Stock  Irrigation   
Industrial  Drainage  Other  Garden/Lawn

\*Describe  
USE: If used for irrigation, industrial, drainage or other. Explain, state number of acres and location or other data (i.e. Lot, Block and Addition).

ESTIMATED ANNUAL WITHDRAWAL

Size of Drilled Hole	Size and Weight of Casing	From (Feet)	To (Feet)	PERFORATIONS		
				Kind/Size	From (Feet)	To (Feet)
<u>6 1/4 TO 1 1/2</u>	<u>10"</u>	<u>0</u>	<u>180</u>	<u>1/2 SLOTS</u>	<u>154</u>	<u>180</u>
<u>4 3/4 TO 1 1/2</u>	<u>4" GALV</u>					

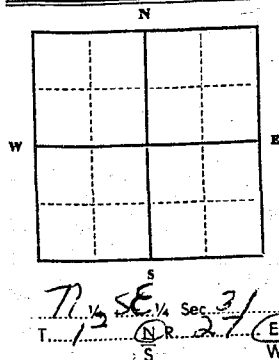

Static water level NA ft.\*  
Pumping water level NA ft.\*  
at 3 gallons per minute,  
measured NA minutes after pumping  
began.  
\*Measured from ground level.  
Well developed by FLOWING  
for 2H hours.  
Power NA Pump NA HP  
Remarks: (Gravel packing, cementing,  
packers, type of shutoff)  
PACHERS @ 158  
140 CEMENTION  
TOP PACHER

INDICATE LOCATION OF WELL AND PLACE OF USE, IF POSSIBLE.  
EACH SMALL SQUARE REPRESENTS 40 ACRES.

Driller's Signature J. J. Bore  
Driller's Address 420 SIOUX LANE  
BILLINGS MONT LICENSE NO. 197

Top of Ground (Elev. above sea level)		
From (Feet)	To (Feet)	
<u>0</u>	<u>30</u>	<u>SANDY TOP SOIL</u>
<u>30</u>	<u>110</u>	<u>BLU SHALE</u>
<u>110</u>	<u>130</u>	<u>SANDY SHALE</u>
<u>130</u>	<u>150</u>	<u>BENTON SANDY SHALE</u>
<u>150</u>	<u>154</u>	<u>BLA SHALE</u>
<u>154</u>	<u>180</u>	<u>SAND</u>
		<u>2 GAL WATER PER</u>
		<u>MIX @ 130-150</u>
		<u>WATER LEVEL @ 55</u>
		<u>WELL FLOWED FROM</u>
		<u>170-180</u>

180 Show exact depth of bottom

418061



875486

STATE OF MONTANA, } ss.  
County of Yellowstone, }  
This instrument was filed in my office  
this JAN 25 1971 day of \_\_\_\_\_ 19\_\_\_\_  
at 3:10 o'clock P. M.  
MICHAEL R. MUMFORD  
County Clerk  
By [Signature] Deputy

RECEIVED

File No. ....

JUL 20 1972

T. 1 N. R. 27  
County Yellowstone

DUPLICATE

MONTANA DEPARTMENT OF NATURAL  
RESOURCES AND CONSERVATION

STATE OF MONTANA  
ADMINISTRATOR OF GROUNDWATER CODE  
OFFICE OF STATE ENGINEER

### Notice of Completion of Groundwater Appropriation by Means of Well

(Under Chapter 237, Montana Session Laws, 1961)

Top of Ground  
(Elev. above sea level.....)  
CLAY SHALE  
 — 120  
BENT & SHALE  
 — 280  
EAGLE SANDSTONE  
 — 420  
 WATER @ 120  
 UNFIT FOR USE  
 WATER @ 300  
 TO 420

Owner T. F. BONES Address 3143 PRAIRIE DR. BILLINGS, MONT.  
 Driller DIGGERS DRILLING Address 3143 PRAIRIE DR. BILLINGS, MONT.

Date of Notice of Appropriation of Groundwater.....  
 Date well started 11-19-71 Date Completed 6-16-72

Type of well DRILLED Equipment Used ROTARY  
 (dug, driven, bored or drilled) (Churn, drill, rotary or other)

Water Use: Domestic  Municipal  Other  Irrigation   
 Industrial  Drainage  Stock

Indicate on the diagram the character and thickness of the different strata met with in drilling, such as soil, clay, shale, gravel, rock or sand, etc. Show depth at which water is encountered, thickness and character of water-bearing strata and height to which water rises in the well.

Size of Drilled Hole	Size and Weight of Casing	From (Feet)	To (Feet)	PERFORATIONS		
				Kind Size	From (Feet)	To (Feet)
6 3/4	10" 4 1/2"	14	400	WELL SCREEN	390	400
				8" PAPE	370	39

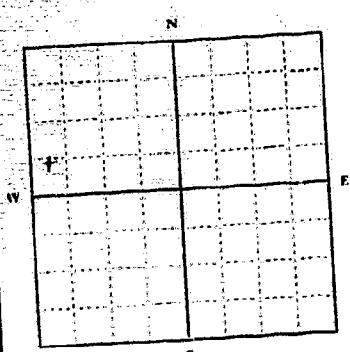

SW 1/4 NW Sec 32 T. 1 N. R. 27 E  
 Indicate location of well and place of use, if possible. Each small square represents 10 acres.

Show exact depth of bottom.

Static Water Level for non-flowing Well 80 feet.

Shut-in Pressure for Flowing Well N.A.

Pumping Water Level 350 feet at 5 gal. per minute.

Discharge in gal. per min. of flowing well N.A.

How Tested PUMP Length of Test 8 HRS

Remarks: (Gravel packing, cementing, packers, type of shutoff, location of place of use of groundwater if not at well, and any other similar pertinent information, including number of acres irrigated, if used for irrigation) PACKERS

@ 200 150 - 120 Bentonite  
SEAL TO 8 FT. Cement  
ON TOP

Doc. No. 911985  
 Filed for record this 19th day of July  
 A. D. 19 72, at 3:00  
 o'clock P.M.

177  
 Driller's License Number  
J. J. Bones  
 Driller's Signature

This form to be prepared by driller, and three copies to be filed by the owner with the County Clerk and Recorder in the county in which the well is located.

Please answer all questions. If not applicable, so state, otherwise the form will be returned.

Original to the County Clerk and Recorder; duplicate to the State Engineer; Triplicate to the Montana Bureau of Mines and Geology and Quadruplicate for the Appropriator.

50,963

911985

STATE OF MONTANA  
COUNTY OF DEER CREEK  
JUL 18 1972

3110

P

*Paul*  
20

Form No. 18  
8-60

T. 1N R. 27E

County Yellowstone

MONTANA BUREAU OF MINES AND GEOLOGY  
Butte, Montana

RECEIVED  
DEC 29 1960

Water Well Log

STATE ENGINEER

	33	

Owner Harold Ruth & L. R. Aldrich, Jr. Address Billings, Montana

Driller Western Drilling & Exploration Co., Inc. Address Billings, Montana

Date Started November 1960 Date Completed December 1960

Location: Sec. 33 T. 1N R. 26E  $\frac{1}{4}$  sec Approx. NE $\frac{1}{4}$ , NW $\frac{1}{4}$

Type of well Drilled Equipment used Rotary  
(Dug, driven, or drilled) (Churn, drill, rotary, other)

Water use: Domestic  Municipal  Stock  Irrigation   
Industrial  Drainage  Other \_\_\_\_\_

Casing: 0 ft. to 846 ft. Type Iron Size 5" inside dimension

Casing: \_\_\_\_\_ ft. to \_\_\_\_\_ ft. Type \_\_\_\_\_ Size \_\_\_\_\_

Casing: \_\_\_\_\_ ft. to \_\_\_\_\_ ft. Type \_\_\_\_\_ Size \_\_\_\_\_

Perforated or screened: <sup>approx.</sup> Ft. 800 to ft. 846 . Ft. \_\_\_\_\_ to ft. \_\_\_\_\_

Type of screen or perforations fine screen

Static water level, for non-flowing well: at 300 foot level feet.

Shut-in pressure, for flowing well: \_\_\_\_\_ lb./sq. in. on: \_\_\_\_\_ (date)

Pumping water level 500 feet at 12 gal. per min.

How tested: Hyers Submersible Pump

Length of test 74 hours

Remarks: (Gravel packing, cementing, packers, type of shut-off, depth of shut-off)

(over)



GW-1

File No. ....

DUPLICATE

T.1N. R.27E 34

County Yellowstone

STATE OF MONTANA  
ADMINISTRATOR OF GROUNDWATER CODE  
OFFICE OF STATE ENGINEER

RECEIVED  
DEC 30 1963

**Declaration of Vested Groundwater Rights**

(Under Chapter 237, Montana Session Laws, 1961)

STATE ENGINEER

1. John + Joe Hensen of Box 1762 Billings  
(Name of Appropriator) (Address) (Town)  
County of Yellowstone State of mont.  
have appropriated groundwater according to the Montana laws in effect prior to January 1, 1962, as follows:

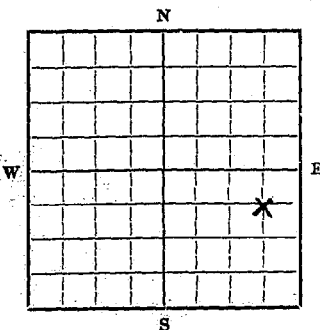

NE 1/4 SE Sec 34 T.1N R.27E

Indicate point of appropriation and place of use, if possible. Each small square represents 10 acres.

2. The beneficial use on which the claim is based Stock water

3. Date or approximate date of earliest beneficial use; and how continuous the use has been 1947 continuous

4. The amount of groundwater claimed (in miner's inches or gallons per minute) 10 gal

5. If used for irrigation, give the acreage and description of the lands to which water has been applied and name of the owner thereof not

6. The means of withdrawing such water from the ground and the location of each well or other means of withdrawal pump

7. The date of commencement and completion of the construction of the well, wells, or other works for withdrawal of groundwater 1947

8. The depth of water table 40 ft

9. So far as it may be available, the type, size and depth of each well or the general specifications of any other works for the withdrawal of groundwater unknown

10. The estimated amount of groundwater withdrawn each year unknown

11. The log of formations encountered in the drilling of each well if available unknown

12. Such other information of a similar nature as may be useful in carrying out the policy of this act, including reference to book and page of any county record unknown

Signature of Owner Joe Hensen

Date Dec 30, 1963

Three copies to be filed by the owner with the County Clerk and Recorder of the county in which the well is located.

Please answer all questions. If not applicable, so state, otherwise the form will be returned.

Original to the County Clerk and Recorder; duplicate to the State Engineer; Triplicate to the School of Mines and Quaduplicate for the Appropriator.

16311

721350

STATE OF MICHIGAN  
County of ...

Attest my office  
this DEC 30 1963 day of ...  
1963 at ...  
County Clerk & Recorder  
By M. H. Deputy

RECORDED  
INDEXED  
DEC 31 1963

File No.

STATE WATER CONSERVATION BOARD

T 1N R 27E  
County Yellowstone

DUPLICATE

JUL 5 1967

STATE OF MONTANA

McDermott ADMINISTRATOR OF GROUNDWATER CODE  
OFFICE OF STATE ENGINEER

Top of Ground  
5' soil  
(Elev. above sea level)

### Notice of Completion of Groundwater Appropriation by Means of Well

(Under Chapter 237, Montana Session Laws, 1961)

Owner BEN HUCKENS Address .....

Driller CLYDE SANDO Address 1141 MILES AVE. BILLINGS

Date of Notice of Appropriation of Groundwater .....

Date well started May 27 1967 Date Completed June 2 1967

Type of well DRILLED Equipment Used CABLE  
(dug, driven, bored or drilled) (Churn, drill, rotary or other)

Water Use: Domestic  Municipal  Other  Irrigation   
Industrial  Drainage  Stock

Indicate on the diagram the character and thickness of the different strata met with in drilling, such as soil, clay, shale, gravel, rock or sand, etc. Show depth at which water is encountered, thickness and character of water-bearing strata and height to which water rises in the well.

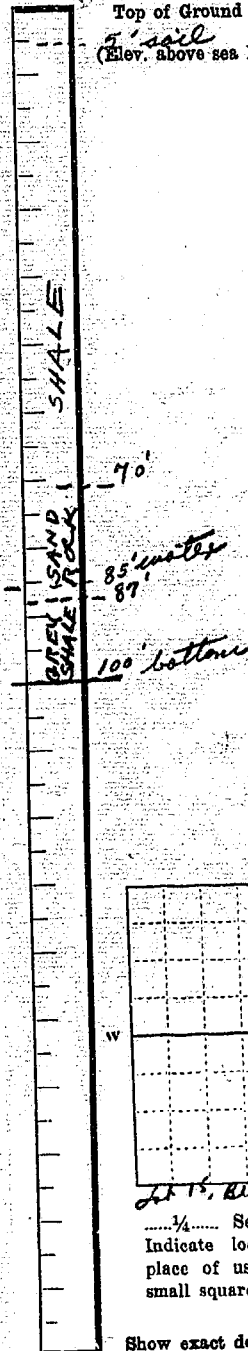

Size of Drilled Hole	Size and Weight of Casing	From (Feet)	To (Feet)	PERFORATIONS		
				Kind Size	From (Feet)	To (Feet)
8"	6" galv.	0'	102'	1/4" SLOTS	70'	100'

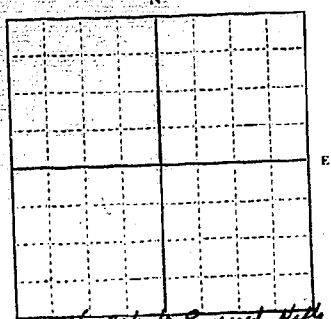

1/4 Sec. T. R.  
Indicate location of well and place of use, if possible. Each small square represents 10 acres.

Static Water Level for non-flowing Well 65 feet.

Shut-in Pressure for Flowing Well NOT APPLY

Pumping Water Level 3 feet at 3 gal. per minute.

Discharge in gal. per min. of flowing well NOT APPLY

How Tested BAILER Length of Test 60 minutes

Remarks: (Gravel packing, cementing, packers, type of shutoff, location of place of use of groundwater if not at well, and any other similar pertinent information, including number of acres irrigated, if used for irrigation) GRAVEL

PACK BETWEEN PIPE & HOLE WALL

Show exact depth of bottom.

Driller's License Number 2

Driller's Signature Clyde Sando

This form to be prepared by driller, and three copies to be filed by the owner with the County Clerk and Recorder in the county in which the well is located.

Please answer all questions. If not applicable, so state, otherwise the form will be returned.

Original to the County Clerk and Recorder; duplicate to the State Engineer; Triplicate to the Montana Bureau of Mines and Geology and Quadruplicate for the Appropriator.



801737

STATE OF MONTANA,  
County of Yellowstone.

This instrument was filed in my office  
this JUN 30 1967 19  
at 4:50 P. M.  
Edmond S. Harding,  
County Clerk & Recorder.  
By Jail Deputy  
na

INDEXED  
FILED  
JUN 30 1967  
COUNTY CLERK & RECORDER  
MONTANA



T. 1 N. R. 28 E  
County Yellowknife

MONTANA BUREAU OF MINES AND GEOLOGY  
Butte, Montana

RECEIVED  
OCT 10 1961

WATER WELL LOG

Owner Ralph Barkmeyer Address Butte, Mont  
Driller Erroy & Johnson Address 1145 Lynn Ave  
Date Started Aug 8, 1961 Date Completed Aug 11, 1961  
Location: Sec. 3 T. 1 N. R. 28 E. 1/4 sec. SE

STATE ENGINEER

Type of well Drilled Equipment used Cable tools  
(Dug, driven, bored, or drilled) (Churn drill, rotary, other)

Water use: Domestic  Municipal  Stock  Irrigation   
Industrial  Drainage  Other: \_\_\_\_\_

Casing: 30 1/2 ft. to 29 1/2 ft. Type Steel Size 8" surface pipe

Casing: 96 ft. to 90 ft. Type Sheet metal Size 6"

Casing: \_\_\_\_\_ ft. to \_\_\_\_\_ ft. Type \_\_\_\_\_ Size \_\_\_\_\_

Perforated or Screened: Ft. 18 ft to ft. from 7.5 Ft. 90 to ft. \_\_\_\_\_

Type of screen or perforations factory made

Static Water level, for non-flowing well: 4.0 ft from grade \_\_\_\_\_ feet.

Shut-in pressure, for flowing well: \_\_\_\_\_ lb./sq. in. on: \_\_\_\_\_ (date)

Pumping water level 5.0 feet at 18 gal. per min.

How tested: Bailer

Length of test 4 hrs.

Remarks: (Gravel packing, cementing, packers, type of shut-off, depth of shut-off)

