

File No. ....

ORIGINAL

STATE OF MONTANA  
ADMINISTRATOR OF GROUNDWATER CODE  
OFFICE OF STATE ENGINEER

T. .... R. ....

County .....

RECEIVED  
JAN 2 1964

DECLARATION of VESTED GROUNDWATER RIGHTS STATE ENGINEER  
(Under Chapter 237, Montana Session Laws, 1961)

1. \_\_\_\_\_, of \_\_\_\_\_ (Town)  
(Name of Appropriator) (Address)

County of \_\_\_\_\_ State of \_\_\_\_\_  
have appropriated groundwater according to the Montana laws in effect prior to  
January 1, 1962, as follows:

Section 28, Sec. 1, R. 256  
Indicate point of appropriation  
and place of use, if possible.  
Each small square represents  
10 acres.

- 2. The beneficial use on which the claim is based  
-----
- 3. Date or approximate date of earliest beneficial  
use; and how continuous the use has been  
-----
- 4. The amount of groundwater claimed (in miner's  
inches or gallons per minute)  
-----
- 5. If used for irrigation, give the acreage and  
description of the lands to which water has been  
applied and name of the owner thereof  
-----
- 6. The means of withdrawing such water from the  
ground and the location of each well or other  
means of withdrawal  
-----

7. The date of commencement and completion of the construction of the well, wells,  
or other works for withdrawal of groundwater  
-----

8. The depth of water table  
-----

9. So far as it may be available, the type, size and depth of each well or the gen-  
eral specifications of any other works for the withdrawal of groundwater  
-----

10. The estimated amount of groundwater withdrawn each year  
-----  
11. The log of formation encountered in the drilling of each well, if available  
-----

12. Such other information of a similar nature as may be useful in carrying out the  
policy of this act, including reference to book and page of any county record  
-----

Signature of Owner  
Date

Three copies to be filed by the owner with the County Clerk and Recorder of the  
County in which the well is located.  
Please answer all questions. If not applicable, so state, otherwise the form will  
be returned.  
Original to the County Clerk & Recorder; Duplicate to the State Engineer; Triplicate  
to the Montana Bureau of Mines and Geology, and Quadruplicate for the appropriator

File No. ....

T. 17 R. 25 28

ORIGINAL

County .....

STATE OF MONTANA  
ADMINISTRATOR OF GROUNDWATER CODE  
OFFICE OF STATE ENGINEER

RECEIVED  
JAN 2 1964

DECLARATION OF VESTED GROUNDWATER RIGHTS STATE ENGINEER  
(Under Chapter 237, Montana Session Laws, 1961)

1. Baron (Name of Appropriator) of Baron (Address) Baron (Town)

County of Baron State of Montana  
have appropriated groundwater according to the Montana laws in effect prior to  
January 1, 1962, as follows:

Sec. 24 sec. 17 I. R. 256  
Indicate point of appropriation  
and place of use, if possible.  
Each small square represents  
10 acres.

2. The beneficial use on which the claim is based  
stock water

3. Date or approximate date of earliest beneficial  
use; and how continuous the use has been  
don't know earliest date  
at least 20 years ago

4. The amount of groundwater claimed (in miner's  
inches or gallons per minute)  
100 gpm

5. If used for irrigation, give the acreage and  
description of the lands to which water has been  
applied and name of the owner thereof

not used for irrigation

6. The means of withdrawing such water from the  
ground and the location of each well or other  
means of withdrawal  
pump  
next to Baron

7. The date of commencement and completion of the well, wells,  
or other works for withdrawal of groundwater  
don't know

8. The depth of water table  
10 feet

9. So far as it may be available, the type, size and depth of each well or the gen-  
eral specifications of any other works for the withdrawal of groundwater  
open well, don't know depth, 2 feet  
to water comes up with cement tile

10. The estimated amount of groundwater withdrawn each year  
at 500,000 gpm

11. The log of formation encountered in the drilling of each well, if available  
not available

12. Such other information of a similar nature as may be useful in carrying out the  
policy of this act, including reference to book and page of any county record

there is no information in any such record

Signature of Owner Baron & Bailey  
Date Jan 21 1964

Three copies to be filed by the owner with the County Clerk and Recorder of the  
county in which the well is located.  
Please answer all questions. If not applicable, so state, otherwise the form will  
be returned.  
Original to the County Clerk & Recorder; Duplicate to the State Engineer; Triplicate to  
the Montana Bureau of Mines and Geology, and Quadruplicate for the appropriator

721830

STATE OF MONTANA,  
County of Yellowstone,

This instrument was filed in my office  
this DEC 31 day of 1963

at 5:15 o'clock P M.

Edmon S. Redding,  
County Clerk & Recorder

By W. H. Deputy

GY

File No. ....

DUPLICATE

T 15 R 25 E 8  
County Yellowstone

STATE OF MONTANA  
ADMINISTRATOR OF GROUNDWATER CODE  
OFFICE OF STATE ENGINEER

RECEIVED  
DEC 26 1963

Declaration of Vested Groundwater Rights

(Under Chapter 237, Montana Session Laws, 1961)

STATE ENGINEER

1. Elmer Giesick of Billings  
(Name of Appropriator) (Address) (Town)  
County of Yell. State of Montana  
have appropriated groundwater according to the Montana laws in effect prior to January 1, 1962, as follows:

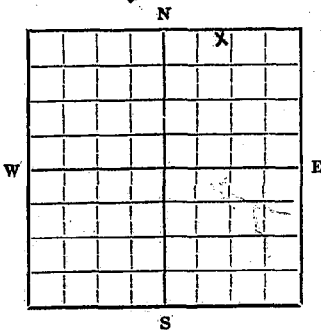

W 8 1/2 NE 1/4 Sec. 8 T. 15 R. 25 E

Indicate point of appropriation and place of use, if possible. Each small square represents 10 acres.

- 2. The beneficial use on which the claim is based Stock Water & irrigation
- 3. Date or approximate date of earliest beneficial use; and how continuous the use has been Jan 1 - 1925  
Continuous use since.
- 4. The amount of groundwater claimed (in miner's inches or gallons per minute) 55 gal per minute
- 5. If used for irrigation, give the acreage and description of the lands to which water has been applied and name of the owner thereof 4 Acres Pasture grass
- 6. The means of withdrawing such water from the ground and the location of each well or other means of withdrawal  
Jet + Centrifical Pumps

- 7. The date of commencement and completion of the construction of the well, wells, or other works for withdrawal of groundwater Oct 1, 1924 Completed Jan 1 - 1925
- 8. The depth of water table 4 feet.
- 9. So far as it may be available, the type, size and depth of each well or the general specifications of any other works for the withdrawal of groundwater 8" Cast iron pipe 60' deep.
- 10. The estimated amount of groundwater withdrawn each year 2,190,000 gallons
- 11. The log of formations encountered in the drilling of each well if available 52 ft sand & loam. 8' gravel.
- 12. Such other information of a similar nature as may be useful in carrying out the policy of this act, including reference to book and page of any county record  
none

Signature of Owner Elmer Giesick  
Date Dec 23 - 1963

Three copies to be filed by the owner with the County Clerk and Recorder of the county in which the well is located.

Please answer all questions. If not applicable, so state, otherwise the form will be returned.

Original to the County Clerk and Recorder; duplicate to the State Engineer; Triplicate to the School of Mines and Quadruplicate for the Appropriator.

2892

720723

Faint, mostly illegible text, possibly a letter or official document, located in the upper and middle sections of the page.

RECEIVED  
 DEC 23 1963  
 at 2:21  
 E. S. Redding,  
 County Clerk & Recorder  
 By Jaw Deputy  
 28

Faint text at the bottom of the page, possibly a footer or reference number.

G7-4

File No.

DUPLICATE

T 15 R 25 E 8

County Yellowstone

STATE OF MONTANA  
ADMINISTRATOR OF GROUNDWATER CODE  
OFFICE OF STATE ENGINEER

RECEIVED  
DEC 30 1963

Declaration of Vested Groundwater Rights  
(Under Chapter 237, Montana Session Laws, 1961)

1. George E. Miller of Rte #1 Box 100, Billings  
(Name of Appropriator) (Address) (Town)  
County of Yellowstone State of Montana  
have appropriated groundwater according to the Montana laws in effect prior to January 1, 1962, as follows:

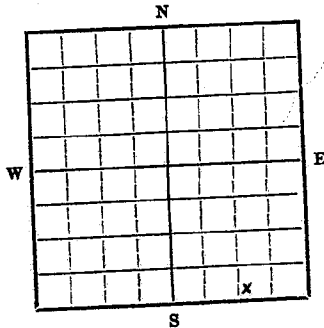

SE 1/4 Sec. 8 T/S R 25 E

Indicate point of appropriation and place of use, if possible. Each small square represents 10 acres.

- 2. The beneficial use on which the claim is based Irrigation
- 3. Date or approximate date of earliest beneficial use; and how continuous the use has been September 1950  
used daily during summer months
- 4. The amount of groundwater claimed (in miner's inches or gallons per minute) 100 gallons per minute
- 5. If used for irrigation, give the acreage and description of the lands to which water has been applied and name of the owner thereof used for approximately 2 acres  
of garden + lawn owned by  
George E. Miller
- 6. The means of withdrawing such water from the ground and the location of each well or other means of withdrawal with drawn by 3" centrifugal pump

- 7. The date of commencement and completion of the construction of the well, wells, or other works for withdrawal of groundwater September 1950
- 8. The depth of water table 11 feet approximately
- 9. So far as it may be available, the type, size and depth of each well or the general specifications of any other works for the withdrawal of groundwater Approximately 30 feet deep  
drilled well with a six inch casing
- 10. The estimated amount of groundwater withdrawn each year approximately 500,000 gallons
- 11. The log of formations encountered in the drilling of each well if available at no time was  
there any kind of rock or gravel encountered
- 12. Such other information of a similar nature as may be useful in carrying out the policy of this act, including reference to book and page of any county record none

Signature of Owner George E. Miller  
Date Dec 27, 1963

Three copies to be filed by the owner with the County Clerk and Recorder of the county in which the well is located.

Please answer all questions. If not applicable, so state, otherwise the form will be returned.

Original to the County Clerk and Recorder; duplicate to the State Engineer; Triplicate to the School of Mines and Quadruplicate for the Appropriator.



File No. ....

DUPLICATE

T 15 R 25E 8

County Yellowstone

STATE OF MONTANA  
ADMINISTRATOR OF GROUNDWATER CODE  
OFFICE OF STATE ENGINEER

RECEIVED  
DEC 30 1963

Declaration of Vested Groundwater Rights

(Under Chapter 237, Montana Session Laws, 1961) STATE ENGINEER

1. George E. Miller, of Rte #1 Box 101, Billings (Address) (Town)  
(Name of Appropriator)  
County of Yellowstone State of Montana  
have appropriated groundwater according to the Montana laws in effect prior to January 1, 1962, as follows:

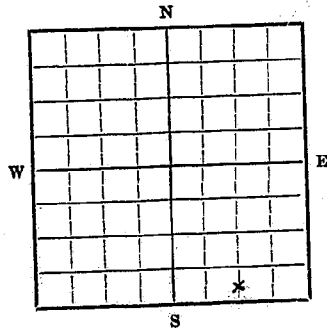

SE 1/4 Sec. 8 T15 R25E

Indicate point of appropriation and place of use, if possible. Each small square represents 10 acres.

- 2. The beneficial use on which the claim is based watering stock
- 3. Date or approximate date of earliest beneficial use; and how continuous the use has been Daily since 1947  
The well was drilled approximately in the early 1920's.
- 4. The amount of groundwater claimed (in miner's inches or gallons per minute) 100 gallons per minute
- 5. If used for irrigation, give the acreage and description of the lands to which water has been applied and name of the owner thereof not used for irrigation
- 6. The means of withdrawing such water from the ground and the location of each well or other means of withdrawal withdrawn by 3" pump

- 7. The date of commencement and completion of the construction of the well, wells, or other works for withdrawal of groundwater I purchased this farm in 1947 and the well was drilled in the early 1920's.
- 8. The depth of water table 11 feet approximately
- 9. So far as it may be available, the type, size and depth of each well or the general specifications of any other works for the withdrawal of groundwater approximately 50 feet deep drilled well with a six inch iron casing.
- 10. The estimated amount of groundwater withdrawn each year approximately 500,000 gallons.
- 11. The log of formations encountered in the drilling of each well if available unavailable  
The well was already drilled when I purchased the place in 1947.
- 12. Such other information of a similar nature as may be useful in carrying out the policy of this act, including reference to book and page of any county record none as far as I can find out.

Signature of Owner

George E. Miller

Date Dec 27, 1963

Three copies to be filed by the owner with the County Clerk and Recorder of the county in which the well is located.

Please answer all questions. If not applicable, so state, otherwise the form will be returned.

Original to the County Clerk and Recorder; duplicate to the State Engineer; Triplicate to the School of Mines and Quadruplicate for the Appropriator.



024 311

721051

STATE OF MONTANA  
County of Yellowstone

This instrument was

DEC 27 19

at 2:13

Edna S. Nelson  
County Clerk

By [Signature]  
2.00

[Faint, mostly illegible text and a table-like structure, possibly a recording or index table]



938468

STATE OF MONTANA, }  
County of Yellowstone, } ss.  
This instrument was filed in my office  
this 21<sup>st</sup> day of APRIL 1974  
at 2:54 o'clock P. M.  
MIRANDA G. KUNDT  
County Clerk & Recorder  
By [Signature] Deputy  
24

GW 4

Approved Stock Form State Publishing Co., Helena, Montana—42234

File No. ....

T. 15 R. 25 E

DUPLICATE

County Yellowstone

STATE OF MONTANA  
ADMINISTRATOR OF GROUNDWATER CODE  
OFFICE OF STATE ENGINEER

RECEIVED  
DEC 30 1963

Declaration of Vested Groundwater Rights

(Under Chapter 237, Montana Session Laws, 1961)

STATE ENGINEER

1. Art Stummert of Route 1 Billings  
(Name of Appropriator) (Address) (Town)

County of Yellowstone State of Montana  
have appropriated groundwater according to the Montana laws in effect prior to January 1, 1962, as follows:

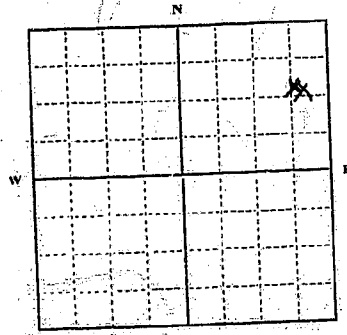

50 1/2 Sec. 8 T. 15 R. 25 E. 15 E.  
Indicate point of appropriation and place of use, if possible. Each small square represents 10 acres.

- 2. The beneficial use on which the claim is based household  
watering cattle
- 3. Date or approximate date of earliest beneficial use; and how continuous the use has been 1945  
well is used continuously
- 4. The amount of groundwater claimed (in miner's inches or gallons per minute) 30 gal per min.
- 5. If used for irrigation, give the acreage and description of the lands to which water has been applied and name of the owner thereof
- 6. The means of withdrawing such water from the ground and the location of each well or other means of withdrawal.  
1 hp. Elec. Pump

- 7. The date of commencement and completion of the construction of the well, wells, or other works for withdrawal of groundwater. approx. completion 1942
- 8. The depth of water table 50 ft
- 9. So far as it may be available, the type, size and depth of each well or the general specifications of any other works for the withdrawal of groundwater. not known
- 10. The estimated amount of groundwater withdrawn each year. approx. 600,000 gals
- 11. The log of formations encountered in the drilling of each well if available. not known
- 12. Such other information of a similar nature as may be useful in carrying out the policy of this act, including reference to book and page of any county record. not known

Signature of Owner Art Stummert  
Date Dec 30, 1963

Three copies to be filed by the owner with the County Clerk and Recorder of the county in which the well is located.  
Please answer all questions. If not applicable, so state, otherwise the form will be returned.

Original to the County Clerk and Recorder; Duplicate to the State Engineer; Triplicate to the Montana Bureau of Mines and Geology, and Quadruplicate for the Appropriator.

721135

STATE OF TEXAS  
County of \_\_\_\_\_  
This order was made  
this \_\_\_\_\_ day of \_\_\_\_\_ 1963  
at \_\_\_\_\_  
F. J. \_\_\_\_\_  
County Clerk & Recorder

By \_\_\_\_\_  
\_\_\_\_\_  
Deputy

File No.....

T. 13 R. 25

County.....

ORIGINAL

STATE OF MONTANA  
ADMINISTRATOR OF GROUNDWATER CODE  
OFFICE OF STATE ENGINEER

RECEIVED  
JAN 2 1964

DECLARATION OF VESTED GROUNDWATER RIGHTS  
(Under Chapter 237, Montana Session Laws, STATE ENGINEER)

1. Pete Harth of State #1 Billings  
(Name of Appropriator) (Address) (Town)

County of Yellowstone State of Montana  
have appropriated groundwater according to the Montana laws in effect prior to  
January 1, 1962, as follows:

1 ESE - Sec. 9 T. 15 R. 25 E

Indicate point of appropriation  
and place of use, if possible.  
Each small square represents  
10 acres.

- The beneficial use on which the claim is based  
Cattle, horses, Horses
- Date or approximate date of earliest beneficial  
use; and how continuous the use has been - 1952  
Daily every winter.
- The amount of groundwater claimed (in miner's  
inches or gallons, per minute) - Don't know
- If used for irrigation, give the acreage and  
description of the lands to which water has been  
applied and name of the owner thereof - 4 ft acre  
4 ft down  
1 ft down
- The means of withdrawing such water from the  
ground and the location of each well or other  
means of withdrawal - one 1 1/2" flow well pump  
one 1 1/2" flow well pump
- The date of commencement and completion of the construc' ion of the well, wells,  
or other works for withdrawal of groundwater - 1952
- The depth of water table - 160 ft summer 20 ft winter
- So far as it may be available, the type, size and depth of each well or the gen-  
eral specifications of any other works for the withdrawal of groundwater -  
one 1 1/2" flow well pump one 1 1/2" flow well pump  
one 1 1/2" flow well pump one 1 1/2" flow well pump
- The estimated amount of groundwater withdrawn each year - 200,000 gal.
- The log of formations encountered in the drilling of each well if available  
Don't know
- Such other information of a similar nature as may be useful in carrying out the  
policy of this act, including reference to book and page of any county record -  
Don't know

Signature of Owner - Pete Harth  
Date - Dec 20, 1963

Three copies to be filed by the owner with the County Clerk and Recorder of the  
county in which the well is located.  
Please answer all questions. If not applicable, so state, otherwise the form will  
be returned.  
Original to the County Clerk & Recorder; Duplicate to the State Engineer; Triplicate  
to the Montana Bureau of mines and Geology, and Quadruplicate for the appropriator

721765

STATE OF MONTANA,  
County of Yellowstone

This instrument was filed in my office

this DEC 31 1968 10

at 4:11 P M

Edmond S. Worthing,  
County Clerk & Recorder

*J. all*  
*2 n* Deputy

721765

STATE OF MONTANA,  
County of Yellowstone ss.

This instrument was filed in my office  
this DEC 31 1963 19

at Billings M.

Edward S. Swadlow  
County Clerk or Recorder

Jaw Deputy  
20.



GW

File No. \_\_\_\_\_

DUPLICATE

GAZETTE 12561

T. 1 S. R. 25 E. M. P. M.  
County Yellowstone

STATE OF MONTANA  
ADMINISTRATOR OF GROUNDWATER CODE  
OFFICE OF STATE ENGINEER  
STATE WATER CONSERVATION BOARD

JAN 9 1967

**Declaration of Vested Groundwater Rights**

(Under Chapter 21, Montana Session Laws, 1965)

1. Henry Lackman, Jr., of Rts. # 1 Box 109 Billings  
(Name of Appropriator) (Address) (Town)  
County of Yellowstone State of Montana  
have appropriated groundwater according to the Montana laws in effect prior to January 1, 1962, as follows:

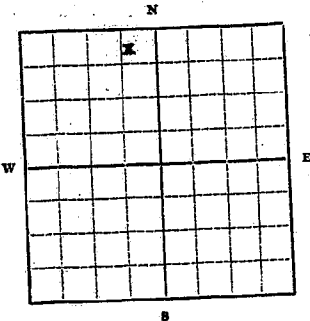

NE 1/4 Sec. 2 T15 R25 E. M. P. M.

Indicate point of appropriation and place of use, if possible. Each small square represents 10 acres.

- 2. The beneficial use on which the claim is based: Household and Livestock water
- 3. Date or approximate date of earliest beneficial use; and how continuous the use has been: 1929 It has been used continuously since.
- 4. The amount of groundwater claimed (in miner's inches or gallons per minute): 50 G. P. M.
- 5. If used for irrigation, give the acreage and description of the lands to which water has been applied and name of the owner thereof: It has not been used for irrigation as yet.
- 6. The means of withdrawing such water from the ground and the location of each well or other means of withdrawal: Electric pressure pump

- 7. The date of commencement and completion of the construction of the well, wells, or other works for withdrawal of groundwater: Started and completed in 1927.
- 8. The depth of water table: 12 feet
- 9. So far as it may be available, the type, size and depth of each well or the general specifications of any other works for the withdrawal of groundwater: Drilled well. 6 inch diameter by 40 feet deep.
- 10. The estimated amount of groundwater withdrawn each year: 2,000 gallons per day
- 11. The log of formations encountered in the drilling of each well if available: Not available.
- 12. Such other information of a similar nature as may be useful in carrying out the policy of this act, including reference to book and page of any county record: NONE

Signature of Owner Henry Lackman Jr.  
Date JANUARY 3, 1967

Three copies to be filed by the owner with the County Clerk and Recorder of the county in which the well is located. Please answer all questions. If not applicable, so state, otherwise the form will be returned. Original to the County Clerk and Recorder; duplicate to the State Engineer; Triplicate to the School of Mines and Quadruplicate for the Appropriator.

41614

791159

STATE OF MONTANA  
County of Yellowstone

This instrument was filed in my office

on JAN 8 1910

at 1:30 P. M.

County Clerk & Recorder

By *Hamilton* Deputy

2

T. 1 So. R. 25 E 11 PM

County Yellowstone

RECEIVED  
NOV 21 1957  
STATE ENGINEER

MONTANA BUREAU OF MINES AND GEOLOGY  
Butte, Montana

WATER WELL LOG

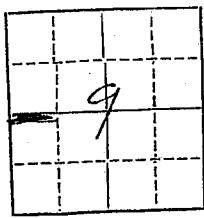

Owner Roal C. Larson Address Rt. #1, Box 134B

Driller Owner Address Same

Date Started May 15, 1957 Date Completed July 20, 1957

Location: Sec. 9 T. 1 So R. 25E 1/4 sec. N 1/2 NW 1/4 SW 1/4

Type of well Driven Equipment used Auger for 15' - drove balance  
(Dug, driven, bored, or drilled) (Churn drill, rotary, other)

Water use: Domestic  Municipal  Stock  Irrigation

Industrial  Drainage  Other: \_\_\_\_\_

Casing: 0' ft. to 31 ft. Type Steel Size 2"

Casing: \_\_\_\_\_ ft. to \_\_\_\_\_ ft. Type \_\_\_\_\_ Size \_\_\_\_\_

Casing: \_\_\_\_\_ ft. to \_\_\_\_\_ ft. Type \_\_\_\_\_ Size \_\_\_\_\_

Perforated or Screened: Ft. 27 to ft. 31 Ft. \_\_\_\_\_ to ft. \_\_\_\_\_  
Type of screen or perforations 3/8" holes cut in 2" pipe

Static Water level, for non-flowing well: 11 feet below surface feet.

Shut-in pressure, for flowing well: \_\_\_\_\_ lb./sq. in. on: \_\_\_\_\_ (date)

Pumping water level: 22' feet at 7 gal. per min.

How tested: Small 3/4" pump - no gal. per minute test taken

Length of test: \_\_\_\_\_

Remarks: (Gravel packing, cementing, packers, type of shut-off, depth of shut-off)  
No gravel packing, cementing, packers etc. used.

(over)



**RECEIVED**  
 NOV 21 1957  
 STATE ENGINEER

T. 1 So. R. 25 E. M. 34  
 County Yellowstone

**MONTANA BUREAU OF MINES AND GEOLOGY**  
 Butte, Montana

**WATER WELL LOG**

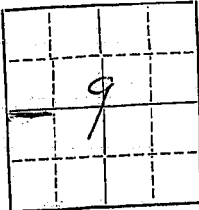

Owner Roal C. Larson Address Rt. #1, Box 134B  
 Driller G. I. Keithler Address Billings, Montana  
 Date Started July, 1955 Date Completed July, 1955  
 Location: Sec. 9 T. 1 So. R. 25 E  $\frac{1}{4}$  sec. N $\frac{1}{2}$  N $\frac{1}{2}$  NW $\frac{1}{4}$  S $\frac{1}{2}$

Type of well Drilled Equipment used Churn Drill  
(Dug, driven, bored, or drilled) (Churn drill, rotary, other)

Water use: Domestic  Municipal  Stock  Irrigation   
 Industrial  Drainage  Other: \_\_\_\_\_

Casing: 0' ft. to 5' ft. Type Well Pit Size 5' in diameter

Casing: 5' ft. to 50' ft. Type Steel Size 6"

Casing: \_\_\_\_\_ ft. to \_\_\_\_\_ ft. Type \_\_\_\_\_ Size \_\_\_\_\_

Perforated or Screened: Ft. None to ft. \_\_\_\_\_ Ft. \_\_\_\_\_ to ft. \_\_\_\_\_

Type of screen or perforations None

Static Water level, for non-flowing well: 11 feet below surface feet.

Shut-in pressure, for flowing well: \_\_\_\_\_ lb./sq. in. on: \_\_\_\_\_ (date)

Pumping water level: 20 feet at 100 gal. per min.

How tested: 1/2" pump

Length of test: 3 hours

Remarks: (Gravel packing, cementing, packers, type of shut-off, depth of shut-off)  
No gravel packing, cementing, packers, etc.

(over)



File No. ....

T 1 S R 25 E

DUPLICATE

County Yellowstone

STATE OF MONTANA  
 ADMINISTRATOR OF GROUNDWATER CODE  
 OFFICE OF STATE ENGINEER

RECEIVED  
 JAN 2 1964

Declaration of Vested Groundwater Rights

(Under Chapter 237, Montana Session Laws, 1961)

STATE ENGINEER

1. Fred Rutt, Jr. of RFD #1, Billings, Montana  
 (Name of Appropriator) (Address) (Town)

County of Yellowstone State of Montana  
 have appropriated groundwater according to the Montana laws in effect prior to January 1, 1962, as follows:

N

S

W E

SW 1/4 SE Sec. 9 T.15 R.25E

Indicate point of appropriation  
 and place of use, if possible. Each  
 small square represents 10 acres.

2. The beneficial use on which the claim is based stock water
3. Date or approximate date of earliest beneficial use; and how continuous the use has been 1917 - all years since
4. The amount of groundwater claimed (in miner's inches or gallons per minute) 1,000 gallons per day
5. If used for irrigation, give the acreage and description of the lands to which water has been applied and name of the owner thereof  
none
6. The means of withdrawing such water from the ground and the location of each well or other means of withdrawal electric pump
7. The date of commencement and completion of the construction of the well, wells, or other works for withdrawal of groundwater 1918 drilled well, dug well before
8. The depth of water table 15 - 18 feet
9. So far as it may be available, the type, size and depth of each well or the general specifications of any other works for the withdrawal of groundwater 6" casing - approximately 50'  
withdrawn by 1/2 H.P. electric motor
10. The estimated amount of groundwater withdrawn each year stock water use 72,000 gal annually
11. The log of formations encountered in the drilling of each well if available unknown
12. Such other information of a similar nature as may be useful in carrying out the policy of this act, including reference to book and page of any county record none

Signature of Owner

*Fred Rutt Jr*  
 Date Jan 31 - 1963

Three copies to be filed by the owner with the County Clerk and Recorder of the county in which the well is located.

Please answer all questions. If not applicable, so state, otherwise the form will be returned.

Original to the County Clerk and Recorder; Duplicate to the State Engineer; Triplicate to the Montana Bureau of Mines and Geology, and Quadruplicate for the Appropriator.

18279

721507

STATE OF MONTANA,  
County of Yellowstone, ss. *A*

This instrument was filed in my office  
this DEC 31 1933 day of \_\_\_\_\_ 19\_\_\_\_

at 10:06 o'clock A M. |

Eaton S. Redding,  
County Clerk & Recorder

By *MR* Deputy |



File No. \_\_\_\_\_

T. 15 R. 25E  
County, Yellowstone

DUPLICATE

STATE OF MONTANA  
ADMINISTRATOR OF GROUNDWATER CODE  
OFFICE OF STATE ENGINEER

Notice of Completion of Groundwater  
Appropriation by Means of Well

(Under Chapter 237, Montana Session Laws, 1961)

Top of Ground  
(Elev. above sea level.....)

From 0 ft to 1 ft top soil

1 ft to 35 ft Sand & gravel

water in gravel

water supply 20 gal per min

water level 8 ft from grade

Owner, Harry Staley Address, Route 1, Billings

Driller, Leroy E Johnson Address, 1145 - 5th Ave, Billings, Mont

Date of Notice of Appropriation of Groundwater.....

Date well started, May 31, 1962 Date Completed, June 3, 1962

Type of well, Drilled Equipment Used, Cable Tools  
(dug, driven, bored or drilled) (Churn, drill, rotary or other)

Water Use: Domestic  Municipal  Other  Irrigation   
Industrial  Drainage  Stock

Indicate on the diagram the character and thickness of the different strata met with in drilling, such as soil, clay, shale, gravel, rock or sand, etc. Show depth at which water is encountered, thickness and character of water-bearing strata and height to which water rises in the well.

Size of Drilled Hole	Size and Weight of Casing	From (Feet)	To (Feet)	PERFORATIONS		
				Kind Size	From (Feet)	To (Feet)
6"	19 lbs 6" I.D.	Grade	39 1/2	none		
				water in gravel		

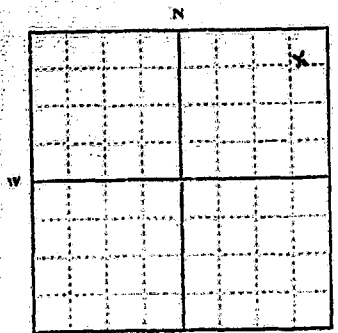

ME 1/4 Sec. 9 T. 15 R. 25 E  
Indicate location of well and place of use, if possible. Each small square represents 10 acres.

Show exact depth of bottom.  
40 ft

Static Water Level for non-flowing Well 8 feet.

Shut-in Pressure for Flowing Well \_\_\_\_\_

Pumping Water Level 14 feet at 20 gal. per minute.

Discharge in gal. per min. of flowing well \_\_\_\_\_

How Tested, Pump Length of Test, 4 hrs

Remarks: (Gravel packing, cementing, packers, type of shutoff, location of place of use of groundwater if not at well, and any other similar pertinent information, including number of acres irrigated, if used for irrigation) none

#4  
Driller's License Number

Leroy E Johnson  
Driller's Signature

This form to be prepared by driller, and three copies to be filed by the owner with the County Clerk and Recorder in the county in which the well is located.

Please answer all questions. If not applicable, so state, otherwise the form will be returned.

Original to the County Clerk and Recorder; duplicate to the State Engineer; Triplicate to the Montana Bureau of Mines and Geology and Quadruplicate for the Appropriator.

719688

STATE OF MONTANA,  
County of Yellowstone,

This instrument was filed in my office  
this DEC 9 1968 19

at L. J. Nelson M.

Edmon S. Nelson,  
County Clerk & Recorder

By [Signature] Deputy  
202

T 1-S R 25-E

County Yellowstone

MONTANA BUREAU OF MINES AND GEOLOGY  
Butte, Montana

RECEIVED  
MAY 18 1961

WATER WELL LOG

STATE ENGINEER

*well*

Owner *David Bell* Address *R 1 Box 122*

Driller *Leroy Johnson* Address *114 S - Lynn Ave  
B3, Elings*

Date Started *May 14, 1961* Date Completed *May 27, 1961*

Location: Sec. *10* T. *1-S* R. *25-1/4* sec. *12E*

Type of well *Drain* Equipment used *Truck & driver*  
(Dug, driven, bored, or drilled) (Churn drill, rotary, other)

Water use: Domestic  Municipal  Stock  Irrigation   
Industrial  Drainage  Other: \_\_\_\_\_

Casing: \_\_\_\_\_ ft. to *34 ft.* Type *Black oil* Size *6"*

Casing: \_\_\_\_\_ ft. to *2* ft. Type \_\_\_\_\_ Size \_\_\_\_\_

Casing: \_\_\_\_\_ ft. to \_\_\_\_\_ ft. Type \_\_\_\_\_ Size \_\_\_\_\_

Perforated or Screened: Ft. \_\_\_\_\_ to ft. \_\_\_\_\_ Ft. \_\_\_\_\_ to ft. \_\_\_\_\_

Type of screen or perforations \_\_\_\_\_

Static Water level, for non-flowing well: *10 ft from ground level* feet.

Shut-in pressure, for flowing well: \_\_\_\_\_ lb./sq. in. on: \_\_\_\_\_ (date)

Pumping water level: *5* feet at *10* gal. per min.

How tested: *1 inch pump test*

Length of test: *2 hrs*

Remarks: (Gravel packing, cementing, packers, type of shut-off, depth of shut-off)

\_\_\_\_\_  
\_\_\_\_\_  
\_\_\_\_\_  
\_\_\_\_\_

(over)





721764

STATE OF MONTANA  
County of Yellowstone

This instrument was filed in my office  
this DEC 31 1963  
at 4.10 o'clock P M.

Edmon S. Redding,  
County Clerk & Recorder  
By Jail Deputy  
7

File No. 886148  
 Filed for record  
 this 9 day of July  
 A. D. 1971 at 3:00  
 o'clock P. M.

T. 15 R. 25  
 YELLOWSTONE COUNTY, MONTANA  
 County

STATE OF MONTANA  
 ADMINISTRATOR OF GROUNDWATER CODE  
 OFFICE OF STATE ENGINEER

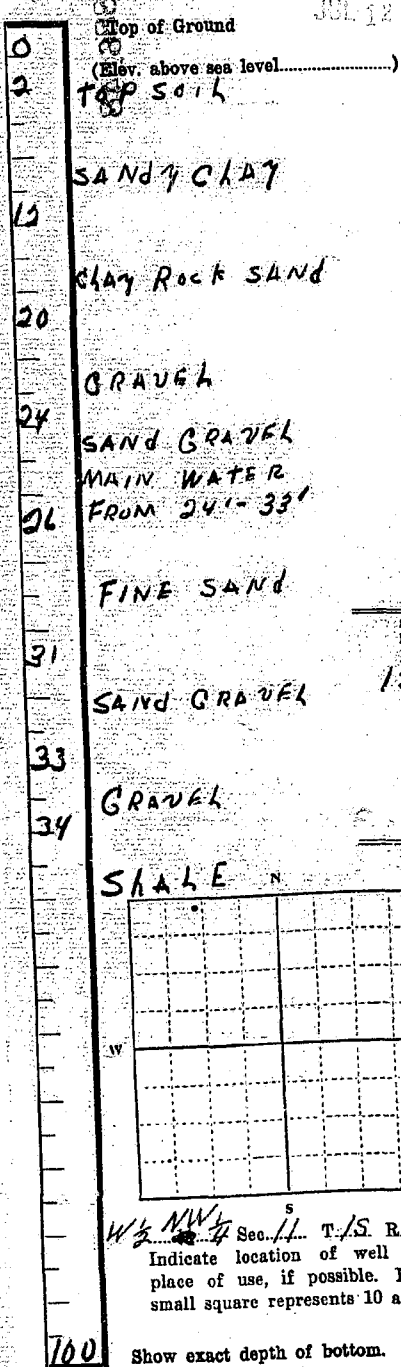

### Notice of Completion of Groundwater Appropriation by Means of Well

(Under Chapter 237, Montana Session Laws, 1961)

Owner Eggebrecht + Gilbert Address 30114 shade Ln  
1035 WYNN MILLER LANE  
 Driller L+O-DRILLING Address BILLINGS MONT

Date of Notice of Appropriation of Groundwater \_\_\_\_\_  
 Date well started 1/22/71 Date Completed 2/12/71  
 Type of well DRILLED Equipment Used CABLE  
 (dug, driven, bored or drilled) (Churn, drill, rotary or other)  
 Water Use: Domestic  Municipal  Other  Irrigation   
 Industrial  Drainage  Stock

Indicate on the diagram the character and thickness of the different strata met with in drilling, such as soil, clay, shale, gravel, rock or sand, etc. Show depth at which water is encountered, thickness and character of water-bearing strata and height to which water rises in the well.

Size of Drilled Hole	Size and Weight of Casing	From (Feet)	To (Feet)	PERFORATIONS		
				Kind Size	From (Feet)	To (Feet)
12"	8" 38#	0	33	cut 4"	32	25

Static Water Level for non-flowing Well 21 feet.  
 Shut-in Pressure for Flowing Well \_\_\_\_\_  
 Pumping Water Level 12 feet at 300 gal. per minute.  
 Discharge in gal. per min. of flowing well \_\_\_\_\_  
 How Tested PUMPS Length of Test 15 HRS

Remarks: (Gravel packing, cementing, packers, type of shutoff, location of place of use of groundwater if not at well, and any other similar pertinent information, including number of acres irrigated, if used for irrigation) DRILLED TO

100' FILLED BACK UP TO 33'  
PACKER AT 30 FT FILLED UP  
TO 5' WITH RED GRAVEL  
Roy R Lenger  
 Driller's License Number  
MON 198

Driller's Signature

This form to be prepared by driller, and three copies to be filed by the owner with the County Clerk and Recorder in the county in which the well is located.

Please answer all questions. If not applicable, so state, otherwise the form will be returned.

Original to the County Clerk and Recorder; duplicate to the State Engineer; Triplicate to the Montana Bureau of Mines and Geology and Quadruplicate for the Appropriator.

Doc No \_\_\_\_\_  
 Filed No \_\_\_\_\_  
 Vol \_\_\_\_\_  
 Page \_\_\_\_\_

886148

30  
31  
32  
33  
34  
35  
36  
37  
38  
39  
40  
41  
42  
43  
44  
45  
46  
47  
48  
49  
50  
51  
52  
53  
54  
55  
56  
57  
58  
59  
60  
61  
62  
63  
64  
65  
66  
67  
68  
69  
70  
71  
72  
73  
74  
75  
76  
77  
78  
79  
80  
81  
82  
83  
84  
85  
86  
87  
88  
89  
90  
91  
92  
93  
94  
95  
96  
97  
98  
99  
100

13"	21 98 #	0	37
14"			
15"			
16"			
17"			
18"			
19"			
20"			
21"			
22"			
23"			
24"			
25"			
26"			
27"			
28"			
29"			
30"			
31"			
32"			
33"			
34"			
35"			
36"			
37"			
38"			
39"			
40"			
41"			
42"			
43"			
44"			
45"			
46"			
47"			
48"			
49"			
50"			
51"			
52"			
53"			
54"			
55"			
56"			
57"			
58"			
59"			
60"			
61"			
62"			
63"			
64"			
65"			
66"			
67"			
68"			
69"			
70"			
71"			
72"			
73"			
74"			
75"			
76"			
77"			
78"			
79"			
80"			
81"			
82"			
83"			
84"			
85"			
86"			
87"			
88"			
89"			
90"			
91"			
92"			
93"			
94"			
95"			
96"			
97"			
98"			
99"			
100"			

STATE OF MONTANA  
 County of Yellowstone  
 This instrument was filed in my office  
 this JUL 9 day of 19  
 at 2:00 o'clock P.M.  
 My commission expires \_\_\_\_\_  
 By [Signature] Deputy

200

138121





938533

STATE OF MONTANA, }  
- County of Yellowstone, } ss.  
This instrument was filed in my office  
this 28 day of JUN 1973  
at 4:01 o'clock P M.  
MERRILL E. KLUNDT  
County Clerk & Recorder  
By [Signature] Deputy

File No.....

T. 15 25 E  
Yellowstone

ORIGINAL

County

STATE OF MONTANA  
ADMINISTRATOR OF GROUNDWATER CODE  
OFFICE OF STATE ENGINEER

RECEIVED  
JAN 2 1964

DECLARATION OF VESTED GROUNDWATER RIGHTS  
(Under Chapter 237, Montana Session Laws, 1961)

STATE ENGINEER

1. Russell & Harry Blunt of Route #1 Lawrel  
(Name of Appropriator) (Address) (Town)  
Yellowstone State of Montana

County of \_\_\_\_\_ State of \_\_\_\_\_  
have appropriated groundwater according to the Montana laws in effect prior to  
January 1, 1962, as follows:

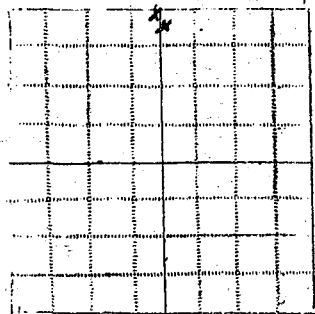

NE 1/4 NW 1/4 15 25 E  
Indicate point of appropriation  
and place of use, if possible.  
Each small square represents  
10 acres.

2. The beneficial use on which this is based  
irrigation, garden, house

3. Date or approximate date of earliest beneficial  
use; and how continuous the use has been  
other well about 1900 used almost daily

4. The amount of groundwater claimed in gallons  
inches or gallons per minute- inches

5. If used for irrigation, give the acreage and  
description of the lands to which water is  
applied and name of the owner thereof  
Russell & Harry Blunt

6. The means of withdrawing such water from the  
ground and the location of each well or other  
means of withdrawal- by pump

7. The date of commencement and completion of the one well the well about  
1900 other works for withdrawal of groundwater- 1928  
about 8 ft. on both wells

8. The depth of water table- about 8 ft. on both wells

9. So far as it may be available, the type, size and depth of each well or the gen-  
eral specifications of any other works for the withdrawal of groundwater-  
one 30 pipe about 12 ft. deep  
other well was drilled about 25 to 30 ft. deep  
not known

10. The estimated amount of groundwater withdrawn each year-

11. The log of formations encountered in the drilling of each well if available  
not known

12. Such other information of a similar nature as may be useful in carrying out the  
policy of this act, including reference to book and page of any county record-  
not known

Signature of Owner- Russell Blunt & Harry Blunt  
Date- Dec. 31, 1963

Three copies to be filed by the owner with the County Clerk and Recorder of the  
county in which the well is located.  
Please answer all questions. If not applicable, so state, otherwise the form will  
be returned.  
Original to the County Clerk & Recorder; Duplicate to the State Engineer; Triplicate  
to the Montana Bureau of mines and Geology, and Quadruplicate for the appropriator

721527

STATE OF MISSISSIPPI  
[County of Adams, MS]

This instrument is for the estate

of DEC 30 1968

W 10:27

By

*[Signature]*

*[Handwritten mark]*



721526

STATE OF MISSISSIPPI  
County of Yalowaha

This instrument was filed in my office

on DEC 30 1968 at 10:26 o'clock P.M.

James B. Manning,  
County Clerk and Recorder

By J. B. Manning Deputy

*J. B. Manning*



938197

STATE OF MONTANA, }  
County of Yellowstone, } ss.  
This instrument was filed in my office  
this JUN 20 1973 day of     19     
at     o'clock     M.  
MERRILL H. KLUNDT  
County Clerk & Recorder  
By     Deputy



STATE OF MONTANA  
ADMINISTRATOR OF GROUNDWATER CODE  
MONTANA WATER RESOURCES BOARD  
**NOTICE OF COMPLETION OF GROUNDWATER  
APPROPRIATION BY MEANS OF WELL**  
Developed after January 1, 1962

RECEIVED

MAR 16 1973

County Yellowstone  
DRILLER'S LOG

Indicate the character, color, thickness of strata such as soil, clay, sand, gravel, shale, sandstone, etc. Show depth at which water is found and height to which water rises in well.

(Under Chapter 237 Montana Session Laws, 1961, as amended)

This form to be prepared by driller, and three copies to be filed by the owner with the County Clerk and Recorder in the county in which the well is located, last copy to be retained by driller. Please answer all questions. If not applicable, so state, otherwise the form may be returned.

Owner Wade Edwards  
Address 2930 St. Joseph  
Billings, Mont.  
Date well started 2/21/73  
completed 2/23/73  
Type of well DRILLED  
Equipment used CABLE TOOL  
Water Use: Domestic  Municipal  Stock  Irrigation   
Industrial  Drainage  Other  Garden/Lawn

For Administrator's Use  
File 929.225  
MARCH 15, 1973  
GW 1 8:16 A.M.

\*Describe  
USE: If used for irrigation, industrial, drainage or other. Explain, state number of acres and location or other data (i.e. Lot, Block and Addition).  
20(1) 200 but 50 ft. lot 2 in Block 20 of section 14, T.25N, R.25E

ESTIMATED ANNUAL WITHDRAWAL 1,000,000 gallons

Size of Drilled Hole	Size and Weight of Casing	From (Feet)	To (Feet)	PERFORMATIONS		
				Kind Size	From (Feet)	To (Feet)
<u>7"</u>	<u>6 3/4 17-87</u>	<u>0</u>	<u>30</u>	<u>1/8 CUT</u>	<u>25</u>	<u>29</u>

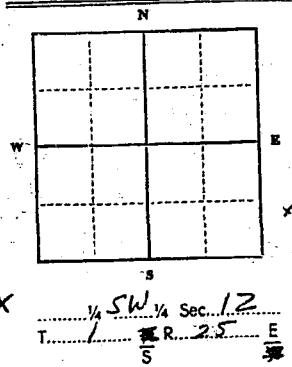

Static water level 11 ft.\*  
Pumping water level 18 ft.\*  
at 30 gallons per minute, measured 18 minutes after pumping began.  
\*Measured from ground level.  
Well developed by PUMP for 2 1/2 hours.  
Power 3 HP Pump 3 HP  
Remarks: (Gravel packing, cementing, packers, type of shutoff) CASING 1" ABOVE GRAVEL GRAVEL PACKED 270 DEPTH OF GRAVEL 1" DEPTH OF GRAVEL IN BOTTOM OF WELL

INDICATE LOCATION OF WELL AND PLACE OF USE, IF POSSIBLE. EACH SMALL SQUARE REPRESENTS 40 ACRES.

Driller's Signature R. R. Senger  
Driller's Address 1035 WINE MILLER LANE  
BILLINGS MONT LICENSE NO. 188  
L & D DRILLING  
1035 WINE MILLER LANE

Top of Ground (Elev. above sea level)

From (Feet)	To (Feet)	
<u>0</u>	<u>2</u>	<u>TOP SOIL</u>
<u>2</u>	<u>11</u>	<u>CLAY</u>
<u>11</u>	<u>30</u>	<u>GRAVEL-SAND</u>
		<u>WATER AT 20</u>
		<u>STATIC WATER LEVEL 11 FEET</u>

30 Show exact depth of bottom

59.644

929225

STATE OF MONTANA } ss.  
County of Yellowstone }  
This instrument was filed in my office  
this MAR 15 1973 day of \_\_\_\_\_  
at 8:10 o'clock A.M.  
Notary Public  
By Caree B. Brund Deputy

8200

RECORDED & INDEXED  
MAR 15 1973  
COUNTY CLERK  
YELLOWSTONE COUNTY  
MONTANA





File No. ....

STATE WATER CONSERVATION BOARD

T1S R 25E

DUPLICATE

RECEIVED  
SEP 10 1965

County Yellowstone

STATE OF MONTANA  
ADMINISTRATOR OF GROUNDWATER CODE  
OFFICE OF STATE ENGINEER

Top of Ground  
(Elev. above sea level 3235.....)

### Notice of Completion of Groundwater Appropriation by Means of Well

(Under Chapter 237, Montana Session Laws, 1961)

Owner Mt. States Telephone Address Helena, Montana

Driller Clyde Sando Address Billings, Montana

Date of Notice of Appropriation of Groundwater August 12, 1965

Date well started August 8, 1965 Date Completed August 10, 1965

Type of well Drilled Equipment Used Cable Tool  
(dug, driven, bored or drilled) (Churn, drill, rotary or other)

Water Use: Domestic  Municipal  Other  Irrigation   
Industrial  Drainage  Stock

Indicate on the diagram the character and thickness of the different strata met with in drilling, such as soil, clay, shale, gravel, rock or sand, etc. Show depth at which water is encountered, thickness and character of water-bearing strata and height to which water rises in the well.

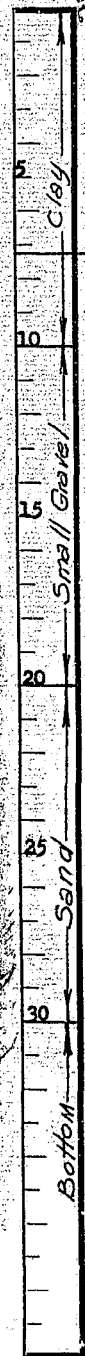

Size of Drilled Hole	Size and Weight of Casing	From (Feet)	To (Feet)	PERFORATIONS		
				Kind Size	From (Feet)	To (Feet)
6" Schedule 40	Schedule 40	0	30	Clay	5	10
				Small Gravel	10	20
				Sand	20	30

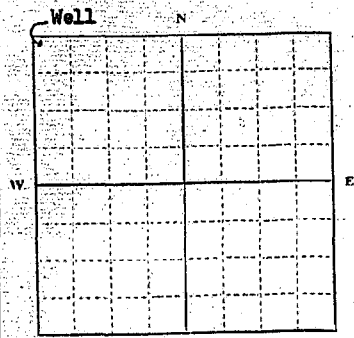

NW 1/4 Sec. 19 T1S R25E  
Indicate location of well and place of use, if possible. Each small square represents 10 acres.

Show exact depth of bottom.

Static Water Level for non-flowing Well 7' 4" feet.

Shut-in Pressure for Flowing Well Not applicable

Pumping Water Level 8' 6" feet at 22 1/2 gal. per minute.

Discharge in g.p.m. of flowing well Not applicable

How Tested Gas Pump Length of Test 20 Min.

Remarks: (Gravel packing, cementing, packers, type of shutoff, location of place of use of groundwater if not at well, and any other similar pertinent information, including number of acres irrigated, if used for irrigation)

Cementing (4" concrete slab around casing)

Driller's License Number

Clyde Sando  
Driller's Signature

This form to be prepared by driller, and three copies to be filed by the owner with the County Clerk and Recorder in the county in which the well is located.

Please answer all questions. If not applicable, so state, otherwise the form will be returned.

Original to the County Clerk and Recorder; duplicate to the State Engineer; Triplicate to the Montana Bureau of Mines and Geology and Quadruplicate for the Appropriator.



File No. \_\_\_\_\_ RECEIVED

T. 15 R. 25E  
County Yellowstone

DUPLICATE MAY 31 1972

MONTANA DEPARTMENT OF NATURAL RESOURCES AND CONSERVATION  
STATE OF MONTANA  
ADMINISTRATOR OF GROUNDWATER CODE  
OFFICE OF STATE ENGINEER

### Notice of Completion of Groundwater Appropriation by Means of Well

(Under Chapter 237, Montana Session Laws, 1961)

Owner Tracy L. Wilcox Address 2931 Lynn Ave. Billings, Mt. 59102  
Driller L.D. DRILLING Address 1035 W. WHEATLAND BLVD. BILLINGS, MONT.

Date of Notice of Appropriation of Groundwater \_\_\_\_\_  
Date well started 5/11/72 Date Completed 5/12/72  
Type of well DRILLED Equipment Used CABLE  
(dug, driven, bored or drilled) (Churn, drill, rotary or other)

Water Use: Domestic  Municipal  Other  Irrigation   
Industrial  Drainage  Stock

Indicate on the diagram the character and thickness of the different strata met with in drilling, such as soil, clay, shale, gravel, rock or sand, etc. Show depth at which water is encountered, thickness and character of water-bearing strata and height to which water rises in the well.



Size of Drilled Hole	Size and Weight of Casing	From (Feet)	To (Feet)	PERFORATIONS		
				Kind Size	From (Feet)	To (Feet)
7"	6 3/8" 17-87#	0	28	cut 1/4"	21	27

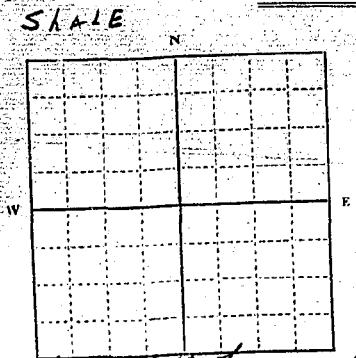

Static Water Level for non-flowing Well 18 feet  
Shut-in Pressure for Flowing Well \_\_\_\_\_  
Pumping Water Level 16 feet at 40 gal. per minute.  
Discharge in gal. per min. of flowing well \_\_\_\_\_  
How Tested BAILER PUMP Length of Test 4 HRS

Remarks: (Gravel packing, cementing, packers, type of shutoff, location of place of use of groundwater if not at well, and any other similar pertinent information, including number of acres irrigated, if used for irrigation) \_\_\_\_\_

Lot 4, Blk 10, Laramie Sub  
July, Sec 12, T. 15 R. 25E  
Indicate location of well and place of use, if possible. Each small square represents 10 acres.

PIPE 1" ABOVE GROUND

Show exact depth of bottom. Doc. No. 909336  
Filed for record this 30<sup>th</sup> day of May  
A. D. 19 72, at 3:03 o'clock P.M.

MON T 188  
Driller's License Number  
Roy R. Senger  
Driller's Signature

This form to be prepared by driller, and three copies to be filed by the owner with the County Clerk and Recorder in the county in which the well is located.

Please answer all questions. If not applicable, so state, otherwise the form will be returned.

Original to the County Clerk and Recorder; duplicate to the State Engineer; Triplicate to the Montana Bureau of Mines and Geology and Quadruplicate for the Appropriator.

50,486



59102  
12  
N.T.

2

on

ferent  
d, etc.  
water-

To:  
7

feet.

minute.

25

f, loca-  
nd any  
ber of

order

u of  
86

908336

STATE OF MONTANA  
County of Yellowstone  
This instrument was filed in my office  
this 30 day of MAY 1972  
at 3:03 o'clock P. M.  
MARCEL E. ELBERT  
County Clerk & Recorder  
By Jan Deputy

22

21113

11/2/72



File No.....

T. 18 R. 25C

ORIGINAL

County.....

STATE OF MONTANA  
ADMINISTRATOR OF GROUNDWATER CODE  
OFFICE OF STATE ENGINEER

RECEIVED  
JAN 2 1964

DECLARATION OF VESTED GROUNDWATER RIGHTS  
(Under Chapter 237, Montana Session Laws, 1961)

STATE ENGINEER

1. TRACY L. WILLETT of 3233 Country Club Circle, Billings  
(Name of Appropriator) (Address) (Town)

County of YELLOWSTONE State of MONTANA  
have appropriated groundwater according to the Montana laws in effect prior to  
January 1, 1962, as follows:

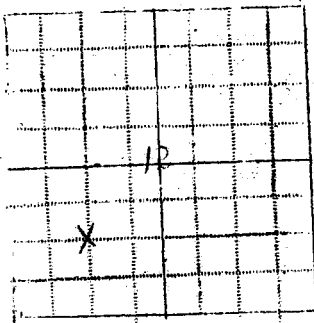

SW - Sec. 12, T. 18, R. 25C.  
Indicate point of appropriation  
and place of use, if possible.  
Each small square represents  
10 acres.

2. The beneficial use on which the claim is based  
MINIATURE GOLF COURSE & GOLF DRIVING RANGE

3. Date or approximate date of earliest beneficial  
use; and how continuous the use has been  
APRIL 1, 1961 - HAS BEEN USED FROM  
APRIL 1 - SEP 30 EACH SINCE

4. The amount of groundwater claimed (in miner's  
inches or gallons per minute)  
20 GALS PER MIN

5. If used for irrigation, give the acreage and  
description of the lands to which water has been  
applied, and name of the owner thereof  
1 1/2 ACRES - TRACY L. WILLETT, WIFE  
WILLETT, S. WIFE WILLETT, TRACY WIFE  
WILLETT, G. WIFE WILLETT

6. The means of withdrawing such water from the  
ground and the location of each well or other  
means of withdrawal - W. HOUST WALK PUMP

7. The date of commencement and completion of the construction of the well, wells,  
or other works for withdrawal of groundwater - APRIL 1, 1961

8. The depth of water table - 15 FT.

9. So far as it may be available, the type, size and depth of each well or the gen-  
eral specifications of any other works for the withdrawal of groundwater -  
2 1/2" WELL WITH 2" CASING

10. The estimated amount of groundwater withdrawn each year - 10000 GALS

11. The log of formations encountered in the drilling of each well if available  
NOT AVAILABLE

12. Such other information of a similar nature as may be useful in carrying out the  
policy of this act, including reference to book and page of any county record -

Signature of Owner - [Signature]  
Date - 3/1/63

Three copies to be filed by the owner with the County Clerk and Recorder of the  
county in which the well is located.  
Please answer all questions. If not applicable, so state, otherwise the form will  
be returned.  
Original to the County Clerk & Recorder; Duplicate to the State Engineer; Triplicate  
to the Montana Bureau of mines and Geology, and Quadruplicate for the appropriator

721462

STATE OF MONTANA,  
County of Yellowstone, ss.  
This instrument was filed in office  
on DEC 31 day of 1983  
at 9:22 o'clock A M.  
Lincoln S. Redding,  
County Clerk & Recorder  
*Paul* Deputy

File No. ....

15 25 13  
T. Billing, R. = 1. ....

ORIGINAT

County. Yellowstone

STATE OF MONTANA  
ADMINISTRATOR OF GROUNDWATER CODE  
OFFICE OF STATE ENGINEER

DECLARATION OF VESTED GROUNDWATER RIGHTS  
(Under Chapter 237, Montana Session Laws, 1961)

RECEIVED  
JAN 2 1964

1. <sup>Bearhollow</sup> George C. Bearhollow, of R-1 STATE ENGINEER  
(Name of Appropriator) (Address) (Town)

County of Yellowstone State of Montana  
have appropriated groundwater according to the Montana laws in effect prior to  
January 1, 1962, as follows:

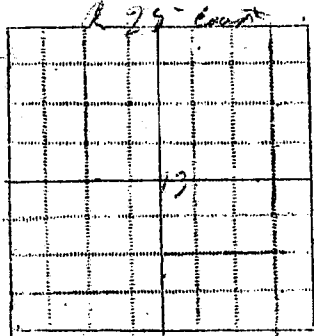

- 2. The beneficial use on which the claim is based  
crop water
- 3. Date or approximate date of earliest beneficial use; and how continuous the use has been  
30 years
- 4. The amount of groundwater claimed (in miner's inches or gallons per minute) 15  
gpm
- 5. If used for irrigation, give the acreage and description of the lands to which water has been applied and name of the owner thereof
- 6. The means of withdrawing such water from the ground and the location of each well or other means of withdrawal  
bank water

Indicate point of appropriation and place of use, if possible. Each small square represents 10 acres.

- 7. The date of commencement and completion of the construction of the well, wells, or other works for withdrawal of groundwater  
3-17-1977
- 8. The depth of water table 40 ft eight ft
- 9. So far as it may be available, the type, size and depth of each well or the general specifications of any other works for the withdrawal of groundwater  
dry as many 40 ft depth
- 10. The estimated amount of groundwater withdrawn each year 240,000
- 11. The log of formations encountered in the drilling of each well if available
- 12. Such other information of a similar nature as may be useful in carrying out the policy of this act, including reference to book and page of any county record

Signature of Owner George C. Bearhollow  
Date 4-27-1963

Three copies to be filed by the owner with the County Clerk and Recorder of the county in which the well is located.  
Please answer all questions. If not applicable, so state, otherwise the form will be returned.  
Original to the County Clerk & Recorder; Duplicate to the State Engineer; Triplicate to the Montana Bureau of Mines and Geology, and Quadruplicate for the appropriator

File No. ....

15 25 13  
T. Billings R. 1  
County Yellowstone

ORIGINAL

STATE OF MONTANA  
ADMINISTRATOR OF GROUNDWATER CODE  
OFFICE OF STATE ENGINEER

DECLARATION OF VESTED GROUNDWATER RIGHTS  
(Under Chapter 237, Montana Session Laws, 1963)

RECEIVED  
JAN 2 1964

1. <sup>Bernhard</sup> George Bernhard, of R-1, STATE ENGINEER  
(Name of Appropriator) (Address) (Town)

County of Yellowstone State of Mont.  
have appropriated groundwater according to the Montana laws in effect prior to  
January 1, 1962, as follows:

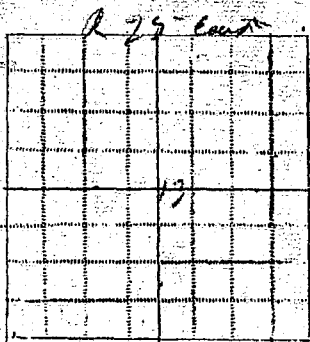

Indicate point of appropriation  
and place of use, if possible.  
Each small square represents  
10 acres.

2. The beneficial use on which the claim is based  
store water

3. Date or approximate date of earliest beneficial  
use; and how continuous the use has been  
30 years

4. The amount of groundwater claimed (in miner's  
inches or gallons per minute) 15 gpm

5. If used for irrigation, give the acreage and  
description of the lands to which water has been  
applied and name of the owner thereof none

6. The means of withdrawing such water from the  
ground and the location of each well or other  
means of withdrawal from bank water

7. The date of commencement and completion of the construction of the well, wells,  
or other works for withdrawal of groundwater  
3-11-1963

8. The depth of water table 40 ft depth

9. So far as it may be available, the type, size and depth of each well or the gen-  
eral specifications of any other works for the withdrawal of groundwater  
discovery 40 ft depth

10. The estimated amount of groundwater withdrawn each year 250-300

11. The log of formations encountered in the drilling of each well if available

12. Such other information of a similar nature as may be useful in carrying out the  
policy of this act, including reference to book and page of any county record

Signature of Owner George Bernhard  
Date 12-21-1963

Three copies to be filed by the owner with the County Clerk and Recorder of the  
county in which the well is located.  
Please answer all questions. If not applicable, so state, otherwise the form will  
be returned.

Original to the County Clerk & Recorder; Duplicate to the State Engineer; Triplicate  
to the Montana Bureau of Mines and Geology, and Quadruplicate for the appropriator

721556

STATE  
County of ... office  
This instrument was filed  
this \_\_\_\_\_ day of \_\_\_\_\_ 1963.  
at 10:56 o'clock AM  
in the presence of  
L. J. ...  
County Clerk & Recorder  
By J. Paul Deputy

File No.

T. 15 R. 25E

13

DUPLICATE

County Yellowstone

STATE OF MONTANA  
ADMINISTRATOR OF GROUNDWATER CODE  
OFFICE OF STATE ENGINEER

Notice of Completion of Groundwater  
Appropriation by Means of Well

(Under Chapter 237, Montana Session Laws, 1961)

Top of Ground

(Elev. above sea level.....)

first 1 ft top soil  
1-32 yellow clay  
32-41 gravel and sand

Owner Frank P. Papp Billings Address 24th St. West S. & P.P.R.

Driller A. D. Koenig Address Billings

Date of Notice of Appropriation of Groundwater Dec 15-66

Date well started Dec 29-66 Date Completed Jan 10-67

Type of well drilled Equipment Used cable tool  
(dug, driven, bored or drilled) (Churn, drill, rotary or other)

Water Use: Domestic  Municipal  Other  Irrigation   
Industrial  Drainage  Stock

Indicate on the diagram the character and thickness of the different strata met with in drilling, such as soil, clay, shale, gravel, rock or sand, etc. Show depth at which water is encountered, thickness and character of water-bearing strata and height to which water rises in the well.

Size of Drilled Hole	Size and Weight of Casing	From (Feet)	To (Feet)	PERFORATIONS		
				Kind Size	From (Feet)	To (Feet)
12 in	12 in 42 lb	Top	41	none	none	none
	10 5/8	16 in TOP (casing)	46 1/2	cws 2 1/2 x 1/4	33	43

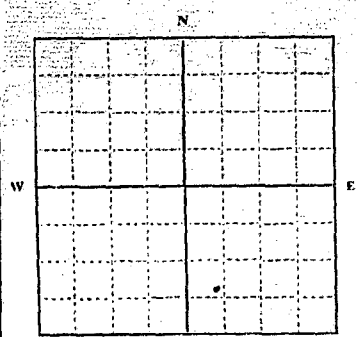

S.W. 1/4, SE 1/4 Sec. 13, T. 15 R. 25E  
Indicate location of well and place of use, if possible. Each small square represents 10 acres.

Show exact depth of bottom.  
1) Well was tested by Tad L. Haugon

Static Water Level for non-flowing Well 9 feet.

Shut-in Pressure for Flowing Well none

Pumping Water Level 31 feet at 300 gal. per minute.

Discharge in gal. per min. of flowing well none

How Tested back and forth Length of Test 2 1/2 hrs

Remarks: (Gravel packing, cementing, packers, type of shutoff, location of place of use of groundwater if not at well, and any other similar pertinent information, including number of acres irrigated, if used for irrigation) no well

was tested 7 hrs and wouldn't clear up 50  
put 10 inch down 3 1/2 ft. Tested 6 hrs  
and got clear water at 200 w.p.m. with a  
2. the fine sand

Driller's License Number 165

Driller's Signature Adolph Koenig  
245-3600

This form to be prepared by driller, and three copies to be filed by the owner with the County Clerk and Recorder in the county in which the well is located.

Please answer all questions. If not applicable, so state, otherwise the form will be returned.

Original to the County Clerk and Recorder; duplicate to the State Engineer; Triplicate to the Montana Bureau of Mines and Geology and Quadruplicate for the Appropriator.

45,170

839929

STATE OF MONTANA, } ss.  
 County of Yellowstone }  
 This instrument was filed in my office  
 this 22 day of APR 1969 19  
 at 2:30 o'clock P M  
 MICHAEL H. KLUNDT  
 County Clerk & Recorder  
 BY Jaw Deputy

Register	10
Index	10
Filed	10
Classified	10
Abstracted	10
Other	10

22







938373

STATE OF MONTANA, }  
County of Yellowstone, } ss.  
This instrument was filed in my office  
this JUN 29 day of 1973  
at 12:57 o'clock P. M.  
MEREDITH F. KLUNDT  
County Clerk & Recorder  
By [Signature] Deputy

[Signature]

STATE OF MONTANA  
ADMINISTRATOR OF GROUNDWATER CODE  
MONTANA WATER RESOURCES BOARD  
**NOTICE OF COMPLETION OF GROUNDWATER  
APPROPRIATION BY MEANS OF WELL**  
Developed after January 1, 1962

RECEIVED  
DEC 1 1972  
MONTANA DEPARTMENT OF NATURAL  
RESOURCES AND CONSERVATION

County Yellowstone

**DRILLER'S LOG**

Indicate the character, color, thickness of strata such as soil, clay, sand, gravel, shale, sandstone, etc. Show depth at which water is found and height to which water rises in well.

(Under Chapter 237 Montana Session Laws, 1961, as amended)

This form to be prepared by driller, and three copies to be filed by the owner with the County Clerk and Recorder in the county in which the well is located, last copy to be retained by driller. Please answer all questions. If not applicable, so state, otherwise the form may be returned.

Owner Harold & Gloria Zeiler  
Address 1412 East Lane  
Billings, Montana  
Date well started June 1968  
completed June 1968

For Administrator's Use  
File 921826  
Nov 30, 1972 9:26am  
GW 1

Type of well driven  
(Dug, driven, bored or drilled)

Equipment used driver  
(Churn drill, rotary or other)

Water Use: Domestic  Municipal  Stock  Irrigation   
Industrial  Drainage  Other \* Garden/Lawn

\*Describe  
USE: If used for irrigation, industrial, drainage or other. Explain, state number of acres and location or other data (i.e. Lot, Block and Addition).

ESTIMATED ANNUAL WITHDRAWAL 30,000 gallons

Size of Drilled Hole	Size and Weight of Casing	From (Feet)	To (Feet)	PERFORATIONS		
				Kind Size	From (Feet)	To (Feet)
6"	4"	0	35'	Slight	35'	27'

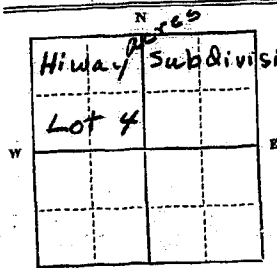

SE 1/4 1/4 Sec. 13  
T. 1 R. 25 E

Static water level 20 ft.\*  
Pumping water level 25 ft.\*  
at 30 gallons per minute,  
measured 10 minutes after pumping  
began.  
\*Measured from ground level.  
Well developed by pumping  
for 1.5 hours.  
Power Electric Pump 1 HP  
Remarks: (Gravel packing, cementing,  
packers, type of shutoff)

Top of Ground (Elev. above sea level)	
From (Feet)	To (Feet)
0	15
15	35
Sand & gravel	
Water found at 20 feet	

INDICATE LOCATION OF WELL AND PLACE OF USE, IF POSSIBLE. EACH SMALL SQUARE REPRESENTS 40 ACRES.

Driller's Signature Harold Zeiler  
Driller's Address 1412 East Lane  
Billings MT LICENSE NO. —

35' Show exact depth of bottom

51935

13

921826

STATE OF MONTANA, } ss.  
 County of Yellowstone, }  
 This instrument was filed in my office  
 this NOV 30 1972 day of Nov 1972  
 at 9:26 o'clock A M.  
 MERRILL H. KLUNDT  
 County Clerk & Recorder  
 By Carol B. [Signature] Deputy

bottom

1,935