

File No.

DUPLICATE

T. 34 R. 25 E

County Phillips

STATE OF MONTANA
ADMINISTRATOR OF GROUNDWATER CODE
OFFICE OF STATE ENGINEER

Top of Ground

(Elev. above sea level.....)

Notice of Completion of Groundwater
Appropriation by Means of Well

(Under Chapter 237, Montana Session Laws, 1961)

Owner Charles A. Hedgcock Address RT 1Driller Charles Hedgcock Address 1114 Highway 22Date of Notice of Appropriation of Groundwater 1-1-67Date well started 4-26-67 Date Completed 4-26-67Type of well Packer Equipment Used McPherson
(dag, driven, bored or (Churn, drill, rotary or
drilled) other)Water Use: Domestic ☒ Municipal ☐ Other ☐ Irrigation ☐
Industrial ☐ Drainage ☐ Stock ☐

Indicate on the diagram the character and thickness of the different strata met with in drilling, such as soil, clay, shale, gravel, rock or sand, etc. Show depth at which water is encountered, thickness and character of water-bearing strata and height to which water rises in the well.

Size of Drilled Hole	Size and Weight of Casing	From (Feet)	To (Feet)	PERFORATIONS		
				Kind Size	From (Feet)	To (Feet)
3"	2"	0.4	27	Slot	24	21

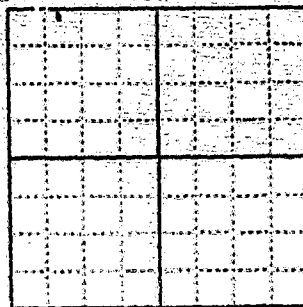
Static Water Level for non-flowing Well 14 feet.

Shut-in Pressure for Flowing Well.....

Pumping Water Level 11' feet at 2.5 gal. per minute.

Discharge in gal. per min. of flowing well.....

How Tested 2" Port Length of Test 1 hr

Remarks: (Gravel packing, cementing, packers, type of shutoff, location of place of use of groundwater if not at well, and any other similar pertinent information, including number of acres irrigated, if used for irrigation).....

Map No. Sec 34 T. 15 R. 25 E
Indicate location of well and place of use, if possible. Each small square represents 10 acres.

For 5, Diagrams
Show exact depth of bottom.

Doc. No. 297214

Filed for record

this 1 day of MarchA. D. 19 7 at 9:44o'clock 4 M.Driller's License Number 161

Charles Hedgcock
Driller's Signature

This form to be prepared by driller, and three copies to be filed by the owner with the County Clerk and Recorder in the county in which the well is located.

Please answer all questions. If not applicable, so state, otherwise the form will be returned.

Original to the County Clerk and Recorder; duplicate to the State Engineer; Triplicate to the Montana Bureau of Mines and Geology and Quadruplicate for the Appropriator.

48187

877314

MAR 1 1971
9:40
SARX

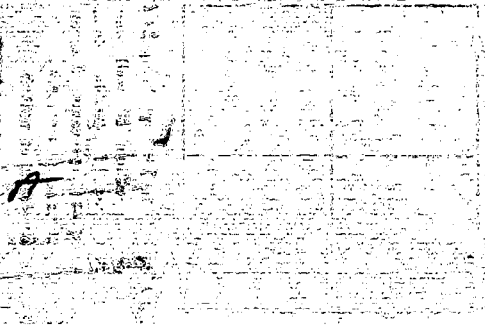

File No. DEC 14 1965

T 1 S? R 25E

County Yellowstone

DUPLICATE

Bille _____
Butzerin _____
Coyle _____
Darlington _____
Dickert _____

STATE OF MONTANA
ADMINISTRATOR OF GROUNDWATER CODE
OFFICE OF STATE ENGINEER

Declaration of Vested Groundwater Rights

(Under Chapter 21, Montana Session Laws, 1965)

1. Willard F. Story, of 1204 Parkhill Drive, Billings
(Name of Appropriator) (Address) (Town)
County of Yellowstone State of Montana
have appropriated groundwater according to the Montana laws in effect prior to January 1, 1962, as follows:

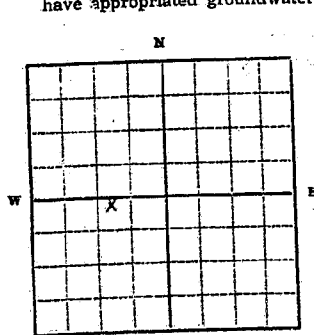

NE 1/4 of Sec 34 T 1 R 25E

Indicate point of appropriation and place of use, if possible. Each small four square represents 10 acres.

2. The beneficial use on which the claim is based domestic use
3. Date or approximate date of earliest beneficial use; and how continuous the use has been 1958 continuously
4. The amount of groundwater claimed (in miner's inches or gallons per minute) 10 gallons per minute
5. If used for irrigation, give the acreage and description of the lands to which water has been applied and name of the owner thereof
Not used for irrigation
6. The means of withdrawing such water from the ground and the location of each well or other means of withdrawal
Pump water
7. The date of commencement and completion of the construction of the well, wells, or other works for withdrawal of groundwater
year 1958
8. The depth of water table 10'
9. So far as it may be available, the type, size and depth of each well or the general specifications of any other works for the withdrawal of groundwater 12" casing and 18' deep
10. The estimated amount of groundwater withdrawn each year. 750,000 gallons
11. The log of formations encountered in the drilling of each well if available Not available
12. Such other information of a similar nature as may be useful in carrying out the policy of this act, including reference to book and page of any county record None available

Signature of Owner

Date

Three copies to be filed by the owner with the County Clerk and Recorder of the county in which the well is located. Please answer all questions. If not applicable, so state, otherwise the form will be returned. Original to the County Clerk and Recorder; duplicate to the State Engineer; Triplicate to the School of Mines and Quadruplicate for the Appropriator.

40003

767997

STATE OF NEW YORK
County of New York

This is to certify that the within and foregoing was filed in my office
this 13th day of Dec 1941 at 2:12 o'clock P. M.

By Jaw Deputy

Jaw

T 1 S² R 25E

County Yellowstone

DUPLICATE _____

 Butcher _____
 Coyle _____
 Darlington _____
 Dickert _____

McDermott _____
 Mulhally _____
 Norton _____
 Sullivan _____

STATE OF MONTANA
ADMINISTRATOR OF GROUNDWATER CODE
OFFICE OF STATE ENGINEER

Declaration of Vested Groundwater Rights (Under Chapter 21, Montana Session Laws, 1965)

1. Willard F. Story, of 1204 Parkhill Drive, Billings
(Name of Appropriator) (Address) (Town)
County of Yellowstone State of Montana
have appropriated groundwater according to the Montana laws in effect prior to January 1, 1962, as follows:

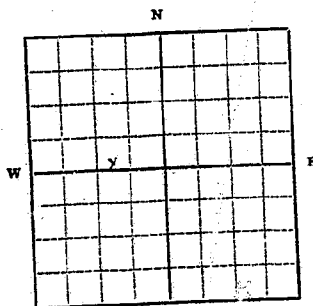

SE $\frac{1}{4}$ of NW ⁸ Sec. 34 T 1 R 25E

Indicate point of appropriation and place of use, if possible. Each small square represents 10 acres. four

- have appropriated groundwater according to the following:
- N
- E
- S
- SE $\frac{1}{4}$ of NW $\frac{1}{4}$ Sec. 34 T. 1 R. 25E
- Indicate point of appropriation and place of use, if possible. Each small square represents 10 acres.
- The beneficial use on which the claim is based. livestock water
 - Date or approximate date of earliest beneficial use; and how continuous the use has been. 1927 continuously
 - The amount of groundwater claimed (in miner's inches or gallons per minute) 30 gallons per minute
 - If used for irrigation, give the acreage and description of the lands to which water has been applied and name of the owner thereof
Not used for irrigation
 - The means of withdrawing such water from the ground and the location of each well or other means of withdrawal
Pump water
 - The date of commencement and completion of the construction of the well, wells, or other works for withdrawal of groundwater
Year 1927
 - The depth of water table
10'
 - So far as it may be available, the type, size and depth of each well or the general specifications of any other works for the withdrawal of groundwater
12" casing and 22' deep
 - The estimated amount of groundwater withdrawn each year
1,250,000
 - The log of formations encountered in the drilling of each well if available. Not available
 - Such other information of a similar nature as may be useful in carrying out the policy of this act, including reference to book and page of any county record
None available

Signature of Owner _____

Date _____

Three copies to be filed by the owner with the County Clerk and Recorder of the county in which the well is located. Please answer all questions. If not applicable, so state, otherwise the form will be returned.

Original to the County Clerk and Recorder; duplicate to the State Engineer; Triplicate to the School of Mines and Quadruplicate for the Appropriator.

40004

767996

CLASSIFIED BY 207

APPROVED FOR RELEASE
EXEMPTED FROM AUTOMATIC
DECLASSIFICATION

1950-1951
1952-1953
1954-1955
1956-1957
1958-1959
1960-1961
1962-1963
1964-1965
1966-1967
1968-1969
1970-1971
1972-1973
1974-1975
1976-1977
1978-1979
1980-1981
1982-1983
1984-1985
1986-1987
1988-1989
1990-1991
1992-1993
1994-1995
1996-1997
1998-1999
2000-2001
2002-2003
2004-2005
2006-2007
2008-2009
2010-2011
2012-2013
2014-2015
2016-2017
2018-2019
2020-2021
2022-2023
2024-2025

SECRET
CONTINUED

DATE 12/13/1965

21/10

21/10

21/10

21/10

21/10

21/10

21/10

21/10

21/10

21/10

21/10

21/10

21/10

21/10

21/10

21/10

21/10

21/10

21/10

21/10

21/10

T 15 R 252

County DECEIVED
 NANTANA
 GROUNDWATER CODE

STATE OF MONTANA
DIRECTOR OF GROUNDWATER CODE
OFFICE OF STATE ENGINEER

Notice of Completion of Groundwater Appropriation by Means of Well

(Under Chapter 237, Montana Session Laws, 1961)

Owner Alfred Weber Address 1044 1/2 St. 10
Driller Williams Home Address Route 1, Chicago, Ill.

Date of Notice of Appropriation of Groundwater

Date well started Sept. 2 Date Completed Sept. 3

Type of well driven Equipment Used free hand
(dug, driven, bored or
drilled) (Churn, drill, rotary or
other)

Water Use: Domestic ☒ Municipal ☐ Other ☐ Irrigation ☒
Industrial ☐ Drainage ☐ Stock ☐

Indicate on the diagram the character and thickness of the different strata met with in drilling, such as soil, clay, shale, gravel, rock or sand, etc. Show depth at which water is encountered, thickness and character of water-bearing strata and height to which water rises in the well.

Size of Drilled Hole	Size and Weight of Casing	From (Feet)	To (Feet)	PERFORATIONS		
				Kind Size	From (Feet)	To (Feet)
2"	3" extra heavy wall steel pipe	0	19	cutting casing back 1/2 mile	0	5 1/2

Static Water Level for non-flowing Well.....13.....feet

Shut-in Pressure for Flowing Well

Pumping Water Level 8 feet at 20 gal. per minut

Discharge in gal. per min. of flowing well.....

How Tested *per sec*.....Length of Test.....*10 minutes*.....

Remarks: (Gravel packing, cementing, packers, type of shutoff, location of place of use of groundwater if not at well, and any other similar pertinent information, including number of

acres irrigated, if used for irrigation) used for

house hold use and some
irrigation

Driller's License Number 88

William L. Love
Driller's Signature

This form to be prepared by driller, and three copies to be filed by the owner with the County Clerk and Recorder in the county in which the well is located.

Please answer all questions. If not applicable, so state, otherwise the form will be returned.

Original to the County Clerk and Recorder; duplicate to the State Engineer; Triplicate to the Montana Bureau of Mines and Geology and Quadruplicate for the Appropriator.

2081.

File No.

DUPLICATE

T. 13 R. 25 E
County Yellowstone

STATE OF MONTANA
ADMINISTRATOR OF GROUNDWATER
OFFICE OF STATE ENGINEER

RECEIVED
JUL 20 1965

Notice of Completion of Groundwater Appropriation by Means of Well

(Under Chapter 237, Montana Session Laws, 1961)

Top of Ground
(Elev. above sea level.....)
22 ft. bottom hole

Owner SETH A. WESTON Address 8624 SUSANNA AVE

Driller SAND DRILLING Address 1141 NILES AVE
BILLINGS

Date of Notice of Appropriation of Groundwater

Date well started May 25 1965 Date Completed May 27 1965

Type of well DRILLED Equipment Used CABLE
(dug, driven, bored or drilled) (Churn, drill, rotary or other)

Water Use: Domestic ☒ Municipal ☐ Other ☐ Irrigation ☐
Industrial ☐ Drainage ☐ Stock ☐

Indicate on the diagram the character and thickness of the different strata met with in drilling, such as soil, clay, shale, gravel, rock or sand, etc. Show depth at which water is encountered, thickness and character of water-bearing strata and height to which water rises in the well.

Size of Drilled Hole	Size and Weight of Casing	From (Feet)	To (Feet)	PERFORATIONS		
				Kind Size	From (Feet)	To (Feet)
6 inch	6"	0	22 1/2			

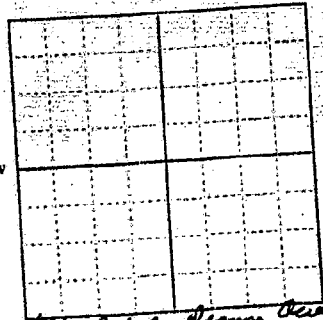

Indicate location of well and place of use if possible. Each small square represents 10 acres.

Show exact depth of bottom.

Static Water Level for non-flowing Well 12 1/2 feet.
Shut-in Pressure for Flowing Well does not apply
Pumping Water Level..... feet at 20 gal. per minute.
Discharge in gal. per min. of flowing well not apply
How Tested baker Length of Test 2 hrs.

Remarks: (Gravel packing, cementing, packers, type of shutoff, location of place of use of groundwater if not at well, and any other similar pertinent information, including number of acres irrigated, if used for irrigation).....

Driller's License Number 2

Driller's Signature [Signature]

This form to be prepared by driller, and three copies to be filed by the owner with the County Clerk and Recorder in the county in which the well is located.

Please answer all questions. If not applicable, so state, otherwise the form will be returned.

Original to the County Clerk and Recorder; duplicate to the State Engineer; Triplicate to the Montana Bureau of Mines and Geology and Quadruplicate for the Appropriator.

39308

758919

STATE OF MONTANA,
County of Yellowstone.
This instrument was filed in my office
this 19 day of July 1965
at 4:10 P. M.
Edmund S. Redding,
County Clerk & Recorder.
By [Signature] Deputy

543/2

938045

STATE OF MONTANA, } ss.
County of Yellowstone, }
This instrument was filed in my office
this 28 day of 19
at 46 o'clock P M.
MERRILL H. KLUNDT
County Clerk & Recorder
By CB Deputy
h200

54215

937624

STATE OF MONTANA,)
County of Yellowstone,) ss.
The instrument was filed in my office
on 11:44 1 16
at 11:44 1 16
by Paul Deputy
2nd

GV
dec
File No. 678557

DUPLICATE 2-20-62
@ 10:48 AM
Fee \$2.00

STATE OF MONTANA
ADMINISTRATOR OF GROUNDWATER CODE
OFFICE OF STATE ENGINEER

T 15 R 25
County Yellowstone
RECEIVED
FEB 21 1962

Declaration of Vested Groundwater Rights STATE ENGINEER
(Under Chapter 237, Montana Session Laws, 1961)

1. Edmund Ball of RT#1 Box 213 Billings
(Name of Appropriator) (Address) (Town)
County of Yellowstone State of Montana
have appropriated groundwater according to the Montana laws in effect prior to January 1, 1962, as follows:

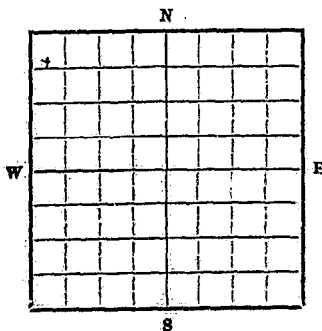

1/4 Sec. T. R.
Indicate point of appropriation
and place of use, if possible.
Each small square represents 10
acres.

2. The beneficial use on which the claim is based Household
and livestock
3. Date or approximate date of earliest beneficial use; and how continuous the use has been June 1947 1948
4. The amount of groundwater claimed (in miner's inches or gallons per minute) 60 gpm
5. If used for irrigation, give the acreage and description of the lands to which water has been applied and name of the owner thereof NO
6. The means of withdrawing such water from the ground and the location of each well or other means of withdrawal
Precise location
7. The date of commencement and completion of the construction of the well, wells, or other works for withdrawal of groundwater June 1947
8. The depth of water table 12 ft
9. So far as it may be available, the type, size and depth of each well or the general specifications of any other works for the withdrawal of groundwater 3.5 ft deep
10. The estimated amount of groundwater withdrawn each year 170,000 gallons
11. The log of formations encountered in the drilling of each well if available don't know
12. Such other information of a similar nature as may be useful in carrying out the policy of this act, including reference to book and page of any county record

Signature of Owner Edmund Ball
Date 2-7-1962

Three copies to be filed by the owner with the County Clerk and Recorder of the county in which the well is located.

Please answer all questions. If not applicable, so state, otherwise the form will be returned.

Original to the County Clerk and Recorder; duplicate to the State Engineer; Triplicate to the School of Mines and Quadruplicate for the Appropriator.

GW-

File No.

DUPLICATE

T

R

County

Yellowstone
RECEIVED
OCT 15 1963

STATE OF MONTANA
ADMINISTRATOR OF GROUNDWATER CODE
OFFICE OF STATE ENGINEER

STATE ENGINEER

Declaration of Vested Groundwater Rights

(Under Chapter 237, Montana Session Laws, 1961)

1. *Ralph F. & Lilith L. Fries* 2740 Hurwys Blvd. Billings
(Name of Appropriator) (Address) (Town)
County of *Yellowstone* State of *Mont*
have appropriated groundwater according to the Montana laws in effect prior to January 1, 1962, as follows:

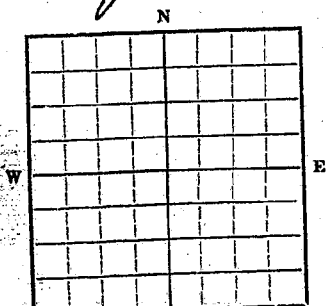

*Lots 6, 7 & 8
Sunrise Sub.*

Indicate point of appropriation and place of use, if possible. Each small square represents 10 acres.

2. The beneficial use on which the claim is based *Household Use*
3. Date or approximate date of earliest beneficial use; and how continuous the use has been *August 1958*
4. The amount of groundwater claimed (in miner's inches or gallons per minute) *Cont. Use 5 gallons per min*
5. If used for irrigation, give the acreage and description of the lands to which water has been applied and name of the owner thereof *Not used for irrigation*
6. The means of withdrawing such water from the ground and the location of each well or other means of withdrawal *Electric pump
Sunrise Sub. Lot 7*
7. The date of commencement and completion of the construction of the well, wells, or other works for withdrawal of groundwater *Aug. 1958*
8. The depth of water table *Not known*
9. So far as it may be available, the type, size and depth of each well or the general specifications of any other works for the withdrawal of groundwater *drilled - 60 feet deep*
10. The estimated amount of groundwater withdrawn each year *Approx. 110,000 gal*
11. The log of formations encountered in the drilling of each well if available *Not available*
12. Such other information of a similar nature as may be useful in carrying out the policy of this act, including reference to book and page of any county record

Signature of Owner

Date

Ralph F. Fries
Oct. 4 - 1963

Three copies to be filed by the owner with the County Clerk and Recorder of the county in which the well is located.

Please answer all questions. If not applicable, so state, otherwise the form will be returned.

Original to the County Clerk and Recorder; duplicate to the State Engineer; Triplicate to the School of Mines and Quadruplicate for the Appropriator.

6419

716253

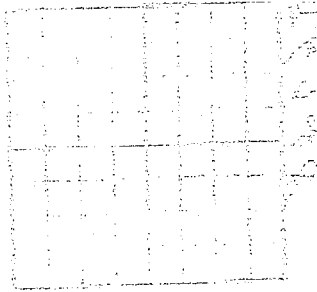

STATE OF MONTANA,
County of Yellowstone,

This instrument was filed in my office
this 14 day of Oct 1963
at 1:06 o'clock P M.

Edman S. Redding,
County Clerk & Recorder

By Teed Schaefer, Deputy

82.00

GW 2

MONTANA WATER RESOURCES BOARD

Approved Stock Form—State Publishing Co., Helena, Montana—46805

File No. _____

RECEIVED

T. 15 R. 25E

DUPLICATE

DEC 13 1968

County

Yellowstone

LOG

STATE OF MONTANA

ADMINISTRATOR OF GROUNDWATER CODE
STATE WATER CONSERVATION BOARDTop of Ground 0-2 Top Soil

(Elev. above sea level.....)

**Notice of Completion of Groundwater
Appropriation by Means of Well**

DEVELOPED AFTER JANUARY 1, 1962

(Under Chapter 237 Montana Session Laws, 1961, as amended)

Owner

Driller

Date of Notice of appropriation of groundwater.....

Date well started

Date completed

Type of well

(Dug, driven, bored or drilled)

Equipment used

(Crown drill, rotary or other)

Water use:

Domestic ☒Municipal ☐Stock ☐Irrigation ☐Industrial ☐Drainage ☐Other ☐

Indicate on the diagram the character and thickness of the different strata met with in drilling, such as soil, clay, shale, gravel, rock or sand, etc. Show depth at which water is encountered, thickness and character of water-bearing strata and height to which the water rises in the well.

Size of Drilled Hole	Size and Weight of Casing	From (Feet)	To (Feet)	PERFORATIONS		
				Kind Size	From (Feet)	To (Feet)
6 inch	6 5/8 280	1+	28	6 inch 6 5/8	25	27

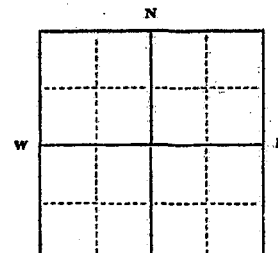

28 1/4
Blk. 1st

1/4 Sec. T. R.
Indicate location of well and place of use, if possible. Each small square represents 40 acres.

Static Water Level for non-flowing well
442 feet.

Shut-in Pressure for Flowing Well.....

Pumping Water Level 15 feet

at 30 gal. per minute.

Discharge in gal. per min. of flowing well.....

How Tested.....

Length of Test.....

Remarks: (Gravel packing, cementing, packers, type of shutoff).....

(Continue on reverse side)

USE—If used for irrigation, industrial, drainage or other. Explain, state number of acres and location or other data (i.e.: Lot, Block and Addition).

Show exact depth of bottom.

28 ft.

This form to be prepared by driller, and three copies to be filed by the owner with the County Clerk and Recorder in the county in which the well is located, tissue copy to be retained by driller.

Please answer all questions. If not applicable, so state, otherwise the form will be returned.

No 27
Driller's License Number

Red L. Hagan
Driller's Signature.

44,850

STATE OF MONTANA
County of Yellowstone,
This instrument was filed in my office
DEC 12 1968
at _____
on 11-4-68. P. N. M.
JESNDT
County Clerk & Recorder
By Jaw Deputy

File No.

T 15 R 25

DUPLICATE

County Yellowstone

STATE OF MONTANA
ADMINISTRATOR OF GROUNDWATER CODE
OFFICE OF STATE ENGINEER

RECEIVED
DEC 30 1963

Declaration of Vested Groundwater Rights

(Under Chapter 237, Montana Session Laws, 1961)

STATE ENGINEER

1. Adolph Senhardt, of 2134 North Place, Billings
(Name of Appropriator) (Address) (Town)
County of Yellowstone State of Montana
have appropriated groundwater according to the Montana laws in effect prior to January 1, 1962, as follows:

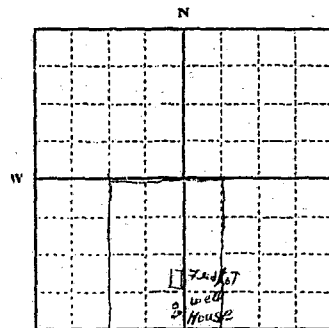

$\frac{1}{4}$ Sec. T. R.
Indicate point of appropriation
and place of use, if possible. Each
small square represents 10 acres.

2. The beneficial use on which the claim is based Feed lot, household, & lawn & garden
3. Date or approximate date of earliest beneficial use; and how continuous the use has been 1940 - continuous since
4. The amount of groundwater claimed (in miner's inches or gallons per minute) 20 gallons per minute
5. If used for irrigation, give the acreage and description of the lands to which water has been applied and name of the owner thereof Lawn & garden
6. The means of withdrawing such water from the ground and the location of each well or other means of withdrawal shallow well pressure system
7. The date of commencement and completion of the construction of the well, wells, or other works for withdrawal of groundwater This well was completed in the late winter or early spring of the year 1960
8. The depth of water table 12 feet from surface
9. So far as it may be available, the type, size and depth of each well or the general specifications of any other works for the withdrawal of groundwater Set such casing well approx. 50 ft deep
10. The estimated amount of groundwater withdrawn each year 3,000,000 gallons
11. The log of formations encountered in the drilling of each well if available non available
12. Such other information of a similar nature as may be useful in carrying out the policy of this act, including reference to book and page of any county record This well has sufficient capacity with a strata of gravel of considerable depth extending downward from within 12 feet of surface

Signature of Owner Adolph SenhardtDate Dec. 30, 1963

Three copies to be filed by the owner with the County Clerk and Recorder of the county in which the well is located.

Please answer all questions. If not applicable, so state, otherwise the form will be returned.

Original to the County Clerk and Recorder; Duplicate to the State Engineer; Triplicate to the Montana Bureau of Mines and Geology, and Quadruplicate for the Appropriator.

16232

721243

STATE OF MONTANA, }
County of Yellowstone, }

This instrument was filed in my office
this DEC 30 1968 day of 19

at 1:12 o'clock P M.

Edmon S. Hedding,
County Clerk & Recorder

By [Signature] Deputy

2.00

STATE OF MONTANA
ADMINISTRATOR OF GROUNDWATER CODE
MONTANA WATER RESOURCES BOARD
**NOTICE OF COMPLETION OF GROUNDWATER
APPROPRIATION BY MEANS OF WELL**
Developed after January 1, 1962

(Under Chapter 237 Montana Session Laws, 1961, as amended)

This form to be prepared by driller, and three copies to be filed by the owner with the County Clerk and Recorder in the county in which the well is located, last copy to be retained by driller. Please answer all questions. If not applicable, so state, otherwise the form may be returned.

Owner Martine J. Orban For Administrator's Use
Address 6640 Neilson Rd File 938102
Billings, Mont. 59102 Date 28, 1973
Date well started 1969 GW 1 2:43 p.m.
completed 1969

Type of well drilled
(Dug, driven, bored or drilled)

Equipment used Churn drill
(Churn drill, rotary or other)

Water Use: Domestic ☒ Municipal ☐ Stock ☒ Irrigation ☐

Industrial ☐ Drainage ☐ Other ☐ Garden/Lawn ☒

*Describe

USE: If used for irrigation, industrial, drainage or other. Explain, state number of acres and location or other data (i.e. Lot, Block and Addition).

ESTIMATED ANNUAL WITHDRAWAL 500,000 gal.

Size of Drilled Hole	Size and Weight of Casing	From (Feet)	To (Feet)	PERFORATIONS		
				Kind Size	From (Feet)	To (Feet)
6"	6"	0	30			

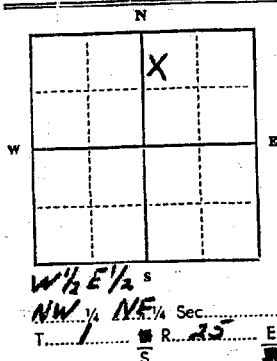

Static water level 10 ft.*
Pumping water level 3 ft.*
at 30 gallons per minute,
measured 8 minutes after pumping
began.

*Measured from ground level.
Well developed by drilling
for 8 hours.

Power 1 HP
Remarks: (Gravel packing, cementing,
packers, type of shutoff)

INDICATE LOCATION OF WELL AND PLACE OF USE, IF POSSIBLE.
EACH SMALL SQUARE REPRESENTS 40 ACRES.

Driller's Signature driller unknown

Driller's Address

LICENSE NO.

County Yellowstone
DRILLER'S LOG

Indicate the character, color, thickness of strata such as soil, clay, sand, gravel, shale, sandstone, etc. Show depth at which water is found and height to which water rises in well.

Top of Ground (Elev. above sea level)	
From (Feet)	To (Feet)
1'	30' clay, sand & gravel

30' Show exact depth of bottom

54347

938102

STATE OF MONTANA, }
County of Yellowstone, } ss.
This instrument was filed in my office
this JAN 28 1973 day of JAN
at 2:43 o'clock P M.
MERRILL H. KLUNDT
County Clerk & Recorder
By [Signature] Deputy
20

GROUNDWATER INDEX

Page 1 of 3County Yellowstone Twp. 15 Rge. 26EFolder #1
Sections 1 thru 5

Sec.	Name of Appropriator	Type of Form	County File No.	Remarks
1	Herman, E. H.	GW 2	938000	
1	Rudolf, Erving	GW 2	938223	
1	Weidler, Gordon W.	GW 4	769133	
2	Gambles Skagmo Marchess	GW 2	691711	
2	Montana Power Co.	1957 Well Log		
2	Montana Power Co.	GW 4	682311	
2	Van Moten, Emil	GW 2	930952	
3	Albert, Gary or Betty	GW 2	938559	
3	Artificial Ice & Cold Storage	GW 4	720449	
3	Bacon, Al	GW 2	910081	
3	Barnes, J. Collins	GW 2	910443	
3	Bender, Duane R.	GW 2	937715	
3	Beringer, Paul	GW 2	911194	
3	Brewster, Gerald W.	GW 2	938204	
3	Deines, Henry	GW 4	721591	
3	Goodman, Earl Jr.	GW 2	938143	
3	Hefenieder, George	GW 2	827512	
3	Kantz, Henry Jr.	GW 2	827349	
3	Knaub, Alex	GW 2	937922	
3	Macrum, S.	GW 2	911188	
3	Ostermiller, H. A.	GW 2	937737	
3	Padilla, Antonio	GW 2	910112	
3	Stephens, Morton H.	GW 4	677391	
4	Biglen, Ronald D.	GW 2	938244	
4	Binkerd, James B.	GW 2	890464	
4	Borchardt, A. H.	GW 2	938151	
4	Bracker, Fred	GW 2	938045	
4	Collins, William T.	GW 2	937567	
4	Dornbach, Joe A.	GW 2	912827	
4	Dorf, Paul M.	GW 2	937245	
4	Disher, Gerald E.	GW 4	678843	
4	Dickert, Mrs. Rossie	GW 2	845029	
4	Elmore, Herman	GW 2	914074	
4	Farnell, Joseph E & Clara	1957 Well Log		
4	Focht, Anton & Marie	GW 2	937710	
4	Head, Violet M.	GW 2	937748	
4	Holden, Edward J.	GW 2	938272	
4	Holden, Edward & Mary	GW 2	938415	
4	Holt, Robert T.	GW 2	914750	
4	Horst, Erwin	GW 4	719152	
4	Jahoff, Arvin	GW 2	890098	
4	Kaser, Fred & Henrietta	GW 2	937231	
4	Keiffer, Bill M.	GW 2	938253	
4	Lemay, Janice Ann	GW 4	721664	
4	Madison, Harv	GW 2	938286	

Sec #
on
pg.
2

County Yellowstone Twp. 15 Rge. 26E

Sec.	Name of Appropriator	Type of Form	County File No.	Remarks
4	Morris, H. Mitchell & Helen	GW2	937241	
4	Papky, L. A.	GW2	889455	
4	Rekdal, John	GW2	938322	
4	Pirtz, Frank	GW2	907359	
4	Samek, Peter P.	GW2	938486	
4	Schuler, Rudolph & Martha	GW2	938342	
4	Sellick, John	GW2	888960	
4	Serich, R. J.	GW2	901805	
4	Shaw, Cliff	GW2	938270	
4	Thaden, Wayne M.	GW2	908238	
4	Topel, Clifford E.	GW2	938202	
4	Wallace, Walter & Helen	GW2	909298	
4	Vashler, John	GW2	937905	
4	Zeilker, Willis	GW2	901850	
* 4	Artificial Ice & Cold Storage	GW4	720449	See Sec. 3 above
5	Andrews, Clayton	GW2	910027	
5	Back, Peter G.	1957 Well Log		
5	Bakke, Nolan	GW2	911847	
5	Bever, Thomas D.	GW2	910883	
5	Buttreys	1957 Well Log		
5	Buttreys	1957 Well Log		
5	Codley, J. C.	GW4	7109175	
5	Dunssaert, E. L.	GW2	801859	
5	Dolore, C. C.	GW2	938416	
5	Duschnar, Joe.	GW2	936337	
5	Erickson, James E.	GW2	938542	
5	Farnes, Gertrude G.	GW4	721640	
5	Fields, Sylvia	GW2	913842	
5	First Covenant Church	GW2	938367	
5	Fitzpatrick, John	GW2	938346	
5	Frankovic, F. S.	GW2	911083	
5	Geck, Clem	GW2	938369	
5	Green, Robert & Beulah	GW4	711836	
5	Heath, Charles & Mildred	1957 Well Log		
5	Jensen, P. M.	GW2	937504	
5	Johnson, Ben M.	GW2	923735	
5	Kilwein, Donald	GW2	938371	
5	Kilwein, Kathryn	GW2	938200	
5	Larson, Carl J.	GW2	938349	
5	McCann, Dorothy G.	GW2	937323	
5	McGiboney, Kenneth & Leona E.	1957 Well Log		
5	Musgrave, Leo O.	GW2	938252	
5	Nelson, Walter H. & Marie	GW2	937926	
5	Norine, Louis	GW2	701443	

County Yellowstone Twp. 15 Rge. 26E

[illegible]

54288

5-4288

938000

三子

STATE OF MONTANA, }
County of Yellowstone, } ss.
This is to certify

This instrument was filed in m
this JUN 28 1973

this JUN 28 1973
 at 11:50 o'clock

11-1-37 8 o'clock
MERRILL M. ELUND
County Clerk & Recorder

County Clerk & Recorder
By Jew

24

[illegible]

55174

938223

STATE OF MONTANA, } ss.
County of Yellowstone, }
his instrument was filed in my office
this JUN 29 day of 1973
9:04 o'clock A. M.
MERRILL M. KLUNDT
County Clerk & Recorder
[Signature] Deputy

File No. _____ STATE WATER CONSERVATION BOARD

T. 1S R. 25E

QUADRUPPLICATE

DEC 31 1965

County Yellowstone

Billie _____ McDermott _____
Butlerin _____ McNulty _____
Coyte _____
Daylinton _____ Sullivan _____
Dickert _____
STATE OF MONTANA
ADMINISTRATOR OF GROUNDWATER CODE
OFFICE OF STATE ENGINEER

Declaration of Vested Groundwater Rights
(Under Chapter 21, Montana Session Laws, 1965)

1. Gordon W. Weidner, of 1643 Yellowstone Ave. Billings, Montana
(Name of Appropriator) (Address) (Town)
County of Yellowstone State of Montana
have appropriated groundwater according to the Montana laws in effect prior to January 1, 1962, as follows:

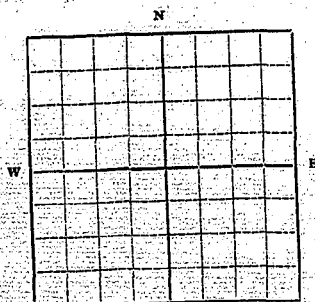

Tract # 9 of Horseshoe Acreage Tracts
1/4 Sec. 1 T5 R25E.

Indicate point of appropriation and place of use, if possible. Each small square represents 10 acres.

2. The beneficial use on which the claim is based
Livestock and Domestic use.
3. Date or approximate date of earliest beneficial use; and how continuous the use has been
August 1961
4. The amount of groundwater claimed (in miner's inches or gallons per minute)
3 Gal per minute
5. If used for irrigation, give the acreage and description of the lands to which water has been applied and name of the owner thereof
NA
6. The means of withdrawing such water from the ground and the location of each well or other means of withdrawal
Electric Pump
7. The date of commencement and completion of the construction of the well, wells, or other works for withdrawal of groundwater
August 1961
8. The depth of water table
50 ft.
9. So far as it may be available, the type, size and depth of each well or the general specifications of any other works for the withdrawal of groundwater
66 ft deep, 12 inch casing
10. The estimated amount of groundwater withdrawn each year
250,000 gal
11. The log of formations encountered in the drilling of each well if available
Unavailable
12. Such other information of a similar nature as may be useful in carrying out the policy of this act, including reference to book and page of any county record
None

Signature of Owner _____

Date December 31, 1965

Three copies to be filed by the owner with the County Clerk and Recorder of the county in which the well is located.

Please answer all questions. If not applicable, so state, otherwise the form will be returned.

Original to the County Clerk and Recorder; duplicate to the State Engineer; Triplicate to the School of Mines and Quadruplicate for the Appropriator.

40263

769133

OFFICE OF THE CLERK
COUNTY OF YELLOWSTONE
MONTANA

RECEIVED
DEC 30 1965

STATE OF MONTANA
County of Yellowstone

This instrument was filed in my office
the DEC 30 1965

10:00
F. S. Redding,
County Clerk & Recorder

[Signature]
212

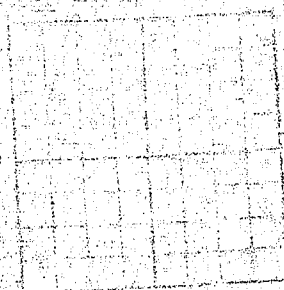

RECEIVED
DEC 30 1965

GW 2

STATE OF MONTANA } ss.
County of Yellowstone }

This instrument was filed in my office

Approved Stock Form—State Publishing Co., Helena, Montana—38496

File No. 691.711this 20 day of Sept 1962
at 2:34 o'clock P M.

T 1 S R 26 E

County Yellowstone

DUPLICATE

CHRIS RUBICH, County Recorder

By

Deputy

STATE OF MONTANA

ADMINISTRATOR OF GROUNDWATER CODE

OFFICE OF STATE ENGINEER

Top of Ground

(Elev. above sea level 3119)Notice of Completion of Groundwater
Appropriation by Means of Well

(Under Chapter 237, Montana Session Laws, 1961)

Owner

Address 2135 Bellings Ave.

Lot 2, Blk 2,

Billings Industrial Park Sub. 1st Filing

Driller

Address 1401 Bellings Ave.

Date of Notice of Appropriation of Groundwater

Date well started

Date Completed July 2, 1962

Type of well

(dug, driven, bored or drilled)

Equipment Used pipe driver
(Churn, drill, rotary or other)Water Use: Domestic ☐
Industrial ☐Municipal ☐
Drainage ☐Other ☐
Stock ☐Irrigation ☒

Indicate on the diagram the character and thickness of the different strata met with in drilling, such as soil, clay, shale, gravel, rock or sand, etc. Show depth at which water is encountered, thickness and character of water-bearing strata and height to which water rises in the well.

Size of Drilled Hole	Size and Weight of Casing	From (Feet)	To (Feet)	PERFORATIONS		
				Kind Size	From (Feet)	To (Feet)
<u>2" inch</u>	<u>2" steel pipe</u>	<u>0</u>	<u>20</u>	<u>slotted 2" long 4" wide</u>	<u>0</u>	<u>6</u>

Static Water Level for non-flowing Well 13' feet.

Shut-in Pressure for Flowing Well

Pumping Water Level 10 feet at 20 gal. per minute.

Discharge in gal. per min. of flowing well

How Tested pump Length of Test 10 minutes

Remarks: (Gravel packing, cementing, packers, type of shutoff, location of place of use of groundwater if not at well, and any other similar pertinent information, including number of

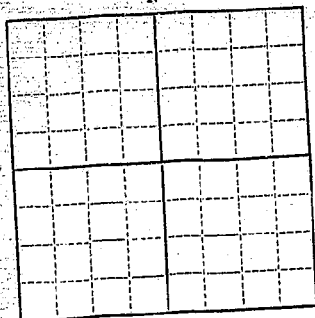
acres irrigated, if used for irrigation) wateringlarge lawn

1/4 Sec. 2 T. 1 S R. 26 E.

Indicate location of well and place of use, if possible. Each small square represents 10 acres.

Show exact depth of bottom.

Driller's License Number 98Driller's Signature William L. Love

This form to be prepared by driller, and three copies to be filed by the owner with the County Clerk and Recorder in the county in which the well is located.

Please answer all questions. If not applicable, so state, otherwise the form will be returned.

Original to the County Clerk and Recorder; duplicate to the State Engineer; Triplicate to the Montana Bureau of Mines and Geology and Quadruplicate for the Appropriator.

2136

RECEIVED

JAN 7 1959

STATE ENGINEER

MONTANA BUREAU OF MINES AND GEOLOGY
Butte, Montana

T. 15 R. 26E

County YELLOWSTONE

WATER WELL LOG

Owner MONTANA POWER CO Address BILLINGS, MONT
 Driller BAND H DRILLING Address FIGHTAIL, MONT
 Date Started 12/14/58 Date Completed 12/17/58
 Location: Sec. 2 T. 15 R. 26E Lot 5

Type of well DRILLED Equipment used CHURN DRILL
 (Dug, driven, bored, or drilled) (Churn drill, rotary, other)

Water use: Domestic ☐ Municipal ☐ Stock ☐ Irrigation ☐

Industrial ☒ Drainage ☐ Other: _____

Casing: 0 ft. to 20'2" ft. Type BLACK IRON Size 12"

Casing: _____ ft. to _____ ft. Type _____ Size _____

Casing: _____ ft. to _____ ft. Type _____ Size _____

Perforated or Screened: Ft. 9 to ft. 20'2" Ft. _____ to ft. _____

Type of screen or perforations _____

Static Water level, for non-flowing well: 10'6" feet.

Shut-in pressure, for flowing well: _____ lb./sq. in. on: _____ (date)

Pumping water level 4'6" feet at 110 gal. per min.

How tested: PUMP

Length of test _____

Remarks: (Gravel packing, cementing, packers, type of shut-off, depth of shut-off)

(over)

der

u of

2136

[illegible][illegible]

File No. 682311

DUPLICATE filed 4-12-62
8:35 AM

T. 18 R. 26E

County Yellowstone

STATE OF MONTANA

ADMINISTRATOR OF GROUNDWATER CODE

OFFICE OF STATE ENGINEER

Declaration of Vested Groundwater Rights

(Under Chapter 237, Montana Session Laws, 1961)

RECEIVED
APR 13 1962

STATE ENGINEER

1. The Montana Power Company of 40 East Broadway Butte
(Name of Appropriator) (Address) (Town)
County of Yellowstone State of Montana
have appropriated groundwater according to the Montana laws in effect prior to January 1, 1962, as follows:

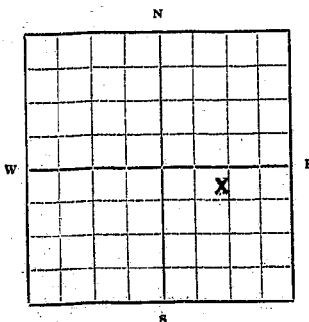

Lot 5-

SE 1/4 Sec. 2 T. 18 R. 26E

Indicate point of appropriation and place of use, if possible. Each small square represents 10 acres.

2. The beneficial use on which the claim is based Industrial

3. Date or approximate date of earliest beneficial use; and how continuous the use has been
Dec. 16, 1958 - continuous

4. The amount of groundwater claimed (in miner's inches or gallons per minute) 70 gallons per minute - 24 hours per day

5. If used for irrigation, give the acreage and description of the lands to which water has been applied and name of the owner thereof

6. The means of withdrawing such water from the ground and the location of each well or other means of withdrawal
Water withdrawn by well - electric pump

7. The date of commencement and completion of the construction of the well, wells, or other works for withdrawal of groundwater
Commencement of well - Dec. 11, 1958
Completion of well - Dec. 16, 1958

8. The depth of water table 4 feet

9. So far as it may be available, the type, size and depth of each well or the general specifications of any other works for the withdrawal of groundwater
12 inch open well casing

10. The estimated amount of groundwater withdrawn each year 18,300,000 gallons per year

11. The log of formations encountered in the drilling of each well if available

12. Such other information of a similar nature as may be useful in carrying out the policy of this act, including reference to book and page of any county record
Using impeller type pump driven by 15 H.P. 440 volt electric motor

(CORPORATE SEAL)

ATTEST:

Its Secretary

THE MONTANA POWER COMPANY

Signature of Owner. By [Signature]

Vice President

Date February 1, 1962

Three copies to be filed by the owner with the County Clerk and Recorder of the county in which the well is located.

Please answer all questions. If not applicable, so state, otherwise the form will be returned.

Original to the County Clerk and Recorder; duplicate to the State Engineer; Triplicate to the Montana Bureau of Mines and Geology and Quadruplicate for the Appropriator.

RECEIVED

County Yellowstone
DRILLER'S LOG

STATE OF MONTANA
ADMINISTRATOR OF GROUNDWATER CODE
MONTANA WATER RESOURCES BOARD

APR 1973

NOTICE OF COMPLETION OF GROUNDWATER
APPROPRIATION BY MEANS OF WELL

Developed after January 1, 1962

(Under Chapter 237 Montana Session Laws, 1961, as amended)

This form to be prepared by driller, and three copies to be filed by the owner with the County Clerk and Recorder in the county in which the well is located, last copy to be retained by driller. Please answer all questions. If not applicable, so state, otherwise the form may be returned.

Owner Emil Van Notten

Address 4331 Murphy Ave

Billings, Montana

Date well started 3-12-73

completed 3-15-73

Type of well drilled

Equipment used Cable Tool

Water Use: Domestic ☒ Municipal ☐ Stock ☐ Irrigation ☐

Industrial ☐ Drainage ☐ Other ☐ Garden/Lawn ☐

*Describe

USE: If used for irrigation, industrial, drainage or other. Explain, state number of acres and location or other data (i.e. Lot, Block and Addition).

ESTIMATED ANNUAL WITHDRAWAL 1000 gal/day

Size of Drilled Hole	Size and Weight of Casing	From (Feet)	To (Feet)	PERFORATIONS	
				Kind Size	From (Feet) To (Feet)
<u>8 3/4"</u>	<u>6 plastic</u>	<u>0</u>	<u>107 9/16</u>	<u>drilled</u>	<u>80' 106'</u>

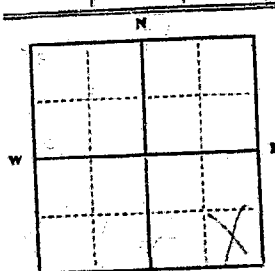

S.E. 1/4 Sec. 2
T. 1 N. R. 26 E.

INDICATE LOCATION OF WELL AND PLACE OF USE, IF POSSIBLE. EACH SMALL SQUARE REPRESENTS 40 ACRES.

Driller's Signature [Signature]
Driller's Address 14223 Rocking Rd
Pls, Montana
License No. 878

Indicate the character, color, thickness of strata such as soil, clay, sand, gravel, shale, sandstone, etc. Show depth at which water is found and height to which water rises in well.

Top of Ground (Elev. above sea level)	
From (Feet)	To (Feet)
<u>0</u>	<u>2'</u> Top Soil
<u>2</u>	<u>12'</u> Clay
<u>12</u>	<u>20'</u> Brown Sandstone
<u>20</u>	<u>40'</u> Light Blue Sand
<u>40</u>	<u>60'</u> Light Grey Sandstone with layer of clay
<u>60</u>	<u>107'</u>
Water at <u>92'</u>	
Static Water Level <u>56'</u>	

Static water level 56 ft.*
Pumping water level 104 ft.*
at 5 gallons per minute,
measured 5 minutes after pumping began.
*Measured from ground level.
Well developed by 25 ft.
for 7 hours.
Power 7 Pump 1 HP
Remarks: (Gravel packing, cementing, packers, type of shutoff)
Gravel packing
Electric shutoff
Casing 1 1/2" O.D.
9" O.D.

107'
107' Show exact depth of bottom

53814

1
Cyl 1101
4-11-61
3-12-13
3-12-13

1000

RECEIVED

County Yellowstone

STATE OF MONTANA
ADMINISTRATOR OF GROUNDWATER CODE
MONTANA WATER RESOURCES BOARD

JUL 3 1973

NOTICE OF COMPLETION OF GROUNDWATER TREATMENT OF NATURAL
APPROPRIATION BY MEANS OF WELL AND CONSERVATION

Developed after January 1, 1962

(Under Chapter 237 Montana Session Laws, 1961, as amended)

This form to be prepared by driller, and three copies to be filed by the owner with the County Clerk and Recorder, in the county in which the well is located, last copy to be retained by driller.

Please answer all questions. If not applicable, so state, otherwise the form may be returned.

Owner GARY or BETTY ALBERT For Adm

Address 3212 - 6th Ave. S. File 938559

Date well started April 1979 GW 1

completed

Type of well driven

(Dug, driven, bored or drilled)

Equipment used Hydraulic Power
(Churn drill, rotary or other)

(Churn drill, rotary or other)

Water Use: Domestic ☐ Municipal ☐ Stock ☐ Irrigation ☐

Industrial ☐ Drainage ☐ Other ☐* Garden/Lawn ☒

★ Describe

USE: If used for irrigation, industrial, drainage or other. Explain, state number of acres and location or other data (i.e. Lot, Block and Addition). B. Flange at 10 ft. Dec. 211

ESTIMATED ANNUAL WITHDRAWAL

Size of Drilled Hole	Size and Weight of Casing	From (Feet)	To (Feet)	PERFORATIONS		
				Kind Size	From (Feet)	To (Feet)
	2 3/4	0	17			

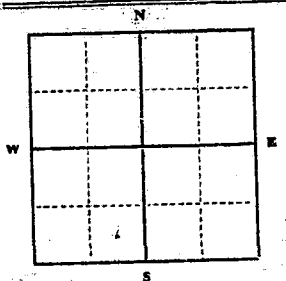

$\frac{F}{T}$ $\frac{1}{4}$ $\frac{1}{4}$ Sec. $\frac{1}{4}$
 $\frac{N}{S}$ $\frac{R}{E}$ $\frac{W}{W}$

INDICATE LOCATION OF WELL AND PLACE OF USE, IF POSSIBLE.
EACH SMALL SQUARE REPRESENTS 40 ACRES.

Driller's Signature Charles Rye

Driller's Address 2441 1st St

LICENSE NO.

DRILLER'S LOG

Indicate the character, color, thickness of strata such as soil, clay, sand, gravel, shale, sandstone, etc. Show depth at which water is found and height to which water rises in well.

Top of Ground (Elev. above sea level)

[illegible]

Static water level 10 ft.
Pumping water level 17 ft.
at 27 gallons per minute,
measured 32 minutes after pumping
began.

*Measured from ground level.

Well developed by
for hours.

Power 10 Pump 7 HP
Remarks: (Gravel packing, cementing,
packers, type of shutoff)

19. Show exact depth of bottom

55/20

STATE OF MONTANA
ADMINISTRATOR OF GROUNDWATER CODE
MONTANA WATER RESOURCES BOARD
NOTICE OF COMPLETION OF GROUNDWATER
APPROPRIATION BY MEANS OF WELL
Developed after January 1, 1962

RECEIVED
JUL 3 1973

County Yellowstone

DRILLER'S LOG

Indicate the character, color, thickness of strata such as soil, clay, sand, gravel, shale, sandstone, etc. Show depth at which water is found and height to which water rises in well.

(Under Chapter 237 Montana Session Laws, 1961, as amended)

This form to be prepared by driller, and three copies to be filed by the owner with the County Clerk and Recorder in the county in which the well is located, last copy to be retained by driller.

Please answer all questions. If not applicable, so state, otherwise the form may be returned.

Owner GARY D. BELL, ALBERT

Address 3212 - 6th Ave. S. File 938559

Date well started April 1972 GW 1

completed

Type of well DRIVEN (Dug, driven, bored or drilled)

Equipment used Hydraulic Driller (Cable drill, rotary or other)

Water Use: Domestic ☐ Municipal ☐ Stock ☐ Irrigation ☐

Industrial ☐ Drainage ☐ Other ☐ * Garden/Lawn ☒

*Describe

USE: If used for irrigation, industrial, drainage or other. Explain, state number of acres and location or other data (i.e. Lot, Block and Addition). B. Hwy. 1st St. S. 3rd St. S. 11

ESTIMATED ANNUAL WITHDRAWAL

Size of Drilled Hole	Size and Weight of Casing	From (Feet)	To (Feet)	PERFORATIONS		
				Kind Size	From (Feet)	To (Feet)
	<u>2 3/4</u>	<u>0</u>	<u>19</u>			

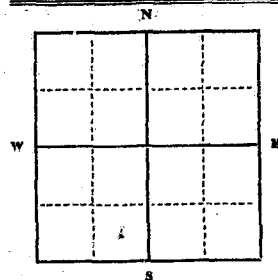

Static water level 10 ft.*
Pumping water level 19 ft.*
at 29 gallons per minute,
measured 30 minutes after pumping
began.

*Measured from ground level.

Well developed by _____
for _____ hours.

Power 1/2 HP Pump 7 HP

Remarks: (Gravel packing, cementing, packers, type of shutoff)

SE 1/4, SW 1/4 Sec. 3
T. 1 N. R. 26 E. W.

INDICATE LOCATION OF WELL AND PLACE OF USE, IF POSSIBLE. EACH SMALL SQUARE REPRESENTS 40 ACRES.

Driller's Signature Charles Rye

Driller's Address Billings

LICENSE NO.

19 Show exact depth of bottom

55720

938559

RECEIVED
STATE OF MONTANA
COUNTY OF YELLOWSTONE

STATE OF MONTANA } ss.
County of Yellowstone }
This instrument was filed in my office
this 20 day of JUN 1973
at 4:27 o'clock P. M.
by MERRILL M. KLUNDT
Deputy Clerk & Recorder
By [Signature] Deputy

puty

20

File No.

DUPLICATE

T. 15 R. 26E

County Yellowstone

STATE OF MONTANA
ADMINISTRATOR OF GROUNDWATER CODE
OFFICE OF STATE ENGINEER

Declaration of Vested Groundwater Rights
(Under Chapter 287, Montana Session Laws, 1961)

RECEIVED
DEC 20 1963
STATE ENGINEER

1. **Artificial Ice & Cold Storage Co.**, of **4147 - 1st Ave. So.**, **Billings**
(Name of Appropriator) (Address) (Town)
County of **Yellowstone** State of **Montana**
have appropriated groundwater according to the Montana laws in effect prior to January 1, 1962, as follows:

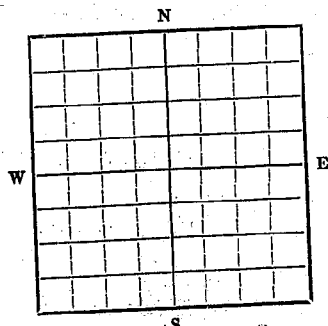

Lot 9-Suburban Sub South

$\frac{1}{4}$ Sec. **364 T. 15 R. 26E**

Indicate point of appropriation
and place of use, if possible.
Each small square represents 10
acres.

2. The beneficial use on which the claim is based **Water is used to cool condensers & compressor for ice mfg. and cold storage.**
3. Date or approximate date of earliest beneficial use; and how continuous the use has been **February, 1920, and has been continuously used since.**
4. The amount of groundwater claimed (in miner's inches or gallons per minute) **165 gallons per minute**
5. If used for irrigation, give the acreage and description of the lands to which water has been applied and name of the owner thereof **none**
6. The means of withdrawing such water from the ground and the location of each well or other means of withdrawal **Water is withdrawn by an electric motor driven pump.**
7. The date of commencement and completion of the construction of the well, wells, or other works for withdrawal of groundwater **December 1919**
8. The depth of water table **20 feet**
9. So far as it may be available, the type, size and depth of each well or the general specifications of any other works for the withdrawal of groundwater **Well is 30 feet deep with concrete casing.**
10. The estimated amount of groundwater withdrawn each year **86,734,000 gallons**
11. The log of formations encountered in the drilling of each well if available **First 25 feet sand and gravel and overburden of dirt - one foot sandstone, balance sand and gravel**
12. Such other information of a similar nature as may be useful in carrying out the policy of this act, including reference to book and page of any county record

ARTIFICIAL ICE & COLD STORAGE COMPANY
Signature of Owner *William S. Goan*
William S. Goan, President
Date **December 19, 1963**

Three copies to be filed by the owner with the County Clerk and Recorder of the county in which the well is located.

Please answer all questions. If not applicable, so state, otherwise the form will be returned.

Original to the County Clerk and Recorder; duplicate to the State Engineer; Triplicate to the School of Mines and Quadruplicate for the Appropriator.

11103

720449

STATE OF MONTANA,
County of Yellowstone.

This instrument was filed in my office
this DEC 19 day of 19

at 2:50 o'clock P. M.

Edmon S. Redding,
County Clerk & Recorder.

By MX Deputy.

\$ 2.00

County Yellowstone

DRILLER'S LOG

STATE OF MONTANA
ADMINISTRATOR OF GROUNDWATER CODE
MONTANA WATER RESOURCES BOARD

MONTANA DEPARTMENT OF NATURAL
RESOURCES AND CONSERVATION

Indicate the character, color, thickness of strata such as soil, clay, sand, gravel, shale, sandstone, etc. Show depth at which water is found and height to which water rises in well.

NOTICE OF COMPLETION OF GROUNDWATER APPROPRIATION BY MEANS OF WELL

Developed after January 1, 1962

(Under Chapter 237 Montana Session Laws, 1961, as amended)

This form to be prepared by driller, and three copies to be filed by the **owner** with the County Clerk and Recorder in the county in which the well is located, last copy to be retained by driller.

Please answer all questions. If not applicable, so state, otherwise the form may be returned.

Owner AL BACON

Address 918 S. 29th ST

Billings, MONTANA

Date well started 6/20/72

completed 6/21/72

Type of well Driven

(Dug, driven, bored or drilled)

Equipment used GAS OPERATED POUNDER
(Churn drill, rotary or other)

(Churn drill, rotary or other)

Water Use: Domestic ☐ Municipal ☐ Stock ☐ Irrigation ☐

Industrial ☐ Drainage ☐ Other ☐* Garden/Lawn ☒

***Describe**

USE: If used for irrigation, industrial, drainage or other. Explain, state number of acres and location or other data (i.e. Lot, Block and Addition). 15345-2K 241-2nd Orig. Township

ESTIMATED ANNUAL WITHDRAWAL 190,000 GAL

Size of Drilled Hole	Size and Weight of Casing	From (Feet)	To (Feet)	PERFORATIONS		
				Kind Size	From (Feet)	To (Feet)
2- $\frac{7}{8}$ "	2- $\frac{7}{8}$ " 6 Lbs Per Ft $\frac{1}{4}$ " Thick	0	21'	SLITS 12" - Lg $\frac{1}{4}$ " - Wd	0	7'

21 Rattan

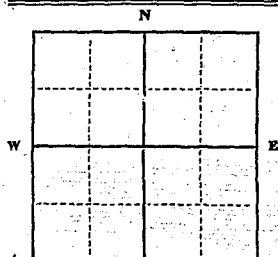

Static water level 9 ft.
Pumping water level 12 ft.
at 13 gallons per minute
measured 60 minutes after pumping
began.

*Measured from ground level.
Well developed by PUMPING
for 4 hours.

Power Elec Pump 4 H.R.
Remarks: (Gravel packing, cementing,
packers, type of shutoff)

Loc 3, 4 + 5 Sh 241. 2nd and
 0.7. Sh
 1/4 1/4 Sec. 3
 T. 1 N. R. 26 E.
 5 10

INDICATE LOCATION OF WELL AND PLACE OF USE, IF POSSIBLE.
EACH SMALL SQUARE REPRESENTS 40 ACRES.

Driller's Signature Lee Schindler

Driller's Address 2915-10 Willie St.

Billings, Montana LICENSE NO. 106

21' Show exact depth of bottom

50, 215

910081

STATE OF MONTANA,) ss.
County of Yellowstone,)

This instrument was filed in my office
this 23 day of JUN 1972

at Billings of clock 1 M
MERRELL M. KLUNDT,
County Clerk & Recorder

By [Signature] Deputy

STATE OF MONTANA)
County of Yellowstone, ss.
The undersigned me, _____ my office
(the _____) JUN-28 1972
at _____ P M.
_____ County Clerk & Ex. Sec.
By _____ Deputy

20

54157

County: Yellowstone

STATE OF MONTANA
ADMINISTRATOR OF GROUNDWATER CODE
MONTANA WATER RESOURCES BOARD

NOTICE OF COMPLETION OF GROUNDWATER APPROPRIATION BY MEANS OF WELL

Developed after January 1, 1962

(Under Chapter 237 Montana Session Laws, 1961, as amended)

This form to be prepared by driller, and three copies to be filed by the **owner** with the County Clerk and Recorder in the county in which the well is located, last copy to be retained by driller.

Please answer all questions. If not applicable, so state; otherwise the form may be returned.

Owner Duane R. Bender

Address 421, South 33 Street

HILLING, AT

Date well started 6/18/73

completed 6/26/73

Type of well Driven

Equipment used Tripod and Weight (Dug, driven, bored or drilled)

Equipment used
(Churn drill, rotary or other)

Water Use: Domestic ☐ Municipal ☐ Stock ☐ Irrigation ☐

Industrial ☐ Drainage ☐ Other ☐* Garden/Lawn ☒

***Describe**

USE: If used for irrigation, industrial, drainage or other. Explain, state number of acres and location or other data (i.e. Lot, Block

and Addition). Lots 22, 23, & 24, all 203

Original Town of Billings

ESTIMATED ANNUAL WITHDRAWAL 600,000 gal.

Size of Drilled Hole	Size and Weight of Casing	From (Feet)	To (Feet)	PERFORATIONS		
				Kind Size	From (Feet)	To (Feet)
2 7/8	3/16"	00'	20'	Slot 1/4"	20'	20' 6"

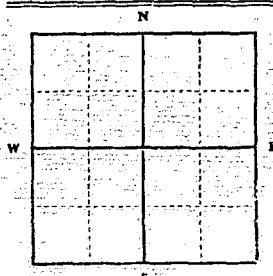

Static water level 18 ft.
Pumping water level 24 ft.
at 50 gallons per minute,
measured 60 minutes after pumping
began.

* Measured from ground level.

Well developed by pump

for 10 hours.

Power: 1.5 HP Pump: 1 HP

Remarks: (Gravel packing, cementing, packers, type of shutoff)

56 1/4 36 1/4 Sec. 3

T. (NK) E

INDICATE LOCATION OF WELL AND PLACE OF USE, IF POSSIBLE.
EACH SMALL SQUARE REPRESENTS 40 ACRES.

Driller's Signature _____

Driller's Address

DRILLER'S LOG

Indicate the character, color, thickness of strata such as soil, clay, sand, gravel, shale, sandstone, etc. Show depth at which water is found and height to which water rises in well.

Top of Ground (Elev. above sea level)

[illegible]

24. Show exact depth of bottom

LICENSE NO.

937715

STATE OF MONTANA } ss.
County of Yellowstone,
This instrument was filed in my office
this 27 day of JUN 27 1913
at 2:04 o'clock P. M.
MERRILL A. KLUNDIT
County Clerk & Recorder
By Jaw Deputy

24

RECEIVED

JUL 11 1972

County Yellowstone
DRILLER'S LOG

STATE OF MONTANA
ADMINISTRATOR OF GROUNDWATER CODE
MONTANA WATER RESOURCES BOARD

MONTANA DEPARTMENT OF NATURAL
RESOURCES AND CONSERVATION

Indicate the character, color, thickness of strata such as soil, clay, sand, gravel, shale, sandstone, etc. Show depth at which water is found and height to which water rises in well.

NOTICE OF COMPLETION OF GROUNDWATER
APPROPRIATION BY MEANS OF WELL

Developed after January 1, 1962

(Under Chapter 237 Montana Session Laws, 1961, as amended)

This form to be prepared by driller, and three copies to be filed by the owner with the County Clerk and Recorder in the county in which the well is located, last copy to be retained by driller. Please answer all questions. If not applicable, so state, otherwise the form may be returned.

Owner Paul Beringer
Address 501 So 37th
Billings, Montana
Date well started 4-15-1942
completed 4-18-1942

For Administrator's Use	
File	<u>911194</u>
Date	<u>July 10, 1972 10:00am</u>
GW 1	

Type of well Dug 12' drove 12' then filled hole level
(Dug, driven, bored or drilled)

Equipment used H and driven with heavy shovels
(Churn drill, rotary or other)

Water Use: Domestic ☐ Municipal ☐ Stock ☐ Irrigation ☐

Industrial ☐ Drainage ☐ Other ☐* Garden/Lawn ☒

*Describe small garden & lawn only

USE: If used for irrigation, industrial, drainage or other. Explain, state number of acres and location or other data (i.e. Lot, Block

and Addition) Southwest Add Lots 13 & 14 B1 Km

ESTIMATED ANNUAL WITHDRAWAL

Size of Drilled Hole	Size and Weight of Casing	From (Feet)	To (Feet)	PERFORATIONS		
				Kind/Size	From (Feet)	To (Feet)
	<u>2 1/2" well casing</u>			<u>open bottom</u>		
	<u>1 1/2" plastic suction pipe</u>					

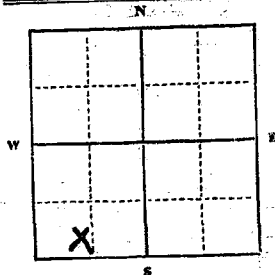

Static water level ft.*
Pumping water level ft.*
at gallons per minute,
measured minutes after pumping
began.

*Measured from ground level.

Well developed by
for hours.

Power..... Pump..... HP

Remarks: (Gravel packing, cementing, packers, type of shutoff)

SW 1/4 Sec. 3
T. 1 N. R. 26 W.

INDICATE LOCATION OF WELL AND PLACE OF USE, IF POSSIBLE.
EACH SMALL SQUARE REPRESENTS 40 ACRES.

Driller's Signature

(See above) P.B.

Driller's Address

LICENSE NO.

24' Show exact depth of bottom

50,877

911194

Water Resources Division
Engineering Bureau
Groundwater Section
Sam W. Mitchell Building
Helena, Montana 59601

As the Administrator of the Groundwater Code for the State of Montana, please take note of the following special instructions, in order to properly protect your ground-water right.

Special Instructions:

Please provide the missing information, as indicated in red on the attached form.

Thank you.

JUL 10 1972

10:00

[Signature]

20

Peringer
So. 37th - Billings
Location 1. IS R. 26E Sec. 3
Doc. No. 911194

RECEIVED

SEP 19 1972

NOTED FOR RECORD IN GROUND
WATER DIVISION, DEN

STATE OF MONTANA
ADMINISTRATOR OF GROUNDWATER CODE
MONTANA WATER RESOURCES BOARD

NOTICE OF COMPLETION OF GROUNDWATER
APPROPRIATION BY MEANS OF WELL

Developed after January 1, 1962

(Under Chapter 237 Montana Session Laws, 1961, as amended)

This form to be prepared by driller, and three copies to be filed by the owner with the County Clerk and Recorder in the county in which the well is located, last copy to be retained by driller. Please answer all questions. If not applicable, so state, otherwise the form may be returned.

Owner Paul Beringer

Address 501 So. 37th St.

Billings, Montana

Date well started 4-15-1962

completed 4-18-1962

Type of well Dug 12' then bored to bottom
(Dug, driven, bored or drilled)

Equipment used Hand driven with heavy drive
(Chain drill, rotary or other)

Water Use: Domestic ☐ Municipal ☐ Stock ☐ Irrigation ☐

Industrial ☐ Drainage ☐ Other ☐* Garden/Lawn ☒

*Describe Small garden & lawn only

USE: If used for irrigation, industrial, drainage or other. Explain, state number of acres and location or other data (i.e. Lot, Block and Addition). Southwest Add. Lots 13 & 14 Blk 4

ESTIMATED ANNUAL WITHDRAWAL

Size of Drilled Hole	Size and Weight of Casing	From (Feet)	To (Feet)	PERFORATIONS	From (Feet)	To (Feet)
2 1/2"	Well casing	Ground level	7'	Kind Size		
1 1/2"	Plastic tubing	2'4"	deep	open Bottom		

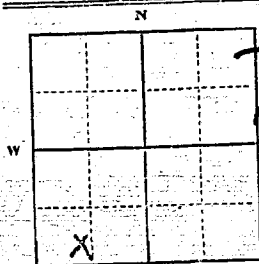

Static water level 16 ft.*
Pumping water level 15' 6" at 30 gallons per minute, measured 15 minutes after pumping began.

*Measured from ground level.
Well developed by PAUL BERINGER for 12 hours. open discharge
Power Pump HP

Remarks: (Gravel packing, cementing, packers, type of shutoff) 1 1/2" valves on 2 discharge lines for lawn sprinklers

4-1/2" valves on garden areas.

INDICATE LOCATION OF WELL AND PLACE OF USE, IF POSSIBLE. EACH SMALL SQUARE REPRESENTS 40 ACRES.

Driller's Signature Paul Beringer

Driller's Address 501 So. 37th St.

Property owner

DRILLER'S LOG

Indicate the character, color, thickness of strata such as soil, clay, sand, gravel, shale, sandstone, etc. Show depth at which water is found and height to which water rises in well.

Indicate the character, color, thickness of strata such as soil, clay, sand, gravel, shale, sandstone, etc. Show depth at which water is found and height to which water rises in well.

From (Feet) To (Feet) 0-16'

16' to ground level

8' water level

STATE OF MONTANA
ADMINISTRATOR OF GROUNDWATER CODE
MONTANA WATER RESOURCES BOARD

NOTICE OF COMPLETION OF GROUNDWATER
APPROPRIATION BY MEANS OF WELL

Developed after January 1, 1962

(Under Chapter 237 Montana Session Laws, 1961, as amended)

This form to be prepared by driller, and three copies to be filed by the owner with the County Clerk and Recorder in the county in which the well is located, last copy to be retained by driller. Please answer all questions. If not applicable, so state, otherwise the form may be returned.

Owner Paul Beringer

Address 501 So. 37th

Billings, Montana

Date well started 4-15-1962

completed 4-18-1962

Type of well Drill 12" hole then 6" hole
(Dug, driven, bored or drilled)

Equipment used 11 and driven with heavy drive
(Cable drill, rotary or other)

Water Use: Domestic ☐ Municipal ☐ Stock ☐ Irrigation ☐

Industrial ☐ Drainage ☐ Other ☐ Garden/Lawn ☒

*Describe small garden & lawn only

USE: If used for irrigation, industrial, drainage or other. Explain:

state number of acres and location or other data (i.e. Lot, Block and Addition). Southwest field Lots 13 & 14 Blk 1

ESTIMATED ANNUAL WITHDRAWAL

Size of Drilled Hole	Size and Weight of Casing	From (Feet)	To (Feet)	PERFORATIONS	From (Feet)	To (Feet)
2 1/2"	Well casing	Ground level	2' 4" deep	open bottom		
1 1/2"	Electric					

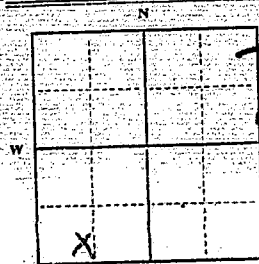

Static water level 16 ft.*
Pumping water level 15' 6" at
at 30 gallons per minute,
measured 15 minutes after pumping
began.

*Measured from ground level.
Well developed by PAUL BERINGER
for 12 hours. open discharge

Power Pump HP
Remarks: (Gravel packing, cementing,
packers, type of shutoff) 1 1/2"

valves on 2 discharge lines for lawn
4-1/2 valves on garden areas.

INDICATE LOCATION OF WELL AND PLACE OF USE, IF POSSIBLE.
EACH SMALL SQUARE REPRESENTS 40 ACRES.

Driller's Signature

Driller's Address

Paul Beringer

501 So. 37th

Property owner

DRILLER'S LOG

Indicate the character, color, thickness of strata such as soil, clay, sand, gravel, shale, sandstone, etc. Show depth at which water is found and height to which water rises in well.

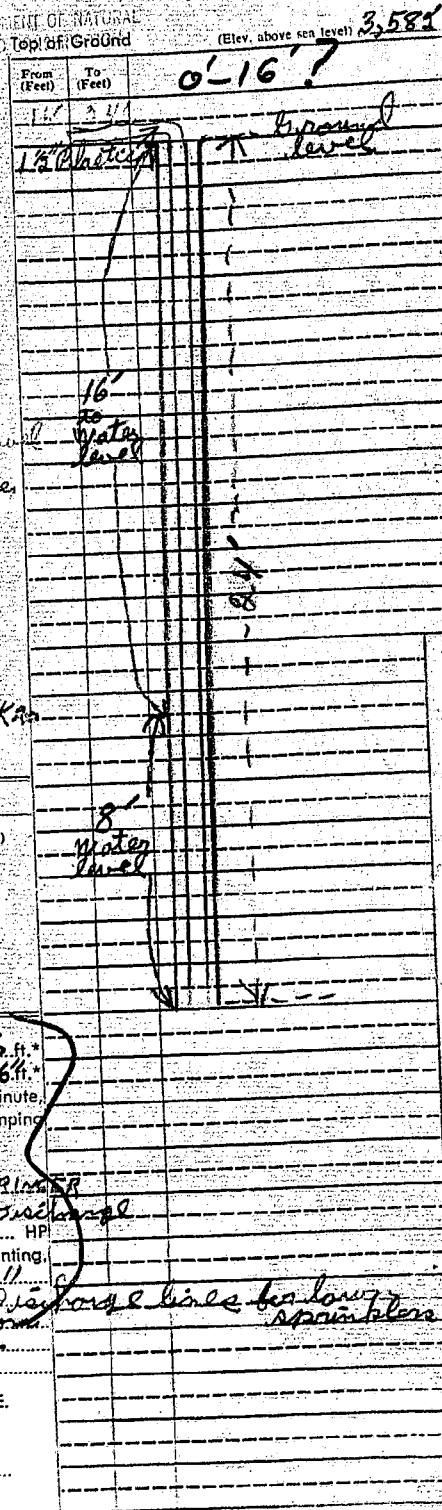

Show exact depth of bottom

FOOTAGE

5,591

45135

55/55

938204

STATE OF MONTANA, } ss.
County of Yellowstone, }
This instrument was filed in my office
this JUN 29 1973 day of 19
at 8:44 o'clock PM M.
MERRILL H. KLUNDT
County Clerk & Recorder
By CBB Deputy
727

File No.

ORIGINAL

T. R.
County Yellowstone

STATE OF MONTANA
ADMINISTRATOR OF GROUNDWATER CODE
OFFICE OF STATE ENGINEER

RECEIVED
JAN 2 1964

DECLARATION of VESTED GROUNDWATER RIGHTS
(Under Chapter 237, Montana Session Laws, 1961)

STATE ENGINEER

1. Henry Deines of 3510 6th Ave So. Billings
(Name of Appropriator) (Address) (Town)

County of Yellowstone State of Montana
have appropriated groundwater according to the Montana laws in effect prior to
January 1, 1962, as follows:

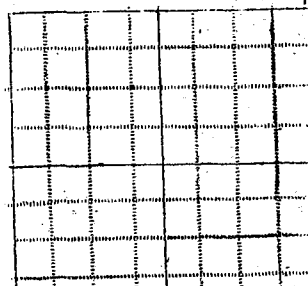

LOTS 10, 11 & 12 BLK 220 2nd ADD.
Billings

Sec. 3 T. 15R. 26E
Indicate point of appropriation
and place of use, if possible.
Each small square represents
10 acres.

2. The beneficial use on which the claim is based
watering lawns and shrubs

3. Date or approximate date of earliest beneficial
use; and how continuous the use has been
April thru October

4. The amount of groundwater claimed (in miner's
inches or gallons per minute)
about 50 gal per minute

5. If used for irrigation, give the acreage and
description of the lands to which water has been
applied and name of the owner thereof
lots 10, 11 & 12 - Block 220 -
in Second Addition of City of Billings

6. The means of withdrawing such water from the
ground and the location of each well or other
means of withdrawal
centrifugal pump

7. The date of commencement and completion of the construction of the well, wells,
or other works for withdrawal of groundwater just brought the
property this summer so am not sure

8. The depth of water table about 20 feet

9. So far as it may be available, the type, size and depth of each well or the gen-
eral specifications of any other works for the withdrawal of groundwater
piped casing size 14" depth 20 feet well

10. The estimated amount of groundwater withdrawn each year not sure

11. The log of formations encountered in the drilling of each well if available
don't know

12. Such other information of a similar nature as may be useful in carrying out the
policy of this act, including reference to book and page of any county record
don't know

Signature of Owner Henry Deines
Date Dec 31 1963

Three copies to be filed by the owner with the County Clerk and Recorder of the
county in which the well is located.

Please answer all questions. If not applicable, so state, otherwise the form will
be returned.

Original to the County Clerk & Recorder; Duplicate to the State Engineer; Triplicate
to the Montana Bureau of mines and Geology, and Quadruplicate for the appropriator

721591

STATE OF MONTANA,
County of Yellowstone,

This instrument was filed in my office

this 31 day of Dec 1963

at 11:37 o'clock A. M.

Edison L. Redding,
County Clerk & Recorder

By JLS Deputy

DRILLER'S LOG

Indicate the character, color, thickness of strata such as soil, clay, sand, gravel, shale, sandstone, etc. Show depth at which water is found and height to which water rises in well.

Top of Ground (Elev. above sea level)

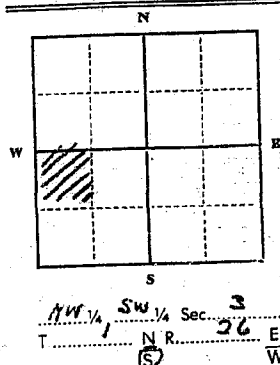
[illegible][illegible]

*Measured from ground level.

Well developed by 1942-43
for 2 hours.

Power 110 Pump 1.5 HP

Remarks: (Gravel packing, cementing packers, type of shutoff)

INDICATE LOCATION OF WELL AND PLACE OF USE, IF POSSIBLE.
EACH SMALL SQUARE REPRESENTS 40 ACRES.

Driller's Signature

Driller's Address

Bilings, Montana

LICENSE NO. NA

55'6" Show exact depth of bottom

1-4359