

File No.

T. 15 R. 26
County

DUPLICATE

STATE OF MONTANA
ADMINISTRATOR OF GROUNDWATER CODE
OFFICE OF STATE ENGINEER

RECEIVED
JAN 2 1964
ENGINEER

Declaration of Vested Groundwater Rights

(Under Chapter 237, Montana Session Laws, 1961).

1. Janice Ann Lemon, of 732 Custer Ave, Billings,
(Name of Appropriator) (Address) (Town)

County of Yellowstone State of Montana
have appropriated groundwater according to the Montana laws in effect prior to January 1, 1962, as follows:

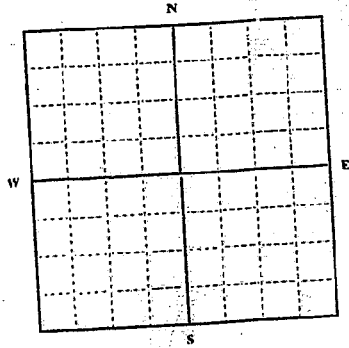

NW 1/4 SW 1/4 Sec. 4 T. 15. R. 26 E
Indicate point of appropriation and place of use, if possible. Each small square represents 10 acres.

- The beneficial use on which the claim is based irrigation;
water for green house & stock
- Date or approximate date of earliest beneficial use; and how continuous the use has been 1957 (approx.); continuous
every year since.
- The amount of groundwater claimed (in miner's inches or gallons per minute) 15 gallons per minute.
- If used for irrigation, give the acreage and description of the lands to which water has been applied and name of the owner thereof
1 acre, 2 tract A Cert. of Survey
492 in NWSW 1/4 4 15 26
Lemon, George M. & Janice A.
- The means of withdrawing such water from the ground and the location of each well or other means of withdrawal One
well located in NW corner of
green house; electric pump above ground
- The date of commencement and completion of the construction of the well, wells, or other works for withdrawal of groundwater May 1957; commencement and completion
within May, 1957.
- The depth of water table 20 feet +
- So far as it may be available, the type, size and depth of each well or the general specifications of any other works for the withdrawal of groundwater.
depth - 20 feet
size - 4" casing
pump size - 1 1/2" centrifugal
- The estimated amount of groundwater withdrawn each year 100,000 gallons
- The log of formations encountered in the drilling of each well if available unknown
- Such other information of a similar nature as may be useful in carrying out the policy of this act, including reference to book and page of any county record unknown

Signature of Owner Janice A. Lemon
Date December 30, 1963

Three copies to be filed by the owner with the County Clerk and Recorder of the county in which the well is located.

Please answer all questions. If not applicable, so state, otherwise the form will be returned.

Original to the County Clerk and Recorder; Duplicate to the State Engineer; Triplicate to the Montana Bureau of Mines and Geology, and Quadruplicate for the Appropriator.

721664

STATE OF MONTANA ss. X
County of Yellowstone
This instrument was filed in my office
this 23^d day of SEP 31 1953 19
at 2:30 o'clock P. M.
F. J. [Signature]
County Clerk & Recorder
By [Signature] Deputy

STATE OF MONTANA
ADMINISTRATOR OF GROUNDWATER CODE
MONTANA WATER RESOURCES BOARD
NOTICE OF COMPLETION OF GROUNDWATER
APPROPRIATION BY MEANS OF WELL
Developed after January 1, 1962

(Under Chapter 237 Montana Session Laws, 1961, as amended)

This form to be prepared by driller, and three copies to be filed by the owner with the County Clerk and Recorder in the county in which the well is located; last copy to be retained by driller. Please answer all questions. If not applicable, so state, otherwise the form may be returned.

Owner <u>Harry Madison</u>	For Administrator's Use
Address <u>219 Custer</u>	File <u>655286</u>
Date well started <u>6-26-73</u>	<u>6-29-73</u>
completed <u>6-26-73</u>	GW 1 <u>10:24 P.M.</u>

Type of well driven (Dug, driven, bored or drilled)

Equipment used mechanical (Churn drill, rotary or other)

Water Use: Domestic Municipal Stock Irrigation

Industrial Drainage Other Garden/Lawn

*Describe USE: If used for irrigation, industrial, drainage or other. Explain, state number of acres and location or other data (i.e. Lot, Block and Addition). Suburban Sub. Lot 7+10 Blk 3

Size of Drilled Hole	Size and Weight of Casing	From (Feet)	To (Feet)	PERFORATIONS		
				Kind	From (Feet)	To (Feet)
<u>2 1/2"</u>	<u>2 1/2"</u>	<u>0</u>	<u>22'</u>			<u>blasted point</u>

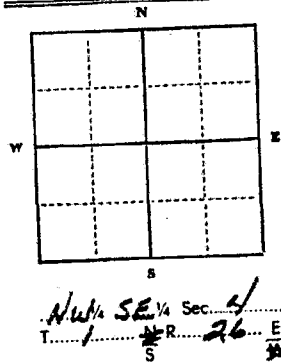

Static water level 12 ft.*
Pumping water level 13 ft.*
at 65 gallons per minute, measured 20 minutes after pumping began.

*Measured from ground level.
Well developed by pumping for 4 hours.
Power gas Pump 3/4 HP
Remarks (Gravel packing, cementing, packers, type of shutoff)

INDICATE LOCATION OF WELL AND PLACE OF USE, IF POSSIBLE. EACH SMALL SQUARE REPRESENTS 40 ACRES.

Driller's Signature Eugene H. Toppo
Driller's Address 2022 Miles Ave.

LICENSE NO. none required Show exact depth of bottom

RECEIVED
MONTANA WATER RESOURCES BOARD
COUNTY Yellowstone
DRILLER'S LOG
Indicate the character, color, thickness of strata such as soil, clay, sand, gravel, shale, sandstone, etc. Show depth at which water is found and height to which water rises in well.

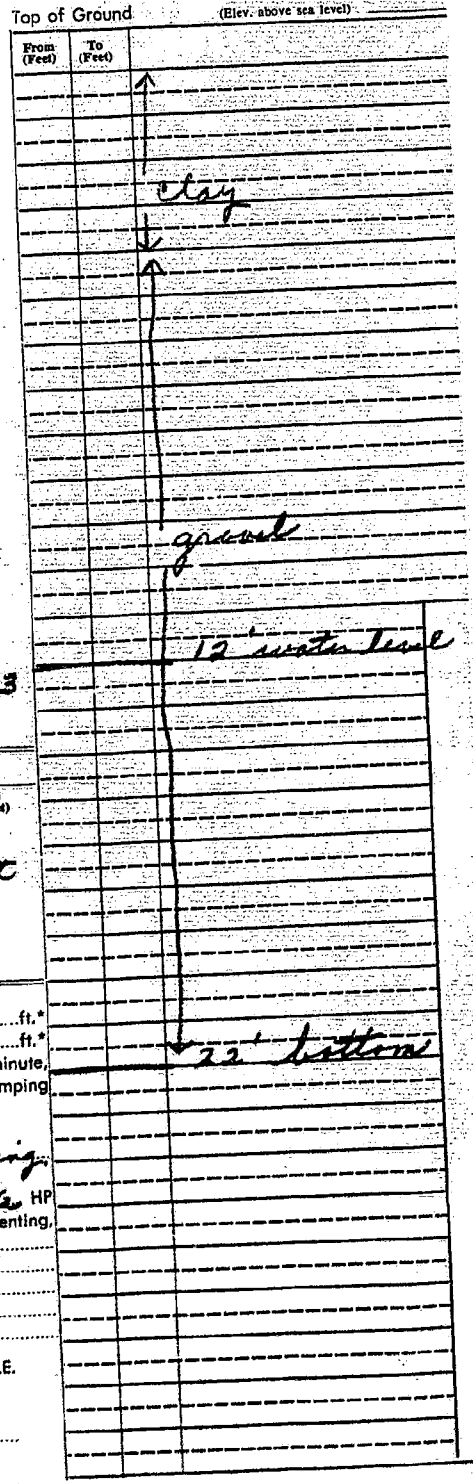

55267

20

938286

STATE OF MONTANA } ss.
County of Yellowstone }
This instrument was filed in my office
this JUN 28 1978, at
at 10:24 o'clock AM
MERRILL H. KLUNDE
County Clerk & Recorder
By [Signature] Deputy
20

REGISTERED

County... Yellowstone

**STATE OF MONTANA
ADMINISTRATOR OF GROUNDWATER
MONTANA WATER RESOURCES BOARD**

**NOTICE OF COMPLETION OF GROUNDWATER
APPROPRIATION BY MEANS OF WELL**

Developed after January 1, 1962

DRILLER'S LOG

Indicate the character, color, thickness of strata such as soil, clay, sand, gravel, shale, sandstone, etc. Show depth at which water is found and height to which water rises in well.

(Under Chapter 237 Montana Session Laws, 1961, as amended)

This form to be prepared by driller, and three copies to be filed by the **owner** with the County Clerk and Recorder in the county in which the well is located, last copy to be retained by driller. Please answer all questions. If not applicable, so state, otherwise the form may be returned.

Owner Helen D. & H. Mitchell Morris
Address 631 Lewis Avenue
Billings, Montana 59102
Date well started June 9, 1973
completed June 9, 1973

For Administrator's Use	
File	<u>937241</u>
	<u>June 21, 1973</u>
GW	<u>1 4:00 p.m.</u>

Type of well Driven (Dug, driven, bored or drilled)
Equipment used pile driver (Churn drill, rotary or other)
Water Use: Domestic Municipal Stock Irrigation
Industrial Drainage Other * Garden/Lawn

*Describe USE: If used for irrigation, industrial, drainage or other. Explain, state number of acres and location or other data (i.e. Lot, Block and Addition). Lots 15, 16, 17, Bl. 47, Sub. Homes Add.

ESTIMATED ANNUAL WITHDRAWAL 500,000 gallons

Size of Pipe	Size and Weight of Casing	From (Feet)	To (Feet)	PERFORATIONS		
				Kind/Size	From (Feet)	To (Feet)
<u>Driven</u> <u>2 3/8"</u>	<u>2 3/8"</u> <u>(Sched. 80)</u>	<u>0</u>	<u>25</u>	<u>6" slots</u>	<u>Bottom</u>	<u>5' from bottom</u>

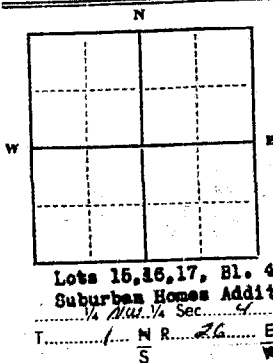

Static water level 16 1/2 ft.*
Pumping water level 16 1/2 ft.*
at 14 (est.) gallons per minute, measured 10 minutes after pumping began.
*Measured from ground level.
Well developed by pumping for 12 hours.
Power Elec. Pump 3/4 HP
Remarks: (Gravel packing, cementing, packers, type of shutoff)
Gate valve shut-off.
Other items not applicable.

INDICATE LOCATION OF WELL AND PLACE OF USE, IF POSSIBLE. EACH SMALL SQUARE REPRESENTS 40 ACRES.

Driller's Signature Geo. E. McCracken
Driller's Address 414 So 28 St Bldg. Well Drives LICENSE NO. None

From (Feet)	To (Feet)	Approx. (Elev. above sea level) <u>3180</u>
Top of Ground		
		Water found at <u>16 1/2'</u>
		Water rises in well to <u>8.4'</u>
		Other items not applicable in a driven well.

531715

337241

STATE OF MONTANA, } ss.
County of Yellowstone, }

This instrument was filed in my office

this JUN 21 1973 19

at 4:00 o'clock P M.

MERRIL M. KLUNDT
County Clerk & Recorder

By Jaid Deputy

24

Doc. No. 889455
 File No. Filed for record
 this 23 day of August
 A. D. 19 71, at 2:00
 o'clock P. M. AUG 25 1971

T. 13 R. 26E
 County Yellowstone

STATE OF MONTANA
 ADMINISTRATOR OF GROUNDWATER CODE
 OFFICE OF STATE ENGINEER

DUPLICATE

Notice of Completion of Groundwater Appropriation by Means of Well

(Under Chapter 237, Montana Session Laws, 1961)

Top of Ground
 (Elev. above sea level.....)

Owner..... Address.....
 Driller..... Address.....
 Date of Notice of Appropriation of Groundwater.....
 Date well started..... Date Completed.....
 Type of well..... Equipment Used.....
 (dug, driven, bored or drilled) (Churn, drill, rotary or other)
 Water Use: Domestic Municipal Other Irrigation
 Industrial Drainage Stock

Indicate on the diagram the character and thickness of the different strata met with in drilling, such as soil, clay, shale, gravel, rock or sand, etc. Show depth at which water is encountered, thickness and character of water-bearing strata and height to which water rises in the well.

Size of Drilled Hole	Size and Weight of Casing	From (Feet)	To (Feet)	PERFORATIONS		
				Kind Size	From (Feet)	To (Feet)

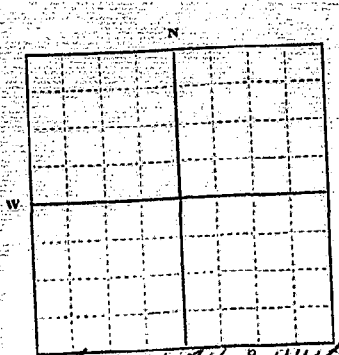

Indicate location of well and place of use, if possible. Each small square represents 10 acres.

Show exact depth of bottom.

Static Water Level for non-flowing Well.....feet.
 Shut-in Pressure for Flowing Well.....
 Pumping Water Level.....feet at.....gal. per minute.
 Discharge in gal. per min. of flowing well.....
 How Tested..... Length of Test.....

Remarks: (Gravel packing, cementing, packers, type of shutoff, location of place of use of groundwater if not at well, and any other similar pertinent information, including number of acres irrigated, if used for irrigation).....

Driller's License Number.....

Driller's Signature.....

This form to be prepared by driller, and three copies to be filed by the owner with the County Clerk and Recorder in the county in which the well is located.

Please answer all questions. If not applicable, so state, otherwise the form will be returned.

Original to the County Clerk and Recorder; duplicate to the State Engineer; Triplicate to the Montana Bureau of Mines and Geology and Quadruplicate for the Appropriator.

48933

File No. 889455
 Filed for record MONTANA WATER RESOURCES BOARD
 this 23 day of August
 DUPLICATE A. D. 19 71, at 2:00
 o'clock P. M. AUG 25 1971

T. 15 R. 26E
 County Yellowstone

STATE OF MONTANA
 ADMINISTRATOR OF GROUNDWATER CODE
 OFFICE OF STATE ENGINEER

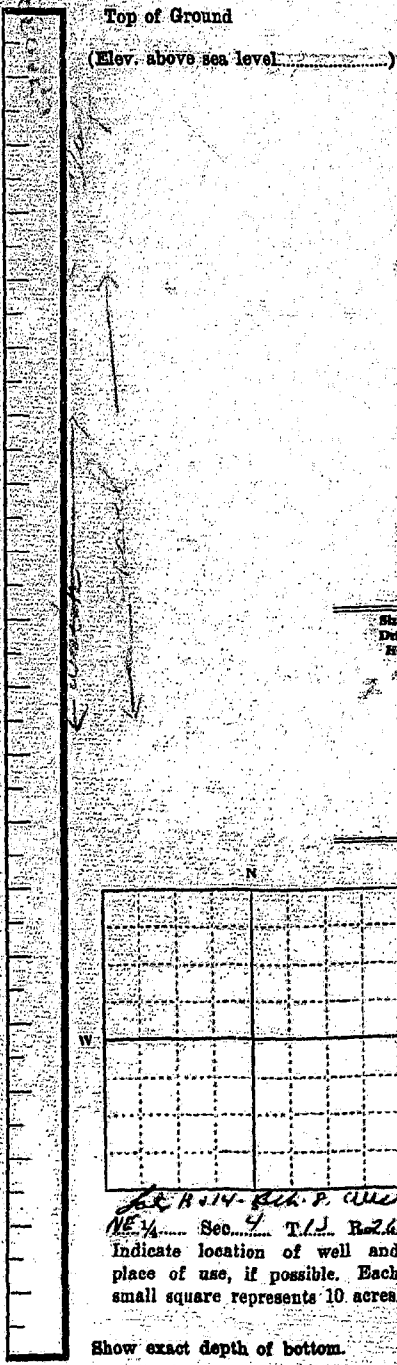

Notice of Completion of Groundwater Appropriation by Means of Well

(Under Chapter 287, Montana Session Laws, 1961)

Owner [Signature] Address [Address]

Driller [Signature] Address [Address]

Date of Notice of Appropriation of Groundwater [Date]

Date well started 7-29-71 Date Completed 7-29-71

Type of well [Type] Equipment Used [Equipment]
 (dug, driven, bored or drilled) (Churn, drill, rotary or other)

Water Use: Domestic Municipal Other Irrigation
 Industrial Drainage Stock

Indicate on the diagram the character and thickness of the different strata met with in drilling, such as soil, clay, shale, gravel, rock or sand, etc. Show depth at which water is encountered, thickness and character of water-bearing strata and height to which water rises in the well.

Size of Drilled Hole	Size and Weight of Casing	From (Feet)	To (Feet)	PERFORATIONS		
				Kind Size	From (Feet)	To (Feet)
<u>2"</u>	<u>2" Steel</u>	<u>0</u>	<u>10</u>	<u>1/2"</u>	<u>0</u>	<u>10</u>

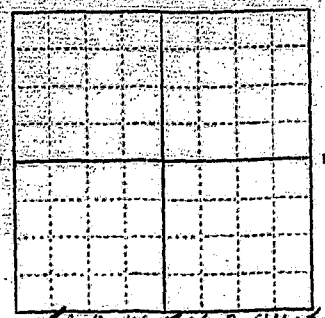

Static Water Level for non-flowing Well [Level] feet.

Shut-in Pressure for Flowing Well [Pressure]

Pumping Water Level [Level] feet at [Rate] gal. per minute.

Discharge in gal. per min. of flowing well [Discharge]

How Tested [Method] Length of Test [Duration]

Remarks: (Gravel packing, cementing, packers, type of shutoff, location of place of use of groundwater if not at well, and any other similar pertinent information, including number of

Ac. R. 14 - Sec. 4 T. 15 R. 26E
 NE 1/4 Sec. 4 T. 15 R. 26E
 Indicate location of well and place of use, if possible. Each small square represents 10 acres.

Show exact depth of bottom.

Driller's License Number [Number]

Driller's Signature [Signature]

This form to be prepared by driller, and three copies to be filed by the owner with the County Clerk and Recorder in the county in which the well is located.

Please answer all questions. If not applicable, so state, otherwise the form will be returned.

Original to the County Clerk and Recorder; duplicate to the State Engineer; Triplicate to the Montana Bureau of Mines and Geology and Quadruplicate for the Appropriator.

48933

889455

STATE OF MONTANA
County of _____
This is to certify that _____
the _____ AUG 23 1971 _____
at _____ P _____ M.
by _____
County Clerk & Recorder
by _____ Deputy

20

938322

STATE OF MONTANA, }
County of Yellowstone, } ss.

This instrument was filed in my office

this JUN 29 1973 day of _____ 1973

at 12:06 o'clock P M.

MERRILL H. KLUNDT
County Clerk & Recorder

By [Signature] Deputy

[Signature]

RECEIVED

County Yellowstone
DRILLER'S LOG

STATE OF MONTANA
ADMINISTRATOR OF GROUNDWATER CODE
MONTANA WATER RESOURCES BOARD

MAY 13 1972

Indicate the character, color, thickness of strata such as soil, clay, sand, gravel, shale, sandstone, etc. Show depth at which water is found and height to which water rises in well.

NOTICE OF COMPLETION OF GROUNDWATER
APPROPRIATION BY MEANS OF WELL

Developed after January 1, 1962

(Under Chapter 237 Montana Session Laws, 1961, as amended)

This form to be prepared by driller, and three copies to be filed by the owner with the County Clerk and Recorder in the county in which the well is located, last copy to be retained by driller. Please answer all questions. If not applicable, so state, otherwise the form may be returned.

Owner Frank Pisty
Address 638 Alder Avenue
Billings, Mont. 59102

Date well started 4-10-72
completed 4-21-72

Type of well D rilled
(Dug, driven, bored or drilled)

Equipment used Cable
(Cable, rotary or other)

Water Use: Domestic Municipal Stock Irrigation
Industrial Drainage Other Garden/Lawn

For Administrator's Use
File 907359
May 17, 1972 2:50 p.m.
GW 1

*Describe
USE: If used for irrigation, industrial, drainage or other. Explain, state number of acres and location or other data (i.e. Lot, Block and Addition):

ESTIMATED ANNUAL WITHDRAWAL

Size of Drilled Hole	Size and Weight of Casing	From (Feet)	To (Feet)	PERFORATIONS		
				Kind Size	From (Feet)	To (Feet)
6"	6" <u>1 1/2 lb.</u>	0	48 1/2			
6"	5" <u>plastic</u>	40	80	1/4" x 4"	0	40

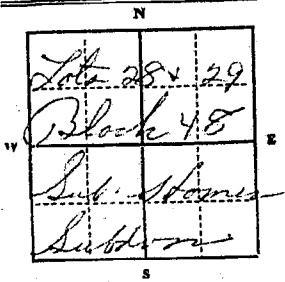

Static water level 26 ft.*
Pumping water level ft.*
at 1.0 gallons per minute,
measured minutes after pumping
began.
*Measured from ground level.
Well developed by bailey
for 3 hours.
Power..... Pump..... HP
Remarks: (Gravel packing, cementing,
packers, type of shutoff)

1/4 NW 1/4 Sec. 4
T. 1 N. R. 26 E
S W

INDICATE LOCATION OF WELL AND PLACE OF USE, IF POSSIBLE. EACH SMALL SQUARE REPRESENTS 40 ACRES.

Driller's Signature Clyde Lando
Driller's Address 1552 Dickie Rd. Pt. 2
Billings, Mont 59101
LICENSE NO. 2

Top of Ground (Elev. above sea level)

From (Feet)	To (Feet)	Description
0	13	soil
13	15	baileys
15	65	yellow clay & boulders
65	80	dirty black shale

80' Show exact depth of bottom
59410

907359

STATE OF MONTANA
County of Yellowstone
This instrument was filed in my office
MAY 17 1972
at 2:50 P.M.
GEOFFREY A. GILNORE
County Clerk & Recorder
Deputy

Law
200

938486

STATE OF MONTANA, }
County of Yellowstone, } ss.

This instrument was filed in my office

this 22 day of JUN 22 1973

at 3:13 o'clock P M.

MERRILL H. LUNDY
County Clerk & Recorder

By Rew Deputy

938342

938342

STATE OF MONTANA, }
County of Yellowstone, } ss.
This instrument was filed in my office
this JUN 29 1973 day of _____ 1973
at 12:26 o'clock P. M.
MERRILL W. KLUNZE
County Clerk & Recorder
By [Signature] Deputy

[Signature]

File No. _____
 DUPLICATE

MONTANA WATER RESOURCES BOARD
 RECEIVED

T. 15 R. 26
 County Yellowstone

AUG 17 1971

STATE OF MONTANA
 ADMINISTRATOR OF GROUNDWATER CODE
 OFFICE OF STATE ENGINEER

Notice of Completion of Groundwater Appropriation by Means of Well

(Under Chapter 237, Montana Session Laws, 1961)

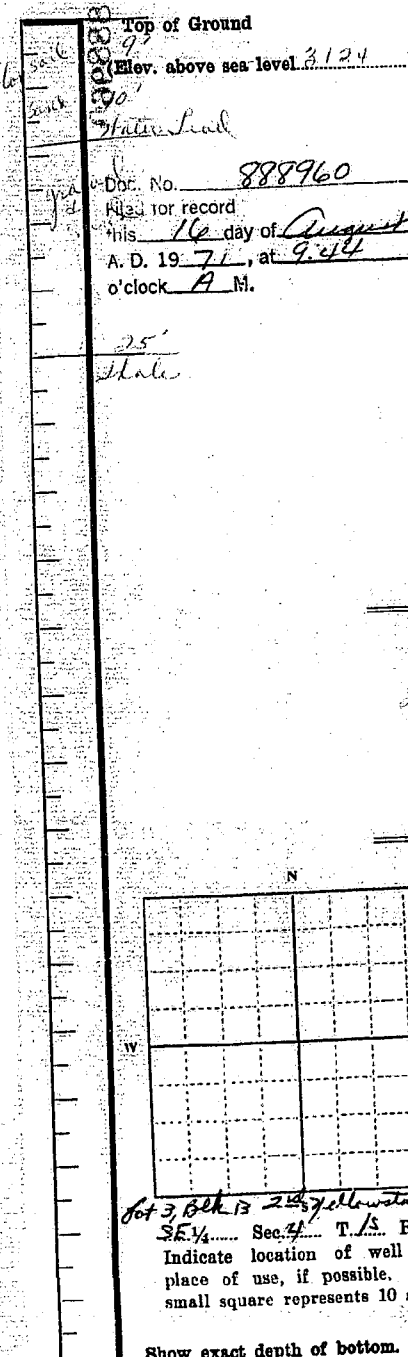

Doc. No. 888960 Owner John S. Lelick Address 201 Harvard
 Filed for record this 16 day of August Driller Ally Mathewson Address 57 S. Broadway
 A. D. 19 71, at 9:44 Date of Notice of Appropriation of Groundwater July 24, 1971
 o'clock A M. Date well started July 24 Date Completed July 24
 Type of well drilled Equipment Used Power rig
 (dug, driven, bored or (Churn, drill, rotary or other)
 drilled) other)
 Water Use: Domestic Municipal Other Irrigation
 Industrial Drainage Stock

Indicate on the diagram the character and thickness of the different strata met with in drilling, such as soil, clay, shale, gravel, rock or sand, etc. Show depth at which water is encountered, thickness and character of water-bearing strata and height to which water rises in the well.

Size of Drilled Hole	Size and Weight of Casing	From (Feet)		PERFORATIONS		
		To (Feet)	To (Feet)	Kind Size	From (Feet)	To (Feet)
2 7/8"	2 7/8" casing tubing	2 7/8 to 25'	25'	1/4" hole	from point to 4'	from point to 4'

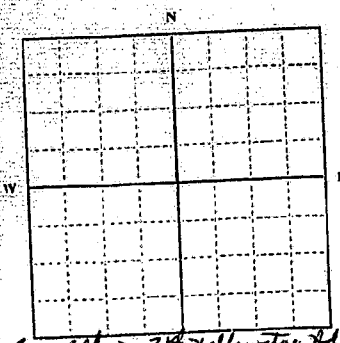

Lot 3, Blk 13 24, Yellowstone Add
 SE 1/4 Sec 7 T. 15 R. 26 E

Static Water Level for non-flowing Well 9 feet.
 Shut-in Pressure for Flowing Well non flowing
 Pumping Water Level 4 1/2 feet at 2.5 gal per minute.
 Discharge in gal. per min. of flowing well not flowing
 How Tested cut pump Length of Test 4 hrs
 Remarks: (Gravel packing, cementing, packers, type of shutoff, location of place of use of groundwater if not at well, and any other similar pertinent information, including number of acres irrigated, if used for irrigation) 3 Lots
2 yellowstone add on Lot no 3

Show exact depth of bottom.

Driller's License Number _____
 Driller's Signature Ally Mathewson

This form to be prepared by driller, and three copies to be filed by the owner with the County Clerk and Recorder in the county in which the well is located.
 Please answer all questions. If not applicable, so state, otherwise the form will be returned.
 Original to the County Clerk and Recorder; duplicate to the State Engineer; Triplicate to the Montana Bureau of Mines and Geology and Quadruplicate for the Appropriator.

48909

888960

STATE OF MONTANA, } ss.
County of Yellowstone, }
This instrument was filed in my office
on AUG 16 1971 of 19
at 9:44 o'clock A M.
MERRILL H. KLUNDT
County Clerk & Recorder
By [Signature] Deputy

20

RECEIVED

File No.

JUN 20 1972

T 15 R 26E

ORIGINAL

County YELLOWSTONE

MONTANA DEPARTMENT OF NATURAL RESOURCES AND CONSERVATION

STATE OF MONTANA ADMINISTRATOR OF GROUNDWATER CODE OFFICE OF STATE ENGINEER

Top of Ground

(Elev. above sea level 3152)

Notice of Completion of Groundwater Appropriation by Means of Well

(Under Chapter 237, Montana Session Laws, 1961)

Owner R. J. SERIC H Address 112 So. 36

Driller R. J. SERIC H Address 112 So. 36

Date of Notice of Appropriation of Groundwater 7-11-69

Date well started 7-7-69 Date Completed 7-17-69

Type of well (dug, driven, bored or drilled) Equipment Used 8" PORTABLE AUGER (Churn, drill, rotary or other)

Water Use: Domestic, Municipal, Other, Irrigation, Industrial, Drainage, Stock

Indicate on the diagram the character and thickness of the different strata met with in drilling, such as soil, clay, shale, gravel, rock or sand, etc.

Vertical scale with handwritten labels: SAND-GRAVEL 8', CLAY 20', WATER RISES TO 20'

CLAY 20' WATER GRAVEL 8' SAND ALSO WATER RISES TO 20'

Table with columns: Size of Drilled Hole (8"), Size and Weight of Casing, From (Feet) (0'), To (Feet) (28'), PERFORATIONS (Kind Size, From (Feet), To (Feet))

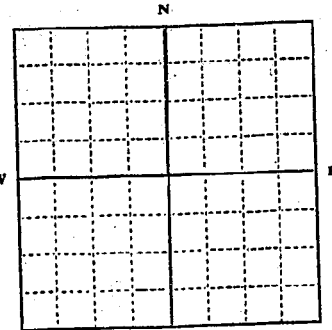

SE 1/4 Sec. 14 T. 15 R. 26E Indicate location of well and place of use, if possible. Each small square represents 10 acres.

Static Water Level for non-flowing Well 5 feet

Shut-in Pressure for Flowing Well

Pumping Water Level 20 feet at 25 gal. per minute

Discharge in gal. per min. of flowing well 25 GAL. PLUS

How Tested WITH SAND PUMP Length of Test 10 HRS.

Remarks: (Gravel packing, cementing, packers, type of shutoff, location of place of use of groundwater if not at well, and any other similar pertinent information, including number of acres irrigated, if used for irrigation)

Show exact depth of bottom.

Doc. No. 909805 Filed for record this 19th day of June A. D. 1972 at 3:41 o'clock P. M.

Driller's License Number

Driller's Signature R. J. SERIC H

Handwritten notes: 38' OP OF SHALE 2 HIGHLAND ADD 687 16

This form to be prepared by driller, and three copies to be filed by the owner with the County Clerk and Recorder in the county in which the well is located.

Please answer all questions. If not applicable, so state, otherwise the form will be returned.

Original to the County Clerk and Recorder; duplicate to the State Engineer; Triplicate to the Montana Bureau of Mines and Geology and Quadruplicate for the Appropriator.

50,602

909805

STATE OF MONTANA
County of Yellowstone
This instrument was filed in the office
this JUN 19 1972 at 3:41 P.M.
at 3:41 P.M.
MERRILL R. BLONDE, M.
County Clerk & Recorder
By Jaw Deputy
20

Static Water Level for non-flowing Well

N

7777

and claimant of the order that no of law

County of Yellowstone

MONTANA DEPARTMENT OF NATURAL RESOURCES AND CONSERVATION

STATE OF MONTANA ADMINISTRATOR OF GROUNDWATER CODE OFFICE OF STATE ENGINEER

Notice of Completion of Groundwater Appropriation by Means of Well
(Under Chapter 237, Montana Session Laws, 1961)

Top of Ground (Elev. above sea level: 3150)

Owner B. J. Serich Address 112 So. 36 Billings
 Driller B. J. Serich Address 112 So. 36
 Date of Notice of Appropriation of Groundwater _____
 Date well started 7-7-69 Date Completed 7-11-69
 Type of well (dug, driven, bored or drilled) 8" Post Hole
 Equipment Used A. R. R.
 Water Use: Domestic Municipal Other Irrigation
 Industrial Drainage Stock

Indicate on the diagram the character and thickness of the different strata met with in drilling, such as soil, clay, shale, gravel, rock or sand, etc. Show depth at which water is encountered, thickness and character of water-bearing strata and height to which water rises in the well.

Size of Drilled Hole	Size and Weight of Casing	From (Feet)	To (Feet)	PERFORATIONS		
				Kind	From (Feet)	To (Feet)
8"			28'	5 SLITS	22'	28'

Static Water Level for non-flowing Well 5 feet.

Shut-in Pressure for Flowing Well _____

Pumping Water Level 20 feet at 25 gal. per minute.

Discharge in gal. per min. of flowing well 25 GAL PER MIN.

How Tested SAND PUMP Length of Test 10 HRS.

Remarks: (Gravel packing, cementing, packers, type of shutoff, location of place of use of groundwater if not at well, and any other similar pertinent information, including number of acres irrigated, if used for irrigation) _____

Driller's License Number _____

B. J. Serich
Driller's Signature

1/4 Sec. 16 T. _____ R. _____
Indicate location of well and place of use, if possible. Each small square represents 10 acres.

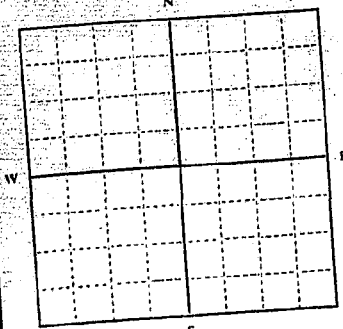

Show exact depth of bottom.
TOP OF SHALE
2 HIGHLAND-ADD.
697-16

This form to be prepared by driller, and three copies to be filed by the owner with the County Clerk and Recorder in the county in which the well is located.

Please answer all questions. If not applicable, so state, otherwise the form will be returned.

Original to the County Clerk and Recorder; duplicate to the State Engineer; Triplicate to the Montana Bureau of Mines and Geology and Quadruplicate for the Appropriator.

50,602

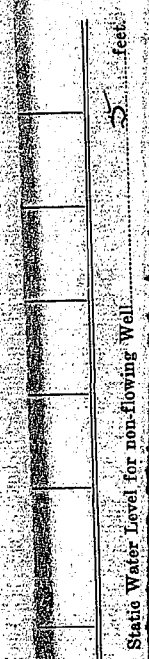

STATE OF MONTANA
 ADMINISTRATOR OF GROUNDWATER CODE
 MONTANA WATER RESOURCES BOARD

NOTICE OF COMPLETION OF GROUNDWATER
 APPROPRIATION BY MEANS OF WELL

Developed after January 1, 1962

(Under Chapter 237 Montana Session Laws, 1961, as amended)

This form to be prepared by driller, and three copies to be filed by the owner with the County Clerk and Recorder in the county in which the well is located, last copy to be retained by driller. Please answer all questions. If not applicable, so state, otherwise the form may be returned:

Owner Cliff Shaw
 Address 212 Custer

For Administrator's Use	
File	<u>735570</u>
	<u>6-29-73</u>
GW 1	<u>10-08 N. 12W</u>

Date well started 6-26-73
 completed 6-26-73

Type of well driven
(Dig, driven, bored or drilled)

Equipment used mechanical
(Churn drill, rotary or other)

Water Use: Domestic Municipal Stock Irrigation
 Industrial Drainage Other * Garden/Lawn

*Describe

USE: If used for Irrigation, industrial, drainage or other. Explain, state number of acres and location or other data (i.e.: Lot, Block and Addition). Sub. Sub. Lot 10-08 N. 12W

ESTIMATED ANNUAL WITHDRAWAL 200,000 gal

Size of Drilled Hole	Size and Weight of Casing	From (Feet)	To (Feet)	PERFORATIONS		
				Kind Size	From (Feet)	To (Feet)
<u>2 1/2"</u>	<u>2 1/2"</u>	<u>0</u>	<u>20</u>	<u>blunt point</u>		

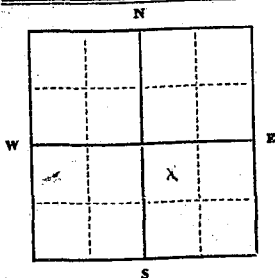

Static water level 12 ft.*
 Pumping water level 13 ft.*
 at 50 gallons per minute,
 measured 1.75 minutes after pumping began.

*Measured from ground level.
 Well developed by pumping
 for 4 1/2 hours.
 Power gas Pump 3 1/2 HP
 Remarks: (Gravel packing, cementing, packers, type of shutoff)

INDICATE LOCATION OF WELL AND PLACE OF USE, IF POSSIBLE. EACH SMALL SQUARE REPRESENTS 40 ACRES.

Driller's Signature Eugene K. Ruppert

Driller's Address 2022 Miles Ave

LICENSE NO. none required

County Yellowstone

DRILLER'S LOG

Indicate the character, color, thickness of strata such as soil, clay, sand, gravel, shale, sandstone, etc. Show depth at which water is found and height to which water rises in well.

Top of Ground (Elev. above sea level)	
From (Feet)	To (Feet)
	<u>along</u>
	<u>12' water level</u>
	<u>gravel</u>
	<u>20' bottom</u>

Show exact depth of bottom

938270

STATE OF MONTANA, }
County of Yellowstone, } ss.
This instrument was filed in my office
JUN 29 1979
this _____ day of _____ 19____
at 10:00 o'clock AM
MERRILL M. KLUNDT
County Clerk & Recorder
By J. Jew Deputy
2 a

RECEIVED

County Yellowstone

STATE OF MONTANA
ADMINISTRATOR OF GROUNDWATER CODE
MONTANA WATER RESOURCES BOARD

MAY 21 1972

DRILLER'S LOG

Indicate the character, color, thickness of strata such as soil, clay, sand, gravel, shale, sandstone, etc. Show depth at which water is found and height to which water rises in well.

NOTICE OF COMPLETION OF GROUNDWATER APPROPRIATION BY MEANS OF WELL

Developed after January 1, 1962

(Under Chapter 237 Montana Session Laws, 1961, as amended)

This form to be prepared by driller, and three copies to be filed by the owner with the County Clerk and Recorder in the county in which the well is located, last copy to be retained by driller. Please answer all questions. If not applicable, so state, otherwise the form may be returned.

Owner Wayne M. Thaler
Address 706 Terry Avenue
Billings, Mont. 59102
Date well started 3/17/72
completed 4/16/72

For Administrator's Use	
File	<u>908238</u>
Date	<u>May 30, 1972 9:18a.m.</u>
GW	<u>1</u>

Type of well driven
(Dug, driven, bored or drilled)
Equipment used drive point
(Churn drill, rotary or other)
Water Use: Domestic Municipal Stock Irrigation
Industrial Drainage Other * Garden/Lawn

*Describe
USE: If used for irrigation, industrial, drainage or other. Explain, state number of acres and location or other data (i.e. Lot, Block and Addition).

Lots 38 & 39, Block 1a
Yellowstone Addition
ESTIMATED ANNUAL WITHDRAWAL 103,680 gallons

Size of Drilled Hole	Size and Weight of Casing	From (Feet)	To (Feet)	PERFORATIONS		
				Kind	From (Feet)	To (Feet)
<u>2 inches</u>	<u>2" drive pipe</u>	<u>ground level</u>	<u>21 ft. below surface</u>	<u>8' drilled hole</u>	<u>18'</u>	<u>21'</u>

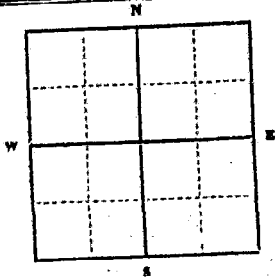

Static water level 11 ft.*
Pumping water level 2 ft.*
at 100 gallons per minute,
measured 15 minutes after pumping
began.
*Measured from ground level.
Well developed by dr. phosph.
for 12 hours.
Power Drinking Pump 3/4 HP
Remarks: (Gravel packing, cementing,
packers, type of shutoff)

1/4 Sec. 4
T. 1 N. R. 26 CB
W

INDICATE LOCATION OF WELL AND PLACE OF USE, IF POSSIBLE. EACH SMALL SQUARE REPRESENTS 40 ACRES.

Driller's Signature Wayne M. Thaler
Driller's Address 726 Terry Ave
Billings, Montana LICENSE NO. _____

Top of Ground (Elev. above sea level)

From (Feet)	To (Feet)	
<u>1</u>	<u>3</u>	<u>22A soil</u>
<u>3</u>	<u>13</u>	<u>hard clay</u>
<u>13</u>	<u>18</u>	<u>gravel</u>
<u>18</u>	<u>21</u>	<u>gravel sand</u>

21 ft. Show exact depth of bottom

908238

STATE OF MONTANA } ss.
County of Yellowstone

This instrument was filed in my office

on MAY 30, 1978

at 9:18 o'clock A. M.
TAMARIS H. STANDEE
County Clerk & Recorder

By Carol B. Brown Deputy

5200

938202

STATE OF MONTANA,) ss.
County of Yellowstone.)
This instrument was filed in my office
this 29 day of 1973 at
at 2:41 o'clock A. M.
MERRILL F. KLUNDY
County Clerk & Recorder
By [Signature] Deputy

[Signature]

RECEIVED

JUN 14 1972

County YELLOWSTONE

STATE OF MONTANA
ADMINISTRATOR OF GROUNDWATER CODE
MONTANA WATER RESOURCES BOARD

MONTANA DEPARTMENT OF WATER RESOURCES AND IRRIGATION

Indicate the character, color, thickness of strata such as soil, clay, sand, gravel, shale, sandstone, etc. Show depth at which water is found and height to which water rises in well.

NOTICE OF COMPLETION OF GROUNDWATER APPROPRIATION BY MEANS OF WELL

Developed after January 1, 1962

(Under Chapter 237 Montana Session Laws, 1961, as amended)

This form to be prepared by driller, and three copies to be filed by the owner with the County Clerk and Recorder in the county in which the well is located, last copy to be retained by driller. Please answer all questions. If not applicable, so state, otherwise the form may be returned.

Owner WALTER H. HETENB WALLACE - 8 Million
RUTH H. FROST - 8 Million

For Administrator's Use
Address 728-732 CUSTER AVE Sale 909298
Bullings MONT. 59102 June 13, 1972 9:10am.
Date well started MAY 29 1972 GW 1
completed MAY 30 1972

Type of well driven (Dug, driven, bored or drilled)
Equipment used driver (Churn drill, rotary or other)

Water Use: Domestic Municipal Stock Irrigation

Industrial Drainage Other Garden/Lawn

*Describe RECREATIONAL AND MANUFACTURING

USE: If used for irrigation, industrial, drainage or other. Explain, state number of acres and location or other data (i.e. Lot, Block and Addition). 6.5 ACRES - 700 BLK CUSTER AVE
YELLOWSTONE SUBDIVISION

ESTIMATED ANNUAL WITHDRAWAL 16 Million Gals

Size of Drilled Hole	Size and Weight of Coating	From (Feet)	To (Feet)	PERFORATIONS		
				Kind Size	From (Feet)	To (Feet)
<u>3 1/2"</u>	<u>11#</u>	<u>0</u>	<u>27'</u>	<u>Cutting touch</u>	<u>22'</u>	<u>27'</u>

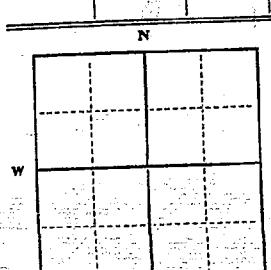

Static water level 14 ft.*
Pumping water level 16 ft.*
at 40 gallons per minute,
measured 20 minutes after pumping began.
*Measured from ground level.
Well developed by P.O.P.
for 5 hours.
Power Elec. Pump 1 1/2
Remarks: (Gravel packing, cementing, packers, type of shutoff)

Well Sub. 12 Add
Foot 23.75 436 Ad 374 W 2125 938 - Blk 5
T. 1 N. R. 26 E S 10

INDICATE LOCATION OF WELL AND PLACE OF USE, IF POSSIBLE. EACH SMALL SQUARE REPRESENTS 40 ACRES.

Driller's Signature Lo Desjardins
Driller's Address 14023 Roundup Road
Land O Drilling LICENSE NO. 188

Top of Ground (Elev. above sea level)	
From (Feet)	To (Feet)
<u>0</u>	<u>11</u>
<u>11</u>	<u>15</u>
<u>15</u>	<u>27</u>

Top Soil
Clay
Gravel
Water Sand

Show exact depth of bottom

50,605

909298

STATE OF MONTANA } ss.
County of Yellowstone }
This instrument was filed in my office
this JUN 18 1972 day of _____ 1972
at 9:10 o'clock A M.
MORRIS L. KLUNDT
County Clerk & Recorder
By [Signature] Deputy

[Signature]

937905

STATE OF MONTANA, }
County of Yellowstone, } ss.
This instrument was filed in my office
this JUN 28 1973 day of
at 8:39 o'clock A M.
MERTIL E. BLUNDT
County Clerk & Recorder
By CBB Deputy

8/202

File No.

RECEIVED

T. 15 R. 260

DUPLICATE

MAR 2 1972

YELLOWSTONE COUNTY, MONTANA

STATE OF MONTANA
ADMINISTRATOR OF GROUNDWATER CODE
OFFICE OF STATE ENGINEER

Top of Ground

(Elev. above sea level.....)

Notice of Completion of Groundwater Appropriation by Means of Well

(Under Chapter 237, Montana Session Laws, 1961)

Owner WILLIS ZEIBER Address 224 So. 35th StDriller Unknown Address Unknown

Date of Notice of Appropriation of Groundwater.....

Date well started 8-14-71 Date Completed 8-16-71Type of well DRIVEN Equipment Used.....
(dug, driven, bored or drilled) (Churn, drill, rotary or other)Water Use: Domestic Municipal Other Irrigation
Industrial Drainage Stock

Indicate on the diagram the character and thickness of the different strata met with in drilling, such as soil, clay, shale, gravel, rock or sand, etc. Show depth at which water is encountered, thickness and character of water-bearing strata and height to which water rises in the well.

13' top soil

3' shale

11' rock + gravel-sand

Size of Drilled Hole	Size and Weight of Casing	From (Feet)	To (Feet)	PERFORATIONS		
				Kind Size	From (Feet)	To (Feet)
3"	3"					

2 Highland add
50x40 SE
Corner Blk 14

3, 4, 7, 8
1/4 Sec. 4 T. 15 R. 260

Indicate location of well and place of use, if possible. Each small square represents 10 acres.

27'

Show exact depth of bottom.

Static Water Level for non-flowing Well..... 18 feet.

Shut-in Pressure for Flowing Well.....

Pumping Water Level 16' feet at 85 gal. per minute.

Discharge in gal. per min. of flowing well.....

How Tested..... Length of Test.....

Remarks: (Gravel packing, cementing, packers, type of shutoff, location of place of use of groundwater if not at well, and any other similar pertinent information, including number of acres irrigated, if used for irrigation)

Doc. No. 9018-50 Unknown
Filed for record Driller's License Number
this 2 day of March
A. D. 19 72, at 4:10
o'clock P.M. Unknown
Driller's Signature

This form to be prepared by driller, and three copies to be filed by the owner with the County Clerk and Recorder in the county in which the well is located.

Please answer all questions. If not applicable, so state, otherwise the form will be returned.

Original to the County Clerk and Recorder; duplicate to the State Engineer; Triplicate to the Montana Bureau of Mines and Geology and Quadruplicate for the Appropriator.

49,960

901850

Groundwater Section
Sam W. Mitchell Building
Helena, Montana 59601

Doc. No. 901850

STATE OF MONTANA, } ss.
County of Yellowstone, }
This instrument was filed in my office
this MAR 1 1972 day of Mar, 1972
at 4:10 o'clock P. M.
MERRILL H. KLUNDT
County Clerk & Recorder
By [Signature] Deputy

200

As the Administrator of the Groundwater Code for the State of Montana, please take note of the following special instructions, in order to properly protect your groundwater right.

Special Instructions:

Please provide, as indicated in red on the enclosed form, the complete location of the well by providing the section number, also indicate the static water level, and gallons per minute of water use claimed for irrigation.

Thank you.

RECEIVED

APR 21 1972

MONTANA DEPARTMENT OF NATURAL
INDUSTRIES AND CONSERVATION

11' static water level - bearing struts and height to which water rises in the well

Notice of Completion of Groundwater Appropriation by Means of Well

(Under Chapter 237, Montana Session Laws, 1961)

Owner WILLIS ZEILER Address 224 So 35th St

Driller Unknown Address Unknown

Date of Notice of Appropriation of Groundwater _____

Date well started 8-14-71 Date Completed 8-16-71

Type of well DRIVEN Equipment Used _____
 (dug, driven, bored or drilled) (Churn, drill, rotary or other)

Water Use: Domestic Municipal Other Irrigation
 Industrial Drainage Stock

Indicate on the diagram the character and thickness of the different strata met with in drilling, such as soil, clay, shale, gravel, rock or sand, etc. Show depth at which water is encountered, thickness and character of water-bearing strata and height to which water rises in the well.

RECEIVED

APR 21 1972

MONTANA DEPARTMENT OF NATURAL RESOURCES AND CONSERVATION

13' top soil

3' shale

11' rock + gravel-sand

Size of Drilled Hole	Size and Weight of Casing	From (Feet)	To (Feet)	PERFORATIONS		
				Kind Size	From (Feet)	To (Feet)
3"	3"					

2 Highland add
 50x40 SE
 Corner Blk 14

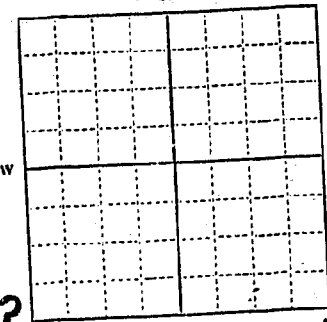

3475 IS 26E

Indicate location of well and place of use, if possible. Each small square represents 10 acres.

? Static Water Level for non-flowing Well 18 feet.

Shut-in Pressure for Flowing Well _____

Pumping Water Level 16' feet at 85 gal. per minute?

Discharge in gal. per min. of flowing well _____

How Tested _____ Length of Test _____

Remarks: (Gravel packing, cementing, packers, type of shutoff, location of place of use of groundwater if not at well, and any other similar pertinent information, including number of acres irrigated, if used for irrigation) _____

Show exact depth of bottom.

Doc. No. 9018-50 Unknown
 Filed for record Driller's License Number
 this 2 day of March
 A. D. 19 72 at 4:10
 o'clock P.M. Unknown
 Driller's Signature

This form to be prepared by driller, and three copies to be filed by the owner with the County Clerk and Recorder in the county in which the well is located.

Please answer all questions. If not applicable, so state, otherwise the form will be returned.

Original to the County Clerk and Recorder; duplicate to the State Engineer; Triplicate to the Montana Bureau of Mines and Geology and Quadruplicate for the Appropriator.

49,960

910027

Informal
from

Please provide
undated

Owner
Address
Location
Doc. No.
Clark
1715 N. 26th St.
910027

Special Instructions:
As the Administrator of the Groundwater Code for the State of Montana, I hereby authorize the following special instructions, in order to properly protect the public interest in the water resources and conservation of the State of Montana.

STATE OF MONTANA
County of Yellowstone
JUN 22 1972
By *[Signature]* Deputy

ja

T. 15 R. 26E

County Yellowstone

MONTANA BUREAU OF MINES AND GEOLOGY
Butte, Montana

RECEIVED
MAY 15 1957

WATER WELL LOG

STATE ENGINEER

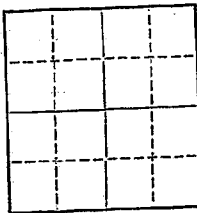

Owner Peter G. Bush Address 1727 Clark ave
Billings

Driller Keith Jones Address 10 45th St. Billings

Date Started April 6, 1953 Date Completed April 7, 1953

Location: Sec. 6 T. 15 R. 26E 1/4 sec. lot 10 block 1 Burg subdivision of Billings Montana

Type of well Driven Equipment used Wet-Mulson case 300# weight
(Dug, driven, bored, or drilled) (Churn drill, rotary, other)

Water use: Domestic Municipal Stock Irrigation
Industrial Drainage Other: _____

Casing: 21 ft. to _____ ft. Type H.P. pipe Size 2"

Casing: _____ ft. to _____ ft. Type _____ Size _____

Casing: _____ ft. to _____ ft. Type _____ Size _____

Perforated or Screened: Ft. 21 to ft. 20 Ft. _____ to ft. _____

Type of screen or perforations end of pipe blower with 1 inch of dynamite

Static Water level, for non-flowing well: from top of ground 12 feet.

Shut-in pressure, for flowing well: _____ lb./sq. in. on: _____ (date)

Pumping water level: 14 feet at _____ 20 gal. per min.

How tested: pumped with 2" gas pump with 1 1/2" suction & 1/2" discharge

Length of test: 8 hrs. with pumping full vacuum & 1/2" of water

Remarks: (Gravel packing, cementing, packers, type of shut-off, depth of shut-off)

(over)

911847

Underwater Section Building
San W. Mitchell
Helena, Montana 59601

Division Resources and Conservation
As the Administrator of the Groundwater Code for the State of Montana
note of the following special instructions, in order to properly provide
Special Instructions:

NOTE:
water level well
attached from garden per minute
development in
Becker

Owner: John A. Becker
Address: 117 S. 8th St.
Location: Helena, MT
Doc. No.: 911847
59/62

STATE OF MONTANA, } ss.
County of Yellowstone, }
This instrument was filed in my office
this 18 day of July 1972
at 9:20 o'clock A. M.
MURRELL H. KLUNDT
County Clerk & Recorder
By Carol B. Berlin Deputy

200

RECEIVED
JUL 16 1972

County Yellowstone

STATE OF MONTANA
ADMINISTRATOR OF GROUNDWATER CODE
MONTANA WATER RESOURCES BOARD
NOTICE OF COMPLETION OF GROUNDWATER
APPROPRIATION BY MEANS OF WELL

MONTANA DEPARTMENT OF NATURAL
RESOURCES AND CONSERVATION

DRILLER'S LOG

Indicate the character, color, thickness of strata such as soil, clay, sand, gravel, shale, sandstone, etc. Show depth at which water is found and height to which water rises in well.

Developed after January 1, 1962

(Under Chapter 237 Montana Session Laws, 1961, as amended)

This form to be prepared by driller, and three copies to be filed by the owner with the County Clerk and Recorder in the county in which the well is located, last copy to be retained by driller. Please answer all questions. If not applicable, so state, otherwise the form may be returned.

Owner Thomas D. Beven
Address 1113 St. Johns Avenue
Billings, Montana
Date well started June 28, 1972
completed June 28, 1972

For Administrator's Use
File 91088.3
July 5, 1972 12:32pm
GW 1

Type of well Driven
(Dug, driven, bored or drilled)

Equipment used Post Driver
(Churn drill, rotary or other)

Water Use: Domestic Municipal Stock Irrigation

Industrial Drainage Other Garden/Lawn

Location: Block 2 Mellor Sub Lot 4 Block 1 A10974

USE: If used for irrigation, industrial, drainage or other. Explain, state number of acres and location or other data (i.e. Lot, Block and Addition)

ESTIMATED ANNUAL WITHDRAWAL 375,000 Gal.

Size of Drilled Hole	Size and Weight of Casing	From (Feet)	To (Feet)	PERFORATIONS		
				Kind Size	From (Feet)	To (Feet)
3"	3" Drill Stem	Surface	26'6"	1/4" Slits	26'6"	21'6"

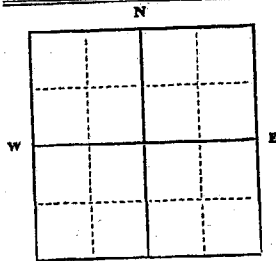

Static water level 13' 5" ft.*
Pumping water level Unknown ft.*
atgallons per minute,
measuredminutes after pumping
began.
*Measured from ground level.
Well developed by
forhours.
Power..... Pump..... HP
Remarks: (Gravel packing, cementing,
packers, type of shutoff)

S 2 1/4 Sec. 5
T. 1 N.R. 26 E
S W

INDICATE LOCATION OF WELL AND PLACE OF USE, IF POSSIBLE.
EACH SMALL SQUARE REPRESENTS 40 ACRES.

Driller's Signature Thomas D. Beven

Driller's Address 1113 St. Johns

Billings, Montana

LICENSE NO.

26 1/2' Show exact depth of bottom

50,825
50,825

910883

STATE OF MONTANA, } ss.
County of Yellowstone, }
This instrument was filed in my office
this 11th day of 1972 19
at 12:32 o'clock P. M.
by MERRIL R. KLUNDT
County Clerk & Recorder
By Jaw Deputy

RECEIVED
JUL 6 1972
County Yellowstone

DRILLER'S LOG
Indicate the character, color, thickness of strata such as soil, clay, sand, gravel, shale, sandstone, etc. Show depth at which water is found and height to which water rises in well.
(See above sec 142b)

STATE OF MONTANA
DEPARTMENT OF NATURAL RESOURCES
STATE OF MONTANA CODE
ADMINISTRATOR OF GROUNDWATER RESOURCES BOARD
NOTICE OF COMPLETION OF GROUNDWATER APPROPRIATION BY MEANS OF WELL
Developed after January 1, 1962, as amended
Montana Session Laws 1961, as amended
Three copies to be filed in the county in which well and recorder in the county in which well is located, otherwise the State, otherwise the

Top of Ground	
From	To
0	10
10	20
20	30
30	40
40	50
50	60
60	70
70	80
80	90
90	100
100	110
110	120
120	130
130	140
140	150
150	160
160	170
170	180
180	190
190	200
200	210
210	220
220	230
230	240
240	250
250	260
260	270
270	280
280	290
290	300
300	310
310	320
320	330
330	340
340	350
350	360
360	370
370	380
380	390
390	400
400	410
410	420
420	430
430	440
440	450
450	460
460	470
470	480
480	490
490	500
500	510
510	520
520	530
530	540
540	550
550	560
560	570
570	580
580	590
590	600
600	610
610	620
620	630
630	640
640	650
650	660
660	670
670	680
680	690
690	700
700	710
710	720
720	730
730	740
740	750
750	760
760	770
770	780
780	790
790	800
800	810
810	820
820	830
830	840
840	850
850	860
860	870
870	880
880	890
890	900
900	910
910	920
920	930
930	940
940	950
950	960
960	970
970	980
980	990
990	1000

FILED 6 1972

County _____

STATE OF MONTANA
ADMINISTRATOR OF GROUNDWATER CODE
MONTANA WATER RESOURCES BOARD
DEPARTMENT OF NATURAL RESOURCES AND CONSERVATION

NOTICE OF COMPLETION OF GROUNDWATER APPROPRIATION BY MEANS OF WELL

Developed after January 1, 1962

(Under Chapter 237 Montana Session Laws, 1961, as amended)

This form to be prepared by driller, and three copies to be filed by the owner with the County Clerk and Recorder in the county in which the well is located, last copy to be retained by driller.

Please answer all questions. If not applicable, so state, otherwise the form may be returned.

DRILLER'S LOG
Indicate the character, color, thickness of strata such as soil, clay, sand, gravel, shale, sandstone, etc. Show depth at which water is found and height to which water rises in well.

Top of Ground (Elev. above sea level) _____

From (Feet)	To (Feet)	
0	12	SOIL
12	20	CLAY
20	26 1/2	SAND * GRAVEL

Owner Thomas D. Beven

Address 1113 St. Johns Avenue
Billings, Montana

Date well started June 28, 1972

completed June 28, 1972

For Administrator's Use

File 910883

July 5, 1972 12:32pm

GW 1

Type of well Driven
(Dug, driven, bored or drilled)

Equipment used Post Driver
(Churn drill, rotary or other)

Water Use: Domestic Municipal Stock Irrigation

Industrial Drainage Other Garden/Lawn

Location: Section 2, Teller Sub Lot 3 Block 1 A10974

USE: If used for irrigation, industrial, drainage or other. Explain, state number of acres and location or other data (i.e. Lot, Block and Addition).

ESTIMATED ANNUAL WITHDRAWAL 375,000 Gal.

Size of Drilled Hole	Size and Weight of Casing	From (Feet)	To (Feet)	PERFORATIONS		
				Kind Size	From (Feet)	To (Feet)
3"	3" Drill Stem	Surface	26'6"	1" Slits	26'6"	21'6"

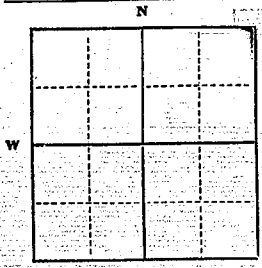

Static water level 13' 5" ft.*
Pumping water level Unknown ft.*
at 50 gallons per minute
measured _____ minutes after pumping began.

*Measured from ground level.
Well developed by _____
for _____ hours.
Power _____ Pump _____ HP
Remarks: (Gravel packing, cementing, packers, type of shutoff)

5' x 5' Sec. 5
T. 7 N-R. 26 E
S. W.

INDICATE LOCATION OF WELL AND PLACE OF USE, IF POSSIBLE. EACH SMALL SQUARE REPRESENTS 40 ACRES.

Driller's Signature Thomas D. Beven

Driller's Address 1113 St. Johns
Billings, Montana

LICENSE NO. _____

26 1/2' Show exact depth of bottom

50.825

Relief No. 2.

T. 15 R. 26 E

RECEIVED

County Yellowstone

JUL 13 1960

MONTANA BUREAU OF MINES AND GEOLOGY
Butte, Montana

STATE ENGINEER

WATER WELL LOG

Owner: Buttraps Address: Grand ave. Billings
 Driller: Clyde Sando Address: 1141 Miles Ave. Billings
 Date Started: May 1, 1959 Date Completed: May 9, 1959
 Location: Sec. 5 T. 15 R. 26 E 1/4 sec. North

Type of well: Drilled Equipment used: Cable
(Dug, driven, bored, or drilled) (Churn drill, rotary, other)

Water use: Domestic Municipal Stock Irrigation
 Industrial Drainage Other: Relief

Casing: 0 ft. to 23 ft. Type: black pipe Size: 8 inch

Casing: _____ ft. to _____ ft. Type _____ Size _____

Casing: _____ ft. to _____ ft. Type _____ Size _____

Perforated or Screened: Ft. _____ to ft. _____ Ft. _____ to ft. _____

Type of screen or perforations: open bottom

Static water level, for non-flowing well: _____ feet.

Shut-in pressure, for flowing well: _____ lb./sq. in. on: _____ (date)

Pumping water level: bottom feet at 6.0 gal. per min.

How tested: pump

Length of test: 2 hrs.

Remarks: (Gravel packing, cementing, packers, type of shut-off, depth of shut-off)

(over)

No. 1.

T. 15 R. 26E
County Yellowstone

RECEIVED
MAY 13 1960

MONTANA BUREAU OF MINES AND GEOLOGY
Butte, Montana

STATE ENGINEER

WATER WELL LOG

Owner: Buttricks Address: Spurd over, Billings
 Driller: Clyde Sando Address: 1141 Miles ave, Billings
 Date Started: May 1, 1959 Date Completed: May 19, 1959
 Location: Sec. 5 T. 15 R. 26E 1/4 sec. N

Type of well: Drilled Equipment used: Cable
(Dug, driven, bored, or drilled) (Churn drill, rotary, other)

Water use: Domestic Municipal Stock Irrigation
 Industrial Drainage Other: Refrigeration

Casing: 0 ft. to 26 1/2 ft. Type: black w/face Size: 7.2 inches
 Casing: _____ ft. to _____ ft. Type: _____ Size: _____
 Casing: _____ ft. to _____ ft. Type: _____ Size: _____

Perforated or Screened: Ft. _____ to Ft. _____ to Ft. _____
 Type of screen or perforations: open bottom casing

Static Water level, for non-flowing well: _____ feet.
 Shut-in pressure, for flowing well: _____ lb./sq. in. on: _____ (date)

Pumping water level: 10 feet at 7.5 gal per min.

How tested: pump
 Length of test: 2 1/2 hours

Remarks: (Gravel packing, cementing, packers, type of shut-off, depth of shut-off)

(over)

File No. STATE WATER CONSERVATION BOARD

T. R. County

DUPLICATE

JAN 4 1966

STATE OF MONTANA

ADMINISTRATOR OF GROUNDWATER CODE
OFFICE OF STATE ENGINEER

Declaration of Vested Groundwater Rights
(Under Chapter 21, Montana Session Laws, 1965)

1. J C Cooley (Name of appropriator) of 928 Cook Ave (Address) Billings (Town)
County of Yellowstone State of Montana
have appropriated groundwater according to the Montana laws in effect prior to January 1, 1962, as follows:

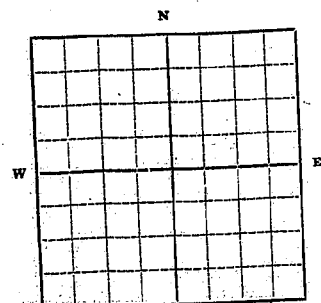

1/4 Sec. 5, T. 15, R. 26E

Indicate point of appropriation and place of use, if possible. Each small square represents 10 acres.

- 2. The beneficial use on which the claim is based: Lawn & Garden
- 3. Date or approximate date of earliest beneficial use; and how continuous the use has been: 6-1-1953
During Summer - during
morning hours
- 4. The amount of groundwater claimed (in miner's inches or gallons per minute): 15 gal. per min
- 5. If used for irrigation, give the acreage and description of the lands to which water has been applied and name of the owner thereof
- 6. The means of withdrawing such water from the ground and the location of each well or other means of withdrawal: Small
Pump with 1/2 Horse Power motor

- 7. The date of commencement and completion of the construction of the well, wells, or other works for withdrawal of groundwater: May 30, 1953 - Complete June 1 - 53
- 8. The depth of water table: 15 ft
- 9. So far as it may be available, the type, size and depth of each well or the general specifications of any other works for the withdrawal of groundwater: 2 in drilled hole - casing 5 1/2 in
to iron pipe
- 10. The estimated amount of groundwater withdrawn each year: 43200 Gal
- 11. The log of formations encountered in the drilling of each well if available: Soil - Subsoil - 4 ft
about 2 ft sand
- 12. Such other information of a similar nature as may be useful in carrying out the policy of this act, including reference to book and page of any county record: not applicable

Signature of Owner: J C Cooley
Date: Dec - 30 - 65

Three copies to be filed by the owner with the County Clerk and Recorder of the county in which the well is located. Please answer all questions. If not applicable, so state, otherwise the form will be returned. Original to the County Clerk and Recorder; duplicate to the State Engineer; Triplicate to the School of Mines and Quadruplicate for the Appropriator.

40548

769175

DEC 30 1965

P
2.00

MISSISSIPPI

MISSISSIPPI

File No. _____

STATE WATER CONSERVATION BOARD

County Yellowstone

DUPLICATE

JUL 7 1967

STATE OF MONTANA
ADMINISTRATOR OF GROUNDWATER CODE
OFFICE OF STATE ENGINEER

Top of Ground _____
(Elev. above sea level 3200 Approx.)
Bottom _____
Depth _____

**Notice of Completion of Groundwater
Appropriation by Means of Well**

(Under Chapter 237, Montana Session Laws, 1961)

Owner E.L. Danssaert Address 1007 Central Ave. Billings

Driller E.L. Danssaert Address same

Date of Notice of Appropriation of Groundwater None

Date well started 10-15-66 Date Completed May 12, 1967

Type of well boxed with Augur Equipment Used Augur
(dug, driven, bored or drilled) (Churn, drill, rotary or other)

Water Use: Domestic Municipal Other Irrigation
Industrial Drainage Stock

Encountered soft soil
ONLY and a little gravel
at the bottom

Water first encountered
at approx. 14'

Indicate on the diagram the character and thickness of the different strata met with in drilling, such as soil, clay, shale, gravel, rock or sand, etc. Show depth at which water is encountered, thickness and character of water-bearing strata and height to which water rises in the well.

Size of Drilled Hole	Size and Weight of Casing	From (Feet)	To (Feet)	PERFORATIONS		
				Rind Size	From (Feet)	To (Feet)
2"	2" Black Steel pipe	21' from top	21' Depth	1/4" Holes	21'	surface

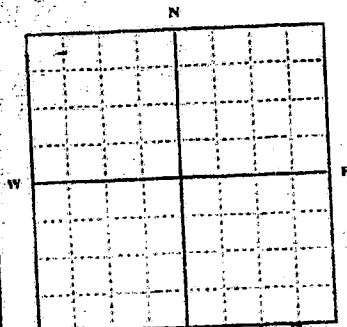

Lot 3 + E. 9' Lot 4 Dahl Run
..... 1/4 Sec..... T..... R.....
Indicate location of well and place of use, if possible. Each small square represents 10 acres.

211 Show exact depth of bottom.

Static Water Level for non-flowing Well None feet.

Shut-in Pressure for Flowing Well For irrigation only

Pumping Water Level at 14' feet at _____ gal per minute.

Discharge in gal per min. of flowing well about 500 gals per hour

How Tested None Length of Test None

Remarks: (Gravel packing, cementing, packers, type of shutoff, location of place of use of groundwater if not at well, and any other similar pertinent information, including number of

acres irrigated, if used for irrigation) about 1/10th of an Acre

The well is about in middle of the lot and at the north East corner of the Garage

Driller's License Number

E.L. Danssaert
Driller's Signature

This form to be prepared by driller, and three copies to be filed by the owner with the County Clerk and Recorder in the county in which the well is located.

Please answer all questions. If not applicable, so state; otherwise the form will be returned.

Original to the County Clerk and Recorder; duplicate to the State Engineer; Triplicate to the Montana Bureau of Mines and Geology and Quadruplicate for the Appropriator.

42.117

File No. 9W2 Sec. 5 T. 15 R. 26 E
 STATE WATER CONSERVATION BOARD
 County Yellowstone

DUPLICATE

JUL 7 1967

STATE OF MONTANA
 ADMINISTRATOR OF GROUNDWATER CODE
 OFFICE OF STATE ENGINEER

Top of Ground _____
 (Elev. above sea level) 3200 Approx. silver
 Bitter _____

Notice of Completion of Groundwater Appropriation by Means of Well
 (Under Chapter 237, Montana Session Laws, 1961)

Owner E.L. Dansaert Address 1007 Central Ave. Billings
 Driller E.L. Dansaert Address same
 Date of Notice of Appropriation of Groundwater None
 Date well started 10-15-66 Date Completed May 12, 1967
 Type of well bored with Augur Equipment Used Augur
 (dug, driven, bored or drilled) (Churn, drill, rotary or other)
 Water Use: Domestic Municipal Other Irrigation
 Industrial Drainage Stock

Encountered soft soil
 ONLY and a little gravel
 at the bottom

Water first encountered
 at approx. 11'

Indicate on the diagram the character and thickness of the different strata met with in drilling, such as soil, clay, shale, gravel, rock or sand, etc. Show depth at which water is encountered, thickness and character of water-bearing strata and height to which water rises in the well.

Size of Drilled Hole	Size and Weight of Casing	From (Feet)	To (Feet)	PERFORATIONS		
				Kind Size	From (Feet)	To (Feet)
2"	2" Black Steel Pipe	21'	21' Depth	1/4" Holes	21'	surface

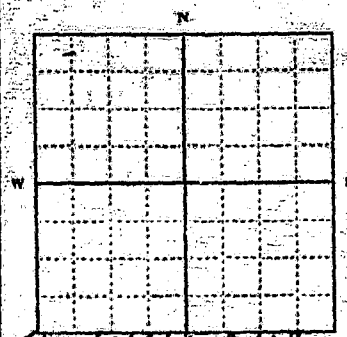

Lot 32 E. 9th 1/2th Dahl Sun
 _____ Sec. _____ T. _____ R. _____
 Indicate location of well and place of use, if possible. Each small square represents 10 acres.

Static Water Level for non-flowing Well None feet
 Shut-in Pressure for Flowing Well For irrigation only _____
 Pumping Water Level at 11' feet at _____ gal. per minute
 Discharge in gal. per min. of flowing well about 500 gals per hour
 How Tested None Length of Test None
 Not tested - irrigation purposes ONLY
 Remarks: (Gravel packing, cementing, packers, type of shutoff, location of place of use of groundwater if not at well, and any other similar pertinent information, including number of acres irrigated, if used for irrigation) about 1/10th of an Acre

The well is about in the middle of the lot and at the north East corner of the Garage

Driller's License Number _____
E. L. Dansaert
 Driller's Signature

This form to be prepared by driller, and three copies to be filed by the owner with the County Clerk and Recorder in the county in which the well is located.

Please answer all questions. If not applicable, so state, otherwise the form will be returned.

Original to the County Clerk and Recorder; duplicate to the State Engineer; Triplicate to the Montana Bureau of Mines and Geology and Quadruplicate for the Appropriator.

42118

801859

STATE OF MONTANA,
County of Yellowstone,

This instrument was filed in my office
this 6 day of JULY 1967 at

at 12:40 o'clock P.M.

acting County Clerk & Recorder

By [Signature] Deputy

72

938416

STATE OF MONTANA }
County of Yellowstone } ss.

This instrument was filed in my office
this 29 day of JUN 1973

at 1:42 o'clock P.

MERRIL M. KLUNDE
County Clerk & Recorder

By [Signature] Deputy

22

RECEIVED
JUN 14 1973

YELLOWSTONE COUNTY, MONTANA

STATE OF MONTANA
ADMINISTRATOR OF GROUNDWATER
MONTANA WATER RESOURCES BOARD

NOTICE OF COMPLETION OF GROUNDWATER
APPROPRIATION BY MEANS OF WELL

Developed after January 1, 1962

(Under Chapter 237 Montana Session Laws, 1961, as amended)

This form to be prepared by driller, and three copies to be filed by the owner with the County Clerk and Recorder in the county in which the well is located, last copy to be retained by driller. Please answer all questions. If not applicable, so state, otherwise the form may be returned.

Owner: Joe Duschnea
Address: 404 Miles Ave
BILLINGS MONT.

For Administrator's Use	
File	<u>936337</u>
Date	<u>JUNE 13 1973</u>
GW T.	<u>8:00 P.M.</u>

Date well started 7/1/72
completed 7/1/72

Type of well DRIVEN (Dug, driven, bored or drilled)

Equipment used DRIVER - HAMMER (Churn drill, rotary or other)

Water Use: Domestic Municipal Stock Irrigation
Industrial Drainage Other * Garden/Lawn

* Describe

USE: If used for irrigation, industrial, drainage or other. Explain, state number of acres and location or other data (i.e. Lot, Block

and Addition). LOT 3, BIRB NORMANDY TRACT, 3rd FILING
ESTIMATED ANNUAL WITHDRAWAL 500,000

Size of Drilled Hole	Size and Weight of Casing	From (Feet)	To (Feet)	PERFORATIONS		
				Kind Size	From (Feet)	To (Feet)
<u>2 7/8"</u>	<u>2 3/8" #12</u>	<u>0'</u>	<u>20'</u>	<u>1/2" cut</u>	<u>16'</u>	<u>19'</u>

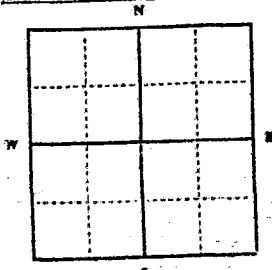

Static water level 12 ft.*
Pumping water level 19 ft.*
at 19 gallons per minute,
measured 30 minutes after pumping
began.
*Measured from ground level.
Well developed by
for hours.
Power: 20 Pump HP
Remarks: (Gravel packing, cementing,
packers, type of shutoff)

1 34 5 E
1 26 W

INDICATE LOCATION OF WELL AND PLACE OF USE, IF POSSIBLE.
EACH SMALL SQUARE REPRESENTS 40 ACRES.

Driller's Signature SAME AS ABOVE

Driller's Address

LICENSE NO.

DRILLER'S LOG

Indicate the character, color, thickness of strata such as soil, clay, sand, gravel, shale, sandstone, etc. Show depth at which water is found and height to which water rises in well.

Top of Ground		(Elev. above sea level)
From (Feet)	To (Feet)	
0	8'	Top Soil
8	9'	Dark clay
9	19'	Shale & Sand
		WATER AT 12'

20' Show exact depth of bottom

ANR

936337

STATE OF MONTANA, }
County of Yellowstone, } ss.

This instrument was filed in my office

this 13 day of 1973

at 8:00 o'clock A. M.

MERRILL M. KLUNDT

County Clerk & Recorder

By [Signature] Deputy

Jay

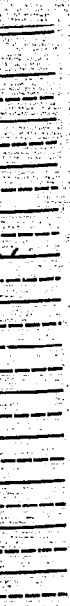

bottom

12

STATE OF MONTANA
 ADMINISTRATOR OF GROUNDWATER CODE
 MONTANA WATER RESOURCES BOARD

RECEIVED
 JUL 3 1973

County Yellowstone

NOTICE OF COMPLETION OF GROUNDWATER
 APPROPRIATION BY MEANS OF WELL
 Developed after January 1, 1962

MONTANA DEPARTMENT OF NATURAL
 RESOURCES AND CONSERVATION

DRILLER'S LOG

Indicate the character, color, thickness of strata such as soil, clay, sand, gravel, shale, sandstone, etc. Show depth at which water is found and height to which water rises in well.

(Under Chapter 237 Montana Session Laws, 1961, as amended)

This form to be prepared by driller, and three copies to be filed by the owner with the County Clerk and Recorder in the county in which the well is located; last copy to be retained by driller. Please answer all questions. If not applicable, so state, otherwise the form may be returned.

Owner James E. Erickson
 Address 1118 Lynn
Billings Montana
 Date well started July 15, 1972
 completed July 15, 1972

For Administrator's Use
 File 938542
6-29-73
 GW 1 4:10 p.m.

Type of well Domestic
 Equipment used Hand
 Water Use: Domestic Municipal Stock Irrigation
 Industrial Drainage Other * Garden/Lawn

*Describe
 USE: If used for irrigation, industrial, drainage or other. Explain, state number of acres and location or other data (i.e. Lot, Block and Addition). Sander Spn Sub Lot 1981K

ESTIMATED ANNUAL WITHDRAWAL

Size of Drilled Hole	Size and Weight of Casing	From (Feet)	To (Feet)	PERFORATIONS		
				Kind	From (Feet)	To (Feet)
3"	3"	0	20'	SLIT	12'	20'

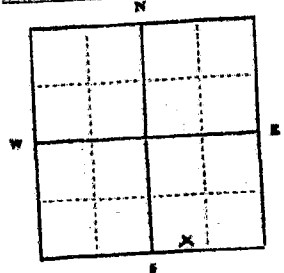

Static water level 12 ft.*
 Pumping water level 18 ft.*
 at 12 gallons per minute,
 measured 60 minutes after pumping began.
 *Measured from ground level.
 Well developed by 1
 for 60 hours Min
 Power: Electric Pump 1/4 HP
 Remarks: (Gravel packing, cementing, packers, type of shutoff)

INDICATE LOCATION OF WELL AND PLACE OF USE, IF POSSIBLE. EACH SMALL SQUARE REPRESENTS 40 ACRES.

Driller's Signature James E. Erickson
 Driller's Address 1118 Lynn Billings Montana

LICENSE NO. _____

Top of Ground (Elev. above sea level)	
From (Feet)	To (Feet)
11	2
2	20
<u>Top Soil</u>	
<u>Sand & Gravel</u>	

20' Show exact depth of bottom

55711

County Yellowstone

STATE OF MONTANA
ADMINISTRATOR OF GROUNDWATER CODE
MONTANA WATER RESOURCES BOARD

RECEIVED

DRILLER'S LOG

NOTICE OF COMPLETION OF GROUNDWATER
APPROPRIATION BY MEANS OF WELL

Developed after January 1, 1962

MONTANA DEPARTMENT OF NATURAL
RESOURCES AND CONSERVATION

1973

Indicate the character, color, thick-
ness of strata such as soil, clay, sand,
gravel, shale, sandstone, etc. Show
depth at which water is found and
height to which water rises in well.

(Under Chapter 237 Montana Session Laws, 1961, as amended)

This form to be prepared by driller, and three copies to be filed
by the owner with the County Clerk and Recorder in the county in
which the well is located, last copy to be retained by driller.

Please answer all questions. If not applicable, so state, otherwise the
form may be returned.

Owner James R. Kwickel
Address 1118 E. Lynn
Bozeman, Montana
Date well started July 15, 1972
completed July 15, 1972

For Administrator's Use
File <u>938845</u>
<u>67973</u>
GW <u>4107111</u>

Type of well Hand
(Dug, driven, bored or drilled)

Equipment used Hand
(Churn drill, rotary or other)

Water Use: Domestic Municipal Stock Irrigation

Industrial Drainage Other * Garden/Lawn

*Describe

USE: If used for irrigation, industrial, drainage or other. Explain,
state number of acres and location or other data (i.e. Lot, Block
and Addition). SANDERSON Sub Lot 1981K

ESTIMATED ANNUAL WITHDRAWAL

Size of Drilled Hole	Size and Weight of Casing	From (Feet)	To (Feet)	PERFORATIONS		
				Kind Size	From (Feet)	To (Feet)
2"	2"	0	20'	Slit 12'	20'	

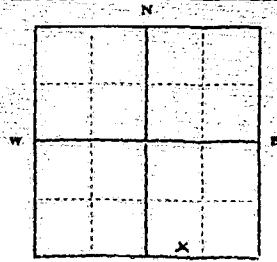

Static water level 1.6 ft.*
Pumping water level 18 ft.*
at 1.2 gallons per minute,
measured 10 minutes after pumping
began.

*Measured from ground level.
Well developed by 1.5 hours.
Power 1/4 HP.
Remarks: (Gravel packing, cementing,
packers, type of shutoff)

Sub Sec 5
T 1 N 24 E
S 5

INDICATE LOCATION OF WELL AND PLACE OF USE, IF POSSIBLE.
EACH SMALL SQUARE REPRESENTS 40 ACRES.

Driller's Signature James R. Kwickel

Driller's Address 1118 E Lynn Bozeman MT

LICENSE NO.

Top of Ground (Elev. above sea level)

From (Feet)	To (Feet)	
<u>0</u>	<u>2</u>	<u>Tap 50%</u>
<u>2</u>	<u>20</u>	<u>Sandy Gravel</u>

Show exact depth of bottom

55/111

938542

STATE OF MONTANA } ss.
County of Yellowstone }
This instrument was filed in my office
this JUN 29 1973 day of _____ 19____
at 4:10 o'clock P M.
MERRILL H. KLUNDT
County Clerk & Recorder
By CRB Deputy

200

File No.

T. J. S. R. 26
County Gallatin

ORIGINAL

STATE OF MONTANA
ADMINISTRATOR OF GROUNDWATER CODE
OFFICE OF STATE ENGINEER

RECEIVED
JAN 2 1964

DECLARATION OF VESTED GROUNDWATER RIGHTS
(Under Chapter 237, Montana Session Laws, 1961)

STATE ENGINEER

1. Estevade & Family, of 924 Milner Billings
(Name of Appropriator) (Address) (Town)

County of Gallatin State of Montana
have appropriated groundwater according to the Montana laws in effect prior to
January 1, 1962, as follows:

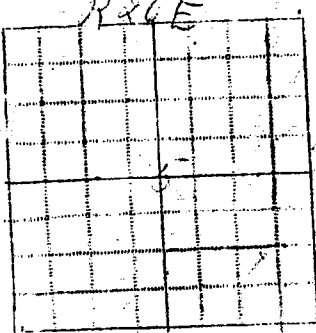

SE 1/4 Sec. 5 T. 12 N. R. 26
Indicate point of appropriation
and place of use, if possible.
Each small square represents
10 acres.

2. The beneficial use on which the claim is based
to Sprinkle Forest
3. Date or approximate date of earliest beneficial
use; and how continuous the use has been about 20
4. The amount of groundwater claimed (in miner's
inches or gallons per minute) 1000 gallons
5. If used for irrigation, give the acreage and
description of the lands to which water has been
applied and name of the owner thereof
Laura Estevade
6. The means of withdrawing such water from the
ground and the location of each well or other
means of withdrawal
Hand-dug Wells
7. The date of commencement and completion of the construction of the well, wells,
or other works for withdrawal of groundwater
8. The depth of water table 22 ft
9. So far as it may be available, the type, size and depth of each well or the gen-
eral specifications of any other works for the withdrawal of groundwater
10. The estimated amount of groundwater withdrawn each year
11. The log of formations encountered in the drilling of each well if available
12. Such other information of a similar nature as may be useful in carrying out the
policy of this act, including reference to book and page of any county record

Signature of Owner Estevade & Family
Date Dec 31 1963

Three copies to be filed by the owner with the County Clerk and Recorder of the
county in which the well is located.
Please answer all questions. If not applicable, so state, otherwise the form will
be returned.
Original to the County Clerk & Recorder; Duplicate to the State Engineer; Triplicate
to the Montana Bureau of Mines and Geology, and quadruplicate for the appropriator

721640

STATE OF MONTANA,
County of Yellowstone,

This instrument was filed in my office

on 2-26 day DEC 31 1963 M.

Jaw
20
Notary Public
County

RECEIVED

AUG 16 1972

County Yellowstone

STATE OF MONTANA
ADMINISTRATOR OF GROUNDWATER CODE
MONTANA WATER RESOURCES BOARD

MONTANA DEPARTMENT OF NATURAL RESOURCES AND CONSERVATION

DRILLER'S LOG

NOTICE OF COMPLETION OF GROUNDWATER APPROPRIATION BY MEANS OF WELL

Developed after January 1, 1962

(Under Chapter 237 Montana Session Laws, 1961, as amended)

This form to be prepared by driller, and three copies to be filed by the owner with the County Clerk and Recorder in the county in which the well is located, last copy to be retained by driller. Please answer all questions. If not applicable, so state, otherwise the form may be returned.

Indicate the character, color, thickness of strata such as soil, clay, sand, gravel, shale, sandstone, etc. Show depth at which water is found and height to which water rises in well.

Top of Ground (Elev. above sea level)

From (Feet)	To (Feet)	
0	14	Top Soil and Sandy Clay
14	27	Gravel and Sand

Owner Sylvia Fields

Address 939 Terry Ave
Billings, Mt.

Date well started 6-3-72

completed 6-3-72

For Administrator's Use	
File	<u>913892</u>
Date	<u>August 15, 1972 10:40am</u>
GW	<u>1</u>

Type of well Driven (Dug, driven, bored or drilled)

Equipment used Driver (Churn drill, rotary or other)

Water Use: Domestic Municipal Stock Irrigation
Industrial Drainage Other * Garden/Lawn

*Describe

USE: If used for irrigation, industrial, drainage or other. Explain, state number of acres and location or other data (i.e. Lot, Block and Addition): Bk. 10 Broadwater Sub

ESTIMATED ANNUAL WITHDRAWAL 1,000,000 gpd

Size of Drilled Hole	Size and Weight of Casing	From (Feet)	To (Feet)	PERFORATIONS		
				Kind Size	From (Feet)	To (Feet)
<u>3 1/2"</u>	<u>11 #</u>	<u>0'</u>	<u>27'</u>	<u>1/8" Cut</u>	<u>20'</u>	<u>27'</u>

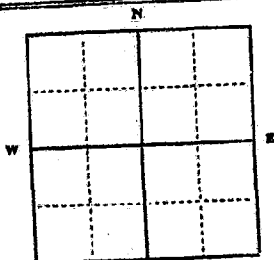

Static water level 12 ft.*
Pumping water level 13 ft.*
at 15 gallons per minute,
measured 20 minutes after pumping
began.

*Measured from ground level.
Well developed by T.M.P.
for 5 hours.

Power..... Pump..... HP
Remarks: (Gravel packing, cementing, packers, type of shutoff)

INDICATE LOCATION OF WELL AND PLACE OF USE, IF POSSIBLE. EACH SMALL SQUARE REPRESENTS 40 ACRES.

Driller's Signature L. Kern Jewett

Driller's Address 14223 Round Road 13195
L. D. Orly LICENSE NO. 188195

27'
27' Show exact depth of bottom

913892

STATE OF MONTANA
County of Yellowstone
This instrument was filed in my office
this 10-10 day of August 1972 at
BY Jaid County Clerk & Recorder
2a Deputy

STATE OF MONTANA
County of Yellowstone
This instrument was filed in my office
this 10-10 day of August 1972 at
BY Jaid County Clerk & Recorder
2a Deputy

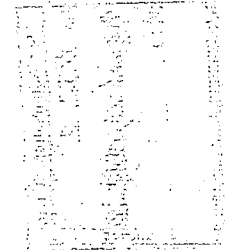

Handwritten notes and signatures on the right side of the document, including what appears to be a date '10-10-72' and some illegible text.

938397

STATE OF MONTANA, } ss.
County of Yellowstone.

This instrument was filed in my office

this JUN 20 1973 of 19
at 1:25 o'clock P M.

MERRILL H. KLUNDT
County Clerk & Recorder

By [Signature] Deputy

ja

STATE OF MONTANA
ADMINISTRATOR OF GROUNDWATER CODE
MONTANA WATER RESOURCES BOARD
**NOTICE OF COMPLETION OF GROUNDWATER
APPROPRIATION BY MEANS OF WELL**
Developed after January 1, 1962

County Yellowstone

DRILLER'S LOG

Indicate the character, color, thickness of strata such as soil, clay, sand, gravel, shale, sandstone, etc. Show depth at which water is found and height to which water rises in well.

(Under Chapter 237 Montana Session Laws, 1961, as amended)

This form to be prepared by driller, and three copies to be filed by the owner with the County Clerk and Recorder in the county in which the well is located, last copy to be retained by driller. Please answer all questions. If not applicable, so state, otherwise the form may be returned.

Owner John J. Thompson
Address 930 Baxter Ave
Biggs, Mont
Date well started 5-19-73
completed 5-19-73

For Administrator's Use	
File	<u>938346</u>
	<u>6-29-73</u>
GW 1	<u>12:30 p.m.</u>

Type of well Driven (Dug, driven, bored or drilled)

Equipment used Driver (Cable drill, rotary or other)

Water Use: Domestic Municipal Stock Irrigation

Industrial Drainage Other * Garden/Lawn

*Describe

USE: If used for irrigation, industrial, drainage or other. Explain, state number of acres and location or other data (i.e. Lot, Block and Addition). See site 14-20-73

ESTIMATED ANNUAL WITHDRAWAL 150,000 Gal

Size of Drilled Hole	Size and Weight of Casing	From (Feet)	To (Feet)	PERFORATIONS		
				Kind	From (Feet)	To (Feet)
<u>3 1/2"</u>	<u>3 1/2" 11#</u>	<u>0</u>	<u>27</u>	<u>1/8" cut</u>	<u>22'</u>	<u>27'</u>

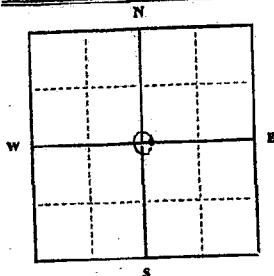

Static water level 10 ft.*
Pumping water level 12 ft.*
at 30 gallons per minute,
measured 30 minutes after pumping began.

*Measured from ground level.
Well developed by Pump
for 6 hours.

Power Pump HP
Remarks: (Gravel packing, cementing, packers, type of shutoff)

INDICATE LOCATION OF WELL AND PLACE OF USE, IF POSSIBLE. EACH SMALL SQUARE REPRESENTS 40 ACRES.

Driller's Signature L. O. Drilling
Driller's Address 14023 Roundup Rd
L & O Drilling LICENSE NO. 188

Top of Ground		(Elev. above sea level)
From (Feet)	To (Feet)	
<u>0</u>	<u>2</u>	<u>Top Soil</u>
<u>2</u>	<u>15</u>	<u>Sandy Clay</u>
<u>15</u>	<u>27</u>	<u>Gravel and Sand</u>
		<u>Water at 15'</u>

27
27 Show exact depth of bottom

938346

STATE OF MONTANA, } 35.
County of Yellowstone, } 86.
This instrument was filed in my office
this JUN 29 1973 day of _____
at 12:30 o'clock AM
by MERRILL F. BLUNDY
County Clerk & Recorder
By [Signature] Deputy

710

RECEIVED
JUL 10 1972

County... YELLOWSTONE

STATE OF MONTANA
ADMINISTRATOR OF GROUNDWATER CODE
MONTANA WATER RESOURCES BOARD

NOTICE OF COMPLETION OF GROUNDWATER
APPROPRIATION BY MEANS OF WELL

Developed after January 1, 1962

(Under Chapter 237 Montana Session Laws, 1961, as amended)

This form to be prepared by driller, and three copies to be filed by the owner with the County Clerk and Recorder in the county in which the well is located, last copy to be retained by driller. Please answer all questions. If not applicable, so state, otherwise the form may be returned.

Owner F. S. Frankovic

Address 421 Merwin

Billings, Montana

Date well started 5/27/72

completed 5/27/72

Type of well Driven

(Dug, driven, bored or drilled)

Equipment used gas operated pounder

(Crown drill, rotary or other)

Water Use: Domestic Municipal Stock Irrigation

Industrial Drainage Other * Garden/Lawn

*Describe

USE: If used for irrigation, industrial, drainage or other. Explain, state number of acres and location or other data (i.e. Lot, Block and Addition)

South 22 Feet of Lot 13 and North 55 Ft. Lot 4, Block 2
and Addition Sydney T. Olson Subdivision

ESTIMATED ANNUAL WITHDRAWAL 120,000

Size of Drilled Hole	Size and Weight of Casing	From (Feet)	To (Feet)	PERFORATIONS		
				Kind	From (Feet)	To (Feet)
2 7/8"	2 7/8" 6 lbs per ft. 1" thk	0	25	slits 12"lg 1/4"wd	0	7

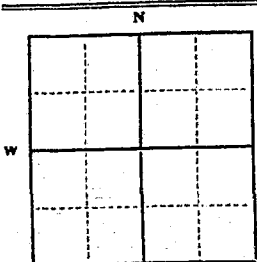

SW 1/4 NW 1/4 S 5 T 1 R 26 E

Static water level 14 ft.* 25
Pumping water level 16 ft.*
at 18 gallons per minute,
measured 120 minutes after pumping
began.

*Measured from ground level.
Well developed by pumping
for 50 hours.
Power ELEC Pump 1 1/2 HP
Remarks: (Gravel packing, cementing,
packers, type of shutoff) valves

INDICATE LOCATION OF WELL AND PLACE OF USE, IF POSSIBLE.
EACH SMALL SQUARE REPRESENTS 40 ACRES.

Driller's Signature Bill Schindler

Driller's Address 2915 10th Ave So.
Billings, Mont.

LICENSE NO. 106

DRILLER'S LOG

Indicate the character, color, thickness of strata such as soil, clay, sand, gravel, shale, sandstone, etc. Show depth at which water is found and height to which water rises in well.

Top of Ground (Elev. above sea level)

From (Feet)	To (Feet)	
0 1/2'	1'	TOP SOIL
1'	16'	CLAY
16'	25'	16" BELOW GROUND WATER RISES WATER-FOUND

25' Show exact depth of bottom

50,856

JNE

ck-
nd,
ow
nd
ell.

WGL
ND

S
ND

bottom
856

911083

STATE OF MONTANA } ss.
 County of Yellowstone } ss.
 This instrument was filed in my office
 this JUL 7 1972 of _____ 19____
 at 1:44 of said _____ P. M.

 County Clerk & Ex. Sec.
 By [Signature] Deputy

[Signature]

RECEIVED
 JUL 10 1972
 COUNTY CLERK
 YELLOWSTONE COUNTY
 MONTANA

938369

STATE OF MONTANA }
County of Yellowstone } ss.
This instrument was filed in my office
this JUN 29 1973 19
at 12:53 o'clock P. M.
MERRILL H. KEUNDE
County Clerk & Recorder
By C. B. [Signature] Deputy

[Signature]

GV
File No.
DUPLICATE

T 15 R 26 E S
County Yellowstone

STATE OF MONTANA
ADMINISTRATOR OF GROUNDWATER CODE
OFFICE OF STATE ENGINEER

RECEIVED
AUG 6 1963
STATE ENGINEER

Declaration of Vested Groundwater Rights
(Under Chapter 287, Montana Session Laws, 1961)

1. Robert G. and Beulah T. Green, of 1701 Clark Avenue Billings, Montana
(Name of Appropriator) (Address) (Town)
County of Yellowstone State of Montana
have appropriated groundwater according to the Montana laws in effect prior to January 1, 1962, as follows:

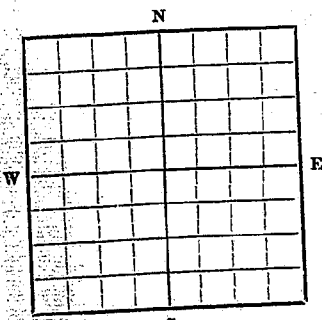

Lot 1, Block 1, Burg Subdivision
2nd Filing, 1701 Clark Ave., Billings, Mont.
1/4 Sec. 5, T. 15, R. 26, E. 5

Indicate point of appropriation and place of use, if possible. Each small square represents 10 acres.

2. The beneficial use on which the claim is based
Irrigation

3. Date or approximate date of earliest beneficial use; and how continuous the use has been
June 1953 and continuous since

4. The amount of groundwater claimed (in miner's inches or gallons per minute)
Approximately 70 gallons per minute

5. If used for irrigation, give the acreage and description of the lands to which water has been applied and name of the owner thereof
City lot described at left

6. The means of withdrawing such water from the ground and the location of each well or other means of withdrawal
A driven well; with electric pump

7. The date of commencement and completion of the construction of the well, wells, or other works for withdrawal of groundwater
started and completed in June 1953

8. The depth of water table
water encountered 14 feet below the surface

9. So far as it may be available, the type, size and depth of each well or the general specifications of any other works for the withdrawal of groundwater
2" driven well, 21' deep
1-1/2 h.p. electric motor

10. The estimated amount of groundwater withdrawn each year
varies with the rainfall - approximately 300,000 gallons

11. The log of formations encountered in the drilling of each well if available
None

12. Such other information of a similar nature as may be useful in carrying out the policy of this act, including reference to book and page of any county record
None

Signature of Owner
Robert G. Green
Beulah T. Green

Date June 25, 1963

Three copies to be filed by the owner with the County Clerk and Recorder of the county in which the well is located.

Please answer all questions. If not applicable, so state, otherwise the form will be returned.

Original to the County Clerk and Recorder; duplicate to the State Engineer; Triplicate to the School of Mines and Quadruplicate for the Appropriator.

527

711836

REGISTERED

RECORDED IN BOOK 711836 PAGE 1

INDEXED IN BOOK 711836 PAGE 1

711836

STATE OF MONTANA,
County of Yellowstone,

This instrument was filed in my office
this AUG 5 day 1963

at 8:15 o'clock A M.
Edmon S. Redding,
County Clerk & Recorder

By MR Deputy

\$
200

T. 15 R. 26 E.
County Yellowstone

MONTANA BUREAU OF MINES AND GEOLOGY
Butte, Montana

RECEIVED
JUL 15 1937

WATER WELL LOG

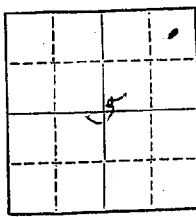

Owner *Charles L. & Mildred M. Heath* Address *542 1/2 W. 1st St. Billings, Wyo.*

Driller *Alfred Sandoz* Address " " "

Date Started *9-1-36* Date Completed *9-12-36*

Location: Sec. *5* T. *15* R. *26 E.* 1/4 sec. *NE 1/4 of NE 1/4*

Type of well *Bored* Equipment used *Churn drill*
(Dug, driven, bored, or drilled) (Churn drill, rotary, other)

Water use: Domestic Municipal Stock Irrigation

Industrial Drainage Other: _____

Casing: *Steel* ft. to *18* ft. Type *Steel* Size *6 inch*

Casing: _____ ft. to _____ ft. Type _____ Size _____

Casing: _____ ft. to _____ ft. Type _____ Size _____

Perforated or Screened: Ft. _____ to ft. _____ Ft. _____ to ft. _____

Type of screen or perforations _____

Static Water level, for non-flowing well: *11 ft down to water 7 ft up to top of casing* feet.

Shut-in pressure, for flowing well: _____ lb./sq. in. on: _____ (date)

Pumping water level: *14* feet at *15 gal* gal. per min.

How tested: *Hand using horse pump & 2 open lines*

Length of test: *4 hours*

Remarks: (Gravel packing, cementing, packers, type of shut-off, depth of shut-off)

*Well completed at 2 pack 2
pump set in place 2nd filling Billings
got ready from 12 1/2 ft of gravel
then started*

(over)

RECEIVED

County Yellowstone

STATE OF MONTANA
ADMINISTRATOR OF GROUNDWATER CODE
MONTANA WATER RESOURCES BOARD
**NOTICE OF COMPLETION OF GROUNDWATER
APPROPRIATION BY MEANS OF WELL**
Developed after January 1, 1962

(Under Chapter 237 Montana Session Laws, 1961, as amended)

This form to be prepared by driller, and three copies to be filed by the owner with the County Clerk and Recorder in the county in which the well is located, last copy to be retained by driller. Please answer all questions. If not applicable, so state, otherwise the form may be returned.

Owner W. Jensen
Address 1009 Central Ave.
Billings Mont
Date well started June 1 - 73
completed June 25 - 73

For Administrator's Use
File <u>937504</u>
<u>June 25, 1973</u>
GW <u>11:10 A.M.</u>

Type of well Driven (Dug, driven, bored or drilled)
Equipment used Pipe Driller (Churn drill, rotary or other)
Water Use: Domestic Municipal Stock Irrigation
Industrial Drainage Other Garden/Lawn

*Describe For Lawn & Garden only
USE: If used for irrigation, industrial, drainage or other. Explain, state number of acres and location (i.e. Lot, Block and Addition). W. 41' Lot 4 - E. 9' 215' Blk. 1
Sub Bld
ESTIMATED ANNUAL WITHDRAWAL 13,000 gal

Size of Drilled Hole	Size and Weight of Casing	From (Feet)	To (Feet)	PERFORATIONS		
				Kind Size	From (Feet)	To (Feet)
<u>2"</u>	<u>2" Poly Weight</u>	<u>1 FT</u>	<u>2 FT</u>			

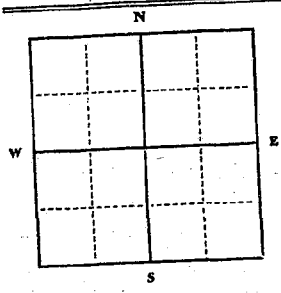

Static water level 12 FT ft.*
Pumping water level 15 ft.*
at 10 gallons per minute,
measured 5 minutes after pumping began.

*Measured from ground level.
Well developed by _____
for _____ hours.
Power Electric Pump 15 HP
Remarks: (Gravel packing, cementing, packers, type of shutoff) _____

Sec. 14 T. 1 S. 26 R. 26 E. 3

INDICATE LOCATION OF WELL AND PLACE OF USE, IF POSSIBLE. EACH SMALL SQUARE REPRESENTS 40 ACRES.

Driller's Signature [Signature]
Driller's Address 1009 Central Ave.

DRILLER'S LOG

Indicate the character, color, thickness of strata such as soil, clay, sand, gravel, shale, sandstone, etc. Show depth at which water is found and height to which water rises in well.

Top of Ground (Elev. above sea level)	
From (Feet)	To (Feet)
<u>1 FT</u>	<u>14 FT</u> <u>SOIL</u>
<u>14 FT</u>	<u>16 FT</u> <u>Sandstone</u>
<u>16 FT</u>	<u>21 FT</u> <u>Gravel & Sand</u>
<u>Rises to</u>	<u>12 FT</u>

51 FT. Show exact depth of bottom

LICENSE NO. _____

53,966

9375 4

STATE OF MONTANA

County Clerk's Office

This instrument was filed in my office

this JUN 25 1973 day

at 11:10 A M.

MURRAY L. H. [unclear]

County Clerk & Recorder

By [Signature] Deputy

20

RECORDED
INDEXED
JUN 25 1973
MONTANA

923738

STATE OF MONTANA, } ss.
County of Yellowstone, }

This instrument was filed in my office

this DEC 27 1972 of _____ 19____

at 8:01 o'clock A M.

MEYER H. KLUNDT

County Clerk & Recorder

By [Signature] Deputy

20

938371

STATE OF MONTANA }
County of Yellowstone }

This instrument was filed in my office

this JUN 28 1983 day of _____ 1983

at 12:55 o'clock P.M.

_____ County Clerk & Recorder

By CBB Secretary

7500

938200

STATE OF MONTANA, } ss.
County of Yellowstone, }
This instrument was filed in my office
this JUN 29 1973 day of _____ 19
at 8:41 o'clock A. M.
of BARRILL COUNTY
by [Signature] Deputy
20

15-26E

RECEIVED County Yellowknife

STATE OF MONTANA
ADMINISTRATOR OF GROUNDWATER CODE
MONTANA WATER RESOURCES BOARD
NOTICE OF COMPLETION OF GROUNDWATER
APPROPRIATION BY MEANS OF WELL
Developed after January 1, 1962

DRILLER'S LOG

Indicate the character, color, thickness of strata such as soil, clay, sand, gravel, shale, sandstone, etc. Show depth at which water is found and height to which water rises in well.

(Under Chapter 237 Montana Session Laws, 1961, as amended)
This form to be prepared by driller, and three copies to be filed by the owner with the County Clerk and Recorder in the county in which the well is located, last copy to be retained by driller. Please answer all questions. If not applicable, so state, otherwise the form may be returned.

Owner Carl J. Larson
Address 931 Terry Ave
Billing, Montana
Date well started 5-21-72
completed 5-21-72

For Administrator's Use
File 3-38349
6-29-73
GW-1 12:33 p.m.

Type of well driven
(Dug, driven, bored or drilled)
Equipment used driller
(Churn drill, rotary or other)
Water Use: Domestic Municipal Stock Irrigation
Industrial Drainage Other Garden/Lawn

*Describe
USE: If used for irrigation, industrial, drainage or other. Explain, state number of acres and location or other data (i.e. Lot, Block and Addition). Brookwater Sub 1-8-19 12-7

ESTIMATED ANNUAL WITHDRAWAL

Size of Drilled Hole	Size and Weight of Casing	PERFORATIONS	
		From (Feet)	To (Feet)
<u>3 1/2"</u>	<u>3 3/4" #11</u>	<u>0</u>	<u>27</u>
			<u>1/8" cut</u>
			<u>25' 26'</u>

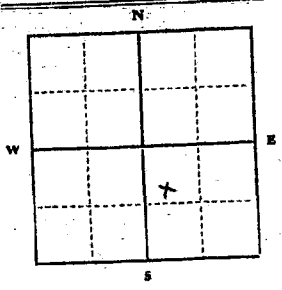

Static water level 10 ft.*
Pumping water level 13 ft.*
at 30 gallons per minute,
measured minutes after pumping began.
*Measured from ground level.
Well developed by P.H.N.P.
for 6 hours.
Power Pump HP
Remarks: (Gravel packing, cementing, packers, type of shutoff)

1/4 Sec. SE N R. 5
15-26E

INDICATE LOCATION OF WELL AND PLACE OF USE, IF POSSIBLE.
EACH SMALL SQUARE REPRESENTS 40 ACRES.

Driller's Signature L. O. Campbell
Driller's Address 14023 Roundup Rd Biggs
L&D Drilling LICENSE NO. 188

Top of Ground (Elev. above sea level)

From (Feet)	To (Feet)	
<u>0</u>	<u>2</u>	<u>Top Soil</u>
<u>2</u>	<u>15</u>	<u>Sandy clay</u>
<u>15</u>	<u>27</u>	<u>Gravel and sand</u>
		<u>Water at 15'</u>

Show exact depth of bottom 27'

938349

STATE OF MONTANA,) ss.
County of Yellowstone,)

This instrument was filed in my office

this JUN 20 1973 19

at 12:33 o'clock P M.

MURRELL H. KLUNDT

County Clerk of Yellowstone

By Jaw Deputy

ju

STATE OF MONTANA
 ADMINISTRATOR OF GROUNDWATER CODE
 MONTANA WATER RESOURCES BOARD

NOTICE OF COMPLETION OF GROUNDWATER
 APPROPRIATION BY MEANS OF WELL

Developed after January 1, 1962

(Under Chapter 237 Montana Session Laws, 1961, as amended)

This form to be prepared by driller, and three copies to be filed by the owner with the County Clerk and Recorder in the county in which the well is located; last copy to be retained by driller. Please answer all questions. If not applicable, so state, otherwise the form may be returned.

Owner GAYLE DOROTHY MCGANN
 Address 1516 CLARK AVE
 Date well started 6-6-73
 completed 6-7-73

For Administrator's Use	
File	<u>937323</u>
Date	<u>June 28, 1973</u>
GW	<u>1 2:13 P.M.</u>

Type of well DRILLED
 (Dug, driven, bored or drilled)
 Equipment used ROTARY
 (Churn drill, rotary or other)
 Water Use: Domestic Municipal Stock Irrigation
 Industrial Drainage Other * Garden/Lawn

*Describe
 USE: If used for irrigation, industrial, drainage or other. Explain, state number of acres and location of other data (i.e. Lot, Block and Addition). Lot 18 Blk 1 - westmeadow

ESTIMATED ANNUAL WITHDRAWAL 9,000 Gal

Size of Drilled Hole	Size and Weight of Casing	From (Feet)	To (Feet)	PERFORATIONS		
				Kind Size	From (Feet)	To (Feet)
<u>8"</u>	<u>6 1/2" Plastic</u>	<u>17</u>	<u>22</u>	<u>1/8" Slots</u>	<u>15</u>	<u>22</u>

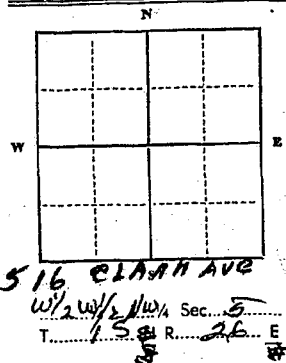

Static water level 13 ft.*
 Pumping water level 20 ft.*
 at 20 gallons per minute,
 measured 120 minutes after pumping
 began.
 *Measured from ground level.
 Well developed by PUMP
 for 10 hours.
 Power Elec. Pump 1/2 HP
 Remarks: (Gravel packing, cementing,
 packers, type of shutoff)
30' to 10' top
12 FT.

INDICATE LOCATION OF WELL AND PLACE OF USE, IF POSSIBLE.
 EACH SMALL SQUARE REPRESENTS 40 ACRES.
 Driller's Signature J.J. Bar
 Driller's Address 3143 PRAIRIE DAIRY
BILLINGS MONT. LICENSE NO. 197

County Yellowstone

DRILLER'S LOG

Indicate the character, color, thickness of strata such as soil, clay, sand, gravel, shale, sandstone, etc. Show depth at which water is found and height to which water rises in well.

Top of Ground		(Elev. above sea level)
From (Feet)	To (Feet)	
<u>0</u>	<u>2</u>	<u>TOP SOIL</u>
<u>2</u>	<u>22</u>	<u>BOULDERS & SAND</u>
<u>22</u>		<u>SHALE</u>
		<u>WATER @ 20 FT.</u>
		<u>WATER @ 12 FT.</u>

22 Show exact depth of bottom

937323

STATE OF MISSISSIPPI, } ss.
County of Lawrence }
This JUN 22 1873 day of _____ 19__
at 2:13 o'clock P M.
MERRILL H. KILPATRICK
County Clerk & Recorder
By [Signature] Deputy

WJR

T. 15 R. 26E

County Yellowstone

MONTANA BUREAU OF MINES AND GEOLOGY
Butte, Montana

RECEIVED
21 1957

WATER WELL LOG

STATE ENGINEER

Owner: Kenneth E. & Leona E. McGiboney Address: 1624 Clark Ave. Billings, Montana
 Driller: Robert G. McCracken Address: 1060 Josephine Dr. Billings, Montana
 Date Started: July 25, 1957 Date Completed: August 8, 1957
 Location: Sec. 5 T. 15 R. 26E 1/4 sec. Lot 19, Block 2, Burg Subdivision, Billings, Montana

Type of well: Driven (Dug, driven, bored, or drilled) Equipment used: Tamper- Motor driven. (Churn drill, rotary, other)

Water use: Domestic Municipal Stock Irrigation
 Industrial Drainage Other: _____

Casing: 22 ft. to ---- ft. Type: Steel Size: 2 inch

Casing: _____ ft. to _____ ft. Type: _____ Size: _____

Casing: _____ ft. to _____ ft. Type: _____ Size: _____

Perforated or Screened: Ft. _____ to ft. _____ Ft. _____ to ft. _____

Type of screen or perforations: _____

Static Water level, for non-flowing well: _____ feet.

Shut-in pressure, for flowing well: _____ lb./sq. in. on: _____ (date)

Pumping water level: _____ feet at _____ gal. per min.

How tested: _____

Length of test: _____

Remarks: (Gravel packing, cementing, packers, type of shut-off, depth of shut-off)

Above information all that was available to well owners.

Kenneth E. McGiboney

(over)

k
d,
w
nd
ll.

938252

STATE OF MONTANA. } ss.
County of Yellowstone. }
This instrument ~~was~~ filed in my office
this _____ day of _____ 19____
at 9-50 o'clock A M.
MERRILL H. KLUNDT
County Clerk & Recorder
By [Signature] Deputy
24

of bottom

55254

File No.

RECEIVED

T.1.S. R.26 East

QUADRUPPLICATE

JUN 29 1973

County Yellowstone

STATE OF MONTANA
MONTANA DEPARTMENT OF ADMINISTRATION
RESOURCES AND CONSERVATION
ADMINISTRATOR OF GROUNDWATER CODE
OFFICE OF STATE ENGINEER

Notice of Completion of Groundwater Appropriation by Means of Well

(Under Chapter 237, Montana Session Laws, 1961) Box 239)

Owner: Walter H. Nelson Address: 1209 Howard
Marie A. Nelson

Driller: L. O. D... Address: ...

Date of Notice of Appropriation of Groundwater:

Date well started: 7/1/71 Date Completed: 8/14/71

Type of well:

(dug, driven, bored or drilled) (Churn, drill, rotary or other)

Water Use: Domestic Municipal Other Irrigation
Industrial Drainage Stock

Indicate on the diagram the character and thickness of the different strata met with in drilling, such as soil, clay, shale, gravel, rock or sand, etc. Show depth at which water is encountered, thickness and character of water-bearing strata and height to which water rises in the well.

Top of Ground
(Elev. above sea level.....)

TOP SOIL

SANDY-CLAY

SAND

WATER AT 35'
15' SAND + GRAVEL
937926
since 28, 1973
9.13.71

SHALE

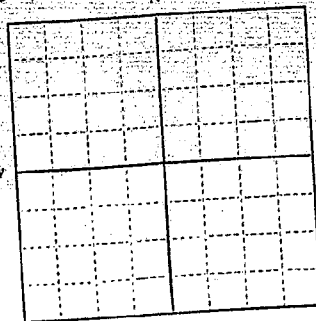

SW 1/4 Sec. 5 T.1.S.R. 26E

Indicate location of well and place of use, if possible. Each small square represents 10 acres.

All of lots 43 & 44 of blk 1 of ... subdivision
Show exact depth of bottom

Size of Drilled Hole	Size and Weight of Casing	From (Feet)	To (Feet)	PERFORATIONS		
				Kind Size	From (Feet)	To (Feet)
3 1/2"	1 1/2"	0	12	41

Static Water Level for non-flowing Well: 14 feet.

Shut-in Pressure for Flowing Well:

Pumping Water Level: 11 feet at 6 gal. per minute.

Discharge in gal. per min. of flowing well: 15

How Tested: ... Length of Test: 12 hrs.

Remarks: (Gravel packing, cementing, packers, type of shutoff, location of place of use of groundwater if not at well, and any other similar pertinent information, including number of acres irrigated, if used for irrigation).

Lawn and gardening irrigation

MONT 188
Driller's License Number

Ray R. Senger
Driller's Signature

This form to be prepared by driller, and three copies to be filed by the owner with the County Clerk and Recorder in the county in which the well is located.

Please answer all questions. If not applicable, so state, otherwise the form will be returned.

Original to the County Clerk and Recorder; duplicate to the State Engineer; Triplicate to the Montana Bureau of Mines and Geology and Quadruplicate for the Appropriator.

54272

File #

T.L.C. R.26. 1973

County Yellowknife

QUADRUPPLICATE

STATE OF MONTANA
ADMINISTRATOR OF GROUNDWATER CODE
OFFICE OF STATE ENGINEER

Notice of Completion of Groundwater
Appropriation by Means of Well

(Under Chapter 237, Montana Session Laws, 1961) Box 239

Owner Walter M. Nelson
Marie A. Nelson Address 1209 Howard

Driller Address

Date of Notice of Appropriation of Groundwater

Date well started 11/1/71 Date Completed 11/1/71

Type of well (dug, driven, bored or drilled) Equipment Used (Churn, drill, rotary or other)

Water Use: Domestic Municipal Other Irrigation
Industrial Drainage Stock

Indicate on the diagram the character and thickness of the different strata met with in drilling, such as soil, clay, shale, gravel, rock or sand, etc. Show depth at which water is encountered, thickness and character of water-bearing strata and height to which water rises in the well.

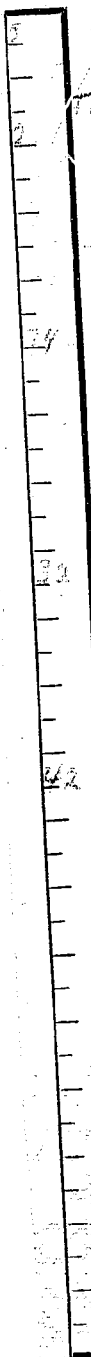

WATER AT 18'
SAND + GRAVEL 38'
937926
June 28, 1973
9.13 H.M.

Size of Drilled Hole	Size and Weight of Casing	From (Feet)	To (Feet)	PERFORATIONS		
				Kind Str	From (Feet)	To (Feet)
		0	2		32	41

Static Water Level for non-flowing Well 18 feet.

Shut-in Pressure for Flowing Well

Pumping Water Level feet at 6 gal. per minute.

Discharge in gal. per min. of flowing well

How Tested Length of Test 12 hours

Remarks: (Gravel packing, cementing, packers, type of shutoff, location of place of use of groundwater if not at well, and any other similar pertinent information, including number of acres irrigated, if used for irrigation)
Lawn and gardening irrigation

Sec. 14, T. 1 N., R. 26 E.
Indicate location of well and place of use, if possible. Each small square represents 10 acres.
All of lots 42, 44, 46, 48, 50, 52, 54, 56, 58, 60, 62, 64, 66, 68, 70, 72, 74, 76, 78, 80, 82, 84, 86, 88, 90, 92, 94, 96, 98, 100.

MONT 158
Driller's License Number
Roy R. Senger
Driller's Signature

This form to be prepared by driller, and three copies to be filed by the owner with the County Clerk and Recorder in the county in which the well is located.
Please answer all questions. If not applicable, so state, otherwise the form will be returned.
Original to the County Clerk and Recorder; duplicate to the State Engineer; Triplicate to the Montana Bureau of Mines and Geology and Quadruplicate for the Appropriator.

54272

937926

STATE OF MONTANA, } ss.
County of Yellowstone, }
This instrument was filed in my office
this JUN 28 1973 day of _____ 1973
at 9:13 o'clock A M.
MERRILL F. FURDT
County Clerk & Recorder
By [Signature] Deputy

[Signature]

File No.

DUPLICATE

T. 15 R. 26 E.

County Yellowstone

STATE OF MONTANA
ADMINISTRATOR OF GROUNDWATER
OFFICE OF STATE ENGINEER

JUN 25 1963

Notice of Completion of Groundwater Appropriation by Means of Well

(Under Chapter 237, Montana Session Laws, 1961)

Owner Louis H. Norman Address 1045 Lewis

Driller William S. Love Address 14th 1st Building

Date of Notice of Appropriation of Groundwater None

Date well started April 23 Date Completed April 23

Type of well Driven Equipment Used Pipe driven
(dug, driven, bored or drilled) (Churn, drill, rotary or other)

Water Use: Domestic Municipal Other Irrigation
Industrial Drainage Stock

Indicate on the diagram the character and thickness of the different strata met with in drilling, such as soil, clay, shale, gravel, rock or sand, etc. Show depth at which water is encountered, thickness and character of water-bearing strata and height to which water rises in the well.

209' sand and gravel
2011' water-bearing sand & gravel

Top of Ground
(Elev. above sea level) 3119

Size of Drilled Hole	Size and Weight of Casing	From (Feet)	To (Feet)	PERFORATIONS		
				Kind Size	From (Feet)	To (Feet)
2 inch	7 inch extra heavy steel pipe	0	20	cut with acetate tooth 2' long 4" wide	0	6

Static Water Level for non-flowing Well 15 feet.

Shut-in Pressure for Flowing Well _____

Pumping Water Level 16 feet at 10 gal. per minute.

Discharge in gal. per min. of flowing well _____

How Tested pump Length of Test 10 minutes

Remarks: (Gravel packing, cementing, packers, type of shutoff, location of place of use of groundwater if not at well, and any other similar pertinent information, including number of acres irrigated, if used for irrigation) used for irrigation

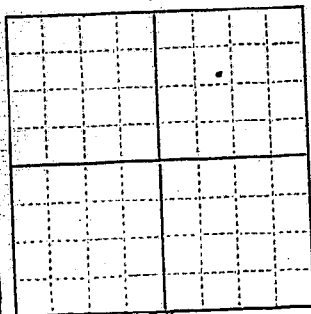

NE 1/4
S.E. 1/4 NW 1/4 Sec. 5 T. 15 R. 26 E.

Indicate location of well and place of use, if possible. Each small square represents 10 acres.

Show exact depth of bottom. Person as Set 9 Bl 1 Shinnick Sub

Driller's License Number 98

Driller's Signature William S. Love

This form to be prepared by driller, and three copies to be filed by the owner with the County Clerk and Recorder in the county in which the well is located.

Please answer all questions. If not applicable, so state, otherwise the form will be returned.

Original to the County Clerk and Recorder; duplicate to the State Engineer; Triplicate to the Montana Bureau of Mines and Geology and Quadruplicate for the Appropriator.

DATE OF RECORDING

709493

709493

STATE OF MONTANA,
County of Yellowstone,

This instrument was filed in my office
this JUN 24 1963 day of

at 4:26 o'clock P.M.

Edmon S. Rodding,
County Clerk & Recorder

By *[Signature]* Deputy

PLATE ENGINEER

[Handwritten notes]

[Handwritten notes]

[Handwritten notes]

RECEIVED

JUL 10 1972

County Yellowstone

STATE PUBLISHING COMPANY

STATE OF MONTANA
ADMINISTRATOR OF GROUNDWATER CODE
MONTANA WATER RESOURCES BOARD

MONTANA DEPARTMENT OF NATURAL
RESOURCES AND CONSERVATION

DRILLER'S LOG

Indicate the character, color, thickness of strata such as soil, clay, sand, gravel, shale, sandstone, etc. Show depth at which water is found and height to which water rises in well.

NOTICE OF COMPLETION OF GROUNDWATER
APPROPRIATION BY MEANS OF WELL

Developed after January 1, 1962

(Under Chapter 237 Montana Session Laws, 1961, as amended)

This form to be prepared by driller, and three copies to be filed by the owner with the County Clerk and Recorder in the county in which the well is located, last copy to be retained by driller. Please answer all questions. If not applicable, so state, otherwise the form may be returned.

Owner Gene Oberwieser

Address 1145 Miles Ave

Billings, Mont.

Date well started 6-10-72

completed 6-12-72

For Administrator's Use	
File	<u>91110.3</u>
Date	<u>July 2, 1972 2:20pm</u>
GW 1	

Type of well DRILLED
(Dug, driven, bored or drilled)

Equipment used CABLE
(Cable drill, rotary or other)

Water Use: Domestic Municipal Stock Irrigation
Industrial Drainage Other * Garden/Lawn

*Describe

USE: If used for irrigation, industrial, drainage or other. Explain, state number of acres and location or other data (i.e. Lot, Block and Addition).

ESTIMATED ANNUAL WITHDRAWAL

Size of Drilled Hole	Size and Weight of Casing	From (Feet)	To (Feet)	PERFORATIONS		
				Kind Size	From (Feet)	To (Feet)
6"	6" 17lb	0	40	1/4x4"	20	60
	5"	0	60			

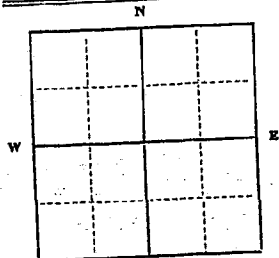

Static water level 20 ft.*
Pumping water level 30 ft.*
at 30 gallons per minute,
measured 30 minutes after pumping
began.
*Measured from ground level.
Well developed by balls
for 3 hours.
Power Pump HP
Remarks: (Gravel packing, cementing,
packers, type of shutoff)

Sec. 26 T. 1 N. R. 26 E.

SE 1/4 1/4 Sec. 5
T. 1 N. R. 26 E.

INDICATE LOCATION OF WELL AND PLACE OF USE, IF POSSIBLE.
EACH SMALL SQUARE REPRESENTS 40 ACRES.

Driller's Signature Clyde Landa

Driller's Address 1532 Dickie P.d. Rt. 2

Billings, Mont. LICENSE NO. 2

Top of Ground (Elev. above sea level)		
From (Feet)	To (Feet)	
0	1	top soil
1	24	yellow clay
24	40	blue shale
40	60	blue coarse sand shale
		water found 45 to 55

60 Show exact depth of bottom

59854

911103

100-1500-1000
SAN FRANCISCO DISTRICT
JUL 11 1912

STATE OF CALIFORNIA
County of ...
This ...
this JUL 7 1912
at 2:20 P. M.
JAMES E. ...
County Clerk & Recorder
By [Signature] Deputy

RECORDED & INDEXED

938111

STATE OF MONTANA, } ss.
County of Yellowstone, }
This instrument was filed in my office
this JUN 28 1973 day of _____
at 2:52 o'clock P M.
MERRILL H. KLUMDT
County Clerk Recorder
By _____ Deputy

je

GW 2

File No.

DUPLICATE

T. 15 R. 26E

County Yellowknife

STATE OF MONTANA
ADMINISTRATOR OF GROUNDWATER CODE
OFFICE OF STATE ENGINEER

RECEIVED
AUG 6 1963

Top of Ground
(Elev. above sea level) 3119

Notice of Completion of Groundwater
Appropriation by Means of Well

(Under Chapter 237, Montana Session Laws, 1961)

Owner *A. J. Patterson* Address *715 Cook Valley road*

Driller *William S. Love* Address *Barzord 1 mile*

Date of Notice of Appropriation of Groundwater

Date well started *Aug 2, 1963* Date Completed *Aug 2, 1963*

Type of well *drum* Equipment Used *page driller*
(dug, driven, bored or drilled) (Churn, drill, rotary or other)

Water Use: Domestic Municipal Other Irrigation
Industrial Drainage Stock

Indicate on the diagram the character and thickness of the different strata met with in drilling, such as soil, clay, shale, gravel, rock or sand, etc. Show depth at which water is encountered, thickness and character of water-bearing strata and height to which water rises in the well.



Size of Drilled Hole	Size and Weight of Casing	From (Feet)	To (Feet)	PERFORATIONS		
				Kind Size	From (Feet)	To (Feet)
2 1/2"	2" standard steel pipe	0	20	cut with acetone torch 8" long 1/2" thick	0	6

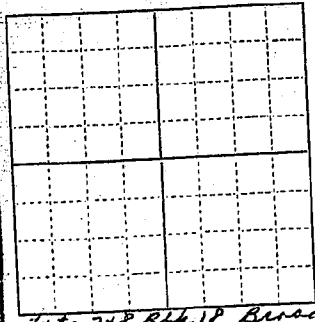

Indicate location of well and place of use, if possible. Each small square represents 10 acres.

Show exact depth of bottom.

Static Water Level for non-flowing Well *10* feet

Shut-in Pressure for Flowing Well

Pumping Water Level *5* feet at *10* gal. per minute

Discharge in gal. per min. of flowing well

How Tested *pump* Length of Test *10 minutes*

Remarks: (Gravel packing, cementing, packers, type of shutoff, location of place of use of groundwater if not at well, and any other similar pertinent information, including number of

acres irrigated, if used for irrigation) *used for irrigation.*

89
Driller's License Number

William S. Love
Driller's Signature

This form to be prepared by driller, and three copies to be filed by the owner with the County Clerk and Recorder in the county in which the well is located.

Please answer all questions. If not applicable, so state, otherwise the form will be returned.

Original to the County Clerk and Recorder; duplicate to the State Engineer; Triplicate to the Montana Bureau of Mines and Geology and Quadruplicate for the Appropriator.

711910

STATE OF MONTANA
County of Yellowstone

This instrument was filed in my office
this 5 day of AUG 1968
at 3:04 o'clock PM M.

Edmon S. Reading,
County Clerk & Recorder
By Jaw Deputy

[Faint, mostly illegible text, likely a recording or filing stamp]

[Vertical stamp or text]

[Vertical stamp or text]

[Handwritten note at the bottom of the page]

[Handwritten note]

[Handwritten note]

[Handwritten note]

[Handwritten note]

[Handwritten note]

[Handwritten note]

[Handwritten note]

[Handwritten note]

933364

STATE OF MONTANA,)
County of Yellowstone,) ss.
This instrument was filed in my office
this MAY 4 1973, at
at 12:26 o'clock P.M.
MERRIL N. LUNDT
County Clerk & Recorder

By Jaw Deputy
Ja

937478

Handwritten notes:
E. J. ...
D. ...
C. ...
M. ...
J. ...

Vertical text on right edge:
RECEIVED
JUN 28 1973
M.M.

STATE OF MONTANA }
County of Yellowstone }

This instrument was filed in my office
this JUN 25 1973

at 9:40 A.M.

MERRILL E. ...

By Jaw Deputy

Handwritten initials: Jaw

928449

STATE OF MONTANA, } ss.
County of Yellowstone, }
This instrument was filed in my office
MAR 5 1973 day of _____ 19__
at 9:40 o'clock A. M.
MERRY L. KLUNDT
County Clerk of Yellowstone
By [Signature] Deputy

[Signature]

938201

STATE OF MONTANA, }
County of Yellowstone, } ss.
This instrument was filed in my of
this 8 day of JUN 23 1917
at 8:42 o'clock A
MERRILL H. KLUNDT
County Clerk & Recorder
By [Signature] Dep.

700

938073

STATE OF MONTANA, } ss.
County of Yellowstone, }
This instrument was filed in my office
this JUN 28 1973 day of _____
at 2:14 o'clock P M.
MERRILL F. KLUNDT
County Clerk & Recorder
By: [Signature] Deputy

[Signature]

T. 15 R. 26E
County. YELLOWSTONE

MONTANA BUREAU OF MINES AND GEOLOGY
Butte, Montana

RECEIVED
MAY 15 1957

WATER WELL LOG

Owner. ARTHUR SCHROTENBOER Address. STATE ENGINEER
17 MILES FIVE

Driller..... Address.....
Date Started. 5/1/40 Date Completed. 9/15/40
Location: Sec. 5 T. 15 R. 26E ¼ sec

Type of well. DUG Equipment used. HAND SHOVEL
(Dug, driven, bored, or drilled) (Churn drill, rotary, other)

Water use: Domestic Municipal Stock Irrigation
Industrial Drainage Other:.....

Casing: T.I.P. ft. to 18 ft. Type. CONCRETE Size. 30 inch

Casing:..... ft. to..... ft. Type..... Size.....

Casing:..... ft. to..... ft. Type..... Size.....

Perforated or Screened: Ft..... to ft..... Ft..... to ft.....

Type of screen or perforations.....

Static Water level, for non-flowing well:..... feet.

Shut-in pressure, for flowing well:..... lb./sq. in. on:..... (date)

Pumping water level..... feet at..... gal. per min.....

How tested:.....

Length of test.....

Remarks: (Gravel packing, cementing, packers, type of shut-off, depth of shut-off)

Lots 9+10 Block 11 Broadwater Sub.

GW

File No. _____

DUPLICATE

T. 15 R. 26 E.
County Yellowstone

STATE OF MONTANA
ADMINISTRATOR OF GROUNDWATER CODE
OFFICE OF STATE ENGINEER

RECEIVED
JUL 20 1965

Declaration of Vested Groundwater Rights
(Under Chapter 21, Montana Session Laws, 1965)

STATE ENGINEER

1. Arthur L. Watne and Mrs. Anne Watne of 1232 Burlington Avenue
(Name of Appropriator) (Address) (Town)
County of Yellowstone State of Montana
have appropriated groundwater according to the Montana laws in effect prior to January 1, 1962, as follows:

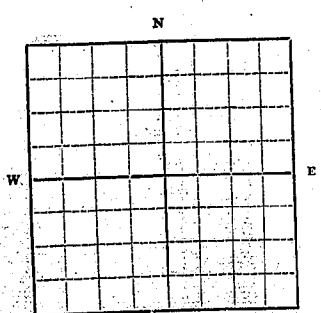

Sec. 3
1/4 Sec. 5 T. 15 R. 26 E.

Indicate point of appropriation and place of use, if possible. Each small square represents 10 acres.
2 Eckroth Sub. Lots 10-11 and 1/2 12

- 2. The beneficial use on which the claim is based Irrigation
- 3. Date or approximate date of earliest beneficial use; and how continuous the use has been March, 1954
as required
- 4. The amount of groundwater claimed (in miner's inches or gallons per minute) unlimited
- 5. If used for irrigation, give the acreage and description of the lands to which water has been applied and name of the owner thereof
2 Eckroth Sub. Lots 10-11 and 1/2 of 12
Arthur L. Watne and Mrs. Anne, husband and wife
- 6. The means of withdrawing such water from the ground and the location of each well or other means of withdrawal
shallow well jet impeller type pump

- 7. The date of commencement and completion of the construction of the well, wells, or other works for withdrawal of groundwater March, 1954
- 8. The depth of water table 11 feet below surface
- 9. So far as it may be available, the type, size and depth of each well or the general specifications of any other works for the withdrawal of groundwater shallow well - steel pipe casing
- 10. The estimated amount of groundwater withdrawn each year Varies as the occasion arises
- 11. The log of formations encountered in the drilling of each well if available None
- 12. Such other information of a similar nature as may be useful in carrying out the policy of this act, including reference to book and page of any county record Book 12 Page 25

Signature of Owner Arthur L. Watne
Mrs. Anne Watne
Date July 15 1965

Three copies to be filed by the owner with the County Clerk and Recorder of the county in which the well is located. Please answer all questions. If not applicable, so state, otherwise the form will be returned.
Original to the County Clerk and Recorder; duplicate to the State Engineer; Triplicate to the School of Mines and Quadruplicate for the Appropriator.

39307

#758909

STATE OF MONTANA
County of Yellowstone

This instrument was filed in my office
this 11 day of July 1937

at 2:56 o'clock P M.

Edmon S. Redding,
County Clerk & Recorder

By [Signature] Deputy

R

is
of

o-

th

ner

ding

ated.

s and

39307

