

938258

STATE OF MONTANA, }
County of Yellowstone, }
This instrument was filed in my office
JUN 28 1973
this _____ day of _____ 19____
at _____ o'clock _____ M.
MERRILL M. KLUNDIE
County Clerk & Recorder
By _____ Deputy
20

RECEIVED

JUL 17 1960

MONTANA BUREAU OF MINES AND GEOLOGY
Butte, Montana

STATE ENGINEER

WATER WELL LOG

T. 13 R. 26E
County Yellowstone

Owner Raymond J. Holbert Address Billings, Mont.
Driller Johnson & Koenig Address Billings, Mont.
Date Started _____ Date Completed 2-6-56
Location: Sec. 34 T. 15 R. 26E 1/4 sec. 34, 35

Type of well Drilled Equipment used Churn drill
(Dug, driven, bored, or drilled) (Churn drill, rotary, other)

Water use: Domestic ☒ Municipal ☐ Stock ☐ Irrigation ☐
Industrial ☐ Drainage ☐ Other: _____

Casing: _____ ft. to _____ ft. Type _____ Size _____

Casing: _____ ft. to _____ ft. Type _____ Size _____

Casing: 40 ft. to _____ ft. Type Steel pipe Size 6"

Perforated or Screened: Ft. _____ to ft. _____ Ft. _____ to ft. _____

Type of screen or perforations _____

Static Water level, for non-flowing well: 30 ft. from surface _____ feet.

Shut-in pressure, for flowing well: _____ lb./sq. in. on: _____ (date)

Pumping water level _____ feet at _____ gal. per min. 20 gal. per min.

How tested: Never has been pumped to capacity

Length of test _____

Remarks: (Gravel packing, cementing, packers, type of shut-off, depth of shut-off)

Well located about 30 feet from south point of triangle

Survey No. 77

(over)

RECEIVED

JUL 13 1960

STATE ENGINEER

MONTANA BUREAU OF MINES AND GEOLOGY
Butte, Montana

WATER WELL LOG

Owner Raymond J. Robert Address Billings, Mont.
Driller Johnson & King Address Billings, Mont.
Date Started _____ Date Completed 2-6-56
Location: Sec. 34 T. 15 R. 26E 1/4 sec. 33E, SW

Type of well Drilled Equipment used Charn drill
(Dug, driven, bored, or drilled) (Charn drill, rotary, other)

Water use: Domestic ☒ Municipal ☐ Stock ☐ Irrigation ☐
Industrial ☐ Drainage ☐ Other: _____

Casing: _____ ft. to _____ ft. Type _____ Size _____

Casing: _____ ft. to _____ ft. Type _____ Size _____

Casing: 40 ft. to _____ ft. Type Steel pipe Size 6"

Perforated or Screened: Ft. _____ to ft. _____ Ft. _____ to ft. _____

Type of screen or perforations _____

Static Water level, for non-flowing well: 20 ft. from surface feet.

Shut-in pressure, for flowing well: _____ lb./sq. in. on: _____ (date)

Pumping water level _____ feet at _____ gal. per min. 20 gal. per min.

How tested: Flow has been pumped to capacity

Length of test _____

Remarks: (Gravel packing, cementing, packers, type of shut-off, depth of shut-off)
Well located about 30 feet from south point of triangle

Survey No. 707

(over)

Log of Well

[illegible]

RECEIVED
JUL 13 1960

T. 15 R. 26E

County Yellowstone

STATE ENGINEER

MONTANA BUREAU OF MINES AND GEOLOGY
Butte, Montana

WATER WELL LOG

Owner Raymond Bakert Address Billings, Mont.

Driller Address

Date Started Date Completed 6-11-60

Location: Sec. 34 T. 15 R. 26E 1/4 sec. SE1, SW1

Type of well Dug Equipment used Backhoe
(Dug, driven, bored, or drilled) (Cable drill, rotary, other)

Water use: Domestic ☐ Municipal ☐ Stock ☐ Irrigation ☒
Industrial ☐ Drainage ☐ Other:

Casing: 13 ft. to ft. Type Cement tile Size 8"

Casing: ft. to ft. Type Size

Casing: ft. to ft. Type Size

Perforated or Screened: Ft. to ft. Ft. to ft.

Type of screen or perforations Bottom 3' tile perforated

Static Water level, for non-flowing well: 7 ft. from surface feet.

Shut-in pressure, for flowing well: lb./sq. in. on: (date)

Pumping water level 10 feet at 100 gal. per min. minute

How tested: centrifugal Pump

Length of test 12 hours

Remarks: (Gravel packing, cementing, packers, type of shut-off, depth of shut-off)

12 yd. holder rock packed around lower half of casing
Well located about center of triangle Survey No. 707

(over)

Log of Well

[illegible]

RECEIVED
NOV 20 1958

T. 18 R. 26E

County Yellowstone

STATE ENGINEER

MONTANA BUREAU OF MINES AND GEOLOGY
Butte, Montana

WATER WELL LOG

X			

Owner D.B. Hill Address Blue Creek Route

Billings, Montana

Driller D.B. Hill Address Blue Creek Route

Billings, Montana

Date Started Oct. 15, 1941 Date Completed Oct. 22, 1941

Location: Sec. 24 T. 18 R. 26E 1/4 sec. 31

Type of well Dug Equipment used Pick and shovel
(Dug, driven, bored, or drilled) (Churn drill, rotary, other)

Water use: Domestic ☒ Municipal ☐ Stock ☒ Irrigation ☒
Industrial ☐ Drainage ☐ Other:

Casing: 30 ft. to 32 ft. Type Tile Size 10 inch

Casing: ft. to ft. Type Size

Casing: ft. to ft. Type Size

Perforated or Screened: Ft. to ft. Ft. to ft.

Type of screen or perforations

Static Water level, for non-flowing well: 24 feet

Shut-in pressure, for flowing well: lb./sq. in. on: (date)

Pumping water level: feet at gal. per min.

How tested:

Length of test

Remarks: (Gravel packing, cementing, packers, type of shut-off, depth of shut-off)

(over)

Log of Well

[illegible]

RECEIVED
NOV 20 1958
STATE ENGINEER

MONTANA BUREAU OF MINES AND GEOLOGY
Butte, Montana

T. 18 R. 26E
County Yellowstone

WATER WELL LOG

X			

Owner: D.B. Hill Address: Blue Creek Rt. Billings, Montana
Driller: Clyde Sando Address: Billings, Montana
Date Started: May 25, 1955 Date Completed: June 4, 1955
Location: Sec. 34 T. 18 R. 26E 1/4 sec. SW 1/4

Type of well: Drilled (Dug, driven, bored, or drilled) Equipment used: Churn Drill (Churn drill, rotary, other)

Water use: Domestic ☒ Municipal ☐ Stock ☒ Irrigation ☒
Industrial ☐ Drainage ☐ Other: _____

Casing: 50 ft. to 60 ft. Type: Iron Size: 8 inch

Casing: _____ ft. to _____ ft. Type: _____ Size: _____

Casing: _____ ft. to _____ ft. Type: _____ Size: _____

Perforated or Screened: Ft. _____ to ft. _____ Ft. _____ to ft. _____

Type of screen or perforations: _____

Static Water level, for non-flowing well: 34 feet to water feet.

Shut-in pressure, for flowing well: _____ lb./sq. in. on: _____ (date)

Pumping water level: _____ feet at _____ gal. per min.

How tested: _____

Length of test: _____

Remarks: (Gravel packing, cementing, packers, type of shut-off, depth of shut-off)

(over)

Log of Well

[illegible]

RECEIVED
NOV 20 1958

STATE ENGINEER

MONTANA BUREAU OF MINES AND GEOLOGY
Butte, Montana

WATER WELL LOG

T. 18 R. 26E

County Yellowstone

Owner D.B. Hall Address Blue Creek Et. Billings, Montana

Driller Unknown Address Unknown

Date Started Year of 1913 Date Completed 1913

Location: Sec. 34 T. 18 R. 26E 1/4 sec. 12-12-12

Now being used by Blue Creek School; District No. 3

Type of well: Dug Equipment used: Pick and Shovel
(Dug, driven, bored, or drilled) (Churn drill, rotary, other)

Water use: Domestic ☒ Municipal ☐ Stock ☒ Irrigation ☒

Industrial ☐ Drainage ☐ Other: _____

Casing: 24 ft. to 35 ft. Type Tile Size 16 inch

Casing: _____ ft. to _____ ft. Type _____ Size _____

Casing: _____ ft. to _____ ft. Type _____ Size _____

Perforated or Screened: Ft. _____ to ft. _____ Ft. _____ to ft. _____

Type of screen or perforations: _____

Static Water level, for non-flowing well: 12 feet.

Shut-in pressure, for flowing well: _____ lb./sq. in. on: _____ (date)

Pumping water level: _____ feet at _____ gal. per min.

How tested: _____

Length of test: _____

Remarks: (Gravel packing, cementing, packers, type of shut-off, depth of shut-off)

(over)

Log of Well

[illegible]

T-1-S R-26-E
County Yellowstone
RECEIVED
APR 19 1961

MONTANA BUREAU OF MINES AND GEOLOGY
Butte, Montana

WATER WELL LOG

STATE ENGINEER

Owner John R. & Lela Robinson Address Billings Mont
Driller Joe Strong Address Billings Mont
Date Started March 1st Date Completed March 1st
Location: Sec. 34 T-1-S R-26-E 1/4 sec. West 1/4 Sec 34 T1S R26E
near Latah Sch. & over B. & N. Ry.

Type of well Dug (Dug, driven, bored, or drilled) Equipment used Back Hoe (Churn drill, rotary, other)

Water use: Domestic ☒ Municipal ☐ Stock ☐ Irrigation ☒
Industrial ☐ Drainage ☐ Other: _____

Casing: _____ ft. to 18 ft. Type Galvanized Size 1 1/2 in. diameter

Casing: _____ ft. to _____ ft. Type tubing Size _____

Casing: _____ ft. to _____ ft. Type _____ Size _____

Perforated or Screened: Ft. 18 to ft. 12 Ft. _____ to ft. _____

Type of screen or perforations 1 in. holes

Static Water level, for non-flowing well: 6-7 ft feet.

Shut-in pressure, for flowing well: _____ lb./sq. in. on: _____ (date)

Pumping water level 19 about feet at _____ gal. per min.

How tested: Pumped by hand 20 minutes Pumped at 65 gpm

Length of test: minutes for 10-12 minutes

Remarks: (Gravel packing, cementing, packers, type of shut-off, depth of shut-off)

Pipe gravel packing

(over)

RECEIVED
SEP 10 1958

T. 1 S. R. 26 E.
County Yellowstone

STATE ENGINEER MONTANA BUREAU OF MINES AND GEOLOGY
Butte, Montana

WATER WELL LOG

Owner John or Lela Robinson Address Blue Creek Rte.
Billings, Montana
Driller Duke & Eaton Construction Co. Address Billings, Montana
Date Started Nov. 1, 1958 Date Completed Nov. 30, 1958
Location: West $\frac{1}{2}$ 34 T 1 S R 26 E $\frac{1}{4}$ sec. Lot 17 Block 6 3rd Filing

Type of well Dug Equipment used Back hoe and Clam shell
(Dug, driven, bored, or drilled) (Churn drill, rotary, other)

Water use: Domestic ☒ Municipal ☐ Stock ☒ Irrigation ☒
Industrial ☐ Drainage ☐ Other:

Casing: 0 ft. to 18 ft. Type Concrete casing Size 3' diameter

Casing: ft. to ft. Type Size

Casing: ft. to ft. Type Size

Perforated or Screened: Ft. Perforated to ft. Ft. to ft.

Type of screen or perforations 5/8 size perforations

Static Water level, for non-flowing well: 8' feet.

Shut-in pressure, for flowing well: lb./sq. in. on: (date)

Pumping water level 12 feet at 6 gal. per min.

How tested: Centrifical pump

Length of test 1 hour

Remarks: (Gravel packing, cementing, packers, type of shut-off, depth of shut-off)
Gravel packing in bottom

(over)

Log of Well

[illegible]

RECEIVED

DEC 1 1958

MONTANA BUREAU OF MINES AND GEOLOGY
STATE ENGINEER Butte, Montana

T. 1 S. R. 26 E.
County. Yellowstone

WATER WELL LOG

Owner E. R. and Gladys D. Sharon Address Blue Creek

Driller Dug by Carl Oakland Address Billings, Montana

Date Started May 1957 Date Completed June 1957

Location: Sec. 34 T. 1 S. R. 26 " 1/4 sec. Lot 17, Block 1, 1st file
Aqui Esta Subdivision

Type of well Hand Dug Equipment used Pick and shovel
(Dug, driven, bored, or drilled) (Churn drill, rotary, other)

Water use: Domestic ☒ Municipal ☐ Stock ☐ Irrigation ☒
Industrial ☐ Drainage ☐ Other:

Casing: Concrete ft. to 29 ft. Type Square Size 4x5' top, 3x4' base

Casing: ft. to ft. Type Size

Casing: ft. to ft. Type Size

Perforated or Screened: Ft. to Ft. to Ft.

Type of screen or perforations

Static Water level, for non-flowing well: 23' feet

Shut-in pressure, for flowing well: lb./sq. in. on: (date)

Pumping water level: feet at gal. per min.

How tested:

Length of test

Remarks: (Gravel packing, cementing, packers, type of shut-off, depth of shut-off)

(over)

Log of Well

[illegible]

County Yellowstone

STATE OF MONTANA
ADMINISTRATOR OF GROUNDWATER CODE
MONTANA WATER RESOURCES BOARD

NOTICE OF COMPLETION OF GROUNDWATER APPROPRIATION BY MEANS OF WELL

Developed after January 1, 1962

(Under Chapter 237 Montana Session Laws, 1961, as amended)

This form to be prepared by driller, and three copies to be filed by the owner with the County Clerk and Recorder in the county in which the well is located; last copy to be retained by driller.

Please answer all questions. If not applicable, so state, otherwise the form may be returned.

Owner: Campbell, Clarence A &
Shirley A.

Address **Blue Creek Star Rte.**

Billings, Mont. 59101

Date well started **Unknown**

completed Unknown

Type of well Dog

(Dug, driven, bored or drilled)

Equipment used **Back Hoe**

(Churn drill, rotary or other)

Water Use: Domestic ☒ Municipal ☐ Stock ☒ Irrigation ☐

Industrial ☐ Drainage ☐ Other ☐* Garden/Lawn ☒

* Describe Block 2, lot 13, Agui Bata Sub. Srd.

USE: If used for irrigation, industrial, drainage or other. Explain, state number of acres and location or other data (i.e. Lot, Block

and Addition), Block 2, Lot 13, Agui Esta Sub 3rd.

ESTIMATED ANNUAL WITHDRAWAL: 1,000,000,000 gal.

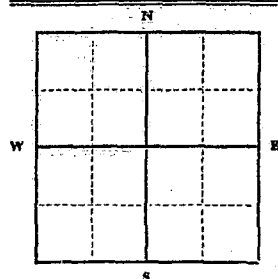
[illegible]

WL/2.1X 1/4 Sec. 34

T. 1 ~~XX~~R. 26 E ~~XX~~

INDICATE LOCATION OF WELL AND PLACE OF USE, IF POSSIBLE.
EACH SMALL SQUARE REPRESENTS 40 ACRES.

Driller's Signature _____

Driller's Address

LICENSE NO.

DRILLER'S LOG

Indicate the character, color, thickness of strata such as soil, clay, sand, gravel, shale, sandstone, etc. Show depth at which water is found and height to which water rises in well.

DRILLER'S LOG

Top of Ground (Elev. above sea level)

[illegible]

Show exact depth of bottom

55250

938259

STATE OF MONTANA, { ss.
County of Yellowstone, }

This instrument was filed in my office

this JUN 29 1979 day of June, 1979

at 9:57 o'clock AM M.

MERRILL A. KLUNDT

County Clerk & Recorder

By [Signature] Deputy

File No.....

ORIGINAL

T-1-S...R-26-E MPM

County Yellow Stone

STATE OF MONTANA
ADMINISTRATOR OF GROUNDWATER RIGHTS
OFFICE OF STATE ENGINEER

West 1/2, Section 34

AQUA ESTA

SUBDIVISION

LOT 14, Block 3

DECLARATION OF VESTED GROUNDWATER RIGHTS
(Under Chapter 237, Montana Code Annotated 1961)

RECEIVED
JAN 2 1964
STATE ENGINEER

George L. Neve - 4626 Ruth Ave - Billings
(Name of Appropriator) (Address) (Town)

County of Yellow Stone State of MONTANA
have appropriated groundwater according to the Montana laws in effect prior to
January 1, 1962, as follows:

AQUA ESTA
SUBDIVISION
(RECORDED)
YELLOWSTONE
COUNTY
LOT 14
BLOCK 3

Indicate point of appropriation
and place of use, if possible.
Each small square represents
10 acres.

2. The beneficial use on which the claim is based

IRRIGATION - STOCK

3. Date or approximate date of earliest beneficial
use; and how continuous the use has been

1959 CONTINUOUS

4. The amount of groundwater claimed (in miner's
inches or gallons per minute)

PER MINUTE 500 GPM

5. If used for irrigation, give the acreage and
description of the lands to which water has been
applied and name of the owner thereof

7 ACRES
E. R. SHERRON & GLADYS D.
George L. Neve (under contract)

6. The means of withdrawing such water from the
ground and the location of each well or other
means of withdrawal

ELECTRIC PUMP
AT 9709 RD LEVEL

7. The date of commencement and completion of the construction of the well, wells,
or other works for withdrawal of groundwater

TO JULY 1, 1959 JUNE 1, 1959

8. The depth of water table

10 FEET

9. So far as it may be available, the type, size and depth of each well or the gen-
eral specifications of any other works for the withdrawal of groundwater

SIZE 2" CASING
17 FEET DEEP

10. The estimated amount of groundwater withdrawn each year

50,000 GAL

11. The log of formations encountered in the drilling of each well if available

8 FEET TOP SOIL
7 FEET SHALE + 2 FEET GRAVEL

12. Such other information of a similar nature as may be useful in carrying out the
policy of this act, including reference to book and page of any county record

AQUA ESTA SUBDIVISION LOT 14 BLOCK 3
RECORDED YELLOWSTONE COUNTY
Signature of Owner George L. Neve
Date Dec 31, 1963

Three copies to be filed by the owner with the County Clerk and Recorder of the
county in which the well is located.

Please answer all questions. If not applicable, so state, otherwise the form will
be returned.

Original to the County Clerk & Recorder; Duplicate to the State Engineer; Triplicate
to the Montana Bureau of Mines and Geology, and Quadruplicate for the appropriator

721554

STATE OF MONTANA,
County of Yellowstone, File.

This instrument was filed in my office

on DEC 31 1968 day of 19
at 10:54 o'clock A.M.

Edmon S. Holding,
County Clerk & Recorder

By [Signature] Deputy

200

GROUNDWATER INDEX

Page 1 of 1

County Yellowstone Twp. 15 Rge. 27E

[illegible]

File No.

DUPLICATE

No. 527
RCounty YELLOWSTONESTATE OF MONTANA
ADMINISTRATOR OF GROUNDWATER CODE
OFFICE OF STATE ENGINEERNotice of Completion of Groundwater
Appropriation by Means of Well

(Under Chapter 237, Montana Session Laws, 1961)

Owner FRANK BRUDER Address BILLINGS SOUTHDriller ROY D. PIERCE Address BILLINGS MONT.

Date of Notice of Appropriation of Groundwater.....

Date well started SEPT 9 68 Date Completed SEPT 10 69Type of well DRILLED Equipment Used CHURN
(dug, driven, bored or (Churn, drill, rotary or
drilled) other)Water Use: Domestic ☒ Municipal ☐ Other ☐ Irrigation ☐
Industrial ☐ Drainage ☐ Stock ☐

Indicate on the diagram the character and thickness of the different strata met with in drilling, such as soil, clay, shale, gravel, rock or sand, etc. Show depth at which water is encountered, thickness and character of water-bearing strata and height to which water rises in the well.

Size of Drilled Hole	Size and Weight of Casing	From (Feet)	To (Feet)	PERFORATIONS		
				Kind Size	From (Feet)	To (Feet)
<u>6 5/8"</u>	<u>6 5/8"-15"</u>	<u>0</u>	<u>50'</u>	<u>NONE</u>		

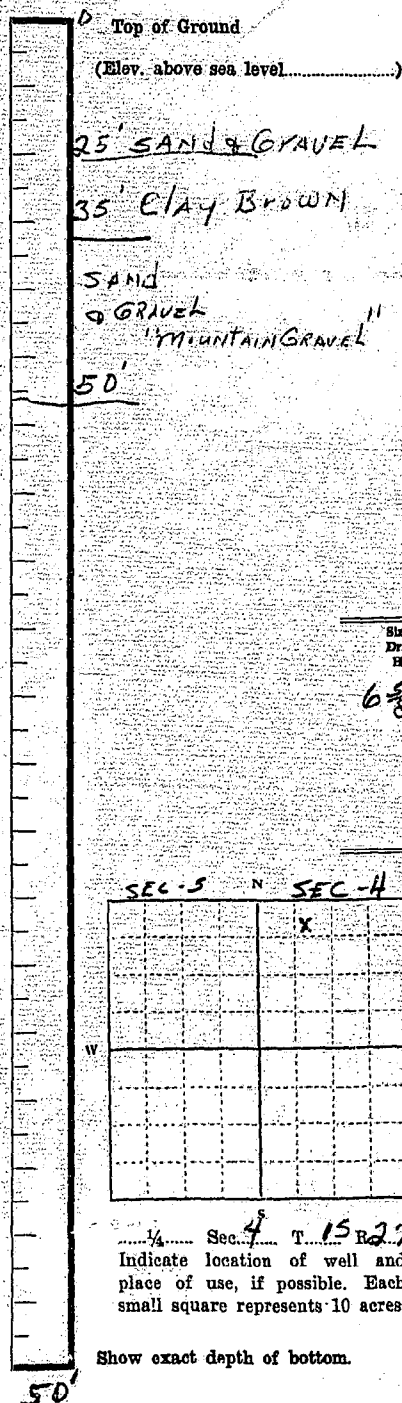
Static Water Level for non-flowing Well 40' feet.

Shut-in Pressure for Flowing Well.....

Pumping Water Level 40 feet at 15 gal. per minute.

Discharge in gal. per min. of flowing well.....

How Tested BAILER Length of Test.....

Remarks: (Gravel packing, cementing, packers, type of shutoff, location of place of use of groundwater if not at well, and any other similar pertinent information, including number of

acres irrigated, if used for irrigation).....

3' Gravel poured in Bottom of WellMont 170
Driller's License NumberRoy D. Pierce
Driller's Signature

This form to be prepared by driller, and three copies to be filed by the owner with the County Clerk and Recorder in the county in which the well is located.

Please answer all questions. If not applicable, so state, otherwise the form will be returned.

Original to the County Clerk and Recorder; duplicate to the State Engineer; Triplicate to the Montana Bureau of Mines and Geology and Quadruplicate for the Appropriator.

45631

847810

STATE OF MONTANA
County of Yellowstone
This instrument was filed in my office
on SEP-10-1969 at 1:40 p.m.
at the County Clerk's Office
By [Signature] Dep

MONTANA WATER RESOURCES BOARD
RECEIVED

SEP 11 1969

SEP 11 1969

SEP 11 1969

SEP 11 1969

RECEIVED

County.....**Yellowstone**

STATE OF MONTANA
ADMINISTRATOR OF GROUNDWATER CODE
MONTANA WATER RESOURCES BOARD

NOTICE OF COMPLETION OF GROUNDWATER APPROPRIATION BY MEANS OF WELL

Developed after January 1, 1962

(Under Chapter 237 Montana Session Laws, 1961, as amended)

This form to be prepared by driller, and three copies to be filed by the owner with the County Clerk and Recorder in the county in which the well is located, last copy to be retained by driller.

Please answer all questions. If not applicable, so state, otherwise the form may be returned.

Owner Dry Creek Ranch, Inc

Address....Route..2.

Billings, Montana

Date well started

completed

Type of well Well was on ranch when purchased
(Pneumatically driven, bored or drilled)

Equipment used ☐ Party purchased from ☐ Did not have information - original owner deceased

Water Use: Domestic ☐ Municipal ☐ Stock ☒ Irrigation ☐

Industrial ☐ Drainage ☐ Other ☐* Garden/Lawn ☒

*** Describe**

USE: If used for irrigation, industrial, drainage or other. Explain, state number of acres and location or other data (i.e. Lot, Block and Addition).

ESTIMATED ANNUAL WITHDRAWAL 200,000 gallons

Size of Drilled Hole	Size and Weight of Casing	From (Feet)	To (Feet)	PERFORATIONS		
				Kind Size	From (Feet)	To (Feet)

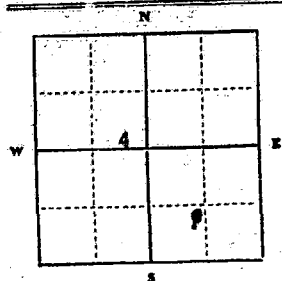

SW 1/4 SE 1/4 Sec. 4

T. 1 N R. 27 E
S W

INDICATE LOCATION OF WELL AND PLACE OF USE, IF POSSIBLE.
EACH SMALL SQUARE REPRESENTS 40 ACRES.

Driller's Signature**Driller's Address**

LICENSE NO.

DRILLER'S LOG

Indicate the character, color, thickness of strata such as soil, clay, sand, gravel, shale, sandstone, etc. Show depth at which water is found and height to which water rises in well.

Top of Ground

(Elev. above sea level)

[illegible]

Show exact depth of bottom

53, 72

937182

STATE OF MONTANA } ss.
County of Yellowstone }
This instrument was filed in my office
this JUN 21 1973
at 10:42 o'clock A M.
MERRILL M. RUNDT
County Clerk & Recorder
By [Signature] Deputy
24.

53, 71.

937183

STATE OF MONTANA, }
County of Yellowstone, } ss.

This instrument was filed in my office

this 10.42 day of JUN 21 1978

at 10.42 o'clock A M.

MERRILL H. KLUNDY

County Clerk & Recorder

By [Signature] Deputy

2 ca

DUPLICATE

T 15 R 27 1/2

County Yellowstone

STATE OF MONTANA
ADMINISTRATOR OF GROUNDWATER CODE
OFFICE OF STATE ENGINEER

Declaration of Vested Groundwater Rights

(Under Chapter 237, Montana Session Laws, 1961)

RECEIVED
JUL 3 - 1963

STATE ENGINEER

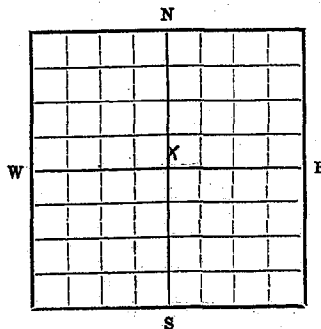
1. Ralph H. Smith, of Pryor Rte. Billings
(Name of Appropriator) (Address) (Town)County of Yellowstone State of Montana
have appropriated groundwater according to the Montana laws in effect prior to January 1, 1962, as follows:

SW 1/4 NE 1/4 Sec. 4 T15 R27E

Indicate point of appropriation
and place of use, if possible.
Each small square represents 10
acres.

2. The beneficial use on which the claim is based

Domestic and livestock

3. Date or approximate date of earliest beneficial use; and how continuous the use has been

Nov. 1958Daily use all year

4. The amount of groundwater claimed (in miner's inches or gallons per minute)

10 Gal. per min.

5. If used for irrigation, give the acreage and description of the lands to which water has been applied and name of the owner thereof

Small lawn, flower garden and a few treesRalph H. Smith

6. The means of withdrawing such water from the ground and the location of each well or other means of withdrawal

Deep well with submersible electric pump

7. The date of commencement and completion of the construction of the well, wells, or other works for withdrawal of groundwater

November 1958 (It took about 30 days to dig)

8. The depth of water table

60 ft.

9. So far as it may be available, the type, size and depth of each well or the general specifications of any other works for the withdrawal of groundwater

Machine drilled, 8 inch pipe to 80 feet then 6 inch to 360 ft. Hauled in under ground cement block well house.

10. The estimated amount of groundwater withdrawn each year

24000 gal. maximum

11. The log of formations encountered in the drilling of each well if available

Not first water gravel at 60 ft. blue shale at 80 ft. more water gravel at 160 ft. and again at 300 ft.

12. Such other information of a similar nature as may be useful in carrying out the policy of this act, including reference to book and page of any county record

Drilled by Mr. Ray Johnson

Signature of Owner

Date

Ralph H. SmithJuly 1st 1963

Three copies to be filed by the owner with the County Clerk and Recorder of the county in which the well is located.

Please answer all questions. If not applicable, so state, otherwise the form will be returned.

Original to the County Clerk and Recorder; duplicate to the State Engineer; Triplicate to the School of Mines and Quadruplicate for the Appropriator.

4896

709923

STATE OF MONTANA,
County of Yellowstone

This instrument was filed in my office

this JUL 2 1983

at 11:22 o'clock A M.

T. M. S. R. O'Neil,
County Clerk & Recorder

By Jaw Deputy

200

NOTED
FILED
JUL 2 1983
COUNTY CLERK & RECORDER
YELLOWSTONE COUNTY, MONTANA

RECORDED
JUL 2 1983
COUNTY CLERK & RECORDER
YELLOWSTONE COUNTY, MONTANA

GY-4

File No.

DUPLICATE

T. 15 R. 27E
County YellowstoneSTATE OF MONTANA
ADMINISTRATOR OF GROUNDWATER CODE
OFFICE OF STATE ENGINEERRECEIVED
JUL 3 - 1963Declaration of Vested Groundwater Rights
(Under Chapter 237, Montana Session Laws, 1961)

STATE ENGINEER

1. Ralph H. Smith, of Prager St. Billings
(Name of Appropriator) (Address) (Town)
County of Yellowstone State of Montana
have appropriated groundwater according to the Montana laws in effect prior to January 1, 1962, as follows:

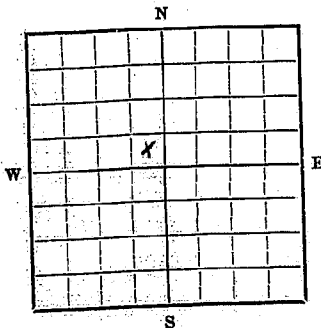

Sec. 5E 1/4 NW Sec. 4 T. 15 R. 27E

Indicate point of appropriation and place of use, if possible. Each small square represents 10 acres.

2. The beneficial use on which the claim is based Domestic & livestock
3. Date or approximate date of earliest beneficial use; and how continuous the use has been Oct. 1946
Daily use all year
4. The amount of groundwater claimed (in miner's inches or gallons per minute) 10 gal per minute
5. If used for irrigation, give the acreage and description of the lands to which water has been applied and name of the owner thereof Small lawn, flower garden
and 2 fruit trees Ralph H. Smith
6. The means of withdrawing such water from the ground and the location of each well or other means of withdrawal Shallow well electric pump

7. The date of commencement and completion of the construction of the well, wells, or other works for withdrawal of groundwater Hand dug prior to Oct. 1946

8. The depth of water table 25 ft.

9. So far as it may be available, the type, size and depth of each well or the general specifications of any other works for the withdrawal of groundwater Hand dug bricked sides
4 ft. across about 10' deep. 2 inch pipe from pump to pressure tank.

10. The estimated amount of groundwater withdrawn each year 20,000 gallons

11. The log of formations encountered in the drilling of each well if available Hand dug to
blue shale then river bed gravel

12. Such other information of a similar nature as may be useful in carrying out the policy of this act, including reference to book and page of any county record Log by Mrs. Joke Rapnak

Signature of Owner

Date

Ralph H. Smith
July 1 - 1963

Three copies to be filed by the owner with the County Clerk and Recorder of the county in which the well is located.

Please answer all questions. If not applicable, so state, otherwise the form will be returned.

Original to the County Clerk and Recorder; duplicate to the State Engineer; Triplicate to the School of Mines and Quadruplicate for the Appropriator.

4897

709924

STATE OF MONTANA,
County of Yellowstone.

This instrument was filed in my office

at JUL 2 1963

at 11:28 o'clock A. M.

Edwin S. Redding,
County Clerk & Recorder

By Jaw Deputy

RECEIVED
STATE ENGINEER

GW 4

File No.

DUPLICATE

T 15 R 27 E

County Yellowstone

STATE OF MONTANA
ADMINISTRATOR OF GROUNDWATER CODE
OFFICE OF STATE ENGINEER

RECEIVED
JUN 20 1963

Declaration of Vested Groundwater Rights
(Under Chapter 237, Montana Session Laws, 1961)

1. Ralph H. Smith of Big Sky Billings
(Name of Appropriator) (Address) (Town)
County of Yellowstone State of Montana
have appropriated groundwater according to the Montana laws in effect prior to January 1, 1962, as follows:

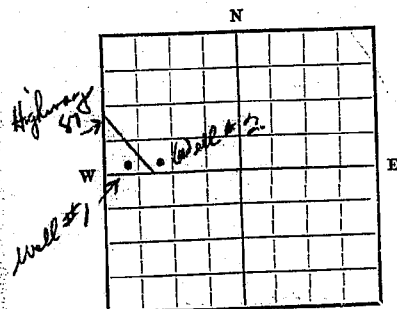

Indicate point of appropriation and place of use, if possible. Each small square represents 10 acres.

2. The beneficial use on which the claim is based Domestic & Livestock
3. Date or approximate date of earliest beneficial use; and how continuous the use has been Well #1, Prior to 1946 Daily use at geyser.
Well #2 Mar 1958. Daily use at geyser.
4. The amount of groundwater claimed (in miner's inches or gallons per minute) Well #1 5 Gal. per min.
Well #2 10 Gal. per min.
5. If used for irrigation, give the acreage and description of the lands to which water has been applied and name of the owner thereof yard trees, flowers & lawn only on both wells. Above owners.
6. The means of withdrawing such water from the ground and the location of each well or other means of withdrawal Well #1 Shallow well elec. pump.
Well #2 Deep submersible elec. pump.
7. The date of commencement and completion of the construction of the well, wells, or other works for withdrawal of groundwater Well #1 Prior to 1946 (Hand dug)
Well #2 November 1958 (30 days to dig)
8. The depth of water table Well #1 20 to 30 ft. Well #2 200 to 300 ft.
9. So far as it may be available, the type, size and depth of each well or the general specifications of any other works for the withdrawal of groundwater Well #1 Hand dug - round 3 to 4 ft across, brick lined, 45 ft. deep.
Well #2 Machine drilled - 8 inch pipe first 80 ft. 6 inch pipe to bottom, 360 feet deep. Hand hauled in well casing.
10. The estimated amount of groundwater withdrawn each year Well #1 2400 Gal. Well #2 13000 Gal.
11. The log of formations encountered in the drilling of each well if available Well #1 dug to blue shale then creek bed gravel.
Well #2 drilled 60 ft. to first gravel bed in shatter, then blue shale, to gravel at 120 ft and water taken to 360 ft. to gravel and more water.
12. Such other information of a similar nature as may be useful in carrying out the policy of this act, including reference to book and page of any county record None

Signature of Owner Ralph H. Smith
Date June 18 - 1963

Three copies to be filed by the owner with the County Clerk and Recorder of the county in which the well is located.

Please answer all questions. If not applicable, so state, otherwise the form will be returned.

Original to the County Clerk and Recorder; duplicate to the State Engineer; Triplicate to the School of Mines and Quadruplicate for the Appropriator.

1704

GW

File No.

DUPLICATE

T. 1 S. R. 27 E

County. Yellowstone

STATE OF MONTANA
ADMINISTRATOR OF GROUNDWATER CODE
OFFICE OF STATE ENGINEER

Declaration of Vested Groundwater Rights

(Under Chapter 237, Montana Session Laws, 1961)

RECEIVED
MAY 28 1963
STATE ENGINEER

1. Pierce J. VanAlstyne of 1425 N. 27th St., Billings
(Name of Appropriator) (Address) (Town)
County of Yellowstone State of Montana
have appropriated groundwater according to the Montana laws in effect prior to January 1, 1962, as follows:

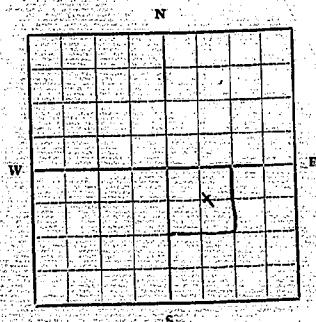

NW SE 1/4 Sec. 4 T. 13S. 27E

Indicate point of appropriation
and place of use, if possible.
Each small square represents 10
acres.

2. The beneficial use on which the claim is based
Livestock
3. Date or approximate date of earliest beneficial use; and how continuous the use has been
May 1, 1963
Daily use
4. The amount of groundwater claimed (in miner's inches or gallons per minute)
10 gallons per minute
5. If used for irrigation, give the acreage and description of the lands to which water has been applied and name of the owner thereof
N. A.
6. The means of withdrawing such water from the ground and the location of each well or other means of withdrawal
Electric Pump
7. The date of commencement and completion of the construction of the well, wells, or other works for withdrawal of groundwater
Well started 3-28-63 Completed 4-5-63
8. The depth of water table
60 ft.
9. So far as it may be available, the type, size and depth of each well or the general specifications of any other works for the withdrawal of groundwater
90 foot well with 8" casing.
10. The estimated amount of groundwater withdrawn each year
36,000 gallons
11. The log of formations encountered in the drilling of each well if available
0 - 5' Sandy loam
5' - 60' Gravel & Shale
60' - 90' Shale
12. Such other information of a similar nature as may be useful in carrying out the policy of this act, including reference to book and page of any county record.
N. A.

Signature of Owner P. J. VanAlstyne

Date May 27, 1963

Three copies to be filed by the owner with the County Clerk and Recorder of the county in which the well is located.

Please answer all questions. If not applicable, so state, otherwise the form will be returned.

Original to the County Clerk and Recorder; duplicate to the State Engineer; Triplicate to the School of Mines and Quadruplicate for the Appropriator.

4513

707653

STATE OF MONTANA } ss.
County of Yellowstone }
This instrument was filed in my office
this MAY 27 1968 19 68
11:46 o'clock A. M.
CHRIS H. NICH, County Recorder
[Signature] Deputy

File No.

DUPLICATE

T

15 R 27E

County

APR 23 1964

STATE OF MONTANA
ADMINISTRATOR OF GROUNDWATER CODE
OFFICE OF STATE ENGINEER

STATE ENGINEER

Notice of Completion of Groundwater Appropriation
Without Well

(Under Chapter 237 Montana Session Laws, 1961)

Date of Appropriation of Groundwater... JAN. 7, 1941

Owner FRANK BRUDER Address ROUTE 2, BILLINGS, MONTANA

Contractor (if any) NONE

Address of Contractor NOT APPLICABLE

Date Started Unknown Date Completed NOT APPLICABLE

Describe means of obtaining groundwater without a well "as by sub-irrigation and other natural processes". Include depth to water when applicable. THESE ARE NATURAL

FLOWING SPRINGS AND ARE BEING USED TO WATER LIVESTOCK FROM THE SPRINGS AND STREAMS CREATED BY THE SPRINGS.

Quantity of water developed and used with explanation of method used to measure or estimate such amount. If use is intermittent

Estimate approximate lengths of periods of use

THE QUANTITY OF WATER VARIES AND IS UNKNOWN, BUT THE APPROPRIATOR IS USING ALL AVAILABLE WATER.

Signature of Owner Frank Bruder
NE 1/4 NW 1/4 SW 1/4 April 20, 1964

This form to be prepared by contractor (if any), otherwise by the owner.

Three copies of this notice are to be filed with the County Clerk and Recorder of the county in which the works are located.

Please answer all questions. If not applicable, so state, otherwise the form will be returned.

Original to the County Clerk and Recorder; duplicate to the State Engineer; Triuplicate to the Montana Bureau of Mines and Geology and Quadruplicate for the Appropriator.

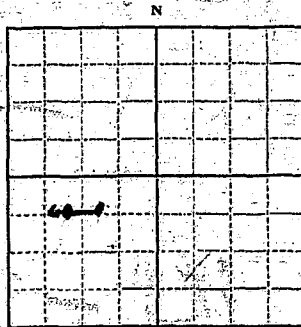

Indicate point of appropriation and place of use, if possible.

35623

729500

STATE OF MONTANA,
County of Yellowstone.
This instrument was filed in my office
this 22 day of APR 1934
at 9:00 o'clock AM.
Edwin S. Redding,
County Clerk & Recorder.
By [Signature] Deputy.

RECEIVED

JUN 20 1973

GAZETTE PRINTING CO.

File No.

TRIPPLICATE

MINES DEPARTMENT OF MINES
RECORDS AND SURVEYING

T. 1 S. R. 2 E. S. 1

County Yellowstone

STATE OF MONTANA
ADMINISTRATOR OF GROUNDWATER CODE
OFFICE OF STATE ENGINEER

Notice of Completion of Groundwater Appropriation
Without Well

(Under Chapter 237 Montana Session Laws, 1961)

Date of Appropriation of Groundwater June, 1973
Route 2,
Owner Dry Creek Ranch, Inc. Address Billings, Montana
Contractor (if any) Kenneth Kramer
Address of Contractor Billings, Montana
to be
Date Started 6/15/73 Date Completed 6/30/73

Describe means of obtaining groundwater without a well "as by sub-irrigation and other natural processes". Include depth to water when applicable.

Stock dam holding run-off water.

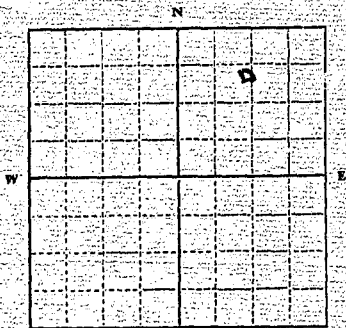

NE 1/4 Sec. 9 T. 1 S. R. 2 E. S. 1

Indicate point of appropriation and place of use, if possible.

937185

This 21st day of June
A.D. 19 73, at 10:45
O'clock A.M.

Dry Creek Ranch, Inc.
Signature of Owner by: [Signature]
Date 6/20/73

This form to be prepared by contractor (if any), otherwise by the owner.

Three copies of this notice are to be filed with the County Clerk and Recorder of the county in which the works are located.

Please answer all questions. If not applicable, so state, otherwise the form will be returned.

Original to the County Clerk and Recorder; duplicate to the State Engineer; Triplicate to the Montana Bureau of Mines and Geology and Quadruplicate for the Appropriator.

53,713

937185

RECEIVED
JUN 21 1973

STATE OF MONTANA, } ss.
County of Yellowstone, }
This instrument was filed in my office
this JUN 21 1973 day of 19
at 10:45 o'clock A M.
MERRILL H. KLUNDY
County Clerk & Recorder
By [Signature] Deputy
24

File No. _____

DUPLICATE

T. 15 R. 27E

County Yellowstone

STATE OF MONTANA
ADMINISTRATOR OF GROUNDWATER CODE
OFFICE OF STATE ENGINEER

RECEIVED
NOV 18 1963

Declaration of Vested Groundwater Rights
(Under Chapter 237, Montana Session Laws, 1961)

STATE ENGINEER

1. Ice) B. Sattlemier (Name of Appropriator), of 2913 1/2 (Address), 6th Ac So Billings (Town)
County of Yellowstone State of Montana
have appropriated groundwater according to the Montana laws in effect prior to January 1, 1962, as follows:

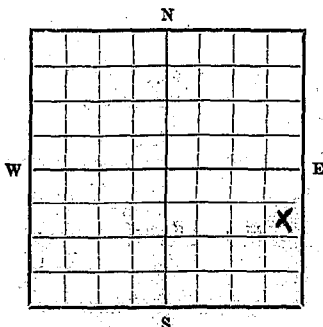

SE 1/4 Sec. 9 T15 R27E

Indicate point of appropriation and place of use, if possible. Each small square represents 10 acres.

2. The beneficial use on which the claim is based Livestock + Household use
3. Date or approximate date of earliest beneficial use; and how continuous the use has been 1906
in use continuously
4. The amount of groundwater claimed (in miner's inches or gallons per minute)
2927.5 per minute
5. If used for irrigation, give the acreage and description of the lands to which water has been applied and name of the owner thereof
Not used for irrigation
6. The means of withdrawing such water from the ground and the location of each well or other means of withdrawal
Electric or Gas driven Pump - See X for location
7. The date of commencement and completion of the construction of the well, wells, or other works for withdrawal of groundwater Commenced 1906 when homeesteaded
Improved as needed after completion in 1906
8. The depth of water table Varies from surface flow to 10 ft deep
9. So far as it may be available, the type, size and depth of each well or the general specifications of any other works for the withdrawal of groundwater
Encased - 5 1/2 x 9 ft - 14 ft deep - casing extends above ground
10. The estimated amount of groundwater withdrawn each year 80000 to 200,000 gals
11. The log of formations encountered in the drilling of each well if available
Spring dug out - encountered gravel - clay - shale
12. Such other information of a similar nature as may be useful in carrying out the policy of this act, including reference to book and page of any county record
None

Signature of Owner Ice) B. Sattlemier

Date Nov 15 1963

Three copies to be filed by the owner with the County Clerk and Recorder of the county in which the well is located.

Please answer all questions. If not applicable, so state, otherwise the form will be returned.

Original to the County Clerk and Recorder; duplicate to the State Engineer; Triplicate to the School of Mines and Quadruplicate for the Appropriator.

deposition
for

12 42 432

CONFIDENTIAL

THE
FIRE
INSURANCE
COMPANY
OF
THE
STATE
OF
NEW
YORK

THE
S
O
F
T
S
P
R
I
N
G
S
O
F
T
S
P
R
I
N
G
S

12567-10112435

1374 6071702

Handwritten: 1000000

10-11-68
10-12-68
10-13-68
10-14-68
10-15-68
10-16-68
10-17-68
10-18-68
10-19-68
10-20-68
10-21-68
10-22-68
10-23-68
10-24-68
10-25-68
10-26-68
10-27-68
10-28-68
10-29-68
10-30-68
10-31-68

This instrument was filed in my office
this 15 day of Nov 1963
at 4:42 o'clock P M.

Edmon S. Hedding,
County Clerk & Recorder
By L. S. Hedding Deputy

GV

File No.

DUPLICATE

T 15 R 27 E 15

County Yellowstone

STATE OF MONTANA
ADMINISTRATOR OF GROUNDWATER CODE
OFFICE OF STATE ENGINEER

RECEIVED
NOV 18 1963

Declaration of Vested Groundwater Rights
(Under Chapter 237, Montana Session Laws, 1961)

STATE ENGINEER

1. Ice) B. Settlemyer of 2913 1/2 6th Ave So Billings
(Name of Appropriator) (Address) (Town)
County of Yellowstone State of Montana
have appropriated groundwater according to the Montana laws in effect prior to January 1, 1962, as follows:

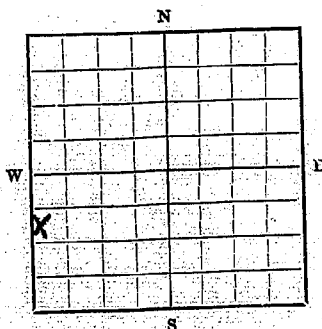

SW 1/4 SW Sec. 15 T. 15 R. 27 E

Indicate point of appropriation and place of use, if possible. Each small square represents 10 acres.

2. The beneficial use on which the claim is based live stock water
3. Date or approximate date of earliest beneficial use; and how continuous the use has been May 1913
use continuously
4. The amount of groundwater claimed (in miner's inches or gallons per minute) 392.5 per minute
5. If used for irrigation, give the acreage and description of the lands to which water has been applied and name of the owner thereof not used for irrigation
6. The means of withdrawing such water from the ground and the location of each well or other means of withdrawal Developed spring
gravity flow to 900 gal tank
7. The date of commencement and completion of the construction of the well, wells, or other works for withdrawal of groundwater Natural flow to July 1961
Improvements commenced & completed July 1961
8. The depth of water table Surface to 3 ft deep
9. So far as it may be available, the type, size and depth of each well or the general specifications of any other works for the withdrawal of groundwater 3 x 9 ft Box - 900 gal tank
10. The estimated amount of groundwater withdrawn each year 60,000 to 100,000 gals
11. The log of formations encountered in the drilling of each well if available Dug out Spring - encountered (24 - State
12. Such other information of a similar nature as may be useful in carrying out the policy of this act, including reference to book and page of any county record none

Signature of Owner

Date Nov 15 1963

Three copies to be filed by the owner with the County Clerk and Recorder of the county in which the well is located.

Please answer all questions. If not applicable, so state, otherwise the form will be returned.

Original to the County Clerk and Recorder; duplicate to the State Engineer; Triplicate to the School of Mines and Quadruplicate for the Appropriator.

7175

718312

THIS IS TO CERTIFY THAT

THE FOLLOWING INSTRUMENT

WAS RECORDED

IN THE COUNTY OF YELLOWSTONE

ON THE 15TH DAY OF

SEPTEMBER 1913

UNDER THE HANDS OF THE

CLERK OF THE COUNTY OF YELLOWSTONE

STATE OF MONTANA
County of Yellowstone

This instrument was filed in my office
this 15 day of Nov 1913
at 4:40 o'clock P.M.

Edmon S. Clark
County Clerk & Recorder

By J. A. W. 24 Deputy

W 3

RECEIVED

GALLETTE PRINTING

File No.

T. 1 S. R. 27 E.

TRIPLICATE

County Yellowstone

STATE OF MONTANA
ADMINISTRATOR OF GROUNDWATER CODE
OFFICE OF STATE ENGINEER

Notice of Completion of Groundwater Appropriation Without Well

(Under Chapter 237 Montana Session Laws, 1961)

Date of Appropriation of Groundwater has been used for 50 yrs
Route 2,Owner Dry Creek Ranch, Address Billings, Montana
Inc.Contractor (if any) Ron KramerAddress of Contractor Billings, Montana

Date Started Date Completed

Describe means of obtaining groundwater without a well "as by
sub-irrigation and other natural processes". Include depth to
water when applicable. Contract with Great PlainsProgram to develop this well the summer of
1973Quantity of water developed and used with explanation of method
used to measure or estimate such amount. If use is intermittent

estimate approximate lengths of periods of use

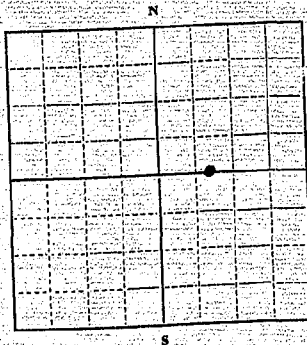

SW 1/4 NE 1/4 Sec. 16 T. 8 R. 27 E.

Indicate point of appropriation
and place of use, if possible.Doc. No. 937187

Filed for record

this 21 day of JuneA. D. 19 73, at 10:47o'clock A.M.

DRY CREEK RANCH, INC.

Signature of Owner by: [Signature]Date 6/20/73

This form to be prepared by contractor (if any), otherwise by the owner.

Three copies of this notice are to be filed with the County Clerk and Recorder of the county in which the
works are located.

Please answer all questions. If not applicable, so state, otherwise the form will be returned.

Original to the County Clerk and Recorder; duplicate to the State Engineer; Triplicate to the Montana
Bureau of Mines and Geology and Quadruplicate for the Appropriator.

53,709

937187

STATE OF MONTANA } ss.
County of Yellowstone }
This instrument was filed in my office
this 21 day of APR 1937
at 10:47 P.M. A M.
MERRILL E. WILSON
County Clerk & Recorder
By C.B.B. Deputy

File No.

DUPLICATE

T / S R 27 E

County Yellowstone

STATE OF MONTANA
ADMINISTRATOR OF GROUNDWATER CODE
OFFICE OF STATE ENGINEER

RECEIVED
DEC 30 1968

Declaration of Vested Groundwater Rights

(Under Chapter 237, Montana Session Laws, 1961) STATE ENGINEER

1. Star Line, of Billings
(Name of Appropriator) (Address) (Town)
County of Yellowstone State of Montana
have appropriated groundwater according to the Montana laws in effect prior to January 1, 1962, as follows:

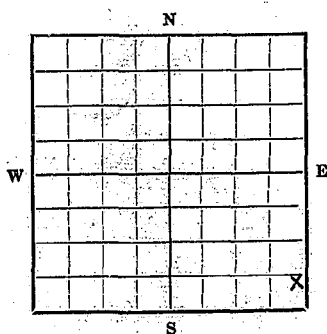

S.E. S.E. 16
~~1/4~~ Sec. ~~3~~ T.5 R.27 E

Indicate point of appropriation and place of use, if possible. Each small square represents 10 acres.

- N
- W
- E
- S
- X
- S. E S. E 16
1/4 Sec. 27 T. 5 R. 27 E
- Indicate point of appropriation
and place of use, if possible.
Each small square represents 10
acres.
2. The beneficial use on which the claim is based *Grain stock
and spraying*
3. Date or approximate date of earliest beneficial use; and how con-
tinuous the use has been *1922
Approximately 50% of the time*
4. The amount of groundwater claimed (in miner's inches or gallons
per minute) *Unknown*
5. If used for irrigation, give the acreage and description of the
lands to which water has been applied and name of the owner
thereof *No irrigation has been
done from this well*
6. The means of withdrawing such water from the ground and the
location of each well or other means of withdrawal *Pump*
7. The date of commencement and completion of the construction of the well, wells, or other works for
withdrawal of groundwater *Not started 1922*
8. The depth of water table *10 ft*
9. So far as it may be available, the type, size and depth of each well or the general specifications of any
other works for the withdrawal of groundwater *23 ft deep x 7' x 4'*
Hand dug and concreted walls
10. The estimated amount of groundwater withdrawn each year *75,000*
11. The log of formations encountered in the drilling of each well if available *Thrust 5' dirt
next 18' Blue shale*
12. Such other information of a similar nature as may be useful in carrying out the policy of this act, includ-
ing reference to book and page of any county record *Unknown*

Signature of Owner _____

Date Dec 22 1963

Three copies to be filed by the owner with the County Clerk and Recorder of the county in which the well is located.

Please answer all questions. If not applicable, so state, otherwise the form will be returned.

Original to the County Clerk and Recorder; duplicate to the State Engineer; Triplicate to the School of Mines and Quadruplicate for the Appropriator.

16074

721001

STATE OF ILLINOIS
County of Alton
This instrument was filed in my office
this DEC 27 1957 day of December
at 11.20 o'clock A. M.
Edmon S. Reiding,
County Clerk & Recorder
By Jail Deputy
200

File No.

DUPLICATE

RECEIVED

MAY 4 1973

W 25E 1/4 Sec. 16

T. 15 R. 27E

County Yellowstone

MONTANA DEPARTMENT OF NATURAL
RESOURCES AND CONSERVATION
STATE OF MONTANA
ADMINISTRATOR OF GROUNDWATER CODE
OFFICE OF STATE ENGINEER

Notice of Completion of Groundwater Appropriation
Without Well

(Under Chapter 237 Montana Session Laws, 1961)

Date of Appropriation of Groundwater 11/8/69
Owner Thomas A Johnston Address 802 Eagle Ridge Rd.
Contractor (if any) James McIntosh
Address of Contractor Rt 2 - Wild Bill Hickock Dr.
Date Started 11/5/69 Date Completed 11/8/69

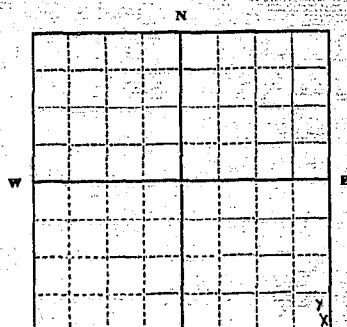

Describe means of obtaining groundwater without a well "as by
sub-irrigation and other natural processes". Include depth to
water when applicable. 16 ft Deep 24"
Casing (corrugated) perforated

Quantity of water developed and used with explanation of method
used to measure or estimate such amount. If use is intermittent

estimate approximate lengths of periods of use 100 gal
per minute - using 100 gal per
minute pump - pumped 6000
gal per hr 4 ft from Bottom
and down is perforated with 4" slots
Gravel Packed
Signature of Owner Thomas A Johnston

W 25E 1/4 Sec. 16 T. 15 R. 27E
Indicate point of appropriation
and place of use, if possible.

Doc. No. 933198
Filed for this 3rd day of May
A.D. 1973 at 10:25
O'clock A.M.

Date 5/2/73

This form to be prepared by contractor (if any), otherwise by the owner.

Three copies of this notice are to be filed with the County Clerk and Recorder of the county in which the
works are located.

Please answer all questions. If not applicable, so state, otherwise the form will be returned.

Original to the County Clerk and Recorder; duplicate to the State Engineer; Triplicate to the Montana
Bureau of Mines and Geology and Quadruplicate for the Appropriator.

53070

933198

STATE OF MONTANA. } ss.
County of Yellowstone.
This is to certify that in my office
on MAY 9, 1973 at 10:25 A M.
CLT

Carol B. Butler Deputy
For

RECEIVED

GAZETTE PRINTING CO.

File No.

T 1 S., R. 27 E.

TRIPLICATE

County.....Yellowstone.....

STATE OF MONTANA
ADMINISTRATOR OF GROUNDWATER CODE
OFFICE OF STATE ENGINEER

Notice of Completion of Groundwater Appropriation
Without Well

(Under Chapter 237 Montana Session Laws, 1961)

Date of Appropriation of Groundwater...has been used for 50
years

Owner...Dry Creek Ranch, Inc. Address...Route 2, Billings, MT.

Contractor (if any) ...Ken Kramer

Address of Contractor ...Billings, Montana

Date Started..... Date Completed.....

Describe means of obtaining groundwater without a well "as by
sub-irrigation and other natural processes". Include depth to
water when applicable. Great Plains program calls
for the development of this spring during summer
of 1973.

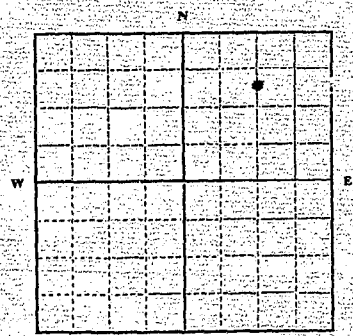

NE 1/4 NE 1/4 Sec. 17, T.18, R.27E.

Indicate point of appropriation
and place of use, if possible.

Filed for record
this 21st day of June
A.D. 1973, at 10:16
o'clock A.M.

Quantity of water developed and used with explanation of method
used to measure or estimate such amount. If use is intermittent
estimate approximate lengths of periods of use

Signature of Owner...
Date...6/20/73

This form to be prepared by contractor (if any), otherwise by the owner.

Three copies of this notice are to be filed with the County Clerk and Recorder of the county in which the
works are located.

Please answer all questions. If not applicable, so state, otherwise the form will be returned.

Original to the County Clerk and Recorder; duplicate to the State Engineer; Triplicate to the Montana
Bureau of Mines and Geology and Quadruplicate for the Appropriator.

337186

STATE OF MONTANA, } ss.
County of Yellowstone, }

This instrument was filed in my office

this 21st day of August 1973

at Bozeman, Montana

County of Yellowstone

By [Signature] Deputy

22

Form No. 18
8-60

T. 1N 27E R. Sec. 19

County Yellowstone

MONTANA BUREAU OF MINES AND GEOLOGY
Butte, Montana

RECEIVED
21 1961

Water Well Log

STATE ENGINEER

Owner Frank W. Palmer Address Alt. #2

Driller None Address None

Date Started June 15 1958 Date Completed June 15 1958

Location: Sec. Lat. 9 R. 1/4 sec. Bogert Sub

Type of well driven sand-pipe Equipment used Pipe Driver
(Dug, driven, bored, or drilled) (Churn, drill, rotary, other)

Water use: Domestic ☒ Municipal ☐ Stock ☐ Irrigation ☐
Industrial ☐ Drainage ☐ Other _____

Casing: 0 ft. to 40 ft. Type Pipe Size 2"

Casing: _____ ft. to _____ ft. Type _____ Size _____

Casing: _____ ft. to _____ ft. Type _____ Size _____

Perforated or Screened: Ft. 40 to ft. 43 . Ft. _____ to ft. _____

Type of screen or perforations sand-pipe

Static water level, for non-flowing well: 12' feet.

Shut-in pressure, for flowing well: None lb./sq. in. on: 1 (date)

Pumping water level 20 feet at 340 gal. per min.

How tested: permanently

Length of test one day 24 hr

Remarks: (Gravel packing, cementing, packers, type of shut-off, depth of shut-off)

(over)

RECEIVED
JAN 2 1962

STATE ENGINEER

Form No. 18
8-60

T. 1N 27E R. 19
County

MONTANA BUREAU OF MINES AND GEOLOGY
Butte, Montana

WATER WELL LOG

Owner FRANK M. PALMER Address RD 2

Driller SAME Address SAME

Date Started 6/10/61 Date Completed 6/10/61

Location: Sec. T. R. $\frac{1}{4}$ Sec. Borgas Sub-
Lot 8

Type of well DRIVEN Equipment used Pipe Driller
(Dug, driven, or drilled) (Churn, drill, rotary
other)

Water use Domestic ☒ Municipal ☐ Stock ☐ Irrigation ☐
Industrial ☐ Drainage ☐ Other

Casing: 00 ft. to 38 ft. Type PIPE Size 2"

Casing: ft. to -ft. Type Size

Casing: ft. to ft. Type Size

Perforated or screened Ft. 35 to ft. 38 Ft. to Ft.

Type of screen or perforations Sandpoint

Static water level, for non-flowing well: 20 feet.

Shut-in pressure for flowing well: NONE lb./sq. in. on: (date)

Pumping water level 25 feet at 340 gal. per min.

How tested: pumped

Length of test 24 hrs or 1 day

Remarks: (Gravel packing, cementing, packers, type of shut-off, depth of shut-off)

File No.

T. 1 South 27 East

DUPLICATE

County Yellowstone

STATE OF MONTANA
ADMINISTRATOR OF GROUNDWATER CODE
OFFICE OF STATE ENGINEER

RECEIVED
JAN 2 1964

Notice of Completion of Groundwater Appropriation
Without Well

(Under Chapter 237 Montana Session Laws, 1961)

Date of Appropriation of Groundwater 1932

Owner R. F. Hibbs Address 15 Valley Drive,
Billings, Montana

Contractor (if any) None

Address of Contractor Not applicable

Date Started 1932 Date Completed 1932

Describe means of obtaining groundwater without a well "as by
sub-irrigation and other natural processes". Include depth to
water when applicable. This is a spring which

flows to the surface. It was boxed with
concrete and piped to dwellings and livestock
-- 1" pipe.

Quantity of water developed and used with explanation of method
used to measure or estimate such amount. If use is intermittent

estimate approximate lengths of periods of use 300 gal.

per day (estimated). The use is uninterrupted.

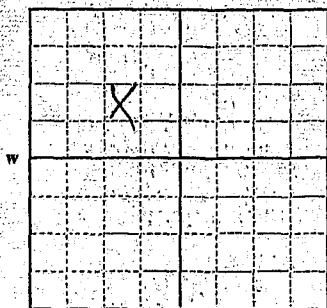

NW 1/4 Sec. 20 T. 18 R. 27E

Indicate point of appropriation
and place of use, if possible.

Signature of Owner

Date December 31, 1963

This form to be prepared by contractor (if any), otherwise by the owner.

Three copies of this notice are to be filed with the County Clerk and Recorder of the county in which the
works are located.

Please answer all questions. If not applicable, so state, otherwise the form will be returned.

Original to the County Clerk and Recorder; duplicate to the State Engineer; Triplicate to the Montana
Bureau of Mines and Geology and Quadruplicate for the Appropriator.

721770

STATE OF MONTANA)
County of Yellowstone, ss. &

This instrument was recorded in my office

this DEC 31 1933 day of 19

at 4:17 o'clock P M.

Edmon S. Redding,
County Clerk & Recorder

By mz Deputy

GW3

File No. 676437

1-18-62
DUPLICATE @ 3:02 P.M.
728200

Property W?

T. 15 R. 27E

County Yellowstone

STATE OF MONTANA
ADMINISTRATOR OF GROUNDWATER CODE

OFFICE OF STATE ENGINEER

RECEIVED
JAN 19 1962

STATE ENGINEER

Notice of Completion of Groundwater Appropriation Without Well

(Under Chapter 237 Montana Session Laws, 1961)

507

Date of Appropriation of Groundwater January 15, 1962

Owner Harold Ruth Address Billings, Montana

Contractor (if any) NIL

Address of Contractor

Date Started NIL Date Completed

Describe means of obtaining groundwater without a well "as by sub-irrigation and other natural processes". Include depth to water when applicable. NIL

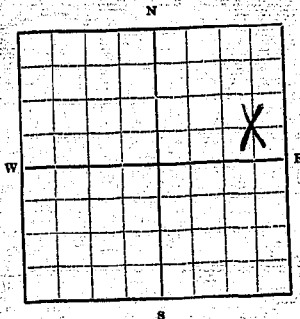

NE 1/4 Sec. 20 T15 R. 27E

Indicate point of appropriation and place of use, if possible.

(Indian Caves Ranch)

Quantity of water developed and used with explanation of method used to measure or estimate such amount. If use is intermittent estimate approximate lengths of periods of use

Spring - livestock use

- formerly domestic use.

year around use

Signature of Owner

Date January 15, 1962

This form to be prepared by contractor (if any), otherwise by the owner.

Three copies of this notice are to be filed with the County Clerk and Recorder of the county in which the works are located.

Please answer all questions. If not applicable, so state, otherwise the form will be returned.

Original to the County Clerk and Recorder; duplicate to the State Engineer; Triplicate to the School of Mines and Quadruplicate for the Appropriator.

GVA

File No.

DUPLICATE

T. 1 S. R. 27 E 21
County YellowstoneSTATE OF MONTANA
ADMINISTRATOR OF GROUNDWATER CODE
OFFICE OF STATE ENGINEERRECEIVED
DEC 30 1963

Declaration of Vested Groundwater Rights

(Under Chapter 237, Montana Session Laws, 1961)

STATE ENGINEER

1. L. R. James, of Route #2 Billings
(Name of Appropriator) (Address) (Town)
County of Yellowstone State of Montana
have appropriated groundwater according to the Montana laws in effect prior to January 1, 1962, as follows:

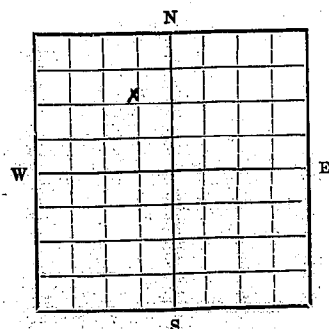

N.E. 1/4 N.W. 1/4 Sec. 31 T. 1 S. R. 27 E

Indicate point of appropriation
and place of use, if possible.
Each small square represents 10
acres.

2. The beneficial use on which the claim is based Home and stock
3. Date or approximate date of earliest beneficial use; and how continuous the use has been 1915
Continuous use
4. The amount of groundwater claimed (in miner's inches or gallons per minute) 10 gal
5. If used for irrigation, give the acreage and description of the lands to which water has been applied and name of the owner thereof 4 acre - Garden and yard
6. The means of withdrawing such water from the ground and the location of each well or other means of withdrawal
Hand pump

7. The date of commencement and completion of the construction of the well, wells, or other works for withdrawal of groundwater Well drilled in 1915
8. The depth of water table 22 ft
9. So far as it may be available, the type, size and depth of each well of the general specifications of any other works for the withdrawal of groundwater Depth 22 ft - 6 inch casing
10. The estimated amount of groundwater withdrawn each year 225,000 Gal
11. The log of formations encountered in the drilling of each well if available ?
Unknown
12. Such other information of a similar nature as may be useful in carrying out the policy of this act, including reference to book and page of any county record ?
Unknown

Signature of Owner

Date

L. R. James
Dec 22, 1963

Three copies to be filed by the owner with the County Clerk and Recorder of the county in which the well is located.

Please answer all questions. If not applicable, so state, otherwise the form will be returned.

Original to the County Clerk and Recorder; duplicate to the State Engineer; Triplicate to the School of Mines and Quadruplicate for the Appropriator.

16075

721002

STATE OF MONTANA
County of Yellowstone
This instrument was filed in my office
this DEC 27 day of 1963
at 11:24 o'clock A M.
Edmon S. Redding,
County Clerk & Recorder
By Jaw Deputy
200

File No.

T. 1S R. 27S

DUPLICATE

County Yellowstone

STATE OF MONTANA
ADMINISTRATOR OF GROUNDWATER CODE
OFFICE OF STATE ENGINEER

RECEIVED
JAN 2 1964

STATE ENGINEER
**Notice of Completion of Groundwater Appropriation
Without Well**

(Under Chapter 237 Montana Session Laws, 1961)

Date of Appropriation of Groundwater 1958Owner FRASER LAND & LIVESTOCK CO INC Address Box 1352-BillingsContractor (if any) R. B. FraserAddress of Contractor Box 1352 Billings, Montana
continuous developmentDate Started 1958 Date Completed

Describe means of obtaining groundwater without a well "as by sub-irrigation and other natural processes". Include depth to water when applicable.

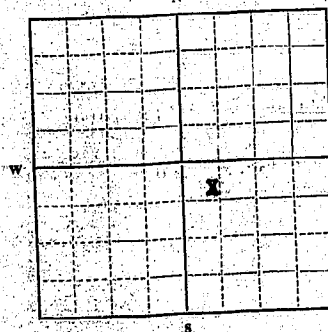
Developed spring & ditching

1/4 Sec. 23 T. 1S R. 27
Indicate point of appropriation
and place of use, if possible.

Quantity of water developed and used with explanation of method used to measure or estimate such amount. If use is intermittent

estimate approximate lengths of periods of use

year around - variable amounts - continuous flowSignature of Owner FRASER LAND & LIVESTOCK CO. INC.
R. B. FraserDate 12/31/63

This form to be prepared by contractor (if any), otherwise by the owner.

Three copies of this notice are to be filed with the County Clerk and Recorder of the county in which the works are located.

Please answer all questions. If not applicable, so state, otherwise the form will be returned.

Original to the County Clerk and Recorder; duplicate to the State Engineer; Triplicate to the Montana Bureau of Mines and Geology and Quadruplicate for the Appropriator.