

GY-4

File No.

DUPLICATE

T. 23 R. 24E

County: Yellowstone

16

STATE OF MONTANA
ADMINISTRATOR OF GROUNDWATER CODE
OFFICE OF STATE ENGINEER

Declaration of Vested Groundwater Rights

(Under Chapter 237, Montana Session Laws, 1961)

RECEIVED
JAN 2 1964

STATE ENGINEER

I, John A. McFate, of Route 1 Box 311 Leurel
(Name of Appropriator) (Address) (Town)
County of Yellowstone State of Montana
have appropriated groundwater according to the Montana laws in effect prior to January 1, 1962, as follows:

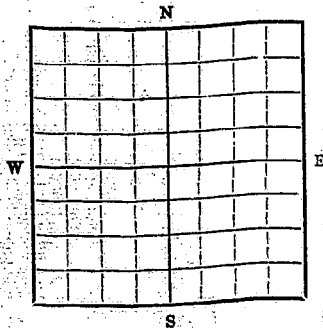

SE 1/4, ~~16~~ Sec. 21, T. 23 R. 24E

Indicate point of appropriation and place of use, if possible. Each small square represents 10 acres.

- The beneficial use on which the claim is based irrigation
- Date or approximate date of earliest beneficial use; and how continuous the use has been Spring of 1933
Seasonal
- The amount of groundwater claimed (in miner's inches or gallons per minute) 17 gallons per minute
- If used for irrigation, give the acreage and description of the lands to which water has been applied and name of the owner thereof approx. 2.5 ac. John A. McFate
lawn and garden
- The means of withdrawing such water from the ground and the location of each well or other means of withdrawal
centrifugal pump 1 well on the above described site

- The date of commencement and completion of the construction of the well, wells, or other works for withdrawal of groundwater 1933
- The depth of water table varies from 3 to 6 ft
- So far as it may be available, the type, size and depth of each well or the general specifications of any other works for the withdrawal of groundwater 10 ft depth approx. 30" in diameter
concrete casing
- The estimated amount of groundwater withdrawn each year 200,000
- The log of formations encountered in the drilling of each well if available river gravel
- Such other information of a similar nature as may be useful in carrying out the policy of this act, including reference to book and page of any county record 3520

Signature of Owner John A. McFate

Date Dec 31 1963

Three copies to be filed by the owner with the County Clerk and Recorder of the county in which the well is located.

Please answer all questions. If not applicable, so state, otherwise the form will be returned.

Original to the County Clerk and Recorder; duplicate to the State Engineer; Triplicate to the School of Mines and Quadruplicate for the Appropriator.

18318

721550

STATE OF MONTANA
County of Yellowstone

This instrument was filed in my office
this 31 day of Dec 1963
at 10:30 o'clock A.M.

Edison S. Hedding,
County Clerk & Recorder
By J. L. Deputy

RECEIVED

County Yellowstone

STATE OF MONTANA
ADMINISTRATOR OF GROUNDWATER CODE
MONTANA WATER RESOURCES BOARD

OCT 5 1972

DRILLER'S LOG

Indicate the character, color, thickness of strata such as soil, clay, sand, gravel, shale, sandstone, etc. Show depth at which water is found and height to which water rises in well.

NOTICE OF COMPLETION OF GROUNDWATER APPROPRIATION BY MEANS OF WELL

Developed after January 1, 1962

(Under Chapter 237 Montana Session Laws, 1961, as amended)

This form to be prepared by driller, and three copies to be filed by the owner with the County Clerk and Recorder in the county in which the well is located. Last copy to be retained by driller.

Please answer all questions. If not applicable, so state, otherwise the form may be returned.

Owner Paul H. Shively

Address P.O. Box 342

Laurel, Mt. 59044

Date well started 9/8/72

completed 9/8/72

Type of well DRIVEN

Equipment used DRIVER

Water Use: Domestic Municipal Stock Irrigation

Industrial Drainage Other * Garden/Lawn

*Describe

USE: If used for irrigation, industrial, drainage or other. Explain, state number of acres and location or other data (i.e. Lot, Block and Addition). Not applicable

ESTIMATED ANNUAL WITHDRAWAL 100,000 gals

| Size of Drilled Hole | Size and Weight of Casing | From (Feet) | To (Feet) | PERFORATIONS | | |
|----------------------|---------------------------|-------------|-----------|----------------|-------------|-----------|
| | | | | Kind Size | From (Feet) | To (Feet) |
| <u>3 1/2"</u> | <u>11# NEW CASING</u> | <u>0</u> | <u>31</u> | <u>1/2 CUT</u> | <u>27</u> | <u>20</u> |

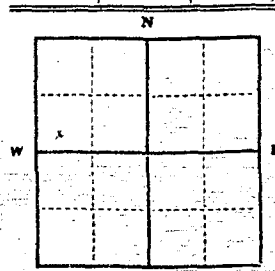

Static water level 7 ft.*
Pumping water level 12 ft.*
at 30 gallons per minute,
measured 120 minutes after pumping began.

*Measured from ground level.
Well developed by PUMP
for hours.

Power Pump 3.1 HP

Remarks: (Gravel packing, cementing, packers, type of shut-off)

PIPE EXT 1'
4' BELOW GROUND

S 1/4 NW 1/4 Sec. 16

T. 2 N. R. 24 E.

INDICATE LOCATION OF WELL AND PLACE OF USE, IF POSSIBLE. EACH SMALL SQUARE REPRESENTS 40 ACRES.

Driller's Signature H.D. DRILLING Loan Jenett

Driller's Address 1035 WINGMILLER LANE

BILLINGS 5 MONT LICENSE NO. 188

FILL IN WHERE MARKED X

| Top of Ground (Elev. above sea level) | |
|---------------------------------------|-----------|
| From (Feet) | To (Feet) |
| <u>0</u> | <u>2</u> |
| <u>2</u> | <u>8</u> |
| <u>8</u> | <u>21</u> |
| <u>21</u> | |

TOP SOIL
ROCK-GRAVEL
GRAVEL + SAND
SHALE

WATER AT 10'
30 GAL PER MIN

Show exact depth of bottom

21

91,532

917773

RECEIVED BY THE SECRETARY OF THE
DEPARTMENT OF THE INTERIOR
WASHINGTON, D. C.

RECEIVED BY THE SECRETARY OF THE
DEPARTMENT OF THE INTERIOR
WASHINGTON, D. C.

RECEIVED BY THE SECRETARY OF THE
DEPARTMENT OF THE INTERIOR
WASHINGTON, D. C.

RECEIVED BY THE SECRETARY OF THE
DEPARTMENT OF THE INTERIOR
WASHINGTON, D. C.

RECEIVED BY THE SECRETARY OF THE
DEPARTMENT OF THE INTERIOR
WASHINGTON, D. C.

STATE OF MONTANA } 89.
COUNTY OF _____ }
4th _____ in my office
1.05 Oct 10 72
P. M.
Carey R. Butler Deputy
750

RECEIVED
FEB 27 1964

File No.

T. 25... R. 24E... 17

ORIGINAL

SECTION No. 1

STATE ENGINEER
STATE OF MONTANA
ADMINISTRATOR OF GROUNDWATER CODE
OFFICE OF STATE ENGINEER

County Yellowstone

RECEIVED
JAN 2 1964

DECLARATION of VESTED GROUNDWATER RIGHTS
(Under Chapter 237, Montana Session Laws, 1961)

STATE ENGINEER

1. Richard S. Johnson, of 191 1st Avenue
(Name of Appropriator) (Address) (Town)

County of Yellowstone State of Montana
have appropriated groundwater according to the Montana laws in effect prior to
January 1, 1962, as follows:

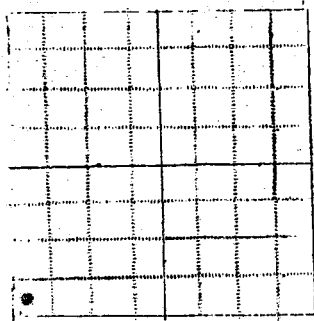

SW 1 - Sec 17 T25 R. 24E
Indicate point of appropriation
and place of use, if possible.
Each small square represents
10 acres.

- 2. The beneficial use on which the claim is based
irrigation - alfalfa
- 3. Date or approximate date of earliest beneficial use; and how continuous the use has been
1946 - continuous use through
- 4. The amount of groundwater claimed (in miner's inches or gallons per minute) - 2-5 gpm
- 5. If used for irrigation, give the acreage and description of the lands to which water has been applied and name of the owner thereof
not used for irrigation
- 6. The means of withdrawing such water from the ground and the location of each well or other means of withdrawal

- 7. The date of commencement and completion of the construction of the well, wells, or other works for withdrawal of groundwater
March 1946
 - 8. The depth of water table
4 to 5 ft
 - 9. So far as it may be available, the type, size and depth of each well or the general specifications of any other works for the withdrawal of groundwater
10 ft deep point drain
 - 10. The estimated amount of groundwater withdrawn each year
30,000 gal
 - 11. The log of formations encountered in the drilling of each well if available
 - 12. Such other information of a similar nature as may be useful in carrying out the policy of this act, including reference to book and page of any county record
- Signature of Owner Richard S. Johnson
Date Jan 2 1964

Three copies to be filed by the owner with the County Clerk and Recorder of the county in which the well is located.
Please answer all questions. If not applicable, so state, otherwise the form will be returned.
Original to the County Clerk & Recorder; Duplicate to the State Engineer; Triplicate to the Montana Bureau of Mines and Geology, and Quadruplicate for the appropriator

RECEIVED
FEB 27 1964

File No.
ORIGINAL

T. 25 S. R. 24 E. 17
County Yellowston

STATE ENGINEER
STATE OF MONTANA
ADMINISTRATOR OF GROUNDWATER CODE
OFFICE OF STATE ENGINEER

RECEIVED
JAN 2 1964
STATE ENGINEER

DECLARATION OF VESTED GROUNDWATER RIGHTS
(Under Chapter 237, Montana Session Laws, 1961)

1. Richard Weisbach of 121 1/2 N. 1st of Lawson
(Name of Appropriator) (Address) (Town)

County of Yellowstone State of Montana
have appropriated groundwater according to the Montana laws in effect prior to
January 1, 1962, as follows:

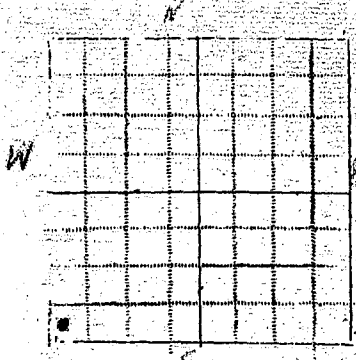

- SW 1/4 - Sec 17 T25 R24E
Indicate point of appropriation
and place of use, if possible.
Each small square represents
10 acres.

- 2. The beneficial use on which the claim is based
Domestic & Stock
- 3. Date or approximate date of earliest beneficial use; and how continuous the use has been
1946 continuous use
- 4. The amount of groundwater claimed (in miner's inches or gallons per minute)
250 gpm
- 5. If used for irrigation, give the acreage and description of the lands to which water has been applied and name of the owner thereof
Not in production
- 6. The means of withdrawing such water from the ground and the location of each well or other means of withdrawal

- 7. The date of commencement and completion of the construction of the well, wells, or other works for withdrawal of groundwater
March 1946
- 8. The depth of water table
7 to 5 ft
- 9. So far as it may be available, the type, size and depth of each well or the general specifications of any other works for the withdrawal of groundwater
2 1/2" steel sand point driven
- 10. The estimated amount of groundwater withdrawn each year
380,000
- 11. The log of formations encountered in the drilling of each well if available
none
- 12. Such other information of a similar nature as may be useful in carrying out the policy of this act, including reference to book and page of any county record

Signature of Owner Richard Weisbach
Date Feb 17 1962

Three copies to be filed by the owner with the County Clerk and Recorder of the county in which the well is located.
Please answer all questions. If not applicable, so state, otherwise the form will be returned.
Original to the County Clerk & Recorder; Duplicate to the State Engineer; Triplicate to the Montana Bureau of Mines and Geology, and Quadruplicate for the appropriator

721504

STATE OF MONTANA,
County of Yellowstone,

This instrument was filed in my office
this DEC 30 1968

at 10:03 o'clock A M.

Erven S. Redding,
County Clerk & Recorder

By [Signature] Deputy

4200

File No.

T 25 R 24 E

DUPLICATE

County Yell

STATE OF MONTANA
ADMINISTRATOR OF GROUNDWATER CODE
OFFICE OF STATE ENGINEER

RECEIVED
DEC 30 1963
STATE ENGINEER

Declaration of Vested Groundwater Rights

(Under Chapter 237, Montana Session Laws, 1961)

1. Alex P Frank of Rt 1 Laurel
(Name of Appropriator) (Address) (Town)
County of Yellowstone State of Mont
have appropriated groundwater according to the Montana laws in effect prior to January 1, 1962, as follows:

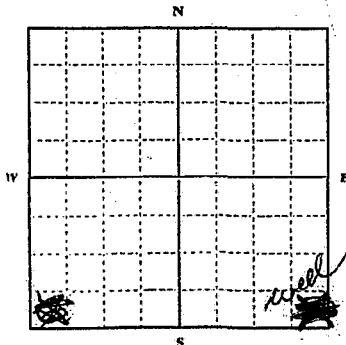

SE 1/4 SE Sec. 18 T. 28. R. 24 E

Indicate point of appropriation and place of use, if possible. Each small square represents 10 acres.

- 2. The beneficial use on which the claim is based. Stock water
- 3. Date or approximate date of earliest beneficial use; and how continuous the use has been. Nov. 15, 1940
daily
- 4. The amount of groundwater claimed (in miner's inches or gallons per minute). 100
- 5. If used for irrigation, give the acreage and description of the lands to which water has been applied and name of the owner thereof.
not used
- 6. The means of withdrawing such water from the ground and the location of each well or other means of withdrawal.
electric pump
- 7. The date of commencement and completion of the construction of the well, wells, or other works for withdrawal of groundwater. Nov. 1940
- 8. The depth of water table. 16 ft.
- 9. So far as it may be available, the type, size and depth of each well or the general specifications of any other works for the withdrawal of groundwater.
2 in. diam - 21 feet deep
- 10. The estimated amount of groundwater withdrawn each year. 240,000 gals
- 11. The log of formations encountered in the drilling of each well if available. 16 feet of earth
1 foot of shale - 4 feet of rock with gravel
- 12. Such other information of a similar nature as may be useful in carrying out the policy of this act, including reference to book and page of any county record.

Signature of Owner Alex P Frank
Date Dec 30, 1963

Three copies to be filed by the owner with the County Clerk and Recorder of the county in which the well is located.
Please answer all questions. If not applicable, so state, otherwise the form will be returned.

Original to the County Clerk and Recorder; Duplicate to the State Engineer; Triplicate to the Montana Bureau of Mines and Geology, and Quadruplicate for the Appropriator.

721207

STATE OF MICHIGAN
County of Ypsilanti
This instrument was filed in my office
this 12th day of May 1969
at A M.
By EE County Clerk of Recorder
Deputy

2.00

GW

File No.

T. 25 R. 24 E
County Yellowston

DUPLICATE

STATE OF MONTANA
ADMINISTRATOR OF GROUNDWATER CODE
OFFICE OF STATE ENGINEER

RECEIVED
DEC 30 1963

Declaration of Vested Groundwater Rights

(Under Chapter 237, Montana Session Laws, 1961)

1. Ally P Frank of Rt 1 Laurel
(Name of Appropriator) (Address) (Town)
County of Yellowston State of Mont
have appropriated groundwater according to the Montana laws in effect prior to January 1, 1962, as follows:

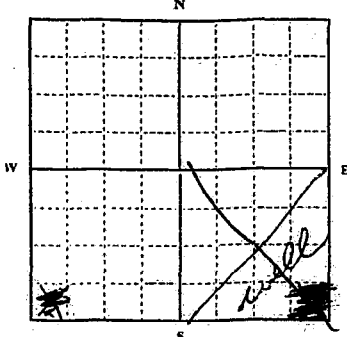

SE 1/4 Sec 18 T. 25 R. 24 E

Indicate point of appropriation and place of use, if possible. Each small square represents 10 acres.

- 2. The beneficial use on which the claim is based Domestic
- 3. Date or approximate date of earliest beneficial use; and how continuous the use has been June 1957
- 4. The amount of groundwater claimed (in miner's inches or gallons per minute) 75
- 5. If used for irrigation, give the acreage and description of the lands to which water has been applied and name of the owner thereof not used
- 6. The means of withdrawing such water from the ground and the location of each well or other means of withdrawal electric pumps

- 7. The date of commencement and completion of the construction of the well, wells, or other works for withdrawal of groundwater June 1957
- 8. The depth of water table 18 ft
- 9. So far as it may be available, the type, size and depth of each well or the general specifications of any other works for the withdrawal of groundwater 2 inches diam. 24 feet deep
- 10. The estimated amount of groundwater withdrawn each year 60,000 gals
- 11. The log of formations encountered in the drilling of each well if available 16 ft earth, 1 foot of shale 7 feet of sand and gravel
- 12. Such other information of a similar nature as may be useful in carrying out the policy of this act, including reference to book and page of any county record

Signature of Owner Ally P Frank
Date Dec 30, 1963

Three copies to be filed by the owner with the County Clerk and Recorder of the county in which the well is located.

Please answer all questions. If not applicable, so state, otherwise the form will be returned.

Original to the County Clerk and Recorder; Duplicate to the State Engineer; Triplicate to the Montana Bureau of Mines and Geology, and Quadruplicate for the Appropriator.

721198

STATE OF MONTANA,
County of Yellowstone.

This instrument was filed in my office
this DEC 30 1943

at 12:06 o'clock P. M. //

Edman B. Hedding,
County Clerk & Recorder

J. W. [Signature] Deputy,
27

File No.

T 25 R 24 E

DUPLICATE

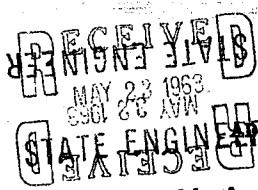

County Yellowstone

STATE OF MONTANA
ADMINISTRATOR OF GROUNDWATER CODE
OFFICE OF STATE ENGINEER

Top of Ground
(Elev. above sea level.....)

Notice of Completion of Groundwater Appropriation by Means of Well

(Under Chapter 237, Montana Session Laws, 1961)



Owner: Sand & Gravel 0-22 ft Albert Kenney Address: Laurel, Mont
22-23 Black Shale Driller: B & H Drilling Address: Fishtail, Mont.

Date of Notice of Appropriation of Groundwater.....
Date well started 5/16/63 Date Completed 5/17/63
Type of well Drilled Equipment Used Churn Drill
(dug, driven, bored or drilled) (Churn, drill, rotary or other)

Water Use: Domestic Municipal Other Irrigation
Industrial Drainage Stock

Indicate on the diagram the character and thickness of the different strata met with in drilling, such as soil, clay, shale, gravel, rock or sand, etc. Show depth at which water is encountered, thickness and character of water bearing strata and height to which water rises in the well.

| Size of Drilled Hole | Size and Weight of Casing | From (Feet) | To (Feet) | PERFORATIONS | | |
|----------------------|---------------------------|-------------|-----------|--------------|-------------|-----------|
| | | | | Kind Size | From (Feet) | To (Feet) |
| 6 in | 6 inch 19# | 17 | 23 | Touch | 22 | Cuts |

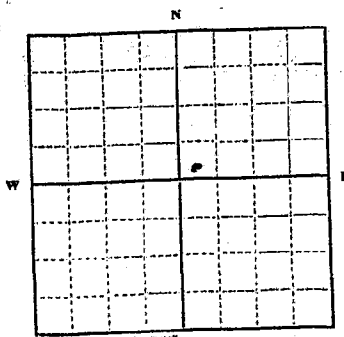

NE 1/4 Sec. 18 T. 25 R. 24 E

Indicate location of well and place of use, if possible. Each small square represents 10 acres.

Show exact depth of bottom.

23 ft 0

Static Water Level for non-flowing Well 7 feet.

Shut-in Pressure for Flowing Well.....

Pumping Water Level 12 feet at 25 gal. per minute.

Discharge in gal. per min. of flowing well.....

How Tested Bailer Length of Test 1 hr

Remarks: (Gravel packing, cementing, packers, type of shutoff, location of place of use of groundwater if not at well, and any other similar pertinent information, including number of acres irrigated, if used for irrigation).....

No 27
Driller's License Number

Red L. Hargis
Driller's Signature

This form to be prepared by driller, and three copies to be filed by the owner, with the County Clerk and Recorder in the county in which the well is located.

Please answer all questions. If not applicable, so state, otherwise the form will be returned.

Original to the County Clerk and Recorder; duplicate to the State Engineer; Triplicate to the Montana Bureau of Mines and Geology and Quadruplicate for the Appropriator

707382

STATE OF MONTANA } ss.
County of Yellowstone }

This instrument was filed in my office
this 22 day of May 1963
at 10:32 o'clock AM M.

CIRUS BURCH County Recorder
By [Signature] Deputy

Handwritten notes and signatures on the right side of the page, including the number 38 and various initials.

RECEIVED

Form 3 GW 3 Revised 1969
2057-1500-1/71

NOV 29 1971

County Yellowstone

STATE OF MONTANA
ADMINISTRATOR OF GROUNDWATER CODE
MONTANA WATER RESOURCES BOARD

NOTICE OF COMPLETION OF GROUNDWATER APPROPRIATION WITHOUT WELL
Developed After January 1, 1962

(Under Chapter 237, Montana Session Laws, 1961, as amended)

This form to be prepared by contractor (if any), otherwise by the owner.

Three copies of this notice are to be filed with the County Clerk and Recorder of the county in which the works are located.

Please answer all questions. If not applicable, so state, otherwise the form may be returned.

For Administrator's Use

File 895833

11-26-71 E. ISA, m.

GW 1

Owner Stanley A. Kinney

Address Rt. # 1 Laurel, Mt. 59044

Contractor (if any) None

Address of Contractor None

Date Started August 5, 1971 Date Completed August 5, 1971

1. Describe means of obtaining groundwater (as by sub-irrigation, developed spring, drains, etc.) Developed spring

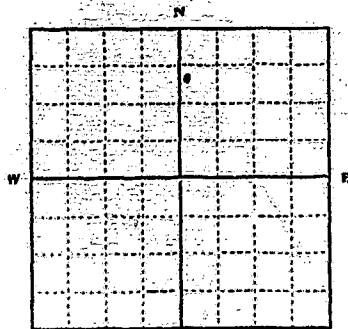

NE

2 3 4 5 6 7 8 9 10 11 12 13 14 15 16 17 18 19 20

T. 2 N R. 24 E

S. W

INDICATE POINT OF APPROPRIATION AND PLACE OF USE, IF POSSIBLE. Elevation of spring, if known or estimated

2. Means of withdrawing water (gravity, pump, canal, etc.)

pump & gravity

3. Depth of water table

4. Use of the water Household & Stock

5. Amount of groundwater claimed (in miner's inches or gallons per minute) 250 Gallons per Minute

6. If used for irrigation, give number of acres and description of land Household (yard) & Stock Pond

7. Estimate amount of water used each year 8,544,000 Gal.

8. Months of year spring flows 12

Signature of Owner Stanley A. Kinney
Date Nov 24, 1971

895833

STATE OF MONTANA, } ss.
County of Yellowstone.

This NOV 26 1977 day of NOV 1977 at Yellowstone in my office

at 8:15 A. M.

By [Signature] Deputy

[Signature]

File No.....

18 T... 2... S... R... 24...
County... Yellowstone

ORIGINAL

STATE OF MONTANA
ADMINISTRATOR OF GROUNDWATER CODE
OFFICE OF STATE ENGINEER

DECLARATION OF VESTED GROUNDWATER RIGHTS
(Under Chapter 237, Montana Session Laws, 1961) JAN 2 1964

RECEIVED

1. Herman G. Stueck, of R#1 STATE ENGINEER, Mont
(Name of Appropriator) (Address) (Town)

County of Bill. State of Mont
have appropriated groundwater according to the Montana laws in effect prior to
January 1, 1962, as follows:

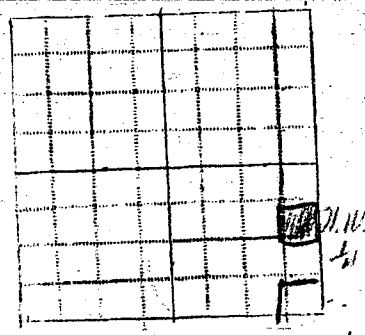

NW 1/4 - Sec. 17, T. 25, R. 24
Indicate point of appropriation
and place of use, if possible.
Each small square represents
10 acres.

- 2. The beneficial use on which the claim is based
Subsistence Water + Home use
+ 1 acre of grass
- 3. Date or approximate date of earliest beneficial
use; and how continuous the use has been
1958 - 5 years
- 4. The amount of groundwater claimed (in miner's
inches or gallons per minute)
55 gals
- 5. If used for irrigation, give the acreage and
description of the lands to which water has been
applied and name of the owner thereof
7 acre lawn H. G. Stueck
sheds
- 6. The means of withdrawing such water from the
ground and the location of each well or other
means of withdrawal
Electric Pump
- 7. The date of commencement and completion of the construction of the well, wells,
or other works for withdrawal of groundwater
1958
- 8. The depth of water table
Depth of well - 28 ft
- 9. So far as it may be available, the type, size and depth of each well or the gen-
eral specifications of any other works for the withdrawal of groundwater
(3 inch pipe - steel casing) 2 inch plastic
inside of casing
- 10. The estimated amount of groundwater withdrawn each year
1,570,000 gals
- 11. The log of formations encountered in the drilling of each well if available
silt - gravel - quicksand
- 12. Such other information of a similar nature as may be useful in carrying out the
policy of this act, including reference to book and page of any county record
County Income effect for location - tax assessments
Herman G. Stueck
Signature of Owner Date - Dec 31, 1963

Three copies to be filed by the owner with the County Clerk and Recorder of the
county in which the well is located.
Please answer all questions. If not applicable, so state, otherwise the form will
be returned.
Original to the County Clerk & Recorder; Duplicate to the State Engineer; Triplicate
to the Montana Bureau of Mines and Geology, and Quadruplicate for the appropriator

721573

STATE OF MONTANA
County of Yellowstone
This instrument was filed in my office
this 11.26 day of Nov 1963
at Bozeman, Montana
County Clerk of the County of Yellowstone
By Jaw Deputy

File No. _____
STATE WATER CONSERVATION BOARD
DUPLICATE

T. 25 R. 24 E
County Yellowstone

JAN 1 1965
STATE OF MONTANA
ADMINISTRATOR OF GROUNDWATER CODE
OFFICE OF STATE ENGINEER

Declaration of Vested Groundwater Rights

(Under Chapter 21, Montana Session Laws, 1965)

1. J. O. Wold, Jr. of B.T. I LAUREL
(Name of Appropriator) (Address) (Town)
County of YELL State of MONT
have appropriated groundwater according to the Montana laws in effect prior to January 1, 1962, as follows:

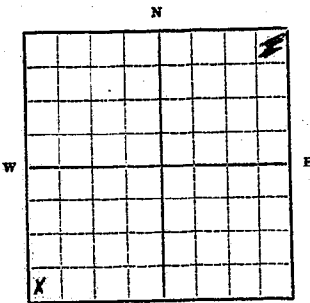

S 1/4 Sec 17 T. 25 R. 24 E

Indicate point of appropriation and place of use, if possible. Each small square represents 10 acres.

- 2. The beneficial use on which the claim is based HOUSEHOLD + LIVESTOCK
- 3. Date or approximate date of earliest beneficial use; and how continuous the use has been 1948 - CONTINUOUS
- 4. The amount of groundwater claimed (in miner's inches or gallons per minute) 1.0 gal per min.
- 5. If used for irrigation, give the acreage and description of the lands to which water has been applied and name of the owner thereof
- 6. The means of withdrawing such water from the ground and the location of each well or other means of withdrawal JET PUMP

- 7. The date of commencement and completion of the construction of the well, wells, or other works for withdrawal of groundwater FEB 1948 - MAR-1948
- 8. The depth of water table 25'
- 9. So far as it may be available, the type, size and depth of each well or the general specifications of any other works for the withdrawal of groundwater DRIVEN 2' - 25' SAND POINT
- 10. The estimated amount of groundwater withdrawn each year 300,000 gal
- 11. The log of formations encountered in the drilling of each well if available SAND 6' - HARD PAN GUMBO 12' - GRAVEL
- 12. Such other information of a similar nature as may be useful in carrying out the policy of this act, including reference to book and page of any county record

Signature of Owner J. O. Wold, Jr.
Date Dec 30 - 1965

Three copies to be filed by the owner with the County Clerk and Recorder of the county in which the well is located. Please answer all questions. If not applicable, so state, otherwise the form will be returned.

Original to the County Clerk and Recorder; duplicate to the State Engineer; Triplicate to the School of Mines and Quadruplicate for the Appropriator.

10541

STATE WATER CONSERVATION BOARD

File No.

APR 25 1966

T. 25 R. 24 E

DUPLICATE

Bille _____ McDermott _____
 Butzerin _____ McNulty _____
 Coyle _____ Morton _____
 Darlinton _____ Sullivan _____
 Dickert _____

County Yellowstone

STATE OF MONTANA
 ADMINISTRATOR OF GROUNDWATER CODE
 OFFICE OF STATE ENGINEER

Top of Ground
 (Elev. above sea level.....)

Notice of Completion of Groundwater Appropriation by Means of Well

(Under Chapter 237, Montana Session Laws, 1961)

*8' top soil
 24' sand & gravel*

Owner Lawrence D. Dyer Address Bullinger

Driller Hande Drilling Address Bullinger

Date of Notice of Appropriation of Groundwater.....

Date well started 4/30/66 Date Completed 4/11/66

Type of well Drilled Equipment Used Callie Tool
 (aug, driven, bored or drilled) (Churn, drill, rotary or other)

Water Use: Domestic Municipal Other Irrigation
 Industrial Drainage Stock

Indicate on the diagram the character and thickness of the different strata met with in drilling, such as soil, clay, shale, gravel, rock or sand, etc. Show depth at which water is encountered, thickness and character of water-bearing strata and height to which water rises in the well.

| Size of Drilled Hole | Size and Weight of Casings | From (Feet) | To (Feet) | PERFORATIONS | | |
|----------------------|----------------------------|-------------|-----------|--------------|-------------|-----------|
| | | | | Kind Size | From (Feet) | To (Feet) |
| <u>6"</u> | <u>6" 13 lb</u> | <u>+2'</u> | <u>32</u> | | | |

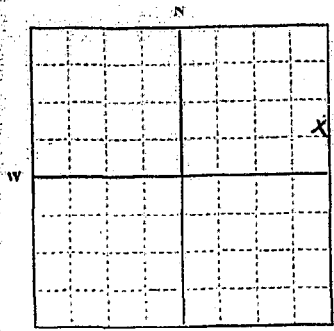

S²NE¹/₄ Sec. 9 T. 25 R. 24 E

Indicate location of well and place of use, if possible. Each small square represents 10 acres.

Show exact depth of bottom.

Static Water Level for non-flowing Well..... feet.

Shut-in Pressure for Flowing Well.....

Pumping Water Level 15 feet at 20 gal. per minute.

Discharge in gal. per min. of flowing well.....

How Tested Packin Length of Test 30 min

Remarks: (Gravel packing, cementing, packers, type of shutoff, location of place of use of groundwater if not at well, and any other similar pertinent information, including number of

acres irrigated, if used for irrigation).....

77036
 Driller's License Number

Charles E. Dyer
 Driller's Signature

This form to be prepared by driller, and three copies to be filed by the owner with the County Clerk and Recorder in the county in which the well is located.

Please answer all questions. If not applicable, so state, otherwise the form will be returned.

Original to the County Clerk and Recorder; duplicate to the State Engineer; Triplicate to the Montana Bureau of Mines and Geology and Quadruplicate for the Appropriator.

41002

777007

STATE OF MONTANA,
County of Yellowstone.

This instrument was filed in 10- of
this 22 day of April 1966
at 1:40 P.M.

Edison B. Redding,
County Clerk & Recorder
By J. J. Call Deputy

2

676702
File No. ~~1711~~

T. 2 S. R. 24 E.

DUPLICATE, -24-62
filed ~~1711~~
@ 8:00 AM
fee 2-

County Yellowstone

STATE OF MONTANA
ADMINISTRATOR OF GROUNDWATER CODE
OFFICE OF STATE ENGINEER

RECEIVED
JAN 25 1962

Declaration of Vested Groundwater Rights
(Under Chapter 237, Montana Session Laws, 1961)

STATE ENGINEER

1. G. W. Fenton of Box 336 Laurel
(Name of Appropriator) (Address) (Town)
County of Yellowstone State of Montana
have appropriated groundwater according to the Montana laws in effect prior to January 1, 1962, as follows:

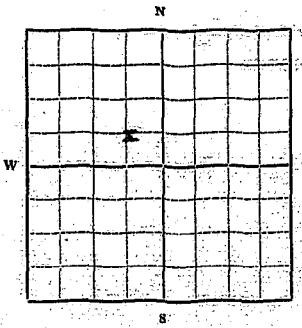

NW 1/4 Sec. 20, T. 2S, R. 24E

Indicate point of appropriation and place of use, if possible. Each small square represents 10 acres.

- The beneficial use on which the claim is based Livestock
- Date or approximate date of earliest beneficial use; and how continuous the use has been about 1881
- The amount of groundwater claimed (in miner's inches or gallons per minute) 20 +
- If used for irrigation, give the acreage and description of the lands to which water has been applied and name of the owner thereof none
- The means of withdrawing such water from the ground and the location of each well or other means of withdrawal pump
- The date of commencement and completion of the construction of the well, wells, or other works for withdrawal of groundwater about 1881
- The depth of water table 8ft
- So far as it may be available, the type, size and depth of each well or the general specifications of any other works for the withdrawal of groundwater about 12 ft deep
dug by hand pick & shovel
- The estimated amount of groundwater withdrawn each year unknown
- The log of formations encountered in the drilling of each well if available unknown
- Such other information of a similar nature as may be useful in carrying out the policy of this act, including reference to book and page of any county record unknown

Signature of Owner G. W. Fenton
Date 1-2-62

Three copies to be filed by the owner with the County Clerk and Recorder of the county in which the well is located.

Please answer all questions. If not applicable, so state, otherwise the form will be returned.

Original to the County Clerk and Recorder; duplicate to the State Engineer; Triplicate to the School of Mines and Quadruplicate for the Appropriator.

1768

20

GW 676703

File No. ~~676703~~

T. 2S R. 24E

DUPLICATE 1-24-62

County Yellowstone

filed
8:01 AM
for 2

STATE OF MONTANA
ADMINISTRATOR OF GROUNDWATER CODE
OFFICE OF STATE ENGINEER

RECEIVED
JAN 25 1962

Declaration of Vested Groundwater Rights
(Under Chapter 237, Montana Session Laws, 1961)

STATE ENGINEER

1. G. W. Fenton, of Box 336 Laurel
(Name of Appropriator) (Address) (Town)

County of Yellowstone State of Montana
have appropriated groundwater according to the Montana laws in effect prior to January 1, 1962, as follows:

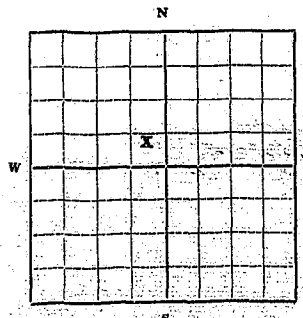

NW 1/4 Sec. 20 T. 2S R. 24E

Indicate point of appropriation and place of use, if possible. Each small square represents 10 acres.

2. The beneficial use on which the claim is based
Livestock

3. Date or approximate date of earliest beneficial use; and how continuous the use has been
about 1939
Continuous

4. The amount of groundwater claimed (in miner's inches or gallons per minute)
20 +

5. If used for irrigation, give the acreage and description of the lands to which water has been applied and name of the owner thereof
none

6. The means of withdrawing such water from the ground and the location of each well or other means of withdrawal
pump

7. The date of commencement and completion of the construction of the well, wells, or other works for withdrawal of groundwater
about 1939

8. The depth of water table
about 10ft

9. So far as it may be available, the type, size and depth of each well or the general specifications of any other works for the withdrawal of groundwater
Well was drilled about 35ft

10. The estimated amount of groundwater withdrawn each year
unknown

11. The log of formations encountered in the drilling of each well if available
about 6ft dirt 24ft gravel

12. Such other information of a similar nature as may be useful in carrying out the policy of this act, including reference to book and page of any county record
unknown

Signature of Owner *G. W. Fenton*
Date 1-24-62

Three copies to be filed by the owner with the County Clerk and Recorder of the county in which the well is located.

Please answer all questions. If not applicable, so state, otherwise the form will be returned.

Original to the County Clerk and Recorder; duplicate to the State Engineer; Triplicate to the School of Mines and Quadruplicate for the Appropriator.

1257

1768

File No.

T. 2^S R. 24

ORIGINAL

County

STATE OF MONTANA
ADMINISTRATOR OF GROUNDWATER CODE
OFFICE OF STATE ENGINEER

RECEIVED
JAN 2 1964

DECLARATION OF VESTED GROUNDWATER RIGHTS
(Under Chapter 237, Montana Session Laws, 1961)

STATE ENGINEER

1. Woodrow Henry, of Rt. 1 Box 147 Laurel, Mont.
(Name of Appropriator) (Address) (Town)

County of Hell Creek State of Montana
have appropriated groundwater according to the Montana laws in effect prior to
January 1, 1962, as follows:

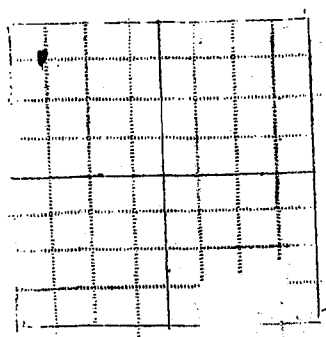

Indicate point of appropriation
and place of use, if possible.
Each small square represents
10 acres.

2. The beneficial use on which the claim is based
Stock & Household

3. Date or approximate date of earliest beneficial
use; and how continuous the use has been
Since 1946 - continuous

4. The amount of groundwater claimed (in miner's
inches or gallons per minute)
100 gallons per min.

5. If used for irrigation, give the acreage and
description of the lands to which water has been
applied and name of the owner thereof
Event Lawn Only

6. The means of withdrawing such water from the
ground and the location of each well or other
means of withdrawal
Pump

7. The date of commencement and completion of the construction of the well, wells,
or other works for withdrawal of groundwater
Since 1946

8. The depth of water table
20' Winter - 24' Summer

9. So far as it may be available, the type, size and depth of each well or the gen-
eral specifications of any other works for the withdrawal of groundwater
2 1/2 feet - Deep

10. The estimated amount of groundwater withdrawn each year
150,000 Gallons

11. The log of formations encountered in the drilling of each well if available
Drilled into gravel

12. Such other information of a similar nature as may be useful in carrying out the
policy of this act, including reference to book and page of any county record

Signature of Owner
Woodrow Henry
Date
12/31/63

Three copies to be filed by the owner with the County Clerk and Recorder of the
county in which the well is located.

Please answer all questions. If not applicable, so state, otherwise the form will
be returned.

Original to the County Clerk & Recorder; Duplicate to the State Engineer; Triplicate
to the Montana Bureau of mines and Geology, and Quadruplicate for the appropriator

Mines
1257

18275

721503

DEC 31 1963
10-02
County Clerk & Recorder
Deputy

File No.

T 2 S R 24 E. 21

DUPLICATE

County Yellowstone

STATE OF MONTANA
ADMINISTRATOR OF GROUNDWATER CODE
OFFICE OF STATE ENGINEER

RECEIVED
DEC 30 1963

Declaration of Vested Groundwater Rights
(Under Chapter 287, Montana Session Laws, 1961) STATE ENGINEER

1. Alma L. Williams, R. M. Williams, and Thelma C. Williams, of Laurel, Montana, have appropriated groundwater according to the Montana laws in effect prior to January 1, 1962, as follows:

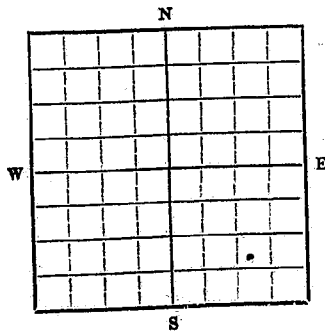

N 7 S E 1/4 Sec. 21 T 2 S R 24 E

Indicate point of appropriation and place of use, if possible. Each small square represents 10 acres.

- 2. The beneficial use on which the claim is based watering stock in coral
- 3. Date or approximate date of earliest beneficial use; and how continuous the use has been July 1948, continuous
- 4. The amount of groundwater claimed (in miner's inches or gallons per minute) 2 gals per minute
- 5. If used for irrigation, give the acreage and description of the lands to which water has been applied and name of the owner thereof none
- 6. The means of withdrawing such water from the ground and the location of each well or other means of withdrawal electric pump at coral - 150' N. of house.

- 7. The date of commencement and completion of the construction of the well, wells, or other works for withdrawal of groundwater July 1948
- 8. The depth of water table 14 feet of surface
- 9. So far as it may be available, the type, size and depth of each well or the general specifications of any other works for the withdrawal of groundwater 2" galvanized pipe, depth 24'
- 10. The estimated amount of groundwater withdrawn each year 275,000 gallons
- 11. The log of formations encountered in the drilling of each well if available 1 1/2' top soil balance gravel and sand
- 12. Such other information of a similar nature as may be useful in carrying out the policy of this act, including reference to book and page of any county record

Signature of Owner Alma L. Williams
Date December 28, 1963

Three copies to be filed by the owner with the County Clerk and Recorder of the county in which the well is located.

Please answer all questions. If not applicable, so state, otherwise the form will be returned.

Original to the County Clerk and Recorder; duplicate to the State Engineer; Triplicate to the School of Mines and Quadruplicate for the Appropriator.

16175

721179

| | | | | | |
|--|--|--|--|--|--|
| | | | | | |
| | | | | | |
| | | | | | |
| | | | | | |
| | | | | | |
| | | | | | |

STATE OF MONTANA,
County of Yellowstone.

This instrument was filed in my office
this DEC 30 1963 19
at 10.00 A
M. S. Running,
County Clerk & Recorder
Deputy
Jaw
Jr.

GV

File No.

T 2 S R 24 E

County Yellowstone

DUPLICATE

STATE OF MONTANA
ADMINISTRATOR OF GROUNDWATER CODE
OFFICE OF STATE ENGINEER

RECEIVED
DEC 30 1963

Declaration of Vested Groundwater Rights
(Under Chapter 237, Montana Session Laws, 1961)

STATE ENGINEER

and Thelma C. Williams
1. Alma L. Williams, R. M. Williams, of Laurel (Town)
(Name of Appropriator) (Address)
County of Yellowstone State of Montana
have appropriated groundwater according to the Montana laws in effect prior to January 1, 1962, as follows:

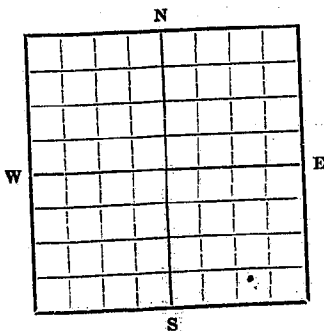

SW SESE 1/4 Sec. 21 T. 28 R. 24 E

Indicate point of appropriation and place of use, if possible. Each small square represents 10 acres.

- 2. The beneficial use on which the claim is based residence
- 3. Date or approximate date of earliest beneficial use; and how continuous the use has been Summer of 1902, continuous
- 4. The amount of groundwater claimed (in miner's inches or gallons per minute) 10 gals per minute
- 5. If used for irrigation, give the acreage and description of the lands to which water has been applied and name of the owner thereof yard irrigation 1/2 acre
- 6. The means of withdrawing such water from the ground and the location of each well or other means of withdrawal electric pump, N.E. corner of home

7. The date of commencement and completion of the construction of the well, wells, or other works for withdrawal of groundwater Summer of 1902

8. The depth of water table 10 feet from surface

9. So far as it may be available, the type, size and depth of each well or the general specifications of any other works for the withdrawal of groundwater Originally a dugged rock-walled well, later put in 6" casing.

10. The estimated amount of groundwater withdrawn each year 300,000

11. The log of formations encountered in the drilling of each well if available first foot top soil then gravel and sand.

12. Such other information of a similar nature as may be useful in carrying out the policy of this act, including reference to book and page of any county record

Signature of Owner Alma L. Williams
Date December 28th, 1963

Three copies to be filed by the owner with the County Clerk and Recorder of the county in which the well is located.

Please answer all questions. If not applicable, so state, otherwise the form will be returned.

Original to the County Clerk and Recorder; duplicate to the State Engineer; Triplicate to the School of Mines and Quadruplicate for the Appropriator.

16174

721178

STATE OF MONTANA
County of Yellowstone

This instrument was filed in my office

this 11:05 day DEC 30 1963

at 11:05 o'clock A.M.
Edmon S. J. [unclear]
County Clerk & Recorder

By Jaw
200



GW

File No.

T. 2S R. 24 E 21

DUPLICATE

County Yellowstone

STATE OF MONTANA
ADMINISTRATOR OF GROUNDWATER CODE
OFFICE OF STATE ENGINEER

RECEIVED
DEC 30 1963

Declaration of Vested Groundwater Rights
(Under Chapter 237, Montana Session Laws, 1961)

1. R. M. WILLIAMS & THELMA C. WILLIAMS, of Box 188 Laurel
(Name of Appropriator) (Address) (Town)
County of Yellowstone State of Montana
have appropriated groundwater according to the Montana laws in effect prior to January 1, 1962, as follows:

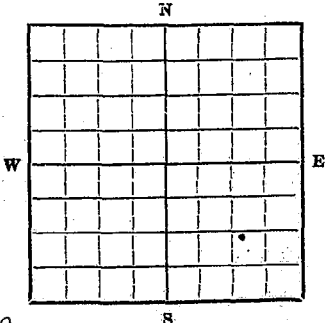

21
NW 1/4 Sec. 21 T2S R. 24E

Indicate point of appropriation and place of use, if possible. Each small square represents 10 acres.

- 2. The beneficial use on which the claim is based residence and irrigation of lawn and garden
- 3. Date or approximate date of earliest beneficial use; and how continuous the use has been October 17, 1956, continuous
- 4. The amount of groundwater claimed (in miner's inches or gallons per minute) 10 gallons per minute
- 5. If used for irrigation, give the acreage and description of the lands to which water has been applied and name of the owner thereof 2 acres, pasture and garden, R. M. and Thelma C. Williams
- 6. The means of withdrawing such water from the ground and the location of each well or other means of withdrawal 1 1/2 Horse Reda pump, located at NE corner of home.

- 7. The date of commencement and completion of the construction of the well, wells, or other works for withdrawal of groundwater completed October 15, 1956
- 8. The depth of water table 14 feet from surface
- 9. So far as it may be available, the type, size and depth of each well or the general specifications of any other works for the withdrawal of groundwater Depth 37 feet, 6" casing 27 feet drilled well
- 10. The estimated amount of groundwater withdrawn each year 365,000
- 11. The log of formations encountered in the drilling of each well if available first foot top soil, 3' gravel, 5' sand, 5' coarse gravel, 22' fine gravel and some sand
- 12. Such other information of a similar nature as may be useful in carrying out the policy of this act, including reference to book and page of any county record

Signature of Owner [Signature]
Date December 28th, 1963

Three copies to be filed by the owner with the County Clerk and Recorder of the county in which the well is located.

Please answer all questions. If not applicable, so state, otherwise the form will be returned.

Original to the County Clerk and Recorder; duplicate to the State Engineer; Triplicate to the School of Mines and Quadruplicate for the Appropriator.

16176

721180

STATE OF MONTANA
 COUNTY OF YELLOWSTONE
 DEPARTMENT OF REVENUE

STATE OF MONTANA,
 County of Yellowstone,

This instrument was filed in my office
 this 11th day of DEC 30 1963
 at 11:08 o'clock A. M.

Edward H. King,
 County Clerk & Recorder

King
 2^a
 Deputy

(Faint, mostly illegible text and tables are present in this section, including what appears to be a large ledger or grid structure.)

| | | | |
|--|--|--|--|
| | | | |
| | | | |
| | | | |
| | | | |

RECEIVED
JAN 2 1962

STATE ENGINEER

Form No. 18
8-60

T. Laurel R.
County Yellowstone

MONTANA BUREAU OF MINES AND GEOLOGY
Butte, Montana

WATER WELL LOG

| | | | |
|-----|-----|-------------------------------------|-----|
| --- | --- | <input checked="" type="checkbox"/> | --- |
| --- | --- | --- | --- |

Owner S. H. P. Bittner Address So. of Laurel
 Driller Not known Address _____
 Date Started Not known Date Completed Not known
 Location: Sec. 22 T. 25 R. 24E 1/4 Sec. S. W 7 S. 24. 16. 4

Type of well Driven Equipment used Not known
 (Dug, driven, or drilled) (Churn, drill, rotary other)

Water use Domestic Municipal Stock Irrigation
 Industrial Drainage Other _____

Casing: _____ ft. to _____ ft. Type Gal Size 2 1/2"

Casing: _____ ft. to _____ ft. Type _____ Size _____

Casing: _____ ft. to _____ ft. Type _____ Size _____

Perforated or screened Ft. _____ to ft. _____ Ft. _____ to Ft. _____

Type of screen or perforations _____

Static water level, for non-flowing well: _____ feet.

Shut-in pressure for flowing well: _____ lb./sq. in. on: _____ (date)

Pumping water level _____ feet at _____ gal. per. min. _____

How tested: _____

Length of test _____

Remarks: (Gravel packing, cementing, packers, type of shut-off, depth of shut-off)

Gravel packing - the well is perfect
When it is built it is as good as new
and of particular

RECEIVED
JAN 2 1962

Form No. 18
8-60

T. ⁵³ Laurd STATE ENGINEER
County Yellowstone ²⁴

MONTANA BUREAU OF MINES AND GEOLOGY
Butte, Montana

WATER WELL LOG

| | | | |
|--|--|--|--|
| | | | |
| | | | |
| | | | |
| | | | |

Owner L. H. De Nittis Address So of Laurd
Driller not known Address _____
Date Started not known Date Completed not known
Location: Sec. 22 T. 2S R. 24E $\frac{1}{4}$ Sec. SW 15-4 16-4

Type of well Driven Equipment used not known
(Dug, driven, or drilled) (Churn, drill, rotary other)

Water use Domestic Municipal Stock Irrigation
Industrial Drainage Other _____

Casing: _____ ft. to _____ ft. Type Gal Size 2 in

Casing: _____ ft. to _____ -ft. Type _____ Size _____

Casing: _____ ft. to _____ ft. Type _____ Size _____

Perforated or screened Ft. _____ to ft. _____ ft. _____ to Ft. _____

Type of screen or perforations _____

Static water level, for non-flowing well: _____ feet.

Shut-in pressure for flowing well: _____ lb./sq. in. on: _____ (date)

Pumping water level _____ feet at _____ gal. per. min. _____

How tested: _____

Length of test _____

Remarks: (Gravel packing, cementing, packers, type of shut-off, depth of shut-off)

Gravel packing - this well on property
when we bought it & we do not know
any of particulars

RECEIVED

County YELLOWSTONE

STATE OF MONTANA
ADMINISTRATOR OF GROUNDWATER CODE
MONTANA WATER RESOURCES BOARD
NOTICE OF COMPLETION OF GROUNDWATER
APPROPRIATION BY MEANS OF WELL

NOV 24 1972

DRILLER'S LOG

Indicate the character, color, thickness of strata such as soil, clay, sand, gravel, shale, sandstone, etc. Show depth at which water is found and height to which water rises in well.

(Under Chapter 237 Montana Session Laws, 1961, as amended)

This form to be prepared by driller, and three copies to be filed by the owner with the County Clerk and Recorder in the county in which the well is located, last copy to be retained by driller. Please answer all questions. If not applicable, so state, otherwise the form may be returned.

Owner Emma MBS WMA FRANK
Address L.A. R. & L. Mont.
Date well started Oct 7-72
completed Oct 9-72

| | |
|-------------------------|---------------------------|
| For Administrator's Use | |
| File | <u>921243</u> |
| Date | <u>Nov 22 1972 9:50am</u> |
| GW | <u>1</u> |

Type of well DRILLED
(Dug, driven, bored or drilled)
Equipment used ROTARY
(Churn drill, rotary or other)
Water Use: Domestic Municipal Stock Irrigation
Industrial Drainage Other * Garden/Lawn

*Describe
USE: If used for irrigation, industrial, drainage or other. Explain, state number of acres and location or other data (i.e. Lot, Block and Addition).

ESTIMATED ANNUAL WITHDRAWAL

| Size of Drilled Hole | Size and Weight of Casing | From (Feet) | To (Feet) | PERFORATIONS | | |
|----------------------|---------------------------|-------------|-----------|--------------|-------------|-----------|
| | | | | Kind Size | From (Feet) | To (Feet) |
| <u>8"</u> | <u>15"</u> | <u>14</u> | <u>21</u> | <u>1/4"</u> | <u>17</u> | <u>21</u> |
| | <u>19"</u> | | | <u>Slots</u> | | |

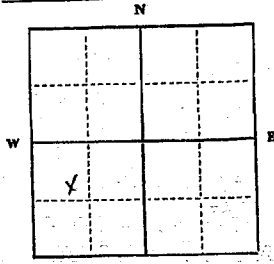

NW 1/4 S. 20 1/4 Sec. 22
T. 2 N. R. 24 W.

Static water level 12 ft.*
Pumping water level 20 ft.*
at 3 gallons per minute,
measured 30 minutes after pumping began.
*Measured from ground level.
Well developed by BAIL
for 2 hours.
Power N Pump A HP
Remarks: (Gravel packing, cementing, packers, type of shutoff)
P.A.C.H. & Co.
15 ft. Bentonite
To G.E. H. Permitt
P.I.T.

INDICATE LOCATION OF WELL AND PLACE OF USE, IF POSSIBLE. EACH SMALL SQUARE REPRESENTS 40 ACRES.

Driller's Signature J. J. B...
Driller's Address 3143 PRAIRIE DRIVE
BILLINGS MONT LICENSE NO. 197

| Top of Ground (Elev. above sea level) | |
|---------------------------------------|-----------------------|
| From (Feet) | To (Feet) |
| <u>0</u> | <u>1</u> |
| <u>1</u> | <u>17</u> |
| <u>17</u> | <u>21</u> |
| | <u>Water @ 15 ft.</u> |
| | <u>Water @ 12 ft.</u> |

21 Show exact depth of bottom

NE

DEPT

7

921243

Emma Frank

to

Water

Re. Notice Compl. Groundwater

Approp. by means of well

STATE OF MONTANA, } ss.

County of Yellowstone, }

This instrument was filed in my office

NOV 22 1972 day of 19

at 9:59 o'clock AM

MERRILL H. KLUNDT

County Clerk & Recorder

By *[Signature]* Deputy

[Handwritten mark]

bottom

88

GW3

File No.....

T. 25 R. 24 E

DUPLICATE

County *Yellowstone*

STATE OF MONTANA
ADMINISTRATOR OF GROUNDWATER CODE
OFFICE OF STATE ENGINEER

Notice of Completion of Groundwater Appropriation Without Well

(Under Chapter 237 Montana Session Laws, 1961)

Date of Appropriation of Groundwater *Mont 1937?*
Owner *Wm Frank* Address *Lared, Mont*
Contractor (if any) *Montana Highway Dept.*
Address of Contractor *Helena, Mont.*
Date Started *1936?* Date Completed *1937?*

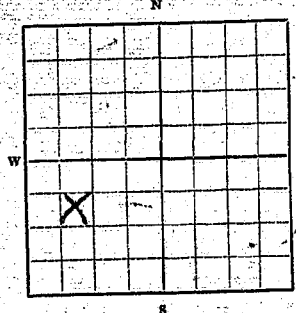

Describe means of obtaining groundwater without a well "as by sub-irrigation and other natural processes". Include depth to water when applicable. *Water is derived from springs which flow from under Nor. Pacific Railway underpass onto my land north east of underpass thru my farm into Clarke Fork river.*

Quantity of water developed and used with explanation of method used to measure or estimate such amount. If use is intermittent estimate approximate lengths of periods of use *constant*
Spring water flows thru 12" pipe used by livestock on Ranch, also used piped to house for drinking and other use.

SW 1/4 Sec. 22, T. 25 R. 24 E
Indicate point of appropriation and place of use, if possible.

Signature of Owner *William Frank*
Date *October 21, 1963*

This form to be prepared by contractor (if any), otherwise by the owner.
Three copies of this notice are to be filed with the County Clerk and Recorder of the county in which the works are located.
Please answer all questions. If not applicable, so state, otherwise the form will be returned.
Original to the County Clerk and Recorder; duplicate to the State Engineer; Triplicate to the School of Mines and Quadruplicate for the Appropriator.

719687

STATE OF MONTANA,)
County of Yellowstone,)

This instrument was filed in my office

this 9 day of Dec 1962

at 12:10 o'clock P. M.

Edmon S. Redding,
County Clerk & Recorder

By Jaw Deputy

20

File No.

T2 S0. R 24 EAST

DUPLICATE

County YELLOWSTONE

JAN 4 1965

M. Dermott
 Secretary
 STATE OF MONTANA
 ADMINISTRATOR OF GROUNDWATER CODE

Sullivan
 OFFICE OF STATE ENGINEER

Declaration of Vested Groundwater Rights
 (Under Chapter 21, Montana Session Laws, 1965)

1. INEZ D. HORNING of P. O. BOX 1056 LAUREL, MONT.
 (Name of Appropriator) (Address) (Town)
 County of YELLOWSTONE State of MONTANA
 have appropriated groundwater according to the Montana laws in effect prior to January 1, 1962, as follows:

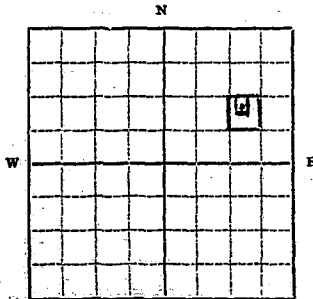

N.W. 1/4 OF S.E. 1/4 OF
 N.E. 1/4 OF Sec. 22 T2S. R. 24E.

Indicate point of appropriation and place of use, if possible. Each small square represents 10 acres.

2. The beneficial use on which the claim is based DRINKING & IRRIGATING
3. Date or approximate date of earliest beneficial use; and how continuous the use has been 1948 - DAILY USE
4. The amount of groundwater claimed (in miner's inches or gallons per minute) _____
5. If used for irrigation, give the acreage and description of the lands to which water has been applied and name of the owner thereof
1/2 ACRE OF LAWN DURING SUMMER MONTHS
9 ACRES OF PASTURE UNTIL DITCH IS TURNED IN
6. The means of withdrawing such water from the ground and the location of each well or other means of withdrawal.
ONE WELL (ARTESIAN TYPE) WITH ELECTRIC PUMP (SEE GRAPH FOR LOCATION)

7. The date of commencement and completion of the construction of the well, wells, or other works for withdrawal of groundwater APPROX 1 WEEK IN 1948
8. The depth of water table _____
9. So far as it may be available, the type, size and depth of each well or the general specifications of any other works for the withdrawal of groundwater. 21 FT. DEEP
10. The estimated amount of groundwater withdrawn each year _____
11. The log of formations encountered in the drilling of each well if available WENT THRU THE SURFACE WATER AND DRILLED THROUGH SHALE OR LIMESTONE TO UNDERGROUND STREAM.
12. Such other information of a similar nature as may be useful in carrying out the policy of this act, including reference to book and page of any county record DRILLER TOLD US THIS IS AN ARTESIAN TYPE WELL CAPABLE OF IRRIGATING THE WHOLE 10 ACRES ALTHO WE HAVE USED IT ONLY FOR LAWN IRRIGATION AND A LITTLE FOR THE PASTURE WHEN DITCH IS NOT TURNED IN.

Signature of Owner Inez D. Horning

Date 12/30/65

Three copies to be filed by the owner with the County Clerk and Recorder of the county in which the well is located.

Please answer all questions. If not applicable, so state, otherwise the form will be returned.

Original to the County Clerk and Recorder; duplicate to the State Engineer; Triplicate to the School of Mines and Quadruplicate for the Appropriator.

4054

769309

DEC 31 1965

12.12

P

SMK

DEPARTMENT OF AGRICULTURE

| | | | | | | | | | |
|--|--|--|--|--|--|--|--|--|--|
| | | | | | | | | | |
| | | | | | | | | | |
| | | | | | | | | | |
| | | | | | | | | | |
| | | | | | | | | | |
| | | | | | | | | | |
| | | | | | | | | | |
| | | | | | | | | | |
| | | | | | | | | | |
| | | | | | | | | | |

U.S. GOVERNMENT PRINTING OFFICE

U.S. GOVERNMENT PRINTING OFFICE

RECEIVED
DEC 29 1961

Form No. 18
8-60

T. _____ R. _____
County Yellowstone

STATE ENGINEER

MONTANA BUREAU OF MINES AND GEOLOGY
Butte, Montana

WATER WELL LOG

| | | |
|--|--|--|
| | | |
| | | |
| | | |
| | | |

Owner Herold D. Spinkhouse Address 411 Laurel, Mont.

Driller None Address None

Date Started 1929 Date Completed 1929

Location: Sec. _____ T. _____ R. _____ ¼ Sec. _____

Type of well Dug Equipment used _____
(Dug, driven, or drilled) (Churn, drill, rotary other)

Water use Domestic Municipal Stock Irrigation
Industrial Drainage Other _____

Casing: 8 ft. to 12 1/2 ft. Type _____ Size 1 1/2 in.

Casing: _____ ft. to _____ ft. Type _____ Size _____

Casing: _____ ft. to _____ ft. Type _____ Size _____

Perforated or screened _____ Ft. to _____ Ft. _____ Ft. to _____ Ft.

Type of screen or perforations _____

Static water level, for non-flowing well: _____ feet.

Shut-in pressure for flowing well: _____ lb./sq. in. on: _____ (date)

Pumping water level 4 1/2 feet at _____ gal. per min.

How tested: _____

Length of test _____

Remarks: (Gravel packing, cementing, packers, type of shut-off, depth of shut-off)

Gravel packing

RECEIVED
DEC 29 1961

Form No. 18
8-60

T. _____
County Yellowstone

STATE ENGINEER

MONTANA BUREAU OF MINES AND GEOLOGY
Butte, Montana

WATER WELL LOG

| | |
|--|--|
| | |
| | |
| | |
| | |

Owner Harold D. Longhouse Address RT 1, Kay, Mont.
 Driller NONE Address NONE
 Date Started Apr 1959 Date Completed Apr 1959
 Location: Sec. T. 45 R. 24 E & Sec. 10 N 24 W

Type of well Dug (Dug, driven, or drilled) Equipment used _____
 (Churn, drill, rotary other)
 Water use Domestic Municipal Stock Irrigation
 Industrial Drainage Other _____

Casing: 2 ft. to 12 1/2 ft. Type Galvanized Size 1 1/2
 Casing: _____ ft. to _____ ft. Type _____ Size _____
 Casing: _____ ft. to _____ ft. Type _____ Size _____

Perforated or screened _____ Ft. _____ to ft. _____ Ft. _____ to Ft. _____

Type of screen or perforations _____

Static water level, for non-flowing well: 2 1/2 feet.

Shut-in pressure for flowing well: _____ lb./sq. in. on: _____ (date)

Pumping water level 4 1/2 feet at _____ gal. per. min.

How tested: _____

Length of test _____

Remarks: (Gravel packing, cementing, packers, type of shut-off, depth of shut-off)

Gravel packing

RECEIVED
DEC 29 1961

STATE ENGINEER

Form No. 18
8-60

T. 25 R. 24E
County Yellowstone

MONTANA BUREAU OF MINES AND GEOLOGY
Butte, Montana

WATER WELL LOG

| | | |
|--|--|--|
| | | |
| | | |
| | | |

Owner Harold D. Ingraham Address RT 1 Laurel Mont
 Driller A Address _____
 Date Started yr 1939 Date Completed yr 1939
 Location: Sec 22 T 2S R 24E 1/2 Sec. E 1/2 Sec 4 SW 1/4 Sec 22 T 2S R 24E

Type of well drilled Equipment used Drill
 (Dug, driven, or drilled) (Churn, drill, rotary other)

Water use Domestic Municipal Stock Irrigation
 Industrial Drainage Other _____

Casing: 20 ft. to 30 ft. Type Panama pump Size _____

Casing: _____ ft. to _____ ft. Type _____ Size _____

Casing: _____ ft. to _____ ft. Type _____ Size _____

Perforated or screened Ft. _____ to ft. _____ Ft. _____ to Ft. _____

Type of screen or perforations _____

Static water level, for non-flowing well: 32 feet.

Shut-in pressure for flowing well: _____ lb./sq. in. on: _____ (date)

Pumping water level 4 1/2 feet at _____ gal. per min.

How tested: None

Length of test _____

Remarks: (Gravel packing, cementing, packers, type of shut-off, depth of shut-off)

Gravel Packing

File No.

T. 23 R. 24

DUPLICATE

County Yellowstone

STATE OF MONTANA
ADMINISTRATOR OF GROUNDWATER CODE
OFFICE OF STATE ENGINEER

RECEIVED
MAR 30 1965

Notice of Appropriation of Groundwater
(Under Chapter 237, Montana Session Laws, 1961)

STATE ENGINEER

1. I, G. C. McMullen, of Box 1194, Laurel
(Name of Appropriator) (Address) (Town)
County of Yellowstone, State of Montana, intend to appropriate groundwater in accordance with Chapter 237, Montana Session Laws of 1961.

2. The beneficial use to which water is to be applied is irrigation on 40 acres on the NWSE 1/4 of Sec. 22, Township 23, Rge. 24, Yellowstone County, Montana
(describe lands to be benefited, if for irrigation)

3. The rate of use in gallons per minute or miner's inches of groundwater claimed 1500 gal. per minute, about 12 hours per use each alternate day

4. The annual period (inclusive dates) of intended use April 1st - Sept. 30th

5. The probable or intended date of first beneficial use April 1, 1965

6. The probable or intended date of commencement and completion of the well* or wells* open pit as reservoir, filled by natural flow through gravel, excavated by dragline, completed February 27, 1965.

7. The location, type, size and depth of well or wells contemplated open pit 9 feet deep, 59 feet wide, and 325 feet long

8. The probable or estimated depth of the water table or artesian aquifer fills to surface

9. Name, address and license number of the driller engaged Chas. Carney, Billings, Montana

10. Give such other similar information as may be useful in carrying out the policy of this act. Open excavated pit as reservoir for irrigation water to be pumped into open ditch for surface irrigation of 40 acres as described

O= pit location below

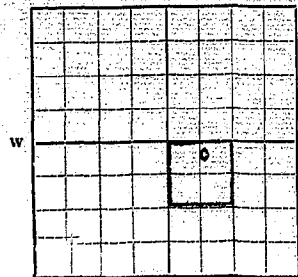

NWSE 1/4 Sec. 22 T. 23 R. 24

Locate well or other means of development as accurately as possible on the plat.

Signature of Appropriator: G. C. McMullen

Date March 22, 1965

* As defined in the Code Sec. 1 (c) "Well" means any artificial opening or excavation in the ground, however made, by which groundwater can be obtained or through which it flows under natural pressures or is artificially withdrawn."

Three copies of this notice are to be filed with County Clerk and Recorder of the county in which the well is located.

Please answer all questions. If not applicable, so state, otherwise the form will be returned.

Original to the County Clerk and Recorder; duplicate to the State Engineer; Triplicate to the School of Mines and Quadruplicate for the Appropriator.

39039

751513

STATE OF MONTANA
County of Yellowstone

This instrument is a

this MAR 29 1965

at 9:32 o'clock AM.

Edmon S. Hedding,
County Clerk & Recorder

By [Signature] Deputy

2nd

File No. _____
DUPLICATE

RECEIVED
MAR 30 1965

T. 29 R. 24

County Yellowstone

STATE OF MONTANA
ADMINISTRATOR OF GROUNDWATER CODE
OFFICE OF STATE ENGINEER

Top of Ground
(Elev. above sea level _____)
STATE ENGINEER

Notice of Completion of Groundwater Appropriation by Means of Well

(Under Chapter 287, Montana Session Laws, 1961)

Owner G.C. McMullen Address Box 1194, Laurel

Contractor Chas. Carney Address Billings, Montana

Date of Notice of Appropriation of Groundwater March 1, 1965

Date well started Jan. 20, 1965 Date Completed Feb. 27, 1965

Type of well open excavated pit Equipment Used drag line
(dug, driven, bored or drilled) (Churn, drill, rotary or other)

Water Use: Domestic Municipal Other Irrigation
Industrial Drainage Stock

Indicate on the diagram the character and thickness of the different strata met with in drilling, such as soil, clay, shale, gravel, rock or sand, etc. Show depth at which water is encountered, thickness and character of water-bearing strata and height to which water rises in the well.

| Size of Drilled Hole | Size and Weight of Casing | From (Feet) | To (Feet) | PERFORATIONS | | |
|----------------------|---------------------------|-------------|-----------|--------------|-------------|-----------|
| | | | | Kind Size | From (Feet) | To (Feet) |
| | | | | | | |

O-pit location below

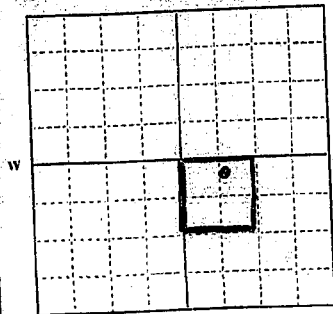

NWSE 4 Sec. 22 T. 29 R. 24
Indicate location of well and place of use, if possible. Each small square represents 10 acres.

Show exact depth of bottom.

Static Water Level for non-flowing Well Ground surface level feet.

Shut-in Pressure for Flowing Well not known

Pumping Water Level 8' below surface feet at 500 gal. per minute.

Discharge in gal. per min. of flowing well non flowing

How Tested pumping Length of Test 15 days

Remarks: (Gravel packing, cementing, packers, type of shutoff, location of place of use of groundwater if not at well, and any other similar pertinent information, including number of

acres irrigated, if used for irrigation) open pit, 8'

below ground surface, fills to surface,

through gravel layer 6' deep, overlaid by

3' soil, 40 acres to be irrigated

Contractors Class C - 3267 License Number

Contractor's Chas. Carney Signature

This form to be prepared by driller, and three copies to be filed by the owner with the County Clerk and Recorder in the county in which the well is located.

Please answer all questions. If not applicable, so state, otherwise the form will be returned.

Original to the County Clerk and Recorder; duplicate to the State Engineer; Triplicate to the Montana Bureau of Mines and Geology and Quadruplicate for the Appropriator.

751511

STATE OF MISSISSIPPI
County of [unclear]

This instrument was duly recorded
this MAR 29 1965 day of [unclear]

at 9:20 o'clock A.M. in the
County of [unclear]

Jaw
20

D



RECORDED BY [unclear]

INDEXED BY [unclear]

FILED BY [unclear]

DATE [unclear]

TIME [unclear]

OFFICE [unclear]

CITY [unclear]

STATE [unclear]

COUNTY [unclear]

NOTARY PUBLIC

GV

File No.

T 2S R 24

DUPLICATE

County Yellowstone

STATE OF MONTANA
ADMINISTRATOR OF GROUNDWATER CODE
OFFICE OF STATE ENGINEER

RECEIVED
MAR 30 1965

Declaration of Vested Groundwater Rights
(Under Chapter 237, Montana Session Laws, 1961)

STATE ENGINEER

1. G.C. McMullen of Box 1194 Laurel
(Name of Appropriator) (Address) (Town)
County of Yellowstone State of Montana
have appropriated groundwater according to the Montana laws in effect prior to January 1, 1962, as follows:

o= pit location below

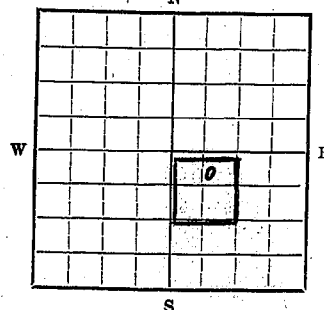

NWSE 1/4 Sec. 22 T.2S R. 24

Indicate point of appropriation and place of use, if possible. Each small square represents 10 acres.

2. The beneficial use on which the claim is based Irrigation and stock water

3. Date or approximate date of earliest beneficial use; and how continuous the use has been April 1, 1965 - use will be continuous after start

4. The amount of groundwater claimed (in miner's inches or gallons per minute) 1500 gal. per minute about 12 hours per use, each alternate day

5. If used for irrigation, give the acreage and description of the lands to which water has been applied and name of the owner thereof 40 acres, NWSE 1/4, Sec. 22, Township 2S, Range 24, owner G.C. McMullen, Box 1194, Laurel, Montana.

6. The means of withdrawing such water from the ground and the location of each well or other means of withdrawal withdrawal by pump. Well or pit located on drawing on plot

7. The date of commencement and completion of the construction of the well, wells, or other works for withdrawal of groundwater well or pit commenced Jan. 20, 1965 completed, February 27, 1965

8. The depth of water table 8 feet, fills to ground surface

9. So far as it may be available, the type, size and depth of each well or the general specifications of any other works for the withdrawal of groundwater open pit excavated by dragline to depth 8 feet, 59 feet wide at surface, 325 feet long at surface, water withdrawal will be by pump into distribution ditch system.

10. The estimated amount of groundwater withdrawn each year 1500 gal. per min., 750 hrs. per year

11. The log of formations encountered in the drilling of each well if available 3 feet soil overlaying 5 feet gravel saturated with water

12. Such other information of a similar nature as may be useful in carrying out the policy of this act, including reference to book and page of any county record

Signature of Owner G.C. McMullen

Date March 22, 1965

Three copies to be filed by the owner with the County Clerk and Recorder of the county in which the well is located.

Please answer all questions. If not applicable, so state, otherwise the form will be returned.

Original to the County Clerk and Recorder; duplicate to the State Engineer; Triplicate to the School of Mines and Quadruplicate for the Appropriator.

390

751514

STATE OF MONTANA
County of Yellowstone

This instrument was filed in the County Clerk's

office on this MAR 29 1965 at 9:34 AM

By DR _____
County Clerk & Recorder

2-00

Montana State Office Building
Helena, Montana
COUNTY CLERK'S OFFICE
COUNTY OF YELLOWSTONE
MONTANA

File No.

T. 2^s R. 211

ORIGINAL

County.....

STATE OF MONTANA
ADMINISTRATOR OF GROUNDWATER CODE
OFFICE OF STATE ENGINEER

RECEIVED
JAN 2 1964

DECLARATION OF VESTED GROUNDWATER RIGHTS STATE ENGINEER
(Under Chapter 237, Montana Session Laws, 1961)

1. FRANKLIN D ROWLAND, of ROUTE 1 LAUREL
(Name of Appropriator) (Address) (Town)

County of YELLOWSTONE State of MONTANA

have appropriated groundwater according to the Montana laws in effect prior to January 1, 1962, as follows:

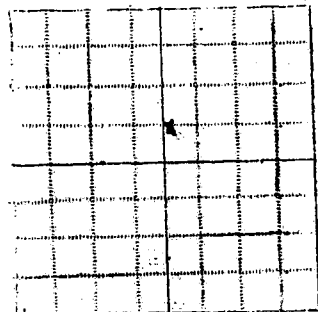

SW NE Sec 22 T 25 R 24E
Indicate point of appropriation and place of use, if possible. Each small square represents 10 acres.

- 2. ~~The beneficial use on which the claim is based~~
House hold use
- 3. Date or approximate date of earliest beneficial use and how continuous the use has been
date unknown continuous since
- 4. The amount of groundwater claimed (in miner's inches or gallons per minute)
10 gpm per acre
- 5. If used for irrigation, give the acreage and description of the lands to which water has been applied and name of the owner thereof
Garden and flows around house
- 6. The means of withdrawing such water from the ground and the location ~~of the well~~ for means of withdrawal

7. The date of commencement and completion of the construction of the well ~~well~~ well
other works for withdrawal of groundwater not purchased

8. The depth of water table
6 ft

9. So far as it may be available, the type, size and depth of each well or the general specifications of any other works for the withdrawal of groundwater
dry well bunch 30 ft deep

10. The estimated amount of groundwater withdrawn each year
10,000

11. The log of formations encountered in the drilling of each well if available
not known

12. Such other information of a similar nature as may be useful in carrying out the policy of this act, including reference to book and page of any county record

Signature of Owner Franklin D Rowland
Date Dec 31, 1963

Three copies to be filed by the owner with the County Clerk and Recorder of the county in which the well is located. Please answer all questions. If not applicable, so state, otherwise the form will be returned. Original to the County Clerk & Recorder; Duplicate to the State Engineer; Triplicate to the Montana Bureau of Mines and Geology, and quadruplicate for the appropriator

721798

DEC 31 1968

at 4:43

County Clerk & Recorder

By Paul Deputy

20

T. 25 R. 24 E
County YELLOWSTONE

MONTANA BUREAU OF MINES AND GEOLOGY
Butte, Montana

RECEIVED
JAN 2 1952

WATER WELL LOG

STATE ENGINEER

| | | |
|--|--|--|
| | | |
| | | |
| | | |

Owner Loyd E. and IRMA Shay Address R.R. Laurel, Mont

Driller MIDLAND DRILLING CO. Address 310 1/2 S 27 St. Billings, Mont.

Date Started 4/16/49 Date Completed 4/19/49

Location: Sec. 22 T. 25 R. 24 E 1/4 sec. NW 1/4 SW 1/4 Sec. 22

Type of well Drilled Equipment used Churn Drill
(Dug, driven, bored, or drilled) (Churn drill, rotary, other)

Water use: Domestic Municipal Stock Irrigation
Industrial Drainage Other: _____

Casing: 7" O.D. ft. to 26 ft. Type _____ Size _____

Casing: _____ ft. to _____ ft. Type _____ Size _____

Casing: _____ ft. to _____ ft. Type _____ Size _____

Perforated or Screened: Ft. _____ to ft. _____ Ft. _____ to ft. _____

Type of screen or perforations None

Static Water level, for non-flowing well: 15 feet feet.

Shut-in pressure, for flowing well: _____ lb./sq. in. on: _____ (date) _____

Pumping water level 14 1/2 ft feet at 750 gal. per hour (date) _____

How tested: 2-750 gal per pump

Length of test: 2 days 48 hours

Remarks: (Gravel packing, cementing, packers, type of shut-off, depth of shut-off)

(over)

Form No. 18
8-6C

T. 25
County Yellowstone RECEIVED
JAN 2 1938

MONTANA BUREAU OF MINES AND GEOLOGY
Butte, Montana

WATER WELL LOG

STATE ENGINEER

Owner L.R. Shay Address Laurel, Mont.
Driller Mr. Norling Address Billings, Montana
Date Started Spring 1938 Date Completed Apr. 1938
Location: Sec. 23 T. 2 R. 34 Sec. _____

Type of well Drilled Equipment used Drill
(Dug, driven, or drilled) (Churn, drill, rotary, other)

Water use Domestic Municipal Stock Irrigation
Industrial Drainage Other _____

Casing: _____ ft. to _____ ft. Type _____ Size _____

Casing: _____ ft. to _____ ft. Type _____ Size _____

Casing: _____ ft. to _____ ft. Type _____ Size _____

Perforated or screened Ft. _____ -to ft. _____ Ft. _____ to Ft. _____

Type of screen or perforations _____

Static water level, for non-flowing well: _____ feet.

Shut-in pressure for flowing well _____ lb./sq. in. on: _____ (date)

Pumping water level _____ feet. at _____ gal. per min.

How tested: _____

Length of test _____

Remarks: (Gravel packing, cementing, packers, type of shut-off, depth of shut-off)

File No. _____

T 2 So. R 24 E
County Yellowstone

DUPLICATE

STATE WATER COMMISSION BOARD

STATE OF MONTANA
ADMINISTRATOR OF GROUNDWATER CODE
OFFICE OF STATE ENGINEER

Declaration of Vested Groundwater Rights

(Under Chapter 21, Montana Session Laws, 1965)

1. Glenn D. Sloop, of Laurel (Town)
(Name of Appropriator) (Address)
County of Yellowstone State of Montana
have appropriated groundwater according to the Montana laws in effect prior to January 1, 1962, as follows:

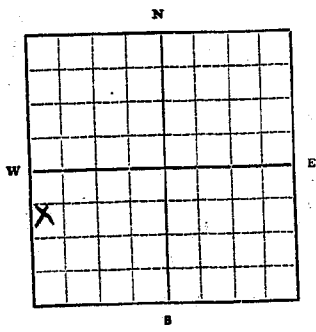

SW 1/4 Sec. 22 T25 N R. 24 E
Indicate point of appropriation and place of use, if possible. Each small square represents 10 acres.

- 2. The beneficial use on which the claim is based irrigation & Household Use
- 3. Date or approximate date of earliest beneficial use; and how continuous the use has been 7/7/1936
Use has been CONTINUOUS FROM above date
- 4. The amount of groundwater claimed (in miner's inches or gallons per minute) 40 GALLONS PER MIN.
- 5. If used for irrigation, give the acreage and description of the lands to which water has been applied and name of the owner thereof
LAWN & GARDEN ON SAME PROPERTY OWNER Glenn D. Sloop
- 6. The means of withdrawing such water from the ground and the location of each well or other means of withdrawal
ELECTRIC OPERATED PUMPS, TWO WELLS LOCATE APPROX. 75' SW-W OF RESIDENCE

- 7. The date of commencement and completion of the construction of the well, wells, or other works for withdrawal of groundwater Started 1/7/1935, Completed 7/7/1965
- 8. The depth of water table 32'
- 9. So far as it may be available, the type, size and depth of each well or the general specifications of any other works for the withdrawal of groundwater one well 39' deep by 6" casing, one well 24' by 4"
- 10. The estimated amount of groundwater withdrawn each year 36000 G31.
- 11. The log of formations encountered in the drilling of each well if available STARTING FROM SURFACE - 7' OF LOAM, & FROM 9' TO DEPTH OF WELLS Gravel + Rock.
- 12. Such other information of a similar nature as may be useful in carrying out the policy of this act, including reference to book and page of any county record unknown

Signature of Owner Glenn D. Sloop
Date 12/30/1965

Three copies to be filed by the owner with the County Clerk and Recorder of the county in which the well is located.
Please answer all questions. If not applicable, so state, otherwise the form will be returned.
Original to the County Clerk and Recorder; duplicate to the State Engineer; Triplicate to the School of Mines and Quadruplicate for the Appropriator.

40546

769182

STATE OF MONTANA,
County of Yellowstone,

This instrument was filed in my office
this DEC 30 1965 day of 19

at 2:34 o'clock P M.

Blair S. Redding,
County Clerk & Recorder

Daw Deputy

20

File No.

T. 25 R. 24E

DUPLICATE

RECEIVED

County Phillips

STATE OF MONTANA
ADMINISTRATOR OF GROUNDWATER CODE
OFFICE OF STATE ENGINEER

Notice of Completion of Groundwater Appropriation by Means of Well

(Under Chapter 237, Montana Session Laws, 1961)

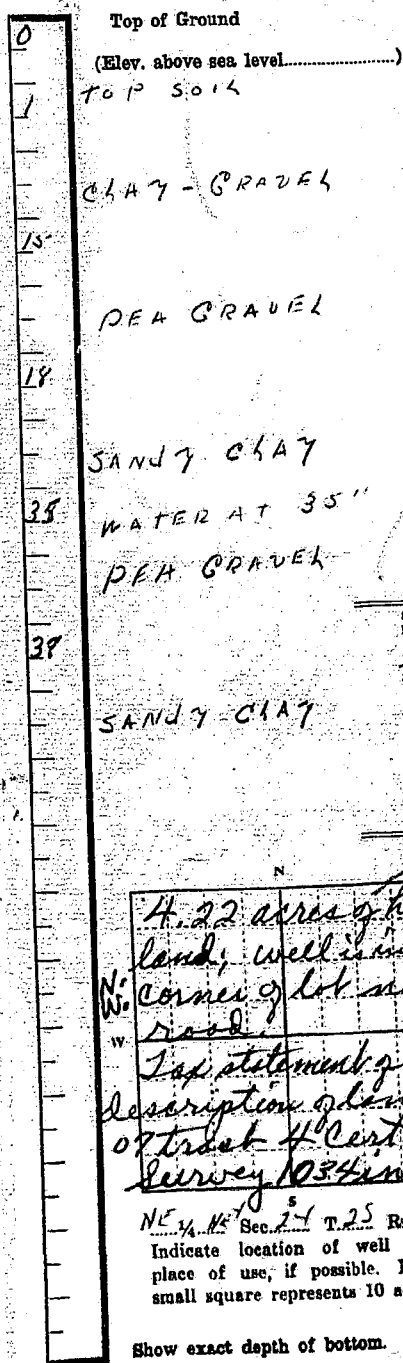

Owner George W. Remmers Address 144 Adams Billings, Mont
 Driller L.D. DRILLING Address 516 SOUTH AVE BILLY, MONT

Date of Notice of Appropriation of Groundwater.....
 Date well started 5/15/70 Date Completed 5/25/70

Type of well DRILLED Equipment Used CABLE
 (dug, driven, bored or drilled) (Churn, drill, rotary or other)

Water Use: Domestic Municipal Other Irrigation
 Industrial Drainage Stock

Indicate on the diagram the character and thickness of the different strata met with in drilling, such as soil, clay, shale, gravel, rock or sand, etc. Show depth at which water is encountered, thickness and character of water-bearing strata and height to which water rises in the well.

| Size of Drilled Hole | Size and Weight of Casing | From (Feet) | To (Feet) | PERFORATIONS | | |
|----------------------|---------------------------|-------------|-----------|--------------|-------------|-----------|
| | | | | Kind Size | From (Feet) | To (Feet) |
| 7" | 1 1/2" 87# 6# | 0 | 38 | OUTER | 34 | 38 |

Static Water Level for non-flowing Well..... 6 feet

Shut-in Pressure for Flowing Well.....

Pumping Water Level..... 3 feet at 8 gal. per minute

Discharge in gal. per min. of flowing well.....

How Tested BAUER TEST Length of Test 11 HRS

Remarks: (Gravel packing, cementing, packers, type of shutoff, location of place of use of groundwater if not at well, and any other similar pertinent information, including number of

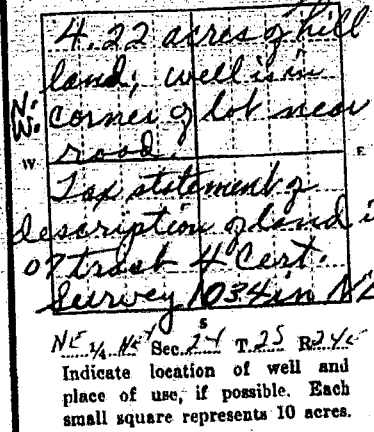

NE 1/4, NW 1/4 Sec. 24 T. 25 R. 24E
 Indicate location of well and place of use, if possible. Each small square represents 10 acres.

acres irrigated, if used for irrigation) none
PIPE F.I.T. 1" ABOVE
GROUND

Show exact depth of bottom. Doc. No. 867646 MONT. 185
 Filed for record Driller's License Number
 Date 9 day of September
 A.D. 19 70, at 3:48
 Check 2 M. Driller's Signature [Signature]

This form to be prepared by driller, and three copies to be filed by the owner with the County Clerk and Recorder in the county in which the well is located.

Please answer all questions. If not applicable, so state, otherwise the form will be returned.

Original to the County Clerk and Recorder; duplicate to the State Engineer; Triplicate to the Montana Bureau of Mines and Geology and Quadruplicate for the Appropriator.

477477

867646

SEP 9 1970
3.48 P
By Jew Deputy
2 vs

SEP 9 1970

File No.

DUPLICATE

RECEIVED

MAY 19 1972

T 25 R 24E

County YELLOWSTONE

MONTANA DEPARTMENT OF NATURAL RESOURCES AND CONSERVATION

STATE OF MONTANA ADMINISTRATOR OF GROUNDWATER CODE OFFICE OF STATE ENGINEER

Notice of Completion of Groundwater Appropriation by Means of Well

(Under Chapter 237, Montana Session Laws, 1961)

Owner C. H. TURNER Address BOX 98 BILLINGS, MONT.

Driller D. G. F. R. DRAKE Address 3143 PRIVATE DRIVE BILLINGS, MONT.

Date of Notice of Appropriation of Groundwater

Date well started 3-21-72 Date Completed 3-21-72

Type of well DRILLED Equipment Used ROTARY
(dug, driven, bored or drilled) (Churn, drill, rotary or other)

Water Use: Domestic Municipal Other Irrigation
Industrial Drainage Stock

Indicate on the diagram the character and thickness of the different strata met with in drilling, such as soil, clay, shale, gravel, rock or sand, etc. Show depth at which water is encountered, thickness and character of water-bearing strata and height to which water rises in the well.



| Size of Drilled Hole | Size and Weight of Casing | From (Feet) | To (Feet) | PERFORATIONS | | |
|----------------------|---------------------------|-------------|-----------|--------------|-------------|-----------|
| | | | | Kind Size | From (Feet) | To (Feet) |
| 8" | 6 5/8" 17# | 14 | 34 | OPEN BOTTOM | | |

Static Water Level for non-flowing Well N/A 1.9 feet.

Shut-in Pressure for Flowing Well N/A

Pumping Water Level 30 feet at 20 gal. per minute.

Discharge in gal. per min. of flowing well N/A

How Tested BAIL Length of Test 2 HRS

Remarks: (Gravel packing, cementing, packers, type of shutoff, location of place of use of groundwater if not at well, and any other similar pertinent information, including number of

acres irrigated, if used for irrigation) PACKER

@ 25 FT. BENT 13.8 FT

CEMENT TO TOP

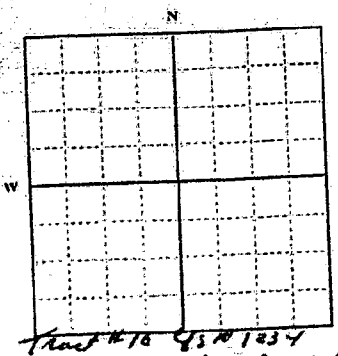

Indicate location of well and place of use, if possible. Each small square represents 10 acres.

Show exact depth of bottom. 38

Doc. No. 907460
Filed for record this 18th day of May
A. D. 19 72, at 2:54
o'clock P. M.

197
Driller's License Number
J. J. Ben
Driller's Signature

This form to be prepared by driller, and three copies to be filed by the owner with the County Clerk and Recorder in the county in which the well is located.

Please answer all questions. If not applicable, so state, otherwise the form will be returned.

Original to the County Clerk and Recorder; duplicate to the State Engineer; Triplicate to the Montana Bureau of Mines and Geology and Quadruplicate for the Appropriator.

50,425

907460

STATE OF MONTANA
County of Yellowstone
This instrument was filed in my office
this MAY 18 1972 day of
at 2:54 o'clock P. M.
MERRILL W. KLUNDT
County Clerk & Recorder
By Jaw Deputy
202

RECORDED
INDEXED
MAY 18 1972

RECEIVED

File No.

T 25 R 24

DUPLICATE

JUL 23 1972

County Yellow Stone

MONTANA DEPARTMENT OF NATURAL RESOURCES AND CONSERVATION

STATE OF MONTANA ADMINISTRATOR OF GROUNDWATER CODE OFFICE OF STATE ENGINEER

Top of Ground

(Elev. above sea level.....)

SANDY TOP SOIL

9

GRAVEL & BOULDERS

- 33 BLUE SHALE - 36

WATER @ 22 FT

WATER @ 11 FT

Notice of Completion of Groundwater Appropriation by Means of Well

(Under Chapter 237, Montana Session Laws, 1961)

Owner THOMAS EASTMAN Address LAUREL MOUNT 3113 PRAIRIE DRIVE Driller DIGGERS DRILLING Address BILLINGS MONT

Date of Notice of Appropriation of Groundwater

Date well started 7-17-72 Date Completed 7-18-72

Type of well DRILLED Equipment Used ROTARY (dug, driven, bored or drilled) (Churn, drill, rotary or other)

Water Use: Domestic [X] Municipal [] Other [] Irrigation [] Industrial [] Drainage [] Stock []

Indicate on the diagram the character and thickness of the different strata met with in drilling, such as soil, clay, shale, gravel, rock or sand, etc. Show depth at which water is encountered, thickness and character of water-bearing strata and height to which water rises in the well.

Table with columns: Size of Drilled Hole, Size and Weight of Casing, From (Feet), To (Feet), PERFORATIONS (Kind Size, From (Feet), To (Feet)). Includes handwritten entries: 2 3/4, 6 5/8 1 1/2, 17, 36, OPEN BOTTOM, 1/4" SLOTS, 30, 36.

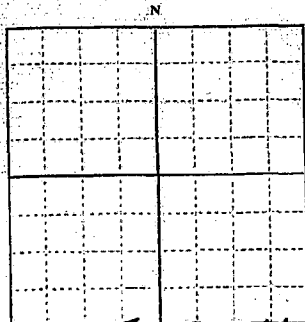

Indicate location of well and place of use, if possible. Each small square represents 10 acres.

Static Water Level for non-flowing Well 11 feet. Shut-in Pressure for Flowing Well N.A. Pumping Water Level 25 feet at 20 gal. per minute. Discharge in gal. per min. of flowing well N.A. How Tested BAIL Length of Test 2 HRS.

Remarks: (Gravel packing, cementing, packers, type of shutoff, location of place of use of groundwater if not at well, and any other similar pertinent information, including number of acres irrigated, if used for irrigation) Bentonite Seal 20 FT. TO TOP.

Show exact depth of bottom.

Doc. No. 912344 197 Filed for record this 25th day of July A. D. 1972 at 11:00 o'clock P.M. Driller's License Number J. J. B... Driller's Signature

This form to be prepared by driller, and three copies to be filed by the owner with the County Clerk and Recorder in the county in which the well is located.

Please answer all questions. If not applicable, so state, otherwise the form will be returned.

Original to the County Clerk and Recorder; duplicate to the State Engineer; Triplicate to the Montana Bureau of Mines and Geology and Quadruplicate for the Appropriator.

5/031