

File No. .... 1 .....

T... 3 N... R. 27 E...

ORIGINAL

County. Yellow .....

STATE OF MONTANA  
ADMINISTRATOR OF GROUNDWATER CODE  
OFFICE OF STATE ENGINEER

RECEIVED  
JAN 2 1964

DECLARATION OF VESTED GROUNDWATER RIGHTS  
(Under Chapter 237, Montana Session Laws, 1961)

STATE ENGINEER

J. A. Healand of Shepherd  
(Name of Appropriator) (Address)

County of Yellowstone State of Montana  
have appropriated groundwater according to the Montana laws in effect prior to  
January 1, 1962, as follows:

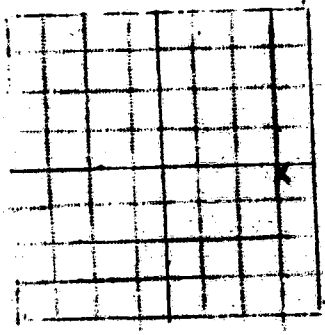

Indicate point of appropriation and piece of use, if possible. Each small square represents 10 acres.

- The beneficial use on which the claim is based - Stockwater
- Date or approximate date of earliest beneficial use; and how continuous the use has been - 1956 and during summer grazing season
- The amount of groundwater claimed (in sines' inches or gallons per minute) - 3 gallons
- If used for irrigation, give the acreage and description of the lands to which water has been applied and name of the owner thereof - Not used for irrigation
- The means of withdrawing such water from the ground and the location of each well or other means of withdrawal Hand-dug well, the top of well is 12 ft. from middle of east border of Sec. 11
- The date of commencement and completion of the construction of the well, wells, or other works for withdrawal of groundwater - Commenced 1955 completed 1956
- The depth of water table - 4 ft.
- So far as it may be available, the type, size and depth of each well or the general specifications of any other works for the withdrawal of groundwater - Hand-dug well, 12 ft. deep
- The estimated amount of groundwater withdrawn each year - 120,000
- The log of formations encountered in the drilling of each well if available - Not available
- Such other information of a similar nature as may be useful in carrying out the policy of this act, including reference to book and page of any county record -

Signature of Owner - J. A. Healand  
Date - Dec. 31, 1963

Three copies to be filed by the owner with the County Clerk and Recorder of the county in which the well is located.  
Please answer all questions. If not applicable, so state, otherwise the form will be returned.  
Original to the County Clerk & Recorder; Duplicate to the State Engineer; Triplicate to the Montana Bureau of Mines and Geology, and Quadruplicate for the appropriator

6 721539

SEARCHED INDEXED  
SERIALIZED FILED  
DEC 31 1963  
Ri 39  
Deputy

GW -

File No. 625202

T. 3 R. 29E

DUPLICATE Filed MAY 25 1962 @ 3:12 PM

County Yellowstone

\$1.00 Fee

STATE OF MONTANA  
ADMINISTRATOR OF GROUNDWATER CODE  
OFFICE OF STATE ENGINEER

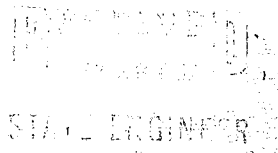

**Declaration of Vested Groundwater Rights**  
(Under Chapter 237, Montana Session Laws, 1961)

1. C. E. Talcott, of Ballantine, Montana  
(Name of Appropriator) (Address) (Town)

County of Yellowstone State of Montana  
have appropriated groundwater according to the Montana laws in effect prior to January 1, 1962, as follows:

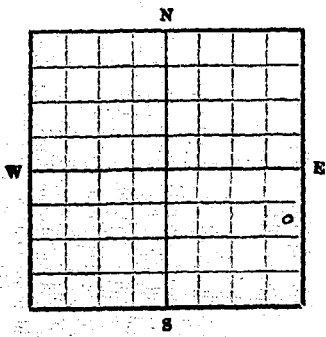

1/4 Sec. 12T3 R.29E

Indicate point of appropriation and place of use, if possible. Each small square represents 10 acres.

- 2. The beneficial use on which the claim is based stock water
- 3. Date or approximate date of earliest beneficial use; and how continuous the use has been 1939 steady
- 4. The amount of groundwater claimed (in miner's inches or gallons per minute) 5 gal. per minute
- 5. If used for irrigation, give the acreage and description of the lands to which water has been applied and name of the owner thereof not used
- 6. The means of withdrawing such water from the ground and the location of each well or other means of withdrawal windmill and stationary engine

- 7. The date of commencement and completion of the construction of the well, wells, or other works for withdrawal of groundwater not available
- 8. The depth of water table 75 feet
- 9. So far as it may be available, the type, size and depth of each well or the general specifications of any other works for the withdrawal of groundwater 90 feet--6 in. casing
- 10. The estimated amount of groundwater withdrawn each year not known
- 11. The log of formations encountered in the drilling of each well if available not available
- 12. Such other information of a similar nature as may be useful in carrying out the policy of this act, including reference to book and page of any county record not available

Signature of Owner C. E. Talcott  
Date May - 25 - 1962

Three copies to be filed by the owner with the County Clerk and Recorder of the county in which the well is located.

Please answer all questions. If not applicable, so state, otherwise the form will be returned.

Original to the County Clerk and Recorder; duplicate to the State Engineer; Triplicate to the School of Mines and Quadruplicate for the Appropriator.

764

RECEIVED  
STATE ENGINEER

T 37 R 29 E  
County Yellowstone

MONTANA BUREAU OF MINES AND GEOLOGY  
Butte, Montana

WATER WELL LOG

Owner: Paul James Address: Warden  
Driller: Wayne Langston Address: Billings  
Date Started: \_\_\_\_\_ Date Completed: \_\_\_\_\_  
Location: Sec. 14 T. 37 N. R. 29 E. 1/4 sec. S. W.

Type of well: \_\_\_\_\_ Equipment used: \_\_\_\_\_ (Churn drill, rotary, other)

Water use: Domestic  Municipal  Stock  Irrigation

Industrial  Drainage  Other: \_\_\_\_\_

Casing: 0 ft. to 112 ft. Type: Galvanized Size: 6

Casing: \_\_\_\_\_ ft. to \_\_\_\_\_ ft. Type: \_\_\_\_\_ Size: \_\_\_\_\_

Casing: \_\_\_\_\_ ft. to \_\_\_\_\_ ft. Type: \_\_\_\_\_ Size: \_\_\_\_\_

Perforated or Screened: Ft. 30 to ft. 14.5 Ft. \_\_\_\_\_ to ft. \_\_\_\_\_

Type of screen or perforations: arched Perforated with Punch

Static Water level, for non-flowing well: 52 feet.

Shut-in pressure, for flowing well: \_\_\_\_\_ lb./sq. in. on: \_\_\_\_\_ (date)

Pumping water level: 70 feet at 3 gal. per min.

How tested: Valve type bucket

Length of test: 30 min

Remarks: (Gravel packing, cementing, packers, type of shut-off, depth of shut-off)

Water identified as water material  
Covered with 3x12 ft  
2 gal water at 32  
2 1/2 gal at 103

(over)





937050

STATE OF MONTANA, }  
County of Yellowstone, } ss.

This ~~10th~~ 20th day of 1973 was filed in my office

this 10:21 day of 19 at 10:21 o'clock A. M.

MERRILL M. KLUNDT  
County Clerk & Recorder

By [Signature] Deputy

20

GW

GALETTE 12885 68

File No.

T911 R 29 C  
County Yellowstone

DUPLICATE WATER CONSERVATION BOARD

JAN 1 1965  
STATE OF MONTANA  
ADMINISTRATOR OF GROUNDWATER CODE  
OFFICE OF STATE ENGINEER

**Declaration of Vested Groundwater Rights**  
(Under Chapter 21, Montana Session Laws, 1965)

1. LESTER E EARLEY of Warden Montana  
(Name of Appropriator) (Address) (Town)  
County of Yellowstone State of Montana  
have appropriated groundwater according to the Montana laws in effect prior to January 1, 1962, as follows:

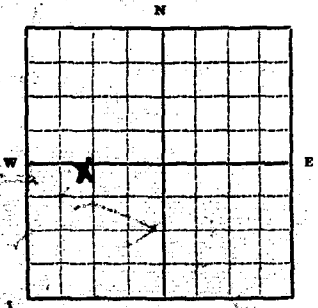

Section 10, 29E

Indicate point of appropriation and place of use, if possible. Each small square represents 10 acres.

- 2. The beneficial use on which the claim is based household
- 3. Date or approximate date of earliest beneficial use; and how continuous the use has been 1960
- 4. The amount of groundwater claimed (in miner's inches or gallons per minute) 7 per minute
- 5. If used for irrigation, give the acreage and description of the lands to which water has been applied and name of the owner thereof Not for irrigation
- 6. The means of withdrawing such water from the ground and the location of each well or other means of withdrawal electric pump

7. The date of commencement and completion of the construction of the well, wells, or other works for withdrawal of groundwater Unknown

8. The depth of water table

9. So far as it may be available, the type, size and depth of each well or the general specifications of any other works for the withdrawal of groundwater. 60 ft - 1 inch electric pump  
100 feet per day

10. The estimated amount of groundwater withdrawn each year 400 100,000 per year  
gallons a day

11. The log of formations encountered in the drilling of each well if available  
Not Available

12. Such other information of a similar nature as may be useful in carrying out the policy of this act, including reference to book and page of any county record

Signature of Owner Lester E. Earley  
Date Dec. 31, 65

Three copies to be filed by the owner with the County Clerk and Recorder of the county in which the well is located. Please answer all questions. If not applicable, so state, otherwise the form will be returned.

Original to the County Clerk and Recorder; duplicate to the State Engineer; Triplicate to the School of Mines and Quadruplicate for the Appropriator.

444 79



769352

DEC 9 1965

336 P

IXS

GW

File No. 689418 Legal AUG 8 1962 9:40 AM

T. 3N R. 29 E

TRIPPLICATE #2<sup>nd</sup> See Ord

County Yellowstone

STATE OF MONTANA  
ADMINISTRATOR OF GROUNDWATER CODE  
OFFICE OF STATE ENGINEER

RECORDING

**Declaration of Vested Groundwater Rights**

(Under Chapter 237, Montana Session Laws, 1961)

STATE ENGINEER

1. Donald G. Pilkington, of Worden Montana  
 (Name of Appropriator) (Address) (Town)  
 County of Yellowstone State of Montana  
 have appropriated groundwater according to the Montana laws in effect prior to January 1, 1962, as follows:

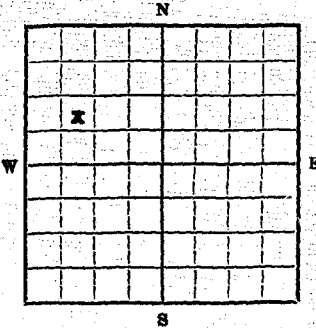

6 to 9 1/4 Sec. 23 & 24  
T. 3N R. 29 E

Indicate point of appropriation and place of use, if possible. Each small square represents 10 acres.

2. The beneficial use on which the claim is based Irrigation
3. Date or approximate date of earliest beneficial use; and how continuous the use has been 1937 CONTINUOUS
4. The amount of groundwater claimed (in miner's inches or gallons per minute) 3,000 gal
5. If used for irrigation, give the acreage and description of the lands to which water has been applied and name of the owner thereof 100 Acres
6. The means of withdrawing such water from the ground and the location of each well or other means of withdrawal Pump
7. The date of commencement and completion of the construction of the well, wells, or other works for withdrawal of groundwater Approx. 1937
8. The depth of water table 15 ft.
9. So far as it may be available, the type, size and depth of each well or the general specifications of any other works for the withdrawal of groundwater 25 ft. depth dug lift cement casing
10. The estimated amount of groundwater withdrawn each year 388,800,000
11. The log of formations encountered in the drilling of each well if available 1 ft. top soil  
24 ft. gravel
12. Such other information of a similar nature as may be useful in carrying out the policy of this act, including reference to book and page of any county record none

Signature of Owner Donald G. Pilkington  
Date August 8, 1962

Three copies to be filed by the owner with the County Clerk and Recorder of the county in which the well is located.

Please answer all questions. If not applicable, so state, otherwise the form will be returned.

Original to the County Clerk and Recorder; duplicate to the State Engineer; Triplicate to the School of Mines and Quadruplicate for the Appropriator.

GW 2

File No. ....

DUPLICATE

T. 3 N R. 29 E

County Yellowstone

STATE OF MONTANA  
ADMINISTRATOR OF GROUNDWATER CODE  
OFFICE OF STATE ENGINEER

RECEIVED

**Notice of Completion of Groundwater Appropriation by Means of a Well**  
ENGINEER

(Under Chapter 237, Montana Session Laws, 1961)

Owner: Margaret J. Remy Address: Worshon Canal Road  
Jess Romney

Driller: William S. Loe Address: 412 1/2, 1st St. Butte, Mont.

Date of Notice of Appropriation of Groundwater .....

Date well started Aug 27, 1962 Date Completed Aug 27, 1962

Type of well drum Equipment Used air driven  
(dug, driven, bored or drilled) (Churn, drill, rotary or other)

Water Use: Domestic  Municipal  Other  Irrigation   
Industrial  Drainage  Stock

Indicate on the diagram the character and thickness of the different strata met with in drilling, such as soil, clay, shale, gravel, rock or sand, etc. Show depth at which water is encountered, thickness and character of water-bearing strata and height to which water rises in the well.

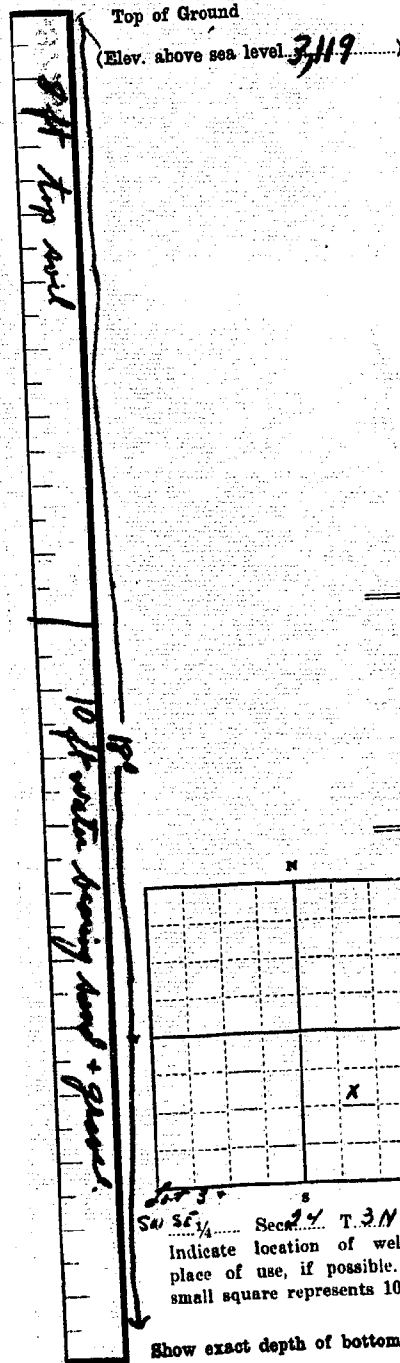

Size of Drilled Hole	Size and Weight of Casing	From (Feet)	To (Feet)	PERFORATIONS		
				Kind Size	From (Feet)	To (Feet)
2 inch	Standard Steel pipe	0	18	cut off casing 12" by 4" well	0	5

Static Water Level for non-flowing Well..... 8 feet.

Shut-in Pressure for Flowing Well.....

Pumping Water Level..... 6 feet at 20 gal. per minute.

Discharge in gal. per min. of flowing well.....

How Tested..... pump Length of Test..... 10 minutes

Remarks: (Gravel packing, cementing, packers, type of shutoff, location of place of use of groundwater if not at well, and any other similar pertinent information, including number of acres irrigated, if used for irrigation) used for irrigation and drinking.

Driller's License Number 88

Driller's Signature William S. Loe

This form to be prepared by driller, and three copies to be filed by the owner with the County Clerk and Recorder in the county in which the well is located.

Please answer all questions. If not applicable, so state, otherwise the form will be returned.

Original to the County Clerk and Recorder; duplicate to the State Engineer; Triplicate to the Montana Bureau of Mines and Geology and Quadruplicate for the Appropriator.

4  
D  
EER  
1969  
rent  
etc.  
water  
at  
feet.  
minute  
and any  
ber of  
order  
au of

6977834 4-10-69

10/10/1969  
18

STATE OF MONTANA } ss.  
County of Yellowstone }  
This instrument was filed in my office  
this 28 day DEC 1962  
at 11.22 o'clock A M.

CHRIS RUSICH, County Recorder  
By *[Signature]*

*[Vertical handwritten notes]*

*[Vertical handwritten notes]*

*[Vertical handwritten notes]*

*[Vertical handwritten notes]*

26

File No. ....

T. 3E R. 202

DUPLICATE

County Yellowstone

STATE OF MONTANA  
ADMINISTRATOR OF GROUNDWATER CODE  
OFFICE OF STATE ENGINEER

Declaration of Vested Groundwater Rights

(Under Chapter 237, Montana Session Laws, 1961)

RECEIVED  
JAN 26 1964  
STATE ENGINEER

1. Robert B. Murray of 2223 Hewitt Dr. Billings  
(Name of Appropriator) (Address) (Town)  
County of Yellowstone State of Montana  
have appropriated groundwater according to the Montana laws in effect prior to January 1, 1962, as follows:

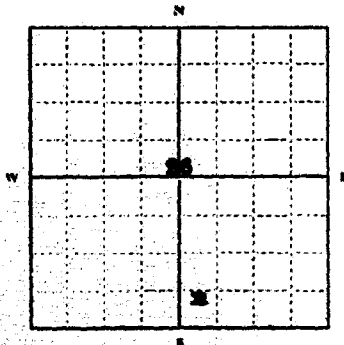

Lot 11  
SE 1/4 Sec. 26 T. 3E R. 20E

Indicate point of appropriation and place of use, if possible. Each small square represents 10 acres.

2. The beneficial use on which the claim is based Household and livestock use.

3. Date or approximate date of earliest beneficial use; and how continuous the use has been November 1961  
Constant use.

4. The amount of groundwater claimed (in miner's inches or gallons per minute) ~~200 GPM~~  
15 Gallons Per Minute

5. If used for irrigation, give the acreage and description of the lands to which water has been applied and name of the owner thereof  
One acre -- Water applied to lawn around house and buildings. Robert Murray

6. The means of withdrawing such water from the ground and the location of each well or other means of withdrawal Shallow well pump. Well located in Lot 11 Section 26 T. 3E R. 20E Yellowstone Co.

7. The date of commencement and completion of the construction of the well, wells, or other works for withdrawal of groundwater October 1961 Completed November 1961

8. The depth of water table Water Table Hit at approximately 21 feet-Depth Unknown.

9. So far as it may be available, the type, size and depth of each well or the general specifications of any other works for the withdrawal of groundwater 2 inch casing approximately 24 feet deep.

10. The estimated amount of groundwater withdrawn each year 147, 800 Gallons

11. The log of formations encountered in the drilling of each well if available  
Soil condition from gumbo to gravel

12. Such other information of a similar nature as may be useful in carrying out the policy of this act, including reference to book and page of any county record

Signature of Owner Robert Murray  
Date December 30, 1963

Three copies to be filed by the owner with the County Clerk and Recorder of the county in which the well is located

Please answer all questions. If not applicable, so state, otherwise the form will be returned.

Original to the County Clerk and Recorder; Duplicate to the State Engineer; Triplicate to the Montana Bureau of Mines and Geology; and Quadruplicate for the Appropriator.

1239

721577

STATE OF MISSISSIPPI  
County of Jefferson  
This instrument was filed in my office  
this 11-24 day of DEC 31 1963  
at 2 o'clock P.M.  
Elliott S. Beal, Jr.  
County Clerk & Recorder  
By Paul Deputy  
200

MISSISSIPPI

GV  
File No.  
DUPLICATE

T 318 R 24  
County

STATE OF MONTANA  
ADMINISTRATOR OF GROUNDWATER CODE  
OFFICE OF STATE ENGINEER

RECEIVED  
DEC 30 1963  
STATE ENGINEER

Declaration of Vested Groundwater Rights  
(Under Chapter 237, Montana Session Laws, 1961)

1. Lela Jane McIntyre Warden  
(Name of Appropriator) (Address) (Town)  
County of Yellowstone State of Mont  
have appropriated groundwater according to the Montana laws in effect prior to January 1, 1962, as follows:

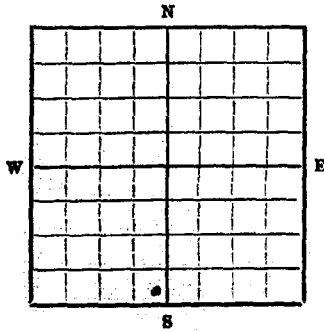

8E 1/4 SW 1/4 Sec 28 T3N R29E

Indicate point of appropriation and place of use, if possible. Each small square represents 10 acres.

- 2. The beneficial use on which the claim is based House hold
- 3. Date or approximate date of earliest beneficial use; and how continuous the use has been 1930  
daily use
- 4. The amount of groundwater claimed (in miner's inches or gallons per minute) 300 gal. per hr
- 5. If used for irrigation, give the acreage and description of the lands to which water has been applied and name of the owner thereof not used for irrigation
- 6. The means of withdrawing such water from the ground and the location of each well or other means of withdrawal Electric pump

- 7. The date of commencement and completion of the construction of the well, wells, or other works for withdrawal of groundwater 1930 - well started and completed
- 8. The depth of water table 8 ft in fall - 18 ft in spring
- 9. So far as it may be available, the type, size and depth of each well or the general specifications of any other works for the withdrawal of groundwater dr. well - 2 inch pipe - 27 ft depth
- 10. The estimated amount of groundwater withdrawn each year 2000 gal
- 11. The log of formations encountered in the drilling of each well if available not available
- 12. Such other information of a similar nature as may be useful in carrying out the policy of this act, including reference to book and page of any county record None

Signature of Owner Lela McIntyre  
Date 12-30-63

Three copies to be filed by the owner with the County Clerk and Recorder of the county in which the well is located.

Please answer all questions. If not applicable, so state, otherwise the form will be returned.

Original to the County Clerk and Recorder; duplicate to the State Engineer; Triplicate to the School of Mines and Quadruplicate for the Appropriator.

721258

indemnity for 1 day...  
...of the...  
...of the...

STATE OF MONTANA  
County of...

DEC 30 1968

2.08

P

EE

2.00



GV 4

File No. ....

DUPLICATE

T. 21 R. 21 30

County.....

STATE OF MONTANA  
ADMINISTRATOR OF GROUNDWATER CODE  
OFFICE OF STATE ENGINEER

**Declaration of Vested Groundwater Rights**

(Under Chapter 237, Montana Session Laws, 1961)

RECEIVED  
JAN 2 1964

STATE ENGINEER

1. Clifford W. Howard, of Bozeman, (Name of Appropriator) (Address)

County of Yellowstone State of Montana  
have appropriated groundwater according to the Montana laws in effect prior to January 1, 1962, as follows:

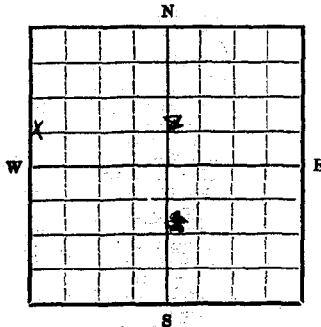

SW 1/4 NW Sec. 30 T32N R29E

Indicate point of appropriation and place of use, if possible. Each small square represents 10 acres.

2. The beneficial use on which the claim is based  
livestock, household and garden

3. Date or approximate date of earliest beneficial use; and how continuous the use has been  
1950

4. The amount of groundwater claimed (in miner's inches or gallons per minute)  
5 gal. per minute

5. If used for irrigation, give the acreage and description of the lands to which water has been applied and name of the owner thereof  
1 acre garden for use

6. The means of withdrawing such water from the ground and the location of each well or other means of withdrawal  
Electric pump

7. The date of commencement and completion of the construction of the well, wells, or other works for withdrawal of groundwater  
1950

8. The depth of water table  
20 ft. to 30 ft.

9. So far as it may be available, the type, size and depth, of each well or the general specifications of any other works for the withdrawal of groundwater  
20' casing

10. The estimated amount of groundwater withdrawn each year  
1,000,000 gal per yr

11. The log of formations encountered in the drilling of each well if available  
None available

12. Such other information of a similar nature as may be useful in carrying out the policy of this act, including reference to book and page of any county record  
None

Signature of Owner Clifford W. Howard

Date 12-31-63

Three copies to be filed by the owner with the County Clerk and Recorder of the county in which the well is located.

Please answer all questions. If not applicable, so state, otherwise the form will be returned.

Original to the County Clerk and Recorder; duplicate to the State Engineer; Triplicate to the School of Mines and Quadruplicate for the Appropriator.

18312

721542

STATE OF MONTANA

STATE OF MONTANA,  
County of Yellowstone,

This instrument was filed in my office

for of **DEC 31 1963**

10:42 AM

*J. [Signature]*  
20

Notary  
Notary

STATE OF MONTANA

NOTARY

STATE OF MONTANA

STATE OF MONTANA

STATE OF MONTANA

STATE OF MONTANA

This office is not a business and no advertisements may be placed here.

GW 4

File No. ....

T. 34 R. 27E 30

DUPLICATE

County. ....

STATE OF MONTANA  
ADMINISTRATOR OF GROUNDWATER CODE  
OFFICE OF STATE ENGINEER

RECEIVED  
JAN 2 1964  
STATE ENGINEER

Declaration of Vested Groundwater Rights

(Under Chapter 237, Montana Session Laws, 1949)

1. Curtis S. Howard of Warden  
(Name of Appropriator) (Address) (Town)  
County of Yellowstone State of Montana  
have appropriated groundwater according to the Montana laws in effect prior to January 1, 1962, as follows:

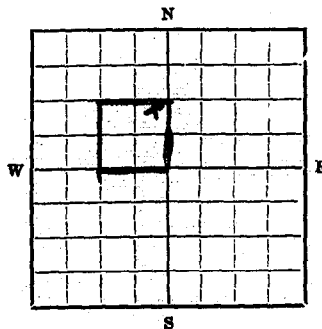

SE 1/4 NW 1/4 Sec 30 T30N R29E

Indicate point of appropriation and place of use, if possible. Each small square represents 10 acres.

- 2. The beneficial use on which the claim is based Household, Stock water and lawn sprinkling
- 3. Date or approximate date of earliest beneficial use; and how continuous the use has been 1908
- 4. The amount of groundwater claimed (in miner's inches or gallons per minute) 39 gallons per minute
- 5. If used for irrigation, give the acreage and description of the lands to which water has been applied and name of the owner thereof 4 acres of lawn
- 6. The means of withdrawing such water from the ground and the location of each well or other means of withdrawal Electric powered pump

- 7. The date of commencement and completion of the construction of the well, wells, or other works for withdrawal of groundwater Well dug in 1908 - power pump added in 1936
- 8. The depth of water table 10ft to 16ft
- 9. So far as it may be available, the type, size and depth of each well or the general specifications of any other works for the withdrawal of groundwater dug well, 30" tiled, 18ft deep
- 10. The estimated amount of groundwater withdrawn each year 1500,000 gallons
- 11. The log of formations encountered in the drilling of each well if available Not available
- 12. Such other information of a similar nature as may be useful in carrying out the policy of this act, including reference to book and page of any county record None

Signature of Owner Curtis Howard  
Date DEC 1, 1963

Three copies to be filed by the owner with the County Clerk and Recorder of the county in which the well is located.

Please answer all questions. If not applicable, so state, otherwise the form will be returned.

Original to the County Clerk and Recorder; duplicate to the State Engineer; Triplicate to the School of Mines and Quadruplicate for the Appropriator.

721565

*Handwritten notes, possibly "11-10-83"*



*Vertical handwritten text on the right side of the page.*

STATE OF MONTANA  
County of Yellowstone

This instrument was recorded in my office  
on DEC 8 1983 at 11:10 AM

I am  
County Clerk of said County

By [Signature] Deputy  
700

*Vertical handwritten notes on the right side of the page, including "11-10-83" and other illegible text.*

File No. ....

T. 3N R. 29E

DUPLICATE

County Yellowstone

STATE OF MONTANA  
ADMINISTRATOR OF GROUNDWATER CODE  
OFFICE OF STATE ENGINEER

RECEIVED  
DEC 30 1963

Declaration of Vested Groundwater Rights

(Under Chapter 237, Montana Session Laws, 1961)

STATE ENGINEER

1. Forrest Thelma Chenoweth of Warden, Mont.  
(Name of Appropriator) (Address) (Town)

County of Yellowstone State of Montana  
have appropriated groundwater according to the Montana laws in effect prior to January 1, 1962, as follows:

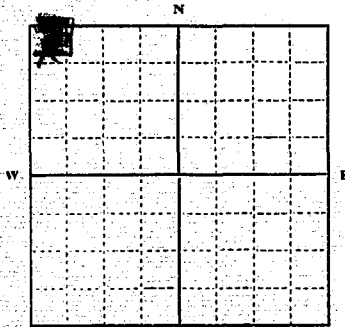

NW 1/4 Sec. 32, T. 3N R. 29E

Indicate point of appropriation and place of use, if possible. Each small square represents 10 acres.

2. The beneficial use on which the claim is based. Household and Stock water.

3. Date or approximate date of earliest beneficial use; and how continuous the use has been. 1919 - Constant  
10 gals per minute

4. The amount of groundwater claimed (in miner's inches or gallons per minute). 10 gals per minute

5. If used for irrigation, give the acreage and description of the lands to which water has been applied and name of the owner thereof. is not used for irrigation

6. The means of withdrawing such water from the ground and the location of each well or other means of withdrawal. pumped

7. The date of commencement and completion of the construction of the well, wells, or other works for withdrawal of groundwater. 1919 during in 1919

8. The depth of water table. 30 ft.

9. So far as it may be available, the type, size and depth of each well or the general specifications of any other works for the withdrawal of groundwater. N/A

10. The estimated amount of groundwater withdrawn each year. 5000 gals

11. The log of formations encountered in the drilling of each well if available. gravel & dirt

12. Such other information of a similar nature as may be useful in carrying out the policy of this act, including reference to book and page of any county record. Nothing

Signature of Owner Forrest Chenoweth  
Thelma Chenoweth  
Date Dec. 30, 1963

Three copies to be filed by the owner with the County Clerk and Recorder of the county in which the well is located.

Please answer all questions. If not applicable, so state, otherwise the form will be returned.

Original to the County Clerk and Recorder; Duplicate to the State Engineer; Triplicate to the Montana Bureau of Mines and Geology, and Quadruplicate for the Appropriator.

721259

STATE OF MONTANA  
County of Yellowstone

This instrument is recorded in my  
book **DEC 30 1968** at **2.09**

By **EE**

2.00

DUPLICATE

T. 39. R. 29  
County *Yellowstone*

STATE OF MONTANA  
ADMINISTRATOR OF GROUNDWATER CODE  
OFFICE OF STATE ENGINEER

RECEIVED  
JAN 2 1964

Declaration of Vested Groundwater Rights STATE ENGI.  
(Under Chapter 237, Montana Session Laws, 1961)

1. *John E. Druff* (Name of Appropriator) of *Worden* (Address) (Town)  
County of *Yellowstone* State of *Montana*  
have appropriated groundwater according to the Montana laws in effect prior to January 1, 1962, as follows:

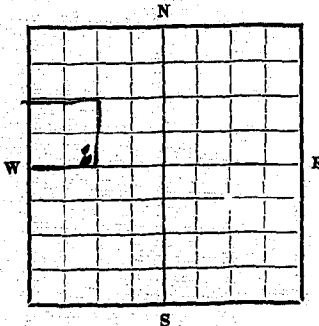

SW of NW 4  
1/4 Sec 32 T39. R19

Indicate point of appropriation and place of use, if possible. Each small square represents 10 acres.

2. The beneficial use on which the claim is based *use for watering stock irrigating fields & pasture*  
3. Date or approximate date of earliest beneficial use; and how continuous the use has been *1908 steady*

4. The amount of groundwater claimed (in miner's inches or gallons per minute) *20 gal*

5. If used for irrigation, give the acreage and description of the lands to which water has been applied and name of the owner thereof *use on riparian face around yard*

6. The means of withdrawing such water from the ground and the location of each well or other means of withdrawal *Electric pump*

7. The date of commencement and completion of the construction of the well, wells, or other works for withdrawal of groundwater *well started in spring of 1908 and completed that spring*

8. The depth of water table *6 feet*

9. So far as it may be available, the type, size and depth of each well or the general specifications of any other works for the withdrawal of groundwater *3" galvanized pipe 35' deep*

10. The estimated amount of groundwater withdrawn each year *273,750 gal*

11. The log of formations encountered in the drilling of each well if available *not available*

12. Such other information of a similar nature as may be useful in carrying out the policy of this act, including reference to book and page of any county record

Signature of Owner *John Druff*  
Date *Dec 31 - 1963*

Three copies to be filed by the owner with the County Clerk and Recorder of the county in which the well is located.

Please answer all questions. If not applicable, so state, otherwise the form will be returned.

Original to the County Clerk and Recorder; duplicate to the State Engineer; Triplicate to the School of Mines and Quadruplicate for the Appropriator.

721816

STATE OF MONTANA,  
County of Yellowstone,  
This instrument was filed in my office  
this 5:01 day of DEC 31 1909  
at 5:01 P. M.  
J. H. Redding  
County Clerk of Recorder  
M. H. Deputy



GF

File No. ....

DUPLICATE

T391, R29  
County *Yellowstone*

STATE OF MONTANA  
ADMINISTRATOR OF GROUNDWATER CODE  
OFFICE OF STATE ENGINEER

RECEIVED  
JAN 2 1964

**Declaration of Vested Groundwater Rights**  
(Under Chapter 287, Montana Session Laws, 1961)

1. *John G. Gross* of *Worden*  
(Name of Appropriator) (Address) (Town)  
County of *Yellowstone* State of *Montana*  
have appropriated groundwater according to the Montana laws in effect prior to January 1, 1962, as follows:

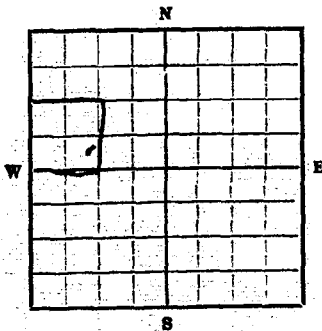

SW 1/4 of NW 1/4 of Sec 32 T14N, R29  
Indicate point of appropriation and place of use, if possible. Each small square represents 10 acres.

- 2. The beneficial use on which the claim is based *irrigating stock raising garden and other use*
- 3. Date or approximate date of earliest beneficial use; and how continuous the use has been *1948 steady*
- 4. The amount of groundwater claimed (in miner's inches or gallons per minute) *20 gal per Min*
- 5. If used for irrigation, give the acreage and description of the lands to which water has been applied and name of the owner thereof *used on fraction of acre around yard*
- 6. The means of withdrawing such water from the ground and the location of each well or other means of withdrawal *Electric pumps*
- 7. The date of commencement and completion of the construction of the well, wells, or other works for withdrawal of groundwater *well completed in 1948*
- 8. The depth of water table *6 feet*
- 9. So far as it may be available, the type, size and depth of each well or the general specifications of any other works for the withdrawal of groundwater *2" pipe 35' deep*
- 10. The estimated amount of groundwater withdrawn each year *273750 gal.*
- 11. The log of formations encountered in the drilling of each well if available *Need to go 35' to find gravel bed for groundwater*
- 12. Such other information of a similar nature as may be useful in carrying out the policy of this act, including reference to book and page of any county record

Signature of Owner *John Gross*  
Date *Dec 31 - 1963*

Three copies to be filed by the owner with the County Clerk and Recorder of the county in which the well is located.

Please answer all questions. If not applicable, so state, otherwise the form will be returned.

Original to the County Clerk and Recorder; duplicate to the State Engineer; Triplicate to the School of Mines and Quadruplicate for the Appropriator.

721812

1963  
12/21/63  
Edna S. ...  
County Clerk & Recorder

STATE OF MONTANA  
(County of Yellowstone)  
This instrument was filed in my office  
this 21 day of DEC 1963  
at Bozeman, Montana  
Edna S. ...  
County Clerk & Recorder  
By J. H. ...

STATE OF MONTANA  
ADMINISTRATOR OF GROUNDWATER CODE  
MONTANA WATER RESOURCES BOARD

APR 21 1971

DRILLER'S LOG

Indicate the character, color, thickness of strata such as soil, clay, sand, gravel, shale, sandstone, etc. Show depth at which water is found and height to which water rises in well.

NOTICE OF COMPLETION OF GROUNDWATER  
APPROPRIATION BY MEANS OF WELL

Developed after January 1, 1962

(Under Chapter 237 Montana Session Laws, 1961, as amended)

This form to be prepared by driller, and three copies to be filed by the owner with the County Clerk and Recorder in the county in which the well is located, last copy to be retained by driller.

Please answer all questions. If not applicable, so state, otherwise the form may be returned.

Owner Henry Urban  
Address WORLD ON MOUNT  
Date well started 4-7-71  
completed 4-8-71

For Administrator's Use	
File	<u>880511</u>
	<u>April 20, 1971</u>
	<u>2:20 PM</u>
GW 1	

Type of well DRILLED  
(Dug, driven, bored or drilled)  
Equipment used ROTARY  
(Cable drill, rotary or other)  
Water Use: Domestic  Municipal  Stock  Irrigation   
Industrial  Drainage  Other \* Garden/Lawn

\*Describe  
USE: If used for irrigation, industrial, drainage or other. Explain, state number of acres and location or other data (i.e. Lot, Block and Addition).

ESTIMATED ANNUAL WITHDRAWAL

Size of Drilled Hole	Size and Weight of Casing	From (Feet)	To (Feet)	PERFORATIONS		
				Kind Size	From (Feet)	To (Feet)
<u>6 3/4"</u>	<u>4 1/2"</u>	<u>0</u>	<u>38</u>	<u>1/2" SLOTS</u>	<u>35</u>	<u>38</u>

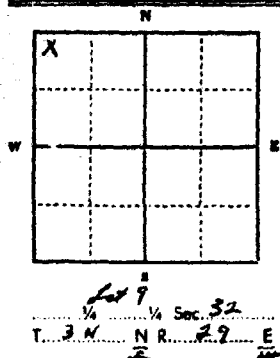

Static water level 8 ft.\*  
Pumping water level 16 ft.\*  
at 20 gallons per minute,  
measured 30 minutes after pumping  
began.  
\*Measured from ground level.  
Well developed by PUMPING  
for 4 hours.  
Power E.A.S. Pump ? HP  
Remarks: (Gravel packing, cementing,  
packers, type of shutoff) PACKING  
12 FT.

INDICATE LOCATION OF WELL AND PLACE OF USE, IF POSSIBLE.  
EACH SMALL SQUARE REPRESENTS 40 ACRES.

Driller's Signature J.J. Dan  
Driller's Address 426 SIOUX LAKE  
BILLINGS MONT LICENSE NO. 197

Top of Ground		(Elev. above sea level)
From (Feet)	To (Feet)	
<u>0</u>	<u>7</u>	<u>CLAY TOP SOIL</u>
<u>7</u>	<u>31</u>	<u>SAND</u>
<u>31</u>	<u>38</u>	<u>GRAVEL</u>
		<u>CLEAR WATER</u>
		<u>@ 31 FT.</u>

38 Show exact depth of bottom

48384

880511

INDIANA, Y  
County of ...  
This ... in my office  
this APR 20 1971 ...  
at 2:20 ... M.  
By Jaw Deputy  
22

File No. ....

T. 3N R. 29E

DUPLICATE

County .....

STATE OF MONTANA  
ADMINISTRATOR OF GROUNDWATER CODE  
OFFICE OF STATE ENGINEER

DEC 30 1963

**Declaration of Vested Groundwater Rights** STATE ENGINEER  
(Under Chapter 237, Montana Session Laws, 1961)

1. Leola Jane McIntyre, of Warden  
(Name of Appropriator) (Address) (Town)

County of Yellowstone State of Mont  
have appropriated groundwater according to the Montana laws in effect prior to January 1, 1962, as follows:

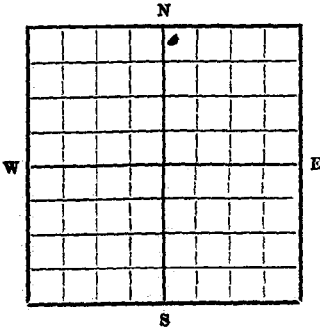

Lot 9 Sec 33 T. 3N R. 29E

Indicate point of appropriation and place of use, if possible. Each small square represents 10 acres.

2. The beneficial use on which the claim is based  
STOCK WATER

3. Date or approximate date of earliest beneficial use; and how continuous the use has been  
1910  
DAILY USE

4. The amount of groundwater claimed (in miner's inches or gallons per minute)  
8 gal per min

5. If used for irrigation, give the acreage and description of the lands to which water has been applied and name of the owner thereof  
not used for irrigation

6. The means of withdrawing such water from the ground and the location of each well or other means of withdrawal  
El. pump

7. The date of commencement and completion of the construction of the well, wells, or other works for withdrawal of groundwater  
Well started 1910, Completed 1910

8. The depth of water table  
2 ft falling - 20 ft falling pump

9. So far as it may be available, the type, size, and depth of each well or the general specifications of any other works for the withdrawal of groundwater  
driven well - 2 inch pipe - 35 ft depth

10. The estimated amount of groundwater withdrawn each year  
15000 gal

11. The log of formations encountered in the drilling of each well if available  
Not available

12. Such other information of a similar nature as may be useful in carrying out the policy of this act, including reference to book and page of any county record  
none

Signature of Owner Leola Jane McIntyre  
Date 12-30-63

Three copies to be filed by the owner with the County Clerk and Recorder of the county in which the well is located.

Please answer all questions. If not applicable, so state, otherwise the form will be returned.

Original to the County Clerk and Recorder; duplicate to the State Engineer; Triplicate to the School of Mines and Quadruplicate for the Appropriator.

721257

DEC 30 1968

2107

P

67  
67

2.00

1968

1968

1968

1968

GV 4

File No. ....

DUPLICATE

T 31 R 29 233  
County yeel

STATE OF MONTANA  
ADMINISTRATOR OF GROUNDWATER CODE  
OFFICE OF STATE ENGINEER

RECEIVED  
DEC 30 1963  
STATE ENGINEER

**Declaration of Vested Groundwater Rights**  
(Under Chapter 237, Montana Session Laws, 1961)

1. MARY Sindelar of BALLANTINE  
(Name of Appropriator) (Address) (Town)  
County of yeel State of Mont  
have appropriated groundwater according to the Montana laws in effect prior to January 1, 1962, as follows:

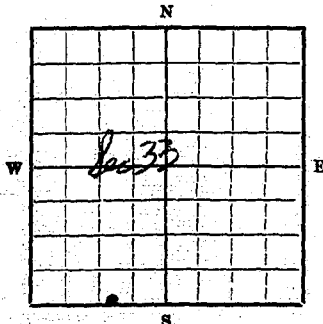

Unit L  
SE 8 W 4 Sec. 33 T. 29 R. 29

Indicate point of appropriation and place of use, if possible. Each small square represents 10 acres.

- 2. The beneficial use on which the claim is based Household + stock water
- 3. Date or approximate date of earliest beneficial use; and how continuous the use has been 1910 - continuous
- 4. The amount of groundwater claimed (in miner's inches or gallons per minute) 8 per min
- 5. If used for irrigation, give the acreage and description of the lands to which water has been applied and name of the owner thereof not used for irrigation
- 6. The means of withdrawing such water from the ground and the location of each well or other means of withdrawal hand pump

7. The date of commencement and completion of the construction of the well, wells, or other works for withdrawal of groundwater

8. The depth of water table 20ft 1910

9. So far as it may be available, the type, size and depth of each well or the general specifications of any other works for the withdrawal of groundwater

dug + driven 3 in pipe - 34ft

10. The estimated amount of groundwater withdrawn each year 5000 gal

11. The log of formations encountered in the drilling of each well if available

not available

12. Such other information of a similar nature as may be useful in carrying out the policy of this act, including reference to book and page of any county record

None

Signature of Owner Mary Sindelar  
Date 12/30-63

Three copies to be filed by the owner with the County Clerk and Recorder of the county in which the well is located.

Please answer all questions. If not applicable, so state, otherwise the form will be returned.

Original to the County Clerk and Recorder; duplicate to the State Engineer; Triplicate to the School of Mines and Quadruplicate for the Appropriator.

721262

ALL INFORMATION CONTAINED  
HEREIN IS UNCLASSIFIED  
DATE 11/19/01 BY 60322  
UCBAW/STP/STP

STATE OF MONTANA  
County of Yellowstone  
This instrument was filed in my office  
this DEC 30 1968  
at 2:12 P  
County Clerk of Yellowstone  
by EE Deputy

3.00



STATE OF MONTANA  
ADMINISTRATOR OF GROUNDWATER CODE  
OFFICE OF STATE ENGINEER

**Declaration of Vested Groundwater Rights**  
(Under Chapter 237, Montana Session Laws, 1961)

RECEIVED  
DEC 20 1963

STATE ENGINEER

1. H. Richard Hanam, of Worden  
(Name of Appropriator) (Address) (Town)  
County of Yellowstons State of Montana  
have appropriated groundwater according to the Montana laws in effect prior to January 1, 1962, as follows:

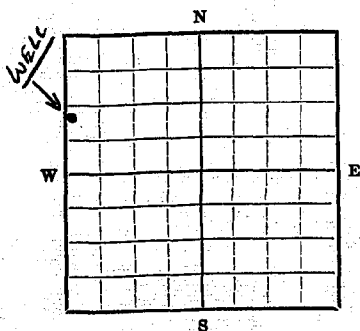

SW 1/4 NW 1/4 Sec. 31 T. 2N R. 29E  
Indicate point of appropriation  
and place of use, if possible.  
Each small square represents 10  
acres.

- 2. The beneficial use on which the claim is based Dwg. and Livestock water.
- 3. Date or approximate date of earliest beneficial use; and how continuous the use has been April, 1963. Continuous since then.
- 4. The amount of groundwater claimed (in miner's inches or gallons per minute) 50 Gallons per minute
- 5. If used for irrigation, give the acreage and description of the lands to which water has been applied and name of the owner thereof No
- 6. The means of withdrawing such water from the ground and the location of each well or other means of withdrawal small electric pump.

- 7. The date of commencement and completion of the construction of the well, wells, or other works for withdrawal of groundwater April, 1963
- 8. The depth of water table 25 Feet
- 9. So far as it may be available, the type, size and depth of each well or the general specifications of any other works for the withdrawal of groundwater 25 Feet.
- 10. The estimated amount of groundwater withdrawn each year 100,000 Gallons
- 11. The log of formations encountered in the drilling of each well if available Quabo
- 12. Such other information of a similar nature as may be useful in carrying out the policy of this act, including reference to book and page of any county record None

Signature of Owner H. R. Hanam  
Date December 14, 1963

Three copies to be filed by the owner with the County Clerk and Recorder of the county in which the well is located.

Please answer all questions. If not applicable, so state, otherwise the form will be returned.

Original to the County Clerk and Recorder; duplicate to the State Engineer; Triplicate to the School of Mines and Quadruplicate for the Appropriator.

4

720411

STATE OF MONTANA )  
County of Yellowstone )  
This instrument was filed in my office  
this DEC 19 day of 19  
at 8:06 o'clock A.M.  
I, W. H. [Signature],  
County Clerk & Recorder  
By [Signature] Deputy

\$ 2.00



938334

RECORDED AND INDEXED  
JUN 28 1973  
COUNTY CLERK'S OFFICE  
YELLOWSTONE COUNTY, MONTANA

STATE OF MONTANA, }  
County of Yellowstone, } ss.

This instrument was filed in my office  
this JUN 28 1973 day of

at 12:18 o'clock P M.

MERRILL A. MAUNY  
County Clerk & Recorder

By [Signature] Deputy

700

e No. ....

T 3N R 29E

DUPLICATE WATER RESOURCES BOARD

County *yeel*

STATE OF MONTANA  
ADMINISTRATOR OF GROUNDWATER CODE  
OFFICE OF STATE ENGINEER

**Declaration of Vested Groundwater Rights**  
(Under Chapter 21, Montana Session Laws, 1965)

1. *J. K. Mueller*, of *Worden*  
(Name of Appropriator) (Address) (Town)  
County of *Yellowstone* State of *Mont*

have appropriated groundwater according to the Montana laws in effect prior to January 1, 1962, as follows:

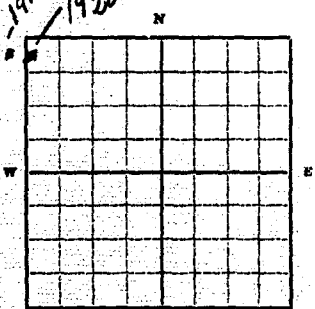

*NW 1/4 NW Sec 35 T3N R29E*

Indicate point of appropriation and place of use, if possible. Each small square represents 10 acres.

2. The beneficial use on which the claim is based *Stock & horse & Irrigation*

3. Date or approximate date of earliest beneficial use; and how continuous the use has been *1915*

4. The amount of ~~water~~ *water* ~~drawn~~ *drawn* (in ~~gallons~~ *gpm* or gallons per minute) *600 gpm 15 feet per minute*

5. If used for irrigation, give the acreage and description of the lands to which water has been applied and name of the owner thereof *1 Acre*

6. The means of withdrawing such water from the ground and the location of each well or other means of withdrawal: *Elec. pump NW 1/4 NW Sec 35 - 3N - 29E Hand pump - NE NE Sec 34 - 3N 29E*

7. The date of commencement and completion of the construction of the well, wells, or other works for withdrawal of groundwater: *1915 - day unknown month unknown 1920 - Sept*

8. The depth of water table *8 ft*

9. So far as it may be available, the type, size and depth of each well or the general specifications of any other works for the withdrawal of groundwater: *1915 - 21 ft deep - hand pump - NE NE Sec 34 Both T3N - R29E 1920 - 18 ft deep - Electric jet - NW NW Sec 35*

10. The estimated amount of groundwater withdrawn each year *650,000 Gal*

11. The log of formations encountered in the drilling of each well if available *all dirt*

12. Such other information of a similar nature as may be useful in carrying out the policy of this act, including reference to book and page of any county record

Signature of Owner *J. K. Mueller*  
Date *Dec 31 - 1965*

Three copies to be filed by the owner with the County Clerk and Recorder of the county in which the well is located. Please answer all questions. If not applicable, so state, otherwise the form will be returned.

Original to the County Clerk and Recorder; duplicate to the State Engineer; Triplicate to the School of Mines and Quadruplicate for the Appropriator.

40492

769320

BY AIR MAIL (MONTANA)  
County of Lincoln

This letter is dated July 1 1965

12.50 P.M.

(County of Lincoln)

By *MH* Deputy

OW

GAZETTE 12598 53

File No. ....

T. 2 N. R. 29 E

DUPLICATE

County Yellowstone

STATE OF MONTANA  
ADMINISTRATOR OF GROUNDWATER CODE  
OFFICE OF STATE ENGINEER

**Declaration of Vested Groundwater Rights**  
(Under Chapter 21, Montana Session Laws, 1965)

1. Kate A. Anderson, of Ballantine  
(Name of Appropriator) (Address) (Town)  
County of Yellowstone State of Montana  
have appropriated groundwater according to the Montana laws in effect prior to January 1, 1962, as follows:

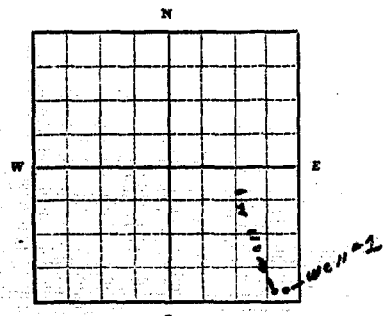

SE 1/4 Sec 36 T 29 N R 29 E

Indicate point of appropriation and place of use, if possible. Each small square represents 10 acres.

- The beneficial use on which the claim is based DOMESTIC LIVESOCK
- Date or approximate date of earliest beneficial use; and how continuous the use has been 1951- continuous  
Both Wells
- The amount of groundwater claimed (in miner's inches or gallons per minute) 15 GAL. Well #1  
10 GAL. Well #2
- If used for irrigation, give the acreage and description of the lands to which water has been applied and name of the owner thereof  
LAWN.
- The means of withdrawing such water from the ground and the location of each well or other means of withdrawal  
Electric Pumps Both Wells
- The date of commencement and completion of the construction of the well, wells, or other works for withdrawal of groundwater Well #1 - 1951  
Well #2 - 1961
- The depth of water table Well #1 - 29 ft Well #2 - 16 ft
- So far as it may be available, the type, size and depth of each well or the general specifications of any other works for the withdrawal of groundwater 2" casing on both wells
- The estimated amount of groundwater withdrawn each year Well #1 - 2,800,000 gal  
Well #2 - 1,800,000 gal
- The log of formations encountered in the drilling of each well if available  
Not known
- Such other information of a similar nature as may be useful in carrying out the policy of this act, including reference to book and page of any county record  
None

Signature of Owner: Kate Anderson  
Date Jan 7, 1965

Three copies to be filed by the owner with the County Clerk and Recorder of the county in which the well is located.  
Please answer all questions. If not applicable, so state, otherwise the form will be returned.

Original to the County Clerk and Recorder; duplicate to the State Engineer; Triplicate to the School of Mines and Quadruplicate for the Appropriator.

46727

769787

STATE OF MONTANA,  
County of Yellowstone,

This instrument was filed in my office  
this JAN 7 day of 1966

at 4:20 o'clock P M.

F. Lynn B. Reading,  
County Clerk & Recorder

Deputy

2.00

RECORDED & INDEXED  
JAN 10 1966  
COUNTY CLERK & RECORDER  
YELLOWSTONE COUNTY, MONTANA

RECORDED & INDEXED  
JAN 10 1966  
COUNTY CLERK & RECORDER  
YELLOWSTONE COUNTY, MONTANA

RECORDED & INDEXED  
JAN 10 1966  
COUNTY CLERK & RECORDER  
YELLOWSTONE COUNTY, MONTANA



File No.....

T. 3N ..... R. 29E .....

ORIGINAL

County Yellowstone .....

STATE OF MONTANA  
ADMINISTRATOR OF GROUNDWATER  
OFFICE OF STATE ENGINEER

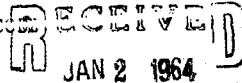

DECLARATION OF VESTED GROUNDWATER RIGHTS  
(Under Chapter 237, Montana Session Laws, 1961)

1. Lester Sherman of Billantine  
(Name of Appropriator) (Address) (Town)

County of Yellowstone State of Montana  
have appropriated groundwater according to the Montana laws in effect prior to  
January 1, 1962, as follows:

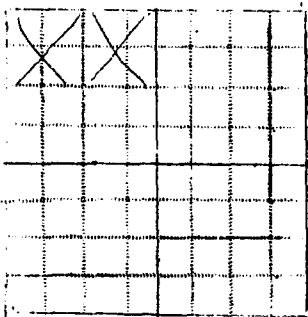

N 1/2 - NW 1/4  
Indicate point of appropriation  
and place of use, if possible.  
Each small square represents  
10 acres.

2. The beneficial use on which the claim is based  
Household use, five room house

3. Date or approximate date of earliest beneficial  
use, and how continuous the use has been -  
1948 and continuous since

4. The amount of groundwater claimed (in miner's  
inches or gallons per minute -  
5 gallons per minute

5. If used for irrigation, give the acreage and  
description of the lands to which water has been  
applied and name of the owner thereof -  
None

6. The means of withdrawing such water from the  
ground and the location of each well or other  
means of withdrawal -  
Driven Sandpoint

7. The date of commencement and completion of the construction of the well, wells,  
or other works for withdrawal of groundwater -  
1948

8. The depth of water table -  
Approximately 15'

9. So far as it may be available, the type, size and depth of each well or the gen-  
eral specifications of any other works for the withdrawal of groundwater -  
Driven Sandpoint, at 15' deep

10. The estimated amount of groundwater withdrawn each year -  
100,000 gallons

11. The log of formations encountered in the drilling of each well if available  
not available

12. Such other information of a similar nature as may be useful in carrying out the  
policy of this act, including reference to book and page of any county record -  
Farm Unitte 8674 - 401 - C395

Signature of Owner - Lester Sherman  
Date - December 31, 1963

Three copies to be filed by the owner with the County Clerk and Recorder of the  
county in which the well is located.  
Please answer all questions. If not applicable, so state, otherwise the form will  
be returned.  
Original to the County Clerk & Recorder; Duplicate to the State Engineer; Triplicate  
to the Montana Bureau of mines and Geology, and Quadruplicate for the appropriator

File No.....

T. 2N ..... R. 29E

ORIGINAL

County Yellowstone

STATE OF MONTANA  
ADMINISTRATOR OF GROUNDWATER CODE  
OFFICE OF STATE ENGINEER

RECEIVED  
JAN 2 1964

DECLARATION OF VESTED GROUNDWATER RIGHTS  
(Under Chapter 237, Montana Session Laws, 1961)

STATE ENGINEER

1. Leater Sherman of Billings  
(Name of Appropriator) (Address) (Town)

County of Yellowstone State of Montana  
have appropriated groundwater according to the Montana laws in effect prior to  
January 1, 1962, as follows:

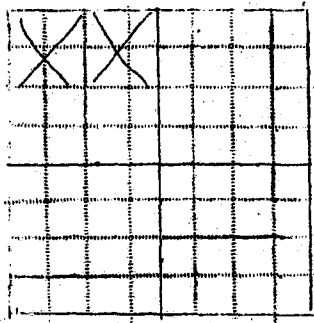

N 1/2 - NW 1/4  
Indicate point of appropriation  
and place of use, if possible.  
Each small square represents  
10 acres.

2. The beneficial use on which the claim is based  
Household use, five room house

3. Date or approximate date of earliest beneficial  
use, and how continuous the use has been  
1957 and continuous since

4. The amount of groundwater claimed (in miner's  
inches or gallons per minute)  
gallons per minute

5. If used for irrigation, give the acreage and  
description of the lands to which water has been  
applied and name of the owner thereof  
None

6. The means of withdrawing such water from the  
ground and the location of each well or other  
means of withdrawal  
Pressure pump

7. The date of commencement and completion of the construction of the well, wells,  
or other works for withdrawal of groundwater  
1959

8. The depth of water table  
Approximately 15'

9. So far as it may be available, the type, size and depth of each well or the gen-  
eral specifications of any other works for the withdrawal of groundwater  
Two sandpits, about 15' deep

10. The estimated amount of groundwater withdrawn each year  
100,000 gallons

11. The log of formations encountered in the drilling of each well if available  
not available

12. Such other information of a similar nature as may be useful in carrying out the  
policy of this act, including reference to book and page of any county record  
Form title 2474 and 2366

Signature of Owner Leater Sherman  
Date January 11, 1963

Three copies to be filed by the owner with the County Clerk and Recorder of the  
county in which the well is located.  
Please answer all questions. If not applicable, so state, otherwise the form will  
be returned.  
Original to the County Clerk & Recorder; Duplicate to the State Engineer; Triplicate  
to the Montana Bureau of mines and Geology, and Quadruplicate for the appropriator

721708

STATE OF MONTANA,  
County of Yellowstone,  
This instrument was filed in my office,  
this DEC 31 1963  
at 3:14 o'clock P. M.  
Simon S. Hedding,  
County Clerk & Recorder  
By Jaw Deputy  
20

File No. STATE WATER CONSERVATION BOARD

T. 3 North R. 29 East

DUPLICATE

JAN 4 1965

County Yellowstone

STATE OF MONTANA  
ADMINISTRATOR OF GROUNDWATER CODE  
OFFICE OF STATE ENGINEER

Declaration of Vested Groundwater Rights

(Under Chapter 21, Montana Session Laws, 1965)

1. HOWARD O. SMITH, of Ballantine, (Name of Appropriator) (Address) (Town)  
County of Yellowstone State of Montana  
have appropriated groundwater according to the Montana laws in effect prior to January 1, 1962, as follows:

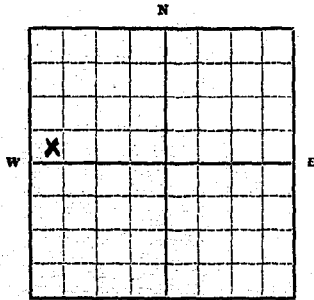

SW 1/4 Sec. 36 T. 3N R. 29 E

Indicate point of appropriation and place of use, if possible. Each small square represents 10 acres.

- 2. The beneficial use on which the claim is based. domestic and watering of livestock.
- 3. Date or approximate date of earliest beneficial use; and how continuous the use has been. Approximately 1920 and continuous since then.
- 4. The amount of groundwater claimed (in miner's inches or gallons per minute). 5 gallons per minute
- 5. If used for irrigation, give the acreage and description of the lands to which water has been applied and name of the owner thereof. None
- 6. The means of withdrawing such water from the ground and the location of each well or other means of withdrawal. Electric pump

7. The date of commencement and completion of the construction of the well, wells, or other works for withdrawal of groundwater. Unknown

8. The depth of water table. Approximately 30 feet

9. So far as it may be available, the type, size and depth of each well or the general specifications of any other works for the withdrawal of groundwater. Cased domestic well, 40 feet deep, 10 inch tile casing.

10. The estimated amount of groundwater withdrawn each year. 100000 gallons

11. The log of formations encountered in the drilling of each well if available. Not available

12. Such other information of a similar nature as may be useful in carrying out the policy of this act, including reference to book and page of any county record. Unknown

Signature of Owner

Date

*Howard O. Smith*  
Dec. 31, 1965

Three copies to be filed by the owner with the County Clerk and Recorder of the county in which the well is located.

Please answer all questions. If not applicable, so state, otherwise the form will be returned.

Original to the County Clerk and Recorder; duplicate to the State Engineer; Triplicate to the School of Mines and Quadruplicate for the Appropriator.

40527

769230

STATE OF MONTANA,  
County of Yellowstone,

This instrument was filed in my office

DEC 31 1965 10  
8:18 a.m. A.M.

Elmer S. Eading,  
County Clerk & Recorder  
SME Deputy

GW 4

File No. ....

DUPLICATE

T 3<sup>W</sup> R 24<sup>36</sup>  
County .....

STATE OF MONTANA  
ADMINISTRATOR OF GROUNDWATER CODE  
OFFICE OF STATE ENGINEER

RECEIVED  
JAN 2 1964

Declaration of Vested Groundwater Rights

(Under Chapter 237, Montana Session Laws, 1961)

STATE ENGINEER

1. Worden Trading Co. of Worden Montana  
(Name of Appropriator) (Address) (Town)  
County of Yellowstone State of Montana  
have appropriated groundwater according to the Montana laws in effect prior to January 1, 1962, as follows:

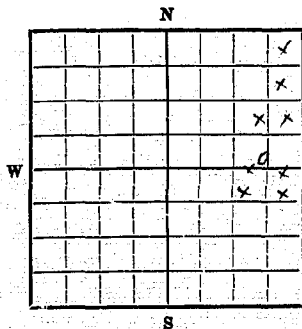

NE 1/4 3 Sec T. 21 N. 27 E  
Indicate point of appropriation and place of use, if possible. Each small square represents 10 acres.

- 2. The beneficial use on which the claim is based .....  
Household, stock water & sprinkling
- 3. Date or approximate date of earliest beneficial use; and how continuous the use has been .....  
May 1916
- 4. The amount of groundwater claimed (in miner's inches or gallons per minute) .....  
25 gallons
- 5. If used for irrigation, give the acreage and description of the lands to which water has been applied and name of the owner thereof .....
- 6. The means of withdrawing such water from the ground and the location of each well or other means of withdrawal .....  
Well & Spring

- 7. The date of commencement and completion of the construction of the well, wells, or other works for withdrawal of groundwater .....
- 8. The depth of water table .....  
20 ft
- 9. So far as it may be available, the type, size and depth of each well or the general specifications of any other works for the withdrawal of groundwater .....  
2 inch pipe well  
1 inch pipe spring
- 10. The estimated amount of groundwater withdrawn each year .....  
50,000 gallons
- 11. The log of formations encountered in the drilling of each well if available .....
- 12. Such other information of a similar nature as may be useful in carrying out the policy of this act, including reference to book and page of any county record .....  
Yellowstone County

Signature of Owner Frank C. Thruent President  
Date .....  
December 30, 1963

Three copies to be filed by the owner with the County Clerk and Recorder of the county in which the well is located.  
Please answer all questions. If not applicable, so state, otherwise the form will be returned.  
Original to the County Clerk and Recorder; duplicate to the State Engineer; Triplicate to the School of Mines and Quadruplicate for the Appropriator.

18500

721769

A grid diagram consisting of a central cross that divides the space into four quadrants. The grid is composed of several small squares, with the central cross lines extending across the grid.

REPRODUCTION OF  
THIS DOCUMENT IS UNLIMITED

DATE OF REPRODUCTION  
DEC 31 1969  
at 4.15

*Jaw*  
*2a*

Approved for Release by NSA on 05-08-2013 pursuant to E.O. 13526

## GROUNDWATER INDEX

Page 1 of 1

County Yellowstone Twp. 3N Rge. 30E

Sec.	Name of Appropriator	Type of Form	County File No.	Remarks
10	Bohl, George	1957 Well Log		
10	Rice, Laurie W.	GW2	891230	
19	Heyd, Lorenz	GW4	720709	
23	Althoff, Charles J. Sr.	GW4	769168	
23	Pearson, Harry W.	GW4	721187	
23	Pearson, Harry W.	GW4	721222	
23	Pearson, Harry W.	GW4	721223	
24	Althoff, Charles J. Sr.	GW4	769167	
24	Kratovich, James	1957 Well Log		
24	Kratovich, James	1957 Well Log		
25	Althoff, Charles J.	GW4	769166	
25	Bohl, George	1957 Well Log		
25	Bohl, George	1957 Well Log		
25	Kratovich, James	1957 Well Log		
26	Berg, Estate of Ellen	GW4	769334	
26	Bohl, George	1957 Well Log		
26	Bohl, George	1957 Well Log		
26	Bohl, George	1957 Well Log		
26	Bohl, George	1957 Well Log		
28	Lofing, Martin	GW4	720568	
30	Bowler, John J.	GW2	936793	
30	Bowler, John S.	GW2	936796	
30	Fark, Wilbur F. Jr.	GW2	912842	
30	Fark, Wilbur F. Jr.	GW2	911382	
30	Heyd, Lorenz	GW4	720710	
30	Toulouse, Frank	GW4	720435	
31	Bowers, John S.	GW2	936794	
31	Bowers, John S.	GW2	936795	
31	Bowers, John S.	GW2	936797	
31	Foss, Clinton A & Elton	GW4	721230	
31	Foss, Clinton A & Elton P.	GW4	721232	
31	Waller, Charles H.	GW4	721024	
31	Waller, Charles H.	GW3	721023	
32	Alles, Emanuel J.	GW4	769554	
32	Foss, Clinton A & Elton P.	GW4	721231	
32	Foss, Clinton A & Elton P.	GW4	721234	
32	Foss, Clinton A & Elton P.	GW4	721233	
32	Lofing, Conrad	GW5	723411	
33	Althoff, Leo	GW4	769165	
33	Bateman, Emily E.	GW2	797087	
33	Cerise, Emilia & Mele, Alma	1957 Well Log		
33	Murphy, Mrs. Bencie	GW3	721496	
33	Murphy, Mrs. Bencie	GW4	721495	
35	Felton, Charles E.	GW4	720727	
36	Felton, Charles E.	GW4	720725	



Form No. 18  
8-60

T. 3 N R. 30

County Yellowstone

MONTANA BUREAU OF MINES AND GEOLOGY  
Butte, Montana

Water Well Log

Owner George Bohl Address Pompey's Pillar, Mont.

Driller Unknown Address \_\_\_\_\_

Date Started \_\_\_\_\_ Date Completed \_\_\_\_\_

Location: Sec. 10 T. 3 N R. 30  $\frac{1}{4}$  sec. NW 1/4 SE 1/4

Type of well Dug Equipment used shovel, handpower  
(Dug, driven, or drilled) (Churn, drill, rotary, other)

Water use: Domestic  Municipal  Stock  Irrigation   
Industrial  Drainage  Other \_\_\_\_\_

Casing: \_\_\_\_\_ ft. to \_\_\_\_\_ ft. Type cement Size 48 inch

Casing: \_\_\_\_\_ ft. to \_\_\_\_\_ ft. Type \_\_\_\_\_ Size \_\_\_\_\_

Casing: \_\_\_\_\_ ft. to \_\_\_\_\_ ft. Type \_\_\_\_\_ Size \_\_\_\_\_

Perforated or screened: Ft. \_\_\_\_\_ to ft. \_\_\_\_\_ . Ft. \_\_\_\_\_ to ft. \_\_\_\_\_

Type of screen or perforations \_\_\_\_\_

Static water level, for non-flowing well: \_\_\_\_\_ feet.

Shut-in pressure, for flowing well: \_\_\_\_\_ lb./sq. in. on: \_\_\_\_\_ (date)

Pumpin- water level Not known feet at \_\_\_\_\_ gal. per min.

How tested: \_\_\_\_\_

Length of test \_\_\_\_\_

Remarks: (Gravel packing, cementing, packers, type of shut-off, depth of shut-off)

\_\_\_\_\_  
\_\_\_\_\_  
\_\_\_\_\_

(over)

File No. \_\_\_\_\_  
 DUPLICATE

Doc. No. 891230  
 Filed for record  
 this 17 day of September T. 3N R. 30E  
 A. D. 19 71, at 2:00 o'clock P.M. County Yellowstone

STATE OF MONTANA  
 ADMINISTRATOR OF GROUNDWATER CODE  
 OFFICE OF STATE ENGINEER

Notice of Completion of Groundwater  
 Appropriation by Means of Well

(Under Chapter 237, Montana Session Laws, 1961)

Owner LAWRENCE D. BIR Address POMPEYS PILLAR  
430 SIOUX LAKE  
 Driller D. S. SPRIDGERS Address BILLINGS MONT

Date of Notice of Appropriation of Groundwater \_\_\_\_\_

Date well started 8-27-71 Date Completed 9-1-71

Type of well DRILLED Equipment Used Rotary  
 (dug, driven, bored or drilled) (Churn, drill, rotary or other)

Water Use: Domestic  Municipal  Other  Irrigation   
 Industrial  Drainage  Stock

Indicate on the diagram the character and thickness of the different strata met with in drilling, such as soil, clay, shale, gravel, rock or sand, etc. Show depth at which water is encountered, thickness and character of water-bearing strata and height to which water rises in the well.

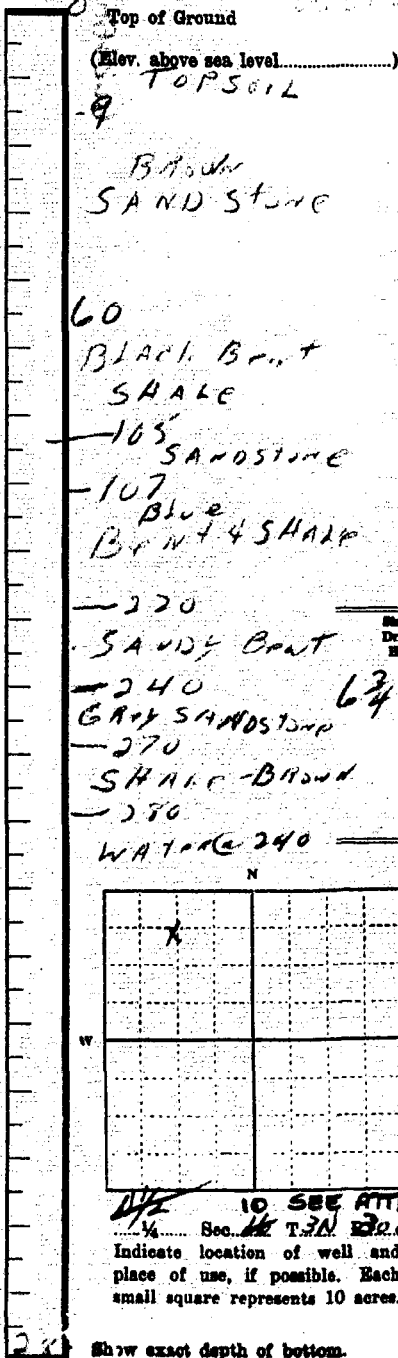

Size of Drilled Hole	Size and Weight of Casing	From (Feet)	To (Feet)	PERFORATIONS		
				Kind	From (Feet)	To (Feet)
6 3/4"	5" PLASTER	17	180	4 Slots	200	280
	6" STEEL	17	8 FT			

Static Water Level for non-flowing Well 200 feet.

Shut-in Pressure for Flowing Well NA

Pumping Water Level 275 feet at 3 gal. per minute.

Discharge in gal. per min. of flowing well NA

How Tested BAIT Length of Test 3 HRS

Remarks: (Gravel packing, cementing, packers, type of shutoff, location of place of use of groundwater if not at well, and any other similar pertinent information, including number of

acres irrigated, if used for irrigation) PAC USE

200 FT. Cement Top

10 FT

Show exact depth of bottom.

10 FT to 100 FT

177  
 Driller's License Number

J. J. [Signature]  
 Driller's Signature

This form to be prepared by driller, and three copies to be filed by the owner with the County Clerk and Recorder in the county in which the well is located.

Please answer all questions. If not applicable, so state, otherwise the form will be returned.

Original to the County Clerk and Recorder; duplicate to the State Engineer; Triplicate to the Montana Bureau of Mines and Geology and Quadruplicate for the Appropriator.

49096

57022  
 er  
 PILLAR  
 0 x 2 1/2  
 S. MANT  
 771  
 44  
 igation   
 different sand, etc. of water  
 To (Feet)  
 280  
 feet.  
 or minute  
 toff, loca- and any number of  
 7.0  
 order  
 au of  
 096

891230  
 file  
 BRUSH SANDSTONE  
 CO  
 BLACK Bent SHALE  
 105 SANDSTONE

THIS IS A CORRECTED COPY OF WELL LOG FOR LAURIE W. RICE. THE LEGAL DESCRIPTION HAS BEEN CHANGED.  
 THANK YOU!

**Notice of Completion of Groundwater Appropriation by Means of Well**  
 (Under Chapter 237, Montana Session Laws, 1961)

STATE OF MONTANA  
 ADMINISTRATOR OF GROUNDWATER CODE  
 OFFICE OF STATE ENGINEER

Owner: Laurie W. Rice Address: Pennington Pillar  
 Driller: D. G. S. & D. A. S. Address: 436 S. 5th St. Billings  
 Date of Notice of Appropriation of Groundwater: \_\_\_\_\_  
 Date well started: 8-27-71 Date Completed: 9-1-71  
 Type of well: Drilled Equipment Used: Rotary  
 (Aug. driven, bored or other)  
 Water Use: Domestic  Municipal  Other   
 Industrial  Drainage  Stock  Irrigation

STATE OF MONTANA  
 County of Blaine  
 This instrument was filed in my office  
 SEP 17 1971  
 P  
 20

Indicate on the diagram the character and thickness of the different strata, shale, gravel, rock or sand, etc.

File No. ....

DUPLICATE

T8 N R30 E of MPM 14

County Yellowstone

STATE OF MONTANA  
ADMINISTRATOR OF GROUNDWATER CODE  
OFFICE OF STATE ENGINEER

RECEIVED  
DEC 26 1963

**Declaration of Vested Groundwater Rights**  
(Under Chapter 287, Montana Session Laws, 1961)

1. Lorenz Heyd, of Varden  
(Name of Appropriator) (Address) (Town)  
County of Yellowstone State of Montana  
have appropriated groundwater according to the Montana laws in effect prior to January 1, 1962, as follows:

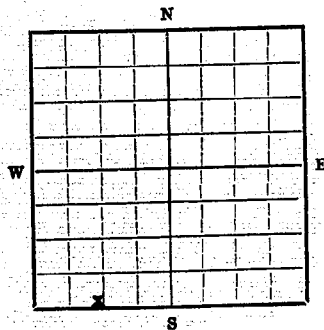

SW 1/4 of Sec. 19 T. 38 N. R. 30 E of MPM

Indicate point of appropriation and place of use, if possible. Each small square represents 10 acres.

- 2. The beneficial use on which the claim is based Livestock Water
- 3. Date or approximate date of earliest beneficial use; and how continuous the use has been 1952, Used continuous
- 4. The amount of groundwater claimed (in miner's inches or gallons per minute) 10 gal. per minute
- 5. If used for irrigation, give the acreage and description of the lands to which water has been applied and name of the owner thereof Not used

6. The means of withdrawing such water from the ground and the location of each well or other means of withdrawal Pressure Pump, S.W. 1/4 of section 19

7. The date of commencement and completion of the construction of the well, wells, or other works for withdrawal of groundwater 1952

8. The depth of water table 10 feet

9. So far as it may be available, the type, size and depth of each well or the general specifications of any other works for the withdrawal of groundwater 2" pipe with sandpoint on end, 20 feet deep

10. The estimated amount of groundwater withdrawn each year 800,000 gal.

11. The log of formations encountered in the drilling of each well if available Not Available

12. Such other information of a similar nature as may be useful in carrying out the policy of this act, including reference to book and page of any county record None

Signature of Owner Lorenz Heyd  
Date Dec. 19, 1963

Three copies to be filed by the owner with the County Clerk and Recorder of the county in which the well is located.

Please answer all questions. If not applicable, so state, otherwise the form will be returned.

Original to the County Clerk and Recorder; duplicate to the State Engineer; Triplicate to the School of Mines and Quadruplicate for the Appropriator.

DESCRIPTION OF WELL LOG

DESCRIPTION HAS BEEN CHANGED.

THANK YOU!

County Hell Creek

STATE OF MONTANA  
ADMINISTRATOR OF GROUNDWATER CODE  
OFFICE OF STATE ENGINEER

### Notice of Completion of Groundwater Appropriation by Means of Well

(Under Chapter 237, Montana Session Laws, 1961)

*file*

60 SANDSTONE  
60 BLACK BENT SHALE  
105 SANDSTONE  
107 Blue BENT & SHALE  
220 SANDY BENT  
240 GRAY SANDSTONE  
270 SHALE - Brown  
280 WATER @ 240

Owner L. A. W. D. R. Address POMPOYS PILLAR

Driller D. J. R. D. R. Address 420 Sioux Lane

Date of Notice of Appropriation of Groundwater.....

Date well started 8-27-71 Date Completed 9-1-71

Type of well DRILLED Equipment Used Rotary  
(dug, driven, bored or drilled) (Churn, drill, rotary or other)

Water Use: Domestic  Municipal  Other  Irrigation   
Industrial  Drainage  Stock

Indicate on the diagram the character and thickness of the different strata met with in drilling, such as soil, clay, shale, gravel, rock or sand, etc. Show depth at which water is encountered, thickness and character of water-bearing strata and height to which water rises in the well.

Size of Drilled Hole	Size and Weight of Casing	From (Feet)	To (Feet)	PERFORATIONS		
				Kind Size	From (Feet)	To (Feet)
	5" PLASTIC	14	180			
	4" steel	14	8 FT	1/8" slots	200	280

Static Water Level for non-flowing Well..... 200 feet.

Shut-in Pressure for Flowing Well..... N.A.

Pumping Water Level..... 275 feet at 3 gal. per minute.

Discharge in gal. per min. of flowing well..... N.A.

How Tested..... B.A.L. Length of Test..... 3 HRS.

Remarks: (Gravel packing, cementing, packers, type of shutoff, location of place of use of groundwater if not at well, and any other similar pertinent information, including number of acres irrigated, if used for irrigation)..... PAC. 1/2 AC.

@ 200 FT. Cement TOP  
10 FT

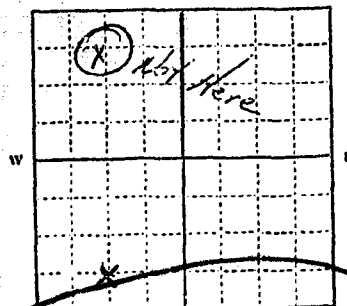

Show exact depth of bottom.

Water Level 200 FT.

197  
Driller's License Number

J. J. R.  
Driller's Signature

This form to be prepared by driller, and three copies to be filed by the owner with the County Clerk and Recorder in the county in which the well is located.

Please answer all questions. If not applicable, so state, otherwise the form will be returned.

Original to the County Clerk and Recorder; duplicate to the State Engineer; Triplicate to the Montana Bureau of Mines and Geology and Quadruplicate for the Appropriator.

720709

DEC 23 1968

2.00

P

*Jan*  
202

GV

STATE WATER CONSERVATION BOARD

GAZETTE 1964

File No. \_\_\_\_\_

T 2N R 30E

DUPLICATE

County YELLOWSTONE

STATE OF MONTANA  
ADMINISTRATOR OF GROUNDWATER CODE  
OFFICE OF STATE ENGINEER

**Declaration of Vested Groundwater Rights**  
(Under Chapter 21, Montana Session Laws, 1965)

1. Charles J Althoff Sr, of Pimpwin P. 1100  
(Name of Appropriator) (Address) (Town)  
County of Yellowstone State of MONTANA  
have appropriated groundwater according to the Montana laws in effect prior to January 1, 1962, as follows:

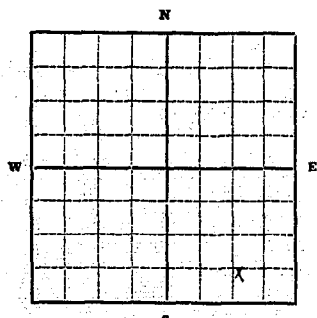

SE 1/4 Sec. 22 T 31N R 30E

Indicate point of appropriation and place of use, if possible. Each small square represents 10 acres.

- 2. The beneficial use on which the claim is based. LIVESTOCK
- 3. Date or approximate date of earliest beneficial use, and how continuous the use has been. 1920 CONTINUOUS
- 4. The amount of groundwater claimed (in miner's inches or gallons per minute). 6.9 gal per min
- 5. If used for irrigation, give the acreage and description of the lands to which water has been applied and name of the owner thereof. NA
- 6. The means of withdrawing such water from the ground and the location of each well or other means of withdrawal. Hand Pump

- 7. The date of commencement and completion of the construction of the well, wells, or other works for withdrawal of groundwater. 1920
- 8. The depth of water table. 25 ft
- 9. So far as it may be available, the type, size and depth of each well or the general specifications of any other works for the withdrawal of groundwater. 25 ft Tile 8"
- 10. The estimated amount of groundwater withdrawn each year. 104,000
- 11. The log of formations encountered in the drilling of each well if available. Not Known
- 12. Such other information of a similar nature as may be useful in carrying out the policy of this act, including reference to book and page of any county record. None

Signature of Owner Charles J Althoff Sr  
Date Dec 30 1965

Three copies to be filed by the owner with the County Clerk and Recorder of the county in which the well is located.

Please answer all questions. If not applicable, so state, otherwise the form will be returned.

Original to the County Clerk and Recorder; duplicate to the State Engineer; Triplicate to the School of Mines and Quadruplicate for the Appropriator.

40555

769168

DEC 30 1965

12/30

*[Handwritten signature]*

202

RECEIVED

RECEIVED



GW

Approved Stock Form—State Publishing Co., Helena, Montana—42234

File No. ....

T. 3N R 30E

DUPLICATE

County Yellowstone

STATE OF MONTANA  
ADMINISTRATOR OF GROUNDWATER CODE  
OFFICE OF STATE ENGINEER

RECEIVED  
DEC 30 1963

Declaration of Vested Groundwater Rights

(Under Chapter 237, Montana Session Laws, 1961)

STATE ENGINEER

1. HARRY W PEARSON, of Pompeys Pillar  
(Name of Appropriator) (Address) (Town)

County of Yellowstone State of Montana  
have appropriated groundwater according to the Montana laws in effect prior to January 1, 1962, as follows:

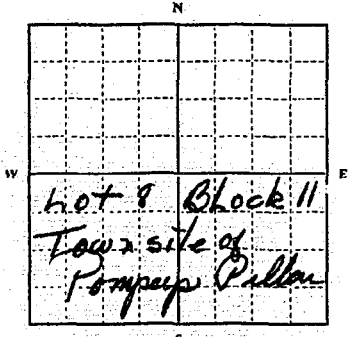

$\frac{1}{4}$  Sec. 23 T. 3N R. 30E

Indicate point of appropriation and place of use, if possible. Each small square represents 10 acres.

2. The beneficial use on which the claim is based  
General Merchandise Store

3. Date or approximate date of earliest beneficial use; and how continuous the use has been  
1946

100 GAL DAY

4. The amount of groundwater claimed (in miner's inches or gallons per minute).  
100 GAL DAY

5. If used for irrigation, give the acreage and description of the lands to which water has been applied and name of the owner thereof  
No

6. The means of withdrawing such water from the ground and the location of each well or other means of withdrawal  
Shallow Well Pump

7. The date of commencement and completion of the construction of the well, wells, or other works for withdrawal of groundwater.  
1946

8. The depth of water table.  
25 ft

9. So far as it may be available, the type, size and depth of each well or the general specifications of any other works for the withdrawal of groundwater  
1/2 knee shallow well Pump

10. The estimated amount of groundwater withdrawn each year 36,500

11. The log of formations encountered in the drilling of each well if available.  
SAND + GRAVEL

12. Such other information of a similar nature as may be useful in carrying out the policy of this act, including reference to book and page of any county record

Signature of Owner Harry Pearson

Date 12/30/63

Three copies to be filed by the owner with the County Clerk and Recorder of the county in which the well is located.

Please answer all questions. If not applicable, so state, otherwise the form will be returned.

Original to the County Clerk and Recorder; Duplicate to the State Engineer; Triplicate to the Montana Bureau of Mines and Geology, and Quadruplicate for the Appropriator.

721187

STATE OF MONTANA,  
County of Yellowstone,

This instrument was filed in my office  
this 30 day of Nov 1963  
at 11:22 o'clock A.M.

Edmon S. Redding,  
County Clerk & Recorder

By [Signature] Deputy

\$2.00

File No. ....

T. 3 N R 30 E

DUPLICATE

County Yellowstone

STATE OF MONTANA  
ADMINISTRATOR OF GROUNDWATER CODE  
OFFICE OF STATE ENGINEER

RECEIVED  
DEC 30 1963  
STATE ENGINEER

Declaration of Vested Groundwater Rights

(Under Chapter 237, Montana Session Laws, 1962)

1. HARRY W PEARSON, of Pompeys Pillar  
(Name of Appropriator) (Address) (Town)  
County of Yellowstone State of MONTANA  
have appropriated groundwater according to the Montana laws in effect prior to January 1, 1962, as follows:

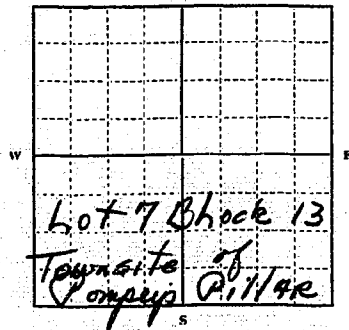

$\frac{1}{4}$  Sec. 23 T. 3N R. 30E

Indicate point of appropriation and place of use, if possible. Each small square represents 10 acres.

2. The beneficial use on which the claim is based.....  
House

3. Date or approximate date of earliest beneficial use; and how continuous the use has been. 1950  
200 gpi DAY

4. The amount of groundwater claimed (in miner's inches or gallons per minute). 200 gpi DAY

5. If used for irrigation, give the acreage and description of the lands to which water has been applied and name of the owner thereof  
No

6. The means of withdrawing such water from the ground and the location of each well or other means of withdrawal.  
SHALLOW WELL PUMP

7. The date of commencement and completion of the construction of the well, wells, or other works for withdrawal of groundwater. 1950

8. The depth of water table. 25 ft

9. So far as it may be available, the type, size and depth of each well or the general specifications of any other works for the withdrawal of groundwater  
1/2 hour SHALLOW PUMP

10. The estimated amount of groundwater withdrawn each year. 75,000 gpi

11. The log of formations encountered in the drilling of each well if available.  
SAND + GRAVEL

12. Such other information of a similar nature as may be useful in carrying out the policy of this act, including reference to book and page of any county record

Signature of Owner Harry Pearson  
Date 12/30/63

Three copies to be filed by the owner with the County Clerk and Recorder of the county in which the well is located.

Please answer all questions. If not applicable, so state, otherwise the form will be returned.

Original to the County Clerk and Recorder; Duplicate to the State Engineer; Triplicate to the Montana Bureau of Mines and Geology, and Quadruplicate for the Appropriator.

13

tail

n

R

follows:

contin-

or gallons

the lands  
or thereof

if the loca-

for with-

any other

including

son

3

is located.

Bureau of  
16215

721222

STATE OF MONTANA  
 County of Yellowstone

This instrument was filed in my office  
 this \_\_\_\_\_ day of **DEC 30, 1963**  
 at 12:37 o'clock P M.  
 Edman S. Reed  
 County Clerk & Recorder

By J. A. W. Deputy  
 2 m